



RECEIVED

By Alameda County Environmental Health at 3:43 pm, Apr 22, 2014

Alexis Fischer
Project Manager
Marketing Business Unit

**Chevron Environmental
Management Company**
6101 Bollinger Canyon Road
San Ramon, CA 94583
Tel (925) 790-6441
afischer@chevron.com

Alameda County Health Care Services
1131 Harbor Bay Parkway, Suite 250
Alameda, CA 94502-6577

Re: Former Signal Oil Station No. 206145
800 Center Street
Oakland, CA

I have reviewed the *First Semi-Annual 2014 Groundwater Monitoring and Sampling Report*.

The information in this report is accurate to the best of my knowledge and all local Agency/Regional Board guidelines have been followed. This report was prepared by Conestoga Rovers Associates, upon whose assistance and advice I have relied.

This letter is submitted pursuant to the requirements of California Water Code Section 13267(b)(1) and the regulating implementation entitled Appendix A pertaining thereto.

I declare under penalty of perjury that the foregoing is true and correct to the best of my knowledge.

Sincerely,

A handwritten signature in blue ink that reads "Alexis Fischer".

Alexis Fischer
Project Manager

Attachment: First Semi-Annual 2014 Groundwater Monitoring and Sampling Report



**CONESTOGA-ROVERS
& ASSOCIATES**

10969 Trade Center Drive, Suite 107
Rancho Cordova, California 95670
Telephone: (916) 889-8900 Fax: (916) 889-8999
<http://www.craworld.com>

April 17, 2014

Reference No. 312002

Mr. Mark Detterman, P.G., C.E.G.
Alameda County Environmental Health (ACEH)
1131 Harbor Bay Parkway
Alameda, California 94502

Re: First Semi-Annual 2014
Groundwater Monitoring and Sampling Report
Former Signal Oil Service Station 206145
800 Center Street
Oakland, California
ACEH Case RO0000454

Dear Mr. Detterman:

Conestoga-Rovers & Associates (CRA) is submitting this *First Semi-Annual 2014 Groundwater Monitoring and Sampling Report* for the site referenced above (Figure 1) on behalf of Chevron Environmental Management Company. Groundwater monitoring and sampling was performed by Gettler-Ryan, Inc. (G-R) of Dublin, California and their *Groundwater Monitoring and Sampling Data Package* is included as Attachment A. Current groundwater monitoring and sampling data are presented in Table 1 and shown on Figure 2. Eurofins Lancaster Laboratories Environmental LLCs' *Analytical Results* report is included as Attachment B. Historical groundwater monitoring and sampling data are included as Attachment C.

Equal
Employment Opportunity
Employer



**CONESTOGA-ROVERS
& ASSOCIATES**

April 17, 2014

Reference No. 312002

- 2 -

Please contact Nate Allen at (916) 889-8929 if you have any questions or require additional information.

Sincerely,

CONESTOGA-ROVERS & ASSOCIATES

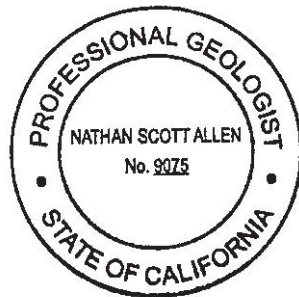

Nathan Allen, P.G. 9075

NA/aa/29

Encl.

Figure 1	Vicinity Map
Figure 2	Shallow Groundwater Elevation and Hydrocarbon Concentration Map
Table 1	Groundwater Monitoring and Sampling Data
Attachment A	Monitoring Data Package
Attachment B	Laboratory Analytical Report
Attachment C	Historical Groundwater Monitoring and Sampling Data

cc: Ms. Alexis Fischer, Chevron (*electronic copy*)

FIGURES

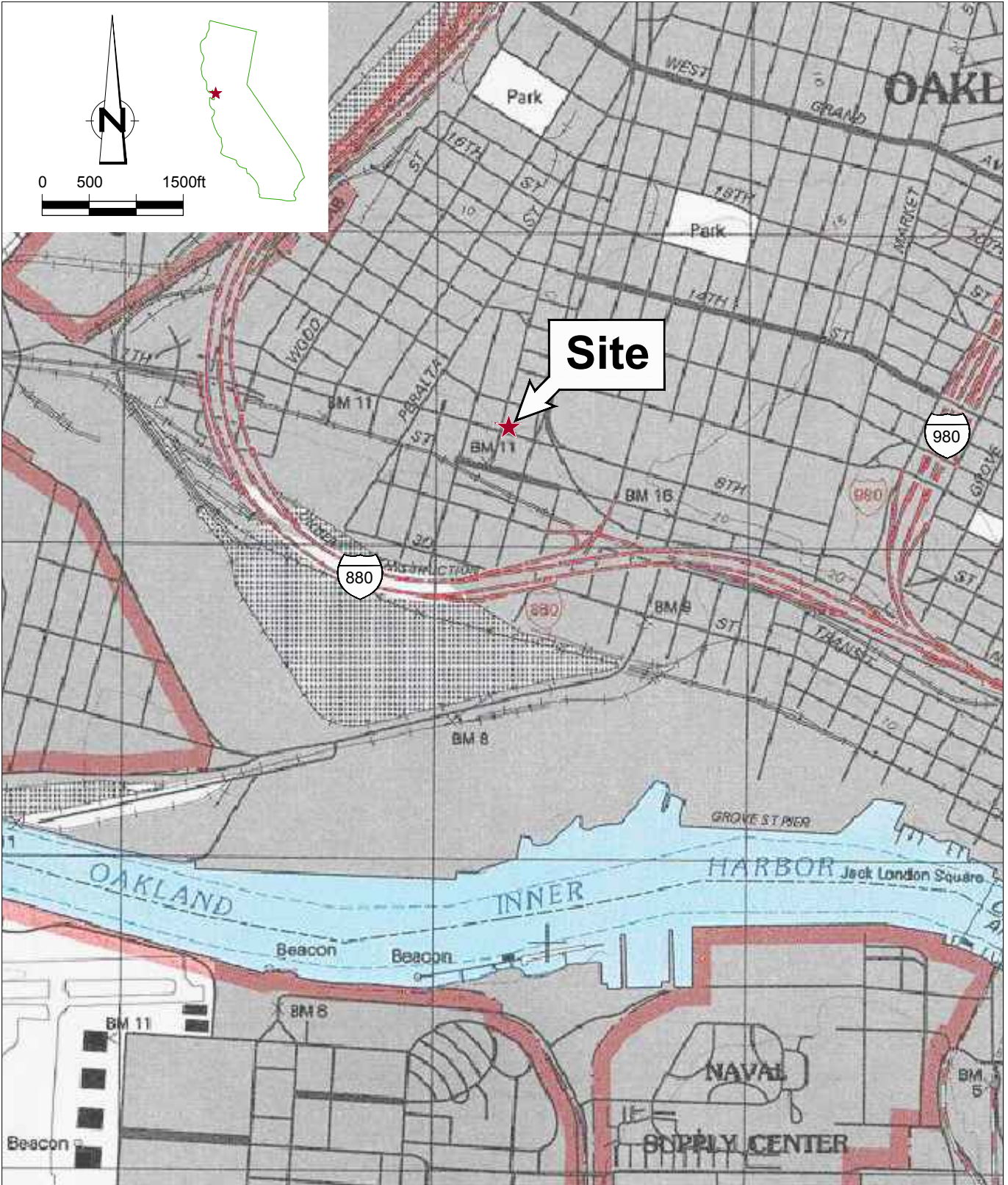

Figure 1
 VICINITY MAP
 FORMER SIGNAL OIL SERVICE STATION 206145
 800 CENTER STREET
 Oakland, California



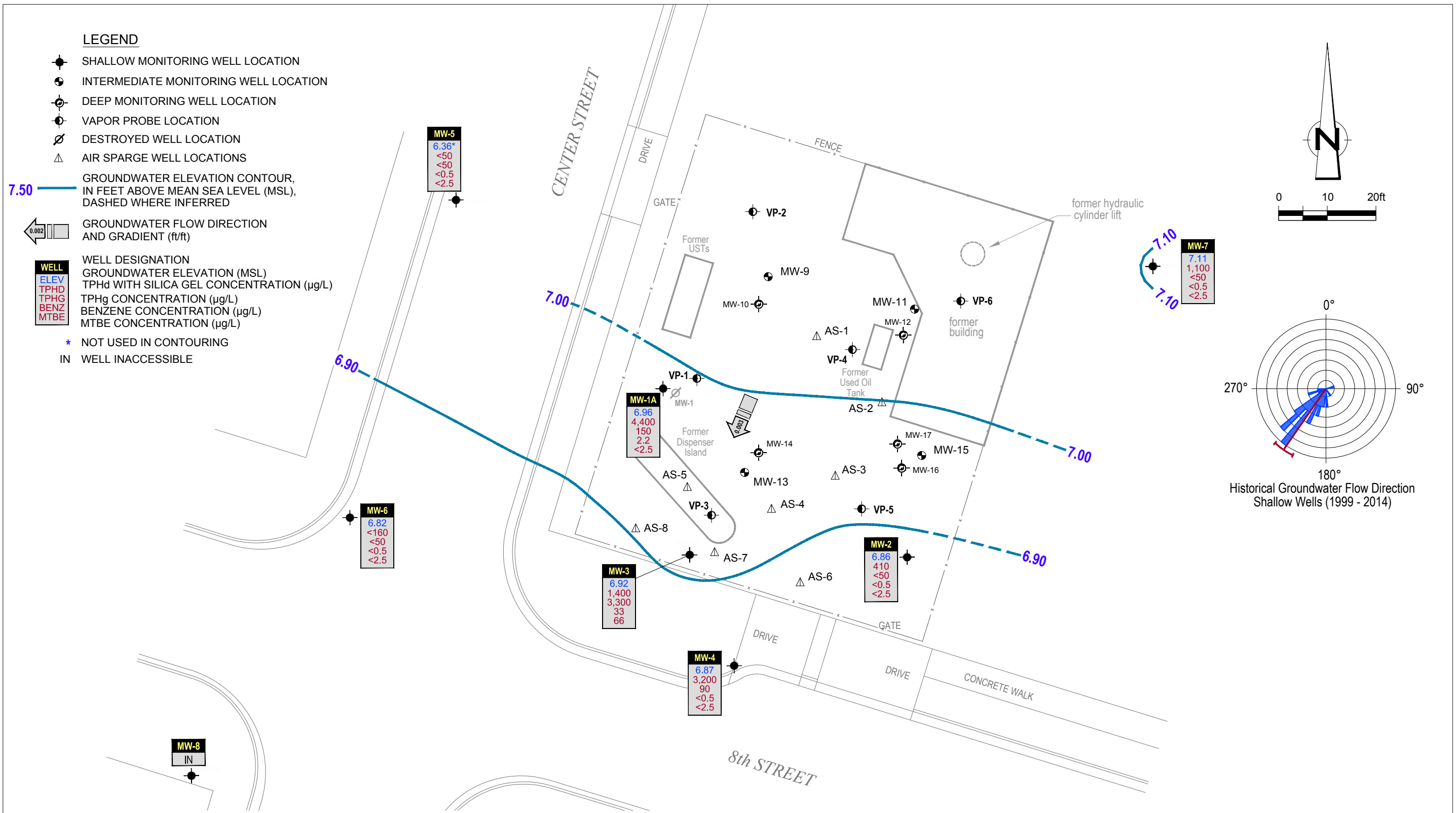

Figure 2
 SHALLOW GROUNDWATER ELEVATION AND HYDROCARBON CONCENTRATION MAP
 FORMER SIGNAL OIL SERVICE STATION 206145
 800 CENTER STREET
 Oakland, California
 January 31, 2014



TABLE

TABLE 1

GROUNDWATER MONITORING AND SAMPLING DATA
 FORMER SIGNAL OIL SERVICE STATION 206145
 800 CENTER STREET
 OAKLAND, CALIFORNIA

Location	Date	TOC	DTW	GWE	HYDROCARBONS		PRIMARY VOCs					GENERAL CHEMISTRY					
					TPH-DRO w/ Si Gel	TPH-GRO	B	T	E	X	MTBE by SW8021	Carbon dioxide	Nitrate Nitrogen	Sulfate	Alkalinity to pH 4.5	Alkalinity to pH 8.3	Ferrous Iron
	Units	ft	ft	ft-amsl	µg/L	µg/L	µg/L	µg/L	µg/L	µg/L	µg/L	µg/L	µg/L	µg/L	µg/L	µg/L	µg/L
MW-1A	09/03/2010 ¹	18.11	9.54	8.57	590	<50	<0.5	<0.5	<0.5	<1.5	<2.5	-	-	-	-	-	-
MW-1A	02/03/2011 ¹	18.11	8.05	10.06	840	100	2.5	0.6	6.7	2.0	<2.5	-	-	-	-	-	-
MW-1A	05/04/2011 ^{1,7}	18.11	7.16	10.95	1,500	<50	6.7	<0.5	<0.5	<1.5	<2.5	-	-	-	-	-	-
MW-1A	08/04/2011 ¹	18.11	8.80	9.31	750	<50	0.9	<0.5	<0.5	<1.5	<2.5	-	-	-	-	-	-
MW-1A	02/29/2012 ^{1,9}	18.11	9.84	8.27	630/250	<50	<0.5	<0.5	<0.5	<1.5	<2.5	-	-	-	-	-	-
MW-1A	08/07/2012 ^{1,9}	18.11	9.64	8.47	540/<50	<50	<0.5	<0.5	<0.5	<1.5	<2.5	-	-	-	-	-	-
MW-1A	02/18/2013 ¹	18.11	8.32	9.79	830 / 110	<50	<0.5	<0.5	<0.5	<1.5	<2.5	-	-	-	-	-	-
MW-1A	09/27/2013 ^{1,9}	18.11	10.51	7.60	950 / 420	<50	0.3	<0.2	<0.2	<0.6	<0.3	-	-	-	-	-	-
MW-1A	01/31/2014^{1,9}	18.11	11.15	6.96	9,100 / 4,400	150	2.2	<0.5	<0.5	<1.5	<2.5	-	-	-	-	-	-
MW-2	09/03/2010 ¹	18.40	9.98	8.42	130	<50	<0.5	<0.5	<0.5	<1.5	<2.5	-	-	-	-	-	-
MW-2	02/03/2011 ¹	18.40	8.61	9.79	430	75	<0.5	<0.5	<0.5	<1.5	8.9	-	-	-	-	-	-
MW-2	05/04/2011 ^{1,7}	18.40	4.55	13.85	160	1,300	12	48	0.7	47	<100	-	-	-	-	-	-
MW-2	08/04/2011 ¹	18.40	9.17	9.23	99	1,500	43	100	1.4	47	34	-	-	-	-	-	-
MW-2	02/29/2012 ^{1,9}	18.40	10.25	8.15	75/<50	<50	<0.5	<0.5	<0.5	<1.5	<2.5	-	-	-	-	-	-
MW-2	08/07/2012 ^{1,9}	18.40	9.98	8.42	410/270	<50	<0.5	<0.5	<0.5	<1.5	<2.5	-	-	-	-	-	-
MW-2	02/18/2013 ¹	18.40	8.72	9.68	430 / <50	<50	<0.5	<0.5	<0.5	<1.5	<2.5	-	-	-	-	-	-
MW-2	09/27/2013 ^{1,9}	18.40	10.81	7.59	150 / <50	<50	<0.2	<0.2	<0.2	<0.6	<0.3	-	-	-	-	-	-
MW-2	01/31/2014^{1,9}	18.40	11.54	6.86	1,200 / 410	<50	<0.5	<0.5	<0.5	<1.5	<2.5	-	-	-	-	-	-
MW-3	09/03/2010	-	-	-	-	-	-	-	-	-	-	160,000	390	45,900	531,000	<460	21,500
MW-3	09/03/2010 ¹	18.07	9.70	8.37	4,000	32,000	65	690	3,100	4,900	380	-	-	-	-	-	-
MW-3	02/03/2011 ¹	18.07	8.39	9.68	1,400	2,000	17	34	250	190	26	44,000	<250	180,000	385,000	<460	28,500
MW-3	05/04/2011 ^{1,7}	18.07	7.30	10.77	340	57	<0.5	1.1	3.8	7.7	<2.5	20,000	<250	222,000	310,000	<460	10,500
MW-3	08/04/2011 ¹	18.07	8.83	9.24	2,100	1,200	6.5	4.6	110	8.9	16	68,000	350	275,000	362,000	<460	32,500
MW-3	02/29/2012 ^{1,9}	18.07	9.90	8.17	1,500/510	2,000	74	2.2	6.5	<5.0	<18	-	-	-	-	-	-

TABLE 1

GROUNDWATER MONITORING AND SAMPLING DATA
 FORMER SIGNAL OIL SERVICE STATION 206145
 800 CENTER STREET
 OAKLAND, CALIFORNIA

Location	Date	TOC	DTW	GWE	HYDROCARBONS		PRIMARY VOCs					GENERAL CHEMISTRY					
					TPH-DRO w/ Si Gel	TPH-GRO	B	T	E	X	MTBE by SW8021	Carbon dioxide	Nitrate Nitrogen	Sulfate	Alkalinity to pH 4.5	Alkalinity to pH 8.3	Ferrous Iron
	Units	ft	ft	ft-amsl	µg/L	µg/L	µg/L	µg/L	µg/L	µg/L	µg/L	µg/L	µg/L	µg/L	µg/L	µg/L	µg/L
MW-3	08/07/2012 ^{1,9}	18.07	9.68	8.39	2,600/1,100	3,800	120	4.1	5.0	14	38	-	-	-	-	-	-
MW-3	02/18/2013 ¹	18.07	8.45	9.62	1,700 / 580	1,700	11	2.6	3.8	19	27	-	-	-	-	-	-
MW-3	09/27/2013 ^{1,9}	18.07	10.52	7.55	1,800 / 1,100	3,100	30	2.4	3.1	16	66	-	-	-	-	-	-
MW-3	01/31/2014^{1,9}	18.07	11.15	6.92	4,100 / 1,400	3,300	33	2.0	3.6	5.9	66	-	-	-	-	-	-
MW-4	09/03/2010	-	-	-	-	-	-	-	-	-	-	210,000	<250	2,000	400,000	<460	7,500
MW-4	09/03/2010 ¹	16.98	8.63	8.35	400	310	<5.0	<0.5	1.2	<1.5	<2.5	-	-	-	-	-	-
MW-4	02/03/2011 ¹	16.98	7.43	9.55	160	55	1.6	<0.5	<0.5	<1.5	<2.5	75,000	<250	52,600	309,000	<460	4,100
MW-4	05/04/2011 ^{1,7}	16.98	6.32	10.66	<50	<50	<0.5	<0.5	<0.5	<1.5	<2.5	76,000	<250	16,700	183,000	<460	2,600
MW-4	08/04/2011 ¹	16.98	7.90	9.08	940	590	110	9.0	10	4.6	4.4	130,000	<250	68,900	361,000	<460	4,200
MW-4	02/29/2012 ^{1,9}	16.98	8.34	8.64	270/<50	130	<0.5	<0.5	0.6	<1.5	<2.5	-	-	-	-	-	-
MW-4	08/07/2012 ^{1,9}	16.98	8.67	8.31	700/54	400	20	<0.5	3.1	<1.5	5.3	-	-	-	-	-	-
MW-4	02/18/2013 ¹	16.98	7.52	9.46	600 / <50	100	<0.5	<0.5	<0.5	<1.5	<2.5	-	-	-	-	-	-
MW-4	09/27/2013 ^{1,9}	16.98	9.57	7.41	650 / <50	370	0.8	0.3	0.7	<3.0	<0.3	-	-	-	-	-	-
MW-4	01/31/2014^{1,9}	16.98	10.11	6.87	6,600 / 3,200	90	<0.5	<0.5	<0.5	<1.5	<2.5	-	-	-	-	-	-
MW-5	09/03/2010 ¹	17.68	9.28	8.40	62	<50	<0.5	<0.5	<0.5	<1.5	<2.5	-	-	-	-	-	-
MW-5	02/03/2011 ¹	17.68	7.83	9.85	<50	<50	<0.5	<0.5	<0.5	<1.5	<2.5	-	-	-	-	-	-
MW-5	05/04/2011 ¹	17.68	-	-	-	-	-	-	-	-	-	-	-	-	-	-	-
MW-5	08/04/2011 ¹	17.68	8.38	9.30	<50	<50	<0.5	<0.5	<0.5	<1.5	<2.5	-	-	-	-	-	-
MW-5	02/29/2012 ^{1,9}	17.68	9.42	8.26	<50/53	<50	<0.5	<0.5	<0.5	<1.5	<2.5	-	-	-	-	-	-
MW-5	08/07/2012 ^{1,9}	17.68	9.18	8.50	<50/<50	<50	<0.5	<0.5	<0.5	<1.5	<2.5	-	-	-	-	-	-
MW-5	02/18/2013 ¹	17.68	7.91	9.77	<50 / <50	<50	<0.5	<0.5	<0.5	<1.5	<2.5	-	-	-	-	-	-
MW-5	09/27/2013 ^{1,9}	17.68	10.08	7.60	<50 / <50	<50	<0.2	<0.2	<0.2	<0.6	<0.3	-	-	-	-	-	-
MW-5	01/31/2014^{1,9}	17.68	11.32	6.36	<50 / <50	<50	<0.5	<0.5	<0.5	<1.5	<2.5	-	-	-	-	-	-

TABLE 1

GROUNDWATER MONITORING AND SAMPLING DATA
 FORMER SIGNAL OIL SERVICE STATION 206145
 800 CENTER STREET
 OAKLAND, CALIFORNIA

Location	Date	TOC	DTW	GWE	HYDROCARBONS		PRIMARY VOCs					GENERAL CHEMISTRY					
					TPH-DRO w/ Si Gel	TPH-GRO	B	T	E	X	MTBE by SW8021	Carbon dioxide	Nitrate Nitrogen	Sulfate	Alkalinity to pH 4.5	Alkalinity to pH 8.3	Ferrous Iron
	Units	ft	ft	ft-amsl	µg/L	µg/L	µg/L	µg/L	µg/L	µg/L	µg/L	µg/L	µg/L	µg/L	µg/L	µg/L	µg/L
MW-6	09/03/2010 ¹	17.33	9.13	8.20	<50	<50	<0.5	<0.5	<0.5	<1.5	<2.5	-	-	-	-	-	-
MW-6	02/03/2011 ¹	17.33	7.65	9.68	<50	<50	<0.5	<0.5	<0.5	<1.5	<2.5	-	-	-	-	-	-
MW-6	05/04/2011 ¹	17.33	-	-	-	-	-	-	-	-	-	-	-	-	-	-	-
MW-6	08/04/2011 ¹	17.33	8.30	9.03	<50	<50	<0.5	<0.5	<0.5	<1.5	<2.5	-	-	-	-	-	-
MW-6	02/29/2012 ^{1,9}	17.33	9.30	8.03	<50/<50	<50	<0.5	<0.5	<0.5	<1.5	<2.5	-	-	-	-	-	-
MW-6	08/07/2012 ^{1,9}	17.33	9.06	8.27	74/<50	<50	<0.5	<0.5	<0.5	<1.5	<2.5	-	-	-	-	-	-
MW-6	02/18/2013 ¹	17.33	7.83	9.50	<50 / <50	<50	<0.5	<0.5	<0.5	<1.5	<2.5	-	-	-	-	-	-
MW-6	09/27/2013 ^{1,9}	17.33	9.88	7.45	<50 / <50	<50	<0.2	<0.2	<0.2	<0.6	<0.3	-	-	-	-	-	-
MW-6	01/31/2014^{1,9}	17.33	10.51	6.82	<160 / <160	<50	<0.5	<0.5	<0.5	<1.5	<2.5	-	-	-	-	-	-
MW-7	09/03/2010 ¹	19.26	10.74	8.52	<50	<50	<0.5	<0.5	<0.5	<1.5	<2.5	-	-	-	-	-	-
MW-7	02/03/2011 ¹	19.26	9.20	10.06	220	<50	<0.5	<0.5	<0.5	<1.5	<2.5	-	-	-	-	-	-
MW-7	05/04/2011 ¹	19.26	-	-	-	-	-	-	-	-	-	-	-	-	-	-	-
MW-7	08/04/2011 ¹	19.26	9.91	9.35	<50	<50	<0.5	<0.5	<0.5	<1.5	<2.5	-	-	-	-	-	-
MW-7	02/29/2012 ^{1,9}	19.26	10.90	8.36	350/<50	<50	<0.5	<0.5	<0.5	<1.5	<2.5	-	-	-	-	-	-
MW-7	08/07/2012 ^{1,9}	19.26	10.67	8.59	96/63	<50	<0.5	<0.5	<0.5	<1.5	<2.5	-	-	-	-	-	-
MW-7	02/18/2013 ¹	19.26	9.31	9.95	520 / 130	<50	<0.5	<0.5	<0.5	<1.5	<2.5	-	-	-	-	-	-
MW-7	09/27/2013 ^{1,9}	19.26	11.57	7.69	1,200 / 880	<50	<0.2	<0.2	<0.2	<0.6	<0.3	-	-	-	-	-	-
MW-7	01/31/2014^{1,9}	19.26	12.15	7.11	2,900 / 1,100	<50	<0.5	<0.5	<0.5	<1.5	<2.5	-	-	-	-	-	-
MW-8	09/03/2010 ¹	17.79	9.75	8.04	<50	<50	<0.5	<0.5	<0.5	<1.5	<2.5	-	-	-	-	-	-
MW-8	02/03/2011 ¹	17.79	8.46	9.33	<50	<50	<0.5	<0.5	<0.5	<1.5	<2.5	-	-	-	-	-	-
MW-8	05/04/2011 ¹	17.79	-	-	-	-	-	-	-	-	-	-	-	-	-	-	-
MW-8	08/04/2011 ¹	17.79	8.98	8.81	<50	<50	<0.5	<0.5	<0.5	<1.5	<2.5	-	-	-	-	-	-
MW-8	02/29/2012 ^{1,9}	17.79	9.90	7.89	<50/<50	<50	<0.5	<0.5	<0.5	<1.5	<2.5	-	-	-	-	-	-
MW-8	08/07/2012 ^{1,9}	17.79	9.71	8.08	<50/<50	<50	<0.5	<0.5	<0.5	<1.5	<2.5	-	-	-	-	-	-

TABLE 1

GROUNDWATER MONITORING AND SAMPLING DATA
 FORMER SIGNAL OIL SERVICE STATION 206145
 800 CENTER STREET
 OAKLAND, CALIFORNIA

Location	Date	TOC	DTW	GWE	HYDROCARBONS		PRIMARY VOCs					GENERAL CHEMISTRY					
					TPH-DRO w/ Si Gel	TPH-GRO	B	T	E	X	MTBE by SW8021	Carbon dioxide	Nitrate Nitrogen	Sulfate	Alkalinity to pH 4.5	Alkalinity to pH 8.3	Ferrous Iron
	Units	ft	ft	ft-amsl	µg/L	µg/L	µg/L	µg/L	µg/L	µg/L	µg/L	µg/L	µg/L	µg/L	µg/L	µg/L	µg/L
MW-8	02/18/2013 ¹	17.79	8.58	9.21	<50 / <50	<50	<0.5	<0.5	<0.5	<1.5	<2.5	-	-	-	-	-	-
MW-8	09/27/2013 ^{1,9}	17.79	10.48	7.31	88 / <50	<50	<0.2	<0.2	<0.2	<0.6	<0.3	-	-	-	-	-	-
MW-8	01/31/2014^{1,10}	17.79	-	-	-	-	-	-	-	-	-	-	-	-	-	-	-
MW-9	09/03/2010 ²	18.42	10.01	8.41	95	<50	<0.5	<0.5	<0.5	<1.5	-	-	-	-	-	-	-
MW-9	02/03/2011 ^{2,4,5}	18.42	-	-	-	-	-	-	-	-	-	-	-	-	-	-	-
MW-9	05/04/2011 ^{2,4,5}	18.42	-	-	-	-	-	-	-	-	-	-	-	-	-	-	-
MW-9	08/04/2011 ^{2,4,5}	18.42	9.13	9.29	-	-	-	-	-	-	-	-	-	-	-	-	-
MW-9	02/29/2012 ^{2,4,5}	18.42	-	-	-	-	-	-	-	-	-	-	-	-	-	-	-
MW-9	08/07/2012 ^{2,4,5,9}	18.42	9.98	8.44	61 / <50	<50	<0.5	<0.5	<0.5	<1.5	-	-	-	-	-	-	-
MW-9	02/18/2013 ^{2,4,5}	18.42	-	-	-	-	-	-	-	-	-	-	-	-	-	-	-
MW-9	09/27/2013 ^{2,4,5}	18.42	10.78	7.64	-	-	-	-	-	-	-	-	-	-	-	-	-
MW-9	01/31/2014^{2,4,5}	18.42	-	-	-	-	-	-	-	-	-	-	-	-	-	-	-
MW-10	09/03/2010 ³	17.99	10.35	7.64	<50	<50	<0.5	<0.5	<0.5	<1.5	-	-	-	-	-	-	-
MW-10	02/03/2011 ^{3,4,5}	17.99	-	-	-	-	-	-	-	-	-	-	-	-	-	-	-
MW-10	05/04/2011 ^{3,4,5}	17.99	-	-	-	-	-	-	-	-	-	-	-	-	-	-	-
MW-10	08/04/2011 ^{3,4,5}	17.99	10.60	7.39	-	-	-	-	-	-	-	-	-	-	-	-	-
MW-10	02/29/2012 ^{3,4,5}	17.99	-	-	-	-	-	-	-	-	-	-	-	-	-	-	-
MW-10	08/07/2012 ^{3,4,5,9}	17.99	10.14	7.85	59 / <50	<50	<0.5	<0.5	<0.5	<1.5	-	-	-	-	-	-	-
MW-10	02/18/2013 ^{3,4,5}	17.99	-	-	-	-	-	-	-	-	-	-	-	-	-	-	-
MW-10	09/27/2013 ^{3,4,5}	17.99	11.22	6.77	-	-	-	-	-	-	-	-	-	-	-	-	-
MW-10	01/31/2014^{3,4,5}	17.99	-	-	-	-	-	-	-	-	-	-	-	-	-	-	-
MW-11	09/03/2010 ²	18.68	10.21	8.47	<50	<50	<0.5	<0.5	<0.5	<1.5	-	-	-	-	-	-	-
MW-11	02/03/2011 ^{2,4,5}	18.68	-	-	-	-	-	-	-	-	-	-	-	-	-	-	-

TABLE 1

GROUNDWATER MONITORING AND SAMPLING DATA
 FORMER SIGNAL OIL SERVICE STATION 206145
 800 CENTER STREET
 OAKLAND, CALIFORNIA

Location	Date	TOC	DTW	GWE	HYDROCARBONS		PRIMARY VOCs					GENERAL CHEMISTRY					
					TPH-DRO w/ Si Gel	TPH-GRO	B	T	E	X	MTBE by SW8021	Carbon dioxide	Nitrate Nitrogen	Sulfate	Alkalinity to pH 4.5	Alkalinity to pH 8.3	Ferrous Iron
	Units	ft	ft	ft-amsl	µg/L	µg/L	µg/L	µg/L	µg/L	µg/L	µg/L	µg/L	µg/L	µg/L	µg/L	µg/L	µg/L
MW-11	05/04/2011 ^{2,4,5}	18.68	-	-	-	-	-	-	-	-	-	-	-	-	-	-	-
MW-11	08/04/2011 ^{2,4,5}	18.68	9.35	9.33	-	-	-	-	-	-	-	-	-	-	-	-	-
MW-11	02/29/2012 ^{2,4,5}	18.68	-	-	-	-	-	-	-	-	-	-	-	-	-	-	-
MW-11	08/07/2012 ^{2,4,5,9}	18.68	10.15	8.53	<50/<50	<50	<0.5	<0.5	<0.5	<1.5	-	-	-	-	-	-	-
MW-11	02/18/2013 ^{2,4,5}	18.68	-	-	-	-	-	-	-	-	-	-	-	-	-	-	-
MW-11	09/27/2013 ^{2,4,5}	18.68	11.00	7.68	-	-	-	-	-	-	-	-	-	-	-	-	-
MW-11	01/31/2014^{2,4,5}	18.68	-	-	-	-	-	-	-	-	-	-	-	-	-	-	-
MW-12	09/03/2010 ³	18.46	11.05	7.41	65	<50	<0.5	<0.5	<0.5	<1.5	-	-	-	-	-	-	-
MW-12	02/03/2011 ^{3,4,5}	18.46	-	-	-	-	-	-	-	-	-	-	-	-	-	-	-
MW-12	05/04/2011 ^{3,4,5}	18.46	-	-	-	-	-	-	-	-	-	-	-	-	-	-	-
MW-12	08/04/2011 ^{3,4,5}	18.46	9.63	8.83	-	-	-	-	-	-	-	-	-	-	-	-	-
MW-12	02/29/2012 ^{3,4,5}	18.46	-	-	-	-	-	-	-	-	-	-	-	-	-	-	-
MW-12	08/07/2012 ^{3,4,5,9}	18.46	10.68	7.78	<50/<50	<50	<0.5	<0.5	<0.5	<1.5	-	-	-	-	-	-	-
MW-12	02/18/2013 ^{3,4,5}	18.46	-	-	-	-	-	-	-	-	-	-	-	-	-	-	-
MW-12	09/27/2013 ^{3,4,5}	18.46	11.56	6.90	-	-	-	-	-	-	-	-	-	-	-	-	-
MW-12	01/31/2014^{3,4,5}	18.46	-	-	-	-	-	-	-	-	-	-	-	-	-	-	-
MW-13	09/03/2010 ²	18.43	10.09	8.34	58	<50	<0.5	<0.5	<0.5	<1.5	-	-	-	-	-	-	-
MW-13	02/03/2011 ^{2,4,5}	18.43	-	-	-	-	-	-	-	-	-	-	-	-	-	-	-
MW-13	05/04/2011 ^{2,4,5}	18.43	-	-	-	-	-	-	-	-	-	-	-	-	-	-	-
MW-13	08/04/2011 ^{2,4,5}	18.43	9.27	9.16	-	-	-	-	-	-	-	-	-	-	-	-	-
MW-13	02/29/2012 ^{2,4,5}	18.43	-	-	-	-	-	-	-	-	-	-	-	-	-	-	-
MW-13	08/07/2012 ^{2,4,5,9}	18.43	10.03	8.40	<50/<50	<50	<0.5	<0.5	<0.5	<1.5	-	-	-	-	-	-	-
MW-13	02/18/2013 ^{2,4,5}	18.43	-	-	-	-	-	-	-	-	-	-	-	-	-	-	-
MW-13	09/27/2013 ^{2,4,5}	18.43	10.87	7.56	-	-	-	-	-	-	-	-	-	-	-	-	-

TABLE 1

GROUNDWATER MONITORING AND SAMPLING DATA
 FORMER SIGNAL OIL SERVICE STATION 206145
 800 CENTER STREET
 OAKLAND, CALIFORNIA

Location	Date	TOC	DTW	GWE	HYDROCARBONS		PRIMARY VOCs					GENERAL CHEMISTRY					
					TPH-DRO <i>cp/Si Gal</i>	TPH-GRO	B	T	E	X	MTBE by SW8021	Carbon dioxide	Nitrate Nitrogen	Sulfate	Alkalinity to pH 4.5	Alkalinity to pH 8.3	Ferrous Iron
Units		ft	ft	ft-amsl	µg/L	µg/L	µg/L	µg/L	µg/L	µg/L	µg/L	µg/L	µg/L	µg/L	µg/L	µg/L	µg/L
MW-13	01/31/2014 ^{2,4,5}	18.43	-	-	-	-	-	-	-	-	-	-	-	-	-	-	-
MW-14	09/03/2010 ³	18.59	11.52	7.07	<50	<50	<0.5	<0.5	<0.5	<1.5	-	-	-	-	-	-	-
MW-14	02/03/2011 ^{3,4,5}	18.59	-	-	-	-	-	-	-	-	-	-	-	-	-	-	-
MW-14	05/04/2011 ^{3,4,5}	18.59	-	-	-	-	-	-	-	-	-	-	-	-	-	-	-
MW-14	08/04/2011 ^{3,4,5}	18.59	9.99	8.60	-	-	-	-	-	-	-	-	-	-	-	-	-
MW-14	02/29/2012 ^{3,4,5}	18.59	-	-	-	-	-	-	-	-	-	-	-	-	-	-	-
MW-14	08/07/2012 ^{3,4,5,9}	18.59	10.79	7.80	61/<50	<50	<0.5	<0.5	<0.5	<1.5	-	-	-	-	-	-	-
MW-14	02/18/2013 ^{3,4,5}	18.59	-	-	-	-	-	-	-	-	-	-	-	-	-	-	-
MW-14	09/27/2013 ^{3,4,5}	18.59	11.76	6.83	-	-	-	-	-	-	-	-	-	-	-	-	-
MW-14	01/31/2014 ^{3,4,5}	18.59	-	-	-	-	-	-	-	-	-	-	-	-	-	-	-
MW-15	09/03/2010 ²	18.38	9.95	8.43	<50	<50	<0.5	<0.5	<0.5	<1.5	-	-	-	-	-	-	-
MW-15	02/03/2011 ^{2,4,5}	18.38	-	-	-	-	-	-	-	-	-	-	-	-	-	-	-
MW-15	05/04/2011 ^{2,4,5}	18.38	-	-	-	-	-	-	-	-	-	-	-	-	-	-	-
MW-15	08/04/2011 ^{2,4,5}	18.38	9.13	9.25	-	-	-	-	-	-	-	-	-	-	-	-	-
MW-15	02/29/2012 ^{2,4,5}	18.38	-	-	-	-	-	-	-	-	-	-	-	-	-	-	-
MW-15	08/07/2012 ^{2,4,5,9}	18.38	9.91	8.47	<50/100	<50	<0.5	<0.5	<0.5	<1.5	-	-	-	-	-	-	-
MW-15	02/18/2013 ^{2,4,5}	18.38	-	-	-	-	-	-	-	-	-	-	-	-	-	-	-
MW-15	09/27/2013 ^{2,4,5}	18.38	10.72	7.66	-	-	-	-	-	-	-	-	-	-	-	-	-
MW-15	01/31/2014 ^{2,4,5}	18.38	-	-	-	-	-	-	-	-	-	-	-	-	-	-	-
MW-16	09/03/2010 ³	18.57	10.95	7.62	<50	<50	<0.5	<0.5	<0.5	<1.5	-	-	-	-	-	-	-
MW-16	02/03/2011 ^{3,4,5}	18.57	-	-	-	-	-	-	-	-	-	-	-	-	-	-	-
MW-16	05/04/2011 ^{3,4,5}	18.57	-	-	-	-	-	-	-	-	-	-	-	-	-	-	-
MW-16	08/04/2011 ^{3,4,5}	18.57	10.13	8.44	-	-	-	-	-	-	-	-	-	-	-	-	-

TABLE 1

GROUNDWATER MONITORING AND SAMPLING DATA
 FORMER SIGNAL OIL SERVICE STATION 206145
 800 CENTER STREET
 OAKLAND, CALIFORNIA

Location	Date	TOC	DTW	GWE	HYDROCARBONS		PRIMARY VOCs					GENERAL CHEMISTRY					
					TPH-DRO w/ Si Gel	TPH-GRO	B	T	E	X	MIBE by SW8021	Carbon dioxide	Nitrate Nitrogen	Sulfate	Alkalinity to pH 4.5	Alkalinity to pH 8.3	Ferrous Iron
	Units	ft	ft	ft-amsl	µg/L	µg/L	µg/L	µg/L	µg/L	µg/L	µg/L	µg/L	µg/L	µg/L	µg/L	µg/L	µg/L
MW-16	02/29/2012 ^{3,4,5}	18.57	-	-	-	-	-	-	-	-	-	-	-	-	-	-	-
MW-16	08/07/2012 ^{3,4,5,9}	18.57	10.83	7.74	<50/<50	<50	<0.5	<0.5	<0.5	<1.5	-	-	-	-	-	-	-
MW-16	02/18/2013 ^{3,4,5}	18.57	-	-	-	-	-	-	-	-	-	-	-	-	-	-	-
MW-16	09/27/2013 ^{3,4,5}	18.57	11.69	6.88	-	-	-	-	-	-	-	-	-	-	-	-	-
MW-16	01/31/2014^{3,4,5}	18.57	-	-	-	-	-	-	-	-	-	-	-	-	-	-	-
MW-17	09/03/2010 ³	18.55	10.81	7.74	67	<50	<0.5	<0.5	<0.5	<1.5	-	-	-	-	-	-	-
MW-17	02/03/2011 ^{3,4,5}	18.55	-	-	-	-	-	-	-	-	-	-	-	-	-	-	-
MW-17	05/04/2011 ^{3,4,5}	18.55	-	-	-	-	-	-	-	-	-	-	-	-	-	-	-
MW-17	08/04/2011 ^{3,4,5}	18.55	10.00	8.55	-	-	-	-	-	-	-	-	-	-	-	-	-
MW-17	02/29/2012 ^{3,4,5}	18.55	-	-	-	-	-	-	-	-	-	-	-	-	-	-	-
MW-17	08/07/2012 ^{3,4,5,9}	18.55	10.78	7.77	<50/<50	<50	<0.5	<0.5	<0.5	<1.5	-	-	-	-	-	-	-
MW-17	02/18/2013 ^{3,4,5}	18.55	-	-	-	-	-	-	-	-	-	-	-	-	-	-	-
MW-17	09/27/2013 ^{3,4,5}	18.55	11.55	7.00	-	-	-	-	-	-	-	-	-	-	-	-	-
MW-17	01/31/2014^{3,4,5}	18.55	-	-	-	-	-	-	-	-	-	-	-	-	-	-	-
AS-1	01/31/2014 ⁸	-	-	-	-	-	-	-	-	-	-	-	-	-	-	-	-
AS-2	01/31/2014 ⁸	-	-	-	-	-	-	-	-	-	-	-	-	-	-	-	-
AS-3	01/31/2014 ⁸	-	-	-	-	-	-	-	-	-	-	-	-	-	-	-	-
AS-4	01/31/2014 ⁸	-	-	-	-	-	-	-	-	-	-	-	-	-	-	-	-
AS-5	01/31/2014 ⁸	-	-	-	-	-	-	-	-	-	-	-	-	-	-	-	-
AS-6	01/31/2014 ⁸	-	-	-	-	-	-	-	-	-	-	-	-	-	-	-	-

TABLE 1

GROUNDWATER MONITORING AND SAMPLING DATA
 FORMER SIGNAL OIL SERVICE STATION 206145
 800 CENTER STREET
 OAKLAND, CALIFORNIA

Location	Date	TOC	DTW	GWE	HYDROCARBONS		PRIMARY VOCS					GENERAL CHEMISTRY					
					TPH-DRO w/ Si Gel	TPH-GRO	B	T	E	X	MTBE by SW8021	Carbon dioxide	Nitrate Nitrogen	Sulfate	Alkalinity to pH 4.5	Alkalinity to pH 8.3	Ferrous Iron
	Units	ft	ft	ft-amsl	µg/L	µg/L	µg/L	µg/L	µg/L	µg/L	µg/L	µg/L	µg/L	µg/L	µg/L	µg/L	µg/L
AS-7	01/31/2014 ⁸	-	-	-	-	-	-	-	-	-	-	-	-	-	-	-	-
AS-8	01/31/2014 ⁸	-	-	-	-	-	-	-	-	-	-	-	-	-	-	-	-
QA	09/03/2010	-	-	-	-	<50	<0.5	<0.5	<0.5	<1.5	<2.5	-	-	-	-	-	-
QA	02/03/2011	-	-	-	-	<50	<0.5	<0.5	<0.5	<1.5	<2.5	-	-	-	-	-	-
QA	05/04/2011	-	-	-	-	<50	<0.5	<0.5	<0.5	<1.5	<2.5	-	-	-	-	-	-
QA	08/04/2011	-	-	-	-	<50	<0.5	<0.5	<0.5	<1.5	<2.5	-	-	-	-	-	-
QA	02/29/2012	-	-	-	-	<50	<0.5	<0.5	<0.5	<1.5	<2.5	-	-	-	-	-	-
QA	08/07/2012	-	-	-	-	<50	<0.5	<0.5	<0.5	<1.5	<2.5	-	-	-	-	-	-
QA	02/18/2013	-	-	-	-	<50	<0.5	<0.5	<0.5	<1.5	<2.5	-	-	-	-	-	-
QA	09/27/2013	-	-	-	-	<50	<0.2	<0.2	<0.2	<0.6	<0.3	-	-	-	-	-	-
QA	01/31/2014	-	-	-	-	<50	<0.5	<0.5	<0.5	<1.5	<2.5	-	-	-	-	-	-

Abbreviations and Notes:

TOC = Top of casing

DTW = Depth to water

GWE = Groundwater elevation

(ft-amsl) = Feet above mean sea level

ft = Feet

µg/L = Micrograms per liter

TPH-DRO = Total petroleum hydrocarbons - diesel range organics

TPH-GRO = Total petroleum hydrocarbons - gasoline range organics

VOCS = Volatile organic compounds

B = Benzene

TABLE 1

GROUNDWATER MONITORING AND SAMPLING DATA
 FORMER SIGNAL OIL SERVICE STATION 206145
 800 CENTER STREET
 OAKLAND, CALIFORNIA

Location	Date	TOC	DTW	GWE	HYDROCARBONS		PRIMARY VOCS					GENERAL CHEMISTRY					
					TPH-DRO w/ Si Gel	TPH-GRO	B	T	E	X	MTBE by SW8021	Carbon dioxide	Nitrate Nitrogen	Sulfate	Alkalinity to pH 4.5	Alkalinity to pH 8.3	Ferrous Iron
	Units	ft	ft	ft-amsl	µg/L	µg/L	µg/L	µg/L	µg/L	µg/L	µg/L	µg/L	µg/L	µg/L	µg/L	µg/L	µg/L

T = Toluene

E = Ethylbenzene

X = Xylene's (total)

MTBE = Methyl tert butyl ether

-- = Not available / not applicable

<x = Not detected at or above laboratory method detection limit

- 1 Shallow Well
- 2 Intermediate Well
- 3 Deep Well
- 4 Monitored annually during the third quarter
- 5 Sampled bi-annually during the third quarter
- 6 Not able to access well. Well connected to Air Sparge System
- 7 Special Sampling Event
- 8 Not monitored or sampled.
- 9 TPHd with silica gel / TPHd with silica gel (reverse surrogate, capric acid, was present at <1%)
- 10 Unable to access.

ATTACHMENT A

MONITORING DATA PACKAGE



TRANSMITTAL

February 14, 2014

G-R #386492

TO: Mr. Nate Allen
Conestoga-Rovers and Associates
5900 Hollis Street, Suite A
Emeryville, CA 94608

FROM: Deanna L. Harding
Project Coordinator
Gettler-Ryan Inc.
6805 Sierra Court, Suite G
Dublin, California 94568

**RE: Former Chevron (Signal Oil)
Service Station #206145 (S-800)
800 Center Street
Oakland, California
RO 0000454**

WE HAVE ENCLOSED THE FOLLOWING:

COPIES	DESCRIPTION
VIA PDF	Groundwater Monitoring and Sampling Data Package First Semi-Annual Event of January 31, 2014

COMMENTS:

Pursuant to your request, we are providing you with copies of the above referenced data for your use.

Please provide us the updated historical data prior to the next monitoring and sampling event for our field use.

Please feel free to contact me if you have any comments/questions.

trans/206145

WELL CONDITION STATUS SHEET

Client/Facility #: **Chevron #206145**
 Site Address: **800 Center Street**
 City: **Oakland, CA**

Job #: **386492**
 Event Date: **1-31-14**
 Sampler: **BW**

WELL ID	Vault Frame Condition	Gasket/O-Ring (M) Missing (R) Replaced	BOLTS (M) Missing (R) Replaced	Bolt Flanges B=Broken S=Stripped R=Retap	APRON Condition C=Cracked B=Broken G=Gone	Grout Seal (Deficient) inches from TOC	Casing (Condition prevents tight cap seal)	REPLACE LOCK Y/N	REPLACE CAP Y/N	WELL VAULT Manufacture/Size/ # of Bolts	Pictures Taken Y/N
MW-5	OK	→	→	2S	OK	→		N	N	Morrison / 8" / 2	N
MW-6	OK	→	→	2S	OK	→		↓	↓	↓	↓
MW-4	OK	→	→	2S	OK	→		↓	↓	↓	↓
MW-8	OK	→	→	UTA							Y
MW-7	OK	→	→			→		N	N	Emco / 8" / 2	N
MW-1A	OK	→	1M	1B	OK	→		↓	↓	Morrison / 6" / 2	↓
MW-3	OK	→	3M	3B	OK	→		↓	↓	BL / 8" / 3	↓
MW-2	OK	→	→	2S	OK	→		↓	↓	Morrison / 8" / 2	↓

Comments _____

STANDARD OPERATING PROCEDURE - GROUNDWATER SAMPLING

Gettler-Ryan Inc. (GR) field personnel adhere to the following procedures for the collection and handling of groundwater samples prior to analysis by the analytical laboratory. All work is performed in accordance with the GR Health & Safety Plan and all client-specific programs. The scope of work and type of analysis to be performed is determined prior to commencing field work.

Prior to sampling, the presence or absence of free-phase hydrocarbons is determined using an interface probe. Product thickness, if present, is measured to the nearest 0.01 foot and is noted in the field notes. In addition, all depth to water level measurements are collected with a static water level indicator and are also recorded in the field notes, prior to purging and sampling any wells.

After water levels are collected and prior to sampling, if purging is to occur, each well is purged a minimum of three well casing volumes of water using pre-cleaned pumps (stack, peristaltic or Grundfos), or disposable bailers. Temperature, pH and electrical conductivity are measured a minimum of three times during the purging (additional parameters such as dissolved oxygen, oxidation reduction potential, turbidity may also be measured, depending on specific scope of work.). Purging continues until these parameters stabilize.

Groundwater samples are collected using disposable bailers. The water samples are transferred from the bailer into appropriate containers. Pre-preserved containers, supplied by analytical laboratories, are used. When pre-preserved containers are not available, the laboratory is instructed to preserve the sample as appropriate. Duplicate samples are collected for the laboratory to use in maintaining quality assurance/quality control standards, as directed by the scope of work. The samples are labeled to include the job number, sample identification, collection date and time, analysis, preservation (if any), and the sample collector's initials. The water samples are placed in a cooler, maintained at 4°C for transport to the laboratory. Once collected in the field, all samples are maintained under chain of custody until delivered to the laboratory.

The chain of custody document includes the job number, type of preservation, if any, analysis requested, sample identification, date and time collected, and the sample collector's name. The chain of custody is signed and dated (including time of transfer) by each person who receives or surrenders the samples, beginning with the field personnel and ending with the laboratory personnel.

A laboratory supplied trip blank accompanies each sampling set. The trip blank is analyzed for some or all of the same compounds as the groundwater samples.

As requested by Chevron Environmental Management Company, the purge water and decontamination water generated during sampling activities is transported by Clean Harbors Environmental Services to Seaport Environmental located in Redwood City, California.



GETTLER-RYAN Inc.

WELL MONITORING/SAMPLING FIELD DATA SHEET

Client/Facility#: Chevron #206145 Job Number: 386492
 Site Address: 800 Center Street Event Date: 1-31-14 (inclusive)
 City: Oakland, CA Sampler: BW

Well ID: MW-1A Date Monitored: 1-31-14
 Well Diameter: 2
 Total Depth: 16.68 ft.
 Depth to Water: 11.15 ft. Check if water column is less than 0.50 ft.
5.53 x VF .17 = 0.94 x3 case volume = Estimated Purge Volume: 3.0 gal.

Volume	3/4" = 0.02	1" = 0.04	2" = 0.17	3" = 0.38
Factor (VF)	4" = 0.66	5" = 1.02	6" = 1.50	12" = 5.80

Depth to Water w/ 80% Recharge [(Height of Water Column x 0.20) + DTW]: 12.25

Purge Equipment:
 Disposable Bailer
 Stainless Steel Bailer _____
 Stack Pump _____
 Suction Pump _____
 Grundfos _____
 Peristaltic Pump _____
 QED Bladder Pump _____
 Other: _____

Sampling Equipment:
 Disposable Bailer
 Pressure Bailer _____
 Metal Filters _____
 Peristaltic Pump _____
 QED Bladder Pump _____
 Other: _____

Time Started: _____ (2400 hrs)
 Time Completed: _____ (2400 hrs)
 Depth to Product: _____ ft
 Depth to Water: _____ ft
 Hydrocarbon Thickness: _____ ft
 Visual Confirmation/Description: _____
 Skimmer / Absorbant Sock (circle one)
 Amt Removed from Skimmer: _____ gal
 Amt Removed from Well: _____ gal
 Water Removed: _____

Start Time (purge): 0900 Weather Conditions: Sunny
 Sample Time/Date: 0926 / 1-31-14 Water Color: Cloudy Odor: Y / N
 Approx. Flow Rate: _____ gpm. Sediment Description: Moderate
 Did well de-water? N If yes, Time: _____ Volume: _____ gal. DTW @ Sampling: 1211

Time (2400 hr.)	Volume (gal.)	pH	Conductivity (µmhos/cm - µS)	Temperature (°C / F)	D.O. (mg/L)	ORP (mV)
<u>0903</u>	<u>1.0</u>	<u>7.16</u>	<u>1.15</u>	<u>15.5</u>		
<u>0906</u>	<u>2.0</u>	<u>7.17</u>	<u>1.20</u>	<u>15.6</u>		
<u>0910</u>	<u>3.0</u>	<u>7.19</u>	<u>1.22</u>	<u>15.8</u>		

LABORATORY INFORMATION

SAMPLE ID	(#) CONTAINER	REFRIG.	PRESERV. TYPE	LABORATORY	ANALYSES
MW-1A	3 x voa vial	YES	HCL	LANCASTER	TPH-GRO(8015)/BTEX+MTBE(8021)
	x voa vial	YES	HCL	LANCASTER	TPH-GRO(8015)/BTEX(8021)
	2 x 500ml ambers	YES	NP	LANCASTER	TPH-DRO w/sgc COLUMN/ TPH-DRO w/sgc (8015)

COMMENTS: _____

Add/Replaced Lock: _____ Add/Replaced Plug: _____ Add/Replaced Bolt: _____



GETTLER-RYAN INC.

WELL MONITORING/SAMPLING FIELD DATA SHEET

Client/Facility#: Chevron #206145 Job Number: 386492
 Site Address: 800 Center Street Event Date: 1-31-14 (inclusive)
 City: Oakland, CA Sampler: AW

Well ID: MW-2 Date Monitored: 1-31-14

Well Diameter: 2

Total Depth: 13.42 ft.

Volume	3/4"= 0.02	1"= 0.04	2"= 0.17	3"= 0.38
Factor (VF)	4"= 0.66	5"= 1.02	6"= 1.50	12"= 5.80

Depth to Water: 11.54 ft. Check if water column is less than 0.50 ft.

1.88 x VF .17 = 0.31 x3 case volume = Estimated Purge Volume: 1.0 gal.

Depth to Water w/ 80% Recharge [(Height of Water Column x 0.20) + DTW]: 11.91

Purge Equipment:

Disposable Bailer
 Stainless Steel Bailer _____
 Stack Pump _____
 Suction Pump _____
 Grundfos _____
 Peristaltic Pump _____
 QED Bladder Pump _____
 Other: _____

Sampling Equipment:

Disposable Bailer
 Pressure Bailer _____
 Metal Filters _____
 Peristaltic Pump _____
 QED Bladder Pump _____
 Other: _____

Time Started: _____ (2400 hrs)
 Time Completed: _____ (2400 hrs)
 Depth to Product: _____ ft
 Depth to Water: _____ ft
 Hydrocarbon Thickness: _____ ft
 Visual Confirmation/Description: _____
 Skimmer / Absorbant Sock (circle one)
 Amt Removed from Skimmer: _____ gal
 Amt Removed from Well: _____ gal
 Water Removed: _____

Start Time (purge): 1005 Weather Conditions: Sunny
 Sample Time/Date: 1030 / 1-31-14 Water Color: Cloudy Odor: Y / 10
 Approx. Flow Rate: - gpm. Sediment Description: Cloudy
 Did well de-water? If yes, Time: - Volume: - gal. DTW @ Sampling: 11.85

Time (2400 hr.)	Volume (gal.)	pH	Conductivity (µmhos/cm - 25°C)	Temperature (°C / F)	D.O. (mg/L)	ORP (mV)
<u>1008</u>	<u>0.25</u>	<u>6.95</u>	<u>0.95</u>	<u>14.9</u>		
<u>1011</u>	<u>0.5</u>	<u>7.02</u>	<u>0.99</u>	<u>15.3</u>		
<u>1014</u>	<u>1.0</u>	<u>7.05</u>	<u>1.02</u>	<u>15.6</u>		

LABORATORY INFORMATION

SAMPLE ID	(#) CONTAINER	REFRIG.	PRESERV. TYPE	LABORATORY	ANALYSES
<u>MW-2</u>	<u>3</u> x voa vial	<u>YES</u>	<u>HCL</u>	<u>LANCASTER</u>	<u>TPH-GRO(8015)/BTEX+MTBE(8021)</u>
	x voa vial	<u>YES</u>	<u>HCL</u>	<u>LANCASTER</u>	<u>TPH-GRO(8015)/BTEX(8021)</u>
	<u>2</u> x 500ml ambers	<u>YES</u>	<u>NP</u>	<u>LANCASTER</u>	<u>TPH-DRO w/sgc COLUMN/ TPH-DRO w/sgc (8015)</u>

COMMENTS: Roots in well.

Add/Replaced Lock: _____ Add/Replaced Plug: _____ Add/Replaced Bolt: _____



GETTLER-RYAN INC.

WELL MONITORING/SAMPLING FIELD DATA SHEET

Client/Facility#: Chevron #206145 Job Number: 386492
 Site Address: 800 Center Street Event Date: 1-31-14 (inclusive)
 City: Oakland, CA Sampler: AW

Well ID: MW-3 Date Monitored: 1-31-14
 Well Diameter: 2
 Total Depth: 14.03 ft.
 Depth to Water: 11.15 ft. Check if water column is less than 0.50 ft.
2.88 x VF .17 = 0.48 x3 case volume = Estimated Purge Volume: 1.5 gal.
 Depth to Water w/ 80% Recharge [(Height of Water Column x 0.20) + DTW]: 11.72

Volume	3/4"= 0.02	1"= 0.04	2"= 0.17	3"= 0.38
Factor (VF)	4"= 0.66	5"= 1.02	6"= 1.50	12"= 5.80

Purge Equipment:
 Disposable Bailer
 Stainless Steel Bailer _____
 Stack Pump _____
 Suction Pump _____
 Grundfos _____
 Peristaltic Pump _____
 QED Bladder Pump _____
 Other: _____

Sampling Equipment:
 Disposable Bailer
 Pressure Bailer _____
 Metal Filters _____
 Peristaltic Pump _____
 QED Bladder Pump _____
 Other: _____

Time Started: _____ (2400 hrs)
 Time Completed: _____ (2400 hrs)
 Depth to Product: _____ ft
 Depth to Water: _____ ft
 Hydrocarbon Thickness: _____ ft
 Visual Confirmation/Description: _____
 Skimmer / Absorbant Sock (circle one)
 Amt Removed from Skimmer: _____ gal
 Amt Removed from Well: _____ gal
 Water Removed: _____

Start Time (purge): 0935 Weather Conditions: Cloudy
 Sample Time/Date: 0955 / 1-31-14 Water Color: black Odor: DN / slight
 Approx. Flow Rate: - gpm. Sediment Description: moderate
 Did well de-water? N If yes, Time: _____ Volume: _____ gal. DTW @ Sampling: 11.60

Time (2400 hr.)	Volume (gal.)	pH	Conductivity (µmhos/cm - µS)	Temperature (°F)	D.O. (mg/L)	ORP (mV)
<u>0938</u>	<u>0.5</u>	<u>7.14</u>	<u>1.08</u>	<u>15.7</u>		
<u>0941</u>	<u>1.0</u>	<u>7.16</u>	<u>1.13</u>	<u>16.0</u>		
<u>0945</u>	<u>1.5</u>	<u>7.19</u>	<u>1.17</u>	<u>16.2</u>		

LABORATORY INFORMATION

SAMPLE ID	(#) CONTAINER	REFRIG.	PRESERV. TYPE	LABORATORY	ANALYSES
<u>MW-3</u>	<u>3</u> x voa vial	YES	HCL	LANCASTER	TPH-GRO(8015)/BTEX+MTBE(8021)
	x voa vial	YES	HCL	LANCASTER	TPH-GRO(8015)/BTEX(8021)
	<u>2</u> x 500ml ambers	YES	NP	LANCASTER	TPH-DRO w/sgc COLUMN/ TPH-DRO w/sgc (8015)

COMMENTS: _____

Add/Replaced Lock: _____ Add/Replaced Plug: _____ Add/Replaced Bolt: _____



GETTLER-RYAN Inc.

WELL MONITORING/SAMPLING FIELD DATA SHEET

Client/Facility#: Chevron #206145 Job Number: 386492
 Site Address: 800 Center Street Event Date: 1-31-14 (inclusive)
 City: Oakland, CA Sampler: AW

Well ID: MW-4 Date Monitored: 1-31-14
 Well Diameter: 2
 Total Depth: 13.22 ft.
 Depth to Water: 10.11 ft. Check if water column is less than 0.50 ft.
2.11 x VF .17 = 0.52 x3 case volume = Estimated Purge Volume: 20 gal.
 Depth to Water w/ 80% Recharge [(Height of Water Column x 0.20) + DTW]: 10.73

Volume	3/4"= 0.02	1"= 0.04	2"= 0.17	3"= 0.38
Factor (VF)	4"= 0.66	5"= 1.02	6"= 1.50	12"= 5.80

Purge Equipment:
 Disposable Bailer
 Stainless Steel Bailer _____
 Stack Pump _____
 Suction Pump _____
 Grundfos _____
 Peristaltic Pump _____
 QED Bladder Pump _____
 Other: _____

Sampling Equipment:
 Disposable Bailer
 Pressure Bailer _____
 Metal Filters _____
 Peristaltic Pump _____
 QED Bladder Pump _____
 Other: _____

Time Started: _____ (2400 hrs)
 Time Completed: _____ (2400 hrs)
 Depth to Product: _____ ft
 Depth to Water: _____ ft
 Hydrocarbon Thickness: _____ ft
 Visual Confirmation/Description: _____
 Skimmer / Absorbant Sock (circle one)
 Amt Removed from Skimmer: _____ gal
 Amt Removed from Well: _____ gal
 Water Removed: _____

Start Time (purge): 0745 Weather Conditions: Sunny
 Sample Time/Date: 0815 / 1-31-14 Water Color: Cloudy Odor: 0 / N Slight
 Approx. Flow Rate: _____ gpm. Sediment Description: moderate
 Did well de-water? N If yes, Time: _____ Volume: _____ gal. DTW @ Sampling: 10.55

Time (2400 hr.)	Volume (gal.)	pH	Conductivity (µmhos/cm - ^{ms} µS)	Temperature (°F)	D.O. (mg/L)	ORP (mV)
<u>0749</u>	<u>0.75</u>	<u>6.32</u>	<u>0.89</u>	<u>15.3</u>		
<u>0754</u>	<u>1.5</u>	<u>6.46</u>	<u>0.95</u>	<u>15.7</u>		
<u>0758</u>	<u>2.0</u>	<u>6.53</u>	<u>0.99</u>	<u>15.9</u>		

LABORATORY INFORMATION

SAMPLE ID	(#) CONTAINER	REFRIG.	PRESERV. TYPE	LABORATORY	ANALYSES
<u>MW-4</u>	<u>3</u> x voa vial	YES	HCL	LANCASTER	TPH-GRO(8015)/BTEX+MTBE(8021)
	x voa vial	YES	HCL	LANCASTER	TPH-GRO(8015)/BTEX(8021)
	<u>2</u> x 500ml ambers	YES	NP	LANCASTER	TPH-DRO w/sgc COLUMN/ TPH-DRO w/sgc (8015)

COMMENTS: Roots in well.

Add/Replaced Lock: _____ Add/Replaced Plug: _____ Add/Replaced Bolt: _____



GETTLER-RYAN INC.

WELL MONITORING/SAMPLING FIELD DATA SHEET

Client/Facility#: Chevron #206145 Job Number: 386492
 Site Address: 800 Center Street Event Date: 1-31-14 (inclusive)
 City: Oakland, CA Sampler: AW

Well ID: MW-5 Date Monitored: 1-31-14
 Well Diameter: 2
 Total Depth: 19.33 ft.
 Depth to Water: 11.32 ft. Check if water column is less than 0.50 ft.
8.01 x VF .17 = 1.36 x3 case volume = Estimated Purge Volume: 40 gal.
 Depth to Water w/ 80% Recharge [(Height of Water Column x 0.20) + DTW]: 12.92

Volume	3/4" = 0.02	1" = 0.04	2" = 0.17	3" = 0.38
Factor (VF)	4" = 0.66	5" = 1.02	6" = 1.50	12" = 5.80

Purge Equipment:
 Disposable Bailer
 Stainless Steel Bailer _____
 Stack Pump _____
 Suction Pump _____
 Grundfos _____
 Peristaltic Pump _____
 QED Bladder Pump _____
 Other: _____

Sampling Equipment:
 Disposable Bailer
 Pressure Bailer _____
 Metal Filters _____
 Peristaltic Pump _____
 QED Bladder Pump _____
 Other: _____

Time Started: _____ (2400 hrs)
 Time Completed: _____ (2400 hrs)
 Depth to Product: _____ ft
 Depth to Water: _____ ft
 Hydrocarbon Thickness: _____ ft
 Visual Confirmation/Description: _____
 Skimmer / Absorbant Sock (circle one)
 Amt Removed from Skimmer: _____ gal
 Amt Removed from Well: _____ gal
 Water Removed: _____

Start Time (purge): 0615 Weather Conditions: Dark
 Sample Time/Date: 0645 / 1-31-14 Water Color: Cloudy Odor: Y 10
 Approx. Flow Rate: _____ gpm. Sediment Description: Cloudy
 Did well de-water? N If yes, Time: _____ Volume: _____ gal. DTW @ Sampling: 12.65

Time (2400 hr.)	Volume (gal.)	pH	Conductivity $\mu\text{mhos/cm} - \mu\text{S}$	Temperature (C / F)	D.O. (mg/L)	ORP (mV)
<u>0620</u>	<u>1.5</u>	<u>7.04</u>	<u>0.51</u>	<u>14.1</u>		
<u>0625</u>	<u>3.0</u>	<u>7.09</u>	<u>0.55</u>	<u>14.3</u>		
<u>0630</u>	<u>4.0</u>	<u>7.12</u>	<u>0.59</u>	<u>14.4</u>		

LABORATORY INFORMATION

SAMPLE ID	(#) CONTAINER	REFRIG.	PRESERV. TYPE	LABORATORY	ANALYSES
<u>MW-5</u>	<u>3</u> x voa vial	YES	HCL	LANCASTER	TPH-GRO(8015)/BTEX+MTBE(8021)
	x voa vial	YES	HCL	LANCASTER	TPH-GRO(8015)/BTEX(8021)
	<u>2</u> x 500ml ambers	YES	NP	LANCASTER	TPH-DRO w/sgc COLUMN/ TPH-DRO w/sgc (8015)

COMMENTS: _____

Add/Replaced Lock: _____ Add/Replaced Plug: _____ Add/Replaced Bolt: _____



GETTLER - RYAN INC.

WELL MONITORING/SAMPLING FIELD DATA SHEET

Client/Facility#: Chevron #206145 Job Number: 386492
 Site Address: 800 Center Street Event Date: 1-31-14 (inclusive)
 City: Oakland, CA Sampler: AW

Well ID: MW-6 Date Monitored: 1-31-14
 Well Diameter: 2
 Total Depth: 15.01 ft.
 Depth to Water: 10.51 ft. Check if water column is less than 0.50 ft.
4.50 xVF .17 = 0.76 x3 case volume = Estimated Purge Volume: 2.5 gal.
 Depth to Water w/ 80% Recharge [(Height of Water Column x 0.20) + DTW]: 11.4

Volume	3/4"= 0.02	1"= 0.04	2"= 0.17	3"= 0.38
Factor (VF)	4"= 0.66	5"= 1.02	6"= 1.50	12"= 5.80

Purge Equipment:
 Disposable Bailer
 Stainless Steel Bailer _____
 Stack Pump _____
 Suction Pump _____
 Grundfos _____
 Peristaltic Pump _____
 QED Bladder Pump _____
 Other: _____

Sampling Equipment:
 Disposable Bailer
 Pressure Bailer _____
 Metal Filters _____
 Peristaltic Pump _____
 QED Bladder Pump _____
 Other: _____

Time Started: _____ (2400 hrs)
 Time Completed: _____ (2400 hrs)
 Depth to Product: _____ ft
 Depth to Water: _____ ft
 Hydrocarbon Thickness: _____ ft
 Visual Confirmation/Description: _____
 Skimmer / Absorbant Sock (circle one)
 Amt Removed from Skimmer: _____ gal
 Amt Removed from Well: _____ gal
 Water Removed: _____

Start Time (purge): 0700 Weather Conditions: Dawn
 Sample Time/Date: 0730 / 1-31-14 Water Color: Cloudy Odor: Y 1(N)
 Approx. Flow Rate: - gpm. Sediment Description: Cloudy
 Did well de-water? N If yes, Time: _____ Volume: _____ gal. DTW @ Sampling: 11.33

Time (2400 hr.)	Volume (gal.)	pH	Conductivity ^{MS} (µmhos/cm - µS)	Temperature (°C / F)	D.O. (mg/L)	ORP (mV)
<u>0703</u>	<u>0.75</u>	<u>6.55</u>	<u>0.57</u>	<u>17.2</u>		
<u>0706</u>	<u>1.5</u>	<u>6.62</u>	<u>0.61</u>	<u>17.5</u>		
<u>0710</u>	<u>2.5</u>	<u>6.64</u>	<u>0.67</u>	<u>17.4</u>		

LABORATORY INFORMATION

SAMPLE ID	(#) CONTAINER	REFRIG.	PRESERV. TYPE	LABORATORY	ANALYSES
MW-6	3 x voa vial	YES	HCL	LANCASTER	TPH-GRO(8015)/BTEX+MTBE(8021)
	x voa vial	YES	HCL	LANCASTER	TPH-GRO(8015)/BTEX(8021)
	2 x 500ml ambers	YES	NP	LANCASTER	TPH-DRO w/sgc COLUMN/ TPH-DRO w/sgc (8015)

COMMENTS: _____

Add/Replaced Lock: _____ Add/Replaced Plug: _____ Add/Replaced Bolt: _____



GETTLER-RYAN INC.

WELL MONITORING/SAMPLING FIELD DATA SHEET

Client/Facility#: Chevron #206145
 Site Address: 800 Center Street
 City: Oakland, CA

Job Number: 386492
 Event Date: 1-31-14 (inclusive)
 Sampler: AW

Well ID: MW-7
 Well Diameter: 2
 Total Depth: 15.75 ft.
 Depth to Water: 12.15 ft.

Date Monitored: 1-31-14

Volume Factor (VF)	3/4" = 0.02	1" = 0.04	2" = 0.17	3" = 0.38
	4" = 0.66	5" = 1.02	6" = 1.50	12" = 5.80

Check if water column is less than 0.50 ft.

Depth to Water w/ 80% Recharge [(Height of Water Column x 0.20) + DTW]: 12.87
 $3.60 \times VF .17 = 0.61 \times 3 \text{ case volume} = \text{Estimated Purge Volume: } 2.0 \text{ gal.}$

Purge Equipment:

Disposable Bailer
 Stainless Steel Bailer _____
 Stack Pump _____
 Suction Pump _____
 Grundfos _____
 Peristaltic Pump _____
 QED Bladder Pump _____
 Other: _____

Sampling Equipment:

Disposable Bailer
 Pressure Bailer _____
 Metal Filters _____
 Peristaltic Pump _____
 QED Bladder Pump _____
 Other: _____

Time Started: _____ (2400 hrs)
 Time Completed: _____ (2400 hrs)
 Depth to Product: _____ ft
 Depth to Water: _____ ft
 Hydrocarbon Thickness: _____ ft
 Visual Confirmation/Description: _____
 Skimmer / Absorbant Sock (circle one)
 Amt Removed from Skimmer: _____ gal
 Amt Removed from Well: _____ gal
 Water Removed: _____

Start Time (purge): 0825 Weather Conditions: Sunny
 Sample Time/Date: 0850 / 1-31-14 Water Color: Cloudy Odor: Y 10
 Approx. Flow Rate: - gpm. Sediment Description: Cloudy
 Did well de-water? N If yes, Time: - Volume: - gal. DTW @ Sampling: 12.80

Time (2400 hr.)	Volume (gal.)	pH	Conductivity (µmhos/cm - µS)	Temperature (C / F)	D.O. (mg/L)	ORP (mV)
<u>0828</u>	<u>0.75</u>	<u>6.95</u>	<u>0.62</u>	<u>13.8</u>		
<u>0831</u>	<u>1.5</u>	<u>7.02</u>	<u>0.70</u>	<u>14.1</u>		
<u>0834</u>	<u>2.0</u>	<u>7.05</u>	<u>0.74</u>	<u>14.2</u>		

LABORATORY INFORMATION

SAMPLE ID	(#) CONTAINER	REFRIG.	PRESERV. TYPE	LABORATORY	ANALYSES
<u>MW-7</u>	<u>3</u> x voa vial	<u>YES</u>	<u>HCL</u>	<u>LANCASTER</u>	<u>TPH-GRO(8015)/BTEX+MTBE(8021)</u>
	x voa vial	<u>YES</u>	<u>HCL</u>	<u>LANCASTER</u>	<u>TPH-GRO(8015)/BTEX(8021)</u>
	<u>2</u> x 500ml ambers	<u>YES</u>	<u>NP</u>	<u>LANCASTER</u>	<u>TPH-DRO w/sgc COLUMN/ TPH-DRO w/sgc (8015)</u>

COMMENTS: _____

Add/Replaced Lock: _____ Add/Replaced Plug: _____ Add/Replaced Bolt: _____



GETTLER-RYAN INC.

WELL MONITORING/SAMPLING FIELD DATA SHEET

Client/Facility#: Chevron #206145 Job Number: 386492
 Site Address: 800 Center Street Event Date: 1-31-14 (inclusive)
 City: Oakland, CA Sampler: AW

Well ID MW- 8 Date Monitored: N/A

Well Diameter 2

Total Depth _____ ft.

Depth to Water _____ ft. Check if water column is less than 0.50 ft.

Volume	3/4"= 0.02	1"= 0.04	2"= 0.17	3"= 0.38
Factor (VF)	4"= 0.66	5"= 1.02	6"= 1.50	12"= 5.80

_____ xVF _____ = _____ x3 case volume = Estimated Purge Volume: _____ gal.

Depth to Water w/ 80% Recharge [(Height of Water Column x 0.20) + DTW]: _____

Purge Equipment:

Disposable Bailer _____
 Stainless Steel Bailer _____
 Stack Pump _____
 Suction Pump _____
 Grundfos _____
 Peristaltic Pump _____
 QED Bladder Pump _____
 Other: _____

Sampling Equipment:

Disposable Bailer _____
 Pressure Bailer _____
 Metal Filters _____
 Peristaltic Pump _____
 QED Bladder Pump _____
 Other: _____

Time Started: _____ (2400 hrs)
 Time Completed: _____ (2400 hrs)
 Depth to Product: _____ ft
 Depth to Water: _____ ft
 Hydrocarbon Thickness: _____ ft
 Visual Confirmation/Description: _____
 Skimmer / Absorbant Sock (circle one)
 Amt Removed from Skimmer: _____ gal
 Amt Removed from Well: _____ gal
 Water Removed: _____

Start Time (purge): _____ Weather Conditions: _____
 Sample Time/Date: / Water Color: _____ Odor: Y / N
 Approx. Flow Rate: _____ gpm. Sediment Description: _____
 Did well de-water? _____ If yes, Time: _____ Volume: _____ gal. DTW @ Sampling: _____

Time (2400 hr.)	Volume (gal.)	pH	Conductivity (µmhos/cm - µS)	Temperature (C / F)	D.O. (mg/L)	ORP (mV)
_____	_____	_____	_____	_____	_____	_____
_____	_____	_____	_____	_____	_____	_____
_____	_____	_____	_____	_____	_____	_____
_____	_____	_____	_____	_____	_____	_____

LABORATORY INFORMATION

SAMPLE ID	(#) CONTAINER	REFRIG.	PRESERV. TYPE	LABORATORY	ANALYSES
MW-	x voa vial	YES	HCL	LANCASTER	TPH-GRO(8015)/BTEX+MTBE(8021)
	x voa vial	YES	HCL	LANCASTER	TPH-GRO(8015)/BTEX(8021)
	x 500ml ambers	YES	NP	LANCASTER	TPH-DRO w/sgc COLUMN/ TPH-DRO w/sgc (8015)

COMMENTS: Unable to access, Area fenced off due to ~~condemned~~ building
from fire. Pictures taken. condemned

Add/Replaced Lock: _____ Add/Replaced Plug: _____ Add/Replaced Bolt: _____

Chevron California Region Analysis Request/Chain of Custody



Lancaster Laboratories

Acct. # _____ Group # _____ Sample # _____
 For Eurofins Lancaster Laboratories use only
 Instructions on reverse side correspond with circled numbers.

1 Client Information				4 Matrix				5 Analyses Requested							
Facility: SS-208145-OML G-R-386492 G10003 D#10600102230				Sediment <input type="checkbox"/> Potable <input type="checkbox"/> Ground <input checked="" type="checkbox"/> Surface <input type="checkbox"/> Water <input type="checkbox"/> NPDES <input type="checkbox"/> Air <input type="checkbox"/> Soil <input type="checkbox"/>				Total Number of Containers BTEX + MTBE 8021 <input type="checkbox"/> 8260 <input type="checkbox"/> TPH-GRO 8015 <input checked="" type="checkbox"/> 8260 <input type="checkbox"/> TPH-DRO 8015 without Silica Gel Cleanup <input checked="" type="checkbox"/> TPH-DRO 8015 with Silica Gel Cleanup <input checked="" type="checkbox"/> 8260 Full Scan Oxygenates Total Lead Method _____ Dissolved Lead Method _____							
Site Address: 800 CENTER STREET, OAKLAND, CA															
Chevron # EM CRAAN Lead Allen															
Consultant: Deanna Ryan, Inc., 6805 Sierra Court, Suite G, Dublin, CA 94568															
Consultant Mgr: Deanna M. Harding, deanna@grinc.com															
Consultant Phone: (925) 551-7444 x180															
Sampler: Alex Wang															

SCR #: _____

- Results in Dry Weight
- J value reporting needed
- Must meet lowest detection limits possible for 8260 compounds
- 8021 MTBE Confirmation
- Confirm highest hit by 8260
- Confirm all hits by 8260
- Run _____ oxy's on highest hit
- Run _____ oxy's on all hits

2 Sample Identification	Soil Depth	3 Collected		Grab	Composite	Soil	Water	Oil	Total Number of Containers	BTEX + MTBE 8021	8260	TPH-GRO 8015	TPH-DRO 8015 without Silica Gel Cleanup	TPH-DRO 8015 with Silica Gel Cleanup	8260 Full Scan	Oxygenates	Total Lead Method	Dissolved Lead Method
		Date	Time															
QA		1-31-14		<input checked="" type="checkbox"/>			<input checked="" type="checkbox"/>		2	<input checked="" type="checkbox"/>	<input checked="" type="checkbox"/>	<input checked="" type="checkbox"/>	<input checked="" type="checkbox"/>					
MW-1A			0926						5	<input checked="" type="checkbox"/>	<input checked="" type="checkbox"/>	<input checked="" type="checkbox"/>	<input checked="" type="checkbox"/>					
MW-2			1030						5	<input checked="" type="checkbox"/>	<input checked="" type="checkbox"/>	<input checked="" type="checkbox"/>	<input checked="" type="checkbox"/>					
MW-3			0955						5	<input checked="" type="checkbox"/>	<input checked="" type="checkbox"/>	<input checked="" type="checkbox"/>	<input checked="" type="checkbox"/>					
MW-4			0815						5	<input checked="" type="checkbox"/>	<input checked="" type="checkbox"/>	<input checked="" type="checkbox"/>	<input checked="" type="checkbox"/>					
MW-5			0645						5	<input checked="" type="checkbox"/>	<input checked="" type="checkbox"/>	<input checked="" type="checkbox"/>	<input checked="" type="checkbox"/>					
MW-6			0730						5	<input checked="" type="checkbox"/>	<input checked="" type="checkbox"/>	<input checked="" type="checkbox"/>	<input checked="" type="checkbox"/>					
MW-7			0850						5	<input checked="" type="checkbox"/>	<input checked="" type="checkbox"/>	<input checked="" type="checkbox"/>	<input checked="" type="checkbox"/>					

6 Remarks

Requesting 10 gram column cleanup on DRO w/sgc COLUMN samples, and normal 1 gram on DRO w/sgc by (8015). Please forward the lab results directly to the Lead Consultant and cc: G-R.

7 Turnaround Time Requested (TAT) (please circle)

Standard 5 day 4 day
 72 hour 48 hour 24 hour **EDF/EDD**

Relinquished by _____	Date: 1-31-14	Time: 1430	Received by _____	Date: 1/31/14	Time: 1430
Relinquished by _____	Date: _____	Time: _____	Received by _____	Date: _____	Time: _____

8 Data Package (circle if required)

Type I - Full
 Type VI (Raw Data)

EDD (circle if required)

EDFFLAT (default)
 Other: _____

Relinquished by Commercial Carrier:

UPS _____ FedEx _____ Other _____

Temperature Upon Receipt _____ °C

Received by _____

Custody Seals Intact? Yes No

ATTACHMENT B

LABORATORY ANALYTICAL REPORT

ANALYTICAL RESULTS

Prepared by:

Eurofins Lancaster Laboratories Environmental
2425 New Holland Pike
Lancaster, PA 17601

Prepared for:

Chevron
L4310
6001 Bollinger Canyon Rd.
San Ramon CA 94583

February 17, 2014

Project: 206145

Submittal Date: 02/04/2014
Group Number: 1450109
PO Number: 0015117333
Release Number: HOPKINS/WAITE
State of Sample Origin: CA

<u>Client Sample Description</u>	<u>Lancaster Labs (LL) #</u>
QA-T-140131 NA Water	7353977
MW-1A-W-140131 Grab Groundwater	7353978
MW-1A-W-140131 Grab Groundwater	7353979
MW-2-W-140131 Grab Groundwater	7353980
MW-2-W-140131 Grab Groundwater	7353981
MW-3-W-140131 Grab Groundwater	7353982
MW-3-W-140131 Grab Groundwater	7353983
MW-4-W-140131 Grab Groundwater	7353984
MW-4-W-140131 Grab Groundwater	7353985
MW-5-W-140131 Grab Groundwater	7353986
MW-5-W-140131 Grab Groundwater	7353987
MW-6-W-140131 Grab Groundwater	7353988
MW-6-W-140131 Grab Groundwater	7353989
MW-7-W-140131 Grab Groundwater	7353990
MW-7-W-140131 Grab Groundwater	7353991

The specific methodologies used in obtaining the enclosed analytical results are indicated on the Laboratory Sample Analysis Record.

ELECTRONIC COPY TO	Gettler-Ryan Inc.	Attn: Gettler Ryan
ELECTRONIC COPY TO	Chevron c/o CRA	Attn: Report Contact
ELECTRONIC COPY TO	Chevron	Attn: Anna Avina
ELECTRONIC COPY TO	Conestoga-Rovers & Associates	Attn: Nathan Allen

Respectfully Submitted,



Amek Carter
Specialist

(717) 556-7252

Sample Description: QA-T-140131 NA Water
Facility# 206145 Job# 386492 GRD
800 Center St-Oakland T0600102230

LL Sample # WW 7353977
LL Group # 1450109
Account # 10904

Project Name: 206145

Collected: 01/31/2014

Chevron

Submitted: 02/04/2014 09:20

L4310

Reported: 02/17/2014 07:49

6001 Bollinger Canyon Rd.
San Ramon CA 94583

CSOQA

CAT No.	Analysis Name	CAS Number	As Received Result	As Received Method Detection Limit	Dilution Factor
GC Volatiles					
01729	TPH-GRO N. CA water C6-C12	SW-846 8015B n.a.	ug/l N.D.	ug/l 50	1
GC Volatiles					
02102	Benzene	SW-846 8021B 71-43-2	ug/l N.D.	ug/l 0.5	1
02102	Ethylbenzene	100-41-4	N.D.	0.5	1
02102	Methyl tert-Butyl Ether	1634-04-4	N.D.	2.5	1
02102	Toluene	108-88-3	N.D.	0.5	1
02102	Total Xylenes	1330-20-7	N.D.	1.5	1

General Sample Comments

CA ELAP Lab Certification No. 2792; CA NELAP Lab Certification No. 10276CA

All QC is compliant unless otherwise noted. Please refer to the Quality Control Summary for overall QC performance data and associated samples.

Laboratory Sample Analysis Record

CAT No.	Analysis Name	Method	Trial#	Batch#	Analysis Date and Time	Analyst	Dilution Factor
01729	TPH-GRO N. CA water C6-C12	SW-846 8015B	1	14034A94B	02/12/2014 11:29	Marie D Beamenderfer	1
02102	Method 8021 Water Master	SW-846 8021B	1	14034A94B	02/12/2014 11:29	Marie D Beamenderfer	1
01146	GC VOA Water Prep	SW-846 5030B	1	14034A94B	02/12/2014 11:29	Marie D Beamenderfer	1

Sample Description: MW-1A-W-140131 Grab Groundwater
Facility# 206145 Job# 386492 GRD
800 Center St-Oakland T0600102230

LL Sample # WW 7353978
LL Group # 1450109
Account # 10904

Project Name: 206145

Collected: 01/31/2014 09:26 by AW Chevron
L4310
Submitted: 02/04/2014 09:20 6001 Bollinger Canyon Rd.
Reported: 02/17/2014 07:49 San Ramon CA 94583

CO1AC

CAT No.	Analysis Name	CAS Number	As Received Result	As Received Method Detection Limit	Dilution Factor
GC Volatiles SW-846 8015B			ug/l	ug/l	
01729	TPH-GRO N. CA water C6-C12	n.a.	150	50	1
A preserved vial was submitted for analysis. However, the pH at the time of analysis was 3.					
GC Volatiles SW-846 8021B			ug/l	ug/l	
02102	Benzene	71-43-2	2.2	0.5	1
02102	Ethylbenzene	100-41-4	N.D.	0.5	1
02102	Methyl tert-Butyl Ether	1634-04-4	N.D.	2.5	1
02102	Toluene	108-88-3	N.D.	0.5	1
02102	Total Xylenes	1330-20-7	N.D.	1.5	1
A preserved vial was submitted for analysis. However, the pH at the time of analysis was 3.					
GC Petroleum SW-846 8015B			ug/l	ug/l	
Hydrocarbons w/Si					
06610	TPH-DRO CA C10-C28 w/ Si Gel	n.a.	4,400	160	1
The reverse surrogate, capric acid, is present at <1%.					

General Sample Comments

CA ELAP Lab Certification No. 2792; CA NELAP Lab Certification No. 10276CA

All QC is compliant unless otherwise noted. Please refer to the Quality Control Summary for overall QC performance data and associated samples.

Laboratory Sample Analysis Record

CAT No.	Analysis Name	Method	Trial#	Batch#	Analysis Date and Time	Analyst	Dilution Factor
01729	TPH-GRO N. CA water C6-C12	SW-846 8015B	1	14034A94B	02/12/2014 11:54	Marie D Beamenderfer	1
02102	Method 8021 Water Master	SW-846 8021B	1	14034A94B	02/12/2014 11:54	Marie D Beamenderfer	1
01146	GC VOA Water Prep	SW-846 5030B	1	14034A94B	02/12/2014 11:54	Marie D Beamenderfer	1
06610	TPH-DRO CA C10-C28 w/ Si Gel	SW-846 8015B	1	140360021A	02/10/2014 19:28	Christine E Dolman	1
11180	Low Vol Ext (W) w/SG	SW-846 3510C	1	140360021A	02/06/2014 12:30	Kelli M Barto	1

Sample Description: MW-1A-W-140131 Grab Groundwater
Facility# 206145 Job# 386492 GRD
800 Center St-Oakland T0600102230

LL Sample # WW 7353979
LL Group # 1450109
Account # 10904

Project Name: 206145

Collected: 01/31/2014 09:26 by AW Chevron
L4310
Submitted: 02/04/2014 09:20 6001 Bollinger Canyon Rd.
Reported: 02/17/2014 07:49 San Ramon CA 94583

CO1AQ

CAT No.	Analysis Name	CAS Number	As Received Result	As Received Method Detection Limit	Dilution Factor
	GC Petroleum Hydrocarbons w/Si	SW-846 8015B	ug/l	ug/l	
06610	TPH-DRO CA C10-C28 w/ Si Gel	n.a.	9,100	160	1

General Sample Comments

CA ELAP Lab Certification No. 2792; CA NELAP Lab Certification No. 10276CA
All QC is compliant unless otherwise noted. Please refer to the Quality Control Summary for overall QC performance data and associated samples.

Laboratory Sample Analysis Record

CAT No.	Analysis Name	Method	Trial#	Batch#	Analysis Date and Time	Analyst	Dilution Factor
06610	TPH-DRO CA C10-C28 w/ Si Gel	SW-846 8015B	1	140360022A	02/07/2014 19:43	Christine E Dolman	1
11180	Low Vol Ext (W) w/SG	SW-846 3510C	1	140360022A	02/06/2014 12:30	Kelli M Barto	1

Sample Description: MW-2-W-140131 Grab Groundwater
Facility# 206145 Job# 386492 GRD
800 Center St-Oakland T0600102230

LL Sample # WW 7353980
LL Group # 1450109
Account # 10904

Project Name: 206145

Collected: 01/31/2014 10:30 by AW Chevron
L4310
Submitted: 02/04/2014 09:20 6001 Bollinger Canyon Rd.
Reported: 02/17/2014 07:49 San Ramon CA 94583

COM2C

CAT No.	Analysis Name	CAS Number	As Received Result	As Received Method Detection Limit	Dilution Factor
GC Volatiles SW-846 8015B ug/l					
01729	TPH-GRO N. CA water C6-C12	n.a.	N.D.	50	1
GC Volatiles SW-846 8021B ug/l					
02102	Benzene	71-43-2	N.D.	0.5	1
02102	Ethylbenzene	100-41-4	N.D.	0.5	1
02102	Methyl tert-Butyl Ether	1634-04-4	N.D.	2.5	1
02102	Toluene	108-88-3	N.D.	0.5	1
02102	Total Xylenes	1330-20-7	N.D.	1.5	1
GC Petroleum SW-846 8015B ug/l					
Hydrocarbons w/Si					
06610	TPH-DRO CA C10-C28 w/ Si Gel	n.a.	410	160	1
The reverse surrogate, capric acid, is present at <1%.					

General Sample Comments

CA ELAP Lab Certification No. 2792; CA NELAP Lab Certification No. 10276CA

All QC is compliant unless otherwise noted. Please refer to the Quality Control Summary for overall QC performance data and associated samples.

Laboratory Sample Analysis Record

CAT No.	Analysis Name	Method	Trial#	Batch#	Analysis Date and Time	Analyst	Dilution Factor
01729	TPH-GRO N. CA water C6-C12	SW-846 8015B	1	14034A94B	02/12/2014 12:20	Marie D Beamenderfer	1
02102	Method 8021 Water Master	SW-846 8021B	1	14034A94B	02/12/2014 12:20	Marie D Beamenderfer	1
01146	GC VOA Water Prep	SW-846 5030B	1	14034A94B	02/12/2014 12:20	Marie D Beamenderfer	1
06610	TPH-DRO CA C10-C28 w/ Si Gel	SW-846 8015B	1	140360021A	02/10/2014 17:11	Christine E Dolman	1
11180	Low Vol Ext(W) w/SG	SW-846 3510C	1	140360021A	02/06/2014 12:30	Kelli M Barto	1

Sample Description: MW-2-W-140131 Grab Groundwater
Facility# 206145 Job# 386492 GRD
800 Center St-Oakland T0600102230

LL Sample # WW 7353981
LL Group # 1450109
Account # 10904

Project Name: 206145

Collected: 01/31/2014 10:30 by AW Chevron
L4310
Submitted: 02/04/2014 09:20 6001 Bollinger Canyon Rd.
Reported: 02/17/2014 07:49 San Ramon CA 94583

COM2Q

CAT No.	Analysis Name	CAS Number	As Received Result	As Received Method Detection Limit	Dilution Factor
	GC Petroleum Hydrocarbons w/Si	SW-846 8015B	ug/l	ug/l	
06610	TPH-DRO CA C10-C28 w/ Si Gel	n.a.	1,200	160	1

General Sample Comments

CA ELAP Lab Certification No. 2792; CA NELAP Lab Certification No. 10276CA

All QC is compliant unless otherwise noted. Please refer to the Quality Control Summary for overall QC performance data and associated samples.

Laboratory Sample Analysis Record

CAT No.	Analysis Name	Method	Trial#	Batch#	Analysis Date and Time	Analyst	Dilution Factor
06610	TPH-DRO CA C10-C28 w/ Si Gel	SW-846 8015B	1	140360022A	02/07/2014 18:12	Christine E Dolman	1
11180	Low Vol Ext (W) w/SG	SW-846 3510C	1	140360022A	02/06/2014 12:30	Kelli M Barto	1

Sample Description: MW-3-W-140131 Grab Groundwater
Facility# 206145 Job# 386492 GRD
800 Center St-Oakland T0600102230

LL Sample # WW 7353982
LL Group # 1450109
Account # 10904

Project Name: 206145

Collected: 01/31/2014 09:55 by AW Chevron
L4310
Submitted: 02/04/2014 09:20 6001 Bollinger Canyon Rd.
Reported: 02/17/2014 07:49 San Ramon CA 94583

COM3C

CAT No.	Analysis Name	CAS Number	As Received Result	As Received Method Detection Limit	Dilution Factor
GC Volatiles SW-846 8015B			ug/l	ug/l	
01729	TPH-GRO N. CA water C6-C12	n.a.	3,300	50	1
A preserved vial was submitted for analysis. However, the pH at the time of analysis was 4.					
GC Volatiles SW-846 8021B			ug/l	ug/l	
02102	Benzene	71-43-2	33	0.5	1
02102	Ethylbenzene	100-41-4	3.6	0.5	1
02102	Methyl tert-Butyl Ether	1634-04-4	66	2.5	1
02102	Toluene	108-88-3	2.0	0.5	1
02102	Total Xylenes	1330-20-7	5.9	1.5	1
A preserved vial was submitted for analysis. However, the pH at the time of analysis was 4.					
GC Petroleum SW-846 8015B			ug/l	ug/l	
Hydrocarbons w/Si					
06610	TPH-DRO CA C10-C28 w/ Si Gel	n.a.	1,400	160	1
The reverse surrogate, capric acid, is present at <1%.					

General Sample Comments

CA ELAP Lab Certification No. 2792; CA NELAP Lab Certification No. 10276CA

All QC is compliant unless otherwise noted. Please refer to the Quality Control Summary for overall QC performance data and associated samples.

Laboratory Sample Analysis Record

CAT No.	Analysis Name	Method	Trial#	Batch#	Analysis Date and Time	Analyst	Dilution Factor
01729	TPH-GRO N. CA water C6-C12	SW-846 8015B	1	14034A94B	02/12/2014 14:26	Marie D Beamenderfer	1
02102	Method 8021 Water Master	SW-846 8021B	1	14034A94B	02/12/2014 14:26	Marie D Beamenderfer	1
01146	GC VOA Water Prep	SW-846 5030B	1	14034A94B	02/12/2014 14:26	Marie D Beamenderfer	1
06610	TPH-DRO CA C10-C28 w/ Si Gel	SW-846 8015B	1	140360021A	02/10/2014 17:34	Christine E Dolman	1
11180	Low Vol Ext (W) w/SG	SW-846 3510C	1	140360021A	02/06/2014 12:30	Kelli M Barto	1

Sample Description: MW-3-W-140131 Grab Groundwater
Facility# 206145 Job# 386492 GRD
800 Center St-Oakland T0600102230

LL Sample # WW 7353983
LL Group # 1450109
Account # 10904

Project Name: 206145

Collected: 01/31/2014 09:55 by AW Chevron
L4310
Submitted: 02/04/2014 09:20 6001 Bollinger Canyon Rd.
Reported: 02/17/2014 07:49 San Ramon CA 94583

COM3Q

CAT No.	Analysis Name	CAS Number	As Received Result	As Received Method Detection Limit	Dilution Factor
	GC Petroleum Hydrocarbons w/Si	SW-846 8015B	ug/l	ug/l	
06610	TPH-DRO CA C10-C28 w/ Si Gel	n.a.	4,100	160	1

General Sample Comments

CA ELAP Lab Certification No. 2792; CA NELAP Lab Certification No. 10276CA

All QC is compliant unless otherwise noted. Please refer to the Quality Control Summary for overall QC performance data and associated samples.

Laboratory Sample Analysis Record

CAT No.	Analysis Name	Method	Trial#	Batch#	Analysis Date and Time	Analyst	Dilution Factor
06610	TPH-DRO CA C10-C28 w/ Si Gel	SW-846 8015B	1	140360022A	02/07/2014 18:57	Christine E Dolman	1
11180	Low Vol Ext (W) w/SG	SW-846 3510C	1	140360022A	02/06/2014 12:30	Kelli M Barto	1

Sample Description: MW-4-W-140131 Grab Groundwater
Facility# 206145 Job# 386492 GRD
800 Center St-Oakland T0600102230

LL Sample # WW 7353984
LL Group # 1450109
Account # 10904

Project Name: 206145

Collected: 01/31/2014 08:15 by AW Chevron
L4310
Submitted: 02/04/2014 09:20 6001 Bollinger Canyon Rd.
Reported: 02/17/2014 07:49 San Ramon CA 94583

COM4C

CAT No.	Analysis Name	CAS Number	As Received Result	As Received Method Detection Limit	Dilution Factor
GC Volatiles SW-846 8015B ug/l					
01729	TPH-GRO N. CA water C6-C12	n.a.	90	50	1
GC Volatiles SW-846 8021B ug/l					
02102	Benzene	71-43-2	N.D.	0.5	1
02102	Ethylbenzene	100-41-4	N.D.	0.5	1
02102	Methyl tert-Butyl Ether	1634-04-4	N.D.	2.5	1
02102	Toluene	108-88-3	N.D.	0.5	1
02102	Total Xylenes	1330-20-7	N.D.	1.5	1
GC Petroleum SW-846 8015B ug/l					
Hydrocarbons w/Si					
06610	TPH-DRO CA C10-C28 w/ Si Gel	n.a.	3,200	160	1
The reverse surrogate, capric acid, is present at <1%.					

General Sample Comments

CA ELAP Lab Certification No. 2792; CA NELAP Lab Certification No. 10276CA

All QC is compliant unless otherwise noted. Please refer to the Quality Control Summary for overall QC performance data and associated samples.

Laboratory Sample Analysis Record

CAT No.	Analysis Name	Method	Trial#	Batch#	Analysis Date and Time	Analyst	Dilution Factor
01729	TPH-GRO N. CA water C6-C12	SW-846 8015B	1	14034A94B	02/12/2014 12:46	Marie D Beamenderfer	1
02102	Method 8021 Water Master	SW-846 8021B	1	14034A94B	02/12/2014 12:46	Marie D Beamenderfer	1
01146	GC VOA Water Prep	SW-846 5030B	1	14034A94B	02/12/2014 12:46	Marie D Beamenderfer	1
06610	TPH-DRO CA C10-C28 w/ Si Gel	SW-846 8015B	1	140360021A	02/10/2014 19:05	Christine E Dolman	1
11180	Low Vol Ext(W) w/SG	SW-846 3510C	1	140360021A	02/06/2014 12:30	Kelli M Barto	1

Sample Description: MW-4-W-140131 Grab Groundwater
Facility# 206145 Job# 386492 GRD
800 Center St-Oakland T0600102230

LL Sample # WW 7353985
LL Group # 1450109
Account # 10904

Project Name: 206145

Collected: 01/31/2014 08:15 by AW Chevron
L4310
Submitted: 02/04/2014 09:20 6001 Bollinger Canyon Rd.
Reported: 02/17/2014 07:49 San Ramon CA 94583

COM4Q

CAT No.	Analysis Name	CAS Number	As Received Result	As Received Method Detection Limit	Dilution Factor
	GC Petroleum Hydrocarbons w/Si	SW-846 8015B	ug/l	ug/l	
06610	TPH-DRO CA C10-C28 w/ Si Gel	n.a.	6,600	160	1

General Sample Comments

CA ELAP Lab Certification No. 2792; CA NELAP Lab Certification No. 10276CA
All QC is compliant unless otherwise noted. Please refer to the Quality Control Summary for overall QC performance data and associated samples.

Laboratory Sample Analysis Record

CAT No.	Analysis Name	Method	Trial#	Batch#	Analysis Date and Time	Analyst	Dilution Factor
06610	TPH-DRO CA C10-C28 w/ Si Gel	SW-846 8015B	1	140360022A	02/07/2014 19:20	Christine E Dolman	1
11180	Low Vol Ext (W) w/SG	SW-846 3510C	1	140360022A	02/06/2014 12:30	Kelli M Barto	1

Sample Description: MW-5-W-140131 Grab Groundwater
Facility# 206145 Job# 386492 GRD
800 Center St-Oakland T0600102230

LL Sample # WW 7353986
LL Group # 1450109
Account # 10904

Project Name: 206145

Collected: 01/31/2014 06:45 by AW Chevron
L4310
Submitted: 02/04/2014 09:20 6001 Bollinger Canyon Rd.
Reported: 02/17/2014 07:49 San Ramon CA 94583

COM5C

CAT No.	Analysis Name	CAS Number	As Received Result	As Received Method Detection Limit	Dilution Factor
GC Volatiles SW-846 8015B ug/l					
01729	TPH-GRO N. CA water C6-C12	n.a.	N.D.	50	1
GC Volatiles SW-846 8021B ug/l					
02102	Benzene	71-43-2	N.D.	0.5	1
02102	Ethylbenzene	100-41-4	N.D.	0.5	1
02102	Methyl tert-Butyl Ether	1634-04-4	N.D.	2.5	1
02102	Toluene	108-88-3	N.D.	0.5	1
02102	Total Xylenes	1330-20-7	N.D.	1.5	1
GC Petroleum SW-846 8015B ug/l					
Hydrocarbons w/Si					
06610	TPH-DRO CA C10-C28 w/ Si Gel	n.a.	N.D.	50	1
The reverse surrogate, capric acid, is present at <1%.					

General Sample Comments

CA ELAP Lab Certification No. 2792; CA NELAP Lab Certification No. 10276CA

All QC is compliant unless otherwise noted. Please refer to the Quality Control Summary for overall QC performance data and associated samples.

Laboratory Sample Analysis Record

CAT No.	Analysis Name	Method	Trial#	Batch#	Analysis Date and Time	Analyst	Dilution Factor
01729	TPH-GRO N. CA water C6-C12	SW-846 8015B	1	14034A94B	02/12/2014 13:11	Marie D Beamenderfer	1
02102	Method 8021 Water Master	SW-846 8021B	1	14034A94B	02/12/2014 13:11	Marie D Beamenderfer	1
01146	GC VOA Water Prep	SW-846 5030B	1	14034A94B	02/12/2014 13:11	Marie D Beamenderfer	1
06610	TPH-DRO CA C10-C28 w/ Si Gel	SW-846 8015B	1	140360021A	02/10/2014 17:57	Christine E Dolman	1
11180	Low Vol Ext(W) w/SG	SW-846 3510C	1	140360021A	02/06/2014 12:30	Kelli M Barto	1

Sample Description: MW-5-W-140131 Grab Groundwater
Facility# 206145 Job# 386492 GRD
800 Center St-Oakland T0600102230

LL Sample # WW 7353987
LL Group # 1450109
Account # 10904

Project Name: 206145

Collected: 01/31/2014 06:45 by AW Chevron
L4310
Submitted: 02/04/2014 09:20 6001 Bollinger Canyon Rd.
Reported: 02/17/2014 07:49 San Ramon CA 94583

COM5Q

CAT No.	Analysis Name	CAS Number	As Received Result	As Received Method Detection Limit	Dilution Factor
	GC Petroleum Hydrocarbons w/Si	SW-846 8015B	ug/l	ug/l	
06610	TPH-DRO CA C10-C28 w/ Si Gel	n.a.	N.D.	50	1

General Sample Comments

CA ELAP Lab Certification No. 2792; CA NELAP Lab Certification No. 10276CA
All QC is compliant unless otherwise noted. Please refer to the Quality Control Summary for overall QC performance data and associated samples.

Laboratory Sample Analysis Record

CAT No.	Analysis Name	Method	Trial#	Batch#	Analysis Date and Time	Analyst	Dilution Factor
06610	TPH-DRO CA C10-C28 w/ Si Gel	SW-846 8015B	1	140360022A	02/07/2014 17:26	Christine E Dolman	1
11180	Low Vol Ext (W) w/SG	SW-846 3510C	1	140360022A	02/06/2014 12:30	Kelli M Barto	1

Sample Description: MW-6-W-140131 Grab Groundwater
Facility# 206145 Job# 386492 GRD
800 Center St-Oakland T0600102230

LL Sample # WW 7353988
LL Group # 1450109
Account # 10904

Project Name: 206145

Collected: 01/31/2014 07:30 by AW Chevron
L4310
Submitted: 02/04/2014 09:20 6001 Bollinger Canyon Rd.
Reported: 02/17/2014 07:49 San Ramon CA 94583

COM6C

CAT No.	Analysis Name	CAS Number	As Received Result	As Received Method Detection Limit	Dilution Factor
GC Volatiles SW-846 8015B ug/l					
01729	TPH-GRO N. CA water C6-C12	n.a.	N.D.	50	1
GC Volatiles SW-846 8021B ug/l					
02102	Benzene	71-43-2	N.D.	0.5	1
02102	Ethylbenzene	100-41-4	N.D.	0.5	1
02102	Methyl tert-Butyl Ether	1634-04-4	N.D.	2.5	1
02102	Toluene	108-88-3	N.D.	0.5	1
02102	Total Xylenes	1330-20-7	N.D.	1.5	1
GC Petroleum SW-846 8015B ug/l					
Hydrocarbons w/Si					
06610	TPH-DRO CA C10-C28 w/ Si Gel	n.a.	N.D.	160	1
The reverse surrogate, capric acid, is present at <1%.					

General Sample Comments

CA ELAP Lab Certification No. 2792; CA NELAP Lab Certification No. 10276CA

All QC is compliant unless otherwise noted. Please refer to the Quality Control Summary for overall QC performance data and associated samples.

Laboratory Sample Analysis Record

CAT No.	Analysis Name	Method	Trial#	Batch#	Analysis Date and Time	Analyst	Dilution Factor
01729	TPH-GRO N. CA water C6-C12	SW-846 8015B	1	14034A94B	02/12/2014 13:36	Marie D Beamenderfer	1
02102	Method 8021 Water Master	SW-846 8021B	1	14034A94B	02/12/2014 13:36	Marie D Beamenderfer	1
01146	GC VOA Water Prep	SW-846 5030B	1	14034A94B	02/12/2014 13:36	Marie D Beamenderfer	1
06610	TPH-DRO CA C10-C28 w/ Si Gel	SW-846 8015B	1	140360021A	02/10/2014 18:20	Christine E Dolman	1
11180	Low Vol Ext(W) w/SG	SW-846 3510C	1	140360021A	02/06/2014 12:30	Kelli M Barto	1

Sample Description: MW-6-W-140131 Grab Groundwater
Facility# 206145 Job# 386492 GRD
800 Center St-Oakland T0600102230

LL Sample # WW 7353989
LL Group # 1450109
Account # 10904

Project Name: 206145

Collected: 01/31/2014 07:30 by AW Chevron
L4310
Submitted: 02/04/2014 09:20 6001 Bollinger Canyon Rd.
Reported: 02/17/2014 07:49 San Ramon CA 94583

COM6Q

CAT No.	Analysis Name	CAS Number	As Received Result	As Received Method Detection Limit	Dilution Factor
	GC Petroleum Hydrocarbons w/Si	SW-846 8015B	ug/l	ug/l	
06610	TPH-DRO CA C10-C28 w/ Si Gel	n.a.	N.D.	160	1

General Sample Comments

CA ELAP Lab Certification No. 2792; CA NELAP Lab Certification No. 10276CA
All QC is compliant unless otherwise noted. Please refer to the Quality Control Summary for overall QC performance data and associated samples.

Laboratory Sample Analysis Record

CAT No.	Analysis Name	Method	Trial#	Batch#	Analysis Date and Time	Analyst	Dilution Factor
06610	TPH-DRO CA C10-C28 w/ Si Gel	SW-846 8015B	1	140360022A	02/07/2014 17:49	Christine E Dolman	1
11180	Low Vol Ext (W) w/SG	SW-846 3510C	1	140360022A	02/06/2014 12:30	Kelli M Barto	1

Sample Description: MW-7-W-140131 Grab Groundwater
Facility# 206145 Job# 386492 GRD
800 Center St-Oakland T0600102230

LL Sample # WW 7353990
LL Group # 1450109
Account # 10904

Project Name: 206145

Collected: 01/31/2014 08:50 by AW Chevron
L4310
Submitted: 02/04/2014 09:20 6001 Bollinger Canyon Rd.
Reported: 02/17/2014 07:49 San Ramon CA 94583

COM7C

CAT No.	Analysis Name	CAS Number	As Received Result	As Received Method Detection Limit	Dilution Factor
GC Volatiles SW-846 8015B ug/l					
01729	TPH-GRO N. CA water C6-C12	n.a.	N.D.	50	1
GC Volatiles SW-846 8021B ug/l					
02102	Benzene	71-43-2	N.D.	0.5	1
02102	Ethylbenzene	100-41-4	N.D.	0.5	1
02102	Methyl tert-Butyl Ether	1634-04-4	N.D.	2.5	1
02102	Toluene	108-88-3	N.D.	0.5	1
02102	Total Xylenes	1330-20-7	N.D.	1.5	1
GC Petroleum SW-846 8015B ug/l					
Hydrocarbons w/Si					
06610	TPH-DRO CA C10-C28 w/ Si Gel	n.a.	1,100	160	1
The reverse surrogate, capric acid, is present at <1%.					

General Sample Comments

CA ELAP Lab Certification No. 2792; CA NELAP Lab Certification No. 10276CA

All QC is compliant unless otherwise noted. Please refer to the Quality Control Summary for overall QC performance data and associated samples.

Laboratory Sample Analysis Record

CAT No.	Analysis Name	Method	Trial#	Batch#	Analysis Date and Time	Analyst	Dilution Factor
01729	TPH-GRO N. CA water C6-C12	SW-846 8015B	1	14034A94B	02/12/2014 14:01	Marie D Beamenderfer	1
02102	Method 8021 Water Master	SW-846 8021B	1	14034A94B	02/12/2014 14:01	Marie D Beamenderfer	1
01146	GC VOA Water Prep	SW-846 5030B	1	14034A94B	02/12/2014 14:01	Marie D Beamenderfer	1
06610	TPH-DRO CA C10-C28 w/ Si Gel	SW-846 8015B	1	140360021A	02/10/2014 18:42	Christine E Dolman	1
11180	Low Vol Ext(W) w/SG	SW-846 3510C	1	140360021A	02/06/2014 12:30	Kelli M Barto	1

Sample Description: MW-7-W-140131 Grab Groundwater
Facility# 206145 Job# 386492 GRD
800 Center St-Oakland T0600102230

LL Sample # WW 7353991
LL Group # 1450109
Account # 10904

Project Name: 206145

Collected: 01/31/2014 08:50 by AW Chevron
L4310
Submitted: 02/04/2014 09:20 6001 Bollinger Canyon Rd.
Reported: 02/17/2014 07:49 San Ramon CA 94583

COM7Q

CAT No.	Analysis Name	CAS Number	As Received Result	As Received Method Detection Limit	Dilution Factor
	GC Petroleum Hydrocarbons w/Si	SW-846 8015B	ug/l	ug/l	
06610	TPH-DRO CA C10-C28 w/ Si Gel	n.a.	2,900	160	1

General Sample Comments

CA ELAP Lab Certification No. 2792; CA NELAP Lab Certification No. 10276CA
All QC is compliant unless otherwise noted. Please refer to the Quality Control Summary for overall QC performance data and associated samples.

Laboratory Sample Analysis Record

CAT No.	Analysis Name	Method	Trial#	Batch#	Analysis Date and Time	Analyst	Dilution Factor
06610	TPH-DRO CA C10-C28 w/ Si Gel	SW-846 8015B	1	140360022A	02/07/2014 18:34	Christine E Dolman	1
11180	Low Vol Ext (W) w/SG	SW-846 3510C	1	140360022A	02/06/2014 12:30	Kelli M Barto	1

Quality Control Summary

Client Name: Chevron Group Number: 1450109
Reported: 02/17/14 at 07:49 AM

Matrix QC may not be reported if insufficient sample or site-specific QC samples were not submitted. In these situations, to demonstrate precision and accuracy at a batch level, a LCS/LCSD was performed, unless otherwise specified in the method.

All Inorganic Initial Calibration and Continuing Calibration Blanks met acceptable method criteria unless otherwise noted on the Analysis Report.

Laboratory Compliance Quality Control

Analysis Name	Blank Result	Blank MDL	Report Units	LCS %REC	LCSD %REC	LCS/LCSD Limits	RPD	RPD Max
Batch number: 14034A94B	Sample number(s): 7353977-7353978,7353980,7353982,7353984,7353986,7353988,7353990							
Benzene	N.D.	0.2	ug/l	112	111	80-120	1	30
Ethylbenzene	N.D.	0.2	ug/l	107	105	80-120	2	30
Methyl tert-Butyl Ether	N.D.	0.3	ug/l	106	101	76-131	4	30
Toluene	N.D.	0.2	ug/l	107	107	80-120	1	30
TPH-GRO N. CA water C6-C12	N.D.	50.	ug/l	126	129	75-135	2	30
Total Xylenes	N.D.	0.2	ug/l	109	108	80-120	1	30
Batch number: 140360021A	Sample number(s): 7353978,7353980,7353982,7353984,7353986,7353988,7353990							
TPH-DRO CA C10-C28 w/ Si Gel	N.D.	32.	ug/l	75	84	43-120	12	20
Batch number: 140360022A	Sample number(s): 7353979,7353981,7353983,7353985,7353987,7353989,7353991							
TPH-DRO CA C10-C28 w/ Si Gel	N.D.	32.	ug/l	87	87	43-120	1	20

Surrogate Quality Control

Surrogate recoveries which are outside of the QC window are confirmed unless attributed to dilution or otherwise noted on the Analysis Report.

Analysis Name: TPH-GRO N. CA water C6-C12
Batch number: 14034A94B

	Trifluorotoluene-F	Trifluorotoluene-P
7353977	86	94
7353978	88	95
7353980	86	94
7353982	203*	181*
7353984	89	92
7353986	86	94
7353988	86	94
7353990	85	95
Blank	86	94
LCS	90	93
LCSD	91	93
Limits:	63-135	51-120

Analysis Name: TPH-DRO CA C10-C28 w/ Si Gel

*- Outside of specification

- (1) The result for one or both determinations was less than five times the LOQ.
- (2) The unspiked result was more than four times the spike added.

Quality Control Summary

Client Name: Chevron
Reported: 02/17/14 at 07:49 AM

Group Number: 1450109

Surrogate Quality Control

Batch number: 140360021A
Orthoterphenyl

7353978	82
7353980	79
7353982	72
7353984	72
7353986	77
7353988	71
7353990	47
Blank	87
LCS	87
LCSD	97

Limits: 46-131

Analysis Name: TPH-DRO CA C10-C28 w/ Si Gel
Batch number: 140360022A
Orthoterphenyl

7353979	101
7353981	87
7353983	85
7353985	89
7353987	94
7353989	86
7353991	71
Blank	96
LCS	99
LCSD	99

Limits: 46-131

*- Outside of specification

- (1) The result for one or both determinations was less than five times the LOQ.
- (2) The unspiked result was more than four times the spike added.

Chevron California Region Analysis Request/Chain of Custody



Lancaster Laboratories

Acct. # 10904

For Eurofins Lancaster Laboratories use only
Group # 1456109 Sample # 7355

3km2
2-4-13

Instructions on reverse side correspond with circled numbers.

7353977-91

013114-06

COM

(1) Client Information				(4) Matrix				(5) Analyses Requested								(6) Remarks				
Facility: SS#206145-OML G-R#386492 Global ID#T0600102230				<input type="checkbox"/> Sediment <input checked="" type="checkbox"/> Ground <input type="checkbox"/> Surface				<input type="checkbox"/> 8260 <input checked="" type="checkbox"/> 8260 <input type="checkbox"/> 8260 <input checked="" type="checkbox"/> 8015 <input checked="" type="checkbox"/> 8015 <input checked="" type="checkbox"/> 8015 <input checked="" type="checkbox"/> 8015 <input type="checkbox"/> 8260 Full Scan Total Lead Method Dissolved Lead Method								SCR #: _____				
Site Address: 600 CENTER STREET, OAKLAND, CA				<input type="checkbox"/> Potable <input type="checkbox"/> NPDES <input type="checkbox"/> Air				Total Number of Containers BTEX + MTBE 80215 <input checked="" type="checkbox"/> TPH-GRO 8015 <input checked="" type="checkbox"/> TPH-DRO 8015 without Silica Gel Cleanup <input checked="" type="checkbox"/> TPH-DRO 8015 with Silica Gel Cleanup <input checked="" type="checkbox"/>								<input type="checkbox"/> Results in Dry Weight <input type="checkbox"/> J value reporting needed <input type="checkbox"/> Must meet lowest detection limits possible for 8260 compounds <input type="checkbox"/> 8021 MTBE Confirmation <input type="checkbox"/> Confirm highest hit by 8260 <input type="checkbox"/> Confirm all hits by 8260 <input type="checkbox"/> Run _____ oxy's on highest hit <input type="checkbox"/> Run _____ oxy's on all hits				
Chevron: DW CRAAN Lead Consultant: Allen																				
Consultant/Office: Center-Ryan, Inc., 6805 Sierra Court, Suite G, Dublin, CA 94568																				
Consultant Project Mgr.: Deanna L. Harding, deanna@grinc.com																				
Consultant Phone #: (925) 551-7444 x180																				
Sampler: Alex Wong																				
Sample Identification		Soil Depth	Collected		Grab	Composite	Soil	Water	Oil	Total Number of Containers	BTEX + MTBE 80215	TPH-GRO 8015	TPH-DRO 8015 without Silica Gel Cleanup	TPH-DRO 8015 with Silica Gel Cleanup	8260 Full Scan	Total Lead Method	Dissolved Lead Method			
			Date	Time																
QA			1-31-14		X		X		2	X	X	X	X							(6) Requesting 10 gram column cleanup on DRO w'sgc COLUMN samples, and normal 1 gram on DRO w'sgc by (8015). Please forward the lab results directly to the Lead Consultant and cc: G-R.
mw-1A			0926						5	X	X	X	X							
mw-2			1030						5											
mw-3			0955						5											
mw-4			0815						5											
mw-5			0645						5											
mw-6			0730						5											
mw-7			0850						5											
(7) Turnaround Time Requested (TAT) (please circle) Standard <u>5</u> day 4 day 72 hour 48 hour 24 hour EDF/EDD				Relinquished by: _____ Date: <u>1-31-14</u> Time: <u>1430</u>				Received by: <u>[Signature]</u> Date: <u>1/31/14</u> Time: <u>1430</u>				Relinquished by: <u>[Signature]</u> Date: <u>2/3/14</u> Time: <u>1600</u>				Received by: <u>UPS</u> Date: _____ Time: _____				
(8) Data Package (circle if required) Type I - Full EDD (circle if required) Type VI (Raw Data) EDFFLAT (default) Other: _____				Relinquished by Commercial Carrier: UPS <input checked="" type="checkbox"/> FedEx _____ Other _____				Received by: <u>[Signature]</u> Date: <u>2.4.14</u> Time: <u>920</u>				Temperature Upon Receipt: <u>02-0.60C</u> Custody Seals Intact? <u>Yes</u> No								

Explanation of Symbols and Abbreviations

The following defines common symbols and abbreviations used in reporting technical data:

RL	Reporting Limit	BMQL	Below Minimum Quantitation Level
N.D.	none detected	MPN	Most Probable Number
TNTC	Too Numerous To Count	CP Units	cobalt-chloroplatinate units
IU	International Units	NTU	nephelometric turbidity units
umhos/cm	micromhos/cm	ng	nanogram(s)
C	degrees Celsius	F	degrees Fahrenheit
meq	milliequivalents	lb.	pound(s)
g	gram(s)	kg	kilogram(s)
µg	microgram(s)	mg	milligram(s)
mL	milliliter(s)	L	liter(s)
m³	cubic meter(s)	µL	microliter(s)
		pg/L	picogram/liter

< less than - The number following the sign is the limit of quantitation, the smallest amount of analyte which can be reliably determined using this specific test.

> greater than

ppm parts per million - One ppm is equivalent to one milligram per kilogram (mg/kg), or one gram per million grams. For aqueous liquids, ppm is usually taken to be equivalent to milligrams per liter (mg/l), because one liter of water has a weight very close to a kilogram. For gases or vapors, one ppm is equivalent to one microliter per liter of gas.

ppb parts per billion

Dry weight basis Results printed under this heading have been adjusted for moisture content. This increases the analyte weight concentration to approximate the value present in a similar sample without moisture. All other results are reported on an as-received basis.

Data Qualifiers:

C – result confirmed by reanalysis.

J - estimated value – The result is \geq the Method Detection Limit (MDL) and $<$ the Limit of Quantitation (LOQ).

U.S. EPA CLP Data Qualifiers:

Organic Qualifiers

- A** TIC is a possible aldol-condensation product
- B** Analyte was also detected in the blank
- C** Pesticide result confirmed by GC/MS
- D** Compound quantitated on a diluted sample
- E** Concentration exceeds the calibration range of the instrument
- N** Presumptive evidence of a compound (TICs only)
- P** Concentration difference between primary and confirmation columns $>25\%$
- U** Compound was not detected
- X,Y,Z** Defined in case narrative

Inorganic Qualifiers

- B** Value is $<$ CRDL, but \geq IDL
- E** Estimated due to interference
- M** Duplicate injection precision not met
- N** Spike sample not within control limits
- S** Method of standard additions (MSA) used for calculation
- U** Compound was not detected
- W** Post digestion spike out of control limits
- *** Duplicate analysis not within control limits
- +** Correlation coefficient for MSA <0.995

Analytical test results meet all requirements of NELAC unless otherwise noted under the individual analysis.

Measurement uncertainty values, as applicable, are available upon request.

Tests results relate only to the sample tested. Clients should be aware that a critical step in a chemical or microbiological analysis is the collection of the sample. Unless the sample analyzed is truly representative of the bulk of material involved, the test results will be meaningless. If you have questions regarding the proper techniques of collecting samples, please contact us. We cannot be held responsible for sample integrity, however, unless sampling has been performed by a member of our staff. This report shall not be reproduced except in full, without the written approval of the laboratory.

Times are local to the area of activity. Parameters listed in the 40 CFR part 136 Table II as “analyze immediately” are not performed within 15 minutes.

WARRANTY AND LIMITS OF LIABILITY - In accepting analytical work, we warrant the accuracy of test results for the sample as submitted. THE FOREGOING EXPRESS WARRANTY IS EXCLUSIVE AND IS GIVEN IN LIEU OF ALL OTHER WARRANTIES, EXPRESSED OR IMPLIED. WE DISCLAIM ANY OTHER WARRANTIES, EXPRESSED OR IMPLIED, INCLUDING A WARRANTY OF FITNESS FOR PARTICULAR PURPOSE AND WARRANTY OF MERCHANTABILITY. IN NO EVENT SHALL EUROFINS LANCASTER LABORATORIES ENVIRONMENTAL, LLC BE LIABLE FOR INDIRECT, SPECIAL, CONSEQUENTIAL, OR INCIDENTAL DAMAGES INCLUDING, BUT NOT LIMITED TO, DAMAGES FOR LOSS OF PROFIT OR GOODWILL REGARDLESS OF (A) THE NEGLIGENCE (EITHER SOLE OR CONCURRENT) OF EUROFINS LANCASTER LABORATORIES ENVIRONMENTAL AND (B) WHETHER EUROFINS LANCASTER LABORATORIES ENVIRONMENTAL HAS BEEN INFORMED OF THE POSSIBILITY OF SUCH DAMAGES. We accept no legal responsibility for the purposes for which the client uses the test results. No purchase order or other order for work shall be accepted by Eurofins Lancaster Laboratories Environmental which includes any conditions that vary from the Standard Terms and Conditions, and Eurofins Lancaster Laboratories Environmental hereby objects to any conflicting terms contained in any acceptance or order submitted by client.

ATTACHMENT C

HISTORICAL GROUNDWATER MONITORING AND SAMPLING DATA

Table 1
Groundwater Monitoring Data and Analytical Results
Former Chevron (Signal Oil) Service Station #206145 (S-800)
800 Center Street
Oakland, California

WELL ID/ DATE	TOC* (ft.)	GWE (msl)	DTW (ft.)	TPH-DRO (µg/L)	TPH-GRO (µg/L)	B (µg/L)	T (µg/L)	E (µg/L)	X (µg/L)	MTBE (µg/L)	CUB (cfu/m)
MW-1A											
02/24-25/03 ¹	15.49	8.17	7.32	4,600	5,100	92	340	66	480	<10	--
06/02/03	15.49	7.15	8.34	5,500	3,800	150	490	72	450	<13	--
09/02/03	15.49	6.10	9.39	10,000	6,200	100	580	110	760	47	--
11/21/03	15.49	5.29	10.20	3,800	3,200	29	150	49	240	<10	--
02/27/04	15.49	9.87	5.62	2,800	280	9.7	19	3.0	30	<2.5	--
05/28/04	15.49	6.88	8.61	5,500	1,100	35	81	27	140	17	--
08/31/04	15.49	5.58	9.91	4,500	1,100	13	68	27	110	<2.5	--
12/17/04	15.49	7.09	8.40	2,300 ^o	560	8.0	17	9.6	36	<2.5	--
03/28/05	15.49	10.36	5.13	340 ^o	87	16	4.2	3.3	11	<2.5	--
06/09/05	15.49	9.69	5.80	6,400 ^o	260	26	3.7	7.7	13	5.3	--
08/19/05	15.49	6.70	8.79	1,100 ^{o,p,q}	440	38	7.8	9.4	17	<2.5	--
11/18/05	15.49	6.25	9.24	1,300 ^{o,q}	450	11	12	17	22	<2.5	--
03/07/06	15.49	10.51	4.98	2,300 ^o	150	33	1.6	3.4	2.7	<2.5	--
05/17/06	15.49	9.02	6.47	2,600 ^o	110	18	<0.5	0.7	<1.5	<2.5	--
08/30/06	15.49	5.68	9.81	3,600 ^o	420	24	0.7	8.1	9.2	<10	--
11/28/06	15.49	5.79	9.70	2,900 ^o	220	8.6	2.7	6.1	9.3	<2.5	--
02/06/07	18.11	8.83	9.28	1,500 ^o	230	19	<0.5	1.8	2.7	<2.5	--
05/02/07	18.11	9.83	8.28	1,300 ^o	190	16	<0.5	1	1.8	<2.5	--
08/17/07	18.11	8.61	9.50	1,100 ^o	160	2.5	0.8	2.0	2.7	<2.5	--
11/16/07 ^v	18.11	8.27	9.84	3,600 ^o	30,000	610	1,100	4,100	2,800	310	--
02/05/08	18.11	11.63	6.48	2,100 ^o	63	4.8	<0.5	<0.5	<1.5	<2.5	--
05/20/08	18.11	9.18	8.93	940 ^o	50	1.5	<0.5	<0.5	<1.5	<2.5	--
08/06/08	18.11	8.25	9.86	1,900 ^o	98	0.7	<0.5	<0.5	<1.5	<2.5	--
12/05/08	18.11	7.68	10.43	940 ^o	96	0.6	<0.5	0.5	<1.5	<2.5	--
02/09/09	18.11	8.10	10.01	630 ^o	130	2.7	<0.5	2.1	<1.5	<2.5	--
05/08/09	18.11	9.91	8.20	1,300 ^o	<50	<0.5	<0.5	<0.5	<1.5	<2.5	--
08/07/09	18.11	8.35	9.76	1,300 ^o	97	<0.5	<0.5	<0.5	<1.5	<2.5	--
02/25/10	18.11	11.03	7.08	500^{o,z}	<50	<0.5	<0.5	<0.5	<1.5	<2.5	--
MW-2											
10/27/95	15.77	10.60	5.17	--	<50	<0.5	<0.5	<0.5	<0.5	--	--
02/20/97	15.72	8.51	7.21	--	<50	<0.5	<0.5	<0.5	<0.5	<2.5	--
04/24/97	15.72	7.82	7.90	--	83 ^d	<0.5	<0.5	<0.5	<0.5	<2.5	--
07/23/97	15.72	5.92	9.80	--	<50	<0.5	<0.5	<0.5	<0.5	<2.5	--
10/29/97	15.72	5.13	10.59	--	<50	<0.5	<0.5	<0.5	<0.5	<2.5	--
01/28/98	15.72	9.21	6.51	--	<50	<0.5	<0.5	<0.5	<0.5	<2.5	--

Table 1
Groundwater Monitoring Data and Analytical Results
Former Chevron (Signal Oil) Service Station #206145 (S-800)
800 Center Street
Oakland, California

WELL ID/ DATE	TOC* (ft.)	GWE (msl)	DTW (ft.)	TPH-DRO (µg/L)	TPH-GRO (µg/L)	B (µg/L)	T (µg/L)	E (µg/L)	X (µg/L)	MTBE (µg/L)	CUB (cfu/m)
MW-2 (cont)											
05/11/98	15.72	8.82	6.90	SAMPLED ANNUALLY		--	--	--	--	--	--
07/16/98	15.72	7.37	8.35	--	--	--	--	--	--	--	--
08/04/98 ^a	15.72	7.03	8.69	--	--	--	--	--	--	--	1.9 x 1
09/03/98 ^a	15.72	6.44	9.28	--	--	--	--	--	--	--	3.0 x 1
10/21/98 ^b	15.72	5.51	10.21	--	--	--	--	--	--	--	8.8 x 1
11/04/98	15.72	5.60	10.12	--	--	--	--	--	--	--	--
01/26/99	15.72	6.87	8.85	--	<50	<0.5	<0.5	<0.5	<0.5	<2.0	--
05/06/99	15.72	8.20	7.52	--	--	--	--	--	--	--	--
08/21/99	15.72	13.21	2.51	--	--	--	--	--	--	--	--
10/28/99	15.72	6.35	9.37	--	--	--	--	--	--	--	--
01/31/00	15.72	7.25	8.47	--	<50	<0.5	0.541	<0.5	<0.5	<2.5	--
05/19/00	15.72	7.65	8.07	--	--	--	--	--	--	--	--
08/07/00	15.72	6.35	9.37	--	<50	<0.50	<0.50	<0.50	<0.50	<2.5/ ^f <2.0 ^f	--
12/01/00	15.72	5.60	10.12	--	<50.0	<0.500	<0.500	<0.500	<0.500	<2.50	--
02/09/01	15.72	6.05	9.67	--	<50	<0.50	<0.50	<0.50	<0.50	<2.5	--
05/29/01	15.72	6.73	8.99	--	<50	<0.50	<0.50	<0.50	<0.50	<2.5	--
08/27/01 ^h	15.72	5.68	10.04	--	<50	<0.50	<0.50	<0.50	<0.50	<5.0 ^f	--
11/28/01	15.72	5.86	9.86	NOT SAMPLED DUE TO INSUFFICIENT WATER				--	--	--	--
02/14/02	15.69	7.86	7.83	--	<50	<0.50	<0.50	<0.50	<1.5	<2.5	--
05/15/02	15.69	7.09	8.60	--	<50	<0.50	<0.50	<0.50	<1.5	<2.5	--
08/05/02	15.69	6.02	9.67	--	<50	<0.50	<0.50	<0.50	<1.5	<2.5	--
11/30/02	15.69	DRY	--	--	--	--	--	--	--	--	--
02/24-25/03 ^l	15.69	8.04	7.65	140	<50	<0.50	<0.50	<0.50	<1.5	<2.5	--
06/02/03	15.69	7.33	8.36	150 ^m	<50	<0.5	<0.5	<0.5	<1.5	<2.5	--
09/02/03	15.69	5.97	9.72	150 ^m	<50	<0.5	<0.5	<0.5	<1.5	<2.5	--
11/21/03	-- ⁿ	-- ⁿ	10.39	180	<50	<0.5	<0.5	<0.5	<1.5	<2.5	--
02/27/04	-- ⁿ	-- ⁿ	6.90	310	<50	<0.5	<0.5	<0.5	<1.5	<2.5	--
05/28/04	-- ⁿ	-- ⁿ	9.13	160	<50	<0.5	<0.5	<0.5	<1.5	<2.5	--
08/31/04	-- ⁿ	-- ⁿ	10.30	180 ^m	<50	<0.5	<0.5	<0.5	<1.5	<2.5	--
12/17/04	-- ⁿ	-- ⁿ	8.91	77 ^o	<50	<0.5	<0.5	<0.5	<1.5	<2.5	--
03/28/05	-- ⁿ	-- ⁿ	6.51	<50 ^o	<50	<0.5	0.5	<0.5	<1.5	<2.5	--
06/09/05	-- ⁿ	-- ⁿ	7.09	53 ^o	<50	<0.5	<0.5	<0.5	<1.5	<2.5	--
08/19/05	-- ⁿ	-- ⁿ	9.27	<50 ^{o,p}	<50	<0.5	<0.5	<0.5	<1.5	<2.5	--
11/18/05	-- ⁿ	-- ⁿ	9.66	<50 ^o	<50	<0.5	<0.5	<0.5	<1.5	<2.5	--
03/07/06	-- ⁿ	-- ⁿ	6.75	<50 ^o	<50	<0.5	<0.5	<0.5	<1.5	<2.5	--
05/17/06	-- ⁿ	-- ⁿ	7.09	<50 ^o	<50	<0.5	<0.5	<0.5	<1.5	<2.5	--
08/30/06	-- ⁿ	-- ⁿ	9.03	640 ^o	<50	<0.5	<0.5	<0.5	<1.5	<2.5	--

Table 1
Groundwater Monitoring Data and Analytical Results
Former Chevron (Signal Oil) Service Station #206145 (S-800)
800 Center Street
Oakland, California

WELL ID/ DATE	TOC* (ft.)	GWE (msl)	DTW (ft.)	TPH-DRO (µg/L)	TPH-GRO (µg/L)	B (µg/L)	T (µg/L)	E (µg/L)	X (µg/L)	MTBE (µg/L)	CUB (cfu/m)	
MW-2 (cont)												
11/28/06	-- ⁿ	-- ⁿ	10.02	560 ^o	<50	<0.5	<0.5	<0.5	<1.5	<2.5	--	
02/06/07	18.40	8.72	9.68	200 ^o	<50	<0.5	<0.5	<0.5	<1.5	<2.5	--	
05/02/07	18.40	9.71	8.69	480 ^o	<50	<0.5	<0.5	<0.5	<1.5	<2.5	--	
08/17/07	18.40	8.52	9.88	1,000 ^o	<50	<0.5	<0.5	<0.5	<1.5	<2.5	--	
11/16/07	18.40	8.30	10.10	1,900 ^o	<50	<0.5	<0.5	<0.5	<1.5	<2.5	--	
02/05/08	18.40	10.97	7.43	1,100 ^o	<50	<0.5	<0.5	<0.5	<1.5	<2.5	--	
05/20/08	18.40	9.09	9.31	650 ^o	<50	<0.5	<0.5	<0.5	<1.5	<2.5	--	
08/06/08	18.40	8.25	10.15	200 ^o	<50	<0.5	<0.5	<0.5	<1.5	<2.5	--	
12/05/08	18.40	7.12	11.28	680 ^o	<50	<0.5	<0.5	<0.5	<1.5	<2.5	--	
02/09/09	18.40	8.08	10.32	420 ^o	<50	<0.5	<0.5	<0.5	<1.5	<2.5	--	
05/08/09	18.40	9.98	8.42	75 ^o	<50	<0.5	<0.5	<0.5	<1.5	<2.5	--	
08/07/09	18.40	8.23	10.17	610 ^o	<50	<0.5	<0.5	<0.5	<1.5	<2.5	--	
02/25/10	18.40	10.54	7.86	120^{o,z}	<50^{aa}	<0.5	<0.5	<0.5	<1.5	<2.5	--	
MW-3												
10/27/95	15.46	10.37	5.09	--	33,000	11,000	1,700	2,300	4,200	--	--	
02/20/97	15.42	8.37	7.05	--	260	56	<1.0	7.6	5.9	<5.0	--	
04/24/97	15.42	7.29	8.13	--	1,400	310	28	76	75	74	--	
07/23/97	15.42	5.84	9.58	--	37,000	10,000	1,500	2,700	4,200	2,500	--	
10/29/97	15.42	5.09	10.33	--	53,000	12,000	1,200	3,000	3,100	2,500	--	
01/28/98	15.42	8.94	6.48	--	210	43	1.5	1.7	3.9	10	--	
05/11/98	15.42	8.49	6.93	--	59	11	<0.5	2.1	<0.5	<2.5	--	
07/16/98	15.42	7.14	8.28	--	260	90	4.8	18	5.7	<10	--	
08/04/98 ^a	15.42	6.88	8.54	--	--	--	--	--	--	--	8.5 x 1	
09/03/98 ^a	15.42	6.34	9.08	--	--	--	--	--	--	--	2.4 x 1	
10/21/98 ^b	15.42	5.62	9.80	--	--	--	--	--	--	--	6.0 x 1	
11/04/98	15.42	5.60	9.82	--	73,000	17,000	3,800	4,900	8,100	<250	--	
01/26/99	15.42	6.70	8.72	--	32,400	10,200	1,850	2,650	3,140	715/<500 ^c	--	
05/06/99	15.42	7.97	7.45	--	3,160	668	89.6	180	123	<200/<10 ^c	--	
08/21/99	15.42	7.95	7.47	--	53,800	9,700	2,040	2,880	5,000	<1,250/<40 ^c	--	
10/28/99	15.42	5.37	10.05	--	71,300	14,000	3,420	4,320	8,360	<1,000	--	
01/31/00	15.42	7.16	8.26	--	1,650	496	49.1	134	82.6	<12.5	--	
05/19/00	15.42	7.60	7.82	--	110 ^e	36	2.5	9.1	4.0	6.3	--	
08/07/00	15.42	6.29	9.13	--	36,000 ^e	9,000	3,000	2,700	2,800	2,500/<10 ^f	--	
12/01/00	15.42	2.45	12.97	NOT SAMPLED DUE TO INSUFFICIENT WATER				--	--	--	--	--
02/09/01	15.42	5.98	9.44	--	32,000 ^e	11,000	3,900	3,200	4,800	3,200/<2.0 ^f	--	

Table 1
Groundwater Monitoring Data and Analytical Results
Former Chevron (Signal Oil) Service Station #206145 (S-800)
800 Center Street
Oakland, California

WELL ID/ DATE	TOC* (ft.)	GWE (msl)	DTW (ft.)	TPH-DRO (µg/L)	TPH-GRO (µg/L)	B (µg/L)	T (µg/L)	E (µg/L)	X (µg/L)	MTBE (µg/L)	CUB (cfu/m)
MW-3 (cont)											
05/29/01	15.42	6.65	8.77	--	13,000	4,200	2,000	1,800	1,500	74/<2.0 ^f	--
08/27/01 ^h	15.42	5.70	9.72	--	40,000	7,600	2,800	2,500	2,700	<25 ^f	--
11/28/01	15.42	5.77	9.65	--	57,000	10,000	2,900	2,900	2,800	<250/<5.0 ^f	--
02/14/02	15.40	7.73	7.67	--	51	2.9	<0.50	1.9	1.8	<2.5/<2 ^f	--
05/15/02	15.40	7.05	8.35	--	4,100	910	250	210	240	<20/<2 ^f	--
08/05/02	15.40	5.96	9.44	--	58,000	11,000	4,300	3,400	4,000	<250/<10 ^f	--
11/30/02	15.40	5.14	10.26	--	46,000	13,000	2,900	3,700	2,600	<100/<10 ^f	--
02/24-25/03 ^l	15.40	7.89	7.51	4,500	52,000	9,600	4,800	2,900	4,100	<130	--
06/02/03	15.40	7.24	8.16	6,500	67,000	11,000	9,600	3,400	5,700	<250	--
09/02/03	15.40	5.89	9.51	10,000	73,000	8,900	10,000	3,600	7,000	300	--
11/21/03	15.40	5.17	10.23	8,000	29,000	3,300	3,200	1,200	1,500	<200	--
02/27/04	15.40	8.84	6.56	200	59	8.2	6.3	1.7	6.8	<2.5	--
05/28/04	15.40	6.57	8.83	5,400	18,000	2,600	970	1,600	950	<100	--
08/31/04	15.40	5.41	9.99	9,100	58,000	3,200	9,600	2,800	7,500	<50	--
12/17/04	15.40	6.81	8.59	2,200 ^o	23,000	1,100	2,100	1,200	2,600	<25	--
03/28/05	15.40	9.29	6.11	3,200 ^o	43,000	1,500	10,000	2,600	7,300	<130	--
06/09/05	15.40	8.65	6.75	7,800 ^o	38,000	980	7,000	2,100	4,800	190	--
08/19/05	15.40	6.43	8.97	5,000 ^{o-p-f}	75,000	1,500	14,000	3,400	9,600	<130	--
11/18/05	15.40	5.95	9.45	3,900 ^{o-f}	72,000	1,400	14,000	3,600	9,700	380	--
03/07/06	15.40	9.05	6.35	1,100 ^o	15,000	280	2,300	820	2,000	<100	--
05/17/06	15.40	8.57	6.83	4,400 ^o	57,000	650	8,100	2,900	8,100	410	--
08/30/06	15.40	5.44	9.96	4,300 ^o	54,000	540	7,600	4,100	10,000	550	--
11/28/06	15.40	5.62	9.78	4,400 ^o	43,000	260	3,400	3,800	5,800	<1,000	--
02/06/07	18.07	8.70	9.37	5,000 ^o	43,000	290	6,200	3,400	6,400	<500	--
05/02/07	18.07	9.67	8.40	4,500 ^o	43,000	290	4,100	3,800	6,500	<500	--
08/17/07	18.07	8.50	9.57	4,900 ^o	46,000	240	1,900	3,800	5,600	310	--
11/16/07 ^v	18.07	8.29	9.78	860 ^o	450	34	23	53	25	4.1	--
02/05/08	18.07	10.97	7.10	2,400 ^o	18,000	210	950	1,800	1,700	<500	--
05/20/08	18.07	8.99	9.08	6,900 ^o	45,000	190	4,900	2,800	6,200	<500 ^w	--
08/06/08	18.07	8.26	9.81	5,000 ^o	40,000	220	1,500	3,200	6,500	<500 ^w	--
12/05/08	18.07	7.56	10.51	4,000 ^o	15,000	26	590	1,800	1,800	230	--
02/09/09	18.07	8.02	10.05	2,800 ^o	20,000	170	710	1,800	2,500	<400 ^w	--
05/08/09	18.07	9.95	8.12	2,900 ^o	15,000	88	900	2,100	1,400	<250 ^w	--
08/07/09	18.07	8.20	9.87	2,900 ^o	41,000	150	2,400	3,800	6,700	<500 ^w	--
02/25/10	18.07	10.57	7.50	1,800^o	15,000	42	320	1,600	1,100	330	--

Table 1
Groundwater Monitoring Data and Analytical Results
Former Chevron (Signal Oil) Service Station #206145 (S-800)
800 Center Street
Oakland, California

WELL ID/ DATE	TOC* (ft.)	GWE (msl)	DTW (ft.)	TPH-DRO (µg/L)	TPH-GRO (µg/L)	B (µg/L)	T (µg/L)	E (µg/L)	X (µg/L)	MTBE (µg/L)	CUB (cfu/m)
MW-4											
10/27/95	14.45	9.37	5.08	--	66	6.8	<0.5	<0.5	<0.5	--	--
02/20/97	14.40	8.12	6.28	--	54	<0.5	<0.5	<0.5	7.4	39	--
04/24/97	14.40	7.29	7.11	--	54	1.4	<0.5	0.65	3.0	100	--
07/23/97	14.40	5.80	8.60	--	<50	<0.5	<0.5	<0.5	<0.5	<2.5	--
10/29/97	14.40	5.74	8.66	--	--	--	--	--	--	--	--
11/13/97	14.40	4.97	9.43	--	<50	<0.5	0.79	<0.5	<0.5	<2.5	--
01/28/98	14.40	8.88	5.52	--	<50	<0.5	<0.5	<0.5	<0.5	<2.5	--
05/11/98	14.40	8.40	6.00	SAMPLED SEMI-ANNUALLY			--	--	--	--	--
07/16/98	14.40	7.08	7.32	--	<50	<0.5	<0.5	<0.5	<0.5	<5.0	--
08/04/98 ^a	14.40	6.28	8.12	--	--	--	--	--	--	--	1.8 x 1
09/03/98 ^a	14.40	6.32	8.08	--	--	--	--	--	--	--	1.4 x 1
10/21/98 ^b	14.40	5.64	8.76	--	--	--	--	--	--	--	8.6 x 1
11/04/98	14.40	5.61	8.79	--	--	--	--	--	--	--	--
01/26/99	14.40	6.71	7.69	--	<50	<0.5	<0.5	<0.5	<0.5	<2.0	--
05/06/99	14.40	8.15	6.25	--	--	--	--	--	--	--	--
08/21/99	14.40	8.13	6.27	--	<50	<0.5	<0.5	<0.5	<0.5	<5.0	--
10/28/99	14.40	4.14	10.26	--	--	--	--	--	--	--	--
01/31/00	14.40	7.07	7.33	--	<50	<0.5	<0.5	<0.5	<0.5	<2.5	--
05/19/00	14.40	7.52	6.88	--	--	--	--	--	--	--	--
08/07/00	14.40	6.23	8.17	--	<50	4.3	0.60	<0.50	<0.50	<2.5/<2.0 ^f	--
12/01/00	14.40	INACCESSIBLE	--	--	--	--	--	--	--	--	--
02/09/01	14.40	INACCESSIBLE	--	--	--	--	--	--	--	--	--
05/29/01	14.40	6.58	7.82	NOT SAMPLED DUE TO INSUFFICIENT WATER			--	--	--	--	--
08/27/01	14.40	6.52	7.88	NOT SAMPLED DUE TO INSUFFICIENT WATER			--	--	--	--	--
11/28/01	14.40	DRY	--	--	--	--	--	--	--	--	--
02/14/02	14.37	7.66	6.71	--	<50	<0.50	<0.50	<0.50	<1.5	<2.5/<2 ^f	--
05/15/02	14.37	6.96	7.41	--	<50	<0.50	<0.50	<0.50	<1.5	<2.5/<2 ^f	--
08/05/02	14.37	DRY	--	--	--	--	--	--	--	--	--
11/30/02	14.37	DRY	--	--	--	--	--	--	--	--	--
02/24-25/03 ¹	14.37	7.77	6.60	200	<50	8.0	<0.50	<0.50	<1.5	<2.5	--
06/02/03	14.37	7.11	7.26	300	<50	4.3	<0.5	<0.5	<1.5	<2.5	--
09/02/03	14.37	5.80	8.57	410	51	4.3	<0.5	<0.5	<1.5	<2.5	--
11/21/03	-- ⁿ	-- ⁿ	10.24	560	110	25	0.6	1.5	<1.5	<2.5	--
02/27/04	-- ⁿ	-- ⁿ	5.71	340	<50	<0.5	<0.5	<0.5	<1.5	<2.5	--
05/28/04	-- ⁿ	-- ⁿ	7.88	430	<50	<0.5	<0.5	<0.5	<1.5	<2.5	--
08/31/04	-- ⁿ	-- ⁿ	9.03	460	<50	<0.5	<0.5	<0.5	<1.5	<2.5	--
12/17/04	-- ⁿ	-- ⁿ	7.67	390 ^o	<50	<0.5	<0.5	<0.5	<1.5	<2.5	--

Table 1
Groundwater Monitoring Data and Analytical Results
Former Chevron (Signal Oil) Service Station #206145 (S-800)
800 Center Street
Oakland, California

WELL ID/ DATE	TOC* (ft.)	GWE (msl)	DTW (ft.)	TPH-DRO (µg/L)	TPH-GRO (µg/L)	B (µg/L)	T (µg/L)	E (µg/L)	X (µg/L)	MTBE (µg/L)	CUB (cfu/m)
MW-4 (cont)											
03/28/05	-- ⁿ	-- ⁿ	5.32	<50 ^o	<50	<0.5	<0.5	<0.5	<1.5	<2.5	--
06/09/05	-- ⁿ	-- ⁿ	6.70	120 ^o	90	<0.5	<0.5	<0.5	<1.5	<2.5	--
08/19/05	-- ⁿ	-- ⁿ	8.03	190 ^{o,p,q}	200	<0.5	<0.5	<0.5	<1.5	<2.5	--
11/18/05	-- ⁿ	-- ⁿ	9.43	310 ^{o,t}	230	2.7	<0.5	0.8	<1.5	<2.5	--
03/07/06	-- ⁿ	-- ⁿ	5.55	230 ^o	<50	<0.5	<0.5	<0.5	<1.5	<2.5	--
05/17/06	-- ⁿ	-- ⁿ	5.89	150 ^o	<50	<0.5	<0.5	<0.5	<1.5	<2.5	--
08/30/06	-- ⁿ	-- ⁿ	7.71	380 ^o	1,300	47	<2.5	<2.5	<7.5	<50	--
11/28/06	-- ⁿ	-- ⁿ	8.75	1,800 ^o	1,200	36	1.1	3.4	<5.0	<20	--
02/06/07	16.98	8.58	8.40	1,600 ^o	13,000 ^u	3,700 ^u	60 ^u	880 ^u	170 ^u	210 ^u	--
05/02/07	16.98	9.53	7.45	170 ^o	1,400	170	0.6	0.9	1.6	<50	--
08/17/07	16.98	8.35	8.63	1,600 ^o	4,700	870	3.8	49	<10	30	--
11/16/07	16.98	8.20	8.78	2,000 ^o	3,700	780	5.6	100	7.8	25	--
02/05/08	16.98	10.75	6.23	250 ^o	1,100	270	2.2	63	7.6	<50	--
05/20/08	16.98	8.91	8.07	1,100 ^o	3,300	720	4.1	13	15	<50 ^w	--
08/06/08	16.98	8.09	8.89	2,200 ^o	11,000	2,700	33	460	87	<100 ^w	--
12/05/08	16.98	7.46	9.52	540 ^o	2,500	380	1.4	22	<5.0 ^x	11	--
02/09/09	16.98	7.97	9.01	610 ^o	890	6.4	0.5	2.9	<1.5	<5.0 ^w	--
05/08/09	16.98	9.80	7.18	140 ^o	560	29	<0.5	1.2	<1.5	<5.0 ^w	--
08/07/09	16.98	8.10	8.88	1,000 ^o	1,900	260	1.2	7.1	3.0	8.3	--
02/25/10	16.98	10.37	6.61	54^{o,z}	56	<0.5	<0.5	<0.5	<1.5	<2.5	--
MW-5											
01/03/97	--	--	--	--	<50	<0.5	<0.5	<0.5	<0.5	--	--
02/20/97	15.03	INACCESSIBLE	--	--	--	--	--	--	--	--	--
04/24/97	15.03	INACCESSIBLE	--	--	--	--	--	--	--	--	--
04/30/97	15.03	7.06	7.97	--	<50	<0.5	<0.5	<0.5	<0.5	<2.5	--
07/23/97	15.03	INACCESSIBLE	--	--	--	--	--	--	--	--	--
10/29/97	15.03	INACCESSIBLE	--	--	--	--	--	--	--	--	--
01/28/98	15.03	8.83	6.20	--	<50	<0.5	<0.5	<0.5	<0.5	<2.5	--
05/11/98	15.03	INACCESSIBLE	--	--	--	--	--	--	--	--	--
07/16/98	15.03	7.28	7.75	--	<50	<0.5	<0.5	<0.5	<0.5	<5.0	--
08/04/98	15.03	INACCESSIBLE	--	--	--	--	--	--	--	--	--
11/04/98	15.03	INACCESSIBLE	--	--	--	--	--	--	--	--	--
01/26/99	15.03	INACCESSIBLE	--	--	--	--	--	--	--	--	--
05/06/99	15.03	INACCESSIBLE	--	--	--	--	--	--	--	--	--
08/21/99	15.03	6.74	8.29	--	<50	<0.5	<0.5	<0.5	<0.5	<5.0	--

Table 1
Groundwater Monitoring Data and Analytical Results
Former Chevron (Signal Oil) Service Station #206145 (S-800)
800 Center Street
Oakland, California

WELL ID/ DATE	TOC* (ft.)	GWE (msl)	DTW (ft.)	TPH-DRO (µg/L)	TPH-GRO (µg/L)	B (µg/L)	T (µg/L)	E (µg/L)	X (µg/L)	MTBE (µg/L)	CUB (cfu/m)
MW-5 (cont)											
10/28/99	15.03	4.60	10.43	--	--	--	--	--	--	--	--
01/31/00	15.03	7.39	7.64	--	<50	<0.5	<0.5	<0.5	<0.5	<2.5	--
05/19/00	15.03	7.85	7.18	--	--	--	--	--	--	--	--
08/07/00	15.03	INACCESSIBLE		--	--	--	--	--	--	--	--
12/01/00	15.03	5.68	9.35	--	<50.0	<0.500	<0.500	<0.500	<0.500	<2.50/<2.0 ^f	--
02/09/01	15.03	6.22	8.81	--	<50	<0.50	<0.50	<0.50	<0.50	<2.5/<2.0 ^f	--
05/29/01	15.03	INACCESSIBLE - CAR PARKED OVER WELL		--	--	--	--	--	--	--	--
08/27/01	15.03	INACCESSIBLE - CAR PARKED OVER WELL		--	--	--	--	--	--	--	--
11/28/01	15.03	INACCESSIBLE - CAR PARKED OVER WELL		--	--	--	--	--	--	--	--
02/14/02	15.01	7.96	7.05	--	<50	<0.50	<0.50	<0.50	<1.5	<2.5/<2 ^f	--
05/15/02	15.01	7.23	7.78	--	<50	<0.50	<0.50	<0.50	<1.5	<2.5/<2 ^f	--
08/05/02	15.01	6.13	8.88	--	<50	<0.50	<0.50	<0.50	<1.5	<2.5/<2 ^f	--
11/30/02	15.01	5.27	9.74	--	<50	<0.50	<0.50	<0.50	<1.5	<2.5/<2 ^f	--
02/24-25/03 ¹	15.01	7.99	7.02	<50	<50	<0.50	<0.50	<0.50	<1.5	<2.5	--
06/02/03	15.01	7.14	7.87	<50	<50	<0.5	<0.5	<0.5	<1.5	<2.5	--
09/02/03	15.01	6.02	8.99	<50	<50	<0.5	<0.5	<0.5	<1.5	<2.5	--
11/21/03	15.01	5.26	9.75	68	<50	<0.5	<0.5	<0.5	<1.5	<2.5	--
02/27/04	15.01	8.42	6.59	140	<50	<0.5	<0.5	<0.5	<1.5	<2.5	--
05/28/04	15.01	6.71	8.30	76	<50	<0.5	<0.5	<0.5	<1.5	<2.5	--
08/31/04	15.01	INACCESSIBLE - CAR PARKED OVER WELL		--	--	--	--	--	--	--	--
12/17/04	15.01	6.98	8.03	52 ^o	<50	<0.5	<0.5	<0.5	<1.5	<2.5	--
03/28/05	15.01	8.66	6.35	51 ^o	<50	<0.5	0.7	<0.5	<1.5	<2.5	--
06/09/05	15.01	9.16	5.85	72 ^o	<50	<0.5	<0.5	<0.5	<1.5	<2.5	--
08/19/05	15.01	6.52	8.49	<50 ^{op}	<50	<0.5	<0.5	<0.5	<1.5	<2.5	--
11/18/05	15.01	6.12	8.89	<50 ^o	<50	<0.5	<0.5	<0.5	<1.5	<2.5	--
03/07/06	15.01	8.98	6.03	<50 ^o	<50	<0.5	<0.5	1.4	<1.5	<2.5	--
05/17/06	15.01	8.83	6.18	<50 ^o	<50	<0.5	<0.5	<0.5	<1.5	<2.5	--
08/30/06	15.01	6.86	8.15	<50 ^o	<50	<0.5	<0.5	<0.5	<1.5	<2.5	--
11/28/06	15.01	6.46	8.55	200 ^o	<50	<0.5	<0.5	<0.5	<1.5	<2.5	--
02/06/07	17.68	8.83	8.85	55 ^o	<50	<0.5	<0.5	<0.5	<1.5	<2.5	--
05/02/07	17.68	9.91	7.77	<50 ^o	<50	<0.5	<0.5	<0.5	<1.5	<2.5	--
08/17/07	17.68	8.63	9.05	66 ^o	<50	<0.5	<0.5	<0.5	<1.5	<2.5	--
11/16/07	17.68	INACCESSIBLE - CAR PARKED OVER WELL		--	--	--	--	--	--	--	--
02/05/08	17.68	INACCESSIBLE - CAR PARKED OVER WELL		--	--	--	--	--	--	--	--
02/29/08	17.68	10.88	6.80	<50 ^o	<50	<0.5	<0.5	<0.5	<1.5	<2.5	--
05/20/08	17.68	9.21	8.47	<50 ^o	<50	<0.5	<0.5	<0.5	<1.5	<2.5	--
08/06/08	17.68	8.29	9.39	<50 ^o	<50	<0.5	<0.5	<0.5	<1.5	<2.5	--

Table 1
Groundwater Monitoring Data and Analytical Results
Former Chevron (Signal Oil) Service Station #206145 (S-800)
800 Center Street
Oakland, California

WELL ID/ DATE	TOC* (ft.)	GWE (msl)	DTW (ft.)	TPH-DRO (µg/L)	TPH-GRO (µg/L)	B (µg/L)	T (µg/L)	E (µg/L)	X (µg/L)	MTBE (µg/L)	CUB (cfu/m)
MW-5 (cont)											
12/05/08	17.68	7.63	10.05	<50 ^o	<50	<0.5	<0.5	<0.5	<1.5	<2.5	--
02/09/09	17.68	8.21	9.47	<50 ^o	<50	<0.5	<0.5	<0.5	<1.5	<2.5	--
05/08/09	17.68	10.16	7.52	<50 ^o	<50	<0.5	<0.5	<0.5	<1.5	<2.5	--
08/07/09	17.68	8.33	9.35	<50 ^o	<50	<0.5	<0.5	<0.5	<1.5	<2.5	--
02/25/10	17.68	10.76	6.92	<50^o	<50	<0.5	<0.5	<0.5	<1.5	<2.5	--
MW-6											
01/03/97	--	--	--	--	<50	<0.5	<0.5	<0.5	<0.5	--	--
02/20/97	14.73	8.11	6.62	--	800	310	23	11	28	<12	--
04/24/97	14.73	7.13	7.60	--	<50	<0.5	<0.5	<0.5	<0.5	<2.5	--
07/23/97	14.73	5.73	9.00	--	<50	<0.5	<0.5	<0.5	<0.5	<2.5	--
10/29/97	14.73	4.98	9.75	--	<50	<0.5	<0.5	<0.5	<0.5	<2.5	--
01/28/98	14.73	8.19	6.54	--	160	38	<0.5	<0.5	<0.5	<2.5	--
05/11/98	14.73	8.08	6.65	--	1,700	490	72	39	52	<25	--
07/16/98	14.73	7.04	7.69	--	<50	<0.5	<0.5	<0.5	<0.5	<5.0	--
08/04/98 ^a	14.73	6.89	7.84	--	--	--	--	--	--	--	8.6 x 1
09/03/98 ^a	14.73	6.24	8.49	--	--	--	--	--	--	--	2.9 x 1
10/21/98 ^b	14.73	5.46	9.27	--	--	--	--	--	--	--	1.8 x 1
11/04/98	14.73	5.52	9.21	--	<50	<0.5	<0.5	<0.5	<0.5	<2.5	--
01/26/99	14.73	6.49	8.24	--	<50	<0.5	<0.5	<0.5	<0.5	<2.0	--
05/06/99	14.73	7.91	6.82	--	<50	<0.5	<0.5	<0.5	<0.5	<5.0	--
08/21/99	14.73	7.93	6.80	--	<50	<0.5	<0.5	<0.5	<0.5	<5.0	--
10/28/99	14.73	5.27	9.46	--	<50	<0.5	<0.5	<0.5	<0.5	<5.0	--
01/31/00	14.73	7.16	7.57	--	<50	<0.5	<0.5	<0.5	<0.5	<2.5	--
05/19/00	14.73	7.60	7.13	--	<50	11	<0.5	<0.5	<0.5	<2.5	--
08/07/00	14.73	6.22	8.51	--	<50	<0.50	<0.50	<0.50	<0.50	<2.5/<2.0 ^f	--
12/01/00	14.73	DRY	--	--	--	--	--	--	--	--	--
02/09/01	14.73	DRY	--	--	--	--	--	--	--	--	--
05/29/01	14.73	6.63	8.10	NOT SAMPLED DUE TO INSUFFICIENT WATER				--	--	--	--
08/27/01 ^h	14.73	9.83	4.90	--	150	<0.50	5.7	<0.50	<0.50	<5.0 ^f	--
11/28/01	14.73	DRY	--	--	--	--	--	--	--	--	--
02/14/02	14.68	7.90	6.78	--	<50	<0.50	<0.50	<0.50	<1.5	<2.5	--
05/15/02	14.68	7.32	7.36	--	<50	<0.50	<0.50	<0.50	<1.5	<2.5	--
08/05/02	14.68	DRY	--	--	--	--	--	--	--	--	--
11/30/02	14.68	DRY	--	--	--	--	--	--	--	--	--
02/24-25/03 ^l	14.68	7.89	6.79	<50	<50	<0.50	<0.50	<0.50	<1.5	<2.5	--

Table 1
Groundwater Monitoring Data and Analytical Results
Former Chevron (Signal Oil) Service Station #206145 (S-800)
800 Center Street
Oakland, California

WELL ID/ DATE	TOC* (ft.)	GWE (msl)	DTW (ft.)	TPH-DRO (µg/L)	TPH-GRO (µg/L)	B (µg/L)	T (µg/L)	E (µg/L)	X (µg/L)	MTBE (µg/L)	CUB (cfu/m)
MW-6 (cont)											
06/02/03	14.68	7.20	7.48	<50	<50	<0.5	<0.5	<0.5	<1.5	<2.5	--
09/02/03	14.68	5.77	8.91	190	<50	<0.5	<0.5	<0.5	<1.5	<2.5	--
11/21/03	14.68	4.86	9.82	98	<50	<0.5	<0.5	<0.5	<1.5	<2.5	--
02/27/04	14.68	8.12	6.56	240	<50	<0.5	<0.5	<0.5	<1.5	<2.5	--
05/28/04	14.68	6.43	8.25	150	<50	<0.5	<0.5	<0.5	<1.5	<2.5	--
08/31/04	14.68	5.29	9.39	360 ^m	<50	<0.5	<0.5	<0.5	<1.5	<2.5	--
12/17/04	14.68	6.85	7.83	91 ^o	<50	<0.5	<0.5	<0.5	<1.5	<2.5	--
03/28/05	14.68	8.34	6.34	61 ^o	<50	<0.5	<0.5	<0.5	<1.5	<2.5	--
06/09/05	14.68	7.95	6.73	64 ^o	<50	<0.5	<0.5	<0.5	<1.5	<2.5	--
08/19/05	14.68	6.27	8.41	<50 ^{o,p}	<50 ^s	<0.5	<0.5	<0.5	<1.5	<2.5	--
11/18/05	14.68	DRY AT 15.70 FEET		--	--	--	--	--	--	--	--
03/07/06	14.68	8.03	6.65	<50 ^o	<50	<0.5	<0.5	0.9	<1.5	<2.5	--
05/17/06	14.68	7.98	6.70	<50 ^o	<50	<0.5	<0.5	<0.5	<1.5	<2.5	--
08/30/06	14.68	6.63	8.05	<50 ^o	<50	<0.5	<0.5	<0.5	<1.5	<2.5	--
11/28/06	14.68	6.09	8.59	120 ^o	<50	<0.5	<0.5	<0.5	<1.5	<2.5	--
02/06/07	17.33	8.58	8.75	96 ^o	<50	<0.5	<0.5	<0.5	<1.5	<2.5	--
05/02/07	17.33	9.64	7.69	<50 ^o	<50	<0.5	<0.5	<0.5	<1.5	<2.5	--
08/17/07	17.33	8.38	8.95	66 ^o	<50	<0.5	<0.5	<0.5	<1.5	<2.5	--
11/16/07	17.33	8.19	9.14	250 ^o	<50	<0.5	<0.5	<0.5	<1.5	<2.5	--
02/05/08	17.33	10.55	6.78	120 ^o	<50	<0.5	<0.5	<0.5	<1.5	<2.5	--
05/20/08	17.33	8.92	8.41	70 ^o	<50	<0.5	<0.5	<0.5	<1.5	<2.5	--
08/06/08	17.33	8.06	9.27	<160 ^o	<50	<0.5	<0.5	<0.5	<1.5	<2.5	--
12/05/08	17.33	7.44	9.89	<50 ^o	<50	<0.5	<0.5	<0.5	<1.5	<2.5	--
02/09/09	17.33	7.99	9.34	<50 ^o	<50	<0.5	<0.5	<0.5	<1.5	<2.5	--
05/08/09	17.33	10.01	7.32	<50 ^o	<50	<0.5	<0.5	<0.5	<1.5	<2.5	--
08/07/09	17.33	8.11	9.22	<50 ^o	<50	<0.5	<0.5	<0.5	<1.5	<2.5	--
02/25/10	17.33	10.58	6.75	<50^o	<50	<0.5	<0.5	<0.5	<1.5	<2.5	--
MW-7											
01/03/97	--	--	--	--	<50	<0.5	<0.5	<0.5	<0.5	--	--
02/20/97	16.36	8.86	7.50	--	<50	<0.5	<0.5	<0.5	<0.5	<2.5	--
04/24/97	16.36	7.59	8.77	--	<50	<0.5	<0.5	<0.5	<0.5	<2.5	--
07/23/97	16.36	6.09	10.27	--	<50	<0.5	<0.5	<0.5	<0.5	<2.5	--
10/29/97	16.36	5.28	11.08	--	<50	<0.5	<0.5	<0.5	<0.5	<2.5	--
01/28/98	16.36	9.10	7.26	--	<50	<0.5	<0.5	<0.5	<0.5	<2.5	--
05/11/98	16.36	9.11	7.25	SAMPLED ANNUALLY		--	--	--	--	--	--

Table 1
Groundwater Monitoring Data and Analytical Results
Former Chevron (Signal Oil) Service Station #206145 (S-800)
800 Center Street
Oakland, California

WELL ID/ DATE	TOC* (ft.)	GWE (msl)	DTW (ft.)	TPH-DRO (µg/L)	TPH-GRO (µg/L)	B (µg/L)	T (µg/L)	E (µg/L)	X (µg/L)	MTBE (µg/L)	CUB (cfu/m)
MW-7 (cont)											
07/16/98	16.36	8.00	8.36	--	--	--	--	--	--	--	--
08/04/98 ^a	16.36	7.32	9.04	--	--	--	--	--	--	--	1.5 x 1
09/03/98 ^a	16.36	6.65	9.71	--	--	--	--	--	--	--	6.5 x 1
10/21/98 ^b	16.36	5.96	10.40	--	--	--	--	--	--	--	4.8 x 1
11/04/98	16.36	5.89	10.47	--	--	--	--	--	--	--	--
01/26/99	16.36	8.25	8.11	--	<50	<0.5	<0.5	<0.5	0.5	<2.0	--
05/06/99	16.36	8.47	7.89	--	--	--	--	--	--	--	--
08/21/99	16.36	8.51	7.85	--	--	--	--	--	--	--	--
10/28/99	16.36	6.04	10.32	--	--	--	--	--	--	--	--
01/31/00	16.36	7.57	8.79	--	<50	<0.5	<0.5	<0.5	<0.5	<2.5	--
05/19/00	16.36	UNABLE TO LOCATE		--	--	--	--	--	--	--	--
08/07/00	16.36	6.67	9.69	--	<50	<0.50	<0.50	<0.50	<0.50	<2.5/<2.0 ^f	--
12/01/00	16.36	5.84	10.52	--	<50.0	<0.500	<0.500	<0.500	<0.500	<2.50	--
02/09/01	16.36	6.30	10.06	--	<50	<0.50	<0.50	<0.50	<0.50	<2.5	--
05/29/01	16.36	UNABLE TO LOCATE		--	--	--	--	--	--	--	--
08/27/01 ^h	16.36	6.02	10.34	--	<50	<0.50	<0.50	<0.50	<0.50	<5.0 ^f	--
11/28/01	16.36	6.09	10.27	--	<50	<0.50	<0.50	<0.50	<1.5	<2.5	--
02/14/02	16.31	8.21	8.10	--	<50	<0.50	<0.50	<0.50	<1.5	<2.5	--
05/15/02	16.31	7.41	8.90	--	<50	<0.50	<0.50	<0.50	<1.5	<2.5	--
08/05/02	16.31	6.26	10.05	--	<50	<0.50	<0.50	<0.50	<1.5	<2.5	--
11/30/02	16.31	5.39	10.92	--	<50	<0.50	<0.50	<0.50	<1.5	<2.5	--
02/24-25/03 ^l	16.31	8.30	8.01	<50	<50	<0.50	<0.50	<0.50	<1.5	<2.5	--
06/02/03	16.31	7.67	8.64	<50	<50	<0.5	<0.5	<0.5	<1.5	<2.5	--
09/02/03	16.31	6.17	10.14	<50	<50	<0.5	<0.5	<0.5	<1.5	<2.5	--
11/21/03	16.31	UNABLE TO LOCATE - BURIED		--	--	--	--	--	--	--	--
02/27/04	16.31	UNABLE TO LOCATE - BURIED		--	--	--	--	--	--	--	--
05/28/04	-- ⁿ	-- ⁿ	9.40	91	<50	<0.5	<0.5	<0.5	<1.5	<2.5	--
08/31/04	-- ⁿ	-- ⁿ	10.61	150 ^m	<50	<0.5	<0.5	<0.5	<1.5	<2.5	--
12/17/04	-- ⁿ	-- ⁿ	9.16	170 ^o	<50	<0.5	<0.5	<0.5	<1.5	<2.5	--
03/28/05	-- ⁿ	-- ⁿ	7.21	<50 ^o	<50	<0.5	<0.5	<0.5	<1.5	<2.5	--
06/09/05	-- ⁿ	-- ⁿ	7.71	86 ^o	55	<0.5	<0.5	<0.5	<1.5	<2.5	--
08/19/05	-- ⁿ	-- ⁿ	9.88	820 ^{o,p,q}	<50	<0.5	<0.5	<0.5	<1.5	<2.5	--
11/18/05	-- ⁿ	-- ⁿ	10.06	<50 ^o	<50	<0.5	<0.5	<0.5	<1.5	<2.5	--
03/07/06	-- ⁿ	-- ⁿ	6.95	<50 ^o	<50	<0.5	<0.5	<0.5	<1.5	<2.5	--
05/17/06	-- ⁿ	-- ⁿ	7.52	<50 ^o	<50	<0.5	<0.5	<0.5	<1.5	<2.5	--
08/30/06	-- ⁿ	-- ⁿ	10.73	<50 ^o	<50	<0.5	<0.5	<0.5	<1.5	<2.5	--
11/28/06	-- ⁿ	-- ⁿ	10.70	<50 ^o	<50	<0.5	<0.5	<0.5	<1.5	<2.5	--

Table 1
Groundwater Monitoring Data and Analytical Results
Former Chevron (Signal Oil) Service Station #206145 (S-800)
800 Center Street
Oakland, California

WELL ID/ DATE	TOC* (ft.)	GWE (msl)	DTW (ft.)	TPH-DRO (µg/L)	TPH-GRO (µg/L)	B (µg/L)	T (µg/L)	E (µg/L)	X (µg/L)	MTBE (µg/L)	CUB (cfu/m)
MW-7 (cont)											
02/06/07	19.26	8.91	10.35	73°	<50	<0.5	<0.5	<0.5	<1.5	<2.5	--
05/02/07	19.26	9.98	9.28	<50°	<50	<0.5	<0.5	<0.5	<1.5	<2.5	--
08/17/07	19.26	8.75	10.51	<50°	<50	<0.5	<0.5	<0.5	<1.5	<2.5	--
11/16/07	19.26	8.56	10.70	<50°	<50	<0.5	<0.5	<0.5	<1.5	<2.5	--
02/05/08	19.26	11.43	7.83	100°	<50	<0.5	<0.5	<0.5	<1.5	<2.5	--
05/20/08	19.26	9.32	9.94	52°	<50	<0.5	<0.5	<0.5	<1.5	<2.5	--
08/06/08	19.26	8.41	10.85	<50°	<50	<0.5	<0.5	<0.5	<1.5	<2.5	--
12/05/08	19.26	7.71	11.55	<50°	<50	<0.5	<0.5	<0.5	<1.5	<2.5	--
02/09/09	19.26	8.23	11.03	<50°	<50	<0.5	<0.5	<0.5	<1.5	<2.5	--
05/08/09	19.26	10.23	9.03	<50°	<50	<0.5	<0.5	<0.5	<1.5	<2.5	--
08/07/09	19.26	8.40	10.86	<50°	<50	<0.5	<0.5	<0.5	<1.5	<2.5	--
02/25/10	19.26	10.84	8.42	<50°	<50	<0.5	<0.5	<0.5	<1.5	<2.5	--
MW-8											
02/14/02 ^{ij}	15.29	7.30	7.99	--	<50	<0.50	<0.50	<0.50	<1.5	<2.5/<2 ^f	--
05/15/02 ^k	15.29	6.66	8.63	--	<50	<0.50	<0.50	<0.50	<1.5	<2.5	--
08/05/02 ^k	15.29	5.48	9.81	--	<50	<0.50	<0.50	<0.50	<1.5	<2.5	--
11/30/02 ^k	15.29	4.85	10.44	--	<50	<0.50	<0.50	<0.50	<1.5	<2.5	--
02/24-25/03 ^l	15.29	7.46	7.83	<50	<50	<0.50	<0.50	<0.50	<1.5	<2.5	--
06/02/03	15.29	6.83	8.46	<50	<50	<0.5	<0.5	<0.5	<1.5	<2.5	--
09/02/03	15.29	5.57	9.72	<50	<50	<0.5	<0.5	<0.5	<1.5	<2.5	--
11/21/03	15.29	4.89	10.40	<50	<50	<0.5	<0.5	<0.5	<1.5	<2.5	--
02/27/04	15.29	8.38	6.91	280	<50	<0.5	<0.5	<0.5	<1.5	<2.5	--
05/28/04	15.29	6.33	8.96	72	<50	<0.5	<0.5	<0.5	<1.5	<2.5	--
08/31/04	15.29	4.79	10.50	92 ^m	<50	<0.5	<0.5	<0.5	<1.5	<2.5	--
12/17/04	15.29	6.68	8.61	53°	<50	<0.5	<0.5	<0.5	<1.5	<2.5	--
03/28/05	15.29	8.79	6.50	<50°	<50	<0.5	0.9	<0.5	<1.5	<2.5	--
06/09/05	15.29	8.26	7.03	63°	<50	<0.5	<0.5	<0.5	<1.5	<2.5	--
08/19/05	15.29	6.18	9.11	<50° ^p	<50	<0.5	<0.5	<0.5	<1.5	<2.5	--
11/18/05	15.29	5.47	9.82	<50°	<50	<0.5	<0.5	<0.5	<1.5	<2.5	--
03/07/06	15.29	8.60	6.69	<50°	<50	<0.5	<0.5	<0.5	<1.5	<2.5	--
05/17/06	15.29	8.21	7.08	<50°	<50	<0.5	<0.5	<0.5	<1.5	<2.5	--
08/30/06	15.29	6.57	8.72	<50°	<50	<0.5	<0.5	<0.5	<1.5	<2.5	--
11/28/06	15.29	6.38	8.91	<50°	<50	<0.5	<0.5	<0.5	<1.5	<2.5	--
02/06/07	17.79	8.39	9.40	<50°	<50	<0.5	<0.5	<0.5	<1.5	<2.5	--
05/02/07	17.79	9.33	8.46	<50°	<50	<0.5	<0.5	<0.5	<1.5	<2.5	--

Table 1
Groundwater Monitoring Data and Analytical Results
Former Chevron (Signal Oil) Service Station #206145 (S-800)
800 Center Street
Oakland, California

WELL ID/ DATE	TOC* (ft.)	GWE (msl)	DTW (ft.)	TPH-DRO (µg/L)	TPH-GRO (µg/L)	B (µg/L)	T (µg/L)	E (µg/L)	X (µg/L)	MTBE (µg/L)	CUB (cfu/m)
MW-8 (cont)											
08/17/07	17.79	8.18	9.61	<50 ^o	<50	<0.5	<0.5	<0.5	<1.5	<2.5	--
11/16/07	17.79	8.04	9.75	<50 ^o	<50	<0.5	<0.5	<0.5	<1.5	<2.5	--
02/05/08	17.79	10.44	7.35	120 ^o	<50	<0.5	<0.5	<0.5	<1.5	<2.5	--
05/20/08	17.79	8.69	9.10	<50 ^o	<50	<0.5	<0.5	<0.5	<1.5	<2.5	--
08/06/08	17.79	7.89	9.90	<50 ^o	<50	<0.5	<0.5	<0.5	<1.5	<2.5	--
12/05/08	17.79	7.30	10.49	<50 ^o	<50	<0.5	<0.5	<0.5	<1.5	<2.5	--
02/09/09	17.79	7.86	9.93	<50 ^o	<50	<0.5	<0.5	<0.5	<1.5	<2.5	--
05/08/09	17.79	9.60	8.19	<50 ^o	<50	<0.5	<0.5	<0.5	<1.5	<2.5	--
08/07/09	17.79	7.95	9.84	<50 ^o	<50	<0.5	<0.5	<0.5	<1.5	<2.5	--
02/25/10	17.79	10.27	7.52	<50^o	<50	<0.5	<0.5	<0.5	<1.5	<2.5	--
MW-9											
04/20/07 ⁱ	18.42	10.39	8.03	1,100 ^o	4,100	28	6.9	9.2	240	--	--
06/22/07	18.42	8.82	9.60	310 ^o	500	4.4	<0.5	<0.5	12	--	--
08/17/07	18.42	8.67	9.75	92 ^o	<50	<0.5	<0.5	<0.5	<1.5	--	--
11/16/07	18.42	8.40	10.02	470 ^o	92	<0.5	<0.5	<0.5	<1.5	--	--
02/05/08	18.42	11.08	7.34	390 ^o	<50	<0.5	<0.5	<0.5	<1.5	--	--
05/20/08	18.42	9.16	9.26	<50 ^o	<50	<0.5	<0.5	<0.5	<1.5	--	--
08/06/08	18.42	8.31	10.11	<50 ^o	<50	<0.5	<0.5	<0.5	<1.5	--	--
12/05/08	18.42	7.64	10.78	<50 ^o	<50	<0.5	<0.5	<0.5	<1.5	--	--
02/09/09	18.42	8.15	10.27	<50 ^o	<50	<0.5	<0.5	<0.5	<1.5	--	--
05/08/09	18.42	10.11	8.31	<50 ^o	<50	<0.5	<0.5	<0.5	<1.5	--	--
08/07/09	18.42	8.33	10.09	SAMPLED SEMI-ANNUALLY		<0.5	--	--	--	--	--
02/25/10	18.42	10.70	7.72	<50^o	<50	<0.5	<0.5	<0.5	<1.5	--	--
MW-10											
04/20/07 ⁱ	17.99	8.35	9.64	260 ^o	1,200	29	31	11	140	--	--
06/22/07	17.99	8.29	9.70	110 ^o	<50	1.5	<0.5	<0.5	<1.5	--	--
08/17/07	17.99	7.81	10.18	53 ^o	<50	<0.5	<0.5	<0.5	<1.5	--	--
11/16/07	17.99	6.90	11.09	140 ^o	<50	<0.5	<0.5	<0.5	<1.5	--	--
02/05/08	17.99	9.65	8.34	330 ^o	<50	<0.5	<0.5	<0.5	<1.5	--	--
05/20/08	17.99	8.28	9.71	120 ^o	<50	<0.5	<0.5	<0.5	<1.5	--	--
08/06/08	17.99	7.50	10.49	<50 ^o	<50	<0.5	<0.5	<0.5	<1.5	--	--
12/05/08	17.99	6.67	11.32	<50 ^o	<50	<0.5	<0.5	<0.5	<1.5	--	--

Table 1
Groundwater Monitoring Data and Analytical Results
Former Chevron (Signal Oil) Service Station #206145 (S-800)
800 Center Street
Oakland, California

WELL ID/ DATE	TOC* (ft.)	GWE (msl)	DTW (ft.)	TPH-DRO (µg/L)	TPH-GRO (µg/L)	B (µg/L)	T (µg/L)	E (µg/L)	X (µg/L)	MTBE (µg/L)	CUB (cfu/m)
MW-10 (cont)											
02/09/09	17.99	7.19	10.80	<50 ^o	<50	<0.5	<0.5	<0.5	<1.5	--	--
05/08/09	17.99	8.96	9.03	<50 ^o	<50	<0.5	<0.5	<0.5	<1.5	--	--
08/07/09	17.99	7.41	10.58	SAMPLED SEMI-ANNUALLY			--	--	--	--	--
02/25/10	17.99	9.11	8.88	<50^o	<50	<0.5	<0.5	<0.5	<1.5	--	--
MW-11											
04/20/07 ⁱ	18.68	9.88	8.80	350 ^o	77	<2.0	4.6	<0.5	3.2	--	--
06/22/07	18.68	9.35	9.33	140 ^o	51	<0.5	<0.5	<0.5	<1.5	--	--
08/17/07	18.68	8.66	10.02	<50 ^o	<50	<0.5	<0.5	<0.5	<1.5	--	--
11/16/07	18.68	8.47	10.21	<50	<50	<0.5	<0.5	<0.5	<1.5	--	--
02/05/08	18.68	11.10	7.58	84 ^o	<50	<0.5	<0.5	<0.5	<1.5	--	--
05/20/08	18.68	9.20	9.48	<50 ^o	<50	<0.5	<0.5	<0.5	<1.5	--	--
08/06/08	18.68	8.37	10.31	<50 ^o	<50	<0.5	<0.5	<0.5	<1.5	--	--
12/05/08	18.68	7.63	11.05	<50 ^o	<50	<0.5	<0.5	<0.5	<1.5	--	--
02/09/09	18.68	8.17	10.51	<50 ^o	<50	<0.5	<0.5	<0.5	<1.5	--	--
05/08/09	18.68	10.12	8.56	<50 ^o	<50	<0.5	<0.5	<0.5	<1.5	--	--
08/07/09	18.68	8.34	10.34	SAMPLED SEMI-ANNUALLY			--	--	--	--	--
02/25/10	18.68	10.70	7.98	<50^o	<50	<0.5	<0.5	<0.5	<1.5	--	--
MW-12											
04/20/07 ⁱ	18.46	12.88	5.58	430 ^o	400	2.3	40	14	49	--	--
06/22/07	18.46	7.75	10.71	390 ^o	<50	0.7	1.1	<0.5	4.3	--	--
08/17/07	18.46	7.91	10.55	<50 ^o	<50	<0.5	<0.5	<0.5	<1.5	--	--
11/16/07	18.46	6.96	11.50	200 ^o	<50	<0.5	<0.5	<0.5	<1.5	--	--
02/05/08	18.46	8.62	9.84	200 ^o	51	0.9	<0.5	<0.5	<1.5	--	--
02/05/08	18.46	8.80	9.66	66 ^o	<50	<0.5	<0.5	<0.5	<1.5	--	--
08/06/08	18.46	6.40	12.06	<50 ^o	<50	<0.5	<0.5	<0.5	<1.5	--	--
12/05/08	18.46	6.20	12.26	<50 ^o	<50	<0.5	<0.5	<0.5	<1.5	--	--
02/09/09	18.46	6.53	11.93	<50 ^o	<50	<0.5	<0.5	<0.5	<1.5	--	--
05/08/09	18.46	8.64	9.82	<50 ^o	<50	<0.5	<0.5	<0.5	<1.5	--	--
08/07/09	18.46	6.41	12.05	SAMPLED SEMI-ANNUALLY			--	--	--	--	--
02/25/10	18.46	8.08	10.38	<50^o	<50	<0.5	<0.5	<0.5	<1.5	--	--

Table 1
Groundwater Monitoring Data and Analytical Results
Former Chevron (Signal Oil) Service Station #206145 (S-800)
800 Center Street
Oakland, California

WELL ID/ DATE	TOC* (ft.)	GWE (msl)	DTW (ft.)	TPH-DRO (µg/L)	TPH-GRO (µg/L)	B (µg/L)	T (µg/L)	E (µg/L)	X (µg/L)	MTBE (µg/L)	CUB (cfu/m)
MW-13											
04/20/07 ⁱ	18.43	9.46	8.97	140 ^o	650	16	23	7.5	61	--	--
06/22/07	18.43	8.99	9.44	400 ^o	<50	0.6	0.9	<0.5	<1.5	--	--
08/17/07	18.43	8.53	9.90	<50 ^o	<50	<0.5	<0.5	<0.5	<1.5	--	--
11/16/07	18.43	8.37	10.06	350 ^o	<50	<0.5	<0.5	<0.5	<1.5	--	--
02/05/08	18.43	10.85	7.58	57 ^o	<50	<0.5	<0.5	<0.5	<1.5	--	--
05/20/08	18.43	8.99	9.44	100 ^o	<50	<0.5	<0.5	<0.5	<1.5	--	--
08/06/08	18.43	8.18	10.25	78 ^o	<50	<0.5	<0.5	<0.5	<1.5	--	--
12/05/08	18.43	7.53	10.90	<50 ^o	<50	<0.5	<0.5	<0.5	<1.5	--	--
02/09/09	18.43	8.00	10.43	<50 ^o	<50	<0.5	<0.5	<0.5	<1.5	--	--
05/08/09	18.43	9.93	8.50	<50 ^o	<50	<0.5	<0.5	<0.5	<1.5	--	--
08/07/09	18.43	8.20	10.23	SAMPLED SEMI-ANNUALLY			--	--	--	--	--
02/25/10	18.43	10.51	7.92	<50^o	<50	<0.5	<0.5	<0.5	<1.5	--	--
MW-14											
04/20/07 ⁱ	18.59	8.17	10.42	2,000 ^o	16,000	550	1,600	620	2,400	--	--
06/22/07	18.59	7.55	11.04	1,300 ^o	3,700	190	150	49	580	--	--
08/17/07	18.59	7.82	10.77	780 ^o	2,600	74	54	11	220	--	--
11/16/07	18.59	7.58	11.01	690 ^o	850	45	3.5	14	32	--	--
02/05/08	18.59	8.99	9.60	160 ^o	450	16	2.7	7.6	3.0	--	--
05/20/08	18.59	7.69	10.90	120 ^o	<50	0.7	<0.5	<0.5	<1.5	--	--
08/06/08	18.59	7.35	11.24	88 ^o	<50	0.9	<0.5	<0.5	<1.5	--	--
12/05/08	18.59	6.83	11.76	<50 ^o	100	1.7	0.5	<0.5	<1.5	--	--
02/09/09	18.59	7.11	11.48	<50 ^o	<50	<0.5	<0.5	<0.5	<1.5	--	--
05/08/09	18.59	8.01	10.58	<50 ^o	<50	<0.5	<0.5	<0.5	<1.5	--	--
08/07/09	18.59	7.48	11.11	SAMPLED SEMI-ANNUALLY			--	--	--	--	--
02/25/10	18.59	8.72	9.87	<50^o	<50	<0.5	<0.5	<0.5	<1.5	--	--
MW-15											
04/20/07 ⁱ	18.38	9.78	8.60	720 ^o	240	1.0	1.3	<0.5	20	--	--
06/22/07	18.38	9.09	9.29	150 ^o	<50	<0.5	<0.5	<0.5	<1.5	--	--
08/17/07	18.38	8.65	9.73	<50 ^o	<50	<0.5	<0.5	<0.5	<1.5	--	--
11/16/07	18.38	8.41	9.97	140 ^o	<50	<0.5	<0.5	<0.5	<1.5	--	--
02/05/08	18.38	10.97	7.41	52 ^o	<50	<0.5	<0.5	<0.5	<1.5	--	--
05/20/08	18.38	9.12	9.26	<50 ^o	<50	<0.5	<0.5	<0.5	<1.5	--	--
08/06/08	18.38	8.30	10.08	190 ^o	<50	<0.5	<0.5	<0.5	<1.5	--	--

Table 1
Groundwater Monitoring Data and Analytical Results
Former Chevron (Signal Oil) Service Station #206145 (S-800)
800 Center Street
Oakland, California

WELL ID/ DATE	TOC* (ft.)	GWE (msl)	DTW (ft.)	TPH-DRO (µg/L)	TPH-GRO (µg/L)	B (µg/L)	T (µg/L)	E (µg/L)	X (µg/L)	MTBE (µg/L)	CUB (cfu/m)
MW-15 (cont)											
12/05/08	18.38	7.58	10.80	<50 ^o	<50	<0.5	<0.5	<0.5	<1.5	--	--
02/09/09	18.38	8.12	10.26	<50 ^o	<50	<0.5	<0.5	<0.5	<1.5	--	--
05/08/09	18.38	10.02	8.36	53 ^o	<50	<0.5	<0.5	<0.5	<1.5	--	--
08/07/09	18.38	8.30	10.08	SAMPLED SEMI-ANNUALLY		--	--	--	--	--	--
02/25/10	18.38	10.61	7.77	<50^o	<50	<0.5	<0.5	<0.5	<1.5	--	--
MW-16											
04/20/07 ⁱ	18.57	8.75	9.82	2,200 ^o	15,000	87	1,200	500	2,000	--	--
06/22/07	18.57	8.20	10.37	2,100 ^o	10,000	130	1,800	580	1,400	--	--
08/17/07	18.57	7.81	10.76	640 ^o	8,200	110	1,400	280	730	--	--
11/16/07	18.57	7.54	11.03	370 ^o	1,600	22	270	60	160	--	--
02/05/08	18.57	9.74	8.83	350 ^o	930	2.6	15	9.3	18	--	--
05/20/08	18.57	8.26	10.31	79 ^o	<50	<0.5	<0.5	<0.5	<1.5	--	--
08/06/08	18.57	7.49	11.08	74 ^o	<50	<0.5	<0.5	0.6	<1.5	--	--
12/05/08	18.57	6.80	11.77	89 ^o	<50	<0.5	<0.5	<0.5	<1.5	--	--
02/09/09	18.57	7.18	11.39	<50 ^o	<50	<0.5	<0.5	<0.5	<1.5	--	--
05/08/09	18.57	8.92	9.65	<50 ^o	<50	<0.5	<0.5	<0.5	<1.5	--	--
08/07/09	18.57	7.52	11.05	SAMPLED SEMI-ANNUALLY		--	--	--	--	--	--
02/25/10	18.57	9.36	9.21	<50^o	<50	<0.5	<0.5	<0.5	<1.5	--	--
MW-17											
04/20/07 ⁱ	18.55	-0.95	19.50	1,300 ^o	7,400	66	880	300	1,300	--	--
06/22/07	18.55	8.21	10.34	690 ^o	2,000	35	27	9.3	360	--	--
08/17/07	18.55	2.33	16.22	240 ^o	380	6.7	2.3	0.5	15	--	--
11/16/07	18.55	3.22	15.33	270 ^o	190	4.0	4.0	1.5	27	--	--
02/05/08	18.55	4.94	13.61	460 ^o	1,000	16	26	49	60	--	--
05/20/08	18.55	8.29	10.26	89 ^o	<50	<0.5	<0.5	<0.5	<1.5	--	--
08/06/08	18.55	5.82	12.73	150 ^o	180	2.5	2.0	2.8	1.5	--	--
12/05/08	18.55	6.62	11.93	120 ^o	360	3.4	<2.0 ^y	0.7	<1.5	--	--
02/09/09	18.55	6.68	11.87	<50 ^o	<50	<0.5	<0.5	<0.5	<1.5	--	--
05/08/09	18.55	8.79	9.76	<50 ^o	<50	<0.5	<0.5	<0.5	<1.5	--	--
08/07/09	18.55	7.51	11.04	SAMPLED SEMI-ANNUALLY		--	--	--	--	--	--
02/25/10	18.55	8.92	9.63	<50	<50	<0.5	<0.5	<0.5	<1.5	--	--

Table 1
Groundwater Monitoring Data and Analytical Results
Former Chevron (Signal Oil) Service Station #206145 (S-800)
800 Center Street
Oakland, California

WELL ID/ DATE	TOC* (ft.)	GWE (msl)	DTW (ft.)	TPH-DRO (µg/L)	TPH-GRO (µg/L)	B (µg/L)	T (µg/L)	E (µg/L)	X (µg/L)	MTBE (µg/L)	CUB (cfu/m)
AS-1											
02/25/10 ⁱ	--	--	7.63	--	--	--	--	--	--	--	--
AS-2											
02/25/10 ⁱ	--	--	8.05	--	--	--	--	--	--	--	--
AS-3											
02/25/10 ⁱ	--	--	8.12	--	--	--	--	--	--	--	--
AS-4											
02/25/10 ⁱ	--	--	7.98	--	--	--	--	--	--	--	--
AS-5											
02/25/10 ⁱ	--	--	7.80	--	--	--	--	--	--	--	--
AS-6											
02/25/10 ⁱ	--	--	8.04	--	--	--	--	--	--	--	--
AS-7											
02/25/10 ⁱ	--	--	8.01	--	--	--	--	--	--	--	--
AS-8											
02/25/10 ⁱ	--	--	7.94	--	--	--	--	--	--	--	--
MW-1											
10/27/95	15.69	10.54	5.15	--	170,000	19,000	34,000	4,800	26,000	--	--
02/20/97	15.64	8.96	6.68	--	18,000	870	3,500	470	2,100	<250	--
04/24/97	15.64	7.30	8.34	--	76,000	4,600	16,000	1,600	8,300	1,000	--
07/23/97	15.64	5.90	9.74	--	37,000	2,700	8,000	870	6,100	<250	--
10/29/97	15.64	INACCESSIBLE		--	--	--	--	--	--	--	--

Table 1
Groundwater Monitoring Data and Analytical Results
Former Chevron (Signal Oil) Service Station #206145 (S-800)
800 Center Street
Oakland, California

WELL ID/ DATE	TOC* (ft.)	GWE (msl)	DTW (ft.)	TPH-DRO (µg/L)	TPH-GRO (µg/L)	B (µg/L)	T (µg/L)	E (µg/L)	X (µg/L)	MTBE (µg/L)	CUB (cfu/m)
MW-1 (cont)											
01/28/98	15.64	9.30	6.34	--	10,000	380	2,000	300	1,500	<25	--
05/11/98	15.64	8.72	6.92	--	17,000	880	3,100	380	2,300	<250	--
07/16/98	15.64	7.23	8.41	--	29,000	2,700	6,800	890	3,900	<1,000	--
08/04/98 ^a	15.64	6.90	8.74	--	--	--	--	--	--	--	<1.0 x 1
09/03/98 ^a	15.64	6.43	9.21	--	--	--	--	--	--	--	4.1 x 1
10/21/98 ^b	15.64	5.59	10.05	--	--	--	--	--	--	--	4.7 x 1
11/04/98	15.64	5.64	10.00	--	25,000	1,900	5,900	810	4,300	<125	--
01/26/99	15.64	6.86	8.78	--	<50	<0.5	<0.5	<0.5	<0.5	<2.0	--
05/06/99	15.64	8.17	7.47	--	8,050	515	1,840	256	1,190	300/<20 ^c	--
08/21/99	15.64	13.27	2.37	--	46,500	2,530	8,700	1,010	5,300	<1,250/<40 ^c	--
10/28/99	15.64	5.46	10.18	--	31,600	1,580	6,100	794	4,400	1,270	--
01/31/00	15.64	7.49	8.15	--	7,270	366	1,280	171	935	<12.5	--
05/19/00	15.64	7.78	7.86	--	8,000 ^e	870	1,200	430	1,200	<250	--
08/07/00	15.64	6.42	9.22	--	37,000 ^e	2,400	8,500	1,100	5,500	1,500/<4.0 ^f	--
12/01/00	15.64	5.25	10.39	--	25,500 ^g	1,390	4,920	801	4,330	<500/<10 ^f	--
02/09/01	15.64	6.10	9.54	--	8,900 ^e	850	1,300	470	1,700	820/<2.0 ^f	--
05/29/01	15.64	6.79	8.85	--	24,000 ^e	1,800	5,600	740	3,700	<250/<2.0 ^f	--
08/27/01 ^h	15.64	5.83	9.81	--	27,000	1,400	4,400	710	3,400	<20 ^f	--
11/28/01	15.64	5.84	9.80	--	26,000	1,300	3,900	620	3,400	<100/<2 ^f	--
02/14/02	15.63	8.34	7.29	--	1,400	100	360	45	240	9.3/<2 ^f	--
05/15/02	15.63	7.18	8.45	--	37,000	2,400	7,300	1,000	4,800	<100/<3.0 ^f	--
08/05/02	15.63	6.09	9.54	--	27,000	1,500	4,600	700	3,400	<100/<3.0 ^f	--
DESTROYED											
TRIP BLANK											
02/20/97	--	--	--	--	<50	<0.5	<0.5	<0.5	<0.5	<2.5	--
04/24/97	--	--	--	--	<50	<0.5	<0.5	<0.5	<0.5	<2.5	--
07/23/97	--	--	--	--	<50	<0.5	<0.5	<0.5	<0.5	<2.5	--
10/29/97	--	--	--	--	<50	<0.5	<0.5	<0.5	<0.5	<2.5	--
01/28/98	--	--	--	--	<50	<0.5	<0.5	<0.5	<0.5	<2.5	--
05/11/98	--	--	--	--	<50	<0.5	<0.5	<0.5	<0.5	<2.5	--
07/16/98	--	--	--	--	<50	<0.5	<0.5	<0.5	<0.5	<5.0	--
11/04/98	--	--	--	--	<50	<0.5	<0.5	<0.5	<0.5	<2.0	--
01/26/99	--	--	--	--	<50	<0.5	<0.5	<0.5	<0.5	<2.0	--
05/06/99	--	--	--	--	<50	<0.5	<0.5	<0.5	<0.5	<5.0	--
01/31/00	--	--	--	--	<50	<0.5	<0.5	<0.5	<0.5	<2.5	--

Table 1
Groundwater Monitoring Data and Analytical Results
Former Chevron (Signal Oil) Service Station #206145 (S-800)
800 Center Street
Oakland, California

WELL ID/ DATE	TOC* (ft.)	GWE (msl)	DTW (ft.)	TPH-DRO (µg/L)	TPH-GRO (µg/L)	B (µg/L)	T (µg/L)	E (µg/L)	X (µg/L)	MTBE (µg/L)	CUB (cfu/m)
TRIP BLANK (cont)											
05/19/00	--	--	--	--	<50	<0.50	<0.50	<0.50	<0.50	<2.5	--
08/07/00	--	--	--	--	<50	<0.50	<0.50	<0.50	<0.50	<2.5	--
12/01/00	--	--	--	--	<50.0	<0.500	<0.500	<0.500	<0.500	<2.50	--
02/09/01	--	--	--	--	<50	<0.50	<0.50	<0.50	<0.50	<2.5	--
05/29/01	--	--	--	--	<50	<0.50	<0.50	<0.50	<0.50	<2.5	--
08/27/01 ^h	--	--	--	--	<50	<0.50	<0.50	<0.50	<0.50	<5.0 ^f	--
QA											
11/28/01	--	--	--	--	<50	<0.50	<0.50	<0.50	<1.5	<2.5	--
02/14/02	--	--	--	--	<50	<0.50	<0.50	<0.50	<1.5	<2.5	--
05/15/02	--	--	--	--	<50	<0.50	<0.50	<0.50	<1.5	<2.5	--
08/05/02	--	--	--	--	<50	<0.50	<0.50	<0.50	<1.5	<2.5	--
11/30/02	--	--	--	--	<50	<0.50	<0.50	<0.50	<1.5	<2.5	--
02/24-25/03	--	--	--	--	<50	<0.50	<0.50	<0.50	<1.5	<2.5	--
06/02/03	--	--	--	--	<50	<0.5	<0.5	<0.5	<1.5	<2.5	--
09/02/03	--	--	--	--	<50	<0.5	<0.5	<0.5	<1.5	<2.5	--
11/21/03	--	--	--	--	<50	<0.5	<0.5	<0.5	<1.5	<2.5	--
02/27/04	--	--	--	--	<50	<0.5	<0.5	<0.5	<1.5	<2.5	--
05/28/04	--	--	--	--	<50	<0.5	<0.5	<0.5	<1.5	<2.5	--
08/31/04	--	--	--	--	<50	<0.5	<0.5	<0.5	<1.5	<2.5	--
12/17/04	--	--	--	--	<50	<0.5	<0.5	<0.5	<1.5	<2.5	--
03/28/05	--	--	--	--	<50	<0.5	<0.5	<0.5	<1.5	<2.5	--
06/09/05	--	--	--	--	<50	<0.5	<0.5	<0.5	<1.5	<2.5	--
08/19/05	--	--	--	--	<50	<0.5	<0.5	<0.5	<1.5	<2.5	--
11/18/05	--	--	--	--	<50	<0.5	<0.5	<0.5	<1.5	<2.5	--
03/07/06	--	--	--	--	<50	<0.5	<0.5	<0.5	<1.5	<2.5	--
05/17/06	--	--	--	--	<50	<0.5	<0.5	<0.5	<1.5	<2.5	--
08/30/06	--	--	--	--	<50	<0.5	<0.5	<0.5	<1.5	<2.5	--
11/28/06	--	--	--	--	<50	<0.5	<0.5	<0.5	<1.5	<2.5	--
02/06/07	--	--	--	--	<50	<0.5	<0.5	<0.5	<1.5	<2.5	--
04/20/07	--	--	--	--	<50	<0.5	<0.5	<0.5	<1.5	<2.5	--
05/02/07	--	--	--	--	<50	<0.5	<0.5	<0.5	<1.5	<2.5	--
06/22/07	--	--	--	--	<50	<0.5	<0.5	<0.5	<1.5	--	--
08/17/07	--	--	--	--	<50	<0.5	<0.5	<0.5	<1.5	<2.5	--
11/16/07	--	--	--	--	<50	<0.5	<0.5	<0.5	<1.5	<2.5	--
02/05/08	--	--	--	--	<50	<0.5	<0.5	<0.5	<1.5	<2.5	--
02/29/08	--	--	--	--	<50	<0.5	<0.5	<0.5	<1.5	<2.5	--
05/20/08	--	--	--	--	<50	<0.5	<0.5	<0.5	<1.5	<2.5	--

Table 1
Groundwater Monitoring Data and Analytical Results
Former Chevron (Signal Oil) Service Station #206145 (S-800)
800 Center Street
Oakland, California

WELL ID/ DATE	TOC* (ft.)	GWE (msl)	DTW (ft.)	TPH-DRO (µg/L)	TPH-GRO (µg/L)	B (µg/L)	T (µg/L)	E (µg/L)	X (µg/L)	MTBE (µg/L)	CUB (cfu/m)
QA (cont)											
08/06/08	--	--	--	--	<50	<0.5	<0.5	<0.5	<1.5	<2.5	--
12/05/08	--	--	--	--	<50	<0.5	<0.5	<0.5	<1.5	<2.5	--
02/09/09	--	--	--	--	<50	<0.5	<0.5	<0.5	<1.5	<2.5	--
05/08/09	--	--	--	--	<50	<0.5	<0.5	<0.5	<1.5	<2.5	--
08/07/09	--	--	--	--	<50	<0.5	<0.5	<0.5	<1.5	<2.5	--
02/25/10	--	--	--	--	<50	<0.5	<0.5	<0.5	<1.5	<2.5	--

Table 1
Groundwater Monitoring Data and Analytical Results
Former Chevron (Signal Oil) Service Station #206145 (S-800)
800 Center Street
Oakland, California

EXPLANATIONS:

Groundwater monitoring data and laboratory analytical results prior to May 19, 2000 were compiled from reports prepared by Blaine Tech Services, Inc.

TOC = Top of Casing (ft.) = Feet	TPH = Total Petroleum Hydrocarbons DRO = Diesel Range Organics	MTBE = Methyl Tertiary Butyl Ether CUB = Contaminate utilizing bacteria
GWE = Groundwater Elevation (msl) = Mean sea level	GRO = Gasoline Range Organics B = Benzene	(cfu/ml) = Colony forming unit per milliliter (µg/L) = Micrograms per liter
DTW = Depth to Water	T = Toluene E = Ethylbenzene	(ppb) = Parts per billion -- = Not Measured/Not Analyzed
TPH-D = Total Petroleum Hydrocarbons as Diesel	X = Xylenes	QA = Quality Assurance/Trip Blank
TPH-G = Total Petroleum Hydrocarbons as Gasoline		

- * TOC elevations were surveyed on May 30, 2007, by Morrow Surveying. Vertical Datum is NAVD 88 from GPS observations. Gettler-Ryan received updated TOC data March 12, 2007. Vertical Datum is NAVD 88 from GPS observations. TOC elevations were surveyed on August 17, 2005, by Morrow Surveying. On February 18, 2003, MW-1A was surveyed using the previous benchmark. TOC elevations were surveyed on December March 4, 2002, by Virgil Chavez Land Surveying. The benchmark for the survey was a City of Oakland benchmark, #25-H monument disk in well casting in sidewalk at the northwest corner of 7th and Center. The latitude, longitude and coordinates are for top of casings and are based on the California State Coordinate System, Zone III (NAD83), (Benchmark Elevation = 10.784 feet NGVD 29).
- ^a Contaminate hydrocarbon utilizing bacteria plate count was run with diesel and jet fuel degraders.
- ^b Contaminate hydrocarbon utilizing bacteria plate count was run with gasoline degraders.
- ^c Confirmation run.
- ^d Chromatogram pattern indicates an unidentified hydrocarbon.
- ^e Laboratory report indicates gasoline C6-C12.
- ^f MTBE by EPA Method 8260.
- ^g Laboratory reports indicates weathered gasoline C6-C12.
- ^h TPH-G and BTEX by EPA Method 8260.
- ⁱ Well development performed.
- ^j TPH-D was detected at 130 ppb.
- ^k TPH-D was <50 ppb.
- ^l Well re-development performed.
- ^m Laboratory report indicates the observed sample pattern is not typical of diesel/#2 fuel oil.
- ⁿ TOC damaged; unable to calculate an accurate GWE.
- ^o Analyzed with silica gel clean-up.
- ^p Laboratory report indicates analysis performed out of hold time.
- ^q Laboratory report indicates the observed sample pattern includes #2 fuel/diesel and an additional pattern which elutes later in the DRO range.
- ^r Laboratory report indicates the observed sample pattern is not typical of #2 fuel/diesel. It elutes in the DRO range earlier than #2 fuel.

Table 1
Groundwater Monitoring Data and Analytical Results
Former Chevron (Signal Oil) Service Station #206145 (S-800)
800 Center Street
Oakland, California

EXPLANATIONS:

- ^s Laboratory report indicates the analysis was performed from a previously opened vial and the results are therefore estimated.
- ^t Laboratory report indicates the observed sample pattern includes #2 fuel/diesel, an additional pattern which elutes later in the DRO range, and individual peaks eluting in the DRO range.
- ^u Laboratory confirmed result.
- ^v Current laboratory analytical results do not coincide with historical data and although laboratory results were confirmed; it appears that the samples were switched.
- ^w Laboratory report indicates that due to the presence of an interferent near its retention time, the normal reporting limit was not attained for MTBE. The presence or concentration of this compound cannot be determined due to the presence of this interferent.
- ^x Laboratory report indicates that due to the presence of an interferent near its retention time, the normal reporting limit was not attained for total xylenes. The presence or concentration of this compound cannot be determined due to the presence of this interferent.
- ^y Laboratory report indicates that due to the presence of an interferent near its retention time, the normal reporting limit was not attained for toluene. The presence or concentration of this compound cannot be determined due to the presence of this interferent.
- ^z Laboratory report indicates DRO was detected in the method blank at a concentration of 50 µg/L. Due to insufficient sample volume, a repeat analysis could not be performed to confirm the results.
- ^{aa} Laboratory report indicates the ending calibration check standard did not meet the 15% criteria for the original analysis. The sample was reanalyzed from the vial with headspace and the result was <50 µg/L.

Table 2
Field Measurements and Analytical Results
Former Chevron (Signal Oil) Service Station #206145 (S-800)
800 Center Street
Oakland, California

WELL ID/ DATE	Pre-purge DO (mg/L)	Post-purge D.O. (mg/L)	Pre-purge ORP (mV)	Post-purge ORP (mV)	Total Alkalinity (µg/L)	Ferrous Iron (µg/L)	Nitrate as Nitrate (µg/L)	Sulfate (µg/L)
MW-1 09/03/98	2.3	1.6	-90	-103	230,000	9,800	<1,000	6,100
MW-2 09/03/98	2.8	2.5	-206	-163	390,000	7,400	<1,000	21,000
MW-3 09/03/98	3.1	0.7	-124	-99	830,000	45,000	<1,000	10,000
MW-4 09/03/98	2.6	1.1	-190	-206	--	--	--	--
MW-6 09/03/98	2.6	3.2	-148	-167	94,000	62	28,000	47,000
MW-7 09/03/98	2.7	3.2	-207	-229	170,000	120	7,800	57,000

EXPLANATIONS:

Groundwater monitoring data and laboratory analytical results were compiled from reports prepared by Blaine Tech Services, Inc.

D.O. = Dissolved Oxygen

(mg/L) = Milligram per liter

ORP = Oxidation Reduction Potential

(mV) = Millivolts

(µg/L) = Micrograms per liter

-- = Not Analyzed

Table 3
Groundwater Analytical Results - Oxygenate Compounds
Former Chevron (Signal Oil) Service Station #206145 (S-800)
800 Center Street
Oakland, California

WELL ID	DATE	METHANOL (mg/L)	ETHANOL (µg/L)	TBA (µg/L)	MTBE (µg/L)	DIPE (µg/L)	ETBE (µg/L)	TAME (µg/L)	1,2-DCA (µg/L)	EDB (µg/L)
MW-1	08/07/00	--	<1,000	410	<4.0	<4.0	<4.0	<4.0	<4.0	<4.0
	12/01/00	--	<2,500	<250	<10	<10	<10	<10	<10	<10
	02/09/01	--	<500	340	<2.0	<2.0	<2.0	53	<2.0	<2.0
	05/29/01	--	<500	<20	<2.0	<2.0	<2.0	<2.0	<2.0	<2.0
	08/27/01	<2.000	<200	230	<20	<20	<20	<20	<20	<20
	11/28/01	--	<500	130	<2	<2	<2	<2	<2	<2
	02/14/02	--	<500	<100	<2	<2	<2	<2	<2	<2
	05/15/02	--	<500	120	<3.0	<3.0	<3.0	<3.0	<3.0	<3.0
	08/05/02	--	<500	100	<3.0	<3.0	<3.0	<3.0	<3.0	<3.0
DESTROYED										
MW-2	08/07/00		<500	<100	<2.0	<2.0	<2.0	<2.0	<2.0	<2.0
	08/27/01	--	--	--	<5.0	--	--	--	--	--
MW-3	08/07/00	--	<500	2,600	<10	<10	<10	<10	490	17
	02/09/01	--	<500	2,000	<2.0	<2.0	<2.0	35	<2.0	<2.0
	05/29/01	--	<500	1,700 ¹	<2.0	<2.0	<2.0	38	980 ¹	7.4
	08/27/01	<5.000	<250	1,300	<25	<25	<25	<25	380	<25
	11/28/01	--	<500	1,500	<5.0	<5.0	<5.0	<5.0	<5.0	<5.0
	02/14/02	--	<500	<100	<2	<2	<2	<2	<2	<2
	05/15/02	--	<500	110	<2	<2	<2	<2	120	<2
	08/05/02	--	<1,000	1,400	<10	<10	<10	<10	670	<10
	11/30/02	--	<1,000	1,200	<10	<10	<10	<10	380	<10
	MW-4	08/07/00	--	<500	<100	<2.0	<2.0	<2.0	<2.0	18
08/27/01		NOT SAMPLED DUE TO INSUFFICIENT WATER				--	--	--	--	--
11/28/01		DRY				--	--	--	--	--
02/14/02		--	<500	<100	<2	<2	<2	<2	9	<2
05/15/02		--	<500	<100	<2	<2	<2	<2	4	<2
08/05/02		DRY				--	--	--	--	--
11/30/02		DRY				--	--	--	--	--
MW-5	12/01/00	--	<500	<50	<2.0	<2.0	<2.0	<2.0	<2.0	<2.0
	02/09/01	--	<500	<50	<2.0	<2.0	<2.0	<2.0	<2.0	<2.0
	08/27/01	INACCESSIBLE - CAR PARKED OVER WELL				--	--	--	--	--
	11/28/01	INACCESSIBLE - CAR PARKED OVER WELL				--	--	--	--	--
	02/14/02	--	<500	<100	<2	<2	<2	<2	<2	<2

Table 3
Groundwater Analytical Results - Oxygenate Compounds
Former Chevron (Signal Oil) Service Station #206145 (S-800)
800 Center Street
Oakland, California

WELL ID	DATE	METHANOL (mg/L)	ETHANOL (µg/L)	TBA (µg/L)	MTBE (µg/L)	DIPE (µg/L)	ETBE (µg/L)	TAME (µg/L)	1,2-DCA (µg/L)	EDB (µg/L)
MW-5 (cont)	05/15/02	--	<500	<100	<2	<2	<2	<2	<2	<2
	08/05/02	--	<500	<100	<2	<2	<2	<2	<2	<2
	11/30/02	--	<500	<100	<2	<2	<2	<2	<2	<2
MW-6	08/07/00	--	<500	<100	<2.0	<2.0	<2.0	<2.0	<2.0	<2.0
	08/27/01	--	--	--	<5.0	--	--	--	--	--
	11/30/02	DRY	--	--	--	--	--	--	--	--
MW-7	08/07/00	--	<500	<100	<2.0	<2.0	<2.0	<2.0	<2.0	<2.0
	08/27/01	--	--	--	<5.0	--	--	--	--	--
MW-8	02/14/02	--	<500	<100	<2	<2	<2	<2	<2	<2

EXPLANATIONS:

TBA = t-Butyl alcohol
MTBE = Methyl Tertiary Butyl Ether
DIPE = Di-Isopropyl ether
ETBE = Ethyl t-butyl ether
TAME = t-Amyl methyl ether

1,2-DCA = 1,2-Dichloroethane
EDB = 1,2-Dibromoethane
(mg/L) = milligrams per liter
(µg/L) = Micrograms per liter
-- = Not Analyzed

ANALYTICAL METHODS:

EPA Method 8260 (modified) for Methanol
EPA Method 8260 for Oxygenate Compounds

¹ Laboratory report indicates this sample was originally analyzed within holding time. Re-analysis for confirmation or dilution was performed past the recommended holding time.