



Brain Waite
Project Manager
Marketing Business Unit

**Chevron Environmental
Management Company**
6101 Bollinger Canyon Road
San Ramon, CA 94583
Tel (925) 790-6486
Fax (925) 549-1441
bwaite@chevron.com

Alameda County Environmental Health (ACEH)
1131 Harbor Bay Parkway, Suite 250
Alameda, CA 94502-6577

Re: Former Signal Oil Station No. 206145
800 Center Street
Oakland, CA

RECEIVED

By Alameda County Environmental Health at 11:59 am, Apr 22, 2013

I have reviewed the attached report dated April, 19, 2013.

I agree with the conclusions and recommendations presented in the referenced report. This information in this report is accurate to the best of my knowledge and all local Agency/Regional Board guidelines have been followed. This report was prepared by Conestoga Rovers Associates, upon who assistance and advice I have relied.

This letter is submitted pursuant to the requirements of California Water Code Section 13267(b)(1) and the regulating implementation entitled Appendix A pertaining thereto.

I declare under penalty of perjury that the foregoing is true and correct to the best of my knowledge.

Sincerely,

Brian A. Waite

Brian Waite
Project Manager

Digitally signed by Brian A. Waite

DN: cn=Brian A. Waite, o=Chevron Environmental Management Company,
ou=Marketing Business Unit, email=BWaite@chevron.com, c=US
Date: 2013.04.17 08:57:08 -07'00'

Attachment: First Semi-Annual 2013 Groundwater Monitoring and Sampling Report



**CONESTOGA-ROVERS
& ASSOCIATES**

5900 Hollis Street, Suite A
Emeryville, California 94608
Telephone: (510) 420-0700 Fax: (510) 420-9170
<http://www.craworld.com>

April 19, 2013

Reference No. 312002

Mr. Mark Detterman
Alameda County Environmental Health (ACEH)
1131 Harbor Bay Parkway
Alameda, California 94502

Re: First Semi-Annual 2013
Groundwater Monitoring and Sampling Report
Former Signal Oil Service Station 206145
800 Center Street
Oakland, California
ACEH Case RO0000454

Dear Mr. Detterman:

Conestoga-Rovers & Associates (CRA) is submitting this *First Semi-Annual 2013 Groundwater Monitoring and Sampling Report* for the site referenced above (Figure 1) on behalf of Chevron Environmental Management Company. Groundwater monitoring and sampling was performed by Gettler-Ryan, Inc. (G-R) of Dublin, California and their *Groundwater Monitoring and Sampling Data Package* is included as Attachment A. Current groundwater monitoring and sampling data are presented in Table 1 and shown on Figure 2. Eurofins Lancaster Laboratories' *Analytical Results* report is included as Attachment B. Historical groundwater monitoring and sampling data are included as Attachment C.

Equal
Employment Opportunity
Employer



**CONESTOGA-ROVERS
& ASSOCIATES**

April 19, 2013

Reference No. 312002

- 2 -

Please contact Judy Gilbert (510) 420-3344 if you have any questions or require additional information.

Sincerely,

CONESTOGA-ROVERS & ASSOCIATES

Judy Gilbert

Brandon S. Wilken, PG 7564



TH/aa/26
Encl.

Figure 1	Vicinity Map
Figure 2	Shallow Groundwater Elevation and Hydrocarbon Concentration Map
Table 1	Groundwater Monitoring and Sampling Data
Attachment A	Monitoring Data Package
Attachment B	Laboratory Analytical Report
Attachment C	Historical Groundwater Monitoring and Sampling Data

cc: Mr. Brian Waite, Chevron (*electronic copy*)
Mr. Rene Boisvert, 800 Center LLC

FIGURES

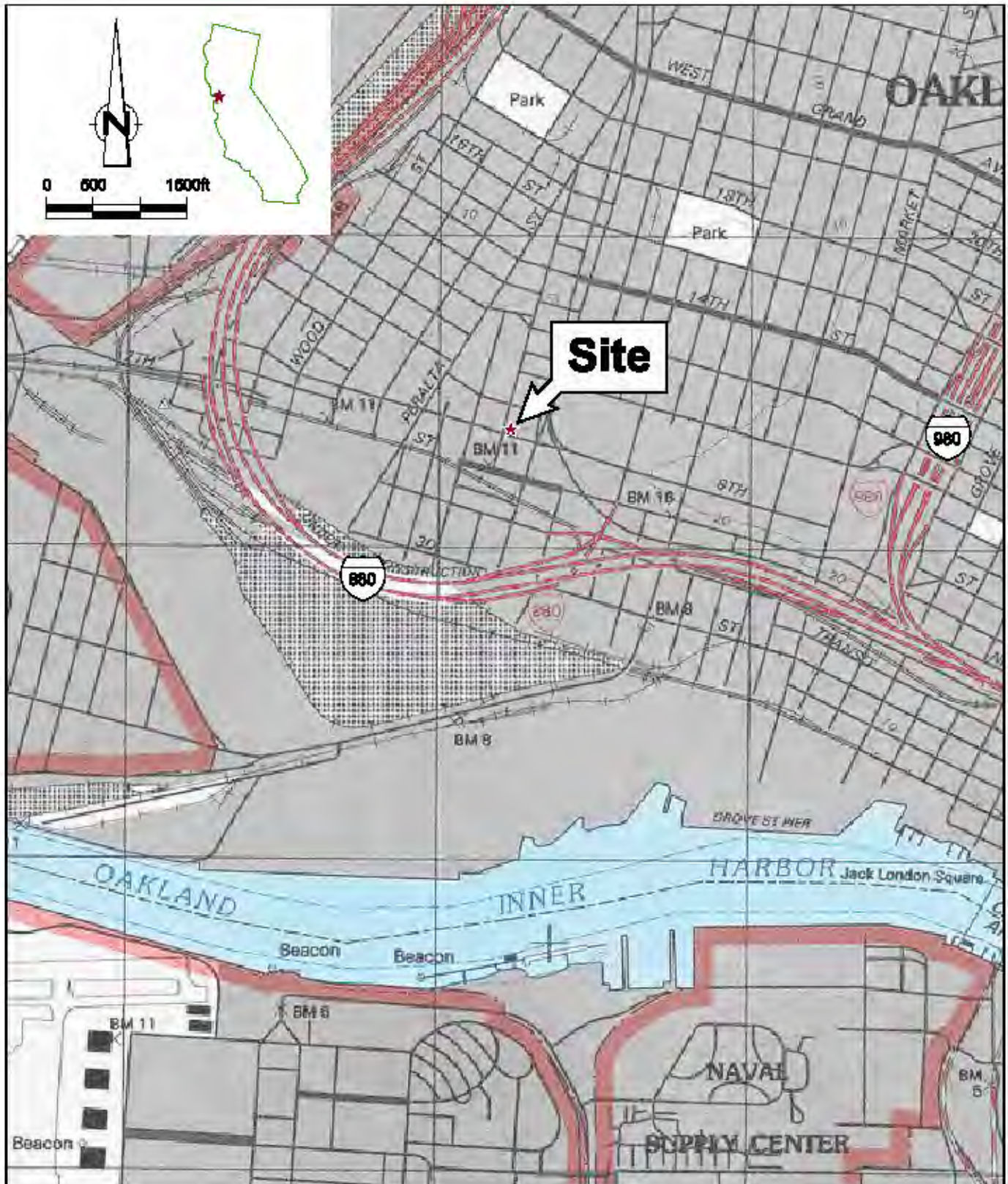

Figure 1
VICINITY MAP
FORMER CHEVRON SERVICE STATION 206145
800 CENTER STREET
Oakland, California



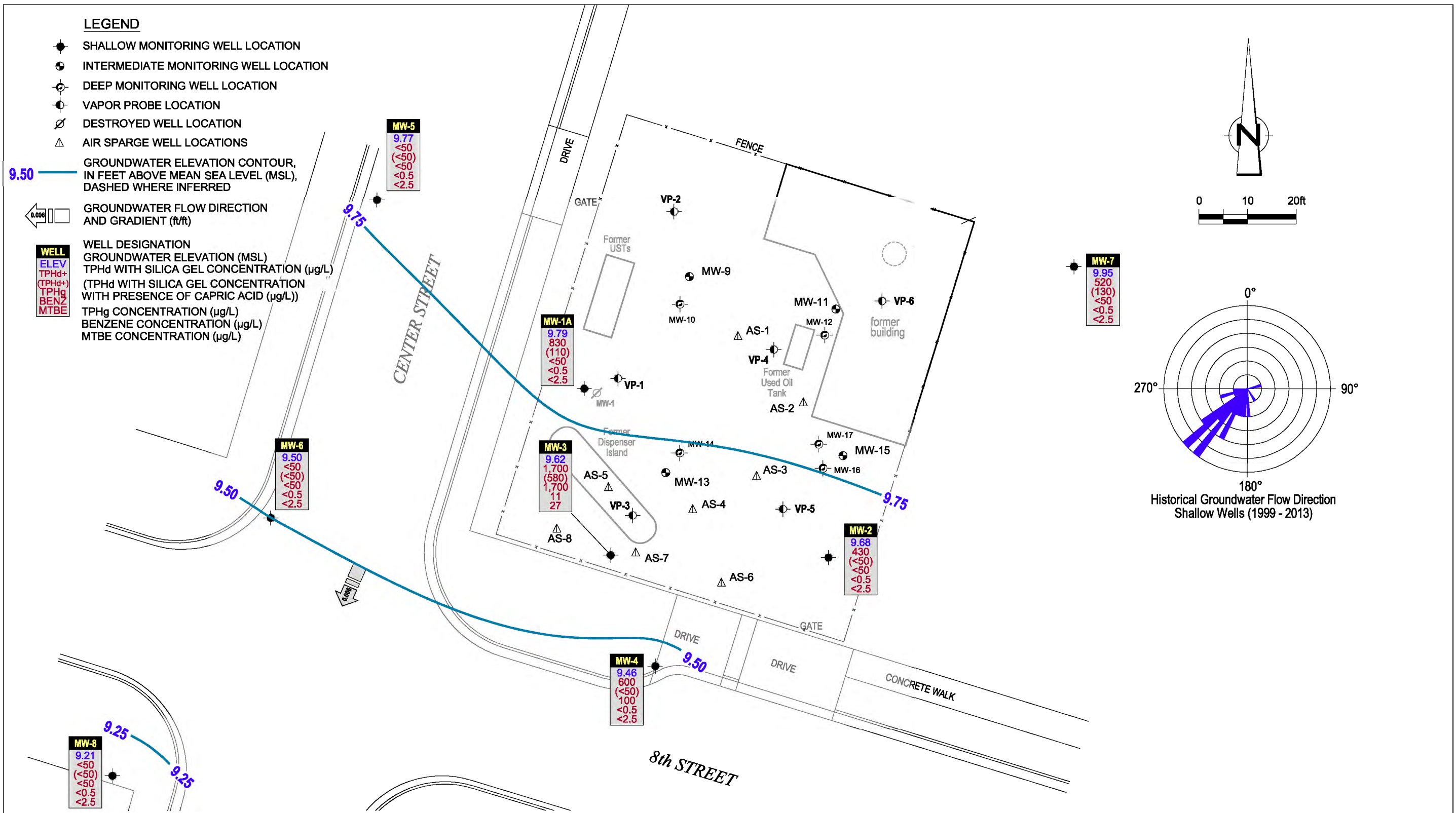

Figure 2
 SHALLOW GROUNDWATER ELEVATION AND HYDROCARBON CONCENTRATION MAP
 FORMER SIGNAL OIL SERVICE STATION 206145
 800 CENTER STREET
 Oakland, California
 February 18, 2013



TABLE

TABLE 1

GROUNDWATER MONITORING AND SAMPLING DATA
 FORMER CHEVRON SERVICE STATION 206145
 800 CENTER STREET
 OAKLAND, CALIFORNIA

Location	Date	TOC	DTW	GWE	HYDROCARBONS		PRIMARY VOCS					GENERAL CHEMISTRY					
					TPH-DRO w/ Si Gel	TPH-CRO	B	T	E	X	MTBE by SW8021	Carbon dioxide	Nitrate Nitrogen	Sulfate	Alkalinity to pH 4.5	Alkalinity to pH 8.3	Ferrous Iron
	Units	ft	ft	ft-amsl	µg/L	µg/L	µg/L	µg/L	µg/L	µg/L	µg/L	µg/L	µg/L	µg/L	µg/L	µg/L	µg/L
MW-1A	09/03/2010 ¹	18.11	9.54	8.57	590	<50	<0.5	<0.5	<0.5	<1.5	<2.5	-	-	-	-	-	-
MW-1A	02/03/2011 ¹	18.11	8.05	10.06	840	100	2.5	0.6	6.7	2.0	<2.5	-	-	-	-	-	-
MW-1A	05/04/2011 ^{1,7}	18.11	7.16	10.95	1,500	<50	6.7	<0.5	<0.5	<1.5	<2.5	-	-	-	-	-	-
MW-1A	08/04/2011 ¹	18.11	8.80	9.31	750	<50	0.9	<0.5	<0.5	<1.5	<2.5	-	-	-	-	-	-
MW-1A	02/29/2012 ^{1,9}	18.11	9.84	8.27	630/250	<50	<0.5	<0.5	<0.5	<1.5	<2.5	-	-	-	-	-	-
MW-1A	08/07/2012 ^{1,9}	18.11	9.64	8.47	540/<50	<50	<0.5	<0.5	<0.5	<1.5	<2.5	-	-	-	-	-	-
MW-1A	02/18/2013¹	18.11	8.32	9.79	830/110	<50	<0.5	<0.5	<0.5	<1.5	<2.5	-	-	-	-	-	-
MW-2	09/03/2010 ¹	18.40	9.98	8.42	130	<50	<0.5	<0.5	<0.5	<1.5	<2.5	-	-	-	-	-	-
MW-2	02/03/2011 ¹	18.40	8.61	9.79	430	75	<0.5	<0.5	<0.5	<1.5	8.9	-	-	-	-	-	-
MW-2	05/04/2011 ^{1,7}	18.40	4.55	13.85	160	1,300	12	48	0.7	47	<100	-	-	-	-	-	-
MW-2	08/04/2011 ¹	18.40	9.17	9.23	99	1,500	43	100	1.4	47	34	-	-	-	-	-	-
MW-2	02/29/2012 ^{1,9}	18.40	10.25	8.15	75/<50	<50	<0.5	<0.5	<0.5	<1.5	<2.5	-	-	-	-	-	-
MW-2	08/07/2012 ^{1,9}	18.40	9.98	8.42	410/270	<50	<0.5	<0.5	<0.5	<1.5	<2.5	-	-	-	-	-	-
MW-2	02/18/2013¹	18.40	8.72	9.68	430/<50	<50	<0.5	<0.5	<0.5	<1.5	<2.5	-	-	-	-	-	-
MW-3	09/03/2010	-	-	-	-	-	-	-	-	-	-	160,000	390	45,900	531,000	<460	21,500
MW-3	09/03/2010 ¹	18.07	9.70	8.37	4,000	32,000	65	690	3,100	4,900	380	-	-	-	-	-	-
MW-3	02/03/2011 ¹	18.07	8.39	9.68	1,400	2,000	17	34	250	190	26	44,000	<250	180,000	385,000	<460	28,500
MW-3	05/04/2011 ^{1,7}	18.07	7.30	10.77	340	57	<0.5	1.1	3.8	7.7	<2.5	20,000	<250	222,000	310,000	<460	10,500
MW-3	08/04/2011 ¹	18.07	8.83	9.24	2,100	1,200	6.5	4.6	110	8.9	16	68,000	350	275,000	362,000	<460	32,500
MW-3	02/29/2012 ^{1,9}	18.07	9.90	8.17	1,500/510	2,000	74	2.2	6.5	<5.0	<18	-	-	-	-	-	-
MW-3	08/07/2012 ^{1,9}	18.07	9.68	8.39	2,600/1,100	3,800	120	4.1	5.0	14	38	-	-	-	-	-	-
MW-3	02/18/2013¹	18.07	8.45	9.62	1,700/580	1,700	11	2.6	3.8	19	27	-	-	-	-	-	-

TABLE 1

GROUNDWATER MONITORING AND SAMPLING DATA
 FORMER CHEVRON SERVICE STATION 206145
 800 CENTER STREET
 OAKLAND, CALIFORNIA

Location	Date	TOC	DTW	GWE	HYDROCARBONS		PRIMARY VOCS					GENERAL CHEMISTRY						
					TPH-DRO w/ Si Gel	TPH-GRO	B	T	E	X	MTBE by SW8021	Carbon dioxide	Nitrate Nitrogen	Sulfate	Alkalinity to pH 4.5	Alkalinity to pH 8.3	Ferrous Iron	
	Units	ft	ft	ft-amsl	µg/L	µg/L	µg/L	µg/L	µg/L	µg/L	µg/L	µg/L	µg/L	µg/L	µg/L	µg/L	µg/L	µg/L
MW-4	09/03/2010	-	-	-	-	-	-	-	-	-	-	210,000	<250	2,000	400,000	<460	7,500	
MW-4	09/03/2010 ¹	16.98	8.63	8.35	400	310	<5.0	<0.5	1.2	<1.5	<2.5	-	-	-	-	-	-	
MW-4	02/03/2011 ¹	16.98	7.43	9.55	160	55	1.6	<0.5	<0.5	<1.5	<2.5	75,000	<250	52,600	309,000	<460	4,100	
MW-4	05/04/2011 ^{1,7}	16.98	6.32	10.66	<50	<50	<0.5	<0.5	<0.5	<1.5	<2.5	76,000	<250	16,700	183,000	<460	2,600	
MW-4	08/04/2011 ¹	16.98	7.90	9.08	940	590	110	9.0	10	4.6	4.4	130,000	<250	68,900	361,000	<460	4,200	
MW-4	02/29/2012 ^{1,9}	16.98	8.34	8.64	270/<50	130	<0.5	<0.5	0.6	<1.5	<2.5	-	-	-	-	-	-	
MW-4	08/07/2012 ^{1,9}	16.98	8.67	8.31	700/54	400	20	<0.5	3.1	<1.5	5.3	-	-	-	-	-	-	
MW-4	02/18/2013¹	16.98	7.52	9.46	600/<50	100	<0.5	<0.5	<0.5	<1.5	<2.5	-	-	-	-	-	-	
MW-5	09/03/2010 ¹	17.68	9.28	8.40	62	<50	<0.5	<0.5	<0.5	<1.5	<2.5	-	-	-	-	-	-	
MW-5	02/03/2011 ¹	17.68	7.83	9.85	<50	<50	<0.5	<0.5	<0.5	<1.5	<2.5	-	-	-	-	-	-	
MW-5	05/04/2011 ¹	17.68	-	-	-	-	-	-	-	-	-	-	-	-	-	-	-	
MW-5	08/04/2011 ¹	17.68	8.38	9.30	<50	<50	<0.5	<0.5	<0.5	<1.5	<2.5	-	-	-	-	-	-	
MW-5	02/29/2012 ^{1,9}	17.68	9.42	8.26	<50/53	<50	<0.5	<0.5	<0.5	<1.5	<2.5	-	-	-	-	-	-	
MW-5	08/07/2012 ^{1,9}	17.68	9.18	8.50	<50/<50	<50	<0.5	<0.5	<0.5	<1.5	<2.5	-	-	-	-	-	-	
MW-5	02/18/2013¹	17.68	7.91	9.77	<50/<50	<50	<0.5	<0.5	<0.5	<1.5	<2.5	-	-	-	-	-	-	
MW-6	09/03/2010 ¹	17.33	9.13	8.20	<50	<50	<0.5	<0.5	<0.5	<1.5	<2.5	-	-	-	-	-	-	
MW-6	02/03/2011 ¹	17.33	7.65	9.68	<50	<50	<0.5	<0.5	<0.5	<1.5	<2.5	-	-	-	-	-	-	
MW-6	05/04/2011 ¹	17.33	-	-	-	-	-	-	-	-	-	-	-	-	-	-	-	
MW-6	08/04/2011 ¹	17.33	8.30	9.03	<50	<50	<0.5	<0.5	<0.5	<1.5	<2.5	-	-	-	-	-	-	
MW-6	02/29/2012 ^{1,9}	17.33	9.30	8.03	<50/<50	<50	<0.5	<0.5	<0.5	<1.5	<2.5	-	-	-	-	-	-	
MW-6	08/07/2012 ^{1,9}	17.33	9.06	8.27	74/<50	<50	<0.5	<0.5	<0.5	<1.5	<2.5	-	-	-	-	-	-	
MW-6	02/18/2013¹	17.33	7.83	9.50	<50/<50	<50	<0.5	<0.5	<0.5	<1.5	<2.5	-	-	-	-	-	-	

TABLE 1

GROUNDWATER MONITORING AND SAMPLING DATA
 FORMER CHEVRON SERVICE STATION 206145
 800 CENTER STREET
 OAKLAND, CALIFORNIA

Location	Date	TOC	DTW	GWE	HYDROCARBONS		PRIMARY VOCS					GENERAL CHEMISTRY					
					TPH-DRO w/ Si Gel	TPH-CRO	B	T	E	X	MTBE by SW8021	Carbon dioxide	Nitrate Nitrogen	Sulfate	Alkalinity to pH 4.5	Alkalinity to pH 8.3	Ferrous Iron
	Units	ft	ft	ft-amsl	µg/L	µg/L	µg/L	µg/L	µg/L	µg/L	µg/L	µg/L	µg/L	µg/L	µg/L	µg/L	µg/L
MW-7	09/03/2010 ¹	19.26	10.74	8.52	<50	<50	<0.5	<0.5	<0.5	<1.5	<2.5	-	-	-	-	-	-
MW-7	02/03/2011 ¹	19.26	9.20	10.06	220	<50	<0.5	<0.5	<0.5	<1.5	<2.5	-	-	-	-	-	-
MW-7	05/04/2011 ¹	19.26	-	-	-	-	-	-	-	-	-	-	-	-	-	-	-
MW-7	08/04/2011 ¹	19.26	9.91	9.35	<50	<50	<0.5	<0.5	<0.5	<1.5	<2.5	-	-	-	-	-	-
MW-7	02/29/2012 ^{1,9}	19.26	10.90	8.36	350/<50	<50	<0.5	<0.5	<0.5	<1.5	<2.5	-	-	-	-	-	-
MW-7	08/07/2012 ^{1,9}	19.26	10.67	8.59	96/63	<50	<0.5	<0.5	<0.5	<1.5	<2.5	-	-	-	-	-	-
MW-7	02/18/2013¹	19.26	9.31	9.95	520/130	<50	<0.5	<0.5	<0.5	<1.5	<2.5	-	-	-	-	-	-
MW-8	09/03/2010 ¹	17.79	9.75	8.04	<50	<50	<0.5	<0.5	<0.5	<1.5	<2.5	-	-	-	-	-	-
MW-8	02/03/2011 ¹	17.79	8.46	9.33	<50	<50	<0.5	<0.5	<0.5	<1.5	<2.5	-	-	-	-	-	-
MW-8	05/04/2011 ¹	17.79	-	-	-	-	-	-	-	-	-	-	-	-	-	-	-
MW-8	08/04/2011 ¹	17.79	8.98	8.81	<50	<50	<0.5	<0.5	<0.5	<1.5	<2.5	-	-	-	-	-	-
MW-8	02/29/2012 ^{1,9}	17.79	9.90	7.89	<50/<50	<50	<0.5	<0.5	<0.5	<1.5	<2.5	-	-	-	-	-	-
MW-8	08/07/2012 ^{1,9}	17.79	9.71	8.08	<50/<50	<50	<0.5	<0.5	<0.5	<1.5	<2.5	-	-	-	-	-	-
MW-8	02/18/2013¹	17.79	8.58	9.21	<50/<50	<50	<0.5	<0.5	<0.5	<1.5	<2.5	-	-	-	-	-	-
MW-9	09/03/2010 ²	18.42	10.01	8.41	95	<50	<0.5	<0.5	<0.5	<1.5	-	-	-	-	-	-	-
MW-9	02/03/2011 ^{2,4,5}	18.42	-	-	-	-	-	-	-	-	-	-	-	-	-	-	-
MW-9	05/04/2011 ^{2,4,5}	18.42	-	-	-	-	-	-	-	-	-	-	-	-	-	-	-
MW-9	08/04/2011 ^{2,4,5}	18.42	9.13	9.29	-	-	-	-	-	-	-	-	-	-	-	-	-
MW-9	02/29/2012 ^{2,4,5}	18.42	-	-	-	-	-	-	-	-	-	-	-	-	-	-	-
MW-9	08/07/2012 ^{2,4,5,9}	18.42	9.98	8.44	61/<50	<50	<0.5	<0.5	<0.5	<1.5	-	-	-	-	-	-	-
MW-9	02/18/2013^{2,4,5}	18.42	-	-	-	-	-	-	-	-	-	-	-	-	-	-	-

TABLE 1

GROUNDWATER MONITORING AND SAMPLING DATA
 FORMER CHEVRON SERVICE STATION 206145
 800 CENTER STREET
 OAKLAND, CALIFORNIA

Location	Date	TOC	DTW	GWE	HYDROCARBONS		PRIMARY VOCS					GENERAL CHEMISTRY					
					TPH-DRO w/ Si Gel	TPH-CRO	B	T	E	X	MTBE by SW8021	Carbon dioxide	Nitrate Nitrogen	Sulfate	Alkalinity to pH 4.5	Alkalinity to pH 8.3	Ferrous Iron
	Units	ft	ft	ft-amsl	µg/L	µg/L	µg/L	µg/L	µg/L	µg/L	µg/L	µg/L	µg/L	µg/L	µg/L	µg/L	µg/L
MW-10	09/03/2010 ³	17.99	10.35	7.64	<50	<50	<0.5	<0.5	<0.5	<1.5	-	-	-	-	-	-	-
MW-10	02/03/2011 ^{3,4,5}	17.99	-	-	-	-	-	-	-	-	-	-	-	-	-	-	-
MW-10	05/04/2011 ^{3,4,5}	17.99	-	-	-	-	-	-	-	-	-	-	-	-	-	-	-
MW-10	08/04/2011 ^{3,4,5}	17.99	10.60	7.39	-	-	-	-	-	-	-	-	-	-	-	-	-
MW-10	02/29/2012 ^{3,4,5}	17.99	-	-	-	-	-	-	-	-	-	-	-	-	-	-	-
MW-10	08/07/2012 ^{3,4,5,9}	17.99	10.14	7.85	59/<50	<50	<0.5	<0.5	<0.5	<1.5	-	-	-	-	-	-	-
MW-10	02/18/2013^{3,4,5}	17.99	-	-	-	-	-	-	-	-	-	-	-	-	-	-	-
MW-11	09/03/2010 ²	18.68	10.21	8.47	<50	<50	<0.5	<0.5	<0.5	<1.5	-	-	-	-	-	-	-
MW-11	02/03/2011 ^{2,4,5}	18.68	-	-	-	-	-	-	-	-	-	-	-	-	-	-	-
MW-11	05/04/2011 ^{2,4,5}	18.68	-	-	-	-	-	-	-	-	-	-	-	-	-	-	-
MW-11	08/04/2011 ^{2,4,5}	18.68	9.35	9.33	-	-	-	-	-	-	-	-	-	-	-	-	-
MW-11	02/29/2012 ^{2,4,5}	18.68	-	-	-	-	-	-	-	-	-	-	-	-	-	-	-
MW-11	08/07/2012 ^{2,4,5,9}	18.68	10.15	8.53	<50/<50	<50	<0.5	<0.5	<0.5	<1.5	-	-	-	-	-	-	-
MW-11	02/18/2013^{2,4,5}	18.68	-	-	-	-	-	-	-	-	-	-	-	-	-	-	-
MW-12	09/03/2010 ³	18.46	11.05	7.41	65	<50	<0.5	<0.5	<0.5	<1.5	-	-	-	-	-	-	-
MW-12	02/03/2011 ^{3,4,5}	18.46	-	-	-	-	-	-	-	-	-	-	-	-	-	-	-
MW-12	05/04/2011 ^{3,4,5}	18.46	-	-	-	-	-	-	-	-	-	-	-	-	-	-	-
MW-12	08/04/2011 ^{3,4,5}	18.46	9.63	8.83	-	-	-	-	-	-	-	-	-	-	-	-	-
MW-12	02/29/2012 ^{3,4,5}	18.46	-	-	-	-	-	-	-	-	-	-	-	-	-	-	-
MW-12	08/07/2012 ^{3,4,5,9}	18.46	10.68	7.78	<50/<50	<50	<0.5	<0.5	<0.5	<1.5	-	-	-	-	-	-	-
MW-12	02/18/2013^{3,4,5}	18.46	-	-	-	-	-	-	-	-	-	-	-	-	-	-	-

TABLE 1

GROUNDWATER MONITORING AND SAMPLING DATA
 FORMER CHEVRON SERVICE STATION 206145
 800 CENTER STREET
 OAKLAND, CALIFORNIA

Location	Date	TOC	DTW	GWE	HYDROCARBONS		PRIMARY VOCS					GENERAL CHEMISTRY					
					TPH-DRO w/ Si Gel	TPH-CRO	B	T	E	X	MTBE by SW8021	Carbon dioxide	Nitrate Nitrogen	Sulfate	Alkalinity to pH 4.5	Alkalinity to pH 8.3	Ferrous Iron
	Units	ft	ft	ft-amsl	µg/L	µg/L	µg/L	µg/L	µg/L	µg/L	µg/L	µg/L	µg/L	µg/L	µg/L	µg/L	µg/L
MW-13	09/03/2010 ²	18.43	10.09	8.34	58	<50	<0.5	<0.5	<0.5	<1.5	-	-	-	-	-	-	-
MW-13	02/03/2011 ^{2,4,5}	18.43	-	-	-	-	-	-	-	-	-	-	-	-	-	-	-
MW-13	05/04/2011 ^{2,4,5}	18.43	-	-	-	-	-	-	-	-	-	-	-	-	-	-	-
MW-13	08/04/2011 ^{2,4,5}	18.43	9.27	9.16	-	-	-	-	-	-	-	-	-	-	-	-	-
MW-13	02/29/2012 ^{2,4,5}	18.43	-	-	-	-	-	-	-	-	-	-	-	-	-	-	-
MW-13	08/07/2012 ^{2,4,5,9}	18.43	10.03	8.40	<50/<50	<50	<0.5	<0.5	<0.5	<1.5	-	-	-	-	-	-	-
MW-13	02/18/2013^{2,4,5}	18.43	-	-	-	-	-	-	-	-	-	-	-	-	-	-	-
MW-14	09/03/2010 ³	18.59	11.52	7.07	<50	<50	<0.5	<0.5	<0.5	<1.5	-	-	-	-	-	-	-
MW-14	02/03/2011 ^{3,4,5}	18.59	-	-	-	-	-	-	-	-	-	-	-	-	-	-	-
MW-14	05/04/2011 ^{3,4,5}	18.59	-	-	-	-	-	-	-	-	-	-	-	-	-	-	-
MW-14	08/04/2011 ^{3,4,5}	18.59	9.99	8.60	-	-	-	-	-	-	-	-	-	-	-	-	-
MW-14	02/29/2012 ^{3,4,5}	18.59	-	-	-	-	-	-	-	-	-	-	-	-	-	-	-
MW-14	08/07/2012 ^{3,4,5,9}	18.59	10.79	7.80	61/<50	<50	<0.5	<0.5	<0.5	<1.5	-	-	-	-	-	-	-
MW-14	02/18/2013^{3,4,5}	18.59	-	-	-	-	-	-	-	-	-	-	-	-	-	-	-
MW-15	09/03/2010 ²	18.38	9.95	8.43	<50	<50	<0.5	<0.5	<0.5	<1.5	-	-	-	-	-	-	-
MW-15	02/03/2011 ^{2,4,5}	18.38	-	-	-	-	-	-	-	-	-	-	-	-	-	-	-
MW-15	05/04/2011 ^{2,4,5}	18.38	-	-	-	-	-	-	-	-	-	-	-	-	-	-	-
MW-15	08/04/2011 ^{2,4,5}	18.38	9.13	9.25	-	-	-	-	-	-	-	-	-	-	-	-	-
MW-15	02/29/2012 ^{2,4,5}	18.38	-	-	-	-	-	-	-	-	-	-	-	-	-	-	-
MW-15	08/07/2012 ^{2,4,5,9}	18.38	9.91	8.47	<50/100	<50	<0.5	<0.5	<0.5	<1.5	-	-	-	-	-	-	-
MW-15	02/18/2013^{2,4,5}	18.38	-	-	-	-	-	-	-	-	-	-	-	-	-	-	-

TABLE 1

GROUNDWATER MONITORING AND SAMPLING DATA
 FORMER CHEVRON SERVICE STATION 206145
 800 CENTER STREET
 OAKLAND, CALIFORNIA

Location	Date	TOC	DTW	GWE	HYDROCARBONS		PRIMARY VOCS					GENERAL CHEMISTRY					
					TPH-DRO w/ Si Gel	TPH-CRO	B	T	E	X	MTBE by SW8021	Carbon dioxide	Nitrate Nitrogen	Sulfate	Alkalinity to pH 4.5	Alkalinity to pH 8.3	Ferrous Iron
	Units	ft	ft	ft-amsl	µg/L	µg/L	µg/L	µg/L	µg/L	µg/L	µg/L	µg/L	µg/L	µg/L	µg/L	µg/L	µg/L
MW-16	09/03/2010 ³	18.57	10.95	7.62	<50	<50	<0.5	<0.5	<0.5	<1.5	-	-	-	-	-	-	-
MW-16	02/03/2011 ^{3,4,5}	18.57	-	-	-	-	-	-	-	-	-	-	-	-	-	-	-
MW-16	05/04/2011 ^{3,4,5}	18.57	-	-	-	-	-	-	-	-	-	-	-	-	-	-	-
MW-16	08/04/2011 ^{3,4,5}	18.57	10.13	8.44	-	-	-	-	-	-	-	-	-	-	-	-	-
MW-16	02/29/2012 ^{3,4,5}	18.57	-	-	-	-	-	-	-	-	-	-	-	-	-	-	-
MW-16	08/07/2012 ^{3,4,5,9}	18.57	10.83	7.74	<50/<50	<50	<0.5	<0.5	<0.5	<1.5	-	-	-	-	-	-	-
MW-16	02/18/2013^{3,4,5}	18.57	-	-	-	-	-	-	-	-	-	-	-	-	-	-	-
MW-17	09/03/2010 ³	18.55	10.81	7.74	67	<50	<0.5	<0.5	<0.5	<1.5	-	-	-	-	-	-	-
MW-17	02/03/2011 ^{3,4,5}	18.55	-	-	-	-	-	-	-	-	-	-	-	-	-	-	-
MW-17	05/04/2011 ^{3,4,5}	18.55	-	-	-	-	-	-	-	-	-	-	-	-	-	-	-
MW-17	08/04/2011 ^{3,4,5}	18.55	10.00	8.55	-	-	-	-	-	-	-	-	-	-	-	-	-
MW-17	02/29/2012 ^{3,4,5}	18.55	-	-	-	-	-	-	-	-	-	-	-	-	-	-	-
MW-17	08/07/2012 ^{3,4,5,9}	18.55	10.78	7.77	<50/<50	<50	<0.5	<0.5	<0.5	<1.5	-	-	-	-	-	-	-
MW-17	02/18/2013^{3,4,5}	18.55	-	-	-	-	-	-	-	-	-	-	-	-	-	-	-
QA	09/03/2010	-	-	-	-	<50	<0.5	<0.5	<0.5	<1.5	<2.5	-	-	-	-	-	-
QA	02/03/2011	-	-	-	-	<50	<0.5	<0.5	<0.5	<1.5	<2.5	-	-	-	-	-	-
QA	05/04/2011	-	-	-	-	<50	<0.5	<0.5	<0.5	<1.5	<2.5	-	-	-	-	-	-
QA	08/04/2011	-	-	-	-	<50	<0.5	<0.5	<0.5	<1.5	<2.5	-	-	-	-	-	-
QA	02/29/2012	-	-	-	-	<50	<0.5	<0.5	<0.5	<1.5	<2.5	-	-	-	-	-	-
QA	08/07/2012	-	-	-	-	<50	<0.5	<0.5	<0.5	<1.5	<2.5	-	-	-	-	-	-
QA	02/18/2013	-	-	-	-	<50	<0.5	<0.5	<0.5	<1.5	<2.5	-	-	-	-	-	-

TABLE 1

**GROUNDWATER MONITORING AND SAMPLING DATA
FORMER CHEVRON SERVICE STATION 206145
800 CENTER STREET
OAKLAND, CALIFORNIA**

Location	Date	TOC	DTW	GWE	HYDROCARBONS		PRIMARY VOCS					GENERAL CHEMISTRY					
					TPH-DRO w/ Si Gel	TPH-GRO	B	T	E	X	MTBE by SW8021	Carbon dioxide	Nitrate Nitrogen	Sulfate	Alkalinity to pH 4.5	Alkalinity to pH 8.3	Ferrous Iron
Units	ft	ft	ft-amsl	μg/L	μg/L	μg/L	μg/L	μg/L	μg/L	μg/L	μg/L	μg/L	μg/L	μg/L	μg/L	μg/L	μg/L

Abbreviations and Notes:

TOC = Top of casing

DTW = Depth to water

GWE = Groundwater elevation

(ft-amsl) = Feet above mean sea level

ft = Feet

μg/L = Micrograms per liter

TPH-DRO = Total petroleum hydrocarbons - diesel range organics

TPH-GRO = Total petroleum hydrocarbons - gasoline range organics

VOCS = Volatile organic compounds

B = Benzene

T = Toluene

E = Ethylbenzene

X = Xylene's (total)

MTBE = Methyl tert butyl ether

-- = Not available / not applicable

<x = Not detected at or above laboratory method detection limit

1 Shallow Well

2 Intermediate Well

3 Deep Well

4 Monitored annually during the third quarter

5 Sampled bi-annually during the third quarter

6 Not able to access well. Well connected to Air Sparge System

7 Special Sampling Event

TABLE 1

GROUNDWATER MONITORING AND SAMPLING DATA
 FORMER CHEVRON SERVICE STATION 206145
 800 CENTER STREET
 OAKLAND, CALIFORNIA

Location	Date	TOC	DTW	GWE	HYDROCARBONS		PRIMARY VOCS					GENERAL CHEMISTRY					
					TPH-DRO w/ Si Gel	TPH-GRO	B	T	E	X	MTBE by SW8021	Carbon dioxide	Nitrate Nitrogen	Sulfate	Alkalinity to pH 4.5	Alkalinity to pH 8.3	Ferrous Iron
Units		ft	ft	ft-amsl	µg/L	µg/L	µg/L	µg/L	µg/L	µg/L	µg/L	µg/L	µg/L	µg/L	µg/L	µg/L	µg/L

8 Not monitored or sampled.

9 TPHd with silica gel / TPHd with silica gel (reverse surrogate, capric acid, was present at <1%)

ATTACHMENT A

MONITORING DATA PACKAGE



GETTLER-RYAN INC.



TRANSMITTAL

February 28, 2013

G-R #386492

TO: Ms. Judy Gilbert
Conestoga-Rovers and Associates
5900 Hollis Street, Suite A
Emeryville, CA 94608

FROM: Deanna L. Harding
Project Coordinator
Gettler-Ryan Inc.
6747 Sierra Court, Suite J
Dublin, California 94568

RE: **Former Chevron (Signal Oil)
Service Station #206145 (S-800)
800 Center Street
Oakland, California
RO 0000454**

WE HAVE ENCLOSED THE FOLLOWING:

COPIES	DESCRIPTION
VIA PDF	Groundwater Monitoring and Sampling Data Package First Semi-Annual Event of February 18, 2013

COMMENTS:

Pursuant to your request, we are providing you with copies of the above referenced data for your use.

Please provide us the updated historical data prior to the next monitoring and sampling event for our field use.

Please feel free to contact me if you have any comments/questions.

trans/206145

STANDARD OPERATING PROCEDURE - GROUNDWATER SAMPLING

Gettler-Ryan Inc. (GR) field personnel adhere to the following procedures for the collection and handling of groundwater samples prior to analysis by the analytical laboratory. All work is performed in accordance with the GR Health & Safety Plan and all client-specific programs. The scope of work and type of analysis to be performed is determined prior to commencing field work.

Prior to sampling, the presence or absence of free-phase hydrocarbons is determined using an interface probe. Product thickness, if present, is measured to the nearest 0.01 foot and is noted in the field notes. In addition, all depth to water level measurements are collected with a static water level indicator and are also recorded in the field notes, prior to purging and sampling any wells.

After water levels are collected and prior to sampling, if purging is to occur, each well is purged a minimum of three well casing volumes of water using pre-cleaned pumps (stack, peristaltic or Grundfos), or disposable bailers. Temperature, pH and electrical conductivity are measured a minimum of three times during the purging (additional parameters such as dissolved oxygen, oxidation reduction potential, turbidity may also be measured, depending on specific scope of work.). Purging continues until these parameters stabilize.

Groundwater samples are collected using disposable bailers. The water samples are transferred from the bailer into appropriate containers. Pre-preserved containers, supplied by analytical laboratories, are used. When pre-preserved containers are not available, the laboratory is instructed to preserve the sample as appropriate. Duplicate samples are collected for the laboratory to use in maintaining quality assurance/quality control standards, as directed by the scope of work. The samples are labeled to include the job number, sample identification, collection date and time, analysis, preservation (if any), and the sample collector's initials. The water samples are placed in a cooler, maintained at 4°C for transport to the laboratory. Once collected in the field, all samples are maintained under chain of custody until delivered to the laboratory.

The chain of custody document includes the job number, type of preservation, if any, analysis requested, sample identification, date and time collected, and the sample collector's name. The chain of custody is signed and dated (including time of transfer) by each person who receives or surrenders the samples, beginning with the field personnel and ending with the laboratory personnel.

A laboratory supplied trip blank accompanies each sampling set. The trip blank is analyzed for some or all of the same compounds as the groundwater samples.

As requested by Chevron Environmental Management Company, the purge water and decontamination water generated during sampling activities is transported by Clean Harbors Environmental Services to Evergreen Oil located in Newark, California.



GETTLER-RYAN INC.

WELL MONITORING/SAMPLING FIELD DATA SHEET

Client/Facility#: Chevron #206145 Job Number: 386492
 Site Address: 800 Center Street Event Date: 2/18/13 (inclusive)
 City: Oakland, CA Sampler: JH

Well ID: MW-1A Date Monitored: 2/18/13

Well Diameter: 2
 Total Depth: 16.69 ft.
 Depth to Water: 8.32 ft.

Volume Factor (VF)	3/4" = 0.02	1" = 0.04	2" = 0.17	3" = 0.38
	4" = 0.66	5" = 1.02	6" = 1.50	12" = 5.80

Depth to Water w/ 80% Recharge [(Height of Water Column x 0.20) + DTW]: 9.99
 Check if water column is less than 0.50 ft.
 xVF .17 = 1.42 x3 case volume = Estimated Purge Volume: 4.26 gal.

Purge Equipment:

Disposable Bailer X
 Stainless Steel Bailer _____
 Stack Pump _____
 Suction Pump _____
 Grundfos _____
 Peristaltic Pump _____
 QED Bladder Pump _____
 Other: _____

Sampling Equipment:

Disposable Bailer X
 Pressure Bailer _____
 Metal Filters _____
 Peristaltic Pump _____
 QED Bladder Pump _____
 Other: _____

Time Started: _____ (2400 hrs)
 Time Completed: _____ (2400 hrs)
 Depth to Product: _____ ft.
 Depth to Water: _____ ft.
 Hydrocarbon Thickness: _____ ft.
 Visual Confirmation/Description: _____
 Skimmer / Absorbent Sock (circle one)
 Amt Removed from Skimmer: _____ gal
 Amt Removed from Well: _____ gal
 Water Removed: _____

Start Time (purge): 1055 Weather Conditions: cloudy
 Sample Time/Date: 1130 / 2/18/13 Water Color: cloudy Odor: GIN LWH
 Approx. Flow Rate: _____ gpm. Sediment Description: LWH
 Did well de-water? No If yes, Time: _____ Volume: _____ gal. DTW @ Sampling: missed in the field

Time (2400 hr.)	Volume (gal.)	pH	Conductivity (µmhos/cm - <u>DS</u>)	Temperature (° / F)	D.O. (mg/L)	ORP (mV)
<u>1100</u>	<u>1.5</u>	<u>7.38</u>	<u>812</u>	<u>20.4</u>	_____	_____
<u>1105</u>	<u>3.0</u>	<u>7.30</u>	<u>847</u>	<u>19.9</u>	_____	_____
<u>1110</u>	<u>4.5</u>	<u>7.24</u>	<u>861</u>	<u>19.7</u>	_____	_____

LABORATORY INFORMATION

SAMPLE ID	(#) CONTAINER	REFRIG.	PRESERV. TYPE	LABORATORY	ANALYSES
<u>MW-1A</u>	<u>3</u> x voa vial	YES	HCL	LANCASTER	TPH-GRO(8015)/BTEX+MTBE(8021)
	x voa vial	YES	HCL	LANCASTER	TPH-GRO(8015)/BTEX(8021)
	<u>2</u> x 500ml ambers	YES	NP	LANCASTER	TPH-DRO w/sgc COLUMN/ TPH-DRO w/sgc (8015)

COMMENTS:

Add/Replaced Lock: X Add/Replaced Plug: X 2" Add/Replaced Bolt: _____



GETTLER - RYAN INC.

WELL MONITORING/SAMPLING FIELD DATA SHEET

Client/Facility#: Chevron #206145 Job Number: 386492
 Site Address: 800 Center Street Event Date: 2/18/13 (inclusive)
 City: Oakland, CA Sampler: JH

Well ID: MW-2 Date Monitored: 2/18/13
 Well Diameter: 2
 Total Depth: 13.42 ft.
 Depth to Water: 8.72 ft. Check if water column is less than 0.50 ft.
4.70 xVF .17 = .79 x3 case volume = Estimated Purge Volume: 2.39 gal.
 Depth to Water w/ 80% Recharge [(Height of Water Column x 0.20) + DTW]: 9.66

Volume	3/4" = 0.02	1" = 0.04	2" = 0.17	3" = 0.38
Factor (VF)	4" = 0.66	5" = 1.02	6" = 1.50	12" = 5.80

Purge Equipment:

Disposable Bailer X
 Stainless Steel Bailer _____
 Stack Pump _____
 Suction Pump _____
 Grundfos _____
 Peristaltic Pump _____
 QED Bladder Pump _____
 Other: _____

Sampling Equipment:

Disposable Bailer X
 Pressure Bailer _____
 Metal Filters _____
 Peristaltic Pump _____
 QED Bladder Pump _____
 Other: _____

Time Started: _____ (2400 hrs)
 Time Completed: _____ (2400 hrs)
 Depth to Product: _____ ft
 Depth to Water: _____ ft
 Hydrocarbon Thickness: _____ ft
 Visual Confirmation/Description: _____
 Skimmer / Absorbant Sock (circle one)
 Amt Removed from Skimmer: _____ gal
 Amt Removed from Well: _____ gal
 Water Removed: _____

Start Time (purge): 1235 Weather Conditions: cloudy
 Sample Time/Date: 1305 / 2/18/13 Water Color: cloudy Odor: Y10
 Approx. Flow Rate: _____ gpm. Sediment Description: L.S.M
 Did well de-water? No If yes, Time: _____ Volume: _____ gal. DTW @ Sampling: 9.20

Time (2400 hr.)	Volume (gal.)	pH	Conductivity (µmhos/cm - 25)	Temperature (°C / F)	D.O. (mg/L)	ORP (mV)
<u>1239</u>	<u>1</u>	<u>7.04</u>	<u>678</u>	<u>20.4</u>		
<u>1243</u>	<u>2</u>	<u>6.92</u>	<u>653</u>	<u>20.2</u>		
<u>1246</u>	<u>2.5</u>	<u>6.86</u>	<u>641</u>	<u>20.1</u>		

LABORATORY INFORMATION

SAMPLE ID	(#) CONTAINER	REFRIG.	PRESERV. TYPE	LABORATORY	ANALYSES
<u>MW-2</u>	<u>3</u> x voa vial	<u>YES</u>	<u>HCL</u>	<u>LANCASTER</u>	<u>TPH-GRO(8015)/BTEX+MTBE(8021)</u>
	x voa vial	<u>YES</u>	<u>HCL</u>	<u>LANCASTER</u>	<u>TPH-GRO(8015)/BTEX(8021)</u>
	<u>2</u> x 500ml ambers	<u>YES</u>	<u>NP</u>	<u>LANCASTER</u>	<u>TPH-DRO w/sgc COLUMN/ TPH-DRO w/sgc (8015)</u>

COMMENTS:

Add/Replaced Lock: X Add/Replaced Plug: X 2" Add/Replaced Bolt: _____



GETTLER-RYAN INC.

WELL MONITORING/SAMPLING FIELD DATA SHEET

Client/Facility#: Chevron #206145 Job Number: 386492
 Site Address: 800 Center Street Event Date: 2/18/13 (inclusive)
 City: Oakland, CA Sampler: JH

Well ID: MW-3 Date Monitored: 2/18/13
 Well Diameter: 2
 Total Depth: 14.03 ft.
 Depth to Water: 8.45 ft. Check if water column is less than 0.50 ft.
5.58 xVF .17 = .94 x3 case volume = Estimated Purge Volume: 2.84 gal.
 Depth to Water w/ 80% Recharge [(Height of Water Column x 0.20) + DTW]: 9.56

Volume	3/4"= 0.02	1"= 0.04	2"= 0.17	3"= 0.38
Factor (VF)	4"= 0.66	5"= 1.02	6"= 1.50	12"= 5.80

Purge Equipment:
 Disposable Bailer X
 Stainless Steel Bailer _____
 Stack Pump _____
 Suction Pump _____
 Grundfos _____
 Peristaltic Pump _____
 QED Bladder Pump _____
 Other: _____

Sampling Equipment:
 Disposable Bailer X
 Pressure Bailer _____
 Metal Filters _____
 Peristaltic Pump _____
 QED Bladder Pump _____
 Other: _____

Time Started: _____ (2400 hrs)
 Time Completed: _____ (2400 hrs)
 Depth to Product: _____ ft
 Depth to Water: _____ ft
 Hydrocarbon Thickness: _____ ft
 Visual Confirmation/Description: _____
 Skimmer / Absorbant Sock (circle one)
 Amt Removed from Skimmer: _____ gal
 Amt Removed from Well: _____ gal
 Water Removed: _____

Start Time (purge): 1145 Weather Conditions: Cloudy
 Sample Time/Date: 1215 / 2/18/13 Water Color: cloudy Odor: DN / L-300
 Approx. Flow Rate: _____ gpm. Sediment Description: L-300
 Did well de-water? no If yes, Time: _____ Volume: _____ gal. DTW @ Sampling: 9.13

Time (2400 hr.)	Volume (gal.)	pH	Conductivity (µmhos/cm - <u>9</u>)	Temperature (° / F)	D.O. (mg/L)	ORP (mV)
<u>1150</u>	<u>1</u>	<u>7.29</u>	<u>753</u>	<u>20.5</u>		
<u>1154</u>	<u>2</u>	<u>7.25</u>	<u>789</u>	<u>20.3</u>		
<u>1158</u>	<u>3</u>	<u>7.16</u>	<u>815</u>	<u>19.8</u>		

LABORATORY INFORMATION

SAMPLE ID	(#) CONTAINER	REFRIG.	PRESERV. TYPE	LABORATORY	ANALYSES
MW-	3 x voa vial	YES	HCL	LANCASTER	TPH-GRO(8015)/BTEX+MTBE(8021)
	x voa vial	YES	HCL	LANCASTER	TPH-GRO(8015)/BTEX(8021)
	2 x 500ml ambers	YES	NP	LANCASTER	TPH-DRO w/sgc COLUMN/ TPH-DRO w/sgc (8015)
	<u>2</u>				<u>Chevron</u>

COMMENTS: _____

Add/Replaced Lock: _____ Add/Replaced Plug: _____ Add/Replaced Bolt: _____



GETTLER-RYAN INC.

WELL MONITORING/SAMPLING FIELD DATA SHEET

Client/Facility#: Chevron #206145 Job Number: 386492
 Site Address: 800 Center Street Event Date: 2/18/10 (inclusive)
 City: Oakland, CA Sampler: JH

Well ID: MW-5 Date Monitored: 2/18/10
 Well Diameter: 2
 Total Depth: 19.33 ft.
 Depth to Water: 7.91 ft. Check if water column is less than 0.50 ft.
11.42 xVF .17 = 1.94 x3 case volume = Estimated Purge Volume: 5.82 gal.
 Depth to Water w/ 80% Recharge [(Height of Water Column x 0.20) + DTW]: 10.19

Volume Factor (VF)	3/4" = 0.02	1" = 0.04	2" = 0.17	3" = 0.38
	4" = 0.68	5" = 1.02	6" = 1.50	12" = 5.80

Purge Equipment:
 Disposable Bailer X
 Stainless Steel Bailer _____
 Stack Pump _____
 Suction Pump _____
 Grundfos _____
 Peristaltic Pump _____
 QED Bladder Pump _____
 Other: _____

Sampling Equipment:
 Disposable Bailer X
 Pressure Bailer _____
 Metal Filters _____
 Peristaltic Pump _____
 QED Bladder Pump _____
 Other: _____

Time Started: _____ (2400 hrs)
 Time Completed: _____ (2400 hrs)
 Depth to Product: _____ ft.
 Depth to Water: _____ ft.
 Hydrocarbon Thickness: _____ ft.
 Visual Confirmation/Description: _____
 Skimmer / Absorbent Sock (circle one)
 Amt Removed from Skimmer: _____ gal
 Amt Removed from Well: _____ gal
 Water Removed: _____

Start Time (purge): 0920 Weather Conditions: Cloudy
 Sample Time/Date: 0955 / 2/18/10 Water Color: Cloudy Odor: Y 10
 Approx. Flow Rate: _____ gpm. Sediment Description: Loose
 Did well de-water? No If yes, Time: _____ Volume: _____ gal. DTW @ Sampling: 8.56

Time (2400 hr.)	Volume (gal.)	pH	Conductivity (µmhos/cm - US)	Temperature (C / F)	D.O. (mg/L)	ORP (mV)
<u>0925</u>	<u>2</u>	<u>6.84</u>	<u>589</u>	<u>20.1</u>		
<u>0930</u>	<u>4</u>	<u>6.89</u>	<u>608</u>	<u>20.7</u>		
<u>0935</u>	<u>6</u>	<u>6.72</u>	<u>625</u>	<u>20.4</u>		

LABORATORY INFORMATION

SAMPLE ID	(#) CONTAINER	REFRIG.	PRESERV. TYPE	LABORATORY	ANALYSES
<u>MW-5</u>	<u>3</u> x voa vial	YES	HCL	LANCASTER	TPH-GRO(8015)/BTEX+MTBE(8021)
	x voa vial	YES	HCL	LANCASTER	TPH-GRO(8015)/BTEX(8021)
	<u>2</u> x 500ml ambers	YES	NP	LANCASTER	TPH-DRO w/sgc COLUMN/ TPH-DRO w/sgc (8015)

COMMENTS: _____

Add/Replaced Lock: _____ Add/Replaced Plug: _____ Add/Replaced Bolt: _____



GETTLER-RYAN INC.

WELL MONITORING/SAMPLING FIELD DATA SHEET

Client/Facility#: Chevron #206145 Job Number: 386492
 Site Address: 800 Center Street Event Date: 2/18/13 (inclusive)
 City: Oakland, CA Sampler: JW

Well ID: MW-6 Date Monitored: 2/18/13

Well Diameter: 2

Total Depth: 15.02 ft.

Depth to Water: 7.83 ft. Check if water column is less than 0.50 ft.

Depth to Water w/ 80% Recharge [(Height of Water Column x 0.20) + DTW]: 9.26

Volume	3/4"= 0.02	1"= 0.04	2"= 0.17	3"= 0.38
Factor (VF)	4"= 0.66	5"= 1.02	6"= 1.50	12"= 5.80

xVF .17 = 1.22 x3 case volume = Estimated Purge Volume: 3.66 gal.

Purge Equipment:
 Disposable Bailer X
 Stainless Steel Bailer _____
 Stack Pump _____
 Suction Pump _____
 Grundfos _____
 Peristaltic Pump _____
 QED Bladder Pump _____
 Other: _____

Sampling Equipment:
 Disposable Bailer X
 Pressure Bailer _____
 Metal Filters _____
 Peristaltic Pump _____
 QED Bladder Pump _____
 Other: _____

Time Started: _____ (2400 hrs)
 Time Completed: _____ (2400 hrs)
 Depth to Product: _____ ft
 Depth to Water: _____ ft
 Hydrocarbon Thickness: _____ ft
 Visual Confirmation/Description: _____
 Skimmer / Absorbant Sock (circle one)
 Amt Removed from Skimmer: _____ gal
 Amt Removed from Well: _____ gal
 Water Removed: _____

Start Time (purge): 0835 Weather Conditions: Cloudy
 Sample Time/Date: 0905 / 2/18/13 Water Color: cloudy Odor: Y16
 Approx. Flow Rate: _____ gpm. Sediment Description: L. 1/2
 Did well de-water? NO If yes, Time: _____ Volume: _____ gal. DTW @ Sampling: 8.45

Time (2400 hr.)	Volume (gal.)	pH	Conductivity (µmhos/cm @ 25)	Temperature (C / F)	D.O. (mg/L)	ORP (mV)
<u>0838</u>	<u>1</u>	<u>7.58</u>	<u>428</u>	<u>19.9</u>		
<u>0842</u>	<u>2</u>	<u>7.39</u>	<u>455</u>	<u>19.7</u>		
<u>0847</u>	<u>3.5</u>	<u>7.25</u>	<u>463</u>	<u>19.6</u>		

LABORATORY INFORMATION

SAMPLE ID	(#) CONTAINER	REFRIG.	PRESERV. TYPE	LABORATORY	ANALYSES
MW-6	3 x voa vial	YES	HCL	LANCASTER	TPH-GRO(8015)/BTEX+MTBE(8021)
	x voa vial	YES	HCL	LANCASTER	TPH-GRO(8015)/BTEX(8021)
	2 x 500ml ambers	YES	NP	LANCASTER	TPH-DRO w/sgc COLUMN/ TPH-DRO w/sgc (8015)

COMMENTS: _____

Add/Replaced Lock: _____ Add/Replaced Plug: _____ Add/Replaced Bolt: _____



GETTLER-RYAN INC.

WELL MONITORING/SAMPLING FIELD DATA SHEET

Client/Facility#: Chevron #206145 Job Number: 386492
 Site Address: 800 Center Street Event Date: 2/18/13 (inclusive)
 City: Oakland, CA Sampler: JH

Well ID: MW-7 Date Monitored: 2/18/13
 Well Diameter: 2
 Total Depth: 15.77 ft.
 Depth to Water: 9.31 ft.

Volume Factor (VF)	3/4" = 0.02	1" = 0.04	2" = 0.17	3" = 0.38
	4" = 0.66	5" = 1.02	6" = 1.50	12" = 5.80

Depth to Water: 6.46 xVF .17 = 1.09 x3 case volume = Estimated Purge Volume: 3.29 gal.
 Depth to Water w/ 80% Recharge [(Height of Water Column x 0.20) + DTW]: 10.60

Purge Equipment:
 Disposable Bailer X
 Stainless Steel Bailer _____
 Stack Pump _____
 Suction Pump _____
 Grundfos _____
 Peristaltic Pump _____
 QED Bladder Pump _____
 Other: _____

Sampling Equipment:
 Disposable Bailer X
 Pressure Bailer _____
 Metal Filters _____
 Peristaltic Pump _____
 QED Bladder Pump _____
 Other: _____

Time Started: _____ (2400 hrs)
 Time Completed: _____ (2400 hrs)
 Depth to Product: _____ ft
 Depth to Water: _____ ft
 Hydrocarbon Thickness: _____ ft
 Visual Confirmation/Description: _____
 Skimmer / Absorbant Sock (circle one)
 Amt Removed from Skimmer: _____ gal
 Amt Removed from Well: _____ gal
 Water Removed: _____

Start Time (purge): 1325 Weather Conditions: Cloudy
 Sample Time/Date: 1400 / 2/18/13 Water Color: Cloudy Odor: Y10
 Approx. Flow Rate: _____ gpm. Sediment Description: Light
 Did well de-water? no If yes, Time: _____ Volume: _____ gal. DTW @ Sampling: 9.84

Time (2400 hr.)	Volume (gal.)	pH	Conductivity (µmhos/cm - σ)	Temperature (°/ F)	D.O. (mg/L)	ORP (mV)
<u>1328</u>	<u>1</u>	<u>6.74</u>	<u>583</u>	<u>20.1</u>		
<u>1332</u>	<u>2</u>	<u>6.80</u>	<u>597</u>	<u>19.8</u>		
<u>1336</u>	<u>3.5</u>	<u>6.65</u>	<u>612</u>	<u>19.7</u>		

LABORATORY INFORMATION

SAMPLE ID	(#) CONTAINER	REFRIG.	PRESERV. TYPE	LABORATORY	ANALYSES
MW-7	3 x voa vial	YES	HCL	LANCASTER	TPH-GRO(8015)/BTEX+MTBE(8021)
	x voa vial	YES	HCL	LANCASTER	TPH-GRO(8015)/BTEX(8021)
	2 x 500ml ambers	YES	NP	LANCASTER	TPH-DRO w/sgc COLUMN/ TPH-DRO w/sgc (8015)

COMMENTS: _____

Add/Replaced Lock: _____ Add/Replaced Plug: _____ Add/Replaced Bolt: _____



GETTLER-RYAN INC.

WELL MONITORING/SAMPLING FIELD DATA SHEET

Client/Facility#: Chevron #206145 Job Number: 386492
 Site Address: 800 Center Street Event Date: 2/18/13 (inclusive)
 City: Oakland, CA Sampler: JH

Well ID: MW-8 Date Monitored: 2/18/13

Well Diameter: 2
 Total Depth: 20.01 ft.
 Depth to Water: 8.58 ft.

Volume Factor (VF)	3/4" = 0.02	1" = 0.04	2" = 0.17	3" = 0.38
	4" = 0.66	5" = 1.02	6" = 1.50	12" = 5.80

Depth to Water w/ 80% Recharge [(Height of Water Column x 0.20) + DTW]: 10.86
 Check if water column is less than 0.50 ft.
 $11.42 \times VF .17 = 1.94$ x3 case volume = Estimated Purge Volume: 5.82 gal.

Purge Equipment:
 Disposable Bailer X
 Stainless Steel Bailer _____
 Stack Pump _____
 Suction Pump _____
 Grundfos _____
 Peristaltic Pump _____
 QED Bladder Pump _____
 Other: _____

Sampling Equipment:
 Disposable Bailer X
 Pressure Bailer _____
 Metal Filters _____
 Peristaltic Pump _____
 QED Bladder Pump _____
 Other: _____

Time Started: _____ (2400 hrs)
 Time Completed: _____ (2400 hrs)
 Depth to Product: _____ ft
 Depth to Water: _____ ft
 Hydrocarbon Thickness: _____ ft
 Visual Confirmation/Description: _____
 Skimmer / Absorbant Sock (circle one)
 Amt Removed from Skimmer: _____ gal
 Amt Removed from Well: _____ gal
 Water Removed: _____

Start Time (purge): 0745 Weather Conditions: Cloudy
 Sample Time/Date: 0820 / 2/18/13 Water Color: Cloudy Odor: Y10
 Approx. Flow Rate: _____ gpm. Sediment Description: L.3M
 Did well de-water? N If yes, Time: _____ Volume: _____ gal. DTW @ Sampling: 9.02

Time (2400 hr.)	Volume (gal.)	pH	Conductivity (µmhos/cm - <u>6</u>)	Temperature (°C / F)	D.O. (mg/L)	ORP (mV)
<u>0750</u>	<u>2</u>	<u>7.18</u>	<u>497</u>	<u>20.2</u>		
<u>0755</u>	<u>4</u>	<u>7.06</u>	<u>518</u>	<u>20.1</u>		
<u>0800</u>	<u>6</u>	<u>6.97</u>	<u>542</u>	<u>19.7</u>		

LABORATORY INFORMATION

SAMPLE ID	(#) CONTAINER	REFRIG.	PRESERV. TYPE	LABORATORY	ANALYSES
<u>MW-8</u>	<u>3</u> x voa vial	YES	HCL	LANCASTER	TPH-GRO(8015)/BTEX+MTBE(8021)
	x voa vial	YES	HCL	LANCASTER	TPH-GRO(8015)/BTEX(8021)
	<u>2</u> x 500ml ambers	YES	NP	LANCASTER	TPH-DRO w/sgc COLUMN/ TPH-DRO w/sgc (8015)

COMMENTS: _____

Add/Replaced Lock: _____ Add/Replaced Plug: _____ Add/Replaced Bolt: _____

Chevron California Region Analysis Request/Chain of Custody



For Lancaster Laboratories use only

Acct. #: _____ Sample #: _____ Group #: **015451**

Facility #: <u>SS#206145-OML G-R#386492 Global ID#T0600102230</u> Site Address: <u>800 CENTER STREET, OAKLAND, CA</u> Chevron PM: <u>EH</u> Lead Consultant: <u>CRAJG Gilbert</u> Consultant/Office: <u>G-R, Inc., 6747 Sierra Court, Suite J, Dublin, CA 94568</u> Consultant Prj. Mgr.: <u>Deanna L. Harding (deanna@grinc.com)</u> Consultant Phone #: <u>925-551-7555</u> Fax #: <u>925-551-7899</u> Sampler: <u>J. Hoza</u>			Matrix <input type="checkbox"/> Potable <input type="checkbox"/> NPDES <input type="checkbox"/> Soil <input type="checkbox"/> Water <input type="checkbox"/> Oil <input type="checkbox"/> Air			Analyses Requested <table border="1" style="width: 100%; border-collapse: collapse;"> <tr> <th colspan="10">Preservation Codes</th> </tr> <tr> <td>H</td><td>H</td><td></td><td></td><td></td><td></td><td></td><td></td><td></td><td></td> </tr> <tr> <td>BTEX + MTBE 8260</td><td>8021</td><td></td><td></td><td></td><td></td><td></td><td></td><td></td><td></td> </tr> <tr> <td>TPH 8015 MOD GRO</td><td></td><td></td><td></td><td></td><td></td><td></td><td></td><td></td><td></td> </tr> <tr> <td>TPH 8015 MOD DRO</td><td></td><td></td><td></td><td></td><td></td><td></td><td></td><td></td><td></td> </tr> <tr> <td>8260 Fullscan</td><td></td><td></td><td></td><td></td><td></td><td></td><td></td><td></td><td></td> </tr> <tr> <td>TPH-DRO</td><td></td><td></td><td></td><td></td><td></td><td></td><td></td><td></td><td></td> </tr> <tr> <td>SGC Column</td><td></td><td></td><td></td><td></td><td></td><td></td><td></td><td></td><td></td> </tr> <tr> <td>Oxygenates</td><td></td><td></td><td></td><td></td><td></td><td></td><td></td><td></td><td></td> </tr> <tr> <td>Total Lead Method</td><td></td><td></td><td></td><td></td><td></td><td></td><td></td><td></td><td></td> </tr> <tr> <td>Dissolved Lead Method</td><td></td><td></td><td></td><td></td><td></td><td></td><td></td><td></td><td></td> </tr> </table>										Preservation Codes										H	H									BTEX + MTBE 8260	8021									TPH 8015 MOD GRO										TPH 8015 MOD DRO										8260 Fullscan										TPH-DRO										SGC Column										Oxygenates										Total Lead Method										Dissolved Lead Method										Preservative Codes H = HCl T = Thiosulfate N = HNO ₃ B = NaOH S = H ₂ SO ₄ O = Other <input type="checkbox"/> J value reporting needed <input checked="" type="checkbox"/> Must meet lowest detection limits possible for 8260 compounds 8021 MTBE Confirmation <input type="checkbox"/> Confirm highest hit by 8260 <input type="checkbox"/> Confirm all hits by 8260 <input type="checkbox"/> Run ___ oxy's on highest hit <input type="checkbox"/> Run ___ oxy's on all hits	
Preservation Codes																																																																																																																															
H	H																																																																																																																														
BTEX + MTBE 8260	8021																																																																																																																														
TPH 8015 MOD GRO																																																																																																																															
TPH 8015 MOD DRO																																																																																																																															
8260 Fullscan																																																																																																																															
TPH-DRO																																																																																																																															
SGC Column																																																																																																																															
Oxygenates																																																																																																																															
Total Lead Method																																																																																																																															
Dissolved Lead Method																																																																																																																															
Sample Identification			Date Collected	Time Collected	Grab	Composite	Soil	Water	Oil	Air	Total Number of Containers	BTEX + MTBE 8260	8021	TPH 8015 MOD GRO	TPH 8015 MOD DRO	8260 Fullscan	TPH-DRO	SGC Column	Oxygenates	Total Lead Method	Dissolved Lead Method	Comments / Remarks																																																																																																									
QA			2/18/17		X						2	X	X	X	X	X	X	X					Requesting 10 gram column cleanup on DRO w/sgc COLUMN samples, and normal 1 gram on DRO w/sgc by (8015). Please forward the lab results directly to the Lead Consultant and cc: G-R. amended removed TPH-DRO (8015) should only be TPH-DRO w/sgc + sgc column																																																																																																								
MW-1A				1130	X		X				2	X	X	X	X	X	X																																																																																																														
MW-2				1305	X		X				2	X	X	X	X	X	X																																																																																																														
MW-3				1215	X		X				2	X	X	X	X	X	X																																																																																																														
MW-4				1035	X		X				2	X	X	X	X	X	X																																																																																																														
MW-5				0955	X		X				2	X	X	X	X	X	X																																																																																																														
MW-6				0905	X		X				2	X	X	X	X	X	X																																																																																																														
MW-7				1700	X		X				2	X	X	X	X	X	X																																																																																																														
MW-8				0820	X		X				2	X	X	X	X	X	X																																																																																																														
Turnaround Time Requested (TAT) (please circle) STD TAT 72 hour 48 hour 24 hour 4 day 5 day			Relinquished by: _____ Date: <u>2/18/17</u> Time: <u>1700</u>			Received by: _____ Date: _____ Time: _____																																																																																																																									
Data Package Options (please circle if required) QC Summary Type I - Full EDF/EDD Type VI (Raw Data) <input type="checkbox"/> Coeff Deliverable not needed WIP (RWQCB) Disk			Relinquished by: _____ Date: _____ Time: _____			Received by: _____ Date: _____ Time: _____																																																																																																																									
Relinquished by Commercial Carrier: UPS FedEx Other _____			Received by: _____ Date: _____ Time: _____																																																																																																																												
Temperature Upon Receipt: _____ C°			Custody Seals Intact? Yes No																																																																																																																												

ATTACHMENT B

LABORATORY ANALYTICAL REPORT

ANALYTICAL RESULTS

Prepared by:

Lancaster Laboratories
2425 New Holland Pike
Lancaster, PA 17605-2425

Prepared for:

Chevron
L4310
6001 Bollinger Canyon Rd.
San Ramon CA 94583

March 04, 2013

Project: 206145

Submittal Date: 02/19/2013

Group Number: 1369742

PO Number: 0015118368

Release Number: HETRICK

State of Sample Origin: CA

Client Sample DescriptionQA-T-130218 NA Water
MW-1A-W-130218 Grab Water
MW-1A-W-130218 Grab Water
MW-2-W-130218 Grab Water
MW-2-W-130218 Grab Water
MW-3-W-130218 Grab Water
MW-3-W-130218 Grab Water
MW-4-W-130218 Grab Water
MW-4-W-130218 Grab Water
MW-5-W-130218 Grab Water
MW-5-W-130218 Grab Water
MW-6-W-130218 Grab Water
MW-6-W-130218 Grab Water
MW-7-W-130218 Grab Water
MW-7-W-130218 Grab Water
MW-8-W-130218 Grab Water
MW-8-W-130218 Grab WaterLancaster Labs (LLD) #6957452
6957453
6957454
6957455
6957456
6957457
6957458
6957459
6957460
6957461
6957462
6957463
6957464
6957465
6957466
6957467
6957468

The specific methodologies used in obtaining the enclosed analytical results are indicated on the Laboratory Sample Analysis Record.

ELECTRONIC COPY TO CRA c/o Gettler-Ryan

Attn: Rachelle Munoz

ELECTRONIC COPY TO

ELECTRONIC COPY TO Chevron c/o CRA

Attn: Report Contact

ELECTRONIC COPY TO

ELECTRONIC COPY TO Chevron

Attn: Anna Avina

ELECTRONIC COPY TO

ELECTRONIC COPY TO Conestoga-Rovers & Associates

Attn: Judy Gilbert

COPY TO

Respectfully Submitted,



Jill M. Parker
Senior Specialist

(717) 556-7262

Sample Description: QA-T-130218 NA Water
Facility# 206145 Job# 386492 GRD
800 Center St-Oakland T0600102230

LLI Sample # WW 6957452
LLI Group # 1369742
Account # 10904

Project Name: 206145

Collected: 02/18/2013

Chevron

Submitted: 02/19/2013 09:20

L4310

Reported: 03/04/2013 21:13

6001 Bollinger Canyon Rd.
 San Ramon CA 94583

CSOQA

CAT No.	Analysis Name	CAS Number	As Received Result	As Received Method Detection Limit	Dilution Factor
GC Volatiles SW-846 8015B ug/l					
01729	TPH-GRO N. CA water C6-C12	n.a.	N.D.	50	1
GC Volatiles SW-846 8021B ug/l					
02102	Benzene	71-43-2	N.D.	0.5	1
02102	Ethylbenzene	100-41-4	N.D.	0.5	1
02102	Methyl tert-Butyl Ether	1634-04-4	N.D.	2.5	1
02102	Toluene	108-88-3	N.D.	0.5	1
02102	Total Xylenes	1330-20-7	N.D.	1.5	1

General Sample Comments

State of California Lab Certification No. 2501

All QC is compliant unless otherwise noted. Please refer to the Quality Control Summary for overall QC performance data and associated samples.

Laboratory Sample Analysis Record

CAT No.	Analysis Name	Method	Trial#	Batch#	Analysis Date and Time	Analyst	Dilution Factor
01729	TPH-GRO N. CA water C6-C12	SW-846 8015B	1	13058A94A	02/28/2013 12:28	Catherine J Schwarz	1
02102	Method 8021 Water Master	SW-846 8021B	1	13058A94A	02/28/2013 12:28	Catherine J Schwarz	1
01146	GC VOA Water Prep	SW-846 5030B	1	13058A94A	02/28/2013 12:28	Catherine J Schwarz	1

Sample Description: MW-1A-W-130218 Grab Water
Facility# 206145 Job# 386492 GRD
800 Center St-Oakland T0600102230

LLI Sample # WW 6957453
LLI Group # 1369742
Account # 10904

Project Name: 206145

Collected: 02/18/2013 11:30 by JH Chevron
 Submitted: 02/19/2013 09:20 L4310
 Reported: 03/04/2013 21:13 6001 Bollinger Canyon Rd.
 San Ramon CA 94583

COM1A

CAT No.	Analysis Name	CAS Number	As Received Result	As Received Method Detection Limit	Dilution Factor
GC Volatiles SW-846 8015B ug/l					
01729	TPH-GRO N. CA water C6-C12	n.a.	N.D.	50	1
GC Volatiles SW-846 8021B ug/l					
02102	Benzene	71-43-2	N.D.	0.5	1
02102	Ethylbenzene	100-41-4	N.D.	0.5	1
02102	Methyl tert-Butyl Ether	1634-04-4	N.D.	2.5	1
02102	Toluene	108-88-3	N.D.	0.5	1
02102	Total Xylenes	1330-20-7	N.D.	1.5	1
GC Petroleum SW-846 8015B ug/l					
Hydrocarbons w/Si					
06610	TPH-DRO CA C10-C28 w/ Si Gel	n.a.	110	50	1
The reverse surrogate, capric acid, is present at <1%.					

General Sample Comments

State of California Lab Certification No. 2501

All QC is compliant unless otherwise noted. Please refer to the Quality Control Summary for overall QC performance data and associated samples.

Laboratory Sample Analysis Record

CAT No.	Analysis Name	Method	Trial#	Batch#	Analysis Date and Time	Analyst	Dilution Factor
01729	TPH-GRO N. CA water C6-C12	SW-846 8015B	1	13058A94A	02/28/2013 13:19	Catherine J Schwarz	1
02102	Method 8021 Water Master	SW-846 8021B	1	13058A94A	02/28/2013 13:19	Catherine J Schwarz	1
01146	GC VOA Water Prep	SW-846 5030B	1	13058A94A	02/28/2013 13:19	Catherine J Schwarz	1
06610	TPH-DRO CA C10-C28 w/ Si Gel	SW-846 8015B	1	130510011A	02/28/2013 10:00	Elizabeth J Marin	1
11180	Low Vol Ext(W) w/SG	SW-846 3510C	1	130510011A	02/20/2013 21:00	Karen L Beyer	1

Sample Description: MW-1A-W-130218 Grab Water
 Facility# 206145 Job# 386492 GRD
 800 Center St-Oakland T0600102230

LLI Sample # WW 6957454
 LLI Group # 1369742
 Account # 10904

Project Name: 206145

Collected: 02/18/2013 11:30 by JH Chevron
 L4310
 Submitted: 02/19/2013 09:20 6001 Bollinger Canyon Rd.
 Reported: 03/04/2013 21:13 San Ramon CA 94583

CO1AQ

CAT No.	Analysis Name	CAS Number	As Received Result	As Received Method Detection Limit	Dilution Factor
GC Petroleum Hydrocarbons w/Si					
	SW-846 8015B		ug/l	ug/l	
06610	TPH-DRO CA C10-C28 w/ Si Gel	n.a.	830	50	1
Due to a laboratory error, only the Laboratory Control Spike was analyzed for quality control. Sufficient sample was not available to repeat the analysis.					

General Sample Comments

State of California Lab Certification No. 2501

All QC is compliant unless otherwise noted. Please refer to the Quality Control Summary for overall QC performance data and associated samples.

Laboratory Sample Analysis Record

CAT No.	Analysis Name	Method	Trial#	Batch#	Analysis Date and Time	Analyst	Dilution Factor
06610	TPH-DRO CA C10-C28 w/ Si Gel	SW-846 8015B	1	130510012A	02/28/2013 17:06	Christine E Dolman	1
11180	Low Vol Ext(W) w/SG	SW-846 3510C	1	130510012A	02/20/2013 21:00	Karen L Beyer	1

Sample Description: MW-2-W-130218 Grab Water
Facility# 206145 Job# 386492 GRD
800 Center St-Oakland T0600102230

LLI Sample # WW 6957455
LLI Group # 1369742
Account # 10904

Project Name: 206145

Collected: 02/18/2013 13:05 by JH Chevron
 Submitted: 02/19/2013 09:20 L4310
 Reported: 03/04/2013 21:13 6001 Bollinger Canyon Rd.
 San Ramon CA 94583

COMW2

CAT No.	Analysis Name	CAS Number	As Received Result	As Received Method Detection Limit	Dilution Factor
GC Volatiles SW-846 8015B ug/l					
01729	TPH-GRO N. CA water C6-C12	n.a.	N.D.	50	1
GC Volatiles SW-846 8021B ug/l					
02102	Benzene	71-43-2	N.D.	0.5	1
02102	Ethylbenzene	100-41-4	N.D.	0.5	1
02102	Methyl tert-Butyl Ether	1634-04-4	N.D.	2.5	1
02102	Toluene	108-88-3	N.D.	0.5	1
02102	Total Xylenes	1330-20-7	N.D.	1.5	1
GC Petroleum SW-846 8015B ug/l					
Hydrocarbons w/Si					
06610	TPH-DRO CA C10-C28 w/ Si Gel	n.a.	N.D.	50	1
The reverse surrogate, capric acid, is present at <1%.					

General Sample Comments

State of California Lab Certification No. 2501

All QC is compliant unless otherwise noted. Please refer to the Quality Control Summary for overall QC performance data and associated samples.

Laboratory Sample Analysis Record

CAT No.	Analysis Name	Method	Trial#	Batch#	Analysis Date and Time	Analyst	Dilution Factor
01729	TPH-GRO N. CA water C6-C12	SW-846 8015B	1	13058A94A	02/28/2013 13:44	Catherine J Schwarz	1
02102	Method 8021 Water Master	SW-846 8021B	1	13058A94A	02/28/2013 13:44	Catherine J Schwarz	1
01146	GC VOA Water Prep	SW-846 5030B	1	13058A94A	02/28/2013 13:44	Catherine J Schwarz	1
06610	TPH-DRO CA C10-C28 w/ Si Gel	SW-846 8015B	1	130510011A	02/27/2013 22:02	Christine E Dolman	1
11180	Low Vol Ext(W) w/SG	SW-846 3510C	1	130510011A	02/20/2013 21:00	Karen L Beyer	1

Sample Description: MW-2-W-130218 Grab Water
Facility# 206145 Job# 386492 GRD
800 Center St-Oakland T0600102230

LLI Sample # WW 6957456
LLI Group # 1369742
Account # 10904

Project Name: 206145

Collected: 02/18/2013 13:05 by JH Chevron
 Submitted: 02/19/2013 09:20 L4310
 Reported: 03/04/2013 21:13 6001 Bollinger Canyon Rd.
 San Ramon CA 94583

COM2Q

CAT No.	Analysis Name	CAS Number	As Received Result	As Received Method Detection Limit	Dilution Factor
GC Petroleum Hydrocarbons w/Si					
		SW-846 8015B	ug/l	ug/l	
06610	TPH-DRO CA C10-C28 w/ Si Gel	n.a.	430	50	1
Due to a laboratory error, only the Laboratory Control Spike was analyzed for quality control. Sufficient sample was not available to repeat the analysis. Target analytes were detected in the method blank associated with the samples as noted on the QC Summary. This sample contains a prominent motor oil pattern whereas the blank does not have this pattern; therefore, the data is reported.					

General Sample Comments

State of California Lab Certification No. 2501

All QC is compliant unless otherwise noted. Please refer to the Quality Control Summary for overall QC performance data and associated samples.

Laboratory Sample Analysis Record

CAT No.	Analysis Name	Method	Trial#	Batch#	Analysis Date and Time	Analyst	Dilution Factor
06610	TPH-DRO CA C10-C28 w/ Si Gel	SW-846 8015B	1	130510012A	02/28/2013 15:35	Christine E Dolman	1
11180	Low Vol Ext(W) w/SG	SW-846 3510C	1	130510012A	02/20/2013 21:00	Karen L Beyer	1

Sample Description: MW-3-W-130218 Grab Water
Facility# 206145 Job# 386492 GRD
800 Center St-Oakland T0600102230

LLI Sample # WW 6957457
LLI Group # 1369742
Account # 10904

Project Name: 206145

Collected: 02/18/2013 12:15 by JH Chevron
 Submitted: 02/19/2013 09:20 L4310
 Reported: 03/04/2013 21:13 6001 Bollinger Canyon Rd.
 San Ramon CA 94583

COMW3

CAT No.	Analysis Name	CAS Number	As Received Result	As Received Method Detection Limit	Dilution Factor
GC Volatiles SW-846 8015B ug/l					
01729	TPH-GRO N. CA water C6-C12	n.a.	1,700	50	1
GC Volatiles SW-846 8021B ug/l					
02102	Benzene	71-43-2	11	0.5	1
02102	Ethylbenzene	100-41-4	3.8	0.5	1
02102	Methyl tert-Butyl Ether	1634-04-4	27	2.5	1
02102	Toluene	108-88-3	2.6	0.5	1
02102	Total Xylenes	1330-20-7	19	1.5	1
GC Petroleum SW-846 8015B ug/l					
Hydrocarbons w/Si					
06610	TPH-DRO CA C10-C28 w/ Si Gel	n.a.	580	50	1
The reverse surrogate, capric acid, is present at <1%.					

General Sample Comments

State of California Lab Certification No. 2501

All QC is compliant unless otherwise noted. Please refer to the Quality Control Summary for overall QC performance data and associated samples.

Laboratory Sample Analysis Record

CAT No.	Analysis Name	Method	Trial#	Batch#	Analysis Date and Time	Analyst	Dilution Factor
01729	TPH-GRO N. CA water C6-C12	SW-846 8015B	1	13058A94A	02/28/2013 14:09	Catherine J Schwarz	1
02102	Method 8021 Water Master	SW-846 8021B	1	13058A94A	02/28/2013 14:09	Catherine J Schwarz	1
01146	GC VOA Water Prep	SW-846 5030B	1	13058A94A	02/28/2013 14:09	Catherine J Schwarz	1
06610	TPH-DRO CA C10-C28 w/ Si Gel	SW-846 8015B	1	130510011A	02/28/2013 09:05	Elizabeth J Marin	1
11180	Low Vol Ext(W) w/SG	SW-846 3510C	1	130510011A	02/20/2013 21:00	Karen L Beyer	1

Sample Description: MW-3-W-130218 Grab Water
 Facility# 206145 Job# 386492 GRD
 800 Center St-Oakland T0600102230

LLI Sample # WW 6957458
 LLI Group # 1369742
 Account # 10904

Project Name: 206145

Collected: 02/18/2013 12:15 by JH Chevron
 Submitted: 02/19/2013 09:20 L4310
 Reported: 03/04/2013 21:13 6001 Bollinger Canyon Rd.
 San Ramon CA 94583

COM3Q

CAT No.	Analysis Name	CAS Number	As Received Result	As Received Method Detection Limit	Dilution Factor
GC Petroleum Hydrocarbons w/Si					
		SW-846 8015B	ug/l	ug/l	
06610	TPH-DRO CA C10-C28 w/ Si Gel	n.a.	1,700	50	1
Due to a laboratory error, only the Laboratory Control Spike was analyzed for quality control. Sufficient sample was not available to repeat the analysis.					

General Sample Comments

State of California Lab Certification No. 2501

All QC is compliant unless otherwise noted. Please refer to the Quality Control Summary for overall QC performance data and associated samples.

Laboratory Sample Analysis Record

CAT No.	Analysis Name	Method	Trial#	Batch#	Analysis Date and Time	Analyst	Dilution Factor
06610	TPH-DRO CA C10-C28 w/ Si Gel	SW-846 8015B	1	130510012A	02/28/2013 16:43	Christine E Dolman	1
11180	Low Vol Ext(W) w/SG	SW-846 3510C	1	130510012A	02/20/2013 21:00	Karen L Beyer	1

Sample Description: MW-4-W-130218 Grab Water
Facility# 206145 Job# 386492 GRD
800 Center St-Oakland T0600102230

LLI Sample # WW 6957459
LLI Group # 1369742
Account # 10904

Project Name: 206145

Collected: 02/18/2013 10:35 by JH Chevron
 Submitted: 02/19/2013 09:20 L4310
 Reported: 03/04/2013 21:13 6001 Bollinger Canyon Rd.
 San Ramon CA 94583

COMW4

CAT No.	Analysis Name	CAS Number	As Received Result	As Received Method Detection Limit	Dilution Factor
GC Volatiles SW-846 8015B ug/l					
01729	TPH-GRO N. CA water C6-C12	n.a.	100	50	1
GC Volatiles SW-846 8021B ug/l					
02102	Benzene	71-43-2	N.D.	0.5	1
02102	Ethylbenzene	100-41-4	N.D.	0.5	1
02102	Methyl tert-Butyl Ether	1634-04-4	N.D.	2.5	1
02102	Toluene	108-88-3	N.D.	0.5	1
02102	Total Xylenes	1330-20-7	N.D.	1.5	1
GC Petroleum SW-846 8015B ug/l					
Hydrocarbons w/Si					
06610	TPH-DRO CA C10-C28 w/ Si Gel	n.a.	N.D.	50	1
The reverse surrogate, capric acid, is present at <1%.					

General Sample Comments

State of California Lab Certification No. 2501

All QC is compliant unless otherwise noted. Please refer to the Quality Control Summary for overall QC performance data and associated samples.

Laboratory Sample Analysis Record

CAT No.	Analysis Name	Method	Trial#	Batch#	Analysis Date and Time	Analyst	Dilution Factor
01729	TPH-GRO N. CA water C6-C12	SW-846 8015B	1	13058A94A	02/28/2013 14:35	Catherine J Schwarz	1
02102	Method 8021 Water Master	SW-846 8021B	1	13058A94A	02/28/2013 14:35	Catherine J Schwarz	1
01146	GC VOA Water Prep	SW-846 5030B	1	13058A94A	02/28/2013 14:35	Catherine J Schwarz	1
06610	TPH-DRO CA C10-C28 w/ Si Gel	SW-846 8015B	1	130510011A	02/27/2013 22:47	Christine E Dolman	1
11180	Low Vol Ext(W) w/SG	SW-846 3510C	1	130510011A	02/20/2013 21:00	Karen L Beyer	1

Sample Description: MW-4-W-130218 Grab Water
 Facility# 206145 Job# 386492 GRD
 800 Center St-Oakland T0600102230

LLI Sample # WW 6957460
 LLI Group # 1369742
 Account # 10904

Project Name: 206145

Collected: 02/18/2013 10:35 by JH Chevron
 L4310
 Submitted: 02/19/2013 09:20 6001 Bollinger Canyon Rd.
 Reported: 03/04/2013 21:13 San Ramon CA 94583

COM4Q

CAT No.	Analysis Name	CAS Number	As Received Result	As Received Method Detection Limit	Dilution Factor
GC Petroleum Hydrocarbons w/Si					
		SW-846 8015B	ug/l	ug/l	
06610	TPH-DRO CA C10-C28 w/ Si Gel	n.a.	600	50	1
Due to a laboratory error, only the Laboratory Control Spike was analyzed for quality control. Sufficient sample was not available to repeat the analysis.					

General Sample Comments

State of California Lab Certification No. 2501

All QC is compliant unless otherwise noted. Please refer to the Quality Control Summary for overall QC performance data and associated samples.

Laboratory Sample Analysis Record

CAT No.	Analysis Name	Method	Trial#	Batch#	Analysis Date and Time	Analyst	Dilution Factor
06610	TPH-DRO CA C10-C28 w/ Si Gel	SW-846 8015B	1	130510012A	02/28/2013 15:57	Christine E Dolman	1
11180	Low Vol Ext(W) w/SG	SW-846 3510C	1	130510012A	02/20/2013 21:00	Karen L Beyer	1

Sample Description: MW-5-W-130218 Grab Water
Facility# 206145 Job# 386492 GRD
800 Center St-Oakland T0600102230

LLI Sample # WW 6957461
LLI Group # 1369742
Account # 10904

Project Name: 206145

Collected: 02/18/2013 09:55 by JH Chevron
 Submitted: 02/19/2013 09:20 L4310
 Reported: 03/04/2013 21:13 6001 Bollinger Canyon Rd.
 San Ramon CA 94583

COMW5

CAT No.	Analysis Name	CAS Number	As Received Result	As Received Method Detection Limit	Dilution Factor
GC Volatiles SW-846 8015B ug/l					
01729	TPH-GRO N. CA water C6-C12	n.a.	N.D.	50	1
GC Volatiles SW-846 8021B ug/l					
02102	Benzene	71-43-2	N.D.	0.5	1
02102	Ethylbenzene	100-41-4	N.D.	0.5	1
02102	Methyl tert-Butyl Ether	1634-04-4	N.D.	2.5	1
02102	Toluene	108-88-3	N.D.	0.5	1
02102	Total Xylenes	1330-20-7	N.D.	1.5	1
GC Petroleum SW-846 8015B ug/l					
Hydrocarbons w/Si					
06610	TPH-DRO CA C10-C28 w/ Si Gel	n.a.	N.D.	50	1
The reverse surrogate, capric acid, is present at <1%.					

General Sample Comments

State of California Lab Certification No. 2501

All QC is compliant unless otherwise noted. Please refer to the Quality Control Summary for overall QC performance data and associated samples.

Laboratory Sample Analysis Record

CAT No.	Analysis Name	Method	Trial#	Batch#	Analysis Date and Time	Analyst	Dilution Factor
01729	TPH-GRO N. CA water C6-C12	SW-846 8015B	1	13058A94A	02/28/2013 15:00	Catherine J Schwarz	1
02102	Method 8021 Water Master	SW-846 8021B	1	13058A94A	02/28/2013 15:00	Catherine J Schwarz	1
01146	GC VOA Water Prep	SW-846 5030B	1	13058A94A	02/28/2013 15:00	Catherine J Schwarz	1
06610	TPH-DRO CA C10-C28 w/ Si Gel	SW-846 8015B	1	130510011A	02/27/2013 23:10	Christine E Dolman	1
11180	Low Vol Ext(W) w/SG	SW-846 3510C	1	130510011A	02/20/2013 21:00	Karen L Beyer	1

Sample Description: MW-5-W-130218 Grab Water
 Facility# 206145 Job# 386492 GRD
 800 Center St-Oakland T0600102230

LLI Sample # WW 6957462
 LLI Group # 1369742
 Account # 10904

Project Name: 206145

Collected: 02/18/2013 09:55 by JH Chevron
 Submitted: 02/19/2013 09:20 L4310
 Reported: 03/04/2013 21:13 6001 Bollinger Canyon Rd.
 San Ramon CA 94583

COM5Q

CAT No.	Analysis Name	CAS Number	As Received Result	As Received Method Detection Limit	Dilution Factor
	GC Petroleum Hydrocarbons w/Si	SW-846 8015B	ug/l	ug/l	
06610	TPH-DRO CA C10-C28 w/ Si Gel	n.a.	N.D.	50	1
Due to a laboratory error, only the Laboratory Control Spike was analyzed for quality control. Sufficient sample was not available to repeat the analysis.					

General Sample Comments

State of California Lab Certification No. 2501

All QC is compliant unless otherwise noted. Please refer to the Quality Control Summary for overall QC performance data and associated samples.

Laboratory Sample Analysis Record

CAT No.	Analysis Name	Method	Trial#	Batch#	Analysis Date and Time	Analyst	Dilution Factor
06610	TPH-DRO CA C10-C28 w/ Si Gel	SW-846 8015B	1	130510012A	02/28/2013 14:26	Christine E Dolman	1
11180	Low Vol Ext(W) w/SG	SW-846 3510C	1	130510012A	02/20/2013 21:00	Karen L Beyer	1

Sample Description: MW-6-W-130218 Grab Water
Facility# 206145 Job# 386492 GRD
800 Center St-Oakland T0600102230

LLI Sample # WW 6957463
LLI Group # 1369742
Account # 10904

Project Name: 206145

Collected: 02/18/2013 09:05 by JH Chevron
 Submitted: 02/19/2013 09:20 L4310
 Reported: 03/04/2013 21:13 6001 Bollinger Canyon Rd.
 San Ramon CA 94583

COMW6

CAT No.	Analysis Name	CAS Number	As Received Result	As Received Method Detection Limit	Dilution Factor
GC Volatiles SW-846 8015B ug/l					
01729	TPH-GRO N. CA water C6-C12	n.a.	N.D.	50	1
GC Volatiles SW-846 8021B ug/l					
02102	Benzene	71-43-2	N.D.	0.5	1
02102	Ethylbenzene	100-41-4	N.D.	0.5	1
02102	Methyl tert-Butyl Ether	1634-04-4	N.D.	2.5	1
02102	Toluene	108-88-3	N.D.	0.5	1
02102	Total Xylenes	1330-20-7	N.D.	1.5	1
GC Petroleum SW-846 8015B ug/l					
Hydrocarbons w/Si					
06610	TPH-DRO CA C10-C28 w/ Si Gel	n.a.	N.D.	50	1
The reverse surrogate, capric acid, is present at <1%.					

General Sample Comments

State of California Lab Certification No. 2501

All QC is compliant unless otherwise noted. Please refer to the Quality Control Summary for overall QC performance data and associated samples.

Laboratory Sample Analysis Record

CAT No.	Analysis Name	Method	Trial#	Batch#	Analysis Date and Time	Analyst	Dilution Factor
01729	TPH-GRO N. CA water C6-C12	SW-846 8015B	1	13058A94A	02/28/2013 15:25	Catherine J Schwarz	1
02102	Method 8021 Water Master	SW-846 8021B	1	13058A94A	02/28/2013 15:25	Catherine J Schwarz	1
01146	GC VOA Water Prep	SW-846 5030B	1	13058A94A	02/28/2013 15:25	Catherine J Schwarz	1
06610	TPH-DRO CA C10-C28 w/ Si Gel	SW-846 8015B	1	130510011A	02/27/2013 23:32	Christine E Dolman	1
11180	Low Vol Ext(W) w/SG	SW-846 3510C	1	130510011A	02/20/2013 21:00	Karen L Beyer	1

Sample Description: MW-6-W-130218 Grab Water
 Facility# 206145 Job# 386492 GRD
 800 Center St-Oakland T0600102230

LLI Sample # WW 6957464
 LLI Group # 1369742
 Account # 10904

Project Name: 206145

Collected: 02/18/2013 09:05 by JH Chevron
 Submitted: 02/19/2013 09:20 L4310
 Reported: 03/04/2013 21:13 6001 Bollinger Canyon Rd.
 San Ramon CA 94583

COM6Q

CAT No.	Analysis Name	CAS Number	As Received Result	As Received Method Detection Limit	Dilution Factor
	GC Petroleum Hydrocarbons w/Si	SW-846 8015B	ug/l	ug/l	
06610	TPH-DRO CA C10-C28 w/ Si Gel	n.a.	N.D.	50	1
Due to a laboratory error, only the Laboratory Control Spike was analyzed for quality control. Sufficient sample was not available to repeat the analysis.					

General Sample Comments

State of California Lab Certification No. 2501

All QC is compliant unless otherwise noted. Please refer to the Quality Control Summary for overall QC performance data and associated samples.

Laboratory Sample Analysis Record

CAT No.	Analysis Name	Method	Trial#	Batch#	Analysis Date and Time	Analyst	Dilution Factor
06610	TPH-DRO CA C10-C28 w/ Si Gel	SW-846 8015B	1	130510012A	02/28/2013 14:49	Christine E Dolman	1
11180	Low Vol Ext(W) w/SG	SW-846 3510C	1	130510012A	02/20/2013 21:00	Karen L Beyer	1

Sample Description: MW-7-W-130218 Grab Water
Facility# 206145 Job# 386492 GRD
800 Center St-Oakland T0600102230

LLI Sample # WW 6957465
LLI Group # 1369742
Account # 10904

Project Name: 206145

Collected: 02/18/2013 14:00 by JH Chevron
 Submitted: 02/19/2013 09:20 L4310
 Reported: 03/04/2013 21:13 6001 Bollinger Canyon Rd.
 San Ramon CA 94583

COMW7

CAT No.	Analysis Name	CAS Number	As Received Result	As Received Method Detection Limit	Dilution Factor
GC Volatiles SW-846 8015B ug/l					
01729	TPH-GRO N. CA water C6-C12	n.a.	N.D.	50	1
GC Volatiles SW-846 8021B ug/l					
02102	Benzene	71-43-2	N.D.	0.5	1
02102	Ethylbenzene	100-41-4	N.D.	0.5	1
02102	Methyl tert-Butyl Ether	1634-04-4	N.D.	2.5	1
02102	Toluene	108-88-3	N.D.	0.5	1
02102	Total Xylenes	1330-20-7	N.D.	1.5	1
GC Petroleum SW-846 8015B ug/l					
Hydrocarbons w/Si					
06610	TPH-DRO CA C10-C28 w/ Si Gel	n.a.	130	50	1
The reverse surrogate, capric acid, is present at <1%.					

General Sample Comments

State of California Lab Certification No. 2501

All QC is compliant unless otherwise noted. Please refer to the Quality Control Summary for overall QC performance data and associated samples.

Laboratory Sample Analysis Record

CAT No.	Analysis Name	Method	Trial#	Batch#	Analysis Date and Time	Analyst	Dilution Factor
01729	TPH-GRO N. CA water C6-C12	SW-846 8015B	1	13058A94A	02/28/2013 15:50	Catherine J Schwarz	1
02102	Method 8021 Water Master	SW-846 8021B	1	13058A94A	02/28/2013 15:50	Catherine J Schwarz	1
01146	GC VOA Water Prep	SW-846 5030B	1	13058A94A	02/28/2013 15:50	Catherine J Schwarz	1
06610	TPH-DRO CA C10-C28 w/ Si Gel	SW-846 8015B	1	130510011A	02/28/2013 09:37	Elizabeth J Marin	1
11180	Low Vol Ext(W) w/SG	SW-846 3510C	1	130510011A	02/20/2013 21:00	Karen L Beyer	1

Sample Description: MW-7-W-130218 Grab Water
 Facility# 206145 Job# 386492 GRD
 800 Center St-Oakland T0600102230

LLI Sample # WW 6957466
 LLI Group # 1369742
 Account # 10904

Project Name: 206145

Collected: 02/18/2013 14:00 by JH Chevron
 Submitted: 02/19/2013 09:20 L4310
 Reported: 03/04/2013 21:13 6001 Bollinger Canyon Rd.
 San Ramon CA 94583

COM7Q

CAT No.	Analysis Name	CAS Number	As Received Result	As Received Method Detection Limit	Dilution Factor
GC Petroleum Hydrocarbons w/Si					
		SW-846 8015B	ug/l	ug/l	
06610	TPH-DRO CA C10-C28 w/ Si Gel	n.a.	520	50	1
Due to a laboratory error, only the Laboratory Control Spike was analyzed for quality control. Sufficient sample was not available to repeat the analysis.					

General Sample Comments

State of California Lab Certification No. 2501

All QC is compliant unless otherwise noted. Please refer to the Quality Control Summary for overall QC performance data and associated samples.

Laboratory Sample Analysis Record

CAT No.	Analysis Name	Method	Trial#	Batch#	Analysis Date and Time	Analyst	Dilution Factor
06610	TPH-DRO CA C10-C28 w/ Si Gel	SW-846 8015B	1	130510012A	02/28/2013 16:20	Christine E Dolman	1
11180	Low Vol Ext(W) w/SG	SW-846 3510C	1	130510012A	02/20/2013 21:00	Karen L Beyer	1

Sample Description: MW-8-W-130218 Grab Water
Facility# 206145 Job# 386492 GRD
800 Center St-Oakland T0600102230

LLI Sample # WW 6957467
LLI Group # 1369742
Account # 10904

Project Name: 206145

Collected: 02/18/2013 08:20 by JH Chevron
 Submitted: 02/19/2013 09:20 L4310
 Reported: 03/04/2013 21:13 6001 Bollinger Canyon Rd.
 San Ramon CA 94583

COMW8

CAT No.	Analysis Name	CAS Number	As Received Result	As Received Method Detection Limit	Dilution Factor
GC Volatiles SW-846 8015B ug/l					
01729	TPH-GRO N. CA water C6-C12	n.a.	N.D.	50	1
GC Volatiles SW-846 8021B ug/l					
02102	Benzene	71-43-2	N.D.	0.5	1
02102	Ethylbenzene	100-41-4	N.D.	0.5	1
02102	Methyl tert-Butyl Ether	1634-04-4	N.D.	2.5	1
02102	Toluene	108-88-3	N.D.	0.5	1
02102	Total Xylenes	1330-20-7	N.D.	1.5	1
GC Petroleum SW-846 8015B ug/l					
Hydrocarbons w/Si					
06610	TPH-DRO CA C10-C28 w/ Si Gel	n.a.	N.D.	50	1
The reverse surrogate, capric acid, is present at <1%.					

General Sample Comments

State of California Lab Certification No. 2501

All QC is compliant unless otherwise noted. Please refer to the Quality Control Summary for overall QC performance data and associated samples.

Laboratory Sample Analysis Record

CAT No.	Analysis Name	Method	Trial#	Batch#	Analysis Date and Time	Analyst	Dilution Factor
01729	TPH-GRO N. CA water C6-C12	SW-846 8015B	1	13058A94A	02/28/2013 16:16	Catherine J Schwarz	1
02102	Method 8021 Water Master	SW-846 8021B	1	13058A94A	02/28/2013 16:16	Catherine J Schwarz	1
01146	GC VOA Water Prep	SW-846 5030B	1	13058A94A	02/28/2013 16:16	Catherine J Schwarz	1
06610	TPH-DRO CA C10-C28 w/ Si Gel	SW-846 8015B	1	130510011A	02/28/2013 00:17	Christine E Dolman	1
11180	Low Vol Ext(W) w/SG	SW-846 3510C	1	130510011A	02/20/2013 21:00	Karen L Beyer	1

Sample Description: MW-8-W-130218 Grab Water
 Facility# 206145 Job# 386492 GRD
 800 Center St-Oakland T0600102230

LLI Sample # WW 6957468
 LLI Group # 1369742
 Account # 10904

Project Name: 206145

Collected: 02/18/2013 08:20 by JH Chevron
 L4310
 Submitted: 02/19/2013 09:20 6001 Bollinger Canyon Rd.
 Reported: 03/04/2013 21:13 San Ramon CA 94583

COM8Q

CAT No.	Analysis Name	CAS Number	As Received Result	As Received Method Detection Limit	Dilution Factor
GC Petroleum Hydrocarbons w/Si					
		SW-846 8015B	ug/l	ug/l	
06610	TPH-DRO CA C10-C28 w/ Si Gel	n.a.	N.D.	50	1
Due to a laboratory error, only the Laboratory Control Spike was analyzed for quality control. Sufficient sample was not available to repeat the analysis.					

General Sample Comments

State of California Lab Certification No. 2501

All QC is compliant unless otherwise noted. Please refer to the Quality Control Summary for overall QC performance data and associated samples.

Laboratory Sample Analysis Record

CAT No.	Analysis Name	Method	Trial#	Batch#	Analysis Date and Time	Analyst	Dilution Factor
06610	TPH-DRO CA C10-C28 w/ Si Gel	SW-846 8015B	1	130510012A	02/28/2013 15:12	Christine E Dolman	1
11180	Low Vol Ext(W) w/SG	SW-846 3510C	1	130510012A	02/20/2013 21:00	Karen L Beyer	1

Quality Control Summary

Client Name: Chevron Group Number: 1369742
Reported: 03/04/13 at 09:13 PM

Matrix QC may not be reported if insufficient sample or site-specific QC samples were not submitted. In these situations, to demonstrate precision and accuracy at a batch level, a LCS/LCSD was performed, unless otherwise specified in the method.

All Inorganic Initial Calibration and Continuing Calibration Blanks met acceptable method criteria unless otherwise noted on the Analysis Report.

Laboratory Compliance Quality Control

<u>Analysis Name</u>	<u>Blank Result</u>	<u>Blank MDL</u>	<u>Report Units</u>	<u>LCS %REC</u>	<u>LCSD %REC</u>	<u>LCS/LCSD Limits</u>	<u>RPD</u>	<u>RPD Max</u>
Batch number: 13058A94A	Sample number(s): 6957452-6957453,6957455,6957457,6957459,6957461,6957463,6957465,6957467							
Benzene	N.D.	0.5	ug/l	102	103	80-120	1	30
Ethylbenzene	N.D.	0.5	ug/l	100	101	80-120	1	30
Methyl tert-Butyl Ether	N.D.	2.5	ug/l	109	106	59-136	3	30
Toluene	N.D.	0.5	ug/l	101	102	80-120	1	30
TPH-GRO N. CA water C6-C12	N.D.	50.	ug/l	106	107	75-135	0	30
Total Xylenes	N.D.	1.5	ug/l	101	102	80-120	1	30
Batch number: 130510011A	Sample number(s): 6957453,6957455,6957457,6957459,6957461,6957463,6957465,6957467							
TPH-DRO CA C10-C28 w/ Si Gel	N.D.	32.	ug/l	69	78	50-118	12	20
Batch number: 130510012A	Sample number(s): 6957454,6957456,6957458,6957460,6957462,6957464,6957466,6957468							
TPH-DRO CA C10-C28 w/ Si Gel	46	32.	ug/l	85		50-118		

Surrogate Quality Control

Surrogate recoveries which are outside of the QC window are confirmed unless attributed to dilution or otherwise noted on the Analysis Report.

Analysis Name: TPH-GRO N. CA water C6-C12
Batch number: 13058A94A

	Trifluorotoluene-F	Trifluorotoluene-P
6957452	73	90
6957453	81	91
6957455	77	91
6957457	112	115
6957459	73	90
6957461	73	91
6957463	80	90
6957465	86	90
6957467	73	90
Blank	74	90
LCS	87	89
LCSD	89	89

*- Outside of specification

- (1) The result for one or both determinations was less than five times the LOQ.
- (2) The unspiked result was more than four times the spike added.

Quality Control Summary

Client Name: Chevron
Reported: 03/04/13 at 09:13 PM

Group Number: 1369742

Surrogate Quality Control

Limits: 63-135 51-120

Analysis Name: TPH-DRO CA C10-C28 w/ Si Gel
Batch number: 130510011A
Orthoterphenyl

6957453	101
6957455	85
6957457	79
6957459	81
6957461	100
6957463	81
6957465	79
6957467	94
Blank	74
LCS	82
LCSD	85

Limits: 50-154

Analysis Name: TPH-DRO CA C10-C28 w/ Si Gel
Batch number: 130510012A
Orthoterphenyl

6957454	105
6957456	106
6957458	102
6957460	95
6957462	99
6957464	88
6957466	87
6957468	98
Blank	93
LCS	112

Limits: 50-154

*- Outside of specification

- (1) The result for one or both determinations was less than five times the LOQ.
- (2) The unspiked result was more than four times the spike added.

Explanation of Symbols and Abbreviations

The following defines common symbols and abbreviations used in reporting technical data:

RL	Reporting Limit	BMQL	Below Minimum Quantitation Level
N.D.	none detected	MPN	Most Probable Number
TNTC	Too Numerous To Count	CP Units	cobalt-chloroplatinate units
IU	International Units	NTU	nephelometric turbidity units
umhos/cm	micromhos/cm	ng	nanogram(s)
C	degrees Celsius	F	degrees Fahrenheit
meq	milliequivalents	lb.	pound(s)
g	gram(s)	kg	kilogram(s)
µg	microgram(s)	mg	milligram(s)
mL	milliliter(s)	L	liter(s)
m³	cubic meter(s)	µL	microliter(s)
		pg/L	picogram/liter
<	less than - The number following the sign is the <u>limit of quantitation</u> , the smallest amount of analyte which can be reliably determined using this specific test.		
>	greater than		
J	estimated value – The result is ≥ the Method Detection Limit (MDL) and < the Limit of Quantitation (LOQ).		
ppm	parts per million - One ppm is equivalent to one milligram per kilogram (mg/kg), or one gram per million grams. For aqueous liquids, ppm is usually taken to be equivalent to milligrams per liter (mg/l), because one liter of water has a weight very close to a kilogram. For gases or vapors, one ppm is equivalent to one microliter of gas per liter of gas.		
ppb	parts per billion		
Dry weight basis	Results printed under this heading have been adjusted for moisture content. This increases the analyte weight concentration to approximate the value present in a similar sample without moisture. All other results are reported on an as-received basis.		

U.S. EPA CLP Data Qualifiers:

Organic Qualifiers	Inorganic Qualifiers
A TIC is a possible aldol-condensation product	B Value is <CRDL, but ≥IDL
B Analyte was also detected in the blank	E Estimated due to interference
C Pesticide result confirmed by GC/MS	M Duplicate injection precision not met
D Compound quantitated on a diluted sample	N Spike sample not within control limits
E Concentration exceeds the calibration range of the instrument	S Method of standard additions (MSA) used for calculation
N Presumptive evidence of a compound (TICs only)	U Compound was not detected
P Concentration difference between primary and confirmation columns >25%	W Post digestion spike out of control limits
U Compound was not detected	* Duplicate analysis not within control limits
X,Y,Z Defined in case narrative	+ Correlation coefficient for MSA <0.995

Analytical test results meet all requirements of NELAC unless otherwise noted under the individual analysis.

Measurement uncertainty values, as applicable, are available upon request.

Tests results relate only to the sample tested. Clients should be aware that a critical step in a chemical or microbiological analysis is the collection of the sample. Unless the sample analyzed is truly representative of the bulk of material involved, the test results will be meaningless. If you have questions regarding the proper techniques of collecting samples, please contact us. We cannot be held responsible for sample integrity, however, unless sampling has been performed by a member of our staff. This report shall not be reproduced except in full, without the written approval of the laboratory.

Times are local to the area of activity. Parameters listed in the 40 CFR part 136 Table II as “analyze immediately” are not performed within 15 minutes.

WARRANTY AND LIMITS OF LIABILITY - In accepting analytical work, we warrant the accuracy of test results for the sample as submitted. THE FOREGOING EXPRESS WARRANTY IS EXCLUSIVE AND IS GIVEN IN LIEU OF ALL OTHER WARRANTIES, EXPRESSED OR IMPLIED. WE DISCLAIM ANY OTHER WARRANTIES, EXPRESSED OR IMPLIED, INCLUDING A WARRANTY OF FITNESS FOR PARTICULAR PURPOSE AND WARRANTY OF MERCHANTABILITY. IN NO EVENT SHALL LANCASTER LABORATORIES BE LIABLE FOR INDIRECT, SPECIAL, CONSEQUENTIAL, OR INCIDENTAL DAMAGES INCLUDING, BUT NOT LIMITED TO, DAMAGES FOR LOSS OF PROFIT OR GOODWILL REGARDLESS OF (A) THE NEGLIGENCE (EITHER SOLE OR CONCURRENT) OF LANCASTER LABORATORIES AND (B) WHETHER LANCASTER LABORATORIES HAS BEEN INFORMED OF THE POSSIBILITY OF SUCH DAMAGES. We accept no legal responsibility for the purposes for which the client uses the test results. No purchase order or other order for work shall be accepted by Lancaster Laboratories which includes any conditions that vary from the Standard Terms and Conditions, and Lancaster hereby objects to any conflicting terms contained in any acceptance or order submitted by client.

ATTACHMENT C

HISTORICAL GROUNDWATER MONITORING AND SAMPLING DATA

Table 1
Groundwater Monitoring Data and Analytical Results
Former Chevron (Signal Oil) Service Station #206145 (S-800)
800 Center Street
Oakland, California

WELL ID/ DATE	TOC* (ft.)	GWE (msl)	DTW (ft.)	TPH-DRO (µg/L)	TPH-GRO (µg/L)	B (µg/L)	T (µg/L)	E (µg/L)	X (µg/L)	MTBE (µg/L)	CUB (cfu/m)
MW-1A											
02/24-25/03 ¹	15.49	8.17	7.32	4,600	5,100	92	340	66	480	<10	--
06/02/03	15.49	7.15	8.34	5,500	3,800	150	490	72	450	<13	--
09/02/03	15.49	6.10	9.39	10,000	6,200	100	580	110	760	47	--
11/21/03	15.49	5.29	10.20	3,800	3,200	29	150	49	240	<10	--
02/27/04	15.49	9.87	5.62	2,800	280	9.7	19	3.0	30	<2.5	--
05/28/04	15.49	6.88	8.61	5,500	1,100	35	81	27	140	17	--
08/31/04	15.49	5.58	9.91	4,500	1,100	13	68	27	110	<2.5	--
12/17/04	15.49	7.09	8.40	2,300 ^o	560	8.0	17	9.6	36	<2.5	--
03/28/05	15.49	10.36	5.13	340 ^o	87	16	4.2	3.3	11	<2.5	--
06/09/05	15.49	9.69	5.80	6,400 ^o	260	26	3.7	7.7	13	5.3	--
08/19/05	15.49	6.70	8.79	1,100 ^{o,p,q}	440	38	7.8	9.4	17	<2.5	--
11/18/05	15.49	6.25	9.24	1,300 ^{o,q}	450	11	12	17	22	<2.5	--
03/07/06	15.49	10.51	4.98	2,300 ^o	150	33	1.6	3.4	2.7	<2.5	--
05/17/06	15.49	9.02	6.47	2,600 ^o	110	18	<0.5	0.7	<1.5	<2.5	--
08/30/06	15.49	5.68	9.81	3,600 ^o	420	24	0.7	8.1	9.2	<10	--
11/28/06	15.49	5.79	9.70	2,900 ^o	220	8.6	2.7	6.1	9.3	<2.5	--
02/06/07	18.11	8.83	9.28	1,500 ^o	230	19	<0.5	1.8	2.7	<2.5	--
05/02/07	18.11	9.83	8.28	1,300 ^o	190	16	<0.5	1	1.8	<2.5	--
08/17/07	18.11	8.61	9.50	1,100 ^o	160	2.5	0.8	2.0	2.7	<2.5	--
11/16/07 ^v	18.11	8.27	9.84	3,600 ^o	30,000	610	1,100	4,100	2,800	310	--
02/05/08	18.11	11.63	6.48	2,100 ^o	63	4.8	<0.5	<0.5	<1.5	<2.5	--
05/20/08	18.11	9.18	8.93	940 ^o	50	1.5	<0.5	<0.5	<1.5	<2.5	--
08/06/08	18.11	8.25	9.86	1,900 ^o	98	0.7	<0.5	<0.5	<1.5	<2.5	--
12/05/08	18.11	7.68	10.43	940 ^o	96	0.6	<0.5	0.5	<1.5	<2.5	--
02/09/09	18.11	8.10	10.01	630 ^o	130	2.7	<0.5	2.1	<1.5	<2.5	--
05/08/09	18.11	9.91	8.20	1,300 ^o	<50	<0.5	<0.5	<0.5	<1.5	<2.5	--
08/07/09	18.11	8.35	9.76	1,300 ^o	97	<0.5	<0.5	<0.5	<1.5	<2.5	--
02/25/10	18.11	11.03	7.08	500^{o,z}	<50	<0.5	<0.5	<0.5	<1.5	<2.5	--
MW-2											
10/27/95	15.77	10.60	5.17	--	<50	<0.5	<0.5	<0.5	<0.5	--	--
02/20/97	15.72	8.51	7.21	--	<50	<0.5	<0.5	<0.5	<0.5	<2.5	--
04/24/97	15.72	7.82	7.90	--	83 ^d	<0.5	<0.5	<0.5	<0.5	<2.5	--
07/23/97	15.72	5.92	9.80	--	<50	<0.5	<0.5	<0.5	<0.5	<2.5	--
10/29/97	15.72	5.13	10.59	--	<50	<0.5	<0.5	<0.5	<0.5	<2.5	--
01/28/98	15.72	9.21	6.51	--	<50	<0.5	<0.5	<0.5	<0.5	<2.5	--

Table 1
Groundwater Monitoring Data and Analytical Results
Former Chevron (Signal Oil) Service Station #206145 (S-800)
800 Center Street
Oakland, California

WELL ID/ DATE	TOC* (ft.)	GWE (msl)	DTW (ft.)	TPH-DRO (µg/L)	TPH-GRO (µg/L)	B (µg/L)	T (µg/L)	E (µg/L)	X (µg/L)	MTBE (µg/L)	CUB (cfu/m)
MW-2 (cont)											
05/11/98	15.72	8.82	6.90	SAMPLED ANNUALLY		--	--	--	--	--	--
07/16/98	15.72	7.37	8.35	--	--	--	--	--	--	--	--
08/04/98 ^a	15.72	7.03	8.69	--	--	--	--	--	--	--	1.9 x 1
09/03/98 ^a	15.72	6.44	9.28	--	--	--	--	--	--	--	3.0 x 1
10/21/98 ^b	15.72	5.51	10.21	--	--	--	--	--	--	--	8.8 x 1
11/04/98	15.72	5.60	10.12	--	--	--	--	--	--	--	--
01/26/99	15.72	6.87	8.85	--	<50	<0.5	<0.5	<0.5	<0.5	<2.0	--
05/06/99	15.72	8.20	7.52	--	--	--	--	--	--	--	--
08/21/99	15.72	13.21	2.51	--	--	--	--	--	--	--	--
10/28/99	15.72	6.35	9.37	--	--	--	--	--	--	--	--
01/31/00	15.72	7.25	8.47	--	<50	<0.5	0.541	<0.5	<0.5	<2.5	--
05/19/00	15.72	7.65	8.07	--	--	--	--	--	--	--	--
08/07/00	15.72	6.35	9.37	--	<50	<0.50	<0.50	<0.50	<0.50	<2.5/ ^f <2.0 ^f	--
12/01/00	15.72	5.60	10.12	--	<50.0	<0.500	<0.500	<0.500	<0.500	<2.50	--
02/09/01	15.72	6.05	9.67	--	<50	<0.50	<0.50	<0.50	<0.50	<2.5	--
05/29/01	15.72	6.73	8.99	--	<50	<0.50	<0.50	<0.50	<0.50	<2.5	--
08/27/01 ^h	15.72	5.68	10.04	--	<50	<0.50	<0.50	<0.50	<0.50	<5.0 ^f	--
11/28/01	15.72	5.86	9.86	NOT SAMPLED DUE TO INSUFFICIENT WATER				--	--	--	--
02/14/02	15.69	7.86	7.83	--	<50	<0.50	<0.50	<0.50	<1.5	<2.5	--
05/15/02	15.69	7.09	8.60	--	<50	<0.50	<0.50	<0.50	<1.5	<2.5	--
08/05/02	15.69	6.02	9.67	--	<50	<0.50	<0.50	<0.50	<1.5	<2.5	--
11/30/02	15.69	DRY	--	--	--	--	--	--	--	--	--
02/24-25/03 ^l	15.69	8.04	7.65	140	<50	<0.50	<0.50	<0.50	<1.5	<2.5	--
06/02/03	15.69	7.33	8.36	150 ^m	<50	<0.5	<0.5	<0.5	<1.5	<2.5	--
09/02/03	15.69	5.97	9.72	150 ^m	<50	<0.5	<0.5	<0.5	<1.5	<2.5	--
11/21/03	-- ⁿ	-- ⁿ	10.39	180	<50	<0.5	<0.5	<0.5	<1.5	<2.5	--
02/27/04	-- ⁿ	-- ⁿ	6.90	310	<50	<0.5	<0.5	<0.5	<1.5	<2.5	--
05/28/04	-- ⁿ	-- ⁿ	9.13	160	<50	<0.5	<0.5	<0.5	<1.5	<2.5	--
08/31/04	-- ⁿ	-- ⁿ	10.30	180 ^m	<50	<0.5	<0.5	<0.5	<1.5	<2.5	--
12/17/04	-- ⁿ	-- ⁿ	8.91	77 ^o	<50	<0.5	<0.5	<0.5	<1.5	<2.5	--
03/28/05	-- ⁿ	-- ⁿ	6.51	<50 ^o	<50	<0.5	0.5	<0.5	<1.5	<2.5	--
06/09/05	-- ⁿ	-- ⁿ	7.09	53 ^o	<50	<0.5	<0.5	<0.5	<1.5	<2.5	--
08/19/05	-- ⁿ	-- ⁿ	9.27	<50 ^{o,p}	<50	<0.5	<0.5	<0.5	<1.5	<2.5	--
11/18/05	-- ⁿ	-- ⁿ	9.66	<50 ^o	<50	<0.5	<0.5	<0.5	<1.5	<2.5	--
03/07/06	-- ⁿ	-- ⁿ	6.75	<50 ^o	<50	<0.5	<0.5	<0.5	<1.5	<2.5	--
05/17/06	-- ⁿ	-- ⁿ	7.09	<50 ^o	<50	<0.5	<0.5	<0.5	<1.5	<2.5	--
08/30/06	-- ⁿ	-- ⁿ	9.03	640 ^o	<50	<0.5	<0.5	<0.5	<1.5	<2.5	--

Table 1
Groundwater Monitoring Data and Analytical Results
Former Chevron (Signal Oil) Service Station #206145 (S-800)
800 Center Street
Oakland, California

WELL ID/ DATE	TOC* (ft.)	GWE (msl)	DTW (ft.)	TPH-DRO (µg/L)	TPH-GRO (µg/L)	B (µg/L)	T (µg/L)	E (µg/L)	X (µg/L)	MTBE (µg/L)	CUB (cfu/m)	
MW-2 (cont)												
11/28/06	-- ⁿ	-- ⁿ	10.02	560 ^o	<50	<0.5	<0.5	<0.5	<1.5	<2.5	--	
02/06/07	18.40	8.72	9.68	200 ^o	<50	<0.5	<0.5	<0.5	<1.5	<2.5	--	
05/02/07	18.40	9.71	8.69	480 ^o	<50	<0.5	<0.5	<0.5	<1.5	<2.5	--	
08/17/07	18.40	8.52	9.88	1,000 ^o	<50	<0.5	<0.5	<0.5	<1.5	<2.5	--	
11/16/07	18.40	8.30	10.10	1,900 ^o	<50	<0.5	<0.5	<0.5	<1.5	<2.5	--	
02/05/08	18.40	10.97	7.43	1,100 ^o	<50	<0.5	<0.5	<0.5	<1.5	<2.5	--	
05/20/08	18.40	9.09	9.31	650 ^o	<50	<0.5	<0.5	<0.5	<1.5	<2.5	--	
08/06/08	18.40	8.25	10.15	200 ^o	<50	<0.5	<0.5	<0.5	<1.5	<2.5	--	
12/05/08	18.40	7.12	11.28	680 ^o	<50	<0.5	<0.5	<0.5	<1.5	<2.5	--	
02/09/09	18.40	8.08	10.32	420 ^o	<50	<0.5	<0.5	<0.5	<1.5	<2.5	--	
05/08/09	18.40	9.98	8.42	75 ^o	<50	<0.5	<0.5	<0.5	<1.5	<2.5	--	
08/07/09	18.40	8.23	10.17	610 ^o	<50	<0.5	<0.5	<0.5	<1.5	<2.5	--	
02/25/10	18.40	10.54	7.86	120^{o,z}	<50^{aa}	<0.5	<0.5	<0.5	<1.5	<2.5	--	
MW-3												
10/27/95	15.46	10.37	5.09	--	33,000	11,000	1,700	2,300	4,200	--	--	
02/20/97	15.42	8.37	7.05	--	260	56	<1.0	7.6	5.9	<5.0	--	
04/24/97	15.42	7.29	8.13	--	1,400	310	28	76	75	74	--	
07/23/97	15.42	5.84	9.58	--	37,000	10,000	1,500	2,700	4,200	2,500	--	
10/29/97	15.42	5.09	10.33	--	53,000	12,000	1,200	3,000	3,100	2,500	--	
01/28/98	15.42	8.94	6.48	--	210	43	1.5	1.7	3.9	10	--	
05/11/98	15.42	8.49	6.93	--	59	11	<0.5	2.1	<0.5	<2.5	--	
07/16/98	15.42	7.14	8.28	--	260	90	4.8	18	5.7	<10	--	
08/04/98 ^a	15.42	6.88	8.54	--	--	--	--	--	--	--	8.5 x 1	
09/03/98 ^a	15.42	6.34	9.08	--	--	--	--	--	--	--	2.4 x 1	
10/21/98 ^b	15.42	5.62	9.80	--	--	--	--	--	--	--	6.0 x 1	
11/04/98	15.42	5.60	9.82	--	73,000	17,000	3,800	4,900	8,100	<250	--	
01/26/99	15.42	6.70	8.72	--	32,400	10,200	1,850	2,650	3,140	715/<500 ^c	--	
05/06/99	15.42	7.97	7.45	--	3,160	668	89.6	180	123	<200/<10 ^c	--	
08/21/99	15.42	7.95	7.47	--	53,800	9,700	2,040	2,880	5,000	<1,250/<40 ^c	--	
10/28/99	15.42	5.37	10.05	--	71,300	14,000	3,420	4,320	8,360	<1,000	--	
01/31/00	15.42	7.16	8.26	--	1,650	496	49.1	134	82.6	<12.5	--	
05/19/00	15.42	7.60	7.82	--	110 ^e	36	2.5	9.1	4.0	6.3	--	
08/07/00	15.42	6.29	9.13	--	36,000 ^e	9,000	3,000	2,700	2,800	2,500/<10 ^f	--	
12/01/00	15.42	2.45	12.97	NOT SAMPLED DUE TO INSUFFICIENT WATER				--	--	--	--	--
02/09/01	15.42	5.98	9.44	--	32,000 ^e	11,000	3,900	3,200	4,800	3,200/<2.0 ^f	--	

Table 1
Groundwater Monitoring Data and Analytical Results
Former Chevron (Signal Oil) Service Station #206145 (S-800)
800 Center Street
Oakland, California

WELL ID/ DATE	TOC* (ft.)	GWE (msl)	DTW (ft.)	TPH-DRO (µg/L)	TPH-GRO (µg/L)	B (µg/L)	T (µg/L)	E (µg/L)	X (µg/L)	MTBE (µg/L)	CUB (cfu/m)
MW-3 (cont)											
05/29/01	15.42	6.65	8.77	--	13,000	4,200	2,000	1,800	1,500	74/<2.0 ^f	--
08/27/01 ^h	15.42	5.70	9.72	--	40,000	7,600	2,800	2,500	2,700	<25 ^f	--
11/28/01	15.42	5.77	9.65	--	57,000	10,000	2,900	2,900	2,800	<250/<5.0 ^f	--
02/14/02	15.40	7.73	7.67	--	51	2.9	<0.50	1.9	1.8	<2.5/<2 ^f	--
05/15/02	15.40	7.05	8.35	--	4,100	910	250	210	240	<20/<2 ^f	--
08/05/02	15.40	5.96	9.44	--	58,000	11,000	4,300	3,400	4,000	<250/<10 ^f	--
11/30/02	15.40	5.14	10.26	--	46,000	13,000	2,900	3,700	2,600	<100/<10 ^f	--
02/24-25/03 ^l	15.40	7.89	7.51	4,500	52,000	9,600	4,800	2,900	4,100	<130	--
06/02/03	15.40	7.24	8.16	6,500	67,000	11,000	9,600	3,400	5,700	<250	--
09/02/03	15.40	5.89	9.51	10,000	73,000	8,900	10,000	3,600	7,000	300	--
11/21/03	15.40	5.17	10.23	8,000	29,000	3,300	3,200	1,200	1,500	<200	--
02/27/04	15.40	8.84	6.56	200	59	8.2	6.3	1.7	6.8	<2.5	--
05/28/04	15.40	6.57	8.83	5,400	18,000	2,600	970	1,600	950	<100	--
08/31/04	15.40	5.41	9.99	9,100	58,000	3,200	9,600	2,800	7,500	<50	--
12/17/04	15.40	6.81	8.59	2,200 ^o	23,000	1,100	2,100	1,200	2,600	<25	--
03/28/05	15.40	9.29	6.11	3,200 ^o	43,000	1,500	10,000	2,600	7,300	<130	--
06/09/05	15.40	8.65	6.75	7,800 ^o	38,000	980	7,000	2,100	4,800	190	--
08/19/05	15.40	6.43	8.97	5,000 ^{o-p,f}	75,000	1,500	14,000	3,400	9,600	<130	--
11/18/05	15.40	5.95	9.45	3,900 ^{o,f}	72,000	1,400	14,000	3,600	9,700	380	--
03/07/06	15.40	9.05	6.35	1,100 ^o	15,000	280	2,300	820	2,000	<100	--
05/17/06	15.40	8.57	6.83	4,400 ^o	57,000	650	8,100	2,900	8,100	410	--
08/30/06	15.40	5.44	9.96	4,300 ^o	54,000	540	7,600	4,100	10,000	550	--
11/28/06	15.40	5.62	9.78	4,400 ^o	43,000	260	3,400	3,800	5,800	<1,000	--
02/06/07	18.07	8.70	9.37	5,000 ^o	43,000	290	6,200	3,400	6,400	<500	--
05/02/07	18.07	9.67	8.40	4,500 ^o	43,000	290	4,100	3,800	6,500	<500	--
08/17/07	18.07	8.50	9.57	4,900 ^o	46,000	240	1,900	3,800	5,600	310	--
11/16/07 ^v	18.07	8.29	9.78	860 ^o	450	34	23	53	25	4.1	--
02/05/08	18.07	10.97	7.10	2,400 ^o	18,000	210	950	1,800	1,700	<500	--
05/20/08	18.07	8.99	9.08	6,900 ^o	45,000	190	4,900	2,800	6,200	<500 ^w	--
08/06/08	18.07	8.26	9.81	5,000 ^o	40,000	220	1,500	3,200	6,500	<500 ^w	--
12/05/08	18.07	7.56	10.51	4,000 ^o	15,000	26	590	1,800	1,800	230	--
02/09/09	18.07	8.02	10.05	2,800 ^o	20,000	170	710	1,800	2,500	<400 ^w	--
05/08/09	18.07	9.95	8.12	2,900 ^o	15,000	88	900	2,100	1,400	<250 ^w	--
08/07/09	18.07	8.20	9.87	2,900 ^o	41,000	150	2,400	3,800	6,700	<500 ^w	--
02/25/10	18.07	10.57	7.50	1,800^o	15,000	42	320	1,600	1,100	330	--

Table 1
Groundwater Monitoring Data and Analytical Results
Former Chevron (Signal Oil) Service Station #206145 (S-800)
800 Center Street
Oakland, California

WELL ID/ DATE	TOC* (ft.)	GWE (msl)	DTW (ft.)	TPH-DRO (µg/L)	TPH-GRO (µg/L)	B (µg/L)	T (µg/L)	E (µg/L)	X (µg/L)	MTBE (µg/L)	CUB (cfu/m)
MW-4											
10/27/95	14.45	9.37	5.08	--	66	6.8	<0.5	<0.5	<0.5	--	--
02/20/97	14.40	8.12	6.28	--	54	<0.5	<0.5	<0.5	7.4	39	--
04/24/97	14.40	7.29	7.11	--	54	1.4	<0.5	0.65	3.0	100	--
07/23/97	14.40	5.80	8.60	--	<50	<0.5	<0.5	<0.5	<0.5	<2.5	--
10/29/97	14.40	5.74	8.66	--	--	--	--	--	--	--	--
11/13/97	14.40	4.97	9.43	--	<50	<0.5	0.79	<0.5	<0.5	<2.5	--
01/28/98	14.40	8.88	5.52	--	<50	<0.5	<0.5	<0.5	<0.5	<2.5	--
05/11/98	14.40	8.40	6.00	SAMPLED SEMI-ANNUALLY			--	--	--	--	--
07/16/98	14.40	7.08	7.32	--	<50	<0.5	<0.5	<0.5	<0.5	<5.0	--
08/04/98 ^a	14.40	6.28	8.12	--	--	--	--	--	--	--	1.8 x 1
09/03/98 ^a	14.40	6.32	8.08	--	--	--	--	--	--	--	1.4 x 1
10/21/98 ^b	14.40	5.64	8.76	--	--	--	--	--	--	--	8.6 x 1
11/04/98	14.40	5.61	8.79	--	--	--	--	--	--	--	--
01/26/99	14.40	6.71	7.69	--	<50	<0.5	<0.5	<0.5	<0.5	<2.0	--
05/06/99	14.40	8.15	6.25	--	--	--	--	--	--	--	--
08/21/99	14.40	8.13	6.27	--	<50	<0.5	<0.5	<0.5	<0.5	<5.0	--
10/28/99	14.40	4.14	10.26	--	--	--	--	--	--	--	--
01/31/00	14.40	7.07	7.33	--	<50	<0.5	<0.5	<0.5	<0.5	<2.5	--
05/19/00	14.40	7.52	6.88	--	--	--	--	--	--	--	--
08/07/00	14.40	6.23	8.17	--	<50	4.3	0.60	<0.50	<0.50	<2.5/<2.0 ^f	--
12/01/00	14.40	INACCESSIBLE	--	--	--	--	--	--	--	--	--
02/09/01	14.40	INACCESSIBLE	--	--	--	--	--	--	--	--	--
05/29/01	14.40	6.58	7.82	NOT SAMPLED DUE TO INSUFFICIENT WATER			--	--	--	--	--
08/27/01	14.40	6.52	7.88	NOT SAMPLED DUE TO INSUFFICIENT WATER			--	--	--	--	--
11/28/01	14.40	DRY	--	--	--	--	--	--	--	--	--
02/14/02	14.37	7.66	6.71	--	<50	<0.50	<0.50	<0.50	<1.5	<2.5/<2 ^f	--
05/15/02	14.37	6.96	7.41	--	<50	<0.50	<0.50	<0.50	<1.5	<2.5/<2 ^f	--
08/05/02	14.37	DRY	--	--	--	--	--	--	--	--	--
11/30/02	14.37	DRY	--	--	--	--	--	--	--	--	--
02/24-25/03 ¹	14.37	7.77	6.60	200	<50	8.0	<0.50	<0.50	<1.5	<2.5	--
06/02/03	14.37	7.11	7.26	300	<50	4.3	<0.5	<0.5	<1.5	<2.5	--
09/02/03	14.37	5.80	8.57	410	51	4.3	<0.5	<0.5	<1.5	<2.5	--
11/21/03	-- ⁿ	-- ⁿ	10.24	560	110	25	0.6	1.5	<1.5	<2.5	--
02/27/04	-- ⁿ	-- ⁿ	5.71	340	<50	<0.5	<0.5	<0.5	<1.5	<2.5	--
05/28/04	-- ⁿ	-- ⁿ	7.88	430	<50	<0.5	<0.5	<0.5	<1.5	<2.5	--
08/31/04	-- ⁿ	-- ⁿ	9.03	460	<50	<0.5	<0.5	<0.5	<1.5	<2.5	--
12/17/04	-- ⁿ	-- ⁿ	7.67	390 ^o	<50	<0.5	<0.5	<0.5	<1.5	<2.5	--

Table 1
Groundwater Monitoring Data and Analytical Results
Former Chevron (Signal Oil) Service Station #206145 (S-800)
800 Center Street
Oakland, California

WELL ID/ DATE	TOC* (ft.)	GWE (msl)	DTW (ft.)	TPH-DRO (µg/L)	TPH-GRO (µg/L)	B (µg/L)	T (µg/L)	E (µg/L)	X (µg/L)	MTBE (µg/L)	CUB (cfu/m)
MW-4 (cont)											
03/28/05	-- ⁿ	-- ⁿ	5.32	<50 ^o	<50	<0.5	<0.5	<0.5	<1.5	<2.5	--
06/09/05	-- ⁿ	-- ⁿ	6.70	120 ^o	90	<0.5	<0.5	<0.5	<1.5	<2.5	--
08/19/05	-- ⁿ	-- ⁿ	8.03	190 ^{o,p,q}	200	<0.5	<0.5	<0.5	<1.5	<2.5	--
11/18/05	-- ⁿ	-- ⁿ	9.43	310 ^{o,t}	230	2.7	<0.5	0.8	<1.5	<2.5	--
03/07/06	-- ⁿ	-- ⁿ	5.55	230 ^o	<50	<0.5	<0.5	<0.5	<1.5	<2.5	--
05/17/06	-- ⁿ	-- ⁿ	5.89	150 ^o	<50	<0.5	<0.5	<0.5	<1.5	<2.5	--
08/30/06	-- ⁿ	-- ⁿ	7.71	380 ^o	1,300	47	<2.5	<2.5	<7.5	<50	--
11/28/06	-- ⁿ	-- ⁿ	8.75	1,800 ^o	1,200	36	1.1	3.4	<5.0	<20	--
02/06/07	16.98	8.58	8.40	1,600 ^o	13,000 ^u	3,700 ^u	60 ^u	880 ^u	170 ^u	210 ^u	--
05/02/07	16.98	9.53	7.45	170 ^o	1,400	170	0.6	0.9	1.6	<50	--
08/17/07	16.98	8.35	8.63	1,600 ^o	4,700	870	3.8	49	<10	30	--
11/16/07	16.98	8.20	8.78	2,000 ^o	3,700	780	5.6	100	7.8	25	--
02/05/08	16.98	10.75	6.23	250 ^o	1,100	270	2.2	63	7.6	<50	--
05/20/08	16.98	8.91	8.07	1,100 ^o	3,300	720	4.1	13	15	<50 ^w	--
08/06/08	16.98	8.09	8.89	2,200 ^o	11,000	2,700	33	460	87	<100 ^w	--
12/05/08	16.98	7.46	9.52	540 ^o	2,500	380	1.4	22	<5.0 ^x	11	--
02/09/09	16.98	7.97	9.01	610 ^o	890	6.4	0.5	2.9	<1.5	<5.0 ^w	--
05/08/09	16.98	9.80	7.18	140 ^o	560	29	<0.5	1.2	<1.5	<5.0 ^w	--
08/07/09	16.98	8.10	8.88	1,000 ^o	1,900	260	1.2	7.1	3.0	8.3	--
02/25/10	16.98	10.37	6.61	54^{o,z}	56	<0.5	<0.5	<0.5	<1.5	<2.5	--
MW-5											
01/03/97	--	--	--	--	<50	<0.5	<0.5	<0.5	<0.5	--	--
02/20/97	15.03	INACCESSIBLE	--	--	--	--	--	--	--	--	--
04/24/97	15.03	INACCESSIBLE	--	--	--	--	--	--	--	--	--
04/30/97	15.03	7.06	7.97	--	<50	<0.5	<0.5	<0.5	<0.5	<2.5	--
07/23/97	15.03	INACCESSIBLE	--	--	--	--	--	--	--	--	--
10/29/97	15.03	INACCESSIBLE	--	--	--	--	--	--	--	--	--
01/28/98	15.03	8.83	6.20	--	<50	<0.5	<0.5	<0.5	<0.5	<2.5	--
05/11/98	15.03	INACCESSIBLE	--	--	--	--	--	--	--	--	--
07/16/98	15.03	7.28	7.75	--	<50	<0.5	<0.5	<0.5	<0.5	<5.0	--
08/04/98	15.03	INACCESSIBLE	--	--	--	--	--	--	--	--	--
11/04/98	15.03	INACCESSIBLE	--	--	--	--	--	--	--	--	--
01/26/99	15.03	INACCESSIBLE	--	--	--	--	--	--	--	--	--
05/06/99	15.03	INACCESSIBLE	--	--	--	--	--	--	--	--	--
08/21/99	15.03	6.74	8.29	--	<50	<0.5	<0.5	<0.5	<0.5	<5.0	--

Table 1
Groundwater Monitoring Data and Analytical Results
Former Chevron (Signal Oil) Service Station #206145 (S-800)
800 Center Street
Oakland, California

WELL ID/ DATE	TOC* (ft.)	GWE (msl)	DTW (ft.)	TPH-DRO (µg/L)	TPH-GRO (µg/L)	B (µg/L)	T (µg/L)	E (µg/L)	X (µg/L)	MTBE (µg/L)	CUB (cfu/m)
MW-5 (cont)											
10/28/99	15.03	4.60	10.43	--	--	--	--	--	--	--	--
01/31/00	15.03	7.39	7.64	--	<50	<0.5	<0.5	<0.5	<0.5	<2.5	--
05/19/00	15.03	7.85	7.18	--	--	--	--	--	--	--	--
08/07/00	15.03	INACCESSIBLE		--	--	--	--	--	--	--	--
12/01/00	15.03	5.68	9.35	--	<50.0	<0.500	<0.500	<0.500	<0.500	<2.50/<2.0 ^f	--
02/09/01	15.03	6.22	8.81	--	<50	<0.50	<0.50	<0.50	<0.50	<2.5/<2.0 ^f	--
05/29/01	15.03	INACCESSIBLE - CAR PARKED OVER WELL		--	--	--	--	--	--	--	--
08/27/01	15.03	INACCESSIBLE - CAR PARKED OVER WELL		--	--	--	--	--	--	--	--
11/28/01	15.03	INACCESSIBLE - CAR PARKED OVER WELL		--	--	--	--	--	--	--	--
02/14/02	15.01	7.96	7.05	--	<50	<0.50	<0.50	<0.50	<1.5	<2.5/<2 ^f	--
05/15/02	15.01	7.23	7.78	--	<50	<0.50	<0.50	<0.50	<1.5	<2.5/<2 ^f	--
08/05/02	15.01	6.13	8.88	--	<50	<0.50	<0.50	<0.50	<1.5	<2.5/<2 ^f	--
11/30/02	15.01	5.27	9.74	--	<50	<0.50	<0.50	<0.50	<1.5	<2.5/<2 ^f	--
02/24-25/03 ¹	15.01	7.99	7.02	<50	<50	<0.50	<0.50	<0.50	<1.5	<2.5	--
06/02/03	15.01	7.14	7.87	<50	<50	<0.5	<0.5	<0.5	<1.5	<2.5	--
09/02/03	15.01	6.02	8.99	<50	<50	<0.5	<0.5	<0.5	<1.5	<2.5	--
11/21/03	15.01	5.26	9.75	68	<50	<0.5	<0.5	<0.5	<1.5	<2.5	--
02/27/04	15.01	8.42	6.59	140	<50	<0.5	<0.5	<0.5	<1.5	<2.5	--
05/28/04	15.01	6.71	8.30	76	<50	<0.5	<0.5	<0.5	<1.5	<2.5	--
08/31/04	15.01	INACCESSIBLE - CAR PARKED OVER WELL		--	--	--	--	--	--	--	--
12/17/04	15.01	6.98	8.03	52 ^o	<50	<0.5	<0.5	<0.5	<1.5	<2.5	--
03/28/05	15.01	8.66	6.35	51 ^o	<50	<0.5	0.7	<0.5	<1.5	<2.5	--
06/09/05	15.01	9.16	5.85	72 ^o	<50	<0.5	<0.5	<0.5	<1.5	<2.5	--
08/19/05	15.01	6.52	8.49	<50 ^{op}	<50	<0.5	<0.5	<0.5	<1.5	<2.5	--
11/18/05	15.01	6.12	8.89	<50 ^o	<50	<0.5	<0.5	<0.5	<1.5	<2.5	--
03/07/06	15.01	8.98	6.03	<50 ^o	<50	<0.5	<0.5	1.4	<1.5	<2.5	--
05/17/06	15.01	8.83	6.18	<50 ^o	<50	<0.5	<0.5	<0.5	<1.5	<2.5	--
08/30/06	15.01	6.86	8.15	<50 ^o	<50	<0.5	<0.5	<0.5	<1.5	<2.5	--
11/28/06	15.01	6.46	8.55	200 ^o	<50	<0.5	<0.5	<0.5	<1.5	<2.5	--
02/06/07	17.68	8.83	8.85	55 ^o	<50	<0.5	<0.5	<0.5	<1.5	<2.5	--
05/02/07	17.68	9.91	7.77	<50 ^o	<50	<0.5	<0.5	<0.5	<1.5	<2.5	--
08/17/07	17.68	8.63	9.05	66 ^o	<50	<0.5	<0.5	<0.5	<1.5	<2.5	--
11/16/07	17.68	INACCESSIBLE - CAR PARKED OVER WELL		--	--	--	--	--	--	--	--
02/05/08	17.68	INACCESSIBLE - CAR PARKED OVER WELL		--	--	--	--	--	--	--	--
02/29/08	17.68	10.88	6.80	<50 ^o	<50	<0.5	<0.5	<0.5	<1.5	<2.5	--
05/20/08	17.68	9.21	8.47	<50 ^o	<50	<0.5	<0.5	<0.5	<1.5	<2.5	--
08/06/08	17.68	8.29	9.39	<50 ^o	<50	<0.5	<0.5	<0.5	<1.5	<2.5	--

Table 1
Groundwater Monitoring Data and Analytical Results
Former Chevron (Signal Oil) Service Station #206145 (S-800)
800 Center Street
Oakland, California

WELL ID/ DATE	TOC* (ft.)	GWE (msl)	DTW (ft.)	TPH-DRO (µg/L)	TPH-GRO (µg/L)	B (µg/L)	T (µg/L)	E (µg/L)	X (µg/L)	MTBE (µg/L)	CUB (cfu/m)
MW-5 (cont)											
12/05/08	17.68	7.63	10.05	<50 ^o	<50	<0.5	<0.5	<0.5	<1.5	<2.5	--
02/09/09	17.68	8.21	9.47	<50 ^o	<50	<0.5	<0.5	<0.5	<1.5	<2.5	--
05/08/09	17.68	10.16	7.52	<50 ^o	<50	<0.5	<0.5	<0.5	<1.5	<2.5	--
08/07/09	17.68	8.33	9.35	<50 ^o	<50	<0.5	<0.5	<0.5	<1.5	<2.5	--
02/25/10	17.68	10.76	6.92	<50^o	<50	<0.5	<0.5	<0.5	<1.5	<2.5	--
MW-6											
01/03/97	--	--	--	--	<50	<0.5	<0.5	<0.5	<0.5	--	--
02/20/97	14.73	8.11	6.62	--	800	310	23	11	28	<12	--
04/24/97	14.73	7.13	7.60	--	<50	<0.5	<0.5	<0.5	<0.5	<2.5	--
07/23/97	14.73	5.73	9.00	--	<50	<0.5	<0.5	<0.5	<0.5	<2.5	--
10/29/97	14.73	4.98	9.75	--	<50	<0.5	<0.5	<0.5	<0.5	<2.5	--
01/28/98	14.73	8.19	6.54	--	160	38	<0.5	<0.5	<0.5	<2.5	--
05/11/98	14.73	8.08	6.65	--	1,700	490	72	39	52	<25	--
07/16/98	14.73	7.04	7.69	--	<50	<0.5	<0.5	<0.5	<0.5	<5.0	--
08/04/98 ^a	14.73	6.89	7.84	--	--	--	--	--	--	--	8.6 x 1
09/03/98 ^a	14.73	6.24	8.49	--	--	--	--	--	--	--	2.9 x 1
10/21/98 ^b	14.73	5.46	9.27	--	--	--	--	--	--	--	1.8 x 1
11/04/98	14.73	5.52	9.21	--	<50	<0.5	<0.5	<0.5	<0.5	<2.5	--
01/26/99	14.73	6.49	8.24	--	<50	<0.5	<0.5	<0.5	<0.5	<2.0	--
05/06/99	14.73	7.91	6.82	--	<50	<0.5	<0.5	<0.5	<0.5	<5.0	--
08/21/99	14.73	7.93	6.80	--	<50	<0.5	<0.5	<0.5	<0.5	<5.0	--
10/28/99	14.73	5.27	9.46	--	<50	<0.5	<0.5	<0.5	<0.5	<5.0	--
01/31/00	14.73	7.16	7.57	--	<50	<0.5	<0.5	<0.5	<0.5	<2.5	--
05/19/00	14.73	7.60	7.13	--	<50	11	<0.5	<0.5	<0.5	<2.5	--
08/07/00	14.73	6.22	8.51	--	<50	<0.50	<0.50	<0.50	<0.50	<2.5/<2.0 ^f	--
12/01/00	14.73	DRY	--	--	--	--	--	--	--	--	--
02/09/01	14.73	DRY	--	--	--	--	--	--	--	--	--
05/29/01	14.73	6.63	8.10	NOT SAMPLED DUE TO INSUFFICIENT WATER				--	--	--	--
08/27/01 ^h	14.73	9.83	4.90	--	150	<0.50	5.7	<0.50	<0.50	<5.0 ^f	--
11/28/01	14.73	DRY	--	--	--	--	--	--	--	--	--
02/14/02	14.68	7.90	6.78	--	<50	<0.50	<0.50	<0.50	<1.5	<2.5	--
05/15/02	14.68	7.32	7.36	--	<50	<0.50	<0.50	<0.50	<1.5	<2.5	--
08/05/02	14.68	DRY	--	--	--	--	--	--	--	--	--
11/30/02	14.68	DRY	--	--	--	--	--	--	--	--	--
02/24-25/03 ^l	14.68	7.89	6.79	<50	<50	<0.50	<0.50	<0.50	<1.5	<2.5	--

Table 1
Groundwater Monitoring Data and Analytical Results
Former Chevron (Signal Oil) Service Station #206145 (S-800)
800 Center Street
Oakland, California

WELL ID/ DATE	TOC* (ft.)	GWE (msl)	DTW (ft.)	TPH-DRO (µg/L)	TPH-GRO (µg/L)	B (µg/L)	T (µg/L)	E (µg/L)	X (µg/L)	MTBE (µg/L)	CUB (cfu/m)
MW-6 (cont)											
06/02/03	14.68	7.20	7.48	<50	<50	<0.5	<0.5	<0.5	<1.5	<2.5	--
09/02/03	14.68	5.77	8.91	190	<50	<0.5	<0.5	<0.5	<1.5	<2.5	--
11/21/03	14.68	4.86	9.82	98	<50	<0.5	<0.5	<0.5	<1.5	<2.5	--
02/27/04	14.68	8.12	6.56	240	<50	<0.5	<0.5	<0.5	<1.5	<2.5	--
05/28/04	14.68	6.43	8.25	150	<50	<0.5	<0.5	<0.5	<1.5	<2.5	--
08/31/04	14.68	5.29	9.39	360 ^m	<50	<0.5	<0.5	<0.5	<1.5	<2.5	--
12/17/04	14.68	6.85	7.83	91 ^o	<50	<0.5	<0.5	<0.5	<1.5	<2.5	--
03/28/05	14.68	8.34	6.34	61 ^o	<50	<0.5	<0.5	<0.5	<1.5	<2.5	--
06/09/05	14.68	7.95	6.73	64 ^o	<50	<0.5	<0.5	<0.5	<1.5	<2.5	--
08/19/05	14.68	6.27	8.41	<50 ^{o-p}	<50 ^s	<0.5	<0.5	<0.5	<1.5	<2.5	--
11/18/05	14.68	DRY AT 15.70 FEET		--	--	--	--	--	--	--	--
03/07/06	14.68	8.03	6.65	<50 ^o	<50	<0.5	<0.5	0.9	<1.5	<2.5	--
05/17/06	14.68	7.98	6.70	<50 ^o	<50	<0.5	<0.5	<0.5	<1.5	<2.5	--
08/30/06	14.68	6.63	8.05	<50 ^o	<50	<0.5	<0.5	<0.5	<1.5	<2.5	--
11/28/06	14.68	6.09	8.59	120 ^o	<50	<0.5	<0.5	<0.5	<1.5	<2.5	--
02/06/07	17.33	8.58	8.75	96 ^o	<50	<0.5	<0.5	<0.5	<1.5	<2.5	--
05/02/07	17.33	9.64	7.69	<50 ^o	<50	<0.5	<0.5	<0.5	<1.5	<2.5	--
08/17/07	17.33	8.38	8.95	66 ^o	<50	<0.5	<0.5	<0.5	<1.5	<2.5	--
11/16/07	17.33	8.19	9.14	250 ^o	<50	<0.5	<0.5	<0.5	<1.5	<2.5	--
02/05/08	17.33	10.55	6.78	120 ^o	<50	<0.5	<0.5	<0.5	<1.5	<2.5	--
05/20/08	17.33	8.92	8.41	70 ^o	<50	<0.5	<0.5	<0.5	<1.5	<2.5	--
08/06/08	17.33	8.06	9.27	<160 ^o	<50	<0.5	<0.5	<0.5	<1.5	<2.5	--
12/05/08	17.33	7.44	9.89	<50 ^o	<50	<0.5	<0.5	<0.5	<1.5	<2.5	--
02/09/09	17.33	7.99	9.34	<50 ^o	<50	<0.5	<0.5	<0.5	<1.5	<2.5	--
05/08/09	17.33	10.01	7.32	<50 ^o	<50	<0.5	<0.5	<0.5	<1.5	<2.5	--
08/07/09	17.33	8.11	9.22	<50 ^o	<50	<0.5	<0.5	<0.5	<1.5	<2.5	--
02/25/10	17.33	10.58	6.75	<50^o	<50	<0.5	<0.5	<0.5	<1.5	<2.5	--
MW-7											
01/03/97	--	--	--	--	<50	<0.5	<0.5	<0.5	<0.5	--	--
02/20/97	16.36	8.86	7.50	--	<50	<0.5	<0.5	<0.5	<0.5	<2.5	--
04/24/97	16.36	7.59	8.77	--	<50	<0.5	<0.5	<0.5	<0.5	<2.5	--
07/23/97	16.36	6.09	10.27	--	<50	<0.5	<0.5	<0.5	<0.5	<2.5	--
10/29/97	16.36	5.28	11.08	--	<50	<0.5	<0.5	<0.5	<0.5	<2.5	--
01/28/98	16.36	9.10	7.26	--	<50	<0.5	<0.5	<0.5	<0.5	<2.5	--
05/11/98	16.36	9.11	7.25	SAMPLED ANNUALLY		--	--	--	--	--	--

Table 1
Groundwater Monitoring Data and Analytical Results
Former Chevron (Signal Oil) Service Station #206145 (S-800)
800 Center Street
Oakland, California

WELL ID/ DATE	TOC* (ft.)	GWE (msl)	DTW (ft.)	TPH-DRO (µg/L)	TPH-GRO (µg/L)	B (µg/L)	T (µg/L)	E (µg/L)	X (µg/L)	MTBE (µg/L)	CUB (cfu/m)
MW-7 (cont)											
07/16/98	16.36	8.00	8.36	--	--	--	--	--	--	--	--
08/04/98 ^a	16.36	7.32	9.04	--	--	--	--	--	--	--	1.5 x 1
09/03/98 ^a	16.36	6.65	9.71	--	--	--	--	--	--	--	6.5 x 1
10/21/98 ^b	16.36	5.96	10.40	--	--	--	--	--	--	--	4.8 x 1
11/04/98	16.36	5.89	10.47	--	--	--	--	--	--	--	--
01/26/99	16.36	8.25	8.11	--	<50	<0.5	<0.5	<0.5	0.5	<2.0	--
05/06/99	16.36	8.47	7.89	--	--	--	--	--	--	--	--
08/21/99	16.36	8.51	7.85	--	--	--	--	--	--	--	--
10/28/99	16.36	6.04	10.32	--	--	--	--	--	--	--	--
01/31/00	16.36	7.57	8.79	--	<50	<0.5	<0.5	<0.5	<0.5	<2.5	--
05/19/00	16.36	UNABLE TO LOCATE		--	--	--	--	--	--	--	--
08/07/00	16.36	6.67	9.69	--	<50	<0.50	<0.50	<0.50	<0.50	<2.5/<2.0 ^f	--
12/01/00	16.36	5.84	10.52	--	<50.0	<0.500	<0.500	<0.500	<0.500	<2.50	--
02/09/01	16.36	6.30	10.06	--	<50	<0.50	<0.50	<0.50	<0.50	<2.5	--
05/29/01	16.36	UNABLE TO LOCATE		--	--	--	--	--	--	--	--
08/27/01 ^h	16.36	6.02	10.34	--	<50	<0.50	<0.50	<0.50	<0.50	<5.0 ^f	--
11/28/01	16.36	6.09	10.27	--	<50	<0.50	<0.50	<0.50	<1.5	<2.5	--
02/14/02	16.31	8.21	8.10	--	<50	<0.50	<0.50	<0.50	<1.5	<2.5	--
05/15/02	16.31	7.41	8.90	--	<50	<0.50	<0.50	<0.50	<1.5	<2.5	--
08/05/02	16.31	6.26	10.05	--	<50	<0.50	<0.50	<0.50	<1.5	<2.5	--
11/30/02	16.31	5.39	10.92	--	<50	<0.50	<0.50	<0.50	<1.5	<2.5	--
02/24-25/03 ^l	16.31	8.30	8.01	<50	<50	<0.50	<0.50	<0.50	<1.5	<2.5	--
06/02/03	16.31	7.67	8.64	<50	<50	<0.5	<0.5	<0.5	<1.5	<2.5	--
09/02/03	16.31	6.17	10.14	<50	<50	<0.5	<0.5	<0.5	<1.5	<2.5	--
11/21/03	16.31	UNABLE TO LOCATE - BURIED		--	--	--	--	--	--	--	--
02/27/04	16.31	UNABLE TO LOCATE - BURIED		--	--	--	--	--	--	--	--
05/28/04	-- ⁿ	-- ⁿ	9.40	91	<50	<0.5	<0.5	<0.5	<1.5	<2.5	--
08/31/04	-- ⁿ	-- ⁿ	10.61	150 ^m	<50	<0.5	<0.5	<0.5	<1.5	<2.5	--
12/17/04	-- ⁿ	-- ⁿ	9.16	170 ^o	<50	<0.5	<0.5	<0.5	<1.5	<2.5	--
03/28/05	-- ⁿ	-- ⁿ	7.21	<50 ^o	<50	<0.5	<0.5	<0.5	<1.5	<2.5	--
06/09/05	-- ⁿ	-- ⁿ	7.71	86 ^o	55	<0.5	<0.5	<0.5	<1.5	<2.5	--
08/19/05	-- ⁿ	-- ⁿ	9.88	820 ^{o,p,q}	<50	<0.5	<0.5	<0.5	<1.5	<2.5	--
11/18/05	-- ⁿ	-- ⁿ	10.06	<50 ^o	<50	<0.5	<0.5	<0.5	<1.5	<2.5	--
03/07/06	-- ⁿ	-- ⁿ	6.95	<50 ^o	<50	<0.5	<0.5	<0.5	<1.5	<2.5	--
05/17/06	-- ⁿ	-- ⁿ	7.52	<50 ^o	<50	<0.5	<0.5	<0.5	<1.5	<2.5	--
08/30/06	-- ⁿ	-- ⁿ	10.73	<50 ^o	<50	<0.5	<0.5	<0.5	<1.5	<2.5	--
11/28/06	-- ⁿ	-- ⁿ	10.70	<50 ^o	<50	<0.5	<0.5	<0.5	<1.5	<2.5	--

Table 1
Groundwater Monitoring Data and Analytical Results
Former Chevron (Signal Oil) Service Station #206145 (S-800)
800 Center Street
Oakland, California

WELL ID/ DATE	TOC* (ft.)	GWE (msl)	DTW (ft.)	TPH-DRO (µg/L)	TPH-GRO (µg/L)	B (µg/L)	T (µg/L)	E (µg/L)	X (µg/L)	MTBE (µg/L)	CUB (cfu/m)
MW-7 (cont)											
02/06/07	19.26	8.91	10.35	73°	<50	<0.5	<0.5	<0.5	<1.5	<2.5	--
05/02/07	19.26	9.98	9.28	<50°	<50	<0.5	<0.5	<0.5	<1.5	<2.5	--
08/17/07	19.26	8.75	10.51	<50°	<50	<0.5	<0.5	<0.5	<1.5	<2.5	--
11/16/07	19.26	8.56	10.70	<50°	<50	<0.5	<0.5	<0.5	<1.5	<2.5	--
02/05/08	19.26	11.43	7.83	100°	<50	<0.5	<0.5	<0.5	<1.5	<2.5	--
05/20/08	19.26	9.32	9.94	52°	<50	<0.5	<0.5	<0.5	<1.5	<2.5	--
08/06/08	19.26	8.41	10.85	<50°	<50	<0.5	<0.5	<0.5	<1.5	<2.5	--
12/05/08	19.26	7.71	11.55	<50°	<50	<0.5	<0.5	<0.5	<1.5	<2.5	--
02/09/09	19.26	8.23	11.03	<50°	<50	<0.5	<0.5	<0.5	<1.5	<2.5	--
05/08/09	19.26	10.23	9.03	<50°	<50	<0.5	<0.5	<0.5	<1.5	<2.5	--
08/07/09	19.26	8.40	10.86	<50°	<50	<0.5	<0.5	<0.5	<1.5	<2.5	--
02/25/10	19.26	10.84	8.42	<50°	<50	<0.5	<0.5	<0.5	<1.5	<2.5	--
MW-8											
02/14/02 ^{ij}	15.29	7.30	7.99	--	<50	<0.50	<0.50	<0.50	<1.5	<2.5/<2 ^f	--
05/15/02 ^k	15.29	6.66	8.63	--	<50	<0.50	<0.50	<0.50	<1.5	<2.5	--
08/05/02 ^k	15.29	5.48	9.81	--	<50	<0.50	<0.50	<0.50	<1.5	<2.5	--
11/30/02 ^k	15.29	4.85	10.44	--	<50	<0.50	<0.50	<0.50	<1.5	<2.5	--
02/24-25/03 ^l	15.29	7.46	7.83	<50	<50	<0.50	<0.50	<0.50	<1.5	<2.5	--
06/02/03	15.29	6.83	8.46	<50	<50	<0.5	<0.5	<0.5	<1.5	<2.5	--
09/02/03	15.29	5.57	9.72	<50	<50	<0.5	<0.5	<0.5	<1.5	<2.5	--
11/21/03	15.29	4.89	10.40	<50	<50	<0.5	<0.5	<0.5	<1.5	<2.5	--
02/27/04	15.29	8.38	6.91	280	<50	<0.5	<0.5	<0.5	<1.5	<2.5	--
05/28/04	15.29	6.33	8.96	72	<50	<0.5	<0.5	<0.5	<1.5	<2.5	--
08/31/04	15.29	4.79	10.50	92 ^m	<50	<0.5	<0.5	<0.5	<1.5	<2.5	--
12/17/04	15.29	6.68	8.61	53°	<50	<0.5	<0.5	<0.5	<1.5	<2.5	--
03/28/05	15.29	8.79	6.50	<50°	<50	<0.5	0.9	<0.5	<1.5	<2.5	--
06/09/05	15.29	8.26	7.03	63°	<50	<0.5	<0.5	<0.5	<1.5	<2.5	--
08/19/05	15.29	6.18	9.11	<50° ^p	<50	<0.5	<0.5	<0.5	<1.5	<2.5	--
11/18/05	15.29	5.47	9.82	<50°	<50	<0.5	<0.5	<0.5	<1.5	<2.5	--
03/07/06	15.29	8.60	6.69	<50°	<50	<0.5	<0.5	<0.5	<1.5	<2.5	--
05/17/06	15.29	8.21	7.08	<50°	<50	<0.5	<0.5	<0.5	<1.5	<2.5	--
08/30/06	15.29	6.57	8.72	<50°	<50	<0.5	<0.5	<0.5	<1.5	<2.5	--
11/28/06	15.29	6.38	8.91	<50°	<50	<0.5	<0.5	<0.5	<1.5	<2.5	--
02/06/07	17.79	8.39	9.40	<50°	<50	<0.5	<0.5	<0.5	<1.5	<2.5	--
05/02/07	17.79	9.33	8.46	<50°	<50	<0.5	<0.5	<0.5	<1.5	<2.5	--

Table 1
Groundwater Monitoring Data and Analytical Results
Former Chevron (Signal Oil) Service Station #206145 (S-800)
800 Center Street
Oakland, California

WELL ID/ DATE	TOC* (ft.)	GWE (msl)	DTW (ft.)	TPH-DRO (µg/L)	TPH-GRO (µg/L)	B (µg/L)	T (µg/L)	E (µg/L)	X (µg/L)	MTBE (µg/L)	CUB (cfu/m)
MW-8 (cont)											
08/17/07	17.79	8.18	9.61	<50 ^o	<50	<0.5	<0.5	<0.5	<1.5	<2.5	--
11/16/07	17.79	8.04	9.75	<50 ^o	<50	<0.5	<0.5	<0.5	<1.5	<2.5	--
02/05/08	17.79	10.44	7.35	120 ^o	<50	<0.5	<0.5	<0.5	<1.5	<2.5	--
05/20/08	17.79	8.69	9.10	<50 ^o	<50	<0.5	<0.5	<0.5	<1.5	<2.5	--
08/06/08	17.79	7.89	9.90	<50 ^o	<50	<0.5	<0.5	<0.5	<1.5	<2.5	--
12/05/08	17.79	7.30	10.49	<50 ^o	<50	<0.5	<0.5	<0.5	<1.5	<2.5	--
02/09/09	17.79	7.86	9.93	<50 ^o	<50	<0.5	<0.5	<0.5	<1.5	<2.5	--
05/08/09	17.79	9.60	8.19	<50 ^o	<50	<0.5	<0.5	<0.5	<1.5	<2.5	--
08/07/09	17.79	7.95	9.84	<50 ^o	<50	<0.5	<0.5	<0.5	<1.5	<2.5	--
02/25/10	17.79	10.27	7.52	<50^o	<50	<0.5	<0.5	<0.5	<1.5	<2.5	--
MW-9											
04/20/07 ⁱ	18.42	10.39	8.03	1,100 ^o	4,100	28	6.9	9.2	240	--	--
06/22/07	18.42	8.82	9.60	310 ^o	500	4.4	<0.5	<0.5	12	--	--
08/17/07	18.42	8.67	9.75	92 ^o	<50	<0.5	<0.5	<0.5	<1.5	--	--
11/16/07	18.42	8.40	10.02	470 ^o	92	<0.5	<0.5	<0.5	<1.5	--	--
02/05/08	18.42	11.08	7.34	390 ^o	<50	<0.5	<0.5	<0.5	<1.5	--	--
05/20/08	18.42	9.16	9.26	<50 ^o	<50	<0.5	<0.5	<0.5	<1.5	--	--
08/06/08	18.42	8.31	10.11	<50 ^o	<50	<0.5	<0.5	<0.5	<1.5	--	--
12/05/08	18.42	7.64	10.78	<50 ^o	<50	<0.5	<0.5	<0.5	<1.5	--	--
02/09/09	18.42	8.15	10.27	<50 ^o	<50	<0.5	<0.5	<0.5	<1.5	--	--
05/08/09	18.42	10.11	8.31	<50 ^o	<50	<0.5	<0.5	<0.5	<1.5	--	--
08/07/09	18.42	8.33	10.09	SAMPLED SEMI-ANNUALLY		<0.5	--	--	--	--	--
02/25/10	18.42	10.70	7.72	<50^o	<50	<0.5	<0.5	<0.5	<1.5	--	--
MW-10											
04/20/07 ⁱ	17.99	8.35	9.64	260 ^o	1,200	29	31	11	140	--	--
06/22/07	17.99	8.29	9.70	110 ^o	<50	1.5	<0.5	<0.5	<1.5	--	--
08/17/07	17.99	7.81	10.18	53 ^o	<50	<0.5	<0.5	<0.5	<1.5	--	--
11/16/07	17.99	6.90	11.09	140 ^o	<50	<0.5	<0.5	<0.5	<1.5	--	--
02/05/08	17.99	9.65	8.34	330 ^o	<50	<0.5	<0.5	<0.5	<1.5	--	--
05/20/08	17.99	8.28	9.71	120 ^o	<50	<0.5	<0.5	<0.5	<1.5	--	--
08/06/08	17.99	7.50	10.49	<50 ^o	<50	<0.5	<0.5	<0.5	<1.5	--	--
12/05/08	17.99	6.67	11.32	<50 ^o	<50	<0.5	<0.5	<0.5	<1.5	--	--

Table 1
Groundwater Monitoring Data and Analytical Results
Former Chevron (Signal Oil) Service Station #206145 (S-800)
800 Center Street
Oakland, California

WELL ID/ DATE	TOC* (ft.)	GWE (msl)	DTW (ft.)	TPH-DRO (µg/L)	TPH-GRO (µg/L)	B (µg/L)	T (µg/L)	E (µg/L)	X (µg/L)	MTBE (µg/L)	CUB (cfu/m)
MW-10 (cont)											
02/09/09	17.99	7.19	10.80	<50 ^o	<50	<0.5	<0.5	<0.5	<1.5	--	--
05/08/09	17.99	8.96	9.03	<50 ^o	<50	<0.5	<0.5	<0.5	<1.5	--	--
08/07/09	17.99	7.41	10.58	SAMPLED SEMI-ANNUALLY			--	--	--	--	--
02/25/10	17.99	9.11	8.88	<50^o	<50	<0.5	<0.5	<0.5	<1.5	--	--
MW-11											
04/20/07 ⁱ	18.68	9.88	8.80	350 ^o	77	<2.0	4.6	<0.5	3.2	--	--
06/22/07	18.68	9.35	9.33	140 ^o	51	<0.5	<0.5	<0.5	<1.5	--	--
08/17/07	18.68	8.66	10.02	<50 ^o	<50	<0.5	<0.5	<0.5	<1.5	--	--
11/16/07	18.68	8.47	10.21	<50	<50	<0.5	<0.5	<0.5	<1.5	--	--
02/05/08	18.68	11.10	7.58	84 ^o	<50	<0.5	<0.5	<0.5	<1.5	--	--
05/20/08	18.68	9.20	9.48	<50 ^o	<50	<0.5	<0.5	<0.5	<1.5	--	--
08/06/08	18.68	8.37	10.31	<50 ^o	<50	<0.5	<0.5	<0.5	<1.5	--	--
12/05/08	18.68	7.63	11.05	<50 ^o	<50	<0.5	<0.5	<0.5	<1.5	--	--
02/09/09	18.68	8.17	10.51	<50 ^o	<50	<0.5	<0.5	<0.5	<1.5	--	--
05/08/09	18.68	10.12	8.56	<50 ^o	<50	<0.5	<0.5	<0.5	<1.5	--	--
08/07/09	18.68	8.34	10.34	SAMPLED SEMI-ANNUALLY			--	--	--	--	--
02/25/10	18.68	10.70	7.98	<50^o	<50	<0.5	<0.5	<0.5	<1.5	--	--
MW-12											
04/20/07 ⁱ	18.46	12.88	5.58	430 ^o	400	2.3	40	14	49	--	--
06/22/07	18.46	7.75	10.71	390 ^o	<50	0.7	1.1	<0.5	4.3	--	--
08/17/07	18.46	7.91	10.55	<50 ^o	<50	<0.5	<0.5	<0.5	<1.5	--	--
11/16/07	18.46	6.96	11.50	200 ^o	<50	<0.5	<0.5	<0.5	<1.5	--	--
02/05/08	18.46	8.62	9.84	200 ^o	51	0.9	<0.5	<0.5	<1.5	--	--
02/05/08	18.46	8.80	9.66	66 ^o	<50	<0.5	<0.5	<0.5	<1.5	--	--
08/06/08	18.46	6.40	12.06	<50 ^o	<50	<0.5	<0.5	<0.5	<1.5	--	--
12/05/08	18.46	6.20	12.26	<50 ^o	<50	<0.5	<0.5	<0.5	<1.5	--	--
02/09/09	18.46	6.53	11.93	<50 ^o	<50	<0.5	<0.5	<0.5	<1.5	--	--
05/08/09	18.46	8.64	9.82	<50 ^o	<50	<0.5	<0.5	<0.5	<1.5	--	--
08/07/09	18.46	6.41	12.05	SAMPLED SEMI-ANNUALLY			--	--	--	--	--
02/25/10	18.46	8.08	10.38	<50^o	<50	<0.5	<0.5	<0.5	<1.5	--	--

Table 1
Groundwater Monitoring Data and Analytical Results
Former Chevron (Signal Oil) Service Station #206145 (S-800)
800 Center Street
Oakland, California

WELL ID/ DATE	TOC* (ft.)	GWE (msl)	DTW (ft.)	TPH-DRO (µg/L)	TPH-GRO (µg/L)	B (µg/L)	T (µg/L)	E (µg/L)	X (µg/L)	MTBE (µg/L)	CUB (cfu/m)
MW-13											
04/20/07 ⁱ	18.43	9.46	8.97	140 ^o	650	16	23	7.5	61	--	--
06/22/07	18.43	8.99	9.44	400 ^o	<50	0.6	0.9	<0.5	<1.5	--	--
08/17/07	18.43	8.53	9.90	<50 ^o	<50	<0.5	<0.5	<0.5	<1.5	--	--
11/16/07	18.43	8.37	10.06	350 ^o	<50	<0.5	<0.5	<0.5	<1.5	--	--
02/05/08	18.43	10.85	7.58	57 ^o	<50	<0.5	<0.5	<0.5	<1.5	--	--
05/20/08	18.43	8.99	9.44	100 ^o	<50	<0.5	<0.5	<0.5	<1.5	--	--
08/06/08	18.43	8.18	10.25	78 ^o	<50	<0.5	<0.5	<0.5	<1.5	--	--
12/05/08	18.43	7.53	10.90	<50 ^o	<50	<0.5	<0.5	<0.5	<1.5	--	--
02/09/09	18.43	8.00	10.43	<50 ^o	<50	<0.5	<0.5	<0.5	<1.5	--	--
05/08/09	18.43	9.93	8.50	<50 ^o	<50	<0.5	<0.5	<0.5	<1.5	--	--
08/07/09	18.43	8.20	10.23	SAMPLED SEMI-ANNUALLY			--	--	--	--	--
02/25/10	18.43	10.51	7.92	<50^o	<50	<0.5	<0.5	<0.5	<1.5	--	--
MW-14											
04/20/07 ⁱ	18.59	8.17	10.42	2,000 ^o	16,000	550	1,600	620	2,400	--	--
06/22/07	18.59	7.55	11.04	1,300 ^o	3,700	190	150	49	580	--	--
08/17/07	18.59	7.82	10.77	780 ^o	2,600	74	54	11	220	--	--
11/16/07	18.59	7.58	11.01	690 ^o	850	45	3.5	14	32	--	--
02/05/08	18.59	8.99	9.60	160 ^o	450	16	2.7	7.6	3.0	--	--
05/20/08	18.59	7.69	10.90	120 ^o	<50	0.7	<0.5	<0.5	<1.5	--	--
08/06/08	18.59	7.35	11.24	88 ^o	<50	0.9	<0.5	<0.5	<1.5	--	--
12/05/08	18.59	6.83	11.76	<50 ^o	100	1.7	0.5	<0.5	<1.5	--	--
02/09/09	18.59	7.11	11.48	<50 ^o	<50	<0.5	<0.5	<0.5	<1.5	--	--
05/08/09	18.59	8.01	10.58	<50 ^o	<50	<0.5	<0.5	<0.5	<1.5	--	--
08/07/09	18.59	7.48	11.11	SAMPLED SEMI-ANNUALLY			--	--	--	--	--
02/25/10	18.59	8.72	9.87	<50^o	<50	<0.5	<0.5	<0.5	<1.5	--	--
MW-15											
04/20/07 ⁱ	18.38	9.78	8.60	720 ^o	240	1.0	1.3	<0.5	20	--	--
06/22/07	18.38	9.09	9.29	150 ^o	<50	<0.5	<0.5	<0.5	<1.5	--	--
08/17/07	18.38	8.65	9.73	<50 ^o	<50	<0.5	<0.5	<0.5	<1.5	--	--
11/16/07	18.38	8.41	9.97	140 ^o	<50	<0.5	<0.5	<0.5	<1.5	--	--
02/05/08	18.38	10.97	7.41	52 ^o	<50	<0.5	<0.5	<0.5	<1.5	--	--
05/20/08	18.38	9.12	9.26	<50 ^o	<50	<0.5	<0.5	<0.5	<1.5	--	--
08/06/08	18.38	8.30	10.08	190 ^o	<50	<0.5	<0.5	<0.5	<1.5	--	--

Table 1
Groundwater Monitoring Data and Analytical Results
Former Chevron (Signal Oil) Service Station #206145 (S-800)
800 Center Street
Oakland, California

WELL ID/ DATE	TOC* (ft.)	GWE (msl)	DTW (ft.)	TPH-DRO (µg/L)	TPH-GRO (µg/L)	B (µg/L)	T (µg/L)	E (µg/L)	X (µg/L)	MTBE (µg/L)	CUB (cfu/m)
MW-15 (cont)											
12/05/08	18.38	7.58	10.80	<50 ^o	<50	<0.5	<0.5	<0.5	<1.5	--	--
02/09/09	18.38	8.12	10.26	<50 ^o	<50	<0.5	<0.5	<0.5	<1.5	--	--
05/08/09	18.38	10.02	8.36	53 ^o	<50	<0.5	<0.5	<0.5	<1.5	--	--
08/07/09	18.38	8.30	10.08	SAMPLED SEMI-ANNUALLY		--	--	--	--	--	--
02/25/10	18.38	10.61	7.77	<50^o	<50	<0.5	<0.5	<0.5	<1.5	--	--
MW-16											
04/20/07 ⁱ	18.57	8.75	9.82	2,200 ^o	15,000	87	1,200	500	2,000	--	--
06/22/07	18.57	8.20	10.37	2,100 ^o	10,000	130	1,800	580	1,400	--	--
08/17/07	18.57	7.81	10.76	640 ^o	8,200	110	1,400	280	730	--	--
11/16/07	18.57	7.54	11.03	370 ^o	1,600	22	270	60	160	--	--
02/05/08	18.57	9.74	8.83	350 ^o	930	2.6	15	9.3	18	--	--
05/20/08	18.57	8.26	10.31	79 ^o	<50	<0.5	<0.5	<0.5	<1.5	--	--
08/06/08	18.57	7.49	11.08	74 ^o	<50	<0.5	<0.5	0.6	<1.5	--	--
12/05/08	18.57	6.80	11.77	89 ^o	<50	<0.5	<0.5	<0.5	<1.5	--	--
02/09/09	18.57	7.18	11.39	<50 ^o	<50	<0.5	<0.5	<0.5	<1.5	--	--
05/08/09	18.57	8.92	9.65	<50 ^o	<50	<0.5	<0.5	<0.5	<1.5	--	--
08/07/09	18.57	7.52	11.05	SAMPLED SEMI-ANNUALLY		--	--	--	--	--	--
02/25/10	18.57	9.36	9.21	<50^o	<50	<0.5	<0.5	<0.5	<1.5	--	--
MW-17											
04/20/07 ⁱ	18.55	-0.95	19.50	1,300 ^o	7,400	66	880	300	1,300	--	--
06/22/07	18.55	8.21	10.34	690 ^o	2,000	35	27	9.3	360	--	--
08/17/07	18.55	2.33	16.22	240 ^o	380	6.7	2.3	0.5	15	--	--
11/16/07	18.55	3.22	15.33	270 ^o	190	4.0	4.0	1.5	27	--	--
02/05/08	18.55	4.94	13.61	460 ^o	1,000	16	26	49	60	--	--
05/20/08	18.55	8.29	10.26	89 ^o	<50	<0.5	<0.5	<0.5	<1.5	--	--
08/06/08	18.55	5.82	12.73	150 ^o	180	2.5	2.0	2.8	1.5	--	--
12/05/08	18.55	6.62	11.93	120 ^o	360	3.4	<2.0 ^y	0.7	<1.5	--	--
02/09/09	18.55	6.68	11.87	<50 ^o	<50	<0.5	<0.5	<0.5	<1.5	--	--
05/08/09	18.55	8.79	9.76	<50 ^o	<50	<0.5	<0.5	<0.5	<1.5	--	--
08/07/09	18.55	7.51	11.04	SAMPLED SEMI-ANNUALLY		--	--	--	--	--	--
02/25/10	18.55	8.92	9.63	<50	<50	<0.5	<0.5	<0.5	<1.5	--	--

Table 1
Groundwater Monitoring Data and Analytical Results
Former Chevron (Signal Oil) Service Station #206145 (S-800)
800 Center Street
Oakland, California

WELL ID/ DATE	TOC* (ft.)	GWE (msl)	DTW (ft.)	TPH-DRO (µg/L)	TPH-GRO (µg/L)	B (µg/L)	T (µg/L)	E (µg/L)	X (µg/L)	MTBE (µg/L)	CUB (cfu/m)
AS-1											
02/25/10 ⁱ	--	--	7.63	--	--	--	--	--	--	--	--
AS-2											
02/25/10 ⁱ	--	--	8.05	--	--	--	--	--	--	--	--
AS-3											
02/25/10 ⁱ	--	--	8.12	--	--	--	--	--	--	--	--
AS-4											
02/25/10 ⁱ	--	--	7.98	--	--	--	--	--	--	--	--
AS-5											
02/25/10 ⁱ	--	--	7.80	--	--	--	--	--	--	--	--
AS-6											
02/25/10 ⁱ	--	--	8.04	--	--	--	--	--	--	--	--
AS-7											
02/25/10 ⁱ	--	--	8.01	--	--	--	--	--	--	--	--
AS-8											
02/25/10 ⁱ	--	--	7.94	--	--	--	--	--	--	--	--
MW-1											
10/27/95	15.69	10.54	5.15	--	170,000	19,000	34,000	4,800	26,000	--	--
02/20/97	15.64	8.96	6.68	--	18,000	870	3,500	470	2,100	<250	--
04/24/97	15.64	7.30	8.34	--	76,000	4,600	16,000	1,600	8,300	1,000	--
07/23/97	15.64	5.90	9.74	--	37,000	2,700	8,000	870	6,100	<250	--
10/29/97	15.64	INACCESSIBLE		--	--	--	--	--	--	--	--

Table 1
Groundwater Monitoring Data and Analytical Results
Former Chevron (Signal Oil) Service Station #206145 (S-800)
800 Center Street
Oakland, California

WELL ID/ DATE	TOC* (ft.)	GWE (msl)	DTW (ft.)	TPH-DRO (µg/L)	TPH-GRO (µg/L)	B (µg/L)	T (µg/L)	E (µg/L)	X (µg/L)	MTBE (µg/L)	CUB (cfu/m)
MW-1 (cont)											
01/28/98	15.64	9.30	6.34	--	10,000	380	2,000	300	1,500	<25	--
05/11/98	15.64	8.72	6.92	--	17,000	880	3,100	380	2,300	<250	--
07/16/98	15.64	7.23	8.41	--	29,000	2,700	6,800	890	3,900	<1,000	--
08/04/98 ^a	15.64	6.90	8.74	--	--	--	--	--	--	--	<1.0 x 1
09/03/98 ^a	15.64	6.43	9.21	--	--	--	--	--	--	--	4.1 x 1
10/21/98 ^b	15.64	5.59	10.05	--	--	--	--	--	--	--	4.7 x 1
11/04/98	15.64	5.64	10.00	--	25,000	1,900	5,900	810	4,300	<125	--
01/26/99	15.64	6.86	8.78	--	<50	<0.5	<0.5	<0.5	<0.5	<2.0	--
05/06/99	15.64	8.17	7.47	--	8,050	515	1,840	256	1,190	300/<20 ^c	--
08/21/99	15.64	13.27	2.37	--	46,500	2,530	8,700	1,010	5,300	<1,250/<40 ^c	--
10/28/99	15.64	5.46	10.18	--	31,600	1,580	6,100	794	4,400	1,270	--
01/31/00	15.64	7.49	8.15	--	7,270	366	1,280	171	935	<12.5	--
05/19/00	15.64	7.78	7.86	--	8,000 ^e	870	1,200	430	1,200	<250	--
08/07/00	15.64	6.42	9.22	--	37,000 ^e	2,400	8,500	1,100	5,500	1,500/<4.0 ^f	--
12/01/00	15.64	5.25	10.39	--	25,500 ^g	1,390	4,920	801	4,330	<500/<10 ^f	--
02/09/01	15.64	6.10	9.54	--	8,900 ^e	850	1,300	470	1,700	820/<2.0 ^f	--
05/29/01	15.64	6.79	8.85	--	24,000 ^e	1,800	5,600	740	3,700	<250/<2.0 ^f	--
08/27/01 ^h	15.64	5.83	9.81	--	27,000	1,400	4,400	710	3,400	<20 ^f	--
11/28/01	15.64	5.84	9.80	--	26,000	1,300	3,900	620	3,400	<100/<2 ^f	--
02/14/02	15.63	8.34	7.29	--	1,400	100	360	45	240	9.3/<2 ^f	--
05/15/02	15.63	7.18	8.45	--	37,000	2,400	7,300	1,000	4,800	<100/<3.0 ^f	--
08/05/02	15.63	6.09	9.54	--	27,000	1,500	4,600	700	3,400	<100/<3.0 ^f	--
DESTROYED											
TRIP BLANK											
02/20/97	--	--	--	--	<50	<0.5	<0.5	<0.5	<0.5	<2.5	--
04/24/97	--	--	--	--	<50	<0.5	<0.5	<0.5	<0.5	<2.5	--
07/23/97	--	--	--	--	<50	<0.5	<0.5	<0.5	<0.5	<2.5	--
10/29/97	--	--	--	--	<50	<0.5	<0.5	<0.5	<0.5	<2.5	--
01/28/98	--	--	--	--	<50	<0.5	<0.5	<0.5	<0.5	<2.5	--
05/11/98	--	--	--	--	<50	<0.5	<0.5	<0.5	<0.5	<2.5	--
07/16/98	--	--	--	--	<50	<0.5	<0.5	<0.5	<0.5	<5.0	--
11/04/98	--	--	--	--	<50	<0.5	<0.5	<0.5	<0.5	<2.0	--
01/26/99	--	--	--	--	<50	<0.5	<0.5	<0.5	<0.5	<2.0	--
05/06/99	--	--	--	--	<50	<0.5	<0.5	<0.5	<0.5	<5.0	--
01/31/00	--	--	--	--	<50	<0.5	<0.5	<0.5	<0.5	<2.5	--

Table 1
Groundwater Monitoring Data and Analytical Results
Former Chevron (Signal Oil) Service Station #206145 (S-800)
800 Center Street
Oakland, California

WELL ID/ DATE	TOC* (ft.)	GWE (msl)	DTW (ft.)	TPH-DRO (µg/L)	TPH-GRO (µg/L)	B (µg/L)	T (µg/L)	E (µg/L)	X (µg/L)	MTBE (µg/L)	CUB (cfu/m)
TRIP BLANK (cont)											
05/19/00	--	--	--	--	<50	<0.50	<0.50	<0.50	<0.50	<2.5	--
08/07/00	--	--	--	--	<50	<0.50	<0.50	<0.50	<0.50	<2.5	--
12/01/00	--	--	--	--	<50.0	<0.500	<0.500	<0.500	<0.500	<2.50	--
02/09/01	--	--	--	--	<50	<0.50	<0.50	<0.50	<0.50	<2.5	--
05/29/01	--	--	--	--	<50	<0.50	<0.50	<0.50	<0.50	<2.5	--
08/27/01 ^h	--	--	--	--	<50	<0.50	<0.50	<0.50	<0.50	<5.0 ^f	--
QA											
11/28/01	--	--	--	--	<50	<0.50	<0.50	<0.50	<1.5	<2.5	--
02/14/02	--	--	--	--	<50	<0.50	<0.50	<0.50	<1.5	<2.5	--
05/15/02	--	--	--	--	<50	<0.50	<0.50	<0.50	<1.5	<2.5	--
08/05/02	--	--	--	--	<50	<0.50	<0.50	<0.50	<1.5	<2.5	--
11/30/02	--	--	--	--	<50	<0.50	<0.50	<0.50	<1.5	<2.5	--
02/24-25/03	--	--	--	--	<50	<0.50	<0.50	<0.50	<1.5	<2.5	--
06/02/03	--	--	--	--	<50	<0.5	<0.5	<0.5	<1.5	<2.5	--
09/02/03	--	--	--	--	<50	<0.5	<0.5	<0.5	<1.5	<2.5	--
11/21/03	--	--	--	--	<50	<0.5	<0.5	<0.5	<1.5	<2.5	--
02/27/04	--	--	--	--	<50	<0.5	<0.5	<0.5	<1.5	<2.5	--
05/28/04	--	--	--	--	<50	<0.5	<0.5	<0.5	<1.5	<2.5	--
08/31/04	--	--	--	--	<50	<0.5	<0.5	<0.5	<1.5	<2.5	--
12/17/04	--	--	--	--	<50	<0.5	<0.5	<0.5	<1.5	<2.5	--
03/28/05	--	--	--	--	<50	<0.5	<0.5	<0.5	<1.5	<2.5	--
06/09/05	--	--	--	--	<50	<0.5	<0.5	<0.5	<1.5	<2.5	--
08/19/05	--	--	--	--	<50	<0.5	<0.5	<0.5	<1.5	<2.5	--
11/18/05	--	--	--	--	<50	<0.5	<0.5	<0.5	<1.5	<2.5	--
03/07/06	--	--	--	--	<50	<0.5	<0.5	<0.5	<1.5	<2.5	--
05/17/06	--	--	--	--	<50	<0.5	<0.5	<0.5	<1.5	<2.5	--
08/30/06	--	--	--	--	<50	<0.5	<0.5	<0.5	<1.5	<2.5	--
11/28/06	--	--	--	--	<50	<0.5	<0.5	<0.5	<1.5	<2.5	--
02/06/07	--	--	--	--	<50	<0.5	<0.5	<0.5	<1.5	<2.5	--
04/20/07	--	--	--	--	<50	<0.5	<0.5	<0.5	<1.5	<2.5	--
05/02/07	--	--	--	--	<50	<0.5	<0.5	<0.5	<1.5	<2.5	--
06/22/07	--	--	--	--	<50	<0.5	<0.5	<0.5	<1.5	--	--
08/17/07	--	--	--	--	<50	<0.5	<0.5	<0.5	<1.5	<2.5	--
11/16/07	--	--	--	--	<50	<0.5	<0.5	<0.5	<1.5	<2.5	--
02/05/08	--	--	--	--	<50	<0.5	<0.5	<0.5	<1.5	<2.5	--
02/29/08	--	--	--	--	<50	<0.5	<0.5	<0.5	<1.5	<2.5	--
05/20/08	--	--	--	--	<50	<0.5	<0.5	<0.5	<1.5	<2.5	--

Table 1
Groundwater Monitoring Data and Analytical Results
Former Chevron (Signal Oil) Service Station #206145 (S-800)
800 Center Street
Oakland, California

WELL ID/ DATE	TOC* (ft.)	GWE (msl)	DTW (ft.)	TPH-DRO (µg/L)	TPH-GRO (µg/L)	B (µg/L)	T (µg/L)	E (µg/L)	X (µg/L)	MTBE (µg/L)	CUB (cfu/m)
QA (cont)											
08/06/08	--	--	--	--	<50	<0.5	<0.5	<0.5	<1.5	<2.5	--
12/05/08	--	--	--	--	<50	<0.5	<0.5	<0.5	<1.5	<2.5	--
02/09/09	--	--	--	--	<50	<0.5	<0.5	<0.5	<1.5	<2.5	--
05/08/09	--	--	--	--	<50	<0.5	<0.5	<0.5	<1.5	<2.5	--
08/07/09	--	--	--	--	<50	<0.5	<0.5	<0.5	<1.5	<2.5	--
02/25/10	--	--	--	--	<50	<0.5	<0.5	<0.5	<1.5	<2.5	--

Table 1
Groundwater Monitoring Data and Analytical Results
Former Chevron (Signal Oil) Service Station #206145 (S-800)
800 Center Street
Oakland, California

EXPLANATIONS:

Groundwater monitoring data and laboratory analytical results prior to May 19, 2000 were compiled from reports prepared by Blaine Tech Services, Inc.

TOC = Top of Casing (ft.) = Feet	TPH = Total Petroleum Hydrocarbons DRO = Diesel Range Organics	MTBE = Methyl Tertiary Butyl Ether CUB = Contaminate utilizing bacteria
GWE = Groundwater Elevation (msl) = Mean sea level	GRO = Gasoline Range Organics B = Benzene	(cfu/ml) = Colony forming unit per milliliter (µg/L) = Micrograms per liter
DTW = Depth to Water	T = Toluene E = Ethylbenzene	(ppb) = Parts per billion -- = Not Measured/Not Analyzed
TPH-D = Total Petroleum Hydrocarbons as Diesel	X = Xylenes	QA = Quality Assurance/Trip Blank
TPH-G = Total Petroleum Hydrocarbons as Gasoline		

- * TOC elevations were surveyed on May 30, 2007, by Morrow Surveying. Vertical Datum is NAVD 88 from GPS observations. Gettler-Ryan received updated TOC data March 12, 2007. Vertical Datum is NAVD 88 from GPS observations. TOC elevations were surveyed on August 17, 2005, by Morrow Surveying. On February 18, 2003, MW-1A was surveyed using the previous benchmark. TOC elevations were surveyed on December March 4, 2002, by Virgil Chavez Land Surveying. The benchmark for the survey was a City of Oakland benchmark, #25-H monument disk in well casting in sidewalk at the northwest corner of 7th and Center. The latitude, longitude and coordinates are for top of casings and are based on the California State Coordinate System, Zone III (NAD83), (Benchmark Elevation = 10.784 feet NGVD 29).
- ^a Contaminate hydrocarbon utilizing bacteria plate count was run with diesel and jet fuel degraders.
- ^b Contaminate hydrocarbon utilizing bacteria plate count was run with gasoline degraders.
- ^c Confirmation run.
- ^d Chromatogram pattern indicates an unidentified hydrocarbon.
- ^e Laboratory report indicates gasoline C6-C12.
- ^f MTBE by EPA Method 8260.
- ^g Laboratory reports indicates weathered gasoline C6-C12.
- ^h TPH-G and BTEX by EPA Method 8260.
- ⁱ Well development performed.
- ^j TPH-D was detected at 130 ppb.
- ^k TPH-D was <50 ppb.
- ^l Well re-development performed.
- ^m Laboratory report indicates the observed sample pattern is not typical of diesel/#2 fuel oil.
- ⁿ TOC damaged; unable to calculate an accurate GWE.
- ^o Analyzed with silica gel clean-up.
- ^p Laboratory report indicates analysis performed out of hold time.
- ^q Laboratory report indicates the observed sample pattern includes #2 fuel/diesel and an additional pattern which elutes later in the DRO range.
- ^r Laboratory report indicates the observed sample pattern is not typical of #2 fuel/diesel. It elutes in the DRO range earlier than #2 fuel.

Table 1
Groundwater Monitoring Data and Analytical Results
Former Chevron (Signal Oil) Service Station #206145 (S-800)
800 Center Street
Oakland, California

EXPLANATIONS:

- ^s Laboratory report indicates the analysis was performed from a previously opened vial and the results are therefore estimated.
- ^t Laboratory report indicates the observed sample pattern includes #2 fuel/diesel, an additional pattern which elutes later in the DRO range, and individual peaks eluting in the DRO range.
- ^u Laboratory confirmed result.
- ^v Current laboratory analytical results do not coincide with historical data and although laboratory results were confirmed; it appears that the samples were switched.
- ^w Laboratory report indicates that due to the presence of an interferent near its retention time, the normal reporting limit was not attained for MTBE. The presence or concentration of this compound cannot be determined due to the presence of this interferent.
- ^x Laboratory report indicates that due to the presence of an interferent near its retention time, the normal reporting limit was not attained for total xylenes. The presence or concentration of this compound cannot be determined due to the presence of this interferent.
- ^y Laboratory report indicates that due to the presence of an interferent near its retention time, the normal reporting limit was not attained for toluene. The presence or concentration of this compound cannot be determined due to the presence of this interferent.
- ^z Laboratory report indicates DRO was detected in the method blank at a concentration of 50 µg/L. Due to insufficient sample volume, a repeat analysis could not be performed to confirm the results.
- ^{aa} Laboratory report indicates the ending calibration check standard did not meet the 15% criteria for the original analysis. The sample was reanalyzed from the vial with headspace and the result was <50 µg/L.

Table 2
Field Measurements and Analytical Results
Former Chevron (Signal Oil) Service Station #206145 (S-800)
800 Center Street
Oakland, California

WELL ID/ DATE	Pre-purge DO (mg/L)	Post-purge D.O. (mg/L)	Pre-purge ORP (mV)	Post-purge ORP (mV)	Total Alkalinity (µg/L)	Ferrous Iron (µg/L)	Nitrate as Nitrate (µg/L)	Sulfate (µg/L)
MW-1								
09/03/98	2.3	1.6	-90	-103	230,000	9,800	<1,000	6,100
MW-2								
09/03/98	2.8	2.5	-206	-163	390,000	7,400	<1,000	21,000
MW-3								
09/03/98	3.1	0.7	-124	-99	830,000	45,000	<1,000	10,000
MW-4								
09/03/98	2.6	1.1	-190	-206	--	--	--	--
MW-6								
09/03/98	2.6	3.2	-148	-167	94,000	62	28,000	47,000
MW-7								
09/03/98	2.7	3.2	-207	-229	170,000	120	7,800	57,000

EXPLANATIONS:

Groundwater monitoring data and laboratory analytical results were compiled from reports prepared by Blaine Tech Services, Inc.

D.O. = Dissolved Oxygen

(mg/L) = Milligram per liter

ORP = Oxidation Reduction Potential

(mV) = Millivolts

(µg/L) = Micrograms per liter

-- = Not Analyzed

Table 3
Groundwater Analytical Results - Oxygenate Compounds
Former Chevron (Signal Oil) Service Station #206145 (S-800)
800 Center Street
Oakland, California

WELL ID	DATE	METHANOL (mg/L)	ETHANOL (µg/L)	TBA (µg/L)	MTBE (µg/L)	DIPE (µg/L)	ETBE (µg/L)	TAME (µg/L)	1,2-DCA (µg/L)	EDB (µg/L)
MW-1	08/07/00	--	<1,000	410	<4.0	<4.0	<4.0	<4.0	<4.0	<4.0
	12/01/00	--	<2,500	<250	<10	<10	<10	<10	<10	<10
	02/09/01	--	<500	340	<2.0	<2.0	<2.0	53	<2.0	<2.0
	05/29/01	--	<500	<20	<2.0	<2.0	<2.0	<2.0	<2.0	<2.0
	08/27/01	<2.000	<200	230	<20	<20	<20	<20	<20	<20
	11/28/01	--	<500	130	<2	<2	<2	<2	<2	<2
	02/14/02	--	<500	<100	<2	<2	<2	<2	<2	<2
	05/15/02	--	<500	120	<3.0	<3.0	<3.0	<3.0	<3.0	<3.0
	08/05/02	--	<500	100	<3.0	<3.0	<3.0	<3.0	<3.0	<3.0
DESTROYED										
MW-2	08/07/00		<500	<100	<2.0	<2.0	<2.0	<2.0	<2.0	<2.0
	08/27/01	--	--	--	<5.0	--	--	--	--	--
MW-3	08/07/00	--	<500	2,600	<10	<10	<10	<10	490	17
	02/09/01	--	<500	2,000	<2.0	<2.0	<2.0	35	<2.0	<2.0
	05/29/01	--	<500	1,700 ¹	<2.0	<2.0	<2.0	38	980 ¹	7.4
	08/27/01	<5.000	<250	1,300	<25	<25	<25	<25	380	<25
	11/28/01	--	<500	1,500	<5.0	<5.0	<5.0	<5.0	<5.0	<5.0
	02/14/02	--	<500	<100	<2	<2	<2	<2	<2	<2
	05/15/02	--	<500	110	<2	<2	<2	<2	120	<2
	08/05/02	--	<1,000	1,400	<10	<10	<10	<10	670	<10
	11/30/02	--	<1,000	1,200	<10	<10	<10	<10	380	<10
	MW-4	08/07/00	--	<500	<100	<2.0	<2.0	<2.0	<2.0	18
08/27/01		NOT SAMPLED DUE TO INSUFFICIENT WATER				--	--	--	--	--
11/28/01		DRY				--	--	--	--	--
02/14/02		--	<500	<100	<2	<2	<2	<2	9	<2
05/15/02		--	<500	<100	<2	<2	<2	<2	4	<2
08/05/02		DRY				--	--	--	--	--
11/30/02		DRY				--	--	--	--	--
MW-5	12/01/00	--	<500	<50	<2.0	<2.0	<2.0	<2.0	<2.0	<2.0
	02/09/01	--	<500	<50	<2.0	<2.0	<2.0	<2.0	<2.0	<2.0
	08/27/01	INACCESSIBLE - CAR PARKED OVER WELL				--	--	--	--	--
	11/28/01	INACCESSIBLE - CAR PARKED OVER WELL				--	--	--	--	--
	02/14/02	--	<500	<100	<2	<2	<2	<2	<2	<2

Table 3
Groundwater Analytical Results - Oxygenate Compounds
Former Chevron (Signal Oil) Service Station #206145 (S-800)
800 Center Street
Oakland, California

WELL ID	DATE	METHANOL (mg/L)	ETHANOL (µg/L)	TBA (µg/L)	MTBE (µg/L)	DIPE (µg/L)	ETBE (µg/L)	TAME (µg/L)	1,2-DCA (µg/L)	EDB (µg/L)
MW-5 (cont)	05/15/02	--	<500	<100	<2	<2	<2	<2	<2	<2
	08/05/02	--	<500	<100	<2	<2	<2	<2	<2	<2
	11/30/02	--	<500	<100	<2	<2	<2	<2	<2	<2
MW-6	08/07/00	--	<500	<100	<2.0	<2.0	<2.0	<2.0	<2.0	<2.0
	08/27/01	--	--	--	<5.0	--	--	--	--	--
	11/30/02	DRY	--	--	--	--	--	--	--	--
MW-7	08/07/00	--	<500	<100	<2.0	<2.0	<2.0	<2.0	<2.0	<2.0
	08/27/01	--	--	--	<5.0	--	--	--	--	--
MW-8	02/14/02	--	<500	<100	<2	<2	<2	<2	<2	<2

EXPLANATIONS:

TBA = t-Butyl alcohol
MTBE = Methyl Tertiary Butyl Ether
DIPE = Di-Isopropyl ether
ETBE = Ethyl t-butyl ether
TAME = t-Amyl methyl ether

1,2-DCA = 1,2-Dichloroethane
EDB = 1,2-Dibromoethane
(mg/L) = milligrams per liter
(µg/L) = Micrograms per liter
-- = Not Analyzed

ANALYTICAL METHODS:

EPA Method 8260 (modified) for Methanol
EPA Method 8260 for Oxygenate Compounds

¹ Laboratory report indicates this sample was originally analyzed within holding time. Re-analysis for confirmation or dilution was performed past the recommended holding time.