



GETTLER-RYAN INC.

RECEIVED

2:10 pm, May 16, 2007

Alameda County
Environmental Health

TRANSMITTAL

March 21, 2007

G-R #386492

TO: Ms. Charlotte Evans
Cambria Environmental Technology, Inc.
5900 Hollis Street, Suite A
Emeryville, CA 94608

CC: Mr. Satya Sinha
Chevron Environmental
Management Company
P.O. Box 6012, Room K2256
San Ramon, California 94583

FROM: Deanna L. Harding
Project Coordinator
Gettler-Ryan Inc.
6747 Sierra Court, Suite J
Dublin, California 94568

RE: **Former Chevron (Signal Oil)
Service Station #206145 (S-800)
800 Center Street
Oakland, California
RO 0000454**

WE HAVE ENCLOSED THE FOLLOWING:

COPIES	DATED	DESCRIPTION
1	March 19, 2007	Groundwater Monitoring and Sampling Report First Quarter - Event of February 6, 2007

COMMENTS:

Pursuant to your request, we are providing you with a copy of the above referenced report for your use and distribution to the following (via PDF):

Mr. Barney Chan, Alameda County Health Care Services, Dept. of Environmental Health, 1131 Harbor Bay Parkway, Suite 250, Alameda, CA 94502-6577 (Distributed by Cambria via PDF)

This report is being sent for your review. Please provide any comments/changes and propose any groundwater monitoring modifications for the next event prior to **April 2, 2007**, at which time the final report will be distributed to the following:

cc: Mr. Rene Boisvert, Boulevard Equity Group, (Owner), 484 Lake Park Ave., #246, Oakland, CA 94610
Mr. Hollis Rodgers, 215 West MacArthur Boulevard, Apt# 434, Oakland, CA 94611

Enclosures

trans/206145-SS



Satya P. Sinha
Project Manager
Retail and Terminal
Business Unit

**Chevron Environmental
Management Company**
6001 Bollinger Canyon Road,
Room K2256
San Ramon, CA 94583
Tel (925) 842-9876
Fax (925) 842-8370
satyasinha@chevron.com

March 21, 2007

Alameda County Health Care Services
1131 Harbor Bay Parkway, Suite 250
Alameda, CA 94502-6577

RE: Chevron Service Station # 206145

Address 800 Center Street, Oakland, California

I have reviewed the attached routine groundwater monitoring report dated March 21, 2007.

I agree with the conclusions and recommendations presented in the referenced report. The information in this report is accurate to the best of my knowledge and all local Agency/Regional Board guidelines have been followed. This report was prepared by Gettler-Ryan, Inc., upon whose assistance and advice I have relied.

This letter is submitted pursuant to the requirements of California Water Code Section 13267(b) (1) and the regulating implementation entitled Appendix A pertaining thereto.

I declare under penalty of perjury that the foregoing is true and correct.

Sincerely,

A handwritten signature in black ink that reads "Satya P. Sinha". The signature is written in a cursive style with a horizontal line under the name.

Satya P Sinha

Attachment: Report



GETTLER - RYAN INC.



March 19, 2007
G-R Job #386492

Mr. Satya Sinha
Chevron Environmental Management Company
P.O. Box 6012, Room K2256
San Ramon, CA 94583

RE: First Quarter Event of February 6, 2007
Groundwater Monitoring & Sampling Report
Former Chevron (Signal Oil) Service Station
#206145 (S-800)
800 Center Street
Oakland, California

Dear Mr. Sinha:

This report documents the most recent groundwater monitoring and sampling event performed by Gettler-Ryan Inc. (G-R) at the referenced site. All field work was conducted in accordance with G-R Standard Operating Procedure - Groundwater Sampling (attached).

Static groundwater levels were measured and the wells were checked for the presence of separate-phase hydrocarbons. Static water level data, groundwater elevations and separate-phase hydrocarbon thickness (if any) are presented in the attached Table 1. A Potentiometric Map is included as Figure 1.

Groundwater samples were collected from the monitoring wells and submitted to a state certified laboratory for analyses. The field data sheets for this event are attached. Analytical results are presented in the table(s) listed below. The chain of custody document and laboratory analytical report are also attached.

Please call if you have any questions or comments regarding this report. Thank you.

Sincerely,

Deanna L. Harding
Project Coordinator

Douglas J. Lee
Senior Geologist, P.G. No. 6882

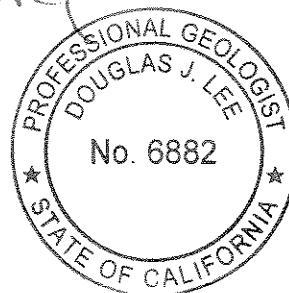
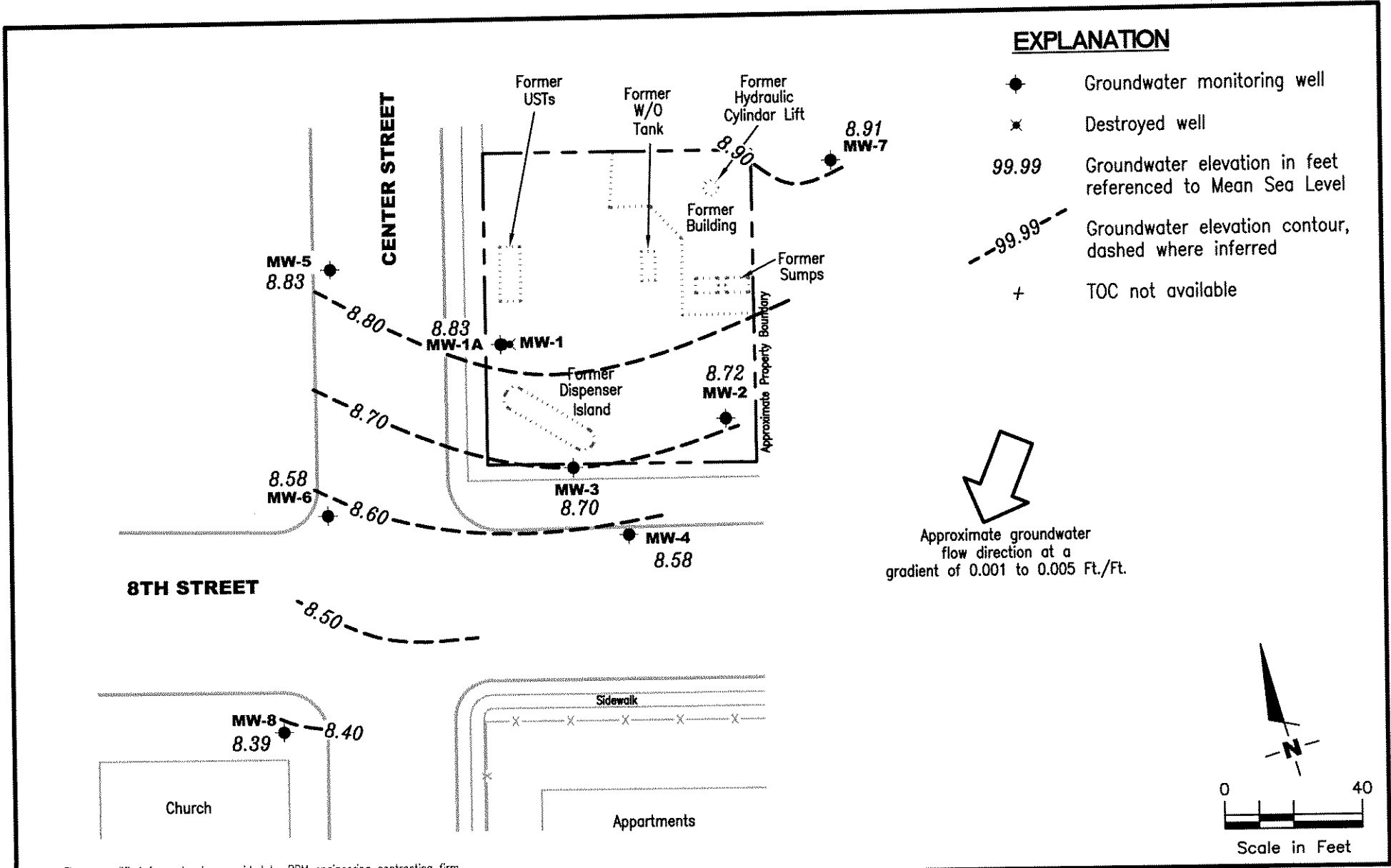

Figure 1: Potentiometric Map
Table 1: Groundwater Monitoring Data and Analytical Results
Table 2: Field Measurements and Analytical Results
Table 3: Groundwater Analytical Results - Oxygenate Compounds
Attachments: Standard Operating Procedure - Groundwater Sampling
Field Data Sheets
Chain of Custody Document and Laboratory Analytical Reports



Source: Figure modified from drawing provided by RRM engineering contracting firm.

GETTLER - RYAN INC.
 6747 Sierra Court, Suite J
 Dublin, CA 94568 (925) 551-7555

POTENTIOMETRIC MAP
 Former Chevron (Signal Oil) Service Station #206145(S-800)
 800 Center Street
 Oakland, California

FIGURE

1

PROJECT NUMBER
 386492

REVIEWED BY

DATE
 February 6, 2007

REVISED DATE

Table 1
Groundwater Monitoring Data and Analytical Results
Former Chevron (Signal Oil) Service Station #206145 (S-800)
800 Center Street
Oakland, California

WELL ID/ DATE	TOC* (ft.)	GWE (msl)	DTW (ft.)	TPH-D (ppb)	TPH-G (ppb)	B (ppb)	T (ppb)	E (ppb)	X (ppb)	MTBE (ppb)	CUB (cfu/ml)
MW-1A											
02/24-25/03 ¹	15.49	8.17	7.32	4,600	5,100	92	340	66	480	<10	--
06/02/03	15.49	7.15	8.34	5,500	3,800	150	490	72	450	<13	--
09/02/03	15.49	6.10	9.39	10,000	6,200	100	580	110	760	47	--
11/21/03	15.49	5.29	10.20	3,800	3,200	29	150	49	240	<10	--
02/27/04	15.49	9.87	5.62	2,800	280	9.7	19	3.0	30	<2.5	--
05/28/04	15.49	6.88	8.61	5,500	1,100	35	81	27	140	17	--
08/31/04	15.49	5.58	9.91	4,500	1,100	13	68	27	110	<2.5	--
12/17/04	15.49	7.09	8.40	2,300 ^o	560	8.0	17	9.6	36	<2.5	--
03/28/05	15.49	10.36	5.13	340 ^o	87	16	4.2	3.3	11	<2.5	--
06/09/05	15.49	9.69	5.80	6,400 ^o	260	26	3.7	7.7	13	5.3	--
08/19/05	15.49	6.70	8.79	1,100 ^{o,p,q}	440	38	7.8	9.4	17	<2.5	--
11/18/05	15.49	6.25	9.24	1,300 ^{o,q}	450	11	12	17	22	<2.5	--
03/07/06	15.49	10.51	4.98	2,300 ^o	150	33	1.6	3.4	2.7	<2.5	--
05/17/06	15.49	9.02	6.47	2,600 ^o	110	18	<0.5	0.7	<1.5	<2.5	--
08/30/06	15.49	5.68	9.81	3,600 ^o	420	24	0.7	8.1	9.2	<10	--
11/28/06	15.49	5.79	9.70	2,900 ^o	220	8.6	2.7	6.1	9.3	<2.5	--
02/06/07	18.11	8.83	9.28	1,500^o	230	19	<0.5	1.8	2.7	<2.5	--
MW-2											
10/27/95	15.77	10.60	5.17	--	<50	<0.5	<0.5	<0.5	<0.5	--	--
02/20/97	15.72	8.51	7.21	--	<50	<0.5	<0.5	<0.5	<0.5	<2.5	--
04/24/97	15.72	7.82	7.90	--	83 ^d	<0.5	<0.5	<0.5	<0.5	<2.5	--
07/23/97	15.72	5.92	9.80	--	<50	<0.5	<0.5	<0.5	<0.5	<2.5	--
10/29/97	15.72	5.13	10.59	--	<50	<0.5	<0.5	<0.5	<0.5	<2.5	--
01/28/98	15.72	9.21	6.51	--	<50	<0.5	<0.5	<0.5	<0.5	<2.5	--
05/11/98	15.72	8.82	6.90	--	SAMPLED ANNUALLY		--	--	--	--	--
07/16/98	15.72	7.37	8.35	--	--	--	--	--	--	--	--
08/04/98 ^a	15.72	7.03	8.69	--	--	--	--	--	--	--	1.9 x 10 ¹
09/03/98 ^a	15.72	6.44	9.28	--	--	--	--	--	--	--	3.0 x 10 ²
10/21/98 ^b	15.72	5.51	10.21	--	--	--	--	--	--	--	8.8 x 10 ²
11/04/98	15.72	5.60	10.12	--	--	--	--	--	--	--	--
01/26/99	15.72	6.87	8.85	--	<50	<0.5	<0.5	<0.5	<0.5	<2.0	--
05/06/99	15.72	8.20	7.52	--	--	--	--	--	--	--	--
08/21/99	15.72	13.21	2.51	--	--	--	--	--	--	--	--
10/28/99	15.72	6.35	9.37	--	--	--	--	--	--	--	--

Table 1
Groundwater Monitoring Data and Analytical Results
Former Chevron (Signal Oil) Service Station #206145 (S-800)
800 Center Street
Oakland, California

WELL ID/ DATE	TOC* (ft.)	GWE (msl)	DTW (ft.)	TPH-D (ppb)	TPH-G (ppb)	B (ppb)	T (ppb)	E (ppb)	X (ppb)	MTBE (ppb)	CUB (cfu/ml)
MW-2 (cont)											
01/31/00	15.72	7.25	8.47	--	<50	<0.5	0.541	<0.5	<0.5	<2.5	--
05/19/00	15.72	7.65	8.07	--	--	--	--	--	--	--	--
08/07/00	15.72	6.35	9.37	--	<50	<0.50	<0.50	<0.50	<0.50	<2.5/<2.0 ^f	--
12/01/00	15.72	5.60	10.12	--	<50.0	<0.500	<0.500	<0.500	<0.500	<2.50	--
02/09/01	15.72	6.05	9.67	--	<50	<0.50	<0.50	<0.50	<0.50	<2.5	--
05/29/01	15.72	6.73	8.99	--	<50	<0.50	<0.50	<0.50	<0.50	<2.5	--
08/27/01 ^h	15.72	5.68	10.04	--	<50	<0.50	<0.50	<0.50	<0.50	--/<5.0 ^f	--
11/28/01	15.72	5.86	9.86	--	NOT SAMPLED DUE TO INSUFFICIENT WATER				--	--	--
02/14/02	15.69	7.86	7.83	--	<50	<0.50	<0.50	<0.50	<1.5	<2.5	--
05/15/02	15.69	7.09	8.60	--	<50	<0.50	<0.50	<0.50	<1.5	<2.5	--
08/05/02	15.69	6.02	9.67	--	<50	<0.50	<0.50	<0.50	<1.5	<2.5	--
11/30/02	15.69	DRY	--	--	--	--	--	--	--	--	--
02/24-25/03 ⁱ	15.69	8.04	7.65	140	<50	<0.50	<0.50	<0.50	<1.5	<2.5	--
06/02/03	15.69	7.33	8.36	150 ^m	<50	<0.5	<0.5	<0.5	<1.5	<2.5	--
09/02/03	15.69	5.97	9.72	150 ^m	<50	<0.5	<0.5	<0.5	<1.5	<2.5	--
11/21/03	-- ⁿ	-- ⁿ	10.39	180	<50	<0.5	<0.5	<0.5	<1.5	<2.5	--
02/27/04	-- ⁿ	-- ⁿ	6.90	310	<50	<0.5	<0.5	<0.5	<1.5	<2.5	--
05/28/04	-- ⁿ	-- ⁿ	9.13	160	<50	<0.5	<0.5	<0.5	<1.5	<2.5	--
08/31/04	-- ⁿ	-- ⁿ	10.30	180 ^m	<50	<0.5	<0.5	<0.5	<1.5	<2.5	--
12/17/04	-- ⁿ	-- ⁿ	8.91	77 ^o	<50	<0.5	<0.5	<0.5	<1.5	<2.5	--
03/28/05	-- ⁿ	-- ⁿ	6.51	<50 ^o	<50	<0.5	0.5	<0.5	<1.5	<2.5	--
06/09/05	-- ⁿ	-- ⁿ	7.09	53 ^o	<50	<0.5	<0.5	<0.5	<1.5	<2.5	--
08/19/05	-- ⁿ	-- ⁿ	9.27	<50 ^{o,p}	<50	<0.5	<0.5	<0.5	<1.5	<2.5	--
11/18/05	-- ⁿ	-- ⁿ	9.66	<50 ^o	<50	<0.5	<0.5	<0.5	<1.5	<2.5	--
03/07/06	-- ⁿ	-- ⁿ	6.75	<50 ^o	<50	<0.5	<0.5	<0.5	<1.5	<2.5	--
05/17/06	-- ⁿ	-- ⁿ	7.09	<50 ^o	<50	<0.5	<0.5	<0.5	<1.5	<2.5	--
08/30/06	-- ⁿ	-- ⁿ	9.03	640 ^o	<50	<0.5	<0.5	<0.5	<1.5	<2.5	--
11/28/06	-- ⁿ	-- ⁿ	10.02	560 ^o	<50	<0.5	<0.5	<0.5	<1.5	<2.5	--
02/06/07	18.40	8.72	9.68	200^o	<50	<0.5	<0.5	<0.5	<1.5	<2.5	--
MW-3											
10/27/95	15.46	10.37	5.09	--	33,000	11,000	1,700	2,300	4,200	--	--
02/20/97	15.42	8.37	7.05	--	260	56	<1.0	7.6	5.9	<5.0	--
04/24/97	15.42	7.29	8.13	--	1,400	310	28	76	75	74	--
07/23/97	15.42	5.84	9.58	--	37,000	10,000	1,500	2,700	4,200	2,500	--

Table 1
Groundwater Monitoring Data and Analytical Results
Former Chevron (Signal Oil) Service Station #206145 (S-800)
800 Center Street
Oakland, California

WELL ID/ DATE	TOC ^a (ft.)	GWE (msl)	DTW (ft.)	TPH-D (ppb)	TPH-G (ppb)	B (ppb)	T (ppb)	E (ppb)	X (ppb)	MTBE (ppb)	CUB (cfu/ml)	
MW-3 (cont)												
10/29/97	15.42	5.09	10.33	--	53,000	12,000	1,200	3,000	3,100	2,500	--	
01/28/98	15.42	8.94	6.48	--	210	43	1.5	1.7	3.9	10	--	
05/11/98	15.42	8.49	6.93	--	59	11	<0.5	2.1	<0.5	<2.5	--	
07/16/98	15.42	7.14	8.28	--	260	90	4.8	18	5.7	<10	--	
08/04/98 ^a	15.42	6.88	8.54	--	--	--	--	--	--	--	8.5 x 10 ²	
09/03/98 ^a	15.42	6.34	9.08	--	--	--	--	--	--	--	2.4 x 10 ³	
10/21/98 ^b	15.42	5.62	9.80	--	--	--	--	--	--	--	6.0 x 10 ¹	
11/04/98	15.42	5.60	9.82	--	73,000	17,000	3,800	4,900	8,100	<250	--	
01/26/99	15.42	6.70	8.72	--	32,400	10,200	1,850	2,650	3,140	715/<500 ^c	--	
05/06/99	15.42	7.97	7.45	--	3,160	668	89.6	180	123	<200/<10 ^c	--	
08/21/99	15.42	7.95	7.47	--	53,800	9,700	2,040	2,880	5,000	<1,250/<40 ^c	--	
10/28/99	15.42	5.37	10.05	--	71,300	14,000	3,420	4,320	8,360	<1,000	--	
01/31/00	15.42	7.16	8.26	--	1,650	496	49.1	134	82.6	<12.5	--	
05/19/00	15.42	7.60	7.82	--	110 ^c	36	2.5	9.1	4.0	6.3	--	
08/07/00	15.42	6.29	9.13	--	36,000 ^e	9,000	3,000	2,700	2,800	2,500/<10 ^f	--	
12/01/00	15.42	2.45	12.97	--	NOT SAMPLED DUE TO INSUFFICIENT WATER					--	--	--
02/09/01	15.42	5.98	9.44	--	32,000 ^e	11,000	3,900	3,200	4,800	3,200/<2.0 ^f	--	
05/29/01	15.42	6.65	8.77	--	13,000	4,200	2,000	1,800	1,500	74/<2.0 ^f	--	
08/27/01 ^b	15.42	5.70	9.72	--	40,000	7,600	2,800	2,500	2,700	--/<25 ^f	--	
11/28/01	15.42	5.77	9.65	--	57,000	10,000	2,900	2,900	2,800	<250/<5.0 ^f	--	
02/14/02	15.40	7.73	7.67	--	51	2.9	<0.50	1.9	1.8	<2.5/<2 ^f	--	
05/15/02	15.40	7.05	8.35	--	4,100	910	250	210	240	<20/<2 ^f	--	
08/05/02	15.40	5.96	9.44	--	58,000	11,000	4,300	3,400	4,000	<250/<10 ^f	--	
11/30/02	15.40	5.14	10.26	--	46,000	13,000	2,900	3,700	2,600	<100/<10 ^f	--	
02/24-25/03 ¹	15.40	7.89	7.51	4,500	52,000	9,600	4,800	2,900	4,100	<130	--	
06/02/03	15.40	7.24	8.16	6,500	67,000	11,000	9,600	3,400	5,700	<250	--	
09/02/03	15.40	5.89	9.51	10,000	73,000	8,900	10,000	3,600	7,000	300	--	
11/21/03	15.40	5.17	10.23	8,000	29,000	3,300	3,200	1,200	1,500	<200	--	
02/27/04	15.40	8.84	6.56	200	59	8.2	6.3	1.7	6.8	<2.5	--	
05/28/04	15.40	6.57	8.83	5,400	18,000	2,600	970	1,600	950	<100	--	
08/31/04	15.40	5.41	9.99	9,100	58,000	3,200	9,600	2,800	7,500	<50	--	
12/17/04	15.40	6.81	8.59	2,200 ^o	23,000	1,100	2,100	1,200	2,600	<25	--	
03/28/05	15.40	9.29	6.11	3,200 ^o	43,000	1,500	10,000	2,600	7,300	<130	--	
06/09/05	15.40	8.65	6.75	7,800 ^o	38,000	980	7,000	2,100	4,800	190	--	
08/19/05	15.40	6.43	8.97	5,000 ^{o,p,r}	75,000	1,500	14,000	3,400	9,600	<130	--	
11/18/05	15.40	5.95	9.45	3,900 ^{o,r}	72,000	1,400	14,000	3,600	9,700	380	--	

Table 1
Groundwater Monitoring Data and Analytical Results
Former Chevron (Signal Oil) Service Station #206145 (S-800)
800 Center Street
Oakland, California

WELL ID/ DATE	TOC* (ft.)	GWE (mst)	DTW (ft.)	TPH-D (ppb)	TPH-G (ppb)	B (ppb)	T (ppb)	E (ppb)	X (ppb)	MTBE (ppb)	CUB (cfu/ml)
MW-3 (cont)											
03/07/06	15.40	9.05	6.35	1,100°	15,000	280	2,300	820	2,000	<100	--
05/17/06	15.40	8.57	6.83	4,400°	57,000	650	8,100	2,900	8,100	410	--
08/30/06	15.40	5.44	9.96	4,300°	54,000	540	7,600	4,100	10,000	550	--
11/28/06	15.40	5.62	9.78	4,400°	43,000	260	3,400	3,800	5,800	<1,000	--
02/06/07	18.07	8.70	9.37	5,000°	43,000	290	6,200	3,400	6,400	<500	--
MW-4											
10/27/95	14.45	9.37	5.08	--	66	6.8	<0.5	<0.5	<0.5	--	--
02/20/97	14.40	8.12	6.28	--	54	<0.5	<0.5	<0.5	7.4	39	--
04/24/97	14.40	7.29	7.11	--	54	1.4	<0.5	0.65	3.0	100	--
07/23/97	14.40	5.80	8.60	--	<50	<0.5	<0.5	<0.5	<0.5	<2.5	--
10/29/97	14.40	5.74	8.66	--	--	--	--	--	--	--	--
11/13/97	14.40	4.97	9.43	--	<50	<0.5	0.79	<0.5	<0.5	<2.5	--
01/28/98	14.40	8.88	5.52	--	<50	<0.5	<0.5	<0.5	<0.5	<2.5	--
05/11/98	14.40	8.40	6.00	--	SAMPLED BIANNUALLY		--	--	--	--	--
07/16/98	14.40	7.08	7.32	--	<50	<0.5	<0.5	<0.5	<0.5	<5.0	--
08/04/98 ^a	14.40	6.28	8.12	--	--	--	--	--	--	--	1.8 x 10 ⁴
09/03/98 ^a	14.40	6.32	8.08	--	--	--	--	--	--	--	1.4 x 10 ⁴
10/21/98 ^b	14.40	5.64	8.76	--	--	--	--	--	--	--	8.6 x 10 ⁴
11/04/98	14.40	5.61	8.79	--	--	--	--	--	--	--	--
01/26/99	14.40	6.71	7.69	--	<50	<0.5	<0.5	<0.5	<0.5	<2.0	--
05/06/99	14.40	8.15	6.25	--	--	--	--	--	--	--	--
08/21/99	14.40	8.13	6.27	--	<50	<0.5	<0.5	<0.5	<0.5	<5.0	--
10/28/99	14.40	4.14	10.26	--	--	--	--	--	--	--	--
01/31/00	14.40	7.07	7.33	--	<50	<0.5	<0.5	<0.5	<0.5	<2.5	--
05/19/00	14.40	7.52	6.88	--	--	--	--	--	--	--	--
08/07/00	14.40	6.23	8.17	--	<50	4.3	0.60	<0.50	<0.50	<2.5/<2.0 ^f	--
12/01/00	14.40	INACCESSIBLE	--	--	--	--	--	--	--	--	--
02/09/01	14.40	INACCESSIBLE	--	--	--	--	--	--	--	--	--
05/29/01	14.40	6.58	7.82	--	NOT SAMPLED DUE TO INSUFFICIENT WATER		--	--	--	--	--
08/27/01	14.40	6.52	7.88	--	NOT SAMPLED DUE TO INSUFFICIENT WATER		--	--	--	--	--
11/28/01	14.40	DRY	--	--	--	--	--	--	--	--	--
02/14/02	14.37	7.66	6.71	--	<50	<0.50	<0.50	<0.50	<1.5	<2.5/<2 ^f	--
05/15/02	14.37	6.96	7.41	--	<50	<0.50	<0.50	<0.50	<1.5	<2.5/<2 ^f	--
08/05/02	14.37	DRY	--	--	--	--	--	--	--	--	--

Table 1
Groundwater Monitoring Data and Analytical Results
Former Chevron (Signal Oil) Service Station #206145 (S-800)
800 Center Street
Oakland, California

WELL ID/ DATE	TOC* (ft.)	GWE (msl)	DTW (ft.)	TPH-D (ppb)	TPH-G (ppb)	B (ppb)	T (ppb)	E (ppb)	X (ppb)	MTBE (ppb)	CUB (cfu/ml)
MW-4 (cont)											
11/30/02	14.37	DRY	--	--	--	--	--	--	--	--	--
02/24-25/03 ¹	14.37	7.77	6.60	200	<50	8.0	<0.50	<0.50	<1.5	<2.5	--
06/02/03	14.37	7.11	7.26	300	<50	4.3	<0.5	<0.5	<1.5	<2.5	--
09/02/03	14.37	5.80	8.57	410	51	4.3	<0.5	<0.5	<1.5	<2.5	--
11/21/03	-- ⁿ	-- ⁿ	10.24	560	110	25	0.6	1.5	<1.5	<2.5	--
02/27/04	-- ⁿ	-- ⁿ	5.71	340	<50	<0.5	<0.5	<0.5	<1.5	<2.5	--
05/28/04	-- ⁿ	-- ⁿ	7.88	430	<50	<0.5	<0.5	<0.5	<1.5	<2.5	--
08/31/04	-- ⁿ	-- ⁿ	9.03	460	<50	<0.5	<0.5	<0.5	<1.5	<2.5	--
12/17/04	-- ⁿ	-- ⁿ	7.67	390 ^o	<50	<0.5	<0.5	<0.5	<1.5	<2.5	--
03/28/05	-- ⁿ	-- ⁿ	5.32	<50 ^o	<50	<0.5	<0.5	<0.5	<1.5	<2.5	--
06/09/05	-- ⁿ	-- ⁿ	6.70	120 ^o	90	<0.5	<0.5	<0.5	<1.5	<2.5	--
08/19/05	-- ⁿ	-- ⁿ	8.03	190 ^{o,p,q}	200	<0.5	<0.5	<0.5	<1.5	<2.5	--
11/18/05	-- ⁿ	-- ⁿ	9.43	310 ^{o,t}	230	2.7	<0.5	0.8	<1.5	<2.5	--
03/07/06	-- ⁿ	-- ⁿ	5.55	230 ^o	<50	<0.5	<0.5	<0.5	<1.5	<2.5	--
05/17/06	-- ⁿ	-- ⁿ	5.89	150 ^o	<50	<0.5	<0.5	<0.5	<1.5	<2.5	--
08/30/06	-- ⁿ	-- ⁿ	7.71	380 ^o	1,300	47	<2.5	<2.5	<7.5	<50	--
11/28/06	-- ⁿ	-- ⁿ	8.75	1,800 ^o	1,200	36	1.1	3.4	<5.0	<20	--
02/06/07	16.98	8.58	8.40	1,600^o	13,000^u	3,700^u	60^u	880^u	170^u	210^u	--
MW-5											
01/03/97	--	--	--	--	<50	<0.5	<0.5	<0.5	<0.5	--	--
02/20/97	15.03	INACCESSIBLE	--	--	--	--	--	--	--	--	--
04/24/97	15.03	INACCESSIBLE	--	--	--	--	--	--	--	--	--
04/30/97	15.03	7.06	7.97	--	<50	<0.5	<0.5	<0.5	<0.5	<2.5	--
07/23/97	15.03	INACCESSIBLE	--	--	--	--	--	--	--	--	--
10/29/97	15.03	INACCESSIBLE	--	--	--	--	--	--	--	--	--
01/28/98	15.03	8.83	6.20	--	<50	<0.5	<0.5	<0.5	<0.5	<2.5	--
05/11/98	15.03	INACCESSIBLE	--	--	--	--	--	--	--	--	--
07/16/98	15.03	7.28	7.75	--	<50	<0.5	<0.5	<0.5	<0.5	<5.0	--
08/04/98	15.03	INACCESSIBLE	--	--	--	--	--	--	--	--	--
11/04/98	15.03	INACCESSIBLE	--	--	--	--	--	--	--	--	--
01/26/99	15.03	INACCESSIBLE	--	--	--	--	--	--	--	--	--
05/06/99	15.03	INACCESSIBLE	--	--	--	--	--	--	--	--	--
08/21/99	15.03	6.74	8.29	--	<50	<0.5	<0.5	<0.5	<0.5	<5.0	--
10/28/99	15.03	4.60	10.43	--	--	--	--	--	--	--	--

Table 1
Groundwater Monitoring Data and Analytical Results
Former Chevron (Signal Oil) Service Station #206145 (S-800)
800 Center Street
Oakland, California

WELL ID/ DATE	TOC* (ft.)	GWE (msl)	DTW (ft.)	TPH-D (ppb)	TPH-G (ppb)	B (ppb)	T (ppb)	E (ppb)	X (ppb)	MTBE (ppb)	CUB (cfu/ml)
MW-5 (cont)											
01/31/00	15.03	7.39	7.64	--	<50	<0.5	<0.5	<0.5	<0.5	<2.5	--
05/19/00	15.03	7.85	7.18	--	--	--	--	--	--	--	--
08/07/00	15.03	INACCESSIBLE		--	--	--	--	--	--	--	--
12/01/00	15.03	5.68	9.35	--	<50.0	<0.500	<0.500	<0.500	<0.500	<2.50/<2.0 ^f	--
02/09/01	15.03	6.22	8.81	--	<50	<0.50	<0.50	<0.50	<0.50	<2.5/<2.0 ^f	--
05/29/01	15.03	INACCESSIBLE - CAR PARKED OVER WELL				--	--	--	--	--	--
08/27/01	15.03	INACCESSIBLE - CAR PARKED OVER WELL				--	--	--	--	--	--
11/28/01	15.03	INACCESSIBLE - CAR PARKED OVER WELL				--	--	--	--	--	--
02/14/02	15.01	7.96	7.05	--	<50	<0.50	<0.50	<0.50	<1.5	<2.5/<2 ^f	--
05/15/02	15.01	7.23	7.78	--	<50	<0.50	<0.50	<0.50	<1.5	<2.5/<2 ^f	--
08/05/02	15.01	6.13	8.88	--	<50	<0.50	<0.50	<0.50	<1.5	<2.5/<2 ^f	--
11/30/02	15.01	5.27	9.74	--	<50	<0.50	<0.50	<0.50	<1.5	<2.5/<2 ^f	--
02/24-25/03 ¹	15.01	7.99	7.02	<50	<50	<0.50	<0.50	<0.50	<1.5	<2.5	--
06/02/03	15.01	7.14	7.87	<50	<50	<0.5	<0.5	<0.5	<1.5	<2.5	--
09/02/03	15.01	6.02	8.99	<50	<50	<0.5	<0.5	<0.5	<1.5	<2.5	--
11/21/03	15.01	5.26	9.75	68	<50	<0.5	<0.5	<0.5	<1.5	<2.5	--
02/27/04	15.01	8.42	6.59	140	<50	<0.5	<0.5	<0.5	<1.5	<2.5	--
05/28/04	15.01	6.71	8.30	76	<50	<0.5	<0.5	<0.5	<1.5	<2.5	--
08/31/04	15.01	INACCESSIBLE - CAR PARKED OVER WELL				--	--	--	--	--	--
12/17/04	15.01	6.98	8.03	52 ^o	<50	<0.5	<0.5	<0.5	<1.5	<2.5	--
03/28/05	15.01	8.66	6.35	51 ^o	<50	<0.5	0.7	<0.5	<1.5	<2.5	--
06/09/05	15.01	9.16	5.85	72 ^o	<50	<0.5	<0.5	<0.5	<1.5	<2.5	--
08/19/05	15.01	6.52	8.49	<50 ^o p	<50	<0.5	<0.5	<0.5	<1.5	<2.5	--
11/18/05	15.01	6.12	8.89	<50 ^o	<50	<0.5	<0.5	<0.5	<1.5	<2.5	--
03/07/06	15.01	8.98	6.03	<50 ^o	<50	<0.5	<0.5	1.4	<1.5	<2.5	--
05/17/06	15.01	8.83	6.18	<50 ^o	<50	<0.5	<0.5	<0.5	<1.5	<2.5	--
08/30/06	15.01	6.86	8.15	<50 ^o	<50	<0.5	<0.5	<0.5	<1.5	<2.5	--
11/28/06	15.01	6.46	8.55	200 ^o	<50	<0.5	<0.5	<0.5	<1.5	<2.5	--
02/06/07	17.68	8.83	8.85	55^o	<50	<0.5	<0.5	<0.5	<1.5	<2.5	--
MW-6											
01/03/97	--	--	--	--	<50	<0.5	<0.5	<0.5	<0.5	--	--
02/20/97	14.73	8.11	6.62	--	800	310	23	11	28	<12	--
04/24/97	14.73	7.13	7.60	--	<50	<0.5	<0.5	<0.5	<0.5	<2.5	--
07/23/97	14.73	5.73	9.00	--	<50	<0.5	<0.5	<0.5	<0.5	<2.5	--

Table 1
Groundwater Monitoring Data and Analytical Results
Former Chevron (Signal Oil) Service Station #206145 (S-800)
800 Center Street
Oakland, California

WELL ID/ DATE	TOC* (ft.)	GWE (mst)	DTW (ft.)	TPH-D (ppb)	TPH-G (ppb)	B (ppb)	T (ppb)	E (ppb)	X (ppb)	MTBE (ppb)	CUB (cfu/ml)	
MW-6 (cont)												
10/29/97	14.73	4.98	9.75	--	<50	<0.5	<0.5	<0.5	<0.5	<2.5	--	
01/28/98	14.73	8.19	6.54	--	160	38	<0.5	<0.5	<0.5	<2.5	--	
05/11/98	14.73	8.08	6.65	--	1,700	490	72	39	52	<25	--	
07/16/98	14.73	7.04	7.69	--	<50	<0.5	<0.5	<0.5	<0.5	<5.0	--	
08/04/98 ^a	14.73	6.89	7.84	--	--	--	--	--	--	--	8.6 x 10 ³	
09/03/98 ^a	14.73	6.24	8.49	--	--	--	--	--	--	--	2.9 x 10 ³	
10/21/98 ^b	14.73	5.46	9.27	--	--	--	--	--	--	--	1.8 x 10 ³	
11/04/98	14.73	5.52	9.21	--	<50	<0.5	<0.5	<0.5	<0.5	<2.5	--	
01/26/99	14.73	6.49	8.24	--	<50	<0.5	<0.5	<0.5	<0.5	<2.0	--	
05/06/99	14.73	7.91	6.82	--	<50	<0.5	<0.5	<0.5	<0.5	<5.0	--	
08/21/99	14.73	7.93	6.80	--	<50	<0.5	<0.5	<0.5	<0.5	<5.0	--	
10/28/99	14.73	5.27	9.46	--	<50	<0.5	<0.5	<0.5	<0.5	<5.0	--	
01/31/00	14.73	7.16	7.57	--	<50	<0.5	<0.5	<0.5	<0.5	<2.5	--	
05/19/00	14.73	7.60	7.13	--	<50	11	<0.5	<0.5	<0.5	<2.5	--	
08/07/00	14.73	6.22	8.51	--	<50	<0.50	<0.50	<0.50	<0.50	<2.5/<2.0 ^f	--	
12/01/00	14.73	DRY	--	--	--	--	--	--	--	--	--	
02/09/01	14.73	DRY	--	--	--	--	--	--	--	--	--	
05/29/01	14.73	6.63	8.10	--	NOT SAMPLED DUE TO INSUFFICIENT WATER						--	--
08/27/01 ^h	14.73	9.83	4.90	--	150	<0.50	5.7	<0.50	<0.50	--/<5.0 ^f	--	
11/28/01	14.73	DRY	--	--	--	--	--	--	--	--	--	
02/14/02	14.68	7.90	6.78	--	<50	<0.50	<0.50	<0.50	<1.5	<2.5	--	
05/15/02	14.68	7.32	7.36	--	<50	<0.50	<0.50	<0.50	<1.5	<2.5	--	
08/05/02	14.68	DRY	--	--	--	--	--	--	--	--	--	
11/30/02	14.68	DRY	--	--	--	--	--	--	--	--	--	
02/24-25/03 ⁱ	14.68	7.89	6.79	<50	<50	<0.50	<0.50	<0.50	<1.5	<2.5	--	
06/02/03	14.68	7.20	7.48	<50	<50	<0.5	<0.5	<0.5	<1.5	<2.5	--	
09/02/03	14.68	5.77	8.91	190	<50	<0.5	<0.5	<0.5	<1.5	<2.5	--	
11/21/03	14.68	4.86	9.82	98	<50	<0.5	<0.5	<0.5	<1.5	<2.5	--	
02/27/04	14.68	8.12	6.56	240	<50	<0.5	<0.5	<0.5	<1.5	<2.5	--	
05/28/04	14.68	6.43	8.25	150	<50	<0.5	<0.5	<0.5	<1.5	<2.5	--	
08/31/04	14.68	5.29	9.39	360 ^m	<50	<0.5	<0.5	<0.5	<1.5	<2.5	--	
12/17/04	14.68	6.85	7.83	91 ^o	<50	<0.5	<0.5	<0.5	<1.5	<2.5	--	
03/28/05	14.68	8.34	6.34	61 ^o	<50	<0.5	<0.5	<0.5	<1.5	<2.5	--	
06/09/05	14.68	7.95	6.73	64 ^o	<50	<0.5	<0.5	<0.5	<1.5	<2.5	--	
08/19/05	14.68	6.27	8.41	<50 ^{o,p}	<50 ^s	<0.5	<0.5	<0.5	<1.5	<2.5	--	
11/18/05	14.68	DRY AT 15.70 FEET		--	--	--	--	--	--	--	--	

Table 1
Groundwater Monitoring Data and Analytical Results
Former Chevron (Signal Oil) Service Station #206145 (S-800)
800 Center Street
Oakland, California

WELL ID/ DATE	TOC* (ft.)	GWE (msl)	DTW (ft.)	TPH-D (ppb)	TPH-G (ppb)	B (ppb)	T (ppb)	E (ppb)	X (ppb)	MTBE (ppb)	CUB (cfu/ml)
MW-6 (cont)											
03/07/06	14.68	8.03	6.65	<50°	<50	<0.5	<0.5	0.9	<1.5	<2.5	--
05/17/06	14.68	7.98	6.70	<50°	<50	<0.5	<0.5	<0.5	<1.5	<2.5	--
08/30/06	14.68	6.63	8.05	<50°	<50	<0.5	<0.5	<0.5	<1.5	<2.5	--
11/28/06	14.68	6.09	8.59	120°	<50	<0.5	<0.5	<0.5	<1.5	<2.5	--
02/06/07	17.33	8.58	8.75	96°	<50	<0.5	<0.5	<0.5	<1.5	<2.5	--
MW-7											
01/03/97	--	--	--	--	<50	<0.5	<0.5	<0.5	<0.5	--	--
02/20/97	16.36	8.86	7.50	--	<50	<0.5	<0.5	<0.5	<0.5	<2.5	--
04/24/97	16.36	7.59	8.77	--	<50	<0.5	<0.5	<0.5	<0.5	<2.5	--
07/23/97	16.36	6.09	10.27	--	<50	<0.5	<0.5	<0.5	<0.5	<2.5	--
10/29/97	16.36	5.28	11.08	--	<50	<0.5	<0.5	<0.5	<0.5	<2.5	--
01/28/98	16.36	9.10	7.26	--	<50	<0.5	<0.5	<0.5	<0.5	<2.5	--
05/11/98	16.36	9.11	7.25	--	SAMPLED ANNUALLY		--	--	--	--	--
07/16/98	16.36	8.00	8.36	--	--	--	--	--	--	--	--
08/04/98 ^a	16.36	7.32	9.04	--	--	--	--	--	--	--	1.5 x 10 ³
09/03/98 ^a	16.36	6.65	9.71	--	--	--	--	--	--	--	6.5 x 10 ²
10/21/98 ^b	16.36	5.96	10.40	--	--	--	--	--	--	--	4.8 x 10 ³
11/04/98	16.36	5.89	10.47	--	--	--	--	--	--	--	--
01/26/99	16.36	8.25	8.11	--	<50	<0.5	<0.5	<0.5	0.5	<2.0	--
05/06/99	16.36	8.47	7.89	--	--	--	--	--	--	--	--
08/21/99	16.36	8.51	7.85	--	--	--	--	--	--	--	--
10/28/99	16.36	6.04	10.32	--	--	--	--	--	--	--	--
01/31/00	16.36	7.57	8.79	--	<50	<0.5	<0.5	<0.5	<0.5	<2.5	--
05/19/00	16.36	UNABLE TO LOCATE		--	--	--	--	--	--	--	--
08/07/00	16.36	6.67	9.69	--	<50	<0.50	<0.50	<0.50	<0.50	<2.5/<2.0 ^f	--
12/01/00	16.36	5.84	10.52	--	<50.0	<0.500	<0.500	<0.500	<0.500	<2.50	--
02/09/01	16.36	6.30	10.06	--	<50	<0.50	<0.50	<0.50	<0.50	<2.5	--
05/29/01	16.36	UNABLE TO LOCATE		--	--	--	--	--	--	--	--
08/27/01 ^h	16.36	6.02	10.34	--	<50	<0.50	<0.50	<0.50	<0.50	--/<5.0 ^f	--
11/28/01	16.36	6.09	10.27	--	<50	<0.50	<0.50	<0.50	<1.5	<2.5	--
02/14/02	16.31	8.21	8.10	--	<50	<0.50	<0.50	<0.50	<1.5	<2.5	--
05/15/02	16.31	7.41	8.90	--	<50	<0.50	<0.50	<0.50	<1.5	<2.5	--
08/05/02	16.31	6.26	10.05	--	<50	<0.50	<0.50	<0.50	<1.5	<2.5	--
11/30/02	16.31	5.39	10.92	--	<50	<0.50	<0.50	<0.50	<1.5	<2.5	--

Table 1
Groundwater Monitoring Data and Analytical Results
Former Chevron (Signal Oil) Service Station #206145 (S-800)
800 Center Street
Oakland, California

WELL ID/ DATE	TOC* (ft.)	GWE (msf)	DTW (ft.)	TPH-D (ppb)	TPH-G (ppb)	B (ppb)	T (ppb)	E (ppb)	X (ppb)	MTBE (ppb)	CUB (cfu/ml)
MW-7 (cont)											
02/24-25/03 ^l	16.31	8.30	8.01	<50	<50	<0.50	<0.50	<0.50	<1.5	<2.5	--
06/02/03	16.31	7.67	8.64	<50	<50	<0.5	<0.5	<0.5	<1.5	<2.5	--
09/02/03	16.31	6.17	10.14	<50	<50	<0.5	<0.5	<0.5	<1.5	<2.5	--
11/21/03	16.31	UNABLE TO LOCATE - BURIED			--	--	--	--	--	--	--
02/27/04	16.31	UNABLE TO LOCATE - BURIED			--	--	--	--	--	--	--
05/28/04	-- ⁿ	-- ⁿ	9.40	91	<50	<0.5	<0.5	<0.5	<1.5	<2.5	--
08/31/04	-- ⁿ	-- ⁿ	10.61	150 ^m	<50	<0.5	<0.5	<0.5	<1.5	<2.5	--
12/17/04	-- ⁿ	-- ⁿ	9.16	170 ^o	<50	<0.5	<0.5	<0.5	<1.5	<2.5	--
03/28/05	-- ⁿ	-- ⁿ	7.21	<50 ^o	<50	<0.5	<0.5	<0.5	<1.5	<2.5	--
06/09/05	-- ⁿ	-- ⁿ	7.71	86 ^o	55	<0.5	<0.5	<0.5	<1.5	<2.5	--
08/19/05	-- ⁿ	-- ⁿ	9.88	820 ^{o,p,q}	<50	<0.5	<0.5	<0.5	<1.5	<2.5	--
11/18/05	-- ⁿ	-- ⁿ	10.06	<50 ^o	<50	<0.5	<0.5	<0.5	<1.5	<2.5	--
03/07/06	-- ⁿ	-- ⁿ	6.95	<50 ^o	<50	<0.5	<0.5	<0.5	<1.5	<2.5	--
05/17/06	-- ⁿ	-- ⁿ	7.52	<50 ^o	<50	<0.5	<0.5	<0.5	<1.5	<2.5	--
08/30/06	-- ⁿ	-- ⁿ	10.73	<50 ^o	<50	<0.5	<0.5	<0.5	<1.5	<2.5	--
11/28/06	-- ⁿ	-- ⁿ	10.70	<50 ^o	<50	<0.5	<0.5	<0.5	<1.5	<2.5	--
02/06/07	19.26	8.91	10.35	73^o	<50	<0.5	<0.5	<0.5	<1.5	<2.5	--
MW-8											
02/14/02 ^{ij}	15.29	7.30	7.99	--	<50	<0.50	<0.50	<0.50	<1.5	<2.5/<2 ^f	--
05/15/02 ^k	15.29	6.66	8.63	--	<50	<0.50	<0.50	<0.50	<1.5	<2.5	--
08/05/02 ^k	15.29	5.48	9.81	--	<50	<0.50	<0.50	<0.50	<1.5	<2.5	--
11/30/02 ^k	15.29	4.85	10.44	--	<50	<0.50	<0.50	<0.50	<1.5	<2.5	--
02/24-25/03 ^l	15.29	7.46	7.83	<50	<50	<0.50	<0.50	<0.50	<1.5	<2.5	--
06/02/03	15.29	6.83	8.46	<50	<50	<0.5	<0.5	<0.5	<1.5	<2.5	--
09/02/03	15.29	5.57	9.72	<50	<50	<0.5	<0.5	<0.5	<1.5	<2.5	--
11/21/03	15.29	4.89	10.40	<50	<50	<0.5	<0.5	<0.5	<1.5	<2.5	--
02/27/04	15.29	8.38	6.91	280	<50	<0.5	<0.5	<0.5	<1.5	<2.5	--
05/28/04	15.29	6.33	8.96	72	<50	<0.5	<0.5	<0.5	<1.5	<2.5	--
08/31/04	15.29	4.79	10.50	92 ^m	<50	<0.5	<0.5	<0.5	<1.5	<2.5	--
12/17/04	15.29	6.68	8.61	53 ^o	<50	<0.5	<0.5	<0.5	<1.5	<2.5	--
03/28/05	15.29	8.79	6.50	<50 ^o	<50	<0.5	0.9	<0.5	<1.5	<2.5	--
06/09/05	15.29	8.26	7.03	63 ^o	<50	<0.5	<0.5	<0.5	<1.5	<2.5	--
08/19/05	15.29	6.18	9.11	<50 ^{o,p}	<50	<0.5	<0.5	<0.5	<1.5	<2.5	--
11/18/05	15.29	5.47	9.82	<50 ^o	<50	<0.5	<0.5	<0.5	<1.5	<2.5	--

Table 1
Groundwater Monitoring Data and Analytical Results
Former Chevron (Signal Oil) Service Station #206145 (S-800)
800 Center Street
Oakland, California

WELL ID/ DATE	TOC* (ft.)	GWE (msl)	DTW (ft.)	TPH-D (ppb)	TPH-G (ppb)	B (ppb)	T (ppb)	E (ppb)	X (ppb)	MTBE (ppb)	CUB (cfu/ml)
MW-8 (cont)											
03/07/06	15.29	8.60	6.69	<50 ^o	<50	<0.5	<0.5	<0.5	<1.5	<2.5	--
05/17/06	15.29	8.21	7.08	<50 ^o	<50	<0.5	<0.5	<0.5	<1.5	<2.5	--
08/30/06	15.29	6.57	8.72	<50 ^o	<50	<0.5	<0.5	<0.5	<1.5	<2.5	--
11/28/06	15.29	6.38	8.91	<50 ^o	<50	<0.5	<0.5	<0.5	<1.5	<2.5	--
02/06/07	17.79	8.39	9.40	<50 ^o	<50	<0.5	<0.5	<0.5	<1.5	<2.5	--
MW-1											
10/27/95	15.69	10.54	5.15	--	170,000	19,000	34,000	4,800	26,000	--	--
02/20/97	15.64	8.96	6.68	--	18,000	870	3,500	470	2,100	<250	--
04/24/97	15.64	7.30	8.34	--	76,000	4,600	16,000	1,600	8,300	1,000	--
07/23/97	15.64	5.90	9.74	--	37,000	2,700	8,000	870	6,100	<250	--
10/29/97	15.64	INACCESSIBLE	--	--	--	--	--	--	--	--	--
01/28/98	15.64	9.30	6.34	--	10,000	380	2,000	300	1,500	<25	--
05/11/98	15.64	8.72	6.92	--	17,000	880	3,100	380	2,300	<250	--
07/16/98	15.64	7.23	8.41	--	29,000	2,700	6,800	890	3,900	<1,000	--
08/04/98 ^a	15.64	6.90	8.74	--	--	--	--	--	--	--	<1.0 x 10 ¹
09/03/98 ^a	15.64	6.43	9.21	--	--	--	--	--	--	--	4.1 x 10 ³
10/21/98 ^b	15.64	5.59	10.05	--	--	--	--	--	--	--	4.7 x 10 ²
11/04/98	15.64	5.64	10.00	--	25,000	1,900	5,900	810	4,300	<125	--
01/26/99	15.64	6.86	8.78	--	<50	<0.5	<0.5	<0.5	<0.5	<2.0	--
05/06/99	15.64	8.17	7.47	--	8,050	515	1,840	256	1,190	300/<20 ^c	--
08/21/99	15.64	13.27	2.37	--	46,500	2,530	8,700	1,010	5,300	<1,250/<40 ^c	--
10/28/99	15.64	5.46	10.18	--	31,600	1,580	6,100	794	4,400	1,270	--
01/31/00	15.64	7.49	8.15	--	7,270	366	1,280	171	935	<12.5	--
05/19/00	15.64	7.78	7.86	--	8,000 ^e	870	1,200	430	1,200	<250	--
08/07/00	15.64	6.42	9.22	--	37,000 ^e	2,400	8,500	1,100	5,500	1,500/<4.0 ^f	--
12/01/00	15.64	5.25	10.39	--	25,500 ^e	1,390	4,920	801	4,330	<500/<10 ^f	--
02/09/01	15.64	6.10	9.54	--	8,900 ^e	850	1,300	470	1,700	820/<2.0 ^f	--
05/29/01	15.64	6.79	8.85	--	24,000 ^e	1,800	5,600	740	3,700	<250/<2.0 ^f	--
08/27/01 ^b	15.64	5.83	9.81	--	27,000	1,400	4,400	710	3,400	--/<20 ^f	--
11/28/01	15.64	5.84	9.80	--	26,000	1,300	3,900	620	3,400	<100/<2 ^f	--
02/14/02	15.63	8.34	7.29	--	1,400	100	360	45	240	9.3/<2 ^f	--
05/15/02	15.63	7.18	8.45	--	37,000	2,400	7,300	1,000	4,800	<100/<3.0 ^f	--

Table 1
Groundwater Monitoring Data and Analytical Results
Former Chevron (Signal Oil) Service Station #206145 (S-800)
800 Center Street
Oakland, California

WELL ID/ DATE	TOC* (ft.)	GWE (msl)	DTW (ft.)	TPH-D (ppb)	TPH-G (ppb)	B (ppb)	T (ppb)	E (ppb)	X (ppb)	MTBE (ppb)	CUB (cfu/ml)
MW-1 (cont)											
08/05/02	15.63	6.09	9.54	--	27,000	1,500	4,600	700	3,400	<100/<3.0 ^f	--
DESTROYED											
TRIP BLANK											
02/20/97	--	--	--	--	<50	<0.5	<0.5	<0.5	<0.5	<2.5	--
04/24/97	--	--	--	--	<50	<0.5	<0.5	<0.5	<0.5	<2.5	--
07/23/97	--	--	--	--	<50	<0.5	<0.5	<0.5	<0.5	<2.5	--
10/29/97	--	--	--	--	<50	<0.5	<0.5	<0.5	<0.5	<2.5	--
01/28/98	--	--	--	--	<50	<0.5	<0.5	<0.5	<0.5	<2.5	--
05/11/98	--	--	--	--	<50	<0.5	<0.5	<0.5	<0.5	<2.5	--
07/16/98	--	--	--	--	<50	<0.5	<0.5	<0.5	<0.5	<5.0	--
11/04/98	--	--	--	--	<50	<0.5	<0.5	<0.5	<0.5	<2.0	--
01/26/99	--	--	--	--	<50	<0.5	<0.5	<0.5	<0.5	<2.0	--
05/06/99	--	--	--	--	<50	<0.5	<0.5	<0.5	<0.5	<5.0	--
01/31/00	--	--	--	--	<50	<0.5	<0.5	<0.5	<0.5	<2.5	--
05/19/00	--	--	--	--	<50	<0.50	<0.50	<0.50	<0.50	<2.5	--
08/07/00	--	--	--	--	<50	<0.50	<0.50	<0.50	<0.50	<2.5	--
12/01/00	--	--	--	--	<50.0	<0.500	<0.500	<0.500	<0.500	<2.50	--
02/09/01	--	--	--	--	<50	<0.50	<0.50	<0.50	<0.50	<2.5	--
05/29/01	--	--	--	--	<50	<0.50	<0.50	<0.50	<0.50	<2.5	--
08/27/01 ^h	--	--	--	--	<50	<0.50	<0.50	<0.50	<0.50	--/<5.0 ^f	--
QA											
11/28/01	--	--	--	--	<50	<0.50	<0.50	<0.50	<1.5	<2.5	--
02/14/02	--	--	--	--	<50	<0.50	<0.50	<0.50	<1.5	<2.5	--
05/15/02	--	--	--	--	<50	<0.50	<0.50	<0.50	<1.5	<2.5	--
08/05/02	--	--	--	--	<50	<0.50	<0.50	<0.50	<1.5	<2.5	--
11/30/02	--	--	--	--	<50	<0.50	<0.50	<0.50	<1.5	<2.5	--
02/24-25/03	--	--	--	--	<50	<0.50	<0.50	<0.50	<1.5	<2.5	--
06/02/03	--	--	--	--	<50	<0.5	<0.5	<0.5	<1.5	<2.5	--
09/02/03	--	--	--	--	<50	<0.5	<0.5	<0.5	<1.5	<2.5	--
11/21/03	--	--	--	--	<50	<0.5	<0.5	<0.5	<1.5	<2.5	--
02/27/04	--	--	--	--	<50	<0.5	<0.5	<0.5	<1.5	<2.5	--
05/28/04	--	--	--	--	<50	<0.5	<0.5	<0.5	<1.5	<2.5	--
08/31/04	--	--	--	--	<50	<0.5	<0.5	<0.5	<1.5	<2.5	--
12/17/04	--	--	--	--	<50	<0.5	<0.5	<0.5	<1.5	<2.5	--
03/28/05	--	--	--	--	<50	<0.5	<0.5	<0.5	<1.5	<2.5	--
06/09/05	--	--	--	--	<50	<0.5	<0.5	<0.5	<1.5	<2.5	--

Table 1
Groundwater Monitoring Data and Analytical Results
Former Chevron (Signal Oil) Service Station #206145 (S-800)
800 Center Street
Oakland, California

WELL ID/ DATE	TOC* (ft.)	GWE (msl)	DTW (ft.)	TPH-D (ppb)	TPH-G (ppb)	B (ppb)	T (ppb)	E (ppb)	X (ppb)	MTBE (ppb)	CUB (cfu/ml)
QA (cont)											
08/19/05	--	--	--	--	<50	<0.5	<0.5	<0.5	<1.5	<2.5	--
11/18/05	--	--	--	--	<50	<0.5	<0.5	<0.5	<1.5	<2.5	--
03/07/06	--	--	--	--	<50	<0.5	<0.5	<0.5	<1.5	<2.5	--
05/17/06	--	--	--	--	<50	<0.5	<0.5	<0.5	<1.5	<2.5	--
08/30/06	--	--	--	--	<50	<0.5	<0.5	<0.5	<1.5	<2.5	--
11/28/06	--	--	--	--	<50	<0.5	<0.5	<0.5	<1.5	<2.5	--
02/06/07	--	--	--	--	<50	<0.5	<0.5	<0.5	<1.5	<2.5	--

Table 1
Groundwater Monitoring Data and Analytical Results
Former Chevron (Signal Oil) Service Station #206145 (S-800)
800 Center Street
Oakland, California

EXPLANATIONS:

Groundwater monitoring data and laboratory analytical results prior to May 19, 2000 were compiled from reports prepared by Blaine Tech Services, Inc.

TOC = Top of Casing (ft.) = Feet	TPH-G = Total Petroleum Hydrocarbons as Gasoline B = Benzene	CUB = Contaminate utilizing bacteria (cfu/ml) = Colony forming unit per milliliter
GWE = Groundwater Elevation (msl) = Mean sea level	T = Toluene E = Ethylbenzene	(ppb) = Parts per billion -- = Not Measured/Not Analyzed
DTW = Depth to Water	X = Xylenes	QA = Quality Assurance/Trip Blank
TPH-D = Total Petroleum Hydrocarbons as Diesel	MTBE = Methyl tertiary butyl ether	

* TOC elevations were surveyed on August 17, 2005, by Morrow Surveying. Gettler-Ryan received updated TOC data March 12, 2007.

On February 18, 2003 MW-1A was surveyed using the previous benchmark.

TOC elevations were surveyed on December March 4, 2002, by Virgil Chavez Land Surveying. The benchmark for the survey was a City of Oakland benchmark, #25-H monument disk in well casing in sidewalk at the northwest corner of 7th and Center. The latitude, longitude and coordinates are for top of casings and are based on the California State Coordinate System, Zone III (NAD83), (Benchmark Elevation = 10.784 feet NGVD 29).

^a Contaminate hydrocarbon utilizing bacteria plate count was run with diesel and jet fuel degraders.

^b Contaminate hydrocarbon utilizing bacteria plate count was run with gasoline degraders.

^c Confirmation run.

^d Chromatogram pattern indicates an unidentified hydrocarbon.

^e Laboratory report indicates gasoline C6-C12.

^f MTBE by EPA Method 8260.

^g Laboratory reports indicates weathered gasoline C6-C12.

^h TPH-G and BTEX by EPA Method 8260.

ⁱ Well development performed.

^j TPH-D was detected at 130 ppb.

^k TPH-D was <50 ppb.

^l Well re-development performed.

^m Laboratory report indicates the observed sample pattern is not typical of diesel/#2 fuel oil.

ⁿ TOC damaged; unable to calculate an accurate GWE.

^o TPH-D with silica gel clean-up.

^p Laboratory report indicates analysis performed out of hold time.

^q Laboratory report indicates the observed sample pattern includes #2 fuel/diesel and an additional pattern which elutes later in the DRO range.

^r Laboratory report indicates the observed sample pattern is not typical of #2 fuel/diesel. It elutes in the DRO range earlier than #2 fuel.

^s Laboratory report indicates the analysis was performed from a previously opened vial and the results are therefore estimated.

^t Laboratory report indicates the observed sample pattern includes #2 fuel/diesel, an additional pattern which elutes later in the DRO range, and individual peaks eluting in the DRO range.

^u Laboratory confirmed result.

Table 2
Field Measurements and Analytical Results
Former Chevron (Signal Oil) Service Station #206145 (S-800)
800 Center Street
Oakland, California

WELL ID/ DATE	Pre-purge DO (mg/L)	Post-purge DO (mg/L)	Pre-purge ORP (mV)	Post-purge ORP (mV)	Total Alkalinity (ppb)	Ferrous Iron (ppb)	Nitrate as Nitrate (ppb)	Sulfate (ppb)
MW-1 09/03/98	2.3	1.6	-90	-103	230,000	9,800	<1,000	6,100
MW-2 09/03/98	2.8	2.5	-206	-163	390,000	7,400	<1,000	21,000
MW-3 09/03/98	3.1	0.7	-124	-99	830,000	45,000	<1,000	10,000
MW-4 09/03/98	2.6	1.1	-190	-206	--	--	--	--
MW-6 09/03/98	2.6	3.2	-148	-167	94,000	62	28,000	47,000
MW-7 09/03/98	2.7	3.2	-207	-229	170,000	120	7,800	57,000

EXPLANATIONS:

Groundwater monitoring data and laboratory analytical results were compiled from reports prepared by Blaine Tech Services, Inc.

DO = Dissolved Oxygen

(mg/L) = Milligram per liter

ORP = Oxidation Reduction Potential

(mV) = Millivolts

(ppb) = Parts per billion

-- = Not Analyzed

Table 3
Groundwater Analytical Results - Oxygenate Compounds
Former Chevron (Signal Oil) Service Station #206145 (S-800)
800 Center Street
Oakland, California

WELL ID	DATE	METHANOL (ppm)	ETHANOL (ppb)	TBA (ppb)	MTBE (ppb)	DIPE (ppb)	ETBE (ppb)	TAME (ppb)	1,2-DCA (ppb)	EDB (ppb)
MW-1	08/07/00	--	<1,000	410	<4.0	<4.0	<4.0	<4.0	<4.0	<4.0
	12/01/00	--	<2,500	<250	<10	<10	<10	<10	<10	<10
	02/09/01	--	<500	340	<2.0	<2.0	<2.0	53	<2.0	<2.0
	05/29/01	--	<500	<20	<2.0	<2.0	<2.0	<2.0	<2.0	<2.0
	08/27/01	<2,000	<200	230	<20	<20	<20	<20	<20	<20
	11/28/01	--	<500	130	<2	<2	<2	<2	<2	<2
	02/14/02	--	<500	<100	<2	<2	<2	<2	<2	<2
	05/15/02	--	<500	120	<3.0	<3.0	<3.0	<3.0	<3.0	<3.0
	08/05/02	--	<500	100	<3.0	<3.0	<3.0	<3.0	<3.0	<3.0
DESTROYED										
MW-2	08/07/00		<500	<100	<2.0	<2.0	<2.0	<2.0	<2.0	<2.0
	08/27/01	--	--	--	<5.0	--	--	--	--	--
MW-3	08/07/00	--	<500	2,600	<10	<10	<10	<10	490	17
	02/09/01	--	<500	2,000	<2.0	<2.0	<2.0	35	<2.0	<2.0
	05/29/01	--	<500	1,700 ¹	<2.0	<2.0	<2.0	38	980 ¹	7.4
	08/27/01	<5,000	<250	1,300	<25	<25	<25	<25	380	<25
	11/28/01	--	<500	1,500	<5.0	<5.0	<5.0	<5.0	<5.0	<5.0
	02/14/02	--	<500	<100	<2	<2	<2	<2	<2	<2
	05/15/02	--	<500	110	<2	<2	<2	<2	120	<2
	08/05/02	--	<1,000	1,400	<10	<10	<10	<10	670	<10
	11/30/02	--	<1,000	1,200	<10	<10	<10	<10	380	<10
MW-4	08/07/00	--	<500	<100	<2.0	<2.0	<2.0	<2.0	18	<2.0
	08/27/01	NOT SAMPLED DUE TO INSUFFICIENT WATER				--	--	--	--	--
	11/28/01	DRY	--	--	--	--	--	--	--	--
	02/14/02	--	<500	<100	<2	<2	<2	<2	9	<2
	05/15/02	--	<500	<100	<2	<2	<2	<2	4	<2
	08/05/02	DRY	--	--	--	--	--	--	--	--
	11/30/02	DRY	--	--	--	--	--	--	--	--
MW-5	12/01/00	--	<500	<50	<2.0	<2.0	<2.0	<2.0	<2.0	<2.0
	02/09/01	--	<500	<50	<2.0	<2.0	<2.0	<2.0	<2.0	<2.0
	08/27/01	INACCESSIBLE - CAR PARKED OVER WELL				--	--	--	--	--
	11/28/01	INACCESSIBLE - CAR PARKED OVER WELL				--	--	--	--	--
	02/14/02	--	<500	<100	<2	<2	<2	<2	<2	<2

Table 3
Groundwater Analytical Results - Oxygenate Compounds
Former Chevron (Signal Oil) Service Station #206145 (S-800)
800 Center Street
Oakland, California

WELL ID	DATE	METHANOL (ppm)	ETHANOL (ppb)	TBA (ppb)	MTBE (ppb)	DIPE (ppb)	ETBE (ppb)	TAME (ppb)	1,2-DCA (ppb)	EDB (ppb)
MW-5 (cont)	05/15/02	--	<500	<100	<2	<2	<2	<2	<2	<2
	08/05/02	--	<500	<100	<2	<2	<2	<2	<2	<2
	11/30/02	--	<500	<100	<2	<2	<2	<2	<2	<2
MW-6	08/07/00	--	<500	<100	<2.0	<2.0	<2.0	<2.0	<2.0	<2.0
	08/27/01	--	--	--	<5.0	--	--	--	--	--
	11/30/02	DRY	--	--	--	--	--	--	--	--
MW-7	08/07/00	--	<500	<100	<2.0	<2.0	<2.0	<2.0	<2.0	<2.0
	08/27/01	--	--	--	<5.0	--	--	--	--	--
MW-8	02/14/02	--	<500	<100	<2	<2	<2	<2	<2	<2

EXPLANATIONS:

TBA = Tertiary butyl alcohol
MTBE = Methyl tertiary butyl ether
DIPE = Di-isopropyl ether
ETBE = Ethyl tertiary butyl ether
TAME = Tertiary amyl methyl ether
1,2-DCA = 1,2-Dichloroethane
EDB = 1,2-Dibromoethane
(ppm) = Parts per million
(ppb) = Parts per billion
-- = Not Analyzed

ANALYTICAL METHODS:

EPA Method 8260 (modified) for Methanol
EPA Method 8260 for Oxygenate Compounds

¹ Laboratory report indicates this sample was originally analyzed within holding time. Re-analysis for confirmation or dilution was performed past the recommended holding time.

STANDARD OPERATING PROCEDURE - GROUNDWATER SAMPLING

Gettler-Ryan Inc. field personnel adhere to the following procedures for the collection and handling of groundwater samples prior to analysis by the analytical laboratory. Prior to sample collection, the type of analysis to be performed is determined. Loss prevention of volatile compounds is controlled and sample preservation for subsequent analysis is maintained.

Prior to sampling, the presence or absence of free-phase hydrocarbons is determined using an interface probe. Product thickness, if present, is measured to the nearest 0.01 foot and is noted in the field notes. In addition, all depth to water level measurements are collected with a static water level indicator and are also recorded in the field notes, prior to purging and sampling any wells.

After water levels are collected and prior to sampling, if purging is to occur, each well is purged a minimum of three well casing volumes of water using pre-cleaned pumps (stack, suction, Grundfos), or disposable bailers. Temperature, pH and electrical conductivity are measured a minimum of three times during the purging. Purging continues until these parameters stabilize.

Groundwater samples are collected using disposable bailers. The water samples are transferred from the bailer into appropriate containers. Pre-preserved containers, supplied by analytical laboratories, are used when possible. When pre-preserved containers are not available, the laboratory is instructed to preserve the sample as appropriate. Duplicate samples are collected for the laboratory to use in maintaining quality assurance/quality control standards. The samples are labeled to include the job number, sample identification, collection date and time, analysis, preservation (if any), and the sample collector's initials. The water samples are placed in a cooler, maintained at 4°C for transport to the laboratory. Once collected in the field, all samples are maintained under chain of custody until delivered to the laboratory.

The chain of custody document includes the job number, type of preservation, if any, analysis requested, sample identification, date and time collected, and the sample collector's name. The chain of custody is signed and dated (including time of transfer) by each person who receives or surrenders the samples, beginning with the field personnel and ending with the laboratory personnel.

A laboratory supplied trip blank accompanies each sampling set. For sampling sets greater than 20 samples, 5% trip blanks are included. The trip blank is analyzed for some or all of the same compounds as the groundwater samples.

As requested by Chevron Environmental Management Company, the purge water and decontamination water generated during sampling activities is transported by IWM to Chemical Waste Management located in Kettleman Hill, California.



GETTLER-RYAN INC.

WELL MONITORING/SAMPLING FIELD DATA SHEET

Client/Facility #: Chevron #206145 Job Number: 386492
 Site Address: 800 Center Street Event Date: 2/6/07 (inclusive)
 City: Oakland, CA Sampler: HAIK

Well ID: MW-1A Date Monitored: 2/6/07 Well Condition: OK

Well Diameter: 2 in.
 Total Depth: 16.72 ft.
 Depth to Water: 9.28 ft.
7.44 x VF 0.17 = 1.2 x3 case volume = Estimated Purge Volume: 3.6 gal.

Volume	3/4"= 0.02	1"= 0.04	2"= 0.17	3"= 0.38
Factor (VF)	4"= 0.66	5"= 1.02	6"= 1.50	12"= 5.80

Purge Equipment:
 Disposable Bailer
 Stainless Steel Bailer _____
 Stack Pump _____
 Suction Pump _____
 Grundfos _____
 Other: _____

Sampling Equipment:
 Disposable Bailer
 Pressure Bailer _____
 Discrete Bailer _____
 Other: _____

Time Started: _____ (2400 hrs)
 Time Completed: _____ (2400 hrs)
 Depth to Product: _____ ft
 Depth to Water: _____ ft
 Hydrocarbon Thickness: 0 ft
 Visual Confirmation/Description: _____

Skimmer / Absorbant Sock (circle one)
 Amt Removed from Skimmer: _____ gal
 Amt Removed from Well: _____ gal
 Water Removed: _____
 Product Transferred to: _____

Start Time (purge): 1050 Weather Conditions: CLOUDY
 Sample Time/Date: 1105 2/6/07 Water Color: cloudy Odor: YES
 Purging Flow Rate: _____ gpm. Sediment Description: _____
 Did well de-water? NO If yes, Time: _____ Volume: _____ gal.

Time (2400 hr.)	Volume (gal.)	pH	Conductivity (u mhos/cm)	Temperature (C F)	D.O. (mg/L)	ORP (mV)
<u>1053</u>	<u>1.5</u>	<u>6.90</u>	<u>598</u>	<u>16.1</u>	_____	_____
<u>1056</u>	<u>2.5</u>	<u>6.85</u>	<u>610</u>	<u>16.2</u>	_____	_____
<u>1059</u>	<u>3.5</u>	<u>6.80</u>	<u>616</u>	<u>16.2</u>	_____	_____

LABORATORY INFORMATION

SAMPLE ID	(#) CONTAINER	REFRIG.	PRESERV. TYPE	LABORATORY	ANALYSES
<u>MW-1A</u>	<u>3</u> x vov vial	YES	HCL	LANCASTER	TPH-G(8015)/BTEX+MTBE(8021)
	<u>2</u> x 500ml Amber	YES	NP	LANCASTER	TPH-Dw/sg(8015)

COMMENTS: _____

Add/Replaced Lock: _____ Add/Replaced Plug: _____ Size: _____



GETTLER-RYAN INC.

WELL MONITORING/SAMPLING FIELD DATA SHEET

Client/Facility #: Chevron #206145 Job Number: 386492
 Site Address: 800 Center Street Event Date: 2/16/07 (inclusive)
 City: Oakland, CA Sampler: HAIG K

Well ID: MW-2 Date Monitored: 2/16/07 Well Condition: OK

Well Diameter: 2 in.
 Total Depth: 14.18 ft.
 Depth to Water: 9.68 ft.
4.50 xVF 0.17 = 0.7 x3 case volume = Estimated Purge Volume: 2.1 gal.

Volume	3/4"= 0.02	1"= 0.04	2"= 0.17	3"= 0.38
Factor (VF)	4"= 0.66	5"= 1.02	6"= 1.50	12"= 5.80

Purge Equipment:
 Disposable Bailer
 Stainless Steel Bailer _____
 Stack Pump _____
 Suction Pump _____
 Grundfos _____
 Other: _____

Sampling Equipment:
 Disposable Bailer
 Pressure Bailer _____
 Discrete Bailer _____
 Other: _____

Time Started: _____ (2400 hrs)
 Time Completed: _____ (2400 hrs)
 Depth to Product: _____ ft
 Depth to Water: _____ ft
 Hydrocarbon Thickness: 0 ft
 Visual Confirmation/Description: _____
 Skimmer / Absorbant Sock (circle one)
 Amt Removed from Skimmer: _____ gal
 Amt Removed from Well: _____ gal
 Water Removed: _____
 Product Transferred to: _____

Start Time (purge): 1017 Weather Conditions: CLOUDY
 Sample Time/Date: 1035/2/16/07 Water Color: CLOUDY Odor: SLIGHT
 Purging Flow Rate: _____ gpm. Sediment Description: _____
 Did well de-water? NO If yes, Time: _____ Volume: _____ gal.

Time (2400 hr.)	Volume (gal.)	pH	Conductivity (umhos/cm)	Temperature (C/F)	D.O. (mg/L)	ORP (mV)
<u>1019</u>	<u>0.75</u>	<u>6.83</u>	<u>625</u>	<u>15.5</u>	_____	_____
<u>1021</u>	<u>1.5</u>	<u>6.77</u>	<u>636</u>	<u>15.9</u>	_____	_____
<u>1023</u>	<u>2</u>	<u>6.74</u>	<u>638</u>	<u>15.4</u>	_____	_____

LABORATORY INFORMATION

SAMPLE ID	(#) CONTAINER	REFRIG.	PRESERV. TYPE	LABORATORY	ANALYSES
MW-2	3 x vov vial	YES	HCL	LANCASTER	TPH-G(8015)/BTEX+MTBE(8021)
	2 x 500ml Amber	YES	NP	LANCASTER	TPH-Dw/sg(8015)

COMMENTS: _____

Add/Replaced Lock: _____ Add/Replaced Plug: _____ Size: _____



GETTLER-RYAN INC.

WELL MONITORING/SAMPLING FIELD DATA SHEET

Client/Facility #: Chevron #206145 Job Number: 386492
 Site Address: 800 Center Street Event Date: 2/6/07 (inclusive)
 City: Oakland, CA Sampler: HAIG K

Well ID: MW-3 Date Monitored: 2/6/07 Well Condition: OK

Well Diameter: 2 in.
 Total Depth: 14.42 ft.
 Depth to Water: 9.37 ft.
5.05 xVF 0.17 = 0.8 x3 case volume = Estimated Purge Volume: 2.4 gal.

Volume Factor (VF)	3/4" = 0.02	1" = 0.04	2" = 0.17	3" = 0.38
	4" = 0.66	5" = 1.02	6" = 1.50	12" = 5.80

Purge Equipment:

Disposable Bailer
 Stainless Steel Bailer _____
 Stack Pump _____
 Suction Pump _____
 Grundfos _____
 Other: _____

Sampling Equipment:

Disposable Bailer
 Pressure Bailer _____
 Discrete Bailer _____
 Other: _____

Time Started: _____ (2400 hrs)
 Time Completed: _____ (2400 hrs)
 Depth to Product: _____ ft
 Depth to Water: 9.37 ft
 Hydrocarbon Thickness: _____ ft
 Visual Confirmation/Description: _____
 Skimmer / Absorbant Sock (circle one)
 Amt Removed from Skimmer: _____ gal
 Amt Removed from Well: _____ gal
 Water Removed: _____
 Product Transferred to: _____

Start Time (purge): 1115 Weather Conditions: CLOUDY
 Sample Time/Date: 1130 2/6/07 Water Color: ~ CLEAR Odor: YES
 Purging Flow Rate: _____ gpm. Sediment Description: _____
 Did well de-water? NO If yes, Time: _____ Volume: _____ gal.

Time (2400 hr.)	Volume (gal.)	pH	Conductivity (umhos/cm)	Temperature (C/F)	D.O. (mg/L)	ORP (mV)
<u>1117</u>	<u>1</u>	<u>7.03</u>	<u>563</u>	<u>16.5</u>		
<u>1119</u>	<u>2</u>	<u>6.96</u>	<u>571</u>	<u>16.7</u>		
<u>1121</u>	<u>2.5</u>	<u>6.93</u>	<u>578</u>	<u>16.8</u>		

LABORATORY INFORMATION

SAMPLE ID	(#) CONTAINER	REFRIG.	PRESERV. TYPE	LABORATORY	ANALYSES
<u>MW-3</u>	<u>3</u> x vov vial	<u>YES</u>	<u>HCL</u>	<u>LANCASTER</u>	<u>TPH-G(8015)/BTEX+MTBE(8021)</u>
	<u>2</u> x 500ml Amber	<u>YES</u>	<u>NP</u>	<u>LANCASTER</u>	<u>TPH-Dw/sg(8015)</u>

COMMENTS:

Add/Replaced Lock: _____ Add/Replaced Plug: _____ Size: _____



GETTLER - RYAN INC.

WELL MONITORING/SAMPLING FIELD DATA SHEET

Client/Facility #: Chevron #206145 Job Number: 386492
 Site Address: 800 Center Street Event Date: 2-6-07 (inclusive)
 City: Oakland, CA Sampler: ML

Well ID: MW-4 Date Monitored: 2-6-07 Well Condition: OK

Well Diameter: 2 in.
 Total Depth: 13.23 ft.
 Depth to Water: 8.40 ft.
4.83

Volume	3/4"= 0.02	1"= 0.04	2"= 0.17	3"= 0.38
Factor (VF)	4"= 0.66	5"= 1.02	6"= 1.50	12"= 5.80

$0.17 \times VF = 0.82 \times 3 \text{ case volume} = \text{Estimated Purge Volume: } 2.46 \text{ gal.}$

Purge Equipment:
 Disposable Bailer X
 Stainless Steel Bailer _____
 Stack Pump _____
 Suction Pump _____
 Grundfos _____
 Other: _____

Sampling Equipment:
 Disposable Bailer X
 Pressure Bailer _____
 Discrete Bailer _____
 Other: _____

Time Started: _____ (2400 hrs)
 Time Completed: _____ (2400 hrs)
 Depth to Product: _____ ft
 Depth to Water: _____ ft
 Hydrocarbon Thickness: _____ ft
 Visual Confirmation/Description: _____
 Skimmer / Absorbant Sock (circle one)
 Amt Removed from Skimmer: _____ gal
 Amt Removed from Well: _____ gal
 Water Removed: _____
 Product Transferred to: _____

Start Time (purge): 11:37 Weather Conditions: Cloudy
 Sample Time/Date: 11:52 / 2-6-07 Water Color: Clear Odor: Yes
 Purging Flow Rate: _____ gpm. Sediment Description: None
 Did well de-water? No If yes, Time: _____ Volume: _____ gal.

Time (2400 hr.)	Volume (gal.)	pH	Conductivity (umhos/cm)	Temperature (C/F)	D.O. (mg/L)	ORP (mV)
<u>11:39</u>	<u>1</u>	<u>6.95</u>	<u>606</u>	<u>16.4</u>	_____	_____
<u>11:41</u>	<u>2</u>	<u>6.90</u>	<u>607</u>	<u>16.2</u>	_____	_____
<u>11:43</u>	<u>3</u>	<u>6.70</u>	<u>621</u>	<u>17.1</u>	_____	_____

LABORATORY INFORMATION

SAMPLE ID	(#) CONTAINER	REFRIG.	PRESERV. TYPE	LABORATORY	ANALYSES
<u>MW-4</u>	<u>3</u> x vov vial	YES	HCL	LANCASTER	TPH-G(8015)/BTEX+MTBE(8021)
	<u>2</u> x 500ml Amber	YES	NP	LANCASTER	TPH-Dw/sg(8015)

COMMENTS: _____

Add/Replaced Lock: _____

Add/Replaced Plug: _____ Size: _____



GETTLER-RYAN INC.

WELL MONITORING/SAMPLING FIELD DATA SHEET

Client/Facility #: Chevron #206145 Job Number: 386492
 Site Address: 800 Center Street Event Date: 2-6-07 (inclusive)
 City: Oakland, CA Sampler: ML

Well ID: MW-5 Date Monitored: 2-6-07 Well Condition: OK
 Well Diameter: 2 in.
 Total Depth: 19.32 ft.
 Depth to Water: 8.85 ft.
10.47 xVF 0.17 = 1.77 x3 case volume = Estimated Purge Volume: 5.31 gal.

Volume	3/4"= 0.02	1"= 0.04	2"= 0.17	3"= 0.38
Factor (VF)	4"= 0.66	5"= 1.02	6"= 1.50	12"= 5.80

Purge Equipment:

Disposable Bailer X
 Stainless Steel Bailer _____
 Stack Pump _____
 Suction Pump _____
 Grundfos _____
 Other: _____

Sampling Equipment:

Disposable Bailer X
 Pressure Bailer _____
 Discrete Bailer _____
 Other: _____

Time Started: _____ (2400 hrs)
 Time Completed: _____ (2400 hrs)
 Depth to Product: _____ ft
 Depth to Water: _____ ft
 Hydrocarbon Thickness: _____ ft
 Visual Confirmation/Description: _____
 Skimmer / Absorbant Sock (circle one)
 Amt Removed from Skimmer: _____ gal
 Amt Removed from Well: _____ gal
 Water Removed: _____
 Product Transferred to: _____

Start Time (purge): 11:07 Weather Conditions: cloudy
 Sample Time/Date: 11:29 / 2-6-07 Water Color: clear Odor: none
 Purging Flow Rate: _____ gpm. Sediment Description: None
 Did well de-water? NO If yes, Time: _____ Volume: _____ gal.

Time (2400 hr.)	Volume (gal.)	pH	Conductivity (umhos/cm)	Temperature (°F)	D.O. (mg/L)	ORP (mV)
<u>11:11</u>	<u>2</u>	<u>7.24</u>	<u>386</u>	<u>16.5</u>	_____	_____
<u>11:15</u>	<u>4</u>	<u>7.21</u>	<u>390</u>	<u>16.5</u>	_____	_____
<u>11:19</u>	<u>6</u>	<u>7.35</u>	<u>396</u>	<u>16.8</u>	_____	_____

LABORATORY INFORMATION

SAMPLE ID	(#) CONTAINER	REFRIG.	PRESERV. TYPE	LABORATORY	ANALYSES
MW-5	<u>3</u> x vva vial	YES	HCL	LANCASTER	TPH-G(8015)/BTEX+MTBE(8021)
	<u>2</u> x 500ml Amber	YES	NP	LANCASTER	TPH-Dw/sg(8015)

COMMENTS: _____

Add/Replaced Lock: _____ Add/Replaced Plug: _____ Size: _____



GETTLER - RYAN INC.

WELL MONITORING/SAMPLING FIELD DATA SHEET

Client/Facility #: Chevron #206145 Job Number: 386492
 Site Address: 800 Center Street Event Date: 2-6-07 (inclusive)
 City: Oakland, CA Sampler: ML

Well ID: MW-6 Date Monitored: 2-6-07 Well Condition: OK

Well Diameter: 2 in.
 Total Depth: 15.67 ft.
 Depth to Water: 8.75 ft.

Volume	3/4"= 0.02	1"= 0.04	2"= 0.17	3"= 0.38
Factor (VF)	4"= 0.66	5"= 1.02	6"= 1.50	12"= 5.80

~~15.67~~ xVF 0.17 = 1.17 x3 case volume = Estimated Purge Volume: 3.51 gal.

Purge Equipment:
 Disposable Bailer
 Stainless Steel Bailer _____
 Stack Pump _____
 Suction Pump _____
 Grundfos _____
 Other: _____

Sampling Equipment:
 Disposable Bailer
 Pressure Bailer _____
 Discrete Bailer _____
 Other: _____

Time Started: _____ (2400 hrs)
 Time Completed: _____ (2400 hrs)
 Depth to Product: _____ ft
 Depth to Water: _____ ft
 Hydrocarbon Thickness: _____ ft
 Visual Confirmation/Description: _____
 Skimmer / Absorbent Sock (circle one)
 Amt Removed from Skimmer: _____ gal
 Amt Removed from Well: _____ gal
 Water Removed: _____
 Product Transferred to: _____

Start Time (purge): 10:42 Weather Conditions: Cloudy
 Sample Time/Date: 11:00 2-6-07 Water Color: Clear Odor: NO
 Purging Flow Rate: - gpm. Sediment Description: None
 Did well de-water? NO If yes, Time: _____ Volume: _____ gal.

Time (2400 hr.)	Volume (gal.)	pH	Conductivity (umhos/cm)	Temperature (°F)	D.O. (mg/L)	ORP (mV)
<u>10:45</u>	<u>1.5</u>	<u>7.02</u>	<u>348</u>	<u>17.4</u>	_____	_____
<u>10:48</u>	<u>3</u>	<u>6.86</u>	<u>335</u>	<u>17.8</u>	_____	_____
<u>10:51</u>	<u>4</u>	<u>6.95</u>	<u>329</u>	<u>17.9</u>	_____	_____

LABORATORY INFORMATION

SAMPLE ID	(#) CONTAINER	REFRIG.	PRESERV. TYPE	LABORATORY	ANALYSES
<u>MW-6</u>	<u>3</u> x voa vial	<u>YES</u>	<u>HCL</u>	<u>LANCASTER</u>	<u>TPH-G(8015)/BTEX+MTBE(8021)</u>
	<u>2</u> x 500ml Amber	<u>YES</u>	<u>NP</u>	<u>LANCASTER</u>	<u>TPH-Dw/sg(8015)</u>

COMMENTS: _____

Add/Replaced Lock: _____

Add/Replaced Plug: _____ Size: _____



GETTLER-RYAN INC.

WELL MONITORING/SAMPLING FIELD DATA SHEET

Client/Facility #: Chevron #206145
 Site Address: 800 Center Street
 City: Oakland, CA

Job Number: 386492
 Event Date: 2/6/07 (inclusive)
 Sampler: HAIG K.

Well ID: MW-7
 Well Diameter: 2 in.
 Total Depth: 15.64 ft.
 Depth to Water: 10.35 ft.
5.29 xVF = 0.17 = 0.9 x3 case volume = Estimated Purge Volume: 2.7 gal.

Date Monitored: 2/6/07 Well Condition: OK

Volume	3/4"= 0.02	1"= 0.04	2"= 0.17	3"= 0.38
Factor (VF)	4"= 0.66	5"= 1.02	6"= 1.50	12"= 5.80

Purge Equipment:
 Disposable Bailer
 Stainless Steel Bailer _____
 Stack Pump _____
 Suction Pump _____
 Grundfos _____
 Other: _____

Sampling Equipment:
 Disposable Bailer
 Pressure Bailer _____
 Discrete Bailer _____
 Other: _____

Time Started: _____ (2400 hrs)
 Time Completed: _____ (2400 hrs)
 Depth to Product: _____ ft
 Depth to Water: _____ ft
 Hydrocarbon Thickness: 0 ft
 Visual Confirmation/Description: _____
 Skimmer / Absorbant Sock (circle one)
 Amt Removed from Skimmer: _____ gal
 Amt Removed from Well: _____ gal
 Water Removed: _____
 Product Transferred to: _____

Start Time (purge): 0948 Weather Conditions: CLOUDY
 Sample Time/Date: 1002/2/6/07 Water Color: CLOUDY Odor: NO
 Purging Flow Rate: _____ gpm. Sediment Description: _____
 Did well de-water? NO If yes, Time: _____ Volume: _____ gal.

Time (2400 hr.)	Volume (gal.)	pH	Conductivity (umhos/cm)	Temperature (C) (F)	D.O. (mg/L)	ORP (mV)
<u>0950</u>	<u>1</u>	<u>7.21</u>	<u>353</u>	<u>14.9</u>	_____	_____
<u>0952</u>	<u>2</u>	<u>7.14</u>	<u>358</u>	<u>14.6</u>	_____	_____
<u>0954</u>	<u>3</u>	<u>7.09</u>	<u>361</u>	<u>14.7</u>	_____	_____

LABORATORY INFORMATION

SAMPLE ID	(#) CONTAINER	REFRIG.	PRESERV. TYPE	LABORATORY	ANALYSES
MW-7	3 x vovial	YES	HCL	LANCASTER	TPH-G(8015)/BTEX+MTBE(8021)
	2 x 500ml Amber	YES	NP	LANCASTER	TPH-Dw/sg(8015)

COMMENTS: _____

Add/Replaced Lock: _____ Add/Replaced Plug: _____ Size: _____



GETTLER-RYAN INC.

WELL MONITORING/SAMPLING FIELD DATA SHEET

Client/Facility #: Chevron #206145
 Site Address: 800 Center Street
 City: Oakland, CA

Job Number: 386492
 Event Date: 2-6-07 (inclusive)
 Sampler: ML

Well ID: MW-8 Date Monitored: 2-6-07 Well Condition: OK
 Well Diameter: 2 in.
 Total Depth: 20.18 ft.
 Depth to Water: 9.40 ft.
10.78 xVF 0.17 = 1.83 x3 case volume = Estimated Purge Volume: 5.49 gal.

Volume	3/4"= 0.02	1"= 0.04	2"= 0.17	3"= 0.38
Factor (VF)	4"= 0.66	5"= 1.02	6"= 1.50	12"= 5.80

Purge Equipment:
 Disposable Bailer X
 Stainless Steel Bailer _____
 Stack Pump _____
 Suction Pump _____
 Grundfos _____
 Other: _____

Sampling Equipment:
 Disposable Bailer X
 Pressure Bailer _____
 Discrete Bailer _____
 Other: _____

Time Started: _____ (2400 hrs)
 Time Completed: _____ (2400 hrs)
 Depth to Product: _____ ft
 Depth to Water: _____ ft
 Hydrocarbon Thickness: _____ ft
 Visual Confirmation/Description: _____
 Skimmer / Absorbant Sock (circle one)
 Amt Removed from Skimmer: _____ gal
 Amt Removed from Well: _____ gal
 Water Removed: _____
 Product Transferred to: _____

Start Time (purge): 10:09 Weather Conditions: cloudy
 Sample Time/Date: 10:35 2-6-07 Water Color: cloudy Odor: no
 Purging Flow Rate: _____ gpm. Sediment Description: none
 Did well de-water? no If yes, Time: _____ Volume: _____ gal.

Time (2400 hr.)	Volume (gal.)	pH	Conductivity (umhos/cm)	Temperature (°F)	D.O. (mg/L)	ORP (mV)
<u>10:14</u>	<u>2</u>	<u>7.62</u>	<u>256</u>	<u>16.1</u>		
<u>10:18</u>	<u>4</u>	<u>7.43</u>	<u>261</u>	<u>16.6</u>		
<u>10:25</u>	<u>6</u>	<u>7.40</u>	<u>306</u>	<u>16.8</u>		

LABORATORY INFORMATION

SAMPLE ID	(#) CONTAINER	REFRIG.	PRESERV. TYPE	LABORATORY	ANALYSES
MW-8	3 x voa vial	YES	HCL	LANCASTER	TPH-G(8015)/BTEX+MTBE(8021)
	2 x 500ml Amber	YES	NP	LANCASTER	TPH-Dw/sg(8015)

COMMENTS: _____

Add/Replaced Lock: _____ Add/Replaced Plug: _____ Size: _____

Chevron California Region Analysis Request/Chain of Custody



For Lancaster Laboratories use only

Acct. #: 10904

Sample # 4977806-14

Group #: 001516

020607-02

Group # 1024815

Facility #: SS#206145-OML G-R#386492 Global ID#T0600T02230
 Site Address: 800 CENTER STREET, OAKLAND, CA
 SS CAMBRIACE
 Chevron PM: G-R, Inc., 6747 Sierra Court, Suite J, Dublin, Ca. 94568
 Lead Consultant:
 Consultant/Office: Deanna L. Harding (deanna@gninc.com)
 Consultant Prj. Mgr.:
 Consultant Phone #: 925-551-7555 Fax #: 925-551-7899
 Sampler: HAIG KEVORK / MIKE LOMBARD

Matrix	Preservation Codes		Total Number of Containers	Analyses Requested	
	Soil	Water		Oil	Air
<input type="checkbox"/> Potable <input type="checkbox"/> NPDES <input type="checkbox"/> Air				<input checked="" type="checkbox"/> H	<input checked="" type="checkbox"/> H
				<input checked="" type="checkbox"/> BTX + MTBE 8260	<input type="checkbox"/> 8021
				<input type="checkbox"/> TPH 8015 MOD GRO	
				<input checked="" type="checkbox"/> TPH 8015 MOD DRO	<input checked="" type="checkbox"/> Silica Gel Cleanup
				<input type="checkbox"/> 8260 full scan	
				<input type="checkbox"/> Oxygenates	
				<input type="checkbox"/> Total Lead Method	
				<input type="checkbox"/> Dissolved Lead Method	

Preservative Codes
 H = HCl T = Thiosulfate
 N = HNO₃ B = NaOH
 S = H₂SO₄ O = Other

J value reporting needed
 Must meet lowest detection limits possible for 8260 compounds

8021 MTBE Confirmation
 Confirm highest hit by 8260
 Confirm all hits by 8260
 Run ___ oxy's on highest hit
 Run ___ oxy's on all hits

Sample Identification	Date Collected	Time Collected	Grab	Composite	Soil	Water	Oil	Air	Total Number of Containers	BTX + MTBE 8260	TPH 8015 MOD GRO	TPH 8015 MOD DRO	8260 full scan	Oxygenates	Total Lead Method	Dissolved Lead Method
<u>GA</u>	<u>2/6/07</u>		<input checked="" type="checkbox"/>													
<u>MW-1A</u>		<u>1105</u>	<input checked="" type="checkbox"/>						<u>5</u>	<input checked="" type="checkbox"/>						
<u>MW-2</u>		<u>1035</u>	<input checked="" type="checkbox"/>						<u>5</u>	<input checked="" type="checkbox"/>						
<u>MW-3</u>		<u>1130</u>	<input checked="" type="checkbox"/>						<u>5</u>	<input checked="" type="checkbox"/>						
<u>MW-4</u>		<u>1152</u>	<input checked="" type="checkbox"/>						<u>5</u>	<input checked="" type="checkbox"/>						
<u>MW-5</u>		<u>1129</u>	<input checked="" type="checkbox"/>						<u>5</u>	<input checked="" type="checkbox"/>						
<u>MW-6</u>		<u>1100</u>	<input checked="" type="checkbox"/>						<u>5</u>	<input checked="" type="checkbox"/>						
<u>MW-7</u>		<u>1002</u>	<input checked="" type="checkbox"/>						<u>5</u>	<input checked="" type="checkbox"/>						
<u>MW-8</u>	<u>Y</u>	<u>1035</u>	<input checked="" type="checkbox"/>						<u>5</u>	<input checked="" type="checkbox"/>						

Comments / Remarks

Turnaround Time Requested (TAT) (please circle)
 STD. TAT 72 hour 48 hour
 24 hour 4 day 5 day

Data Package Options (please circle if required)
 QC Summary Type I - Full
 Type VI (Raw Data) Coeff Deliverable not needed
 WIP (RWQCB)
 Disk

Relinquished by: <u>[Signature]</u>	Date: <u>2/6/07</u>	Time: <u></u>	Received by: <u>[Signature]</u>	Date: <u>2/6/07</u>	Time: <u>1230</u>
Relinquished by: <u>[Signature]</u>	Date: <u>2/6/07</u>	Time: <u>1530</u>	Received by: <u>DHL</u>	Date: <u>2/6/07</u>	Time: <u>1230</u>
Relinquished by:	Date:	Time:	Received by:	Date:	Time:
Relinquished by Commercial Carrier: UPS FedEx Other <u>own</u>	Received by: <u>[Signature]</u>		Date: <u>2/8/07</u>	Time: <u>0945</u>	
Temperature Upon Receipt: <u>6 Celsius W-20</u> °C	Custody Seals Intact? <u>Yes</u> No				

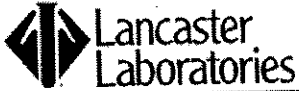

Analysis Report

2425 New Holland Pike, PO Box 12425, Lancaster, PA 17605-2425 • 717-656-2300 Fax: 717-656-2681 • www.lancasterlabs.com

ANALYTICAL RESULTS

Prepared for:

Chevron
6001 Bollinger Canyon Rd L4310
San Ramon CA 94583

925-842-8582

Prepared by:

Lancaster Laboratories
2425 New Holland Pike
Lancaster, PA 17605-2425

RECEIVED

FEB 9 2007

GETTLER-RYAN INC
GENERAL CONTRACTOR

SAMPLE GROUP

The sample group for this submittal is 1024815. Samples arrived at the laboratory on Thursday, February 08, 2007. The PO# for this group is 0015009981 and the release number is SINHA.

<u>Client Description</u>		<u>Lancaster Labs Number</u>
QA-T-070206	NA Water	4977806
MW-1A-W-070206	Grab Water	4977807
MW-2-W-070206	Grab Water	4977808
MW-3-W-070206	Grab Water	4977809
MW-4-W-070206	Grab Water	4977810
MW-5-W-070206	Grab Water	4977811
MW-6-W-070206	Grab Water	4977812
MW-7-W-070206	Grab Water	4977813
MW-8-W-070206	Grab Water	4977814

ELECTRONIC COPY TO Cambria c/o Gettler-Ryan

Attn: Cheryl Hansen



Analysis Report

2425 New Holland Pike, PO Box 12425, Lancaster, PA 17605-2425 • 717-656-2300 Fax: 717-656-2681 • www.lancasterlabs.com

Questions? Contact your Client Services Representative
Angela M Miller at (717) 656-2300

Respectfully Submitted,

A handwritten signature in black ink that reads "Valerie L. Tomayko".

Valerie L. Tomayko
Group Leader



Analysis Report

2425 New Holland Pike, PO Box 12425, Lancaster, PA 17605-2425 • 717-656-2300 Fax: 717-656-2681 • www.lancasterlabs.com

Lancaster Laboratories Sample No. WW 4977806

QA-T-070206 NA Water
 Facility# 206145 Job# 386492 GRD
 800 Center St-Oakland T0600102230 QA
 Collected: 02/06/2007

Account Number: 10904

Submitted: 02/08/2007 09:45
 Reported: 02/19/2007 at 14:13
 Discard: 03/22/2007

Chevron
 6001 Bollinger Canyon Rd L4310
 San Ramon CA 94583

800QA

CAT No.	Analysis Name	CAS Number	As Received Result	As Received Method Detection Limit	Units	Dilution Factor
01729	TPH-GRO - Waters					
01730	TPH-GRO - Waters	n.a.	N.D.	50.	ug/l	1
	The reported concentration of TPH-GRO does not include MTBE or other gasoline constituents eluting prior to the C6 (n-hexane) TPH-GRO range start time.					
02159	BTEX, MTBE					
02161	Benzene	71-43-2	N.D.	0.5	ug/l	1
02164	Toluene	108-88-3	N.D.	0.5	ug/l	1
02166	Ethylbenzene	100-41-4	N.D.	0.5	ug/l	1
02171	Total Xylenes	1330-20-7	N.D.	1.5	ug/l	1
02172	Methyl tert-Butyl Ether	1634-04-4	N.D.	2.5	ug/l	1

State of California Lab Certification No. 2116

All QC is compliant unless otherwise noted. Please refer to the Quality Control Summary for overall QC performance data and associated samples.

Laboratory Chronicle

CAT No.	Analysis Name	Method	Trial#	Analysis		Analyst	Dilution Factor
				Date and Time			
01729	TPH-GRO - Waters	TPH GRO SW-846 8015B mod	1	02/09/2007 22:41		Martha L Seidel	1
02159	BTEX, MTBE	SW-846 8021B	1	02/09/2007 22:41		Martha L Seidel	1
01146	GC VOA Water Prep	SW-846 5030B	1	02/09/2007 22:41		Martha L Seidel	1



Analysis Report

2425 New Holland Pike, PO Box 12425, Lancaster, PA 17605-2425 • 717-656-2300 Fax: 717-656-2681 • www.lancasterlabs.com

Page 1 of 1

Lancaster Laboratories Sample No. WW 4977807

MW-1A-W-070206 Grab Water
 Facility# 206145 Job# 386492 GRD
 800 Center St-Oakland T0600102230 MW-1A
 Collected: 02/06/2007 11:05 by HK

Account Number: 10904

Submitted: 02/08/2007 09:45
 Reported: 02/19/2007 at 14:13
 Discard: 03/22/2007

Chevron
 6001 Bollinger Canyon Rd L4310
 San Ramon CA 94583

8001A

CAT No.	Analysis Name	CAS Number	As Received Result	As Received Method Detection Limit	Units	Dilution Factor
06610	TPH-DRO (Water) w/Si Gel	n.a.	1,500.	50.	ug/l	1
01729	TPH-GRO - Waters					
01730	TPH-GRO - Waters	n.a.	230.	50.	ug/l	1
	The reported concentration of TPH-GRO does not include MTBE or other gasoline constituents eluting prior to the C6 (n-hexane) TPH-GRO range start time.					
02159	BTEX, MTBE					
02161	Benzene	71-43-2	19.	0.5	ug/l	1
02164	Toluene	108-88-3	N.D.	0.5	ug/l	1
02166	Ethylbenzene	100-41-4	1.8	0.5	ug/l	1
02171	Total Xylenes	1330-20-7	2.7	1.5	ug/l	1
02172	Methyl tert-Butyl Ether	1634-04-4	N.D.	2.5	ug/l	1

State of California Lab Certification No. 2116

All QC is compliant unless otherwise noted. Please refer to the Quality Control Summary for overall QC performance data and associated samples.

Laboratory Chronicle

CAT No.	Analysis Name	Method	Trial#	Analysis Date and Time	Analyst	Dilution Factor
06610	TPH-DRO (Water) w/Si Gel	SW-846 8015B	1	02/16/2007 21:36	Tracy A Cole	1
01729	TPH-GRO - Waters	TPH GRO SW-846 8015B mod	1	02/10/2007 03:35	Martha L Seidel	1
02159	BTEX, MTBE	SW-846 8021B	1	02/10/2007 03:35	Martha L Seidel	1
01146	GC VOA Water Prep	SW-846 5030B	1	02/10/2007 03:35	Martha L Seidel	1
02376	Extraction - Fuel/TPH (Waters)	SW-846 3510C	1	02/12/2007 07:15	Tracy L Schickel	1



Analysis Report

2425 New Holland Pike, PO Box 12425, Lancaster, PA 17605-2425 • 717-656-2300 Fax: 717-656-2681 • www.lancasterlabs.com

Page 1 of 1

Lancaster Laboratories Sample No. WW 4977808

MW-2-W-070206 Grab Water
 Facility# 206145 Job# 386492 GRD
 800 Center St-Oakland T0600102230 MW-2
 Collected: 02/06/2007 10:35 by HK

Account Number: 10904

Submitted: 02/08/2007 09:45
 Reported: 02/19/2007 at 14:13
 Discard: 03/22/2007

Chevron
 6001 Bollinger Canyon Rd L4310
 San Ramon CA 94583

800M2

CAT No.	Analysis Name	CAS Number	As Received Result	As Received Method Detection Limit	Units	Dilution Factor
06610	TPH-DRO (Water) w/Si Gel	n.a.	200.	50.	ug/l	1
01729	TPH-GRO - Waters					
01730	TPH-GRO - Waters	n.a.	N.D.	50.	ug/l	1
	The reported concentration of TPH-GRO does not include MTBE or other gasoline constituents eluting prior to the C6 (n-hexane) TPH-GRO range start time.					
02159	BTEX, MTBE					
02161	Benzene	71-43-2	N.D.	0.5	ug/l	1
02164	Toluene	108-88-3	N.D.	0.5	ug/l	1
02166	Ethylbenzene	100-41-4	N.D.	0.5	ug/l	1
02171	Total Xylenes	1330-20-7	N.D.	1.5	ug/l	1
02172	Methyl tert-Butyl Ether	1634-04-4	N.D.	2.5	ug/l	1

State of California Lab Certification No. 2116

All QC is compliant unless otherwise noted. Please refer to the Quality Control Summary for overall QC performance data and associated samples.

Laboratory Chronicle

CAT No.	Analysis Name	Method	Analysis		Analyst	Dilution Factor
			Trial#	Date and Time		
06610	TPH-DRO (Water) w/Si Gel	SW-846 8015B	1	02/16/2007 06:50	Tracy A Cole	1
01729	TPH-GRO - Waters	TPH GRO SW-846 8015B mod	1	02/10/2007 03:55	Martha L Seidel	1
02159	BTEX, MTBE	SW-846 8021B	1	02/10/2007 03:55	Martha L Seidel	1
01146	GC VOA Water Prep	SW-846 5030B	1	02/10/2007 03:55	Martha L Seidel	1
02376	Extraction - Fuel/TPH (Waters)	SW-846 3510C	1	02/12/2007 07:15	Tracy L Schickel	1



Analysis Report

2425 New Holland Pike, PO Box 12425, Lancaster, PA 17605-2425 • 717-656-2300 Fax: 717-656-2681 • www.lancasterlabs.com

Lancaster Laboratories Sample No. WW 4977809

MW-3-W-070206 Grab Water
Facility# 206145 Job# 386492 GRD
800 Center St-Oakland T0600102230 MW-3
Collected: 02/06/2007 11:30 by HK

Account Number: 10904

Submitted: 02/08/2007 09:45
Reported: 02/19/2007 at 14:13
Discard: 03/22/2007

Chevron
6001 Bollinger Canyon Rd L4310
San Ramon CA 94583

800M3

CAT No.	Analysis Name	CAS Number	As Received Result	As Received Method Detection Limit	Units	Dilution Factor
06610	TPH-DRO (Water) w/Si Gel	n.a.	5,000.	300.	ug/l	10
01729	TPH-GRO - Waters					
01730	TPH-GRO - Waters The reported concentration of TPH-GRO does not include MTBE or other gasoline constituents eluting prior to the C6 (n-hexane) TPH-GRO range start time.	n.a.	43,000.	500.	ug/l	10
02159	BTEX, MTBE					
02161	Benzene	71-43-2	290.	5.0	ug/l	10
02164	Toluene	108-88-3	6,200.	50.	ug/l	10
02166	Ethylbenzene	100-41-4	3,400.	5.0	ug/l	10
02171	Total Xylenes	1330-20-7	6,400.	15.	ug/l	10
02172	Methyl tert-Butyl Ether Due to the presence of an interferent near its retention time, the normal reporting limit was not attained for MTBE. The presence or concentration of this compound cannot be determined due to the presence of this interferent.	1634-04-4	N.D.	500.	ug/l	10

State of California Lab Certification No. 2116

All QC is compliant unless otherwise noted. Please refer to the Quality Control Summary for overall QC performance data and associated samples.

Laboratory Chronicle

CAT No.	Analysis Name	Method	Trial#	Analysis Date and Time	Analyst	Dilution Factor
06610	TPH-DRO (Water) w/Si Gel	SW-846 8015B	1	02/16/2007 21:13	Tracy A Cole	10
01729	TPH-GRO - Waters	TPH GRO SW-846 8015B	1	02/12/2007 13:38	Martha L Seidel	10
02159	BTEX, MTBE	SW-846 8021B	1	02/10/2007 04:16	Martha L Seidel	100
02159	BTEX, MTBE	SW-846 8021B	1	02/12/2007 13:38	Martha L Seidel	10
01146	GC VOA Water Prep	SW-846 5030B	1	02/10/2007 04:16	Martha L Seidel	100
01146	GC VOA Water Prep	SW-846 5030B	2	02/12/2007 13:38	Martha L Seidel	10
02376	Extraction - Fuel/TPH (Waters)	SW-846 3510C	1	02/12/2007 07:15	Tracy L Schickel	1

Lancaster Laboratories Sample No. WW 4977809

MW-3-W-070206 Grab Water
Facility# 206145 Job# 386492 GRD
800 Center St-Oakland T0600102230 MW-3
Collected: 02/06/2007 11:30 by HK

Account Number: 10904

Submitted: 02/08/2007 09:45
Reported: 02/19/2007 at 14:13
Discard: 03/22/2007

Chevron
6001 Bollinger Canyon Rd L4310
San Ramon CA 94583

800M3

Lancaster Laboratories Sample No. WW 4977810

MW-4-W-070206 Grab Water
 Facility# 206145 Job# 386492 GRD
 800 Center St-Oakland T0600102230 MW-4
 Collected: 02/06/2007 11:52 by HK

Account Number: 10904

Submitted: 02/08/2007 09:45
 Reported: 02/19/2007 at 14:13
 Discard: 03/22/2007

Chevron
 6001 Bollinger Canyon Rd L4310
 San Ramon CA 94583

800M4

CAT No.	Analysis Name	CAS Number	As Received Result	As Received Method Detection Limit	Units	Dilution Factor
06610	TPH-DRO (Water) w/Si Gel	n.a.	1,600.	50.	ug/l	1
01729	TPH-GRO - Waters					
01730	TPH-GRO - Waters	n.a.	13,000.	250.	ug/l	5
The reported concentration of TPH-GRO does not include MTBE or other gasoline constituents eluting prior to the C6 (n-hexane) TPH-GRO range start time.						
02159	BTEX, MTBE					
02161	Benzene	71-43-2	3,700.	10.	ug/l	20
02164	Toluene	108-88-3	60.	2.5	ug/l	5
02166	Ethylbenzene	100-41-4	880.	2.5	ug/l	5
02171	Total Xylenes	1330-20-7	170.	7.5	ug/l	5
02172	Methyl tert-Butyl Ether	1634-04-4	210.	13.	ug/l	5

State of California Lab Certification No. 2116

All QC is compliant unless otherwise noted. Please refer to the Quality Control Summary for overall QC performance data and associated samples.

Laboratory Chronicle

CAT No.	Analysis Name	Method	Analysis		Analyst	Dilution Factor
			Trial#	Date and Time		
06610	TPH-DRO (Water) w/Si Gel	SW-846 8015B	1	02/16/2007 07:37	Tracy A Cole	1
01729	TPH-GRO - Waters	TPH GRO SW-846 8015B mod	1	02/12/2007 13:17	Martha L Seidel	5
02159	BTEX, MTBE	SW-846 8021B	1	02/10/2007 04:37	Martha L Seidel	20
02159	BTEX, MTBE	SW-846 8021B	1	02/12/2007 13:17	Martha L Seidel	5
01146	GC VOA Water Prep	SW-846 5030B	1	02/10/2007 04:37	Martha L Seidel	20
01146	GC VOA Water Prep	SW-846 5030B	2	02/12/2007 13:17	Martha L Seidel	5
02376	Extraction - Fuel/TPH (Waters)	SW-846 3510C	1	02/12/2007 07:15	Tracy L Schickel	1

Lancaster Laboratories Sample No. WW 4977811

MW-5-W-070206 Grab Water
 Facility# 206145 Job# 386492 GRD
 800 Center St-Oakland T0600102230 MW-5
 Collected: 02/06/2007 11:29 by HK

Account Number: 10904

Submitted: 02/08/2007 09:45
 Reported: 02/19/2007 at 14:13
 Discard: 03/22/2007

Chevron
 6001 Bollinger Canyon Rd L4310
 San Ramon CA 94583

800M5

CAT No.	Analysis Name	CAS Number	As Received Result	As Received Method Detection Limit	Units	Dilution Factor
06610	TPH-DRO (Water) w/Si Gel	n.a.	55.	50.	ug/l	1
01729	TPH-GRO - Waters					
01730	TPH-GRO - Waters	n.a.	N.D.	50.	ug/l	1
	The reported concentration of TPH-GRO does not include MTBE or other gasoline constituents eluting prior to the C6 (n-hexane) TPH-GRO range start time.					
02159	BTEX, MTBE					
02161	Benzene	71-43-2	N.D.	0.5	ug/l	1
02164	Toluene	108-88-3	N.D.	0.5	ug/l	1
02166	Ethylbenzene	100-41-4	N.D.	0.5	ug/l	1
02171	Total Xylenes	1330-20-7	N.D.	1.5	ug/l	1
02172	Methyl tert-Butyl Ether	1634-04-4	N.D.	2.5	ug/l	1

State of California Lab Certification No. 2116

All QC is compliant unless otherwise noted. Please refer to the Quality Control Summary for overall QC performance data and associated samples.

Laboratory Chronicle

CAT No.	Analysis Name	Method	Trial#	Analysis		Analyst	Dilution Factor
				Date	Time		
06610	TPH-DRO (Water) w/Si Gel	SW-846 8015B	1	02/16/2007	08:00	Tracy A Cole	1
01729	TPH-GRO - Waters	TPH GRO SW-846 8015B mod	1	02/10/2007	04:58	Martha L Seidel	1
02159	BTEX, MTBE	SW-846 8021B	1	02/10/2007	04:58	Martha L Seidel	1
01146	GC VOA Water Prep	SW-846 5030B	1	02/10/2007	04:58	Martha L Seidel	1
02376	Extraction - Fuel/TPH (Waters)	SW-846 3510C	1	02/12/2007	07:15	Tracy L Schickel	1

Lancaster Laboratories Sample No. WW 4977812

MW-6-W-070206 Grab Water
 Facility# 206145 Job# 386492 GRD
 800 Center St-Oakland T0600102230 MW-6
 Collected: 02/06/2007 11:00 by HK

Account Number: 10904

Submitted: 02/08/2007 09:45
 Reported: 02/19/2007 at 14:13
 Discard: 03/22/2007

Chevron
 6001 Bollinger Canyon Rd L4310
 San Ramon CA 94583

800M6

CAT No.	Analysis Name	CAS Number	As Received Result	As Received Method Detection Limit	Units	Dilution Factor
06610	TPH-DRO (Water) w/Si Gel	n.a.	96.	50.	ug/l	1
01729	TPH-GRO - Waters					
01730	TPH-GRO - Waters	n.a.	N.D.	50.	ug/l	1
	The reported concentration of TPH-GRO does not include MTBE or other gasoline constituents eluting prior to the C6 (n-hexane) TPH-GRO range start time.					
02159	BTEX, MTBE					
02161	Benzene	71-43-2	N.D.	0.5	ug/l	1
02164	Toluene	108-88-3	N.D.	0.5	ug/l	1
02166	Ethylbenzene	100-41-4	N.D.	0.5	ug/l	1
02171	Total Xylenes	1330-20-7	N.D.	1.5	ug/l	1
02172	Methyl tert-Butyl Ether	1634-04-4	N.D.	2.5	ug/l	1

State of California Lab Certification No. 2116

All QC is compliant unless otherwise noted. Please refer to the Quality Control Summary for overall QC performance data and associated samples.

Laboratory Chronicle

CAT No.	Analysis Name	Method	Trial#	Analysis Date and Time	Analyst	Dilution Factor
06610	TPH-DRO (Water) w/Si Gel	SW-846 8015B	1	02/16/2007 08:24	Tracy A Cole	1
01729	TPH-GRO - Waters	TPH GRO SW-846 8015B mod	1	02/10/2007 05:19	Martha L Seidel	1
02159	BTEX, MTBE	SW-846 8021B	1	02/10/2007 05:19	Martha L Seidel	1
01146	GC VOA Water Prep	SW-846 5030B	1	02/10/2007 05:19	Martha L Seidel	1
02376	Extraction - Fuel/TPH (Waters)	SW-846 3510C	1	02/12/2007 07:15	Tracy L Schickel	1



Analysis Report

2425 New Holland Pike, PO Box 12425, Lancaster, PA 17605-2425 • 717-656-2300 Fax: 717-656-2681 • www.lancasterlabs.com

Page 1 of 1

Lancaster Laboratories Sample No. WW 4977813

MW-7-W-070206 Grab Water
 Facility# 206145 Job# 386492 GRD
 800 Center St-Oakland T0600102230 MW-7
 Collected: 02/06/2007 10:02 by HK

Account Number: 10904

Submitted: 02/08/2007 09:45
 Reported: 02/19/2007 at 14:13
 Discard: 03/22/2007

Chevron
 6001 Bollinger Canyon Rd L4310
 San Ramon CA 94583

800M7

CAT No.	Analysis Name	CAS Number	As Received Result	As Received Method Detection Limit	Units	Dilution Factor
06610	TPH-DRO (Water) w/Si Gel	n.a.	73.	50.	ug/l	1
01729	TPH-GRO - Waters					
01730	TPH-GRO - Waters The reported concentration of TPH-GRO does not include MTBE or other gasoline constituents eluting prior to the C6 (n-hexane) TPH-GRO range start time.	n.a.	N.D.	50.	ug/l	1
02159	BTEX, MTBE					
02161	Benzene	71-43-2	N.D.	0.5	ug/l	1
02164	Toluene	108-88-3	N.D.	0.5	ug/l	1
02166	Ethylbenzene	100-41-4	N.D.	0.5	ug/l	1
02171	Total Xylenes	1330-20-7	N.D.	1.5	ug/l	1
02172	Methyl tert-Butyl Ether	1634-04-4	N.D.	2.5	ug/l	1

State of California Lab Certification No. 2116

All QC is compliant unless otherwise noted. Please refer to the Quality Control Summary for overall QC performance data and associated samples.

Laboratory Chronicle

CAT No.	Analysis Name	Method	Analysis		Analyst	Dilution Factor
			Trial#	Date and Time		
06610	TPH-DRO (Water) w/Si Gel	SW-846 8015B	1	02/16/2007 08:47	Tracy A Cole	1
01729	TPH-GRO - Waters	TPH GRO SW-846 mod	1	02/10/2007 05:40	Martha L Seidel	1
02159	BTEX, MTBE	SW-846 8021B	1	02/10/2007 05:40	Martha L Seidel	1
01146	GC VOA Water Prep	SW-846 5030B	1	02/10/2007 05:40	Martha L Seidel	1
02376	Extraction - Fuel/TPH (Waters)	SW-846 3510C	1	02/12/2007 07:15	Tracy L Schickel	1



Analysis Report

2425 New Holland Pike, PO Box 12425, Lancaster, PA 17605-2425 • 717-656-2300 Fax: 717-656-2681 • www.lancasterlabs.com

Page 1 of 1

Lancaster Laboratories Sample No. WW 4977814

MW-8-W-070206 Grab Water
Facility# 206145 Job# 386492 GRD
800 Center St-Oakland T0600102230 MW-8
Collected: 02/06/2007 10:35 by HK

Account Number: 10904

Submitted: 02/08/2007 09:45
Reported: 02/19/2007 at 14:13
Discard: 03/22/2007

Chevron
6001 Bollinger Canyon Rd L4310
San Ramon CA 94583

800M8

CAT No.	Analysis Name	CAS Number	As Received Result	As Received Method Detection Limit	Units	Dilution Factor
06610	TPH-DRO (Water) w/Si Gel	n.a.	N.D.	50.	ug/l	1
01729	TPH-GRO - Waters					
01730	TPH-GRO - Waters The reported concentration of TPH-GRO does not include MTBE or other gasoline constituents eluting prior to the C6 (n-hexane) TPH-GRO range start time.	n.a.	N.D.	50.	ug/l	1
02159	BTEX, MTBE					
02161	Benzene	71-43-2	N.D.	0.5	ug/l	1
02164	Toluene	108-88-3	N.D.	0.5	ug/l	1
02166	Ethylbenzene	100-41-4	N.D.	0.5	ug/l	1
02171	Total Xylenes	1330-20-7	N.D.	1.5	ug/l	1
02172	Methyl tert-Butyl Ether	1634-04-4	N.D.	2.5	ug/l	1

State of California Lab Certification No. 2116

All QC is compliant unless otherwise noted. Please refer to the Quality Control Summary for overall QC performance data and associated samples.

Laboratory Chronicle

CAT No.	Analysis Name	Method	Analysis		Analyst	Dilution Factor
			Trial#	Date and Time		
06610	TPH-DRO (Water) w/Si Gel	SW-846 8015B	1	02/16/2007 09:10	Tracy A Cole	1
01729	TPH-GRO - Waters	TPH GRO SW-846 8015B mod	1	02/10/2007 06:01	Martha L Seidel	1
02159	BTEX, MTBE	SW-846 8021B	1	02/10/2007 06:01	Martha L Seidel	1
01146	GC VOA Water Prep	SW-846 5030B	1	02/10/2007 06:01	Martha L Seidel	1
02376	Extraction - Fuel/TPH (Waters)	SW-846 3510C	1	02/12/2007 07:15	Tracy L Schickel	1

Quality Control Summary

 Client Name: Chevron
 Reported: 02/19/07 at 02:13 PM

Group Number: 1024815

Matrix QC may not be reported if site-specific QC samples were not submitted. In these situations, to demonstrate precision and accuracy at a batch level, a LCS/LCSD was performed, unless otherwise specified in the method.

Laboratory Compliance Quality Control

<u>Analysis Name</u>	<u>Blank Result</u>	<u>Blank MDL</u>	<u>Report Units</u>	<u>LCS %REC</u>	<u>LCSD %REC</u>	<u>LCS/LCSD Limits</u>	<u>RPD</u>	<u>RPD Max</u>
Batch number: 07040A54A Sample number(s): 4977806-4977814								
TPH-GRO - Waters	N.D.	50.	ug/l	124	122	75-135	2	30
Benzene	N.D.	0.5	ug/l	104	107	86-119	3	30
Toluene	N.D.	0.5	ug/l	101	103	82-119	2	30
Ethylbenzene	N.D.	0.5	ug/l	103	105	81-119	2	30
Total Xylenes	N.D.	1.5	ug/l	103	106	82-120	3	30
Methyl tert-Butyl Ether	N.D.	2.5	ug/l	100	102	82-124	2	30
Batch number: 07040A54B Sample number(s): 4977809-4977810								
TPH-GRO - Waters	N.D.	50.	ug/l	124	122	75-135	2	30
Benzene	N.D.	0.5	ug/l	104	107	86-119	3	30
Toluene	N.D.	0.5	ug/l	101	103	82-119	2	30
Ethylbenzene	N.D.	0.5	ug/l	103	105	81-119	2	30
Total Xylenes	N.D.	1.5	ug/l	103	106	82-120	3	30
Methyl tert-Butyl Ether	N.D.	2.5	ug/l	100	102	82-124	2	30
Batch number: 070410011A Sample number(s): 4977807-4977814								
TPH-DRO (Water) w/Si Gel	N.D.	29.	ug/l	94	96	63-119	3	20

Sample Matrix Quality Control

Unspiked (UNSPK) = the sample used in conjunction with the matrix spike
 Background (BKG) = the sample used in conjunction with the duplicate

<u>Analysis Name</u>	<u>MS %REC</u>	<u>MSD %REC</u>	<u>MS/MSD Limits</u>	<u>RPD</u>	<u>BKG MAX Conc</u>	<u>DUP Conc</u>	<u>DUP RPD</u>	<u>Dup RPD Max</u>
Batch number: 07040A54A Sample number(s): 4977806-4977814 UNSPK: P977652, P977653								
TPH-GRO - Waters	127		63-154					
Benzene	119		78-131					
Toluene	115		78-129					
Ethylbenzene	116		75-133					
Total Xylenes	117		84-131					
Methyl tert-Butyl Ether	105		70-134					
Batch number: 07040A54B Sample number(s): 4977809-4977810 UNSPK: P977652, P977653								
TPH-GRO - Waters	127		63-154					
Benzene	119		78-131					
Toluene	115		78-129					
Ethylbenzene	116		75-133					
Total Xylenes	117		84-131					
Methyl tert-Butyl Ether	105		70-134					

*- Outside of specification

- (1) The result for one or both determinations was less than five times the LOQ.
- (2) The background result was more than four times the spike added.

Quality Control Summary

Client Name: Chevron
Reported: 02/19/07 at 02:13 PM

Group Number: 1024815

Surrogate Quality Control

Surrogate recoveries which are outside of the QC window are confirmed unless attributed to dilution or otherwise noted on the Analysis Report.

Analysis Name: BTEX, MTBE
Batch number: 07040A54A

	Trifluorotoluene-F	Trifluorotoluene-P
4977806	94	96
4977807	95	97
4977808	92	97
4977810		122
4977811	93	96
4977812	89	95
4977813	91	96
4977814	92	95
Blank	92	95
LCS	103	95
LCSD	103	95
MS	102	97
<hr/>		
Limits:	63-135	69-129

Analysis Name: BTEX, MTBE
Batch number: 07040A54B

	Trifluorotoluene-F	Trifluorotoluene-P
4977809	129	120
4977810	133	122
Blank	90	96
LCS	103	95
LCSD	103	95
MS	102	97
<hr/>		
Limits:	63-135	69-129

Analysis Name: TPH-DRO (Water) w/Si Gel
Batch number: 070410011A
Orthoterphenyl

4977807	113
4977808	122
4977809	127
4977810	118
4977811	105
4977812	103
4977813	106
4977814	108
Blank	108
LCS	117
LCSD	121
<hr/>	
Limits:	59-131

*- Outside of specification

- (1) The result for one or both determinations was less than five times the LOQ.
- (2) The background result was more than four times the spike added.

Lancaster Laboratories Explanation of Symbols and Abbreviations

The following defines common symbols and abbreviations used in reporting technical data:

N.D.	none detected	BMQL	Below Minimum Quantitation Level
TNTC	Too Numerous To Count	MPN	Most Probable Number
IU	International Units	CP Units	cobalt-chloroplatinate units
umhos/cm	micromhos/cm	NTU	nephelometric turbidity units
C	degrees Celsius	F	degrees Fahrenheit
Cal	(diet) calories	lb.	pound(s)
meq	milliequivalents	kg	kilogram(s)
g	gram(s)	mg	milligram(s)
ug	microgram(s)	l	liter(s)
ml	milliliter(s)	ul	microliter(s)
m3	cubic meter(s)	fib >5 um/ml	fibers greater than 5 microns in length per ml

< less than – The number following the sign is the limit of quantitation, the smallest amount of analyte which can be reliably determined using this specific test.

> greater than

ppm parts per million – One ppm is equivalent to one milligram per kilogram (mg/kg), or one gram per million grams. For aqueous liquids, ppm is usually taken to be equivalent to milligrams per liter (mg/l), because one liter of water has a weight very close to a kilogram. For gases or vapors, one ppm is equivalent to one microliter of gas per liter of gas.

ppb parts per billion

Dry weight basis Results printed under this heading have been adjusted for moisture content. This increases the analyte weight concentration to approximate the value present in a similar sample without moisture.

U.S. EPA data qualifiers:

Organic Qualifiers

A	TIC is a possible aldol-condensation product
B	Analyte was also detected in the blank
C	Pesticide result confirmed by GC/MS
D	Compound quantitated on a diluted sample
E	Concentration exceeds the calibration range of the instrument
J	Estimated value
N	Presumptive evidence of a compound (TICs only)
P	Concentration difference between primary and confirmation columns >25%
U	Compound was not detected
X,Y,Z	Defined in case narrative

Inorganic Qualifiers

B	Value is <CRDL, but ≥IDL
E	Estimated due to interference
M	Duplicate injection precision not met
N	Spike amount not within control limits
S	Method of standard additions (MSA) used for calculation
U	Compound was not detected
W	Post digestion spike out of control limits
*	Duplicate analysis not within control limits
+	Correlation coefficient for MSA <0.995

Analytical test results for methods listed on the laboratories' accreditation scope meet all requirements of NELAC unless otherwise noted under the individual analysis.

Tests results relate only to the sample tested. Clients should be aware that a critical step in a chemical or microbiological analysis is the collection of the sample. Unless the sample analyzed is truly representative of the bulk of material involved, the test results will be meaningless. If you have questions regarding the proper techniques of collecting samples, please contact us. We cannot be held responsible for sample integrity, however, unless sampling has been performed by a member of our staff. This report shall not be reproduced except in full, without the written approval of the laboratory.

WARRANTY AND LIMITS OF LIABILITY – In accepting analytical work, we warrant the accuracy of test results for the sample as submitted. THE FOREGOING EXPRESS WARRANTY IS EXCLUSIVE AND IS GIVEN IN LIEU OF ALL OTHER WARRANTIES, EXPRESSED OR IMPLIED. WE DISCLAIM ANY OTHER WARRANTIES, EXPRESSED OR IMPLIED, INCLUDING A WARRANTY OF FITNESS FOR PARTICULAR PURPOSE AND WARRANTY OF MERCHANTABILITY. IN NO EVENT SHALL LANCASTER LABORATORIES BE LIABLE FOR INDIRECT, SPECIAL, CONSEQUENTIAL, OR INCIDENTAL DAMAGES INCLUDING, BUT NOT LIMITED TO, DAMAGES FOR LOSS OF PROFIT OR GOODWILL REGARDLESS OF (A) THE NEGLIGENCE (EITHER SOLE OR CONCURRENT) OF LANCASTER LABORATORIES AND (B) WHETHER LANCASTER LABORATORIES HAS BEEN INFORMED OF THE POSSIBILITY OF SUCH DAMAGES. We accept no legal responsibility for the purposes for which the client uses the test results. No purchase order or other order for work shall be accepted by Lancaster Laboratories which includes any conditions that vary from the Standard Terms and Conditions of Lancaster Laboratories and we hereby object to any conflicting terms contained in any acceptance or order submitted by client.