



RECEIVED

By dehloptoxic at 9:27 am, Jan 16, 2007

Satya P. Sinha
Project Manager
Retail and Terminal
Business Unit

Chevron Environmental
Management Company
6001 Bollinger Canyon Road,
Room K2256
San Ramon, CA 94583
Tel (925) 842-9876
Fax (925) 842-8370
satyasinha@chevron.com

January 16, 2007

Alameda County Health Care Services
1131 Harbor Bay Parkway, Suite 250
Alameda, CA 94502-6577

RE: Chevron Service Station # 206145

Address 800 Center St., Oakland

I have reviewed the attached report dated Jan. 4, 2007.

I agree with the conclusions and recommendations presented in the referenced report. The information in this report is accurate to the best of my knowledge and all local Agency/Regional Board guidelines have been followed. This report was prepared by Cambria Environmental Technology, Inc., upon whose assistance and advice I have relied.

This letter is submitted pursuant to the requirements of California Water Code Section 13267(b) (1) and the regulating implementation entitled Appendix A pertaining thereto.

I declare under penalty of perjury that the foregoing is true and correct.

Sincerely,

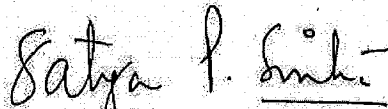
Satya P. Sinha

Attachment: Report



GETTLER-RYAN INC.

TRANSMITTAL

January 4, 2007
G-R #386492

TO: Ms. Charlotte Evans
Cambria Environmental Technology, Inc.
5900 Hollis Street, Suite A
Emeryville, CA 94608

CC: Mr. Satya Sinha
Chevron Environmental
Management Company
P.O. Box 6012, Room K2256
San Ramon, California 94583

FROM: Deanna L. Harding
Project Coordinator
Gettler-Ryan Inc.
6747 Sierra Court, Suite J
Dublin, California 94568

RE: **Former Chevron (Signal Oil)
Service Station #206145 (S-800)
800 Center Street
Oakland, California
RO 0000454**

WE HAVE ENCLOSED THE FOLLOWING:

COPIES	DATED	DESCRIPTION
1	January 3, 2007	Groundwater Monitoring and Sampling Report Fourth Quarter - Event of November 28, 2006

COMMENTS:

Pursuant to your request, we are providing you with a copy of the above referenced report for **your use and distribution to the following (via PDF):**

Mr. Barney Chan, Alameda County Health Care Services, Dept. of Environmental Health, 1131 Harbor Bay Parkway, Suite 250, Alameda, CA 94502-6577 (**Distributed by Cambria via PDF**)

This report is being sent for your review. Please provide any comments/changes and propose any groundwater monitoring modifications for the next event prior to **January 18, 2007**, at which time the final report will be distributed to the following:

cc: Mr. Rene Boisvert, Boulevard Equity Group, (Owner), 484 Lake Park Ave., #246, Oakland, CA 94610
Mr. Hollis Rodgers, 215 West MacArthur Boulevard, Apt# 434, Oakland, CA 94611

Enclosures

trans/206145-SS



Satya P. Sinha
Project Manager
Retail and Terminal
Business Unit

**Chevron Environmental
Management Company**
6001 Bollinger Canyon Road,
Room K2256
San Ramon, CA 94583
Tel (925) 842-9876
Fax (925) 842-8370
satyasinha@chevron.com

Jan. 4, 2006

Alameda County Health Care Services
1131 Harbor Bay Parkway, Suite 250
Alameda, CA 94502-6577

RE: Chevron Service Station # 206145

Address 800 Center Street, Oakland, California

I have reviewed the attached routine groundwater monitoring report dated January 4, 2006.

I agree with the conclusions and recommendations presented in the referenced report. The information in this report is accurate to the best of my knowledge and all local Agency/Regional Board guidelines have been followed. This report was prepared by Gettler-Ryan, Inc., upon whose assistance and advice I have relied.

This letter is submitted pursuant to the requirements of California Water Code Section 13267(b) (1) and the regulating implementation entitled Appendix A pertaining thereto.

I declare under penalty of perjury that the foregoing is true and correct.

Sincerely,

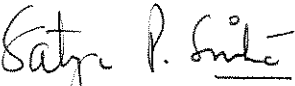
Satya P. Sinha

Attachment: Report



GETTLER - RYAN INC.

January 3, 2007
G-R Job #386492

Mr. Satya Sinha
Chevron Environmental Management Company
P.O. Box 6012, Room K2256
San Ramon, CA 94583

RE: Fourth Quarter Event of November 28, 2006
Groundwater Monitoring & Sampling Report
Former Chevron (Signal Oil) Service Station
#206145 (S-800)
800 Center Street
Oakland, California

Dear Mr. Sinha:

This report documents the most recent groundwater monitoring and sampling event performed by Gettler-Ryan Inc. (G-R) at the referenced site. All field work was conducted in accordance with G-R Standard Operating Procedure - Groundwater Sampling (attached).

Static groundwater levels were measured and the wells were checked for the presence of separate-phase hydrocarbons. Static water level data, groundwater elevations and separate-phase hydrocarbon thickness (if any) are presented in the attached Table 1. A Potentiometric Map is included as Figure 1.

Groundwater samples were collected from the monitoring wells and submitted to a state certified laboratory for analyses. The field data sheets for this event are attached. Analytical results are presented in the table(s) listed below. The chain of custody document and laboratory analytical report are also attached.

Please call if you have any questions or comments regarding this report. Thank you.

Sincerely,

Deanna L. Harding
Project Coordinator

Douglas J. Lee
Senior Geologist, P.G. No. 6882

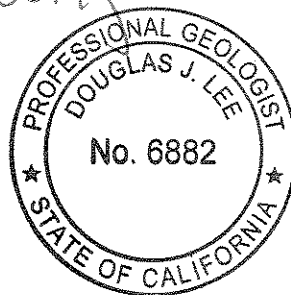
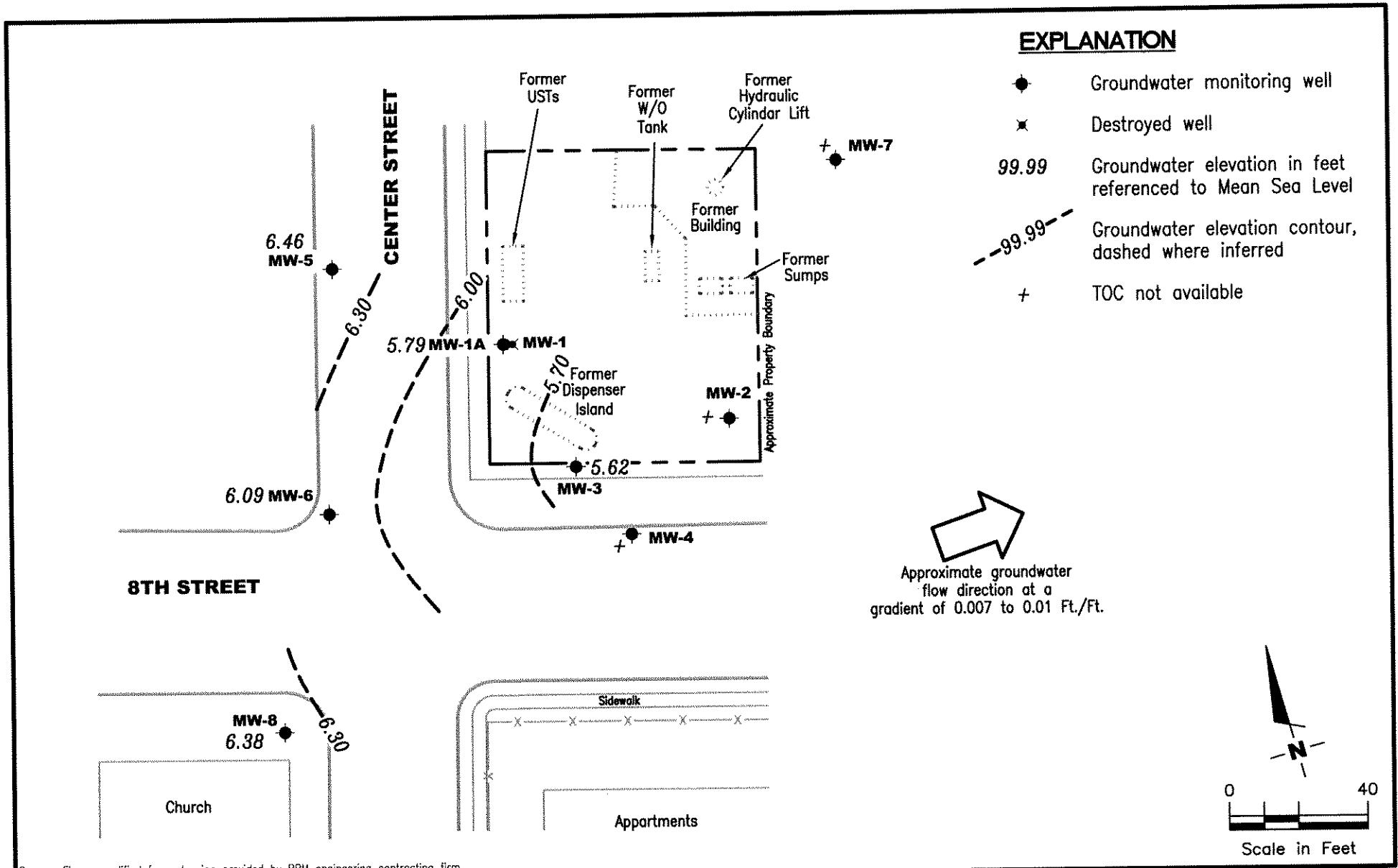

Figure 1: Potentiometric Map
Table 1: Groundwater Monitoring Data and Analytical Results
Table 2: Field Measurements and Analytical Results
Table 3: Groundwater Analytical Results - Oxygenate Compounds
Attachments: Standard Operating Procedure - Groundwater Sampling
Field Data Sheets
Chain of Custody Document and Laboratory Analytical Reports



Source: Figure modified from drawing provided by RRM engineering contracting firm.

GETTLER - RYAN INC.
 6747 Sierra Court, Suite J
 Dublin, CA 94568 (925) 551-7555

POTENTIOMETRIC MAP
 Former Chevron (Signal Oil) Service Station #206145(S-800)
 800 Center Street
 Oakland, California

FIGURE
1

PROJECT NUMBER
386492

REVIEWED BY

DATE
 November 28, 2006

REVISED DATE

Table 1
Groundwater Monitoring Data and Analytical Results
Former Chevron (Signal Oil) Service Station #206145 (S-800)
800 Center Street
Oakland, California

WELL ID/ DATE	TOC* (ft.)	GWE (msl)	DTW (ft.)	TPH-D (ppb)	TPH-G (ppb)	B (ppb)	T (ppb)	E (ppb)	X (ppb)	MTBE (ppb)	CUB (cfu/ml)
MW-1A											
02/24-25/03 ¹	15.49	8.17	7.32	4,600	5,100	92	340	66	480	<10	--
06/02/03	15.49	7.15	8.34	5,500	3,800	150	490	72	450	<13	--
09/02/03	15.49	6.10	9.39	10,000	6,200	100	580	110	760	47	--
11/21/03	15.49	5.29	10.20	3,800	3,200	29	150	49	240	<10	--
02/27/04	15.49	9.87	5.62	2,800	280	9.7	19	3.0	30	<2.5	--
05/28/04	15.49	6.88	8.61	5,500	1,100	35	81	27	140	17	--
08/31/04	15.49	5.58	9.91	4,500	1,100	13	68	27	110	<2.5	--
12/17/04	15.49	7.09	8.40	2,300 ^o	560	8.0	17	9.6	36	<2.5	--
03/28/05	15.49	10.36	5.13	340 ^o	87	16	4.2	3.3	11	<2.5	--
06/09/05	15.49	9.69	5.80	6,400 ^o	260	26	3.7	7.7	13	5.3	--
08/19/05	15.49	6.70	8.79	1,100 ^{o,p,q}	440	38	7.8	9.4	17	<2.5	--
11/18/05	15.49	6.25	9.24	1,300 ^{o,q}	450	11	12	17	22	<2.5	--
03/07/06	15.49	10.51	4.98	2,300 ^o	150	33	1.6	3.4	2.7	<2.5	--
05/17/06	15.49	9.02	6.47	2,600 ^o	110	18	<0.5	0.7	<1.5	<2.5	--
08/30/06	15.49	5.68	9.81	3,600 ^o	420	24	0.7	8.1	9.2	<10	--
11/28/06	15.49	5.79	9.70	2,900^o	220	8.6	2.7	6.1	9.3	<2.5	--
MW-2											
10/27/95	15.77	10.60	5.17	--	<50	<0.5	<0.5	<0.5	<0.5	--	--
02/20/97	15.72	8.51	7.21	--	<50	<0.5	<0.5	<0.5	<0.5	<2.5	--
04/24/97	15.72	7.82	7.90	--	83 ^d	<0.5	<0.5	<0.5	<0.5	<2.5	--
07/23/97	15.72	5.92	9.80	--	<50	<0.5	<0.5	<0.5	<0.5	<2.5	--
10/29/97	15.72	5.13	10.59	--	<50	<0.5	<0.5	<0.5	<0.5	<2.5	--
01/28/98	15.72	9.21	6.51	--	<50	<0.5	<0.5	<0.5	<0.5	<2.5	--
05/11/98	15.72	8.82	6.90	--	SAMPLED ANNUALLY		--	--	--	--	--
07/16/98	15.72	7.37	8.35	--	--	--	--	--	--	--	--
08/04/98 ^a	15.72	7.03	8.69	--	--	--	--	--	--	--	1.9 x 10 ¹
09/03/98 ^a	15.72	6.44	9.28	--	--	--	--	--	--	--	3.0 x 10 ²
10/21/98 ^b	15.72	5.51	10.21	--	--	--	--	--	--	--	8.8 x 10 ²
11/04/98	15.72	5.60	10.12	--	--	--	--	--	--	--	--
01/26/99	15.72	6.87	8.85	--	<50	<0.5	<0.5	<0.5	<0.5	<2.0	--
05/06/99	15.72	8.20	7.52	--	--	--	--	--	--	--	--
08/21/99	15.72	13.21	2.51	--	--	--	--	--	--	--	--
10/28/99	15.72	6.35	9.37	--	--	--	--	--	--	--	--
01/31/00	15.72	7.25	8.47	--	<50	<0.5	0.541	<0.5	<0.5	<2.5	--

Table 1
Groundwater Monitoring Data and Analytical Results
Former Chevron (Signal Oil) Service Station #206145 (S-800)
800 Center Street
Oakland, California

WELL ID/ DATE	TOC* (ft.)	GWE (msl)	DTW (ft.)	TPH-D (ppb)	TPH-G (ppb)	B (ppb)	T (ppb)	E (ppb)	X (ppb)	MTBE (ppb)	CUB (cfu/ml)
MW-2 (cont)											
05/19/00	15.72	7.65	8.07	--	--	--	--	--	--	--	--
08/07/00	15.72	6.35	9.37	--	<50	<0.50	<0.50	<0.50	<0.50	<2.5/<2.0 ^f	--
12/01/00	15.72	5.60	10.12	--	<50.0	<0.500	<0.500	<0.500	<0.500	<2.50	--
02/09/01	15.72	6.05	9.67	--	<50	<0.50	<0.50	<0.50	<0.50	<2.5	--
05/29/01	15.72	6.73	8.99	--	<50	<0.50	<0.50	<0.50	<0.50	<2.5	--
08/27/01 ^h	15.72	5.68	10.04	--	<50	<0.50	<0.50	<0.50	<0.50	--/<5.0 ^f	--
11/28/01	15.72	5.86	9.86	--	NOT SAMPLED DUE TO INSUFFICIENT WATER					--	--
02/14/02	15.69	7.86	7.83	--	<50	<0.50	<0.50	<0.50	<1.5	<2.5	--
05/15/02	15.69	7.09	8.60	--	<50	<0.50	<0.50	<0.50	<1.5	<2.5	--
08/05/02	15.69	6.02	9.67	--	<50	<0.50	<0.50	<0.50	<1.5	<2.5	--
11/30/02	15.69	DRY	--	--	--	--	--	--	--	--	--
02/24-25/03 ¹	15.69	8.04	7.65	140	<50	<0.50	<0.50	<0.50	<1.5	<2.5	--
06/02/03	15.69	7.33	8.36	150 ^m	<50	<0.5	<0.5	<0.5	<1.5	<2.5	--
09/02/03	15.69	5.97	9.72	150 ^m	<50	<0.5	<0.5	<0.5	<1.5	<2.5	--
11/21/03	-- ⁿ	-- ⁿ	10.39	180	<50	<0.5	<0.5	<0.5	<1.5	<2.5	--
02/27/04	-- ⁿ	-- ⁿ	6.90	310	<50	<0.5	<0.5	<0.5	<1.5	<2.5	--
05/28/04	-- ⁿ	-- ⁿ	9.13	160	<50	<0.5	<0.5	<0.5	<1.5	<2.5	--
08/31/04	-- ⁿ	-- ⁿ	10.30	180 ^m	<50	<0.5	<0.5	<0.5	<1.5	<2.5	--
12/17/04	-- ⁿ	-- ⁿ	8.91	77 ^o	<50	<0.5	<0.5	<0.5	<1.5	<2.5	--
03/28/05	-- ⁿ	-- ⁿ	6.51	<50 ^o	<50	<0.5	0.5	<0.5	<1.5	<2.5	--
06/09/05	-- ⁿ	-- ⁿ	7.09	53 ^o	<50	<0.5	<0.5	<0.5	<1.5	<2.5	--
08/19/05	-- ⁿ	-- ⁿ	9.27	<50 ^{o,p}	<50	<0.5	<0.5	<0.5	<1.5	<2.5	--
11/18/05	-- ⁿ	-- ⁿ	9.66	<50 ^o	<50	<0.5	<0.5	<0.5	<1.5	<2.5	--
03/07/06	-- ⁿ	-- ⁿ	6.75	<50 ^o	<50	<0.5	<0.5	<0.5	<1.5	<2.5	--
05/17/06	-- ⁿ	-- ⁿ	7.09	<50 ^o	<50	<0.5	<0.5	<0.5	<1.5	<2.5	--
08/30/06	-- ⁿ	-- ⁿ	9.03	640 ^o	<50	<0.5	<0.5	<0.5	<1.5	<2.5	--
11/28/06	-- ⁿ	-- ⁿ	10.02	560 ^o	<50	<0.5	<0.5	<0.5	<1.5	<2.5	--
MW-3											
10/27/95	15.46	10.37	5.09	--	33,000	11,000	1,700	2,300	4,200	--	--
02/20/97	15.42	8.37	7.05	--	260	56	<1.0	7.6	5.9	<5.0	--
04/24/97	15.42	7.29	8.13	--	1,400	310	28	76	75	74	--
07/23/97	15.42	5.84	9.58	--	37,000	10,000	1,500	2,700	4,200	2,500	--
10/29/97	15.42	5.09	10.33	--	53,000	12,000	1,200	3,000	3,100	2,500	--
01/28/98	15.42	8.94	6.48	--	210	43	1.5	1.7	3.9	10	--

Table 1
Groundwater Monitoring Data and Analytical Results
Former Chevron (Signal Oil) Service Station #206145 (S-800)
800 Center Street
Oakland, California

WELL ID/ DATE	TOC* (ft.)	GWE (msl)	DTW (ft.)	TPH-D (ppb)	TPH-G (ppb)	B (ppb)	T (ppb)	E (ppb)	X (ppb)	MTBE (ppb)	CUB (cfu/ml)
MW-3 (cont)											
05/11/98	15.42	8.49	6.93	--	59	11	<0.5	2.1	<0.5	<2.5	--
07/16/98	15.42	7.14	8.28	--	260	90	4.8	18	5.7	<10	--
08/04/98 ^a	15.42	6.88	8.54	--	--	--	--	--	--	--	8.5 x 10 ²
09/03/98 ^a	15.42	6.34	9.08	--	--	--	--	--	--	--	2.4 x 10 ³
10/21/98 ^b	15.42	5.62	9.80	--	--	--	--	--	--	--	6.0 x 10 ¹
11/04/98	15.42	5.60	9.82	--	73,000	17,000	3,800	4,900	8,100	<250	--
01/26/99	15.42	6.70	8.72	--	32,400	10,200	1,850	2,650	3,140	715/<500 ^e	--
05/06/99	15.42	7.97	7.45	--	3,160	668	89.6	180	123	<200/<10 ^e	--
08/21/99	15.42	7.95	7.47	--	53,800	9,700	2,040	2,880	5,000	<1,250/<40 ^e	--
10/28/99	15.42	5.37	10.05	--	71,300	14,000	3,420	4,320	8,360	<1,000	--
01/31/00	15.42	7.16	8.26	--	1,650	496	49.1	134	82.6	<12.5	--
05/19/00	15.42	7.60	7.82	--	110 ^e	36	2.5	9.1	4.0	6.3	--
08/07/00	15.42	6.29	9.13	--	36,000 ^e	9,000	3,000	2,700	2,800	2,500/<10 ^f	--
12/01/00	15.42	2.45	12.97	--	NOT SAMPLED DUE TO INSUFFICIENT WATER					--	--
02/09/01	15.42	5.98	9.44	--	32,000 ^e	11,000	3,900	3,200	4,800	3,200/<2.0 ^f	--
05/29/01	15.42	6.65	8.77	--	13,000	4,200	2,000	1,800	1,500	74/<2.0 ^f	--
08/27/01 ^h	15.42	5.70	9.72	--	40,000	7,600	2,800	2,500	2,700	--/<25 ^f	--
11/28/01	15.42	5.77	9.65	--	57,000	10,000	2,900	2,900	2,800	<250/<5.0 ^f	--
02/14/02	15.40	7.73	7.67	--	51	2.9	<0.50	1.9	1.8	<2.5/<2 ^f	--
05/15/02	15.40	7.05	8.35	--	4,100	910	250	210	240	<20/<2 ^f	--
08/05/02	15.40	5.96	9.44	--	58,000	11,000	4,300	3,400	4,000	<250/<10 ^f	--
11/30/02	15.40	5.14	10.26	--	46,000	13,000	2,900	3,700	2,600	<100/<10 ^f	--
02/24-25/03 ¹	15.40	7.89	7.51	4,500	52,000	9,600	4,800	2,900	4,100	<130	--
06/02/03	15.40	7.24	8.16	6,500	67,000	11,000	9,600	3,400	5,700	<250	--
09/02/03	15.40	5.89	9.51	10,000	73,000	8,900	10,000	3,600	7,000	300	--
11/21/03	15.40	5.17	10.23	8,000	29,000	3,300	3,200	1,200	1,500	<200	--
02/27/04	15.40	8.84	6.56	200	59	8.2	6.3	1.7	6.8	<2.5	--
05/28/04	15.40	6.57	8.83	5,400	18,000	2,600	970	1,600	950	<100	--
08/31/04	15.40	5.41	9.99	9,100	58,000	3,200	9,600	2,800	7,500	<50	--
12/17/04	15.40	6.81	8.59	2,200 ^o	23,000	1,100	2,100	1,200	2,600	<25	--
03/28/05	15.40	9.29	6.11	3,200 ^o	43,000	1,500	10,000	2,600	7,300	<130	--
06/09/05	15.40	8.65	6.75	7,800 ^o	38,000	980	7,000	2,100	4,800	190	--
08/19/05	15.40	6.43	8.97	5,000 ^{o,p,r}	75,000	1,500	14,000	3,400	9,600	<130	--
11/18/05	15.40	5.95	9.45	3,900 ^{o,r}	72,000	1,400	14,000	3,600	9,700	380	--
03/07/06	15.40	9.05	6.35	1,100 ^o	15,000	280	2,300	820	2,000	<100	--
05/17/06	15.40	8.57	6.83	4,400 ^o	57,000	650	8,100	2,900	8,100	410	--

Table 1
Groundwater Monitoring Data and Analytical Results
Former Chevron (Signal Oil) Service Station #206145 (S-800)
800 Center Street
Oakland, California

WELL ID/ DATE	TOC* (ft.)	GWE (msl)	DTW (ft.)	TPH-D (ppb)	TPH-G (ppb)	B (ppb)	T (ppb)	E (ppb)	X (ppb)	MTBE (ppb)	CUB (cfu/ml)
MW-3 (cont)											
08/30/06	15.40	5.44	9.96	4,300 ^o	54,000	540	7,600	4,100	10,000	550	--
11/28/06	15.40	5.62	9.78	4,400 ^o	43,000	260	3,400	3,800	5,800	<1,000	--
MW-4											
10/27/95	14.45	9.37	5.08	--	66	6.8	<0.5	<0.5	<0.5	--	--
02/20/97	14.40	8.12	6.28	--	54	<0.5	<0.5	<0.5	7.4	39	--
04/24/97	14.40	7.29	7.11	--	54	1.4	<0.5	0.65	3.0	100	--
07/23/97	14.40	5.80	8.60	--	<50	<0.5	<0.5	<0.5	<0.5	<2.5	--
10/29/97	14.40	5.74	8.66	--	--	--	--	--	--	--	--
11/13/97	14.40	4.97	9.43	--	<50	<0.5	0.79	<0.5	<0.5	<2.5	--
01/28/98	14.40	8.88	5.52	--	<50	<0.5	<0.5	<0.5	<0.5	<2.5	--
05/11/98	14.40	8.40	6.00	--	SAMPLED BIANNUALLY		--	--	--	--	--
07/16/98	14.40	7.08	7.32	--	<50	<0.5	<0.5	<0.5	<0.5	<5.0	--
08/04/98 ^a	14.40	6.28	8.12	--	--	--	--	--	--	--	1.8 x 10 ⁴
09/03/98 ^a	14.40	6.32	8.08	--	--	--	--	--	--	--	1.4 x 10 ⁴
10/21/98 ^b	14.40	5.64	8.76	--	--	--	--	--	--	--	8.6 x 10 ⁴
11/04/98	14.40	5.61	8.79	--	--	--	--	--	--	--	--
01/26/99	14.40	6.71	7.69	--	<50	<0.5	<0.5	<0.5	<0.5	<2.0	--
05/06/99	14.40	8.15	6.25	--	--	--	--	--	--	--	--
08/21/99	14.40	8.13	6.27	--	<50	<0.5	<0.5	<0.5	<0.5	<5.0	--
10/28/99	14.40	4.14	10.26	--	--	--	--	--	--	--	--
01/31/00	14.40	7.07	7.33	--	<50	<0.5	<0.5	<0.5	<0.5	<2.5	--
05/19/00	14.40	7.52	6.88	--	--	--	--	--	--	--	--
08/07/00	14.40	6.23	8.17	--	<50	4.3	0.60	<0.50	<0.50	<2.5/<2.0 ^f	--
12/01/00	14.40	INACCESSIBLE	--	--	--	--	--	--	--	--	--
02/09/01	14.40	INACCESSIBLE	--	--	--	--	--	--	--	--	--
05/29/01	14.40	6.58	7.82	--	NOT SAMPLED DUE TO INSUFFICIENT WATER				--	--	--
08/27/01	14.40	6.52	7.88	--	NOT SAMPLED DUE TO INSUFFICIENT WATER				--	--	--
11/28/01	14.40	DRY	--	--	--	--	--	--	--	--	--
02/14/02	14.37	7.66	6.71	--	<50	<0.50	<0.50	<0.50	<1.5	<2.5/<2 ^f	--
05/15/02	14.37	6.96	7.41	--	<50	<0.50	<0.50	<0.50	<1.5	<2.5/<2 ^f	--
08/05/02	14.37	DRY	--	--	--	--	--	--	--	--	--
11/30/02	14.37	DRY	--	--	--	--	--	--	--	--	--
02/24-25/03 ¹	14.37	7.77	6.60	200	<50	8.0	<0.50	<0.50	<1.5	<2.5	--
06/02/03	14.37	7.11	7.26	300	<50	4.3	<0.5	<0.5	<1.5	<2.5	--

Table 1
Groundwater Monitoring Data and Analytical Results
Former Chevron (Signal Oil) Service Station #206145 (S-800)
800 Center Street
Oakland, California

WELL ID/ DATE	TOC* (ft.)	GWE (msl)	DTW (ft.)	TPH-D (ppb)	TPH-G (ppb)	B (ppb)	T (ppb)	E (ppb)	X (ppb)	MTBE (ppb)	CUB (cfu/ml)
MW-4 (cont)											
09/02/03	14.37	5.80	8.57	410	51	4.3	<0.5	<0.5	<1.5	<2.5	--
11/21/03	-- ⁿ	-- ⁿ	10.24	560	110	25	0.6	1.5	<1.5	<2.5	--
02/27/04	-- ⁿ	-- ⁿ	5.71	340	<50	<0.5	<0.5	<0.5	<1.5	<2.5	--
05/28/04	-- ⁿ	-- ⁿ	7.88	430	<50	<0.5	<0.5	<0.5	<1.5	<2.5	--
08/31/04	-- ⁿ	-- ⁿ	9.03	460	<50	<0.5	<0.5	<0.5	<1.5	<2.5	--
12/17/04	-- ⁿ	-- ⁿ	7.67	390 ^o	<50	<0.5	<0.5	<0.5	<1.5	<2.5	--
03/28/05	-- ⁿ	-- ⁿ	5.32	<50 ^o	<50	<0.5	<0.5	<0.5	<1.5	<2.5	--
06/09/05	-- ⁿ	-- ⁿ	6.70	120 ^o	90	<0.5	<0.5	<0.5	<1.5	<2.5	--
08/19/05	-- ⁿ	-- ⁿ	8.03	190 ^{o,p,q}	200	<0.5	<0.5	<0.5	<1.5	<2.5	--
11/18/05	-- ⁿ	-- ⁿ	9.43	310 ^{o,t}	230	2.7	<0.5	0.8	<1.5	<2.5	--
03/07/06	-- ⁿ	-- ⁿ	5.55	230 ^o	<50	<0.5	<0.5	<0.5	<1.5	<2.5	--
05/17/06	-- ⁿ	-- ⁿ	5.89	150 ^o	<50	<0.5	<0.5	<0.5	<1.5	<2.5	--
08/30/06	-- ⁿ	-- ⁿ	7.71	380 ^o	1,300	47	<2.5	<2.5	<7.5	<50	--
11/28/06	-- ⁿ	-- ⁿ	8.75	1,800^o	1,200	36	1.1	3.4	<5.0	<20	--
MW-5											
01/03/97	--	--	--	--	<50	<0.5	<0.5	<0.5	<0.5	--	--
02/20/97	15.03	INACCESSIBLE	--	--	--	--	--	--	--	--	--
04/24/97	15.03	INACCESSIBLE	--	--	--	--	--	--	--	--	--
04/30/97	15.03	7.06	7.97	--	<50	<0.5	<0.5	<0.5	<0.5	<2.5	--
07/23/97	15.03	INACCESSIBLE	--	--	--	--	--	--	--	--	--
10/29/97	15.03	INACCESSIBLE	--	--	--	--	--	--	--	--	--
01/28/98	15.03	8.83	6.20	--	<50	<0.5	<0.5	<0.5	<0.5	<2.5	--
05/11/98	15.03	INACCESSIBLE	--	--	--	--	--	--	--	--	--
07/16/98	15.03	7.28	7.75	--	<50	<0.5	<0.5	<0.5	<0.5	<5.0	--
08/04/98	15.03	INACCESSIBLE	--	--	--	--	--	--	--	--	--
11/04/98	15.03	INACCESSIBLE	--	--	--	--	--	--	--	--	--
01/26/99	15.03	INACCESSIBLE	--	--	--	--	--	--	--	--	--
05/06/99	15.03	INACCESSIBLE	--	--	--	--	--	--	--	--	--
08/21/99	15.03	6.74	8.29	--	<50	<0.5	<0.5	<0.5	<0.5	<5.0	--
10/28/99	15.03	4.60	10.43	--	--	--	--	--	--	--	--
01/31/00	15.03	7.39	7.64	--	<50	<0.5	<0.5	<0.5	<0.5	<2.5	--
05/19/00	15.03	7.85	7.18	--	--	--	--	--	--	--	--
08/07/00	15.03	INACCESSIBLE	--	--	--	--	--	--	--	--	--
12/01/00	15.03	5.68	9.35	--	<50.0	<0.500	<0.500	<0.500	<0.500	<2.50/<2.0 ^f	--

Table 1
Groundwater Monitoring Data and Analytical Results
Former Chevron (Signal Oil) Service Station #206145 (S-800)
800 Center Street
Oakland, California

WELL ID/ DATE	TOC* (ft.)	GWE (msl)	DTW (ft.)	TPH-D (ppb)	TPH-G (ppb)	B (ppb)	T (ppb)	E (ppb)	X (ppb)	MTBE (ppb)	CUB (cfu/ml)
MW-5 (cont)											
02/09/01	15.03	6.22	8.81	--	<50	<0.50	<0.50	<0.50	<0.50	<2.5/<2.0 ^f	--
05/29/01	15.03	INACCESSIBLE - CAR PARKED OVER WELL				--	--	--	--	--	--
08/27/01	15.03	INACCESSIBLE - CAR PARKED OVER WELL				--	--	--	--	--	--
11/28/01	15.03	INACCESSIBLE - CAR PARKED OVER WELL				--	--	--	--	--	--
02/14/02	15.01	7.96	7.05	--	<50	<0.50	<0.50	<0.50	<1.5	<2.5/<2 ^f	--
05/15/02	15.01	7.23	7.78	--	<50	<0.50	<0.50	<0.50	<1.5	<2.5/<2 ^f	--
08/05/02	15.01	6.13	8.88	--	<50	<0.50	<0.50	<0.50	<1.5	<2.5/<2 ^f	--
11/30/02	15.01	5.27	9.74	--	<50	<0.50	<0.50	<0.50	<1.5	<2.5/<2 ^f	--
02/24-25/03 ¹	15.01	7.99	7.02	<50	<50	<0.50	<0.50	<0.50	<1.5	<2.5	--
06/02/03	15.01	7.14	7.87	<50	<50	<0.5	<0.5	<0.5	<1.5	<2.5	--
09/02/03	15.01	6.02	8.99	<50	<50	<0.5	<0.5	<0.5	<1.5	<2.5	--
11/21/03	15.01	5.26	9.75	68	<50	<0.5	<0.5	<0.5	<1.5	<2.5	--
02/27/04	15.01	8.42	6.59	140	<50	<0.5	<0.5	<0.5	<1.5	<2.5	--
05/28/04	15.01	6.71	8.30	76	<50	<0.5	<0.5	<0.5	<1.5	<2.5	--
08/31/04	15.01	INACCESSIBLE - CAR PARKED OVER WELL				--	--	--	--	--	--
12/17/04	15.01	6.98	8.03	52 ^o	<50	<0.5	<0.5	<0.5	<1.5	<2.5	--
03/28/05	15.01	8.66	6.35	51 ^o	<50	<0.5	0.7	<0.5	<1.5	<2.5	--
06/09/05	15.01	9.16	5.85	72 ^o	<50	<0.5	<0.5	<0.5	<1.5	<2.5	--
08/19/05	15.01	6.52	8.49	<50 ^{o-p}	<50	<0.5	<0.5	<0.5	<1.5	<2.5	--
11/18/05	15.01	6.12	8.89	<50 ^o	<50	<0.5	<0.5	<0.5	<1.5	<2.5	--
03/07/06	15.01	8.98	6.03	<50 ^o	<50	<0.5	<0.5	1.4	<1.5	<2.5	--
05/17/06	15.01	8.83	6.18	<50 ^o	<50	<0.5	<0.5	<0.5	<1.5	<2.5	--
08/30/06	15.01	6.86	8.15	<50 ^o	<50	<0.5	<0.5	<0.5	<1.5	<2.5	--
11/28/06	15.01	6.46	8.55	200 ^o	<50	<0.5	<0.5	<0.5	<1.5	<2.5	--
MW-6											
01/03/97	--	--	--	--	<50	<0.5	<0.5	<0.5	<0.5	--	--
02/20/97	14.73	8.11	6.62	--	800	310	23	11	28	<12	--
04/24/97	14.73	7.13	7.60	--	<50	<0.5	<0.5	<0.5	<0.5	<2.5	--
07/23/97	14.73	5.73	9.00	--	<50	<0.5	<0.5	<0.5	<0.5	<2.5	--
10/29/97	14.73	4.98	9.75	--	<50	<0.5	<0.5	<0.5	<0.5	<2.5	--
01/28/98	14.73	8.19	6.54	--	160	38	<0.5	<0.5	<0.5	<2.5	--
05/11/98	14.73	8.08	6.65	--	1,700	490	72	39	52	<25	--
07/16/98	14.73	7.04	7.69	--	<50	<0.5	<0.5	<0.5	<0.5	<5.0	--
08/04/98 ²	14.73	6.89	7.84	--	--	--	--	--	--	--	8.6 x 10 ³

Table 1
Groundwater Monitoring Data and Analytical Results
Former Chevron (Signal Oil) Service Station #206145 (S-800)
800 Center Street
Oakland, California

WELL ID/ DATE	TOC* (ft.)	GWE (msl)	DTW (ft.)	TPH-D (ppb)	TPH-G (ppb)	B (ppb)	T (ppb)	E (ppb)	X (ppb)	MTBE (ppb)	CUB (cfu/ml)	
MW-6 (cont)												
09/03/98 ^a	14.73	6.24	8.49	--	--	--	--	--	--	--	2.9 x 10 ³	
10/21/98 ^b	14.73	5.46	9.27	--	--	--	--	--	--	--	1.8 x 10 ³	
11/04/98	14.73	5.52	9.21	--	<50	<0.5	<0.5	<0.5	<0.5	<2.5	--	
01/26/99	14.73	6.49	8.24	--	<50	<0.5	<0.5	<0.5	<0.5	<2.0	--	
05/06/99	14.73	7.91	6.82	--	<50	<0.5	<0.5	<0.5	<0.5	<5.0	--	
08/21/99	14.73	7.93	6.80	--	<50	<0.5	<0.5	<0.5	<0.5	<5.0	--	
10/28/99	14.73	5.27	9.46	--	<50	<0.5	<0.5	<0.5	<0.5	<5.0	--	
01/31/00	14.73	7.16	7.57	--	<50	<0.5	<0.5	<0.5	<0.5	<2.5	--	
05/19/00	14.73	7.60	7.13	--	<50	11	<0.5	<0.5	<0.5	<2.5	--	
08/07/00	14.73	6.22	8.51	--	<50	<0.50	<0.50	<0.50	<0.50	<2.5/<2.0 ^f	--	
12/01/00	14.73	DRY	--	--	--	--	--	--	--	--	--	
02/09/01	14.73	DRY	--	--	--	--	--	--	--	--	--	
05/29/01	14.73	6.63	8.10	--	NOT SAMPLED DUE TO INSUFFICIENT WATER						--	--
08/27/01 ^b	14.73	9.83	4.90	--	150	<0.50	5.7	<0.50	<0.50	--/<5.0 ^f	--	
11/28/01	14.73	DRY	--	--	--	--	--	--	--	--	--	
02/14/02	14.68	7.90	6.78	--	<50	<0.50	<0.50	<0.50	<1.5	<2.5	--	
05/15/02	14.68	7.32	7.36	--	<50	<0.50	<0.50	<0.50	<1.5	<2.5	--	
08/05/02	14.68	DRY	--	--	--	--	--	--	--	--	--	
11/30/02	14.68	DRY	--	--	--	--	--	--	--	--	--	
02/24-25/03 ¹	14.68	7.89	6.79	<50	<50	<0.50	<0.50	<0.50	<1.5	<2.5	--	
06/02/03	14.68	7.20	7.48	<50	<50	<0.5	<0.5	<0.5	<1.5	<2.5	--	
09/02/03	14.68	5.77	8.91	190	<50	<0.5	<0.5	<0.5	<1.5	<2.5	--	
11/21/03	14.68	4.86	9.82	98	<50	<0.5	<0.5	<0.5	<1.5	<2.5	--	
02/27/04	14.68	8.12	6.56	240	<50	<0.5	<0.5	<0.5	<1.5	<2.5	--	
05/28/04	14.68	6.43	8.25	150	<50	<0.5	<0.5	<0.5	<1.5	<2.5	--	
08/31/04	14.68	5.29	9.39	360 ^m	<50	<0.5	<0.5	<0.5	<1.5	<2.5	--	
12/17/04	14.68	6.85	7.83	91 ^o	<50	<0.5	<0.5	<0.5	<1.5	<2.5	--	
03/28/05	14.68	8.34	6.34	61 ^o	<50	<0.5	<0.5	<0.5	<1.5	<2.5	--	
06/09/05	14.68	7.95	6.73	64 ^o	<50	<0.5	<0.5	<0.5	<1.5	<2.5	--	
08/19/05	14.68	6.27	8.41	<50 ^{o-p}	<50 ^s	<0.5	<0.5	<0.5	<1.5	<2.5	--	
11/18/05	14.68	DRY AT 15.70 FEET		--	--	--	--	--	--	--	--	
03/07/06	14.68	8.03	6.65	<50 ^o	<50	<0.5	<0.5	0.9	<1.5	<2.5	--	
05/17/06	14.68	7.98	6.70	<50 ^o	<50	<0.5	<0.5	<0.5	<1.5	<2.5	--	
08/30/06	14.68	6.63	8.05	<50 ^o	<50	<0.5	<0.5	<0.5	<1.5	<2.5	--	
11/28/06	14.68	6.09	8.59	120^o	<50	<0.5	<0.5	<0.5	<1.5	<2.5	--	

Table 1
Groundwater Monitoring Data and Analytical Results
Former Chevron (Signal Oil) Service Station #206145 (S-800)
800 Center Street
Oakland, California

WELL ID/ DATE	TOC* (ft.)	GWE (msl)	DTW (ft.)	TPH-D (ppb)	TPH-G (ppb)	B (ppb)	T (ppb)	E (ppb)	X (ppb)	MTBE (ppb)	CUB (cfu/ml)
MW-7											
01/03/97	--	--	--	--	<50	<0.5	<0.5	<0.5	<0.5	--	--
02/20/97	16.36	8.86	7.50	--	<50	<0.5	<0.5	<0.5	<0.5	<2.5	--
04/24/97	16.36	7.59	8.77	--	<50	<0.5	<0.5	<0.5	<0.5	<2.5	--
07/23/97	16.36	6.09	10.27	--	<50	<0.5	<0.5	<0.5	<0.5	<2.5	--
10/29/97	16.36	5.28	11.08	--	<50	<0.5	<0.5	<0.5	<0.5	<2.5	--
01/28/98	16.36	9.10	7.26	--	<50	<0.5	<0.5	<0.5	<0.5	<2.5	--
05/11/98	16.36	9.11	7.25	--	SAMPLED ANNUALLY		--	--	--	--	--
07/16/98	16.36	8.00	8.36	--	--	--	--	--	--	--	--
08/04/98 ^a	16.36	7.32	9.04	--	--	--	--	--	--	--	1.5 x 10 ³
09/03/98 ^a	16.36	6.65	9.71	--	--	--	--	--	--	--	6.5 x 10 ²
10/21/98 ^b	16.36	5.96	10.40	--	--	--	--	--	--	--	4.8 x 10 ³
11/04/98	16.36	5.89	10.47	--	--	--	--	--	--	--	--
01/26/99	16.36	8.25	8.11	--	<50	<0.5	<0.5	<0.5	0.5	<2.0	--
05/06/99	16.36	8.47	7.89	--	--	--	--	--	--	--	--
08/21/99	16.36	8.51	7.85	--	--	--	--	--	--	--	--
10/28/99	16.36	6.04	10.32	--	--	--	--	--	--	--	--
01/31/00	16.36	7.57	8.79	--	<50	<0.5	<0.5	<0.5	<0.5	<2.5	--
05/19/00	16.36	UNABLE TO LOCATE		--	--	--	--	--	--	--	--
08/07/00	16.36	6.67	9.69	--	<50	<0.50	<0.50	<0.50	<0.50	<2.5/<2.0 ^f	--
12/01/00	16.36	5.84	10.52	--	<50.0	<0.500	<0.500	<0.500	<0.500	<2.50	--
02/09/01	16.36	6.30	10.06	--	<50	<0.50	<0.50	<0.50	<0.50	<2.5	--
05/29/01	16.36	UNABLE TO LOCATE		--	--	--	--	--	--	--	--
08/27/01 ^h	16.36	6.02	10.34	--	<50	<0.50	<0.50	<0.50	<0.50	--/<5.0 ^f	--
11/28/01	16.36	6.09	10.27	--	<50	<0.50	<0.50	<0.50	<1.5	<2.5	--
02/14/02	16.31	8.21	8.10	--	<50	<0.50	<0.50	<0.50	<1.5	<2.5	--
05/15/02	16.31	7.41	8.90	--	<50	<0.50	<0.50	<0.50	<1.5	<2.5	--
08/05/02	16.31	6.26	10.05	--	<50	<0.50	<0.50	<0.50	<1.5	<2.5	--
11/30/02	16.31	5.39	10.92	--	<50	<0.50	<0.50	<0.50	<1.5	<2.5	--
02/24-25/03 ^l	16.31	8.30	8.01	<50	<50	<0.50	<0.50	<0.50	<1.5	<2.5	--
06/02/03	16.31	7.67	8.64	<50	<50	<0.5	<0.5	<0.5	<1.5	<2.5	--
09/02/03	16.31	6.17	10.14	<50	<50	<0.5	<0.5	<0.5	<1.5	<2.5	--
11/21/03	16.31	UNABLE TO LOCATE - BURIED		--	--	--	--	--	--	--	--
02/27/04	16.31	UNABLE TO LOCATE - BURIED		--	--	--	--	--	--	--	--
05/28/04	-- ⁿ	-- ⁿ	9.40	91	<50	<0.5	<0.5	<0.5	<1.5	<2.5	--
08/31/04	-- ⁿ	-- ⁿ	10.61	150 ^m	<50	<0.5	<0.5	<0.5	<1.5	<2.5	--
12/17/04	-- ⁿ	-- ⁿ	9.16	170 ^o	<50	<0.5	<0.5	<0.5	<1.5	<2.5	--

Table 1
Groundwater Monitoring Data and Analytical Results
Former Chevron (Signal Oil) Service Station #206145 (S-800)
800 Center Street
Oakland, California

WELL ID/ DATE	TOC* (ft.)	GWE (msl)	DTW (ft.)	TPH-D (ppb)	TPH-G (ppb)	B (ppb)	T (ppb)	E (ppb)	X (ppb)	MTBE (ppb)	CUB (cfu/ml)
MW-7 (cont)											
03/28/05	-- ⁿ	-- ⁿ	7.21	<50 ^o	<50	<0.5	<0.5	<0.5	<1.5	<2.5	--
06/09/05	-- ⁿ	-- ⁿ	7.71	86 ^o	55	<0.5	<0.5	<0.5	<1.5	<2.5	--
08/19/05	-- ⁿ	-- ⁿ	9.88	820 ^{o,p,q}	<50	<0.5	<0.5	<0.5	<1.5	<2.5	--
11/18/05	-- ⁿ	-- ⁿ	10.06	<50 ^o	<50	<0.5	<0.5	<0.5	<1.5	<2.5	--
03/07/06	-- ⁿ	-- ⁿ	6.95	<50 ^o	<50	<0.5	<0.5	<0.5	<1.5	<2.5	--
05/17/06	-- ⁿ	-- ⁿ	7.52	<50 ^o	<50	<0.5	<0.5	<0.5	<1.5	<2.5	--
08/30/06	-- ⁿ	-- ⁿ	10.73	<50 ^o	<50	<0.5	<0.5	<0.5	<1.5	<2.5	--
11/28/06	-- ⁿ	-- ⁿ	10.70	<50^o	<50	<0.5	<0.5	<0.5	<1.5	<2.5	--
MW-8											
02/14/02 ^{ij}	15.29	7.30	7.99	--	<50	<0.50	<0.50	<0.50	<1.5	<2.5/<2 ^f	--
05/15/02 ^k	15.29	6.66	8.63	--	<50	<0.50	<0.50	<0.50	<1.5	<2.5	--
08/05/02 ^k	15.29	5.48	9.81	--	<50	<0.50	<0.50	<0.50	<1.5	<2.5	--
11/30/02 ^k	15.29	4.85	10.44	--	<50	<0.50	<0.50	<0.50	<1.5	<2.5	--
02/24-25/03 ^l	15.29	7.46	7.83	<50	<50	<0.50	<0.50	<0.50	<1.5	<2.5	--
06/02/03	15.29	6.83	8.46	<50	<50	<0.5	<0.5	<0.5	<1.5	<2.5	--
09/02/03	15.29	5.57	9.72	<50	<50	<0.5	<0.5	<0.5	<1.5	<2.5	--
11/21/03	15.29	4.89	10.40	<50	<50	<0.5	<0.5	<0.5	<1.5	<2.5	--
02/27/04	15.29	8.38	6.91	280	<50	<0.5	<0.5	<0.5	<1.5	<2.5	--
05/28/04	15.29	6.33	8.96	72	<50	<0.5	<0.5	<0.5	<1.5	<2.5	--
08/31/04	15.29	4.79	10.50	92 ^m	<50	<0.5	<0.5	<0.5	<1.5	<2.5	--
12/17/04	15.29	6.68	8.61	53 ^o	<50	<0.5	<0.5	<0.5	<1.5	<2.5	--
03/28/05	15.29	8.79	6.50	<50 ^o	<50	<0.5	0.9	<0.5	<1.5	<2.5	--
06/09/05	15.29	8.26	7.03	63 ^o	<50	<0.5	<0.5	<0.5	<1.5	<2.5	--
08/19/05	15.29	6.18	9.11	<50 ^{o,p}	<50	<0.5	<0.5	<0.5	<1.5	<2.5	--
11/18/05	15.29	5.47	9.82	<50 ^o	<50	<0.5	<0.5	<0.5	<1.5	<2.5	--
03/07/06	15.29	8.60	6.69	<50 ^o	<50	<0.5	<0.5	<0.5	<1.5	<2.5	--
05/17/06	15.29	8.21	7.08	<50 ^o	<50	<0.5	<0.5	<0.5	<1.5	<2.5	--
08/30/06	15.29	6.57	8.72	<50 ^o	<50	<0.5	<0.5	<0.5	<1.5	<2.5	--
11/28/06	15.29	6.38	8.91	<50^o	<50	<0.5	<0.5	<0.5	<1.5	<2.5	--
MW-1											
10/27/95	15.69	10.54	5.15	--	170,000	19,000	34,000	4,800	26,000	--	--
02/20/97	15.64	8.96	6.68	--	18,000	870	3,500	470	2,100	<250	--

Table 1
Groundwater Monitoring Data and Analytical Results
Former Chevron (Signal Oil) Service Station #206145 (S-800)
800 Center Street
Oakland, California

WELL ID/ DATE	TOC* (ft.)	GWE (msl)	DTW (ft.)	TPH-D (ppb)	TPH-G (ppb)	B (ppb)	T (ppb)	E (ppb)	X (ppb)	MTBE (ppb)	CUB (cfu/ml)
MW-1 (cont)											
04/24/97	15.64	7.30	8.34	--	76,000	4,600	16,000	1,600	8,300	1,000	--
07/23/97	15.64	5.90	9.74	--	37,000	2,700	8,000	870	6,100	<250	--
10/29/97	15.64	INACCESSIBLE		--	--	--	--	--	--	--	--
01/28/98	15.64	9.30	6.34	--	10,000	380	2,000	300	1,500	<25	--
05/11/98	15.64	8.72	6.92	--	17,000	880	3,100	380	2,300	<250	--
07/16/98	15.64	7.23	8.41	--	29,000	2,700	6,800	890	3,900	<1,000	--
08/04/98 ^a	15.64	6.90	8.74	--	--	--	--	--	--	--	<1.0 x 10 ¹
09/03/98 ^a	15.64	6.43	9.21	--	--	--	--	--	--	--	4.1 x 10 ³
10/21/98 ^b	15.64	5.59	10.05	--	--	--	--	--	--	--	4.7 x 10 ²
11/04/98	15.64	5.64	10.00	--	25,000	1,900	5,900	810	4,300	<125	--
01/26/99	15.64	6.86	8.78	--	<50	<0.5	<0.5	<0.5	<0.5	<2.0	--
05/06/99	15.64	8.17	7.47	--	8,050	515	1,840	256	1,190	300/<20 ^e	--
08/21/99	15.64	13.27	2.37	--	46,500	2,530	8,700	1,010	5,300	<1,250/<40 ^e	--
10/28/99	15.64	5.46	10.18	--	31,600	1,580	6,100	794	4,400	1,270	--
01/31/00	15.64	7.49	8.15	--	7,270	366	1,280	171	935	<12.5	--
05/19/00	15.64	7.78	7.86	--	8,000 ^e	870	1,200	430	1,200	<250	--
08/07/00	15.64	6.42	9.22	--	37,000 ^e	2,400	8,500	1,100	5,500	1,500/<4.0 ^f	--
12/01/00	15.64	5.25	10.39	--	25,500 ^b	1,390	4,920	801	4,330	<500/<10 ^f	--
02/09/01	15.64	6.10	9.54	--	8,900 ^e	850	1,300	470	1,700	820/<2.0 ^f	--
05/29/01	15.64	6.79	8.85	--	24,000 ^e	1,800	5,600	740	3,700	<250/<2.0 ^f	--
08/27/01 ^h	15.64	5.83	9.81	--	27,000	1,400	4,400	710	3,400	--/<20 ^f	--
11/28/01	15.64	5.84	9.80	--	26,000	1,300	3,900	620	3,400	<100/<2 ^f	--
02/14/02	15.63	8.34	7.29	--	1,400	100	360	45	240	9.3/<2 ^f	--
05/15/02	15.63	7.18	8.45	--	37,000	2,400	7,300	1,000	4,800	<100/<3.0 ^f	--
08/05/02	15.63	6.09	9.54	--	27,000	1,500	4,600	700	3,400	<100/<3.0 ^f	--
DESTROYED											
TRIP BLANK											
02/20/97	--	--	--	--	<50	<0.5	<0.5	<0.5	<0.5	<2.5	--
04/24/97	--	--	--	--	<50	<0.5	<0.5	<0.5	<0.5	<2.5	--
07/23/97	--	--	--	--	<50	<0.5	<0.5	<0.5	<0.5	<2.5	--
10/29/97	--	--	--	--	<50	<0.5	<0.5	<0.5	<0.5	<2.5	--
01/28/98	--	--	--	--	<50	<0.5	<0.5	<0.5	<0.5	<2.5	--
05/11/98	--	--	--	--	<50	<0.5	<0.5	<0.5	<0.5	<2.5	--
07/16/98	--	--	--	--	<50	<0.5	<0.5	<0.5	<0.5	<5.0	--
11/04/98	--	--	--	--	<50	<0.5	<0.5	<0.5	<0.5	<2.0	--
01/26/99	--	--	--	--	<50	<0.5	<0.5	<0.5	<0.5	<2.0	--

Table 1
Groundwater Monitoring Data and Analytical Results
Former Chevron (Signal Oil) Service Station #206145 (S-800)
800 Center Street
Oakland, California

WELL ID/ DATE	TOC* (ft.)	GWE (msl)	DTW (ft.)	TPH-D (ppb)	TPH-G (ppb)	B (ppb)	T (ppb)	E (ppb)	X (ppb)	MTBE (ppb)	CUB (cfu/ml)
TRIP BLANK (cont)											
05/06/99	--	--	--	--	<50	<0.5	<0.5	<0.5	<0.5	<5.0	--
01/31/00	--	--	--	--	<50	<0.5	<0.5	<0.5	<0.5	<2.5	--
05/19/00	--	--	--	--	<50	<0.50	<0.50	<0.50	<0.50	<2.5	--
08/07/00	--	--	--	--	<50	<0.50	<0.50	<0.50	<0.50	<2.5	--
12/01/00	--	--	--	--	<50.0	<0.500	<0.500	<0.500	<0.500	<2.50	--
02/09/01	--	--	--	--	<50	<0.50	<0.50	<0.50	<0.50	<2.5	--
05/29/01	--	--	--	--	<50	<0.50	<0.50	<0.50	<0.50	<2.5	--
08/27/01 ^h	--	--	--	--	<50	<0.50	<0.50	<0.50	<0.50	--/ <5.0 ^f	--
QA											
11/28/01	--	--	--	--	<50	<0.50	<0.50	<0.50	<1.5	<2.5	--
02/14/02	--	--	--	--	<50	<0.50	<0.50	<0.50	<1.5	<2.5	--
05/15/02	--	--	--	--	<50	<0.50	<0.50	<0.50	<1.5	<2.5	--
08/05/02	--	--	--	--	<50	<0.50	<0.50	<0.50	<1.5	<2.5	--
11/30/02	--	--	--	--	<50	<0.50	<0.50	<0.50	<1.5	<2.5	--
02/24-25/03	--	--	--	--	<50	<0.50	<0.50	<0.50	<1.5	<2.5	--
06/02/03	--	--	--	--	<50	<0.5	<0.5	<0.5	<1.5	<2.5	--
09/02/03	--	--	--	--	<50	<0.5	<0.5	<0.5	<1.5	<2.5	--
11/21/03	--	--	--	--	<50	<0.5	<0.5	<0.5	<1.5	<2.5	--
02/27/04	--	--	--	--	<50	<0.5	<0.5	<0.5	<1.5	<2.5	--
05/28/04	--	--	--	--	<50	<0.5	<0.5	<0.5	<1.5	<2.5	--
08/31/04	--	--	--	--	<50	<0.5	<0.5	<0.5	<1.5	<2.5	--
12/17/04	--	--	--	--	<50	<0.5	<0.5	<0.5	<1.5	<2.5	--
03/28/05	--	--	--	--	<50	<0.5	<0.5	<0.5	<1.5	<2.5	--
06/09/05	--	--	--	--	<50	<0.5	<0.5	<0.5	<1.5	<2.5	--
08/19/05	--	--	--	--	<50	<0.5	<0.5	<0.5	<1.5	<2.5	--
11/18/05	--	--	--	--	<50	<0.5	<0.5	<0.5	<1.5	<2.5	--
03/07/06	--	--	--	--	<50	<0.5	<0.5	<0.5	<1.5	<2.5	--
05/17/06	--	--	--	--	<50	<0.5	<0.5	<0.5	<1.5	<2.5	--
08/30/06	--	--	--	--	<50	<0.5	<0.5	<0.5	<1.5	<2.5	--
11/28/06	--	--	--	--	<50	<0.5	<0.5	<0.5	<1.5	<2.5	--

Table 1
Groundwater Monitoring Data and Analytical Results
Former Chevron (Signal Oil) Service Station #206145 (S-800)
800 Center Street
Oakland, California

EXPLANATIONS:

Groundwater monitoring data and laboratory analytical results prior to May 19, 2000 were compiled from reports prepared by Blaine Tech Services, Inc.

TOC = Top of Casing (ft.) = Feet	TPH-G = Total Petroleum Hydrocarbons as Gasoline B = Benzene T = Toluene E = Ethylbenzene X = Xylenes MTBE = Methyl tertiary butyl ether	CUB = Contaminate utilizing bacteria (cfu/ml) = Colony forming unit per milliliter (ppb) = Parts per billion -- = Not Measured/Not Analyzed QA = Quality Assurance/Trip Blank
GWE = Groundwater Elevation (msl) = Mean sea level		
DTW = Depth to Water		
TPH-D = Total Petroleum Hydrocarbons as Diesel		

- * On February 18, 2003 MW-1A was surveyed using the previous benchmark. TOC elevations were surveyed on December March 4, 2002, by Virgil Chavez Land Surveying. The benchmark for the survey was a City of Oakland benchmark, #25-H monument disk in well casing in sidewalk at the northwest corner of 7th and Center. The latitude, longitude and coordinates are for top of casings and are based on the California State Coordinate System, Zone III (NAD83), (Benchmark Elevation = 10.784 feet NGVD 29).
- ^a Contaminate hydrocarbon utilizing bacteria plate count was run with diesel and jet fuel degraders.
- ^b Contaminate hydrocarbon utilizing bacteria plate count was run with gasoline degraders.
- ^c Confirmation run.
- ^d Chromatogram pattern indicates an unidentified hydrocarbon.
- ^e Laboratory report indicates gasoline C6-C12.
- ^f MTBE by EPA Method 8260.
- ^g Laboratory reports indicates weathered gasoline C6-C12.
- ^h TPH-G and BTEX by EPA Method 8260.
- ⁱ Well development performed.
- ^j TPH-D was detected at 130 ppb.
- ^k TPH-D was <50 ppb.
- ^l Well re-development performed.
- ^m Laboratory report indicates the observed sample pattern is not typical of diesel/#2 fuel oil.
- ⁿ TOC damaged; unable to calculate an accurate GWE.
- ^o TPH-D with silica gel clean-up.
- ^p Laboratory report indicates analysis performed out of hold time.
- ^q Laboratory report indicates the observed sample pattern includes #2 fuel/diesel and an additional pattern which elutes later in the DRO range.
- ^r Laboratory report indicates the observed sample pattern is not typical of #2 fuel/diesel. It elutes in the DRO range earlier than #2 fuel.
- ^s Laboratory report indicates the analysis was performed from a previously opened vial and the results are therefore estimated.
- ^t Laboratory report indicates the observed sample pattern includes #2 fuel/diesel, an additional pattern which elutes later in the DRO range, and individual peaks eluting in the DRO range.

Table 2
Field Measurements and Analytical Results
Former Chevron (Signal Oil) Service Station #206145 (S-800)
800 Center Street
Oakland, California

WELL ID/ DATE	Pre-purge DO (mg/L)	Post-purge DO (mg/L)	Pre-purge ORP (mV)	Post-purge ORP (mV)	Total Alkalinity (ppb)	Ferrous Iron (ppb)	Nitrate as Nitrate (ppb)	Sulfate (ppb)
MW-1 09/03/98	2.3	1.6	-90	-103	230,000	9,800	<1,000	6,100
MW-2 09/03/98	2.8	2.5	-206	-163	390,000	7,400	<1,000	21,000
MW-3 09/03/98	3.1	0.7	-124	-99	830,000	45,000	<1,000	10,000
MW-4 09/03/98	2.6	1.1	-190	-206	--	--	--	--
MW-6 09/03/98	2.6	3.2	-148	-167	94,000	62	28,000	47,000
MW-7 09/03/98	2.7	3.2	-207	-229	170,000	120	7,800	57,000

EXPLANATIONS:

Groundwater monitoring data and laboratory analytical results were compiled from reports prepared by Blaine Tech Services, Inc.

DO = Dissolved Oxygen

(mg/L) = Milligram per liter

ORP = Oxidation Reduction Potential

(mV) = Millivolts

(ppb) = Parts per billion

-- = Not Analyzed

Table 3
Groundwater Analytical Results - Oxygenate Compounds
Former Chevron (Signal Oil) Service Station #206145 (S-800)
800 Center Street
Oakland, California

WELL ID	DATE	METHANOL (ppm)	ETHANOL (ppb)	TBA (ppb)	MTBE (ppb)	DIPE (ppb)	ETBE (ppb)	TAME (ppb)	1,2-DCA (ppb)	EDB (ppb)
MW-1	08/07/00	--	<1,000	410	<4.0	<4.0	<4.0	<4.0	<4.0	<4.0
	12/01/00	--	<2,500	<250	<10	<10	<10	<10	<10	<10
	02/09/01	--	<500	340	<2.0	<2.0	<2.0	53	<2.0	<2.0
	05/29/01	--	<500	<20	<2.0	<2.0	<2.0	<2.0	<2.0	<2.0
	08/27/01	<2,000	<200	230	<20	<20	<20	<20	<20	<20
	11/28/01	--	<500	130	<2	<2	<2	<2	<2	<2
	02/14/02	--	<500	<100	<2	<2	<2	<2	<2	<2
	05/15/02	--	<500	120	<3.0	<3.0	<3.0	<3.0	<3.0	<3.0
	08/05/02	--	<500	100	<3.0	<3.0	<3.0	<3.0	<3.0	<3.0
DESTROYED										
MW-2	08/07/00		<500	<100	<2.0	<2.0	<2.0	<2.0	<2.0	<2.0
	08/27/01	--	--	--	<5.0	--	--	--	--	--
MW-3	08/07/00	--	<500	2,600	<10	<10	<10	<10	490	17
	02/09/01	--	<500	2,000	<2.0	<2.0	<2.0	35	<2.0	<2.0
	05/29/01	--	<500	1,700 ¹	<2.0	<2.0	<2.0	38	980 ¹	7.4
	08/27/01	<5,000	<250	1,300	<25	<25	<25	<25	380	<25
	11/28/01	--	<500	1,500	<5.0	<5.0	<5.0	<5.0	<5.0	<5.0
	02/14/02	--	<500	<100	<2	<2	<2	<2	<2	<2
	05/15/02	--	<500	110	<2	<2	<2	<2	120	<2
	08/05/02	--	<1,000	1,400	<10	<10	<10	<10	670	<10
	11/30/02	--	<1,000	1,200	<10	<10	<10	<10	380	<10
MW-4	08/07/00	--	<500	<100	<2.0	<2.0	<2.0	<2.0	18	<2.0
	08/27/01	NOT SAMPLED DUE TO INSUFFICIENT WATER				--	--	--	--	--
	11/28/01	DRY	--	--	--	--	--	--	--	--
	02/14/02	--	<500	<100	<2	<2	<2	<2	9	<2
	05/15/02	--	<500	<100	<2	<2	<2	<2	4	<2
	08/05/02	DRY	--	--	--	--	--	--	--	--
	11/30/02	DRY	--	--	--	--	--	--	--	--
MW-5	12/01/00	--	<500	<50	<2.0	<2.0	<2.0	<2.0	<2.0	<2.0
	02/09/01	--	<500	<50	<2.0	<2.0	<2.0	<2.0	<2.0	<2.0
	08/27/01	INACCESSIBLE - CAR PARKED OVER WELL				--	--	--	--	--
	11/28/01	INACCESSIBLE - CAR PARKED OVER WELL				--	--	--	--	--
	02/14/02	--	<500	<100	<2	<2	<2	<2	<2	<2

Table 3
Groundwater Analytical Results - Oxygenate Compounds
Former Chevron (Signal Oil) Service Station #206145 (S-800)
800 Center Street
Oakland, California

WELL ID	DATE	METHANOL (ppm)	ETHANOL (ppb)	TBA (ppb)	MTBE (ppb)	DIPE (ppb)	ETBE (ppb)	TAME (ppb)	1,2-DCA (ppb)	EDB (ppb)
MW-5 (cont)	05/15/02	--	<500	<100	<2	<2	<2	<2	<2	<2
	08/05/02	--	<500	<100	<2	<2	<2	<2	<2	<2
	11/30/02	--	<500	<100	<2	<2	<2	<2	<2	<2
MW-6	08/07/00	--	<500	<100	<2.0	<2.0	<2.0	<2.0	<2.0	<2.0
	08/27/01	--	--	--	<5.0	--	--	--	--	--
	11/30/02	DRY	--	--	--	--	--	--	--	--
MW-7	08/07/00	--	<500	<100	<2.0	<2.0	<2.0	<2.0	<2.0	<2.0
	08/27/01	--	--	--	<5.0	--	--	--	--	--
MW-8	02/14/02	--	<500	<100	<2	<2	<2	<2	<2	<2

EXPLANATIONS:

TBA = Tertiary butyl alcohol
MTBE = Methyl tertiary butyl ether
DIPE = Di-isopropyl ether
ETBE = Ethyl tertiary butyl ether
TAME = Tertiary amyl methyl ether
1,2-DCA = 1,2-Dichloroethane
EDB = 1,2-Dibromoethane
(ppm) = Parts per million
(ppb) = Parts per billion
-- = Not Analyzed

ANALYTICAL METHODS:

EPA Method 8260 (modified) for Methanol
EPA Method 8260 for Oxygenate Compounds

¹ Laboratory report indicates this sample was originally analyzed within holding time. Re-analysis for confirmation or dilution was performed past the recommended holding time.

STANDARD OPERATING PROCEDURE - GROUNDWATER SAMPLING

Gettler-Ryan Inc. field personnel adhere to the following procedures for the collection and handling of groundwater samples prior to analysis by the analytical laboratory. Prior to sample collection, the type of analysis to be performed is determined. Loss prevention of volatile compounds is controlled and sample preservation for subsequent analysis is maintained.

Prior to sampling, the presence or absence of free-phase hydrocarbons is determined using an interface probe. Product thickness, if present, is measured to the nearest 0.01 foot and is noted in the field notes. In addition, all depth to water level measurements are collected with a static water level indicator and are also recorded in the field notes, prior to purging and sampling any wells.

After water levels are collected and prior to sampling, if purging is to occur, each well is purged a minimum of three well casing volumes of water using pre-cleaned pumps (stack, suction, Grundfos), or disposable bailers. Temperature, pH and electrical conductivity are measured a minimum of three times during the purging. Purging continues until these parameters stabilize.

Groundwater samples are collected using disposable bailers. The water samples are transferred from the bailer into appropriate containers. Pre-preserved containers, supplied by analytical laboratories, are used when possible. When pre-preserved containers are not available, the laboratory is instructed to preserve the sample as appropriate. Duplicate samples are collected for the laboratory to use in maintaining quality assurance/quality control standards. The samples are labeled to include the job number, sample identification, collection date and time, analysis, preservation (if any), and the sample collector's initials. The water samples are placed in a cooler, maintained at 4°C for transport to the laboratory. Once collected in the field, all samples are maintained under chain of custody until delivered to the laboratory.

The chain of custody document includes the job number, type of preservation, if any, analysis requested, sample identification, date and time collected, and the sample collector's name. The chain of custody is signed and dated (including time of transfer) by each person who receives or surrenders the samples, beginning with the field personnel and ending with the laboratory personnel.

A laboratory supplied trip blank accompanies each sampling set. For sampling sets greater than 20 samples, 5% trip blanks are included. The trip blank is analyzed for some or all of the same compounds as the groundwater samples.

As requested by Chevron Environmental Management Company, the purge water and decontamination water generated during sampling activities is transported by IWM to Chemical Waste Management located in Kettleman Hill, California.



GETTLER-RYAN INC.

WELL MONITORING/SAMPLING FIELD DATA SHEET

Client/Facility #: Chevron #206145
 Site Address: 800 Center Street
 City: Oakland, CA

Job Number: 386492
 Event Date: 11-28-06 (inclusive)
 Sampler: Joc

Well ID: MW-1A
 Well Diameter: 2 in.
 Total Depth: 16.70 ft.
 Depth to Water: 9.70 ft.
7.00

Date Monitored: 11-28-06 Well Condition: o.k.

Volume	3/4"= 0.02	1"= 0.04	2"= 0.17	3"= 0.38
Factor (VF)	4"= 0.66	5"= 1.02	6"= 1.50	12"= 5.80

$xVF = 0.17 = 1.19$ x3 case volume= Estimated Purge Volume: 4.5 gal.

Purge Equipment:

Disposable Bailer
 Stainless Steel Bailer
 Stack Pump
 Suction Pump
 Grundfos
 Other:

Sampling Equipment:

Disposable Bailer
 Pressure Bailer
 Discrete Bailer
 Other:

Time Started: _____ (2400 hrs)
 Time Completed: _____ (2400 hrs)
 Depth to Product: _____ ft
 Depth to Water: _____ ft
 Hydrocarbon Thickness: 0 ft
 Visual Confirmation/Description: _____

Skimmer / Absorbant Sock (circle one)
 Amt Removed from Skimmer: _____ gal
 Amt Removed from Well: _____ gal
 Water Removed: _____
 Product Transferred to: _____

Start Time (purge): 1035 Weather Conditions: clear
 Sample Time/Date: 1100 11-28-06 Water Color: clear Odor: yes
 Purging Flow Rate: 0.5 gpm. Sediment Description: _____
 Did well de-water? _____ If yes, Time: _____ Volume: _____ gal.

Time (2400 hr.)	Volume (gal.)	pH	Conductivity (μ mhos/cm)	Temperature (C/F)	D.O. (mg/L)	ORP (mV)
<u>1045</u>	<u>1.5</u>	<u>6.57</u>	<u>1112</u>	<u>59.2</u>	_____	_____
<u>1048</u>	<u>2</u>	<u>6.62</u>	<u>1116</u>	<u>59.5</u>	_____	_____
<u>1053</u>	<u>4.5</u>	<u>6.65</u>	<u>1122</u>	<u>59.6</u>	_____	_____

LABORATORY INFORMATION

SAMPLE ID	(#) CONTAINER	REFRIG.	PRESERV. TYPE	LABORATORY	ANALYSES
<u>MW-1A</u>	<u>3</u> x vov vial	<u>YES</u>	<u>HCL</u>	<u>LANCASTER</u>	<u>TPH-G(8015)/BTEX+MTBE(8021)</u>
	<u>2</u> x 500ml Amber	<u>YES</u>	<u>NP</u>	<u>LANCASTER</u>	<u>TPH-Dw/sg(8015)</u>

COMMENTS: _____

Add/Replaced Lock: _____

Add/Replaced Plug: _____ Size: _____



GETTLER-RYAN INC.

WELL MONITORING/SAMPLING FIELD DATA SHEET

Client/Facility #: Chevron #206145 Job Number: 386492
 Site Address: 800 Center Street Event Date: 11-28-06 (inclusive)
 City: Oakland, CA Sampler: Site

Well ID: MW-2 Date Monitored: 11-28-06 Well Condition: o.k.
 Well Diameter: 2 in.
 Total Depth: 14.20 ft.
 Depth to Water: 10.02 ft.
 $9.18 \times VF = 0.17 = 0.71 \times 3 \text{ case volume} = \text{Estimated Purge Volume: } 2 \text{ gal.}$

Volume	3/4" = 0.02	1" = 0.04	2" = 0.17	3" = 0.38
Factor (VF)	4" = 0.66	5" = 1.02	6" = 1.50	12" = 5.80

Purge Equipment:

Disposable Bailer
 Stainless Steel Bailer _____
 Stack Pump _____
 Suction Pump _____
 Grundfos _____
 Other: _____

Sampling Equipment:

Disposable Bailer
 Pressure Bailer _____
 Discrete Bailer _____
 Other: _____

Time Started: _____ (2400 hrs)
 Time Completed: _____ (2400 hrs)
 Depth to Product: _____ ft
 Depth to Water: _____ ft
 Hydrocarbon Thickness: 0 ft
 Visual Confirmation/Description: _____
 Skimmer / Absorbant Sock (circle one)
 Amt Removed from Skimmer: _____ gal
 Amt Removed from Well: _____ gal
 Water Removed: _____
 Product Transferred to: _____

Start Time (purge): 1015 Weather Conditions: clear
 Sample Time/Date: 1035 / 11-28-06 Water Color: clear Odor: yes
 Purging Flow Rate: 0.5 gpm. Sediment Description: _____
 Did well de-water? _____ If yes, Time: _____ Volume: _____ gal.

Time (2400 hr.)	Volume (gal.)	pH	Conductivity (umhos/cm)	Temperature (C/F)	D.O. (mg/L)	ORP (mV)
<u>1020</u>	<u>0.5</u>	<u>6.91</u>	<u>936</u>	<u>60.4</u>	_____	_____
<u>1023</u>	<u>1</u>	<u>6.81</u>	<u>944</u>	<u>59.8</u>	_____	_____
<u>1027</u>	<u>2</u>	<u>6.86</u>	<u>940</u>	<u>59.6</u>	_____	_____

LABORATORY INFORMATION

SAMPLE ID	(#) CONTAINER	REFRIG.	PRESERV. TYPE	LABORATORY	ANALYSES
MW-2	3 x vov vial	YES	HCL	LANCASTER	TPH-G(8015)/BTEX+MTBE(8021)
	2 x 500ml Amber	YES	NP	LANCASTER	TPH-Dw/sg(8015)

COMMENTS: Removed roots from well. Poplar roots in the area.

Add/Replaced Lock: Add/Replaced Plug: _____ Size: _____



GETTLER-RYAN INC.

WELL MONITORING/SAMPLING FIELD DATA SHEET

Client/Facility #: Chevron #206145 Job Number: 386492
 Site Address: 800 Center Street Event Date: 11-28-06 (inclusive)
 City: Oakland, CA Sampler: Jax

Well ID: MW-3 Date Monitored: 11-28-06 Well Condition: OK
 Well Diameter: 2 in.
 Total Depth: 14.40 ft.
 Depth to Water: 9.78 ft.
9.62 x VF 0.17 = 0.78 x3 case volume = Estimated Purge Volume: 2.5 gal.

Volume Factor (VF)	3/4"= 0.02	1"= 0.04	2"= 0.17	3"= 0.38
	4"= 0.66	5"= 1.02	6"= 1.50	12"= 5.80

Purge Equipment:

Disposable Bailer
 Stainless Steel Bailer _____
 Stack Pump _____
 Suction Pump _____
 Grundfos _____
 Other: _____

Sampling Equipment:

Disposable Bailer
 Pressure Bailer _____
 Discrete Bailer _____
 Other: _____

Time Started: _____ (2400 hrs)
 Time Completed: _____ (2400 hrs)
 Depth to Product: _____ ft
 Depth to Water: _____ ft
 Hydrocarbon Thickness: 2 ft
 Visual Confirmation/Description: _____
 Skimmer / Absorbent Sock (circle one)
 Amt Removed from Skimmer: _____ gal
 Amt Removed from Well: _____ gal
 Water Removed: _____
 Product Transferred to: _____

Start Time (purge): 1110 Weather Conditions: clear
 Sample Time/Date: 1135 / 11-28-06 Water Color: clear Odor: yes
 Purging Flow Rate: 0.5 gpm. Sediment Description: _____
 Did well de-water? _____ If yes, Time: _____ Volume: _____ gal.

Time (2400 hr.)	Volume (gal.)	pH	Conductivity (u mhos/cm)	Temperature (C/F)	D.O. (mg/L)	ORP (mV)
<u>1117</u>	<u>0.5</u>	<u>6.80</u>	<u>882</u>	<u>61.0</u>	_____	_____
<u>1122</u>	<u>1.5</u>	<u>6.81</u>	<u>891</u>	<u>60.8</u>	_____	_____
<u>1127</u>	<u>2.5</u>	<u>6.77</u>	<u>890</u>	<u>60.6</u>	_____	_____

LABORATORY INFORMATION

SAMPLE ID	(#) CONTAINER	REFRIG.	PRESERV. TYPE	LABORATORY	ANALYSES
MW-3	3 x vovial	YES	HCL	LANCASTER	TPH-G(8015)/BTEX+MTBE(8021)
	2 x 500ml Amber	YES	NP	LANCASTER	TPH-Dw/sg(8015)

COMMENTS: _____

Add/Replaced Lock: _____ Add/Replaced Plug: _____ Size: _____



GETTLER-RYAN INC.

WELL MONITORING/SAMPLING FIELD DATA SHEET

Client/Facility #: Chevron #206145 Job Number: 386492
 Site Address: 800 Center Street Event Date: 11-28-06 (inclusive)
 City: Oakland, CA Sampler: Joe

Well ID: MW-4 Date Monitored: 11-28-06 Well Condition: o.k.
 Well Diameter: 2 in.
 Total Depth: 13.25 ft.
 Depth to Water: 8.75 ft.
 Volume Factor (VF) table:

Volume	3/4"= 0.02	1"= 0.04	2"= 0.17	3"= 0.38
Factor (VF)	4"= 0.66	5"= 1.02	6"= 1.50	12"= 5.80

 xVF 0.17 = 0.77 x3 case volume= Estimated Purge Volume: 2.5 gal.

Purge Equipment:

Disposable Bailer
 Stainless Steel Bailer
 Stack Pump
 Suction Pump
 Grundfos
 Other:

Sampling Equipment:

Disposable Bailer
 Pressure Bailer
 Discrete Bailer
 Other:

Time Started: _____ (2400 hrs)
 Time Completed: _____ (2400 hrs)
 Depth to Product: _____ ft
 Depth to Water: _____ ft
 Hydrocarbon Thickness: 0.2 ft
 Visual Confirmation/Description: _____
 Skimmer / Absorbent Sock (circle one)
 Amt Removed from Skimmer: _____ gal
 Amt Removed from Well: _____ gal
 Water Removed: _____
 Product Transferred to: _____

Start Time (purge): 0940 Weather Conditions: clear
 Sample Time/Date: 1005 / 11-28-06 Water Color: clear Odor: yes
 Purging Flow Rate: 0.5 gpm. Sediment Description: _____
 Did well de-water? _____ If yes, Time: _____ Volume: _____ gal.

Time (2400 hr.)	Volume (gal.)	pH	Conductivity (umhos/cm)	Temperature (C/E)	D.O. (mg/L)	ORP (mV)
<u>0945</u>	<u>0.5</u>	<u>6.90</u>	<u>897</u>	<u>60.1</u>	_____	_____
<u>0948</u>	<u>1.5</u>	<u>6.64</u>	<u>908</u>	<u>59.5</u>	_____	_____
<u>0953</u>	<u>2.5</u>	<u>6.72</u>	<u>915</u>	<u>59.8</u>	_____	_____

LABORATORY INFORMATION

SAMPLE ID	(#) CONTAINER	REFRIG.	PRESERV. TYPE	LABORATORY	ANALYSES
MW-4	<u>3</u> x vov vial	YES	HCL	LANCASTER	TPH-G(8015)/BTEX+MTBE(8021)
	<u>2</u> x 500ml Amber	YES	NP	LANCASTER	TPH-Dw/sg(8015)

COMMENTS:

Add/Replaced Lock: _____ Add/Replaced Plug: _____ Size: _____



GETTLER-RYAN INC.

WELL MONITORING/SAMPLING FIELD DATA SHEET

Client/Facility #: Chevron #206145 Job Number: 386492
 Site Address: 800 Center Street Event Date: 11-28-06 (inclusive)
 City: Oakland, CA Sampler: Joe

Well ID: MW-5 Date Monitored: 11-28-06 Well Condition: o/c

Well Diameter: 2 in.
 Total Depth: 19.30 ft.
 Depth to Water: 8.55 ft.
 Volume Factor (VF) table:

3/4" = 0.02	1" = 0.04	2" = 0.17	3" = 0.38
4" = 0.66	5" = 1.02	6" = 1.50	12" = 5.80

 xVF 0.17 = 1.83 x3 case volume = Estimated Purge Volume: 5.5 gal.

Purge Equipment:

Disposable Bailer
 Stainless Steel Bailer _____
 Stack Pump _____
 Suction Pump _____
 Grundfos _____
 Other: _____

Sampling Equipment:

Disposable Bailer
 Pressure Bailer _____
 Discrete Bailer _____
 Other: _____

Time Started: _____ (2400 hrs)
 Time Completed: _____ (2400 hrs)
 Depth to Product: _____ ft
 Depth to Water: _____ ft
 Hydrocarbon Thickness: 0 ft
 Visual Confirmation/Description: _____
 Skimmer / Absorbant Sock (circle one)
 Amt Removed from Skimmer: _____ gal
 Amt Removed from Well: _____ gal
 Water Removed: _____
 Product Transferred to: _____

Start Time (purge): 0810 Weather Conditions: clear
 Sample Time/Date: 0830 / 11-28-06 Water Color: clear Odor: none
 Purging Flow Rate: 1.5 gpm. Sediment Description: _____
 Did well de-water? _____ If yes, Time: _____ Volume: _____ gal.

Time (2400 hr.)	Volume (gal.)	pH	Conductivity (umhos/cm)	Temperature (C/F)	D.O. (mg/L)	ORP (mV)
<u>0817</u>	<u>1.5</u>	<u>7.60</u>	<u>1097</u>	<u>59.2</u>	_____	_____
<u>0820</u>	<u>3</u>	<u>7.56</u>	<u>1131</u>	<u>59.5</u>	_____	_____
<u>0823</u>	<u>5.5</u>	<u>7.57</u>	<u>1135</u>	<u>59.3</u>	_____	_____

LABORATORY INFORMATION

SAMPLE ID	(#) CONTAINER	REFRIG.	PRESERV. TYPE	LABORATORY	ANALYSES
MW-5	3 x voa vial	YES	HCL	LANCASTER	TPH-G(8015)/BTEX+MTBE(8021)
	2 x 500ml Amber	YES	NP	LANCASTER	TPH-Dw/sg(8015)

COMMENTS: _____

Add/Replaced Lock: _____ Add/Replaced Plug: _____ Size: _____



GETTLER-RYAN INC.

WELL MONITORING/SAMPLING FIELD DATA SHEET

Client/Facility #: Chevron #206145
 Site Address: 800 Center Street
 City: Oakland, CA

Job Number: 386492
 Event Date: 11-28-06 (inclusive)
 Sampler: JVC

Well ID: MW-6
 Well Diameter: 2 in.
 Total Depth: 15.63 ft.
 Depth to Water: 8.59 ft.
7.09

Date Monitored: 11-28-06 Well Condition: O.K.

Volume	3/4"= 0.02	1"= 0.04	2"= 0.17	3"= 0.38
Factor (VF)	4"= 0.66	5"= 1.02	6"= 1.50	12"= 5.80

xVF 0.17 = 1.21 x3 case volume= Estimated Purge Volume: 4 gal.

Purge Equipment:
 Disposable Bailer
 Stainless Steel Bailer _____
 Stack Pump _____
 Suction Pump _____
 Grundfos _____
 Other: _____

Sampling Equipment:
 Disposable Bailer
 Pressure Bailer _____
 Discrete Bailer _____
 Other: _____

Time Started: _____ (2400 hrs)
 Time Completed: _____ (2400 hrs)
 Depth to Product: _____ ft
 Depth to Water: _____ ft
 Hydrocarbon Thickness: 0 ft
 Visual Confirmation/Description: _____
 Skimmer / Absorbant Sock (circle one)
 Amt Removed from Skimmer: _____ gal
 Amt Removed from Well: _____ gal
 Water Removed: _____
 Product Transferred to: _____

Start Time (purge): 0837 Weather Conditions: clear
 Sample Time/Date: 0900 / 11-28-06 Water Color: clear Odor: none
 Purging Flow Rate: 0.5 gpm. Sediment Description: _____
 Did well de-water? _____ If yes, Time: _____ Volume: _____ gal.

Time (2400 hr.)	Volume (gal.)	pH	Conductivity (umhos/cm)	Temperature (C/F)	D.O. (mg/L)	ORP (mV)
<u>0845</u>	<u>1</u>	<u>6.96</u>	<u>1010</u>	<u>54.3</u>	_____	_____
<u>0849</u>	<u>2.5</u>	<u>7.10</u>	<u>1035</u>	<u>54.8</u>	_____	_____
<u>0853</u>	<u>4</u>	<u>7.08</u>	<u>1042</u>	<u>60.1</u>	_____	_____

LABORATORY INFORMATION

SAMPLE ID	(#) CONTAINER	REFRIG.	PRESERV. TYPE	LABORATORY	ANALYSES
MW- 6	<u>3</u> x vov vial	YES	HCL	LANCASTER	TPH-G(8015)/BTEX+MTBE(8021)
	<u>2</u> x 500ml Amber	YES	NP	LANCASTER	TPH-Dw/sg(8015)

COMMENTS: _____

Add/Replaced Lock: _____ Add/Replaced Plug: _____ Size: _____



GETTLER-RYAN INC.

WELL MONITORING/SAMPLING FIELD DATA SHEET

Client/Facility #: Chevron #206145 Job Number: 386492
 Site Address: 800 Center Street Event Date: 11-28-06 (inclusive)
 City: Oakland, CA Sampler: Joc

Well ID: MW-7 Date Monitored: 11-28-06 Well Condition: o.k.

Well Diameter: 2 in.
 Total Depth: 15.65 ft.
 Depth to Water: 10.70 ft.
4.95 x VF 0.17 = 0.84

Volume	3/4"= 0.02	1"= 0.04	2"= 0.17	3"= 0.38
Factor (VF)	4"= 0.66	5"= 1.02	6"= 1.50	12"= 5.80

x3 case volume = Estimated Purge Volume: 3 gal.

Purge Equipment:
 Disposable Bailer
 Stainless Steel Bailer _____
 Stack Pump _____
 Suction Pump _____
 Grundfos _____
 Other: _____

Sampling Equipment:
 Disposable Bailer
 Pressure Bailer _____
 Discrete Bailer _____
 Other: _____

Time Started: _____ (2400 hrs)
 Time Completed: _____ (2400 hrs)
 Depth to Product: _____ ft
 Depth to Water: _____ ft
 Hydrocarbon Thickness: 0 ft
 Visual Confirmation/Description: _____
 Skimmer / Absorbant Sock (circle one)
 Amt Removed from Skimmer: _____ gal
 Amt Removed from Well: _____ gal
 Water Removed: _____
 Product Transferred to: _____

Start Time (purge): 0912 Weather Conditions: clear
 Sample Time/Date: 0935 11-28-06 Water Color: clear Odor: none
 Purging Flow Rate: 0.5 gpm. Sediment Description: _____
 Did well de-water? _____ If yes, Time: _____ Volume: _____ gal.

Time (2400 hr.)	Volume (gal.)	pH	Conductivity (umhos/cm)	Temperature (C/E)	D.O. (mg/L)	ORP (mV)
<u>0920</u>	<u>1</u>	<u>7.44</u>	<u>1136</u>	<u>60.6</u>	_____	_____
<u>0924</u>	<u>2</u>	<u>7.43</u>	<u>1131</u>	<u>60.1</u>	_____	_____
<u>0928</u>	<u>2</u>	<u>7.48</u>	<u>1119</u>	<u>60.4</u>	_____	_____

LABORATORY INFORMATION

SAMPLE ID	(#) CONTAINER	REFRIG.	PRESERV. TYPE	LABORATORY	ANALYSES
MW-7	3 x voa vial	YES	HCL	LANCASTER	TPH-G(8015)/BTEX+MTBE(8021)
	<u>2</u> x 500ml Amber	YES	NP	LANCASTER	TPH-Dw/sg(8015)

COMMENTS: _____

Add/Replaced Lock: _____ Add/Replaced Plug: _____ Size: _____



GETTLER - RYAN INC.

WELL MONITORING/SAMPLING FIELD DATA SHEET

Client/Facility #: Chevron #206145 Job Number: 386492
 Site Address: 800 Center Street Event Date: 11-28-06 (inclusive)
 City: Oakland, CA Sampler: Jve

Well ID: MW-8 Date Monitored: 11-28-06 Well Condition: OK
 Well Diameter: 2 in.
 Total Depth: 20.20 ft.
 Depth to Water: 8.91 ft.
11.29 xVF 0.17 = 1.92 x3 case volume = Estimated Purge Volume: 6 gal.

Volume	3/4"= 0.02	1"= 0.04	2"= 0.17	3"= 0.38
Factor (VF)	4"= 0.66	5"= 1.02	6"= 1.50	12"= 5.80

Purge Equipment:

Disposable Bailer
 Stainless Steel Bailer _____
 Stack Pump _____
 Suction Pump _____
 Grundfos _____
 Other: _____

Sampling Equipment:

Disposable Bailer
 Pressure Bailer _____
 Discrete Bailer _____
 Other: _____

Time Started: _____ (2400 hrs)
 Time Completed: _____ (2400 hrs)
 Depth to Product: _____ ft
 Depth to Water: _____ ft
 Hydrocarbon Thickness: 0 ft
 Visual Confirmation/Description: _____
 Skimmer / Absorbant Sock (circle one)
 Amt Removed from Skimmer: _____ gal
 Amt Removed from Well: _____ gal
 Water Removed: _____
 Product Transferred to: _____

Start Time (purge): 0725 Weather Conditions: clear
 Sample Time/Date: 0800 / 11-28-06 Water Color: clear Odor: none
 Purging Flow Rate: 0.5 gpm. Sediment Description: _____
 Did well de-water? _____ If yes, Time: _____ Volume: _____ gal.

Time (2400 hr.)	Volume (gal.)	pH	Conductivity (umhos/cm)	Temperature (C/F)	D.O. (mg/L)	ORP (mV)
<u>0735</u>	<u>2</u>	<u>7.51</u>	<u>1201</u>	<u>60.3</u>	_____	_____
<u>0740</u>	<u>4</u>	<u>7.37</u>	<u>1165</u>	<u>61.0</u>	_____	_____
<u>0746</u>	<u>6</u>	<u>7.32</u>	<u>1166</u>	<u>60.8</u>	_____	_____

LABORATORY INFORMATION

SAMPLE ID	(#) CONTAINER	REFRIG.	PRESERV. TYPE	LABORATORY	ANALYSES
MW-8	3 x vov vial	YES	HCL	LANCASTER	TPH-G(8015)/BTEX+MTBE(8021)
	2 x 500ml Amber	YES	NP	LANCASTER	TPH-Dw/sg(8015)

COMMENTS: _____

Add/Replaced Lock: _____

Add/Replaced Plug: _____ Size: _____

Chevron California Region Analysis Request/Chain of Custody



112806-02

Accel. #: 10904 For Lancaster Laboratories use only
 Sample #: 4925134-42

SCR#: _____
 Group# 1015782

Facility #: SS#206145-OML G-R#386492 Global ID#T0600102230
 Site Address: 800 CENTER STREET, OAKLAND, CA
 Chevron PM: SS Lead Consultant: CAMBRIAGL
 Consultant/Office: G-R, Inc., 6747 Sierra Court, Suite J, Dublin, Ca. 94568
 Consultant Prj. Mgr.: Deanna L. Harding (deanna@grinc.com)
 Consultant Phone #: 925-551-7555 Fax #: 925-551-7899
 Sampler: JOE ASEMIAN
 Service Order #: _____ Non SAR:

Matrix	Preservation Codes		Total Number of Containers	Analytes Requested	
	H	H			
Soil <input type="checkbox"/> Potable <input type="checkbox"/> NPDDES	<input checked="" type="checkbox"/>	<input type="checkbox"/>	2	BTEX + MTBE 8260 <input checked="" type="checkbox"/> 8021	
	<input type="checkbox"/>	<input type="checkbox"/>	5	TPH 8015 MOD GRO	
Water <input type="checkbox"/> Air	<input type="checkbox"/>	<input type="checkbox"/>	5	TPH 8015 MOD DRO <input checked="" type="checkbox"/> Silica Gel Cleanup	
	<input type="checkbox"/>	<input type="checkbox"/>	5	8260 full scan	
Oil	<input type="checkbox"/>	<input type="checkbox"/>	5	Oxygenates	
	<input type="checkbox"/>	<input type="checkbox"/>	5	Lead 7420 <input type="checkbox"/> 7421	

Preservative Codes
 H = HCl T = Thiosulfate
 N = HNO₃ B = NaOH
 S = H₂SO₄ O = Other

J value reporting needed
 Must meet lowest detection limits possible for 8260 compounds

8021 MTBE Confirmation
 Confirm highest hit by 8260
 Confirm all hits by 8260
 Run _____ oxy s on highest hit
 Run _____ oxy s on all hits

Sample Identification	Date Collected	Time Collected	Grab	Composite	Soil	Water	Oil	Air
QA			<input checked="" type="checkbox"/>		<input checked="" type="checkbox"/>			
MW-1A	11-28-06	1100						
MW-2		1035						
MW-3		1135						
MW-4		1005						
MW-5		0830						
MW-6		0900						
MW-7		0935						
MW-8		0800						

Comments / Remarks

Turnaround Time Requested (TAT) (please circle)
 8TD TAT 72 hour 48 hour
 24 hour 4 day 5 day

Data Package Options (please circle if required)
 QC Summary Type I — Full
 Type VI (Raw Data) Coelt Deliverable not needed **EDF/EDD**
 WIP (RWQCB)
 Disk

Relinquished by: <i>[Signature]</i>	Date: 11-28-06	Time: 1300	Received by: <i>[Signature]</i>	Date: 11-28-06	Time: 1300
Relinquished by: <i>[Signature]</i>	Date: 11-28-06	Time: 1530	Received by: <i>[Signature]</i>	Date: 11-28-06	Time: 1530
Relinquished by:	Date:	Time:	Received by:	Date:	Time:
Relinquished by Commercial Carrier: UPS FedEx Other <u>OHL</u>	Temperature Upon Receipt: <u>516, 24°C</u>		Received by: <i>[Signature]</i>	Date: 11/29/06	Time: 0940
			Custody Seals Intact? <input checked="" type="checkbox"/> Yes <input type="checkbox"/> No		

ANALYTICAL RESULTS

Prepared for:

Chevron
6001 Bollinger Canyon Rd L4310
San Ramon CA 94583

925-842-8582

Prepared by:

Lancaster Laboratories
2425 New Holland Pike
Lancaster, PA 17605-2425

SAMPLE GROUP

The sample group for this submittal is 1015782. Samples arrived at the laboratory on Wednesday, November 29, 2006. The PO# for this group is 0015009981 and the release number is SINHA.

<u>Client Description</u>			<u>Lancaster Labs Number</u>
QA-T-061128	NA	Water	4925134
MW-1A-W-061128	Grab	Water	4925135
MW-2-W-061128	Grab	Water	4925136
MW-3-W-061128	Grab	Water	4925137
MW-4-W-061128	Grab	Water	4925138
MW-5-W-061128	Grab	Water	4925139
MW-6-W-061128	Grab	Water	4925140
MW-7-W-061128	Grab	Water	4925141
MW-8-W-061128	Grab	Water	4925142

ELECTRONIC COPY TO Cambria c/o Gettler-Ryan

Attn: Cheryl Hansen



Analysis Report

2425 New Holland Pike, PO Box 12425, Lancaster, PA 17605-2425 • 717-656-2300 Fax: 717-656-2681 • www.lancasterlabs.com

Questions? Contact your Client Services Representative
Angela M Miller at (717) 656-2300

Respectfully Submitted,

A handwritten signature in black ink, appearing to read "Elizabeth A. Smith".

Elizabeth A. Smith
Senior Specialist



Analysis Report

2425 New Holland Pike, PO Box 12425, Lancaster, PA 17605-2425 • 717-656-2300 Fax: 717-656-2681 • www.lancasterlabs.com

Lancaster Laboratories Sample No. WW 4925134

QA-T-061128 NA Water
 Facility# 206145 Job# 386492 GRD
 800 Center St-Oakland T0600102230 QA
 Collected: 11/28/2006

Account Number: 10904

Submitted: 11/29/2006 09:40
 Reported: 12/05/2006 at 16:57
 Discard: 01/05/2007

Chevron
 6001 Bollinger Canyon Rd L4310
 San Ramon CA 94583

800QA

CAT No.	Analysis Name	CAS Number	As Received Result	As Received Method Detection Limit	Units	Dilution Factor
01729	TPH-GRO - Waters					
01730	TPH-GRO - Waters The reported concentration of TPH-GRO does not include MTBE or other gasoline constituents eluting prior to the C6 (n-hexane) TPH-GRO range start time.	n.a.	N.D.	50.	ug/l	1
02159	BTEX, MTBE					
02161	Benzene	71-43-2	N.D.	0.5	ug/l	1
02164	Toluene	108-88-3	N.D.	0.5	ug/l	1
02166	Ethylbenzene	100-41-4	N.D.	0.5	ug/l	1
02171	Total Xylenes	1330-20-7	N.D.	1.5	ug/l	1
02172	Methyl tert-Butyl Ether	1634-04-4	N.D.	2.5	ug/l	1

State of California Lab Certification No. 2116

All QC is compliant unless otherwise noted. Please refer to the Quality Control Summary for overall QC performance data and associated samples.

Laboratory Chronicle

CAT No.	Analysis Name	Method	Trial#	Analysis		Analyst	Dilution Factor	
				Date	Time			
01729	TPH-GRO - Waters	TPH GRO SW-846 mod	8015E	1	11/30/2006	10:15	Martha L Seidel	1
02159	BTEX, MTBE	SW-846	8021E	1	11/30/2006	10:15	Martha L Seidel	1
01146	GC VOA Water Prep	SW-846	5030E	1	11/30/2006	10:15	Martha L Seidel	1



Analysis Report

2425 New Holland Pike, PO Box 12425, Lancaster, PA 17605-2425 • 717-656-2300 Fax: 717-656-2681 • www.lancasterlabs.com

Lancaster Laboratories Sample No. WW 4925135

MW-1A-W-061128 Grab Water
 Facility# 206145 Job# 386492 GRD
 800 Center St-Oakland T0600102230 MW-1A
 Collected: 11/28/2006 11:00 by JA

Account Number: 10904

Submitted: 11/29/2006 09:40
 Reported: 12/05/2006 at 16:57
 Discard: 01/05/2007

Chevron
 6001 Bollinger Canyon Rd L4310
 San Ramon CA 94583

8001A

CAT No.	Analysis Name	CAS Number	As Received Result	As Received Method Detection Limit	Units	Dilution Factor
06610	TPH-DRO (Water) w/Si Gel	n.a.	2,900.	150.	ug/l	5
01729	TPH-GRO - Waters					
01730	TPH-GRO - Waters The reported concentration of TPH-GRO does not include MTBE or other gasoline constituents eluting prior to the C6 (n-hexane) TPH-GRO range start time.	n.a.	220.	50.	ug/l	1
02159	BTEX, MTBE					
02161	Benzene	71-43-2	8.6	0.5	ug/l	1
02164	Toluene	108-88-3	2.7	0.5	ug/l	1
02166	Ethylbenzene	100-41-4	6.1	0.5	ug/l	1
02171	Total Xylenes	1330-20-7	9.3	1.5	ug/l	1
02172	Methyl tert-Butyl Ether	1634-04-4	N.D.	2.5	ug/l	1

State of California Lab Certification No. 2116

All QC is compliant unless otherwise noted. Please refer to the Quality Control Summary for overall QC performance data and associated samples.

Laboratory Chronicle

CAT No.	Analysis Name	Method	Analysis		Analyst	Dilution Factor
			Trial#	Date and Time		
06610	TPH-DRO (Water) w/Si Gel	SW-846 8015B	1	12/01/2006 13:30	Tracy A Cole	5
01729	TPH-GRO - Waters	TPH GRO SW-846 8015B mcd	1	11/30/2006 10:48	Martha L Seidel	1
02159	BTEX, MTBE	SW-846 8021B	1	11/30/2006 10:48	Martha L Seidel	1
01146	GC VOA Water Prep	SW-846 5030B	1	11/30/2006 10:48	Martha L Seidel	1
02376	Extraction - Fuel/TPH (Waters)	SW-846 3510C	1	11/29/2006 20:05	Elaine F Stoltzfus	1

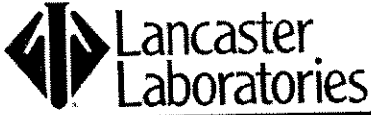

Analysis Report

2425 New Holland Pike, PO Box 12425, Lancaster, PA 17605-2425 • 717-656-2300 Fax: 717-656-2681 • www.lancasterlabs.com

Lancaster Laboratories Sample No. WW 4925136

MW-2-W-061128 Grab Water
 Facility# 206145 Job# 386492 GRD
 800 Center St-Oakland T0600102230 MW-2
 Collected: 11/28/2006 10:35 by JA

Account Number: 10904

Submitted: 11/29/2006 09:40
 Reported: 12/05/2006 at 16:57
 Discard: 01/05/2007

Chevron
 6001 Bollinger Canyon Rd L4310
 San Ramon CA 94583

800-2

CAT No.	Analysis Name	CAS Number	As Received Result	As Received Method Detection Limit	Units	Dilution Factor
06610	TPH-DRO (Water) w/Si Gel	n.a.	560.	50.	ug/l	1
01729	TPH-GRO - Waters					
01730	TPH-GRO - Waters The reported concentration of TPH-GRO does not include MTBE or other gasoline constituents eluting prior to the C6 (n-hexane) TPH-GRO range start time.	n.a.	N.D.	50.	ug/l	1
02159	BTEX, MTBE					
02161	Benzene	71-43-2	N.D.	0.5	ug/l	1
02164	Toluene	108-88-3	N.D.	0.5	ug/l	1
02166	Ethylbenzene	100-41-4	N.D.	0.5	ug/l	1
02171	Total Xylenes	1330-20-7	N.D.	1.5	ug/l	1
02172	Methyl tert-Butyl Ether	1634-04-4	N.D.	2.5	ug/l	1

State of California Lab Certification No. 2116

All QC is compliant unless otherwise noted. Please refer to the Quality Control Summary for overall QC performance data and associated samples.

Laboratory Chronicle

CAT No.	Analysis Name	Method	Analysis		Analyst	Dilution Factor
			Trial#	Date and Time		
06610	TPH-DRO (Water) w/Si Gel	SW-846 8015B	1	11/30/2006 21:02	Tracy A Cole	1
01729	TPH-GRO - Waters	TPH GRO SW-846 8015B mcd	1	11/30/2006 11:21	Martha L Seidel	1
02159	BTEX, MTBE	SW-846 8021B	1	11/30/2006 11:21	Martha L Seidel	1
01146	GC VOA Water Prep	SW-846 5030B	1	11/30/2006 11:21	Martha L Seidel	1
02376	Extraction - Fuel/TPH (Waters)	SW-846 3510C	1	11/29/2006 20:05	Elaine F Stoltzfus	1



Analysis Report

2425 New Holland Pike, PO Box 12425, Lancaster, PA 17605-2425 • 717-656-2300 Fax: 717-656-2681 • www.lancasterlabs.com

Lancaster Laboratories Sample No. WW 4925137

MW-3-W-061128 Grab Water
Facility# 206145 Job# 386492 GRD
800 Center St-Oakland T0600102230 MW-3
Collected: 11/28/2006 11:35 by JA

Account Number: 10904

Submitted: 11/29/2006 09:40
Reported: 12/05/2006 at 16:57
Discard: 01/05/2007

Chevron
6001 Bollinger Canyon Rd L4310
San Ramon CA 94583

800-3

CAT No.	Analysis Name	CAS Number	As Received Result	As Received Method Detection Limit	Units	Dilution Factor
06610	TPH-DRO (Water) w/Si Gel	n.a.	4,400.	300.	ug/l	10
01729	TPH-GRO - Waters					
01730	TPH-GRO - Waters	n.a.	43,000.	500.	ug/l	10
The reported concentration of TPH-GRO does not include MTBE or other gasoline constituents eluting prior to the C6 (n-hexane) TPH-GRO range start time.						
02159	BTEX, MTBE					
02161	Benzene	71-43-2	260.	5.0	ug/l	10
02164	Toluene	108-88-3	3,400.	5.0	ug/l	10
02166	Ethylbenzene	100-41-4	3,800.	10.	ug/l	20
02171	Total Xylenes	1330-20-7	5,800.	15.	ug/l	10
02172	Methyl tert-Butyl Ether	1634-04-4	N.D.	1,000.	ug/l	10

State of California Lab Certification No. 2116

All QC is compliant unless otherwise noted. Please refer to the Quality Control Summary for overall QC performance data and associated samples.

Laboratory Chronicle

CAT No.	Analysis Name	Method	Analysis		Analyst	Dilution Factor
			Trial#	Date and Time		
06610	TPH-DRO (Water) w/Si Gel	SW-846 8015B	1	11/30/2006 22:37	Tracy A Cole	10
01729	TPH-GRO - Waters	TPH GRO SW-846 8015B mod	1	11/30/2006 11:54	Martha L Seidel	10
02159	BTEX, MTBE	SW-846 8021B	1	11/30/2006 11:54	Martha L Seidel	10
02159	BTEX, MTBE	SW-846 8021B	1	12/01/2006 01:57	Martha L Seidel	20
01146	GC VOA Water Prep	SW-846 5030B	1	11/30/2006 11:54	Martha L Seidel	10
01146	GC VOA Water Prep	SW-846 5030B	2	12/01/2006 01:57	Martha L Seidel	20
02376	Extraction - Fuel/TPH (Waters)	SW-846 3510C	1	11/29/2006 20:05	Elaine F Stoltzfus	1



Analysis Report

2425 New Holland Pike, PO Box 12425, Lancaster, PA 17605-2425 • 717-656-2300 Fax: 717-656-2681 • www.lancasterlabs.com

Lancaster Laboratories Sample No. **WW 4925138**

MW-4-W-061128 **Grab Water**
 Facility# 206145 Job# 386492 **GRD**
 800 Center St-Oakland T0600102230 MW-4
 Collected: 11/28/2006 10:05 by JA

Account Number: 10904

Submitted: 11/29/2006 09:40
 Reported: 12/05/2006 at 16:57
 Discard: 01/05/2007

Chevron
 6001 Bollinger Canyon Rd L4310
 San Ramon CA 94583

800-4

CAT No.	Analysis Name	CAS Number	As Received Result	As Received Method Detection Limit	Units	Dilution Factor
06610	TPH-DRO (Water) w/Si Gel	n.a.	1,800.	150.	ug/l	5
01729	TPH-GRO - Waters					
01730	TPH-GRO - Waters	n.a.	1,200.	50.	ug/l	1
The reported concentration of TPH-GRO does not include MTBE or other gasoline constituents eluting prior to the C6 (n-hexane) TPH-GRO range start time.						
02159	BTEX, MTBE					
02161	Benzene	71-43-2	36.	0.5	ug/l	1
02164	Toluene	108-88-3	1.1	0.5	ug/l	1
02166	Ethylbenzene	100-41-4	3.4	0.5	ug/l	1
02171	Total Xylenes	1330-20-7	N.D.	5.0	ug/l	1
02172	Methyl tert-Butyl Ether	1634-04-4	N.D.	20.	ug/l	1
Due to the presence of interferents near their retention time, normal reporting limits were not attained for MTBE and xylenes. The presence or concentration of these compounds cannot be determined below the reporting limits due to the presence of these interferents.						

State of California Lab Certification No. 2116

All QC is compliant unless otherwise noted. Please refer to the Quality Control Summary for overall QC performance data and associated samples.

Laboratory Chronicle

CAT No.	Analysis Name	Method	Analysis		Analyst	Dilution Factor
			Trial#	Date and Time		
06610	TPH-DRO (Water) w/Si Gel	SW-846 8015B	1	12/01/2006 13:53	Tracy A Cole	5
01729	TPH-GRO - Waters	TPH GRO SW-846 8015B mod	1	11/30/2006 12:27	Martha L Seidel	1
02159	BTEX, MTBE	SW-846 8021B	1	11/30/2006 12:27	Martha L Seidel	1
01146	GC VOA Water Prep	SW-846 5030B	1	11/30/2006 12:27	Martha L Seidel	1
02376	Extraction - Fuel/TPH (Waters)	SW-846 3510C	1	11/29/2006 20:05	Elaine F Stoltzfus	1



Analysis Report

2425 New Holland Pike, PO Box 12425, Lancaster, PA 17605-2425 • 717-656-2300 Fax: 717-656-2681 • www.lancasterlabs.com

Lancaster Laboratories Sample No. **WW 4925139**

MW-5-W-061128 **Grab Water**
Facility# 206145 Job# 386492 **GRD**
800 Center St-Oakland T0600102230 MW-5
Collected: 11/28/2006 08:30 by JA

Account Number: 10904

Submitted: 11/29/2006 09:40
Reported: 12/05/2006 at 16:57
Discard: 01/05/2007

Chevron
6001 Bollinger Canyon Rd L4310
San Ramon CA 94583

800-5

CAT No.	Analysis Name	CAS Number	As Received Result	As Received Method Detection Limit	Units	Dilution Factor
06610	TPH-DRO (Water) w/Si Gel	n.a.	200.	50.	ug/l	1
01729	TPH-GRO - Waters					
01730	TPH-GRO - Waters	n.a.	N.D.	50.	ug/l	1
	The reported concentration of TPH-GRO does not include MTBE or other gasoline constituents eluting prior to the C6 (n-hexane) TPH-GRO range start time.					
02159	BTEX, MTBE					
02161	Benzene	71-43-2	N.D.	0.5	ug/l	1
02164	Toluene	108-88-3	N.D.	0.5	ug/l	1
02166	Ethylbenzene	100-41-4	N.D.	0.5	ug/l	1
02171	Total Xylenes	1330-20-7	N.D.	1.5	ug/l	1
02172	Methyl tert-Butyl Ether	1634-04-4	N.D.	2.5	ug/l	1

State of California Lab Certification No. 2116

All QC is compliant unless otherwise noted. Please refer to the Quality Control Summary for overall QC performance data and associated samples.

Laboratory Chronicle

CAT No.	Analysis Name	Method	Analysis		Analyst	Dilution Factor
			Trial#	Date and Time		
06610	TPH-DRO (Water) w/Si Gel	SW-846 8015B	1	11/30/2006 21:51	Tracy A Cole	1
01729	TPH-GRO - Waters	TPH GRO SW-846 8015B mod	1	11/30/2006 13:00	Martha L Seidel	1
02159	BTEX, MTBE	SW-846 8021B	1	11/30/2006 13:00	Martha L Seidel	1
01146	GC VOA Water Prep	SW-846 5030B	1	11/30/2006 13:00	Martha L Seidel	1
02376	Extraction - Fuel/TPH (Waters)	SW-846 3510C	1	11/29/2006 20:05	Elaine F Stoltzfus	1



Analysis Report

2425 New Holland Pike, PO Box 12425, Lancaster, PA 17605-2425 • 717-656-2300 Fax: 717-656-2681 • www.lancasterlabs.com

Lancaster Laboratories Sample No. **WW 4925140**

MW-6-W-061128 Grab Water
 Facility# 206145 Job# 386492 GRD
 800 Center St-Oakland T0600102230 MW-6
 Collected: 11/28/2006 09:00 by JA

Account Number: 10904

Submitted: 11/29/2006 09:40
 Reported: 12/05/2006 at 16:57
 Discard: 01/05/2007

Chevron
 6001 Bollinger Canyon Rd L4310
 San Ramon CA 94583

800-6

CAT No.	Analysis Name	CAS Number	As Received Result	As Received Method Detection Limit	Units	Dilution Factor
06610	TPH-DRO (Water) w/Si Gel	n.a.	120.	50.	ug/l	1
01729	TPH-GRO - Waters					
01730	TPH-GRO - Waters The reported concentration of TPH-GRO does not include MTBE or other gasoline constituents eluting prior to the C6 (n-hexane) TPH-GRO range start time.	n.a.	N.D.	50.	ug/l	1
02159	BTEX, MTBE					
02161	Benzene	71-43-2	N.D.	0.5	ug/l	1
02164	Toluene	108-88-3	N.D.	0.5	ug/l	1
02166	Ethylbenzene	100-41-4	N.D.	0.5	ug/l	1
02171	Total Xylenes	1330-20-7	N.D.	1.5	ug/l	1
02172	Methyl tert-Butyl Ether	1634-04-4	N.D.	2.5	ug/l	1

State of California Lab Certification No. 2116

All QC is compliant unless otherwise noted. Please refer to the Quality Control Summary for overall QC performance data and associated samples.

Laboratory Chronicle

CAT No.	Analysis Name	Method	Analysis		Analyst	Dilution Factor
			Trial#	Date and Time		
06610	TPH-DRO (Water) w/Si Gel	SW-846 8015B	1	11/30/2006 22:14	Tracy A Cole	1
01729	TPH-GRO - Waters	TPH GRO SW-846 8015B mod	1	11/30/2006 16:23	Martha L Seidel	1
02159	BTEX, MTBE	SW-846 8021B	1	11/30/2006 16:23	Martha L Seidel	1
01146	GC VOA Water Prep	SW-846 5030B	1	11/30/2006 15:50	Martha L Seidel	1
02376	Extraction - Fuel/TPH (Waters)	SW-846 3510C	1	11/29/2006 20:05	Elaine F Stoltzfus	1

Lancaster Laboratories Sample No. **WW 4925141**

MW-7-W-061128 Grab Water
 Facility# 206145 Job# 386492 GRD
 800 Center St-Oakland T0600102230 MW-7
 Collected: 11/28/2006 09:35 by JA

Account Number: 10904

Submitted: 11/29/2006 09:40
 Reported: 12/05/2006 at 16:57
 Discard: 01/05/2007

Chevron
 6001 Bollinger Canyon Rd L4310
 San Ramon CA 94583

800-7

CAT No.	Analysis Name	CAS Number	As Received Result	As Received Method Detection Limit	Units	Dilution Factor
06610	TPH-DRO (Water) w/Si Gel	n.a.	N.D.	50.	ug/l	1
01729	TPH-GRO - Waters					
01730	TPH-GRO - Waters	n.a.	N.D.	50.	ug/l	1
<p>The reported concentration of TPH-GRO does not include MTBE or other gasoline constituents eluting prior to the C6 (n-hexane) TPH-GRO range start time. The vial submitted for volatile analysis did not have a pH < 2 at the time of analysis. Due to the volatile nature of the analytes, it is not appropriate for the laboratory to adjust the pH at the time of sample receipt. The pH of this sample was pH = 7.</p>						
02159	BTEX, MTBE					
02161	Benzene	71-43-2	N.D.	0.5	ug/l	1
02164	Toluene	108-88-3	N.D.	0.5	ug/l	1
02166	Ethylbenzene	100-41-4	N.D.	0.5	ug/l	1
02171	Total Xylenes	1330-20-7	N.D.	1.5	ug/l	1
02172	Methyl tert-Butyl Ether	1634-04-4	N.D.	2.5	ug/l	1
<p>The vial submitted for volatile analysis did not have a pH < 2 at the time of analysis. Due to the volatile nature of the analytes, it is not appropriate for the laboratory to adjust the pH at the time of sample receipt. The pH of this sample was pH = 7.</p>						

State of California Lab Certification No. 2116

All QC is compliant unless otherwise noted. Please refer to the Quality Control Summary for overall QC performance data and associated samples.

Laboratory Chronicle

CAT No.	Analysis Name	Method	Analysis		Analyst	Dilution Factor
			Trial#	Date and Time		
06610	TPH-DRO (Water) w/Si Gel	SW-846 8015B	1	11/30/2006 20:16	Tracy A Cole	1
01729	TPH-GRO - Waters	TPH GRO SW-846 8015B mod	1	11/30/2006 16:58	Martha L Seidel	1
02159	BTEX, MTBE	SW-846 8021B	1	11/30/2006 16:58	Martha L Seidel	1
01146	GC VOA Water Prep	SW-846 5030B	1	11/30/2006 16:23	Martha L Seidel	1



Analysis Report

2425 New Holland Pike, PO Box 12425, Lancaster, PA 17605-2425 • 717-656-2300 Fax: 717-656-2681 • www.lancasterlabs.com

Page 2 of 2

Lancaster Laboratories Sample No. WW 4925141

MW-7-W-061128 Grab Water
Facility# 206145 Job# 386492 GRD
800 Center St-Oakland T0600102230 MW-7
Collected: 11/28/2006 09:35 by JA

Account Number: 10904

Submitted: 11/29/2006 09:40
Reported: 12/05/2006 at 16:57
Discard: 01/05/2007

Chevron
6001 Bollinger Canyon Rd L4310
San Ramon CA 94583

800-7 Extraction - Fuel/TPH SW-846 3510C 1 11/29/2006 20:05 Elaine F Stoltzfus 1
02376 (Waters)



Analysis Report

2425 New Holland Pike, PO Box 12425, Lancaster, PA 17605-2425 • 717-656-2300 Fax: 717-656-2681 • www.lancasterlabs.com

Lancaster Laboratories Sample No. WW 4925142

MW-8-W-061128 Grab Water
 Facility# 206145 Job# 386492 GRD
 800 Center St-Oakland T0600102230 MW-8
 Collected: 11/28/2006 08:00 by JA

Account Number: 10904

Submitted: 11/29/2006 09:40
 Reported: 12/05/2006 at 16:57
 Discard: 01/05/2007

Chevron
 6001 Bollinger Canyon Rd L4310
 San Ramon CA 94583

800-8

CAT No.	Analysis Name	CAS Number	As Received Result	As Received Method Detection Limit	Units	Dilution Factor
06610	TPH-DRO (Water) w/Si Gel	n.a.	N.D.	50.	ug/l	1
01729	TPH-GRO - Waters					
01730	TPH-GRO - Waters	n.a.	N.D.	50.	ug/l	1
	The reported concentration of TPH-GRO does not include MTBE or other gasoline constituents eluting prior to the C6 (n-hexane) TPH-GRO range start time.					
02159	BTEX, MTBE					
02161	Benzene	71-43-2	N.D.	0.5	ug/l	1
02164	Toluene	108-88-3	N.D.	0.5	ug/l	1
02166	Ethylbenzene	100-41-4	N.D.	0.5	ug/l	1
02171	Total Xylenes	1330-20-7	N.D.	1.5	ug/l	1
02172	Methyl tert-Butyl Ether	1634-04-4	N.D.	2.5	ug/l	1

State of California Lab Certification No. 2116

All QC is compliant unless otherwise noted. Please refer to the Quality Control Summary for overall QC performance data and associated samples.

Laboratory Chronicle

CAT No.	Analysis Name	Method	Analysis		Analyst	Dilution Factor
			Trial#	Date and Time		
06610	TPH-DRO (Water) w/Si Gel	SW-846 8015B	1	11/30/2006 20:39	Tracy A Cole	1
01729	TPH-GRO - Waters	TPH GRO SW-846 8015B mod	1	11/30/2006 17:31	Martha L Seidel	1
02159	BTEX, MTBE	SW-846 8021B	1	11/30/2006 17:31	Martha L Seidel	1
01146	GC VOA Water Prep	SW-846 5030B	1	11/30/2006 16:58	Martha L Seidel	1
02376	Extraction - Fuel/TPH (Waters)	SW-846 3510C	1	11/29/2006 20:05	Elaine F Stoltzfus	1

Quality Control Summary

 Client Name: Chevron
 Reported: 12/05/06 at 04:57 PM

Group Number: 1015782

Matrix QC may not be reported if site-specific QC samples were not submitted. In these situations, to demonstrate precision and accuracy at a batch level, a LCS/LCSD was performed, unless otherwise specified in the method.

Laboratory Compliance Quality Control

Analysis Name	Blank Result	Blank MDL	Report Units	LCS %REC	LCSD %REC	LCS/LCSD Limits	RPD	RPD Max
Batch number: 063330013A TPH-DRO (Water) w/Si Gel	N.D.	29.	ug/l	95	94	63-119	1	20
Batch number: 06334A51A TPH-GRO - Waters	N.D.	50.	ug/l	115	127	70-130	11	30
Benzene	N.D.	0.5	ug/l	97	101	86-119	5	30
Toluene	N.D.	0.5	ug/l	100	105	82-119	5	30
Ethylbenzene	N.D.	0.5	ug/l	100	105	81-119	4	30
Total Xylenes	N.D.	1.5	ug/l	101	106	82-120	5	30
Methyl tert-Butyl Ether	N.D.	2.5	ug/l	102	104	82-124	2	30
Batch number: 06334A51B Ethylbenzene	N.D.	0.5	ug/l	100	105	81-119	4	30

Sample Matrix Quality Control

Unspiked (UNSPK) = the sample used in conjunction with the matrix spike
 Background (BKG) = the sample used in conjunction with the duplicate

Analysis Name	MS %REC	MSD %REC	MS/MSD Limits	RPD	RPD MAX	BKG Conc	DUP Conc	DUP RPD	Dup RPD Max
Batch number: 06334A51A TPH-GRO - Waters	133	111	63-154						
Benzene	117	115	78-131						
Toluene	116	115	78-129						
Ethylbenzene	116	115	75-133						
Total Xylenes	116	115	84-131						
Methyl tert-Butyl Ether	102	115	70-134						
Batch number: 06334A51B Ethylbenzene	115	115	75-133						

Surrogate Quality Control

Surrogate recoveries which are outside of the QC window are confirmed unless attributed to dilution or otherwise noted on the Analysis Report.

Analysis Name: TPH-DRO (Water) w/Si Gel
 Batch number: 063330013A
 Orthoterphenyl

4925135 90

*- Outside of specification

- (1) The result for one or both determinations was less than five times the LOQ.
- (2) The background result was more than four times the spike added.

Quality Control Summary

Client Name: Chevron
Reported: 12/05/06 at 04:57 PM

Group Number: 1015782

Surrogate Quality Control

4925136	97
4925137	101
4925138	82
4925139	83
4925140	96
4925141	89
4925142	91
Blank	87
LCS	106
LCS D	103

Limits: 59-131

Analysis Name: TPH-GRO - Waters
Batch number: 06334A51A

	Trifluorotoluene-F	Trifluorotoluene-P
4925134	84	104
4925135	89	104
4925136	83	97
4925137	107	116
4925138	97	101
4925139	84	101
4925140	84	103
4925141	83	96
4925142	85	103
Blank	87	103
LCS	87	97
LCS D	90	96
MS	88	96

Limits: 63-135

69-129

Analysis Name: TPH-GRO - Waters
Batch number: 06334A51B

	Trifluorotoluene-F	Trifluorotoluene-P
Blank	84	103
LCS	87	97
LCS D	90	96
MS	88	96

Limits: 63-135

69-129

*- Outside of specification

- (1) The result for one or both determinations was less than five times the LOQ.
- (2) The background result was more than four times the spike added.

Lancaster Laboratories Explanation of Symbols and Abbreviations

The following defines common symbols and abbreviations used in reporting technical data:

N.D.	none detected	BMQL	Below Minimum Quantitation Level
TNTC	Too Numerous To Count	MPN	Most Probable Number
IU	International Units	CP Units	cobalt-chloroplatinate units
umhos/cm	micromhos/cm	NTU	nephelometric turbidity units
C	degrees Celsius	F	degrees Fahrenheit
Cal	(diet) calories	lb.	pound(s)
meq	milliequivalents	kg	kilogram(s)
g	gram(s)	mg	milligram(s)
ug	microgram(s)	l	liter(s)
ml	milliliter(s)	ul	microliter(s)
m3	cubic meter(s)	fib >5 um/ml	fibers greater than 5 microns in length per ml
<	less than – The number following the sign is the <u>limit of quantitation</u> , the smallest amount of analyte which can be reliably determined using this specific test.		
>	greater than		
ppm	parts per million – One ppm is equivalent to one milligram per kilogram (mg/kg), or one gram per million grams. For aqueous liquids, ppm is usually taken to be equivalent to milligrams per liter (mg/l), because one liter of water has a weight very close to a kilogram. For gases or vapors, one ppm is equivalent to one microliter of gas per liter of gas.		
ppb	parts per billion		
Dry weight basis	Results printed under this heading have been adjusted for moisture content. This increases the analyte weight concentration to approximate the value present in a similar sample without moisture.		

U.S. EPA data qualifiers:

Organic Qualifiers

A	TIC is a possible aldol-condensation product
B	Analyte was also detected in the blank
C	Pesticide result confirmed by GC/MS
D	Compound quantitated on a diluted sample
E	Concentration exceeds the calibration range of the instrument
J	Estimated value
N	Presumptive evidence of a compound (TICs only)
P	Concentration difference between primary and confirmation columns >25%
U	Compound was not detected
X,Y,Z	Defined in case narrative

Inorganic Qualifiers

B	Value is <CRDL, but ≥IDL
E	Estimated due to interference
M	Duplicate injection precision not met
N	Spike amount not within control limits
S	Method of standard additions (MSA) used for calculation
U	Compound was not detected
W	Post digestion spike out of control limits
*	Duplicate analysis not within control limits
+	Correlation coefficient for MSA <0.995

Analytical test results for methods listed on the laboratories' accreditation scope meet all requirements of NELAC unless otherwise noted under the individual analysis.

Tests results relate only to the sample tested. Clients should be aware that a critical step in a chemical or microbiological analysis is the collection of the sample. Unless the sample analyzed is truly representative of the bulk of material involved, the test results will be meaningless. If you have questions regarding the proper techniques of collecting samples, please contact us. We cannot be held responsible for sample integrity, however, unless sampling has been performed by a member of our staff. This report shall not be reproduced except in full, without the written approval of the laboratory.

WARRANTY AND LIMITS OF LIABILITY – In accepting analytical work, we warrant the accuracy of test results for the sample as submitted. THE FOREGOING EXPRESS WARRANTY IS EXCLUSIVE AND IS GIVEN IN LIEU OF ALL OTHER WARRANTIES, EXPRESSED OR IMPLIED. WE DISCLAIM ANY OTHER WARRANTIES, EXPRESSED OR IMPLIED, INCLUDING A WARRANTY OF FITNESS FOR PARTICULAR PURPOSE AND WARRANTY OF MERCHANTABILITY. IN NO EVENT SHALL LANCASTER LABORATORIES BE LIABLE FOR INDIRECT, SPECIAL, CONSEQUENTIAL, OR INCIDENTAL DAMAGES INCLUDING, BUT NOT LIMITED TO, DAMAGES FOR LOSS OF PROFIT OR GOODWILL REGARDLESS OF (A) THE NEGLIGENCE (EITHER SOLE OR CONCURRENT) OF LANCASTER LABORATORIES AND (B) WHETHER LANCASTER LABORATORIES HAS BEEN INFORMED OF THE POSSIBILITY OF SUCH DAMAGES. We accept no legal responsibility for the purposes for which the client uses the test results. No purchase order or other order for work shall be accepted by Lancaster Laboratories which includes any conditions that vary from the Standard Terms and Conditions of Lancaster Laboratories and we hereby object to any conflicting terms contained in any acceptance or order submitted by client.