



GETTLER-RYAN INC. ^{Re 454}

TRANSMITTAL

March 28, 2002

G-R #386492

APR 16 2002

TO: Mr. James Brownell
Delta Environmental Consultants, Inc.
3164 Gold Camp Drive, Suite 200
Rancho Cordova, California 95670

CC: Mr. Thomas Bauhs
Chevron Products Company
P.O. Box 6004
San Ramon, California 94583

FROM: Deanna L. Harding
Project Coordinator
Gettler-Ryan Inc.
6747 Sierra Court, Suite J
Dublin, California 94568

RE: Chevron (Former Signal Oil)
Service Station #206145 (S-800)
800 Center Street
Oakland, California

WE HAVE ENCLOSED THE FOLLOWING:

COPIES	DATED	DESCRIPTION
1	March 26, 2002	Groundwater Monitoring and Sampling Report First Quarter - Event of February 14, 2002

COMMENTS:

This report is being sent for your review. Please provide any comments/changes and propose any groundwater monitoring modifications for the next event prior to **April 11, 2002**, at which time the final report will be distributed to the following:

- cc: Mr. Barney Chan, Alameda County Health Care Services, Dept. of Environmental Health, 1153 Harbor Bay Parkway, Suite 250, Alameda, CA 94502-6577
- Mr. Greg Gurs, Gettler-Ryan Inc., 3140 Gold Camp Drive, Suite 170, Rancho Cordova, CA 95670
- Mr. Terrell A. Sadler, 618 Brooklyn Avenue, Oakland, CA 94606
- Mr. James Scott, BPH, Inc., 333 Hegenberger Road, Suite 209, Oakland, CA 94621
- Mr. Hollis Rodgers, c/o Victor E. Brown, Esq., 580 Grand Avenue, Oakland, CA 94610

Enclosures

trans/206145-TB



GETTLER-RYAN INC.

March 26, 2002
G-R Job #386492

Mr. Thomas Bauhs
Chevron Products Company
P.O. Box 6004
San Ramon, CA 94583

RE: First Quarter Event of February 14, 2002
Groundwater Monitoring & Sampling Report
Chevron (Former Signal Oil) Service Station #206145 (S-800)
800 Center Street
Oakland, California

Dear Mr. Bauhs:

This report documents the well development and the most recent groundwater monitoring and sampling event performed by Gettler-Ryan Inc. (G-R) at the referenced site. All field work was conducted in accordance with G-R Standard Operating Procedure - Groundwater Sampling (attached).

Static groundwater levels were measured and the wells were checked for the presence of separate-phase hydrocarbons. Static water level data, groundwater elevations and separate-phase hydrocarbon thickness (if any) are presented in the attached Table 1. A Potentiometric Map is included as Figure 1.

Groundwater samples were collected from the monitoring wells and submitted to a state certified laboratory for analyses. The field data sheets for this event are attached. Analytical results are presented in the table(s) listed below. The chain of custody document and laboratory analytical report are also attached.

Please call if you have any questions or comments regarding this report. Thank you.

Sincerely,

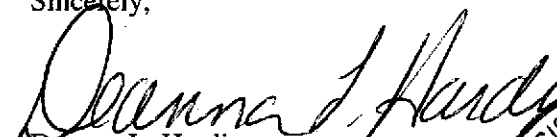
Deanna L. Harding
Project Coordinator

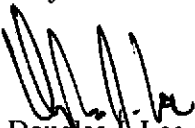

Douglas J. Lee
Senior Geologist, R.G. No. 6882

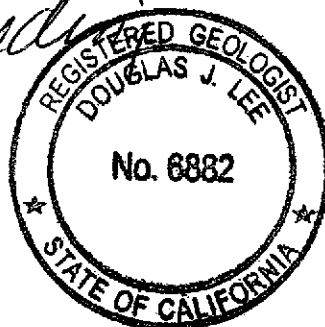
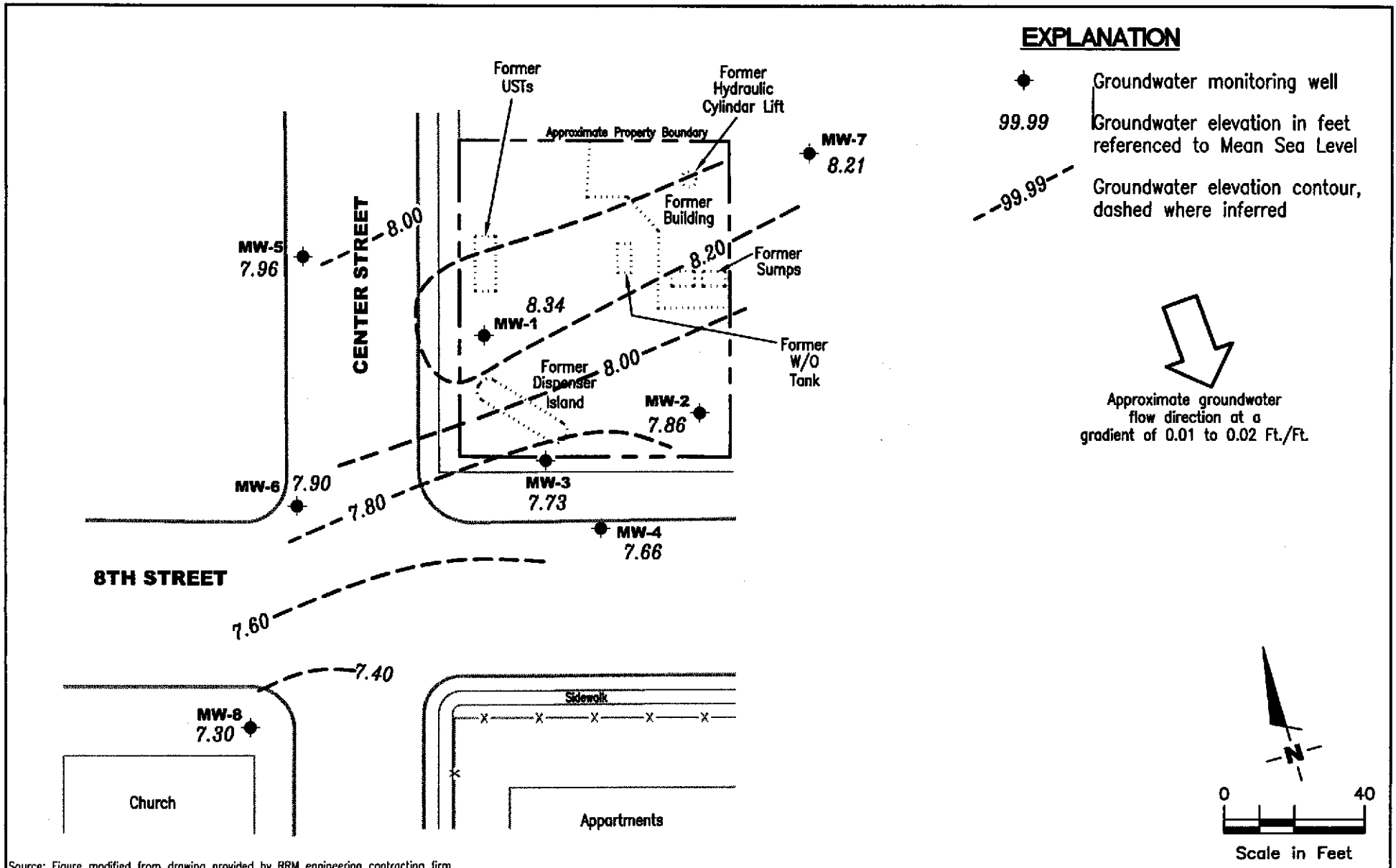

Figure 1: Potentiometric Map
Table 1: Groundwater Monitoring Data and Analytical Results
Table 2: Field Measurements and Analytical Results
Table 3: Groundwater Analytical Results - Oxygenate Compounds
Attachments: Standard Operating Procedure - Groundwater Sampling
Field Data Sheets
Chain of Custody Document and Laboratory Analytical Reports



Source: Figure modified from drawing provided by RRM engineering contracting firm.

GETTLER - RYAN INC.
 6747 Sierra Ct., Suite J
 Dublin, CA 94568 (925) 551-7555

POTENTIOMETRIC MAP
 Chevron (Former Signal Oil) Service Station #20-6145(S-800)
 800 Center Street
 Oakland, California

FIGURE
1

PROJECT NUMBER 386492	REVIEWED BY	DATE February 14, 2002	REVISED DATE
--------------------------	-------------	---------------------------	--------------

Table 1
Groundwater Monitoring Data and Analytical Results
Chevron (Former Signal Oil) Service Station #206145 (S-800)
800 Center Street
Oakland, California

WELL ID/ DATE	TOC* (ft.)	GWE (msl)	DTW (ft.)	TPH-G (ppb)	B (ppb)	T (ppb)	E (ppb)	X (ppb)	MTBE (ppb)	CUB (cfu/ml)
MW-1										
10/27/95	15.69	10.54	5.15	170,000	19,000	34,000	4,800	26,000	--	--
02/20/97	15.64	8.96	6.68	18,000	870	3,500	470	2,100	<250	--
04/24/97	15.64	7.30	8.34	76,000	4,600	16,000	1,600	8,300	1,000	--
07/23/97	15.64	5.90	9.74	37,000	2,700	8,000	870	6,100	<250	--
10/29/97	15.64	INACCESSIBLE		--	--	--	--	--	--	--
01/28/98	15.64	9.30	6.34	10,000	380	2,000	300	1,500	<25	--
05/11/98	15.64	8.72	6.92	17,000	880	3,100	380	2,300	<250	--
07/16/98	15.64	7.23	8.41	29,000	2,700	6,800	890	3,900	<1,000	--
08/04/98 ^a	15.64	6.90	8.74	--	--	--	--	--	--	<1.0 x 10 ¹
09/03/98 ^a	15.64	6.43	9.21	--	--	--	--	--	--	4.1 x 10 ³
10/21/98 ^b	15.64	5.59	10.05	--	--	--	--	--	--	4.7 x 10 ²
11/04/98	15.64	5.64	10.00	25,000	1,900	5,900	810	4,300	<125	--
01/26/99	15.64	6.86	8.78	<50	<0.5	<0.5	<0.5	<0.5	<2.0	--
05/06/99	15.64	8.17	7.47	8,050	515	1,840	256	1,190	300/<20 ^e	--
08/21/99	15.64	13.27	2.37	46,500	2,530	8,700	1,010	5,300	<1,250/<40 ^e	--
10/28/99	15.64	5.46	10.18	31,600	1,580	6,100	794	4,400	1,270	--
01/31/00	15.64	7.49	8.15	7,270	366	1,280	171	935	<12.5	--
05/19/00	15.64	7.78	7.86	8,000 ^e	870	1,200	430	1,200	<250	--
08/07/00	15.64	6.42	9.22	37,000 ^e	2,400	8,500	1,100	5,500	1,500/<4.0 ^f	--
12/01/00	15.64	5.25	10.39	25,500 ^g	1,390	4,920	801	4,330	<500/<10 ^f	--
02/09/01	15.64	6.10	9.54	8,900 ^e	850	1,300	470	1,700	820/<2.0 ^f	--
05/29/01	15.64	6.79	8.85	24,000 ^e	1,800	5,600	740	3,700	<250/<2.0 ^f	--
08/27/01 ^h	15.64	5.83	9.81	27,000	1,400	4,400	710	3,400	--/<20 ^f	--
11/28/01	15.64	5.84	9.80	26,000	1,300	3,900	620	3,400	<100/<2 ^f	--
02/14/02	15.63	8.34	7.29	1,400	100	360	45	240	9.3/<2 ^f	--
MW-2										
10/27/95	15.77	10.60	5.17	<50	<0.5	<0.5	<0.5	<0.5	--	--
02/20/97	15.72	8.51	7.21	<50	<0.5	<0.5	<0.5	<0.5	<2.5	--
04/24/97	15.72	7.82	7.90	83 ^d	<0.5	<0.5	<0.5	<0.5	<2.5	--

Table 1
Groundwater Monitoring Data and Analytical Results
Chevron (Former Signal Oil) Service Station #206145 (S-800)
800 Center Street
Oakland, California

WELL ID/ DATE	TOC* (ft.)	GWE (msl)	DTW (ft.)	TPH-G (ppb)	B (ppb)	T (ppb)	E (ppb)	X (ppb)	MTBE (ppb)	CUB (cfu/ml)
MW-2 (cont)										
07/23/97	15.72	5.92	9.80	<50	<0.5	<0.5	<0.5	<0.5	<2.5	--
10/29/97	15.72	5.13	10.59	<50	<0.5	<0.5	<0.5	<0.5	<2.5	--
01/28/98	15.72	9.21	6.51	<50	<0.5	<0.5	<0.5	<0.5	<2.5	--
05/11/98	15.72	8.82	6.90	SAMPLED ANNUALLY			--	--	--	--
07/16/98	15.72	7.37	8.35	--	--	--	--	--	--	--
08/04/98 ^a	15.72	7.03	8.69	--	--	--	--	--	--	1.9 x 10 ¹
09/03/98 ^a	15.72	6.44	9.28	--	--	--	--	--	--	3.0 x 10 ²
10/21/98 ^h	15.72	5.51	10.21	--	--	--	--	--	--	8.8 x 10 ²
11/04/98	15.72	5.60	10.12	--	--	--	--	--	--	--
01/26/99	15.72	6.87	8.85	<50	<0.5	<0.5	<0.5	<0.5	<2.0	--
05/06/99	15.72	8.20	7.52	--	--	--	--	--	--	--
08/21/99	15.72	13.21	2.51	--	--	--	--	--	--	--
10/28/99	15.72	6.35	9.37	--	--	--	--	--	--	--
01/31/00	15.72	7.25	8.47	<50	<0.5	0.541	<0.5	<0.5	<2.5	--
05/19/00	15.72	7.65	8.07	--	--	--	--	--	--	--
08/07/00	15.72	6.35	9.37	<50	<0.50	<0.50	<0.50	<0.50	<2.5/<2.0 ^f	--
12/01/00	15.72	5.60	10.12	<50.0	<0.500	<0.500	<0.500	<0.500	<2.50	--
02/09/01	15.72	6.05	9.67	<50	<0.50	<0.50	<0.50	<0.50	<2.5	--
05/29/01	15.72	6.73	8.99	<50	<0.50	<0.50	<0.50	<0.50	<2.5	--
08/27/01 ^h	15.72	5.68	10.04	<50	<0.50	<0.50	<0.50	<0.50	--/<5.0 ^f	--
11/28/01	15.72	5.86	9.86	NOT SAMPLED DUE TO INSUFFICIENT WATER			--	--	--	--
02/14/02	15.69	7.86	7.83	<50	<0.50	<0.50	<0.50	<1.5	<2.5	--
MW-3										
10/27/95	15.46	10.37	5.09	33,000	11,000	1,700	2,300	4,200	--	--
02/20/97	15.42	8.37	7.05	260	56	<1.0	7.6	5.9	<5.0	--
04/24/97	15.42	7.29	8.13	1,400	310	28	76	75	74	--
07/23/97	15.42	5.84	9.58	37,000	10,000	1,500	2,700	4,200	2,500	--
10/29/97	15.42	5.09	10.33	53,000	12,000	1,200	3,000	3,100	2,500	--
01/28/98	15.42	8.94	6.48	210	43	1.5	1.7	3.9	10	--

Table 1
Groundwater Monitoring Data and Analytical Results
Chevron (Former Signal Oil) Service Station #206145 (S-800)
800 Center Street
Oakland, California

WELL ID/ DATE	TOC* (ft.)	GWE (msl)	DTW (ft.)	TPH-G (ppb)	B (ppb)	T (ppb)	E (ppb)	X (ppb)	MTBE (ppb)	CUB (cfu/ml)
MW-3 (cont)										
05/11/98	15.42	8.49	6.93	59	11	<0.5	2.1	<0.5	<2.5	--
07/16/98	15.42	7.14	8.28	260	90	4.8	18	5.7	<10	--
08/04/98 ^a	15.42	6.88	8.54	--	--	--	--	--	--	8.5 x 10 ²
09/03/98 ^a	15.42	6.34	9.08	--	--	--	--	--	--	2.4 x 10 ³
10/21/98 ^b	15.42	5.62	9.80	--	--	--	--	--	--	6.0 x 10 ¹
11/04/98	15.42	5.60	9.82	73,000	17,000	3,800	4,900	8,100	<250	--
01/26/99	15.42	6.70	8.72	32,400	10,200	1,850	2,650	3,140	715/<500 ^e	--
05/06/99	15.42	7.97	7.45	3,160	668	89.6	180	123	<200/<10 ^e	--
08/21/99	15.42	7.95	7.47	53,800	9,700	2,040	2,880	5,000	<1,250/<40 ^e	--
10/28/99	15.42	5.37	10.05	71,300	14,000	3,420	4,320	8,360	<1,000	--
01/31/00	15.42	7.16	8.26	1,650	496	49.1	134	82.6	<12.5	--
05/19/00	15.42	7.60	7.82	110 ^e	36	2.5	9.1	4.0	6.3	--
08/07/00	15.42	6.29	9.13	36,000 ^e	9,000	3,000	2,700	2,800	2,500/<10 ^f	--
12/01/00	15.42	2.45	12.97	NOT SAMPLED DUE TO INSUFFICIENT WATER				--	--	--
02/09/01	15.42	5.98	9.44	32,000 ^e	11,000	3,900	3,200	4,800	3,200/<2.0 ^f	--
05/29/01	15.42	6.65	8.77	13,000	4,200	2,000	1,800	1,500	74/<2.0 ^f	--
08/27/01 ^h	15.42	5.70	9.72	40,000	7,600	2,800	2,500	2,700	--/<25 ^f	--
11/28/01	15.42	5.77	9.65	57,000	10,000	2,900	2,900	2,800	<250/<5.0 ^f	--
02/14/02	15.40	7.73	7.67	51	2.9	<0.50	1.9	1.8	<2.5/<2 ^f	--
MW-4										
10/27/95	14.45	9.37	5.08	66	6.8	<0.5	<0.5	<0.5	--	--
02/20/97	14.40	8.12	6.28	54	<0.5	<0.5	<0.5	7.4	39	--
04/24/97	14.40	7.29	7.11	54	1.4	<0.5	0.65	3.0	100	--
07/23/97	14.40	5.80	8.60	<50	<0.5	<0.5	<0.5	<0.5	<2.5	--
10/29/97	14.40	5.74	8.66	--	--	--	--	--	--	--
11/13/97	14.40	4.97	9.43	<50	<0.5	0.79	<0.5	<0.5	<2.5	--
01/28/98	14.40	8.88	5.52	<50	<0.5	<0.5	<0.5	<0.5	<2.5	--
05/11/98	14.40	8.40	6.00	SAMPLED BIANNUALLY		--	--	--	--	--
07/16/98	14.40	7.08	7.32	<50	<0.5	<0.5	<0.5	<0.5	<5.0	--

Table 1
Groundwater Monitoring Data and Analytical Results
Chevron (Former Signal Oil) Service Station #206145 (S-800)
800 Center Street
Oakland, California

WELL ID/ DATE	TOC* (ft.)	GWE (msl)	DTW (ft.)	TPH-G (ppb)	B (ppb)	T (ppb)	E (ppb)	X (ppb)	MTBE (ppb)	CUB (cfu/ml)	
MW-4 (cont)											
08/04/98 ^a	14.40	6.28	8.12	--	--	--	--	--	--	1.8 x 10 ⁴	
09/03/98 ^a	14.40	6.32	8.08	--	--	--	--	--	--	1.4 x 10 ⁴	
10/21/98 ^b	14.40	5.64	8.76	--	--	--	--	--	--	8.6 x 10 ⁴	
11/04/98	14.40	5.61	8.79	--	--	--	--	--	--	--	
01/26/99	14.40	6.71	7.69	<50	<0.5	<0.5	<0.5	<0.5	<2.0	--	
05/06/99	14.40	8.15	6.25	--	--	--	--	--	--	--	
08/21/99	14.40	8.13	6.27	<50	<0.5	<0.5	<0.5	<0.5	<5.0	--	
10/28/99	14.40	4.14	10.26	--	--	--	--	--	--	--	
01/31/00	14.40	7.07	7.33	<50	<0.5	<0.5	<0.5	<0.5	<2.5	--	
05/19/00	14.40	7.52	6.88	--	--	--	--	--	--	--	
08/07/00	14.40	6.23	8.17	<50	4.3	0.60	<0.50	<0.50	<2.5/<2.0 ^f	--	
12/01/00	14.40	INACCESSIBLE	--	--	--	--	--	--	--	--	
02/09/01	14.40	INACCESSIBLE	--	--	--	--	--	--	--	--	
05/29/01	14.40	6.58	7.82	NOT SAMPLED DUE TO INSUFFICIENT WATER							--
08/27/01	14.40	6.52	7.88	NOT SAMPLED DUE TO INSUFFICIENT WATER							--
11/28/01	14.40	DRY	--	--	--	--	--	--	--	--	
02/14/02	14.37	7.66	6.71	<50	<0.50	<0.50	<0.50	<1.5	<2.5/<2 ^f	--	
MW-5											
01/03/97	--	--	--	<50	<0.5	<0.5	<0.5	<0.5	--	--	
02/20/97	15.03	INACCESSIBLE	--	--	--	--	--	--	--	--	
04/24/97	15.03	INACCESSIBLE	--	--	--	--	--	--	--	--	
04/30/97	15.03	7.06	7.97	<50	<0.5	<0.5	<0.5	<0.5	<2.5	--	
07/23/97	15.03	INACCESSIBLE	--	--	--	--	--	--	--	--	
10/29/97	15.03	INACCESSIBLE	--	--	--	--	--	--	--	--	
01/28/98	15.03	8.83	6.20	<50	<0.5	<0.5	<0.5	<0.5	<2.5	--	
05/11/98	15.03	INACCESSIBLE	--	--	--	--	--	--	--	--	
07/16/98	15.03	7.28	7.75	<50	<0.5	<0.5	<0.5	<0.5	<5.0	--	
08/04/98	15.03	INACCESSIBLE	--	--	--	--	--	--	--	--	
11/04/98	15.03	INACCESSIBLE	--	--	--	--	--	--	--	--	

Table 1
Groundwater Monitoring Data and Analytical Results
Chevron (Former Signal Oil) Service Station #206145 (S-800)
800 Center Street
Oakland, California

WELL ID/ DATE	TOC* (ft.)	GWE (msl)	DTW (ft.)	TPH-G (ppb)	B (ppb)	T (ppb)	E (ppb)	X (ppb)	MTBE (ppb)	CUR (cfu/ml)
MW-5 (cont)										
01/26/99	15.03	INACCESSIBLE		--	--	--	--	--	--	--
05/06/99	15.03	INACCESSIBLE		--	--	--	--	--	--	--
08/21/99	15.03	6.74	8.29	<50	<0.5	<0.5	<0.5	<0.5	<5.0	--
10/28/99	15.03	4.60	10.43	--	--	--	--	--	--	--
01/31/00	15.03	7.39	7.64	<50	<0.5	<0.5	<0.5	<0.5	<2.5	--
05/19/00	15.03	7.85	7.18	--	--	--	--	--	--	--
08/07/00	15.03	INACCESSIBLE		--	--	--	--	--	--	--
12/01/00	15.03	5.68	9.35	<50.0	<0.500	<0.500	<0.500	<0.500	<2.50/<2.0 ^f	--
02/09/01	15.03	6.22	8.81	<50	<0.50	<0.50	<0.50	<0.50	<2.5/<2.0 ^f	--
05/29/01	INACCESSIBLE - CAR PARKED OVER WELL				--	--	--	--	--	--
08/27/01	INACCESSIBLE - CAR PARKED OVER WELL				--	--	--	--	--	--
11/28/01	INACCESSIBLE - CAR PARKED OVER WELL				--	--	--	--	--	--
02/14/02	15.01	7.96	7.05	<50	<0.50	<0.50	<0.50	<1.5	<2.5/<2 ^f	--
MW-6										
01/03/97	--	--	--	<50	<0.5	<0.5	<0.5	<0.5	--	--
02/20/97	14.73	8.11	6.62	800	310	23	11	28	<12	--
04/24/97	14.73	7.13	7.60	<50	<0.5	<0.5	<0.5	<0.5	<2.5	--
07/23/97	14.73	5.73	9.00	<50	<0.5	<0.5	<0.5	<0.5	<2.5	--
10/29/97	14.73	4.98	9.75	<50	<0.5	<0.5	<0.5	<0.5	<2.5	--
01/28/98	14.73	8.19	6.54	160	38	<0.5	<0.5	<0.5	<2.5	--
05/11/98	14.73	8.08	6.65	1,700	490	72	39	52	<25	--
07/16/98	14.73	7.04	7.69	<50	<0.5	<0.5	<0.5	<0.5	<5.0	--
08/04/98 ^a	14.73	6.89	7.84	--	--	--	--	--	--	8.6 x 10 ³
09/03/98 ^a	14.73	6.24	8.49	--	--	--	--	--	--	2.9 x 10 ³
10/21/98 ^b	14.73	5.46	9.27	--	--	--	--	--	--	1.8 x 10 ³
11/04/98	14.73	5.52	9.21	<50	<0.5	<0.5	<0.5	<0.5	<2.5	--
01/26/99	14.73	6.49	8.24	<50	<0.5	<0.5	<0.5	<0.5	<2.0	--
05/06/99	14.73	7.91	6.82	<50	<0.5	<0.5	<0.5	<0.5	<5.0	--
08/21/99	14.73	7.93	6.80	<50	<0.5	<0.5	<0.5	<0.5	<5.0	--

Table 1
Groundwater Monitoring Data and Analytical Results
Chevron (Former Signal Oil) Service Station #206145 (S-800)
800 Center Street
Oakland, California

WELL ID/ DATE	TOC* (ft.)	GWE (msl)	DTW (ft.)	TPH-G (ppb)	B (ppb)	T (ppb)	E (ppb)	X (ppb)	MTBE (ppb)	CUB (cfu/ml)	
MW-6 (cont)											
10/28/99	14.73	5.27	9.46	<50	<0.5	<0.5	<0.5	<0.5	<5.0	--	
01/31/00	14.73	7.16	7.57	<50	<0.5	<0.5	<0.5	<0.5	<2.5	--	
05/19/00	14.73	7.60	7.13	<50	11	<0.5	<0.5	<0.5	<2.5	--	
08/07/00	14.73	6.22	8.51	<50	<0.50	<0.50	<0.50	<0.50	<2.5/2.0 ^f	--	
12/01/00	14.73	DRY	--	--	--	--	--	--	--	--	
02/09/01	14.73	DRY	--	--	--	--	--	--	--	--	
05/29/01	14.73	6.63	8.10	NOT SAMPLED DUE TO INSUFFICIENT WATER							--
08/27/01 ^h	14.73	9.83	4.90	150	<0.50	5.7	<0.50	<0.50	--/2.5 ^f	--	
11/28/01	14.73	DRY	--	--	--	--	--	--	--	--	
02/14/02	14.68	7.90	6.78	<50	<0.50	<0.50	<0.50	<1.5	<2.5	--	
MW-7											
01/03/97	--	--	--	<50	<0.5	<0.5	<0.5	<0.5	--	--	
02/20/97	16.36	8.86	7.50	<50	<0.5	<0.5	<0.5	<0.5	<2.5	--	
04/24/97	16.36	7.59	8.77	<50	<0.5	<0.5	<0.5	<0.5	<2.5	--	
07/23/97	16.36	6.09	10.27	<50	<0.5	<0.5	<0.5	<0.5	<2.5	--	
10/29/97	16.36	5.28	11.08	<50	<0.5	<0.5	<0.5	<0.5	<2.5	--	
01/28/98	16.36	9.10	7.26	<50	<0.5	<0.5	<0.5	<0.5	<2.5	--	
05/11/98	16.36	9.11	7.25	SAMPLED ANNUALLY			--	--	--	--	
07/16/98	16.36	8.00	8.36	--	--	--	--	--	--	--	
08/04/98 ⁿ	16.36	7.32	9.04	--	--	--	--	--	--	1.5 x 10 ³	
09/03/98 ⁿ	16.36	6.65	9.71	--	--	--	--	--	--	6.5 x 10 ²	
10/21/98 ^h	16.36	5.96	10.40	--	--	--	--	--	--	4.8 x 10 ³	
11/04/98	16.36	5.89	10.47	--	--	--	--	--	--	--	
01/26/99	16.36	8.25	8.11	<50	<0.5	<0.5	<0.5	0.5	<2.0	--	
05/06/99	16.36	8.47	7.89	--	--	--	--	--	--	--	
08/21/99	16.36	8.51	7.85	--	--	--	--	--	--	--	
10/28/99	16.36	6.04	10.32	--	--	--	--	--	--	--	
01/31/00	16.36	7.57	8.79	<50	<0.5	<0.5	<0.5	<0.5	<2.5	--	
05/19/00	16.36	UNABLE TO LOCATE		--	--	--	--	--	--	--	

Table 1
Groundwater Monitoring Data and Analytical Results
Chevron (Former Signal Oil) Service Station #206145 (S-800)
800 Center Street
Oakland, California

WELL ID/ DATE	TOC* (ft.)	GWE (msl)	DTW (ft.)	TPH-G (ppb)	B (ppb)	T (ppb)	E (ppb)	X (ppb)	MTBE (ppb)	CUB (cfu/ml)
MW-7 (cont)										
08/07/00	16.36	6.67	9.69	<50	<0.50	<0.50	<0.50	<0.50	<2.5/<2.0 ^f	--
12/01/00	16.36	5.84	10.52	<50.0	<0.500	<0.500	<0.500	<0.500	<2.50	--
02/09/01	16.36	6.30	10.06	<50	<0.50	<0.50	<0.50	<0.50	<2.5	--
05/29/01	16.36	UNABLE TO LOCATE		--	--	--	--	--	--	--
08/27/01 ^h	16.36	6.02	10.34	<50	<0.50	<0.50	<0.50	<0.50	--/<5.0 ^f	--
11/28/01	16.36	6.09	10.27	<50	<0.50	<0.50	<0.50	<1.5	<2.5	--
02/14/02	16.31	8.21	8.10	<50	<0.50	<0.50	<0.50	<1.5	<2.5	--
MW-8										
02/14/02 ^{ij}	15.29	7.30	7.99	<50	<0.50	<0.50	<0.50	<1.5	<2.5/<2 ^f	--
TRIP BLANK										
02/20/97	--	--	--	<50	<0.5	<0.5	<0.5	<0.5	<2.5	--
04/24/97	--	--	--	<50	<0.5	<0.5	<0.5	<0.5	<2.5	--
07/23/97	--	--	--	<50	<0.5	<0.5	<0.5	<0.5	<2.5	--
10/29/97	--	--	--	<50	<0.5	<0.5	<0.5	<0.5	<2.5	--
01/28/98	--	--	--	<50	<0.5	<0.5	<0.5	<0.5	<2.5	--
05/11/98	--	--	--	<50	<0.5	<0.5	<0.5	<0.5	<2.5	--
07/16/98	--	--	--	<50	<0.5	<0.5	<0.5	<0.5	<5.0	--
11/04/98	--	--	--	<50	<0.5	<0.5	<0.5	<0.5	<2.0	--
01/26/99	--	--	--	<50	<0.5	<0.5	<0.5	<0.5	<2.0	--
05/06/99	--	--	--	<50	<0.5	<0.5	<0.5	<0.5	<5.0	--
01/31/00	--	--	--	<50	<0.5	<0.5	<0.5	<0.5	<2.5	--
05/19/00	--	--	--	<50	<0.50	<0.50	<0.50	<0.50	<2.5	--
08/07/00	--	--	--	<50	<0.50	<0.50	<0.50	<0.50	<2.5	--
12/01/00	--	--	--	<50.0	<0.500	<0.500	<0.500	<0.500	<2.50	--
02/09/01	--	--	--	<50	<0.50	<0.50	<0.50	<0.50	<2.5	--
05/29/01	--	--	--	<50	<0.50	<0.50	<0.50	<0.50	<2.5	--
08/27/01 ^h	--	--	--	<50	<0.50	<0.50	<0.50	<0.50	--/<5.0 ^f	--

Table 1
Groundwater Monitoring Data and Analytical Results
 Chevron (Former Signal Oil) Service Station #206145 (S-800)
 800 Center Street
 Oakland, California

WELL ID/ DATE	TOC* (ft.)	GWE (msl)	DTW (ft.)	TPH-G (ppb)	B (ppb)	T (ppb)	E (ppb)	X (ppb)	MTBE (ppb)	CUB (cfu/ml)
QA										
11/28/01	--	--	--	<50	<0.50	<0.50	<0.50	<1.5	<2.5	--
02/14/02	--	--	--	<50	<0.50	<0.50	<0.50	<1.5	<2.5	--

Table 1
Groundwater Monitoring Data and Analytical Results
Chevron (Former Signal Oil) Service Station #206145 (S-800)
800 Center Street
Oakland, California

EXPLANATIONS:

Groundwater monitoring data and laboratory analytical results prior to May 19, 2000 were compiled from reports prepared by Blaine Tech Services, Inc.

TOC = Top of Casing (ft.) = Feet	B = Benzene T = Toluene	CUB = Contaminate utilizing bacteria (cfu/ml) = Colony forming unit per milliliter
GWE = Groundwater Elevation (msl) = Mean sea level	E = Ethylbenzene X = Xylenes	(ppb) = Parts per billion -- = Not Measured/Not Analyzed
DTW = Depth to Water	MTBE = Methyl tertiary butyl ether	QA = Quality Assurance
TPH-G = Total Petroleum Hydrocarbons as Gasoline		

- * TOC elevations were surveyed on December March 4, 2002, by Virgil Chavez Land Surveying. The benchmark for the survey was a City of Oakland benchmark, #25-H monument disk in well casting in sidewalk at the northwest corner of 7th and Center. The latitude, longitude and coordinates are for top of casings and are based on the California State Coordinate System, Zone III (NAD83), (Benchmark Elevation = 10.784 feet NGVD 29).
- ^a Contaminate hydrocarbon utilizing bacteria plate count was run with diesel and jet fuel degraders.
- ^b Contaminate hydrocarbon utilizing bacteria plate count was run with gasoline degraders.
- ^c Confirmation run.
- ^d Chromatogram pattern indicates an unidentified hydrocarbon.
- ^e Laboratory report indicates gasoline C6-C12.
- ^f MTBE by EPA Method 8260.
- ^g Laboratory reports indicates weathered gasoline C6-C12.
- ^h TPH-G and BTEX by EPA Method 8260.
- ⁱ Well development performed.
- ^j Total Petroleum Hydrocarbons as Diesel (TPH-D) was detected at 130 ppb.

Table 2
Field Measurements and Analytical Results
Chevron (Former Signal Oil) Service Station #206145 (S-800)
800 Center Street
Oakland, California

WELL ID/ DATE	Pre-purge DO (mg/L)	Post-purge DO (mg/L)	Pre-purge ORP (mV)	Post-purge ORP (mV)	Total Alkalinity (ppb)	Ferrous Iron (ppb)	Nitrate as Nitrate (ppb)	Sulfate (ppb)
MW-1 09/03/98	2.3	1.6	-90	-103	230,000	9,800	<1,000	6,100
MW-2 09/03/98	2.8	2.5	-206	-163	390,000	7,400	<1,000	21,000
MW-3 09/03/98	3.1	0.7	-124	-99	830,000	45,000	<1,000	10,000
MW-4 09/03/98	2.6	1.1	-190	-206	--	--	--	--
MW-6 09/03/98	2.6	3.2	-148	-167	94,000	62	28,000	47,000
MW-7 09/03/98	2.7	3.2	-207	-229	170,000	120	7,800	57,000

EXPLANATIONS:

Groundwater monitoring data and laboratory analytical results were compiled from reports prepared by Blaine Tech Services, Inc.

DO = Dissolved Oxygen

(mg/L) = Milligram per liter

ORP = Oxidation Reduction Potential

(mV) = Millivolts

(ppb) = Parts per billion

-- = Not Analyzed

Table 3
Groundwater Analytical Results - Oxygenate Compounds
Chevron (Former Signal Oil) Service Station #206145 (S-800)
800 Center Street
Oakland, California

WELL ID	DATE	METHANOL (ppm)	ETHANOL (ppb)	TBA (ppb)	MTBE (ppb)	DIPE (ppb)	ETBE (ppb)	TAME (ppb)	1,2-DCA (ppb)	EDB (ppb)
MW-1	08/07/00	--	<1,000	410	<4.0	<4.0	<4.0	<4.0	<4.0	<4.0
	12/01/00	--	<2,500	<250	<10	<10	<10	<10	<10	<10
	02/09/01	--	<500	340	<2.0	<2.0	<2.0	53	<2.0	<2.0
	05/29/01	--	<500	<20	<2.0	<2.0	<2.0	<2.0	<2.0	<2.0
	08/27/01	<2,000	<200	230	<20	<20	<20	<20	<20	<20
	11/28/01	--	<500	130	<2	<2	<2	<2	<2	<2
	02/14/02	--	<500	<100	<2	<2	<2	<2	<2	<2
MW-2	08/07/00		<500	<100	<2.0	<2.0	<2.0	<2.0	<2.0	<2.0
	08/27/01	--	--	--	<5.0	--	--	--	--	--
MW-3	08/07/00	--	<500	2,600	<10	<10	<10	<10	490	17
	02/09/01	--	<500	2,000	<2.0	<2.0	<2.0	35	<2.0	<2.0
	05/29/01	--	<500	1,700	<2.0	<2.0	<2.0	38	980	7.4
	08/27/01	<5,000	<250	1,300	<25	<25	<25	<25	380	<25
	11/28/01	--	<500	1,500	<5.0	<5.0	<5.0	<5.0	<5.0	<5.0
	02/14/02	--	<500	<100	<2	<2	<2	<2	<2	<2
MW-4	08/07/00	--	<500	<100	<2.0	<2.0	<2.0	<2.0	18	<2.0
	08/27/01	NOT SAMPLED DUE TO INSUFFICIENT WATER				--	--	--	--	--
	11/28/01	DRY				--	--	--	--	--
	02/14/02	--	<500	<100	<2	<2	<2	<2	9	<2
MW-5	12/01/00	--	<500	<50	<2.0	<2.0	<2.0	<2.0	<2.0	<2.0
	02/09/01	--	<500	<50	<2.0	<2.0	<2.0	<2.0	<2.0	<2.0
	08/27/01	INACCESSIBLE - CAR PARKED OVER WELL				--	--	--	--	--
	11/28/01	INACCESSIBLE - CAR PARKED OVER WELL				--	--	--	--	--
	02/14/02	--	<500	<100	<2	<2	<2	<2	<2	<2

Table 3

Groundwater Analytical Results - Oxygenate Compounds
Chevron (Former Signal Oil) Service Station #206145 (S-800)
800 Center Street
Oakland, California

WELL ID	DATE	METHANOL (ppm)	ETHANOL (ppb)	TBA (ppb)	MTBE (ppb)	DIPE (ppb)	ETBE (ppb)	TAME (ppb)	1,2-DCA (ppb)	EDB (ppb)
MW-6	08/07/00	--	<500	<100	<2.0	<2.0	<2.0	<2.0	<2.0	<2.0
	08/27/01	--	--	--	<5.0	--	--	--	--	--
MW-7	08/07/00	--	<500	<100	<2.0	<2.0	<2.0	<2.0	<2.0	<2.0
	08/27/01	--	--	--	<5.0	--	--	--	--	--
MW-8	02/14/02	--	<500	<100	<2	<2	<2	<2	<2	<2

Table 3
Groundwater Analytical Results - Oxygenate Compounds
Chevron (Former Signal Oil) Service Station #206145 (S-800)
800 Center Street
Oakland, California

WELL ID	DATE	METHANOL (ppm)	ETHANOL (ppb)	TBA (ppb)	MTBE (ppb)	DIPE (ppb)	ETBE (ppb)	TAME (ppb)	1,2-DCA (ppb)	EDB (ppb)
MW-1	08/07/00	--	<1,000	410	<4.0	<4.0	<4.0	<4.0	<4.0	<4.0
	12/01/00	--	<2,500	<250	<10	<10	<10	<10	<10	<10
	02/09/01	--	<500	340	<2.0	<2.0	<2.0	53	<2.0	<2.0
	05/29/01	--	<500	<20	<2.0	<2.0	<2.0	<2.0	<2.0	<2.0
	08/27/01	<2,000	<200	230	<20	<20	<20	<20	<20	<20
	11/28/01	--	<500	130	<2	<2	<2	<2	<2	<2
	02/14/02	--	<500	<100	<2	<2	<2	<2	<2	<2
MW-2	08/07/00		<500	<100	<2.0	<2.0	<2.0	<2.0	<2.0	<2.0
	08/27/01	--	--	--	<5.0	--	--	--	--	--
MW-3	08/07/00	--	<500	2,600	<10	<10	<10	<10	490	17
	02/09/01	--	<500	2,000	<2.0	<2.0	<2.0	35	<2.0	<2.0
	05/29/01	--	<500	1,700	<2.0	<2.0	<2.0	38	980	7.4
	08/27/01	<5,000	<250	1,300	<25	<25	<25	<25	380	<25
	11/28/01	--	<500	1,500	<5.0	<5.0	<5.0	<5.0	<5.0	<5.0
	02/14/02	--	<500	<100	<2	<2	<2	<2	<2	<2
MW-4	08/07/00	--	<500	<100	<2.0	<2.0	<2.0	<2.0	18	<2.0
	08/27/01	NOT SAMPLED DUE TO INSUFFICIENT WATER				--	--	--	--	--
	11/28/01	DRY				--	--	--	--	--
	02/14/02	--	<500	<100	<2	<2	<2	<2	9	<2
MW-5	12/01/00	--	<500	<50	<2.0	<2.0	<2.0	<2.0	<2.0	<2.0
	02/09/01	--	<500	<50	<2.0	<2.0	<2.0	<2.0	<2.0	<2.0
	08/27/01	INACCESSIBLE - CAR PARKED OVER WELL				--	--	--	--	--
	11/28/01	INACCESSIBLE - CAR PARKED OVER WELL				--	--	--	--	--
	02/14/02	--	<500	<100	<2	<2	<2	<2	<2	<2

Table 3

Groundwater Analytical Results - Oxygenate Compounds
Chevron (Former Signal Oil) Service Station #206145 (S-800)
800 Center Street
Oakland, California

WELL ID	DATE	METHANOL (ppb)	METHANOL (ppb)	IBP (ppb)	IBP (ppb)	DECA (ppb)	DECA (ppb)	AME (ppb)	2-DCA (ppb)	IBP (ppb)
W-1	05/01/00	--	<100	<100	<100	<2.0	<2.0	<2.0	<2.0	<2.0
	08/01/00	--	<100	<100	<100	<2.0	<2.0	--	--	<2.0
W-2	08/01/00	--	<100	<100	<100	<2.0	<2.0	<2.0	<2.0	<2.0
	08/22/00	--	<100	<100	<100	<2.0	<2.0	--	--	<2.0
	02/14/01	--	<100	<100	<100	<2.0	<2.0	<2.0	<2.0	<2.0

Table 3
Groundwater Analytical Results - Oxygenate Compounds
Chevron (Former Signal Oil) Service Station #206145 (S-800)
800 Center Street
Oakland, California

EXPLANATIONS:

TBA = Tertiary butyl alcohol

MTBE = Methyl tertiary butyl ether

DIPE = Di-isopropyl ether

ETBE = Ethyl tertiary butyl ether

TAME = Tertiary amyl methyl ether

1,2-DCA = 1,2-Dichloroethane

EDB = Ethylene Dibromide/1,2-Dibromoethane

(ppm) = Parts per million

(ppb) = Parts per billion

-- = Not Analyzed

ANALYTICAL METHODS:

EPA Method 8260 for Methanol

EPA Method 8260 for Oxygenate Compounds

¹ Laboratory report indicates this sample was originally analyzed within holding time. Re-analysis for confirmation or dilution was performed past the recommended holding time.

STANDARD OPERATING PROCEDURE - GROUNDWATER SAMPLING

Gettler-Ryan Inc. field personnel adhere to the following procedures for the collection and handling of groundwater samples prior to analysis by the analytical laboratory. Prior to sample collection, the type of analysis to be performed is determined. Loss prevention of volatile compounds is controlled and sample preservation for subsequent analysis is maintained.

Prior to sampling, the presence or absence of free-phase hydrocarbons is determined using an interface probe. Product thickness, if present, is measured to the nearest 0.01 foot and is noted in the field notes. In addition, static water level measurements are collected with the interface probe and are also recorded in the field notes.

After water levels are collected and prior to sampling, each well is purged a minimum of three well casing volumes of water using pre-cleaned pumps (stack, suction, Grundfos), or polyvinyl chloride bailers. Temperature, pH and electrical conductivity are measured a minimum of three times during the purging. Purging continues until these parameters stabilize.

Groundwater samples are collected using Chevron-designated disposable bailers. The water samples are transferred from the bailer into appropriate containers. Pre-preserved containers, supplied by analytical laboratories, are used when possible. When pre-preserved containers are not available, the laboratory is instructed to preserve the sample as appropriate. Duplicate samples are collected for the laboratory to use in maintaining quality assurance/quality control standards. The samples are labeled to include the job number, sample identification, collection date and time, analysis, preservation (if any), and the sample collector's initials. The water samples are placed in a cooler, maintained at 4°C for transport to the laboratory. Once collected in the field, all samples are maintained under chain of custody until delivered to the laboratory.

The chain of custody document includes the job number, type of preservation, if any, analysis requested, sample identification, date and time collected, and the sample collector's name. The chain of custody is signed and dated (including time of transfer) by each person who receives or surrenders the samples, beginning with the field personnel and ending with the laboratory personnel.

A laboratory supplied trip blank accompanies each sampling set. For sampling sets greater than 20 samples, 5% trip blanks are included. The trip blank is analyzed for some or all of the same compounds as the groundwater samples.

As requested by Chevron Products Company, the purge water and decontamination water generated during sampling activities is transported by IWM to McKittrick Waste Management located in McKittrick, California.

**WELL MONITORING/SAMPLING
FIELD DATA SHEET.**

Client/CHEVRON

Facility # 206145

Job#: 386492

Address: 800 Center St.

Date: 2/14/02

City: Oakland, CA

Sampler: T.L

Well ID MW-1

Well Condition: o.k

Well Diameter 2 in.

Hydrocarbon Thickness: 0 (feet) Amount Bailed (product/water): 0 (Gallons)

Total Depth 13.70 ft.

Depth to Water 7.29 ft.

Volume Factor (VF)	2" = 0.17	3" = 0.38	4" = 0.66
	6" = 1.50	12" = 5.80	

6.4 x VF .17 = 1.0 x 3 (case volume) = Estimated Purge Volume: 3.0 (gal.)

Purge Equipment: Disposable Bailer
Bailer
Stack
Suction
Grundfos
Other: _____

Sampling Equipment: Disposable Bailer
Bailer
Pressure Bailer
Grab Sample
Other: _____

Starting Time: 1306

Weather Conditions: partly cloudy

Sampling Time: 1317

Water Color: cloudy Odor: yes

Purging Flow Rate: _____ gpm.

Sediment Description: _____

Did well de-water? no

If yes; Time: _____ Volume: _____ (gal.)

Time	Volume (gal.)	pH	Conductivity μ mhos/cm	Temperature $^{\circ}$ F	D.O. (mg/L)	ORP (mV)	Alkalinity (ppm)
<u>1308</u>	<u>1.0</u>	<u>7.32</u>	<u>862</u>	<u>65.5</u>			
<u>1310</u>	<u>2.0</u>	<u>7.28</u>	<u>791</u>	<u>65.0</u>			
<u>1315</u>	<u>3.0</u>	<u>7.24</u>	<u>788</u>	<u>64.8</u>			

LABORATORY INFORMATION

SAMPLE ID	(#) - CONTAINER	REFRIG.	PRESERV. TYPE	LABORATORY	ANALYSES
<u>MW-1</u>	<u>6x500ml</u>	<u>Y</u>	<u>HEC</u>	<u>LANCASTER</u>	<u>TPHIG/btex/mntbe</u>
					<u>(8) days 8260</u>

COMMENTS: _____

**WELL MONITORING/SAMPLING
FIELD DATA SHEET.**

Client/CHEVRON

Facility # 206145

Job #: 386492

Address: 800 Center St.

Date: 2/14/02

City: Oakland, CA

Sampler: TU

Well ID MW-2

Well Condition: o.k

Well Diameter 2 in.

Hydrocarbon Thickness: 0 (feet) Amount Bailed 0 (Gallons)
(product/water):

Total Depth 9.93 ft.

Depth to Water 7.83 ft.

Volume Factor (VF)	2" = 0.17	3" = 0.38	4" = 0.66
	6" = 1.50	12" = 5.80	

2.10 X VF .17 = .357 X 3 (case volume) = Estimated Purge Volume: 1.0 (gal.)

Purge Equipment: Disposable Bailer
Bailer
Stack
Suction
Grundfos
Other: _____

Sampling Equipment: Disposable Bailer
Bailer
Pressure Bailer
Grab Sample
Other: _____

Starting Time: 1245

Weather Conditions: PTLY Cloudy

Sampling Time: 1254

Water Color: cloudy Odor: NO

Purging Flow Rate: _____ gpm.

Sediment Description: _____

Did well de-water? NO

If yes; Time: _____ Volume: _____ (gal.)

Time	Volume (gal.)	pH	Conductivity μ mhos/cm	Temperature $^{\circ}$ F	D.O. (mg/L)	ORP (mV)	Alkalinity (ppm)
<u>1246</u>	<u>.25</u>	<u>7.16</u>	<u>686</u>	<u>65.1</u>			
<u>1247</u>	<u>.50</u>	<u>7.12</u>	<u>641</u>	<u>64.2</u>			
<u>1249</u>	<u>1.0</u>	<u>7.10</u>	<u>634</u>	<u>64.1</u>			
_____	_____	_____	_____	_____	_____	_____	_____

LABORATORY INFORMATION

SAMPLE ID	(#) - CONTAINER	REFRIG.	PRESERV. TYPE	LABORATORY	ANALYSES
<u>MW-2</u>	<u>3XUOAJ:AD</u>	<u>Y</u>	<u>HCL</u>	<u>LANCASTER</u>	<u>TPH(G)/btex/mtbe</u>
_____	_____	_____	_____	_____	_____
_____	_____	_____	_____	_____	_____

COMMENTS: _____

**WELL MONITORING/SAMPLING
FIELD DATA SHEET.**

Client/CHEVRON

Facility # 206145

Job#: 386492

Address: 800 Center St.

Date: 2/14/02

City: Oakland, CA

Sampler: T-L

Well ID MW-3

Well Condition: ok

Well Diameter 2 in.

Hydrocarbon Thickness: 0 (feet) Amount Bailed (product/water): 0 (Gallons)

Total Depth 14.10 ft.

Depth to Water 7.67 ft.

Volume Factor (VF)	2" = 0.17	3" = 0.38	4" = 0.66
	6" = 1.50	12" = 5.80	

6.43 X VF .17 = 1.0 X 3 (case volume) = Estimated Purge Volume: 3.0 (gal.)

Purge Equipment: Disposable Bailer
 Bailer
 Stack
 Suction
 Grundfos
 Other: _____

Sampling Equipment: Disposable Bailer
 Bailer
 Pressure Bailer
 Grab Sample
 Other: _____

Starting Time: 1325

Weather Conditions: Partly Cloudy

Sampling Time: 1338

Water Color: cloudy Odor: yes

Purging Flow Rate: _____ gpm.

Sediment Description: _____

Did well de-water? no

If yes; Time: _____ Volume: _____ (gal.)

Time	Volume (gal.)	pH	Conductivity μ mhos/cm	Temperature $^{\circ}$ F	D.O. (mg/L)	ORP (mV)	Alkalinity (ppm)
<u>1327</u>	<u>1.0</u>	<u>7.48</u>	<u>816</u>	<u>65.3</u>			
<u>1330</u>	<u>2.0</u>	<u>7.31</u>	<u>791</u>	<u>65.1</u>			
<u>1332</u>	<u>3.0</u>	<u>7.28</u>	<u>788</u>	<u>64.9</u>			
_____	_____	_____	_____	_____	_____	_____	_____
_____	_____	_____	_____	_____	_____	_____	_____

LABORATORY INFORMATION

SAMPLE ID	(#) - CONTAINER	REFRIG.	PRESEV. TYPE	LABORATORY	ANALYSES
<u>MW-3</u>	<u>6XUOAWM</u>	<u>Y</u>	<u>ITC</u>	<u>LANCASTER</u>	<u>TPHIG)/btex/mtbe</u>
					<u>(8) oxy's 8260</u>

COMMENTS: _____

**WELL MONITORING/SAMPLING
FIELD DATA SHEET.**

Client/CHEVRON

Facility # 206145

Job#: 386492

Address: 800 Center St.

Date: 2/14/02

City: Oakland, CA

Sampler: T.C

Well ID MW-4

Well Condition: ok

Well Diameter 2 in.

Hydrocarbon Thickness: 0 (feet) Amount Bailed (product/water): 0 (Gallons)

Total Depth 8.55 ft.

Volume	2" = 0.17	3" = 0.38	4" = 0.66
Factor (VF)	6" = 1.50	12" = 5.80	

Depth to Water 6.71 ft.

1.84 X VF .17 = .31 X 3 (case volume) = Estimated Purge Volume: 1.0 (gal.)

Purge Equipment: Disposable Bailer
 Bailer
 Stack
 Suction
 Grundfos
 Other: _____

Sampling Equipment: Disposable Bailer
 Bailer
 Pressure Bailer
 Grab Sample
 Other: _____

Starting Time: 1200

Weather Conditions: pty. Cloudy

Sampling Time: 1208

Water Color: cloudy Odor: SLIGHT

Purging Flow Rate: _____ gpm.

Sediment Description: _____

Did well de-water? NO

If yes; Time: _____ Volume: _____ (gal.)

Time	Volume (gal.)	pH	Conductivity μ mhos/cm	Temperature $^{\circ}$ F	D.O. (mg/L)	ORP (mV)	Alkalinity (ppm)
<u>1201</u>	<u>.25</u>	<u>7.07</u>	<u>622</u>	<u>65.2</u>			
<u>1202</u>	<u>.50</u>	<u>7.01</u>	<u>636</u>	<u>64.8</u>			
<u>1204</u>	<u>1.0</u>	<u>7.03</u>	<u>631</u>	<u>64.6</u>			
_____	_____	_____	_____	_____	_____	_____	_____
_____	_____	_____	_____	_____	_____	_____	_____

LABORATORY INFORMATION

SAMPLE ID	(#) - CONTAINER	REFRIG.	PRESERV. TYPE	LABORATORY	ANALYSES
<u>MW-4</u>	<u>6X JOURNAL</u>	<u>Y</u>	<u>HCL</u>	<u>LANCASTER</u>	<u>TPH(G)/btex/mtbe</u> <u>(8) orgs 8260</u>
_____	_____	_____	_____	_____	_____
_____	_____	_____	_____	_____	_____

COMMENTS: _____

**WELL MONITORING/SAMPLING
FIELD DATA SHEET.**

Client/CHEVRON

Facility # 206145

Job#: 386492

Address: 800 Center St.

Date: 2/14/02

City: Oakland, CA

Sampler: TCC

Well ID MW-5

Well Condition: ok

Well Diameter 2 in.

Hydrocarbon Thickness: 0 (feet) Amount Bailed (Gallons): 0

Total Depth 19.25 ft.

Volume Factor (VF)	2" = 0.17	3" = 0.38	4" = 0.66
	6" = 1.50	12" = 5.80	

Depth to Water 7.05 ft.

12.20 X VF .17 = 2.0 X 3 (case volume) = Estimated Purge Volume: 6.0 (gal.)

Purge Equipment: Disposable Bailer
Bailer
Stack
Suction
Grundfos
Other: _____

Sampling Equipment: Disposable Bailer
Bailer
Pressure Bailer
Grab Sample
Other: _____

Starting Time: 1100

Weather Conditions: partly cloudy

Sampling Time: 1117

Water Color: light brown Odor: NO

Purging Flow Rate: _____ gpm.

Sediment Description: _____

Did well de-water? NO

If yes; Time: _____ Volume: _____ (gal.)

Time	Volume (gal.)	pH	Conductivity $\mu\text{mhos/cm}$	Temperature $^{\circ}\text{F}$	D.O. (mg/L)	ORP (mV)	Alkalinity (ppm)
<u>1103</u>	<u>2.0</u>	<u>7.12</u>	<u>682</u>	<u>64.5</u>			
<u>1107</u>	<u>4.0</u>	<u>7.06</u>	<u>646</u>	<u>63.2</u>			
<u>1111</u>	<u>6.0</u>	<u>7.01</u>	<u>632</u>	<u>62.5</u>			
_____	_____	_____	_____	_____	_____	_____	_____
_____	_____	_____	_____	_____	_____	_____	_____

LABORATORY INFORMATION

SAMPLE ID	(#) - CONTAINER	REFRIG.	PRESERV. TYPE	LABORATORY	ANALYSES
<u>MW-5</u>	<u>6x200ml</u>	<u>Y</u>	<u>HC</u>	<u>LANCASTER</u>	<u>TPH(G)/btex/mtbe</u> <u>(8)oxys Fe60</u>
_____	_____	_____	_____	_____	_____
_____	_____	_____	_____	_____	_____

COMMENTS: _____

**WELL MONITORING/SAMPLING
FIELD DATA SHEET.**

Client/CHEVRON
 Facility # 206145
 Address: 800 Center St.
 City: Oakland, CA

Job#: 386492
 Date: 2/14/02
 Sampler: T.L

Well ID MW-6
 Well Diameter 2 in.
 Total Depth 8.51 ft.
 Depth to Water 6.78 ft.

Well Condition: ok

Hydrocarbon Thickness:	<u>0</u> (feet)	Amount Bailed (product/water):	<u>0</u> (Gallons)
Volume Factor (VF)	2" = 0.17	3" = 0.38	4" = 0.66
	6" = 1.50	12" = 5.80	

1.73 X VF .17 = .29 X 3 (case volume) = Estimated Purge Volume: 1.0 (gal.)

Purge Equipment: Disposable Bailer
 Bailer
 Stack
 Suction
 Grundfos
 Other: _____

Sampling Equipment: Disposable Bailer
 Bailer
 Pressure Bailer
 Grab Sample
 Other: _____

Starting Time: 1140
 Sampling Time: 1151
 Purging Flow Rate: _____ gpm.
 Did well de-water? NO

Weather Conditions: ptly. Cloudy
 Water Color: Cloudy Odor: NO
 Sediment Description: _____
 If yes; Time: _____ Volume: _____ (gal.)

Time	Volume (gal.)	pH	Conductivity μ mhos/cm	Temperature $^{\circ}$ F	D.O. (mg/L)	ORP (mV)	Alkalinity (ppm)
<u>1142</u>	<u>.25</u>	<u>7.17</u>	<u>712</u>	<u>65.1</u>			
<u>1144</u>	<u>.50</u>	<u>7.12</u>	<u>692</u>	<u>64.6</u>			
<u>1146</u>	<u>1.0</u>	<u>7.08</u>	<u>686</u>	<u>64.4</u>			

LABORATORY INFORMATION

SAMPLE ID	(#) - CONTAINER	REFRIG.	PRESERV. TYPE	LABORATORY	ANALYSES
<u>MW-6</u>	<u>3X00A01M</u>	<u>Y</u>	<u>HL</u>	<u>LANCASTER</u>	<u>TPH(G)/btex/mtbe</u>

COMMENTS: _____

**WELL MONITORING/SAMPLING
FIELD DATA SHEET.**

Client/CHEVRON

Facility # 206145

Job#: 386492

Address: 800 Center St.

Date: 2/14/07

City: Oakland, CA

Sampler: T.C

Well ID MW-7

Well Condition: o.k

Well Diameter 2 in.

Hydrocarbon Thickness: 0 (feet) Amount Bailed (Gallons)

Total Depth 17.98 ft.

Volume Factor (VF)	2" = 0.17	3" = 0.38	4" = 0.66
	6" = 1.50	12" = 5.80	

Depth to Water 8.10 ft.

7.88 x VF .17 = 1.6 x 3 (case volume) = Estimated Purge Volume: 5.0 (gal.)

Purge Equipment: Disposable Bailer
 Bailer
 Stack
 Suction
 Grundfos
 Other: _____

Sampling Equipment: Disposable Bailer
 Bailer
 Pressure Bailer
 Grab Sample
 Other: _____

Starting Time: 1220

Weather Conditions: ptly. Cloudy

Sampling Time: 1238

Water Color: LT. BROWN Odor: NO

Purging Flow Rate: _____ gpm.

Sediment Description: _____

Did well de-water? NO

If yes; Time: _____ Volume: _____ (gal.)

Time	Volume (gal.)	pH	Conductivity μ mhos/cm	Temperature $^{\circ}$ F	D.O. (mg/L)	ORP (mV)	Alkalinity (ppm)
<u>1223</u>	<u>1.5</u>	<u>7.19</u>	<u>698</u>	<u>65.8</u>			
<u>1227</u>	<u>3.0</u>	<u>7.16</u>	<u>710</u>	<u>65.1</u>			
<u>1230</u>	<u>5.0</u>	<u>7.08</u>	<u>706</u>	<u>64.8</u>			

LABORATORY INFORMATION

SAMPLE ID	(#) - CONTAINER	REFRIG.	PRESERV. TYPE	LABORATORY	ANALYSES
<u>MW-7</u>	<u>BYUADID</u>	<u>Y</u>	<u>HC</u>	<u>LANGASTER</u>	<u>TPH(G)/btex/mtbe</u>

COMMENTS: _____

**WELL MONITORING/DEVELOPMENT
FIELD DATA SHEET**

Client/ Facility CHEVRON #200145
 Address: 800 CENTER ST.
 City: OAKLAND, CA.

Job#: 386492
 Date: 2/14/07
 Sampler: T-C

Well ID MW-8
 Well Diameter 2" in.
 Total Depth 18.68 ft.
 Depth to Water 7.99 ft.

Well Condition: O.K.

Hydrocarbon Thickness: 0 Ft. Amount Bailed (product/water): 0 (gal.)

Volume Factor (VF)	2" = 0.17	3" = 0.38	4" = 0.66
	6" = 1.50	12" = 5.80	

10.69 x VF .17 = 1.8 ^{x10} (case volume) = Estimated Purge Volume: 18.0 (gal.)

Purge Equipment:

- Disposable Bailer
- Bailer
- Stack
- Suction
- Grundfos

Other: 2" STAINLESS BAILER

Sampling Equipment:

- Disposable Bailer
- Bailer
- Pressure Bailer
- Grab Sample

Other: _____

Starting Time: 1354
 Sampling Time: 1452
 Purging Flow Rate: 2.0 gpm.
 Did well de-water? NO

Weather Conditions: Partly Cloudy
 Water Color: BROWN Odor: NO
 Sediment Description: _____
 If yes; Time: _____ Volume: _____ (gal.)

Time	Volume (gal.)	pH	Conductivity μ hos/cm	Temperature $^{\circ}$ C	D.O. (mg/L)	ORP (mV)	Alkalinity (ppm)
1359	2.0	8.16	989	69.2			
1403	4.0	8.02	973	68.1			
1408	6.0	7.91	962	66.6			
1415	8.0	7.64	910	65.4			
1418	10.0	7.22	864	65.8			
1425	12.0	7.24	791	65.3			
1429	14.0	7.24	764	64.8			
1438	16.0	7.16	732	64.9			
1439	18.0	7.12	716	64.6			
1440	20.0	7.14	712	64.8			
1443	25.0	7.08	715	64.9			

LABORATORY INFORMATION

SAMPLE ID	(#) - CONTAINER	REFRIG.	PRESERV. TYPE	LABORATORY	ANALYSES
MW-8	6X VOA 20ml	Y	ICE	LANCASTER	TOT-G/PTOX/MTDC
					(8) DRY 8260
MW-8	2X AMBER	Y	NP	11 11	TPH-D

COMMENTS: Took well A while to clean up. Purged an extra 7gal depth to bottom after development 19.84

Chevron California Region Analysis Request/Chain of Custody



150202-001

Acct. #: 10905 For Lancaster Laboratories use only Sample #: 3715751-99 SCR#: _____

Facility #: <u>206145</u> Job # <u>386492</u> Global ID # <u>T0600102230</u> Site Address: <u>800 CENTER ST., OAKLAND, CA</u> Chevron PM: <u>Tom Bauhs</u> Lead Consultant: <u>Delta/G-R</u> Consultant/Office: <u>G-R, Inc., 6747 Sierra Court, Dublin, Ca 94568</u> Consultant Prj. Mgr. <u>Deanna L. Harding</u> (<u>Deanna@grinc.com</u>) Consultant Phone # <u>925-551-7555</u> Fax #: <u>925-551-7899</u> Sampler: <u>TONY CAMARDA</u> Service Order #: _____ <input type="checkbox"/> Non SAR: _____				Matrix <input type="checkbox"/> Potable <input type="checkbox"/> NPDES <input type="checkbox"/> Water <input type="checkbox"/> Soil <input type="checkbox"/> Air		Analyses Requested Preservation Codes: <u>H H H H H</u> Total Number of Containers: _____ BTEX + MTBE 8280 <input type="checkbox"/> 8021 <input checked="" type="checkbox"/> TPH 8015 MOD GRO _____ TPH 8015 MOD DRO <input type="checkbox"/> Silica Gel Cleanup _____ 8260 full scan _____ Oxygenates <u>8260</u> <input type="checkbox"/> Lead 7420 <input type="checkbox"/> 7421 <input type="checkbox"/>										Preservative Codes H = HCl T = Thiosulfate N = HNO ₃ B = NaOH S = H ₂ SO ₄ O = Other <input type="checkbox"/> J value reporting needed <input type="checkbox"/> Must meet lowest detection limits possible for 8260 compounds 8021 MTBE Confirmation <input type="checkbox"/> Confirm highest hit by 8260 <input type="checkbox"/> Confirm all hits by 8260 <input type="checkbox"/> Run ___ oxy s on highest hit <input type="checkbox"/> Run ___ oxy s on all hits			
Sample Identification		Date Collected	Time Collected	Grab	Composite	Soil	Water	Oil	Air	Total Number of Containers	BTEX + MTBE 8280	TPH 8015 MOD GRO	TPH 8015 MOD DRO	8260 full scan	Oxygenates	Lead 7420	7421	Comments / Remarks	
QA		2/14/02					X			2	X	X							
MW-1			1317	X			X			6	X	X			X				
MW-2			1254	X			X			3	X	X							
MW-3			1338	X			X			6	X	X			X				
MW-4			1208	X			X			6	X	X			X				
MW-5			1119	X			X			6	X	X			X				
MW-6			1151	X			X			3	X	X							
MW-7			1238	X			X			3	X	X							
MW-8			1452	X			X			8	X	X	X		X				

Turnaround Time Requested (TAT) (please circle)

STD. TAT -72 hour 48 hour
 24 hour 4 day 5 day

Relinquished by: <u>[Signature]</u>	Date: <u>2/15/02</u>	Time: <u>0600</u>	Received by: <u>[Signature]</u>	Date: <u>2/15/02</u>	Time: <u>12:10</u>	
Relinquished by: <u>[Signature]</u>	Date: <u>2/15/02</u>	Time: <u>2:15/02</u>	Received by: <u>[Signature]</u>	Date: <u>2/15/02</u>	Time: <u>3:30</u>	
Relinquished by: <u>[Signature]</u>	Date: <u>2-18-02</u>	Time: <u>1500</u>	Received by: <u>Airborne</u>	Date: <u>2-18-02</u>	Time: _____	
Relinquished by Commercial Carrier: <u>[Signature]</u>	UPS	FedEx	Other: <u>Airborne</u>	Received by: <u>[Signature]</u>	Date: <u>2/18/02</u>	Time: <u>0935</u>
Temperature Upon Receipt: <u>15-2.8°</u>	Custody Seals Intact? <u>Yes</u> No					



ANALYTICAL RESULTS

Prepared for:

Chevron Products Company
6001 Bollinger Canyon Road
Building L PO Box 6004
San Ramon CA 94583-0904
925-842-8582

Prepared by:

Lancaster Laboratories
2425 New Holland Pike
Lancaster, PA 17605-2425

RECEIVED

FEB 19 2002

GETTLER-RYAN INC.
GENERAL CONTRACTORS

SAMPLE GROUP

The sample group for this submittal is 797424. Samples arrived at the laboratory on Tuesday, February 19, 2002. The PO# for this group is 99011184 and the release number is BAUHS.

Client Description

<u>Client Description</u>	<u>NA</u>	<u>Water</u>
QA-T-020214		
MW-1-W-020214	Grab	Water
MW-2-W-020214	Grab	Water
MW-3-W-020214	Grab	Water
MW-4-W-020214	Grab	Water
MW-5-W-020214	Grab	Water
MW-6-W-020214	Grab	Water
MW-7-W-020214	Grab	Water
MW-8-W-020214	Grab	Water

Lancaster Labs Number

3775751
3775752
3775753
3775754
3775755
3775756
3775757
3775758
3775759

METHODOLOGY

The specific methodologies used in obtaining the enclosed analytical results are indicated on the laboratory chronicles.

1 COPY TO

Delta C/O Gettler-Ryan

Attn: Deanna L. Harding



Lancaster Laboratories, Inc.
2425 New Holland Pike
PO Box 12425
Lancaster, PA 17605-2425
717-656-2300 Fax: 717-656-2681



Lancaster Laboratories
Where quality is a science.

Questions? Contact your Client Services Representative
Teresa M Lis at (717) 656-2300.

Respectfully Submitted,

Matthew E. Barton
Sr. Chemist/Coordinator



Lancaster Laboratories, Inc.
2425 New Holland Pike
PO Box 12425
Lancaster, PA 17605-2425
717-656-2300 Fax: 717-656-2681



Lancaster Laboratories Sample No. **WW 3775751**

Collected: 02/14/2002 00:00

Account Number: 10905

Submitted: 02/19/2002 09:05
 Reported: 03/04/2002 at 16:30
 Discard: 04/04/2002

Chevron Products Company
 6001 Bollinger Canyon Road
 Building L PO Box 6004
 San Ramon CA 94583-0904

QA-T-020214 NA Water

Facility# 206145 Job# 386492 GRD
 800 Center St-Oakland T0600102230 QA

CAT No.	Analysis Name	CAS Number	As Received Result	As Received Method Detection Limit	Units	Dilution Factor
01729	TPH-GRO - Waters					
01730	TPH-GRO - Waters	n.a.	N.D.	50.	ug/l	1
The reported concentration of TPH-GRO does not include MTBE or other gasoline constituents eluting prior to the C6 (n-hexane) TPH-GRO range start time. A site-specific MSD sample was not submitted for the project. A LCS/LCSD was performed to demonstrate precision and accuracy at a batch level.						
08214	BTEX, MTBE (8021)					
00776	Benzene	71-43-2	N.D.	0.50	ug/l	1
00777	Toluene	108-88-3	N.D.	0.50	ug/l	1
00778	Ethylbenzene	100-41-4	N.D.	0.50	ug/l	1
00779	Total Xylenes	1330-20-7	N.D.	1.5	ug/l	1
00780	Methyl tert-Butyl Ether	1634-04-4	N.D.	2.5	ug/l	1

State of California Lab Certification No. 2116

Laboratory Chronicle

CAT No.	Analysis Name	Method	Trial#	Analysis Date and Time	Analyst	Dilution Factor
01729	TPH-GRO - Waters	N. CA LUFT Gasoline Method	1	02/21/2002 02:23	Melissa-Ann S McAlpine	1
08214	BTEX, MTBE (8021)	SW-846 8021B	1	02/21/2002 02:23	Melissa-Ann S McAlpine	1
01146	GC VOA Water Prep	SW-846 5030B	1	02/21/2002 02:23	Melissa-Ann S McAlpine	n.a.

#=Laboratory Method Detection Limit exceeded target detection limit
 N.D.=Not detected above the Reporting Limit

Lancaster Laboratories, Inc.
 2425 New Holland Pike
 Lancaster, PA 17605-2425
 717-656-2300 Fax: 717-656-2681



Lancaster Laboratories Sample No. **WW 3775752**

Collected: 02/14/2002 13:17 by TC

Account Number: 10905

Submitted: 02/19/2002 09:05

Chevron Products Company

Reported: 03/04/2002 at 16:30

6001 Bollinger Canyon Road

Discard: 04/04/2002

Building L PO Box 6004

MW-1-W-020214

Grab

Water

San Ramon CA 94583-0904

Facility# 206145 Job# 386492 GRD
800 Center St-Oakland T0600102230 MW-1

COMW1

CAT No.	Analysis Name	CAS Number	As Received Result	As Received Method Detection Limit	Units	Dilution Factor
01729	TPH-GRO - Waters					
01730	TPH-GRO - Waters	n.a.	1,400.	50.	ug/l	1
The reported concentration of TPH-GRO does not include MTBE or other gasoline constituents eluting prior to the C6 (n-hexane) TPH-GRO range start time. A site-specific MSD sample was not submitted for the project. A LCS/LCSD was performed to demonstrate precision and accuracy at a batch level.						
08214	BTEX, MTBE (8021)					
00776	Benzene	71-43-2	100.	0.50	ug/l	1
00777	Toluene	108-88-3	360.	0.50	ug/l	1
00778	Ethylbenzene	100-41-4	45.	0.50	ug/l	1
00779	Total Xylenes	1330-20-7	240.	1.5	ug/l	1
00780	Methyl tert-Butyl Ether	1634-04-4	9.3	2.5	ug/l	1
01594	BTEX + Oxygenates by 8260B					
01587	Ethanol	64-17-5	N.D.	500.	ug/l	1
02010	Methyl t-butyl ether	1634-04-4	N.D.	2.	ug/l	1
02011	di-Isopropyl ether	108-20-3	N.D.	2.	ug/l	1
02013	Ethyl t-butyl ether	637-92-3	N.D.	2.	ug/l	1
02014	t-Amyl methyl ether	994-05-8	N.D.	2.	ug/l	1
02015	t-Butyl alcohol	75-65-0	N.D.	100.	ug/l	1
05402	1,2-Dichloroethane	107-06-2	N.D.	2.	ug/l	1
05412	1,2-Dibromoethane	106-93-4	N.D.	2.	ug/l	1

State of California Lab Certification No. 2116

Laboratory Chronicle

#=Laboratory Method Detection Limit exceeded target detection limit
N.D.=Not detected or above the Reporting Limit



Lancaster Laboratories, Inc.
2425 New Holland Pike
Lancaster, PA 17605-2425
717-656-2300 Fax: 717-656-2681



Lancaster Laboratories Sample No. WW 3775752

Collected: 02/14/2002 13:17 by TC

Account Number: 10905

Submitted: 02/19/2002 09:05

Chevron Products Company

Reported: 03/04/2002 at 16:30

6001 Bollinger Canyon Road

Discard: 04/04/2002

Building L PO Box 6004

MW-1-W-020214

Grab

Water

San Ramon CA 94583-0904

Facility# 206145 Job# 386492 GRD
800 Center St-Oakland T0600102230 MW-1

COMW1

CAT No.	Analysis Name	Method	Analysis		Analyst	Dilution Factor
			Trial#	Date and Time		
01729	TPH-GRO - Waters	N. CA LUFT Gasoline Method	1	02/21/2002 14:41	Melissa-Ann S McAlpine	1
08214	BTEX, MTBE (8021)	SW-846 8021B	1	02/21/2002 14:41	Melissa-Ann S McAlpine	1
01594	BTEX + Oxygenates by 8260B	SW-846 8260B	1	02/23/2002 02:14	Nicole S Albright	1
01146	GC VOA Water Prep	SW-846 5030B	1	02/21/2002 14:41	Melissa-Ann S McAlpine	n.a.
01163	GC/MS VOA Water Prep	SW-846 5030B	1	02/23/2002 02:14	Nicole S Albright	n.a.

#=Laboratory Method Detection Limit exceeded target detection limit

N.D.=Not detected or below Reporting Limit



2425 New Holland Pike
Lancaster, PA 17605-2425
717-656-2300 Fax: 717-656-2681



Lancaster Laboratories Sample No. WW 3775753

Collected: 02/14/2002 12:54 by TC

Account Number: 10905

Submitted: 02/19/2002 09:05

Chevron Products Company

Reported: 03/04/2002 at 16:30

6001 Bollinger Canyon Road

Discard: 04/04/2002

Building L PO Box 6004

MW-2-W-020214

Grab Water

San Ramon CA 94583-0904

Facility# 206145 Job# 386492 GRD
800 Center St-Oakland T0600102230 MW-2

CAT No.	Analysis Name	CAS Number	As Received Result	As Received Method Detection Limit	Units	Dilution Factor
01729	TPH-GRO - Waters					
01730	TPH-GRO - Waters	n.a.	N.D.	50.	ug/l	1
	The reported concentration of TPH-GRO does not include MTBE or other gasoline constituents eluting prior to the C6 (n-hexane) TPH-GRO range start time.					
	A site-specific MSD sample was not submitted for the project. A LCS/LCSD was performed to demonstrate precision and accuracy at a batch level.					
08214	BTEX, MTBE (8021)					
00776	Benzene	71-43-2	N.D.	0.50	ug/l	1
00777	Toluene	108-88-3	N.D.	0.50	ug/l	1
00778	Ethylbenzene	100-41-4	N.D.	0.50	ug/l	1
00779	Total Xylenes	1330-20-7	N.D.	1.5	ug/l	1
00780	Methyl tert-Butyl Ether	1634-04-4	N.D.	2.5	ug/l	1

State of California Lab Certification No. 2116

Laboratory Chronicle

CAT No.	Analysis Name	Method	Trial#	Analysis Date and Time	Analyst	Dilution Factor
01729	TPH-GRO - Waters	N. CA LUFT Gasoline Method	1	02/21/2002 04:44	Melissa-Ann S McAlpine	1
08214	BTEX, MTBE (8021)	SW-846 8021B	1	02/21/2002 04:44	Melissa-Ann S McAlpine	1
01146	GC VOA Water Prep	SW-846 5030B	1	02/21/2002 04:44	Melissa-Ann S McAlpine	n.a.

#=Laboratory Method Detection Limit exceeded target detection limit
N.D.=Not detected or above the Reporting Limit



Lancaster Laboratories, Inc.
2425 New Holland Pike
PO Box 1242
Lancaster, PA 17605-2425
717-656-2300 Fax: 717-656-2681



Lancaster Laboratories Sample No. WW 3775754

Collected: 02/14/2002 13:38 by TC Account Number: 10905

Submitted: 02/19/2002 09:05
 Reported: 03/04/2002 at 16:30
 Discard: 04/04/2002
 MW-3-W-020214 Grab Water
 Chevron Products Company
 6001 Bollinger Canyon Road
 Building L PO Box 6004
 San Ramon CA 94583-0904

Facility# 206145 Job# 386492 GRD
 800 Center St-Oakland T0600102230 MW-3

COMW3

CAT No.	Analysis Name	CAS Number	As Received Result	As Received Method Detection Limit	Units	Dilution Factor
01729	TPH-GRO - Waters					
01730	TPH-GRO - Waters	n.a.	51.	50.	ug/l	1
The reported concentration of TPH-GRO does not include MTBE or other gasoline constituents eluting prior to the C6 (n-hexane) TPH-GRO range start time. A site-specific MSD sample was not submitted for the project. A LCS/LCSD was performed to demonstrate precision and accuracy at a batch level.						
08214	BTEX, MTBE (8021)					
00776	Benzene	71-43-2	2.9	0.50	ug/l	1
00777	Toluene	108-88-3	N.D.	0.50	ug/l	1
00778	Ethylbenzene	100-41-4	1.9	0.50	ug/l	1
00779	Total Xylenes	1330-20-7	1.8	1.5	ug/l	1
00780	Methyl tert-Butyl Ether	1634-04-4	N.D.	2.5	ug/l	1
01594	BTEX + Oxygenates by 8260B					
01587	Ethanol	64-17-5	N.D.	500.	ug/l	1
02010	Methyl t-butyl ether	1634-04-4	N.D.	2.	ug/l	1
02011	di-Isopropyl ether	108-20-3	N.D.	2.	ug/l	1
02013	Ethyl t-butyl ether	637-92-3	N.D.	2.	ug/l	1
02014	t-Amyl methyl ether	994-05-8	N.D.	2.	ug/l	1
02015	t-Butyl alcohol	75-65-0	N.D.	100.	ug/l	1
05402	1,2-Dichloroethane	107-06-2	N.D.	2.	ug/l	1
05412	1,2-Dibromoethane	106-93-4	N.D.	2.	ug/l	1

State of California Lab Certification No. 2116

Laboratory Chronicle

#=Laboratory Method Detection Limit exceeds target detection limit
 N.D.=Not detected or above the Reporting Limit



2425 New Holland Pike
 Lancaster, PA 17605-2425
 717-656-2300 Fax: 717-656-2681



Lancaster Laboratories Sample No. WW 3775754

Collected: 02/14/2002 13:38 by TC

Account Number: 10905

Submitted: 02/19/2002 09:05

Chevron Products Company

Reported: 03/04/2002 at 16:30

6001 Bollinger Canyon Road

Discard: 04/04/2002

Building L PO Box 6004

MW-3-W-020214

Grab

Water

San Ramon CA 94583-0904

Facility# 206145 Job# 386492 GRD
800 Center St-Oakland T0600102230 MW-3

COMW3

CAT	No.	Analysis Name	Method	Trial#	Analysis Date and Time	Analyst	Dilution Factor
	01729	TPH-GRO - Waters	N. CA LUFT Gasoline Method	1	02/21/2002 05:19	Melissa-Ann S McAlpine	1
	08214	BTEX, MTBE (8021)	SW-846 8021B	1	02/21/2002 05:19	Melissa-Ann S McAlpine	1
	01594	BTEX + Oxygenates by 8260B	SW-846 8260B	1	02/25/2002 07:45	Kenneth L Boley Jr	1
	01146	GC VOA Water Prep	SW-846 5030B	1	02/21/2002 05:19	Melissa-Ann S McAlpine	n.a.
	01163	GC/MS VOA Water Prep	SW-846 5030B	1	02/25/2002 07:45	Kenneth L Boley Jr	n.a.

#=Laboratory Method Detection Limit Exceeded Target detection limit

N.D.=Not detected or above the Reporting Limit



Lancaster, PA 17605-2425
717-656-2300 Fax: 717-656-2681



Lancaster Laboratories Sample No. **WW 3775755**

Collected: 02/14/2002 12:08 by TC

Account Number: 10905

Submitted: 02/19/2002 09:05
 Reported: 03/04/2002 at 16:30
 Discard: 04/04/2002

Chevron Products Company
 6001 Bollinger Canyon Road
 Building L PO Box 6004
 San Ramon CA 94583-0904

MW-4-W-020214 Grab Water

Facility# 206145 Job# 386492 GRD
 800 Center St-Oakland T0600102230 MW-4

COMW4

CAT No.	Analysis Name	CAS Number	As Received Result	As Received Method Detection Limit	Units	Dilution Factor
01729	TPH-GRO - Waters					
01730	TPH-GRO - Waters	n.a.	N.D.	50.	ug/l	1
The reported concentration of TPH-GRO does not include MTBE or other gasoline constituents eluting prior to the C6 (n-hexane) TPH-GRO range start time. A site-specific MSD sample was not submitted for the project. A LCS/LCSD was performed to demonstrate precision and accuracy at a batch level.						
08214	BTEX, MTBE (8021)					
00776	Benzene	71-43-2	N.D.	0.50	ug/l	1
00777	Toluene	108-88-3	N.D.	0.50	ug/l	1
00778	Ethylbenzene	100-41-4	N.D.	0.50	ug/l	1
00779	Total Xylenes	1330-20-7	N.D.	1.5	ug/l	1
00780	Methyl tert-Butyl Ether	1634-04-4	N.D.	2.5	ug/l	1
01594	BTEX + Oxygenates by 8260B					
01587	Ethanol	64-17-5	N.D.	500.	ug/l	1
02010	Methyl t-butyl ether	1634-04-4	N.D.	2.	ug/l	1
02011	di-Isopropyl ether	108-20-3	N.D.	2.	ug/l	1
02013	Ethyl t-butyl ether	637-92-3	N.D.	2.	ug/l	1
02014	t-Amyl methyl ether	994-05-8	N.D.	2.	ug/l	1
02015	t-Butyl alcohol	75-65-0	N.D.	100.	ug/l	1
05402	1,2-Dichloroethane	107-06-2	9.	2.	ug/l	1
05412	1,2-Dibromoethane	106-93-4	N.D.	2.	ug/l	1

State of California Lab Certification No. 2116

Laboratory Chronicle

#=Laboratory Method Detection Limit exceeded target detection limit
 N.D.=Not detected or above reporting limit



Lancaster, PA 17605-2425
 717-656-2300 Fax: 717-656-2681



Lancaster Laboratories Sample No. WW 3775755

Collected: 02/14/2002 12:08 by TC

Account Number: 10905

Submitted: 02/19/2002 09:05

Reported: 03/04/2002 at 16:30

Discard: 04/04/2002

MW-4-W-020214

Grab Water

Chevron Products Company
6001 Bollinger Canyon Road
Building L PO Box 6004
San Ramon CA 94583-0904

Facility# 206145 Job# 386492 GRD
800 Center St-Oakland T0600102230 MW-4

COMW4

CAT	Analysis Name	Method	Trial#	Analysis Date and Time	Analyst	Dilution Factor
01729	TPH-GRO - Waters	N. CA LUFT Gasoline Method	1	02/21/2002 05:54	Melissa-Ann S McAlpine	1
08214	BTEX, MTBE (8021)	SW-846 8021B	1	02/21/2002 05:54	Melissa-Ann S McAlpine	1
01594	BTEX + Oxygenates by 8260B	SW-846 8260B	1	02/25/2002 09:02	Kenneth L Boley Jr	1
01146	GC VOA Water Prep	SW-846 5030B	1	02/21/2002 05:54	Melissa-Ann S McAlpine	n.a.
01163	GC/MS VOA Water Prep	SW-846 5030B	1	02/25/2002 09:02	Kenneth L Boley Jr	n.a.

#=Laboratory Method Detection Limit exceeded target detection limit
N.D.=Not detected
M.E.M.F.S. Shows the Reporting Limit



Lancaster Laboratories, Inc.
2425 New Holland Pike
Lancaster, PA 17605-2425
717-656-2300 Fax: 717-656-2681



Lancaster Laboratories Sample No. **WW 3775756**

Collected: 02/14/2002 11:17 by TC

Account Number: 10905

Submitted: 02/19/2002 09:05

Chevron Products Company

Reported: 03/04/2002 at 16:30

6001 Bollinger Canyon Road

Discard: 04/04/2002

Building L PO Box 6004

MW-5-W-020214

Grab

Water

San Ramon CA 94583-0904

Facility# 206145 Job# 386492 GRD
800 Center St-Oakland T0600102230 MW-5

COMW5

CAT No.	Analysis Name	CAS Number	As Received Result	As Received Method Detection Limit	Units	Dilution Factor
01729	TPH-GRO - Waters					
01730	TPH-GRO - Waters	n.a.	N.D.	50.	ug/l	1
	The reported concentration of TPH-GRO does not include MTBE or other gasoline constituents eluting prior to the C6 (n-hexane) TPH-GRO range start time.					
	A site-specific MSD sample was not submitted for the project. A LCS/LCSD was performed to demonstrate precision and accuracy at a batch level.					
08214	BTEX, MTBE (8021)					
00776	Benzene	71-43-2	N.D.	0.50	ug/l	1
00777	Toluene	108-88-3	N.D.	0.50	ug/l	1
00778	Ethylbenzene	100-41-4	N.D.	0.50	ug/l	1
00779	Total Xylenes	1330-20-7	N.D.	1.5	ug/l	1
00780	Methyl tert-Butyl Ether	1634-04-4	N.D.	2.5	ug/l	1
01594	BTEX + Oxygenates by 8260B					
01587	Ethanol	64-17-5	N.D.	500.	ug/l	1
02010	Methyl t-butyl ether	1634-04-4	N.D.	2.	ug/l	1
02011	di-Isopropyl ether	108-20-3	N.D.	2.	ug/l	1
02013	Ethyl t-butyl ether	637-92-3	N.D.	2.	ug/l	1
02014	t-Amyl methyl ether	994-05-8	N.D.	2.	ug/l	1
02015	t-Butyl alcohol	75-65-0	N.D.	100.	ug/l	1
05402	1,2-Dichloroethane	107-06-2	N.D.	2.	ug/l	1
05412	1,2-Dibromoethane	106-93-4	N.D.	2.	ug/l	1

State of California Lab Certification No. 2116

Laboratory Chronicle

#=Laboratory Method Detection Limit exceeded target detection limit

N.D.=Not detected or above the Reporting Limit



Lancaster Laboratories, Inc.
2425 New Holland Pike.
Lancaster, PA 17605-2425
717-656-2300 Fax: 717-656-2681



Lancaster Laboratories Sample No. **WW 3775756**

Collected: 02/14/2002 11:17 by TC

Account Number: 10905

Submitted: 02/19/2002 09:05
Reported: 03/04/2002 at 16:30
Discard: 04/04/2002

Chevron Products Company
6001 Bollinger Canyon Road
Building L PO Box 6004
San Ramon CA 94583-0904

MW-5-W-020214 Grab Water

Facility# 206145 Job# 386492 GRD
800 Center St-Oakland T0600102230 MW-5

COMW5

CAT No.	Analysis Name	Method	Analysis		Analyst	Dilution Factor
			Trial#	Date and Time		
01729	TPH-GRO - Waters	N. CA LUFT Gasoline Method	1	02/21/2002 06:30	Melissa-Ann S McAlpine	1
08214	BTEX, MTBE (8021)	SW-846 8021B	1	02/21/2002 06:30	Melissa-Ann S McAlpine	1
01594	BTEX + Oxygenates by 8260B	SW-846 8260B	1	02/25/2002 09:27	Kenneth L Boley Jr	1
01146	GC VOA Water Prep	SW-846 5030B	1	02/21/2002 06:30	Melissa-Ann S McAlpine	n.a.
01163	GC/MS VOA Water Prep	SW-846 5030B	1	02/25/2002 09:27	Kenneth L Boley Jr	n.a.

#=Laboratory Method Detection Limit exceeded target detection limit
N.D.=Not detected
M.E.M.B.F.=Above the Reporting Limit



Lancaster, PA 17605-2425
717-656-2300 Fax: 717-656-2681



Lancaster Laboratories Sample No. **WW 3775757**

Collected: 02/14/2002 11:51 by TC

Account Number: 10905

Submitted: 02/19/2002 09:05
 Reported: 03/04/2002 at 16:31
 Discard: 04/04/2002

Chevron Products Company
 6001 Bollinger Canyon Road
 Building L PO Box 6004
 San Ramon CA 94583-0904

MW-6-W-020214 Grab Water

Facility# 206145 Job# 386492 GRD
 800 Center St-Oakland T0600102230 MW-6

CAT No.	Analysis Name	CAS Number	As Received Result	As Received Method Detection Limit	Units	Dilution Factor
01729	TPH-GRO - Waters					
01730	TPH-GRO - Waters	n.a.	N.D.	50.	ug/l	1
The reported concentration of TPH-GRO does not include MTBE or other gasoline constituents eluting prior to the C6 (n-hexane) TPH-GRO range start time. A site-specific MSD sample was not submitted for the project. A LCS/LCSD was performed to demonstrate precision and accuracy at a batch level.						
08214	BTEX, MTBE (8021)					
00776	Benzene	71-43-2	N.D.	0.50	ug/l	1
00777	Toluene	108-88-3	N.D.	0.50	ug/l	1
00778	Ethylbenzene	100-41-4	N.D.	0.50	ug/l	1
00779	Total Xylenes	1330-20-7	N.D.	1.5	ug/l	1
00780	Methyl tert-Butyl Ether	1634-04-4	N.D.	2.5	ug/l	1

State of California Lab Certification No. 2116

Laboratory Chronicle

CAT No.	Analysis Name	Method	Trial#	Analysis		Analyst	Dilution Factor
				Date and Time			
01729	TPH-GRO - Waters	N. CA LUFT Gasoline Method	1	02/21/2002	07:05	Melissa-Ann S McAlpine	1
08214	BTEX, MTBE (8021)	SW-846 8021B	1	02/21/2002	07:05	Melissa-Ann S McAlpine	1
01146	GC VOA Water Prep	SW-846 5030B	1	02/21/2002	07:05	Melissa-Ann S McAlpine	n.a.

#=Laboratory Method Detection Limit exceeded target detection limit
 N.D.=Not detected or above the Reporting Limit



Lancaster, PA 17605-2425
 717-656-2300 Fax: 717-656-2681



Lancaster Laboratories Sample No. WW 3775758

Collected: 02/14/2002 12:38 by TC

Account Number: 10905

Submitted: 02/19/2002 09:05
 Reported: 03/04/2002 at 16:31
 Discard: 04/04/2002

Chevron Products Company
 6001 Bollinger Canyon Road
 Building L PO Box 6004
 San Ramon CA 94583-0904

MW-7-W-020214 Grab Water

Facility# 206145 Job# 386492 GRD
 800 Center St-Oakland T0600102230 MW-7

CAT No.	Analysis Name	CAS Number	As Received Result	As Received Method Detection Limit	Units	Dilution Factor
01729	TPH-GRO - Waters					
01730	TPH-GRO - Waters	n.a.	N.D.	50.	ug/l	1
The reported concentration of TPH-GRO does not include MTBE or other gasoline constituents eluting prior to the C6 (n-hexane) TPH-GRO range start time. A site-specific MSD sample was not submitted for the project. A LCS/LCSD was performed to demonstrate precision and accuracy at a batch level.						
08214	BTEX, MTBE (8021)					
00776	Benzene	71-43-2	N.D.	0.50	ug/l	1
00777	Toluene	108-88-3	N.D.	0.50	ug/l	1
00778	Ethylbenzene	100-41-4	N.D.	0.50	ug/l	1
00779	Total Xylenes	1330-20-7	N.D.	1.5	ug/l	1
00780	Methyl tert-Butyl Ether	1634-04-4	N.D.	2.5	ug/l	1

State of California Lab Certification No. 2116

Laboratory Chronicle

CAT No.	Analysis Name	Method	Trial#	Analysis		Analyst	Dilution Factor
				Date and Time			
01729	TPH-GRO - Waters	N. CA LUFT Gasoline Method	1	02/21/2002 07:40		Melissa-Ann S McAlpine	1
08214	BTEX, MTBE (8021)	SW-846 8021B	1	02/21/2002 07:40		Melissa-Ann S McAlpine	1
01146	GC VOA Water Prep	SW-846 5030B	1	02/21/2002 07:40		Melissa-Ann S McAlpine	n.a.

#=Laboratory Method Detection Limit exceeded target detection limit
 N.D.=Not detected or above Reporting Limit



2425 New Holland Pike
 Lancaster, PA 17605-2425
 717-656-2300 Fax: 717-656-2681



Lancaster Laboratories Sample No. **WW 3775759**

Collected: 02/14/2002 14:52 by TC Account Number: 10905

Submitted: 02/19/2002 09:05
 Reported: 03/04/2002 at 16:31
 Discard: 04/04/2002
 MW-8-W-020214 Grab Water
 Chevron Products Company
 6001 Bollinger Canyon Road
 Building L PO Box 6004
 San Ramon CA 94583-0904

Facility# 206145 Job# 386492 GRD
 800 Center St-Oakland T0600102230 MW-8

COMW8

CAT No.	Analysis Name	CAS Number	As Received Result	As Received Method Detection Limit	Units	Dilution Factor
05553	TPH - DRO CA LUFT (Waters)	n.a.	130.	100.	ug/l	1
According to the California LUFT Protocol, the quantitation for Diesel Range Organics was performed by peak area comparison of the sample pattern to that of our #2 fuel oil reference standard (between C10 and C28 normal hydrocarbons). Site-specific MS/MSD samples were not submitted for the project. A LCS/LCSD was performed to demonstrate precision and accuracy at a batch level. The observed sample pattern is not typical of diesel/#2 fuel oil. Due to interferences from the sample matrix (high sediment content), the reporting limit was increased.						
01729	TPH-GRO - Waters					
01730	TPH-GRO - Waters	n.a.	N.D.	50.	ug/l	1
The reported concentration of TPH-GRO does not include MTBE or other gasoline constituents eluting prior to the C6 (n-hexane) TPH-GRO range start time. A site-specific MSD sample was not submitted for the project. A LCS/LCSD was performed to demonstrate precision and accuracy at a batch level.						
08214	BTEX, MTBE (8021)					
00776	Benzene	71-43-2	N.D.	0.50	ug/l	1
00777	Toluene	108-88-3	N.D.	0.50	ug/l	1
00778	Ethylbenzene	100-41-4	N.D.	0.50	ug/l	1
00779	Total Xylenes	1330-20-7	N.D.	1.5	ug/l	1
00780	Methyl tert-Butyl Ether	1634-04-4	N.D.	2.5	ug/l	1
01594	BTEX + Oxygenates by 8260B					
01587	Ethanol	64-17-5	N.D.	500.	ug/l	1
02010	Methyl t-butyl ether	1634-04-4	N.D.	2.	ug/l	1
02011	di-Isopropyl ether	108-20-3	N.D.	2.	ug/l	1
02013	Ethyl t-butyl ether	637-92-3	N.D.	2.	ug/l	1
02014	t-Amyl methyl ether	994-05-8	N.D.	2.	ug/l	1

#=Laboratory Method Detection Limit exceeds the target detection limit

N.D.=Not detected by the Reporting Limit



2425 New Holland Pike
 Lancaster, PA 17605-2425
 717-656-2300 Fax: 717-656-2681



Lancaster Laboratories
Where quality is a science.

Lancaster Laboratories Sample No. **WW 3775759**

Collected: 02/14/2002 14:52 by TC

Account Number: 10905

Submitted: 02/19/2002 09:05
Reported: 03/04/2002 at 16:31
Discard: 04/04/2002

Chevron Products Company
6001 Bollinger Canyon Road
Building L PO Box 6004
San Ramon CA 94583-0904

MW-8-W-020214 Grab Water

Facility# 206145 Job# 386492 GRD
800 Center St-Oakland T0600102230 MW-8

COMW8

CAT No.	Analysis Name	CAS Number	As Received Result	As Received		Dilution Factor
				Method	Units	
02015	t-Butyl alcohol	75-65-0	N.D.	Detection Limit	ug/l	1
05402	1,2-Dichloroethane	107-06-2	N.D.	2.	ug/l	1
05412	1,2-Dibromoethane	106-93-4	N.D.	2.	ug/l	1

State of California Lab Certification No. 2116

Laboratory Chronicle

CAT No.	Analysis Name	Method	Trial#	Analysis		Analyst	Dilution Factor
				Date	Time		
05553	TPH - DRO CA LUFT (Waters)	CA LUFT Diesel Range Organics	1	02/27/2002	07:34	Tracy A Cole	1
01729	TPH-GRO - Waters	N. CA LUFT Gasoline Method	1	02/21/2002	10:35	Melissa-Ann S McAlpine	1
08214	BTEX, MTBE (8021)	SW-846 8021B	1	02/21/2002	10:35	Melissa-Ann S McAlpine	1
01594	BTEX + Oxygenates by 8260B	SW-846 8260B	1	02/25/2002	09:53	Kenneth L Boley Jr	1
01146	GC VOA Water Prep	SW-846 5030B	1	02/21/2002	10:35	Melissa-Ann S McAlpine	n.a.
01163	GC/MS VOA Water Prep	SW-846 5030B	1	02/25/2002	09:53	Kenneth L Boley Jr	n.a.
07003	Extraction - DRO (Waters)	TPH by CA LUFT	1	02/21/2002	01:35	JoElla L Rice	1

#=Laboratory Method Detection Limit exceeded target detection limit
N.D.=Not detected above the Reporting Limit



Lancaster, PA 17605-2425
717-656-2300 Fax: 717-656-2681



Lancaster Laboratories

Where quality is a science.

Quality Control Summary

Client Name: Chevron Products Company
 Reported: 03/04/02 at 04:31 PM

Group Number: 797424

Laboratory Compliance Quality Control

Analysis Name	Blank Result	Blank MDL	Report Units	LCS %REC	LCSD %REC	LCS/LCSD Limits	RPD	RPD Max
Batch number: 020510022A								
TPH - DRO CA LUFT (Waters)	N.D.	50.	ug/l	85	86	54-120	1	20
Batch number: 02051A55								
Benzene	N.D.	0.5	ug/l	104	100	80-118	4	30
Toluene	N.D.	0.5	ug/l	111	106	82-119	5	30
Ethylbenzene	N.D.	0.5	ug/l	115	109	81-119	5	30
Total Xylenes	N.D.	1.5	ug/l	114	109	82-120	4	30
Methyl tert-Butyl Ether	N.D.	2.5	ug/l	102	99	79-127	3	30
TPH-GRO - Waters	N.D.	50.	ug/l	88	85	76-126	3	30
Batch number: P020531AA								
Ethanol	N.D.	500.	ug/l	71		44-139		
Methyl t-butyl ether	N.D.	2.	ug/l	97		77-127		
di-Isopropyl ether	N.D.	2.	ug/l	97		74-125		
Ethyl t-butyl ether	N.D.	2.	ug/l	94		74-120		
t-Amyl methyl ether	N.D.	2.	ug/l	93		71-114		
t-Butyl alcohol	N.D.	100.	ug/l	87		59-139		
1,2-Dichloroethane	N.D.	2.	ug/l	94		77-132		
1,2-Dibromoethane	N.D.	2.	ug/l	95		84-119		
Batch number: P020561AA								
Ethanol	N.D.	500.	ug/l	77		44-139		
Methyl t-butyl ether	N.D.	2.	ug/l	95		77-127		
di-Isopropyl ether	N.D.	2.	ug/l	93		74-125		
Ethyl t-butyl ether	N.D.	2.	ug/l	89		74-120		
t-Amyl methyl ether	N.D.	2.	ug/l	89		71-114		
t-Butyl alcohol	N.D.	100.	ug/l	83		59-139		
1,2-Dichloroethane	N.D.	2.	ug/l	94		77-132		
1,2-Dibromoethane	N.D.	2.	ug/l	92		84-119		

Sample Matrix Quality Control

Analysis Name	MS %REC	MSD %REC	MS/MSD Limits	RPD	BKG MAX	DUP Conc	DUP RPD	Dup RFD Max
Batch number: 02051A55								
Benzene	106	106	77-131	0	30			
Toluene	114	113	80-128	1	30			
Ethylbenzene	119	118	76-132	1	30			
Total Xylenes	118	116	76-132	1	30			
Methyl tert-Butyl Ether	106	111	61-144	4	30			
TPH-GRO - Waters	95		74-132					
Batch number: P020531AA								
Ethanol	88	90	70-130	2	30			
Methyl t-butyl ether	95	96	69-134	1	30			
di-Isopropyl ether	95	96	68-133	2	30			

*- Outside of specification

- (1) The result for one or both determinations was less than five times the LOQ.
- (2) The background result was more than four times the spike added.



Lancaster Laboratories, Inc.
 2425 New Holland Pike
 PO Box 12425
 Lancaster, PA 17605-2425
 717-656-2300 Fax: 717-656-2681



Lancaster Laboratories

Where quality is a science.

Quality Control Summary

Client Name: Chevron Products Company
 Reported: 03/04/02 at 04:31 PM

Group Number: 797424

Sample Matrix Quality Control

Analysis Name	MS	MSD	MS/MSD	RPD	BRG	DUP	DUP	Dup	
	<u>%REC</u>	<u>%REC</u>	<u>Limits</u>	<u>RPD</u>	<u>MAX</u>	<u>Conc</u>	<u>Conc</u>	<u>RPD</u>	
								<u>RPD</u>	
								<u>Max</u>	
Ethyl t-butyl ether	91	92	73-123	1	30				
t-Amyl methyl ether	91	92	69-118	1	30				
t-Butyl alcohol	86	90	51-148	5	30				
1,2-Dichloroethane	94	95	75-141	1	30				
1,2-Dibromoethane	92	95	78-120	3	30				
Batch number: P020561AA Sample number(s): 3775754-3775756,3775759									
Ethanol	81	69*	70-130	16	30				
Methyl t-butyl ether	98	97	69-134	1	30				
di-Isopropyl ether	98	97	68-133	2	30				
Ethyl t-butyl ether	95	96	73-123	1	30				
t-Amyl methyl ether	93	93	69-118	0	30				
t-Butyl alcohol	98	97	51-148	1	30				
1,2-Dichloroethane	98	97	75-141	1	30				
1,2-Dibromoethane	94	95	78-120	1	30				

Surrogate Quality Control

Analysis Name: TPH - DRO CA LUFT (Waters)
 Batch number: 020510022A
 Orthoterphenyl

3775759	94
Blank	101
LCS	75
LCSD	81
<hr/>	
Limits:	59-139

Analysis Name: TPH-GRO - Waters
 Batch number: 02051A55

	Trifluorotoluene-F	Trifluorotoluene-P
3775751	89	86
3775752	88	89
3775753	91	86
3775754	86	84
3775755	85	83
3775756	90	87
3775757	90	86
3775758	90	86
3775759	90	87
Blank	91	87
LCS	99	87
LCSD	98	87
MS	101	87
MSD		86

***- Outside of specification**

- (1) The result for one or both determinations was less than five times the LOQ.
- (2) The background result was more than four times the spike added.



Lancaster Laboratories, Inc.
 2425 New Holland Pike
 PO Box 12425
 Lancaster, PA 17605-2425
 717-656-2300 Fax: 717-656-2681



Lancaster Laboratories

Where quality is a science.

Quality Control Summary

Page 3 of 3

Client Name: Chevron Products Company
Reported: 03/04/02 at 04:31 PM

Group Number: 797424

Surrogate Quality Control

Limits: 67-135 71-130

Analysis Name: BTEX + Oxygenates by 8260B

Batch number: P020531AA

	Dibromofluoromethane	1,2-Dichloroethane-d4	Toluene-d8	4-Bromofluorobenzene
3775752	96	94	94	92
Blank	96	95	95	93
LCS	94	94	96	94
MS	95	94	96	94
MSD	95	95	97	94

Limits: 86-118 80-120 88-110 86-115

Analysis Name: BTEX + Oxygenates by 8260B

Batch number: P020561AA

	Dibromofluoromethane	1,2-Dichloroethane-d4	Toluene-d8	4-Bromofluorobenzene
3775754	97	95	94	91
3775755	97	97	94	91
3775756	97	95	94	91
3775759	97	95	94	90
Blank	97	94	95	91
LCS	96	95	96	94
MS	97	94	95	93
MSD	96	94	95	94

Limits: 86-118 80-120 88-110 86-115

*- Outside of specification

- (1) The result for one or both determinations was less than five times the LOQ.
- (2) The background result was more than four times the spike added.



Lancaster Laboratories, Inc.
2425 New Holland Pike
PO Box 12425
Lancaster, PA 17605-2425
717-656-2300 Fax: 717-656-2681