



**EMCON**

1921 Ringwood Avenue • San Jose, California 95131-1721 • (408) 453-7300 • Fax (408) 437-9526

95 MAR 29 PM 12:45

Date March 20, 1995  
Project 0805-132.01

To:

Ms. Eva Chu  
Alameda County Health Care Services Agency  
Department of Environmental Health  
1131 Harborbay Parkway, Suite 250  
Alameda, California 94502-6577

*> 120 days to get ampr*

We are enclosing:

| Copies   | Description  |
|----------|--|
| <u>1</u> | <u>Fourth quarter 1994 groundwater monitoring report</u><br><u>for ARCO service station 6041, Deblin, California</u> |
|          |  |
|          |  |

|           |                 |             |          |                 |                             |
|-----------|-----------------|-------------|----------|-----------------|-----------------------------|
| For your: | <u>  X  </u>    | Use         | Sent by: | <u>        </u> | Regular Mail                |
|           | <u>        </u> | Approval    |          | <u>        </u> | Standard Air                |
|           | <u>        </u> | Review      |          | <u>        </u> | Courier                     |
|           | <u>        </u> | Information |          | <u>  X  </u>    | Other <u>Certified Mail</u> |

Comments:

The enclosed groundwater monitoring report is being sent to you per the request of ARCO Products Company. Please call if you have questions or comments.

*David Larsen*  
David Larsen  
Project Coordinator

cc: Copy entire document:  
Kevin Graves, RWQCB - SFBR  
Michael Whelan, ARCO Products Company  
David Larsen, EMCON  
File

Copy transmittal and Table 2 only:  
Scott T. Hooton, BP Oil Company



ARCO Products Company  
2000 Alameda de las Pulgas  
Mailing Address: Box 5811  
San Mateo, California 94402  
Telephone 415 571 2400



Date: March 20, 1995

Re: ARCO Station # 6041 • 7249 Village Parkway • Dublin, CA  
Fourth Quarter 1994 Groundwater Monitoring Report

" I declare, that to the best of my knowledge at the present time, that the information and/or recommendations contained in the attached proposal or report are true and correct."

Submitted by:

A handwritten signature in black ink that reads "Michael R. Whelan". The signature is written in a cursive style.

Michael R. Whelan  
Environmental Engineer (415) 571-2449



**EMCON**

1921 Ringwood Avenue • San Jose, California 95131-1721 • (408) 453-7300 • Fax (408) 437-9526

March 17, 1995  
Project 0805-132.01

Mr. Michael Whelan  
ARCO Products Company  
2155 South Bascom Avenue, Suite 202  
Campbell, California 95008

Re: Fourth quarter 1994 groundwater monitoring program results, ARCO service station 6041, Dublin, California

Dear Mr. Whelan:

This letter presents the results of the fourth quarter 1994 groundwater monitoring program at ARCO Products Company (ARCO) service station 6041, 7249 Village Parkway, Dublin, California (Figure 1). The quarterly monitoring program complies with Alameda County Health Care Services Agency (ACHCSA) requirements regarding underground tank investigations.

## **BACKGROUND**

In June 1990, a waste-oil tank was removed from the site. In September 1991, RESNA conducted an initial subsurface environmental investigation to evaluate the impact of a gasoline spill beneath a gasoline dispenser pump. This investigation included installing three groundwater monitoring wells (MW-1, MW-2, and MW-3) beneath the tank pit to assess the presence of hydrocarbons.

Between October and November 1992, RESNA conducted a second phase of investigation. This investigation included installing three additional groundwater monitoring wells (MW-4, MW-5 and MW-6) and four vadose wells (VW-1 through VW-4) in October 1992, and conducting a soil-vapor extraction (SVE) pilot test in November 1992.

Between August 1993 and February 1994, RESNA conducted a third phase of investigation to further evaluate potential sources of gasoline hydrocarbons in soil, and to aid in the design of interim SVE and air-sparge (AS) systems. The work included installing one vadose well (VW-5) and two AS wells (AS-1 and AS-2), and conducting an AS pilot test.

Groundwater monitoring and sampling at this site was initiated in September 1991. There are currently six groundwater monitoring wells, five vadose wells, and two AS wells on site. For additional background information, please refer to *Report of Findings, Air Sparge Pilot Test* (RESNA, June 10, 1994).



Wells MW-1 through MW-6 are monitored quarterly.

## **MONITORING PROGRAM FIELD PROCEDURES AND RESULTS**

The fourth quarter 1994 groundwater monitoring event was performed by Integrated Wastestream Management (IWM) on November 18, 1994. Field work performed by IWM during this quarter included (1) measuring depths to groundwater and subjectively analyzing groundwater for the presence of floating product in wells MW-1 through MW-6, (2) purging and subsequently sampling groundwater monitoring wells MW-1 through MW-6 for laboratory analysis, and (3) directing a state-certified laboratory to analyze the groundwater samples. The results of IWM's field work were transmitted to EMCON in a report dated December 29, 1994. These data are presented in Appendix A.

## **ANALYTICAL PROCEDURES**

Groundwater samples collected during fourth quarter 1994 monitoring were analyzed for total petroleum hydrocarbons as gasoline (TPHG) and benzene, toluene, ethylbenzene, and total xylenes (BTEX). Groundwater samples were prepared for analysis by U.S. Environmental Protection Agency (USEPA) method 5030 (purge and trap). Groundwater was analyzed for TPHG by the methods accepted by the Department of Toxic Substances Control, California Environmental Protection Agency (Cal-EPA), and referenced in the *Leaking Underground Fuel Tank (LUFT) Field Manual* (State Water Resources Control Board, October 1989). Samples were analyzed for BTEX by USEPA method 8020, as described in *Test Methods for Evaluating Solid Waste: Physical/Chemical Methods* (USEPA, SW-846, November 1986, Third Edition). These methods are recommended for samples from petroleum-hydrocarbon-impacted sites in the *Tri-Regional Board Staff Recommendations for Preliminary Evaluation and Investigation of Underground Tank Sites* (August 10, 1990).

## **MONITORING PROGRAM RESULTS**

Results of the fourth quarter 1994 groundwater monitoring event are summarized in Table 1 and illustrated in Figure 2. Historical groundwater elevation data, including top-of-casing elevations, depth-to-water measurements, calculated groundwater elevations, floating-product thickness measurements, and groundwater flow direction and gradient data, are summarized in Table 2. Table 3 summarizes historical laboratory data for TPHG and BTEX. Table 4 summarizes historical groundwater elevation data for the British Petroleum (BP) station at 7197 Village Parkway, the former Shell station at 7194 Amador Valley Boulevard, and the UNOCAL station at 7375 Amador Valley Boulevard. Figure 3 illustrates vicinity groundwater elevation data for all four service stations (ARCO, BP, Shell, and UNOCAL) during the fourth quarter of 1994. Copies of

the fourth quarter 1994 analytical results and chain-of-custody documentation are included in Appendix B.

## **MONITORING PROGRAM EVALUATION**

On-site groundwater contours and analytical data for the fourth quarter of 1994 are presented in Figure 2. An approximate direction of groundwater flow and hydraulic gradient could not be determined based on the groundwater elevation data collected at the site during the fourth quarter of 1994. An approximate groundwater flow direction and gradient for the site vicinity were calculated using groundwater elevation data collected from the UNOCAL, ARCO, and BP stations during the November 18, 1994, cooperative sampling event. Based on these data, groundwater in the site vicinity flows northeast at an approximate hydraulic gradient of 0.004 foot per foot (Figure 3).

Groundwater samples collected from wells MW-4, MW-5, and MW-6 did not contain detectable concentrations of TPHG or BTEX. Groundwater samples collected from wells MW-1, MW-2, and MW-3 contained 2,500, 237, and 1,850 parts per billion (ppb) TPHG, and 1.5, 1.9, and 3.5 ppb benzene, respectively. Similar analytical results were reported for all wells during previous monitoring events.

## **LIMITATIONS**

Field procedures were performed by, and field data acquired from, IWM. EMCON does not warrant the accuracy of data supplied by IWM. EMCON's scope of work was limited to interpreting field data, which included evaluating trends in the groundwater gradient, groundwater flow direction, and dissolved-petroleum-hydrocarbon concentrations beneath the site.

No monitoring event is thorough enough to describe all geologic/hydrogeologic conditions of interest at a given site. If conditions have not been identified during the monitoring event, such a finding should not therefore be construed as a guarantee of the absence of such conditions at the site, but rather as the result of the scope, limitations, and cost of work performed during the monitoring event.

## **SITE STATUS UPDATE**

This update reports site activities performed during the fourth quarter of 1994 and the anticipated site activities for the first quarter of 1995.

#### Fourth Quarter 1994 Activities

- Prepared and submitted quarterly groundwater monitoring report for third quarter 1994.
- Performed quarterly groundwater monitoring for fourth quarter 1994.

#### Work Anticipated for First Quarter 1995

- Prepare and submit quarterly groundwater monitoring report for fourth quarter 1994.
- Perform quarterly groundwater monitoring for first quarter 1995.

Please call if you have questions.

Sincerely,

EMCON

  
David Larsen  
Project Coordinator

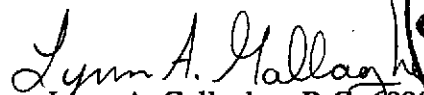
  
Lynn A. Gallagher, R.G. 6090  
Project Geologist

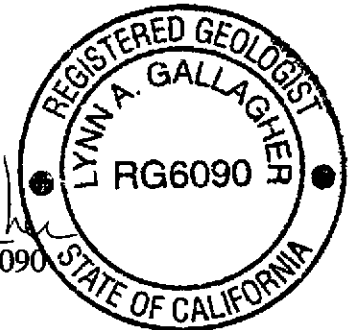

- Attachments:
- Table 1 - Groundwater Monitoring Data, Fourth Quarter 1994
  - Table 2 - Historical Groundwater Elevation Data
  - Table 3 - Historical Groundwater Analytical Data (TPHG and BTEX)
  - Table 4 - Historical Groundwater Elevation Data (BP, Shell, and UNOCAL Stations)
  - Figure 1 - Site Location
  - Figure 2 - Groundwater Data, Fourth Quarter 1994
  - Figure 3 - Vicinity Groundwater contours (ARCO, BP, Shell, and UNOCAL Stations)
  - Appendix A - Field Data Report, Integrated Wastestream Management, December 29, 1994
  - Appendix B - Analytical Results and Chain-of-Custody Documentation, Fourth Quarter 1994

Table 1  
Groundwater Monitoring Data  
Fourth Quarter 1994  
Summary Report

ARCO Service Station 6041  
7249 Village Parkway, Dublin, California

Date: 02-08-95  
Project Number: 0805-132.01

| Well<br>Desig-<br>nation | Water<br>Level<br>Field<br>Date | TOC<br>Elevation<br>ft-MSL | Depth<br>to<br>Water<br>feet | Ground-<br>Water<br>Elevation<br>ft-MSL | Floating<br>Product<br>Thickness<br>feet | Ground-<br>Water<br>Flow<br>Direction<br>MWN | Hydraulic<br>Gradient<br>foot/foot | Water<br>Sample<br>Field<br>Date | TPHG<br>ppb | Benzene<br>ppb | Toluene<br>ppb | Ethyl-<br>benzene<br>ppb | Total<br>Xylenes<br>ppb |
|--------------------------|---------------------------------|----------------------------|------------------------------|---|--|--|------------------------------------|----------------------------------|-------------|----------------|----------------|--------------------------|-------------------------|
| MW-1                     | 11-18-94                        | 336.56                     | 10.25                        | 326.31                                  | ND                                       | NR   | NR                                 | 11-18-94                         | 2500        | 1.5            | <0.5           | 1.4                      | <1                      |
| MW-2                     | 11-18-94                        | 334.80                     | 8.70                         | 326.10                                  | ND                                       | NR   | NR                                 | 11-18-94                         | 237         | 1.9            | 0.6            | <0.5                     | <1                      |
| MW-3                     | 11-18-94                        | 335.53                     | 9.79                         | 325.74                                  | ND                                       | NR   | NR                                 | 11-18-94                         | 1850        | 3.5            | <0.5           | 0.9                      | <1                      |
| MW-4                     | 11-18-94                        | 334.22                     | 8.31                         | 325.91                                  | ND                                       | NR   | NR                                 | 11-18-94                         | <50         | <0.5           | <0.5           | <0.5                     | <1                      |
| MW-5                     | 11-18-94                        | 335.87                     | 9.65                         | 326.22                                  | ND                                       | NR   | NR                                 | 11-18-94                         | <50         | <0.5           | <0.5           | <0.5                     | <1                      |
| MW-6                     | 11-18-94                        | 335.84                     | 9.54                         | 326.30                                  | ND                                       | NR   | NR                                 | 11-18-94                         | <50         | <0.5           | <0.5           | <0.5                     | <1                      |

TOC = Top of casing

ft-MSL = Elevation in feet, relative to mean sea level

MWN = Ground-water flow direction and gradient apply to the entire monitoring well network

TPHG = Total petroleum hydrocarbons as gasoline

ppb = Parts per billion or micrograms per liter ( $\mu\text{g/l}$ )

ND = None detected

NR = Not reported; data not available or not measurable

Table 2  
Historical Groundwater Elevation Data  
Summary Report

ARCO Service Station 6041  
7249 Village Parkway, Dublin, California

Date: 02-08-95  
Project Number: 0805-132.01

| Well Designation | Water Level Field Date | TOC Elevation<br>ft-MSL | Depth to Water<br>feet | Ground-Water Elevation<br>ft-MSL | Floating Product Thickness<br>feet | Ground-Water Flow Direction<br>MWN | Hydraulic Gradient<br>foot/foot |
|------------------|------------------------|-------------------------|------------------------|----------------------------------|------------------------------------|------------------------------------|---------------------------------|
| MW-1             | 09-20-91               | 336.56                  | 11.20                  | 325.36                           | ND                                 | NR                                 | NR                              |
| MW-1             | 10-22-91               | 336.56                  | 11.48                  | 325.08                           | ND                                 | NR                                 | NR                              |
| MW-1             | 11-27-91               | 336.56                  | 11.27                  | 325.29                           | ND                                 | NR                                 | NR                              |
| MW-1             | 12-16-91               | 336.56                  | 11.55                  | 325.01                           | ND                                 | NR                                 | NR                              |
| MW-1             | 01-18-92               | 336.56                  | 11.37                  | 325.19                           | ND                                 | NR                                 | NR                              |
| MW-1             | 02-21-92               | 336.56                  | 9.13                   | 327.43                           | ND                                 | NR                                 | NR                              |
| MW-1             | 03-16-92               | 336.56                  | 9.70                   | 326.86                           | ND                                 | NR                                 | NR                              |
| MW-1             | 04-24-92               | 336.56                  | 10.20                  | 326.36                           | ND                                 | NR                                 | NR                              |
| MW-1             | 05-15-92               | 336.56                  | 10.46                  | 326.10                           | ND                                 | NR                                 | NR                              |
| MW-1             | 06-09-92               | 336.56                  | 10.73                  | 325.83                           | ND                                 | NR                                 | NR                              |
| MW-1             | 07-28-92               | 336.56                  | 11.04                  | 325.52                           | ND                                 | NR                                 | NR                              |
| MW-1             | 08-24-92               | 336.56                  | 11.32                  | 325.24                           | ND                                 | NR                                 | NR                              |
| MW-1             | 09-09-92               | 336.56                  | 11.54                  | 325.02                           | ND                                 | NR                                 | NR                              |
| MW-1             | 10-26-92               | 336.56                  | 11.80                  | 324.76                           | ND                                 | NR                                 | NR                              |
| MW-1             | 11-10-92               | 336.56                  | 11.74                  | 324.82                           | ND                                 | NR                                 | NR                              |
| MW-1             | 12-14-92               | 336.56                  | 10.77                  | 325.79                           | ND                                 | NR                                 | NR                              |
| MW-1             | 01-15-93               | 336.56                  | 8.88                   | 327.68                           | ND                                 | NR                                 | NR                              |
| MW-1             | 02-10-93               | 336.56                  | 9.66                   | 326.90                           | ND                                 | NR                                 | NR                              |
| MW-1             | 03-29-93               | 336.56                  | 8.31                   | 328.25                           | ND                                 | NR                                 | NR                              |
| MW-1             | 04-27-93               | 336.56                  | 9.03                   | 327.53                           | ND                                 | NR                                 | NR                              |
| MW-1             | 05-10-93               | 336.56                  | 9.50                   | 327.06                           | ND                                 | NR                                 | NR                              |
| MW-1             | 06-18-93               | 336.56                  | 10.16                  | 326.40                           | ND                                 | NR                                 | NR                              |
| MW-1             | 07-28-93               | 336.56                  | 10.68                  | 325.88                           | ND                                 | NR                                 | NR                              |
| MW-1             | 08-30-93               | 336.56                  | 10.59                  | 325.97                           | ND                                 | NR                                 | NR                              |
| MW-1             | 09-28-93               | 336.56                  | 10.82                  | 325.74                           | ND                                 | NR                                 | NR                              |
| MW-1             | 10-31-93               | 336.56                  | 10.94                  | 325.62                           | ND                                 | NR                                 | NR                              |
| MW-1             | 11-11-93               | 336.56                  | 10.70                  | 325.86                           | ND                                 | NR                                 | NR                              |
| MW-1             | 12-15-93               | 336.56                  | 10.56                  | 326.00                           | ND                                 | NR                                 | NR                              |
| MW-1             | 02-11-94               | 336.56                  | 10.35                  | 326.21                           | ND                                 | NR                                 | NR                              |
| MW-1             | 03-13-94               | 336.56                  | 9.99                   | 326.57                           | ND                                 | NR                                 | NR                              |
| MW-1             | 05-17-94               | 336.56                  | 9.82                   | 326.74                           | ND                                 | NR                                 | NR                              |
| MW-1             | 08-25-94               | 336.56                  | 10.11                  | 326.45                           | ND                                 | NR                                 | NR                              |
| MW-1             | 09-22-94               | 336.56                  | 11.20                  | 325.36                           | ND                                 | NR                                 | NR                              |
| MW-1             | 11-18-94               | 336.56                  | 10.25                  | 326.31                           | ND                                 | NR                                 | NR                              |



Table 2  
 Historical Groundwater Elevation Data  
 Summary Report

ARCO Service Station 6041  
 7249 Village Parkway, Dublin, California

Date: 02-08-95  
 Project Number: 0805-132.01

| Well<br>Designation | Water<br>Level<br>Field<br>Date | TOC<br>Elevation<br>ft-MSL | Depth<br>to<br>Water<br>feet | Ground-<br>Water<br>Elevation<br>ft-MSL | Floating<br>Product<br>Thickness<br>feet | Ground-<br>Water<br>Flow<br>Direction<br>MWN | Hydraulic<br>Gradient<br>foot/foot |
|---------------------|---------------------------------|----------------------------|------------------------------|---|--|--|------------------------------------|
| MW-2                | 09-20-91                        | 334.80                     | 9.22                         | 325.58                                  | ND                                       | NR   | NR                                 |
| MW-2                | 10-22-91                        | 334.80                     | 9.66                         | 325.14                                  | ND                                       | NR   | NR                                 |
| MW-2                | 11-27-91                        | 334.80                     | 9.48                         | 325.32                                  | ND                                       | NR   | NR                                 |
| MW-2                | 12-16-91                        | 334.80                     | 9.76                         | 325.04                                  | ND                                       | NR   | NR                                 |
| MW-2                | 01-18-92                        | 334.80                     | 9.47                         | 325.33                                  | ND                                       | NR   | NR                                 |
| MW-2                | 02-21-92                        | 334.80                     | 7.62                         | 327.18                                  | ND                                       | NR   | NR                                 |
| MW-2                | 03-16-92                        | 334.80                     | 7.84                         | 326.96                                  | ND                                       | NR   | NR                                 |
| MW-2                | 04-24-92                        | 334.80                     | 8.34                         | 326.46                                  | ND                                       | NR   | NR                                 |
| MW-2                | 05-15-92                        | 334.80                     | 8.62                         | 326.18                                  | ND                                       | NR   | NR                                 |
| MW-2                | 06-09-92                        | 334.80                     | 8.88                         | 325.92                                  | ND                                       | NR   | NR                                 |
| MW-2                | 07-28-92                        | 334.80                     | 9.38                         | 325.42                                  | ND                                       | NR   | NR                                 |
| MW-2                | 08-24-92                        | 334.80                     | 9.81                         | 324.99                                  | ND                                       | NR   | NR                                 |
| MW-2                | 09-09-92                        | 334.80                     | 9.92                         | 324.88                                  | ND                                       | NR   | NR                                 |
| MW-2                | 10-26-92                        | 334.80                     | 10.13                        | 324.67                                  | ND                                       | NR   | NR                                 |
| MW-2                | 11-10-92                        | 334.80                     | 10.12                        | 324.68                                  | ND                                       | NR   | NR                                 |
| MW-2                | 12-14-92                        | 334.80                     | 8.99                         | 325.81                                  | ND                                       | NR   | NR                                 |
| MW-2                | 01-15-93                        | 334.80                     | 7.20                         | 327.60                                  | ND                                       | NR   | NR                                 |
| MW-2                | 02-10-93                        | 334.80                     | 7.30                         | 327.50                                  | ND                                       | NR   | NR                                 |
| MW-2                | 03-29-93                        | 334.80                     | 6.60                         | 328.20                                  | ND                                       | NR   | NR                                 |
| MW-2                | 04-27-93                        | 334.80                     | 7.10                         | 327.70                                  | ND                                       | NR   | NR                                 |
| MW-2                | 05-10-93                        | 334.80                     | 7.40                         | 327.40                                  | ND                                       | NR   | NR                                 |
| MW-2                | 06-18-93                        | 334.80                     | 8.02                         | 326.78                                  | ND                                       | NR   | NR                                 |
| MW-2                | 07-28-93                        | 334.80                     | 8.47                         | 326.33                                  | ND                                       | NR   | NR                                 |
| MW-2                | 08-30-93                        | 334.80                     | 8.80                         | 326.00                                  | ND                                       | NR   | NR                                 |
| MW-2                | 09-28-93                        | 334.80                     | 9.19                         | 325.61                                  | ND                                       | NR   | NR                                 |
| MW-2                | 10-31-93                        | 334.80                     | 9.12                         | 325.68                                  | ND                                       | NR   | NR                                 |
| MW-2                | 11-11-93                        | 334.80                     | 9.02                         | 325.78                                  | ND                                       | NR   | NR                                 |
| MW-2                | 12-15-93                        | 334.80                     | 8.82                         | 325.98                                  | ND                                       | NR   | NR                                 |
| MW-2                | 02-11-94                        | 334.80                     | 8.59                         | 326.21                                  | ND                                       | NR   | NR                                 |
| MW-2                | 03-13-94                        | 334.80                     | 8.09                         | 326.71                                  | ND                                       | NR   | NR                                 |
| MW-2                | 05-17-94                        | 334.80                     | 7.99                         | 326.81                                  | ND                                       | NR   | NR                                 |
| MW-2                | 08-25-94                        | 334.80                     | 9.23                         | 325.57                                  | ND                                       | NR   | NR                                 |
| MW-2                | 09-22-94                        | 334.80                     | 9.47                         | 325.33                                  | ND                                       | NR   | NR                                 |
| MW-2                | 11-18-94                        | 334.80                     | 8.70                         | 326.10                                  | ND                                       | NR   | NR                                 |

Table 2  
Historical Groundwater Elevation Data  
Summary Report

ARCO Service Station 6041  
7249 Village Parkway, Dublin, California

Date: 02-08-95  
Project Number: 0805-132.01

| Well Designation | Water Level Field Date | TOC              | Depth to Water feet | Ground-Water Elevation ft-MSL | Floating Product Thickness feet | Ground-Water Flow Direction | Hydraulic Gradient foot/foot |
|------------------|------------------------|------------------|---------------------|-------------------------------|---------------------------------|-----------------------------|------------------------------|
|                  |                        | Elevation ft-MSL |                     |                               |                                 | MWN                         |                              |
| MW-3             | 09-20-91               | 335.53           | 10.16               | 325.37                        | ND                              | NR                          | NR                           |
| MW-3             | 10-22-91               | 335.53           | 10.48               | 325.05                        | ND                              | NR                          | NR                           |
| MW-3             | 11-27-91               | 335.53           | 10.17               | 325.36                        | ND                              | NR                          | NR                           |
| MW-3             | 12-16-91               | 335.53           | 10.25               | 325.28                        | ND                              | NR                          | NR                           |
| MW-3             | 01-18-92               | 335.53           | 10.71               | 324.82                        | ND                              | NR                          | NR                           |
| MW-3             | 02-21-92               | 335.53           | 8.68                | 326.85                        | ND                              | NR                          | NR                           |
| MW-3             | 03-16-92               | 335.53           | 8.91                | 326.62                        | ND                              | NR                          | NR                           |
| MW-3             | 04-24-92               | 335.53           | 9.14                | 326.39                        | ND                              | NR                          | NR                           |
| MW-3             | 05-15-92               | 335.53           | 9.54                | 325.99                        | ND                              | NR                          | NR                           |
| MW-3             | 06-09-92               | 335.53           | 9.72                | 325.81                        | ND                              | NR                          | NR                           |
| MW-3             | 07-28-92               | 335.53           | 10.15               | 325.38                        | ND                              | NR                          | NR                           |
| MW-3             | 08-24-92               | 335.53           | 10.42               | 325.11                        | ND                              | NR                          | NR                           |
| MW-3             | 09-09-92               | 335.53           | 10.53               | 325.00                        | ND                              | NR                          | NR                           |
| MW-3             | 10-26-92               | 335.53           | 10.92               | 324.61                        | ND                              | NR                          | NR                           |
| MW-3             | 11-10-92               | 335.53           | 10.72               | 324.81                        | ND                              | NR                          | NR                           |
| MW-3             | 12-14-92               | 335.53           | 9.78                | 325.75                        | ND                              | NR                          | NR                           |
| MW-3             | 01-15-93               | 335.53           | 7.66                | 327.87                        | ND                              | NR                          | NR                           |
| MW-3             | 02-10-93               | 335.53           | 7.87                | 327.66                        | ND                              | NR                          | NR                           |
| MW-3             | 03-29-93               | 335.53           | 7.35                | 328.18                        | ND                              | NR                          | NR                           |
| MW-3             | 04-27-93               | 335.53           | 7.70                | 327.83                        | ND                              | NR                          | NR                           |
| MW-3             | 05-10-93               | 335.53           | 8.46                | 327.07                        | ND                              | NR                          | NR                           |
| MW-3             | 06-18-93               | 335.53           | 9.13                | 326.40                        | ND                              | NR                          | NR                           |
| MW-3             | 07-28-93               | 335.53           | 9.49                | 326.04                        | ND                              | NR                          | NR                           |
| MW-3             | 08-30-93               | 335.53           | 9.62                | 325.91                        | ND                              | NR                          | NR                           |
| MW-3             | 09-28-93               | 335.53           | 9.80                | 325.73                        | ND                              | NR                          | NR                           |
| MW-3             | 10-31-93               | 335.53           | 9.84                | 325.69                        | ND                              | NR                          | NR                           |
| MW-3             | 11-11-93               | 335.53           | 9.81                | 325.72                        | ND                              | NR                          | NR                           |
| MW-3             | 12-15-93               | 335.53           | 10.23               | 325.30                        | ND                              | NR                          | NR                           |
| MW-3             | 02-11-94               | 335.53           | 9.60                | 325.93                        | ND                              | NR                          | NR                           |
| MW-3             | 03-13-94               | 335.53           | 9.03                | 326.50                        | ND                              | NR                          | NR                           |
| MW-3             | 05-17-94               | 335.53           | 9.11                | 326.42                        | ND                              | NR                          | NR                           |
| MW-3             | 08-25-94               | 335.53           | 11.09               | 324.44                        | ND                              | NR                          | NR                           |
| MW-3             | 09-22-94               | 335.53           | 10.21               | 325.32                        | ND                              | NR                          | NR                           |
| MW-3             | 11-18-94               | 335.53           | 9.79                | 325.74                        | ND                              | NR                          | NR                           |

Table 2  
Historical Groundwater Elevation Data  
Summary Report

ARCO Service Station 6041  
7249 Village Parkway, Dublin, California

Date: 02-08-95  
Project Number: 0805-132.01

| Well Designation | Water Level Field Date | TOC Elevation<br>ft-MSL | Depth to Water<br>feet | Ground-Water Elevation<br>ft-MSL | Floating Product Thickness<br>feet | Ground-Water Flow Direction<br>MWN | Hydraulic Gradient<br>foot/foot |
|------------------|------------------------|-------------------------|------------------------|----------------------------------|------------------------------------|------------------------------------|---------------------------------|
| MW-4             | 11-10-92               | 334.22                  | 9.58                   | 324.64                           | ND                                 | NR                                 | NR                              |
| MW-4             | 12-14-92               | 334.22                  | 8.72                   | 325.50                           | ND                                 | NR                                 | NR                              |
| MW-4             | 01-15-93               | 334.22                  | 7.27                   | 326.95                           | ND                                 | NR                                 | NR                              |
| MW-4             | 02-10-93               | 334.22                  | 6.80                   | 327.42                           | ND                                 | NR                                 | NR                              |
| MW-4             | 03-29-93               | 334.22                  | 6.29                   | 327.93                           | ND                                 | NR                                 | NR                              |
| MW-4             | 04-27-93               | 334.22                  | 6.33                   | 327.89                           | ND                                 | NR                                 | NR                              |
| MW-4             | 05-10-93               | 334.22                  | 6.68                   | 327.54                           | ND                                 | NR                                 | NR                              |
| MW-4             | 06-18-93               | 334.22                  | 7.05                   | 327.17                           | ND                                 | NR                                 | NR                              |
| MW-4             | 07-28-93               | 334.22                  | 7.77                   | 326.45                           | ND                                 | NR                                 | NR                              |
| MW-4             | 08-30-93               | 334.22                  | 8.09                   | 326.13                           | ND                                 | NR                                 | NR                              |
| MW-4             | 09-28-93               | 334.22                  | 8.40                   | 325.82                           | ND                                 | NR                                 | NR                              |
| MW-4             | 10-31-93               | 334.22                  | 8.56                   | 325.66                           | ND                                 | NR                                 | NR                              |
| MW-4             | 11-11-93               | 334.22                  | 8.48                   | 325.74                           | ND                                 | NR                                 | NR                              |
| MW-4             | 12-15-93               | 334.22                  | 8.38                   | 325.84                           | ND                                 | NR                                 | NR                              |
| MW-4             | 02-11-94               | 334.22                  | 8.15                   | 326.07                           | ND                                 | NR                                 | NR                              |
| MW-4             | 03-13-94               | 334.22                  | 7.57                   | 326.65                           | ND                                 | NR                                 | NR                              |
| MW-4             | 05-17-94               | 334.22                  | 7.49                   | 326.73                           | ND                                 | NR                                 | NR                              |
| MW-4             | 08-25-94               | 334.22                  | 8.79                   | 325.43                           | ND                                 | NR                                 | NR                              |
| MW-4             | 09-22-94               | 334.22                  | 8.99                   | 325.23                           | ND                                 | NR                                 | NR                              |
| MW-4             | 11-18-94               | 334.22                  | 8.31                   | 325.91                           | ND                                 | NR                                 | NR                              |
|                  |                        |                         |                        |                                  |                                    |                                    |                                 |
| MW-5             | 11-10-92               | 335.87                  | 11.02                  | 324.85                           | ND                                 | NR                                 | NR                              |
| MW-5             | 12-14-92               | 335.87                  | 10.17                  | 325.70                           | ND                                 | NR                                 | NR                              |
| MW-5             | 01-15-93               | 335.87                  | 8.14                   | 327.73                           | ND                                 | NR                                 | NR                              |
| MW-5             | 02-10-93               | 335.87                  | 8.00                   | 327.87                           | ND                                 | NR                                 | NR                              |
| MW-5             | 03-29-93               | 335.87                  | 7.52                   | 328.35                           | ND                                 | NR                                 | NR                              |
| MW-5             | 04-27-93               | 335.87                  | 8.26                   | 327.61                           | ND                                 | NR                                 | NR                              |
| MW-5             | 05-10-93               | 335.87                  | 8.64                   | 327.23                           | ND                                 | NR                                 | NR                              |
| MW-5             | 06-18-93               | 335.87                  | 9.26                   | 326.61                           | ND                                 | NR                                 | NR                              |
| MW-5             | 07-28-93               | 335.87                  | 9.65                   | 326.22                           | ND                                 | NR                                 | NR                              |
| MW-5             | 08-30-93               | 335.87                  | 9.81                   | 326.06                           | ND                                 | NR                                 | NR                              |
| MW-5             | 09-28-93               | 335.87                  | 9.99                   | 325.88                           | ND                                 | NR                                 | NR                              |
| MW-5             | 10-31-93               | 335.87                  | 10.02                  | 325.85                           | ND                                 | NR                                 | NR                              |
| MW-5             | 11-11-93               | 335.87                  | 10.09                  | 325.78                           | ND                                 | NR                                 | NR                              |
| MW-5             | 12-15-93               | 335.87                  | 10.08                  | 325.79                           | ND                                 | NR                                 | NR                              |
| MW-5             | 02-11-94               | 335.87                  | 9.63                   | 326.24                           | ND                                 | NR                                 | NR                              |
| MW-5             | 03-13-94               | 335.87                  | 9.26                   | 326.61                           | ND                                 | NR                                 | NR                              |
| MW-5             | 05-17-94               | 335.87                  | 8.99                   | 326.88                           | ND                                 | NR                                 | NR                              |
| MW-5             | 08-25-94               | 335.87                  | 10.23                  | 325.64                           | ND                                 | NR                                 | NR                              |
| MW-5             | 09-22-94               | 335.87                  | 10.39                  | 325.48                           | ND                                 | NR                                 | NR                              |
| MW-5             | 11-18-94               | 335.87                  | 9.65                   | 326.22                           | ND                                 | NR                                 | NR                              |

Table 2  
 Historical Groundwater Elevation Data  
 Summary Report

ARCO Service Station 6041  
 7249 Village Parkway, Dublin, California

Date: 02-08-95  
 Project Number: 0805-132.01

| Well<br>Designation | Water<br>Level<br>Field<br>Date | TOC<br>Elevation<br>ft-MSL | Depth<br>to<br>Water<br>feet | Ground-<br>Water<br>Elevation<br>ft-MSL | Floating<br>Product<br>Thickness<br>feet | Ground-<br>Water<br>Flow<br>Direction<br>MWN | Hydraulic<br>Gradient<br>foot/foot |
|---------------------|---------------------------------|----------------------------|------------------------------|---|--|--|------------------------------------|
|                     |                                 |                            |                              |   |  |  |                                    |
| MW-6                | 11-10-92                        | 335.84                     | 11.03                        | 324.81                                  | ND                                       | NR   | NR                                 |
| MW-6                | 12-14-92                        | 335.84                     | 10.03                        | 325.81                                  | ND                                       | NR   | NR                                 |
| MW-6                | 01-15-93                        | 335.84                     | 7.64                         | 328.20                                  | ND                                       | NR   | NR                                 |
| MW-6                | 02-10-93                        | 335.84                     | 8.22                         | 327.62                                  | ND                                       | NR   | NR                                 |
| MW-6                | 03-29-93                        | 335.84                     | 7.59                         | 328.25                                  | ND                                       | NR   | NR                                 |
| MW-6                | 04-27-93                        | 335.84                     | 8.20                         | 327.64                                  | ND                                       | NR   | NR                                 |
| MW-6                | 05-10-93                        | 335.84                     | 8.85                         | 326.99                                  | ND                                       | NR   | NR                                 |
| MW-6                | 06-18-93                        | 335.84                     | 9.26                         | 326.58                                  | ND                                       | NR   | NR                                 |
| MW-6                | 07-28-93                        | 335.84                     | 9.83                         | 326.01                                  | ND                                       | NR   | NR                                 |
| MW-6                | 08-30-93                        | 335.84                     | 10.15                        | 325.69                                  | ND                                       | NR   | NR                                 |
| MW-6                | 09-28-93                        | 335.84                     | 9.95                         | 325.89                                  | ND                                       | NR   | NR                                 |
| MW-6                | 10-31-93                        | 335.84                     | 10.16                        | 325.68                                  | ND                                       | NR   | NR                                 |
| MW-6                | 11-11-93                        | 335.84                     | 10.02                        | 325.82                                  | ND                                       | NR   | NR                                 |
| MW-6                | 12-15-93                        | 335.84                     | 10.28                        | 325.56                                  | ND                                       | NR   | NR                                 |
| MW-6                | 02-11-94                        | 335.84                     | 9.66                         | 326.18                                  | ND                                       | NR   | NR                                 |
| MW-6                | 03-13-94                        | 335.84                     | 9.28                         | 326.56                                  | ND                                       | NR   | NR                                 |
| MW-6                | 05-17-94                        | 335.84                     | 9.10                         | 326.74                                  | ND                                       | NR   | NR                                 |
| MW-6                | 08-25-94                        | 335.84                     | 10.39                        | 325.45                                  | ND                                       | NR   | NR                                 |
| MW-6                | 09-22-94                        | 335.84                     | 10.50                        | 325.34                                  | ND                                       | NR   | NR                                 |
| MW-6                | 11-18-94                        | 335.84                     | 9.54                         | 326.30                                  | ND                                       | NR   | NR                                 |

TOC = Top of casing  
 ft-MSL = Elevation in feet, relative to mean sea level  
 MWN = Ground-water flow direction and gradient apply to the entire monitoring well network  
 ND = None detected  
 NR = Not reported; data not available or not measurable

**Table 3**  
**Historical Groundwater Analytical Data**  
**Summary Report**

ARCO Service Station 6041  
 7249 Village Parkway, Dublin, California

Date: 02-08-95  
 Project Number: 0805-132.01

| Well<br>Designation | Water<br>Sample<br>Field<br>Date | TPHG | Benzene | Toluene | Ethyl-<br>benzene | Total<br>Xylenes |
|---------------------|----------------------------------|------|---------|---------|-------------------|------------------|
|                     |                                  | ppb  | ppb     | ppb     | ppb               | ppb              |
| MW-1                | 09-20-91                         | 410  | 28      | 36      | 4.3               | 89               |
| MW-1                | 12-16-91                         | 840  | 50      | 50      | 3.9               | 12               |
| MW-1                | 03-16-92                         | 780  | 22      | 12      | 45                | 22               |
| MW-1                | 06-09-92                         | 700  | 8.8     | 15      | 16                | 18               |
| MW-1                | 09-09-92                         | 400  | 5.4     | 8.4     | 4.6               | 6.7              |
| MW-1                | 11-10-92                         | 2800 | 93      | 56      | 190               | 390              |
| MW-1                | 02-10-93                         | 9700 | 180     | 100     | 450               | 740              |
| MW-1                | 05-10-93                         | 6400 | 120     | 12      | 410               | 300              |
| MW-1                | 08-30-93                         | 2000 | 2.5     | <2.5    | 110               | 61               |
| MW-1                | 11-11-93                         | 2100 | <2.5    | <2.5    | 66                | 20               |
| MW-1                | 02-11-94                         | 2000 | <2.5    | <2.5    | 25                | 5.7              |
| MW-1                | 05-17-94                         | 1400 | 79      | 1.4     | 11                | 2.4              |
| MW-1                | 08-25-94                         | 880  | 2.4     | <1      | 4.6               | <1               |
|                     |                                  |      |         |         |                   |                  |
| MW-2                | 09-20-91                         | 130  | 6.6     | 0.96    | 1.4               | 1.5              |
| MW-2                | 12-16-91                         | 83   | 0.96    | <0.3    | <0.3              | <0.3             |
| MW-2                | 03-16-92                         | 430  | 130     | <2.5    | 37                | 5                |
| MW-2                | 06-09-92                         | 120  | 3.7     | <0.5    | 5.7               | <0.5             |
| MW-2                | 09-09-92                         | <50  | <0.5    | <0.5    | <0.5              | <0.5             |
| MW-2                | 11-10-92                         | <50  | <0.5    | <0.5    | <0.5              | <0.5             |
| MW-2                | 02-10-93                         | 740  | 110     | <5      | 35                | <5               |
| MW-2                | 05-10-93                         | 2000 | 650     | 14      | 86                | 28               |
| MW-2                | 08-30-93                         | 170  | 1.4     | 7.9     | 1.6               | 15               |
| MW-2                | 11-11-93                         | 78   | <0.5    | 2.8     | 0.7               | 5.9              |
| MW-2                | 02-11-94                         | <50  | 2.4     | 0.7     | <0.5              | <0.5             |
| MW-2                | 05-17-94                         | 150  | 19      | <0.5    | 2.5               | 1.2              |
| MW-2                | 08-25-94                         | <50  | <0.5    | <0.5    | <0.5              | <0.5             |

Table 3  
 Historical Groundwater Analytical Data  
 Summary Report

ARCO Service Station 6041  
 7249 Village Parkway, Dublin, California

Date: 02-08-95  
 Project Number: 0805-132.01

| Well<br>Designation | Water<br>Sample<br>Field<br>Date | TPHG<br><br>ppb | Benzene<br><br>ppb | Toluene<br><br>ppb | Ethyl-<br>benzene<br><br>ppb | Total<br>Xylenes<br><br>ppb |
|---------------------|----------------------------------|-----------------|--------------------|--------------------|------------------------------|-----------------------------|
| MW-3                | 09-20-91                         | 990             | 50                 | 100                | 11                           | 200                         |
| MW-3                | 12-16-91                         | 1000            | 180                | 5.1                | 23                           | 4.3                         |
| MW-3                | 03-16-92                         | 430             | 86                 | <1.0               | 22                           | 3.4                         |
| MW-3                | 06-09-92                         | 1800            | 290                | 2.4                | 49                           | 17                          |
| MW-3                | 09-09-92                         | 2600            | 550                | <5                 | 120                          | 12                          |
| MW-3                | 11-10-92                         | 1100            | 280                | <5                 | 100                          | <5                          |
| MW-3                | 02-10-93                         | 980             | 190                | <5                 | 52                           | <5                          |
| MW-3                | 05-10-93                         | 1100            | 280                | <2.5               | 70                           | <2.5                        |
| MW-3                | 08-30-93                         | 470             | 120                | <1                 | 22                           | <1                          |
| MW-3                | 11-11-93                         | 830             | 96                 | <2.5               | 25                           | <2.5                        |
| MW-3                | 02-11-94                         | 220             | 42                 | <1.0               | 84                           | <1.0                        |
| MW-3                | 05-17-94                         | 200             | 44                 | <0.5               | 9.3                          | <0.5                        |
| MW-3                | 08-25-94                         | 100             | 4.3                | <0.5               | 1.1                          | <0.5                        |
|                     |                                  |                 |                    |                    |                              |                             |
| MW-4                | 11-10-92                         | <50             | <0.5               | <0.5               | <0.5                         | <0.5                        |
| MW-4                | 02-10-93                         | <50             | <0.5               | <0.5               | <0.5                         | <0.5                        |
| MW-4                | 05-10-93                         | <50             | <0.5               | <0.5               | <0.5                         | <0.5                        |
| MW-4                | 08-30-93                         | <50             | <0.5               | <0.5               | <0.5                         | <0.5                        |
| MW-4                | 11-11-93                         | <50             | <0.5               | <0.5               | <0.5                         | <0.5                        |
| MW-4                | 02-11-94                         | <50             | <0.5               | <0.5               | <0.5                         | <0.5                        |
| MW-4                | 05-17-94                         | <50             | <0.5               | <0.5               | <0.5                         | <0.5                        |
| MW-4                | 08-25-94                         | <50             | <0.5               | <0.5               | <0.5                         | <0.5                        |
|                     |                                  |                 |                    |                    |                              |                             |
| MW-5                | 11-10-92                         | <50             | <0.5               | <0.5               | <0.5                         | <0.5                        |
| MW-5                | 02-10-93                         | <50             | <0.5               | <0.5               | <0.5                         | <0.5                        |
| MW-5                | 05-10-93                         | <50             | <0.5               | <0.5               | <0.5                         | <0.5                        |
| MW-5                | 08-30-93                         | <50             | <0.5               | <0.5               | <0.5                         | <0.5                        |
| MW-5                | 11-11-93                         | <50             | <0.5               | <0.5               | <0.5                         | <0.5                        |
| MW-5                | 02-11-94                         | <50             | <0.5               | <0.5               | <0.5                         | <0.5                        |
| MW-5                | 05-17-94                         | <50             | <0.5               | <0.5               | <0.5                         | <0.5                        |
| MW-5                | 08-25-94                         | <50             | <0.5               | <0.5               | <0.5                         | <0.5                        |

**Table 3**  
**Historical Groundwater Analytical Data**  
**Summary Report**

ARCO Service Station 6041  
 7249 Village Parkway, Dublin, California

Date: 02-08-95  
 Project Number: 0805-132.01

| Well<br>Desig-<br>nation | Water<br>Sample<br>Field<br>Date | TPHG<br><br>ppb | Benzene<br><br>ppb | Toluene<br><br>ppb | Ethyl-<br>benzene<br><br>ppb | Total<br>Xylenes<br><br>ppb |
|--------------------------|----------------------------------|-----------------|--------------------|--------------------|------------------------------|-----------------------------|
| MW-6                     | 11-10-92                         | <50             | <0.5               | <0.5               | <0.5                         | <0.5                        |
| MW-6                     | 02-10-93                         | <50             | <0.5               | <0.5               | <0.5                         | <0.5                        |
| MW-6                     | 05-10-93                         | <50             | <0.5               | <0.5               | <0.5                         | <0.5                        |
| MW-6                     | 08-30-93                         | <50             | <0.5               | <0.5               | <0.5                         | <0.5                        |
| MW-6                     | 11-11-93                         | <50             | <0.5               | <0.5               | <0.5                         | <0.5                        |
| MW-6                     | 02-11-94                         | <50             | <0.5               | <0.5               | <0.5                         | <0.5                        |
| MW-6                     | 05-17-94                         | <50             | <0.5               | <0.5               | <0.5                         | <0.5                        |
| MW-6                     | 08-25-94                         | <50             | <0.5               | <0.5               | <0.5                         | <0.5                        |

---

TPHG = Total petroleum hydrocarbons as gasoline  
 ppb = Parts per billion or micrograms per liter (µg/l)

---

Table 4  
 Historical Groundwater Elevation Data  
 Summary Report

BP Station 1116, 7197 Village Parkway,  
 Former Shell Station, 7194 Amador Valley Blvd.,  
 and UNOCAL Station, 7375 Amador Valley Blvd.,  
 Dublin, California

Date: 02-08-95  
 Project Number: 0805-132.01

| Well<br>Desig-<br>nation | Water<br>Level<br>Date | TOC<br>Elevation<br>ft-MSL | Depth<br>to<br>Water<br>feet        | Ground-<br>Water<br>Elevation<br>ft-MSL | Comments |
|--------------------------|------------------------|----------------------------|-------------------------------------|---|----------|
| <b>BP Station 1116</b>   |                        |                            |                                     |   |          |
| MW-1                     | 11-10-92               | 335.17                     | 10.67                               | 324.50                                  |          |
| MW-1                     | 02-10-93               | 335.17                     | 5.25                                | 329.92                                  |          |
| MW-1                     | 05-21-93               | 335.17                     | 5.73                                | 329.44                                  |          |
| MW-1                     | 08-12-93               | 335.17                     | 8.99                                | 326.18                                  |          |
| MW-1                     | 11-11-93               | 335.17                     | 9.65                                | 325.52                                  |          |
| MW-1                     | 02-11-94               | 335.17                     | 8.72                                | 326.45                                  |          |
| MW-1                     | 10-04-94               | 335.17                     | 9.66                                | 325.51                                  |          |
| MW-1                     | 11-18-94               | 335.17                     | Not surveyed:                       |   |          |
| MW-2                     | 11-10-92               | 334.58                     | 10.27                               | 324.31                                  |          |
| MW-2                     | 02-10-93               | 334.58                     | 6.46                                | 328.12                                  |          |
| MW-2                     | 05-21-93               | 334.58                     | 6.96                                | 327.62                                  |          |
| MW-2                     | 08-12-93               | 334.58                     | 8.58                                | 326.00                                  |          |
| MW-2                     | 11-11-93               | 334.58                     | 9.28                                | 325.30                                  |          |
| MW-2                     | 02-11-94               | 334.58                     | 8.10                                | 326.48                                  |          |
| MW-2                     | 10-04-94               | 334.58                     | 9.27                                | 325.31                                  |          |
| MW-2                     | 11-18-94               | 334.58                     | Not surveyed:                       |   |          |
| MW-3                     | 11-10-92               | 335.13                     | 10.78                               | 324.35                                  |          |
| MW-3                     | 02-10-93               | 335.13                     | 7.16                                | 327.97                                  |          |
| MW-3                     | 05-21-93               | 335.13                     | 7.69                                | 327.44                                  |          |
| MW-3                     | 08-12-93               | 335.13                     | 9.11                                | 326.02                                  |          |
| MW-3                     | 11-11-93               | 335.13                     | 9.78                                | 325.35                                  |          |
| MW-3                     | 02-11-94               | 335.13                     | 8.60                                | 326.53                                  |          |
| MW-3                     | 10-04-94               | 335.13                     | 9.81                                | 325.32                                  |          |
| MW-3                     | 11-18-94               | 335.13                     | Not surveyed:                       |   |          |
| AW-4                     | 11-10-92               | 333.41                     | 9.10                                | 324.31                                  |          |
| AW-4                     | 02-10-93               | 333.41                     | Not surveyed: well was inaccessible |   |          |
| AW-4                     | 05-21-93               | 333.41                     | Not surveyed: well was inaccessible |   |          |
| AW-4                     | 08-12-93               | 333.41                     | Not surveyed: well was inaccessible |   |          |
| AW-4                     | 11-11-93               | 333.41                     | 8.00                                | 325.41                                  |          |
| AW-4                     | 02-11-94               | 333.41                     | 6.84                                | 326.57                                  |          |
| AW-4                     | 10-04-94               | 333.41                     | 8.04                                | 325.37                                  |          |
| AW-4                     | 11-18-94               | 333.41                     | 6.80                                | 326.61                                  |          |



**Table 4**  
**Historical Groundwater Elevation Data**  
**Summary Report**

BP Station 1116, 7197 Village Parkway,  
 Former Shell Station, 7194 Amador Valley Blvd.,  
 and UNOCAL Station, 7375 Amador Valley Blvd.,  
 Dublin, California

Date: 02-08-95  
 Project Number: 0805-132.01

| Well<br>Desig-<br>nation | Water<br>Level<br>Field<br>Date | TOC<br>Elevation<br>ft-MSL | Depth<br>to<br>Water<br>feet | Ground-<br>Water<br>Elevation<br>ft-MSL | Comments |
|--------------------------|---------------------------------|----------------------------|------------------------------|---|----------|
| AW-5                     | 11-10-92                        | 334.81                     | 10.27                        | 324.54                                  |          |
| AW-5                     | 02-10-93                        | 334.81                     | 7.29                         | 327.52                                  |          |
| AW-5                     | 05-21-93                        | 334.81                     | 7.77                         | 327.04                                  |          |
| AW-5                     | 08-12-93                        | 334.81                     | 8.87                         | 325.94                                  |          |
| AW-5                     | 11-11-93                        | 334.81                     | 9.13                         | 325.68                                  |          |
| AW-5                     | 02-11-94                        | 334.81                     | 8.20                         | 326.61                                  |          |
| AW-5                     | 10-04-94                        | 334.81                     | 8.70                         | 326.11                                  |          |
| AW-5                     | 11-18-94                        | 334.81                     | 8.20                         | 326.61                                  |          |
|                          |                                 |                            |                              |   |          |
| AW-6                     | 11-10-92                        | 334.90                     | 10.10                        | 324.80                                  |          |
| AW-6                     | 02-10-93                        | 334.90                     | 7.13                         | 327.77                                  |          |
| AW-6                     | 05-21-93                        | 334.90                     | 7.64                         | 327.26                                  |          |
| AW-6                     | 08-12-93                        | 334.90                     | 8.64                         | 326.26                                  |          |
| AW-6                     | 11-11-93                        | 334.90                     | 8.67                         | 326.23                                  |          |
| AW-6                     | 02-11-94                        | 334.90                     | 8.04                         | 326.86                                  |          |
| AW-6                     | 10-04-94                        | 334.90                     | 9.33                         | 325.57                                  |          |
| AW-6                     | 11-18-94                        | 334.90                     | 7.17                         | 327.73                                  |          |

**Former Shell Station**

|      |          |        |       |        |  |
|------|----------|--------|-------|--------|--|
| MW-1 | 11-10-92 | 334.83 | 10.04 | 324.79 |  |
| MW-1 | 02-10-93 | 334.83 | 7.24  | 327.59 |  |
| MW-1 | 05-10-93 | 334.83 | 7.78  | 327.05 |  |
| MW-1 | 08-12-93 | 334.83 | 8.54  | 326.29 |  |
| MW-1 | 11-11-93 | 334.83 | 8.56  | 326.27 |  |
| MW-1 | 02-11-94 | 334.83 | 8.62  | 326.21 |  |
| MW-1 | 08-25-94 | 334.83 | 9.24  | 325.59 |  |
| MW-1 | 11-23-94 | 334.83 | 8.74  | 326.09 |  |
|      |          |        |       |        |  |
| MW-2 | 11-10-92 | 336.96 | 12.05 | 324.91 |  |
| MW-2 | 02-10-93 | 336.96 | 9.28  | 327.68 |  |
| MW-2 | 05-10-93 | 336.96 | 9.65  | 327.31 |  |
| MW-2 | 08-12-93 | 336.96 | 10.70 | 326.26 |  |
| MW-2 | 11-11-93 | 336.96 | 11.36 | 325.60 |  |
| MW-2 | 02-11-94 | 336.96 | 11.04 | 325.92 |  |
| MW-2 | 08-25-94 | 336.96 | 11.29 | 325.67 |  |
| MW-2 | 11-23-94 | 336.96 | 10.92 | 326.04 |  |

Table 4  
 Historical Groundwater Elevation Data  
 Summary Report

BP Station 1116, 7197 Village Parkway,  
 Former Shell Station, 7194 Amador Valley Blvd.,  
 and UNOCAL Station, 7375 Amador Valley Blvd.,  
 Dublin, California

Date: 02-08-95  
 Project Number: 0805-132.01

| Well<br>Desig-<br>nation | Water<br>Level<br>Field<br>Date | TOC<br>Elevation<br>ft-MSL | Depth<br>to<br>Water<br>feet | Ground-<br>Water<br>Elevation<br>ft-MSL | Comments |
|--------------------------|---------------------------------|----------------------------|------------------------------|---|----------|
| MW-3                     | 11-10-92                        | 336.93                     | 11.84                        | 325.09                                  |          |
| MW-3                     | 02-10-93                        | 336.93                     | 8.82                         | 328.11                                  |          |
| MW-3                     | 05-10-93                        | 336.93                     | 10.88                        | 326.05                                  |          |
| MW-3                     | 08-12-93                        | 336.93                     | 10.36                        | 326.57                                  |          |
| MW-3                     | 11-11-93                        | 336.93                     | 10.64                        | 326.29                                  |          |
| MW-3                     | 02-11-94                        | 336.93                     | 10.68                        | 326.25                                  |          |
| MW-3                     | 08-25-94                        | 336.93                     | 11.30                        | 325.63                                  |          |
| MW-3                     | 11-23-94                        | 336.93                     | 10.48                        | 326.45                                  |          |
|                          |                                 |                            |                              |   |          |
| MW-4                     | 11-10-92                        | 337.14                     | 12.12                        | 325.02                                  |          |
| MW-4                     | 02-10-93                        | 337.14                     | 9.40                         | 327.74                                  |          |
| MW-4                     | 05-10-93                        | 337.14                     | 9.54                         | 327.60                                  |          |
| MW-4                     | 08-12-93                        | 337.14                     | 10.68                        | 326.46                                  |          |
| MW-4                     | 11-11-93                        | 337.14                     | 11.97                        | 325.17                                  |          |
| MW-4                     | 02-11-94                        | 337.14                     | 10.71                        | 326.43                                  |          |
| MW-4                     | 08-25-94                        | 337.14                     | 10.84                        | 326.30                                  |          |
| MW-4                     | 11-23-94                        | 337.14                     | 10.78                        | 326.36                                  |          |
|                          |                                 |                            |                              |   |          |
| MW-5                     | 11-10-92                        | 334.96                     | 9.65                         | 325.31                                  |          |
| MW-5                     | 02-10-93                        | 334.96                     | 7.97                         | 326.99                                  |          |
| MW-5                     | 05-10-93                        | 334.96                     | Not surveyed:                |   |          |
| MW-5                     | 08-12-93                        | 334.96                     | 8.75                         | 326.21                                  |          |
| MW-5                     | 11-11-93                        | 334.96                     | 9.32                         | 325.64                                  |          |
| MW-5                     | 02-11-94                        | 334.96                     | 8.97                         | 325.99                                  |          |
| MW-5                     | 08-25-94                        | 334.96                     | 9.19                         | 325.77                                  |          |
| MW-5                     | 11-23-94                        | 334.96                     | 8.78                         | 326.18                                  |          |
|                          |                                 |                            |                              |   |          |
| MW-6                     | 11-10-92                        | 335.42                     | 10.56                        | 324.86                                  |          |
| MW-6                     | 02-10-93                        | 335.42                     | 7.65                         | 327.77                                  |          |
| MW-6                     | 05-10-93                        | 335.42                     | 8.10                         | 327.32                                  |          |
| MW-6                     | 08-12-93                        | 335.42                     | 9.18                         | 326.24                                  |          |
| MW-6                     | 11-11-93                        | 335.42                     | 9.38                         | 326.04                                  |          |
| MW-6                     | 02-11-94                        | 335.42                     | 9.02                         | 326.40                                  |          |
| MW-6                     | 08-25-94                        | 335.42                     | 9.79                         | 325.63                                  |          |
| MW-6                     | 11-23-94                        | 335.42                     | 9.20                         | 326.22                                  |          |

Table 4  
 Historical Groundwater Elevation Data  
 Summary Report

BP Station 1116, 7197 Village Parkway,  
 Former Shell Station, 7194 Amador Valley Blvd.,  
 and UNOCAL Station, 7375 Amador Valley Blvd.,  
 Dublin, California

Date: 02-08-95  
 Project Number: 0805-132.01

| Well<br>Desig-<br>nation | Water<br>Level<br>Field<br>Date | TOC<br>Elevation<br>ft-MSL | Depth<br>to<br>Water<br>feet | Ground-<br>Water<br>Elevation<br>ft-MSL | Comments |
|--------------------------|---------------------------------|----------------------------|------------------------------|---|----------|
| MW-7                     | 11-10-92                        | 333.23                     | 8.82                         | 324.41                                  |          |
| MW-7                     | 02-10-93                        | 333.23                     | 6.06                         | 327.17                                  |          |
| MW-7                     | 05-10-93                        | 333.23                     | 6.68                         | 326.55                                  |          |
| MW-7                     | 08-12-93                        | 333.23                     | 6.83                         | 326.40                                  |          |
| MW-7                     | 11-11-93                        | 333.23                     | 6.90                         | 326.33                                  |          |
| MW-7                     | 02-11-94                        | 333.23                     | 6.12                         | 327.11                                  |          |
| MW-7                     | 08-25-94                        | 333.23                     | 6.76                         | 326.47                                  |          |
| MW-7                     | 11-23-94                        | 333.23                     | 6.75                         | 326.48                                  |          |
|                          |                                 |                            |                              |   |          |
| MW-8                     | 11-10-92                        | 335.80                     | 10.41                        | 325.39                                  |          |
| MW-8                     | 02-10-93                        | 335.80                     | 7.35                         | 328.45                                  |          |
| MW-8                     | 05-10-93                        | 335.80                     | 8.00                         | 327.80                                  |          |
| MW-8                     | 08-12-93                        | 335.80                     | 9.00                         | 326.80                                  |          |
| MW-8                     | 11-11-93                        | 335.80                     | 9.47                         | 326.33                                  |          |
| MW-8                     | 02-11-94                        | 335.80                     | 8.80                         | 327.00                                  |          |
| MW-8                     | 08-25-94                        | 335.80                     | 9.52                         | 326.28                                  |          |
| MW-8                     | 11-23-94                        | 335.80                     | 9.08                         | 326.72                                  |          |
|                          |                                 |                            |                              |   |          |
| MW-9                     | 11-10-92                        | 334.57                     | 9.61                         | 324.96                                  |          |
| MW-9                     | 02-10-93                        | 334.57                     | 7.20                         | 327.37                                  |          |
| MW-9                     | 05-10-93                        | 334.57                     | 7.56                         | 327.01                                  |          |
| MW-9                     | 08-12-93                        | 334.57                     | 8.25                         | 326.32                                  |          |
| MW-9                     | 11-11-93                        | 334.57                     | 10.30                        | 324.27                                  |          |
| MW-9                     | 02-11-94                        | 334.57                     | 8.88                         | 325.69                                  |          |
| MW-9                     | 08-25-94                        | 334.57                     | 8.79                         | 325.78                                  |          |
| MW-9                     | 11-23-94                        | 334.57                     | 8.65                         | 325.92                                  |          |
|                          |                                 |                            |                              |   |          |
| MW-11                    | 11-10-92                        | 334.20                     | 9.47                         | 324.73                                  |          |
| MW-11                    | 02-10-93                        | 334.20                     | 6.79                         | 327.41                                  |          |
| MW-11                    | 05-10-93                        | 334.20                     | 7.18                         | 327.02                                  |          |
| MW-11                    | 08-12-93                        | 334.20                     | 8.10                         | 326.10                                  |          |
| MW-11                    | 11-11-93                        | 334.20                     | 8.56                         | 325.64                                  |          |
| MW-11                    | 02-11-94                        | 334.20                     | 8.21                         | 325.99                                  |          |
| MW-11                    | 08-25-94                        | 334.20                     | 8.68                         | 325.52                                  |          |
| MW-11                    | 11-23-94                        | 334.20                     | 8.27                         | 325.93                                  |          |

Table 4  
Historical Groundwater Elevation Data  
Summary Report

BP Station 1116, 7197 Village Parkway,  
Former Shell Station, 7194 Amador Valley Blvd.,  
and UNOCAL Station, 7375 Amador Valley Blvd.,  
Dublin, California

Date: 02-08-95  
Project Number: 0805-132.01

| Well<br>Desig-<br>nation     | Water<br>Level<br>Field<br>Date | TOC<br>Elevation<br><br>ft-MSL | Depth<br>to<br>Water<br>feet | Ground-<br>Water<br>Elevation<br><br>ft-MSL | Comments            |
|------------------------------|---------------------------------|--------------------------------|------------------------------|---|---------------------|
| MW-12                        | 11-10-92                        | 332.53                         | 8.32                         | 324.21                                      |                     |
| MW-12                        | 02-10-93                        | 332.53                         | 6.75                         | 325.78                                      |                     |
| MW-12                        | 05-10-93                        | 332.53                         | Not surveyed:                |   |                     |
| MW-12                        | 08-12-93                        | 332.53                         | 6.23                         | 326.30                                      |                     |
| MW-12                        | 11-11-93                        | 332.53                         | 7.43                         | 325.10                                      |                     |
| MW-12                        | 02-11-94                        | 332.53                         | 7.18                         | 325.35                                      |                     |
| MW-12                        | 08-25-94                        | 332.53                         | 7.24                         | 325.29                                      |                     |
| MW-12                        | 11-23-94                        | 332.53                         | 7.16                         | 325.37                                      |                     |
|                              |                                 |                                |                              |   |                     |
| MW-13                        | 11-10-92                        | 335.64                         | 10.69                        | 324.95                                      |                     |
| MW-13                        | 02-10-93                        | 335.64                         | 7.49                         | 328.15                                      |                     |
| MW-13                        | 05-10-93                        | 335.64                         | 8.06                         | 327.58                                      |                     |
| MW-13                        | 08-12-93                        | 335.64                         | 8.73                         | 326.91                                      |                     |
| MW-13                        | 11-11-93                        | 335.64                         | 9.15                         | 326.49                                      |                     |
| MW-13                        | 02-11-94                        | 335.64                         | 9.12                         | 326.52                                      |                     |
| MW-13                        | 08-25-94                        | 335.64                         | 9.32                         | 326.32                                      |                     |
| MW-13                        | 11-23-94                        | 335.64                         | 9.37                         | 326.27                                      |                     |
|                              |                                 |                                |                              |   |                     |
| RW-1                         | 08-25-94                        | 336.19                         | 10.56                        | 325.63                                      |                     |
| RW-1                         | 11-23-94                        | 336.19                         | 10.07                        | 326.12                                      |                     |
|                              |                                 |                                |                              |   |                     |
| <b><u>UNOCAL Station</u></b> |                                 |                                |                              |   |                     |
| MW-1                         | 11-10-92                        | 336.72                         | 11.97                        | 324.75                                      |                     |
| MW-1                         | 02-10-93                        | 336.72                         | 8.63                         | 328.09                                      |                     |
| MW-1                         | 05-10-93                        | 336.72                         | 9.57                         | 327.15                                      |                     |
| MW-1                         | 08-12-93                        | 336.08                         | 9.91                         | 326.17                                      |                     |
| MW-1                         | 11-11-93                        | 336.08                         | 10.17                        | 325.90                                      | Corrected elevation |
| MW-1                         | 02-11-94                        | 336.08                         | 9.72                         | 326.35                                      | Corrected elevation |
| MW-1                         | 05-17-94                        | 336.08                         | 9.26                         | 326.81                                      | Corrected elevation |
| MW-1                         | 08-25-94                        | 336.08                         | 10.58                        | 325.49                                      | Corrected elevation |
| MW-1                         | 11-18-94                        | 336.08                         | 9.69                         | 326.38                                      | Corrected elevation |

Table 4  
 Historical Groundwater Elevation Data  
 Summary Report

BP Station 1116, 7197 Village Parkway,  
 Former Shell Station, 7194 Amador Valley Blvd.,  
 and UNOCAL Station, 7375 Amador Valley Blvd.,  
 Dublin, California

Date: 02-08-95  
 Project Number: 0805-132.01

| Well<br>Desig-<br>nation | Water<br>Level<br>Field<br>Date | TOC<br>Elevation<br><br>ft-MSL | Depth<br>to<br>Water<br><br>feet | Ground-<br>Water<br>Elevation<br><br>ft-MSL | Comments            |
|--------------------------|---------------------------------|--------------------------------|----------------------------------|---|---------------------|
| MW-2                     | 11-10-92                        | 337.36                         | 12.15                            | 325.21                                      |                     |
| MW-2                     | 02-10-93                        | 337.36                         | 8.81                             | 328.55                                      |                     |
| MW-2                     | 05-10-93                        | 337.36                         | 9.75                             | 327.61                                      |                     |
| MW-2                     | 08-12-93                        | 336.78                         | 10.11                            | 326.67                                      |                     |
| MW-2                     | 11-11-93                        | 336.78                         | 10.51                            | 326.27                                      |                     |
| MW-2                     | 02-11-94                        | 336.78                         | 9.85                             | 326.93                                      |                     |
| MW-2                     | 05-17-94                        | 336.78                         | 9.31                             | 327.47                                      |                     |
| MW-2                     | 08-25-94                        | 336.78                         | 10.75                            | 326.03                                      |                     |
| MW-2                     | 11-18-94                        | 336.78                         | 9.95                             | 326.83                                      |                     |
|                          |                                 |                                |                                  |   |                     |
| MW-3                     | 11-10-92                        | 337.53                         | 12.33                            | 325.20                                      |                     |
| MW-3                     | 02-10-93                        | 337.53                         | 8.95                             | 328.58                                      |                     |
| MW-3                     | 05-10-93                        | 337.53                         | 9.91                             | 327.62                                      |                     |
| MW-3                     | 08-12-93                        | 336.98                         | 10.34                            | 326.64                                      |                     |
| MW-3                     | 11-11-93                        | 336.98                         | 10.64                            | 326.34                                      |                     |
| MW-3                     | 02-11-94                        | 336.98                         | 10.01                            | 326.97                                      |                     |
| MW-3                     | 05-17-94                        | 336.98                         | 9.49                             | 327.49                                      |                     |
| MW-3                     | 08-25-94                        | 336.98                         | 10.93                            | 326.05                                      |                     |
| MW-3                     | 11-18-94                        | 336.98                         | 10.15                            | 326.83                                      |                     |
|                          |                                 |                                |                                  |   |                     |
| MW-4                     | 11-10-92                        | 337.00                         | 12.32                            | 324.68                                      |                     |
| MW-4                     | 02-10-93                        | 337.00                         | 8.94                             | 328.06                                      |                     |
| MW-4                     | 05-10-93                        | 337.00                         | 9.90                             | 327.10                                      |                     |
| MW-4                     | 08-12-93                        | 336.42                         | 10.32                            | 326.10                                      |                     |
| MW-4                     | 11-11-93                        | 336.42                         | 10.48                            | 325.95                                      | Corrected elevation |
| MW-4                     | 02-11-94                        | 336.42                         | 10.10                            | 326.33                                      | Corrected elevation |
| MW-4                     | 05-17-94                        | 336.42                         | 9.63                             | 326.80                                      | Corrected elevation |
| MW-4                     | 08-25-94                        | 336.42                         | 10.94                            | 325.49                                      | Corrected elevation |
| MW-4                     | 11-18-94                        | 336.42                         | 10.10                            | 326.33                                      | Corrected elevation |
|                          |                                 |                                |                                  |   |                     |
| MW-5                     | 02-11-94                        | 335.96                         | 10.08                            | 325.88                                      |                     |
| MW-5                     | 05-17-94                        | 335.96                         | 9.24                             | 326.72                                      |                     |
| MW-5                     | 08-25-94                        | 335.96                         | 10.43                            | 325.53                                      |                     |
| MW-5                     | 11-18-94                        | 335.96                         | 10.09                            | 325.87                                      |                     |

TOC = Top of casing  
 ft-MSL = Elevation in feet, relative to mean sea level

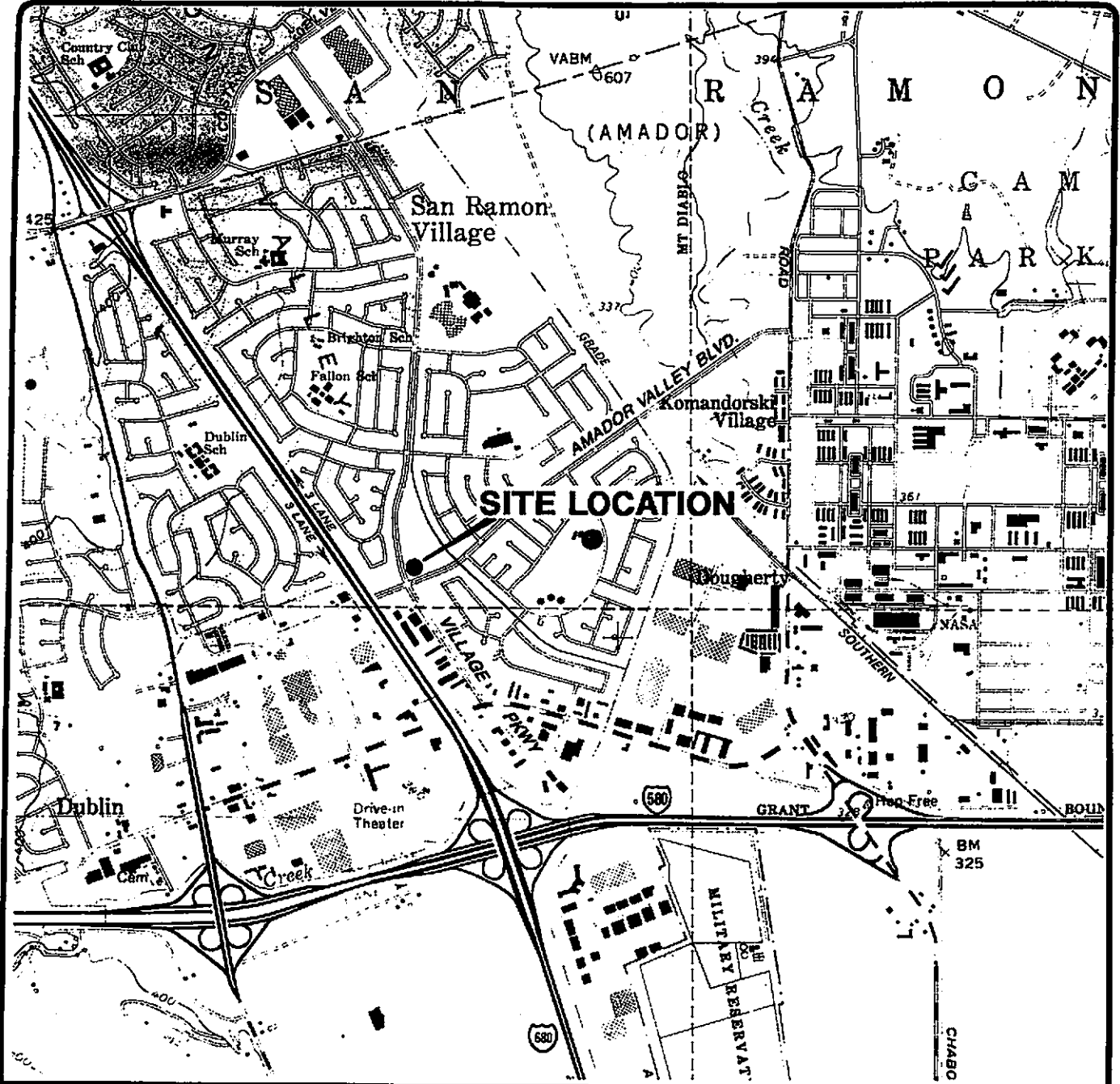

Base map from USGS 7.5' Quad. Map:  
Dublin, California. (Photorevised 1980).

Scale : 0                      2000                      4000 Feet

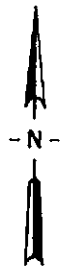

**EMCON**  
Associates

ARCO PRODUCTS COMPANY  
SERVICE STATION 6041, 7249 VILLAGE PARKWAY  
QUARTERLY GROUNDWATER MONITORING  
DUBLIN, CALIFORNIA

---

SITE LOCATION

FIGURE  
**1**  
PROJECT NO.  
805-132.01

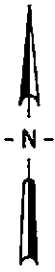

SCALE: 0 40 FEET  
(Approximate)

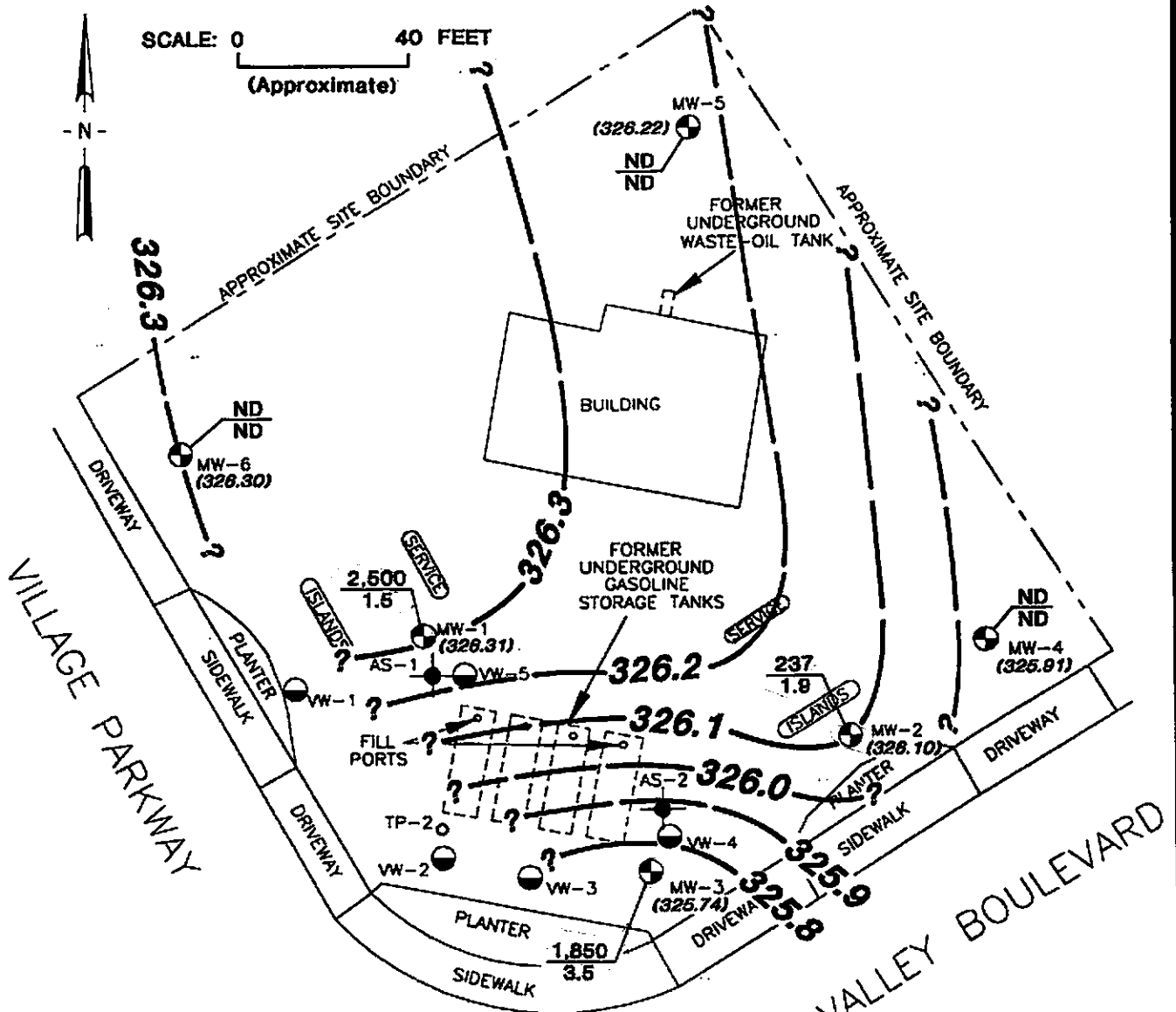

**EXPLANATION**

- Groundwater monitoring well
- Tank pit observation well
- Vapor extraction well
- ⊕ Air sparge well

(326.31) Groundwater elevation (Ft.-MSL);  
measured 11/18/94

237 / 1.9 — TPHG concentration in groundwater (ppb);  
sampled 11/18/94  
Benzene concentration in groundwater (ppb);  
sampled 11/18/94

ND Not detected above method reporting limit  
for TPHG (50 ppb) and benzene (0.5 ppb)

? — Groundwater elevation contour (Ft.-MSL)

3/85

Base map modified from RESNA, 1994.



**EMCON**  
Associates

ARCO PRODUCTS COMPANY  
SERVICE STATION 6041, 7249 VILLAGE PARKWAY  
QUARTERLY GROUNDWATER MONITORING  
DUBLIN, CALIFORNIA

GROUNDWATER DATA  
FOURTH QUARTER 1994

FIGURE

**2**

PROJECT NO.  
805-132.01

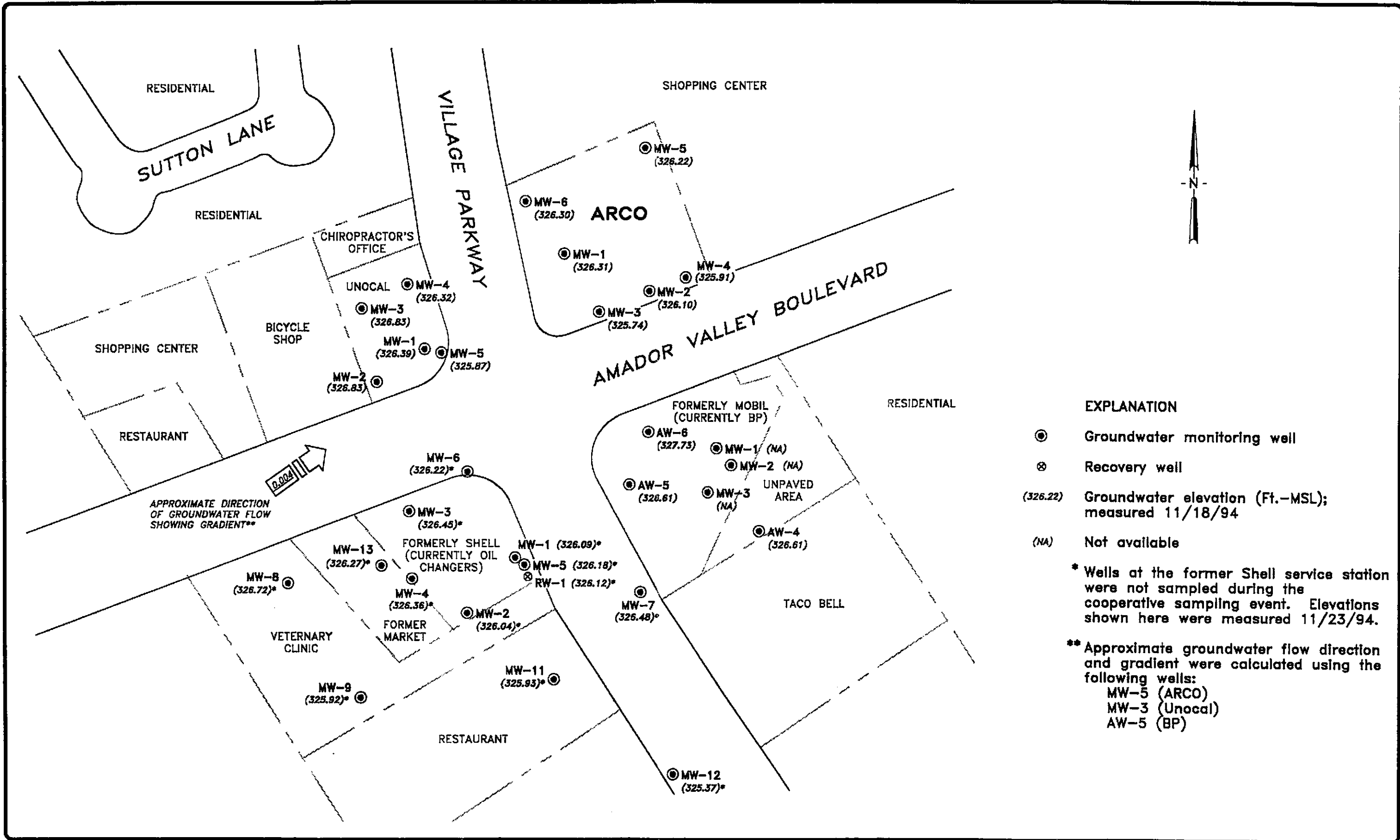

- EXPLANATION**
- ⊙ Groundwater monitoring well
  - ⊗ Recovery well
  - (326.22) Groundwater elevation (Ft.-MSL); measured 11/18/94
  - (NA) Not available
- \* Wells at the former Shell service station were not sampled during the cooperative sampling event. Elevations shown here were measured 11/23/94.
- \*\* Approximate groundwater flow direction and gradient were calculated using the following wells:  
 MW-5 (ARCO)  
 MW-3 (Unocal)  
 AW-5 (BP)

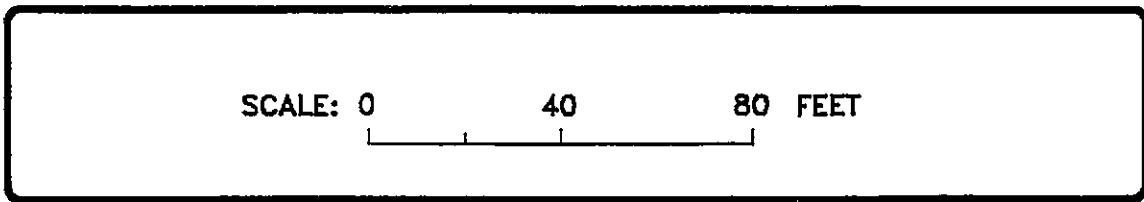

ARCO PRODUCTS COMPANY  
 SERVICE STATION 6041, 7249 VILLAGE PARKWAY  
 QUARTERLY GROUNDWATER MONITORING  
 DUBLIN, CALIFORNIA

GROUNDWATER DATA  
 FOURTH QUARTER 1994

FIGURE  
**3**  
 PROJECT NO.  
 805-132.01

MWV EPR00171 02/11/94 2 1/4" 0001701 0001701



**APPENDIX A**

**FIELD REPORT, INTEGRATED WASTESTREAM MANAGEMENT,  
DECEMBER 29, 1994**

**I** NTEGRATED  
**W** ASTESTREAM  
**M** ANAGEMENT

December 29, 1994

John Young  
EMCON Associates  
1921 Ringwood Avenue  
San Jose, CA 95131

Dear Mr. Young:

Attached are the field data sheets and analytical results for quarterly ground water sampling at ARCO Facility No. 6041 in Dublin, California. Integrated Wastestream Management measured the depth to water and collected samples from wells at this site on November 18, 1994.

Sampling was carried out in accordance with the protocols described in the "Request for Bid for Quarterly Sampling at ARCO Facilities in Northern California".

Please call us if you have any questions.

Sincerely,  
Integrated Wastestream Management



Tom DeLon  
Project Manager



Walter H. Howe

EMCON ASSOCIATES Registered Geologist

JAN 11 1995

RECEIVED

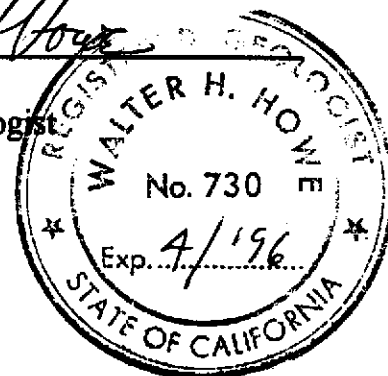

**Summary of Ground Water Sample Analyses for ARCO Facility A-6041, Dublin, California**

| WELL NUMBER       | MW-1     | MW-2     | MW-3     | MW-4     | MW-5     | MW-6     |
|-------------------|----------|----------|----------|----------|----------|----------|
| DATE SAMPLED      | 11/18/94 | 11/18/94 | 11/18/94 | 11/18/94 | 11/18/94 | 11/18/94 |
| DEPTH TO WATER    | 10.25    | 8.70     | 9.79     | 8.31     | 9.65     | 9.54     |
| SHEEN             | NONE     | NONE     | NONE     | NONE     | NONE     | NONE     |
| PRODUCT THICKNESS | NA       | NA       | NA       | NA       | NA       | NA       |
| TPHg              | 2,500    | 237#     | 1,850#   | ND       | ND       | ND       |
| <b>BTEX</b>       |          |          |          |          |          |          |
| BENZENE           | 1.5      | 1.9      | 3.5      | ND       | ND       | ND       |
| TOLUENE           | ND       | 0.6      | ND       | ND       | ND       | ND       |
| ETHLYBENZENE      | 1.4      | ND       | 0.9      | ND       | ND       | ND       |
| XYLENES           | ND       | ND       | ND       | ND       | ND       | ND       |

**FOOTNOTES:**

Concentrations reported in ug/L (ppb)

TPHg = Total Purgeable Petroleum Hydrocarbons (USEPA Method 8015 Modified)

BTEX Distinction (USEPA Method 8020)

PCE = Tetrachloroethene (USEPA Method 8010)

\* = Well inaccessible

\*\* = Not sampled per consultant request

DCE = cis-1, 2-Dichloroethene (USEPA Method 8010)

TCE = Trichloroethene (USEPA Method 8010)

ND = Not Detected

NA = Not applicable

FP = Floating product

# = See laboratory analytical report

# FIELD REPORT<sup>4</sup>

## Depth To Water / Floating Product Survey

Site Arrival Time: 1330

Site Departure Time: 1643

Weather Conditions: Sunny Clear

DTW: Well Box or Well Casing (circle one)

Project No.: \_\_\_\_\_ Location: 7249 Village Pkwy Dublin Date: Nov. 18, 1994  
 Client / Station#: Orco 6041 Field Technician: Vince Valdes Day of Week: Friday

| DTW ORDER | WELL ID | SURFACE SEAL | LID SECURE | GASKET | LOCK | EXPANDING CAP | TOTAL DEPTH (Feet) | FIRST DEPTH TO WATER (Feet) | SECOND DEPTH TO WATER (Feet) | DEPTH TO FLOATING PRODUCT (Feet) | FLOATING PRODUCT THICKNESS (Feet) | SHEEN (Y=YES, N=NO)<br>FP=FLOATING PRODUCT | COMMENTS  | MATERIALS |
|-----------|---------|--------------|------------|--------|------|---------------|--------------------|-----------------------------|------------------------------|----------------------------------|-----------------------------------|--|---|-----------|
| 6         | mw-1    | OK           | <u>yes</u> | OK     | OK   | OK            | 17.24              | 10.25                       | 10.25                        | N/A                              | N/A                               | N  | 4" H <sub>2</sub> O in Box  | 15/16     |
| 4         | mw-2    | OK           | <u>yes</u> | OK     | OK   | OK            | 14.24              | 8.70                        | 8.70                         | N/A                              | N/A                               | N  | 4" EXPANDING CAP cannot attach<br>good seal due to broken clamp lip | 15/16     |
| 5         | mw-3    | OK           | <u>yes</u> | OK     | OK   | OK            | 15.02              | 10.25                       | 9.79+                        | N/A                              | N/A                               | N  | 4" 2ND DTW = 9.79+<br>H <sub>2</sub> O in Box                       | 15/16     |
| 1         | mw-4    | OK           | <u>yes</u> | OK     | OK   | OK            | 14.90              | 8.31                        | 8.31                         | N/A                              | N/A                               | N  | 4"  | 15/16     |
| 2         | mw-5    | OK           | <u>yes</u> | OK     | OK   | OK            | 17.90              | 9.65+                       | 9.65+                        | N/A                              | N/A                               | N  | 4"  | 15/16     |
| 3         | mw-6    | OK           | <u>yes</u> | OK     | OK   | R             | 16.13              | 9.54-                       | 9.54-                        | N/A                              | N/A                               | N  | 4" H <sub>2</sub> O in Box<br>replaced broken Exp. CAP              | 15/16     |
|           |         |              |            |        |      |               |                    |                             |                              |                                  |                                   |  |   |           |
|           |         |              |            |        |      |               |                    |                             |                              |                                  |                                   |  |   |           |
|           |         |              |            |        |      |               |                    |                             |                              |                                  |                                   |  |   |           |
|           |         |              |            |        |      |               |                    |                             |                              |                                  |                                   |  |   |           |
|           |         |              |            |        |      |               |                    |                             |                              |                                  |                                   |  |   |           |
|           |         |              |            |        |      |               |                    |                             |                              |                                  |                                   |  |   |           |
|           |         |              |            |        |      |               |                    |                             |                              |                                  |                                   |  |   |           |
|           |         |              |            |        |      |               |                    |                             |                              |                                  |                                   |  |   |           |
|           |         |              |            |        |      |               |                    |                             |                              |                                  |                                   |  |   |           |
|           |         |              |            |        |      |               |                    |                             |                              |                                  |                                   |  |   |           |
|           |         |              |            |        |      |               |                    |                             |                              |                                  |                                   |  |   |           |
|           |         |              |            |        |      |               |                    |                             |                              |                                  |                                   |  |   |           |
|           |         |              |            |        |      |               |                    |                             |                              |                                  |                                   |  |   |           |
|           |         |              |            |        |      |               |                    |                             |                              |                                  |                                   |  |   |           |
|           |         |              |            |        |      |               |                    |                             |                              |                                  |                                   |  |   |           |
|           |         |              |            |        |      |               |                    |                             |                              |                                  |                                   |  |   |           |
|           |         |              |            |        |      |               |                    |                             |                              |                                  |                                   |  |   |           |

\* H<sub>2</sub>O in Box

ARCO 6041 (Regional WLS)

ALISTO ENGINEERING GROUP  
GROUNDWATER MONITORING

Client: BP Oil  
Alisto Project No: 10-017-03-003  
Service Station No: 1116

Date: 11-18-97  
Field Personnel: Dave Cusack  
Site Address: 7197 Village King  
Dublin

FIELD ACTIVITY:

- Groundwater Monitoring
- Groundwater Sampling
- Well Development

QUALITY CONTROL SAMPLES:

- QC-1 Sample Duplicate (Well ID)
- QC-2 Trip Blank
- QC-3 Rinsate Blank

| Well ID | Well Diam | Order Measured/ Sampled | Total Depth | Depth to Water | Depth to Product | Product Thick-ness | Comments |
|---------|-----------|-------------------------|-------------|----------------|------------------|--------------------|----------|
| Aw4     | 4         |                         | 32.2        | 6.80           | <del>0</del>     |                    |          |
| Aw5     | 4         |                         | 37.9        | 8.20           | <del>0</del>     |                    |          |
| Aw6     | 4         |                         | 14.5        | 7.17           | <del>0</del>     |                    |          |
|         |           |                         |             |                |                  |                    |          |
|         |           |                         |             |                |                  |                    |          |
|         |           |                         |             |                |                  |                    |          |
|         |           |                         |             |                |                  |                    |          |
|         |           |                         |             |                |                  |                    |          |
|         |           |                         |             |                |                  |                    |          |
|         |           |                         |             |                |                  |                    |          |
|         |           |                         |             |                |                  |                    |          |
|         |           |                         |             |                |                  |                    |          |
|         |           |                         |             |                |                  |                    |          |

70c  
33.41  
34.81  
334.90

GWE  
326.61  
326.61  
327.73

Notes:  
\_\_\_\_\_  
\_\_\_\_\_  
\_\_\_\_\_  
\_\_\_\_\_

# ARCO 6041 (Area data)

## WELL GAUGING DATA

204-2217-0105

Project # 941123J3

Date 11/23/94

Client SHELL

Site 7194 AMADOR VLY. BL, DUBLIN, CA.

| Well I.D. | Well Size (in.) | Sheen/Odor | Depth to Immiscible Liquid (feet) | Thickness of Immiscible Liquid (ft.) | Volume of Immiscibles Removed (ml) | Depth to Water (feet) | Depth to Well Bottom (feet) | Survey Point: TOB or TOC |
|-----------|-----------------|------------|-----------------------------------|--------------------------------------|------------------------------------|-----------------------|-----------------------------|--------------------------|
| MW-1      | 4               |            |                                   |                                      |                                    | 8.74                  | 25.10                       | TOC                      |
| MW-2      | 4               |            |                                   |                                      |                                    | 10.92                 | 24.49                       |                          |
| MW-3      | 4               |            |                                   |                                      |                                    | 10.48                 | 24.18                       |                          |
| MW-4      | 4               |            |                                   |                                      |                                    | 10.78                 | 24.69                       |                          |
| MW-5      | 4               |            |                                   |                                      |                                    | 8.78                  | 44.58                       |                          |
| MW-6      | 4               |            |                                   |                                      |                                    | 9.20                  | 22.80                       |                          |
| MW-7      | 4               |            |                                   |                                      |                                    | 8.75                  | 16.42                       |                          |
| MW-8      | 4               |            |                                   |                                      |                                    | 9.08                  | 16.04                       |                          |
| MW-9      | 4               |            |                                   |                                      |                                    | 8.65                  | 17.80                       |                          |
| MW-11     | 4               |            |                                   |                                      |                                    | 8.27                  | 16.29                       |                          |
| MW-12     | 4               |            |                                   |                                      |                                    | 7.16                  | 17.08                       |                          |
| MW-13     | 4               |            |                                   |                                      |                                    | 9.37                  | 16.97                       |                          |
| BW-1      | 6               |            |                                   |                                      |                                    | 10.07                 | 30.92                       | ✓                        |

**TABLE 1****SUMMARY OF MONITORING DATA  
UNOCAL MONITORING WELLS**

| Well #  | Ground Water Elevation (feet) | Depth to Water (feet)* | Total Well Depth (feet) | Product Thickness (feet) | Sheen | Water Purged (gallons) |
|---|-------------------------------|------------------------|-------------------------|--------------------------|-------|------------------------|
| <b>(Monitored and Sampled November 18, 1994)</b>    |                               |                        |                         |                          |       |                        |
|   | <u>TOC</u>                    |                        |                         |                          |       | <u>GWE</u>             |
| MW1   | 326.08                        | 9.69                   | 19.49                   | 0                        | No    | 7 <del>27.2</del>      |
| MW2*  | 326.78                        | 9.95                   | 19.26                   | 0                        | --    | 0 326.83               |
| MW3*  | 326.98                        | 10.15                  | 18.91                   | 0                        | --    | 0 326.83               |
| MW4*  | 326.42                        | 10.10                  | 19.44                   | 0                        | --    | 0 326.32               |
| MW5   | 325.96                        | 10.09                  | 19.99                   | 0                        | No    | 7 325.87               |
| <b>(Monitored and Sampled August 25, 1994)</b>      |                               |                        |                         |                          |       |                        |
| MW1   | 325.49                        | 10.58                  | 19.49                   | 0                        | No    | 6.5                    |
| MW2*  | 326.03                        | 10.75                  | 19.27                   | 0                        | --    | 0                      |
| MW3*  | 326.05                        | 10.93                  | 18.94                   | 0                        | --    | 0                      |
| MW4*  | 325.49                        | 10.94                  | 19.43                   | 0                        | --    | 0                      |
| MW5   | 325.53                        | 10.43                  | 20.00                   | 0                        | No    | 7                      |
| <b>(Monitored and Sampled on May 17, 1994)</b>      |                               |                        |                         |                          |       |                        |
| MW1   | 326.81                        | 9.26                   | 19.50                   | 0                        | No    | 8                      |
| MW2*  | 327.47                        | 9.31                   | 19.26                   | 0                        | --    | 0                      |
| MW3*  | 327.49                        | 9.49                   | 18.94                   | 0                        | --    | 0                      |
| MW4*  | 326.80                        | 9.63                   | 19.44                   | 0                        | --    | 0                      |
| MW5   | 326.72                        | 9.24                   | 20.00                   | 0                        | No    | 8                      |
| <b>(Monitored and Sampled on February 11, 1994)</b> |                               |                        |                         |                          |       |                        |
| MW1   | 326.35                        | 9.72                   | 19.46                   | 0                        | No    | 7                      |
| MW2   | 326.93                        | 9.85                   | 19.23                   | 0                        | No    | 6.5                    |
| MW3   | 326.97                        | 10.01                  | 18.90                   | 0                        | No    | 6.5                    |
| MW4   | 326.33                        | 10.10                  | 19.40                   | 0                        | No    | 6.5                    |
| MW5   | 325.88                        | 10.08                  | 19.96                   | 0                        | No    | 7                      |

WELL ID: MW-6 TD 16.13 DTW 9.54 \* 0.66 X 3 - 13.04  
Linear Ft. Volume Purge

DATE PURGED: 11-18-94 START (2400 HR): 1504 END (2400 HR): 1509  
 DATE SAMPLED: 11-18-94 TIME (2400 HR): 1512 DTW: 12.8

| TIME (2400 HR) | VOLUME (GAL) | pH (UNITS)  | (E.C. X 1,000) (UMHOS/CM@25 C) | TEMP. (F)   | COLOR (VISUAL) |
|----------------|--------------|-------------|--------------------------------|-------------|----------------|
| <u>1505</u>    | <u>2</u>     | <u>7.63</u> | <u>0.39</u>                    | <u>71.1</u> | <u>cloudy</u>  |
| <u>1506</u>    | <u>6</u>     | <u>7.52</u> | <u>0.37</u>                    | <u>70.8</u> | <u>clear</u>   |
| <u>1508</u>    | <u>9</u>     | <u>7.42</u> | <u>0.37</u>                    | <u>70.5</u> | <u>clear</u>   |
| <u>1509</u>    | <u>10</u>    | <u>7.40</u> | <u>0.37</u>                    | <u>70.3</u> | <u>clear</u>   |

Total purge: 10

PURGING EQUIP.:  Centrifugal Pump  Bailer Disp. SAMPLING EQUIP.:  Bailer Disp.

REMARKS: well pumped dry at 9 and again at 10 gallons.

WELL ID: MW-5 TD 17.90 DTW 9.65 \* 0.66 X 3 - 16.33  
Linear Ft. Volume Purge

DATE PURGED: 11-18-94 START (2400 HR): 1518 END (2400 HR): 1522  
 DATE SAMPLED: 11-18-94 TIME (2400 HR): 1524 DTW: 14.1

| TIME (2400 HR) | VOLUME (GAL) | pH (UNITS)  | (E.C. X 1,000) (UMHOS/CM@25 C) | TEMP. (F)   | COLOR (VISUAL) |
|----------------|--------------|-------------|--------------------------------|-------------|----------------|
| <u>1520</u>    | <u>2</u>     | <u>7.42</u> | <u>3.01</u>                    | <u>68.9</u> | <u>clear</u>   |
| <u>1521</u>    | <u>6</u>     | <u>7.23</u> | <u>3.45</u>                    | <u>68.8</u> | <u>clear</u>   |
| <u>1522</u>    | <u>10</u>    | <u>7.21</u> | <u>3.66</u>                    | <u>68.6</u> | <u>clear</u>   |

Total purge: 10

PURGING EQUIP.:  Centrifugal Pump  Bailer Disp. SAMPLING EQUIP.:  Bailer Disp.

REMARKS: well pumped dry at 10 gallons

WELL ID: MW-4 TD 14.90 DTW 8.31 \* 0.66 X 3 - 13.04  
Linear Ft. Volume Purge

DATE PURGED: 11-18-94 START (2400 HR): 1535 END (2400 HR): 1541  
 DATE SAMPLED: 11-18-94 TIME (2400 HR): 1543 DTW: 11.8

| TIME (2400 HR) | VOLUME (GAL) | pH (UNITS)  | (E.C. X 1,000) (UMHOS/CM@25 C) | TEMP. (F)   | COLOR (VISUAL) |
|----------------|--------------|-------------|--------------------------------|-------------|----------------|
| <u>1537</u>    | <u>1</u>     | <u>7.38</u> | <u>2.31</u>                    | <u>71.2</u> | <u>clear</u>   |
| <u>1539</u>    | <u>6</u>     | <u>7.28</u> | <u>1.80</u>                    | <u>70.6</u> | <u>clear</u>   |
| <u>1541</u>    | <u>7</u>     | <u>7.26</u> | <u>1.71</u>                    | <u>70.4</u> | <u>clear</u>   |

Total purge: 7

PURGING EQUIP.:  Centrifugal Pump  Bailer Disp. SAMPLING EQUIP.:  Bailer Disp.

REMARKS: well pumped dry at 6 and again at 7 gallons.

WELL ID: MW-2 TD 14.24 DTW 8.70 \* 0.66 X 3 - 10.96  
Linear Ft. Volume Purge

DATE PURGED: 11-18-94 START (2400 HR): 1546 END (2400 HR): 1551  
 DATE SAMPLED: 11-18-94 TIME (2400 HR): 1553 DTW: 12.0

| TIME (2400 HR) | VOLUME (GAL) | pH (UNITS)  | (E.C. X 1,000) (UMHOS/CM@25 C) | TEMP. (F)   | COLOR (VISUAL) |
|----------------|--------------|-------------|--------------------------------|-------------|----------------|
| <u>1547</u>    | <u>1</u>     | <u>7.44</u> | <u>2.46</u>                    | <u>70.5</u> | <u>clear</u>   |
| <u>1549</u>    | <u>3</u>     | <u>7.21</u> | <u>1.85</u>                    | <u>70.3</u> | <u>clear</u>   |
| <u>1551</u>    | <u>6</u>     | <u>7.19</u> | <u>1.80</u>                    | <u>70.1</u> | <u>clear</u>   |

Total purge: 6

PURGING EQUIP.:  Centrifugal Pump  Bailer Disp. SAMPLING EQUIP.:  Bailer Disp.

REMARKS: well pumped at 3, 5, and again at 6 gallons

PRINT NAME: Vince Valdes

SIGNATURE: [Signature]

|                           |             |             |             |            |            |            |              |
|---------------------------|-------------|-------------|-------------|------------|------------|------------|--------------|
| CASING DIAMETER (inches): | <u>2</u>    | <u>3</u>    | <u>4</u>    | <u>6</u>   | <u>8</u>   | <u>12</u>  | Other: _____ |
| GALLON/LINEAR FOOT:       | <u>0.17</u> | <u>0.38</u> | <u>0.66</u> | <u>1.5</u> | <u>2.6</u> | <u>5.8</u> | Other: _____ |



WELL ID: MW-3 TD 15.02 DTW 9.79 X 0.66 Gal. X 3 Casing - 10.35 Calculated  
Linear Ft. Volume Purge

DATE PURGED: 11-18-94 START (2400 HR): 1538 END (2400 HR) 1604  
DATE SAMPLED: 11-18-94 TIME (2400 HR): 1607 DTW: 12.8

| TIME (2400 HR) | VOLUME (GAL) | pH (UNITS) | (E.C. X 1,000) (UMHOS/CM@25 C) | TEMP. (F) | COLOR (VISUAL) |
|----------------|--------------|------------|--------------------------------|-----------|----------------|
| 1600           | 1            | 7.35       | 1.37                           | 70.8      | clear          |
| 1602           | 5            | 7.19       | 0.13                           | 70.4      | clear          |
| 1604           | 6            | 7.17       | 2.08                           | 70.1      | clear          |

Total purge: 6  
PURGING EQUIP.: Centrifugal Pump Bailer Disp. SAMPLING EQUIP: Bailer Disp.  
REMARKS: well pumped dry at 3.5, and again at 6 gallons.

WELL ID: MW-1 TD 17.84 DTW 10.25 X 0.66 Gal. X 3 Casing - 15.02 Calculated  
Linear Ft. Volume Purge

DATE PURGED: 11-18-94 START (2400 HR): 1610 END (2400 HR) 1616  
DATE SAMPLED: 11-18-94 TIME (2400 HR): 1618 DTW: 15

| TIME (2400 HR) | VOLUME (GAL) | pH (UNITS) | (E.C. X 1,000) (UMHOS/CM@25 C) | TEMP. (F) | COLOR (VISUAL) |
|----------------|--------------|------------|--------------------------------|-----------|----------------|
| 1612           | 1            | 7.29       | 2.11                           | 69.0      | clear          |
| 1614           | 4            | 7.18       | 1.79                           | 68.8      | clear          |
| 1616           | 6            | 7.16       | 1.74                           | 68.5      | clear          |

Total purge: 6  
PURGING EQUIP.: Centrifugal Pump Bailer Disp. SAMPLING EQUIP: Bailer Disp.  
REMARKS: well pumped dry at 3.5, and again at 6 gallons.

WELL ID: \_\_\_\_\_ TD \_\_\_\_\_ DTW \_\_\_\_\_ X \_\_\_\_\_ Gal. X \_\_\_\_\_ Casing - \_\_\_\_\_ Calculated  
Linear Ft. Volume Purge

DATE PURGED: \_\_\_\_\_ START (2400 HR): \_\_\_\_\_ END (2400 HR) \_\_\_\_\_  
DATE SAMPLED: \_\_\_\_\_ TIME (2400 HR): \_\_\_\_\_ DTW: \_\_\_\_\_

| TIME (2400 HR) | VOLUME (GAL) | pH (UNITS) | (E.C. X 1,000) (UMHOS/CM@25 C) | TEMP. (F) | COLOR (VISUAL) |
|----------------|--------------|------------|--------------------------------|-----------|----------------|
|                |              |            |                                |           |                |
|                |              |            |                                |           |                |
|                |              |            |                                |           |                |
|                |              |            |                                |           |                |

Total purge: \_\_\_\_\_  
PURGING EQUIP.: Centrifugal Pump Bailer Disp. SAMPLING EQUIP: Bailer Disp.  
REMARKS: \_\_\_\_\_

WELL ID: \_\_\_\_\_ TD \_\_\_\_\_ DTW \_\_\_\_\_ X \_\_\_\_\_ Gal. X \_\_\_\_\_ Casing - \_\_\_\_\_ Calculated  
Linear Ft. Volume Purge

DATE PURGED: \_\_\_\_\_ START (2400 HR): \_\_\_\_\_ END (2400 HR) \_\_\_\_\_  
DATE SAMPLED: \_\_\_\_\_ TIME (2400 HR): \_\_\_\_\_ DTW: \_\_\_\_\_

| TIME (2400 HR) | VOLUME (GAL) | pH (UNITS) | (E.C. X 1,000) (UMHOS/CM@25 C) | TEMP. (F) | COLOR (VISUAL) |
|----------------|--------------|------------|--------------------------------|-----------|----------------|
|                |              |            |                                |           |                |
|                |              |            |                                |           |                |
|                |              |            |                                |           |                |
|                |              |            |                                |           |                |

Total purge: \_\_\_\_\_  
PURGING EQUIP.: Centrifugal Pump Bailer Disp. SAMPLING EQUIP: Bailer Disp.  
REMARKS: \_\_\_\_\_

PRINT NAME:

Vince Valdes

SIGNATURE:

Vince Valdes

CASING DIAMETER (inches): 2 3 4 6 8 12 Other: \_\_\_\_\_  
GALLON/LINEAR FOOT: 0.17 0.38 0.66 1.5 2.6 5.8 Other: \_\_\_\_\_

**APPENDIX B**

**ANALYTICAL RESULTS AND CHAIN-OF-CUSTODY  
DOCUMENTATION, FOURTH QUARTER 1994**



RECEIVED DEC 28 1994

December 22, 1994

Service Request No.: K947395S

Gina Austin  
Tom DeLon  
IWM  
950 Ames Avenue  
Milpitas, CA 95035

RECEIVED  
DEC 28 1994

Re: ARCO Dublin/Project# SJ94-1509

Dear Ms. Austin/Mr. DeLon:

Enclosed are the results of the sample(s) submitted to our laboratory on November 18, 1994. For your reference, these analyses have been assigned our service request number K947395S.

All analyses were performed consistent with our laboratory's quality assurance program. All results are intended to be considered in their entirety, and Columbia Analytical Services, Inc. (CAS) is not responsible for use of less than the complete report. Results apply only to the samples analyzed.

Please call if you have any questions. My extension is 239.

Respectfully submitted,

Columbia Analytical Services, Inc.

A handwritten signature in cursive script, appearing to read "Howard Boorse", written in dark ink over a white background.

Howard Boorse  
Project Chemist

HB/sl

Page 1 of 10

# COLUMBIA ANALYTICAL SERVICES, Inc.

## Acronyms

|            |  |
|------------|--|
| ASTM       | American Society for Testing and Materials   |
| CARB       | California Air Resources Board   |
| CAS Number | Chemical Abstract Service registry Number  |
| CFC        | Chlorofluorocarbon   |
| CFU        | Colony-Forming Unit  |
| DEC        | Department of Environmental Conservation   |
| DEQ        | Department of Environmental Quality  |
| DHS        | Department of Health Services  |
| DOE        | Department of Ecology  |
| DOH        | Department of Health   |
| EPA        | U. S. Environmental Protection Agency  |
| GC         | Gas Chromatography   |
| GC/MS      | Gas Chromatography/Mass Spectrometry   |
| LUFT       | Leaking Underground Fuel Tank  |
| MCL        | Maximum Contaminant Level is the highest permissible concentration of a substance allowed in drinking water as established by the USEPA. |
| MDL        | Method Detection Limit   |
| MPN        | Most Probable Number   |
| MRL        | Method Reporting Limit   |
| NA         | Not Applicable   |
| NAN        | Not Analyzed   |
| NC         | Not Calculated   |
| NCASI      | National Council of the Paper Industry for Air and Stream Improvement  |
| ND         | Not Detected at or above the MRL   |
| NIOSH      | National Institute for Occupational Safety and Health  |
| PQL        | Practical Quantitation Limit   |
| RCRA       | Resource Conservation and Recovery Act   |
| SIM        | Selected Ion Monitoring  |
| TPH        | Total Petroleum Hydrocarbons   |

00002

**COLUMBIA ANALYTICAL SERVICES, INC.**

**Analytical Report**

**Client:** IWA  
**Project:** ARCO Dublin/#6041  
**Sample Matrix:** Water

**Service Request:** K947395S  
**Date Collected:** 11/18/94  
**Date Received:** 11/28/94  
**Date Extracted:** NA  
**Date Analyzed:** 11/29,30/94

**BTEX and Total Petroleum Hydrocarbons as Gasoline**  
**EPA Methods 5030/8020 and California DHS LUFT Method**  
**Units: µg/L (ppb)**

|                                |                |                |                     |                      |                        |
|--------------------------------|----------------|----------------|---------------------|----------------------|------------------------|
| <b>Analyte:</b>                | <b>Benzene</b> | <b>Toluene</b> | <b>Ethylbenzene</b> | <b>Total Xylenes</b> | <b>TPH as Gasoline</b> |
| <b>Method Reporting Limit:</b> | 0.5            | 0.5            | 0.5                 | 1                    | 50                     |

| <b>Sample Name</b> | <b>Lab Code</b> | <b>Benzene</b> | <b>Toluene</b> | <b>Ethylbenzene</b> | <b>Total Xylenes</b> | <b>TPH as Gasoline</b> |
|--------------------|-----------------|----------------|----------------|---------------------|----------------------|------------------------|
| MW-1               | K947395-001     | 1.5            | ND             | 1.4                 | ND                   | 2500                   |
| MW-2               | K947395-002     | 1.9            | 0.6            | ND                  | ND                   | 237(a)                 |
| MW-3               | K947395-003     | 3.5            | ND             | 0.9                 | ND                   | 1850(a)                |
| MW-4               | K947395-004     | ND             | ND             | ND                  | ND                   | ND                     |
| MW-5               | K947395-005     | ND             | ND             | ND                  | ND                   | ND                     |
| MW-6               | K947395-006     | ND             | ND             | ND                  | ND                   | ND                     |
| FB-1               | K947395-007     | ND             | ND             | ND                  | ND                   | ND                     |
| Method Blank       | K941129-WB      | ND             | ND             | ND                  | ND                   | ND                     |

a Quantified as gasoline. The sample contained a single, discrete peak which eluted within the gasoline range.

Approved By:  Date: 12/22/94 00003

**COLUMBIA ANALYTICAL SERVICES, INC.**

QA/QC Report

**Client:** IWA  
**Project:** ARCO Dublin/#6041  
**Sample Matrix:** Water

**Service Request:** K947395S  
**Date Collected:** 11/18/94  
**Date Received:** 11/28/94  
**Date Extracted:** NA  
**Date Analyzed:** 11/29,30/94

**Surrogate Recovery Summary**  
**BTEX and Total Petroleum Hydrocarbons as Gasoline**  
**EPA Methods 5030/8020 and California DHS LUFT Method**

| Sample Name               | Lab Code      | Percent Recovery<br>4-BFB (PID - BTEX) | Percent Recovery<br>4-BFB (FID - GAS) |
|---------------------------|---------------|--|---------------------------------------|
| MW-1                      | K947395-001   | 84                                     | 101                                   |
| MW-2                      | K947395-002   | 92                                     | 97                                    |
| MW-3                      | K947395-003   | 92                                     | 101                                   |
| MW-4                      | K947395-004   | 91                                     | 90                                    |
| MW-5                      | K947395-005   | 91                                     | 94                                    |
| MW-6                      | K947395-006   | 92                                     | 96                                    |
| FB-1                      | K947395-007   | 93                                     | 95                                    |
| MW-1                      | K947395-001D  | 85                                     | 107                                   |
| MW-3                      | K947395-003MS | 94                                     | -                                     |
| Batch QC                  | K947394-006MS | -                                      | 99                                    |
| Laboratory Control Sample | K941129-WL    | 97                                     | 101                                   |
| Method Blank              | K941129-WB    | 91                                     | 97                                    |

CAS Acceptance Limits:                      70-122                      51-143

Approved By:                     Howard Fournier                                          Date:                     12/22/94                                          00004

COLUMBIA ANALYTICAL SERVICES, INC.

QA/QC Report

Client: IWA  
Project: ARCO Dublin/#6041  
Sample Matrix: Water

Service Request: K947395S  
Date Collected: 11/18/94  
Date Received: 11/28/94  
Date Extracted: NA  
Date Analyzed: 11/30/94

Duplicate Summary  
BTEX and Total Petroleum Hydrocarbons as Gasoline  
EPA Methods 5030/8020 and California DHS LUFT Method  
Units: µg/L (ppb)

Sample Name: MW-1  
Lab Code: K947395-001

| Analyte       | MRL | Sample Result | Duplicate Sample Result | Average | Relative Percent Difference | CAS RPD Acceptance Limit |
|---------------|-----|---------------|-------------------------|---------|-----------------------------|--------------------------|
| Benzene       | 0.5 | 1.5           | 1.5                     | 1.5     | <1                          | 30                       |
| Toluene       | 0.5 | ND            | ND                      | ND      | -                           | 30                       |
| Ethylbenzene  | 0.5 | 1.4           | 1.3                     | 1.4     | 7                           | 30                       |
| Total Xylenes | 0.1 | ND            | ND                      | ND      | -                           | 30                       |
| Gasoline      | 50  | 2500          | 2460                    | 2480    | 2                           | 30                       |

Approved By: \_\_\_\_\_



Date: \_\_\_\_\_

12/22/94

00005

COLUMBIA ANALYTICAL SERVICES, INC.

QA/QC Report

Client: IWA  
Project: ARCO Dublin/#6041  
Sample Matrix: Water

Service Request: K947395S  
Date Collected: 11/18/94  
Date Received: 11/28/94  
Date Extracted: NA  
Date Analyzed: 11/30/94

Matrix Spike Summary  
BTEX and Total Petroleum Hydrocarbons as Gasoline  
EPA Methods 5030/8020 and California DHS LUFT Method  
Units: µg/L (ppb)

Sample Name: MW-3  
Lab Code: K947395-003

| Analyte      | MRL | Spike Level | Sample Result | Spiked Sample Result | Percent Recovery | CAS Percent Recovery Acceptance Limits |
|--------------|-----|-------------|---------------|----------------------|------------------|--|
| Benzene      | 0.5 | 100         | 3.5           | 87.7                 | 84               | 56-129                                 |
| Toluene      | 0.5 | 100         | ND            | 81.0                 | 81               | 61-126                                 |
| Ethylbenzene | 0.5 | 100         | 0.9           | 76.6                 | 76               | 54-132                                 |

Approved By: \_\_\_\_\_

*Howard Fournier*

Date: 12/22/94

00000



COLUMBIA ANALYTICAL SERVICES, INC.

QA/QC Report

Client: IWA  
Project: ARCO Dublin/#6041  
Sample Matrix: Water

Service Request: K947395S  
Date Collected: NA  
Date Received: NA  
Date Extracted: NA  
Date Analyzed: 11/30/94

Matrix Spike Summary  
BTEX and Total Petroleum Hydrocarbons as Gasoline  
EPA Methods 5030/8020 and California DHS LUFT Method  
Units: µg/L (ppb)

Sample Name: Batch QC  
Lab Code: K947394-006

| Analyte  | MRL | Spike Level | Sample Result | Spiked Sample Result | Percent Recovery | CAS Percent Recovery Acceptance Limits |
|----------|-----|-------------|---------------|----------------------|------------------|--|
| Gasoline | 50  | 2500        | 98            | 2670                 | 103              | 52-133                                 |

Approved By: \_\_\_\_\_



Date: 12/22/94 00007

COLUMBIA ANALYTICAL SERVICES, INC.

QA/QC Report

Client: IWA  
Project: ARCO Dublin/#6041  
LCS Matrix: Water

Service Request: K947395S  
Date Collected: NA  
Date Received: NA  
Date Extracted: NA  
Date Analyzed: 11/30/94

Laboratory Control Sample Summary  
BTEX and Total Petroleum Hydrocarbons as Gasoline  
EPA Methods 5030/8020 and California DHS LUFT Method  
Units:  $\mu\text{g/L}$  (ppb)

| Analyte      | True Value | Result | Percent Recovery | CAS Percent Recovery Acceptance Limits |
|--------------|------------|--------|------------------|--|
| Benzene      | 100        | 85.1   | 85               | 70-120                                 |
| Toluene      | 100        | 84.9   | 85               | 73-120                                 |
| Ethylbenzene | 100        | 82.0   | 82               | 72-125                                 |
| Gasoline     | 2500       | 2610   | 104              | 74-141                                 |

Approved By: \_\_\_\_\_



Date: \_\_\_\_\_

12/22/94

00008

LCS/102194

K947395S.XLS - BTEXwLCS 12/22/94

Page No.:

**APPENDIX B**  
**CHAIN OF CUSTODY INFORMATION**

00009