



RD 450

720 Southpoint Blvd. Suite 207  
Petaluma, CA 94954  
Phone (707) 765-0466, Fax (707) 765-0366

# TRANSMITTAL

TO: Mr. Amir Gholami  
Alameda County Dept. of Public Health  
1131 Harbor Bay Parkway, Suite 250  
Alameda, CA 94502

DATE: April 27, 2004  
PROJECT NO: 06-459-2349-02  
SUBJECT: 76 Service Station 2349  
(0843)  
Alameda, California

From: Jeremy Smith

Alameda County  
APR 29 2004  
Environmental Health

### WE ARE SENDING YOU:

COPIES	DATED	DESCRIPTION
1	4/27/04	First Quarter Site Status Report

### THESE ARE TRANSMITTED as checked below:

- For review and comment
- As Requested
- For Approval
- Approved as submitted
- Approved as noted
- Returned for corrections
- For your files
- For your use
- As noted below

### COMMENTS:

Attached is a copy of the First Quarter 2004 Site Status Report for the above referenced site.

Signed: 

COPIES TO: Mr. Thomas Kosel, (electronic copy)  
Mr. George Leyva, RWQCB – SF Bay Region, 1515 Clay Street Suite 1400, Oakland,  
CA 94612



April 27, 2004

Mr. Amir Gholami  
Alameda County Department of Public Health  
1131 Harbor Bay Parkway, Suite 250  
Alameda, CA 94502

RE: **Quarterly Summary Report-First Quarter 2004**  
Miller Brooks Environmental, Inc. Project No.: 06-459-2349-03

Dear Mr. Gholami:

On behalf of ConocoPhillips Company (ConocoPhillips), Miller Brooks Environmental, Incorporated (Miller Brooks) is forwarding the quarterly summary report for the following location:

**Service Station**

Former 76 Service Station No. 82349 (0843)  
COP NO. WNO.2807

**Location**

1629 Webster Street  
Alameda, California

Sincerely,  
**Miller Brooks Environmental, Incorporated**



Jed Douglas, R.G. No. 7516  
Senior Geologist

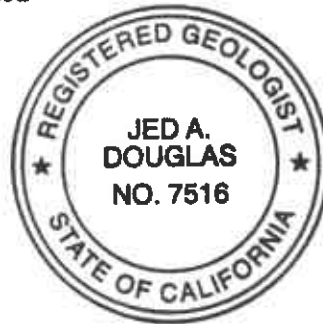

Attachment: Site Plan

cc: Mr. Thomas Kosel, ConocoPhillips  
Mr. George Leyva, RWQCB – SF Bay Region, 1515 Clay Street Suite 1400, Oakland,  
CA 94612

**QUARTERLY SUMMARY REPORT**  
**First Quarter 2004**

Former 76 Service Station No. 2349 (0843)  
1629 Webster Street  
Alameda, California

City/County ID #: Alameda

County: Alameda

**PREVIOUS ASSESSMENT**

In June 1998, Tosco Marketing Company (Tosco, now ConocoPhillips), removed two 10,000-gallon gasoline underground storage tanks (USTs), one 550-gallon used-oil UST, product lines, and dispensers. Two holes approximately 3/4-inch in diameter were observed in the used-oil tank during removal. No holes or other evidence of leakage were observed in the remaining tanks or piping. Low levels of hydrocarbon impact were reported in the soil samples collected during UST removal activities.

In March 1999, Environmental Resolutions Inc. (ERI) installed four on-site groundwater monitoring wells (MW1 through MW4) at the subject site. In December 1999, ERI installed two off-site monitoring wells (MW5 and MW6) at the subject site.

In March 2001, ERI performed an underground utility survey to identify and locate underground utility lines beneath and in the vicinity of the site that may provide potential preferential pathways for groundwater flow.

In May 2001, ERI advanced five direct-push soil borings (GP1 through GP5), to evaluate whether underground utility trenches in the vicinity of the site may provide preferential pathways for groundwater flow and the migration of dissolved hydrocarbons. The results of the investigation indicated that there was insufficient evidence to suggest that underground utility lines were providing preferential pathways for the off-site migration of dissolved petroleum hydrocarbons.

In December 1999, ERI advanced twelve direct-push soil borings (GP6 through GP17) to further assess the extent of residual hydrocarbons in the vadose zone beneath the site. The results of the investigation indicated that the extent of residual hydrocarbons detected during previous investigations is limited and that remedial action for residual gasoline hydrocarbons at the site is not warranted.

In December 2002, ERI destroyed one on-site monitoring well (MW2), performed a remedial excavation of hydrocarbon-impacted soil in the vicinity of the former eastern dispenser island, and replaced former well MW2 with on-site backfill monitoring well MW2A.

ERI submitted a *Request and Work Plan for Case Closure* to the Alameda County Health Care Services Agency, dated September 10, 2003. The report summarizes why no further action is needed for the site, and details plans to destroy the existing wells upon regulatory acceptance for no further action.

## **SENSITIVE RECEPTORS**

In June and July 2002, ERI conducted a groundwater receptor survey. Three irrigation wells were located within a ½ mile radius of the site. The wells are reportedly located approximately 1,980 feet west, 2,245 feet west, and 2,245 feet southwest of the site, cross or upgradient of the site.

## **MONITORING AND SAMPLING**

Quarterly groundwater monitoring and sampling were initiated in March 1999. During the most recent groundwater monitoring and sampling event, performed on February 12, 2004, groundwater was present at depths ranging from 5.02 to 6.02 feet below the top of casing (TOC). The groundwater flow direction was reported towards the north with a gradient of 0.005 ft/ft. During the February 12, 2004 sampling event, total petroleum hydrocarbons as gasoline (TPHg), benzene, and methyl tertiary butyl ether (MTBE) were detected at concentrations up to 1,100, 2.6, and 2,800 micrograms per liter (µg/L), respectively.

## **REMEDIATION STATUS**

Approximately 338 tons of hydrocarbon impacted soil and backfill were removed from beneath the former USTs, dispensers, and product lines during UST removal activities at the site. Approximately 292 tons of hydrocarbon-impacted soil was removed from beneath the former eastern dispenser island during the December 2002 excavation.

## **CHARACTERIZATION STATUS**

Groundwater appears to be delineated at the site based on the results from well MW-5.

## **RECENT CORRESPONDENCE**

There was no correspondence during the first quarter 2004.

## **THIS QUARTER ACTIVITIES (First Quarter 2004)**

1. The groundwater monitoring well network was monitored and sampled by TRC Companies Inc. (TRC).

## **WASTE DISPOSAL SUMMARY**

No waste was generated during this reporting period.

## **NEXT QUARTER ACTIVITIES (Second Quarter 2004)**

1. The monitoring well network will be properly destroyed and a report detailing the destruction activities will be submitted upon receipt of regulatory closure for the site.

**CONSULTANT:** Miller Brooks Environmental, Incorporated

M-1 Aug-04/11/04

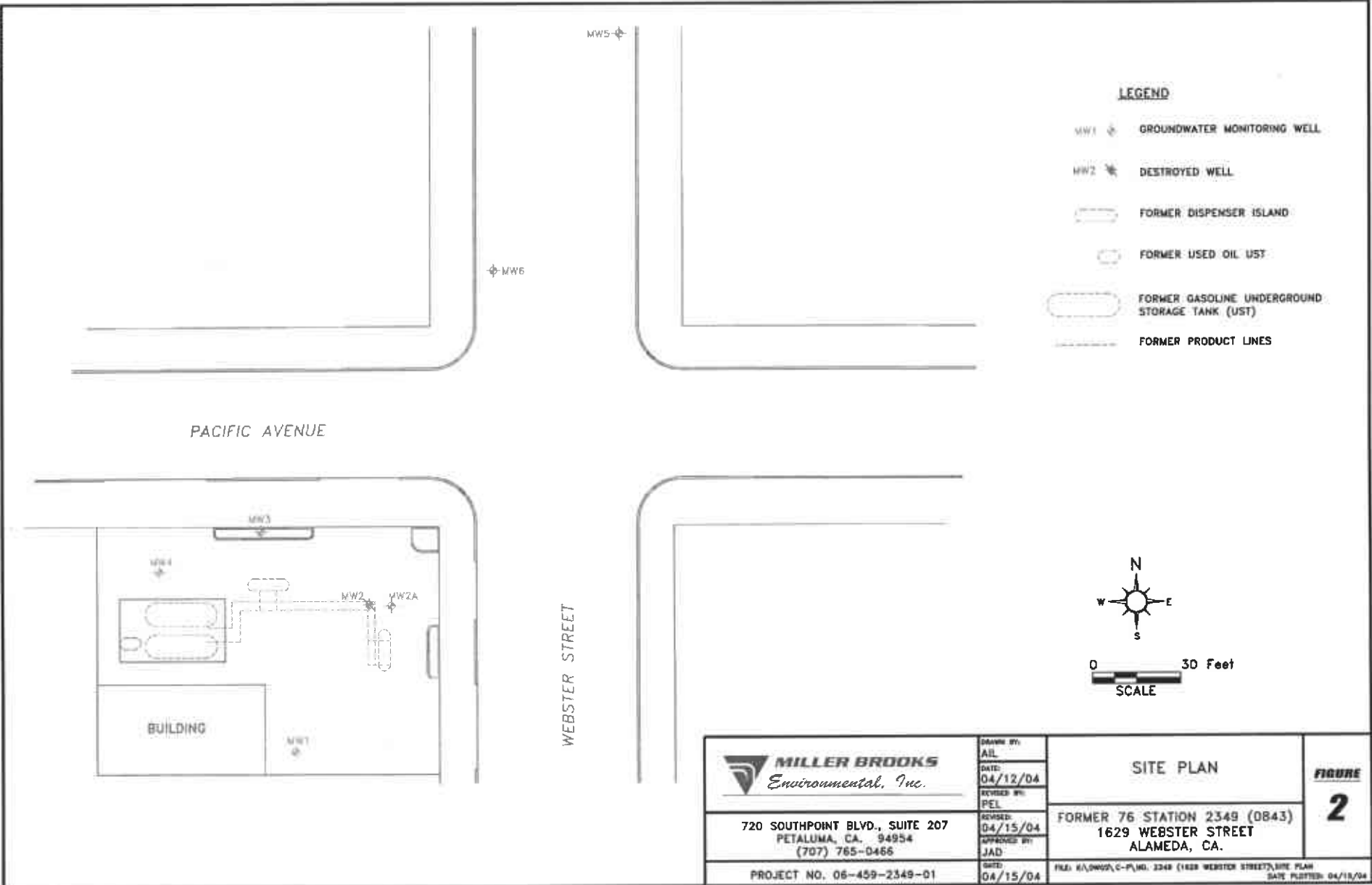

	DRAWN BY: AIL	SITE PLAN	FIGURE <b>2</b>
	DATE: 04/12/04		
720 SOUTHPOINT BLVD., SUITE 207 PETALUMA, CA. 94954 (707) 765-0466	REVISION BY: PEL	FORMER 76 STATION 2349 (0843) 1629 WEBSTER STREET ALAMEDA, CA.	
PROJECT NO. 06-459-2349-01	REVISED: 04/15/04		
	APPROVED BY: JAD		
	DATE: 04/15/04	FILE: K:\DWG\C-P\MG_2349 (1629 WEBSTER STREET).SITE PLAN DATE PLOTTED: 04/15/04	