



**ALISTO ENGINEERING GROUP**

ENVIRONMENTAL  
PROTECTION

99 JUL -9 PM 2:38

July 8, 1999

Mr. Barney Chan  
Alameda County Health Care Services Agency  
1131 Harbor Bay Parkway, Suite 250  
Alameda, California 94502-6577

10-479-01-001

Subject: Stockpiled Soil Sampling and Analysis  
6301 San Pablo Avenue  
Oakland, California

Dear Mr. Chan:

On behalf of Ms. Connie Lam, Alisto Engineering Group is pleased to submit additional information regarding stockpiled soil sampling at 6301 San Pablo Avenue, Oakland, California. This information is in addition to that provided in the letter dated June 28, 1999, and includes: 1) a site plan showing the location of the stockpiled soil and samples, and 2) methodology and procedures during collection of stockpiled soil samples. This additional information is in support of use of the stockpiled soil as backfill during future grading activities at the site.

On June 22, 1999, soil samples were collected from the stockpile soil for characterization. The soil was divided into two stockpiles, and the contractor estimated volume of the stockpiled soil to be 225 cubic yards. Soil Samples S-1 through S-4 were collected from the east stockpile, and Soil Samples S-5 through S-8 were collected from the west stockpile at the locations shown on the attached site plan. Soil Samples S-1 through S-4 were collected from at least 2 feet into the stockpile by hand digging. Soil Samples S-5 through S-8 were collected after up to 5 feet of soil was scraped off the top of the pile using a backhoe.

The soil samples were retained within the stainless steel tubes, and both ends were immediately covered with Teflon sheeting and polyurethane caps. The caps were sealed with tape and labeled with the following information: Alisto's project number, sample number, sampler's initials, and date of collection. The samples were immediately placed in a waterproof plastic bag and stored in a cooler containing blue ice. Possession of the samples was documented from the field to a state-certified analytical laboratory by using a chain of custody form.

The eight discrete samples were composited by the analytical laboratory into two samples for the following analysis:

- Total petroleum hydrocarbons as gasoline using EPA Method 8015
- Benzene, toluene, ethylbenzene, and total xylenes using EPA Method 8020
- Total lead using EPA Method 6010

f:\04\10-479\soil.doc

Mr. Barney Chan  
July 8, 1999  
Page 2

Analysis of the stockpiled soil did not detect petroleum hydrocarbons above the reported detection limits. Total lead was detected at concentrations of 8.2 and 11.2 milligrams per kilogram. A copy of the analytical report is attached.

Please call if you have questions or need additional information.

Sincerely,

ALISTO ENGINEERING GROUP

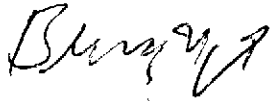

Brady Nagle  
Project Manager

Enclosure

Cc: Ms. Connie Lam

f:\04\10-479\soil.doc

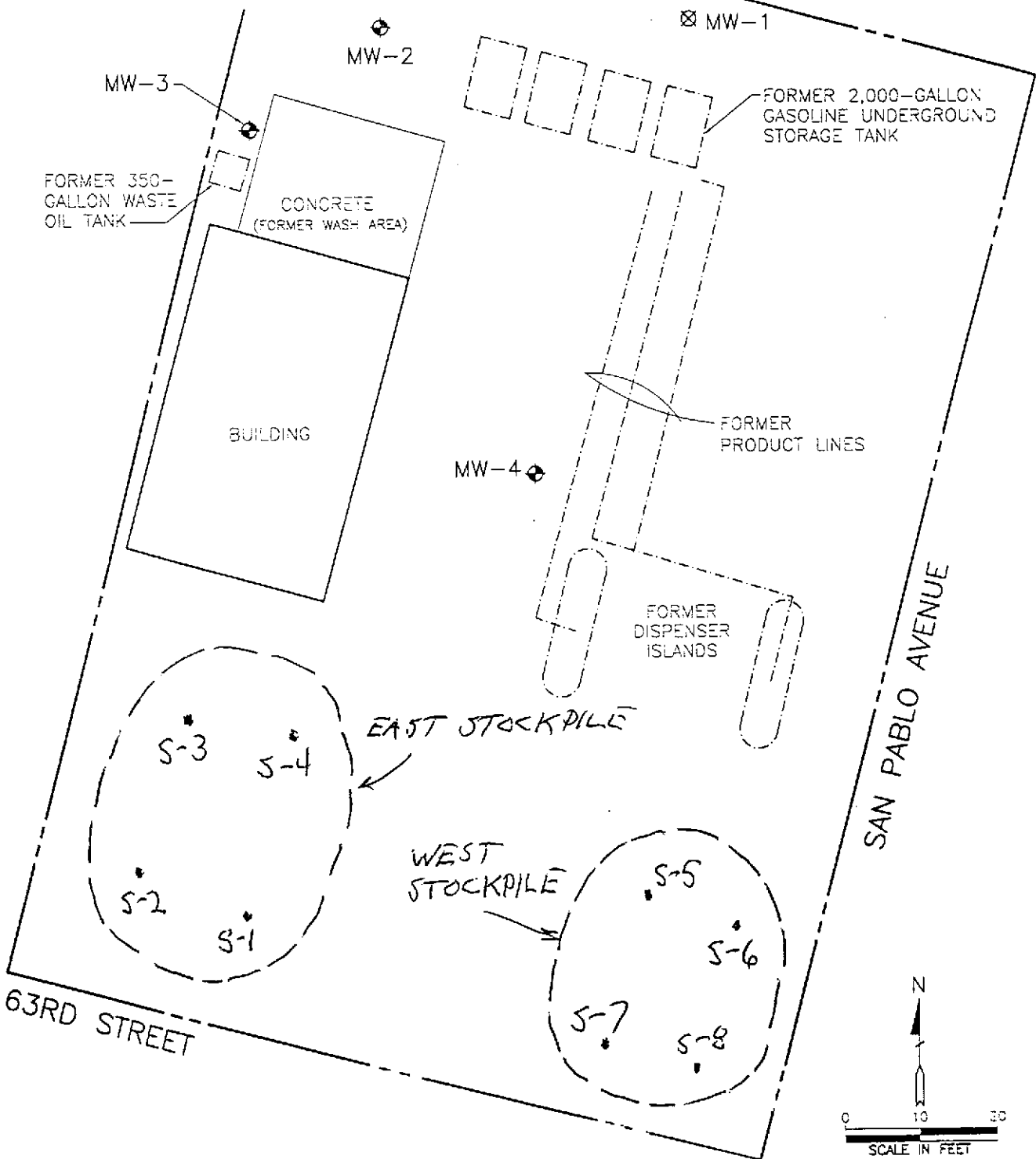

**LEGEND**

- ◆ GROUNDWATER MONITORING WELL
- ⊠ DESTROYED WELL
- STOCKPILE SOIL SAMPLE

**SITE PLAN**

6301 SAN PABLO AVENUE  
OAKLAND, CALIFORNIA

PROJECT NO. 10-479

