

(510) 429-8088  
(800) 523-8088  
FAX (510) 429-8089

Of Northern California, Inc.

FROM: TANK PROTECT ENGINEERING

DATE: August 23, 1994

TO: ACHCSA (Hazardous Materials)

ATTN: Susan Hugo

RE.: ECRU, Inc.

NO. OF PAGES: 10

(Include cover sheet)

**If all pages are not received please notify sender.**

MESSAGE:



# LETTER OF TRANSMITTAL

DATE	8/23/94	JOB NO.	314
ATTENTION	Ms. Susan Hugo		
RE:	ECRU, Inc.		
AUG 24 RECD			

TO: Alameda County Health Care Services Agency

1131 Harbor Bay Parkway, 2nd Floor

Alameda, CA 94502-6577

WE ARE SENDING YOU  Attached  Under separate cover via mail the following items:

- Shop drawings   
  Prints   
  Plans   
  Samples   
  Specifications  
 Copy of letter   
  Change Order   
  \_\_\_\_\_

COPIES	DATE	NO.	DESCRIPTION
1	8/5/94	4652	Analytical Results and Chain-of-Custody

THESE ARE TRANSMITTED as checked below:

- For approval   
  Approved as submitted   
  Resubmit \_\_\_\_\_ copies for approval  
 For your use   
  Approved as noted   
  Submit \_\_\_\_\_ copies for distribution  
 As requested   
  Returned for corrections   
  Return \_\_\_\_\_ corrected prints  
 For review and <sup>file</sup> ~~documentation~~   
  \_\_\_\_\_  
 FOR BIDS DUE \_\_\_\_\_ 19\_\_\_\_  PRINTS RETURNED AFTER LOAN TO US

REMARKS \_\_\_\_\_  
 \_\_\_\_\_  
 \_\_\_\_\_  
 \_\_\_\_\_

COPY TO File

SIGNED:

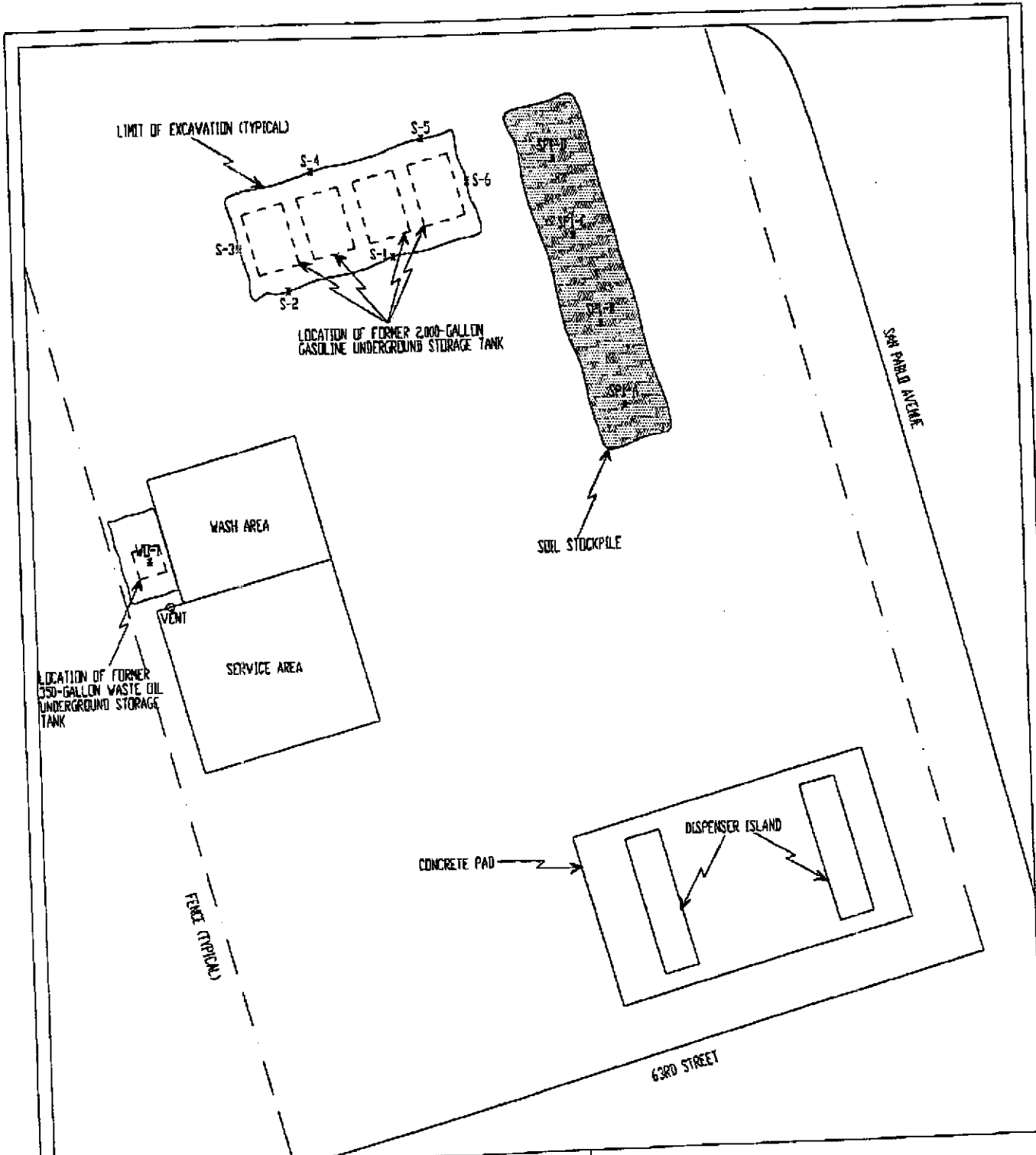

LEGEND

SP1-A NAME AND LOCATION OF SOIL SAMPLE

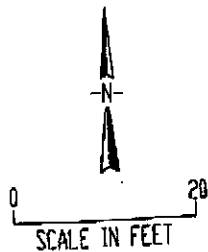

TANK PROTECT ENGINEERING

SITE PLAN: TANK REMOVAL (8/5/94)

ECRU, INC. 6301 SAN PABLO AVENUE OAKLAND, CA 94608

DATE	8/15/94
FIGURE	1
FILE #	314-1
DRAWN BY	NT
CHECKED BY	



LOG NUMBER: 4652  
 DATE SAMPLED: 08/05/94  
 DATE RECEIVED: 08/08/94  
 DATE EXTRACTED: 08/10/94  
 DATE ANALYZED: 08/18/94  
 DATE REPORTED: 08/22/94  
 PAGE: Two

Sample Type: Soil

Method and Constituent:	Units	WO-1		Method Blank	
		Concen- tration	Reporting Limit	Concen- tration	Reporting Limit
DHS Method:					
Total Petroleum Hydro- carbons as Diesel	ug/kg	1,200	1,000	ND	1,000

QC Summary:

% Recovery: 81  
 % RPD: 4.9

Concentrations reported as ND were not detected at or above the reporting limit.



LOG NUMBER: 4652  
 DATE SAMPLED: 08/05/94  
 DATE RECEIVED: 08/08/94  
 DATE EXTRACTED: 08/10/94  
 DATE ANALYZED: 08/12/94  
 DATE REPORTED: 08/22/94  
 PAGE: Three

Sample Type: Soil

Method and Constituent:	Units	S-1		S-2		S-3	
		Concen- tration	Reporting Limit	Concen- tration	Reporting Limit	Concen- tration	Reporting Limit
DHS Method:							
Total Petroleum Hydro- carbons as Gasoline	ug/kg	6,500	500	3,200	500	540,000	73,000
Modified EPA Method 8020 for:							
Benzene	ug/kg	180	5.0	110	5.0	ND	1,500
Toluene	ug/kg	82	5.0	ND	5.0	4,100	1,500
Ethylbenzene	ug/kg	370	5.0	160	5.0	24,000	1,500
Xylenes	ug/kg	1,200	15	210	15	72,000	4,400
Method and Constituent:	Units	S-4		S-5		S-6	
		Concen- tration	Reporting Limit	Concen- tration	Reporting Limit	Concen- tration	Reporting Limit
DHS Method:							
Total Petroleum Hydro- carbons as Gasoline	ug/kg	73,000	3,300	840	500	40,000	690
Modified EPA Method 8020 for:							
Benzene	ug/kg	ND	67	ND	5.0	ND	14
Toluene	ug/kg	210	67	ND	5.0	59	14
Ethylbenzene	ug/kg	1,500	67	ND	5.0	250	14
Xylenes	ug/kg	6,800	200	31	15	600	41

Concentrations reported as ND were not detected at or above the reporting limit.

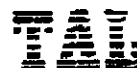

LOG NUMBER: 4652  
 DATE SAMPLED: 08/05/94  
 DATE RECEIVED: 08/08/94  
 DATE EXTRACTED: 08/10/94  
 DATE ANALYZED: 08/12/94  
 DATE REPORTED: 08/22/94  
 PAGE: Four

Sample Type: Soil

Method and Constituent:	Units	Composite of SP1-A, SP1-B, SP1-C, SP1-D		WO-1		Method Blank	
		Concen- tration	Reporting Limit	Concen- tration	Reporting Limit	Concen- tration	Reporting Limit
DHS Method:							
Total Petroleum Hydro- carbons as Gasoline	ug/kg	150,000	3,700	21,000	740	ND	500
Modified EPA Method 8020 for:							
Benzene	ug/kg	ND	74	ND	15	ND	5.0
Toluene	ug/kg	140	74	110	15	ND	5.0
Ethylbenzene	ug/kg	1,700	74	340	15	ND	5.0
Xylenes	ug/kg	4,500	220	1,500	45	ND	15

QC Summary:

% Recovery: 109  
 % RPD: 12

Concentrations reported as ND were not detected at or above the reporting limit.

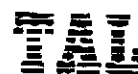

Trace Analysis Laboratory, Inc.

LOG NUMBER: 4652  
 DATE SAMPLED: 08/05/94  
 DATE RECEIVED: 08/08/94  
 DATE EXTRACTED: 08/08/94  
 DATE ANALYZED: 08/09/94  
 DATE REPORTED: 08/22/94  
 PAGE: Five

Sample Type: Soil

Method and Constituent	Units	WO-1		Method Blank	
		Concen- tration	Reporting Limit	Concen- tration	Reporting Limit
EPA Method 8010:					
Benzyl Chloride	ug/kg	ND	1,200	ND	1,200
Bromobenzene	ug/kg	ND	1,200	ND	1,200
Bromodichloromethane	ug/kg	ND	20	ND	20
Bromoform	ug/kg	ND	20	ND	20
Bromomethane	ug/kg	ND	60	ND	60
Carbon Tetrachloride	ug/kg	ND	60	ND	60 <sup>2</sup>
Chlorobenzene	ug/kg	ND	20	ND	20
Chloroethane	ug/kg	ND	60	ND	60
2-Chloroethyl Vinyl Ether	ug/kg	ND	60	ND	60
Chloroform	ug/kg	ND	20	ND	20
Chloromethane	ug/kg	ND	60	ND	60
Dibromochloromethane	ug/kg	ND	20	ND	20
Dibromomethane	ug/kg	ND	1,200	ND	1,200
1,2-Dichlorobenzene	ug/kg	ND	60	ND	60
1,3-Dichlorobenzene	ug/kg	ND	60	ND	60
1,4-Dichlorobenzene	ug/kg	ND	60	ND	60
Dichlorodifluoromethane	ug/kg	ND	60	ND	60
1,1-Dichloroethane	ug/kg	ND	20	ND	20
1,2-Dichloroethane	ug/kg	ND	20	ND	20
1,1-Dichloroethene	ug/kg	ND	20	ND	20

Concentrations reported as ND were not detected at or above the reporting limit.



LOG NUMBER: 4652  
 DATE SAMPLED: 08/05/94  
 DATE RECEIVED: 08/08/94  
 DATE EXTRACTED: 08/08/94  
 DATE ANALYZED: 08/09/94  
 DATE REPORTED: 08/22/94  
 PAGE: Six

Sample Type: Soil

Method and Constituent	Units	WO-1		Method Blank	
		Concen- tration	Reporting Limit	Concen- tration	Reporting Limit
EPA Method 8010 (Continued):					
cis and trans-1,2 Dichloroethene	ug/kg	ND	20	ND	20
Dichloromethane	ug/kg	ND	1,200	ND	1,200
1,2-Dichloropropane	ug/kg	ND	20	ND	20
cis-1,3-Dichloropropene	ug/kg	ND	20	ND	20
trans-1,3-Dichloropropene	ug/kg	ND	20	ND	20
1,1,2,2-Tetrachloro- ethane	ug/kg	ND	20	ND	20
1,1,1,2-Tetrachloro- ethane	ug/kg	ND	1,200	ND	1,200
Tetrachloroethene	ug/kg	ND	20	ND	20
1,1,1-Trichloroethane	ug/kg	ND	20	ND	20
1,1,2-Trichloroethane	ug/kg	ND	20	ND	20
Trichloroethene	ug/kg	ND	20	ND	20
Trichlorofluoro- methane	ug/kg	ND	20	ND	20
1,2,3-Trichloropropane	ug/kg	ND	1,200	ND	1,200
Vinyl Chloride	ug/kg	ND	60	ND	60

QC Summary:

% Recovery: 103  
 % RPD: 1.9

Concentrations reported as ND were not detected at or above the reporting limit.





LOG NUMBER: 4652  
 DATE SAMPLED: 08/05/94  
 DATE RECEIVED: 08/08/94  
 DATE EXTRACTED: 08/09/94  
 DATE ANALYZED: 08/09/94 and 08/10/94  
 DATE REPORTED: 08/22/94  
 PAGE: Seven

Sample Type: Soil

Method and Constituent:	Units	WQ-1		Method Blank		QC Summary	
		Concen- tration	Reporting Limit	Concen- tration	Reporting Limit	% Recovery	% RPD
EPA Method 7130: Cadmium	ug/kg	ND	250	ND	250	68	2.9
EPA Method 7190: Chromium	ug/kg	12,000	1,200	ND	1,200	81*	7.2
EPA Method 7420: Lead	ug/kg	4,300	3,600	ND	3,600	71	1.6
EPA Method 7520: Nickel	ug/kg	38,000	7,500	ND	7,500	69	1.9
EPA Method 7950: Zinc	ug/kg	71,000	1,200	ND	1,200	63	2.9

Concentrations reported as ND were not detected at or above the reporting limit.

\* The Recovery is for the Laboratory Control Sample, due to interference in the spiked sample

  
 Louis W. DuPuis  
 Quality Assurance/Quality Control Manager

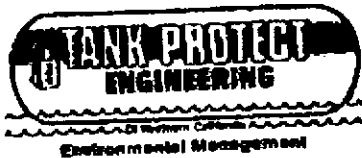

**TANK PROTECT ENGINEERING**

2821 WHIPPLE ROAD  
UNION CITY, CA 94587  
(415) 429-8088  
(800) 523-8088  
FAX (415) 429-8089

**4652**

LAB: Trace

TURNAROUND: 10 day

P.O. #: 888

PAGE 1 OF 2

**CHAIN OF CUSTODY**

PROJECT NO. 314080594		SITE NAME & ADDRESS ECRU 6301 San Pablo Ave Oakland				(1) TYPE OF CON- TAINER	ANALYTES REQUESTED						REMARKS	
SAMPLE NAME, ADDRESS AND TELEPHONE NUMBER Rhetta Arbuckle 2821 WHIPPLE ROAD, UNION CITY, CA 94587 (415) 429-8088							TOTAL LIGHT BC	AROMATIC BC	TOTAL BEVY BC	OIL & GREASES BC	PPC SCAN	HEAVY METALS (As listed)		
ID NO.	DATE	TIME	SOIL	WATER	SAMPLING LOCATION									
S-1	8/5/94	12:00	X		South Sidewalk @ 11'	2" x 6" Brass Tube	X	X						
S-2		12:06			South Sidewalk @ 11'									
S-3		12:15			West Sidewalk @ 11'									
S-4		12:19			North Sidewalk @ 11'									
S-5		12:24			North Sidewalk @ 11'									
S-6		12:35			East Sidewalk @ 11'									
WO-1		12:38			Greenhouse Floor @ 6'									metals - Cd, Cr, Pb, Zn, + Ni by AA
Relinquished by: (Signature)		Date / Time		Received by: (Signature)		Date / Time		Received by: (Signature)		Date / Time		Received by: (Signature)		
[Signature]		8/5/94 10:30		[Signature]		8/8/94 11:32		[Signature]		8/8/94 11:32		[Signature]		
Relinquished by: (Signature)		Date / Time		Received by: (Signature)		Date / Time		Received by: (Signature)		Date / Time		Received by: (Signature)		
[Signature]				[Signature]				[Signature]				[Signature]		
Relinquished by: (Signature)		Date / Time		Received for Laboratory by: (Signature)		Date / Time		Remarks						
[Signature]				[Signature]		8/8/94 11:32								

flu. soil, 1-BT each, Y-6, 10-Day

DATE: 8/8/94



**TANK PROTECT ENGINEERING**

2821 WHIPPLE ROAD  
UNION CITY, CA 94587  
(415) 429-8088  
(800) 523-8088  
FAX (415) 429-8089

**4652**

LAB: Trace

TURNAROUND: 10 day

P.O. #: 888

PAGE 2 OF 2

**CHAIN OF CUSTODY**

PROJECT NO.		SITE NAME & ADDRESS				(1) TYPE OF CON- TAINER	ANALYTES REQUESTED						REMARKS
314080594		ECCA 634 San Pablo Ave Oakland					TOTAL LEAD	AROMATIC HC	TOTAL BTEX HC	OIL & GREASE	VOC SCAN (241's)	OTHER	
SAMPLER NAME, ADDRESS AND TELEPHONE NUMBER													
E-Att Arbuckle 2821 WHIPPLE ROAD, UNION CITY, CA 94587 (415) 429-8088													
ID NO.	DATE	TIME	SOIL	WATER	SAMPLING LOCATION								
SPI-A	8/8/94	12:50	X		Stockpile @ 1.5'	2" x 26" Brass Tube	X	X					Composite 4 into 1
SPI-B		12:55	X		Stockpile @ 1.5'								
SPI-C		13:00	X		Stockpile @ 1.5'								
SPI-D		13:05	X		Stockpile @ 1.5'								
Relinquished by: (Signature)		Date / Time	Received by: (Signature)		Relinquished by: (Signature)		Date / Time	Received by: (Signature)		Date / Time		Received by: (Signature)	
[Signature]		8/8/94 10:30	[Signature]		[Signature]		8/8/94 11:30	[Signature]					
Relinquished by: (Signature)		Date / Time	Received by: (Signature)		Relinquished by: (Signature)		Date / Time	Received by: (Signature)		Date / Time		Received by: (Signature)	
[Signature]			[Signature]		[Signature]			[Signature]					
Relinquished by: (Signature)		Date / Time	Received for Laboratory by: (Signature)		Date / Time		Remarks						
[Signature]			[Signature]		8/8/94 11:32								

DATE: 8/8/94



LOG NUMBER: 4652  
DATE SAMPLED: 08/05/94  
DATE RECEIVED: 08/08/94  
DATE EXTRACTED: 08/10/94  
DATE ANALYZED: 08/18/94  
DATE REPORTED: 08/22/94  
PAGE: Two

Sample Type: Soil

<u>Method and Constituent:</u>	<u>Units</u>	<u>WO-1</u>		<u>Method Blank</u>	
		<u>Concen- tration</u>	<u>Reporting Limit</u>	<u>Concen- tration</u>	<u>Reporting Limit</u>
DHS Method: Total Petroleum Hydro- carbons as Diesel	ug/kg	1,200	1,000	ND	1,000

QC Summary:

% Recovery: 81  
% RPD: 4.9

Concentrations reported as ND were not detected at or above the reporting limit.

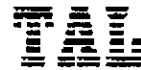

LOG NUMBER: 4652  
 DATE SAMPLED: 08/05/94  
 DATE RECEIVED: 08/08/94  
 DATE EXTRACTED: 08/10/94  
 DATE ANALYZED: 08/12/94  
 DATE REPORTED: 08/22/94  
 PAGE: Three

Sample Type: Soil

Method and Constituent:	Units	S-1		S-2		S-3	
		Concentration	Reporting Limit	Concentration	Reporting Limit	Concentration	Reporting Limit
DHS Method:							
Total Petroleum Hydrocarbons as Gasoline	ug/kg	6,500	500	3,200	500	540,000	73,000
Modified EPA Method 8020 for:							
Benzene	ug/kg	180	5.0	110	5.0	ND	1,500
Toluene	ug/kg	82	5.0	ND	5.0	4,100	1,500
Ethylbenzene	ug/kg	370	5.0	160	5.0	24,000	1,500
Xylenes	ug/kg	1,200	15	210	15	72,000	4,400

Method and Constituent:	Units	S-4		S-5		S-6	
		Concentration	Reporting Limit	Concentration	Reporting Limit	Concentration	Reporting Limit
DHS Method:							
Total Petroleum Hydrocarbons as Gasoline	ug/kg	73,000	3,300	840	500	40,000	690
Modified EPA Method 8020 for:							
Benzene	ug/kg	ND	67	ND	5.0	ND	14
Toluene	ug/kg	210	67	ND	5.0	59	14
Ethylbenzene	ug/kg	1,500	67	ND	5.0	250	14
Xylenes	ug/kg	6,800	200	31	15	600	41

Concentrations reported as ND were not detected at or above the reporting limit.

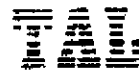

LOG NUMBER: 4652  
 DATE SAMPLED: 08/05/94  
 DATE RECEIVED: 08/08/94  
 DATE EXTRACTED: 08/10/94  
 DATE ANALYZED: 08/12/94  
 DATE REPORTED: 08/22/94  
 PAGE: Four

Sample Type: Soil

Method and Constituent:	Units	Composite of SP1-A, SP1-B, SP1-C, SP1-D		WO-1		Method Blank	
		Concen- tration	Reporting Limit	Concen- tration	Reporting Limit	Concen- tration	Reporting Limit
DHS Method:							
Total Petroleum Hydro- carbons as Gasoline	ug/kg	150,000	3,700	21,000	740	ND	500
Modified EPA Method 8020 for:							
Benzene	ug/kg	ND	74	ND	15	ND	5.0
Toluene	ug/kg	140	74	110	15	ND	5.0
Ethylbenzene	ug/kg	1,700	74	340	15	ND	5.0
Xylenes	ug/kg	4,500	220	1,500	45	ND	15

QC Summary:

% Recovery: 109  
 % RPD: 12

Concentrations reported as ND were not detected at or above the reporting limit.

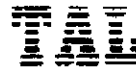

LOG NUMBER: 4652  
DATE SAMPLED: 08/05/94  
DATE RECEIVED: 08/08/94  
DATE EXTRACTED: 08/08/94  
DATE ANALYZED: 08/09/94  
DATE REPORTED: 08/22/94  
PAGE: Five

Sample Type: Soil

Method and Constituent	Units	WC-1		Method Blank	
		Concen- tration	Reporting Limit	Concen- tration	Reporting Limit
EPA Method 8010:					
Benzyl Chloride	ug/kg	ND	1,200	ND	1,200
Bromobenzene	ug/kg	ND	1,200	ND	1,200
Bromodichloromethane	ug/kg	ND	20	ND	20
Bromoform	ug/kg	ND	20	ND	20
Bromomethane	ug/kg	ND	60	ND	60
Carbon Tetrachloride	ug/kg	ND	60	ND	60 <sup>3</sup>
Chlorobenzene	ug/kg	ND	20	ND	20
Chloroethane	ug/kg	ND	60	ND	60
2-Chloroethyl Vinyl Ether	ug/kg	ND	60	ND	60
Chloroform	ug/kg	ND	20	ND	20
Chloromethane	ug/kg	ND	60	ND	60
Dibromochloromethane	ug/kg	ND	20	ND	20
Dibromomethane	ug/kg	ND	1,200	ND	1,200
1,2-Dichlorobenzene	ug/kg	ND	60	ND	60
1,3-Dichlorobenzene	ug/kg	ND	60	ND	60
1,4-Dichlorobenzene	ug/kg	ND	60	ND	60
Dichlorodifluoromethane	ug/kg	ND	60	ND	60
1,1-Dichloroethane	ug/kg	ND	20	ND	20
1,2-Dichloroethane	ug/kg	ND	20	ND	20
1,1-Dichloroethene	ug/kg	ND	20	ND	20

Concentrations reported as ND were not detected at or above the reporting limit.



LOG NUMBER: 4652  
DATE SAMPLED: 08/05/94  
DATE RECEIVED: 08/08/94  
DATE EXTRACTED: 08/08/94  
DATE ANALYZED: 08/09/94  
DATE REPORTED: 08/22/94  
PAGE: Six

Sample Type: Soil

<u>Method and Constituent</u>	<u>Units</u>	<u>WO-1</u>		<u>Method Blank</u>	
		<u>Concen- tration</u>	<u>Reporting Limit</u>	<u>Concen- tration</u>	<u>Reporting Limit</u>
EPA Method 8010 (Continued):					
cis and trans-1,2 Dichloroethene	ug/kg	ND	20	ND	20
Dichloromethane	ug/kg	ND	1,200	ND	1,200
1,2-Dichloropropane	ug/kg	ND	20	ND	20
cis-1,3-Dichloropropene	ug/kg	ND	20	ND	20
trans-1,3-Dichloropropene	ug/kg	ND	20	ND	20
1,1,2,2-Tetrachloro- ethane	ug/kg	ND	20	ND	20
1,1,1,2-Tetrachloro- ethane	ug/kg	ND	1,200	ND	1,200
Tetrachloroethene	ug/kg	ND	20	ND	20
1,1,1-Trichloroethane	ug/kg	ND	20	ND	20
1,1,2-Trichloroethane	ug/kg	ND	20	ND	20
Trichloroethene	ug/kg	ND	20	ND	20
Trichlorofluoro- methane	ug/kg	ND	20	ND	20
1,2,3-Trichloropropane	ug/kg	ND	1,200	ND	1,200
Vinyl Chloride	ug/kg	ND	60	ND	60

QC Summary:

% Recovery: 103  
% RPD: 1.9

Concentrations reported as ND were not detected at or above the reporting limit.





LOG NUMBER: 4652  
 DATE SAMPLED: 08/05/94  
 DATE RECEIVED: 08/08/94  
 DATE EXTRACTED: 08/09/94  
 DATE ANALYZED: 08/09/94 and 08/10/94  
 DATE REPORTED: 08/22/94  
 PAGE: Seven

Sample Type: Soil

Method and Constituent:	Units	WO-1		Method Blank		QC Summary	
		Concentration	Reporting Limit	Concentration	Reporting Limit	% Recovery	% RPD
EPA Method 7130: Cadmium	ug/kg	ND	250	ND	250	68	2.9
EPA Method 7190: Chromium	ug/kg	12,000	1,200	ND	1,200	81*	7.2
EPA Method 7420: Lead	ug/kg	<del>4,300</del>	3,600	ND	3,600	71	1.6
EPA Method 7520: Nickel	ug/kg	38,000	7,500	ND	7,500	69	1.9
EPA Method 7950: Zinc	ug/kg	<del>71,000</del>	1,200	ND	1,200	63	2.9

Concentrations reported as ND were not detected at or above the reporting limit.

\* The Recovery is for the Laboratory Control Sample, due to interference in the spiked sample.

  
 Louis W. DuPuis  
 Quality Assurance/Quality Control Manager



TANK PROTECT ENGINEERING

2821 WHIPPLE ROAD  
 UNION CITY, CA 94587  
 (415) 429-8088  
 (800) 523-8088  
 FAX (415) 429-8089

4652

LAB: Trace  
 TURNAROUND: 10 day  
 P.O. #: 888

PAGE 1 OF 2

CHAIN OF CUSTODY

PROJECT NO. 314080594		SITE NAME & ADDRESS ELCRU 6301 San Pablo Ave Oakland				(1) TYPE OF CON- TAINER	ANALYTES REQUESTED TOTAL LIGHT BC AROMATIC BC TOTAL HEAVY BC (BTZ) OIL & GREASES PCB SCAN OTHER Metals (See List)	REMARKS
SAMPLER NAME, ADDRESS AND TELEPHONE NUMBER Rhett Arbuckle 2821 WHIPPLE ROAD, UNION CITY, CA 94587 (415) 429-8088								
ID NO.	DATE	TIME	SOIL	WATER	SAMPLING LOCATION			
S-1	8/5/94	12:00	X		South Sidewall @ 11'	2" x 6" Brass Tube		
S-2		12:06			South Sidewall @ 11'			
S-3		12:15			West Sidewall @ 11'			
S-4		12:19			North Sidewall @ 11'			
S-5		12:24			North Sidewall @ 11'			
S-6		12:35			East Sidewall @ 11'			
WO-1		12:38			Excavation Floor @ 6'		Metals - Cd, Cr, Pb, Zn, + Ni by AA	
Relinquished by: (Signature)		Date / Time	Received by: (Signature)		Relinquished by: (Signature)	Date / Time	Received by: (Signature)	
[Signature]		8/8/94 10:30	[Signature]		[Signature]	8/8/94 11:32	[Signature]	
Relinquished by: (Signature)		Date / Time	Received by: (Signature)		Relinquished by: (Signature)	Date / Time	Received by: (Signature)	
[Signature]			[Signature]		[Signature]		[Signature]	
Relinquished by: (Signature)		Date / Time	Received for Laboratory by: (Signature)		Date / Time	Remarks		
[Signature]			[Signature]		8/8/94 11:32			

Plu. soil, 1-BT each, Y-6, 10-Day

DATE: 8/8/94



**TANK PROTECT ENGINEERING**

2021 WHIPPLE ROAD  
 UNION CITY, CA 94587  
 (415) 429-8088  
 (800) 523-8088  
 FAX (415) 429-9089

**4652**

LAB: Trace

TURNAROUND: 10 day

P.O. #: 888

PAGE 2 OF 2

**CHAIN OF CUSTODY**

PROJECT NO. 314080594		SITE NAME & ADDRESS ECRU 634 San Pablo Ave Oakland				(1) TYPE OF CONTAINER	ANALYTES REQUESTED						REMARKS
SAMPLER NAME, ADDRESS AND TELEPHONE NUMBER Brett Arbuckle 2021 WHIPPLE ROAD, UNION CITY, CA 94587 (415) 429-8088							TOTAL LIGHT BC	AROMATIC BC	TOTAL HEAVY BC (HTX)	OIL & GREASE	POC SCAN (624's)	OTHER	
ID NO.	DATE	TIME	SOIL	WATER	SAMPLING LOCATION								
SPI-A	8/5/94	12:50	X		stackpile @ 1.5'	2" 26" Press Tube	X	X				Composite 4 into 1	
SPI-B		12:55	X		stackpile @ 1.5'								
SPI-C		13:00	X		stackpile @ 1.5'								
SPI-D		13:05	X		stackpile @ 1.5'								
Relinquished by: (Signature)		Date / Time		Received by: (Signature)		Relinquished by: (Signature)		Date / Time		Received by: (Signature)			
[Signature]		8/5/94 10:30		[Signature]		[Signature]		8/5/94 10:30		[Signature]			
Relinquished by: (Signature)		Date / Time		Received by: (Signature)		Relinquished by: (Signature)		Date / Time		Received by: (Signature)			
[Signature]													
Relinquished by: (Signature)		Date / Time		Received for Laboratory by: (Signature)		Date / Time		Remarks					
[Signature]				Scott J. Lerner		8/8/94 11:32							

DATE: 8/8/94