

FACSIMILE MEMORANDUM SHEET

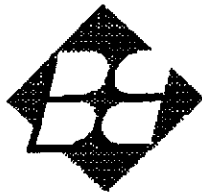

BLYMYER
ENGINEERS, INC.

Date: June 10, 1999

Job No.: 88288.1

Fax No.: 510/337-9335

TO: Eva Chew At: ACHCSA

Subject: G.I. Trucking, San Leandro, STID 1373

Comments: A copy of the preliminary lab results and sample locations for your records. We are running the two hottest soil samples, EX-2 and EX-10 for PNAs, but based upon these numbers I don't think they will be real hot, but then I've been wrong before.

Removed 1-2' of South wall. Well removed 1-2' from east and ~~East~~ 1/4 of north wall. Witness SS from South wall (3) & east wall. Skimming of floaters from surface ~ 10 barrels (500 gal)

From: Mark Detterman

Total number of pages (including this memo): 4 Originals to be mailed YES NO

Copy: File

If this transmission has not arrived as described or is not in readable condition, please contact Blymyer Engineers, Inc. and we will re-transmit.

(510) 521-3773

1829 Clement Avenue, Alameda, CA 94501-1395 Fax (510) 865-2594

rev. 10/4/93

md88288Faxabc.01

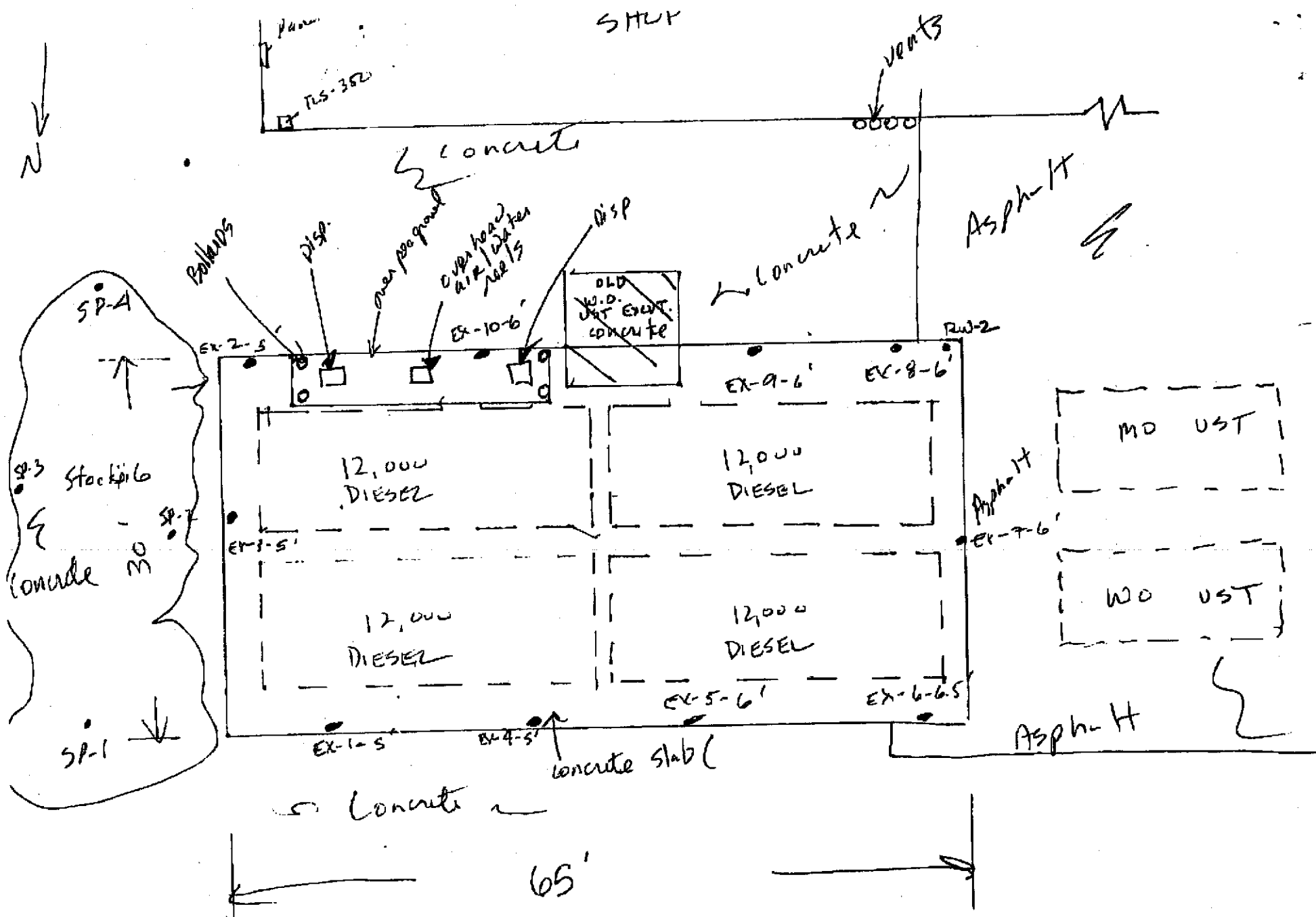

G.I. TRUCKING
 1750 ADAMS AVE
 SAN LEANDRO, GA

 McCAMPBELL ANALYTICAL INC.	110 2nd Avenue South, #D7, Pacheco, CA 94533-5560 Telephone: 925-798-1620 Fax: 925-798-1622 http://www.mccampbell.com E-mail: main@mccampbell.com
	Blymyer Engineers, Inc. 1829 Clement Avenue Alameda, CA 94501

Blymyer Engineers, Inc. 1829 Clement Avenue Alameda, CA 94501	Client Project ID: G.I. Trucking, San Leandro	Date Sampled: 06/09/99
	Client Contact: Sue Black	Date Received: 06/09/99
	Client P.O.:	Date Extracted: 06/09/99
		Date Analyzed: 06/09-06/10/99

Diesel Range (C10-C23) Extractable Hydrocarbons as Diesel *
 EPA methods modified 8015, and 3550 or 3510; California RWQCB (SF Bay Region) method GCFID(3550) or GCFID(3510)

Lab ID	Client ID	Matrix	TPH(d)*	% Recovery Surrogate
12853	EX-1	S	2300,c	104
12854	EX-2	S	4500,a	105
12855	EX-3	S	2100,a	105
12856	EX-4	S	ND	102
12857	EX-5	S	ND	100
12858	EX-6	S	85,c	106
12859	EX-7	S	ND	97
12860	EX-8	S	2000,c	104
12861	EX-9	S	2000,a	118
12862	EX-10	S	2900,c,d	107
12863	SP-1-4	S	190,c	106
Reporting Limit unless otherwise stated; ND means not detected above the reporting limit		W	50 ug/L	
		S	1.0 mg/kg	

* water and vapor samples are reported in ug/L, wipe samples in ug/wipe, soil and sludge samples in mg/kg, and all TCLP / STLC / SPLP extracts in ug/L.
 * clustered chromatogram resulting in coeluted surrogate and sample peaks, or, surrogate peak is on elevated baseline, or, surrogate has been diminished by dilution of original extract.
 *The following descriptions of the TPH chromatogram are cursory in nature and McCampbell Analytical is not responsible for their interpretation: a) unmodified or weakly modified diesel is significant; b) diesel range compounds are significant, no recognizable pattern; c) aged diesel? is significant; d) gasoline range compounds are significant; e) medium boiling point pattern that does not match diesel (?); f) one or a few isolated peaks present; g) oil range compounds are significant; h) lighter than water immiscible stream is present; i) liquid sample that contains greater than ~5 vol. % sediment.

DHS Certification No. 1644

 Edward Hamilton, Lab Director

 McCAMPBELL ANALYTICAL INC.	110 2nd Avenue South, #D7, Pacheco, CA 94553-5560 Telephone: 925-798-1620 Fax: 925-798-1623 http://www.mccampbell.com E-mail: main@mccampbell.com
	Blymyer Engineers, Inc. 1829 Clement Avenue Alameda, CA 94501

Blymyer Engineers, Inc. 1829 Clement Avenue Alameda, CA 94501	Client Project ID: G.L Trucking, San Leandro	Date Sampled: 06/09/99
	Client Contact: Sue Black	Date Received: 06/09/99
	Client P.O:	Date Extracted: 06/09/99
		Date Analyzed: 06/09/99

Gasoline Range (C6-C12) Volatile Hydrocarbons as Gasoline*, with Methyl tert-Butyl Ether* & BTEX*
 EPA methods 5030, modified 8015, and 8020 or 602; California RWQCB (SF Bay Region) method GC/FID(5030)

Lab ID	Client ID	Matrix	TPH(g) ⁺	MTBE	Benzene	Toluene	Ethylbenzene	Xylenes	% Recovery Surrogate
12853	EX-1	S	81.g	ND	ND	ND	ND	ND	102
12854	EX-2	S	120.g	ND	ND	ND	ND	ND	101
12855	EX-3	S	26.g	ND	ND	ND	ND	ND	97
12856	EX-4	S	ND	ND	ND	ND	ND	ND	99
12857	EX-5	S	ND	ND	ND	ND	ND	ND	100
12858	EX-6	S	3.7.g	ND	ND	ND	ND	ND	100
12859	EX-7	S	ND	ND	ND	ND	ND	ND	106
12860	EX-8	S	120.g	ND	ND	ND<0.01	ND	0.17	104
12861	EX-9	S	120.g	ND	ND	0.013	ND	0.19	100
12862	EX-10	S	390.g ^j	ND<0.20	ND<0.03	0.45	0.45	1.5	96
12863	9P-1-4	S	7.9.g	ND	ND	0.010	ND	0.008	98
Reporting Limit unless otherwise stated; ND means not detected above the reporting limit		W	50 ug/L	5.0	0.5	0.5	0.5	0.5	
		S	1.0 mg/kg	0.05	0.005	0.005	0.005	0.005	

* water and vapor samples are reported in ug/L, wipe samples in ug/wipe, soil and sludge samples in mg/kg, and all TCLP and SPLP extracts in ug/L

* cluttered chromatogram; sample peak coelutes with surrogate peak

The following descriptions of the TPH chromatogram are cursory in nature and McCampbell Analytical is not responsible for their interpretation: a) unmodified or weakly modified gasoline is significant; b) heavier gasoline range compounds are significant (aged gasoline?); c) lighter gasoline range compounds (the most mobile fraction) are significant; d) gasoline range compounds having broad chromatographic peaks are significant; biologically altered gasoline?; e) TPH pattern that does not appear to be derived from gasoline (??); one to a few isolated peaks present; g) strongly aged gasoline or diesel range compounds are significant; h) lighter than water immiscible sheen is present; i) liquid sample that contains greater than ~5 vol. % sediment; j) no recognizable pattern.

DHS Certification No. 1644

 Edward Hamilton, Lab Director