

ENVIRONMENTAL
PROTECTION

97 APR 29 PM 2:30



Chevron

April 25, 1997

Mr. Scott Seery
Alameda County Health Care Services
Department of Environmental Health
1131 Harbor Bay Parkway, Suite 250
Alameda, CA 94502-6577

Chevron Products Company
6001 Bollinger Canyon Road
Building L
San Ramon, CA 94583
P.O. Box 6004
San Ramon, CA 94583-0904

Marketing - Sales West
Phone 510 842-9500

Re: Chevron Service Station #9-0917
5820 Hopyard Road, Pleasanton, California

Dear Mr. Seery:

Enclosed is the First Quarter Groundwater Monitoring & Sampling Report for 1997 report prepared by Gettler-Ryan Inc., for the above noted site. The groundwater samples were analyzed for the presence of TPH-g, BTEX and MtBE constituents in monitoring wells MW-5 and MW-6, while well MW-4 is monitored semi-annually (December and June).

Concentrations of all constituents declined from the previous sampling event in both wells MW-5 and MW-6, except for xylene, in MW-6 which remained at below method detection limits.

Depth to groundwater varied from 8.85 feet to 9.72 feet below grade with the direction of flow northeasterly.

Chevron has been waiting to receive the final access agreement from one property owner south of our site, so that we could proceed to install the three groundwater monitoring wells as outlined in the approved Work Plan for this site. This access has been received and installation of the wells is expected within the next 30 days.

Chevron will continue to monitor the site as outlined above. If you have any questions call me at (510) 842-9136.

Sincerely,
CHEVRON PRODUCTS COMPANY

Philip R. Briggs
Site Assessment and Remediation Project Manager

Enclosure

April 24, 1997
Mr. Scott Seery
Chevron Service Station # 9-0917
Page 2

cc: Mr. Eddie So
RWQCB-San Francisco Bay Region
2101 Webster St., Suite 500
Oakland, CA 94612

Mr. Dan Christopoulos
C & H Development Co.
3744 Mt. Diablo Blvd., Suite 301
Lafayette, CA 94549

Ms. Bette Owen, Chevron



GETTLER-^{ENVIRONMENTAL}RYAN^{INC.}

97 APR 29 PM 2:34

April 18, 1997

Job #5242.80

Mr. Phil Briggs
Chevron Products Company
P.O. Box 6004
San Ramon, CA 94583

Re: First Quarter Groundwater Monitoring & Sampling Report
Chevron Service Station #9-0917
5280 Hopyard Road
Pleasanton, California

Dear Mr. Briggs:

This report documents the quarterly groundwater sampling event performed by Gettler-Ryan Inc. (G-R). On March 13, 1997, field personnel were on-site to monitor three wells (MW-4, MW-5 and MW-6) and sample two wells (MW-5 and MW-6) at Chevron Service Station #9-0917 located at 5280 Hopyard Road in Pleasanton, California.

Static groundwater levels were measured on March 13, 1997. All wells were checked for the presence of separate-phase hydrocarbons. Separate-phase hydrocarbons were not present in any of the wells. Static water level data and groundwater elevations are presented in Table 1. A potentiometric map is included as Figure 1.

Groundwater samples were collected from the monitoring wells as specified by G-R Standard Operating Procedure - Groundwater Sampling (attached). The field data sheets for this event are also attached. The samples were analyzed by NEI/GTEL Environmental Laboratories, Inc. Analytical results are presented in Table 1. The chain of custody document and laboratory analytical reports are attached.

Thank you for allowing Gettler-Ryan Inc. to provide environmental services to Chevron. Please call if you have any questions or comments regarding this report.

Sincerely,

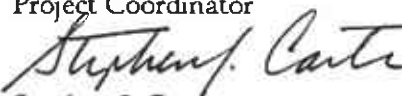

Deanna L. Harding
Project Coordinator

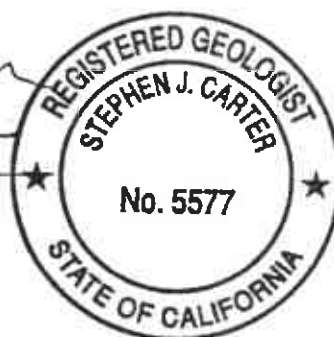
Stephen J. Carter
Senior Geologist, R.G. No. 5577

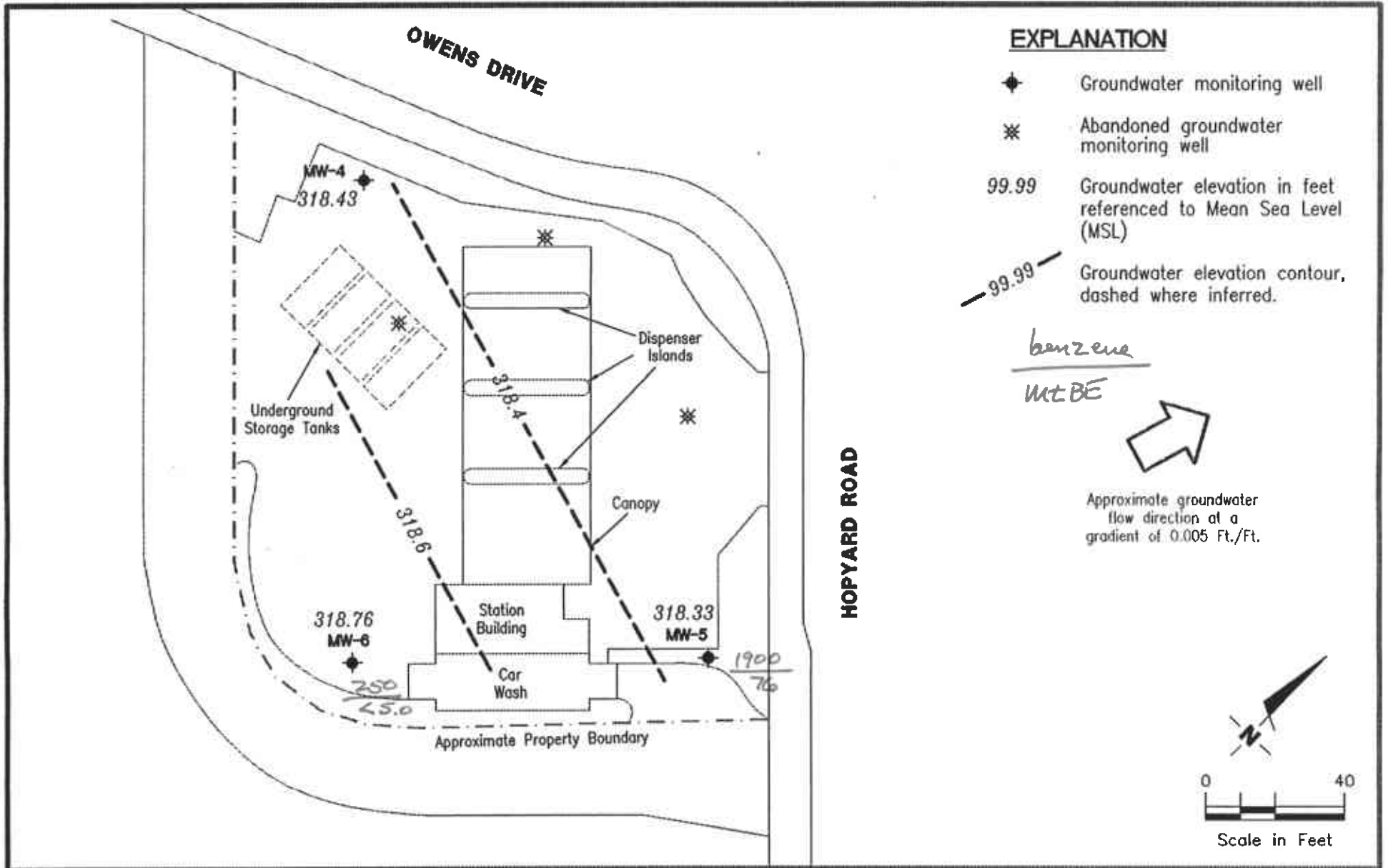

DLH/SJC/ah
5242.QML

- Figure 1: Potentiometric Map
- Table 1: Water Level Data and Groundwater Analytical Results
- Attachments: Standard Operating Procedure - Groundwater Sampling
Field Data Sheets
Chain of Custody Document and Laboratory Analytical Reports



Gettler - Ryan Inc.

6747 Sierra Ct., Suite J (510) 551-7555
Dublin, CA 94568

POTENTIOMETRIC MAP
Chevron Service Station No. 9-0917
5280 Hopyard Road
Pleasanton, California

FIGURE

1

JOB NUMBER
5242

REVIEWED BY

DATE
March 13, 1997

REVISED DATE



Table 1. Water Level Data and Groundwater Analytical Results - Chevron Service Station #9-0917, 5280 Hopyard Road, Pleasanton, California

Well ID/ TOC (ft)	Date	DTW (ft)	GWE (msl)	Product Thickness* (ft)	TPH(G)	B T E X				MTBE
						←-----ppb----->				
MW-1¹										
326.48	7/12/89	---	---	---	100	<0.5	<0.5	6	<0.5	---
	8/2/89	8.10	318.38	0	---	---	---	---	---	---
	10/24/89	7.51	318.97	0	<50	1	<0.5	13	<0.5	---
	3/12/90	8.41	318.07	0	140	0.8	<0.5	1	<0.5	---
	3/26/90	8.14	318.34	0	---	---	---	---	---	---
	6/22/90	8.31	318.17	0	<50	<0.5	<0.5	<0.5	<0.5	---
	9/11/90	8.14	318.35	0	<50	<0.5	<0.5	<0.5	<0.5	---
	4/18/91	8.02	318.34	0	77	<0.5	<0.5	<0.5	<0.5	---
MW-2¹										
327.53	7/17/89	---	---	0	<50	<0.5	<0.5	<0.5	<0.5	---
	8/2/89	9.05	318.48	0	---	---	---	---	---	---
	10/24/89	9.24	318.29	0	<50	<0.5	<0.5	<0.5	<0.5	---
	3/12/90	10.07	317.46	0	<50	<0.5	<0.5	<0.5	<0.5	---
	3/26/90	10.05	317.48	0	---	---	---	---	---	---
	6/22/90	10.05	317.48	0	<50	<0.5	<0.5	<0.5	<0.5	---
	9/11/90	9.68	317.85	0	<50	<0.5	<0.5	<0.5	<0.5	---
	4/18/91	9.23	318.30	0	<50	<0.5	<0.5	<0.5	<0.5	---
MW-3¹										
326.47	7/17/89	---	---	---	<50	<0.5	<0.5	<0.5	<0.5	---
	8/2/89	8.15	318.32	0	---	---	---	---	---	---
	10/24/89	7.59	318.88	0	<50	<0.5	<0.5	<0.5	<0.5	---
	3/12/90	8.47	318.00	0	<50	<0.5	<0.5	<0.5	<0.5	---
	3/26/90	8.83	317.64	0	---	---	---	---	---	---
	6/22/90	8.83	317.64	0	<50	0.4	<0.5	0.8	<0.5	---
	9/11/90	8.41	318.06	0	<50	<0.5	<0.5	<0.5	<0.5	---
	4/18/91	7.98	318.49	0	<50	<0.5	<0.5	<0.5	<0.5	---
MW-4¹										
327.28	9/16/91	9.59	317.69	0	<50	<0.5	<0.5	<0.5	<0.5	---
	1/22/92	9.49	317.79	0	<50	<0.5	<0.5	<0.5	<0.5	---
	3/26/92	8.89	318.39	0	<50	<0.5	<0.5	<0.5	<0.5	---
	6/5/92	9.22	318.06	0	<50	<0.5	<0.5	<0.5	<0.5	---
	9/23/92	9.35	317.93	0	<50	<0.5	<0.5	<0.5	<0.5	---
	12/30/92	8.28	319.00	0	<50	<0.5	<0.5	<0.5	<0.5	---
	3/22/93	8.25	319.03	0	<50	<0.5	<0.5	<0.5	<0.5	---
	6/14/93	9.16	318.12	0	---	---	---	---	---	---
	7/25/93	9.10	318.18	0	<50	<0.5	<0.5	<0.5	<0.5	---
	9/23/93	8.70	318.58	0	<50	<0.5	<0.5	<0.5	<0.5	---
	12/28/93	9.90	317.38	0	<50	<0.5	<0.5	<0.5	0.5	---
	3/21/94	9.25	318.03	0	<50	1.0	2.0	0.5	1.9	---
	6/7/94	9.05	318.23	0	<50	<0.5	<0.5	<0.5	<0.5	---



Table 1. Water Level Data and Groundwater Analytical Results - Chevron Service Station #9-0917, 5280 Hopyard Road, Pleasanton, California
(continued)

Well ID/ TOC (ft)	Date	DTW (ft)	GWE (msl)	Product Thickness* (ft)	TPH(G)	←-----ppb----->				MTBE
						B	T	E	X	
MW-4 (cont)	10/7/94	8.97	318.31	0	<50	<0.5	<0.5	<0.5	<0.5	---
	12/29/94	9.22	318.06	0	<50 ²	<0.5	1.1	0.8	2.7	---
	3/6/95	9.02	318.26	0	<50	<0.5	<0.5	<0.5	<0.5	---
	6/14/95	8.81	318.47	0	170	<0.5	<0.5	<0.5	<0.5	---
	9/14/95	9.28	318.00	0	<50	1.0	<0.5	1.6	<0.5	---
	12/16/95	7.86	319.42	0	<50	<0.5	<0.5	<0.5	<0.5	150
	3/28/96	8.34	318.94	0	<50	<0.5	<0.5	<0.5	<0.5	53
	6/28/96	8.49	318.79	0	70	<0.5	<0.5	<0.5	<0.5	92
	9/26/96	8.44	318.84	0	---	---	---	---	---	---
	12/30/96	8.18	319.10	0	<50 ⁴	<0.5	<0.5	<0.5	<0.5	100
	3/13/97	8.85	318.43	0	---	---	---	---	---	---
MW-5/ 327.82	9/16/91	10.06	317.76	0	12,000	4,000	29	1,600	92	---
	1/22/92	10.58	317.24	0	44,000	2,000	320	5,700	2,400	---
	3/26/92	9.18	318.64	0	39,000	3,200	210	5,700	2,400	---
	6/5/92	9.90	317.92	0	28,000	3,800	140	4,000	2,000	---
	9/23/92	9.97	317.85	0	40,000	2,000	290	2,900	1,800	---
	12/30/92	8.80	319.02	0	44,000	9,000	190	3,100	1,600	---
	3/22/93	9.33	318.49	0	43,000	6,500	170	2,400	2,400	---
	6/14/93	9.78	318.04	0	---	---	---	---	---	---
	7/25/93	9.72	318.10	0	43,000	550	45	2,700	1,100	---
	9/23/93	9.42	318.40	0	44,000 ²	14,000	640	3,700	1,800	---
	12/28/93	9.67	318.15	0	56,000	12,000	590	4,100	1,600	---
	3/21/94	9.71	318.11	0	48,000	12,000	600	4,700	1,600	---
	6/7/94	9.72	318.10	0	42,000	13,000	480	3,700	1,200	---
	10/7/94	9.55	318.27	0	15,000	1,100	41	950	34	---
	12/29/94	9.92	317.90	0	45,000	12,000	460	3,600	1,400	---
	3/6/95	9.32	318.50	0	40,000	9,700	210	3,500	700	---
	6/14/95	9.41	318.41	0	42,000	8,000	170	3,700	640	---
	9/14/95	10.52	317.30	0	26,000 ²	4,100	85	2,000	270	---
	12/16/95	8.34	319.48	0	35,000	7,300	<0.5	2,900	420	<500
	3/28/96	9.73	318.09	0	30,000	5,200	160	3,500	600	<250
6/28/96	9.45	318.37	0	26,000	4,300	60	2,100	200	680	
9/26/96	9.87	317.95	0	15,000	2,700	59	1,300	140	400	
12/30/96	9.00	318.82	0	34,000	4,600	120	2,800	660	310	
3/13/97	9.49	318.33	0	13,000	---	34	1,300	220	---	
MW-6/ 328.48	9/16/91	10.61	317.87	0	6,200	1,300	3.9	550	78	---
	1/22/92	10.30	318.18	0	18,000	2,800	48	2,000	440	---
	3/26/92	9.50	318.98	0	21,000	3,300	17	2,100	300	---
	6/5/92	10.34	318.14	0	14,000	2,800	9.2	1,800	270	---



Table 1. Water Level Data and Groundwater Analytical Results - Chevron Service Station #9-0917, 5280 Hopyard Road, Pleasanton, California
(continued)

Well ID/ TOC (ft)	Date	DTW (ft)	GWE (msl)	Product Thickness* (ft)	TPH(G)	←-----ppb----->				MTBE
						B	T	E	X	
MW-6 (cont)	9/23/92	10.56	317.92	0	19,000	1,000	40	1,200	230	—
	12/30/92	9.75	318.71	0	15,000	1,100	<5	1,000	77	—
	3/22/93	9.27	319.21	0	15,000	1,300	10	770	220	—
	6/14/93	10.15	318.33	0	—	—	—	—	—	—
	7/25/93	10.25	318.23	0	6,400	630	<2.5	440	6	—
	9/23/93	10.17	318.31	0	9,500	1,000	23	690	110	—
	12/28/93	10.52	317.96	0	11,000	890	31	730	48	—
	3/21/94	10.28	318.20	0	5,700	380	10	270	22	—
	6/7/94	10.28	318.20	0	5,300	600	4.4	370	26	—
	10/7/94	10.42	318.06	0	2,600	270	<5.0	110	<5.0	—
	12/29/94	10.25	318.23	0	4,500	560	6.2	360	<5.0	—
	3/6/95	9.36	319.12	0	4,100	480	15	290	20	—
	6/14/95	10.11	318.37	0	2,800	180	6.9	110	6.6	—
	9/14/95	10.27	318.21	0	3,100 ^b	370	<0.5	250	<0.5	—
	12/16/95	9.27	319.21	0	1,900	210	<0.5	76	<0.5	<13
	3/28/96	9.35	319.13	0	1,000	120	<0.5	64	<0.5	<5.0
	6/28/96	9.78	318.70	0	950	110	0.8	44	<0.5	22
	9/26/96	9.46	319.02	0	1,100	120	1.6	48	<0.5	17
	12/30/96	9.03	319.45	0	3,200	260	2.3	120	<0.5	23
3/13/97	9.72	318.76	0	2,000	250	<0.5	110	<0.5	<5.0	
Trip Blank	6/22/90	—	—	—	<50	<0.3	<0.3	<0.3	<0.6	—
	9/16/91	—	—	—	<50	<0.5	<0.5	<0.5	<0.5	—
	1/22/92	—	—	—	<50	<0.5	<0.5	<0.5	<0.5	—
	3/26/92	—	—	—	<50	<0.5	<0.5	<0.5	<0.5	—
	6/5/92	—	—	—	<50	<0.5	<0.5	<0.5	<0.5	—
TB-LB	9/23/92	—	—	—	<50	<0.5	<0.5	<0.5	<0.5	—
	12/30/92	—	—	—	<50	<0.5	<0.5	<0.5	<0.5	—
	3/22/93	—	—	—	<50	<0.5	<0.5	<0.5	<0.5	—
	7/25/93	—	—	—	<50	<0.5	<0.5	<0.5	<0.5	—
	9/23/93	—	—	—	<50	<0.5	<0.5	<0.5	<0.5	—
	12/28/93	—	—	—	<50	<0.5	<0.5	<0.5	<0.5	—
	3/21/94	—	—	—	<50	<0.5	<0.5	<0.5	<0.5	—
	6/7/94	—	—	—	<50	<0.5	<0.5	<0.5	<0.5	—
	10/7/94	—	—	—	<50	<0.5	<0.5	<0.5	<0.5	—
	12/29/94	—	—	—	<50	<0.5	<0.5	<0.5	<0.5	—
	3/6/95	—	—	—	<50	<0.5	<0.5	<0.5	<0.5	—
	6/14/95	—	—	—	<50	<0.5	<0.5	<0.5	<0.5	—
	9/14/95	—	—	—	<50	<0.5	<0.5	<0.5	<0.5	—
	12/16/95	—	—	—	<50	<0.5	<0.5	<0.5	<0.5	<2.5
3/28/96	—	—	—	<50	<0.5	<0.5	<0.5	<0.5	<5.0	
6/28/96	—	—	—	<50	<0.5	<0.5	<0.5	<0.5	<5.0	



Table 1. Water Level Data and Groundwater Analytical Results - Chevron Service Station #9-0917, 5280 Hopyard Road, Pleasanton, California
(continued)

Well ID/ TOC (ft)	Date	DTW (ft)	GWE (msl)	Product Thickness* (ft)	TPH(G)	←-----ppb----->				
						B	T	E	X	MTBE
TB-LB (cont)	9/26/96	--	--	--	<50	<0.5	<0.5	<0.5	<0.5	<5.0
	12/30/96	--	--	--	<50	<0.5	<0.5	<0.5	<0.5	<5.0
	3/13/97	--	--	--	<50	<0.5	<0.5	<0.5	<0.5	<5.0
Bailer Blank BB	3/22/93	--	--	--	<50	<0.5	<0.5	<0.5	<0.5	--
	7/25/93	--	--	--	<50	<0.5	<0.5	<0.5	<0.5	--
	9/23/93	--	--	--	<50	<0.5	<0.5	<0.5	<0.5	--
	12/28/93	--	--	--	<50	<0.5	<0.5	<0.5	<0.5	--
	3/21/94	--	--	--	<50	<0.5	<0.5	<0.5	<0.5	--



Table 1. Water Level Data and Groundwater Analytical Results - Chevron Service Station #9-0917, 5280 Hopyard Road, Pleasanton, California
(continued)

EXPLANATION:

TOC = Top of casing elevation
(ft) = feet
DTW = Depth to water
GWE = Groundwater elevation
msl = Measurements referenced relative to mean sea level
TPH(G) = Total Purgeable Petroleum Hydrocarbons as Gasoline
B = Benzene
T = Toluene
E = Ethylbenzene
X = Xylenes
MTBE = Methyl-tertiary-butyl ether
ppb = Parts per billion
-- = Not applicable/not available

ANALYTICAL METHODS:

EPA Method 8015/5030 for TPH(G)
EPA Method 8020 for BTEX & MTBE

NOTES:

Water level elevation data and laboratory analytical results prior to June 14, 1995,, were compiled from Quarterly Monitoring Reports prepared for Chevron by Sierra Environmental Services.

- * Product thickness was measured with an MMC flexi-dip interface probe on and after March 22, 1993.
- ¹ Wells MW-1, MW-2 and MW-3 were abandoned on April 18 and 19, 1991.
- ² Uncategorized compound not included in gasoline hydrocarbon concentration.
- ³ Uncategorized compound not included in gasoline concentration. Data obtained from multiple dilutions. Dilution factor noted represents the dilution used for majority of results.
- ⁴ Laboratory report indicates the TPH as gasoline value was 100 mg/L which was attributed to the presence of MTBE.



STANDARD OPERATING PROCEDURE - GROUNDWATER SAMPLING

Gettler-Ryan Inc. field personnel adhere to the following procedures for the collection and handling of groundwater samples prior to analysis by the analytical laboratory. Prior to sample collection, the type of analysis to be performed is determined. Loss prevention of volatile compounds is controlled and sample preservation for subsequent analysis is maintained.

Prior to sampling, the presence or absence of free-phase hydrocarbons is determined using a MMC flexi-dip interface probe. Product thickness, if present, is measured to the nearest 0.01 foot and is noted in the field notes. In addition, static water level measurements are collected with the interface probe and are also recorded in the field notes.

After water levels are collected and prior to sampling, each well is purged a minimum of three well casing volumes of water using pre-cleaned pumps (stack, suction, Grundfos), or polyvinyl chloride bailers. Temperature, pH and electrical conductivity are measured a minimum of three times during the purging. Purging continues until these parameters stabilize.

Groundwater samples are collected using Chevron-designated disposable bailers. The water samples are transferred from the bailer into appropriate containers. Pre-preserved containers, supplied by analytical laboratories, are used when possible. When pre-preserved containers are not available, the laboratory is instructed to preserve the sample as appropriate. Duplicate samples are collected for the laboratory to use in maintaining quality assurance/quality control standards. The samples are labeled to include the job number, sample identification, collection date and time, analysis, preservation (if any), and the sample collector's initials. The water samples are placed in a cooler, maintained at 4°C for transport to the laboratory. Once collected in the field, all samples are maintained under chain of custody until delivered to the laboratory.

The chain of custody document includes the job number, type of preservation, if any, analysis requested, sample identification, date and time collected, and the sample collector's name. The chain of custody is signed and dated (including time of transfer) by each person who receives or surrenders the samples, beginning with the field personnel and ending with the laboratory personnel.

A laboratory supplied trip blank accompanies each sampling set. For sampling sets greater than 20 samples, 5% trip blanks are included. The trip blank is analyzed for some or all of the same compounds as the groundwater samples.

As requested by Chevron Products Company, the purge water and decontamination water generated during sampling activities is transported by IWM to McKittrick Waste Management located in McKittrick, California.

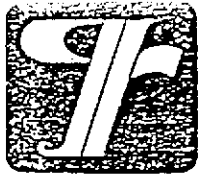

WELL SAMPLING FIELD DATA SHEET

SAMPLER Clyde Galantone DATE 3/13/97
 ADDRESS 5280 Hopyard Rd JOB # 5242.85
 CITY Pleasanton SS# 9-0917

Well ID MW-4 Well Condition OK

Well Location Description _____

Well Diameter 2" in Hydrocarbon Thickness _____
 Total Depth 25 ft
 Depth to Liquid 8.85 ft

Volume	2" = 0.17	6" = 1.50	12" = 5.80
Factor	3" = 0.38		
(VF)	4" = 0.66		

of casing Volume 16.15 x _____ x(VF) #Estimated _____ gal.
 purge Volume

Purge Equipment stack pump Sampling Equipment disp bailer

Did well dewater _____ If yes, Time _____ Volume _____

Starting Time _____ Purging Flow Rate _____ gpm.

Sampling Time _____

Time	pH	Conductivity	Temperature	Volume
_____	_____	_____	_____	_____
_____	_____	_____	_____	_____
_____	_____	_____	_____	_____
_____	_____	_____	_____	_____

Weather Conditions _____

Water Color: _____ Odor: _____

Sediment Description _____

LABORATORY INFORMATION

Sample ID	Container	Refrig	Preservative Type	Lab	Analysis
<u>MW-2</u>					

Comments Sampled Semi-Annually (June & December.)

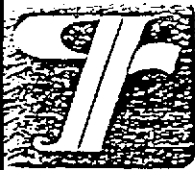

WELL SAMPLING FIELD DATA SHEET

SAMPLER Clyde Galantine DATE 3/13/97
 ADDRESS 5280 Hopyard Rd JOB # 5242.85
 CITY Pleasanton SS# 9-0917

Well ID MW-S Well Condition OK

Well Location Description _____

Well Diameter 2" in Hydrocarbon Thickness _____
 Total Depth 24 ft
 Depth to Liquid 9.49 ft
 # of casing Volume 14.51 x .17 x(VF) 3 #Estimated purge Volume 7.64 gal.

Volume	2" = 0.17	6" = 1.50	12" = 5.80
Factor	3" = 0.38		
(VF)	4" = 0.66		

Purge Equipment stack pump Sampling Equipment disp bailer
 Did well dewater No If yes, Time _____ Volume _____

Starting Time 9:52 Purging Flow Rate 2-2.5 gpm.
 Sampling Time 10:07

Time	pH	Conductivity	Temperature	Volume
<u>9:53</u>	<u>6.58</u>	<u>4370</u>	<u>20.5</u>	<u>1</u>
<u>9:54</u>	<u>6.54</u>	<u>5100</u>	<u>20.0</u>	<u>3</u>
<u>9:55</u>	<u>6.51</u>	<u>5520</u>	<u>21.1</u>	<u>5.5</u>
<u>9:57</u>	<u>6.43</u>	<u>6190</u>	<u>21.2</u>	<u>8</u>
<u>10:07</u>	<u>6.49</u>	<u>5670</u>	<u>20.9</u>	<u>Sample</u>

Weather Conditions clear
 Water Color: lt yellow Odor: hydrocarbon
 Sediment Description _____

LABORATORY INFORMATION

Sample ID	Container	Refrig	Preservative Type	Lab	Analysis
<u>MW-S</u>	<u>VOAS</u>	<u>X</u>	<u>HCL</u>	<u>GTEL</u>	<u>TATE BTIX</u> <u>MTBE</u>

Comments _____

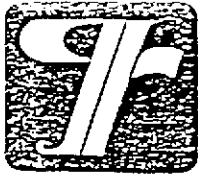

WELL SAMPLING FIELD DATA SHEET

SAMPLER Clyde Galantine DATE 3/13/97
 ADDRESS 5280 Hopyard Rd JOB # 5242.85
 CITY Pleasanton SS# 9-0917

Well ID MW-6 Well Condition OK

Well Location Description _____

Well Diameter 2" in
 Total Depth 25 ft
 Depth to Liquid 9.72 ft

Hydrocarbon Thickness

Volume	2" = 0.17	6" = 1.50	12" = 5.80
Factor	3" = 0.38		
(VF)	4" = 0.66		

of casing Volume 15.28 x 0.17 x (VF) 3 #Estimated 7.8 gal.
 Volume

Purge Equipment stack pump Sampling Equipment deep bailer

Did well dewater No If yes, Time _____ Volume _____

Starting Time 9:24 Purging Flow Rate 22.5 gpm.
 Sampling Time 9:38

Time	pH	Conductivity	Temperature	Volume
<u>9:24</u>	<u>6.59</u>	<u>6310</u>	<u>19.20.9</u>	<u>1</u>
<u>9:25</u>	<u>6.59</u>	<u>6640</u>	<u>21.9</u>	<u>3</u>
<u>9:28</u>	<u>6.57</u>	<u>7450</u>	<u>22.4</u>	<u>5.5</u>
<u>9:29</u>	<u>6.62</u>	<u>6950</u>	<u>22.2</u>	<u>8</u>
<u>9:38</u>	<u>6.69</u>	<u>7200</u>	<u>20.7</u>	

Weather Conditions clear
 Water Color: lt brown Odor: hydrocarbon
 Sediment Description silt

LABORATORY INFORMATION

Sample ID	Container	Refrig	Preservative Type	Lab	Analysis
<u>MW-6</u>	<u>Voas</u>	<u>X</u>	<u>HCL</u>	<u>GTEL</u>	<u>TPHs BTEX</u> <u>MTBE</u>

Comments _____

Chevron U.S.A. Inc. P.O. BOX 5004 San Ramon, CA 94583 FAX (415)842-9591	Chevron Facility Number <u>#9-0917</u> Facility Address <u>5280 Hopyard Road, Pleasanton, CA</u> Consultant Project Number <u>5242</u> Consultant Name <u>Gettler-Ryan</u> Address <u>6747 Sierra Ct, Ste J, Dublin 94568</u> Project Contact (Name) <u>Deanna Harding</u> (Phone) <u>551-7555</u> (Fax Number) <u>551-7888</u>	Chevron Contact (Name) <u>Mr. Phil Briggs</u> (Phone) <u>(510) 842-9136</u> Laboratory Name <u>NEI/GTEL</u> Laboratory Service Order # <u>9033195</u> Samples Collected by (Name) <u>Clyde Galantire</u> Collection Date <u>3/13/97</u> Signature <u>[Signature]</u>
--	---	--

Sample Number	Lab Sample Number	Number of Containers	Matrix S = Soil W = Water	A = Air C = Charcoal	Type G = Grab C = Composite D = Discrete	Time	Sample Preservation	Iced (Yes or No)	Analyses To Be Performed											Remarks			
									TPH Gas + BTEX w/MTBE (8015)	TPH Diesel (8015)	Oil and Grease (5520)	Purgeable Hydrocarbons (8010)	Purgeable Aromatics (8020)	Purgeable Organics (8240)	Extractable Organics (8270)	Metals Cd, Cr, Pb, Zn, Ni (ICAP or AA)							
MW-6		3	W		G	9:38		Y	X														
MW-5		3	W		G	10:07		Y	X														
TB-D		2	W		G			Y	X														
	2703.0254																						

DO NOT BILL TB-LB ANALYSIS

Relinquished By (Signature) <u>[Signature]</u>	Organization G-R Inc.	Date/Time 3/13/97 15:00	Received By (Signature) <u>D. Harding</u>	Organization G-R Inc.	Date/Time 3/13/97	Turn Around Time (Circle Choice) 24 Hrs. 48 Hrs. 5 Days 10 Days As Contracted
Relinquished By (Signature) <u>D. Harding</u>	Organization G-R	Date/Time 3/13/97	Received By (Signature) <u>[Signature]</u>	Organization NEI/GTEL	Date/Time 3/14/97	
Relinquished By (Signature) <u>[Signature]</u>	Organization NEI/GTEL	Date/Time 3/14/97	Received For Laboratory By (Signature) <u>[Signature]</u>		Date/Time 3/18/97 0825	



Midwest Region
4211 May Avenue
Wichita, KS 67209
(316) 945-2624
(800) 633-7936
(316) 945-0506 (FAX)

March 24, 1997

Deanna Harding
GETTLER-RYAN
6747 Sierra Ct.
Suite J
Dublin, CA 94568

RECEIVED

MAR 27 1997

GETTLER-RYAN INC.
GENERAL CONTRACTORS

RE: NEI/GTEL Client ID: GTR01CHV08
Login Number: W7030254
Project ID (number): 5242
Project ID (name): CHEVRON/9-0917/5280 HOPYARD RD/PLEASANTON/CA

Dear Deanna Harding:

Enclosed please find the analytical results for the samples received by NEI/GTEL Environmental Laboratories, Inc. on 03/18/97.

A formal Quality Assurance/Quality Control (QA/QC) program is maintained by NEI/GTEL, which is designed to meet or exceed the EPA requirements. Analytical work for this project met QA/QC criteria unless otherwise stated in the footnotes. This report is to be reproduced only in full.

NEI/GTEL is certified by the California Department of Health Service under Certification Number 1845.

If you have any questions regarding this analysis, or if we can be of further assistance, please call our Customer Service Representative.

Sincerely,
NEI/GTEL Environmental Laboratories, Inc.

Justin Ward, Project Coordinator for
Terry R. Loucks
Laboratory Director

ANALYTICAL RESULTS
Volatile Organics

NEI/GTEL Client ID: GTR01CHV08

Login Number: W7030254

Project ID (number): 5242

Project ID (name): CHEVRON/9-0917/5280 HOPYARD RD/PLEASANTON/CA

Method: EPA 8020A

Matrix: Aqueous

NEI/GTEL Sample Number	W7030254-01	W7030254-02	W7030254-03	--
Client ID	MW-6	MW-5	TBLB	--
Date Sampled	03/13/97	03/13/97		--
Date Analyzed	03/21/97	03/21/97	03/21/97	--
Dilution Factor	1.00	10.0	1.00	--

Analyte	Reporting		Concentration:			
	Limit	Units				
MTBE	5.0	ug/L	< 5.0	76.	< 5.0	--
Benzene	0.5	ug/L	250	1900	< 0.5	--
Toluene	0.5	ug/L	< 0.5	34.	< 0.5	--
Ethylbenzene	0.5	ug/L	110	1300	< 0.5	--
Xylenes (total)	0.5	ug/L	< 0.5	220	< 0.5	--
BTEX (total)	--	ug/L	360	3500	--	--
TPH as Gasoline	50	ug/L	2000	13000	< 50	--

Notes:

Dilution Factor:

Dilution factor indicates the adjustments made for sample dilution.

EPA 8020A:

Gasoline range hydrocarbons (TPH) quantitated by GC/FID with purge and trap and modified EPA Method 8015. Analyte list modified to include additional compounds. "Test Methods for Evaluating Solid Waste. Physical/Chemical Methods". SW-846. Third Edition including promulgated Update II.

NEI/GTEL Client ID: GTR01CHV08

QUALITY CONTROL RESULTS

Login Number: W7030254

Volatile Organics

Project ID (number): 5242

Method: EPA 8020A

Project ID (name): CHEVRON/9-0917/5280 HOPYARD RD/PLEASANTON/CA

Matrix: Aqueous

Conformance/Non-Conformance Summary

(X = Requirements Met * = See Comments -- = Not Required NA = Not Applicable)

Conformance Item	Volatile Organics	Semi-Volatile Organics	Inorganics (MT, WC)
GC/MS Tune	--	--	NA
Initial Calibration	--	--	--
Continuing Calibration	X	--	--
Surrogate Recovery	X	--	NA
Holding Time	X	--	--
Method Accuracy	X	--	--
Method Precision	X	--	--
Blank Contamination	X	--	--

Comments:

NEI/GTEL Client ID: GTR01CHV08

QUALITY CONTROL RESULTS

Login Number: W7030254

Volatile Organics

Project ID (number): 5242

Method: EPA 8020A

Project ID (name): CHEVRON/9-0917/5280 HOPYARD RD/PLEASANTON/CA

Matrix: Aqueous

Surrogate Results

QC Batch No.	Reference	Sample ID	TFT
Method: EPA 8020A	Acceptability Limits:		43-136%
032197GC10-1	CV0321972010	Calibration Verifi	96.4
032197GC10-2	BW03219710	Method Blank Water	89.4
032197GC10-5	DP03025402	Duplicate	90.2
032197GC10-6	LW0321972010	Laboratory Control	90.1
--	03025401	MW-6	109
--	03025402	MW-5	102
--	03025403	TBLB	88.3

Notes:

*: Indicates values outside of acceptability limits. See Nonconformance Summary.

Project ID (Number): 5242
Project ID (Name): Chevron SS #9-0917
5280 Hopyard Rd.
Pleasanton, CA
Work Order Number: W7-03-0254
Date Reported: 03-24-97

METHOD BLANK REPORT

Volatile Organics in Water
EA Method 8020A

Date of Analysis: 21-Mar-97 QC Batch No: 032197GC10-2

Analyte	Concentration, ug/L
MTBE	<5.0
Benzene	<0.5
Toluene	<0.5
Ethylbenzene	<0.5
Xylene (total)	<0.5
TPH as Gasoline	<50

NEI/GTEL Client ID: GTR01CHV08

QUALITY CONTROL RESULTS

Login Number: W7030254

Volatile Organics

Project ID (number): 5242

Method: EPA 8020A

Project ID (name): CHEVRON/9-0917/5280 HOPYARD RD/PLEASANTON/CA

Matrix: Aqueous

Calibration Verification Sample Summary

Analyte	Spike Amount	Check Sample Concentration	QC Percent Recovery	Acceptability Limits Recovery
EPA 8020A	Units:ug/L	QC Batch:032197GC10-1		
Benzene	20.0	23.3	117.	77-123%
Toluene	20.0	24.2	121.	77.5-122.5%
Ethylbenzene	20.0	25.9	130.	63-137%
Xylenes (Total)	60.0	68.7	115.	85-115%
TPH as Gasoline	500.	522.	104.	80-120%

Notes:

QC check source: Supelco #LA12389

NEI/GTEL Client ID: GTR01CHV08

QUALITY CONTROL RESULTS

Login Number: W7030254

Volatile Organics

Project ID (number): 5242

Method: EPA 8020A

Project ID (name): CHEVRON/9-0917/5280 HOPYARD RD/PLEASANTON/CA

Matrix: Aqueous

Laboratory Control Sample Summary

Analyte	Spike Amount	Check Sample Concentration	QC Percent Recovery	Acceptability Limits Recovery
EPA 8020A	Units:ug/L	QC Batch:032197GC10-6		
Benzene	20.0	16.1	80.5	39-150%
Toluene	20.0	14.7	73.5	46-148%
Ethylbenzene	20.0	15.7	78.5	32-160%
Xylenes (Total)	60.0	46.6	77.7	51-145%

Notes:

NEI/GTEL Client ID: GTR01CHV08
Login Number: W7030254
Project ID (number): 5242
Project ID (name): CHEVRON/9-0917/5280 HOPYARD RD/PLEASANTON/CA

QUALITY CONTROL RESULTS

Volatile Organics
Method: EPA 8020A
Matrix: Aqueous

Duplicate Sample Results

Analyte	Original Concentration	Duplicate Concentration	RPD, %	Acceptability Limits, %
EPA 8020A	Units: ug/L	QC Batch: 032197GC10-5	GTEL Sample ID: W7030254-02	Client ID: MW-5
MTBE	< 100	< 100	NA	20
Benzene	1870	1670	11.3	23.9
Toluene	33.7	40.8	19.1	27.2
Ethylbenzene	1290	1150	11.5	21.6
Xylenes (Total)	216	200	7.69	22.0
TPH as Gasoline	12900	11400	12.3	20

Notes:

NA - The concentration of the analyte is less than the reporting limit.