



RO 438

June 30, 2003  
Project: FA03

Amir K. Gholami, REHS  
Hazardous Materials Specialist  
County of Alameda  
Public Works Agency, Water Resources  
399 Elmhurst Street  
Hayward, California 94544-1395

Re: *½-Mile Radius Well Survey and Request For Site Case Closure*  
Former Firestone Tire Facility  
265 30<sup>th</sup> Street  
Oakland, California

Dear Mr. Gholami:

This letter, prepared by RRM, Inc. (RRM) on behalf of Mr. Warren Hagstrom of Hagstrom Properties, LLC, presents the well survey results and a request for site case closure for the Former Firestone Tire Facility located at 265 30<sup>th</sup> Street in Oakland, California. A well survey was completed to identify potential sensitive groundwater receptors by locating all documented existing and abandoned wells within a ½-mile radius of the site. The only well located was at 5000 Piedmont Street in Oakland, shown on Figure 1. This irrigation well was found to be approximately 6,800 feet from the above referenced site at 265 30<sup>th</sup> Street.

Historical soil and groundwater analytical data from the underground storage tank (UST) removal and subsequent Geoprobe® drilling investigation conducted by RRM are shown on Figure 2. A completed Alameda County Environmental Health Case Closure Summary has been completed for this site and it is included as Attachment A. A UST Unauthorized Release (leak)/Contamination Site Report, and a table of well survey results provided by the Alameda County Public Works Agency Water Resources Section are provided as Attachment B.

By the submittal of the above data and information, RRM believes the County now has sufficient documentation to grant final closure for this site. Should you have any questions regarding the contents of this document, please do not hesitate to call RRM at (831) 475-8141.

Sincerely,

**RRM, Inc.**

  
Dave A. Reinsma  
Senior Geologist  
RG 6906



Attachments:      Figure 1 – Half-Mile Radius Well Survey Map  
                            Figure 2 – Historical Soil and Groundwater Sample Location Map  
                            Attachment A – Case Closure Summary  
                            Attachment B – UST Unauthorized Release (Leak)/Contamination  
                            Report and Table of Well Survey Results

Cc: Ms. Corrine Hagstrom Vasquez, Hagstrom Properties, 260 Village Square, Orinda, CA  
94563 (C/o Warren Hagstrom)

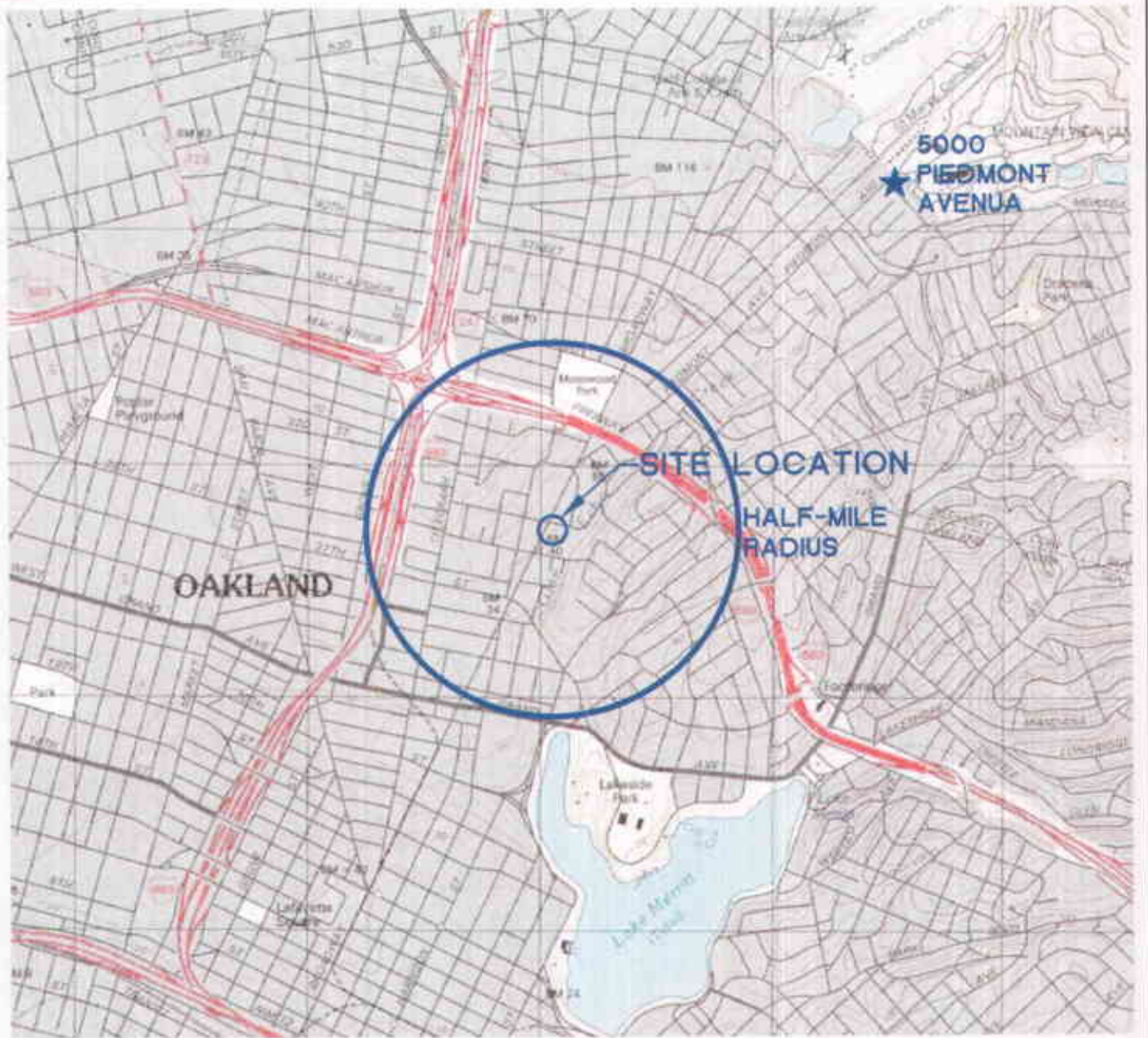

QUADRANGLE LOCATION

EXPLANATION

- ★ IRRIGATION WELL LOCATION



SCALE IN FEET



*Ref. FA03/FA03-WELLSURVING  
Base Map from TOPGATE HIGH*

**HALF-MILE RADIUS WELL SURVEY MAP**

265 30th Street  
Oakland, California

FIGURE:  
**1**  
PROJECT:  
FA03

PREPARED BY



BROADWAY

30TH STREET

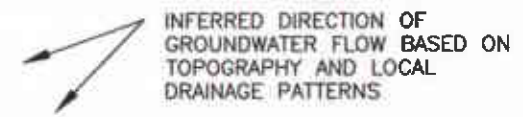
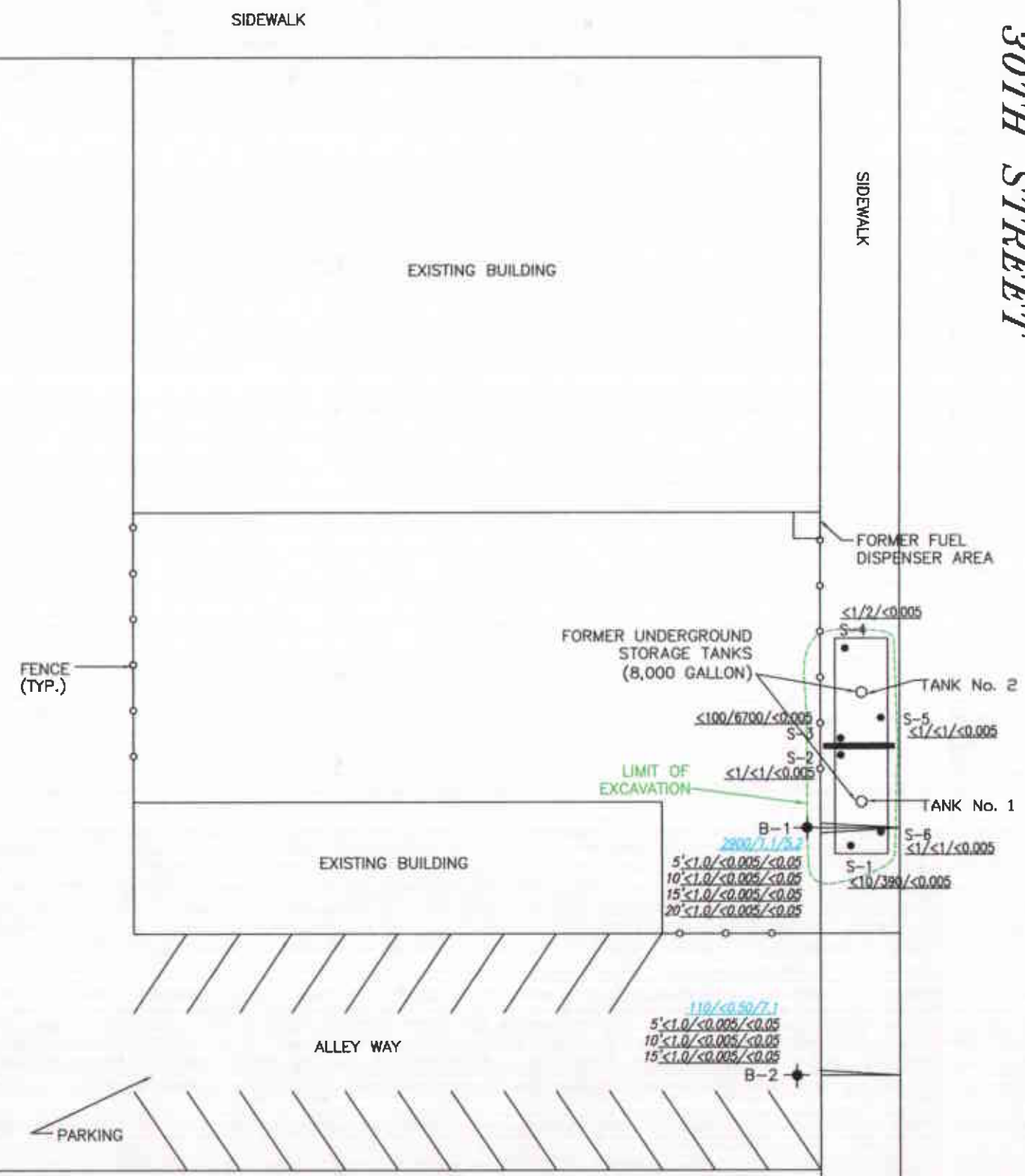

EXPLANATION

B-1 ◆ SOIL BORING LOCATION, RRM 9/17/99

S-1 ● SOIL SAMPLE LOCATION, COMPLIANCE AND CLOSURE, INC. 12/7/95

$< 10 / 390 / < 0.005$  TPHd/TPHg/BENZENE CONCENTRATIONS IN SOIL IN PARTS PER MILLION (ppm) (SAMPLES COLLECTED 12/7/95)

$2,900 / 1.1 / 2.2$  TPHg/BENZENE/MtBE CONCENTRATIONS IN GROUNDWATER IN PARTS PER BILLION (ppb) (SAMPLES COLLECTED 9/17/99)

$5' < 1.0 / < 0.005 / < 0.05$  TPHg/BENZENE/MtBE CONCENTRATIONS IN SOIL IN PPM AND SAMPLE DEPTH IN FEET (SAMPLES COLLECTED 9/17/99)

< NOT DETECTED AT OR ABOVE LABORATORY DETECTION LIMIT SHOWN

TPHd DIESEL RANGE TOTAL PETROLEUM HYDROCARBONS

TPHg GASOLINE RANGE TOTAL PETROLEUM HYDROCARBONS

MtBE METHYL TERTIARY BUTYL ETHER, BY EPA METHOD 8020

RM, FRIEDRICH-SIEGHE SOURCE: CCL INC. 1998

|                 |   |                     |
|-----------------|---|---------------------|
| PREPARED BY<br> | <b>HISTORICAL SOIL AND GROUNDWATER SAMPLE LOCATION MAP</b>                      | FIGURE:<br><b>2</b> |
|                 | <b>FORMER FIRESTONE TIRE FACILITY</b><br>265 30th Street<br>Oakland, California | PROJECT:<br>FA03    |

**ATTACHMENT A**

**CASE CLOSURE SUMMARY**

---

**CASE CLOSURE SUMMARY  
UNDERGROUND FUEL STORAGE TANK LOCAL OVERSIGHT PROGRAM**

**I. AGENCY INFORMATION**

Date: 11/25/2002

|  |                                       |
|--|---------------------------------------|
| Agency Name: Alameda County Environmental Health | Address: 1131 Harbor Bay Parkway      |
| City/State/Zip: Alameda, CA 94502                | Phone: (510) 567-6700                 |
| Responsible Staff Person: Amir Gholami           | Title: Hazardous Materials Specialist |

**II. CASE INFORMATION**

| Site Facility Name: Former Firestone Facility                   |  |                         |
|---|--|-------------------------|
| Site Facility Address: 265 30 <sup>th</sup> Street, Oakland, CA |  |                         |
| RB LUSTIS Case No.: ---   | Local Case No.:                        | LOP Case No.: Stid 4732 |
| URF Filing Date:  | SWEEPS No.: ---                        | APN:                    |
| Responsible Parties   | Addresses                              | Phone Number            |
| Mr. Warren Hagstrom<br>Hagstrom Properties, L.L.C.              | 260 Village Square<br>Orinda, CA 94563 | (925) 254.2814          |
|   |  |                         |

| Tank I.D. No         | Size in Gallons | Contents                      | Closed In Place/Removed? | Date      |
|----------------------|-----------------|-------------------------------|--------------------------|-----------|
| Tank 1               | 8,000           | Petroleum Hydrocarbons (Fuel) | Removed                  | 12/7-8/95 |
| Tank 2               | 8,000           | Petroleum Hydrocarbons (Fuel) | Removed                  | 12/7-8/95 |
| Dispenser and Piping | --              | --                            | Removed                  | 12/7-8/95 |
|                      |                 |                               |                          |           |

**III. RELEASE AND SITE CHARACTERIZATION INFORMATION**

|   |  |  |
|---|--|--|
| Cause and Type of Release: No holes found in either UST. Possibly leaking piping or overspill during tank filling |  |  |
| Site characterization complete? Yes   | Date Approved By Oversight Agency: 1/19/00 |  |
| Monitoring wells installed? No  | Number: 0                                  | Proper screened interval? --                           |
| Highest GW Depth Below Ground Surface:<br>Approximately 6 to 7 feet from geoprobe drilling                        | Lowest Depth: Not Available                | Flow Direction: South to Southeast based on topography |
| Most Sensitive Current Use:   |  |  |

Summary of Production Wells in Vicinity: There are no documented production wells within a ½-mile radius of the site based on a well survey conducted via the Alameda County public works Agency Water Resources Section in May 2003.

Are drinking water wells affected? Not from this site      Aquifer Name: Unknown

Is surface water affected? No      Nearest SW Name: Glen Echo Creek, about 250 feet east

Off-Site Beneficial Use Impacts (Addresses/Locations): None

Reports on file? Unknown      Where are reports filed? Alameda County Environmental Health

TREATMENT AND DISPOSAL OF AFFECTED MATERIAL

| Material     | Amount (Include Units)    | Action (Treatment or Disposal w/Destination) | Date    |
|--------------|---------------------------|--|---------|
| Tanks        | Two steel 8,000 gal. USTs | Erickson, Inc., Richmond, CA                 | 12/7/95 |
| Piping       | Not reported              | Not reported                                 | 12/7/95 |
| Free Product | None observed             |  |         |
| Soil         | 297 cubic yards           | BFI Vasco Road Landfill, Livermore, CA       |         |
| Groundwater  | None                      |  |         |

MAXIMUM DOCUMENTED CONTAMINANT CONCENTRATIONS BEFORE AND AFTER CLEANUP  
(Please see Attachment for additional information on contaminant locations and concentrations)

| Contaminant  | Soil (ppm) |                 | Water (ppb) |       | Contaminant                                   | Soil (ppm)      |                 | Water (ppb)     |       |
|--------------|------------|-----------------|-------------|-------|---|-----------------|-----------------|-----------------|-------|
|              | 1          | 2               | 3           | 4     |   | 1               | 2               | 3               | 4     |
|              | Before     | After           | Before      | After |   | Before          | After           | Before          | After |
| TPH (Gas)    | 6,700      | ND <sup>1</sup> | --          | 2,900 | Benzene                                       | ND              | ND              | --              | 1.1   |
| TPH (Diesel) | ND         | ND              | --          | --    | Toluene                                       | 35              | ND <sup>1</sup> | --              | 1.2   |
| Oil & Grease | --         | --              | --          | --    | Ethyl Benzene                                 | 25              | ND <sup>1</sup> | --              | 3.7   |
| Heavy Metals | --         | --              | --          | --    | Total Xylenes                                 | 67              | ND <sup>1</sup> | --              | 7.0   |
| TPH          | --         | --              | --          | --    | MTBE by 8020 (if not analyzed, explain below) | -- <sup>2</sup> | ND              | -- <sup>2</sup> | 7.1   |

Notes: (1) The highest TPHg concentration detected during UST excavation activities was 6,700 ppm, detected in Soil Sample S-3 collected beneath the east end of Tank 2. Following over-excavation of approximately 35 cubic yards of visibly impacted soil from the pit bottom, Soil Samples S-5 and S-6 were collected. These two soil samples were non-detect for all parameters analyzed. On September 17, 1999, RRM drilled two Geoprobe® soil borings at the request of Alameda County and TPHg, BTEX compounds and MTBE were not detected in seven out of seven soil samples collected from Borings B-1 and B-2 drilled near the former UST complex.

(2) In 1995, MTBE was not a typical analytical parameter included for EPA Method 8020 analysis for UST removal projects. Therefore, MTBE analysis was not performed on any of the soil samples analyzed during UST removal activities. MTBE was analyzed by EPA Method 8020 for all soil and groundwater samples submitted for analyses to the laboratory by RRM, Inc. in 1999.

-- = Not analyzed

Site History and Description of Corrective Actions:

1. On December 7 and 8, 1995 two 8,000-gallon USTs were removed from beneath the sidewalk on the south side of 30<sup>th</sup> Street. The USTs were of steel construction and upon removal and inspection both tanks had

some visible corrosion but neither tank appeared to have holes. The USTs were used for fuel distribution but the contents are unknown. Upon removal, four soil samples (S-1 through S-4) were collected from beneath the tanks at approximately 13 feet below ground surface (bgs). Approximately 320 cubic yards of soil associated with the UST pull was stockpiled on-site and an additional 35 cubic yards of visually impacted soil was over-excavated, for a total of 350 cubic yards. After soil over-excavation work was completed, two additional soil samples (S-5 and S-6) were collected from the UST pit bottom at approximately 16 feet bgs. It was reported that some visually impacted soil was left in place along the northern excavation sidewall adjacent to 30<sup>th</sup> Street to keep the street from caving into the pit and protect underground utilities. Following completion of tank removal and over-excavation activities, the UST excavation was backfilled with 5 to 6 feet of imported ¾-inch drain rock, then class 2 baserock to the ground surface.

2. Compliance & Closure, Inc. (CCI) prepared a *Workplan For Site Investigation* dated May 2, 1996 and an Addendum Letter dated June 5, 1996 to perform a soil and groundwater investigation at the site. The workplan and addenda were prepared in response to a letter from Alameda County Health Care Services (ACHCS) dated April 4, 1996. The workplan and addenda were approved by ACHSC in a letter dated June 12, 1996.
3. On September 17, 1999, RRM, Inc. implemented the above approved workplan and drilled two Geoprobe® soil borings, designated B-1 and B-2, near the former UST complex. RRM documented the results in a *Soil and Groundwater Investigation Report* dated October 6, 1999. Based on the results of the investigation, RRM recommended site case closure. In a letter from ACHCS dated January 19, 2000, the report was approved and the site was being evaluated for closure. During the closure review process, ACHCS staff discovered that leak report forms were incorrectly filed and additional forms needed to be completed. These completed forms are attached to this site closure request summary.

#### IV. CLOSURE

|   |                          |                    |
|---|--------------------------|--------------------|
| Does completed corrective action protect existing beneficial uses per the Regional Board Basin Plan? Yes  |                          |                    |
| Does completed corrective action protect potential beneficial uses per the Regional Board Basin Plan? Yes   |                          |                    |
| Does corrective action protect public health for current land use? Yes. Alameda County Environmental Health staff does not make specific determinations concerning public health risk. However, it does not appear that the release would present a risk to human health. |                          |                    |
| Site Management Requirements:   |                          |                    |
| Should corrective action be reviewed if land use changes? Yes   |                          |                    |
| Monitoring Wells Decommissioned: None   | Number Decommissioned: 0 | Number Retained: 0 |
| List Enforcement Actions Taken: none  |                          |                    |
| List Enforcement Actions Rescinded: none  |                          |                    |

#### V. ADDITIONAL COMMENTS, DATA, ETC.

|   |
|---|
| <p>Considerations and/or Variances:</p><br><br><br><br><br><br><br><br><br><br><p>Conclusion:</p> |
|---|

#### VI. LOCAL AGENCY REPRESENTATIVE DATA

|  |
|--|
|  |
|--|



|                              |                                       |
|------------------------------|---------------------------------------|
| Prepared by: Amir K. Gholami | Title: Hazardous Materials Specialist |
| Signature:                   | Date:                                 |
| Reviewed by:                 | Title:                                |
| Signature:                   | Date:                                 |
| Approved by: .               | Title:                                |
| Signature:                   | Date:                                 |

This closure approval is based upon the available information and with the provision that the information provided to this agency was accurate and representative of site conditions.

**VII. REGIONAL BOARD NOTIFICATION**

|  |                       |
|--|-----------------------|
| Regional Board Staff Name:   | Title:                |
| RB Response: Concur, based solely upon information contained in this case closure summary. | Date Submitted to RB: |
| Signature:   | Date:                 |

**Attachments: Figure A1 – ½ Mile Well Survey Map**  
**Figure A2 – Historical Soil and Groundwater Sample Location Map**

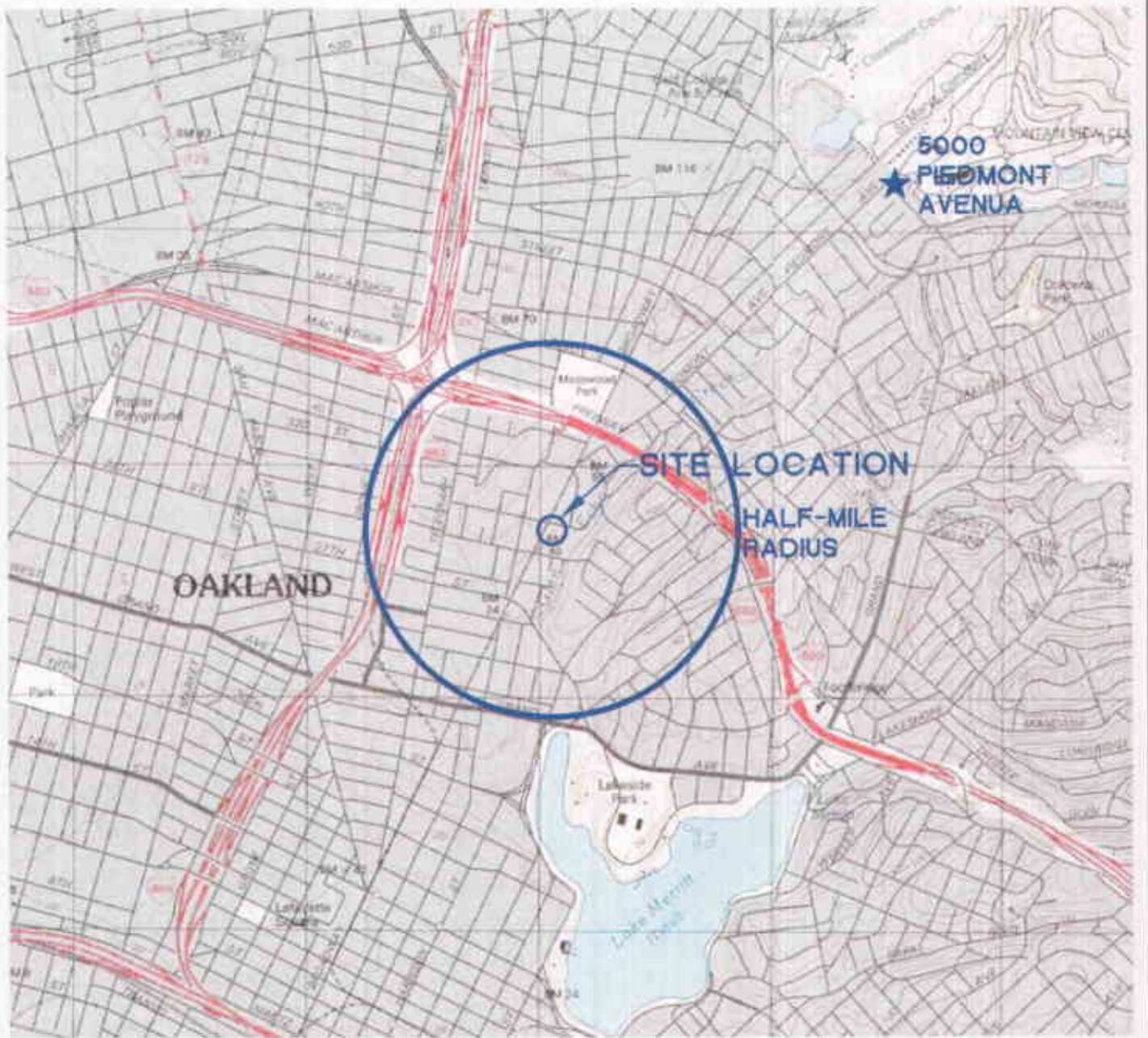

QUADRANGLE LOCATION

EXPLANATION

- ★ IRRIGATION WELL LOCATION



SCALE IN FEET



Ref. FA03/FA03-HELLSWALENG  
Base Map from TOPG11 NGM

**HALF-MILE RADIUS WELL SURVEY MAP**

265 30th Street  
Oakland, California

FIGURE:  
**A1**  
PROJECT:  
FA03



BROADWAY

30TH STREET

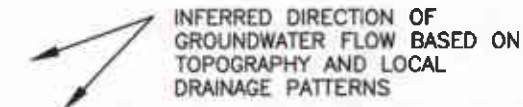
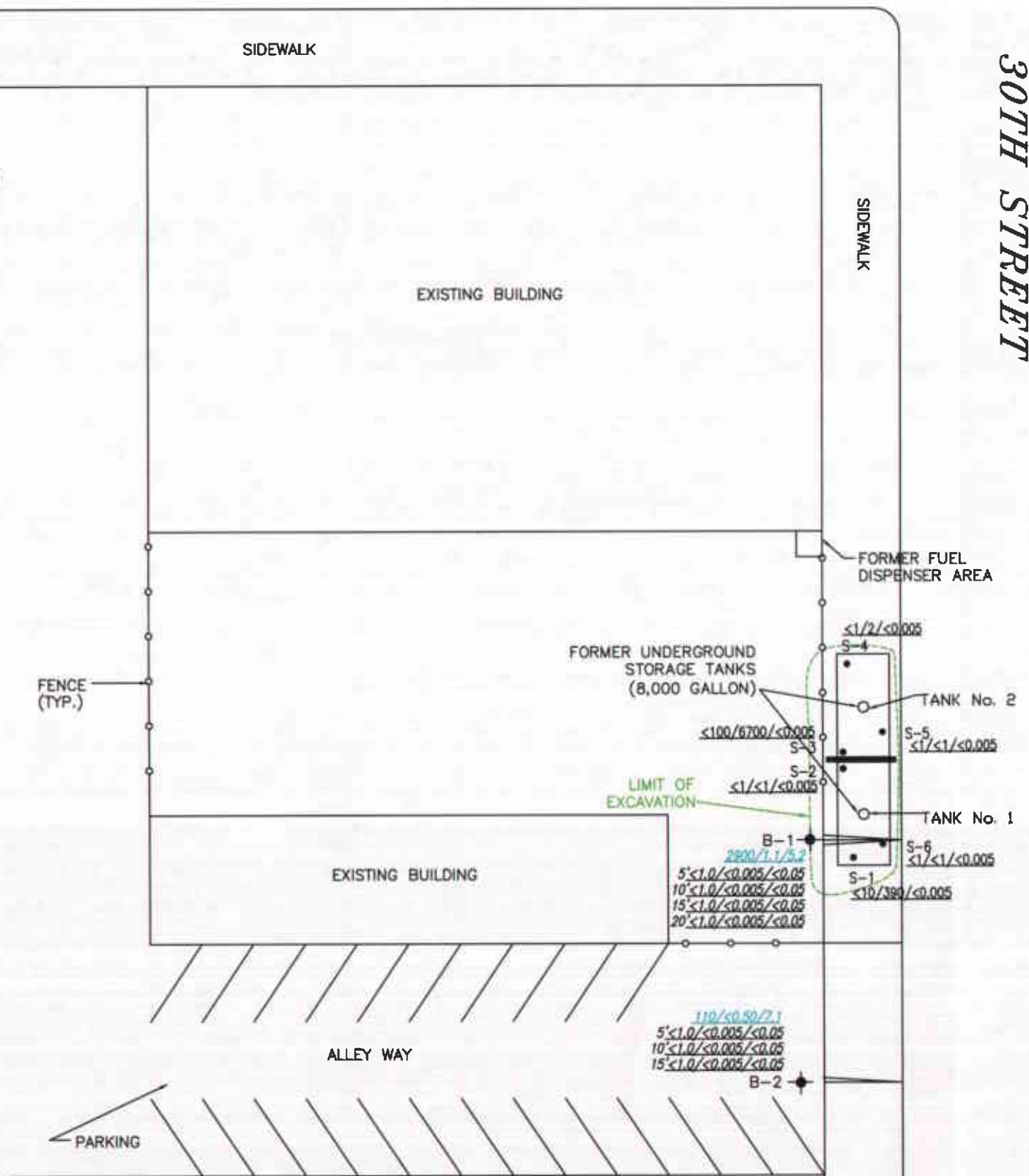
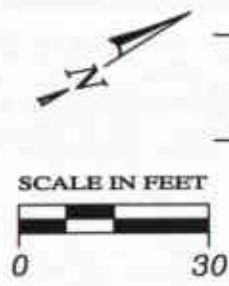

EXPLANATION

- B-1 ◆ SOIL BORING LOCATION, RRM 9/17/99
- S-1 ● SOIL SAMPLE LOCATION, COMPLIANCE AND CLOSURE, INC. 12/7/95

$<10 / 380 / <0.005$  TPHd/TPHg/BENZENE CONCENTRATIONS IN SOIL IN PARTS PER MILLION (ppm) (SAMPLES COLLECTED 12/7/95)

$2.900 / 1.1 / 5.2$  TPHg/BENZENE/MtBE CONCENTRATIONS IN GROUNDWATER IN PARTS PER BILLION (ppb) (SAMPLES COLLECTED 9/17/99)

$5' < 1.0 / <0.005 / <0.05$  TPHg/BENZENE/MtBE CONCENTRATIONS IN SOIL IN PPM AND SAMPLE DEPTH IN FEET (SAMPLES COLLECTED 9/17/99)

< NOT DETECTED AT OR ABOVE LABORATORY DETECTION LIMIT SHOWN

- TPHd DIESEL RANGE TOTAL PETROLEUM HYDROCARBONS
- TPHg GASOLINE RANGE TOTAL PETROLEUM HYDROCARBONS
- MtBE METHYL TERTIARY BUTYL ETHER, BY EPA METHOD 8020

REF: ENR/PAINT-07E/07P SOURCE: CG, Feb. 1994

|  |   |  |
|--|---|--|
| PREPARED BY<br> | <b>HISTORICAL SOIL AND GROUNDWATER SAMPLE LOCATION MAP</b>                      | FIGURE:<br><b>A2</b><br>PROJECT:<br>FA03 |
|  | <b>FORMER FIRESTONE TIRE FACILITY</b><br>265 30th Street<br>Oakland, California |  |

**ATTACHMENT B**

**UST UNAUTHORIZED RELEASE (LEAK)/CONTAMINATION  
REPORT AND TABLE OF WELL SURVEY RESULTS**

---

# UNDERGROUND STORAGE TANK UNAUTHORIZED RELEASE (LEAK) / CONTAMINATION SITE REPORT

|  |  |   |  |  |                     |
|--|--|---|--|--|---------------------|
| EMERGENCY<br><input type="checkbox"/> YES <input checked="" type="checkbox"/> NO |  | HAS STATE OFFICE OF EMERGENCY SERVICES REPORT BEEN FILED?<br><input type="checkbox"/> YES <input type="checkbox"/> NO |  | FOR LOCAL AGENCY USE ONLY<br>I HEREBY CERTIFY THAT I HAVE DISTRIBUTED THIS INFORMATION ACCORDING TO THE DISTRIBUTION SHOWN ON THE INSTRUCTION SHEET ON THE BACK PAGE OF THIS FORM. |                     |
| REPORT DATE<br>03/10/03  |  | CASE #  |  | SIGNED _____ DATE _____  |                     |
| REPORTED BY  | NAME OF INDIVIDUAL FILING REPORT<br>DAVE REINSMMA, RRM, INC.   |   | PHONE<br>(831) 475-9141  | SIGNATURE<br>  |                     |
|  | REPRESENTING<br><input type="checkbox"/> LOCAL AGENCY <input checked="" type="checkbox"/> OWNER/OPERATOR <input type="checkbox"/> REGIONAL BOARD <input type="checkbox"/> OTHER  |   | COMPANY OR AGENCY NAME<br>RRM, INC.  |  |                     |
| ADDRESS<br>3912 STREET PORTOLA DRIVE, SR B CITY SANTA CRUZ STATE CA ZIP 95062    |  |   |  |  |                     |
| RESPONSIBLE PARTY  | NAME<br>HAGSTROM PROPERTIES, LLC <input type="checkbox"/> UNKNOWN  |   | CONTACT PERSON<br>Mr. WARREN HAGSTROM  | PHONE<br>(925) 251-2814  |                     |
|  | ADDRESS<br>200 STREET Village Square CITY ORINDA STATE CA ZIP 94503  |   |  |  |                     |
| SITE LOCATION  | FACILITY NAME (IF APPLICABLE)<br>FORMER FIRESTONE TIRE Facility  |   | OPERATOR<br>UNKNOWN  | PHONE<br>( ) - NA -  |                     |
|  | ADDRESS<br>205 30th STREET CITY OAKLAND COUNTY ALAMEDA ZIP 94601   |   | CROSS STREET<br>BROADWAY   |  |                     |
| IMPLEMENTING AGENCIES  | LOCAL AGENCY<br>ALAMEDA CO. HEALTH CARE SERV.  |   | AGENCY NAME<br>AMIR K. GHOLAMI   | CONTACT PERSON<br>(510) 567 0876   |                     |
|  | REGIONAL BOARD<br>SF-RWQCB   |   | UNKNOWN  |  | PHONE<br>( ) - NA - |
| SUBSTANCES INVOLVED  | (1) NAME<br>PETROLEUM HYDROCARBON FUEL - GAS OR DIESEL   |   |  | QUANTITY LOST (GALLONS)<br><input checked="" type="checkbox"/> UNKNOWN   |                     |
|  | (2)  |   |  | <input checked="" type="checkbox"/> UNKNOWN  |                     |
| DISCOVERY/ABATEMENT  | DATE DISCOVERED<br>1/2/03  |   | HOW DISCOVERED<br><input type="checkbox"/> INVENTORY CONTROL <input type="checkbox"/> SUBSURFACE MONITORING <input type="checkbox"/> NUISANCE CONDITIONS<br><input type="checkbox"/> TANK TEST <input checked="" type="checkbox"/> TANK REMOVAL <input type="checkbox"/> OTHER   |  |                     |
|  | DATE DISCHARGE BEGAN<br>UNKNOWN  |   | METHOD USED TO STOP DISCHARGE (CHECK ALL THAT APPLY)<br><input checked="" type="checkbox"/> REMOVE CONTENTS <input checked="" type="checkbox"/> CLOSE TANK & REMOVE <input type="checkbox"/> REPAIR PIPING<br><input type="checkbox"/> REPAIR TANK <input type="checkbox"/> CLOSE TANK & FILL IN PLACE <input type="checkbox"/> CHANGE PROCEDURE<br><input type="checkbox"/> REPLACE TANK <input type="checkbox"/> OTHER |  |                     |
|  | HAS DISCHARGE BEEN STOPPED?<br><input checked="" type="checkbox"/> YES <input type="checkbox"/> NO IF YES, DATE 1/2/03   |   |  |  |                     |
| SOURCE/CAUSE   | SOURCE OF DISCHARGE<br><input type="checkbox"/> TANK LEAK <input type="checkbox"/> UNKNOWN<br><input checked="" type="checkbox"/> PIPING LEAK <input checked="" type="checkbox"/> OTHER  |   | CAUSE(S)<br><input checked="" type="checkbox"/> OVERFILL <input type="checkbox"/> RUPTURE/FAILURE <input type="checkbox"/> SPILL<br><input type="checkbox"/> CORROSION <input checked="" type="checkbox"/> UNKNOWN <input type="checkbox"/> OTHER  |  |                     |
|  | CASE TYPE<br>CHECK ONE ONLY<br><input type="checkbox"/> UNDETERMINED <input type="checkbox"/> SOIL ONLY <input checked="" type="checkbox"/> GROUNDWATER <input type="checkbox"/> DRINKING WATER - (CHECK ONLY IF WATER WELLS HAVE ACTUALLY BEEN AFFECTED)  |   |  |  |                     |
| CURRENT STATUS   | CHECK ONE ONLY<br><input type="checkbox"/> NO ACTION TAKEN <input type="checkbox"/> PRELIMINARY SITE ASSESSMENT WORKPLAN SUBMITTED <input type="checkbox"/> POLLUTION CHARACTERIZATION<br><input type="checkbox"/> LEAK BEING CONFIRMED <input type="checkbox"/> PRELIMINARY SITE ASSESSMENT UNDERWAY <input checked="" type="checkbox"/> POST CLEANUP MONITORING IN PROGRESS<br><input type="checkbox"/> REMEDIATION PLAN <input type="checkbox"/> CASE CLOSED (CLEANUP COMPLETED OR UNNECESSARY) <input type="checkbox"/> CLEANUP UNDERWAY   |   |  |  |                     |
|  | REMEDIAL ACTION<br>CHECK APPROPRIATE ACTION(S) (SEE BACK FOR DETAILS)<br><input checked="" type="checkbox"/> EXCAVATE & DISPOSE (ED) <input type="checkbox"/> REMOVE FREE PRODUCT (FP) <input type="checkbox"/> ENHANCED BIO DEGRADATION (IT)<br><input type="checkbox"/> CAP SITE (CD) <input type="checkbox"/> EXCAVATE & TREAT (ET) <input type="checkbox"/> PUMP & TREAT GROUNDWATER (GT) <input type="checkbox"/> REPLACE SUPPLY (RS)<br><input type="checkbox"/> CONTAINMENT BARRIER (CB) <input type="checkbox"/> NO ACTION REQUIRED (NA) <input type="checkbox"/> TREATMENT AT HOOKUP (HU) <input type="checkbox"/> VENT SOIL (VS)<br><input type="checkbox"/> VACUUM EXTRACT (VE) <input type="checkbox"/> OTHER (OT) |   |  |  |                     |
| COMMENTS   | 1) LIMITED SOIL OVER-EXCAVATION COMPLETED  |   |  |  |                     |
|  | 2) SOIL AND GROUNDWATER ASSESSMENT PERFORMED<br>3) CASE CLOSURE IN REVIEW  |   |  |  |                     |

FA03

| <u>Permit</u> | <u>Tr</u> | <u>Section</u> | <u>Address</u>         | <u>Longcity</u> | <u>Owner</u>              | <u>Update</u> | <u>Xcoord</u> | <u>Ycoord</u> | <u>Matchleve</u> |
|---------------|-----------|----------------|------------------------|-----------------|---------------------------|---------------|---------------|---------------|------------------|
| 1S/4W         | 24L 2     |                | 3943 Broadway          | Oakland         | Unocal Corp.              | 5/30/1990     | 1.22E+08      | 37827497      | 0                |
| 1S/4W         | 24L 3     |                | 3943 Broadway          | Oakland         | Unocal Corp.              | 5/30/1990     | 1.22E+08      | 37827497      | 0                |
| 1S/4W         | 24M 1     |                | 411 W. MacArthur Blvd. | Oakland         | Unocal Corporation        | 6/5/1990      | 1.22E+08      | 37825545      | 3                |
| 1S/4W         | 24M 2     |                | 411 W. MacArthur Blvd. | Oakland         | Unocal Corporation        | 6/5/1990      | 1.22E+08      | 37825545      | 3                |
| 1S/4W         | 24M 3     |                | 411 W. MacArthur Blvd. | Oakland         | Unocal Corporation        | 6/5/1990      | 1.22E+08      | 37825545      | 3                |
| 1S/4W         | 24M 4     |                | 411 W. MacArthur Blvd. | Oakland         | Unocal Corporation        | 6/5/1990      | 1.22E+08      | 37825545      | 3                |
| 1S/4W         | 25A 5     |                | 29 Wildwood Avenue     | Piedmont        | Shell Oil Company         | 5/29/1990     | 1.22E+08      | 37819286      | 0                |
| 1S/4W         | 25A 6     |                | 29 Wildwood Avenue     | Piedmont        | Shell Oil Company         | 5/29/1990     | 1.22E+08      | 37819286      | 0                |
| 1S/4W         | 25A 7     |                | 29 Wildwood Avenue     | Piedmont        | Shell Oil Company         | 5/29/1990     | 1.22E+08      | 37819286      | 0                |
| 1S/4W         | 25Q 3     |                | 500 Grand Avenue       | Oakland         | Texaco Refining & Mrkting | 6/4/1990      | 1.22E+08      | 37809214      | 0                |
| 1S/4W         | 25Q 4     |                | 500 Grand Avenue       | Oakland         | Texaco Refining & Mrkting | 6/4/1990      | 1.22E+08      | 37809214      | 0                |
| 1S/4W         | 25Q 5     |                | 500 Grand Avenue       | Oakland         | Texaco Refining & Mrkting | 6/4/1990      | 1.22E+08      | 37809214      | 0                |
| 1S/4W         | 25Q       |                | 500 Grand Avenue       | Oakland         | Texaco Refining & Mrkting | 6/4/1990      | 1.22E+08      | 37809214      | 0                |
| 1S/4W         | 26D       |                | 958 28th Street        | Oakland         | Aratex Servisco           | 6/21/1990     | 1.22E+08      | 37819674      | 0                |
| 1S/4W         | 26D 5     |                | 958 28th Street        | Oakland         | Aratex Servisco           | 6/21/1990     | 1.22E+08      | 37819674      | 0                |
| 1S/4W         | 26D 6     |                | 958 28th Street        | Oakland         | Aratex Servisco           | 6/21/1990     | 1.22E+08      | 37819674      | 0                |
| 1S/4W         | 26D 7     |                | 958 28th Street        | Oakland         | Aratex Servisco           | 6/21/1990     | 1.22E+08      | 37819674      | 0                |
| 1S/4W         | 25P 4     |                | 363 Grand Avenue       | Oakland         | Quik Stop Markets, Inc.   | 6/21/1990     | 1.22E+08      | 37809442      | 0                |
| 1S/4W         | 25P 5     |                | 363 Grand Avenue       | Oakland         | Quik Stop Markets, Inc.   | 6/21/1990     | 1.22E+08      | 37809442      | 0                |
| 1S/4W         | 25P 6     |                | 363 Grand Avenue       | Oakland         | Quik Stop Markets, Inc.   | 6/21/1990     | 1.22E+08      | 37809442      | 0                |
| 1S/4W         | 25P 7     |                | 363 Grand Avenue       | Oakland         | Quik Stop Markets, Inc.   | 6/21/1990     | 1.22E+08      | 37809442      | 0                |
| 1S/4W         | 25P 8     |                | 363 Grand Avenue       | Oakland         | Quik Stop Markets, Inc.   | 6/21/1990     | 1.22E+08      | 37809442      | 0                |
| 1S/4W         | 25A 4     |                | 29 Wildwood Avenue     | Piedmont        | Shell Oil Company         | 6/21/1990     | 1.22E+08      | 37819286      | 0                |
| 1S/4W         | 25A 8     |                | 29 Wildwood Avenue     | Piedmont        | Shell Oil Company         | 6/21/1990     | 1.22E+08      | 37819286      | 0                |
| 1S/4W         | 24P 7     |                | 230 MacArthur Blvd.    | Oakland         | Shell Oil Company         | 6/21/1990     | 1.22E+08      | 37823860      | 3                |
| 1S/4W         | 26H 6     |                | 2915 Broadway          | Oakland         | European Motors           | 6/21/1990     | 1.22E+08      | 37818081      | 0                |
| 1S/4W         | 26H 7     |                | 2915 Broadway          | Oakland         | European Motors           | 6/21/1990     | 1.22E+08      | 37818081      | 0                |
| 1S/4W         | 26H 8     |                | 2915 Broadway          | Oakland         | European Motors           | 6/21/1990     | 1.22E+08      | 37818081      | 0                |
| 1S/4W         | 24H 1     |                | 5000 Piedmont Avenue   | Oakland         | Mountain View Cemetary    | 6/26/1990     | 1.22E+08      | 37832324      | 8                |
| 1S/4W         | 24P       |                | 230 MacArthur Blvd     | Oakland         | Shell Oil Company         | 6/27/1990     | 1.22E+08      | 37823860      | 3                |
| 1S/4W         | 23D 2     |                | 989 41st Street        | Oakland         | California Linen Rental   | 6/27/1990     | 1.22E+08      | 37831932      | 0                |
| 1S/4W         | 23D 3     |                | 989 41st Street        | Oakland         | California Linen Rental   | 6/27/1990     | 1.22E+08      | 37831932      | 0                |
| 1S/4W         | 23D 4     |                | 989 41st Street        | Oakland         | California Linen Rental   | 6/27/1990     | 1.22E+08      | 37831932      | 0                |
| 1S/4W         | 24L 4     |                | 3943 Broadway          | Oakland         | Unocal Corporation        | 7/3/1990      | 1.22E+08      | 37827497      | 0                |
| 1S/4W         | 24L 5     |                | 3943 Broadway          | Oakland         | Unocal Corporation        | 7/3/1990      | 1.22E+08      | 37827497      | 0                |
| 1S/4W         | 24L 6     |                | 3943 Broadway          | Oakland         | Unocal Corporation        | 7/3/1990      | 1.22E+08      | 37827497      | 0                |

|       |       |                           |         |                         |           |          |          |   |
|-------|-------|---------------------------|---------|-------------------------|-----------|----------|----------|---|
| 1S/4W | 24N 3 | 3505 Broadway             | Oakland | Kaiser Foundation       | 7/9/1990  | 1.22E+08 | 37823077 | 0 |
| 1S/4W | 24N 4 | 3505 Broadway             | Oakland | Kaiser Foundation       | 7/9/1990  | 1.22E+08 | 37823077 | 0 |
| 1S/4W | 24N 5 | 3505 Broadway             | Oakland | Kaiser Foundation       | 7/9/1990  | 1.22E+08 | 37823077 | 0 |
| 1S/4W | 23M18 | 3400 San Pablo Avenue     | Oakland | Thrifty Oil Company     | 7/9/1990  | 1.22E+08 | 37825787 | 0 |
| 1S/4W | 25R 1 | 637 Beacon                | Oakland | Ranger Pipeline         | 7/13/1990 | 1.22E+08 | 37808986 | 3 |
| 1S/4W | 25R   | 637 Beacon                | Oakland | Ranger Pipeline         | 7/13/1990 | 1.22E+08 | 37808986 | 3 |
| 1S/4W | 24N 6 | 3505 Broadway             | Oakland | Kaiser Foundation       | 7/24/1990 | 1.22E+08 | 37823077 | 0 |
| 1S/4W | 24P   | 230 MacArthur Boulevard   | Oakland | Shell Service Station   | 7/24/1990 | 1.22E+08 | 37823860 | 8 |
| 1S/4W | 23H 4 | 500 40th Street           | Oakland | Shell Oil Company       | 7/24/1990 | 1.22E+08 | 37829644 | 0 |
| 1S/4W | 26J 8 | Valdez St.and 23rd Street | Oakland | Oakland Tribune         | 7/27/1990 | 1.22E+08 | 37812100 | 3 |
| 1S/4W | 26J 9 | Valdez St.and 23rd Street | Oakland | Oakland Tribune         | 7/29/1990 | 1.22E+08 | 37812100 | 3 |
| 1S/4W | 26K   | Broadway/W Grand Ave      | Oakland | Commonwealth Companies  | 7/27/1990 | 1.22E+08 | 37811900 | 3 |
| 1S/4W | 26K 2 | 2225 Telegraph Avenue     | Oakland | Texaco                  | 7/30/1990 | 1.22E+08 | 37812090 | 8 |
| 1S/4W | 26K 6 | 2225 Telegraph Avenue     | Oakland | Texaco                  | 7/30/1990 | 1.22E+08 | 37812090 | 8 |
| 1S/4W | 26K 7 | 2225 Telegraph Avenue     | Oakland | Texaco                  | 7/30/1990 | 1.22E+08 | 37811700 | 3 |
| 1S/4W | 24B 2 | 5175 Broadway             | Oakland | M.Mehdizaden            | 7/31/1990 | 1.22E+08 | 37835727 | 0 |
| 1S/4W | 24B 1 | 5175 Broadway             | Oakland | M.Mehdizaden            | 7/31/1990 | 1.22E+08 | 37835727 | 0 |
| 1S/4W | 24B 3 | 5175 Broadway             | Oakland | M.Mehdizadeh            | 7/31/1990 | 1.22E+08 | 37835727 | 0 |
| 1S/4W | 26M 6 | Isabella/W.Grand          | Oakland | Chevron USA             | 8/31/1990 | 1.22E+08 | 37814600 | 8 |
| 1S/4W | 26M 7 | Isabella/W.Grand          | Oakland | Chevron USA             | 8/31/1990 | 1.22E+08 | 37814600 | 8 |
| 1S/4W | 25M 9 | 210 Grand Ave             | Oakland | Chevron SS #90019       | 8/31/1990 | 1.22E+08 | 37811384 | 0 |
| 1S/4W | 25M10 | 210 Grand Ave             | Oakland | Chevron SS #90019       | 8/31/1990 | 1.22E+08 | 37811384 | 0 |
| 1S/4W | 25M11 | 210 Grand Ave             | Oakland | Chevron S/S #90019      | 8/31/1990 | 1.22E+08 | 37811384 | 0 |
| 1S/4W | 25M12 | 210 Grand Ave             | Oakland | Chevron SS #90019       | 8/31/1990 | 1.22E+08 | 37811384 | 0 |
| 1S/4W | 26R 1 | 300 Lakeside Drive        | Oakland | Kaiser Center           | 2/27/1991 | 1.22E+08 | 37808352 | 8 |
| 1S/4W | 25H 1 | 3669 Grand Avenue         | Oakland | Martini Company         | 2/27/1991 | 1.22E+08 | 37816226 | 0 |
| 1S/4W | 24M 5 | 3785 Broadway             | Oakland | Firestone Tire & Rubber | 3/8/1991  | 1.22E+08 | 37826500 | 0 |
| 1S/4W | 25P 9 | 350 Grand Ave.            | Oakland | Shell Oil Company       | 3/8/1991  | 1.22E+08 | 37809678 | 0 |
| 1S/4W | 25P10 | 350 Grand Ave.            | Oakland | Shell Oil Company       | 3/8/1991  | 1.22E+08 | 37809678 | 0 |
| 1S/4W | 25P11 | 350 Grand Ave.            | Oakland | Shell Oil Company       | 3/8/1991  | 1.22E+08 | 37809678 | 0 |
| 1S/4W | 24N 7 | 3505 Broadway             | Oakland | Kaiser Foundation       | 3/8/1991  | 1.22E+08 | 37823077 | 0 |
| 1S/4W | 26M 8 | 850 W. Grand Ave.         | Oakland | Chevron                 | 3/8/1991  | 1.22E+08 | 37814422 | 0 |
| 1S/4W | 24L 7 | 3943 Broadway             | Oakland | Unocal Corporation      | 3/14/1991 | 1.22E+08 | 37827497 | 0 |
| 1S/4W | 24L 8 | 3943 Broadway             | Oakland | Unocal Corporation      | 3/14/1991 | 1.22E+08 | 37827497 | 0 |
| 1S/4W | 24L 9 | 3943 Broadway             | Oakland | Unocal Corporation      | 3/14/1991 | 1.22E+08 | 37827497 | 0 |
| 1S/4W | 24L10 | 3943 Broadway             | Oakland | Unocal Corporation      | 3/14/1991 | 1.22E+08 | 37827497 | 0 |
| 1S/4W | 26A   | 3093 Broadway             | Oakland | Connel Oldsmobile       | 3/14/1991 | 1.22E+08 | 37820830 | 0 |



| <u>Tsrqg</u> | <u>Rec code</u> | <u>Phone</u> | <u>City</u> | <u>Drilldate</u> | <u>Elevation</u> | <u>Totaldept</u> | <u>Waterdept</u> | <u>Diameter</u> | <u>Use</u> |
|--------------|-----------------|--------------|-------------|------------------|------------------|------------------|------------------|-----------------|------------|
| 1S/4W 24L    | 62              |              | 0 OAK       | 1/90             | 0                | 20               | 11               |                 | 2 MON      |
| 1S/4W 24L    | 63              |              | 0 OAK       | 1/90             | 0                | 20               | 12               |                 | 2 MON      |
| 1S/4W 24M    | 151             |              | 0 OAK       | 9/89             | 0                | 29               | 19               |                 | 2 MON      |
| 1S/4W 24M    | 152             |              | 0 OAK       | 9/89             | 0                | 29               | 19               |                 | 2 MON      |
| 1S/4W 24M    | 153             |              | 0 OAK       | 9/89             | 0                | 29               | 19               |                 | 2 MON      |
| 1S/4W 24M    | 154             |              | 0 OAK       | 9/89             | 0                | 29               | 19               |                 | 2 MON      |
| 1S/4W 25A    | 13              |              | 0 PIE       | 7/89             | 0                | 15               | 4                |                 | 4 MON      |
| 1S/4W 25A    | 14              |              | 0 PIE       | 7/89             | 0                | 12               | 4                |                 | 4 MON      |
| 1S/4W 25A    | 15              |              | 0 PIE       | 7/89             | 0                | 10               | 4                |                 | 4 MON      |
| 1S/4W 25C    | 119             |              | 0 OAK       | 1/90             | 0                | 15               | 4                |                 | 4 MON      |
| 1S/4W 25C    | 120             |              | 0 OAK       | 1/90             | 0                | 15               | 6                |                 | 4 MON      |
| 1S/4W 25C    | 121             |              | 0 OAK       | 1/90             | 0                | 15               | 6                |                 | 4 MON      |
| 1S/4W 25C    | 122             |              | 0 OAK       | Oct-89           | 0                | 0                | 0                |                 | 8 BOR*     |
| 1S/4W 26E    | 303             |              | 0 OAK       | 3/90             | 0                | 0                | 0                |                 | 9 BOR*     |
| 1S/4W 26E    | 304             |              | 0 OAK       | 3/90             | 0                | 25               | 22               |                 | 2 MON      |
| 1S/4W 26E    | 305             |              | 0 OAK       | 3/90             | 0                | 30               | 17               |                 | 4 MON      |
| 1S/4W 26E    | 306             |              | 0 OAK       | 2/90             | 0                | 30               | 18               |                 | 4 MON      |
| 1S/4W 25F    | 307             |              | 0 OAK       | 3/90             | 0                | 30               | 3                |                 | 2 MON      |
| 1S/4W 25F    | 308             |              | 0 OAK       | 3/90             | 0                | 30               | 25               |                 | 2 MON      |
| 1S/4W 25F    | 309             |              | 0 OAK       | 3/90             | 0                | 30               | 23               |                 | 2 MON      |
| 1S/4W 25F    | 310             |              | 0 OAK       | 3/90             | 0                | 24               | 15               |                 | 2 MON      |
| 1S/4W 25F    | 311             |              | 0 OAK       | 3/90             | 0                | 29               | 20               |                 | 2 MON      |
| 1S/4W 25A    | 312             |              | 0 PIE       | 1/90             | 34               | 16               | 6                |                 | 4 MON      |
| 1S/4W 25A    | 313             |              | 0 PIE       | 1/90             | 32               | 17               | 6                |                 | 4 MON      |
| 1S/4W 24F    | 314             |              | 0 OAK       | 1/90             | 0                | 25               | 15               |                 | 4 MON      |
| 1S/4W 26F    | 322             |              | 0 OAK       | 2/90             | 45               | 30               | 12               |                 | 2 MON      |
| 1S/4W 26F    | 323             |              | 0 OAK       | 2/90             | 44               | 30               | 11               |                 | 2 MON      |
| 1S/4W 26F    | 324             |              | 0 OAK       | 2/90             | 44               | 30               | 10               |                 | 2 MON      |
| 1S/4W 24F    | 357             |              | 0 OAK       | 4/89             | 0                | 290              | 55               |                 | 6 IRR      |
| 1S/4W 24F    | 387             |              | 0 OAK       | 8/89             | 0                | 13               | 0                |                 | 8 BOR*     |
| 1S/4W 23E    | 390             |              | 0 OAK       | 9/89             | 54               | 22               | 8                |                 | 4 MON      |
| 1S/4W 23E    | 391             |              | 0 OAK       | 9/89             | 54               | 23               | 9                |                 | 4 MON      |
| 1S/4W 23E    | 392             |              | 0 OAK       | 9/89             | 53               | 22               | 7                |                 | 4 MON      |
| 1S/4W 24L    | 429             |              | 0 OAK       | Oct-89           | 0                | 20               | 11               |                 | 2 MON      |
| 1S/4W 24L    | 430             |              | 0 OAK       | Oct-89           | 0                | 20               | 13               |                 | 2 MON      |
| 1S/4W 24L    | 431             |              | 0 OAK       | Oct-89           | 0                | 23               | 12               |                 | 2 MON      |

|           |      |       |        |     |    |    |        |
|-----------|------|-------|--------|-----|----|----|--------|
| 1S/4W 24N | 486  | 0 OAK | Oct-89 | 98  | 27 | 22 | 2 MON  |
| 1S/4W 24N | 487  | 0 OAK | Nov-89 | 97  | 24 | 20 | 2 MON  |
| 1S/4W 24N | 488  | 0 OAK | Nov-89 | 96  | 22 | 16 | 2 MON  |
| 1S/4W 23N | 518  | 0 OAK | Oct-89 | 0   | 25 | 9  | 6 MON  |
| 1S/4W 25F | 564  | 0 OAK | Oct-89 | 0   | 36 | 19 | 2 MON  |
| 1S/4W 25F | 565  | 0 OAK | Oct-89 | 0   | 20 | 18 | 6 BOR* |
| 1S/4W 24N | 644  | 0 OAK | Apr-90 | 0   | 35 | 0  | 2 MON  |
| 1S/4W 24F | 646  | 0 OAK | Jul-88 | 0   | 18 | 0  | 1 BOR  |
| 1S/4W 23F | 680  | 0 OAK | Sep-89 | 0   | 20 | 0  | 8 MON  |
| 1S/4W 26J | 722  | 0 OAK | May-90 | 0   | 27 | 0  | 4 MON  |
| 1S/4W 26J | 723  | 0 OAK | May-90 | 0   | 25 | 0  | 4 MON  |
| 1S/4W 26F | 739  | 0 OAK | May-90 | 0   | 15 | 0  | 0 BOR  |
| 1S/4W 26F | 750  | 0 OAK | May-90 | 99  | 25 | 14 | 4 EXT  |
| 1S/4W 26F | 751  | 0 OAK | May-90 | 100 | 25 | 0  | 4 EXT  |
| 1S/4W 26F | 752  | 0 OAK | May-90 | 98  | 25 | 0  | 4 EXT  |
| 1S/4W 24E | 816  | 0 OAK | Apr-90 | 0   | 23 | 22 | 4 TES  |
| 1S/4W 24E | 817  | 0 OAK | Apr-90 | 0   | 23 | 10 | 4 TES  |
| 1S/4W 24E | 818  | 0 OAK | Apr-90 | 0   | 27 | 12 | 4 TES  |
| 1S/4W 26N | 839  | 0 OAK | Jul-90 | 0   | 27 | 13 | 2 MON  |
| 1S/4W 26N | 840  | 0 OAK | Jul-90 | 9   | 25 | 13 | 2 MON  |
| 1S/4W 25N | 841  | 0 OAK | Jun-90 | 0   | 12 | 0  | 2 MON  |
| 1S/4W 25N | 842  | 0 OAK | Jun-90 | 0   | 12 | 0  | 2 MON  |
| 1S/4W 25N | 843  | 0 OAK | Jun-90 | 0   | 14 | 0  | 2 MON  |
| 1S/4W 25N | 844  | 0 OAK | Jun-90 | 0   | 12 | 0  | 2 MON  |
| 1S/4W 26F | 1082 | 0 OAK | 1/91   | 0   | 13 | 0  | 2 DES  |
| 1S/4W 25F | 1083 | 0 OAK | Oct-90 | 0   | 40 | 6  | 2 MON  |
| 1S/4W 24N | 1101 | 0 OAK | 2/91   | 0   | 30 | 10 | 2 MON  |
| 1S/4W 25F | 1105 | 0 OAK | Nov-90 | 0   | 39 | 0  | 2 PIE  |
| 1S/4W 25F | 1106 | 0 OAK | 1/91   | 0   | 17 | 11 | 3 MON  |
| 1S/4W 25F | 1107 | 0 OAK | 1/91   | 0   | 15 | 11 | 3 MON  |
| 1S/4W 24N | 1159 | 0 OAK | Nov-90 | 0   | 14 | 9  | 8 BOR* |
| 1S/4W 26N | 1160 | 0 OAK | Dec-90 | 18  | 24 | 19 | 4 MON  |
| 1S/4W 24L | 1238 | 0 OAK | Oct-90 | 0   | 55 | 45 | 2 TES  |
| 1S/4W 24L | 1239 | 0 OAK | Oct-90 | 0   | 20 | 12 | 2 MON  |
| 1S/4W 24L | 1240 | 0 OAK | Oct-90 | 0   | 20 | 12 | 2 MON  |
| 1S/4W 24L | 1241 | 0 OAK | Oct-90 | 0   | 22 | 12 | 2 MON  |
| 1S/4W 26F | 1242 | 0 OAK | Oct-90 | 0   | 22 | 13 | 2 MON  |

FA03

**Well Legend**

DOM=Domestic well

IRR=Irrigation well

MUN= Municipal well

IND=Industrial well

CAT=Cathodic well

DES=well destroyed (through permit)

ABN=Abandoned and not being used (but has not been destroyed through permit process)

TES=Test well

BOR= Geotechnical investigation

MON= Monitoring well

EXT=Extraction/ Vapor wells

PIE=Piezometers

REC=Recovery well (extraction/ vapor)

? = Unknown or no information found or given