

AGENDA
MAY 14, 1998 10:00 AM

FORMER DORR-OLIVER SITE
2901 GLASCOCK STREET
OAKLAND, CA

- 1) **Introductions/Purpose of Meeting**
- 2) **Site Background**
 - **Site History**
 - **Remedial Actions**
 - **Current Conditions**
- 3) **Property Transaction**
 - **Property Transaction Requirements**
 - **Forward Plan for Completing Property Transaction**

o Nov 92 - June 93 - 2457s removed

o RWQCB required removal of metal shavings on shoreline

- 1700-3800 diesel
- 390 m/s
- 16 mg/l 120 TOG

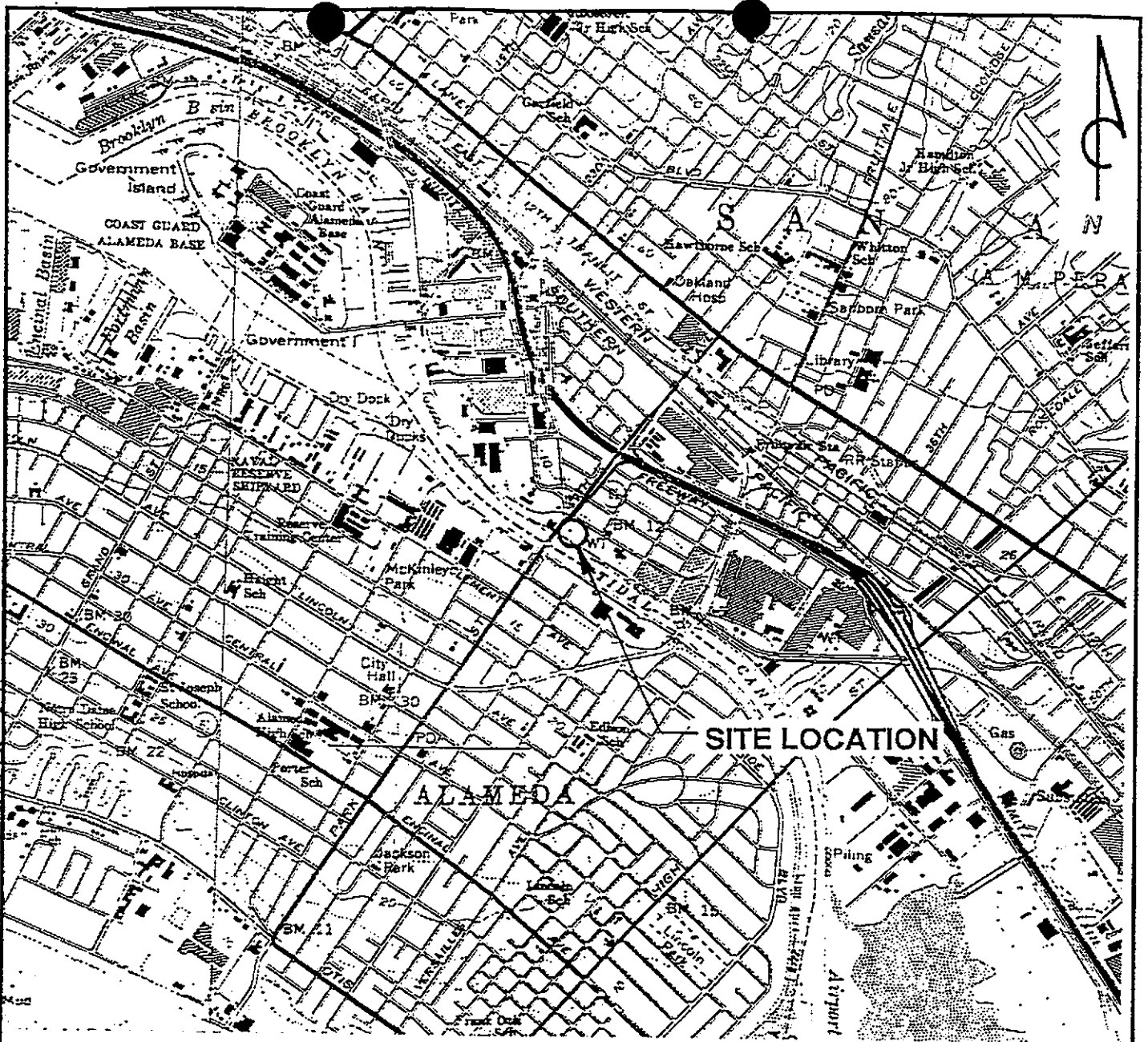

QUADRANGLE
LOCATION

REFERENCES:

USGS 7.5 MIN. TOPOGRAPHIC MAP
 TITLED: OAKLAND EAST, CALIFORNIA
 DATED: 1959 REVISED: 1980
 TITLED: OAKLAND WEST, CALIFORNIA
 DATED: 1959 REVISED: 1980

SCALE IN FEET

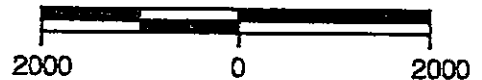

PACIFIC
 ENVIRONMENTAL
 GROUP, INC.

FORMER DORR-OLIVER SITE
 2901 Glascock Street
 Oakland, California

SITE LOCATION MAP

FIGURE:
 1
PROJECT:
 360-014.2B



PETERSON STREET

GLASCOCK STREET

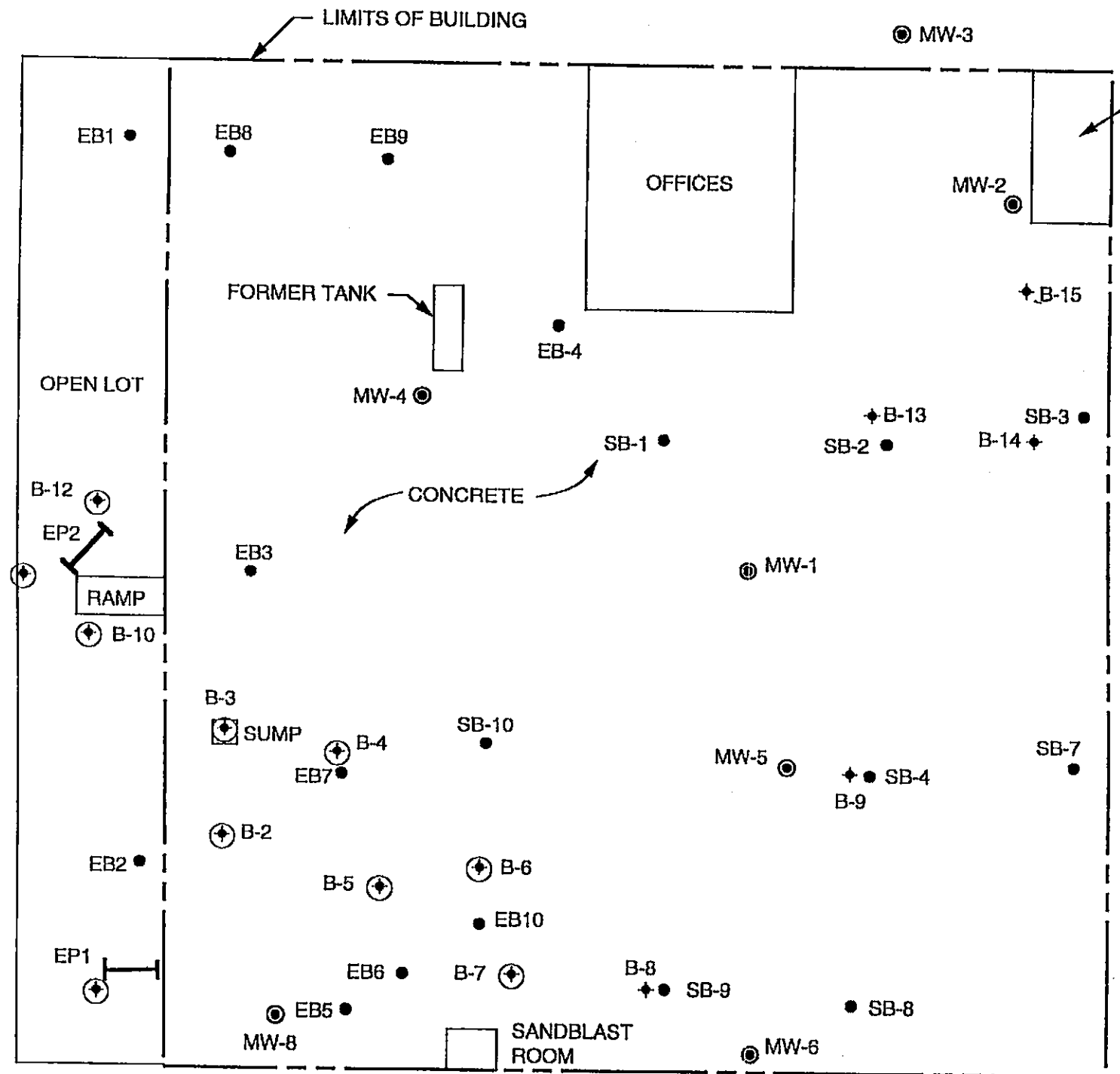

FORMER TANK

OFFICES

OPEN LOT

CONCRETE

SUMP

RAMP

SANDBLAST ROOM

LEGEND

- MW-1 ● GROUNDWATER MONITORING WELL LOCATION AND DESIGNATION
- EB1, SB-1 ● SOIL SAMPLE LOCATION AND DESIGNATION
- EP1 ▤ TEST PIT LOCATION AND DESIGNATION
- B-13 ◆ SOIL SAMPLE LOCATION FOR TPH
- B-7 ⊕ SOIL SAMPLE LOCATION FOR PCB'S AND METALS

SOURCE: Map from W.A. Craig dated 6-95

OAKLAND ESTUARY



PACIFIC ENVIRONMENTAL GROUP, INC.

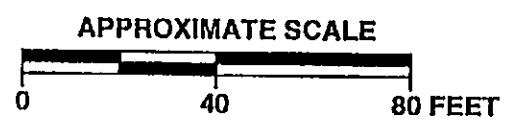

FORMER DORR-OLIVER SITE
2901 Glascock Street
Oakland, California

SOIL SAMPLE AND MONITORING WELL LOCATION MAP

FIGURE:
2
PROJECT:
360-014.1A



PETERSON STREET

GLASCOCK STREET

APPROXIMATE LIMITS OF BUILDING

FORMER TANK

OFFICES

FORMER TANKS

OPEN LOT

CONCRETE FOOTING
APPROXIMATELY 5'
THICK BELOW FLOOR

- LEGEND**
- MW-4 ● GROUNDWATER MONITORING WELL LOCATION AND DESIGNATION
 - MW-5 ∅ DESTROYED GROUNDWATER MONITORING WELL LOCATION AND DESIGNATION
 - B13-N-3 ● SOIL SAMPLE LOCATION AND DESIGNATION

EP2-N-1.5
EP2-W2-1.5
EP2-W-1.5
EP2-BT-3
EP2-E-1.5
RAMP
EP2-S-1.5

B13-BT-5
B13-N-3
B13-E-3
B13-S-3

SUMP

APPROXIMATE LIMITS OF EXCAVATION (TYP)

CONCRETE STRUCTURES

MW5-BT-5
MW5-N-3
MW5-W-3
MW5-E-3
MW5
MW5-S-3
EB10-N-3
EB10-E-3
EB10-W-3
EB10-S-3
EB10-BT-5

MW-8

SANDBLAST ROOM

MW-6

OAKLAND ESTUARY

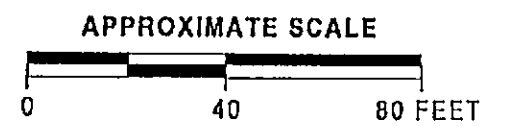

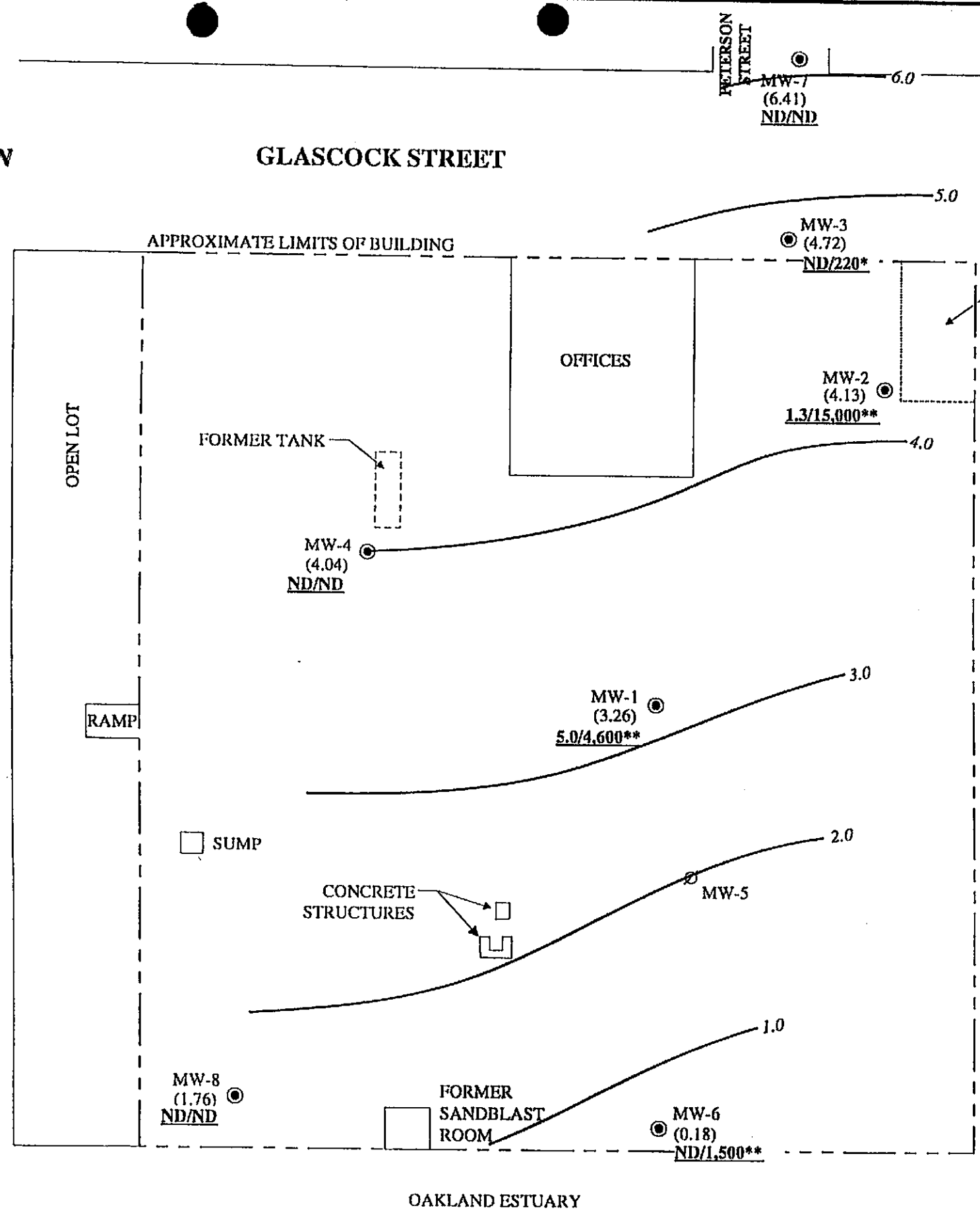

 PACIFIC ENVIRONMENTAL GROUP, INC.	TITLE: REMEDIAL SOIL EXCAVATION MAP		
	PREPARED FOR: FORMER DORR-OLIVER SITE 2901 Glascock Street Oakland, California		
	DATE: 5-1-97	PROJECT: 360-014.2B	FIGURE:

Reference: 360/014/5Hemp40.rsd

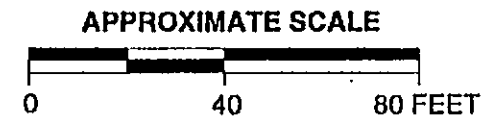

- LEGEND**
- MW-4 ● GROUNDWATER MONITORING WELL LOCATION AND DESIGNATION
 - MW-5 ∅ DESTROYED GROUNDWATER MONITORING WELL LOCATION AND DESIGNATION
 - (3.26) GROUNDWATER ELEVATION IN FEET - MSL, 3-27-98
 - 6.0 — GROUNDWATER ELEVATION CONTOUR IN FEET - MSL, 3-27-98
 - ND/1,500** BENZENE/TEPH-d CONCENTRATION IN GROUNDWATER, IN PARTS PER BILLION, 3-27-98
 - ND NOT DETECTED
 - * NOT DIESEL; UNIDENTIFIED HYDROCARBONS C9-C24
 - ** WEATHERED DIESEL C9-C24
- APPROXIMATE GRADIENT = 0.018



 PACIFIC ENVIRONMENTAL GROUP, INC.	TITLE: GROUNDWATER MONITORING MAP - FIRST QUARTER 1998		
	PREPARED FOR: FORMER DORR-OLIVER SITE 2901 Glascock Street Oakland, California		
DATE: 5/6/98	PROJECT: 360-014.2B	FIGURE:	