



SECOR
INTERNATIONAL
INCORPORATED

WWW.SECOR.COM

3017 Kilgore Road, Suite 100
Rancho Cordova, CA 95670
916-861-0400 TEL
916-861-0430 FAX

April 30, 2004

Mr. Thomas Kosel
ConocoPhillips
76 Broadway
Sacramento, CA 95818



RE: **Quarterly Remedial Performance Summary-First Quarter 2004**

76 Service Station No. 4186
1771 First Street
Livermore, CA
SECOR Project No.: 77CP.60004.01.4186

Dear Mr. Kosel:

This letter, prepared by SECOR International Incorporated (SECOR) on behalf of ConocoPhillips, presents a remedial action performance summary for the ozone injection system operating at the site referenced above. Attachment A presents the remedial performance summary for the first quarter 2004. Field data sheets are presented as Attachment B and analytical reports are presented as Attachment C. A brief site background and the status of recent remedial activities are presented below.

SITE BACKGROUND

The site is an operating 76 service station located at First Street between N and O Streets in Livermore, California. The current station configuration consists of a service station building, four product dispenser islands, and two underground storage tanks (USTs). There is an ozone injection remediation system on the sites that injects a mixture of ozone and air to ten sparge points. The system was put into operation on December 19, 2001. SECOR took over operation of the system in September, 2003.

REMEDIAL PERFORMANCE EVALUATION

Ozone Injection Operation

The ozone injection system consists of a panel mounted KVA C-Sparge™ System that produces 4 grams per hour (0.009 pounds per hour) of ozone. The system supplies ozone to ten sparge points in eight wells for seven minutes per well, 18 cycles per day. The ozone injection system operation was initiated on December 19, 2001. During the current quarter, the ozone injection system operated for 437 hours, resulting in 27% operation. The system was shutting down due to a problem with the breaker tripping. SECOR has ordered a replacement part which will be installed in April 2004. The system injected approximately 3.9 pounds of ozone during the first quarter of 2004. Operational data is provided in Table A-1.

Ozone Injection Performance

The performance of the ozone injection system in causing breakdown of contaminants beneath the site is evaluated based on the results of regular groundwater sampling. Monthly groundwater samples are collected from monitoring wells U-3 and U-6 and analyzed for total petroleum hydrocarbons as gasoline (TPHg), benzene, toluene, ethylbenzene, and total xylenes (BTEX compounds), and methyl tert-butyl ether (MtBE). Results of monthly groundwater sampling events are summarized in Table A-2. Concentration versus time graphs for dissolved TPHg, benzene, and MtBE in monitoring wells U-3 and U-6 are provided in Figures A-1 and A-2. Certified laboratory

SECOR

Quarterly Remedial Performance Summary
April 30, 2004
Page 2

analytical reports and chain-of-custody documentation for the groundwater monitoring events conducted during the first quarter of 2004 are provided in Attachment C.

If you have any questions, please contact us at (916) 861-0400.

Sincerely,
SECOR International Incorporated

Amy Draffan
Staff Engineer

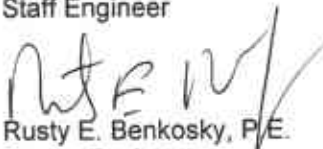
Rusty E. Benkosky, P.E.
Senior Engineer



Attachments: Figure 1 – Site Plan

Attachment A – Quarterly Remedial Performance Summary – First Quarter 2004
Attachment B – Field Data Sheets
Attachment C – Certified Laboratory Analytical Reports and Chain-of-Custody Documentation

cc: Ms. Eva Chu, Alameda County Environmental Health Services
Ms. Carol Mahoney, Zone 7 Water Agency
Ms. Barbara Moed, TRC

RB/ad

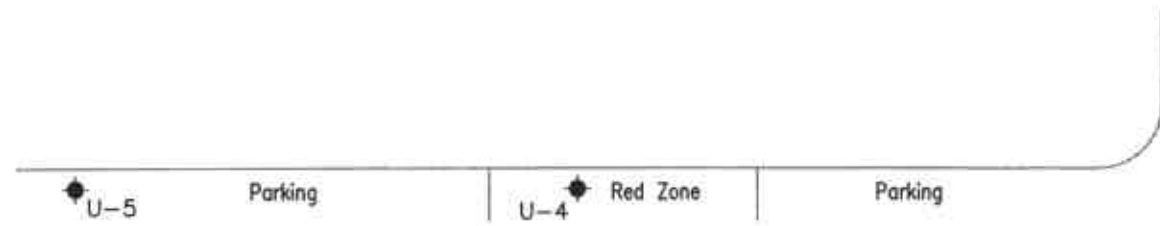

LEGEND

- ◆ GROUNDWATER MONITORING WELL
- ⊙ OZONE SPARGE POINT
- UNDERGROUND OZONE SPARGE LINE

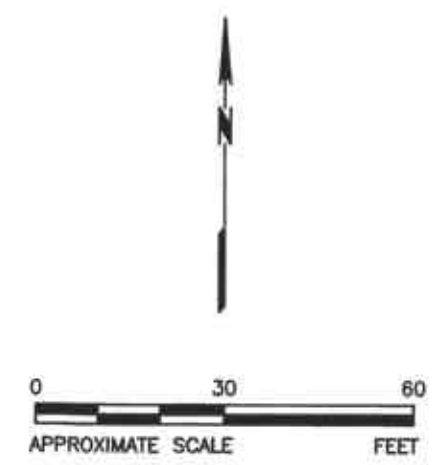
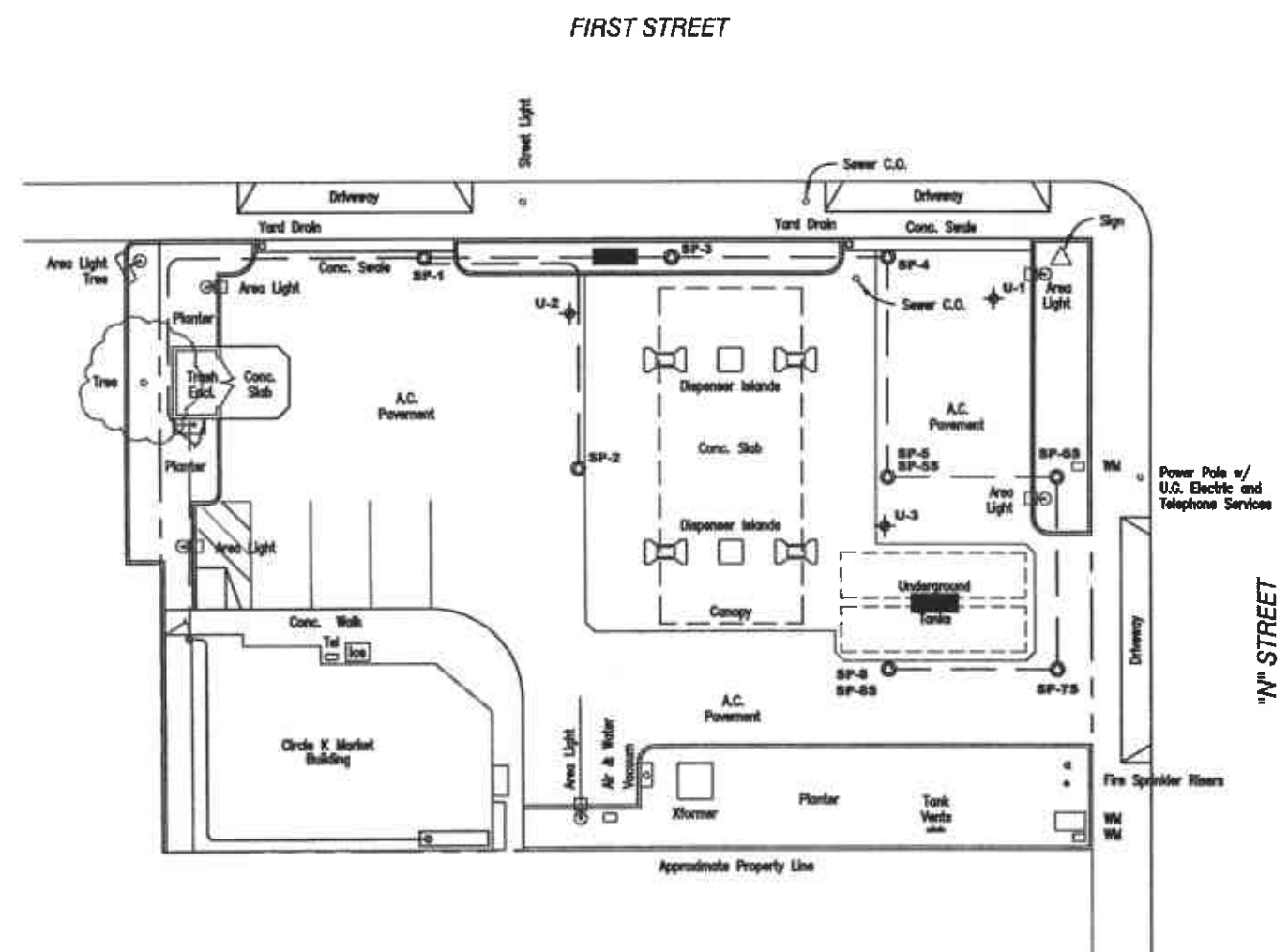

REFERENCE: THIS FIGURE IS BASED ON A 'SITE PLAN' PROVIDED BY GETTLER-RYAN INC., DATED JULY 2001, AND IS INTENDED FOR ILLUSTRATION ONLY.

DRAWN BY: DWR
 CHECKED: AD
 APPROVED: AD
 DATE: 4/2/04
 JOB NO.: 77CP.60004.01.4186
 CAD FILE: CP-SITEPLAN

PREPARED BY:

SECOR
 3017 KILGORE ROAD, SUITE 100
 RANCHO CORDOVA, CA 95670

PREPARED FOR:
 CONOCOPHILLIPS
 STATION NO. 4186
 1771 FIRST STREET
 LIVERMORE, CALIFORNIA

FIGURE 1
 SITE PLAN

ATTACHMENT A
QUARTERLY REMEDIAL PERFORMANCE SUMMARY–
FIRST QUARTER 2004

Quarterly Remedial Performance Summary
76 Service Station No. 4186
1771 First Street
Livermore, CA
SECOR Project No.: 77CP.60004.01.4186

ATTACHMENT A
REMEDIAL ACTION PERFORMANCE SUMMARY: FIRST QUARTER 2004
Ozone Sparge System

Site Name: 76 Service Station No. 4186
 Site Address: 1771 First St., Livermore

Start-up Date: 12/19/01
 Estimated Shutdown Date: NA

REMEDIAL OBJECTIVES

OPERATIONAL DATA (First Quarter 2004)

Ozone Sparge Treatment System Data

Operational Status

Mass Ozone Injected (lbs)

	January	February	March	Cumulative
Operational Status	Operational	Operational	Operational	
Mass Ozone Injected (lbs)	3.12	0.04	3.55	71

TPHg, Benzene and MtBE Summary

U-3 Concentration TPHg (µg/L)

Concentration Benzene(µg/L)

Concentration MtBE (µg/L)

U-6 Concentration TPHg (µg/L)

Concentration Benzene(µg/L)

Concentration MtBE (µg/L)

	January	February	March
U-3 Concentration TPHg (µg/L)	25,000	17,000	8,000
Concentration Benzene(µg/L)	310	180	78
Concentration MtBE (µg/L)	9,600	5,600	7,500
U-6 Concentration TPHg (µg/L)	3,500	2,800	710
Concentration Benzene(µg/L)	44	18	0.92
Concentration MtBE (µg/L)	36	23	22

REMEDIAL ACTION PERFORMANCE EVALUATION

ACTIONS/RECOMMENDATIONS

- o Continue operation of the ozone sparge system

NOTES:

µg/L = Parts per million by volume
 lbs = Pounds
 TPHg = Total petroleum hydrocarbons as gasoline
 MtBE = Methyl tert-butyl ether
 - = Not available

Note: When appropriate, tabulated data is followed by graphical presentation.

Table A-1
Ozone Injection - System Operation Data
 76 Service Station No. 4186
 1771 First Street, Livermore, California

Date	OZONE SPARGE SYSTEM					OZ-1	OZ-2	OZ-3	OZ-4	OZ-5	OZ-6	OZ-7	OZ-8	OZ-9	OZ-10	Comments
	System Status on Arrival (On/Off)	System Status on Deprature (On/Off)	Hourmeter Reading	Cummulative Online Factor	Ozone Injected (lbs)	Pressure (psi)	Pressure (psi)	Pressure (psi)	Pressure (psi)	Pressure (psi)	Pressure (psi)	Pressure (psi)	Pressure (psi)	Pressure (psi)	Pressure (psi)	
6/19/2003	On	On	6997.92	--	--	30	24	22	28	33	28	30	32	35	29	
07/30/03	On	On	NM	--	--	40	35	42	38	36	39	22	20	28	45	
08/28/03	Off	On	7127.87	0.09	--	36	48	22	42	37	33	35	40	50	35	
09/19/03	On	On	7131.66	0.07	0.03	35.2	36.1	23.7	38.0	34.9	31.1	34.8	38.0	49.3	32.2	
10/16/2003	On	On	7146.57	0.06	0.13	35.0	40.0	24.2	38.2	16.5	31.4	35.1	36.6	45.8	34	
11/18/2003	On	Off	7152.34	0.05	0.05	37.0	36.5	26.0	35.0	16.0	33.0	38.0	19.0	52.0	35.0	
12/3/2003	Off	On	7153.15	0.04	0.01	38.0	38.2	26.5	39.2	40.9	33.8	39.1	40.0	48.2	36.8	
1/16/2004	Off	--	7499.58	0.11	3.12	44.0	48.0	27.5	48.0	39.0	37.0	--	43.0	54.0	40.0	
2/6/2004	Off	Off	7541.66	0.11	0.38	40.0	38.5	--	--	--	--	--	--	--	--	b
2/17/2004	Off	On	7542.14	0.11	0.00	39.0	38.5	26.5	38.5	38.0	37.0	39.2	40.0	53.0	35.8	c
3/24/2004	Off	On	7937.07	0.16	3.55	42.0	38.2	27.5	42.0	38.0	38.0	39.7	41.5	60.0	36.0	d
Sparge time per cycle (min)						7	7	7	7	7	7	7	7	7	7	a
Reporting Period: First Quarter 2004 (1/16/04 to 3/24/04) Total Hours Operational: 7,937 Total Pounds Ozone Injected: 71 Period Hours Operational: 437 Period Percent Operational: 27% Period Pounds Ozone Injected: 3.9																
Definitions: psi Pounds per square inch scfm Standard cubic feet per minute -- Data not available NA Not applicable Notes: a = System cycles program 18 times per day, for 87.5% utilization b = GFI switch would not reset. c = Need to replace compressor feet d = System's 16amp breaker was thrown.																

Figure A-2
U-6 TPHg, Benzene, and MtBE Groundwater Concentrations
 76 Service Station No. 4186
 171 First Street, Livermore, California

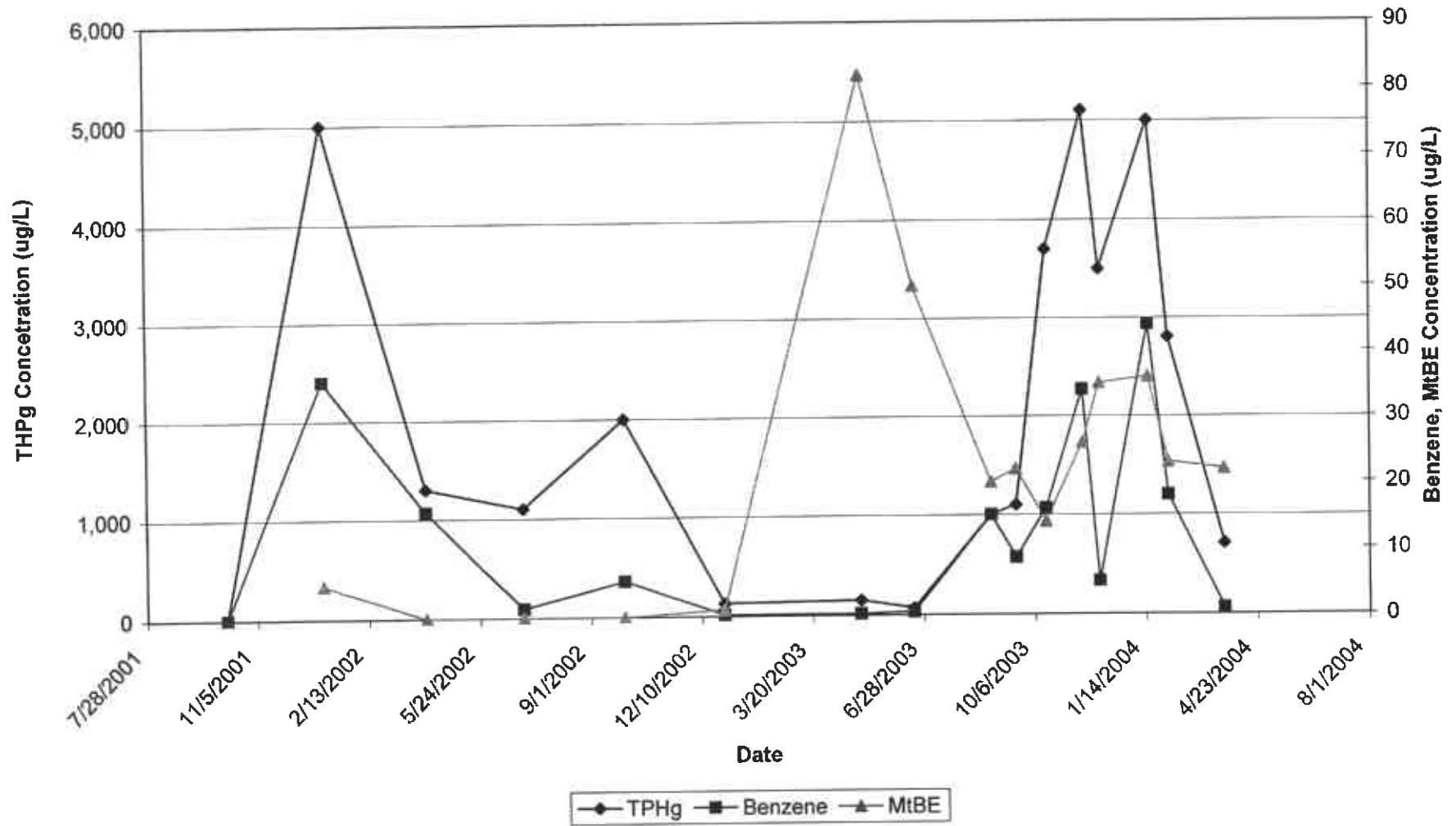
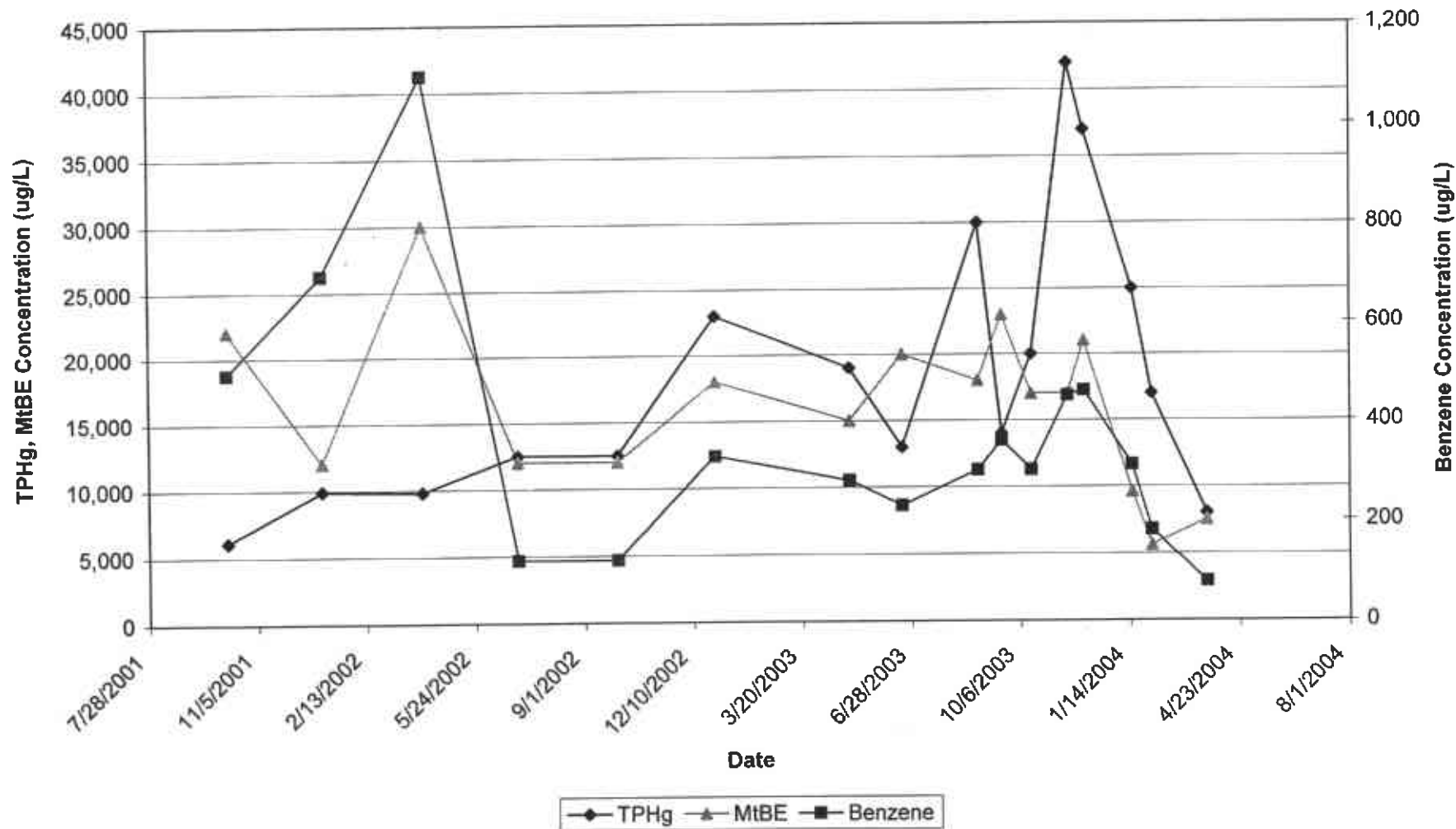

Figure A-1
U-3 TPHg, Benzene, and MtBE Groundwater Concentrations
 76 Service Station No. 4186
 1771 First Street, Livermore, California



**ATTACHMENT B
FIELD DATA SHEETS**

Quarterly Remedial Performance Summary
76 Service Station No. 4186
1771 First Street
Livermore, CA
SECOR Project No.: 77CP.60004.01.4186

014

Field Data Sheet
Ozone Sparge System

ConocoPhillips Site # 4186
1771 First Street
Livermore, California

Requested By: Amy Draffan
Lab: STL

Initials	Date	Time	System Status on Arrival On/Off	Electrical Meter Reading	Ozone Meter		Hourmeter	Ozone Readings			
					Brand	Range		Outside Compound (ppm)	Inside Compound (ppm)	Inside Shed/Panel (ppm)	Secondary Containment (ppm)
MSK	1/16/04	1130	OFF	—	ECO	1-16	7499.58	0.02	0.02	0.02	0.03

SECOR SF

Initials	Date	Well Data																			
		S-1		S-2		S-3		S-4		S-5		S-6		S-7		S-8		S-9		S-10	
		Press	O ₃	Press	O ₃	Press	O ₃	Press	O ₃	Press	O ₃	Press	O ₃	Press	O ₃	Press	O ₃	Press	O ₃	Press	O ₃
MSK	1/16	44.0	0.03	48.0	0.03	27.5	0.03	48.0	0.03	39	0.03	37	0.03			43.0	0.03	54.0	0.03	40.0	0.03
Units:		psi	ppm	psi	ppm	psi	ppm	psi	ppm	psi	ppm	psi	ppm	psi	ppm	psi	ppm	psi	ppm	psi	ppm

Initials	Date	Weather Conditions (estimated)		Temp in Ozone Panel	Monthly Sampling		System Status on Departure On/Off	Ozone Badge Color (White/Tan/Brown)
		Wind Dir.	Wind Speed		U-3 ORP (mV)	U-6 ORP (mV)		
MSK	1/16	NE	5-7 mph	50° F	3.12	3.09		TAN

01/13/04 MON 09:50 FAX 1 510 285 2568

Field Data Sheet
Ozone Sparge System

ConocoPhillips Site # 4186
1771 First Street
Livermore, California

Requested By: Amy Draffan
Lab: STL

System Maintenance	Frequency	Date Performed				
Check Integrity of All Hoses, Fittings, Piping, Valves	Monthly	1-16-04				
Measure Blower Running Amperage	Monthly					
Air Filter-Visually Inspect	Monthly	1-16-04				
Sparge Blower-Check V-belt Tension and Condition	Monthly					
Sparge Blower-Grease Bearings	Monthly					
Check/Test All Safety Override systems	Monthly					
Sample Monitoring Wells	Monthly	1-16-04				
Sparge Blower-Replace Oil	Bimonthly					
Sparge Blower-Adjust or Replace as Necessary	As-Needed					
Air Filter-Replace as Necessary	As-Needed					

NOTES AND DESCRIPTION OF ACTIVITIES ON SITE

1/16/04 Breaker was thrown - System down upon arrival. #7 solenoid
had a significant leak coming from the tubing. I repaired it. when the program
gets to solenoid #7 it throws the breaker. I bypassed the #7
solenoid for now.

01/19/04 MON 09:50 FAX 1 510 285 2566 SECOR SF

Field Data Sheet
Ozone Sparge System

ConocoPhillips Site # 4186
1771 First Street
Livermore, California

Requested By: Amy Draffan
Lab: STL

Initials	Date	Time	System Status on Arrival On/Off	Electrical Meter Reading	Ozone Meter		Hourmeter	Ozone Readings			
					Brand	Range		Outside Compound (ppm)	Inside Compound (ppm)	Inside Shed/Panel (ppm)	Secondary Containment (ppm)
MSK	2-6/04	12:00	OFF	—	ECO	1-10	7541.66	0.03	0.03	0.03	0.03
MSK	2/17/04	11:00	OFF	—	ECO	1-10	7542.14	0.03	0.03	0.03	0.03
MSK	3-24-04	1:30	OFF	—	ECO	1-10	7937.07	0.02	0.02	0.02	0.03

Initials	Date	Well Data																			
		1		2		3		4		5		6		7		8		9		10	
		Press	O ₃	Press	O ₃	Press	O ₃	Press	O ₃	Press	O ₃	Press	O ₃	Press	O ₃	Press	O ₃	Press	O ₃	Press	O ₃
MSK	2/6/04	40.0	0.03	38.5		SEE NOTES															
MSK	2/17/04	39.0	0.03	38.5	0.03	26.5	0.03	38.5	0.03	38.0	0.03	37.0	0.03	39.2	0.03	40.0	0.03	53.0	0.03	35.8	0.03
MSK	3-24-04	42.0	0.03	38.2	0.03	27.5	0.03	42.0	0.03	38.0	0.03	38.0	0.03	39.7	0.03	41.5	0.03	60.0	0.03	36.0	0.03

Units: psi ppm psi ppm psi ppm psi ppm psi ppm psi ppm psi ppm psi ppm psi ppm psi ppm

Initials	Date	Weather Conditions (estimated)			Temp in Ozone Panel	Monthly Sampling		System Status on Departure On/Off	Ozone Badge Color (White/Tan/Brown)
		Wind Dir.	Wind Speed	U-3 ORP (mV)		U-6 ORP (mV)			
MSK	2/6/04	NE	3 mph	55°	—	—	OFF	TAN	
MSK	2/17/04	NW	5 mph	50°	—	—	ON	TAN	
MSK	3-24-04	NW	5-7 mph	63°	58	78	ON	TAN	

009

KINKOS # 5160 SF

03/29/04 07:57 FAX 415 750 1295

Field Data Sheet
Ozone Sparge System

ConocoPhillips Site # 4186
1771 First Street
Livermore, California

Requested By: Amy Draffan
Lab: STL

System Maintenance	Frequency	Date Performed		
Check Integrity of All Hoses, Fittings, Piping, Valves	Monthly	2/6/04	2-17-04	3-24-04
Measure Blower Running Amperage	Monthly	—	—	—
Air Filter-Visually Inspect	Monthly	2-6-04	2-17-04	3-24-04
Sparge Blower-Check V-belt Tension and Condition	Monthly	—	—	—
Sparge Blower-Grease Bearings	Monthly	—	—	—
Check/Test All Safety Override systems	Monthly	—	—	—
Sample Monitoring Wells	Monthly	2-3-04	—	3-24-04
Sparge Blower-Replace Oil	Bimonthly	—	—	—
Sparge Blower-Adjust or Replace as Necessary	As-Needed	—	—	—
Air Filter-Replace as Necessary	As-Needed	—	—	—

NOTES AND DESCRIPTION OF ACTIVITIES ON SITE

* Power was off upon arrival, I reset the GFI and it began running. While running through the pressure = 0³ checks the power shut off and the GFI switch would not reset. I will get a new gfci for the panel.

2-17-04 Replaced GFCT. We need to replace the COMPRESSOR Feet.

3-24-04 system's 16amp breaker was thrown - The breaker was just replaced by Bill M. The probable cause of shutting the system down is the Ozone Generator.

010

KINKOS # 5160 SF

03/29/04 07:57 FAX 415 750 1295

ATTACHMENT C
CERTIFIED LABORATORY ANALYTICAL REPORTS AND
CHAIN-OF-CUSTODY DOCUMENTATION

Quarterly Remedial Performance Summary

76 Service Station No. 4186

1771 First Street

Livermore, CA

SECOR Project No.: 77CP.60004.01.4186

SECOR-Sacramento

January 30, 2004

3017 Kilgore Road, Suite 100
Rancho Cordova, CA 95670

Attn.: Amy Draffan

Project#: Conoco Philips Site #4186

Project: Conoco Philips

Site: 1771 First Street, Livermore, CA

Attached is our report for your samples received on 01/16/2004 13:35

This report has been reviewed and approved for release. Reproduction of this report is permitted only in its entirety.

Please note that any unused portion of the samples will be discarded after 03/01/2004 unless you have requested otherwise.

We appreciate the opportunity to be of service to you. If you have any questions, please call me at (925) 484-1919.

You can also contact me via email. My email address is: asalimpour@stl-inc.com

Sincerely,

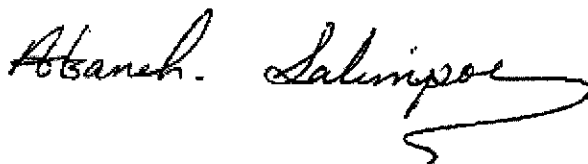

Afsaneh Salimpour
Project Manager

Gas/BTEX/MTBE by 8260B

SECOR-Sacramento

Attn.: Amy Draffan

3017 Kilgore Road, Suite 100
Rancho Cordova, CA 95670
Phone: (916) 861-0400 Fax: (916) 861-0430Project: Conoco Phillips Site #4186
Conoco Phillips

Received: 01/16/2004 13:35

Site: 1771 First Street, Livermore, CA

Samples Reported

Sample Name	Date Sampled	Matrix	Lab #
U-3	01/16/2004 11:50	Water	1
U-6	01/16/2004 12:30	Water	2

Severn Trent Laboratories, Inc.

STL San Francisco * 1220 Quarry Lane, Pleasanton, CA 94566

Tel 925 484 1919 Fax 925 484 1096 * www.stl-inc.com * CA DHS ELAP# 2496

01/29/2004 15:50

Gas/BTEX/MTBE by 8260B

SECOR-Sacramento

Attn.: Amy Draffan

3017 Kilgore Road, Suite 100
Rancho Cordova, CA 95670
Phone: (916) 861-0400 Fax: (916) 861-0430

Project: Conoco Philips Site #4186
Conoco Philips

Received: 01/16/2004 13:35

Site: 1771 First Street, Livermore, CA

Batch QC Report

Prep(s): 5030B

Method Blank

MB: 2004/01/28-1B.68-034

Water

Test(s): 8260B

QC Batch # 2004/01/28-1B.68

Date Extracted: 01/28/2004 11:34

Compound	Conc.	RL	Unit	Analyzed	Flag
Gasoline	ND	50	ug/L	01/28/2004 11:34	
Benzene	ND	0.5	ug/L	01/28/2004 11:34	
Toluene	ND	0.5	ug/L	01/28/2004 11:34	
Ethylbenzene	ND	0.5	ug/L	01/28/2004 11:34	
Total xylenes	ND	1.0	ug/L	01/28/2004 11:34	
Methyl tert-butyl ether (MTBE)	ND	2.0	ug/L	01/28/2004 11:34	
Surrogates(s)					
1,2-Dichloroethane-d4	87.7	76-114	%	01/28/2004 11:34	
Toluene-d8	91.0	88-110	%	01/28/2004 11:34	

Gas/BTEX/MTBE by 8260B

SECOR-Sacramento

Attn.: Amy Draffan

3017 Kilgore Road, Suite 100
 Rancho Cordova, CA 95670
 Phone: (916) 861-0400 Fax: (916) 861-0430

Project: Conoco Phillips Site #4186
 Conoco Phillips

Received: 01/16/2004 13:35

Site: 1771 First Street, Livermore, CA

Batch QC Report

Prep(s): 5030B

Test(s): 8260B

Laboratory Control Spike

Water

QC Batch # 2004/01/28-1B.68

LCS 2004/01/28-1B.68-049

Extracted: 01/28/2004

Analyzed: 01/28/2004 09:49

LCSD 2004/01/28-1B.68-008

Extracted: 01/28/2004

Analyzed: 01/28/2004 10:08

Compound	Conc. ug/L		Exp.Conc.	Recovery %		RPD	Ctrl.Limits %			Flags	
	LCS	LCSD		LCS	LCSD		%	Rec.	RPD	LCS	LCSD
Benzene	24.5	26.1	25	98.0	104.4	6.3	69-129	20			
Toluene	25.0	26.3	25	100.0	105.2	5.1	70-130	20			
Methyl tert-butyl ether (MTBE)	22.4	24.5	25	89.6	98.0	9.0	65-165	20			
Surrogates(s)											
1,2-Dichloroethane-d4	388	402	500	77.6	80.4		76-114				
Toluene-d8	461	446	500	92.2	89.2		88-110				

Gas/BTEX/MTBE by 8260B

SECOR-Sacramento

Attn.: Amy Draffan

3017 Kilgore Road, Suite 100
Rancho Cordova, CA 95670
Phone: (916) 861-0400 Fax: (916) 861-0430

Project: Conoco Phillips Site #4186
Conoco Phillips

Received: 01/16/2004 13:35

Site: 1771 First Street, Livermore, CA

Legend and Notes

Analysis Flag

o

Reporting limits were raised due to high level of analyte present in the sample.

STL San Francisco

Sample Receipt Checklist

Submission #: 2004- 01 - 0441

Checklist completed by: (initials) NK Date: 01/16/04

Courier name: STL San Francisco Client _____

Custody seals intact on shipping container/samples

Yes _____ No _____ Not Present

Chain of custody present?

Yes No _____

Chain of custody signed when relinquished and received?

Yes No _____

Chain of custody agrees with sample labels?

Yes No _____

Samples in proper container/bottle?

Yes No _____

Sample containers intact?

Yes No _____

Sufficient sample volume for indicated test?

Yes No _____

All samples received within holding time?

Yes No _____

Container/Temp Blank temperature in compliance ($4^{\circ}C \pm 2$)?

Temp: 9.6c Yes No _____

Ice Present Yes No _____

Water - VOA vials have zero headspace?

No VOA vials submitted Yes No _____

(If bubble is present, refer to approximate bubble size and itemize in comments as S (small - O), M (medium - O) or L (large - O)

Water - pH acceptable upon receipt? Yes No

pH adjusted- Preservative used: HNO₃ HCl H₂SO₄ NaOH ZnOAc --Lot #(s) _____

For any item check-listed "No", provided detail of discrepancy in comment section below:

Comments: 24 hrs from sampling

Project Management [Routing for instruction of indicated discrepancy(ies)]

Project Manager: (Initials) _____ Date: _____ / _____ /04

Client contacted: Yes No

Summary of discussion:

Corrective Action (per PM/Client):

STL-San Francisco

2004-01-0441

ConocoPhillips Chain Of Custody Record

82077

1220 Quarry Lane

Pleasanton, CA 94586

(925) 484-1919 (925) 484-1096 fax

ConocoPhillips Site Manager:

INVOICE REMITTANCE ADDRESS:

CONOCOPHILLIPS
Attn: Dee Hutchinson
3611 South Harbor, Suite 200
Santa Ana, CA. 92704

DATE: 01-16-04

PAGE: 01 of 01

SAMPLING COMPANY: SECOR International Inc		Valid Value ID:	CONOCOPHILLIPS SITE NUMBER: 4188	GLOBAL ID NO.:
ADDRESS: 3017 Kilgore Rd Suite 100, Rancho Cordova, CA 95670		SITE ADDRESS (Street and City): 1771 First Street, Livermore, California		CONOCOPHILLIPS SITE MANAGER: Dave DeWitt
PROJECT CONTACT (hardcopy or PDF Report to): Amy Draffan		CON DELIVERABLE TO (RF or Designer): Amy Draffan	PHONE NO.:(916) 881-0400 ext 235	EMAIL: adraffan@secor.com
TELEPHONE: (916) 881-0400 x 235	FAX: (916) 881-0430	E-MAIL: adraffan@secor.com		

SAMPLER NAME(S) (Print): Maureen Kean	CONTRACT PROJECT NUMBER: 77CP.60004.00.4188	REQUESTED ANALYSES		
--	--	---------------------------	--	--

TURNAROUND TIME (CALENDAR DAYS):
 14 DAYS 7 DAYS 72 HOURS 48 HOURS 24 HOURS LESS THAN 24 HOURS

SPECIAL INSTRUCTIONS OR NOTES: _____ CHECK BOX IF EDD IS NEEDED

* Field Point name only required if different from Sample ID

Sample ID	Sample Identification/Field Point Name*	SAMPLING		MATRIX	NO. OF CONF.	8015m - TPHd Extractable	8260B - TPHg/BTEX/8 Oxygenates	8260B - TPHg/BTEX/8 Oxygenates + methanol (8015M)	8260B - Full Scan VOCs (does not include oxygenates)	6270C - Semi-Volatiles	8015M / 8021B - TPHg/BTEX/MIBE	Lead	Total	STLC	DTCLP	FIELD NOTES: Container/Preservative or PID Readings or Laboratory Notes 9.6 (<4 hrs) TEMPERATURE ON RECEIPT OF
		DATE	TIME													
	U-3	1/16	1150	Water	3		X									
	U-6	1/16	1230	Water	3		X									

Released by: (Signature) <i>Maureen Kean</i>	Received by: (Signature) <i>Nounak</i>	Date: 1-16-04	Time: 1335
Released by: (Signature)	Received by: (Signature)	Date:	Time:
Released by: (Signature)	Received by: (Signature)	Date: 1/16/04	Time: 1335

SECOR-Sacramento

February 16, 2004

3017 Kilgore Road, Suite 100
Rancho Cordova, CA 95670

Attn.: Amy Draffan

Project#: 77CP.60004.00.4186

Project: Conoco Philips #4186

Site: 1771 First Street, Livermore, California

Attached is our report for your samples received on 02/03/2004 14:30

This report has been reviewed and approved for release. Reproduction of this report is permitted only in its entirety.

Please note that any unused portion of the samples will be discarded after 03/19/2004 unless you have requested otherwise.

We appreciate the opportunity to be of service to you. If you have any questions, please call me at (925) 484-1919.

You can also contact me via email. My email address is: asalimpour@stl-inc.com

Sincerely,



Afsaneh Salimpour
Project Manager

Gas/BTEX/MTBE by 8260B

SECOR-Sacramento

Attn.: Amy Draffan

3017 Kilgore Road, Suite 100
Rancho Cordova, CA 95670
Phone: (916) 861-0400 Fax: (916) 861-0430Project: Conoco Philips Site # 4186
Conoco Philips

Received: 02/03/2004 14:30

Site: 1771 First Street, Livermore, California

Samples Reported

Sample Name	Date Sampled	Matrix	Lab #
U-3	02/03/2004 13:30	Water	1
U-6	02/03/2004 13:45	Water	2

Gas/BTEX/MTBE by 8260B

SECOR-Sacramento

Attn.: Amy Draffan

3017 Kilgore Road, Suite 100
Rancho Cordova, CA 95670
Phone: (916) 861-0400 Fax: (916) 861-0430

Project: Conoco Philips Site # 4186
Conoco Philips

Received: 02/03/2004 14:30

Site: 1771 First Street, Livermore, California

Prep(s): 5030B Test(s): 8260B
Sample ID: U-6 Lab ID: 2004-02-0094 - 2
Sampled: 02/03/2004 13:45 Extracted: 2/9/2004 23:44
Matrix: Water QC Batch#: 2004/02/09-1A.66
Analysis Flag: o (See Legend and Note Section)

Compound	Conc.	RL	Unit	Dilution	Analyzed	Flag
Gasoline	2800	500	ug/L	10.00	02/09/2004 23:44	g
Benzene	18	5.0	ug/L	10.00	02/09/2004 23:44	
Toluene	ND	5.0	ug/L	10.00	02/09/2004 23:44	
Ethylbenzene	49	5.0	ug/L	10.00	02/09/2004 23:44	
Total xylenes	12	10	ug/L	10.00	02/09/2004 23:44	
Methyl tert-butyl ether (MTBE)	23	20	ug/L	10.00	02/09/2004 23:44	
Surrogate(s)						
1,2-Dichloroethane-d4	98.7	76-114	%	10.00	02/09/2004 23:44	
Toluene-d8	101.6	88-110	%	10.00	02/09/2004 23:44	

Gas/BTEX/MTBE by 8260B

SECOR-Sacramento

Attn.: Amy Draffan

3017 Kilgore Road, Suite 100
Rancho Cordova, CA 95670
Phone: (916) 861-0400 Fax: (916) 861-0430

Project: Conoco Philips Site # 4186
Conoco Philips

Received: 02/03/2004 14:30

Site: 1771 First Street, Livermore, California

Batch QC Report

Prep(s): 5030B
Method Blank
MB: 2004/02/09-1A.66-050

Water

Test(s): 8260B
QC Batch # 2004/02/09-1A.66
Date Extracted: 02/09/2004 18:50

Compound	Conc.	RL	Unit	Analyzed	Flag
Gasoline	ND	50	ug/L	02/09/2004 18:50	
Methyl tert-butyl ether (MTBE)	ND	2.0	ug/L	02/09/2004 18:50	
Benzene	ND	0.5	ug/L	02/09/2004 18:50	
Toluene	ND	0.5	ug/L	02/09/2004 18:50	
Ethylbenzene	ND	0.5	ug/L	02/09/2004 18:50	
Total xylenes	ND	1.0	ug/L	02/09/2004 18:50	
Surrogates(s)					
1,2-Dichloroethane-d4	100.2	76-114	%	02/09/2004 18:50	
Toluene-d8	102.6	88-110	%	02/09/2004 18:50	

Gas/BTEX/MTBE by 8260B

SECOR-Sacramento

Attn.: Amy Draffan

3017 Kilgore Road, Suite 100
Rancho Cordova, CA 95670
Phone: (916) 861-0400 Fax: (916) 861-0430

Project: Conoco Philips Site # 4186
Conoco Philips

Received: 02/03/2004 14:30

Site: 1771 First Street, Livermore, California

Batch QC Report

Prep(s): 5030B

Test(s): 8260B

Laboratory Control Spike

Water

QC Batch # 2004/02/09-1A.66

LCS 2004/02/09-1A.66-002

Extracted: 02/09/2004

Analyzed: 02/09/2004 18:02

LCSD 2004/02/09-1A.66-026

Extracted: 02/09/2004

Analyzed: 02/09/2004 18:26

Compound	Conc. ug/L		Exp. Conc.	Recovery %		RPD	Ctrl.Limits %		Flags	
	LCS	LCSD		LCS	LCSD		%	Rec.	RPD	LCS
Methyl tert-butyl ether (MTBE)	20.8	21.6	25	83.2	86.4	3.8	65-165	20		
Benzene	23.0	24.5	25	92.0	98.0	6.3	69-129	20		
Toluene	23.9	23.5	25	95.6	94.0	1.7	70-130	20		
Surrogates(s)										
1,2-Dichloroethane-d4	453	471	500	90.6	94.2		76-114			
Toluene-d8	500	486	500	100.0	97.2		88-110			

Severn Trent Laboratories, Inc.

STL San Francisco * 1220 Quarry Lane, Pleasanton, CA 94566

Tel 925 484 1919 Fax 925 484 1096 * www.stl-inc.com * CA DHS ELAP# 2496

02/16/2004 10:29

Gas/BTEX/MTBE by 8260B

SECOR-Sacramento

Attn.: Amy Draffan

3017 Kilgore Road, Suite 100
Rancho Cordova, CA 95670
Phone: (916) 861-0400 Fax: (916) 861-0430

Project: Conoco Phillips Site # 4186
Conoco Phillips

Received: 02/03/2004 14:30

Site: 1771 First Street, Livermore, California

Legend and Notes

Analysis Flag

- o Reporting limits were raised due to high level of analyte present in the sample.

Result Flag

- g Hydrocarbon reported in the gasoline range does not match our gasoline standard.

STL-San Francisco

2004-02-0094

ConocoPhillips Chain Of Custody Record

82568

1220 Quarry Lane
Pleasanton, CA 94568

(925) 484-1919 (925) 484-1096 fax

ConocoPhillips Site Manager:
INVOICE REMITTANCE ADDRESS:

CONOCOPHILLIPS
Attn: Dee Hutchinson
3611 South Harbor, Suite 200
Santa Ana, CA. 92704

DATE: 2-3-04
PAGE: 01 of 01

CONOCOPHILLIPS SITE NUMBER 4155		GLOBAL ID NO.:	
CONOCOPHILLIPS SITE ADDRESS (Street and City): 1771 First Street, Livermore, California		CONOCOPHILLIPS SITE MANAGER: Dave DeWitt	
CONOCOPHILLIPS CONTACT (Person and Title): Amy Draffan		PHONE NO.: (915) 861-0400 ext. 225	
CONOCOPHILLIPS CONTACT (E-MAIL): adraffan@conoco.com		E-MAIL: adraffan@conoco.com	

CLIENT NAME(S) (Print): Meureen Kean
CONSULTANT PROJECT NUMBER: 77CP.60004.00.4188

REQUESTED ANALYSES

DELIVERY TIME (CALENDAR DAYS):
 14 DAYS 7 DAYS 72 HOURS 48 HOURS 24 HOURS LESS THAN 24 HOURS

SPECIAL INSTRUCTIONS OR NOTES: CHECK BOX IF EDO IS NEEDED

Sample ID	Matrix	8015m - TPHd Extractable	8260B - TPHg/BTEX/MBE	8260B - TPHg/BTEX/MBE + methanol (8015M)	8260B - Full Scan VOCs (does not include oxygenates)	8270C - Semi-Volatiles	8015M / 8021B - TPHg/BTEX/MBE	Lead	OTotal	OTCUP
U-3	Water		X							
U-8	Water		X							

FIELD NOTES:
 Container/Preservative or PID Readings or Laboratory Notes
 54°C
 24°C SK 2/13/04
 TEMPERATURE ON RECEIPT OF

Field Point name only required if different from Sample ID

Sample Identification/Field Point Name	SAMPLING		MATRIX	NO. OF COYS.
	DATE	TIME		
U-3	2/3	1330	Water	3
U-8	2/3	1345	Water	3

Submitted by: (Signature) <i>Meureen Kean</i>	Received by: (Signature) <i>[Signature]</i>	Date: 2-3-04	Time: 1430
Submitted by: (Signature)	Received by: (Signature)	Date: 2-3-04	Time: 1430

SECOR-Sacramento

April 06, 2004

3017 Kilgore Road, Suite 100

Rancho Cordova, CA 95670

Attn.: Amy Draffan

Project#: 77CP.60004.00.4186

Project: Conoco Philips Site # 4186

Site: 1771 First Street, Livermore, CA

Attached is our report for your samples received on 03/24/2004 14:30

This report has been reviewed and approved for release. Reproduction of this report is permitted only in its entirety.

Please note that any unused portion of the samples will be discarded after 05/08/2004 unless you have requested otherwise.

We appreciate the opportunity to be of service to you. If you have any questions, please call me at (925) 484-1919.

You can also contact me via email. My email address is: asalimpour@stl-inc.com

Sincerely,



Afsaneh Salimpour
Project Manager

Severn Trent Laboratories, Inc.

STL San Francisco * 1220 Quarry Lane, Pleasanton, CA 94566

Tei 925 484 1919 Fax 925 484 1096 * www.stl-inc.com * CA DHS ELAP# 2496

Gas/BTEX/MTBE by 8260B

SECOR-Sacramento

Attn.: Amy Draffan

3017 Kilgore Road, Suite 100
Rancho Cordova, CA 95670
Phone: (916) 861-0400 Fax: (916) 861-0430Project: 77CP.60004.00.4186
Conoco Philips Site # 4186

Received: 03/24/2004 14:30

Site: 1771 First Street, Livermore, CA

Samples Reported

Sample Name	Date Sampled	Matrix	Lab #
U-3	03/24/2004 13:45	Water	1
U-6	03/24/2004 14:00	Water	2

Severn Trent Laboratories, Inc.

STL San Francisco * 1220 Quarry Lane, Pleasanton, CA 94566
Tel 925 484 1919 Fax 925 484 1096 * www.stl-inc.com * CA DHS ELAP# 2496

04/02/2004 17:42

Gas/BTEX/MTBE by 8260B

SECOR-Sacramento

Attn.: Amy Draffan

3017 Kilgore Road, Suite 100
Rancho Cordova, CA 95670
Phone: (916) 861-0400 Fax: (916) 861-0430

Project: 77CP.60004.00.4186
Conoco Philips Site # 4186

Received: 03/24/2004 14:30

Site: 1771 First Street, Livermore, CA

Prep(s): 5030B Test(s): 8260B
Sample ID: U-3 Lab ID: 2004-03-0786 - 1
Sampled: 03/24/2004 13:45 Extracted: 3/31/2004 23:16
Matrix: Water QC Batch#: 2004/03/31-2A.64
Analysis Flag: o (See Legend and Note Section)

Compound	Conc.	RL	Unit	Dilution	Analyzed	Flag
Gasoline	8000	2500	ug/L	50.00	03/31/2004 23:16	
Benzene	78	25	ug/L	50.00	03/31/2004 23:16	
Toluene	ND	25	ug/L	50.00	03/31/2004 23:16	
Ethylbenzene	340	25	ug/L	50.00	03/31/2004 23:16	
Total xylenes	1200	50	ug/L	50.00	03/31/2004 23:16	
Methyl tert-butyl ether (MTBE)	7500	100	ug/L	50.00	03/31/2004 23:16	
Surrogate(s)						
1,2-Dichloroethane-d4	97.2	76-114	%	50.00	03/31/2004 23:16	
Toluene-d8	92.6	88-110	%	50.00	03/31/2004 23:16	

Gas/BTEX/MTBE by 8260B

SECOR-Sacramento
Attn.: Amy Draffan

3017 Kilgore Road, Suite 100
Rancho Cordova, CA 95670
Phone: (916) 861-0400 Fax: (916) 861-0430
Project: 77CP.60004.00.4186
Conoco Philips Site # 4186

Received: 03/24/2004 14:30
Site: 1771 First Street, Livermore, CA

Batch QC Report

Prep(s): 5030B
Method Blank
MB: 2004/03/31-2A.64-022
Water
Test(s): 8260B
QC Batch # 2004/03/31-2A.64
Date Extracted: 03/31/2004 18:22

Compound	Conc.	RL	Unit	Analyzed	Flag
Gasoline	ND	50	ug/L	03/31/2004 18:22	
Methyl tert-butyl ether (MTBE)	ND	0.5	ug/L	03/31/2004 18:22	
Benzene	ND	0.5	ug/L	03/31/2004 18:22	
Toluene	ND	0.5	ug/L	03/31/2004 18:22	
Ethylbenzene	ND	0.5	ug/L	03/31/2004 18:22	
Total xylenes	ND	1.0	ug/L	03/31/2004 18:22	
Surrogates(s)					
1,2-Dichloroethane-d4	91.8	76-114	%	03/31/2004 18:22	
Toluene-d8	91.8	88-110	%	03/31/2004 18:22	

Gas/BTEX/MTBE by 8260B

SECOR-Sacramento

Attn.: Amy Draffan

3017 Kilgore Road, Suite 100
 Rancho Cordova, CA 95670
 Phone: (916) 861-0400 Fax: (916) 861-0430

Project: 77CP.60004.00.4186
 Conoco Phillips Site # 4186

Received: 03/24/2004 14:30

Site: 1771 First Street, Livermore, CA

Batch QC Report

Prep(s): 5030B

Method Blank

MB: 2004/04/01-2A.64-000

Water

Test(s): 8260B

QC Batch # 2004/04/01-2A.64

Date Extracted: 04/01/2004 20:00

Compound	Conc.	RL	Unit	Analyzed	Flag
Gasoline	ND	50	ug/L	04/01/2004 20:00	
Methyl tert-butyl ether (MTBE)	ND	0.5	ug/L	04/01/2004 20:00	
Benzene	ND	0.5	ug/L	04/01/2004 20:00	
Toluene	ND	0.5	ug/L	04/01/2004 20:00	
Ethylbenzene	ND	0.5	ug/L	04/01/2004 20:00	
Total xylenes	ND	1.0	ug/L	04/01/2004 20:00	
Surrogates(s)					
1,2-Dichloroethane-d4	90.4	76-114	%	04/01/2004 20:00	
Toluene-d8	92.0	88-110	%	04/01/2004 20:00	

Gas/BTEX/MTBE by 8260B

SECOR-Sacramento

Attn.: Amy Draffan

3017 Kilgore Road, Suite 100
Rancho Cordova, CA 95670
Phone: (916) 861-0400 Fax: (916) 861-0430

Project: 77CP.60004.00.4186
Conoco Philips Site # 4186

Received: 03/24/2004 14:30

Site: 1771 First Street, Livermore, CA

Batch QC Report

Prep(s): 5030B

Test(s): 8260B

Laboratory Control Spike

Water

QC Batch # 2004/03/31-2A.64

LCS 2004/03/31-2A.64-038

Extracted: 03/31/2004

Analyzed: 03/31/2004 17:38

LCSD 2004/03/31-2A.64-000

Extracted: 03/31/2004

Analyzed: 03/31/2004 18:00

Compound	Conc. ug/L		Exp. Conc.	Recovery %		RPD	Ctrl. Limits %			Flags	
	LCS	LCSD		LCS	LCSD		%	Rec.	RPD	LCS	LCSD
Methyl tert-butyl ether (MTBE)	23.6	24.7	25	94.4	98.8	4.6	65-165	20			
Benzene	25.2	26.0	25	100.8	104.0	3.1	69-129	20			
Toluene	24.6	25.3	25	98.4	101.2	2.8	70-130	20			
Surrogates(s)											
1,2-Dichloroethane-d4	453	429	500	90.6	85.8		76-114				
Toluene-d8	457	448	500	91.4	89.6		88-110				

Severn Trent Laboratories, Inc.

STL San Francisco * 1220 Quarry Lane, Pleasanton, CA 94566

Tel 925 484 1919 Fax 925 484 1096 * www.stl-inc.com * CA DHS ELAP# 2496

04/02/2004 17:42

Gas/BTEX/MTBE by 8260B

SECOR-Sacramento

Attn.: Amy Draffan

3017 Kilgore Road, Suite 100
Rancho Cordova, CA 95670
Phone: (916) 861-0400 Fax: (916) 861-0430

Project: 77CP.60004.00.4186
Conoco Philips Site # 4186

Received: 03/24/2004 14:30

Site: 1771 First Street, Livermore, CA

Batch QC Report

Prep(s): 5030B

Test(s): 8260B

Laboratory Control Spike

Water

QC Batch # 2004/04/01-2A.64

LCS 2004/04/01-2A.64-015

Extracted: 04/01/2004

Analyzed: 04/01/2004 19:15

LCSD 2004/04/01-2A.64-037

Extracted: 04/01/2004

Analyzed: 04/01/2004 19:37

Compound	Conc. ug/L		Exp. Conc.	Recovery %		RPD	Ctrl. Limits %		Flags	
	LCS	LCSD		LCS	LCSD		%	Rec.	RPD	LCS
Methyl tert-butyl ether (MTBE)	23.9	21.3	25	95.6	85.2	11.5	65-165	20		
Benzene	25.4	23.7	25	101.6	94.8	6.9	69-129	20		
Toluene	24.4	24.0	25	97.6	96.0	1.7	70-130	20		
Surrogates(s)										
1,2-Dichloroethane-d4	436	433	500	87.2	86.6		76-114			
Toluene-d8	460	459	500	92.0	91.8		88-110			

Severn Trent Laboratories, Inc.

STL San Francisco * 1220 Quarry Lane, Pleasanton, CA 94566

Tel 925 484 1919 Fax 925 484 1096 * www.stl-inc.com * CA DHS ELAP# 2496

04/02/2004 17:42

Gas/BTEX/MTBE by 8260B

SECOR-Sacramento

Attn.: Amy Draffan

3017 Kilgore Road, Suite 100
Rancho Cordova, CA 95670
Phone: (916) 861-0400 Fax: (916) 861-0430

Project: 77CP.60004.00.4186
Conoco Phillips Site # 4186

Received: 03/24/2004 14:30

Site: 1771 First Street, Livermore, CA

Legend and Notes

Analysis Flag

- o Reporting limits were raised due to high level of analyte present in the sample.

Result Flag

- g Hydrocarbon reported in the gasoline range does not match our gasoline standard.

2004-03-0786

ConocoPhillips Chain Of Custody Record

54160

STL-San Francisco

1220 Quarry Lane

Pleasanton, CA 94566

(925) 484-5819 (925) 484-1096 fax

ConocoPhillips Site Manager:

INVOICE REMITTANCE ADDRESS:

CONOCOPHILLIPS
Attn: Dee Hutchinson
3611 South Harbor, Suite 200
San Jose, CA 95128

ConocoPhillips Work Order Number

12375EC550/551

ConocoPhillips Cost Object

DATE: 03-24-04

PAGE 01 of 01

SAMPLING COMPANY: SECOR International Inc.		FIELD VALUE ID:	CONOCOPHILLIPS SITE NUMBER: 4168	ORDER ID NO.: T0600101493
ADDRESS: 3017 Kilgore Rd Suite 100, Rancho Cordova, CA 95670		SITE ADDRESS (Street and City): 1771 First Street, Livermore, California		CONOCOPHILLIPS SITE MANAGER: Dave DeWitt
PROJECT CONTACT (the sender of PDF Report to): Amy Draffan		EDF DELIVERABLE TO (RIP or Designee): Amy Draffan	PHONE NO: (916) 881-0400 ext 235	E-MAIL: adraffan@secor.co m
TELEPHONE: (916) 881-0400 x 235	FAX: (916) 881-0430	EMAIL: adraffan@secor.com	LAB USE ONLY	

SAMPLER NAME(S) (Print): Maureen Kean	CONSULTANT PROJECT NUMBER: 77CP:80004.00.4168	REQUESTED ANALYSES
--	--	--------------------

TURNAROUND TIME (CALENDAR DAYS):
 14 DAYS 7 DAYS 72 HOURS 48 HOURS 24 HOURS LESS THAN 24 HOURS

SPECIAL INSTRUCTIONS OR NOTES: CHECK BOX IF EDD IS NEEDED

8015m - TPHid Extractable	8260B - TPHg/BTEX/MBE	8260B - TPHg / BTEX / s Oxygenates	8260B - TPHg / BTEX / s Oxygenates + methanol (8015M)	8260B - Full Scan VOCs (does not include oxygenates)	8270C - Semi-Volatiles	8015M / 8021B - TPHg/BTEX/MBE	Lead	Total ESTLC	OTCLP
	X								
	X								

FIELD NOTES:
 Contained/Preservative or PID Readings or Laboratory Notes
 5.7°C

SAMPLER NAME	SAMPLING		MATRIX	NO. OF CONT.
	DATE	TIME		
U-3	3/24	1345	Water	3
U-6	3/24	1400	Water	3

Requested by: (Signature) Maureen Kean	Received by: (Signature)	Date: 3-24-04	Time: 1430
Requested by: (Signature)	Received by: (Signature)	Date:	Time:
Requested by: (Signature)	Received by: (Signature) Maureen K	Date: 3-24-04	Time: 1430