

GALLAGHER & MIERSCH, INC.

COMMERCIAL REAL ESTATE SERVICES  
1390 WILLOW PASS ROAD, SUITE 220  
CONCORD, CALIFORNIA 94520  
(925) 671-7000 FAX (925) 671-9107

TRANSMITTAL COVER SHEET

TO: MS EVA CHU

DATE: 9-9-99

FAX#: 510-~~510-5100~~  
337-9335

FROM: Thomas M. Foley, CSM, CPM

RE: BECON STATIC #604  
LICENSE

This is 1 of 3 pages.  
(including this cover sheet)

REMARKS: HERE ETC  
Here is the size  
pipe you requested  
Tom

CC: \_\_\_\_\_

Should you have any questions or if there is a problem with the transmission, please call Gallagher & Miersch at (925) 671-7000.

THIS MESSAGE IS INTENDED ONLY FOR THE USE OF THE INDIVIDUAL OR ENTITY TO WHOM IT IS ADDRESSED AND MAY CONTAIN INFORMATION THAT IS PRIVILEGED, CONFIDENTIAL, OR EXEMPT FROM DISCLOSURE UNDER APPLICABLE FEDERAL OR STATE LAW. IF THE READER OF THIS MESSAGE IS NOT THE INTENDED RECIPIENT OR THE EMPLOYEE OR AGENT RESPONSIBLE FOR DELIVERING THE MESSAGE TO THE INTENDED RECIPIENT, YOU ARE HEREBY NOTIFIED THAT ANY DISSEMINATION, DISTRIBUTION, OR COPYING OF THIS COMMUNICATION IS STRICTLY PROHIBITED. IF YOU HAVE RECEIVED THIS COMMUNICATION IN ERROR, PLEASE NOTIFY US IMMEDIATELY BY TELEPHONE AND RETURN THE ORIGINAL MESSAGE TO US AT THE ADDRESS LISTED ABOVE VIA U.S. POSTAL SERVICE.

140'-0" SITE PLAN

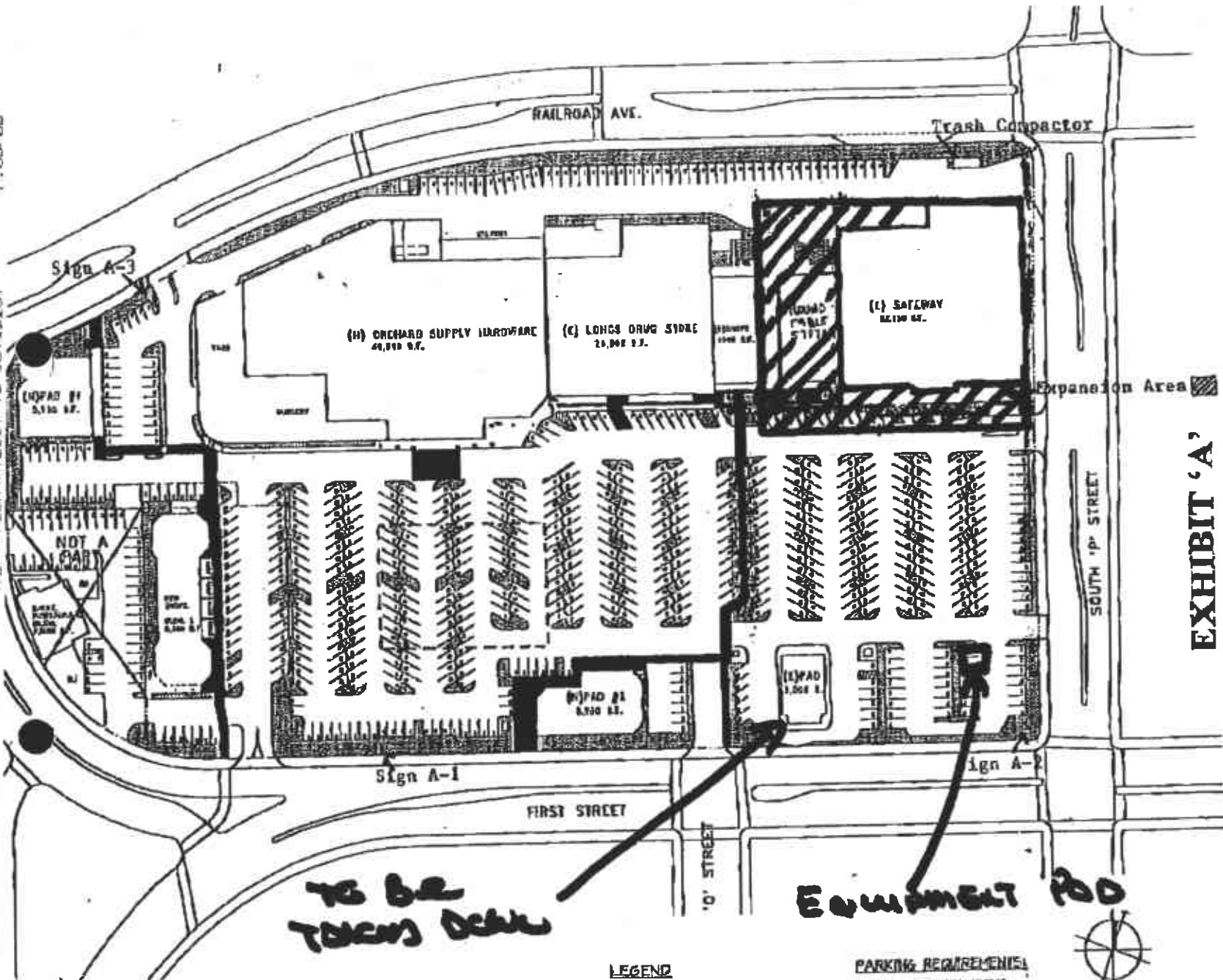

TO BE TAKEN DOWN

EQUIPMENT PAD

LEGEND

- CONCRETE PARKING SPACE
- UNPAVED ACCESSION & PARKING SPACE
- ▨ ADA ACCESSIBLE/HANDICAPPED PARKING SPACE
- ON A ROAD (LOOK BY ROAD)

- ▭ LANDSCAPE
- ▭ SPECIAL FEATURES

PARKING REQUIREMENTS

TRAFFIC SIGNAL, 100% 100% 100%  
 HOUR / MIN - 10 - 100%  
 ON STREET PARKING  
 100 SPACES PROVIDED



EXHIBIT 'A'

VINTNER SQUARE SHOPPING CENTER  
 SITE WORK  
 First Street, Bldg. South 'P' & South 'S' Streets  
 Livermore, California

LOVING & CAMPOS ARCHITECTS J  
 ARCHITECTS  
 1000 ...  
 ...

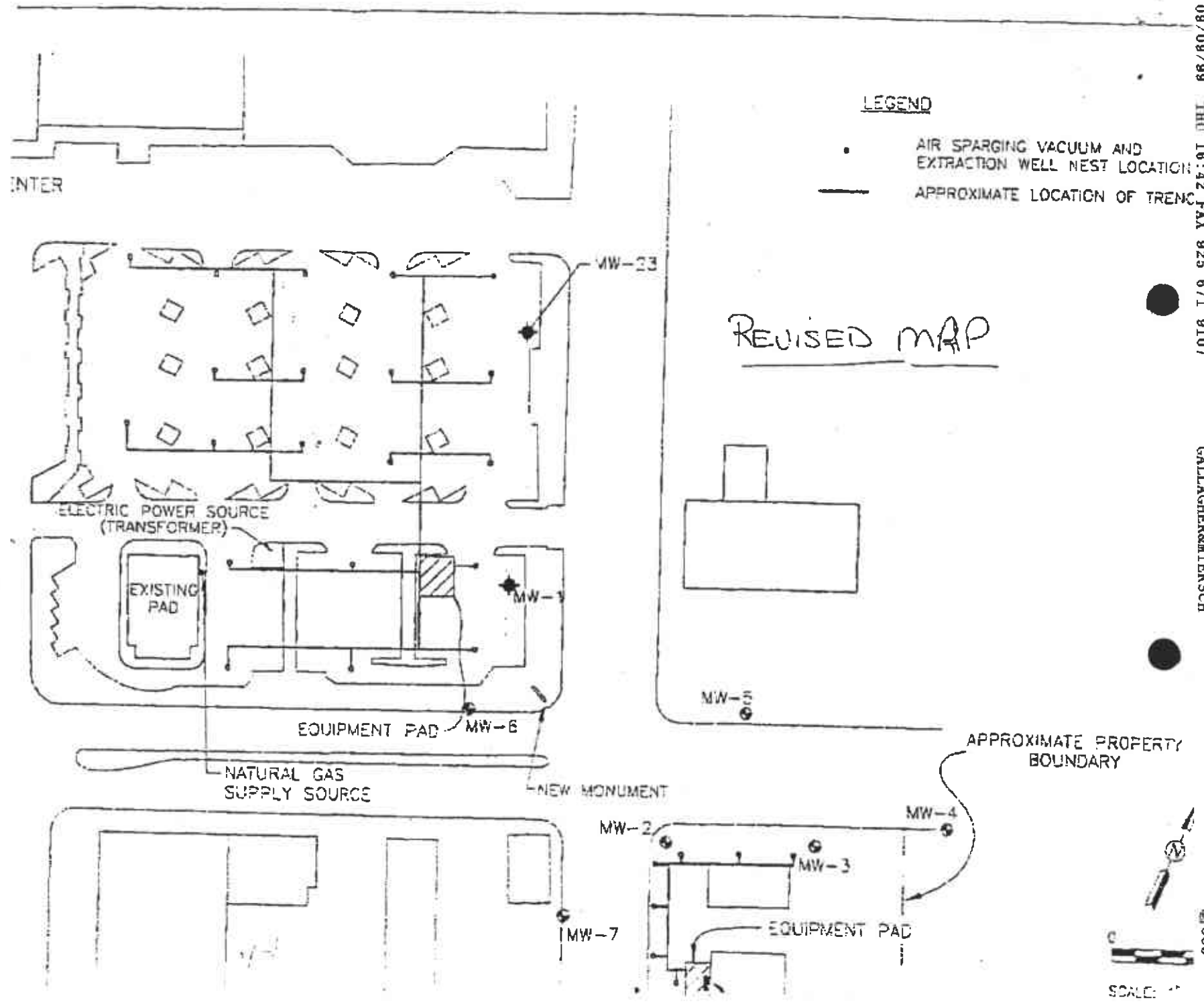

REVISED MAP

TOTAL P.L.03



SCALE: 1"