

ACTON • MICKELSON • van DAM, INC.
Consulting Scientists, Engineers, and Geologists

5090 Robert J. Mathews Parkway, #4
El Dorado Hills, California 95762

(916) 939-7550
Fax (916) 939-7570

TO: Eva Chu

DATE: 11-23-93

COMPANY: Alameda HES

PROJECT NO. _____

FAX NUMBER: 1-510-589-4757

NO. OF PAGES _____

SUBJECT/COMMENTS: Eva, here is the proposed location
for an up gradient well for 1619 Street
Givermore. Please call that we may discuss
this matter.

12/14/93 Hal Hansen says mu will be placed
across P st. He will send me ^{revised} site plan
for me to approve w.P.

H Hansen

SENT BY: Hal Hansen

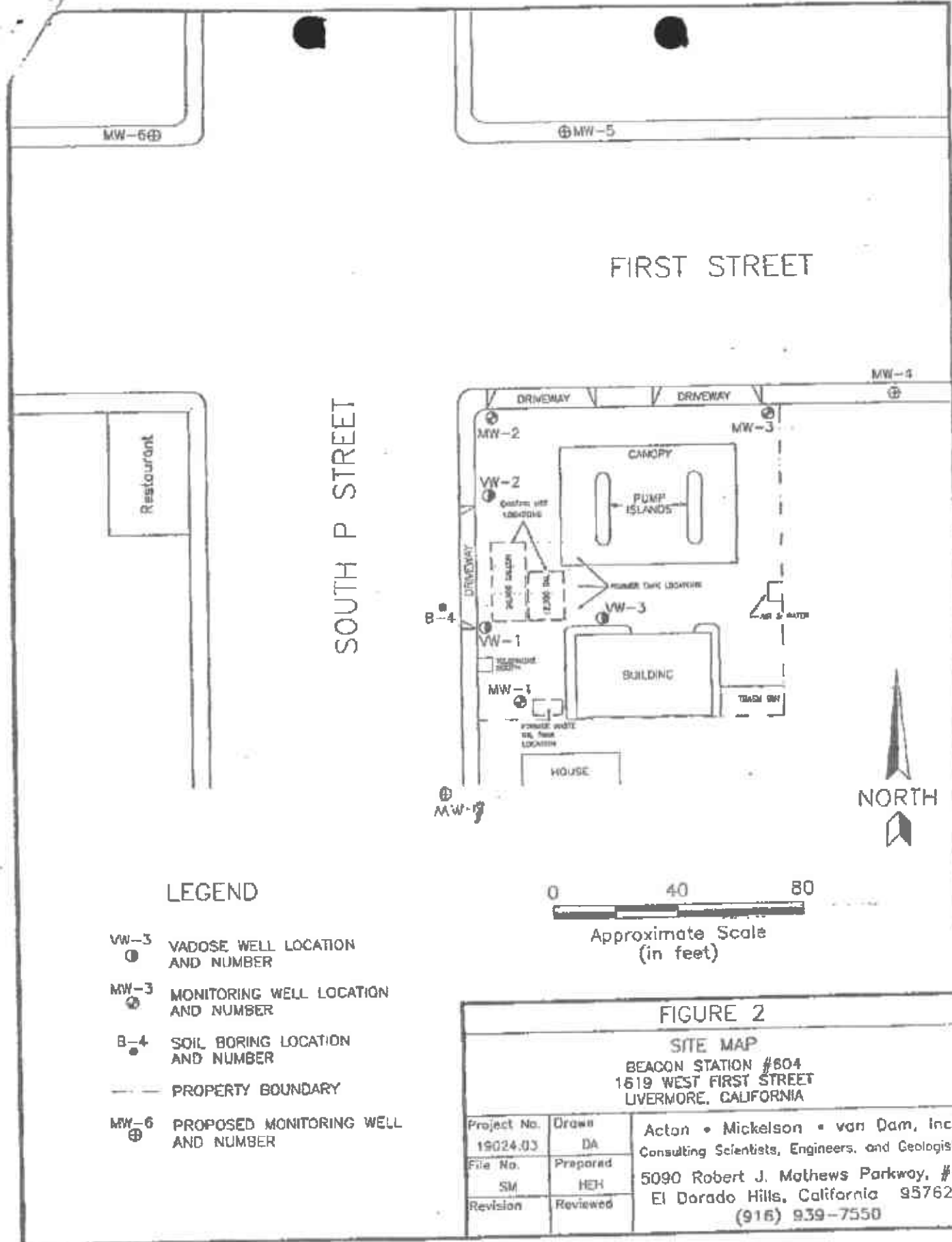

LEGEND

- VW-3 VADOSE WELL LOCATION AND NUMBER
- MW-3 MONITORING WELL LOCATION AND NUMBER
- B-4 SOIL BORING LOCATION AND NUMBER
- PROPERTY BOUNDARY
- MW-6 PROPOSED MONITORING WELL AND NUMBER



Approximate Scale (in feet)

FIGURE 2

SITE MAP
 BEACON STATION #604
 1619 WEST FIRST STREET
 LIVERMORE, CALIFORNIA

Project No. 19024.03	Drawn DA	Acton • Mickelson • van Dam, Inc. Consulting Scientists, Engineers, and Geologists 5090 Robert J. Mathews Parkway, #4 El Dorado Hills, California 95762 (916) 939-7550
File No. SM	Prepared HEH	
Revision	Reviewed	