



# LETTER OF TRANSMITTAL

DATE	9/17/93	JOB NO.	150
ATTENTION	Jennifer Eberle		
RE:	1230 14th Street		
	Oakland, CA 94607		

TO: Alameda County Health Care Servs. Agency  
Department of Environmental Health  
Hazardous Material Program  
80 Swan Way, Room 200  
Oakland, CA 94621

WE ARE SENDING YOU  Attached  Under separate cover via \_\_\_\_\_ the following items:

- Shop drawings     Prints     Plans     Samples     Specifications  
 Copy of letter     Change Order     \_\_\_\_\_

COPIES	DATE	NO.	DESCRIPTION
1	8/31/93		Analytical Results and Chain-of-Custody
1	9/1/93		Site Plan
1	9/17/93		Underground Storage Tank Unauthorized Release (Leak)/Contamination
			Site Report

98 SEP 20 PM 12:02

THESE ARE TRANSMITTED as checked below:

- For approval     Approved as submitted     Resubmit \_\_\_\_\_ copies for approval  
 For your use     Approved as noted     Submit \_\_\_\_\_ copies for distribution  
 As requested     Returned for corrections     Return \_\_\_\_\_ corrected prints  
 For review and <sup>file</sup> ~~submit~~  \_\_\_\_\_  
 FOR BIDS DUE \_\_\_\_\_ 19 \_\_\_\_\_  PRINTS RETURNED AFTER LOAN TO US

REMARKS \_\_\_\_\_  
 \_\_\_\_\_  
 \_\_\_\_\_  
 \_\_\_\_\_

COPY TO File \_\_\_\_\_

SIGNED: *Maria Travis*

If enclosures are not as noted, kindly notify us at once.



# PRIORITY ENVIRONMENTAL LABS

Precision Environmental Analytical Laboratory

August 31, 1993

PEL #: 9308104

TANK PROTECT ENGINEERING, INC.

Attn: Jeff

Project name : Sabek, Inc.  
Project location: 1230 14th St.  
Sample I.D.: S-1

Project number: 150A082693

Date Sampled: Aug 25, 1993  
Date Analyzed: Aug 30, 1993

Date Submitted: Aug 27, 1993

Method of Analysis: EPA 8010

Detection limit: 5.0 ug/Kg

COMPOUND NAME	CONCENTRATION ( ug/Kg )	SPIKE RECOVERY ( % )
Chloromethane	N.D.	-----
Vinyl Chloride	N.D.	91.6
Bromomethane	N.D.	-----
Chloroethane	N.D.	-----
Trichlorofluoromethane	N.D.	-----
1,1-Dichloroethene	N.D.	87.8
Methylene Chloride	N.D.	-----
1,2-Dichloroethene (TOTAL)	N.D.	-----
1,1-Dichloroethane	N.D.	83.5
Chloroform	N.D.	-----
1,1,1-Trichloroethane	N.D.	89.2
Carbon Tetrachloride	N.D.	-----
1,2-Dichloroethane	N.D.	-----
Trichloroethene	N.D.	101.6
1,2-Dichloropropane	N.D.	-----
Bromodichloromethane	N.D.	-----
2-Chloroethylvinylether	N.D.	-----
Trans-1,3-Dichloropropene	N.D.	-----
Cis-1,3-Dichloropropene	N.D.	-----
1,1,2-Trichloroethane	N.D.	-----
Tetrachloroethene	N.D.	103.8
Dibromochloromethane	N.D.	-----
Chlorobenzene	N.D.	-----
Bromoform	N.D.	-----
1,1,2,2-Tetrachloroethane	N.D.	-----
1,3-Dichlorobenzene	N.D.	-----
1,4-Dichlorobenzene	N.D.	-----
1,2-Dichlorobenzene	N.D.	-----

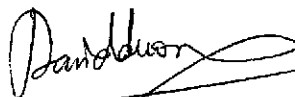
  
David Duong  
Laboratory Director



# PRIORITY ENVIRONMENTAL LABS

Precision Environmental Analytical Laboratory

September 02, 1993

PEL # 9308104

TANK PROTECT ENGINEERING, INC.

Attn: Jeff

Re: Five soil samples for Cadmium, Chromium, Lead, Nickel,  
and Zinc analyses.

Project name: Sabek, Inc.

Project location: 1230 14th St.

Project number: 150A082693

Date sampled: Aug 25-26, 1993

Date extracted: Aug 31, 1993

Date submitted: Aug 27, 1993

Date analyzed: Aug 31, 1993

## RESULTS:

SAMPLE I.D.	Cadmium (mg/Kg)	Chromium (mg/Kg)	Lead (mg/Kg)	Nickel (mg/Kg)	Zinc (mg/Kg)
S-1	N.D.	43	47	36	35
S-2	---	---	N.D.	---	---
S-6	---	---	N.D.	---	---
DS-1	---	---	33	---	---
DS-4	---	---	11	---	---
Blank	N.D.	N.D.	N.D.	N.D.	N.D.
Detection limit	0.5	1.0	1.0	1.0	1.0
Method of Analysis	7130	7190	7420	7520	7950

David Duong  
Laboratory Director



# PRIORITY ENVIRONMENTAL LABS

Precision Environmental Analytical Laboratory

August 31, 1993

PEL # 9308104

TANK PROTECT ENGINEERING, INC.

Attn: Jeff

Re: Twenty two soil samples for Gasoline/BTEX, Diesel, and Oil & Grease analyses.

Project name: Sabek, Inc.  
Project number: 150A082693

Project location: 1230 14th St.

Date sampled: Aug 25-26, 1993  
Date extracted: Aug 27-30, 1993

Date submitted: Aug 27, 1993  
Date analyzed: Aug 27-30, 1993

## RESULTS:

SAMPLE I.D.	Gasoline (mg/Kg)	Diesel (mg/Kg)	Benzene (ug/Kg)	Toluene (ug/Kg)	Ethyl Benzene (ug/Kg)	Total Xylenes (ug/Kg)	Oil & Grease (mg/Kg)
DS-1	13	---	7.0	17	21	72	---
DS-2	2.0	---	5.3	8.9	12	31	---
DS-3	1.3	---	N.D.	5.9	6.1	18	---
DS-4	2.7	---	5.5	9.4	16	47	---
DS-5	3.4	---	5.9	11	18	61	---
DS-6	11	---	6.8	15	18	64	---
S-1	67	1200	38	89	110	380	7700
S-2	2200	---	1400	3200	3500	13000	---
S-3	530	---	400	760	830	3100	---
S-4	40	---	31	59	66	290	---
S-5	1.4	---	N.D.	6.3	8.1	25	---
S-6	1600	---	970	2300	2700	10000	---
S-7	11000	---	6700	16000	18000	69000	---
S-8	18000	---	11000	26000	30000	110000	---
S-9	6200	---	3700	8700	10000	37000	---
SP1-1,2,3,4*	960	---	580	1400	1600	5900	---
SP1-5,6,7,8*	950	---	560	1400	1500	5700	---
SP2-1,2,3,4*	3500	---	2200	5100	5900	22000	---
SP2-5,6,7,8*	4800	---	2800	7100	8200	31000	---
VSPC-1	1.7	---	N.D.	6.6	9.6	28	---
VSW-1	4800	---	2900	7000	8000	30000	---
VSW-2	21	---	150	290	330	1300	---
Blank	N.D.	N.D.	N.D.	N.D.	N.D.	N.D.	N.D.
Spiked Recovery	82.3%	94.1%	84.0%	85.2%	83.1%	92.2%	---
Duplicate Spiked Recovery	92.0%	93.6%	89.5%	90.6%	88.4%	98.7%	---
Detection limit	1.0	1.0	5.0	5.0	5.0	5.0	10
Method of Analysis	5030/8015	3550/8015	8020	8020	8020	8020	5520 D & F

\*Composited soil samples.



David Duong  
Laboratory Director



**TANK PROTECT ENGINEERING**

2821 WHIPPLE ROAD  
 UNION CITY, CA 94587  
 (415) 429-8088  
 (800) 523-8088  
 FAX (415) 429-8089

PEL # 9308104 (1 of 4)

INV # 23944

LAB: Priority Env

TURNAROUND: Normal

P.O. #: 686

PAGE 1 OF 4

**CHAIN OF CUSTODY**

PROJECT NO.		SITE NAME & ADDRESS					(1) TYPE OF CONTAINER	ANALYTES REQUESTED							REMARKS																										
150A082693		Sabek Inc 1230 14th Street						Brass	X	X																															
SAMPLER NAME, ADDRESS AND TELEPHONE NUMBER																				TOTAL LIGHT HC																					
Lee Huckins 2821 WHIPPLE ROAD, UNION CITY, CA 94587 (415) 429-8088							AROMATIC HC							TOTAL HEAVY HC							OIL & GREASE							POC SCAN							OTHER						
ID NO.	DATE	TIME	SOIL	WATER	SAMPLING LOCATION																																				
SPH	8/25/93	1215	X		3.0																																				
SP1-2	8/25	1220	L		3.0									Composite into 1 sample <sup>SPI</sup> (1-4)																											
SP1-3	8/25	1225	L		3.0																																				
SP1-4	8/25	1230	L		3.0																																				
SP1-5	8/25	1240	L		3.0																																				
SP1-6	8/25	1245	L		3.0									Composite into 1 sample <sup>SPI</sup> (5-8)																											
SP1-7	8/25	1250	L		3.0																																				
SP1-8	8/25	1255	L		3.0																																				
S-1	8/25	1330	L		8.5'									OEG EPA 5520-F																											
Relinquished by: (Signature)		Date / Time		Received by: (Signature)		Relinquished by: (Signature)		Date / Time		Received by: (Signature)																															
Lee Huckins		8/26/93 11:00		Jei Miller		Jei Miller		8/27/93 9:42																																	
Relinquished by: (Signature)		Date / Time		Received by: (Signature)		Relinquished by: (Signature)		Date / Time		Received by: (Signature)																															
				PEL																																					
Relinquished by: (Signature)		Date / Time		Received for Laboratory by: (Signature)		Date / Time		Remarks																																	
		8/27/93 9:45		[Signature]																																					

DATE: 8-26-93



**TANK PROTECT ENGINEERING**

2021 WHIPPLE ROAD  
 UNION CITY, CA 94587  
 (415) 429-8089  
 (800) 523-8088  
 FAX (415) 429-8089

PEL # 9308104 (2 of 4)

INV # 23944

LAB: Priority Env

TURNAROUND: Normal

P.O. #: 686

PAGE 2 OF 4

**CHAIN OF CUSTODY**

PROJECT NO.		SITE NAME & ADDRESS					(1) TYPE OF CON- TAINER	ANALYTES REQUESTED							REMARKS			
1500082693		Sabel Inc 1230 14th St						TOTAL LIGHT HC	AROMATIC HC	TOTAL HEAVY HC	OIL & GREASE	POC SCAN (924's)	OTHER	Total Pb				
SAMPLER NAME, ADDRESS AND TELEPHONE NUMBER																		
Lee Hutchins 2821 WHIPPLE ROAD, UNION CITY, CA 94587 (415) 429-8088																		
ID NO.	DATE	TIME	SOIL	WATER	SAMPLING LOCATION													
S-2	8/25	1400	↓		14'		Brass	X	X									
S-3	8/25	1415	↓		11.0		Brass	X	X									
S-4	8/25	1425	↓		11.0		Brass	X	X									
S-5	8/25	15	↓		11.0		Brass	X	X									
S-6	8/25	1440	↓		13.0		Brass	X	X									X
S-7	8/25	1455	↓		11.0		Brass	X	X									
S-8	8/25	1500	↓		11.0		Brass	X	X									
S-9	8/25	1510	↓		11.0		Brass	X	X									
DS-1	8/25	1550	↓		1.0		Brass	X	X									X
Relinquished by: (Signature)		Date / Time		Received by: (Signature)			Relinquished by: (Signature)			Date / Time		Received by: (Signature)						
Lee Hutchins		8/26/93 14:00		[Signature]			[Signature]			8/28/93 14:22		[Signature]						
Relinquished by: (Signature)		Date / Time		Received by: (Signature)			Relinquished by: (Signature)			Date / Time		Received by: (Signature)						
[Signature]		[Signature]		[Signature]			[Signature]			[Signature]		[Signature]						
Relinquished by: (Signature)		Date / Time		Received for Laboratory by: (Signature)			Date / Time		Remarks									
[Signature]		8/27/93 09:55		[Signature]			[Signature]		[Signature]									

DATE: 8-26-93



TANK PROTECT ENGINEERING

2821 WHIPPLE ROAD  
 UNION CITY, CA 94587  
 (415) 429-8088  
 (800) 523-8088  
 FAX (415) 429-8089

PEL # 9308104 (3 of 4)

INV # 23944

LAB: Priority Env

TURNAROUND: Normal

P.O. #: 1286

PAGE 3 OF 4

CHAIN OF CUSTODY

PROJECT NO.		SITE NAME & ADDRESS					(1) TYPE OF CON- TAINER	ANALYTES REQUESTED							REMARKS
A KDE 93082693		Sabel Inc 1230 14th St						TOTAL LIGHT HC	AROMATIC HC	TOTAL HEAVY HC (BTP)	OIL & GREASE	POC SCAN (624's)	OTHER	Total Pb	
SAMPLER NAME, ADDRESS AND TELEPHONE NUMBER															
Lee Huckins 2821 WHIPPLE ROAD, UNION CITY, CA 94587 (415) 429-8088															
ID NO.	DATE	TIME	SOIL	WATER	SAMPLING LOCATION										
DS-2	8/25/93	1535	+		1.0		Brass	x	x						
DS-3	8/25	1400	+		1.0		Brass	x	x						
DS-4	8/25	1412	+		1.0		Brass	x	x			x			
DS-5	8/25	1605	+		1.0		Brass	x	x						
DS-6	8/25	1605	+		1.0		Brass	x	x						
VSW-1	8/25	1630	+		6.0		Brass	x	x						
VSW-2	8/25	1635	+		6.0		Brass	x	x						
SP2-1	8/26	1205	+		3.0		Brass	x	x				Composite into 1 sample SP2(1-4)		
SP2-2	8/26	1209	+		3.0		Brass	x	x						
Relinquished by: (Signature)		Date / Time		Received by: (Signature)		Relinquished by: (Signature)		Date / Time		Received by: (Signature)					
Lee Huckins		8/26/93 4:00		[Signature]		[Signature]		8/27/93 9:43		[Signature]					
Relinquished by: (Signature)		Date / Time		Received by: (Signature)		Relinquished by: (Signature)		Date / Time		Received by: (Signature)					
[Signature]		[Signature]		[Signature]		[Signature]		[Signature]		[Signature]					
Relinquished by: (Signature)		Date / Time		Received for Laboratory by: (Signature)		Date / Time		Remarks							
[Signature]		8/27/93 9:45		PEL		[Signature]		[Signature]							

DATE: 8-26-93



**TANK PROTECT ENGINEERING**

2821 WHIPPLE ROAD  
 UNION CITY, CA 94587  
 (415) 429-8088  
 (800) 523-8088  
 FAX (415) 429-8089

PEL # 9308104 (4 of 4)

INV # 23944

LAB: Priority Env

TURNAROUND: Normal

P.O. #: 686

PAGE 4 OF 4

**CHAIN OF CUSTODY**

PROJECT NO.		SITE NAME & ADDRESS				(1) TYPE OF CON- TAINER	ANALYTES REQUESTED							REMARKS					
SAMPLER NAME, ADDRESS AND TELEPHONE NUMBER		ID NO.	DATE	TIME	SOIL		WATER	SAMPLING LOCATION	TOTAL LIGHT HC	AROMATIC HC	TOTAL HEAVY HC	OIL & GREASE	VOC SCAN (624's)		OTHER				
Lee Huckins 2821 WHIPPLE ROAD, UNION CITY, CA 94587 (415) 429-8088																			
A 150-082693		Sabek Inc 1730 14th St																	
SP2-3	8/26	1214	x			3.0		Brass	x	x								Composite into 1 sample SP2(1-4)	
SP2-4	8/26	1218	x			3.0		Brass	x	x									
SP2-5	8/26	1223	x			3.0		Brass	x	x									
SP2-6	8/26	1227	x			3.0		Brass	x	x									Composite into 1 sample SP2(5-8)
SP2-7	8/26	1233	x			3.0		Brass	x	x									
SP2-8	8/26	1240	x			3.0		Brass	x	x									
USPC-1	8/26	1250	x			3.0		Brass	x	x									
<del>USPC-2</del>	<del>8/26</del>	<del>1255</del>	<del>x</del>			<del>3.0</del>		<del>Brass</del>	<del>x</del>	<del>x</del>									
Relinquished by: (Signature) <i>Lee Huckins</i>		Date / Time 8/26/93 4:00		Received by: (Signature) <i>John Miller</i>		Relinquished by: (Signature) <i>John Miller</i>		Date / Time 8/27/93 9:43		Received by: (Signature)									
Relinquished by: (Signature)		Date / Time		Received by: (Signature) <i>Unknown</i>		Relinquished by: (Signature)		Date / Time		Received by: (Signature)									
Relinquished by: (Signature)		Date / Time 8/27/93 9:45		Received for Laboratory by: (Signature) <i>PEL</i>		Date / Time		Remarks											

DATE: 8-26-93



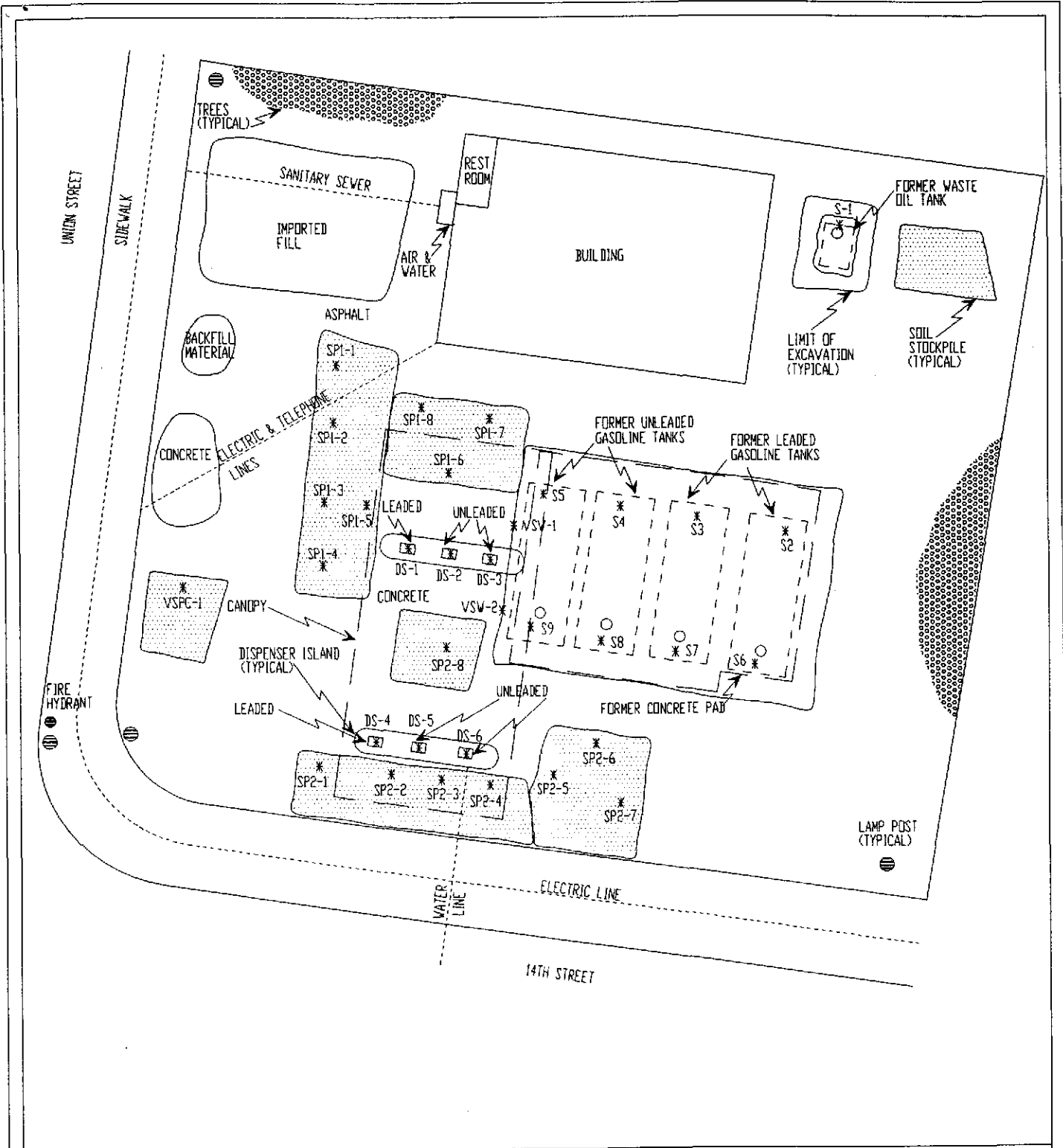

LEGEND

- FILL HOLE
- S-1 NAME AND LOCATION
- \* OF SOIL SAMPLE

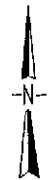

TANK PROTECT ENGINEERING

SITE PLAN

1230 14TH STREET  
- OAKLAND, CA

DATE	9/1/93
FIGURE	
FILE #	150-L
DRAWN BY	TM
CHECKED BY	AK