



PRIORITY ENVIRONMENTAL LABS

Precision Environmental Analytical Laboratory

August 31, 1993

PEL #: 9308104

TANK PROTECT ENGINEERING, INC.

Attn: Jeff

Project name : Sabek, Inc.
 Project location: 1230 14th St.
 Sample I.D.: S-1 *waste oil pit*

Project number: 150A082693

Date Sampled: Aug 25, 1993
 Date Analyzed: Aug 30, 1993

Date Submitted: Aug 27, 1993

Method of Analysis: ~~EPA 8010~~

Detection limit: 5.0 ug/Kg

COMPOUND NAME	CONCENTRATION (ug/Kg)	SPIKE RECOVERY (%)
Chloromethane	N.D.	-----
Vinyl Chloride	N.D.	91.6
Bromomethane	N.D.	-----
Chloroethane	N.D.	-----
Trichlorofluoromethane	N.D.	-----
1,1-Dichloroethene	N.D.	87.8
Methylene Chloride	N.D.	-----
1,2-Dichloroethene (TOTAL)	N.D.	-----
1,1-Dichloroethane	N.D.	83.5
Chloroform	N.D.	-----
1,1,1-Trichloroethane	N.D.	89.2
Carbon Tetrachloride	N.D.	-----
1,2-Dichloroethane	N.D.	-----
Trichloroethene	N.D.	101.6
1,2-Dichloropropane	N.D.	-----
Bromodichloromethane	N.D.	-----
2-Chloroethylvinylether	N.D.	-----
Trans-1,3-Dichloropropene	N.D.	-----
Cis-1,3-Dichloropropene	N.D.	-----
1,1,2-Trichloroethane	N.D.	-----
Tetrachloroethene	N.D.	103.8
Dibromochloromethane	N.D.	-----
Chlorobenzene	N.D.	-----
Bromoform	N.D.	-----
1,1,2,2-Tetrachloroethane	N.D.	-----
1,3-Dichlorobenzene	N.D.	-----
1,4-Dichlorobenzene	N.D.	-----
1,2-Dichlorobenzene	N.D.	-----

 David Duong
 Laboratory Director

1764 Houret Court Milpitas, CA. 95035

Tel: 408-946-9636

Fax: 408-946-9662



PRIORITY ENVIRONMENTAL LABS

Precision Environmental Analytical Laboratory

September 02, 1993

PEL # 9308104

TANK PROTECT ENGINEERING, INC.

Attn: Jeff

Re: Five soil samples for Cadmium, Chromium, Lead, Nickel,
and Zinc analyses.

Project name: Sabek, Inc.
Project location: 1230 14th St.
Project number: 150A082693

Date sampled: Aug 25-26, 1993
Date extracted: Aug 31, 1993

Date submitted: Aug 27, 1993
Date analyzed: Aug 31, 1993

RESULTS:

SAMPLE I.D.	Cadmium (mg/Kg)	Chromium (mg/Kg)	Lead (mg/Kg)	Nickel (mg/Kg)	Zinc (mg/Kg)
S-1	N.D.	43	47	36	35
S-2 ✓	---	---	N.D. ✓	---	---
S-6 ✓	---	---	N.D. ✓	---	---
DS-1 ✓	---	---	33 ✓	---	---
DS-4 ✓	---	---	11 ✓	---	---
Blank	STLC 1.0	5.0	5.0	20	250
	N.D.	N.D.	N.D.	N.D.	N.D.
Detection limit	0.5	1.0	1.0	1.0	1.0
Method of Analysis	7130	7190	7420	7520	7950

David Duong
Laboratory Director



PRIORITY ENVIRONMENTAL LABS

Precision Environmental Analytical Laboratory

August 31, 1993

PEL # 9308104

TANK PROTECT ENGINEERING, INC.

Attn: Jeff

Re: Twenty two soil samples for Gasoline/BTEX, Diesel, and Oil & Grease analyses.

Project name: Sabek, Inc.
Project number: 150A082693

Project location: 1230 14th St.

Date sampled: Aug 25-26, 1993
Date extracted: Aug 27-30, 1993

Date submitted: Aug 27, 1993
Date analyzed: Aug 27-30, 1993

RESULTS:

SAMPLE I.D.	Gasoline	Diesel	Benzene	Toluene	Ethyl Benzene	Total Xylenes	Oil & Grease
	(mg/Kg)	(mg/Kg)	(ug/Kg)	(ug/Kg)	(ug/Kg)	(ug/Kg)	(mg/Kg)
DS-1	13	---	7.0	17	21	72	---
DS-2	2.0	---	5.3	8.9	12	31	---
DS-3	1.3	---	N.D.	5.9	6.1	18	---
DS-4	2.7	---	5.5	9.4	16	47	---
DS-5	3.4	---	5.9	11	18	61	---
DS-6	11	---	6.8	15	18	64	---
S-1 waste oil UST	67	1300	38	89	110	380	7700
S-2	2200	---	1400	3200	3500	13000	---
S-3	530	---	400	760	830	3100	---
S-4	40	---	31	59	66	290	---
S-5	1.4	---	N.D.	6.3	8.1	25	---
S-6	1500	---	970	2300	2700	10000	---
S-7	11000	---	6700	16000	18000	69000	---
S-8	12000	---	11000	26000	30000	110000	---
S-9	6200	---	3700	8700	10000	37000	---
SP1-1,2,3,4*	960	---	580	1400	1600	5900	---
SP1-5,6,7,8*	950	---	560	1400	1500	5700	---
SP2-1,2,3,4*	3500	---	2200	5100	5900	22000	---
SP2-5,6,7,8*	4800	---	2800	7100	8200	31000	---
VSPC-1	1.7	---	N.D.	6.6	9.6	28	---
VSW-1	4900	---	2900	7000	8000	30000	---
VSW-2	21	---	150	290	330	1300	---
Blank	N.D.	N.D.	N.D.	N.D.	N.D.	N.D.	N.D.
Spiked Recovery	82.3%	94.1%	84.0%	85.2%	83.1%	92.2%	---
Duplicate Spiked Recovery	92.0%	93.6%	89.5%	90.6%	88.4%	98.7%	---
Detection limit	1.0	1.0	5.0	5.0	5.0	5.0	10
Method of Analysis	5030/ 8015	3550/ 8015	8020	8020	8020	8020	5520 D & F

*Composited soil samples.

David Duong
Laboratory Director



TANK PROTECT ENGINEERING

2021 WHIPPLE ROAD
 UNION CITY, CA 94587
 (415) 429-8088
 (800) 523-8088
 FAX (415) 429-8089

PEL # 9308104(1 of 4)

INV # 23944

LAB: Priority Env

TURNAROUND: Normal

P.O. #: 686

CHAIN OF CUSTODY

PAGE 1 OF 4

PROJECT NO.		SITE NAME & ADDRESS					(1) TYPE OF CONTAINER	ANALYTES REQUESTED							REMARKS
150A082693		Sabel Inc 1230 14th Street Lee Hudkins 2821 WHIPPLE ROAD, UNION CITY, CA 94587 (415) 429-8088						TOTAL LIGHT HC	AROMATIC HC (BTEX)	TOTAL HEAVY HC	OIL & GREASE	PCB SEM	OTHER	ORG EPA 5520-F	
ID NO.	DATE	TIME	SOIL	WATER	SAMPLING LOCATION										
SPH	8/25/93	1215	X		3-6	BRASS	X	X						Composite into 1 sample. ^{SP} (1-4)	
SP1-2	8/25	1220	X		3-0	BRASS	X	X							
SP1-3	8/25	1225	X		3-0	BRASS	X	X							
SP1-4	8/25	1230	X		3-0	BRASS	X	X							
SP1-5	8/25	1240	X		3-0	BRASS	X	X							
SP1-6	8/25	1245	X		7-0	BRASS	X	X					Composite into 1 sample. ^{SP} (5-8)		
SP1-7	8/25	1250	X		3-0	BRASS	X	X							
SP1-8	8/25	1255	X		3-0	BRASS	X	X							
S-1	8/25	1330	X		85'	BRASS	X	X	X	X	X	X			
Relinquished by: (Signature)		Date / Time		Received by: (Signature)		Relinquished by: (Signature)		Date / Time		Received by: (Signature)					
Lee Hudkins		8/26/93 11:00		Jim Miller		Jim Miller		8/25/93 9:42							
Relinquished by: (Signature)		Date / Time		Received by: (Signature)		Relinquished by: (Signature)		Date / Time		Received by: (Signature)					
				PEL											
Relinquished by: (Signature)		Date / Time		Received for Laboratory by: (Signature)		Date / Time		Remarks							
		8/27/93 9:45		[Signature]											

DATE: 8-26-93



TANK PROTECT ENGINEERING

2821 WHIPPLE ROAD
UNION CITY, CA 94587
(415) 429-8088
(800) 523-8088
FAX (415) 429-8089

PEL # 9308104 (2 of 4)

INV # 23944

LAB: Priority Env

TURNAROUND: Normal

P.O. #: 686

PAGE 2 OF 4

CHAIN OF CUSTODY

PROJECT NO.		SITE NAME & ADDRESS				(1) TYPE OF CONTAINER	ANALYTES REQUESTED							REMARKS					
150A082693		Sabel Inc 1230 14th St					TOTAL LIGHT HC	AROMATIC HC	TOTAL HEAVY HC	DI & GREASE	PCC SCUM	OTHER (cat's)	Total Pb						
SAMPLER NAME, ADDRESS AND TELEPHONE NUMBER						ID NO.	DATE	TIME	SOIL	WATER	SAMPLING LOCATION								
Lee Hutchins 2821 WHIPPLE ROAD, UNION CITY, CA 94587 (415) 429-8088																			
S-2	8/25	1400	✓		14'	BRASS	✓	✓											
S-3	8/25	1415	✓		11.0	BRASS	✓	✓											
S-4	8/25	1425	✓		11.0	BRASS	✓	✓											
S-5	8/25	15	✓		11.0	BRASS	✓	✓											
S-6	8/25	1440	✓		13.0	BRASS	✓	✓											X
S-7	8/25	1455	✓		17.0	BRASS	✓	✓											
S-8	8/25	1500	✓		11.0	BRASS	✓	✓											
S-9	8/25	1510	✓		11.0	BRASS	✓	✓											
DS-1	8/25	1530	✓		7.0	BRASS	✓	✓											X
Relinquished by: (Signature)		Date / Time		Received by: (Signature)		Relinquished by: (Signature)		Date / Time		Received by: (Signature)									
Lee Hutchins		8/26/93 14:00		[Signature]		[Signature]		8/28/93 14:2											
Relinquished by: (Signature)		Date / Time		Received by: (Signature)		Relinquished by: (Signature)		Date / Time		Received by: (Signature)									
		1		[Signature]				1											
Relinquished by: (Signature)		Date / Time		Received for Laboratory by: (Signature)		Date / Time		Remarks											
		8/27/93 09:45		[Signature]		PEL													

DATE: 8-26-93



TANK PROTECT ENGINEERING

2821 WHIPPLE ROAD
UNION CITY, CA 94587
(415) 429-8088
(800) 523-8088
FAX (415) 429-8089

PEL # 9308104 (3 of 4)

INV # 23944

LAB: Priority Env

TURNAROUND: Normal

P.O. #: 1686

PAGE 3 OF 4

CHAIN OF CUSTODY

PROJECT NO.		SITE NAME & ADDRESS				(1) TYPE OF CONTAINER	ANALYTES REQUESTED							REMARKS
SAMPLER NAME, ADDRESS AND TELEPHONE NUMBER		SAMPLER NAME, ADDRESS AND TELEPHONE NUMBER					TOTAL LUBR HC	AROMATIC HC	TOTAL HEAVY HC	OIL & GREASE	PCB SCAN (21.2)	OTHER		
ID NO.	DATE	TIME	SOIL	WATER	SAMPLING LOCATION									
DS-2	8/24	1535	+		1.0	Brass	x	x						
DS-3	8/25	1400	+		1.0	Brass	x	x						
DS-4	8/25	1412	+		1.0	Brass	x	x			x			
DS-5	8/25	1605	+		1.0	Brass	x	x						
DS-6	8/25	1605	+		1.0	Brass	x	x						
VSW-1	8/25	1630	+		6.0	Brass	x	x						
VSW-2	8/25	1635	+		6.0	Brass	x	x						
SP2-1	8/26	1205	+		3.0	Brass	x	x						
SP2-2	8/26	1209	+		3.0	Brass	x	x					Composite into 1 sample SP2(1-4)	
Relinquished by: (Signature)		Date / Time		Received by: (Signature)		Relinquished by: (Signature)		Date / Time		Received by: (Signature)				
Relinquished by: (Signature)		Date / Time		Received by: (Signature)		Relinquished by: (Signature)		Date / Time		Received by: (Signature)				
Relinquished by: (Signature)		Date / Time		Received for Laboratory by: (Signature)		Date / Time		Remarks						

DATE: 8-26-93

453 PPT SEP 16 '93 16:07

453 P28 SEP 16 '93 16:07



TANK PROTECT ENGINEERING

2921 WHIPPLE ROAD
 UNION CITY, CA 94587
 (415) 429-8088
 (800) 523-8088
 FAX (415) 429-8089

PEL # 9308104 (4 of 4)

INV # 23944

LAB: Priority Env

TURNAROUND: Normal

P.O. #: 686

PAGE 4 OF 4

CHAIN OF CUSTODY

PROJECT NO.		SITE NAME & ADDRESS				(1) TYPE OF CONTAINER	ANALYTES REQUESTED							REMARKS			
150-082693		Sabek Inc 1230 W 4th St					TOTAL LEAD	AROMATIC HC	TOTAL HC (BFR)	OIL & GREASE	VOC SEMI (B2+3)	OTHER					
SAMPLER NAME, ADDRESS AND TELEPHONE NUMBER						ID NO.	DATE	TIME	SOIL	WATER	SAMPLING LOCATION						
Lee Hutchins 2921 WHIPPLE ROAD, UNION CITY, CA 94587 (415) 429-8088																	
SP23	8/26	12:41	x		30	Brass	x	x									Composite into 1 sample SP2 (1-4)
SP24	8/26	12:18	x		30	Brass	x	x									
SP25	8/26	12:25	x		30	Brass	x	x									
SP26	8/26	12:27	x		30	Brass	x	x									
SP27	8/26	12:33	x		30	Brass	x	x									
SP28	8/26	12:40	x		30	Brass	x	x									
USPC-1	8/26	12:50	x		30	Brass	x	x									
USPC-2	8/26	12:55	x		30	Brass	x	x									

Relinquished by: (Signature) <i>Lee Hutchins</i>	Date / Time 8/26/93 4:00	Received by: (Signature) <i>John Miller</i>	Relinquished by: (Signature) <i>John Miller</i>	Date / Time 8/27/93 9:43	Received by: (Signature)
Relinquished by: (Signature)	Date / Time	Received by: (Signature) <i>John Miller</i>	Relinquished by: (Signature)	Date / Time	Received by: (Signature)
Relinquished by: (Signature)	Date / Time 8/27/93 9:45	Received for Laboratory by: (Signature) <i>PEL</i>	Date / Time	Remarks	

DATE: 8-26-93

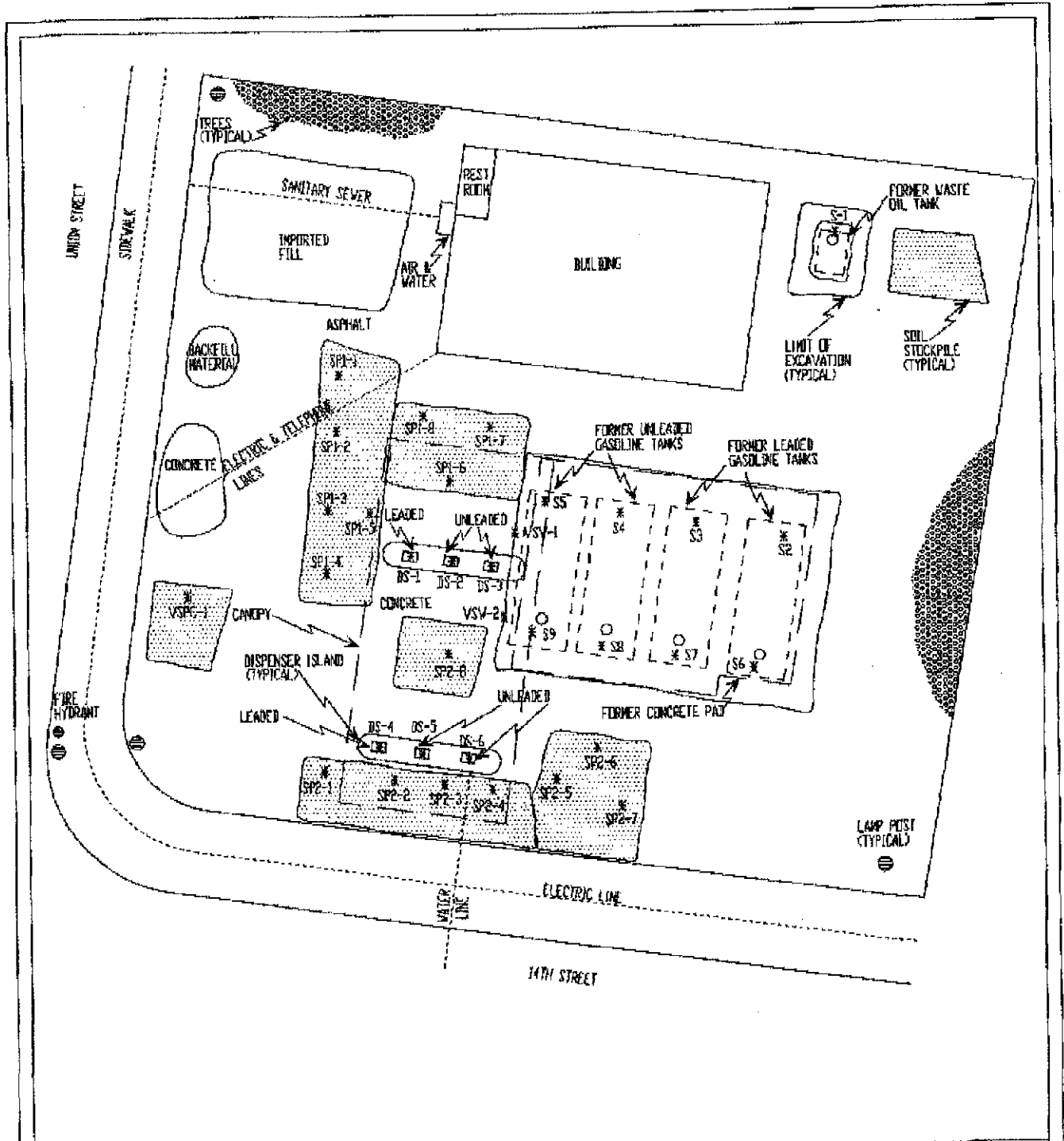

LEGEND

○ FILL HOLE

S-1 NAME AND LOCATION
* OF SOIL SAMPLE

0 20
SCALE IN FEET

N

TANK PROTECT ENGINEERING

SITE PLAN

DATE	9/1/93
FIGURE	
FILE #	150-1
DRAWN BY	TM
CHECKED BY	AK

1230 14TH STREET
OAKLAND, CA