



CAMBRIA ENVIRONMENTAL TECHNOLOGY, INC.

1144 65th Street, Suite C

Oakland, CA 94608

Phone (510) 420-0700

Fax (510) 420-9170

FAX TRANSMITTAL

#103

To: Barney Chan

From: Gina Kathuria

Company: Alameda Co. Health

Date: October 30, 1997

Fax #: (510) 337-9335

Project #: NA

Re: Basement and Well Survey
Chevron- 4265 Foothill, Oak
~~Shell-4411 Foothill, Oak~~

No. Pages (incl. cover): 4

Dear Mr. Chan:

In a letter dated August 21, 1997, you requested Chevron "to perform a survey of the neighboring residents looking for domestic wells and basements. This was to be done by looking for permits and doing a physical site survey."

Cambria has looked through the site histories for both sites and discovered a basement survey done in October 95 and a Well Survey done in 12/90. These items are included in this fax.

Please review them to see if they are adequate. Also, is a site reconnaissance needed to complete this survey?

After receipt of the fax, you can call me at 510-420-3330.

1) site visit, hand out forms



EAST 17th STREET

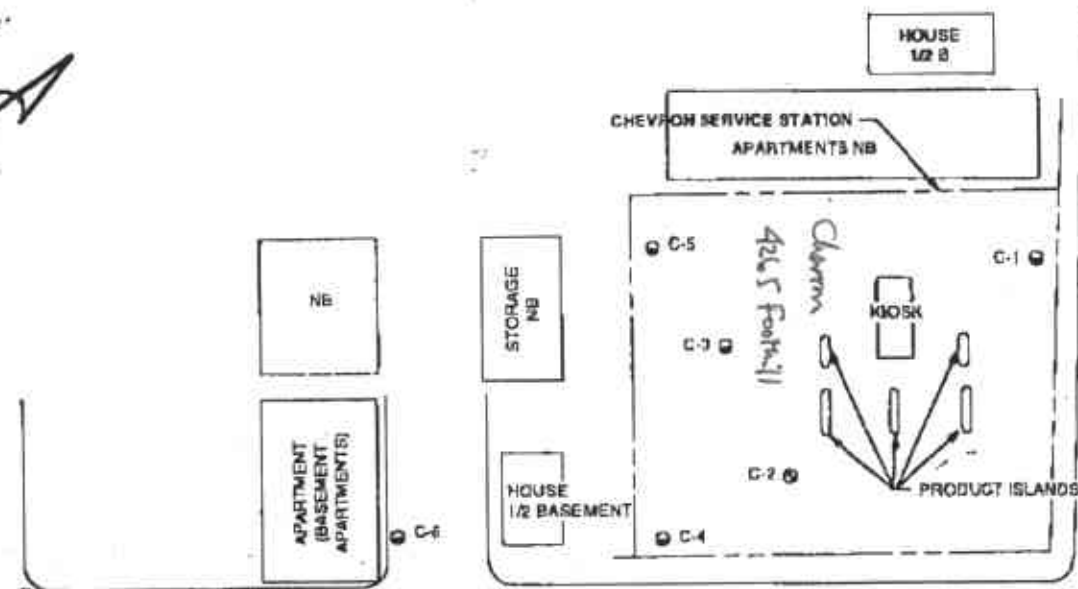

FOOTHILL BOULEVARD

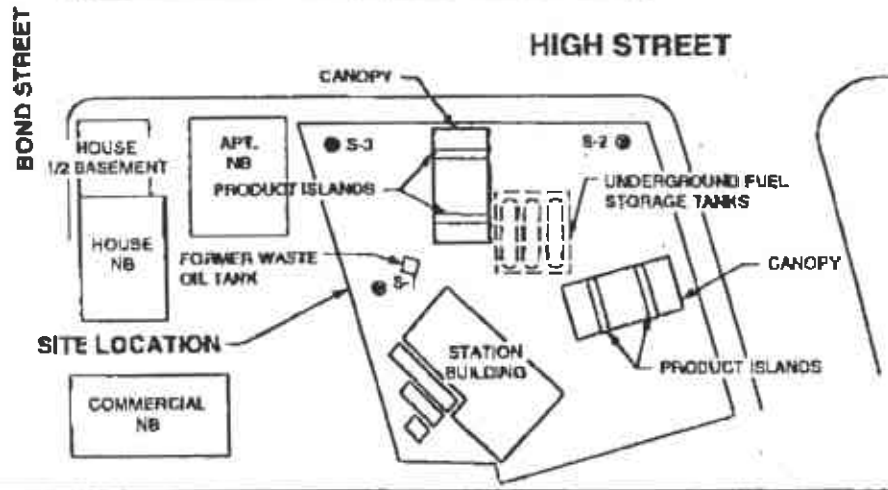
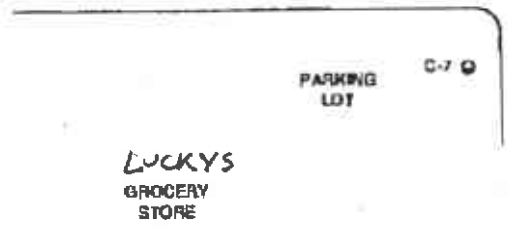
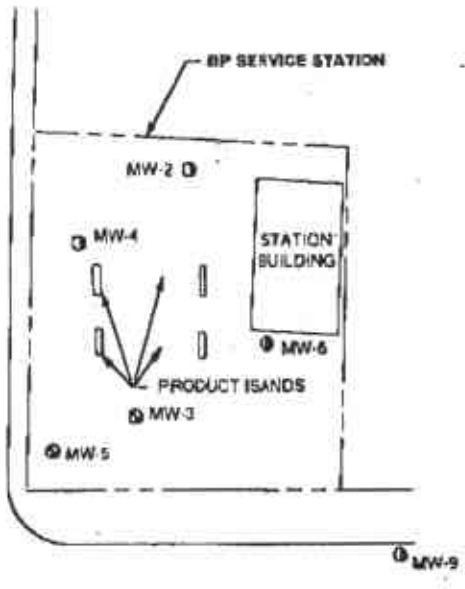

- LEGEND**
- S-3 ● GROUNDWATER MONITORING WELL LOCATION AND DESIGNATION, (SHELL)
 - C-1 ● GROUNDWATER MONITORING WELL LOCATION AND DESIGNATION, (CHEVRON)
 - MW-5 ● GROUNDWATER MONITORING WELL LOCATION AND DESIGNATION, (BP)
 - C-2 ● GROUNDWATER EXTRACTION WELL LOCATION AND DESIGNATION
 - NB NO BASEMENT OBSERVED



PACIFIC ENVIRONMENTAL GROUP, INC.



SHELL SERVICE STATION
4411 Foothill Boulevard at High Street
Oakland, California

BASEMENT SURVEY MAP

FIGURE: 3
PROJECT: 305-131.2B

Phil This map was provided in the 3Q95 Report for the Shell site cited to Mark Miller. Please call with comments.

Post-It™ brand fax transmittal memo 7671 # of pages: 1	
To: <i>Phil Briggs</i>	From: <i>Ross Tinline</i>
Co: <i>Chevron</i>	Co: <i>Pacific</i>
Dept:	Phone: <i>408 441 7500</i>
Fax: <i>510 842 8370</i>	Fax: <i>408 441 7539</i>

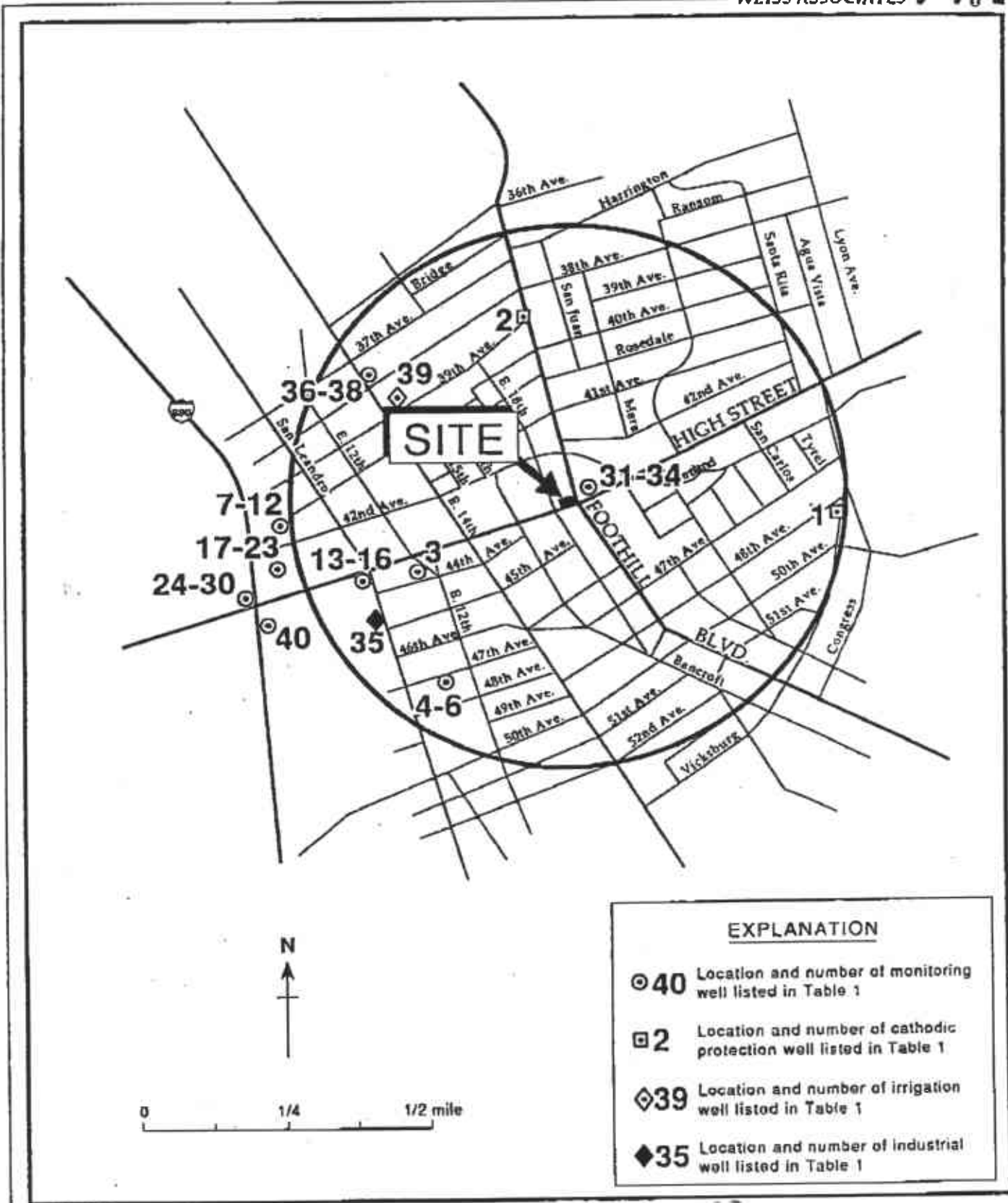

- 1990

Figure 4. Wells Within Approximately 1/2 Mile of Chevron Service Station #9-0076, 4265 Foothill Boulevard, Oakland, California

WEISS ASSOCIATES



TABLE 1. Wells Within a One-half Mile Radius of Chevron SS #90076, 4265 Foothill Blvd., Oakland, California

Well ID	Owner	Well Location	Date Drilled	Well Use
1	PG&E	S/S Vicksburg 38 ft east of 48th	1975	Cathodic Protection
2	PG&E	39th/Foothill Blvd.	Jan. 1975	Cathodic Protection
3	Craig Levitt	1033 44th Ave.	Oct. 1988	Monitoring
4-6	Peterson Properties	1066 47th Ave.	Mar. 1989	Monitoring
7-12	Clorox Co.	860-42nd Ave.	Aug. 1982 - Oct. 1983	Monitoring
13-16	Commercial Fueling Sys.	4301 San Leandro St.	Oct. 1986	Monitoring
17-23	Clorox Co.	850-42nd St.	Sept. 1986	Monitoring
24-30	Exxon Station #7-3006	720 High St.	Sept. 1987	Monitoring
31-34	B.P. Oil	4280 Foothill Blvd.	April 1989	Monitoring
35	Natl'l Lead Co.	4801 San Leandro St.	1923	Industrial
36-38	Shell Oil Co.	3750 E. 14th Avenue	1990	Monitoring
39	Trust for Public Land	1601 39th Avenue	1977	Irrigation
40	Robert Hekeboll	45th/Coliseum/High St.	1989	Monitoring

Comment on RA for Chevron - 4265 Foothill
Oakland.
April 13, 1998

Barney,

For this site, I do know the name of the contact person. Anyway I took a guess from the correspondence and left a message with Gina Kathuria. But I never got a response from her. Here are the questions:

1. Does not look like they used California slope factor, they will use CA S F.
2. They averaged all the benzene concentrations from all the wells (C1 to C9) and then compared it to the cleanup levels for a residential scenario. However, only the concentrations from C-2, C-3, C-4 and C-5 should be averaged, as these are the wells that are close to the residences, at least based on the diagram. (This is for onsite residential exposure) - OK
3. Also, for ^{off-site} residential exposure, the concentrations from off site wells should be compared with the cleanup levels. They cannot use just one average value for all exposures ^{pathways}. OK
4. I am not sure if they have a planned future development for the site or are they going to maintain it as now. They need to mention about this so that we can decide if a separate evaluation is needed for the future scenario. *The site is in an active status & intends to continue as one*
5. If you take a look at screen 7.3 at the back of the risk assessment, it gives you the soil concentrations that they used to calculate the average. Can you please check to see if they included all the pertinent soil samples (except for the areas that have been excavated) Also, since they have not included a sample location map in the risk assessment, I have no idea where these borings are located. They have averaged all the soil concentrations to compare with the cleanup levels, and they do exceed the SSTLs for a risk of 10-5. Based on the sample location, they may have to include only those samples near or under the buildings for the indoor air pathway (for the current scenario). ~~CSF~~
6. They can use a simple average instead of using the GSI software for this purpose, since it appears that *the GSI* they use the geometric mean.

9/22/98

? onsite soil data for residential soil & GW exposures *including wells & borings & piping onsite*

? use onsite data C6, C7, C8 & C9 for soil & GW for offsite exposures

Madhulla - The contact for the RA is Curt Peck 510-242-7086, I called him & told him your concerns, he was amenable to them. I gave him your ph #. He wants to clarify your concerns.