



GETTLER-RYAN Inc.



TRANSMITTAL

January 9, 2009

G-R #386495

TO: Ms. Charlotte Evans
Conestoga-Rovers & Associates
5900 Hollis Street, Suite A
Emeryville, CA 94608
(VIA PDF)

CC: Mr. Aaron Costa
Chevron Environmental
Management Company
6111 Bollinger Canyon Road,
Room 3660
San Ramon, California 94583
(VIA PDF)

FROM: Deanna L. Harding
Project Coordinator
Gettler-Ryan Inc.
6747 Sierra Court, Suite J
Dublin, California 94568

RE: **Chevron Service Station
#9-0076
4265 Foothill Boulevard
Oakland, California
RO 0000427**

WE HAVE ENCLOSED THE FOLLOWING:

COPIES	DATED	DESCRIPTION
1	January 8, 2009	Groundwater Monitoring and Sampling Report Fourth Quarter Event of December 3, 2008

COMMENTS:

Pursuant to your request, we are providing you with copies of the above referenced items for **your use and distribution (including PDF submittal of the entire report to GeoTracker)**:

Mr. Steven Plunkett, Alameda County Health Care Services, Dept. of Environmental Health, 1131 Harbor Bay Parkway, Suite 250, Alameda, CA 94502-6577 **(Distributed by CRA via PDF)**

Ms. Liz Sewell, ConocoPhillips, 76 Broadway Avenue, Sacramento, CA 95818

Loi Van Le and Josephine N. Le. (Owners) 4265 Foothill Blvd, Oakland, CA 94601-4621

Enclosures
trans/9-0076-AC

RECEIVED

9:35 am, Jul 16, 2012

Alameda County
Environmental Health



Aaron Costa
Project Manager
Marketing Business Unit

**Chevron Environmental
Management Company**
6111 Bollinger Canyon Road
San Ramon, CA 94583
Tel (925) 543-2961
Fax (925) 543-2324
acosta@chevron.com

January 9, 2009

Alameda County Health Care Services
1131 Harbor Bay Parkway, Suite 250
Alameda, CA 94502-6577

Re: Chevron Service Station No. 9-0076
Address 4265 Foothill Blvd.

I have reviewed the attached routine groundwater monitoring report dated
January 9, 2009.

I agree with the conclusions and recommendations presented in the referenced report. The information in this report is accurate to the best of my knowledge and all local Agency/Regional Board guidelines have been followed. This report was prepared by Gettler-Ryan Inc., upon who assistance and advice I have relied.

This letter is submitted pursuant to the requirements of California Water Code Section 13267(b)(1) and the regulating implementation entitled Appendix A pertaining thereto.

I declare under penalty of perjury that the foregoing is true and correct.

Sincerely,

A handwritten signature in black ink that reads "Aaron Costa". The signature is written in a cursive, flowing style.

Aaron Costa
Project Manager

Attachment: Report

WELL CONDITION STATUS SHEET

Client/Facility #: Chevron #9-0076
 Site Address: 4265 Foothill Blvd.
 City: Oakland, CA

Job # 386495
 Event Date: 12-3-08
 Sampler: JOE

WELL ID	Vault Frame Condition	Gasket/O-Ring (M)missing	BOLTS (M) Missing (R) Replaced	Bolt Flanges B= Broken S= Stripped R=Retap	APRON Condition C=Cracked B=Broken G=Gone	Grout Seal (Deficient) inches from TOC	Casing (Condition prevents tight cap seal)	REPLACE LOCK Y/N	REPLACE CAP Y/N	WELL VAULT Manufacture/Size/ # of Bolts	Pictures Taken Yes / No
C-1	O.K	O.K	N/A	N/A	O.K	O.K	O.K	N	N	Christy box	No
C-2	↓	↓	N/A	N/A	↓	↓	↓	↓	↓	24" x 36" box	↓
C-3	↓	↓	O.K	O.K	↓	↓	↓	↓	↓	12" Morrison/2	↓
C-4	↓	↓	O.K	O.K	↓	↓	↓	↓	↓	"	↓
C-5	↓	↓	O.K	O.K	↓	↓	↓	↓	↓	"	↓
C-6	↓	↓	N/A	N/A	↓	↓	↓	↓	↓	8" City Monument	↓
C-7	↓	↓	O.K	O.K	↓	↓	↓	↓	↓	12" EMCO/2	↓
C-8	↓	↓	N/A	N/A	↓	↓	↓	↓	↓	8" City Monument	↓
C-9	↓	↓	O.K	O.K	↓	↓	↓	↓	↓	8" Morrison/2	↓
C-10	↓	↓	O.K	O.K	↓	↓	↓	↓	↓	12" EMCO/2	↓

Comments _____



GETTLER-RYAN Inc.



January 8, 2009
G-R Job #386495

Mr. Aaron Costa
Chevron Environmental Management Company
6111 Bollinger Canyon Road, Room 3660
San Ramon, CA 94583

RE: Fourth Quarter Event of December 3, 2008
Groundwater Monitoring & Sampling Report
Chevron Service Station #9-0076
4265 Foothill Boulevard
Oakland, California

Dear Mr. Costa:

This report documents the most recent groundwater monitoring and sampling event performed by Gettler-Ryan Inc. (G-R) at the referenced site. All field work was conducted in accordance with G-R Standard Operating Procedure - Groundwater Sampling (attached). A joint groundwater monitoring event is conducted with BP Service Station #11109 located at 4280 Foothill Boulevard, Oakland, California, first and third quarters only.

Static groundwater levels were measured and the wells were checked for the presence of separate-phase hydrocarbons. Static water level data, groundwater elevations, and separate-phase hydrocarbon thickness (if any) are presented in the attached Table 1. A Potentiometric Map is included as Figure 1.

Groundwater samples were collected from the monitoring wells and submitted to a state certified laboratory for analyses. The field data sheets for this event are attached. Analytical results are presented in the table(s) listed below. The chain of custody document and the laboratory analytical reports are also attached. All groundwater and decontamination water generated during sampling activities was removed from the site, per the Standard Operating Procedure.

Please call if you have any questions or comments regarding this report. Thank you.

Sincerely,

- FOR -

Deanna L. Harding
Project Coordinator

Douglas J. Lee
Senior Geologist, P.G. No. 6882

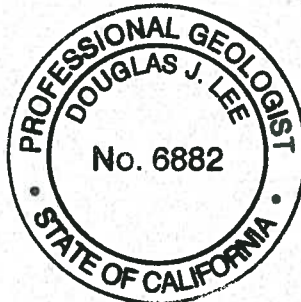
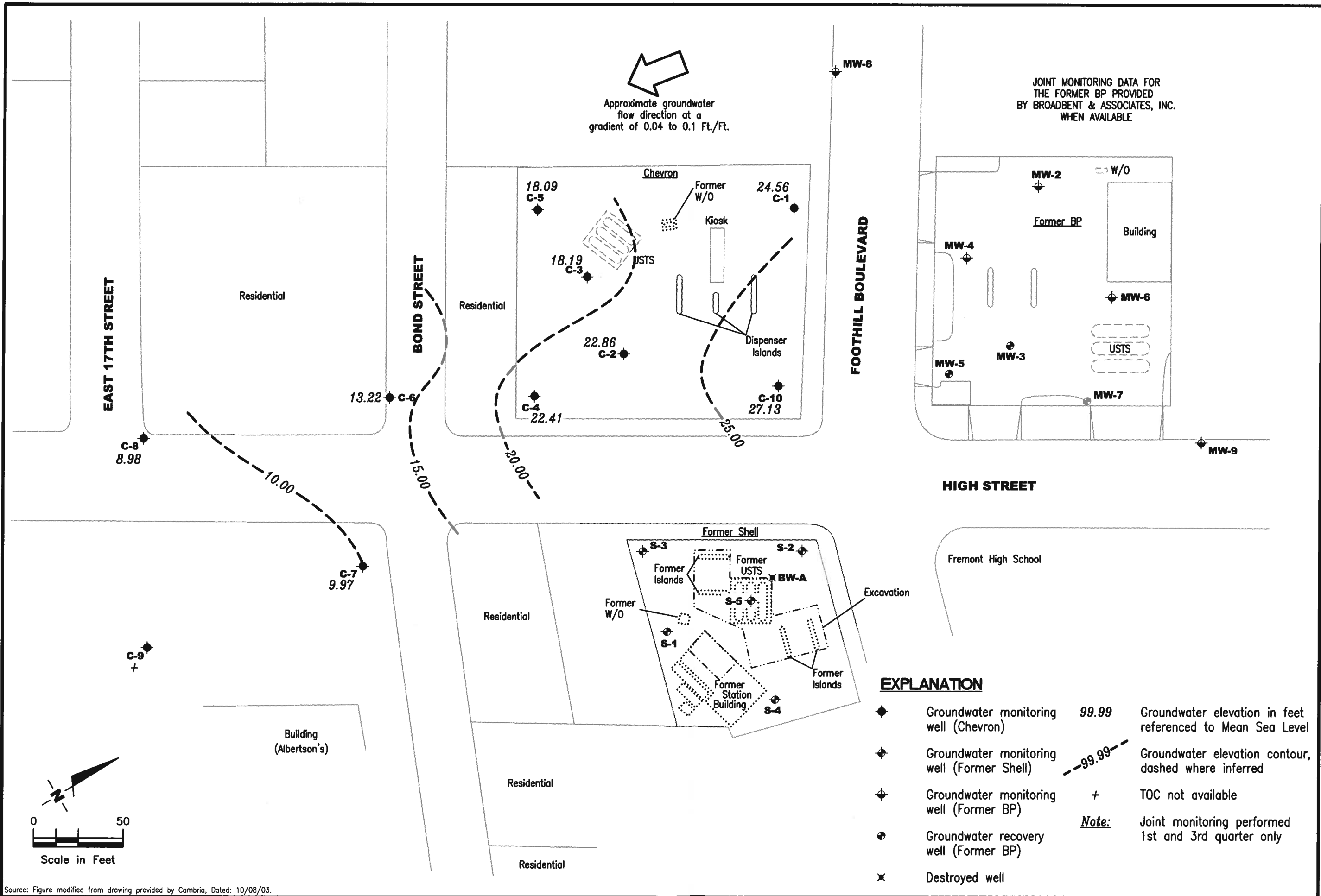

Figure 1: Potentiometric Map
Table 1: Groundwater Monitoring Data and Analytical Results
Table 2: Field Measurements and Groundwater Analytical Results
Table 3: Joint Groundwater Monitoring Data - BP #11109
Attachments: Standard Operating Procedure - Groundwater Sampling
Field Data Sheets
Chain of Custody Document and Laboratory Analytical Reports



Source: Figure modified from drawing provided by Cambria, Dated: 10/08/03.

Table 1
Groundwater Monitoring Data and Analytical Results
Chevron Service Station #9-0076
4265 Foothill Boulevard
Oakland, California

WELL ID/ DATE	TOC* (ft.)	GWE (msl)	DTW (ft.)	SPHT (ft.)	SPH REMOVED (gallons)	TPH-G (µg/L)	B (µg/L)	T (µg/L)	E (µg/L)	X (µg/L)	MTBE (µg/L)	ETHANOL (µg/L)
C-1												
04/28/89	35.42	15.37	20.05	--	--	940	30	1.3	11	13	--	--
08/08/89	35.42	11.35	24.07	--	--	820	45	2.0	13	13	--	--
12/21/89	35.42	12.61	22.81	--	--	--	--	--	--	--	--	--
08/27/90	35.42	13.30	22.12	--	--	440	15	1.0	6.0	13	--	--
11/04/90	35.42	9.86	25.56	--	--	--	--	--	--	--	--	--
06/18/91	35.42	13.78	21.64	--	--	74	5.6	0.6	1.9	1.3	--	--
09/19/91	35.42	10.84	24.58	--	--	150	7.1	<0.5	2.3	3.0	--	--
12/20/91	35.42	9.25	26.17	--	--	250	10	<0.5	3.7	1.6	--	--
03/18/92	35.42	17.17	18.25	--	--	190	16	<0.5	8.5	3	--	--
07/14/92	35.42	7.81	27.61	--	--	20,000	480	2,200	510	2,900	--	--
10/08/92	35.42	10.98	24.44	--	--	360	34	4.6	19	12	--	--
01/08/93	35.42	15.74	19.68	--	--	120	9.1	0.5	5.1	1.8	--	--
04/14/93	35.42	19.04	16.38	--	--	190	74	0.6	1.0	2.0	--	--
07/16/93	35.42	--	--	--	--	--	--	--	--	--	--	--
07/27/93	35.42	26.03	9.39	--	--	300	12	<0.5	5.0	2.0	--	--
09/21/93	38.41	16.99	21.42	--	--	360	12	1.2	5.8	3.7	--	--
01/28/94	38.41	18.84	19.57	--	--	370	24	1.0	13	4.0	--	--
03/17/94	38.41	21.56	16.85	--	--	460	42	<0.5	6.7	3.7	--	--
06/16/94	38.41	20.58	17.83	--	--	320	20	0.7	8.7	3.0	--	--
09/22/94	38.41	18.15	20.26	--	--	380	24	0.6	8.8	1.9	--	--
12/15/94	38.41	22.59	15.82	--	--	280	23	7.6	7.8	13	--	--
03/30/95	38.41	26.39	12.02	--	--	2,200	890	8.9	15	<5.0	--	--
06/20/95	38.41	24.01	14.40	--	--	690	140	<2.0	9.4	2.8	--	--
09/20/95	38.41	24.59	13.82	--	--	730	27	78	26	130	--	--
12/06/95	38.41	17.81	20.60	--	--	220	16	<0.5	7.2	1.7	11	--
03/21/96	38.41	26.76	11.65	--	--	640	170	<2.0	6.7	<2.0	35	--
06/21/96	38.41	24.16	14.25	--	--	640	140	<1.2	8.7	2.0	23	--
09/06/96	38.41	21.66	16.75	--	--	460	24	0.56	10	2.4	43	--
12/19/96	38.41	24.43	13.98	--	--	790	120	22	13	19	<25	--
03/17/97	38.41	25.63	12.78	--	--	2,200	660	<10	15	<10	110	--
06/11/97	38.41	23.25	15.16	--	--	1,500	130	<2.0	16	3.4	130	--
09/17/97	38.41	21.47	16.94	--	--	910	160	23	13	49	180	--
12/11/97	38.41	25.23	13.18	--	--	2,000	270	7.0	53	7.4	460	--
03/12/98	38.41	28.92	9.49	--	--	3,100	1,300	<20	42	<20	760	--
06/23/98	38.41	28.19	10.22	--	--	1,300	650	6.9	22	6.5	290	--

Table 1
Groundwater Monitoring Data and Analytical Results
Chevron Service Station #9-0076
4265 Foothill Boulevard
Oakland, California

WELL ID/ DATE	TOC* (ft.)	GWE (msl)	DTW (ft.)	SPHT (ft.)	SPH		TPH-G (µg/L)	B (µg/L)	T (µg/L)	E (µg/L)	X (µg/L)	MTBE (µg/L)	ETHANOL (µg/L)
					REMOVED (gallons)								
C-1 (cont)													
09/01/98	38.41	21.43	16.98	--	--	270	6.0	<2.5	<2.5	<2.5	950	--	
12/30/98	38.41	22.29	16.12	--	--	2,020	578	<5.0	<5.0	<5.0	1,720	--	
03/31/99	38.41	24.53	13.88	--	--	2,140	776	5.89	<5.0	5.15	1,170	--	
06/14/99	38.41	23.09	15.32	--	--	1,450	524	<5.0	<5.0	<5.0	1,150	--	
06/14/99 ¹	38.41	23.09	15.32	--	--	--	--	--	--	--	1,360 ²	--	
09/30/99	38.41	22.30	16.11	--	--	79	1.12	<0.5	1.07	<0.5	677	--	
12/22/99	38.41	23.37	15.04	--	--	501	157	4.45	<2.5	4.81	744	--	
03/09/00	38.41	31.28	7.13	--	--	3,300	2,500	28	37	<25	1,700	--	
06/23/00 ³	38.41	25.86	12.55	0.00	0.00	2,200 ⁴	1,000	6.9	5.7	9.3	1,900	--	
09/05/00 ³	38.41	21.28	17.13	0.00	0.00	<200	8.3	<2.0	<2.0	<2.0	1,000	--	
12/04/00	38.41	21.48	16.93	0.00	0.00	1,400 ⁴	600	<5.0	<5.0	<5.0	1,500	--	
03/08/01 ³	38.41	30.45	7.96	0.00	0.00	2,570	1,040	7.93	12.0	<5.00	1,470	--	
06/07/01 ³	38.41	25.45	12.96	0.00	0.00	750 ⁴	220	5.6	4.8	2.6	2,500 ⁵	--	
09/13/01 ³	38.41	19.91	18.50	0.00	0.00	670 ⁶	<5.0	<5.0	<5.0	<5.0	660	--	
12/13/01 ³	38.41	23.02	15.39	0.00	0.00	1,100	340	2.1	0.95	7.9	630	--	
03/08/02 ³	38.41	28.35	10.06	0.00	0.00	3,600	1,400	9.5	17	6.5	1,900	--	
06/19/02 ³	38.41	24.92	13.49	0.00	0.00	1,300	220	3.4	2.7	<3.0	1,400	--	
09/11/02 ³	38.41	21.18	17.23	0.00	0.00	400	22	<0.50	<0.50	<1.5	780	--	
12/11/02 ³	38.41	19.81	18.60	0.00	0.00	180	4.2	<0.50	1.1	<1.5	350	--	
03/11/03 ³	38.41	25.81	12.60	0.00	0.00	3,500	1,100	9.1	12	8.0	1,600	--	
06/10/03 ^{3,7}	38.41	25.73	12.68	0.00	0.00	1,600	350	2	3	3	1,300	--	
09/09/03 ^{3,7}	38.41	21.66	16.75	0.00	0.00	290	4	<1	1	1	710	<100	
12/09/03 ^{7,9}	38.41	20.73	17.68	0.00	0.00	<50	<0.5	<0.5	<0.5	<0.5	200	<50	
03/09/04 ⁷	38.41	30.61	7.80	0.00	0.00	7,100	2,000	15	23	10	1,100	<50	
06/08/04 ⁷	38.41	27.29	11.12	0.00	0.00	2,300	840	6	5	4	1,100	<50	
09/08/04 ⁷	38.41	24.11	14.30	0.00	0.00	150	110	2	0.5	1	730	<50	
12/06/04 ⁷	38.41	25.15	13.26	0.00	0.00	2,100	480	4	2	2	530	<50	
03/07/05 ⁷	38.41	31.93	6.48	0.00	0.00	4,100	1,200	9	10	5	1,100	<100	
06/06/05 ⁷	38.41	29.56	8.85	0.00	0.00	3,400	990	8	9	5	1,100	<100	
09/06/05 ⁷	38.41	26.99	11.42	0.00	0.00	1,100	83	2	0.9	1	810	<50	
12/05/05 ⁷	38.41	27.43	10.98	0.00	0.00	<50	<0.5	<0.5	<0.5	<0.5	78	<50	
03/06/06 ⁷	38.41	30.64	7.77	0.00	0.00	3,700	880	10	8	7	1,300	<50	
06/05/06 ⁷	38.41	29.51	8.90	0.00	0.00	380	7	<0.5	<0.5	<0.5	960	<50	
09/05/06 ⁷	38.41	27.32	11.09	0.00	0.00	260	<0.5	<0.5	<0.5	<0.5	390	<50	

Table 1
Groundwater Monitoring Data and Analytical Results
Chevron Service Station #9-0076
4265 Foothill Boulevard
Oakland, California

WELL ID/ DATE	TOC* (fL)	GWE (msl)	DTW (ft.)	SPHT (ft.)	SPH							ETHANOL (µg/L)
					REMOVED (gallons)	TPH-G (µg/L)	B (µg/L)	T (µg/L)	E (µg/L)	X (µg/L)	MTBE (µg/L)	
C-1 (cont)												
12/04/06 ⁷	38.41	27.49	10.92	0.00	0.00	270	20	<0.5	<0.5	<0.5	250	<50
03/05/07 ⁷	38.41	28.63	9.78	0.00	0.00	2,000	370	5	2	2	820	<50
06/04/07 ⁷	38.41	29.01	9.40	0.00	0.00	180	<0.5	<0.5	<0.5	<0.5	320	<50
09/07/07 ⁷	38.41	27.86	10.55	0.00	0.00	120	<0.5	<0.5	<0.5	<0.5	72	<50
12/06/07 ⁷	38.41	26.26	12.15	0.00	0.00	170	<0.5	<0.5	<0.5	<0.5	58	<50
03/06/08 ⁷	38.41	30.13	8.28	0.00	0.00	3,400	790	8	4	4	610	<50
06/05/08 ⁷	38.41	28.30	10.11	0.00	0.00	210	<0.5	<0.5	<0.5	<0.5	290	<50
09/03/08 ⁷	38.41	25.51	12.90	0.00	0.00	130	<0.5	<0.5	<0.5	<0.5	110	<50
12/03/08 ⁷	38.41	24.56	13.85	0.00	0.00	70	<0.5	<0.5	<0.5	<0.5	29	<50
C-2												
04/28/89	35.18	8.74	26.44	--	--	120,000	30,000	22,000	3,000	17,000	--	--
08/08/89	35.18	5.29	29.90	0.01	--	--	--	--	--	--	--	--
12/21/89	35.18	5.86	29.32	--	--	--	--	--	--	--	--	--
08/27/90	35.18	5.77	29.55	0.17	--	--	--	--	--	--	--	--
11/04/90	35.18	4.71	30.47	--	--	--	--	--	--	--	--	--
06/18/91	35.18	6.90	28.33	0.06	--	--	--	--	--	--	--	--
09/19/91	35.18	5.84	29.39	0.06	--	--	--	--	--	--	--	--
12/20/91	35.18	5.95	29.23	--	--	170,000	20,000	10,000	2,800	19,000	--	--
03/18/92	35.18	21.58	13.60	0.09	--	--	--	--	--	--	--	--
07/14/92	35.18	--	--	--	--	--	--	--	--	--	--	--
10/08/92	35.18	--	--	--	--	--	--	--	--	--	--	--
01/08/93	35.18	10.98	24.20	Sheen	--	79,000	14,000	7,200	3,500	16,000	--	--
04/14/93	35.18	--	--	--	--	--	--	--	--	--	--	--
07/16/93	35.18	5.03	30.15	--	--	2200	440	73	24	350	--	--
09/21/93	37.47	11.18	26.29	--	--	11,000	2,300	300	270	910	--	--
01/28/94	37.47	13.51	23.96	--	--	49,000	11,000	3,900	1,600	12,000	--	--
03/17/94	37.47	11.48	25.99	--	--	16,000	3,300	1,000	220	3,500	--	--
06/16/94	37.47	13.55	23.92	--	--	20,000	4,800	1,500	520	4,300	--	--
09/22/94	37.47	11.85	25.62	--	--	35,000	5,600	850	1,700	7,300	--	--
12/15/94	37.47	16.31	21.16	--	--	96,000	9,000	3,500	3,300	13,000	--	--
03/30/95	37.47	20.29	17.18	--	--	100,000	9,400	3,700	3,900	14,000	--	--
06/20/95	37.47	18.52	18.95	--	--	93,000	6,400	1,900	2,900	11,000	--	--
09/20/95	37.47	19.27	18.20	--	--	58,000	6,600	330	1,600	5,500	--	--

Table 1
Groundwater Monitoring Data and Analytical Results
Chevron Service Station #9-0076
4265 Foothill Boulevard
Oakland, California

WELL ID/ DATE	TOC* (ft.)	GWE (msl)	DTW (ft.)	SPHT (ft.)	SPH							ETHANOL (µg/L)	
					REMOVED (gallons)	TPH-G (µg/L)	B (µg/L)	T (µg/L)	E (µg/L)	X (µg/L)	MTBE (µg/L)		
C-2 (cont)													
12/06/95	37.47	12.71	24.76	--	--	40,000	5,000	86	1,800	3,700	<500	--	
03/21/96	37.47	21.30	16.17	0.00	0.13	--	--	--	--	--	--	--	
06/21/96	37.47	19.34	18.15	0.02	0.03	--	--	--	--	--	--	--	
09/06/96	37.47	16.36	21.14	0.04	0.08	--	--	--	--	--	--	--	
12/19/96	37.47	19.94	17.55	0.03	0.05	--	--	--	--	--	--	--	
03/17/97	37.47	18.88	18.59	--	--	58,000	4,800	1,200	1,800	6,300	3,400	--	
06/11/97	37.47	16.17	21.30	--	--	40,000	5,500	720	1,400	4,100	3,100	--	
09/17/97	37.47	14.33	23.14	--	--	30,000	4,800	220	1,200	1,800	3,200	--	
12/11/97	37.47	20.26	17.21	--	--	76,000	6,100	1,300	2,200	8,000	3,800	--	
03/12/98	37.47	23.30	14.17	--	--	45,000	6,000	1,400	1,800	5,900	2,700	--	
06/23/98 ³	37.47	22.65	14.82	--	--	1,100,000	6,800	5,100	13,000	38,000	<1,000	--	
09/01/98	37.47	15.69	21.78	--	--	9,700	300	8.2	6.2	250	3,700	--	
12/30/98	37.47	15.61	21.86	--	--	110,000	4,790	1,300	841	5,570	2,420	--	
03/31/99	37.47	20.57	16.90	--	--	48,000	4,800	1,110	1,520	5,450	2,160	--	
06/14/99	37.47	17.32	20.15	Sheen	--	56,400	5,380	671	1,300	3,960	2,480	--	
06/14/99 ¹	37.47	17.32	20.15	--	--	--	--	--	--	--	2,630 ²	--	
09/30/99	37.47	14.50	22.97	--	--	22,100	623	<100	529	1,250	2,430	--	
12/22/99	37.47	16.47	21.00	--	--	10,200	1,750	102	222	963	1,980	--	
03/09/00	37.47	25.27	12.20	--	--	26,000	4,800	930	1,200	4,400	1,800	--	
06/23/00 ³	37.47	18.53	18.94	0.00	0.00	29,000 ⁴	3,400	360	440	2,500	2,800	--	
09/05/00 ³	37.47	17.01	20.46	0.00	0.00	35,000 ⁴	3,800	54	980	750	5,200	--	
12/04/00	37.47	16.54	20.93	0.00	0.00	16,000 ⁴	2,500	120	360	1,100	2,100	--	
03/08/01 ³	37.47	20.53	16.94	0.00	0.00	42,300	3,930	828	2,010	5,180	1,660	--	
06/07/01 ³	37.47	18.13	19.34	0.00	0.00	15,000 ⁴	3,400	150	700	1,300	1,900	--	
09/13/01 ³	37.47	15.28	22.19	0.00	0.00	9,600	1,200	<50	120	160	2,200	--	
12/13/01 ³	37.47	19.87	17.60	0.00	0.00	33,000	3,200	430	1,300	3,700	1,400	--	
03/08/02 ³	37.47	23.18	14.29	0.00	0.00	26,000	2,900	390	1,200	2,800	1,100	--	
06/19/02 ³	37.47	18.36	19.11	0.00	0.00	19,000	3,000	100	720	1,100	1,400	--	
09/11/02 ³	37.47	16.79	20.68	0.00	0.00	10,000	1,400	23	120	78	1,800	--	
12/11/02 ³	37.47	15.36	22.11	0.00	0.00	8,700	1,300	24	100	250	1,900	--	
03/11/03 ³	37.47	22.86	14.61	0.00	0.00	23,000	2,000	280	1,100	2,100	990	--	
06/10/03 ^{3,7}	37.47	20.36	17.11	0.00	0.00	14,000	1,300	91	450	720	480	--	
09/09/03 ^{3,7}	37.47	16.33	21.14	0.00	0.00	6,800	1,100	9	83	47	1,300	<200	
12/09/03 ⁷	37.47	18.27	19.20	0.00	0.00	22,000	1,100	120	570	1,000	460	<250	
03/09/04 ⁷	37.47	25.65	11.82	0.00	0.00	24,000	1,800	420	820	2,100	480	<250	

Table 1
Groundwater Monitoring Data and Analytical Results
Chevron Service Station #9-0076
4265 Foothill Boulevard
Oakland, California

WELL ID/ DATE	TOC* (ft.)	GWE (msl)	DTW (ft.)	SPHT (ft.)	SPH							
					REMOVED (gallons)	TPH-G (µg/L)	B (µg/L)	T (µg/L)	E (µg/L)	X (µg/L)	MTBE (µg/L)	ETHANOL (µg/L)
C-2 (cont)												
06/08/04 ⁷	37.47	21.05	16.42	0.00	0.00	1,200	180	5	1	10	170	<50
09/08/04 ⁷	37.47	24.32**	13.16	0.01	0.00	16,000	340	13	290	200	170	<250
12/06/04 ⁷	37.47	23.36**	14.12	0.01	0.00	13,000	730	130	340	570	280	<100
03/07/05 ⁷	37.47	26.91**	10.57	0.01	0.00	18,000	2,200	470	770	2,000	420	<250
06/06/05 ⁷	37.47	24.78	12.69	0.00	0.00	9,800	940	79	300	490	200	<100
09/06/05 ⁷	37.47	22.69	14.78	0.00	0.00	9,300	380	8	89	76	170	<100
12/05/05 ⁷	37.47	23.25	14.22	0.00	0.00	8,300	190	8	68	67	56	<50
03/06/06 ⁷	37.47	27.73	9.74	0.00	0.00	1,900	41	5	13	43	6	<50
06/05/06 ⁷	37.47	27.72	9.75	0.00	0.00	8,800	680	99	200	460	170	<50
09/05/06 ⁷	37.47	25.51	11.96	0.00	0.00	8,200	1,200	24	170	65	65	<100
12/04/06 ⁷	37.47	25.04	12.43	0.00	0.00	9,500	1,800	38	140	94	94	<100
03/05/07 ⁷	37.47	26.86	10.61	0.00	0.00	15,000 ¹¹	1,900 ¹¹	300 ¹¹	570 ¹¹	1,300 ¹¹	250 ¹¹	<250 ¹¹
06/04/07 ⁷	37.47	27.13	10.34	0.00	0.00	6,200	410	16	76	100	110	<50
09/07/07 ⁷	37.47	25.82	11.65	0.00	0.00	6,400	240	6	71	82	67	<50
12/06/07 ⁷	37.47	19.07	18.40	0.00	0.00	7,300	200	12	47	79	56	<50
03/06/08 ⁷	37.47	28.00	9.47	0.00	0.00	18,000	2,400	340	850	1,600	260	<100
06/05/08 ⁷	37.47	26.40	11.07	0.00	0.00	5,800	530	18	47	80	100	<250
09/03/08 ⁷	37.47	24.27	13.20	0.00	0.00	5,600	340	10	81	48	83	<50
12/03/08⁷	37.47	22.86	14.61	0.00	0.00	9,600	1,100	58	250	210	220	<130
C-3												
04/28/89	35.28	7.28	28.00	--	--	<500	1.7	<0.5	<0.5	<0.5	--	--
08/08/89	35.28	5.28	30.00	--	--	<500	1.0	<0.5	<0.5	<0.5	--	--
12/21/89	35.28	4.75	30.53	--	--	--	--	--	--	--	--	--
08/27/90	35.28	5.60	29.68	--	--	<50	<0.3	<0.3	<0.3	<0.6	--	--
11/04/90	35.30	4.94	30.36	--	--	--	--	--	--	--	--	--
06/18/91	35.30	6.84	28.46	--	--	52	1.1	<0.5	<0.5	1.2	--	--
09/19/91	35.30	5.97	29.33	--	--	73	1.2	<0.5	<0.5	<0.5	--	--
12/20/91	35.30	5.53	29.77	--	--	<50	0.7	<0.5	<0.5	<0.5	--	--
03/18/92	35.30	9.55	25.75	--	--	<50	<0.5	<0.5	<0.5	<0.5	--	--
07/14/92	35.30	7.43	27.87	--	--	<50	<0.5	<0.5	<0.5	<0.5	--	--
10/08/92	35.30	6.75	28.55	--	--	<50	<0.5	<0.5	<0.5	0.5	--	--
01/08/93	35.30	9.45	25.85	--	--	<50	<0.5	<0.5	<0.5	<0.5	--	--
04/14/93	35.30	11.34	23.96	--	--	<50	<0.5	<0.5	<0.5	<0.5	--	--

Table 1
Groundwater Monitoring Data and Analytical Results
Chevron Service Station #9-0076
4265 Foothill Boulevard
Oakland, California

WELL ID/ DATE	TOC* (ft.)	GWE (msl)	DTW (ft.)	SPHT (ft.)	SPH		B (µg/L)	T (µg/L)	E (µg/L)	X (µg/L)	MTBE (µg/L)	ETHANOL (µg/L)
					REMOVED (gallons)	TPH-G (µg/L)						
C-3 (cont)												
07/16/93	35.30	9.66	25.64	--	--	<50	<0.5	<0.5	<0.5	<0.5	--	--
09/21/93	38.37	12.15	26.22	--	--	<50	0.7	<0.5	<0.5	<0.8	--	--
01/28/94	38.37	12.71	25.66	--	--	<50	2.0	<0.5	<0.5	1.0	--	--
03/17/94	38.37	13.42	24.95	--	--	<50	2.8	<0.5	0.6	1.5	--	--
06/16/94	38.37	14.06	24.31	--	--	<50	1.4	<0.5	<0.5	<0.5	--	--
09/22/94	38.37	13.33	25.04	--	--	<50	0.6	<0.5	<0.5	<0.5	--	--
12/15/94	38.37	16.15	22.22	--	--	<50	2.6	1.7	0.82	4.5	--	--
03/30/95	38.37	19.95	18.42	--	--	<50	<0.5	<0.5	<0.5	<0.5	--	--
06/20/95	38.37	18.58	19.79	--	--	110	2.2	<0.5	<0.5	1.2	--	--
09/20/95	38.37	19.42	18.95	--	--	560	21	80	23	120	--	--
12/06/95	38.37	14.21	24.16	--	--	<50	0.73	<0.5	<0.5	0.67	<2.5	--
03/21/96	38.37	20.52	17.85	--	--	<50	<0.5	<0.5	<0.5	<0.5	<2.5	--
06/21/96	38.37	18.59	19.78	--	--	57	<0.5	<0.5	<0.5	<0.5	<2.5	--
09/06/96	38.37	16.74	21.63	--	--	<50	0.9	<0.5	<0.5	<0.5	<2.5	--
12/19/96	38.37	16.07	22.30	--	--	310	36	33	6.5	28	<2.5	--
03/17/97	38.37	19.42	18.95	--	--	54	1.1	<0.5	<0.5	0.76	<2.5	--
06/11/97	38.37	17.22	21.15	--	--	120	1.1	<0.5	<0.5	<0.5	<2.5	--
09/17/97	38.37	15.96	22.41	--	--	240	19	19	6.6	40	13	--
12/11/97	38.37	16.11	22.26	--	--	<50	1.8	<0.5	<0.5	0.5	<2.5	--
03/12/98	38.37	20.02	18.35	--	--	72	6.3	<0.5	0.64	3.1	2.6	--
06/23/98	38.37	19.33	19.04	--	--	<50	<0.5	<0.5	<0.5	<0.5	<2.5	--
09/01/98	38.37	18.40	19.97	--	--	200	6.8	0.31	0.52	2.0	<2.5	--
12/30/98	38.37	17.06	21.31	--	--	<50	<0.5	<0.5	<0.5	<0.5	<2.0	--
03/31/99	38.37	20.60	17.77	--	--	<50	<0.5	<0.5	<0.5	<0.5	12.6	--
06/14/99	38.37	20.12	18.25	--	--	<50	<0.5	<0.5	<0.5	<0.5	<2.5	--
09/30/99	38.37	17.18	21.19	--	--	79.2	3.04	0.794	<0.5	1.04	6.17	--
12/22/99	38.37	16.05	22.32	--	--	<50	1.53	1.08	<0.5	0.66	12	--
03/09/00	38.37	21.27	17.10	--	--	99	6.9	0.8	0.89	3.8	12	--
06/23/00	38.37	19.22	19.15	0.00	0.00	<50	<0.50	<0.50	<0.50	<0.50	<2.5	--
09/05/00	38.37	17.53	20.84	0.00	0.00	52 ⁴	4.3	<0.50	<0.50	0.93	29	--
12/04/00	38.37	17.17	21.20	0.00	0.00	70 ⁴	4.0	<0.50	<0.50	0.71	25	--
03/08/01	38.37	20.70	17.67	0.00	0.00	<50.0	0.873	<0.500	<0.500	<0.500	3.24	--
06/07/01	38.37	19.47	18.90	0.00	0.00	140 ⁴	16	0.67	1.4	3.8	30	--
09/13/01	38.37	17.36	21.01	0.00	0.00	<50	<0.50	<0.50	<0.50	<0.50	<2.5	--
12/13/01	38.37	18.57	19.80	0.00	0.00	<50	1.2	<0.50	<0.50	<1.5	15	--

Table 1
Groundwater Monitoring Data and Analytical Results
Chevron Service Station #9-0076
4265 Foothill Boulevard
Oakland, California

WELL ID/ DATE	TOC* (ft.)	GWE (msl)	DTW (ft.)	SPH								
				SPHT (ft.)	REMOVED (gallons)	TPH-G (µg/L)	B (µg/L)	T (µg/L)	E (µg/L)	X (µg/L)	MTBE (µg/L)	ETHANOL (µg/L)
C-3 (cont)												
03/08/02	38.37	20.59	17.78	0.00	0.00	82	5.4	<0.50	<0.50	<1.5	68	--
06/19/02	38.37	19.97	18.40	0.00	0.00	74	2.1	<0.50	<0.50	<1.5	77	--
09/11/02	38.37	18.20	20.17	0.00	0.00	110	4.7	<0.50	<0.50	<1.5	76	--
12/11/02	38.37	16.62	21.75	0.00	0.00	79	1.5	<0.50	<0.50	<1.5	96	--
03/11/03	38.37	19.30	19.07	0.00	0.00	<50	2.1	<0.50	<0.50	<1.5	18	--
06/10/03 ⁷	38.37	19.29	19.08	0.00	0.00	86	2	<0.5	<0.5	<0.5	93	--
09/09/03 ⁷	38.37	17.67	20.70	0.00	0.00	<50	2	<0.5	<0.5	<0.5	160	<50
12/09/03 ⁷	38.37	17.32	21.05	0.00	0.00	<50	<0.5	<0.5	<0.5	<0.5	0.9	<50
03/09/04 ⁷	38.37	22.12	16.25	0.00	0.00	<50	<0.5	<0.5	<0.5	<0.5	<0.5	<50
06/08/04 ⁷	38.37	19.87	18.50	0.00	0.00	<50	<0.5	<0.5	<0.5	<0.5	<0.5	<50
09/08/04 ⁷	38.37	18.36	20.01	0.00	0.00	<50	<0.5	<0.5	<0.5	<0.5	22	<50
12/06/04 ⁷	38.37	19.07	19.30	0.00	0.00	<50	<0.5	<0.5	<0.5	<0.5	<0.5	<50
03/07/05 ⁷	38.37	20.35	18.02	0.00	0.00	<50	<0.5	<0.5	<0.5	<0.5	<0.5	<50
06/06/05 ⁷	38.37	19.29	19.08	0.00	0.00	<50	<0.5	<0.5	<0.5	<0.5	<0.5	<50
09/06/05 ⁷	38.37	20.22	18.15	0.00	0.00	<50	<0.5	<0.5	<0.5	<0.5	<0.5	<50
12/05/05 ⁷	38.37	20.52	17.85	0.00	0.00	<50	<0.5	<0.5	<0.5	<0.5	<0.5	<50
03/06/06 ⁷	38.37	20.44	17.93	0.00	0.00	<50	<0.5	<0.5	<0.5	<0.5	<0.5	<50
06/05/06 ⁷	38.37	23.02	15.35	0.00	0.00	<50	<0.5	<0.5	<0.5	<0.5	65	<50
09/05/06 ⁷	38.37	19.95	18.42	0.00	0.00	<50	<0.5	<0.5	<0.5	<0.5	<0.5	<50
12/04/06 ⁷	38.37	20.08	18.29	0.00	0.00	<50	<0.5	<0.5	<0.5	<0.5	<0.5	<50
03/05/07 ⁷	38.37	23.63	14.74	0.00	0.00	<50	<0.5	<0.5	<0.5	<0.5	<0.5	<50
06/04/07 ⁷	38.37	22.69	15.68	0.00	0.00	<50	<0.5	<0.5	<0.5	<0.5	<0.5	<50
09/07/07 ⁷	38.37	19.86	18.51	0.00	0.00	<50	<0.5	<0.5	<0.5	<0.5	<0.5	<50
12/06/07 ⁷	38.37	18.96	19.41	0.00	0.00	<50	<0.5	<0.5	<0.5	<0.5	<0.5	<50
03/06/08 ⁷	38.37	22.42	15.95	0.00	0.00	<50	<0.5	<0.5	<0.5	<0.5	1	<50
06/05/08 ⁷	38.37	20.89	17.48	0.00	0.00	<50	<0.5	<0.5	<0.5	<0.5	0.6	<50
09/03/08 ⁷	38.37	19.39	18.98	0.00	0.00	<50	<0.5	<0.5	<0.5	<0.5	<0.5	<50
12/03/08 ⁷	38.37	18.19	20.18	0.00	0.00	<50	<0.5	<0.5	<0.5	<0.5	<0.5	<50
C-4												
01/12/89	33.45	3.96	29.49	--	--	--	--	--	--	--	--	--
04/12/89	33.45	6.01	27.44	--	--	--	--	--	--	--	--	--
04/28/89	33.45	3.96	29.49	--	--	20,000	6,300	550	230	1,500	--	--
08/08/89	33.45	3.90	29.55	--	--	8,000	7,500	340	88	1,000	--	--

Table 1
Groundwater Monitoring Data and Analytical Results
Chevron Service Station #9-0076
4265 Foothill Boulevard
Oakland, California

WELL ID/ DATE	TOC* (ft.)	GWE (msl)	DTW (ft.)	SPHT (ft.)	SPH							MTBE (µg/L)	ETHANOL (µg/L)
					REMOVED (gallons)	TPH-G (µg/L)	B (µg/L)	T (µg/L)	E (µg/L)	X (µg/L)			
C-4 (cont)													
12/21/89	33.45	3.43	30.02	--	--	--	--	--	--	--	--	--	--
08/27/90	33.48	4.46	29.02	--	--	26,000	10,000	280	410	1,400	--	--	--
11/04/90	33.48	3.67	29.81	--	--	--	--	--	--	--	--	--	--
06/18/91	33.48	6.03	27.45	--	--	34,000	14,000	410	450	1,300	--	--	--
09/19/91	33.48	4.83	28.65	--	--	16,000	7,400	90	110	460	--	--	--
12/20/91	33.48	4.64	28.84	--	--	24,000	12,000	120	260	740	--	--	--
03/18/92	33.48	11.05	24.43	--	--	48,000	6,000	1,300	1,300	2,400	--	--	--
07/14/92	33.48	6.59	26.89	--	--	40,000	14,000	920	550	2,400	--	--	--
10/08/92	33.48	5.69	27.79	--	--	29,000	13,000	190	110	1,400	--	--	--
01/08/93	33.48	9.98	23.50	--	--	25,000	7,000	630	860	1,800	--	--	--
04/14/93	33.48	12.35	21.13	--	--	27,000	6,300	1,000	900	1,400	--	--	--
07/16/93	33.48	9.52	23.96	--	--	28,000	7,800	1,100	830	2,100	--	--	--
09/21/93	36.49	10.98	25.51	--	--	30,000	9,600	130	390	1,300	--	--	--
01/28/94	36.49	13.18	23.31	--	--	18,000	7,800	440	260	1,200	--	--	--
03/17/94	36.49	15.14	21.35	--	--	32,000	7,800	820	820	1,800	--	--	--
06/16/94	36.49	13.99	22.50	--	--	25,000	7,600	710	600	1,800	--	--	--
09/22/94	36.49	12.56	23.93	--	--	25,000	7,800	140	600	1,100	--	--	--
12/15/94	36.49	17.47	19.02	--	--	38,000	7,600	460	1,200	2,000	--	--	--
03/30/95	36.49	21.63	14.86	--	--	41,000	8,700	1,600	1,800	3,000	--	--	--
06/20/95	36.49	19.59	16.90	--	--	29,000	6,000	890	960	1,800	--	--	--
09/20/95	36.49	20.29	16.20	--	--	12,000	6,900	510	290	1,300	--	--	--
12/06/95	36.49	13.37	23.12	--	--	13,000	3,900	42	30	250	<250	--	--
03/21/96	36.49	22.39	14.10	--	--	39,000	4,800	640	1,000	1,800	<1,000	--	--
06/21/96	36.49	19.54	16.95	--	--	26,000	4,400	640	960	1,800	2,000	--	--
09/06/96	36.49	16.36	20.13	--	--	23,000	500	200	230	1,000	3,100	--	--
12/19/96	36.49	19.57	16.92	--	--	23,000	4,900	320	1,100	2,000	<250	--	--
03/17/97	36.49	19.09	17.40	--	--	30,000	5,800	700	1,400	2,200	1,700	--	--
06/11/97	36.49	18.15	18.34	--	--	29,000	4,400	520	790	1,800	2,000	--	--
09/17/97	36.49	15.03	21.46	--	--	17,000	4,300	140	940	1,100	4,600	--	--
12/11/97	36.49	19.84	16.65	--	--	12,000	2,500	130	300	1,000	1,400	--	--
03/12/98	36.49	19.90	16.59	--	--	46,000	11,000	1,500	2,300	5,000	3,400	--	--
06/23/98 ³	36.49	19.47	17.02	--	--	27,000	1,600	160	180	690	100	--	--
09/01/98	36.49	15.04	21.45	--	--	520	14	2.3	<0.5	4.8	61	--	--
12/30/98	36.49	15.07	21.42	--	--	122	14.1	1.86	<1.0	3.61	349	--	--
03/31/99	36.49	21.29	15.20	--	--	20,300	4,450	443	1,000	2,130	1,320	--	--

Table 1
Groundwater Monitoring Data and Analytical Results
Chevron Service Station #9-0076
4265 Foothill Boulevard
Oakland, California

WELL ID/ DATE	TOC* (ft.)	GWE (msl)	DTW (ft.)	SPHT (ft.)	SPH REMOVED (gallons)	TPH-G (µg/L)	B (µg/L)	T (µg/L)	E (µg/L)	X (µg/L)	MTBE (µg/L)	ETHANOL (µg/L)
C-4 (cont)												
06/14/99	36.49	14.69	21.80	--	--	1,820	183	7.14	36.7	56.5	291	--
06/14/99 ¹	36.49	14.69	21.80	--	--	--	--	--	--	--	280 ²	--
09/30/99	36.49	16.68	19.81	--	--	1,030	11.6	2.14	29.2	68.7	91.5	--
12/22/99	36.49	16.22	20.27	--	--	217	4.45	0.765	2.82	8.21	70.2	--
03/09/00	36.49	23.13	13.36	--	--	8,300	2,600	270	510	1,400	650	--
06/23/00 ³	36.49	17.09	19.40	0.00	0.00	55 ⁴	1.2	<0.50	<0.50	<0.50	250	--
09/05/00 ³	36.49	15.06	21.43	0.00	0.00	110 ⁴	5.4	<0.50	<0.50	1.1	52	--
12/04/00	36.49	14.71	21.78	0.00	0.00	<50	<0.50	0.56	<0.50	1.1	22	--
03/08/01 ³	36.49	19.87	16.62	0.00	0.00	9,080	2,260	229	395	1,060	718	--
06/07/01 ³	36.49	16.89	19.60	0.00	0.00	800 ⁴	75	4.3	22	33	340	--
09/13/01 ³	36.49	14.78	21.71	0.00	0.00	<50	0.68	<0.50	<0.50	<0.50	18	--
12/13/01 ³	36.49	18.54	17.95	0.00	0.00	5,800	1,400	43	21	470	540	--
03/08/02 ³	36.49	19.71	16.78	0.00	0.00	7,000	1,300	67	280	390	610	--
06/19/02 ³	36.49	17.69	18.80	0.00	0.00	3,100	130	6.5	29	55	250	--
09/11/02 ³	36.49	16.19	20.30	0.00	0.00	820	6.2	1.0	2.2	2.5	26	--
12/11/02 ³	36.49	14.52	21.97	0.00	0.00	<50	0.74	<0.50	<0.50	<1.5	9.3	--
03/11/03 ³	36.49	18.10	18.39	0.00	0.00	5,500	490	12	100	210	330	--
06/10/03 ^{3,7}	36.49	17.74	18.75	0.00	0.00	3,300	370	15	120	200	200	--
09/09/03 ^{3,7}	36.49	15.70	20.79	0.00	0.00	690	8	0.8	5	5	30	<50
12/09/03 ^{7,9}	36.49	16.19	20.30	0.00	0.00	<50	<0.5	<0.5	<0.5	<0.5	57	<50
03/09/04 ⁷	36.49	23.03	13.46	0.00	0.00	15,000	1,600	73	520	460	230	<250
06/08/04 ⁷	36.49	19.47	17.02	0.00	0.00	550	120	2	0.7	5	93	<50
09/08/04 ⁷	36.49	18.91	17.58	0.00	0.00	<50	<0.5	<0.5	<0.5	<0.5	37	<50
12/06/04 ⁷	36.49	19.71	16.78	0.00	0.00	7,000	1,600	39	230	260	180	<50
03/07/05 ⁷	36.49	24.33	12.16	0.00	0.00	9,500	2,100	67	330	160	170	<250
06/06/05 ⁷	36.49	22.86	13.63	0.00	0.00	7,700	2,000	39	280	130	130	<250
09/06/05 ⁷	36.49	20.79	15.70	0.00	0.00	3,600	830	10	79	21	110	<50
12/05/05 ⁷	36.49	20.04	16.45	0.00	0.00	4,400	1,000	11	80	23	120	<250
03/06/06 ⁷	36.49	23.54	12.95	0.00	0.00	10,000	2,400	92	240	170	130	<500
06/05/06 ⁷	36.49	25.47	11.02	0.00	0.00	16,000	3,300	160	350	370	150	<500
09/05/06 ⁷	36.49	23.89	12.60	0.00	0.00	9,600	1,400	29	200	78	81	<100
12/04/06 ⁷	36.49	23.29	13.20	0.00	0.00	13,000	1,800	40	150	99	100	<250
03/05/07 ⁷	36.49	25.84	10.65	0.00	0.00	11,000	2,800	58	230	270	100	<500
06/04/07 ⁷	36.49	24.95	11.54	0.00	0.00	13,000	3,500	87	300	230	94	<250
09/07/07 ⁷	36.49	23.99	12.50	0.00	0.00	5,100	1,000	24	70	43	39	<130

Table 1
Groundwater Monitoring Data and Analytical Results
Chevron Service Station #9-0076
4265 Foothill Boulevard
Oakland, California

WELL ID/ DATE	TOC* (ft.)	GWE (msl)	DTW (ft.)	SPHT (ft.)	SPH REMOVED (gallons)	TPH-G (µg/L)	B (µg/L)	T (µg/L)	E (µg/L)	X (µg/L)	MTBE (µg/L)	ETHANOL (µg/L)
C-4 (cont)												
12/06/07 ⁷	36.49	24.07	12.42	0.00	0.00	9,900	2,000	65	210	210	74	<130
03/06/08 ⁷	36.49	26.35	10.14	0.00	0.00	17,000	3,500	210	510	510	77	<250
06/05/08 ⁷	36.49	24.91	11.58	0.00	0.00	12,000	3,500	120	300	240	76	<250
09/03/08 ⁷	36.49	24.02	12.47	0.00	0.00	13,000	3,400	72	210	130	73	<250
12/03/08 ⁷	36.49	22.41	14.08	0.00	0.00	12,000	2,600	55	200	160	60	<250
C-5												
08/27/90	35.50	5.67	29.83	--	--	<50	<0.3	<0.3	<0.3	<0.6	--	--
11/14/90	35.50	4.94	30.56	--	--	--	--	--	--	--	--	--
06/18/91	35.50	6.98	28.52	--	--	<50	<0.5	<0.5	<0.5	--	--	--
09/19/91	35.50	5.99	29.51	--	--	<50	<0.5	<0.5	<0.5	<0.5	--	--
12/20/91	35.50	5.54	29.96	--	--	<50	<0.5	<0.5	<0.5	<0.5	--	--
03/18/92	35.50	9.58	25.92	--	--	<50	<0.5	<0.5	<0.5	<0.5	--	--
07/14/92	35.50	7.50	28.00	--	--	<50	<0.5	<0.5	<0.5	<0.5	--	--
10/08/92	35.50	6.85	28.65	--	--	<50	<0.5	<0.5	<0.5	<0.5	--	--
01/08/93	35.50	9.48	26.02	--	--	<50	<0.5	<0.5	<0.5	<0.5	--	--
04/14/93	35.50	11.46	24.04	--	--	<50	<0.5	<0.5	<0.5	<0.5	--	--
07/16/93	35.50	10.29	25.21	--	--	<50	<0.5	<0.5	<0.5	<0.5	--	--
09/21/93	38.50	12.14	26.36	--	--	60	10	8.1	1.9	9.4	--	--
01/28/94	38.50	12.60	25.90	--	--	<50	<0.5	<0.5	<0.5	<0.5	--	--
03/17/94	38.50	14.00	24.50	--	--	<50	<0.5	<0.5	<0.5	<0.5	--	--
06/16/94	38.50	14.10	24.40	--	--	<50	<0.5	<0.5	<0.5	<0.5	--	--
09/22/94	38.50	13.34	25.16	--	--	<50	<0.5	<0.5	<0.5	<0.5	--	--
12/15/94	38.50	15.61	22.89	--	--	<50	<0.5	<0.5	<0.5	<0.5	--	--
03/30/95	38.50	19.96	18.54	--	--	<50	<0.5	<0.5	<0.5	<0.5	--	--
06/20/95	38.50	18.37	20.13	--	--	<50	<0.5	<0.5	<0.5	<0.5	--	--
09/20/95	38.50	14.16	24.34	--	--	<50	<0.5	<0.5	<0.5	<0.5	--	--
12/06/95	38.50	14.40	24.10	--	--	<50	<0.5	<0.5	<0.5	<0.5	--	--
03/21/96	38.50	20.10	18.40	--	--	<50	<0.5	<0.5	<0.5	<0.5	<2.5	--
06/21/96	38.50	18.23	20.27	--	--	<50	<0.5	<0.5	<0.5	<0.5	<2.5	--
06/06/96	38.50	16.60	21.90	--	--	<50	<0.5	<0.5	<0.5	<0.5	8.7	--
12/19/96	38.50	17.35	21.15	--	--	<50	<0.5	<0.5	<0.5	<0.5	<2.5	--
03/17/97	38.50	18.66	19.84	--	--	<50	<0.5	<0.5	<0.5	<0.5	<2.5	--
06/11/97	38.50	16.90	21.60	--	--	<50	<0.5	<0.5	<0.5	<0.5	<2.5	--

Table 1
Groundwater Monitoring Data and Analytical Results
Chevron Service Station #9-0076
4265 Foothill Boulevard
Oakland, California

WELL ID/ DATE	TOC* (ft.)	GWE (msl)	DTW (ft.)	SPHT (ft.)	SPH REMOVED (gallons)	TPH-G (µg/L)	B (µg/L)	T (µg/L)	E (µg/L)	X (µg/L)	MTBE (µg/L)	ETHANOL (µg/L)
C-5 (cont)												
09/17/97	38.50	10.67	27.83	--	--	SAMPLED ANNUALLY	--	--	--	--	--	--
12/11/97	38.50	17.50	21.00	--	--	--	--	--	--	--	--	--
03/12/98	38.50	22.08	16.42	--	--	<50	<0.5	<0.5	<0.5	<0.5	<2.5	--
06/23/98	38.50	21.52	16.98	--	--	--	--	--	--	--	--	--
09/01/98	38.50	18.08	20.42	--	--	--	--	--	--	--	--	--
12/30/98	38.50	17.71	20.79	--	--	--	--	--	--	--	--	--
03/31/99	38.50	21.45	17.05	--	--	<50	<0.5	<0.5	<0.5	<0.5	15	--
06/14/99	38.50	21.02	17.48	--	--	--	--	--	--	--	--	--
09/30/99	38.50	19.77	18.73	--	--	--	--	--	--	--	--	--
12/22/99	38.50	16.32	22.18	--	--	--	--	--	--	--	--	--
03/09/00	38.50	21.52	16.98	--	--	<50	<0.5	<0.5	<0.5	0.87	3.5	--
06/23/00	38.50	18.85	19.65	0.00	0.00	SAMPLED ANNUALLY	--	--	--	--	--	--
09/05/00	38.50	18.03	20.47	0.00	0.00	--	--	--	--	--	--	--
12/04/00	38.50	17.04	21.46	0.00	0.00	--	--	--	--	--	--	--
03/08/01	38.50	20.97	17.53	0.00	0.00	<50.0	<0.500	<0.500	<0.500	<0.500	5.15	--
06/07/01	38.50	19.00	19.50	0.00	0.00	SAMPLED ANNUALLY	--	--	--	--	--	--
09/13/01	38.50	17.07	21.43	0.00	0.00	SAMPLED ANNUALLY	--	--	--	--	--	--
12/13/01	38.50	18.66	19.84	0.00	0.00	SAMPLED ANNUALLY	--	--	--	--	--	--
03/08/02	38.50	20.32	18.18	0.00	0.00	<50	<0.50	<0.50	<0.50	<1.5	3.5	--
06/19/02	38.50	19.62	18.88	0.00	0.00	SAMPLED ANNUALLY	--	--	--	--	--	--
09/11/02	38.50	17.94	20.56	0.00	0.00	SAMPLED ANNUALLY	--	--	--	--	--	--
12/11/02	38.50	16.68	21.82	0.00	0.00	SAMPLED ANNUALLY	--	--	--	--	--	--
03/11/03	38.50	19.54	18.96	0.00	0.00	<50	<0.50	<0.50	<0.50	<1.5	3.2	--
06/10/03	38.50	19.63	18.87	0.00	0.00	SAMPLED ANNUALLY	--	--	--	--	--	--
09/09/03	38.50	17.82	20.68	0.00	0.00	SAMPLED ANNUALLY	--	--	--	--	--	--
12/09/03	38.50	18.25	20.25	0.00	0.00	SAMPLED ANNUALLY	--	--	--	--	--	--
03/09/04 ⁷	38.50	21.82	16.68	0.00	0.00	<50	<0.5	<0.5	<0.5	<0.5	1	<50
06/08/04	38.50	19.16	19.34	0.00	0.00	SAMPLED ANNUALLY	--	--	--	--	--	--
09/08/04	38.50	18.40	20.10	0.00	0.00	SAMPLED ANNUALLY	--	--	--	--	--	--
12/06/04	38.50	18.75	19.75	0.00	0.00	SAMPLED ANNUALLY	--	--	--	--	--	--
03/07/05 ⁷	38.50	20.35	18.15	0.00	0.00	<50	<0.5	<0.5	<0.5	<0.5	<0.5	<50
06/06/05	38.50	19.14	19.36	0.00	0.00	SAMPLED ANNUALLY	--	--	--	--	--	--
09/06/05	38.50	20.24	18.26	0.00	0.00	SAMPLED ANNUALLY	--	--	--	--	--	--
12/05/05	38.50	20.59	17.91	0.00	0.00	SAMPLED ANNUALLY	--	--	--	--	--	--
03/06/06 ⁷	38.50	20.30	18.20	0.00	0.00	<50	<0.5	<0.5	<0.5	<0.5	<0.5	<50

Table 1
Groundwater Monitoring Data and Analytical Results
Chevron Service Station #9-0076
4265 Foothill Boulevard
Oakland, California

WELL ID/ DATE	TOC* (fL)	GWE (msl)	DTW (ft.)	SPHT (ft.)	SPH						MTBE (µg/L)	ETHANOL (µg/L)
					REMOVED (gallons)	TPH-G (µg/L)	B (µg/L)	T (µg/L)	E (µg/L)	X (µg/L)		
C-5 (cont)												
06/05/06	38.50	22.63	15.87	0.00	0.00	SAMPLED ANNUALLY	--	--	--	--	--	--
09/05/06	38.50	19.72	18.78	0.00	0.00	SAMPLED ANNUALLY	--	--	--	--	--	--
12/04/06	38.50	19.79	18.71	0.00	0.00	SAMPLED ANNUALLY	--	--	--	--	--	--
03/05/07 ⁷	38.50	22.23	16.27	0.00	0.00	<50	<0.5	<0.5	<0.5	<0.5	1	<50
06/04/07	38.50	22.23	16.27	0.00	0.00	SAMPLED ANNUALLY	--	--	--	--	--	--
09/07/07	38.50	19.59	18.91	0.00	0.00	SAMPLED ANNUALLY	--	--	--	--	--	--
12/06/07	38.50	19.15	19.35	0.00	0.00	SAMPLED ANNUALLY	--	--	--	--	--	--
03/06/08 ⁷	38.50	22.66	15.84	0.00	0.00	<50	<0.5	<0.5	<0.5	<0.5	0.7	<50
06/05/08	38.50	21.09	17.41	0.00	0.00	SAMPLED ANNUALLY	--	--	--	--	--	--
09/03/08	38.50	19.19	19.31	0.00	0.00	SAMPLED ANNUALLY	--	--	--	--	--	--
12/03/08	38.50	18.09	20.41	0.00	0.00	SAMPLED ANNUALLY	--	--	--	--	--	--
C-6												
08/27/90	32.40	-11.71	44.11	--	--	7,200	2,100	6.0	41	300	--	--
11/14/90	32.40	-11.63	44.03	--	--	--	--	--	--	--	--	--
06/18/91	32.40	-11.09	43.49	--	--	4,400	2,500	18	160	77	--	--
09/19/91	32.40	-1.92	34.32	--	--	3,100	1,600	8.3	73	8.0	--	--
12/20/91	32.40	-8.95	41.35	--	--	4,400	1,300	3.2	74	10	--	--
03/18/92	32.40	-8.29	40.69	--	--	9,800	3,200	34	250	500	--	--
07/14/92	32.40	-6.49	38.89	--	--	6,500	2,200	100	96	240	--	--
10/08/92	32.40	-6.27	38.67	--	--	1,800	1,000	3.1	15	41	--	--
01/08/93	32.40	-5.41	37.81	--	--	5,200	1,600	6.8	63	120	--	--
04/14/93	32.40	-2.30	34.70	--	--	11,000	1,800	13	110	200	--	--
07/16/93	32.40	-1.47	33.87	--	--	4,800	820	10	41	57	--	--
09/21/93	35.40	1.42	33.98	--	--	4,100	1,200	<50	75	130	--	--
01/28/94	35.40	1.54	33.86	--	--	3,100	930	14	40	34	--	--
03/17/94	35.40	3.09	32.31	--	--	5,100	950	18	61	83	--	--
06/16/94	35.40	3.90	31.50	--	--	3,800	970	6.4	52	62	--	--
09/22/94	35.40	4.18	31.22	--	--	4,100	980	7.8	43	48	--	--
12/15/94	35.40	4.00	31.40	--	--	5,000	1,400	<20	73	61	--	--
03/30/95	35.40	9.02	26.38	--	--	5,500	1,700	<13	120	97	--	--
06/20/95	35.40	10.39	25.01	--	--	1,700	470	<10	29	16	--	--
09/20/95	35.40	11.35	24.05	--	--	3,500	770	<5.0	45	17	--	--
12/06/95	35.40	7.28	28.12	--	--	3,100	710	<10	41	20	<50	--

Table 1
Groundwater Monitoring Data and Analytical Results
Chevron Service Station #9-0076
4265 Foothill Boulevard
Oakland, California

WELL ID/ DATE	TOC* (ft.)	GWE (msl)	DTW (ft.)	SPHT (ft.)	SPH		B (µg/L)	T (µg/L)	E (µg/L)	X (µg/L)	MTBE (µg/L)	ETHANOL (µg/L)	
					REMOVED (gallons)	TPH-G (µg/L)							
C-6 (cont)													
03/21/96	35.40	12.28	23.12	--	--	1,400	330	<2.5	15	8.1	19	--	
06/21/96	35.40	11.90	23.50	--	--	2,200	560	<5.0	18	<5.0	77	--	
09/06/96	35.40	10.57	24.83	--	--	2,800	720	<10	13	<10	160	--	
12/19/96	35.40	10.90	24.50	--	--	830	320	<2.5	<2.5	<2.5	14	--	
03/17/97	35.40	12.81	22.59	--	--	2,200	500	<10	25	<10	<50	--	
06/11/97	35.40	11.64	23.76	--	--	3,000	570	<5.0	29	10	220	--	
09/17/97	35.40	10.66	24.74	--	--	1,400	330	<5.0	<5.0	<5.0	76	--	
12/11/97	35.40	10.75	24.65	--	--	1,600	230	<5.0	7.3	6.4	46	--	
03/12/98	35.40	8.28	27.12	--	--	980	300	<5.0	15	12	49	--	
06/23/98 ³	35.40	7.48	27.92	--	--	220	35	<0.5	2.5	1.1	<2.5	--	
09/01/98	35.40	3.80	31.60	--	--	1,800	370	2.8	19	5	44	--	
12/30/98	35.40	3.58	31.82	--	--	1,600	244	<1.0	8.53	<1.0	54.9	--	
03/31/99	35.40	9.34	26.06	--	--	741	92.2	<1.0	6.60	<1.0	27.9	--	
06/14/99	35.40	5.72	29.68	--	--	434	110	<1.0	5.76	1.46	13	--	
06/14/99 ¹	35.40	5.72	29.68	--	--	--	--	--	--	--	6.96 ²	--	
09/30/99	35.40	12.34	23.06	--	--	481	92.7	<1.0	3.69	<1.0	32.9	--	
12/22/99	35.40	12.85	22.55	--	--	1,310	158	2.16	5.5	1.41	113	--	
03/09/00	35.40	15.37	20.03	--	--	470	120	0.74	5.0	2.5	36	--	
06/23/00 ³	35.40	13.25	22.15	0.00	0.00	1,700 ⁴	210	<5.0	<5.0	5.8	64	--	
09/05/00 ³	35.40	8.35	27.05	0.00	0.00	740 ⁴	99	0.60	5.1	2.2	80	--	
12/04/00	35.40	10.25	25.15	0.00	0.00	450 ⁴	31	0.71	<0.50	<0.50	54	--	
03/08/01 ³	35.40	11.56	23.84	0.00	0.00	1,550	228	3.93	19.9	32.5	46.2	--	
06/07/01 ³	35.40	9.67	25.73	0.00	0.00	360 ⁴	21	1.8	2.4	3.8	100	--	
09/13/01 ³	35.40	11.60	23.80	0.00	0.00	950	180	<5.0	5.9	<5.0	170	--	
12/13/01 ³	35.40	10.21	25.19	0.00	0.00	2,000	170	0.86	6.4	4.1	77	--	
03/08/02 ³	35.40	14.32	21.08	0.00	0.00	600	33	0.91	1.8	<1.5	90	--	
06/19/02 ³	35.40	10.78	24.62	0.00	0.00	370	11	<0.50	<0.50	<1.5	88	--	
09/11/02 ³	35.40	6.40	29.00	0.00	0.00	490	16	0.50	<0.50	<1.5	120	--	
12/11/02 ³	35.40	11.22	24.18	0.00	0.00	430	17	<0.50	<0.50	<1.5	100	--	
03/11/03 ³	35.40	7.70	27.70	0.00	0.00	410	8.8	0.88	<0.50	<1.5	120	--	
06/10/03 ^{3,7}	35.40	13.80	21.60	0.00	0.00	460	10	<0.5	<0.5	<0.5	100	--	
09/09/03	35.40	INACCESSIBLE - VEHICLE PARKED OVER WELL					--	--	--	--	--	--	--
12/09/03 ^{7,9}	35.40	9.51	25.89	0.00	0.00	1,700	69	<0.5	3	0.6	83	<50	
03/09/04 ⁷	35.40	15.89	19.51	0.00	0.00	6,800	280	1	10	4	96	<50	
06/08/04 ⁷	35.40	14.57	20.83	0.00	0.00	560	13	<0.5	<0.5	0.5	68	<50	

Table 1
Groundwater Monitoring Data and Analytical Results
Chevron Service Station #9-0076
4265 Foothill Boulevard
Oakland, California

WELL ID/ DATE	TOC* (ft.)	GWE (msl)	DTW (ft.)	SPHT (ft.)	SPH							MTBE (µg/L)	ETHANOL (µg/L)
					REMOVED (gallons)	TPH-G (µg/L)	B (µg/L)	T (µg/L)	E (µg/L)	X (µg/L)			
C-6 (cont)													
09/08/04 ⁷	35.40	13.52	21.88	0.00	0.00	290	16	<0.5	<0.5	<0.5	50	<50	
12/06/04 ⁷	35.40	14.06	21.34	0.00	0.00	290	18	<0.5	0.5	<0.5	44	<50	
03/07/05 ⁷	35.40	17.13	18.27	0.00	0.00	2,500	150	0.7	5	2	71	<50	
06/06/05 ⁷	35.40	16.88	18.52	0.00	0.00	1,900	110	<1	3	2	59	<100	
09/06/05 ⁷	35.40	15.02	20.38	0.00	0.00	800	16	<0.5	0.5	0.6	51	<50	
12/05/05 ⁷	35.40	15.34	20.06	0.00	0.00	540	15	<0.5	<0.5	0.6	45	<50	
03/06/06 ⁷	35.40	16.64	18.76	0.00	0.00	<50	<0.5	<0.5	<0.5	<0.5	<0.5	<50	
06/05/06 ⁷	35.40	17.60	17.80	0.00	0.00	<50	<0.5	<0.5	<0.5	<0.5	0.7	<50	
09/05/06 ⁷	35.40	15.40	20.00	0.00	0.00	1,200	17	<0.5	0.7	0.8	29	<50	
12/04/06 ⁷	35.40	14.49	20.91	0.00	0.00	<50	<0.5	<0.5	<0.5	<0.5	<0.5	<50	
03/05/07 ⁷	35.40	16.45	18.95	0.00	0.00	<50	<0.5	<0.5	<0.5	<0.5	<0.5	<50	
06/04/07 ⁷	35.40	17.04	18.36	0.00	0.00	<50	<0.5	<0.5	<0.5	<0.5	3	<50	
09/07/07 ⁷	35.40	14.35	21.05	0.00	0.00	<50	<0.5	<0.5	<0.5	<0.5	<0.5	<50	
12/06/07 ⁷	35.40	13.53	21.87	0.00	0.00	<50	<0.5	<0.5	<0.5	<0.5	<0.5	<50	
03/06/08 ⁷	35.40	13.72	21.68	0.00	0.00	<50	<0.5	<0.5	<0.5	<0.5	<0.5	<50	
06/05/08 ⁷	35.40	14.15	21.25	0.00	0.00	<50	<0.5	<0.5	<0.5	<0.5	2	<50	
09/03/08 ⁷	35.40	14.00	21.40	0.00	0.00	56	0.8	<0.5	<0.5	<0.5	5	<50	
12/03/08⁷	35.40	13.22	22.18	0.00	0.00	120	2	<0.5	<0.5	<0.5	5	<50	
C-7													
08/27/90	32.17	-12.06	44.23	--	--	110	26	0.8	4.0	6.0	--	--	
11/14/90	32.17	-11.94	44.11	--	--	--	--	--	--	--	--	--	
06/18/91	32.17	-9.88	42.05	--	--	23,000	5,700	420	1,000	2,800	--	--	
09/19/91	32.17	-9.55	41.72	--	--	26,000	4,600	330	970	2,400	--	--	
12/20/91	32.17	-9.50	41.67	--	--	33,000	5,500	270	1,000	2,100	--	--	
03/18/92	32.17	-9.03	41.20	--	--	27,000	5,800	410	1,300	3,300	--	--	
07/14/92	32.17	-7.60	39.77	--	--	46,000	12,000	720	1,700	4,600	--	--	
10/08/92	32.17	-6.97	39.14	--	--	22,000	6,800	370	1,300	3,200	--	--	
01/08/93	32.17	-6.33	38.50	--	--	36,000	7,600	540	1,700	4,200	--	--	
04/14/93	32.17	-3.76	35.93	--	--	23,000	3,100	450	670	1,900	--	--	
07/16/93	32.17	-3.21	35.38	--	--	19,000	3,200	330	550	1,800	--	--	
09/21/93	35.19	-0.27	35.46	--	--	17,000	2,700	160	410	760	--	--	
01/28/94	35.19	-0.26	35.45	--	--	14,000	1,800	210	390	1,000	--	--	
03/17/94	35.19	1.95	33.24	--	--	17,000	1,600	210	410	1,200	--	--	

Table 1
Groundwater Monitoring Data and Analytical Results
Chevron Service Station #9-0076
4265 Foothill Boulevard
Oakland, California

WELL ID/ DATE	TOC* (fL)	GWE (msl)	DTW (ft.)	SPHT (ft.)	SPH						MTBE (µg/L)	ETHANOL (µg/L)
					REMOVED (gallons)	TPH-G (µg/L)	B (µg/L)	T (µg/L)	E (µg/L)	X (µg/L)		
C-7 (cont)												
06/16/94	35.19	2.12	33.07	--	--	12,000	1,600	180	410	1,200	--	--
09/22/94	35.19	2.45	32.74	--	--	10,000	1,700	110	320	580	--	--
12/15/94	35.19	3.27	31.92	--	--	10,000	1,200	120	280	710	--	--
03/30/95	35.19	7.59	27.60	--	--	4,600	460	73	160	460	--	--
06/20/95	35.19	7.32	27.87	--	--	26,000	4,400	450	900	2,400	--	--
09/20/95	35.19	7.11	28.08	--	--	9,400	610	81	250	800	--	--
12/06/95	35.19	4.57	30.62	--	--	1,200	110	12	25	71	34	--
03/21/96	35.19	7.34	27.85	--	--	17,000	1,300	160	410	1,300	<100	--
09/06/96	35.19	6.84	28.35	--	--	15,000	3,400	<50	460	850	<250	--
12/19/96	35.19	6.08	29.11	--	--	530	9	0.5	0.85	3.4	<2.5	--
03/17/97	35.19	8.05	27.14	--	--	4,600	310	46	110	310	98	--
06/11/97	35.19	7.14	28.05	--	--	420	15	<0.5	3.3	5.1	<2.5	--
09/17/97	35.19	6.19	29.00	--	--	1,400	120	11	31	84	54	--
12/11/97	35.19	5.93	29.26	--	--	210	10	<0.5	0.97	1.6	<2.5	--
03/12/98	35.19	10.27	24.92	--	--	68	<0.5	<0.5	<0.5	<0.5	<2.5	--
06/23/98	35.19	9.89	25.30	--	--	<50	<0.5	<0.5	<0.5	<0.5	<2.5	--
09/01/98	35.19	8.92	26.27	--	--	570	24	1.4	8.4	22	24	--
12/30/98	35.19	8.67	26.52	--	--	<50	4.85	1.26	<0.5	1.29	167	--
03/31/99	35.19	10.43	24.76	--	--	53.1	<0.5	<0.5	<0.5	<0.5	<2.0	--
06/14/99	35.19	9.75	25.44	--	--	109	4.43	<0.5	<0.5	<0.5	<2.5	--
06/14/99 ¹	35.19	9.75	25.44	--	--	--	--	--	--	--	<2.0 ²	--
09/30/99	35.19	8.32	26.87	--	--	2,400	282	26.3	120	236	126	--
12/22/99	35.19	7.42	27.77	--	--	3,840	162	18.1	44.7	85.3	141	--
03/09/00	35.19	9.62	25.57	--	--	13,000	2,700	110	700	1,500	<130	--
06/23/00	35.19	9.53	25.66	0.00	0.00	190 ⁴	3.4	<0.50	<0.50	1.6	7.3	--
09/05/00	35.19	8.44	26.75	0.00	0.00	4,200 ⁴	330	26	120	200	190	--
12/04/00	35.19	8.03	27.16	0.00	0.00	2,600 ⁴	550	<5.0	73	62	<25	--
03/08/01	35.19	9.76	25.43	0.00	0.00	1,180	39.2	2.41	15.5	30.8	10.3	--
06/07/01	35.19	9.80	25.39	0.00	0.00	2,600 ⁴	440	14	110	130	56	--
09/13/01	35.19	8.58	26.61	0.00	0.00	23,000 ⁶	670	<100	150	210	<500	--
12/13/01	35.19	8.50	26.69	0.00	0.00	2,400	160	5.8	42	54	<10	--
03/08/02	35.19	10.39	24.80	0.00	0.00	3,900	380	21	110	160	<20	--
06/19/02	35.19	7.78	27.41	0.00	0.00	3,600	440	8.5	87	73	<10	--
09/11/02	35.19	9.41	25.78	0.00	0.00	11,000	1,800	18	360	380	<10	--
12/11/02	35.19	4.44	30.75	0.00	0.00	6,000	1,100	9.3	190	190	<10	--

Table 1
Groundwater Monitoring Data and Analytical Results
Chevron Service Station #9-0076
4265 Foothill Boulevard
Oakland, California

WELL ID/ DATE	TOC* (ft.)	GWE (msl)	DTW (ft.)	SPHT (ft.)	SPH							MTBE (µg/L)	ETHANOL (µg/L)
					REMOVED (gallons)	TPH-G (µg/L)	B (µg/L)	T (µg/L)	E (µg/L)	X (µg/L)			
C-7 (cont)													
03/11/03	35.19	8.29	26.90	0.00	0.00	4,900	940	13	150	160	<25	--	
06/10/03 ⁷	35.19	4.28	30.91	0.00	0.00	3,100	500	7	83	77	4	--	
09/09/03 ⁷	35.19	3.38	31.81	0.00	0.00	3,900	310	9	110	130	5	<50	
12/09/03 ⁷	35.19	6.74	28.45	0.00	0.00	170	0.8	<0.5	<0.5	<0.5	5	<50	
03/09/04 ⁷	35.19	10.73	24.46	0.00	0.00	80	<0.5	<0.5	<0.5	<0.5	4	<50	
06/08/04 ⁷	35.19	8.23	26.96	0.00	0.00	<50	<0.5	<0.5	<0.5	<0.5	6	<50	
09/08/04 ⁷	35.19	9.99	25.20	0.00	0.00	<50	<0.5	<0.5	<0.5	<0.5	7	<50	
12/06/04 ⁷	35.19	10.28	24.91	0.00	0.00	<50	<0.5	<0.5	<0.5	<0.5	7	<50	
03/07/05 ⁷	35.19	11.76	23.43	0.00	0.00	590	9	0.7	4	6	7	<50	
06/06/05 ⁷	35.19	13.31	21.88	0.00	0.00	<50	<0.5	<0.5	<0.5	<0.5	6	<50	
09/06/05 ⁷	35.19	11.60	23.59	0.00	0.00	<50	<0.5	<0.5	<0.5	<0.5	9	<50	
12/05/05 ⁷	35.19	11.44	23.75	0.00	0.00	<50	0.6	<0.5	<0.5	<0.5	9	<50	
03/06/06 ⁷	35.19	13.80	21.39	0.00	0.00	<50	<0.5	<0.5	<0.5	<0.5	7	<50	
06/05/06 ⁷	35.19	14.78	20.41	0.00	0.00	<50	<0.5	<0.5	<0.5	<0.5	4	<50	
09/05/06 ⁷	35.19	12.38	22.81	0.00	0.00	<50	<0.5	<0.5	<0.5	<0.5	2	<50	
12/04/06 ⁷	35.19	11.84	23.35	0.00	0.00	<50	<0.5	<0.5	<0.5	<0.5	3	<50	
03/05/07 ⁷	35.19	12.47	22.72	0.00	0.00	<50	<0.5	<0.5	<0.5	<0.5	2	<50	
06/04/07 ⁷	35.19	14.24	20.95	0.00	0.00	<50	<0.5	<0.5	<0.5	<0.5	4	<50	
09/07/07 ⁷	35.19	11.71	23.48	0.00	0.00	<50	<0.5	<0.5	<0.5	<0.5	5	<50	
12/06/07 ⁷	35.19	10.87	24.32	0.00	0.00	<50	<0.5	<0.5	<0.5	<0.5	5	<50	
03/06/08 ⁷	35.19	11.90	23.29	0.00	0.00	<50	<0.5	<0.5	<0.5	<0.5	6	<50	
06/05/08 ⁷	35.19	11.92	23.27	0.00	0.00	<50	<0.5	<0.5	<0.5	<0.5	6	<50	
09/03/08 ⁷	35.19	10.58	24.61	0.00	0.00	<50	<0.5	<0.5	<0.5	<0.5	4	<50	
12/03/08 ⁷	35.19	9.97	25.22	0.00	0.00	<50	<0.5	<0.5	<0.5	<0.5	4	<50	
C-8													
11/14/90	30.68	-12.61	43.29	--	--	<50	<0.3	<0.3	<0.3	<0.6	--	--	
06/18/91	30.68	-11.94	42.62	--	--	<50	<0.5	<0.5	<0.5	<0.5	--	--	
09/19/91	30.68	-11.04	41.72	--	--	<50	<0.5	<0.5	<0.5	<0.5	--	--	
12/20/91	30.68	-10.30	40.98	--	--	<50	<0.5	<0.5	<0.5	<0.5	--	--	
03/18/92	30.68	-9.34	40.02	--	--	<50	<0.5	<0.5	<0.5	<0.5	--	--	
07/14/92	30.68	-8.34	39.02	--	--	<50	<0.5	<0.5	<0.5	<0.5	--	--	
10/08/92	30.68	-8.00	38.68	--	--	<50	<0.5	<0.5	<0.5	1.1	--	--	
01/08/93	30.68	-7.39	38.07	--	--	<50	<0.5	<0.5	<0.5	<0.5	--	--	

Table 1
Groundwater Monitoring Data and Analytical Results
Chevron Service Station #9-0076
4265 Foothill Boulevard
Oakland, California

WELL ID/ DATE	TOC* (ft.)	GWE (msl)	DTW (ft.)	SPHT (ft.)	SPH						MTBE (µg/L)	ETHANOL (µg/L)
					REMOVED (gallons)	TPH-G (µg/L)	B (µg/L)	T (µg/L)	E (µg/L)	X (µg/L)		
C-8 (cont)												
04/14/93	30.68	-5.31	35.99	--	--	<50	<0.5	<0.5	<0.5	<0.5	--	--
07/16/93	30.68	-4.64	35.32	--	--	<50	<0.5	<0.5	<0.5	<0.5	--	--
09/21/93	34.68	-0.62	35.30	--	--	<50	<0.5	<0.5	<0.5	<0.8	--	--
01/28/94	34.68	-0.93	35.61	--	--	<50	<0.5	<0.5	<0.5	<0.5	--	--
03/17/94	34.68	0.31	34.37	--	--	<50	<0.5	<0.5	<0.5	<0.5	--	--
06/16/94	34.68	1.32	33.36	--	--	<50	<0.5	<0.5	<0.5	<0.5	--	--
09/22/94	34.68	1.86	32.82	--	--	<50	<0.5	<0.5	<0.5	<0.5	--	--
12/15/94	34.68	2.32	32.36	--	--	<50	<0.5	<0.5	<0.5	<0.5	--	--
03/30/95	34.68	5.44	29.24	--	--	<50	<0.5	<0.5	<0.5	<0.5	--	--
06/20/95	34.68	6.34	28.34	--	--	<50	<0.5	<0.5	<0.5	<0.5	--	--
09/20/95	34.68	5.20	29.48	--	--	<50	<0.5	<0.5	<0.5	<0.5	--	--
12/06/95	34.68	3.76	30.92	--	--	<50	<0.5	<0.5	<0.5	<0.5	<2.5	--
03/21/96	34.68	6.03	28.65	--	--	<50	<0.5	<0.5	<0.5	<0.5	<2.5	--
06/21/96	34.68	6.78	27.90	--	--	<50	<0.5	<0.5	<0.5	<0.5	<2.5	--
09/06/96	34.68	5.98	28.70	--	--	<50	<0.5	<0.5	<0.5	<0.5	<2.5	--
12/19/96	34.68	4.98	29.70	--	--	<50	<0.5	<0.5	<0.5	<0.5	<2.5	--
03/17/97	34.68	6.92	27.76	--	--	<50	<0.5	<0.5	<0.5	<0.5	<2.5	--
06/11/97	34.68	5.87	28.81	--	--	<50	<0.5	<0.5	<0.5	<0.5	<2.5	--
09/17/97	34.68	5.32	29.36	--	--	SAMPLED ANNUALLY		--	--	--	--	--
12/11/97	34.68	4.88	29.80	--	--	--	--	--	--	--	--	--
03/12/98	34.68	8.95	25.73	--	--	<50	<0.5	<0.5	<0.5	<0.5	2.6	--
06/23/98	34.68	8.38	26.30	--	--	--	--	--	--	--	--	--
09/01/98	34.68	8.17	26.51	--	--	--	--	--	--	--	--	--
12/30/98	34.68	7.79	26.89	--	--	--	--	--	--	--	--	--
03/31/99	34.68	8.32	26.36	--	--	<50	<0.5	<0.5	<0.5	<0.5	11.8	--
06/14/99	34.68	8.65	26.03	--	--	--	--	--	--	--	--	--
09/30/99	34.68	7.40	27.28	--	--	--	--	--	--	--	--	--
12/22/99	34.68	6.48	28.20	--	--	--	--	--	--	--	--	--
03/09/00	34.68	8.35	26.33	--	--	<50	<0.5	<0.5	<0.5	1.8	<2.5	--
06/23/00	34.68	8.49	26.19	0.00	0.00	SAMPLED ANNUALLY		--	--	--	--	--
09/05/00	34.68	7.71	26.97	0.00	0.00	--	--	--	--	--	--	--
12/04/00	34.68	7.26	27.42	0.00	0.00	--	--	--	--	--	--	--
03/08/01	34.68	8.58	26.10	0.00	0.00	<50.0	<0.500	<0.500	<0.500	<0.500	<2.50	--
06/07/01	34.68	8.89	25.79	0.00	0.00	SAMPLED ANNUALLY		--	--	--	--	--
09/13/01	34.68	7.87	26.81	0.00	0.00	SAMPLED ANNUALLY		--	--	--	--	--

Table 1
Groundwater Monitoring Data and Analytical Results
Chevron Service Station #9-0076
4265 Foothill Boulevard
Oakland, California

WELL ID/ DATE	TOC* (fL)	GWE (msl)	DTW (ft.)	SPHT (ft.)	SPH						MTBE (µg/L)	ETHANOL (µg/L)
					REMOVED (gallons)	TPH-G (µg/L)	B (µg/L)	T (µg/L)	E (µg/L)	X (µg/L)		
C-8 (cont)												
12/13/01	34.68	7.52	27.16	0.00	0.00	SAMPLED ANNUALLY	--	--	--	--	--	--
03/08/02	34.68	9.38	25.30	0.00	0.00	<50	<0.50	<0.50	<0.50	<1.5	<2.5	--
06/19/02	34.68	9.75	24.93	0.00	0.00	SAMPLED ANNUALLY	--	--	--	--	--	--
09/11/02	34.68	8.76	25.92	0.00	0.00	SAMPLED ANNUALLY	--	--	--	--	--	--
12/11/02	34.68	7.37	27.31	0.00	0.00	SAMPLED ANNUALLY	--	--	--	--	--	--
03/11/03	34.68	8.89	25.79	0.00	0.00	<50	<0.50	<0.50	<0.50	<1.5	<2.5	--
06/10/03	34.68	9.40	25.28	0.00	0.00	SAMPLED ANNUALLY	--	--	--	--	--	--
09/09/03	34.68	8.57	26.11	0.00	0.00	SAMPLED ANNUALLY	--	--	--	--	--	--
12/09/03	34.68	6.17	28.51	0.00	0.00	SAMPLED ANNUALLY	--	--	--	--	--	--
03/09/04 ⁷	34.68	10.70	23.98	0.00	0.00	<50	<0.5	<0.5	<0.5	<0.5	<0.5	<50
06/08/04	34.68	9.41	25.27	0.00	0.00	SAMPLED ANNUALLY	--	--	--	--	--	--
09/08/04	34.68	8.85	25.83	0.00	0.00	SAMPLED ANNUALLY	--	--	--	--	--	--
12/06/04	34.68	9.62	25.06	0.00	0.00	SAMPLED ANNUALLY	--	--	--	--	--	--
03/07/05 ⁷	34.68	11.33	23.35	0.00	0.00	<50	<0.5	<0.5	<0.5	<0.5	<0.5	<50
06/06/05	34.68	11.84	22.84	0.00	0.00	SAMPLED ANNUALLY	--	--	--	--	--	--
09/06/05	34.68	9.77	24.91	0.00	0.00	SAMPLED ANNUALLY	--	--	--	--	--	--
12/05/05	34.68	10.52	24.16	0.00	0.00	SAMPLED ANNUALLY	--	--	--	--	--	--
03/06/06 ⁷	34.68	12.13	22.55	0.00	0.00	<50	<0.5	<0.5	<0.5	<0.5	<0.5	<50
06/05/06	34.68	13.08	21.60	0.00	0.00	SAMPLED ANNUALLY	--	--	--	--	--	--
09/05/06	34.68	10.93	23.75	0.00	0.00	SAMPLED ANNUALLY	--	--	--	--	--	--
12/04/06	34.68	10.71	23.97	0.00	0.00	SAMPLED ANNUALLY	--	--	--	--	--	--
03/05/07 ⁷	34.68	11.63	23.05	0.00	0.00	<50	<0.5	<0.5	<0.5	<0.5	<0.5	<50
06/04/07	34.68	12.57	22.11	0.00	0.00	SAMPLED ANNUALLY	--	--	--	--	--	--
09/07/07	34.68	10.61	24.07	0.00	0.00	SAMPLED ANNUALLY	--	--	--	--	--	--
12/06/07	34.68	10.30	24.38	0.00	0.00	SAMPLED ANNUALLY	--	--	--	--	--	--
03/06/08 ⁷	34.68	11.32	23.36	0.00	0.00	<50	<0.5	<0.5	<0.5	<0.5	<0.5	<50
06/05/08	34.68	11.62	23.06	0.00	0.00	SAMPLED ANNUALLY	--	--	--	--	--	--
09/03/08	34.68	9.75	24.93	0.00	0.00	SAMPLED ANNUALLY	--	--	--	--	--	--
12/03/08	34.68	8.98	25.70	0.00	0.00	SAMPLED ANNUALLY	--	--	--	--	--	--
C-9												
08/13/96	--	--	28.27	--	--	ND	ND	ND	ND	ND	ND	--
09/06/96	--	--	28.47	--	--	<50	<0.5	<0.5	<0.5	<0.5	<2.5	--
12/19/96	30.68	1.39	29.29	--	--	<50	<0.5	<0.5	<0.5	<0.5	<2.5	--

Table 1
Groundwater Monitoring Data and Analytical Results
Chevron Service Station #9-0076
4265 Foothill Boulevard
Oakland, California

WELL ID/ DATE	TOC* (fL)	GWE (msl)	DTW (ft.)	SPHT (ft.)	SPH							ETHANOL (µg/L)	
					REMOVED (gallons)	TPH-G (µg/L)	B (µg/L)	T (µg/L)	E (µg/L)	X (µg/L)	MTBE (µg/L)		
C-9 (cont)													
03/17/97	30.68	3.11	27.57	--	--	<50	<0.5	<0.5	<0.5	<0.5	<0.5	<2.5	--
06/11/97	30.68	2.41	28.27	--	--	<50	<0.5	<0.5	<0.5	<0.5	<0.5	<2.5	--
09/17/97	30.68	2.05	28.63	--	--	SAMPLED ANNUALLY		--	--	--	--	--	--
12/11/97	30.68	1.25	29.43	--	--	--	--	--	--	--	--	--	--
03/12/98	30.68	5.06	25.62	--	--	<50	<0.5	<0.5	<0.5	<0.5	<0.5	<2.5	--
06/23/98	30.68	4.53	26.15	--	--	--	--	--	--	--	--	--	--
09/01/98	30.68	4.30	26.38	--	--	--	--	--	--	--	--	--	--
12/30/98	30.68	3.93	26.75	--	--	--	--	--	--	--	--	--	--
03/31/99	30.68	5.35	25.33	--	--	<50	<0.5	<0.5	<0.5	<0.5	12.5	--	--
06/14/99	30.68	4.16	26.52	--	--	--	--	--	--	--	--	--	--
09/30/99	30.68	3.89	26.79	--	--	--	--	--	--	--	--	--	--
12/22/99	30.68	2.99	27.69	--	--	--	--	--	--	--	--	--	--
03/09/00	30.68	4.64	26.04	--	--	<50	<0.5	<0.5	<0.5	0.75	<2.5	--	--
06/23/00	30.68	4.83	25.85	0.00	0.00	--	--	--	--	--	--	--	--
09/05/00	30.68	3.99	26.69	0.00	0.00	--	--	--	--	--	--	--	--
12/04/00	30.68	3.61	27.07	0.00	0.00	--	--	--	--	--	--	--	--
03/08/01	30.68	4.93	25.75	0.00	0.00	<50.0	<0.500	<0.500	<0.500	<0.500	<2.50	--	--
06/07/01	30.68	5.18	25.50	0.00	0.00	SAMPLED ANNUALLY		--	--	--	--	--	--
09/13/01	30.68	4.13	26.55	0.00	0.00	SAMPLED ANNUALLY		--	--	--	--	--	--
12/13/01	30.68	3.91	26.77	0.00	0.00	SAMPLED ANNUALLY		--	--	--	--	--	--
03/08/02	30.68	5.68	25.00	0.00	0.00	<50	<0.50	<0.50	<0.50	<1.5	<2.5	--	--
06/19/02	30.68	6.01	24.67	0.00	0.00	SAMPLED ANNUALLY		--	--	--	--	--	--
09/11/02	30.68	4.98	25.70	0.00	0.00	SAMPLED ANNUALLY		--	--	--	--	--	--
12/11/02	30.68	3.61	27.07	0.00	0.00	SAMPLED ANNUALLY		--	--	--	--	--	--
03/11/03	30.68	6.20	24.48	0.00	0.00	<50	<0.50	<0.50	<0.50	<1.5	<2.5	--	--
06/10/03	30.68	5.68	25.00	0.00	0.00	SAMPLED ANNUALLY		--	--	--	--	--	--
09/09/03	30.68	4.88	25.80	0.00	0.00	SAMPLED ANNUALLY		--	--	--	--	--	--
12/09/03	30.68	2.46	28.22	0.00	0.00	SAMPLED ANNUALLY		--	--	--	--	--	--
03/09/04 ⁷	30.68	6.82	23.86	0.00	0.00	<50	<0.5	<0.5	<0.5	<0.5	<0.5	<0.5	<50
06/08/04	-- ¹⁰	-- ¹⁰	25.21	0.00	0.00	SAMPLED ANNUALLY		--	--	--	--	--	--
09/08/04	-- ¹⁰	-- ¹⁰	25.61	0.00	0.00	SAMPLED ANNUALLY		--	--	--	--	--	--
12/06/04	-- ¹⁰	-- ¹⁰	24.77	0.00	0.00	SAMPLED ANNUALLY		--	--	--	--	--	--
03/07/05 ⁷	-- ¹⁰	-- ¹⁰	23.18	0.00	0.00	<50	<0.5	<0.5	<0.5	<0.5	<0.5	<0.5	<50
06/06/05	-- ¹⁰	-- ¹⁰	22.65	0.00	0.00	SAMPLED ANNUALLY		--	--	--	--	--	--
09/06/05	-- ¹⁰	-- ¹⁰	24.58	0.00	0.00	SAMPLED ANNUALLY		--	--	--	--	--	--

Table 1
Groundwater Monitoring Data and Analytical Results
 Chevron Service Station #9-0076
 4265 Foothill Boulevard
 Oakland, California

WELL ID/ DATE	TOC* (ft.)	GWE (msl)	DTW (ft.)	SPHT (ft.)	SPH REMOVED (gallons)	TPH-G (µg/L)	B (µg/L)	T (µg/L)	E (µg/L)	X (µg/L)	MTBE (µg/L)	ETHANOL (µg/L)
C-9 (cont)												
12/05/05	-- ¹⁰	-- ¹⁰	23.80	0.00	0.00	SAMPLED ANNUALLY	--	--	--	--	--	--
03/06/06 ⁷	-- ¹⁰	-- ¹⁰	22.44	0.00	0.00	<50	<0.5	<0.5	<0.5	<0.5	<0.5	<50
06/05/06	-- ¹⁰	-- ¹⁰	21.54	0.00	0.00	SAMPLED ANNUALLY	--	--	--	--	--	--
09/05/06	-- ¹⁰	-- ¹⁰	23.49	0.00	0.00	SAMPLED ANNUALLY	--	--	--	--	--	--
12/04/06	-- ¹⁰	-- ¹⁰	23.72	0.00	0.00	SAMPLED ANNUALLY	--	--	--	--	--	--
03/05/07 ⁷	-- ¹⁰	-- ¹⁰	22.97	0.00	0.00	<50	<0.5	<0.5	<0.5	<0.5	<0.5	<50
06/04/07	-- ¹⁰	-- ¹⁰	21.89	0.00	0.00	SAMPLED ANNUALLY	--	--	--	--	--	--
09/07/07	-- ¹⁰	-- ¹⁰	23.76	0.00	0.00	SAMPLED ANNUALLY	--	--	--	--	--	--
12/06/07	-- ¹⁰	-- ¹⁰	24.17	0.00	0.00	SAMPLED ANNUALLY	--	--	--	--	--	--
03/06/08 ⁷	-- ¹⁰	-- ¹⁰	23.18	0.00	0.00	<50	<0.5	<0.5	<0.5	<0.5	<0.5	<50
06/05/08	-- ¹⁰	-- ¹⁰	23.11	0.00	0.00	SAMPLED ANNUALLY	--	--	--	--	--	--
09/03/08	-- ¹⁰	-- ¹⁰	24.91	0.00	0.00	SAMPLED ANNUALLY	--	--	--	--	--	--
12/03/08	-- ¹⁰	-- ¹⁰	25.51	0.00	0.00	SAMPLED ANNUALLY	--	--	--	--	--	--
C-10												
09/09/03 ^{7,8}	--	--	17.18	0.00	0.00	<50	<0.5	<0.5	<0.5	0.5	14	<50
12/09/03 ⁷	--	--	14.24	0.00	0.00	<50	<0.5	<0.5	<0.5	<0.5	2	<50
03/09/04 ⁷	38.37	28.67	9.70	0.00	0.00	<50	<0.5	<0.5	<0.5	<0.5	15	<50
06/08/04 ⁷	38.37	26.67	11.70	0.00	0.00	<50	<0.5	<0.5	<0.5	<0.5	44	<50
09/08/04 ⁷	38.37	25.37	13.00	0.00	0.00	<50	<0.5	<0.5	<0.5	<0.5	2	<50
12/06/04 ⁷	38.37	25.84	12.53	0.00	0.00	<50	<0.5	<0.5	<0.5	<0.5	3	<50
03/07/05 ⁷	38.38	30.54	7.84	0.00	0.00	<50	<0.5	<0.5	<0.5	<0.5	140	<50
06/06/05 ⁷	38.38	28.76	9.62	0.00	0.00	<50	<0.5	<0.5	<0.5	<0.5	390	<50
09/06/05 ⁷	38.39	26.81	11.58	0.00	0.00	<50	<0.5	<0.5	<0.5	<0.5	190	<50
12/05/05 ⁷	38.39	27.51	10.88	0.00	0.00	<50	<0.5	<0.5	<0.5	<0.5	67	<50
03/06/06 ⁷	38.39	31.02	7.37	0.00	0.00	<50	<0.5	<0.5	<0.5	<0.5	280	<50
06/05/06 ⁷	38.39	29.14	9.25	0.00	0.00	<50	<0.5	<0.5	<0.5	<0.5	280	<50
09/05/06 ⁷	38.39	28.01	10.38	0.00	0.00	<50	3	3	2	16	63	<50
12/04/06 ⁷	38.39	27.74	10.65	0.00	0.00	<50	<0.5	<0.5	<0.5	<0.5	93	<50
03/05/07 ⁷	38.39	29.42	8.97	0.00	0.00	<50	<0.5	<0.5	<0.5	<0.5	100	<50
06/04/07 ⁷	38.39	28.59	9.80	0.00	0.00	<50	<0.5	<0.5	<0.5	<0.5	48	<50
09/07/07 ⁷	38.39	27.19	11.20	0.00	0.00	<50	<0.5	<0.5	<0.5	<0.5	18	<50

Table 1
Groundwater Monitoring Data and Analytical Results
Chevron Service Station #9-0076
4265 Foothill Boulevard
Oakland, California

WELL ID/ DATE	TOC* (ft.)	GWE (msl)	DTW (ft.)	SPHT (ft.)	SPH		B (µg/L)	T (µg/L)	E (µg/L)	X (µg/L)	MTBE (µg/L)	ETHANOL (µg/L)
					REMOVED (gallons)	TPH-G (µg/L)						
C-10 (cont)												
12/06/07 ⁷	38.39	27.86	10.53	0.00	0.00	<50	<0.5	<0.5	<0.5	<0.5	19	<50
03/06/08 ⁷	38.39	29.64	8.75	0.00	0.00	<50	<0.5	<0.5	<0.5	<0.5	43	<50
06/05/08 ⁷	38.39	28.44	9.95	0.00	0.00	<50	<0.5	<0.5	<0.5	<0.5	25	<50
09/03/08 ⁷	38.39	26.98	11.41	0.00	0.00	<50	<0.5	<0.5	<0.5	<0.5	12	<50
12/03/08 ⁷	38.39	27.13	11.26	0.00	0.00	<50	<0.5	<0.5	<0.5	<0.5	8	<50
TRIP BLANK												
04/28/89	--	--	--	--	--	<500	<0.5	<0.5	<0.5	<0.5	--	--
08/08/89	--	--	--	--	--	<500	<0.5	<0.5	<0.5	<0.5	--	--
08/27/90	--	--	--	--	--	<50	<0.3	<0.3	<0.3	<0.6	--	--
11/14/90	--	--	--	--	--	<50	<0.3	<0.3	<0.3	<0.6	--	--
06/18/91	--	--	--	--	--	<50	<0.5	<0.5	<0.5	<0.5	--	--
09/19/91	--	--	--	--	--	<50	<0.5	<0.5	<0.5	<0.5	--	--
12/20/91	--	--	--	--	--	<50	<0.5	<0.5	<0.5	<0.5	--	--
03/18/92	--	--	--	--	--	<50	<0.5	<0.5	<0.5	<0.5	--	--
07/14/92	--	--	--	--	--	<50	<0.5	<0.5	<0.5	<0.5	--	--
10/08/92	--	--	--	--	--	<50	<0.5	<0.5	<0.5	<0.5	--	--
01/08/93	--	--	--	--	--	<50	<0.5	<0.5	<0.5	<0.5	--	--
04/14/93	--	--	--	--	--	<50	<0.5	<0.5	<0.5	<0.5	--	--
07/16/93	--	--	--	--	--	<50	<0.5	<0.5	<0.5	<0.5	--	--
09/21/93	--	--	--	--	--	<50	<0.5	<0.5	<0.5	<0.8	--	--
01/28/94	--	--	--	--	--	<50	<0.5	<0.5	<0.5	<0.5	--	--
03/17/94	--	--	--	--	--	<50	<0.5	<0.5	<0.5	<0.5	--	--
06/16/94	--	--	--	--	--	<50	<0.5	<0.5	<0.5	<0.5	--	--
09/22/94	--	--	--	--	--	<50	<0.5	<0.5	<0.5	<0.5	--	--
12/15/94	--	--	--	--	--	<50	<0.5	<0.5	<0.5	<0.5	--	--
03/30/95	--	--	--	--	--	<50	<0.5	<0.5	<0.5	<0.5	--	--
06/20/95	--	--	--	--	--	<50	<0.5	<0.5	<0.5	<0.5	--	--
09/20/95	--	--	--	--	--	<50	<0.5	<0.5	<0.5	<0.5	--	--
12/06/95	--	--	--	--	--	<50	<0.5	<0.5	<0.5	<0.5	--	--
03/21/96	--	--	--	--	--	<50	<0.5	<0.5	<0.5	<0.5	<2.5	--
06/21/96	--	--	--	--	--	<50	<0.5	<0.5	<0.5	<0.5	<2.5	--
09/06/96	--	--	--	--	--	<50	<0.5	<0.5	<0.5	<0.5	--	--
12/19/96	--	--	--	--	--	<50	<0.5	<0.5	<0.5	<0.5	<2.5	--

Table 1
Groundwater Monitoring Data and Analytical Results
Chevron Service Station #9-0076
4265 Foothill Boulevard
Oakland, California

WELL ID/ DATE	TOC* (ft.)	GWE (msl)	DTW (ft.)	SPHT (ft.)	SPH REMOVED (gallons)	TPH-G (µg/L)	B (µg/L)	T (µg/L)	E (µg/L)	X (µg/L)	MTBE (µg/L)	ETHANOL (µg/L)
TRIP BLANK (cont)												
03/17/97	--	--	--	--	--	<50	<0.5	<0.5	<0.5	<0.5	<2.5	--
06/11/97	--	--	--	--	--	<50	<0.5	<0.5	<0.5	<0.5	<2.5	--
09/17/97	--	--	--	--	--	<50	<0.5	<0.5	<0.5	<0.5	<2.5	--
12/11/97	--	--	--	--	--	<50	<0.5	<0.5	<0.5	<0.5	<2.5	--
03/12/98	--	--	--	--	--	<50	<0.5	<0.5	<0.5	<0.5	<2.5	--
06/23/98	--	--	--	--	--	<50	<0.5	<0.5	<0.5	<0.5	<2.5	--
09/01/98	--	--	--	--	--	<50	<0.5	<0.5	<0.5	<0.5	<2.5	--
12/30/98	--	--	--	--	--	<50	<0.5	<0.5	<0.5	<0.5	<2.5	--
03/31/99	--	--	--	--	--	<50	<0.5	<0.5	<0.5	<0.5	<2.0	--
06/14/99	--	--	--	--	--	<50	<0.5	<0.5	<0.5	<0.5	<2.5	--
12/22/99	--	--	--	--	--	<50	<0.5	<0.5	<0.5	<0.5	<2.5	--
06/23/00	--	--	--	--	--	<50	<0.50	<0.50	<0.50	<0.50	<2.5	--
09/05/00	--	--	--	--	--	<50	<0.50	<0.50	<0.50	<0.50	<2.5	--
12/04/00	--	--	--	--	--	<50	<0.50	<0.50	<0.50	<0.50	<2.5	--
03/08/01	--	--	--	--	--	<50.0	<0.500	<0.500	<0.500	<0.500	<2.50	--
06/07/01	--	--	--	--	--	<50	<0.50	<0.50	<0.50	<0.50	<2.5	--
09/13/01	--	--	--	--	--	<50	<0.50	<0.50	<0.50	<0.50	<2.5	--
QA												
12/13/01	--	--	--	--	--	<50	<0.50	<0.50	<0.50	<1.5	<2.5	--
03/08/02	--	--	--	--	--	<50	<0.50	<0.50	<0.50	<1.5	<2.5	--
06/19/02	--	--	--	--	--	<50	<0.50	<0.50	<0.50	<1.5	<2.5	--
09/11/02	--	--	--	--	--	<50	<0.50	<0.50	<0.50	<1.5	<2.5	--
12/11/02	--	--	--	--	--	<50	<0.50	<0.50	<0.50	<1.5	<2.5	--
03/11/03	--	--	--	--	--	<50	<0.50	<0.50	<0.50	<1.5	<2.5	--
06/10/03 ⁷	--	--	--	--	--	<50	<0.5	<0.5	<0.5	<0.5	<0.5	--
09/09/03 ⁷	--	--	--	--	--	<50	<0.5	<0.5	<0.5	<0.5	<0.5	--
12/09/03 ⁷	--	--	--	--	--	<50	<0.5	<0.5	<0.5	<0.5	<0.5	--
03/09/04 ⁷	--	--	--	--	--	<50	<0.5	<0.5	<0.5	<0.5	<0.5	--
06/08/04 ⁷	--	--	--	--	--	<50	<0.5	<0.5	<0.5	<0.5	<0.5	--
09/08/04 ⁷	--	--	--	--	--	<50	<0.5	<0.5	<0.5	<0.5	<0.5	--
12/06/04 ⁷	--	--	--	--	--	<50	<0.5	<0.5	<0.5	<0.5	<0.5	--
03/07/05 ⁷	--	--	--	--	--	<50	<0.5	<0.5	<0.5	<0.5	<0.5	--
06/06/05 ⁷	--	--	--	--	--	<50	<0.5	<0.5	<0.5	<0.5	<0.5	--
09/06/05 ⁷	--	--	--	--	--	<50	<0.5	<0.5	<0.5	<0.5	<0.5	--
12/05/05 ⁷	--	--	--	--	--	<50	<0.5	<0.5	<0.5	<0.5	<0.5	--

Table 1
Groundwater Monitoring Data and Analytical Results
Chevron Service Station #9-0076
4265 Foothill Boulevard
Oakland, California

WELL ID/ DATE	TOC* (ft.)	GWE (msl)	DTW (ft.)	SPHT (ft.)	SPH								
					REMOVED (gallons)	TPH-G (µg/L)	B (µg/L)	T (µg/L)	E (µg/L)	X (µg/L)	MTBE (µg/L)	ETHANOL (µg/L)	
QA (cont)													
03/06/06 ⁷	--	--	--	--	--	<50	<0.5	<0.5	<0.5	<0.5	<0.5	<0.5	--
06/05/06 ⁷	--	--	--	--	--	<50	<0.5	<0.5	<0.5	<0.5	<0.5	<0.5	--
09/05/06 ⁷	--	--	--	--	--	<50	<0.5	<0.5	<0.5	<0.5	<0.5	<0.5	--
12/04/06 ⁷	--	--	--	--	--	<50	<0.5	<0.5	<0.5	<0.5	<0.5	<0.5	--
03/05/07 ⁷	--	--	--	--	--	<50	<0.5	<0.5	<0.5	<0.5	<0.5	<0.5	--
06/04/07 ⁷	--	--	--	--	--	<50	<0.5	<0.5	<0.5	<0.5	<0.5	<0.5	--
09/07/07 ⁷	--	--	--	--	--	<50	<0.5	<0.5	<0.5	<0.5	<0.5	<0.5	--
12/06/07 ⁷	--	--	--	--	--	<50	<0.5	<0.5	<0.5	<0.5	<0.5	<0.5	--
03/06/08 ⁷	--	--	--	--	--	<50	<0.5	<0.5	<0.5	<0.5	<0.5	<0.5	--
06/05/08 ⁷	--	--	--	--	--	<50	<0.5	<0.5	<0.5	<0.5	<0.5	<0.5	--
09/03/08 ⁷	--	--	--	--	--	<50	<0.5	<0.5	<0.5	<0.5	<0.5	<0.5	--
12/03/08 ⁷	--	--	--	--	--	<50	<0.5	<0.5	<0.5	<0.5	<0.5	<0.5	--

Table 1
Groundwater Monitoring Data and Analytical Results
Chevron Service Station #9-0076
4265 Foothill Boulevard
Oakland, California

EXPLANATIONS:

Groundwater monitoring data and laboratory analytical results prior to June 23, 2000, were compiled from reports prepared by Blaine Tech Services, Inc.

TOC = Top of Casing

(ft.) = Feet

GWE = Groundwater Elevation

(msl) = Mean sea level

DTW = Depth to Water

SPHT = Separate Phase Hydrocarbons Thickness

SPH = Separate Phase Hydrocarbons

TPH-G = Total Petroleum Hydrocarbons as Gasoline

B = Benzene

T = Toluene

E = Ethylbenzene

X = Xylenes

MTBE = Methyl Tertiary Butyl Ether

(µg/L) = Micrograms per liter

ND = Not Detected

-- = Not Measured/Not Analyzed

QA = Quality Assurance/Trip Blank

* TOC elevation for C-10 was surveyed on September 26, 2003, by Virgil Chavez Land Surveying. The benchmark for this survey was a City of Oakland No. 1589, a cut square in the sidewalk at the mid-return at the west corner of High Street and Foothill Blvd., (Benchmark Elevation = 38.54 feet, NGVD 29).

** GWE corrected for the presence of SPH; correction factor: $[(TOC - DTW) + (SPHT \times 0.80)]$.

¹ Confirmation run.

² Sample was analyzed past hold-time, the results should be considered as estimated.

³ ORC present in well.

⁴ Laboratory report indicates gasoline C6-C12.

⁵ Laboratory report indicates sample was originally analyzed within holding time. Re-analysis for confirmation or dilution was performed past the recommended holding time.

⁶ Laboratory report indicates hydrocarbon pattern is present in the requested fuel quantitation range but does not resemble the pattern of the requested fuel. BTEX and MTBE by EPA Method 8260.

⁸ Well development performed.

⁹ ORC removed from well.

¹⁰ TOC has been altered; unable to determine an accurate GWE.

¹¹ Laboratory confirmed result.

Table 2
Field Measurements and Groundwater Analytical Results
Chevron Service Station #9-0076
4265 Foothill Boulevard
Oakland, California

WELL ID/ DATE	D.O. Pre-Purge (mg/L)	D.O. Post-Purge (mg/L)	ORP Pre-Purge (mV)	ORP Post-Purge (mV)	Total Alkalinity (mg/L)	Ferrous Iron (mg/L)	Nitrate as Nitrate (mg/L)	Sulfate (mg/L)
C-1								
09/17/97	1.4	8.8	101	104	2.0	1.1	<1.0	12
03/12/98	1.7	3.6	171	171	550	3.0	<1.0	6.6
03/31/99	6.5	1.8	99	89	382	2520 ¹	0.418	8.23
12/22/99	0.95	2.0	-95	-128	568	0.19	<0.1	11
03/09/00	1.8	2.4	-47	-38	520	0.84	0.54	15
09/05/00	1.74	2.66	105	59	520	0.41	1.6	10
C-2								
09/17/97	1.3	--	150	--	560	4.7	<1.0	<1.0
03/12/98	1.1	1.1	176	174	420	3.5	<1.0	<1.0
03/31/99	1.5	1.6	151	157	456	2100 ¹	0.118	19.7
12/22/99	0.6	0.65	-90	-84	782	1.0	5.34	5.38
03/09/00	1.0	1.6	-68	-70	450	0.31	<0.1	0.39
09/05/00	1.31	1.85	65	44	690	0.34	<1.0	<1.0
C-3								
09/17/97	2.1	0.8	59	67	340	0.012	100	33
03/12/98	2.8	2.5	165	163	260	0.14	88	32
03/31/99	4.1	3.3	101	89	256	<500 ¹	18.4	72
12/22/99	0.98	1.48	69	107	402	0.013	67.7	37.6
03/09/00	3.3	1.6	110	97	390	0.12	60	38
09/05/00	3.79	2.53	202	203	430	0.011	52	40
C-4								
09/17/97	0.6	0.2	102	107	540	5.9	<1.0	<1.0
03/12/98	1.5	2.6	173	175	550	1.3	<1.0	2.7
03/31/99	1.8	2.2	170	176	492	1,560 ¹	0.191	<1.0
12/22/99	6.8	5.68	-25	14	739	0.87	1.85	39.6
03/09/00	1.1	1.9	-13	-39	530	<0.01	<0.1	4.5
09/05/00	2.22	2.02	105	138	530	<0.010	<1.0	29
C-5								
03/12/98	1.7	1.9	70	169	210	0.074	69	74
03/31/99	12.8	6.7	92	97	254	<500 ¹	16.7	69.7
03/09/00	2.8	3.6	120	118	230	0.39	60	74

Table 2
Field Measurements and Groundwater Analytical Results
 Chevron Service Station #9-0076
 4265 Foothill Boulevard
 Oakland, California

WELL ID/ DATE	D.O. Pre-Purge (mg/L)	D.O. Post-Purge (mg/L)	ORP Pre-Purge (mV)	ORP Post-Purge (mV)	Total Alkalinity (mg/L)	Ferrous Iron (mg/L)	Nitrate as Nitrate (mg/L)	Sulfate (mg/L)
C-6								
09/17/97	1.5	1.2	-57	-48	620	1.1	<1.0	18
03/12/98	14.1	11.3	173	174	200	0.11	14	14
03/31/99	9.8	8.4	162	168	534	<500 ¹	0.849	45.3
12/22/99	1.02	1.22	-65	-60	614	0.36	0.421	32
03/09/00	5.4	1.6	-113	-35	540	0.26	0.14	24
09/05/00	1.90	2.73	45	31	550	0.18	<1.0	38
C-7								
09/17/97	0.6	0.4	126	115	600	4.8	<1.0	18
03/12/98	2.2	2.1	167	167	460	0.16	<1.0	29
03/31/99	2.0	1.8	137	135	486	<500 ¹	<0.1	29.4
12/22/99	1.8	1.5	20	-60	400	1.6	0.434	16.9
03/09/00	0.7	2.5	10	-13	610	2.1	<0.1	5.5
09/05/00	1.77	1.46	133	46	590	1.8	<1.0	12
C-8								
03/12/98	1.0	1.1	171	169	110	0.16	7.4	8.2
03/31/99	1.8	1.5	149	132	264	<500 ¹	17	71
03/09/00	2.7	3.3	141	160	270	0.24	29	35
C-9								
03/12/98	2.5	2.5	172	168	230	0.048	59	58
03/31/99	2.1	2.3	154	142	236	<500 ¹	18	72.7
03/09/00	2.5	3.7	108	138	190	0.79	100	73

EXPLANATIONS:

Groundwater laboratory analytical results prior to September 5, 2000, were compiled from reports prepared by Blaine Tech Services, Inc.

D.O. = Dissolved Oxygen

(mV) = Millivolts

(mg/L) = Milligrams per liter

-- = Not Measured

ORP = Oxidation Reduction Potential

(ppb) = Parts per billion

¹ Analyzed in part per billion (ppb).

Table 3
Joint Groundwater Monitoring Data
 BP Service Station #11109
 4280 Foothill Boulevard
 Oakland, California

WELL ID	DATE	TOC* <i>(ft.)</i>	DTW <i>(ft.)</i>	SPHT <i>(ft.)</i>	GWE <i>(msl)</i>
MW-2	09/05/06	41.22	10.46	0.00	30.76
	03/05/07	41.22	12.25	0.00	28.97
	09/07/07 ¹	41.22	--	--	--
	12/06/07	41.22	SAMPLED SEMI-ANNUALLY		--
	03/06/08 ¹	41.22	--	--	--
	09/03/08	41.22	DRY	--	--
	MW-3	09/05/06	40.13	9.86	0.00
03/05/07		42.92	8.33	0.00	34.59
09/07/07 ¹		42.92	--	--	--
12/06/07		42.92	SAMPLED SEMI-ANNUALLY		--
03/06/08 ¹		42.92	--	--	--
09/03/08		42.92	12.19	0.00	30.73
MW-4		09/05/06	40.11	13.81	0.00
	03/05/07	42.88	10.63	0.00	32.25
	09/07/07 ¹	42.88	--	--	--
	12/06/07	42.88	SAMPLED SEMI-ANNUALLY		--
	03/06/08 ¹	42.88	--	--	--
	09/03/08	42.88	16.11	0.00	26.77
	MW-5	09/05/06	39.14	6.16	0.03
03/05/07		41.98	8.34	0.00	33.64
09/07/07 ¹		41.98	--	--	--
12/06/07		41.98	SAMPLED SEMI-ANNUALLY		--
03/06/08 ¹		41.98	--	--	--
09/03/08		41.98	12.90	0.99	29.87**
MW-6		09/05/06	41.59	14.10	0.00
	03/05/07	44.37	11.43	0.00	32.94
	09/07/07 ¹	44.37	--	--	--
	12/06/07	44.37	SAMPLED SEMI-ANNUALLY		--
	03/06/08 ¹	44.37	--	--	--
	09/03/08	44.37	16.24	0.00	28.13
	MW-7	09/05/06	40.32	11.45	0.00
03/05/07		43.10	9.31	0.00	33.79
09/07/07 ¹		43.10	--	--	--
12/06/07		43.10	SAMPLED SEMI-ANNUALLY		--
03/06/08 ¹		43.10	--	--	--
09/03/08		43.10	13.17	0.00	29.93
MW-8		09/05/06	38.18	12.61	0.00
	03/05/07	40.95	9.12	0.00	31.83
	09/07/07 ¹	40.95	--	--	--

Table 3
Joint Groundwater Monitoring Data
 BP Service Station #11109
 4280 Foothill Boulevard
 Oakland, California

WELL ID	DATE	TOC* (ft.)	DTW (ft.)	SPHT (ft.)	GWE (msl)
MW-8 (cont)	12/06/07	40.95	SAMPLED SEMI-ANNUALLY		--
	03/06/08 ¹	40.95	--	--	--
	09/03/08	40.95	14.20	0.00	26.75
MW-9	09/05/06	41.25	11.63	0.00	29.62
	03/05/07	44.06	9.33	0.00	34.73
	09/07/07 ¹	44.06	--	--	--
	12/06/07	44.06	SAMPLED SEMI-ANNUALLY		--
	03/06/08 ¹	44.06	--	--	--
	09/03/08	44.06	13.49	0.00	30.57

Table 3
Joint Groundwater Monitoring Data
BP Service Station #11109
4280 Foothill Boulevard
Oakland, California

EXPLANATIONS:

Groundwater monitoring data provided by Broadbent & Associates, Inc.

TOC = Top of Casing

(ft.) = Feet

DTW = Depth to Water

SPHT = Separate Phase Hydrocarbons Thickness

GWE = Groundwater Elevation

(msl) = Mean sea level

* TOC elevation relative to msl.

** GWE corrected for the presence of SPH; correction factor: $[(TOC - DTW) + (SPHT \times 0.80)]$.

¹ Joint Monitoring data was not provided.

STANDARD OPERATING PROCEDURE - GROUNDWATER SAMPLING

Gettler-Ryan Inc. field personnel adhere to the following procedures for the collection and handling of groundwater samples prior to analysis by the analytical laboratory. Prior to sample collection, the type of analysis to be performed is determined. Loss prevention of volatile compounds is controlled and sample preservation for subsequent analysis is maintained.

Prior to sampling, the presence or absence of free-phase hydrocarbons is determined using an interface probe. Product thickness, if present, is measured to the nearest 0.01 foot and is noted in the field notes. In addition, all depth to water level measurements are collected with a static water level indicator and are also recorded in the field notes, prior to purging and sampling any wells.

After water levels are collected and prior to sampling, if purging is to occur, each well is purged a minimum of three well casing volumes of water using pre-cleaned pumps (stack, suction, Grundfos), or disposable bailers. Temperature, pH and electrical conductivity are measured a minimum of three times during the purging. Purging continues until these parameters stabilize.

Groundwater samples are collected using disposable bailers. The water samples are transferred from the bailer into appropriate containers. Pre-preserved containers, supplied by analytical laboratories, are used when possible. When pre-preserved containers are not available, the laboratory is instructed to preserve the sample as appropriate. Duplicate samples are collected for the laboratory to use in maintaining quality assurance/quality control standards. The samples are labeled to include the job number, sample identification, collection date and time, analysis, preservation (if any), and the sample collector's initials. The water samples are placed in a cooler, maintained at 4°C for transport to the laboratory. Once collected in the field, all samples are maintained under chain of custody until delivered to the laboratory.

The chain of custody document includes the job number, type of preservation, if any, analysis requested, sample identification, date and time collected, and the sample collector's name. The chain of custody is signed and dated (including time of transfer) by each person who receives or surrenders the samples, beginning with the field personnel and ending with the laboratory personnel.

A laboratory supplied trip blank accompanies each sampling set. For sampling sets greater than 20 samples, 5% trip blanks are included. The trip blank is analyzed for some or all of the same compounds as the groundwater samples.

As requested by Chevron Environmental Management Company, the purge water and decontamination water generated during sampling activities is transported by IWM to Chemical Waste Management located in Kettleman Hills, California.



GETTLER - RYAN INC.

WELL MONITORING/SAMPLING FIELD DATA SHEET

Client/Facility#: Chevron #9-0076 Job Number: 386495
 Site Address: 4265 Foothill Blvd. Event Date: 12-3-08 (inclusive)
 City: Oakland, CA Sampler: Joe

Well ID: C-1
 Well Diameter: 2 1/3 in.
 Total Depth: 38.16 ft.
 Depth to Water: 13.85 ft.

Date Monitored: 12-3-08

Volume	3/4"= 0.02	1"= 0.04	2"= 0.17	3"= 0.38
Factor (VF)	4"= 0.66	5"= 1.02	6"= 1.50	12"= 5.80

Check if water column is less than 0.50 ft.

24.31 xVF 0.38 = 9.24 x3 case volume = Estimated Purge Volume: 28 gal.

Depth to Water w/ 80% Recharge [(Height of Water Column x 0.20) + DTW]: 18.71

Purge Equipment:

Disposable Bailer _____
 Stainless Steel Bailer _____
 Stack Pump _____
 Suction Pump _____
 Grundfos _____
 Peristaltic Pump _____
 QED Bladder Pump _____
 Other: _____

Sampling Equipment:

Disposable Bailer _____
 Pressure Bailer _____
 Discrete Bailer _____
 Peristaltic Pump _____
 QED Bladder Pump _____
 Other: _____

Time Started: _____ (2400 hrs)
 Time Completed: _____ (2400 hrs)
 Depth to Product: _____ ft
 Depth to Water: _____ ft
 Hydrocarbon Thickness: 0 ft
 Visual Confirmation/Description: _____
 Skimmer / Absorbent Sock (circle one)
 Amt Removed from Skimmer: _____ gal
 Amt Removed from Well: _____ gal
 Water Removed: _____
 Product Transferred to: _____

Start Time (purge): _____ Weather Conditions: F0999
 Sample Time/Date: 1135 12-3-08 Water Color: clear Odor: DI N medium
 Approx. Flow Rate: 1-3 gpm. Sediment Description: _____
 Did well de-water? yes If yes, Time: 1107 Volume: 11 gal. DTW @ Sampling: 26.43

Time (2400 hr.)	Volume (gal.)	pH	Conductivity (µmhos/cm - US)	Temperature (° F)	D.O. (mg/L)	ORP (mV)
<u>1106</u>	<u>10</u>	<u>6.71</u>	<u>793</u>	<u>18.9</u>		
<u>1107</u>	<u>11</u>					

LABORATORY INFORMATION

SAMPLE ID	(#) CONTAINER	REFRIG.	PRESERV. TYPE	LABORATORY	ANALYSES
<u>C-1</u>	<u>6</u> x voa vial	<u>YES</u>	<u>HCL</u>	<u>LANCASTER</u>	<u>TPH-G(8015)/BTEX+MTBE(8260)/ETHANOL (8260)</u>

COMMENTS:

Add/Replaced Lock: _____ Add/Replaced Plug: _____ Add/Replaced Bolt: _____



GETTLER-RYAN INC.

WELL MONITORING/SAMPLING FIELD DATA SHEET

Client/Facility#: Chevron #9-0076 Job Number: 386495
 Site Address: 4265 Foothill Blvd. Event Date: 12-3-08 (inclusive)
 City: Oakland, CA Sampler: Joc

Well ID: C-2 Date Monitored: 12.3.08
 Well Diameter: 213 in.
 Total Depth: 36.62 ft.
 Depth to Water: 14.61 ft. Check if water column is less than 0.50 ft.
22.01 xVF 0.38 = ~~28.36~~ x3 case volume = Estimated Purge Volume: 25 gal.
 Depth to Water w/ 80% Recharge [(Height of Water Column x 0.20) + DTW]: 19.01

Volume	3/4"= 0.02	1"= 0.04	2"= 0.17	3"= 0.38
Factor (VF)	4"= 0.66	5"= 1.02	6"= 1.50	12"= 5.80

Purge Equipment:

Disposable Bailer ~~✓~~
 Stainless Steel Bailer _____
 Stack Pump ✓
 Suction Pump _____
 Grundfos _____
 Peristaltic Pump _____
 QED Bladder Pump _____
 Other: _____

Sampling Equipment:

Disposable Bailer ✓
 Pressure Bailer _____
 Discrete Bailer _____
 Peristaltic Pump _____
 QED Bladder Pump _____
 Other: _____

Time Started: _____ (2400 hrs)
 Time Completed: _____ (2400 hrs)
 Depth to Product: _____ ft
 Depth to Water: _____ ft
 Hydrocarbon Thickness: 0 ft
 Visual Confirmation/Description: _____
 Skimmer / Absorbant Sock (circle one)
 Amt Removed from Skimmer: _____ gal
 Amt Removed from Well: _____ gal
 Water Removed: _____
 Product Transferred to: _____

Start Time (purge): 1220 Weather Conditions: Hazy
 Sample Time/Date: 1305 / 12-3-08 Water Color: clear Odor: 01 N Strong
 Approx. Flow Rate: 1-4 gpm. Sediment Description: _____
 Did well de-water? yes If yes, Time: 1228 Volume: 10 gal. DTW @ Sampling: 15.15

Time (2400 hr.)	Volume (gal.)	pH	Conductivity (µmhos/cm - µS)	Temperature (°F)	D.O. (mg/L)	ORP (mV)
<u>1226</u>	<u>9</u>	<u>6.73</u>	<u>698</u>	<u>19.2</u>		
<u>1228</u>	<u>10</u>	<u>6.73</u>				

LABORATORY INFORMATION

SAMPLE ID	(#) CONTAINER	REFRIG.	PRESERV. TYPE	LABORATORY	ANALYSES
<u>C-2</u>	<u>6</u> x vovial	<u>YES</u>	<u>HCL</u>	<u>LANCASTER</u>	<u>TPH-G(8015)/BTEX+MTBE(8260)/ETHANOL (8260)</u>

COMMENTS:

Add/Replaced Lock: _____ Add/Replaced Plug: _____ Add/Replaced Bolt: _____



GETTLER-RYAN INC.

WELL MONITORING/SAMPLING FIELD DATA SHEET

Client/Facility#: Chevron #9-0076 Job Number: 386495
 Site Address: 4265 Foothill Blvd. Event Date: 12-3-08 (inclusive)
 City: Oakland, CA Sampler: Jax

Well ID: C-3 Date Monitored: 12-3-08
 Well Diameter: 21(3) in.
 Total Depth: 39.45 ft.
 Depth to Water: 20.18 ft.

Volume	3/4"= 0.02	1"= 0.04	2"= 0.17	3"= 0.38
Factor (VF)	4"= 0.66	5"= 1.02	6"= 1.50	12"= 5.80

Check if water column is less than 0.50 ft.
 $19.27 \times VF \ 0.38 = 7.32 \times 3 \text{ case volume} = \text{Estimated Purge Volume: } 22 \text{ gal.}$
 Depth to Water w/ 80% Recharge [(Height of Water Column x 0.20) + DTW]: 24.03

- | | |
|--|---|
| Purge Equipment: | Sampling Equipment: |
| Disposable Bailer _____ | Disposable Bailer _____ <input checked="" type="checkbox"/> |
| Stainless Steel Bailer _____ | Pressure Bailer _____ |
| Stack Pump _____ <input checked="" type="checkbox"/> | Discrete Bailer _____ |
| Suction Pump _____ | Peristaltic Pump _____ |
| Grundfos _____ | QED Bladder Pump _____ |
| Peristaltic Pump _____ | Other: _____ |
| QED Bladder Pump _____ | |
| Other: _____ | |

Time Started: _____ (2400 hrs)
Time Completed: _____ (2400 hrs)
Depth to Product: _____ ft
Depth to Water: _____ ft
Hydrocarbon Thickness: <u>0</u> ft
Visual Confirmation/Description: _____
Skimmer / Absorbant Sock (circle one)
Amt Removed from Skimmer: _____ gal
Amt Removed from Well: _____ gal
Water Removed: _____
Product Transferred to: _____

Start Time (purge): 0935 Weather Conditions: Foggy
 Sample Time/Date: 1010 / 12-3-08 Water Color: clear Odor: YIP
 Approx. Flow Rate: 1-3 gpm. Sediment Description: _____
 Did well de-water? yes If yes, Time: 0944 Volume: 8.5 gal. DTW @ Sampling: 21.63

Time (2400 hr.)	Volume (gal.)	pH	Conductivity (µmhos/cm - <u>DB</u>)	Temperature (<u>0</u> / F)	D.O. (mg/L)	ORP (mV)
<u>0942</u>	<u>8</u>	<u>7.37</u>	<u>913</u>	<u>18.2</u>		
<u>0944</u>	<u>8.5</u>					

LABORATORY INFORMATION

SAMPLE ID	(#) CONTAINER	REFRIG.	PRESERV. TYPE	LABORATORY	ANALYSES
<u>C-3</u>	<u>6</u> x vov vial	YES	HCL	LANCASTER	TPH-G(8015)/BTEX+MTBE(8260)/ETHANOL (8260)

COMMENTS: _____

Add/Replaced Lock: _____ Add/Replaced Plug: _____ Add/Replaced Bolt: _____



GETTLER-RYAN INC.

WELL MONITORING/SAMPLING FIELD DATA SHEET

Client/Facility#: Chevron #9-0076
 Site Address: 4265 Foothill Blvd.
 City: Oakland, CA

Job Number: 386495
 Event Date: 12-3-08 (inclusive)
 Sampler: Joe

Well ID: C-4
 Well Diameter: 21³ in.
 Total Depth: 39.38 ft.
 Depth to Water: 14.08 ft.

Date Monitored: 12-3-08

Volume	3/4"= 0.02	1"= 0.04	2"= 0.17	3"= 0.38
Factor (VF)	4"= 0.66	5"= 1.02	6"= 1.50	12"= 5.80

Check if water column is less than 0.50 ft.

25.30 xVF 0.38 = 9.61 x3 case volume = Estimated Purge Volume: 29 gal.

Depth to Water w/ 80% Recharge [(Height of Water Column x 0.20) + DTW]: 19.14

Purge Equipment:

Disposable Bailer _____
 Stainless Steel Bailer _____
 Stack Pump / _____
 Suction Pump _____
 Grundfos _____
 Peristaltic Pump _____
 QED Bladder Pump _____
 Other: _____

Sampling Equipment:

Disposable Bailer ✓ _____
 Pressure Bailer _____
 Discrete Bailer _____
 Peristaltic Pump _____
 QED Bladder Pump _____
 Other: _____

Time Started:	_____ (2400 hrs)
Time Completed:	_____ (2400 hrs)
Depth to Product:	_____ ft
Depth to Water:	_____ ft
Hydrocarbon Thickness:	<u>0</u> ft
Visual Confirmation/Description:	_____
Skimmer / Absorbent Sock (circle one)	_____
Amt Removed from Skimmer:	_____ gal
Amt Removed from Well:	_____ gal
Water Removed:	_____
Product Transferred to:	_____

Start Time (purge): 1142 Weather Conditions: Hazy
 Sample Time/Date: 1208 / 12-3-08 Water Color: clear Odor: 1^N Medium
 Approx. Flow Rate: 1-3 gpm. Sediment Description: _____
 Did well de-water? yes If yes, Time: 1148 Volume: 11 gal. DTW @ Sampling: 15.39

Time (2400 hr.)	Volume (gal.)	pH	Conductivity (µmhos/cm - <u>65</u>)	Temperature (°F)	D.O. (mg/L)	ORP (mV)
<u>1147</u>	<u>10</u>	<u>6.81</u>	<u>657</u>	<u>18.6</u>	_____	_____
<u>1148</u>	<u>11</u>	_____	_____	_____	_____	_____
_____	_____	_____	_____	_____	_____	_____

LABORATORY INFORMATION

SAMPLE ID	(#) CONTAINER	REFRIG.	PRESERV. TYPE	LABORATORY	ANALYSES
<u>C-4</u>	<u>6</u> x voa vial	<u>YES</u>	<u>HCL</u>	<u>LANCASTER</u>	<u>TPH-G(8015)/BTEX+MTBE(8260)/ETHANOL (8260)</u>
_____	_____	_____	_____	_____	_____
_____	_____	_____	_____	_____	_____
_____	_____	_____	_____	_____	_____
_____	_____	_____	_____	_____	_____

COMMENTS: _____

Add/Replaced Lock: _____ Add/Replaced Plug: _____ Add/Replaced Bolt: _____



GETTLER-RYAN INC.

WELL MONITORING/SAMPLING FIELD DATA SHEET

Client/Facility#: Chevron #9-0076 Job Number: 386495
 Site Address: 4265 Foothill Blvd. Event Date: 12-3-08 (inclusive)
 City: Oakland, CA Sampler: Joc

Well ID: C-5
 Well Diameter: 213 in.
 Total Depth: 44.10 ft.
 Depth to Water: 20.41 ft.

Date Monitored: 12-3-08

Volume	3/4"= 0.02	1"= 0.04	2"= 0.17	3"= 0.38
Factor (VF)	4"= 0.66	5"= 1.02	6"= 1.50	12"= 5.80

Check if water column is less than 0.50 ft.

xVF _____ = _____ x3 case volume = Estimated Purge Volume: _____ gal.

Depth to Water w/ 80% Recharge [(Height of Water Column x 0.20) + DTW]: _____

Purge Equipment:

Disposable Bailer _____
 Stainless Steel Bailer _____
 Stack Pump _____
 Suction Pump _____
 Grundfos _____
 Peristaltic Pump _____
 QED Bladder Pump _____
 Other: _____

Sampling Equipment:

Disposable Bailer _____
 Pressure Bailer _____
 Discrete Bailer _____
 Peristaltic Pump _____
 QED Bladder Pump _____
 Other: _____

Time Started:	_____ (2400 hrs)
Time Completed:	_____ (2400 hrs)
Depth to Product:	_____ ft
Depth to Water:	_____ ft
Hydrocarbon Thickness:	<u>0</u> ft
Visual Confirmation/Description:	_____
Skimmer / Absorbant Sock (circle one)	_____
Amt Removed from Skimmer:	_____ gal
Amt Removed from Well:	_____ gal
Water Removed:	_____
Product Transferred to:	_____

Start Time (purge): _____ Weather Conditions: _____
 Sample Time/Date: / Water Color: _____ Odor: Y / N
 Approx. Flow Rate: _____ gpm. Sediment Description: _____
 Did well de-water? _____ If yes, Time: _____ Volume: _____ gal. DTW @ Sampling: _____

Time (2400 hr.)	Volume (gal.)	pH	Conductivity (µmhos/cm - µS)	Temperature (C / F)	D.O. (mg/L)	ORP (mV)

LABORATORY INFORMATION

SAMPLE ID	(#) CONTAINER	REFRIG.	PRESERV. TYPE	LABORATORY	ANALYSES
C-	x voa vial	YES	HCL	LANCASTER	TPH-G(8015)/BTEX+MTBE(8260)/ETHANOL (8260)

COMMENTS: M. only

Add/Replaced Lock: _____ Add/Replaced Plug: _____ Add/Replaced Bolt: _____



GETTLER-RYAN INC.

WELL MONITORING/SAMPLING FIELD DATA SHEET

Client/Facility#: Chevron #9-0076 Job Number: 386495
 Site Address: 4265 Foothill Blvd. Event Date: 12-3-08 (inclusive)
 City: Oakland, CA Sampler: Jac

Well ID: C-6 Date Monitored: 12-3-08
 Well Diameter: 213 in.
 Total Depth: 53.67 ft.
 Depth to Water: 22.18 ft.

Volume	3/4"= 0.02	1"= 0.04	2"= 0.17	3"= 0.38
Factor (VF)	4"= 0.66	5"= 1.02	6"= 1.50	12"= 5.80

Depth to Water w/ 80% Recharge [(Height of Water Column x 0.20) + DTW]: 28.47
 Check if water column is less than 0.50 ft.
 $31.49 \times VF 0.17 = 5.35$ x3 case volume = Estimated Purge Volume: 16.5 gal.

Purge Equipment:

Disposable Bailer _____
 Stainless Steel Bailer _____
 Stack Pump ✓
 Suction Pump _____
 Grundfos _____
 Peristaltic Pump _____
 QED Bladder Pump _____
 Other: _____

Sampling Equipment:

Disposable Bailer _____
 Pressure Bailer _____
 Discrete Bailer _____
 Peristaltic Pump _____
 QED Bladder Pump _____
 Other: _____

Time Started:	_____ (2400 hrs)
Time Completed:	_____ (2400 hrs)
Depth to Product:	_____ ft
Depth to Water:	_____ ft
Hydrocarbon Thickness:	<u>0</u> ft
Visual Confirmation/Description:	_____
Skimmer / Absorbant Sock (circle one)	_____
Amt Removed from Skimmer:	_____ gal
Amt Removed from Well:	_____ gal
Water Removed:	_____
Product Transferred to:	_____

Start Time (purge): 0845 Weather Conditions: Foggy
 Sample Time/Date: 0918 / 12-3-08 Water Color: Clear Odor: Y 10
 Approx. Flow Rate: 1-4 gpm. Sediment Description: _____
 Did well de-water? yes If yes, Time: 0853 Volume: 6.5 gal. DTW @ Sampling: 24.16

Time (2400 hr.)	Volume (gal.)	pH	Conductivity (µmhos/cm - <u>US</u>)	Temperature (° F)	D.O. (mg/L)	ORP (mV)
<u>0850</u>	<u>6</u>	<u>7.26</u>	<u>845</u>	<u>18.9</u>		
<u>0853</u>	<u>6.5</u>					

LABORATORY INFORMATION

SAMPLE ID	(#) CONTAINER	REFRIG.	PRESERV. TYPE	LABORATORY	ANALYSES
<u>C-6</u>	<u>6</u> x voa vial	<u>YES</u>	<u>HCL</u>	<u>LANCASTER</u>	<u>TPH-G(8015)/BTEX+MTBE(8260)/ ETHANOL (8260)</u>

COMMENTS: _____

Add/Replaced Lock: _____ Add/Replaced Plug: _____ Add/Replaced Bolt: _____



GETTLER-RYAN INC.

WELL MONITORING/SAMPLING FIELD DATA SHEET

Client/Facility#: Chevron #9-0076 Job Number: 386495
 Site Address: 4265 Foothill Blvd. Event Date: 12-3-08 (inclusive)
 City: Oakland, CA Sampler: Joe

Well ID: C-7
 Well Diameter: 213 in.
 Total Depth: 51.08 ft.
 Depth to Water: 25.22 ft.

Date Monitored: 12-3-08

Volume	3/4"= 0.02	1"= 0.04	2"= 0.17	3"= 0.38
Factor (VF)	4"= 0.66	5"= 1.02	6"= 1.50	12"= 5.80

Check if water column is less than 0.50 ft.
 $25.86 \times VF 0.17 = 4.40$ x3 case volume = Estimated Purge Volume: 13.5 gal.

Depth to Water w/ 80% Recharge [(Height of Water Column x 0.20) + DTW]: 30.37

Purge Equipment:

Disposable Bailer _____
 Stainless Steel Bailer _____
 Stack Pump ✓
 Suction Pump _____
 Grundfos _____
 Peristaltic Pump _____
 QED Bladder Pump _____
 Other: _____

Sampling Equipment:

Disposable Bailer ✓
 Pressure Bailer _____
 Discrete Bailer _____
 Peristaltic Pump _____
 QED Bladder Pump _____
 Other: _____

Time Started: _____ (2400 hrs)
 Time Completed: _____ (2400 hrs)
 Depth to Product: _____ ft
 Depth to Water: _____ ft
 Hydrocarbon Thickness: 0 ft
 Visual Confirmation/Description: _____
 Skimmer / Absorbent Sock (circle one)
 Amt Removed from Skimmer: _____ gal
 Amt Removed from Well: _____ gal
 Water Removed: _____
 Product Transferred to: _____

Start Time (purge): 0752 Weather Conditions: Foggy
 Sample Time/Date: 0825 / 12-3-08 Water Color: clear Odor: 01 N faint
 Approx. Flow Rate: 1-3 gpm. Sediment Description: _____
 Did well de-water? yes If yes, Time: 0802 Volume: 6 gal. DTW @ Sampling: 27.64

Time (2400 hr.)	Volume (gal.)	pH	Conductivity (µmhos/cm - <u>CS</u>)	Temperature (C / F)	D.O. (mg/L)	ORP (mV)
<u>0759</u>	<u>5</u>	<u>7.14</u>	<u>891</u>	<u>19.2</u>		
<u>0802</u>	<u>6</u>					

LABORATORY INFORMATION

SAMPLE ID	(#) CONTAINER	REFRIG.	PRESERV. TYPE	LABORATORY	ANALYSES
<u>C-7</u>	<u>6</u> x vov vial	<u>YES</u>	<u>HCL</u>	<u>LANCASTER</u>	<u>TPH-G(8015)/BTEX+MTBE(8260)/ETHANOL (8260)</u>

COMMENTS:

Add/Replaced Lock: _____ Add/Replaced Plug: _____ Add/Replaced Bolt: _____



GETTLER-RYAN INC.

WELL MONITORING/SAMPLING FIELD DATA SHEET

Client/Facility#: Chevron #9-0076 Job Number: 386495
 Site Address: 4265 Foothill Blvd. Event Date: 12-3-08 (inclusive)
 City: Oakland, CA Sampler: Joe

Well ID: C-8 Date Monitored: 12-3-08
 Well Diameter: 213 in.
 Total Depth: 56.20 ft.
 Depth to Water: 25.70 ft. Check if water column is less than 0.50 ft.

Volume	3/4"= 0.02	1"= 0.04	2"= 0.17	3"= 0.38
Factor (VF)	4"= 0.66	5"= 1.02	6"= 1.50	12"= 5.80

xVF _____ = _____ x3 case volume = Estimated Purge Volume: _____ gal.

Depth to Water w/ 80% Recharge [(Height of Water Column x 0.20) + DTW]: _____

Purge Equipment:
 Disposable Bailer _____
 Stainless Steel Bailer _____
 Stack Pump _____
 Suction Pump _____
 Grundfos _____
 Peristaltic Pump _____
 QED Bladder Pump _____
 Other: _____

Sampling Equipment:
 Disposable Bailer _____
 Pressure Bailer _____
 Discrete Bailer _____
 Peristaltic Pump _____
 QED Bladder Pump _____
 Other: _____

Time Started: _____ (2400 hrs)
 Time Completed: _____ (2400 hrs)
 Depth to Product: _____ ft
 Depth to Water: _____ ft
 Hydrocarbon Thickness: _____ ft
 Visual Confirmation/Description: _____
 Skimmer / Absorbant Sock (circle one)
 Amt Removed from Skimmer: _____ gal
 Amt Removed from Well: _____ gal
 Water Removed: _____
 Product Transferred to: _____

Start Time (purge): _____ Weather Conditions: _____
 Sample Time/Date: _____ / _____ Water Color: _____ Odor: Y / N
 Approx. Flow Rate: _____ gpm. Sediment Description: _____
 Did well de-water? _____ If yes, Time: _____ Volume: _____ gal. DTW @ Sampling: _____

Time (2400 hr.)	Volume (gal.)	pH	Conductivity (µmhos/cm - µS)	Temperature (C / F)	D.O. (mg/L)	ORP (mV)
_____	_____	_____	_____	_____	_____	_____
_____	_____	_____	_____	_____	_____	_____
_____	_____	_____	_____	_____	_____	_____

LABORATORY INFORMATION

SAMPLE ID	(#) CONTAINER	REFRIG.	PRESERV. TYPE	LABORATORY	ANALYSES
C-	x voa vial	YES	HCL	LANCASTER	TPH-G(8015)/BTEX+MTBE(8260)/ETHANOL (8260)

COMMENTS: m-only

Add/Replaced Lock: _____ Add/Replaced Plug: _____ Add/Replaced Bolt: _____



GETTLER-RYAN INC.

WELL MONITORING/SAMPLING FIELD DATA SHEET

Client/Facility#: Chevron #9-0076 Job Number: 386495
 Site Address: 4265 Foothill Blvd. Event Date: 12-3-08 (inclusive)
 City: Oakland, CA Sampler: Joe

Well ID: C-9 Date Monitored: 12-3-08
 Well Diameter: 213 in.
 Total Depth: 45.15 ft.
 Depth to Water: 25.51 ft. Check if water column is less than 0.50 ft.

Volume	3/4"= 0.02	1"= 0.04	2"= 0.17	3"= 0.38
Factor (VF)	4"= 0.66	5"= 1.02	6"= 1.50	12"= 5.80

 xVF = x3 case volume = Estimated Purge Volume: gal.
 Depth to Water w/ 80% Recharge [(Height of Water Column x 0.20) + DTW]:

- Purge Equipment:**
 Disposable Bailer _____
 Stainless Steel Bailer _____
 Stack Pump _____
 Suction Pump _____
 Grundfos _____
 Peristaltic Pump _____
 QED Bladder Pump _____
 Other: _____
- Sampling Equipment:**
 Disposable Bailer _____
 Pressure Bailer _____
 Discrete Bailer _____
 Peristaltic Pump _____
 QED Bladder Pump _____
 Other: _____

Time Started: _____ (2400 hrs)
 Time Completed: _____ (2400 hrs)
 Depth to Product: _____ ft
 Depth to Water: _____ ft
 Hydrocarbon Thickness: 8 ft
 Visual Confirmation/Description: _____
 Skimmer / Absorbant Sock (circle one)
 Amt Removed from Skimmer: _____ gal
 Amt Removed from Well: _____ gal
 Water Removed: _____
 Product Transferred to: _____

Start Time (purge): _____ Weather Conditions: _____
 Sample Time/Date: / Water Color: _____ Odor: Y / N
 Approx. Flow Rate: _____ gpm. Sediment Description: _____
 Did well de-water? _____ If yes, Time: _____ Volume: _____ gal. DTW @ Sampling: _____

Time (2400 hr.)	Volume (gal.)	pH	Conductivity (µmhos/cm - µS)	Temperature (C / F)	D.O. (mg/L)	ORP (mV)

LABORATORY INFORMATION

SAMPLE ID	(#) CONTAINER	REFRIG.	PRESERV. TYPE	LABORATORY	ANALYSES
C-	x voa vial	YES	HCL	LANCASTER	TPH-G(8015)/BTEX+MTBE(8260)/ETHANOL (8260)

COMMENTS: n-only

Add/Replaced Lock: _____ Add/Replaced Plug: _____ Add/Replaced Bolt: _____



GETTLER-RYAN INC.

WELL MONITORING/SAMPLING FIELD DATA SHEET

Client/Facility#: Chevron #9-0076 Job Number: 386495
 Site Address: 4265 Foothill Blvd. Event Date: 12-3-08 (inclusive)
 City: Oakland, CA Sampler: Soe

Well ID: C-10 Date Monitored: 12-3-08
 Well Diameter: Ø13 in.
 Total Depth: 30.14 ft.
 Depth to Water: 11.26 ft.

Volume	3/4"= 0.02	1"= 0.04	2"= 0.17	3"= 0.38
Factor (VF)	4"= 0.66	5"= 1.02	6"= 1.50	12"= 5.80

Check if water column is less than 0.50 ft.

18.88 xVF 0.17 = 3.21 x3 case volume = Estimated Purge Volume: 10 gal.

Depth to Water w/ 80% Recharge [(Height of Water Column x 0.20) + DTW]: 15.03

Purge Equipment:

Disposable Bailer _____
 Stainless Steel Bailer _____
 Stack Pump ✓
 Suction Pump _____
 Grundfos _____
 Peristaltic Pump _____
 QED Bladder Pump _____
 Other: _____

Sampling Equipment:

Disposable Bailer ✓
 Pressure Bailer _____
 Discrete Bailer _____
 Peristaltic Pump _____
 QED Bladder Pump _____
 Other: _____

Time Started: _____ (2400 hrs)
 Time Completed: _____ (2400 hrs)
 Depth to Product: _____ ft
 Depth to Water: _____ ft
 Hydrocarbon Thickness: 0 ft
 Visual Confirmation/Description: _____
 Skimmer / Absorbent Sock (circle one)
 Amt Removed from Skimmer: _____ gal
 Amt Removed from Well: _____ gal
 Water Removed: _____
 Product Transferred to: _____

Start Time (purge): 1022 Weather Conditions: Foggy
 Sample Time/Date: 1055/12-3-08 Water Color: clear Odor: Y10
 Approx. Flow Rate: 1-2 gpm. Sediment Description: _____
 Did well de-water? yes If yes, Time: 1027 Volume: 4.5 gal. DTW @ Sampling: 12.65

Time (2400 hr.)	Volume (gal.)	pH	Conductivity (µmhos/cm - µS)	Temperature (C/F)	D.O. (mg/L)	ORP (mV)
<u>1026</u>	<u>4</u>	<u>7.23</u>	<u>798</u>	<u>18.2</u>		
<u>1027</u>	<u>4.5</u>					

LABORATORY INFORMATION

SAMPLE ID	(#) CONTAINER	REFRIG.	PRESERV. TYPE	LABORATORY	ANALYSES
<u>C-10</u>	<u>6</u> x voa vial	<u>YES</u>	<u>HCL</u>	<u>LANCASTER</u>	<u>TPH-G(8015)/BTEX+MTBE(8260)/ ETHANOL (8260)</u>

COMMENTS: _____

Add/Replaced Lock: _____ Add/Replaced Plug: _____ Add/Replaced Bolt: _____

Chevron California Region Analysis Request/Chain of Custody



120408-06

Acct. #: 10904 For Lancaster Laboratories use only Sample # 5548189-96 Group #: 009199

Group # 1123093

Facility #: SS#9-0076-OML G-R#386495 Global ID#T0600100339
 Site Address: 4265 FOOTHILL BLVD., OAKLAND, CA
 Chevron PM: AC CRACE
 Consultant/Office: G-R, Inc., 6747 Sierra Court, Suite J, Dublin, CA 94568
 Consultant Prj. Mgr.: Deanna L. Harding (deanna@grinc.com)
 Consultant Phone #: 925-551-7555 Fax #: 925-551-7899
 Sampler: JOE ASEMIAN

Sample Identification			Date Collected		Time Collected		Grab Composite		Matrix			Analyses Requested										
												Preservation Codes										
									Soil	Potable	NPDES	Total Number of Containers	BTEX + MTBE 8260	TPH 8015 MOD GRO	TPH 8015 MOD DRO	Silica Gel Cleanup	8260 full scan	Oxygenates	Total Lead Method	Dissolved Lead Method	Ethanol (8260)	
QA												2	<input checked="" type="checkbox"/>	<input checked="" type="checkbox"/>								
C-1	12-3-08	1135										6	<input checked="" type="checkbox"/>	<input checked="" type="checkbox"/>								
C-2		1305										6	<input checked="" type="checkbox"/>	<input checked="" type="checkbox"/>								
C-3		1010										6	<input checked="" type="checkbox"/>	<input checked="" type="checkbox"/>								
C-4		1208										6	<input checked="" type="checkbox"/>	<input checked="" type="checkbox"/>								
C-6		0918										6	<input checked="" type="checkbox"/>	<input checked="" type="checkbox"/>								
C-7		0825										6	<input checked="" type="checkbox"/>	<input checked="" type="checkbox"/>								
C-10		1055										6	<input checked="" type="checkbox"/>	<input checked="" type="checkbox"/>								

Preservative Codes
 H = HCl T = Thiosulfate
 N = HNO₃ B = NaOH
 S = H₂SO₄ O = Other

J value reporting needed
 Must meet lowest detection limits possible for 8260 compounds
 8021 MTBE Confirmation
 Confirm highest hit by 8260
 Confirm all hits by 8260
 Run ___ oxy's on highest hit
 Run ___ oxy's on all hits

Turnaround Time Requested (TAT) (please circle)
 24 hour 72 hour 48 hour
 4 day 5 day

Data Package Options (please circle if required)
 QC Summary Type I - Full
 Type VI (Raw Data) Coelt Deliverable not needed
 WIP (RWQCB)
 Disk

EDF/EDD

Relinquished by: <u>[Signature]</u>	Date: 12-4-08	Time: 12:55	Received by: <u>[Signature]</u>	Date: 04 DEC 08	Time: 1125
Relinquished by: <u>[Signature]</u>	Date: 12/4/08	Time: 1600	Received by: <u>[Signature]</u>	Date: 12/4/08	Time: 1600
Relinquished by: _____	Date: _____	Time: _____	Received by: _____	Date: _____	Time: _____
Relinquished by Commercial Carrier: UPS FedEx Other _____	Temperature Upon Receipt: <u>17.39</u> °C		Received by: <u>[Signature]</u>	Date: 12/6/08	Time: 0820
Custody Seals Intact? <u>Yes</u> No					



Analysis Report

2425 New Holland Pike, PO Box 12425, Lancaster, PA 17605-2425 • 717-656-2300 Fax: 717-656-2681 • www.lancasterlabs.com

ANALYTICAL RESULTS

Prepared for:

Chevron
6001 Bollinger Canyon Rd L4310
San Ramon CA 94583

925-842-8582

Prepared by:

Lancaster Laboratories
2425 New Holland Pike
Lancaster, PA 17605-2425

RECEIVED

DEC 15 2008

GETTLER-RYAN INC.
GENERAL CONTRACTORS

SAMPLE GROUP

The sample group for this submittal is 1123093. Samples arrived at the laboratory on Friday, December 05, 2008. The PO# for this group is 0015025028 and the release number is COSTA.

<u>Client Description</u>	<u>Lancaster Labs Number</u>
QA-T-081203 NA Water	5548189
C-1-W-081203 Grab Water	5548190
C-2-W-081203 Grab Water	5548191
C-3-W-081203 Grab Water	5548192
C-4-W-081203 Grab Water	5548193
C-6-W-081203 Grab Water	5548194
C-7-W-081203 Grab Water	5548195
C-10-W-081203 Grab Water	5548196

ELECTRONIC COPY TO CRA c/o Gettler-Ryan

Attn: Cheryl Hansen



Analysis Report

2425 New Holland Pike, PO Box 12425, Lancaster, PA 17605-2425 • 717-656-2300 Fax: 717-656-2681 • www.lancasterlabs.com

Questions? Contact your Client Services Representative
Jill M Parker at (717) 656-2300

Respectfully Submitted,

A handwritten signature in cursive script, appearing to read "Christine Dulaney".

Christine Dulaney
Senior Specialist

Lancaster Laboratories Sample No. **WW5548189**

Group No. **1123093**

QA-T-081203 NA Water
Facility# 90076 Job# 386495 GRD
4265 Foothill Blvd-Oakland T0600100339 QA
 Collected: 12/03/2008

Account Number: 10904

Submitted: 12/05/2008 08:45
 Reported: 12/14/2008 at 19:39
 Discard: 01/14/2009

Chevron
 6001 Bollinger Canyon Rd L4310
 San Ramon CA 94583

426QA

CAT No.	Analysis Name	CAS Number	As Received Result	As Received		Units	Dilution Factor
				Method	Detection Limit		
01728	TPH-GRO N. CA water C6-C12	n.a.	N.D.		50	ug/l	1
06054	BTEX+MTBE by 8260B						
02010	Methyl Tertiary Butyl Ether	1634-04-4	N.D.		0.5	ug/l	1
05401	Benzene	71-43-2	N.D.		0.5	ug/l	1
05407	Toluene	108-88-3	N.D.		0.5	ug/l	1
05415	Ethylbenzene	100-41-4	N.D.		0.5	ug/l	1
06310	Xylene (Total)	1330-20-7	N.D.		0.5	ug/l	1

State of California Lab Certification No. 2116

All QC is compliant unless otherwise noted. Please refer to the Quality Control Summary for overall QC performance data and associated samples.

Laboratory Chronicle

CAT No.	Analysis Name	Method	Analysis		Analyst	Dilution Factor
			Trial#	Date and Time		
01728	TPH-GRO N. CA water C6-C12	SW-846 8015B	1	12/12/2008 16:53	Marie D John	1
06054	BTEX+MTBE by 8260B	SW-846 8260B	1	12/10/2008 06:22	Michael A Ziegler	1
01146	GC VOA Water Prep	SW-846 5030B	1	12/12/2008 16:53	Marie D John	1
01163	GC/MS VOA Water Prep	SW-846 5030B	1	12/10/2008 06:22	Michael A Ziegler	1

Lancaster Laboratories Sample No. WW5548190
Group No. 1123093
C-1-W-081203 Grab Water
Facility# 90076 Job# 386495 GRD
4265 Foothill Blvd-Oakland T0600100339 C-1
 Collected: 12/03/2008 11:35 by JA

Account Number: 10904

 Submitted: 12/05/2008 08:45
 Reported: 12/14/2008 at 19:39
 Discard: 01/14/2009

 Chevron
 6001 Bollinger Canyon Rd L4310
 San Ramon CA 94583

426C1

CAT No.	Analysis Name	CAS Number	As Received Result	As Received		Dilution Factor
				Method	Detection Limit	
01728	TPH-GRO N. CA water C6-C12	n.a.	70		50	ug/l 1
06067	BTEX, MTBE, ETOH					
01587	Ethanol	64-17-5	N.D.		50	ug/l 1
02010	Methyl Tertiary Butyl Ether	1634-04-4	29		0.5	ug/l 1
05401	Benzene	71-43-2	N.D.		0.5	ug/l 1
05407	Toluene	108-88-3	N.D.		0.5	ug/l 1
05415	Ethylbenzene	100-41-4	N.D.		0.5	ug/l 1
06310	Xylene (Total)	1330-20-7	N.D.		0.5	ug/l 1

State of California Lab Certification No. 2116

All QC is compliant unless otherwise noted. Please refer to the Quality Control Summary for overall QC performance data and associated samples.

Laboratory Chronicle

CAT No.	Analysis Name	Method	Analysis		Analyst	Dilution Factor
			Trial#	Date and Time		
01728	TPH-GRO N. CA water C6-C12	SW-846 8015B	1	12/12/2008 17:42	Marie D John	1
06067	BTEX, MTBE, ETOH	SW-846 8260B	1	12/11/2008 09:10	Ginelle L Feister	1
01146	GC VOA Water Prep	SW-846 5030B	1	12/12/2008 17:42	Marie D John	1
01163	GC/MS VOA Water Prep	SW-846 5030B	1	12/11/2008 09:10	Ginelle L Feister	1

Lancaster Laboratories Sample No. WW5548191
Group No. 1123093
C-2-W-081203 Grab Water
Facility# 90076 Job# 386495 GRD
4265 Foothill Blvd-Oakland T0600100339 C-2
 Collected: 12/03/2008 13:05 by JA

Account Number: 10904

 Submitted: 12/05/2008 08:45
 Reported: 12/14/2008 at 19:39
 Discard: 01/14/2009

 Chevron
 6001 Bollinger Canyon Rd L4310
 San Ramon CA 94583

426C2

CAT No.	Analysis Name	CAS Number	As Received Result	As Received		Units	Dilution Factor
				Method	Detection Limit		
01728	TPH-GRO N. CA water C6-C12	n.a.	9,600		250	ug/l	5
06067	BTEX, MTBE, ETOH						
01587	Ethanol	64-17-5	N.D.		130	ug/l	2.5
02010	Methyl Tertiary Butyl Ether	1634-04-4	220		1	ug/l	2.5
05401	Benzene	71-43-2	1,100		13	ug/l	25
05407	Toluene	108-88-3	58		1	ug/l	2.5
05415	Ethylbenzene	100-41-4	250		1	ug/l	2.5
06310	Xylene (Total)	1330-20-7	210		1	ug/l	2.5

State of California Lab Certification No. 2116

All QC is compliant unless otherwise noted. Please refer to the Quality Control Summary for overall QC performance data and associated samples.

Laboratory Chronicle

CAT No.	Analysis Name	Method	Analysis		Analyst	Dilution Factor
			Trial#	Date and Time		
01728	TPH-GRO N. CA water C6-C12	SW-846 8015B	1	12/13/2008 01:27	Marie D John	5
06067	BTEX, MTBE, ETOH	SW-846 8260B	1	12/11/2008 10:24	Ginelle L Feister	2.5
06067	BTEX, MTBE, ETOH	SW-846 8260B	1	12/11/2008 10:48	Ginelle L Feister	25
01146	GC VOA Water Prep	SW-846 5030B	1	12/13/2008 01:27	Marie D John	5
01163	GC/MS VOA Water Prep	SW-846 5030B	1	12/11/2008 10:24	Ginelle L Feister	2.5
01163	GC/MS VOA Water Prep	SW-846 5030B	2	12/11/2008 10:48	Ginelle L Feister	25



Analysis Report

2425 New Holland Pike, PO Box 12425, Lancaster, PA 17605-2425 • 717-656-2300 Fax: 717-656-2681 • www.lancasterlabs.com

Page 1 of 1

Lancaster Laboratories Sample No. WW5548192

Group No. 1123093

C-3-W-081203 Grab Water
Facility# 90076 Job# 386495 GRD
4265 Foothill Blvd-Oakland T0600100339 C-3
Collected: 12/03/2008 10:10 by JA

Account Number: 10904

Submitted: 12/05/2008 08:45
Reported: 12/14/2008 at 19:39
Discard: 01/14/2009

Chevron
6001 Bollinger Canyon Rd L4310
San Ramon CA 94583

426C3

CAT No.	Analysis Name	CAS Number	As Received Result	As Received Method Detection Limit	Units	Dilution Factor
01728	TPH-GRO N. CA water C6-C12	n.a.	N.D.	50	ug/l	1
06067	BTEX, MTBE, ETOH					
01587	Ethanol	64-17-5	N.D.	50	ug/l	1
02010	Methyl Tertiary Butyl Ether	1634-04-4	N.D.	0.5	ug/l	1
05401	Benzene	71-43-2	N.D.	0.5	ug/l	1
05407	Toluene	108-88-3	N.D.	0.5	ug/l	1
05415	Ethylbenzene	100-41-4	N.D.	0.5	ug/l	1
06310	Xylene (Total)	1330-20-7	N.D.	0.5	ug/l	1

State of California Lab Certification No. 2116

All QC is compliant unless otherwise noted. Please refer to the Quality Control Summary for overall QC performance data and associated samples.

Laboratory Chronicle

CAT No.	Analysis Name	Method	Analysis			Dilution Factor
			Trial#	Date and Time	Analyst	
01728	TPH-GRO N. CA water C6-C12	SW-846 8015B	1	12/12/2008 18:31	Marie D John	1
06067	BTEX, MTBE, ETOH	SW-846 8260B	1	12/11/2008 11:13	Ginelle L Feister	1
01146	GC VOA Water Prep	SW-846 5030B	1	12/12/2008 18:31	Marie D John	1
01163	GC/MS VOA Water Prep	SW-846 5030B	1	12/11/2008 11:13	Ginelle L Feister	1



Analysis Report

2425 New Holland Pike, PO Box 12425, Lancaster, PA 17605-2425 • 717-656-2300 Fax: 717-656-2681 • www.lancasterlabs.com

Page 1 of 1

Lancaster Laboratories Sample No. **WW5548193**

Group No. **1123093**

C-4-W-081203 Grab Water
Facility# 90076 Job# 386495 GRD
4265 Foothill Blvd-Oakland T0600100339 C-4
Collected: 12/03/2008 12:08 by JA

Account Number: 10904

Submitted: 12/05/2008 08:45
Reported: 12/14/2008 at 19:39
Discard: 01/14/2009

Chevron
6001 Bollinger Canyon Rd L4310
San Ramon CA 94583

426C4

CAT No.	Analysis Name	CAS Number	As Received Result	As Received Method Detection Limit	Units	Dilution Factor
01728	TPH-GRO N. CA water C6-C12	n.a.	12,000	500	ug/l	10
06067	BTEX, MTBE, ETOH					
01587	Ethanol	64-17-5	N.D.	250	ug/l	5
02010	Methyl Tertiary Butyl Ether	1634-04-4	60	3	ug/l	5
05401	Benzene	71-43-2	2,600	25	ug/l	50
05407	Toluene	108-88-3	55	3	ug/l	5
05415	Ethylbenzene	100-41-4	200	3	ug/l	5
06310	Xylene (Total)	1330-20-7	160	3	ug/l	5

State of California Lab Certification No. 2116

All QC is compliant unless otherwise noted. Please refer to the Quality Control Summary for overall QC performance data and associated samples.

Laboratory Chronicle

CAT No.	Analysis Name	Method	Analysis		Analyst	Dilution Factor
			Trial#	Date and Time		
01728	TPH-GRO N. CA water C6-C12	SW-846 8015B	1	12/12/2008 18:55	Marie D John	10
06067	BTEX, MTBE, ETOH	SW-846 8260B	1	12/11/2008 11:38	Ginelle L Feister	5
06067	BTEX, MTBE, ETOH	SW-846 8260B	1	12/11/2008 12:02	Ginelle L Feister	50
01146	GC VOA Water Prep	SW-846 5030B	1	12/12/2008 18:55	Marie D John	10
01163	GC/MS VOA Water Prep	SW-846 5030B	1	12/11/2008 11:38	Ginelle L Feister	5
01163	GC/MS VOA Water Prep	SW-846 5030B	2	12/11/2008 12:02	Ginelle L Feister	50



Analysis Report

2425 New Holland Pike, PO Box 12425, Lancaster, PA 17605-2425 • 717-656-2300 Fax: 717-656-2681 • www.lancasterlabs.com

Page 1 of 1

Lancaster Laboratories Sample No. **WW5548194**

Group No. **1123093**

C-6-W-081203 Grab Water
Facility# 90076 Job# 386495 GRD
4265 Foothill Blvd-Oakland T0600100339 C-6
Collected:12/03/2008 09:18 by JA

Account Number: 10904

Submitted: 12/05/2008 08:45
Reported: 12/14/2008 at 19:39
Discard: 01/14/2009

Chevron
6001 Bollinger Canyon Rd L4310
San Ramon CA 94583

426C6

CAT No.	Analysis Name	CAS Number	As Received Result	As Received		Dilution Factor
				Method	Units	
01728	TPH-GRO N. CA water C6-C12	n.a.	120	Detection Limit 50	ug/l	1
06067	BTEX, MTBE, ETOH					
01587	Ethanol	64-17-5	N.D.	50	ug/l	1
02010	Methyl Tertiary Butyl Ether	1634-04-4	5	0.5	ug/l	1
05401	Benzene	71-43-2	2	0.5	ug/l	1
05407	Toluene	108-88-3	N.D.	0.5	ug/l	1
05415	Ethylbenzene	100-41-4	N.D.	0.5	ug/l	1
06310	Xylene (Total)	1330-20-7	N.D.	0.5	ug/l	1

State of California Lab Certification No. 2116

All QC is compliant unless otherwise noted. Please refer to the Quality Control Summary for overall QC performance data and associated samples.

Laboratory Chronicle

CAT No.	Analysis Name	Method	Analysis		Analyst	Dilution Factor
			Trial#	Date and Time		
01728	TPH-GRO N. CA water C6-C12	SW-846 8015B	1	12/12/2008 19:20	Marie D John	1
06067	BTEX, MTBE, ETOH	SW-846 8260B	1	12/11/2008 12:27	Ginelle L Feister	1
01146	GC VOA Water Prep	SW-846 5030B	1	12/12/2008 19:20	Marie D John	1
01163	GC/MS VOA Water Prep	SW-846 5030B	1	12/11/2008 12:27	Ginelle L Feister	1



Analysis Report

2425 New Holland Pike, PO Box 12425, Lancaster, PA 17605-2425 • 717-656-2300 Fax: 717-656-2681 • www.lancasterlabs.com

Lancaster Laboratories Sample No. **WW5548195**

Group No. **1123093**

C-7-W-081203 Grab Water
Facility# 90076 Job# 386495 GRD
4265 Foothill Blvd-Oakland T0600100339 C-7
 Collected: 12/03/2008 08:25 by JA

Account Number: 10904

Submitted: 12/05/2008 08:45
 Reported: 12/14/2008 at 19:39
 Discard: 01/14/2009

Chevron
 6001 Bollinger Canyon Rd L4310
 San Ramon CA 94583

426C7

CAT No.	Analysis Name	CAS Number	As Received Result	As Received		Dilution Factor
				Method	Detection Limit	
01728	TPH-GRO N. CA water C6-C12	n.a.	N.D.	50	ug/l	1
06067	BTEX, MTBE, ETOH					
01587	Ethanol	64-17-5	N.D.	50	ug/l	1
02010	Methyl Tertiary Butyl Ether	1634-04-4	4	0.5	ug/l	1
05401	Benzene	71-43-2	N.D.	0.5	ug/l	1
05407	Toluene	108-88-3	N.D.	0.5	ug/l	1
05415	Ethylbenzene	100-41-4	N.D.	0.5	ug/l	1
06310	Xylene (Total)	1330-20-7	N.D.	0.5	ug/l	1

State of California Lab Certification No. 2116

All QC is compliant unless otherwise noted. Please refer to the Quality Control Summary for overall QC performance data and associated samples.

Laboratory Chronicle

CAT No.	Analysis Name	Method	Analysis			Dilution Factor
			Trial#	Date and Time	Analyst	
01728	TPH-GRO N. CA water C6-C12	SW-846 8015B	1	12/12/2008 19:44	Marie D John	1
06067	BTEX, MTBE, ETOH	SW-846 8260B	1	12/11/2008 12:52	Ginelle L Feister	1
01146	GC VOA Water Prep	SW-846 5030B	1	12/12/2008 19:44	Marie D John	1
01163	GC/MS VOA Water Prep	SW-846 5030B	1	12/11/2008 12:52	Ginelle L Feister	1



Analysis Report

2425 New Holland Pike, PO Box 12425, Lancaster, PA 17605-2425 • 717-656-2300 Fax: 717-656-2681 • www.lancasterlabs.com

Page 1 of 1

Lancaster Laboratories Sample No. **WW5548196**

Group No. **1123093**

C-10-W-081203 Grab Water
 Facility# 90076 Job# 386495 GRD
 4265 Foothill Blvd-Oakland T0600100339 C-10
 Collected: 12/03/2008 10:55 by JA

Account Number: 10904

Submitted: 12/05/2008 08:45
 Reported: 12/14/2008 at 19:39
 Discard: 01/14/2009

Chevron
 6001 Bollinger Canyon Rd L4310
 San Ramon CA 94583

42610

CAT No.	Analysis Name	CAS Number	As Received Result	As Received Method Detection Limit	Units	Dilution Factor
01728	TPH-GRO N. CA water C6-C12	n.a.	N.D.	50	ug/l	1
06067	BTEX, MTBE, ETOH					
01587	Ethanol	64-17-5	N.D.	50	ug/l	1
02010	Methyl Tertiary Butyl Ether	1634-04-4	8	0.5	ug/l	1
05401	Benzene	71-43-2	N.D.	0.5	ug/l	1
05407	Toluene	108-88-3	N.D.	0.5	ug/l	1
05415	Ethylbenzene	100-41-4	N.D.	0.5	ug/l	1
06310	Xylene (Total)	1330-20-7	N.D.	0.5	ug/l	1

State of California Lab Certification No. 2116

All QC is compliant unless otherwise noted. Please refer to the Quality Control Summary for overall QC performance data and associated samples.

Laboratory Chronicle

CAT No.	Analysis Name	Method	Analysis		Analyst	Dilution Factor
			Trial#	Date and Time		
01728	TPH-GRO N. CA water C6-C12	SW-846 8015B	1	12/12/2008 20:08	Marie D John	1
06067	BTEX, MTBE, ETOH	SW-846 8260B	1	12/11/2008 13:17	Ginelle L Feister	1
01146	GC VOA Water Prep	SW-846 5030B	1	12/12/2008 20:08	Marie D John	1
01163	GC/MS VOA Water Prep	SW-846 5030B	1	12/11/2008 13:17	Ginelle L Feister	1

Quality Control Summary

 Client Name: Chevron
 Reported: 12/14/08 at 07:39 PM

Group Number: 1123093

Matrix QC may not be reported if site-specific QC samples were not submitted. In these situations, to demonstrate precision and accuracy at a batch level, a LCS/LCSD was performed, unless otherwise specified in the method.

Laboratory Compliance Quality Control

<u>Analysis Name</u>	<u>Blank Result</u>	<u>Blank MDL</u>	<u>Report Units</u>	<u>LCS %REC</u>	<u>LCSD %REC</u>	<u>LCS/LCSD Limits</u>	<u>RPD</u>	<u>RPD Max</u>
Batch number: 08346B07A TPH-GRO N. CA water C6-C12	N.D.	50.	ug/l	100	100	75-135	0	30
Batch number: D083443AA Methyl Tertiary Butyl Ether	N.D.	0.5	ug/l	100		73-119		
Benzene	N.D.	0.5	ug/l	94		78-119		
Toluene	N.D.	0.5	ug/l	98		85-115		
Ethylbenzene	N.D.	0.5	ug/l	100		82-119		
Xylene (Total)	N.D.	0.5	ug/l	102		83-113		
Batch number: Z083462AA Ethanol	N.D.	50.	ug/l	116		45-156		
Methyl Tertiary Butyl Ether	N.D.	0.5	ug/l	99		73-119		
Benzene	N.D.	0.5	ug/l	100		78-119		
Toluene	N.D.	0.5	ug/l	97		85-115		
Ethylbenzene	N.D.	0.5	ug/l	98		82-119		
Xylene (Total)	N.D.	0.5	ug/l	98		83-113		

Sample Matrix Quality Control

Unspiked (UNSPK) = the sample used in conjunction with the matrix spike
 Background (BKG) = the sample used in conjunction with the duplicate

<u>Analysis Name</u>	<u>MS %REC</u>	<u>MSD %REC</u>	<u>MS/MSD Limits</u>	<u>RPD</u>	<u>RPD MAX</u>	<u>BKG Conc</u>	<u>DUP Conc</u>	<u>DUP RPD</u>	<u>Dup RPD Max</u>
Batch number: 08346B07A TPH-GRO N. CA water C6-C12									
Batch number: D083443AA Methyl Tertiary Butyl Ether	91	91	69-127	0	30				
Benzene	86	88	83-128	2	30				
Toluene	88	89	83-127	1	30				
Ethylbenzene	88	91	82-129	3	30				
Xylene (Total)	90	92	82-130	2	30				
Batch number: Z083462AA Ethanol	70	75	32-164	7	30				
Methyl Tertiary Butyl Ether	89	92	69-127	1	30				
Benzene	103	104	83-128	1	30				
Toluene	100	101	83-127	2	30				
Ethylbenzene	100	103	82-129	3	30				
Xylene (Total)	99	101	82-130	2	30				

*- Outside of specification

- (1) The result for one or both determinations was less than five times the LOQ.
- (2) The unspiked result was more than four times the spike added.

Quality Control Summary

 Client Name: Chevron
 Reported: 12/14/08 at 07:39 PM

Group Number: 1123093

Surrogate Quality Control

Surrogate recoveries which are outside of the QC window are confirmed unless attributed to dilution or otherwise noted on the Analysis Report.

 Analysis Name: TPH-GRO N. CA water C6-C12
 Batch number: 08346B07A
 Trifluorotoluene-F

5548189	99
5548190	103
5548191	128
5548192	101
5548193	121
5548194	104
5548195	100
5548196	99
Blank	105
LCS	113
LCSD	111
MS	113

Limits: 63-135

 Analysis Name: BTEX+MTBE by 8260B
 Batch number: D083443AA

	Dibromofluoromethane	1,2-Dichloroethane-d4	Toluene-d8	4-Bromofluorobenzene
5548189	102	101	91	96
Blank	97	98	89	94
LCS	97	98	91	98
MS	97	102	89	98
MSD	98	98	89	98

Limits: 80-116 77-113 80-113 78-113

 Analysis Name: BTEX, MTBE, ETOH
 Batch number: Z083462AA

	Dibromofluoromethane	1,2-Dichloroethane-d4	Toluene-d8	4-Bromofluorobenzene
5548190	91	89	94	88
5548191	90	87	97	94
5548192	91	88	95	88
5548193	88	85	96	89
5548194	91	89	95	88
5548195	92	89	95	88
5548196	91	88	95	88
Blank	91	86	94	88
LCS	90	89	94	89
MS	90	89	94	90
MSD	89	88	93	90

Limits: 80-116 77-113 80-113 78-113

*- Outside of specification

- (1) The result for one or both determinations was less than five times the LOQ.
- (2) The unspiked result was more than four times the spike added.

Lancaster Laboratories Explanation of Symbols and Abbreviations

The following defines common symbols and abbreviations used in reporting technical data:

N.D.	none detected	BMQL	Below Minimum Quantitation Level
TNTC	Too Numerous To Count	MPN	Most Probable Number
IU	International Units	CP Units	cobalt-chloroplatinate units
umhos/cm	micromhos/cm	NTU	nephelometric turbidity units
C	degrees Celsius	F	degrees Fahrenheit
Cal	(diet) calories	lb.	pound(s)
meq	milliequivalents	kg	kilogram(s)
g	gram(s)	mg	milligram(s)
ug	microgram(s)	l	liter(s)
ml	milliliter(s)	ul	microliter(s)
m3	cubic meter(s)	fib >5 um/ml	fibers greater than 5 microns in length per ml
<	less than – The number following the sign is the <u>limit of quantitation</u> , the smallest amount of analyte which can be reliably determined using this specific test.		
>	greater than		
ppm	parts per million – One ppm is equivalent to one milligram per kilogram (mg/kg), or one gram per million grams. For aqueous liquids, ppm is usually taken to be equivalent to milligrams per liter (mg/l), because one liter of water has a weight very close to a kilogram. For gases or vapors, one ppm is equivalent to one microliter of gas per liter of gas.		
ppb	parts per billion		
Dry weight basis	Results printed under this heading have been adjusted for moisture content. This increases the analyte weight concentration to approximate the value present in a similar sample without moisture.		

U.S. EPA data qualifiers:

Organic Qualifiers	Inorganic Qualifiers
A TIC is a possible aldol-condensation product	B Value is <CRDL, but ≥IDL
B Analyte was also detected in the blank	E Estimated due to interference
C Pesticide result confirmed by GC/MS	M Duplicate injection precision not met
D Compound quantitated on a diluted sample	N Spike amount not within control limits
E Concentration exceeds the calibration range of the instrument	S Method of standard additions (MSA) used for calculation
J Estimated value	U Compound was not detected
N Presumptive evidence of a compound (TICs only)	W Post digestion spike out of control limits
P Concentration difference between primary and confirmation columns >25%	* Duplicate analysis not within control limits
U Compound was not detected	+ Correlation coefficient for MSA <0.995
X,Y,Z Defined in case narrative	

Analytical test results for methods listed on the laboratories' accreditation scope meet all requirements of NELAC unless otherwise noted under the individual analysis.

Tests results relate only to the sample tested. Clients should be aware that a critical step in a chemical or microbiological analysis is the collection of the sample. Unless the sample analyzed is truly representative of the bulk of material involved, the test results will be meaningless. If you have questions regarding the proper techniques of collecting samples, please contact us. We cannot be held responsible for sample integrity, however, unless sampling has been performed by a member of our staff. This report shall not be reproduced except in full, without the written approval of the laboratory.

WARRANTY AND LIMITS OF LIABILITY – In accepting analytical work, we warrant the accuracy of test results for the sample as submitted. THE FOREGOING EXPRESS WARRANTY IS EXCLUSIVE AND IS GIVEN IN LIEU OF ALL OTHER WARRANTIES, EXPRESSED OR IMPLIED. WE DISCLAIM ANY OTHER WARRANTIES, EXPRESSED OR IMPLIED, INCLUDING A WARRANTY OF FITNESS FOR PARTICULAR PURPOSE AND WARRANTY OF MERCHANTABILITY. IN NO EVENT SHALL LANCASTER LABORATORIES BE LIABLE FOR INDIRECT, SPECIAL, CONSEQUENTIAL, OR INCIDENTAL DAMAGES INCLUDING, BUT NOT LIMITED TO, DAMAGES FOR LOSS OF PROFIT OR GOODWILL REGARDLESS OF (A) THE NEGLIGENCE (EITHER SOLE OR CONCURRENT) OF LANCASTER LABORATORIES AND (B) WHETHER LANCASTER LABORATORIES HAS BEEN INFORMED OF THE POSSIBILITY OF SUCH DAMAGES. We accept no legal responsibility for the purposes for which the client uses the test results. No purchase order or other order for work shall be accepted by Lancaster Laboratories which includes any conditions that vary from the Standard Terms and Conditions of Lancaster Laboratories and we hereby object to any conflicting terms contained in any acceptance or order submitted by client.