



**CONESTOGA-ROVERS
& ASSOCIATES**

RECEIVED

1:36 pm, Nov 24, 2008

Alameda County
Environmental Health

5900 Hollis Street, Suite A, Emeryville, California 94608
Telephone: 510-420-0700 Facsimile: 510-420-9170
www.CRAworld.com

November 14, 2008

Reference No. 311977

Mr. Steven Plunkett
Alameda County Environmental Health Services
1131 Harbor Bay Parkway, Suite 250
Alameda, California 94502-6577

Re: Third Quarter 2008 Groundwater Monitoring Report
Chevron Service Station 9-0076
4265 Foothill Boulevard
Oakland, California
Fuel Leak Case No. RO0000427

Dear Mr. Plunkett:

Conestoga-Rovers & Associates is submitting the attached *Groundwater Monitoring and Sampling Report* for the site referenced above on behalf of Chevron Environmental Management Company (Chevron). The report prepared by Gettler-Ryan Inc. (G R) and dated October 20, 2008, presents the results of the Third Quarter 2008 sampling and monitoring event. Also attached are Figure 1 (Vicinity Map) and Figure 2 (Concentration Map) presenting the third quarter 2008 analytical results and groundwater flow direction data. A perjury letter from Chevron and Professional Geologist stamp are included within the G-R report.

Please contact Charlotte Evans at (510) 420-3351 if you have any questions or require additional information.

Sincerely,

CONESTOGA ROVERS & ASSOCIATES

Charlotte Evans

CE/doh/1
Enc.

cc: Mr. Aaron Costa, Chevron Environmental Management Company

Equal
Employment
Opportunity Employer

FIGURES

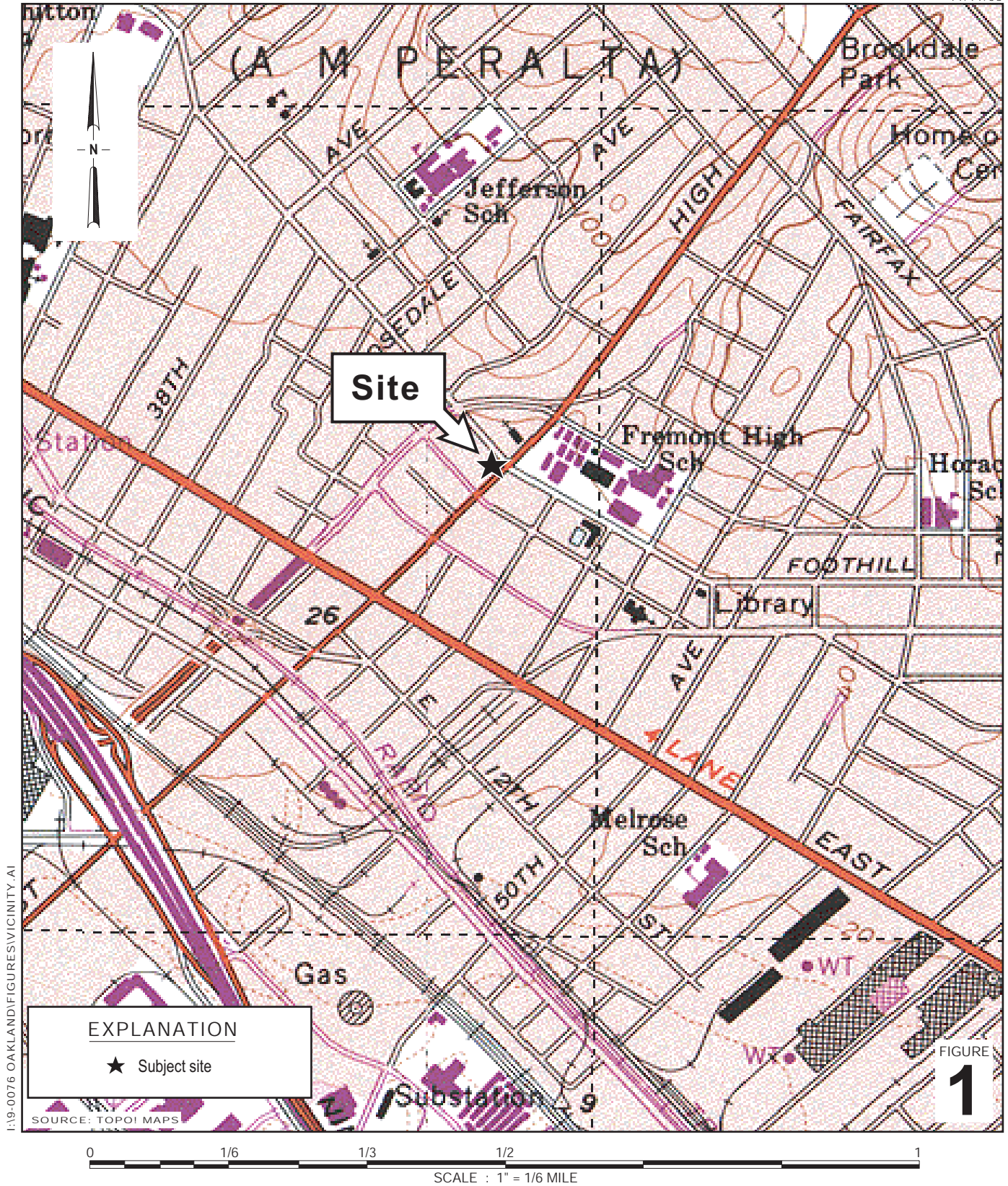

I:\19-0076 OAKLAND\FIGURES\VICINITY.A1

EXPLANATION

★ Subject site

SOURCE: TOPOI MAPS

FIGURE 1

0 1/6 1/3 1/2 1

SCALE : 1" = 1/6 MILE

Chevron Service Station 9-0076
 4265 Foothill Boulevard
 Oakland, California



CONESTOGA-ROVERS & ASSOCIATES

Vicinity Map

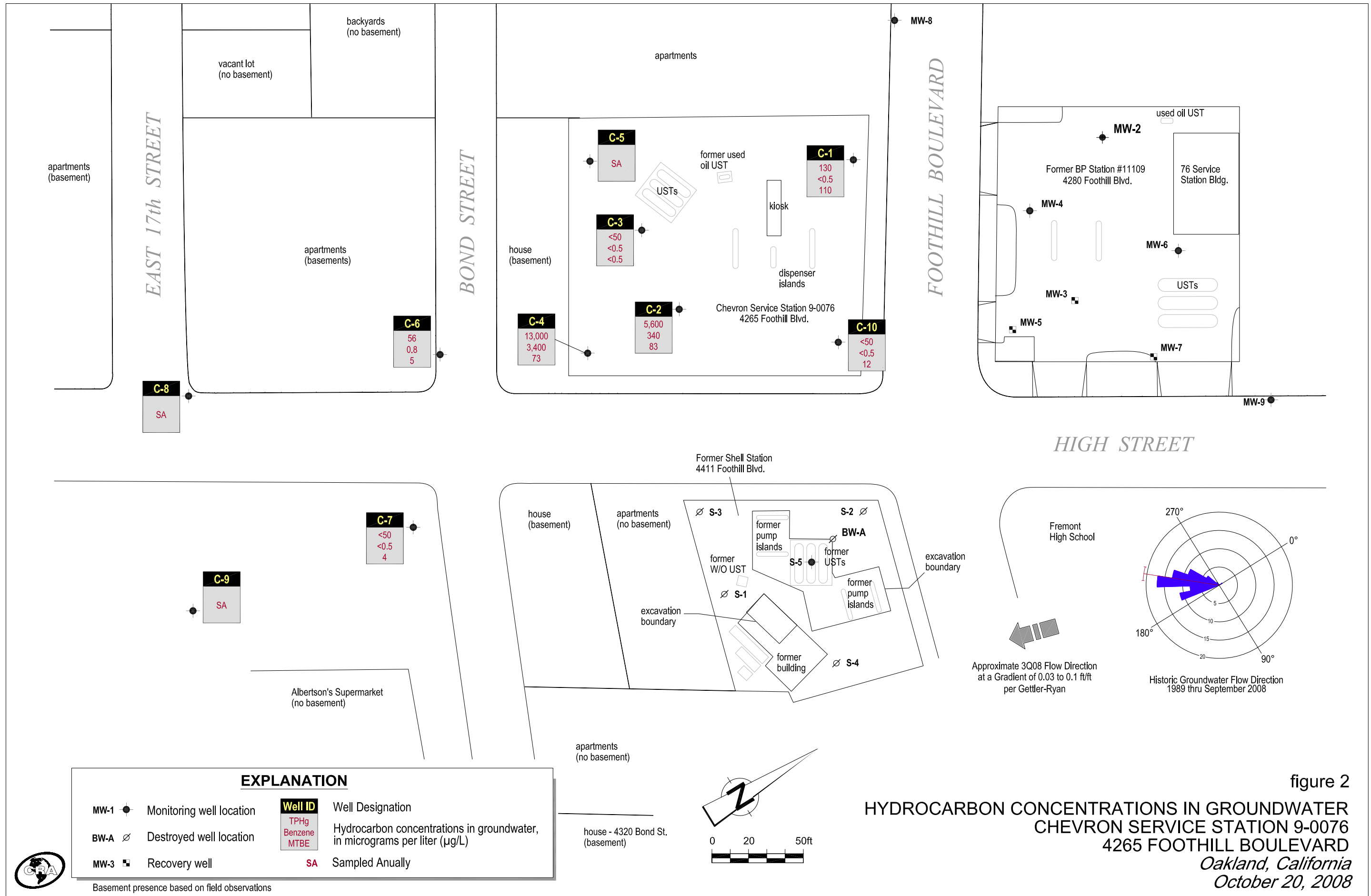

figure 2
HYDROCARBON CONCENTRATIONS IN GROUNDWATER
CHEVRON SERVICE STATION 9-0076
4265 FOOTHILL BOULEVARD
Oakland, California
October 20, 2008

G-R Third Quarter, 2008 Quarterly Monitoring Report
October 20, 2008



GETTLER-RYAN INC.



TRANSMITTAL

October 20, 2008

G-R #386495

TO: Ms. Charlotte Evans
Conestoga-Rovers & Associates
5900 Hollis Street, Suite A
Emeryville, CA 94608

CC: Mr. Aaron Costa
Chevron Environmental
Management Company
6111 Bollinger Canyon Road,
Room 3660
San Ramon, California 94583
(VIA PDF)

FROM: Deanna L. Harding
Project Coordinator
Gettler-Ryan Inc.
6747 Sierra Court, Suite J
Dublin, California 94568

RE: **Chevron Service Station
#9-0076
4265 Foothill Boulevard
Oakland, California
RO 0000427**

WE HAVE ENCLOSED THE FOLLOWING:

COPIES	DATED	DESCRIPTION
1	October 15, 2008	Groundwater Monitoring and Sampling Report Third Quarter Event of September 3, 2008

COMMENTS:

Pursuant to your request, we are providing you with a copy of the above referenced report for **your use and distribution to the following (via PDF):**

Mr. Steven Plunkett, Alameda County Health Care Services, Dept. of Environmental Health, 1131 Harbor Bay Parkway, Suite 250, Alameda, CA 94502-6577 **(Distributed by CRA via PDF)**

Please provide any comments/changes and propose any groundwater monitoring modifications for the next event prior to **November 3, 2008**, at which time this final report will be distributed to the following:

cc: Ms. Liz Sewell, ConocoPhillips, 76 Broadway Avenue, Sacramento, CA 95818
Loi Van Le and Josephine N. Le. (Owners) 4265 Foothill Blvd, Oakland, CA 94601-4621

Enclosures



Aaron Costa
Project Manager
Marketing Business Unit

**Chevron Environmental
Management Company**
6111 Bollinger Canyon Road
San Ramon, CA 94583
Tel (925) 543-2961
Fax (925) 543-2324
acosta@chevron.com

October 20, 2008

Alameda County Health Care Services
1131 Harbor Bay Parkway, Suite 250
Alameda, CA 94502-6577

Re: Chevron Service Station No. 9-0076
Address 4265 Foothill Blvd.

I have reviewed the attached routine groundwater monitoring report dated
October 20, 2008.

I agree with the conclusions and recommendations presented in the referenced report. The information in this report is accurate to the best of my knowledge and all local Agency/Regional Board guidelines have been followed. This report was prepared by Gettler-Ryan Inc., upon who assistance and advice I have relied.

This letter is submitted pursuant to the requirements of California Water Code Section 13267(b)(1) and the regulating implementation entitled Appendix A pertaining thereto.

I declare under penalty of perjury that the foregoing is true and correct.

Sincerely,

A handwritten signature in black ink that reads "Aaron Costa".

Aaron Costa
Project Manager

Attachment: Report

WELL CONDITION STATUS SHEET

Client/Facility #: Chevron #9-0076
 Site Address: 4265 Foothill Blvd.
 City: Oakland, CA

Job # 386495
 Event Date: 9-3-08
 Sampler: Joe/Steve R

WELL ID	Vault Frame Condition	Gasket/O-Ring (M)missing	BOLTS (M) Missing (R) Replaced	Bolt Flanges B= Broken S= Stripped R=Retap	APRON Condition C=Cracked B=Broken G=Gone	Grout Seal (Deficient) inches from TOC	Casing (Condition prevents tight cap seal)	REPLACE LOCK Y/N	REPLACE CAP Y/N	WELL VAULT Manufacture/Size/ # of Bolts	Pictures Taken Yes / No
C-1	O.K	O.K	N/A	N/A	O.K	O.K	O.K	N	N	Christy box	No
C-2	↓	↓	N/A	N/A	↓	↓	↓	↓	↓	24x36 box	↓
C-3	↓	↓	O.K	O.K	↓	↓	↓	↓	↓	12" Morrison/2	↓
C-4	↓	↓	O.K	O.K	↓	↓	↓	↓	↓	"	↓
C-5	↓	↓	O.K	O.K	↓	↓	↓	↓	↓	"	↓
C-6	↓	↓	N/A	N/A	↓	↓	↓	↓	↓	8" City Monument	↓
C-7	↓	↓	O.K	O.K	↓	↓	↓	↓	↓	12" EMCO/2	↓
C-8	↓	↓	N/A	N/A	↓	↓	↓	↓	↓	8" City Monument	↓
C-9	↓	↓	O.K	O.K	↓	↓	↓	↓	↓	8" Morrison/2	↓
C-10	↓	↓	O.K	O.K	↓	↓	↓	↓	↓	12" EMCO/2	↓

Comments _____



GETTLER - RYAN INC.



October 15, 2008
G-R Job #386495

Mr. Aaron Costa
Chevron Environmental Management Company
6111 Bollinger Canyon Road, Room 3660
San Ramon, CA 94583

RE: Third Quarter Event of September 3, 2008
Groundwater Monitoring & Sampling Report
Chevron Service Station #9-0076
4265 Foothill Boulevard
Oakland, California

Dear Mr. Costa:

This report documents the most recent groundwater monitoring and sampling event performed by Gettler-Ryan Inc. (G-R) at the referenced site. All field work was conducted in accordance with G-R Standard Operating Procedure - Groundwater Sampling (attached). A joint groundwater monitoring event is conducted with BP Service Station #11109 located at 4280 Foothill Boulevard, Oakland, California, first and third quarters only.

Static groundwater levels were measured and the wells were checked for the presence of separate-phase hydrocarbons. Static water level data, groundwater elevations, and separate-phase hydrocarbon thickness (if any) are presented in the attached Table 1. A Potentiometric Map is included as Figure 1.

Groundwater samples were collected from the monitoring wells and submitted to a state certified laboratory for analyses. The field data sheets for this event are attached. Analytical results are presented in the table(s) listed below. The chain of custody document and the laboratory analytical reports are also attached. All groundwater and decontamination water generated during sampling activities was removed from the site, per the Standard Operating Procedure.

Please call if you have any questions or comments regarding this report. Thank you.

Sincerely,

Deanna L. Harding
Project Coordinator

Douglas J. Lee
Senior Geologist, P.G. No. 6882

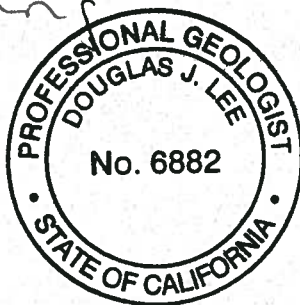

- Figure 1: Potentiometric Map
- Table 1: Groundwater Monitoring Data and Analytical Results
- Table 2: Field Measurements and Groundwater Analytical Results
- Table 3: Joint Groundwater Monitoring Data - BP #11109
- Attachments: Standard Operating Procedure - Groundwater Sampling
Field Data Sheets
Chain of Custody Document and Laboratory Analytical Reports

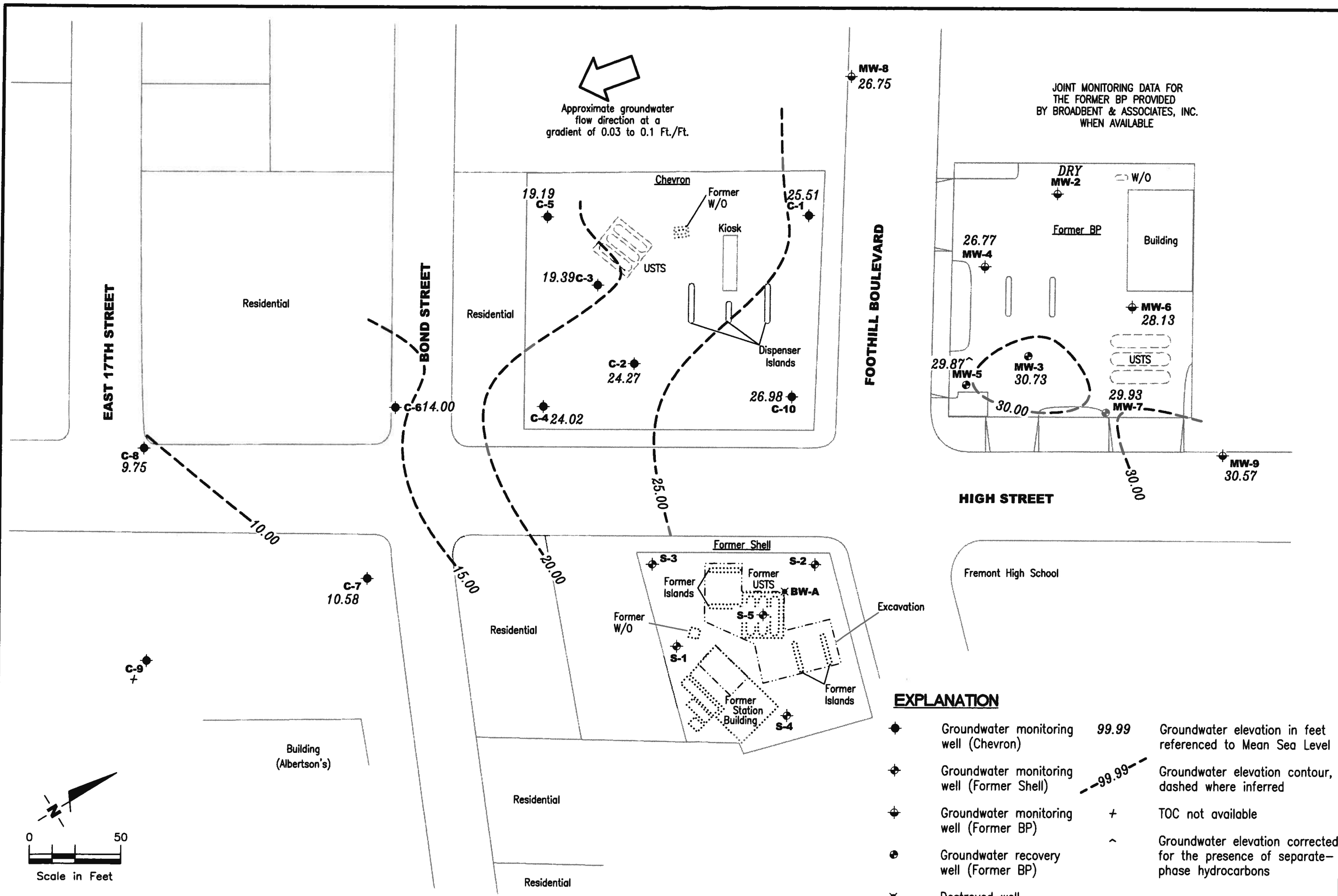

POTENTIOMETRIC MAP
 Chevron Service Station #9-0076
 4265 Foothill Boulevard
 Oakland, California

GETTLER - RYAN INC.
 6747 Sierra Court, Suite J
 Dublin, CA 94568
 (925) 551-7555

PROJECT NUMBER: 386495
 DATE: September 3, 2008
 REVISED DATE: [Blank]

Source: Figure modified from drawing provided by Cambrio, Dated: 10/08/03.

Table 1
Groundwater Monitoring Data and Analytical Results
Chevron Service Station #9-0076
4265 Foothill Boulevard
Oakland, California

WELL ID/ DATE	TOC* (ft.)	GWE (msl)	DTW (ft.)	SPHT (ft.)	SPH REMOVED (gallons)	TPH-G (µg/L)	B (µg/L)	T (µg/L)	E (µg/L)	X (µg/L)	MTBE (µg/L)	ETHANOL (µg/L)
C-1												
04/28/89	35.42	15.37	20.05	--	--	940	30	1.3	11	13	--	--
08/08/89	35.42	11.35	24.07	--	--	820	45	2.0	13	13	--	--
12/21/89	35.42	12.61	22.81	--	--	--	--	--	--	--	--	--
08/27/90	35.42	13.30	22.12	--	--	440	15	1.0	6.0	13	--	--
11/04/90	35.42	9.86	25.56	--	--	--	--	--	--	--	--	--
06/18/91	35.42	13.78	21.64	--	--	74	5.6	0.6	1.9	1.3	--	--
09/19/91	35.42	10.84	24.58	--	--	150	7.1	<0.5	2.3	3.0	--	--
12/20/91	35.42	9.25	26.17	--	--	250	10	<0.5	3.7	1.6	--	--
03/18/92	35.42	17.17	18.25	--	--	190	16	<0.5	8.5	3	--	--
07/14/92	35.42	7.81	27.61	--	--	20,000	480	2,200	510	2,900	--	--
10/08/92	35.42	10.98	24.44	--	--	360	34	4.6	19	12	--	--
01/08/93	35.42	15.74	19.68	--	--	120	9.1	0.5	5.1	1.8	--	--
04/14/93	35.42	19.04	16.38	--	--	190	74	0.6	1.0	2.0	--	--
07/16/93	35.42	--	--	--	--	--	--	--	--	--	--	--
07/27/93	35.42	26.03	9.39	--	--	300	12	<0.5	5.0	2.0	--	--
09/21/93	38.41	16.99	21.42	--	--	360	12	1.2	5.8	3.7	--	--
01/28/94	38.41	18.84	19.57	--	--	370	24	1.0	13	4.0	--	--
03/17/94	38.41	21.56	16.85	--	--	460	42	<0.5	6.7	3.7	--	--
06/16/94	38.41	20.58	17.83	--	--	320	20	0.7	8.7	3.0	--	--
09/22/94	38.41	18.15	20.26	--	--	380	24	0.6	8.8	1.9	--	--
12/15/94	38.41	22.59	15.82	--	--	280	23	7.6	7.8	13	--	--
03/30/95	38.41	26.39	12.02	--	--	2,200	890	8.9	15	<5.0	--	--
06/20/95	38.41	24.01	14.40	--	--	690	140	<2.0	9.4	2.8	--	--
09/20/95	38.41	24.59	13.82	--	--	730	27	78	26	130	--	--
12/06/95	38.41	17.81	20.60	--	--	220	16	<0.5	7.2	1.7	11	--
03/21/96	38.41	26.76	11.65	--	--	640	170	<2.0	6.7	<2.0	35	--
06/21/96	38.41	24.16	14.25	--	--	640	140	<1.2	8.7	2.0	23	--
09/06/96	38.41	21.66	16.75	--	--	460	24	0.56	10	2.4	43	--
12/19/96	38.41	24.43	13.98	--	--	790	120	22	13	19	<25	--
03/17/97	38.41	25.63	12.78	--	--	2,200	660	<10	15	<10	110	--
06/11/97	38.41	23.25	15.16	--	--	1,500	130	<2.0	16	3.4	130	--
09/17/97	38.41	21.47	16.94	--	--	910	160	23	13	49	180	--
12/11/97	38.41	25.23	13.18	--	--	2,000	270	7.0	53	7.4	460	--
03/12/98	38.41	28.92	9.49	--	--	3,100	1,300	<20	42	<20	760	--
06/23/98	38.41	28.19	10.22	--	--	1,300	650	6.9	22	6.5	290	--

Table 1
Groundwater Monitoring Data and Analytical Results
Chevron Service Station #9-0076
4265 Foothill Boulevard
Oakland, California

WELL ID/ DATE	TOC* (ft.)	GWE (msl)	DTW (ft.)	SPHT (ft.)	SPH REMOVED (gallons)	TPH-G (ug/L)	B (ug/L)	T (ug/L)	E (ug/L)	X (ug/L)	MTBE (ug/L)	ETHANOL (ug/L)
C-1 (cont)												
09/01/98	38.41	21.43	16.98	--	--	270	6.0	<2.5	<2.5	<2.5	950	--
12/30/98	38.41	22.29	16.12	--	--	2,020	578	<5.0	<5.0	<5.0	1,720	--
03/31/99	38.41	24.53	13.88	--	--	2,140	776	5.89	<5.0	5.15	1,170	--
06/14/99	38.41	23.09	15.32	--	--	1,450	524	<5.0	<5.0	<5.0	1,150	--
06/14/99 ¹	38.41	23.09	15.32	--	--	--	--	--	--	--	1,360 ²	--
09/30/99	38.41	22.30	16.11	--	--	79	1.12	<0.5	1.07	<0.5	677	--
12/22/99	38.41	23.37	15.04	--	--	501	157	4.45	<2.5	4.81	744	--
03/09/00	38.41	31.28	7.13	--	--	3,300	2,500	28	37	<25	1,700	--
06/23/00 ³	38.41	25.86	12.55	0.00	0.00	2,200 ⁴	1,000	6.9	5.7	9.3	1,900	--
09/05/00 ³	38.41	21.28	17.13	0.00	0.00	<200	8.3	<2.0	<2.0	<2.0	1,000	--
12/04/00	38.41	21.48	16.93	0.00	0.00	1,400 ⁴	600	<5.0	<5.0	<5.0	1,500	--
03/08/01 ³	38.41	30.45	7.96	0.00	0.00	2,570	1,040	7.93	12.0	<5.00	1,470	--
06/07/01 ³	38.41	25.45	12.96	0.00	0.00	750 ⁴	220	5.6	4.8	2.6	2,500 ⁵	--
09/13/01 ³	38.41	19.91	18.50	0.00	0.00	670 ⁶	<5.0	<5.0	<5.0	<5.0	660	--
12/13/01 ³	38.41	23.02	15.39	0.00	0.00	1,100	340	2.1	0.95	7.9	630	--
03/08/02 ³	38.41	28.35	10.06	0.00	0.00	3,600	1,400	9.5	17	6.5	1,900	--
06/19/02 ³	38.41	24.92	13.49	0.00	0.00	1,300	220	3.4	2.7	<3.0	1,400	--
09/11/02 ³	38.41	21.18	17.23	0.00	0.00	400	22	<0.50	<0.50	<1.5	780	--
12/11/02 ³	38.41	19.81	18.60	0.00	0.00	180	4.2	<0.50	1.1	<1.5	350	--
03/11/03 ³	38.41	25.81	12.60	0.00	0.00	3,500	1,100	9.1	12	8.0	1,600	--
06/10/03 ^{3,7}	38.41	25.73	12.68	0.00	0.00	1,600	350	2	3	3	1,300	--
09/09/03 ^{3,7}	38.41	21.66	16.75	0.00	0.00	290	4	<1	1	1	710	<100
12/09/03 ^{7,9}	38.41	20.73	17.68	0.00	0.00	<50	<0.5	<0.5	<0.5	<0.5	200	<50
03/09/04 ⁷	38.41	30.61	7.80	0.00	0.00	7,100	2,000	15	23	10	1,100	<50
06/08/04 ⁷	38.41	27.29	11.12	0.00	0.00	2,300	840	6	5	4	1,100	<50
09/08/04 ⁷	38.41	24.11	14.30	0.00	0.00	150	110	2	0.5	1	730	<50
12/06/04 ⁷	38.41	25.15	13.26	0.00	0.00	2,100	480	4	2	2	530	<50
03/07/05 ⁷	38.41	31.93	6.48	0.00	0.00	4,100	1,200	9	10	5	1,100	<100
06/06/05 ⁷	38.41	29.56	8.85	0.00	0.00	3,400	990	8	9	5	1,100	<100
09/06/05 ⁷	38.41	26.99	11.42	0.00	0.00	1,100	83	2	0.9	1	810	<50
12/05/05 ⁷	38.41	27.43	10.98	0.00	0.00	<50	<0.5	<0.5	<0.5	<0.5	78	<50
03/06/06 ⁷	38.41	30.64	7.77	0.00	0.00	3,700	880	10	8	7	1,300	<50
06/05/06 ⁷	38.41	29.51	8.90	0.00	0.00	380	7	<0.5	<0.5	<0.5	960	<50
09/05/06 ⁷	38.41	27.32	11.09	0.00	0.00	260	<0.5	<0.5	<0.5	<0.5	390	<50

Table 1
Groundwater Monitoring Data and Analytical Results
Chevron Service Station #9-0076
4265 Foothill Boulevard
Oakland, California

WELL ID/ DATE	TOC* (ft.)	GWE (msl)	DTW (ft.)	SPHT (ft.)	SPH						MTBE (µg/L)	ETHANOL (µg/L)
					REMOVED (gallons)	TPH-G (µg/L)	B (µg/L)	T (µg/L)	E (µg/L)	X (µg/L)		
C-1 (cont)												
12/04/06 ⁷	38.41	27.49	10.92	0.00	0.00	270	20	<0.5	<0.5	<0.5	250	<50
03/05/07 ⁷	38.41	28.63	9.78	0.00	0.00	2,000	370	5	2	2	820	<50
06/04/07 ⁷	38.41	29.01	9.40	0.00	0.00	180	<0.5	<0.5	<0.5	<0.5	320	<50
09/07/07 ⁷	38.41	27.86	10.55	0.00	0.00	120	<0.5	<0.5	<0.5	<0.5	72	<50
12/06/07 ⁷	38.41	26.26	12.15	0.00	0.00	170	<0.5	<0.5	<0.5	<0.5	58	<50
03/06/08 ⁷	38.41	30.13	8.28	0.00	0.00	3,400	790	8	4	4	610	<50
06/05/08 ⁷	38.41	28.30	10.11	0.00	0.00	210	<0.5	<0.5	<0.5	<0.5	290	<50
09/03/08⁷	38.41	25.51	12.90	0.00	0.00	130	<0.5	<0.5	<0.5	<0.5	110	<50
C-2												
04/28/89	35.18	8.74	26.44	--	--	120,000	30,000	22,000	3,000	17,000	--	--
08/08/89	35.18	5.29	29.90	0.01	--	--	--	--	--	--	--	--
12/21/89	35.18	5.86	29.32	--	--	--	--	--	--	--	--	--
08/27/90	35.18	5.77	29.55	0.17	--	--	--	--	--	--	--	--
11/04/90	35.18	4.71	30.47	--	--	--	--	--	--	--	--	--
06/18/91	35.18	6.90	28.33	0.06	--	--	--	--	--	--	--	--
09/19/91	35.18	5.84	29.39	0.06	--	--	--	--	--	--	--	--
12/20/91	35.18	5.95	29.23	--	--	170,000	20,000	10,000	2,800	19,000	--	--
03/18/92	35.18	21.58	13.60	0.09	--	--	--	--	--	--	--	--
07/14/92	35.18	--	--	--	--	--	--	--	--	--	--	--
10/08/92	35.18	--	--	--	--	--	--	--	--	--	--	--
01/08/93	35.18	10.98	24.20	Sheen	--	79,000	14,000	7,200	3,500	16,000	--	--
04/14/93	35.18	--	--	--	--	--	--	--	--	--	--	--
07/16/93	35.18	5.03	30.15	--	--	2200	440	73	24	350	--	--
09/21/93	37.47	11.18	26.29	--	--	11,000	2,300	300	270	910	--	--
01/28/94	37.47	13.51	23.96	--	--	49,000	11,000	3,900	1,600	12,000	--	--
03/17/94	37.47	11.48	25.99	--	--	16,000	3,300	1,000	220	3,500	--	--
06/16/94	37.47	13.55	23.92	--	--	20,000	4,800	1,500	520	4,300	--	--
09/22/94	37.47	11.85	25.62	--	--	35,000	5,600	850	1,700	7,300	--	--
12/15/94	37.47	16.31	21.16	--	--	96,000	9,000	3,500	3,300	13,000	--	--
03/30/95	37.47	20.29	17.18	--	--	100,000	9,400	3,700	3,900	14,000	--	--
06/20/95	37.47	18.52	18.95	--	--	93,000	6,400	1,900	2,900	11,000	--	--
09/20/95	37.47	19.27	18.20	--	--	58,000	6,600	330	1,600	5,500	--	--
12/06/95	37.47	12.71	24.76	--	--	40,000	5,000	86	1,800	3,700	<500	--

Table 1
Groundwater Monitoring Data and Analytical Results
Chevron Service Station #9-0076
4265 Foothill Boulevard
Oakland, California

WELL ID/ DATE	TOC* (ft.)	GWE (msl)	DTW (ft.)	SPHT (ft.)	SPH REMOVED (gallons)	TPH-G (ug/L)	B (ug/L)	T (ug/L)	E (ug/L)	X (ug/L)	MTBE (ug/L)	ETHANOL (ug/L)
C-2 (cont)												
03/21/96	37.47	21.30	16.17	0.00	0.13	--	--	--	--	--	--	--
06/21/96	37.47	19.34	18.15	0.02	0.03	--	--	--	--	--	--	--
09/06/96	37.47	16.36	21.14	0.04	0.08	--	--	--	--	--	--	--
12/19/96	37.47	19.94	17.55	0.03	0.05	--	--	--	--	--	--	--
03/17/97	37.47	18.88	18.59	--	--	58,000	4,800	1,200	1,800	6,300	3,400	--
06/11/97	37.47	16.17	21.30	--	--	40,000	5,500	720	1,400	4,100	3,100	--
09/17/97	37.47	14.33	23.14	--	--	30,000	4,800	220	1,200	1,800	3,200	--
12/11/97	37.47	20.26	17.21	--	--	76,000	6,100	1,300	2,200	8,000	3,800	--
03/12/98	37.47	23.30	14.17	--	--	45,000	6,000	1,400	1,800	5,900	2,700	--
06/23/98 ³	37.47	22.65	14.82	--	--	1,100,000	6,800	5,100	13,000	38,000	<1,000	--
09/01/98	37.47	15.69	21.78	--	--	9,700	300	8.2	6.2	250	3,700	--
12/30/98	37.47	15.61	21.86	--	--	110,000	4,790	1,300	841	5,570	2,420	--
03/31/99	37.47	20.57	16.90	--	--	48,000	4,800	1,110	1,520	5,450	2,160	--
06/14/99	37.47	17.32	20.15	Sheen	--	56,400	5,380	671	1,300	3,960	2,480	--
06/14/99 ¹	37.47	17.32	20.15	--	--	--	--	--	--	--	2,630 ²	--
09/30/99	37.47	14.50	22.97	--	--	22,100	623	<100	529	1,250	2,430	--
12/22/99	37.47	16.47	21.00	--	--	10,200	1,750	102	222	963	1,980	--
03/09/00	37.47	25.27	12.20	--	--	26,000	4,800	930	1,200	4,400	1,800	--
06/23/00 ³	37.47	18.53	18.94	0.00	0.00	29,000 ⁴	3,400	360	440	2,500	2,800	--
09/05/00 ³	37.47	17.01	20.46	0.00	0.00	35,000 ⁴	3,800	54	980	750	5,200	--
12/04/00	37.47	16.54	20.93	0.00	0.00	16,000 ⁴	2,500	120	360	1,100	2,100	--
03/08/01 ³	37.47	20.53	16.94	0.00	0.00	42,300	3,930	828	2,010	5,180	1,660	--
06/07/01 ³	37.47	18.13	19.34	0.00	0.00	15,000 ⁴	3,400	150	700	1,300	1,900	--
09/13/01 ³	37.47	15.28	22.19	0.00	0.00	9,600	1,200	<50	120	160	2,200	--
12/13/01 ³	37.47	19.87	17.60	0.00	0.00	33,000	3,200	430	1,300	3,700	1,400	--
03/08/02 ³	37.47	23.18	14.29	0.00	0.00	26,000	2,900	390	1,200	2,800	1,100	--
06/19/02 ³	37.47	18.36	19.11	0.00	0.00	19,000	3,000	100	720	1,100	1,400	--
09/11/02 ³	37.47	16.79	20.68	0.00	0.00	10,000	1,400	23	120	78	1,800	--
12/11/02 ³	37.47	15.36	22.11	0.00	0.00	8,700	1,300	24	100	250	1,900	--
03/11/03 ³	37.47	22.86	14.61	0.00	0.00	23,000	2,000	280	1,100	2,100	990	--
06/10/03 ^{3,7}	37.47	20.36	17.11	0.00	0.00	14,000	1,300	91	450	720	480	--
09/09/03 ^{3,7}	37.47	16.33	21.14	0.00	0.00	6,800	1,100	9	83	47	1,300	<200
12/09/03 ⁷	37.47	18.27	19.20	0.00	0.00	22,000	1,100	120	570	1,000	460	<250
03/09/04 ⁷	37.47	25.65	11.82	0.00	0.00	24,000	1,800	420	820	2,100	480	<250

Table 1
Groundwater Monitoring Data and Analytical Results
Chevron Service Station #9-0076
4265 Foothill Boulevard
Oakland, California

WELL ID/ DATE	TOC* (ft.)	GWE (msl)	DTW (ft.)	SPHT (ft.)	SPH							
					REMOVED (gallons)	TPH-G (µg/L)	B (µg/L)	T (µg/L)	E (µg/L)	X (µg/L)	MTBE (µg/L)	ETHANOL (µg/L)
C-2 (cont)												
06/08/04 ⁷	37.47	21.05	16.42	0.00	0.00	1,200	180	5	1	10	170	<50
09/08/04 ⁷	37.47	24.32**	13.16	0.01	0.00	16,000	340	13	290	200	170	<250
12/06/04 ⁷	37.47	23.36**	14.12	0.01	0.00	13,000	730	130	340	570	280	<100
03/07/05 ⁷	37.47	26.91**	10.57	0.01	0.00	18,000	2,200	470	770	2,000	420	<250
06/06/05 ⁷	37.47	24.78	12.69	0.00	0.00	9,800	940	79	300	490	200	<100
09/06/05 ⁷	37.47	22.69	14.78	0.00	0.00	9,300	380	8	89	76	170	<100
12/05/05 ⁷	37.47	23.25	14.22	0.00	0.00	8,300	190	8	68	67	56	<50
03/06/06 ⁷	37.47	27.73	9.74	0.00	0.00	1,900	41	5	13	43	6	<50
06/05/06 ⁷	37.47	27.72	9.75	0.00	0.00	8,800	680	99	200	460	170	<50
09/05/06 ⁷	37.47	25.51	11.96	0.00	0.00	8,200	1,200	24	170	65	65	<100
12/04/06 ⁷	37.47	25.04	12.43	0.00	0.00	9,500	1,800	38	140	94	94	<100
03/05/07 ⁷	37.47	26.86	10.61	0.00	0.00	15,000 ¹¹	1,900 ¹¹	300 ¹¹	570 ¹¹	1,300 ¹¹	250 ¹¹	<250 ¹¹
06/04/07 ⁷	37.47	27.13	10.34	0.00	0.00	6,200	410	16	76	100	110	<50
09/07/07 ⁷	37.47	25.82	11.65	0.00	0.00	6,400	240	6	71	82	67	<50
12/06/07 ⁷	37.47	19.07	18.40	0.00	0.00	7,300	200	12	47	79	56	<50
03/06/08 ⁷	37.47	28.00	9.47	0.00	0.00	18,000	2,400	340	850	1,600	260	<100
06/05/08 ⁷	37.47	26.40	11.07	0.00	0.00	5,800	530	18	47	80	100	<250
09/03/08⁷	37.47	24.27	13.20	0.00	0.00	5,600	340	10	81	48	83	<50
C-3												
04/28/89	35.28	7.28	28.00	--	--	<500	1.7	<0.5	<0.5	<0.5	--	--
08/08/89	35.28	5.28	30.00	--	--	<500	1.0	<0.5	<0.5	<0.5	--	--
12/21/89	35.28	4.75	30.53	--	--	--	--	--	--	--	--	--
08/27/90	35.28	5.60	29.68	--	--	<50	<0.3	<0.3	<0.3	<0.6	--	--
11/04/90	35.30	4.94	30.36	--	--	--	--	--	--	--	--	--
06/18/91	35.30	6.84	28.46	--	--	52	1.1	<0.5	<0.5	1.2	--	--
09/19/91	35.30	5.97	29.33	--	--	73	1.2	<0.5	<0.5	<0.5	--	--
12/20/91	35.30	5.53	29.77	--	--	<50	0.7	<0.5	<0.5	<0.5	--	--
03/18/92	35.30	9.55	25.75	--	--	<50	<0.5	<0.5	<0.5	<0.5	--	--
07/14/92	35.30	7.43	27.87	--	--	<50	<0.5	<0.5	<0.5	<0.5	--	--
10/08/92	35.30	6.75	28.55	--	--	<50	<0.5	<0.5	<0.5	0.5	--	--
01/08/93	35.30	9.45	25.85	--	--	<50	<0.5	<0.5	<0.5	<0.5	--	--
04/14/93	35.30	11.34	23.96	--	--	<50	<0.5	<0.5	<0.5	<0.5	--	--
07/16/93	35.30	9.66	25.64	--	--	<50	<0.5	<0.5	<0.5	<0.5	--	--

Table 1
Groundwater Monitoring Data and Analytical Results
Chevron Service Station #9-0076
4265 Foothill Boulevard
Oakland, California

WELL ID/ DATE	TOC* (ft.)	GWE (msl)	DTW (ft.)	SPHT (ft.)	SPH REMOVED (gallons)	TPH-G (µg/L)	B (µg/L)	T (µg/L)	E (µg/L)	X (µg/L)	MTBE (µg/L)	ETHANOL (µg/L)
C-3 (cont)												
09/21/93	38.37	12.15	26.22	--	--	<50	0.7	<0.5	<0.5	<0.8	--	--
01/28/94	38.37	12.71	25.66	--	--	<50	2.0	<0.5	<0.5	1.0	--	--
03/17/94	38.37	13.42	24.95	--	--	<50	2.8	<0.5	0.6	1.5	--	--
06/16/94	38.37	14.06	24.31	--	--	<50	1.4	<0.5	<0.5	<0.5	--	--
09/22/94	38.37	13.33	25.04	--	--	<50	0.6	<0.5	<0.5	<0.5	--	--
12/15/94	38.37	16.15	22.22	--	--	<50	2.6	1.7	0.82	4.5	--	--
03/30/95	38.37	19.95	18.42	--	--	<50	<0.5	<0.5	<0.5	<0.5	--	--
06/20/95	38.37	18.58	19.79	--	--	110	2.2	<0.5	<0.5	1.2	--	--
09/20/95	38.37	19.42	18.95	--	--	560	21	80	23	120	--	--
12/06/95	38.37	14.21	24.16	--	--	<50	0.73	<0.5	<0.5	0.67	<2.5	--
03/21/96	38.37	20.52	17.85	--	--	<50	<0.5	<0.5	<0.5	<0.5	<2.5	--
06/21/96	38.37	18.59	19.78	--	--	57	<0.5	<0.5	<0.5	<0.5	<2.5	--
09/06/96	38.37	16.74	21.63	--	--	<50	0.9	<0.5	<0.5	<0.5	<2.5	--
12/19/96	38.37	16.07	22.30	--	--	310	36	33	6.5	28	<2.5	--
03/17/97	38.37	19.42	18.95	--	--	54	1.1	<0.5	<0.5	0.76	<2.5	--
06/11/97	38.37	17.22	21.15	--	--	120	1.1	<0.5	<0.5	<0.5	<2.5	--
09/17/97	38.37	15.96	22.41	--	--	240	19	19	6.6	40	13	--
12/11/97	38.37	16.11	22.26	--	--	<50	1.8	<0.5	<0.5	0.5	<2.5	--
03/12/98	38.37	20.02	18.35	--	--	72	6.3	<0.5	0.64	3.1	2.6	--
06/23/98	38.37	19.33	19.04	--	--	<50	<0.5	<0.5	<0.5	<0.5	<2.5	--
09/01/98	38.37	18.40	19.97	--	--	200	6.8	0.31	0.52	2.0	<2.5	--
12/30/98	38.37	17.06	21.31	--	--	<50	<0.5	<0.5	<0.5	<0.5	<2.0	--
03/31/99	38.37	20.60	17.77	--	--	<50	<0.5	<0.5	<0.5	<0.5	12.6	--
06/14/99	38.37	20.12	18.25	--	--	<50	<0.5	<0.5	<0.5	<0.5	<2.5	--
09/30/99	38.37	17.18	21.19	--	--	79.2	3.04	0.794	<0.5	1.04	6.17	--
12/22/99	38.37	16.05	22.32	--	--	<50	1.53	1.08	<0.5	0.66	12	--
03/09/00	38.37	21.27	17.10	--	--	99	6.9	0.8	0.89	3.8	12	--
06/23/00	38.37	19.22	19.15	0.00	0.00	<50	<0.50	<0.50	<0.50	<0.50	<2.5	--
09/05/00	38.37	17.53	20.84	0.00	0.00	52 ⁴	4.3	<0.50	<0.50	0.93	29	--
12/04/00	38.37	17.17	21.20	0.00	0.00	70 ⁴	4.0	<0.50	<0.50	0.71	25	--
03/08/01	38.37	20.70	17.67	0.00	0.00	<50.0	0.873	<0.500	<0.500	<0.500	3.24	--
06/07/01	38.37	19.47	18.90	0.00	0.00	140 ⁴	16	0.67	1.4	3.8	30	--
09/13/01	38.37	17.36	21.01	0.00	0.00	<50	<0.50	<0.50	<0.50	<0.50	<2.5	--
12/13/01	38.37	18.57	19.80	0.00	0.00	<50	1.2	<0.50	<0.50	<1.5	15	--
03/08/02	38.37	20.59	17.78	0.00	0.00	82	5.4	<0.50	<0.50	<1.5	68	--

Table 1
Groundwater Monitoring Data and Analytical Results
Chevron Service Station #9-0076
4265 Foothill Boulevard
Oakland, California

WELL ID/ DATE	TOC* (ft.)	GWE (msl)	DTW (ft.)	SPHT (ft.)	SPH		B (ug/L)	T (ug/L)	E (ug/L)	X (ug/L)	MTBE (ug/L)	ETHANOL (ug/L)
					REMOVED (gallons)	TPH-G (ug/L)						
C-3 (cont)												
06/19/02	38.37	19.97	18.40	0.00	0.00	74	2.1	<0.50	<0.50	<1.5	77	--
09/11/02	38.37	18.20	20.17	0.00	0.00	110	4.7	<0.50	<0.50	<1.5	76	--
12/11/02	38.37	16.62	21.75	0.00	0.00	79	1.5	<0.50	<0.50	<1.5	96	--
03/11/03	38.37	19.30	19.07	0.00	0.00	<50	2.1	<0.50	<0.50	<1.5	18	--
06/10/03 ⁷	38.37	19.29	19.08	0.00	0.00	86	2	<0.5	<0.5	<0.5	93	--
09/09/03 ⁷	38.37	17.67	20.70	0.00	0.00	<50	2	<0.5	<0.5	<0.5	160	<50
12/09/03 ⁷	38.37	17.32	21.05	0.00	0.00	<50	<0.5	<0.5	<0.5	<0.5	0.9	<50
03/09/04 ⁷	38.37	22.12	16.25	0.00	0.00	<50	<0.5	<0.5	<0.5	<0.5	<0.5	<50
06/08/04 ⁷	38.37	19.87	18.50	0.00	0.00	<50	<0.5	<0.5	<0.5	<0.5	<0.5	<50
09/08/04 ⁷	38.37	18.36	20.01	0.00	0.00	<50	<0.5	<0.5	<0.5	<0.5	22	<50
12/06/04 ⁷	38.37	19.07	19.30	0.00	0.00	<50	<0.5	<0.5	<0.5	<0.5	<0.5	<50
03/07/05 ⁷	38.37	20.35	18.02	0.00	0.00	<50	<0.5	<0.5	<0.5	<0.5	<0.5	<50
06/06/05 ⁷	38.37	19.29	19.08	0.00	0.00	<50	<0.5	<0.5	<0.5	<0.5	<0.5	<50
09/06/05 ⁷	38.37	20.22	18.15	0.00	0.00	<50	<0.5	<0.5	<0.5	<0.5	<0.5	<50
12/05/05 ⁷	38.37	20.52	17.85	0.00	0.00	<50	<0.5	<0.5	<0.5	<0.5	<0.5	<50
03/06/06 ⁷	38.37	20.44	17.93	0.00	0.00	<50	<0.5	<0.5	<0.5	<0.5	<0.5	<50
06/05/06 ⁷	38.37	23.02	15.35	0.00	0.00	<50	<0.5	<0.5	<0.5	<0.5	65	<50
09/05/06 ⁷	38.37	19.95	18.42	0.00	0.00	<50	<0.5	<0.5	<0.5	<0.5	<0.5	<50
12/04/06 ⁷	38.37	20.08	18.29	0.00	0.00	<50	<0.5	<0.5	<0.5	<0.5	<0.5	<50
03/05/07 ⁷	38.37	23.63	14.74	0.00	0.00	<50	<0.5	<0.5	<0.5	<0.5	<0.5	<50
06/04/07 ⁷	38.37	22.69	15.68	0.00	0.00	<50	<0.5	<0.5	<0.5	<0.5	<0.5	<50
09/07/07 ⁷	38.37	19.86	18.51	0.00	0.00	<50	<0.5	<0.5	<0.5	<0.5	<0.5	<50
12/06/07 ⁷	38.37	18.96	19.41	0.00	0.00	<50	<0.5	<0.5	<0.5	<0.5	<0.5	<50
03/06/08 ⁷	38.37	22.42	15.95	0.00	0.00	<50	<0.5	<0.5	<0.5	<0.5	1	<50
06/05/08 ⁷	38.37	20.89	17.48	0.00	0.00	<50	<0.5	<0.5	<0.5	<0.5	0.6	<50
09/03/08⁷	38.37	19.39	18.98	0.00	0.00	<50	<0.5	<0.5	<0.5	<0.5	<0.5	<50
C-4												
01/12/89	33.45	3.96	29.49	--	--	--	--	--	--	--	--	--
04/12/89	33.45	6.01	27.44	--	--	--	--	--	--	--	--	--
04/28/89	33.45	3.96	29.49	--	--	20,000	6,300	550	230	1,500	--	--
08/08/89	33.45	3.90	29.55	--	--	8,000	7,500	340	88	1,000	--	--
12/21/89	33.45	3.43	30.02	--	--	--	--	--	--	--	--	--

Table 1
Groundwater Monitoring Data and Analytical Results
Chevron Service Station #9-0076
4265 Foothill Boulevard
Oakland, California

WELL ID/ DATE	TOC* (ft.)	GWE (msl)	DTW (ft.)	SPHT (ft.)	SPH							MTBE (µg/L)	ETHANOL (µg/L)
					REMOVED (gallons)	TPH-G (µg/L)	B (µg/L)	T (µg/L)	E (µg/L)	X (µg/L)			
C-4 (cont)													
08/27/90	33.48	4.46	29.02	--	--	26,000	10,000	280	410	1,400	--	--	
11/04/90	33.48	3.67	29.81	--	--	--	--	--	--	--	--	--	
06/18/91	33.48	6.03	27.45	--	--	34,000	14,000	410	450	1,300	--	--	
09/19/91	33.48	4.83	28.65	--	--	16,000	7,400	90	110	460	--	--	
12/20/91	33.48	4.64	28.84	--	--	24,000	12,000	120	260	740	--	--	
03/18/92	33.48	11.05	24.43	--	--	48,000	6,000	1,300	1,300	2,400	--	--	
07/14/92	33.48	6.59	26.89	--	--	40,000	14,000	920	550	2,400	--	--	
10/08/92	33.48	5.69	27.79	--	--	29,000	13,000	190	110	1,400	--	--	
01/08/93	33.48	9.98	23.50	--	--	25,000	7,000	630	860	1,800	--	--	
04/14/93	33.48	12.35	21.13	--	--	27,000	6,300	1,000	900	1,400	--	--	
07/16/93	33.48	9.52	23.96	--	--	28,000	7,800	1,100	830	2,100	--	--	
09/21/93	36.49	10.98	25.51	--	--	30,000	9,600	130	390	1,300	--	--	
01/28/94	36.49	13.18	23.31	--	--	18,000	7,800	440	260	1,200	--	--	
03/17/94	36.49	15.14	21.35	--	--	32,000	7,800	820	820	1,800	--	--	
06/16/94	36.49	13.99	22.50	--	--	25,000	7,600	710	600	1,800	--	--	
09/22/94	36.49	12.56	23.93	--	--	25,000	7,800	140	600	1,100	--	--	
12/15/94	36.49	17.47	19.02	--	--	38,000	7,600	460	1,200	2,000	--	--	
03/30/95	36.49	21.63	14.86	--	--	41,000	8,700	1,600	1,800	3,000	--	--	
06/20/95	36.49	19.59	16.90	--	--	29,000	6,000	890	960	1,800	--	--	
09/20/95	36.49	20.29	16.20	--	--	12,000	6,900	510	290	1,300	--	--	
12/06/95	36.49	13.37	23.12	--	--	13,000	3,900	42	30	250	<250	--	
03/21/96	36.49	22.39	14.10	--	--	39,000	4,800	640	1,000	1,800	<1,000	--	
06/21/96	36.49	19.54	16.95	--	--	26,000	4,400	640	960	1,800	2,000	--	
09/06/96	36.49	16.36	20.13	--	--	23,000	500	200	230	1,000	3,100	--	
12/19/96	36.49	19.57	16.92	--	--	23,000	4,900	320	1,100	2,000	<250	--	
03/17/97	36.49	19.09	17.40	--	--	30,000	5,800	700	1,400	2,200	1,700	--	
06/11/97	36.49	18.15	18.34	--	--	29,000	4,400	520	790	1,800	2,000	--	
09/17/97	36.49	15.03	21.46	--	--	17,000	4,300	140	940	1,100	4,600	--	
12/11/97	36.49	19.84	16.65	--	--	12,000	2,500	130	300	1,000	1,400	--	
03/12/98	36.49	19.90	16.59	--	--	46,000	11,000	1,500	2,300	5,000	3,400	--	
06/23/98 ³	36.49	19.47	17.02	--	--	27,000	1,600	160	180	690	100	--	
09/01/98	36.49	15.04	21.45	--	--	520	14	2.3	<0.5	4.8	61	--	
12/30/98	36.49	15.07	21.42	--	--	122	14.1	1.86	<1.0	3.61	349	--	
03/31/99	36.49	21.29	15.20	--	--	20,300	4,450	443	1,000	2,130	1,320	--	
06/14/99	36.49	14.69	21.80	--	--	1,820	183	7.14	36.7	56.5	291	--	

Table 1
Groundwater Monitoring Data and Analytical Results
Chevron Service Station #9-0076
4265 Foothill Boulevard
Oakland, California

WELL ID/ DATE	TOC* (ft.)	GWE (msl)	DTW (ft.)	SPH		TPH-G (µg/L)	B (µg/L)	T (µg/L)	E (µg/L)	X (µg/L)	MTBE (µg/L)	ETHANOL (µg/L)
				SPHT (ft.)	REMOVED (gallons)							
C-4 (cont)												
06/14/99 ¹	36.49	14.69	21.80	--	--	--	--	--	--	--	280 ²	--
09/30/99	36.49	16.68	19.81	--	--	1,030	11.6	2.14	29.2	68.7	91.5	--
12/22/99	36.49	16.22	20.27	--	--	217	4.45	0.765	2.82	8.21	70.2	--
03/09/00	36.49	23.13	13.36	--	--	8,300	2,600	270	510	1,400	650	--
06/23/00 ³	36.49	17.09	19.40	0.00	0.00	55 ⁴	1.2	<0.50	<0.50	<0.50	250	--
09/05/00 ³	36.49	15.06	21.43	0.00	0.00	110 ⁴	5.4	<0.50	<0.50	1.1	52	--
12/04/00	36.49	14.71	21.78	0.00	0.00	<50	<0.50	0.56	<0.50	1.1	22	--
03/08/01 ³	36.49	19.87	16.62	0.00	0.00	9,080	2,260	229	395	1,060	718	--
06/07/01 ³	36.49	16.89	19.60	0.00	0.00	800 ⁴	75	4.3	22	33	340	--
09/13/01 ³	36.49	14.78	21.71	0.00	0.00	<50	0.68	<0.50	<0.50	<0.50	18	--
12/13/01 ³	36.49	18.54	17.95	0.00	0.00	5,800	1,400	43	21	470	540	--
03/08/02 ³	36.49	19.71	16.78	0.00	0.00	7,000	1,300	67	280	390	610	--
06/19/02 ³	36.49	17.69	18.80	0.00	0.00	3,100	130	6.5	29	55	250	--
09/11/02 ³	36.49	16.19	20.30	0.00	0.00	820	6.2	1.0	2.2	2.5	26	--
12/11/02 ³	36.49	14.52	21.97	0.00	0.00	<50	0.74	<0.50	<0.50	<1.5	9.3	--
03/11/03 ³	36.49	18.10	18.39	0.00	0.00	5,500	490	12	100	210	330	--
06/10/03 ^{3,7}	36.49	17.74	18.75	0.00	0.00	3,300	370	15	120	200	200	--
09/09/03 ^{3,7}	36.49	15.70	20.79	0.00	0.00	690	8	0.8	5	5	30	<50
12/09/03 ^{7,9}	36.49	16.19	20.30	0.00	0.00	<50	<0.5	<0.5	<0.5	<0.5	57	<50
03/09/04 ⁷	36.49	23.03	13.46	0.00	0.00	15,000	1,600	73	520	460	230	<250
06/08/04 ⁷	36.49	19.47	17.02	0.00	0.00	550	120	2	0.7	5	93	<50
09/08/04 ⁷	36.49	18.91	17.58	0.00	0.00	<50	<0.5	<0.5	<0.5	<0.5	37	<50
12/06/04 ⁷	36.49	19.71	16.78	0.00	0.00	7,000	1,600	39	230	260	180	<50
03/07/05 ⁷	36.49	24.33	12.16	0.00	0.00	9,500	2,100	67	330	160	170	<250
06/06/05 ⁷	36.49	22.86	13.63	0.00	0.00	7,700	2,000	39	280	130	130	<250
09/06/05 ⁷	36.49	20.79	15.70	0.00	0.00	3,600	830	10	79	21	110	<50
12/05/05 ⁷	36.49	20.04	16.45	0.00	0.00	4,400	1,000	11	80	23	120	<250
03/06/06 ⁷	36.49	23.54	12.95	0.00	0.00	10,000	2,400	92	240	170	130	<500
06/05/06 ⁷	36.49	25.47	11.02	0.00	0.00	16,000	3,300	160	350	370	150	<500
09/05/06 ⁷	36.49	23.89	12.60	0.00	0.00	9,600	1,400	29	200	78	81	<100
12/04/06 ⁷	36.49	23.29	13.20	0.00	0.00	13,000	1,800	40	150	99	100	<250
03/05/07 ⁷	36.49	25.84	10.65	0.00	0.00	11,000	2,800	58	230	270	100	<500
06/04/07 ⁷	36.49	24.95	11.54	0.00	0.00	13,000	3,500	87	300	230	94	<250
09/07/07 ⁷	36.49	23.99	12.50	0.00	0.00	5,100	1,000	24	70	43	39	<130
12/06/07 ⁷	36.49	24.07	12.42	0.00	0.00	9,900	2,000	65	210	210	74	<130

Table 1
Groundwater Monitoring Data and Analytical Results
Chevron Service Station #9-0076
4265 Foothill Boulevard
Oakland, California

WELL ID/ DATE	TOC* (ft.)	GWE (msl)	DTW (ft.)	SPHT (ft.)	SPH REMOVED (gallons)	TPH-G (µg/L)	B (µg/L)	T (µg/L)	E (µg/L)	X (µg/L)	MTBE (µg/L)	ETHANOL (µg/L)
C-4 (cont)												
03/06/08 ⁷	36.49	26.35	10.14	0.00	0.00	17,000	3,500	210	510	510	77	<250
06/05/08 ⁷	36.49	24.91	11.58	0.00	0.00	12,000	3,500	120	300	240	76	<250
09/03/08⁷	36.49	24.02	12.47	0.00	0.00	13,000	3,400	72	210	130	73	<250
C-5												
08/27/90	35.50	5.67	29.83	--	--	<50	<0.3	<0.3	<0.3	<0.6	--	--
11/14/90	35.50	4.94	30.56	--	--	--	--	--	--	--	--	--
06/18/91	35.50	6.98	28.52	--	--	<50	<0.5	<0.5	<0.5	--	--	--
09/19/91	35.50	5.99	29.51	--	--	<50	<0.5	<0.5	<0.5	<0.5	--	--
12/20/91	35.50	5.54	29.96	--	--	<50	<0.5	<0.5	<0.5	<0.5	--	--
03/18/92	35.50	9.58	25.92	--	--	<50	<0.5	<0.5	<0.5	<0.5	--	--
07/14/92	35.50	7.50	28.00	--	--	<50	<0.5	<0.5	<0.5	<0.5	--	--
10/08/92	35.50	6.85	28.65	--	--	<50	<0.5	<0.5	<0.5	<0.5	--	--
01/08/93	35.50	9.48	26.02	--	--	<50	<0.5	<0.5	<0.5	<0.5	--	--
04/14/93	35.50	11.46	24.04	--	--	<50	<0.5	<0.5	<0.5	<0.5	--	--
07/16/93	35.50	10.29	25.21	--	--	<50	<0.5	<0.5	<0.5	<0.5	--	--
09/21/93	38.50	12.14	26.36	--	--	60	10	8.1	1.9	9.4	--	--
01/28/94	38.50	12.60	25.90	--	--	<50	<0.5	<0.5	<0.5	<0.5	--	--
03/17/94	38.50	14.00	24.50	--	--	<50	<0.5	<0.5	<0.5	<0.5	--	--
06/16/94	38.50	14.10	24.40	--	--	<50	<0.5	<0.5	<0.5	<0.5	--	--
09/22/94	38.50	13.34	25.16	--	--	<50	<0.5	<0.5	<0.5	<0.5	--	--
12/15/94	38.50	15.61	22.89	--	--	<50	<0.5	<0.5	<0.5	<0.5	--	--
03/30/95	38.50	19.96	18.54	--	--	<50	<0.5	<0.5	<0.5	<0.5	--	--
06/20/95	38.50	18.37	20.13	--	--	<50	<0.5	<0.5	<0.5	<0.5	--	--
09/20/95	38.50	14.16	24.34	--	--	<50	<0.5	<0.5	<0.5	<0.5	--	--
12/06/95	38.50	14.40	24.10	--	--	<50	<0.5	<0.5	<0.5	<0.5	<2.5	--
03/21/96	38.50	20.10	18.40	--	--	<50	<0.5	<0.5	<0.5	<0.5	<2.5	--
06/21/96	38.50	18.23	20.27	--	--	<50	<0.5	<0.5	<0.5	<0.5	8.7	--
06/06/96	38.50	16.60	21.90	--	--	<50	<0.5	<0.5	<0.5	<0.5	<2.5	--
12/19/96	38.50	17.35	21.15	--	--	<50	<0.5	<0.5	<0.5	<0.5	<2.5	--
03/17/97	38.50	18.66	19.84	--	--	<50	<0.5	<0.5	<0.5	<0.5	<2.5	--
06/11/97	38.50	16.90	21.60	--	--	<50	<0.5	<0.5	<0.5	<0.5	<2.5	--
09/17/97	38.50	10.67	27.83	--	--	SAMPLED ANNUALLY		--	--	--	--	--
12/11/97	38.50	17.50	21.00	--	--	--	--	--	--	--	--	--

Table 1
Groundwater Monitoring Data and Analytical Results
Chevron Service Station #9-0076
4265 Foothill Boulevard
Oakland, California

WELL ID/ DATE	TOC* (ft.)	GWE (msl)	DTW (ft.)	SPHT (ft.)	SPH		B (µg/L)	T (µg/L)	E (µg/L)	X (µg/L)	MTBE (µg/L)	ETHANOL (µg/L)
					REMOVED (gallons)	TPH-G (µg/L)						
C-5 (cont)												
03/12/98	38.50	22.08	16.42	--	--	<50	<0.5	<0.5	<0.5	<0.5	<2.5	--
06/23/98	38.50	21.52	16.98	--	--	--	--	--	--	--	--	--
09/01/98	38.50	18.08	20.42	--	--	--	--	--	--	--	--	--
12/30/98	38.50	17.71	20.79	--	--	--	--	--	--	--	--	--
03/31/99	38.50	21.45	17.05	--	--	<50	<0.5	<0.5	<0.5	<0.5	15	--
06/14/99	38.50	21.02	17.48	--	--	--	--	--	--	--	--	--
09/30/99	38.50	19.77	18.73	--	--	--	--	--	--	--	--	--
12/22/99	38.50	16.32	22.18	--	--	--	--	--	--	--	--	--
03/09/00	38.50	21.52	16.98	--	--	<50	<0.5	<0.5	<0.5	0.87	3.5	--
06/23/00	38.50	18.85	19.65	0.00	0.00	SAMPLED ANNUALLY		--	--	--	--	--
09/05/00	38.50	18.03	20.47	0.00	0.00	--	--	--	--	--	--	--
12/04/00	38.50	17.04	21.46	0.00	0.00	--	--	--	--	--	--	--
03/08/01	38.50	20.97	17.53	0.00	0.00	<50.0	<0.500	<0.500	<0.500	<0.500	5.15	--
06/07/01	38.50	19.00	19.50	0.00	0.00	SAMPLED ANNUALLY		--	--	--	--	--
09/13/01	38.50	17.07	21.43	0.00	0.00	SAMPLED ANNUALLY		--	--	--	--	--
12/13/01	38.50	18.66	19.84	0.00	0.00	SAMPLED ANNUALLY		--	--	--	--	--
03/08/02	38.50	20.32	18.18	0.00	0.00	<50	<0.50	<0.50	<0.50	<1.5	3.5	--
06/19/02	38.50	19.62	18.88	0.00	0.00	SAMPLED ANNUALLY		--	--	--	--	--
09/11/02	38.50	17.94	20.56	0.00	0.00	SAMPLED ANNUALLY		--	--	--	--	--
12/11/02	38.50	16.68	21.82	0.00	0.00	SAMPLED ANNUALLY		--	--	--	--	--
03/11/03	38.50	19.54	18.96	0.00	0.00	<50	<0.50	<0.50	<0.50	<1.5	3.2	--
06/10/03	38.50	19.63	18.87	0.00	0.00	SAMPLED ANNUALLY		--	--	--	--	--
09/09/03	38.50	17.82	20.68	0.00	0.00	SAMPLED ANNUALLY		--	--	--	--	--
12/09/03	38.50	18.25	20.25	0.00	0.00	SAMPLED ANNUALLY		--	--	--	--	--
03/09/04 ⁷	38.50	21.82	16.68	0.00	0.00	<50	<0.5	<0.5	<0.5	<0.5	1	<50
06/08/04	38.50	19.16	19.34	0.00	0.00	SAMPLED ANNUALLY		--	--	--	--	--
09/08/04	38.50	18.40	20.10	0.00	0.00	SAMPLED ANNUALLY		--	--	--	--	--
12/06/04	38.50	18.75	19.75	0.00	0.00	SAMPLED ANNUALLY		--	--	--	--	--
03/07/05 ⁷	38.50	20.35	18.15	0.00	0.00	<50	<0.5	<0.5	<0.5	<0.5	<0.5	<50
06/06/05	38.50	19.14	19.36	0.00	0.00	SAMPLED ANNUALLY		--	--	--	--	--
09/06/05	38.50	20.24	18.26	0.00	0.00	SAMPLED ANNUALLY		--	--	--	--	--
12/05/05	38.50	20.59	17.91	0.00	0.00	SAMPLED ANNUALLY		--	--	--	--	--
03/06/06 ⁷	38.50	20.30	18.20	0.00	0.00	<50	<0.5	<0.5	<0.5	<0.5	<0.5	<50
06/05/06	38.50	22.63	15.87	0.00	0.00	SAMPLED ANNUALLY		--	--	--	--	--
09/05/06	38.50	19.72	18.78	0.00	0.00	SAMPLED ANNUALLY		--	--	--	--	--

Table 1
Groundwater Monitoring Data and Analytical Results
Chevron Service Station #9-0076
4265 Foothill Boulevard
Oakland, California

WELL ID/ DATE	TOC* (ft.)	GWE (msl)	DTW (ft.)	SPHT (ft.)	SPH		TPH-G (µg/L)	B (µg/L)	T (µg/L)	E (µg/L)	X (µg/L)	MTBE (µg/L)	ETHANOL (µg/L)
					REMOVED (gallons)								
C-5 (cont)													
12/04/06	38.50	19.79	18.71	0.00	0.00	SAMPLED ANNUALLY		--	--	--	--	--	--
03/05/07 ⁷	38.50	22.23	16.27	0.00	0.00	<50	<0.5	<0.5	<0.5	<0.5	<0.5	1	<50
06/04/07	38.50	22.23	16.27	0.00	0.00	SAMPLED ANNUALLY		--	--	--	--	--	--
09/07/07	38.50	19.59	18.91	0.00	0.00	SAMPLED ANNUALLY		--	--	--	--	--	--
12/06/07	38.50	19.15	19.35	0.00	0.00	SAMPLED ANNUALLY		--	--	--	--	--	--
03/06/08 ⁷	38.50	22.66	15.84	0.00	0.00	<50	<0.5	<0.5	<0.5	<0.5	<0.5	0.7	<50
06/05/08	38.50	21.09	17.41	0.00	0.00	SAMPLED ANNUALLY		--	--	--	--	--	--
09/03/08	38.50	19.19	19.31	0.00	0.00	SAMPLED ANNUALLY		--	--	--	--	--	--
C-6													
08/27/90	32.40	-11.71	44.11	--	--	7,200	2,100	6.0	41	300	--	--	--
11/14/90	32.40	-11.63	44.03	--	--	--	--	--	--	--	--	--	--
06/18/91	32.40	-11.09	43.49	--	--	4,400	2,500	18	160	77	--	--	--
09/19/91	32.40	-1.92	34.32	--	--	3,100	1,600	8.3	73	8.0	--	--	--
12/20/91	32.40	-8.95	41.35	--	--	4,400	1,300	3.2	74	10	--	--	--
03/18/92	32.40	-8.29	40.69	--	--	9,800	3,200	34	250	500	--	--	--
07/14/92	32.40	-6.49	38.89	--	--	6,500	2,200	100	96	240	--	--	--
10/08/92	32.40	-6.27	38.67	--	--	1,800	1,000	3.1	15	41	--	--	--
01/08/93	32.40	-5.41	37.81	--	--	5,200	1,600	6.8	63	120	--	--	--
04/14/93	32.40	-2.30	34.70	--	--	11,000	1,800	13	110	200	--	--	--
07/16/93	32.40	-1.47	33.87	--	--	4,800	820	10	41	57	--	--	--
09/21/93	35.40	1.42	33.98	--	--	4,100	1,200	<50	75	130	--	--	--
01/28/94	35.40	1.54	33.86	--	--	3,100	930	14	40	34	--	--	--
03/17/94	35.40	3.09	32.31	--	--	5,100	950	18	61	83	--	--	--
06/16/94	35.40	3.90	31.50	--	--	3,800	970	6.4	52	62	--	--	--
09/22/94	35.40	4.18	31.22	--	--	4,100	980	7.8	43	48	--	--	--
12/15/94	35.40	4.00	31.40	--	--	5,000	1,400	<20	73	61	--	--	--
03/30/95	35.40	9.02	26.38	--	--	5,500	1,700	<13	120	97	--	--	--
06/20/95	35.40	10.39	25.01	--	--	1,700	470	<10	29	16	--	--	--
09/20/95	35.40	11.35	24.05	--	--	3,500	770	<5.0	45	17	--	--	--
12/06/95	35.40	7.28	28.12	--	--	3,100	710	<10	41	20	<50	--	--
03/21/96	35.40	12.28	23.12	--	--	1,400	330	<2.5	15	8.1	19	--	--
06/21/96	35.40	11.90	23.50	--	--	2,200	560	<5.0	18	<5.0	77	--	--
09/06/96	35.40	10.57	24.83	--	--	2,800	720	<10	13	<10	160	--	--

Table 1
Groundwater Monitoring Data and Analytical Results
Chevron Service Station #9-0076
4265 Foothill Boulevard
Oakland, California

WELL ID/ DATE	TOC* (ft.)	GWE (msl)	DTW (ft.)	SPHT (ft.)	SPH		B (ug/L)	T (ug/L)	E (ug/L)	X (ug/L)	MTBE (ug/L)	ETHANOL (ug/L)	
					REMOVED (gallons)	TPH-G (ug/L)							
C-6 (cont)													
12/19/96	35.40	10.90	24.50	--	--	830	320	<2.5	<2.5	<2.5	14	--	
03/17/97	35.40	12.81	22.59	--	--	2,200	500	<10	25	<10	<50	--	
06/11/97	35.40	11.64	23.76	--	--	3,000	570	<5.0	29	10	220	--	
09/17/97	35.40	10.66	24.74	--	--	1,400	330	<5.0	<5.0	<5.0	76	--	
12/11/97	35.40	10.75	24.65	--	--	1,600	230	<5.0	7.3	6.4	46	--	
03/12/98	35.40	8.28	27.12	--	--	980	300	<5.0	15	12	49	--	
06/23/98 ³	35.40	7.48	27.92	--	--	220	35	<0.5	2.5	1.1	<2.5	--	
09/01/98	35.40	3.80	31.60	--	--	1,800	370	2.8	19	5	44	--	
12/30/98	35.40	3.58	31.82	--	--	1,600	244	<1.0	8.53	<1.0	54.9	--	
03/31/99	35.40	9.34	26.06	--	--	741	92.2	<1.0	6.60	<1.0	27.9	--	
06/14/99	35.40	5.72	29.68	--	--	434	110	<1.0	5.76	1.46	13	--	
06/14/99 ¹	35.40	5.72	29.68	--	--	--	--	--	--	--	6.96 ²	--	
09/30/99	35.40	12.34	23.06	--	--	481	92.7	<1.0	3.69	<1.0	32.9	--	
12/22/99	35.40	12.85	22.55	--	--	1,310	158	2.16	5.5	1.41	113	--	
03/09/00	35.40	15.37	20.03	--	--	470	120	0.74	5.0	2.5	36	--	
06/23/00 ³	35.40	13.25	22.15	0.00	0.00	1,700 ⁴	210	<5.0	<5.0	5.8	64	--	
09/05/00 ³	35.40	8.35	27.05	0.00	0.00	740 ⁴	99	0.60	5.1	2.2	80	--	
12/04/00	35.40	10.25	25.15	0.00	0.00	450 ⁴	31	0.71	<0.50	<0.50	54	--	
03/08/01 ³	35.40	11.56	23.84	0.00	0.00	1,550	228	3.93	19.9	32.5	46.2	--	
06/07/01 ³	35.40	9.67	25.73	0.00	0.00	360 ⁴	21	1.8	2.4	3.8	100	--	
09/13/01 ³	35.40	11.60	23.80	0.00	0.00	950	180	<5.0	5.9	<5.0	170	--	
12/13/01 ³	35.40	10.21	25.19	0.00	0.00	2,000	170	0.86	6.4	4.1	77	--	
03/08/02 ³	35.40	14.32	21.08	0.00	0.00	600	33	0.91	1.8	<1.5	90	--	
06/19/02 ³	35.40	10.78	24.62	0.00	0.00	370	11	<0.50	<0.50	<1.5	88	--	
09/11/02 ³	35.40	6.40	29.00	0.00	0.00	490	16	0.50	<0.50	<1.5	120	--	
12/11/02 ³	35.40	11.22	24.18	0.00	0.00	430	17	<0.50	<0.50	<1.5	100	--	
03/11/03 ³	35.40	7.70	27.70	0.00	0.00	410	8.8	0.88	<0.50	<1.5	120	--	
06/10/03 ^{3,7}	35.40	13.80	21.60	0.00	0.00	460	10	<0.5	<0.5	<0.5	100	--	
09/09/03	35.40	INACCESSIBLE - VEHICLE PARKED OVER WELL						--	--	--	--	--	--
12/09/03 ^{7,9}	35.40	9.51	25.89	0.00	0.00	1,700	69	<0.5	3	0.6	83	<50	
03/09/04 ⁷	35.40	15.89	19.51	0.00	0.00	6,800	280	1	10	4	96	<50	
06/08/04 ⁷	35.40	14.57	20.83	0.00	0.00	560	13	<0.5	<0.5	0.5	68	<50	
09/08/04 ⁷	35.40	13.52	21.88	0.00	0.00	290	16	<0.5	<0.5	<0.5	50	<50	
12/06/04 ⁷	35.40	14.06	21.34	0.00	0.00	290	18	<0.5	0.5	<0.5	44	<50	

Table 1
Groundwater Monitoring Data and Analytical Results
Chevron Service Station #9-0076
4265 Foothill Boulevard
Oakland, California

WELL ID/ DATE	TOC* (ft.)	GWE (msl)	DTW (ft.)	SPHT (ft.)	SPH REMOVED (gallons)	TPH-G (ug/L)	B (ug/L)	T (ug/L)	E (ug/L)	X (ug/L)	MTBE (ug/L)	ETHANOL (ug/L)
C-6 (cont)												
03/07/05 ⁷	35.40	17.13	18.27	0.00	0.00	2,500	150	0.7	5	2	71	<50
06/06/05 ⁷	35.40	16.88	18.52	0.00	0.00	1,900	110	<1	3	2	59	<100
09/06/05 ⁷	35.40	15.02	20.38	0.00	0.00	800	16	<0.5	0.5	0.6	51	<50
12/05/05 ⁷	35.40	15.34	20.06	0.00	0.00	540	15	<0.5	<0.5	0.6	45	<50
03/06/06 ⁷	35.40	16.64	18.76	0.00	0.00	<50	<0.5	<0.5	<0.5	<0.5	<0.5	<50
06/05/06 ⁷	35.40	17.60	17.80	0.00	0.00	<50	<0.5	<0.5	<0.5	<0.5	0.7	<50
09/05/06 ⁷	35.40	15.40	20.00	0.00	0.00	1,200	17	<0.5	0.7	0.8	29	<50
12/04/06 ⁷	35.40	14.49	20.91	0.00	0.00	<50	<0.5	<0.5	<0.5	<0.5	<0.5	<50
03/05/07 ⁷	35.40	16.45	18.95	0.00	0.00	<50	<0.5	<0.5	<0.5	<0.5	<0.5	<50
06/04/07 ⁷	35.40	17.04	18.36	0.00	0.00	<50	<0.5	<0.5	<0.5	<0.5	3	<50
09/07/07 ⁷	35.40	14.35	21.05	0.00	0.00	<50	<0.5	<0.5	<0.5	<0.5	<0.5	<50
12/06/07 ⁷	35.40	13.53	21.87	0.00	0.00	<50	<0.5	<0.5	<0.5	<0.5	<0.5	<50
03/06/08 ⁷	35.40	13.72	21.68	0.00	0.00	<50	<0.5	<0.5	<0.5	<0.5	<0.5	<50
06/05/08 ⁷	35.40	14.15	21.25	0.00	0.00	<50	<0.5	<0.5	<0.5	<0.5	2	<50
09/03/08⁷	35.40	14.00	21.40	0.00	0.00	56	0.8	<0.5	<0.5	<0.5	5	<50
C-7												
08/27/90	32.17	-12.06	44.23	--	--	110	26	0.8	4.0	6.0	--	--
11/14/90	32.17	-11.94	44.11	--	--	--	--	--	--	--	--	--
06/18/91	32.17	-9.88	42.05	--	--	23,000	5,700	420	1,000	2,800	--	--
09/19/91	32.17	-9.55	41.72	--	--	26,000	4,600	330	970	2,400	--	--
12/20/91	32.17	-9.50	41.67	--	--	33,000	5,500	270	1,000	2,100	--	--
03/18/92	32.17	-9.03	41.20	--	--	27,000	5,800	410	1,300	3,300	--	--
07/14/92	32.17	-7.60	39.77	--	--	46,000	12,000	720	1,700	4,600	--	--
10/08/92	32.17	-6.97	39.14	--	--	22,000	6,800	370	1,300	3,200	--	--
01/08/93	32.17	-6.33	38.50	--	--	36,000	7,600	540	1,700	4,200	--	--
04/14/93	32.17	-3.76	35.93	--	--	23,000	3,100	450	670	1,900	--	--
07/16/93	32.17	-3.21	35.38	--	--	19,000	3,200	330	550	1,800	--	--
09/21/93	35.19	-0.27	35.46	--	--	17,000	2,700	160	410	760	--	--
01/28/94	35.19	-0.26	35.45	--	--	14,000	1,800	210	390	1,000	--	--
03/17/94	35.19	1.95	33.24	--	--	17,000	1,600	210	410	1,200	--	--
06/16/94	35.19	2.12	33.07	--	--	12,000	1,600	180	410	1,200	--	--
09/22/94	35.19	2.45	32.74	--	--	10,000	1,700	110	320	580	--	--
12/15/94	35.19	3.27	31.92	--	--	10,000	1,200	120	280	710	--	--

Table 1
Groundwater Monitoring Data and Analytical Results
Chevron Service Station #9-0076
4265 Foothill Boulevard
Oakland, California

WELL ID/ DATE	TOC* (ft.)	GWE (msl)	DTW (ft.)	SPHT (ft.)	SPH							MTBE (µg/L)	ETHANOL (µg/L)
					REMOVED (gallons)	TPH-G (µg/L)	B (µg/L)	T (µg/L)	E (µg/L)	X (µg/L)			
C-7 (cont)													
03/30/95	35.19	7.59	27.60	--	--	4,600	460	73	160	460	--	--	
06/20/95	35.19	7.32	27.87	--	--	26,000	4,400	450	900	2,400	--	--	
09/20/95	35.19	7.11	28.08	--	--	9,400	610	81	250	800	--	--	
12/06/95	35.19	4.57	30.62	--	--	1,200	110	12	25	71	34	--	
03/21/96	35.19	7.34	27.85	--	--	17,000	1,300	160	410	1,300	<100	--	
09/06/96	35.19	6.84	28.35	--	--	15,000	3,400	<50	460	850	<250	--	
12/19/96	35.19	6.08	29.11	--	--	530	9	0.5	0.85	3.4	<2.5	--	
03/17/97	35.19	8.05	27.14	--	--	4,600	310	46	110	310	98	--	
06/11/97	35.19	7.14	28.05	--	--	420	15	<0.5	3.3	5.1	<2.5	--	
09/17/97	35.19	6.19	29.00	--	--	1,400	120	11	31	84	54	--	
12/11/97	35.19	5.93	29.26	--	--	210	10	<0.5	0.97	1.6	<2.5	--	
03/12/98	35.19	10.27	24.92	--	--	68	<0.5	<0.5	<0.5	<0.5	<2.5	--	
06/23/98	35.19	9.89	25.30	--	--	<50	<0.5	<0.5	<0.5	<0.5	<2.5	--	
09/01/98	35.19	8.92	26.27	--	--	570	24	1.4	8.4	22	24	--	
12/30/98	35.19	8.67	26.52	--	--	<50	4.85	1.26	<0.5	1.29	167	--	
03/31/99	35.19	10.43	24.76	--	--	53.1	<0.5	<0.5	<0.5	<0.5	<2.0	--	
06/14/99	35.19	9.75	25.44	--	--	109	4.43	<0.5	<0.5	<0.5	<2.5	--	
06/14/99 ¹	35.19	9.75	25.44	--	--	--	--	--	--	--	<2.0 ²	--	
09/30/99	35.19	8.32	26.87	--	--	2,400	282	26.3	120	236	126	--	
12/22/99	35.19	7.42	27.77	--	--	3,840	162	18.1	44.7	85.3	141	--	
03/09/00	35.19	9.62	25.57	--	--	13,000	2,700	110	700	1,500	<130	--	
06/23/00	35.19	9.53	25.66	0.00	0.00	190 ⁴	3.4	<0.50	<0.50	1.6	7.3	--	
09/05/00	35.19	8.44	26.75	0.00	0.00	4,200 ⁴	330	26	120	200	190	--	
12/04/00	35.19	8.03	27.16	0.00	0.00	2,600 ⁴	550	<5.0	73	62	<25	--	
03/08/01	35.19	9.76	25.43	0.00	0.00	1,180	39.2	2.41	15.5	30.8	10.3	--	
06/07/01	35.19	9.80	25.39	0.00	0.00	2,600 ⁴	440	14	110	130	56	--	
09/13/01	35.19	8.58	26.61	0.00	0.00	23,000 ⁶	670	<100	150	210	<500	--	
12/13/01	35.19	8.50	26.69	0.00	0.00	2,400	160	5.8	42	54	<10	--	
03/08/02	35.19	10.39	24.80	0.00	0.00	3,900	380	21	110	160	<20	--	
06/19/02	35.19	7.78	27.41	0.00	0.00	3,600	440	8.5	87	73	<10	--	
09/11/02	35.19	9.41	25.78	0.00	0.00	11,000	1,800	18	360	380	<10	--	
12/11/02	35.19	4.44	30.75	0.00	0.00	6,000	1,100	9.3	190	190	<10	--	
03/11/03	35.19	8.29	26.90	0.00	0.00	4,900	940	13	150	160	<25	--	
06/10/03 ⁷	35.19	4.28	30.91	0.00	0.00	3,100	500	7	83	77	4	--	
09/09/03 ⁷	35.19	3.38	31.81	0.00	0.00	3,900	310	9	110	130	5	<50	

Table 1
Groundwater Monitoring Data and Analytical Results
Chevron Service Station #9-0076
4265 Foothill Boulevard
Oakland, California

WELL ID/ DATE	TOC* (ft.)	GWE (msl)	DTW (ft.)	SPHT (ft.)	SPH						MTBE (µg/L)	ETHANOL (µg/L)
					REMOVED (gallons)	TPH-G (µg/L)	B (µg/L)	T (µg/L)	E (µg/L)	X (µg/L)		
C-7 (cont)												
12/09/03 ⁷	35.19	6.74	28.45	0.00	0.00	170	0.8	<0.5	<0.5	<0.5	5	<50
03/09/04 ⁷	35.19	10.73	24.46	0.00	0.00	80	<0.5	<0.5	<0.5	<0.5	4	<50
06/08/04 ⁷	35.19	8.23	26.96	0.00	0.00	<50	<0.5	<0.5	<0.5	<0.5	6	<50
09/08/04 ⁷	35.19	9.99	25.20	0.00	0.00	<50	<0.5	<0.5	<0.5	<0.5	7	<50
12/06/04 ⁷	35.19	10.28	24.91	0.00	0.00	<50	<0.5	<0.5	<0.5	<0.5	7	<50
03/07/05 ⁷	35.19	11.76	23.43	0.00	0.00	590	9	0.7	4	6	7	<50
06/06/05 ⁷	35.19	13.31	21.88	0.00	0.00	<50	<0.5	<0.5	<0.5	<0.5	6	<50
09/06/05 ⁷	35.19	11.60	23.59	0.00	0.00	<50	<0.5	<0.5	<0.5	<0.5	9	<50
12/05/05 ⁷	35.19	11.44	23.75	0.00	0.00	<50	0.6	<0.5	<0.5	<0.5	9	<50
03/06/06 ⁷	35.19	13.80	21.39	0.00	0.00	<50	<0.5	<0.5	<0.5	<0.5	7	<50
06/05/06 ⁷	35.19	14.78	20.41	0.00	0.00	<50	<0.5	<0.5	<0.5	<0.5	4	<50
09/05/06 ⁷	35.19	12.38	22.81	0.00	0.00	<50	<0.5	<0.5	<0.5	<0.5	2	<50
12/04/06 ⁷	35.19	11.84	23.35	0.00	0.00	<50	<0.5	<0.5	<0.5	<0.5	3	<50
03/05/07 ⁷	35.19	12.47	22.72	0.00	0.00	<50	<0.5	<0.5	<0.5	<0.5	2	<50
06/04/07 ⁷	35.19	14.24	20.95	0.00	0.00	<50	<0.5	<0.5	<0.5	<0.5	4	<50
09/07/07 ⁷	35.19	11.71	23.48	0.00	0.00	<50	<0.5	<0.5	<0.5	<0.5	5	<50
12/06/07 ⁷	35.19	10.87	24.32	0.00	0.00	<50	<0.5	<0.5	<0.5	<0.5	5	<50
03/06/08 ⁷	35.19	11.90	23.29	0.00	0.00	<50	<0.5	<0.5	<0.5	<0.5	6	<50
06/05/08 ⁷	35.19	11.92	23.27	0.00	0.00	<50	<0.5	<0.5	<0.5	<0.5	6	<50
09/03/08⁷	35.19	10.58	24.61	0.00	0.00	<50	<0.5	<0.5	<0.5	<0.5	4	<50
C-8												
11/14/90	30.68	-12.61	43.29	--	--	<50	<0.3	<0.3	<0.3	<0.6	--	--
06/18/91	30.68	-11.94	42.62	--	--	<50	<0.5	<0.5	<0.5	<0.5	--	--
09/19/91	30.68	-11.04	41.72	--	--	<50	<0.5	<0.5	<0.5	<0.5	--	--
12/20/91	30.68	-10.30	40.98	--	--	<50	<0.5	<0.5	<0.5	<0.5	--	--
03/18/92	30.68	-9.34	40.02	--	--	<50	<0.5	<0.5	<0.5	<0.5	--	--
07/14/92	30.68	-8.34	39.02	--	--	<50	<0.5	<0.5	<0.5	<0.5	--	--
10/08/92	30.68	-8.00	38.68	--	--	<50	<0.5	<0.5	<0.5	1.1	--	--
01/08/93	30.68	-7.39	38.07	--	--	<50	<0.5	<0.5	<0.5	<0.5	--	--
04/14/93	30.68	-5.31	35.99	--	--	<50	<0.5	<0.5	<0.5	<0.5	--	--
07/16/93	30.68	-4.64	35.32	--	--	<50	<0.5	<0.5	<0.5	<0.5	--	--
09/21/93	34.68	-0.62	35.30	--	--	<50	<0.5	<0.5	<0.5	<0.8	--	--
01/28/94	34.68	-0.93	35.61	--	--	<50	<0.5	<0.5	<0.5	<0.5	--	--

Table 1
Groundwater Monitoring Data and Analytical Results
Chevron Service Station #9-0076
4265 Foothill Boulevard
Oakland, California

WELL ID/ DATE	TOC* (ft.)	GWE (msl)	DTW (ft.)	SPHT (ft.)	SPH REMOVED (gallons)	TPH-G (µg/L)	B (µg/L)	T (µg/L)	E (µg/L)	X (µg/L)	MTBE (µg/L)	ETHANOL (µg/L)
C-8 (cont)												
03/17/94	34.68	0.31	34.37	--	--	<50	<0.5	<0.5	<0.5	<0.5	--	--
06/16/94	34.68	1.32	33.36	--	--	<50	<0.5	<0.5	<0.5	<0.5	--	--
09/22/94	34.68	1.86	32.82	--	--	<50	<0.5	<0.5	<0.5	<0.5	--	--
12/15/94	34.68	2.32	32.36	--	--	<50	<0.5	<0.5	<0.5	<0.5	--	--
03/30/95	34.68	5.44	29.24	--	--	<50	<0.5	<0.5	<0.5	<0.5	--	--
06/20/95	34.68	6.34	28.34	--	--	<50	<0.5	<0.5	<0.5	<0.5	--	--
09/20/95	34.68	5.20	29.48	--	--	<50	<0.5	<0.5	<0.5	<0.5	--	--
12/06/95	34.68	3.76	30.92	--	--	<50	<0.5	<0.5	<0.5	<0.5	<2.5	--
03/21/96	34.68	6.03	28.65	--	--	<50	<0.5	<0.5	<0.5	<0.5	<2.5	--
06/21/96	34.68	6.78	27.90	--	--	<50	<0.5	<0.5	<0.5	<0.5	<2.5	--
09/06/96	34.68	5.98	28.70	--	--	<50	<0.5	<0.5	<0.5	<0.5	<2.5	--
12/19/96	34.68	4.98	29.70	--	--	<50	<0.5	<0.5	<0.5	<0.5	<2.5	--
03/17/97	34.68	6.92	27.76	--	--	<50	<0.5	<0.5	<0.5	<0.5	<2.5	--
06/11/97	34.68	5.87	28.81	--	--	<50	<0.5	<0.5	<0.5	<0.5	<2.5	--
09/17/97	34.68	5.32	29.36	--	--	SAMPLED ANNUALLY	--	--	--	--	--	--
12/11/97	34.68	4.88	29.80	--	--	--	--	--	--	--	--	--
03/12/98	34.68	8.95	25.73	--	--	<50	<0.5	<0.5	<0.5	<0.5	2.6	--
06/23/98	34.68	8.38	26.30	--	--	--	--	--	--	--	--	--
09/01/98	34.68	8.17	26.51	--	--	--	--	--	--	--	--	--
12/30/98	34.68	7.79	26.89	--	--	--	--	--	--	--	--	--
03/31/99	34.68	8.32	26.36	--	--	<50	<0.5	<0.5	<0.5	<0.5	11.8	--
06/14/99	34.68	8.65	26.03	--	--	--	--	--	--	--	--	--
09/30/99	34.68	7.40	27.28	--	--	--	--	--	--	--	--	--
12/22/99	34.68	6.48	28.20	--	--	--	--	--	--	--	--	--
03/09/00	34.68	8.35	26.33	--	--	<50	<0.5	<0.5	<0.5	1.8	<2.5	--
06/23/00	34.68	8.49	26.19	0.00	0.00	SAMPLED ANNUALLY	--	--	--	--	--	--
09/05/00	34.68	7.71	26.97	0.00	0.00	--	--	--	--	--	--	--
12/04/00	34.68	7.26	27.42	0.00	0.00	--	--	--	--	--	--	--
03/08/01	34.68	8.58	26.10	0.00	0.00	<50.0	<0.500	<0.500	<0.500	<0.500	<2.50	--
06/07/01	34.68	8.89	25.79	0.00	0.00	SAMPLED ANNUALLY	--	--	--	--	--	--
09/13/01	34.68	7.87	26.81	0.00	0.00	SAMPLED ANNUALLY	--	--	--	--	--	--
12/13/01	34.68	7.52	27.16	0.00	0.00	SAMPLED ANNUALLY	--	--	--	--	--	--
03/08/02	34.68	9.38	25.30	0.00	0.00	<50	<0.50	<0.50	<0.50	<1.5	<2.5	--
06/19/02	34.68	9.75	24.93	0.00	0.00	SAMPLED ANNUALLY	--	--	--	--	--	--
09/11/02	34.68	8.76	25.92	0.00	0.00	SAMPLED ANNUALLY	--	--	--	--	--	--

Table 1
Groundwater Monitoring Data and Analytical Results
Chevron Service Station #9-0076
4265 Foothill Boulevard
Oakland, California

WELL ID/ DATE	TOC* (ft.)	GWE (msl)	DTW (ft.)	SPHT (ft.)	SPH REMOVED (gallons)	TPH-G (µg/L)	B (µg/L)	T (µg/L)	E (µg/L)	X (µg/L)	MTBE (µg/L)	ETHANOL (µg/L)
C-8 (cont)												
12/11/02	34.68	7.37	27.31	0.00	0.00	SAMPLED ANNUALLY		--	--	--	--	--
03/11/03	34.68	8.89	25.79	0.00	0.00	<50	<0.50	<0.50	<0.50	<1.5	<2.5	--
06/10/03	34.68	9.40	25.28	0.00	0.00	SAMPLED ANNUALLY		--	--	--	--	--
09/09/03	34.68	8.57	26.11	0.00	0.00	SAMPLED ANNUALLY		--	--	--	--	--
12/09/03	34.68	6.17	28.51	0.00	0.00	SAMPLED ANNUALLY		--	--	--	--	--
03/09/04 ⁷	34.68	10.70	23.98	0.00	0.00	<50	<0.5	<0.5	<0.5	<0.5	<0.5	<50
06/08/04	34.68	9.41	25.27	0.00	0.00	SAMPLED ANNUALLY		--	--	--	--	--
09/08/04	34.68	8.85	25.83	0.00	0.00	SAMPLED ANNUALLY		--	--	--	--	--
12/06/04	34.68	9.62	25.06	0.00	0.00	SAMPLED ANNUALLY		--	--	--	--	--
03/07/05 ⁷	34.68	11.33	23.35	0.00	0.00	<50	<0.5	<0.5	<0.5	<0.5	<0.5	<50
06/06/05	34.68	11.84	22.84	0.00	0.00	SAMPLED ANNUALLY		--	--	--	--	--
09/06/05	34.68	9.77	24.91	0.00	0.00	SAMPLED ANNUALLY		--	--	--	--	--
12/05/05	34.68	10.52	24.16	0.00	0.00	SAMPLED ANNUALLY		--	--	--	--	--
03/06/06 ⁷	34.68	12.13	22.55	0.00	0.00	<50	<0.5	<0.5	<0.5	<0.5	<0.5	<50
06/05/06	34.68	13.08	21.60	0.00	0.00	SAMPLED ANNUALLY		--	--	--	--	--
09/05/06	34.68	10.93	23.75	0.00	0.00	SAMPLED ANNUALLY		--	--	--	--	--
12/04/06	34.68	10.71	23.97	0.00	0.00	SAMPLED ANNUALLY		--	--	--	--	--
03/05/07 ⁷	34.68	11.63	23.05	0.00	0.00	<50	<0.5	<0.5	<0.5	<0.5	<0.5	<50
06/04/07	34.68	12.57	22.11	0.00	0.00	SAMPLED ANNUALLY		--	--	--	--	--
09/07/07	34.68	10.61	24.07	0.00	0.00	SAMPLED ANNUALLY		--	--	--	--	--
12/06/07	34.68	10.30	24.38	0.00	0.00	SAMPLED ANNUALLY		--	--	--	--	--
03/06/08 ⁷	34.68	11.32	23.36	0.00	0.00	<50	<0.5	<0.5	<0.5	<0.5	<0.5	<50
06/05/08	34.68	11.62	23.06	0.00	0.00	SAMPLED ANNUALLY		--	--	--	--	--
09/03/08	34.68	9.75	24.93	0.00	0.00	SAMPLED ANNUALLY		--	--	--	--	--
C-9												
08/13/96	--	--	28.27	--	--	ND	ND	ND	ND	ND	ND	--
09/06/96	--	--	28.47	--	--	<50	<0.5	<0.5	<0.5	<0.5	<2.5	--
12/19/96	30.68	1.39	29.29	--	--	<50	<0.5	<0.5	<0.5	<0.5	<2.5	--
03/17/97	30.68	3.11	27.57	--	--	<50	<0.5	<0.5	<0.5	<0.5	<2.5	--
06/11/97	30.68	2.41	28.27	--	--	<50	<0.5	<0.5	<0.5	<0.5	<2.5	--
09/17/97	30.68	2.05	28.63	--	--	SAMPLED ANNUALLY		--	--	--	--	--
12/11/97	30.68	1.25	29.43	--	--	--	--	--	--	--	--	--
03/12/98	30.68	5.06	25.62	--	--	<50	<0.5	<0.5	<0.5	<0.5	<2.5	--

Table 1
Groundwater Monitoring Data and Analytical Results
Chevron Service Station #9-0076
4265 Foothill Boulevard
Oakland, California

WELL ID/ DATE	TOC* (ft.)	GWE (msl)	DTW (ft.)	SPHT (ft.)	SPH REMOVED (gallons)	TPH-G (µg/L)	B (µg/L)	T (µg/L)	E (µg/L)	X (µg/L)	MTBE (µg/L)	ETHANOL (µg/L)
C-9 (cont)												
06/23/98	30.68	4.53	26.15	--	--	--	--	--	--	--	--	--
09/01/98	30.68	4.30	26.38	--	--	--	--	--	--	--	--	--
12/30/98	30.68	3.93	26.75	--	--	--	--	--	--	--	--	--
03/31/99	30.68	5.35	25.33	--	--	<50	<0.5	<0.5	<0.5	<0.5	12.5	--
06/14/99	30.68	4.16	26.52	--	--	--	--	--	--	--	--	--
09/30/99	30.68	3.89	26.79	--	--	--	--	--	--	--	--	--
12/22/99	30.68	2.99	27.69	--	--	--	--	--	--	--	--	--
03/09/00	30.68	4.64	26.04	--	--	<50	<0.5	<0.5	<0.5	0.75	<2.5	--
06/23/00	30.68	4.83	25.85	0.00	0.00	--	--	--	--	--	--	--
09/05/00	30.68	3.99	26.69	0.00	0.00	--	--	--	--	--	--	--
12/04/00	30.68	3.61	27.07	0.00	0.00	--	--	--	--	--	--	--
03/08/01	30.68	4.93	25.75	0.00	0.00	<50.0	<0.500	<0.500	<0.500	<0.500	<2.50	--
06/07/01	30.68	5.18	25.50	0.00	0.00	SAMPLED ANNUALLY	--	--	--	--	--	--
09/13/01	30.68	4.13	26.55	0.00	0.00	SAMPLED ANNUALLY	--	--	--	--	--	--
12/13/01	30.68	3.91	26.77	0.00	0.00	SAMPLED ANNUALLY	--	--	--	--	--	--
03/08/02	30.68	5.68	25.00	0.00	0.00	<50	<0.50	<0.50	<0.50	<1.5	<2.5	--
06/19/02	30.68	6.01	24.67	0.00	0.00	SAMPLED ANNUALLY	--	--	--	--	--	--
09/11/02	30.68	4.98	25.70	0.00	0.00	SAMPLED ANNUALLY	--	--	--	--	--	--
12/11/02	30.68	3.61	27.07	0.00	0.00	SAMPLED ANNUALLY	--	--	--	--	--	--
03/11/03	30.68	6.20	24.48	0.00	0.00	<50	<0.50	<0.50	<0.50	<1.5	<2.5	--
06/10/03	30.68	5.68	25.00	0.00	0.00	SAMPLED ANNUALLY	--	--	--	--	--	--
09/09/03	30.68	4.88	25.80	0.00	0.00	SAMPLED ANNUALLY	--	--	--	--	--	--
12/09/03	30.68	2.46	28.22	0.00	0.00	SAMPLED ANNUALLY	--	--	--	--	--	--
03/09/04 ⁷	30.68	6.82	23.86	0.00	0.00	<50	<0.5	<0.5	<0.5	<0.5	<0.5	<50
06/08/04	-- ¹⁰	-- ¹⁰	25.21	0.00	0.00	SAMPLED ANNUALLY	--	--	--	--	--	--
09/08/04	-- ¹⁰	-- ¹⁰	25.61	0.00	0.00	SAMPLED ANNUALLY	--	--	--	--	--	--
12/06/04	-- ¹⁰	-- ¹⁰	24.77	0.00	0.00	SAMPLED ANNUALLY	--	--	--	--	--	--
03/07/05 ⁷	-- ¹⁰	-- ¹⁰	23.18	0.00	0.00	<50	<0.5	<0.5	<0.5	<0.5	<0.5	<50
06/06/05	-- ¹⁰	-- ¹⁰	22.65	0.00	0.00	SAMPLED ANNUALLY	--	--	--	--	--	--
09/06/05	-- ¹⁰	-- ¹⁰	24.58	0.00	0.00	SAMPLED ANNUALLY	--	--	--	--	--	--
12/05/05	-- ¹⁰	-- ¹⁰	23.80	0.00	0.00	SAMPLED ANNUALLY	--	--	--	--	--	--
03/06/06 ⁷	-- ¹⁰	-- ¹⁰	22.44	0.00	0.00	<50	<0.5	<0.5	<0.5	<0.5	<0.5	<50
06/05/06	-- ¹⁰	-- ¹⁰	21.54	0.00	0.00	SAMPLED ANNUALLY	--	--	--	--	--	--
09/05/06	-- ¹⁰	-- ¹⁰	23.49	0.00	0.00	SAMPLED ANNUALLY	--	--	--	--	--	--
12/04/06	-- ¹⁰	-- ¹⁰	23.72	0.00	0.00	SAMPLED ANNUALLY	--	--	--	--	--	--

Table 1
Groundwater Monitoring Data and Analytical Results
Chevron Service Station #9-0076
4265 Foothill Boulevard
Oakland, California

WELL ID/ DATE	TOC* (ft.)	GWE (msl)	DTW (ft.)	SPHT (ft.)	SPH REMOVED (gallons)	TPH-G (ug/L)	B (ug/L)	T (ug/L)	E (ug/L)	X (ug/L)	MTBE (ug/L)	ETHANOL (ug/L)
C-9 (cont)												
03/05/07 ⁷	-- ¹⁰	-- ¹⁰	22.97	0.00	0.00	<50	<0.5	<0.5	<0.5	<0.5	<0.5	<50
06/04/07	-- ¹⁰	-- ¹⁰	21.89	0.00	0.00	SAMPLED ANNUALLY		--	--	--	--	--
09/07/07	-- ¹⁰	-- ¹⁰	23.76	0.00	0.00	SAMPLED ANNUALLY		--	--	--	--	--
12/06/07	-- ¹⁰	-- ¹⁰	24.17	0.00	0.00	SAMPLED ANNUALLY		--	--	--	--	--
03/06/08 ⁷	-- ¹⁰	-- ¹⁰	23.18	0.00	0.00	<50	<0.5	<0.5	<0.5	<0.5	<0.5	<50
06/05/08	-- ¹⁰	-- ¹⁰	23.11	0.00	0.00	SAMPLED ANNUALLY		--	--	--	--	--
09/03/08	-- ¹⁰	-- ¹⁰	24.91	0.00	0.00	SAMPLED ANNUALLY		--	--	--	--	--
C-10												
09/09/03 ^{7,8}	--	--	17.18	0.00	0.00	<50	<0.5	<0.5	<0.5	0.5	14	<50
12/09/03 ⁷	--	--	14.24	0.00	0.00	<50	<0.5	<0.5	<0.5	<0.5	2	<50
03/09/04 ⁷	38.37	28.67	9.70	0.00	0.00	<50	<0.5	<0.5	<0.5	<0.5	15	<50
06/08/04 ⁷	38.37	26.67	11.70	0.00	0.00	<50	<0.5	<0.5	<0.5	<0.5	44	<50
09/08/04 ⁷	38.37	25.37	13.00	0.00	0.00	<50	<0.5	<0.5	<0.5	<0.5	2	<50
12/06/04 ⁷	38.37	25.84	12.53	0.00	0.00	<50	<0.5	<0.5	<0.5	<0.5	3	<50
03/07/05 ⁷	38.38	30.54	7.84	0.00	0.00	<50	<0.5	<0.5	<0.5	<0.5	140	<50
06/06/05 ⁷	38.38	28.76	9.62	0.00	0.00	<50	<0.5	<0.5	<0.5	<0.5	390	<50
09/06/05 ⁷	38.39	26.81	11.58	0.00	0.00	<50	<0.5	<0.5	<0.5	<0.5	190	<50
12/05/05 ⁷	38.39	27.51	10.88	0.00	0.00	<50	<0.5	<0.5	<0.5	<0.5	67	<50
03/06/06 ⁷	38.39	31.02	7.37	0.00	0.00	<50	<0.5	<0.5	<0.5	<0.5	280	<50
06/05/06 ⁷	38.39	29.14	9.25	0.00	0.00	<50	<0.5	<0.5	<0.5	<0.5	280	<50
09/05/06 ⁷	38.39	28.01	10.38	0.00	0.00	<50	3	3	2	16	63	<50
12/04/06 ⁷	38.39	27.74	10.65	0.00	0.00	<50	<0.5	<0.5	<0.5	<0.5	93	<50
03/05/07 ⁷	38.39	29.42	8.97	0.00	0.00	<50	<0.5	<0.5	<0.5	<0.5	100	<50
06/04/07 ⁷	38.39	28.59	9.80	0.00	0.00	<50	<0.5	<0.5	<0.5	<0.5	48	<50
09/07/07 ⁷	38.39	27.19	11.20	0.00	0.00	<50	<0.5	<0.5	<0.5	<0.5	18	<50
12/06/07 ⁷	38.39	27.86	10.53	0.00	0.00	<50	<0.5	<0.5	<0.5	<0.5	19	<50
03/06/08 ⁷	38.39	29.64	8.75	0.00	0.00	<50	<0.5	<0.5	<0.5	<0.5	43	<50
06/05/08 ⁷	38.39	28.44	9.95	0.00	0.00	<50	<0.5	<0.5	<0.5	<0.5	25	<50
09/03/08⁷	38.39	26.98	11.41	0.00	0.00	<50	<0.5	<0.5	<0.5	<0.5	12	<50

Table 1
Groundwater Monitoring Data and Analytical Results
Chevron Service Station #9-0076
4265 Foothill Boulevard
Oakland, California

WELL ID/ DATE	TOC* (ft.)	GWE (msl)	DTW (ft.)	SPHT (ft.)	SPH REMOVED (gallons)	TPH-G (ug/L)	B (ug/L)	T (ug/L)	E (ug/L)	X (ug/L)	MTBE (ug/L)	ETHANOL (ug/L)
TRIP BLANK												
04/28/89	--	--	--	--	--	<500	<0.5	<0.5	<0.5	<0.5	--	--
08/08/89	--	--	--	--	--	<500	<0.5	<0.5	<0.5	<0.5	--	--
08/27/90	--	--	--	--	--	<50	<0.3	<0.3	<0.3	<0.6	--	--
11/14/90	--	--	--	--	--	<50	<0.3	<0.3	<0.3	<0.6	--	--
06/18/91	--	--	--	--	--	<50	<0.5	<0.5	<0.5	<0.5	--	--
09/19/91	--	--	--	--	--	<50	<0.5	<0.5	<0.5	<0.5	--	--
12/20/91	--	--	--	--	--	<50	<0.5	<0.5	<0.5	<0.5	--	--
03/18/92	--	--	--	--	--	<50	<0.5	<0.5	<0.5	<0.5	--	--
07/14/92	--	--	--	--	--	<50	<0.5	<0.5	<0.5	<0.5	--	--
10/08/92	--	--	--	--	--	<50	<0.5	<0.5	<0.5	<0.5	--	--
01/08/93	--	--	--	--	--	<50	<0.5	<0.5	<0.5	<0.5	--	--
04/14/93	--	--	--	--	--	<50	<0.5	<0.5	<0.5	<0.5	--	--
07/16/93	--	--	--	--	--	<50	<0.5	<0.5	<0.5	<0.5	--	--
09/21/93	--	--	--	--	--	<50	<0.5	<0.5	<0.5	<0.8	--	--
01/28/94	--	--	--	--	--	<50	<0.5	<0.5	<0.5	<0.5	--	--
03/17/94	--	--	--	--	--	<50	<0.5	<0.5	<0.5	<0.5	--	--
06/16/94	--	--	--	--	--	<50	<0.5	<0.5	<0.5	<0.5	--	--
09/22/94	--	--	--	--	--	<50	<0.5	<0.5	<0.5	<0.5	--	--
12/15/94	--	--	--	--	--	<50	<0.5	<0.5	<0.5	<0.5	--	--
03/30/95	--	--	--	--	--	<50	<0.5	<0.5	<0.5	<0.5	--	--
06/20/95	--	--	--	--	--	<50	<0.5	<0.5	<0.5	<0.5	--	--
09/20/95	--	--	--	--	--	<50	<0.5	<0.5	<0.5	<0.5	--	--
12/06/95	--	--	--	--	--	<50	<0.5	<0.5	<0.5	<0.5	--	--
03/21/96	--	--	--	--	--	<50	<0.5	<0.5	<0.5	<0.5	<2.5	--
06/21/96	--	--	--	--	--	<50	<0.5	<0.5	<0.5	<0.5	<2.5	--
09/06/96	--	--	--	--	--	<50	<0.5	<0.5	<0.5	<0.5	--	--
12/19/96	--	--	--	--	--	<50	<0.5	<0.5	<0.5	<0.5	<2.5	--
03/17/97	--	--	--	--	--	<50	<0.5	<0.5	<0.5	<0.5	<2.5	--
06/11/97	--	--	--	--	--	<50	<0.5	<0.5	<0.5	<0.5	<2.5	--
09/17/97	--	--	--	--	--	<50	<0.5	<0.5	<0.5	<0.5	<2.5	--
12/11/97	--	--	--	--	--	<50	<0.5	<0.5	<0.5	<0.5	<2.5	--
03/12/98	--	--	--	--	--	<50	<0.5	<0.5	<0.5	<0.5	<2.5	--
06/23/98	--	--	--	--	--	<50	<0.5	<0.5	<0.5	<0.5	<2.5	--
09/01/98	--	--	--	--	--	<50	<0.5	<0.5	<0.5	<0.5	<2.5	--
12/30/98	--	--	--	--	--	<50	<0.5	<0.5	<0.5	<0.5	<2.0	--

Table 1
Groundwater Monitoring Data and Analytical Results
Chevron Service Station #9-0076
4265 Foothill Boulevard
Oakland, California

WELL ID/ DATE	TOC* (ft.)	GWE (msl)	DTW (ft.)	SPHT (ft.)	SPH REMOVED (gallons)	TPH-G (µg/L)	B (µg/L)	T (µg/L)	E (µg/L)	X (µg/L)	MTBE (µg/L)	ETHANOL (µg/L)
TRIP BLANK (cont)												
03/31/99	--	--	--	--	--	<50	<0.5	<0.5	<0.5	<0.5	<2.0	--
06/14/99	--	--	--	--	--	<50	<0.5	<0.5	<0.5	<0.5	<2.5	--
12/22/99	--	--	--	--	--	<50	<0.5	<0.5	<0.5	<0.5	<2.5	--
06/23/00	--	--	--	--	--	<50	<0.50	<0.50	<0.50	<0.50	<2.5	--
09/05/00	--	--	--	--	--	<50	<0.50	<0.50	<0.50	<0.50	<2.5	--
12/04/00	--	--	--	--	--	<50	<0.50	<0.50	<0.50	<0.50	<2.5	--
03/08/01	--	--	--	--	--	<50.0	<0.500	<0.500	<0.500	<0.500	<2.50	--
06/07/01	--	--	--	--	--	<50	<0.50	<0.50	<0.50	<0.50	<2.5	--
09/13/01	--	--	--	--	--	<50	<0.50	<0.50	<0.50	<0.50	<2.5	--
QA												
12/13/01	--	--	--	--	--	<50	<0.50	<0.50	<0.50	<1.5	<2.5	--
03/08/02	--	--	--	--	--	<50	<0.50	<0.50	<0.50	<1.5	<2.5	--
06/19/02	--	--	--	--	--	<50	<0.50	<0.50	<0.50	<1.5	<2.5	--
09/11/02	--	--	--	--	--	<50	<0.50	<0.50	<0.50	<1.5	<2.5	--
12/11/02	--	--	--	--	--	<50	<0.50	<0.50	<0.50	<1.5	<2.5	--
03/11/03	--	--	--	--	--	<50	<0.50	<0.50	<0.50	<1.5	<2.5	--
06/10/03 ⁷	--	--	--	--	--	<50	<0.5	<0.5	<0.5	<0.5	<0.5	--
09/09/03 ⁷	--	--	--	--	--	<50	<0.5	<0.5	<0.5	<0.5	<0.5	--
12/09/03 ⁷	--	--	--	--	--	<50	<0.5	<0.5	<0.5	<0.5	<0.5	--
03/09/04 ⁷	--	--	--	--	--	<50	<0.5	<0.5	<0.5	<0.5	<0.5	--
06/08/04 ⁷	--	--	--	--	--	<50	<0.5	<0.5	<0.5	<0.5	<0.5	--
09/08/04 ⁷	--	--	--	--	--	<50	<0.5	<0.5	<0.5	<0.5	<0.5	--
12/06/04 ⁷	--	--	--	--	--	<50	<0.5	<0.5	<0.5	<0.5	<0.5	--
03/07/05 ⁷	--	--	--	--	--	<50	<0.5	<0.5	<0.5	<0.5	<0.5	--
06/06/05 ⁷	--	--	--	--	--	<50	<0.5	<0.5	<0.5	<0.5	<0.5	--
09/06/05 ⁷	--	--	--	--	--	<50	<0.5	<0.5	<0.5	<0.5	<0.5	--
12/05/05 ⁷	--	--	--	--	--	<50	<0.5	<0.5	<0.5	<0.5	<0.5	--
03/06/06 ⁷	--	--	--	--	--	<50	<0.5	<0.5	<0.5	<0.5	<0.5	--
06/05/06 ⁷	--	--	--	--	--	<50	<0.5	<0.5	<0.5	<0.5	<0.5	--
09/05/06 ⁷	--	--	--	--	--	<50	<0.5	<0.5	<0.5	<0.5	<0.5	--
12/04/06 ⁷	--	--	--	--	--	<50	<0.5	<0.5	<0.5	<0.5	<0.5	--
03/05/07 ⁷	--	--	--	--	--	<50	<0.5	<0.5	<0.5	<0.5	<0.5	--
06/04/07 ⁷	--	--	--	--	--	<50	<0.5	<0.5	<0.5	<0.5	<0.5	--

Table 1
Groundwater Monitoring Data and Analytical Results
 Chevron Service Station #9-0076
 4265 Foothill Boulevard
 Oakland, California

WELL ID/ DATE	TOC* (ft.)	GWE (msl)	DTW (ft.)	SPHT (ft.)	SPH REMOVED (gallons)	TPH-G (ug/L)	B (ug/L)	T (ug/L)	E (ug/L)	X (ug/L)	MTBE (ug/L)	ETHANOL (ug/L)
QA (cont)												
09/07/07 ⁷	--	--	--	--	--	<50	<0.5	<0.5	<0.5	<0.5	<0.5	--
12/06/07 ⁷	--	--	--	--	--	<50	<0.5	<0.5	<0.5	<0.5	<0.5	--
03/06/08 ⁷	--	--	--	--	--	<50	<0.5	<0.5	<0.5	<0.5	<0.5	--
06/05/08 ⁷	--	--	--	--	--	<50	<0.5	<0.5	<0.5	<0.5	<0.5	--
09/03/08 ⁷	--	--	--	--	--	<50	<0.5	<0.5	<0.5	<0.5	<0.5	--

Table 1
Groundwater Monitoring Data and Analytical Results
Chevron Service Station #9-0076
4265 Foothill Boulevard
Oakland, California

EXPLANATIONS:

Groundwater monitoring data and laboratory analytical results prior to June 23, 2000, were compiled from reports prepared by Blaine Tech Services, Inc.

TOC = Top of Casing	TPH-G = Total Petroleum Hydrocarbons as Gasoline	ND = Not Detected
(ft.) = Feet	B = Benzene	-- = Not Measured/Not Analyzed
GWE = Groundwater Elevation	T = Toluene	QA = Quality Assurance/Trip Blank
(msl) = Mean sea level	E = Ethylbenzene	
DTW = Depth to Water	X = Xylenes	
SPHT = Separate Phase Hydrocarbons Thickness	MTBE = Methyl tertiary butyl ether	
SPH = Separate Phase Hydrocarbons	(µg/L) = Micrograms per liters	

* TOC elevation for C-10 was surveyed on September 26, 2003, by Virgil Chavez Land Surveying. The benchmark for this survey was a City of Oakland No. 1589, a cut square in the sidewalk at the mid-return at the west corner of High Street and Foothill Blvd., (Benchmark Elevation = 38.54 feet, NGVD 29).

** GWE corrected for the presence of SPH; correction factor: $[(TOC - DTW) + (SPHT \times 0.80)]$.

- 1 Confirmation run.
- 2 Sample was analyzed past hold-time, the results should be considered as estimated.
- 3 ORC present in well.
- 4 Laboratory report indicates gasoline C6-C12.
- 5 Laboratory report indicates sample was originally analyzed within holding time. Re-analysis for confirmation or dilution was performed past the recommended holding time.
- 6 Laboratory report indicates hydrocarbon pattern is present in the requested fuel quantitation range but does not resemble the pattern of the requested fuel. BTEX and MTBE by EPA Method 8260.
- 7 Well development performed.
- 8 ORC removed from well.
- 9 TOC has been altered; unable to determine an accurate GWE.
- 10 TOC has been altered; unable to determine an accurate GWE.
- 11 Laboratory confirmed result.

Table 2
Field Measurements and Groundwater Analytical Results
Chevron Service Station #9-0076
4265 Foothill Boulevard
Oakland, California

WELL ID/ DATE	D.O. Pre-Purge (mg/L)	D.O. Post-Purge (mg/L)	ORP Pre-Purge (mV)	ORP Post-Purge (mV)	Total Alkalinity (mg/L)	Ferrous Iron (mg/L)	Nitrate as Nitrate (mg/L)	Sulfate (mg/L)
C-1								
09/17/97	1.4	8.8	101	104	2.0	1.1	<1.0	12
03/12/98	1.7	3.6	171	171	550	3.0	<1.0	6.6
03/31/99	6.5	1.8	99	89	382	2520 ¹	0.418	8.23
12/22/99	0.95	2.0	-95	-128	568	0.19	<0.1	11
03/09/00	1.8	2.4	-47	-38	520	0.84	0.54	15
09/05/00	1.74	2.66	105	59	520	0.41	1.6	10
C-2								
09/17/97	1.3	--	150	--	560	4.7	<1.0	<1.0
03/12/98	1.1	1.1	176	174	420	3.5	<1.0	<1.0
03/31/99	1.5	1.6	151	157	456	2100 ¹	0.118	19.7
12/22/99	0.6	0.65	-90	-84	782	1.0	5.34	5.38
03/09/00	1.0	1.6	-68	-70	450	0.31	<0.1	0.39
09/05/00	1.31	1.85	65	44	690	0.34	<1.0	<1.0
C-3								
09/17/97	2.1	0.8	59	67	340	0.012	100	33
03/12/98	2.8	2.5	165	163	260	0.14	88	32
03/31/99	4.1	3.3	101	89	256	<500 ¹	18.4	72
12/22/99	0.98	1.48	69	107	402	0.013	67.7	37.6
03/09/00	3.3	1.6	110	97	390	0.12	60	38
09/05/00	3.79	2.53	202	203	430	0.011	52	40
C-4								
09/17/97	0.6	0.2	102	107	540	5.9	<1.0	<1.0
03/12/98	1.5	2.6	173	175	550	1.3	<1.0	2.7
03/31/99	1.8	2.2	170	176	492	1,560 ¹	0.191	<1.0
12/22/99	6.8	5.68	-25	14	739	0.87	1.85	39.6
03/09/00	1.1	1.9	-13	-39	530	<0.01	<0.1	4.5
09/05/00	2.22	2.02	105	138	530	<0.010	<1.0	29
C-5								
03/12/98	1.7	1.9	70	169	210	0.074	69	74
03/31/99	12.8	6.7	92	97	254	<500 ¹	16.7	69.7
03/09/00	2.8	3.6	120	118	230	0.39	60	74

Table 2
Field Measurements and Groundwater Analytical Results
Chevron Service Station #9-0076
4265 Foothill Boulevard
Oakland, California

WELL ID/ DATE	D.O. Pre-Purge (mg/L)	D.O. Post-Purge (mg/L)	ORP Pre-Purge (mV)	ORP Post-Purge (mV)	Total Alkalinity (mg/L)	Ferrous Iron (mg/L)	Nitrate as Nitrate (mg/L)	Sulfate (mg/L)
C-6								
09/17/97	1.5	1.2	-57	-48	620	1.1	<1.0	18
03/12/98	14.1	11.3	173	174	200	0.11	14	14
03/31/99	9.8	8.4	162	168	534	<500 ¹	0.849	45.3
12/22/99	1.02	1.22	-65	-60	614	0.36	0.421	32
03/09/00	5.4	1.6	-113	-35	540	0.26	0.14	24
09/05/00	1.90	2.73	45	31	550	0.18	<1.0	38
C-7								
09/17/97	0.6	0.4	126	115	600	4.8	<1.0	18
03/12/98	2.2	2.1	167	167	460	0.16	<1.0	29
03/31/99	2.0	1.8	137	135	486	<500 ¹	<0.1	29.4
12/22/99	1.8	1.5	20	-60	400	1.6	0.434	16.9
03/09/00	0.7	2.5	10	-13	610	2.1	<0.1	5.5
09/05/00	1.77	1.46	133	46	590	1.8	<1.0	12
C-8								
03/12/98	1.0	1.1	171	169	110	0.16	7.4	8.2
03/31/99	1.8	1.5	149	132	264	<500 ¹	17	71
03/09/00	2.7	3.3	141	160	270	0.24	29	35
C-9								
03/12/98	2.5	2.5	172	168	230	0.048	59	58
03/31/99	2.1	2.3	154	142	236	<500 ¹	18	72.7
03/09/00	2.5	3.7	108	138	190	0.79	100	73

EXPLANATIONS:

Groundwater laboratory analytical results prior to September 5, 2000, were compiled from reports prepared by Blaine Tech Services, Inc.

D.O. = Dissolved Oxygen

(mg/L) = Milligrams per liter

ORP = Oxidation Reduction Potential

(mV) = Millivolts

-- = Not Measured

¹ Analyzed in part per billion (ppb).

Table 3
Joint Groundwater Monitoring Data
 BP Service Station #11109
 4280 Foothill Boulevard
 Oakland, California

WELL ID	DATE	TOC* <i>(ft.)</i>	DTW <i>(ft.)</i>	SPHT <i>(ft.)</i>	GWE <i>(mst)</i>
MW-2	09/05/06	41.22	10.46	0.00	30.76
	03/05/07	41.22	12.25	0.00	28.97
	09/07/07 ¹	41.22	--	--	--
	12/06/07	41.22	SAMPLED SEMI-ANNUALLY		--
	03/06/08 ¹	41.22	--	--	--
	09/03/08	41.22	DRY	--	--
MW-3	09/05/06	40.13	9.86	0.00	30.27
	03/05/07	42.92	8.33	0.00	34.59
	09/07/07 ¹	42.92	--	--	--
	12/06/07	42.92	SAMPLED SEMI-ANNUALLY		--
	03/06/08 ¹	42.92	--	--	--
	09/03/08	42.92	12.19	0.00	30.73
MW-4	09/05/06	40.11	13.81	0.00	26.30
	03/05/07	42.88	10.63	0.00	32.25
	09/07/07 ¹	42.88	--	--	--
	12/06/07	42.88	SAMPLED SEMI-ANNUALLY		--
	03/06/08 ¹	42.88	--	--	--
	09/03/08	42.88	16.11	0.00	26.77
MW-5	09/05/06	39.14	6.16	0.03	33.00**
	03/05/07	41.98	8.34	0.00	33.64
	09/07/07 ¹	41.98	--	--	--
	12/06/07	41.98	SAMPLED SEMI-ANNUALLY		--
	03/06/08 ¹	41.98	--	--	--
	09/03/08	41.98	12.90	0.99	29.87**
MW-6	09/05/06	41.59	14.10	0.00	27.49
	03/05/07	44.37	11.43	0.00	32.94
	09/07/07 ¹	44.37	--	--	--
	12/06/07	44.37	SAMPLED SEMI-ANNUALLY		--
	03/06/08 ¹	44.37	--	--	--
	09/03/08	44.37	16.24	0.00	28.13
MW-7	09/05/06	40.32	11.45	0.00	28.87
	03/05/07	43.10	9.31	0.00	33.79
	09/07/07 ¹	43.10	--	--	--
	12/06/07	43.10	SAMPLED SEMI-ANNUALLY		--
	03/06/08 ¹	43.10	--	--	--
	09/03/08	43.10	13.17	0.00	29.93
MW-8	09/05/06	38.18	12.61	0.00	25.57
	03/05/07	40.95	9.12	0.00	31.83
	09/07/07 ¹	40.95	--	--	--

Table 3
Joint Groundwater Monitoring Data
 BP Service Station #11109
 4280 Foothill Boulevard
 Oakland, California

WELL ID	DATE	TOC* <i>(ft.)</i>	DTW <i>(ft.)</i>	SPHT <i>(ft.)</i>	GWE <i>(msl)</i>
MW-8 (cont)	12/06/07	40.95	SAMPLED SEMI-ANNUALLY		--
	03/06/08 ¹	40.95	--	--	--
	09/03/08	40.95	14.20	0.00	26.75
MW-9	09/05/06	41.25	11.63	0.00	29.62
	03/05/07	44.06	9.33	0.00	34.73
	09/07/07 ¹	44.06	--	--	--
	12/06/07	44.06	SAMPLED SEMI-ANNUALLY		--
	03/06/08 ¹	44.06	--	--	--
	09/03/08	44.06	13.49	0.00	30.57

Table 3
Joint Groundwater Monitoring Data
BP Service Station #11109
4280 Foothill Boulevard
Oakland, California

EXPLANATIONS:

Groundwater monitoring data provided by Broadbent & Associates, Inc.

TOC = Top of Casing

(ft.) = Feet

DTW = Depth to Water

SPHT = Separate Phase Hydrocarbons Thickness

GWE = Groundwater Elevation

(msl) = Mean sea level

* TOC elevation relative to msl.

** GWE corrected for the presence of SPH; correction factor: $[(TOC - DTW) + (SPHT \times 0.80)]$.

¹ Joint Monitoring data was not provided.

STANDARD OPERATING PROCEDURE - GROUNDWATER SAMPLING

Gettler-Ryan Inc. field personnel adhere to the following procedures for the collection and handling of groundwater samples prior to analysis by the analytical laboratory. Prior to sample collection, the type of analysis to be performed is determined. Loss prevention of volatile compounds is controlled and sample preservation for subsequent analysis is maintained.

Prior to sampling, the presence or absence of free-phase hydrocarbons is determined using an interface probe. Product thickness, if present, is measured to the nearest 0.01 foot and is noted in the field notes. In addition, all depth to water level measurements are collected with a static water level indicator and are also recorded in the field notes, prior to purging and sampling any wells.

After water levels are collected and prior to sampling, if purging is to occur, each well is purged a minimum of three well casing volumes of water using pre-cleaned pumps (stack, suction, Grundfos), or disposable bailers. Temperature, pH and electrical conductivity are measured a minimum of three times during the purging. Purging continues until these parameters stabilize.

Groundwater samples are collected using disposable bailers. The water samples are transferred from the bailer into appropriate containers. Pre-preserved containers, supplied by analytical laboratories, are used when possible. When pre-preserved containers are not available, the laboratory is instructed to preserve the sample as appropriate. Duplicate samples are collected for the laboratory to use in maintaining quality assurance/quality control standards. The samples are labeled to include the job number, sample identification, collection date and time, analysis, preservation (if any), and the sample collector's initials. The water samples are placed in a cooler, maintained at 4°C for transport to the laboratory. Once collected in the field, all samples are maintained under chain of custody until delivered to the laboratory.

The chain of custody document includes the job number, type of preservation, if any, analysis requested, sample identification, date and time collected, and the sample collector's name. The chain of custody is signed and dated (including time of transfer) by each person who receives or surrenders the samples, beginning with the field personnel and ending with the laboratory personnel.

A laboratory supplied trip blank accompanies each sampling set. For sampling sets greater than 20 samples, 5% trip blanks are included. The trip blank is analyzed for some or all of the same compounds as the groundwater samples.

As requested by Chevron Environmental Management Company, the purge water and decontamination water generated during sampling activities is transported by IWM to Chemical Waste Management located in Kettleman Hills, California.



GETTLER-RYAN INC.

WELL MONITORING/SAMPLING FIELD DATA SHEET

Client/Facility#: Chevron #9-0076
 Site Address: 4265 Foothill Blvd.
 City: Oakland, CA

Job Number: 386495
 Event Date: 9-3-08 (inclusive)
 Sampler: Soe / Steve R

Well ID: C-1
 Well Diameter: 21(3) in.
 Total Depth: 38.16 ft.
 Depth to Water: 12.90 ft.

Date Monitored: 9-3-08

Volume	3/4"= 0.02	1"= 0.04	2"= 0.17	3"= 0.38
Factor (VF)	4"= 0.66	5"= 1.02	6"= 1.50	12"= 5.80

Check if water column is less than 0.50 ft.
 Depth to Water w/ 80% Recharge [(Height of Water Column x 0.20) + DTW]: 17.95
 xVF 0.38 = 9.60 x3 case volume = Estimated Purge Volume: 29 gal.

Purge Equipment:
 Disposable Bailer _____
 Stainless Steel Bailer _____
 Stack Pump _____
 Suction Pump ✓
 Grundfos _____
 Peristaltic Pump _____
 QED Bladder Pump _____
 Other: _____

Sampling Equipment:
 Disposable Bailer ✓
 Pressure Bailer _____
 Discrete Bailer _____
 Peristaltic Pump _____
 QED Bladder Pump _____
 Other: _____

Time Started: _____ (2400 hrs)
 Time Completed: _____ (2400 hrs)
 Depth to Product: _____ ft
 Depth to Water: _____ ft
 Hydrocarbon Thickness: 0 ft
 Visual Confirmation/Description: _____
 Skimmer / Absorbant Sock (circle one)
 Amt Removed from Skimmer: _____ gal
 Amt Removed from Well: _____ gal
 Water Removed: _____
 Product Transferred to: _____

Start Time (purge): 1255 Weather Conditions: Hot
 Sample Time/Date: 1320 19-3-08 Water Color: clear Odor: PTN
 Approx. Flow Rate: 1-3 gpm. Sediment Description: _____
 Did well de-water? yes If yes, Time: 1303 Volume: 9 gal. DTW @ Sampling: 13.68

Time (2400 hr.)	Volume (gal.)	pH	Conductivity (µmhos/cm - <u>DS</u>)	Temperature (°F)	D.O. (mg/L)	ORP (mV)
<u>1300</u>	<u>9</u>	<u>6.84</u>	<u>791</u>	<u>22.6</u>	_____	_____
<u>1303</u>	<u>11</u>	_____	_____	_____	_____	_____
_____	_____	_____	_____	_____	_____	_____

LABORATORY INFORMATION

SAMPLE ID	(#) CONTAINER	REFRIG.	PRESERV. TYPE	LABORATORY	ANALYSES
<u>C-1</u>	<u>6</u> x voa vial	<u>YES</u>	<u>HCL</u>	<u>LANCASTER</u>	<u>TPH-G(8015)/BTEX+MTBE(8260)/ETHANOL (8260)</u>
_____	_____	_____	_____	_____	_____
_____	_____	_____	_____	_____	_____
_____	_____	_____	_____	_____	_____
_____	_____	_____	_____	_____	_____

COMMENTS: _____

Add/Replaced Lock: _____ Add/Replaced Plug: _____ Add/Replaced Bolt: _____



GETTLER-RYAN INC.

WELL MONITORING/SAMPLING FIELD DATA SHEET

Client/Facility#: Chevron #9-0076
 Site Address: 4265 Foothill Blvd.
 City: Oakland, CA

Job Number: 386495
 Event Date: 9-3-08 (inclusive)
 Sampler: Joe / Steve R

Well ID: C-2
 Well Diameter: 21(3) in.
 Total Depth: 36.62 ft.
 Depth to Water: 13.20 ft.

Date Monitored: 9-3-08

Volume	3/4"= 0.02	1"= 0.04	2"= 0.17	3"= 0.38
Factor (VF)	4"= 0.66	5"= 1.02	6"= 1.50	12"= 5.80

Depth to Water w/ 80% Recharge [(Height of Water Column x 0.20) + DTW]: 17.88
 Check if water column is less than 0.50 ft.
 $23.42 \times VF \ 0.38 = 8.90$ x3 case volume = Estimated Purge Volume: 27 gal.

Purge Equipment:
 Disposable Bailer _____
 Stainless Steel Bailer _____
 Stack Pump _____
 Suction Pump / _____
 Grundfos _____
 Peristaltic Pump _____
 QED Bladder Pump _____
 Other: _____

Sampling Equipment:
 Disposable Bailer ✓ _____
 Pressure Bailer _____
 Discrete Bailer _____
 Peristaltic Pump _____
 QED Bladder Pump _____
 Other: _____

Time Started: _____ (2400 hrs)
 Time Completed: _____ (2400 hrs)
 Depth to Product: _____ ft
 Depth to Water: _____ ft
 Hydrocarbon Thickness: 0 ft
 Visual Confirmation/Description: _____
 Skimmer / Absorbant Sock (circle one)
 Amt Removed from Skimmer: _____ gal
 Amt Removed from Well: _____ gal
 Water Removed: _____
 Product Transferred to: _____

Start Time (purge): _____ Weather Conditions: clear/hot
 Sample Time/Date: 1440 9-3-08 Water Color: clear Odor: 0 IN
 Approx. Flow Rate: 1-3 gpm. Sediment Description: _____
 Did well de-water? yes If yes, Time: 1422 Volume: 10 gal. DTW @ Sampling: 14.10

Time (2400 hr.)	Volume (gal.)	pH	Conductivity (µmhos/cm - µS)	Temperature (° / F)	D.O. (mg/L)	ORP (mV)
<u>1418</u>	<u>9</u>	<u>6.51</u>	<u>648</u>	<u>24.1</u>		
<u>1422</u>	<u>10</u>					

LABORATORY INFORMATION

SAMPLE ID	(#) CONTAINER	REFRIG.	PRESERV. TYPE	LABORATORY	ANALYSES
<u>C-2</u>	<u>6</u> x voa vial	<u>YES</u>	<u>HCL</u>	<u>LANCASTER</u>	<u>TPH-G(8015)/BTEX+MTBE(8260)/ETHANOL (8260)</u>

COMMENTS: Oil like droplets in well

Add/Replaced Lock: _____ Add/Replaced Plug: _____ Add/Replaced Bolt: _____



GETTLER - RYAN INC.

WELL MONITORING/SAMPLING FIELD DATA SHEET

Client/Facility#: Chevron #9-0076 Job Number: 386495
 Site Address: 4265 Foothill Blvd. Event Date: 9-3-08 (inclusive)
 City: Oakland, CA Sampler: Joc/Stere R

Well ID: C-3 Date Monitored: 9-3-08
 Well Diameter: 210 in.
 Total Depth: 39.45 ft.
 Depth to Water: 18.98 ft. Check if water column is less than 0.50 ft.
20.47 xVF 0.38 = 7.78 x3 case volume = Estimated Purge Volume: 23.5 gal.
 Depth to Water w/ 80% Recharge [(Height of Water Column x 0.20) + DTW]: 23.07

Volume	3/4"= 0.02	1"= 0.04	2"= 0.17	3"= 0.38
Factor (VF)	4"= 0.66	5"= 1.02	6"= 1.50	12"= 5.80

Purge Equipment:

Disposable Bailer _____
 Stainless Steel Bailer _____
 Stack Pump _____
 Suction Pump
 Grundfos _____
 Peristaltic Pump _____
 QED Bladder Pump _____
 Other: _____

Sampling Equipment:

Disposable Bailer
 Pressure Bailer _____
 Discrete Bailer _____
 Peristaltic Pump _____
 QED Bladder Pump _____
 Other: _____

Time Started: _____ (2400 hrs)
 Time Completed: _____ (2400 hrs)
 Depth to Product: _____ ft
 Depth to Water: _____ ft
 Hydrocarbon Thickness: 0 ft
 Visual Confirmation/Description: _____
 Skimmer / Absorbant Sock (circle one)
 Amt Removed from Skimmer: _____ gal
 Amt Removed from Well: _____ gal
 Water Removed: _____
 Product Transferred to: _____

Start Time (purge): 1045 Weather Conditions: Hot
 Sample Time/Date: 1110 19-3-08 Water Color: clear Odor: YIN
 Approx. Flow Rate: 1-3 gpm. Sediment Description: _____
 Did well de-water? yes If yes, Time: 1053 Volume: 812 gal. DTW @ Sampling: 19.16

Time (2400 hr.)	Volume (gal.)	pH	Conductivity (µmhos/cm - µS)	Temperature (°F)	D.O. (mg/L)	ORP (mV)
<u>1051</u>	<u>8</u>	<u>7.36</u>	<u>815</u>	<u>23.3</u>		
<u>1053</u>	<u>12</u>					

LABORATORY INFORMATION

SAMPLE ID	(#) CONTAINER	REFRIG.	PRESERV. TYPE	LABORATORY	ANALYSES
<u>C-3</u>	<u>6</u> x voa vial	<u>YES</u>	<u>HCL</u>	<u>LANCASTER</u>	<u>TPH-G(8015)/BTEX+MTBE(8260)/ETHANOL (8260)</u>

COMMENTS:

Add/Replaced Lock: _____ Add/Replaced Plug: _____ Add/Replaced Bolt: _____



GETTLER-RYAN INC.

WELL MONITORING/SAMPLING FIELD DATA SHEET

Client/Facility#: Chevron #9-0076
 Site Address: 4265 Foothill Blvd.
 City: Oakland, CA

Job Number: 386495
 Event Date: 9-3-08 (inclusive)
 Sampler: See Steve R

Well ID: C-4
 Well Diameter: 2 1/8 in.
 Total Depth: 39.38 ft.
 Depth to Water: 12.47 ft.

Date Monitored: 9-3-08

Volume	3/4" = 0.02	1" = 0.04	2" = 0.17	3" = 0.38
Factor (VF)	4" = 0.66	5" = 1.02	6" = 1.50	12" = 5.80

Depth to Water w/ 80% Recharge [(Height of Water Column x 0.20) + DTW]: 17.85
 Check if water column is less than 0.50 ft.
 xVF 0.38 = 10.23 x3 case volume = Estimated Purge Volume: 31 gal.

Purge Equipment:
 Disposable Bailer _____
 Stainless Steel Bailer _____
 Stack Pump _____
 Suction Pump ✓
 Grundfos _____
 Peristaltic Pump _____
 QED Bladder Pump _____
 Other: _____

Sampling Equipment:
 Disposable Bailer ✓
 Pressure Bailer _____
 Discrete Bailer _____
 Peristaltic Pump _____
 QED Bladder Pump _____
 Other: _____

Time Started: _____ (2400 hrs)
 Time Completed: _____ (2400 hrs)
 Depth to Product: _____ ft
 Depth to Water: _____ ft
 Hydrocarbon Thickness: 0 ft
 Visual Confirmation/Description: _____
 Skimmer / Absorbant Sock (circle one)
 Amt Removed from Skimmer: _____ gal
 Amt Removed from Well: _____ gal
 Water Removed: _____
 Product Transferred to: _____

Start Time (purge): 1335 Weather Conditions: Hot
 Sample Time/Date: 1400 19-3-08 Water Color: clear Odor: (Y) N
 Approx. Flow Rate: 1.3 gpm. Sediment Description: _____
 Did well de-water? yes If yes, Time: 1342 Volume: 12 gal. DTW @ Sampling: 13.16

Time (2400 hr.)	Volume (gal.)	pH	Conductivity (µmhos/cm - µS)	Temperature (° F)	D.O. (mg/L)	ORP (mV)
<u>1340</u>	<u>10</u>	<u>6.91</u>	<u>716</u>	<u>22.9</u>	_____	_____
<u>1342</u>	<u>12</u>	_____	_____	_____	_____	_____
_____	_____	_____	_____	_____	_____	_____

LABORATORY INFORMATION

SAMPLE ID	(#) CONTAINER	REFRIG.	PRESERV. TYPE	LABORATORY	ANALYSES
<u>C-4</u>	<u>6</u> x voa vial	<u>YES</u>	<u>HCL</u>	<u>LANCASTER</u>	<u>TPH-G(8015)/BTEX+MTBE(8260)/ETHANOL (8260)</u>
_____	_____	_____	_____	_____	_____
_____	_____	_____	_____	_____	_____
_____	_____	_____	_____	_____	_____
_____	_____	_____	_____	_____	_____

COMMENTS: _____

Add/Replaced Lock: _____ Add/Replaced Plug: _____ Add/Replaced Bolt: _____



GETTLER-RYAN INC.

WELL MONITORING/SAMPLING FIELD DATA SHEET

Client/Facility#: Chevron #9-0076
 Site Address: 4265 Foothill Blvd.
 City: Oakland, CA

Job Number: 386495
 Event Date: 9-3-08 (inclusive)
 Sampler: Joe

Well ID: C-5
 Well Diameter: 2.3 in.
 Total Depth: 44.10 ft.
 Depth to Water: 19.31 ft.

Date Monitored: 9-3-08

Volume	3/4"= 0.02	1"= 0.04	2"= 0.17	3"= 0.38
Factor (VF)	4"= 0.66	5"= 1.02	6"= 1.50	12"= 5.80

Check if water column is less than 0.50 ft.

xVF _____ = _____ x3 case volume = Estimated Purge Volume: _____ gal.

Depth to Water w/ 80% Recharge [(Height of Water Column x 0.20) + DTW]: _____

Purge Equipment:

Disposable Bailer _____
 Stainless Steel Bailer _____
 Stack Pump _____
 Suction Pump _____
 Grundfos _____
 Peristaltic Pump _____
 QED Bladder Pump _____
 Other: _____

Sampling Equipment:

Disposable Bailer _____
 Pressure Bailer _____
 Discrete Bailer _____
 Peristaltic Pump _____
 QED Bladder Pump _____
 Other: _____

Time Started: _____ (2400 hrs)
 Time Completed: _____ (2400 hrs)
 Depth to Product: _____ ft
 Depth to Water: _____ ft
 Hydrocarbon Thickness: 0 ft
 Visual Confirmation/Description: _____

Skimmer / Absorbant Sock (circle one)
 Amt Removed from Skimmer: _____ gal
 Amt Removed from Well: _____ gal
 Water Removed: _____
 Product Transferred to: _____

Start Time (purge): _____
 Sample Time/Date: _____ / _____
 Approx. Flow Rate: _____ gpm.
 Did well de-water? _____ If yes, Time: _____

Weather Conditions: _____
 Water Color: _____ Odor: Y / N
 Sediment Description: _____
 Volume: _____ gal. DTW @ Sampling: _____

Time (2400 hr.)	Volume (gal.)	pH	Conductivity (µmhos/cm - µS)	Temperature (C / F)	D.O. (mg/L)	ORP (mV)
_____	_____	_____	_____	_____	_____	_____
_____	_____	_____	_____	_____	_____	_____
_____	_____	_____	_____	_____	_____	_____

LABORATORY INFORMATION

SAMPLE ID	(#) CONTAINER	REFRIG.	PRESERV. TYPE	LABORATORY	ANALYSES
C-	x voa vial	YES	HCL	LANCASTER	TPH-G(8015)/BTX+MTBE(8260)/ETHANOL (8260)

COMMENTS: mon

Add/Replaced Lock: _____ Add/Replaced Plug: _____ Add/Replaced Bolt: _____



GETTLER-RYAN INC.

WELL MONITORING/SAMPLING FIELD DATA SHEET

Client/Facility#: Chevron #9-0076
 Site Address: 4265 Foothill Blvd.
 City: Oakland, CA

Job Number: 386495
 Event Date: 9-3-08 (inclusive)
 Sampler: Joc / Jever

Well ID: C-6
 Well Diameter: 213 in.
 Total Depth: 53.67 ft.
 Depth to Water: 21.40 ft.

Date Monitored: 9-3-08

Volume	3/4"= 0.02	1"= 0.04	2"= 0.17	3"= 0.38
Factor (VF)	4"= 0.66	5"= 1.02	6"= 1.50	12"= 5.80

Check if water column is less than 0.50 ft.

Depth to Water w/ 80% Recharge [(Height of Water Column x 0.20) + DTW]: 27.85
 $32.27 \times VF \ 0.17 = 5.49$ x3 case volume = Estimated Purge Volume: 16.5 gal.

Purge Equipment:
 Disposable Bailer _____
 Stainless Steel Bailer _____
 Stack Pump ✓
 Suction Pump _____
 Grundfos _____
 Peristaltic Pump _____
 QED Bladder Pump _____
 Other: _____

Sampling Equipment:
 Disposable Bailer ✓
 Pressure Bailer _____
 Discrete Bailer _____
 Peristaltic Pump _____
 QED Bladder Pump _____
 Other: _____

Time Started: _____ (2400 hrs)
 Time Completed: _____ (2400 hrs)
 Depth to Product: _____ ft
 Depth to Water: _____ ft
 Hydrocarbon Thickness: 0 ft
 Visual Confirmation/Description: _____
 Skimmer / Absorbant Sock (circle one)
 Amt Removed from Skimmer: _____ gal
 Amt Removed from Well: _____ gal
 Water Removed: _____
 Product Transferred to: _____

Start Time (purge): 1215 Weather Conditions: Hot
 Sample Time/Date: 1240 19-3-08 Water Color: clean Odor: Y 1(N)
 Approx. Flow Rate: 1-2 gpm. Sediment Description: _____
 Did well de-water? yes If yes, Time: 1221 Volume: 6.5 gal. DTW @ Sampling: 22-16

Time (2400 hr.)	Volume (gal.)	pH	Conductivity (µmhos/cm - DS)	Temperature (C L F)	D.O. (mg/L)	ORP (mV)
<u>1219</u>	<u>5</u>	<u>7.51</u>	<u>743</u>	<u>24.1</u>		
<u>1221</u>	<u>6.5</u>					

LABORATORY INFORMATION

SAMPLE ID	(#) CONTAINER	REFRIG.	PRESERV. TYPE	LABORATORY	ANALYSES
<u>C-6</u>	<u>6</u> x voa vial	<u>YES</u>	<u>HCL</u>	<u>LANCASTER</u>	<u>TPH-G(8015)/BTEX+MTBE(8260)/ETHANOL (8260)</u>

COMMENTS: _____

Add/Replaced Lock: _____ Add/Replaced Plug: _____ Add/Replaced Bolt: _____



GETTLER-RYAN INC.

WELL MONITORING/SAMPLING FIELD DATA SHEET

Client/Facility#: Chevron #9-0076
 Site Address: 4265 Foothill Blvd.
 City: Oakland, CA

Job Number: 386495
 Event Date: 9-3-08 (inclusive)
 Sampler: Joe / Steve R

Well ID: C-7
 Well Diameter: 213 in.
 Total Depth: 51.08 ft.
 Depth to Water: 24.61 ft.

Date Monitored: 9-3-08

Volume	3/4"= 0.02	1"= 0.04	2"= 0.17	3"= 0.38
Factor (VF)	4"= 0.66	5"= 1.02	6"= 1.50	12"= 5.80

Check if water column is less than 0.50 ft.

Depth to Water w/ 80% Recharge [(Height of Water Column x 0.20) + DTW]: 2.90

Purge Equipment:
 Disposable Bailer _____
 Stainless Steel Bailer _____
 Stack Pump _____
 Suction Pump ✓ _____
 Grundfos _____
 Peristaltic Pump _____
 QED Bladder Pump _____
 Other: _____

Sampling Equipment:
 Disposable Bailer _____
 Pressure Bailer _____
 Discrete Bailer _____
 Peristaltic Pump _____
 QED Bladder Pump _____
 Other: _____

Time Started: _____ (2400 hrs)
 Time Completed: _____ (2400 hrs)
 Depth to Product: _____ ft
 Depth to Water: _____ ft
 Hydrocarbon Thickness: 0 ft
 Visual Confirmation/Description: _____
 Skimmer / Absorbant Sock (circle one)
 Amt Removed from Skimmer: _____ gal
 Amt Removed from Well: _____ gal
 Water Removed: _____
 Product Transferred to: _____

Start Time (purge): 1130 Weather Conditions: Hot
 Sample Time/Date: 1200 9-3-08 Water Color: clear Odor: Y1(N)
 Approx. Flow Rate: 1-2 gpm. Sediment Description: _____
 Did well de-water? yes If yes, Time: 1137 Volume: 5.5 gal. DTW @ Sampling: 25.58

Time (2400 hr.)	Volume (gal.)	pH	Conductivity (µmhos/cm - QS)	Temperature (°F)	D.O. (mg/L)	ORP (mV)
<u>1136</u>	<u>5</u>	<u>7.19</u>	<u>776</u>	<u>23.8</u>		
<u>1137</u>	<u>5.5</u>					

LABORATORY INFORMATION

SAMPLE ID	(#) CONTAINER	REFRIG.	PRESERV. TYPE	LABORATORY	ANALYSES
<u>C-7</u>	<u>6</u> x voa vial	<u>YES</u>	<u>HCL</u>	<u>LANCASTER</u>	<u>TPH-G(8015)/BTEX+MTBE(8260)/ETHANOL (8260)</u>

COMMENTS: _____

Add/Replaced Lock: _____ Add/Replaced Plug: _____ Add/Replaced Bolt: _____



GETTLER-RYAN INC.

WELL MONITORING/SAMPLING FIELD DATA SHEET

Client/Facility#: Chevron #9-0076 Job Number: 386495
 Site Address: 4265 Foothill Blvd. Event Date: 9-3-08 (inclusive)
 City: Oakland, CA Sampler: Joe

Well ID: C-8 Date Monitored: 9-3-08
 Well Diameter: 213 in.
 Total Depth: 56.20 ft.
 Depth to Water: 24.93 ft. Check if water column is less than 0.50 ft.

Volume	3/4"= 0.02	1"= 0.04	2"= 0.17	3"= 0.38
Factor (VF)	4"= 0.66	5"= 1.02	6"= 1.50	12"= 5.80

$\text{Depth to Water w/ 80\% Recharge} = \text{Height of Water Column} \times 0.20 + \text{DTW}$
 xVF _____ = _____ x3 case volume = Estimated Purge Volume: _____ gal.

Purge Equipment:
 Disposable Bailer _____
 Stainless Steel Bailer _____
 Stack Pump _____
 Suction Pump _____
 Grundfos _____
 Peristaltic Pump _____
 QED Bladder Pump _____
 Other: _____

Sampling Equipment:
 Disposable Bailer _____
 Pressure Bailer _____
 Discrete Bailer _____
 Peristaltic Pump _____
 QED Bladder Pump _____
 Other: _____

Time Started: _____ (2400 hrs)
 Time Completed: _____ (2400 hrs)
 Depth to Product: _____ ft
 Depth to Water: _____ ft
 Hydrocarbon Thickness: 0 ft
 Visual Confirmation/Description: _____
 Skimmer / Absorbant Sock (circle one)
 Amt Removed from Skimmer: _____ gal
 Amt Removed from Well: _____ gal
 Water Removed: _____
 Product Transferred to: _____

Start Time (purge): _____ Weather Conditions: _____
 Sample Time/Date: _____ / _____ Water Color: _____ Odor: Y / N
 Approx. Flow Rate: _____ gpm. Sediment Description: _____
 Did well de-water? _____ If yes, Time: _____ Volume: _____ gal. DTW @ Sampling: _____

Time (2400 hr.)	Volume (gal.)	pH	Conductivity (µmhos/cm - µS)	Temperature (C / F)	D.O. (mg/L)	ORP (mV)
_____	_____	_____	_____	_____	_____	_____
_____	_____	_____	_____	_____	_____	_____
_____	_____	_____	_____	_____	_____	_____
_____	_____	_____	_____	_____	_____	_____

LABORATORY INFORMATION

SAMPLE ID	(#) CONTAINER	REFRIG.	PRESERV. TYPE	LABORATORY	ANALYSES
C-	x voa vial	YES	HCL	LANCASTER	TPH-G(8015)/BTEX+MTBE(8260)/ETHANOL (8260)

COMMENTS: no only.

Add/Replaced Lock: _____ Add/Replaced Plug: _____ Add/Replaced Bolt: _____



GETTLER-RYAN INC.

WELL MONITORING/SAMPLING FIELD DATA SHEET

Client/Facility#: Chevron #9-0076 Job Number: 386495
 Site Address: 4265 Foothill Blvd. Event Date: 9-3-08 (inclusive)
 City: Oakland, CA Sampler: Joc

Well ID: C-9 Date Monitored: 9-3-08
 Well Diameter: 213 in.
 Total Depth: 45.15 ft.
 Depth to Water: 24.91 ft. Check if water column is less than 0.50 ft.

Volume	3/4"= 0.02	1"= 0.04	2"= 0.17	3"= 0.38
Factor (VF)	4"= 0.66	5"= 1.02	6"= 1.50	12"= 5.80

xVF _____ = _____ x3 case volume = Estimated Purge Volume: _____ gal.
 Depth to Water w/ 80% Recharge [(Height of Water Column x 0.20) + DTW]: _____

Purge Equipment:
 Disposable Bailer _____
 Stainless Steel Bailer _____
 Stack Pump _____
 Suction Pump _____
 Grundfos _____
 Peristaltic Pump _____
 QED Bladder Pump _____
 Other: _____

Sampling Equipment:
 Disposable Bailer _____
 Pressure Bailer _____
 Discrete Bailer _____
 Peristaltic Pump _____
 QED Bladder Pump _____
 Other: _____

Time Started: _____ (2400 hrs)
 Time Completed: _____ (2400 hrs)
 Depth to Product: _____ ft
 Depth to Water: _____ ft
 Hydrocarbon Thickness: 0 ft
 Visual Confirmation/Description: _____
 Skimmer / Absorbent Sock (circle one)
 Amt Removed from Skimmer: _____ gal
 Amt Removed from Well: _____ gal
 Water Removed: _____
 Product Transferred to: _____

Start Time (purge): _____ Weather Conditions: _____
 Sample Time/Date: / Water Color: _____ Odor: Y / N
 Approx. Flow Rate: _____ gpm. Sediment Description: _____
 Did well de-water? _____ If yes, Time: _____ Volume: _____ gal. DTW @ Sampling: _____

Time (2400 hr.)	Volume (gal.)	pH	Conductivity (µmhos/cm - µS)	Temperature (C / F)	D.O. (mg/L)	ORP (mV)
_____	_____	_____	_____	_____	_____	_____
_____	_____	_____	_____	_____	_____	_____
_____	_____	_____	_____	_____	_____	_____

LABORATORY INFORMATION

SAMPLE ID	(#) CONTAINER	REFRIG.	PRESERV. TYPE	LABORATORY	ANALYSES
C-	x voa vial	YES	HCL	LANCASTER	TPH-G(8015)/BTEX+MTBE(8260)/ETHANOL (8260)

COMMENTS: in. on 1/4

Add/Replaced Lock: _____ Add/Replaced Plug: _____ Add/Replaced Bolt: _____



GETTLER - RYAN INC.

WELL MONITORING/SAMPLING FIELD DATA SHEET

Client/Facility#: Chevron #9-0076 Job Number: 386495
 Site Address: 4265 Foothill Blvd. Event Date: 9-3-08 (inclusive)
 City: Oakland, CA Sampler: Joe/Steve R

Well ID: C-10 Date Monitored: 9-3-08
 Well Diameter: 213 in.
 Total Depth: 30.14 ft.
 Depth to Water: 11.41 ft. Check if water column is less than 0.50 ft.
18.73 xVF 0.17 = 3.18 x3 case volume = Estimated Purge Volume: 10 gal.
 Depth to Water w/ 80% Recharge [(Height of Water Column x 0.20) + DTW]: 15.15

Volume	3/4"= 0.02	1"= 0.04	2"= 0.17	3"= 0.38
Factor (VF)	4"= 0.66	5"= 1.02	6"= 1.50	12"= 5.80

Purge Equipment:
 Disposable Bailer
 Stainless Steel Bailer _____
 Stack Pump _____
 Suction Pump
 Grundfos _____
 Peristaltic Pump _____
 QED Bladder Pump _____
 Other: _____

Sampling Equipment:
 Disposable Bailer
 Pressure Bailer _____
 Discrete Bailer _____
 Peristaltic Pump _____
 QED Bladder Pump _____
 Other: _____

Time Started: _____ (2400 hrs)
 Time Completed: _____ (2400 hrs)
 Depth to Product: _____ ft
 Depth to Water: 11.41 ft
 Hydrocarbon Thickness: _____ ft
 Visual Confirmation/Description: _____
 Skimmer / Absorbant Sock (circle one)
 Amt Removed from Skimmer: _____ gal
 Amt Removed from Well: _____ gal
 Water Removed: _____
 Product Transferred to: _____

Start Time (purge): 0948 Weather Conditions: Hot
 Sample Time/Date: 1030 9-3-08 Water Color: clear Odor: Y10
 Approx. Flow Rate: 1 gpm. Sediment Description: _____
 Did well de-water? yes If yes, Time: 0956 Volume: 4 gal. DTW @ Sampling: 1824

Time (2400 hr.)	Volume (gal.)	pH	Conductivity (µmhos/cm -48)	Temperature (° / F)	D.O. (mg/L)	ORP (mV)
<u>0955</u>	<u>3.5</u>	<u>6.75</u>	<u>698</u>	<u>23.5</u>		
<u>0956</u>	<u>4</u>					

LABORATORY INFORMATION

SAMPLE ID	(#) CONTAINER	REFRIG.	PRESERV. TYPE	LABORATORY	ANALYSES
<u>C-10</u>	<u>6</u> x voa vial	<u>YES</u>	<u>HCL</u>	<u>LANCASTER</u>	<u>TPH-G(8015)/BTEX+MTBE(8260)/ETHANOL (8260)</u>

COMMENTS: _____

Add/Replaced Lock: _____ Add/Replaced Plug: _____ Add/Replaced Bolt: _____

Chevron California Region Analysis Request/Chain of Custody



09D408-04

Acct #: 10904

For Lancaster Laboratories use only

Sample # 5459588-95

Group #: 003973

Group# 1108573

Facility #: SS#9-0076 OML G-R#386495 Global ID#T0600100339
 Site Address: 4265 FOOTHILL BLVD., OAKLAND, CA
 Chevron PM: AC Lead Consultant: CRACE
 Consultant/Office: G-R, Inc., 6747 Sierra Court, Suite J, Dublin, Ca. 94568
 Consultant Prj. Mgr.: Deanna L. Harding (deanna@grinc.com)
 Consultant Phone #: 925-551-7555 Fax #: 925-551-7899
 Sampler: JOE AJEMIAN / SR

Matrix		Total Number of Containers	Analyses Requested																	
Soil	Water		Preservation Codes																	
<input type="checkbox"/> Potable	<input type="checkbox"/> NPDES		#	#																
<input type="checkbox"/>	<input type="checkbox"/>		BTEX + MTBE 8260	8021																
			TPH 8015 MOD GPO																	
			TPH 8015 MOD DPO																	
			8260 full scan																	
			Oxygenates																	
			Total Lead Method																	
			Disolved Lead Method																	
			Ethanol (8260)																	

Preservative Codes
 H = HCl T = Thiosulfate
 N = HNO₃ B = NaOH
 S = H₂SO₄ O = Other

J value reporting needed
 Must meet lowest detection limits possible for 8260 compounds
 8021 MTBE Confirmation
 Confirm highest hit by 8260
 Confirm all hits by 8260
 Run ___ oxy's on highest hit
 Run ___ oxy's on all hits

Sample Identification	Date Collected	Time Collected	Grab	Composite	Soil	Water	Oil	Air
QA			✓					
C-1	9-3-08	1320	✓					
C-2		1440	✓					
C-3		1110	✓					
C-4		1400	✓					
C-6		1240	✓					
C-7		1200	✓					
C-10	✓	1030	✓					

Comments / Remarks

Turnaround Time Requested (TAT) (please circle)
 STD. TAT: 72 hour, 48 hour, 24 hour, 4 day, 5 day

Data Package Options (please circle if required)
 QC Summary Type I - Full
 Type VI (Raw Data) Coelt Deliverable not needed
 WIP (RWQCB)
 Disk

EDF/EDD

Relinquished by: [Signature]	Date: 9-9-08	Time: 12:00	Received by: [Signature]	Date: 04 SEP 08	Time: 12:00
Relinquished by: [Signature]	Date: 9-8-08	Time: 16:05	Received by: [Signature]	Date: 9-8-08	Time: 16:05
Relinquished by: [Signature]	Date: [Blank]	Time: [Blank]	Received by: [Signature]	Date: [Blank]	Time: [Blank]
Relinquished by Commercial Carrier: UPS	FedEx	Other: DHL	Received by: [Signature]	Date: 9/8/08	Time: 10:15
Temperature Upon Receipt: 06.50	C°		Custody Seals Intact?	Yes	No



2425 New Holland Pike, PO Box 12425, Lancaster, PA 17605-2425 • 717-656-2900 Fax: 717-656-2681 • www.lancasterlabs.com

Analysis Report

ANALYTICAL RESULTS

Prepared for:

Chevron
6001 Bollinger Canyon Rd L4310
San Ramon CA 94583

925-842-8582

Prepared by:

Lancaster Laboratories
2425 New Holland Pike
Lancaster, PA 17605-2425

RECEIVED

SEP 18 2008

GETTLER-RYAN INC.
GENERAL CONTRACTORS

SAMPLE GROUP

The sample group for this submittal is 1108573. Samples arrived at the laboratory on Friday, September 05, 2008. The PO# for this group is 0015025028 and the release number is COSTA.

Client Description

QA-T-080903 NA Water
C-1-W-080903 Grab Water
C-2-W-080903 Grab Water
C-3-W-080903 Grab Water
C-4-W-080903 Grab Water
C-6-W-080903 Grab Water
C-7-W-080903 Grab Water
C-10-W-080903 Grab Water

Lancaster Labs Number

5459588
5459589
5459590
5459591
5459592
5459593
5459594
5459595

ELECTRONIC CRA c/o Gettler-Ryan
COPY TO

Attn: Cheryl Hansen



Analysis Report

2425 New Holland Pike, PO Box 12425, Lancaster, PA 17605-2425 • 717-656-2300 Fax: 717-656-2681 • www.lancasterlabs.com

Questions? Contact your Client Services Representative
Jill M Parker at (717) 656-2300

Respectfully Submitted,

A handwritten signature in cursive script that reads "Dorothy M. Love".

Dorothy M. Love
Group Leader



Analysis Report

2425 New Holland Pike, PO Box 12425, Lancaster, PA 17605-2425 • 717-656-2300 Fax: 717-656-2681 • www.lancasterlabs.com

Page 1 of 1

Lancaster Laboratories Sample No. WW5459588

Group No. 1108573

QA-T-080903 NA Water
Facility# 90076 Job# 386495 GRD
4265 Foothill Blvd-Oakland T0600100339 QA
Collected: 09/03/2008

Account Number: 10904

Submitted: 09/05/2008 10:15
Reported: 09/17/2008 at 13:48
Discard: 10/18/2008

Chevron
6001 Bollinger Canyon Rd L4310
San Ramon CA 94583

OAKQA

CAT No.	Analysis Name	CAS Number	As Received Result	As Received		Dilution Factor
				Method Detection Limit	Units	
01728	TPH-GRO - Waters	n.a.	N.D.	50	ug/l	1
06054	BTEX+MTBE by 8260B					
02010	Methyl Tertiary Butyl Ether	1634-04-4	N.D.	0.5	ug/l	1
05401	Benzene	71-43-2	N.D.	0.5	ug/l	1
05407	Toluene	108-88-3	N.D.	0.5	ug/l	1
05415	Ethylbenzene	100-41-4	N.D.	0.5	ug/l	1
06310	Xylene (Total)	1330-20-7	N.D.	0.5	ug/l	1

State of California Lab Certification No. 2116

All QC is compliant unless otherwise noted. Please refer to the Quality Control Summary for overall QC performance data and associated samples.

Laboratory Chronicle

CAT No.	Analysis Name	Method	Trial#	Analysis		Analyst	Dilution Factor
				Date	Time		
01728	TPH-GRO - Waters	SW-846 8015B modified	1	09/14/2008	00:30	Carrie E Youtzy	1
06054	BTEX+MTBE by 8260B	SW-846 8260B	1	09/11/2008	18:06	Michael A Ziegler	1
01146	GC VOA Water Prep	SW-846 5030B	1	09/14/2008	00:30	Carrie E Youtzy	1
01163	GC/MS VOA Water Prep	SW-846 5030B	1	09/11/2008	18:06	Michael A Ziegler	1



Analysis Report

2425 New Holland Pike, PO Box 12425, Lancaster, PA 17605-2425 • 717-656-2300 Fax: 717-656-2681 • www.lancasterlabs.com

Lancaster Laboratories Sample No. **WW5459589**

Group No. **1108573**

C-1-W-080903 Grab Water

Facility# 90076 Job# 386495 GRD

4265 Foothill Blvd-Oakland T0600100339 C-1

Collected: 09/03/2008 13:20 by JA

Account Number: 10904

Submitted: 09/05/2008 10:15

Reported: 09/17/2008 at 13:48

Discard: 10/18/2008

Chevron

6001 Bollinger Canyon Rd L4310

San Ramon CA 94583

OAKC1

CAT No.	Analysis Name	CAS Number	As Received Result	As Received		Dilution Factor
				Method	Units	
01728	TPH-GRO - Waters	n.a.	130	Detection Limit 50	ug/l	1
06067	BTEX, MTBE, ETOH					
01587	Ethanol	64-17-5	N.D.	50	ug/l	1
02010	Methyl Tertiary Butyl Ether	1634-04-4	110	0.5	ug/l	1
05401	Benzene	71-43-2	N.D.	0.5	ug/l	1
05407	Toluene	108-88-3	N.D.	0.5	ug/l	1
05415	Ethylbenzene	100-41-4	N.D.	0.5	ug/l	1
06310	Xylene (Total)	1330-20-7	N.D.	0.5	ug/l	1

State of California Lab Certification No. 2116

All QC is compliant unless otherwise noted. Please refer to the Quality Control Summary for overall QC performance data and associated samples.

Laboratory Chronicle

CAT No.	Analysis Name	Method	Trial#	Analysis		Analyst	Dilution Factor
				Date and Time			
01728	TPH-GRO - Waters	SW-846 8015B modified	1	09/14/2008 00:52		Carrie E Youtzy	1
06067	BTEX, MTBE, ETOH	SW-846 8260B	1	09/10/2008 17:35		Ginelle L Feister	1
01146	GC VOA Water Prep	SW-846 5030B	1	09/14/2008 00:52		Carrie E Youtzy	1
01163	GC/MS VOA Water Prep	SW-846 5030B	1	09/10/2008 17:35		Ginelle L Feister	1



Analysis Report

2425 New Holland Pike, PO Box 12425, Lancaster, PA 17605-2425 • 717-656-2300 Fax: 717-656-2681 • www.lancasterlabs.com

Page 1 of 1

Lancaster Laboratories Sample No. WW5459590

Group No. 1108573

C-2-W-080903 Grab Water

Facility# 90076 Job# 386495 GRD

4265 Foothill Blvd-Oakland T0600100339 C-2

Collected: 09/03/2008 14:40 by JA

Account Number: 10904

Submitted: 09/05/2008 10:15

Reported: 09/17/2008 at 13:48

Discard: 10/18/2008

Chevron

6001 Bollinger Canyon Rd L4310

San Ramon CA 94583

OAKC2

CAT No.	Analysis Name	CAS Number	As Received Result	As Received		Dilution Factor
				Method Detection Limit	Units	
01728	TPH-GRO - Waters	n.a.	5,600	250	ug/l	5
06067	BTEX, MTBE, ETOH					
01587	Ethanol	64-17-5	N.D.	50	ug/l	1
02010	Methyl Tertiary Butyl Ether	1634-04-4	83	0.5	ug/l	1
05401	Benzene	71-43-2	340	5	ug/l	10
05407	Toluene	108-88-3	10	0.5	ug/l	1
05415	Ethylbenzene	100-41-4	81	0.5	ug/l	1
06310	Xylene (Total)	1330-20-7	48	0.5	ug/l	1

State of California Lab Certification No. 2116

All QC is compliant unless otherwise noted. Please refer to the Quality Control Summary for overall QC performance data and associated samples.

Laboratory Chronicle

CAT No.	Analysis Name	Method	Trial#	Analysis		Analyst	Dilution Factor
				Date and Time			
01728	TPH-GRO - Waters	SW-846 8015B modified	1	09/13/2008 11:55		Carrie E Youtzy	5
06067	BTEX, MTBE, ETOH	SW-846 8260B	1	09/10/2008 17:59		Ginelle L Feister	1
06067	BTEX, MTBE, ETOH	SW-846 8260B	1	09/10/2008 18:23		Ginelle L Feister	10
01146	GC VOA Water Prep	SW-846 5030B	2	09/13/2008 11:55		Carrie E Youtzy	5
01163	GC/MS VOA Water Prep	SW-846 5030B	1	09/10/2008 17:59		Ginelle L Feister	1
01163	GC/MS VOA Water Prep	SW-846 5030B	2	09/10/2008 18:23		Ginelle L Feister	10



Analysis Report

2425 New Holland Pike, PO Box 12425, Lancaster, PA 17605-2425 • 717-656-2300 Fax: 717-656-2681 • www.lancasterlabs.com

Page 1 of 1

Lancaster Laboratories Sample No. WW5459591

Group No. 1108573

C-3-W-080903 Grab Water
Facility# 90076 Job# 386495 GRD
4265 Foothill Blvd-Oakland T0600100339 C-3
Collected: 09/03/2008 11:10 by JA

Account Number: 10904

Submitted: 09/05/2008 10:15
Reported: 09/17/2008 at 13:48
Discard: 10/18/2008

Chevron
6001 Bollinger Canyon Rd L4310
San Ramon CA 94583

OAKC3

CAT No.	Analysis Name	CAS Number	As Received Result	As Received		Dilution Factor
				Method	Units	
01728	TPH-GRO - Waters	n.a.	N.D.	Detection Limit 50	ug/l	1
06067	BTEX, MTBE, ETOH					
01587	Ethanol	64-17-5	N.D.	50	ug/l	1
02010	Methyl Tertiary Butyl Ether	1634-04-4	N.D.	0.5	ug/l	1
05401	Benzene	71-43-2	N.D.	0.5	ug/l	1
05407	Toluene	108-88-3	N.D.	0.5	ug/l	1
05415	Ethylbenzene	100-41-4	N.D.	0.5	ug/l	1
06310	Xylene (Total)	1330-20-7	N.D.	0.5	ug/l	1

State of California Lab Certification No. 2116

All QC is compliant unless otherwise noted. Please refer to the Quality Control Summary for overall QC performance data and associated samples.

Laboratory Chronicle

CAT No.	Analysis Name	Method	Trial#	Analysis		Analyst	Dilution Factor
				Date and Time			
01728	TPH-GRO - Waters	SW-846 8015B modified	1	09/12/2008 20:34		Carrie E Youtzy	1
06067	BTEX, MTBE, ETOH	SW-846 8260B	1	09/10/2008 18:46		Ginelle L Feister	1
01146	GC VOA Water Prep	SW-846 5030B	1	09/12/2008 20:34		Carrie E Youtzy	1
01163	GC/MS VOA Water Prep	SW-846 5030B	1	09/10/2008 18:46		Ginelle L Feister	1

Lancaster Laboratories Sample No. WW5459592
Group No. 1108573
C-4-W-080903 Grab Water
Facility# 90076 Job# 386495 GRD
4265 Foothill Blvd-Oakland T0600100339 C-4
Collected: 09/03/2008 14:00 by JA
Account Number: 10904
Submitted: 09/05/2008 10:15
Reported: 09/17/2008 at 13:48
Discard: 10/18/2008
Chevron
6001 Bollinger Canyon Rd L4310
San Ramon CA 94583
OAKC4

CAT No.	Analysis Name	CAS Number	As Received Result	As Received		Dilution Factor
				Method	Units	
01728	TPH-GRO - Waters	n.a.	13,000	Detection Limit 500	ug/l	10
06067	BTEX, MTBE, ETOH					
01587	Ethanol	64-17-5	N.D.	250	ug/l	5
02010	Methyl Tertiary Butyl Ether	1634-04-4	73	3	ug/l	5
05401	Benzene	71-43-2	3,400	25	ug/l	50
05407	Toluene	108-88-3	72	3	ug/l	5
05415	Ethylbenzene	100-41-4	210	3	ug/l	5
06310	Xylene (Total)	1330-20-7	130	3	ug/l	5

State of California Lab Certification No. 2116

All QC is compliant unless otherwise noted. Please refer to the Quality Control Summary for overall QC performance data and associated samples.

Laboratory Chronicle

CAT No.	Analysis Name	Method	Trial#	Analysis		Analyst	Dilution Factor
				Date	Time		
01728	TPH-GRO - Waters	SW-846 8015B modified	1	09/12/2008	20:55	Carrie E Youtzy	10
06067	BTEX, MTBE, ETOH	SW-846 8260B	1	09/10/2008	19:10	Ginelle L Feister	5
06067	BTEX, MTBE, ETOH	SW-846 8260B	1	09/10/2008	19:34	Ginelle L Feister	50
01146	GC VOA Water Prep	SW-846 5030B	1	09/12/2008	20:55	Carrie E Youtzy	10
01163	GC/MS VOA Water Prep	SW-846 5030B	1	09/10/2008	19:10	Ginelle L Feister	5
01163	GC/MS VOA Water Prep	SW-846 5030B	2	09/10/2008	19:34	Ginelle L Feister	50



Analysis Report

2425 New Holland Pike, PO Box 12425, Lancaster, PA 17605-2425 • 717-656-2300 Fax: 717-656-2681 • www.lancasterlabs.com

Page 1 of 1

Lancaster Laboratories Sample No. WW5459593

Group No. 1108573

C-6-W-080903 Grab Water

Facility# 90076 Job# 386495 GRD

4265 Foothill Blvd-Oakland T0600100339 C-6

Collected: 09/03/2008 12:40 by JA

Account Number: 10904

Submitted: 09/05/2008 10:15

Reported: 09/17/2008 at 13:48

Discard: 10/18/2008

Chevron

6001 Bollinger Canyon Rd L4310

San Ramon CA 94583

OAKC6

CAT No.	Analysis Name	CAS Number	As Received Result	As Received		Dilution Factor
				Method	Units	
01728	TPH-GRO - Waters	n.a.	56	Detection Limit 50	ug/l	1
06067	BTEX, MTBE, ETOH					
01587	Ethanol	64-17-5	N.D.	50	ug/l	1
02010	Methyl Tertiary Butyl Ether	1634-04-4	5	0.5	ug/l	1
05401	Benzene	71-43-2	0.8	0.5	ug/l	1
05407	Toluene	108-88-3	N.D.	0.5	ug/l	1
05415	Ethylbenzene	100-41-4	N.D.	0.5	ug/l	1
06310	Xylene (Total)	1330-20-7	N.D.	0.5	ug/l	1

State of California Lab Certification No. 2116

All QC is compliant unless otherwise noted. Please refer to the Quality Control Summary for overall QC performance data and associated samples.

Laboratory Chronicle

CAT No.	Analysis Name	Method	Trial#	Analysis		Analyst	Dilution Factor
				Date	Time		
01728	TPH-GRO - Waters	SW-846 8015B modified	1	09/12/2008	21:17	Carrie E Youtzy	1
06067	BTEX, MTBE, ETOH	SW-846 8260B	1	09/10/2008	19:58	Ginelle L Feister	1
01146	GC VOA Water Prep	SW-846 5030B	1	09/12/2008	21:17	Carrie E Youtzy	1
01163	GC/MS VOA Water Prep	SW-846 5030B	1	09/10/2008	19:58	Ginelle L Feister	1

Lancaster Laboratories Sample No. WW5459594
Group No. 1108573
C-7-W-080903 Grab Water
Facility# 90076 Job# 386495 GRD
4265 Foothill Blvd-Oakland T0600100339 C-7
Collected: 09/03/2008 12:00 by JA
Account Number: 10904
Submitted: 09/05/2008 10:15
Reported: 09/17/2008 at 13:48
Discard: 10/18/2008
Chevron
6001 Bollinger Canyon Rd L4310
San Ramon CA 94583
OAKC7

CAT No.	Analysis Name	CAS Number	As Received Result	As Received		Dilution Factor
				Method	Units	
01728	TPH-GRO - Waters	n.a.	N.D.	Detection Limit 50	ug/l	1
06067	BTEX, MTBE, ETOH					
01587	Ethanol	64-17-5	N.D.	50	ug/l	1
02010	Methyl Tertiary Butyl Ether	1634-04-4	4	0.5	ug/l	1
05401	Benzene	71-43-2	N.D.	0.5	ug/l	1
05407	Toluene	108-88-3	N.D.	0.5	ug/l	1
05415	Ethylbenzene	100-41-4	N.D.	0.5	ug/l	1
06310	Xylene (Total)	1330-20-7	N.D.	0.5	ug/l	1

State of California Lab Certification No. 2116

All QC is compliant unless otherwise noted. Please refer to the Quality Control Summary for overall QC performance data and associated samples.

Laboratory Chronicle

CAT No.	Analysis Name	Method	Trial#	Analysis		Analyst	Dilution Factor
				Date	Time		
01728	TPH-GRO - Waters	SW-846 8015B modified	1	09/12/2008	21:39	Carrie E Youtzy	1
06067	BTEX, MTBE, ETOH	SW-846 8260B	1	09/11/2008	19:40	Michael A Ziegler	1
01146	GC VOA Water Prep	SW-846 5030B	1	09/12/2008	21:39	Carrie E Youtzy	1
01163	GC/MS VOA Water Prep	SW-846 5030B	1	09/11/2008	19:40	Michael A Ziegler	1

Lancaster Laboratories Sample No. WW5459595
Group No. 1108573
C-10-W-080903 Grab Water
Facility# 90076 Job# 386495 GRD
4265 Foothill Blvd-Oakland T0600100339 C-10
Collected: 09/03/2008 10:30 by JA
Account Number: 10904
Submitted: 09/05/2008 10:15
Reported: 09/17/2008 at 13:48
Discard: 10/18/2008
Chevron
6001 Bollinger Canyon Rd L4310
San Ramon CA 94583

OA-10

CAT No.	Analysis Name	CAS Number	As Received Result	As Received		Dilution Factor
				Method	Units	
01728	TPH-GRO - Waters	n.a.	N.D.	Detection Limit 50	ug/l	1
06067	BTEX, MTBE, ETOH					
01587	Ethanol	64-17-5	N.D.	50	ug/l	1
02010	Methyl Tertiary Butyl Ether	1634-04-4	12	0.5	ug/l	1
05401	Benzene	71-43-2	N.D.	0.5	ug/l	1
05407	Toluene	108-88-3	N.D.	0.5	ug/l	1
05415	Ethylbenzene	100-41-4	N.D.	0.5	ug/l	1
06310	Xylene (Total)	1330-20-7	N.D.	0.5	ug/l	1

State of California Lab Certification No. 2116

All QC is compliant unless otherwise noted. Please refer to the Quality Control Summary for overall QC performance data and associated samples.

Laboratory Chronicle

CAT No.	Analysis Name	Method	Trial#	Analysis		Analyst	Dilution Factor
				Date	Time		
01728	TPH-GRO - Waters	SW-846 8015B modified	1	09/12/2008	22:01	Carrie E Youtzy	1
06067	BTEX, MTBE, ETOH	SW-846 8260B	1	09/11/2008	20:04	Michael A Ziegler	1
01146	GC VOA Water Prep	SW-846 5030B	1	09/12/2008	22:01	Carrie E Youtzy	1
01163	GC/MS VOA Water Prep	SW-846 5030B	1	09/11/2008	20:04	Michael A Ziegler	1

Quality Control Summary

Client Name: Chevron
Reported: 09/17/08 at 01:48 PM

Group Number: 1108573

Matrix QC may not be reported if site-specific QC samples were not submitted. In these situations, to demonstrate precision and accuracy at a batch level, a LCS/LCSD was performed, unless otherwise specified in the method.

Laboratory Compliance Quality Control

<u>Analysis Name</u>	<u>Blank Result</u>	<u>Blank MDL</u>	<u>Report Units</u>	<u>LCS %REC</u>	<u>LCSD %REC</u>	<u>LCS/LCSD Limits</u>	<u>RPD</u>	<u>RPD Max</u>
Batch number: 08256B20A TPH-GRO - Waters	Sample number(s): 5459591-5459595 N.D.	50.	ug/l	118	118	75-135	0	30
Batch number: 08256B20B TPH-GRO - Waters	Sample number(s): 5459590 N.D.	50.	ug/l	118	118	75-135	0	30
Batch number: 08256D20A TPH-GRO - Waters	Sample number(s): 5459588-5459589 N.D.	50.	ug/l	112	122	75-135	9	30
Batch number: D082542AA Ethanol	Sample number(s): 5459589-5459593 N.D.	50.	ug/l	90		45-156		
Methyl Tertiary Butyl Ether	N.D.	0.5	ug/l	86		73-119		
Benzene	N.D.	0.5	ug/l	91		78-119		
Toluene	N.D.	0.5	ug/l	93		85-115		
Ethylbenzene	N.D.	0.5	ug/l	92		82-119		
Xylene (Total)	N.D.	0.5	ug/l	94		83-113		
Batch number: D082553AA Ethanol	Sample number(s): 5459588,5459594-5459595 N.D.	50.	ug/l	114		45-156		
Methyl Tertiary Butyl Ether	N.D.	0.5	ug/l	95		73-119		
Benzene	N.D.	0.5	ug/l	101		78-119		
Toluene	N.D.	0.5	ug/l	101		85-115		
Ethylbenzene	N.D.	0.5	ug/l	99		82-119		
Xylene (Total)	N.D.	0.5	ug/l	102		83-113		

Sample Matrix Quality Control

Unspiked (UNSPK) = the sample used in conjunction with the matrix spike
Background (BKG) = the sample used in conjunction with the duplicate

<u>Analysis Name</u>	<u>MS %REC</u>	<u>MSD %REC</u>	<u>MS/MSD Limits</u>	<u>RPD</u>	<u>RPD MAX</u>	<u>BKG Conc</u>	<u>DUP Conc</u>	<u>DUP RPD</u>	<u>Dup RPD Max</u>
Batch number: 08256D20A TPH-GRO - Waters	Sample number(s): 5459588-5459589 98		63-154			UNSPK: P458149			
Batch number: D082542AA Ethanol	Sample number(s): 5459589-5459593 84	109	32-164	26	30	UNSPK: P458307			
Methyl Tertiary Butyl Ether	75 (2)	82 (2)	69-127	1	30				
Benzene	107	109	83-128	2	30				
Toluene	108	110	83-127	2	30				
Ethylbenzene	108	109	82-129	1	30				
Xylene (Total)	110	111	82-130	1	30				

*- Outside of specification

- (1) The result for one or both determinations was less than five times the LOQ.
- (2) The unspiked result was more than four times the spike added.

Quality Control Summary

Client Name: Chevron
Reported: 09/17/08 at 01:48 PM

Group Number: 1108573

Sample Matrix Quality Control

Unspiked (UNSPK) = the sample used in conjunction with the matrix spike
Background (BKG) = the sample used in conjunction with the duplicate

Analysis Name	MS %REC	MSD %REC	MS/MSD Limits	RPD	RPD MAX	BKG Conc	DUP Conc	DUP RPD	Dup RPD Max
Batch number: D082553AA	Sample number(s): 5459588, 5459594-5459595 UNSPK: 5459595								
Ethanol	115	116	32-164	1	30				
Methyl Tertiary Butyl Ether	97	97	69-127	0	30				
Benzene	99	96	83-128	4	30				
Toluene	100	95	83-127	5	30				
Ethylbenzene	98	94	82-129	5	30				
Xylene (Total)	101	97	82-130	4	30				

Surrogate Quality Control

Surrogate recoveries which are outside of the QC window are confirmed unless attributed to dilution or otherwise noted on the Analysis Report.

Analysis Name: TPH-GRO - Waters
Batch number: 08256B20A
Trifluorotoluene-F

5459591	97
5459592	114
5459593	99
5459594	97
5459595	99
Blank	97
LCS	124
LCSD	122

Limits: 63-135

Analysis Name: TPH-GRO - Waters
Batch number: 08256B20B
Trifluorotoluene-F

5459590	161*
Blank	97
LCS	124
LCSD	122

Limits: 63-135

Analysis Name: TPH-GRO - Waters
Batch number: 08256D20A
Trifluorotoluene-F

5459588	98
5459589	100
Blank	100
LCS	123
LCSD	127
MS	122

*- Outside of specification

- (1) The result for one or both determinations was less than five times the LOQ.
- (2) The unspiked result was more than four times the spike added.

Quality Control Summary

Client Name: Chevron
Reported: 09/17/08 at 01:48 PM

Group Number: 1108573

Surrogate Quality Control

Limits: 63-135

Analysis Name: BTEX, MTBE, ETOH
Batch number: D082542AA

	Dibromofluoromethane	1,2-Dichloroethane-d4	Toluene-d8	4-Bromofluorobenzene
5459589	84	89	90	99
5459590	82	86	90	109
5459591	85	88	91	97
5459592	82	86	89	98
5459593	86	90	91	99
Blank	86	92	92	98
LCS	86	92	91	99
MS	86	92	90	98
MSD	88	93	92	100

Limits: 80-116 77-113 80-113 78-113

Analysis Name: BTEX+MTBE by 8260B
Batch number: D082553AA

	Dibromofluoromethane	1,2-Dichloroethane-d4	Toluene-d8	4-Bromofluorobenzene
5459588	90	93	91	101
5459594	87	92	88	96
5459595	88	92	90	98
Blank	88	92	88	97
LCS	90	93	90	101
MS	86	92	88	101
MSD	90	95	92	103

Limits: 80-116 77-113 80-113 78-113

*- Outside of specification

- (1) The result for one or both determinations was less than five times the LOQ.
- (2) The unspiked result was more than four times the spike added.

Lancaster Laboratories Explanation of Symbols and Abbreviations

The following defines common symbols and abbreviations used in reporting technical data:

N.D.	none detected	BMQL	Below Minimum Quantitation Level
TNTC	Too Numerous To Count	MPN	Most Probable Number
IU	International Units	CP Units	cobalt-chloroplatinate units
umhos/cm	micromhos/cm	NTU	nephelometric turbidity units
C	degrees Celsius	F	degrees Fahrenheit
Cal	(diet) calories	lb.	pound(s)
meq	milliequivalents	kg	kilogram(s)
g	gram(s)	mg	milligram(s)
ug	microgram(s)	l	liter(s)
ml	milliliter(s)	ul	microliter(s)
m3	cubic meter(s)	fib >5 um/ml	fibers greater than 5 microns in length per ml
<	less than – The number following the sign is the <u>limit of quantitation</u> , the smallest amount of analyte which can be reliably determined using this specific test.		
>	greater than		
ppm	parts per million – One ppm is equivalent to one milligram per kilogram (mg/kg), or one gram per million grams. For aqueous liquids, ppm is usually taken to be equivalent to milligrams per liter (mg/l), because one liter of water has a weight very close to a kilogram. For gases or vapors, one ppm is equivalent to one microliter of gas per liter of gas.		
ppb	parts per billion		
Dry weight basis	Results printed under this heading have been adjusted for moisture content. This increases the analyte weight concentration to approximate the value present in a similar sample without moisture.		

U.S. EPA data qualifiers:

Organic Qualifiers

A	TIC is a possible aldol-condensation product
B	Analyte was also detected in the blank
C	Pesticide result confirmed by GC/MS
D	Compound quantitated on a diluted sample
E	Concentration exceeds the calibration range of the instrument
J	Estimated value
N	Presumptive evidence of a compound (TICs only)
P	Concentration difference between primary and confirmation columns >25%
U	Compound was not detected
X,Y,Z	Defined in case narrative

Inorganic Qualifiers

B	Value is <CRDL, but ≥IDL
E	Estimated due to interference
M	Duplicate injection precision not met
N	Spike amount not within control limits
S	Method of standard additions (MSA) used for calculation
U	Compound was not detected
W	Post digestion spike out of control limits
*	Duplicate analysis not within control limits
+	Correlation coefficient for MSA <0.995

Analytical test results for methods listed on the laboratories' accreditation scope meet all requirements of NELAC unless otherwise noted under the individual analysis.

Tests results relate only to the sample tested. Clients should be aware that a critical step in a chemical or microbiological analysis is the collection of the sample. Unless the sample analyzed is truly representative of the bulk of material involved, the test results will be meaningless. If you have questions regarding the proper techniques of collecting samples, please contact us. We cannot be held responsible for sample integrity, however, unless sampling has been performed by a member of our staff. This report shall not be reproduced except in full, without the written approval of the laboratory.

WARRANTY AND LIMITS OF LIABILITY – In accepting analytical work, we warrant the accuracy of test results for the sample as submitted. THE FOREGOING EXPRESS WARRANTY IS EXCLUSIVE AND IS GIVEN IN LIEU OF ALL OTHER WARRANTIES, EXPRESSED OR IMPLIED. WE DISCLAIM ANY OTHER WARRANTIES, EXPRESSED OR IMPLIED, INCLUDING A WARRANTY OF FITNESS FOR PARTICULAR PURPOSE AND WARRANTY OF MERCHANTABILITY. IN NO EVENT SHALL LANCASTER LABORATORIES BE LIABLE FOR INDIRECT, SPECIAL, CONSEQUENTIAL, OR INCIDENTAL DAMAGES INCLUDING, BUT NOT LIMITED TO, DAMAGES FOR LOSS OF PROFIT OR GOODWILL REGARDLESS OF (A) THE NEGLIGENCE (EITHER SOLE OR CONCURRENT) OF LANCASTER LABORATORIES AND (B) WHETHER LANCASTER LABORATORIES HAS BEEN INFORMED OF THE POSSIBILITY OF SUCH DAMAGES. We accept no legal responsibility for the purposes for which the client uses the test results. No purchase order or other order for work shall be accepted by Lancaster Laboratories which includes any conditions that vary from the Standard Terms and Conditions of Lancaster Laboratories and we hereby object to any conflicting terms contained in any acceptance or order submitted by client.