



GETTLER - RYAN INC.

TRANSMITTAL

Alameda County

NOV 20 2002

Environmental Health

November 1, 2002

G-R #386495

20427

TO: Mr. James Brownell
Delta Environmental Consultants, Inc.
3164 Gold Camp Drive, Suite 200
Rancho Cordova, California 95670

CC: Ms. Karen Streich
Chevron Products Company
P.O. Box 6004
San Ramon, California 94583

FROM: Deanna L. Harding
Project Coordinator
Gettler-Ryan Inc.
6747 Sierra Court, Suite J
Dublin, California 94568

RE: **Chevron Service Station
#9-0076
4265 Foothill Boulevard
Oakland, California**

WE HAVE ENCLOSED THE FOLLOWING:

COPIES	DATED	DESCRIPTION
1	October 24, 2002	Groundwater Monitoring and Sampling Report Third Quarter - Event of September 11, 2002

COMMENTS:

This report is being sent for your review. Please provide any comments/changes and propose any groundwater monitoring modifications for the next event prior to **November 15, 2002**, at which time the final report will be distributed to the following:

- cc: Mr. Barney Chan, Alameda County Health Care Services, Dept. of Environmental Health, 1131 Harbor Bay Parkway, Suite 250, Alameda, CA 94502-6577
- Mr. Greg Gurss, Gettler-Ryan Inc., 3140 Gold Camp Drive, Suite 170, Rancho Cordova, CA 95670
- Ms. Karen Petryna, Equiva Services, LLC, P.O. Box 7869, Burbank, CA 91510-7869
- Mr. David DeWitt, Tosco Oil Company, Environmental Remediation Management, 2000 Crow Canyon Place, Suite 400, San Ramon, CA 94583
- Ms. Erica Myran, Albertson's, Inc., P.O. Box 20, Dept. 74200, Boise, ID 83726

Enclosures

trans/9-0076-ks



GETTLER - RYAN INC.

October 24, 2002
G-R Job #386495

Ms. Karen Streich
Chevron Products Company
P.O. Box 6004
San Ramon, CA 94583

RE: Third Quarter Event of September 11, 2002
Groundwater Monitoring & Sampling Report
Chevron Service Station #9-0076
4265 Foothill Boulevard
Oakland, California

Dear Ms. Streich:

This report documents the most recent groundwater monitoring and sampling event performed by Gettler-Ryan Inc. (G-R) at the referenced site. All field work was conducted in accordance with G-R Standard Operating Procedure - Groundwater Sampling (attached). A joint monitoring event was conducted with the Shell Service Station, located at 4411 Foothill Boulevard, Oakland, California. Joint monitoring is conducted in the first quarter with the BP Service Station, located at 4280 Foothill Boulevard.

Static groundwater levels were measured and the wells were checked for the presence of separate-phase hydrocarbons. Static water level data, groundwater elevations, and separate-phase hydrocarbon thickness (if any) are presented in the attached Table 1. A Potentiometric Map is included as Figure 1.

Groundwater samples were collected from the monitoring wells and submitted to a state certified laboratory for analyses. The field data sheets for this event are attached. Analytical results are presented in the table(s) listed below. The chain of custody document and laboratory analytical report are also attached.

Please call if you have any questions or comments regarding this report. Thank you.

Sincerely,

Deanna L. Harding
Project Coordinator

Douglas J. Lee
Senior Geologist, R.G. No. 6882

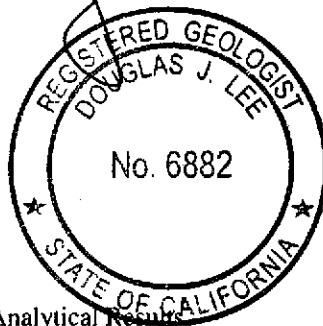
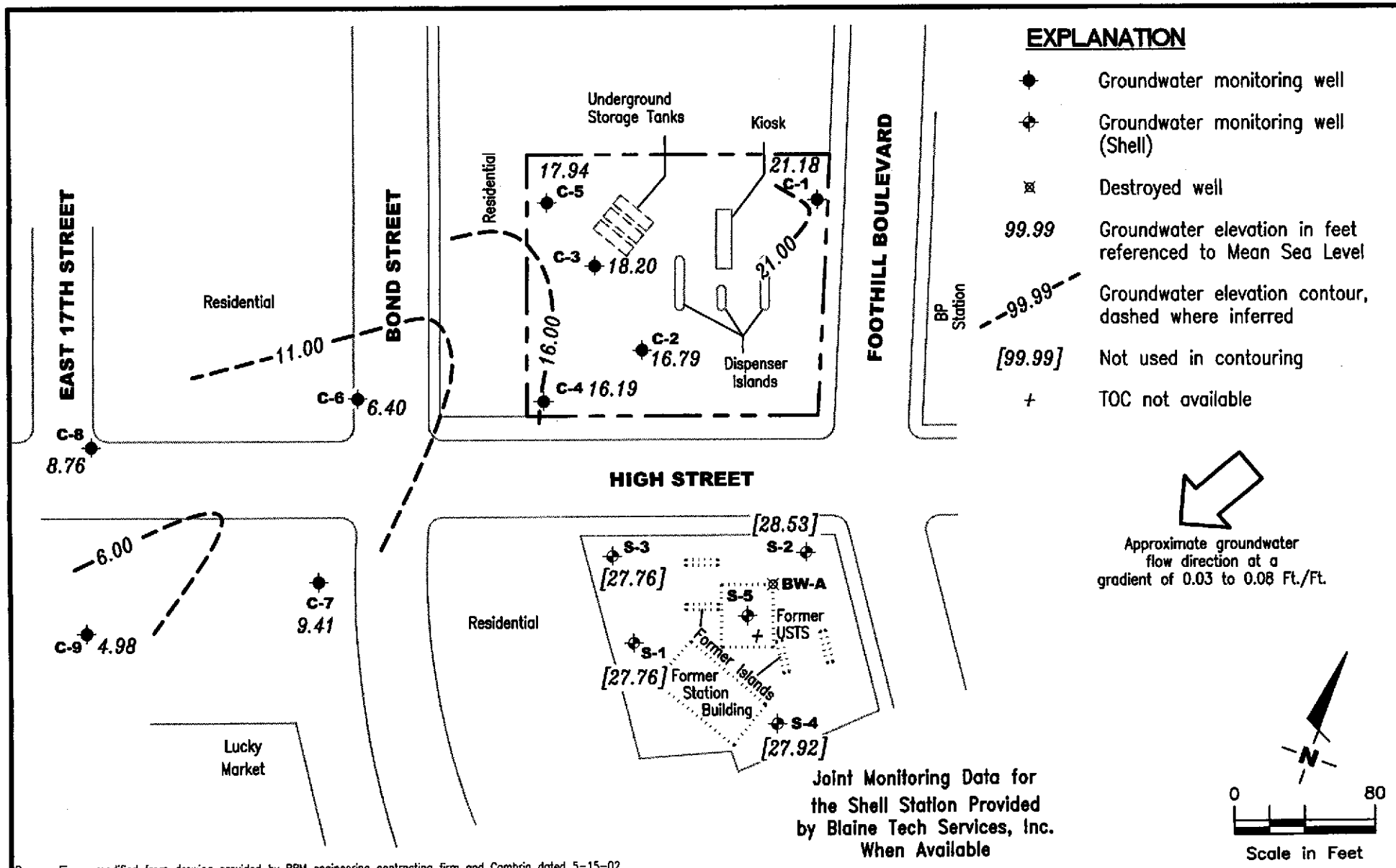

Figure 1: Potentiometric Map
Table 1: Groundwater Monitoring Data and Analytical Results
Table 2: Field Measurements and Groundwater Analytical Results
Attachments: Standard Operating Procedure - Groundwater Sampling
Field Data Sheets
Chain of Custody Document and Laboratory Analytical Reports



Source: Figure modified from drawing provided by RRM engineering contracting firm and Cambria dated 5-15-02

GETTLER - RYAN INC.
 6747 Sierra Ct., Suite J
 Dublin, CA 94568 (925) 551-7555

POTENTIOMETRIC MAP
 Chevron Service Station #9-0076
 4265 Foothill Boulevard
 Oakland, California

FIGURE

1

PROJECT NUMBER
 386495

REVIEWED BY

DATE

September 11, 2002

REVISED DATE

Table 1
Groundwater Monitoring Data and Analytical Results
Chevron Service Station #9-0076
4265 Foothill Boulevard
Oakland, California

WELL ID/ DATE	TOC (ft.)	GWE (msl)	DTW (ft.)	SPHT (ft.)	SPH REMOVED (gallons)	TPH-G (ppb)	B (ppb)	T (ppb)	E (ppb)	X (ppb)	MTBE (ppb)
C-1											
04/28/89	35.42	15.37	20.05	--	--	940	30	1.3	11	13	--
08/08/89	35.42	11.35	24.07	--	--	820	45	2.0	13	13	--
12/21/89	35.42	12.61	22.81	--	--	--	--	--	--	--	--
08/27/90	35.42	13.30	22.12	--	--	440	15	1.0	6.0	13	--
11/04/90	35.42	9.86	25.56	--	--	--	--	--	--	--	--
06/18/91	35.42	13.78	21.64	--	--	74	5.6	0.6	1.9	1.3	--
09/19/91	35.42	10.84	24.58	--	--	150	7.1	<0.5	2.3	3.0	--
12/20/91	35.42	9.25	26.17	--	--	250	10	<0.5	3.7	1.6	--
03/18/92	35.42	17.17	18.25	--	--	190	16	<0.5	8.5	3	--
07/14/92	35.42	7.81	27.61	--	--	20,000	480	2,200	510	2,900	--
10/08/92	35.42	10.98	24.44	--	--	360	34	4.6	19	12	--
01/08/93	35.42	15.74	19.68	--	--	120	9.1	0.5	5.1	1.8	--
04/14/93	35.42	19.04	16.38	--	--	190	74	0.6	1.0	2.0	--
07/16/93	35.42	--	--	--	--	--	--	--	--	--	--
07/27/93	35.42	26.03	9.39	--	--	300	12	<0.5	5.0	2.0	--
09/21/93	38.41	16.99	21.42	--	--	360	12	1.2	5.8	3.7	--
01/28/94	38.41	18.84	19.57	--	--	370	24	1.0	13	4.0	--
03/17/94	38.41	21.56	16.85	--	--	460	42	<0.5	6.7	3.7	--
06/16/94	38.41	20.58	17.83	--	--	320	20	0.7	8.7	3.0	--
09/22/94	38.41	18.15	20.26	--	--	380	24	0.6	8.8	1.9	--
12/15/94	38.41	22.59	15.82	--	--	280	23	7.6	7.8	13	--
03/30/95	38.41	26.39	12.02	--	--	2,200	890	8.9	15	<5.0	--
06/20/95	38.41	24.01	14.40	--	--	690	140	<2.0	9.4	2.8	--
09/20/95	38.41	24.59	13.82	--	--	730	27	78	26	130	--
12/06/95	38.41	17.81	20.60	--	--	220	16	<0.5	7.2	1.7	11
03/21/96	38.41	26.76	11.65	--	--	640	170	<2.0	6.7	<2.0	35
06/21/96	38.41	24.16	14.25	--	--	640	140	<1.2	8.7	2.0	23
09/06/96	38.41	21.66	16.75	--	--	460	24	0.56	10	2.4	43
12/19/96	38.41	24.43	13.98	--	--	790	120	22	13	19	<25
03/17/97	38.41	25.63	12.78	--	--	2,200	660	<10	15	<10	110
06/11/97	38.41	23.25	15.16	--	--	1,500	130	<2.0	16	3.4	130

Table 1
Groundwater Monitoring Data and Analytical Results
Chevron Service Station #9-0076
4265 Foothill Boulevard
Oakland, California

WELL ID/ DATE	TOC (ft.)	GWE (msl)	DTW (ft.)	SPHT (ft.)	SPH REMOVED (gallons)	TPH-G (ppb)	B (ppb)	T (ppb)	E (ppb)	X (ppb)	MTBE (ppb)
C-1 (cont)											
09/17/97	38.41	21.47	16.94	--	--	910	160	23	13	49	180
12/11/97	38.41	25.23	13.18	--	--	2,000	270	7.0	53	7.4	460
03/12/98	38.41	28.92	9.49	--	--	3,100	1,300	<20	42	<20	760
06/23/98	38.41	28.19	10.22	--	--	1,300	650	6.9	22	6.5	290
09/01/98	38.41	21.43	16.98	--	--	270	6.0	<2.5	<2.5	<2.5	950
12/30/98	38.41	22.29	16.12	--	--	2,020	578	<5.0	<5.0	<5.0	1,720
03/31/99	38.41	24.53	13.88	--	--	2,140	776	5.89	<5.0	5.15	1,170
06/14/99	38.41	23.09	15.32	--	--	1,450	524	<5.0	<5.0	<5.0	1,150
06/14/99 ¹	38.41	23.09	15.32	--	--	--	--	--	--	--	1,360 ²
09/30/99	38.41	22.30	16.11	--	--	79	1.12	<0.5	1.07	<0.5	677
12/22/99	38.41	23.37	15.04	--	--	501	157	4.45	<2.5	4.81	744
03/09/00	38.41	31.28	7.13	--	--	3,300	2,500	28	37	<25	1,700
06/23/00 ³	38.41	25.86	12.55	0.00	0.00	2,200 ⁴	1,000	6.9	5.7	9.3	1,900
09/05/00 ³	38.41	21.28	17.13	0.00	0.00	<200	8.3	<2.0	<2.0	<2.0	1,000
12/04/00	38.41	21.48	16.93	0.00	0.00	1,400 ⁴	600	<5.0	<5.0	<5.0	1,500
03/08/01 ³	38.41	30.45	7.96	0.00	0.00	2,570	1,040	7.93	12.0	<5.00	1,470
06/07/01 ³	38.41	25.45	12.96	0.00	0.00	750 ⁴	220	5.6	4.8	2.6	2,500 ⁵
09/13/01 ³	38.41	19.91	18.50	0.00	0.00	670 ⁶	<5.0	<5.0	<5.0	<5.0	660
12/13/01 ³	38.41	23.02	15.39	0.00	0.00	1,100	340	2.1	0.95	7.9	630
03/08/02 ³	38.41	28.35	10.06	0.00	0.00	3,600	1,400	9.5	17	6.5	1,900
06/19/02 ³	38.41	24.92	13.49	0.00	0.00	1,300	220	3.4	2.7	<3.0	1,400
09/11/02 ³	38.41	21.18	17.23	0.00	0.00	400	22	<0.50	<0.50	<1.5	780
C-2											
04/28/89	35.18	8.74	26.44	--	--	120,000	30,000	22,000	3,000	17,000	--
08/08/89	35.18	5.29	29.90	0.01	--	--	--	--	--	--	--
12/21/89	35.18	5.86	29.32	--	--	--	--	--	--	--	--
08/27/90	35.18	5.77	29.55	0.17	--	--	--	--	--	--	--
11/04/90	35.18	4.71	30.47	--	--	--	--	--	--	--	--
06/18/91	35.18	6.90	28.33	0.06	--	--	--	--	--	--	--

Table 1
Groundwater Monitoring Data and Analytical Results
Chevron Service Station #9-0076
4265 Foothill Boulevard
Oakland, California

WELL ID/ DATE	TOC (ft.)	GWE (msl)	DTW (ft.)	SPHT (ft.)	SPH REMOVED (gallons)	TPH-G (ppb)	B (ppb)	T (ppb)	E (ppb)	X (ppb)	MTBE (ppb)
C-2 (cont)											
09/19/91	35.18	5.84	29.39	0.06	--	--	--	--	--	--	--
12/20/91	35.18	5.95	29.23	--	--	170,000	20,000	10,000	2,800	19,000	--
03/18/92	35.18	21.58	13.60	0.09	--	--	--	--	--	--	--
07/14/92	35.18	--	--	--	--	--	--	--	--	--	--
10/08/92	35.18	--	--	--	--	--	--	--	--	--	--
01/08/93	35.18	10.98	24.20	Sheen	--	79,000	14,000	7,200	3,500	16,000	--
04/14/93	35.18	--	--	--	--	--	--	--	--	--	--
07/16/93	35.18	5.03	30.15	--	--	2200	440	73	24	350	--
09/21/93	37.47	11.18	26.29	--	--	11,000	2,300	300	270	910	--
01/28/94	37.47	13.51	23.96	--	--	49,000	11,000	3,900	1,600	12,000	--
03/17/94	37.47	11.48	25.99	--	--	16,000	3,300	1,000	220	3,500	--
06/16/94	37.47	13.55	23.92	--	--	20,000	4,800	1,500	520	4,300	--
09/22/94	37.47	11.85	25.62	--	--	35,000	5,600	850	1,700	7,300	--
12/15/94	37.47	16.31	21.16	--	--	96,000	9,000	3,500	3,300	13,000	--
03/30/95	37.47	20.29	17.18	--	--	100,000	9,400	3,700	3,900	14,000	--
06/20/95	37.47	18.52	18.95	--	--	93,000	6,400	1,900	2,900	11,000	--
09/20/95	37.47	19.27	18.20	--	--	58,000	6,600	330	1,600	5,500	--
12/06/95	37.47	12.71	24.76	--	--	40,000	5,000	86	1,800	3,700	<500
03/21/96	37.47	21.30	16.17	0.00	0.13	--	--	--	--	--	--
06/21/96	37.47	19.34	18.15	0.02	0.03	--	--	--	--	--	--
09/06/96	37.47	16.36	21.14	0.04	0.08	--	--	--	--	--	--
12/19/96	37.47	19.94	17.55	0.03	0.05	--	--	--	--	--	--
03/17/97	37.47	18.88	18.59	--	--	58,000	4,800	1,200	1,800	6,300	3,400
06/11/97	37.47	16.17	21.30	--	--	40,000	5,500	720	1,400	4,100	3,100
09/17/97	37.47	14.33	23.14	--	--	30,000	4,800	220	1,200	1,800	3,200
12/11/97	37.47	20.26	17.21	--	--	76,000	6,100	1,300	2,200	8,000	3,800
03/12/98	37.47	23.30	14.17	--	--	45,000	6,000	1,400	1,800	5,900	2,700
06/23/98 ³	37.47	22.65	14.82	--	--	1,100,000	6,800	5,100	13,000	38,000	<1,000
09/01/98	37.47	15.69	21.78	--	--	9,700	300	8.2	6.2	250	3,700
12/30/98	37.47	15.61	21.86	--	--	110,000	4,790	1,300	841	5,570	2,420
03/31/99	37.47	20.57	16.90	--	--	48,000	4,800	1,110	1,520	5,450	2,160

Table 1
Groundwater Monitoring Data and Analytical Results
Chevron Service Station #9-0076
4265 Foothill Boulevard
Oakland, California

WELL ID/ DATE	TOC (ft.)	GWE (msl)	DTW (ft.)	SPHT (ft.)	SPH		B (ppb)	T (ppb)	E (ppb)	X (ppb)	MTBE (ppb)
					REMOVED (gallons)	TPH-G (ppb)					
C-2 (cont)											
06/14/99	37.47	17.32	20.15	Sheen	--	56,400	5,380	671	1,300	3,960	2,480
06/14/99 ¹	37.47	17.32	20.15	--	--	--	--	--	--	--	2,630 ²
09/30/99	37.47	14.50	22.97	--	--	22,100	623	<100	529	1,250	2,430
12/22/99	37.47	16.47	21.00	--	--	10,200	1,750	102	222	963	1,980
03/09/00	37.47	25.27	12.20	--	--	26,000	4,800	930	1,200	4,400	1,800
06/23/00 ³	37.47	18.53	18.94	0.00	0.00	29,000 ⁴	3,400	360	440	2,500	2,800
09/05/00 ³	37.47	17.01	20.46	0.00	0.00	35,000 ⁴	3,800	54	980	750	5,200
12/04/00	37.47	16.54	20.93	0.00	0.00	16,000 ⁴	2,500	120	360	1,100	2,100
03/08/01 ³	37.47	20.53	16.94	0.00	0.00	42,300	3,930	828	2,010	5,180	1,660
06/07/01 ³	37.47	18.13	19.34	0.00	0.00	15,000 ⁴	3,400	150	700	1,300	1,900
09/13/01 ³	37.47	15.28	22.19	0.00	0.00	9,600	1,200	<50	120	160	2,200
12/13/01 ³	37.47	19.87	17.60	0.00	0.00	33,000	3,200	430	1,300	3,700	1,400
03/08/02 ³	37.47	23.18	14.29	0.00	0.00	26,000	2,900	390	1,200	2,800	1,100
06/19/02 ³	37.47	18.36	19.11	0.00	0.00	19,000	3,000	100	720	1,100	1,400
09/11/02³	37.47	16.79	20.68	0.00	0.00	10,000	1,400	23	120	78	1,800
C-3											
04/28/89	35.28	7.28	28.00	--	--	<500	1.7	<0.5	<0.5	<0.5	--
08/08/89	35.28	5.28	30.00	--	--	<500	1.0	<0.5	<0.5	<0.5	--
12/21/89	35.28	4.75	30.53	--	--	--	--	--	--	--	--
08/27/90	35.28	5.60	29.68	--	--	<50	<0.3	<0.3	<0.3	<0.6	--
11/04/90	35.30	4.94	30.36	--	--	--	--	--	--	--	--
06/18/91	35.30	6.84	28.46	--	--	52	1.1	<0.5	<0.5	1.2	--
09/19/91	35.30	5.97	29.33	--	--	73	1.2	<0.5	<0.5	<0.5	--
12/20/91	35.30	5.53	29.77	--	--	<50	0.7	<0.5	<0.5	<0.5	--
03/18/92	35.30	9.55	25.75	--	--	<50	<0.5	<0.5	<0.5	<0.5	--
07/14/92	35.30	7.43	27.87	--	--	<50	<0.5	<0.5	<0.5	<0.5	--
10/08/92	35.30	6.75	28.55	--	--	<50	<0.5	<0.5	<0.5	0.5	--
01/08/93	35.30	9.45	25.85	--	--	<50	<0.5	<0.5	<0.5	<0.5	--
04/14/93	35.30	11.34	23.96	--	--	<50	<0.5	<0.5	<0.5	<0.5	--

Table 1
Groundwater Monitoring Data and Analytical Results
Chevron Service Station #9-0076
4265 Foothill Boulevard
Oakland, California

WELL ID/ DATE	TOC (ft.)	GWE (msl)	DTW (ft.)	SPHT (ft.)	SPH REMOVED (gallons)	TPH-G (ppb)	B (ppb)	T (ppb)	E (ppb)	X (ppb)	MTBE (ppb)
C-3 (cont)											
07/16/93	35.30	9.66	25.64	--	--	<50	<0.5	<0.5	<0.5	<0.5	--
09/21/93	38.37	12.15	26.22	--	--	<50	0.7	<0.5	<0.5	<0.8	--
01/28/94	38.37	12.71	25.66	--	--	<50	2.0	<0.5	<0.5	1.0	--
03/17/94	38.37	13.42	24.95	--	--	<50	2.8	<0.5	0.6	1.5	--
06/16/94	38.37	14.06	24.31	--	--	<50	1.4	<0.5	<0.5	<0.5	--
09/22/94	38.37	13.33	25.04	--	--	<50	0.6	<0.5	<0.5	<0.5	--
12/15/94	38.37	16.15	22.22	--	--	<50	2.6	1.7	0.82	4.5	--
03/30/95	38.37	19.95	18.42	--	--	<50	<0.5	<0.5	<0.5	<0.5	--
06/20/95	38.37	18.58	19.79	--	--	110	2.2	<0.5	<0.5	1.2	--
09/20/95	38.37	19.42	18.95	--	--	560	21	80	23	120	--
12/06/95	38.37	14.21	24.16	--	--	<50	0.73	<0.5	<0.5	0.67	<2.5
03/21/96	38.37	20.52	17.85	--	--	<50	<0.5	<0.5	<0.5	<0.5	<2.5
06/21/96	38.37	18.59	19.78	--	--	57	<0.5	<0.5	<0.5	<0.5	<2.5
09/06/96	38.37	16.74	21.63	--	--	<50	0.9	<0.5	<0.5	<0.5	<2.5
12/19/96	38.37	16.07	22.30	--	--	310	36	33	6.5	28	<2.5
03/17/97	38.37	19.42	18.95	--	--	54	1.1	<0.5	<0.5	0.76	<2.5
06/11/97	38.37	17.22	21.15	--	--	120	1.1	<0.5	<0.5	<0.5	<2.5
09/17/97	38.37	15.96	22.41	--	--	240	19	19	6.6	40	13
12/11/97	38.37	16.11	22.26	--	--	<50	1.8	<0.5	<0.5	0.5	<2.5
03/12/98	38.37	20.02	18.35	--	--	72	6.3	<0.5	0.64	3.1	2.6
06/23/98	38.37	19.33	19.04	--	--	<50	<0.5	<0.5	<0.5	<0.5	<2.5
09/01/98	38.37	18.40	19.97	--	--	200	6.8	0.31	0.52	2.0	<2.5
12/30/98	38.37	17.06	21.31	--	--	<50	<0.5	<0.5	<0.5	<0.5	<2.0
03/31/99	38.37	20.60	17.77	--	--	<50	<0.5	<0.5	<0.5	<0.5	12.6
06/14/99	38.37	20.12	18.25	--	--	<50	<0.5	<0.5	<0.5	<0.5	<2.5
09/30/99	38.37	17.18	21.19	--	--	79.2	3.04	0.794	<0.5	1.04	6.17
12/22/99	38.37	16.05	22.32	--	--	<50	1.53	1.08	<0.5	0.66	12
03/09/00	38.37	21.27	17.10	--	--	99	6.9	0.8	0.89	3.8	12
06/23/00	38.37	19.22	19.15	0.00	0.00	<50	<0.50	<0.50	<0.50	<0.50	<2.5
09/05/00	38.37	17.53	20.84	0.00	0.00	52 ⁴	4.3	<0.50	<0.50	0.93	29
12/04/00	38.37	17.17	21.20	0.00	0.00	70 ⁴	4.0	<0.50	<0.50	0.71	25

Table 1
Groundwater Monitoring Data and Analytical Results
Chevron Service Station #9-0076
4265 Foothill Boulevard
Oakland, California

WELL ID/ DATE	TOC (ft.)	GWE (msl)	DTW (ft.)	SPHT (ft.)	SPH REMOVED (gallons)	TPH-G (pph)	B (pph)	T (pph)	E (ppb)	X (ppb)	MTBE (ppb)
C-3 (cont)											
03/08/01	38.37	20.70	17.67	0.00	0.00	<50.0	0.873	<0.500	<0.500	<0.500	3.24
06/07/01	38.37	19.47	18.90	0.00	0.00	140 ⁴	16	0.67	1.4	3.8	30
09/13/01	38.37	17.36	21.01	0.00	0.00	<50	<0.50	<0.50	<0.50	<0.50	<2.5
12/13/01	38.37	18.57	19.80	0.00	0.00	<50	1.2	<0.50	<0.50	<1.5	15
03/08/02	38.37	20.59	17.78	0.00	0.00	82	5.4	<0.50	<0.50	<1.5	68
06/19/02	38.37	19.97	18.40	0.00	0.00	74	2.1	<0.50	<0.50	<1.5	77
09/11/02	38.37	18.20	20.17	0.00	0.00	110	4.7	<0.50	<0.50	<1.5	76
C-4											
01/12/89	33.45	3.96	29.49	--	--	--	--	--	--	--	--
04/12/89	33.45	6.01	27.44	--	--	--	--	--	--	--	--
04/28/89	33.45	3.96	29.49	--	--	20,000	6,300	550	230	1,500	--
08/08/89	33.45	3.90	29.55	--	--	8,000	7,500	340	88	1,000	--
12/21/89	33.45	3.43	30.02	--	--	--	--	--	--	--	--
08/27/90	33.48	4.46	29.02	--	--	26,000	10,000	280	410	1,400	--
11/04/90	33.48	3.67	29.81	--	--	--	--	--	--	--	--
06/18/91	33.48	6.03	27.45	--	--	34,000	14,000	410	450	1,300	--
09/19/91	33.48	4.83	28.65	--	--	16,000	7,400	90	110	460	--
12/20/91	33.48	4.64	28.84	--	--	24,000	12,000	120	260	740	--
03/18/92	33.48	11.05	24.43	--	--	48,000	6,000	1,300	1,300	2,400	--
07/14/92	33.48	6.59	26.89	--	--	40,000	14,000	920	550	2,400	--
10/08/92	33.48	5.69	27.79	--	--	29,000	13,000	190	110	1,400	--
01/08/93	33.48	9.98	23.50	--	--	25,000	7,000	630	860	1,800	--
04/14/93	33.48	12.35	21.13	--	--	27,000	6,300	1,000	900	1,400	--
07/16/93	33.48	9.52	23.96	--	--	28,000	7,800	1,100	830	2,100	--
09/21/93	36.49	10.98	25.51	--	--	30,000	9,600	130	390	1,300	--
01/28/94	36.49	13.18	23.31	--	--	18,000	7,800	440	260	1,200	--
03/17/94	36.49	15.14	21.35	--	--	32,000	7,800	820	820	1,800	--
06/16/94	36.49	13.99	22.50	--	--	25,000	7,600	710	600	1,800	--
09/22/94	36.49	12.56	23.93	--	--	25,000	7,800	140	600	1,100	--

Table 1
Groundwater Monitoring Data and Analytical Results
Chevron Service Station #9-0076
4265 Foothill Boulevard
Oakland, California

WELL ID/ DATE	TOC (ft.)	GWE (msl)	DTW (ft.)	SPHT (ft.)	SPH REMOVED (gallons)	TPH-G (ppb)	B (ppb)	T (ppb)	E (ppb)	X (ppb)	MTBE (ppb)
C-4 (cont)											
12/15/94	36.49	17.47	19.02	--	--	38,000	7,600	460	1,200	2,000	--
03/30/95	36.49	21.63	14.86	--	--	41,000	8,700	1,600	1,800	3,000	--
06/20/95	36.49	19.59	16.90	--	--	29,000	6,000	890	960	1,800	--
09/20/95	36.49	20.29	16.20	--	--	12,000	6,900	510	290	1,300	--
12/06/95	36.49	13.37	23.12	--	--	13,000	3,900	42	30	250	<250
03/21/96	36.49	22.39	14.10	--	--	39,000	4,800	640	1,000	1,800	<1,000
06/21/96	36.49	19.54	16.95	--	--	26,000	4,400	640	960	1,800	2,000
09/06/96	36.49	16.36	20.13	--	--	23,000	500	200	230	1,000	3,100
12/19/96	36.49	19.57	16.92	--	--	23,000	4,900	320	1,100	2,000	<250
03/17/97	36.49	19.09	17.40	--	--	30,000	5,800	700	1,400	2,200	1,700
06/11/97	36.49	18.15	18.34	--	--	29,000	4,400	520	790	1,800	2,000
09/17/97	36.49	15.03	21.46	--	--	17,000	4,300	140	940	1,100	4,600
12/11/97	36.49	19.84	16.65	--	--	12,000	2,500	130	300	1,000	1,400
03/12/98	36.49	19.90	16.59	--	--	46,000	11,000	1,500	2,300	5,000	3,400
06/23/98 ³	36.49	19.47	17.02	--	--	27,000	1,600	160	180	690	100
09/01/98	36.49	15.04	21.45	--	--	520	14	2.3	<0.5	4.8	61
12/30/98	36.49	15.07	21.42	--	--	122	14.1	1.86	<1.0	3.61	349
03/31/99	36.49	21.29	15.20	--	--	20,300	4,450	443	1,000	2,130	1,320
06/14/99	36.49	14.69	21.80	--	--	1,820	183	7.14	36.7	56.5	291
06/14/99 ¹	36.49	14.69	21.80	--	--	--	--	--	--	--	280 ²
09/30/99	36.49	16.68	19.81	--	--	1,030	11.6	2.14	29.2	68.7	91.5
12/22/99	36.49	16.22	20.27	--	--	217	4.45	0.765	2.82	8.21	70.2
03/09/00	36.49	23.13	13.36	--	--	8,300	2,600	270	510	1,400	650
06/23/00 ³	36.49	17.09	19.40	0.00	0.00	55 ⁴	1.2	<0.50	<0.50	<0.50	250
09/05/00 ³	36.49	15.06	21.43	0.00	0.00	110 ⁴	5.4	<0.50	<0.50	1.1	52
12/04/00	36.49	14.71	21.78	0.00	0.00	<50	<0.50	0.56	<0.50	1.1	22
03/08/01 ³	36.49	19.87	16.62	0.00	0.00	9,080	2,260	229	395	1,060	718
06/07/01 ³	36.49	16.89	19.60	0.00	0.00	800 ⁴	75	4.3	22	33	340
09/13/01 ³	36.49	14.78	21.71	0.00	0.00	<50	0.68	<0.50	<0.50	<0.50	18
12/13/01 ³	36.49	18.54	17.95	0.00	0.00	5,800	-1,400	43	21	470	540

Table 1
Groundwater Monitoring Data and Analytical Results
Chevron Service Station #9-0076
4265 Foothill Boulevard
Oakland, California

WELL ID/ DATE	TOC (ft.)	GWE (msl)	DTW (ft.)	SPHT (ft.)	SPH REMOVED (gallons)	TPH-G (ppb)	B (ppb)	T (ppb)	E (ppb)	X (ppb)	MTBE (ppb)
C-4 (cont)											
03/08/02 ³	36.49	19.71	16.78	0.00	0.00	7,000	1,300	67	280	390	610
06/19/02 ³	36.49	17.69	18.80	0.00	0.00	3,100	130	6.5	29	55	250
09/11/02 ³	36.49	16.19	20.30	0.00	0.00	820	6.2	1.0	2.2	2.5	26
C-5											
08/27/90	35.50	5.67	29.83	--	--	<50	<0.3	<0.3	<0.3	<0.6	--
11/14/90	35.50	4.94	30.56	--	--	--	--	--	--	--	--
06/18/91	35.50	6.98	28.52	--	--	<50	<0.5	<0.5	<0.5	--	--
09/19/91	35.50	5.99	29.51	--	--	<50	<0.5	<0.5	<0.5	<0.5	--
12/20/91	35.50	5.54	29.96	--	--	<50	<0.5	<0.5	<0.5	<0.5	--
03/18/92	35.50	9.58	25.92	--	--	<50	<0.5	<0.5	<0.5	<0.5	--
07/14/92	35.50	7.50	28.00	--	--	<50	<0.5	<0.5	<0.5	<0.5	--
10/08/92	35.50	6.85	28.65	--	--	<50	<0.5	<0.5	<0.5	<0.5	--
01/08/93	35.50	9.48	26.02	--	--	<50	<0.5	<0.5	<0.5	<0.5	--
04/14/93	35.50	11.46	24.04	--	--	<50	<0.5	<0.5	<0.5	<0.5	--
07/16/93	35.50	10.29	25.21	--	--	<50	<0.5	<0.5	<0.5	<0.5	--
09/21/93	38.50	12.14	26.36	--	--	60	10	8.1	1.9	9.4	--
01/28/94	38.50	12.60	25.90	--	--	<50	<0.5	<0.5	<0.5	<0.5	--
03/17/94	38.50	14.00	24.50	--	--	<50	<0.5	<0.5	<0.5	<0.5	--
06/16/94	38.50	14.10	24.40	--	--	<50	<0.5	<0.5	<0.5	<0.5	--
09/22/94	38.50	13.34	25.16	--	--	<50	<0.5	<0.5	<0.5	<0.5	--
12/15/94	38.50	15.61	22.89	--	--	<50	<0.5	<0.5	<0.5	<0.5	--
03/30/95	38.50	19.96	18.54	--	--	<50	<0.5	<0.5	<0.5	<0.5	--
06/20/95	38.50	18.37	20.13	--	--	<50	<0.5	<0.5	<0.5	<0.5	--
09/20/95	38.50	14.16	24.34	--	--	<50	<0.5	<0.5	<0.5	<0.5	--
12/06/95	38.50	14.40	24.10	--	--	<50	<0.5	<0.5	<0.5	<0.5	<2.5
03/21/96	38.50	20.10	18.40	--	--	<50	<0.5	<0.5	<0.5	<0.5	<2.5
06/21/96	38.50	18.23	20.27	--	--	<50	<0.5	<0.5	<0.5	<0.5	8.7
06/06/96	38.50	16.60	21.90	--	--	<50	<0.5	<0.5	<0.5	<0.5	<2.5
12/19/96	38.50	17.35	21.15	--	--	<50	<0.5	<0.5	<0.5	<0.5	<2.5

Table 1
Groundwater Monitoring Data and Analytical Results
Chevron Service Station #9-0076
4265 Foothill Boulevard
Oakland, California

WELL ID/ DATE	TOC (ft.)	GWE (msl)	DTW (ft.)	SPHT (ft.)	SPH		B (ppb)	T (ppb)	E (ppb)	X (ppb)	MTBE (ppb)
					REMOVED (gallons)	TPH-G (ppb)					
C-5 (cont)											
03/17/97	38.50	18.66	19.84	--	--	<50	<0.5	<0.5	<0.5	<0.5	<2.5
06/11/97	38.50	16.90	21.60	--	--	<50	<0.5	<0.5	<0.5	<0.5	<2.5
09/17/97	38.50	10.67	27.83	--	--	SAMPLED ANNUALLY		--	--	--	--
12/11/97	38.50	17.50	21.00	--	--	--	--	--	--	--	--
03/12/98	38.50	22.08	16.42	--	--	<50	<0.5	<0.5	<0.5	<0.5	<2.5
06/23/98	38.50	21.52	16.98	--	--	--	--	--	--	--	--
09/01/98	38.50	18.08	20.42	--	--	--	--	--	--	--	--
12/30/98	38.50	17.71	20.79	--	--	--	--	--	--	--	--
03/31/99	38.50	21.45	17.05	--	--	<50	<0.5	<0.5	<0.5	<0.5	15
06/14/99	38.50	21.02	17.48	--	--	--	--	--	--	--	--
09/30/99	38.50	19.77	18.73	--	--	--	--	--	--	--	--
12/22/99	38.50	16.32	22.18	--	--	--	--	--	--	--	--
03/09/00	38.50	21.52	16.98	--	--	<50	<0.5	<0.5	<0.5	0.87	3.5
06/23/00	38.50	18.85	19.65	0.00	0.00	SAMPLED ANNUALLY		--	--	--	--
09/05/00	38.50	18.03	20.47	0.00	0.00	--	--	--	--	--	--
12/04/00	38.50	17.04	21.46	0.00	0.00	--	--	--	--	--	--
03/08/01	38.50	20.97	17.53	0.00	0.00	<50.0	<0.500	<0.500	<0.500	<0.500	5.15
06/07/01	38.50	19.00	19.50	0.00	0.00	SAMPLED ANNUALLY		--	--	--	--
09/13/01	38.50	17.07	21.43	0.00	0.00	SAMPLED ANNUALLY		--	--	--	--
12/13/01	38.50	18.66	19.84	0.00	0.00	SAMPLED ANNUALLY		--	--	--	--
03/08/02	38.50	20.32	18.18	0.00	0.00	<50	<0.50	<0.50	<0.50	<1.5	3.5
06/19/02	38.50	19.62	18.88	0.00	0.00	SAMPLED ANNUALLY		--	--	--	--
09/11/02	38.50	17.94	20.56	0.00	0.00	SAMPLED ANNUALLY		--	--	--	--
C-6											
08/27/90	32.40	-11.71	44.11	--	--	7,200	2,100	6.0	41	300	--
11/14/90	32.40	-11.63	44.03	--	--	--	--	--	--	--	--
06/18/91	32.40	-11.09	43.49	--	--	4,400	2,500	18	160	77	--
09/19/91	32.40	-1.92	34.32	--	--	3,100	-1,600	8.3	73	8.0	--
12/20/91	32.40	-8.95	41.35	--	--	4,400	1,300	3.2	74	10	--

Table 1
Groundwater Monitoring Data and Analytical Results
Chevron Service Station #9-0076
4265 Foothill Boulevard
Oakland, California

WELL ID/ DATE	TOC (ft.)	GWE (msl)	DTW (ft.)	SPHT (ft.)	SPH		B (ppb)	T (ppb)	E (ppb)	X (ppb)	MTBE (ppb)
					REMOVED (gallons)	TPH-G (ppb)					
C-6 (cont)											
03/18/92	32.40	-8.29	40.69	--	--	9,800	3,200	34	250	500	--
07/14/92	32.40	-6.49	38.89	--	--	6,500	2,200	100	96	240	--
10/08/92	32.40	-6.27	38.67	--	--	1,800	1,000	3.1	15	41	--
01/08/93	32.40	-5.41	37.81	--	--	5,200	1,600	6.8	63	120	--
04/14/93	32.40	-2.30	34.70	--	--	11,000	1,800	13	110	200	--
07/16/93	32.40	-1.47	33.87	--	--	4,800	820	10	41	57	--
09/21/93	35.40	1.42	33.98	--	--	4,100	1,200	<50	75	130	--
01/28/94	35.40	1.54	33.86	--	--	3,100	930	14	40	34	--
03/17/94	35.40	3.09	32.31	--	--	5,100	950	18	61	83	--
06/16/94	35.40	3.90	31.50	--	--	3,800	970	6.4	52	62	--
09/22/94	35.40	4.18	31.22	--	--	4,100	980	7.8	43	48	--
12/15/94	35.40	4.00	31.40	--	--	5,000	1,400	<20	73	61	--
03/30/95	35.40	9.02	26.38	--	--	5,500	1,700	<13	120	97	--
06/20/95	35.40	10.39	25.01	--	--	1,700	470	<10	29	16	--
09/20/95	35.40	11.35	24.05	--	--	3,500	770	<5.0	45	17	--
12/06/95	35.40	7.28	28.12	--	--	3,100	710	<10	41	20	<50
03/21/96	35.40	12.28	23.12	--	--	1,400	330	<2.5	15	8.1	19
06/21/96	35.40	11.90	23.50	--	--	2,200	560	<5.0	18	<5.0	77
09/06/96	35.40	10.57	24.83	--	--	2,800	720	<10	13	<10	160
12/19/96	35.40	10.90	24.50	--	--	830	320	<2.5	<2.5	<2.5	14
03/17/97	35.40	12.81	22.59	--	--	2,200	500	<10	25	<10	<50
06/11/97	35.40	11.64	23.76	--	--	3,000	570	<5.0	29	10	220
09/17/97	35.40	10.66	24.74	--	--	1,400	330	<5.0	<5.0	<5.0	76
12/11/97	35.40	10.75	24.65	--	--	1,600	230	<5.0	7.3	6.4	46
03/12/98	35.40	8.28	27.12	--	--	980	300	<5.0	15	12	49
06/23/98 ³	35.40	7.48	27.92	--	--	220	35	<0.5	2.5	1.1	<2.5
09/01/98	35.40	3.80	31.60	--	--	1,800	370	2.8	19	5	44
12/30/98	35.40	3.58	31.82	--	--	1,600	244	<1.0	8.53	<1.0	54.9
03/31/99	35.40	9.34	26.06	--	--	741	92.2	<1.0	6.60	<1.0	27.9
06/14/99	35.40	5.72	29.68	--	--	434	110	<1.0	5.76	1.46	13
06/14/99 ¹	35.40	5.72	29.68	--	--	--	--	--	--	--	6.96 ²

Table 1
Groundwater Monitoring Data and Analytical Results
Chevron Service Station #9-0076
4265 Foothill Boulevard
Oakland, California

WELL ID/ DATE	TOC (ft.)	GWE (msl)	DTW (ft.)	SPHT (ft.)	SPH REMOVED (gallons)	TPH-G (ppb)	B (ppb)	T (ppb)	E (ppb)	X (ppb)	MTBE (ppb)
C-6 (cont)											
09/30/99	35.40	12.34	23.06	--	--	481	92.7	<1.0	3.69	<1.0	32.9
12/22/99	35.40	12.85	22.55	--	--	1,310	158	2.16	5.5	1.41	113
03/09/00	35.40	15.37	20.03	--	--	470	120	0.74	5.0	2.5	36
06/23/00 ³	35.40	13.25	22.15	0.00	0.00	1,700 ⁴	210	<5.0	<5.0	5.8	64
09/05/00 ³	35.40	8.35	27.05	0.00	0.00	740 ⁴	99	0.60	5.1	2.2	80
12/04/00	35.40	10.25	25.15	0.00	0.00	450 ⁴	31	0.71	<0.50	<0.50	54
03/08/01 ³	35.40	11.56	23.84	0.00	0.00	1,550	228	3.93	19.9	32.5	46.2
06/07/01 ³	35.40	9.67	25.73	0.00	0.00	360 ⁴	21	1.8	2.4	3.8	100
09/13/01 ³	35.40	11.60	23.80	0.00	0.00	950	180	<5.0	5.9	<5.0	170
12/13/01 ³	35.40	10.21	25.19	0.00	0.00	2,000	170	0.86	6.4	4.1	77
03/08/02 ³	35.40	14.32	21.08	0.00	0.00	600	33	0.91	1.8	<1.5	90
06/19/02 ³	35.40	10.78	24.62	0.00	0.00	370	11	<0.50	<0.50	<1.5	88
09/11/02 ³	35.40	6.40	29.00	0.00	0.00	490	16	0.50	<0.50	<1.5	120
C-7											
08/27/90	32.17	-12.06	44.23	--	--	110	26	0.8	4.0	6.0	--
11/14/90	32.17	-11.94	44.11	--	--	--	--	--	--	--	--
06/18/91	32.17	-9.88	42.05	--	--	23,000	5,700	420	1,000	2,800	--
09/19/91	32.17	-9.55	41.72	--	--	26,000	4,600	330	970	2,400	--
12/20/91	32.17	-9.50	41.67	--	--	33,000	5,500	270	1,000	2,100	--
03/18/92	32.17	-9.03	41.20	--	--	27,000	5,800	410	1,300	3,300	--
07/14/92	32.17	-7.60	39.77	--	--	46,000	12,000	720	1,700	4,600	--
10/08/92	32.17	-6.97	39.14	--	--	22,000	6,800	370	1,300	3,200	--
01/08/93	32.17	-6.33	38.50	--	--	36,000	7,600	540	1,700	4,200	--
04/14/93	32.17	-3.76	35.93	--	--	23,000	3,100	450	670	1,900	--
07/16/93	32.17	-3.21	35.38	--	--	19,000	3,200	330	550	1,800	--
09/21/93	35.19	-0.27	35.46	--	--	17,000	2,700	160	410	760	--
01/28/94	35.19	-0.26	35.45	--	--	14,000	1,800	210	390	1,000	--
03/17/94	35.19	1.95	33.24	--	--	17,000	-1,600	210	410	1,200	--
06/16/94	35.19	2.12	33.07	--	--	12,000	1,600	180	410	1,200	--

Table 1
Groundwater Monitoring Data and Analytical Results
Chevron Service Station #9-0076
4265 Foothill Boulevard
Oakland, California

WELL ID/ DATE	TOC (ft.)	GWE (msl)	DTW (ft.)	SPHT (ft.)	SPH		TPH-G (ppb)	B (ppb)	T (ppb)	E (ppb)	X (ppb)	MTBE (ppb)
					REMOVED (gallons)							
C-7 (cont)												
09/22/94	35.19	2.45	32.74	--	--		10,000	1,700	110	320	580	--
12/15/94	35.19	3.27	31.92	--	--		10,000	1,200	120	280	710	--
03/30/95	35.19	7.59	27.60	--	--		4,600	460	73	160	460	--
06/20/95	35.19	7.32	27.87	--	--		26,000	4,400	450	900	2,400	--
09/20/95	35.19	7.11	28.08	--	--		9,400	610	81	250	800	--
12/06/95	35.19	4.57	30.62	--	--		1,200	110	12	25	71	34
03/21/96	35.19	7.34	27.85	--	--		17,000	1,300	160	410	1,300	<100
09/06/96	35.19	6.84	28.35	--	--		15,000	3,400	<50	460	850	<250
12/19/96	35.19	6.08	29.11	--	--		530	9	0.5	0.85	3.4	<2.5
03/17/97	35.19	8.05	27.14	--	--		4,600	310	46	110	310	98
06/11/97	35.19	7.14	28.05	--	--		420	15	<0.5	3.3	5.1	<2.5
09/17/97	35.19	6.19	29.00	--	--		1,400	120	11	31	84	54
12/11/97	35.19	5.93	29.26	--	--		210	10	<0.5	0.97	1.6	<2.5
03/12/98	35.19	10.27	24.92	--	--		68	<0.5	<0.5	<0.5	<0.5	<2.5
06/23/98	35.19	9.89	25.30	--	--		<50	<0.5	<0.5	<0.5	<0.5	<2.5
09/01/98	35.19	8.92	26.27	--	--		570	24	1.4	8.4	22	24
12/30/98	35.19	8.67	26.52	--	--		<50	4.85	1.26	<0.5	1.29	167
03/31/99	35.19	10.43	24.76	--	--		53.1	<0.5	<0.5	<0.5	<0.5	<2.0
06/14/99	35.19	9.75	25.44	--	--		109	4.43	<0.5	<0.5	<0.5	<2.5
06/14/99 ¹	35.19	9.75	25.44	--	--		--	--	--	--	--	<2.0 ²
09/30/99	35.19	8.32	26.87	--	--		2,400	282	26.3	120	236	126
12/22/99	35.19	7.42	27.77	--	--		3,840	162	18.1	44.7	85.3	141
03/09/00	35.19	9.62	25.57	--	--		13,000	2,700	110	700	1,500	<130
06/23/00	35.19	9.53	25.66	0.00	0.00		190 ⁴	3.4	<0.50	<0.50	1.6	7.3
09/05/00	35.19	8.44	26.75	0.00	0.00		4,200 ⁴	330	26	120	200	190
12/04/00	35.19	8.03	27.16	0.00	0.00		2,600 ⁴	550	<5.0	73	62	<25
03/08/01	35.19	9.76	25.43	0.00	0.00		1,180	39.2	2.41	15.5	30.8	10.3
06/07/01	35.19	9.80	25.39	0.00	0.00		2,600 ⁴	440	14	110	130	56
09/13/01	35.19	8.58	26.61	0.00	0.00		23,000 ⁶	670	<100	150	210	<500

Table 1
Groundwater Monitoring Data and Analytical Results
Chevron Service Station #9-0076
4265 Foothill Boulevard
Oakland, California

WELL ID/ DATE	TOC (ft.)	GWE (msl)	DTW (ft.)	SPHT (ft.)	SPH REMOVED (gallons)	TPH-G (ppb)	B (ppb)	T (ppb)	E (ppb)	X (ppb)	MTBE (ppb)
C-7 (cont)											
12/13/01	35.19	8.50	26.69	0.00	0.00	2,400	160	5.8	42	54	<10
03/08/02	35.19	10.39	24.80	0.00	0.00	3,900	380	21	110	160	<20
06/19/02	35.19	7.78	27.41	0.00	0.00	3,600	440	8.5	87	73	<10
09/11/02	35.19	9.41	25.78	0.00	0.00	11,000	1,800	18	360	380	<10
C-8											
11/14/90	30.68	-12.61	43.29	--	--	<50	<0.3	<0.3	<0.3	<0.6	--
06/18/91	30.68	-11.94	42.62	--	--	<50	<0.5	<0.5	<0.5	<0.5	--
09/19/91	30.68	-11.04	41.72	--	--	<50	<0.5	<0.5	<0.5	<0.5	--
12/20/91	30.68	-10.30	40.98	--	--	<50	<0.5	<0.5	<0.5	<0.5	--
03/18/92	30.68	-9.34	40.02	--	--	<50	<0.5	<0.5	<0.5	<0.5	--
07/14/92	30.68	-8.34	39.02	--	--	<50	<0.5	<0.5	<0.5	<0.5	--
10/08/92	30.68	-8.00	38.68	--	--	<50	<0.5	<0.5	<0.5	1.1	--
01/08/93	30.68	-7.39	38.07	--	--	<50	<0.5	<0.5	<0.5	<0.5	--
04/14/93	30.68	-5.31	35.99	--	--	<50	<0.5	<0.5	<0.5	<0.5	--
07/16/93	30.68	-4.64	35.32	--	--	<50	<0.5	<0.5	<0.5	<0.5	--
09/21/93	34.68	-0.62	35.30	--	--	<50	<0.5	<0.5	<0.5	<0.8	--
01/28/94	34.68	-0.93	35.61	--	--	<50	<0.5	<0.5	<0.5	<0.5	--
03/17/94	34.68	0.31	34.37	--	--	<50	<0.5	<0.5	<0.5	<0.5	--
06/16/94	34.68	1.32	33.36	--	--	<50	<0.5	<0.5	<0.5	<0.5	--
09/22/94	34.68	1.86	32.82	--	--	<50	<0.5	<0.5	<0.5	<0.5	--
12/15/94	34.68	2.32	32.36	--	--	<50	<0.5	<0.5	<0.5	<0.5	--
03/30/95	34.68	5.44	29.24	--	--	<50	<0.5	<0.5	<0.5	<0.5	--
06/20/95	34.68	6.34	28.34	--	--	<50	<0.5	<0.5	<0.5	<0.5	--
09/20/95	34.68	5.20	29.48	--	--	<50	<0.5	<0.5	<0.5	<0.5	--
12/06/95	34.68	3.76	30.92	--	--	<50	<0.5	<0.5	<0.5	<0.5	<2.5
03/21/96	34.68	6.03	28.65	--	--	<50	<0.5	<0.5	<0.5	<0.5	<2.5
06/21/96	34.68	6.78	27.90	--	--	<50	<0.5	<0.5	<0.5	<0.5	<2.5
09/06/96	34.68	5.98	28.70	--	--	<50	<0.5	<0.5	<0.5	<0.5	<2.5
12/19/96	34.68	4.98	29.70	--	--	<50	<0.5	<0.5	<0.5	<0.5	<2.5

Table 1
Groundwater Monitoring Data and Analytical Results
Chevron Service Station #9-0076
4265 Foothill Boulevard
Oakland, California

WELL ID/ DATE	TOC (ft.)	GWE (msl)	DTW (ft.)	SPHT (ft.)	SPH		B (ppb)	T (ppb)	E (ppb)	X (ppb)	MTBE (ppb)
					REMOVED (gallons)	TPH-G (ppb)					
C-8 (cont)											
03/17/97	34.68	6.92	27.76	--	--	<50	<0.5	<0.5	<0.5	<0.5	<2.5
06/11/97	34.68	5.87	28.81	--	--	<50	<0.5	<0.5	<0.5	<0.5	<2.5
09/17/97	34.68	5.32	29.36	--	--	SAMPLED ANNUALLY		--	--	--	--
12/11/97	34.68	4.88	29.80	--	--	--	--	--	--	--	--
03/12/98	34.68	8.95	25.73	--	--	<50	<0.5	<0.5	<0.5	<0.5	2.6
06/23/98	34.68	8.38	26.30	--	--	--	--	--	--	--	--
09/01/98	34.68	8.17	26.51	--	--	--	--	--	--	--	--
12/30/98	34.68	7.79	26.89	--	--	--	--	--	--	--	--
03/31/99	34.68	8.32	26.36	--	--	<50	<0.5	<0.5	<0.5	<0.5	11.8
06/14/99	34.68	8.65	26.03	--	--	--	--	--	--	--	--
09/30/99	34.68	7.40	27.28	--	--	--	--	--	--	--	--
12/22/99	34.68	6.48	28.20	--	--	--	--	--	--	--	--
03/09/00	34.68	8.35	26.33	--	--	<50	<0.5	<0.5	<0.5	1.8	<2.5
06/23/00	34.68	8.49	26.19	0.00	0.00	SAMPLED ANNUALLY		--	--	--	--
09/05/00	34.68	7.71	26.97	0.00	0.00	--	--	--	--	--	--
12/04/00	34.68	7.26	27.42	0.00	0.00	--	--	--	--	--	--
03/08/01	34.68	8.58	26.10	0.00	0.00	<50.0	<0.500	<0.500	<0.500	<0.500	<2.50
06/07/01	34.68	8.89	25.79	0.00	0.00	SAMPLED ANNUALLY		--	--	--	--
09/13/01	34.68	7.87	26.81	0.00	0.00	SAMPLED ANNUALLY		--	--	--	--
12/13/01	34.68	7.52	27.16	0.00	0.00	SAMPLED ANNUALLY		--	--	--	--
03/08/02	34.68	9.38	25.30	0.00	0.00	<50	<0.50	<0.50	<0.50	<1.5	<2.5
06/19/02	34.68	9.75	24.93	0.00	0.00	SAMPLED ANNUALLY		--	--	--	--
09/11/02	34.68	8.76	25.92	0.00	0.00	SAMPLED ANNUALLY		--	--	--	--
C-9											
08/13/96	--	--	28.27	--	--	ND	ND	ND	ND	ND	ND
09/06/96	--	--	28.47	--	--	<50	<0.5	<0.5	<0.5	<0.5	<2.5
12/19/96	30.68	1.39	29.29	--	--	<50	<0.5	<0.5	<0.5	<0.5	<2.5
03/17/97	30.68	3.11	27.57	--	--	<50	<0.5	<0.5	<0.5	<0.5	<2.5
06/11/97	30.68	2.41	28.27	--	--	<50	<0.5	<0.5	<0.5	<0.5	<2.5

Table 1
Groundwater Monitoring Data and Analytical Results
Chevron Service Station #9-0076
4265 Foothill Boulevard
Oakland, California

WELL ID/ DATE	TOC (ft.)	GWE (msl)	DTW (ft.)	SPHT (ft.)	SPH		TPH-G (ppb)	B (ppb)	T (ppb)	E (ppb)	X (ppb)	MTBE (ppb)
					REMOVED (gallons)							
C-9 (cont)												
09/17/97	30.68	2.05	28.63	--	--		SAMPLED ANNUALLY	--	--	--	--	--
12/11/97	30.68	1.25	29.43	--	--		--	--	--	--	--	--
03/12/98	30.68	5.06	25.62	--	--		<50	<0.5	<0.5	<0.5	<0.5	<2.5
06/23/98	30.68	4.53	26.15	--	--		--	--	--	--	--	--
09/01/98	30.68	4.30	26.38	--	--		--	--	--	--	--	--
12/30/98	30.68	3.93	26.75	--	--		--	--	--	--	--	--
03/31/99	30.68	5.35	25.33	--	--		<50	<0.5	<0.5	<0.5	<0.5	12.5
06/14/99	30.68	4.16	26.52	--	--		--	--	--	--	--	--
09/30/99	30.68	3.89	26.79	--	--		--	--	--	--	--	--
12/22/99	30.68	2.99	27.69	--	--		--	--	--	--	--	--
03/09/00	30.68	4.64	26.04	--	--		<50	<0.5	<0.5	<0.5	0.75	<2.5
06/23/00	30.68	4.83	25.85	0.00	0.00		--	--	--	--	--	--
09/05/00	30.68	3.99	26.69	0.00	0.00		--	--	--	--	--	--
12/04/00	30.68	3.61	27.07	0.00	0.00		--	--	--	--	--	--
03/08/01	30.68	4.93	25.75	0.00	0.00		<50.0	<0.500	<0.500	<0.500	<0.500	<2.50
06/07/01	30.68	5.18	25.50	0.00	0.00		SAMPLED ANNUALLY	--	--	--	--	--
09/13/01	30.68	4.13	26.55	0.00	0.00		SAMPLED ANNUALLY	--	--	--	--	--
12/13/01	30.68	3.91	26.77	0.00	0.00		SAMPLED ANNUALLY	--	--	--	--	--
03/08/02	30.68	5.68	25.00	0.00	0.00		<50	<0.50	<0.50	<0.50	<1.5	<2.5
06/19/02	30.68	6.01	24.67	0.00	0.00		SAMPLED ANNUALLY	--	--	--	--	--
09/11/02	30.68	4.98	25.70	0.00	0.00		SAMPLED ANNUALLY	--	--	--	--	--
TRIP BLANK												
04/28/89	--	--	--	--	--		<500	<0.5	<0.5	<0.5	<0.5	--
08/08/89	--	--	--	--	--		<500	<0.5	<0.5	<0.5	<0.5	--
08/27/90	--	--	--	--	--		<50	<0.3	<0.3	<0.3	<0.6	--
11/14/90	--	--	--	--	--		<50	<0.3	<0.3	<0.3	<0.6	--
06/18/91	--	--	--	--	--		<50	<0.5	<0.5	<0.5	<0.5	--
09/19/91	--	--	--	--	--		<50	<0.5	<0.5	<0.5	<0.5	--
12/20/91	--	--	--	--	--		<50	<0.5	<0.5	<0.5	<0.5	--

Table 1
Groundwater Monitoring Data and Analytical Results
Chevron Service Station #9-0076
4265 Foothill Boulevard
Oakland, California

WELL ID/ DATE	TOC (ft.)	GWE (msl)	DTW (ft.)	SPHT (ft.)	SPH REMOVED (gallons)	TPH-G (ppb)	B (ppb)	T (ppb)	E (ppb)	X (ppb)	MTBE (ppb)
TRIP BLANK (cont)											
03/18/92	--	--	--	--	--	<50	<0.5	<0.5	<0.5	<0.5	--
07/14/92	--	--	--	--	--	<50	<0.5	<0.5	<0.5	<0.5	--
10/08/92	--	--	--	--	--	<50	<0.5	<0.5	<0.5	<0.5	--
01/08/93	--	--	--	--	--	<50	<0.5	<0.5	<0.5	<0.5	--
04/14/93	--	--	--	--	--	<50	<0.5	<0.5	<0.5	<0.5	--
07/16/93	--	--	--	--	--	<50	<0.5	<0.5	<0.5	<0.5	--
09/21/93	--	--	--	--	--	<50	<0.5	<0.5	<0.5	<0.8	--
01/28/94	--	--	--	--	--	<50	<0.5	<0.5	<0.5	<0.5	--
03/17/94	--	--	--	--	--	<50	<0.5	<0.5	<0.5	<0.5	--
06/16/94	--	--	--	--	--	<50	<0.5	<0.5	<0.5	<0.5	--
09/22/94	--	--	--	--	--	<50	<0.5	<0.5	<0.5	<0.5	--
12/15/94	--	--	--	--	--	<50	<0.5	<0.5	<0.5	<0.5	--
03/30/95	--	--	--	--	--	<50	<0.5	<0.5	<0.5	<0.5	--
06/20/95	--	--	--	--	--	<50	<0.5	<0.5	<0.5	<0.5	--
09/20/95	--	--	--	--	--	<50	<0.5	<0.5	<0.5	<0.5	--
12/06/95	--	--	--	--	--	<50	<0.5	<0.5	<0.5	<0.5	--
03/21/96	--	--	--	--	--	<50	<0.5	<0.5	<0.5	<0.5	<2.5
06/21/96	--	--	--	--	--	<50	<0.5	<0.5	<0.5	<0.5	<2.5
09/06/96	--	--	--	--	--	<50	<0.5	<0.5	<0.5	<0.5	--
12/19/96	--	--	--	--	--	<50	<0.5	<0.5	<0.5	<0.5	<2.5
03/17/97	--	--	--	--	--	<50	<0.5	<0.5	<0.5	<0.5	<2.5
06/11/97	--	--	--	--	--	<50	<0.5	<0.5	<0.5	<0.5	<2.5
09/17/97	--	--	--	--	--	<50	<0.5	<0.5	<0.5	<0.5	<2.5
12/11/97	--	--	--	--	--	<50	<0.5	<0.5	<0.5	<0.5	<2.5
03/12/98	--	--	--	--	--	<50	<0.5	<0.5	<0.5	<0.5	<2.5
06/23/98	--	--	--	--	--	<50	<0.5	<0.5	<0.5	<0.5	<2.5
09/01/98	--	--	--	--	--	<50	<0.5	<0.5	<0.5	<0.5	<2.5
12/30/98	--	--	--	--	--	<50	<0.5	<0.5	<0.5	<0.5	<2.0
03/31/99	--	--	--	--	--	<50	<0.5	<0.5	<0.5	<0.5	<2.0
06/14/99	--	--	--	--	--	<50	<0.5	<0.5	<0.5	<0.5	<2.5
12/22/99	--	--	--	--	--	<50	<0.5	<0.5	<0.5	<0.5	<2.5

Table 1
Groundwater Monitoring Data and Analytical Results
Chevron Service Station #9-0076
4265 Foothill Boulevard
Oakland, California

WELL ID/ DATE	TOC (ft.)	GWE (msl)	DTW (ft.)	SPHT (ft.)	SPH REMOVED (gallons)	TPH-G (ppb)	B (ppb)	T (ppb)	E (ppb)	X (ppb)	MTBE (ppb)
TRIP BLANK (cont)											
06/23/00	--	--	--	--	--	<50	<0.50	<0.50	<0.50	<0.50	<2.5
09/05/00	--	--	--	--	--	<50	<0.50	<0.50	<0.50	<0.50	<2.5
12/04/00	--	--	--	--	--	<50	<0.50	<0.50	<0.50	<0.50	<2.5
03/08/01	--	--	--	--	--	<50.0	<0.500	<0.500	<0.500	<0.500	<2.50
06/07/01	--	--	--	--	--	<50	<0.50	<0.50	<0.50	<0.50	<2.5
09/13/01	--	--	--	--	--	<50	<0.50	<0.50	<0.50	<0.50	<2.5
QA											
12/13/01	--	--	--	--	--	<50	<0.50	<0.50	<0.50	<1.5	<2.5
03/08/02	--	--	--	--	--	<50	<0.50	<0.50	<0.50	<1.5	<2.5
06/19/02	--	--	--	--	--	<50	<0.50	<0.50	<0.50	<1.5	<2.5
09/11/02	--	--	--	--	--	<50	<0.50	<0.50	<0.50	<1.5	<2.5

Table 1
Groundwater Monitoring Data and Analytical Results
Chevron Service Station #9-0076
4265 Foothill Boulevard
Oakland, California

EXPLANATIONS:

Groundwater monitoring data and laboratory analytical results prior to June 23, 2000, were compiled from reports prepared by Blaine Tech Services, Inc.

TOC = Top of Casing
(ft.) = Feet

GWE = Groundwater Elevation
(msl) = Mean sea level

DTW = Depth to Water

SPHT = Separate Phase Hydrocarbons Thickness

SPH = Separate Phase Hydrocarbons

TPH-G = Total Petroleum Hydrocarbons as Gasoline

B = Benzene

T = Toluene

E = Ethylbenzene

X = Xylenes

MTBE = Methyl tertiary butyl ether

(ppb) = Parts per billion

ND = Not Detected

-- = Not Measured/Not Analyzed

QA = Quality Assurance

- 1 Confirmation run.
- 2 Sample were analyzed past hold-time, the results should be considered as estimated.
- 3 ORC present in well.
- 4 Laboratory report indicates gasoline C6-C12.
- 5 Laboratory report indicates sample was originally analyzed within holding time. Re-analysis for confirmation or dilution was performed past the recommended holding time.
- 6 Laboratory report indicates hydrocarbon pattern is present in the requested fuel quantitation range but does not resemble the pattern of the requested fuel.

Table 2
Field Measurements and Groundwater Analytical Results
Chevron Service Station #9-0076
4265 Foothill Boulevard
Oakland, California

WELL ID/ DATE	DO Pre-Purge (mg/L)	DO Post-Purge (mg/L)	ORP Pre-Purge (mV)	ORP Post-Purge (mV)	Total Alkalinity (mg/L)	Ferrous Iron (ppm)	Nitrate as Nitrate (ppm)	Sulfate (ppm)
C-1								
09/17/97	1.4	8.8	101	104	2.0	1.1	<1.0	12
03/12/98	1.7	3.6	171	171	550	3.0	<1.0	6.6
03/31/99	6.5	1.8	99	89	382	2520 ¹	0.418	8.23
12/22/99	0.95	2.0	-95	-128	568	0.19	<0.1	11
03/09/00	1.8	2.4	-47	-38	520	0.84	0.54	15
09/05/00	1.74	2.66	105	59	520	0.41	1.6	10
C-2								
09/17/97	1.3	--	150	--	560	4.7	<1.0	<1.0
03/12/98	1.1	1.1	176	174	420	3.5	<1.0	<1.0
03/31/99	1.5	1.6	151	157	456	2100 ¹	0.118	19.7
12/22/99	0.6	0.65	-90	-84	782	1.0	5.34	5.38
03/09/00	1.0	1.6	-68	-70	450	0.31	<0.1	0.39
09/05/00	1.31	1.85	65	44	690	0.34	<1.0	<1.0
C-3								
09/17/97	2.1	0.8	59	67	340	0.012	100	33
03/12/98	2.8	2.5	165	163	260	0.14	88	32
03/31/99	4.1	3.3	101	89	256	<500 ¹	18.4	72
12/22/99	0.98	1.48	69	107	402	0.013	67.7	37.6
03/09/00	3.3	1.6	110	97	390	0.12	60	38
09/05/00	3.79	2.53	202	203	430	0.011	52	40
C-4								
09/17/97	0.6	0.2	102	107	540	5.9	<1.0	<1.0
03/12/98	1.5	2.6	173	175	550	1.3	<1.0	2.7
03/31/99	1.8	2.2	170	176	492	1,560 ¹	0.191	<1.0

Table 2
Field Measurements and Groundwater Analytical Results
Chevron Service Station #9-0076
4265 Foothill Boulevard
Oakland, California

WELL ID/ DATE	DO Pre-Purge (mg/L)	DO Post-Purge (mg/L)	ORP Pre-Purge (mV)	ORP Post-Purge (mV)	Total Alkalinity (mg/L)	Ferrous Iron (ppm)	Nitrate as Nitrate (ppm)	Sulfate (ppm)
C-4 (cont)								
12/22/99	6.8	5.68	-25	14	739	0.87	1.85	39.6
03/09/00	1.1	1.9	-13	-39	530	<0.01	<0.1	4.5
09/05/00	2.22	2.02	105	138	530	<0.010	<1.0	29
C-5								
03/12/98	1.7	1.9	70	169	210	0.074	69	74
03/31/99	12.8	6.7	92	97	254	<500 [†]	16.7	69.7
03/09/00	2.8	3.6	120	118	230	0.39	60	74
C-6								
09/17/97	1.5	1.2	-57	-48	620	1.1	<1.0	18
03/12/98	14.1	11.3	173	174	200	0.11	14	14
03/31/99	9.8	8.4	162	168	534	<500 [†]	0.849	45.3
12/22/99	1.02	1.22	-65	-60	614	0.36	0.421	32
03/09/00	5.4	1.6	-113	-35	540	0.26	0.14	24
09/05/00	1.90	2.73	45	31	550	0.18	<1.0	38
C-7								
09/17/97	0.6	0.4	126	115	600	4.8	<1.0	18
03/12/98	2.2	2.1	167	167	460	0.16	<1.0	29
03/31/99	2.0	1.8	137	135	486	<500 [†]	<0.1	-29.4
12/22/99	1.8	1.5	20	-60	400	1.6	0.434	16.9
03/09/00	0.7	2.5	10	-13	610	2.1	<0.1	5.5
09/05/00	1.77	1.46	133	46	590	1.8	<1.0	12

Table 2
Field Measurements and Groundwater Analytical Results
 Chevron Service Station #9-0076
 4265 Foothill Boulevard
 Oakland, California

WELL ID/ DATE	DO Pre-Purge (mg/L)	DO Post-Purge (mg/L)	ORP Pre-Purge (mV)	ORP Post-Purge (mV)	Total Alkalinity (mg/L)	Ferrous Iron (ppm)	Nitrate as Nitrate (ppm)	Sulfate (ppm)
C-8								
03/12/98	1.0	1.1	171	169	110	0.16	7.4	8.2
03/31/99	1.8	1.5	149	132	264	<500 ¹	17	71
03/09/00	2.7	3.3	141	160	270	0.24	29	35
C-9								
03/12/98	2.5	2.5	172	168	230	0.048	59	58
03/31/99	2.1	2.3	154	142	236	<500 ¹	18	72.7
03/09/00	2.5	3.7	108	138	190	0.79	100	73

EXPLANATIONS:

Groundwater laboratory analytical results prior to September 5, 2000, were compiled from reports prepared by Blaine Tech Services, Inc.

DO = Dissolved Oxygen

(mg/L) = Milligrams per liter

ORP = Oxidation Reduction Potential

(mV) = Millivolts

(ppm) = Parts per million

-- = Not Measured

¹ Analyzed in part per billion (ppb).

STANDARD OPERATING PROCEDURE - GROUNDWATER SAMPLING

Gettler-Ryan Inc. field personnel adhere to the following procedures for the collection and handling of groundwater samples prior to analysis by the analytical laboratory. Prior to sample collection, the type of analysis to be performed is determined. Loss prevention of volatile compounds is controlled and sample preservation for subsequent analysis is maintained.

Prior to sampling, the presence or absence of free-phase hydrocarbons is determined using an interface probe. Product thickness, if present, is measured to the nearest 0.01 foot and is noted in the field notes. In addition, static water level measurements are collected with the interface probe and are also recorded in the field notes.

After water levels are collected and prior to sampling, each well is purged a minimum of three well casing volumes of water using pre-cleaned pumps (stack, suction, Grundfos), or polyvinyl chloride bailers. Temperature, pH and electrical conductivity are measured a minimum of three times during the purging. Purging continues until these parameters stabilize.

Groundwater samples are collected using Chevron-designated disposable bailers. The water samples are transferred from the bailer into appropriate containers. Pre-preserved containers, supplied by analytical laboratories, are used when possible. When pre-preserved containers are not available, the laboratory is instructed to preserve the sample as appropriate. Duplicate samples are collected for the laboratory to use in maintaining quality assurance/quality control standards. The samples are labeled to include the job number, sample identification, collection date and time, analysis, preservation (if any), and the sample collector's initials. The water samples are placed in a cooler, maintained at 4°C for transport to the laboratory. Once collected in the field, all samples are maintained under chain of custody until delivered to the laboratory.

The chain of custody document includes the job number, type of preservation, if any, analysis requested, sample identification, date and time collected, and the sample collector's name. The chain of custody is signed and dated (including time of transfer) by each person who receives or surrenders the samples, beginning with the field personnel and ending with the laboratory personnel.

A laboratory supplied trip blank accompanies each sampling set. For sampling sets greater than 20 samples, 5% trip blanks are included. The trip blank is analyzed for some or all of the same compounds as the groundwater samples.

As requested by Chevron Products Company, the purge water and decontamination water generated during sampling activities is transported by IWM to McKittrick Waste Management located in McKittrick, California.



GETTLER-RYAN INC.

WELL MONITORING/SAMPLING FIELD DATA SHEET

Client/Facility #: ChevronTexaco #9-0076 Job Number: 386495
 Site Address: 4265 Foothill Blvd. Event Date: 9.11.02
 City: Oakland, CA Sampler: ET

Well ID: C-1 Well Condition: OK
 Well Diameter: 2 1/3 in. Hydrocarbon Amount Bailed
 Total Depth: 38.05 ft. Thickness: 0 ft. (product/water): 0 gal.
 Depth to Water: 17.23 ft.

Volume	3/4"= 0.02	1"= 0.04	2"= 0.17	3"= 0.38
Factor (VF)	4"= 0.66	5"= 1.02	6"= 1.50	12"= 5.80

20.82 xVF .38 = 7.91 x3 (case volume) = Estimated Purge Volume: 23.73 gal.

Purge Equipment: Disposable Bailer _____
 Stainless Steel Bailer _____
 Stack Pump
 Suction Pump
 Grundfos _____
 Other: _____

Sampling Equipment: Disposable Bailer
 Pressure Bailer _____
 Discrete Bailer _____
 Other: _____

Start Time (purge): 11:12 Weather Conditions: SUNNY
 Sample Time/Date: 11:36 / 9.11.02 Water Color: CLEAR Odor: Yes
 Purging Flow Rate: 2.5 gpm. Sediment Description: _____
 Did well de-water? NO If yes, Time: _____ Volume: _____ gal.

Time (2400 hr.)	Volume (gal.)	pH	Conductivity (u mhos/cm)	Temperature (°F)	D.O. (mg/L)	ORP (mV)
<u>11:15</u>	<u>8.0</u>	<u>7.09</u>	<u>116</u>	<u>23.0</u>	_____	_____
<u>11:18</u>	<u>16.0</u>	<u>7.12</u>	<u>114</u>	<u>22.6</u>	_____	_____
<u>11:26</u>	<u>24.0</u>	<u>7.15</u>	<u>109</u>	<u>22.4</u>	_____	_____
_____	_____	_____	_____	_____	_____	_____

LABORATORY INFORMATION

SAMPLE ID	(#) CONTAINER	REFRIG.	PRESERV. TYPE	LABORATORY	ANALYSES
<u>C-1</u>	<u>3</u> x voa vial	<u>YES</u>	<u>HCL</u>	<u>LANCASTER</u>	<u>TPH-G(8015)/BTEX+MTBE(8021)</u>
_____	_____	_____	_____	_____	_____
_____	_____	_____	_____	_____	_____

COMMENTS: SLOW RECOVERY LAST CASE
VOLUME.
ORC IN WELL

Add/Replaced Lock: _____ Add/Replaced Plug: _____ Size: _____



GETTLER-RYAN INC.

WELL MONITORING/SAMPLING FIELD DATA SHEET

Client/Facility #: ChevronTexaco #9-0076 Job Number: 386495
 Site Address: 4265 Foothill Blvd. Event Date: 9.11.02
 City: Oakland, CA Sampler: FT

Well ID: C-2
 Well Diameter: 2 1/8 in.
 Total Depth: 35.95 ft.
 Depth to Water: 20.68 ft.

Well Condition: OK
 Hydrocarbon Thickness: 0 ft. Amount Bailed (product/water): 0 gal.

Volume Factor (VF)	3/4"= 0.02	1"= 0.04	2"= 0.17	3"= 0.38
	4"= 0.66	5"= 1.02	6"= 1.50	12"= 5.80

15.27 xVF .38 = 5.80 x3 (case volume) = Estimated Purge Volume: 17.40 gal.

Purge Equipment: Disposable Bailer _____
 Stainless Steel Bailer _____
 Stack Pump ✓
 Suction Pump ✓
 Grundfos _____
 Other: _____

Sampling Equipment: Disposable Bailer ✓
 Pressure Bailer _____
 Discrete Bailer _____
 Other: _____

Start Time (purge): 1:36 Weather Conditions: SUNNY
 Sample Time/Date: 2:00 19.11.02 Water Color: CLEAR Odor: YES
 Purging Flow Rate: 2.0 gpm. Sediment Description: _____
 Did well de-water? NO If yes, Time: _____ Volume: _____ gal.

Time (2400 hr.)	Volume (gal.)	pH	Conductivity (u mhos/cm)	Temperature (°F)	D.O. (mg/L)	ORP (mV)
<u>1:39</u>	<u>5.5</u>	<u>7.02</u>	<u>136</u>	<u>24.2</u>		
<u>1:42</u>	<u>11.0</u>	<u>7.04</u>	<u>129</u>	<u>23.9</u>		
<u>1:46</u>	<u>17.0</u>	<u>7.07</u>	<u>121</u>	<u>23.8</u>		

LABORATORY INFORMATION

SAMPLE ID	(#) CONTAINER	REFRIG.	PRESERV. TYPE	LABORATORY	ANALYSES
<u>C-2</u>	<u>3</u> x voa vial	<u>YES</u>	<u>HCL</u>	<u>LANCASTER</u>	<u>TPH-G(8015)/BTEX+MTBE(8021)</u>

COMMENTS: EXTRACTION WELL
OK IN WELL

Add/Replaced Lock: _____

Add/Replaced Plug: _____ Size: _____



GETTLER-RYAN INC.

WELL MONITORING/SAMPLING FIELD DATA SHEET

Client/Facility #: ChevronTexaco #9-0076 Job Number: 386495
 Site Address: 4265 Foothill Blvd. Event Date: 9.11.02
 City: Oakland, CA Sampler: FT

Well ID: C-3 Well Condition: OK
 Well Diameter: 2 1/8 in. Hydrocarbon Amount Bailed
 Total Depth: 39.22 ft. Thickness: 0 ft. (product/water): 0 gal.
 Depth to Water: 20.17 ft.

Volume	3/4"= 0.02	1"= 0.04	2"= 0.17	3"= 0.38
Factor (VF)	4"= 0.66	5"= 1.02	6"= 1.50	12"= 5.80

19.05 xVF .38 = 7.23 x3 (case volume) = Estimated Purge Volume: 21.71 gal.

Purge Equipment: Disposable Bailer _____
 Stainless Steel Bailer _____
 Stack Pump
 Suction Pump
 Grundfos _____
 Other: _____

Sampling Equipment: Disposable Bailer'
 Pressure Bailer _____
 Discrete Bailer _____
 Other: _____

Start Time (purge): 10:43 Weather Conditions: SUNNY
 Sample Time/Date: 11:02 / 9.11.02 Water Color: CLEAR Odor: NO
 Purging Flow Rate: 2.5 gpm. Sediment Description: _____
 Did well de-water? NO If yes, Time: _____ Volume: _____ gal.

Time (2400 hr.)	Volume (gal.)	pH	Conductivity (umhos/cm)	Temperature (°F)	D.O. (mg/L)	ORP (mV)
<u>10:46</u>	<u>7.5</u>	<u>7.07</u>	<u>135</u>	<u>22.5</u>	_____	_____
<u>10:49</u>	<u>15.0</u>	<u>7.08</u>	<u>117</u>	<u>22.3</u>	_____	_____
<u>10:52</u>	<u>22.0</u>	<u>7.10</u>	<u>110</u>	<u>22.1</u>	_____	_____
_____	_____	_____	_____	_____	_____	_____

LABORATORY INFORMATION

SAMPLE ID	(#) CONTAINER	REFRIG.	PRESERV. TYPE	LABORATORY	ANALYSES
<u>C-3</u>	<u>3</u> x voa vial	<u>YES</u>	<u>HCL</u>	<u>LANCASTER</u>	<u>TPH-G(8015)/BTEX+MTBE(8021)</u>
_____	_____	_____	_____	_____	_____
_____	_____	_____	_____	_____	_____

COMMENTS: _____

Add/Replaced Lock: Add/Replaced Plug: Size: 3"



GETTLER-RYAN INC.

WELL MONITORING/SAMPLING FIELD DATA SHEET

Client/Facility #: ChevronTexaco #9-0076 Job Number: 386495
 Site Address: 4265 Foothill Blvd. Event Date: 9.11.02
 City: Oakland, CA Sampler: FT

Well ID: C-4
 Well Diameter: 2 1/8 in.
 Total Depth: 39.30 ft.
 Depth to Water: 20.30 ft.

Well Condition: ok
 Hydrocarbon Thickness: 0 ft. Amount Bailed (product/water): 0 gal.

Volume Factor (VF)	3/4"= 0.02	1"= 0.04	2"= 0.17	3"= 0.38
	4"= 0.66	5"= 1.02	6"= 1.50	12"= 5.80

19.00 xVF .38 = 7.22 x3 (case volume) = Estimated Purge Volume: 21.66 gal.

Purge Equipment: Disposable Bailer _____
 Stainless Steel Bailer _____
 Stack Pump
 Suction Pump
 Grundfos _____
 Other: _____

Sampling Equipment: Disposable Bailer
 Pressure Bailer _____
 Discrete Bailer _____
 Other: _____

Start Time (purge): 11:45 Weather Conditions: SUNNY
 Sample Time/Date: 12:03 / 9.11.02 Water Color: CLEAR Odor: YES
 Purging Flow Rate: 2.5 gpm. Sediment Description: _____
 Did well de-water? NO If yes, Time: _____ Volume: _____ gal.

Time (2400 hr.)	Volume (gal.)	pH	Conductivity (umhos/cm)	Temperature (°F)	D.O. (mg/L)	ORP (mV)
<u>11:48</u>	<u>7.5</u>	<u>7.08</u>	<u>121</u>	<u>22.7</u>	_____	_____
<u>11:51</u>	<u>15.0</u>	<u>7.09</u>	<u>105</u>	<u>22.6</u>	_____	_____
<u>11:54</u>	<u>22.0</u>	<u>7.11</u>	<u>98</u>	<u>22.4</u>	_____	_____
_____	_____	_____	_____	_____	_____	_____

LABORATORY INFORMATION

SAMPLE ID	(#) CONTAINER	REFRIG.	PRESERV. TYPE	LABORATORY	ANALYSES
<u>C-4</u>	<u>3</u> x vva vial	<u>YES</u>	<u>HCL</u>	<u>LANCASTER</u>	<u>TPH-G(8015)/BTEX+MTBE(8021)</u>
_____	_____	_____	_____	_____	_____
_____	_____	_____	_____	_____	_____

COMMENTS: ORC IN WELL

Add/Replaced Lock: _____

Add/Replaced Plug: _____ Size: _____



GETTLER-RYAN INC.

WELL MONITORING/SAMPLING FIELD DATA SHEET

Client/Facility #: ChevronTexaco #9-0076 Job Number: 386495
 Site Address: 4265 Foothill Blvd. Event Date: 9.11.02
 City: Oakland, CA Sampler: FT

Well ID: C-5
 Well Diameter: 2 1/3 in.
 Total Depth: 43.85 ft.
 Depth to Water: 20.56 ft.

Well Condition: OK
 Hydrocarbon Thickness: 0 ft. Amount Bailed (product/water): 0 gal.

Volume	3/4"= 0.02	1"= 0.04	2"= 0.17	3"= 0.38
Factor (VF)	4"= 0.66	5"= 1.02	6"= 1.50	12"= 5.80

NA xVF _____ = _____ x3 (case volume) = Estimated Purge Volume: _____ gal.

Purge Equipment:
 Disposable Bailer _____
 Stainless Steel Bailer _____
 Stack Pump _____
 Suction Pump _____
 Grundfos _____
 Other: _____

Sampling Equipment:
 Disposable Bailer _____
 Pressure Bailer _____
 Discrete Bailer _____
 Other: _____

Start Time (purge): _____ Weather Conditions: _____
 Sample Time/Date: 1 Water Color: _____ Odor: _____
 Purging Flow Rate: _____ gpm. Sediment Description: _____
 Did well de-water? _____ If yes, Time: _____ Volume: _____ gal.

Time (2400 hr.)	Volume (gal.)	pH	Conductivity (u mhos/cm)	Temperature (C/F)	D.O. (mg/L)	ORP (mV)

LABORATORY INFORMATION

SAMPLE ID	(#) CONTAINER	REFRIG.	PRESERV. TYPE	LABORATORY	ANALYSES
C-	x voa vial	YES	HCL	LANCASTER	TPH-G(8015)/BTEX+MTBE(8021)

COMMENTS: MONITORED ONLY

Add/Replaced Lock: _____ Add/Replaced Plug: _____ Size: _____



GETTLER-RYAN INC.

WELL MONITORING/SAMPLING FIELD DATA SHEET

Client/Facility #: ChevronTexaco #9-0076 Job Number: 386495
 Site Address: 4265 Foothill Blvd. Event Date: 9.11.02
 City: Oakland, CA Sampler: FT

Well ID: C-6
 Well Diameter: 2 / 3 in.
 Total Depth: 53.69 ft.
 Depth to Water: 29.00 ft.

Well Condition: OK
 Hydrocarbon Thickness: 0 ft. Amount Bailed (product/water): 0 gal.

Volume	3/4"= 0.02	1"= 0.04	2"= 0.17	3"= 0.38
Factor (VF)	4"= 0.66	5"= 1.02	6"= 1.50	12"= 5.80

24.69 xVF .17 = 4.19 x3 (case volume) = Estimated Purge Volume: 12.59 gal.

Purge Equipment: Disposable Bailer _____
 Stainless Steel Bailer _____
 Stack Pump
 Suction Pump
 Grundfos _____
 Other: _____

Sampling Equipment: Disposable Bailer
 Pressure Bailer _____
 Discrete Bailer _____
 Other: _____

Start Time (purge): 12:28 Weather Conditions: SUNNY
 Sample Time/Date: 12:49 / 9.11.02 Water Color: CLEAR Odor: YES
 Purging Flow Rate: 2.0 gpm. Sediment Description: _____
 Did well de-water? NO If yes, Time: _____ Volume: _____ gal.

Time (2400 hr.)	Volume (gal.)	pH	Conductivity (umhos/cm)	Temperature (°F)	D.O. (mg/L)	ORP (mV)
<u>12:30</u>	<u>4.5</u>	<u>7.06</u>	<u>151</u>	<u>24.8</u>	_____	_____
<u>12:32</u>	<u>9.0</u>	<u>7.08</u>	<u>146</u>	<u>24.4</u>	_____	_____
<u>12:37</u>	<u>12.5</u>	<u>7.09</u>	<u>142</u>	<u>23.9</u>	_____	_____
_____	_____	_____	_____	_____	_____	_____

LABORATORY INFORMATION

SAMPLE ID	(#) CONTAINER	REFRIG.	PRESERV. TYPE	LABORATORY	ANALYSES
<u>C-6</u>	<u>3</u> x voa vial	<u>YES</u>	<u>HCL</u>	<u>LANCASTER</u>	<u>TPH-G(8015)/BTEX+MTBE(8021)</u>
_____	_____	_____	_____	_____	_____
_____	_____	_____	_____	_____	_____

COMMENTS: ORC IN WELL

Add/Replaced Lock: _____

Add/Replaced Plug: _____ Size: _____



GETTLER-RYAN INC.

WELL MONITORING/SAMPLING FIELD DATA SHEET

Client/Facility #: ChevronTexaco #9-0076 Job Number: 386495
 Site Address: 4265 Foothill Blvd. Event Date: 9.11.02
 City: Oakland, CA Sampler: FT

Well ID: C-7 Well Condition: OK
 Well Diameter: 2 / 3 in. Hydrocarbon: _____ Amount Bailed: _____
 Total Depth: 50.88 ft. Thickness: 0 ft. (product/water): 0 gal.
 Depth to Water: 25.78 ft.

Volume	3/4"= 0.02	1"= 0.04	2"= 0.17	3"= 0.38
Factor (VF)	4"= 0.66	5"= 1.02	6"= 1.50	12"= 5.80

25.10 xVF .17 = 4.26 x3 (case volume) = Estimated Purge Volume: 12.80 gal.

Purge Equipment: Disposable Bailer _____
 Stainless Steel Bailer _____
 Stack Pump
 Suction Pump
 Grundfos _____
 Other: _____

Sampling Equipment: Disposable Bailer
 Pressure Bailer _____
 Discrete Bailer _____
 Other: _____

Start Time (purge): 1:05 Weather Conditions: SUNNY
 Sample Time/Date: 1:24 / 9.11.02 Water Color: CLEAR Odor: YES
 Purging Flow Rate: 2.0 gpm. Sediment Description: _____
 Did well de-water? NO If yes, Time: _____ Volume: _____ gal.

Time (2400 hr.)	Volume (gal.)	pH	Conductivity (umhos/cm)	Temperature (°F)	D.O. (mg/L)	ORP (mV)
<u>1:07</u>	<u>4.5</u>	<u>7.10</u>	<u>128</u>	<u>22.8</u>		
<u>1:09</u>	<u>9.0</u>	<u>7.12</u>	<u>117</u>	<u>23.4</u>		
<u>1:13</u>	<u>13.0</u>	<u>7.14</u>	<u>112</u>	<u>23.9</u>		

LABORATORY INFORMATION

SAMPLE ID	(#) CONTAINER	REFRIG.	PRESERV. TYPE	LABORATORY	ANALYSES
<u>C-7</u>	<u>3</u> x voa vial	<u>YES</u>	<u>HCL</u>	<u>LANCASTER</u>	<u>TPH-G(8015)/BTEX+MTBE(8021)</u>

COMMENTS: _____

Add/Replaced Lock: _____ Add/Replaced Plug: _____ Size: _____



GETTLER-RYAN INC.

WELL MONITORING/SAMPLING FIELD DATA SHEET

Client/Facility #: ChevronTexaco #9-0076 Job Number: 386495
 Site Address: 4265 Foothill Blvd. Event Date: 9.11.02
 City: Oakland, CA Sampler: FT

Well ID: C-8
 Well Diameter: 2 1/3 in.
 Total Depth: 56.14 ft.
 Depth to Water: 25.92 ft.

Well Condition: OK
 Hydrocarbon Thickness: 0 ft. Amount Bailed (product/water): 0 gal.

Volume Factor (VF)	3/4" = 0.02	1" = 0.04	2" = 0.17	3" = 0.38
	4" = 0.66	5" = 1.02	6" = 1.50	12" = 5.80

NA xVF = _____ x3 (case volume) = Estimated Purge Volume: _____ gal.

Purge Equipment: Disposable Bailer _____
 Stainless Steel Bailer _____
 Stack Pump _____
 Suction Pump _____
 Grundfos _____
 Other: _____

Sampling Equipment: Disposable Bailer _____
 Pressure Bailer _____
 Discrete Bailer _____
 Other: _____

Start Time (purge): _____ Weather Conditions: _____
 Sample Time/Date: 1 Water Color: _____ Odor: _____
 Purging Flow Rate: _____ gpm. Sediment Description: _____
 Did well de-water? _____ If yes, Time: _____ Volume: _____ gal.

Time (2400 hr.)	Volume (gal.)	pH	Conductivity (μ mhos/cm)	Temperature (C/F)	D.O. (mg/L)	ORP (mV)
_____	_____	_____	_____	_____	_____	_____
_____	_____	_____	_____	_____	_____	_____
_____	_____	_____	_____	_____	_____	_____
_____	_____	_____	_____	_____	_____	_____

LABORATORY INFORMATION

SAMPLE ID	(#) CONTAINER	REFRIG.	PRESERV. TYPE	LABORATORY	ANALYSES
C-	x voa vial	YES	HCL	LANCASTER	TPH-G(8015)/BTEX+MTBE(8021)

COMMENTS: MONITORED ONLY

Add/Replaced Lock:

Add/Replaced Plug: Size: 2"



GETTLER-RYAN INC.

WELL MONITORING/SAMPLING FIELD DATA SHEET

Client/Facility #: ChevronTexaco #9-0076 Job Number: 386495
 Site Address: 4265 Foothill Blvd. Event Date: 9.11.02
 City: Oakland, CA Sampler: FT

Well ID: C-9 Well Condition: OK
 Well Diameter: 2 1/3 in. Hydrocarbon Amount Bailed
 Total Depth: 45.25 ft. Thickness: 0 ft. (product/water): 0 gal.
 Depth to Water: 25.70 ft.

Volume	3/4"= 0.02	1"= 0.04	2"= 0.17	3"= 0.38
Factor (VF)	4"= 0.66	5"= 1.02	6"= 1.50	12"= 5.80

NA xVF = _____ x3 (case volume) = Estimated Purge Volume: _____ gal.

Purge Equipment: Disposable Bailer _____
 Stainless Steel Bailer _____
 Stack Pump _____
 Suction Pump _____
 Grundfos _____
 Other: _____

Sampling Equipment: Disposable Bailer' _____
 Pressure Bailer _____
 Discrete Bailer _____
 Other: _____

Start Time (purge): _____ Weather Conditions: _____
 Sample Time/Date: / / Water Color: _____ Odor: _____
 Purging Flow Rate: _____ gpm. Sediment Description: _____
 Did well de-water? _____ If yes, Time: _____ Volume: _____ gal.

Time (2400 hr.)	Volume (gal.)	pH	Conductivity (umhos/cm)	Temperature (C/F)	D.O. (mg/L)	ORP (mV)
_____	_____	_____	_____	_____	_____	_____
_____	_____	_____	_____	_____	_____	_____
_____	_____	_____	_____	_____	_____	_____
_____	_____	_____	_____	_____	_____	_____

LABORATORY INFORMATION

SAMPLE ID	(#) CONTAINER	REFRIG.	PRESERV. TYPE	LABORATORY	ANALYSES
C-	x voa vial	YES	HCL	LANCASTER	TPH-G(8015)/BTEX+MTBE(8021)

COMMENTS: MONITORED ONLY

Add/Replaced Lock: _____ Add/Replaced Plug: _____ Size: _____



For Lancaster Laboratories use only

Acct. #: 10905 Sample #: 389871324 SCR#: _____

091302-008

gr # 822850

Facility #: 9-0076 Job #386495 Global ID#T0600100339
 Site Address: 4265 FOOTHILL BLVD., OAKLAND, CA
 Chevron PM: Streich Lead Consultant: DELTA/G-R
 Consultant/Office: G-R, Inc., 6747 Sierra Court, Dublin, Ca 94568
 Consultant Prj. Mgr.: Deanna L. Harding (Deanna@grinc.com)
 Consultant Phone #925-551-7555 Fax #: 925-551-7899
 Sampler: FRANK TERRINONI
 Service Order #: _____ Non SAR:

Matrix	Analyses Requested									
	Preservation Codes									
<input type="checkbox"/> Potable <input type="checkbox"/> NPDES <input type="checkbox"/> Oil <input type="checkbox"/> Air	Total Number of Containers	<input checked="" type="checkbox"/> BTEX + MTBE 8260	<input type="checkbox"/> 8021	<input type="checkbox"/>	<input type="checkbox"/>	<input type="checkbox"/>	<input type="checkbox"/>	<input type="checkbox"/>	<input type="checkbox"/>	<input type="checkbox"/>
		<input checked="" type="checkbox"/> TPH 8015 MOD GRO	<input type="checkbox"/>	<input type="checkbox"/>	<input type="checkbox"/>	<input type="checkbox"/>	<input type="checkbox"/>	<input type="checkbox"/>	<input type="checkbox"/>	<input type="checkbox"/>
		<input type="checkbox"/> TPH 8015 MOD DRO	<input type="checkbox"/> Silica Gel Cleanup	<input type="checkbox"/>	<input type="checkbox"/>	<input type="checkbox"/>	<input type="checkbox"/>	<input type="checkbox"/>	<input type="checkbox"/>	<input type="checkbox"/>
		<input type="checkbox"/> 8260 full scan	<input type="checkbox"/>	<input type="checkbox"/>	<input type="checkbox"/>	<input type="checkbox"/>	<input type="checkbox"/>	<input type="checkbox"/>	<input type="checkbox"/>	<input type="checkbox"/>
		<input type="checkbox"/> Oxygenates	<input type="checkbox"/>	<input type="checkbox"/>	<input type="checkbox"/>	<input type="checkbox"/>	<input type="checkbox"/>	<input type="checkbox"/>	<input type="checkbox"/>	<input type="checkbox"/>
		<input type="checkbox"/> Lead 7420	<input type="checkbox"/> 7421	<input type="checkbox"/>	<input type="checkbox"/>	<input type="checkbox"/>	<input type="checkbox"/>	<input type="checkbox"/>	<input type="checkbox"/>	<input type="checkbox"/>

Preservative Codes
 H = HCl T = Thiosulfate
 N = HNO₃ B = NaOH
 S = H₂SO₄ O = Other

J value reporting needed
 Must meet lowest detection limits possible for 8260 compounds

8021 MTBE Confirmation
 Confirm highest hit by 8260
 Confirm all hits by 8260
 Run ___ oxy s on highest hit
 Run ___ oxy s on all hits

Sample Identification	Date Collected	Time Collected	Grab	Composite	Soil	Water	Oil	Air	Total Number of Containers	BTEX + MTBE 8260	TPH 8015 MOD GRO	TPH 8015 MOD DRO	8260 full scan	Oxygenates	Lead 7420	7421
<u>QA</u>	<u>9-11-02</u>					<u>W</u>			<u>2</u>	<u>X</u>	<u>X</u>					
<u>C-1</u>		<u>1136</u>	<u>X</u>						<u>3</u>	<u>X</u>	<u>X</u>					
<u>C-2</u>		<u>1400</u>	<u>X</u>						<u>3</u>	<u>X</u>	<u>X</u>					
<u>C-3</u>		<u>1102</u>	<u>X</u>						<u>3</u>	<u>X</u>	<u>X</u>					
<u>C-4</u>		<u>1203</u>	<u>X</u>						<u>3</u>	<u>X</u>	<u>X</u>					
<u>C-6</u>		<u>1249</u>	<u>X</u>						<u>3</u>	<u>X</u>	<u>X</u>					
<u>C-7</u>		<u>1324</u>	<u>X</u>						<u>3</u>	<u>X</u>	<u>X</u>					

Comments / Remarks

Turnaround Time Requested (TAT) (please circle)
 STD. TAT 24 hour 72 hour 48 hour 4 day 5 day

Data Package Options (please circle if required)
 QC Summary Type I — Full
 Type VI (Raw Data) Coelt Deliverable not needed
 WIP (RWQCB)
 Disk

Relinquished by: <u>Frank Terini</u>	Date: <u>9-11-02</u>	Time: _____	Received by: <u>[Signature]</u>	Date: <u>9-11-02</u>	Time: <u>1350</u>
Relinquished by: <u>[Signature]</u>	Date: <u>9-13-02</u>	Time: <u>1350</u>	Received by: <u>[Signature]</u>	Date: <u>9-13-02</u>	Time: <u>1350</u>
Relinquished by: <u>[Signature]</u>	Date: <u>9-13-02</u>	Time: <u>1530</u>	Received by: <u>Airborne</u>	Date: <u>9-13-02</u>	Time: _____
Relinquished by Commercial Carrier: <u>Airborne</u>	UPS FedEx <input checked="" type="checkbox"/> Other	Temperature Upon Receipt: <u>2.5 C°</u>	Received by: <u>[Signature]</u>	Date: <u>9/11/02</u>	Time: <u>1000</u>
Custody Seals Intact? <input checked="" type="checkbox"/> Yes <input type="checkbox"/> No					



ANALYTICAL RESULTS

Prepared for:

ChevronTexaco
6001 Bollinger Canyon Rd L4310
San Ramon CA 94583

925-842-8582

Prepared by:

Lancaster Laboratories
2425 New Holland Pike
Lancaster, PA 17605-2425

SAMPLE GROUP

The sample group for this submittal is 822850. Samples arrived at the laboratory on Saturday, September 14, 2002. The PO# for this group is 99011184 and the release number is STREICH.

<u>Client Description</u>		<u>Lancaster Labs Number</u>
QA-T-020911	NA Water	3898718
C-1-W-020911	Grab Water	3898719
C-2-W-020911	Grab Water	3898720
C-3-W-020911	Grab Water	3898721
C-4-W-020911	Grab Water	3898722
C-6-W-020911	Grab Water	3898723
C-7-W-020911	Grab Water	3898724

1 COPY TO Delta C/O Gettler-Ryan

Attn: Deanna L. Harding

Questions? Contact your Client Services Representative
Teresa M Lis at (717) 656-2300.

Respectfully Submitted,

Steven A. Skiles
Steven A. Skiles
Sr. Chemist



Lancaster Laboratories, Inc.
2425 New Holland Pike
PO Box 12425
Lancaster, PA 17605-2425
717-656-2300 Fax: 717-656-2681



Lancaster Laboratories Sample No. **WW 3898718**

Collected: 09/11/2002 00:00

Account Number: 10905

Submitted: 09/14/2002 10:00

ChevronTexaco

Reported: 09/19/2002 at 14:08

6001 Bollinger Canyon Rd L4310

Discard: 10/20/2002

San Ramon CA 94583

QA-T-020911 NA Water
 Facility# 90076 Job# 386495 GRD
 4265 Foothill-Oakland T0600100339 QA

CAT No.	Analysis Name	CAS Number	As Received Result	As Received Method Detection Limit	Units	Dilution Factor
01729	TPH-GRO - Waters					
01730	TPH-GRO - Waters	n.a.	N.D.	50.	ug/l	1
The reported concentration of TPH-GRO does not include MTBE or other gasoline constituents eluting prior to the C6 (n-hexane) TPH-GRO range start time. A site-specific MSD sample was not submitted for the project. A LCS/LCSD was performed to demonstrate precision and accuracy at a batch level.						
08214	BTEX, MTBE (8021)					
00776	Benzene	71-43-2	N.D.	0.50	ug/l	1
00777	Toluene	108-88-3	N.D.	0.50	ug/l	1
00778	Ethylbenzene	100-41-4	N.D.	0.50	ug/l	1
00779	Total Xylenes	1330-20-7	N.D.	1.5	ug/l	1
00780	Methyl tert-Butyl Ether	1634-04-4	N.D.	2.5	ug/l	1
A site-specific MSD sample was not submitted for the project. A LCS/LCSD was performed to demonstrate precision and accuracy at a batch level.						

State of California Lab Certification No. 2116

Laboratory Chronicle

CAT No.	Analysis Name	Method	Trial#	Analysis Date and Time	Analyst	Dilution Factor
01729	TPH-GRO - Waters	N. CA LUFT Gasoline	1	09/17/2002 18:33	Matthew E Barton	1
08214	BTEX, MTBE (8021)	SW-846 8021B	1	09/17/2002 18:33	Matthew E Barton	1
01146	GC VOA Water Prep	SW-846 5030B	1	09/17/2002 18:33	Matthew E Barton	n.a.

#=Laboratory Method Detection Limit exceeded target detection limit

N.D.=Not detected at or above the Reporting Limit



Lancaster, PA 17605-2425
 717-656-2300 Fax: 717-656-2681



Lancaster Laboratories Sample No. WW 3898719

Collected: 09/11/2002 11:36 by FT

Account Number: 10905

Submitted: 09/14/2002 10:00
 Reported: 09/19/2002 at 14:09
 Discard: 10/20/2002

ChevronTexaco
 6001 Bollinger Canyon Rd L4310
 San Ramon CA 94583

C-1-W-020911 Grab Water
 Facility# 90076 Job# 386495 GRD
 4265 Foothill-Oakland T0600100339 C-1

CAT No.	Analysis Name	CAS Number	As Received Result	As Received Method Detection Limit	Units	Dilution Factor
01729	TPH-GRO - Waters					
01730	TPH-GRO - Waters	n.a.	400.	50.	ug/l	1
	The reported concentration of TPH-GRO does not include MTBE or other gasoline constituents eluting prior to the C6 (n-hexane) TPH-GRO range start time. A site-specific MSD sample was not submitted for the project. A LCS/LCSD was performed to demonstrate precision and accuracy at a batch level.					
08214	BTEX, MTBE (8021)					
00776	Benzene	71-43-2	22.	0.50	ug/l	1
00777	Toluene	108-88-3	N.D.	0.50	ug/l	1
00778	Ethylbenzene	100-41-4	N.D.	0.50	ug/l	1
00779	Total Xylenes	1330-20-7	N.D.	1.5	ug/l	1
00780	Methyl tert-Butyl Ether	1634-04-4	780.	2.5	ug/l	5
	A site-specific MSD sample was not submitted for the project. A LCS/LCSD was performed to demonstrate precision and accuracy at a batch level.					

State of California Lab Certification No. 2116

Laboratory Chronicle

CAT No.	Analysis Name	Method	Trial#	Analysis Date and Time	Analyst	Dilution Factor
01729	TPH-GRO - Waters	N. CA LUFT Gasoline Method	1	09/18/2002 03:55	Matthew E Barton	1
08214	BTEX, MTBE (8021)	SW-846 8021B	1	09/18/2002 01:06	Matthew E Barton	5
08214	BTEX, MTBE (8021)	SW-846 8021B	1	09/18/2002 03:55	Matthew E Barton	1
01146	GC VOA Water Prep	SW-846 5030B	1	09/18/2002 01:06	Matthew E Barton	n.a.

#=Laboratory Method Detection Limit exceeded target detection limit
 N.D.=Not detected or above the Reporting Limit



Lancaster, PA 17605-2425
 717-656-2300 Fax: 717-656-2681



Lancaster Laboratories Sample No. **WW 3898720**

Collected: 09/11/2002 14:00 by FT

Account Number: 10905

Submitted: 09/14/2002 10:00
 Reported: 09/19/2002 at 14:09
 Discard: 10/20/2002
 C-2-W-020911
 Facility# 90076 Job# 386495
 4265 Foothill-Oakland T0600100339 C-2

ChevronTexaco
 6001 Bollinger Canyon Rd L4310
 San Ramon CA 94583

Grab Water
 GRD

CAT No.	Analysis Name	CAS Number	As Received Result	As Received Method Detection Limit	Units	Dilution Factor
01729	TPH-GRO - Waters					
01730	TPH-GRO - Waters	n.a.	10,000.	500.	ug/l	10
The reported concentration of TPH-GRO does not include MTBE or other gasoline constituents eluting prior to the C6 (n-hexane) TPH-GRO range start time. A site-specific MSD sample was not submitted for the project. A LCS/LCSD was performed to demonstrate precision and accuracy at a batch level.						
08214	BTEX, MTBE (8021)					
00776	Benzene	71-43-2	1,400.	2.0	ug/l	10
00777	Toluene	108-88-3	23.	2.0	ug/l	10
00778	Ethylbenzene	100-41-4	120.	2.0	ug/l	10
00779	Total Xylenes	1330-20-7	78.	6.0	ug/l	10
00780	Methyl tert-Butyl Ether	1634-04-4	1,800.	3.0	ug/l	10
A site-specific MSD sample was not submitted for the project. A LCS/LCSD was performed to demonstrate precision and accuracy at a batch level.						

State of California Lab Certification No. 2116

Laboratory Chronicle

CAT No.	Analysis Name	Method	Trial#	Analysis Date and Time	Analyst	Dilution Factor
01729	TPH-GRO - Waters	N. CA LUFT Gasoline Method	1	09/18/2002 01:40	Matthew E Barton	10
08214	BTEX, MTBE (8021)	SW-846 8021B	1	09/18/2002 01:40	Matthew E Barton	10
01146	GC VOA Water Prep	SW-846 5030B	1	09/18/2002 01:40	Matthew E Barton	n.a.

#=Laboratory Method Detection Limit exceeded target detection limit
 N.D.=Not detected or above the Reporting Limit



2425 New Holland Pike
 PO Box 12425
 Lancaster, PA 17605-2425
 717-656-2300 Fax: 717-656-2681



Lancaster Laboratories Sample No. WW 3898721

Collected: 09/11/2002 11:02 by FT

Account Number: 10905

Submitted: 09/14/2002 10:00

ChevronTexaco

Reported: 09/19/2002 at 14:09

6001 Bollinger Canyon Rd L4310

Discard: 10/20/2002

San Ramon CA 94583

C-3-W-020911 Grab Water
 Facility# 90076 Job# 386495 GRD
 4265 Foothill-Oakland T0600100339 C-3

CAT No.	Analysis Name	CAS Number	As Received Result	As Received Method Detection Limit	Units	Dilution Factor
01729	TPH-GRO - Waters					
01730	TPH-GRO - Waters	n.a.	110.	50.	ug/l	1
The reported concentration of TPH-GRO does not include MTBE or other gasoline constituents eluting prior to the C6 (n-hexane) TPH-GRO range start time. A site-specific MSD sample was not submitted for the project. A LCS/LCSD was performed to demonstrate precision and accuracy at a batch level.						
08214	BTEX, MTBE (8021)					
00776	Benzene	71-43-2	4.7	0.50	ug/l	1
00777	Toluene	108-88-3	N.D.	0.50	ug/l	1
00778	Ethylbenzene	100-41-4	N.D.	0.50	ug/l	1
00779	Total Xylenes	1330-20-7	N.D.	1.5	ug/l	1
00780	Methyl tert-Butyl Ether	1634-04-4	76.	2.5	ug/l	1
A site-specific MSD sample was not submitted for the project. A LCS/LCSD was performed to demonstrate precision and accuracy at a batch level.						

State of California Lab Certification No. 2116

Laboratory Chronicle

CAT No.	Analysis Name	Method	Trial#	Analysis Date and Time	Analyst	Dilution Factor
01729	TPH-GRO - Waters	N. CA LUFT Gasoline Method	1	09/18/2002 10:21	Matthew E Barton	1
08214	BTEX, MTBE (8021)	SW-846 8021B	1	09/18/2002 10:21	Matthew E Barton	1
01146	GC VOA Water Prep	SW-846 5030B	1	09/18/2002 10:21	Matthew E Barton	n.a.

#=Laboratory Method Detection Limit exceeded target detection limit
 N.D.=Not detected at or above the Reporting Limit



2425 New Holland Pike
 Lancaster, PA 17605-2425
 717-656-2300 Fax: 717-656-2681



Lancaster Laboratories Sample No. **WW 3898722**

Collected: 09/11/2002 12:03

by FT

Account Number: 10905

Submitted: 09/14/2002 10:00

Reported: 09/19/2002 at 14:09

Discard: 10/20/2002

ChevronTexaco

6001 Bollinger Canyon Rd L4310

San Ramon CA 94583

C-4-W-020911

Grab

Water

Facility# 90076 Job# 386495

GRD

4265 Foothill-Oakland T0600100339 C-4

CAT No.	Analysis Name	CAS Number	As Received Result	As Received Method Detection Limit	Units	Dilution Factor
01729	TPH-GRO - Waters					
01730	TPH-GRO - Waters	n.a.	820.	50.	ug/l	1
	The reported concentration of TPH-GRO does not include MTBE or other gasoline constituents eluting prior to the C6 (n-hexane) TPH-GRO range start time.					
	A site-specific MSD sample was not submitted for the project. A LCS/LCSD was performed to demonstrate precision and accuracy at a batch level.					
08214	BTEX, MTBE (8021)					
00776	Benzene	71-43-2	6.2	0.50	ug/l	1
00777	Toluene	108-88-3	1.0	0.50	ug/l	1
00778	Ethylbenzene	100-41-4	2.2	0.50	ug/l	1
00779	Total Xylenes	1330-20-7	2.5	1.5	ug/l	1
00780	Methyl tert-Butyl Ether	1634-04-4	26.	2.5	ug/l	1
	A site-specific MSD sample was not submitted for the project. A LCS/LCSD was performed to demonstrate precision and accuracy at a batch level.					

State of California Lab Certification No. 2116

Laboratory Chronicle

CAT No.	Analysis Name	Method	Trial#	Analysis Date and Time	Analyst	Dilution Factor
01729	TPH-GRO - Waters	N. CA LUFT Gasoline Method	1	09/18/2002 08:29	Matthew E Barton	1
08214	BTEX, MTBE (8021)	SW-846 8021B	1	09/18/2002 08:29	Matthew E Barton	1
01146	GC VOA Water Prep	SW-846 5030B	1	09/18/2002 08:29	Matthew E Barton	n.a.

#=Laboratory Method Detection Limit exceeded target detection limit

N.D.=Not detected at or above the Reporting Limit



7425 New Holland Blvd
PO Box 12425
Lancaster, PA 17605-2425
717-656-2300 Fax: 717-656-2681



Lancaster Laboratories Sample No. WW 3898723

Collected: 09/11/2002 12:49 by FT

Account Number: 10905

Submitted: 09/14/2002 10:00
 Reported: 09/19/2002 at 14:09
 Discard: 10/20/2002

ChevronTexaco
 6001 Bollinger Canyon Rd L4310
 San Ramon CA 94583

C-6-W-020911 Grab Water
 Facility# 90076 Job# 386495 GRD
 4265 Foothill-Oakland T0600100339 C-6

CAT No.	Analysis Name	CAS Number	As Received Result	As Received Method Detection Limit	Units	Dilution Factor
01729	TPH-GRO - Waters					
01730	TPH-GRO - Waters	n.a.	490.	50.	ug/l	1
The reported concentration of TPH-GRO does not include MTBE or other gasoline constituents eluting prior to the C6 (n-hexane) TPH-GRO range start time. A site-specific MSD sample was not submitted for the project. A LCS/LCSD was performed to demonstrate precision and accuracy at a batch level.						
08214	BTEX, MTBE (8021)					
00776	Benzene	71-43-2	16.	0.50	ug/l	1
00777	Toluene	108-88-3	0.50	0.50	ug/l	1
00778	Ethylbenzene	100-41-4	N.D.	0.50	ug/l	1
00779	Total Xylenes	1330-20-7	N.D.	1.5	ug/l	1
00780	Methyl tert-Butyl Ether	1634-04-4	120.	2.5	ug/l	1
A site-specific MSD sample was not submitted for the project. A LCS/LCSD was performed to demonstrate precision and accuracy at a batch level.						

State of California Lab Certification No. 2116

Laboratory Chronicle

CAT No.	Analysis Name	Method	Trial#	Analysis Date and Time	Analyst	Dilution Factor
01729	TPH-GRO - Waters	N. CA LUFT Gasoline Method	1	09/18/2002 09:03	Matthew E Barton	1
08214	BTEX, MTBE (8021)	SW-846 8021B	1	09/18/2002 09:03	Matthew E Barton	1
01146	GC VOA Water Prep	SW-846 5030B	1	09/18/2002 09:03	Matthew E Barton	n.a.

#=Laboratory Method Detection Limit exceeded target detection limit
 N.D.=Not detected or above the Reporting Limit



2425 New Holland Pike
 Lancaster, PA 17605-2425
 717-656-2300 Fax: 717-656-2681



Lancaster Laboratories Sample No. WW 3898724

Collected: 09/11/2002 13:24 by FT

Account Number: 10905

Submitted: 09/14/2002 10:00
 Reported: 09/19/2002 at 14:10
 Discard: 10/20/2002

ChevronTexaco
 6001 Bollinger Canyon Rd L4310
 San Ramon CA 94583

C-7-W-020911 Grab Water GRD
 Facility# 90076 Job# 386495
 4265 Foothill-Oakland T0600100339 C-7

CAT No.	Analysis Name	CAS Number	As Received Result	As Received Method Detection Limit	Units	Dilution Factor
01729	TPH-GRO - Waters					
01730	TPH-GRO - Waters	n.a.	11,000.	500.	ug/l	10
	The reported concentration of TPH-GRO does not include MTBE or other gasoline constituents eluting prior to the C6 (n-hexane) TPH-GRO range start time. A site-specific MSD sample was not submitted for the project. A LCS/LCSD was performed to demonstrate precision and accuracy at a batch level.					
08214	BTEX, MTBE (8021)					
00776	Benzene	71-43-2	1,800.	2.0	ug/l	10
00777	Toluene	108-88-3	18.	2.0	ug/l	10
00778	Ethylbenzene	100-41-4	360.	2.0	ug/l	10
00779	Total Xylenes	1330-20-7	380.	6.0	ug/l	10
00780	Methyl tert-Butyl Ether	1634-04-4	N.D. #	10.	ug/l	10
	A site-specific MSD sample was not submitted for the project. A LCS/LCSD was performed to demonstrate precision and accuracy at a batch level.					

Due to the presence of an interferent near its retention time, the normal reporting limit was not attained for MTBE. The presence or concentration of this compound cannot be determined due to the presence of this interferent.

State of California Lab Certification No. 2116

Laboratory Chronicle

CAT No.	Analysis Name	Method	Trial#	Analysis Date and Time	Analyst	Dilution Factor
01729	TPH-GRO - Waters	N. CA LUFT Gasoline Method	1	09/18/2002 06:42	Matthew E Barton	10
08214	BTEX, MTBE (8021)	SW-846 8021B	1	09/18/2002 06:42	Matthew E Barton	10
01146	GC VOA Water Prep	SW-846 5030B	1	09/18/2002 06:42	Matthew E Barton	n.a.

#=Laboratory Method Detection Limit exceeded target detection limit

N.D.=Not detected at or above the Reporting Limit



2428 New Holland Blvd
 PO Box 12425
 Lancaster, PA 17605-2425
 717-656-2300 Fax: 717-656-2681



Quality Control Summary

Client Name: ChevronTexaco
 Reported: 09/19/02 at 02:10 PM

Group Number: 822850

Laboratory Compliance Quality Control

Analysis Name	Blank Result	Blank MDL	Report Units	LCS %REC	LCSD %REC	LCS/LCSD Limits	RPD	RPD Max
Batch number: 02260A16A Sample number(s): 3898718-3898720								
Benzene	N.D.	.2	ug/l	89	93	80-118	4	30
Toluene	N.D.	.2	ug/l	94	98	82-119	4	30
Ethylbenzene	N.D.	.2	ug/l	89	92	81-119	3	30
Total Xylenes	N.D.	.6	ug/l	92	95	82-120	4	30
Methyl tert-Butyl Ether	N.D.	.3	ug/l	90	99	79-127	10	30
TPH-GRO - Waters	N.D.	50.	ug/l	91	91	74-116	0	30
Batch number: 02260A16B Sample number(s): 3898721-3898724								
Benzene	N.D.	.2	ug/l	89	93	80-118	4	30
Toluene	N.D.	.2	ug/l	94	98	82-119	4	30
Ethylbenzene	N.D.	.2	ug/l	89	92	81-119	3	30
Total Xylenes	N.D.	.6	ug/l	92	95	82-120	4	30
Methyl tert-Butyl Ether	N.D.	.3	ug/l	90	99	79-127	10	30
TPH-GRO - Waters	N.D.	50.	ug/l	91	91	74-116	0	30

Sample Matrix Quality Control

Analysis Name	MS %REC	MSD %REC	MS/MSD Limits	RPD	BKG MAX	DUP Conc	DUP RPD	Dup RPD Max
Batch number: 02260A16A Sample number(s): 3898718-3898720								
Benzene	107		83-130					
Toluene	114		87-129					
Ethylbenzene	113		86-133					
Total Xylenes	115		86-132					
Methyl tert-Butyl Ether	104		66-140					
TPH-GRO - Waters	121		74-132					
Batch number: 02260A16B Sample number(s): 3898721-3898724								
Benzene	107		83-130					
Toluene	114		87-129					
Ethylbenzene	113		86-133					
Total Xylenes	115		86-132					
Methyl tert-Butyl Ether	104		66-140					
TPH-GRO - Waters	121		74-132					

Surrogate Quality Control

Analysis Name: TPH-GRO - Waters
 Batch number: 02260A16A
 Trifluorotoluene-F Trifluorotoluene-P

3898718	98	92
3898719	115	95
3898720	119	99
Blank	97	93
LCS	116	93
LCSD	107	93

*- Outside of specification

- (1) The result for one or both determinations was less than five times the LOQ.
- (2) The background result was more than four times the spike added.



Lancaster Laboratories, Inc.
 2425 New Holland Pike
 PO Box 12425
 Lancaster, PA 17605-2425
 717-656-2300 Fax: 717-656-2681



Lancaster Laboratories

Where quality is a science.

Quality Control Summary

Client Name: ChevronTexaco
Reported: 09/19/02 at 02:10 PM

Group Number: 822850

Surrogate Quality Control

MS	123	92
Limits:	57-146	71-130

Analysis Name: TPH-GRO - Waters
Batch number: 02260A16B
Trifluorotoluene-F

Trifluorotoluene-P

3898721	88	91
3898722	122	102
3898723	98	103
3898724	114	99
Blank	105	93
LCS	116	93
LCSD	107	93
MS	123	92

Limits:	57-146	71-130
---------	--------	--------

*- Outside of specification

- (1) The result for one or both determinations was less than five times the LOQ.
- (2) The background result was more than four times the spike added.



Lancaster Laboratories, Inc.
2425 New Holland Pike
PO Box 12425
Lancaster, PA 17605-2425
717-656-2300 Fax: 717-656-2681