

RECORDED

ALCO  
HAZMAT  
94 MAY 18 AM 11:36



**Chevron**

May 17, 1994

**Chevron U.S.A. Products Company**  
2410 Camino Ramon  
San Ramon, CA 94583  
P.O. Box 5004  
San Ramon, CA 94583-0804

Mr. Barney Chan  
Alameda County Health Care Services  
Department of Environmental Health  
80 Swan Way, Room 200  
Oakland, CA 94621

# 103

**Marketing Department**  
Phone 510 842 9500

**Re: Chevron Service Station #9-0076  
4265 Foothill Boulevard, Oakland, CA**

Dear Mr. Chan:

Enclosed is the Groundwater Monitoring and Sampling Activities report dated April 15, 1994, prepared by our consultant Groundwater Technology, Inc. for the above referenced site. As indicated in the report, ground water samples collected were analyzed for total petroleum hydrocarbons as gasoline (TPH-G) and BTEX. Dissolved concentrations of these constituents are consistent with historical sampling results.

Depth to ground water was measured at approximately 16.9 to 34.4 feet below grade. The depth to ground water data presented in the enclosed report has been contoured on the potentiometric surface map to show one continuous water bearing zone with the flow direction towards the southwest. This map reflects Chevron's current understanding of the ground water depth and movement beneath the site. Ground water monitoring events are coordinated with the adjacent Shell site to provide a more comprehensive picture of ground water movement in the area.

In response to your letter of May 6, 1994, Chevron is very willing to meet with Alameda County Health Care Services and any other interested parties to develop mutual remediation goals for the Chevron site and the adjacent BP and Shell sites. I look forward to hearing from your office soon regarding available meeting dates.

Chevron will continue to monitor and sample all wells at this site on a quarterly basis. If you have any questions or comments, please do not hesitate to contact me at (510) 842-8134.

Sincerely,  
CHEVRON U.S.A. PRODUCTS COMPANY

Mark A. Miller  
Site Assessment and Remediation Engineer

Enclosure

cc: Mr. Rich Hiatt, RWQCB - Bay Area  
Mr. Mike Cooke, Weiss Associates  
Mr. S.A. Willer

File: 9-0076 QM9



# GROUNDWATER TECHNOLOGY, INC.

4057 Port Chicago Highway, Concord, CA 94520 (415) 671-2387

FAX: (415) 685-9148

April 15, 1994

Project No. 020104102

Mr. Mark Miller  
Chevron U.S.A. Products Company  
2410 Camino Ramon  
San Ramon, CA 94583-0804

SUBJECT: *Groundwater Monitoring and Sampling Activities*  
Chevron Service Station No. 9-0076  
4265 Foothill Boulevard, Oakland, California

Dear Mr. Miller:

Groundwater Technology, Inc. presents the quarterly groundwater monitoring and sampling data collected on March 17, 1994. Eight groundwater wells were gauged to measure depth to groundwater (DTW) and to check for separate-phase hydrocarbons. Separate-phase hydrocarbons were not detected in the monitoring wells. A potentiometric surface map and a summary of groundwater monitoring data are presented in Attachments 1 and 2, respectively. After the DTW was measured, each monitoring well was purged and sampled. Field data sheets are presented in Attachment 3. The groundwater samples were analyzed for benzene, toluene, ethylbenzene, xylenes, and total petroleum hydrocarbons-as-gasoline. Results of the chemical analyses are summarized in Table 1. The laboratory report and chain-of-custody record are included in Attachment 4. Monitoring-well purge water was transported by Groundwater Technology to the Chevron Terminal in Richmond, California, for recycling.

Groundwater Technology is pleased to assist Chevron on this project. If you have any questions or comments, please contact our Concord office at (510) 671-2387.

Sincerely,  
**Groundwater Technology, Inc.**  
Written/Submitted by

  
\_\_\_\_\_  
Tim Watchers  
Project Manager

PR KJ

Attachment 1 Figure  
Attachment 2 Table  
Attachment 3 Field Data Sheets  
Attachment 4 Laboratory Report

For:  
Wendell W. Lattz  
Vice President, General Manager  
West Region

**ATTACHMENT 1**

**Figure**

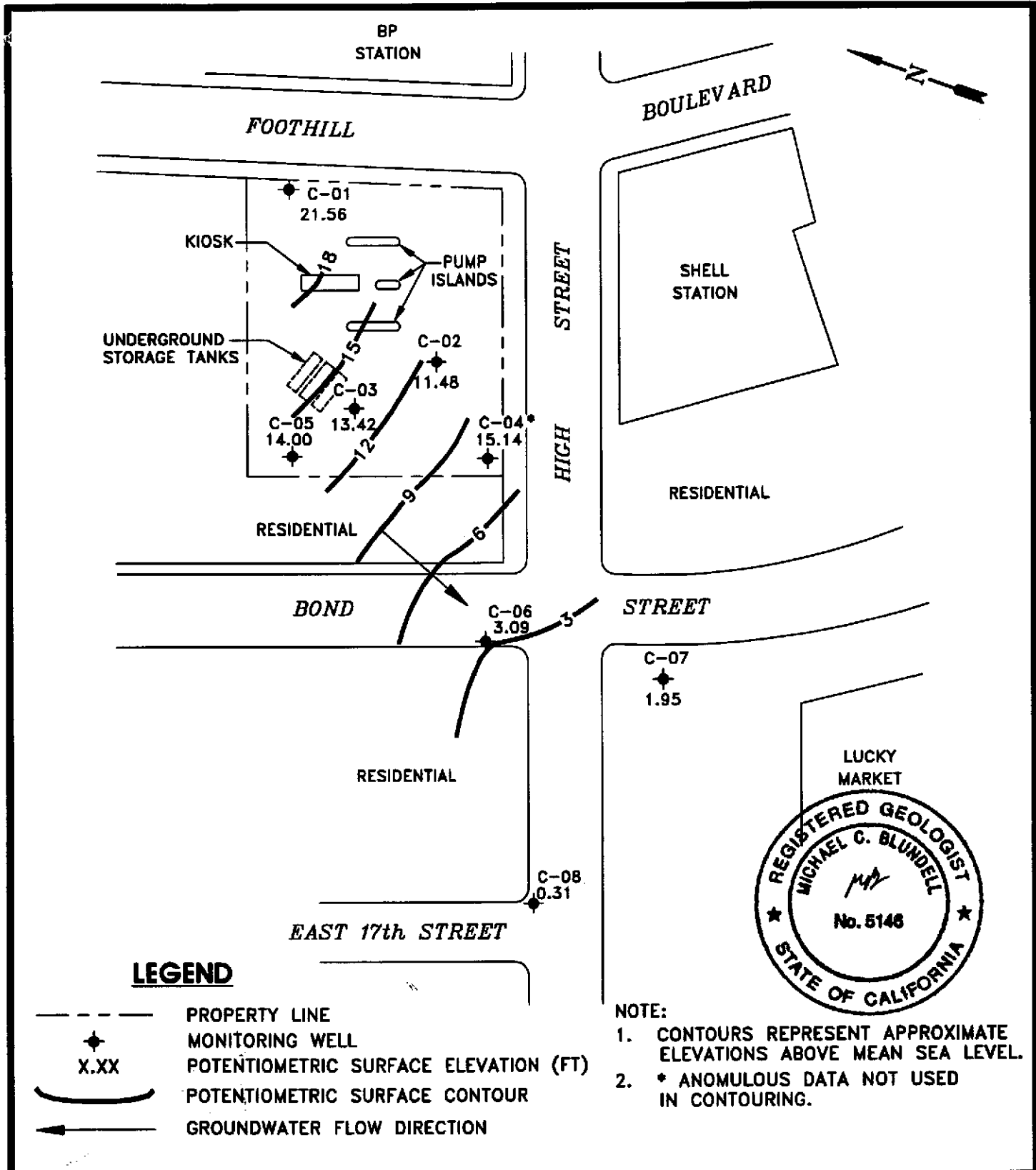

**LEGEND**

- PROPERTY LINE
- MONITORING WELL  
X.XX POTENTIOMETRIC SURFACE ELEVATION (FT)
- POTENTIOMETRIC SURFACE CONTOUR
- GROUNDWATER FLOW DIRECTION

- NOTE:
1. CONTOURS REPRESENT APPROXIMATE ELEVATIONS ABOVE MEAN SEA LEVEL.
  2. \* ANOMULOUS DATA NOT USED IN CONTOURING.

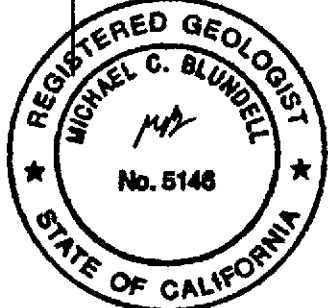

**GROUNDWATER TECHNOLOGY**

0 FEET 80

SCALE

**POTENTIOMETRIC SURFACE MAP (2/17/94)**

CLIENT: <b>CHEVRON U.S.A. PRODUCTS CO.          SERVICE STATION NO. 9-0076</b>	FILE: <b>4102-PSM</b>	PROJECT NO.: <b>020104102</b>	PM <i>JAW</i>	PE/RG <i>MB</i>
	LOCATION: <b>4265 FOOTHILL BOULEVARD          OAKLAND, CALIFORNIA</b>			FIGURE: <b>1</b>
DES. TW		DET. SS		DATE: <b>4/4/94</b>

**TABLE 1**  
**HISTORICAL GROUNDWATER ANALYTICAL RESULTS AND MONITORING DATA**  
**Chevron Service Station No. 9-0076**  
**4265 Foothill Boulevard, Oakland, California**

Well ID/ Elev	Date	TPH-G	Benzene	Toluene	Ethyl- benzene	Xylenes	DTW (ft)	SPT (ft)	WTE (ft)
C-1  35.42	04/28/89a	940	30	1.3	11	13	20.05	0.00	15.37
	08/08/89a	820	45	2	13	13	24.07	0.00	11.35
	12/21/89	---	---	---	---	---	22.81	0.00	12.61
	08/27/90	440	15	1	6	13	22.12	0.00	13.30
	11/04/90	---	---	---	---	---	25.56	0.00	9.86
	06/18/91	74	5.6	0.6	1.9	1.3	21.64	0.00	13.78
	09/19/91	150	7.1	<0.5	2.3	3	24.58	0.00	10.84
	12/20/91	250	10	<0.5	3.7	1.6	26.17	0.00	9.25
	03/18/92	190	16	<0.5	8.5	2.9	18.25	0.00	17.17
	07/14/92	20,000	480	2,200	510	2,900	27.61	0.00	7.81
	10/08/92	360	34	4.6	19	12	24.44	0.00	10.98
	01/08/93	120	9.1	0.5	5.1	1.8	19.68	0.00	15.74
	04/14/93	190	74	0.6	1	2	16.38	0.00	19.04
07/16/93	---	---	---	---	---	---	---	---	
38.41	07/27/93	300	12	<0.5	5	2	9.39	0.00	26.03
	09/21/93	360	12	1.2	5.8	3.7	21.42	0.00	16.99
	01/28/94	370	24	1	13	4	19.57	0.00	18.84
	03/17/94	460	42	<0.5	6.7	3.7	16.85	0.00	21.56

**TABLE 1**  
**HISTORICAL GROUNDWATER ANALYTICAL RESULTS AND MONITORING DATA**  
**Chevron Service Station No. 9-0076**  
**4265 Foothill Boulevard, Oakland, California**

Well ID/ Elev	Date	TPH-G	Benzene	Toluene	Ethyl- benzene	Xylenes	DTW (ft)	SPT (ft)	WTE (ft)
C-2  35.18	04/28/89a	120,000	30,000	22,000	3,000	17,000	26.44	0.00	8.74
	08/08/89a	---	---	---	---	---	29.90	0.01	5.29
	12/21/89	---	---	---	---	---	29.32	0.00	5.86
	08/27/90	---	---	---	---	---	29.55	0.17	5.77
	11/04/90	---	---	---	---	---	30.47	0.00	4.71
	06/18/91	---	---	---	---	---	28.33	0.06	6.90
	09/19/91	---	---	---	---	---	29.39	0.06	5.84
	12/20/91	170,000	20,000	10,000	2,800	19,000	29.23	0.00	5.95
	03/18/92	---	---	---	---	---	13.60	0.09	21.58
	07/14/92	---	---	---	---	---	---	---	---
37.47	10/08/92	---	---	---	---	---	---	---	---
	01/08/93	79,000	14,000	7,200	3,500	16,000	24.20	Sheen	10.98
	04/14/93	---	---	---	---	---	---	---	---
	07/16/93	2,200	440	73	24	350	30.15	0.00	5.03
	**09/21/93	11,000	2,300	300	270	910	26.29	0.00	11.18
	01/28/94	49,000	11,000	3,900	1,600	12,000	23.96	0.00	13.51
	03/17/94	16,000	3,300	1,000	220	3,500	25.99	0.00	11.48

**TABLE 1**  
**HISTORICAL GROUNDWATER ANALYTICAL RESULTS AND MONITORING DATA**  
**Chevron Service Station No. 9-0076**  
**4265 Foothill Boulevard, Oakland, California**

Well ID/ Elev	Date	TPH-G	Benzene	Toluene	Ethyl- benzene	Xylenes	DTW (ft)	SPT (ft)	WTE (ft)
C-3	04/28/89a	<500	1.7	<0.5	<0.5	<0.5	28.00	0.00	7.28
	08/08/89a	<500	1	<0.5	<0.5	<0.5	30.00	0.00	5.28
35.28	12/21/89	---	---	---	---	---	30.53	0.00	4.75
	08/27/90	<50	<0.3	<0.3	<0.3	<0.6	29.68	0.00	5.60
35.30	11/04/90	---	---	---	---	---	30.36	0.00	4.94
	06/18/91	52	1.1	<0.5	<0.5	1.2	28.46	0.00	6.84
	09/19/91	73	1.2	<0.5	<0.5	<0.5	29.33	0.00	5.97
	12/20/91	<50	0.7	<0.5	<0.5	<0.5	29.77	0.00	5.53
	03/18/92	<50	<0.5	<0.5	<0.5	<0.5	25.75	0.00	9.55
	07/14/92	<50	<0.5	<0.5	<0.5	<0.5	27.87	0.00	7.43
	10/08/92	<50	<0.5	<0.5	<0.5	0.5	28.55	0.00	6.75
	01/08/93	<50	<0.5	<0.5	<0.5	<0.5	25.85	0.00	9.45
	04/14/93	<50	<0.5	<0.5	<0.5	<0.5	23.96	0.00	11.34
	07/16/93	<50	<0.5	<0.5	<0.5	<0.5	25.64	0.00	9.66
38.37	**09/21/93	<50	0.7	<0.5	<0.5	<0.8	26.22	0.00	12.15
	01/28/94	<50	2	<0.5	<0.5	1	25.66	0.00	12.71
	03/17/94	<50	2.8	<0.5	0.6	1.5	24.95	0.00	13.42

**TABLE 1**  
**HISTORICAL GROUNDWATER ANALYTICAL RESULTS AND MONITORING DATA**  
 Chevron Service Station No. 9-0076  
 4265 Foothill Boulevard, Oakland, California

Well ID/ Elev	Date	TPH-G	Benzene	Toluene	Ethyl- benzene	Xylenes	DTW (ft)	SPT (ft)	WTE (ft)
C-4	01/12/89a	---	---	---	---	---	29.49	0.00	3.96
	04/12/89a	---	---	---	---	---	27.44	0.00	6.01
33.45	04/28/89	20,000	6,300	550	230	1,500	29.49	0.00	3.96
	08/08/89a	8,000	7,500	340	88	1,000	29.55	0.00	3.90
33.48	12/21/89	---	---	---	---	---	30.02	0.00	3.43
	08/27/90	26,000	10,000	280	410	1,400	29.02	0.00	4.46
	11/04/90	---	---	---	---	---	29.81	0.00	3.67
	06/18/91	34,000	14,000	410	450	1,300	27.45	0.00	6.03
	09/19/91	16,000	7,400	90	110	460	28.65	0.00	4.83
	12/20/91	24,000	12,000	120	260	740	28.84	0.00	4.64
	03/18/92	48,000	6,000	1,300	1,300	2,400	24.43	0.00	11.05
	07/14/92	40,000	14,000	920	550	2,400	26.89	0.00	6.59
	10/08/92	29,000	13,000	190	110	1,400	27.79	0.00	5.69
	01/08/93	25,000	7,000	630	860	1,800	23.50	0.00	9.98
36.49	04/14/93	*27,000	6,300	1,000	900	1,400	21.13	0.00	12.35
	07/16/93	28,000	7,800	1,100	830	2,100	23.96	0.00	9.52
	**09/21/93	30,000	9,600	130	390	1,300	25.51	0.00	10.98
	01/28/94	18,000	7,800	440	260	1,200	23.31	0.00	13.18
	03/17/94	32,000	7,800	820	820	1,800	21.35	0.00	15.14



**TABLE 1**  
**HISTORICAL GROUNDWATER ANALYTICAL RESULTS AND MONITORING DATA**  
**Chevron Service Station No. 9-0076**  
**4265 Foothill Boulevard, Oakland, California**

Well ID/ Elev	Date	TPH-G	Benzene	Toluene	Ethyl- benzene	Xylenes	DTW (ft)	SPT (ft)	WTE (ft)
C-5          38.50	08/27/90	<50	<0.3	<0.3	<0.3	<0.6	29.83	0.00	5.67
	11/14/90	---	---	---	---	---	30.56	0.00	4.94
	06/18/91	<50	<0.5	<0.5	<0.5	<0.5	28.52	0.00	6.98
	09/19/91	<50	<0.5	<0.5	<0.5	<0.5	29.51	0.00	5.99
	12/20/91	<50	<0.5	<0.5	<0.5	<0.5	29.96	0.00	5.54
	03/18/92	<50	<0.5	<0.5	<0.5	<0.5	25.92	0.00	9.58
	07/14/92	<50	<0.5	<0.5	<0.5	<0.5	28.00	0.00	7.50
	10/08/92	<50	<0.5	<0.5	<0.5	<0.5	28.65	0.00	6.85
	01/08/93	<50	<0.5	<0.5	<0.5	<0.5	26.02	0.00	9.48
	04/14/93	<50	<0.5	<0.5	<0.5	<0.5	24.04	0.00	11.46
	07/16/93	<50	<0.5	<0.5	<0.5	<0.5	25.21	0.00	10.29
	**09/21/93	60	10	8.1	1.9	9.4	26.36	0.00	12.14
	01/28/94	<50	<0.5	<0.5	<0.5	<0.5	25.90	0.00	12.60
	03/17/94	<50	<0.5	<0.5	<0.5	<0.5	24.50	0.00	14.00
C-6          32.40          35.40	08/27/90	7,200	2,100	6	41	300	44.11	0.00	-11.71
	11/14/90	---	---	---	---	---	44.03	0.00	-11.63
	06/18/91	4,400	2,500	18	160	77	43.49	0.00	-11.09
	09/19/91	3,100	1,600	8.3	73	8	34.32	0.00	-1.92
	12/20/91	4,400	1,300	3.2	74	10	41.35	0.00	-8.95
	03/18/92	9,800	3,200	34	250	500	40.69	0.00	-8.29
	07/14/92	6,500	2,200	100	96	240	38.89	0.00	-6.49
	10/08/92	1,800	1,000	3.1	15	41	38.67	0.00	-6.27
	01/08/93	5,200	1,600	6.8	63	120	37.81	0.00	-5.41
	04/14/93	11,000	1,800	13	110	200	34.70	0.00	-2.30
	07/16/93	4,800	820	10	41	57	33.87	0.00	-1.47
	**09/21/93	4,100	1,200	<50	75	130	33.98	0.00	1.42
	01/28/94	3,100	930	14	40	34	33.86	0.00	1.54
	03/17/94	5,100	950	18	61	83	32.31	0.00	3.09

**TABLE 1**  
**HISTORICAL GROUNDWATER ANALYTICAL RESULTS AND MONITORING DATA**  
**Chevron Service Station No. 9-0076**  
**4265 Foothill Boulevard, Oakland, California**

Well ID/ Elev	Date	TPH-G	Benzene	Toluene	Ethyl- benzene	Xylenes	DTW (ft)	SPT (ft)	WTE (ft)
C-7	08/27/90	110	26	0.8	4	6	44.23	0.00	-12.06
	11/14/90	---	---	---	---	---	44.11	0.00	-11.94
32.17	06/18/91	23,000	5,700	420	1,000	2,800	42.05	0.00	-9.88
	09/19/91	26,000	4,600	330	970	2,400	41.72	0.00	-9.55
	12/20/91	33,000	5,500	270	1,000	2,100	41.67	0.00	-9.50
	03/18/92	27,000	5,800	410	1,300	3,300	41.20	0.00	-9.03
	07/14/92	46,000	12,000	720	1,700	4,600	39.77	0.00	-7.60
	10/08/92	22,000	6,800	370	1,300	3,200	39.14	0.00	-6.97
	01/08/93	36,000	7,600	540	1,700	4,200	38.50	0.00	-6.33
	04/14/93	23,000	3,100	450	670	1,900	35.93	0.00	-3.76
35.19	07/16/93	19,000	3,200	330	550	1,800	35.38	0.00	-3.21
	**09/21/93	17,000	2,700	160	410	760	35.46	0.00	-0.27
	01/28/94	14,000	1,800	210	390	1,000	35.45	0.00	-0.26
	03/17/94	17,000	1,600	210	410	1,200	33.24	0.00	1.95
C-8	11/14/90	<50	<0.3	<0.3	<0.3	<0.6	43.29	0.00	-12.61
	06/18/91	<50	<0.5	<0.5	<0.5	<0.5	42.62	0.00	-11.94
30.68	09/19/91	<50	<0.5	<0.5	<0.5	<0.5	41.72	0.00	-11.04
	12/20/91	<50	<0.5	<0.5	<0.5	<0.5	40.98	0.00	-10.30
	03/18/92	<50	<0.5	<0.5	<0.5	<0.5	40.02	0.00	-9.34
	07/14/92	<50	<0.5	<0.5	<0.5	<0.5	39.02	0.00	-8.34
	10/08/92	<50	<0.5	<0.5	<0.5	1.1	38.68	0.00	-8.00
	01/08/93	<50	<0.5	<0.5	<0.5	<0.5	38.07	0.00	-7.39
	04/14/93	<50	<0.5	<0.5	<0.5	<0.5	35.99	0.00	-5.31
	07/16/93	<50	<0.5	<0.5	<0.5	<0.5	35.32	0.00	-4.64
34.68	**09/21/93	<50	<0.5	<0.5	<0.5	<0.8	35.30	0.00	-0.62
	01/28/94	<50	<0.5	<0.5	<0.5	<0.5	35.61	0.00	-0.93
	03/17/94	<50	<0.5	<0.5	<0.5	<0.5	34.37	0.00	0.31

**TABLE 1**  
**HISTORICAL GROUNDWATER ANALYTICAL RESULTS AND MONITORING DATA**  
**Chevron Service Station No. 9-0076**  
**4265 Foothill Boulevard, Oakland, California**

Well ID/ Elev	Date	TPH-G	Benzene	Toluene	Ethyl- benzene	Xylenes	DTW (ft)	SPT (ft)	WTE (ft)
TBLB	04/28/89	<500	<0.5	<0.5	<0.5	<0.5	---	---	---
	08/08/89	<500	<0.5	<0.5	<0.5	<0.5	---	---	---
	08/27/90	<50	<0.3	<0.3	<0.3	<0.6	---	---	---
	11/14/90	<50	<0.3	<0.3	<0.3	<0.6	---	---	---
	06/18/91	<50	<0.5	<0.5	<0.5	<0.5	---	---	---
	09/19/91	<50	<0.5	<0.5	<0.5	<0.5	---	---	---
	12/20/91	<50	<0.5	<0.5	<0.5	<0.5	---	---	---
	03/18/92	<50	<0.5	<0.5	<0.5	<0.5	---	---	---
	07/14/92	<50	<0.5	<0.5	<0.5	<0.5	---	---	---
	10/08/92	<50	<0.5	<0.5	<0.5	<0.5	---	---	---
	01/08/93	<50	<0.5	<0.5	<0.5	<0.5	---	---	---
	04/14/93	<50	<0.5	<0.5	<0.5	<0.5	---	---	---
	07/16/93	<50	<0.5	<0.5	<0.5	<0.5	---	---	---
	**09/21/93	<50	<0.5	<0.5	<0.5	<0.8	---	---	---
	01/28/94	<50	<0.5	<0.5	<0.5	<0.5	---	---	---
03/17/94	<50	<0.5	<0.5	<0.5	<0.5	---	---	---	

- TPH-G = Total petroleum hydrocarbons-as-gasoline  
DTW = Depth to groundwater  
SPT = Separate-phase hydrocarbon thickness  
WTE = Water-table elevation  
--- = Not applicable, not sampled, not measured  
\* = Uncategorized compound not included in gasoline hydrocarbon concentration.

All elevations are presented as feet above mean sea level.

Analytical results are in micrograms per liter, equivalent to parts per billion.

Top-of-casing elevations were surveyed September 21, 1993.

Data for April 28, 1989, through December 20, 1991, were taken from *Fourth Quarter 1991 Ground Water Monitoring Report*, dated January 30, 1992 (Weiss Associates).

**ATTACHMENT 3**

**Field Data Sheets**

Project Name: Chevron - Foothill Blvd.

Date: 3/17/94

Site Address: 4265 Foothill Blvd., Oakland

Page 1 of 8

Project Number: 020104102.0610

Project Manager: Tim Watchers

Well ID: MW-5 C-5

DTW Measurements:

Well Diameter: 2"

Initial: 24.57 Calc Well Volume: 3.30 gal  
Recharge: \_\_\_\_\_ Well Volume: 10 gal

Purge Method W Pump Depth \_\_\_\_\_ ft.  
 Peristaltic \_\_\_\_\_ Hand Bailed   
 Gear Drive \_\_\_\_\_ Air Lift \_\_\_\_\_  
 Submersible  Other \_\_\_\_\_

Instruments Used  
 YSI: \_\_\_\_\_ Other: \_\_\_\_\_  
 Hydac: \_\_\_\_\_  
 Omega: \_\_\_\_\_  
 Horiba

Time	Temp	Conductivity	pH	Purge Volume Gallons	Turbidity	Comments
	<input checked="" type="checkbox"/> C _____ F					
1020	21.1	.54	7.52	2	cloudy	brown
1050	18.7	.71	7.46	4	↓	↓
1053	18.8	.74	7.47	6		
1056	18.7	.73	6.91	8		
1058	18.5	.74	7.71	10		
		very sandy well				

Pump stopped hand bailed  
 too much sand

Project Name: Chevron - Foothill Blvd.

Date: 3/17/94

Site Address: 4265 Foothill Blvd., Oakland

Page 2 of 8

Project Number: 020104102.0610

Project Manager: Tim Watchers

Well ID: C-8

DTW Measurements:

Initial: 34.37

Calc Well Volume: 4 gal

Well Diameter: 2"

Recharge: \_\_\_\_\_

Well Volume: 12 gal

Purge Method \_\_\_\_\_ Pump Depth \_\_\_\_\_ ft.  
 Peristaltic \_\_\_\_\_ Hand Bailed \_\_\_\_\_  
 Gear Drive \_\_\_\_\_ Air Lift \_\_\_\_\_  
 Submersible  Other \_\_\_\_\_

Instruments Used  
 YSI: \_\_\_\_\_ Other: \_\_\_\_\_  
 Hydac: \_\_\_\_\_  
 Omega: \_\_\_\_\_  
 Hriba

Time	Temp <input checked="" type="checkbox"/> C <input type="checkbox"/> F	Conductivity	pH	Purge Volume Gallons	Turbidity	Comments
1105	19.1	.93	7.24	2		
1107	20.1	.71	7.19	4		
1109	20.3	.71	7.24	6		
1111	20.2	.89	7.45	8		
1113	20.5	.98	7.67	12		

Project Name: Chevron - Foothill Blvd.

Date: 3/17/94

Site Address: 4265 Foothill Blvd., Oakland

Page 3 of 8

Project Number: 020104102.0610

Project Manager: Tim Watchers

Well ID: C-3

DTW Measurements:

Well Diameter: 3"

Initial: 24.95

Calc Well Volume: 55 gal

Recharge: \_\_\_\_\_

Well Volume: 16 gal

Purge Method \_\_\_\_\_ Pump Depth \_\_\_\_\_ ft.  
 Peristaltic \_\_\_\_\_ Hand Bailed \_\_\_\_\_  
 Gear Drive \_\_\_\_\_ Air Lift \_\_\_\_\_  
 Submersible  Other \_\_\_\_\_

Instruments Used  
 YSI: \_\_\_\_\_ Other: \_\_\_\_\_  
 Hydac: \_\_\_\_\_  
 Omega: \_\_\_\_\_  
 Horiba

Time	Temp	Conductivity	pH	Purge Volume Gallons	Turbidity	Comments
	<input checked="" type="checkbox"/> C _____ F					
1119	19.9	1.04	6.96	3	clear	clear
1121	20.4	.78	6.85	6	↓	↓
1123	20.6	.72	7.29	9		
1125	20.6	.75	7.31	12		
1128	20.7	.82	7.32	16		





Project Name: Chevron - Foothill Blvd.

Date: 3/17/94

Site Address: 4265 Foothill Blvd., Oakland

Page 5 of 8

Project Number: 020104102.0610

Project Manager: Tim Watchers

Well ID: C-6

DTW Measurements:

Well Diameter: 2"

Initial: 32.31

Calc Well Volume: 4 gal

Recharge: \_\_\_\_\_

Well Volume: 12 gal

Purge Method \_\_\_\_\_ Pump Depth \_\_\_\_\_ ft.  
 Peristaltic \_\_\_\_\_ Hand Bailed \_\_\_\_\_  
 Gear Drive \_\_\_\_\_ Air Lift \_\_\_\_\_  
 Submersible  Other \_\_\_\_\_

Instruments Used  
 YSI: \_\_\_\_\_ Other: \_\_\_\_\_  
 Hydac: \_\_\_\_\_  
 Omega: \_\_\_\_\_

*Handed* ✓

Time	Temp	Conductivity	pH	Purge Volume Gallons	Turbidity	Comments
	<input checked="" type="checkbox"/> C _____ F					
1150	22.2	1.21	7.00	2	cloudy	dark gray
1151	22.9	1.17	7.45	4	"	"
1152	22.4	1.16	7.42	6		
1153	23.3	1.18	7.41	8		
1154	23.7	1.16	7.42	12		

Project Name: Chevron - Foothill Blvd.

Date: 3/17/12

Site Address: 4265 Foothill Blvd., Oakland

Page 6 of 8

Project Number: 020104102.0610

Project Manager: Tim Watchers

Well ID: C-7

DTW Measurements:

Initial: 33.27

Calc Well Volume: 3.5 gal

Well Diameter: 2"

Recharge: \_\_\_\_\_

Well Volume: 11 gal

Purge Method \_\_\_\_\_ Pump Depth \_\_\_\_\_ ft.  
 Peristaltic \_\_\_\_\_ Hand Bailed \_\_\_\_\_  
 Gear Drive \_\_\_\_\_ Air Lift \_\_\_\_\_  
 Submersible  Other \_\_\_\_\_

Instruments Used  
 YSI: \_\_\_\_\_ Other: \_\_\_\_\_  
 Hydac: \_\_\_\_\_  
 Omega: \_\_\_\_\_  
 Horiba

Time	Temp	Conductivity	pH	Purge Volume Gallons	Turbidity	Comments
	<u>C</u> <u>F</u>					
<u>1157</u> [redacted]	<u>20.4</u>	<u>1.29</u>	<u>7.24</u>	<u>2</u>	<u>slightly cloudy - clear</u>	
<u>1158</u> [redacted]	<u>20.5</u>	<u>1.27</u>	<u>7.42</u>	<u>4</u>	↓	
<u>1159</u> [redacted]	<u>20.5</u>	<u>1.29</u>	<u>7.50</u>	<u>6</u>	↓	
<u>1200</u> [redacted]	<u>20.5</u>	<u>1.39</u>	<u>7.45</u>	<u>8</u>	↓	
<u>1201</u> [redacted]	<u>20.6</u>	<u>1.43</u>	<u>7.44</u>	<u>11</u>	↓	↓

Project Name: Chevron - Foothill Blvd.

Date: 3/17/14

Site Address: 4265 Foothill Blvd., Oakland

Page 7 of 8

Project Number: 020104102.0610

Project Manager: Tim Watchers

Well ID: C-4

DTW Measurements:

Well Diameter: 3"

Initial: 21.35

Calc Well Volume: 7 gal

Recharge: \_\_\_\_\_

Well Volume: 21 gal

Purge Method \_\_\_\_\_ Pump Depth \_\_\_\_\_ ft.  
 Peristaltic \_\_\_\_\_ Hand Bailed \_\_\_\_\_  
 Gear Drive \_\_\_\_\_ Air Lift \_\_\_\_\_  
 Submersible  Other \_\_\_\_\_

Instruments Used  
 YSI: \_\_\_\_\_ Other: \_\_\_\_\_  
 Hydac: \_\_\_\_\_  
 Omega: \_\_\_\_\_  
 Horiba

Time	Temp ✓ C F	Conductivity	pH	Purge Volume Gallons	Turbidity	Comments
1232	19.5	1.03	7.31	5	clear	clear
1234	19.7	1.05	7.47	9	↓	↓
1236	20.0	1.04	7.34	13		
1238	19.9	1.04	7.36	18		
1240	20.8	1.06	7.36	21		

Project Name: Chevron - Foothill Blvd.

Date: 3/17/94

Site Address: 4265 Foothill Blvd., Oakland

Page 8 of 8

Project Number: 020104102.0610

Project Manager: Tim Watchers

Well ID: 0-2

DTW Measurements:

Initial: 25.99

Calc Well Volume: 33 gal

Well Diameter: 3"

Recharge: \_\_\_\_\_

Well Volume: 10 gal

Purge Method \_\_\_\_\_ Pump Depth \_\_\_\_\_ ft.  
 Peristaltic \_\_\_\_\_ Hand Bailed \_\_\_\_\_  
 Gear Drive \_\_\_\_\_ Air Lift \_\_\_\_\_  
 Submersible  Other \_\_\_\_\_

Instruments Used  
 YSI: \_\_\_\_\_ Other: \_\_\_\_\_  
 Hydac: \_\_\_\_\_  
 Omega: \_\_\_\_\_  
*Horba* ✓

Time	Temp	Conductivity	pH	Purge Volume Gallons	Turbidity	Comments
	<input checked="" type="checkbox"/> C _____ F					
1244	20.1	1.01	7.34	2	Cloudy	ET Rusty
1246	20.4	1.02	7.39	4		
1248	21.5	1.04	7.44	6		
1250	21.7	1.01	7.25	8		Failed dry at 8 gal.
				10		

**ATTACHMENT 4**

**Laboratory Report**



**Northwest Region**

4080 Pike Lane  
Suite C  
Concord, CA 94520  
(510) 685-7852  
(800) 544-3422 Inside CA  
FAX (510) 825-0720

Client Number: 020104102  
Consultant Project Number: 020104102.0610  
Facility Number: 9-0076  
Project ID: 4265 Foothill  
Oakland  
Work Order Number: C4-03-0338

March 24, 1994

Tim Watchers  
Groundwater Technology, Inc.  
4057 Port Chicago Hwy.  
Concord, CA 94520

Enclosed please find the analytical results for samples received by GTEL Environmental Laboratories, Inc. on 03/18/94.

A formal Quality Assurance/Quality Control (QA/QC) program is maintained by GTEL, which is designed to meet or exceed the EPA requirements. Analytical work for this project met QA/QC criteria, unless otherwise stated in the footnotes.

GTEL is certified by the California State Department of Health Services, Laboratory certification number E1075, to perform analyses for drinking water, wastewater, and hazardous waste materials according to EPA protocols.

If you have any questions concerning this analysis or if we can be of further assistance, please call our Customer Service Representative.

Sincerely,  
GTEL Environmental Laboratories, Inc.

A handwritten signature in cursive script, appearing to read 'Rashmi Shah', is written over the typed name.

Rashmi Shah  
Laboratory Director

Client Number: 020104102  
 Consultant Project Number: 020104102.0610  
 Facility Number: 9-0076  
 Project ID: 4265 Foothill  
 Oakland  
 Work Order Number: C4-03-0338

**ANALYTICAL RESULTS**  
**Aromatic Volatile Organics and**  
**Total Petroleum Hydrocarbons as Gasoline in Water**  
**EPA Methods 5030, 8020, and Modified 8015<sup>a</sup>**

GTEL Sample Number		01	02	03	04
Client Identification		C-5	C-8	C-3	C-1
Date Sampled		03/17/94	03/17/94	03/17/94	03/17/94
Date Analyzed		03/20/94	03/20/94	03/20/94	03/20/94
Analyte	Detection Limit, ug/L	Concentration, ug/L			
Benzene	0.5	<0.5	<0.5	2.8	42
Toluene	0.5	<0.5	<0.5	<0.5	<0.5
Ethylbenzene	0.5	<0.5	<0.5	0.6	6.7
Xylene, total	0.5	<0.5	<0.5	1.5	3.7
TPH as Gasoline	50	<50	<50	<50	460
Detection Limit Multiplier		1	1	1	1
BFB surrogate, % recovery		98.1	96.1	97.3	99.5

- a. Test Methods for Evaluating Solid Waste, SW-846, Third Edition, Revision 0, US EPA November 1986. Modification for TPH as gasoline as per California State Water Resources Board LUFT Manual procedures. Bromofluorobenzene surrogate recovery acceptability limits are 70-130%.

Client Number: 020104102  
 Consultant Project Number: 020104102.0610  
 Facility Number: 9-0076  
 Project ID: 4265 Foothill  
 Oakland  
 Work Order Number: C4-03-0338

## ANALYTICAL RESULTS

### Aromatic Volatile Organics and

### Total Petroleum Hydrocarbons as Gasoline in Water

### EPA Methods 5030, 8020, and Modified 8015<sup>a</sup>

GTEL Sample Number		05	06	07	08
Client Identification		C-6	C-7	C-4	C-2
Date Sampled		03/17/94	03/17/94	03/17/94	03/17/94
Date Analyzed		03/20/94	03/21/94	03/22/94	03/22/94
Analyte	Detection Limit, ug/L	Concentration, ug/L			
Benzene	0.5	950	1600	7800	3300
Toluene	0.5	18	210	820	1000
Ethylbenzene	0.5	61	410	820	220
Xylene, total	0.5	83	1200	1800	3500
TPH as Gasoline	50	5100	17000	32000	16000
Detection Limit Multiplier		1	25	50	50
BFB surrogate, % recovery		111	97.4	95.7	95.6

- a. Test Methods for Evaluating Solid Waste, SW-846, Third Edition, Revision 0, US EPA November 1986. Modification for TPH as gasoline as per California State Water Resources Board LUFT Manual procedures. Bromofluorobenzene surrogate recovery acceptability limits are 70-130%.



Client Number: 020104102  
 Consultant Project Number: 020104102.0610  
 Facility Number: 9-0076  
 Project ID: 4265 Foothill  
 Oakland  
 Work Order Number: C4-03-0338

## ANALYTICAL RESULTS

### Aromatic Volatile Organics and

### Total Petroleum Hydrocarbons as Gasoline in Water

### EPA Methods 5030, 8020, and Modified 8015<sup>a</sup>

GTEL Sample Number		09	Q032094		
Client Identification		TB	METHOD BLANK		
Date Sampled		03/17/94	--		
Date Analyzed		03/20/94	03/20/94		
Analyte	Detection Limit, ug/L	Concentration, ug/L			
Benzene	0.5	<0.5	<0.5		
Toluene	0.5	<0.5	<0.5		
Ethylbenzene	0.5	<0.5	<0.5		
Xylene, total	0.5	<0.5	<0.5		
TPH as Gasoline	50	<50	<50		
Detection Limit Multiplier		1	1		
BFB surrogate, % recovery		95.9	95.3		

- a. Test Methods for Evaluating Solid Waste, SW-846, Third Edition, Revision 0, US EPA November 1986. Modification for TPH as gasoline as per California State Water Resources Board LUFT Manual procedures. Bromofluorobenzene surrogate recovery acceptability limits are 70-130%.

Client Number: 020104102  
 Consultant Project Number: 020104102.0610  
 Facility Number: 9-0076  
 Project ID: 4265 Foothill  
 Oakland  
 Work Order Number: C4-03-0338

### QC Matrix Spike and Duplicate Spike Results

Matrix: Water

Analyte	Sample ID	Spike Amount	Units	Recovery, %	Duplicate Recovery, %	RPD, %	Control Limits
<b>Modified EPA 8020:</b>							
Benzene	C4030338-01	20.0	ug/L	87.0	92.5	6.2	57.3 - 138
Toluene	C4030338-01	20.0	ug/L	88.5	91.0	2.8	63.0 - 134
Ethylbenzene	C4030338-01	20.0	ug/L	92.0	93.5	1.6	59.3 - 137
Xylene, total	C4030338-01	60.0	ug/L	96.5	100	3.6	59.3 - 144

Fax copy of Lab Report and COC to Chevron Contact:  Yes  No

# Chain-of-Custody-Report

Chevron U.S.A. Inc.  
 P.O. Box 5034  
 San Ramon, CA 94583  
 FAX: (415) 542-9581

Chevron Facility Number: 4-0276 ✓  
 Facility Address: 4415 Fruitland Ave ✓  
 Executive Project Number: 4415 Fruitland Ave ✓  
Environmental Technology Inc. ✓  
1201 West Chicago Hwy, Concord, CA 94520 ✓  
 Project Contact (Name): Tim Watchers ✓  
 (Phone) 510-671-2387 (Fax Number)

Chevron Contact (Name): Mark Miller  
 (Phone): (510) 842-8189  
 Laboratory Name: GTT  
 Laboratory Release Number: 12-1-100  
 Samples Collected by (Name): Tim Watchers  
 Collection Date: 3/17/94  
 Signature: [Signature]

Sample Number	Lab Sample Number	Number of Containers	Matrix S = Soil A = Air W = Water C = Charcoal	Type C = Grab C = Composite D = Discrete	Time	Sample Preservation	Lead (Yes or No)	Analyses To Be Performed										Remarks			
								BTEX + TPH GUS (8020 + 8015)	TPH Diesel (8015)	Oil and Grease (5520)	Purgeable Hydrocarbons (8010)	Purgeable Aromatics (8020)	Purgeable Organics (8240)	Extractable Organics (8270)	Metals Cd, Cr, Pb, Zn, Ni (ICAP or AA)						
C-5	01	3	W	G	1330	HCL	X	X													
C-8	02				1330																
C-3	03				1340																
C-1	04				1357																
C-4	05				1400																
C-7	06				1410																
C-4	07				1420																
C-2	08	V	V	V	1430	V	V	V													
TB	09	1	W	G	1310	HCL	X	X													

NOTE:  
 Do NOT BILL  
 TB-LB SAMPLES  
 40 seals intact

F-2  
 C4030338

Acquired By (Signature): <u>[Signature]</u>	Organization: <u>GTT</u>	Date/Time: <u>3-18-94</u>	Received By (Signature): <u>[Signature]</u>	Organization: <u>GTT</u>	Date/Time: <u>3-18-94</u>
Acquired By (Signature): <u>[Signature]</u>	Organization: <u>GTT</u>	Date/Time: <u>3-18-94</u>	Received By (Signature): <u>[Signature]</u>	Organization: <u>GTEL</u>	Date/Time: <u>3-18-94</u>
Acquired By (Signature): <u>[Signature]</u>	Organization: <u>GTEL</u>	Date/Time: <u>3-18-94</u>	Received For Laboratory By (Signature): <u>[Signature]</u>	Organization: <u>GTEL</u>	Date/Time: <u>3/18/94 10:00</u>

Turn Around Time (Circle Choice)

- 24 Hrs.
- 48 Hrs.
- 6 Days
- 10 Days
- As Controlled