

GROUNDWATER TECHNOLOGY, INC.

SEP 2 '93 J.M.M.

4057 Port Chicago Highway, Concord, CA 94520 (415) 671-2387

FAX: (415) 685-9148

August 25, 1993

Project No. 020204102

Mr. Mark Miller
Chevron U.S.A. Products Company
2410 Camino Ramon
San Ramon, CA 94583-0804

SUBJECT: Groundwater Monitoring and Sampling Activities
Chevron Service Station No. 9-0076
4265 Foothill Boulevard, Oakland, California

Dear Mr. Miller:

Groundwater Technology, Inc. presents the attached quarterly groundwater monitoring and sampling data collected on July 16 and July 27, 1993. Eight groundwater wells were gauged to measure depth to groundwater (DTW) and to check for separate-phase hydrocarbons. Separate-phase hydrocarbons were not detected in the monitoring wells. Monitoring well C-1 was not gauged or sampled on July 16, 1993, because the lock was inoperable but was monitored and sampled on July 27. A potentiometric surface map (Figure 1) and a summary of groundwater monitoring data (Table 1) are presented in Attachments 1 and 2, respectively. After the DTW was measured, each monitoring well, except C-1, was purged and sampled. The groundwater samples were analyzed for benzene, toluene, ethylbenzene, and total xylenes and total petroleum hydrocarbons-as-gasoline. Results of the chemical analyses are summarized in Table 1. The laboratory report and chain-of-custody record are included in Attachment 3. Monitoring-well purge water was transported by Groundwater Technology to the Chevron Terminal in Richmond, California, for recycling.

Groundwater Technology is pleased to assist Chevron on this project. If you have any questions or comments, please contact our Concord office at (510) 671-2387.

Sincerely,
Groundwater Technology, Inc.
Written/Submitted by

Groundwater Technology, Inc.
Reviewed/Approved by



Tim Watchers
Project Geologist



David R. Kleesattel
Registered Geologist
No. 5136

For:
Wendell Lattz
Vice President, General Manager
West Region

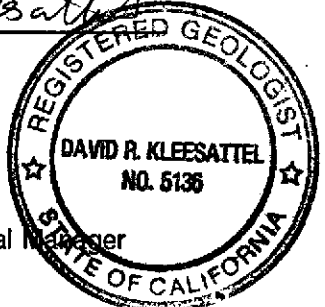

Attachment 1 Figure
Attachment 2 Table
Attachment 3 Laboratory Report

4102R023.020

ATTACHMENT 1

Figure

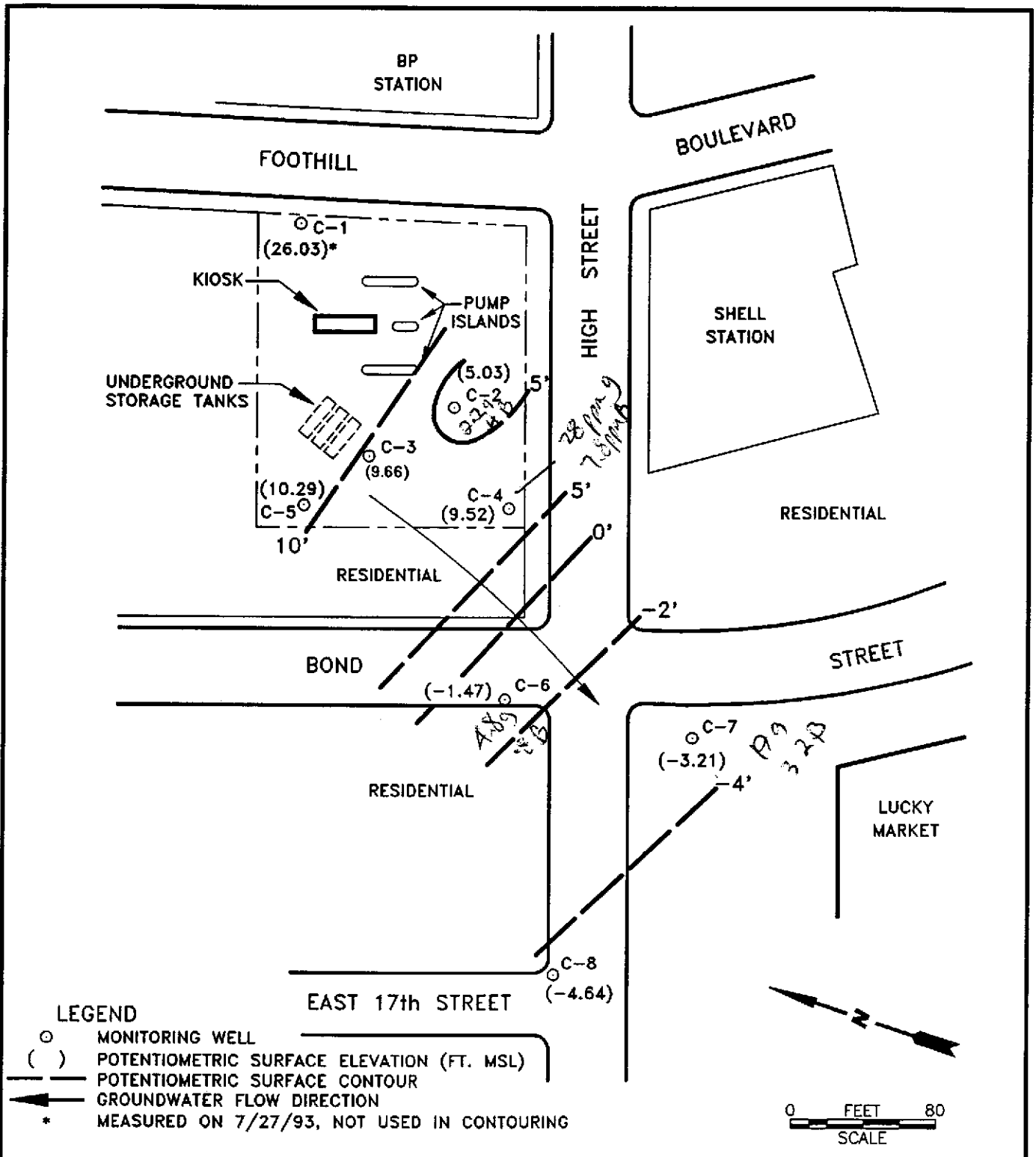

		GROUNDWATER TECHNOLOGY 4057 PORT CHICAGO HWY CONCORD, CA 94520 (510) 671-2387		POTENTIOMETRIC SURFACE MAP (7/16/93)		
CLIENT: CHEVRON U.S.A. PRODUCTS Co. SERVICE STATION No. 9-0076			LOCATION: 4265 FOOTHILL BLVD. OAKLAND, CALIFORNIA		REV. NO.: 0	DATE: 8/19/93
PM: <i>JAW</i>	PE/RC: <i>DRK</i>	DESIGNED: TW	DETAILED: ML	ACAD FILE: PSM71693/SP392	PROJECT NO.: 020204098	FIGURE: 1

ATTACHMENT 2

Table

TABLE 1
HISTORICAL GROUNDWATER ANALYTICAL RESULTS AND MONITORING DATA
Chevron Service Station No. 9-0076
4265 Foothill Boulevard, Oakland, California

Well ID/ Elev	Date	TPH-G	Benzene	Toluene	Ethyl- benzene	Xylenes	DTW (ft)	SPT (ft)	WTE (ft)
C-1 35.42	04/28/89a	940	30	1.3	11	13	20.05	0.00	15.37
	08/08/89a	820	45	2	13	13	24.07	0.00	11.35
	12/21/89	---	---	---	---	---	22.81	0.00	12.61
	08/27/90	440	15	1	6	13	22.12	0.00	13.30
	11/04/90	---	---	---	---	---	25.56	0.00	9.86
	06/18/91	74	5.6	0.6	1.9	1.3	21.64	0.00	13.78
	09/19/91	150	7.1	<0.5	2.3	3	24.58	0.00	10.84
	12/20/91	250	10	<0.5	3.7	1.6	26.17	0.00	9.25
	03/18/92	190	16	<0.5	8.5	2.9	18.25	0.00	17.17
	07/14/92	20,000	480	2,200	510	2,900	27.61	0.00	7.81
	10/08/92	360	34	4.6	19	12	24.44	0.00	10.98
	01/08/93	120	9.1	0.5	5.1	1.8	19.68	0.00	15.74
	04/14/93	190	74	0.6	1	2	16.38	0.00	19.04
	07/16/93	---	---	---	---	---	---	---	---
	07/27/93	300	12	<0.5	5	2	9.39	0.00	26.03
C-2 35.18	04/28/89a	120,000	30,000	22,000	3,000	17,000	26.44	0.00	8.74
	08/08/89a	---	---	---	---	---	29.90	0.01	5.29
	12/21/89	---	---	---	---	---	29.32	0.00	5.86
	08/27/90	---	---	---	---	---	29.55	0.17	5.77
	11/04/90	---	---	---	---	---	30.47	0.00	4.71
	06/18/91	---	---	---	---	---	28.33	0.06	6.90
	09/19/91	---	---	---	---	---	29.39	0.06	5.84
	12/20/91	170,000	20,000	10,000	2,800	19,000	29.23	0.00	5.95
	03/18/92	---	---	---	---	---	13.60	0.09	21.58
	07/14/92	---	---	---	---	---	---	---	---
	10/08/92	---	---	---	---	---	---	---	---
	01/08/93	79,000	14,000	7,200	3,500	16,000	24.20	Sheen	10.98
	04/14/93	---	---	---	---	---	---	---	---
	07/16/93	2,200	440	73	24	350	30.15	0.00	5.03

TABLE 1
HISTORICAL GROUNDWATER ANALYTICAL RESULTS AND MONITORING DATA
Chevron Service Station No. 9-0076
4265 Foothill Boulevard, Oakland, California

Well ID/ Elev	Date	TPH-G	Benzene	Toluene	Ethyl- benzene	Xylenes	DTW (ft)	SPT (ft)	WTE (ft)
C-3 35.28 35.30	04/28/89a	<500	1.7	<0.5	<0.5	<0.5	28.00	0.00	7.28
	08/08/89a	<500	1	<0.5	<0.5	<0.5	30.00	0.00	5.28
	12/21/89	—	—	—	—	—	30.53	0.00	4.75
	08/27/90	<50	<0.3	<0.3	<0.3	<0.6	29.68	0.00	5.60
	11/04/90	—	—	—	—	—	30.36	0.00	4.94
	06/18/91	52	1.1	<0.5	<0.5	1.2	28.46	0.00	6.84
	09/19/91	73	1.2	<0.5	<0.5	<0.5	29.33	0.00	5.97
	12/20/91	<50	0.7	<0.5	<0.5	<0.5	29.77	0.00	5.53
	03/18/92	<50	<0.5	<0.5	<0.5	<0.5	25.75	0.00	9.55
	07/14/92	<50	<0.5	<0.5	<0.5	<0.5	27.87	0.00	7.43
	10/08/92	<50	<0.5	<0.5	<0.5	0.5	28.55	0.00	6.75
	01/08/93	<50	<0.5	<0.5	<0.5	<0.5	25.85	0.00	9.45
	04/14/93	<50	<0.5	<0.5	<0.5	<0.5	23.96	0.00	11.34
	07/16/93	<50	<0.5	<0.5	<0.5	<0.5	25.64	0.00	9.66
C-4 33.45 33.48	01/12/89a	—	—	—	—	—	29.49	0.00	3.96
	04/12/89a	—	—	—	—	—	27.44	0.00	6.01
	04/28/89	20,000	6,300	550	230	1,500	29.49	0.00	3.96
	08/08/89a	8,000	7,500	340	88	1,000	29.55	0.00	3.90
	12/21/89	—	—	—	—	—	30.02	0.00	3.43
	08/27/90	26,000	10,000	280	410	1,400	29.02	0.00	4.46
	11/04/90	—	—	—	—	—	29.81	0.00	3.67
	06/18/91	34,000	14,000	410	450	1,300	27.45	0.00	6.03
	09/19/91	16,000	7,400	90	110	460	28.65	0.00	4.83
	12/20/91	24,000	12,000	120	260	740	28.84	0.00	4.64
	03/18/92	48,000	6,000	1,300	1,300	2,400	24.43	0.00	11.05
	07/14/92	40,000	14,000	920	550	2,400	26.89	0.00	6.59
	10/08/92	29,000	13,000	190	110	1,400	27.79	0.00	5.69
	01/08/93	25,000	7,000	630	860	1,800	23.50	0.00	9.98
04/14/93	*27,000	6,300	1,000	900	1,400	21.13	0.00	12.35	
07/16/93	28,000	7,800	1,100	830	2,100	23.96	0.00	9.52	

TABLE 1
HISTORICAL GROUNDWATER ANALYTICAL RESULTS AND MONITORING DATA
Chevron Service Station No. 9-0076
4265 Foothill Boulevard, Oakland, California

Well ID/ Elev	Date	TPH-G	Benzene	Toluene	Ethyl- benzene	Xylenes	DTW (ft)	SPT (ft)	WTE (ft)
C-5 35.50	08/27/90	<50	<0.3	<0.3	<0.3	<0.6	29.83	0.00	5.67
	11/14/90	---	---	---	---	---	30.56	0.00	4.94
	06/18/91	<50	<0.5	<0.5	<0.5	<0.5	28.52	0.00	6.98
	09/19/91	<50	<0.5	<0.5	<0.5	<0.5	29.51	0.00	5.99
	12/20/91	<50	<0.5	<0.5	<0.5	<0.5	29.96	0.00	5.54
	03/18/92	<50	<0.5	<0.5	<0.5	<0.5	25.92	0.00	9.58
	07/14/92	<50	<0.5	<0.5	<0.5	<0.5	28.00	0.00	7.50
	10/08/92	<50	<0.5	<0.5	<0.5	<0.5	28.65	0.00	6.85
	01/08/93	<50	<0.5	<0.5	<0.5	<0.5	26.02	0.00	9.48
	04/14/93	<50	<0.5	<0.5	<0.5	<0.5	24.04	0.00	11.46
07/16/93	<50	<0.5	<0.5	<0.5	<0.5	25.21	0.00	10.29	
C-6 32.40	08/27/90	7,200	2,100	6	41	300	44.11	0.00	-11.71
	11/14/90	---	---	---	---	---	44.03	0.00	-11.63
	06/18/91	4,400	2,500	18	160	77	43.49	0.00	-11.09
	09/19/91	3,100	1,600	8.3	73	8	34.32	0.00	-1.92
	12/20/91	4,400	1,300	3.2	74	10	41.35	0.00	-8.95
	03/18/92	9,800	3,200	34	250	500	40.69	0.00	-8.29
	07/14/92	6,500	2,200	100	96	240	38.89	0.00	-6.49
	10/08/92	1,800	1,000	3.1	15	41	38.67	0.00	-6.27
	01/08/93	5,200	1,600	6.8	63	120	37.81	0.00	-5.41
	04/14/93	11,000	1,800	13	110	200	34.70	0.00	-2.30
07/16/93	4,800	820	10	41	57	33.87	0.00	-1.47	

TABLE 1
HISTORICAL GROUNDWATER ANALYTICAL RESULTS AND MONITORING DATA
Chevron Service Station No. 9-0076
4265 Foothill Boulevard, Oakland, California

Well ID/ Elev	Date	TPH-G	Benzene	Toluene	Ethyl- benzene	Xylenes	DTW (ft)	SPT (ft)	WTE (ft)
C-7 32.17	08/27/90	110	26	0.8	4	6	44.23	0.00	-12.06
	11/14/90	—	—	—	—	—	44.11	0.00	-11.94
	06/18/91	23,000	5,700	420	1,000	2,800	42.05	0.00	-9.88
	09/19/91	26,000	4,600	330	970	2,400	41.72	0.00	-9.55
	12/20/91	33,000	5,500	270	1,000	2,100	41.67	0.00	-9.50
	03/18/92	27,000	5,800	410	1,300	3,300	41.20	0.00	-9.03
	07/14/92	46,000	12,000	720	1,700	4,600	39.77	0.00	-7.60
	10/08/92	22,000	6,800	370	1,300	3,200	39.14	0.00	-6.97
	01/08/93	36,000	7,600	540	1,700	4,200	38.50	0.00	-6.33
	04/14/93	23,000	3,100	450	670	1,900	35.93	0.00	-3.76
07/16/93	19,000	3,200	330	550	1,800	35.38	0.00	-3.21	
C-8 30.68	11/14/90	<50	<0.3	<0.3	<0.3	<0.6	43.29	0.00	-12.61
	06/18/91	<50	<0.5	<0.5	<0.5	<0.5	42.62	0.00	-11.94
	09/19/91	<50	<0.5	<0.5	<0.5	<0.5	41.72	0.00	-11.04
	12/20/91	<50	<0.5	<0.5	<0.5	<0.5	40.98	0.00	-10.30
	03/18/92	<50	<0.5	<0.5	<0.5	<0.5	40.02	0.00	-9.34
	07/14/92	<50	<0.5	<0.5	<0.5	<0.5	39.02	0.00	-8.34
	10/08/92	<50	<0.5	<0.5	<0.5	1.1	38.68	0.00	-8.00
	01/08/93	<50	<0.5	<0.5	<0.5	<0.5	38.07	0.00	-7.39
	04/14/93	<50	<0.5	<0.5	<0.5	<0.5	35.99	0.00	-5.31
07/16/93	<50	<0.5	<0.5	<0.5	<0.5	35.32	0.00	-4.64	

TABLE 1
HISTORICAL GROUNDWATER ANALYTICAL RESULTS AND MONITORING DATA
Chevron Service Station No. 9-0076
4265 Foothill Boulevard, Oakland, California

Well ID/ Elev	Date	TPH-G	Benzene	Toluene	Ethyl- benzene	Xylenes	DTW (ft)	SPT (ft)	WTE (ft)
Trip Blank	04/28/89	<500	<0.5	<0.5	<0.5	<0.5	—	—	—
	08/08/89	<500	<0.5	<0.5	<0.5	<0.5	—	—	—
	08/27/90	<50	<0.3	<0.3	<0.3	<0.6	—	—	—
	11/14/90	<50	<0.3	<0.3	<0.3	<0.6	—	—	—
	06/18/91	<50	<0.5	<0.5	<0.5	<0.5	—	—	—
	09/19/91	<50	<0.5	<0.5	<0.5	<0.5	—	—	—
	12/20/91	<50	<0.5	<0.5	<0.5	<0.5	—	—	—
	03/18/92	<50	<0.5	<0.5	<0.5	<0.5	—	—	—
	07/14/92	<50	<0.5	<0.5	<0.5	<0.5	—	—	—
	10/08/92	<50	<0.5	<0.5	<0.5	<0.5	—	—	—
	01/08/93	<50	<0.5	<0.5	<0.5	<0.5	—	—	—
	04/14/93	<50	<0.5	<0.5	<0.5	<0.5	—	—	—
	07/16/93	<50	<0.5	<0.5	<0.5	<0.5	—	—	—

- TPH-G = Total petroleum hydrocarbons-as-gasoline
DTW = Depth to groundwater
SPT = Separate-phase hydrocarbon thickness
WTE = Water-table elevation
— = Not applicable, not sampled, not measured
a = Water elevations measured to grade
* = Uncategorized compound not included in gasoline hydrocarbon concentration.

All elevations are presented as feet above mean sea level.

Analytical results are in micrograms per liter, equivalent to parts per billion.

Top-of-casing elevations were surveyed January 3, 1990, and August 21, 1990.

Data for April 28, 1989, through December 20, 1991, were taken from Fourth Quarter 1991 Ground Water Monitoring Report, dated January 30, 1992 (Weiss Associates).

ATTACHMENT 3

Laboratory Report



4080 Pike Lane
Concord, CA 94520
(510) 685-7852
(800) 544-3422 Inside CA
(800) 423-7143 Outside CA
(510) 825-0720 FAX

Client Number: 020204102
Project ID: 4265 Foothill Blvd.
Oakland
Work Order Number: C3-07-0421

August 9, 1993

Nicole Merchant
Groundwater Technology, Inc.
4057 Port Chicago Hwy.
Concord, CA 94520

Enclosed please find the analytical results for samples received by GTEL Environmental Laboratories, Inc. on 07/23/93.

A formal Quality Assurance/Quality Control (QA/QC) program is maintained by GTEL, which is designed to meet or exceed the EPA requirements. Analytical work for this project met QA/QC criteria, unless otherwise stated in the footnotes.

GTEL is certified by the California State Department of Health Services, Laboratory certification number E1075, to perform analyses for drinking water, wastewater, and hazardous waste materials according to EPA protocols.

If you have any questions concerning this analysis or if we can be of further assistance, please call our Customer Service Representative.

Sincerely,
GTEL Environmental Laboratories, Inc.

Eileen F. Bullen - INORGANICS
GROUP
LABOR

Eileen F. Bullen
Laboratory Director

Client Number: 020204102
 Project ID: 4265 Foothill Blvd.
 Oakland
 Work Order Number: C3-07-0421

Table 1

ANALYTICAL RESULTS

**Aromatic Volatile Organics and
 Total Petroleum Hydrocarbons as Gasoline in Water**

EPA Methods 5030, 8020, and Modified 8015^a

GTEL Sample Number		01	03	080493 GCE	
Client Identification		TB-LB	C1	METHOD BLANK	
Date Sampled		07/27/93	07/27/93	--	
Date Analyzed		08/04/93	08/05/93	08/04/93	
Analyte	Detection Limit, ug/L	Concentration, ug/L			
Benzene	0.5	<0.5	12	<0.5	
Toluene	0.5	<0.5	<0.5	<0.5	
Ethylbenzene	0.5	<0.5	5	<0.5	
Xylene, total	0.5	<0.5	2	<0.5	
BTEX, total	--	--	19	--	
TPH as Gasoline	50	<50	300	<50	
Detection Limit Multiplier		1	1	1	
BFB surrogate, % recovery		110	113	99.6	

- a. Test Methods for Evaluating Solid Waste, SW-846, Third Edition, Revision 0, US EPA November 1986. Modification for TPH as gasoline as per California State Water Resources Control Board LUFT Manual protocols, May 1988 revision. Bromofluorobenzene surrogate recovery acceptability limits are 70 - 130%.

Client Number: 020204102
Project ID: 4265 Foothill Blvd.
Oakland
Work Order Number: C3-07-0421

QC Matrix Spike and Duplicate Spike Results

Matrix: Water

Analyte	Sample ID	Spike Amount	Units	Recovery, %	Duplicate Recovery, %	RPD, %	Control Limits
Modified EPA 8020:							
Benzene	C3070398-05	20.0	ug/L	93.5	104	10.6	55 - 129
Toluene	C3070398-05	20.0	ug/L	90.5	104	13.9	72 - 149
Ethylbenzene	C3070398-05	20.0	ug/L	87.0	103	16.8	75 - 138
Xylene, total	C3070398-05	60.0	ug/L	86.8	90.0	3.6	74 - 147

Chevron U.S.A. Inc.
P.O. BOX 5004
San Ramon, CA 94583
FAX (415)842-9591

Chevron Facility Number 9-0076
Facility Address 4265 Foothill Blvd., Oakland
Consultant Project Number 02020 4102 061099
Consultant Name Groundwater Technology
Address 4057 Port Chicago Highway
Project Contact (Name) Nicole Merchant
(Phone) 671-2387 (Fax Number) 685-9148

Chevron Contact (Name) Mark Miller
(Phone) 842-8134
Laboratory Name GT&L
Laboratory Release Number 876-6690
Samples Collected by (Name) Greg MASON
Collection Date 7/27-93
Signature [Signature]

Sample Number	Lab Sample Number	Number of Containers	Matrix S = Soil W = Water A = Air C = Chloroform	Type G = Grab C = Composite D = Discrete	Time	Sample Preservation	Iced (Yes or No)	Analytes To Be Performed													Remarks			
								BTX + TPH GAS (8020 + 8015)	TPH Diesel (8015)	Oil and Greases (5520)	Purgeable Hydrocarbons (8010)	Purgeable Aromatics (8020)	Purgeable Organics (8240)	Extractable Organics (8270)	Metals Cd, Cr, Pb, Zn, Ni (1049 or 10)									
TB-LB	01	2	W	G		HCl	yes	X															SEAN - INSTAT ON IC&AS 6°C 7/27/93 <u>(15)</u> Remarks	
RB-C1	02	1																						
C1	03	2	↓	↓	11:45	↓	↓	X																

BTC 08/10/93
J. [Signature]

C3070421

Relinquished By (Signature) <u>[Signature]</u>	Organization <u>GT&L</u>	Date/Time <u>7/27</u>	Received By (Signature)	Organization	Date/Time	Turn Around Time (Circle Choice) 24 Hrs. 48 Hrs. 5 Days 10 Days <u>As Contracted</u>
Relinquished By (Signature)	Organization	Date/Time	Received By (Signature)	Organization	Date/Time	
Relinquished By (Signature)	Organization	Date/Time	Received For Laboratory By (Signature) <u>[Signature]</u>	Organization	Date/Time <u>7/27/93</u>	



4080 Pike Lane
Concord, CA 94520
(510) 685-7852
(800) 544-3422 Inside CA
(800) 423-7143 Outside CA
(510) 825-0720 FAX

Client Number: 020204102
Consultant Project Number: 020204102
Facility Number: 9-0076
Project ID: 4265 Foothill Blvd.
Work Order Number: C3-07-0282

July 30, 1993

Nicole Merchant
Groundwater Technology, Inc.
4057 Port Chicago Highway
Concord, CA 94520

Enclosed please find the analytical results for samples received by GTEL Environmental Laboratories, Inc. on 07/19/93.

A formal Quality Assurance/Quality Control (QA/QC) program is maintained by GTEL, which is designed to meet or exceed the EPA requirements. Analytical work for this project met QA/QC criteria, unless otherwise stated in the footnotes.

GTEL is certified by the California State Department of Health Services, Laboratory certification number E1075, to perform analyses for drinking water, wastewater, and hazardous waste materials according to EPA protocols.

If you have any questions concerning this analysis or if we can be of further assistance, please call our Customer Service Representative.

Sincerely,
GTEL Environmental Laboratories, Inc.

 - Inorganics
Group
LABOR

Eileen F. Bullen
Laboratory Director

Client Number: 020204102
 Consultant Project Number: 020204102
 Facility Number: 9-0076
 Project ID: 4265 Foothill Blvd.
 Work Order Number: C3-07-0282

Table 1

ANALYTICAL RESULTS

**Aromatic Volatile Organics and
 Total Petroleum Hydrocarbons as Gasoline in Water**

EPA Methods 5030, 8020, and Modified 8015^a

GTEL Sample Number		01	03	05	07
Client Identification		TB-LB	C5	C8	C3
Date Sampled		07/16/93	07/16/93	07/16/93	07/16/93
Date Analyzed		07/26/93	07/26/93	07/26/93	07/26/93
Analyte	Detection Limit, ug/L	Concentration, ug/L			
Benzene	0.5	<0.5	<0.5	<0.5	<0.5
Toluene	0.5	<0.5	<0.5	<0.5	<0.5
Ethylbenzene	0.5	<0.5	<0.5	<0.5	<0.5
Xylene, total	0.5	<0.5	<0.5	<0.5	<0.5
BTEX, total	--	--	--	--	--
TPH as Gasoline	50	<50	<50	<50	<50
Detection Limit Multiplier		1	1	1	1
BFB surrogate, % recovery		98.5	90.7	90.8	83.9

- a. Test Methods for Evaluating Solid Waste, SW-846, Third Edition, Revision 0, US EPA November 1986. Modification for TPH as gasoline as per California State Water Resources Control Board LUFT Manual protocols, May 1988 revision. Bromofluorobenzene surrogate recovery acceptability limits are 70 - 130%.

Client Number: 020204102
 Consultant Project Number: 020204102
 Facility Number: 9-0076
 Project ID: 4265 Foothill Blvd.
 Work Order Number: C3-07-0282

Table 1 (Continued)

ANALYTICAL RESULTS

**Aromatic Volatile Organics and
 Total Petroleum Hydrocarbons as Gasoline in Water**

EPA Methods 5030, 8020, and Modified 8015^a

GTEL Sample Number		11	13	15	17
Client Identification		C6	C7	C4	C2
Date Sampled		07/16/93	07/16/93	07/16/93	07/16/93
Date Analyzed		07/29/93	07/28/93	07/29/93	07/29/93
Analyte	Detection Limit, ug/L	Concentration, ug/L			
Benzene	0.5	820	3200	7800	440
Toluene	0.5	10	330	1100	73
Ethylbenzene	0.5	41	550	830	24
Xylene, total	0.5	57	1800	2100	350
BTEX, total	--	930	5900	12000	890
TPH as Gasoline	50	4800	19000	28000	2200
Detection Limit Multiplier		1	50	25	1
BFB surrogate, % recovery		87.9	85.0	77.5	86.4

a. Test Methods for Evaluating Solid Waste, SW-846, Third Edition, Revision 0, US EPA November 1986. Modification for TPH as gasoline as per California State Water Resources Control Board LUFT Manual protocols, May 1988 revision. Bromofluorobenzene surrogate recovery acceptability limits are 70 - 130%.

Client Number: 020204102
 Consultant Project Number: 020204102
 Facility Number: 9-0076
 Project ID: 4265 Foothill Blvd.
 Work Order Number: C3-07-0282

Table 1 (Continued)

ANALYTICAL RESULTS

**Aromatic Volatile Organics and
 Total Petroleum Hydrocarbons as Gasoline in Water**

EPA Methods 5030, 8020, and Modified 8015^a

GTEL Sample Number		072693Q			
Client Identification		METHOD BLANK			
Date Sampled		--			
Date Analyzed		07/26/93			
Analyte	Detection Limit, ug/L	Concentration, ug/L			
Benzene	0.5	<0.5			
Toluene	0.5	<0.5			
Ethylbenzene	0.5	<0.5			
Xylene, total	0.5	<0.5			
BTEX, total	--	--			
TPH as Gasoline	50	<50			
Detection Limit Multiplier		1			
BFB surrogate, % recovery		96.0			

- a. Test Methods for Evaluating Solid Waste, SW-846, Third Edition, Revision 0, US EPA November 1986. Modification for TPH as gasoline as per California State Water Resources Control Board LUFT Manual protocols, May 1988 revision. Bromofluorobenzene surrogate recovery acceptability limits are 70 - 130%.

Client Number: 020204102
Consultant Project Number: 020204102
Facility Number: 9-0076
Project ID: 4265 Foothill Blvd.
Work Order Number: C3-07-0282

QC Matrix Spike and Duplicate Spike Results

Matrix: Water

Analyte	Sample ID	Spike Amount	Units	Recovery, %	Duplicate Recovery, %	RPD, %	Control Limits
Modified EPA 8020:							
Benzene	C3070308-04	20.0	ug/L	87.0	88.0	1.1	55 - 129
Toluene	C3070308-04	20.0	ug/L	89.0	84.0	5.8	72 - 149
Ethylbenzene	C3070308-04	20.0	ug/L	75.0	72.0	4.1	75 - 138
Xylene, total	C3070308-04	60.0	ug/L	90.0	87.0	3.4	74 - 147

Fax copy of Lab Report and COC to Chevron Contact: Yes No

Chain-of-Custody-Record

Chevron U.S.A. Inc.
P.O. BOX 5004
San Ramon, CA 94583
FAX (415)842-9591

Chevron Facility Number 9-0096
Facility Address 4265 Foothill Blvd
Consultant Project Number 020204102
Consultant Name Groundwater Technology, Inc.
Address 4057 Port Chicago Hwy, Concord, CA 94520
Project Contact (Name) Nicole Merchant
(Phone) 671-2387 (Fax Number) 685-9148

Chevron Contact (Name) Mr. Mark Miller
(Phone) 842-8134
Laboratory Name GTEL
Laboratory Release Number 876-6690
Samples Collected by (Name) Hector Merino
Collection Date 7/16/93
Signature [Signature]

Sample Number	Lab Sample Number	Number of Containers	Matrix S = Soil W = Water A = Air C = Charcoal	Type C = Grab C = Composite D = Discrete	Time	Sample Preservation	Iced (Yes or No)	Analyses To Be Performed										Remarks
								BTEX + TPH GAS (8020 + 8015)	TPH Diesel (8015)	Oil and Grease (5520)	Purgeable Halocarbons (8010)	Purgeable Aromatics (8020)	Purgeable Organics (8240)	Extractable Organics (8270)	Metals Cd, Cr, Pb, Zn, Ni (ICAP or AA)	Hold		
TB-LB	01	1	W	G		Hel	YES	X										TB-LB Do Not Bill Pg 1-2
RBC5	02	1			200													SEALS / INSTRUCTIONS ON ICE AS PER 7/19/93 (BSC)
C5	03	3			200			X										
RBC8	04	1			210													
C8	05	13			210			X										
RBC3	06	1			220													
C3	07	13			220			X										
RBC1	08	1			230													
C1	09	3			230			X										
RBC6	10	1			280													
C6	11	3			290			(X)										
RBC7	12	1			240													
C7	13	3			240			(X)										

Relinquished By (Signature)	Organization	Date/Time	Received By (Signature)	Organization	Date/Time
[Signature]	GTEL	7/19/93	[Signature]		
Relinquished By (Signature)	Organization	Date/Time	Received By (Signature)	Organization	Date/Time
Relinquished By (Signature)	Organization	Date/Time	Received For Laboratory By (Signature)	Organization	Date/Time
			[Signature]		7/19/93

Turn Around Time (Circle Choice)

24 Hrs.
48 Hrs.
5 Days
10 Days
As Contracted

COC-3.0/MS/CU/12/1/93

