



**Chevron**

June 17, 1993

**Chevron U.S.A. Products Company**  
2410 Camino Ramon  
San Ramon, CA 94583

**Marketing Department**  
Phone 510 842 9500

Mr. Barney Chan  
Alameda County Health Care Services  
Department of Environmental Health  
80 Swan Way, Room 200  
Oakland, CA 94621

#103  
←

**Re: Chevron Service Station #9-0076**  
**4265 Foothill Boulevard, Oakland, CA**

Dear Mr. Chan:

Enclosed is the Groundwater Monitoring and Sampling Activities report dated May 12, 1993, prepared by our consultant Groundwater Technology, Inc. for the above referenced site. As indicated in the report, groundwater samples collected were analyzed for total petroleum hydrocarbons as gasoline (TPH-G) and BTEX. Benzene was detected only in monitor wells C-1, C-4, C-6, and C-7 at concentrations of 74, 6300, 1800, and 3100 ppb, respectively.

Depth to groundwater was measured at approximately 16.4 to 36.0 feet below grade. The depth to ground water data presented in the enclosed report has been contoured on the potentiometric surface map to show one continuous flow direction towards the southwest. This map reflects Chevron's current understanding of the ground water depth and movement beneath the site.

As we discussed by telephone on June 15, 1993, Chevron will further evaluate remedial strategies at this site with its consultants to devise a remedial work plan which adequately addresses containment and/or remediation of hydrocarbon impacted ground water. I will contact you by phone within the next week to keep you apprised of our progress.

Chevron will continue to monitor and sample all wells at this site on a quarterly basis.

If you have any questions or comments, please do not hesitate to contact me at (510) 842-8134.

Very truly yours,  
CHEVRON U.S.A. PRODUCTS COMPANY

Mark A. Miller  
Site Assessment and Remediation Engineer

Enclosure

cc: Mr. Rich Hiatt, RWQCB - Bay Area  
Mr. Mike Cook, Weiss Associates  
Mr. S.A. Willer

File (9-0076 QM4)

# 17 '93 J.M.M.



# GROUNDWATER TECHNOLOGY, INC.

4057 Port Chicago Highway, Concord, CA 94520 (415) 671-2387

FAX: (415) 685-9148

May 12, 1993

Project No. 020302227

Mr. Mark Miller  
Chevron U.S.A. Products Company  
2410 Camino Ramon  
San Ramon, CA 94583-0804

**SUBJECT:** Groundwater Monitoring and Sampling Activities  
Chevron Service Station No. 9-0076  
4265 Foothill Boulevard, Oakland, California

Dear Mr. Miller:

Groundwater Technology, Inc. presents the attached quarterly groundwater monitoring and sampling data collected on April 14, 1993. Seven of the eight groundwater wells at this site were gauged to measure depth to groundwater (DTW) and to check for separate-phase hydrocarbons. Separate-phase hydrocarbons were not detected in the monitoring wells. Monitoring well C-2 was not gauged or sampled, because of a pump installed in the well. A potentiometric surface map (Figure 1) and a summary of groundwater monitoring data (Table 1) are presented in Attachments 1 and 2, respectively. After measuring the DTW, each monitoring well, except C-2, was purged and sampled. The groundwater samples were analyzed for benzene, toluene, ethylbenzene, and total xylenes and total petroleum hydrocarbons-as-gasoline. Results of the chemical analyses are summarized in Table 1. The laboratory report and chain-of-custody record are included in Attachment 3. Monitoring-well purge water was transported by Groundwater Technology to the Chevron Terminal in Richmond, California for recycling.

Groundwater Technology is pleased to assist Chevron on this project. If you have any questions or comments, please contact our Concord, California office at (510) 671-2387.

Sincerely,  
Groundwater Technology, Inc.  
Written/Submitted by

  
\_\_\_\_\_  
Tim Watchers  
Project Geologist

Attachment 1 Figure  
Attachment 2 Table  
Attachment 3 Laboratory Report

Groundwater Technology, Inc.  
Reviewed/Approved by

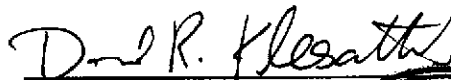
  
David R. Kleesattel  
Registered Geologist  
No. 5136

For:  
John S. Gaines  
Vice President, General Manager  
West Region

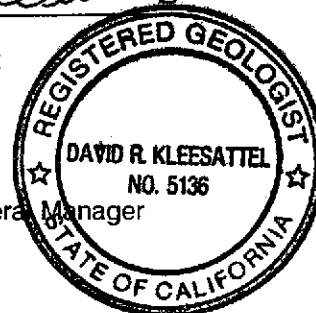

2227R013

**ATTACHMENT 1**

**FIGURE**

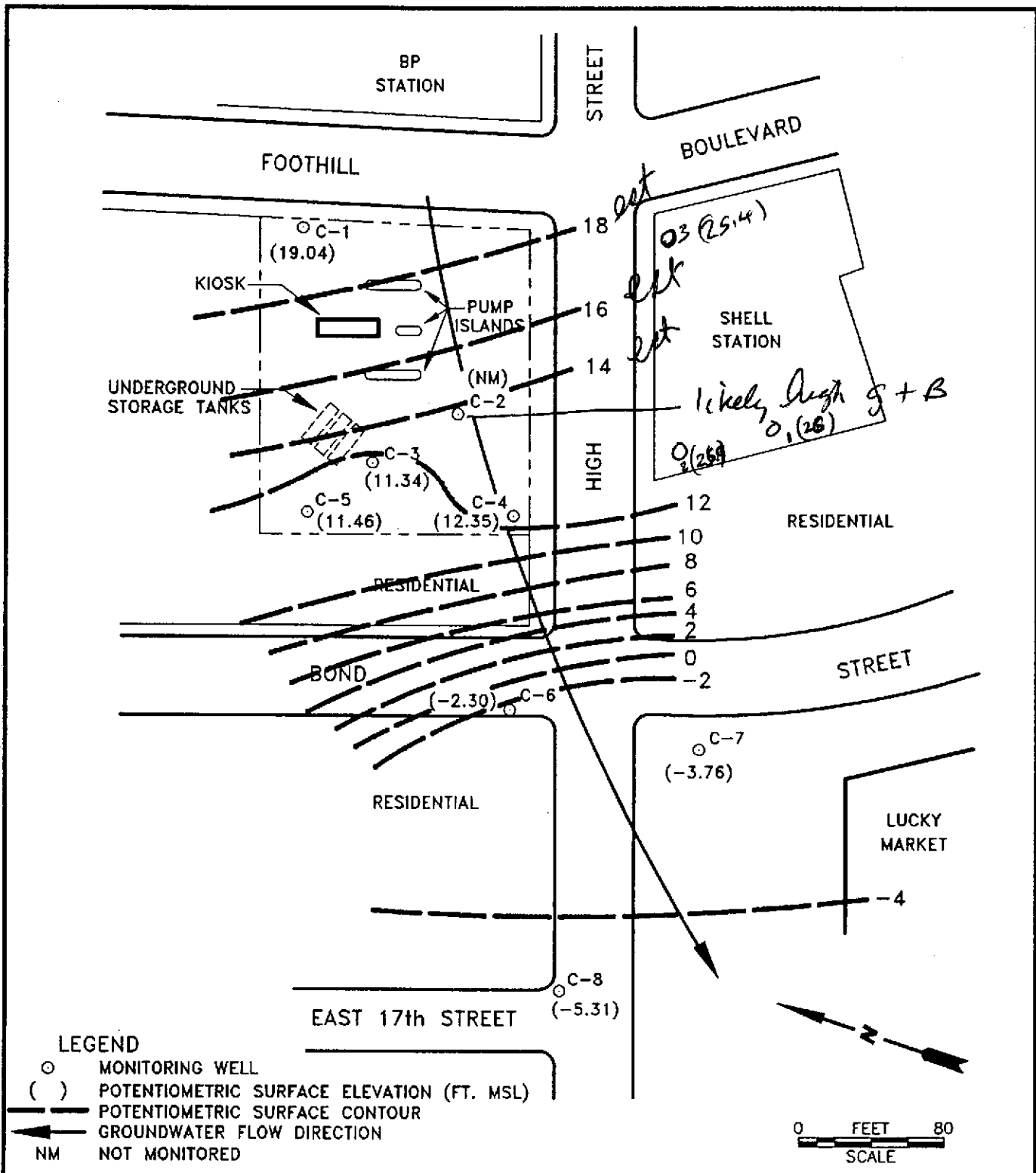

		<b>GROUNDWATER TECHNOLOGY</b> 4057 PORT CHICAGO HWY CONCORD, CA 94520 (510) 671-2387		<b>POTENTIOMETRIC SURFACE MAP</b> <b>(4/14/93)</b>	
<b>CLIENT:</b> CHEVRON U.S.A. PRODUCTS Co. SERVICE STATION No. 9-0076		<b>LOCATION:</b> 4265 FOOTHILL BLVD. OAKLAND, CALIFORNIA		<b>REV. NO.:</b> 0	<b>DATE:</b> 5/12/93
<b>PM</b> <i>DRK</i>	<b>PE/RG</b> DRK	<b>DESIGNED</b> TW	<b>DETAILED</b> ML	<b>ACAD FILE:</b> PSM593/SP392	<b>PROJECT NO.:</b> 020302227
					<b>FIGURE:</b> 1

**ATTACHMENT 2**

**TABLE**

**TABLE 1**  
**HISTORICAL GROUNDWATER ANALYTICAL RESULTS AND MONITORING DATA**  
**Chevron Service Station No. 9-0076**  
**4265 Foothill Boulevard, Oakland, California**

*water table elevat*

TOC

Well ID/ Elev	Date	TPH-as- Gasoline	Benzene	Toluene	Ethyl- benzene	Xylenes	DTW (ft)	SPT (ft)	WTE (ft)
C-1 35.42	04/28/89a	940	30	1.3	11	13	20.05	0.00	15.37
	08/08/89a	820	45	2	13	13	24.07	0.00	11.35
	12/21/89	---	---	---	---	---	22.81	0.00	12.61
	08/27/90	440	15	1	6	13	22.12	0.00	13.30
	11/04/90	---	---	---	---	---	25.56	0.00	9.86
	06/18/91	74	5.6	0.6	1.9	1.3	21.64	0.00	13.78
	09/19/91	150	7.1	<0.5	2.3	3	24.58	0.00	10.84
	12/20/91	250	10	<0.5	3.7	1.6	26.17	0.00	9.25
	03/18/92	190	16	<0.5	8.5	2.9	18.25	0.00	17.17
	07/14/92	20,000	480	2,200	510	2,900	27.61	0.00	7.81
	10/08/92	360	34	4.6	19	12	24.44	0.00	10.98
	01/08/93	120	9.1	0.5	5.1	1.8	19.68	0.00	15.74
	04/14/93	190	74	0.6	1	2	16.38	0.00	19.04
	C-2 35.18	04/28/89a	120,000	30,000	22,000	3,000	17,000	26.44	0.00
08/08/89a		---	---	---	---	---	29.90	0.01	5.29
12/21/89		---	---	---	---	---	29.32	0.00	5.86
08/27/90		---	---	---	---	---	29.55	0.17	5.77
11/04/90		---	---	---	---	---	30.47	0.00	4.71
06/18/91		---	---	---	---	---	28.33	0.06	6.90
09/19/91		---	---	---	---	---	29.39	0.06	5.84
12/20/91		170,000	20,000	10,000	2,800	19,000	29.23	0.00	5.95
03/18/92		---	---	---	---	---	13.60	0.09	21.58
07/14/92		---	---	---	---	---	---	---	---
10/08/92		---	---	---	---	---	---	---	---
01/08/93		79,000	14,000	7,200	3,500	16,000	24.20	Sheen	10.98
04/14/93		---	---	---	---	---	---	---	---
C-3 35.28 35.30	04/28/89a	<500	1.7	<0.5	<0.5	<0.5	28.00	0.00	7.28
	08/08/89a	<500	1	<0.5	<0.5	<0.5	30.00	0.00	5.28
	12/21/89	---	---	---	---	---	30.53	0.00	4.75
	08/27/90	<50	<0.3	<0.3	<0.3	<0.6	29.68	0.00	5.60
	11/04/90	---	---	---	---	---	30.36	0.00	4.94
	06/18/91	52	1.1	<0.5	<0.5	1.2	28.46	0.00	6.84
	09/19/91	73	1.2	<0.5	<0.5	<0.5	29.33	0.00	5.97
	12/20/91	<50	0.7	<0.5	<0.5	<0.5	29.77	0.00	5.53
	03/18/92	<50	<0.5	<0.5	<0.5	<0.5	25.75	0.00	9.55
	07/14/92	<50	<0.5	<0.5	<0.5	<0.5	27.87	0.00	7.43
	10/08/92	<50	<0.5	<0.5	<0.5	0.5	28.55	0.00	6.75
	01/08/93	<50	<0.5	<0.5	<0.5	<0.5	25.85	0.00	9.45
	04/14/93	<50	<0.5	<0.5	<0.5	<0.5	23.96	0.00	11.34

35.42

*Mark Keller 842-8134*

**TABLE 1**  
**HISTORICAL GROUNDWATER ANALYTICAL RESULTS AND MONITORING DATA**  
**Chevron Service Station No. 9-0076**  
**4265 Foothill Boulevard, Oakland, California**

Well ID/ Elev	Date	TPH-as- Gasoline	Benzene	Toluene	Ethyl- benzene	Xylenes	DTW (ft)	SPT (ft)	WTE (ft)
C-4  33.45  33.48	01/12/89a	—	—	—	—	—	29.49	0.00	3.96
	04/12/89a	—	—	—	—	—	27.44	0.00	6.01
	04/28/89	20,000	6,300	550	230	1,500	29.49	0.00	3.96
	08/08/89a	8,000	7,500	340	88	1,000	29.55	0.00	3.90
	12/21/89	—	—	—	—	—	30.02	0.00	3.43
	08/27/90	26,000	10,000	280	410	1,400	29.02	0.00	4.46
	11/04/90	—	—	—	—	—	29.81	0.00	3.67
	06/18/91	34,000	14,000	410	450	1,300	27.45	0.00	6.03
	09/19/91	16,000	7,400	90	110	460	28.65	0.00	4.83
	12/20/91	24,000	12,000	120	260	740	28.84	0.00	4.64
	03/18/92	48,000	6,000	1,300	1,300	2,400	24.43	0.00	11.05
	07/14/92	40,000	14,000	920	550	2,400	26.89	0.00	6.59
	10/08/92	29,000	13,000	190	110	1,400	27.79	0.00	5.69
	01/08/93	25,000	7,000	630	860	1,800	23.50	0.00	9.98
04/14/93	*27,000	6,300	1,000	900	1,400	21.13	0.00	12.35	
C-5  35.50	08/27/90	<50	<0.3	<0.3	<0.3	<0.6	29.83	0.00	5.67
	11/14/90	—	—	—	—	—	30.56	0.00	4.94
	06/18/91	<50	<0.5	<0.5	<0.5	<0.5	28.52	0.00	6.98
	09/19/91	<50	<0.5	<0.5	<0.5	<0.5	29.51	0.00	5.99
	12/20/91	<50	<0.5	<0.5	<0.5	<0.5	29.96	0.00	5.54
	03/18/92	<50	<0.5	<0.5	<0.5	<0.5	25.92	0.00	9.58
	07/14/92	<50	<0.5	<0.5	<0.5	<0.5	28.00	0.00	7.50
	10/08/92	<50	<0.5	<0.5	<0.5	<0.5	28.65	0.00	6.85
	01/08/93	<50	<0.5	<0.5	<0.5	<0.5	26.02	0.00	9.48
	04/14/93	<50	<0.5	<0.5	<0.5	<0.5	24.04	0.00	11.46
C-6  32.40	08/27/90	7,200	2,100	6	41	300	44.11	0.00	-11.71
	11/14/90	—	—	—	—	—	44.03	0.00	-11.63
	06/18/91	4,400	2,500	18	160	77	43.49	0.00	-11.09
	09/19/91	3,100	1,600	8.3	73	8	34.32	0.00	-1.92
	12/20/91	4,400	1,300	3.2	74	10	41.35	0.00	-8.95
	03/18/92	9,800	3,200	34	250	500	40.69	0.00	-8.29
	07/14/92	6,500	2,200	100	96	240	38.89	0.00	-6.49
	10/08/92	1,800	1,000	3.1	15	41	38.67	0.00	-6.27
	01/08/93	5,200	1,600	6.8	63	120	37.81	0.00	-5.41
	04/14/93	11,000	1,800	13	110	200	34.70	0.00	-2.30
C-7  32.17	08/27/90	110	26	0.8	4	6	44.23	0.00	-12.06
	11/14/90	—	—	—	—	—	44.11	0.00	-11.94
	06/18/91	23,000	5,700	420	1,000	2,800	42.05	0.00	-9.88
	09/19/91	26,000	4,600	330	970	2,400	41.72	0.00	-9.55
	12/20/91	33,000	5,500	270	1,000	2,100	41.67	0.00	-9.50
	03/18/92	27,000	5,800	410	1,300	3,300	41.20	0.00	-9.03
	07/14/92	46,000	12,000	720	1,700	4,600	39.77	0.00	-7.60
	10/08/92	22,000	6,800	370	1,300	3,200	39.14	0.00	-6.97
	01/08/93	36,000	7,600	540	1,700	4,200	38.50	0.00	-6.33
	04/14/93	23,000	3,100	450	670	1,900	35.93	0.00	-3.76

**TABLE 1**  
**HISTORICAL GROUNDWATER ANALYTICAL RESULTS AND MONITORING DATA**  
**Chevron Service Station No. 9-0076**  
**4265 Foothill Boulevard, Oakland, California**

Well ID/ Elev	Date	TPH-as Gasoline	Benzene	Toluene	Ethyl- benzene	Xylenes	DTW (ft)	SPT (ft)	WTE (ft)
C-8  30.68	11/14/90	<50	<0.3	<0.3	<0.3	<0.6	43.29	0.00	-12.61
	06/18/91	<50	<0.5	<0.5	<0.5	<0.5	42.62	0.00	-11.94
	09/19/91	<50	<0.5	<0.5	<0.5	<0.5	41.72	0.00	-11.04
	12/20/91	<50	<0.5	<0.5	<0.5	<0.5	40.98	0.00	-10.30
	03/18/92	<50	<0.5	<0.5	<0.5	<0.5	40.02	0.00	-9.34
	07/14/92	<50	<0.5	<0.5	<0.5	<0.5	39.02	0.00	-8.34
	10/08/92	<50	<0.5	<0.5	<0.5	1.1	38.683	0.00	-8.00
	01/08/93	<50	<0.5	<0.5	<0.5	<0.5	8.07	0.00	-7.39
	04/14/93	<50	<0.5	<0.5	<0.5	<0.5	35.99	0.00	-5.31
Trip Blank	04/28/89	<500	<0.5	<0.5	<0.5	<0.5	--	--	--
	08/08/89	<500	<0.5	<0.5	<0.5	<0.5	--	--	--
	08/27/90	<50	<0.3	<0.3	<0.3	<0.6	--	--	--
	11/14/90	<50	<0.3	<0.3	<0.3	<0.6	--	--	--
	06/18/91	<50	<0.5	<0.5	<0.5	<0.5	--	--	--
	09/19/91	<50	<0.5	<0.5	<0.5	<0.5	--	--	--
	12/20/91	<50	<0.5	<0.5	<0.5	<0.5	--	--	--
	03/18/92	<50	<0.5	<0.5	<0.5	<0.5	--	--	--
	07/14/92	<50	<0.5	<0.5	<0.5	<0.5	--	--	--
	10/08/92	<50	<0.5	<0.5	<0.5	<0.5	--	--	--
	01/08/93	<50	<0.5	<0.5	<0.5	<0.5	--	--	--
	04/14/93	<50	<0.5	<0.5	<0.5	<0.5	--	--	--

- TPH = Total petroleum hydrocarbons  
DTW = Depth to groundwater  
SPT = Separate-phase hydrocarbon thickness  
WTE = Water-table elevation  
-- = Not applicable, not sampled, not measured  
a = Water elevations measured to grade  
\* = Uncategorized compound not included in gasoline hydrocarbon concentration.

All elevations are presented as feet above mean sea level.  
Analytical results are in micrograms per liter, equivalent to parts per billion.  
Top-of-casing elevations were surveyed January 3, 1990 and August 21, 1990.  
Data for April 28, 1989 through December 20, 1991 were taken from Fourth Quarter 1991 Ground Water Monitoring Report, dated January 30, 1992 (Weiss Associates).



**ATTACHMENT 3**  
**LABORATORY REPORT**

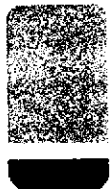

# GTEL

ENVIRONMENTAL  
LABORATORIES, INC.

**Northwest Region**

4080-C Pike Lane  
Concord, CA 94520  
(510) 685-7852  
(800) 544-3422 *from inside California*  
(800) 423-7143 *from outside California*  
(510) 825-0720 (FAX)

Client Number: 020302227  
Consultant Project Number: 020302227.061004  
Project ID: Chevron, Oakland  
Work Order Number: C3-04-0211  
Reissue Date: May 4, 1993

April 27, 1993

Sandra Lindsey  
Groundwater Technology, Inc.  
4057 Port Chicago Hwy.  
Concord, CA 94520

Enclosed please find the analytical results for samples received by GTEL Environmental Laboratories, Inc. on 04/15/93.

A formal Quality Assurance/Quality Control (QA/QC) program is maintained by GTEL, which is designed to meet or exceed the EPA requirements. Analytical work for this project met QA/QC criteria, unless otherwise stated in the footnotes.

GTEL is certified by the California State Department of Health Services, Laboratory certificate numbers 194 and 1075, to perform analyses for drinking water, wastewater, and hazardous waste materials according to EPA protocols.

If you have any questions concerning this analysis or if we can be of further assistance, please call our Customer Service Representative.

Sincerely,  
GTEL Environmental Laboratories, Inc.

Eileen F. Bullen  
Laboratory Director

Client Number: 020302227  
 Consultant Project Number: 020302227.061004  
 Project ID: Chevron, Oakland  
 Work Order Number: C3-04-0211  
 Reissue Date: May 4, 1993

**Table 1**

**ANALYTICAL RESULTS**

**Aromatic Volatile Organics and  
 Total Petroleum Hydrocarbons as Gasoline in Water**

EPA Methods 5030, 8020, and Modified 8015<sup>a</sup>

GTEL Sample Number		01	03	05	07
Client Identification		TB-LB	C5	C8	C3
Date Sampled		04/14/93	04/14/93	04/14/93	04/14/93
Date Analyzed		04/18/93	04/18/93	04/18/93	04/18/93
Analyte	Detection Limit, ug/L	Concentration, ug/L			
Benzene	0.5	<0.5	<0.5	<0.5	<0.5
Toluene	0.5	<0.5	<0.5	<0.5	<0.5
Ethylbenzene	0.5	<0.5	<0.5	<0.5	<0.5
Xylene, total	0.5	<0.5	<0.5	<0.5	<0.5
BTEX, total	--	--	--	--	--
TPH as Gasoline	50	<50	<50	<50	<50
Detection Limit Multiplier		1	1	1	1
BFB surrogate, % recovery		85.0	84.4	83.5	83.5

- a. Test Methods for Evaluating Solid Waste, SW-846, Third Edition, Revision 0, US EPA November 1986. Modification for TPH as gasoline as per California State Water Resources Control Board LUFT Manual protocols, May 1988 revision. BFB Acceptability limits 70 - 130.

Client Number: 020302227  
 Consultant Project Number: 020302227.061004  
 Project ID: Chevron, Oakland  
 Work Order Number: C3-04-0211  
 Reissue Date: May 4, 1993

**Table 1 (Continued)**

**ANALYTICAL RESULTS**

**Aromatic Volatile Organics and  
 Total Petroleum Hydrocarbons as Gasoline in Water**

EPA Methods 5030, 8020, and Modified 8015<sup>a</sup>

GTEL Sample Number		09	11	13	15
Client Identification		C1	C6	C4	C7
Date Sampled		04/14/93	04/14/93	04/14/93	04/14/93
Date Analyzed		04/19/93	04/19/93	04/19/93	04/19/93
Analyte	Detection Limit, ug/L	Concentration, ug/L			
Benzene	0.5	74	1800	6300	3100
Toluene	0.5	0.6	13	1000	450
Ethylbenzene	0.5	1	110	900	670
Xylene, total	0.5	2	200	1400	1900
BTEX, total	--	78	2100	9600	6100
TPH as Gasoline	50	190	11000	27000*	23000
Detection Limit Multiplier		1	1	50	10
BFB surrogate, % recovery		97.6	84.0	83.7	70.1

a. Test Methods for Evaluating Solid Waste, SW-846, Third Edition, Revision 0, US EPA November 1986. Modification for TPH as gasoline as per California State Water Resources Control Board LUFT Manual protocols, May 1988 revision. BFB Acceptability limits 70 - 130.

\* Uncategorized compound not included in gasoline hydrocarbon concentration.

Client Number: 020302227  
 Consultant Project Number: 020302227.061004  
 Project ID: Chevron, Oakland  
 Work Order Number: C3-04-0211  
 Reissue Date: May 4, 1993

**Table 1 (Continued)**

**ANALYTICAL RESULTS**

**Aromatic Volatile Organics and  
 Total Petroleum Hydrocarbons as Gasoline in Water**

EPA Methods 5030, 8020, and Modified 8015<sup>a</sup>

GTEL Sample Number		041893			
Client Identification		METHOD BLANK			
Date Sampled		--			
Date Analyzed		04/18/93			
Analyte	Detection Limit, ug/L	Concentration, ug/L			
Benzene	0.5	<0.5			
Toluene	0.5	<0.5			
Ethylbenzene	0.5	<0.5			
Xylene, total	0.5	<0.5			
BTEX, total	--	--			
TPH as Gasoline	50	<50			
Detection Limit Multiplier		1			
BFB surrogate, % recovery		83.4			

a. Test Methods for Evaluating Solid Waste, SW-846, Third Edition, Revision 0, US EPA November 1986. Modification for TPH as gasoline as per California State Water Resources Control Board LUFT Manual protocols, May 1988 revision. BFB Acceptability limits 70 - 130.

Client Number: 020302227  
 Consultant Project Number: 020302227.061004  
 Project ID: Chevron, Oakland  
 Work Order Number: C3-04-0211  
 Reissue Date: May 4, 1993

### QC Matrix Spike and Duplicate Spike Results

Matrix: Water

Analyte	Sample ID	Spike Amount	Units	Recovery, %	Duplicate Recovery, %	RPD, %	Control Limits
<b>Modified EPA 8020:</b>							
Benzene	Reagent Water	20.0	ug/L	79.5	77.0	3.2	70 - 147
Toluene	Reagent Water	20.0	ug/L	87.5	84.5	3.5	67 - 150
Ethylbenzene	Reagent Water	20.0	ug/L	86.5	84.5	2.3	69 - 145
Xylene, total	Reagent Water	60.0	ug/L	89.5	87.3	2.5	71 - 152

Chevron U.S.A. Inc.  
 P.O. BOX 5004  
 San Ramon, CA 94583  
 FAX (415)842-9591

Chevron Facility Number 9-0076  
 Facility Address 4265 Foothill Blvd, Oakland  
 Consultant Project Number 020302227. 061004  
 Consultant Name Groundwater Technology, Inc.  
 Address 4057 Port Chicago Hwy, Concord, CA  
 Project Contact (Name) Ms. Sandra L. Lindsey  
 (Phone) 671-2387 (Fax Number) 685-9148

Chevron Contact (Name) Mr. Mark Miller  
 (Phone) 842-8134  
 Laboratory Name Superior Analytical GTEL  
 Laboratory Release Number 876-6690  
 Samples Collected by (Name) Heather Marie Kuehn  
 Collection Date 4/14/93  
 Signature [Handwritten Signature]

Sample Number	Lab Sample Number	Number of Containers	Matrix S = Soil W = Water C = Charcoal	Type G = Grab C = Composite D = Diurnal	Time	Sample Preservation	Iced (Yes or No)	Analyses To Be Performed											Remarks				
								BTEX + TPH GAS (8020 + 8015)	TPH Diesel (8015)	Oil and Grease (5520)	Purgeable Hydrocarbons (8010)	Purgeable Aromatics (8020)	Purgeable Organics (8240)	Extractable Organics (8270)	Metals Cd, Cr, Pb, Zn, Ni (ICAP or AA)	Hold							
TB-LB		1	W	G		Hel	Yes	X															TB-LB DO NOT BILL Good 2.9c Remarks 4/15/93
RBC5		1			12:05			X															02040211
C5		3			12:05			X															
RBC8		1			12:15			X															
C8		3			12:15			X															
RBC3		1			12:20			X															
C3		3			12:40			X															
RBC1		1			12:30			X															
C1		3			12:20			X															
RBC6		1			12:40			X															
C6		3			12:40			X															
RBC4		1			12:50			X															
C4		3			12:50			X															
RBC7		1	✓	✓	1:00	✓	✓	X															
Relinquished By (Signature) <u>[Handwritten Signature]</u>		Organization GTI		Date/Time 4/14/93		Received By (Signature) <u>[Handwritten Signature]</u>		Organization		Date/Time		Turn Around Time (Circle Choice) 24 Hrs. 48 Hrs. 5 Days 10 Days <u>As Contracted</u>											
Relinquished By (Signature)		Organization		Date/Time		Received By (Signature)		Organization		Date/Time													
Relinquished By (Signature)		Organization		Date/Time		Received For Laboratory By (Signature) <u>Nancy Baird</u>		Organization		Date/Time 4/15/93 8:00													

Chevron U.S.A. Inc.  
P.O. BOX 5004  
San Ramon, CA 94583  
FAX (415)842-9591

Chevron Facility Number 9-0076  
Facility Address 4265 Foothill Blvd, Oakland  
Consultant Project Number 020302227. 061004  
Consultant Name Groundwater Technology, Inc.  
Address 4057 Port Chicago Hwy, Concord, CA  
Project Contact (Name) Ms, Sandra L. Lindsey  
(Phone) 671-2387 (Fax Number) 685-9148

Chevron Contact (Name) Mark Miller  
(Phone) 842-8134  
Laboratory Name Superior Analytical GTEL-Concord  
Laboratory Release Number 876-6690  
Samples Collected by (Name) Victor Moreno / Cely Mason  
Collection Date 4/11/93  
Signature [Signature]

Sample Number	Lab Sample Number	Number of Containers	Matrix S = Soil A = Air W = Water C = Charcoal	Type G = Grab C = Composite D = Discrete	Time	Sample Preservation	Iced (Yes or No)	Analytes To Be Performed											Remarks				
								BTEX + TPH GAS (8020 + 8015)	TPH Diesel (8015)	Oil and Grease (8520)	Purgeable Halocarbons (8010)	Purgeable Aromatics (8020)	Purgeable Organics (8240)	Extractable Organics (8270)	Metals Cd, Cr, Pb, Zn, Ni (104P or AA)	Hold							
C-7		3	W	G	11:00	Hel		X														seal intact leak 2.9c 10/3 4/15/93	
RBC2																							
C2																							304021

Relinquished By (Signature) <u>[Signature]</u>	Organization <u>GTI</u>	Date/Time <u>4/11/93</u>	Received By (Signature) <u>[Signature]</u>	Organization	Date/Time	Turn Around Time (Circle Choice) 24 Hrs. 48 Hrs. 5 Days 10 Days <u>As Contracted</u>
Relinquished By (Signature)	Organization	Date/Time	Received By (Signature)	Organization	Date/Time	
Relinquished By (Signature)	Organization	Date/Time	Received For Laboratory By (Signature) <u>[Signature]</u>		Date/Time <u>4/15/93</u>	