



Atlantic Richfield Company  
(a BP affiliated company)

P.O. Box 1257  
San Ramon, California 94583  
Phone: (925) 275-3801  
Fax: (925) 275-3815

6 July 2007

Re: Second Quarter 2007 Status Report  
Former BP Service Station # 11109  
4280 Foothill Boulevard  
Oakland, California  
ACEH Case #RO0000426

**RECEIVED**

1:52 pm, Jul 27, 2007

Alameda County  
Environmental Health



"I declare, that to the best of my knowledge at the present time, that the information and/or recommendations contained in the attached document are true and correct."

Submitted by:

Paul Supple  
Environmental Business Manager

6 July 2007

Project No. 06-08-656

Atlantic Richfield Company  
P.O. Box 1257  
San Ramon, California 94583  
Submitted via ENFOS

Attn.: Mr. Paul Supple

Re: Second Quarter 2007 Status Report, Former BP Service Station #11109, 4280 Foothill Boulevard, Oakland, Alameda County, California; ACEH Case No.RO0000426

Dear Mr. Supple:

Provided herein is the *Second Quarter 2007 Status Report* for Former BP Service Station #11109 (herein referred to as Station #11109) located at 4280 Foothill Boulevard, Oakland, California (Site).

Should you have questions regarding the work performed or results obtained, please do not hesitate to contact us at (530) 566-1400.

Sincerely,

BROADBENT & ASSOCIATES, INC.



Thomas A. Venus, P.E.  
Senior Engineer

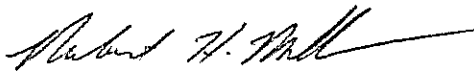

Robert H. Miller, P.G., C.HG.  
Principal Hydrogeologist

Enclosures

cc: Mr. Steven Plunkett, Alameda County Environmental Health (Submitted via ACEH ftp Site)  
Ms. Shelby Lathrop, ConocoPhillips (Submitted via WebXtender)  
Mr. Chris Jimmerson, Delta Environmental Consultants (Submitted via ENFOS)  
Electronic copy uploaded to GeoTracker

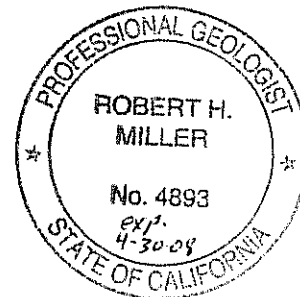

## STATION #11109 QUARTERLY STATUS REPORT

Facility: #11109	Address: 4280 Foothill Boulevard, Oakland
Environmental Business Manager:	Mr. Paul Supple
Consulting Co./Contact Persons:	Broadbent & Associates, Inc.(BAI)/Rob Miller & Tom Venus (530) 566-1400
Primary Agency/Regulatory ID No.:	Alameda County Environmental Health (ACEH) ACEH Case #RO0000426
Consultant Project No.:	06-08-656
Facility Permits/Permitting Agency:	NA

### WORK PERFORMED THIS QUARTER (Second Quarter 2007):

1. Prepared and submitted First Quarter 2007 Semi-Annual Groundwater Monitoring Report.
2. No environmental work was conducted during Second Quarter 2007.

### WORK PROPOSED FOR NEXT QUARTER (Third Quarter 2007):

1. Prepared and submitted this Second Quarter 2007 Status Report (contained herein).
2. Conduct semi-annual ground-water monitoring/sampling for Third Quarter 2007.

### QUARTERLY RESULTS SUMMARY:

Current phase of project:	<b>Ground-water monitoring/sampling</b>
Frequency of ground-water monitoring:	<b>Monthly: MW-5</b> <b>Semi-Annually (1Q &amp; 3Q): MW-2, MW-3, MW-4, MW-6, MW-7, MW-8, MW-9</b>
Frequency of ground-water sampling:	<b>Semi-Annually (1Q &amp; 3Q): MW-2, MW-4, MW-5, MW-7</b> <b>Annually (1Q): MW-3, MW-6, MW-8, MW-9</b>
Current remediation techniques:	<b>NA</b>
Is free product (FP) present on-site:	<b>No (Formerly seen in MW-5)</b>
FP recovered this quarter:	<b>0 gallons</b>
Depth to ground water (below TOC):	<b>NA</b>
General ground-water flow direction:	<b>NA</b>
Approximate hydraulic gradient:	<b>NA</b>

### DISCUSSION:

Monthly gauging and bailing of free product from well MW-5 was not performed this quarter. Free product has not been seen on the Site since 5 September 2006. Sheen was observed in well MW-5 during the First Quarter 2007 sampling event. Table 1 provides historical free product removal data from the Site. The most recent analytical data can be referenced in the First Quarter 2007 Semi-Annual Ground-Water Monitoring Report. A Ground-Water Elevation Contour and Analytical Summary Map from First Quarter 2007 is provided as Drawing 1.

### ATTACHMENTS:

- Drawing 1. Ground-Water Elevation Contours and Analytical Summary Map, 5 March 2007, Former BP Station #11109, 4280 Foothill Boulevard, Oakland, California
- Table 1. Summary of Free Product Removal, Former BP Service Station #11109, 4280 Foothill Boulevard, Oakland, CA

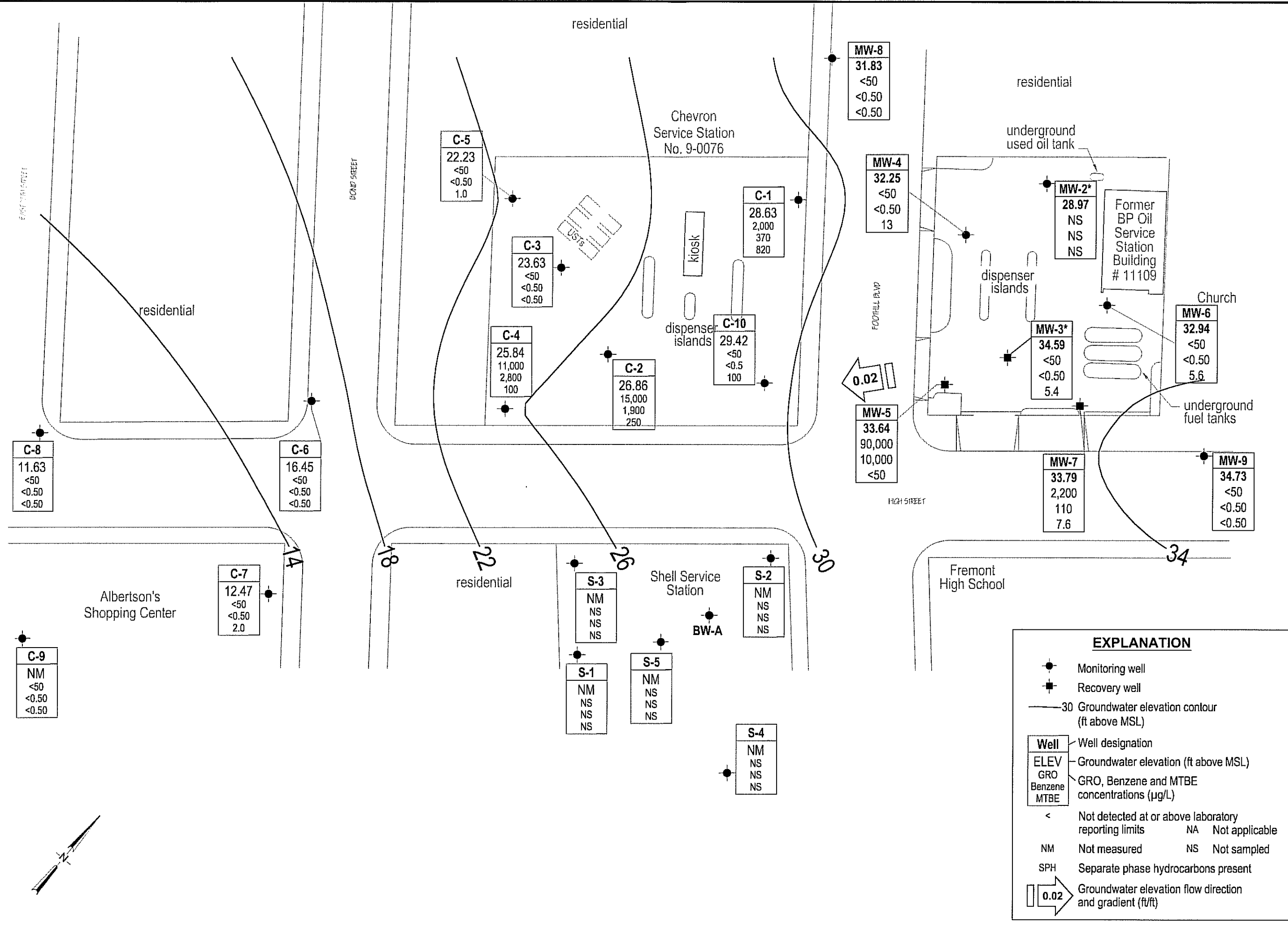

**EXPLANATION**

- Monitoring well
- ⊕ Recovery well
- 30 Groundwater elevation contour (ft above MSL)

Well	Well designation
ELEV	Groundwater elevation (ft above MSL)
GRO	GRO, Benzene and MTBE concentrations (µg/L)
Benzene	
MTBE	

- < Not detected at or above laboratory reporting limits
- NA Not applicable
- NM Not measured
- NS Not sampled
- SPH Separate phase hydrocarbons present

0.02 Groundwater elevation flow direction and gradient (ft/ft)

**C-8**  
11.63  
<50  
<0.50  
<0.50

**C-6**  
16.45  
<50  
<0.50  
<0.50

**C-7**  
12.47  
<50  
<0.50  
2.0

**C-9**  
NM  
<50  
<0.50  
<0.50

**C-5**  
22.23  
<50  
<0.50  
1.0

**C-3**  
23.63  
<50  
<0.50  
<0.50

**C-4**  
25.84  
11,000  
2,800  
100

**C-2**  
26.86  
15,000  
1,900  
250

**C-1**  
28.63  
2,000  
370  
820

**C-10**  
29.42  
<50  
<0.5  
100

**MW-8**  
31.83  
<50  
<0.50  
<0.50

**MW-4**  
32.25  
<50  
<0.50  
13

**MW-2\***  
28.97  
NS  
NS  
NS

**MW-3\***  
34.59  
<50  
<0.50  
5.4

**MW-5**  
33.64  
90,000  
10,000  
<50

**MW-7**  
33.79  
2,200  
110  
7.6

**MW-6**  
32.94  
<50  
<0.50  
5.6

**MW-9**  
34.73  
<50  
<0.50  
<0.50

**S-3**  
NM  
NS  
NS  
NS

**S-1**  
NM  
NS  
NS  
NS

**S-5**  
NM  
NS  
NS  
NS

**S-2**  
NM  
NS  
NS  
NS

**S-4**  
NM  
NS  
NS  
NS

**BW-A**

0.02

**Table 1**

**Summary of Free Product Removal**  
Former BP Service Station #11109  
4280 Foothill Boulevard, Oakland, CA

WELL ID	DATE OF MONITORING EVENT	DEPTH TO WATER (feet)	PRODUCT THICKNESS (feet)	PRODUCT REMOVED (gallons)	CUMULATIVE PRODUCT REMOVED (gallons)
MW-5	8/25/1999	--	--	0.070	0.070
MW-5	3/9/2000	--	--	0.400	0.470
MW-5	7/14/2003	12.72	0.03	0.019	0.489
MW-5	8/25/2003	14.04	0.00	0.000	0.489
MW-5	9/25/2003	14.38	0.08	0.052	0.542
MW-5	10/3/2003	12.15	0.06	0.040	0.582
MW-5	11/12/2003	12.74	0.19	0.120	0.702
MW-5	12/9/2003	11.44	0.03	0.040	0.742
MW-5	2/2/2004	6.47	0.04	0.030	0.772
MW-5	2/9/2004	10.61	0.04	0.030	0.802
MW-5	3/9/2004	7.91	--	--	0.800
MW-5	4/13/2004	9.68	0.28	0.200	0.820
MW-5	5/5/2004	11.93	Sheen	--	0.820
MW-5	6/3/2004	12.60	Sheen	--	0.820
MW-5	7/2/2004	11.11	0.10	0.060	0.880
MW-5	8/31/2004	12.80	0.05	0.132	1.012
MW-5	9/17/2004	12.13	0.15	--	1.012
MW-5	10/25/2004	10.66	0.26	0.170	1.182
MW-5	11/8/2004	9.98	0.02	0.020	1.202
MW-5	12/15/2004	8.76	0.01	0.010	1.212
MW-5	1/13/2005	7.12	--	--	1.212
MW-5	2/1/2005	8.10	0.01	0.007	1.219
MW-5	3/7/2005	8.62	0.02	0.013	1.232
MW-5	4/29/2005	9.39	--	--	1.232
MW-5	5/12/2005	7.51	0.01	0.007	1.239
MW-5	6/23/2005	7.70	--	--	1.239
MW-5	7/2/2005	10.81	--	--	1.239
MW-5	8/24/2005	10.53	--	--	1.239
MW-5	9/6/2005	11.16	0.18	0.119	1.358
MW-5	1/27/2006	9.02	0.02	0.013	1.252
MW-5	2/15/2006	8.38	0.02	0.013	1.265
MW-5	3/6/2006	8.60	Sheen	--	1.384
MW-5	4/21/2006	8.02	0.27	0.251	1.635
MW-5	5/30/2006	9.13	0.07	0.045	1.680
MW-5	6/27/2006	9.49	0.09	0.058	1.739
MW-5	7/31/2006	10.08	0.08	0.052	1.791
MW-5	8/28/2006	10.75	0.09	0.059	1.849
MW-5	9/5/2006	6.16	0.03	0.020	1.869
MW-5	10/1/2006	--	--	--	1.869
MW-5	11/1/2006	--	--	--	1.869
MW-5	12/1/2006	--	--	--	1.869
MW-5	1/1/2007	--	--	--	1.869
MW-5	2/1/2007	--	--	--	1.869
MW-5	3/5/2007	8.34	Sheen	--	1.869
MW-5	4/1/2007	--	--	--	1.869
MW-5	5/1/2007	--	--	--	1.869
MW-5	6/1/2007	--	--	--	1.869
			<b>FP Removed this Quarter:</b>		<b>0.000</b>

**ABBREVIATIONS & SYMBOLS:**

-- = Not available/applicable/measured/calculated

**NOTES:**

The data within this table collected prior to April 2006 was provided to Broadbent & Associates, Inc. by Atlantic Richfield Company and their previous consultants. Broadbent & Associates, Inc. has not verified the accuracy of this information.