



JONAS & ASSOCIATES INC.
Environmental Consultants

(510) 933-5360
Walnut Creek, California

FAX/TELECOPY TRANSMITTAL

From: <i>Romana Jonas</i>	of:	FAX #: () -
To: <i>Susan Hugo</i>	of:	FAX #: (<i>937</i>) <i>9335</i>

Date: <i>10 / 3 / 1995</i>	Project:
Time: <i>11:00 am / pm</i>	J&A Project #:

Attachments:
1)
2)
3)

Number of attached pages (not including transmittal page): <i>2 2</i>
--

Message:

10/3/95
Talked to Romana Jones

Distribution: (1)

(2)

Project: *J&A Truck Repair and Container Freight Underground Storage Tank Removal Project*

STID 2265

Dear Ms. Hugo:

As you requested, this letter summarizes results of our telephone conversation on October 2, 1995 regarding J&A Truck Repair and Container Freight underground storage tank (UST) removal projects.

J&A TRUCK REPAIR

The following activities need to be performed in order to obtain closure for the J&A Truck Repair UST project:

1. Since the entire site will undergo excavation, Caltrans has the

... Since the entire site will undergo excavation, Caltrans has the following options:

- a) Backfill the excavation pit with clean soil.
 - b) Do not backfill the pit; however, cover the pit with sheet metal for safety.
 - c) Line the pit with visquin and backfill the pit with the excavated material.
2. Complete and submit an Unauthorized Leaking Underground Storage Tank Report.
 3. Prepare and submit an UST closure report.
 4. Submit a copy of Remedial Design Implementation Plan to Ms. Hugo.

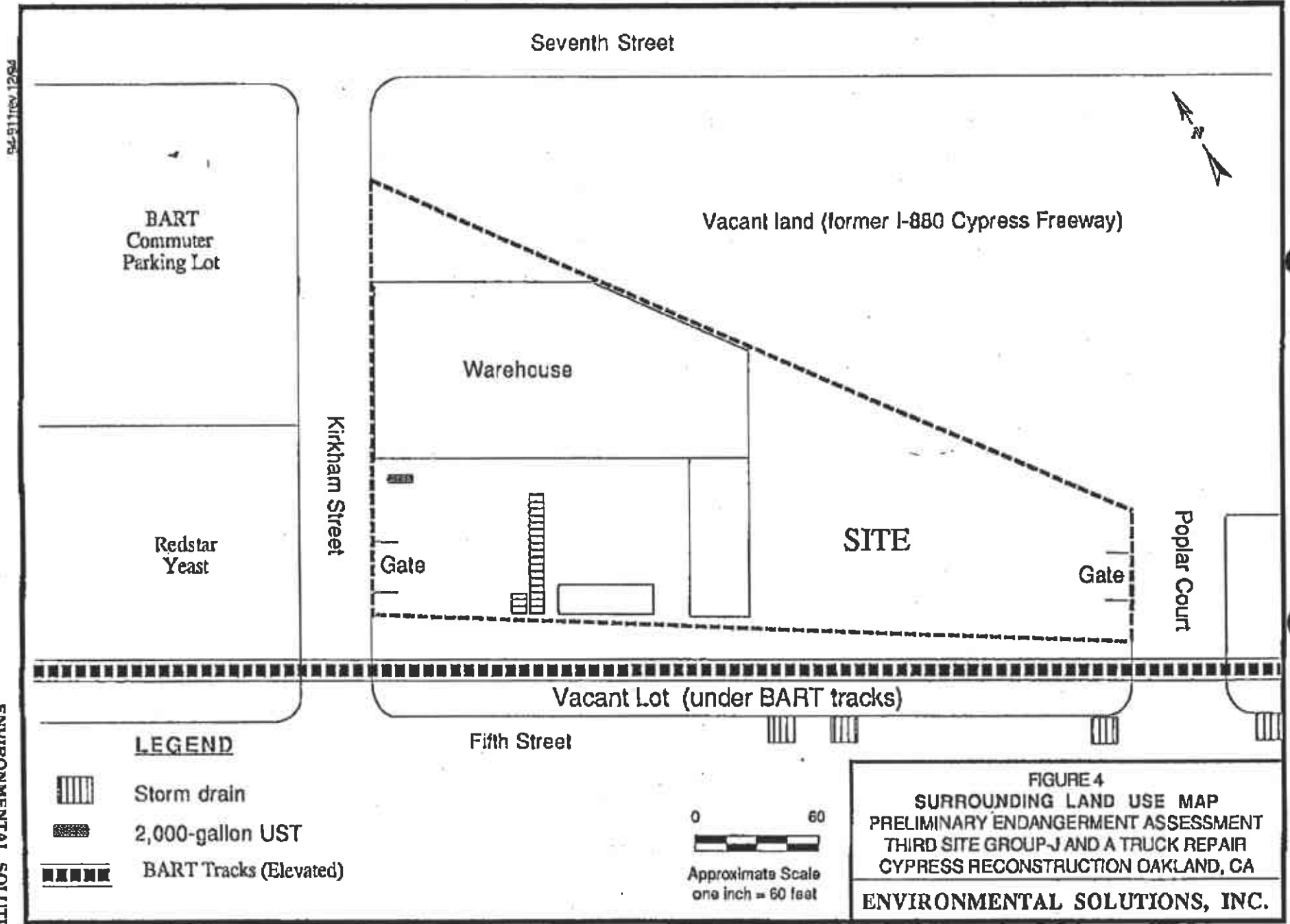

54-511 Rev. 12/94

ENVIRONMENTAL SOLUTIONS

BART
Commuter
Parking Lot

Redstar
Yeast

Seventh Street

Vacant land (former I-880 Cypress Freeway)

Warehouse

SITE

Kirkham Street

Gate

Gate

Poplar Court

Vacant Lot (under BART tracks)

Fifth Street

LEGEND



Storm drain



2,000-gallon UST



BART Tracks (Elevated)



Approximate Scale
one inch = 60 feet

FIGURE 4
SURROUNDING LAND USE MAP
 PRELIMINARY ENDANGERMENT ASSESSMENT
 THIRD SITE GROUP-J AND A TRUCK REPAIR
 CYPRESS RECONSTRUCTION OAKLAND, CA
ENVIRONMENTAL SOLUTIONS, INC.

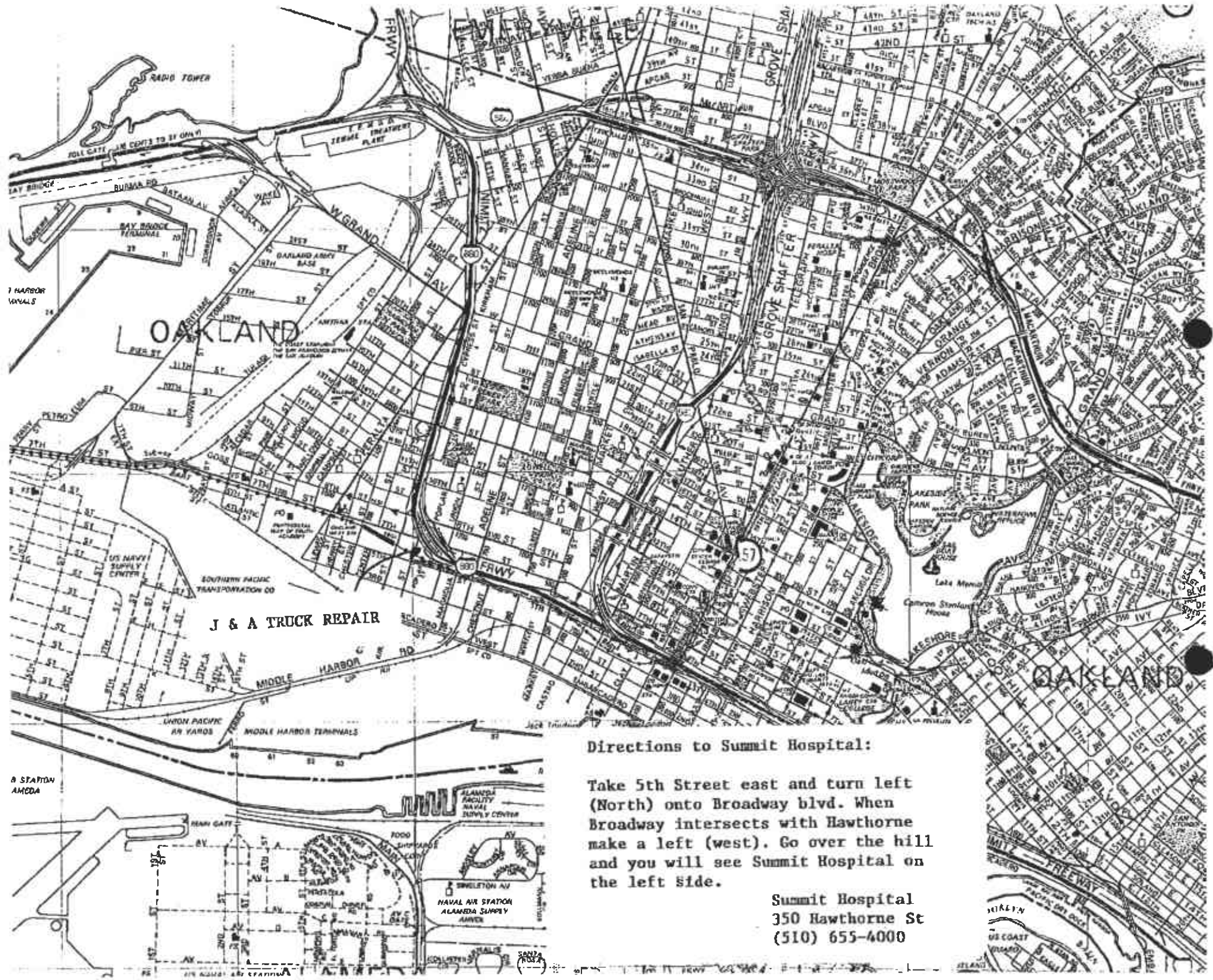

Directions to Summit Hospital:

Take 5th Street east and turn left (North) onto Broadway blvd. When Broadway intersects with Hawthorne make a left (west). Go over the hill and you will see Summit Hospital on the left side.

Summit Hospital
350 Hawthorne St
(510) 655-4000

7 HARBOR
1044LS

8 STATION
AMCDA

OAKLAND

J & A TRUCK REPAIR

OAKLAND

NAVAL AIR STATION
ALAMEDA SUPPLY CENTER