

ENVIRONMENTAL
PROTECTION



Chevron

98 JUL -1 PM 3:27

June 30, 1998

Chevron Products Company

6001 Bollinger Canyon Road
Building L
San Ramon, CA 94583
P.O. Box 6004
San Ramon, CA 94583-0904

Marketing - Sales West

Phone 510 842-9500

Mr. Scott Seery
Alameda County Health Care Services
Department of Environmental Health
1131 Harbor Bay Parkway, Suite 250
Alameda, CA 94502-6577

**Re: Former Chevron Service Station #9-4930
3369 Castro Valley Blvd., Castro Valley, California**

Dear Mr. Seery:

Enclosed is the Second Quarter Groundwater Monitoring Report for 1998 that was prepared by Blaine Tech Services Inc., for the above noted site. The groundwater samples were analyzed for TPH-g, BTEX and MtBE constituents. Monitoring wells MW-1, MW-2 and MW-4 are sampled quarterly while well MW-3 is sampled semi-annually (1st and 3rd quarters).

The benzene concentration increased slightly in monitoring wells MW-1, MW-2 and MW-4 from the previous sampling event.

Depth to ground water varied from 4.51 feet to 6.81 feet below grade with a direction of flow to the west southwest.

Chevron will continue to monitor the site as outlined above. If you have any questions call me at (925) 842-9136.

Sincerely,

CHEVRON PRODUCTS COMPANY

A handwritten signature in cursive script that reads "Philip R. Briggs".

Philip R. Briggs
Site Assessment and Remediation Project Manager

Enclosure

June 30, 1998
Mr. Scott Seery
Former Chevron Service Station #9-4930
Page 2

Cc. Ms. Bette Owen, Chevron Products Co.

Mr. Chuck Headlee
RWQCB-San Francisco Bay Region
2101 Webster Street, Suite 500
Oakland, CA 94612

Anna Counelis & Tula Gallanes
109 Casa Vieja
Orinda, CA 94563

BLAINE
TECH SERVICES INC.



1680 ROGERS AVENUE
SAN JOSE, CALIFORNIA 95112
(408) 573-7771 FAX
(408) 573-0555 PHONE

June 18, 1998

Phil Briggs
Chevron U.S.A. Products Company
P.O. Box 6004
San Ramon, CA 94583-0904

2nd Quarter 1998 Monitoring at 9-4930

Second Quarter 1998 Groundwater Monitoring at
Former Chevron Service Station Number 9-4930
3369 Castro Valley Blvd.
Castro Valley, CA

Monitoring Performed on May 8, 1998

Groundwater Sampling Report 980508-T-2

This report covers the routine monitoring of groundwater wells at this Chevron facility. Blaine Tech Services, Inc.'s work at the site includes inspection, gauging, evacuation, purgewater containment, sample collection and sample handling in accordance with standard procedures that conform to Regional Water Quality Control Board requirements.

Routine field data collection includes depth to water, total well depth, thickness of any separate immiscible layer, water column volume, calculated volume of a three-case volume purge, elapsed evacuation time, total volume of water removed, and standard water parameter instrument readings. Sample material is collected, contained, stored, and transported to the laboratory in conformance with EPA standards. Purgewater is, likewise, collected and transported to McKittrick Waste Treatment Site for disposal.

Basic field information is presented alongside analytical values excerpted from the laboratory report in the cumulative table of **WELL DATA AND ANALYTICAL RESULTS**. The full analytical report for the most recent samples is located in the **Analytical Appendix**. The table also contains new groundwater elevation calculations taken from the computer plotted gradient map which is located in the **Professional Engineering Appendix**.

At a minimum, Blaine Tech Services, Inc. field personnel are certified upon completion of a forty-hour Hazardous Materials and Emergency Response training course per 29 CFR 1910.120. Field personnel are also enrolled in annual eight hour refresher courses.

Blaine Tech Services, Inc. conducts sampling and documentation assignments of this type as an independent third party. In order to avoid compromising the objectivity necessary for the proper and disinterested performance of this work, Blaine Tech Services, Inc. concentrates on objective data collection and does not participate in the interpretation of analytical results, the definition of geological or hydrological conditions, the formulation of recommendations, or the marketing of remedial systems.

Please call if you have any questions.

Yours truly,

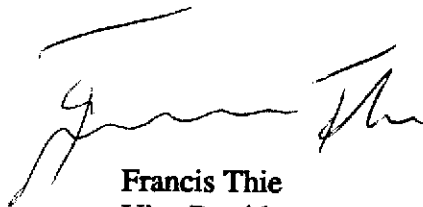
A handwritten signature in black ink, appearing to read 'Francis Thie', is written over a horizontal line.

Francis Thie
Vice President

FPT/ap

attachments: Professional Engineering Appendix
Cumulative Table of Well Data and Analytical Results
Analytical Appendix
Field Data Sheets

Professional Engineering Appendix

CASTRO VALLEY BLVD.

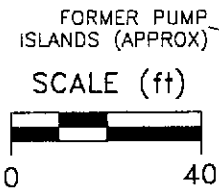

WILBEAM AVE.

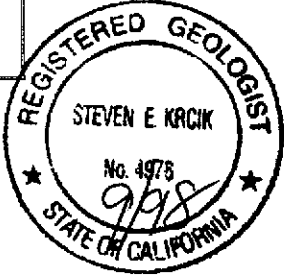
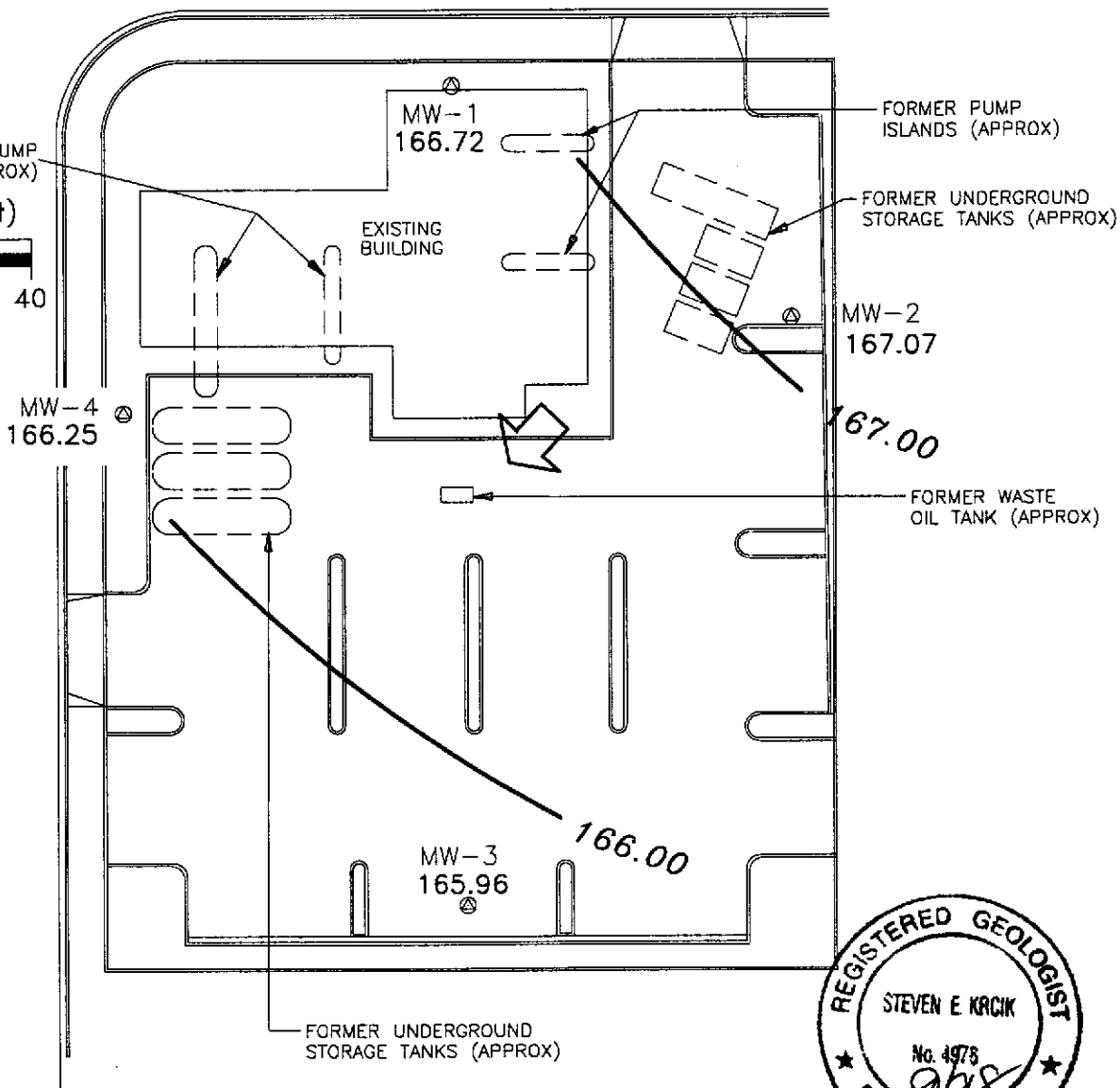

EXPLANATION

- ⊙ MONITORING WELL
- 166.72 GROUNDWATER ELEVATION (FT, MSL)
- 166.00 — GROUNDWATER ELEVATION CONTOUR (FT, MSL)
- APPROXIMATE GROUNDWATER FLOW DIRECTION;
APPROXIMATE GRADIENT = 0.007

Basemap from Geoconsultants, Inc.

PREPARED BY

RRM
engineering contracting firm

Former Chevron Station 9-4930
3369 Castro Valley Boulevard
Castro Valley, California

GROUNDWATER ELEVATION CONTOUR MAP,
MAY 8, 1998

FIGURE:
1

PROJECT:
DAC04

**Table of
Well Data and
Analytical Results**

Cumulative Table of Well Data and Analytical Results

Vertical Measurements are in feet.

Analytical results are in parts per billion (ppb)

DATE	Well Head Elev.	Ground Water Elev.	Depth To Water	Notes	Analytical results are in parts per billion (ppb)									
					TPH-Gasoline	Benzene	Toluene	Ethyl-Benzene	Xylene	1,2-DCE	TCE	DCFM	PCE	MTBE
MW-1														
10/29/93	172.90	166.15	6.75	--	1000	11	17	32	110	--	--	--	--	--
02/25/94	172.90	166.80	6.10	--	250	6.0	1.0	5.0	3.0	--	--	--	--	--
04/04/94	172.90	166.14	6.76	--	--	--	--	--	--	--	--	--	--	--
04/29/94	172.90	166.35	6.55	--	--	--	--	--	--	--	--	--	--	--
06/13/94	172.90	166.12	6.78	--	670	35	3.5	43	3.9	0.8	16	14	47	--
06/30/94	172.90	166.06	6.84	--	--	--	--	--	--	--	--	--	--	--
07/28/94	172.90	166.03	6.87	--	--	--	--	--	--	--	--	--	--	--
08/31/94	172.90	166.00	6.90	--	560	43	9.5	25	5.0	1.3	19	13	65	--
11/11/94	172.90	167.00	5.90	--	460	53	4.0	50	3.4	--	--	--	--	--
02/01/95	172.90	166.88	6.02	--	240	25	0.60	4.0	<0.5	--	--	--	--	--
05/18/95	172.90	166.82	6.08	--	580	42	1.0	53	2.6	--	--	--	--	--
08/22/95	172.90	166.52	6.38	--	840	73	1.2	110	1.6	--	--	--	--	--
11/01/95	172.90	166.40	6.50	--	350	36	<0.5	30	<0.5	--	--	--	--	15
01/26/96	172.90	166.85	6.05	--	210	23	<0.5	12	<0.5	--	--	--	--	4.7
05/08/96	172.90	166.50	6.40	--	310	42	2.3	56	1.1	--	--	--	--	52
10/03/96	173.53	166.61	6.92	--	240	31	<0.5	1.7	<0.5	--	--	--	--	16
02/04/97	173.53	167.02	6.51	--	200	9.9	<0.5	3.7	<0.5	--	--	--	--	16
04/30/97	173.53	166.64	6.89	--	260	11	<0.5	17	<0.5	--	--	--	--	13
07/22/97	173.53	166.49	7.04	--	170	5.0	<0.5	<0.5	<0.5	--	--	--	--	<2.5
11/03/97	173.53	166.55	6.98	--	230	13	<0.5	7.8	0.68	--	--	--	--	*
02/11/98	173.53	167.52	6.01	--	110	3.1	0.63	<0.5	<0.5	--	--	--	--	<2.5
05/08/98	173.53	166.72	6.81	--	170	4.2	1.8	2.1	<0.5	--	--	--	--	<2.5

* No value for MTBE could be determined; see lab report.

Cumulative Table of Well Data and Analytical Results

Vertical Measurements are in feet.

Analytical results are in parts per billion (ppb)

DATE	Well Head Elev.	Ground Water Elev.	Depth To Water	Notes	TPH-Gasoline	Benzene	Toluene	Ethyl-Benzene	Xylene	1,2-DCE	TCE	DCFM	PCE	MTBE
MW-2														
10/29/93	173.91	166.05	7.86	--	5600	140	3.2	17	330	--	--	--	--	--
02/25/94	173.91	166.96	6.95	--	820	41	<0.5	17	5.0	--	--	--	--	--
04/04/94	173.91	166.18	7.73	--	--	--	--	--	--	--	--	--	--	--
04/29/94	173.91	166.23	7.68	--	--	--	--	--	--	--	--	--	--	--
06/13/94	173.91	166.20	7.71	--	1100	160	0.8	64	2.0	<0.5	0.9	<0.5	2.0	--
06/30/94	173.91	165.87	8.04	--	--	--	--	--	--	--	--	--	--	--
07/28/94	173.91	165.99	7.92	--	--	--	--	--	--	--	--	--	--	--
08/31/94	173.91	165.98	7.93	--	190	7.1	4.1	3.1	1.2	<0.5	1.1	<0.5	4.5	--
11/11/94	173.91	167.08	6.83	--	440	120	<1.0	18	<1.0	--	--	--	--	--
02/01/95	173.91	167.77	6.14	--	240	81	<1.0	<1.0	<1.0	--	--	--	--	--
05/18/95	173.91	166.91	7.00	--	330	74	<0.5	26	1.3	--	--	--	--	--
08/22/95	173.91	166.58	7.33	--	390	84	<1.0	2.1	<1.0	--	--	--	--	--
11/01/95	173.91	166.54	7.37	--	190	46	<0.5	1.6	<0.5	--	--	--	--	<2.5
01/26/96	173.91	168.13	5.78	--	<50	13	<0.5	<0.5	<0.5	--	--	--	--	<2.5
05/08/96	173.91	166.76	7.15	--	<50	4.5	<0.5	<0.5	<0.5	--	--	--	--	<2.5
10/03/96	172.67	166.66	6.01	--	63	4.3	<0.5	<0.5	<0.5	--	--	--	--	<2.5
02/04/97	172.67	167.40	5.27	--	<50	1.6	<0.5	<0.5	<0.5	--	--	--	--	<2.5
04/30/97	172.67	166.74	5.93	--	<50	5.4	<0.5	0.80	<0.5	--	--	--	--	<2.5
07/22/97	172.67	166.53	6.14	--	<50	<0.5	<0.5	<0.5	<0.5	--	--	--	--	<2.5
11/03/97	172.67	--	--	Inaccessible	--	--	--	--	--	--	--	--	--	--
02/11/98	172.67	167.95	4.72	--	<50	0.52	0.63	<0.5	<0.5	--	--	--	--	<2.5
05/08/98	172.67	167.07	5.60	--	<50	1.1	1.2	<0.5	<0.5	--	--	--	--	<2.5

Cumulative Table of Well Data and Analytical Results

Vertical Measurements are in feet.

Analytical results are in parts per billion (ppb)

DATE	Well Head Elev.	Ground Water Elev.	Depth To Water	Notes	TPH-Gasoline	Benzene	Toluene	Ethyl-Benzene	Xylene	1,2-DCE	TCE	DCFM	PCE	MTBE
MW-3														
10/29/93	172.60	164.96	7.64	--	110	<0.5	<0.5	<0.5	<0.5	--	--	--	--	--
02/25/94	172.60	166.22	6.38	--	<50	<0.5	<0.5	<0.5	<0.5	--	--	--	--	--
04/04/94	172.60	165.21	7.39	--	--	--	--	--	--	--	--	--	--	--
04/29/94	172.60	165.62	6.98	--	--	--	--	--	--	--	--	--	--	--
06/13/94	172.60	165.15	7.45	--	<50	<0.5	<0.5	<0.5	<0.5	<0.5	2.0	<0.5	220	--
06/30/94	172.60	165.05	7.55	--	--	--	--	--	--	--	--	--	--	--
07/28/94	172.60	164.93	7.67	--	--	--	--	--	--	--	--	--	--	--
08/31/94	172.60	164.81	7.79	--	<50	<0.5	<0.5	<0.5	<0.5	<0.5	1.6	<0.5	320	--
11/11/94	172.60	165.73	6.87	Sampled biannually	--	--	--	--	--	--	--	--	--	--
02/01/95	172.60	167.03	5.57	--	89	<0.5	<0.5	<0.5	<0.5	--	--	--	--	--
05/18/95	172.60	165.79	6.81	--	--	--	--	--	--	--	--	--	--	--
08/22/95	172.60	165.35	7.25	--	190	<0.5	<0.5	<0.5	<0.5	--	--	--	--	--
11/01/95	172.60	165.70	6.90	--	--	--	--	--	--	--	--	--	--	--
01/26/96	172.60	167.35	5.25	--	160	<2.5	<0.5	<0.5	<0.5	--	--	--	--	<2.5
05/08/96	172.60	165.55	7.05	--	--	--	--	--	--	--	--	--	--	--
10/03/96	170.47	165.29	5.18	--	150	<0.5	<0.5	<0.5	<0.5	--	--	--	--	<2.5
02/04/97	170.47	166.27	4.20	--	88	<0.5	<0.5	<0.5	<0.5	--	--	--	--	<2.5
04/30/97	170.47	165.37	5.10	--	--	--	--	--	--	--	--	--	--	--
07/22/97	170.47	165.15	5.32	--	180	<0.5	<0.5	<0.5	<0.5	--	--	--	--	<2.5
11/03/97	170.47	165.12	5.35	--	--	--	--	--	--	--	--	--	--	--
02/11/98	170.47	167.47	3.00	--	<50	<0.5	<0.5	<0.5	<0.5	--	--	--	--	<2.5
05/08/98	170.47	165.96	4.51	--	--	--	--	--	--	--	--	--	--	--

Cumulative Table of Well Data and Analytical Results

Vertical Measurements are in feet.

Analytical results are in parts per billion (ppb)

DATE	Well Head Elev.	Ground Water Elev.	Depth To Water	Notes	TPH-Gasoline	Benzene	Toluene	Ethyl-Benzene	Xylene	1,2-DCE	TCE	DCFM	PCE	MTBE
MW-4														
10/29/93	170.68	165.18	5.50	--	640	6.7	3.3	0.6	6.7	--	--	--	--	--
02/25/94	170.68	165.86	4.82	--	450	20	0.8	12	6.0	--	--	--	--	--
04/04/94	170.68	165.23	5.45	--	--	--	--	--	--	--	--	--	--	--
04/29/94	170.68	165.45	5.23	--	--	--	--	--	--	--	--	--	--	--
06/13/94	170.68	165.14	5.54	--	1700	130	1.4	100	11	22	59	13	180	--
06/30/94	170.68	165.13	5.55	--	--	--	--	--	--	--	--	--	--	--
07/28/94	170.68	165.06	5.62	--	--	--	--	--	--	--	--	--	--	--
08/31/94	170.68	165.00	5.68	--	800	17	3.5	9.3	4.4	25	53	22	510	--
11/11/94	170.68	165.46	5.22	--	500	26	<0.5	30	4.3	--	--	--	--	--
02/01/95	170.68	165.12	5.56	--	1600	180	<2.0	31	42	--	--	--	--	--
05/18/95	170.68	165.70	4.98	--	1300	130	<2.0	140	5.5	--	--	--	--	--
08/22/95	170.68	165.35	5.33	--	970	50	<1.2	75	<1.2	--	--	--	--	--
11/01/95	170.68	165.28	5.40	--	320	3.3	<0.5	4.1	<0.5	--	--	--	--	27
01/26/96	170.68	166.40	4.28	--	1400	65	<2.5	98	71	--	--	--	--	100
05/08/96	170.68	165.33	5.35	--	610	28	1.2	58	4.4	--	--	--	--	70
10/03/96	171.70	165.48	6.22	--	210	4.2	<0.5	<0.5	<0.5	--	--	--	--	12
02/04/97	171.70	166.57	5.13	--	60	4.4	<0.5	<0.5	<0.5	--	--	--	--	--
04/30/97	171.70	165.60	6.10	--	870	49	<2.0	100	<2.0	--	--	--	--	18
07/22/97	171.70	165.36	6.34	--	420	16	<0.5	23	<0.5	--	--	--	--	9.4
11/03/97	171.70	165.35	6.35	--	370	8.1	0.54	10	7.6	--	--	--	--	30
02/11/98	171.70	167.16	4.54	--	<50	2.0	0.58	<0.5	<0.5	--	--	--	--	<2.5
05/08/98	171.70	166.25	5.45	--	230	13	2.3	37	4.3	--	--	--	--	15

Cumulative Table of Well Data and Analytical Results

Vertical Measurements are in feet.

Analytical results are in parts per billion (ppb)

DATE	Well Head Elev.	Ground Water Elev.	Depth To Water	Notes	TPH-Gasoline	Benzene	Toluene	Ethyl-Benzene	Xylene	1,2-DCE	TCE	DCFM	PCE	MTBE
TRIP BLANK														
02/25/94	--	---	---	--	<50	<0.5	<0.5	<0.5	<0.5	--	--	--	--	--
06/13/94	--	---	---	--	<50	<0.5	<0.5	<0.5	<0.5	--	--	--	--	--
08/31/94	--	---	---	--	<50	<0.5	<0.5	<0.5	<0.5	--	--	--	--	--
11/11/94	--	---	---	--	<50	<0.5	<0.5	<0.5	<0.5	--	--	--	--	--
02/01/95	--	---	---	--	<50	<0.5	<0.5	<0.5	<0.5	--	--	--	--	--
05/18/95	--	---	---	--	<50	<0.5	<0.5	<0.5	<0.5	--	--	--	--	--
08/22/95	--	---	---	--	<50	<0.5	<0.5	<0.5	<0.5	--	--	--	--	--
11/01/95	--	---	---	--	<50	<0.5	<0.5	<0.5	<0.5	--	--	--	--	--
01/26/96	--	---	---	--	<50	<0.5	<0.5	<0.5	<0.5	--	--	--	--	<2.5
05/08/96	--	---	---	--	<50	<0.5	<0.5	<0.5	<0.5	--	--	--	--	<2.5
10/03/96	--	---	---	--	<50	<0.5	<0.5	<0.5	<0.5	--	--	--	--	<2.5
02/04/97	--	---	---	--	<50	<0.5	<0.5	<0.5	<0.5	--	--	--	--	<2.5
04/30/97	--	---	---	--	<50	<0.5	<0.5	<0.5	<0.5	--	--	--	--	<2.5
07/22/97	--	---	---	--	<50	<0.5	<0.5	<0.5	<0.5	--	--	--	--	<2.5
02/11/98	--	---	---	--	<50	<0.5	<0.5	<0.5	<0.5	--	--	--	--	<2.5
05/08/98	--	---	---	--	<50	<0.5	<0.5	<0.5	<0.5	--	--	--	--	<2.5

Note: Blaine Tech Services, Inc. began routine monitoring of the groundwater wells at this site on November 1, 1994.
 Earlier field data and analytical results are drawn from the September 27, 1994 Groundwater Technology, Inc. report.
 New survey information drawn from the October 11, 1996 Ron Archer Civil Engineer Inc. report.

ABBREVIATIONS:

TPH = Total Petroleum Hydrocarbons
 1,2-DCE = 1,2-Dichloroethene
 TCE = Trichloroethene
 DCFM = Dichlorodifluoromethane
 PCE = Tetrachloroethene
 MTBE = Methyl t-Butyl Ether

Analytical Appendix



Sequoia Analytical

680 Chesapeake Drive
404 N. Wiget Lane
819 Striker Avenue, Suite 8
1455 McDowell Blvd. North, Ste. D

Redwood City, CA 94063
Walnut Creek, CA 94598
Sacramento, CA 95834
Petaluma, CA 94954

(650) 364-9600 FAX (650) 364-9233
(510) 988-9600 FAX (510) 988-9673
(916) 921-9600 FAX (916) 921-0100
(707) 792-1865 FAX (707) 792-0342

Blaine Tech Services 1680 Rogers Avenue San Jose, CA 95112	Client Proj. ID: Chevron 9-4930/980508-T2 Sample Descript: MW1 Matrix: LIQUID Analysis Method: 8015Mod/8020 Lab Number: 9805638-01	Sampled: 05/08/98 Received: 05/11/98 Analyzed: 05/20/98 Reported: 06/02/98
--	--	---

QC Batch Number: GC052098BTEX04A
Instrument ID: GCHP4

Analyte	Detection Limit ug/L	Sample Results ug/L
TPPH as Gas	50	170
Methyl t-Butyl Ether	2.5	N.D.
Benzene	0.50	4.2
Toluene	0.50	1.8
Ethyl Benzene	0.50	2.1
Xylenes (Total)	0.50	N.D.
Chromatogram Pattern: Unidentified HC	
Surrogates	Control Limits %	% Recovery
Trifluorotoluene	70 130	95

Analytes reported as N.D. were not present above the stated limit of detection.

SEQUOIA ANALYTICAL - ELAP #1210

Mike Gregory
Project Manager





Sequoia Analytical

680 Chesapeake Drive
404 N. Wiget Lane
819 Striker Avenue, Suite 8
1455 McDowell Blvd, North, Ste. D

Redwood City, CA 94063
Walnut Creek, CA 94598
Sacramento, CA 95834
Petaluma, CA 94954

(650) 364-9600
(510) 988-9600
(916) 921-9600
(707) 792-1865

FAX (650) 364-9233
FAX (510) 988-9673
FAX (916) 921-0100
FAX (707) 792-0342

Blaine Tech Services 1680 Rogers Avenue San Jose, CA 95112	Client Proj. ID: Chevron 9-4930/980508-T2 Sample Descript: MW2 Matrix: LIQUID Analysis Method: 8015Mod/8020 Lab Number: 9805638-02	Sampled: 05/08/98 Received: 05/11/98 Analyzed: 05/20/98 Reported: 06/02/98
Attention: Fran Thie		

QC Batch Number: GC052098BTEX04A
Instrument ID: GCHP4

Analyte	Detection Limit ug/L	Sample Results ug/L
TPPH as Gas	50	N.D.
Methyl t-Butyl Ether	2.5	N.D.
Benzene	0.50	1.1
Toluene	0.50	1.2
Ethyl Benzene	0.50	N.D.
Xylenes (Total)	0.50	N.D.
Chromatogram Pattern:		
Surrogates	Control Limits %	% Recovery
Trifluorotoluene	70 130	86

Analytes reported as N.D. were not present above the stated limit of detection.

SEQUOIA ANALYTICAL - ELAP #1210

Mike Gregory
Project Manager





Sequoia Analytical

680 Chesapeake Drive
404 N. Wiget Lane
819 Striker Avenue, Suite 8
1455 McDowell Blvd. North, Ste. D

Redwood City, CA 94063
Walnut Creek, CA 94598
Sacramento, CA 95834
Petaluma, CA 94954

(650) 364-9600 FAX (650) 364-9233
(510) 988-9600 FAX (510) 988-9673
(916) 921-9600 FAX (916) 921-0100
(707) 792-1865 FAX (707) 792-0342

Blaine Tech Services 1680 Rogers Avenue San Jose, CA 95112	Client Proj. ID: Chevron 9-4930/980508-T2 Sample Descript: MW4 Matrix: LIQUID Analysis Method: 8015Mod/8020 Lab Number: 9805638-03	Sampled: 05/08/98 Received: 05/11/98 Analyzed: 05/20/98 Reported: 06/02/98
--	--	---

QC Batch Number: GC052098BTEX04A
Instrument ID: GCHP4

Analyte	Detection Limit ug/L	Sample Results ug/L
TPPH as Gas	50	230
Methyl t-Butyl Ether	2.5	15
Benzene	0.50	13
Toluene	0.50	2.3
Ethyl Benzene	0.50	37
Xylenes (Total)	0.50	4.3
Chromatogram Pattern:		Gas

Surrogates	Control Limits %	% Recovery
Trifluorotoluene	70 130	80

Analytes reported as N.D. were not present above the stated limit of detection.

SEQUOIA ANALYTICAL - ELAP #1210

Mike Gregery
Project Manager





Sequoia Analytical

680 Chesapeake Drive
404 N. Wiget Lane
819 Striker Avenue, Suite B
1455 McDowell Blvd. North, Ste. D

Redwood City, CA 94063
Walnut Creek, CA 94598
Sacramento, CA 95834
Petaluma, CA 94954

(650) 364-9600 FAX (650) 364-9233
(510) 988-9600 FAX (510) 988-9673
(916) 921-9600 FAX (916) 921-0100
(707) 792-1865 FAX (707) 792-0342

Blaine Tech Services
1680 Rogers Avenue
San Jose, CA 95112

Attention: Fran Thie

Client Proj. ID: Chevron 9-4930/980508-T2
Sample Descript: TB
Matrix: LIQUID
Analysis Method: 8015Mod/8020
Lab Number: 9805638-04

Sampled: 05/08/98
Received: 05/11/98

Analyzed: 05/20/98
Reported: 06/02/98

QC Batch Number: GC052098BTEX04A
Instrument ID: GCHP4

Analyte	Detection Limit ug/L	Sample Results ug/L
TPPH as Gas	50	N.D.
Methyl t-Butyl Ether	2.5	N.D.
Benzene	0.50	N.D.
Toluene	0.50	N.D.
Ethyl Benzene	0.50	N.D.
Xylenes (Total)	0.50	N.D.
Chromatogram Pattern:		
Surrogates	Control Limits %	% Recovery
Trifluorotoluene	70 130	68 Q

Analytes reported as N.D. were not present above the stated limit of detection.

SEQUOIA ANALYTICAL - ELAP #1210

Mike Gregory
Project Manager





**Sequoia
Analytical**

680 Chesapeake Drive
404 N. Wiger Lane
819 Striker Avenue, Suite 8
1455 McDowell Blvd. North, Ste. D

Redwood City, CA 94063
Walnut Creek, CA 94598
Sacramento, CA 95834
Petaluma, CA 94954

(650) 364-9600 FAX (650) 364-9233
(510) 988-9600 FAX (510) 988-9673
(916) 921-9600 FAX (916) 921-0100
(707) 792-1865 FAX (707) 792-0342

Blaine Tech Services
1680 Rogers Avenue
San Jose, CA 95112
Attention: Fran Thie

Client Proj. ID: Chevron 9-4930/980508-T2

Received: 05/11/98

Lab Proj. ID: 9805638

Reported: 06/02/98

LABORATORY NARRATIVE

In order to properly interpret this report, it must be reproduced in its entirety. This report contains a total of 7 pages including the laboratory narrative, sample results, quality control, and related documents as required (cover page, COC, raw data, etc.).

SEQUOIA ANALYTICAL

Mike Gregory
Project Manager





Sequoia Analytical

680 Chesapeake Drive
404 N. Wiget Lane
819 Striker Avenue, Suite 8
1455 McDowell Blvd. North, Ste. D

Redwood City, CA 94063
Walnut Creek, CA 94598
Sacramento, CA 95834
Petaluma, CA 94954

(650) 364-9600
(510) 988-9600
(916) 921-9600
(707) 792-1865

FAX (650) 364-9233
FAX (510) 988-9673
FAX (916) 921-0100
FAX (707) 792-0342

Blaine Tech Services, Inc.
1680 Rogers Ave.
San Jose, CA 95112
Attention: Fran Thie

Client Project ID: Chevron 9-4930/ 980508-T2
Matrix: Liquid

Work Order #: 9805638 -01-04

Reported: Jun 4, 1998

QUALITY CONTROL DATA REPORT

Analyte:	Benzene	Toluene	Ethyl Benzene	Xylenes	Gas
QC Batch#:	GC052098802004A	GC052098802004A	GC052098802004A	GC052098802004A	GC052098802004A
Analy. Method:	EPA 8020	EPA 8020	EPA 8020	EPA 8020	EPA 8015M
Prep. Method:	EPA 5030	EPA 5030	EPA 5030	EPA 5030	EPA 5030

Analyst:	A.S.	A.S.	A.S.	A.S.	A.S.
MS/MSD #:	98050735	98050735	98050735	98050735	-
Sample Conc.:	1.1	1.2	N.D.	N.D.	-
Prepared Date:	5/20/98	5/20/98	5/20/98	5/20/98	-
Analyzed Date:	5/20/98	5/20/98	5/20/98	5/20/98	-
Instrument I.D.#:	GC4	GC4	GC4	GC4	-
Conc. Spiked:	20 µg/L	20 µg/L	20 µg/L	60 µg/L	-
Result:	19.5	19.9	19.9	60	-
MS % Recovery:	92	94	100	100	-
Dup. Result:	20.1	21.4	20.5	61	-
MSD % Recov.:	95	101	103	102	-
RPD:	3.0	7.3	3.0	1.7	-
RPD Limit:	0-25	0-25	0-25	0-25	-

LCS #:	LCS052098	LCS052098	LCS052098	LCS052098	LCS052098
Prepared Date:	5/20/98	5/20/98	5/20/98	5/20/98	5/20/98
Analyzed Date:	5/20/98	5/20/98	5/20/98	5/20/98	5/20/98
Instrument I.D.#:	GC4	GC4	GC4	GC4	GC4
Conc. Spiked:	20 µg/L	20 µg/L	20 µg/L	60 µg/L	500 µg/L
LCS Result:	18.7	19.4	20.6	64.2	441
LCS % Recov.:	94	97	103	107	88

MS/MSD	60-140	60-140	60-140	60-140	60-140
LCS	70-130	70-130	70-130	70-130	70-130
Control Limits					

SEQUOIA ANALYTICAL
Elap #2142

Mike Gregory
Project Manager

Please Note:

The LCS is a control sample of known, interferent-free matrix that is analyzed using the same reagents, preparation, and analytical methods employed for the samples. The matrix spike is an aliquot of sample fortified with known quantities of specific compounds and subjected to the entire analytical procedure. If the recovery of analytes from the matrix spike does not fall within specified control limits due to matrix interference, the LCS recovery is to be used to validate the batch.

** MS= Matrix Spike, MSD=MS Duplicate, RPD=Relative % Difference

9805638.BLA <1>



Chevron U.S.A. Inc.
 P.O. BOX 5004
 San Ramon, CA 94583
 FAX (415)842-9591

Chevron Facility Number 9-4930
 Facility Address 3369 Castro Valley Blvd., Castro Valley, CA
 Consultant Project Number 980508-T2
 Consultant Name Blaine Tech Services, Inc.
 Address 1680 Rogers Ave., San Jose, CA 95112
 Project Contact (Name) Fran Thie
 (Phone) (408)573-0555 (Fax Number) (408)573-7771

Chevron Contact (Name) Phil Briggs
 (Phone) (510) 842-9136
 Laboratory Name Sequoia
 Laboratory Release Number 9034497
 Samples Collected by (Name) Mike Toll
 Collection Date 5/11/98
 Signature Mike Toll

Sample Number	Lab Sample Number	Number of Containers	Matrix S = Soil W = Water A = Air C = Charcoal	Type G = Grab C = Composite D = Discrete	Time	Sample Preservation	Iced (Yes or No)	Analytes To Be Performed <u>9805638</u>											Remarks
								BTEX + TPH GAS (8020 + 8015)	TPH Diesel (8015)	Oil and Grease (5520)	Purgeable Halocarbons (8010)	Purgeable Aromatics (8020)	Purgeable Organics (8240)	Extractable Organics (8270)	Metals Cd, Cr, Pb, Zn, Ni (ICAP or AA)				
MW1	1	3	W		1250	HCL	Y	X											
MW2	2	3		A	1210			Y											
MW4	3	3			1230			Y											
TB	4	2						X											

Relinquished By (Signature) <u>Mike Toll</u>	Organization <u>BTS</u>	Date/Time <u>5/11/98</u> 2:50	Received By (Signature) <u>Fran Thie</u>	Organization <u>Sequoia</u>	Date/Time <u>5/11/98</u> 2:30	Turn Around Time (Circle Choice) 24 Hrs. 48 Hrs. 5 Days 10 Days As Contracted
Relinquished By (Signature) <u>Fran Thie</u>	Organization <u>Sequoia</u>	Date/Time <u>5/11/98</u>	Received By (Signature)	Organization	Date/Time	
Relinquished By (Signature)	Organization	Date/Time	Received For Laboratory By (Signature) <u>Juni Torres</u>		Date/Time <u>5/11 1517</u>	

01/HCH

Field Data Sheets

CHEVRON WELL MONITORING DATA SHEET

Project #: 980508-T2	Station #: 9-4930
Sampler: MT	Date: 5/8
Well I.D.: MW1	Well Diameter: <input checked="" type="radio"/> 3 <input type="radio"/> 4 <input type="radio"/> 6 <input type="radio"/> 8 _____
Total Well Depth: 18.35	Depth to Water: 6.81
Depth to Free Product:	Thickness of Free Product (feet):
Referenced to: PVC Grade	D.O. Meter (if req'd): YSI HACH

Well Diameter	Multiplier	Well Diameter	Multiplier
2"	0.16	5"	1.02
3"	0.37	6"	1.47
4"	0.65	Other	radius ² * 0.163

Purge Method: <input type="checkbox"/> Bailer <input checked="" type="checkbox"/> Disposable Bailer <input type="checkbox"/> Middleburg <input type="checkbox"/> Electric Submersible <input type="checkbox"/> Extraction Pump Other: _____	Sampling Method: <input type="checkbox"/> Bailer <input checked="" type="checkbox"/> Disposable Bailer <input type="checkbox"/> Extraction Port Other: _____
--	---

1.9	x	3	=	5.7	Gals.
1 Case Volume (Gals.)		Specified Volumes		Calculated Volume	

Time	Temp (°F)	pH	Cond.	Gals. Removed	Observations
1238	62.4	7.1	910	2	
1241	62.6	7.1	879	4	
1246	62.8	7.0	879	5.75	

Did well dewater? Yes <input checked="" type="checkbox"/> No <input checked="" type="checkbox"/>	Gallons actually evacuated: 5.75
Sampling Time: 1250	Sampling Date: 5/8
Sample I.D.: MW1	Laboratory: Sequoia GTEL N. Creek Assoc. Labs
Analyzed for: TPH-G BTEX MTBE TPH-D Other:	
Duplicate I.D.:	Analyzed for: TPH-G BTEX MTBE TPH-D Other:
D.O. (if req'd):	Pre-purge: <input type="text"/> mg/L Post-purge: <input type="text"/> mg/L
O.R.P. (if req'd):	Pre-purge: <input type="text"/> mV Post-purge: <input type="text"/> mV

CHEVRON WELL MONITORING DATA SHEET

Project #: 980508-T2	Station #: 9-4930
Sampler: KIT	Date: 5/8
Well I.D.: MW2	Well Diameter: <input checked="" type="radio"/> 3 <input type="radio"/> 4 <input type="radio"/> 6 <input type="radio"/> 8 <input type="checkbox"/> _____
Total Well Depth: 16.94	Depth to Water: 5.00
Depth to Free Product:	Thickness of Free Product (feet):
Referenced to: <input checked="" type="radio"/> PVC <input type="radio"/> Grade	D.O. Meter (if req'd): <input type="checkbox"/> YSI <input type="checkbox"/> HACH

Well Diameter	Multiplier	Well Diameter	Multiplier
2"	0.16	5"	1.02
3"	0.37	6"	1.47
4"	0.65	Other	radius ² * 0.163

Purge Method: <input type="checkbox"/> Bailer <input checked="" type="checkbox"/> Disposable Bailer <input type="checkbox"/> Middleburg <input type="checkbox"/> Electric Submersible <input type="checkbox"/> Extraction Pump Other: _____	Sampling Method: <input type="checkbox"/> Bailer <input checked="" type="checkbox"/> Disposable Bailer <input type="checkbox"/> Extraction Port Other: _____
--	---

<u>1.8</u>	x	<u>3</u>	=	<u>5.4</u>	Gals.
I Case Volume (Gals.)		Specified Volumes		Calculated Volume	

Time	Temp (°F)	pH	Cond.	Gals. Removed	Observations
1158	62.4	7.3	1077	2	
1201	62.0	7.2	1020	4	
1205	62.5	7.1	1005	5.5	

Did well dewater? Yes <input checked="" type="checkbox"/> No <input type="checkbox"/>	Gallons actually evacuated: 5.5
Sampling Time: 1210	Sampling Date: 5/8
Sample I.D.: MW2	Laboratory: <input checked="" type="radio"/> Sequoia GTEL N. Creek Assoc. Labs
Analyzed for: <input checked="" type="checkbox"/> TPH-G <input checked="" type="checkbox"/> BTEX <input checked="" type="checkbox"/> MTBE <input type="checkbox"/> TPH-D Other:	
Duplicate I.D.:	Analyzed for: TPH-G BTEX MTBE TPH-D Other:
D.O. (if req'd):	Pre-purge: <input type="checkbox"/> mg/L Post-purge: <input type="checkbox"/> mg/L
O.R.P. (if req'd):	Pre-purge: <input type="checkbox"/> mV Post-purge: <input type="checkbox"/> mV

CHEVRON WELL MONITORING DATA SHEET

Project #: <u>980508-T2</u>	Station #: <u>9-4930</u>
Sampler: <u>MT</u>	Date: <u>5/8</u>
Well I.D.: <u>MWA</u>	Well Diameter: <u>2</u> 3 4 6 8 _____
Total Well Depth: <u>17.90</u>	Depth to Water: <u>5.45</u>
Depth to Free Product:	Thickness of Free Product (feet):
Referenced to: <u>PVC</u> Grade	D.O. Meter (if req'd): YSI HACH

Well Diameter	Multiplier	Well Diameter	Multiplier
2"	0.16	5"	1.02
3"	0.37	6"	1.47
4"	0.65	Other	radius ² * 0.163

Purge Method: <input type="checkbox"/> Bailer <input checked="" type="checkbox"/> Disposable Bailer <input type="checkbox"/> Middleburg <input type="checkbox"/> Electric Submersible <input type="checkbox"/> Extraction Pump Other: _____	Sampling Method: <input type="checkbox"/> Bailer <input checked="" type="checkbox"/> Disposable Bailer <input type="checkbox"/> Extraction Port Other: _____
--	---

<u>2.0</u>	\times	<u>3</u>	$=$	<u>6.0</u>	Gals.
1 Case Volume (Gals.)		Specified Volumes		Calculated Volume	

Time	Temp (°F)	pH	Cond.	Gals. Removed	Observations
<u>12:18</u>	<u>62.2</u>	<u>7.2</u>	<u>802</u>	<u>2</u>	
<u>12:21</u>	<u>62.6</u>	<u>7.2</u>	<u>767</u>	<u>4</u>	
<u>12:25</u>	<u>62.9</u>	<u>7.1</u>	<u>727</u>	<u>6.25</u>	

Did well dewater? Yes No Gallons actually evacuated: 6

Sampling Time: 1230 Sampling Date: 5/8

Sample I.D.: MWA Laboratory: Sequoia GTEL N. Creek Assoc. Labs

Analyzed for: TPH-G BTEX MTBE TPH-D Other:

Duplicate I.D.: Analyzed for: TPH-G BTEX MTBE TPH-D Other:

D.O. (if req'd):	Pre-purge:	mg/L	Post-purge:	mg/L
O.R.P. (if req'd):	Pre-purge:	mV	Post-purge:	mV