

RECEIVED

By Alameda County Environmental Health 11:41 am, Nov 13, 2014

Mr. Keith Nowell
Alameda County Environmental Health Services
1131 Harbor Bay Parkway, Suite 250
Alameda, CA 94502-6577

Re: Gritmit Auto Repair and Service, 1970 Seminary Boulevard, Oakland, California
(Fuel Leak Case No. RO0000413)

Dear Mr. Nowell:

Stratus Environmental, Inc. (Stratus) has recently prepared a letter entitled *Request for Capacity Fee Revision*, on my behalf. The report was prepared in regards to Alameda County Fuel Leak Case No. RO0000413, for Gritmit Auto Repair and Service, 1970 Seminary Boulevard, Oakland, California.

I have reviewed a copy of this report, sent to me by representatives of Stratus, and "I declare, under penalty of perjury, that the information and/or recommendations contained in the attached document or report is true and correct to the best of my knowledge."

If you have any questions, please contact me via electronic mail at peggy.h.garcia@sbcglobal.net, or my daughter Angel LaMarca at angelcpt@gmail.com.

Sincerely,

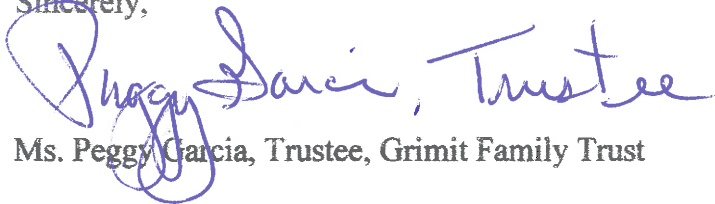
Handwritten signature in blue ink that reads "Peggy Garcia, Trustee". The signature is written in a cursive style.

Ms. Peggy Garcia, Trustee, Gritmit Family Trust

cc: Angel LaMarca



3330 Cameron Park Drive, Ste 550
Cameron Park, California 95682
(530) 676-6004 ~ Fax: (530) 676-6005

August 10, 2015
Project No. 2090-1970-01

East Bay Municipal Utility District
Environmental Services
Attn: Ms. Deirdre Mena
P.O. Box 24055
Oakland, CA 94623-1055

Re: Request for Capacity Fee Revision
Former Gritmit Auto Repair and Service
1970 Seminary Boulevard, Oakland, California

To Ms. Mena:

Stratus Environmental, Inc. (Stratus) has prepared this letter, on behalf of the Gritmit Family Trust, for the Former Gritmit Auto Repair and Service facility, located at 1970 Seminary Boulevard, Oakland, California (Figures 1 and 2). Stratus would like to request a revision of the capacity fee for the Special Groundwater Discharge Permit (Permit No. 62203411), because the actual discharge volume observed during the last eight months of operation was significantly less than the permit application average (267.4Ccf/month).

Per email correspondence, dated July 17, 2015, Stratus would like to proceed with the East Bay Municipal Utility Districts (EBMUD) offer of revising the remaining monthly charges. To date (from start-up on November 18, 2014 through July 15, 2015) Stratus has discharged approximately 22,570 gallons of treated groundwater (see Appendix A) and foresees the discharge flow rate to remain steady as presented in the operational summary attached.

I certify under penalty of law that this document and any attachments were prepared under my direction or supervision in accordance with a system designed to assure that qualified personnel properly gather and evaluate the information submitted. Based on my inquiry of the person or persons who manage the system, or those persons directly responsible for gathering information, the information submitted is, to the best of my knowledge and belief, true, accurate, and complete. I am aware that there are significant penalties for submitting false information, including the possibility of fine and imprisonment for knowing violations.

August 10, 2015

If you have any questions or require additional information, please contact Deborah L. Barr at (530) 313-9974.

Sincerely,

STRATUS ENVIRONMENTAL, INC.



Deborah L. Barr, P.E.
Project Engineer

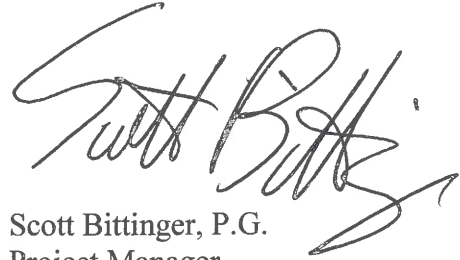

Scott Bittinger, P.G.
Project Manager

Attachments:

Figure 1	Site Location Map
Figure 2	Site Plan
Figure 3	Process Flow Diagram
Appendix A	DPE Remediation Event Table

cc: Ms. Peggy Garcia, Trustee, Grit Auto Family Trust
([email:peggy.h.garcia@sbcglobal.net](mailto:peggy.h.garcia@sbcglobal.net))
Ms. Angel LaMarca ([email:angelcpt@gmail.com](mailto:angelcpt@gmail.com))

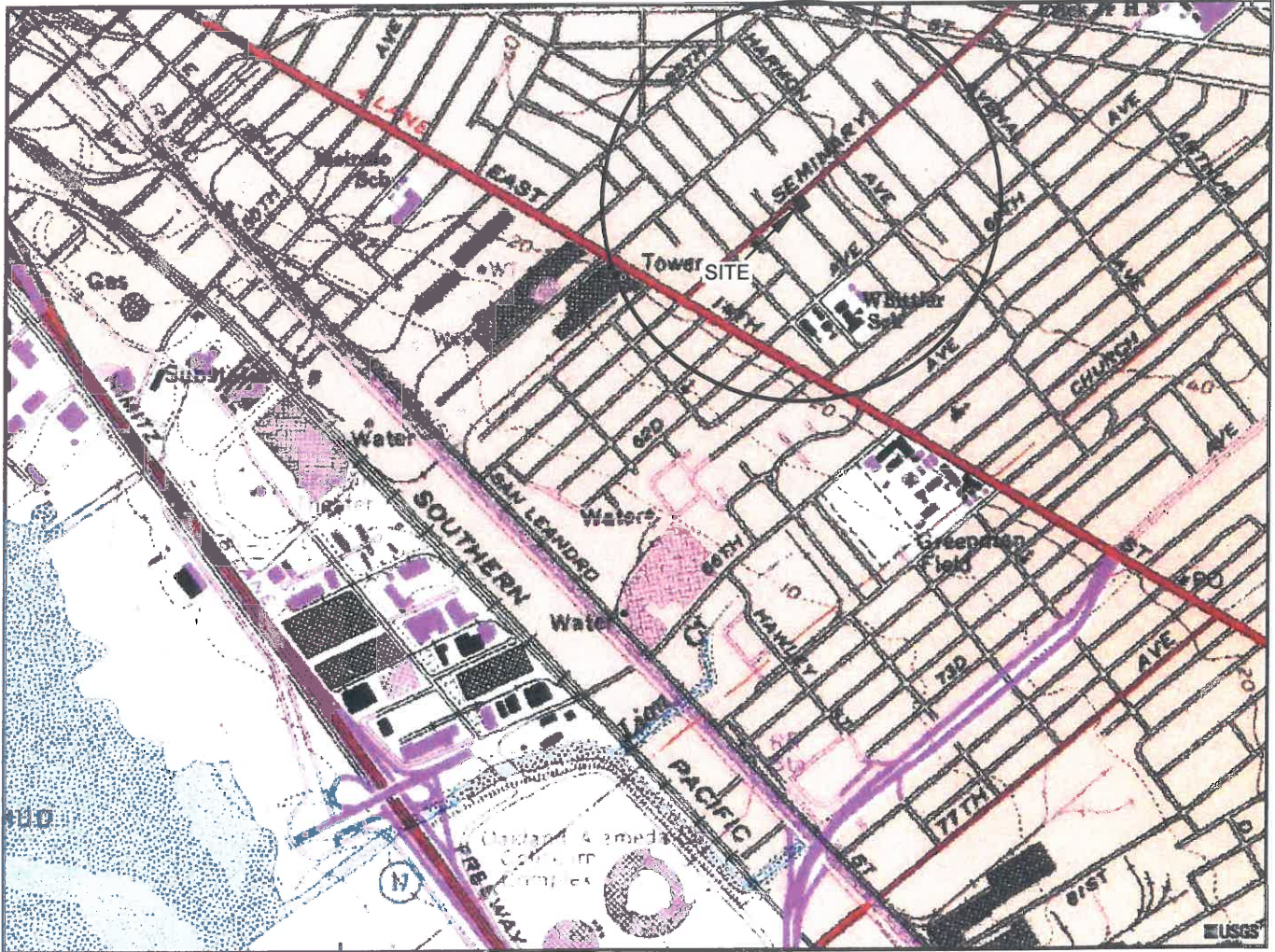

GENERAL NOTES:
 BASE MAP FROM U.S.G.S.
 OAKLAND, CA.
 7.5 MINUTE TOPOGRAPHIC
 PHOTOREVISED 1996



APPROXIMATE SCALE



QUADRANGLE LOCATION

STRATUS
 ENVIRONMENTAL, INC.

FORMER GRIMIT AUTO
 1970 SEMINARY AVENUE
 OAKLAND, CALIFORNIA

SITE LOCATION MAP

FIGURE

1

PROJECT NO.
 2090-1970-01

LEGEND

- ⊕ MW-1 GROUNDWATER MONITORING WELL LOCATION
- ⊖ EX-1 APPROXIMATE EXTRACTION WELL LOCATION
- EB-1 APPROXIMATE EXPLORATORY BORING LOCATION
- ⊗ CPT-1 CPT/LIF BORING LOCATION
- ⊕ SV-1A SOIL VAPOR SAMPLING WELL LOCATION
- ⊙ DP-14A DIRECT PUSH BORING LOCATION

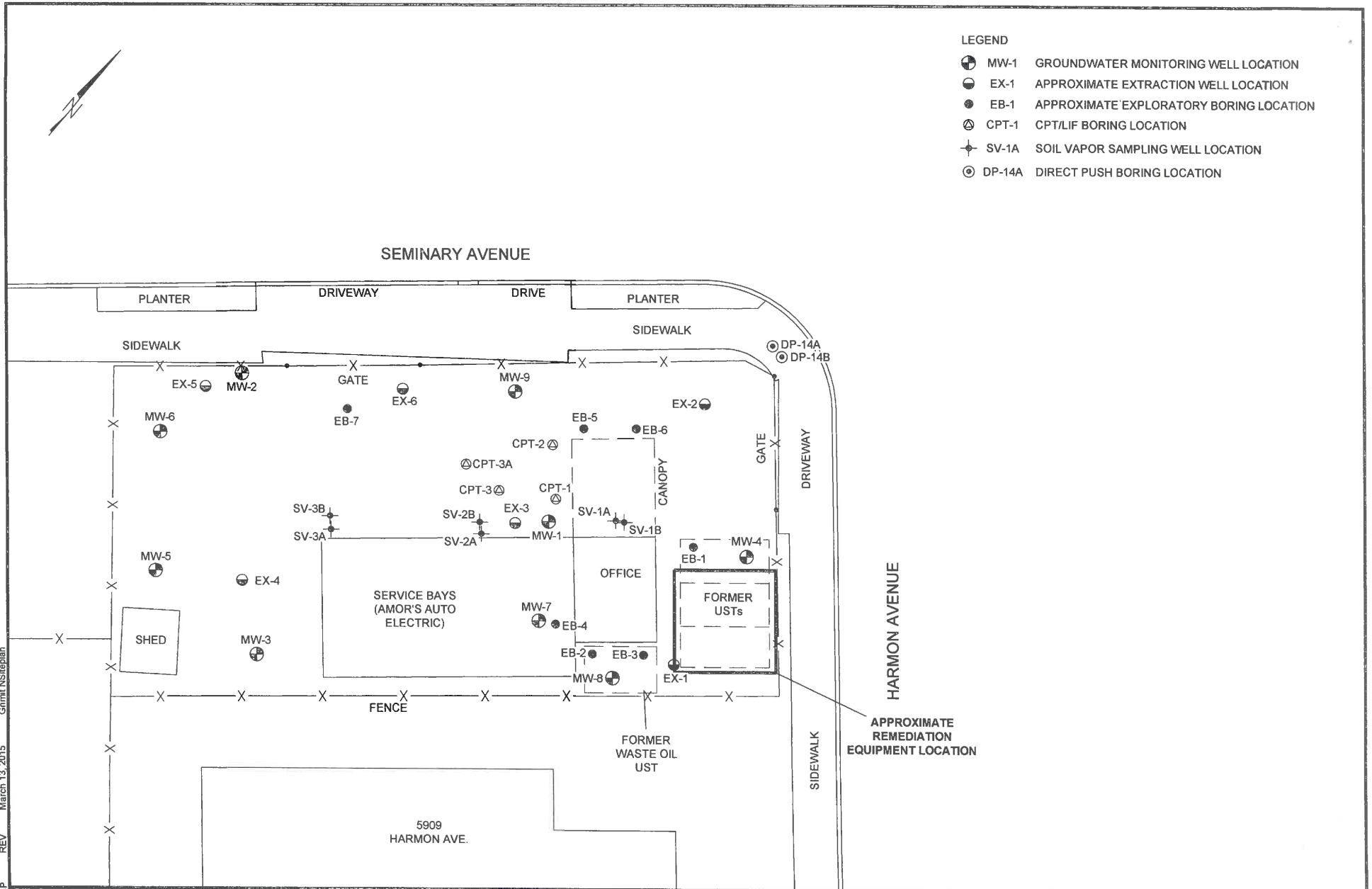

JMP REV March 13, 2015 Grrmt NSiteplan Grrmt Auto

STRATUS
ENVIRONMENTAL, INC.

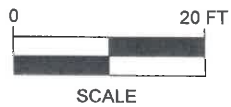

FORMER GRIMIT AUTO
1970 SEMINARY AVENUE
OAKLAND, CALIFORNIA

SITE PLAN

FIGURE

2

PROJECT NO.
2090-1970-1

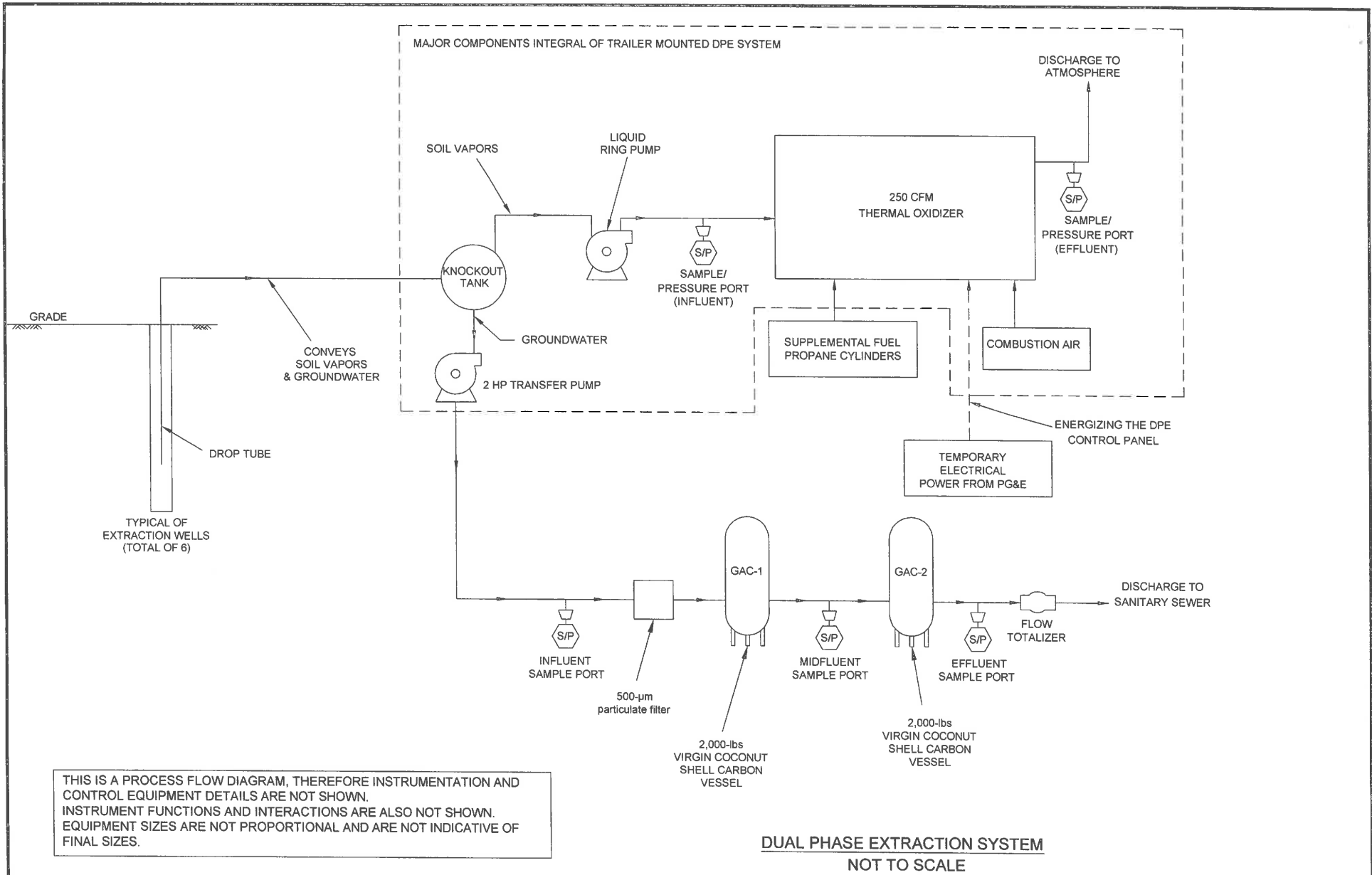

FORMER GRIMIT AUTO
1970 SEMINARY AVENUE
OAKLAND, CALIFORNIA

PROCESS FLOW DIAGRAM

FIGURE
3
PROJECT NO.
2090-1970-01

APPENDIX A

DPE REMEDIATION EVENT TABLE

TABLE 10
DPE REMEDIATION EVENT
GROUNDWATER EXTRACTION COMPONENT - OPERATIONAL PERFORMANCE AND MASS REMOVAL SUMMARY
 Gritit Auto, 1970 Seminary Ave, Oakland, California

Date	Notes	Sample Time	Hour Meter Reading ¹	Sewer Discharge Data			Analytical Results	Mass Removed	Cumulative	
				Totalizer Reading (gallons)	Period (gallons)	Cumulative Flow (gallons)	Average Extraction Rate (gpm) ^a	Influent	This Period ^b	Mass Removed
							GRO (µg/L)	GRO (lbs)	GRO (lbs)	
11/18/14	1	8:30	15,631.0	214,690						
11/25/14	1	10:35	15,632.0	215,430	740	740	12.33	--		
12/19/14	2	7:10	20.0	216,030	600	1,340	0.50	75	0.0005	
1/5/15		9:25	430.0	219,180	3,150	4,490	0.13	130	0.0007	
2/2/15		8:35	1,101.0	221,340	2,160	6,650	0.05	<50	0.0013	
3/10/15		9:22	1,965.0	226,420	5,080	11,730	0.10	<50	0.0009	
4/2/15		6:20	2,514.0	228,870	2,450	14,180	0.07	<50	0.0021	
5/5/15		9:20	3,309.0	232,510	3,640	17,820	0.08	92	0.0019	
6/2/15		6:35	3,979.0	235,120	2,610	20,430	0.06	<50	0.0015	
7/15/15		9:17	4,654.0	237,260	2,140	22,570	0.05	<50	0.0011	
								200,000	3.5717	3.5816

Legend / Key:

GRO = Gasoline Range Organics C4-C13 µg/L = micrograms per litre lbs = pounds
 DRO = Diesel Range Organics C13-C22 gpm = gallons per minute -- = data not collected/not calculated
 MTBE = Methyl tertiary butyl ether

TBA = Tertiary Butyl Alcohol

^a Approximate groundwater extraction rate between sampling periods, actual extraction rate varies due to system down time.

^b Mass removed this period (pounds) = Average concentration (µg/L) [between the sample dates] x Period gallons x (2.2046 x 10⁻⁹)(lb/µg) / 0.26418 (gal/L)

¹ Hour meter readings were not taken at exact sampling times, therefore, times noted are readings obtained closest to the actual sampling times.

Notes:

- 1 DPE test, extracting from extraction wells EX-1, EX-2, EX-3, and EX-6.
- 2 New hour meter was installed, therefore, hour readings re-started at zero reading.