

RECEIVED

By Alameda County Environmental Health 3:04 pm, Nov 13, 2015

Mr. Keith Nowell
Alameda County Environmental Health Services
1131 Harbor Bay Parkway, Suite 250
Alameda, CA 94502-6577

Re: Gritit Auto Repair and Service, 1970 Seminary Boulevard, Oakland, California
(Fuel Leak Case No. RO0000413)

Dear Mr. Nowell:

Stratus Environmental, Inc. (Stratus) has recently prepared a report entitled *Quarterly Groundwater Discharge Report, Third Quarter 2015* on my behalf. The report was prepared in regards to Alameda County Fuel Leak Case No. RO0000413, for Gritit Auto Repair and Service, 1970 Seminary Boulevard, Oakland, California.

I have reviewed a copy of this report, sent to me by representatives of Stratus, and "I declare, under penalty of perjury, that the information and/or recommendations contained in the attached document or report is true and correct to the best of my knowledge."

If you have any questions, please contact me via electronic mail at peggy.h.garcia@sbcglobal.net, or my daughter Angel LaMarca at angelcpt@gmail.com.

Sincerely,

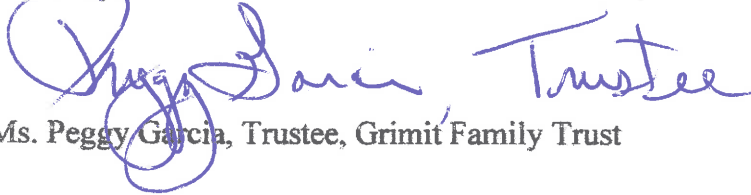
A handwritten signature in blue ink that reads "Peggy Garcia, Trustee". The signature is written in a cursive style and is positioned above the typed name.

Ms. Peggy Garcia, Trustee, Gritit Family Trust

cc: Angel LaMarca



3330 Cameron Park Drive, Ste 550
Cameron Park, California 95682
(530) 676-6004 ~ Fax: (530) 676-6005

October 8, 2015
Project No. 2090-1970-01

East Bay Municipal Utility District
Environmental Services
Attn: Ms. Deirdre Mena
P.O. Box 24055
Oakland, CA 94623-1055

Re: Quarterly Groundwater Discharge Report, Third Quarter 2015
Former Gritmit Auto Repair and Service
1970 Seminary Boulevard, Oakland, California

To Ms. Mena:

Stratus Environmental, Inc. (Stratus) has prepared this letter, on behalf of the Gritmit Family Trust, for the Former Gritmit Auto Repair and Service facility, located at 1970 Seminary Boulevard, Oakland, California (Figures 1 and 2). As required by the Special Groundwater Discharge Permit (Permit No. 62203411), this letter acts as a *Quarterly Groundwater Discharge Report* to the East Bay Municipal Utility District (EBMUD) for the pretreatment system maintenance of the groundwater remediation system.

During the third quarter 2015, all extracted groundwater was treated using carbon vessels, and discharged into the sanitary sewer (Figure 3). The total quarterly discharge was approximately 4,110 gallons between June 2 and September 1, 2015. The average monthly discharge and extraction rates for the third quarter 2015 are as follows:

- June 2 – July 15, 2015: 2,140 gallons (0.05 gpm)
- July 15 – August 10, 2015: 940 gallons (0.07 gpm)
- August 10 – September 1, 2015: 1,030 gallons (0.03 gpm)

The system operated in compliance with permit conditions and all effluent sample results were within the permit limitations. A copy of tables consisting of the system's uptime and operational summary, including the totalizer readings, is included in Appendix A. The analytical results and chain-of-custody documentation for the influent, midfluent, and effluent groundwater samples obtained during the third quarter 2015 are included in Appendix B.

October 8, 2015

During the third quarter 2015, the system is expected to continue to operate, and Stratus will continue to monitor the system a minimum of twice a month.

I certify under penalty of law that this document and any attachments were prepared under my direction or supervision in accordance with a system designed to assure that qualified personnel properly gather and evaluate the information submitted. Based on my inquiry of the person or persons who manage the system, or those persons directly responsible for gathering information, the information submitted is, to the best of my knowledge and belief, true, accurate, and complete. I am aware that there are significant penalties for submitting false information, including the possibility of fine and imprisonment for knowing violations.

If you have any questions or comments, please call Deborah L. Barr at (530) 313-9974.

Sincerely,

STRATUS ENVIRONMENTAL, INC.



Deborah L. Barr, P.E.
Project Engineer



Attachments:

- | | |
|------------|--|
| Figure 1 | Site Location Map |
| Figure 2 | Site Plan |
| Figure 3 | Process Flow Diagram |
| Appendix A | DPE Remediation Event Tables |
| Appendix B | Laboratory Analytical Reports and Chain-of-Custody Documentation |

cc: Ms. Peggy Garcia, Trustee, Gruit Family Trust
(email: peggy.h.garcia@sbcglobal.net)
Ms. Angel LaMarca (email: angelcpt@gmail.com)

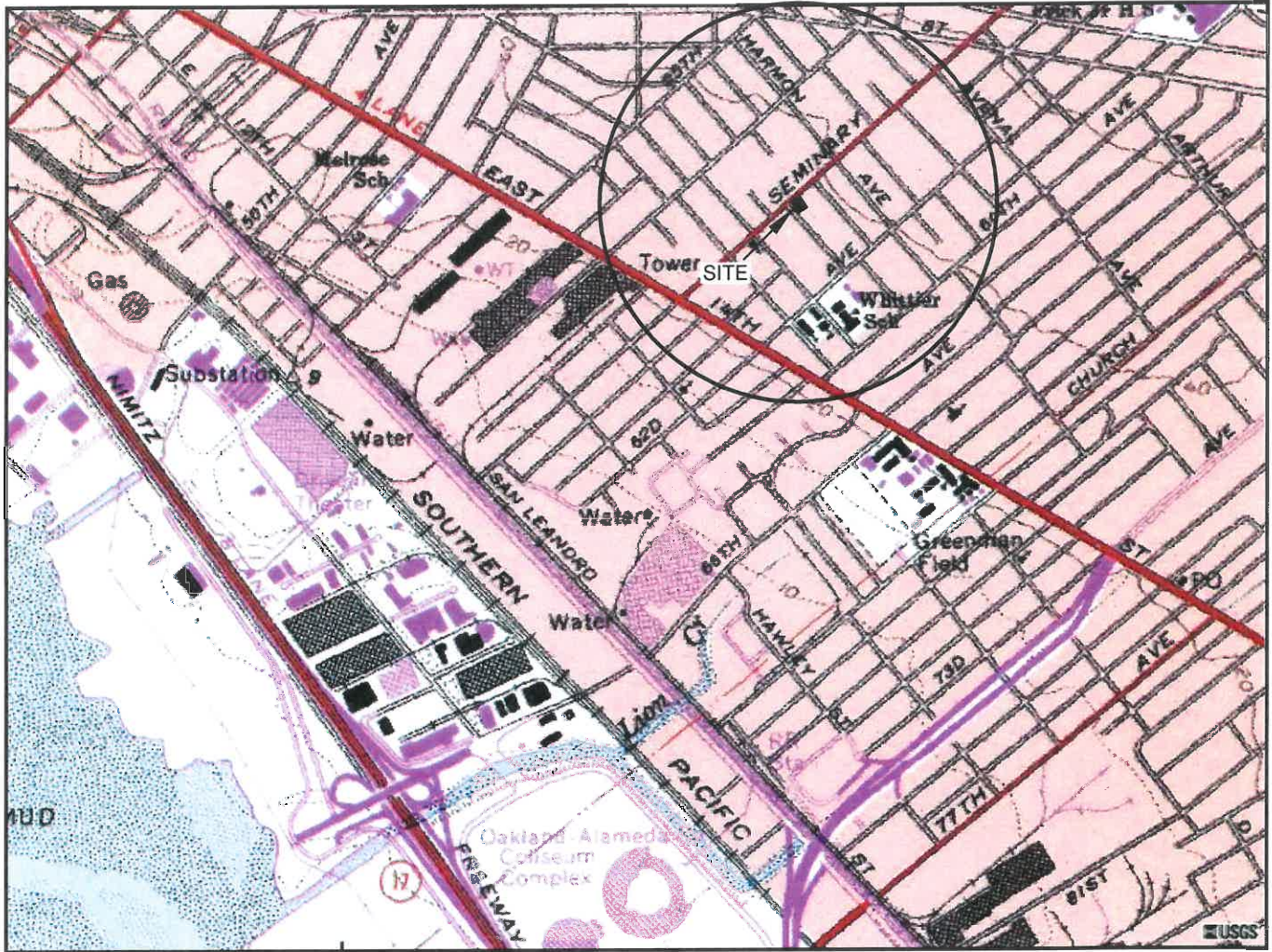

GENERAL NOTES:
 BASE MAP FROM U.S.G.S.
 OAKLAND, CA.
 7.5 MINUTE TOPOGRAPHIC
 PHOTOREVISED 1996

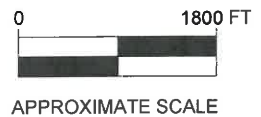

QUADRANGLE LOCATION

STRATUS
 ENVIRONMENTAL, INC.

FORMER GRIMIT AUTO
 1970 SEMINARY AVENUE
 OAKLAND, CALIFORNIA

FIGURE

1

PROJECT NO.
 2090-1970-01

SITE LOCATION MAP

LEGEND

- ⊕ MW-1 GROUNDWATER MONITORING WELL LOCATION
- ⊖ EX-1 APPROXIMATE EXTRACTION WELL LOCATION
- EB-1 APPROXIMATE EXPLORATORY BORING LOCATION
- ⊙ CPT-1 CPT/LIF BORING LOCATION
- ⊕ SV-1A SOIL VAPOR SAMPLING WELL LOCATION
- ⊙ DP-14A DIRECT PUSH BORING LOCATION

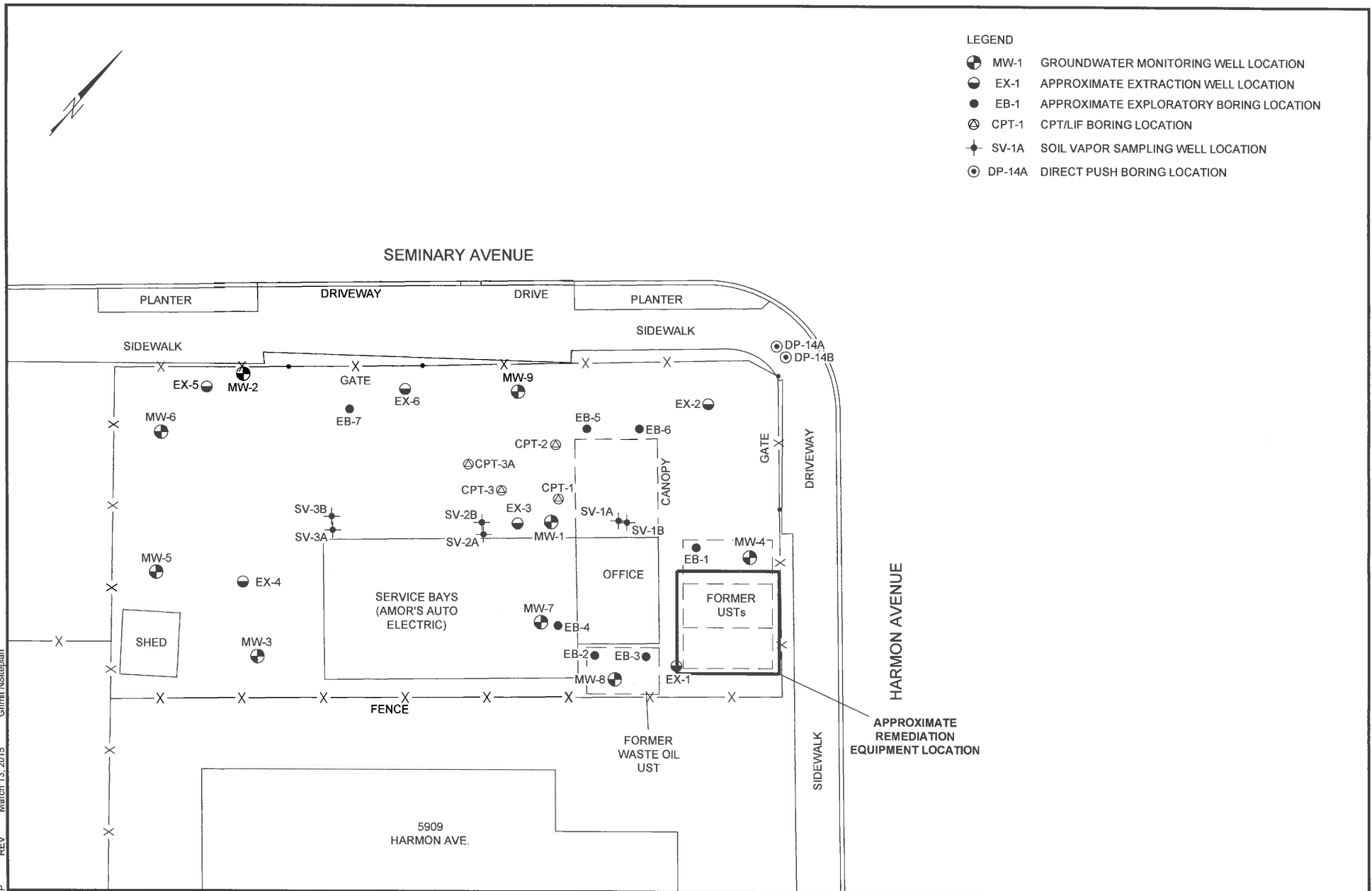

Grimt NSiteplan
REV March 13, 2015
JMP
Grimt Auto

STRATUS
ENVIRONMENTAL, INC.

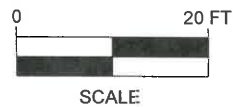

FORMER GRIMIT AUTO
1970 SEMINARY AVENUE
OAKLAND, CALIFORNIA

SITE PLAN

FIGURE

2

PROJECT NO.
2090-1970-1

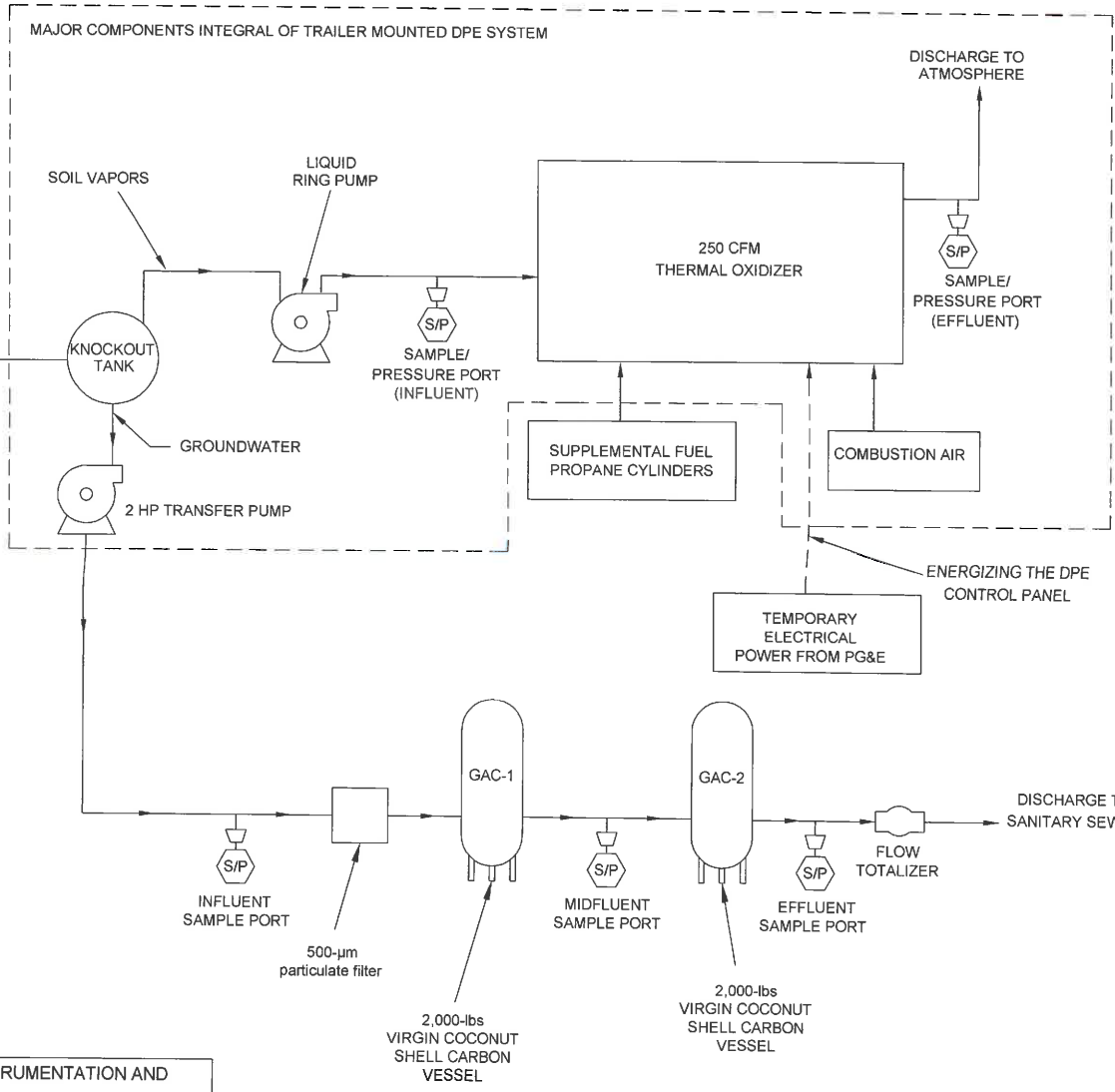

THIS IS A PROCESS FLOW DIAGRAM, THEREFORE INSTRUMENTATION AND CONTROL EQUIPMENT DETAILS ARE NOT SHOWN. INSTRUMENT FUNCTIONS AND INTERACTIONS ARE ALSO NOT SHOWN. EQUIPMENT SIZES ARE NOT PROPORTIONAL AND ARE NOT INDICATIVE OF FINAL SIZES.

DUAL PHASE EXTRACTION SYSTEM
NOT TO SCALE



FORMER GRIMIT AUTO
1970 SEMINARY AVENUE
OAKLAND, CALIFORNIA

PROCESS FLOW DIAGRAM

FIGURE
3
PROJECT NO.
2090-1970-01

APPENDIX A
DPE REMEDIATION EVENT TABLES

TABLE 5
DPE REMEDIATION EVENT
OPERATIONAL UPTIME AND FLOW SUMMARY
 Grit Auto, 1970 Seminary Ave, Oakland, California

Date & Time	Notes	Hour Meter Reading	Applied Vac	Area	Sys Inf Temp	Sys Inf Air Velocity	Sys Inf Air Flowrate	Control Temp	Effluent Air Temp	Area	Dilution Air Temp	Dilution Air Velocity	Dilution Air Flowrate	PID	
														Sys Inf	Eff
														"Hg	ft ²
11/18/14 8:30	1	15,631.0	--	0.0873	--	--	--	--	--	--	--	--	--	--	--
11/20/14 8:00		15,631.9	15.0	0.0873	78	1,500	130.9	1,450	1,002	0.0218	65	2,504	55	30	3.6
11/20/14 10:00		15,632.1	10.5	0.0873	95	1,500	130.9	1,543	1,253	0.0218	72	2,222	48	410	2.9
11/20/14 11:00		15,632.1	10.0	0.0873	80	1,500	130.9	1,554	1,285	0.0218	60	2,260	49	35	2.3
11/20/14 12:00		15,632.1	10.0	0.0873	80	1,500	130.9	1,559	1,311	0.0218	67	2,186	48	40	2.1
11/21/14 7:00		15,632.1	10.0	0.0873	90	1,500	130.9	1,537	1,368	0.0218	65	2,140	47	20	2.0
11/25/14 10:10	2	15,632.0	10.0	0.0873	90	1,500	130.9	1,450	1,224	0.0218	--	--	--	58	2.1
12/18/14 7:30	3	0.0	13.5	0.0873	92	1,500	130.9	1,484	--	0.0218	64	2,503	55	8	1.2
12/19/14 7:00		20.0	13.0	0.0873	90	1,500	130.9	1,492	1,305	0.0218	61	2,910	63	100	1.2
12/29/14 7:15		260.0	7.5	0.0873	82	1,500	130.9	1,500	1,430	0.0218	--	--	--	10	1.3
1/5/15 8:50		430.0	8.0	0.0873	100	1,500	130.9	1,451	1,259	0.0218	57	3,020	66	10	2.1
1/19/15 8:00		765.0	10.0	0.0873	90	1,400	122.2	1,491	1,303	0.0218	63	3,122	68	5	1.1
2/2/15 8:00		1,101.0	11.0	0.0873	95	1,500	130.9	1,452	1,268	0.0218	60	3,233	71	1.4	0.8
2/16/15 7:15		1,436.0	11.0	0.0873	90	1,350	117.8	1,485	1,308	0.0218	58	3,314	72	2.0	0.8
3/10/15 8:30		1,965.0	11.0	0.0873	90	1,250	109.1	1,493	1,311	0.0218	63	2,971	65	15	2.1
3/23/15 7:50	4	2,276.0	12.0	0.0873	92	1,250	109.1	1,504	--	0.0218	64	3,418	75	47	1.0
4/2/15 5:45		2,514.0	12.0	0.0873	90	1,250	109.1	1,489	1,307	0.0218	57	3,463	76	100	0.9
4/22/15 6:56		2,995.0	12.0	0.0873	93	1,500	130.9	1,493	--	0.0218	56	3,370	74	25	0.5
5/5/15 8:30		3,309.0	12.0	0.0873	100	1,350	117.8	1,481	1,160	0.0218	63	2,867	63	12	1.8
5/20/15 8:15		3,669.0	12.0	0.0873	100	1,150	100.4	1,560	1,380	0.0218	67	3,011	66	33	0.9
6/2/15 6:10		3,979.0	12.0	0.0873	92	1,200	104.7	1,599	1,321	0.0218	68	3,064	67	40	0.9
6/22/15 8:00		4,460.0	12.0	0.0873	88	1,100	96.0	1,474	840	0.0218	65	3,457	75	30	0.9
7/1/15 7:30	5	4,653.0	--	--	--	--	--	--	--	--	--	--	--	--	--
7/15/15 6:30	6	4,654.0	12.0	0.0873	103	1,500	130.9	1,500	1,172	0.0218	76	2,796	61	45	1.6

**TABLE 5
DPE REMEDIATION EVENT
OPERATIONAL UPTIME AND FLOW SUMMARY
Grimit Auto, 1970 Seminary Ave, Oakland, California**

Date & Time	Notes	Hour Meter Reading	Applied Vac	Area	Sys Inf Temp	Sys Inf Air Velocity	Sys Inf Air Flowrate	Control Temp	Effluent Air Temp	Area	Dilution Air Temp	Dilution Air Velocity	Dilution Air Flowrate	PID		
														Sys Inf	Eff	
														"Hg	ft ²	°F
8/3/15 7:25	7	4,889.0	--	--	--	--	--	--	--	--	--	--	--	--	--	--
8/10/15 7:00	8	4,890.0	12.0	0.0873	96	1,200	104.7	1,526	1,266	0.0218	69	2,620	57	150	1.5	
8/25/15 7:00		5,248.0	11.0	0.0873	100.0	1,500	130.9	1,582	1,100	0.0218	71	2,133	47	31	0.9	
9/1/15 6:20		5,416.0	11.0	0.0873	110.0	1,500	130.9	1,520	--	0.0218	66	3,195	70	27	2.1	
9/22/15 5:50		5,919.0	10.0	0.0873	92.0	1,500	130.9	1,543	1,347	0.0218	71	3,517	77	16	1.3	
Average			11		92	1,404	122.5	1,508	1,251		65	2,887	63	50	1.5	

Legend / Key:

Vac = Vacuum
 "Hg = inches mercury
 ft² = square feet
 Temp = temperature
 °F = Fahrenheit
 Inf = Influent
 -- = not applicable/ not measured

fpm = feet per minute
 acfm = actual cubic feet per minute
 ppmv = parts per million by volume
 PID = Photoionization Detector
 Sys Inf = System Influent (includes dilution air)
 Eff = Effluent

Sample Calculation:

air flow = area of pipe (0.0491 ft²) × air velocity (fpm) = flowrate (acfm)

Notes:

Influent pipe diameter = 3.0 inches

- 1 System operating with DPE, extracting from extraction wells EX-1, EX-2, EX-3, and EX-6. Stingers placed within extraction wells at 29-feet in well EX-1 and 27-feet bgs in wells EX-2, EX-3 and EX-6.
- 2 System down upon departure waiting groundwater sample results and approval from EBMUD to discharge to the sanitary sewer.
- 3 System down upon arrival, new hour meter installed, system started for continuous operation upon departure.
- 4 System modified, well MW-1 brought on-line. System extracting from wells EX-1 through EX-3, EX-6 and MW-1 simultaneously.
- 5 System down upon arrival, lack of propane, and filter blocked on liquid ring pump. System remained down upon departure.
- 6 System down upon arrival, system re-started and sampling event completed upon departure.
- 7 System down upon arrival, system requires a new motor starter, system remained down upon departure.
- 8 System down upon arrival, repair motor, system re-started for continuous operation.

TABLE 10
DPE REMEDIATION EVENT
GROUNDWATER EXTRACTION COMPONENT - OPERATIONAL PERFORMANCE AND MASS REMOVAL SUMMARY
 Gritmit Auto, 1970 Seminary Ave, Oakland, California

Date	Notes	Sample Time	Hour Meter Reading ¹	Sewer Discharge Data				Analytical Results	Mass Removed	Cumulative
				Totalizer Reading (gallons)	Period (gallons)	Cumulative Flow (gallons)	Average Extraction Rate (gpm) ^a	Influent	This Period ^b	Mass Removed
							GRO (µg/L)	GRO (lbs)	GRO (lbs)	
11/18/14	1	8:30	15,631.0	214,690				--		
11/25/14	1	10:35	15,632.0	215,430	740	740	12.33	75	0.0005	0.0005
12/19/14	2	7:10	20.0	216,030	600	1,340	0.50	130	0.0007	0.001
1/5/15		9:25	430.0	219,180	3,150	4,490	0.13	<50	0.0013	0.002
2/2/15		8:35	1,101.0	221,340	2,160	6,650	0.05	<50	0.0009	0.003
3/10/15		9:22	1,965.0	226,420	5,080	11,730	0.10	<50	0.0021	0.005
4/2/15	3	6:20	2,514.0	228,870	2,450	14,180	0.07	92	0.0019	0.007
5/5/15		9:20	3,309.0	232,510	3,640	17,820	0.08	<50	0.0015	0.009
6/2/15		6:35	3,979.0	235,120	2,610	20,430	0.06	<50	0.0011	0.010
7/15/15		9:17	4,654.0	237,260	2,140	22,570	0.05	200,000	1.79	1.80
8/10/15		10:05	4,890.0	238,200	940	23,510	0.07	7,600	0.81	2.61
9/1/15		6:36	5,416.0	239,230	1,030	24,540	0.03	<50	0.03	2.64

Legend / Key:

GRO = Gasoline Range Organics C4-C13

µg/L = micrograms per litre

lbs = pounds

DRO = Diesel Range Organics C13-C22

gpm = gallons per minute

-- = data not collected/not calculated

MTBE = Methyl tertiary butyl ether

TBA = Tertiary Butyl Alcohol

^a Approximate groundwater extraction rate between sampling periods, actual extraction rate varies due to system down time.

^b Mass removed this period (pounds) = Average concentration (µg/L) [between the sample dates] x Period gallons x (2.2046 x 10⁻⁹)(lb/µg) / 0.26418 (gal/L)

¹ Hour meter readings were not taken at exact sampling times, therefore, times noted are readings obtained closest to the actual sampling times.

Notes:

1 DPE test, extracting from extraction wells EX-1, EX-2, EX-3, and EX-6.

2 New hour meter was installed, therefore, hour readings re-started at zero reading.

3 On March 23, 2015 system modified extracting from wells EX-1 through EX-3, EX-6 and MW-1.

APPENDIX B

LABORATORY ANALYTICAL REPORTS AND CHAIN- OF-CUSTODY DOCUMENTATION



Alpha Analytical, Inc.

255 Glendale Ave. • Suite 21 • Sparks, Nevada 89431-5778
(775) 355-1044 • (775) 355-0406 FAX • 1-800-283-1183

ANALYTICAL REPORT

Stratus Environmental
3330 Cameron Park Drive
Cameron Park, CA 956828861

Attn: Scott Bittinger
Phone: (530) 676-2062
Fax: (530) 676-6005
Date Received : 07/16/15

Job: Gritmit Auto

Total Petroleum Hydrocarbons - Purgeable (TPH-P) EPA Method SW8015B / SW8260B

Client ID :	Parameter	Concentration	Reporting Limit	Date Extracted	Date Analyzed
Grim A SYS INF Lab ID : STR15071641-01A Date Sampled 07/15/15 09:25	TPH-P (GRO)	46	20 mg/m ³	07/16/15 15:55	07/19/15
Grim A EFF Lab ID : STR15071641-02A Date Sampled 07/15/15 09:30	TPH-P (GRO)	ND	20 mg/m ³	07/16/15 15:55	07/19/15
Grim W INF Lab ID : STR15071641-03A Date Sampled 07/15/15 09:17	TPH-P (GRO)	200,000	10,000 µg/L	07/23/15	07/23/15
Grim W GAC1 Lab ID : STR15071641-04A Date Sampled 07/15/15 08:45	TPH-P (GRO)	ND	50 µg/L	07/23/15	07/23/15
Grim W EFF Lab ID : STR15071641-05A Date Sampled 07/15/15 08:40	TPH-P (GRO)	ND	50 µg/L	07/23/15	07/23/15

Gasoline Range Organics (GRO) C4-C13

Note: For samples -01A & -02A concentrations of air in Tedlar Bags are at 29 degrees Celsius and 25.52 inches of mercury.

ND = Not Detected

Reported in micrograms per Liter, per client request.



Roger Scholl

Randy Gardner

Roger L. Scholl, Ph.D., Laboratory Director • Randy Gardner, Laboratory Manager
Sacramento, CA • (916) 366-9089 / Las Vegas, NV • (702) 281-4848 / Carson, CA • (714) 386-2901 / info@alpha-analytical.com
Alpha Analytical, Inc. certifies that the test results meet all requirements of NELAC unless footnoted otherwise.

Statement of Data Authenticity : Alpha Analytical, Inc. attests that the data reported has not been altered in any way.

Alpha Analytical, Inc. currently holds appropriate and available California (#2019) and NELAC (01154CA) certifications for the data reported. Test results relate only to reported samples.



[Signature]
7/24/15

Report Date



Alpha Analytical, Inc.

255 Glendale Ave. • Suite 21 • Sparks, Nevada 89431-5778
(775) 355-1044 • (775) 355-0406 FAX • 1-800-283-1183

ANALYTICAL REPORT

Stratus Environmental
3330 Cameron Park Drive
Cameron Park, CA 956828861
Job: Gritit Auto

Attn: Scott Bittinger
Phone: (530) 676-2062
Fax: (530) 676-6005

Alpha Analytical Number: STR15071641-03A
Client I.D. Number: Grim W INF

Sampled: 07/15/15 09:17
Received: 07/16/15
Extracted: 07/23/15
Analyzed: 07/23/15

Volatile Organics by GC/MS EPA Method 624/8260

Compound	Concentration	Reporting Limit	Compound	Concentration	Reporting Limit
1 Chloromethane	ND	400 µg/L	26 1,1,2-Trichloroethane	ND	100 µg/L
2 Vinyl chloride	ND	100 µg/L	27 Toluene	ND	50 µg/L
3 Chloroethane	ND	100 µg/L	28 Dibromochloromethane	ND	100 µg/L
4 Bromomethane	ND	400 µg/L	29 1,2-Dibromoethane (EDB)	ND	200 µg/L
5 Trichlorofluoromethane	ND	100 µg/L	30 Tetrachloroethene	ND	100 µg/L
6 1,1-Dichloroethene	ND	100 µg/L	31 Chlorobenzene	ND	100 µg/L
7 Tertiary Butyl Alcohol (TBA)	ND	1,000 µg/L	32 Ethylbenzene	210	50 µg/L
8 Dichloromethane	ND	400 µg/L	33 m,p-Xylene	2,000	50 µg/L
9 trans-1,2-Dichloroethene	ND	100 µg/L	34 Bromoform	ND	100 µg/L
10 Methyl tert-butyl ether (MTBE)	ND	50 µg/L	35 o-Xylene	620	50 µg/L
11 1,1-Dichloroethane	ND	100 µg/L	36 1,1,2,2-Tetrachloroethane	ND	100 µg/L
12 Di-isopropyl Ether (DIPE)	ND	100 µg/L	37 1,3-Dichlorobenzene	ND	100 µg/L
13 cis-1,2-Dichloroethene	ND	100 µg/L	38 1,4-Dichlorobenzene	ND	100 µg/L
14 Chloroform	ND	100 µg/L	39 1,2-Dichlorobenzene	ND	100 µg/L
15 Ethyl Tertiary Butyl Ether (ETBE)	ND	100 µg/L	40 Naphthalene	450	400 µg/L
16 1,2-Dichloroethane	ND	100 µg/L			
17 1,1,1-Trichloroethane	ND	100 µg/L			
18 Carbon tetrachloride	ND	100 µg/L			
19 Benzene	ND	50 µg/L			
20 Tertiary Amyl Methyl Ether (TAME)	ND	100 µg/L			
21 1,2-Dichloropropane	ND	100 µg/L			
22 Trichloroethene	ND	100 µg/L			
23 Bromodichloromethane	ND	100 µg/L			
24 cis-1,3-Dichloropropene	ND	100 µg/L			
25 trans-1,3-Dichloropropene	ND	100 µg/L			

Reporting Limits were increased due to high concentrations of target analytes.

ND = Not Detected



Roger Scholl

Randy Gardner

Roger L. Scholl, Ph.D., Laboratory Director • Randy Gardner, Laboratory Manager

Sacramento, CA • (916) 366-9089 / Las Vegas, NV • (702) 281-4848 / Carson, CA • (714) 386-2901 / info@alpha-analytical.com

Alpha Analytical, Inc. certifies that the test results meet all requirements of NELAC unless footnoted otherwise.

Statement of Data Authenticity: Alpha Analytical, Inc. attests that the data reported has not been altered in any way.



RS
7/24/15

Report Date

Page 1 of 1

Alpha Analytical, Inc. currently holds appropriate and available California (#2019) and NELAC (01154CA) certifications for the data reported. Test results relate only to reported samples.



Alpha Analytical, Inc.

255 Glendale Ave. • Suite 21 • Sparks, Nevada 89431-5778
(775) 355-1044 • (775) 355-0406 FAX • 1-800-283-1183

ANALYTICAL REPORT

Stratus Environmental
3330 Cameron Park Drive
Cameron Park, CA 956828861
Job: Grit Auto

Attn: Scott Bittinger
Phone: (530) 676-2062
Fax: (530) 676-6005

Alpha Analytical Number: STR15071641-04A
Client I.D. Number: Grim W GAC1

Sampled: 07/15/15 08:45
Received: 07/16/15
Extracted: 07/23/15
Analyzed: 07/23/15

Volatile Organics by GC/MS EPA Method 624/8260

Compound	Concentration	Reporting Limit	Compound	Concentration	Reporting Limit
1 Chloromethane	ND	2.0 µg/L	26 1,1,2-Trichloroethane	ND	1.0 µg/L
2 Vinyl chloride	ND	1.0 µg/L	27 Toluene	ND	0.50 µg/L
3 Chloroethane	2.5	1.0 µg/L	28 Dibromochloromethane	ND	1.0 µg/L
4 Bromomethane	ND	2.0 µg/L	29 1,2-Dibromoethane (EDB)	ND	2.0 µg/L
5 Trichlorofluoromethane	ND	1.0 µg/L	30 Tetrachloroethene	ND	1.0 µg/L
6 1,1-Dichloroethene	ND	1.0 µg/L	31 Chlorobenzene	ND	1.0 µg/L
7 Tertiary Butyl Alcohol (TBA)	ND	10 µg/L	32 Ethylbenzene	ND	0.50 µg/L
8 Dichloromethane	ND	2.0 µg/L	33 m,p-Xylene	ND	0.50 µg/L
9 trans-1,2-Dichloroethene	ND	1.0 µg/L	34 Bromoform	ND	1.0 µg/L
10 Methyl tert-butyl ether (MTBE)	ND	0.50 µg/L	35 o-Xylene	ND	0.50 µg/L
11 1,1-Dichloroethane	ND	1.0 µg/L	36 1,1,2,2-Tetrachloroethane	ND	1.0 µg/L
12 Di-isopropyl Ether (DIPE)	ND	1.0 µg/L	37 1,3-Dichlorobenzene	ND	1.0 µg/L
13 cis-1,2-Dichloroethene	ND	1.0 µg/L	38 1,4-Dichlorobenzene	ND	1.0 µg/L
14 Chloroform	ND	1.0 µg/L	39 1,2-Dichlorobenzene	ND	1.0 µg/L
15 Ethyl Tertiary Butyl Ether (ETBE)	ND	1.0 µg/L	40 Naphthalene	ND	2.0 µg/L
16 1,2-Dichloroethane	ND	1.0 µg/L			
17 1,1,1-Trichloroethane	ND	1.0 µg/L			
18 Carbon tetrachloride	ND	1.0 µg/L			
19 Benzene	ND	0.50 µg/L			
20 Tertiary Amyl Methyl Ether (TAME)	ND	1.0 µg/L			
21 1,2-Dichloropropane	ND	1.0 µg/L			
22 Trichloroethene	ND	1.0 µg/L			
23 Bromodichloromethane	ND	1.0 µg/L			
24 cis-1,3-Dichloropropene	ND	1.0 µg/L			
25 trans-1,3-Dichloropropene	ND	1.0 µg/L			

ND = Not Detected

Roger Scholl

Randy Gardner

Roger L. Scholl, Ph.D., Laboratory Director • Randy Gardner, Laboratory Manager

Sacramento, CA • (916) 366-9089 / Las Vegas, NV • (702) 281-4848 / Carson, CA • (714) 386-2901 / info@alpha-analytical.com

Alpha Analytical, Inc. certifies that the test results meet all requirements of NELAC unless footnoted otherwise.

Statement of Data Authenticity: Alpha Analytical, Inc. attests that the data reported has not been altered in any way.



VS
7/24/15

Report Date

Page 1 of 1



Alpha Analytical, Inc. currently holds appropriate and available California (#2019) and NELAC (01154CA) certifications for the data reported. Test results relate only to reported samples.



Alpha Analytical, Inc.

255 Glendale Ave. • Suite 21 • Sparks, Nevada 89431-5778
(775) 355-1044 • (775) 355-0406 FAX • 1-800-283-1183

ANALYTICAL REPORT

Stratus Environmental
3330 Cameron Park Drive
Cameron Park, CA 956828861
Job: Grit Auto

Attn: Scott Bittinger
Phone: (530) 676-2062
Fax: (530) 676-6005

Alpha Analytical Number: STR15071641-05A
Client I.D. Number: Grim W EFF

Sampled: 07/15/15 08:40
Received: 07/16/15
Extracted: 07/23/15
Analyzed: 07/23/15

Volatile Organics by GC/MS EPA Method 624/8260

Compound	Concentration	Reporting Limit	Compound	Concentration	Reporting Limit
1 Chloromethane	ND	2.0 µg/L	26 1,1,2-Trichloroethane	ND	1.0 µg/L
2 Vinyl chloride	ND	1.0 µg/L	27 Toluene	ND	0.50 µg/L
3 Chloroethane	ND	1.0 µg/L	28 Dibromochloromethane	ND	1.0 µg/L
4 Bromomethane	ND	2.0 µg/L	29 1,2-Dibromoethane (EDB)	ND	2.0 µg/L
5 Trichlorofluoromethane	ND	1.0 µg/L	30 Tetrachloroethene	ND	1.0 µg/L
6 1,1-Dichloroethene	ND	1.0 µg/L	31 Chlorobenzene	ND	1.0 µg/L
7 Tertiary Butyl Alcohol (TBA)	ND	10 µg/L	32 Ethylbenzene	ND	0.50 µg/L
8 Dichloromethane	ND	2.0 µg/L	33 m,p-Xylene	ND	0.50 µg/L
9 trans-1,2-Dichloroethene	ND	1.0 µg/L	34 Bromoform	ND	1.0 µg/L
10 Methyl tert-butyl ether (MTBE)	ND	0.50 µg/L	35 o-Xylene	ND	0.50 µg/L
11 1,1-Dichloroethane	ND	1.0 µg/L	36 1,1,2,2-Tetrachloroethane	ND	1.0 µg/L
12 Di-isopropyl Ether (DIPE)	ND	1.0 µg/L	37 1,3-Dichlorobenzene	ND	1.0 µg/L
13 cis-1,2-Dichloroethene	ND	1.0 µg/L	38 1,4-Dichlorobenzene	ND	1.0 µg/L
14 Chloroform	ND	1.0 µg/L	39 1,2-Dichlorobenzene	ND	1.0 µg/L
15 Ethyl Tertiary Butyl Ether (ETBE)	ND	1.0 µg/L	40 Naphthalene	ND	2.0 µg/L
16 1,2-Dichloroethane	ND	1.0 µg/L			
17 1,1,1-Trichloroethane	ND	1.0 µg/L			
18 Carbon tetrachloride	ND	1.0 µg/L			
19 Benzene	ND	0.50 µg/L			
20 Tertiary Amyl Methyl Ether (TAME)	ND	1.0 µg/L			
21 1,2-Dichloropropane	ND	1.0 µg/L			
22 Trichloroethene	ND	1.0 µg/L			
23 Bromodichloromethane	ND	1.0 µg/L			
24 cis-1,3-Dichloropropene	ND	1.0 µg/L			
25 trans-1,3-Dichloropropene	ND	1.0 µg/L			

ND = Not Detected



Roger Scholl

Randy Gardner

Roger L. Scholl, Ph.D., Laboratory Director • Randy Gardner, Laboratory Manager

Sacramento, CA • (916) 366-9089 / Las Vegas, NV • (702) 281-4848 / Carson, CA • (714) 386-2901 / info@alpha-analytical.com

Alpha Analytical, Inc. certifies that the test results meet all requirements of NELAC unless footnoted otherwise.

Statement of Data Authenticity: Alpha Analytical, Inc. attests that the data reported has not been altered in any way.

Alpha Analytical, Inc. currently holds appropriate and available California (#2019) and NELAC (01154CA) certifications for the data reported. Test results relate only to reported samples.



128

7/24/15

Report Date

Page 1 of 1



Alpha Analytical, Inc.

255 Glendale Ave. • Suite 21 • Sparks, Nevada 89431-5778
(775) 355-1044 • (775) 355-0406 FAX • 1-800-283-1183

VOC Sample Preservation Report

Work Order: STR15071641

Job: Grimit Auto

Alpha's Sample ID	Client's Sample ID	Matrix	pH
15071641-03A	Grim W INF	Aqueous	2
15071641-04A	Grim W GAC1	Aqueous	2
15071641-05A	Grim W EFF	Aqueous	2

7/24/15

Report Date



Alpha Analytical, Inc.

255 Glendale Ave. • Suite 21 • Sparks, Nevada 89431-5778
(775) 355-1044 • (775) 355-0406 FAX • 1-800-283-1183

ANALYTICAL REPORT

Stratus Environmental
3330 Cameron Park Drive
Cameron Park, CA 95628861
Job: Grituit Auto

Attn: Scott Bittinger
Phone: (530) 676-2062
Fax: (530) 676-6005

Alpha Analytical Number: STR15071641-01A
Client I.D. Number: Grim A SYS INF

Sampled: 07/15/15 09:25
Received: 07/16/15
Extracted: 07/16/15 15:55
Analyzed: 07/19/15

Volatile Organics by GC/MS EPA Method SW8260B

Compound	Concentration	Reporting Limit	Compound	Concentration	Reporting Limit
1 Chloromethane	ND	0.80 mg/m ³	26 1,1,2-Trichloroethane	ND	0.40 mg/m ³
2 Vinyl chloride	ND	0.40 mg/m ³	27 Toluene	ND	0.20 mg/m ³
3 Chloroethane	ND	0.40 mg/m ³	28 Dibromochloromethane	ND	0.40 mg/m ³
4 Bromomethane	ND	0.80 mg/m ³	29 1,2-Dibromoethane (EDB)	ND	0.80 mg/m ³
5 Trichlorofluoromethane	ND	0.40 mg/m ³	30 Tetrachloroethene	ND	0.40 mg/m ³
6 1,1-Dichloroethene	ND	0.40 mg/m ³	31 Chlorobenzene	ND	0.40 mg/m ³
7 Tertiary Butyl Alcohol (TBA)	ND	10 mg/m ³	32 Ethylbenzene	0.24	0.20 mg/m ³
8 Dichloromethane	ND	0.80 mg/m ³	33 m,p-Xylene	1.2	0.20 mg/m ³
9 trans-1,2-Dichloroethene	ND	0.40 mg/m ³	34 Bromoform	ND	0.40 mg/m ³
10 Methyl tert-butyl ether (MTBE)	ND	0.20 mg/m ³	35 o-Xylene	0.32	0.20 mg/m ³
11 1,1-Dichloroethane	ND	0.40 mg/m ³	36 1,1,1,2-Tetrachloroethane	ND	0.40 mg/m ³
12 Di-isopropyl Ether (DIPE)	ND	0.40 mg/m ³	37 n-Propylbenzene	ND	0.40 mg/m ³
13 cis-1,2-Dichloroethene	ND	0.40 mg/m ³	38 1,2,4-Trimethylbenzene	0.44	0.40 mg/m ³
14 Chloroform	ND	0.40 mg/m ³	39 1,3-Dichlorobenzene	ND	0.40 mg/m ³
15 Ethyl Tertiary Butyl Ether (ETBE)	ND	0.40 mg/m ³	40 1,4-Dichlorobenzene	ND	0.40 mg/m ³
16 1,2-Dichloroethane	ND	0.40 mg/m ³	41 1,2-Dichlorobenzene	ND	0.40 mg/m ³
17 1,1,1-Trichloroethane	ND	0.40 mg/m ³			
18 Carbon tetrachloride	ND	0.40 mg/m ³			
19 Benzene	ND	0.20 mg/m ³			
20 Tertiary Amyl Methyl Ether (TAME)	ND	0.40 mg/m ³			
21 1,2-Dichloropropane	ND	0.40 mg/m ³			
22 Trichloroethene	ND	0.40 mg/m ³			
23 Bromodichloromethane	ND	0.40 mg/m ³			
24 cis-1,3-Dichloropropene	ND	0.40 mg/m ³			
25 trans-1,3-Dichloropropene	ND	0.40 mg/m ³			

Note: Concentrations of air in a Tedlar Bag are at 29 degrees Celsius and 25.52 inches of mercury.
This replaces the report signed 7/24/15 due to a change in the analyte list, per client request.
ND = Not Detected



Roger Scholl

Randy Gardner

Roger L. Scholl, Ph.D., Laboratory Director • Randy Gardner, Laboratory Manager
Sacramento, CA • (916) 366-9089 / Las Vegas, NV • (702) 281-4848 / Carson, CA • (714) 386-2901 / info@alpha-analytical.com

Alpha Analytical, Inc. certifies that the test results meet all requirements of NELAC unless footnoted otherwise.
Statement of Data Authenticity: Alpha Analytical, Inc. attests that the data reported has not been altered in any way.



RS
8/18/15

Report Date

Page 1 of 1



Alpha Analytical, Inc.

255 Glendale Ave. • Suite 21 • Sparks, Nevada 89431-5778
(775) 355-1044 • (775) 355-0406 FAX • 1-800-283-1183

ANALYTICAL REPORT

Stratus Environmental
3330 Cameron Park Drive
Cameron Park, CA 956828861
Job: Grit Auto

Attn: Scott Bittinger
Phone: (530) 676-2062
Fax: (530) 676-6005

Alpha Analytical Number: STR15071641-02A
Client I.D. Number: Grim A EFF

Sampled: 07/15/15 09:30
Received: 07/16/15
Extracted: 07/16/15 15:55
Analyzed: 07/19/15

Volatile Organics by GC/MS EPA Method SW8260B

Compound	Concentration	Reporting Limit	Compound	Concentration	Reporting Limit
1 Chloromethane	ND	0.80 mg/m ³	26 1,1,2-Trichloroethane	ND	0.40 mg/m ³
2 Vinyl chloride	ND	0.40 mg/m ³	27 Toluene	ND	0.20 mg/m ³
3 Chloroethane	ND	0.40 mg/m ³	28 Dibromochloromethane	ND	0.40 mg/m ³
4 Bromomethane	ND	0.80 mg/m ³	29 1,2-Dibromoethane (EDB)	ND	0.80 mg/m ³
5 Trichlorofluoromethane	ND	0.40 mg/m ³	30 Tetrachloroethene	ND	0.40 mg/m ³
6 1,1-Dichloroethene	ND	0.40 mg/m ³	31 Chlorobenzene	ND	0.40 mg/m ³
7 Tertiary Butyl Alcohol (TBA)	ND	10 mg/m ³	32 Ethylbenzene	ND	0.20 mg/m ³
8 Dichloromethane	ND	0.80 mg/m ³	33 m,p-Xylene	ND	0.20 mg/m ³
9 trans-1,2-Dichloroethene	ND	0.40 mg/m ³	34 Bromoform	ND	0.40 mg/m ³
10 Methyl tert-butyl ether (MTBE)	ND	0.20 mg/m ³	35 o-Xylene	ND	0.20 mg/m ³
11 1,1-Dichloroethane	ND	0.40 mg/m ³	36 1,1,2,2-Tetrachloroethane	ND	0.40 mg/m ³
12 Di-isopropyl Ether (DIPE)	ND	0.40 mg/m ³	37 n-Propylbenzene	ND	0.40 mg/m ³
13 cis-1,2-Dichloroethene	ND	0.40 mg/m ³	38 1,2,4-Trimethylbenzene	ND	0.40 mg/m ³
14 Chloroform	ND	0.40 mg/m ³	39 1,3-Dichlorobenzene	ND	0.40 mg/m ³
15 Ethyl Tertiary Butyl Ether (ETBE)	ND	0.40 mg/m ³	40 1,4-Dichlorobenzene	ND	0.40 mg/m ³
16 1,2-Dichloroethane	ND	0.40 mg/m ³	41 1,2-Dichlorobenzene	ND	0.40 mg/m ³
17 1,1,1-Trichloroethane	ND	0.40 mg/m ³			
18 Carbon tetrachloride	ND	0.40 mg/m ³			
19 Benzene	ND	0.20 mg/m ³			
20 Tertiary Amyl Methyl Ether (TAME)	ND	0.40 mg/m ³			
21 1,2-Dichloropropane	ND	0.40 mg/m ³			
22 Trichloroethene	ND	0.40 mg/m ³			
23 Bromodichloromethane	ND	0.40 mg/m ³			
24 cis-1,3-Dichloropropene	ND	0.40 mg/m ³			
25 trans-1,3-Dichloropropene	ND	0.40 mg/m ³			

Note: Concentrations of air in a Tedlar Bag are at 29 degrees Celsius and 25.52 inches of mercury.
This replaces the report signed 7/24/15 due to a change in the analyte list, per client request.
ND = Not Detected



Roger Scholl

Randy Gardner

Roger L. Scholl, Ph.D., Laboratory Director • Randy Gardner, Laboratory Manager
Sacramento, CA • (916) 366-9089 / Las Vegas, NV • (702) 281-4848 / Carson, CA • (714) 386-2901 / info@alpha-analytical.com

Alpha Analytical, Inc. certifies that the test results meet all requirements of NELAC unless footnoted otherwise.

Statement of Data Authenticity: Alpha Analytical, Inc. attests that the data reported has not been altered in any way.



PS
8/18/15

Report Date

Page 1 of 1



Alpha Analytical, Inc.

255 Glendale Ave. • Suite 21 • Sparks, Nevada 89431-5778
(775) 355-1044 • (775) 355-0406 FAX • 1-800-283-1183

Date:
24-Jul-15

QC Summary Report

Work Order:
15071641

Method Blank

File ID: 15071906.D

Type MBLK

Test Code: EPA Method SW8015B/C / SW8260B

Batch ID: MS09A0719B

Analysis Date: 07/19/2015 15:03

Sample ID: MBLK MS09A0719B

Units : mg/m³

Run ID: MSD_09_150719A

Prep Date: 07/19/2015 15:03

Analyte	Result	PQL	SpkVal	SpkRefVal	%REC	LCL(ME)	UCL(ME)	RPDRefVal	%RPD(Limit)	Qual
TPH-P (GRO)	ND	10								
Surr: 1,2-Dichloroethane-d4	1.89		2		95	70	130			
Surr: Toluene-d8	2.08		2		104	70	130			
Surr: 4-Bromofluorobenzene	2.02		2		101	70	130			

Laboratory Control Spike

File ID: 15071903.D

Type LCS

Test Code: EPA Method SW8015B/C / SW8260B

Batch ID: MS09A0719B

Analysis Date: 07/19/2015 13:50

Sample ID: GLCS MS09A0719B

Units : mg/m³

Run ID: MSD_09_150719A

Prep Date: 07/19/2015 13:50

Analyte	Result	PQL	SpkVal	SpkRefVal	%REC	LCL(ME)	UCL(ME)	RPDRefVal	%RPD(Limit)	Qual
TPH-P (GRO)	390	10	400		98	70	130			
Surr: 1,2-Dichloroethane-d4	9.18		10		92	70	130			
Surr: Toluene-d8	10.3		10		103	70	130			
Surr: 4-Bromofluorobenzene	10.2		10		102	70	130			

Comments:

Calculations are based off of raw (non-rounded) data. However, for reporting purposes, all QC data is rounded to three significant figures. Therefore, hand calculated values may differ slightly.



Alpha Analytical, Inc.

255 Glendale Ave. • Suite 21 • Sparks, Nevada 89431-5778
(775) 355-1044 • (775) 355-0406 FAX • 1-800-283-1183

Date:
24-Jul-15

QC Summary Report

Work Order:
15071641

Method Blank

File ID: 15072239.D

Type MBLK

Test Code: EPA Method SW8015B/C / SW8260B

Batch ID: MS09W0722D

Analysis Date: 07/23/2015 03:02

Sample ID: MBLK MS09W0722D

Units: µg/L

Run ID: MSD_09_150722D

Prep Date: 07/23/2015 03:02

Analyte	Result	PQL	SpkVal	SpkRefVal	%REC	LCL(ME)	UCL(ME)	RPDRefVal	%RPD(Limit)	Qual
TPH-P (GRO)	ND	50								
Surr: 1,2-Dichloroethane-d4	10.8		10		108	70	130			
Surr: Toluene-d8	9.88		10		99	70	130			
Surr: 4-Bromofluorobenzene	10.3		10		103	70	130			

Laboratory Control Spike

File ID: 15072237.D

Type LCS

Test Code: EPA Method SW8015B/C / SW8260B

Batch ID: MS09W0722D

Analysis Date: 07/23/2015 02:13

Sample ID: GLCS MS09W0722D

Units: µg/L

Run ID: MSD_09_150722D

Prep Date: 07/23/2015 02:13

Analyte	Result	PQL	SpkVal	SpkRefVal	%REC	LCL(ME)	UCL(ME)	RPDRefVal	%RPD(Limit)	Qual
TPH-P (GRO)	396	50	400		99	70	130			
Surr: 1,2-Dichloroethane-d4	10.6		10		106	70	130			
Surr: Toluene-d8	9.5		10		95	70	130			
Surr: 4-Bromofluorobenzene	11.1		10		111	70	130			

Sample Matrix Spike

File ID: 15072260.D

Type MS

Test Code: EPA Method SW8015B/C / SW8260B

Batch ID: MS09W0722D

Analysis Date: 07/23/2015 11:48

Sample ID: 15071702-04AGS

Units: µg/L

Run ID: MSD_09_150722D

Prep Date: 07/23/2015 11:48

Analyte	Result	PQL	SpkVal	SpkRefVal	%REC	LCL(ME)	UCL(ME)	RPDRefVal	%RPD(Limit)	Qual
TPH-P (GRO)	1250	250	2000		62	54	143			
Surr: 1,2-Dichloroethane-d4	47.3		50		95	70	130			
Surr: Toluene-d8	48.6		50		97	70	130			
Surr: 4-Bromofluorobenzene	53.3		50		107	70	130			

Sample Matrix Spike Duplicate

File ID: 15072261.D

Type MSD

Test Code: EPA Method SW8015B/C / SW8260B

Batch ID: MS09W0722D

Analysis Date: 07/23/2015 12:13

Sample ID: 15071702-04AGSD

Units: µg/L

Run ID: MSD_09_150722D

Prep Date: 07/23/2015 12:13

Analyte	Result	PQL	SpkVal	SpkRefVal	%REC	LCL(ME)	UCL(ME)	RPDRefVal	%RPD(Limit)	Qual
TPH-P (GRO)	1260	250	2000		63	54	143	1249	0.9(23)	
Surr: 1,2-Dichloroethane-d4	48.2		50		96	70	130			
Surr: Toluene-d8	49.2		50		98	70	130			
Surr: 4-Bromofluorobenzene	52.4		50		105	70	130			

Comments:

Calculations are based off of raw (non-rounded) data. However, for reporting purposes, all QC data is rounded to three significant figures. Therefore, hand-calculated values may differ slightly.

Reported in micrograms per Liter, per client request.



Alpha Analytical, Inc.

255 Glendale Ave. • Suite 21 • Sparks, Nevada 89431-5778
(775) 355-1044 • (775) 355-0406 FAX • 1-800-283-1183

Date:
24-Jul-15

QC Summary Report

Work Order:
15071641

Method Blank

File ID: 15072239.D

Type MBLK Test Code: EPA Method 624/8260

Batch ID: MS09W0722C

Analysis Date: 07/23/2015 03:02

Sample ID: MBLK MS09W0722C

Units : µg/L

Run ID: MSD_09_150722D

Prep Date: 07/23/2015 03:02

Analyte	Result	PQL	SpkVal	SpkRefVal	%REC	LCL(ME)	UCL(ME)	RPDRefVal	%RPD(Limit)	Qual
Chloromethane	ND		2							
Vinyl chloride	ND		1							
Chloroethane	ND		1							
Bromomethane	ND		2							
Trichlorofluoromethane	ND		1							
1,1-Dichloroethene	ND		1							
Tertiary Butyl Alcohol (TBA)	ND		10							
Dichloromethane	ND		2							
trans-1,2-Dichloroethene	ND		1							
Methyl tert-butyl ether (MTBE)	ND		0.5							
1,1-Dichloroethane	ND		1							
Di-isopropyl Ether (DIPE)	ND		1							
cis-1,2-Dichloroethene	ND		1							
Chloroform	ND		1							
Ethyl Tertiary Butyl Ether (ETBE)	ND		1							
1,2-Dichloroethane	ND		1							
1,1,1-Trichloroethane	ND		1							
Carbon tetrachloride	ND		1							
Benzene	ND		0.5							
Tertiary Amyl Methyl Ether (TAME)	ND		1							
1,2-Dichloropropane	ND		1							
Trichloroethene	ND		1							
Bromodichloromethane	ND		1							
cis-1,3-Dichloropropene	ND		1							
trans-1,3-Dichloropropene	ND		1							
1,1,2-Trichloroethane	ND		1							
Toluene	ND		0.5							
Dibromochloromethane	ND		1							
1,2-Dibromoethane (EDB)	ND		2							
Tetrachloroethene	ND		1							
Chlorobenzene	ND		1							
Ethylbenzene	ND		0.5							
m,p-Xylene	ND		0.5							
Bromoform	ND		1							
o-Xylene	ND		0.5							
1,1,2,2-Tetrachloroethane	ND		1							
1,3-Dichlorobenzene	ND		1							
1,4-Dichlorobenzene	ND		1							
1,2-Dichlorobenzene	ND		1							
Naphthalene	ND		2							
Surr: 1,2-Dichloroethane-d4	10.8		10		108	70	130			
Surr: Toluene-d8	9.88		10		99	70	130			
Surr: 4-Bromofluorobenzene	10.3		10		103	70	130			

Laboratory Control Spike

File ID: 15072235.D

Type LCS Test Code: EPA Method 624/8260

Batch ID: MS09W0722C

Analysis Date: 07/23/2015 01:23

Sample ID: LCS MS09W0722C

Units : µg/L

Run ID: MSD_09_150722D

Prep Date: 07/23/2015 01:23

Analyte	Result	PQL	SpkVal	SpkRefVal	%REC	LCL(ME)	UCL(ME)	RPDRefVal	%RPD(Limit)	Qual
1,1-Dichloroethene	9	1	10		90	70	130			
Methyl tert-butyl ether (MTBE)	10.1	0.5	10		101	63	137			
Benzene	10.7	0.5	10		107	70	130			
Trichloroethene	10.7	1	10		107	68	138			
Toluene	10.6	0.5	10		106	70	130			
Chlorobenzene	9.52	1	10		95	70	130			
Ethylbenzene	9.8	0.5	10		98	70	130			
m,p-Xylene	8.27	0.5	10		83	65	139			
o-Xylene	9.03	0.5	10		90	70	130			
Surr: 1,2-Dichloroethane-d4	11.1		10		111	70	130			
Surr: Toluene-d8	9.16		10		92	70	130			
Surr: 4-Bromofluorobenzene	10.5		10		105	70	130			



Alpha Analytical, Inc.

255 Glendale Ave. • Suite 21 • Sparks, Nevada 89431-5778
(775) 355-1044 • (775) 355-0406 FAX • 1-800-283-1183

Date:
24-Jul-15

QC Summary Report

Work Order:
15071641

Sample Matrix Spike

File ID: 15072306.D

Type MS

Test Code: EPA Method 624/8260

Batch ID: MS09W0722C

Analysis Date: 07/23/2015 15:40

Sample ID: 15071702-04AMS

Units: µg/L

Run ID: MSD_09_150722D

Prep Date: 07/23/2015 15:40

Analyte	Result	PQL	SpkVal	SpkRefVal	%REC	LCL(ME)	UCL(ME)	RPDRefVal	%RPD(Limit)	Qual
1,1-Dichloroethene	45.2	2.5	50	0	90	62	133			
Methyl tert-butyl ether (MTBE)	45.5	1.3	50	0	91	56	140			
Benzene	47.4	1.3	50	0	95	67	134			
Trichloroethene	46.6	2.5	50	0	93	68	138			
Toluene	46.5	1.3	50	0	93	38	130			
Chlorobenzene	43.5	2.5	50	0	87	70	130			
Ethylbenzene	45.3	1.3	50	0	91	70	130			
m,p-Xylene	39.4	1.3	50	0	79	65	139			
o-Xylene	42.1	1.3	50	0	84	69	130			
Surr: 1,2-Dichloroethane-d4	50.1		50		100	70	130			
Surr: Toluene-d8	47.4		50		95	70	130			
Surr: 4-Bromofluorobenzene	51.7		50		103	70	130			

Sample Matrix Spike Duplicate

File ID: 15072259.D

Type MSD

Test Code: EPA Method 624/8260

Batch ID: MS09W0722C

Analysis Date: 07/23/2015 11:23

Sample ID: 15071702-04AMSD

Units: µg/L

Run ID: MSD_09_150722D

Prep Date: 07/23/2015 11:23

Analyte	Result	PQL	SpkVal	SpkRefVal	%REC	LCL(ME)	UCL(ME)	RPDRefVal	%RPD(Limit)	Qual
1,1-Dichloroethene	44.7	2.5	50	0	89	62	133	45.23	1.3(35)	
Methyl tert-butyl ether (MTBE)	43.7	1.3	50	0	87	56	140	45.51	4.2(40)	
Benzene	46.8	1.3	50	0	94	67	134	47.4	1.2(21)	
Trichloroethene	44.1	2.5	50	0	88	68	138	46.6	5.6(20)	
Toluene	44.6	1.3	50	0	89	38	130	46.54	4.3(20)	
Chlorobenzene	41.6	2.5	50	0	83	70	130	43.53	4.5(20)	
Ethylbenzene	41.9	1.3	50	0	84	70	130	45.27	7.7(20)	
m,p-Xylene	36.2	1.3	50	0	72	65	139	39.42	8.6(20)	
o-Xylene	39.9	1.3	50	0	80	69	130	42.07	5.2(20)	
Surr: 1,2-Dichloroethane-d4	48.3		50		97	70	130			
Surr: Toluene-d8	48.4		50		97	70	130			
Surr: 4-Bromofluorobenzene	53.1		50		106	70	130			

Comments:

Calculations are based off of raw (non-rounded) data. However, for reporting purposes, all QC data is rounded to three significant figures. Therefore, hand calculated values may differ slightly.



Alpha Analytical, Inc.

255 Glendale Ave. • Suite 21 • Sparks, Nevada 89431-5778
(775) 355-1044 • (775) 355-0406 FAX • 1-800-283-1183

Date:
17-Aug-15

QC Summary Report

Work Order:
15071641

Method Blank

File ID: 15071906.D

Type MBLK Test Code: EPA Method SW8260B

Batch ID: MS09A0719A

Analysis Date: 07/19/2015 15:03

Sample ID: MBLK MS09A0719A

Units : mg/m³

Run ID: MSD_09_150719A

Prep Date: 07/19/2015 15:03

Analyte	Result	PQL	SpkVal	SpkRefVal	%REC	LCL(ME)	UCL(ME)	RPDRefVal	%RPD(Limit)	Qual
Chloromethane	ND	0.4								
Vinyl chloride	ND	0.2								
Chloroethane	ND	0.2								
Bromomethane	ND	0.4								
Trichlorofluoromethane	ND	0.2								
1,1-Dichloroethene	ND	0.2								
Tertiary Butyl Alcohol (TBA)	ND	5								
Dichloromethane	ND	0.4								
trans-1,2-Dichloroethene	ND	0.2								
Methyl tert-butyl ether (MTBE)	ND	0.1								
1,1-Dichloroethane	ND	0.2								
Di-isopropyl Ether (DIPE)	ND	0.2								
cis-1,2-Dichloroethene	ND	0.2								
Chloroform	ND	0.2								
Ethyl Tertiary Butyl Ether (ETBE)	ND	0.2								
1,2-Dichloroethane	ND	0.2								
1,1,1-Trichloroethane	ND	0.2								
Carbon tetrachloride	ND	0.2								
Benzene	ND	0.1								
Tertiary Amyl Methyl Ether (TAME)	ND	0.2								
1,2-Dichloropropane	ND	0.2								
Trichloroethene	ND	0.2								
Bromodichloromethane	ND	0.2								
cis-1,3-Dichloropropene	ND	0.2								
trans-1,3-Dichloropropene	ND	0.2								
1,1,2-Trichloroethane	ND	0.2								
Toluene	ND	0.1								
Dibromochloromethane	ND	0.2								
1,2-Dibromoethane (EDB)	ND	0.4								
Tetrachloroethene	ND	0.2								
Chlorobenzene	ND	0.2								
Ethylbenzene	ND	0.1								
m,p-Xylene	ND	0.1								
Bromoform	ND	0.2								
o-Xylene	ND	0.1								
1,1,2,2-Tetrachloroethane	ND	0.2								
n-Propylbenzene	ND	0.2								
1,2,4-Trimethylbenzene	ND	0.2								
1,3-Dichlorobenzene	ND	0.2								
1,4-Dichlorobenzene	ND	0.2								
1,2-Dichlorobenzene	ND	0.2								
Surr: 1,2-Dichloroethane-d4	1.89		2		95	70	130			
Surr: Toluene-d8	2.08		2		104	70	130			
Surr: 4-Bromofluorobenzene	2.02		2		101	70	130			

Laboratory Control Spike

File ID: 15071902.D

Type LCS Test Code: EPA Method SW8260B

Batch ID: MS09A0719A

Analysis Date: 07/19/2015 13:26

Sample ID: LCS MS09A0719A

Units : mg/m³

Run ID: MSD_09_150719A

Prep Date: 07/19/2015 13:26

Analyte	Result	PQL	SpkVal	SpkRefVal	%REC	LCL(ME)	UCL(ME)	RPDRefVal	%RPD(Limit)	Qual
1,1-Dichloroethene	9	0.2	10		90	70	130			
Methyl tert-butyl ether (MTBE)	8.57	0.1	10		86	63	137			
Benzene	9.21	0.1	10		92	70	130			
Trichloroethene	9.21	0.2	10		92	68	138			
Toluene	9.1	0.1	10		91	70	130			
Chlorobenzene	9.24	0.2	10		92	70	130			
Ethylbenzene	9.39	0.1	10		94	70	130			
m,p-Xylene	8.31	0.1	10		83	65	139			
o-Xylene	8.8	0.1	10		88	70	130			
Surr: 1,2-Dichloroethane-d4	9.15		10		92	70	130			
Surr: Toluene-d8	10.2		10		102	70	130			
Surr: 4-Bromofluorobenzene	10.1		10		101	70	130			



Alpha Analytical, Inc.

255 Glendale Ave. • Suite 21 • Sparks, Nevada 89431-5778
(775) 355-1044 • (775) 355-0406 FAX • 1-800-283-1183

Date:
17-Aug-15

QC Summary Report

Work Order:
15071641

Comments:

Calculations are based off of raw (non-rounded) data. However, for reporting purposes, all QC data is rounded to three significant figures. Therefore, hand calculated values may differ slightly.

Billing Information :

CHAIN-OF-CUSTODY RECORD

AMENDED CA

Alpha Analytical, Inc.
 255 Glendale Avenue, Suite 21 Sparks, Nevada 89431-5778
 TEL: (775) 355-1044 FAX: (775) 355-0406

WorkOrder : STR15071641
Report Due By : 5:00 PM On : 23-Jul-15

Client:
 Stratus Environmental
 3330 Cameron Park Drive
 Suite 550
 Cameron Park, CA 95682-8861

Report Attention	Phone Number	EEmail Address
Scott Bittinger	(530) 676-2062 x	sbittinger@stratusinc.net

EDD Required : Yes

Sampled by : C. Hill

PO :
 Client's COC # : 04309 Job : Gritmit Auto

Cooler Temp	Samples Received	Date Printed
2 °C	16-Jul-15	14-Aug-15

QC Level : S3 = Final Rpt, MBLK, LCS, MS/MSD With Surrogates

Alpha Sample ID	Client Sample ID	Collection Matrix	No. of Bottles Alpha Sub TAT	Requested Tests						Sample Remarks	
				TPH/P_A	TPH/P_W	VOC_A	VOC_W				
STR15071641-01A	Grim A SYS INF	AR 07/15/15 09:25	1 0 5	GAS-N/C		8260/OXYS/EDB_S					Tedlar
STR15071641-02A	Grim A EFF	AR 07/15/15 09:30	1 0 5	GAS-N/C		8260/OXYS/EDB_S					Tedlar.
STR15071641-03A	Grim W INF	AQ 07/15/15 09:17	6 0 5		GAS-C	8260/OXYS/EDB/Naph_C					
STR15071641-04A	Grim W GAC1	AQ 07/15/15 08:45	6 0 5		GAS-C	8260/OXYS/EDB/Naph_C					
STR15071641-05A	Grim W EFF	AQ 07/15/15 08:40	6 0 5		GAS-C	8260/OXYS/EDB/Naph_C					

Comments: Security seals intact. Frozen ice. Standard TAT per Scott. Amended on 8/14/15 to add n-Propylbenzene and 1,2,4-Trimethylbenzene to samples -01A and -02A per Debra. JA :

Signature	Print Name	Company	Date/Time
	JESSICA ALVARADO	Alpha Analytical, Inc.	8/14/15 1040

NOTE: Samples are discarded 60 days after results are reported unless other arrangements are made. Hazardous samples will be returned to client or disposed of at client expense.
 The report for the analysis of the above samples is applicable only to those samples received by the laboratory with this COC. The liability of the laboratory is limited to the amount paid for the report.
 Matrix Type : AQ(Aqueous) AR(Air) SO(Soil) WS(Waste) DW(Drinking Water) OT(Other) Bottle Type: L-Liter V-Voa S-Soil Jar O-Orbo T-Tedlar B-Brass P-Plastic OT-Other

Billing Information :

CHAIN-OF-CUSTODY RECORD

Alpha Analytical, Inc.
 255 Glendale Avenue, Suite 21 Sparks, Nevada 89431-5778
 TEL: (775) 355-1044 FAX: (775) 355-0406

CA

WorkOrder : STR15071641
Report Due By : 5:00 PM On : 23-Jul-15

Client:
 Stratus Environmental
 3330 Cameron Park Drive
 Suite 550
 Cameron Park, CA 95682-8861

Report Attention	Phone Number	Email Address
Scott Bittinger	(530) 676-2062 x	sbittinger@stratusinc.net

EDD Required : Yes

Sampled by : C. Hill

PO : Cooler Temp Samples Received Date Printed
 Client's COC # : 04309 Job : Gritit Auto 2 °C 16-Jul-15 16-Jul-15

QC Level : S3 = Final Rpt, MBLK, LCS, MS/MSD With Surrogates

Alpha Sample ID	Client Sample ID	Collection Matrix	Date	No. of Bottles			Requested Tests								Sample Remarks			
				Alpha	Sub	TAT	TPH/P_A	TPH/P_W	VOC_A	VOC_W								
STR15071641-01A	Grim A SYS INF	AR	07/15/15 09:25	1	0	5	GAS-N/C		8260/OXYS/ EDB_S									Tedlar
STR15071641-02A	Grim A EFF	AR	07/15/15 09:30	1	0	5	GAS-N/C		8260/OXYS/ EDB_S									Tedlar.
STR15071641-03A	Grim W INF	AQ	07/15/15 09:17	6	0	5		GAS-C		8260/OXYS/ EDB/Naph_C s								
STR15071641-04A	Grim W GAC1	AQ	07/15/15 08:45	6	0	5		GAS-C		8260/OXYS/ EDB/Naph_C s								
STR15071641-05A	Grim W EFF	AQ	07/15/15 08:40	6	0	5		GAS-C		8260/OXYS/ EDB/Naph_C s								

Comments: Security seals intact. Frozen ice. Standard TAT per Scott. :

Logged in by:	Signature	Print Name	Company	Date/Time
		JESSICA ALVARADO.	Alpha Analytical, Inc.	7/16/15 950

NOTE: Samples are discarded 60 days after results are reported unless other arrangements are made. Hazardous samples will be returned to client or disposed of at client expense.

The report for the analysis of the above samples is applicable only to those samples received by the laboratory with this COC. The liability of the laboratory is limited to the amount paid for the report.

Matrix Type : AQ(Aqueous) AR(Air) SO(Soil) WS(Waste) DW(Drinking Water) OT(Other) Bottle Type: L-Liter V-Voa S-Soil Jar O-Orbo T-Tedlar B-Brass P-Plastic OT-Other

Company: Stuyk's
 Attn: Scott
 Address: 5330 Cameron Plz Dr
 City, State, Zip: Channahon IL
 Phone Number: _____ Fax: _____



Alpha Analytical, Inc.
 Main Laboratory: 255 Glendale Ave, Suite 21 Sparks, NV 89431
Satellite Service Centers:
 Northern CA: 9891 Horn Road, Suite C, Rancho Cordova, CA 95827
 Southern CA: 1007 E. Dominguez St., Suite O, Carson, CA 90746
 Northern NV: 1250 Lamaille Hwy., #310, Elko, NV 89801
 Southern NV: 6255 McLeod Ave, Suite 24, Las Vegas, NV 89120

Phone: 775-355-1044
 Fax: 775-355-0406
 Phone: 916-366-9089
 Phone: 714-386-2901
 Phone: 775-388-7043
 Phone: 702-281-4848

04309

Page # 1 of 1

Consultant/Client Info: Company: Stuyk's
Job and Purchase Order Info: Job #: _____ Job Name: Grimm Auto P.O. #: _____
Report Attention/Project Manager: Name: Scott Email Address: _____ Phone #: _____ Cell #: _____
QC Deliverable Info: EDD Required? Yes / No _____ EDF Required? Yes / No _____
 Global ID: _____ Data Validation Packages: III or IV _____

Samples Collected from which State? (circle one) AR CA KS NV OR WA DOD Site Other

Time Sampled (MM/DD)	Date Sampled (MM/DD)	Matrix* (See Key Below)	Lab ID Number (For Lab Use Only)	Sample Description	TAT	# Containers* (See Key Below)	Analysis Requested											Remarks
							Field Filtered?		GRO	BTEX	MTBE	1,2 DCA	Naphthalene	VOC's	PCE, TCE	Vinylchloride	Chlorobenzene	
0925	7/2/15	AQ	15071041-01A	Grimm A Sys INF		1	X	X	X	X		X	X	X	X			
0930		AQ	-02A	Grimm IT EFF		1	X	X	X	X		X	X	X	X			
0917	7/3/15	AQ	-03A	Grimm W INF		6	X	X	X	X	X	X	X	X	X			
0945			-04A	Grimm W GACI		6	X	X	X	X	X	X	X	X	X			
0950			-05A	Grimm W EFF		6	X	X	X	X	X	X	X	X	X			

ADDITIONAL INSTRUCTIONS:

I (field sampler) attest to the validity and authenticity of this sample(s). I am aware that tampering with or intentionally mislabeling the sample location, date or time of collection is considered fraud and may be grounds for legal action. NAC 445.0636 (c) (2).

Relinquished by: (Signature/Affiliation): <u>Scott Stuyk</u>	Date: <u>7/15/15</u>	Time: <u>1305</u>	Received by: (Signature/Affiliation): <u>Maryssa T</u>	Date: <u>7-15-15</u>	Time: <u>1315</u>
Relinquished by: (Signature/Affiliation): _____	Date: _____	Time: _____	Received by: (Signature/Affiliation): <u>[Signature]</u>	Date: <u>7/14/15</u>	Time: <u>940</u>
Relinquished by: (Signature/Affiliation): _____	Date: _____	Time: _____	Received by: (Signature/Affiliation): _____	Date: _____	Time: _____

* Key: AQ - Aqueous OT - Other So-Soil WA - Waste **B - Brass L - Liter O - Orbo OT - Other P - Plastic S-Soil Jar T - Tedlar V - VOA

NOTE: Samples are discarded 60 days after sample receipt unless other arrangements are made. Hazardous samples will be returned to client or disposed of at client expense. The report for the analysis of the above samples is applicable only to those samples received by the laboratory with this COC. The liability of the laboratory is limited to the amount paid for the report.



Alpha Analytical, Inc.

255 Glendale Ave. • Suite 21 • Sparks, Nevada 89431-5778
(775) 355-1044 • (775) 355-0406 FAX • 1-800-283-1183

ANALYTICAL REPORT

Stratus Environmental
3330 Cameron Park Drive
Cameron Park, CA 956828861

Attn: Scott Bittinger
Phone: (530) 676-2062
Fax: (530) 676-6005
Date Received : 08/11/15

Job: Grimit Auto

Total Petroleum Hydrocarbons - Purgeable (TPH-P) EPA Method SW8015B / SW8260B

Parameter	Concentration	Reporting Limit	Date Extracted	Date Analyzed
Client ID : Grim A SYS INF Lab ID : STR15081141-01A Date Sampled 08/10/15 10:15	TPH-P (GRO) 32	20 mg/m ³	08/11/15 10:35	08/13/15
Client ID : Grim W INF Lab ID : STR15081141-02A Date Sampled 08/10/15 10:05	TPH-P (GRO) 7,600	1,000 µg/L	08/13/15	08/13/15
Client ID : Grim W GAC1 Lab ID : STR15081141-03A Date Sampled 08/10/15 07:40	TPH-P (GRO) ND	50 µg/L	08/13/15	08/13/15

Gasoline Range Organics (GRO) C4-C13

Note: For sample -01A concentrations of air in a Tedlar Bag are at 23 degrees Celsius and 25.57 inches of mercury.

ND = Not Detected

Reported in micrograms per Liter, per client request.



Roger Scholl

Randy Gardner

Roger L. Scholl, Ph.D., Laboratory Director • Randy Gardner, Laboratory Manager

Sacramento, CA • (916) 366-9089 / Las Vegas, NV • (702) 281-4848 / Carson, CA • (714) 386-2901 / info@alpha-analytical.com

Alpha Analytical, Inc. certifies that the test results meet all requirements of NELAC unless footnoted otherwise.

Statement of Data Authenticity: Alpha Analytical, Inc. attests that the data reported has not been altered in any way.

Alpha Analytical, Inc. currently holds appropriate and available California (#2019) and NELAC (01154CA) certifications for the data reported. Test results relate only to reported samples.



PS

8/18/15

Report Date



Alpha Analytical, Inc.

255 Glendale Ave. • Suite 21 • Sparks, Nevada 89431-5778
(775) 355-1044 • (775) 355-0406 FAX • 1-800-283-1183

ANALYTICAL REPORT

Stratus Environmental
3330 Cameron Park Drive
Cameron Park, CA 956828861
Job: Gritmit Auto

Attn: Scott Bittinger
Phone: (530) 676-2062
Fax: (530) 676-6005

Alpha Analytical Number: STR15081141-01A
Client I.D. Number: Grim A SYS INF

Sampled: 08/10/15 10:15
Received: 08/11/15
Extracted: 08/11/15 10:35
Analyzed: 08/13/15

Volatile Organics by GC/MS EPA Method SW8260B

Compound	Concentration	Reporting Limit	Compound	Concentration	Reporting Limit
1 Chloromethane	ND	0.80 mg/m ³	26 1,1,2-Trichloroethane	ND	0.40 mg/m ³
2 Vinyl chloride	ND	0.40 mg/m ³	27 Toluene	ND	0.20 mg/m ³
3 Chloroethane	ND	0.40 mg/m ³	28 Dibromochloromethane	ND	0.40 mg/m ³
4 Bromomethane	ND	0.80 mg/m ³	29 1,2-Dibromoethane (EDB)	ND	0.80 mg/m ³
5 Trichlorofluoromethane	ND	0.40 mg/m ³	30 Tetrachloroethene	ND	0.40 mg/m ³
6 1,1-Dichloroethene	ND	0.40 mg/m ³	31 Chlorobenzene	ND	0.40 mg/m ³
7 Tertiary Butyl Alcohol (TBA)	ND	10 mg/m ³	32 Ethylbenzene	0.26	0.20 mg/m ³
8 Dichloromethane	ND	0.80 mg/m ³	33 m,p-Xylene	0.83	0.20 mg/m ³
9 trans-1,2-Dichloroethene	ND	0.40 mg/m ³	34 Bromoform	ND	0.40 mg/m ³
10 Methyl tert-butyl ether (MTBE)	ND	0.20 mg/m ³	35 o-Xylene	ND	0.20 mg/m ³
11 1,1-Dichloroethane	ND	0.40 mg/m ³	36 1,1,2,2-Tetrachloroethane	ND	0.40 mg/m ³
12 Di-isopropyl Ether (DIPE)	ND	0.40 mg/m ³	37 n-Propylbenzene	ND	0.40 mg/m ³
13 cis-1,2-Dichloroethene	ND	0.40 mg/m ³	38 1,2,4-Trimethylbenzene	ND	0.40 mg/m ³
14 Chloroform	ND	0.40 mg/m ³	39 1,3-Dichlorobenzene	ND	0.40 mg/m ³
15 Ethyl Tertiary Butyl Ether (ETBE)	ND	0.40 mg/m ³	40 1,4-Dichlorobenzene	ND	0.40 mg/m ³
16 1,2-Dichloroethane	ND	0.40 mg/m ³	41 1,2-Dichlorobenzene	ND	0.40 mg/m ³
17 1,1,1-Trichloroethane	ND	0.40 mg/m ³			
18 Carbon tetrachloride	ND	0.40 mg/m ³			
19 Benzene	ND	0.20 mg/m ³			
20 Tertiary Amyl Methyl Ether (TAME)	ND	0.40 mg/m ³			
21 1,2-Dichloropropane	ND	0.40 mg/m ³			
22 Trichloroethene	ND	0.40 mg/m ³			
23 Bromodichloromethane	ND	0.40 mg/m ³			
24 cis-1,3-Dichloropropene	ND	0.40 mg/m ³			
25 trans-1,3-Dichloropropene	ND	0.40 mg/m ³			

Note: Concentrations of air in Tedlar Bags are at 23 degrees Celsius and 25.57 inches of mercury.

ND = Not Detected



Roger Scholl

Randy Gardner

Roger L. Scholl, Ph.D., Laboratory Director • Randy Gardner, Laboratory Manager

Sacramento, CA • (916) 366-9089 / Las Vegas, NV • (702) 281-4848 / Carson, CA • (714) 386-2901 / info@alpha-analytical.com

Alpha Analytical, Inc. certifies that the test results meet all requirements of NELAC unless footnoted otherwise.

Statement of Data Authenticity: Alpha Analytical, Inc. attests that the data reported has not been altered in any way.

Alpha Analytical, Inc. currently holds appropriate and available California (#2019) and NELAC (01154CA) certifications for the data reported. Test results relate only to reported samples.



[Signature]

8/18/15

Report Date

Page 1 of 1



Alpha Analytical, Inc.

255 Glendale Ave. • Suite 21 • Sparks, Nevada 89431-5778
(775) 355-1044 • (775) 355-0406 FAX • 1-800-283-1183

ANALYTICAL REPORT

Stratus Environmental
3330 Cameron Park Drive
Cameron Park, CA 956828861
Job: Gritmit Auto

Attn: Scott Bittinger
Phone: (530) 676-2062
Fax: (530) 676-6005

Alpha Analytical Number: STR15081141-02A
Client I.D. Number: Grim WINF

Sampled: 08/10/15 10:05
Received: 08/11/15
Extracted: 08/13/15
Analyzed: 08/13/15

Volatile Organics by GC/MS EPA Method 624/8260

Compound	Concentration	Reporting Limit	Compound	Concentration	Reporting Limit
1 Chloromethane	ND	40 µg/L	26 1,1,2-Trichloroethane	ND	10 µg/L
2 Vinyl chloride	ND	10 µg/L	27 Toluene	ND	5.0 µg/L
3 Chloroethane	ND	10 µg/L	28 Dibromochloromethane	ND	10 µg/L
4 Bromomethane	ND	40 µg/L	29 1,2-Dibromoethane (EDB)	ND	20 µg/L
5 Trichlorofluoromethane	ND	10 µg/L	30 Tetrachloroethene	ND	10 µg/L
6 1,1-Dichloroethene	ND	10 µg/L	31 Chlorobenzene	ND	10 µg/L
7 Tertiary Butyl Alcohol (TBA)	ND	100 µg/L	32 Ethylbenzene	13	5.0 µg/L
8 Dichloromethane	ND	40 µg/L	33 m,p-Xylene	67	5.0 µg/L
9 trans-1,2-Dichloroethene	ND	10 µg/L	34 Bromoform	ND	10 µg/L
10 Methyl tert-butyl ether (MTBE)	ND	5.0 µg/L	35 o-Xylene	24	5.0 µg/L
11 1,1-Dichloroethane	ND	10 µg/L	36 1,1,2,2-Tetrachloroethane	ND	10 µg/L
12 Di-isopropyl Ether (DIPE)	ND	10 µg/L	37 1,3-Dichlorobenzene	ND	10 µg/L
13 cis-1,2-Dichloroethene	ND	10 µg/L	38 1,4-Dichlorobenzene	ND	10 µg/L
14 Chloroform	ND	10 µg/L	39 1,2-Dichlorobenzene	ND	10 µg/L
15 Ethyl Tertiary Butyl Ether (ETBE)	ND	10 µg/L	40 Naphthalene	ND	40 µg/L
16 1,2-Dichloroethane	ND	10 µg/L			
17 1,1,1-Trichloroethane	ND	10 µg/L			
18 Carbon tetrachloride	ND	10 µg/L			
19 Benzene	ND	5.0 µg/L			
20 Tertiary Amyl Methyl Ether (TAME)	ND	10 µg/L			
21 1,2-Dichloropropane	ND	10 µg/L			
22 Trichloroethene	ND	10 µg/L			
23 Bromodichloromethane	ND	10 µg/L			
24 cis-1,3-Dichloropropene	ND	10 µg/L			
25 trans-1,3-Dichloropropene	ND	10 µg/L			

Reporting Limits were increased due to high concentrations of target analytes.

ND = Not Detected



Roger Scholl

Randy Gardner

Roger L. Scholl, Ph.D., Laboratory Director • Randy Gardner, Laboratory Manager
Sacramento, CA • (916) 366-9089 / Las Vegas, NV • (702) 281-4848 / Carson, CA • (714) 386-2901 / info@alpha-analytical.com

Alpha Analytical, Inc. certifies that the test results meet all requirements of NELAC unless footnoted otherwise.

Statement of Data Authenticity: Alpha Analytical, Inc. attests that the data reported has not been altered in any way.



PS
8/18/15

Report Date

Page 1 of 1

Alpha Analytical, Inc. currently holds appropriate and available California (#2019) and NELAC (01154CA) certifications for the data reported. Test results relate only to reported samples.



Alpha Analytical, Inc.

255 Glendale Ave. • Suite 21 • Sparks, Nevada 89431-5778
(775) 355-1044 • (775) 355-0406 FAX • 1-800-283-1183

ANALYTICAL REPORT

Stratus Environmental
3330 Cameron Park Drive
Cameron Park, CA 956828861
Job: Grit Auto

Attn: Scott Bittinger
Phone: (530) 676-2062
Fax: (530) 676-6005

Alpha Analytical Number: STR15081141-03A
Client I.D. Number: Grim W GAC1

Sampled: 08/10/15 07:40
Received: 08/11/15
Extracted: 08/13/15
Analyzed: 08/13/15

Volatile Organics by GC/MS EPA Method 624/8260

Compound	Concentration	Reporting Limit	Compound	Concentration	Reporting Limit
1 Chloromethane	ND	2.0 µg/L	26 1,1,2-Trichloroethane	ND	1.0 µg/L
2 Vinyl chloride	ND	1.0 µg/L	27 Toluene	ND	0.50 µg/L
3 Chloroethane	ND	1.0 µg/L	28 Dibromochloromethane	ND	1.0 µg/L
4 Bromomethane	ND	2.0 µg/L	29 1,2-Dibromoethane (EDB)	ND	2.0 µg/L
5 Trichlorofluoromethane	ND	1.0 µg/L	30 Tetrachloroethene	ND	1.0 µg/L
6 1,1-Dichloroethene	ND	1.0 µg/L	31 Chlorobenzene	ND	1.0 µg/L
7 Tertiary Butyl Alcohol (TBA)	ND	10 µg/L	32 Ethylbenzene	ND	0.50 µg/L
8 Dichloromethane	ND	2.0 µg/L	33 m,p-Xylene	ND	0.50 µg/L
9 trans-1,2-Dichloroethene	ND	1.0 µg/L	34 Bromoform	ND	1.0 µg/L
10 Methyl tert-butyl ether (MTBE)	ND	0.50 µg/L	35 o-Xylene	ND	0.50 µg/L
11 1,1-Dichloroethane	ND	1.0 µg/L	36 1,1,2,2-Tetrachloroethane	ND	1.0 µg/L
12 Di-isopropyl Ether (DIPE)	ND	1.0 µg/L	37 1,3-Dichlorobenzene	ND	1.0 µg/L
13 cis-1,2-Dichloroethene	ND	1.0 µg/L	38 1,4-Dichlorobenzene	ND	1.0 µg/L
14 Chloroform	ND	1.0 µg/L	39 1,2-Dichlorobenzene	ND	1.0 µg/L
15 Ethyl Tertiary Butyl Ether (ETBE)	ND	1.0 µg/L	40 Naphthalene	ND	2.0 µg/L
16 1,2-Dichloroethane	ND	1.0 µg/L			
17 1,1,1-Trichloroethane	ND	1.0 µg/L			
18 Carbon tetrachloride	ND	1.0 µg/L			
19 Benzene	ND	0.50 µg/L			
20 Tertiary Amyl Methyl Ether (TAME)	ND	1.0 µg/L			
21 1,2-Dichloropropane	ND	1.0 µg/L			
22 Trichloroethene	ND	1.0 µg/L			
23 Bromodichloromethane	ND	1.0 µg/L			
24 cis-1,3-Dichloropropene	ND	1.0 µg/L			
25 trans-1,3-Dichloropropene	ND	1.0 µg/L			

ND = Not Detected



Roger Scholl

Randy Gardner

Roger L. Scholl, Ph.D., Laboratory Director • Randy Gardner, Laboratory Manager

Sacramento, CA • (916) 366-9089 / Las Vegas, NV • (702) 281-4848 / Carson, CA • (714) 386-2901 / info@alpha-analytical.com

Alpha Analytical, Inc. certifies that the test results meet all requirements of NELAC unless footnoted otherwise.

Statement of Data Authenticity: Alpha Analytical, Inc. attests that the data reported has not been altered in any way.

Alpha Analytical, Inc. currently holds appropriate and available California (#2019) and NELAC (01154CA) certifications for the data reported. Test results relate only to reported samples.



JS

8/18/15

Report Date

Page 1 of 1



Alpha Analytical, Inc.

255 Glendale Ave. • Suite 21 • Sparks, Nevada 89431-5778
(775) 355-1044 • (775) 355-0406 FAX • 1-800-283-1183

VOC Sample Preservation Report

Work Order: STR15081141

Job: Gritmit Auto

Alpha's Sample ID	Client's Sample ID	Matrix	pH
15081141-02A	Grim W INF	Aqueous	2
15081141-03A	Grim W GACI	Aqueous	2

8/18/15
Report Date



Alpha Analytical, Inc.

255 Glendale Ave. • Suite 21 • Sparks, Nevada 89431-5778
(775) 355-1044 • (775) 355-0406 FAX • 1-800-283-1183

Date:
17-Aug-15

QC Summary Report

Work Order:
15081141

Method Blank		Type	Test Code: EPA Method SW8015B/C / SW8260B							
File ID: 15081305.D			Batch ID: MS09W0813B			Analysis Date: 08/13/2015 10:30				
Sample ID:	MBLK MS09W0813B	Units : µg/L	Run ID: MSD_09_150813A			Prep Date: 08/13/2015 10:30				
Analyte	Result	PQL	SpkVal	SpkRefVal	%REC	LCL(ME)	UCL(ME)	RPDRefVal	%RPD(Limit)	Qual
TPH-P (GRO)	ND	50								
Surr: 1,2-Dichloroethane-d4	7.01		10		70	70	130			
Surr: Toluene-d8	11.9		10		119	70	130			
Surr: 4-Bromofluorobenzene	11.4		10		114	70	130			

Laboratory Control Spike		Type	Test Code: EPA Method SW8015B/C / SW8260B							
File ID: 15081304.D			Batch ID: MS09W0813B			Analysis Date: 08/13/2015 09:53				
Sample ID:	GLCS MS09W0813B	Units : µg/L	Run ID: MSD_09_150813A			Prep Date: 08/13/2015 09:53				
Analyte	Result	PQL	SpkVal	SpkRefVal	%REC	LCL(ME)	UCL(ME)	RPDRefVal	%RPD(Limit)	Qual
TPH-P (GRO)	420	50	400		105	70	130			
Surr: 1,2-Dichloroethane-d4	6.63		10		66	70	130			S54
Surr: Toluene-d8	11.7		10		117	70	130			
Surr: 4-Bromofluorobenzene	11.4		10		114	70	130			

Sample Matrix Spike		Type	Test Code: EPA Method SW8015B/C / SW8260B							
File ID: 15081327.D			Batch ID: MS09W0813B			Analysis Date: 08/13/2015 19:25				
Sample ID:	15081243-01AGS	Units : µg/L	Run ID: MSD_09_150813A			Prep Date: 08/13/2015 19:25				
Analyte	Result	PQL	SpkVal	SpkRefVal	%REC	LCL(ME)	UCL(ME)	RPDRefVal	%RPD(Limit)	Qual
TPH-P (GRO)	1170	250	2000		0	58	54	143		
Surr: 1,2-Dichloroethane-d4	40		50		80	70	130			
Surr: Toluene-d8	56.1		50		112	70	130			
Surr: 4-Bromofluorobenzene	53.7		50		107	70	130			

Sample Matrix Spike Duplicate		Type	Test Code: EPA Method SW8015B/C / SW8260B							
File ID: 15081328.D			Batch ID: MS09W0813B			Analysis Date: 08/13/2015 19:49				
Sample ID:	15081243-01AGSD	Units : µg/L	Run ID: MSD_09_150813A			Prep Date: 08/13/2015 19:49				
Analyte	Result	PQL	SpkVal	SpkRefVal	%REC	LCL(ME)	UCL(ME)	RPDRefVal	%RPD(Limit)	Qual
TPH-P (GRO)	1120	250	2000		0	56	54	143	1165	3.7(23)
Surr: 1,2-Dichloroethane-d4	39.8		50		80	70	130			
Surr: Toluene-d8	56.5		50		113	70	130			
Surr: 4-Bromofluorobenzene	55.4		50		111	70	130			

Comments:

Calculations are based off of raw (non-rounded) data. However, for reporting purposes, all QC data is rounded to three significant figures. Therefore, hand calculated values may differ slightly.

S54 = Surrogate recovery was below laboratory acceptance limits.



Alpha Analytical, Inc.

255 Glendale Ave. • Suite 21 • Sparks, Nevada 89431-5778
(775) 355-1044 • (775) 355-0406 FAX • 1-800-283-1183

Date:
17-Aug-15

QC Summary Report

Work Order:
15081141

Method Blank

Type MBLK Test Code: EPA Method SW8260B

File ID: 15081307.D

Batch ID: MS15A0813A

Analysis Date: 08/13/2015 13:16

Sample ID: MBLK MS15A0813A

Units : mg/m³

Run ID: MSD_15_150813A

Prep Date: 08/13/2015 13:16

Analyte	Result	PQL	SpkVal	SpkRefVal	%REC	LCL(ME)	UCL(ME)	RPDRefVal	%RPD(Limit)	Qual
Chloromethane	ND	0.4								
Vinyl chloride	ND	0.2								
Chloroethane	ND	0.2								
Bromomethane	ND	0.4								
Trichlorofluoromethane	ND	0.2								
1,1-Dichloroethene	ND	0.2								
Tertiary Butyl Alcohol (TBA)	ND	5								
Dichloromethane	ND	0.4								
trans-1,2-Dichloroethene	ND	0.2								
Methyl tert-butyl ether (MTBE)	ND	0.1								
1,1-Dichloroethane	ND	0.2								
Di-isopropyl Ether (DIPE)	ND	0.2								
cis-1,2-Dichloroethene	ND	0.2								
Chloroform	ND	0.2								
Ethyl Tertiary Butyl Ether (ETBE)	ND	0.2								
1,2-Dichloroethane	ND	0.2								
1,1,1-Trichloroethane	ND	0.2								
Carbon tetrachloride	ND	0.2								
Benzene	ND	0.1								
Tertiary Amyl Methyl Ether (TAME)	ND	0.2								
1,2-Dichloropropane	ND	0.2								
Trichloroethene	ND	0.2								
Bromodichloromethane	ND	0.2								
cis-1,3-Dichloropropene	ND	0.2								
trans-1,3-Dichloropropene	ND	0.2								
1,1,2-Trichloroethane	ND	0.2								
Toluene	ND	0.1								
Dibromochloromethane	ND	0.2								
1,2-Dibromoethane (EDB)	ND	0.4								
Tetrachloroethene	ND	0.2								
Chlorobenzene	ND	0.2								
Ethylbenzene	ND	0.1								
m,p-Xylene	ND	0.1								
Bromoform	ND	0.2								
o-Xylene	ND	0.1								
1,1,2,2-Tetrachloroethane	ND	0.2								
n-Propylbenzene	ND	0.2								
1,2,4-Trimethylbenzene	ND	0.2								
1,3-Dichlorobenzene	ND	0.2								
1,4-Dichlorobenzene	ND	0.2								
1,2-Dichlorobenzene	ND	0.2								

Laboratory Control Spike

Type LCS Test Code: EPA Method SW8260B

File ID: 15081302.D

Batch ID: MS15A0813A

Analysis Date: 08/13/2015 10:48

Sample ID: LCS MS15A0813A

Units : mg/m³

Run ID: MSD_15_150813A

Prep Date: 08/13/2015 10:48

Analyte	Result	PQL	SpkVal	SpkRefVal	%REC	LCL(ME)	UCL(ME)	RPDRefVal	%RPD(Limit)	Qual
1,1-Dichloroethene	8.97	0.2	10		90	70	130			
Methyl tert-butyl ether (MTBE)	6.82	0.1	10		68	63	137			
Benzene	8.66	0.1	10		87	70	130			
Trichloroethene	8.94	0.2	10		89	68	138			
Toluene	9.25	0.1	10		93	70	130			
Chlorobenzene	9.53	0.2	10		95	70	130			
Ethylbenzene	9.05	0.1	10		91	70	130			
m,p-Xylene	9.19	0.1	10		92	65	139			
o-Xylene	8.92	0.1	10		89	70	130			



Alpha Analytical, Inc.

255 Glendale Ave. • Suite 21 • Sparks, Nevada 89431-5778
(775) 355-1044 • (775) 355-0406 FAX • 1-800-283-1183

Date:
17-Aug-15

QC Summary Report

Work Order:
15081141

Comments:

Calculations are based off of raw (non-rounded) data. However, for reporting purposes, all QC data is rounded to three significant figures. Therefore, hand calculated values may differ slightly.



Alpha Analytical, Inc.

255 Glendale Ave. • Suite 21 • Sparks, Nevada 89431-5778
(775) 355-1044 • (775) 355-0406 FAX • 1-800-283-1183

Date:
17-Aug-15

QC Summary Report

Work Order:
15081141

Method Blank

File ID: 15081305.D

Type MBLK Test Code: EPA Method 624/8260

Batch ID: MS09W0813A

Analysis Date: 08/13/2015 10:30

Sample ID: MBLK MS09W0813A

Units : µg/L

Run ID: MSD_09_150813A

Prep Date: 08/13/2015 10:30

Analyte	Result	PQL	SpkVal	SpkRefVal	%REC	LCL(ME)	UCL(ME)	RPDRefVal	%RPD(Limit)	Qual
Chloromethane	ND	2								
Vinyl chloride	ND	1								
Chloroethane	ND	1								
Bromomethane	ND	2								
Trichlorofluoromethane	ND	1								
1,1-Dichloroethene	ND	1								
Tertiary Butyl Alcohol (TBA)	ND	10								
Dichloromethane	ND	2								
trans-1,2-Dichloroethene	ND	1								
Methyl tert-butyl ether (MTBE)	ND	0.5								
1,1-Dichloroethane	ND	1								
Di-isopropyl Ether (DIPE)	ND	1								
cis-1,2-Dichloroethene	ND	1								
Chloroform	ND	1								
Ethyl Tertiary Butyl Ether (ETBE)	ND	1								
1,2-Dichloroethane	ND	1								
1,1,1-Trichloroethane	ND	1								
Carbon tetrachloride	ND	1								
Benzene	ND	0.5								
Tertiary Amyl Methyl Ether (TAME)	ND	1								
1,2-Dichloropropane	ND	1								
Trichloroethene	ND	1								
Bromodichloromethane	ND	1								
cis-1,3-Dichloropropene	ND	1								
trans-1,3-Dichloropropene	ND	1								
1,1,2-Trichloroethane	ND	1								
Toluene	ND	0.5								
Dibromochloromethane	ND	1								
1,2-Dibromoethane (EDB)	ND	2								
Tetrachloroethene	ND	1								
Chlorobenzene	ND	1								
Ethylbenzene	ND	0.5								
m,p-Xylene	ND	0.5								
Bromoform	ND	1								
o-Xylene	ND	0.5								
1,1,2,2-Tetrachloroethane	ND	1								
1,3-Dichlorobenzene	ND	1								
1,4-Dichlorobenzene	ND	1								
1,2-Dichlorobenzene	ND	1								
Naphthalene	ND	2								
Surr: 1,2-Dichloroethane-d4	7.01		10		70	70	130			
Surr: Toluene-d8	11.9		10		119	70	130			
Surr: 4-Bromofluorobenzene	11.4		10		114	70	130			

Laboratory Control Spike

File ID: 15081302.D

Type LCS Test Code: EPA Method 624/8260

Batch ID: MS09W0813A

Analysis Date: 08/13/2015 08:39

Sample ID: LCS MS09W0813A

Units : µg/L

Run ID: MSD_09_150813A

Prep Date: 08/13/2015 08:39

Analyte	Result	PQL	SpkVal	SpkRefVal	%REC	LCL(ME)	UCL(ME)	RPDRefVal	%RPD(Limit)	Qual
1,1-Dichloroethene	9.47	1	10		95	70	130			
Methyl tert-butyl ether (MTBE)	8.46	0.5	10		85	63	137			
Benzene	9.69	0.5	10		97	70	130			
Trichloroethene	8.89	1	10		89	68	138			
Toluene	9.34	0.5	10		93	70	130			
Chlorobenzene	9.71	1	10		97	70	130			
Ethylbenzene	9.04	0.5	10		90	70	130			
m,p-Xylene	8.69	0.5	10		87	65	139			
o-Xylene	9.26	0.5	10		93	70	130			
Surr: 1,2-Dichloroethane-d4	7.49		10		75	70	130			
Surr: Toluene-d8	11.4		10		114	70	130			
Surr: 4-Bromofluorobenzene	10.5		10		105	70	130			



Alpha Analytical, Inc.

255 Glendale Ave. • Suite 21 • Sparks, Nevada 89431-5778
(775) 355-1044 • (775) 355-0406 FAX • 1-800-283-1183

Date:
17-Aug-15

QC Summary Report

Work Order:
15081141

Sample Matrix Spike

File ID: 15081325.D

Type MS

Test Code: EPA Method 624/8260

Sample ID: 15081243-01AMS

Units: µg/L

Run ID: MSD_09_150813A

Batch ID: MS09W0813A

Analysis Date: 08/13/2015 18:37

Prep Date: 08/13/2015 18:37

Analyte	Result	PQL	SpkVal	SpkRefVal	%REC	LCL(ME)	UCL(ME)	RPDRefVal	%RPD(Limit)	Qual
1,1-Dichloroethene	44.2	2.5	50	0	88	62	133			
Methyl tert-butyl ether (MTBE)	44.1	1.3	50	0	88	56	140			
Benzene	46.4	1.3	50	0	93	67	134			
Trichloroethene	42.5	2.5	50	0	85	68	138			
Toluene	45.3	1.3	50	0	91	38	130			
Chlorobenzene	45	2.5	50	0	90	70	130			
Ethylbenzene	42.3	1.3	50	0	85	70	130			
m,p-Xylene	39.7	1.3	50	0	79	65	139			
o-Xylene	43.1	1.3	50	0	86	69	130			
Surr: 1,2-Dichloroethane-d4	43.2		50		86	70	130			
Surr: Toluene-d8	53.6		50		107	70	130			
Surr: 4-Bromofluorobenzene	52.4		50		105	70	130			

Sample Matrix Spike Duplicate

File ID: 15081406.D

Type MSD

Test Code: EPA Method 624/8260

Sample ID: 15081243-01AMSD

Units: µg/L

Run ID: MSD_09_150813A

Batch ID: MS09W0813A

Analysis Date: 08/14/2015 12:16

Prep Date: 08/14/2015 12:16

Analyte	Result	PQL	SpkVal	SpkRefVal	%REC	LCL(ME)	UCL(ME)	RPDRefVal	%RPD(Limit)	Qual
1,1-Dichloroethene	53.7	2.5	50	0	107	62	133	44.15	19.5(35)	
Methyl tert-butyl ether (MTBE)	47.5	1.3	50	0	95	56	140	44.12	7.4(40)	
Benzene	53	1.3	50	0	106	67	134	46.37	13.4(21)	
Trichloroethene	49.9	2.5	50	0	99.7	68	138	42.51	15.9(20)	
Toluene	52.7	1.3	50	0	105	38	130	45.28	15.1(20)	
Chlorobenzene	50.7	2.5	50	0	101	70	130	44.95	12.0(20)	
Ethylbenzene	48.1	1.3	50	0	96	70	130	42.32	12.8(20)	
m,p-Xylene	46.8	1.3	50	0	94	65	139	39.65	16.6(20)	
o-Xylene	50.3	1.3	50	0	101	69	130	43.06	15.6(20)	
Surr: 1,2-Dichloroethane-d4	41.5		50		83	70	130			
Surr: Toluene-d8	55.2		50		110	70	130			
Surr: 4-Bromofluorobenzene	54.2		50		108	70	130			

Comments:

Calculations are based off of raw (non-rounded) data. However, for reporting purposes, all QC data is rounded to three significant figures. Therefore, hand calculated values may differ slightly.

Billing Information :

CHAIN-OF-CUSTODY RECORD **AMENDED** **CA**

Alpha Analytical, Inc.
255 Glendale Avenue, Suite 21 Sparks, Nevada 89431-5778
TEL: (775) 355-1044 FAX: (775) 355-0406

WorkOrder : STR15081141
Report Due By : 5:00 PM On : 18-Aug-15

Client:
Stratus Environmental
3330 Cameron Park Drive
Suite 550
Cameron Park, CA 95682-8861

Report Attention	Phone Number	E-Mail Address
Scott Bittinger	(530) 676-2062 x	sbittinger@stratusinc.net

EDD Required : Yes
Sampled by : C. Hill

PO :
Client's COC # : 04322 Job : Grimit Auto
Cooler Temp Samples Received Date Printed
0 °C 11-Aug-15 14-Aug-15

QC Level : S3 = Final Rpt, MBLK, LCS, MS/MSD With Surrogates

Alpha Sample ID	Client Sample ID	Collection Matrix	Date	No. of Bottles			Requested Tests						Sample Remarks			
				Alpha	Sub	TAT	TPHP_A	TPHP_W	VOC_A	VOC_W						
STR15081141-01A	Grim A SYS INF	AR	08/10/15 10:15	1	0	5	GAS-N/C		8260/OXYS/ EDB_S							Tedlar.
STR15081141-02A	Grim W INF	AQ	08/10/15 10:05	6	0	5		GAS-C		8260/OXYS/ EDB/Naph_C s						
STR15081141-03A	Grim W GAC1	AQ	08/10/15 07:40	6	0	5		GAS-C		8260/OXYS/ EDB/Naph_C s						

Comments: Security seals intact. Frozen ice. Chain split due to different TATs. Amended on 8/14/15 to add n-Propylbenzene and 1,2,4-Trimethylbenzene to sample -01A per Debra. JA :

Signature	Print Name	Company	Date/Time
	JESSICA ALVARADO	Alpha Analytical, Inc.	8/14/15 1045

Logged in by: _____

NOTE: Samples are discarded 60 days after results are reported unless other arrangements are made. Hazardous samples will be returned to client or disposed of at client expense.
The report for the analysis of the above samples is applicable only to those samples received by the laboratory with this COC. The liability of the laboratory is limited to the amount paid for the report.
Matrix Type : AQ(Aqueous) AR(Air) SO(Soil) WS(Waste) DW(Drinking Water) OT(Other) Bottle Type: L-Liter V-Voa S-Soil Jar O-Orbo T-Tedlar B-Brass P-Plastic OT-Other

Billing Information :

CHAIN-OF-CUSTODY RECORD

Alpha Analytical, Inc.
 255 Glendale Avenue, Suite 21 Sparks, Nevada 89431-5778
 TEL: (775) 355-1044 FAX: (775) 355-0406

CA

WorkOrder : STR15081141
Report Due By : 5:00 PM On : 18-Aug-15

Client:
 Stratus Environmental
 3330 Cameron Park Drive
 Suite 550
 Cameron Park, CA 95682-8861

Report Attention	Phone Number	E-Mail Address
Scott Bittinger	(530) 676-2062 x	sbittinger@stratusinc.net

EDD Required : Yes

Sampled by : C. Hill

PO :
 Client's COC # : 04322 Job : Gritmit Auto

<u>Cooler Temp</u>	<u>Samples Received</u>	<u>Date Printed</u>
0 °C	11-Aug-15	11-Aug-15

QC Level : S3 = Final Rpt, MBLK, LCS, MS/MSD With Surrogates

Alpha Sample ID	Client Sample ID	Collection Matrix	Collection Date	No. of Bottles			Requested Tests						Sample Remarks			
				Alpha	Sub	TAT	TPH/P_A	TPH/P_W	VOC_A	VOC_W						
STR15081141-01A	Grim A SYS INF	AR	08/10/15 10:15	1	0	5	GAS-N/C		8260/OXYS/ EDB_S							Tedlar.
STR15081141-02A	Grim W INF	AQ	08/10/15 10:05	6	0	5		GAS-C		8260/OXYS/ EDB/Naph_C s						
STR15081141-03A	Grim W GAC1	AQ	08/10/15 07:40	6	0	5		GAS-C		8260/OXYS/ EDB/Naph_C s						

Comments: Security seals intact. Frozen ice. Chain split due to different TATs. :

Signature	Print Name	Company	Date/Time
	JESSICA ALVARADO	Alpha Analytical, Inc.	8/11/15 10:15

NOTE: Samples are discarded 60 days after results are reported unless other arrangements are made. Hazardous samples will be returned to client or disposed of at client expense. The report for the analysis of the above samples is applicable only to those samples received by the laboratory with this COC. The liability of the laboratory is limited to the amount paid for the report.

Matrix Type : AQ(Aqueous) AR(Air) SO(Soil) WS(Waste) DW(Drinking Water) OT(Other) Bottle Type: L-Liter V-Voa S-Soil Jar O-Orbo T-Tedlar B-Brass P-Plastic OT-Other

Billing Information:
 Company: Starkes
 Attn: Debbie
 Address: 3331 Cameron Plz
 City, State, Zip: Cameron Plz
 Phone Number: _____ Fax: _____



Alpha Analytical, Inc.
 Main Laboratory: 255 Glendale Ave, Suite 21 Sparks, NV 89431
 Satellite Service Centers:
 Northern CA: 9891 Horn Road, Suite C, Rancho Cordova, CA 95827
 Southern CA: 1007 E. Dominguez St., Suite O, Carson, CA 90746
 Northern NV: 1250 Lamoille Hwy., #310, Eiko, NV 89801
 Southern NV: 6255 McLeod Ave, Suite 24, Las Vegas, NV 89120

Phone: 775-355-1044
 Fax: 775-355-0406
 Phone: 916-366-9089
 Phone: 714-386-2901
 Phone: 775-388-7043
 Phone: 702-281-4848

04322

Page # 1 of L

Consultant/Client Info: Starkes Job and Purchase Order Info: Job # _____ Job Name: Carmit Auto Report Attention/Project Manager: SLD H QC Deliverable Info: EDD Required? Yes / No _____ EDF Required? Yes / No _____ Global ID: _____ Data Validation Packages: III or IV _____

Time Sampled (HHMM)	Date Sampled (MMDD)	Matrix (See Key Below)	Lab ID Number (For Lab Use Only)	Sample Description	TAT	# Containers* (See Key Below)	Field Filtered?		Analysis Requested								Remarks
							Yes	No	GRO	BTEX	MTBE	1,2 DCA	Napthalene	PCB	VOC 5 TCE	Vinyltoluene	
1015	8/10			Grim A Sys Invi	STD	1	X		X	X	X			X	X	X	
0800				Grim A LFI	24	1	X		X	X	X			X	X	X	
1026	8/10			Grim W Invi	STD	6	X	X	X	X	X	X	X	X	X		
0740				Grim W GHEL	STD	6	X	X	X	X	X	X	X	X			
0733				Grim W LFI	24	6	X	X	X	X	X	X	X	X			

ADDITIONAL INSTRUCTIONS:

I (field sampler) attest to the validity and authenticity of this sample(s). I am aware that tampering with or intentionally mislabeling the sample location, date or time of collection is considered fraud and may be grounds for legal action. NAC 445.0636 (c) (2).

Sampled By: <u>Debbie Starkes</u>	Date: <u>8/10/15</u>	Time: <u>1321</u>	Received by: (Signature/Affiliation): <u>Menissa T</u>	Date: <u>8-10-15</u>	Time: <u>1321</u>
Relinquished by: (Signature/Affiliation):	Date:	Time:	Received by: (Signature/Affiliation): <u>fol.</u>	Date: <u>8/11/15</u>	Time: <u>1000</u>
Relinquished by: (Signature/Affiliation):	Date:	Time:	Received by: (Signature/Affiliation):	Date:	Time:

* Key: AQ - Aqueous OT - Other So-Soil WA - Waste ** B - Brass L - Liter O - Orbo OT - Other P - Plastic S-Soil Jar T - Tedlar V - VOA
 NOTE: Samples are discarded 60 days after sample receipt unless other arrangements are made. Hazardous samples will be returned to client or disposed of at client expense. The report for the analysis of the above samples is applicable only to those samples received by the laboratory with this COC. The liability of the laboratory is limited to the amount paid for the report.



Alpha Analytical, Inc.

255 Glendale Ave. • Suite 21 • Sparks, Nevada 89431-5778
(775) 355-1044 • (775) 355-0406 FAX • 1-800-283-1183

ANALYTICAL REPORT

Stratus Environmental
3330 Cameron Park Drive
Cameron Park, CA 956828861

Attn: Scott Bittinger
Phone: (530) 676-2062
Fax: (530) 676-6005
Date Received : 08/11/15

Job: Grit Auto

Total Petroleum Hydrocarbons - Purgeable (TPH-P) EPA Method SW8015B / SW8260B

Parameter	Concentration	Reporting Limit	Date Extracted	Date Analyzed	
Client ID : Grim A EFF Lab ID : STR15081140-01A Date Sampled 08/10/15 08:00	TPH-P (GRO)	ND	15 mg/m ³	08/11/15 10:10	08/11/15
Client ID : Grim W EFF Lab ID : STR15081140-02A Date Sampled 08/10/15 07:35	TPH-P (GRO)	ND	50 µg/L	08/11/15	08/11/15

Gasoline Range Organics (GRO) C4-C13

Note: For sample -01A concentrations of air in a Tedlar Bag are at 22 degrees Celsius and 25.57 inches of mercury.

ND = Not Detected

Reported in micrograms per Liter, per client request.



Roger Scholl

Randy Gardner

Roger L. Scholl, Ph.D., Laboratory Director • Randy Gardner, Laboratory Manager
Sacramento, CA • (916) 366-9089 / Las Vegas, NV • (702) 281-4848 / Carson, CA • (714) 386-2901 / info@alpha-analytical.com

Alpha Analytical, Inc. certifies that the test results meet all requirements of NELAC unless footnoted otherwise.

Statement of Data Authenticity: Alpha Analytical, Inc. attests that the data reported has not been altered in any way.

Alpha Analytical, Inc. currently holds appropriate and available California (#2019) and NELAC (01154CA) certifications for the data reported. Test results relate only to reported samples.



[Signature]

8/11/15

Report Date



Alpha Analytical, Inc.

255 Glendale Ave. • Suite 21 • Sparks, Nevada 89431-5778
(775) 355-1044 • (775) 355-0406 FAX • 1-800-283-1183

ANALYTICAL REPORT

Stratus Environmental
3330 Cameron Park Drive
Cameron Park, CA 956828861
Job: Grit Auto

Attn: Scott Bittinger
Phone: (530) 676-2062
Fax: (530) 676-6005

Alpha Analytical Number: STR15081140-01A
Client I.D. Number: Grim A EFF

Sampled: 08/10/15 08:00
Received: 08/11/15
Extracted: 08/11/15 10:10
Analyzed: 08/11/15

Volatile Organics by GC/MS EPA Method SW8260B

Compound	Concentration	Reporting Limit	Compound	Concentration	Reporting Limit
1 Chloromethane	ND	0.60 mg/m ³	26 1,1,2-Trichloroethane	ND	0.30 mg/m ³
2 Vinyl chloride	ND	0.30 mg/m ³	27 Toluene	ND	0.15 mg/m ³
3 Chloroethane	ND	0.30 mg/m ³	28 Dibromochloromethane	ND	0.30 mg/m ³
4 Bromomethane	ND	0.60 mg/m ³	29 1,2-Dibromoethane (EDB)	ND	0.60 mg/m ³
5 Trichlorofluoromethane	ND	0.30 mg/m ³	30 Tetrachloroethene	ND	0.30 mg/m ³
6 1,1-Dichloroethene	ND	0.30 mg/m ³	31 Chlorobenzene	ND	0.30 mg/m ³
7 Tertiary Butyl Alcohol (TBA)	ND	7.5 mg/m ³	32 Ethylbenzene	ND	0.15 mg/m ³
8 Dichloromethane	ND	0.60 mg/m ³	33 m,p-Xylene	ND	0.15 mg/m ³
9 trans-1,2-Dichloroethene	ND	0.30 mg/m ³	34 Bromoform	ND	0.30 mg/m ³
10 Methyl tert-butyl ether (MTBE)	ND	0.15 mg/m ³	35 o-Xylene	ND	0.15 mg/m ³
11 1,1-Dichloroethane	ND	0.30 mg/m ³	36 1,1,2,2-Tetrachloroethane	ND	0.30 mg/m ³
12 Di-isopropyl Ether (DIPE)	ND	0.30 mg/m ³	37 n-Propylbenzene	ND	0.30 mg/m ³
13 cis-1,2-Dichloroethene	ND	0.30 mg/m ³	38 1,2,4-Trimethylbenzene	ND	0.30 mg/m ³
14 Chloroform	ND	0.30 mg/m ³	39 1,3-Dichlorobenzene	ND	0.30 mg/m ³
15 Ethyl Tertiary Butyl Ether (ETBE)	ND	0.30 mg/m ³	40 1,4-Dichlorobenzene	ND	0.30 mg/m ³
16 1,2-Dichloroethane	ND	0.30 mg/m ³	41 1,2-Dichlorobenzene	ND	0.30 mg/m ³
17 1,1,1-Trichloroethane	ND	0.30 mg/m ³			
18 Carbon tetrachloride	ND	0.30 mg/m ³			
19 Benzene	ND	0.15 mg/m ³			
20 Tertiary Amyl Methyl Ether (TAME)	ND	0.30 mg/m ³			
21 1,2-Dichloropropane	ND	0.30 mg/m ³			
22 Trichloroethene	ND	0.30 mg/m ³			
23 Bromodichloromethane	ND	0.30 mg/m ³			
24 cis-1,3-Dichloropropene	ND	0.30 mg/m ³			
25 trans-1,3-Dichloropropene	ND	0.30 mg/m ³			

Note: Concentrations of air in a Tedlar Bag are at 22 degrees Celsius and 25.57 inches of mercury.
This replaces the report signed 8/11/15 due to a change in the analyte list, per client request.
ND = Not Detected



Roger Scholl

Randy Gardner

Roger L. Scholl, Ph.D., Laboratory Director • Randy Gardner, Laboratory Manager
Sacramento, CA • (916) 366-9089 / Las Vegas, NV • (702) 281-4848 / Carson, CA • (714) 386-2901 / info@alpha-analytical.com

Alpha Analytical, Inc. certifies that the test results meet all requirements of NELAC unless footnoted otherwise.

Statement of Data Authenticity: Alpha Analytical, Inc. attests that the data reported has not been altered in any way.



[Signature]
8/18/15

Report Date

Page 1 of 1



Alpha Analytical, Inc.

255 Glendale Ave. • Suite 21 • Sparks, Nevada 89431-5778
(775) 355-1044 • (775) 355-0406 FAX • 1-800-283-1183

ANALYTICAL REPORT

Stratus Environmental
3330 Cameron Park Drive
Cameron Park, CA 956828861
Job: Grit Auto

Attn: Scott Bittinger
Phone: (530) 676-2062
Fax: (530) 676-6005

Alpha Analytical Number: STR15081140-02A
Client I.D. Number: Grim W EFF

Sampled: 08/10/15 07:35
Received: 08/11/15
Extracted: 08/11/15
Analyzed: 08/11/15

Volatile Organics by GC/MS EPA Method 624/8260

Compound	Concentration	Reporting Limit	Compound	Concentration	Reporting Limit
1 Chloromethane	ND	2.0 µg/L	26 1,1,2-Trichloroethane	ND	1.0 µg/L
2 Vinyl chloride	ND	1.0 µg/L	27 Toluene	ND	0.50 µg/L
3 Chloroethane	ND	1.0 µg/L	28 Dibromochloromethane	ND	1.0 µg/L
4 Bromomethane	ND	2.0 µg/L	29 1,2-Dibromoethane (EDB)	ND	2.0 µg/L
5 Trichlorofluoromethane	ND	1.0 µg/L	30 Tetrachloroethene	ND	1.0 µg/L
6 1,1-Dichloroethene	ND	1.0 µg/L	31 Chlorobenzene	ND	1.0 µg/L
7 Tertiary Butyl Alcohol (TBA)	ND	10 µg/L	32 Ethylbenzene	ND	0.50 µg/L
8 Dichloromethane	ND	2.0 µg/L	33 m,p-Xylene	ND	0.50 µg/L
9 trans-1,2-Dichloroethene	ND	1.0 µg/L	34 Bromoform	ND	1.0 µg/L
10 Methyl tert-butyl ether (MTBE)	ND	0.50 µg/L	35 o-Xylene	ND	0.50 µg/L
11 1,1-Dichloroethane	ND	1.0 µg/L	36 1,1,2,2-Tetrachloroethane	ND	1.0 µg/L
12 Di-isopropyl Ether (DIPE)	ND	1.0 µg/L	37 1,3-Dichlorobenzene	ND	1.0 µg/L
13 cis-1,2-Dichloroethene	ND	1.0 µg/L	38 1,4-Dichlorobenzene	ND	1.0 µg/L
14 Chloroform	ND	1.0 µg/L	39 1,2-Dichlorobenzene	ND	1.0 µg/L
15 Ethyl Tertiary Butyl Ether (ETBE)	ND	1.0 µg/L	40 Naphthalene	ND	2.0 µg/L
16 1,2-Dichloroethane	ND	1.0 µg/L			
17 1,1,1-Trichloroethane	ND	1.0 µg/L			
18 Carbon tetrachloride	ND	1.0 µg/L			
19 Benzene	ND	0.50 µg/L			
20 Tertiary Amyl Methyl Ether (TAME)	ND	1.0 µg/L			
21 1,2-Dichloropropane	ND	1.0 µg/L			
22 Trichloroethene	ND	1.0 µg/L			
23 Bromodichloromethane	ND	1.0 µg/L			
24 cis-1,3-Dichloropropene	ND	1.0 µg/L			
25 trans-1,3-Dichloropropene	ND	1.0 µg/L			

ND = Not Detected

Roger Scholl

Randy Gardner

Roger L. Scholl, Ph.D., Laboratory Director • Randy Gardner, Laboratory Manager

Sacramento, CA • (916) 366-9089 / Las Vegas, NV • (702) 281-4848 / Carson, CA • (714) 386-2901 / info@alpha-analytical.com

Alpha Analytical, Inc. certifies that the test results meet all requirements of NELAC unless footnoted otherwise.

Statement of Data Authenticity: Alpha Analytical, Inc. attests that the data reported has not been altered in any way.



8/11/15

Report Date

Page 1 of 1



Alpha Analytical, Inc. currently holds appropriate and available California (#2019) and NELAC (01154CA) certifications for the data reported. Test results relate only to reported samples.



Alpha Analytical, Inc.

255 Glendale Ave. • Suite 21 • Sparks, Nevada 89431-5778
(775) 355-1044 • (775) 355-0406 FAX • 1-800-283-1183

VOC Sample Preservation Report

Work Order: STR15081140

Job: Gritmit Auto

Alpha's Sample ID	Client's Sample ID	Matrix	pH
15081140-02A	Grim W EFF	Aqueous	2

8/11/15
Report Date



Alpha Analytical, Inc.

255 Glendale Ave. • Suite 21 • Sparks, Nevada 89431-5778
(775) 355-1044 • (775) 355-0406 FAX • 1-800-283-1183

Date:
17-Aug-15

QC Summary Report

Work Order:
15081140

Method Blank

File ID: 15081109.D

Type MBLK Test Code: EPA Method SW8015B/C / SW8260B

Batch ID: MS15A0811B

Analysis Date: 08/11/2015 15:29

Sample ID: MBLK MS15A0811B

Units : mg/m³

Run ID: MSD_15_150811A

Prep Date: 08/11/2015 15:29

Analyte	Result	PQL	SpkVal	SpkRefVal	%REC	LCL(ME)	UCL(ME)	RPDRefVal	%RPD(Limit)	Qual
TPH-P (GRO)	ND	10								
Surr: 1,2-Dichloroethane-d4	1.97		2		99	70	130			
Surr: Toluene-d8	2.07		2		104	70	130			
Surr: 4-Bromofluorobenzene	1.8		2		90	70	130			

Laboratory Control Spike

File ID: 15081105.D

Type LCS Test Code: EPA Method SW8015B/C / SW8260B

Batch ID: MS15A0811B

Analysis Date: 08/11/2015 13:43

Sample ID: GLCS MS15A0811B

Units : mg/m³

Run ID: MSD_15_150811A

Prep Date: 08/11/2015 13:43

Analyte	Result	PQL	SpkVal	SpkRefVal	%REC	LCL(ME)	UCL(ME)	RPDRefVal	%RPD(Limit)	Qual
TPH-P (GRO)	389	10	400		97	70	130			
Surr: 1,2-Dichloroethane-d4	9.36		10		94	70	130			
Surr: Toluene-d8	10.4		10		104	70	130			
Surr: 4-Bromofluorobenzene	9.34		10		93	70	130			

Comments:

Calculations are based off of raw (non-rounded) data. However, for reporting purposes, all QC data is rounded to three significant figures. Therefore, hand calculated values may differ slightly.



Alpha Analytical, Inc.

255 Glendale Ave. • Suite 21 • Sparks, Nevada 89431-5778
(775) 355-1044 • (775) 355-0406 FAX • 1-800-283-1183

Date:
17-Aug-15

QC Summary Report

Work Order:
15081140

Method Blank

File ID: 15081104.D

Type MBLK

Test Code: EPA Method SW8015B/C / SW8260B

Batch ID: MS09W0811B

Analysis Date: 08/11/2015 12:21

Sample ID: MBLK MS09W0811B

Units : µg/L

Run ID: MSD_09_150811A

Prep Date: 08/11/2015 12:21

Analyte

Result

PQL

SpkVal

SpkRefVal

%REC

LCL(ME)

UCL(ME)

RPDRefVal

%RPD(Limit)

Qual

TPH-P (GRO)

ND

50

Surr: 1,2-Dichloroethane-d4

11.6

10

116

70

130

Surr: Toluene-d8

10.5

10

105

70

130

Surr: 4-Bromofluorobenzene

10.8

10

108

70

130

Laboratory Control Spike

File ID: 15081106.D

Type LCS

Test Code: EPA Method SW8015B/C / SW8260B

Batch ID: MS09W0811B

Analysis Date: 08/11/2015 13:17

Sample ID: GLCS MS09W0811B

Units : µg/L

Run ID: MSD_09_150811A

Prep Date: 08/11/2015 13:17

Analyte

Result

PQL

SpkVal

SpkRefVal

%REC

LCL(ME)

UCL(ME)

RPDRefVal

%RPD(Limit)

Qual

TPH-P (GRO)

371

50

400

93

70

130

Surr: 1,2-Dichloroethane-d4

11.4

10

114

70

130

Surr: Toluene-d8

9.99

10

99.9

70

130

Surr: 4-Bromofluorobenzene

11.1

10

111

70

130

Sample Matrix Spike

File ID: 15081118.D

Type MS

Test Code: EPA Method SW8015B/C / SW8260B

Batch ID: MS09W0811B

Analysis Date: 08/11/2015 18:41

Sample ID: 15081140-02AGS

Units : µg/L

Run ID: MSD_09_150811A

Prep Date: 08/11/2015 18:41

Analyte

Result

PQL

SpkVal

SpkRefVal

%REC

LCL(ME)

UCL(ME)

RPDRefVal

%RPD(Limit)

Qual

TPH-P (GRO)

1740

250

2000

0

87

54

143

Surr: 1,2-Dichloroethane-d4

42

50

84

70

130

Surr: Toluene-d8

56.4

50

113

70

130

Surr: 4-Bromofluorobenzene

52

50

104

70

130

Sample Matrix Spike Duplicate

File ID: 15081119.D

Type MSD

Test Code: EPA Method SW8015B/C / SW8260B

Batch ID: MS09W0811B

Analysis Date: 08/11/2015 19:06

Sample ID: 15081140-02AGSD

Units : µg/L

Run ID: MSD_09_150811A

Prep Date: 08/11/2015 19:06

Analyte

Result

PQL

SpkVal

SpkRefVal

%REC

LCL(ME)

UCL(ME)

RPDRefVal

%RPD(Limit)

Qual

TPH-P (GRO)

2100

250

2000

0

105

54

143

1742

18.7(23)

Surr: 1,2-Dichloroethane-d4

39.4

50

79

70

130

Surr: Toluene-d8

56.8

50

114

70

130

Surr: 4-Bromofluorobenzene

53.4

50

107

70

130

Comments:

Calculations are based off of raw (non-rounded) data. However, for reporting purposes, all QC data is rounded to three significant figures. Therefore, hand calculated values may differ slightly.

Reported in micrograms per Liter, per client request.



Alpha Analytical, Inc.

255 Glendale Ave. • Suite 21 • Sparks, Nevada 89431-5778
(775) 355-1044 • (775) 355-0406 FAX • 1-800-283-1183

Date:
17-Aug-15

QC Summary Report

Work Order:
15081140

Method Blank

File ID: 15081109.D

Type MBLK Test Code: EPA Method SW8260B

Batch ID: MS15A0811A

Analysis Date: 08/11/2015 15:29

Sample ID: MBLK MS15A0811A

Units : mg/m³

Run ID: MSD_15_150811A

Prep Date: 08/11/2015 15:29

Analyte	Result	PQL	SpkVal	SpkRefVal	%REC	LCL(ME)	UCL(ME)	RPDRefVal	%RPD(Limit)	Qual
Chloromethane	ND	0.4								
Vinyl chloride	ND	0.2								
Chloroethane	ND	0.2								
Bromomethane	ND	0.4								
Trichlorofluoromethane	ND	0.2								
1,1-Dichloroethene	ND	0.2								
Tertiary Butyl Alcohol (TBA)	ND	5								
Dichloromethane	ND	0.4								
trans-1,2-Dichloroethene	ND	0.2								
Methyl tert-butyl ether (MTBE)	ND	0.1								
1,1-Dichloroethane	ND	0.2								
Di-isopropyl Ether (DIPE)	ND	0.2								
cis-1,2-Dichloroethene	ND	0.2								
Chloroform	ND	0.2								
Ethyl Tertiary Butyl Ether (ETBE)	ND	0.2								
1,2-Dichloroethane	ND	0.2								
1,1,1-Trichloroethane	ND	0.2								
Carbon tetrachloride	ND	0.2								
Benzene	ND	0.1								
Tertiary Amyl Methyl Ether (TAME)	ND	0.2								
1,2-Dichloropropane	ND	0.2								
Trichloroethene	ND	0.2								
Bromodichloromethane	ND	0.2								
cis-1,3-Dichloropropene	ND	0.2								
trans-1,3-Dichloropropene	ND	0.2								
1,1,2-Trichloroethane	ND	0.2								
Toluene	ND	0.1								
Dibromochloromethane	ND	0.2								
1,2-Dibromoethane (EDB)	ND	0.4								
Tetrachloroethene	ND	0.2								
Chlorobenzene	ND	0.2								
Ethylbenzene	ND	0.1								
m,p-Xylene	ND	0.1								
Bromoform	ND	0.2								
o-Xylene	ND	0.1								
1,1,2,2-Tetrachloroethane	ND	0.2								
n-Propylbenzene	ND	0.2								
1,2,4-Trimethylbenzene	ND	0.2								
1,3-Dichlorobenzene	ND	0.2								
1,4-Dichlorobenzene	ND	0.2								
1,2-Dichlorobenzene	ND	0.2								
Surr: 1,2-Dichloroethane-d4	1.97		2		99	70	130			
Surr: Toluene-d8	2.07		2		104	70	130			
Surr: 4-Bromofluorobenzene	1.8		2		90	70	130			

Laboratory Control Spike

File ID: 15081103.D

Type LCS Test Code: EPA Method SW8260B

Batch ID: MS15A0811A

Analysis Date: 08/11/2015 12:43

Sample ID: LCS MS15A0811A

Units : mg/m³

Run ID: MSD_15_150811A

Prep Date: 08/11/2015 12:43

Analyte	Result	PQL	SpkVal	SpkRefVal	%REC	LCL(ME)	UCL(ME)	RPDRefVal	%RPD(Limit)	Qual
1,1-Dichloroethene	8.7	0.2	10		87	70	130			
Methyl tert-butyl ether (MTBE)	9.2	0.1	10		92	63	137			
Benzene	8.73	0.1	10		87	70	130			
Trichloroethene	9.44	0.2	10		94	68	138			
Toluene	9.43	0.1	10		94	70	130			
Chlorobenzene	10.3	0.2	10		103	70	130			
Ethylbenzene	8.82	0.1	10		88	70	130			
m,p-Xylene	9.64	0.1	10		96	65	139			
o-Xylene	9.61	0.1	10		96	70	130			
Surr: 1,2-Dichloroethane-d4	10.1		10		101	70	130			
Surr: Toluene-d8	10		10		100	70	130			
Surr: 4-Bromofluorobenzene	8.81		10		88	70	130			



Alpha Analytical, Inc.

255 Glendale Ave. • Suite 21 • Sparks, Nevada 89431-5778
(775) 355-1044 • (775) 355-0406 FAX • 1-800-283-1183

Date:
17-Aug-15

QC Summary Report

Work Order:
15081140

Comments:

Calculations are based off of raw (non-rounded) data. However, for reporting purposes, all QC data is rounded to three significant figures. Therefore, hand calculated values may differ slightly.



Alpha Analytical, Inc.

255 Glendale Ave. • Suite 21 • Sparks, Nevada 89431-5778
(775) 355-1044 • (775) 355-0406 FAX • 1-800-283-1183

Date:
17-Aug-15

QC Summary Report

Work Order:
15081140

Method Blank

Type MBLK Test Code: EPA Method 624/8260

File ID: 15081104.D

Batch ID: MS09W0811A

Analysis Date: 08/11/2015 12:21

Sample ID: MBLK MS09W0811A

Units: µg/L

Run ID: MSD_09_150811A

Prep Date: 08/11/2015 12:21

Analyte	Result	PQL	SpkVal	SpkRefVal	%REC	LCL(ME)	UCL(ME)	RPDRefVal	%RPD(Limit)	Qual
Chloromethane	ND	2								
Vinyl chloride	ND	1								
Chloroethane	ND	1								
Bromomethane	ND	2								
Trichlorofluoromethane	ND	1								
1,1-Dichloroethene	ND	1								
Tertiary Butyl Alcohol (TBA)	ND	10								
Dichloromethane	ND	2								
trans-1,2-Dichloroethene	ND	1								
Methyl tert-butyl ether (MTBE)	ND	0.5								
1,1-Dichloroethane	ND	1								
Di-isopropyl Ether (DIPE)	ND	1								
cis-1,2-Dichloroethene	ND	1								
Chloroform	ND	1								
Ethyl Tertiary Butyl Ether (ETBE)	ND	1								
1,2-Dichloroethane	ND	1								
1,1,1-Trichloroethane	ND	1								
Carbon tetrachloride	ND	1								
Benzene	ND	0.5								
Tertiary Amyl Methyl Ether (TAME)	ND	1								
1,2-Dichloropropane	ND	1								
Trichloroethene	ND	1								
Bromodichloromethane	ND	1								
cis-1,3-Dichloropropene	ND	1								
trans-1,3-Dichloropropene	ND	1								
1,1,2-Trichloroethane	ND	1								
Toluene	ND	0.5								
Dibromochloromethane	ND	1								
1,2-Dibromoethane (EDB)	ND	2								
Tetrachloroethene	ND	1								
Chlorobenzene	ND	1								
Ethylbenzene	ND	0.5								
m,p-Xylene	ND	0.5								
Bromoform	ND	1								
o-Xylene	ND	0.5								
1,1,2,2-Tetrachloroethane	ND	1								
1,3-Dichlorobenzene	ND	1								
1,4-Dichlorobenzene	ND	1								
1,2-Dichlorobenzene	ND	1								
Naphthalene	ND	2								
Surr: 1,2-Dichloroethane-d4	11.6		10		116	70	130			
Surr: Toluene-d8	10.5		10		105	70	130			
Surr: 4-Bromofluorobenzene	10.8		10		108	70	130			

Laboratory Control Spike

Type LCS Test Code: EPA Method 624/8260

File ID: 15081105.D

Batch ID: MS09W0811A

Analysis Date: 08/11/2015 12:52

Sample ID: LCS MS09W0811A

Units: µg/L

Run ID: MSD_09_150811A

Prep Date: 08/11/2015 12:52

Analyte	Result	PQL	SpkVal	SpkRefVal	%REC	LCL(ME)	UCL(ME)	RPDRefVal	%RPD(Limit)	Qual
1,1-Dichloroethene	8.82	1	10		88	70	130			
Methyl tert-butyl ether (MTBE)	8.22	0.5	10		82	63	137			
Benzene	9.24	0.5	10		92	70	130			
Trichloroethene	8.5	1	10		85	68	138			
Toluene	9.38	0.5	10		94	70	130			
Chlorobenzene	9.15	1	10		92	70	130			
Ethylbenzene	8.8	0.5	10		88	70	130			
m,p-Xylene	8.35	0.5	10		84	65	139			
o-Xylene	8.93	0.5	10		89	70	130			
Surr: 1,2-Dichloroethane-d4	11.2		10		112	70	130			
Surr: Toluene-d8	9.88		10		99	70	130			
Surr: 4-Bromofluorobenzene	11.2		10		112	70	130			



Alpha Analytical, Inc.

255 Glendale Ave. • Suite 21 • Sparks, Nevada 89431-5778
(775) 355-1044 • (775) 355-0406 FAX • 1-800-283-1183

Date:
17-Aug-15

QC Summary Report

Work Order:
15081140

Sample Matrix Spike		Type	Test Code: EPA Method 624/8260								
File ID: 15081211.D		MS	Batch ID: MS09W0811A								
Sample ID: 15081140-02AMS		Units : µg/L	Run ID: MSD_09_150811A				Analysis Date: 08/12/2015 15:38				
Analyte		Result	PQL	SpkVal	SpkRefVal	%REC	LCL(ME)	UCL(ME)	RPDRefVal	%RPD(Limit)	Qual
1,1-Dichloroethene		43.9	2.5	50	0	88	62	133			
Methyl tert-butyl ether (MTBE)		39.1	1.3	50	0	78	56	140			
Benzene		44.9	1.3	50	0	90	67	134			
Trichloroethene		42.8	2.5	50	0	86	68	138			
Toluene		43.3	1.3	50	0	87	38	130			
Chlorobenzene		46.3	2.5	50	0	93	70	130			
Ethylbenzene		43.1	1.3	50	0	86	70	130			
m,p-Xylene		41.6	1.3	50	0	83	65	139			
o-Xylene		45	1.3	50	0	90	69	130			
Surr: 1,2-Dichloroethane-d4		36.6		50		73	70	130			
Surr: Toluene-d8		56.6		50		113	70	130			
Surr: 4-Bromofluorobenzene		52.3		50		105	70	130			

Sample Matrix Spike Duplicate		Type	Test Code: EPA Method 624/8260								
File ID: 15081117.D		MSD	Batch ID: MS09W0811A								
Sample ID: 15081140-02AMSD		Units : µg/L	Run ID: MSD_09_150811A				Analysis Date: 08/11/2015 18:16				
Analyte		Result	PQL	SpkVal	SpkRefVal	%REC	LCL(ME)	UCL(ME)	RPDRefVal	%RPD(Limit)	Qual
1,1-Dichloroethene		50.5	2.5	50	0	101	62	133	43.92	13.9(35)	
Methyl tert-butyl ether (MTBE)		54.3	1.3	50	0	109	56	140	39.13	32.5(40)	
Benzene		54.2	1.3	50	0	108	67	134	44.9	18.8(21)	
Trichloroethene		48.2	2.5	50	0	96	68	138	42.79	11.9(20)	
Toluene		52.6	1.3	50	0	105	38	130	43.3	19.4(20)	
Chlorobenzene		54.4	2.5	50	0	109	70	130	46.33	16.1(20)	
Ethylbenzene		49.6	1.3	50	0	99	70	130	43.05	14.2(20)	
m,p-Xylene		47	1.3	50	0	94	65	139	41.64	12.1(20)	
o-Xylene		52.2	1.3	50	0	104	69	130	45.01	14.7(20)	
Surr: 1,2-Dichloroethane-d4		41.2		50		82	70	130			
Surr: Toluene-d8		55.2		50		110	70	130			
Surr: 4-Bromofluorobenzene		51.9		50		104	70	130			

Comments:

Calculations are based off of raw (non-rounded) data. However, for reporting purposes, all QC data is rounded to three significant figures. Therefore, hand calculated values may differ slightly.

Billing Information :

CHAIN-OF-CUSTODY RECORD

AMENDED
CA RUSH

Alpha Analytical, Inc.
255 Glendale Avenue, Suite 21 Sparks, Nevada 89431-5778
TEL: (775) 355-1044 FAX: (775) 355-0406

WorkOrder : STR15081140
Report Due By : 5:00 PM On : 11-Aug-15

Client:
Stratus Environmental
3330 Cameron Park Drive
Suite 550
Cameron Park, CA 95682-8861

Report Attention	Phone Number	EEmail Address
Scott Bittinger	(530) 676-2062 x	sbittinger@stratusinc.net

EDD Required : Yes

Sampled by : C. Hill

PO :
Client's COC # : 04322 Job : Gritmit Auto

Cooler Temp	Samples Received	Date Printed
0 °C	11-Aug-15	14-Aug-15

QC Level : S3 = Final Rpt, MBLK, LCS, MS/MSD With Surrogates

Alpha Sample ID	Client Sample ID	Collection Matrix	Collection Date	No. of Bottles			Requested Tests						Sample Remarks			
				Alpha	Sub	TAT	TPHP_A	TPHP_W	VOC_A	VOC_W						
STR15081140-01A	Grim A EFF	AR	08/10/15 08:00	1	0	0	GAS-N/C		8260/OXYS/ EDB_S							Tedlar.
STR15081140-02A	Grim W EFF	AQ	08/10/15 07:35	6	0	0		GAS-C		8260/OXYS/ EDB/Naph_C						

Comments: ASAP TAT. Security seals intact. Frozen ice. Chain split due to different TATs. Amended on 8/14/15 to add n-Propylbenzene and 1,2,4-Trimethylbenzene to sample -01A per Debra. JA :

Signature	Print Name	Company	Date/Time
	JESSICA ALVARADO	Alpha Analytical, Inc.	8/14/15 045

NOTE: Samples are discarded 60 days after results are reported unless other arrangements are made. Hazardous samples will be returned to client or disposed of at client expense. The report for the analysis of the above samples is applicable only to those samples received by the laboratory with this COC. The liability of the laboratory is limited to the amount paid for the report. Matrix Type : AQ(Aqueous) AR(Air) SO(Soil) WS(Waste) DW(Drinking Water) OT(Other) Bottle Type: L-Liter V-Voa S-Soil Jar O-Orbo T-Tedlar B-Brass P-Plastic OT-Other

BUSH CA

Billing Information :

CHAIN-OF-CUSTODY RECORD

Alpha Analytical, Inc.
 255 Glendale Avenue, Suite 21 Sparks, Nevada 89431-5778
 TEL: (775) 355-1044 FAX: (775) 355-0406

WorkOrder : STR15081140
Report Due By : 5:00 PM On : 11-Aug-15

Client:
 Stratus Environmental
 3330 Cameron Park Drive
 Suite 550
 Cameron Park, CA 95682-8861

Report Attention	Phone Number	EEmail Address
Scott Bittinger	(530) 676-2062 x	sbittinger@stratusinc.net

EDD Required : Yes

Sampled by : C. Hill

PO :
 Client's COC # : 04322 Job : Grimit Auto

Cooler Temp	Samples Received	Date Printed
0 °C	11-Aug-15	11-Aug-15

QC Level : S3 = Final Rpt, MBLK, LCS, MS/MSD With Surrogates

Alpha Sample ID	Client Sample ID	Collection Matrix	No. of Bottles Alpha Sub TAT	Requested Tests						Sample Remarks	
				TPHP_A	TPHP_W	VOC_A	VOC_W				
STR15081140-01A	Grim A EFF	AR 08/10/15 08:00	1 0 0	GAS-N/C		8260/OXYS/EDB_S					Tedlar.
STR15081140-02A	Grim W EFF	AQ 08/10/15 07:35	6 0 0		GAS-C	8260/OXYS/EDB/Naph_C					

Comments: ASAP TAT. Security seals intact. Frozen ice. Chain split due to different TATs. :

Signature	Print Name	Company	Date/Time
	JESSICA ALVARADO	Alpha Analytical, Inc.	8/11/15 0950

NOTE: Samples are discarded 60 days after results are reported unless other arrangements are made. Hazardous samples will be returned to client or disposed of at client expense. The report for the analysis of the above samples is applicable only to those samples received by the laboratory with this COC. The liability of the laboratory is limited to the amount paid for the report.

Matrix Type : AQ(Aqueous) AR(Air) SO(Soil) WS(Waste) DW(Drinking Water) OT(Other) Bottle Type: L-Liter V-Voa S-Soil Jar O-Orbo T-Tedlar B-Brass P-Plastic OT-Other

Billing Information:
 Company: Starkes
 Attn: Dobby
 Address: 3320 Cinnamon Pl
Cummin Pl
 City, State, Zip: _____
 Phone Number: _____ Fax: _____



Alpha Analytical, Inc.
 Main Laboratory: 255 Glendale Ave, Suite 21 Sparks, NV 89431
 Satellite Service Centers:
 Northern CA: 9891 Horn Road, Suite C, Rancho Cordova, CA 95827
 Southern CA: 1007 E. Dominguez St., Suite O, Carson, CA 90746
 Northern NV: 1250 Lamoille Hwy., #310, Elko, NV 89801
 Southern NV: 6255 McLeod Ave, Suite 24, Las Vegas, NV 89120

Phone: 775-355-1044
 Fax: 775-355-0406
 Phone: 916-366-9089
 Phone: 714-386-2901
 Phone: 775-388-7043
 Phone: 702-281-4848

04322

Page # 1 of 1

Company: Starkes Job # _____ Name: SLD II
 Address: _____ Job Name: GRIMM AUTO Email Address: _____
 City, State, Zip: _____ P.O. #: _____ Phone #: _____
 Samples Collected from which State? (circle one) AR CA KS NV OR WA DOD Site Other
 Data Validation Packages: III or IV

Time Sampled (HHMM)	Date Sampled (MM/DD)	Matrix* (See Key Below)	Lab ID Number (For Lab Use Only)	Sample Description	TAT	# Containers* (See Key Below)	Field Filtered?		Analysis Requested							Remarks	
							Yes	No	GRO	BTEX	MYBE	1,2 DCM	Naphthalene	PCB	VOCS		TEL
1015	8/10			Grim A Sys Int STD	24	1	X		X	X	X			X	X	X	
0800			STR15081040-01	Grim A EPI	24	1	X		X	X	X			X	X	X	
1025	8/10			Grim W Int STD	24	6	X	X	X	X	X	X	X	X	X	X	
0740				Grim W BAEI STD	24	6	X	X	X	X	X	X	X	X	X	X	
0733			STR15081140-D2A	Grim W EPI	24	6	X	X	X	X	X	X	X	X	X	X	

ADDITIONAL INSTRUCTIONS:

I (field sampler) attest to the validity and authenticity of this sample(s). I am aware that tampering with or intentionally mislabeling the sample location, date or time of collection is considered fraud and may be grounds for legal action. NAC 445.0636 (c) (2).

Sampled By: <u>[Signature]</u>	Date: <u>8/10/15</u>	Time: <u>1321</u>	Received by: (Signature/Affiliation): <u>Meyssa + [Signature]</u>	Date: <u>8-10-15</u>	Time: <u>1321</u>
Relinquished by: (Signature/Affiliation): <u>[Signature]</u>	Date: _____	Time: _____	Received by: (Signature/Affiliation): <u>[Signature]</u>	Date: <u>8/11/15</u>	Time: <u>940</u>
Relinquished by: (Signature/Affiliation): _____	Date: _____	Time: _____	Received by: (Signature/Affiliation): _____	Date: _____	Time: _____

* Key: AQ - Aqueous OT - Other So-Soil WA - Waste ** B - Brass L - Liter O - Orbo OT - Other P - Plastic S-Soil Jar T - Tedlar V - VOA

NOTE: Samples are discarded 60 days after sample receipt unless other arrangements are made. Hazardous samples will be returned to client or disposed of at client expense. The report for the analysis of the above samples is applicable only to those samples received by the laboratory with this COC. The liability of the laboratory is limited to the amount paid for the report.



Alpha Analytical, Inc.

255 Glendale Ave. • Suite 21 • Sparks, Nevada 89431-5778
(775) 355-1044 • (775) 355-0406 FAX • 1-800-283-1183

ANALYTICAL REPORT

Stratus Environmental
3330 Cameron Park Drive
Cameron Park, CA 956828861

Attn: Scott Bittinger
Phone: (530) 676-2062
Fax: (530) 676-6005
Date Received : 09/02/15

Job: Grit Auto

Total Petroleum Hydrocarbons - Purgeable (TPH-P) EPA Method SW8015B / SW8260B

Parameter	Concentration	Reporting Limit	Date Extracted	Date Analyzed	
Client ID : Grim W INF Lab ID : STR15090250-01A Date Sampled 09/01/15 06:36	TPH-P (GRO)	ND	50 µg/L	09/04/15	09/04/15
Client ID : Grim W GAC1 Lab ID : STR15090250-02A Date Sampled 09/01/15 06:33	TPH-P (GRO)	ND	50 µg/L	09/04/15	09/04/15
Client ID : Grim A SYS INF Lab ID : STR15090250-03A Date Sampled 09/01/15 06:51	TPH-P (GRO)	65	20 mg/m ³	09/02/15 16:05	09/08/15

Gasoline Range Organics (GRO) C4-C13

Note: For sample -03A concentrations of air in a Tedlar Bag are at 28 degrees Celsius and 25.47 inches of mercury.

ND = Not Detected

Reported in micrograms per Liter, per client request.



Roger Scholl

Randy Gardner

Roger L. Scholl, Ph.D., Laboratory Director • Randy Gardner, Laboratory Manager

Sacramento, CA • (916) 366-9089 / Las Vegas, NV • (702) 281-4848 / Carson, CA • (714) 386-2901 / info@alpha-analytical.com

Alpha Analytical, Inc. certifies that the test results meet all requirements of NELAC unless footnoted otherwise.

Statement of Data Authenticity : Alpha Analytical, Inc. attests that the data reported has not been altered in any way.

Alpha Analytical, Inc. currently holds appropriate and available California (#2019) and NELAC (01154CA) certifications for the data reported. Test results relate only to reported samples.



RS

9/10/15

Report Date



Alpha Analytical, Inc.

255 Glendale Ave. • Suite 21 • Sparks, Nevada 89431-5778
(775) 355-1044 • (775) 355-0406 FAX • 1-800-283-1183

ANALYTICAL REPORT

Stratus Environmental
3330 Cameron Park Drive
Cameron Park, CA 956828861
Job: Grit Auto

Attn: Scott Bittinger
Phone: (530) 676-2062
Fax: (530) 676-6005

Alpha Analytical Number: STR15090250-01A
Client I.D. Number: Grim W INF

Sampled: 09/01/15 06:36
Received: 09/02/15
Extracted: 09/04/15
Analyzed: 09/04/15

Volatile Organics by GC/MS EPA Method 624/8260

Compound	Concentration	Reporting Limit	Compound	Concentration	Reporting Limit
1 Chloromethane	ND	2.0 µg/L	26 1,1,2-Trichloroethane	ND	1.0 µg/L
2 Vinyl chloride	ND	1.0 µg/L	27 Toluene	ND	0.50 µg/L
3 Chloroethane	ND	1.0 µg/L	28 Dibromochloromethane	ND	1.0 µg/L
4 Bromomethane	ND	2.0 µg/L	29 1,2-Dibromoethane (EDB)	ND	2.0 µg/L
5 Trichlorofluoromethane	ND	1.0 µg/L	30 Tetrachloroethene	ND	1.0 µg/L
6 1,1-Dichloroethene	ND	1.0 µg/L	31 Chlorobenzene	ND	1.0 µg/L
7 Tertiary Butyl Alcohol (TBA)	ND	10 µg/L	32 Ethylbenzene	ND	0.50 µg/L
8 Dichloromethane	ND	2.0 µg/L	33 m,p-Xylene	1.3	0.50 µg/L
9 trans-1,2-Dichloroethene	ND	1.0 µg/L	34 Bromoform	ND	1.0 µg/L
10 Methyl tert-butyl ether (MTBE)	ND	0.50 µg/L	35 o-Xylene	0.51	0.50 µg/L
11 1,1-Dichloroethane	ND	1.0 µg/L	36 1,1,2,2-Tetrachloroethane	ND	1.0 µg/L
12 Di-isopropyl Ether (DIPE)	ND	1.0 µg/L	37 1,3-Dichlorobenzene	ND	1.0 µg/L
13 cis-1,2-Dichloroethene	ND	1.0 µg/L	38 1,4-Dichlorobenzene	ND	1.0 µg/L
14 Chloroform	ND	1.0 µg/L	39 1,2-Dichlorobenzene	ND	1.0 µg/L
15 Ethyl Tertiary Butyl Ether (ETBE)	ND	1.0 µg/L	40 Naphthalene	ND	2.0 µg/L
16 1,2-Dichloroethane	ND	1.0 µg/L			
17 1,1,1-Trichloroethane	ND	1.0 µg/L			
18 Carbon tetrachloride	ND	1.0 µg/L			
19 Benzene	ND	0.50 µg/L			
20 Tertiary Amyl Methyl Ether (TAME)	ND	1.0 µg/L			
21 1,2-Dichloropropane	ND	1.0 µg/L			
22 Trichloroethene	ND	1.0 µg/L			
23 Bromodichloromethane	ND	1.0 µg/L			
24 cis-1,3-Dichloropropene	ND	1.0 µg/L			
25 trans-1,3-Dichloropropene	ND	1.0 µg/L			

ND = Not Detected



Roger Scholl

Randy Gardner

Roger L. Scholl, Ph.D., Laboratory Director • Randy Gardner, Laboratory Manager
Sacramento, CA • (916) 366-9089 / Las Vegas, NV • (702) 281-4848 / Carson, CA • (714) 386-2901 / info@alpha-analytical.com

Alpha Analytical, Inc. certifies that the test results meet all requirements of NELAC unless footnoted otherwise.

Statement of Data Authenticity: Alpha Analytical, Inc. attests that the data reported has not been altered in any way.

Alpha Analytical, Inc. currently holds appropriate and available California (#2019) and NELAC (01154CA) certifications for the data reported. Test results relate only to reported samples.



[Signature]

9/10/15

Report Date

Page 1 of 1



Alpha Analytical, Inc.

255 Glendale Ave. • Suite 21 • Sparks, Nevada 89431-5778
(775) 355-1044 • (775) 355-0406 FAX • 1-800-283-1183

ANALYTICAL REPORT

Stratus Environmental
3330 Cameron Park Drive
Cameron Park, CA 956828861
Job: Grit Auto

Attn: Scott Bittinger
Phone: (530) 676-2062
Fax: (530) 676-6005

Alpha Analytical Number: STR15090250-02A
Client I.D. Number: Grim W GAC1

Sampled: 09/01/15 06:33
Received: 09/02/15
Extracted: 09/04/15
Analyzed: 09/04/15

Volatile Organics by GC/MS EPA Method 624/8260

Compound	Concentration	Reporting Limit	Compound	Concentration	Reporting Limit
1 Chloromethane	ND	2.0 µg/L	26 1,1,2-Trichloroethane	ND	1.0 µg/L
2 Vinyl chloride	ND	1.0 µg/L	27 Toluene	ND	0.50 µg/L
3 Chloroethane	ND	1.0 µg/L	28 Dibromochloromethane	ND	1.0 µg/L
4 Bromomethane	ND	2.0 µg/L	29 1,2-Dibromoethane (EDB)	ND	2.0 µg/L
5 Trichlorofluoromethane	ND	1.0 µg/L	30 Tetrachloroethane	ND	1.0 µg/L
6 1,1-Dichloroethene	ND	1.0 µg/L	31 Chlorobenzene	ND	1.0 µg/L
7 Tertiary Butyl Alcohol (TBA)	ND	10 µg/L	32 Ethylbenzene	ND	0.50 µg/L
8 Dichloromethane	ND	2.0 µg/L	33 m,p-Xylene	ND	0.50 µg/L
9 trans-1,2-Dichloroethene	ND	1.0 µg/L	34 Bromoform	ND	1.0 µg/L
10 Methyl tert-butyl ether (MTBE)	ND	0.50 µg/L	35 o-Xylene	ND	0.50 µg/L
11 1,1-Dichloroethane	ND	1.0 µg/L	36 1,1,2,2-Tetrachloroethane	ND	1.0 µg/L
12 Di-isopropyl Ether (DIPE)	ND	1.0 µg/L	37 1,3-Dichlorobenzene	ND	1.0 µg/L
13 cis-1,2-Dichloroethene	ND	1.0 µg/L	38 1,4-Dichlorobenzene	ND	1.0 µg/L
14 Chloroform	ND	1.0 µg/L	39 1,2-Dichlorobenzene	ND	1.0 µg/L
15 Ethyl Tertiary Butyl Ether (ETBE)	ND	1.0 µg/L	40 Naphthalene	ND	2.0 µg/L
16 1,2-Dichloroethane	ND	1.0 µg/L			
17 1,1,1-Trichloroethane	ND	1.0 µg/L			
18 Carbon tetrachloride	ND	1.0 µg/L			
19 Benzene	ND	0.50 µg/L			
20 Tertiary Amyl Methyl Ether (TAME)	ND	1.0 µg/L			
21 1,2-Dichloropropane	ND	1.0 µg/L			
22 Trichloroethene	ND	1.0 µg/L			
23 Bromodichloromethane	ND	1.0 µg/L			
24 cis-1,3-Dichloropropene	ND	1.0 µg/L			
25 trans-1,3-Dichloropropene	ND	1.0 µg/L			

ND = Not Detected



Roger Scholl

Randy Gardner

Roger L. Scholl, Ph.D., Laboratory Director • Randy Gardner, Laboratory Manager
Sacramento, CA • (916) 366-9089 / Las Vegas, NV • (702) 281-4848 / Carson, CA • (714) 386-2901 / info@alpha-analytical.com

Alpha Analytical, Inc. certifies that the test results meet all requirements of NELAC unless footnoted otherwise.

Statement of Data Authenticity: Alpha Analytical, Inc. attests that the data reported has not been altered in any way.



JS
9/10/15

Report Date

Page 1 of 1

Alpha Analytical, Inc. currently holds appropriate and available California (#2019) and NELAC (01154CA) certifications for the data reported. Test results relate only to reported samples.



Alpha Analytical, Inc.

255 Glendale Ave. • Suite 21 • Sparks, Nevada 89431-5778
(775) 355-1044 • (775) 355-0406 FAX • 1-800-283-1183

ANALYTICAL REPORT

Stratus Environmental
3330 Cameron Park Drive
Cameron Park, CA 956828861
Job: Grit Auto

Attn: Scott Bittinger
Phone: (530) 676-2062
Fax: (530) 676-6005

Alpha Analytical Number: STR15090250-03A
Client I.D. Number: Grim A SYS INF

Sampled: 09/01/15 06:51
Received: 09/02/15
Extracted: 09/02/15 16:05
Analyzed: 09/08/15

Volatile Organics by GC/MS EPA Method SW8260B

Compound	Concentration	Reporting Limit	Compound	Concentration	Reporting Limit
1 Chloromethane	ND	0.80 mg/m ³	26 Toluene	ND	0.20 mg/m ³
2 Vinyl chloride	ND	0.40 mg/m ³	27 Dibromochloromethane	ND	0.40 mg/m ³
3 Chloroethane	ND	0.40 mg/m ³	28 1,2-Dibromoethane (EDB)	ND	0.80 mg/m ³
4 Bromomethane	ND	0.80 mg/m ³	29 Tetrachloroethene	ND	0.40 mg/m ³
5 Trichlorofluoromethane	ND	0.40 mg/m ³	30 Chlorobenzene	ND	0.40 mg/m ³
6 1,1-Dichloroethene	ND	0.40 mg/m ³	31 Ethylbenzene	ND	0.20 mg/m ³
7 Tertiary Butyl Alcohol (TBA)	ND	10 mg/m ³	32 m,p-Xylene	0.33	0.20 mg/m ³
8 Dichloromethane	ND	0.80 mg/m ³	33 Bromoform	ND	0.40 mg/m ³
9 trans-1,2-Dichloroethene	ND	0.40 mg/m ³	34 o-Xylene	ND	0.20 mg/m ³
10 Methyl tert-butyl ether (MTBE)	ND	0.20 mg/m ³	35 1,1,2,2-Tetrachloroethane	ND	0.40 mg/m ³
11 1,1-Dichloroethane	ND	0.40 mg/m ³	36 n-Propylbenzene	ND	0.40 mg/m ³
12 Di-isopropyl Ether (DIPE)	ND	0.40 mg/m ³	37 1,2,4-Trimethylbenzene	ND	0.40 mg/m ³
13 cis-1,2-Dichloroethene	ND	0.40 mg/m ³	38 1,3-Dichlorobenzene	ND	0.40 mg/m ³
14 Chloroform	ND	0.40 mg/m ³	39 1,4-Dichlorobenzene	ND	0.40 mg/m ³
15 Ethyl Tertiary Butyl Ether (ETBE)	ND	0.40 mg/m ³	40 1,2-Dichlorobenzene	ND	0.40 mg/m ³
16 1,1,1-Trichloroethane	ND	0.40 mg/m ³			
17 Carbon tetrachloride	ND	0.40 mg/m ³			
18 Benzene	ND	0.20 mg/m ³			
19 Tertiary Amyl Methyl Ether (TAME)	ND	0.40 mg/m ³			
20 1,2-Dichloropropane	ND	0.40 mg/m ³			
21 Trichloroethene	ND	0.40 mg/m ³			
22 Bromodichloromethane	ND	0.40 mg/m ³			
23 cis-1,3-Dichloropropene	ND	0.40 mg/m ³			
24 trans-1,3-Dichloropropene	ND	0.40 mg/m ³			
25 1,1,2-Trichloroethane	ND	0.40 mg/m ³			

Note: Concentrations of air in a Tedlar Bag are at 28 degrees Celsius and 25.47 inches of mercury.

ND = Not Detected



Roger Scholl

Randy Gardner

Roger L. Scholl, Ph.D., Laboratory Director • Randy Gardner, Laboratory Manager

Sacramento, CA • (916) 366-9089 / Las Vegas, NV • (702) 281-4848 / Carson, CA • (714) 386-2901 / info@alpha-analytical.com

Alpha Analytical, Inc. certifies that the test results meet all requirements of NELAC unless footnoted otherwise.

Statement of Data Authenticity: Alpha Analytical, Inc. attests that the data reported has not been altered in any way.



PS

9/10/15

Report Date

Page 1 of 1

Alpha Analytical, Inc. currently holds appropriate and available California (#2019) and NELAC (01154CA) certifications for the data reported. Test results relate only to reported samples.



Alpha Analytical, Inc.

255 Glendale Ave. • Suite 21 • Sparks, Nevada 89431-5778
(775) 355-1044 • (775) 355-0406 FAX • 1-800-283-1183

VOC Sample Preservation Report

Work Order: STR15090250

Job: Grimit Auto

Alpha's Sample ID	Client's Sample ID	Matrix	pH
15090250-01A	Grim W INF	Aqueous	2
15090250-02A	Grim W GAC1	Aqueous	2

9/10/15
Report Date



Alpha Analytical, Inc.

255 Glendale Ave. • Suite 21 • Sparks, Nevada 89431-5778
(775) 355-1044 • (775) 355-0406 FAX • 1-800-283-1183

Date:
09-Sep-15

QC Summary Report

Work Order:
15090250

Method Blank

Type MBLK Test Code: EPA Method SW8015B/C / SW8260B

File ID: 15090805.D

Batch ID: MS08A0908B

Analysis Date: 09/08/2015 12:42

Sample ID: MBLK MS08A0908B

Units: mg/m³

Run ID: MSD_08_150908A

Prep Date: 09/08/2015 12:42

Analyte	Result	PQL	SpkVal	SpkRefVal	%REC	LCL(ME)	UCL(ME)	RPDRefVal	%RPD(Limit)	Qual
TPH-P (GRO)	ND	10								
Surr: 1,2-Dichloroethane-d4	1.94		2		97	70	130			
Surr: Toluene-d8	2.24		2		112	70	130			
Surr: 4-Bromofluorobenzene	1.63		2		82	70	130			

Laboratory Control Spike

Type LCS Test Code: EPA Method SW8015B/C / SW8260B

File ID: 15090803.D

Batch ID: MS08A0908B

Analysis Date: 09/08/2015 11:40

Sample ID: GLCS MS08A0908B

Units: mg/m³

Run ID: MSD_08_150908A

Prep Date: 09/08/2015 11:40

Analyte	Result	PQL	SpkVal	SpkRefVal	%REC	LCL(ME)	UCL(ME)	RPDRefVal	%RPD(Limit)	Qual
TPH-P (GRO)	454	10	400		114	70	130			
Surr: 1,2-Dichloroethane-d4	9.7		10		97	70	130			
Surr: Toluene-d8	9.29		10		93	70	130			
Surr: 4-Bromofluorobenzene	10.6		10		106	70	130			

Comments:

Calculations are based off of raw (non-rounded) data. However, for reporting purposes, all QC data is rounded to three significant figures. Therefore, hand calculated values may differ slightly.



Alpha Analytical, Inc.

255 Glendale Ave. • Suite 21 • Sparks, Nevada 89431-5778
(775) 355-1044 • (775) 355-0406 FAX • 1-800-283-1183

Date:
09-Sep-15

QC Summary Report

Work Order:
15090250

Method Blank

File ID: 15090404.D

Type MBLK

Test Code: EPA Method SW8015B/C / SW8260B

Batch ID: MS08W0904B

Analysis Date: 09/04/2015 11:46

Sample ID: MBLK MS08W0904B

Units: µg/L

Run ID: MSD_08_150904A

Prep Date: 09/04/2015 11:46

Analyte	Result	PQL	SpkVal	SpkRefVal	%REC	LCL(ME)	UCL(ME)	RPDRefVal	%RPD(Limit)	Qual
TPH-P (GRO)	ND	50								
Surr: 1,2-Dichloroethane-d4	10.8		10		108	70	130			
Surr: Toluene-d8	10.6		10		106	70	130			
Surr: 4-Bromofluorobenzene	8.77		10		88	70	130			

Laboratory Control Spike

File ID: 15090403.D

Type LCS

Test Code: EPA Method SW8015B/C / SW8260B

Batch ID: MS08W0904B

Analysis Date: 09/04/2015 11:14

Sample ID: GLCS MS08W0904B

Units: µg/L

Run ID: MSD_08_150904A

Prep Date: 09/04/2015 11:14

Analyte	Result	PQL	SpkVal	SpkRefVal	%REC	LCL(ME)	UCL(ME)	RPDRefVal	%RPD(Limit)	Qual
TPH-P (GRO)	387	50	400		97	70	130			
Surr: 1,2-Dichloroethane-d4	10		10		100	70	130			
Surr: Toluene-d8	9.53		10		95	70	130			
Surr: 4-Bromofluorobenzene	10.2		10		102	70	130			

Sample Matrix Spike

File ID: 15090429.D

Type MS

Test Code: EPA Method SW8015B/C / SW8260B

Batch ID: MS08W0904B

Analysis Date: 09/04/2015 21:34

Sample ID: 15090248-01AGS

Units: µg/L

Run ID: MSD_08_150904A

Prep Date: 09/04/2015 21:34

Analyte	Result	PQL	SpkVal	SpkRefVal	%REC	LCL(ME)	UCL(ME)	RPDRefVal	%RPD(Limit)	Qual
TPH-P (GRO)	2210	250	2000	0	110	54	143			
Surr: 1,2-Dichloroethane-d4	53.6		50		107	70	130			
Surr: Toluene-d8	48		50		96	70	130			
Surr: 4-Bromofluorobenzene	50		50		100	70	130			

Sample Matrix Spike Duplicate

File ID: 15090430.D

Type MSD

Test Code: EPA Method SW8015B/C / SW8260B

Batch ID: MS08W0904B

Analysis Date: 09/04/2015 21:58

Sample ID: 15090248-01AGSD

Units: µg/L

Run ID: MSD_08_150904A

Prep Date: 09/04/2015 21:58

Analyte	Result	PQL	SpkVal	SpkRefVal	%REC	LCL(ME)	UCL(ME)	RPDRefVal	%RPD(Limit)	Qual
TPH-P (GRO)	2140	250	2000	0	107	54	143	2209	3.0(23)	
Surr: 1,2-Dichloroethane-d4	53.3		50		107	70	130			
Surr: Toluene-d8	48.4		50		97	70	130			
Surr: 4-Bromofluorobenzene	51.7		50		103	70	130			

Comments:

Calculations are based off of raw (non-rounded) data. However, for reporting purposes, all QC data is rounded to three significant figures. Therefore, hand calculated values may differ slightly.

Reported in micrograms per Liter, per client request.



Alpha Analytical, Inc.

255 Glendale Ave. • Suite 21 • Sparks, Nevada 89431-5778
(775) 355-1044 • (775) 355-0406 FAX • 1-800-283-1183

Date:
09-Sep-15

QC Summary Report

Work Order:
15090250

Method Blank

Type MBLK Test Code: EPA Method SW8260B

File ID: 15090805.D

Batch ID: MS08A0908A

Analysis Date: 09/08/2015 12:42

Sample ID: MBLK MS08A0908A

Units : mg/m³

Run ID: MSD_08_150908A

Prep Date: 09/08/2015 12:42

Analyte	Result	PQL	SpkVal	SpkRefVal	%REC	LCL(ME)	UCL(ME)	RPDRefVal	%RPD(Limit)	Qual
Chloromethane	ND	0.4								
Vinyl chloride	ND	0.2								
Chloroethane	ND	0.2								
Bromomethane	ND	0.4								
Trichlorofluoromethane	ND	0.2								
1,1-Dichloroethene	ND	0.2								
Tertiary Butyl Alcohol (TBA)	ND	5								
Dichloromethane	ND	0.4								
trans-1,2-Dichloroethene	ND	0.2								
Methyl tert-butyl ether (MTBE)	ND	0.1								
1,1-Dichloroethane	ND	0.2								
Di-isopropyl Ether (DIPE)	ND	0.2								
cis-1,2-Dichloroethene	ND	0.2								
Chloroform	ND	0.2								
Ethyl Tertiary Butyl Ether (ETBE)	ND	0.2								
1,1,1-Trichloroethane	ND	0.2								
Carbon tetrachloride	ND	0.2								
Benzene	ND	0.1								
Tertiary Amyl Methyl Ether (TAME)	ND	0.2								
1,2-Dichloropropane	ND	0.2								
Trichloroethene	ND	0.2								
Bromodichloromethane	ND	0.2								
cis-1,3-Dichloropropene	ND	0.2								
trans-1,3-Dichloropropene	ND	0.2								
1,1,2-Trichloroethane	ND	0.2								
Toluene	ND	0.1								
Dibromochloromethane	ND	0.2								
1,2-Dibromoethane (EDB)	ND	0.4								
Tetrachloroethene	ND	0.2								
Chlorobenzene	ND	0.2								
Ethylbenzene	ND	0.1								
m,p-Xylene	ND	0.1								
Bromoform	ND	0.2								
o-Xylene	ND	0.1								
1,1,2,2-Tetrachloroethane	ND	0.2								
n-Propylbenzene	ND	0.2								
1,2,4-Trimethylbenzene	ND	0.2								
1,3-Dichlorobenzene	ND	0.2								
1,4-Dichlorobenzene	ND	0.2								
1,2-Dichlorobenzene	ND	0.2								
Surr: 1,2-Dichloroethane-d4	1.94		2		97	70	130			
Surr: Toluene-d8	2.24		2		112	70	130			
Surr: 4-Bromofluorobenzene	1.63		2		82	70	130			

Laboratory Control Spike

Type LCS Test Code: EPA Method SW8260B

File ID: 15090802.D

Batch ID: MS08A0908A

Analysis Date: 09/08/2015 11:09

Sample ID: LCS MS08A0908A

Units : mg/m³

Run ID: MSD_08_150908A

Prep Date: 09/08/2015 11:09

Analyte	Result	PQL	SpkVal	SpkRefVal	%REC	LCL(ME)	UCL(ME)	RPDRefVal	%RPD(Limit)	Qual
1,1-Dichloroethene	9.58	0.2	10		96	70	130			
Methyl tert-butyl ether (MTBE)	12.3	0.1	10		123	63	137			
Benzene	10.7	0.1	10		107	70	130			
Trichloroethene	10.1	0.2	10		101	68	138			
Toluene	10.8	0.1	10		108	70	130			
Chlorobenzene	10.7	0.2	10		107	70	130			
Ethylbenzene	10.6	0.1	10		106	70	130			
m,p-Xylene	10.6	0.1	10		106	65	139			
o-Xylene	10.3	0.1	10		103	70	130			
Surr: 1,2-Dichloroethane-d4	10.3		10		103	70	130			
Surr: Toluene-d8	9.67		10		97	70	130			
Surr: 4-Bromofluorobenzene	9.53		10		95	70	130			



Alpha Analytical, Inc.

255 Glendale Ave. • Suite 21 • Sparks, Nevada 89431-5778
(775) 355-1044 • (775) 355-0406 FAX • 1-800-283-1183

Date:
09-Sep-15

QC Summary Report

Work Order:
15090250

Comments:

Calculations are based off of raw (non-rounded) data. However, for reporting purposes, all QC data is rounded to three significant figures. Therefore, hand calculated values may differ slightly.



Alpha Analytical, Inc.

255 Glendale Ave. • Suite 21 • Sparks, Nevada 89431-5778
(775) 355-1044 • (775) 355-0406 FAX • 1-800-283-1183

Date:
09-Sep-15

QC Summary Report

Work Order:
15090250

Method Blank

Type MBLK Test Code: EPA Method 624/8260

File ID: 15090404.D

Batch ID: MS08W0904A

Analysis Date: 09/04/2015 11:46

Sample ID: MBLK MS08W0904A

Units: µg/L

Run ID: MSD_08_150904A

Prep Date: 09/04/2015 11:46

Analyte	Result	PQL	SpkVal	SpkRefVal	%REC	LCL(ME)	UCL(ME)	RPDRefVal	%RPD(Limit)	Qual
Chloromethane	ND	2								
Vinyl chloride	ND	1								
Chloroethane	ND	1								
Bromomethane	ND	2								
Trichlorofluoromethane	ND	1								
1,1-Dichloroethene	ND	1								
Tertiary Butyl Alcohol (TBA)	ND	10								
Dichloromethane	ND	2								
trans-1,2-Dichloroethene	ND	1								
Methyl tert-butyl ether (MTBE)	ND	0.5								
1,1-Dichloroethane	ND	1								
Di-isopropyl Ether (DIPE)	ND	1								
cis-1,2-Dichloroethene	ND	1								
Chloroform	ND	1								
Ethyl Tertiary Butyl Ether (ETBE)	ND	1								
1,2-Dichloroethane	ND	1								
1,1,1-Trichloroethane	ND	1								
Carbon tetrachloride	ND	1								
Benzene	ND	0.5								
Tertiary Amyl Methyl Ether (TAME)	ND	1								
1,2-Dichloropropane	ND	1								
Trichloroethene	ND	1								
Bromodichloromethane	ND	1								
cis-1,3-Dichloropropene	ND	1								
trans-1,3-Dichloropropene	ND	1								
1,1,2-Trichloroethane	ND	1								
Toluene	ND	0.5								
Dibromochloromethane	ND	1								
1,2-Dibromoethane (EDB)	ND	2								
Tetrachloroethene	ND	1								
Chlorobenzene	ND	1								
Ethylbenzene	ND	0.5								
m,p-Xylene	ND	0.5								
Bromoform	ND	1								
o-Xylene	ND	0.5								
1,1,2,2-Tetrachloroethane	ND	1								
1,3-Dichlorobenzene	ND	1								
1,4-Dichlorobenzene	ND	1								
1,2-Dichlorobenzene	ND	1								
Naphthalene	ND	2								
Surr: 1,2-Dichloroethane-d4	10.8		10		108	70	130			
Surr: Toluene-d8	10.6		10		106	70	130			
Surr: 4-Bromofluorobenzene	8.77		10		88	70	130			

Laboratory Control Spike

Type LCS Test Code: EPA Method 624/8260

File ID: 15090402.D

Batch ID: MS08W0904A

Analysis Date: 09/04/2015 10:47

Sample ID: LCS MS08W0904A

Units: µg/L

Run ID: MSD_08_150904A

Prep Date: 09/04/2015 10:47

Analyte	Result	PQL	SpkVal	SpkRefVal	%REC	LCL(ME)	UCL(ME)	RPDRefVal	%RPD(Limit)	Qual
1,1-Dichloroethene	10.2	1	10		102	70	130			
Methyl tert-butyl ether (MTBE)	11.8	0.5	10		118	63	137			
Benzene	10.5	0.5	10		105	70	130			
Trichloroethene	9.48	1	10		95	68	138			
Toluene	10.1	0.5	10		101	70	130			
Chlorobenzene	10.1	1	10		101	70	130			
Ethylbenzene	9.81	0.5	10		98	70	130			
m,p-Xylene	9.75	0.5	10		98	65	139			
o-Xylene	9.76	0.5	10		98	70	130			
Surr: 1,2-Dichloroethane-d4	10.7		10		107	70	130			
Surr: Toluene-d8	9.38		10		94	70	130			
Surr: 4-Bromofluorobenzene	9.59		10		96	70	130			



Alpha Analytical, Inc.

255 Glendale Ave. • Suite 21 • Sparks, Nevada 89431-5778
(775) 355-1044 • (775) 355-0406 FAX • 1-800-283-1183

Date:
09-Sep-15

QC Summary Report

Work Order:
15090250

Sample Matrix Spike

File ID: 15090427.D

Type MS

Test Code: EPA Method 624/8260

Batch ID: MS08W0904A

Analysis Date: 09/04/2015 20:48

Sample ID: 15090248-01AMS

Units: µg/L

Run ID: MSD_08_150904A

Prep Date: 09/04/2015 20:48

Analyte	Result	PQL	SpkVal	SpkRefVal	%REC	LCL(ME)	UCL(ME)	RPDRefVal	%RPD(Limit)	Qual
1,1-Dichloroethene	47.8	2.5	50	0	96	62	133			
Methyl tert-butyl ether (MTBE)	73.9	1.3	50	9.7	128	56	140			
Benzene	52.1	1.3	50	0	104	67	134			
Trichloroethene	47.4	2.5	50	0	95	68	138			
Toluene	54.2	1.3	50	0	108	38	130			
Chlorobenzene	53.6	2.5	50	0	107	70	130			
Ethylbenzene	52.6	1.3	50	0	105	70	130			
m,p-Xylene	51.4	1.3	50	0	103	65	139			
o-Xylene	50.6	1.3	50	0	101	69	130			
Surr: 1,2-Dichloroethane-d4	54.9		50		110	70	130			
Surr: Toluene-d8	47.4		50		95	70	130			
Surr: 4-Bromofluorobenzene	46.3		50		93	70	130			

Sample Matrix Spike Duplicate

File ID: 15090428.D

Type MSD

Test Code: EPA Method 624/8260

Batch ID: MS08W0904A

Analysis Date: 09/04/2015 21:12

Sample ID: 15090248-01AMSD

Units: µg/L

Run ID: MSD_08_150904A

Prep Date: 09/04/2015 21:12

Analyte	Result	PQL	SpkVal	SpkRefVal	%REC	LCL(ME)	UCL(ME)	RPDRefVal	%RPD(Limit)	Qual
1,1-Dichloroethene	47.2	2.5	50	0	94	62	133	47.76	1.3(35)	
Methyl tert-butyl ether (MTBE)	76.4	1.3	50	9.7	133	56	140	73.91	3.3(40)	
Benzene	53.6	1.3	50	0	107	67	134	52.11	2.9(21)	
Trichloroethene	47.5	2.5	50	0	95	68	138	47.35	0.2(20)	
Toluene	54.3	1.3	50	0	109	38	130	54.23	0.2(20)	
Chlorobenzene	54.1	2.5	50	0	108	70	130	53.55	1.0(20)	
Ethylbenzene	51.5	1.3	50	0	103	70	130	52.61	2.1(20)	
m,p-Xylene	50.9	1.3	50	0	102	65	139	51.37	0.9(20)	
o-Xylene	50.2	1.3	50	0	100	69	130	50.61	0.8(20)	
Surr: 1,2-Dichloroethane-d4	56.3		50		113	70	130			
Surr: Toluene-d8	47.3		50		95	70	130			
Surr: 4-Bromofluorobenzene	45.4		50		91	70	130			

Comments:

Calculations are based off of raw (non-rounded) data. However, for reporting purposes, all QC data is rounded to three significant figures. Therefore, hand calculated values may differ slightly.

Billing Information :

CHAIN-OF-CUSTODY RECORD

Alpha Analytical, Inc.
 255 Glendale Avenue, Suite 21 Sparks, Nevada 89431-5778
 TEL: (775) 355-1044 FAX: (775) 355-0406

CA

WorkOrder : STR15090250
Report Due By : 5:00 PM On : 10-Sep-15

Client:
 Stratus Environmental
 3330 Cameron Park Drive
 Suite 550
 Cameron Park, CA 95682-8861

Report Attention	Phone Number	Email Address
Scott Bittinger	(530) 676-2062 x	sbittinger@stratusinc.net

EDD Required : Yes

Sampled by : C. Hill

PO :
 Client's COC # : 04632 Job : Grimit Auto

Cooler Temp Samples Received Date Printed
 0 °C 02-Sep-15 02-Sep-15

QC Level : S3 = Final Rpt, MBLK, LCS, MS/MSD With Surrogates

Alpha Sample ID	Client Sample ID	Collection Matrix	Date	No. of Bottles			Requested Tests						Sample Remarks			
				Alpha	Sub	TAT	TPHP_A	TPHP_W	VOC_A	VOC_W						
STR15090250-01A	Grim W INF	AQ	09/01/15 06:36	6	0	5		GAS-C		8260/OXYS/ EDB/Naph_C						
STR15090250-02A	Grim W GAC1	AQ	09/01/15 06:33	6	0	5		GAS-C		8260/OXYS/ EDB/Naph_C						
STR15090250-03A	Grim A SYS INF	AR	09/01/15 06:51	1	0	5	GAS-N/C		8260/OXYS/ EDB_S							Tedlar.

Comments: Security seals intact. Frozen ice. Chain split due to different TATs. :

Signature	Print Name	Company	Date/Time
	JESSICA ALVARADO	Alpha Analytical, Inc.	9/2/15 1240

NOTE: Samples are discarded 60 days after results are reported unless other arrangements are made. Hazardous samples will be returned to client or disposed of at client expense.
 The report for the analysis of the above samples is applicable only to those samples received by the laboratory with this COC. The liability of the laboratory is limited to the amount paid for the report.
 Matrix Type : AQ(Aqueous) AR(Air) SO(Soil) WS(Waste) DW(Drinking Water) OT(Other) Bottle Type: L-Liter V-Voa S-Soil Jar O-Orbo T-Tedlar B-Brass P-Plastic OT-Other

Company: STUNKS
 Attn: _____
 Address: 3530 Cameron Pk Dr
Cameron PA
 City, State, Zip: _____
 Phone Number: _____ Fax: _____



Alpha Analytical, Inc.
 Main Laboratory: 255 Glendale Ave, Suite 21 Sparks, NV 89431
Satellite Service Centers:
 Northern CA: 9891 Horn Road, Suite C, Rancho Cordova, CA 95827
 Southern CA: 1007 E. Dominguez St., Suite O, Carson, CA 90746
 Northern NV: 1250 Lamoille Hwy., #310, Elko, NV 89801
 Southern NV: 6255 McLeod Ave, Suite 24, Las Vegas, NV 89120

Phone: 775-355-1044
 Fax: 775-355-0406
 Phone: 916-366-9089
 Phone: 714-386-2901
 Phone: 775-388-7043
 Phone: 702-281-4848

04632

Page # 1 of 1

Consultant/Client Info: STUNKS
Job and Purchase Order Info: Job # _____ Job Name: GRUNT AUTO P.O. # _____
Report Attention/Project Manager: Name: SCOTT Email Address: _____ Phone #: _____ Cell #: _____
QC Deliverable Info: EDD Required? Yes / No _____ EDF Required? Yes / No _____
 Global ID: _____ Data Validation Packages: III or IV _____

Samples Collected from which State? (circle one) AR CA KS NV OR WA DOD Site Other

Time Sampled (HHMM)	Date Sampled (MM/DD)	Matrix* (See Key Below)	Lab ID Number (For Lab Use Only)	Sample Description	TAT	#Containers* (See Key Below)	Field Filtered?		Analysis Requested										Remarks		
							Yes	No	GRD	BTEX	MTBE	1,2 DCA	1,4 DCA	VOCS	TOC	Vinylchloride	Chlorobenzene	nPropyl benzene		1,2,4 trimethyl benzene	
0636	9/15	AR	STR15090250-01A	Grum W INF	STD	6	X	X	X	X	X	X	X	X	X	X					
0633)	1		Grum W GAC 1	STD	6	X	X	X	X	X	X	X	X	X	X					
0631)	AR		Grum W EFF	24	6	X	X	X	X	X	X	X	X	X	X					
0628	9/15	AR		Grum A Sys INF	STD	1	X	X	X	X		X	X	X	X	X	X	X	X		
0645)	AR		Grum A EFF	24	1	X	X	X	X		X	X	X	X	X	X	X	X		

ADDITIONAL INSTRUCTIONS:

I (field sampler) attest to the validity and authenticity of this sample(s). I am aware that tampering with or intentionally mislabeling the sample location, date or time of collection is considered fraud and may be grounds for legal action. NAC 445.0636 (c) (2).

Relinquished by: Chris Stucky Date: 9/15 Time: 12:10
 Received by: MEYSSA T Date: 9-1-15 Time: 12:10
 Relinquished by: _____ Date: _____ Time: _____
 Received by: _____ Date: 9/2/15 Time: 12:40
 Relinquished by: _____ Date: _____ Time: _____
 Received by: _____ Date: _____ Time: _____

* Key: AQ - Aqueous OT - Other So-Soil WA - Waste ** B - Brass L - Liter O - Orbo OT - Other P - Plastic S - Soil Jar T - Tedlar V - VOA

NOTE: Samples are discarded 60 days after sample receipt unless other arrangements are made. Hazardous samples will be returned to client or disposed of at client expense. The report for the analysis of the above samples is applicable only to those samples received by the laboratory with this COC. The liability of the laboratory is limited to the amount paid for the report.



Alpha Analytical, Inc.

255 Glendale Ave. • Suite 21 • Sparks, Nevada 89431-5778
(775) 355-1044 • (775) 355-0406 FAX • 1-800-283-1183

ANALYTICAL REPORT

Stratus Environmental
3330 Cameron Park Drive
Cameron Park, CA 956828861

Attn: Scott Bittinger
Phone: (530) 676-2062
Fax: (530) 676-6005
Date Received : 09/02/15

Job: Grit Auto

Total Petroleum Hydrocarbons - Purgeable (TPH-P) EPA Method SW8015B / SW8260B

Parameter	Concentration	Reporting Limit	Date Extracted	Date Analyzed
Client ID : Grim W EFF Lab ID : STR15090241-01A Date Sampled 09/01/15 06:31	TPH-P (GRO) ND	50 µg/L	09/02/15	09/02/15
Client ID : Grim A EFF Lab ID : STR15090241-02A Date Sampled 09/01/15 06:48	TPH-P (GRO) ND	15 mg/m ³	09/02/15 10:25	09/02/15

Gasoline Range Organics (GRO) C4-C13

Note: For sample -02A concentrations of air in a Tedlar Bag are at 24 degrees Celsius and 30.00 inches of mercury.

ND = Not Detected

Reported in micrograms per Liter, per client request.



Roger Scholl

Randy Gardner

Roger L. Scholl, Ph.D., Laboratory Director • Randy Gardner, Laboratory Manager
Sacramento, CA • (916) 366-9089 / Las Vegas, NV • (702) 281-4848 / Carson, CA • (714) 386-2901 / info@alpha-analytical.com
Alpha Analytical, Inc. certifies that the test results meet all requirements of NELAC unless footnoted otherwise.



MS
9/2/15

Report Date

Statement of Data Authenticity : Alpha Analytical, Inc. attests that the data reported has not been altered in any way.
Alpha Analytical, Inc. currently holds appropriate and available California (#2019) and NELAC (01154CA) certifications for the data reported. Test results relate only to reported samples.



Alpha Analytical, Inc.

255 Glendale Ave. • Suite 21 • Sparks, Nevada 89431-5778
(775) 355-1044 • (775) 355-0406 FAX • 1-800-283-1183

ANALYTICAL REPORT

Stratus Environmental
3330 Cameron Park Drive
Cameron Park, CA 956828861
Job: Grit Auto

Attn: Scott Bittinger
Phone: (530) 676-2062
Fax: (530) 676-6005

Alpha Analytical Number: STR15090241-01A
Client I.D. Number: Grim W EFF

Sampled: 09/01/15 06:31
Received: 09/02/15
Extracted: 09/02/15
Analyzed: 09/02/15

Volatile Organics by GC/MS EPA Method 624/8260

Compound	Concentration	Reporting Limit	Compound	Concentration	Reporting Limit
1 Chloromethane	ND	2.0 µg/L	26 1,1,2-Trichloroethane	ND	1.0 µg/L
2 Vinyl chloride	ND	1.0 µg/L	27 Toluene	ND	0.50 µg/L
3 Chloroethane	ND	1.0 µg/L	28 Dibromochloromethane	ND	1.0 µg/L
4 Bromomethane	ND	2.0 µg/L	29 1,2-Dibromoethane (EDB)	ND	2.0 µg/L
5 Trichlorofluoromethane	ND	1.0 µg/L	30 Tetrachloroethene	ND	1.0 µg/L
6 1,1-Dichloroethene	ND	1.0 µg/L	31 Chlorobenzene	ND	1.0 µg/L
7 Tertiary Butyl Alcohol (TBA)	ND	10 µg/L	32 Ethylbenzene	ND	0.50 µg/L
8 Dichloromethane	ND	2.0 µg/L	33 m,p-Xylene	ND	0.50 µg/L
9 trans-1,2-Dichloroethene	ND	1.0 µg/L	34 Bromoform	ND	1.0 µg/L
10 Methyl tert-butyl ether (MTBE)	ND	0.50 µg/L	35 o-Xylene	ND	0.50 µg/L
11 1,1-Dichloroethane	ND	1.0 µg/L	36 1,1,2,2-Tetrachloroethane	ND	1.0 µg/L
12 Di-isopropyl Ether (DIPE)	ND	1.0 µg/L	37 1,3-Dichlorobenzene	ND	1.0 µg/L
13 cis-1,2-Dichloroethene	ND	1.0 µg/L	38 1,4-Dichlorobenzene	ND	1.0 µg/L
14 Chloroform	ND	1.0 µg/L	39 1,2-Dichlorobenzene	ND	1.0 µg/L
15 Ethyl Tertiary Butyl Ether (ETBE)	ND	1.0 µg/L	40 Naphthalene	ND	2.0 µg/L
16 1,2-Dichloroethane	ND	1.0 µg/L			
17 1,1,1-Trichloroethane	ND	1.0 µg/L			
18 Carbon tetrachloride	ND	1.0 µg/L			
19 Benzene	ND	0.50 µg/L			
20 Tertiary Amyl Methyl Ether (TAME)	ND	1.0 µg/L			
21 1,2-Dichloropropane	ND	1.0 µg/L			
22 Trichloroethene	ND	1.0 µg/L			
23 Bromodichloromethane	ND	1.0 µg/L			
24 cis-1,3-Dichloropropene	ND	1.0 µg/L			
25 trans-1,3-Dichloropropene	ND	1.0 µg/L			

ND = Not Detected



Roger Scholl

Randy Gardner

Roger L. Scholl, Ph.D., Laboratory Director • Randy Gardner, Laboratory Manager

Sacramento, CA • (916) 366-9089 / Las Vegas, NV • (702) 281-4848 / Carson, CA • (714) 386-2901 / info@alpha-analytical.com

Alpha Analytical, Inc. certifies that the test results meet all requirements of NELAC unless footnoted otherwise.

Statement of Data Authenticity: Alpha Analytical, Inc. attests that the data reported has not been altered in any way.

Alpha Analytical, Inc. currently holds appropriate and available California (#2019) and NELAC (01154CA) certifications for the data reported. Test results relate only to reported samples.



JG

9/2/15

Report Date

Page 1 of 1



Alpha Analytical, Inc.

255 Glendale Ave. • Suite 21 • Sparks, Nevada 89431-5778

(775) 355-1044 • (775) 355-0406 FAX • 1-800-283-1183

ANALYTICAL REPORT

Stratus Environmental
3330 Cameron Park Drive
Cameron Park, CA 956828861
Job: Grit Auto

Attn: Scott Bittinger
Phone: (530) 676-2062
Fax: (530) 676-6005

Alpha Analytical Number: STR15090241-02A
Client I.D. Number: Grim A EFF

Sampled: 09/01/15 06:48
Received: 09/02/15
Extracted: 09/02/15 10:25
Analyzed: 09/02/15

Volatiles Organics by GC/MS EPA Method SW8260B

Compound	Concentration	Reporting Limit	Compound	Concentration	Reporting Limit
1 Chloromethane	ND	0.60 mg/m ³	26 Toluene	ND	0.15 mg/m ³
2 Vinyl chloride	ND	0.30 mg/m ³	27 Dibromochloromethane	ND	0.30 mg/m ³
3 Chloroethane	ND	0.30 mg/m ³	28 1,2-Dibromoethane (EDB)	ND	0.60 mg/m ³
4 Bromomethane	ND	0.60 mg/m ³	29 Tetrachloroethene	ND	0.30 mg/m ³
5 Trichlorofluoromethane	ND	0.30 mg/m ³	30 Chlorobenzene	ND	0.30 mg/m ³
6 1,1-Dichloroethene	ND	0.30 mg/m ³	31 Ethylbenzene	ND	0.15 mg/m ³
7 Tertiary Butyl Alcohol (TBA)	ND	7.5 mg/m ³	32 m,p-Xylene	ND	0.15 mg/m ³
8 Dichloromethane	ND	0.60 mg/m ³	33 Bromoform	ND	0.30 mg/m ³
9 trans-1,2-Dichloroethene	ND	0.30 mg/m ³	34 o-Xylene	ND	0.15 mg/m ³
10 Methyl tert-butyl ether (MTBE)	ND	0.15 mg/m ³	35 1,1,2,2-Tetrachloroethane	ND	0.30 mg/m ³
11 1,1-Dichloroethane	ND	0.30 mg/m ³	36 n-Propylbenzene	ND	0.30 mg/m ³
12 Di-isopropyl Ether (DIPE)	ND	0.30 mg/m ³	37 1,2,4-Trimethylbenzene	ND	0.30 mg/m ³
13 cis-1,2-Dichloroethene	ND	0.30 mg/m ³	38 1,3-Dichlorobenzene	ND	0.30 mg/m ³
14 Chloroform	ND	0.30 mg/m ³	39 1,4-Dichlorobenzene	ND	0.30 mg/m ³
15 Ethyl Tertiary Butyl Ether (ETBE)	ND	0.30 mg/m ³	40 1,2-Dichlorobenzene	ND	0.30 mg/m ³
16 1,1,1-Trichloroethane	ND	0.30 mg/m ³			
17 Carbon tetrachloride	ND	0.30 mg/m ³			
18 Benzene	ND	0.15 mg/m ³			
19 Tertiary Amyl Methyl Ether (TAME)	ND	0.30 mg/m ³			
20 1,2-Dichloropropane	ND	0.30 mg/m ³			
21 Trichloroethene	ND	0.30 mg/m ³			
22 Bromodichloromethane	ND	0.30 mg/m ³			
23 cis-1,3-Dichloropropene	ND	0.30 mg/m ³			
24 trans-1,3-Dichloropropene	ND	0.30 mg/m ³			
25 1,1,2-Trichloroethane	ND	0.30 mg/m ³			

Note: Concentrations of air in a Tedlar Bag are at 24 degrees Celsius and 30.00 inches of mercury.

ND = Not Detected



Roger Scholl

Randy Gardner

Roger L. Scholl, Ph.D., Laboratory Director • Randy Gardner, Laboratory Manager

Sacramento, CA • (916) 366-9089 / Las Vegas, NV • (702) 281-4848 / Carson, CA • (714) 386-2901 / info@alpha-analytical.com

Alpha Analytical, Inc. certifies that the test results meet all requirements of NELAC unless footnoted otherwise.

Statement of Data Authenticity: Alpha Analytical, Inc. attests that the data reported has not been altered in any way.

Alpha Analytical, Inc. currently holds appropriate and available California (#2019) and NELAC (01154CA) certifications for the data reported. Test results relate only to reported samples.



[Signature]

9/2/15

Report Date

Page 1 of 1



Alpha Analytical, Inc.

255 Glendale Ave. • Suite 21 • Sparks, Nevada 89431-5778
(775) 355-1044 • (775) 355-0406 FAX • 1-800-283-1183

VOC Sample Preservation Report

Work Order: STR15090241

Job: Grimit Auto

Alpha's Sample ID	Client's Sample ID	Matrix	pH
15090241-01A	Grim W EFF	Aqueous	2

9/2/15

Report Date

Page 1 of 1



Alpha Analytical, Inc.

255 Glendale Ave. • Suite 21 • Sparks, Nevada 89431-5778
(775) 355-1044 • (775) 355-0406 FAX • 1-800-283-1183

Date:
04-Sep-15

QC Summary Report

Work Order:
15090241

Method Blank

Type MBLK Test Code: EPA Method SW8015B/C / SW8260B

File ID: 15090205.D

Batch ID: MS15A0902B

Analysis Date: 09/02/2015 11:54

Sample ID: MBLK MS15A0902B

Units: mg/m³

Run ID: MSD_15_150902A

Prep Date: 09/02/2015 11:54

Analyte	Result	PQL	SpkVal	SpkRefVal	%REC	LCL(ME)	UCL(ME)	RPDRefVal	%RPD(Limit)	Qual
TPH-P (GRO)	ND	10								
Surr: 1,2-Dichloroethane-d4	1.78		2		89	70	130			
Surr: Toluene-d8	2.08		2		104	70	130			
Surr: 4-Bromofluorobenzene	2.02		2		101	70	130			

Laboratory Control Spike

Type LCS Test Code: EPA Method SW8015B/C / SW8260B

File ID: 15090203.D

Batch ID: MS15A0902B

Analysis Date: 09/02/2015 10:50

Sample ID: GLCS MS15A0902B

Units: mg/m³

Run ID: MSD_15_150902A

Prep Date: 09/02/2015 10:50

Analyte	Result	PQL	SpkVal	SpkRefVal	%REC	LCL(ME)	UCL(ME)	RPDRefVal	%RPD(Limit)	Qual
TPH-P (GRO)	427	10	400		107	70	130			
Surr: 1,2-Dichloroethane-d4	8.8		10		88	70	130			
Surr: Toluene-d8	10.5		10		105	70	130			
Surr: 4-Bromofluorobenzene	10		10		100	70	130			

Comments:

Calculations are based off of raw (non-rounded) data. However, for reporting purposes, all QC data is rounded to three significant figures. Therefore, hand calculated values may differ slightly.



Alpha Analytical, Inc.

255 Glendale Ave. • Suite 21 • Sparks, Nevada 89431-5778
(775) 355-1044 • (775) 355-0406 FAX • 1-800-283-1183

Date:
04-Sep-15

QC Summary Report

Work Order:
15090241

Method Blank		Type	Test Code: EPA Method SW8015B/C / SW8260B							
File ID: 15090204.D			Batch ID: MS09W0902B				Analysis Date: 09/02/2015 12:34			
Sample ID:	MBLK MS09W0902B	Units : µg/L	Run ID: MSD_09_150902A				Prep Date: 09/02/2015 12:34			
Analyte	Result	PQL	SpkVal	SpkRefVal	%REC	LCL(ME)	UCL(ME)	RPDRefVal	%RPD(Limit)	Qual
TPH-P (GRO)	ND	50								
Surr: 1,2-Dichloroethane-d4	10.2		10		102	70	130			
Surr: Toluene-d8	10.2		10		102	70	130			
Surr: 4-Bromofluorobenzene	9.68		10		97	70	130			

Laboratory Control Spike		Type	Test Code: EPA Method SW8015B/C / SW8260B							
File ID: 15090203.D			Batch ID: MS09W0902B				Analysis Date: 09/02/2015 12:09			
Sample ID:	GLCS MS09W0902B	Units : µg/L	Run ID: MSD_09_150902A				Prep Date: 09/02/2015 12:09			
Analyte	Result	PQL	SpkVal	SpkRefVal	%REC	LCL(ME)	UCL(ME)	RPDRefVal	%RPD(Limit)	Qual
TPH-P (GRO)	421	50	400		105	70	130			
Surr: 1,2-Dichloroethane-d4	10.3		10		103	70	130			
Surr: Toluene-d8	9.97		10		99.7	70	130			
Surr: 4-Bromofluorobenzene	10.1		10		101	70	130			

Sample Matrix Spike		Type	Test Code: EPA Method SW8015B/C / SW8260B							
File ID: 15090216.D			Batch ID: MS09W0902B				Analysis Date: 09/02/2015 17:26			
Sample ID:	15090240-01AGS	Units : µg/L	Run ID: MSD_09_150902A				Prep Date: 09/02/2015 17:26			
Analyte	Result	PQL	SpkVal	SpkRefVal	%REC	LCL(ME)	UCL(ME)	RPDRefVal	%RPD(Limit)	Qual
TPH-P (GRO)	2130	250	2000		0	107	54	143		
Surr: 1,2-Dichloroethane-d4	51.4		50		103	70	130			
Surr: Toluene-d8	49.8		50		99.6	70	130			
Surr: 4-Bromofluorobenzene	50		50		100	70	130			

Sample Matrix Spike Duplicate		Type	Test Code: EPA Method SW8015B/C / SW8260B							
File ID: 15090217.D			Batch ID: MS09W0902B				Analysis Date: 09/02/2015 17:50			
Sample ID:	15090240-01AGSD	Units : µg/L	Run ID: MSD_09_150902A				Prep Date: 09/02/2015 17:50			
Analyte	Result	PQL	SpkVal	SpkRefVal	%REC	LCL(ME)	UCL(ME)	RPDRefVal	%RPD(Limit)	Qual
TPH-P (GRO)	2250	250	2000		0	113	54	143	2132	5.6(23)
Surr: 1,2-Dichloroethane-d4	51.3		50		103	70	130			
Surr: Toluene-d8	50.4		50		101	70	130			
Surr: 4-Bromofluorobenzene	48.6		50		97	70	130			

Comments:

Calculations are based off of raw (non-rounded) data. However, for reporting purposes, all QC data is rounded to three significant figures. Therefore, hand calculated values may differ slightly.

Reported in micrograms per Liter, per client request.



Alpha Analytical, Inc.

255 Glendale Ave. • Suite 21 • Sparks, Nevada 89431-5778
(775) 355-1044 • (775) 355-0406 FAX • 1-800-283-1183

Date:
04-Sep-15

QC Summary Report

Work Order:
15090241

Method Blank

Type MBLK Test Code: EPA Method SW8260B

File ID: 15090205.D

Batch ID: MS15A0902A

Analysis Date: 09/02/2015 11:54

Sample ID: MBLK MS15A0902A

Units: mg/m³

Run ID: MSD_15_150902A

Prep Date: 09/02/2015 11:54

Analyte	Result	PQL	SpkVal	SpkRefVal	%REC	LCL(ME)	UCL(ME)	RPDRefVal	%RPD(Limit)	Qual
Chloromethane	ND	0.4								
Vinyl chloride	ND	0.2								
Chloroethane	ND	0.2								
Bromomethane	ND	0.4								
Trichlorofluoromethane	ND	0.2								
1,1-Dichloroethene	ND	0.2								
Tertiary Butyl Alcohol (TBA)	ND	5								
Dichloromethane	ND	0.4								
trans-1,2-Dichloroethene	ND	0.2								
Methyl tert-butyl ether (MTBE)	ND	0.1								
1,1-Dichloroethane	ND	0.2								
Di-isopropyl Ether (DIPE)	ND	0.2								
cis-1,2-Dichloroethene	ND	0.2								
Chloroform	ND	0.2								
Ethyl Tertiary Butyl Ether (ETBE)	ND	0.2								
1,1,1-Trichloroethane	ND	0.2								
Carbon tetrachloride	ND	0.2								
Benzene	ND	0.1								
Tertiary Amyl Methyl Ether (TAME)	ND	0.2								
1,2-Dichloropropane	ND	0.2								
Trichloroethene	ND	0.2								
Bromodichloromethane	ND	0.2								
cis-1,3-Dichloropropene	ND	0.2								
trans-1,3-Dichloropropene	ND	0.2								
1,1,2-Trichloroethane	ND	0.2								
Toluene	ND	0.1								
Dibromochloromethane	ND	0.2								
1,2-Dibromoethane (EDB)	ND	0.4								
Tetrachloroethene	ND	0.2								
Chlorobenzene	ND	0.2								
Ethylbenzene	ND	0.1								
m,p-Xylene	ND	0.1								
Bromoform	ND	0.2								
o-Xylene	ND	0.1								
1,1,2,2-Tetrachloroethane	ND	0.2								
n-Propylbenzene	ND	0.2								
1,2,4-Trimethylbenzene	ND	0.2								
1,3-Dichlorobenzene	ND	0.2								
1,4-Dichlorobenzene	ND	0.2								
1,2-Dichlorobenzene	ND	0.2								
Surr: 1,2-Dichloroethane-d4	1.78		2		89	70	130			
Surr: Toluene-d8	2.08		2		104	70	130			
Surr: 4-Bromofluorobenzene	2.02		2		101	70	130			

Laboratory Control Spike

Type LCS Test Code: EPA Method SW8260B

File ID: 15090202.D

Batch ID: MS15A0902A

Analysis Date: 09/02/2015 10:25

Sample ID: LCS MS15A0902A

Units: mg/m³

Run ID: MSD_15_150902A

Prep Date: 09/02/2015 10:25

Analyte	Result	PQL	SpkVal	SpkRefVal	%REC	LCL(ME)	UCL(ME)	RPDRefVal	%RPD(Limit)	Qual
1,1-Dichloroethene	9.25	0.2	10		93	70	130			
Methyl tert-butyl ether (MTBE)	8.74	0.1	10		87	63	137			
Benzene	8.97	0.1	10		90	70	130			
Trichloroethene	9.28	0.2	10		93	68	138			
Toluene	10	0.1	10		100	70	130			
Chlorobenzene	9.65	0.2	10		97	70	130			
Ethylbenzene	9.36	0.1	10		94	70	130			
m,p-Xylene	9.8	0.1	10		98	65	139			
o-Xylene	9.44	0.1	10		94	70	130			
Surr: 1,2-Dichloroethane-d4	8.94		10		89	70	130			
Surr: Toluene-d8	10.4		10		104	70	130			
Surr: 4-Bromofluorobenzene	9.98		10		99.8	70	130			



Alpha Analytical, Inc.

255 Glendale Ave. • Suite 21 • Sparks, Nevada 89431-5778
(775) 355-1044 • (775) 355-0406 FAX • 1-800-283-1183

Date:
04-Sep-15

QC Summary Report

Work Order:
15090241

Comments:

Calculations are based off of raw (non-rounded) data. However, for reporting purposes, all QC data is rounded to three significant figures. Therefore, hand calculated values may differ slightly.



Alpha Analytical, Inc.

255 Glendale Ave. • Suite 21 • Sparks, Nevada 89431-5778

(775) 355-1044 • (775) 355-0406 FAX • 1-800-283-1183

Date:
04-Sep-15

QC Summary Report

Work Order:
15090241

Method Blank

Type MBLK Test Code: EPA Method 624/8260

File ID: 15090204.D

Batch ID: MS09W0902A

Analysis Date: 09/02/2015 12:34

Sample ID: MBLK MS09W0902A

Units: µg/L

Run ID: MSD_09_150902A

Prep Date: 09/02/2015 12:34

Analyte	Result	PQL	SpkVal	SpkRefVal	%REC	LCL(ME)	UCL(ME)	RPDRefVal	%RPD(Limit)	Qual
Chloromethane	ND	2								
Vinyl chloride	ND	1								
Chloroethane	ND	1								
Bromomethane	ND	2								
Trichlorofluoromethane	ND	1								
1,1-Dichloroethene	ND	1								
Tertiary Butyl Alcohol (TBA)	ND	10								
Dichloromethane	ND	2								
trans-1,2-Dichloroethene	ND	1								
Methyl tert-butyl ether (MTBE)	ND	0.5								
1,1-Dichloroethane	ND	1								
Di-isopropyl Ether (DIPE)	ND	1								
cis-1,2-Dichloroethene	ND	1								
Chloroform	ND	1								
Ethyl Tertiary Butyl Ether (ETBE)	ND	1								
1,2-Dichloroethane	ND	1								
1,1,1-Trichloroethane	ND	1								
Carbon tetrachloride	ND	1								
Benzene	ND	0.5								
Tertiary Amyl Methyl Ether (TAME)	ND	1								
1,2-Dichloropropane	ND	1								
Trichloroethene	ND	1								
Bromodichloromethane	ND	1								
cis-1,3-Dichloropropene	ND	1								
trans-1,3-Dichloropropene	ND	1								
1,1,2-Trichloroethane	ND	1								
Toluene	ND	0.5								
Dibromochloromethane	ND	1								
1,2-Dibromoethane (EDB)	ND	2								
Tetrachloroethene	ND	1								
Chlorobenzene	ND	1								
Ethylbenzene	ND	0.5								
m,p-Xylene	ND	0.5								
Bromoform	ND	1								
o-Xylene	ND	0.5								
1,1,2,2-Tetrachloroethane	ND	1								
1,3-Dichlorobenzene	ND	1								
1,4-Dichlorobenzene	ND	1								
1,2-Dichlorobenzene	ND	1								
Naphthalene	ND	2								
Surr: 1,2-Dichloroethane-d4	10.2		10		102	70	130			
Surr: Toluene-d8	10.2		10		102	70	130			
Surr: 4-Bromofluorobenzene	9.68		10		97	70	130			

Laboratory Control Spike

Type LCS Test Code: EPA Method 624/8260

File ID: 15090202.D

Batch ID: MS09W0902A

Analysis Date: 09/02/2015 11:44

Sample ID: LCS MS09W0902A

Units: µg/L

Run ID: MSD_09_150902A

Prep Date: 09/02/2015 11:44

Analyte	Result	PQL	SpkVal	SpkRefVal	%REC	LCL(ME)	UCL(ME)	RPDRefVal	%RPD(Limit)	Qual
1,1-Dichloroethene	10.4	1	10		104	70	130			
Methyl tert-butyl ether (MTBE)	9.06	0.5	10		91	63	137			
Benzene	10	0.5	10		100	70	130			
Trichloroethene	9.95	1	10		100	68	138			
Toluene	9.7	0.5	10		97	70	130			
Chlorobenzene	9.78	1	10		98	70	130			
Ethylbenzene	8.74	0.5	10		87	70	130			
m,p-Xylene	9.21	0.5	10		92	65	139			
o-Xylene	9.93	0.5	10		99	70	130			
Surr: 1,2-Dichloroethane-d4	10		10		100	70	130			
Surr: Toluene-d8	10		10		100	70	130			
Surr: 4-Bromofluorobenzene	9.84		10		98	70	130			



Alpha Analytical, Inc.

255 Glendale Ave. • Suite 21 • Sparks, Nevada 89431-5778
(775) 355-1044 • (775) 355-0406 FAX • 1-800-283-1183

Date:
04-Sep-15

QC Summary Report

Work Order:
15090241

Sample Matrix Spike

Type MS Test Code: EPA Method 624/8260

File ID: 15090214.D

Batch ID: MS09W0902A

Analysis Date: 09/02/2015 16:37

Sample ID: 15090240-01AMS

Units : µg/L

Run ID: MSD_09_150902A

Prep Date: 09/02/2015 16:37

Analyte	Result	PQL	SpkVal	SpkRefVal	%REC	LCL(ME)	UCL(ME)	RPDRefVal	%RPD(Limit)	Qual
1,1-Dichloroethene	50.6	2.5	50	0	101	62	133			
Methyl tert-butyl ether (MTBE)	48.8	1.3	50	0	98	56	140			
Benzene	51.1	1.3	50	0	102	67	134			
Trichloroethene	48.7	2.5	50	0	97	68	138			
Toluene	47.9	1.3	50	0	96	38	130			
Chlorobenzene	48	2.5	50	0	96	70	130			
Ethylbenzene	41.8	1.3	50	0	84	70	130			
m,p-Xylene	43.2	1.3	50	0	86	65	139			
o-Xylene	48.6	1.3	50	0	97	69	130			
Surr: 1,2-Dichloroethane-d4	52		50		104	70	130			
Surr: Toluene-d8	49.1		50		98	70	130			
Surr: 4-Bromofluorobenzene	49.6		50		99	70	130			

Sample Matrix Spike Duplicate

Type MSD Test Code: EPA Method 624/8260

File ID: 15090215.D

Batch ID: MS09W0902A

Analysis Date: 09/02/2015 17:01

Sample ID: 15090240-01AMS

Units : µg/L

Run ID: MSD_09_150902A

Prep Date: 09/02/2015 17:01

Analyte	Result	PQL	SpkVal	SpkRefVal	%REC	LCL(ME)	UCL(ME)	RPDRefVal	%RPD(Limit)	Qual
1,1-Dichloroethene	58	2.5	50	0	116	62	133	50.63	13.6(35)	
Methyl tert-butyl ether (MTBE)	54	1.3	50	0	108	56	140	48.79	10.1(40)	
Benzene	57.1	1.3	50	0	114	67	134	51.11	11.0(21)	
Trichloroethene	54.4	2.5	50	0	109	68	138	48.7	11.1(20)	
Toluene	53.1	1.3	50	0	106	38	130	47.86	10.4(20)	
Chlorobenzene	53.8	2.5	50	0	108	70	130	48.03	11.2(20)	
Ethylbenzene	47.2	1.3	50	0	94	70	130	41.81	12.1(20)	
m,p-Xylene	49.2	1.3	50	0	98	65	139	43.23	13.0(20)	
o-Xylene	54.5	1.3	50	0	109	69	130	48.62	11.4(20)	
Surr: 1,2-Dichloroethane-d4	51		50		102	70	130			
Surr: Toluene-d8	49		50		98	70	130			
Surr: 4-Bromofluorobenzene	48.7		50		97	70	130			

Comments:

Calculations are based off of raw (non-rounded) data. However, for reporting purposes, all QC data is rounded to three significant figures. Therefore, hand calculated values may differ slightly.

Billing Information :

CHAIN-OF-CUSTODY RECORD

RUSH CA

Alpha Analytical, Inc.
 255 Glendale Avenue, Suite 21 Sparks, Nevada 89431-5778
 TEL: (775) 355-1044 FAX: (775) 355-0406

WorkOrder : STR15090241
Report Due By : 5:00 PM On : 02-Sep-15

Client:
 Stratus Environmental
 3330 Cameron Park Drive
 Suite 550
 Cameron Park, CA 95682-8861

Report Attention	Phone Number	EMail Address
Scott Bittinger	(530) 676-2062 x	sbittinger@stratusinc.net

EDD Required : Yes

Sampled by : C. Hill

PO :
 Client's COC # : 04632 Job : Grit Auto

Cooler Temp	Samples Received	Date Printed
0 °C	02-Sep-15	02-Sep-15

QC Level : S3 = Final Rpt, MBLK, LCS, MS/MSD With Surrogates

Alpha Sample ID	Client Sample ID	Collection Matrix	Date	No. of Bottles Alpha Sub TAT			Requested Tests						Sample Remarks			
							TPHP_A	TPHP_W	VOC_A	VOC_W						
STR15090241-01A	Grim W EFF	AQ	09/01/15 06:31	6	0	0	GAS-C		8260/OXYS/ EDB/Naph_C							
STR15090241-02A	Grim A EFF	AR	09/01/15 06:48	1	0	0	GAS-N/C		8260/OXYS/ EDB_S							Tedlar.

Comments: ASAP TAT. Security seals intact. Frozen ice. Chain split due to different TATs. :

	Signature	Print Name	Company	Date/Time
Logged in by:		JESSICA ALVARADO	Alpha Analytical, Inc.	9/2/15 1015

NOTE: Samples are discarded 60 days after results are reported unless other arrangements are made. Hazardous samples will be returned to client or disposed of at client expense. The report for the analysis of the above samples is applicable only to those samples received by the laboratory with this COC. The liability of the laboratory is limited to the amount paid for the report.
 Matrix Type : AQ(Aqueous) AR(Air) SO(Soil) WS(Waste) DW(Drinking Water) OT(Other) Bottle Type: L-Liter V-Voa S-Soil Jar O-Orbo T-Tedlar B-Brass P-Plastic OT-Other

Company: STUNKS
 Attn: _____
 Address: 3530 Cameron Pk Dr
Cameron PA
 City, State, Zip: _____
 Phone Number: _____ Fax: _____



Alpha Analytical, Inc.
 Main Laboratory: 255 Glendale Ave., Suite 21 Sparks, NV 89431
 Satellite Service Centers:
 Northern CA: 9891 Horn Road, Suite C, Rancho Cordova, CA 95827
 Southern CA: 1007 E. Dominguez St., Suite O, Carson, CA 90746
 Northern NV: 1250 Lamoille Hwy., #310, Elko, NV 89801
 Southern NV: 6255 McLeod Ave., Suite 24, Las Vegas, NV 89120

Phone: 775-355-1044
 Fax: 775-355-0406
 Phone: 916-366-9089
 Phone: 714-366-2901
 Phone: 775-388-7043
 Phone: 702-281-4848

04632

Page # 1 of 1

Consultant/Client Info: STUNKS Job and Purchase Order Info: Job # _____ Job Name: Grunt AUTO Report Attention/Project Manager: SCOTT QC Deliverable Info: EDD Required? Yes / No _____ EDF Required? Yes / No _____
 Address: _____ City, State, Zip: _____ P.O. #: _____ Name: _____ Email Address: _____ Phone #: _____ Cell #: _____
 Samples Collected from which State? (circle one) AR CA KS NV OR WA DOD Site Other _____ Global ID: _____ Data Validation Packages: III or IV

Time Sampled (HHMM)	Date Sampled (MM/DD)	Matrix* (See Key Below)	Lab ID Number (For Lab Use Only)	Sample Description	TAT	#Containers** (See Key Below)	Field Filtered?		Analysis Requested										Remarks
							Yes	No	GRD	BKX	MTBE	1,2 DCA	Mapthalene	PCB	VOCS TEL	Vinylchloride	Chlorobenzene	Npropyl benzene	
0636	9/15	AR		Grum W INF	STD	6	X	X	X	X	X	X	X	X	X				
0633				Grum W GAC 1	STD	6	X	X	X	X	X	X	X	X	X				
0631		AR		Grum W EFF	24	6	X	X	X	X	X	X	X	X	X				
0645	9/15	AR		Grum A Sys INF	STD	1	X	X	X	X	X	X	X	X	X	X	X	X	
0645		AR		Grum A EFF	24	1	X	X	X	X	X	X	X	X	X	X	X	X	

ADDITIONAL INSTRUCTIONS:

I (field sampler) attest to the validity and authenticity of this sample(s). I am aware that tampering with or intentionally mislabeling the sample location, date or time of collection is considered fraud and may be grounds for legal action. NAC 445.0636 (c) (2).

Relinquished by: Chris C. Stucky Date: 9/15 Time: 12:10 Received by: Maryssa T Date: 9-1-15 Time: 1210
 Relinquished by: _____ Date: _____ Time: _____ Received by: _____ Date: 9/2/15 Time: 1000
 Relinquished by: _____ Date: _____ Time: _____ Received by: _____ Date: _____ Time: _____

* Key: AQ - Aqueous OT - Other So-Soil WA - Waste ** B - Brass L - Liter O - Orbo OT - Other P - Plastic S-Soil Jar T - Tedlar V - VOA
 NOTE: Samples are discarded 60 days after sample receipt unless other arrangements are made. Hazardous samples will be returned to client or disposed of at client expense. The report for the analysis of the above samples is applicable only to those samples received by the laboratory with this COC. The liability of the laboratory is limited to the amount paid for the report.