

Comments: Ron, here is the lab data for Chevron 9-8341 on 3530 MacArthur, Oakland. We are faxing you this data for Kenneth Kan of Chevron. The report is in progress and will be finished this week.

Samples P-1 → P-6 were collected beneath the piping after the product lines were 11st removed. PX-1 → PX-11 were collected after we performed some overexcavation. Chevron left the canopy footing in place so there is some hydrocarbon impacted soil around this.

Please call if you have questions.
Jeff Monroe

- ① Jeff Monroe →
- ② Kenneth Kan → 842-8752 (510)



Northwest Region
4080 Pike Lane
Suite C
Concord, CA 94520
(510) 685-7852
(800) 544-3422 Inside CA
FAX (510) 825-0720

Client Number: T0001CHV08
Consultant Project Number: 8341-8
Facility Number: 9-8841
Project ID: 3530 MacArthur
Oakland
Work Order Number: C4-05-0009

May 10, 1994

Jeff Monroe
Touchstone Developments
P.O. Box 2554
Santa Rosa, CA 95405

Enclosed please find the analytical results for samples received by GTEL Environmental Laboratories, Inc. on 05/03/94.

A formal Quality Assurance/Quality Control (QA/QC) program is maintained by GTEL, which is designed to meet or exceed the EPA requirements. Analytical work for this project met QA/QC criteria, unless otherwise stated in the footnotes.

GTEL is certified by the California State Department of Health Services, Laboratory certification number E1075, to perform analyses for drinking water, wastewater, and hazardous waste materials according to EPA protocols.

If you have any questions concerning this analysis or if we can be of further assistance, please call our Customer Service Representative.

Sincerely,
GTEL Environmental Laboratories, Inc.

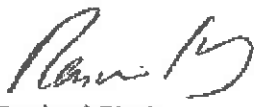
Rashmi Shah
Laboratory Director

Client Number: TOL01CHV08
 Consultant Project Number: 8341-3
 Facility Number: 8-8341
 Project ID: 9530 MacArthur
 Oakland
 Work Order Number: C4-05-0009

ANALYTICAL RESULTS

Volatile Organics in Water

EPA Methods 8020 and Modified 8015^a

GTEL Sample Number		10	M050394		
Client Identification		TH ₂ O-3	METHOD BLANK		
Date Sampled		05/02/94	-		
Date Analyzed		05/04/94	05/03/94		
Analyte	Detection Limit, ug/L	Concentration, ug/L			
Benzene	0.5	<0.5	<0.5		
Toluene	0.5	<0.5	<0.5		
Ethylbenzene	0.5	<0.5	<0.5		
Xylene, total	0.5	0.9	<0.5		
Gasoline	50	<50	<50		
Detection Limit Multiplier		1	1		
BFB surrogate, % recovery		95.8	110		

- a. Test Methods for Evaluating Solid Waste, SW-846, Third Edition, Revision 0, US EPA November 1988. Modification for TPH as gasoline as per California State Water Resources Board LUFT Manual procedures. Bromofluorobenzene surrogate recovery acceptability limits are 70-130%.

Client Number: TCU01CHM08
 Consultant Project Number: 8341-3
 Facility Number: 0-8341
 Project ID: 3530 MacArthur
 Oakland
 Work Order Number: 04-05-0008

ANALYTICAL RESULTS

Aromatic Volatile Organics and Total Petroleum Hydrocarbons as Gasoline in Soil

EPA Methods 5030, 8020, and Modified 8015^a

GTEL Sample Number		01 ^b	02	03 ^b	04
Client Identification		PX-1	PX-2	PX-3	PX-4
Date Sampled		05/02/94	05/02/94	05/02/94	05/02/94
Date Analyzed		05/05/94	05/03/94	05/03/95	05/03/94
Analyte	Detection Limit, mg/Kg	Concentration, mg/Kg			
Benzene	0.005	0.52	1.9	1.1	<0.005
Toluene	0.005	0.15	4.2	0.028	<0.005
Ethylbenzene	0.005	0.41	9.2	0.044	<0.005
Xylene, total	0.015	0.330	1.80	0.12	<0.015
TPH as Gasoline	1	35	540	<1	<1
Detection Limit Multiplier		1	5	1	1
Percent solids		75.4	75.8	81.3	80.3
BFB Surrogate, % recovery		104	106	82.3	80.8

- a. Test Methods for Evaluating Solid Waste, SW-846, Third Edition, Revision 0, US EPA November 1988. Modification for TPH as gasoline as per California State Water Resources Control Board LUFT Manual protocols, May 1988 revision. Results reported on a wet weight basis. Bromofluorobenzene surrogate recovery acceptability limits are 72.1-127%.
- b. Uncategorized compound is not included in gasoline concentration.

Client Number: TOL01CHM08
 Consultant Project Number: 8341-3
 Facility Number: 9-8341
 Project ID: 2530 MacArthur
 Oakland
 Work Order Number: C4-05-0008

ANALYTICAL RESULTS

**Aromatic Volatile Organics and
 Total Petroleum Hydrocarbons as Gasoline in Soil**

EPA Methods 5030, 8020, and Modified 8015^a

GTCL Sample Number		05	06	07	08
Client Identification		PX-5	PX-6	PX-7	PX-8
Date Sampled		05/02/94	05/02/94	05/02/94	05/02/94
Date Analyzed		05/05/94	05/05/94	05/04/94	05/05/94
Analyte	Detection Limit, mg/Kg	Concentration, mg/Kg			
Benzene	0.005	<0.005	1.2	1.3	6.0
Toluene	0.005	<0.005	0.15	0.92	38
Ethylbenzene	0.005	<0.005	2.0	6.0	33
Xylene, total	0.015	<0.015	0.62	29	170
TPH as Gasoline	1	<1	36	230	1300
Detection Limit Multiplier		1	1	10	10
Percent solids		80.5	77.7	78.1	76.3
BFB Surrogate, % recovery		79.5	100	91.0	97.3

^a Test Methods for Evaluating Solid Waste, SW-846, Third Edition, Revision 0, US EPA November 1988. Modification for TPH as gasoline as per California State Water Resources Control Board LUFT Manual protocols, May 1988 revision. Results reported on a wet weight basis. Bromofluorobenzene surrogate recovery acceptability limits are 72.1-127%



FACSIMILE COVER SHEET

To: Ron Oukarz Date: 6-3-94

Client Number: TDU01CHM08
 Consultant Project Number: 8041-3
 Facility Number: 0-8941
 Project ID: 3830 MacArthur
 Oakland
 Work Order Number: C4-05-0009

ANALYTICAL RESULTS

Aromatic Volatile Organics and Total Petroleum Hydrocarbons as Gasoline in Soil

EPA Methods 5030, 8020, and Modified 8015^a

GTEL Sample Number		09	A050394		
Client Identification		PX-9	METHOD BLANK		
Date Sampled		05/02/94	-		
Date Analyzed		05/05/94	05/05/94		
Analyte	Detection Limit, mg/Kg	Concentration, mg/Kg			
Benzene	0.005	<0.005	<0.005		
Toluene	0.005	<0.005	<0.005		
Ethylbenzene	0.005	<0.005	<0.005		
Xylene, total	0.015	<0.015	<0.015		
TPH as Gasoline	1	<1	<1		
Detection Limit Multiplier		1	1		
Percent solids		77.2	NA		
SFB Surrogate, % recovery		39.4	94.5		

- a. Test Methods for Evaluating Solid Waste, SW-846, Third Edition, Revision 0, US EPA November 1989. Modification for TPH as gasoline as per California State Water Resources Control Board LUFT Manual protocols, May 1988 revision. Results reported on a wet weight basis. Bromofluorobenzene surrogate recovery acceptability limits are 72.1-127%
 NA = Not Applicable.

Fax copy of Lab Report and COC to Chevron Contact: Yes No

Chain-of-Cust

P.01

Chevron U.S.A. Inc.
P.O. BOX 5004
San Ramon, CA 94583
FAX (415)842-9591

Chevron Facility Number 9-8341
Facility Address 3530 MacArthur, Oakland
Consultant Project Number 8341-3
Consultant Name Trickstone Developments
Address 10101 2654 Santa Rita 95405
Project Contact (Name) Jeff Morrow
(Phone) 915-888-8818 (Fax Number) 518-8812

Chevron Contact (Name) Richard Kim
(Phone) 510 842 8775
Laboratory Name GTEL
Laboratory Release Number 1016521
Samples Collected by (Name) Jeff Morrow
Collection Date 5-2-94
Signature Jeff Morrow

Sample Number	Lab Sample Number	Number of Containers	Matrix S = Soil W = Water A = Air C = Charcoal	Type G = Grab C = Composite D = Discrete	Time	Sample Preservation	Iced (Yes or No)	Analytes To Be Performed													
								BTEX + TPH GAS (8020 + 8015)	TPH Diesel (8015)	Oil and Grease (5520)	Purgeable Halocarbons (8010)	Purgeable Aromatics (8020)	Purgeable Organics (8240)	Extractable Organics (8270)	Metals Cd, Cr, Pb, Zn, Ni (ICAP or AA)						
PX-1	01	1	S	D	10:30		Yes	X													
PX-2	02				10:32																
PX-3	03				10:35																
PX-4	04				10:45																
PX-5	05				10:48																
PX-6	06				16:55																
PX-7	07				16:59																
PX-8	08				16:58																
PX-9	09	↓	↓	↓	17:00																
SP-2a	10	4	↓	C	17:05																
TH2O-3	10	8	W	G	17:15																

Handwritten note: Volatility 515

Handwritten signature/initials: [Signature]

C405 00 10-24 H
C405 00 09-5 DA

Relinquished By (Signature) <u>Jeff Morrow</u>	Organization <u>TD</u>	Date/Time <u>5-2-94 17:00</u>	Received By (Signature) <u>[Signature]</u>	Organization <u>GTEL</u>	Date/Time <u>17:10</u>	Turn Around Tim 24 48 5 C 10 I As Car
Relinquished By (Signature) <u>[Signature]</u>	Organization <u>[Signature]</u>	Date/Time <u>5-2-94</u>	Received By (Signature) <u>[Signature]</u>	Organization <u>GTEL</u>	Date/Time <u>5-2-94</u>	
Relinquished By (Signature) <u>[Signature]</u>	Organization <u>[Signature]</u>	Date/Time <u>[Signature]</u>	Received For Laboratory By (Signature) <u>INPUT BY [Signature]</u>	Organization <u>[Signature]</u>	Date/Time <u>08:05 5/3/94</u>	

COC-3.DMS/03.01/ACH

ANALYTICAL RESULTS

Aromatic Volatile Organics and Total Petroleum Hydrocarbons as Gasoline in Soil

EPA Methods 5030, 8020, and Modified 8015^a

GTEL Sample Number		01	02	F050694
Client Identification		PX-10	PX-11	METHOD BLANK
Date Sampled		05/05/94	05/05/94	--
Date Analyzed		05/06/94	05/06/94	05/06/94
Analyte	Detection Limit, mg/Kg	Concentration, mg/Kg		
Benzene	0.005	<0.005	<0.005	<0.005
Toluene	0.005	<0.005	<0.005	<0.005
Ethylbenzene	0.005	<0.005	<0.005	<0.005
Xylene, total	0.015	<0.015	<0.015	<0.015
TPH as Gasoline	1	<1	<1	<1
Detection Limit Multiplier		1	1	1
Percent solids		84.8	84.7	NA
BFB Surrogate, % recovery		37.3 ^b	37.5 ^b	99.2

- a. Test Methods for Evaluating Solid Waste, SW-846, Third Edition, Revision 0, US EPA November 1986. Modification for TPH as gasoline as per California State Water Resources Control Board LUFT Manual protocols, May 1998 revision. Results reported on a wet weight basis. Bromofluorobenzene surrogate recovery acceptability limits are 72.1-127%. NA = Not Applicable.
- b. Estimated concentration surrogate recovery demonstrated sample matrix effect. LCS indicated the analysis was within control limits.

Client Number: TQ001CHV08
 Consultant Project Number: 8341-2
 Facility Number: 0-8341
 Project ID: 3550 MacArthur, Oakland
 Work Order Number: C4-04-0450

ANALYTICAL RESULTS

Aromatic Volatile Organics and Total Petroleum Hydrocarbons as Gasoline in Soil

EPA Methods 5030, 8020, and Modified 8015^a

GTEL Sample Number		01	02	03	04
Client Identification		P-1-2.5	P-2-3.5	P-3-4.5	P-4-4.5
Date Sampled		04/26/94	04/26/94	04/26/94	04/26/94
Date Analyzed		04/27/94	04/27/94	04/26/94	04/26/94
Analyte	Detection Limit, mg/Kg	Concentration, mg/Kg			
Benzene	0.005	0.42	2.2	<0.005	<0.005
Toluene	0.005	0.15	5.6	<0.005	<0.005
Ethylbenzene	0.005	0.20	3.4	<0.005	<0.005
Xylene, total	0.015	0.77	70.9	<0.015	<0.015
TPH as Gasoline	1	59	1200	<1	<1
Detection Limit Multiplier		1	10	1	1
Percent solids		78.3	68.8	65.9	77.9
BFB Surrogate, % recovery		102	118	87.5	85.1

- a. Test Methods for Evaluating Solid Waste, SW-846, Third Edition, Revision 0, US EPA November 1986. Modification for TPH as gasoline as per California State Water Resources Control Board LUFT Manual protocols, May 1988 revision. Results reported on a wet weight basis. Bromofluorobenzene surrogate recovery acceptability limits are 72.1-127%

Client Number: TOLUICHV06
 Consultant Project Number: 8341-2
 Facility Number: 6-8341
 Project ID: 3530 MacArthur, Oakland
 Work Order Number: C4-04-0460

ANALYTICAL RESULTS

Aromatic Volatile Organics and Total Petroleum Hydrocarbons as Gasoline in Soil

EPA Methods 5030, 8020, and Modified 8015^a

GTEL Sample Number		05	F042694	
Client Identification		P-5-2.0	METHOD BLANK	
Date Sampled		04/26/94	--	
Date Analyzed		04/27/94	04/26/94	
Analyte	Detection Limit, mg/Kg	Concentration, mg/Kg		
Benzene	0.005	0.40	<0.005	
Toluene	0.005	0.096	<0.005	
Ethylbenzene	0.005	0.086	<0.005	
Xylene, total	0.015	0.61	<0.015	
TPH as Gasoline	1	14	<1	
Detection Limit Multiplier		1	1	
Percent solids		77.1	NA	
BFB Surrogate, % recovery		95.4	97.9	

- a. Test Methods for Evaluating Solid Waste, SW-846, Third Edition, Revision 0, US EPA November 1986. Modification for TPH as gasoline as per California State Water Resources Control Board LUFT Manual protocols, May 1988 revision. Results reported on a wet weight basis. Bromofluorobenzene surrogate recovery acceptability limits are 72.1-127%. NA = Not Applicable.



**ENVIRONMENTAL
LABORATORIES, INC.**

Northwest Region
4080 Pike Lane
Suite C
Concord, CA 94520
(510) 685-7852
(800) 544-3422 Inside CA
FAX (510) 625-0720

Client Number: T0U01CH908
Consultant Project Number: 834-1-2
Facility Number: 9-0341
Project ID: 2030 Main Arthur, Oakland
Work Order Number: C4-04-0499

17075388812 P.01

May 2, 1994

Jeff Monroe
Touchstone Developments
P.O. Box 2554
Santa Rosa, CA 95405

Enclosed please find the analytical results for samples received by GTEL Environmental Laboratories, Inc. on 04/28/94.

A formal Quality Assurance/Quality Control (QA/QC) program is maintained by GTEL, which is designed to meet or exceed the EPA requirements. Analytical work for this project met QA/QC criteria, unless otherwise stated in the footnotes.

GTEL is certified by the California State Department of Health Services, Laboratory certification number E1075, to perform analyses for drinking water, wastewater, and hazardous waste materials according to EPA protocols.

If you have any questions concerning this analysis or if we can be of further assistance, please call our Customer Service Representative.

Sincerely,
GTEL Environmental Laboratories, Inc.

Rashmi Shah
Laboratory Director

Client Number: T0401CHM08
 Consultant Project Number: 894-1-2
 Facility Number: 2-8341
 Project ID: 2530 Men Arthur, Oakland
 Work Order Number: C4-04-0488

ANALYTICAL RESULTS

Aromatic Volatile Organics and Total Petroleum Hydrocarbons as Gasoline in Soil

EPA Methods 5030, 8020, and Modified 8015a

GTEL Sample Number		01 ^b	02 ^b	F042994
Client Identification		SP-1a-d	P-6	METHOD BLANK
Date Sampled		04/28/94	04/28/94	--
Date Analyzed		04/29/94	04/29/94	NA
Analyte	Detection Limit, mg/Kg	Concentration, mg/Kg		
Benzene	0.005	<0.020	<0.020	<0.020
Toluene	0.005	<0.020	<0.020	<0.020
Ethylbenzene	0.005	<0.020	<0.020	<0.020
Xylene, total	0.015	1.6	0.74	<0.060
TPH as Gasoline	1	130	63	<1
Detection Limit Multiplier		1	1	1
BFB Surrogate, % recovery		174	147	102

- a. Test Methods for Evaluating Solid Waste, SW-846, Third Edition, Revision 0, US EPA November 1988. Modification for TPH as gasoline as per California State Water Resources Control Board LUFT Manual protocols, May 1988 revision. Results reported on a wet weight basis. Bromofluorobenzene surrogate recovery acceptability limits are 72.1-127%. NA = Not Applicable.
- b. BFB recovery high due to interference of hydrocarbons. Hydrocarbon pattern is not characteristic of gasoline. Detection limit raised due to high levels of hydrocarbons.

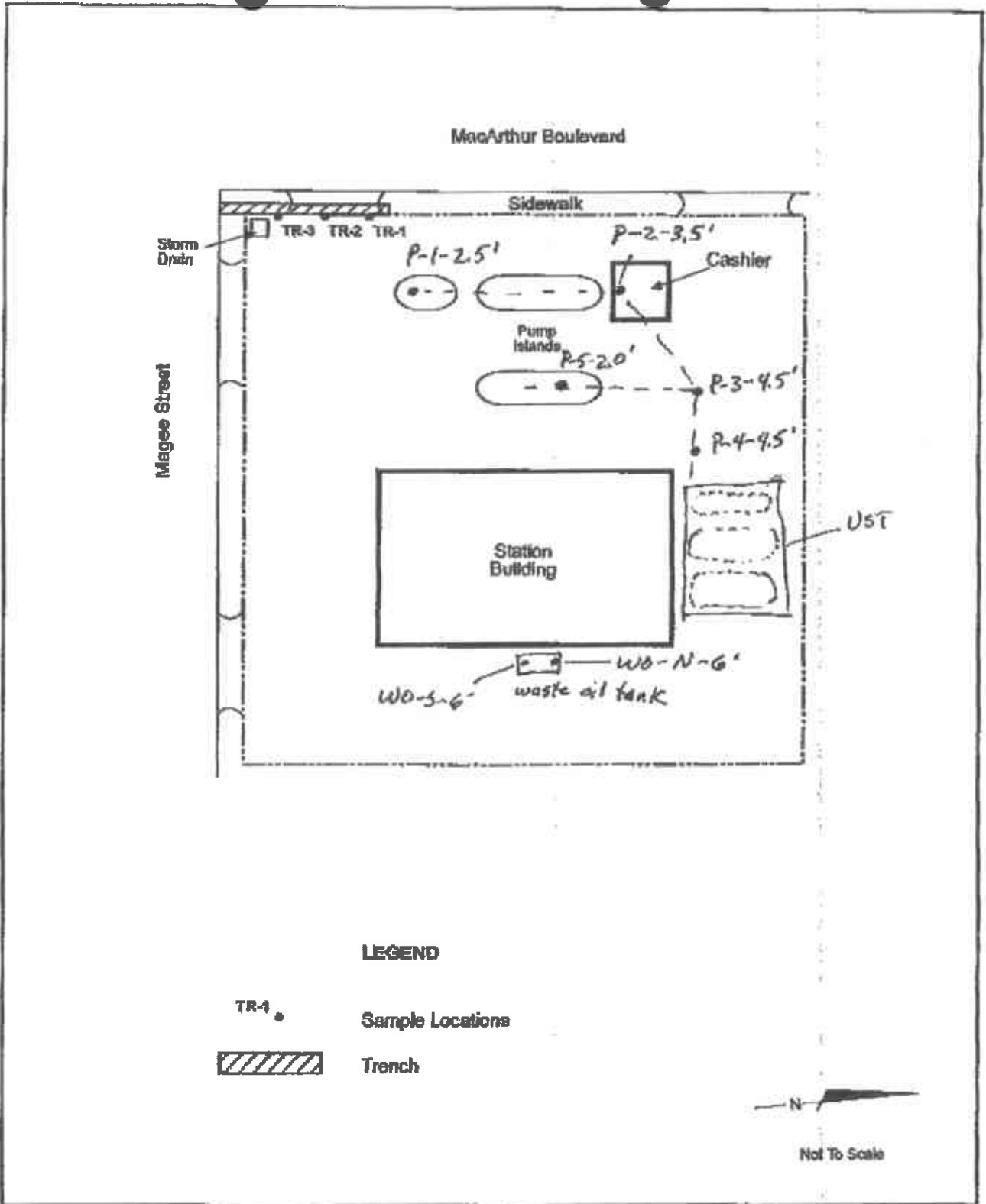

LEGEND

TR-1 • Sample Locations

▨ Trench



Not To Scale



**Touchstone
Developments**
Environmental Management

Site Plan
Former Chevron Station 9-8341
3530 MacArthur Boulevard
Oakland, California

FIGURE

1

PROJECT NUMBER
8341-1

DRAWN
PM

APPROVED

DATE
1/93