

RECEIVED

By dehloptoxic at 1:06 pm, Feb 08, 2007



Denis L. Brown

Shell Oil Products US

Jerry Wickham
Alameda County Health Care Services Agency
1131 Harbor Bay Parkway, Suite 250
Alameda, California 94502-6577

HSE – Environmental Services
20945 S. Wilmington Ave.
Carson, CA 90810-1039
Tel (707) 865 0251
Fax (707) 865 2542
Email denis.l.brown@shell.com

Re: Former Shell Service Station
8930 Bancroft Avenue
Oakland, California
SAP Code 135678
Incident No. 98995742
ACHCSA Case No. RO0000404

Dear Mr. Wickham:

The attached document is provided for your review and comment. Upon information and belief, I declare, under penalty of perjury, that the information contained in the attached document is true and correct.

If you have any questions or concerns, please call me at (707) 865-0251.

Sincerely,

A handwritten signature in black ink that reads "Denis L. Brown". The signature is written in a cursive style with a long horizontal flourish at the end.

Denis L. Brown
Project Manager

February 8, 2007

Mr. Jerry Wickham
Alameda County Health Care Services Agency
1131 Harbor Bay Parkway, 2nd Floor
Alameda, California 94502

Re: **Groundwater Monitoring Report – Fourth Quarter 2006**
Former Shell Service Station
8930 Bancroft Avenue
Oakland, California
SAP Code 135678
Incident No. 98995742
Agency Case No. RO0000404



Dear Mr. Wickham:

Cambria Environmental Technology, Inc. (Cambria) prepared this report on behalf of Equilon Enterprises LLC dba Shell Oil Products US (Shell) in accordance with the quarterly reporting requirements of 23 CCR 2652d.

If you have any questions regarding the contents of this document, please call Dennis Baertschi (707) 268-3813.

Sincerely,
Cambria Environmental Technology, Inc.

Dennis Baertschi
Project Geologist

Ana Friel, PG
Associate Geologist



Enclosure: Groundwater Monitoring Report – Fourth Quarter 2006

cc: Mr. Denis Brown, Shell
Sidhu Associates, 8930 Bancroft Ave., Oakland, CA 94605

**Cambria
Environmental
Technology, Inc.**

19449 Riverside Drive
Suite 230
Sonoma, CA 95476
Tel (707) 935-4850
Fax (707) 935-6649

C A M B R I A

GROUNDWATER MONITORING REPORT – FOURTH QUARTER 2006

Site Address	<u>8930 Bancroft Avenue, Oakland</u>
Site Use	<u>Former Shell Service Station</u>
Shell Project Manager	<u>Denis Brown</u>
Consultant and Contact Person	<u>Cambria, Dennis Baertschi</u>
Lead Agency and Contact	<u>ACHCSA, Jerry Wickham</u>
Agency Case No.	<u>RO0000404</u>
Shell SAP Code	<u>135678</u>
Shell Incident No.	<u>98995742</u>
Date of Most Recent Agency Correspondence	<u>May 16, 2006</u>



Current Quarter's Activities

1. Blaine Tech Services, Inc. (Blaine) gauged and sampled wells according to the established monitoring program for this site.
2. Cambria prepared a vicinity map (Figure 1) and a groundwater contour and chemical concentration map (Figure 2). The Blaine report, presenting the analytical data, is included in Attachment A.

Current Quarter's Findings

Groundwater Flow Direction	<u>Westerly</u>
Hydraulic Gradient	<u>0.014</u>
Depth to Water	<u>8.62 to 11.51 feet below top of well casing</u>

Proposed Activities for Next Quarter

1. Blaine will gauge and sample wells during the third month of the quarter, according to the established monitoring program for this site.

C A M B R I A

Discussion

Site groundwater monitoring data continues to support the conclusions in Cambria's September 28, 2006 *Subsurface Investigation Report*, that additional attempts to collect offsite data do not seem warranted, that the site should be reviewed for closure potential as a low risk fuel site, and that no further action be required. Cambria intends to prepare and submit a closure request document requesting that the site be considered for closure.



Figures: 1 - Vicinity Map
 2 - Groundwater Contour and Chemical Concentration Map

Attachment: A - Blaine Tech Services, Inc. - Groundwater Monitoring Report

Cambria Environmental Technology, Inc. (Cambria) prepared this document for use by our client and appropriate regulatory agencies. It is based partially on information available to Cambria from outside sources and/or in the public domain, and partially on information supplied by Cambria and its subcontractors. Cambria makes no warranty or guarantee, expressed or implied, included or intended in this document, with respect to the accuracy of information obtained from these outside sources or the public domain, or any conclusions or recommendations based on information that was not independently verified by Cambria. This document represents the best professional judgment of Cambria. None of the work performed hereunder constitutes or shall be represented as a legal opinion of any kind or nature.

K:\Oakland 8930 Bancroft\QM\2006\4Q06\Text 8930 Bancroft Oakland 4Q06.doc

EXPLANATION	
4	○ Active water producing well
8	⊕ Other well (monitoring, vadose)
28,29	⊖ Out-of-service monitoring well
6	⊙ Cathodic Protection well
7	⊕ Vapor Extraction well
5	⊕ Irrigation/Agricultural well
26	⊗ Abandoned well
28	⊖ Unknown well
★	Subject site
○	Study area

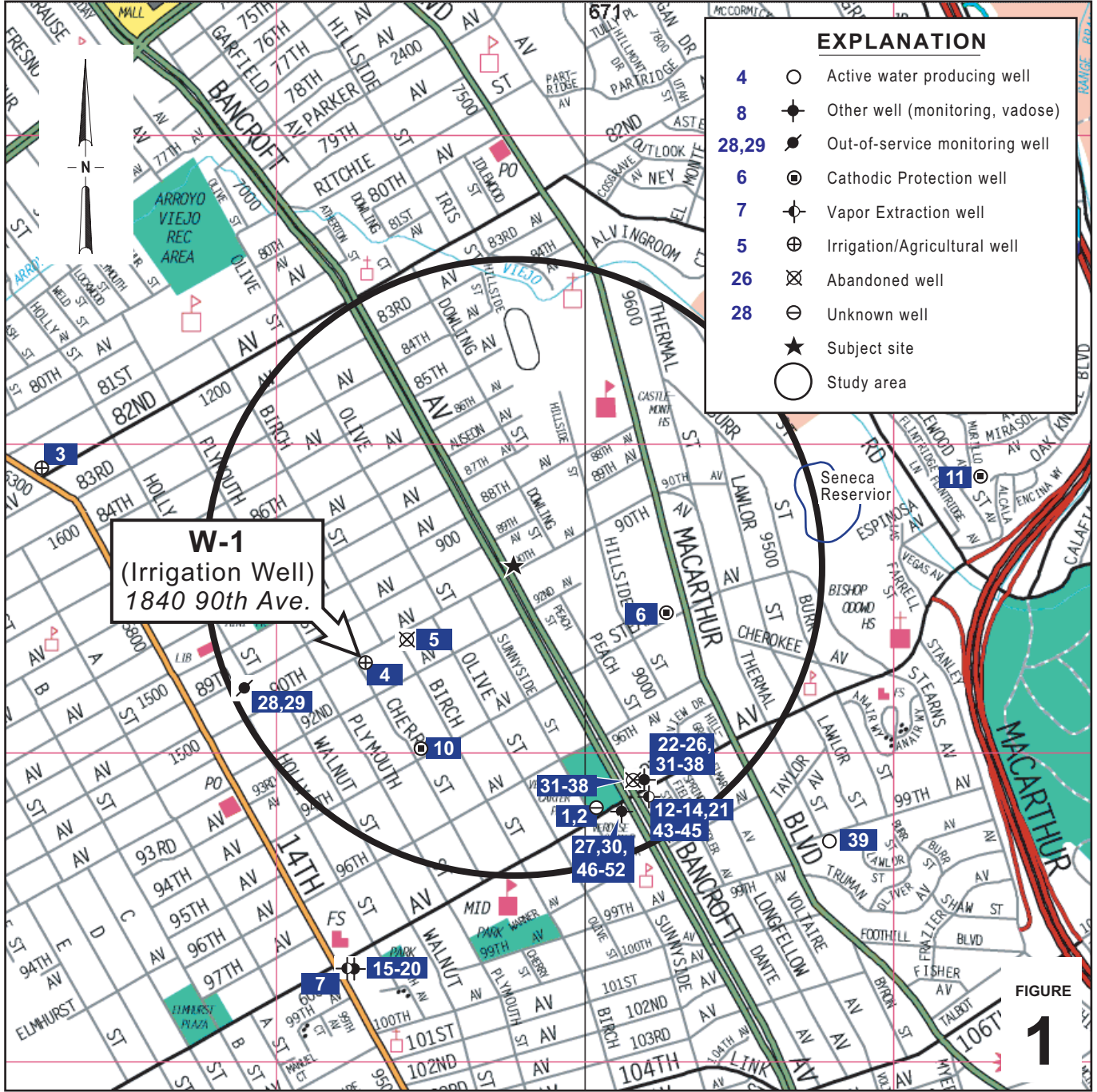
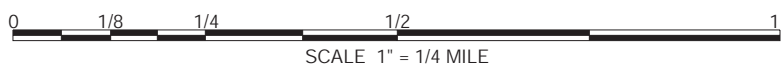

FIGURE 1



Former Shell Service Station

8930 Bancroft Avenue
Oakland, California
Incident No.98995742



C A M B R I A

Vicinity Map

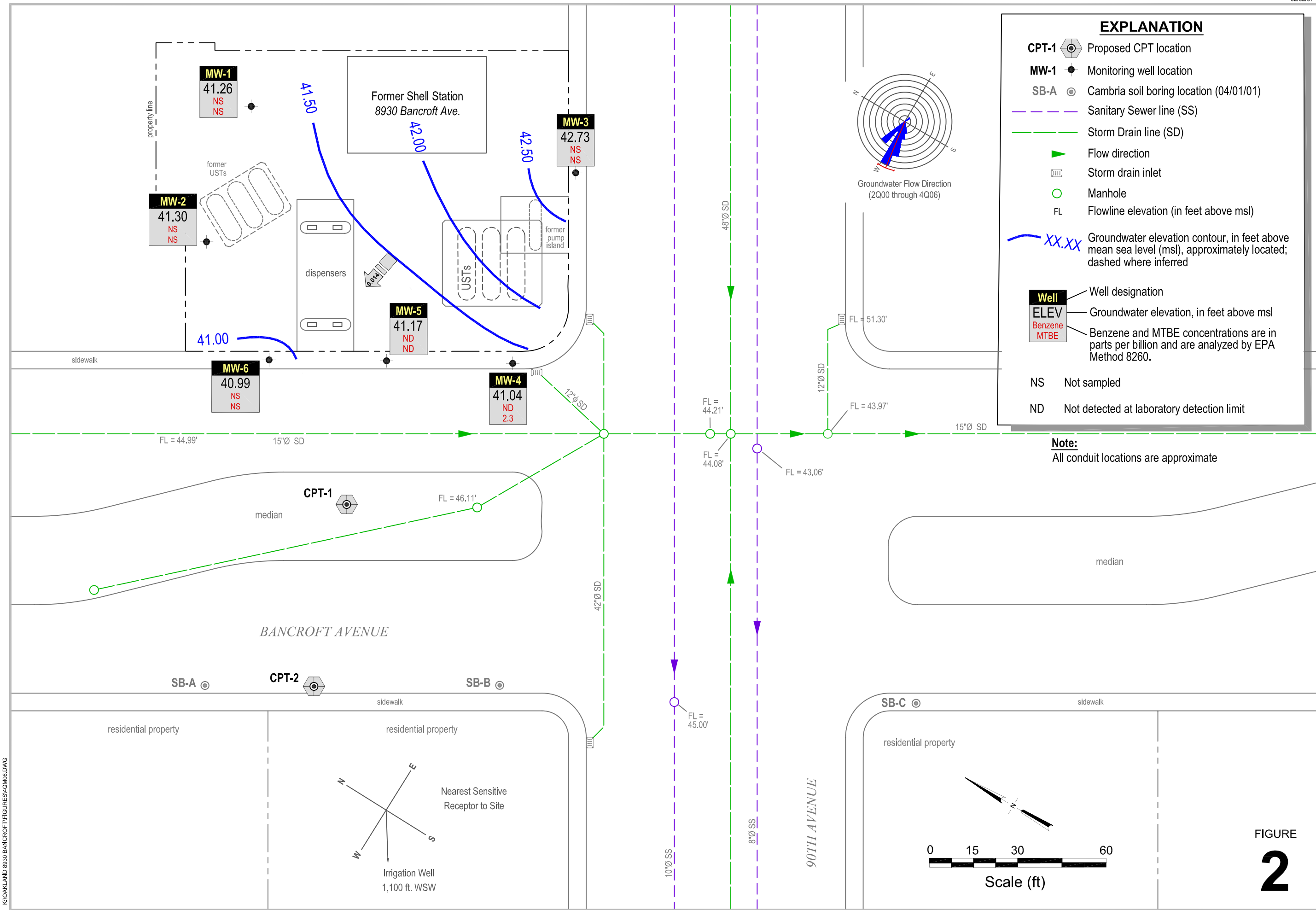

FIGURE
2

K:\OAKLAND 8930 BANCROFT\FIGURES\Q0M06.DWG

Attachment A

**Blaine Tech Services, Inc.
Groundwater Monitoring Report**

BLAINE
TECH SERVICES INC.

GROUNDWATER SAMPLING SPECIALISTS
SINCE 1985

January 15, 2007

Denis Brown
Shell Oil Products US
20945 South Wilmington Avenue
Carson, CA 90810

Fourth Quarter 2006 Groundwater Monitoring at
Former Shell Service Station
8930 Bancroft Avenue
Oakland, CA

Monitoring performed on December 20, 2006

Groundwater Monitoring Report **061220-JD-2**

This report covers the routine monitoring of groundwater wells at this former Shell facility. In accordance with standard procedures that conform to Regional Water Quality Control Board requirements, routine field data collection includes depth to water, total well depth, thickness of any separate immiscible layer, water column volume, calculated purge volume (if applicable), elapsed evacuation time (if applicable), total volume of water removed (if applicable), and standard water parameter instrument readings. Sample material is collected, contained, stored, and transported to the laboratory in conformance with EPA standards. Purgewater (if applicable) is, likewise, collected and transported to the Shell Martinez Manufacturing Complex.

Basic field information is presented alongside analytical values excerpted from the laboratory report in the cumulative table of **WELL CONCENTRATIONS**. The full analytical report for the most recent samples and the field data sheets are attached to this report.

At a minimum, Blaine Tech Services, Inc. field personnel are certified on completion of a forty-hour Hazardous Materials and Emergency Response training course per 29 CFR 1910.120. Field personnel are also enrolled in annual eight-hour refresher courses.

Blaine Tech Services, Inc. conducts sampling and documentation assignments of this type as an independent third party. Our activities at this site consisted of objective data and sample collection only. No interpretation of analytical results, defining of hydrological conditions or formulation of recommendations was performed.

Please call if you have any questions.

Yours truly,

Mike Ninokata
Project Manager

MN/ks

attachments: Cumulative Table of WELL CONCENTRATIONS
Certified Analytical Report
Field Data Sheet

cc: Dennis Baertschi
Cambria Environmental Technology, Inc.
19449 Riverside Dr., Suite 230
Sonoma, CA 95476

WELL CONCENTRATIONS
Former Shell Service Station
8930 Bancroft Avenue
Oakland, CA

Well ID	Date	TPPH (ug/L)	TEPH (ug/L)	B (ug/L)	T (ug/L)	E (ug/L)	X (ug/L)	MTBE 8020 (ug/L)	MTBE 8260 (ug/L)	DIPE (ug/L)	ETBE (ug/L)	TAME (ug/L)	TBA (ug/L)	TOC (MSL)	Depth to Water (ft.)	Depth to SPH (ft.)	GW Elevation (MSL)	SPH Thickness (ft.)	DO Reading (mg/L)
MW-1	12/17/1998	<50	NA	<0.50	<0.50	<0.50	<0.50	<2.5	NA	NA	NA	NA	NA	53.19	11.87	NA	41.32	NA	NA
MW-1	03/09/1999	<50.0	NA	<0.500	<0.500	<0.500	<0.500	<5.00	NA	NA	NA	NA	NA	53.19	8.21	NA	44.98	NA	NA
MW-1	06/16/1999	<50.0	NA	<0.500	<0.500	<0.500	<0.500	<5.00	NA	NA	NA	NA	NA	53.19	15.04	NA	38.15	NA	NA
MW-1	09/30/1999	<50.0	NA	<0.500	<0.500	<0.500	<0.500	<5.00	NA	NA	NA	NA	NA	53.19	16.02	NA	37.17	NA	NA
MW-1	12/23/1999	<50.0	NA	<0.500	<0.500	<0.500	<0.500	<2.50	NA	NA	NA	NA	NA	53.19	14.78	NA	38.41	NA	NA
MW-1	03/22/2000	<50.0	NA	<0.500	<0.500	<0.500	<0.500	<5.00	NA	NA	NA	NA	NA	53.19	8.44	NA	44.75	NA	NA
MW-1	06/01/2000	<50.0	NA	<0.500	<0.500	<0.500	<0.500	<2.50	NA	NA	NA	NA	NA	53.19	13.71	NA	39.48	NA	NA
MW-1	09/08/2000	<50.0	NA	<0.500	<0.500	<0.500	<0.500	<2.50	NA	NA	NA	NA	NA	53.19	14.95	NA	38.24	NA	NA
MW-1	12/04/2000	<50.0	NA	<0.500	<0.500	<0.500	<0.500	5.82	NA	NA	NA	NA	NA	53.19	13.85	NA	39.34	NA	NA
MW-1	03/09/2001	<50.0	NA	<0.500	<0.500	<0.500	<0.500	<2.50	NA	NA	NA	NA	NA	53.19	9.07	NA	44.12	NA	NA
MW-1	06/27/2001	<50	NA	<0.50	<0.50	<0.50	<0.50	<2.5	NA	NA	NA	NA	NA	53.19	14.90	NA	38.29	NA	NA
MW-1	09/20/2001	NA	NA	NA	NA	NA	NA	NA	NA	NA	NA	NA	NA	53.19	15.53	NA	37.66	NA	NA
MW-1	12/05/2001	NA	NA	NA	NA	NA	NA	NA	NA	NA	NA	NA	NA	53.19	10.41	NA	42.78	NA	3.8
MW-1	02/26/2002	<50	NA	<0.50	<0.50	<0.50	<0.50	NA	<0.50	NA	NA	NA	NA	53.19	11.09	NA	42.10	NA	NA
MW-1	06/06/2002	NA	NA	NA	NA	NA	NA	NA	NA	NA	NA	NA	NA	53.19	14.13	NA	39.06	NA	NA
MW-1	09/09/2002	NA	NA	NA	NA	NA	NA	NA	NA	NA	NA	NA	NA	53.20	15.55	NA	37.65	NA	NA
MW-1	12/19/2002	NA	NA	NA	NA	NA	NA	NA	NA	NA	NA	NA	NA	53.20	8.67	NA	44.53	NA	NA
MW-1	03/28/2003	<50	NA	<0.50	<0.50	<0.50	<0.50	NA	<5.0	NA	NA	NA	NA	53.20	13.33	NA	39.87	NA	NA
MW-1	06/30/2003	NA	NA	NA	NA	NA	NA	NA	NA	NA	NA	NA	NA	53.20	14.71	NA	38.49	NA	NA
MW-1	09/25/2003	<50	NA	<0.50	<0.50	<0.50	<1.0	NA	<0.50	NA	NA	NA	NA	53.20	15.13	NA	38.07	NA	NA
MW-1	12/02/2003	NA	NA	NA	NA	NA	NA	NA	NA	NA	NA	NA	NA	53.20	14.42	NA	38.78	NA	NA
MW-1	03/18/2004	<50	NA	<0.50	<0.50	<0.50	<1.0	NA	<0.50	NA	NA	NA	NA	53.20	10.38	NA	42.82	NA	NA
MW-1	06/17/2004	NA	NA	NA	NA	NA	NA	NA	NA	NA	NA	NA	NA	53.20	14.95	NA	38.25	NA	NA
MW-1	09/02/2004	NA	NA	NA	NA	NA	NA	NA	NA	NA	NA	NA	NA	53.20	15.75	NA	37.45	NA	NA
MW-1	12/14/2004	NA	NA	NA	NA	NA	NA	NA	NA	NA	NA	NA	NA	53.20	11.20	NA	42.00	NA	NA
MW-1	02/28/2005	<50	NA	<0.50	<0.50	<0.50	<1.0	NA	<0.50	NA	NA	NA	NA	53.20	8.53	NA	44.67	NA	NA
MW-1	06/21/2005	NA	NA	NA	NA	NA	NA	NA	NA	NA	NA	NA	NA	53.20	13.22	NA	39.98	NA	NA
MW-1	08/29/2005	NA	NA	NA	NA	NA	NA	NA	NA	NA	NA	NA	NA	53.20	15.15	NA	38.05	NA	NA
MW-1	12/05/2005	NA	NA	NA	NA	NA	NA	NA	NA	NA	NA	NA	NA	53.20	12.95	NA	40.25	NA	NA
MW-1	03/31/2006	<50.0	NA	<0.500	<0.500	<0.500	<0.500	NA	<0.500	NA	NA	NA	NA	53.20	7.68	NA	45.52	NA	NA
MW-1	06/14/2006	NA	NA	NA	NA	NA	NA	NA	NA	NA	NA	NA	NA	53.20	13.37	NA	39.83	NA	NA
MW-1	09/20/2006	Well inaccessible		NA	NA	NA	NA	NA	NA	NA	NA	NA	NA	53.20	NA	NA	NA	NA	NA

WELL CONCENTRATIONS
Former Shell Service Station
8930 Bancroft Avenue
Oakland, CA

Well ID	Date	TPPH (ug/L)	TEPH (ug/L)	B (ug/L)	T (ug/L)	E (ug/L)	X (ug/L)	MTBE 8020 (ug/L)	MTBE 8260 (ug/L)	DIPE (ug/L)	ETBE (ug/L)	TAME (ug/L)	TBA (ug/L)	TOC (MSL)	Depth to Water (ft.)	Depth to SPH (ft.)	GW Elevation (MSL)	SPH Thickness (ft.)	DO Reading (mg/L)
MW-1	12/20/2006	NA	NA	NA	NA	NA	NA	NA	NA	NA	NA	NA	NA	53.20	11.51	NA	41.26	NA	NA
MW-2	12/17/1998	9,900	NA	<5.0	37	22	47	48	<20	NA	NA	NA	NA	52.66	11.65	NA	41.01	NA	NA
MW-2	03/09/1999	2,760	NA	12.3	7.50	85.4	444	<50.0	NA	NA	NA	NA	NA	52.66	8.07	NA	44.59	NA	NA
MW-2	06/16/1999	2,570	NA	36.3	11.6	6.19	10.8	<50.0	NA	NA	NA	NA	NA	52.66	14.63	NA	38.03	NA	NA
MW-2	09/30/1999	1,960	NA	19.1	3.20	4.55	26.9	<25.0	NA	NA	NA	NA	NA	52.66	15.63	NA	37.03	NA	NA
MW-2	12/23/1999	145	NA	1.30	<0.500	<0.500	0.899	<2.50	NA	NA	NA	NA	NA	52.66	14.42	NA	38.24	NA	NA
MW-2	03/22/2000	6,060	NA	18.9	<10.0	210	651	<100	NA	NA	NA	NA	NA	52.66	8.19	NA	44.47	NA	NA
MW-2	06/01/2000	<50.0	NA	<0.500	<0.500	<0.500	<0.500	<2.50	NA	NA	NA	NA	NA	52.66	11.46	NA	41.20	NA	NA
MW-2	09/08/2000	<50.0	NA	<0.500	<0.500	<0.500	<0.500	<2.50	NA	NA	NA	NA	NA	52.66	14.63	NA	38.03	NA	NA
MW-2	12/04/2000	201	NA	1.35	<0.500	3.39	8.58	<2.50	NA	NA	NA	NA	NA	52.66	13.45	NA	39.21	NA	NA
MW-2	03/09/2001	396	NA	2.82	<0.500	8.69	18.7	<2.50	NA	NA	NA	NA	NA	52.66	8.89	NA	43.77	NA	NA
MW-2	06/27/2001	<50	NA	<0.50	<0.50	<0.50	<0.50	<2.5	NA	NA	NA	NA	NA	52.66	14.88	NA	37.78	NA	NA
MW-2	09/20/2001	<50	NA	<0.50	<0.50	<0.50	<0.50	NA	<5.0	NA	NA	NA	NA	52.66	15.19	NA	37.47	NA	NA
MW-2	12/05/2001	NA	NA	NA	NA	NA	NA	NA	NA	NA	NA	NA	NA	52.66	10.02	NA	42.64	NA	2.8
MW-2	02/26/2002	180	NA	<0.50	<0.50	2.7	4.1	NA	<0.50	NA	NA	NA	NA	52.66	10.76	NA	41.90	NA	NA
MW-2	06/06/2002	NA	NA	NA	NA	NA	NA	NA	NA	NA	NA	NA	NA	52.66	13.83	NA	38.83	NA	NA
MW-2	09/09/2002	<50	NA	<0.50	<0.50	<0.50	<0.50	NA	<5.0	NA	NA	NA	NA	52.66	15.23	NA	37.43	NA	NA
MW-2	12/19/2002	NA	NA	NA	NA	NA	NA	NA	NA	NA	NA	NA	NA	52.66	8.46	NA	44.20	NA	NA
MW-2	03/28/2003	53	NA	<0.50	<0.50	0.51	1.4	NA	<5.0	NA	NA	NA	NA	52.66	12.96	NA	39.70	NA	NA
MW-2	06/30/2003	NA	NA	NA	NA	NA	NA	NA	NA	NA	NA	NA	NA	52.66	14.49	NA	38.17	NA	NA
MW-2	09/25/2003	Well inaccessible		NA	NA	NA	NA	NA	NA	NA	NA	NA	NA	52.66	NA	NA	NA	NA	NA
MW-2	10/03/2003	54 c	NA	<0.50	<0.50	<0.50	<1.0	NA	<0.50	NA	NA	NA	NA	52.66	15.03	NA	37.63	NA	NA
MW-2	12/02/2003	NA	NA	NA	NA	NA	NA	NA	NA	NA	NA	NA	NA	52.66	14.08	NA	38.58	NA	NA
MW-2	03/18/2004	130	NA	<0.50	<0.50	1.9	2.4	NA	<0.50	NA	NA	NA	NA	52.66	10.08	NA	42.58	NA	NA
MW-2	06/17/2004	NA	NA	NA	NA	NA	NA	NA	NA	NA	NA	NA	NA	52.66	14.65	NA	38.01	NA	NA
MW-2	09/02/2004	<50	NA	<0.50	<0.50	<0.50	<1.0	NA	<0.50	<2.0	<2.0	<2.0	<5.0	52.66	15.38	NA	37.28	NA	NA
MW-2	12/14/2004	NA	NA	NA	NA	NA	NA	NA	NA	NA	NA	NA	NA	52.66	10.89	NA	41.77	NA	NA
MW-2	02/28/2005	<50	NA	<0.50	<0.50	<0.50	<1.0	NA	<0.50	NA	NA	NA	NA	52.77 d	8.48	NA	44.29	NA	NA
MW-2	06/21/2005	NA	NA	NA	NA	NA	NA	NA	NA	NA	NA	NA	NA	52.77	13.06	NA	39.71	NA	NA
MW-2	08/29/2005	<50	NA	<0.50	<0.50	<0.50	<1.0	NA	<0.50	<2.0	<2.0	<2.0	<5.0	52.77	14.88	NA	37.89	NA	NA
MW-2	12/05/2005	NA	NA	NA	NA	NA	NA	NA	NA	NA	NA	NA	NA	52.77	12.78	NA	39.99	NA	NA
MW-2	03/31/2006	<50.0	NA	<0.500	<0.500	<0.500	<0.500	NA	<0.500	NA	NA	NA	NA	52.77	7.66	NA	45.11	NA	NA

WELL CONCENTRATIONS
Former Shell Service Station
8930 Bancroft Avenue
Oakland, CA

Well ID	Date	TPPH (ug/L)	TEPH (ug/L)	B (ug/L)	T (ug/L)	E (ug/L)	X (ug/L)	MTBE 8020 (ug/L)	MTBE 8260 (ug/L)	DIPE (ug/L)	ETBE (ug/L)	TAME (ug/L)	TBA (ug/L)	TOC (MSL)	Depth to Water (ft.)	Depth to SPH (ft.)	GW Elevation (MSL)	SPH Thickness (ft.)	DO Reading (mg/L)
MW-2	06/14/2006	NA	NA	NA	NA	NA	NA	NA	NA	NA	NA	NA	NA	52.77	13.18	NA	39.59	NA	NA
MW-2	09/20/2006	<50.0	NA	<0.500	<0.500	<0.500	<0.500	NA	<0.500	<0.500	<0.500	<0.500	<10.0	52.77	15.00	NA	37.77	NA	NA
MW-2	12/20/2006	NA	NA	NA	NA	NA	NA	NA	NA	NA	NA	NA	NA	52.77	11.47	NA	41.30	NA	NA
MW-3	12/17/1998	<50	NA	<0.50	<0.50	<0.50	<0.50	10	11	NA	NA	NA	NA	51.30	11.85	NA	39.45	NA	NA
MW-3	03/09/1999	<50.0	NA	<0.500	<0.500	<0.500	<0.500	<5.00	NA	NA	NA	NA	NA	51.30	6.53	NA	44.77	NA	NA
MW-3	06/16/1999	<50.0	NA	<0.500	<0.500	<0.500	<0.500	<5.00	NA	NA	NA	NA	NA	51.30	12.71	NA	38.59	NA	NA
MW-3	09/30/1999	<50.0	NA	<0.500	<0.500	<0.500	<0.500	5.14	NA	NA	NA	NA	NA	51.30	14.07	NA	37.23	NA	NA
MW-3	12/23/1999	<500	NA	<5.00	<5.00	<5.00	<5.00	<25.0	NA	NA	NA	NA	NA	51.30	12.82	NA	38.48	NA	NA
MW-3	03/22/2000	<50.0	NA	<0.500	1.48	<0.500	1.90	<5.00	NA	NA	NA	NA	NA	51.30	6.81	NA	44.49	NA	NA
MW-3	06/01/2000	<50.0	NA	<0.500	0.821	<0.500	<0.500	4.39	NA	NA	NA	NA	NA	51.30	11.85	NA	39.45	NA	NA
MW-3	09/08/2000	<50.0	NA	<0.500	<0.500	<0.500	<0.500	3.62	NA	NA	NA	NA	NA	51.30	12.55	NA	38.75	NA	NA
MW-3	12/04/2000	<50.0	NA	<0.500	<0.500	<0.500	0.588	4.74	NA	NA	NA	NA	NA	51.30	11.65	NA	39.65	NA	NA
MW-3	03/09/2001	<50.0	NA	<0.500	<0.500	<0.500	<0.500	<2.50	NA	NA	NA	NA	NA	51.30	7.28	NA	44.02	NA	NA
MW-3	06/27/2001	<50	NA	<0.50	<0.50	<0.50	<0.50	<2.5	NA	NA	NA	NA	NA	51.30	13.16	NA	38.14	NA	NA
MW-3	09/20/2001	NA	NA	NA	NA	NA	NA	NA	NA	NA	NA	NA	NA	51.30	13.35	NA	37.95	NA	NA
MW-3	12/05/2001	NA	NA	NA	NA	NA	NA	NA	NA	NA	NA	NA	NA	51.30	8.14	NA	43.16	NA	1.2
MW-3	02/26/2002	<50	NA	<0.50	7.2	<0.50	<0.50	NA	1.5	NA	NA	NA	NA	51.30	9.09	NA	42.21	NA	0.6
MW-3	06/06/2002	NA	NA	NA	NA	NA	NA	NA	NA	NA	NA	NA	NA	51.30	12.13	NA	39.17	NA	0.8
MW-3	09/09/2002	NA	NA	NA	NA	NA	NA	NA	NA	NA	NA	NA	NA	51.35	13.54	NA	37.81	NA	1.0
MW-3	12/19/2002	NA	NA	NA	NA	NA	NA	NA	NA	NA	NA	NA	NA	51.35	6.75	NA	44.60	NA	0.6
MW-3	03/28/2003	<50	NA	<0.50	<0.50	<0.50	<0.50	NA	<5.0	NA	NA	NA	NA	51.35	11.28	NA	40.07	NA	0.7
MW-3	06/30/2003	NA	NA	NA	NA	NA	NA	NA	NA	NA	NA	NA	NA	51.35	12.68	NA	38.67	NA	NA
MW-3	09/25/2003	<50	NA	<0.50	2.0	0.73	<1.0	NA	<0.50	NA	NA	NA	NA	51.35	13.22	NA	38.13	NA	NA
MW-3	12/02/2003	NA	NA	NA	NA	NA	NA	NA	NA	NA	NA	NA	NA	51.35	12.48	NA	38.87	NA	NA
MW-3	03/18/2004	<50	NA	<0.50	13	<0.50	<1.0	NA	<0.50	NA	NA	NA	NA	51.35	8.52	NA	42.83	NA	NA
MW-3	06/17/2004	NA	NA	NA	NA	NA	NA	NA	NA	NA	NA	NA	NA	51.35	12.80	NA	38.55	NA	NA
MW-3	09/02/2004	NA	NA	NA	NA	NA	NA	NA	NA	NA	NA	NA	NA	51.35	13.75	NA	37.60	NA	NA
MW-3	12/14/2004	NA	NA	NA	NA	NA	NA	NA	NA	NA	NA	NA	NA	51.35	9.37	NA	41.98	NA	NA
MW-3	02/28/2005	<50	NA	<0.50	<0.50	<0.50	<1.0	NA	<0.50	NA	NA	NA	NA	51.35	6.62	NA	44.73	NA	NA
MW-3	06/21/2005	NA	NA	NA	NA	NA	NA	NA	NA	NA	NA	NA	NA	51.35	11.26	NA	40.09	NA	NA
MW-3	08/29/2005	NA	NA	NA	NA	NA	NA	NA	NA	NA	NA	NA	NA	51.35	13.00	NA	38.35	NA	NA
MW-3	12/05/2005	NA	NA	NA	NA	NA	NA	NA	NA	NA	NA	NA	NA	51.35	11.05	NA	40.30	NA	NA

WELL CONCENTRATIONS
Former Shell Service Station
8930 Bancroft Avenue
Oakland, CA

Well ID	Date	TPPH (ug/L)	TEPH (ug/L)	B (ug/L)	T (ug/L)	E (ug/L)	X (ug/L)	MTBE 8020 (ug/L)	MTBE 8260 (ug/L)	DIPE (ug/L)	ETBE (ug/L)	TAME (ug/L)	TBA (ug/L)	TOC (MSL)	Depth to Water (ft.)	Depth to SPH (ft.)	GW Elevation (MSL)	SPH Thickness (ft.)	DO Reading (mg/L)
MW-3	03/31/2006	<50.0	NA	<0.500	<0.500	<0.500	<0.500	NA	<0.500	NA	NA	NA	NA	51.35	5.93	NA	45.42	NA	NA
MW-3	06/14/2006	NA	NA	NA	NA	NA	NA	NA	NA	NA	NA	NA	NA	51.35	11.40	NA	39.95	NA	NA
MW-3	09/20/2006	NA	NA	NA	NA	NA	NA	NA	NA	NA	NA	NA	NA	51.35	12.98	NA	38.37	NA	NA
MW-3	12/20/2006	NA	NA	NA	NA	NA	NA	NA	NA	NA	NA	NA	NA	51.35	8.62	NA	42.73	NA	NA

MW-4	12/17/1998	700	NA	4.3	0.88	<0.50	<0.50	21,000	26,000	NA	NA	NA	NA	50.73	10.80	NA	39.93	NA	NA
MW-4	03/09/1999	83.9	NA	<0.500	<0.500	<0.500	<0.500	17,900	23,700	NA	NA	NA	NA	50.73	6.91	NA	43.82	NA	NA
MW-4	06/16/1999	<50.0	NA	<0.500	<0.500	<0.500	<0.500	10,600	19,200	NA	NA	NA	NA	50.73	12.84	NA	37.89	NA	NA
MW-4	09/30/1999	51.2	NA	<0.500	<0.500	<0.500	<0.500	12,200	12,300	NA	NA	NA	NA	50.73	13.74	NA	36.99	NA	NA
MW-4	12/23/1999	<100	NA	<1.00	<1.00	<1.00	<1.00	7,990	8,400	NA	NA	NA	NA	50.73	12.40	NA	38.33	NA	NA
MW-4	03/22/2000	<500	NA	<5.00	<5.00	<5.00	<5.00	4,970	5,020	NA	NA	NA	NA	50.73	7.32	NA	43.41	NA	NA
MW-4	06/01/2000	<100	NA	<1.00	<1.00	<1.00	<1.00	5,260	3,580	NA	NA	NA	NA	50.73	11.50	NA	39.23	NA	NA
MW-4	09/08/2000	<50.0	NA	<0.500	<0.500	<0.500	<0.500	3,610	3,300a	NA	NA	NA	NA	50.73	12.55	NA	38.18	NA	NA
MW-4	12/04/2000	<50.0	NA	<0.500	<0.500	<0.500	<0.500	2,960	3,520a	NA	NA	NA	NA	50.73	11.77	NA	38.96	NA	NA
MW-4	03/09/2001	<50.0	NA	<0.500	<0.500	<0.500	<0.500	1,930	2,500	NA	NA	NA	NA	50.73	7.48	NA	43.25	NA	NA
MW-4	06/27/2001	<50	NA	<0.50	<0.50	<0.50	<0.50	1,100	1,100	NA	NA	NA	NA	50.73	12.97	NA	37.76	NA	NA
MW-4	09/20/2001	<250	NA	3.8	14	2.6	7.8	NA	940	NA	NA	NA	NA	50.73	13.30	NA	37.43	NA	NA
MW-4	12/05/2001	<200	NA	<2.0	<2.0	<2.0	<2.0	NA	750	NA	NA	NA	NA	50.73	8.41	NA	42.32	NA	1.2
MW-4	02/26/2002	<50	NA	<0.50	<0.50	<0.50	<0.50	NA	320	NA	NA	NA	NA	50.73	9.40	NA	41.33	NA	0.7
MW-4	06/06/2002	<50	NA	<0.50	<0.50	<0.50	<0.50	NA	160	NA	NA	NA	NA	50.73	11.97	NA	38.76	NA	0.6
MW-4	09/09/2002	<50	NA	<0.50	<0.50	<0.50	<0.50	NA	50	NA	NA	NA	NA	50.72	13.23	NA	37.49	NA	3.6
MW-4	12/19/2002	Unable to sample		NA	NA	NA	NA	NA	NA	NA	NA	NA	NA	50.72	7.08	NA	43.64	NA	0.8
MW-4	12/26/2002	<50	NA	<0.50	<0.50	<0.50	<0.50	NA	47	NA	NA	NA	NA	50.72	7.23	NA	43.49	NA	1.8
MW-4	03/28/2003	<50	NA	<0.50	1.2	<0.50	<0.50	NA	17	NA	NA	NA	NA	50.72	11.30	NA	39.42	NA	1.7
MW-4	06/30/2003	54 c	NA	<0.50	<0.50	<0.50	<1.0	NA	16	NA	NA	NA	NA	50.72	12.51	NA	38.21	NA	NA
MW-4	09/25/2003	<50	NA	<0.50	<0.50	<0.50	<1.0	NA	110	NA	NA	NA	NA	50.72	13.10	NA	37.62	NA	NA
MW-4	12/02/2003	<250	NA	<2.5	<2.5	<2.5	<5.0	NA	280	NA	NA	NA	NA	50.72	12.39	NA	38.33	NA	NA
MW-4	03/18/2004	<50	NA	<0.50	<0.50	<0.50	<1.0	NA	33	NA	NA	NA	NA	50.72	8.63	NA	42.09	NA	NA
MW-4	06/17/2004	<50	NA	<0.50	<0.50	<0.50	<1.0	NA	16	NA	NA	NA	NA	50.72	12.77	NA	37.95	NA	NA
MW-4	09/02/2004	<50	NA	<0.50	<0.50	<0.50	<1.0	NA	7.7	<2.0	<2.0	<2.0	<5.0	50.72	13.54	NA	37.18	NA	NA
MW-4	12/14/2004	<50	NA	<0.50	<0.50	<0.50	<1.0	NA	7.2	NA	NA	NA	NA	50.72	9.40	NA	41.32	NA	NA
MW-4	02/28/2005	<50	NA	<0.50	<0.50	<0.50	<1.0	NA	3.7	NA	NA	NA	NA	50.72	7.18	NA	43.54	NA	NA
MW-4	06/21/2005	<50	NA	<0.50	<0.50	<0.50	<1.0	NA	7.3	NA	NA	NA	NA	50.72	11.30	NA	39.42	NA	NA

WELL CONCENTRATIONS
Former Shell Service Station
8930 Bancroft Avenue
Oakland, CA

Well ID	Date	TPPH (ug/L)	TEPH (ug/L)	B (ug/L)	T (ug/L)	E (ug/L)	X (ug/L)	MTBE 8020 (ug/L)	MTBE 8260 (ug/L)	DIPE (ug/L)	ETBE (ug/L)	TAME (ug/L)	TBA (ug/L)	TOC (MSL)	Depth to Water (ft.)	Depth to SPH (ft.)	GW Elevation (MSL)	SPH Thickness (ft.)	DO Reading (mg/L)
MW-4	08/29/2005	<50	NA	<0.50	<0.50	<0.50	<1.0	NA	5.6	<2.0	<2.0	<2.0	<5.0	50.72	12.95	NA	37.77	NA	NA
MW-4	12/05/2005	<50	NA	<0.50	<0.50	<0.50	<0.50	NA	2.5	NA	NA	NA	NA	50.72	11.01	NA	39.71	NA	NA
MW-4	03/31/2006	<50.0	NA	<0.500	<0.500	<0.500	<0.500	NA	1.32	NA	NA	NA	NA	50.72	6.47	NA	44.25	NA	NA
MW-4	06/14/2006	<50.0	NA	<0.500	<0.500	<0.500	<0.500	NA	2.13	NA	NA	NA	NA	50.72	11.31	NA	39.41	NA	NA
MW-4	09/20/2006	<50.0	NA	<0.500	<0.500	<0.500	<0.500	NA	4.73	<0.500	<0.500	<0.500	<10.0	50.72	12.92	NA	37.80	NA	NA
MW-4	12/20/2006	<50	NA	<0.50	<0.50	<0.50	<0.50	NA	2.3 e	NA	NA	NA	NA	50.72	9.68	NA	41.04	NA	NA

MW-5	12/17/1998	750	NA	<0.50	17	1.8	3.5	33	32	NA	NA	NA	NA	51.43	11.51	NA	39.92	NA	NA
MW-5	03/09/1999	<50.0	NA	<0.500	<0.500	<0.500	<0.500	<5.00	NA	NA	NA	NA	NA	51.43	7.15	NA	44.28	NA	NA
MW-5	06/16/1999	646	NA	9.26	1.05	<1.00	<1.00	<10.0	NA	NA	NA	NA	NA	51.43	13.47	NA	37.96	NA	NA
MW-5	09/30/1999	484	NA	1.93	0.511	<0.500	<0.500	159	NA	NA	NA	NA	NA	51.43	14.41	NA	37.02	NA	NA
MW-5	12/23/1999	944	NA	4.59	17.7	3.79	16.7	214	NA	NA	NA	NA	NA	51.43	14.07	NA	37.36	NA	NA
MW-5	03/22/2000	8,770	NA	197	96.5	<50.0	188	2,450	NA	NA	NA	NA	NA	51.43	7.31	NA	44.12	NA	NA
MW-5	06/01/2000	227	NA	0.565	<0.500	<0.500	<0.500	35.9	NA	NA	NA	NA	NA	51.43	12.15	NA	39.28	NA	NA
MW-5	09/08/2000	159	NA	0.606	<0.500	<0.500	1.74	1,000	NA	NA	NA	NA	NA	51.43	13.30	NA	38.13	NA	NA
MW-5	12/04/2000	1,510	NA	19.2	<10.0	<10.0	134	1,360	NA	NA	NA	NA	NA	51.43	12.19	NA	39.24	NA	NA
MW-5	03/09/2001	3,460	NA	37.9	121	40.6	208	235	NA	NA	NA	NA	NA	51.43	7.79	NA	43.64	NA	NA
MW-5	06/27/2001	310	NA	0.97	<0.50	<0.50	<0.50	14	NA	NA	NA	NA	NA	51.43	13.89	NA	37.54	NA	NA
MW-5	09/20/2001	310	NA	<0.50	<0.50	<0.50	<0.50	NA	21	NA	NA	NA	NA	51.43	13.95	NA	37.48	NA	NA
MW-5	12/05/2001	8,800	NA	14	2.9	33	410	NA	2,300	NA	NA	NA	NA	51.43	8.89	NA	42.54	NA	0.6
MW-5	02/26/2002	NA	NA	NA	NA	NA	NA	NA	NA	NA	NA	NA	NA	51.43	9.87	NA	NA	b	NA
MW-5	03/12/2002	NA	NA	NA	NA	NA	NA	NA	NA	NA	NA	NA	NA	51.43	8.84	8.64	42.75	0.20	NA
MW-5	06/06/2002	NA	NA	NA	NA	NA	NA	NA	NA	NA	NA	NA	NA	51.43	12.59	12.54	38.88	0.05	NA
MW-5	09/09/2002	210	NA	<0.50	<0.50	<0.50	0.90	NA	200	NA	NA	NA	NA	51.44	13.94	NA	37.50	NA	NA
MW-5	12/19/2002	Unable to sample		NA	NA	NA	NA	NA	NA	NA	NA	NA	NA	51.44	7.35	NA	44.09	NA	NA
MW-5	12/26/2002	1,400	NA	<0.50	21	6.9	60	NA	180	NA	NA	NA	NA	51.44	7.13	NA	44.31	NA	NA
MW-5	03/28/2003	240	NA	<0.50	<0.50	<0.50	2.1	NA	130	NA	NA	NA	NA	51.44	11.73	NA	39.71	NA	NA
MW-5	06/30/2003	NA	NA	NA	NA	NA	NA	NA	NA	NA	NA	NA	NA	51.44	13.34	13.30	38.13	0.04	NA
MW-5	09/25/2003	12,000	NA	<5.0	<5.0	24	210	NA	220	NA	NA	NA	NA	51.44	13.60	NA	37.84	NA	NA
MW-5	12/02/2003	2,500	NA	<5.0	14	<5.0	11	NA	25	NA	NA	NA	NA	51.44	12.92	NA	38.52	NA	NA
MW-5	03/18/2004	2,100	NA	2.9	2.8	<1.0	780	NA	4.7	NA	NA	NA	NA	51.44	9.05	NA	42.39	NA	NA
MW-5	06/17/2004	68	NA	<0.50	<0.50	<0.50	<1.0	NA	0.89	NA	NA	NA	NA	51.44	13.45	NA	37.99	NA	NA
MW-5	09/02/2004	NA	NA	NA	NA	NA	NA	NA	NA	NA	NA	NA	NA	51.44	14.25	14.18	37.25	0.07	NA

WELL CONCENTRATIONS
Former Shell Service Station
8930 Bancroft Avenue
Oakland, CA

Well ID	Date	TPPH (ug/L)	TEPH (ug/L)	B (ug/L)	T (ug/L)	E (ug/L)	X (ug/L)	MTBE 8020 (ug/L)	MTBE 8260 (ug/L)	DIPE (ug/L)	ETBE (ug/L)	TAME (ug/L)	TBA (ug/L)	TOC (MSL)	Depth to Water (ft.)	Depth to SPH (ft.)	GW Elevation (MSL)	SPH Thickness (ft.)	DO Reading (mg/L)
MW-5	12/14/2004	80,000	NA	<50	3,100	2,200	17,000	NA	<50	NA	NA	NA	NA	51.44	9.82	NA	41.62	NA	NA
MW-5	02/28/2005	12,000	NA	<10	<10	<10	570	NA	<10	NA	NA	NA	NA	51.44	7.40	NA	44.04	NA	NA
MW-5	06/21/2005	5,200	NA	<2.5	<2.5	9.5	37	NA	<2.5	NA	NA	NA	NA	51.44	11.74	NA	39.70	NA	NA
MW-5	08/29/2005	330	NA	<0.50	<0.50	0.71	1.2	NA	<0.50	<2.0	<2.0	<2.0	<5.0	51.44	13.58	NA	37.86	NA	NA
MW-5	12/05/2005	71	NA	<0.50	1.4	0.53	6.2	NA	<0.50	NA	NA	NA	NA	51.44	11.53	NA	39.91	NA	NA
MW-5	03/31/2006	<50.0	NA	<0.500	<0.500	<0.500	<0.500	NA	<0.500	NA	NA	NA	NA	51.44	6.74	NA	44.70	NA	NA
MW-5	06/14/2006	<50.0	NA	<0.500	<0.500	<0.500	<0.500	NA	<0.500	NA	NA	NA	NA	51.44	11.88	NA	39.56	NA	NA
MW-5	09/20/2006	<50.0	NA	<0.500	<0.500	<0.500	<0.500	NA	<0.500	<0.500	<0.500	<0.500	<10.0	51.44	13.66	NA	37.78	NA	NA
MW-5	12/20/2006	<50	NA	<0.50	<0.50	<0.50	<0.50	NA	<2.0	NA	NA	NA	NA	51.44	10.27	NA	41.17	NA	NA

MW-6	12/17/1998	940	NA	27	0.32	2.4	2.3	3.0	3.2	NA	NA	NA	NA	51.88	11.37	NA	40.51	NA	NA
MW-6	03/09/1999	336	NA	7.78	1.60	2.40	6.36	<10.0	NA	NA	NA	NA	NA	51.88	8.10	NA	43.78	NA	NA
MW-6	06/16/1999	308	NA	2.45	<0.500	<0.500	<0.500	7.39	NA	NA	NA	NA	NA	51.88	14.49	NA	37.39	NA	NA
MW-6	09/30/1999	80.2	NA	<0.500	<0.500	<0.500	<0.500	24.8	NA	NA	NA	NA	NA	51.88	15.30	NA	36.58	NA	NA
MW-6	12/23/1999	149	NA	0.518	<0.500	<0.500	<0.500	6.43	NA	NA	NA	NA	NA	51.88	13.19	NA	38.69	NA	NA
MW-6	03/22/2000	382	NA	3.31	2.18	0.619	2.35	5.61	NA	NA	NA	NA	NA	51.88	8.27	NA	43.61	NA	NA
MW-6	06/01/2000	158	NA	0.830	<0.500	<0.500	1.10	10.9	NA	NA	NA	NA	NA	51.88	11.13	NA	40.75	NA	NA
MW-6	09/08/2000	<50.0	NA	<0.500	<0.500	<0.500	<0.500	<2.50	NA	NA	NA	NA	NA	51.88	14.28	NA	37.60	NA	NA
MW-6	12/04/2000	231	NA	4.93	<0.500	<0.500	<0.500	4.57	NA	NA	NA	NA	NA	51.88	12.62	NA	39.26	NA	NA
MW-6	03/09/2001	789	NA	11.6	2.72	<2.00	<2.00	28.0	NA	NA	NA	NA	NA	51.88	8.65	NA	43.23	NA	NA
MW-6	06/27/2001	140	NA	<0.50	1.1	<0.50	<0.50	<2.5	NA	NA	NA	NA	NA	51.88	14.95	NA	36.93	NA	NA
MW-6	09/20/2001	<50	NA	<0.50	<0.50	<0.50	<0.50	NA	<5.0	NA	NA	NA	NA	51.88	14.70	NA	37.18	NA	NA
MW-6	12/05/2001	NA	NA	NA	NA	NA	NA	NA	NA	NA	NA	NA	NA	51.88	9.62	NA	42.26	NA	1.8
MW-6	02/26/2002	130	NA	<0.50	2.6	0.69	4.1	NA	6.4	NA	NA	NA	NA	51.88	10.14	NA	41.74	NA	NA
MW-6	06/06/2002	NA	NA	NA	NA	NA	NA	NA	NA	NA	NA	NA	NA	51.88	13.52	NA	38.36	NA	NA
MW-6	09/09/2002	<50	NA	<0.50	<0.50	<0.50	<0.50	NA	<5.0	NA	NA	NA	NA	51.86	14.92	NA	36.94	NA	NA
MW-6	12/19/2002	NA	NA	NA	NA	NA	NA	NA	NA	NA	NA	NA	NA	51.86	8.22	NA	43.64	NA	NA
MW-6	03/28/2003	740	NA	<0.50	<0.50	<0.50	<0.50	NA	14	NA	NA	NA	NA	51.86	12.57	NA	39.29	NA	NA
MW-6	06/30/2003	NA	NA	NA	NA	NA	NA	NA	NA	NA	NA	NA	NA	51.86	14.14	NA	37.72	NA	NA
MW-6	09/25/2003	<250	NA	<2.5	160	<2.5	<5.0	NA	5.3	NA	NA	NA	NA	51.86	14.30	NA	37.56	NA	NA
MW-6	12/02/2003	NA	NA	NA	NA	NA	NA	NA	NA	NA	NA	NA	NA	51.86	13.72	NA	38.14	NA	NA
MW-6	03/18/2004	1,200	NA	<1.0	7.1	1.5	2.7	NA	16	NA	NA	NA	NA	51.86	9.72	NA	42.14	NA	NA
MW-6	06/17/2004	NA	NA	NA	NA	NA	NA	NA	NA	NA	NA	NA	NA	51.86	14.48	NA	37.38	NA	NA

WELL CONCENTRATIONS
Former Shell Service Station
8930 Bancroft Avenue
Oakland, CA

Well ID	Date	TPPH (ug/L)	TEPH (ug/L)	B (ug/L)	T (ug/L)	E (ug/L)	X (ug/L)	MTBE 8020 (ug/L)	MTBE 8260 (ug/L)	DIPE (ug/L)	ETBE (ug/L)	TAME (ug/L)	TBA (ug/L)	TOC (MSL)	Depth to Water (ft.)	Depth to SPH (ft.)	GW Elevation (MSL)	SPH Thickness (ft.)	DO Reading (mg/L)
MW-6	09/02/2004	75	NA	<0.50	<0.50	<0.50	<1.0	NA	11	<2.0	<2.0	<2.0	<5.0	51.86	15.16	NA	36.70	NA	NA
MW-6	12/14/2004	NA	NA	NA	NA	NA	NA	NA	NA	NA	NA	NA	NA	51.86	10.55	NA	41.31	NA	NA
MW-6	02/28/2005	500	NA	<0.50	<0.50	<0.50	<1.0	NA	4.6	NA	NA	NA	NA	51.86	8.40	NA	43.46	NA	NA
MW-6	06/21/2005	NA	NA	NA	NA	NA	NA	NA	NA	NA	NA	NA	NA	51.86	12.58	NA	39.28	NA	NA
MW-6	08/29/2005	96	NA	<0.50	<0.50	<0.50	<1.0	NA	0.56	<2.0	<2.0	<2.0	<5.0	51.86	14.61	NA	37.25	NA	NA
MW-6	12/05/2005	NA	NA	NA	NA	NA	NA	NA	NA	NA	NA	NA	NA	51.86	12.22	NA	39.64	NA	NA
MW-6	03/31/2006	308	NA	<0.500	<0.500	<0.500	<0.500	NA	1.39	NA	NA	NA	NA	51.86	7.66	NA	44.20	NA	NA
MW-6	06/14/2006	NA	NA	NA	NA	NA	NA	NA	NA	NA	NA	NA	NA	51.86	12.65	NA	39.21	NA	NA
MW-6	09/20/2006	241	NA	<0.500	<0.500	<0.500	<0.500	NA	1.77	<0.500	<0.500	<0.500	<10.0	51.86	14.63	NA	37.23	NA	NA
MW-6	12/20/2006	NA	NA	NA	NA	NA	NA	NA	NA	NA	NA	NA	NA	51.86	10.87	NA	40.99	NA	NA

Abbreviations:

TPPH = Total petroleum hydrocarbons as gasoline by EPA Method 8260B; prior to September 20, 2001, analyzed by EPA Method 8015.

TEPH = Total petroleum hydrocarbons as diesel by modified EPA Method 8015.

BTEX = Benzene, toluene, ethylbenzene, xylenes by EPA Method 8260B; prior to September 20, 2001, analyzed by EPA Method 8020.

MTBE = Methyl tertiary butyl ether

DIPE = Di-isopropyl ether, analyzed by EPA Method 8260B

ETBE = Ethyl tertiary butyl ether, analyzed by EPA Method 8260B

TAME = Tertiary amyl methyl ether, analyzed by EPA Method 8260B

TBA = Tertiary butyl alcohol, analyzed by EPA Method 8260B

TOC = Top of Casing Elevation

SPH = Separate-phase hydrocarbons

GW = Groundwater

ug/L = Parts per billion

MSL = Mean sea level

ft. = Feet

<n = Below detection limit

NA = Not applicable

DO = Dissolved oxygen

mg/L = Parts per million

WELL CONCENTRATIONS
Former Shell Service Station
8930 Bancroft Avenue
Oakland, CA

Well ID	Date	TPPH (ug/L)	TEPH (ug/L)	B (ug/L)	T (ug/L)	E (ug/L)	X (ug/L)	MTBE 8020 (ug/L)	MTBE 8260 (ug/L)	DIPE (ug/L)	ETBE (ug/L)	TAME (ug/L)	TBA (ug/L)	TOC (MSL)	Depth to Water (ft.)	Depth to SPH (ft.)	GW Elevation (MSL)	SPH Thickness (ft.)	DO Reading (mg/L)
---------	------	----------------	----------------	-------------	-------------	-------------	-------------	------------------------	------------------------	----------------	----------------	----------------	---------------	--------------	----------------------------	--------------------------	--------------------------	---------------------------	-------------------------

Notes:

a = This sample analyzed outside of EPA recommended holding time.

b = SPH detected in well, but exact thickness could not be measured.

c = Hydrocarbon does not match pattern of laboratory's standard.

d = Top of casing altered +0.11 feet during wellhead maintenance on December 28, 2004.

e = Result confirmed by GC/MS.

When separate-phase hydrocarbons are present, groundwater elevation is adjusted using the relation: Groundwater Elevation = Top-of-Casing Elevation - Depth to Water + (0.8 x Hydrocarbon Thickness).

Site surveyed February 12 and May 16, 2002 by Virgil Chavez Land Surveying of Vallejo, CA.

10 January, 2007

Michael Ninokata
Blaine Tech Services (Shell)
1680 Rogers Avenue
San Jose, CA 95112

RE: 8930 Bancroft Rd, Oakland
Work Order: S612453

Enclosed are the results of analyses for samples received by the laboratory on 12/27/06 09:00. If you have any questions concerning this report, please feel free to contact me.

Sincerely,



Sylvia Krenn
Project Manager

CA ELAP Certificate # 2630

Blaine Tech Services (Shell) 1680 Rogers Avenue San Jose CA, 95112	Project: 8930 Bancroft Rd, Oakland Project Number: 98995742 Project Manager: Michael Ninokata	S612453 Reported: 01/10/07 23:32
--	---	---

ANALYTICAL REPORT FOR SAMPLES

Sample ID	Laboratory ID	Matrix	Date Sampled	Date Received
MW-4	S612453-01	Water	12/20/06 14:25	12/27/06 09:00
MW-5	S612453-02	Water	12/20/06 14:55	12/27/06 09:00

Blaine Tech Services (Shell)
1680 Rogers Avenue
San Jose CA, 95112

Project: 8930 Bancroft Rd, Oakland
Project Number: 98995742
Project Manager: Michael Ninokata

S612453
Reported:
01/10/07 23:32

Purgeable Hydrocarbons and BTEX by EPA 8015B/8021B
TestAmerica - Sacramento, CA

Analyte	Result	Reporting Limit	Units	Dilution	Batch	Prepared	Analyzed	Method	Notes
MW-4 (S612453-01) Water Sampled: 12/20/06 14:25 Received: 12/27/06 09:00									
Gasoline Range Organics (C4-C12)	ND	50	ug/l	1	6120334	12/29/06	12/30/06	EPA 8015B/8021B	
Benzene	ND	0.50	"	"	"	"	"	"	
Toluene	ND	0.50	"	"	"	"	"	"	
Ethylbenzene	ND	0.50	"	"	"	"	"	"	
Xylenes (total)	ND	0.50	"	"	"	"	"	"	
Methyl tert-butyl ether	2.3	2.0	"	"	"	"	"	"	A-01
<i>Surrogate: 4-BFB (FID)</i>		117 %		61-142	"	"	"	"	
<i>Surrogate: a,a,a-TFT (PID)</i>		101 %		75-122	"	"	"	"	
MW-5 (S612453-02) Water Sampled: 12/20/06 14:55 Received: 12/27/06 09:00									
Gasoline Range Organics (C4-C12)	ND	50	ug/l	1	6120334	12/29/06	12/30/06	EPA 8015B/8021B	
Benzene	ND	0.50	"	"	"	"	"	"	
Toluene	ND	0.50	"	"	"	"	"	"	
Ethylbenzene	ND	0.50	"	"	"	"	"	"	
Xylenes (total)	ND	0.50	"	"	"	"	"	"	
Methyl tert-butyl ether	ND	2.0	"	"	"	"	"	"	
<i>Surrogate: 4-BFB (FID)</i>		102 %		61-142	"	"	"	"	
<i>Surrogate: a,a,a-TFT (PID)</i>		103 %		75-122	"	"	"	"	

Blaine Tech Services (Shell)
1680 Rogers Avenue
San Jose CA, 95112

Project: 8930 Bancroft Rd, Oakland
Project Number: 98995742
Project Manager: Michael Ninokata

S612453
Reported:
01/10/07 23:32

Purgeable Hydrocarbons and BTEX by EPA 8015B/8021B - Quality Control
TestAmerica - Sacramento, CA

Analyte	Result	Reporting Limit	Units	Spike Level	Source Result	%REC	%REC Limits	RPD	RPD Limit	Notes
---------	--------	-----------------	-------	-------------	---------------	------	-------------	-----	-----------	-------

Batch 6120334 - EPA 5030B (P/T) / EPA 8015B/8021B

Blank (6120334-BLK1)

Prepared & Analyzed: 12/29/06

Gasoline Range Organics (C4-C12)	ND	50	ug/l							
Benzene	ND	0.50	"							
Toluene	ND	0.50	"							
Ethylbenzene	ND	0.50	"							
Xylenes (total)	ND	0.50	"							
Methyl tert-butyl ether	ND	2.0	"							
<i>Surrogate: 4-BFB (FID)</i>	<i>11.0</i>		<i>"</i>	<i>10.0</i>		<i>110</i>	<i>61-142</i>			
<i>Surrogate: a,a,a-TFT (PID)</i>	<i>10.1</i>		<i>"</i>	<i>10.0</i>		<i>101</i>	<i>75-122</i>			

Laboratory Control Sample (6120334-BS1)

Prepared & Analyzed: 12/29/06

Benzene	10.1	0.50	ug/l	10.0		101	76-119			
Toluene	10.2	0.50	"	10.0		102	74-122			
Ethylbenzene	9.88	0.50	"	10.0		99	74-122			
Xylenes (total)	29.2	0.50	"	30.0		97	70-126			
Methyl tert-butyl ether	10.0	2.0	"	10.0		100	70-136			
<i>Surrogate: 4-BFB (FID)</i>	<i>11.4</i>		<i>"</i>	<i>10.0</i>		<i>114</i>	<i>61-142</i>			
<i>Surrogate: a,a,a-TFT (PID)</i>	<i>10.4</i>		<i>"</i>	<i>10.0</i>		<i>104</i>	<i>75-122</i>			

Matrix Spike (6120334-MS1)

Source: S612399-04

Prepared & Analyzed: 12/29/06

Benzene	11.5	0.50	ug/l	10.0	0.619	109	76-119			
Toluene	9.93	0.50	"	10.0	0.576	94	74-122			
Ethylbenzene	10.4	0.50	"	10.0	0.360	100	74-122			
Xylenes (total)	30.8	0.50	"	30.0	0.550	101	70-126			
Methyl tert-butyl ether	10.1	2.0	"	10.0	ND	101	70-136			
<i>Surrogate: 4-BFB (FID)</i>	<i>13.7</i>		<i>"</i>	<i>10.0</i>		<i>137</i>	<i>61-142</i>			
<i>Surrogate: a,a,a-TFT (PID)</i>	<i>11.2</i>		<i>"</i>	<i>10.0</i>		<i>112</i>	<i>75-122</i>			

Matrix Spike Dup (6120334-MSD1)

Source: S612399-04

Prepared & Analyzed: 12/29/06

Benzene	11.5	0.50	ug/l	10.0	0.619	109	76-119	0	12	
Toluene	10.0	0.50	"	10.0	0.576	94	74-122	0.7	13	
Ethylbenzene	10.5	0.50	"	10.0	0.360	101	74-122	1	12	
Xylenes (total)	31.1	0.50	"	30.0	0.550	102	70-126	1	18	
Methyl tert-butyl ether	10.3	2.0	"	10.0	ND	103	70-136	2	25	
<i>Surrogate: 4-BFB (FID)</i>	<i>15.0</i>		<i>"</i>	<i>10.0</i>		<i>150</i>	<i>61-142</i>			<i>ZX</i>
<i>Surrogate: a,a,a-TFT (PID)</i>	<i>11.4</i>		<i>"</i>	<i>10.0</i>		<i>114</i>	<i>75-122</i>			

Blaine Tech Services (Shell)
1680 Rogers Avenue
San Jose CA, 95112

Project: 8930 Bancroft Rd, Oakland
Project Number: 98995742
Project Manager: Michael Ninokata

S612453
Reported:
01/10/07 23:32

Notes and Definitions

ZX Due to sample matrix effects, the surrogate recovery was outside the acceptance limits.

A-01 Result confirmed by GC/MS

DET Analyte DETECTED

ND Analyte NOT DETECTED at or above the reporting limit or MDL, if MDL is specified

NR Not Reported

dry Sample results reported on a dry weight basis

RPD Relative Percent Difference

- LAB:
- TA - Irvine, California
 - TA - Morgan Hill, California
 - TA - Sacramento, California
 - TA - Nashville, Tennessee
 - Calscience
 - Other _____



SHELL Chain Of Custody Record

5012453

NAME OF PERSON TO BILL: Denis Brown

ENVIRONMENTAL SERVICES

NETWORK DEV / FE

COMPLIANCE

BILL CONSULTANT

RMT/CRMT

CHECK BOX TO VERIFY IF NO INCIDENT # APPLIES

INCIDENT # (ES ONLY)

9 8 9 9 5 7 4 2

DATE: 12

PAGE: 1 of 1

SAMPLING COMPANY:

Blaine Tech Services

LOG CODE:

BTSS

SITE ADDRESS: Street and City

8930 Bancroft Rd., Oakland

State

CA

GLOBAL ID NO.:

T0600118567

ADDRESS:

1680 Rogers Avenue, San Jose, CA 95112

EDF DELIVERABLE TO (Name, Company, Office Location):

Dennis Baertschl, Cambria, Sonoma Office

PHONE NO.:

(707) 268-3813

E-MAIL:

sonomaedf@cambria-env.com

CONSULTANT PROJECT NO.:

BTS # 061220-502

PROJECT CONTACT (Hardcopy or PDF Report to):

Michael Ninokata

TELEPHONE:

408-573-0555

FAX:

408-573-7771

E-MAIL:

mminokata@blainetech.com

SAMPLER NAME(S) (Print):

Dan Rompf

LAB USE ONLY

TAT (STD IS 10 BUSINESS DAYS / RUSH IS CALENDAR DAYS):

STD 5 DAY 3 DAY 2 DAY 24 HOURS

RESULTS NEEDED ON WEEKEND

REQUESTED ANALYSIS

[Signature]

LA - RWQCB REPORT FORMAT UST AGENCY:

SPECIAL INSTRUCTIONS OR NOTES:

- EDD NOT NEEDED
- SHELL CONTRACT RATE APPLIES
- STATE REIMB RATE APPLIES
- RECEIPT VERIFICATION REQUESTED

FIELD NOTES:

Container/Preservative or PID Readings or Laboratory Notes

TEMPERATURE ON RECEIPT C°

LAB USE ONLY	Field Sample Identification	SAMPLING		MATRIX	NO. OF CONT.	TPH - Gas, Purgeable (8260B)	TPH - Diesel Extractable (8015M)	BTEX (8260B)	5 Oxygenates (8260B) (MTBE, TBA, DIPE, TAME, ETBE)	MTBE (8260B)	TBA (8260B)	DIPE (8260B)	TAME (8260B)	ETBE (8260B)	1,2 DCA (8260B)	EDB (8260B)	Ethanol (8260B)	Methanol (8015M)	TDS (190.1)	Total Iron (6010B)	Total Lead (6010B)				
		DATE	TIME																						
	MW-4	12-20-06	1425	H ₂ O	3	X		X	X															5.4	
	MW-5	12-20-06	1455	H ₂ O	3	X		X	X																

Relinquished by: (Signature)
[Signature]

Received by: (Signature)
[Signature] (sample custodian)

Date: 12-20-06 Time: 1610

Relinquished by: (Signature)
[Signature]

Received by: (Signature)
[Signature]

Date: 12-21-06 Time: 15205

Relinquished by: (Signature)
[Signature]

Received by: (Signature)
[Signature]

Date: 12-21-06 Time: 1730

Sulu Ng (MT) 12/26 1700

[Signature] 12/27/06 900 40

WELL GAUGING DATA

Project # 061220-JD-2 Date 12-20-06 Client Shell

Site 8930 Bancroft Ave, Oakland

Well ID	Time	Well Size (in.)	Sheen / Odor	Depth to Immiscible Liquid (ft.)	Thickness of Immiscible Liquid (ft.)	Volume of Immiscibles Removed (ml)	Depth to water (ft.)	Depth to well bottom (ft.)	Survey Point: TOB or TOS	Notes
MW-1	1340	3					11.51	17.03	TOB	1
MW-2	1355	3					11.47	19.80		4
MW-3	1345	3					8.62	19.71		2
MW-4	1400	3	stringer in well!				9.68	19.20		5
MW-5	1350	3	stringer removed to gauge!				10.27	19.80		3
MW-6	1405	3					10.87	19.80	↓	6
MW-5	NO SPH DETECTED!									

ORDER
Notes
1 GO
4 GO
2 GO
5 S
3 S
6 GO

SHELL WELL MONITORING DATA SHEET

BTS #: 061220-5D-2	Site: 8980 Bancroft, Oakland
Sampler: Dan R.	Date: 12-20-06
Well I.D.: MW-4	Well Diameter: 2 (3) 4 6 8
Total Well Depth (TD): 19.20	Depth to Water (DTW): 9.68
Depth to Free Product:	Thickness of Free Product (feet):
Referenced to: FVC Grade	D.O. Meter (if req'd): YSI HACH
DTW with 80% Recharge [(Height of Water Column x 0.20) + DTW]: 11.24	

Purge Method: Bailer Waterra Sampling Method: Bailer
 Disposable Bailer Peristaltic Disposable Bailer
 Positive Air Displacement Extraction Pump Extraction Port
 Electric Submersible Other _____ Dedicated Tubing

Stinger removed from well!

3.5 (Gals.) X 3 = 10.5 Gals.
 I Case Volume Specified Volumes Calculated Volume

Well Diameter	Multiplier	Well Diameter	Multiplier
1"	0.04	4"	0.65
2"	0.16	6"	1.47
3"	0.37	Other	radius ² * 0.163

Time	Temp (°F)	pH	Cond. (mS or μ S)	Turbidity (NTUs)	Gals. Removed	Observations
1405	68.1	6.4	351	>1,000	3.5	muddy
1410	70.0	6.4	357	>1,000	7.0	muddy
1415	69.6	6.6	368	>1,000	10.5	muddy / a bit
silt in the groundwater as well!						more clear
could not remove stinger!						

Did well dewater? Yes No Gallons actually evacuated: 10.5

Sampling Date: 12-20-06 Sampling Time: 1425 Depth to Water: 10.89

Sample I.D.: MW-4 Laboratory: STL TA

Analyzed for: TPH-G BTEX MTBE TPH-D Other:

EB I.D. (if applicable): @ Time Duplicate I.D. (if applicable):

Analyzed for: TPH-G BTEX MTBE TPH-D Other:

D.O. (if req'd):	Pre-purge:	mg/L	Post-purge:	mg/L
O.R.P. (if req'd):	Pre-purge:	mV	Post-purge:	mV

SHELL WELL MONITORING DATA SHEET

BTS #: 061220-5D-2	Site: 8430 Bancroft, Oakland
Sampler: Dan R.	Date: 12-20-06
Well I.D.: MW-5	Well Diameter: 2 <input checked="" type="radio"/> 4 <input type="radio"/> 6 <input type="radio"/> 8 <input type="radio"/>
Total Well Depth (TD): 19.80	Depth to Water (DTW): 10.27
Depth to Free Product:	Thickness of Free Product (feet):
Referenced to: <input checked="" type="radio"/> Grade	D.O. Meter (if req'd): YSI <input type="checkbox"/> HACH <input type="checkbox"/>
DTW with 80% Recharge [(Height of Water Column x 0.20) + DTW]: 11.89	

Purge Method: Disposable Bailer Waterra Peristaltic Sampling Method: Disposable Bailer
 Positive Air Displacement Extraction Pump Extraction Port
 Electric Submersible Other _____ Dedicated Tubing

Stinger removed to gauge!

3.2 (Gals.) X	3	= 9.6 Gals.
Case Volume	Specified Volumes	Calculated Volume

Well Diameter	Multiplier	Well Diameter	Multiplier
1"	0.04	4"	0.65
2"	0.16	6"	1.47
3"	0.37	Other	radius ² * 0.163

Time	Temp (°F)	pH	Cond. (mS or μ S)	Turbidity (NTUs)	Gals. Removed	Observations
1435	64.4	6.5	325	71,000	3.2	muddy
1441	65.5	6.3	319	71,000	6.4	-
1446	67.1	6.1	313	71,000	9.6	-
		Stinger removed for gauge/sample				
	NO	SPM Detected w/ interface				

Did well dewater? Yes Gallons actually evacuated: 9.6

Sampling Date: 12-20-06 Sampling Time: 1455 Depth to Water: 11.60

Sample I.D.: MW-5 Laboratory: STL TA

Analyzed for: TPH-D BTEX MTBE TPH-D Other: _____

EB I.D. (if applicable): @ _____ Time Duplicate I.D. (if applicable): _____

Analyzed for: TPH-G BTEX MTBE TPH-D Other: _____

D.O. (if req'd):	Pre-purge:		mg/L	Post-purge:		mg/L
O.R.P. (if req'd):	Pre-purge:		mV	Post-purge:		mV