



RD 404
C

Denis L. Brown

January 18, 2006

Jerry Wickham
Alameda County Health Care Services Agency
1131 Harbor Bay Parkway, Suite 250
Alameda, CA 94502-6577

Shell Oil Products US
HSE – Environmental Services
20945 S. Wilmington Ave.
Carson, CA 90810-1039
Tel (707) 865 0251
Fax (707) 865 2542
Email denis.l.brown@shell.com

Re: Fourth Quarter 2005 Monitoring Report
Former Shell Service Station/Current 24-7 Quick Mart Service Station
8930 Bancroft Avenue
Oakland, California
SAP Code 135678
Incident No. 98995742

Alameda County
JAN 24 2006
Environmental Health

Dear Mr. Wickham:

Attached for your review and comment is a copy of the *Fourth Quarter 2005 Monitoring Report* for the above referenced site. Upon information and belief, I declare, under penalty of perjury, that the information contained in the attached document is true and correct.

If you have any questions or concerns, please call me at (707) 865-0251.

Sincerely,

Denis L. Brown
Sr. Environmental Engineer

January 18, 2006

Jerry Wickham
Alameda County Health Care Services Agency
1131 Harbor Bay Parkway, 2nd Floor
Alameda, California 94502

Re: **Fourth Quarter 2005 Monitoring Report**
Former Shell Service Station/Current 24-7 Quick Mart Service Station
8930 Bancroft Avenue
Oakland, California
Incident #98995742
Cambria Project #247-1408-002
SAP #135678
ACEH Case #3962



Alameda County
JAN 24 2006
Environmental Health

Dear Mr. Wickham:

On behalf of Equilon Enterprises LLC dba Shell Oil Products US (Shell), Cambria Environmental Technology, Inc. (Cambria) is submitting this groundwater monitoring report in accordance with the reporting requirements of 23 CCR 2652d. The site is located on the corner of Bancroft Avenue and 90th Avenue in Oakland, California (Figures 1 and 2). Shell ceased operations in July 1999 when three 10,000-gallon fiberglass underground storage tanks, associated piping, and dispensers were removed and replaced at the site. The site is currently owned and operated by 24-7 Quick-Mart.

FOURTH QUARTER 2005 ACTIVITIES

Groundwater Monitoring: Blaine Tech Services, Inc. (Blaine) of San Jose, California gauged the site wells, sampled selected wells, calculated groundwater elevations, and compiled the analytical data. Cambria prepared a vicinity map that includes previously submitted well survey information (Figure 1) and a groundwater elevation contour map (Figure 2). Blaine's report, presenting the laboratory report and supporting field documents, is included as Attachment A.

**Cambria
Environmental
Technology, Inc.**

5900 Hollis Street
Suite A
Emeryville, CA 94608
Tel (510) 420-0700
Fax (510) 420-9170

ANTICIPATED FIRST QUARTER 2006 ACTIVITIES

Groundwater Monitoring: Blaine will gauge all site wells, sample selected site wells, and tabulate the data. Cambria will prepare a monitoring report.

CLOSING



We appreciate the opportunity to work with you on this project. Please call David Gibbs at (510) 420-3363 if you have any questions or comments.

Sincerely,
Cambria Environmental Technology, Inc.

David M. Gibbs, P.G.
Project Geologist

Aubrey K. Cool, P.G.
Senior Project Geologist



Figures: 1 - Vicinity/Area Well Survey Map
2 - Groundwater Elevation Contour Map

Attachment: A - Blaine Groundwater Monitoring Report and Field Notes

cc: Denis Brown, Shell Oil Products US, 20945 S. Wilmington Ave., Carson, CA 90810
Sidhu Associates, 8930 Bancroft Ave., Oakland, CA 94605

G:\Oakland 8930 Bancroft\QM\4q05\4q05qm.doc

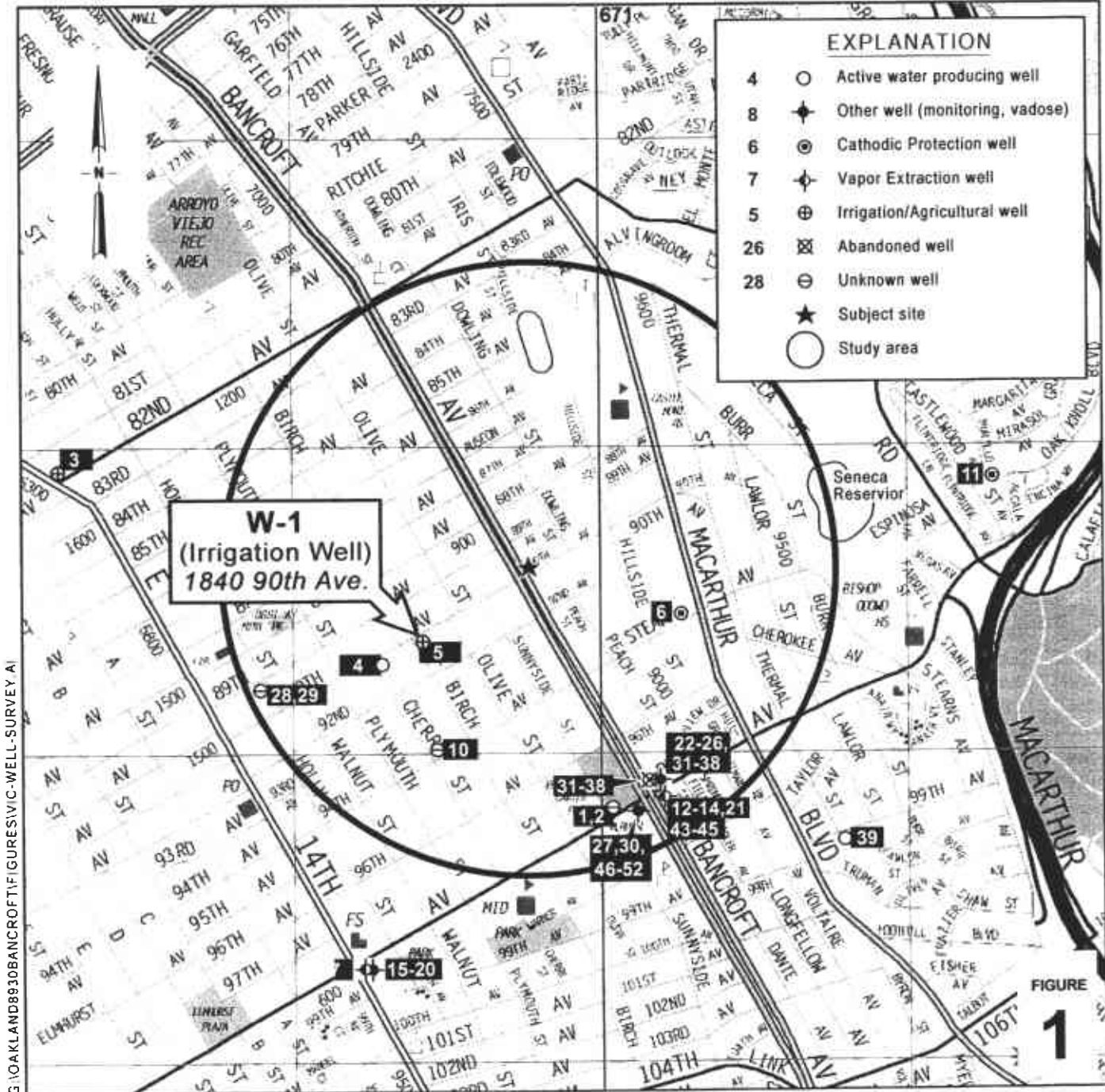

G:\OAKLAND\8930BANCROFT\FIGURES\VIC-WELL-SURVEY A1

EXPLANATION	
4	○ Active water producing well
8	◆ Other well (monitoring, vadose)
6	⊙ Cathodic Protection well
7	⋄ Vapor Extraction well
5	⊕ Irrigation/Agricultural well
26	⊗ Abandoned well
28	⊖ Unknown well
	★ Subject site
	○ Study area

W-1
 (Irrigation Well)
 1840 90th Ave.

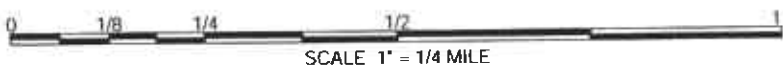

SCALE 1" = 1/4 MILE

FIGURE 1

**Former Shell-branded Station/
 Current 24-7 Quick Mart
 Service Station**

8930 Bancroft Avenue
 Oakland, California
 Incident #98995742



C A M B R I A

**Vicinity/Area Well
 Survey Map**

(1/2 Mile Radius)

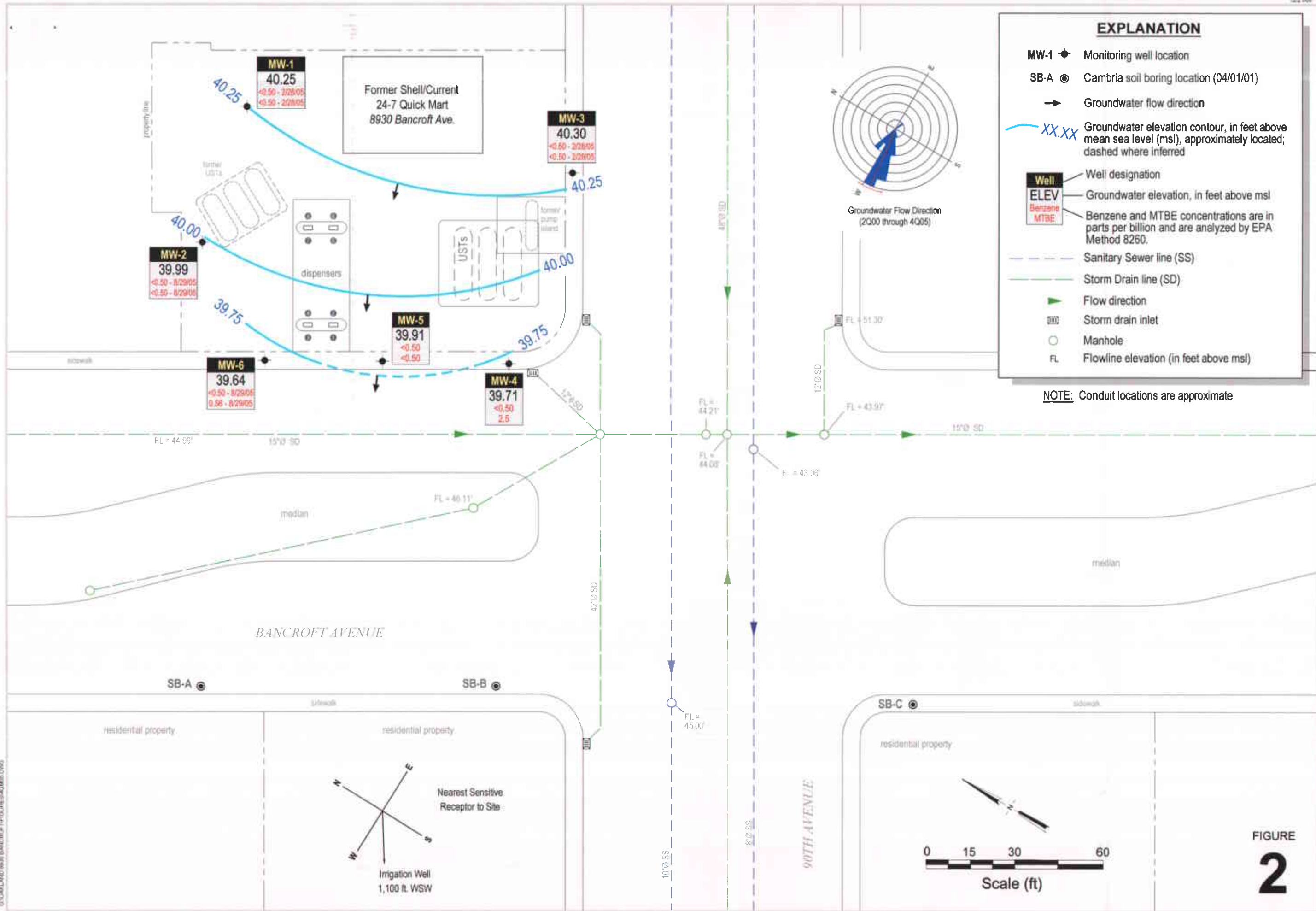

ATTACHMENT A
Blaine Groundwater Monitoring Report
and Field Notes

BLAINE

TECH SERVICES^{INC.}

GROUNDWATER SAMPLING SPECIALISTS
SINCE 1985

December 20, 2005

Denis Brown
Shell Oil Products US
20945 South Wilmington Avenue
Carson, CA 90810

Fourth Quarter 2005 Groundwater Monitoring at
Former Shell Service Station
8930 Bancroft Avenue
Oakland, CA

Monitoring performed on December 5, 2005

Groundwater Monitoring Report 051205-WC-1

This report covers the routine monitoring of groundwater wells at this former Shell facility. In accordance with standard procedures that conform to Regional Water Quality Control Board requirements, routine field data collection includes depth to water, total well depth, thickness of any separate immiscible layer, water column volume, calculated purge volume (if applicable), elapsed evacuation time (if applicable), total volume of water removed (if applicable), and standard water parameter instrument readings. Sample material is collected, contained, stored, and transported to the laboratory in conformance with EPA standards. Purgewater (if applicable) is, likewise, collected and transported to the Shell Martinez Manufacturing Complex.

Basic field information is presented alongside analytical values excerpted from the laboratory report in the cumulative table of **WELL CONCENTRATIONS**. The full analytical report for the most recent samples and the field data sheets are attached to this report.

At a minimum, Blaine Tech Services, Inc. field personnel are certified on completion of a forty-hour Hazardous Materials and Emergency Response training course per 29 CFR 1910.120. Field personnel are also enrolled in annual eight-hour refresher courses.

Blaine Tech Services, Inc. conducts sampling and documentation assignments of this type as an independent third party. Our activities at this site consisted of objective data and sample collection only. No interpretation of analytical results, defining of hydrological conditions or formulation of recommendations was performed.

Please call if you have any questions.

Yours truly,

Mike Ninokata
Project Coordinator

MN/ks

attachments: Cumulative Table of WELL CONCENTRATIONS
Certified Analytical Report
Field Data Sheet

cc: Anni Kreml
Cambria Environmental Technology, Inc.
5900 Hollis Street, Suite A
Emeryville, CA 94608

WELL CONCENTRATIONS
Former Shell Service Station
8930 Bancroft Avenue
Oakland, CA

Well ID	Date	TPPH (ug/L)	TEPH (ug/L)	B (ug/L)	T (ug/L)	E (ug/L)	X (ug/L)	MTBE 8020 (ug/L)	MTBE 8260 (ug/L)	DIPE (ug/L)	ETBE (ug/L)	TAME (ug/L)	TBA (ug/L)	TOC (MSL)	Depth to Water (ft.)	Depth to SPH (ft.)	GW Elevation (MSL)	SPH Thickness (ft.)	DO Reading (mg/L)
MW-1	12/17/1998	<50	NA	<0.50	<0.50	<0.50	<0.50	<2.5	NA	NA	NA	NA	NA	53.19	11.87	NA	41.32	NA	NA
MW-1	03/09/1999	<50.0	NA	<0.500	<0.500	<0.500	<0.500	<5.00	NA	NA	NA	NA	NA	53.19	8.21	NA	44.98	NA	NA
MW-1	06/16/1999	<50.0	NA	<0.500	<0.500	<0.500	<0.500	<5.00	NA	NA	NA	NA	NA	53.19	15.04	NA	38.15	NA	NA
MW-1	09/30/1999	<50.0	NA	<0.500	<0.500	<0.500	<0.500	<5.00	NA	NA	NA	NA	NA	53.19	16.02	NA	37.17	NA	NA
MW-1	12/23/1999	<50.0	NA	<0.500	<0.500	<0.500	<0.500	<2.50	NA	NA	NA	NA	NA	53.19	14.78	NA	38.41	NA	NA
MW-1	03/22/2000	<50.0	NA	<0.500	<0.500	<0.500	<0.500	<5.00	NA	NA	NA	NA	NA	53.19	8.44	NA	44.75	NA	NA
MW-1	06/01/2000	<50.0	NA	<0.500	<0.500	<0.500	<0.500	<2.50	NA	NA	NA	NA	NA	53.19	13.71	NA	39.48	NA	NA
MW-1	09/08/2000	<50.0	NA	<0.500	<0.500	<0.500	<0.500	<2.50	NA	NA	NA	NA	NA	53.19	14.95	NA	38.24	NA	NA
MW-1	12/04/2000	<50.0	NA	<0.500	<0.500	<0.500	<0.500	5.82	NA	NA	NA	NA	NA	53.19	13.85	NA	39.34	NA	NA
MW-1	03/09/2001	<50.0	NA	<0.500	<0.500	<0.500	<0.500	<2.50	NA	NA	NA	NA	NA	53.19	9.07	NA	44.12	NA	NA
MW-1	06/27/2001	<50	NA	<0.50	<0.50	<0.50	<0.50	<2.5	NA	NA	NA	NA	NA	53.19	14.90	NA	38.29	NA	NA
MW-1	09/20/2001	NA	NA	NA	NA	NA	NA	NA	NA	NA	NA	NA	NA	53.19	15.53	NA	37.66	NA	NA
MW-1	12/05/2001	NA	NA	NA	NA	NA	NA	NA	NA	NA	NA	NA	NA	53.19	10.41	NA	42.78	NA	3.8
MW-1	02/26/2002	<50	NA	<0.50	<0.50	<0.50	<0.50	NA	<0.50	NA	NA	NA	NA	53.19	11.09	NA	42.10	NA	NA
MW-1	06/06/2002	NA	NA	NA	NA	NA	NA	NA	NA	NA	NA	NA	NA	53.19	14.13	NA	39.06	NA	NA
MW-1	09/09/2002	NA	NA	NA	NA	NA	NA	NA	NA	NA	NA	NA	NA	53.20	15.55	NA	37.65	NA	NA
MW-1	12/19/2002	NA	NA	NA	NA	NA	NA	NA	NA	NA	NA	NA	NA	53.20	8.67	NA	44.53	NA	NA
MW-1	03/28/2003	<50	NA	<0.50	<0.50	<0.50	<0.50	NA	<5.0	NA	NA	NA	NA	53.20	13.33	NA	39.87	NA	NA
MW-1	06/30/2003	NA	NA	NA	NA	NA	NA	NA	NA	NA	NA	NA	NA	53.20	14.71	NA	38.49	NA	NA
MW-1	09/25/2003	<50	NA	<0.50	<0.50	<0.50	<1.0	NA	<0.50	NA	NA	NA	NA	53.20	15.13	NA	38.07	NA	NA
MW-1	12/02/2003	NA	NA	NA	NA	NA	NA	NA	NA	NA	NA	NA	NA	53.20	14.42	NA	38.78	NA	NA
MW-1	03/18/2004	<50	NA	<0.50	<0.50	<0.50	<1.0	NA	<0.50	NA	NA	NA	NA	53.20	10.38	NA	42.82	NA	NA
MW-1	06/17/2004	NA	NA	NA	NA	NA	NA	NA	NA	NA	NA	NA	NA	53.20	14.95	NA	38.25	NA	NA
MW-1	09/02/2004	NA	NA	NA	NA	NA	NA	NA	NA	NA	NA	NA	NA	53.20	15.75	NA	37.45	NA	NA
MW-1	12/14/2004	NA	NA	NA	NA	NA	NA	NA	NA	NA	NA	NA	NA	53.20	11.20	NA	42.00	NA	NA
MW-1	02/28/2005	<50	NA	<0.50	<0.50	<0.50	<1.0	NA	<0.50	NA	NA	NA	NA	53.20	8.53	NA	44.67	NA	NA
MW-1	06/21/2005	NA	NA	NA	NA	NA	NA	NA	NA	NA	NA	NA	NA	53.20	13.22	NA	39.98	NA	NA
MW-1	08/29/2005	NA	NA	NA	NA	NA	NA	NA	NA	NA	NA	NA	NA	53.20	15.15	NA	38.05	NA	NA
MW-1	12/05/2005	NA	NA	NA	NA	NA	NA	NA	NA	NA	NA	NA	NA	53.20	12.95	NA	40.25	NA	NA
MW-2	12/17/1998	9,900	NA	<5.0	37	22	47	48	<20	NA	NA	NA	NA	52.66	11.65	NA	41.01	NA	NA
MW-2	03/09/1999	2,760	NA	12.3	7.50	85.4	444	<50.0	NA	NA	NA	NA	NA	52.66	8.07	NA	44.59	NA	NA

WELL CONCENTRATIONS
Former Shell Service Station
8930 Bancroft Avenue
Oakland, CA

Well ID	Date	TPPH (ug/L)	TEPH (ug/L)	B (ug/L)	T (ug/L)	E (ug/L)	X (ug/L)	MTBE 8020 (ug/L)	MTBE 8260 (ug/L)	DIPE (ug/L)	ETBE (ug/L)	TAME (ug/L)	TBA (ug/L)	TOC (MSL)	Depth to Water (ft.)	Depth to SPH (ft.)	GW Elevation (MSL)	SPH Thickness (ft.)	DO Reading (mg/L)
MW-2	06/16/1999	2,570	NA	36.3	11.6	6.19	10.8	<50.0	NA	NA	NA	NA	NA	52.66	14.63	NA	38.03	NA	NA
MW-2	09/30/1999	1,960	NA	19.1	3.20	4.55	26.9	<25.0	NA	NA	NA	NA	NA	52.66	15.63	NA	37.03	NA	NA
MW-2	12/23/1999	145	NA	1.30	<0.500	<0.500	0.899	<2.50	NA	NA	NA	NA	NA	52.66	14.42	NA	38.24	NA	NA
MW-2	03/22/2000	6,060	NA	18.9	<10.0	210	651	<100	NA	NA	NA	NA	NA	52.66	8.19	NA	44.47	NA	NA
MW-2	06/01/2000	<50.0	NA	<0.500	<0.500	<0.500	<0.500	<2.50	NA	NA	NA	NA	NA	52.66	11.46	NA	41.20	NA	NA
MW-2	09/08/2000	<50.0	NA	<0.500	<0.500	<0.500	<0.500	<2.50	NA	NA	NA	NA	NA	52.66	14.63	NA	38.03	NA	NA
MW-2	12/04/2000	201	NA	1.35	<0.500	3.39	8.58	<2.50	NA	NA	NA	NA	NA	52.66	13.45	NA	39.21	NA	NA
MW-2	03/09/2001	396	NA	2.82	<0.500	8.69	18.7	<2.50	NA	NA	NA	NA	NA	52.66	8.89	NA	43.77	NA	NA
MW-2	06/27/2001	<50	NA	<0.50	<0.50	<0.50	<0.50	<2.5	NA	NA	NA	NA	NA	52.66	14.88	NA	37.78	NA	NA
MW-2	09/20/2001	<50	NA	<0.50	<0.50	<0.50	<0.50	NA	<5.0	NA	NA	NA	NA	52.66	15.19	NA	37.47	NA	NA
MW-2	12/05/2001	NA	NA	NA	NA	NA	NA	NA	NA	NA	NA	NA	NA	52.66	10.02	NA	42.64	NA	2.8
MW-2	02/26/2002	180	NA	<0.50	<0.50	2.7	4.1	NA	<0.50	NA	NA	NA	NA	52.66	10.76	NA	41.90	NA	NA
MW-2	06/06/2002	NA	NA	NA	NA	NA	NA	NA	NA	NA	NA	NA	NA	52.66	13.83	NA	38.83	NA	NA
MW-2	09/09/2002	<50	NA	<0.50	<0.50	<0.50	<0.50	NA	<5.0	NA	NA	NA	NA	52.66	15.23	NA	37.43	NA	NA
MW-2	12/19/2002	NA	NA	NA	NA	NA	NA	NA	NA	NA	NA	NA	NA	52.66	8.46	NA	44.20	NA	NA
MW-2	03/28/2003	53	NA	<0.50	<0.50	0.51	1.4	NA	<5.0	NA	NA	NA	NA	52.66	12.96	NA	39.70	NA	NA
MW-2	06/30/2003	NA	NA	NA	NA	NA	NA	NA	NA	NA	NA	NA	NA	52.66	14.49	NA	38.17	NA	NA
MW-2	09/25/2003	Well inaccessible		NA	NA	NA	NA	NA	NA	NA	NA	NA	NA	52.66	NA	NA	NA	NA	NA
MW-2	10/03/2003	54 c	NA	<0.50	<0.50	<0.50	<1.0	NA	<0.50	NA	NA	NA	NA	52.66	15.03	NA	37.63	NA	NA
MW-2	12/02/2003	NA	NA	NA	NA	NA	NA	NA	NA	NA	NA	NA	NA	52.66	14.08	NA	38.58	NA	NA
MW-2	03/18/2004	130	NA	<0.50	<0.50	1.9	2.4	NA	<0.50	NA	NA	NA	NA	52.66	10.08	NA	42.58	NA	NA
MW-2	06/17/2004	NA	NA	NA	NA	NA	NA	NA	NA	NA	NA	NA	NA	52.66	14.65	NA	38.01	NA	NA
MW-2	09/02/2004	<50	NA	<0.50	<0.50	<0.50	<1.0	NA	<0.50	<2.0	<2.0	<2.0	<5.0	52.66	15.38	NA	37.28	NA	NA
MW-2	12/14/2004	NA	NA	NA	NA	NA	NA	NA	NA	NA	NA	NA	NA	52.66	10.89	NA	41.77	NA	NA
MW-2	02/28/2005	<50	NA	<0.50	<0.50	<0.50	<1.0	NA	<0.50	NA	NA	NA	NA	52.77 d	8.48	NA	44.29	NA	NA
MW-2	06/21/2005	NA	NA	NA	NA	NA	NA	NA	NA	NA	NA	NA	NA	52.77	13.06	NA	39.71	NA	NA
MW-2	08/29/2005	<50	NA	<0.50	<0.50	<0.50	<1.0	NA	<0.50	<2.0	<2.0	<2.0	<5.0	52.77	14.88	NA	37.89	NA	NA
MW-2	12/05/2005	NA	NA	NA	NA	NA	NA	NA	NA	NA	NA	NA	NA	52.77	12.78	NA	39.99	NA	NA
MW-3	12/17/1998	<50	NA	<0.50	<0.50	<0.50	<0.50	10	11	NA	NA	NA	NA	51.30	11.85	NA	39.45	NA	NA
MW-3	03/09/1999	<50.0	NA	<0.500	<0.500	<0.500	<0.500	<5.00	NA	NA	NA	NA	NA	51.30	6.53	NA	44.77	NA	NA
MW-3	06/16/1999	<50.0	NA	<0.500	<0.500	<0.500	<0.500	<5.00	NA	NA	NA	NA	NA	51.30	12.71	NA	38.59	NA	NA
MW-3	09/30/1999	<50.0	NA	<0.500	<0.500	<0.500	<0.500	5.14	NA	NA	NA	NA	NA	51.30	14.07	NA	37.23	NA	NA

WELL CONCENTRATIONS
Former Shell Service Station
8930 Bancroft Avenue
Oakland, CA

Well ID	Date	TPPH (ug/L)	TEPH (ug/L)	B (ug/L)	T (ug/L)	E (ug/L)	X (ug/L)	MTBE 8020 (ug/L)	MTBE 8260 (ug/L)	DIPE (ug/L)	ETBE (ug/L)	TAME (ug/L)	TBA (ug/L)	TOC (MSL)	Depth to Water (ft.)	Depth to SPH (ft.)	GW Elevation (MSL)	SPH Thickness (ft.)	DO Reading (mg/L)
MW-3	12/23/1999	<500	NA	<5.00	<5.00	<5.00	<5.00	<25.0	NA	NA	NA	NA	NA	51.30	12.82	NA	38.48	NA	NA
MW-3	03/22/2000	<50.0	NA	<0.500	1.48	<0.500	1.90	<5.00	NA	NA	NA	NA	NA	51.30	6.81	NA	44.49	NA	NA
MW-3	06/01/2000	<50.0	NA	<0.500	0.821	<0.500	<0.500	4.39	NA	NA	NA	NA	NA	51.30	11.85	NA	39.45	NA	NA
MW-3	09/08/2000	<50.0	NA	<0.500	<0.500	<0.500	<0.500	3.62	NA	NA	NA	NA	NA	51.30	12.55	NA	38.75	NA	NA
MW-3	12/04/2000	<50.0	NA	<0.500	<0.500	<0.500	0.588	4.74	NA	NA	NA	NA	NA	51.30	11.65	NA	39.65	NA	NA
MW-3	03/09/2001	<50.0	NA	<0.500	<0.500	<0.500	<0.500	<2.50	NA	NA	NA	NA	NA	51.30	7.28	NA	44.02	NA	NA
MW-3	06/27/2001	<50	NA	<0.50	<0.50	<0.50	<0.50	<2.5	NA	NA	NA	NA	NA	51.30	13.16	NA	38.14	NA	NA
MW-3	09/20/2001	NA	NA	NA	NA	NA	NA	NA	NA	NA	NA	NA	NA	51.30	13.35	NA	37.95	NA	NA
MW-3	12/05/2001	NA	NA	NA	NA	NA	NA	NA	NA	NA	NA	NA	NA	51.30	8.14	NA	43.16	NA	1.2
MW-3	02/26/2002	<50	NA	<0.50	7.2	<0.50	<0.50	NA	1.5	NA	NA	NA	NA	51.30	9.09	NA	42.21	NA	0.6
MW-3	06/06/2002	NA	NA	NA	NA	NA	NA	NA	NA	NA	NA	NA	NA	51.30	12.13	NA	39.17	NA	0.8
MW-3	09/09/2002	NA	NA	NA	NA	NA	NA	NA	NA	NA	NA	NA	NA	51.35	13.54	NA	37.81	NA	1.0
MW-3	12/19/2002	NA	NA	NA	NA	NA	NA	NA	NA	NA	NA	NA	NA	51.35	6.75	NA	44.60	NA	0.6
MW-3	03/28/2003	<50	NA	<0.50	<0.50	<0.50	<0.50	NA	<5.0	NA	NA	NA	NA	51.35	11.28	NA	40.07	NA	0.7
MW-3	06/30/2003	NA	NA	NA	NA	NA	NA	NA	NA	NA	NA	NA	NA	51.35	12.68	NA	38.67	NA	NA
MW-3	09/25/2003	<50	NA	<0.50	2.0	0.73	<1.0	NA	<0.50	NA	NA	NA	NA	51.35	13.22	NA	38.13	NA	NA
MW-3	12/02/2003	NA	NA	NA	NA	NA	NA	NA	NA	NA	NA	NA	NA	51.35	12.48	NA	38.87	NA	NA
MW-3	03/18/2004	<50	NA	<0.50	13	<0.50	<1.0	NA	<0.50	NA	NA	NA	NA	51.35	8.52	NA	42.83	NA	NA
MW-3	06/17/2004	NA	NA	NA	NA	NA	NA	NA	NA	NA	NA	NA	NA	51.35	12.80	NA	38.55	NA	NA
MW-3	09/02/2004	NA	NA	NA	NA	NA	NA	NA	NA	NA	NA	NA	NA	51.35	13.75	NA	37.60	NA	NA
MW-3	12/14/2004	NA	NA	NA	NA	NA	NA	NA	NA	NA	NA	NA	NA	51.35	9.37	NA	41.98	NA	NA
MW-3	02/28/2005	<50	NA	<0.50	<0.50	<0.50	<1.0	NA	<0.50	NA	NA	NA	NA	51.35	6.62	NA	44.73	NA	NA
MW-3	06/21/2005	NA	NA	NA	NA	NA	NA	NA	NA	NA	NA	NA	NA	51.35	11.26	NA	40.09	NA	NA
MW-3	08/29/2005	NA	NA	NA	NA	NA	NA	NA	NA	NA	NA	NA	NA	51.35	13.00	NA	38.35	NA	NA
MW-3	12/05/2005	NA	NA	NA	NA	NA	NA	NA	NA	NA	NA	NA	NA	51.35	11.05	NA	40.30	NA	NA

MW-4	12/17/1998	700	NA	4.3	0.88	<0.50	<0.50	21,000	26,000	NA	NA	NA	NA	50.73	10.80	NA	39.93	NA	NA
MW-4	03/09/1999	83.9	NA	<0.500	<0.500	<0.500	<0.500	17,900	23,700	NA	NA	NA	NA	50.73	6.91	NA	43.82	NA	NA
MW-4	06/16/1999	<50.0	NA	<0.500	<0.500	<0.500	<0.500	10,600	19,200	NA	NA	NA	NA	50.73	12.84	NA	37.89	NA	NA
MW-4	09/30/1999	51.2	NA	<0.500	<0.500	<0.500	<0.500	12,200	12,300	NA	NA	NA	NA	50.73	13.74	NA	36.99	NA	NA
MW-4	12/23/1999	<100	NA	<1.00	<1.00	<1.00	<1.00	7,990	8,400	NA	NA	NA	NA	50.73	12.40	NA	38.33	NA	NA
MW-4	03/22/2000	<500	NA	<5.00	<5.00	<5.00	<5.00	4,970	5,020	NA	NA	NA	NA	50.73	7.32	NA	43.41	NA	NA
MW-4	06/01/2000	<100	NA	<1.00	<1.00	<1.00	<1.00	5,260	3,580	NA	NA	NA	NA	50.73	11.50	NA	39.23	NA	NA

WELL CONCENTRATIONS
Former Shell Service Station
8930 Bancroft Avenue
Oakland, CA

Well ID	Date	TPPH (ug/L)	TEPH (ug/L)	B (ug/L)	T (ug/L)	E (ug/L)	X (ug/L)	MTBE 8020 (ug/L)	MTBE 8260 (ug/L)	DIPE (ug/L)	ETBE (ug/L)	TAME (ug/L)	TBA (ug/L)	TOC (MSL)	Depth to Water (ft.)	Depth to SPH (ft.)	GW Elevation (MSL)	SPH Thickness (ft.)	DO Reading (mg/L)
MW-4	09/08/2000	<50.0	NA	<0.500	<0.500	<0.500	<0.500	3,610	3,300a	NA	NA	NA	NA	50.73	12.55	NA	38.18	NA	NA
MW-4	12/04/2000	<50.0	NA	<0.500	<0.500	<0.500	<0.500	2,960	3,520a	NA	NA	NA	NA	50.73	11.77	NA	38.96	NA	NA
MW-4	03/09/2001	<50.0	NA	<0.500	<0.500	<0.500	<0.500	1,930	2,500	NA	NA	NA	NA	50.73	7.48	NA	43.25	NA	NA
MW-4	06/27/2001	<50	NA	<0.50	<0.50	<0.50	<0.50	1,100	1,100	NA	NA	NA	NA	50.73	12.97	NA	37.76	NA	NA
MW-4	09/20/2001	<250	NA	3.8	14	2.6	7.8	NA	940	NA	NA	NA	NA	50.73	13.30	NA	37.43	NA	NA
MW-4	12/05/2001	<200	NA	<2.0	<2.0	<2.0	<2.0	NA	750	NA	NA	NA	NA	50.73	8.41	NA	42.32	NA	1.2
MW-4	02/26/2002	<50	NA	<0.50	<0.50	<0.50	<0.50	NA	320	NA	NA	NA	NA	50.73	9.40	NA	41.33	NA	0.7
MW-4	06/06/2002	<50	NA	<0.50	<0.50	<0.50	<0.50	NA	160	NA	NA	NA	NA	50.73	11.97	NA	38.76	NA	0.6
MW-4	09/09/2002	<50	NA	<0.50	<0.50	<0.50	<0.50	NA	50	NA	NA	NA	NA	50.72	13.23	NA	37.49	NA	3.6
MW-4	12/19/2002	Unable to sample	NA	NA	NA	NA	NA	NA	NA	NA	NA	NA	NA	50.72	7.08	NA	43.64	NA	0.8
MW-4	12/26/2002	<50	NA	<0.50	<0.50	<0.50	<0.50	NA	47	NA	NA	NA	NA	50.72	7.23	NA	43.49	NA	1.8
MW-4	03/28/2003	<50	NA	<0.50	1.2	<0.50	<0.50	NA	17	NA	NA	NA	NA	50.72	11.30	NA	39.42	NA	1.7
MW-4	06/30/2003	54 c	NA	<0.50	<0.50	<0.50	<1.0	NA	16	NA	NA	NA	NA	50.72	12.51	NA	38.21	NA	NA
MW-4	09/25/2003	<50	NA	<0.50	<0.50	<0.50	<1.0	NA	110	NA	NA	NA	NA	50.72	13.10	NA	37.62	NA	NA
MW-4	12/02/2003	<250	NA	<2.5	<2.5	<2.5	<5.0	NA	280	NA	NA	NA	NA	50.72	12.39	NA	38.33	NA	NA
MW-4	03/18/2004	<50	NA	<0.50	<0.50	<0.50	<1.0	NA	33	NA	NA	NA	NA	50.72	8.63	NA	42.09	NA	NA
MW-4	06/17/2004	<50	NA	<0.50	<0.50	<0.50	<1.0	NA	16	NA	NA	NA	NA	50.72	12.77	NA	37.95	NA	NA
MW-4	09/02/2004	<50	NA	<0.50	<0.50	<0.50	<1.0	NA	7.7	<2.0	<2.0	<2.0	<5.0	50.72	13.54	NA	37.18	NA	NA
MW-4	12/14/2004	<50	NA	<0.50	<0.50	<0.50	<1.0	NA	7.2	NA	NA	NA	NA	50.72	9.40	NA	41.32	NA	NA
MW-4	02/28/2005	<50	NA	<0.50	<0.50	<0.50	<1.0	NA	3.7	NA	NA	NA	NA	50.72	7.18	NA	43.54	NA	NA
MW-4	06/21/2005	<50	NA	<0.50	<0.50	<0.50	<1.0	NA	7.3	NA	NA	NA	NA	50.72	11.30	NA	39.42	NA	NA
MW-4	08/29/2005	<50	NA	<0.50	<0.50	<0.50	<1.0	NA	5.6	<2.0	<2.0	<2.0	<5.0	50.72	12.95	NA	37.77	NA	NA
MW-4	12/05/2005	<50	NA	<0.50	<0.50	<0.50	<0.50	NA	2.5	NA	NA	NA	NA	50.72	11.01	NA	39.71	NA	NA
MW-5	12/17/1998	750	NA	<0.50	17	1.8	3.5	33	32	NA	NA	NA	NA	51.43	11.51	NA	39.92	NA	NA
MW-5	03/09/1999	<50.0	NA	<0.500	<0.500	<0.500	<0.500	<5.00	NA	NA	NA	NA	NA	51.43	7.15	NA	44.28	NA	NA
MW-5	06/16/1999	646	NA	9.26	1.05	<1.00	<1.00	<10.0	NA	NA	NA	NA	NA	51.43	13.47	NA	37.96	NA	NA
MW-5	09/30/1999	484	NA	1.93	0.511	<0.500	<0.500	159	NA	NA	NA	NA	NA	51.43	14.41	NA	37.02	NA	NA
MW-5	12/23/1999	944	NA	4.59	17.7	3.79	16.7	214	NA	NA	NA	NA	NA	51.43	14.07	NA	37.36	NA	NA
MW-5	03/22/2000	8,770	NA	197	96.5	<50.0	188	2,450	NA	NA	NA	NA	NA	51.43	7.31	NA	44.12	NA	NA
MW-5	06/01/2000	227	NA	0.565	<0.500	<0.500	<0.500	35.9	NA	NA	NA	NA	NA	51.43	12.15	NA	39.28	NA	NA
MW-5	09/08/2000	159	NA	0.606	<0.500	<0.500	1.74	1,000	NA	NA	NA	NA	NA	51.43	13.30	NA	38.13	NA	NA
MW-5	12/04/2000	1,510	NA	19.2	<10.0	<10.0	134	1,360	NA	NA	NA	NA	NA	51.43	12.19	NA	39.24	NA	NA

WELL CONCENTRATIONS
Former Shell Service Station
8930 Bancroft Avenue
Oakland, CA

Well ID	Date	TPPH (ug/L)	TEPH (ug/L)	B (ug/L)	T (ug/L)	E (ug/L)	X (ug/L)	MTBE 8020 (ug/L)	MTBE 8260 (ug/L)	DIPE (ug/L)	ETBE (ug/L)	TAME (ug/L)	TBA (ug/L)	TOC (MSL)	Depth to Water (ft.)	Depth to SPH (ft.)	GW Elevation (MSL)	SPH Thickness (ft.)	DO Reading (mg/L)
MW-5	03/09/2001	3,460	NA	37.9	121	40.6	208	235	NA	NA	NA	NA	NA	51.43	7.79	NA	43.64	NA	NA
MW-5	06/27/2001	310	NA	0.97	<0.50	<0.50	<0.50	14	NA	NA	NA	NA	NA	51.43	13.89	NA	37.54	NA	NA
MW-5	09/20/2001	310	NA	<0.50	<0.50	<0.50	<0.50	NA	21	NA	NA	NA	NA	51.43	13.95	NA	37.48	NA	NA
MW-5	12/05/2001	8,800	NA	14	2.9	33	410	NA	2,300	NA	NA	NA	NA	51.43	8.89	NA	42.54	NA	0.6
MW-5	02/26/2002	NA	NA	NA	NA	NA	NA	NA	NA	NA	NA	NA	NA	51.43	9.87	NA	NA	b	NA
MW-5	03/12/2002	NA	NA	NA	NA	NA	NA	NA	NA	NA	NA	NA	NA	51.43	8.84	8.64	42.75	0.20	NA
MW-5	06/06/2002	NA	NA	NA	NA	NA	NA	NA	NA	NA	NA	NA	NA	51.43	12.59	12.54	38.88	0.05	NA
MW-5	09/09/2002	210	NA	<0.50	<0.50	<0.50	0.90	NA	200	NA	NA	NA	NA	51.44	13.94	NA	37.50	NA	NA
MW-5	12/19/2002	Unable to sample		NA	NA	NA	NA	NA	NA	NA	NA	NA	NA	51.44	7.35	NA	44.09	NA	NA
MW-5	12/26/2002	1,400	NA	<0.50	21	6.9	60	NA	180	NA	NA	NA	NA	51.44	7.13	NA	44.31	NA	NA
MW-5	03/28/2003	240	NA	<0.50	<0.50	<0.50	2.1	NA	130	NA	NA	NA	NA	51.44	11.73	NA	39.71	NA	NA
MW-5	06/30/2003	NA	NA	NA	NA	NA	NA	NA	NA	NA	NA	NA	NA	51.44	13.34	13.30	38.13	0.04	NA
MW-5	09/25/2003	12,000	NA	<5.0	<5.0	24	210	NA	220	NA	NA	NA	NA	51.44	13.60	NA	37.84	NA	NA
MW-5	12/02/2003	2,500	NA	<5.0	14	<5.0	11	NA	25	NA	NA	NA	NA	51.44	12.92	NA	38.52	NA	NA
MW-5	03/18/2004	2,100	NA	2.9	2.8	<1.0	780	NA	4.7	NA	NA	NA	NA	51.44	9.05	NA	42.39	NA	NA
MW-5	06/17/2004	68	NA	<0.50	<0.50	<0.50	<1.0	NA	0.89	NA	NA	NA	NA	51.44	13.45	NA	37.99	NA	NA
MW-5	09/02/2004	NA	NA	NA	NA	NA	NA	NA	NA	NA	NA	NA	NA	51.44	14.25	14.18	37.25	0.07	NA
MW-5	12/14/2004	80,000	NA	<50	3,100	2,200	17,000	NA	<50	NA	NA	NA	NA	51.44	9.82	NA	41.62	NA	NA
MW-5	02/28/2005	12,000	NA	<10	<10	<10	570	NA	<10	NA	NA	NA	NA	51.44	7.40	NA	44.04	NA	NA
MW-5	06/21/2005	5,200	NA	<2.5	<2.5	9.5	37	NA	<2.5	NA	NA	NA	NA	51.44	11.74	NA	39.70	NA	NA
MW-5	08/29/2005	330	NA	<0.50	<0.50	0.71	1.2	NA	<0.50	<2.0	<2.0	<2.0	<5.0	51.44	13.58	NA	37.86	NA	NA
MW-5	12/05/2005	71	NA	<0.50	1.4	0.53	6.2	NA	<0.50	NA	NA	NA	NA	51.44	11.53	NA	39.91	NA	NA
MW-6	12/17/1998	940	NA	27	0.32	2.4	2.3	3.0	3.2	NA	NA	NA	NA	51.88	11.37	NA	40.51	NA	NA
MW-6	03/09/1999	336	NA	7.78	1.60	2.40	6.36	<10.0	NA	NA	NA	NA	NA	51.88	8.10	NA	43.78	NA	NA
MW-6	06/16/1999	308	NA	2.45	<0.500	<0.500	<0.500	7.39	NA	NA	NA	NA	NA	51.88	14.49	NA	37.39	NA	NA
MW-6	09/30/1999	80.2	NA	<0.500	<0.500	<0.500	<0.500	24.8	NA	NA	NA	NA	NA	51.88	15.30	NA	36.58	NA	NA
MW-6	12/23/1999	149	NA	0.518	<0.500	<0.500	<0.500	6.43	NA	NA	NA	NA	NA	51.88	13.19	NA	38.69	NA	NA
MW-6	03/22/2000	382	NA	3.31	2.18	0.619	2.35	5.61	NA	NA	NA	NA	NA	51.88	8.27	NA	43.61	NA	NA
MW-6	06/01/2000	158	NA	0.830	<0.500	<0.500	1.10	10.9	NA	NA	NA	NA	NA	51.88	11.13	NA	40.75	NA	NA
MW-6	09/08/2000	<50.0	NA	<0.500	<0.500	<0.500	<0.500	<2.50	NA	NA	NA	NA	NA	51.88	14.28	NA	37.60	NA	NA
MW-6	12/04/2000	231	NA	4.93	<0.500	<0.500	<0.500	4.57	NA	NA	NA	NA	NA	51.88	12.62	NA	39.26	NA	NA
MW-6	03/09/2001	789	NA	11.6	2.72	<2.00	<2.00	28.0	NA	NA	NA	NA	NA	51.88	8.65	NA	43.23	NA	NA

WELL CONCENTRATIONS
Former Shell Service Station
8930 Bancroft Avenue
Oakland, CA

Well ID	Date	TPPH (ug/L)	TEPH (ug/L)	B (ug/L)	T (ug/L)	E (ug/L)	X (ug/L)	MTBE 8020 (ug/L)	MTBE 8260 (ug/L)	DIPE (ug/L)	ETBE (ug/L)	TAME (ug/L)	TBA (ug/L)	TOC (MSL)	Depth to Water (ft.)	Depth to SPH (ft.)	GW Elevation (MSL)	SPH Thickness (ft.)	DO Reading (mg/L)
MW-6	06/27/2001	140	NA	<0.50	1.1	<0.50	<0.50	<2.5	NA	NA	NA	NA	NA	51.88	14.95	NA	36.93	NA	NA
MW-6	09/20/2001	<50	NA	<0.50	<0.50	<0.50	<0.50	NA	<5.0	NA	NA	NA	NA	51.88	14.70	NA	37.18	NA	NA
MW-6	12/05/2001	NA	NA	NA	NA	NA	NA	NA	NA	NA	NA	NA	NA	51.88	9.62	NA	42.26	NA	1.8
MW-6	02/26/2002	130	NA	<0.50	2.6	0.69	4.1	NA	6.4	NA	NA	NA	NA	51.88	10.14	NA	41.74	NA	NA
MW-6	06/06/2002	NA	NA	NA	NA	NA	NA	NA	NA	NA	NA	NA	NA	51.88	13.52	NA	38.36	NA	NA
MW-6	09/09/2002	<50	NA	<0.50	<0.50	<0.50	<0.50	NA	<5.0	NA	NA	NA	NA	51.86	14.92	NA	36.94	NA	NA
MW-6	12/19/2002	NA	NA	NA	NA	NA	NA	NA	NA	NA	NA	NA	NA	51.86	8.22	NA	43.64	NA	NA
MW-6	03/28/2003	740	NA	<0.50	<0.50	<0.50	<0.50	NA	14	NA	NA	NA	NA	51.86	12.57	NA	39.29	NA	NA
MW-6	06/30/2003	NA	NA	NA	NA	NA	NA	NA	NA	NA	NA	NA	NA	51.86	14.14	NA	37.72	NA	NA
MW-6	09/25/2003	<250	NA	<2.5	160	<2.5	<5.0	NA	5.3	NA	NA	NA	NA	51.86	14.30	NA	37.56	NA	NA
MW-6	12/02/2003	NA	NA	NA	NA	NA	NA	NA	NA	NA	NA	NA	NA	51.86	13.72	NA	38.14	NA	NA
MW-6	03/18/2004	1,200	NA	<1.0	7.1	1.5	2.7	NA	16	NA	NA	NA	NA	51.86	9.72	NA	42.14	NA	NA
MW-6	06/17/2004	NA	NA	NA	NA	NA	NA	NA	NA	NA	NA	NA	NA	51.86	14.48	NA	37.38	NA	NA
MW-6	09/02/2004	75	NA	<0.50	<0.50	<0.50	<1.0	NA	11	<2.0	<2.0	<2.0	<5.0	51.86	15.16	NA	36.70	NA	NA
MW-6	12/14/2004	NA	NA	NA	NA	NA	NA	NA	NA	NA	NA	NA	NA	51.86	10.55	NA	41.31	NA	NA
MW-6	02/28/2005	500	NA	<0.50	<0.50	<0.50	<1.0	NA	4.6	NA	NA	NA	NA	51.86	8.40	NA	43.46	NA	NA
MW-6	06/21/2005	NA	NA	NA	NA	NA	NA	NA	NA	NA	NA	NA	NA	51.86	12.58	NA	39.28	NA	NA
MW-6	08/29/2005	96	NA	<0.50	<0.50	<0.50	<1.0	NA	0.56	<2.0	<2.0	<2.0	<5.0	51.86	14.61	NA	37.25	NA	NA
MW-6	12/05/2005	NA	NA	NA	NA	NA	NA	NA	NA	NA	NA	NA	NA	51.86	12.22	NA	39.64	NA	NA

WELL CONCENTRATIONS
Former Shell Service Station
8930 Bancroft Avenue
Oakland, CA

Well ID	Date	TPPH (ug/L)	TEPH (ug/L)	B (ug/L)	T (ug/L)	E (ug/L)	X (ug/L)	MTBE 8020 (ug/L)	MTBE 8260 (ug/L)	DIPE (ug/L)	ETBE (ug/L)	TAME (ug/L)	TBA (ug/L)	TOC (MSL)	Depth to Water (ft.)	Depth to SPH (ft.)	GW Elevation (MSL)	SPH Thickness (ft.)	DO Reading (mg/L)
---------	------	----------------	----------------	-------------	-------------	-------------	-------------	------------------------	------------------------	----------------	----------------	----------------	---------------	--------------	----------------------------	--------------------------	--------------------------	---------------------------	-------------------------

Abbreviations:

TPPH = Total petroleum hydrocarbons as gasoline by EPA Method 8260B; prior to September 20, 2001, analyzed by EPA Method 8015.

TEPH = Total petroleum hydrocarbons as diesel by modified EPA Method 8015.

BTEX = Benzene, toluene, ethylbenzene, xylenes by EPA Method 8260B; prior to September 20, 2001, analyzed by EPA Method 8020.

MTBE = Methyl tertiary butyl ether

DIPE = Di-isopropyl ether, analyzed by EPA Method 8260B

ETBE = Ethyl tertiary butyl ether, analyzed by EPA Method 8260B

TAME = Tertiary amyl methyl ether, analyzed by EPA Method 8260B

TBA = Tertiary butyl alcohol, analyzed by EPA Method 8260B

TOC = Top of Casing Elevation

SPH = Separate-phase hydrocarbons

GW = Groundwater

ug/L = Parts per billion

MSL = Mean sea level

ft. = Feet

<n = Below detection limit

NA = Not applicable

DO = Dissolved oxygen

mg/L = Parts per million

Notes:

a = This sample analyzed outside of EPA recommended holding time.

b = SPH detected in well, but exact thickness could not be measured.

c = Hydrocarbon does not match pattern of laboratory's standard.

d = Top of casing altered +0.11 feet during wellhead maintenance on December 28, 2004.

When separate-phase hydrocarbons are present, groundwater elevation is adjusted using the relation: Groundwater Elevation = Top-of-Casing Elevation - Depth to Water + (0.8 x Hydrocarbon Thickness).

Site surveyed February 12 and May 16, 2002 by Virgil Chavez Land Surveying of Vallejo, CA.



19 December, 2005

Michael Ninokata
Blaine Tech Services - San Jose (Shell)
1680 Rogers Avenue
San Jose, CA 95112

RE: 8930 Bancroft Rd., Oakland
Work Order: MOL0340

Enclosed are the results of analyses for samples received by the laboratory on 12/06/05 16:10. If you have any questions concerning this report, please feel free to contact me.

Sincerely,

Theresa Allen
Project Manager

CA ELAP Certificate #1210



Blaine Tech Services - San Jose (Shell)
1680 Rogers Avenue
San Jose CA, 95112

Project:8930 Bancroft Rd., Oakland
Project Number:051205-WC-1
Project Manager:Michael Ninokata

MOL0340
Reported:
12/19/05 18:27

ANALYTICAL REPORT FOR SAMPLES

Sample ID	Laboratory ID	Matrix	Date Sampled	Date Received
MW-4	MOL0340-01	Water	12/05/05 09:00	12/06/05 16:10
MW-5	MOL0340-02	Water	12/05/05 09:24	12/06/05 16:10

Blaine Tech Services - San Jose (Shell)
1680 Rogers Avenue
San Jose CA, 95112

Project: 8930 Bancroft Rd., Oakland
Project Number: 051205-WC-1
Project Manager: Michael Ninokata

MOL0340
Reported:
12/19/05 18:27

Purgeable Hydrocarbons and Volatile Organic Compounds by EPA method 8260B
Sequoia Analytical - Morgan Hill

Analyte	Result	Reporting Limit	Units	Dilution	Batch	Prepared	Analyzed	Method	Notes
MW-4 (MOL0340-01) Water Sampled: 12/05/05 09:00 Received: 12/06/05 16:10									
Methyl tert-butyl ether	2.5	0.50	ug/l	1	5L15021	12/15/05	12/16/05	EPA 8260B	
Gasoline Range Organics (C4-C12)	ND	50	"	"	"	"	"	"	
Benzene	ND	0.50	"	"	"	"	"	"	
Toluene	ND	0.50	"	"	"	"	"	"	
Ethylbenzene	ND	0.50	"	"	"	"	"	"	
Xylenes (total)	ND	0.50	"	"	"	"	"	"	
<i>Surrogate: 1,2-Dichloroethane-d4</i>		82 %	60-135		"	"	"	"	
MW-5 (MOL0340-02) Water Sampled: 12/05/05 09:24 Received: 12/06/05 16:10									
Methyl tert-butyl ether	ND	0.50	ug/l	1	5L15021	12/15/05	12/16/05	EPA 8260B	
Gasoline Range Organics (C4-C12)	71	50	"	"	"	"	"	"	
Benzene	ND	0.50	"	"	"	"	"	"	
Toluene	1.4	0.50	"	"	"	"	"	"	
Ethylbenzene	0.53	0.50	"	"	"	"	"	"	
Xylenes (total)	6.2	0.50	"	"	"	"	"	"	
<i>Surrogate: 1,2-Dichloroethane-d4</i>		79 %	60-135		"	"	"	"	



Blaine Tech Services - San Jose (Shell)
1680 Rogers Avenue
San Jose CA, 95112

Project: 8930 Bancroft Rd., Oakland
Project Number: 051205-WC-1
Project Manager: Michael Ninokata

MOL0340
Reported:
12/19/05 18:27

**Purgeable Hydrocarbons and Volatile Organic Compounds by EPA method 8260B - Quality Control
Sequoia Analytical - Morgan Hill**

Analyte	Result	Reporting Limit	Units	Spike Level	Source Result	%REC	%REC Limits	RPD	RPD Limit	Notes
---------	--------	-----------------	-------	-------------	---------------	------	-------------	-----	-----------	-------

Batch 5L15021 - EPA 5030B P/T / EPA 8260B

Blank (5L15021-BLK1)

Prepared: 12/15/05 Analyzed: 12/16/05

Methyl tert-butyl ether	ND	0.50	ug/l							
Gasoline Range Organics (C4-C12)	ND	50	"							
Benzene	ND	0.50	"							
Toluene	ND	0.50	"							
Ethylbenzene	ND	0.50	"							
Xylenes (total)	ND	0.50	"							
<i>Surrogate: 1,2-Dichloroethane-d4</i>	2.16		"	2.50		86	60-135			

Laboratory Control Sample (5L15021-BS1)

Prepared: 12/15/05 Analyzed: 12/16/05

Methyl tert-butyl ether	5.96	0.50	ug/l	7.02		85	65-125			
Gasoline Range Organics (C4-C12)	462	50	"	440		105	53-126			
Benzene	5.58	0.50	"	5.16		108	65-115			
Toluene	39.8	0.50	"	37.2		107	85-120			
Ethylbenzene	7.45	0.50	"	7.54		99	75-135			
Xylenes (total)	37.6	0.50	"	41.2		91	85-125			
<i>Surrogate: 1,2-Dichloroethane-d4</i>	2.28		"	2.50		91	60-135			

Matrix Spike (5L15021-MS1)

Source: MOL0341-04

Prepared: 12/15/05 Analyzed: 12/16/05

Methyl tert-butyl ether	30.0	2.5	ug/l	35.1	ND	85	65-125			
Gasoline Range Organics (C4-C12)	4450	250	"	2200	2900	70	53-126			
Benzene	44.6	2.5	"	25.8	20	95	65-115			
Toluene	206	2.5	"	186	2.2	110	85-120			
Ethylbenzene	268	2.5	"	37.7	270	0	75-135			QM05
Xylenes (total)	198	2.5	"	206	19	87	85-125			
<i>Surrogate: 1,2-Dichloroethane-d4</i>	2.37		"	2.50		95	60-135			

Matrix Spike Dup (5L15021-MSD1)

Source: MOL0341-04

Prepared: 12/15/05 Analyzed: 12/16/05

Methyl tert-butyl ether	31.4	2.5	ug/l	35.1	ND	89	65-125	5	20	
Gasoline Range Organics (C4-C12)	4500	250	"	2200	2900	73	53-126	1	20	
Benzene	45.0	2.5	"	25.8	20	97	65-115	0.9	20	
Toluene	206	2.5	"	186	2.2	110	85-120	0	20	
Ethylbenzene	274	2.5	"	37.7	270	11	75-135	2	15	QM05
Xylenes (total)	201	2.5	"	206	19	88	85-125	2	20	
<i>Surrogate: 1,2-Dichloroethane-d4</i>	2.24		"	2.50		90	60-135			

Sequoia Analytical - Morgan Hill

The results in this report apply to the samples analyzed in accordance with the chain of custody document. Unless otherwise stated, results are reported on a wet weight basis. This analytical report must be reproduced in its entirety.

Blaine Tech Services - San Jose (Shell)
1680 Rogers Avenue
San Jose CA, 95112Project:8930 Bancroft Rd., Oakland
Project Number:051205-WC-1
Project Manager:Michael NinokataMOL0340
Reported:
12/19/05 18:27**Notes and Definitions**

- QM05 The spike recovery was below control limits for the MS and/or MSD due to analyte concentration at 4 times or greater the spike concentration. The QC batch was accepted based on LCS and/or LCSD recoveries within the acceptance limits.
- DET Analyte DETECTED
- ND Analyte NOT DETECTED at or above the reporting limit or MDL, if MDL is specified
- NR Not Reported
- dry Sample results reported on a dry weight basis
- RPD Relative Percent Difference

SHELL Chain Of Custody Record

Shell Project Manager to be Invoiced:
 ENVIRONMENTAL SERVICES Denis Brown
 TECHNICAL SERVICES
 CRMT HOUSTON
 NOT FOR ENV. REMEDIATION - NO ETIM - SEND PAPER INVOICE

INCIDENT NUMBER (ES ONLY)
 9 8 9 9 5 7 4 2
 DATE: 12/5/05
 PAGE: 1 of 1

SAMPLING COMPANY:
Blaine Tech Services
 ADDRESS:
1680 Rogers Avenue, San Jose, CA 95112
 PROJECT CONTACT (Hardcopy or PDF Report to):
Michael Ninokata
 TELEPHONE: **408-573-0555** FAX: **408-573-7771** E-MAIL: **mminokata@blainetech.com**

LOG CODE: **BTSS** SITE ADDRESS: Street and City
8930 Bancroft Rd., Oakland
 State: **CA** GLOBAL ID NO.: **T0600118567**
 EDF DELIVERABLE TO (Responsible Party or Designee):
Anni Kremf PHONE NO.: **510-420-3335** E-MAIL: **Shell.em.edf@cambria-env.com** CONSULTANT PROJECT NO.: **051205-WC-1**
 BTS #

TURNAROUND TIME (STANDARD IS 10 CALENDAR DAYS):
 STD 5 DAY 3 DAY 2 DAY 24 HOURS
 RESULTS NEEDED ON WEEKEND

Will Crow
 LAB USE ONLY

LA - RWQCB REPORT FORMAT UST AGENCY:
 GC/MS MTBE CONFIRMATION: HIGHEST _____ HIGHEST per BORING _____ ALL _____
 SPECIAL INSTRUCTIONS OR NOTES: CHECK BOX IF EDD IS NOT NEEDED

REQUESTED ANALYSIS

MOL0340

RECEIPT VERIFICATION REQUESTED

LAB USE ONLY	Field Sample Identification				MATRIX	NO. OF CONT.	TPH - Purgeable (8260B)	TPH - Extractable (8015M)	BTEX (8260B)	5 Oxygenates (8260B)	MTBE (8260B)	TBA (8260B)	DIPE (8260B)	TAME (8260B)	ETBE (8260B)	1,2 DCA (8260B)	EDB (8260B)	Ethanol (8260B)	Methanol (8015M)
	DATE	TIME																	
	MW-4	12/5/05	0900	H ₂ O	SHCL	X	X	X											
	MW-5	↓	0924	↓	↓	X	X	X											

FIELD NOTES:
 Container/Preservative or PID Readings or Laboratory Notes

TEMPERATURE ON RECEIPT C°

Relinquished by (Signature): <u>Will Crow</u>	Received by (Signature): <u>[Signature]</u>	Date: <u>12/5/05</u>	Time: <u>1619</u>
Relinquished by (Signature): <u>[Signature]</u>	Received by (Signature): <u>[Signature]</u>	Date: <u>12/6/05</u>	Time: <u>1951</u>
Relinquished by (Signature): <u>[Signature]</u>	Received by (Signature): <u>[Signature]</u>	Date: <u>12/6/05</u>	Time: <u>1610</u>

(Sample Custodian)

SEQUOIA ANALYTICAL SAMPLE RECEIPT LOG

CLIENT NAME: Shell
 REC. BY (PRINT) JT
 WORKORDER: MOL 6340

DATE REC'D AT LAB: 12/06/05
 TIME REC'D AT LAB: 16:10
 DATE LOGGED IN: 12-9-05

For Regulatory Purposes?
 DRINKING WATER YES/NO YES NO
 WASTE WATER YES/NO YES NO

CIRCLE THE APPROPRIATE RESPONSE	LAB SAMPLE #	DASH #	CLIENT ID	CONTAINER DESCRIPTION	PRESERVATIVE	PH	SAMPLE MATRIX	DATE SAMPLED	REMARKS: CONDITION (ETC.)
1. Custody Seal(s) Present / <input checked="" type="radio"/> Absent Intact / Broken*									<div style="position: absolute; top: 0; right: 0; transform: rotate(45deg); font-size: 2em; font-weight: bold;"> 12/06/05 JT see WOC </div>
2. Chain-of-Custody <input checked="" type="radio"/> Present / Absent*									
3. Traffic Reports or Packing List: Present / <input checked="" type="radio"/> Absent									
4. Airbill: Airbill / Sticker Present / <input checked="" type="radio"/> Absent									
5. Airbill #:									
6. Sample Labels: <input checked="" type="radio"/> Present / Absent									
7. Sample IDs: <input checked="" type="radio"/> Listed / Not Listed on Chain-of-Custody									
8. Sample Condition: <input checked="" type="radio"/> Intact / Broken* / Leaking*									
9. Does information on chain-of-custody, traffic reports and sample labels agree? <input checked="" type="radio"/> Yes / No*									
10. Sample received within hold time? <input checked="" type="radio"/> Yes / No*									
11. Adequate sample volume received? <input checked="" type="radio"/> Yes / No*									
12. Proper preservatives used? <input checked="" type="radio"/> Yes / No*									
13. Trip Blank / Temp Blank Received? (circle which, if yes) <input checked="" type="radio"/> Yes / <input type="radio"/> No*									
14. Read Temp: <u>2.1°C</u> Corrected Temp: <u>2.1°C</u> Is corrected temp 4 +/- 2°C? <input checked="" type="radio"/> Yes / No**									

*IF CIRCLED, CONTACT PROJECT MANAGER AND ATTACH RECORD OF RESOLUTION.

WELL GAUGING DATA

Project # 051205-xxx Date 12/5/05 Client Shell

Site 8930 Bancroft Ave., Oakland

Well ID	Well Size (in.)	Sheen / Odor	Depth to Immiscible Liquid (ft.)	Thickness of Immiscible Liquid (ft.)	Volume of Immiscibles Removed (ml)	Depth to water (ft.)	Depth to well bottom (ft.)	Survey Point: TOB or TOC
MW-1	3					12.95	16.84	↓
MW-2	3					12.78	19.86	
MW-3	3					11.05	19.77	
MW-4	3	g gauged w/ stringer well				11.01	19.34 17.79	
MW-5	3	g gauged w/ stringer well				11.53	19.77	
MW-6	3					12.22	19.83	

SHELL WELL MONITORING DATA SHEET

BTS #: <u>051205-WC-1</u>	Site: <u>8930 Bancroft + Ave., Oakland</u>
Sampler: <u>WC</u>	Date: <u>12/5/05</u>
Well I.D.: <u>MW-4</u>	Well Diameter: 2 <input checked="" type="checkbox"/> 4 <input type="checkbox"/> 6 <input type="checkbox"/> 8 <input type="checkbox"/>
Total Well Depth (TD): <u>17.879-19.3</u>	Depth to Water (DTW): <u>11.01</u>
Depth to Free Product:	Thickness of Free Product (feet):
Referenced to: <input checked="" type="checkbox"/> PVC <input type="checkbox"/> Grade	D.O. Meter (if req'd): YSI <input type="checkbox"/> HACH <input type="checkbox"/>
DTW with 80% Recharge [(Height of Water Column x 0.20) + DTW]: <u>12.68</u>	

Purge Method: Bailer Watera Sampling Method: Bailer
 Disposable Bailer Peristaltic Disposable Bailer
 Positive Air Displacement Extraction Pump Extraction Port
 Electric Submersible Other _____ Dedicated Tubing

Other: _____

$3.1 \text{ (Gals.)} \times 3 = 9.3 \text{ Gals.}$ 1 Case Volume Specified Volumes Calculated Volume	<table border="1" style="width: 100%; border-collapse: collapse; font-size: small;"> <thead> <tr> <th>Well Diameter</th> <th>Multiplier</th> <th>Well Diameter</th> <th>Multiplier</th> </tr> </thead> <tbody> <tr> <td>1"</td> <td>0.04</td> <td>4"</td> <td>0.65</td> </tr> <tr> <td>2"</td> <td>0.16</td> <td>6"</td> <td>1.47</td> </tr> <tr> <td>3"</td> <td>0.37</td> <td>Other</td> <td>radius² * 0.163</td> </tr> </tbody> </table>	Well Diameter	Multiplier	Well Diameter	Multiplier	1"	0.04	4"	0.65	2"	0.16	6"	1.47	3"	0.37	Other	radius ² * 0.163
Well Diameter	Multiplier	Well Diameter	Multiplier														
1"	0.04	4"	0.65														
2"	0.16	6"	1.47														
3"	0.37	Other	radius ² * 0.163														

Time	Temp (°F)	pH	Cond. (mS or μ S)	Turbidity (NTUs)	Gals. Removed	Observations
0852	69.3	6.2	143	79	3.1	odor
0854	70.0	6.3	164	126	6.2	↓
0856	70.7	6.4	187	64	9.3	↓

Did well dewater? Yes No Gallons actually evacuated: 9.3

Sampling Date: 12/5/05 Sampling Time: 0900 Depth to Water: 11.13

Sample I.D.: MW-4 Laboratory: STL Other 7A

Analyzed for: TPH-G BTEX MTBE TPH-D Other: _____

EB I.D. (if applicable): _____ @ _____ Time Duplicate I.D. (if applicable): _____

Analyzed for: TPH-G BTEX MTBE TPH-D Other: _____

D.O. (if req'd):	Pre-purge:	mg/L	Post-purge:	mg/L
O.R.P. (if req'd):	Pre-purge:	mV	Post-purge:	mV

SHELL WELL MONITORING DATA SHEET

BTS #: <u>051205-WC-1</u>	Site: <u>8930 Bancroft Ave, Oakland</u>
Sampler: <u>WC</u>	Date: <u>12/5/05</u>
Well I.D.: <u>MW-5</u>	Well Diameter: 2 <input type="checkbox"/> 4 <input type="checkbox"/> 6 <input type="checkbox"/> 8 <input type="checkbox"/>
Total Well Depth (TD): <u>19.77</u>	Depth to Water (DTW): <u>11.53</u>
Depth to Free Product:	Thickness of Free Product (feet):
Referenced to: <u>WC</u> Grade	D.O. Meter (if req'd): YSI <input type="checkbox"/> HACH <input type="checkbox"/>
DTW with 80% Recharge [(Height of Water Column x 0.20) + DTW]: <u>13.18</u>	

Purge Method: Bailer Waterra Sampling Method: Bailer
 Disposable Bailer Peristaltic Disposable Bailer
 Positive Air Displacement Extraction Pump Extraction Port
 Electric Submersible Other _____ Dedicated Tubing

Other: _____

$3.1 \text{ (Gals.)} \times 3 = 9.3 \text{ Gals.}$ <p>1 Case Volume Specified Volumes Calculated Volume</p>	<table border="1" style="width: 100%; border-collapse: collapse;"> <thead> <tr> <th>Well Diameter</th> <th>Multiplier</th> <th>Well Diameter</th> <th>Multiplier</th> </tr> </thead> <tbody> <tr> <td>1"</td> <td>0.04</td> <td>4"</td> <td>0.65</td> </tr> <tr> <td>2"</td> <td>0.16</td> <td>6"</td> <td>1.47</td> </tr> <tr> <td>3"</td> <td>0.37</td> <td>Other</td> <td>radius² * 0.163</td> </tr> </tbody> </table>	Well Diameter	Multiplier	Well Diameter	Multiplier	1"	0.04	4"	0.65	2"	0.16	6"	1.47	3"	0.37	Other	radius ² * 0.163
Well Diameter	Multiplier	Well Diameter	Multiplier														
1"	0.04	4"	0.65														
2"	0.16	6"	1.47														
3"	0.37	Other	radius ² * 0.163														

Time	Temp (°F)	pH	Cond. (mS or μ S)	Turbidity (NTUs)	Gals. Removed	Observations
0916	69.0	6.5	283	214	3.1	odor
0918	71.0	6.5	288	151	6.2	↓
0920	71.2	6.5	296	73	9.3	↓

Did well dewater? Yes No Gallons actually evacuated: 9.3

Sampling Date: 12/5/05 Sampling Time: 0924 Depth to Water: 11.69

Sample I.D.: MW-5 Laboratory: STL Other 7A

Analyzed for: TPH-G BTEX MTBE TPH-D Other: _____

EB I.D. (if applicable): _____ @ _____ Time Duplicate I.D. (if applicable): _____

Analyzed for: TPH-G BTEX MTBE TPH-D Other: _____

D.O. (if req'd):	Pre-purge:	mg/L	Post-purge:	mg/L
O.R.P. (if req'd):	Pre-purge:	mV	Post-purge:	mV

