



RO 404 G
Request ECM

Denis L. Brown

July 20, 2005

Jerry Wickham
Alameda County Health Care Services Agency
1131 Harbor Bay Parkway, Suite 250
Alameda, CA 94502-6577

Shell Oil Products US
HSE – Environmental Services
20945 S. Wilmington Ave.
Carson, CA 90810-1039
Tel (707) 865 0251
Fax (707) 865 2542
Email denis.l.brown@shell.com

Re: Second Quarter 2005 Monitoring Report
Former Shell Service Station/Current 24-7 Quick Mart Service Station
8930 Bancroft Avenue
Oakland, California
SAP Code 135678
Incident No. 98995742

Alameda County
JUL 25 2005
Environmental Health

Dear Mr. Wickham:

Attached for your review and comment is a copy of the *Second Quarter 2005 Monitoring Report* for the above referenced site. Upon information and belief, I declare, under penalty of perjury, that the information contained in the attached document is true and correct.

If you have any questions or concerns, please call me at (707) 865-0251.

Sincerely,

Denis L. Brown
Sr. Environmental Engineer

July 20, 2005

Jerry Wickham
Alameda County Health Care Services Agency
1131 Harbor Bay Parkway, 2nd Floor
Alameda, California 94502

Re: Second Quarter 2005 Monitoring Report
Former Shell Service Station/Current 24-7 Quick Mart Service Station
8930 Bancroft Avenue
Oakland, California
Incident #98995742
Cambria Project #247-1408-002
SAP #135678
ACEH Case #3962



Alameda County
JUL 25 2005
Environmental Health

Dear Mr. Wickham:

On behalf of Equilon Enterprises LLC dba Shell Oil Products US (Shell), Cambria Environmental Technology, Inc. (Cambria) is submitting this groundwater monitoring report in accordance with the reporting requirements of 23 CCR 2652d. The site is located on the corner of Bancroft Avenue and 90th Avenue in Oakland, California (Figures 1 and 2). Shell ceased operations in July 1999 when three 10,000-gallon fiberglass underground storage tanks, associated piping, and dispensers were removed and replaced at the site. The site is currently owned and operated by 24-7 Quick-Mart.

SECOND QUARTER 2005 ACTIVITIES

Groundwater Monitoring: Blaine Tech Services, Inc. (Blaine) of San Jose, California gauged the site wells, sampled selected wells, calculated groundwater elevations, and compiled the analytical data. Cambria prepared a vicinity map that includes previously submitted well survey information (Figure 1) and a groundwater elevation contour map (Figure 2). Blaine's report, presenting the laboratory report and supporting field documents, is included as Attachment A.

During the September 2, 2004 quarterly monitoring event, approximately 0.07 feet of SPH were observed in well MW-5. On December 15, 2004, Blaine verbally reported to Cambria that hydrocarbon sheen was observed on water extracted from well MW-5 during the sampling event on December 14, 2004. However, Blaine was able to sample the well since there was no measurable SPH observed. No SPH or hydrocarbon sheen was observed when samples were collected from well MW-5 during the first and second quarter 2005 sampling events.

**Cambria
Environmental
Technology, Inc.**

5900 Hollis Street
Suite A
Emeryville, CA 94608
Tel (510) 420-0700
Fax (510) 420-9170

ANTICIPATED THIRD QUARTER 2005 ACTIVITIES

Groundwater Monitoring: Blaine will gauge all site wells, sample selected site wells, and tabulate the data. Cambria will prepare a monitoring report.

CLOSING



We appreciate the opportunity to work with you on this project. Please call David Gibbs at (510) 420-3363 if you have any questions or comments.

Sincerely,
Cambria Environmental Technology, Inc

David M. Gibbs, P.G.
Project Geologist

Matthew W. Derby, P.E.
Senior Project Engineer



Figures: 1 - Vicinity/Area Well Survey Map
2 - Groundwater Elevation Contour Map

Attachment: A - Blaine Groundwater Monitoring Report and Field Notes

cc: Denis Brown, Shell Oil Products US, 20945 S. Wilmington Ave., Carson, CA 90810
Sidhu Associates, 8930 Bancroft Ave., Oakland, CA 94605

G:\Oakland 8930 Bancroft\QM\2q05\2q05qm.doc

EXPLANATION

- 4 ○ Active water producing well
- 8 ◆ Other well (monitoring, vadose)
- 6 ⊙ Cathodic Protection well
- 7 ⚡ Vapor Extraction well
- 5 ⊕ Irrigation/Agricultural well
- 26 ⊗ Abandoned well
- 28 ⊖ Unknown well
- ★ Subject site
- Study area

W-1
 (Irrigation Well)
 1840 90th Ave.

G:\OAKLAND\8930BANCROFT\FIGURES\I.C.-WELL-SURVEY.A1

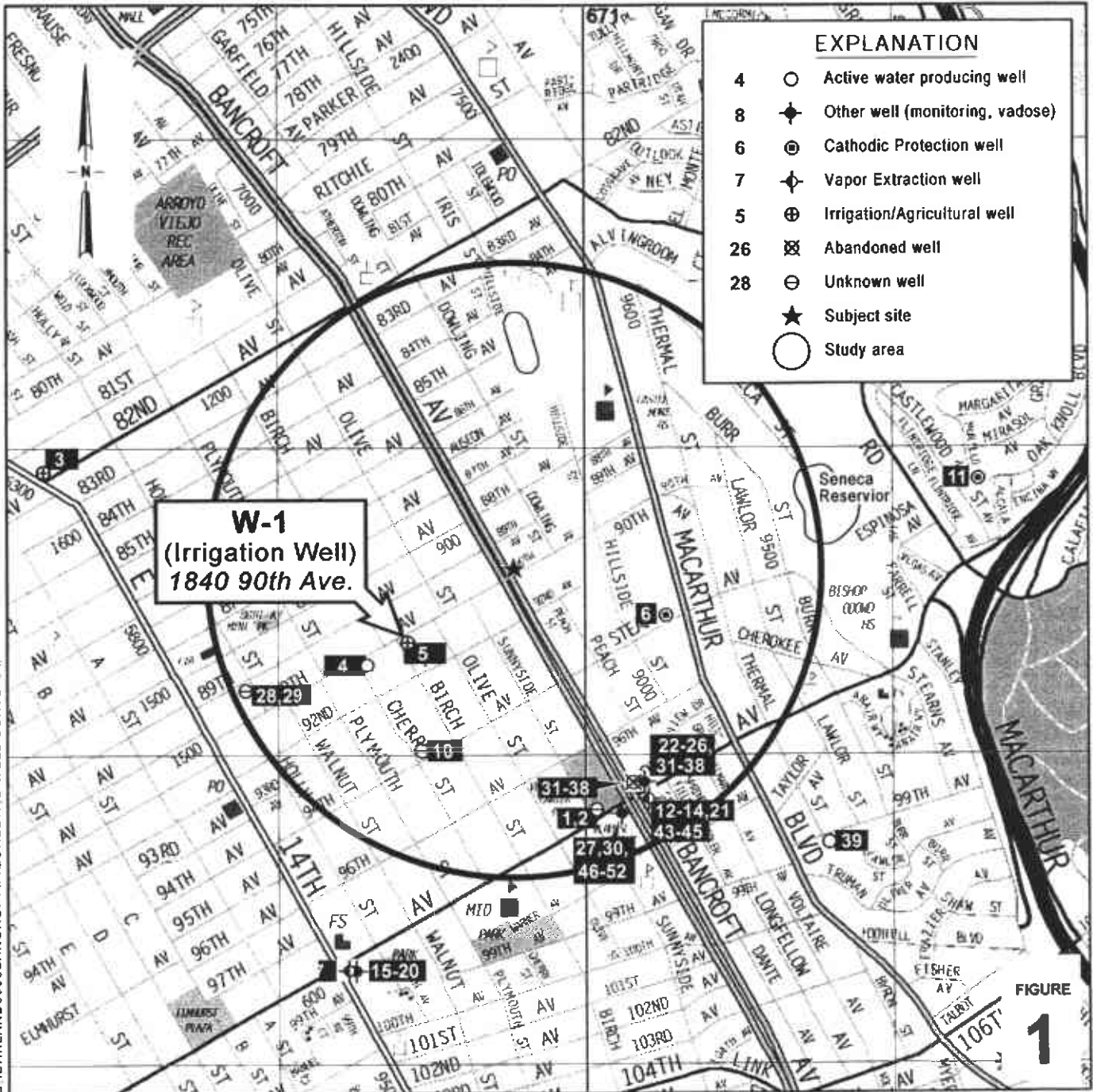

FIGURE 1

0 1/8 1/4 1/2 1
 SCALE 1" = 1/4 MILE

**Former Shell-branded Station/
 Current 24-7 Quick Mart
 Service Station**

8930 Bancroft Avenue
 Oakland, California
 Incident #98995742



C A M B R I A

**Vicinity/Area Well
 Survey Map**

(1/2 Mile Radius)

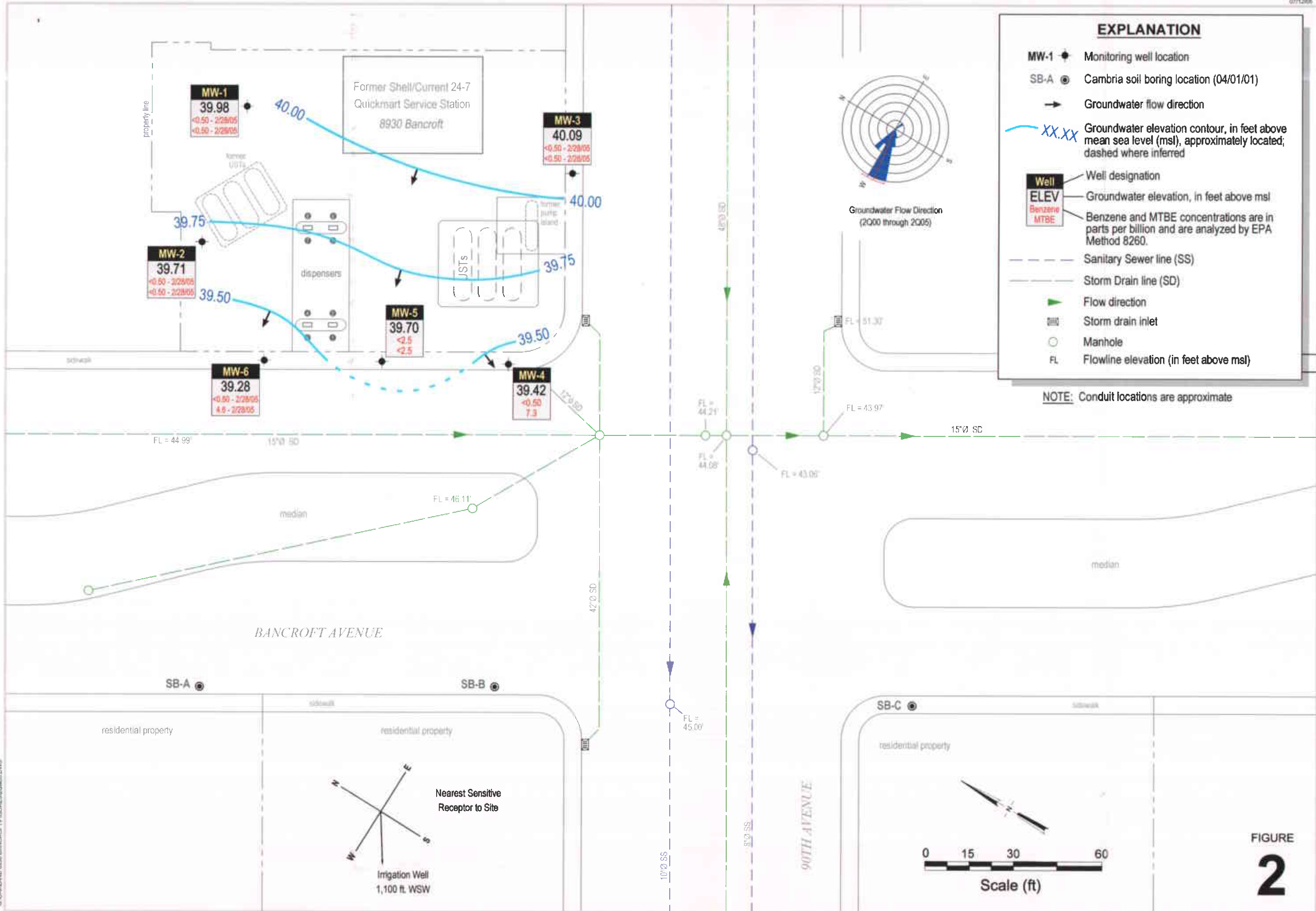

Groundwater Elevation Contour Map

June 21, 2005



C A M B R I A

Former Shell-branded/Current 24-7 Quick Mart Service Station

8930 Bancroft Avenue
Oakland, California
Incident No. 98895742

ATTACHMENT A
Blaine Groundwater Monitoring Report
and Field Notes

BLAINE
TECH SERVICES^{INC.}

GROUNDWATER SAMPLING SPECIALISTS
SINCE 1983

July 8, 2005

Denis Brown
Shell Oil Products US
20945 South Wilmington Avenue
Carson, CA 90810

Second Quarter 2005 Groundwater Monitoring at
Former Shell-branded Service Station
8930 Bancroft Avenue
Oakland, CA

Monitoring performed on June 21, 2005

Groundwater Monitoring Report **050621-MD-1**

This report covers the routine monitoring of groundwater wells at this former Shell facility. In accordance with standard procedures that conform to Regional Water Quality Control Board requirements, routine field data collection includes depth to water, total well depth, thickness of any separate immiscible layer, water column volume, calculated purge volume (if applicable), elapsed evacuation time (if applicable), total volume of water removed (if applicable), and standard water parameter instrument readings. Sample material is collected, contained, stored, and transported to the laboratory in conformance with EPA standards. Purgewater (if applicable) is, likewise, collected and transported to the Shell Martinez Manufacturing Complex.

Basic field information is presented alongside analytical values excerpted from the laboratory report in the cumulative table of **WELL CONCENTRATIONS**. The full analytical report for the most recent samples and the field data sheets are attached to this report.

At a minimum, Blaine Tech Services, Inc. field personnel are certified on completion of a forty-hour Hazardous Materials and Emergency Response training course per 29 CFR 1910.120. Field personnel are also enrolled in annual eight-hour refresher courses.

Blaine Tech Services, Inc. conducts sampling and documentation assignments of this type as an independent third party. Our activities at this site consisted of objective data and sample collection only. No interpretation of analytical results, defining of hydrological conditions or formulation of recommendations was performed.

Please call if you have any questions.

Yours truly,

Leon Gearhart
Project Coordinator

LG/cl

attachments: Cumulative Table of WELL CONCENTRATIONS
Certified Analytical Report
Field Data Sheet

cc: Anni Kreml
Cambria Environmental Technology, Inc.
5900 Hollis Street, Suite A
Emeryville, CA 94608

WELL CONCENTRATIONS
Former Shell Service Station
8930 Bancroft Avenue
Oakland, CA

Well ID	Date	TPPH (ug/L)	TEPH (ug/L)	B (ug/L)	T (ug/L)	E (ug/L)	X (ug/L)	MTBE 8020 (ug/L)	MTBE 8260 (ug/L)	DIPE (ug/L)	ETBE (ug/L)	TAME (ug/L)	TBA (ug/L)	TOC (MSL)	Depth to Water (ft.)	Depth to SPH (ft.)	GW Elevation (MSL)	SPH Thickness (ft.)	DO Reading (mg/L)
MW-1	12/17/1998	<50	NA	<0.50	<0.50	<0.50	<0.50	<2.5	NA	NA	NA	NA	NA	53.19	11.87	NA	41.32	NA	NA
MW-1	3/9/1999	<50.0	NA	<0.500	<0.500	<0.500	<0.500	<5.00	NA	NA	NA	NA	NA	53.19	8.21	NA	44.98	NA	NA
MW-1	6/16/1999	<50.0	NA	<0.500	<0.500	<0.500	<0.500	<5.00	NA	NA	NA	NA	NA	53.19	15.04	NA	38.15	NA	NA
MW-1	9/30/1999	<50.0	NA	<0.500	<0.500	<0.500	<0.500	<5.00	NA	NA	NA	NA	NA	53.19	16.02	NA	37.17	NA	NA
MW-1	12/23/1999	<50.0	NA	<0.500	<0.500	<0.500	<0.500	<2.50	NA	NA	NA	NA	NA	53.19	14.78	NA	38.41	NA	NA
MW-1	3/22/2000	<50.0	NA	<0.500	<0.500	<0.500	<0.500	<5.00	NA	NA	NA	NA	NA	53.19	8.44	NA	44.75	NA	NA
MW-1	6/1/2000	<50.0	NA	<0.500	<0.500	<0.500	<0.500	<2.50	NA	NA	NA	NA	NA	53.19	13.71	NA	39.48	NA	NA
MW-1	9/8/2000	<50.0	NA	<0.500	<0.500	<0.500	<0.500	<2.50	NA	NA	NA	NA	NA	53.19	14.95	NA	38.24	NA	NA
MW-1	12/4/2000	<50.0	NA	<0.500	<0.500	<0.500	<0.500	5.82	NA	NA	NA	NA	NA	53.19	13.85	NA	39.34	NA	NA
MW-1	3/9/2001	<50.0	NA	<0.500	<0.500	<0.500	<0.500	<2.50	NA	NA	NA	NA	NA	53.19	9.07	NA	44.12	NA	NA
MW-1	6/27/2001	<50	NA	<0.50	<0.50	<0.50	<0.50	<2.5	NA	NA	NA	NA	NA	53.19	14.90	NA	38.29	NA	NA
MW-1	9/20/2001	NA	NA	NA	NA	NA	NA	NA	NA	NA	NA	NA	NA	53.19	15.53	NA	37.66	NA	NA
MW-1	12/5/2001	NA	NA	NA	NA	NA	NA	NA	NA	NA	NA	NA	NA	53.19	10.41	NA	42.78	NA	3.8
MW-1	2/26/2002	<50	NA	<0.50	<0.50	<0.50	<0.50	NA	<0.50	NA	NA	NA	NA	53.19	11.09	NA	42.10	NA	NA
MW-1	6/6/2002	NA	NA	NA	NA	NA	NA	NA	NA	NA	NA	NA	NA	53.19	14.13	NA	39.06	NA	NA
MW-1	9/9/2002	NA	NA	NA	NA	NA	NA	NA	NA	NA	NA	NA	NA	53.20	15.55	NA	37.65	NA	NA
MW-1	12/19/2002	NA	NA	NA	NA	NA	NA	NA	NA	NA	NA	NA	NA	53.20	8.67	NA	44.53	NA	NA
MW-1	3/28/2003	<50	NA	<0.50	<0.50	<0.50	<0.50	NA	<5.0	NA	NA	NA	NA	53.20	13.33	NA	39.87	NA	NA
MW-1	6/30/2003	NA	NA	NA	NA	NA	NA	NA	NA	NA	NA	NA	NA	53.20	14.71	NA	38.49	NA	NA
MW-1	9/25/2003	<50	NA	<0.50	<0.50	<0.50	<1.0	NA	<0.50	NA	NA	NA	NA	53.20	15.13	NA	38.07	NA	NA
MW-1	12/2/2003	NA	NA	NA	NA	NA	NA	NA	NA	NA	NA	NA	NA	53.20	14.42	NA	38.78	NA	NA
MW-1	3/18/2004	<50	NA	<0.50	<0.50	<0.50	<1.0	NA	<0.50	NA	NA	NA	NA	53.20	10.38	NA	42.82	NA	NA
MW-1	6/17/2004	NA	NA	NA	NA	NA	NA	NA	NA	NA	NA	NA	NA	53.20	14.95	NA	38.25	NA	NA
MW-1	9/2/2004	NA	NA	NA	NA	NA	NA	NA	NA	NA	NA	NA	NA	53.20	15.75	NA	37.45	NA	NA
MW-1	12/14/2004	NA	NA	NA	NA	NA	NA	NA	NA	NA	NA	NA	NA	53.20	11.20	NA	42.00	NA	NA
MW-1	2/28/2005	<50	NA	<0.50	<0.50	<0.50	<1.0	NA	<0.50	NA	NA	NA	NA	53.20	8.53	NA	44.67	NA	NA
MW-1	6/21/2005	NA	NA	NA	NA	NA	NA	NA	NA	NA	NA	NA	NA	53.20	13.22	NA	39.98	NA	NA
MW-2	12/17/1998	9,900	NA	<5.0	37	22	47	48	<20	NA	NA	NA	NA	52.66	11.65	NA	41.01	NA	NA
MW-2	3/9/1999	2,760	NA	12.3	7.50	85.4	444	<50.0	NA	NA	NA	NA	NA	52.66	8.07	NA	44.59	NA	NA
MW-2	6/16/1999	2,570	NA	36.3	11.6	6.19	10.8	<50.0	NA	NA	NA	NA	NA	52.66	14.63	NA	38.03	NA	NA
MW-2	9/30/1999	1,960	NA	19.1	3.20	4.55	26.9	<25.0	NA	NA	NA	NA	NA	52.66	15.63	NA	37.03	NA	NA
MW-2	12/23/1999	145	NA	1.30	<0.500	<0.500	0.899	<2.50	NA	NA	NA	NA	NA	52.66	14.42	NA	38.24	NA	NA
MW-2	3/22/2000	6,060	NA	18.9	<10.0	210	651	<100	NA	NA	NA	NA	NA	52.66	8.19	NA	44.47	NA	NA
MW-2	6/1/2000	<50.0	NA	<0.500	<0.500	<0.500	<0.500	<2.50	NA	NA	NA	NA	NA	52.66	11.46	NA	41.20	NA	NA

WELL CONCENTRATIONS
Former Shell Service Station
8930 Bancroft Avenue
Oakland, CA

Well ID	Date	TPPH (ug/L)	TEPH (ug/L)	B (ug/L)	T (ug/L)	E (ug/L)	X (ug/L)	MTBE 8020 (ug/L)	MTBE 8260 (ug/L)	DIPE (ug/L)	ETBE (ug/L)	TAME (ug/L)	TBA (ug/L)	TOC (MSL)	Depth to Water (ft.)	Depth to SPH (ft.)	GW Elevation (MSL)	SPH Thickness (ft.)	DO Reading (mg/L)
MW-2	9/8/2000	<50.0	NA	<0.500	<0.500	<0.500	<0.500	<2.50	NA	NA	NA	NA	NA	52.66	14.63	NA	38.03	NA	NA
MW-2	12/4/2000	201	NA	1.35	<0.500	3.39	8.58	<2.50	NA	NA	NA	NA	NA	52.66	13.45	NA	39.21	NA	NA
MW-2	3/9/2001	396	NA	2.82	<0.500	8.69	18.7	<2.50	NA	NA	NA	NA	NA	52.66	8.89	NA	43.77	NA	NA
MW-2	6/27/2001	<50	NA	<0.50	<0.50	<0.50	<0.50	<2.5	NA	NA	NA	NA	NA	52.66	14.88	NA	37.78	NA	NA
MW-2	9/20/2001	<50	NA	<0.50	<0.50	<0.50	<0.50	NA	<5.0	NA	NA	NA	NA	52.66	15.19	NA	37.47	NA	NA
MW-2	12/5/2001	NA	NA	NA	NA	NA	NA	NA	NA	NA	NA	NA	NA	52.66	10.02	NA	42.64	NA	2.8
MW-2	2/26/2002	180	NA	<0.50	<0.50	2.7	4.1	NA	<0.50	NA	NA	NA	NA	52.66	10.76	NA	41.90	NA	NA
MW-2	6/6/2002	NA	NA	NA	NA	NA	NA	NA	NA	NA	NA	NA	NA	52.66	13.83	NA	38.83	NA	NA
MW-2	9/9/2002	<50	NA	<0.50	<0.50	<0.50	<0.50	NA	<5.0	NA	NA	NA	NA	52.66	15.23	NA	37.43	NA	NA
MW-2	12/19/2002	NA	NA	NA	NA	NA	NA	NA	NA	NA	NA	NA	NA	52.66	8.46	NA	44.20	NA	NA
MW-2	3/28/2003	53	NA	<0.50	<0.50	0.51	1.4	NA	<5.0	NA	NA	NA	NA	52.66	12.96	NA	39.70	NA	NA
MW-2	6/30/2003	NA	NA	NA	NA	NA	NA	NA	NA	NA	NA	NA	NA	52.66	14.49	NA	38.17	NA	NA
MW-2	9/25/2003	Well inaccessible		NA	NA	NA	NA	NA	NA	NA	NA	NA	NA	52.66	NA	NA	NA	NA	NA
MW-2	10/3/2003	54 c	NA	<0.50	<0.50	<0.50	<1.0	NA	<0.50	NA	NA	NA	NA	52.66	15.03	NA	37.63	NA	NA
MW-2	12/2/2003	NA	NA	NA	NA	NA	NA	NA	NA	NA	NA	NA	NA	52.66	14.08	NA	38.58	NA	NA
MW-2	3/18/2004	130	NA	<0.50	<0.50	1.9	2.4	NA	<0.50	NA	NA	NA	NA	52.66	10.08	NA	42.58	NA	NA
MW-2	6/17/2004	NA	NA	NA	NA	NA	NA	NA	NA	NA	NA	NA	NA	52.66	14.65	NA	38.01	NA	NA
MW-2	9/2/2004	<50	NA	<0.50	<0.50	<0.50	<1.0	NA	<0.50	<2.0	<2.0	<2.0	<5.0	52.66	15.38	NA	37.28	NA	NA
MW-2	12/14/2004	NA	NA	NA	NA	NA	NA	NA	NA	NA	NA	NA	NA	52.66	10.89	NA	41.77	NA	NA
MW-2	2/28/2005	<50	NA	<0.50	<0.50	<0.50	<1.0	NA	<0.50	NA	NA	NA	NA	52.77 d	8.48	NA	44.29	NA	NA
MW-2	6/21/2005	NA	NA	NA	NA	NA	NA	NA	NA	NA	NA	NA	NA	52.77	13.06	NA	39.71	NA	NA
MW-3	12/17/1998	<50	NA	<0.50	<0.50	<0.50	<0.50	10	11	NA	NA	NA	NA	51.30	11.85	NA	39.45	NA	NA
MW-3	3/9/1999	<50.0	NA	<0.500	<0.500	<0.500	<0.500	<5.00	NA	NA	NA	NA	NA	51.30	6.53	NA	44.77	NA	NA
MW-3	6/16/1999	<50.0	NA	<0.500	<0.500	<0.500	<0.500	<5.00	NA	NA	NA	NA	NA	51.30	12.71	NA	38.59	NA	NA
MW-3	9/30/1999	<50.0	NA	<0.500	<0.500	<0.500	<0.500	5.14	NA	NA	NA	NA	NA	51.30	14.07	NA	37.23	NA	NA
MW-3	12/23/1999	<500	NA	<5.00	<5.00	<5.00	<5.00	<25.0	NA	NA	NA	NA	NA	51.30	12.82	NA	38.48	NA	NA
MW-3	3/22/2000	<50.0	NA	<0.500	1.48	<0.500	1.90	<5.00	NA	NA	NA	NA	NA	51.30	6.81	NA	44.49	NA	NA
MW-3	6/1/2000	<50.0	NA	<0.500	0.821	<0.500	<0.500	4.39	NA	NA	NA	NA	NA	51.30	11.85	NA	39.45	NA	NA
MW-3	9/8/2000	<50.0	NA	<0.500	<0.500	<0.500	<0.500	3.62	NA	NA	NA	NA	NA	51.30	12.55	NA	38.75	NA	NA
MW-3	12/4/2000	<50.0	NA	<0.500	<0.500	<0.500	0.588	4.74	NA	NA	NA	NA	NA	51.30	11.65	NA	39.65	NA	NA
MW-3	3/9/2001	<50.0	NA	<0.500	<0.500	<0.500	<0.500	<2.50	NA	NA	NA	NA	NA	51.30	7.28	NA	44.02	NA	NA
MW-3	6/27/2001	<50	NA	<0.50	<0.50	<0.50	<0.50	<2.5	NA	NA	NA	NA	NA	51.30	13.16	NA	38.14	NA	NA
MW-3	9/20/2001	NA	NA	NA	NA	NA	NA	NA	NA	NA	NA	NA	NA	51.30	13.35	NA	37.95	NA	NA
MW-3	12/5/2001	NA	NA	NA	NA	NA	NA	NA	NA	NA	NA	NA	NA	51.30	8.14	NA	43.16	NA	1.2
MW-3	2/26/2002	<50	NA	<0.50	7.2	<0.50	<0.50	NA	1.5	NA	NA	NA	NA	51.30	9.09	NA	42.21	NA	0.6

WELL CONCENTRATIONS
Former Shell Service Station
8930 Bancroft Avenue
Oakland, CA

Well ID	Date	TPPH (ug/L)	TEPH (ug/L)	B (ug/L)	T (ug/L)	E (ug/L)	X (ug/L)	MTBE 8020 (ug/L)	MTBE 8260 (ug/L)	DIPE (ug/L)	ETBE (ug/L)	TAME (ug/L)	TBA (ug/L)	TOC (MSL)	Depth to Water (ft.)	Depth to SPH (ft.)	GW Elevation (MSL)	SPH Thickness (ft.)	DO Reading (mg/L)
MW-3	6/6/2002	NA	NA	NA	NA	NA	NA	NA	NA	NA	NA	NA	NA	51.30	12.13	NA	39.17	NA	0.8
MW-3	9/9/2002	NA	NA	NA	NA	NA	NA	NA	NA	NA	NA	NA	NA	51.35	13.54	NA	37.81	NA	1.0
MW-3	12/19/2002	NA	NA	NA	NA	NA	NA	NA	NA	NA	NA	NA	NA	51.35	6.75	NA	44.60	NA	0.6
MW-3	3/28/2003	<50	NA	<0.50	<0.50	<0.50	<0.50	NA	<5.0	NA	NA	NA	NA	51.35	11.28	NA	40.07	NA	0.7
MW-3	6/30/2003	NA	NA	NA	NA	NA	NA	NA	NA	NA	NA	NA	NA	51.35	12.68	NA	38.67	NA	NA
MW-3	9/25/2003	<50	NA	<0.50	2.0	0.73	<1.0	NA	<0.50	NA	NA	NA	NA	51.35	13.22	NA	38.13	NA	NA
MW-3	12/2/2003	NA	NA	NA	NA	NA	NA	NA	NA	NA	NA	NA	NA	51.35	12.48	NA	38.87	NA	NA
MW-3	3/18/2004	<50	NA	<0.50	13	<0.50	<1.0	NA	<0.50	NA	NA	NA	NA	51.35	8.52	NA	42.83	NA	NA
MW-3	6/17/2004	NA	NA	NA	NA	NA	NA	NA	NA	NA	NA	NA	NA	51.35	12.80	NA	38.55	NA	NA
MW-3	9/2/2004	NA	NA	NA	NA	NA	NA	NA	NA	NA	NA	NA	NA	51.35	13.75	NA	37.60	NA	NA
MW-3	12/14/2004	NA	NA	NA	NA	NA	NA	NA	NA	NA	NA	NA	NA	51.35	9.37	NA	41.98	NA	NA
MW-3	2/28/2005	<50	NA	<0.50	<0.50	<0.50	<1.0	NA	<0.50	NA	NA	NA	NA	51.35	6.62	NA	44.73	NA	NA
MW-3	6/21/2005	NA	NA	NA	NA	NA	NA	NA	NA	NA	NA	NA	NA	51.35	11.26	NA	40.09	NA	NA

MW-4	12/17/1998	700	NA	4.3	0.88	<0.50	<0.50	21,000	26,000	NA	NA	NA	NA	50.73	10.80	NA	39.93	NA	NA
MW-4	3/9/1999	83.9	NA	<0.500	<0.500	<0.500	<0.500	17,900	23,700	NA	NA	NA	NA	50.73	6.91	NA	43.82	NA	NA
MW-4	6/16/1999	<50.0	NA	<0.500	<0.500	<0.500	<0.500	10,600	19,200	NA	NA	NA	NA	50.73	12.84	NA	37.89	NA	NA
MW-4	9/30/1999	51.2	NA	<0.500	<0.500	<0.500	<0.500	12,200	12,300	NA	NA	NA	NA	50.73	13.74	NA	36.99	NA	NA
MW-4	12/23/1999	<100	NA	<1.00	<1.00	<1.00	<1.00	7,990	8,400	NA	NA	NA	NA	50.73	12.40	NA	38.33	NA	NA
MW-4	3/22/2000	<500	NA	<5.00	<5.00	<5.00	<5.00	4,970	5,020	NA	NA	NA	NA	50.73	7.32	NA	43.41	NA	NA
MW-4	6/1/2000	<100	NA	<1.00	<1.00	<1.00	<1.00	5,260	3,580	NA	NA	NA	NA	50.73	11.50	NA	39.23	NA	NA
MW-4	9/8/2000	<50.0	NA	<0.500	<0.500	<0.500	<0.500	3,610	3,300a	NA	NA	NA	NA	50.73	12.55	NA	38.18	NA	NA
MW-4	12/4/2000	<50.0	NA	<0.500	<0.500	<0.500	<0.500	2,960	3,520a	NA	NA	NA	NA	50.73	11.77	NA	38.96	NA	NA
MW-4	3/9/2001	<50.0	NA	<0.500	<0.500	<0.500	<0.500	1,930	2,500	NA	NA	NA	NA	50.73	7.48	NA	43.25	NA	NA
MW-4	6/27/2001	<50	NA	<0.50	<0.50	<0.50	<0.50	1,100	1,100	NA	NA	NA	NA	50.73	12.97	NA	37.76	NA	NA
MW-4	9/20/2001	<250	NA	3.8	14	2.6	7.8	NA	940	NA	NA	NA	NA	50.73	13.30	NA	37.43	NA	NA
MW-4	12/5/2001	<200	NA	<2.0	<2.0	<2.0	<2.0	NA	750	NA	NA	NA	NA	50.73	8.41	NA	42.32	NA	1.2
MW-4	2/26/2002	<50	NA	<0.50	<0.50	<0.50	<0.50	NA	320	NA	NA	NA	NA	50.73	9.40	NA	41.33	NA	0.7
MW-4	6/6/2002	<50	NA	<0.50	<0.50	<0.50	<0.50	NA	160	NA	NA	NA	NA	50.73	11.97	NA	38.76	NA	0.6
MW-4	9/9/2002	<50	NA	<0.50	<0.50	<0.50	<0.50	NA	50	NA	NA	NA	NA	50.72	13.23	NA	37.49	NA	3.6
MW-4	12/19/2002	Unable to sample	NA	NA	NA	NA	NA	NA	NA	NA	NA	NA	NA	50.72	7.08	NA	43.64	NA	0.8
MW-4	12/26/2002	<50	NA	<0.50	<0.50	<0.50	<0.50	NA	47	NA	NA	NA	NA	50.72	7.23	NA	43.49	NA	1.8
MW-4	3/28/2003	<50	NA	<0.50	1.2	<0.50	<0.50	NA	17	NA	NA	NA	NA	50.72	11.30	NA	39.42	NA	1.7
MW-4	6/30/2003	54 c	NA	<0.50	<0.50	<0.50	<1.0	NA	16	NA	NA	NA	NA	50.72	12.51	NA	38.21	NA	NA
MW-4	9/25/2003	<50	NA	<0.50	<0.50	<0.50	<1.0	NA	110	NA	NA	NA	NA	50.72	13.10	NA	37.62	NA	NA
MW-4	12/2/2003	<250	NA	<2.5	<2.5	<2.5	<5.0	NA	280	NA	NA	NA	NA	50.72	12.39	NA	38.33	NA	NA

WELL CONCENTRATIONS
Former Shell Service Station
8930 Bancroft Avenue
Oakland, CA

Well ID	Date	TPPH (ug/L)	TEPH (ug/L)	B (ug/L)	T (ug/L)	E (ug/L)	X (ug/L)	MTBE 8020 (ug/L)	MTBE 8260 (ug/L)	DIPE (ug/L)	ETBE (ug/L)	TAME (ug/L)	TBA (ug/L)	TOC (MSL)	Depth to Water (ft.)	Depth to SPH (ft.)	GW Elevation (MSL)	SPH Thickness (ft.)	DO Reading (mg/L)
MW-4	3/18/2004	<50	NA	<0.50	<0.50	<0.50	<1.0	NA	33	NA	NA	NA	NA	50.72	8.63	NA	42.09	NA	NA
MW-4	6/17/2004	<50	NA	<0.50	<0.50	<0.50	<1.0	NA	16	NA	NA	NA	NA	50.72	12.77	NA	37.95	NA	NA
MW-4	9/2/2004	<50	NA	<0.50	<0.50	<0.50	<1.0	NA	7.7	<2.0	<2.0	<2.0	<5.0	50.72	13.54	NA	37.18	NA	NA
MW-4	12/14/2004	<50	NA	<0.50	<0.50	<0.50	<1.0	NA	7.2	NA	NA	NA	NA	50.72	9.40	NA	41.32	NA	NA
MW-4	2/28/2005	<50	NA	<0.50	<0.50	<0.50	<1.0	NA	3.7	NA	NA	NA	NA	50.72	7.18	NA	43.54	NA	NA
MW-4	6/21/2005	<50	NA	<0.50	<0.50	<0.50	<1.0	NA	7.3	NA	NA	NA	NA	50.72	11.30	NA	39.42	NA	NA
MW-5	12/17/1998	750	NA	<0.50	17	1.8	3.5	33	32	NA	NA	NA	NA	51.43	11.51	NA	39.92	NA	NA
MW-5	3/9/1999	<50.0	NA	<0.500	<0.500	<0.500	<0.500	<5.00	NA	NA	NA	NA	NA	51.43	7.15	NA	44.28	NA	NA
MW-5	6/16/1999	646	NA	9.26	1.05	<1.00	<1.00	<10.0	NA	NA	NA	NA	NA	51.43	13.47	NA	37.96	NA	NA
MW-5	9/30/1999	484	NA	1.93	0.511	<0.500	<0.500	159	NA	NA	NA	NA	NA	51.43	14.41	NA	37.02	NA	NA
MW-5	12/23/1999	944	NA	4.59	17.7	3.79	16.7	214	NA	NA	NA	NA	NA	51.43	14.07	NA	37.36	NA	NA
MW-5	3/22/2000	8,770	NA	197	96.5	<50.0	188	2,450	NA	NA	NA	NA	NA	51.43	7.31	NA	44.12	NA	NA
MW-5	6/1/2000	227	NA	0.565	<0.500	<0.500	<0.500	35.9	NA	NA	NA	NA	NA	51.43	12.15	NA	39.28	NA	NA
MW-5	9/8/2000	159	NA	0.606	<0.500	<0.500	1.74	1,000	NA	NA	NA	NA	NA	51.43	13.30	NA	38.13	NA	NA
MW-5	12/4/2000	1,510	NA	19.2	<10.0	<10.0	134	1,360	NA	NA	NA	NA	NA	51.43	12.19	NA	39.24	NA	NA
MW-5	3/9/2001	3,460	NA	37.9	121	40.6	208	235	NA	NA	NA	NA	NA	51.43	7.79	NA	43.64	NA	NA
MW-5	6/27/2001	310	NA	0.97	<0.50	<0.50	<0.50	14	NA	NA	NA	NA	NA	51.43	13.89	NA	37.54	NA	NA
MW-5	9/20/2001	310	NA	<0.50	<0.50	<0.50	<0.50	NA	21	NA	NA	NA	NA	51.43	13.95	NA	37.48	NA	NA
MW-5	12/5/2001	8,800	NA	14	2.9	33	410	NA	2,300	NA	NA	NA	NA	51.43	8.89	NA	42.54	NA	0.6
MW-5	2/26/2002	NA	NA	NA	NA	NA	NA	NA	NA	NA	NA	NA	NA	51.43	9.87	NA	NA	b	NA
MW-5	3/12/2002	NA	NA	NA	NA	NA	NA	NA	NA	NA	NA	NA	NA	51.43	8.84	8.64	42.75	0.20	NA
MW-5	6/6/2002	NA	NA	NA	NA	NA	NA	NA	NA	NA	NA	NA	NA	51.43	12.59	12.54	38.88	0.05	NA
MW-5	9/9/2002	210	NA	<0.50	<0.50	<0.50	0.90	NA	200	NA	NA	NA	NA	51.44	13.94	NA	37.50	NA	NA
MW-5	12/19/2002	Unable to sample	NA	NA	NA	NA	NA	NA	NA	NA	NA	NA	NA	51.44	7.35	NA	44.09	NA	NA
MW-5	12/26/2002	1,400	NA	<0.50	21	6.9	60	NA	180	NA	NA	NA	NA	51.44	7.13	NA	44.31	NA	NA
MW-5	3/28/2003	240	NA	<0.50	<0.50	<0.50	2.1	NA	130	NA	NA	NA	NA	51.44	11.73	NA	39.71	NA	NA
MW-5	6/30/2003	NA	NA	NA	NA	NA	NA	NA	NA	NA	NA	NA	NA	51.44	13.34	13.30	38.13	0.04	NA
MW-5	9/25/2003	12,000	NA	<5.0	<5.0	24	210	NA	220	NA	NA	NA	NA	51.44	13.60	NA	37.84	NA	NA
MW-5	12/2/2003	2,500	NA	<5.0	14	<5.0	11	NA	25	NA	NA	NA	NA	51.44	12.92	NA	38.52	NA	NA
MW-5	3/18/2004	2,100	NA	2.9	2.8	<1.0	780	NA	4.7	NA	NA	NA	NA	51.44	9.05	NA	42.39	NA	NA
MW-5	6/17/2004	68	NA	<0.50	<0.50	<0.50	<1.0	NA	0.89	NA	NA	NA	NA	51.44	13.45	NA	37.99	NA	NA
MW-5	9/2/2004	NA	NA	NA	NA	NA	NA	NA	NA	NA	NA	NA	NA	51.44	14.25	14.18	37.25	0.07	NA
MW-5	12/14/2004	80,000	NA	<50	3,100	2,200	17,000	NA	<50	NA	NA	NA	NA	51.44	9.82	NA	41.62	NA	NA
MW-5	2/28/2005	12,000	NA	<10	<10	<10	570	NA	<10	NA	NA	NA	NA	51.44	7.40	NA	44.04	NA	NA
MW-5	6/21/2005	5,200	NA	<2.5	<2.5	9.5	37	NA	<2.5	NA	NA	NA	NA	51.44	11.74	NA	39.70	NA	NA

WELL CONCENTRATIONS
Former Shell Service Station
8930 Bancroft Avenue
Oakland, CA

Well ID	Date	TPPH (ug/L)	TEPH (ug/L)	B (ug/L)	T (ug/L)	E (ug/L)	X (ug/L)	MTBE 8020 (ug/L)	MTBE 8260 (ug/L)	DIPE (ug/L)	ETBE (ug/L)	TAME (ug/L)	TBA (ug/L)	TOC (MSL)	Depth to Water (ft.)	Depth to SPH (ft.)	GW Elevation (MSL)	SPH Thickness (ft.)	DO Reading (mg/L)
---------	------	----------------	----------------	-------------	-------------	-------------	-------------	------------------------	------------------------	----------------	----------------	----------------	---------------	--------------	----------------------------	--------------------------	--------------------------	---------------------------	-------------------------

MW-6	12/17/1998	940	NA	27	0.32	2.4	2.3	3.0	3.2	NA	NA	NA	NA	51.88	11.37	NA	40.51	NA	NA
MW-6	3/9/1999	336	NA	7.78	1.60	2.40	6.36	<10.0	NA	NA	NA	NA	NA	51.88	8.10	NA	43.78	NA	NA
MW-6	6/16/1999	308	NA	2.45	<0.500	<0.500	<0.500	7.39	NA	NA	NA	NA	NA	51.88	14.49	NA	37.39	NA	NA
MW-6	9/30/1999	80.2	NA	<0.500	<0.500	<0.500	<0.500	24.8	NA	NA	NA	NA	NA	51.88	15.30	NA	36.58	NA	NA
MW-6	12/23/1999	149	NA	0.518	<0.500	<0.500	<0.500	6.43	NA	NA	NA	NA	NA	51.88	13.19	NA	38.69	NA	NA
MW-6	3/22/2000	382	NA	3.31	2.18	0.619	2.35	5.61	NA	NA	NA	NA	NA	51.88	8.27	NA	43.61	NA	NA
MW-6	6/1/2000	158	NA	0.830	<0.500	<0.500	1.10	10.9	NA	NA	NA	NA	NA	51.88	11.13	NA	40.75	NA	NA
MW-6	9/8/2000	<50.0	NA	<0.500	<0.500	<0.500	<0.500	<2.50	NA	NA	NA	NA	NA	51.88	14.28	NA	37.60	NA	NA
MW-6	12/4/2000	231	NA	4.93	<0.500	<0.500	<0.500	4.57	NA	NA	NA	NA	NA	51.88	12.62	NA	39.26	NA	NA
MW-6	3/9/2001	789	NA	11.6	2.72	<2.00	<2.00	28.0	NA	NA	NA	NA	NA	51.88	8.65	NA	43.23	NA	NA
MW-6	6/27/2001	140	NA	<0.50	1.1	<0.50	<0.50	<2.5	NA	NA	NA	NA	NA	51.88	14.95	NA	36.93	NA	NA
MW-6	9/20/2001	<50	NA	<0.50	<0.50	<0.50	<0.50	NA	<5.0	NA	NA	NA	NA	51.88	14.70	NA	37.18	NA	NA
MW-6	12/5/2001	NA	NA	NA	NA	NA	NA	NA	NA	NA	NA	NA	NA	51.88	9.62	NA	42.26	NA	1.8
MW-6	2/26/2002	130	NA	<0.50	2.6	0.69	4.1	NA	6.4	NA	NA	NA	NA	51.88	10.14	NA	41.74	NA	NA
MW-6	6/6/2002	NA	NA	NA	NA	NA	NA	NA	NA	NA	NA	NA	NA	51.88	13.52	NA	38.36	NA	NA
MW-6	9/9/2002	<50	NA	<0.50	<0.50	<0.50	<0.50	NA	<5.0	NA	NA	NA	NA	51.86	14.92	NA	36.94	NA	NA
MW-6	12/19/2002	NA	NA	NA	NA	NA	NA	NA	NA	NA	NA	NA	NA	51.86	8.22	NA	43.64	NA	NA
MW-6	3/28/2003	740	NA	<0.50	<0.50	<0.50	<0.50	NA	14	NA	NA	NA	NA	51.86	12.57	NA	39.29	NA	NA
MW-6	6/30/2003	NA	NA	NA	NA	NA	NA	NA	NA	NA	NA	NA	NA	51.86	14.14	NA	37.72	NA	NA
MW-6	9/25/2003	<250	NA	<2.5	160	<2.5	<5.0	NA	5.3	NA	NA	NA	NA	51.86	14.30	NA	37.56	NA	NA
MW-6	12/2/2003	NA	NA	NA	NA	NA	NA	NA	NA	NA	NA	NA	NA	51.86	13.72	NA	38.14	NA	NA
MW-6	3/18/2004	1,200	NA	<1.0	7.1	1.5	2.7	NA	16	NA	NA	NA	NA	51.86	9.72	NA	42.14	NA	NA
MW-6	6/17/2004	NA	NA	NA	NA	NA	NA	NA	NA	NA	NA	NA	NA	51.86	14.48	NA	37.38	NA	NA
MW-6	9/2/2004	75	NA	<0.50	<0.50	<0.50	<1.0	NA	11	<2.0	<2.0	<2.0	<5.0	51.86	15.16	NA	36.70	NA	NA
MW-6	12/14/2004	NA	NA	NA	NA	NA	NA	NA	NA	NA	NA	NA	NA	51.86	10.55	NA	41.31	NA	NA
MW-6	2/28/2005	500	NA	<0.50	<0.50	<0.50	<1.0	NA	4.6	NA	NA	NA	NA	51.86	8.40	NA	43.46	NA	NA
MW-6	6/21/2005	NA	NA	NA	NA	NA	NA	NA	NA	NA	NA	NA	NA	51.86	12.58	NA	39.28	NA	NA

WELL CONCENTRATIONS
Former Shell Service Station
8930 Bancroft Avenue
Oakland, CA

Well ID	Date	TPPH (ug/L)	TEPH (ug/L)	B (ug/L)	T (ug/L)	E (ug/L)	X (ug/L)	MTBE 8020 (ug/L)	MTBE 8260 (ug/L)	DIPE (ug/L)	ETBE (ug/L)	TAME (ug/L)	TBA (ug/L)	TOC (MSL)	Depth to Water (ft.)	Depth to SPH (ft.)	GW Elevation (MSL)	SPH Thickness (ft.)	DO Reading (mg/L)
---------	------	----------------	----------------	-------------	-------------	-------------	-------------	------------------------	------------------------	----------------	----------------	----------------	---------------	--------------	----------------------------	--------------------------	--------------------------	---------------------------	-------------------------

Abbreviations:

TPPH = Total petroleum hydrocarbons as gasoline by EPA Method 8260B; prior to September 20, 2001, analyzed by EPA Method 8015.

TEPH = Total petroleum hydrocarbons as diesel by modified EPA Method 8015.

BTEX = Benzene, toluene, ethylbenzene, xylenes by EPA Method 8260B; prior to September 20, 2001, analyzed by EPA Method 8020.

MTBE = Methyl tertiary butyl ether

DIPE = Di-isopropyl ether, analyzed by EPA Method 8260B

ETBE = Ethyl tertiary butyl ether, analyzed by EPA Method 8260B

TAME = Tertiary amyl methyl ether, analyzed by EPA Method 8260B

TBA = Tertiary butyl alcohol, analyzed by EPA Method 8260B

TOC = Top of Casing Elevation

SPH = Separate-phase hydrocarbons

GW = Groundwater

ug/L = Parts per billion

MSL = Mean sea level

ft. = Feet

<n = Below detection limit

NA = Not applicable

DO = Dissolved oxygen

mg/L = Parts per million

Notes:

a = This sample analyzed outside of EPA recommended holding time.

b = SPH detected in well, but exact thickness could not be measured.

c = Hydrocarbon does not match pattern of laboratory's standard.

d = Top of casing altered +0.11 feet during wellhead maintenance on December 28, 2004.

When separate-phase hydrocarbons are present, groundwater elevation is adjusted using the relation: Groundwater Elevation = Top-of-Casing Elevation - Depth to Water + (0.8 x Hydrocarbon Thickness).

Site surveyed February 12 and May 16, 2002 by Virgil Chavez Land Surveying of Vallejo, CA.

Blaine Tech Services, Inc.

July 06, 2005

1680 Rogers Avenue
San Jose, CA 95112-1105
Attn.: Leon Gearhart
Project#: BTS#050621-MD1
Project: 98995742
Site: 8930 Bancroft Avenue, Oakland

Dear Mr. Gearhart,

Attached is our report for your samples received on 06/22/2005 14:32
This report has been reviewed and approved for release. Reproduction of this report
is permitted only in its entirety.

Please note that any unused portion of the samples will be discarded after
08/06/2005 unless you have requested otherwise.

We appreciate the opportunity to be of service to you. If you have any questions,

You can also contact me via email. My email address is: mbrewer@stl-inc.com

Sincerely,

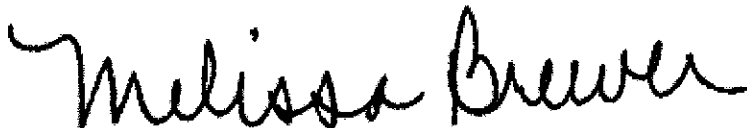

Melissa Brewer
Project Manager

Gas/BTEX/MTBE by 8260B (C6-C12)

Blaine Tech Services, Inc.

Attn.: Leon Gearhart

1680 Rogers Avenue
San Jose, CA 95112-1105
Phone: (408) 573-0555 Fax: (408) 573-7771Project: BTS#050621-MD1
98995742

Received: 06/22/2005 14:32

Site: 8930 Bancroft Avenue, Oakland

Samples Reported

Sample Name	Date Sampled	Matrix	Lab #
MW-4	06/21/2005 08:35	Water	1
MW-5	06/21/2005 09:20	Water	2

Severn Trent Laboratories, Inc.

STL San Francisco * 1220 Quarry Lane, Pleasanton, CA 94566

Tel 925 484 1919 Fax 925 484 1096 * www.stl-inc.com * CA DHS ELAP# 2496

07/05/2005 15:24

Gas/BTEX/MTBE by 8260B (C6-C12)

Blaine Tech Services, Inc.
Attn.: Leon Gearhart

1680 Rogers Avenue
San Jose, CA 95112-1105
Phone: (408) 573-0555 Fax: (408) 573-7771

Project: BTS#050621-MD1
98995742

Received: 06/22/2005 14:32

Site: 8930 Bancroft Avenue, Oakland

Prep(s): 5030B Test(s): 8260B
Sample ID: MW-4 Lab ID: 2005-06-0654 - 1
Sampled: 06/21/2005 08:35 Extracted: 6/30/2005 20:59
Matrix: Water QC Batch#: 2005/06/30-2B.66
pH: <2

Compound	Conc.	RL	Unit	Dilution	Analyzed	Flag
Gasoline [Shell]	ND	50	ug/L	1.00	06/30/2005 20:59	
Benzene	ND	0.50	ug/L	1.00	06/30/2005 20:59	
Toluene	ND	0.50	ug/L	1.00	06/30/2005 20:59	
Ethylbenzene	ND	0.50	ug/L	1.00	06/30/2005 20:59	
Total xylenes	ND	1.0	ug/L	1.00	06/30/2005 20:59	
Methyl tert-butyl ether (MTBE)	7.3	0.50	ug/L	1.00	06/30/2005 20:59	
Surrogate(s)						
1,2-Dichloroethane-d4	116.4	73-130	%	1.00	06/30/2005 20:59	
Toluene-d8	96.0	81-114	%	1.00	06/30/2005 20:59	

Gas/BTEX/MTBE by 8260B (C6-C12)

Blaine Tech Services, Inc.

Attn.: Leon Gearhart

1680 Rogers Avenue
San Jose, CA 95112-1105
Phone: (408) 573-0555 Fax: (408) 573-7771

Project: BTS#050621-MD1
98995742

Received: 06/22/2005 14:32

Site: 8930 Bancroft Avenue, Oakland

Prep(s): 5030B Test(s): 8260B
Sample ID: MW-5 Lab ID: 2005-06-0654 - 2
Sampled: 06/21/2005 09:20 Extracted: 7/1/2005 21:07
Matrix: Water QC Batch#: 2005/07/01-2C.69
Analysis Flag: L2, pH: <2 (See Legend and Note Section)

Compound	Conc.	RL	Unit	Dilution	Analyzed	Flag
Gasoline [Shell]	5200	250	ug/L	5.00	07/01/2005 21:07	
Benzene	ND	2.5	ug/L	5.00	07/01/2005 21:07	
Toluene	ND	2.5	ug/L	5.00	07/01/2005 21:07	
Ethylbenzene	9.5	2.5	ug/L	5.00	07/01/2005 21:07	
Total xylenes	37	5.0	ug/L	5.00	07/01/2005 21:07	
Methyl tert-butyl ether (MTBE)	ND	2.5	ug/L	5.00	07/01/2005 21:07	
Surrogate(s)						
1,2-Dichloroethane-d4	120.6	73-130	%	5.00	07/01/2005 21:07	
Toluene-d8	100.5	81-114	%	5.00	07/01/2005 21:07	

Gas/BTEX/MTBE by 8260B (C6-C12)

Blaine Tech Services, Inc.

Attn.: Leon Gearhart

1680 Rogers Avenue

San Jose, CA 95112-1105

Phone: (408) 573-0555 Fax: (408) 573-7771

Project: BTS#050621-MD1
98995742

Received: 06/22/2005 14:32

Site: 8930 Bancroft Avenue, Oakland

Batch QC Report

Prep(s): 5030B

Method Blank

MB: 2005/06/30-2B.66-000

Water

Test(s): 8260B

QC Batch # 2005/06/30-2B.66

Date Extracted: 06/30/2005 20:00

Compound	Conc.	RL	Unit	Analyzed	Flag
Gasoline [Shell]	ND	50	ug/L	06/30/2005 20:00	
Methyl tert-butyl ether (MTBE)	ND	0.5	ug/L	06/30/2005 20:00	
Benzene	ND	0.5	ug/L	06/30/2005 20:00	
Toluene	ND	0.5	ug/L	06/30/2005 20:00	
Ethylbenzene	ND	0.5	ug/L	06/30/2005 20:00	
Total xylenes	ND	1.0	ug/L	06/30/2005 20:00	
Surrogates(s)					
1,2-Dichloroethane-d4	105.6	73-130	%	06/30/2005 20:00	
Toluene-d8	100.0	81-114	%	06/30/2005 20:00	

Gas/BTEX/MTBE by 8260B (C6-C12)

Blaine Tech Services, Inc.

Attn.: Leon Gearhart

1680 Rogers Avenue
San Jose, CA 95112-1105
Phone: (408) 573-0555 Fax: (408) 573-7771

Project: BTS#050621-MD1
98995742

Received: 06/22/2005 14:32

Site: 8930 Bancroft Avenue, Oakland

Batch QC Report

Prep(s): 5030B

Test(s): 8260B

Method Blank

Water

QC Batch # 2005/07/01-2C.69

MB: 2005/07/01-2C.69-037

Date Extracted: 07/01/2005 17:37

Compound	Conc.	RL	Unit	Analyzed	Flag
Gasoline [Shell]	ND	50	ug/L	07/01/2005 17:37	
Methyl tert-butyl ether (MTBE)	ND	0.5	ug/L	07/01/2005 17:37	
Benzene	ND	0.5	ug/L	07/01/2005 17:37	
Toluene	ND	0.5	ug/L	07/01/2005 17:37	
Ethylbenzene	ND	0.5	ug/L	07/01/2005 17:37	
Total xylenes	ND	1.0	ug/L	07/01/2005 17:37	
Surrogates(s)					
1,2-Dichloroethane-d4	97.2	73-130	%	07/01/2005 17:37	
Toluene-d8	102.0	81-114	%	07/01/2005 17:37	

Gas/BTEX/MTBE by 8260B (C6-C12)

Blaine Tech Services, Inc.

Attn.: Leon Gearhart

1680 Rogers Avenue

San Jose, CA 95112-1105

Phone: (408) 573-0555 Fax: (408) 573-7771

Project: BTS#050621-MD1

98995742

Received: 06/22/2005 14:32

Site: 8930 Bancroft Avenue, Oakland

Batch QC Report

Prep(s): 5030B

Test(s): 8260B

Laboratory Control Spike

Water

QC Batch # 2005/06/30-2B.66

LCS 2005/06/30-2B.66-035

Extracted: 06/30/2005

Analyzed: 06/30/2005 19:35

LCSD

Compound	Conc. ug/L		Exp. Conc.	Recovery %		RPD	Ctrl.Limits %		Flags	
	LCS	LCSD		LCS	LCSD		%	Rec.	RPD	LCS
Methyl tert-butyl ether (MTBE)	32.1		25	128.4			65-165	20		
Benzene	22.5		25	90.0			69-129	20		
Toluene	25.8		25	103.2			70-130	20		
Surrogates(s)										
1,2-Dichloroethane-d4	476		500	95.2			73-130			
Toluene-d8	469		500	93.8			81-114			

Severn Trent Laboratories, Inc.

STL San Francisco * 1220 Quarry Lane, Pleasanton, CA 94566

Tel 925 484 1919 Fax 925 484 1096 * www.stl-inc.com * CA DHS ELAP# 2496

07/05/2005 15:24

Gas/BTEX/MTBE by 8260B (C6-C12)

Blaine Tech Services, Inc.

Attn.: Leon Gearhart

1680 Rogers Avenue
San Jose, CA 95112-1105
Phone: (408) 573-0555 Fax: (408) 573-7771

Project: BTS#050621-MD1
98995742

Received: 06/22/2005 14:32

Site: 8930 Bancroft Avenue, Oakland

Batch QC Report

Prep(s): 5030B

Test(s): 8260B

Laboratory Control Spike

Water

QC Batch # 2005/07/01-2C.69

LCS 2005/07/01-2C.69-019

Extracted: 07/01/2005

Analyzed: 07/01/2005 17:19

LCSD

Compound	Conc. ug/L		Exp.Conc.	Recovery %		RPD	Ctrl.Limits %		Flags	
	LCS	LCSD		LCS	LCSD		%	Rec.	RPD	LCS
Methyl tert-butyl ether (MTBE)	22.2		25	88.8			65-165	20		
Benzene	24.3		25	97.2			69-129	20		
Toluene	25.8		25	103.2			70-130	20		
Surrogates(s)										
1,2-Dichloroethane-d4	474		500	94.8			73-130			
Toluene-d8	509		500	101.8			81-114			

Severn Trent Laboratories, Inc.

STL San Francisco * 1220 Quarry Lane, Pleasanton, CA 94566

Tel 925 484 1919 Fax 925 484 1096 * www.stl-inc.com * CA DHS ELAP# 2496

07/05/2005 15:24

Gas/BTEX/MTBE by 8260B (C6-C12)

Blaine Tech Services, Inc.

Attn.: Leon Gearhart

1680 Rogers Avenue

San Jose, CA 95112-1105

Phone: (408) 573-0555 Fax: (408) 573-7771

Project: BTS#050621-MD1
98995742

Received: 06/22/2005 14:32

Site: 8930 Bancroft Avenue, Oakland

Batch QC Report

Prep(s): 5030B

Test(s): 8260B

Matrix Spike (MS / MSD)

Water

QC Batch # 2005/06/30-2B.66

MW-4 >> MS

Lab ID: 2005-06-0654 - 001

MS: 2005/06/30-2B.66-024

Extracted: 06/30/2005

Analyzed: 06/30/2005 21:24

Dilution: 1.00

MSD: 2005/06/30-2B.66-049

Extracted: 06/30/2005

Analyzed: 06/30/2005 21:49

Dilution: 1.00

Compound	Conc. ug/L			Spk.Level ug/L	Recovery %			Limits %		Flags	
	MS	MSD	Sample		MS	MSD	RPD	Rec.	RPD	MS	MSD
Methyl tert-butyl ether	41.0	35.7	7.35	25	134.6	113.4	17.1	65-165	20		
Benzene	25.6	21.8	ND	25	102.4	87.2	16.0	69-129	20		
Toluene	27.8	22.4	ND	25	111.2	89.6	21.5	70-130	20		R1
Surrogate(s)											
1,2-Dichloroethane-d4	530	536		500	106.0	107.2		73-130			
Toluene-d8	472	482		500	94.4	96.4		81-114			

Gas/BTEX/MTBE by 8260B (C6-C12)

Blaine Tech Services, Inc.

Attn.: Leon Gearhart

1680 Rogers Avenue
San Jose, CA 95112-1105
Phone: (408) 573-0555 Fax: (408) 573-7771

Project: BTS#050621-MD1
98995742

Received: 06/22/2005 14:32

Site: 8930 Bancroft Avenue, Oakland

Batch QC Report

Prep(s): 5030B

Test(s): 8260B

Matrix Spike (MS / MSD)

Water

QC Batch # 2005/07/01-2C.69

MS/MSD

Lab ID: 2005-06-0713 - 003

MS: 2005/07/01-2C.69-023

Extracted: 07/01/2005

Analyzed: 07/01/2005 18:23

Dilution: 1.00

MSD: 2005/07/01-2C.69-041

Extracted: 07/01/2005

Analyzed: 07/01/2005 18:41

Dilution: 1.00

Compound	Conc. ug/L			Spk.Level ug/L	Recovery %			Limits %		Flags	
	MS	MSD	Sample		MS	MSD	RPD	Rec.	RPD	MS	MSD
Methyl tert-butyl ether	20.3	22.1	ND	25	81.2	88.4	8.5	65-165	20		
Benzene	25.4	25.6	ND	25	101.6	102.4	0.8	69-129	20		
Toluene	28.5	28.2	ND	25	114.0	112.8	1.1	70-130	20		
Surrogate(s)											
1,2-Dichloroethane-d4	472	489		500	94.4	97.8		73-130			
Toluene-d8	511	518		500	102.2	103.6		81-114			

Severn Trent Laboratories, Inc.

STL San Francisco * 1220 Quarry Lane, Pleasanton, CA 94566

Tel 925 484 1919 Fax 925 484 1096 * www.stl-inc.com * CA DHS ELAP# 2496

07/05/2005 15:24

Gas/BTEX/MTBE by 8260B (C6-C12)

Blaine Tech Services, Inc.

Attn.: Leon Gearhart

1680 Rogers Avenue

San Jose, CA 95112-1105

Phone: (408) 573-0555 Fax: (408) 573-7771

Project: BTS#050621-MD1

98995742

Received: 06/22/2005 14:32

Site: 8930 Bancroft Avenue, Oakland

Legend and Notes

Analysis Flag

L2

Reporting limits were raised due to high level of analyte present in the sample.

Result Flag

R1

Analyte RPD was out of QC limits.

SHELL Chain Of Custody Record

116810

Lab Identification (if necessary):

Address:

City, State, Zip:

Shell Project Manager to be Invoiced:

- SCIENCE & ENGINEERING
- TECHNICAL SERVICES
- CRMT HOUSTON

Denis Brown

2005-06-0654

INCIDENT NUMBER (S&E ONLY)

9 8 9 9 5 7 4 2

SAP or CRMT NUMBER (TS/CRMT)

DATE: 6/21/05

PAGE: 1 of 1

SAMPLING COMPANY: Blaine Tech Services		LOG CODE: BTSS	SITE ADDRESS (Street and City): 8930 Bancroft Avenue, Oakland		GLOBAL ID NO.: T0600118567
ADDRESS: 1680 Rogers Avenue, San Jose, CA 95112		EDF DELIVERABLE TO (Responsible Party or Developer): Anni Kreml		PHONE NO.: 510-420-3335	E-MAIL: ShellOaklandEDF@cambria-env.com
PROJECT CONTACT (Name only or POC Report #): Leon Gearhart		SAMPLER NAME(S) (Open): <i>John DeLong</i>		CONSULTANT PROJECT NO.: 050521-MPI	
TELEPHONE: 408-573-0555	FAX: 408-573-7771	E-MAIL: lgearhart@blainetech.com	LAB USE ONLY		

TURNAROUND TIME (BUSINESS DAYS): <input checked="" type="checkbox"/> 10 DAYS <input type="checkbox"/> 5 DAYS <input type="checkbox"/> 72 HOURS <input type="checkbox"/> 48 HOURS <input type="checkbox"/> 24 HOURS <input type="checkbox"/> LESS THAN 24 HOURS		REQUESTED ANALYSIS
<input type="checkbox"/> LA - RWQCB REPORT FORMAT <input type="checkbox"/> UST AGENCY		
GC/MS MTBE CONFIRMATION: HIGHEST _____ HIGHEST PER BORING _____ ALL _____		
SPECIAL INSTRUCTIONS OR NOTES: _____		FIELD NOTES: Container/Preservative or PID Readings or Laboratory Notes <div style="font-size: 2em; font-weight: bold; text-align: center;">3</div>
CHECK BOX IF EDD IS NOT NEEDED <input type="checkbox"/>		

LAB USE ONLY	Field Sample Identification				ANALYSIS											TEMPERATURE ON RECEIPT °C
					TPH - Gas, Purgeable	BTEX	MTBE (0021B - 5ppb RL)	MTBE (0260B - 0.5ppb RL)	Oxygenates (5) by (0260B)	Ethanol (0260B)	Methanol	1,2-DCA (0260B)	EDB (0260B)	TPH - Diesel, Extractable (0015m)		
	DATE	TIME	MATRIX	NO. OF CONT.												
	MW-4	6/15/05	W	3	X	X		X								
	MW-5	6/15/05	W	3	X	X		X								

Retrieved by (Signature): <i>[Signature]</i>	Received by (Signature): <i>[Signature]</i>	Date: 6/21/05	Time: 1541
Retrieved by (Signature): <i>[Signature]</i>	Received by (Signature): <i>[Signature]</i>	Date: 6/22/05	Time: 1438
Retrieved by (Signature): <i>[Signature]</i>	Received by (Signature): <i>[Signature]</i>	Date: 6/22/05	Time: 1814

WELL GAUGING DATA

Project # 050621-M01 Date 6/2/05 Client shell

Site 8930 Bancroft, Oakland

Well ID	Well Size (in.)	Sheen / Odor	Depth to Immiscible Liquid (ft.)	Thickness of Immiscible Liquid (ft.)	Volume of Immiscibles Removed (ml)	Depth to water (ft.)	Depth to well bottom (ft.)	Survey Point: TOB or TOC
MW-1	3					13.22	16.86	
MW-2	3					13.06	19.79	
MW-3	3					11.26	19.72	
MW-4	3		gauged w/ stinger in well			11.30	19.02	
MW-5	3		gauged w/ stinger in well			11.74	19.75	
MW-6	3					12.58	19.77	

SHELL WELL MONITORING DATA SHEET

BTS #: <u>050621-MW1</u>	Site: <u>98885792</u>
Sampler: <u>MW</u>	Date: <u>6/21/05</u>
Well I.D.: <u>MW-5</u>	Well Diameter: 2 <input checked="" type="radio"/> 4 <input type="radio"/> 6 <input type="radio"/> 8 <input type="radio"/>
Total Well Depth (TD): <u>19.75</u>	Depth to Water (DTW): <u>11.74</u>
Depth to Free Product:	Thickness of Free Product (feet):
Referenced to: <u>PVC</u> Grade	D.O. Meter (if req'd): YSI HACH
DTW with 80% Recharge [(Height of Water Column x 0.20) + DTW]: <u>13.34</u>	

Purge Method: Bailer Watera Sampling Method: Bailer
 Disposable Bailer Peristaltic Disposable Bailer
 Positive Air Displacement Extraction Pump Extraction Port
 Electric Submersible Other _____ Dedicated Tubing

<u>3</u> (Gals.) X <u>3</u> = <u>9</u> Gals. Case Volume Specified Volumes Calculated Volume	<table border="1" style="width: 100%; border-collapse: collapse;"> <tr> <th>Well Diameter</th> <th>Multiplier</th> <th>Well Diameter</th> <th>Multiplier</th> </tr> <tr> <td>1"</td> <td>0.04</td> <td>4"</td> <td>0.65</td> </tr> <tr> <td>2"</td> <td>0.16</td> <td>6"</td> <td>1.47</td> </tr> <tr> <td>3"</td> <td>0.37</td> <td>Other</td> <td>radius² * 0.163</td> </tr> </table>	Well Diameter	Multiplier	Well Diameter	Multiplier	1"	0.04	4"	0.65	2"	0.16	6"	1.47	3"	0.37	Other	radius ² * 0.163
Well Diameter	Multiplier	Well Diameter	Multiplier														
1"	0.04	4"	0.65														
2"	0.16	6"	1.47														
3"	0.37	Other	radius ² * 0.163														

Time	Temp (°F)	pH	Cond. (mS or µS)	Turbidity (NTUs)	Gals. Removed	Observations
<u>0855</u>	<u>64.5</u>	<u>6.6</u>	<u>370</u>	<u>362</u>	<u>3</u>	<u>cloudy, strong odor</u>
<u>0859</u>	<u>65.5</u>	<u>6.3</u>	<u>372</u>	<u>119</u>	<u>6</u>	<u>clear, " "</u>
<u>0903</u>	<u>66.1</u>	<u>6.3</u>	<u>374</u>	<u>86</u>	<u>9</u>	<u>clear, strong odor</u>

Did well dewater? Yes No Gallons actually evacuated: 9

Sampling Date: 6/21/05 Sampling Time: 0920 Depth to Water: 11.83

Sample I.D.: MW-5 Laboratory: STL Other _____

Analyzed for: TPH-G BTEX MTBE TPH-D Other: _____

EB I.D. (if applicable): _____ @ _____ Time Duplicate I.D. (if applicable): _____

Analyzed for: TPH-G BTEX MTBE TPH-D Other: _____

D.O. (if req'd):	Pre-purge:	mg/L	Post-purge:	mg/L
O.R.P. (if req'd):	Pre-purge:	mV	Post-purge:	mV