

RO404



March 4, 2005

Alameda County
MAR 09 2005
Environmental Health

Roseanna Garcia-La Grille
Alameda County Health Care Services Agency
1131 Harbor Bay Parkway, Suite 250
Alameda, California 94502-6577

Subject: **Former Shell Service Station/Current 24-7 Quick Mart Service Station**
8930 Bancroft Avenue
Oakland, California

Dear Ms. Garcia-La Grille:

Attached for your review and comment is a copy of the *Fourth Quarter 2004 Monitoring Report* for the above referenced site. Upon information and belief, I declare, under penalty of perjury, that the information contained in the attached document is true and correct.

As always, please feel free to contact me directly at (559) 645-9306 with any questions or concerns.

Sincerely,

Shell Oil Products US

Karen Petryna
Sr. Environmental Engineer

March 4, 2005

Roseanna Garcia-La Grille
Alameda County Health Care Services Agency
1131 Harbor Bay Parkway, 2nd Floor
Alameda, California 94502

Re: **Fourth Quarter 2004 Monitoring Report**
Former Shell Service Station/Current 24-7 Quick Mart Service Station
8930 Bancroft Avenue
Oakland, California
Incident #98995742
Cambria Project #247-1408-002



Dear Ms. Garcia-La Grille:

On behalf of Equilon Enterprises LLC dba Shell Oil Products US (Shell), Cambria Environmental Technology, Inc. (Cambria) is submitting this groundwater monitoring report in accordance with the reporting requirements of 23 CCR 2652d. The site is located on the corner of Bancroft Avenue and 90th Avenue in Oakland, California (Figures 1 and 2). Shell ceased operations in July 1999 when three 10,000-gallon fiberglass underground storage tanks and associated piping and dispensers were removed and replaced at the site. The site is currently owned and operated by 24-7 Quick-Mart.

REMEDIATION SUMMARY

2000 Mobile Groundwater Extraction (GWE): Weekly mobile GWE was performed on well MW-4 during March through May 2000. Mobile GWE is the process of extracting groundwater from wells using a vacuum truck. In this process, the vacuum created by the truck is applied to a dedicated extraction "stinger" installed in the extraction well. The extracted water is contained by the truck and removed from the site for disposal. The volume of extracted fluid is recorded and used to calculate the quantity of aqueous-phase constituents removed from the subsurface. Approximately 1,875 gallons of water were extracted from well MW-4, and an estimated total of 0.003 pounds of total petroleum hydrocarbons as gasoline (TPHg) and 0.1 pounds of methyl tertiary butyl ether (MTBE) was removed. GWE was discontinued due to low extraction volumes.

**Cambria
Environmental
Technology, Inc.**

5900 Hollis Street
Suite A
Emeryville, CA 94608
Tel (510) 420-0700
Fax (510) 420-9170

2002 and 2003 Mobile GWE: Due to the presence of separate phase hydrocarbons (SPH) in well MW-5 beginning in February 2002, four additional weekly mobile GWE events using well MW-5 were conducted at the site in August 2002. An estimated total of 0.04 pounds of TPHg and 0.10 pounds of MTBE was removed from the subsurface. During the initial extraction event, approximately 0.02 feet of SPH were measured in well MW-5 prior to extraction. No SPH had been detected in MW-5 since the August 2002 extraction events; however, SPH was encountered once again in well MW-5 during the June 30, 2003 sampling event. Cambria reinstated mobile GWE for two semi-weekly events in September 2003. Table 1 summarizes mass removal data.



FOURTH QUARTER 2004 ACTIVITIES

Groundwater Monitoring: Blaine Tech Services, Inc. (Blaine) of San Jose, California gauged the site wells, sampled selected wells, calculated groundwater elevations, and compiled the analytical data. Cambria prepared a vicinity map that includes previously submitted well survey information (Figure 1) and a groundwater elevation contour map (Figure 2). Blaine's report, presenting the laboratory report and supporting field documents, is included as Attachment A.

During the September 2, 2004 quarterly monitoring event, approximately 0.07 feet of SPH were observed in well MW-5. On December 15, 2004 Blaine verbally reported to Cambria that hydrocarbon sheen was observed on water extracted from well MW-5 for the fourth quarter 2004 sampling event on December 14, 2004. However, Blaine was able to sample the well since there was no measurable SPH observed.

Irrigation Well Sampling: Cambria's September 25, 2001 *Door-to-Door Well Survey Report* identified one likely active irrigation well approximately 1,300 feet downgradient from the site. After several attempts by Shell and the Alameda County Health Services Agency to contact the property owner by mail, a response was received by Ms. Wanda Brooks, the contact for the property owner. Cambria spoke with Ms. Brooks on October 7, 2004 at which time she confirmed that the well is currently being used as a backyard irrigation well, that the well was installed in 1980, and that it is approximately 50 feet deep. She also verbally granted permission for Shell to sample water from the well. At Shell's request, Cambria collected one water sample from this well and analyzed it for MTBE on November 10, 2004. MTBE was not detected above the laboratory reporting limit of 0.50 parts per billion. The location of this well is labeled "5" on Figure 1.

ANTICIPATED FIRST QUARTER 2005 ACTIVITIES

Groundwater Monitoring: Blaine will gauge all site wells, sample selected site wells, and tabulate the data. Cambria will prepare a monitoring report.

CLOSING



We appreciate the opportunity to work with you on this project. Please call David Gibbs at (510) 420-3363 if you have any questions or comments.

Sincerely,
Cambria Environmental Technology, Inc

David Gibbs
Project Geologist

Matthew W. Derby, P.E.
Senior Project Engineer



Figures: 1 - Vicinity/Area Well Survey Map
2 - Groundwater Elevation Contour Map

Table: 1 - Groundwater Extraction – Mass Removal Data

Attachment: A - Blaine Groundwater Monitoring Report and Field Notes

cc: Karen Petryna, Shell Oil Products US, 20945 S. Wilmington Ave., Carson, CA 90810
Sidhu Associates, 8930 Bancroft Ave., Oakland, CA 94605

G:\Oakland 8930 Bancroft\QM\4q04\4q04qm.doc

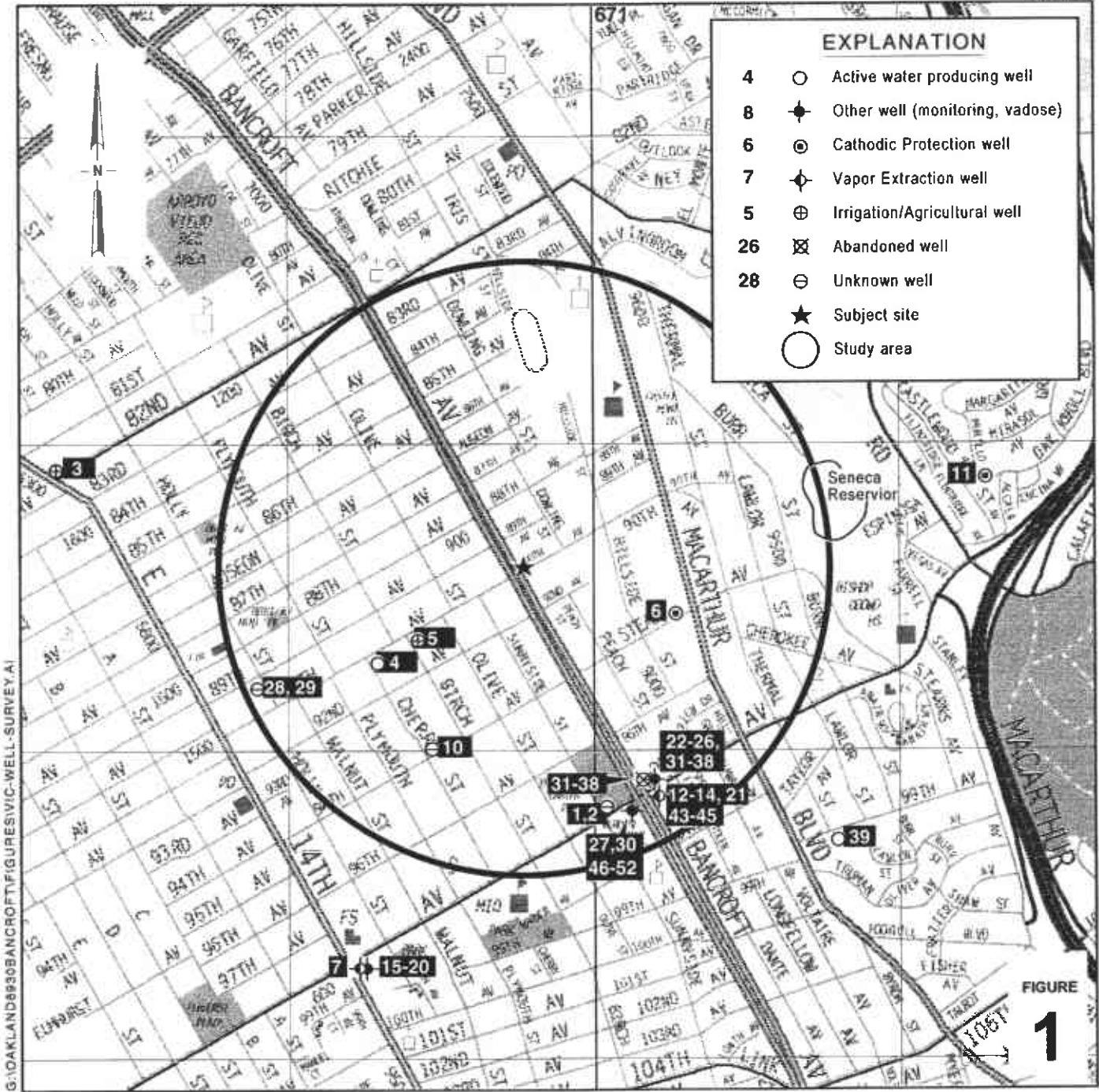

**Former Shell-branded Station/
Current 24-7 Quick Mart
Service Station**

8930 Bancroft Avenue
Oakland, California
Incident #98995742



C A M B R I A

**Vicinity/Area Well
Survey Map**

(1/2 Mile Radius)

FIGURE
1

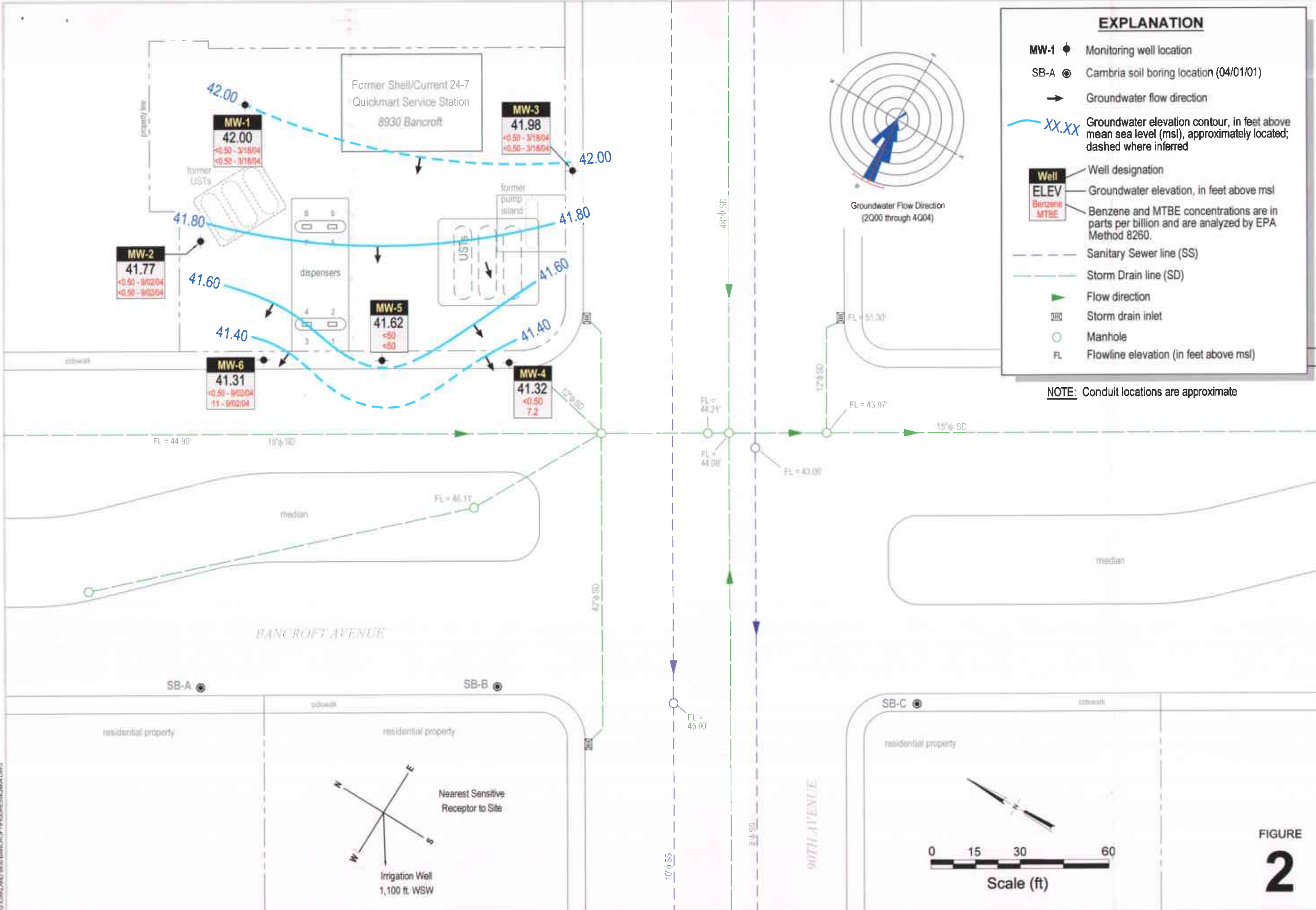

Groundwater Elevation Contour Map

December 14, 2004



C A M B R I A

Former Shell-branded/Current 24-7 Quick Mart Service Station

8930 Bancroft Avenue
Oakland, California
Incident #98995742

Table 1: Groundwater Extraction - Mass Removal Data - Shell-branded Service Station, Incident #98995742, 8930 Bancroft Avenue, Oakland, California

Date Purged	Well ID	Volume Pumped (gal)	Cumulative Volume Pumped (gal)	Date Sampled	TPPH			Benzene			MTBE			
					TPPH Concentration (ppb)	TPPH Removed (pounds)	TPPH Removed To Date (pounds)	Benzene Concentration (ppb)	Benzene Removed (pounds)	Benzene Removed To Date (pounds)	MTBE Concentration (ppb)	MTBE Removed (pounds)	MTBE Removed To Date (pounds)	
03/15/00	MW-4	650	650	12/23/99	<100	0.00027	0.00027	<1.0	0.00000	0.00000	8,400	0.04556	0.04556	
03/22/00	MW-4	100	750	03/22/00	<500	0.00021	0.00048	<5.00	0.00000	0.00000	5,020	0.00419	0.04975	
03/27/00	MW-4	75	825	03/22/00	<500	0.00016	0.00064	<5.00	0.00000	0.00001	5,020	0.00314	0.05289	
04/03/00	MW-4	150	975	03/22/00	<500	0.00031	0.00095	<5.00	0.00000	0.00001	5,020	0.00628	0.05917	
04/17/00	MW-4	300	1,275	03/22/00	<500	0.00063	0.00157	<5.00	0.00001	0.00002	5,020	0.01257	0.07174	
04/24/00	MW-4	150	1,425	03/22/00	<500	0.00031	0.00189	<5.00	0.00000	0.00002	5,020	0.00628	0.07802	
05/01/00	MW-4	75	1,500	03/22/00	<500	0.00016	0.00204	<5.00	0.00000	0.00002	5,020	0.00314	0.08117	
05/08/00	MW-4	150	1,650	03/22/00	<500	0.00031	0.00236	<5.00	0.00000	0.00002	5,020	0.00628	0.08745	
05/15/00	MW-4	75	1,725	03/22/00	<500	0.00016	0.00251	<5.00	0.00000	0.00003	5,020	0.00314	0.09059	
05/22/00	MW-4	75	1,800	03/22/00	<500	0.00016	0.00267	<5.00	0.00000	0.00003	5,020	0.00314	0.09373	
05/29/00	MW-4	75	1,875	03/22/00	<500	0.00016	0.00283	<5.00	0.00000	0.00003	5,020	0.00314	0.09687	
08/08/02	MW-5	163	163	08/08/02	350	0.00048	0.00048	<0.50	0.00000	0.00000	65	0.00009	0.00009	
08/16/02	MW-5	218	381	08/16/02	16,000	0.02911	0.02958	<2.5	0.00000	0.00000	310	0.00056	0.00065	
08/16/02	MW-5	0	381	08/16/02	58	0.00000	0.02958	<0.50	0.00000	0.00000	60	0.00000	0.00065	
08/22/02	MW-5	377	758	08/22/02	1,500	0.00472	0.03430	<0.50	0.00000	0.00000	110	0.00035	0.00100	
08/29/02	MW-5	146	904	08/22/02	120	0.00015	0.03445	<0.50	0.00000	0.00000	76	0.00009	0.00109	
09/09/03	MW-5	252	1,156	03/28/03	240	0.00050	0.03495	<0.50	0.00000	0.00000	130	0.00027	0.00136	
09/17/03	MW-5	70	1,226	03/28/03	240	0.00014	0.03509	<0.50	0.00000	0.00000	130	0.00008	0.00144	
Total Gallons Extracted:			3,101		Total Pounds Removed:		0.03792		Total Pounds Removed:		0.00003	Total Pounds Removed:		0.09831
					Total Gallons Removed:		0.00622		Total Gallons Removed:		0.00000	Total Gallons Removed:		0.01586

Table 1: Groundwater Extraction - Mass Removal Data - Shell-branded Service Station, Incident #98995742, 8930 Bancroft Avenue, Oakland, California

Date Purged	Well ID	Volume Pumped (gal)	Cumulative Volume Pumped (gal)	Date Sampled	<u>TPPH</u>			<u>Benzene</u>			<u>MTBE</u>		
					TPPH Concentration (ppb)	TPPH Removed (pounds)	TPPH Removed To Date (pounds)	Benzene Concentration (ppb)	Benzene Removed (pounds)	Benzene Removed To Date (pounds)	MTBE Concentration (ppb)	MTBE Removed (pounds)	MTBE Removed To Date (pounds)

Abbreviations & Notes:

TPPH = Total purgeable hydrocarbons as gasoline

MtBE = Methyl tert-butyl ether

ppb = Parts per billion

gal = Gallon

Mass removed based on the formula: volume extracted (gal) x Concentration (µg/L) x (g/10⁶µg) x (pound/453.6g) x (3.785 L/gal)

Volume removal data based on the formula: density (in gms/cc) x 9.339 (ccxlbs/gmsxgals)

TPPH, benzene, and MTBE analyzed by EPA Method 8260

Concentrations based on most recent groundwater monitoring results

If concentration is less than the laboratory detection limit, one half of the detection limit concentration is used in the mass removal calculation.

Groundwater extracted by vacuum trucks provided by Onyx. Water disposed of at a Martinez Refinery.

ATTACHMENT A
Blaine Groundwater Monitoring Report
and Field Notes

BLAINE TECH SERVICES INC.

GROUNDWATER SAMPLING SPECIALISTS
SINCE 1985

January 4, 2005

Karen Petryna
Shell Oil Products US
P.O. Box 7869
Burbank, CA 91510-7869

Fourth Quarter 2004 Groundwater Monitoring at
Former Shell Service Station
8930 Bancroft Avenue
Oakland, CA

Monitoring performed on December 14, 2004

Groundwater Monitoring Report 041214-WC-2

This report covers the routine monitoring of groundwater wells at this former Shell facility. In accordance with standard procedures that conform to Regional Water Quality Control Board requirements, routine field data collection includes depth to water, total well depth, thickness of any separate immiscible layer, water column volume, calculated purge volume (if applicable), elapsed evacuation time (if applicable), total volume of water removed (if applicable), and standard water parameter instrument readings. Sample material is collected, contained, stored, and transported to the laboratory in conformance with EPA standards. Purgewater (if applicable) is, likewise, collected and transported to the Shell Martinez Manufacturing Complex.

Basic field information is presented alongside analytical values excerpted from the laboratory report in the cumulative table of **WELL CONCENTRATIONS**. The full analytical report for the most recent samples and the field data sheets are attached to this report.

At a minimum, Blaine Tech Services, Inc. field personnel are certified on completion of a forty-hour Hazardous Materials and Emergency Response training course per 29 CFR 1910.120. Field personnel are also enrolled in annual eight-hour refresher courses.

Blaine Tech Services, Inc. conducts sampling and documentation assignments of this type as an independent third party. Our activities at this site consisted of objective data and sample collection only. No interpretation of analytical results, defining of hydrological conditions or formulation of recommendations was performed.

Please call if you have any questions.

Yours truly,

Leon Gearhart
Project Coordinator

LG/ks

attachments: Cumulative Table of WELL CONCENTRATIONS
Certified Analytical Report
Field Data Sheet

cc: Anni Kreml
Cambria Environmental Technology, Inc.
5900 Hollis Street, Suite A
Emeryville, CA 94608

WELL CONCENTRATIONS
Former Shell Service Station
8930 Bancroft Avenue
Oakland, CA

Well ID	Date	TPPH (ug/L)	TEPH (ug/L)	B (ug/L)	T (ug/L)	E (ug/L)	X (ug/L)	MTBE 8020 (ug/L)	MTBE 8260 (ug/L)	DIPE (ug/L)	ETBE (ug/L)	TAME (ug/L)	TBA (ug/L)	TOC (MSL)	Depth to Water (ft.)	Depth to SPH (ft.)	GW Elevation (MSL)	SPH Thickness (ft.)	DO Reading (mg/L)
MW-1	12/17/1998	<50	NA	<0.50	<0.50	<0.50	<0.50	<2.5	NA	NA	NA	NA	NA	53.19	11.87	NA	41.32	NA	NA
MW-1	3/9/1999	<50.0	NA	<0.500	<0.500	<0.500	<0.500	<5.00	NA	NA	NA	NA	NA	53.19	8.21	NA	44.98	NA	NA
MW-1	6/16/1999	<50.0	NA	<0.500	<0.500	<0.500	<0.500	<5.00	NA	NA	NA	NA	NA	53.19	15.04	NA	38.15	NA	NA
MW-1	9/30/1999	<50.0	NA	<0.500	<0.500	<0.500	<0.500	<5.00	NA	NA	NA	NA	NA	53.19	16.02	NA	37.17	NA	NA
MW-1	12/23/1999	<50.0	NA	<0.500	<0.500	<0.500	<0.500	<2.50	NA	NA	NA	NA	NA	53.19	14.78	NA	38.41	NA	NA
MW-1	3/22/2000	<50.0	NA	<0.500	<0.500	<0.500	<0.500	<5.00	NA	NA	NA	NA	NA	53.19	8.44	NA	44.75	NA	NA
MW-1	6/1/2000	<50.0	NA	<0.500	<0.500	<0.500	<0.500	<2.50	NA	NA	NA	NA	NA	53.19	13.71	NA	39.48	NA	NA
MW-1	9/8/2000	<50.0	NA	<0.500	<0.500	<0.500	<0.500	<2.50	NA	NA	NA	NA	NA	53.19	14.95	NA	38.24	NA	NA
MW-1	12/4/2000	<50.0	NA	<0.500	<0.500	<0.500	<0.500	5.82	NA	NA	NA	NA	NA	53.19	13.85	NA	39.34	NA	NA
MW-1	3/9/2001	<50.0	NA	<0.500	<0.500	<0.500	<0.500	<2.50	NA	NA	NA	NA	NA	53.19	9.07	NA	44.12	NA	NA
MW-1	6/27/2001	<50	NA	<0.50	<0.50	<0.50	<0.50	<2.5	NA	NA	NA	NA	NA	53.19	14.90	NA	38.29	NA	NA
MW-1	9/20/2001	NA	NA	NA	NA	NA	NA	NA	NA	NA	NA	NA	NA	53.19	15.53	NA	37.66	NA	NA
MW-1	12/5/2001	NA	NA	NA	NA	NA	NA	NA	NA	NA	NA	NA	NA	53.19	10.41	NA	42.78	NA	3.8
MW-1	2/26/2002	<50	NA	<0.50	<0.50	<0.50	<0.50	NA	<0.50	NA	NA	NA	NA	53.19	11.09	NA	42.10	NA	NA
MW-1	6/6/2002	NA	NA	NA	NA	NA	NA	NA	NA	NA	NA	NA	NA	53.19	14.13	NA	39.06	NA	NA
MW-1	9/9/2002	NA	NA	NA	NA	NA	NA	NA	NA	NA	NA	NA	NA	53.20	15.55	NA	37.65	NA	NA
MW-1	12/19/2002	NA	NA	NA	NA	NA	NA	NA	NA	NA	NA	NA	NA	53.20	8.67	NA	44.53	NA	NA
MW-1	3/28/2003	<50	NA	<0.50	<0.50	<0.50	<0.50	NA	<5.0	NA	NA	NA	NA	53.20	13.33	NA	39.87	NA	NA
MW-1	6/30/2003	NA	NA	NA	NA	NA	NA	NA	NA	NA	NA	NA	NA	53.20	14.71	NA	38.49	NA	NA
MW-1	9/25/2003	<50	NA	<0.50	<0.50	<0.50	<1.0	NA	<0.50	NA	NA	NA	NA	53.20	15.13	NA	38.07	NA	NA
MW-1	12/2/2003	NA	NA	NA	NA	NA	NA	NA	NA	NA	NA	NA	NA	53.20	14.42	NA	38.78	NA	NA
MW-1	3/18/2004	<50	NA	<0.50	<0.50	<0.50	<1.0	NA	<0.50	NA	NA	NA	NA	53.20	10.38	NA	42.82	NA	NA
MW-1	6/17/2004	NA	NA	NA	NA	NA	NA	NA	NA	NA	NA	NA	NA	53.20	14.95	NA	38.25	NA	NA
MW-1	9/2/2004	NA	NA	NA	NA	NA	NA	NA	NA	NA	NA	NA	NA	53.20	15.75	NA	37.45	NA	NA
MW-1	12/14/2004	NA	NA	NA	NA	NA	NA	NA	NA	NA	NA	NA	NA	53.20	11.20	NA	42.00	NA	NA
MW-2	12/17/1998	9,900	NA	<5.0	37	22	47	48	<20	NA	NA	NA	NA	52.66	11.65	NA	41.01	NA	NA
MW-2	3/9/1999	2,760	NA	12.3	7.50	85.4	444	<50.0	NA	NA	NA	NA	NA	52.66	8.07	NA	44.59	NA	NA
MW-2	6/16/1999	2,570	NA	36.3	11.6	6.19	10.8	<50.0	NA	NA	NA	NA	NA	52.66	14.63	NA	38.03	NA	NA
MW-2	9/30/1999	1,960	NA	19.1	3.20	4.55	26.9	<25.0	NA	NA	NA	NA	NA	52.66	15.63	NA	37.03	NA	NA
MW-2	12/23/1999	145	NA	1.30	<0.500	<0.500	0.899	<2.50	NA	NA	NA	NA	NA	52.66	14.42	NA	38.24	NA	NA
MW-2	3/22/2000	6,060	NA	18.9	<10.0	210	651	<100	NA	NA	NA	NA	NA	52.66	8.19	NA	44.47	NA	NA

WELL CONCENTRATIONS
Former Shell Service Station
8930 Bancroft Avenue
Oakland, CA

Well ID	Date	TPPH (ug/L)	TEPH (ug/L)	B (ug/L)	T (ug/L)	E (ug/L)	X (ug/L)	MTBE 8020 (ug/L)	MTBE 8260 (ug/L)	DIPE (ug/L)	ETBE (ug/L)	TAME (ug/L)	TBA (ug/L)	TOC (MSL)	Depth to Water (ft.)	Depth to SPH (ft.)	GW Elevation (MSL)	SPH Thickness (ft.)	DO Reading (mg/L)
MW-2	6/1/2000	<50.0	NA	<0.500	<0.500	<0.500	<0.500	<2.50	NA	NA	NA	NA	NA	52.66	11.46	NA	41.20	NA	NA
MW-2	9/8/2000	<50.0	NA	<0.500	<0.500	<0.500	<0.500	<2.50	NA	NA	NA	NA	NA	52.66	14.63	NA	38.03	NA	NA
MW-2	12/4/2000	201	NA	1.35	<0.500	3.39	8.58	<2.50	NA	NA	NA	NA	NA	52.66	13.45	NA	39.21	NA	NA
MW-2	3/9/2001	396	NA	2.82	<0.500	8.69	18.7	<2.50	NA	NA	NA	NA	NA	52.66	8.89	NA	43.77	NA	NA
MW-2	6/27/2001	<50	NA	<0.50	<0.50	<0.50	<0.50	<2.5	NA	NA	NA	NA	NA	52.66	14.88	NA	37.78	NA	NA
MW-2	9/20/2001	<50	NA	<0.50	<0.50	<0.50	<0.50	NA	<5.0	NA	NA	NA	NA	52.66	15.19	NA	37.47	NA	NA
MW-2	12/5/2001	NA	NA	NA	NA	NA	NA	NA	NA	NA	NA	NA	NA	52.66	10.02	NA	42.64	NA	2.8
MW-2	2/26/2002	180	NA	<0.50	<0.50	2.7	4.1	NA	<0.50	NA	NA	NA	NA	52.66	10.76	NA	41.90	NA	NA
MW-2	6/6/2002	NA	NA	NA	NA	NA	NA	NA	NA	NA	NA	NA	NA	52.66	13.83	NA	38.83	NA	NA
MW-2	9/9/2002	<50	NA	<0.50	<0.50	<0.50	<0.50	NA	<5.0	NA	NA	NA	NA	52.66	15.23	NA	37.43	NA	NA
MW-2	12/19/2002	NA	NA	NA	NA	NA	NA	NA	NA	NA	NA	NA	NA	52.66	8.46	NA	44.20	NA	NA
MW-2	3/28/2003	53	NA	<0.50	<0.50	0.51	1.4	NA	<5.0	NA	NA	NA	NA	52.66	12.96	NA	39.70	NA	NA
MW-2	6/30/2003	NA	NA	NA	NA	NA	NA	NA	NA	NA	NA	NA	NA	52.66	14.49	NA	38.17	NA	NA
MW-2	9/25/2003	Well inaccessible		NA	NA	NA	NA	NA	NA	NA	NA	NA	NA	52.66	NA	NA	NA	NA	NA
MW-2	10/3/2003	54 c	NA	<0.50	<0.50	<0.50	<1.0	NA	<0.50	NA	NA	NA	NA	52.66	15.03	NA	37.63	NA	NA
MW-2	12/2/2003	NA	NA	NA	NA	NA	NA	NA	NA	NA	NA	NA	NA	52.66	14.08	NA	38.58	NA	NA
MW-2	3/18/2004	130	NA	<0.50	<0.50	1.9	2.4	NA	<0.50	NA	NA	NA	NA	52.66	10.08	NA	42.58	NA	NA
MW-2	6/17/2004	NA	NA	NA	NA	NA	NA	NA	NA	NA	NA	NA	NA	52.66	14.65	NA	38.01	NA	NA
MW-2	9/2/2004	<50	NA	<0.50	<0.50	<0.50	<1.0	NA	<0.50	<2.0	<2.0	<2.0	<5.0	52.66	15.38	NA	37.28	NA	NA
MW-2	12/14/2004	NA	NA	NA	NA	NA	NA	NA	NA	NA	NA	NA	NA	52.66	10.89	NA	41.77	NA	NA

MW-3	12/17/1998	<50	NA	<0.50	<0.50	<0.50	<0.50	10	11	NA	NA	NA	NA	51.30	11.85	NA	39.45	NA	NA
MW-3	3/9/1999	<50.0	NA	<0.500	<0.500	<0.500	<0.500	<5.00	NA	NA	NA	NA	NA	51.30	6.53	NA	44.77	NA	NA
MW-3	6/16/1999	<50.0	NA	<0.500	<0.500	<0.500	<0.500	<5.00	NA	NA	NA	NA	NA	51.30	12.71	NA	38.59	NA	NA
MW-3	9/30/1999	<50.0	NA	<0.500	<0.500	<0.500	<0.500	5.14	NA	NA	NA	NA	NA	51.30	14.07	NA	37.23	NA	NA
MW-3	12/23/1999	<500	NA	<5.00	<5.00	<5.00	<5.00	<25.0	NA	NA	NA	NA	NA	51.30	12.82	NA	38.48	NA	NA
MW-3	3/22/2000	<50.0	NA	<0.500	1.48	<0.500	1.90	<5.00	NA	NA	NA	NA	NA	51.30	6.81	NA	44.49	NA	NA
MW-3	6/1/2000	<50.0	NA	<0.500	0.821	<0.500	<0.500	4.39	NA	NA	NA	NA	NA	51.30	11.85	NA	39.45	NA	NA
MW-3	9/8/2000	<50.0	NA	<0.500	<0.500	<0.500	<0.500	3.62	NA	NA	NA	NA	NA	51.30	12.55	NA	38.75	NA	NA
MW-3	12/4/2000	<50.0	NA	<0.500	<0.500	<0.500	0.588	4.74	NA	NA	NA	NA	NA	51.30	11.65	NA	39.65	NA	NA
MW-3	3/9/2001	<50.0	NA	<0.500	<0.500	<0.500	<0.500	<2.50	NA	NA	NA	NA	NA	51.30	7.28	NA	44.02	NA	NA
MW-3	6/27/2001	<50	NA	<0.50	<0.50	<0.50	<0.50	<2.5	NA	NA	NA	NA	NA	51.30	13.16	NA	38.14	NA	NA

WELL CONCENTRATIONS
Former Shell Service Station
8930 Bancroft Avenue
Oakland, CA

Well ID	Date	TPPH (ug/L)	TEPH (ug/L)	B (ug/L)	T (ug/L)	E (ug/L)	X (ug/L)	MTBE 8020 (ug/L)	MTBE 8260 (ug/L)	DIPE (ug/L)	ETBE (ug/L)	TAME (ug/L)	TBA (ug/L)	TOC (MSL)	Depth to Water (ft.)	Depth to SPH (ft.)	GW Elevation (MSL)	SPH Thickness (ft.)	DO Reading (mg/L)
MW-3	9/20/2001	NA	NA	NA	NA	NA	NA	NA	NA	NA	NA	NA	NA	51.30	13.35	NA	37.95	NA	NA
MW-3	12/5/2001	NA	NA	NA	NA	NA	NA	NA	NA	NA	NA	NA	NA	51.30	8.14	NA	43.16	NA	1.2
MW-3	2/26/2002	<50	NA	<0.50	7.2	<0.50	<0.50	NA	1.5	NA	NA	NA	NA	51.30	9.09	NA	42.21	NA	0.6
MW-3	6/6/2002	NA	NA	NA	NA	NA	NA	NA	NA	NA	NA	NA	NA	51.30	12.13	NA	39.17	NA	0.8
MW-3	9/9/2002	NA	NA	NA	NA	NA	NA	NA	NA	NA	NA	NA	NA	51.35	13.54	NA	37.81	NA	1.0
MW-3	12/19/2002	NA	NA	NA	NA	NA	NA	NA	NA	NA	NA	NA	NA	51.35	6.75	NA	44.60	NA	0.6
MW-3	3/28/2003	<50	NA	<0.50	<0.50	<0.50	<0.50	NA	<5.0	NA	NA	NA	NA	51.35	11.28	NA	40.07	NA	0.7
MW-3	6/30/2003	NA	NA	NA	NA	NA	NA	NA	NA	NA	NA	NA	NA	51.35	12.68	NA	38.67	NA	NA
MW-3	9/25/2003	<50	NA	<0.50	2.0	0.73	<1.0	NA	<0.50	NA	NA	NA	NA	51.35	13.22	NA	38.13	NA	NA
MW-3	12/2/2003	NA	NA	NA	NA	NA	NA	NA	NA	NA	NA	NA	NA	51.35	12.48	NA	38.87	NA	NA
MW-3	3/18/2004	<50	NA	<0.50	13	<0.50	<1.0	NA	<0.50	NA	NA	NA	NA	51.35	8.52	NA	42.83	NA	NA
MW-3	6/17/2004	NA	NA	NA	NA	NA	NA	NA	NA	NA	NA	NA	NA	51.35	12.80	NA	38.55	NA	NA
MW-3	9/2/2004	NA	NA	NA	NA	NA	NA	NA	NA	NA	NA	NA	NA	51.35	13.75	NA	37.60	NA	NA
MW-3	12/14/2004	NA	NA	NA	NA	NA	NA	NA	NA	NA	NA	NA	NA	51.35	9.37	NA	41.98	NA	NA
MW-4	12/17/1998	700	NA	4.3	0.88	<0.50	<0.50	21,000	26,000	NA	NA	NA	NA	50.73	10.80	NA	39.93	NA	NA
MW-4	3/9/1999	83.9	NA	<0.500	<0.500	<0.500	<0.500	17,900	23,700	NA	NA	NA	NA	50.73	6.91	NA	43.82	NA	NA
MW-4	6/16/1999	<50.0	NA	<0.500	<0.500	<0.500	<0.500	10,600	19,200	NA	NA	NA	NA	50.73	12.84	NA	37.89	NA	NA
MW-4	9/30/1999	51.2	NA	<0.500	<0.500	<0.500	<0.500	12,200	12,300	NA	NA	NA	NA	50.73	13.74	NA	36.99	NA	NA
MW-4	12/23/1999	<100	NA	<1.00	<1.00	<1.00	<1.00	7,990	8,400	NA	NA	NA	NA	50.73	12.40	NA	38.33	NA	NA
MW-4	3/22/2000	<500	NA	<5.00	<5.00	<5.00	<5.00	4,970	5,020	NA	NA	NA	NA	50.73	7.32	NA	43.41	NA	NA
MW-4	6/1/2000	<100	NA	<1.00	<1.00	<1.00	<1.00	5,260	3,580	NA	NA	NA	NA	50.73	11.50	NA	39.23	NA	NA
MW-4	9/8/2000	<50.0	NA	<0.500	<0.500	<0.500	<0.500	3,610	3,300a	NA	NA	NA	NA	50.73	12.55	NA	38.18	NA	NA
MW-4	12/4/2000	<50.0	NA	<0.500	<0.500	<0.500	<0.500	2,960	3,520a	NA	NA	NA	NA	50.73	11.77	NA	38.96	NA	NA
MW-4	3/9/2001	<50.0	NA	<0.500	<0.500	<0.500	<0.500	1,930	2,500	NA	NA	NA	NA	50.73	7.48	NA	43.25	NA	NA
MW-4	6/27/2001	<50	NA	<0.50	<0.50	<0.50	<0.50	1,100	1,100	NA	NA	NA	NA	50.73	12.97	NA	37.76	NA	NA
MW-4	9/20/2001	<250	NA	3.8	14	2.6	7.8	NA	940	NA	NA	NA	NA	50.73	13.30	NA	37.43	NA	NA
MW-4	12/5/2001	<200	NA	<2.0	<2.0	<2.0	<2.0	NA	750	NA	NA	NA	NA	50.73	8.41	NA	42.32	NA	1.2
MW-4	2/26/2002	<50	NA	<0.50	<0.50	<0.50	<0.50	NA	320	NA	NA	NA	NA	50.73	9.40	NA	41.33	NA	0.7
MW-4	6/6/2002	<50	NA	<0.50	<0.50	<0.50	<0.50	NA	160	NA	NA	NA	NA	50.73	11.97	NA	38.76	NA	0.6
MW-4	9/9/2002	<50	NA	<0.50	<0.50	<0.50	<0.50	NA	50	NA	NA	NA	NA	50.72	13.23	NA	37.49	NA	3.6
MW-4	12/19/2002	Unable to sample	NA	NA	NA	NA	NA	NA	NA	NA	NA	NA	NA	50.72	7.08	NA	43.64	NA	0.8

WELL CONCENTRATIONS
Former Shell Service Station
8930 Bancroft Avenue
Oakland, CA

Well ID	Date	TPPH (ug/L)	TEPH (ug/L)	B (ug/L)	T (ug/L)	E (ug/L)	X (ug/L)	MTBE 8020 (ug/L)	MTBE 8260 (ug/L)	DIPE (ug/L)	ETBE (ug/L)	TAME (ug/L)	TBA (ug/L)	TOC (MSL)	Depth to Water (ft.)	Depth to SPH (ft.)	GW Elevation (MSL)	SPH Thickness (ft.)	DO Reading (mg/L)
MW-4	12/26/2002	<50	NA	<0.50	<0.50	<0.50	<0.50	NA	47	NA	NA	NA	NA	50.72	7.23	NA	43.49	NA	1.8
MW-4	3/28/2003	<50	NA	<0.50	1.2	<0.50	<0.50	NA	17	NA	NA	NA	NA	50.72	11.30	NA	39.42	NA	1.7
MW-4	6/30/2003	54 c	NA	<0.50	<0.50	<0.50	<1.0	NA	16	NA	NA	NA	NA	50.72	12.51	NA	38.21	NA	NA
MW-4	9/25/2003	<50	NA	<0.50	<0.50	<0.50	<1.0	NA	110	NA	NA	NA	NA	50.72	13.10	NA	37.62	NA	NA
MW-4	12/2/2003	<250	NA	<2.5	<2.5	<2.5	<5.0	NA	280	NA	NA	NA	NA	50.72	12.39	NA	38.33	NA	NA
MW-4	3/18/2004	<50	NA	<0.50	<0.50	<0.50	<1.0	NA	33	NA	NA	NA	NA	50.72	8.63	NA	42.09	NA	NA
MW-4	6/17/2004	<50	NA	<0.50	<0.50	<0.50	<1.0	NA	16	NA	NA	NA	NA	50.72	12.77	NA	37.95	NA	NA
MW-4	9/2/2004	<50	NA	<0.50	<0.50	<0.50	<1.0	NA	7.7	<2.0	<2.0	<2.0	<5.0	50.72	13.54	NA	37.18	NA	NA
MW-4	12/14/2004	<50	NA	<0.50	<0.50	<0.50	<1.0	NA	7.2	NA	NA	NA	NA	50.72	9.40	NA	41.32	NA	NA

MW-5	12/17/1998	750	NA	<0.50	17	1.8	3.5	33	32	NA	NA	NA	NA	51.43	11.51	NA	39.92	NA	NA
MW-5	3/9/1999	<50.0	NA	<0.500	<0.500	<0.500	<0.500	<5.00	NA	NA	NA	NA	NA	51.43	7.15	NA	44.28	NA	NA
MW-5	6/16/1999	646	NA	9.26	1.05	<1.00	<1.00	<10.0	NA	NA	NA	NA	NA	51.43	13.47	NA	37.96	NA	NA
MW-5	9/30/1999	484	NA	1.93	0.511	<0.500	<0.500	159	NA	NA	NA	NA	NA	51.43	14.41	NA	37.02	NA	NA
MW-5	12/23/1999	944	NA	4.59	17.7	3.79	16.7	214	NA	NA	NA	NA	NA	51.43	14.07	NA	37.36	NA	NA
MW-5	3/22/2000	8,770	NA	197	96.5	<50.0	188	2,450	NA	NA	NA	NA	NA	51.43	7.31	NA	44.12	NA	NA
MW-5	6/1/2000	227	NA	0.565	<0.500	<0.500	<0.500	35.9	NA	NA	NA	NA	NA	51.43	12.15	NA	39.28	NA	NA
MW-5	9/8/2000	159	NA	0.606	<0.500	<0.500	1.74	1,000	NA	NA	NA	NA	NA	51.43	13.30	NA	38.13	NA	NA
MW-5	12/4/2000	1,510	NA	19.2	<10.0	<10.0	134	1,360	NA	NA	NA	NA	NA	51.43	12.19	NA	39.24	NA	NA
MW-5	3/9/2001	3,460	NA	37.9	121	40.6	208	235	NA	NA	NA	NA	NA	51.43	7.79	NA	43.64	NA	NA
MW-5	6/27/2001	310	NA	0.97	<0.50	<0.50	<0.50	14	NA	NA	NA	NA	NA	51.43	13.89	NA	37.54	NA	NA
MW-5	9/20/2001	310	NA	<0.50	<0.50	<0.50	<0.50	NA	21	NA	NA	NA	NA	51.43	13.95	NA	37.48	NA	NA
MW-5	12/5/2001	8,800	NA	14	2.9	33	410	NA	2,300	NA	NA	NA	NA	51.43	8.89	NA	42.54	NA	0.6
MW-5	2/26/2002	NA	NA	NA	NA	NA	NA	NA	NA	NA	NA	NA	NA	51.43	9.87	NA	NA	b	NA
MW-5	3/12/2002	NA	NA	NA	NA	NA	NA	NA	NA	NA	NA	NA	NA	51.43	8.84	8.64	42.75	0.20	NA
MW-5	6/6/2002	NA	NA	NA	NA	NA	NA	NA	NA	NA	NA	NA	NA	51.43	12.59	12.54	38.88	0.05	NA
MW-5	9/9/2002	210	NA	<0.50	<0.50	<0.50	0.90	NA	200	NA	NA	NA	NA	51.44	13.94	NA	37.50	NA	NA
MW-5	12/19/2002	Unable to sample	NA	NA	NA	NA	NA	NA	NA	NA	NA	NA	NA	51.44	7.35	NA	44.09	NA	NA
MW-5	12/26/2002	1,400	NA	<0.50	21	6.9	60	NA	180	NA	NA	NA	NA	51.44	7.13	NA	44.31	NA	NA
MW-5	3/28/2003	240	NA	<0.50	<0.50	<0.50	2.1	NA	130	NA	NA	NA	NA	51.44	11.73	NA	39.71	NA	NA
MW-5	6/30/2003	NA	NA	NA	NA	NA	NA	NA	NA	NA	NA	NA	NA	51.44	13.34	13.30	38.13	0.04	NA
MW-5	9/25/2003	12,000	NA	<5.0	<5.0	24	210	NA	220	NA	NA	NA	NA	51.44	13.60	NA	37.84	NA	NA

WELL CONCENTRATIONS
Former Shell Service Station
8930 Bancroft Avenue
Oakland, CA

Well ID	Date	TPPH (ug/L)	TEPH (ug/L)	B (ug/L)	T (ug/L)	E (ug/L)	X (ug/L)	MTBE 8020 (ug/L)	MTBE 8260 (ug/L)	DIPE (ug/L)	ETBE (ug/L)	TAME (ug/L)	TBA (ug/L)	TOC (MSL)	Depth to Water (ft.)	Depth to SPH (ft.)	GW Elevation (MSL)	SPH Thickness (ft.)	DO Reading (mg/L)
MW-5	12/2/2003	2,500	NA	<5.0	14	<5.0	11	NA	25	NA	NA	NA	NA	51.44	12.92	NA	38.52	NA	NA
MW-5	3/18/2004	2,100	NA	2.9	2.8	<1.0	780	NA	4.7	NA	NA	NA	NA	51.44	9.05	NA	42.39	NA	NA
MW-5	6/17/2004	68	NA	<0.50	<0.50	<0.50	<1.0	NA	0.89	NA	NA	NA	NA	51.44	13.45	NA	37.99	NA	NA
MW-5	9/2/2004	NA	NA	NA	NA	NA	NA	NA	NA	NA	NA	NA	NA	51.44	14.25	14.18	37.25	0.07	NA
MW-5	12/14/2004	80,000	NA	<50	3,100	2,200	17,000	NA	<50	NA	NA	NA	NA	51.44	9.82	NA	41.62	0.00	NA
MW-6	12/17/1998	940	NA	27	0.32	2.4	2.3	3.0	3.2	NA	NA	NA	NA	51.88	11.37	NA	40.51	NA	NA
MW-6	3/9/1999	336	NA	7.78	1.60	2.40	6.36	<10.0	NA	NA	NA	NA	NA	51.88	8.10	NA	43.78	NA	NA
MW-6	6/16/1999	308	NA	2.45	<0.500	<0.500	<0.500	7.39	NA	NA	NA	NA	NA	51.88	14.49	NA	37.39	NA	NA
MW-6	9/30/1999	80.2	NA	<0.500	<0.500	<0.500	<0.500	24.8	NA	NA	NA	NA	NA	51.88	15.30	NA	36.58	NA	NA
MW-6	12/23/1999	149	NA	0.518	<0.500	<0.500	<0.500	6.43	NA	NA	NA	NA	NA	51.88	13.19	NA	38.69	NA	NA
MW-6	3/22/2000	382	NA	3.31	2.18	0.619	2.35	5.61	NA	NA	NA	NA	NA	51.88	8.27	NA	43.61	NA	NA
MW-6	6/1/2000	158	NA	0.830	<0.500	<0.500	1.10	10.9	NA	NA	NA	NA	NA	51.88	11.13	NA	40.75	NA	NA
MW-6	9/8/2000	<50.0	NA	<0.500	<0.500	<0.500	<0.500	<2.50	NA	NA	NA	NA	NA	51.88	14.28	NA	37.60	NA	NA
MW-6	12/4/2000	231	NA	4.93	<0.500	<0.500	<0.500	4.57	NA	NA	NA	NA	NA	51.88	12.62	NA	39.26	NA	NA
MW-6	3/9/2001	789	NA	11.6	2.72	<2.00	<2.00	28.0	NA	NA	NA	NA	NA	51.88	8.65	NA	43.23	NA	NA
MW-6	6/27/2001	140	NA	<0.50	1.1	<0.50	<0.50	<2.5	NA	NA	NA	NA	NA	51.88	14.95	NA	36.93	NA	NA
MW-6	9/20/2001	<50	NA	<0.50	<0.50	<0.50	<0.50	NA	<5.0	NA	NA	NA	NA	51.88	14.70	NA	37.18	NA	NA
MW-6	12/5/2001	NA	NA	NA	NA	NA	NA	NA	NA	NA	NA	NA	NA	51.88	9.62	NA	42.26	NA	1.8
MW-6	2/26/2002	130	NA	<0.50	2.6	0.69	4.1	NA	6.4	NA	NA	NA	NA	51.88	10.14	NA	41.74	NA	NA
MW-6	6/6/2002	NA	NA	NA	NA	NA	NA	NA	NA	NA	NA	NA	NA	51.88	13.52	NA	38.36	NA	NA
MW-6	9/9/2002	<50	NA	<0.50	<0.50	<0.50	<0.50	NA	<5.0	NA	NA	NA	NA	51.86	14.92	NA	36.94	NA	NA
MW-6	12/19/2002	NA	NA	NA	NA	NA	NA	NA	NA	NA	NA	NA	NA	51.86	8.22	NA	43.64	NA	NA
MW-6	3/28/2003	740	NA	<0.50	<0.50	<0.50	<0.50	NA	14	NA	NA	NA	NA	51.86	12.57	NA	39.29	NA	NA
MW-6	6/30/2003	NA	NA	NA	NA	NA	NA	NA	NA	NA	NA	NA	NA	51.86	14.14	NA	37.72	NA	NA
MW-6	9/25/2003	<250	NA	<2.5	160	<2.5	<5.0	NA	5.3	NA	NA	NA	NA	51.86	14.30	NA	37.56	NA	NA
MW-6	12/2/2003	NA	NA	NA	NA	NA	NA	NA	NA	NA	NA	NA	NA	51.86	13.72	NA	38.14	NA	NA
MW-6	3/18/2004	1,200	NA	<1.0	7.1	1.5	2.7	NA	16	NA	NA	NA	NA	51.86	9.72	NA	42.14	NA	NA
MW-6	6/17/2004	NA	NA	NA	NA	NA	NA	NA	NA	NA	NA	NA	NA	51.86	14.48	NA	37.38	NA	NA
MW-6	9/2/2004	75	NA	<0.50	<0.50	<0.50	<1.0	NA	11	<2.0	<2.0	<2.0	<5.0	51.86	15.16	NA	36.70	NA	NA
MW-6	12/14/2004	NA	NA	NA	NA	NA	NA	NA	NA	NA	NA	NA	NA	51.86	10.55	NA	41.31	NA	NA

WELL CONCENTRATIONS
Former Shell Service Station
8930 Bancroft Avenue
Oakland, CA

Well ID	Date	TPPH (ug/L)	TEPH (ug/L)	B (ug/L)	T (ug/L)	E (ug/L)	X (ug/L)	MTBE 8020 (ug/L)	MTBE 8260 (ug/L)	DIPE (ug/L)	ETBE (ug/L)	TAME (ug/L)	TBA (ug/L)	TOC (MSL)	Depth to Water (ft.)	Depth to SPH (ft.)	GW Elevation (MSL)	SPH Thickness (ft.)	DO Reading (mg/L)
---------	------	----------------	----------------	-------------	-------------	-------------	-------------	------------------------	------------------------	----------------	----------------	----------------	---------------	--------------	----------------------------	--------------------------	--------------------------	---------------------------	-------------------------

Abbreviations:

TPPH = Total petroleum hydrocarbons as gasoline by EPA Method 8260B; prior to September 20, 2001, analyzed by EPA Method 8015.

TEPH = Total petroleum hydrocarbons as diesel by modified EPA Method 8015.

BTEX = Benzene, toluene, ethylbenzene, xylenes by EPA Method 8260B; prior to September 20, 2001, analyzed by EPA Method 8020.

MTBE = Methyl tertiary butyl ether

DIPE = Di-isopropyl ether, analyzed by EPA Method 8260B

ETBE = Ethyl tertiary butyl ether, analyzed by EPA Method 8260B

TAME = Tertiary amyl methyl ether, analyzed by EPA Method 8260B

TBA = Tertiary butyl alcohol, analyzed by EPA Method 8260B

TOC = Top of Casing Elevation

SPH = Separate-phase hydrocarbons

GW = Groundwater

ug/L = Parts per billion

MSL = Mean sea level

ft. = Feet

<n = Below detection limit

NA = Not applicable

DO = Dissolved oxygen

mg/L = Parts per million

Notes:

a = This sample analyzed outside of EPA recommended holding time.

b = SPH detected in well, but exact thickness could not be measured.

c = Hydrocarbon does not match pattern of laboratory's standard.

When separate-phase hydrocarbons are present, groundwater elevation is adjusted using the relation: Groundwater Elevation = Top-of-Casing Elevation - Depth to Water + (0.8 x Hydrocarbon Thickness).

Site surveyed February 12 and May 16, 2002 by Virgil Chavez Land Surveying of Vallejo, CA.

Blaine Tech Services, Inc.

December 29, 2004

1680 Rogers Avenue
San Jose, CA 95112-1105
Attn.: Leon Gearhart
Project#: 041214-WC2
Project: 98995742
Site: 8930 Bancroft Ave., Oakland

Dear Mr. Gearhart,

Attached is our report for your samples received on 12/14/2004 15:23
This report has been reviewed and approved for release. Reproduction of this report
is permitted only in its entirety.

Please note that any unused portion of the samples will be discarded after
01/28/2005 unless you have requested otherwise.

We appreciate the opportunity to be of service to you. If you have any questions,

You can also contact me via email. My email address is: mbrewer@stl-inc.com

Sincerely,

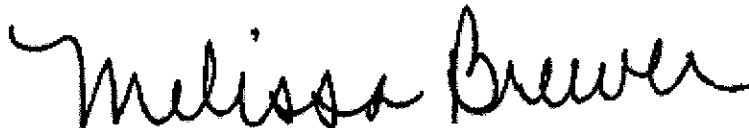

Melissa Brewer
Project Manager

Gas/BTEX/MTBE by 8260B (C6-C12)

Blaine Tech Services, Inc.

Attn.: Leon Gearhart

1680 Rogers Avenue

San Jose, CA 95112-1105

Phone: (408) 573-0555 Fax: (408) 573-7771

Project: 041214-WC2

98995742

Received: 12/14/2004 15:23

Site: 8930 Bancroft Ave., Oakland

Samples Reported

Sample Name	Date Sampled	Matrix	Lab #
MW-4	12/14/2004 14:18	Water	1
MW-5	12/14/2004 14:56	Water	2

Gas/BTEX/MTBE by 8260B (C6-C12)

Blaine Tech Services, Inc.

Attn.: Leon Gearhart

1680 Rogers Avenue
San Jose, CA 95112-1105
Phone: (408) 573-0555 Fax: (408) 573-7771

Project: 041214-WC2
98995742

Received: 12/14/2004 15:23

Site: 8930 Bancroft Ave., Oakland

Prep(s): 5030B	Test(s): 8260B
Sample ID: MW-4	Lab ID: 2004-12-0566 - 1
Sampled: 12/14/2004 14:18	Extracted: 12/23/2004 01:26
Matrix: Water	QC Batch#: 2004/12/22-2B.62

Compound	Conc.	RL	Unit	Dilution	Analyzed	Flag
Gasoline [Shell]	ND	50	ug/L	1.00	12/23/2004 01:26	
Benzene	ND	0.50	ug/L	1.00	12/23/2004 01:26	
Toluene	ND	0.50	ug/L	1.00	12/23/2004 01:26	
Ethylbenzene	ND	0.50	ug/L	1.00	12/23/2004 01:26	
Total xylenes	ND	1.0	ug/L	1.00	12/23/2004 01:26	
Methyl tert-butyl ether (MTBE)	7.2	0.50	ug/L	1.00	12/23/2004 01:26	
Surrogate(s)						
1,2-Dichloroethane-d4	106.1	73-130	%	1.00	12/23/2004 01:26	
Toluene-d8	96.8	81-114	%	1.00	12/23/2004 01:26	

Gas/BTEX/MTBE by 8260B (C6-C12)

Blaine Tech Services, Inc.

Attn.: Leon Gearhart

1680 Rogers Avenue
San Jose, CA 95112-1105
Phone: (408) 573-0555 Fax: (408) 573-7771

Project: 041214-WC2
98995742

Received: 12/14/2004 15:23

Site: 8930 Bancroft Ave., Oakland

Prep(s): 5030B Test(s): 8260B
Sample ID: MW-5 Lab ID: 2004-12-0566 - 2
Sampled: 12/14/2004 14:56 Extracted: 12/23/2004 01:48
Matrix: Water QC Batch#: 2004/12/22-2B.62
Analysis Flag: L2 (See Legend and Note Section)

Compound	Conc.	RL	Unit	Dilution	Analyzed	Flag
Gasoline [Shell]	80000	5000	ug/L	100.00	12/23/2004 01:48	
Benzene	ND	50	ug/L	100.00	12/23/2004 01:48	
Toluene	3100	50	ug/L	100.00	12/23/2004 01:48	
Ethylbenzene	2200	50	ug/L	100.00	12/23/2004 01:48	
Total xylenes	17000	100	ug/L	100.00	12/23/2004 01:48	
Methyl tert-butyl ether (MTBE)	ND	50	ug/L	100.00	12/23/2004 01:48	
Surrogate(s)						
1,2-Dichloroethane-d4	105.1	73-130	%	100.00	12/23/2004 01:48	
Toluene-d8	93.1	81-114	%	100.00	12/23/2004 01:48	

Gas/BTEX/MTBE by 8260B (C6-C12)

Blaine Tech Services, Inc.

Attn.: Leon Gearhart

1680 Rogers Avenue

San Jose, CA 95112-1105

Phone: (408) 573-0555 Fax: (408) 573-7771

Project: 041214-WC2

98995742

Received: 12/14/2004 15:23

Site: 8930 Bancroft Ave., Oakland

Batch QC Report

Prep(s): 5030B

Method Blank

MB: 2004/12/22-2B.62-048

Water

Test(s): 8260B

QC Batch # 2004/12/22-2B.62

Date Extracted: 12/22/2004 18:48

Compound	Conc.	RL	Unit	Analyzed	Flag
Gasoline [Shell]	ND	50	ug/L	12/22/2004 18:48	
Methyl tert-butyl ether (MTBE)	ND	0.5	ug/L	12/22/2004 18:48	
Benzene	ND	0.5	ug/L	12/22/2004 18:48	
Toluene	ND	0.5	ug/L	12/22/2004 18:48	
Ethylbenzene	ND	0.5	ug/L	12/22/2004 18:48	
Total xylenes	ND	1.0	ug/L	12/22/2004 18:48	
Surrogates(s)					
1,2-Dichloroethane-d4	102.9	73-130	%	12/22/2004 18:48	
Toluene-d8	93.1	81-114	%	12/22/2004 18:48	

Gas/BTEX/MTBE by 8260B (C6-C12)

Blaine Tech Services, Inc.

Attn.: Leon Gearhart

1680 Rogers Avenue
San Jose, CA 95112-1105
Phone: (408) 573-0555 Fax: (408) 573-7771

Project: 041214-WC2
98995742

Received: 12/14/2004 15:23

Site: 8930 Bancroft Ave., Oakland

Batch QC Report

Prep(s): 5030B

Test(s): 8260B

Laboratory Control Spike

Water

QC Batch # 2004/12/22-2B.62

LCS 2004/12/22-2B.62-027
LCSD

Extracted: 12/22/2004

Analyzed: 12/22/2004 18:27

Compound	Conc. ug/L		Exp.Conc.	Recovery %		RPD	Ctrl.Limits %		Flags	
	LCS	LCSD		LCS	LCSD		%	Rec.	RPD	LCS
Methyl tert-butyl ether (MTBE)	24.7		25	98.8			65-165	20		
Benzene	24.1		25	96.4			69-129	20		
Toluene	25.9		25	103.6			70-130	20		
Surrogates(s)										
1,2-Dichloroethane-d4	462		500	92.4			73-130			
Toluene-d8	493		500	98.6			81-114			

Sewern Trent Laboratories, Inc.

STL San Francisco * 1220 Quarry Lane, Pleasanton, CA 94566

Tel 925 484 1919 Fax 925 484 1096 * www.stl-inc.com * CA DHS ELAP# 2496

12/25/2004 15:04

Gas/BTEX/MTBE by 8260B (C6-C12)

Blaine Tech Services, Inc.

Attn.: Leon Gearhart

1680 Rogers Avenue
San Jose, CA 95112-1105
Phone: (408) 573-0555 Fax: (408) 573-7771

Project: 041214-WC2
98995742

Received: 12/14/2004 15:23

Site: 8930 Bancroft Ave., Oakland

Batch QC Report

Prep(s): 5030B

Test(s): 8260B

Matrix Spike (MS / MSD)

Water

QC Batch # 2004/12/22-2B.62

MS/MSD

Lab ID: 2004-12-0489 - 001

MS: 2004/12/22-2B.62-039

Extracted: 12/22/2004

Analyzed: 12/22/2004 19:39

Dilution: 1.00

MSD: 2004/12/22-2B.62-050

Extracted: 12/22/2004

Analyzed: 12/22/2004 20:00

Dilution: 1.00

Compound	Conc. ug/L			Spk.Level ug/L	Recovery %			Limits %		Flags	
	MS	MSD	Sample		MS	MSD	RPD	Rec.	RPD	MS	MSD
Benzene	23.3	23.0	ND	25	93.2	92.0	1.3	69-129	20		
Toluene	24.1	22.9	ND	25	96.4	91.6	5.1	70-130	20		
Methyl tert-butyl ether	24.8	26.1	0.71	25	96.4	101.6	5.3	65-165	20		
Surrogate(s)											
1,2-Dichloroethane-d4	509	496		500	101.8	99.1		73-130			
Toluene-d8	486	479		500	97.1	95.8		81-114			

Gas/BTEX/MTBE by 8260B (C6-C12)

Blaine Tech Services, Inc.

Attn.: Leon Gearhart

1680 Rogers Avenue

San Jose, CA 95112-1105

Phone: (408) 573-0555 Fax: (408) 573-7771

Project: 041214-WC2

98995742

Received: 12/14/2004 15:23

Site: 8930 Bancroft Ave., Oakland

Legend and Notes

Analysis Flag

L2

Reporting limits were raised due to high level of analyte present
in the sample.

SHELL Chain Of Custody Record

46663

Lab identification if necessary:

Address:

City, State, Zip:

Shell Project Manager to be Invoiced:

- SCIENCE & ENGINEERING
- TECHNICAL SERVICES
- CRMT JACKSON

Karen Petryna

2004-12-0566

INCIDENT NUMBER (S&E ONLY):

9 8 9 9 5 7 4 2

SAP or CRMT NUMBER (TS/CRMT):

DATE 12/14/04

PAGE: 1 of 1

SAMPLE INFORMATION Blaine Tech Services ADDRESS: 1680 Rogers Avenue, San Jose, CA 95112 PROJECT CONTACT (Developer / EOP Reporter): Leon Gearhart TELEPHONE: 408-573-0555 FAX: 408-573-7771 EMAIL: lgearhart@blainetech.com		LAB CODE: BTSS	STREET ADDRESS (Street and City): 8930 Bancroft Avenue, Oakland	GLOBAL ID NO.: T0600118567
PROJECT CONTACT (Developer / EOP Reporter): Leon Gearhart		PROJECT CONTACT (Developer / EOP Reporter): Ann Krout PHONE NO. (Area Code and Number): 510-420-3335	PROJECT CONTACT (Developer / EOP Reporter): Ann Krout	PROJECT CONTACT (Developer / EOP Reporter): ShellOaklandEDF@cambria-env.com
TURNAROUND TIME (BUSINESS DAYS): <input checked="" type="checkbox"/> 30 DAYS <input type="checkbox"/> 5 DAYS <input type="checkbox"/> 72 HOURS <input type="checkbox"/> 48 HOURS <input type="checkbox"/> 24 HOURS <input type="checkbox"/> LESS THAN 24 HOURS		REQUESTED ANALYSIS		

LA - RWQOB REPORT FORMAT LIST AGENCY:
 GC/MS NTEE CONFIRMATION, HIGHEST _____ HIGHEST per BORING _____ ALL _____
 SPECIAL INSTRUCTIONS OR NOTES: CHECK BOX IF EOP IS NOT NEEDED

TPH - Gas, Purgeable	BTX	MTBE (402TB - 5ppb RL)	MtBE (425GB - 0.5ppb RL)	Oxygenates (S) by (426GB)	Ethanol (426GB)	Methanol	1,2-DCA (426GB)	EDB (426GB)	TPH - Diesel, Extractable (4215m)

FIELD NOTES:

Container/Preservative or PID Readings or Laboratory Notes

2°C

TEMPERATURE ON RECEIPT 0°

LAB USE ONLY	Field Sample Identification	SAMPLING		MATHC	NO. OF CONT.	TPH - Gas, Purgeable	BTX	MTBE (402TB - 5ppb RL)	MtBE (425GB - 0.5ppb RL)	Oxygenates (S) by (426GB)	Ethanol (426GB)	Methanol	1,2-DCA (426GB)	EDB (426GB)	TPH - Diesel, Extractable (4215m)
		DATE	TIME												
	MW-4	12/14	1418	H2O	SHCI	X	X		X						
	MW-5	12/14	1456	H2O	SHCI	X	X		X						

Requested by (Signature): <i>Will Crow</i>	Received by (Signature): <i>[Signature]</i>	Date: 12/14/04	Time: 1527
Requested by (Signature): <i>[Signature]</i>	Received by (Signature): <i>[Signature]</i>	Date: 12/14/04	Time: 1808

WELL GAUGING DATA

Project # 041214-WC2 Date 12/14/04 Client Shell

Site 8930 Bancroft Ave., Oakland

Well ID	Well Size (in.)	Sheen / Odor	Depth to Immiscible Liquid (ft.)	Thickness of Immiscible Liquid (ft.)	Volume of Immiscibles Removed (ml)	Depth to water (ft.)	Depth to well bottom (ft.)	Survey Point: TOB or TPC
MW-1	3					11.20	16.85	↓
MW-2	3					10.89	19.75	
MW-3	3					9.37	19.80	
MW-4	3	Sheen	gaged w/ stinger in well			9.40	19.00	
MW-5	3		gaged w/ stinger in well			9.82	19.75	
MW-6	3					10.55	19.84	

SHELL WELL MONITORING DATA SHEET

BTS #: 041214-WC2	Site: 8930 Bancroft Ave, Oakland
Sampler: WC	Date: 12/14/04
Well I.D.: MW-4	Well Diameter: 2 (3) 4 6 8
Total Well Depth (TD): 19.00	Depth to Water (DTW): 9.40
Depth to Free Product:	Thickness of Free Product (feet):
Referenced to: <u>VE</u> Grade	D.O. Meter (if req'd): YSI HACH
DTW with 80% Recharge [(Height of Water Column x 0.20) + DTW]: 11.32	

Purge Method: Bailer Waterra Sampling Method: Bailer
 Disposable Bailer Peristaltic Disposable Bailer
 Positive Air Displacement Extraction Pump Extraction Port
 Electric Submersible Other _____ Dedicated Tubing

Other: _____

$3.5 \text{ (Gals.)} \times 3 = 10.5 \text{ Gals.}$ 1 Case Volume Specified Volumes Calculated Volume	<table border="1" style="width: 100%; border-collapse: collapse;"> <thead> <tr> <th>Well Diameter</th> <th>Multiplier</th> <th>Well Diameter</th> <th>Multiplier</th> </tr> </thead> <tbody> <tr> <td>1"</td> <td>0.04</td> <td>4"</td> <td>0.65</td> </tr> <tr> <td>2"</td> <td>0.16</td> <td>6"</td> <td>1.47</td> </tr> <tr> <td>3"</td> <td>0.37</td> <td>Other</td> <td>radius² * 0.163</td> </tr> </tbody> </table>	Well Diameter	Multiplier	Well Diameter	Multiplier	1"	0.04	4"	0.65	2"	0.16	6"	1.47	3"	0.37	Other	radius ² * 0.163
Well Diameter	Multiplier	Well Diameter	Multiplier														
1"	0.04	4"	0.65														
2"	0.16	6"	1.47														
3"	0.37	Other	radius ² * 0.163														

Time	Temp (°F)	pH	Cond. (mS or μ S)	Turbidity (NTUs)	Gals. Removed	Observations
1405	67.9	7.1	429	941	4	Sheen / grey
1408	69.6	6.7	386	892	7	" / "
1413	69.9	6.6	406	161	11	" / clear

Did well dewater? Yes NO Gallons actually evacuated: 11

Sampling Date: 12/14/04 Sampling Time: 1418 Depth to Water: 9.85

Sample I.D.: MW-4 Laboratory: STL Other _____

Analyzed for: TPH-G BTEX MTBE TPH-D Other: _____

EB I.D. (if applicable): _____ @ _____ Time Duplicate I.D. (if applicable): _____

Analyzed for: TPH-G BTEX MTBE TPH-D Other: _____

D.O. (if req'd):	Pre-purge:	mg/L	Post-purge:	mg/L
O.R.P. (if req'd):	Pre-purge:	mV	Post-purge:	mV

SHELL WELL MONITORING DATA SHEET

BTS #: 041214-WC2	Site: 8930 Bancroft Ave., Oakland
Sampler: WC	Date: 12/14/04
Well I.D.: MW-5	Well Diameter: 2 <input checked="" type="radio"/> 4 <input type="radio"/> 6 <input type="radio"/> 8 <input type="radio"/>
Total Well Depth (TD): 19.75	Depth to Water (DTW): 9.82
Depth to Free Product:	Thickness of Free Product (feet):
Referenced to: <input checked="" type="radio"/> PVC <input type="radio"/> Grade	D.O. Meter (if req'd): YSI <input type="radio"/> HACH
DTW with 80% Recharge [(Height of Water Column x 0.20) + DTW]: 11.81	

Purge Method: Bailer Disposable Bailer Positive Air Displacement Electric Submersible Water: Peristaltic Extraction Pump Other _____

Sampling Method: Bailer Disposable Bailer Extraction Port Dedicated Tubing Other: _____

$3.7 \text{ (Gals.)} \times 3 = 11.1 \text{ Gals.}$ I Case Volume Specified Volumes Calculated Volume	<table border="1" style="width: 100%; border-collapse: collapse; font-size: small;"> <thead> <tr> <th>Well Diameter</th> <th>Multiplier</th> <th>Well Diameter</th> <th>Multiplier</th> </tr> </thead> <tbody> <tr> <td>1"</td> <td>0.04</td> <td>4"</td> <td>0.65</td> </tr> <tr> <td>2"</td> <td>0.16</td> <td>6"</td> <td>1.47</td> </tr> <tr> <td>3"</td> <td>0.37</td> <td>Other</td> <td>radius² * 0.163</td> </tr> </tbody> </table>	Well Diameter	Multiplier	Well Diameter	Multiplier	1"	0.04	4"	0.65	2"	0.16	6"	1.47	3"	0.37	Other	radius ² * 0.163
Well Diameter	Multiplier	Well Diameter	Multiplier														
1"	0.04	4"	0.65														
2"	0.16	6"	1.47														
3"	0.37	Other	radius ² * 0.163														

Time	Temp (°F)	pH	Cond. (mS or μ S)	Turbidity (NTUs)	Gals. Removed	Observations
1441	68.0	6.6	357	163	4	slight odor/clear
1446	68.6	6.5	360	280	8	clear
1451	68.9	6.5	361	103	12	clear

Did well dewater? Yes No Gallons actually evacuated: 12

Sampling Date: 12/14/04 Sampling Time: 1456 Depth to Water: 10.61

Sample I.D.: MW-5 Laboratory: ST Other _____

Analyzed for: TPH-G BTEX MTBE TPH-D Other: _____

EB I.D. (if applicable): _____ @ _____ Time Duplicate I.D. (if applicable): _____

Analyzed for: TPH-G BTEX MTBE TPH-D Other: _____

D.O. (if req'd):	Pre-purge:	mg/L	Post-purge:	mg/L
O.R.P. (if req'd):	Pre-purge:	mV	Post-purge:	mV