

Ro - 404

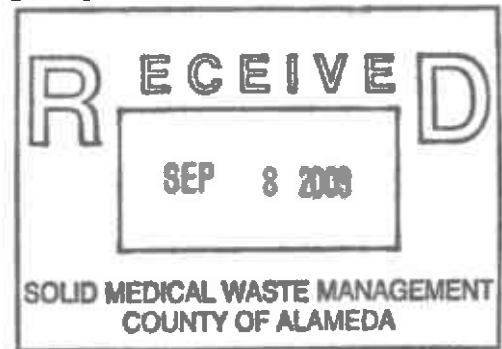

**Shell Oil Products US**



September 3, 2003

eva chu  
Alameda County Health Care Services Agency  
1131 Harbor Bay Parkway, Suite 250  
Alameda, California 94502-6577

Subject: **Former Shell Service Station/Current 24-7 Quick Mart Service Station**  
8930 Bancroft Avenue  
Oakland, California

Dear Ms. chu:

Attached for your review and comment is a copy of the *Second Quarter 2003 Monitoring Report* for the above referenced site. Upon information and belief, I declare, under penalty of perjury, that the information contained in the attached document is true and correct.

As always, please feel free to contact me directly at (559) 645-9306 with any questions or concerns.

Sincerely,

**Shell Oil Products US**

*Karen Petryna*

Karen Petryna  
Sr. Environmental Engineer

September 3, 2003

eva chu  
Alameda County Health Care Services Agency  
1131 Harbor Bay Parkway, 2nd Floor  
Alameda, California 94502

**Re: Second Quarter 2003 Monitoring Report**  
Former Shell Service Station/Current 24-7 Quick Mart Service Station  
8930 Bancroft Avenue  
Oakland, California  
Incident #98995742  
Cambria Project #245-1408-002



Dear Ms. chu:

On behalf of Equilon Enterprises LLC dba Shell Oil Products US (Shell), Cambria Environmental Technology, Inc. (Cambria) is submitting this groundwater monitoring report in accordance with the reporting requirements of 23 CCR 2652d. The site is located on the corner of Bancroft Avenue and 90<sup>th</sup> Avenue in Oakland, California (Figures 1 and 2). Shell ceased operations in July 1999, when three 10,000-gallon fiberglass USTs and associated piping and dispensers were removed and replaced at the site. The site is currently owned and operated by 24-7 Quick-Mart.

## REMEDIATION SUMMARY

**2000 Mobile Groundwater Extraction (GWE):** Weekly mobile GWE was performed on well MW-4 during March through May 2000. Mobile GWE is the process of extracting groundwater from wells using a vacuum truck. In this process, the vacuum created by the truck is applied to a dedicated extraction "stinger" installed in the extraction well. The extracted water is contained by the truck and removed from the site for disposal. The volume of extracted fluid is recorded and used to calculate the quantity of aqueous-phase constituents removed from the subsurface. Approximately 1,875 gallons of water were extracted from well MW-4, and an estimated total of 0.003 pounds of total petroleum hydrocarbons as gasoline (TPHg) and 0.1 pounds of methyl tertiary butyl ether (MTBE) were removed. GWE was discontinued due to low extraction volumes.

**Cambria  
Environmental  
Technology, Inc.**

5900 Hollis Street  
Suite A  
Emeryville, CA 94608  
Tel (510) 420-0700  
Fax (510) 420-9170

**2002 Mobile GWE:** Due to the presence of separate phase hydrocarbons (SPH) in well MW-5 beginning in February 2002, four additional weekly mobile GWE events were conducted at the site in August 2002 using well MW-5. An estimated total of 0.04 pounds of TPHg and 0.10 pounds of MTBE were removed from the subsurface. During the initial extraction event, approximately 0.02 feet of SPH were measured in well MW-5 prior to extraction. No SPH had been detected in MW-5 since the August 2002 extraction events; however, SPH was encountered once again in well MW-5 during the June 30, 2003 sampling event. Cambria will reinstate mobile GWE for two semi-weekly events in September 2003.



## SECOND QUARTER 2003 ACTIVITIES

**Groundwater Monitoring:** Blaine Tech Services, Inc. (Blaine) of San Jose, California gauged and sampled selected site wells, calculated groundwater elevations, and compiled the analytical data. Cambria prepared a vicinity map that includes previously submitted well survey information (Figure 1) and a groundwater elevation contour map (Figure 2). Blaine's report, presenting the laboratory report and supporting field documents, is included as Attachment A.

## ANTICIPATED THIRD QUARTER 2003 ACTIVITIES

**Groundwater Monitoring:** Blaine will gauge all site wells, sample selected site wells, and tabulate the data. Cambria will prepare a monitoring report.

**Mobile GWE:** As noted above, Cambria will reinstate mobile GWE for two semi-weekly events in September 2003.

**CLOSING**

We appreciate the opportunity to work with you on this project. Please call Melody Munz at (510) 420-3324 if you have any questions or comments.

Sincerely,  
**Cambria Environmental Technology, Inc**

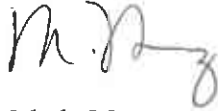

Melody Munz  
Project Engineer

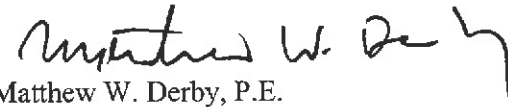

Matthew W. Derby, P.E.  
Senior Project Engineer



Figures: 1 - Vicinity/Area Well Survey Map  
2 - Groundwater Elevation Contour Map

Attachment: A - Blaine Groundwater Monitoring Report and Field Notes

cc: Karen Petryna, Shell Oil Products US, P.O. Box 7869, Burbank, CA 91510-7869  
Leroy Griffin, Fire Prevention Bureau, 250 Frank Ogawa Plaza, 3<sup>rd</sup> Floor, Suite 3341,  
Oakland, CA 94612  
Sidhu Associates, 8930 Bancroft Ave., Oakland, CA 94605

G:\Oakland 8930 Bancroft\QM\2q03\2q03qm.doc

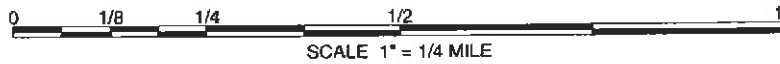
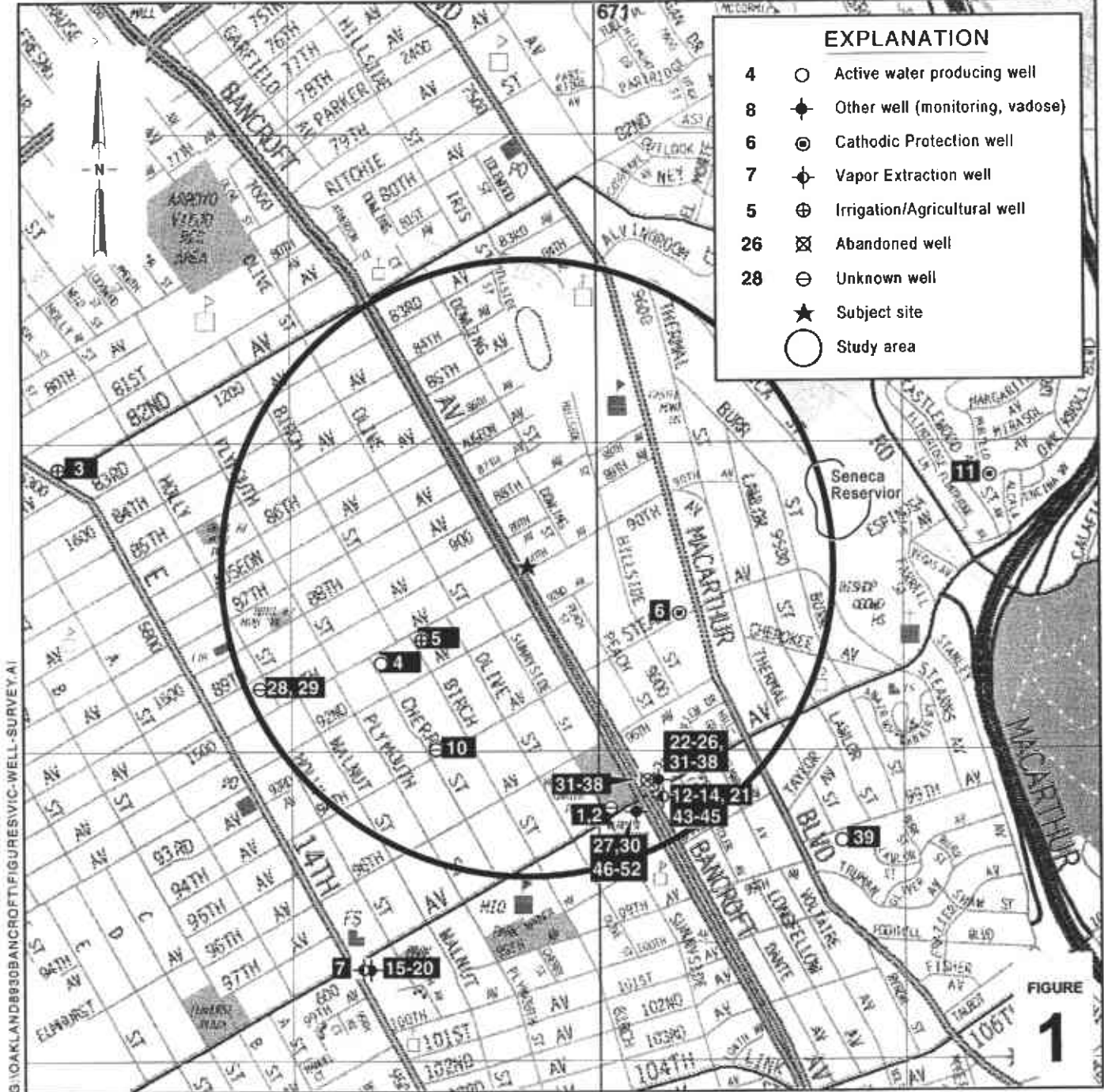

**Former Shell-branded Station/  
Current 24-7 Quick Mart  
Service Station**

8930 Bancroft Avenue  
Oakland, California  
Incident #98995742



C A M B R I A

**Vicinity/Area Well  
Survey Map**

(1/2 Mile Radius)

FIGURE  
**1**

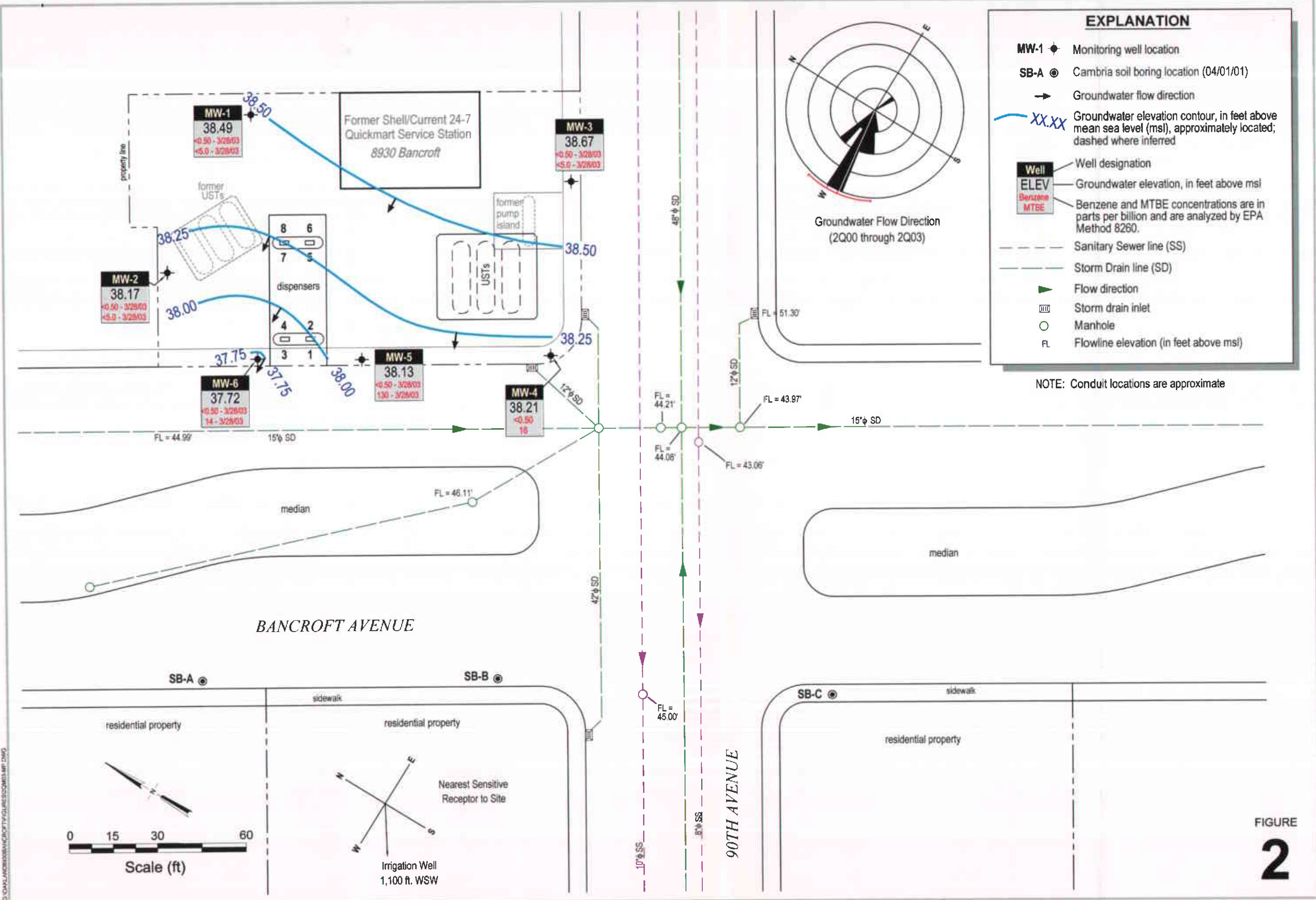

**ATTACHMENT A**  
**Blaine Groundwater Monitoring Report**  
**and Field Notes**

**BLAINE  
TECH SERVICES**



1680 ROGERS AVENUE  
SAN JOSE, CA 95112-1105  
(408) 573-7771 FAX  
(408) 573-0555 PHONE  
CONTRACTOR'S LICENSE #746684  
www.blainetech.com

July 16, 2003

Karen Petryna  
Shell Oil Products US  
P.O. Box 7869  
Burbank, CA 91510-7869

Second Quarter 2003 Groundwater Monitoring at  
Former Shell Service Station  
8930 Bancroft Avenue  
Oakland, CA

Monitoring performed on June 30, 2003

---

Groundwater Monitoring Report 030630-MN-1

This report covers the routine monitoring of groundwater wells at this former Shell facility. In accordance with standard procedures that conform to Regional Water Quality Control Board requirements, routine field data collection includes depth to water, total well depth, thickness of any separate immiscible layer, water column volume, calculated purge volume (if applicable), elapsed evacuation time (if applicable), total volume of water removed (if applicable), and standard water parameter instrument readings. Sample material is collected, contained, stored, and transported to the laboratory in conformance with EPA standards. Purgewater (if applicable) is, likewise, collected and transported to the Shell Martinez Manufacturing Complex.

Basic field information is presented alongside analytical values excerpted from the laboratory report in the cumulative table of **WELL CONCENTRATIONS**. The full analytical report for the most recent samples and the field data sheets are attached to this report.

At a minimum, Blaine Tech Services, Inc. field personnel are certified on completion of a forty-hour Hazardous Materials and Emergency Response training course per 29 CFR 1910.120. Field personnel are also enrolled in annual eight-hour refresher courses.



Blaine Tech Services, Inc. conducts sampling and documentation assignments of this type as an independent third party. Our activities at this site consisted of objective data and sample collection only. No interpretation of analytical results, defining of hydrological conditions or formulation of recommendations was performed.

Please call if you have any questions.

Yours truly,

Leon Gearhart  
Project Coordinator

LG/jt

attachments: Cumulative Table of WELL CONCENTRATIONS  
Certified Analytical Report  
Field Data Sheet

cc: Anni Kreml  
Cambria Environmental Technology, Inc.  
5900 Hollis Street, Suite A  
Oakland, CA 94608

**WELL CONCENTRATIONS**  
**Former Shell Service Station**  
**8930 Bancroft Avenue**  
**Oakland, CA**

Well ID	Date	TPPH (ug/L)	TEPH (ug/L)	B (ug/L)	T (ug/L)	E (ug/L)	X (ug/L)	MTBE 8020 (ug/L)	MTBE 8260 (ug/L)	TOC (MSL)	Depth to Water (ft)	Depth to SPH (ft)	GW Elevation (MSL)	SPH Thickness (ft)	DO Reading (mg/L)
MW-1	12/17/1998	<50	NA	<0.50	<0.50	<0.50	<0.50	<2.5	NA	53.19	11.87	NA	41.32	NA	NA
MW-1	03/09/1999	<50.0	NA	<0.500	<0.500	<0.500	<0.500	<5.00	NA	53.19	8.21	NA	44.98	NA	NA
MW-1	06/16/1999	<50.0	NA	<0.500	<0.500	<0.500	<0.500	<5.00	NA	53.19	15.04	NA	38.15	NA	NA
MW-1	09/30/1999	<50.0	NA	<0.500	<0.500	<0.500	<0.500	<5.00	NA	53.19	16.02	NA	37.17	NA	NA
MW-1	12/23/1999	<50.0	NA	<0.500	<0.500	<0.500	<0.500	<2.50	NA	53.19	14.78	NA	38.41	NA	NA
MW-1	03/22/2000	<50.0	NA	<0.500	<0.500	<0.500	<0.500	<5.00	NA	53.19	8.44	NA	44.75	NA	NA
MW-1	06/01/2000	<50.0	NA	<0.500	<0.500	<0.500	<0.500	<2.50	NA	53.19	13.71	NA	39.48	NA	NA
MW-1	09/08/2000	<50.0	NA	<0.500	<0.500	<0.500	<0.500	<2.50	NA	53.19	14.95	NA	38.24	NA	NA
MW-1	12/04/2000	<50.0	NA	<0.500	<0.500	<0.500	<0.500	5.82	NA	53.19	13.85	NA	39.34	NA	NA
MW-1	03/09/2001	<50.0	NA	<0.500	<0.500	<0.500	<0.500	<2.50	NA	53.19	9.07	NA	44.12	NA	NA
MW-1	06/27/2001	<50	NA	<0.50	<0.50	<0.50	<0.50	<2.5	NA	53.19	14.90	NA	38.29	NA	NA
MW-1	09/20/2001	NA	NA	NA	NA	NA	NA	NA	NA	53.19	15.53	NA	37.66	NA	NA
MW-1	12/05/2001	NA	NA	NA	NA	NA	NA	NA	NA	53.19	10.41	NA	42.78	NA	3.8
MW-1	02/26/2002	<50	NA	<0.50	<0.50	<0.50	<0.50	NA	<0.50	53.19	11.09	NA	42.10	NA	NA
MW-1	06/06/2002	NA	NA	NA	NA	NA	NA	NA	NA	53.19	14.13	NA	39.06	NA	NA
MW-1	09/09/2002	NA	NA	NA	NA	NA	NA	NA	NA	53.20	15.55	NA	37.65	NA	NA
MW-1	12/19/2002	NA	NA	NA	NA	NA	NA	NA	NA	53.20	8.67	NA	44.53	NA	NA
MW-1	03/28/2003	<50	NA	<0.50	<0.50	<0.50	<0.50	NA	<5.0	53.20	13.33	NA	39.87	NA	NA
MW-1	06/30/2003	NA	NA	NA	NA	NA	NA	NA	NA	53.20	14.71	NA	38.49	NA	NA
MW-2	12/17/1998	9,900	NA	<5.0	37	22	47	48	<20	52.66	11.65	NA	41.01	NA	NA
MW-2	03/09/1999	2,760	NA	12.3	7.50	85.4	444	<50.0	NA	52.66	8.07	NA	44.59	NA	NA
MW-2	06/16/1999	2,570	NA	36.3	11.6	6.19	10.8	<50.0	NA	52.66	14.63	NA	38.03	NA	NA
MW-2	09/30/1999	1,960	NA	19.1	3.20	4.55	26.9	<25.0	NA	52.66	15.63	NA	37.03	NA	NA
MW-2	12/23/1999	145	NA	1.30	<0.500	<0.500	0.899	<2.50	NA	52.66	14.42	NA	38.24	NA	NA
MW-2	03/22/2000	6,060	NA	18.9	<10.0	210	651	<100	NA	52.66	8.19	NA	44.47	NA	NA
MW-2	06/01/2000	<50.0	NA	<0.500	<0.500	<0.500	<0.500	<2.50	NA	52.66	11.46	NA	41.20	NA	NA

**WELL CONCENTRATIONS**  
**Former Shell Service Station**  
**8930 Bancroft Avenue**  
**Oakland, CA**

Well ID	Date	TPPH (ug/L)	TEPH (ug/L)	B (ug/L)	T (ug/L)	E (ug/L)	X (ug/L)	MTBE 8020 (ug/L)	MTBE 8260 (ug/L)	TOC (MSL)	Depth to Water (ft.)	Depth to SPH (ft.)	GW Elevation (MSL)	SPH Thickness (ft.)	DO Reading (mg/L)
MW-2	09/08/2000	<50.0	NA	<0.500	<0.500	<0.500	<0.500	<2.50	NA	52.66	14.63	NA	38.03	NA	NA
MW-2	12/04/2000	201	NA	1.35	<0.500	3.39	8.58	<2.50	NA	52.66	13.45	NA	39.21	NA	NA
MW-2	03/09/2001	396	NA	2.82	<0.500	8.69	18.7	<2.50	NA	52.66	8.89	NA	43.77	NA	NA
MW-2	06/27/2001	<50	NA	<0.50	<0.50	<0.50	<0.50	<2.5	NA	52.66	14.88	NA	37.78	NA	NA
MW-2	09/20/2001	<50	NA	<0.50	<0.50	<0.50	<0.50	NA	<5.0	52.66	15.19	NA	37.47	NA	NA
MW-2	12/05/2001	NA	NA	NA	NA	NA	NA	NA	NA	52.66	10.02	NA	42.64	NA	2.8
MW-2	02/26/2002	180	NA	<0.50	<0.50	2.7	4.1	NA	<0.50	52.66	10.76	NA	41.90	NA	NA
MW-2	06/06/2002	NA	NA	NA	NA	NA	NA	NA	NA	52.66	13.83	NA	38.83	NA	NA
MW-2	09/09/2002	<50	NA	<0.50	<0.50	<0.50	<0.50	NA	<5.0	52.66	15.23	NA	37.43	NA	NA
MW-2	12/19/2002	NA	NA	NA	NA	NA	NA	NA	NA	52.66	8.46	NA	44.20	NA	NA
MW-2	03/28/2003	53	NA	<0.50	<0.50	0.51	1.4	NA	<5.0	52.66	12.96	NA	39.70	NA	NA
MW-2	06/30/2003	NA	NA	NA	NA	NA	NA	NA	NA	52.66	14.49	NA	38.17	NA	NA
MW-3	12/17/1998	<50	NA	<0.50	<0.50	<0.50	<0.50	10	11	51.30	11.85	NA	39.45	NA	NA
MW-3	03/09/1999	<50.0	NA	<0.500	<0.500	<0.500	<0.500	<5.00	NA	51.30	6.53	NA	44.77	NA	NA
MW-3	06/16/1999	<50.0	NA	<0.500	<0.500	<0.500	<0.500	<5.00	NA	51.30	12.71	NA	38.59	NA	NA
MW-3	09/30/1999	<50.0	NA	<0.500	<0.500	<0.500	<0.500	5.14	NA	51.30	14.07	NA	37.23	NA	NA
MW-3	12/23/1999	<500	NA	<5.00	<5.00	<5.00	<5.00	<25.0	NA	51.30	12.82	NA	38.48	NA	NA
MW-3	03/22/2000	<50.0	NA	<0.500	1.48	<0.500	1.90	<5.00	NA	51.30	6.81	NA	44.49	NA	NA
MW-3	06/01/2000	<50.0	NA	<0.500	0.821	<0.500	<0.500	4.39	NA	51.30	11.85	NA	39.45	NA	NA
MW-3	09/08/2000	<50.0	NA	<0.500	<0.500	<0.500	<0.500	3.62	NA	51.30	12.55	NA	38.75	NA	NA
MW-3	12/04/2000	<50.0	NA	<0.500	<0.500	<0.500	0.588	4.74	NA	51.30	11.65	NA	39.65	NA	NA
MW-3	03/09/2001	<50.0	NA	<0.500	<0.500	<0.500	<0.500	<2.50	NA	51.30	7.28	NA	44.02	NA	NA
MW-3	06/27/2001	<50	NA	<0.50	<0.50	<0.50	<0.50	<2.5	NA	51.30	13.16	NA	38.14	NA	NA
MW-3	09/20/2001	NA	NA	NA	NA	NA	NA	NA	NA	51.30	13.35	NA	37.95	NA	NA
MW-3	12/05/2001	NA	NA	NA	NA	NA	NA	NA	NA	51.30	8.14	NA	43.16	NA	1.2
MW-3	02/26/2002	<50	NA	<0.50	7.2	<0.50	<0.50	NA	1.5	51.30	9.09	NA	42.21	NA	0.6
MW-3	06/06/2002	NA	NA	NA	NA	NA	NA	NA	NA	51.30	12.13	NA	39.17	NA	0.8

**WELL CONCENTRATIONS**  
**Former Shell Service Station**  
**8930 Bancroft Avenue**  
**Oakland, CA**

Well ID	Date	TPPH (ug/L)	TEPH (ug/L)	B (ug/L)	T (ug/L)	E (ug/L)	X (ug/L)	MTBE 8020 (ug/L)	MTBE 8260 (ug/L)	TOC (MSL)	Depth to Water (ft.)	Depth to SPH (ft.)	GW Elevation (MSL)	SPH Thickness (ft.)	DO Reading (mg/L)
MW-3	09/09/2002	NA	NA	NA	NA	NA	NA	NA	NA	51.35	13.54	NA	37.81	NA	1.0
MW-3	12/19/2002	NA	NA	NA	NA	NA	NA	NA	NA	51.35	6.75	NA	44.60	NA	0.6
MW-3	03/28/2003	<50	NA	<0.50	<0.50	<0.50	<0.50	NA	<5.0	51.35	11.28	NA	40.07	NA	0.7
<b>MW-3</b>	<b>06/30/2003</b>	<b>NA</b>	<b>NA</b>	<b>NA</b>	<b>NA</b>	<b>NA</b>	<b>NA</b>	<b>NA</b>	<b>NA</b>	<b>51.35</b>	<b>12.68</b>	<b>NA</b>	<b>38.67</b>	<b>NA</b>	<b>NA</b>
MW-4	12/17/1998	700	NA	4.3	0.88	<0.50	<0.50	21,000	26,000	50.73	10.80	NA	39.93	NA	NA
MW-4	03/09/1999	83.9	NA	<0.500	<0.500	<0.500	<0.500	17,900	23,700	50.73	6.91	NA	43.82	NA	NA
MW-4	06/16/1999	<50.0	NA	<0.500	<0.500	<0.500	<0.500	10,600	19,200	50.73	12.84	NA	37.89	NA	NA
MW-4	09/30/1999	51.2	NA	<0.500	<0.500	<0.500	<0.500	12,200	12,300	50.73	13.74	NA	36.99	NA	NA
MW-4	12/23/1999	<100	NA	<1.00	<1.00	<1.00	<1.00	7,990	8,400	50.73	12.40	NA	38.33	NA	NA
MW-4	03/22/2000	<500	NA	<5.00	<5.00	<5.00	<5.00	4,970	5,020	50.73	7.32	NA	43.41	NA	NA
MW-4	06/01/2000	<100	NA	<1.00	<1.00	<1.00	<1.00	5,260	3,580	50.73	11.50	NA	39.23	NA	NA
MW-4	09/08/2000	<50.0	NA	<0.500	<0.500	<0.500	<0.500	3,610	3,300a	50.73	12.55	NA	38.18	NA	NA
MW-4	12/04/2000	<50.0	NA	<0.500	<0.500	<0.500	<0.500	2,960	3,520a	50.73	11.77	NA	38.96	NA	NA
MW-4	03/09/2001	<50.0	NA	<0.500	<0.500	<0.500	<0.500	1,930	2,500	50.73	7.48	NA	43.25	NA	NA
MW-4	06/27/2001	<50	NA	<0.50	<0.50	<0.50	<0.50	1,100	1,100	50.73	12.97	NA	37.76	NA	NA
MW-4	09/20/2001	<250	NA	3.8	14	2.6	7.8	NA	940	50.73	13.30	NA	37.43	NA	NA
MW-4	12/05/2001	<200	NA	<2.0	<2.0	<2.0	<2.0	NA	750	50.73	8.41	NA	42.32	NA	1.2
MW-4	02/26/2002	<50	NA	<0.50	<0.50	<0.50	<0.50	NA	320	50.73	9.40	NA	41.33	NA	0.7
MW-4	06/06/2002	<50	NA	<0.50	<0.50	<0.50	<0.50	NA	160	50.73	11.97	NA	38.76	NA	0.6
MW-4	09/09/2002	<50	NA	<0.50	<0.50	<0.50	<0.50	NA	50	50.72	13.23	NA	37.49	NA	3.6
MW-4	12/19/2002	Unable to sample		NA	NA	NA	NA	NA	NA	50.72	7.08	NA	43.64	NA	0.8
MW-4	12/26/2002	<50	NA	<0.50	<0.50	<0.50	<0.50	NA	47	50.72	7.23	NA	43.49	NA	1.8
MW-4	03/28/2003	<50	NA	<0.50	1.2	<0.50	<0.50	NA	17	50.72	11.30	NA	39.42	NA	1.7
<b>MW-4</b>	<b>06/30/2003</b>	<b>54 c</b>	<b>NA</b>	<b>&lt;0.50</b>	<b>&lt;0.50</b>	<b>&lt;0.50</b>	<b>&lt;1.0</b>	<b>NA</b>	<b>16</b>	<b>50.72</b>	<b>12.51</b>	<b>NA</b>	<b>38.21</b>	<b>NA</b>	<b>NA</b>
MW-5	12/17/1998	750	NA	<0.50	17	1.8	3.5	33	32	51.43	11.51	NA	39.92	NA	NA
MW-5	03/09/1999	<50.0	NA	<0.500	<0.500	<0.500	<0.500	<5.00	NA	51.43	7.15	NA	44.28	NA	NA

**WELL CONCENTRATIONS**  
**Former Shell Service Station**  
**8930 Bancroft Avenue**  
**Oakland, CA**

Well ID	Date	TPPH (ug/L)	TEPH (ug/L)	B (ug/L)	T (ug/L)	E (ug/L)	X (ug/L)	MTBE 8020 (ug/L)	MTBE 8260 (ug/L)	TOC (MSL)	Depth to Water (ft)	Depth to SPH (ft)	GW Elevation (MSL)	SPH Thickness (ft)	DO Reading (mg/L)
MW-5	06/16/1999	646	NA	9.26	1.05	<1.00	<1.00	<10.0	NA	51.43	13.47	NA	37.96	NA	NA
MW-5	09/30/1999	484	NA	1.93	0.511	<0.500	<0.500	159	NA	51.43	14.41	NA	37.02	NA	NA
MW-5	12/23/1999	944	NA	4.59	17.7	3.79	16.7	214	NA	51.43	14.07	NA	37.36	NA	NA
MW-5	03/22/2000	8,770	NA	197	96.5	<50.0	188	2,450	NA	51.43	7.31	NA	44.12	NA	NA
MW-5	06/01/2000	227	NA	0.565	<0.500	<0.500	<0.500	35.9	NA	51.43	12.15	NA	39.28	NA	NA
MW-5	09/08/2000	159	NA	0.606	<0.500	<0.500	1.74	1,000	NA	51.43	13.30	NA	38.13	NA	NA
MW-5	12/04/2000	1,510	NA	19.2	<10.0	<10.0	134	1,360	NA	51.43	12.19	NA	39.24	NA	NA
MW-5	03/09/2001	3,460	NA	37.9	121	40.6	208	235	NA	51.43	7.79	NA	43.64	NA	NA
MW-5	06/27/2001	310	NA	0.97	<0.50	<0.50	<0.50	14	NA	51.43	13.89	NA	37.54	NA	NA
MW-5	09/20/2001	310	NA	<0.50	<0.50	<0.50	<0.50	NA	21	51.43	13.95	NA	37.48	NA	NA
MW-5	12/05/2001	8,800	NA	14	2.9	33	410	NA	2,300	51.43	8.89	NA	42.54	NA	0.6
MW-5	02/26/2002	NA	NA	NA	NA	NA	NA	NA	NA	51.43	9.87	NA	NA	b	NA
MW-5	03/12/2002	NA	NA	NA	NA	NA	NA	NA	NA	51.43	8.84	8.64	42.75	0.20	NA
MW-5	06/06/2002	NA	NA	NA	NA	NA	NA	NA	NA	51.43	12.59	12.54	38.88	0.05	NA
MW-5	09/09/2002	210	NA	<0.50	<0.50	<0.50	0.90	NA	200	51.44	13.94	NA	37.50	NA	NA
MW-5	12/19/2002	Unable to sample		NA	NA	NA	NA	NA	NA	51.44	7.35	NA	44.09	NA	NA
MW-5	12/26/2002	1,400	NA	<0.50	21	6.9	60	NA	180	51.44	7.13	NA	44.31	NA	NA
MW-5	03/28/2003	240	NA	<0.50	<0.50	<0.50	2.1	NA	130	51.44	11.73	NA	39.71	NA	NA
MW-5	06/30/2003	NA	NA	NA	NA	NA	NA	NA	NA	51.44	13.34	13.30	38.13	0.04	NA
MW-6	12/17/1998	940	NA	27	0.32	2.4	2.3	3.0	3.2	51.88	11.37	NA	40.51	NA	NA
MW-6	03/09/1999	336	NA	7.78	1.60	2.40	6.36	<10.0	NA	51.88	8.10	NA	43.78	NA	NA
MW-6	06/16/1999	308	NA	2.45	<0.500	<0.500	<0.500	7.39	NA	51.88	14.49	NA	37.39	NA	NA
MW-6	09/30/1999	80.2	NA	<0.500	<0.500	<0.500	<0.500	24.8	NA	51.88	15.30	NA	36.58	NA	NA
MW-6	12/23/1999	149	NA	0.518	<0.500	<0.500	<0.500	6.43	NA	51.88	13.19	NA	38.69	NA	NA
MW-6	03/22/2000	382	NA	3.31	2.18	0.619	2.35	5.61	NA	51.88	8.27	NA	43.61	NA	NA
MW-6	06/01/2000	158	NA	0.830	<0.500	<0.500	1.10	10.9	NA	51.88	11.13	NA	40.75	NA	NA
MW-6	09/08/2000	<50.0	NA	<0.500	<0.500	<0.500	<0.500	<2.50	NA	51.88	14.28	NA	37.60	NA	NA

**WELL CONCENTRATIONS**  
**Former Shell Service Station**  
**8930 Bancroft Avenue**  
**Oakland, CA**

Well ID	Date	TPPH (ug/L)	TEPH (ug/L)	B (ug/L)	T (ug/L)	E (ug/L)	X (ug/L)	MTBE 8020 (ug/L)	MTBE 8260 (ug/L)	TOC (MSL)	Depth to Water (ft)	Depth to SPH (ft.)	GW Elevation (MSL)	SPH Thickness (ft)	DO Reading (mg/L)
MW-6	12/04/2000	231	NA	4.93	<0.500	<0.500	<0.500	4.57	NA	51.88	12.62	NA	39.26	NA	NA
MW-6	03/09/2001	789	NA	11.6	2.72	<2.00	<2.00	28.0	NA	51.88	8.65	NA	43.23	NA	NA
MW-6	06/27/2001	140	NA	<0.50	1.1	<0.50	<0.50	<2.5	NA	51.88	14.95	NA	36.93	NA	NA
MW-6	09/20/2001	<50	NA	<0.50	<0.50	<0.50	<0.50	NA	<5.0	51.88	14.70	NA	37.18	NA	NA
MW-6	12/05/2001	NA	NA	NA	NA	NA	NA	NA	NA	51.88	9.62	NA	42.26	NA	1.8
MW-6	02/26/2002	130	NA	<0.50	2.6	0.69	4.1	NA	6.4	51.88	10.14	NA	41.74	NA	NA
MW-6	06/06/2002	NA	NA	NA	NA	NA	NA	NA	NA	51.88	13.52	NA	38.36	NA	NA
MW-6	09/09/2002	<50	NA	<0.50	<0.50	<0.50	<0.50	NA	<5.0	51.86	14.92	NA	36.94	NA	NA
MW-6	12/19/2002	NA	NA	NA	NA	NA	NA	NA	NA	51.86	8.22	NA	43.64	NA	NA
MW-6	03/28/2003	740	NA	<0.50	<0.50	<0.50	<0.50	NA	14	51.86	12.57	NA	39.29	NA	NA
MW-6	06/30/2003	NA	NA	NA	NA	NA	NA	NA	NA	51.86	14.14	NA	37.72	NA	NA

Abbreviations:

TPPH = Total petroleum hydrocarbons as gasoline by EPA Method 8260B; prior to September 20, 2001, analyzed by EPA Method 8015.

TEPH = Total petroleum hydrocarbons as diesel by modified EPA Method 8015.

BTEX = Benzene, toluene, ethylbenzene, xylenes by EPA Method 8260B; prior to September 20, 2001, analyzed by EPA Method 8020.

MTBE = Methyl-tertiary-butyl ether

TOC = Top of Casing Elevation

SPH = Separate-phase hydrocarbons

GW = Groundwater

ug/L = Parts per billion

MSL = Mean sea level

ft = Feet

<n = Below detection limit

NA = Not applicable

DO = Dissolved oxygen

mg/L = Parts per million

**WELL CONCENTRATIONS**  
**Former Shell Service Station**  
**8930 Bancroft Avenue**  
**Oakland, CA**

Well ID	Date	TPPH (ug/L)	TEPH (ug/L)	B (ug/L)	T (ug/L)	E (ug/L)	X (ug/L)	MTBE 8020 (ug/L)	MTBE 8260 (ug/L)	TOC (MSL)	Depth to Water (ft.)	Depth to SPH (ft.)	GW Elevation (MSL)	SPH Thickness (ft.)	DO Reading (mg/L)
---------	------	----------------	----------------	-------------	-------------	-------------	-------------	------------------------	------------------------	--------------	----------------------------	--------------------------	--------------------------	---------------------------	-------------------------

Notes:

a = This sample analyzed outside of EPA recommended holding time.

b = SPH detected in well, but exact thickness could not be measured.

c = Hydrocarbon does not match pattern of laboratory's standard.

When separate-phase hydrocarbons are present, groundwater elevation is adjusted using the relation:

$$\text{Groundwater Elevation} = \text{Top-of-Casing Elevation} - \text{Depth to Water} + (0.8 \times \text{Hydrocarbon Thickness}).$$

Site surveyed February 12 and May 16, 2002, by Virgil Chavez Land Surveying of Vallejo, California.

Blaine Tech Services, Inc.

July 14, 2003

1680 Rogers Avenue  
San Jose, CA 95112-1105  
Attn.: Leon Gearhart  
Project#: 030630-MN1  
Project: 98995742  
Site: 8930 Bancroft Avenue, Oakland

Dear Mr. Gearhart,

Attached is our report for your samples received on 06/30/2003 17:08

This report has been reviewed and approved for release. Reproduction of this report is permitted only in its entirety.

Please note that any unused portion of the samples will be discarded after 08/14/2003 unless you have requested otherwise.

We appreciate the opportunity to be of service to you. If you have any questions, please call me at (925) 484-1919.

You can also contact me via email. My email address is: [tgranicher@stl-inc.com](mailto:tgranicher@stl-inc.com)

Sincerely,



Tod Granicher  
Project Manager



**Gas/BTEX/MTBE by 8260B (C6-C12)**

Blaine Tech Services, Inc.

Attn.: Leon Gearhart

1680 Rogers Avenue

San Jose, CA 95112-1105

Phone: (408) 573-0555 Fax: (408) 573-7771

Project: 030630-MN1

98995742

Received: 06/30/2003 17:08

Site: 8930 Bancroft Avenue, Oakland

**Samples Reported**

Sample Name	Date Sampled	Matrix	Lab #
MW-4	06/30/2003 08:50	Water	1

Severn Trent Laboratories, Inc.

STL San Francisco \* 1220 Quarry Lane, Pleasanton, CA 94566

Tel 925 484 1919 Fax 925 484 1096 \* www.stl-inc.com \* CA DHS ELAP# 2496

07/14/2003 11:40

**Gas/BTEX/MTBE by 8260B (C6-C12)**

Blaine Tech Services, Inc.

Attn.: Leon Gearhart

1680 Rogers Avenue

San Jose, CA 95112-1105

Phone: (408) 573-0555 Fax: (408) 573-7771

Project: 030630-MN1

98995742

Received: 06/30/2003 17:08

Site: 8930 Bancroft Avenue, Oakland

Batch QC Report										
Prep(s): 5030B						Test(s): 8260FAB				
Laboratory Control Spike				Water			QC Batch # 2003/07/08-2b.62			
LCS	2003/07/08-2b.62-017			Extracted: 07/08/2003			Analyzed: 07/08/2003 20:17			
LCSD	2003/07/08-2b.62-040			Extracted: 07/08/2003			Analyzed: 07/08/2003 20:40			
Compound	Conc. ug/L		Exp.Conc.	Recovery %		RPD	Ctrl.Limits %		Flags	
	LCS	LCSD		LCS	LCSD		%	Rec.	RPD	LCS
Benzene	27.1	28.3	25	108.4	113.2	4.3	69-129	20		
Toluene	25.7	26.9	25	102.8	107.6	4.6	70-130	20		
Methyl tert-butyl ether (MTBE)	27.9	28.8	25	111.6	115.2	3.2	65-165	20		
<b>Surrogates(s)</b>										
1,2-Dichloroethane-d4	487	476	500	97.4	95.2		76-130			
Toluene-d8	507	513	500	101.4	102.6		78-115			

**Gas/BTEX/MTBE by 8260B (C6-C12)**

Blaine Tech Services, Inc.

Attn.: Leon Gearhart

1680 Rogers Avenue  
San Jose, CA 95112-1105  
Phone: (408) 573-0555 Fax: (408) 573-7771

Project: 030630-MN1  
98995742

Received: 06/30/2003 17:08

Site: 8930 Bancroft Avenue, Oakland

Batch QC Report			
Prep(s):	5030B	Test(s):	8260FAB
<b>Matrix Spike ( MS / MSD )</b>		<b>Water</b>	<b>QC Batch # 2003/07/08-2b.62</b>
MW-4 >> MS		Lab ID:	2003-07-0006 - 001
MS: 2003/07/08-2b.62-053	Extracted: 07/08/2003	Analyzed:	07/08/2003 22:53
		Dilution:	1.00
MSD: 2003/07/08-2b.62-016	Extracted: 07/08/2003	Analyzed:	07/08/2003 23:16
		Dilution:	1.00

Compound	Conc. ug/L			Spk.Level	Recovery %			Limits %		Flags	
	MS	MSD	Sample		ug/L	MS	MSD	RPD	Rec.	RPD	MS
Benzene	25.9	26.8	ND	25	103.6	107.2	3.4	69-129	20		
Toluene	24.2	25.7	ND	25	96.8	102.8	6.0	70-130	20		
Methyl tert-butyl ether	39.6	41.1	16.4	25	92.8	98.8	6.3	65-165	20		
<b>Surrogate(s)</b>											
1,2-Dichloroethane-d4	488	485		500	97.6	97.0		76-130			
Toluene-d8	503	500		500	100.6	100.0		78-115			

**Gas/BTEX/MTBE by 8260B (C6-C12)**

Blaine Tech Services, Inc.

Attn.: Leon Gearhart

1680 Rogers Avenue

San Jose, CA 95112-1105

Phone: (408) 573-0555 Fax: (408) 573-7771

Project: 030630-MN1

98995742

Received: 06/30/2003 17:08

Site: 8930 Bancroft Avenue, Oakland

**Legend and Notes**

**Result Flag**

g

Hydrocarbon reported in the gasoline range does not match our gasoline standard.

# SHELL Chain Of Custody Record

T060C

Lab Identification (if necessary):

Address:

City, State, ZIP:

Shell Project Manager to be Invoiced:

SCIENCE & ENGINEERING  
 TECHNICAL SERVICES  
 CRMT HOUSTON

Karen Petryna

2003-07-0006

INCIDENT NUMBER (S&E ONLY)

9 8 9 9 5 7 4 2

S&E or CRMT NUMBER (ITS/CRMT)

DATE: 6/30/03

PAGE: 1 of 1

SUPPLIER <b>Blaine Tech Services</b> 1880 Rogers Avenue, San Jose, CA 95112 PROJECT CONTACT (Name, Title, or PCF Request No.) <b>Leon Gearhart</b>	LOG CODE: <b>BTSS</b>	SITE ADDRESS (Street and City): <b>8930 Bancroft Avenue, Oakland</b>	GLOBAL ID NO.:	EDP DELIVERABLE TO (Responsible Party or Designee): <b>Anni Kraml</b>	PHONE NO.: <b>510-420-3335</b>	E-MAIL: <b>ShellOaklandEDF@cambridge-env.com</b>	CONSULTANT PROJECT NO.: <b>BT's # D30630-NA1</b>	
TELEPHONE: <b>408-573-0555</b>	FAX: <b>408-573-7771</b>	E-MAIL: <b>lgearhart@blainetech.com</b>	ANALYSE NUMBER (Print): <b>MIKE McMANAMA</b>					LAB USE ONLY

TURNAROUND TIME (BUSINESS DAYS):  
 18 DAYS  5 DAYS  72 HOURS  48 HOURS  24 HOURS  LESS THAN 24 HOURS

LA - AWWQB REPORT FORMAT  LIST AGENCY:

GC/MS MTBE CONFIRMATION: HIGHEST \_\_\_\_\_ HIGHEST PER BORING \_\_\_\_\_ ALL \_\_\_\_\_

SPECIAL INSTRUCTIONS OR NOTES: CHECK BOX IF EDO IS NOT NEEDED

REQUESTED ANALYSIS												FIELD NOTES: Container/Preservative or PID Readings or Laboratory Notes  4.6°C TEMPERATURE ON RECEIPT:
TPH - Gas, Purgeable	BTEX	MTBE (0.021B - 5ppb RL)	MTSE (0.001B - 0.5ppb RL)	Oxygenates (5) by (0.050B)	Ethanol (0.050B)	Methanol	1,2-DCA (0.260B)	EDB (0.260B)	TPH - Diesel, Extractable (0.015M)			
XX	XX	X										

LAB USE ONLY	Field Sample Identification	SAMPLING		MATRIX	NO. OF CONT.	TPH - Gas, Purgeable	BTEX	MTBE (0.021B - 5ppb RL)	MTSE (0.001B - 0.5ppb RL)	Oxygenates (5) by (0.050B)	Ethanol (0.050B)	Methanol	1,2-DCA (0.260B)	EDB (0.260B)	TPH - Diesel, Extractable (0.015M)				
		DATE	TIME																
	MW-4	6/20/03	850	GW	3	XX	XX	X											

Retrieved by (Signature):	Retrieved by (Signature):	Date: 6/30/03	Time: 1708
Retrieved by (Signature):	Retrieved by (Signature):	Date: 6/30/03	Time: 1817

# WELL GAUGING DATA

Project # 030630-MMI

Date 6/30/13

Client Shell

Site 0930 Bancroft, Oakland

	Well ID	Well Size (in.)	Sheen / Odor	Depth to Immiscible Liquid (ft.)	Thickness of Immiscible Liquid (ft.)	Volume of Immiscibles Removed (ml)	Depth to water (ft.)	Depth to well bottom (ft.)	Survey Point: TOB or TOC		
1	MW-1	3					14.71	16.84	TOC		
4	MW-2	3					14.49	19.20	}		
3	MW-3	3					12.68	19.60			
2	MW-4	3	* gauged with stinger				12.51	19.55			
5	MW-5	3	X <sup>0</sup>	13.30	.04	<del>13.30</del>	13.34	19.63	}	* remove ord's	
6	MW-6	3					14.14	19.70			interface pr
			* - gauged with stinger								
			X <sup>0</sup> - no drum on site, unable to bail product, or sample								

### SHELL WELL MONITORING DATA SHEET

BTS #: <u>030630-1M1</u>	Site: <u>8930 Bancroft, Oakland</u>
Sampler: <u>MM</u>	Date: <u>6/30/03</u>
Well I.D.: <u>MW-4</u>	Well Diameter: 2 <input checked="" type="radio"/> 3 4 6 8
Total Well Depth (TD): <u>19.55</u>	Depth to Water (DTW): <u>12.51</u>
Depth to Free Product:	Thickness of Free Product (feet):
Referenced to: <u>PVC</u> Grade	D.O. Meter (if req'd): <u>YSI</u> <u>HACH</u>
DTW with 80% Recharge [(Height of Water Column x 0.20) + DTW]: <u>13.92</u>	

Purge Method: Bailer  Disposable Bailer  Middleburg  Electric Submersible  Waterra  Peristaltic  Extraction Pump  Other: \_\_\_\_\_ Sampling Method: Bailer  Disposable Bailer  Extraction Port  Dedicated Tubing  Other: \_\_\_\_\_

<u>2.6</u> (Gals.) X <u>3</u> = <u>7.8</u> Gals. 1 Case Volume          Specified Volumes          Calculated Volume	<table border="1" style="font-size: small;"><tr><th>Well Diameter</th><th>Multiplier</th><th>Well Diameter</th><th>Multiplier</th></tr><tr><td>1"</td><td>0.04</td><td>4"</td><td>0.65</td></tr><tr><td>2"</td><td>0.16</td><td>6"</td><td>1.47</td></tr><tr><td><input checked="" type="radio"/> 3"</td><td>0.37</td><td>Other</td><td>radius<sup>2</sup> * 0.163</td></tr></table>	Well Diameter	Multiplier	Well Diameter	Multiplier	1"	0.04	4"	0.65	2"	0.16	6"	1.47	<input checked="" type="radio"/> 3"	0.37	Other	radius <sup>2</sup> * 0.163
Well Diameter	Multiplier	Well Diameter	Multiplier														
1"	0.04	4"	0.65														
2"	0.16	6"	1.47														
<input checked="" type="radio"/> 3"	0.37	Other	radius <sup>2</sup> * 0.163														

Time	Temp (°F)	pH	Cond. (mS or μS)	Turbidity (NTUs)	Gals. Removed	Observations
<u>843</u>	<u>67.2</u>	<u>6.3</u>	<u>500</u>	<u>613</u>	<u>2.6</u>	<u>slightly cloudy</u>
		<u>dewatered</u>	<u>@ 3.0 gals</u>			<u>DTW = 12.95</u>
<u>849</u>	<u>67.2</u>	<u>6.6</u>	<u>416</u>	<u>600</u>		

Did well dewater?	<input checked="" type="radio"/> Yes   No	Gallons actually evacuated:	<u>3.0</u>	
Sampling Date:	<u>6/30/03</u>	Sampling Time:	<u>850</u> <small>site depth</small> Depth to Water:	<u>12.95</u> <small>site depth</small>
Sample I.D.:	<u>MW-4</u>	Laboratory:	<u>STL</u> Other: _____	
Analyzed for:	<input checked="" type="checkbox"/> TPH-G <input checked="" type="checkbox"/> BTEX <input checked="" type="checkbox"/> MTBE <input type="checkbox"/> TPH-D	Other: _____		
EB I.D. (if applicable):	<u>_____</u> @ <u>_____</u> Time	Duplicate I.D. (if applicable):		
Analyzed for:	<input type="checkbox"/> TPH-G <input type="checkbox"/> BTEX <input type="checkbox"/> MTBE <input type="checkbox"/> TPH-D	Other: _____		
D.O. (if req'd):	Pre-purge:	<u>_____</u> mg/L	Post-purge:	<u>_____</u> mg/L
O.R.P. (if req'd):	Pre-purge:	<u>_____</u> mV	Post-purge:	<u>_____</u> mV

## SHELL WELL MONITORING DATA SHEET

BTS #: 030630-M1	Site: 8930 Bancroft, Oakland
Sampler: M1	Date: 6/30/03
Well I.D.: MW-5	Well Diameter: 2 (3) 4 6 8
Total Well Depth (TD):	Depth to Water (DTW): 13.34
Depth to Free Product: 13.30	Thickness of Free Product (feet): .04
Referenced to: PVC Grade	D.O. Meter (if req'd): YSI HACH
DTW with 80% Recharge [(Height of Water Column x 0.20) + DTW]:	

Purge Method: ~~Bailer~~ ~~Disposable Bailer~~ Middleburg ~~Electric Submersible~~      ~~Water~~ ~~Peristaltic~~ ~~Extraction Pump~~ ~~Other~~      Sampling Method: Bailer ~~Disposable Bailer~~ ~~Extraction Port~~ ~~Dedicated Tubing~~ ~~Other~~

product in well

(Gals.) X <u>3</u>	=	Gals.	
I Case Volume	Specified Volumes	Calculated Volume	

Well Diameter	Multiplier	Well Diameter	Multiplier
1"	0.04	4"	0.65
2"	0.16	6"	1.47
<u>3"</u>	0.37	Other	radius <sup>2</sup> * 0.163

Time	Temp (°F)	pH	Cond. (mS or µS)	Turbidity (NTUs)	Gals. Removed	Observations
						Unable to sample as product was in well (.04 thickness) (No drum on site = unable to bail product)

Did well dewater?    Yes    No      Gallons actually evacuated:

Sampling Date: 6/30/03    Sampling Time:      Depth to Water:

Sample I.D.: MW-5      Laboratory: STL Other \_\_\_\_\_

Analyzed for: TPH-G BTEX MTBE TPH-D Other:

EB I.D. (if applicable): @ Time      Duplicate I.D. (if applicable):

Analyzed for: TPH-G BTEX MTBE TPH-D Other:

D.O. (if req'd):	Pre-purge:	mg/L	Post-purge:	mg/L
O.R.P. (if req'd):	Pre-purge:	mV	Post-purge:	mV