



Atlantic Richfield Company
(a BP affiliated company)

P.O. Box 1257
San Ramon, CA 94583
Phone: (925) 275-3801
Fax: (925) 275-3815

March 17, 2009

Re: Soil and Ground-Water Investigation Work Plan
Former BP Service Station # 11133
2220 98th Avenue
Oakland, California
ACEH Case #RO0000403

“I declare, that to the best of my knowledge at the present time, that the information and/or recommendations contained in the attached document are true and correct.”

Submitted by:

Paul Supple
Environmental Business Manger

RECEIVED

11:35 am, Mar 19, 2009

Alameda County
Environmental Health



March 17, 2009

Project No. 06-88-656

Atlantic Richfield Company
P.O. Box 1257
San Ramon, California 94583
Submitted via ENFOS

Attn.: Mr. Paul Supple

Re: Soil and Ground-Water Investigation Work Plan, Former BP Service Station #11133, 2220
98th Avenue, Oakland, Alameda County, California. Case No. RO0000403.

Dear Mr. Supple:

Broadbent & Associates, Inc. (BAI) is pleased to submit this Work Plan to conduct a soil and ground-water investigation at Former BP Service Station #11133 (herein referred to as Station #11133) located at 2220 98th Avenue, Oakland, California (Property). This Work Plan has been prepared in accordance with the Alameda County Environmental Health (ACEH) Letter dated January 16, 2009.

Should you have any questions concerning this Work Plan, please do not hesitate to contact us at (530) 566-1400.

Sincerely,
BROADBENT & ASSOCIATES, INC.



Matthew G. Herrick, P.G., C.HG.
Senior Hydrogeologist



Robert H. Miller, P.G., C.HG.
Principal Hydrogeologist

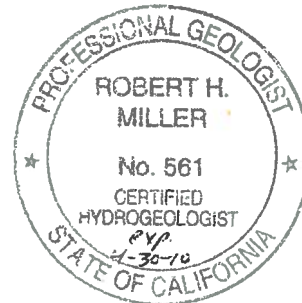

cc: Mr. Paresh Khatri, Alameda County Environmental Health, 1131 Harbor Bay Parkway, Suite
250, Alameda, CA 94502 (Submitted via ACEH ftp Site)
Ms. Shelby Lathrop, ConocoPhillips, 76 Broadway, Sacramento, CA 95818
GeoTracker

TABLE OF CONTENTS

	<u>PAGE</u>
1.0 Background	1
2.0 Scope of Work.....	1
3.0 Project Setup.....	2
4.0 Soil Investigation.....	2
5.0 Ground-Water Investigation.....	2
6.0 Schedule and Reporting.....	3
7.0 Closure.....	4

LIST OF DRAWINGS

- Drawing 1: Site Vicinity Map, Station #11133, Oakland, CA
- Drawing 2: Site Map with Proposed Well Locations, Station #11133, Oakland, CA

LIST OF TABLES

- Table 1: Summary of Ground-Water Monitoring Data, Station #11133, 2220 98th Avenue, Oakland, California
- Table 2: Summary of Fuel Additives Analytical Data, Station #11133, 2220 98th Avenue, Oakland, California
- Table 3: Historical Ground-Water Flow Direction and Gradient, Station #11133, 2220 98th Avenue, Oakland, California

1.0 Background

Provided herein is a Work Plan to conduct a soil and ground-water investigation at Station #11133 located in Oakland, California. The Property is currently a vacant lot located at the southeastern corner of 98th Avenue and Bancroft Avenue in Oakland. The land use in the immediate vicinity of the Site is mixed commercial and residential. The property consists of a flat lot covered with gravel, soil, concrete, and low lying vegetation. A site vicinity map is provided as Drawing 1. BP acquired the facility from Mobil Oil Corporation in 1989. In January 1994, BP transferred the property to TOSCO Marketing Company (now known as ConocoPhillips) and has not operated the facility since that time. TOSCO ceased gasoline retail operations on the Property in 1999.

During UST removal and replacement activities conducted by Kaprealian Engineering, Inc. in June 1987, five soil samples (A1, A2, B1, B2, and C1) were collected from the bottom of the tank cavity at depths of approximately 13.5 to 14 feet below land surface (bls). Total purgeable hydrocarbons as gasoline (TPHg) were detected in the soil samples at concentrations between 12 parts per million (ppm) (C1 at 13.5' bls) and 420 ppm (A1 at 13.5' bls). Benzene was detected at concentrations between 0.74 ppm (C1 at 13.5' bls) and 23 ppm (B1 at 13.5' bls).

In 1994, a soil vapor extraction (SVE) and ground-water treatment system were installed on-site. The SVE system began operation in November 1994 and was connected to eight vapor extraction wells (VW-1 through VW-3 and VEW-4 through VEW-8). Vapor extraction well VEW-9 was connected to the system in April 1996. The ground-water extraction system began operation in March 1995 and was connected to recovery well RW-1. Based on available operational data for the remediation system, as of December 27, 1995, a total of approximately 13,495.8 pounds of hydrocarbons had been removed from on-site soils by the system. Operational data for the SVE system after December 1995 was not found. Based on available operational data for the ground-water treatment system, as of December 14, 1998, a total of approximately 344.4 pounds of hydrocarbons had been removed from the system and operation of the system was discontinued.

Upon reviewing the case file for Station #11133, ACEH issued the January 16, 2009 Letter stating that hydrocarbon concentrations within off-site well AW-2 appear to be increasing and the down-gradient ground-water contaminant plume does not appear to be defined. Accordingly, this *Soil and Ground-Water Investigation Work Plan* has been prepared.

2.0 Scope of Work

The January 16, 2009 Letter from ACEH recommended justification that the ground-water contaminant plume is defined or preparation of a work plan to address the potential migration of contaminants down-gradient of the Site. Based on our review of the data from AW-2, further investigation work activities to the west and general downgradient direction appear warranted. It is important to note that the gradient direction over the last four monitoring events (July 2007 through October 2008) has been either westerly or west-southwest. Prior to 2007 the gradient direction fluctuated considerably. Accordingly, it is proposed that one boring be installed down-gradient and to the west of existing well AW-2 and be completed as monitor well AW-10. It is also proposed that one boring be installed approximately eight feet to the northeast of well AW-1 and be completed as well IW-1. It is anticipated that a well will be needed on this portion of the Property to facilitate

future remedial activities. The proposed well locations are depicted in Drawing 2. Table 1 includes a summary of ground-water monitoring data including relative water elevations and laboratory analyses. Table 2 provides a summary of fuel additives analytical data. Table 3 lists historic ground-water flow direction and gradient.

3.0 Project Setup

In accordance with the current contract with Atlantic Richfield Company, Stratus Environmental, Inc. (Stratus) will complete the field work associated with this soil and ground-water investigation (i.e., drilling, gauging, well installation, and sampling). Stratus will obtain any permits necessary prior to the initiation of field work. It is anticipated that an encroachment permit through the City of Oakland will be necessary for installation of off-site well AW-10 located on Bancroft Avenue. Once the field work is complete, Stratus will provide a data package which will include field notes, lithologic and well construction logs, laboratory analytical reports, and survey information from the investigation. BAI will then use this data package to generate a report for submittal to ACEH summarizing the soil and ground-water investigation including data interpretation and recommendations.

4.0 Soil Investigation

The proposed soil borings will be advanced using a hollow stem auger drilling technique. Soils will be lithologically logged by a qualified geologist using the Unified Soil Classification System (USCS). The expected depth to static ground-water in the vicinity of the proposed borings is estimated to be approximately 12 to 26 feet bls (based on the range of historic depth to ground-water measurements from wells AW-1 and AW-2 located in the general vicinity of the proposed borings). Soil samples will be collected at five foot intervals beginning five feet bls and continuing to just above the capillary fringe using a split-spoon sampler and brass sleeves. A minimum of three soil samples will be submitted for laboratory analysis. The three soil samples will include: (1) the deepest sample collected just above the capillary fringe, (2) the sample with the highest photo-ionization detector (PID) reading, and (3) a sample to be determined in the field. Each sample collected for submittal to a laboratory for analysis will be sealed on both ends with Teflon tape, capped with plastic end caps, labeled, and placed in an ice-filled cooler for preservation. The soil samples will be transported under chain-of-custody protocol to a California State-certified analytical laboratory and analyzed for the following:

- Gasoline range organics (GRO) and BTEX via EPA Method 8260B; and
- Fuel additives MTBE, tert-butyl alcohol (TBA), ethyl tert-butyl ether (ETBE), tert-amyl methyl ether (TAME), di-isopropyl ether (DIPE), 1,2-dichloroethane (1,2-DCA), 1,2-dibromoethane (EDB), and ethanol via EPA Method 8260B.

Investigation-derived residuals will be collected in 55-gallon steel drums, stored on the Property, and profiled prior to disposal at an approved Atlantic Richfield Company disposal facility.

5.0 Ground-Water Investigation

As stated above, depth to static ground water is expected to be between 12 and 26 feet bls. The proposed well design for AW-10 calls for a total well depth of 28 feet, with 15 feet of well

screen from total depth to 13 feet bls. Off-site well AW-10 will be constructed using two-inch diameter schedule 40 PVC well casing. The proposed well design for IW-1 calls for a total well depth of 30 feet, with 20 feet of well screen from total depth to 10 feet bls. On-site well IW-1 will be constructed using six-inch diameter schedule 40 PVC well casing. Both wells will use factory slotted well screen (0.02 inch slots) with flush threaded water tight connections. The casing will be surrounded by silica sand compatible with 0.02 inch slots in the annular space from total depth to three feet above top of screen. A sanitary seal will be installed consisting of approximately three feet of bentonite well-seal overlain by neat cement grout to the surface. The well head will be completed with a lockable water-tight plug and traffic rated monitor well vault.

Appropriate changes, if necessary, will be made to the total well depth and screen interval based on conditions encountered in the borehole during drilling activities.

Upon completion of well construction, the wells will be developed by surging/bailing or pumping water until relatively silt free water is removed from the well. Ground water will be removed until water quality parameters have stabilized. After development, the well will be left to hydraulically equilibrate prior to water level measurement and sampling. When equilibrated, depth to water and presence of free-phase product will be measured in the wells.

Prior to water sample collection, a minimum of three casing volumes of water will be purged from the wells. Purge water will be transported and disposed at an approved Atlantic Richfield Company disposal facility. Ground-water samples will be collected with factory decontaminated disposable bailers and placed in laboratory prepared containers. Samples will be labeled and chilled prior to transport under chain-of-custody protocol to a California State-certified analytical laboratory and analyzed for the following:

- GRO and BTEX via EPA Method 8260B; and
- Fuel additives MTBE, TBA, ETBE, TAME, DIPE, 1,2-DCA, EDB, and ethanol via EPA Method 8260B.

A California-licensed Professional Land Surveyor will be scheduled to survey the well heads and other relevant structures and land features. All elevations will be surveyed with respect to mean sea level. The survey information will be used to generate an accurate site map and ground water gradient map. A site map, the lithologic and monitor well construction logs, and well survey information will be uploaded to GeoTracker.

6.0 Schedule and Reporting

Once the ACEH has approved this Soil and Ground-Water Investigation Work Plan, Stratus will be directed to execute the work. As stated above, to facilitate installation of off-site well AW-10, it is anticipated that Stratus will need to request an encroachment permit through the City of Oakland prior to commencement of field work. Based on our recent experience at other sites in Oakland where an encroachment permit has been necessary, it seems to take several months for the City of Oakland to process the permit request. Upon completion of field work and receipt of a data packet from Stratus summarizing field activities including laboratory analytical reports, BAI will complete a soil and ground-water investigation report for submittal to the ACEH.

In accordance with the ACEH January 16, 2009 Letter, BAI is also working on a Feasibility Study/Corrective Action Plan for Station #11133 which will be submitted to the ACEH for review once completed.

7.0 Closure

Our services will be performed in accordance with the generally accepted standard of practice at the time work commences. Results and recommendations will be based on review of available documentation and written or verbal correspondence with appropriate regulatory agencies, laboratory results, observations of Stratus field personnel, and the points investigated. No other warranty, expressed or implied is made.

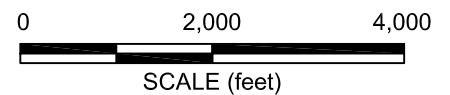
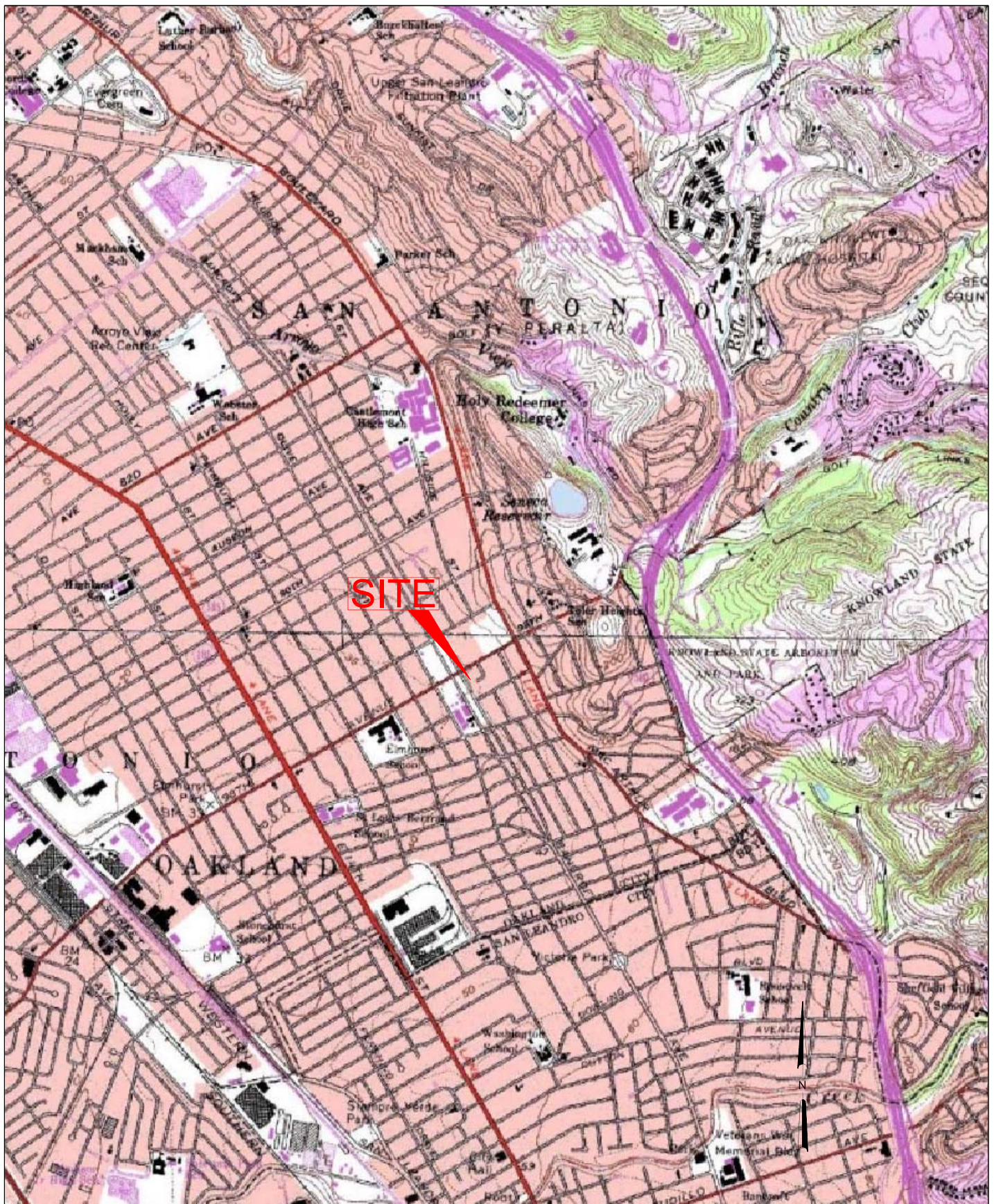

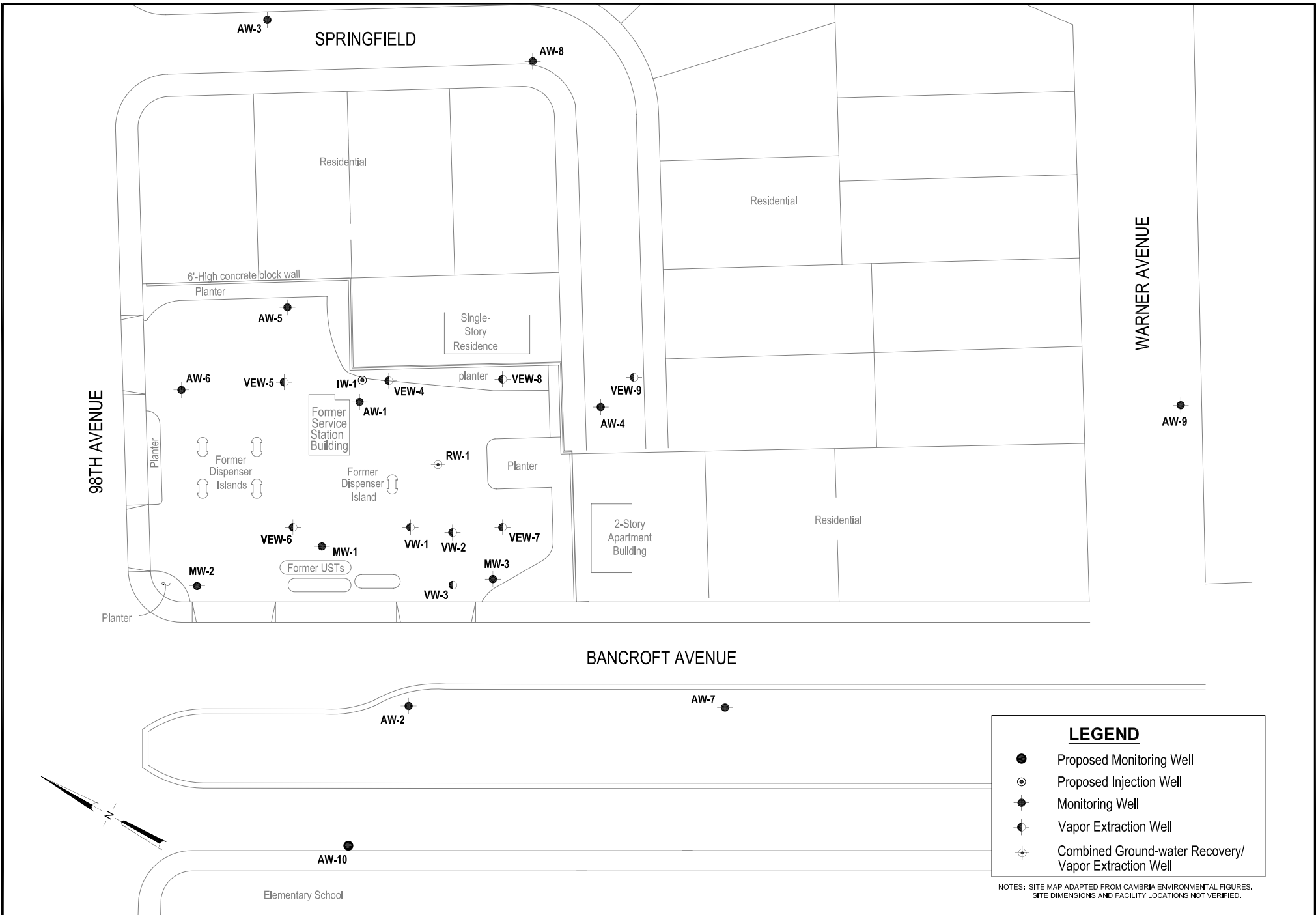

LEGEND

- Proposed Monitoring Well
- ⊙ Proposed Injection Well
- Monitoring Well
- ⊖ Vapor Extraction Well
- ⊕ Combined Ground-water Recovery/Vapor Extraction Well

NOTES: SITE MAP ADAPTED FROM CAMBRIA ENVIRONMENTAL FIGURES. SITE DIMENSIONS AND FACILITY LOCATIONS NOT VERIFIED.

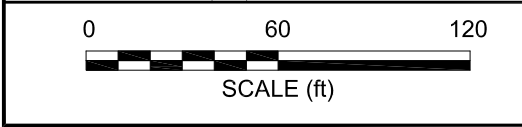

BROADBENT & ASSOCIATES, INC.
 ENGINEERING, WATER RESOURCES & ENVIRONMENTAL
 1324 Mangrove Ave. Suite 212, Chico, California 95926
 Project No.: 06-88-656 Date: 2/24/09

Former BP Service Station #11133
 2220 98th Avenue
 Oakland, California

Site Map with
 Proposed Well Locations

Table 1. Summary of Ground-Water Monitoring Data: Relative Water Elevations and Laboratory Analyses

Station #11133, 2220 98th Ave., Oakland, CA

Well and Sample Date	P/NP	TOC Elevation (feet msl)	Depth to Water (feet bgs)	Product Thickness (feet)	Water Level Elevation (feet msl)	Concentrations in (µg/L)						DO (mg/L)	Lab	pH	Comments
						GRO/TPHg	Benzene	Toluene	Ethyl-Benzene	Total Xylenes	MTBE				
AW-1															
4/5/1991	--	38.11	25.44	--	12.67	4,100	1,500	69	100	83	--	--	SUP	--	
4/1/1992	--	38.11	23.22	--	14.89	--	--	--	--	--	--	--	--	--	
4/2/1992	--	38.11	--	--	--	11,000	1,800	210	210	490	--	--	APP	--	
7/6/1992	--	38.11	24.89	--	13.22	6,500	4,000	40	290	530	--	--	ANA	--	
10/7/1992	--	38.11	--	--	--	2,900	1,200	25	37	210	--	--	ANA	--	e
10/7/1992	--	38.11	26.55	--	11.56	4,700	1,500	41	47	300	--	--	ANA	--	
1/14/1993	--	38.11	--	--	--	4,100	1,700	28	130	230	--	--	PACE	--	m, e
1/14/1993	--	38.11	23.73	--	14.38	2,800	830	31	140	240	--	--	PACE	--	m
4/22/1993	--	38.11	--	--	--	39,000	14,000	530	1,800	6,100	987	--	PACE	--	c, m
7/15/1993	--	38.11	22.50	--	15.61	6,200	2,200	28	210	540	838	--	PACE	--	c, m
10/21/1993	--	38.11	24.32	--	13.79	2,400	820	13	55	120	832	--	PACE	--	c, m
1/27/1994	--	38.11	23.72	--	14.39	3,500	1,400	26	130	220	650	--	PACE	--	c, n
4/21/1994	--	38.11	22.48	--	15.63	40,000	12,000	1,900	1,600	5,000	1,119	1.4	PACE	--	m
9/9/1994	--	38.11	--	--	--	3,900	1,900	5.5	190	240	--	--	PACE	--	e
9/9/1994	--	38.11	23.04	--	15.07	3,500	1,600	5	200	250	--	2.1	PACE	--	m
12/21/1994	--	38.11	21.70	--	16.41	7,600	3,100	36	370	320	855	1.6	PACE	--	m
1/30/1995	--	38.11	17.71	--	20.40	35,000	23,000	650	3,200	4,100	--	1.7	ATI	--	
4/10/1995	--	38.11	20.04	--	18.07	60,000	18,000	2,000	4,300	11,000	--	7.9	ATI	--	
4/10/1995	--	38.11	--	--	--	56,000	17,000	2,000	3,900	10,000	--	--	ATI	--	e
6/29/1995	--	38.11	--	--	--	86,000	12,000	8,400	4,800	18,000	--	--	ATI	--	e
6/29/1995	--	38.11	20.60	--	17.51	72,000	10,000	7,300	4,200	15,000	--	6.2	ATI	--	
9/18/1995	--	38.11	21.87	--	16.24	--	--	--	--	--	--	--	--	--	
9/19/1995	--	38.11	--	--	--	65,000	12,000	3,100	4,400	14,000	1,000	8.5	ATI	--	
12/7/1995	--	38.11	22.06	--	16.05	25,000	8,700	<50	2,500	1,300	1,100	2.9	ATI	--	
3/28/1996	--	38.11	16.91	--	21.20	24,000	11,000	<100	3,200	3,390	<1000	6.6	SPL	--	
6/20/1996	--	38.11	20.82	--	17.29	38,000	6,900	1,100	3,200	7,300	<100	6.4	SPL	--	
10/11/1996	--	38.11	23.20	--	14.91	33,000	8,500	69	3,300	4,230	580	6.3	SPL	--	
1/2/1997	--	38.11	20.41	--	17.70	32,000	8,000	<50	3,100	2,300	700	6.7	SPL	--	
4/14/1997	--	38.11	21.61	--	16.50	--	--	--	--	--	--	--	--	--	
4/15/1997	--	38.11	--	--	--	31,000	5,000	160	2,400	4,540	340	5.4	SPL	--	
7/2/1997	--	38.11	21.17	--	16.94	26,000	5,800	<100	2,600	2,200	<1000	6.2	SPL	--	

Table 1. Summary of Ground-Water Monitoring Data: Relative Water Elevations and Laboratory Analyses
Station #11133, 2220 98th Ave., Oakland, CA

Well and Sample Date	P/NP	TOC Elevation (feet msl)	Depth to Water (feet bgs)	Product Thickness (feet)	Water Level Elevation (feet msl)	Concentrations in (µg/L)						DO (mg/L)	Lab	pH	Comments
						GRO/TPHg	Benzene	Toluene	Ethyl-Benzene	Total Xylenes	MTBE				
AW-1 Cont.															
9/30/1997	--	38.11	21.48	--	16.63	29,000	9,200	17	1,400	130	560	6.9	SPL	--	
1/21/1998	--	38.11	20.02	--	18.09	50,000	6,900	450	3,200	4,450	720	5.8	SPL	--	
4/9/1998	--	38.11	13.37	--	24.74	--	--	--	--	--	--	--	--	--	
4/10/1998	--	38.11	--	--	--	46,000	5,800	1,900	3,000	7,400	1,000	4.3	SPL	--	
6/19/1998	--	38.11	19.12	--	18.99	42,000	6,600	200	3,000	3,350	660	4.9	SPL	--	
6/19/1998	--	38.11	--	--	--	43,000	6,800	260	3,100	3,490	620	--	SPL	--	e
11/30/1998	--	38.11	21.13	--	16.98	23,000	6,700	<25	3,100	130	710/820	--	SPL	--	g
1/21/1999	--	38.11	20.77	--	17.34	25,000	4,800	54	2,800	780	1,000	--	SPL	--	
4/30/1999	--	38.11	20.80	--	17.31	21,000	5,300	67	2,800	750	1,500	--	SPL	--	
7/9/1999	--	38.11	20.41	--	17.70	11,000	3,000	<10	760	180	1,300	--	SPL	--	
11/3/1999	--	38.11	20.82	--	17.29	--	--	--	--	--	--	--	--	--	
1/12/2000	--	38.11	19.99	--	18.12	330,000	5,300	10	2,900	560	2,200	--	PACE	--	
4/13/2000	--	38.11	20.14	--	17.97	--	--	--	--	--	--	--	--	--	
5/24/2000	--	38.11	20.17	--	17.94	--	--	--	--	--	--	--	--	--	
6/1/2000	--	38.11	23.05	--	15.06	--	--	--	--	--	--	--	--	--	
6/8/2000	--	38.11	17.08	--	21.03	--	--	--	--	--	--	--	--	--	
6/15/2000	--	38.11	16.93	--	21.18	--	--	--	--	--	--	--	--	--	
7/26/2000	--	38.11	20.07	--	18.04	15,000	290	98	77	220	37,000	--	PACE	--	
10/24/2000	--	38.11	20.10	--	18.01	--	--	--	--	--	--	--	--	--	
1/19/2001	--	38.11	19.82	--	18.29	7,600	2,220	10.9	415	58.4	1,630	--	PACE	--	
7/24/2001	--	38.11	19.86	--	18.25	9,600	2,140	6.34	281	43	1,440	--	PACE	--	
1/18/2002	--	38.11	15.60	--	22.51	20,000	2,170	75.2	1,800	2,080	1,250	--	PACE	--	
8/1/2002	--	38.11	19.55	--	18.56	14,000	2,150	<12.5	197	42.4	1,120	--	PACE	--	
1/16/2003	--	38.11	16.32	--	21.79	15,000	2,300	75	1,600	1,800	1,100	--	SEQ	--	p
7/7/2003	--	38.11	19.80	--	18.31	9,700	1,600	<25	540	110	1,100	--	SEQ	--	q, u
02/05/2004	--	38.11	18.75	--	19.36	12,000	2,000	<50	820	590	930	--	SEQM	6.7	
07/01/2004	P	38.11	19.72	--	18.39	9,900	2,600	<25	300	<25	1,100	--	SEQM	6.5	
03/16/2005	P	38.11	18.78	--	19.33	10,000	1,100	30	630	560	720	0.8	SEQM	6.7	
07/22/2005	P	38.11	15.53	--	22.58	8,000	770	5.4	520	50	510	--	SEQM	6.5	
01/25/2006	P	38.11	18.10	--	20.01	6,400	1,200	10	490	290	490	--	SEQM	7.0	
7/6/2006	P	38.11	17.44	--	20.67	6,200	1,300	70	570	180	270	--	TAMC	6.8	

Table 1. Summary of Ground-Water Monitoring Data: Relative Water Elevations and Laboratory Analyses
Station #11133, 2220 98th Ave., Oakland, CA

Well and Sample Date	P/NP	TOC Elevation (feet msl)	Depth to Water (feet bgs)	Product Thickness (feet)	Water Level Elevation (feet msl)	Concentrations in (µg/L)						DO (mg/L)	Lab	pH	Comments
						GRO/TPHg	Benzene	Toluene	Ethyl-Benzene	Total Xylenes	MTBE				
AW-1 Cont.															
1/8/2007	P	38.11	16.74	--	21.37	3700	690	19	110	30	380	2.53	TAMC	6.77	
7/10/2007	P	38.11	17.30	--	20.81	4,200	560	12	93	40	220	1.79	TAMC	6.90	
1/15/2008	P	38.11	15.96	--	22.15	5,000	670	<10	490	200	230	0.92	TAMC	6.91	
7/15/2008	P	38.11	18.63	--	19.48	3,400	340	4.5	27	17	<0.50	1.80	CEL	6.79	
10/21/2008	P	38.11	19.96	--	18.15	1,900	160	<5.0	15	<5.0	120	2.40	CEL	7.01	
AW-2															
4/5/1991	--	36.83	22.36	--	14.47	<50	<0.3	<0.3	<0.3	<0.3	--	--	SUP	--	
4/1/1992	--	36.83	20.81	--	16.02	--	--	--	--	--	--	--	--	--	
4/2/1992	--	36.83	--	--	--	130	25	2.3	0.7	2.1	--	--	APP	--	
7/6/1992	--	36.83	23.57	--	13.26	<50	<0.5	<0.5	<0.5	<0.5	--	--	ANA	--	
10/7/1992	--	36.83	25.24	--	11.59	<50	<0.5	<0.5	<0.5	<0.5	--	--	ANA	--	
1/14/1993	--	36.83	20.82	--	16.01	<50	<0.5	<0.5	<0.5	<0.5	--	--	PACE	--	m
4/22/1993	--	36.83	19.37	--	17.46	<50	<0.5	<0.5	<0.5	<0.5	--	--	PACE	--	m
7/15/1993	--	36.83	21.29	--	15.54	<50	<0.5	<0.5	<0.5	<0.5	<5.0	--	PACE	--	m
10/21/1993	--	36.83	23.14	--	13.69	<50	1.3	1.1	0.9	2.1	<5.0	--	PACE	--	m
1/27/1994	--	36.83	22.34	--	14.49	<50	<0.5	<0.5	<0.5	<0.5	--	--	PACE	--	m
4/21/1994	--	36.83	21.15	--	15.68	<50	<0.5	<0.5	<0.5	<0.5	<5.0	2.0	PACE	--	m
9/9/1994	--	36.83	22.09	--	14.74	<50	<0.5	<0.5	<0.5	<0.5	--	4.1	PACE	--	m
12/21/1994	--	36.83	20.12	--	16.71	<50	<0.5	<0.5	<0.5	<0.5	<5.0	2.0	PACE	--	m
1/30/1995	--	36.83	16.65	--	20.18	<50	<0.50	<0.50	<0.50	<1.0	--	2.5	ATI	--	
4/10/1995	--	36.83	16.22	--	20.61	<50	<0.50	<0.50	<0.50	<1.0	--	4.4	ATI	--	
6/29/1995	--	36.83	17.55	--	19.28	<50	<0.50	<0.50	<0.50	<1.0	--	7.8	ATI	--	
9/18/1995	--	36.83	19.87	--	16.96	--	--	--	--	--	--	--	--	--	
9/19/1995	--	36.83	--	--	--	<50	<0.50	<0.50	<0.50	<1.0	<5.0	4.5	ATI	--	
9/19/1995	--	36.83	--	--	--	<50	<0.50	<0.50	<0.50	<1.0	<5.0	--	ATI	--	e
12/7/1995	--	36.83	21.31	--	15.52	<50	<0.50	<0.50	<0.50	<1.0	<5.0	4.9	ATI	--	
3/28/1996	--	36.83	15.61	--	21.22	<50	<0.5	<1	<1	<1	<10	4.1	SPL	--	
6/20/1996	--	36.83	16.30	--	20.53	<50	<0.5	<1	<1	<1	<10	5.2	SPL	--	
10/11/1996	--	36.83	19.60	--	17.23	<50	<0.5	<1.0	<1.0	<1.0	<10	6.0	SPL	--	
1/2/1997	--	36.83	15.97	--	20.86	<50	<0.5	<1.0	<1.0	<1.0	<10	6.1	SPL	--	

Table 1. Summary of Ground-Water Monitoring Data: Relative Water Elevations and Laboratory Analyses
Station #11133, 2220 98th Ave., Oakland, CA

Well and Sample Date	P/NP	TOC Elevation (feet msl)	Depth to Water (feet bgs)	Product Thickness (feet)	Water Level Elevation (feet msl)	Concentrations in (µg/L)						DO (mg/L)	Lab	pH	Comments
						GRO/TPHg	Benzene	Toluene	Ethyl-Benzene	Total Xylenes	MTBE				
AW-2 Cont.															
4/14/1997	--	36.83	17.19	--	19.64	<50	<0.5	<1.0	<1.0	<1.0	<10	5.3	SPL	--	
7/2/1997	--	36.83	18.11	--	18.72	<50	<0.5	<1.0	<1.0	<1.0	<10	5.7	SPL	--	
9/30/1997	--	36.83	18.52	--	18.31	<50	<0.5	<1.0	<1.0	<1.0	860	5.4	SPL	--	
1/21/1998	--	36.83	14.46	--	22.37	160	13	<1.0	<1.0	<1.0	110	4.9	SPL	--	
4/9/1998	--	36.83	12.85	--	23.98	--	--	--	--	--	--	--	--	--	
4/10/1998	--	36.83	--	--	--	<50	<0.5	<1.0	<1.0	<1.0	<10	3.9	SPL	--	
6/19/1998	--	36.83	14.37	--	22.46	60	<0.5	<1.0	<1.0	<1.0	<10	3.6	SPL	--	
11/30/1998	--	36.83	16.90	--	19.93	--	--	--	--	--	--	--	--	--	
1/21/1999	--	36.83	16.87	--	19.96	<50	<1.0	<1.0	<1.0	<1.0	<1.0	--	SPL	--	
4/30/1999	--	36.83	17.01	--	19.82	--	--	--	--	--	--	--	--	--	
7/9/1999	--	36.83	17.83	--	19.00	--	--	--	--	--	--	--	--	--	
11/3/1999	--	36.83	19.74	--	17.09	--	--	--	--	--	--	--	--	--	
1/12/2000	--	36.83	19.90	--	16.93	<50	<0.5	<0.5	<0.5	<0.5	<0.5	--	PACE	--	
4/13/2000	--	36.83	19.75	--	17.08	--	--	--	--	--	--	--	--	--	
7/26/2000	--	36.83	19.86	--	16.97	--	--	--	--	--	--	--	--	--	
10/24/2000	--	36.83	18.77	--	18.06	--	--	--	--	--	--	--	--	--	
1/19/2001	--	36.83	--	--	--	--	--	--	--	--	--	--	--	--	f
7/24/2001	--	36.83	--	--	--	--	--	--	--	--	--	--	--	--	f
1/18/2002	--	36.83	15.17	--	21.66	<50	<0.5	<0.5	<0.5	<1.0	<0.5	--	PACE	--	
8/1/2002	--	36.83	17.17	--	19.66	--	--	--	--	--	--	--	--	--	
1/16/2003	--	36.83	14.81	--	22.02	<50	<0.50	<0.50	<0.50	<0.50	<2.5	--	SEQ	--	p
7/7/2003	--	36.83	16.65	--	20.18	--	--	--	--	--	--	--	--	--	
02/05/2004	--	36.83	15.37	--	21.46	<50	3.0	<0.50	<0.50	<0.50	5.1	--	SEQM	6.6	
07/01/2004	--	36.83	17.55	--	19.28	--	--	--	--	--	--	--	--	--	
03/16/2005	P	36.83	14.58	--	22.25	<50	0.75	<0.50	1.1	1.1	<0.50	1.7	SEQM	6.7	
07/22/2005	--	36.83	15.41	--	21.42	--	--	--	--	--	--	--	--	--	
01/25/2006	P	36.83	14.17	--	22.66	280	110	<1.0	3.9	8.7	12	--	SEQM	7.1	
7/6/2006	--	36.83	14.00	--	22.83	--	--	--	--	--	--	--	--	--	
1/8/2007	P	36.83	15.85	--	20.98	1900	550	160	58	180	40	2.09	TAMC	7.2	
7/10/2007	--	36.83	17.25	--	19.58	--	--	--	--	--	--	--	--	--	
1/15/2008	P	36.83	15.75	--	21.08	2,300	900	87	100	140	48	0.83	TAMC	6.79	

Table 1. Summary of Ground-Water Monitoring Data: Relative Water Elevations and Laboratory Analyses
Station #11133, 2220 98th Ave., Oakland, CA

Well and Sample Date	P/NP	TOC Elevation (feet msl)	Depth to Water (feet bgs)	Product Thickness (feet)	Water Level Elevation (feet msl)	Concentrations in (µg/L)						DO (mg/L)	Lab	pH	Comments
						GRO/TPHg	Benzene	Toluene	Ethyl-Benzene	Total Xylenes	MTBE				
AW-2 Cont.															
7/15/2008	P	36.83	17.99	--	18.84	6,400	1,700	550	340	940	<50	2.14	CEL	7.05	
10/21/2008	P	36.83	19.19	--	17.64	2,600	580	96	110	180	16	1.65	CEL	7.33	
AW-3															
4/5/1991	--	39.13	23.90	--	15.23	5,200	980	450	95	310	--	--	SUP	--	
4/1/1992	--	39.13	22.50	--	16.63	4,700	890	47	43	110	--	--	APP	--	
7/6/1992	--	39.13	23.26	--	15.87	3,900	3,100	30	80	99	--	--	ANA	--	
10/7/1992	--	39.13	24.75	--	14.38	5,000	2,600	<0.5	<0.5	59	--	--	ANA	--	
1/14/1993	--	39.13	23.59	--	15.54	350	250	<0.5	<0.5	<0.5	--	--	PACE	--	m
4/22/1993	--	39.13	19.42	--	19.71	240	71	2.4	0.6	4	--	--	PACE	--	m
7/15/1993	--	39.13	20.09	--	19.04	650	71	2.8	1.5	1.1	37.3	--	PACE	--	c, m
10/21/1993	--	39.13	21.88	--	17.25	160	4.8	1.7	1.6	3.6	8.95	--	PACE	--	m
10/21/1993	--	39.13	--	--	--	170	6.1	2	1.7	4.4	--	--	PACE	--	e
1/27/1994	--	39.13	22.33	--	16.80	92	2.1	<0.5	<0.5	<0.5	7.37	--	PACE	--	m
1/27/1994	--	39.13	--	--	--	90	2.9	0.5	<0.5	<0.5	--	--	PACE	--	e
4/21/1994	--	39.13	20.96	--	18.17	150	3.6	0.8	0.9	2.5	9.36	1.3	PACE	--	m
9/9/1994	--	39.13	21.60	--	17.53	53	<0.5	<0.5	<0.5	<0.5	--	1.9	PACE	--	m
12/21/1994	--	39.13	--	--	--	--	--	--	--	--	--	--	--	--	f
1/30/1995	--	39.13	--	--	--	--	--	--	--	--	--	--	--	--	f
4/10/1995	--	39.13	--	--	--	--	--	--	--	--	--	--	--	--	f
6/29/1995	--	39.13	15.41	--	23.72	<50	<0.50	<0.50	<0.50	<1.0	--	8.0	ATI	--	
9/18/1995	--	39.13	17.83	--	21.30	--	--	--	--	--	--	--	--	--	
9/19/1995	--	39.13	--	--	--	61,000	11,000	2,900	4,100	13,000	790	7.4	ATI	--	
12/7/1995	--	39.13	--	--	--	<50	<0.50	<0.50	<0.50	<1.0	<5.0	--	ATI	--	e
12/7/1995	--	39.13	19.27	--	19.86	<50	<0.50	<0.50	<0.50	<1.0	<5.0	3.4	ATI	--	
3/28/1996	--	39.13	--	--	--	<50	<0.5	<1	<1	<1	<10	--	SPL	--	e
3/28/1996	--	39.13	13.85	--	25.28	<50	<0.5	<1	<1	<1	<10	4.1	SPL	--	
6/20/1996	--	39.13	14.47	--	24.66	<50	<0.5	<1	<1	<1	<10	4.2	SPL	--	
6/20/1996	--	39.13	--	--	--	<50	<0.5	<1	<1	<1	<10	--	SPL	--	e
10/11/1996	--	39.13	--	--	--	<50	<0.5	<1.0	<1.0	<1.0	<10	--	SPL	--	e
10/11/1996	--	39.13	17.97	--	21.16	<50	<0.5	<1.0	<1.0	<1.0	<10	4.7	SPL	--	

Table 1. Summary of Ground-Water Monitoring Data: Relative Water Elevations and Laboratory Analyses
Station #11133, 2220 98th Ave., Oakland, CA

Well and Sample Date	P/NP	TOC Elevation (feet msl)	Depth to Water (feet bgs)	Product Thickness (feet)	Water Level Elevation (feet msl)	Concentrations in (µg/L)						DO (mg/L)	Lab	pH	Comments
						GRO/TPHg	Benzene	Toluene	Ethyl-Benzene	Total Xylenes	MTBE				
AW-3 Cont.															
1/2/1997	--	39.13	13.00	--	26.13	<50	<0.5	<1.0	<1.0	<1.0	<10	5.6	SPL	--	
4/14/1997	--	39.13	14.36	--	24.77	<50	<0.5	<1.0	<1.0	<1.0	<10	5.0	SPL	--	
4/15/1997	--	39.13	--	--	--	<50	<0.5	<1.0	<1.0	<1.0	<10	--	SPL	--	e
7/2/1997	--	39.13	15.87	--	23.26	<50	<0.5	<1.0	<1.0	<1.0	<10	5.4	SPL	--	
9/30/1997	--	39.13	17.50	--	21.63	<250	<2.5	<5.0	<5.0	<5.0	810	5.7	SPL	--	
1/21/1998	--	39.13	11.98	--	27.15	140	<0.5	<1.0	<1.0	<1.0	99	4.6	SPL	--	
1/21/1998	--	39.13	--	--	--	150	<0.5	<1.0	<1.0	1.2	110	--	SPL	--	e
4/9/1998	--	39.13	9.45	--	29.68	--	--	--	--	--	--	--	--	--	
4/10/1998	--	39.13	--	--	--	<50	<0.5	<1.0	<1.0	1.6	<10	4.5	SPL	--	
4/10/1998	--	39.13	--	--	--	<50	<0.5	<1.0	1.4	1.7	<10	--	SPL	--	e
6/19/1998	--	39.13	12.13	--	27.00	<50	<0.5	<1.0	<1.0	<1.0	<10	4.4	SPL	--	
11/30/1998	--	39.13	15.91	--	23.22	--	--	--	--	--	--	--	--	--	
1/21/1999	--	39.13	15.93	--	23.20	<50	<1.0	<1.0	<1.0	<1.0	<1.0	--	SPL	--	
4/30/1999	--	39.13	15.98	--	23.15	--	--	--	--	--	--	--	--	--	
7/9/1999	--	39.13	14.58	--	24.55	--	--	--	--	--	--	--	--	--	
11/3/1999	--	39.13	17.43	--	21.70	--	--	--	--	--	--	--	--	--	
1/12/2000	--	39.13	18.30	--	20.83	<50	<0.5	<0.5	<0.5	<0.5	<0.5	--	PACE	--	
4/13/2000	--	39.13	18.89	--	20.24	--	--	--	--	--	--	--	--	--	
7/26/2000	--	39.13	18.67	--	20.46	--	--	--	--	--	--	--	--	--	
10/24/2000	--	39.13	18.98	--	20.15	--	--	--	--	--	--	--	--	--	
1/19/2001	--	39.13	16.74	--	22.39	--	--	--	--	--	--	--	--	--	
7/24/2001	--	39.13	18.55	--	20.58	--	--	--	--	--	--	--	--	--	
1/18/2002	--	39.13	14.49	--	24.64	--	--	--	--	--	--	--	--	--	
8/1/2002	--	39.13	14.27	--	24.86	--	--	--	--	--	--	--	--	--	
1/16/2003	--	39.13	14.25	--	24.88	--	--	--	--	--	--	--	--	--	
7/7/2003	--	39.13	14.70	--	24.43	--	--	--	--	--	--	--	--	--	
02/05/2004	--	39.13	14.61	--	24.52	--	--	--	--	--	--	--	--	--	
07/01/2004	--	39.13	15.62	--	23.51	--	--	--	--	--	--	--	--	--	
03/16/2005	P	39.13	12.70	--	26.43	<50	<0.50	<0.50	<0.50	<0.50	<0.50	1.1	SEQM	7.3	
07/22/2005	--	39.13	13.44	--	25.69	--	--	--	--	--	--	--	--	--	
01/25/2006	--	39.13	13.56	--	25.57	--	--	--	--	--	--	--	--	--	

Table 1. Summary of Ground-Water Monitoring Data: Relative Water Elevations and Laboratory Analyses
Station #11133, 2220 98th Ave., Oakland, CA

Well and Sample Date	P/NP	TOC Elevation (feet msl)	Depth to Water (feet bgs)	Product Thickness (feet)	Water Level Elevation (feet msl)	Concentrations in (µg/L)						DO (mg/L)	Lab	pH	Comments
						GRO/TPHg	Benzene	Toluene	Ethyl-Benzene	Total Xylenes	MTBE				
AW-3 Cont.															
7/6/2006	--	39.13	11.60	--	27.53	--	--	--	--	--	--	--	--	--	
1/8/2007	--	39.13	14.97	--	24.16	--	--	--	--	--	--	--	--	--	
7/10/2007	--	39.13	15.81	--	23.32	--	--	--	--	--	--	--	--	--	
1/15/2008	--	39.13	15.97	--	23.16	--	--	--	--	--	--	--	--	--	
7/15/2008	--	39.13	16.70	--	22.43	--	--	--	--	--	--	--	--	--	
10/21/2008	--	39.13	18.16	--	20.97	--	--	--	--	--	--	--	--	--	
AW-4															
4/5/1991	--	39.08	25.12	--	13.96	110,000	40,000	13,000	2,000	5,500	--	--	SUP	--	
4/1/1992	--	39.08	--	--	--	210,000	55,000	23,000	2,900	7,000	--	--	APP	--	e
4/1/1992	--	39.08	23.56	--	15.52	230,000	57,000	31,000	2,900	7,600	--	--	APP	--	
7/6/1992	--	39.08	25.87	--	13.21	38,000	16,000	5,400	2,000	6,100	--	--	ANA	--	
10/7/1992	--	39.08	27.53	--	11.55	120,000	41,000	26,000	4,700	13,000	--	--	ANA	--	
1/14/1993	--	39.08	24.12	--	14.96	62,000	18,000	14,000	2,700	7,700	1,400	--	PACE	--	c, m
4/22/1993	--	39.08	21.47	--	17.61	18,000	1,100	2,100	320	3,500	--	--	PACE	--	m
7/15/1993	--	39.08	23.30	--	15.78	21,000	820	2,300	590	3,800	1,978	--	PACE	--	c, m
10/21/1993	--	39.08	25.08	--	14.00	11,000	570	83	630	2,300	4,600	--	PACE	--	c, m
1/27/1994	--	39.08	24.61	--	14.47	12,000	420	460	600	2,200	6,400	--	PACE	--	c, m
4/21/1994	--	39.08	22.96	--	16.12	12,000	110	250	150	1,900	16,010	1.5	PACE	--	c, m
4/21/1994	--	39.08	--	--	--	14,000	71	160	29	1,200	13,000	--	PACE	--	c, e
9/9/1994	--	39.08	23.85	--	15.23	9,700	75	64	280	2,000	--	2.1	PACE	--	m
12/21/1994	--	39.08	--	--	--	--	--	--	--	--	--	--	--	--	f
1/30/1995	--	39.08	--	--	--	--	--	--	--	--	--	--	--	--	f
4/10/1995	--	39.08	18.07	--	21.01	3,700	69	8.7	44	130	--	8.5	ATI	--	
6/29/1995	--	39.08	19.25	--	19.83	8,000	62	190	190	1,100	--	7.5	ATI	--	
9/18/1995	--	39.08	20.73	--	18.35	--	--	--	--	--	--	--	--	--	
9/19/1995	--	39.08	--	--	--	12,000	660	1,600	200	1,900	7,100	8.3	ATI	--	
12/7/1995	--	39.08	22.49	--	16.59	41,000	8,400	7,200	710	6,300	5,200	3.6	ATI	--	
3/28/1996	--	39.08	16.49	--	22.59	--	--	--	--	--	--	--	--	--	f
6/20/1996	--	39.08	16.00	--	23.08	<50	<0.5	<1	<1	<1	12	--	SPL	--	
10/11/1996	--	39.08	19.52	--	19.56	36,000	12,000	5,500	<25	3,800	880/1000	6.2	SPL	--	g

Table 1. Summary of Ground-Water Monitoring Data: Relative Water Elevations and Laboratory Analyses
Station #11133, 2220 98th Ave., Oakland, CA

Well and Sample Date	P/NP	TOC Elevation (feet msl)	Depth to Water (feet bgs)	Product Thickness (feet)	Water Level Elevation (feet msl)	Concentrations in (µg/L)						DO (mg/L)	Lab	pH	Comments
						GRO/TPHg	Benzene	Toluene	Ethyl-Benzene	Total Xylenes	MTBE				
AW-4 Cont.															
1/2/1997	--	39.08	15.80	--	23.28	<50	<0.5	<1.0	<1.0	<1.0	22	6.4	SPL	--	
1/2/1997	--	39.08	--	--	--	<50	61	3.8	3.5	8.1	110	--	SPL	--	e
4/14/1997	--	39.08	17.01	--	22.07	--	--	--	--	--	--	--	--	--	
4/15/1997	--	39.08	--	--	--	<50	<0.5	<1.0	<1.0	<1.0	<10	5.4	SPL	--	
7/2/1997	--	39.08	19.68	--	19.40	<50	21	<1.0	<1.0	<1.0	41	4.1	SPL	--	
9/30/1997	--	39.08	22.71	--	16.37	--	--	--	--	--	--	--	--	--	f
1/21/1998	--	39.08	15.89	--	23.19	13,000	2,900	<10	230	314	3,100	3.9	SPL	--	
4/9/1998	--	39.08	13.50	--	25.58	--	--	--	--	--	--	--	--	--	
4/10/1998	--	39.08	--	--	--	890	<0.5	<1	<1	<1	730	4.9	SPL	--	
6/19/1998	--	39.08	14.75	--	24.33	60	<0.5	<1.0	<1.0	<1.0	34	4.3	SPL	--	
11/30/1998	--	39.08	19.25	--	19.83	--	--	--	--	--	--	--	--	--	
1/21/1999	--	39.08	18.94	--	20.14	3,700	830	93	200	360	30	--	--	--	
4/30/1999	--	39.08	19.10	--	19.98	--	--	--	--	--	--	--	--	--	
7/9/1999	--	39.08	18.93	--	20.15	76,000	12,000	6,600	2,000	8,700	320	--	SPL	--	
11/3/1999	--	39.08	20.65	--	18.43	--	--	--	--	--	--	--	--	--	
1/12/2000	--	39.08	21.21	--	17.87	67,000	12,000	3,500	2,900	15,000	280	--	PACE	--	
4/13/2000	--	39.08	21.33	--	17.75	--	--	--	--	--	--	--	--	--	
5/24/2000	--	39.08	19.84	--	19.24	--	--	--	--	--	--	--	--	--	
6/1/2000	--	39.08	19.04	--	20.04	--	--	--	--	--	--	--	--	--	
6/8/2000	--	39.08	18.32	--	20.76	--	--	--	--	--	--	--	--	--	
6/15/2000	--	39.08	16.70	--	22.38	--	--	--	--	--	--	--	--	--	
7/26/2000	--	39.08	21.50	--	17.58	910	<0.5	<0.5	<0.5	<0.5	3,500	--	PACE	--	
10/24/2000	--	39.08	22.00	--	17.08	--	--	--	--	--	--	--	--	--	
1/19/2001	--	39.08	18.97	--	20.11	6,600	2,460	24	497	534	267	--	PACE	--	
7/24/2001	--	39.08	18.55	--	20.53	5,100	1,080	143	409	827	115	--	PACE	--	
1/18/2002	--	39.08	17.22	--	21.86	3,900	442	241	157	681	85.3	--	PACE	--	
8/1/2002	--	39.08	--	--	--	--	--	--	--	--	--	--	--	--	f
1/16/2003	--	39.08	16.85	--	22.23	2,900	260	160	120	590	<120	--	SEQ	--	p
7/7/2003	--	39.08	17.94	--	21.14	600	90	7.9	18	36	56	--	SEQ	--	q
02/05/2004	--	39.08	16.94	--	22.14	420	40	3.1	15	27	40	--	SEQM	6.8	
07/01/2004	P	39.08	18.24	--	20.84	6,000	970	200	310	1,500	64	--	SEQM	6.7	

Table 1. Summary of Ground-Water Monitoring Data: Relative Water Elevations and Laboratory Analyses
Station #11133, 2220 98th Ave., Oakland, CA

Well and Sample Date	P/NP	TOC Elevation (feet msl)	Depth to Water (feet bgs)	Product Thickness (feet)	Water Level Elevation (feet msl)	Concentrations in (µg/L)						DO (mg/L)	Lab	pH	Comments
						GRO/TPHg	Benzene	Toluene	Ethyl-Benzene	Total Xylenes	MTBE				
AW-4 Cont.															
03/16/2005	P	39.08	16.16	--	22.92	3,600	71	31	200	870	23	0.6	SEQM	6.5	
07/22/2005	P	39.08	15.89	--	23.19	4,800	750	48	300	840	59	--	SEQM	6.7	
01/25/2006	P	39.08	15.48	--	23.60	<500	13	<5.0	14	62	12	--	SEQM	7.0	
7/6/2006	P	39.08	14.87	--	24.21	2,800	430	21	230	680	39	--	TAMC	6.7	
1/8/2007	P	39.08	16.48	--	22.60	190	6.6	<0.50	4.1	14	38	3.00	TAMC	6.80	
7/10/2007	P	39.08	17.95	--	21.13	160	2.7	<0.50	0.90	1.0	27	2.54	TAMC	7.19	
1/15/2008	P	39.08	17.70	--	21.38	150	<0.50	<0.50	0.71	<0.50	17	1.30	TAMC	6.75	
7/15/2008	P	39.08	18.74	--	20.34	250	44	1.1	44	78	25	2.64	CEL	6.91	
10/21/2008	P	39.08	20.07	--	19.01	270	1.6	<1.0	<1.0	<1.0	18	1.54	CEL	7.25	
AW-5															
4/5/1991	--	38.51	25.48	--	13.03	420	31	7.5	20	68	--	--	SUP	--	
4/1/1992	--	38.51	23.95	--	14.56	--	--	--	--	--	--	--	--	--	
4/2/1992	--	38.51	--	--	--	4,000	270	63	190	290	--	--	APP	--	
7/6/1992	--	38.51	26.48	--	12.03	1,400	160	<2.5	250	58	--	--	ANA	--	
10/7/1992	--	38.51	28.18	--	10.33	360	12	0.6	8.7	5	--	--	ANA	--	
1/14/1993	--	38.51	24.15	--	14.36	1,700	270	7.5	130	62	--	--	PACE	--	m
4/22/1993	--	38.51	22.43	--	16.08	2,700	780	30	220	180	--	--	PACE	--	m
4/22/1993	--	38.51	--	--	--	3,500	780	29	240	210	--	--	PACE	--	m, e
7/15/1993	--	38.51	24.31	--	14.20	1,300	69	16	67	120	<50	--	PACE	--	m
7/15/1993	--	38.51	--	--	--	1,300	68	8.3	64	99	<50	--	PACE	--	m, e
10/21/1993	--	38.51	26.05	--	12.46	510	9.6	1.5	17	45	75	--	PACE	--	c, m
1/27/1994	--	38.51	26.42	--	12.09	420	3.3	<0.5	1	0.9	48.9	--	PACE	--	m
4/21/1994	--	38.51	24.36	--	14.15	1,000	110	25	56	27	75	1.3	PACE	--	c, m
9/9/1994	--	38.51	24.55	--	13.96	210	<0.5	<0.5	0.5	0.9	--	2.7	PACE	--	m
12/21/1994	--	38.51	22.30	--	16.21	410	<0.5	20	4.3	1.4	114	1.1	PACE	--	m
12/21/1994	--	38.51	--	--	--	340	<0.5	15	3.3	1.4	104	--	PACE	--	m, e
1/30/1995	--	38.51	18.88	--	19.63	210	0.6	11	8.8	2	--	1.5	ATI	--	
4/10/1995	--	38.51	18.44	--	20.07	500	1.4	0.59	6.5	4.3	--	8.3	ATI	--	
6/29/1995	--	38.51	19.92	--	18.59	490	1.2	0.58	7.3	2.2	--	6.9	ATI	--	d
9/18/1995	--	38.51	22.15	--	16.36	--	--	--	--	--	--	--	--	--	

Table 1. Summary of Ground-Water Monitoring Data: Relative Water Elevations and Laboratory Analyses
Station #11133, 2220 98th Ave., Oakland, CA

Well and Sample Date	P/NP	TOC Elevation (feet msl)	Depth to Water (feet bgs)	Product Thickness (feet)	Water Level Elevation (feet msl)	Concentrations in (µg/L)						DO (mg/L)	Lab	pH	Comments
						GRO/TPHg	Benzene	Toluene	Ethyl-Benzene	Total Xylenes	MTBE				
AW-5 Cont.															
9/19/1995	--	38.51	--	--	--	260	0.62	<0.50	3.1	1.1	110	8.2	ATI	--	
12/7/1995	--	38.51	23.75	--	14.76	60	<0.50	<0.50	<0.50	<1.0	210	4.3	ATI	--	
3/28/1996	--	38.51	17.76	--	20.75	<50	<0.5	<1	<1	<1	63	3.0	SPL	--	
6/20/1996	--	38.51	18.46	--	20.05	<50	<0.5	<1	<1	<1	<10	3.6	SPL	--	
10/11/1996	--	38.51	21.84	--	16.67	<50	<0.5	<1.0	<1.0	<1.0	<10	4.5	SPL	--	
1/2/1997	--	38.51	18.01	--	20.50	<50	<0.5	<1.0	<1.0	<1.0	<10	4.6	SPL	--	
4/14/1997	--	38.51	19.35	--	19.16	<50	<0.5	<1.0	<1.0	<1.0	<10	5.1	SPL	--	
7/2/1997	--	38.51	20.29	--	18.22	<50	<0.5	<1.0	<1.0	<1.0	<10	4.0	SPL	--	
9/30/1997	--	38.51	23.15	--	15.36	<250	<2.5	<5.0	<5.0	<5.0	1,300	6.3	SPL	--	
1/21/1998	--	38.51	17.33	--	21.18	6,100	<0.5	2.1	<1.0	<1.0	3,700	4.5	SPL	--	
4/9/1998	--	38.51	15.25	--	23.26	--	--	--	--	--	--	--	--	--	
4/10/1998	--	38.51	--	--	--	3,500	<0.5	<1.0	<1.0	<1.0	3,000	5.4	SPL	--	
6/19/1998	--	38.51	17.39	--	21.12	3,300	<0.5	<1.0	<1.0	<1.0	2,500	5.2	SPL	--	
11/30/1998	--	38.51	--	--	--	--	--	--	--	--	--	--	--	--	f
1/21/1999	--	38.51	21.22	--	17.29	2,800	<1.0	<1.0	<1.0	<1.0	1,800	--	SPL	--	
4/30/1999	--	38.51	21.50	--	17.01	--	--	--	--	--	--	--	--	--	
7/9/1999	--	38.51	20.15	--	18.36	4,000	<1.0	<1.0	<1.0	<1.0	3400/3500	--	SPL	--	g
11/3/1999	--	38.51	22.04	--	16.47	--	--	--	--	--	--	--	--	--	
1/12/2000	--	38.51	22.59	--	15.92	1,000	7.3	30	6.7	40	4,600	--	PACE	--	j (TPH-g/GRO)
4/13/2000	--	38.51	23.11	--	15.40	--	--	--	--	--	--	--	--	--	
7/26/2000	--	38.51	22.72	--	15.79	1,800	94	35	5.9	27	16,000	--	PACE	--	
10/24/2000	--	38.51	20.15	--	18.36	--	--	--	--	--	--	--	--	--	
1/19/2001	--	38.51	19.79	--	18.72	2,600	<0.5	<0.5	<0.5	<0.5	4,580	--	PACE	--	
7/24/2001	--	38.51	20.17	--	18.34	5,400	18.4	17.2	<12.5	40.8	5,170	--	PACE	--	
1/18/2002	--	38.51	17.34	--	21.17	3,800	343	0.738	<0.5	<1.0	3,750	--	PACE	--	
8/1/2002	--	38.51	19.49	--	19.02	5,300	<12.5	<12.5	<12.5	<25	3,470	--	PACE	--	
1/16/2003	--	38.51	17.30	--	21.21	1,400	140	<10	<10	<10	1,600	--	SEQ	--	p
7/7/2003	--	38.51	18.43	--	20.08	1,400	<10	<10	<10	<10	980	--	SEQ	--	q
02/05/2004	--	38.51	17.24	--	21.27	1,800	<10	<10	<10	<10	810	--	SEQM	6.7	
07/01/2004	P	38.51	19.43	--	19.08	1,100	<5.0	<5.0	<5.0	<5.0	550	--	SEQM	6.6	
03/16/2005	P	38.51	15.30	--	23.21	<5,000	<50	<50	<50	130	890	2.1	SEQM	6.7	

Table 1. Summary of Ground-Water Monitoring Data: Relative Water Elevations and Laboratory Analyses

Station #11133, 2220 98th Ave., Oakland, CA

Well and Sample Date	P/NP	TOC Elevation (feet msl)	Depth to Water (feet bgs)	Product Thickness (feet)	Water Level Elevation (feet msl)	Concentrations in (µg/L)						DO (mg/L)	Lab	pH	Comments
						GRO/TPHg	Benzene	Toluene	Ethyl-Benzene	Total Xylenes	MTBE				
AW-5 Cont.															
07/22/2005	P	38.51	17.22	--	21.29	<500	5.2	<5.0	<5.0	6.9	390	--	SEQM	6.6	
01/25/2006	P	38.51	15.28	--	23.23	<500	<5.0	<5.0	<5.0	<5.0	26	--	SEQM	7.0	
7/6/2006	P	38.51	15.93	--	22.58	220	<5.0	<5.0	<5.0	<5.0	170	--	TAMC	6.5	
1/8/2007	P	38.51	17.90	--	20.61	170	<2.5	<2.5	<2.5	<2.5	220	5.22	TAMC	6.84	
7/10/2007	P	38.51	19.00	--	19.51	350	<2.5	<2.5	<2.5	<2.5	360	1.96	TAMC	7.02	
1/15/2008	P	38.51	18.16	--	20.35	130	0.54	<0.50	<0.50	<0.50	85	0.90	TAMC	6.82	w
7/15/2008	P	38.51	19.88	--	18.63	100	<0.50	<0.50	<0.50	<0.50	11	2.13	CEL	6.85	
10/21/2008	P	38.51	20.88	--	17.63	86	<0.50	<0.50	<0.50	<0.50	63	1.01	CEL	7.10	
AW-6															
4/5/1991	--	37.08	22.48	--	14.60	1,100	80	19	1.4	230	--	--	SUP	--	
4/1/1992	--	37.08	22.50	--	14.58	--	--	--	--	--	--	--	--	--	
4/2/1992	--	37.08	--	--	--	<50	<0.5	<0.5	<0.5	<0.5	--	--	APP	--	
7/6/1992	--	37.08	22.74	--	14.34	<50	<0.5	<0.5	<0.5	<0.5	--	--	ANA	--	
10/7/1992	--	37.08	24.64	--	12.44	<50	<0.5	<0.5	<0.5	<0.5	--	--	ANA	--	
1/14/1993	--	37.08	22.36	--	14.72	<50	<0.5	<0.5	<0.5	<0.5	--	--	PACE	--	m
4/22/1993	--	37.08	22.82	--	14.26	<50	<0.5	<0.5	<0.5	<0.5	--	--	PACE	--	m
7/15/1993	--	37.08	20.49	--	16.59	<50	<0.5	<0.5	<0.5	0.8	<5.0	--	PACE	--	m
10/21/1993	--	37.08	22.84	--	14.24	<50	0.5	0.6	<0.5	0.7	<5.0	--	PACE	--	m
1/27/1994	--	37.08	22.33	--	14.75	<50	<0.5	0.9	3.1	12	<5.0	--	PACE	--	m
4/21/1994	--	37.08	20.66	--	16.42	<50	<0.5	<0.5	<0.5	<0.5	<5.0	1.7	PACE	--	m
9/9/1994	--	37.08	21.57	--	15.51	<50	0.9	<0.5	<0.5	0.5	--	2.9	PACE	--	m
12/21/1994	--	37.08	19.40	--	17.68	<50	1.8	0.8	0.8	3.2	5.19	1.1	PACE	--	m
1/30/1995	--	37.08	--	--	--	<50	<0.50	<0.50	<0.50	<1.0	--	--	ATI	--	e
1/30/1995	--	37.08	16.74	--	20.34	<50	<0.50	<0.50	<0.50	<1.0	--	2.2	ATI	--	
4/10/1995	--	37.08	16.01	--	21.07	<50	<0.50	<0.50	<0.50	<1.0	--	8.6	ATI	--	
6/29/1995	--	37.08	17.54	--	19.54	<50	<0.50	<0.50	<0.50	<1.0	--	6.3	ATI	--	
9/18/1995	--	37.08	19.65	--	17.43	--	--	--	--	--	--	--	--	--	
9/19/1995	--	37.08	--	--	--	<50	<0.50	<0.50	<0.50	<1.0	25	8.3	ATI	--	
12/7/1995	--	37.08	20.35	--	16.73	<50	<0.50	<0.50	<0.50	<1.0	16	4.7	ATI	--	
3/28/1996	--	37.08	14.99	--	22.09	<50	<0.5	<1	<1	<1	<10	4.0	SPL	--	

Table 1. Summary of Ground-Water Monitoring Data: Relative Water Elevations and Laboratory Analyses
Station #11133, 2220 98th Ave., Oakland, CA

Well and Sample Date	P/NP	TOC Elevation (feet msl)	Depth to Water (feet bgs)	Product Thickness (feet)	Water Level Elevation (feet msl)	Concentrations in (µg/L)						DO (mg/L)	Lab	pH	Comments
						GRO/TPHg	Benzene	Toluene	Ethyl-Benzene	Total Xylenes	MTBE				
AW-6 Cont.															
6/20/1996	--	37.08	15.59	--	21.49	<50	<0.5	<1	<1	<1	<10	4.6	SPL	--	
10/11/1996	--	37.08	19.09	--	17.99	<50	<0.5	<1.0	<1.0	<1.0	<10	5.3	SPL	--	
1/2/1997	--	37.08	15.11	--	21.97	<50	<0.5	<1.0	<1.0	<1.0	<10	5.5	SPL	--	
4/14/1997	--	37.08	16.25	--	20.83	<50	<0.5	<1.0	<1.0	<1.0	<10	3.9	SPL	--	
7/2/1997	--	37.08	17.99	--	19.09	<50	<0.5	<1.0	<1.0	<1.0	<10	5.2	SPL	--	
9/30/1997	--	37.08	20.50	--	16.58	<50	<0.5	<1.0	<1.0	<1.0	<10	6.0	SPL	--	
1/21/1998	--	37.08	15.72	--	21.36	160	<0.5	<1.0	<1.0	<1.0	110	5.0	SPL	--	
4/9/1998	--	37.08	13.31	--	23.77	--	--	--	--	--	--	--	--	--	
4/10/1998	--	37.08	--	--	--	370	<0.5	<1.0	<1.0	<1.0	300	4.3	SPL	--	
6/19/1998	--	37.08	15.18	--	21.90	830	2	<1.0	<1.0	<1.0	690	4.0	SPL	--	
11/30/1998	--	37.08	--	--	--	--	--	--	--	--	--	--	--	--	f
1/21/1999	--	37.08	15.78	--	21.30	2,300	<1.0	<1.0	<1.0	<1.0	1,900	--	SPL	--	
4/30/1999	--	37.08	16.01	--	21.07	--	--	--	--	--	--	--	--	--	
7/9/1999	--	37.08	17.63	--	19.45	--	--	--	--	--	--	--	--	--	
11/3/1999	--	37.08	18.42	--	18.66	--	--	--	--	--	--	--	--	--	
1/12/2000	--	37.08	19.92	--	17.16	<50	<0.5	<0.5	<0.5	<0.5	2,700	--	PACE	--	
4/13/2000	--	37.08	19.87	--	17.21	--	--	--	--	--	--	--	--	--	
7/26/2000	--	37.08	19.99	--	17.09	--	--	--	--	--	--	--	--	--	
10/24/2000	--	37.08	18.12	--	18.96	--	--	--	--	--	--	--	--	--	
1/19/2001	--	37.08	17.04	--	20.04	2,700	<0.5	<0.5	<0.5	<0.5	4,850	--	PACE	--	
7/24/2001	--	37.08	17.83	--	19.25	--	--	--	--	--	--	--	--	--	
1/18/2002	--	37.08	15.54	--	21.54	5,500	614	<0.5	<0.5	<1.0	5,390	--	PACE	--	
8/1/2002	--	37.08	16.98	--	20.10	--	--	--	--	--	--	--	--	--	
1/16/2003	--	37.08	15.05	--	22.03	2,900	<20	<20	<20	63	2,500	--	SEQ	--	p
7/7/2003	--	37.08	16.58	--	20.50	--	--	--	--	--	--	--	--	--	
02/05/2004	--	37.08	15.84	--	21.24	7,000	<50	<50	<50	<50	5,400	--	SEQM	6.7	
07/01/2004	P	37.08	17.91	--	19.17	9,600	<50	<50	<50	<50	4,600	--	SEQM	6.5	
03/16/2005	P	37.08	16.04	--	21.04	6,700	<25	<25	<25	<25	4,400	3.0	SEQM	6.8	
07/22/2005	P	37.08	14.20	--	22.88	<5,000	<50	<50	<50	<50	5,500	--	SEQM	6.7	
01/25/2006	P	37.08	14.17	--	22.91	<5,000	<50	<50	<50	<50	3,000	--	SEQM	7.0	
7/6/2006	P	37.08	14.82	--	22.26	3,100	<50	<50	<50	<50	2,800	--	TAMC	6.5	

Table 1. Summary of Ground-Water Monitoring Data: Relative Water Elevations and Laboratory Analyses
Station #11133, 2220 98th Ave., Oakland, CA

Well and Sample Date	P/NP	TOC Elevation (feet msl)	Depth to Water (feet bgs)	Product Thickness (feet)	Water Level Elevation (feet msl)	Concentrations in (µg/L)						DO (mg/L)	Lab	pH	Comments
						GRO/TPHg	Benzene	Toluene	Ethyl-Benzene	Total Xylenes	MTBE				
AW-6 Cont.															
1/8/2007	P	37.08	15.72	--	21.36	5100	<50	<50	<50	<50	7400	3.18	TAMC	6.78	
7/10/2007	P	37.08	16.99	--	20.09	3,700	<100	<100	<100	<100	3,900	2.09	TAMC	6.83	w
1/15/2008	P	37.08	15.55	--	21.53	120	1.1	<1.0	<1.0	<1.0	150	0.58	TAMC	6.80	w
7/15/2008	P	37.08	17.84	--	19.24	130	<0.50	<0.50	<0.50	<0.50	270	2.12	CEL	6.87	
10/21/2008	P	37.08	18.92	--	18.16	81	<5.0	<5.0	<5.0	<5.0	160	1.01	CEL	7.19	
AW-7															
4/5/1991	--	37.60	23.38	--	14.22	<50	0.4	0.7	<0.3	<0.3	--	--	SUP	--	
4/1/1992	--	37.60	21.92	--	15.68	--	--	--	--	--	--	--	--	--	
4/2/1992	--	37.60	--	--	--	<50	<0.5	3.2	1	5.4	--	--	APP	--	
7/6/1992	--	37.60	24.50	--	13.10	<50	<0.5	<0.5	<0.5	<0.5	--	--	ANA	--	
10/7/1992	--	37.60	26.18	--	11.42	<50	<0.5	<0.5	<0.5	<0.5	--	--	ANA	--	
1/14/1993	--	37.60	22.03	--	15.57	<50	<0.5	<0.5	<0.5	<0.5	--	--	PACE	--	m
4/22/1993	--	37.60	21.18	--	16.42	<50	<0.5	<0.5	<0.5	<0.5	--	--	PACE	--	m
7/15/1993	--	37.60	22.09	--	15.51	<50	<0.5	<0.5	<0.5	<0.5	<5.0	--	PACE	--	m
10/21/1993	--	37.60	24.05	--	13.55	51	5	4.2	3.5	8.2	<5.0	--	PACE	--	m
1/27/1994	--	37.60	23.40	--	14.20	<50	<0.5	<0.5	<0.5	<0.5	<5.0	--	PACE	--	m
4/21/1994	--	37.60	22.24	--	15.36	<50	<0.5	<0.5	<0.5	<0.5	<5.0	2.5	PACE	--	m
9/9/1994	--	37.60	22.94	--	14.66	<50	<0.5	<0.5	<0.5	0.5	--	4.3	PACE	--	m
12/21/1994	--	37.60	20.86	--	16.74	<50	<0.5	<0.5	<0.5	<0.5	<5.0	2.2	PACE	--	m
1/30/1995	--	37.60	17.51	--	20.09	<50	<0.50	<0.50	<0.50	<1.0	--	2.7	ATI	--	
4/10/1995	--	37.60	16.69	--	20.91	<50	<0.50	<0.50	<0.50	<1.0	--	4.8	ATI	--	
6/29/1995	--	37.60	18.33	--	19.27	<50	<0.50	<0.50	<0.50	<1.0	--	7.6	ATI	--	
9/18/1995	--	37.60	20.68	--	16.92	--	--	--	--	--	--	--	--	--	
9/19/1995	--	37.60	--	--	--	<50	<0.50	<0.50	<0.50	<1.0	<5.0	5.1	ATI	--	
12/7/1995	--	37.60	22.15	--	15.45	<50	<0.50	<0.50	<0.50	<1.0	<5.0	5.2	ATI	--	
3/28/1996	--	37.60	16.38	--	21.22	<50	<0.5	<1	<1	<1	<10	3.9	SPL	--	
6/20/1996	--	37.60	17.02	--	20.58	<50	<0.5	<1	<1	<1	<10	5.0	SPL	--	
10/11/1996	--	37.60	20.47	--	17.13	<50	<0.5	<1.0	<1.0	<1.0	<10	6.3	SPL	--	
1/2/1997	--	37.60	16.70	--	20.90	<50	<0.5	<1.0	<1.0	<1.0	<10	6.2	SPL	--	
4/14/1997	--	37.60	17.96	--	19.64	<50	<0.5	<1.0	<1.0	<1.0	<10	5.0	SPL	--	

Table 1. Summary of Ground-Water Monitoring Data: Relative Water Elevations and Laboratory Analyses
Station #11133, 2220 98th Ave., Oakland, CA

Well and Sample Date	P/NP	TOC Elevation (feet msl)	Depth to Water (feet bgs)	Product Thickness (feet)	Water Level Elevation (feet msl)	Concentrations in (µg/L)						DO (mg/L)	Lab	pH	Comments
						GRO/TPHg	Benzene	Toluene	Ethyl-Benzene	Total Xylenes	MTBE				
AW-7 Cont.															
7/2/1997	--	37.60	19.11	--	18.49	<50	<0.5	<1.0	<1.0	<1.0	<10	5.4	SPL	--	
9/30/1997	--	37.60	22.97	--	14.63	<250	<2.5	<5.0	<5.0	<5.0	1,100	6.5	SPL	--	
1/21/1998	--	37.60	16.50	--	21.10	<50	<0.5	<1.0	<1.0	<1.0	<10	4.9	SPL	--	
4/9/1998	--	37.60	13.56	--	24.04	<50	<0.5	<1.0	<1.0	<1.0	<10	4.9	SPL	--	
6/19/1998	--	37.60	15.41	--	22.19	<50	<0.5	<1.0	<1.0	<1.0	<10	4.4	SPL	--	
11/30/1998	--	37.60	18.90	--	18.70	--	--	--	--	--	--	--	--	--	
1/21/1999	--	37.60	18.39	--	19.21	--	--	--	--	--	--	--	--	--	
4/30/1999	--	37.60	18.54	--	19.06	--	--	--	--	--	--	--	--	--	
7/9/1999	--	37.60	17.98	--	19.62	--	--	--	--	--	--	--	--	--	
11/3/1999	--	37.60	20.22	--	17.38	--	--	--	--	--	--	--	--	--	
1/12/2000	--	37.60	19.46	--	18.14	--	--	--	--	--	--	--	--	--	
4/13/2000	--	37.60	19.59	--	18.01	--	--	--	--	--	--	--	--	--	
7/26/2000	--	37.60	19.69	--	17.91	--	--	--	--	--	--	--	--	--	
10/24/2000	--	37.60	18.78	--	18.82	--	--	--	--	--	--	--	--	--	
1/19/2001	--	37.60	--	--	--	--	--	--	--	--	--	--	--	--	f
7/25/2001	--	37.60	--	--	--	--	--	--	--	--	--	--	--	--	f
1/18/2002	--	37.60	--	--	--	--	--	--	--	--	--	--	--	--	o
8/1/2002	--	37.60	--	--	--	--	--	--	--	--	--	--	--	--	o
1/16/2003	--	37.60	--	--	--	--	--	--	--	--	--	--	--	--	o
7/7/2003	--	37.60	--	--	--	--	--	--	--	--	--	--	--	--	o
02/05/2004	--	37.60	--	--	--	--	--	--	--	--	--	--	--	--	o
07/01/2004	--	37.60	--	--	--	--	--	--	--	--	--	--	--	--	o
03/16/2005	--	37.60	--	--	--	--	--	--	--	--	--	--	--	--	o
07/22/2005	--	37.60	--	--	--	--	--	--	--	--	--	--	--	--	o
01/25/2006	--	37.60	--	--	--	--	--	--	--	--	--	--	--	--	o
AW-8															
4/5/1991	--	40.86	26.68	--	14.18	80	1.9	2.2	0.5	1.3	--	--	SUP	--	
4/1/1992	--	40.86	25.11	--	15.75	73	<0.5	0.7	<0.5	0.6	--	--	APP	--	
7/6/1992	--	40.86	26.43	--	14.43	<50	<0.5	<0.5	<0.5	<0.5	--	--	ANA	--	
10/7/1992	--	40.86	28.59	--	12.27	<50	<0.5	<0.5	<0.5	<0.5	--	--	ANA	--	

Table 1. Summary of Ground-Water Monitoring Data: Relative Water Elevations and Laboratory Analyses

Station #11133, 2220 98th Ave., Oakland, CA

Well and Sample Date	P/NP	TOC Elevation (feet msl)	Depth to Water (feet bgs)	Product Thickness (feet)	Water Level Elevation (feet msl)	Concentrations in (µg/L)						DO (mg/L)	Lab	pH	Comments
						GRO/TPHg	Benzene	Toluene	Ethyl-Benzene	Total Xylenes	MTBE				
AW-8 Cont.															
1/14/1993	--	40.86	25.55	--	15.31	<50	<0.5	<0.5	<0.5	<0.5	--	--	PACE	--	m
4/22/1993	--	40.86	22.29	--	18.57	<50	<0.5	<0.5	<0.5	<0.5	--	--	PACE	--	m
7/15/1993	--	40.86	23.42	--	17.44	<50	<0.5	<0.5	<0.5	<0.5	<5.0	--	PACE	--	m
10/21/1993	--	40.86	25.15	--	15.71	<50	1.9	1.8	1.3	3.3	<5.0	--	PACE	--	m
1/27/1994	--	40.86	25.42	--	15.44	<50	<0.5	0.5	0.6	8.5	<5.0	--	PACE	--	m
4/21/1994	--	40.86	24.14	--	16.72	<50	<0.5	<0.5	<0.5	<0.5	<5.0	1.5	PACE	--	m
9/9/1994	--	40.86	24.55	--	16.31	<50	<0.5	<0.5	<0.5	<0.5	--	2.4	PACE	--	m
12/21/1994	--	40.86	22.72	--	18.14	<50	<0.5	<0.5	<0.5	<0.5	<5.0	1.1	PACE	--	m
1/30/1995	--	40.86	19.75	--	21.11	<50	<0.50	1	<0.50	1	--	0.8	ATI	--	
4/10/1995	--	40.86	17.78	--	23.08	<50	<0.50	<0.50	<0.50	<1.0	--	8.3	ATI	--	
6/29/1995	--	40.86	18.18	--	22.68	<50	<0.50	<0.50	<0.50	<1.0	--	8.3	ATI	--	
9/18/1995	--	40.86	20.20	--	20.66	--	--	--	--	--	--	--	--	--	
9/19/1995	--	40.86	--	--	--	<50	<0.50	<0.50	<0.50	<1.0	<5.0	7.7	ATI	--	
12/7/1995	--	40.86	21.54	--	19.32	<50	<0.50	<0.50	<0.50	<1.0	<5.0	4.4	ATI	--	
3/28/1996	--	40.86	15.77	--	25.09	<50	<0.5	<1	<1	<1	<10	3.8	SPL	--	
6/20/1996	--	40.86	16.41	--	24.45	<50	<0.5	<1	<1	<1	<10	3.6	SPL	--	
10/11/1996	--	40.86	19.90	--	20.96	<50	<0.5	<1.0	<1.0	<1.0	<10	6.4	SPL	--	
1/2/1997	--	40.86	15.89	--	24.97	<50	<0.5	<1.0	<1.0	<1.0	<10	5.9	SPL	--	
4/14/1997	--	40.86	17.07	--	23.79	<50	<0.5	<1.0	<1.0	<1.0	<10	4.6	SPL	--	
7/2/1997	--	40.86	18.67	--	22.19	<50	<0.5	<1.0	<1.0	<1.0	<10	5.6	SPL	--	
9/30/1997	--	40.86	22.52	--	18.34	<50	<5	<10	<10	<10	820	6.7	SPL	--	
1/21/1998	--	40.86	16.01	--	24.85	<50	<0.5	<1.0	<1.0	<1.0	<10	5.2	SPL	--	
4/9/1998	--	40.86	11.18	--	29.68	<50	<0.5	<1.0	<1.0	<1.0	<10	4.4	SPL	--	
6/19/1998	--	40.86	13.01	--	27.85	<50	<0.5	<1.0	<1.0	<1.0	<10	4.1	SPL	--	
11/30/1998	--	40.86	17.46	--	23.40	--	--	--	--	--	--	--	--	--	
1/21/1999	--	40.86	17.47	--	23.39	--	--	--	--	--	--	--	--	--	
4/30/1999	--	40.86	17.60	--	23.26	--	--	--	--	--	--	--	--	--	
7/9/1999	--	40.86	16.50	--	24.36	--	--	--	--	--	--	--	--	--	
11/3/1999	--	40.86	19.29	--	21.57	--	--	--	--	--	--	--	--	--	
1/12/2000	--	40.86	21.49	--	19.37	--	--	--	--	--	--	--	--	--	
4/13/2000	--	40.86	21.60	--	19.26	--	--	--	--	--	--	--	--	--	

Table 1. Summary of Ground-Water Monitoring Data: Relative Water Elevations and Laboratory Analyses
Station #11133, 2220 98th Ave., Oakland, CA

Well and Sample Date	P/NP	TOC Elevation (feet msl)	Depth to Water (feet bgs)	Product Thickness (feet)	Water Level Elevation (feet msl)	Concentrations in (µg/L)						DO (mg/L)	Lab	pH	Comments
						GRO/TPHg	Benzene	Toluene	Ethyl-Benzene	Total Xylenes	MTBE				
AW-8 Cont.															
7/26/2000	--	40.86	21.53	--	19.33	--	--	--	--	--	--	--	--	--	
10/24/2000	--	40.86	19.37	--	21.49	--	--	--	--	--	--	--	--	--	
1/19/2001	--	40.86	18.60	--	22.26	--	--	--	--	--	--	--	--	--	
7/24/2001	--	40.86	18.22	--	22.64	--	--	--	--	--	--	--	--	--	
1/18/2002	--	40.86	16.29	--	24.57	--	--	--	--	--	--	--	--	--	
8/1/2002	--	40.86	17.25	--	23.61	--	--	--	--	--	--	--	--	--	
1/16/2003	--	40.86	15.82	--	25.04	--	--	--	--	--	--	--	--	--	
7/7/2003	--	40.86	18.55	--	22.31	--	--	--	--	--	--	--	--	--	
02/05/2004	--	40.86	--	--	--	--	--	--	--	--	--	--	--	--	t
07/01/2004	--	40.86	18.25	--	22.61	--	--	--	--	--	--	--	--	--	t
03/16/2005	P	40.86	15.20	--	25.66	<50	<0.50	<0.50	<0.50	<0.50	<0.50	1.5	SEQM	7.3	
07/22/2005	--	40.86	--	--	--	--	--	--	--	--	--	--	--	--	f
01/25/2006	--	40.86	--	--	--	--	--	--	--	--	--	--	--	--	f
7/6/2006	--	40.86	13.05	--	27.81	--	--	--	--	--	--	--	--	--	
1/8/2007	--	40.86	16.57	--	24.29	--	--	--	--	--	--	--	--	--	
7/10/2007	--	40.86	17.73	--	23.13	--	--	--	--	--	--	--	--	--	
1/15/2008	--	40.86	17.88	--	22.98	--	--	--	--	--	--	--	--	--	
7/15/2008	--	40.86	18.57	--	22.29	--	--	--	--	--	--	--	--	--	
10/21/2008	--	40.86	20.09	--	20.77	--	--	--	--	--	--	--	--	--	
AW-9															
1/2/1997	--	37.78	10.00	--	27.78	<50	<0.5	<1.0	<1.0	<1.0	<10	6.7	SPL	--	
4/14/1997	--	37.78	--	--	--	--	--	--	--	--	--	--	--	--	f
7/2/1997	--	37.78	12.71	--	25.07	<50	<0.5	<1.0	<1.0	<1.0	<10	6.0	SPL	--	
9/30/1997	--	37.78	21.22	--	16.56	<50	<0.5	<1.0	<1.0	<1.0	<10	6.8	SPL	--	
1/21/1998	--	37.78	10.26	--	27.52	<50	<0.5	<1.0	<1.0	<1.0	<10	5.3	SPL	--	
4/9/1998	--	37.78	6.77	--	31.01	<50	<0.5	<1.0	<1.0	<1.0	<10	5.6	SPL	--	
6/19/1998	--	37.78	8.96	--	28.82	<50	<0.5	<1.0	<1.0	<1.0	<10	4.8	SPL	--	
1/8/2007	--	37.78	17.35	--	20.43	--	--	--	--	--	--	--	--	--	
7/10/2007	--	37.78	18.65	--	19.13	--	--	--	--	--	--	--	--	--	
1/15/2008	--	37.78	18.51	--	19.27	--	--	--	--	--	--	--	--	--	

Table 1. Summary of Ground-Water Monitoring Data: Relative Water Elevations and Laboratory Analyses
Station #11133, 2220 98th Ave., Oakland, CA

Well and Sample Date	P/NP	TOC Elevation (feet msl)	Depth to Water (feet bgs)	Product Thickness (feet)	Water Level Elevation (feet msl)	Concentrations in (µg/L)						DO (mg/L)	Lab	pH	Comments
						GRO/TPHg	Benzene	Toluene	Ethyl-Benzene	Total Xylenes	MTBE				
AW-9 Cont.															
7/15/2008	--	37.78	19.56	--	18.22	--	--	--	--	--	--	--	--	--	
10/21/2008	--	37.78	21.07	--	16.71	--	--	--	--	--	--	--	--	--	
MW-1															
4/5/1991	--	34.46	--	--	--	--	--	--	--	--	--	--	--	--	
4/1/1992	--	34.46	11.25	--	23.21	--	--	--	--	--	--	--	--	--	
7/6/1992	--	34.46	13.61	--	20.85	--	--	--	--	--	--	--	--	--	
10/7/1992	--	34.46	15.15	--	19.31	--	--	--	--	--	--	--	--	--	
1/14/1993	--	34.46	10.73	--	23.73	--	--	--	--	--	--	--	--	--	
4/22/1993	--	34.46	11.64	--	22.82	--	--	--	--	--	--	--	--	--	
7/15/1993	--	34.46	13.50	--	20.96	--	--	--	--	--	--	--	--	--	
10/21/1993	--	34.46	15.21	--	19.25	--	--	--	--	--	--	--	--	--	
1/27/1994	--	34.46	17.48	--	16.98	--	--	--	--	--	--	--	--	--	
4/21/1994	--	34.46	10.94	--	23.52	110,000	1,400	9,100	3,400	30,000	11,000	1.6	PACE	--	c
9/9/1994	--	34.46	13.80	--	20.66	--	--	--	--	--	--	--	--	--	
12/21/1994	--	34.46	12.60	--	21.86	--	--	--	--	--	--	--	--	--	
1/30/1995	--	34.46	--	--	--	--	--	--	--	--	--	--	--	--	
4/10/1995	--	34.46	10.62	--	23.84	--	--	--	--	--	--	--	--	--	
6/29/1995	--	34.46	18.72	--	15.74	--	--	--	--	--	--	--	--	--	
9/18/1995	--	34.46	12.92	--	21.54	--	--	--	--	--	--	--	--	--	
12/7/1995	--	34.46	13.82	--	20.64	--	--	--	--	--	--	--	--	--	
3/28/1996	--	34.46	10.03	--	24.43	--	--	--	--	--	--	--	--	--	
6/20/1996	--	34.46	11.29	--	23.17	--	--	--	--	--	--	--	--	--	
10/11/1996	--	34.46	14.86	--	19.60	--	--	--	--	--	--	--	--	--	
1/2/1997	--	34.46	11.03	--	23.43	--	--	--	--	--	--	--	--	--	
4/14/1997	--	34.46	12.25	--	22.21	--	--	--	--	--	--	--	--	--	
4/15/1997	--	34.46	--	--	--	35,000	130	650	1,700	8,200	4,800	--	SPL	--	
7/2/1997	--	34.46	14.11	--	20.35	42,000	<250	<500	2,000	9,600	<5000	5.5	SPL	--	
9/30/1997	--	34.46	14.40	--	20.06	61,000	130	1,100	2,700	14,600	2,000	6.7	SPL	--	
1/21/1998	--	34.46	7.99	--	26.47	14,000	11	60	310	1,790	1,300	4.5	SPL	--	
4/9/1998	--	34.46	7.89	--	26.57	--	--	--	--	--	--	--	--	--	

Table 1. Summary of Ground-Water Monitoring Data: Relative Water Elevations and Laboratory Analyses

Station #11133, 2220 98th Ave., Oakland, CA

Well and Sample Date	P/NP	TOC Elevation (feet msl)	Depth to Water (feet bgs)	Product Thickness (feet)	Water Level Elevation (feet msl)	Concentrations in (µg/L)						DO (mg/L)	Lab	pH	Comments
						GRO/TPHg	Benzene	Toluene	Ethyl-Benzene	Total Xylenes	MTBE				
MW-1 Cont.															
4/10/1998	--	34.46	--	--	--	45,000	380	520	2,100	6,800	9,300	5.3	SPL	--	
6/19/1998	--	34.46	10.31	--	24.15	35,000	170	100	1,100	3,590	5,000	4.9	SPL	--	
11/30/1998	--	34.46	11.16	--	23.30	10,000	100	24	350	1,040	1800/2800	--	SPL	--	g
1/21/1999	--	34.46	10.76	--	23.70	18,000	120	37	590	1,800	2,700	--	SPL	--	
4/30/1999	--	34.46	10.78	--	23.68	17,000	240	89	1,100	1,900	1,600	--	SPL	--	
7/9/1999	--	34.46	12.62	--	21.84	58,000	140	100	1,800	6,900	1,200	--	SPL	--	
11/3/1999	--	34.46	14.00	--	20.46	20,000	62	42	620	2,100	630	--	PACE	--	
1/12/2000	--	34.46	15.25	--	19.21	72,000	110	120	2,400	8,200	630	--	PACE	--	
4/13/2000	--	34.46	15.57	--	18.89	37,000	300	32	1,000	1,700	810	--	PACE	--	
5/24/2000	--	34.46	11.75	--	22.71	--	--	--	--	--	--	--	--	--	
6/1/2000	--	34.46	11.41	--	23.05	--	--	--	--	--	--	--	--	--	
6/8/2000	--	34.46	11.68	--	22.78	--	--	--	--	--	--	--	--	--	
6/15/2000	--	34.46	11.85	--	22.61	--	--	--	--	--	--	--	--	--	
7/26/2000	--	34.46	16.19	--	18.27	10,000	480	210	470	710	1,100	--	PACE	--	
10/24/2000	--	34.46	13.89	--	20.57	9,900	31	7.2	550	1,200	4,400	--	PACE	--	
1/19/2001	--	34.46	12.90	--	21.56	57,000	199	7.66	1,170	3,260	514	--	PACE	--	
7/24/2001	--	34.46	13.55	--	20.91	27,000	96.7	<5.0	548	1,460	285	--	PACE	--	
1/18/2002	--	34.46	10.91	--	23.55	25,000	150	31.5	597	1,040	138	--	PACE	--	
8/1/2002	--	34.46	12.97	--	21.49	25,000	80.2	17.7	714	1,280	489	--	PACE	--	
1/16/2003	--	34.46	10.45	--	24.01	22,000	170	110	630	670	<500	--	SEQ	--	p
7/7/2003	--	34.46	12.40	--	22.06	9,900	42	<5.0	160	150	24	--	SEQ	--	q, u
02/05/2004	--	34.46	10.26	--	24.20	6,200	56	11	250	210	9.2	--	SEQM	6.9	
07/01/2004	--	34.46	13.20	--	21.26	18,000	<50	<50	210	300	<50	--	SEQM	--	u
03/16/2005	P	34.46	9.62	--	24.84	7,600	33	5.4	200	130	<5.0	0.9	SEQM	6.9	
07/22/2005	P	34.46	11.23	--	23.23	15,000	<10	<10	110	130	<10	--	SEQM	6.8	u
01/25/2006	P	34.46	8.75	--	25.71	8,300	8.4	4.8	130	120	<2.5	--	SEQM	7.3	u
7/6/2006	P	34.46	10.36	--	24.10	5,100	<2.5	<2.5	16	12	<2.5	--	TAMC	6.9	
1/8/2007	P	34.46	11.55	--	22.91	2700	4.6	0.66	35	27	2.1	1.83	TAMC	6.92	
7/10/2007	P	34.46	13.01	SHEEN	21.45	1,800	1.9	<0.50	13	4.8	2.4	2.16	TAMC	7.04	
1/15/2008	P	34.46	10.96	--	23.50	2,900	8.0	4.0	84	87	1.2	0.94	TAMC	7.13	
7/15/2008	P	34.46	13.82	--	20.64	3,200	<0.50	<0.50	8.5	4.8	<0.50	1.20	CEL	7.06	

Table 1. Summary of Ground-Water Monitoring Data: Relative Water Elevations and Laboratory Analyses

Station #11133, 2220 98th Ave., Oakland, CA

Well and Sample Date	P/NP	TOC Elevation (feet msl)	Depth to Water (feet bgs)	Product Thickness (feet)	Water Level Elevation (feet msl)	Concentrations in (µg/L)						DO (mg/L)	Lab	pH	Comments
						GRO/TPHg	Benzene	Toluene	Ethyl-Benzene	Total Xylenes	MTBE				
MW-1 Cont.															
10/21/2008	P	34.46	14.70	--	19.76	2,300	2.6	<0.50	5.4	2.4	<0.50	1.99	CEL	7.30	
MW-2															
4/5/1991	--	35.50	16.62	--	18.88	<50	0.6	0.9	<0.3	<0.3	--	--	SUP	--	
4/1/1992	--	35.50	11.25	--	24.25	--	--	--	--	--	--	--	--	--	
4/2/1992	--	35.50	--	--	--	<50	<0.5	<0.5	<0.5	<0.5	--	--	APP	--	
7/6/1992	--	35.50	12.72	--	22.78	<50	<0.5	<0.5	<0.5	<0.5	--	--	ANA	--	
10/7/1992	--	35.50	15.08	--	20.42	<50	<0.5	1.8	<0.5	2.3	--	--	ANA	--	
1/14/1993	--	35.50	9.69	--	25.81	<50	<0.5	<0.5	<0.5	<0.5	--	--	PACE	--	m
4/22/1993	--	35.50	10.46	--	25.04	<50	<0.5	<0.5	<0.5	<0.5	30	--	PACE	--	c
7/15/1993	--	35.50	12.02	--	23.48	<50	<0.5	<0.5	<0.5	<0.5	21.7	--	PACE	--	c, m
10/21/1993	--	35.50	13.12	--	22.38	<50	0.7	0.9	<0.5	0.9	14.9	--	PACE	--	m
1/27/1994	--	35.50	12.01	--	23.49	<50	0.6	<0.5	<0.5	<0.5	11.5	--	PACE	--	m
4/21/1994	--	35.50	10.60	--	24.90	<50	<0.5	<0.5	<0.5	<0.5	11.4	1.1	PACE	--	m
9/9/1994	--	35.50	12.42	--	23.08	<50	<0.5	<0.5	<0.5	0.6	--	2.2	PACE	--	m
12/21/1994	--	35.50	10.85	--	24.65	<50	<0.5	<0.5	<0.5	<0.5	<5.0	1.2	PACE	--	m
1/30/1995	--	35.50	8.38	--	27.12	<50	<0.50	<0.50	<0.50	<1.0	--	1.7	ATI	--	
4/10/1995	--	35.50	9.00	--	26.50	<50	<0.50	<0.50	<0.50	<1.0	--	7.8	ATI	--	
6/29/1995	--	35.50	9.91	--	25.59	<50	<0.50	<0.50	<0.50	<1.0	--	9.1	ATI	--	
9/18/1995	--	35.50	10.98	--	24.52	--	--	--	--	--	--	--	--	--	
9/19/1995	--	35.50	--	--	--	<50	<0.50	<0.50	<0.50	<1.0	<5.0	7.2	ATI	--	
12/7/1995	--	35.50	12.30	--	23.20	<50	<0.50	<0.50	<0.50	<1.0	<5.0	2.4	ATI	--	
3/28/1996	--	35.50	8.57	--	26.93	<50	<0.5	<1	<1	<1	<10	3.2	SPL	--	
6/20/1996	--	35.50	9.77	--	25.73	<50	<0.5	<1	<1	<1	<10	4.2	SPL	--	
10/11/1996	--	35.50	13.32	--	22.18	<50	<0.5	<1.0	<1.0	<1.0	<10	6.3	SPL	--	
1/2/1997	--	35.50	9.60	--	25.90	<50	<0.5	<1.0	<1.0	<1.0	<10	6.7	SPL	--	
4/14/1997	--	35.50	10.93	--	24.57	<50	<0.5	<1.0	<1.0	<1.0	<10	5.7	SPL	--	
7/2/1997	--	35.50	12.57	--	22.93	<50	<0.5	<1.0	<1.0	<1.0	<10	5.9	SPL	--	
9/30/1997	--	35.50	12.91	--	22.59	<50	<0.5	<1.0	<1.0	<1.0	<10	6.3	SPL	--	
1/21/1998	--	35.50	10.12	--	25.38	160	<0.5	<1.0	<1.0	<1.0	100	5.4	SPL	--	
4/9/1998	--	35.50	6.82	--	28.68	--	--	--	--	--	--	--	--	--	

Table 1. Summary of Ground-Water Monitoring Data: Relative Water Elevations and Laboratory Analyses

Station #11133, 2220 98th Ave., Oakland, CA

Well and Sample Date	P/NP	TOC Elevation (feet msl)	Depth to Water (feet bgs)	Product Thickness (feet)	Water Level Elevation (feet msl)	Concentrations in (µg/L)						DO (mg/L)	Lab	pH	Comments
						GRO/TPHg	Benzene	Toluene	Ethyl-Benzene	Total Xylenes	MTBE				
MW-2 Cont.															
4/10/1998	--	35.50	--	--	--	<50	1	<1.0	<1.0	<1.0	23	5.0	SPL	--	
6/19/1998	--	35.50	9.00	--	26.50	<50	<0.5	<1.0	<1.0	<1.0	<10	4.9	SPL	--	
11/30/1998	--	35.50	9.44	--	26.06	--	--	--	--	--	--	--	--	--	
1/21/1999	--	35.50	8.96	--	26.54	<50	<1.0	<1.0	<1.0	<1.0	1.9	--	SPL	--	
4/30/1999	--	35.50	9.15	--	26.35	--	--	--	--	--	--	--	--	--	
7/9/1999	--	35.50	10.82	--	24.68	--	--	--	--	--	--	--	--	--	
11/3/1999	--	35.50	11.86	--	23.64	--	--	--	--	--	--	--	--	--	
1/12/2000	--	35.50	12.35	--	23.15	<50	<0.5	<0.5	<0.5	<0.5	<0.5	--	PACE	--	
4/13/2000	--	35.50	13.01	--	22.49	--	--	--	--	--	--	--	--	--	
7/26/2000	--	35.50	13.01	--	22.49	--	--	--	--	--	--	--	--	--	
10/24/2000	--	35.50	11.57	--	23.93	--	--	--	--	--	--	--	--	--	
1/19/2001	--	35.50	10.52	--	24.98	--	--	--	--	--	--	--	--	--	
7/24/2001	--	35.50	11.13	--	24.37	--	--	--	--	--	--	--	--	--	
1/18/2002	--	35.50	8.85	--	26.65	--	--	--	--	--	--	--	--	--	
8/1/2002	--	35.50	10.47	--	25.03	--	--	--	--	--	--	--	--	--	
1/14/2003	--	35.50	8.49	--	27.01	--	--	--	--	--	--	--	--	--	
7/7/2003	--	35.50	9.63	--	25.87	--	--	--	--	--	--	--	--	--	
02/05/2004	--	35.50	8.40	--	27.10	--	--	--	--	--	--	--	--	--	
07/01/2004	NP	35.50	9.94	--	25.56	--	--	--	--	--	--	--	--	--	
03/16/2005	P	35.50	8.39	--	27.11	<50	<0.50	<0.50	<0.50	<0.50	<0.50	1.3	SEQM	7.1	
07/22/2005	--	35.50	8.80	--	26.70	--	--	--	--	--	--	--	--	--	
01/25/2006	--	35.50	7.85	--	27.65	--	--	--	--	--	--	--	--	--	
7/6/2006	--	35.50	8.33	--	27.17	--	--	--	--	--	--	--	--	--	
1/8/2007	--	35.50	9.35	--	26.15	--	--	--	--	--	--	--	--	--	
7/10/2007	--	35.50	10.45	--	25.05	--	--	--	--	--	--	--	--	--	
1/15/2008	--	35.50	18.83	--	16.67	--	--	--	--	--	--	--	--	--	
7/15/2008	--	35.50	11.07	--	24.43	--	--	--	--	--	--	--	--	--	
10/21/2008	--	35.50	11.30	--	24.20	--	--	--	--	--	--	--	--	--	
MW-3															
4/5/1991	--	36.53	17.84	--	18.69	<50	<0.3	<0.3	<0.3	<0.3	--	--	SUP	--	

Table 1. Summary of Ground-Water Monitoring Data: Relative Water Elevations and Laboratory Analyses

Station #11133, 2220 98th Ave., Oakland, CA

Well and Sample Date	P/NP	TOC Elevation (feet msl)	Depth to Water (feet bgs)	Product Thickness (feet)	Water Level Elevation (feet msl)	Concentrations in (µg/L)						DO (mg/L)	Lab	pH	Comments
						GRO/TPHg	Benzene	Toluene	Ethyl-Benzene	Total Xylenes	MTBE				
MW-3 Cont.															
4/1/1992	--	36.53	15.64	--	20.89	--	--	--	--	--	--	--	--	--	
4/2/1992	--	36.53	--	--	--	<50	1.4	<0.5	<0.5	<0.5	--	--	APP	--	
7/6/1992	--	36.53	19.03	--	17.50	<50	<0.5	<0.5	<0.5	<0.5	--	--	ANA	--	
10/7/1992	--	36.53	21.83	--	14.70	<50	<0.5	<0.5	<0.5	<0.5	--	--	ANA	--	
1/14/1993	--	36.53	15.96	--	20.57	350	<0.5	<0.5	<0.5	<0.5	714	--	PACE	--	c, m
4/22/1993	--	36.53	16.20	--	20.33	2,800	<0.5	<0.5	<0.5	<0.5	3,600	--	PACE	--	c, m
7/15/1993	--	36.53	16.82	--	19.71	1,400	1.2	<0.5	2	3.5	2,204	--	PACE	--	c, m
10/21/1993	--	36.53	18.84	--	17.69	370	2.1	2.3	2.3	6	847	--	PACE	--	c, m
1/27/1994	--	36.53	18.00	--	18.53	1,300	6.3	<0.5	<0.5	<0.5	3,892	--	PACE	--	c, m
4/21/1994	--	36.53	16.62	--	19.91	2,000	<0.5	<0.5	<0.5	<0.5	3,864	1.4	PACE	--	c, m
9/9/1994	--	36.53	18.38	--	18.15	1,300	<0.5	<0.5	0.5	1.2	--	3.0	PACE	--	m
12/21/1994	--	36.53	15.28	--	21.25	420	16	0.7	3.5	5.9	800	1.9	PACE	--	m
1/30/1995	--	36.53	12.62	--	23.91	<50	<0.50	<0.50	<0.50	<1.0	--	2.5	ATI	--	
4/10/1995	--	36.53	12.41	--	24.12	150	<0.50	<0.50	<0.50	<1.0	--	6.9	ATI	--	
6/29/1995	--	36.53	14.95	--	21.58	100	<0.50	<0.50	<0.50	<1.0	--	6.4	ATI	--	d (TPH-g)
9/18/1995	--	36.53	15.82	--	20.71	--	--	--	--	--	--	--	--	--	
9/19/1995	--	36.53	--	--	--	82	<0.50	<0.50	<0.50	<1.0	260	7.0	ATI	--	
12/7/1995	--	36.53	17.09	--	19.44	<50	<0.50	<0.50	<0.50	<1.0	91	4.5	ATI	--	
3/28/1996	--	36.53	11.90	--	24.63	<50	<0.5	<1	<1	<1	230	4.2	SPL	--	
6/20/1996	--	36.53	12.66	--	23.87	260	<0.5	<1	<1	<1	370	4.4	SPL	--	
10/11/1996	--	36.53	16.23	--	20.30	330	<0.5	<1.0	<1.0	<1.0	440	5.8	SPL	--	
1/2/1997	--	36.53	12.17	--	24.36	<50	<0.5	<1.0	<1.0	<1.0	140	6.0	SPL	--	
4/14/1997	--	36.53	13.45	--	23.08	--	--	--	--	--	--	--	--	--	
4/15/1997	--	36.53	--	--	--	1,500	<0.5	<1.0	<1.0	<1.0	1,800	5.6	SPL	--	
7/2/1997	--	36.53	15.60	--	20.93	880	<0.5	<1.0	<1.0	<1.0	940	5.3	SPL	--	
9/30/1997	--	36.53	17.16	--	19.37	40,000	13,000	2,400	870	3,100	510	6.6	SPL	--	
1/21/1998	--	36.53	11.77	--	24.76	120	<0.5	<1.0	<1.0	<1.0	98	4.7	SPL	--	
4/9/1998	--	36.53	9.42	--	27.11	950	<0.5	<1.0	<1.0	<1.0	890	5.7	SPL	--	
6/19/1998	--	36.53	15.28	--	21.25	1,800	<0.5	<1.0	<1.0	<1.0	1,900	4.7	SPL	--	
6/19/1998	--	36.53	12.09	--	24.44	1,800	<0.5	<1.0	<1.0	<1.0	1,900	4.7	SPL	--	
1/21/1999	--	36.53	14.67	--	21.86	1,100	<1.0	<1.0	<1.0	<1.0	1,200	--	SPL	--	

Table 1. Summary of Ground-Water Monitoring Data: Relative Water Elevations and Laboratory Analyses
Station #11133, 2220 98th Ave., Oakland, CA

Well and Sample Date	P/NP	TOC Elevation (feet msl)	Depth to Water (feet bgs)	Product Thickness (feet)	Water Level Elevation (feet msl)	Concentrations in (µg/L)						DO (mg/L)	Lab	pH	Comments
						GRO/TPHg	Benzene	Toluene	Ethyl-Benzene	Total Xylenes	MTBE				
MW-3 Cont.															
4/30/1999	--	36.53	16.00	--	20.53	--	--	--	--	--	--	--	--	--	
7/9/1999	--	36.53	14.64	--	21.89	470	<1.0	<1.0	<1.0	<1.0	460/470	--	SPL	--	g
11/3/1999	--	36.53	16.39	--	20.14	--	--	--	--	--	--	--	--	--	
1/12/2000	--	36.53	16.80	--	19.73	<50	<0.5	<0.5	<0.5	<0.5	34	--	PACE	--	
4/13/2000	--	36.53	16.43	--	20.10	--	--	--	--	--	--	--	--	--	
7/26/2000	--	36.53	16.93	--	19.60	<50	<0.5	<0.5	<0.5	<0.5	<0.5	--	PACE	--	
10/24/2000	--	36.53	15.69	--	20.84	--	--	--	--	--	--	--	--	--	
1/19/2001	--	36.53	14.84	--	21.69	<50	<0.5	<0.5	<0.5	1	25.9	--	PACE	--	
7/23/2001	--	36.53	15.11	--	21.42	62	<0.5	<0.5	<0.5	<1.5	28.7	--	PACE	--	
1/18/2002	--	36.53	12.37	--	24.16	<50	<0.5	<0.5	<0.5	<1.0	17.8	--	PACE	--	
8/1/2002	--	36.53	14.44	--	22.09	66	<0.5	<0.5	<0.5	<1.0	<0.5	--	PACE	--	
1/16/2003	--	36.53	12.07	--	24.46	<50	<0.50	<0.50	<0.50	<0.50	20	--	SEQ	--	p
7/7/2003	--	36.53	13.90	--	22.63	<50	<0.50	<0.50	<0.50	<0.50	8.8	--	SEQ	--	q
02/05/2004	--	36.53	12.60	--	23.93	<50	<0.50	<0.50	<0.50	<0.50	4.6	--	SEQM	7.0	
07/01/2004	--	36.53	14.57	--	21.96	<50	<0.50	<0.50	<0.50	<0.50	3.3	--	SEQM	--	
03/16/2005	P	36.53	11.03	--	25.50	<50	<0.50	<0.50	<0.50	<0.50	4.4	1.5	SEQM	6.8	
07/22/2005	P	36.53	12.68	--	23.85	<50	<0.50	<0.50	<0.50	<0.50	4.1	--	SEQM	6.8	
01/25/2006	P	36.53	11.35	--	25.18	81	<0.50	<0.50	<0.50	<0.50	3.0	--	SEQM	6.9	
7/6/2006	P	36.53	11.47	--	25.06	<50	<0.50	<0.50	<0.50	<0.50	3.0	--	TAMC	6.9	
1/8/2007	P	36.53	12.92	--	23.61	<50	<0.50	<0.50	<0.50	<0.50	3.2	2.87	TAMC	7.12	
7/10/2007	P	36.53	14.46	--	22.07	<50	<0.50	<0.50	<0.50	<0.50	2.8	2.87	TAMC	7.25	
1/15/2008	P	36.53	12.99	--	23.54	<50	<0.50	<0.50	<0.50	<0.50	0.88	1.04	TAMC	7.10	
7/15/2008	P	36.53	15.30	--	21.23	<50	<0.50	<0.50	<0.50	<0.50	1.3	1.60	CEL	7.06	
10/21/2008	P	36.53	16.30	--	20.23	<50	<0.50	<0.50	<0.50	<0.50	0.94	2.21	CEL	7.28	
QC-2															
10/7/1992	--	37.73	--	--	--	<50	<0.5	<0.5	<0.5	<0.5	--	--	ANA	--	i
1/14/1993	--	37.73	--	--	--	<50	<0.5	<0.5	<0.5	<0.5	--	--	PACE	--	i, m
4/22/1993	--	37.73	--	--	--	<50	<0.5	<0.5	<0.5	<0.5	--	--	PACE	--	i, m
7/15/1993	--	37.73	--	--	--	<50	<0.5	<0.5	<0.5	<0.5	<5.0	--	PACE	--	i, m
10/21/1993	--	37.73	--	--	--	<50	<0.5	<0.5	<0.5	<0.5	--	--	PACE	--	i

Table 1. Summary of Ground-Water Monitoring Data: Relative Water Elevations and Laboratory Analyses
Station #11133, 2220 98th Ave., Oakland, CA

Well and Sample Date	P/NP	TOC Elevation (feet msl)	Depth to Water (feet bgs)	Product Thickness (feet)	Water Level Elevation (feet msl)	Concentrations in (µg/L)						DO (mg/L)	Lab	pH	Comments
						GRO/TPHg	Benzene	Toluene	Ethyl-Benzene	Total Xylenes	MTBE				
QC-2 Cont.															
1/27/1994	--	37.73	--	--	--	<50	<0.5	<0.5	<0.5	<0.5	--	--	PACE	--	i
4/21/1994	--	37.73	--	--	--	<50	<0.5	<0.5	<0.5	<0.5	--	--	PACE	--	i
9/9/1994	--	37.73	--	--	--	<50	<0.5	<0.5	<0.5	<0.5	--	--	PACE	--	i
12/21/1994	--	37.73	--	--	--	<50	<0.5	<0.5	<0.5	<0.5	--	--	PACE	--	i
1/30/1995	--	37.73	--	--	--	<50	<0.50	<0.50	<0.50	<1.0	--	--	ATI	--	i
4/10/1995	--	37.73	--	--	--	<50	<0.50	<0.50	<0.50	<1.0	--	--	ATI	--	i
6/27/1995	--	37.73	--	--	--	<50	<0.50	<0.50	<0.50	<1.0	--	--	ATI	--	i
9/19/1995	--	37.73	--	--	--	<50	<0.50	<0.50	<0.50	<1.0	<5.0	--	ATI	--	i
12/7/1995	--	37.73	--	--	--	<50	<0.50	<0.50	<0.50	<1.0	<5.0	--	ATI	--	i
3/28/1996	--	37.73	--	--	--	<50	<0.5	<1	<1	<1	<10	--	SPL	--	i
6/20/1996	--	37.73	--	--	--	<50	<0.5	<1	<1	<1	<10	--	SPL	--	i
RW-1															
4/5/1991	--	37.73	--	--	--	--	--	--	--	--	--	--	--	--	--
4/1/1992	--	37.73	22.81	--	14.92	--	--	--	--	--	--	--	--	--	--
7/6/1992	--	37.73	26.92	--	10.81	--	--	--	--	--	--	--	--	--	--
10/7/1992	--	37.73	28.51	--	9.22	--	--	--	--	--	--	--	--	--	--
1/14/1993	--	37.73	23.75	--	13.98	--	--	--	--	--	--	--	--	--	--
4/22/1993	--	37.73	22.70	--	15.03	--	--	--	--	--	--	--	--	--	--
7/15/1993	--	37.73	26.10	--	11.63	--	--	--	--	--	--	--	--	--	--
10/21/1993	--	37.73	25.40	--	12.33	--	--	--	--	--	--	--	--	--	--
1/27/1994	--	37.73	28.02	--	9.71	--	--	--	--	--	--	--	--	--	--
4/21/1994	--	37.73	23.10	--	14.63	--	--	--	--	--	--	--	--	--	--
9/9/1994	--	37.73	24.39	--	13.34	--	--	--	--	--	--	--	--	--	--
12/21/1994	--	37.73	--	--	--	--	--	--	--	--	--	--	--	--	h
12/7/1995	--	37.73	25.71	--	12.02	150,000	34,000	35,000	4,300	21,000	2,700	--	ATI	--	--
3/28/1996	--	37.73	16.75	--	20.98	--	--	--	--	--	--	--	--	--	--
6/20/1996	--	37.73	25.10	--	12.63	--	--	--	--	--	--	--	--	--	h
10/11/1996	--	37.73	25.51	--	12.22	130,000	20,000	32,000	2,800	20,700	1400/1200	7.4	SPL	--	g
1/2/1997	--	37.73	24.49	--	13.24	--	--	--	--	--	--	--	--	--	--
4/14/1997	--	37.73	23.99	--	13.74	--	--	--	--	--	--	--	--	--	--

Table 1. Summary of Ground-Water Monitoring Data: Relative Water Elevations and Laboratory Analyses
Station #11133, 2220 98th Ave., Oakland, CA

Well and Sample Date	P/NP	TOC Elevation (feet msl)	Depth to Water (feet bgs)	Product Thickness (feet)	Water Level Elevation (feet msl)	Concentrations in (µg/L)						DO (mg/L)	Lab	pH	Comments
						GRO/TPHg	Benzene	Toluene	Ethyl-Benzene	Total Xylenes	MTBE				
RW-1 Cont.															
4/15/1997	--	37.73	--	--	--	1,800,000	38,000	190,000	48,000	281,000	<25000	--	SPL	--	
7/2/1997	--	37.73	16.40	--	21.33	140,000	19,000	55,000	4,400	32,400	<10000	5.7	SPL	--	
7/2/1997	--	37.73	--	--	--	130,000	19,000	54,000	4,700	33,400	<10000	--	SPL	--	e
9/30/1997	--	37.73	27.97	--	9.76	110,000	13,000	22,000	2,000	12,500	1,100	7.0	SPL	--	
9/30/1997	--	37.73	--	--	--	140,000	17,000	29,000	2,500	15,900	1,200	--	SPL	--	e
1/21/1998	--	37.73	14.14	--	23.59	270,000	21,000	48,000	3,500	25,000	1,100	4.8	SPL	--	
4/9/1998	--	37.73	25.01	--	12.72	--	--	--	--	--	--	--	--	--	
4/10/1998	--	37.73	--	--	--	220,000	26,000	46,000	4,400	24,500	<2500	5.1	SPL	--	
6/19/1998	--	37.73	11.43	--	26.30	180,000	19,000	32,000	3,000	17,400	<2500	4.6	SPL	--	
11/30/1998	--	37.73	7.87	--	29.86	--	--	--	--	--	--	--	--	--	
1/21/1999	--	37.73	18.90	--	18.83	260,000	24,000	46,000	5,100	30,000	1,700	--	SPL	--	
7/9/1999	--	37.73	18.58	--	19.15	--	--	--	--	--	--	--	--	--	
11/3/1999	--	37.73	20.85	--	16.88	160,000	19,000	37,000	3,800	25,000	1,500	--	PACE	--	
1/12/2000	--	37.73	21.20	--	16.53	240,000	18,000	46,000	5,800	26,000	2,100	--	PACE	--	
4/13/2000	--	37.73	21.71	--	16.02	120,000	2,100	33,000	2,800	28,000	1,500	--	PACE	--	
5/24/2000	--	37.73	21.89	--	15.84	--	--	--	--	--	--	--	--	--	
6/1/2000	--	37.73	16.30	--	21.43	--	--	--	--	--	--	--	--	--	
6/8/2000	--	37.73	17.88	--	19.85	--	--	--	--	--	--	--	--	--	
6/15/2000	--	37.73	16.72	--	21.01	--	--	--	--	--	--	--	--	--	
6/20/2000	--	37.73	21.04	--	16.69	--	--	--	--	--	--	--	--	--	
7/7/2000	--	37.73	17.21	--	20.52	--	--	--	--	--	--	--	--	--	
7/20/2000	--	37.73	21.87	--	15.86	--	--	--	--	--	--	--	--	--	
7/26/2000	--	37.73	21.45	--	16.28	67,000	160	5,300	2,100	18,000	1,100	--	PACE	--	
7/31/2000	--	37.73	22.11	--	15.62	--	--	--	--	--	--	--	--	--	
8/8/2000	--	37.73	17.80	--	19.93	--	--	--	--	--	--	--	--	--	
8/16/2000	--	37.73	17.92	--	19.81	--	--	--	--	--	--	--	--	--	
8/23/2000	--	37.73	18.11	--	19.62	--	--	--	--	--	--	--	--	--	
10/24/2000	--	37.73	18.93	--	18.80	--	--	--	--	--	--	--	--	--	
10/25/2000	--	37.73	19.04	--	18.69	360,000	18,000	78,000	34,000	180,000	2,100	--	PACE	--	k
1/19/2001	--	37.73	18.19	--	19.54	110,000	9,450	19,600	3,510	21,100	1,270	--	PACE	--	
7/24/2001	--	37.73	17.93	--	19.80	--	--	--	--	--	--	--	--	--	l

Table 1. Summary of Ground-Water Monitoring Data: Relative Water Elevations and Laboratory Analyses

Station #11133, 2220 98th Ave., Oakland, CA

Well and Sample Date	P/NP	TOC Elevation (feet msl)	Depth to Water (feet bgs)	Product Thickness (feet)	Water Level Elevation (feet msl)	Concentrations in (µg/L)						DO (mg/L)	Lab	pH	Comments
						GRO/TPHg	Benzene	Toluene	Ethyl-Benzene	Total Xylenes	MTBE				
RW-1 Cont.															
1/18/2002	--	37.73	14.87	--	22.86	63,000	2,060	4,370	1,770	13,900	491	--	PACE	--	
8/1/2002	--	37.73	16.84	--	20.89	60,000	1,210	2,200	1,520	10,600	390	--	PACE	--	
1/16/2003	--	37.73	14.42	--	23.31	34,000	2,500	2,700	780	5,300	680	--	SEQ	--	p
7/7/2003	--	37.73	16.11	--	21.62	50,000	640	280	1,600	10,000	<250	--	SEQ	--	q, u
07/01/2004	P	37.73	16.75	--	20.98	47,000	320	87	1,900	7,500	72	--	SEQM	6.7	
03/16/2005	P	37.73	12.48	--	25.25	17,000	28	23	350	590	53	1.0	SEQM	6.8	
07/22/2005	P	37.73	14.40	--	23.33	5,900	50	35	120	220	51	--	SEQM	6.7	u
01/25/2006	P	37.73	12.00	--	25.73	7,000	22	5.9	190	--	34	--	SEQM	7.1	
7/6/2006	P	37.73	13.01	--	24.72	16,000	37	14	470	230	64	--	TAMC	6.8	
1/8/2007	P	37.73	14.75	--	22.98	2400	16	10	56	54	22	3.61	TAMC	6.86	
7/10/2007	P	37.73	16.21	--	21.52	3,800	4.4	2.8	72	22	21	2.65	TAMC	6.98	
1/15/2008	P	37.73	14.63	--	23.10	1,700	21	1.6	45	10	14	1.31	TAMC	6.82	
7/15/2008	P	37.73	17.04	--	20.69	1,600	<0.50	0.66	4.4	3.0	12	1.32	CEL	6.95	
10/21/2008	P	37.73	18.44	--	19.29	3,600	<0.50	1.3	19	10	12	0.79	CEL	7.17	
VEW-4															
07/22/2005	P	--	14.04	--	--	680	41	24	20	67	<0.50	--	SEQM	6.8	
1/15/2008	P	--	15.05	--	--	350	19	1.1	5.0	3.3	<0.50	0.54	TAMC	6.99	
7/15/2008	P	--	17.24	--	--	53	<0.50	<0.50	<0.50	<0.50	<0.50	0.59	CEL	6.95	
10/21/2008	--	--	--	--	--	--	--	--	--	--	--	--	--	--	v
VEW-5															
07/22/2005	--	--	--	--	--	--	--	--	--	--	--	--	--	--	v
1/15/2008	--	--	--	--	--	--	--	--	--	--	--	--	--	--	v
7/15/2008	--	--	--	--	--	--	--	--	--	--	--	--	--	--	v
10/21/2008	--	--	--	--	--	--	--	--	--	--	--	--	--	--	v
VEW-6															
1/15/2008	--	--	11.83	--	--	--	--	--	--	--	--	--	--	--	
7/15/2008	--	--	14.81	--	--	--	--	--	--	--	--	--	--	--	
10/21/2008	--	--	16.02	--	--	--	--	--	--	--	--	--	--	--	

Table 1. Summary of Ground-Water Monitoring Data: Relative Water Elevations and Laboratory Analyses
Station #11133, 2220 98th Ave., Oakland, CA

Well and Sample Date	P/NP	TOC Elevation (feet msl)	Depth to Water (feet bgs)	Product Thickness (feet)	Water Level Elevation (feet msl)	Concentrations in (µg/L)						DO (mg/L)	Lab	pH	Comments
						GRO/TPHg	Benzene	Toluene	Ethyl-Benzene	Total Xylenes	MTBE				
VEW-7															
1/15/2008	--	--	13.24	--	--	--	--	--	--	--	--	--	--	--	
7/15/2008	--	--	15.91	--	--	--	--	--	--	--	--	--	--	--	
10/21/2008	--	--	16.89	--	--	--	--	--	--	--	--	--	--	--	
VEW-8															
07/22/2005	P	--	14.24	--	--	<50	<0.50	<0.50	<0.50	<0.50	<0.50	--	SEQM	6.8	
1/15/2008	--	--	--	--	--	--	--	--	--	--	--	--	--	--	v
7/15/2008	--	--	--	--	--	--	--	--	--	--	--	--	--	--	v
10/21/2008	--	--	--	--	--	--	--	--	--	--	--	--	--	--	v
VEW-9															
1/15/2008	--	--	5.31	--	--	--	--	--	--	--	--	--	--	--	
7/15/2008	--	--	--	--	--	--	--	--	--	--	--	--	--	--	v
10/21/2008	--	--	--	--	--	--	--	--	--	--	--	--	--	--	v
VW-1															
1/15/2008	--	--	--	--	--	--	--	--	--	--	--	--	--	--	v
7/15/2008	--	--	--	--	--	--	--	--	--	--	--	--	--	--	v
10/21/2008	--	--	--	--	--	--	--	--	--	--	--	--	--	--	v
VW-2															
1/15/2008	--	--	0.25	--	--	--	--	--	--	--	--	--	--	--	
7/15/2008	--	--	0.65	--	--	--	--	--	--	--	--	--	--	--	
10/21/2008	--	--	0.68	--	--	--	--	--	--	--	--	--	--	--	
VW-3															
1/15/2008	--	--	2.08	--	--	--	--	--	--	--	--	--	--	--	
7/15/2008	--	--	4.10	--	--	--	--	--	--	--	--	--	--	--	
10/21/2008	--	--	4.95	--	--	--	--	--	--	--	--	--	--	--	

ABBREVIATIONS & SYMBOLS:

-- = Not analyzed/applicable/measured/available
< = Not detected at or above specified laboratory reporting limit
DO = Dissolved oxygen
DTW = Depth to water in ft bgs
ft bgs = Feet below ground surface
ft MSL = Feet above mean sea level
GRO = Gasoline range organics
GWE = Groundwater elevation in ft MSL
mg/L = Milligrams per liter
MTBE = Methyl tert-butyl ether
NP = Well not purged prior to sampling
P = Well purged prior to sampling
TOC = Top of casing in ft MSL
TPH-g = Total petroleum hydrocarbons as gasoline
µg/L = Micrograms per liter
ANA = Anametrix, Inc.
PACE = Pace, Inc.
ATI = Analytical Technologies, Inc.
CEI = Ceimic Corporation
SPL = Southern Petroleum Laboratories
SEQ/SEQM= Sequoia Analytical/Sequoia Analytical Morgan Hill Laboratories
CEL = CalScience Environmental Laboratories, Inc.

FOOTNOTES:

c = A copy of the documentation for this data is included in Appendix C of Alistoreport 10-025-13-003.
d = MTBE peak. See documentation in Appendix C of Alisto report 10-025-13-003.
e = Blind duplicate.
f = Well inaccessible.
g = EPA Methods 8020/8260 used.
h = Well not monitored and/or sampled due to vapor extraction system.
i = Travel blank.
j = This gasoline does not include MTBE.
k = Well was sampled on a different date from the other wells due to lack of proper equipment.
l = Unable to sample due to nature of product.
m = A copy of the documentation for this data is included in Blaine Tech Services, Inc., Report 010724-B-2. The data for sampling events January 14, 1993 and April 22, 1993 has been destroyed. No chromatograms could be located for samples AW-2 on January 27, 1994, and for samples AW-1, AW-2, AW-3, AW-4, AW-5, AW-6, AW-7, AW-8, MW-2 and MW-3 on September 9, 1994.
n = On June 1, 2001, after reviewing chromatograms, Sequoia reported the value as <5.0.
o = Unable to locate well.
p = TPH-g data analyzed by EPA Method 8015B modified; BTEX and MTBE by EPA Method 8021B
q = TPH-g, BTEX, and MTBE analyzed by EPA method 8260B beginning on the third quarter 2003 sampling event 07/07/03.
r = Discrete peak at C5.
t = Well was not gauged during the quarter due to an oversight by the technician.
u = Sheen in well.
v = Well was dry.
w = Hydrocarbon result partly due to individ. peak(s) in quant. range.

NOTES:

Beginning in the fourth quarter 2003, the laboratory modified the reported analyte list. TPH-g was changed to GRO. The resulting data may be impacted by the potential of non-TPH-g analytes within the requested fuel range resulting in a higher concentration being reported.

Beginning in the second quarter 2004, the carbon range for GRO was changed from C6-C10 to C4-C12.

Values for DO and pH were obtained through field measurements.

GWEs adjusted assuming a specific gravity of 0.75 for free product

GRO analysis was completed by EPA method 8260B (C4-C12) for samples collected from the time period April 2006 through February 4, 2008. The analysis for GRO was changed to EPA method 8015B (C6-C12) for samples collected from the time period February 5, 2008 through the present.

Note: The data within this table collected prior to April 2006 was provided to Broadbent & Associates, Inc. by Atlantic Richfield Company and their previous consultants. Broadbent & Associates, Inc. has not verified the accuracy of this information.

Table 2. Summary of Fuel Additives Analytical Data
Station #11133, 2220 98th Ave., Oakland, CA

Well and Sample Date	Concentrations in (µg/L)								Comments
	Ethanol	TBA	MTBE	DIPE	ETBE	TAME	1,2-DCA	EDB	
AW-1									
7/7/2003	<5,000	<1,000	1,100	<25	<25	190	--	--	
02/05/2004	<10,000	<2,000	930	<50	<50	160	<50	<50	
07/01/2004	<5,000	<1,000	1,100	<25	<25	170	<25	<25	
03/16/2005	<5,000	<1,000	720	<25	<25	130	<25	<25	
07/22/2005	<1,000	<200	510	<5.0	<5.0	93	31	<5.0	
01/25/2006	<6,000	<400	490	<10	<10	94	21	<10	
7/6/2006	<6,000	<400	270	<10	<10	49	<10	<10	
1/8/2007	<3000	240	380	<5.0	<5.0	64	<5.0	--	
7/10/2007	<6,000	<400	220	<10	<10	36	<10	<10	
1/15/2008	<6,000	<400	230	<10	<10	45	<10	<10	
7/15/2008	<300	<10	<0.50	<0.50	<0.50	15	<0.50	<0.50	
10/21/2008	<3,000	390	120	<5.0	<5.0	22	<5.0	<5.0	
AW-2									
02/05/2004	<100	<20	5.1	<0.50	<0.50	<0.50	<0.50	<0.50	
03/16/2005	<100	<20	<0.50	<0.50	<0.50	<0.50	<0.50	<0.50	
01/25/2006	<600	<40	12	<1.0	<1.0	1.0	<1.0	<1.0	
1/8/2007	<3000	<200	40	<5.0	<5.0	<5.0	<5.0	--	
1/15/2008	<6,000	<400	48	<10	<10	<10	<10	<10	
7/15/2008	<30,000	<1,000	<50	<50	<50	<50	<50	<50	
10/21/2008	<7,500	<250	16	<12	<12	<12	<12	<12	
AW-3									
03/16/2005	<100	<20	<0.50	<0.50	<0.50	<0.50	<0.50	<0.50	
AW-4									
7/7/2003	<1,000	<200	56	<5.0	<5.0	<5.0	--	--	
02/05/2004	<200	<40	40	<1.0	<1.0	3.7	<1.0	<1.0	
07/01/2004	<1,000	<200	64	<5.0	<5.0	9.6	<5.0	<5.0	
03/16/2005	<500	<100	23	<2.5	<2.5	<2.5	<2.5	<2.5	
07/22/2005	<2,000	<400	59	<10	<10	<10	<10	<10	
01/25/2006	<3,000	<200	12	<5.0	<5.0	<5.0	<5.0	<5.0	
7/6/2006	<3,000	<5.0	39	<5.0	<5.0	<5.0	<5.0	<5.0	

Table 2. Summary of Fuel Additives Analytical Data
Station #11133, 2220 98th Ave., Oakland, CA

Well and Sample Date	Concentrations in (µg/L)								Comments
	Ethanol	TBA	MTBE	DIPE	ETBE	TAME	1,2-DCA	EDB	
AW-4 Cont.									
1/8/2007	<300	<20	38	<0.50	<0.50	6.2	<0.50	--	
7/10/2007	<300	<20	27	<0.50	<0.50	4.2	<0.50	<0.50	
1/15/2008	<300	<20	17	<0.50	<0.50	2.3	<0.50	<0.50	
7/15/2008	<300	<10	25	<0.50	<0.50	3.4	<0.50	<0.50	
10/21/2008	<600	<20	18	<1.0	<1.0	1.9	<1.0	<1.0	
AW-5									
7/7/2003	<2,000	1,200	980	<10	<10	210	--	--	
02/05/2004	<2,000	1,200	810	<10	<10	160	<10	<10	
07/01/2004	<1,000	1,600	550	<5.0	<5.0	94	<5.0	<5.0	
03/16/2005	<10,000	2,100	890	<50	<50	190	<50	<50	
07/22/2005	<1,000	370	390	<5.0	<5.0	78	<5.0	<5.0	
01/25/2006	<3,000	580	26	<5.0	<5.0	5.2	<5.0	<5.0	
7/6/2006	<3,000	240	170	<5.0	<5.0	37	<5.0	<5.0	
1/8/2007	<1500	240	220	<2.5	<2.5	51	<2.5	--	
7/10/2007	<1,500	110	360	<2.5	<2.5	92	<2.5	<2.5	
1/15/2008	<300	200	85	<0.50	<0.50	21	<0.50	<0.50	
7/15/2008	<300	100	11	<0.50	<0.50	2.4	<0.50	<0.50	
10/21/2008	<300	130	63	<0.50	<0.50	16	<0.50	<0.50	
AW-6									
02/05/2004	<10,000	<2,000	5,400	<50	<50	1,800	<50	<50	
07/01/2004	<10,000	<2,000	4,600	<50	<50	1,600	<50	<50	
03/16/2005	<5,000	<1,000	4,400	<25	<25	1,400	<25	<25	
07/22/2005	<10,000	<2,000	5,500	<50	<50	1,400	<50	<50	
01/25/2006	<30,000	<2,000	3,000	<50	<50	940	<50	<50	
7/6/2006	<30,000	<2,000	2,800	<50	<50	780	<50	<50	
1/8/2007	<30000	<2000	7400	<50	<50	1900	<50	--	
7/10/2007	<60,000	<4,000	3,900	<100	<100	890	<100	<100	
1/15/2008	<600	<40	150	<1.0	<1.0	42	<1.0	<1.0	
7/15/2008	<300	20	270	<0.50	<0.50	66	<0.50	<0.50	
10/21/2008	<3,000	<100	160	<5.0	<5.0	37	<5.0	<5.0	

Table 2. Summary of Fuel Additives Analytical Data
Station #11133, 2220 98th Ave., Oakland, CA

Well and Sample Date	Concentrations in (µg/L)								Comments
	Ethanol	TBA	MTBE	DIPE	ETBE	TAME	1,2-DCA	EDB	
AW-7									
AW-8									
03/16/2005	<100	<20	<0.50	<0.50	<0.50	<0.50	<0.50	<0.50	a
MW-1									
7/7/2003	<1,000	<200	24	<5.0	<5.0	<5.0	--	--	
02/05/2004	<1,000	<200	9.2	<5.0	<5.0	<5.0	<5.0	<5.0	
07/01/2004	<10,000	<2,000	<50	<50	<50	<50	<50	<50	
03/16/2005	<1,000	<200	<5.0	<5.0	<5.0	<5.0	<5.0	<5.0	
07/22/2005	<2,000	<400	<10	<10	<10	<10	<10	<10	
01/25/2006	<1,500	<100	<2.5	<2.5	<2.5	<2.5	<2.5	<2.5	
7/6/2006	<1,500	<100	<2.5	<2.5	<2.5	<2.5	<2.5	<2.5	
1/8/2007	<300	<20	2.1	<0.50	<0.50	<0.50	<0.50	--	
7/10/2007	<300	<20	2.4	<0.50	<0.50	<0.50	<0.50	<0.50	
1/15/2008	<300	<20	1.2	<0.50	<0.50	<0.50	<0.50	<0.50	
7/15/2008	<300	<10	<0.50	<0.50	<0.50	<0.50	<0.50	<0.50	
10/21/2008	<300	<10	<0.50	<0.50	<0.50	<0.50	<0.50	<0.50	
MW-2									
03/16/2005	<100	<20	<0.50	<0.50	<0.50	<0.50	<0.50	<0.50	
MW-3									
7/7/2003	<100	<20	8.8	<0.50	<0.50	0.65	--	--	
02/05/2004	<100	<20	4.6	<0.50	<0.50	<0.50	<0.50	<0.50	
07/01/2004	<100	<20	3.3	<0.50	<0.50	<0.50	<0.50	<0.50	
03/16/2005	<100	<20	4.4	<0.50	<0.50	<0.50	<0.50	<0.50	
07/22/2005	<100	<20	4.1	<0.50	<0.50	<0.50	<0.50	<0.50	
01/25/2006	<300	<20	3.0	<0.50	<0.50	<0.50	<0.50	<0.50	
7/6/2006	<300	<50	3.0	<0.50	<0.50	<0.50	<0.50	<0.50	
1/8/2007	<300	<20	3.2	<0.50	<0.50	<0.50	<0.50	--	
7/10/2007	<300	<20	2.8	<0.50	<0.50	<0.50	<0.50	<0.50	
1/15/2008	<300	<20	0.88	<0.50	<0.50	<0.50	<0.50	<0.50	
7/15/2008	<300	<10	1.3	<0.50	<0.50	<0.50	<0.50	<0.50	

Table 2. Summary of Fuel Additives Analytical Data
Station #11133, 2220 98th Ave., Oakland, CA

Well and Sample Date	Concentrations in (µg/L)								Comments
	Ethanol	TBA	MTBE	DIPE	ETBE	TAME	1,2-DCA	EDB	
MW-3 Cont.									
10/21/2008	<300	<10	0.94	<0.50	<0.50	<0.50	<0.50	<0.50	
RW-1									
7/7/2003	<50,000	<10,000	<250	<250	<250	<250	--	--	
07/01/2004	<10,000	<2,000	72	<50	<50	<50	<50	<50	
03/16/2005	<2,000	<400	53	<10	<10	<10	<10	<10	
07/22/2005	<500	<100	51	<2.5	<2.5	5.6	<2.5	<2.5	
01/25/2006	<3,000	<200	34	<5.0	<5.0	<5.0	<5.0	<5.0	
7/6/2006	<6,000	<400	64	<10	<10	<10	<10	<10	
1/8/2007	<6000	<400	22	<10	<10	<10	<10	--	
7/10/2007	<600	<40	21	<1.0	<1.0	<1.0	<1.0	<1.0	
1/15/2008	<600	<40	14	<1.0	<1.0	1.3	<1.0	<1.0	
7/15/2008	<300	<10	12	<0.50	<0.50	1.0	<0.50	<0.50	
10/21/2008	<300	17	12	<0.50	<0.50	<0.50	<0.50	<0.50	
VEW-4									
07/22/2005	<100	<20	<0.50	<0.50	<0.50	<0.50	<0.50	<0.50	
1/15/2008	<300	<20	<0.50	<0.50	<0.50	<0.50	<0.50	<0.50	
7/15/2008	<300	<10	<0.50	<0.50	<0.50	<0.50	<0.50	<0.50	
VEW-5									
VEW-8									
07/22/2005	<100	<20	<0.50	<0.50	<0.50	<0.50	<0.50	<0.50	

ABBREVIATIONS & SYMBOLS:

-- = Not analyzed/applicable/measured/available

< = Not detected at or above specified laboratory reporting limit

1,2-DCA = 1,2-Dichloroethane

DIPE = Di-isopropyl ether

EDB = 1,2-Dibromoethane

ETBE = Ethyl tert-butyl ether

MTBE = Methyl tert-butyl ether

TAME = tert-Amyl methyl ether

TBA = tert-Butyl alcohol

µg/L = Micrograms per Liter

FOOTNOTES:

a = Calibration verification for ethanol is within method limits but outside contractual limits.

NOTES:

All volatile organic compounds analyzed using EPA Method 8260B.

Note: The data within this table collected prior to April 2006 was provided to Broadbent & Associates, Inc. by Atlantic Richfield Company and their previous consultants. Broadbent & Associates, Inc. has not verified the accuracy of this information.

**Table 3. Historical Ground-Water Flow Direction and Gradient
Station #11133, 2220 98th Ave., Oakland, CA**

Date Sampled	Approximate Flow Direction	Approximate Hydraulic Gradient
1/25/2006	Variable: East to Southwest	0.03 to 0.09
7/6/2006	Variable: East to W towards Center	0.04 to 0.05
1/8/2007	Variable: East to W towards Center	0.03 to 0.05
7/10/2007	West	0.01
1/15/2008	West-Southwest	0.006
7/15/2008	West-Southwest	0.01
10/21/2008	West-Southwest	0.01

Note: The data within this table collected prior to April 2006 was provided to Broadbent & Associates, Inc. by Atlantic Richfield Company and their previous consultants. Broadbent & Associates, Inc. has not verified the accuracy of this information.