



**RECEIVED**

9:05 am, Jan 28, 2010

Alameda County  
Environmental Health

ARCADIS U.S., Inc.  
100 Montgomery Street, Suite 300  
San Francisco, California 94105  
Tel 415.374.2744  
Fax 415.374.2745  
www.arcadis-us.com

Re: Fourth Quarter 2009 Status Report  
Former BP Station #11133  
2220 98<sup>th</sup> Avenue  
Oakland, California  
ACEH Case #RO0000403

ENVIRONMENTAL

"I declare that to the best of my knowledge at the present time, that the information and/or recommendations contained in the attached document are true and correct."

Date:  
01/25/2010

Submitted by:  
ARCADIS U.S., Inc.

Contact:  
Hollis E. Phillips

Phone:  
415.374.2744 ext 13

Hollis E. Phillips, PG  
Project Manager

Email:  
Hollis.phillips@arcadis-us.com

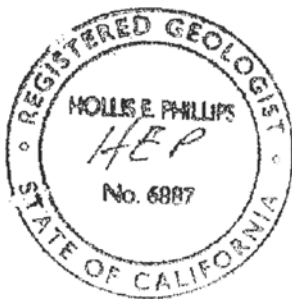

Our ref:  
GP09BPNA.C107

Broadbent & Associates, Inc.  
1324 Mangrove Ave., Suite 212  
Chico, CA 95926  
Voice (530) 566-1400  
Fax (530) 566-1401



January 25, 2010

Project No. 09-88-656

ARCADIS-US, Inc.  
100 Montgomery Street, Ste. 300  
San Francisco, California 94104

Attn.: Ms. Hollis Phillips, PG

Re: Fourth Quarter 2009 Status Report, Former BP Station #11133, 2220 98<sup>th</sup> Ave, Oakland, CA. ACEH Case #RO0000403.

Dear Ms. Phillips:

Provided herein is the *Fourth Quarter 2009 Status Report* for Former BP Station #11133 (herein referred to as Station #11133) located at 2220 98<sup>th</sup> Ave, Oakland, CA (Site). This report presents a summary of current developments at the Site during the Fourth Quarter of 2009.

Should you have questions regarding the work performed or results obtained, please do not hesitate to contact us at (530) 566-1400.

Sincerely,

BROADBENT & ASSOCIATES, INC.

Jason Duda  
Project Scientist

Matthew G. Herrick, P.G., C.HG.  
Senior Hydrogeologist

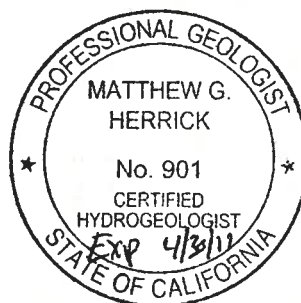

Enclosures

cc: Mr. Paresh Khatri, Alameda County Environmental Health (Submitted via ACEH ftp site)  
Ms. Shelby Lathrop, ConocoPhillips, 76 Broadway, Sacramento, CA 95818  
Electronic copy uploaded to GeoTracker

## STATION #11133 QUARTERLY STATUS REPORT

Facility: #11133	Address: 2220 98 <sup>th</sup> Ave, Oakland
ARCADIS Project Manager:	Ms. Hollis Phillips, PG
Consulting Co./Contact Persons:	Broadbent & Associates, Inc.(BAI)/Jason Duda & Matt Herrick (530) 566-1400
Primary Agency/Regulatory ID No.:	Alameda County Environmental Health (ACEH) ACEH Case #RO0000403
Consultant Project No.:	09-88-656
Facility Permits/Permitting Agency:	NA

### WORK PERFORMED THIS QUARTER (Fourth Quarter 2009):

1. Submitted *Third Quarter 2009 Ground-Water Monitoring Report* (BAI, 10/5/2009).
2. No environmental work was conducted at the Site during the Fourth Quarter of 2009.

### WORK PROPOSED FOR NEXT QUARTER (First Quarter 2010):

1. Prepared and submit this *Fourth Quarter 2009 Status Report* (contained herein).
2. Conduct semi-annual ground-water monitoring/sampling for First Quarter 2010.

### QUARTERLY RESULTS SUMMARY:

Current phase of project:	<b>Ground-water monitoring/sampling</b>
Frequency of ground-water monitoring:	<b>All Wells Semi-Annually (1Q &amp; 3Q)</b>
Frequency of ground-water sampling:	<b>Semi-Annually (1Q &amp; 3Q) = MW-1, MW-3, AW-1, AW-4, AW-5, AW-6 &amp; RW-1; Annual (1Q) = AW-2</b>
Is free product (FP) present on-site:	<b>NA</b>
Current remediation techniques:	<b>NA</b>
Depth to ground water (below TOC):	<b>NA</b>
General ground-water flow direction:	<b>NA</b>
Approximate hydraulic gradient:	<b>NA</b>

### DISCUSSION:

No environmental work was conducted at the Site during the Fourth Quarter of 2009. Semi-annual monitoring/sampling occurred during the Third Quarter of 2009. A Site Location Map is provided as Drawing 1. For reference, a ground-water elevation and analytical summary map depicting data from the Third Quarter 2009 ground-water sampling event is provided as Drawing 2. Semi-annual ground-water monitoring/sampling is scheduled to be conducted at the Site during the First Quarter of 2010.

### ATTACHMENTS:

- Drawing 1. Site Location Map, Station #11133, 2220 98<sup>th</sup> Ave., Oakland, CA
- Drawing 2. Ground-Water Elevation Contour and Analytical Summary Map, July 21, 2009, Station #11133, 2220 98<sup>th</sup> Ave, Oakland, CA

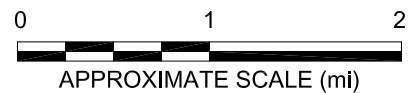
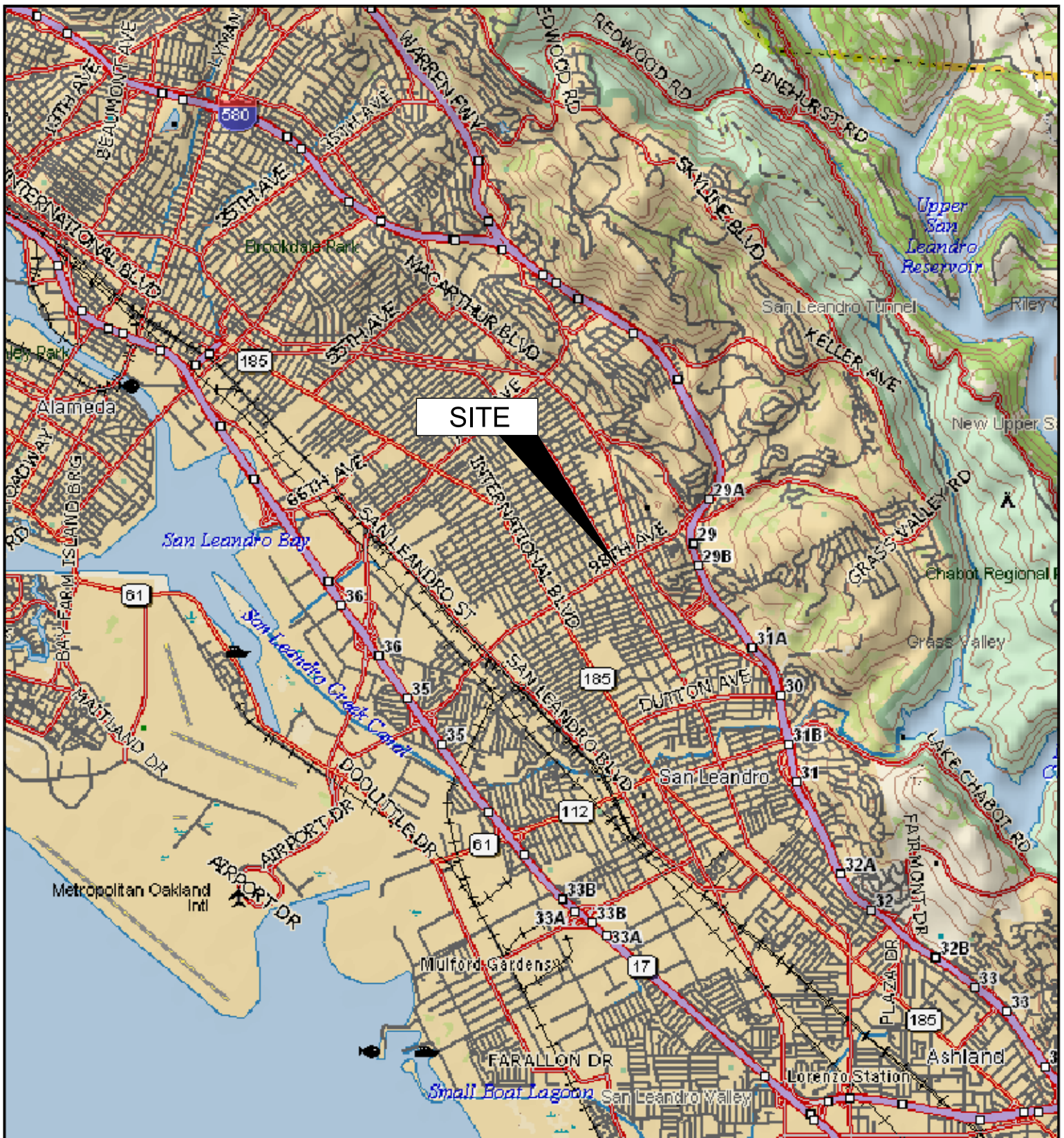

IMAGE SOURCE: DELORME

**BROADBENT & ASSOCIATES, INC.**  
 ENGINEERING, WATER RESOURCES & ENVIRONMENTAL  
 1324 Mangrove Ave. Suite 212, Chico, California 95926  
 Project No.: 06-88-656 Date: 9/30/2009

Former BP Service Station #11133  
 2220 98th Avenue  
 Oakland, California

Site Location Map

Drawing

1

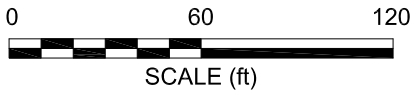
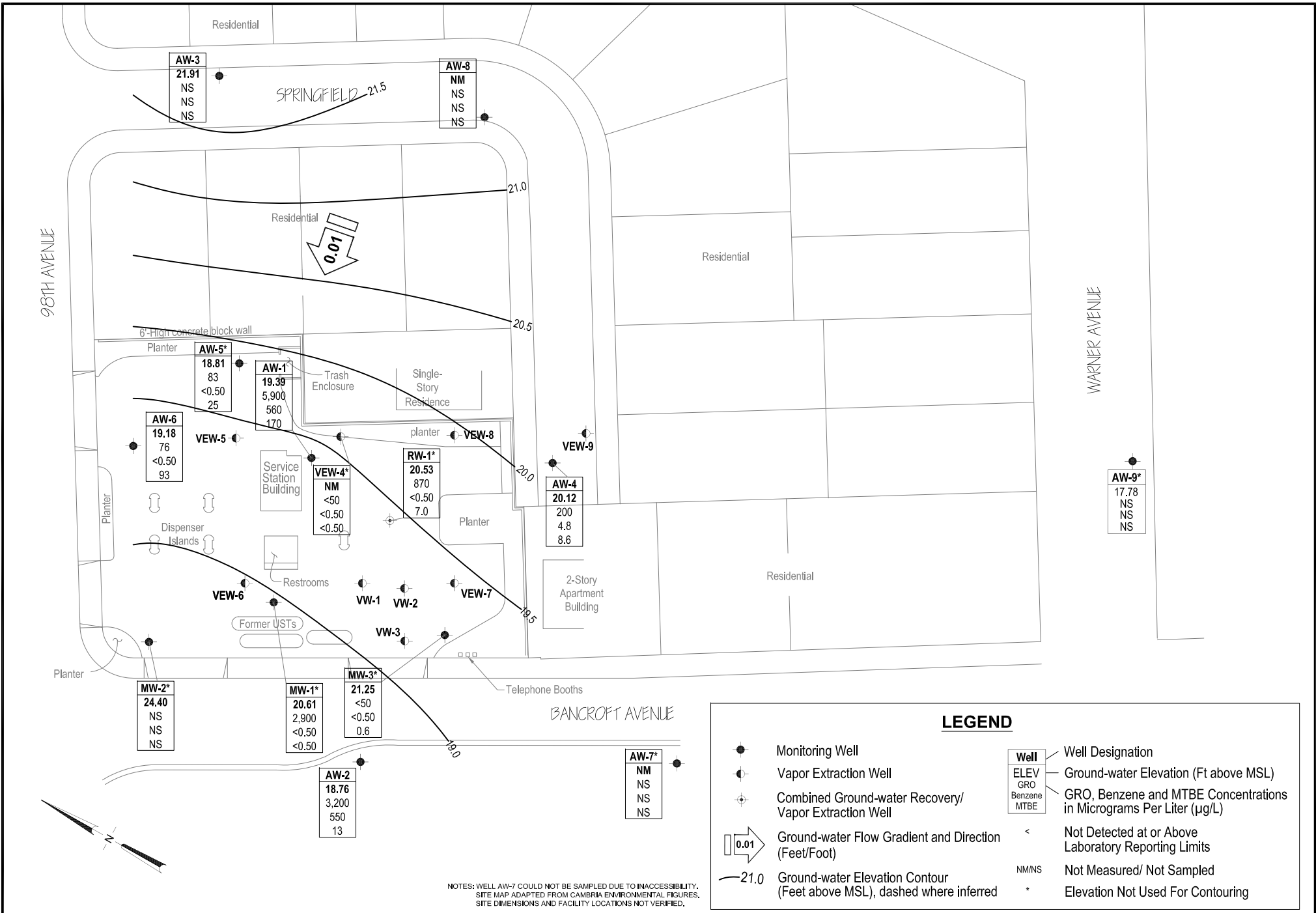

**BROADBENT & ASSOCIATES, INC.**  
 ENGINEERING, WATER RESOURCES & ENVIRONMENTAL  
 1324 Mangrove Ave. Suite 212, Chico, California 95926  
 Project No.: 06-88-656 Date: 9/16/09

Former BP Service Station #11133  
 2220 98th Avenue  
 Oakland, California

Ground-Water Elevation Contour  
 and Analytical Summary Map  
 21 July 2009

Drawing

2