



Atlantic Richfield Company  
(a BP affiliated company)

P.O. Box 1257  
San Ramon, CA 94583  
Phone: (925) 275-3801  
Fax: (925) 275-3815

30 October 2007

Re: Third Quarter 2007 Semi-Annual Ground-Water Monitoring Report  
Former BP Service Station # 11133  
2220 98<sup>th</sup> Avenue  
Oakland, California  
ACEH Case #RO0000403

“I declare, that to the best of my knowledge at the present time, that the information and/or recommendations contained in the attached document are true and correct.”

Submitted by:

Paul Supple  
Environmental Business Manger

**RECEIVED**

9:50 am, Nov 02, 2007

Alameda County  
Environmental Health



**Third Quarter 2007 Semi-Annual  
Ground-Water Monitoring Report**  
Former BP Service Station #11133  
2220 98<sup>th</sup> Avenue  
Oakland, California

Prepared for

Mr. Paul Supple  
Environmental Business Manager  
Atlantic Richfield Company  
P.O. Box 1257  
San Ramon, California 94583

Prepared by



1324 Mangrove Avenue, Suite 212  
Chico, California 95926  
(530) 566-1400  
[www.broadbentinc.com](http://www.broadbentinc.com)

30 October 2007

Project No. 06-08-656

30 October 2007

Project No. 06-08-656

Atlantic Richfield Company  
P.O. Box 1257  
San Ramon, California 94583  
Submitted via ENFOS

Attn.: Mr. Paul Supple

Re: Third Quarter 2007 Semi-Annual Ground-Water Monitoring Report, Former BP Service Station #11133, 2220 98<sup>th</sup> Avenue, Oakland, Alameda County, California; ACEH Case #RO0000403

Dear Mr. Supple:

Provided herein is the *Third Quarter 2007 Semi-Annual Ground-Water Monitoring Report* for Former BP Service Station #11133 (herein referred to as Station #11133) located at 2220 98<sup>th</sup> Avenue, Oakland, California (Property). This report presents the results of ground-water monitoring conducted at Station #11133 during the Third Quarter of 2007.

Should you have questions regarding the work performed or results obtained, please do not hesitate to contact us at (530) 566-1400.

Sincerely,

BROADBENT & ASSOCIATES, INC.

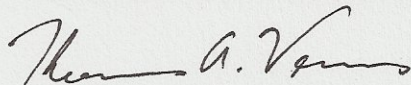

Thomas A. Venus, P.E.  
Senior Engineer

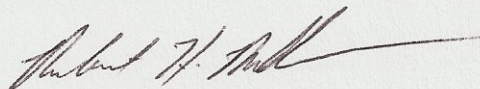

Robert H. Miller, P.G., C.HG.  
Principal Hydrogeologist

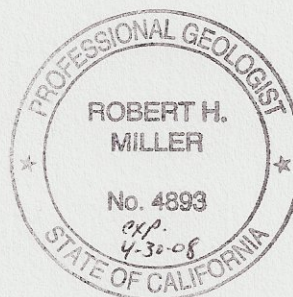

Enclosure

cc: Mr. Steven Plunkett, Alameda County Environmental Health (Submitted via ACEH ftp site)  
Ms. Shelby Lathrop, ConocoPhillips, 76 Broadway, Sacramento, California 95818  
Electronic copy uploaded to GeoTracker

## STATION #11133 SEMI-ANNUAL GROUNDWATER MONITORING REPORT

Facility: #11133	Address: 2220 98 <sup>th</sup> Avenue, Oakland
Environmental Business Manager:	Mr. Paul Supple
Consulting Co./Contact Persons:	Broadbent & Associates, Inc.(BAI)/Rob Miller & Tom Venus (530) 566-1400
Primary Agency/Regulatory ID No.:	Alameda County Environmental Health (ACEH) ACEH Case #RO0000403
Consultant Project No.:	06-08-656
Facility Permits/Permitting Agency:	NA

### WORK PERFORMED THIS QUARTER (Third Quarter 2007):

1. Prepared and submitted Second Quarter 2007 Status Report.
2. Conducted semi-annual ground-water monitoring/sampling for Third Quarter 2007. Work performed by Stratus Environmental, Inc. (Stratus) on 10 July 2007.

### WORK PROPOSED FOR NEXT QUARTER (Fourth Quarter 2007):

1. Prepared and submitted this Third Quarter 2007 Semi-Annual Ground-Water Monitoring Report (contained herein).
2. No environmental work is scheduled for the Fourth Quarter 2007.

### QUARTERLY RESULTS SUMMARY:

Current phase of project:	<b>Ground-water monitoring/sampling</b>
Frequency of ground-water monitoring:	<b>Semi-Annually (1Q &amp; 3Q): Wells MW-1, MW-2, MW-3, AW-1 through AW-9, RW-1</b>
Frequency of ground-water sampling:	<b>Semi-Annually (1Q &amp; 3Q): Wells MW-1, MW-3, AW-1, AW-4, AW-5, AW-6, and RW-1</b> <b>Annually (1Q): Well AW-2</b> <b>Not Sampled: Wells MW-2, AW-3, AW-7, AW-8, AW-9</b>
Is free product (FP) present on-site:	<b>No</b>
FP recovered this quarter:	<b>None</b>
Current remediation techniques:	<b>NA</b>
Depth to ground water (below TOC):	<b>10.45 ft (MW-2) to 19.00 ft (AW-5)</b>
General ground-water flow direction:	<b>West</b>
Approximate hydraulic gradient:	<b>0.01 ft/ft</b>

### DISCUSSION:

Third Quarter 2007 semi-annual ground-water monitoring and sampling was conducted at Station #11133 on 10 July 2007 by Stratus. Water levels were gauged in 12 of the 13 wells scheduled to be gauged at the Site. Stratus reported that well A-7 could not be located and that a sheen was present in well MW-1. No other irregularities were noted during water level gauging. Depth to ground-water measurements ranged from 10.45 ft at well MW-2 to 19.00 ft at well AW-5. Resulting ground-water surface elevations ranged from 25.05 ft above mean sea level in well MW-2 to 19.13 ft at well AW-9. Water level elevations were between historic minimum and maximum ranges for each well, as summarized in Table 1. Water level elevations yielded a potentiometric ground-water flow direction and gradient towards the west at approximately 0.01 ft/ft. Ground-water monitoring field data sheets are provided within Appendix A. Measured depths to ground-water and respective ground-water elevations

are summarized in Table 1. Current and historic ground-water flow directions and gradients are provided in Table 3. Potentiometric ground-water elevation contours are presented in Drawing 1.

Consistent with the current ground-water sampling schedule, water samples were collected from seven wells: AW-1, AW-4, AW-5, AW-6, MW-1, MW-3, and RW-1. No irregularities were reported during sampling. Samples were submitted under chain-of-custody protocol to Test America Analytical Testing Corporation (Morgan Hill, California), for analysis of Gasoline Range Organics (GRO, C4-12) by the LUFT GCMS Method; for Benzene, Toluene, Ethylbenzene, and Total Xylenes (BTEX) by EPA Method 8260B; and tert-Amyl methyl ether (TAME), tert-Butyl alcohol (TBA), Di-isopropyl ether (DIPE), 1,2-Dibromomethane (EDB), 1,2-Dichloroethane (1,2-DCA), Ethanol, Ethyl tert-butyl ether (ETBE), and Methyl tert-butyl ether (MTBE) by EPA Method 8260B. The laboratory reported that the GRO concentration for the sample from well AW-6 was partly due to individual peak(s) in the quantitation range. No other irregularities were encountered during laboratory analysis of the samples. Ground-water sampling field data sheets and the laboratory analytical report, including chain-of-custody documentation, are provided in Appendix A.

Gasoline range organics (GRO) were detected above the laboratory reporting limits in six of the seven wells sampled at concentrations up to 4,200 micrograms per liter ( $\mu\text{g/L}$ ) in well AW-1. Benzene was detected above the laboratory reporting limit in four of the seven wells sampled at concentrations up to 560  $\mu\text{g/L}$  in well AW-1. Toluene was detected above the laboratory reporting limit in two of the seven wells sampled at concentrations up to 12  $\mu\text{g/L}$  in well AW-1. Ethylbenzene was detected above the laboratory reporting limit in four of the seven wells sampled at concentrations up to 93  $\mu\text{g/L}$  in well AW-1. Total Xylenes were detected above the laboratory reporting limit in four of the seven wells sampled at concentrations up to 40  $\mu\text{g/L}$  in well AW-1. TAME was detected above the laboratory reporting limit in four of the seven wells sampled at concentrations up to 890  $\mu\text{g/L}$  in well AW-6. TBA was detected above the laboratory reporting limit in well AW-5 at a concentration of 110  $\mu\text{g/L}$ . MTBE was detected above the laboratory reporting limit in each of the seven wells sampled at concentrations up to 3,900  $\mu\text{g/L}$  in well AW-6. The remaining fuel additives and oxygenates were not detected above their laboratory reporting limits in the seven wells sampled this quarter.

Detected analyte concentrations were within the historic minimum and maximum ranges recorded for each well, with the following exceptions: the TAME concentration reported in well AW-1 was the lowest on record for this well; the TBA concentration reported in well AW-5 was the lowest on record; the GRO, benzene, ethylbenzene, and total xylene concentrations reported in well MW-1 were the lowest on record for this well; and the benzene, toluene, total xylene and MTBE concentrations reported in well RW-1 were the lowest on record for this well. Historic laboratory analytical results are summarized in Table 1 and Table 2. A copy of the Laboratory Analytical Report, including chain-of-custody documentation is provided in Appendix A. Third Quarter 2007 groundwater monitoring data (GEO\_WELL) and laboratory analytical results (EDF) were uploaded to the GeoTracker AB2886 Database. Upload confirmation pages have been provided in Appendix C.

## **CLOSURE:**

The findings presented in this report are based upon: observations of Stratus field personnel (see Appendix A), the points investigated, and results of laboratory tests performed by Test America (Morgan Hill, California). Our services were performed in accordance with the generally accepted standard of practice at the time this report was written. No other warranty, expressed or implied was made. This report has been prepared for the exclusive use of Atlantic Richfield Company. It is possible that variations in soil or ground-water conditions could exist beyond points explored in this investigation.

Also, changes in site conditions could occur in the future due to variations in rainfall, temperature, regional water usage, or other factors.

**ATTACHMENTS:**

- Drawing 1. Ground-Water Elevation Contour and Analytical Summary Map, 10 July 2007, Former BP Service Station #11133, 2220 98<sup>th</sup> Avenue, Oakland, California
- Table 1. Summary of Ground-Water Monitoring Data: Relative Water Elevations and Laboratory Analyses, Station #11133, 2220 98<sup>th</sup> Avenue, Oakland, CA
- Table 2. Summary of Fuel Additives Analytical Data, Station #11133, 2220 98<sup>th</sup> Avenue, Oakland, CA
- Table 3. Historical Ground-Water Flow Direction and Gradient, Station #11133, 2220 98<sup>th</sup> Avenue, Oakland, CA
- Appendix A. Stratus Ground-Water Sampling Data Package (Includes Field Data Sheets, Laboratory Report and Chain-of-Custody Documentation)
- Appendix B. GeoTracker Upload Confirmation

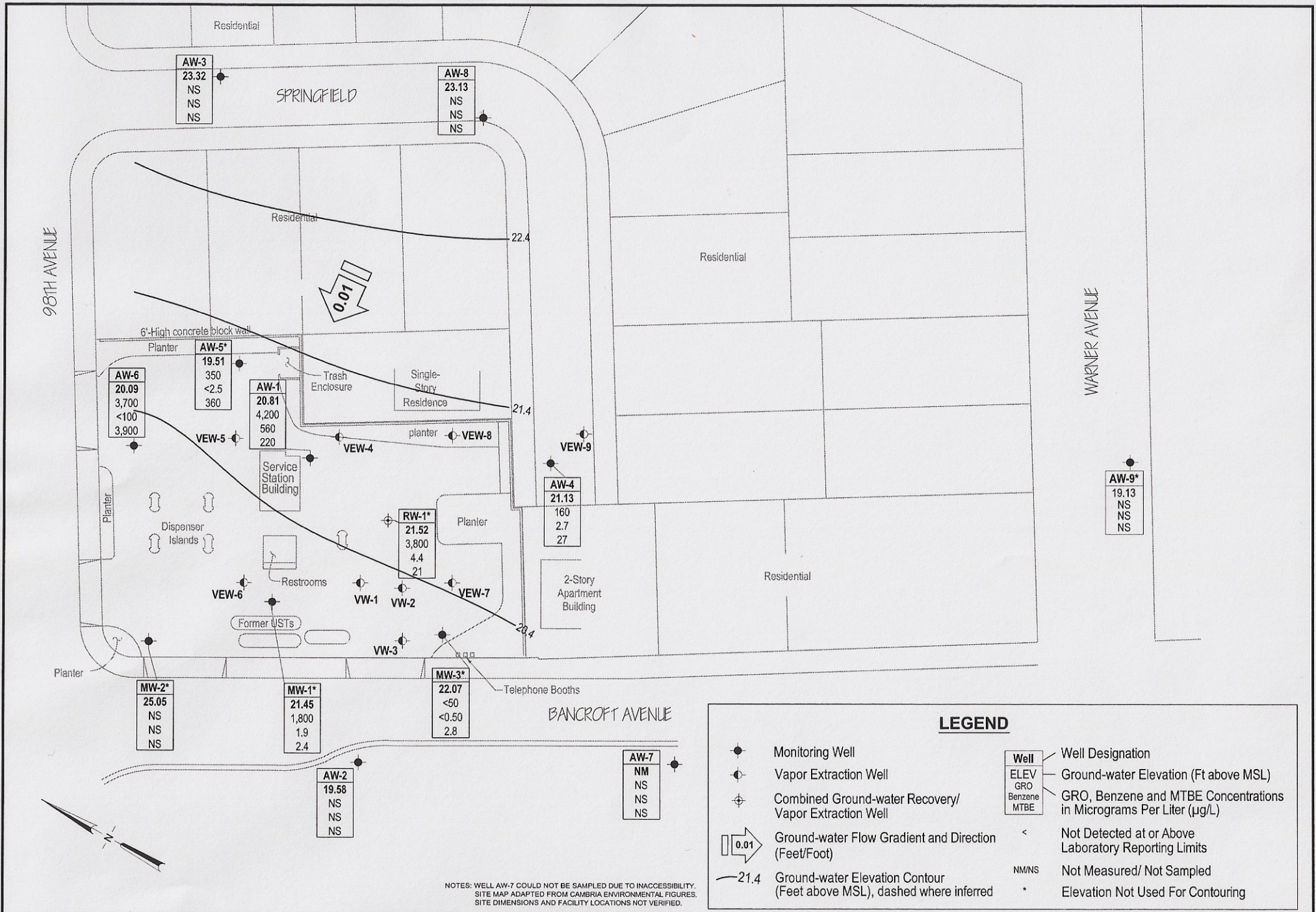

NOTES: WELL AW-7 COULD NOT BE SAMPLED DUE TO INACCESSIBILITY.  
 SITE MAP ADAPTED FROM CAMBRIA ENVIRONMENTAL FIGURES.  
 SITE DIMENSIONS AND FACILITY LOCATIONS NOT VERIFIED.

**LEGEND**

- Monitoring Well
- ◐ Vapor Extraction Well
- ⊕ Combined Ground-water Recovery/  
Vapor Extraction Well
- ↘ 0.01 Ground-water Flow Gradient and Direction  
(Feet/Foot)
- - - 21.4 Ground-water Elevation Contour  
(Feet above MSL), dashed where inferred
- Well
- ELEV Ground-water Elevation (Ft above MSL)
- GRO Benzene MTBE GRO, Benzene and MTBE Concentrations  
in Micrograms Per Liter (µg/L)
- < Not Detected at or Above  
Laboratory Reporting Limits
- NM/NS Not Measured/ Not Sampled
- \* Elevation Not Used For Contouring

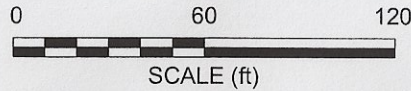

**BROADBENT & ASSOCIATES, INC.**  
 ENGINEERING, WATER RESOURCES & ENVIRONMENTAL  
 1324 Mangrove Ave. Suite 212, Chico, California 95926  
 Project No.: 06-08-656 Date: 08/08/07

Former BP Service Station #11133  
 2220 98th Avenue  
 Oakland, California

Ground-Water Elevation Contour  
 and Analytical Summary Map  
 10 July 2007

Drawing  
**1**

Table 1. Summary of Ground-Water Monitoring Data: Relative Water Elevations and Laboratory Analyses

Station #11133, 2220 98th Ave., Oakland, CA

Well and Sample Date	P/NP	TOC Elevation (feet msl)	Depth to Water (feet bgs)	Product Thickness (feet)	Water Level Elevation (feet msl)	Concentrations in (µg/L)						DO (mg/L)	Lab	pH	Comments
						GRO/TPHg	Benzene	Toluene	Ethyl-Benzene	Total Xylenes	MTBE				
AW-1															
4/5/1991	--	38.11	25.44	--	12.67	4,100	1,500	69	100	83	--	--	SUP	--	
4/1/1992	--	38.11	23.22	--	14.89	--	--	--	--	--	--	--	--	--	
4/2/1992	--	38.11	--	--	--	11,000	1,800	210	210	490	--	--	APP	--	
7/6/1992	--	38.11	24.89	--	13.22	6,500	4,000	40	290	530	--	--	ANA	--	
10/7/1992	--	38.11	26.55	--	11.56	4,700	1,500	41	47	300	--	--	ANA	--	
10/7/1992	--	38.11	--	--	--	2,900	1,200	25	37	210	--	--	ANA	--	e
1/14/1993	--	38.11	23.73	--	14.38	2,800	830	31	140	240	--	--	PACE	--	m
1/14/1993	--	38.11	--	--	--	4,100	1,700	28	130	230	--	--	PACE	--	m, e
4/22/1993	--	38.11	--	--	--	39,000	14,000	530	1,800	6,100	987	--	PACE	--	c, m
7/15/1993	--	38.11	22.50	--	15.61	6,200	2,200	28	210	540	838	--	PACE	--	c, m
10/21/1993	--	38.11	24.32	--	13.79	2,400	820	13	55	120	832	--	PACE	--	c, m
1/27/1994	--	38.11	23.72	--	14.39	3,500	1,400	26	130	220	650	--	PACE	--	c, n
4/21/1994	--	38.11	22.48	--	15.63	40,000	12,000	1,900	1,600	5,000	1,119	1.4	PACE	--	m
9/9/1994	--	38.11	--	--	--	3,900	1,900	5.5	190	240	--	--	PACE	--	e
9/9/1994	--	38.11	23.04	--	15.07	3,500	1,600	5	200	250	--	2.1	PACE	--	m
12/21/1994	--	38.11	21.70	--	16.41	7,600	3,100	36	370	320	855	1.6	PACE	--	m
1/30/1995	--	38.11	17.71	--	20.40	35,000	23,000	650	3,200	4,100	--	1.7	ATI	--	
4/10/1995	--	38.11	20.04	--	18.07	60,000	18,000	2,000	4,300	11,000	--	7.9	ATI	--	
4/10/1995	--	38.11	--	--	--	56,000	17,000	2,000	3,900	10,000	--	--	ATI	--	e
6/29/1995	--	38.11	--	--	--	86,000	12,000	8,400	4,800	18,000	--	--	ATI	--	e
6/29/1995	--	38.11	20.60	--	17.51	72,000	10,000	7,300	4,200	15,000	--	6.2	ATI	--	
9/18/1995	--	38.11	21.87	--	16.24	--	--	--	--	--	--	--	--	--	
9/19/1995	--	38.11	--	--	--	65,000	12,000	3,100	4,400	14,000	1,000	8.5	ATI	--	
12/7/1995	--	38.11	22.06	--	16.05	25,000	8,700	<50	2,500	1,300	1,100	2.9	ATI	--	
3/28/1996	--	38.11	16.91	--	21.20	24,000	11,000	<100	3,200	3,390	<1000	6.6	SPL	--	
6/20/1996	--	38.11	20.82	--	17.29	38,000	6,900	1,100	3,200	7,300	<100	6.4	SPL	--	
10/11/1996	--	38.11	23.20	--	14.91	33,000	8,500	69	3,300	4,230	580	6.3	SPL	--	
1/2/1997	--	38.11	20.41	--	17.70	32,000	8,000	<50	3,100	2,300	700	6.7	SPL	--	
4/14/1997	--	38.11	21.61	--	16.50	--	--	--	--	--	--	--	--	--	
4/15/1997	--	38.11	--	--	--	31,000	5,000	160	2,400	4,540	340	5.4	SPL	--	
7/2/1997	--	38.11	21.17	--	16.94	26,000	5,800	<100	2,600	2,200	<1000	6.2	SPL	--	



Table 1. Summary of Ground-Water Monitoring Data: Relative Water Elevations and Laboratory Analyses

Station #11133, 2220 98th Ave., Oakland, CA

Well and Sample Date	P/NP	TOC Elevation (feet msl)	Depth to Water (feet bgs)	Product Thickness (feet)	Water Level Elevation (feet msl)	Concentrations in (µg/L)						DO (mg/L)	Lab	pH	Comments
						GRO/TPHg	Benzene	Toluene	Ethyl-Benzene	Total Xylenes	MTBE				
AW-1 Cont.															
9/30/1997	--	38.11	21.48	--	16.63	29,000	9,200	17	1,400	130	560	6.9	SPL	--	
1/21/1998	--	38.11	20.02	--	18.09	50,000	6,900	450	3,200	4,450	720	5.8	SPL	--	
4/9/1998	--	38.11	13.37	--	24.74	--	--	--	--	--	--	--	--	--	
4/10/1998	--	38.11	--	--	--	46,000	5,800	1,900	3,000	7,400	1,000	4.3	SPL	--	
6/19/1998	--	38.11	19.12	--	18.99	42,000	6,600	200	3,000	3,350	660	4.9	SPL	--	
6/19/1998	--	38.11	--	--	--	43,000	6,800	260	3,100	3,490	620	--	SPL	--	e
11/30/1998	--	38.11	21.13	--	16.98	23,000	6,700	<25	3,100	130	710/820	--	SPL	--	g
1/21/1999	--	38.11	20.77	--	17.34	25,000	4,800	54	2,800	780	1,000	--	SPL	--	
4/30/1999	--	38.11	20.80	--	17.31	21,000	5,300	67	2,800	750	1,500	--	SPL	--	
7/9/1999	--	38.11	20.41	--	17.70	11,000	3,000	<10	760	180	1,300	--	SPL	--	
11/3/1999	--	38.11	20.82	--	17.29	--	--	--	--	--	--	--	--	--	
1/12/2000	--	38.11	19.99	--	18.12	330,000	5,300	10	2,900	560	2,200	--	PACE	--	
4/13/2000	--	38.11	20.14	--	17.97	--	--	--	--	--	--	--	--	--	
5/24/2000	--	38.11	20.17	--	17.94	--	--	--	--	--	--	--	--	--	
6/1/2000	--	38.11	23.05	--	15.06	--	--	--	--	--	--	--	--	--	
6/8/2000	--	38.11	17.08	--	21.03	--	--	--	--	--	--	--	--	--	
6/15/2000	--	38.11	16.93	--	21.18	--	--	--	--	--	--	--	--	--	
7/26/2000	--	38.11	20.07	--	18.04	15,000	290	98	77	220	37,000	--	PACE	--	
10/24/2000	--	38.11	20.10	--	18.01	--	--	--	--	--	--	--	--	--	
1/19/2001	--	38.11	19.82	--	18.29	7,600	2,220	10.9	415	58.4	1,630	--	PACE	--	
7/24/2001	--	38.11	19.86	--	18.25	9,600	2,140	6.34	281	43	1,440	--	PACE	--	
1/18/2002	--	38.11	15.60	--	22.51	20,000	2,170	75.2	1,800	2,080	1,250	--	PACE	--	
8/1/2002	--	38.11	19.55	--	18.56	14,000	2,150	<12.5	197	42.4	1,120	--	PACE	--	
1/16/2003	--	38.11	16.32	--	21.79	15,000	2,300	75	1,600	1,800	1,100	--	SEQ	--	p
7/7/2003	--	38.11	19.80	--	18.31	9,700	1,600	<25	540	110	1,100	--	SEQ	--	q, u
02/05/2004	--	38.11	18.75	--	19.36	12,000	2,000	<50	820	590	930	--	SEQM	6.7	
07/01/2004	P	38.11	19.72	--	18.39	9,900	2,600	<25	300	<25	1,100	--	SEQM	6.5	
03/16/2005	P	38.11	18.78	--	19.33	10,000	1,100	30	630	560	720	0.8	SEQM	6.7	
07/22/2005	P	38.11	15.53	--	22.58	8,000	770	5.4	520	50	510	--	SEQM	6.5	
01/25/2006	P	38.11	18.10	--	20.01	6,400	1,200	10	490	290	490	--	SEQM	7.0	
7/6/2006	P	38.11	17.44	--	20.67	6,200	1,300	70	570	180	270	--	TAMC	6.8	

Table 1. Summary of Ground-Water Monitoring Data: Relative Water Elevations and Laboratory Analyses

Station #11133, 2220 98th Ave., Oakland, CA

Well and Sample Date	P/NP	TOC Elevation (feet msl)	Depth to Water (feet bgs)	Product Thickness (feet)	Water Level Elevation (feet msl)	Concentrations in (µg/L)						DO (mg/L)	Lab	pH	Comments
						GRO/TPHg	Benzene	Toluene	Ethyl-Benzene	Total Xylenes	MTBE				
<b>AW-1 Cont.</b>															
1/8/2007	P	38.11	16.74	--	21.37	3700	690	19	110	30	380	2.53	TAMC	6.77	
7/10/2007	P	38.11	17.30	--	20.81	4,200	560	12	93	40	220	1.79	TAMC	6.90	
<b>AW-2</b>															
4/5/1991	--	36.83	22.36	--	14.47	<50	<0.3	<0.3	<0.3	<0.3	--	--	SUP	--	
4/1/1992	--	36.83	20.81	--	16.02	--	--	--	--	--	--	--	--	--	
4/2/1992	--	36.83	--	--	--	130	25	2.3	0.7	2.1	--	--	APP	--	
7/6/1992	--	36.83	23.57	--	13.26	<50	<0.5	<0.5	<0.5	<0.5	--	--	ANA	--	
10/7/1992	--	36.83	25.24	--	11.59	<50	<0.5	<0.5	<0.5	<0.5	--	--	ANA	--	
1/14/1993	--	36.83	20.82	--	16.01	<50	<0.5	<0.5	<0.5	<0.5	--	--	PACE	--	m
4/22/1993	--	36.83	19.37	--	17.46	<50	<0.5	<0.5	<0.5	<0.5	--	--	PACE	--	m
7/15/1993	--	36.83	21.29	--	15.54	<50	<0.5	<0.5	<0.5	<0.5	<5.0	--	PACE	--	m
10/21/1993	--	36.83	23.14	--	13.69	<50	1.3	1.1	0.9	2.1	<5.0	--	PACE	--	m
1/27/1994	--	36.83	22.34	--	14.49	<50	<0.5	<0.5	<0.5	<0.5	--	--	PACE	--	m
4/21/1994	--	36.83	21.15	--	15.68	<50	<0.5	<0.5	<0.5	<0.5	<5.0	2.0	PACE	--	m
9/9/1994	--	36.83	22.09	--	14.74	<50	<0.5	<0.5	<0.5	<0.5	--	4.1	PACE	--	m
12/21/1994	--	36.83	20.12	--	16.71	<50	<0.5	<0.5	<0.5	<0.5	<5.0	2.0	PACE	--	m
1/30/1995	--	36.83	16.65	--	20.18	<50	<0.50	<0.50	<0.50	<1.0	--	2.5	ATI	--	
4/10/1995	--	36.83	16.22	--	20.61	<50	<0.50	<0.50	<0.50	<1.0	--	4.4	ATI	--	
6/29/1995	--	36.83	17.55	--	19.28	<50	<0.50	<0.50	<0.50	<1.0	--	7.8	ATI	--	
9/18/1995	--	36.83	19.87	--	16.96	--	--	--	--	--	--	--	--	--	
9/19/1995	--	36.83	--	--	--	<50	<0.50	<0.50	<0.50	<1.0	<5.0	--	ATI	--	e
9/19/1995	--	36.83	--	--	--	<50	<0.50	<0.50	<0.50	<1.0	<5.0	4.5	ATI	--	
12/7/1995	--	36.83	21.31	--	15.52	<50	<0.50	<0.50	<0.50	<1.0	<5.0	4.9	ATI	--	
3/28/1996	--	36.83	15.61	--	21.22	<50	<0.5	<1	<1	<1	<10	4.1	SPL	--	
6/20/1996	--	36.83	16.30	--	20.53	<50	<0.5	<1	<1	<1	<10	5.2	SPL	--	
10/11/1996	--	36.83	19.60	--	17.23	<50	<0.5	<1.0	<1.0	<1.0	<10	6.0	SPL	--	
1/2/1997	--	36.83	15.97	--	20.86	<50	<0.5	<1.0	<1.0	<1.0	<10	6.1	SPL	--	
4/14/1997	--	36.83	17.19	--	19.64	<50	<0.5	<1.0	<1.0	<1.0	<10	5.3	SPL	--	
7/2/1997	--	36.83	18.11	--	18.72	<50	<0.5	<1.0	<1.0	<1.0	<10	5.7	SPL	--	
9/30/1997	--	36.83	18.52	--	18.31	<50	<0.5	<1.0	<1.0	<1.0	860	5.4	SPL	--	

**Table 1. Summary of Ground-Water Monitoring Data: Relative Water Elevations and Laboratory Analyses**

**Station #11133, 2220 98th Ave., Oakland, CA**

Well and Sample Date	P/NP	TOC Elevation (feet msl)	Depth to Water (feet bgs)	Product Thickness (feet)	Water Level Elevation (feet msl)	Concentrations in (µg/L)						DO (mg/L)	Lab	pH	Comments
						GRO/TPHg	Benzene	Toluene	Ethyl-Benzene	Total Xylenes	MTBE				
<b>AW-2 Cont.</b>															
1/21/1998	--	36.83	14.46	--	22.37	160	13	<1.0	<1.0	<1.0	110	4.9	SPL	--	
4/9/1998	--	36.83	12.85	--	23.98	--	--	--	--	--	--	--	--	--	
4/10/1998	--	36.83	--	--	--	<50	<0.5	<1.0	<1.0	<1.0	<10	3.9	SPL	--	
6/19/1998	--	36.83	14.37	--	22.46	60	<0.5	<1.0	<1.0	<1.0	<10	3.6	SPL	--	
11/30/1998	--	36.83	16.90	--	19.93	--	--	--	--	--	--	--	--	--	
1/21/1999	--	36.83	16.87	--	19.96	<50	<1.0	<1.0	<1.0	<1.0	<1.0	--	SPL	--	
4/30/1999	--	36.83	17.01	--	19.82	--	--	--	--	--	--	--	--	--	
7/9/1999	--	36.83	17.83	--	19.00	--	--	--	--	--	--	--	--	--	
11/3/1999	--	36.83	19.74	--	17.09	--	--	--	--	--	--	--	--	--	
1/12/2000	--	36.83	19.90	--	16.93	<50	<0.5	<0.5	<0.5	<0.5	<0.5	--	PACE	--	
4/13/2000	--	36.83	19.75	--	17.08	--	--	--	--	--	--	--	--	--	
7/26/2000	--	36.83	19.86	--	16.97	--	--	--	--	--	--	--	--	--	
10/24/2000	--	36.83	18.77	--	18.06	--	--	--	--	--	--	--	--	--	
1/19/2001	--	36.83	--	--	--	--	--	--	--	--	--	--	--	--	f
7/24/2001	--	36.83	--	--	--	--	--	--	--	--	--	--	--	--	f
1/18/2002	--	36.83	15.17	--	21.66	<50	<0.5	<0.5	<0.5	<1.0	<0.5	--	PACE	--	
8/1/2002	--	36.83	17.17	--	19.66	--	--	--	--	--	--	--	--	--	
1/16/2003	--	36.83	14.81	--	22.02	<50	<0.50	<0.50	<0.50	<0.50	<2.5	--	SEQ	--	p
7/7/2003	--	36.83	16.65	--	20.18	--	--	--	--	--	--	--	--	--	
02/05/2004	--	36.83	15.37	--	21.46	<50	3.0	<0.50	<0.50	<0.50	5.1	--	SEQM	6.6	
07/01/2004	--	36.83	17.55	--	19.28	--	--	--	--	--	--	--	--	--	
03/16/2005	P	36.83	14.58	--	22.25	<50	0.75	<0.50	1.1	1.1	<0.50	1.7	SEQM	6.7	
07/22/2005	--	36.83	15.41	--	21.42	--	--	--	--	--	--	--	--	--	
01/25/2006	P	36.83	14.17	--	22.66	280	110	<1.0	3.9	8.7	12	--	SEQM	7.1	
7/6/2006	--	36.83	14.00	--	22.83	--	--	--	--	--	--	--	--	--	
1/8/2007	P	36.83	15.85	--	20.98	1900	550	160	58	180	40	2.09	TAMC	7.2	
<b>7/10/2007</b>	--	<b>36.83</b>	<b>17.25</b>	--	<b>19.58</b>	--	--	--	--	--	--	--	--	--	
<b>AW-3</b>															
4/5/1991	--	39.13	23.90	--	15.23	5,200	980	450	95	310	--	--	SUP	--	
4/1/1992	--	39.13	22.50	--	16.63	4,700	890	47	43	110	--	--	APP	--	

**Table 1. Summary of Ground-Water Monitoring Data: Relative Water Elevations and Laboratory Analyses**  
**Station #11133, 2220 98th Ave., Oakland, CA**

Well and Sample Date	P/NP	TOC Elevation (feet msl)	Depth to Water (feet bgs)	Product Thickness (feet)	Water Level Elevation (feet msl)	Concentrations in (µg/L)						DO (mg/L)	Lab	pH	Comments
						GRO/TPHg	Benzene	Toluene	Ethyl-Benzene	Total Xylenes	MTBE				
<b>AW-3 Cont.</b>															
7/6/1992	--	39.13	23.26	--	15.87	3,900	3,100	30	80	99	--	--	ANA	--	
10/7/1992	--	39.13	24.75	--	14.38	5,000	2,600	<0.5	<0.5	59	--	--	ANA	--	
1/14/1993	--	39.13	23.59	--	15.54	350	250	<0.5	<0.5	<0.5	--	--	PACE	--	m
4/22/1993	--	39.13	19.42	--	19.71	240	71	2.4	0.6	4	--	--	PACE	--	m
7/15/1993	--	39.13	20.09	--	19.04	650	71	2.8	1.5	1.1	37.3	--	PACE	--	c, m
10/21/1993	--	39.13	--	--	--	170	6.1	2	1.7	4.4	--	--	PACE	--	e
10/21/1993	--	39.13	21.88	--	17.25	160	4.8	1.7	1.6	3.6	8.95	--	PACE	--	m
1/27/1994	--	39.13	22.33	--	16.80	92	2.1	<0.5	<0.5	<0.5	7.37	--	PACE	--	m
1/27/1994	--	39.13	--	--	--	90	2.9	0.5	<0.5	<0.5	--	--	PACE	--	e
4/21/1994	--	39.13	20.96	--	18.17	150	3.6	0.8	0.9	2.5	9.36	1.3	PACE	--	m
9/9/1994	--	39.13	21.60	--	17.53	53	<0.5	<0.5	<0.5	<0.5	--	1.9	PACE	--	m
12/21/1994	--	39.13	--	--	--	--	--	--	--	--	--	--	--	--	f
1/30/1995	--	39.13	--	--	--	--	--	--	--	--	--	--	--	--	f
4/10/1995	--	39.13	--	--	--	--	--	--	--	--	--	--	--	--	f
6/29/1995	--	39.13	15.41	--	23.72	<50	<0.50	<0.50	<0.50	<1.0	--	8.0	ATI	--	
9/18/1995	--	39.13	17.83	--	21.30	--	--	--	--	--	--	--	--	--	
9/19/1995	--	39.13	--	--	--	61,000	11,000	2,900	4,100	13,000	790	7.4	ATI	--	
12/7/1995	--	39.13	--	--	--	<50	<0.50	<0.50	<0.50	<1.0	<5.0	--	ATI	--	e
12/7/1995	--	39.13	19.27	--	19.86	<50	<0.50	<0.50	<0.50	<1.0	<5.0	3.4	ATI	--	
3/28/1996	--	39.13	13.85	--	25.28	<50	<0.5	<1	<1	<1	<10	4.1	SPL	--	
3/28/1996	--	39.13	--	--	--	<50	<0.5	<1	<1	<1	<10	--	SPL	--	e
6/20/1996	--	39.13	14.47	--	24.66	<50	<0.5	<1	<1	<1	<10	4.2	SPL	--	
6/20/1996	--	39.13	--	--	--	<50	<0.5	<1	<1	<1	<10	--	SPL	--	e
10/11/1996	--	39.13	--	--	--	<50	<0.5	<1.0	<1.0	<1.0	<10	--	SPL	--	e
10/11/1996	--	39.13	17.97	--	21.16	<50	<0.5	<1.0	<1.0	<1.0	<10	4.7	SPL	--	
1/2/1997	--	39.13	13.00	--	26.13	<50	<0.5	<1.0	<1.0	<1.0	<10	5.6	SPL	--	
4/14/1997	--	39.13	14.36	--	24.77	<50	<0.5	<1.0	<1.0	<1.0	<10	5.0	SPL	--	
4/15/1997	--	39.13	--	--	--	<50	<0.5	<1.0	<1.0	<1.0	<10	--	SPL	--	e
7/2/1997	--	39.13	15.87	--	23.26	<50	<0.5	<1.0	<1.0	<1.0	<10	5.4	SPL	--	
9/30/1997	--	39.13	17.50	--	21.63	<250	<2.5	<5.0	<5.0	<5.0	810	5.7	SPL	--	
1/21/1998	--	39.13	11.98	--	27.15	140	<0.5	<1.0	<1.0	<1.0	99	4.6	SPL	--	

Table 1. Summary of Ground-Water Monitoring Data: Relative Water Elevations and Laboratory Analyses

Station #11133, 2220 98th Ave., Oakland, CA

Well and Sample Date	P/NP	TOC Elevation (feet msl)	Depth to Water (feet bgs)	Product Thickness (feet)	Water Level Elevation (feet msl)	Concentrations in (µg/L)						DO (mg/L)	Lab	pH	Comments
						GRO/TPHg	Benzene	Toluene	Ethyl-Benzene	Total Xylenes	MTBE				
<b>AW-3 Cont.</b>															
1/21/1998	--	39.13	--	--	--	150	<0.5	<1.0	<1.0	1.2	110	--	SPL	--	e
4/9/1998	--	39.13	9.45	--	29.68	--	--	--	--	--	--	--	--	--	
4/10/1998	--	39.13	--	--	--	<50	<0.5	<1.0	1.4	1.7	<10	--	SPL	--	e
4/10/1998	--	39.13	--	--	--	<50	<0.5	<1.0	<1.0	1.6	<10	4.5	SPL	--	
6/19/1998	--	39.13	12.13	--	27.00	<50	<0.5	<1.0	<1.0	<1.0	<10	4.4	SPL	--	
11/30/1998	--	39.13	15.91	--	23.22	--	--	--	--	--	--	--	--	--	
1/21/1999	--	39.13	15.93	--	23.20	<50	<1.0	<1.0	<1.0	<1.0	<1.0	--	SPL	--	
4/30/1999	--	39.13	15.98	--	23.15	--	--	--	--	--	--	--	--	--	
7/9/1999	--	39.13	14.58	--	24.55	--	--	--	--	--	--	--	--	--	
11/3/1999	--	39.13	17.43	--	21.70	--	--	--	--	--	--	--	--	--	
1/12/2000	--	39.13	18.30	--	20.83	<50	<0.5	<0.5	<0.5	<0.5	<0.5	--	PACE	--	
4/13/2000	--	39.13	18.89	--	20.24	--	--	--	--	--	--	--	--	--	
7/26/2000	--	39.13	18.67	--	20.46	--	--	--	--	--	--	--	--	--	
10/24/2000	--	39.13	18.98	--	20.15	--	--	--	--	--	--	--	--	--	
1/19/2001	--	39.13	16.74	--	22.39	--	--	--	--	--	--	--	--	--	
7/24/2001	--	39.13	18.55	--	20.58	--	--	--	--	--	--	--	--	--	
1/18/2002	--	39.13	14.49	--	24.64	--	--	--	--	--	--	--	--	--	
8/1/2002	--	39.13	14.27	--	24.86	--	--	--	--	--	--	--	--	--	
1/16/2003	--	39.13	14.25	--	24.88	--	--	--	--	--	--	--	--	--	
7/7/2003	--	39.13	14.70	--	24.43	--	--	--	--	--	--	--	--	--	
02/05/2004	--	39.13	14.61	--	24.52	--	--	--	--	--	--	--	--	--	
07/01/2004	--	39.13	15.62	--	23.51	--	--	--	--	--	--	--	--	--	
03/16/2005	P	39.13	12.70	--	26.43	<50	<0.50	<0.50	<0.50	<0.50	<0.50	1.1	SEQM	7.3	
07/22/2005	--	39.13	13.44	--	25.69	--	--	--	--	--	--	--	--	--	
01/25/2006	--	39.13	13.56	--	25.57	--	--	--	--	--	--	--	--	--	
7/6/2006	--	39.13	11.60	--	27.53	--	--	--	--	--	--	--	--	--	
1/8/2007	--	39.13	14.97	--	24.16	--	--	--	--	--	--	--	--	--	
<b>7/10/2007</b>	--	<b>39.13</b>	<b>15.81</b>	--	<b>23.32</b>	--	--	--	--	--	--	--	--	--	
<b>AW-4</b>															
4/5/1991	--	39.08	25.12	--	13.96	110,000	40,000	13,000	2,000	5,500	--	--	SUP	--	

**Table 1. Summary of Ground-Water Monitoring Data: Relative Water Elevations and Laboratory Analyses**

**Station #11133, 2220 98th Ave., Oakland, CA**

Well and Sample Date	P/NP	TOC Elevation (feet msl)	Depth to Water (feet bgs)	Product Thickness (feet)	Water Level Elevation (feet msl)	Concentrations in (µg/L)						DO (mg/L)	Lab	pH	Comments
						GRO/TPHg	Benzene	Toluene	Ethyl-Benzene	Total Xylenes	MTBE				
<b>AW-4 Cont.</b>															
4/1/1992	--	39.08	--	--	--	210,000	55,000	23,000	2,900	7,000	--	--	APP	--	e
4/1/1992	--	39.08	23.56	--	15.52	230,000	57,000	31,000	2,900	7,600	--	--	APP	--	
7/6/1992	--	39.08	25.87	--	13.21	38,000	16,000	5,400	2,000	6,100	--	--	ANA	--	
10/7/1992	--	39.08	27.53	--	11.55	120,000	41,000	26,000	4,700	13,000	--	--	ANA	--	
1/14/1993	--	39.08	24.12	--	14.96	62,000	18,000	14,000	2,700	7,700	1,400	--	PACE	--	c, m
4/22/1993	--	39.08	21.47	--	17.61	18,000	1,100	2,100	320	3,500	--	--	PACE	--	m
7/15/1993	--	39.08	23.30	--	15.78	21,000	820	2,300	590	3,800	1,978	--	PACE	--	c, m
10/21/1993	--	39.08	25.08	--	14.00	11,000	570	83	630	2,300	4,600	--	PACE	--	c, m
1/27/1994	--	39.08	24.61	--	14.47	12,000	420	460	600	2,200	6,400	--	PACE	--	c, m
4/21/1994	--	39.08	22.96	--	16.12	12,000	110	250	150	1,900	16,010	1.5	PACE	--	c, m
4/21/1994	--	39.08	--	--	--	14,000	71	160	29	1,200	13,000	--	PACE	--	c, e
9/9/1994	--	39.08	23.85	--	15.23	9,700	75	64	280	2,000	--	2.1	PACE	--	m
12/21/1994	--	39.08	--	--	--	--	--	--	--	--	--	--	--	--	f
1/30/1995	--	39.08	--	--	--	--	--	--	--	--	--	--	--	--	f
4/10/1995	--	39.08	18.07	--	21.01	3,700	69	8.7	44	130	--	8.5	ATI	--	
6/29/1995	--	39.08	19.25	--	19.83	8,000	62	190	190	1,100	--	7.5	ATI	--	
9/18/1995	--	39.08	20.73	--	18.35	--	--	--	--	--	--	--	--	--	
9/19/1995	--	39.08	--	--	--	12,000	660	1,600	200	1,900	7,100	8.3	ATI	--	
12/7/1995	--	39.08	22.49	--	16.59	41,000	8,400	7,200	710	6,300	5,200	3.6	ATI	--	
3/28/1996	--	39.08	16.49	--	22.59	--	--	--	--	--	--	--	--	--	f
6/20/1996	--	39.08	16.00	--	23.08	<50	<0.5	<1	<1	<1	12	--	SPL	--	
10/11/1996	--	39.08	19.52	--	19.56	36,000	12,000	5,500	<25	3,800	880/1000	6.2	SPL	--	g
1/2/1997	--	39.08	--	--	--	<50	61	3.8	3.5	8.1	110	--	SPL	--	e
1/2/1997	--	39.08	15.80	--	23.28	<50	<0.5	<1.0	<1.0	<1.0	22	6.4	SPL	--	
4/14/1997	--	39.08	17.01	--	22.07	--	--	--	--	--	--	--	--	--	
4/15/1997	--	39.08	--	--	--	<50	<0.5	<1.0	<1.0	<1.0	<10	5.4	SPL	--	
7/2/1997	--	39.08	19.68	--	19.40	<50	21	<1.0	<1.0	<1.0	41	4.1	SPL	--	
9/30/1997	--	39.08	22.71	--	16.37	--	--	--	--	--	--	--	--	--	f
1/21/1998	--	39.08	15.89	--	23.19	13,000	2,900	<10	230	314	3,100	3.9	SPL	--	
4/9/1998	--	39.08	13.50	--	25.58	--	--	--	--	--	--	--	--	--	
4/10/1998	--	39.08	--	--	--	890	<0.5	<1	<1	<1	730	4.9	SPL	--	

**Table 1. Summary of Ground-Water Monitoring Data: Relative Water Elevations and Laboratory Analyses**  
**Station #11133, 2220 98th Ave., Oakland, CA**

Well and Sample Date	P/NP	TOC Elevation (feet msl)	Depth to Water (feet bgs)	Product Thickness (feet)	Water Level Elevation (feet msl)	Concentrations in (µg/L)						DO (mg/L)	Lab	pH	Comments
						GRO/TPHg	Benzene	Toluene	Ethyl-Benzene	Total Xylenes	MTBE				
<b>AW-4 Cont.</b>															
6/19/1998	--	39.08	14.75	--	24.33	60	<0.5	<1.0	<1.0	<1.0	34	4.3	SPL	--	
11/30/1998	--	39.08	19.25	--	19.83	--	--	--	--	--	--	--	--	--	
1/21/1999	--	39.08	18.94	--	20.14	3,700	830	93	200	360	30	--	--	--	
4/30/1999	--	39.08	19.10	--	19.98	--	--	--	--	--	--	--	--	--	
7/9/1999	--	39.08	18.93	--	20.15	76,000	12,000	6,600	2,000	8,700	320	--	SPL	--	
11/3/1999	--	39.08	20.65	--	18.43	--	--	--	--	--	--	--	--	--	
1/12/2000	--	39.08	21.21	--	17.87	67,000	12,000	3,500	2,900	15,000	280	--	PACE	--	
4/13/2000	--	39.08	21.33	--	17.75	--	--	--	--	--	--	--	--	--	
5/24/2000	--	39.08	19.84	--	19.24	--	--	--	--	--	--	--	--	--	
6/1/2000	--	39.08	19.04	--	20.04	--	--	--	--	--	--	--	--	--	
6/8/2000	--	39.08	18.32	--	20.76	--	--	--	--	--	--	--	--	--	
6/15/2000	--	39.08	16.70	--	22.38	--	--	--	--	--	--	--	--	--	
7/26/2000	--	39.08	21.50	--	17.58	910	<0.5	<0.5	<0.5	<0.5	3,500	--	PACE	--	
10/24/2000	--	39.08	22.00	--	17.08	--	--	--	--	--	--	--	--	--	
1/19/2001	--	39.08	18.97	--	20.11	6,600	2,460	24	497	534	267	--	PACE	--	
7/24/2001	--	39.08	18.55	--	20.53	5,100	1,080	143	409	827	115	--	PACE	--	
1/18/2002	--	39.08	17.22	--	21.86	3,900	442	241	157	681	85.3	--	PACE	--	
8/1/2002	--	39.08	--	--	--	--	--	--	--	--	--	--	--	--	f
1/16/2003	--	39.08	16.85	--	22.23	2,900	260	160	120	590	<120	--	SEQ	--	p
7/7/2003	--	39.08	17.94	--	21.14	600	90	7.9	18	36	56	--	SEQ	--	q
02/05/2004	--	39.08	16.94	--	22.14	420	40	3.1	15	27	40	--	SEQM	6.8	
07/01/2004	P	39.08	18.24	--	20.84	6,000	970	200	310	1,500	64	--	SEQM	6.7	
03/16/2005	P	39.08	16.16	--	22.92	3,600	71	31	200	870	23	0.6	SEQM	6.5	
07/22/2005	P	39.08	15.89	--	23.19	4,800	750	48	300	840	59	--	SEQM	6.7	
01/25/2006	P	39.08	15.48	--	23.60	<500	13	<5.0	14	62	12	--	SEQM	7.0	
7/6/2006	P	39.08	14.87	--	24.21	2,800	430	21	230	680	39	--	TAMC	6.7	
1/8/2007	P	39.08	16.48	--	22.60	190	6.6	<0.50	4.1	14	38	3.00	TAMC	6.80	
<b>7/10/2007</b>	<b>P</b>	<b>39.08</b>	<b>17.95</b>	<b>--</b>	<b>21.13</b>	<b>160</b>	<b>2.7</b>	<b>&lt;0.50</b>	<b>0.90</b>	<b>1.0</b>	<b>27</b>	<b>2.54</b>	<b>TAMC</b>	<b>7.19</b>	
<b>AW-5</b>															
4/5/1991	--	38.51	25.48	--	13.03	420	31	7.5	20	68	--	--	SUP	--	

Table 1. Summary of Ground-Water Monitoring Data: Relative Water Elevations and Laboratory Analyses

Station #11133, 2220 98th Ave., Oakland, CA

Well and Sample Date	P/NP	TOC Elevation (feet msl)	Depth to Water (feet bgs)	Product Thickness (feet)	Water Level Elevation (feet msl)	Concentrations in (µg/L)						DO (mg/L)	Lab	pH	Comments
						GRO/TPHg	Benzene	Toluene	Ethyl-Benzene	Total Xylenes	MTBE				
AW-5 Cont.															
4/1/1992	--	38.51	23.95	--	14.56	--	--	--	--	--	--	--	--	--	
4/2/1992	--	38.51	--	--	--	4,000	270	63	190	290	--	--	APP	--	
7/6/1992	--	38.51	26.48	--	12.03	1,400	160	<2.5	250	58	--	--	ANA	--	
10/7/1992	--	38.51	28.18	--	10.33	360	12	0.6	8.7	5	--	--	ANA	--	
1/14/1993	--	38.51	24.15	--	14.36	1,700	270	7.5	130	62	--	--	PACE	--	m
4/22/1993	--	38.51	22.43	--	16.08	2,700	780	30	220	180	--	--	PACE	--	m
4/22/1993	--	38.51	--	--	--	3,500	780	29	240	210	--	--	PACE	--	m, e
7/15/1993	--	38.51	--	--	--	1,300	68	8.3	64	99	<50	--	PACE	--	m, e
7/15/1993	--	38.51	24.31	--	14.20	1,300	69	16	67	120	<50	--	PACE	--	m
10/21/1993	--	38.51	26.05	--	12.46	510	9.6	1.5	17	45	75	--	PACE	--	c, m
1/27/1994	--	38.51	26.42	--	12.09	420	3.3	<0.5	1	0.9	48.9	--	PACE	--	m
4/21/1994	--	38.51	24.36	--	14.15	1,000	110	25	56	27	75	1.3	PACE	--	c, m
9/9/1994	--	38.51	24.55	--	13.96	210	<0.5	<0.5	0.5	0.9	--	2.7	PACE	--	m
12/21/1994	--	38.51	22.30	--	16.21	410	<0.5	20	4.3	1.4	114	1.1	PACE	--	m
12/21/1994	--	38.51	--	--	--	340	<0.5	15	3.3	1.4	104	--	PACE	--	m, e
1/30/1995	--	38.51	18.88	--	19.63	210	0.6	11	8.8	2	--	1.5	ATI	--	
4/10/1995	--	38.51	18.44	--	20.07	500	1.4	0.59	6.5	4.3	--	8.3	ATI	--	
6/29/1995	--	38.51	19.92	--	18.59	490	1.2	0.58	7.3	2.2	--	6.9	ATI	--	d
9/18/1995	--	38.51	22.15	--	16.36	--	--	--	--	--	--	--	--	--	
9/19/1995	--	38.51	--	--	--	260	0.62	<0.50	3.1	1.1	110	8.2	ATI	--	
12/7/1995	--	38.51	23.75	--	14.76	60	<0.50	<0.50	<0.50	<1.0	210	4.3	ATI	--	
3/28/1996	--	38.51	17.76	--	20.75	<50	<0.5	<1	<1	<1	63	3.0	SPL	--	
6/20/1996	--	38.51	18.46	--	20.05	<50	<0.5	<1	<1	<1	<10	3.6	SPL	--	
10/11/1996	--	38.51	21.84	--	16.67	<50	<0.5	<1.0	<1.0	<1.0	<10	4.5	SPL	--	
1/2/1997	--	38.51	18.01	--	20.50	<50	<0.5	<1.0	<1.0	<1.0	<10	4.6	SPL	--	
4/14/1997	--	38.51	19.35	--	19.16	<50	<0.5	<1.0	<1.0	<1.0	<10	5.1	SPL	--	
7/2/1997	--	38.51	20.29	--	18.22	<50	<0.5	<1.0	<1.0	<1.0	<10	4.0	SPL	--	
9/30/1997	--	38.51	23.15	--	15.36	<250	<2.5	<5.0	<5.0	<5.0	1,300	6.3	SPL	--	
1/21/1998	--	38.51	17.33	--	21.18	6,100	<0.5	2.1	<1.0	<1.0	3,700	4.5	SPL	--	
4/9/1998	--	38.51	15.25	--	23.26	--	--	--	--	--	--	--	--	--	
4/10/1998	--	38.51	--	--	--	3,500	<0.5	<1.0	<1.0	<1.0	3,000	5.4	SPL	--	



Table 1. Summary of Ground-Water Monitoring Data: Relative Water Elevations and Laboratory Analyses

Station #11133, 2220 98th Ave., Oakland, CA

Well and Sample Date	P/NP	TOC Elevation (feet msl)	Depth to Water (feet bgs)	Product Thickness (feet)	Water Level Elevation (feet msl)	Concentrations in (µg/L)						DO (mg/L)	Lab	pH	Comments
						GRO/TPHg	Benzene	Toluene	Ethyl-Benzene	Total Xylenes	MTBE				
<b>AW-5 Cont.</b>															
6/19/1998	--	38.51	17.39	--	21.12	3,300	<0.5	<1.0	<1.0	<1.0	2,500	5.2	SPL	--	
11/30/1998	--	38.51	--	--	--	--	--	--	--	--	--	--	--	--	f
1/21/1999	--	38.51	21.22	--	17.29	2,800	<1.0	<1.0	<1.0	<1.0	1,800	--	SPL	--	
4/30/1999	--	38.51	21.50	--	17.01	--	--	--	--	--	--	--	--	--	
7/9/1999	--	38.51	20.15	--	18.36	4,000	<1.0	<1.0	<1.0	<1.0	3400/3500	--	SPL	--	g
11/3/1999	--	38.51	22.04	--	16.47	--	--	--	--	--	--	--	--	--	
1/12/2000	--	38.51	22.59	--	15.92	1,000	7.3	30	6.7	40	4,600	--	PACE	--	j (TPH-g/GRO)
4/13/2000	--	38.51	23.11	--	15.40	--	--	--	--	--	--	--	--	--	
7/26/2000	--	38.51	22.72	--	15.79	1,800	94	35	5.9	27	16,000	--	PACE	--	
10/24/2000	--	38.51	20.15	--	18.36	--	--	--	--	--	--	--	--	--	
1/19/2001	--	38.51	19.79	--	18.72	2,600	<0.5	<0.5	<0.5	<0.5	4,580	--	PACE	--	
7/24/2001	--	38.51	20.17	--	18.34	5,400	18.4	17.2	<12.5	40.8	5,170	--	PACE	--	
1/18/2002	--	38.51	17.34	--	21.17	3,800	343	0.738	<0.5	<1.0	3,750	--	PACE	--	
8/1/2002	--	38.51	19.49	--	19.02	5,300	<12.5	<12.5	<12.5	<25	3,470	--	PACE	--	
1/16/2003	--	38.51	17.30	--	21.21	1,400	140	<10	<10	<10	1,600	--	SEQ	--	p
7/7/2003	--	38.51	18.43	--	20.08	1,400	<10	<10	<10	<10	980	--	SEQ	--	q
02/05/2004	--	38.51	17.24	--	21.27	1,800	<10	<10	<10	<10	810	--	SEQM	6.7	
07/01/2004	P	38.51	19.43	--	19.08	1,100	<5.0	<5.0	<5.0	<5.0	550	--	SEQM	6.6	
03/16/2005	P	38.51	15.30	--	23.21	<5,000	<50	<50	<50	130	890	2.1	SEQM	6.7	
07/22/2005	P	38.51	17.22	--	21.29	<500	5.2	<5.0	<5.0	6.9	390	--	SEQM	6.6	
01/25/2006	P	38.51	15.28	--	23.23	<500	<5.0	<5.0	<5.0	<5.0	26	--	SEQM	7.0	
7/6/2006	P	38.51	15.93	--	22.58	220	<5.0	<5.0	<5.0	<5.0	170	--	TAMC	6.5	
1/8/2007	P	38.51	17.90	--	20.61	170	<2.5	<2.5	<2.5	<2.5	220	5.22	TAMC	6.84	
<b>7/10/2007</b>	<b>P</b>	<b>38.51</b>	<b>19.00</b>	<b>--</b>	<b>19.51</b>	<b>350</b>	<b>&lt;2.5</b>	<b>&lt;2.5</b>	<b>&lt;2.5</b>	<b>&lt;2.5</b>	<b>360</b>	<b>1.96</b>	<b>TAMC</b>	<b>7.02</b>	
<b>AW-6</b>															
4/5/1991	--	37.08	22.48	--	14.60	1,100	80	19	1.4	230	--	--	SUP	--	
4/1/1992	--	37.08	22.50	--	14.58	--	--	--	--	--	--	--	--	--	
4/2/1992	--	37.08	--	--	--	<50	<0.5	<0.5	<0.5	<0.5	--	--	APP	--	
7/6/1992	--	37.08	22.74	--	14.34	<50	<0.5	<0.5	<0.5	<0.5	--	--	ANA	--	
10/7/1992	--	37.08	24.64	--	12.44	<50	<0.5	<0.5	<0.5	<0.5	--	--	ANA	--	

**Table 1. Summary of Ground-Water Monitoring Data: Relative Water Elevations and Laboratory Analyses**  
**Station #11133, 2220 98th Ave., Oakland, CA**

Well and Sample Date	P/NP	TOC Elevation (feet msl)	Depth to Water (feet bgs)	Product Thickness (feet)	Water Level Elevation (feet msl)	Concentrations in (µg/L)						DO (mg/L)	Lab	pH	Comments
						GRO/TPHg	Benzene	Toluene	Ethyl-Benzene	Total Xylenes	MTBE				
<b>AW-6 Cont.</b>															
1/14/1993	--	37.08	22.36	--	14.72	<50	<0.5	<0.5	<0.5	<0.5	--	--	PACE	--	m
4/22/1993	--	37.08	22.82	--	14.26	<50	<0.5	<0.5	<0.5	<0.5	--	--	PACE	--	m
7/15/1993	--	37.08	20.49	--	16.59	<50	<0.5	<0.5	<0.5	0.8	<5.0	--	PACE	--	m
10/21/1993	--	37.08	22.84	--	14.24	<50	0.5	0.6	<0.5	0.7	<5.0	--	PACE	--	m
1/27/1994	--	37.08	22.33	--	14.75	<50	<0.5	0.9	3.1	12	<5.0	--	PACE	--	m
4/21/1994	--	37.08	20.66	--	16.42	<50	<0.5	<0.5	<0.5	<0.5	<5.0	1.7	PACE	--	m
9/9/1994	--	37.08	21.57	--	15.51	<50	0.9	<0.5	<0.5	0.5	--	2.9	PACE	--	m
12/21/1994	--	37.08	19.40	--	17.68	<50	1.8	0.8	0.8	3.2	5.19	1.1	PACE	--	m
1/30/1995	--	37.08	--	--	--	<50	<0.50	<0.50	<0.50	<1.0	--	--	ATI	--	e
1/30/1995	--	37.08	16.74	--	20.34	<50	<0.50	<0.50	<0.50	<1.0	--	2.2	ATI	--	
4/10/1995	--	37.08	16.01	--	21.07	<50	<0.50	<0.50	<0.50	<1.0	--	8.6	ATI	--	
6/29/1995	--	37.08	17.54	--	19.54	<50	<0.50	<0.50	<0.50	<1.0	--	6.3	ATI	--	
9/18/1995	--	37.08	19.65	--	17.43	--	--	--	--	--	--	--	--	--	
9/19/1995	--	37.08	--	--	--	<50	<0.50	<0.50	<0.50	<1.0	25	8.3	ATI	--	
12/7/1995	--	37.08	20.35	--	16.73	<50	<0.50	<0.50	<0.50	<1.0	16	4.7	ATI	--	
3/28/1996	--	37.08	14.99	--	22.09	<50	<0.5	<1	<1	<1	<10	4.0	SPL	--	
6/20/1996	--	37.08	15.59	--	21.49	<50	<0.5	<1	<1	<1	<10	4.6	SPL	--	
10/11/1996	--	37.08	19.09	--	17.99	<50	<0.5	<1.0	<1.0	<1.0	<10	5.3	SPL	--	
1/2/1997	--	37.08	15.11	--	21.97	<50	<0.5	<1.0	<1.0	<1.0	<10	5.5	SPL	--	
4/14/1997	--	37.08	16.25	--	20.83	<50	<0.5	<1.0	<1.0	<1.0	<10	3.9	SPL	--	
7/2/1997	--	37.08	17.99	--	19.09	<50	<0.5	<1.0	<1.0	<1.0	<10	5.2	SPL	--	
9/30/1997	--	37.08	20.50	--	16.58	<50	<0.5	<1.0	<1.0	<1.0	<10	6.0	SPL	--	
1/21/1998	--	37.08	15.72	--	21.36	160	<0.5	<1.0	<1.0	<1.0	110	5.0	SPL	--	
4/9/1998	--	37.08	13.31	--	23.77	--	--	--	--	--	--	--	--	--	
4/10/1998	--	37.08	--	--	--	370	<0.5	<1.0	<1.0	<1.0	300	4.3	SPL	--	
6/19/1998	--	37.08	15.18	--	21.90	830	2	<1.0	<1.0	<1.0	690	4.0	SPL	--	
11/30/1998	--	37.08	--	--	--	--	--	--	--	--	--	--	--	--	f
1/21/1999	--	37.08	15.78	--	21.30	2,300	<1.0	<1.0	<1.0	<1.0	1,900	--	SPL	--	
4/30/1999	--	37.08	16.01	--	21.07	--	--	--	--	--	--	--	--	--	
7/9/1999	--	37.08	17.63	--	19.45	--	--	--	--	--	--	--	--	--	
11/3/1999	--	37.08	18.42	--	18.66	--	--	--	--	--	--	--	--	--	

Table 1. Summary of Ground-Water Monitoring Data: Relative Water Elevations and Laboratory Analyses

Station #11133, 2220 98th Ave., Oakland, CA

Well and Sample Date	P/NP	TOC Elevation (feet msl)	Depth to Water (feet bgs)	Product Thickness (feet)	Water Level Elevation (feet msl)	Concentrations in (µg/L)						DO (mg/L)	Lab	pH	Comments
						GRO/TPHg	Benzene	Toluene	Ethyl-Benzene	Total Xylenes	MTBE				
<b>AW-6 Cont.</b>															
1/12/2000	--	37.08	19.92	--	17.16	<50	<0.5	<0.5	<0.5	<0.5	2,700	--	PACE	--	
4/13/2000	--	37.08	19.87	--	17.21	--	--	--	--	--	--	--	--	--	
7/26/2000	--	37.08	19.99	--	17.09	--	--	--	--	--	--	--	--	--	
10/24/2000	--	37.08	18.12	--	18.96	--	--	--	--	--	--	--	--	--	
1/19/2001	--	37.08	17.04	--	20.04	2,700	<0.5	<0.5	<0.5	<0.5	4,850	--	PACE	--	
7/24/2001	--	37.08	17.83	--	19.25	--	--	--	--	--	--	--	--	--	
1/18/2002	--	37.08	15.54	--	21.54	5,500	614	<0.5	<0.5	<1.0	5,390	--	PACE	--	
8/1/2002	--	37.08	16.98	--	20.10	--	--	--	--	--	--	--	--	--	
1/16/2003	--	37.08	15.05	--	22.03	2,900	<20	<20	<20	63	2,500	--	SEQ	--	p
7/7/2003	--	37.08	16.58	--	20.50	--	--	--	--	--	--	--	--	--	
02/05/2004	--	37.08	15.84	--	21.24	7,000	<50	<50	<50	<50	5,400	--	SEQM	6.7	
07/01/2004	P	37.08	17.91	--	19.17	9,600	<50	<50	<50	<50	4,600	--	SEQM	6.5	
03/16/2005	P	37.08	16.04	--	21.04	6,700	<25	<25	<25	<25	4,400	3.0	SEQM	6.8	
07/22/2005	P	37.08	14.20	--	22.88	<5,000	<50	<50	<50	<50	5,500	--	SEQM	6.7	
01/25/2006	P	37.08	14.17	--	22.91	<5,000	<50	<50	<50	<50	3,000	--	SEQM	7.0	
7/6/2006	P	37.08	14.82	--	22.26	3,100	<50	<50	<50	<50	2,800	--	TAMC	6.5	
1/8/2007	P	37.08	15.72	--	21.36	5100	<50	<50	<50	<50	7400	3.18	TAMC	6.78	
<b>7/10/2007</b>	<b>P</b>	<b>37.08</b>	<b>16.99</b>	<b>--</b>	<b>20.09</b>	<b>3,700</b>	<b>&lt;100</b>	<b>&lt;100</b>	<b>&lt;100</b>	<b>&lt;100</b>	<b>3,900</b>	<b>2.09</b>	<b>TAMC</b>	<b>6.83</b>	<b>w</b>
<b>AW-7</b>															
4/5/1991	--	37.60	23.38	--	14.22	<50	0.4	0.7	<0.3	<0.3	--	--	SUP	--	
4/1/1992	--	37.60	21.92	--	15.68	--	--	--	--	--	--	--	--	--	
4/2/1992	--	37.60	--	--	--	<50	<0.5	3.2	1	5.4	--	--	APP	--	
7/6/1992	--	37.60	24.50	--	13.10	<50	<0.5	<0.5	<0.5	<0.5	--	--	ANA	--	
10/7/1992	--	37.60	26.18	--	11.42	<50	<0.5	<0.5	<0.5	<0.5	--	--	ANA	--	
1/14/1993	--	37.60	22.03	--	15.57	<50	<0.5	<0.5	<0.5	<0.5	--	--	PACE	--	m
4/22/1993	--	37.60	21.18	--	16.42	<50	<0.5	<0.5	<0.5	<0.5	--	--	PACE	--	m
7/15/1993	--	37.60	22.09	--	15.51	<50	<0.5	<0.5	<0.5	<0.5	<5.0	--	PACE	--	m
10/21/1993	--	37.60	24.05	--	13.55	51	5	4.2	3.5	8.2	<5.0	--	PACE	--	m
1/27/1994	--	37.60	23.40	--	14.20	<50	<0.5	<0.5	<0.5	<0.5	<5.0	--	PACE	--	m
4/21/1994	--	37.60	22.24	--	15.36	<50	<0.5	<0.5	<0.5	<0.5	<5.0	2.5	PACE	--	m

**Table 1. Summary of Ground-Water Monitoring Data: Relative Water Elevations and Laboratory Analyses**  
**Station #11133, 2220 98th Ave., Oakland, CA**

Well and Sample Date	P/NP	TOC Elevation (feet msl)	Depth to Water (feet bgs)	Product Thickness (feet)	Water Level Elevation (feet msl)	Concentrations in (µg/L)						DO (mg/L)	Lab	pH	Comments
						GRO/TPHg	Benzene	Toluene	Ethyl-Benzene	Total Xylenes	MTBE				
<b>AW-7 Cont.</b>															
9/9/1994	--	37.60	22.94	--	14.66	<50	<0.5	<0.5	<0.5	0.5	--	4.3	PACE	--	m
12/21/1994	--	37.60	20.86	--	16.74	<50	<0.5	<0.5	<0.5	<0.5	<5.0	2.2	PACE	--	m
1/30/1995	--	37.60	17.51	--	20.09	<50	<0.50	<0.50	<0.50	<1.0	--	2.7	ATI	--	
4/10/1995	--	37.60	16.69	--	20.91	<50	<0.50	<0.50	<0.50	<1.0	--	4.8	ATI	--	
6/29/1995	--	37.60	18.33	--	19.27	<50	<0.50	<0.50	<0.50	<1.0	--	7.6	ATI	--	
9/18/1995	--	37.60	20.68	--	16.92	--	--	--	--	--	--	--	--	--	
9/19/1995	--	37.60	--	--	--	<50	<0.50	<0.50	<0.50	<1.0	<5.0	5.1	ATI	--	
12/7/1995	--	37.60	22.15	--	15.45	<50	<0.50	<0.50	<0.50	<1.0	<5.0	5.2	ATI	--	
3/28/1996	--	37.60	16.38	--	21.22	<50	<0.5	<1	<1	<1	<10	3.9	SPL	--	
6/20/1996	--	37.60	17.02	--	20.58	<50	<0.5	<1	<1	<1	<10	5.0	SPL	--	
10/11/1996	--	37.60	20.47	--	17.13	<50	<0.5	<1.0	<1.0	<1.0	<10	6.3	SPL	--	
1/2/1997	--	37.60	16.70	--	20.90	<50	<0.5	<1.0	<1.0	<1.0	<10	6.2	SPL	--	
4/14/1997	--	37.60	17.96	--	19.64	<50	<0.5	<1.0	<1.0	<1.0	<10	5.0	SPL	--	
7/2/1997	--	37.60	19.11	--	18.49	<50	<0.5	<1.0	<1.0	<1.0	<10	5.4	SPL	--	
9/30/1997	--	37.60	22.97	--	14.63	<250	<2.5	<5.0	<5.0	<5.0	1,100	6.5	SPL	--	
1/21/1998	--	37.60	16.50	--	21.10	<50	<0.5	<1.0	<1.0	<1.0	<10	4.9	SPL	--	
4/9/1998	--	37.60	13.56	--	24.04	<50	<0.5	<1.0	<1.0	<1.0	<10	4.9	SPL	--	
6/19/1998	--	37.60	15.41	--	22.19	<50	<0.5	<1.0	<1.0	<1.0	<10	4.4	SPL	--	
11/30/1998	--	37.60	18.90	--	18.70	--	--	--	--	--	--	--	--	--	
1/21/1999	--	37.60	18.39	--	19.21	--	--	--	--	--	--	--	--	--	
4/30/1999	--	37.60	18.54	--	19.06	--	--	--	--	--	--	--	--	--	
7/9/1999	--	37.60	17.98	--	19.62	--	--	--	--	--	--	--	--	--	
11/3/1999	--	37.60	20.22	--	17.38	--	--	--	--	--	--	--	--	--	
1/12/2000	--	37.60	19.46	--	18.14	--	--	--	--	--	--	--	--	--	
4/13/2000	--	37.60	19.59	--	18.01	--	--	--	--	--	--	--	--	--	
7/26/2000	--	37.60	19.69	--	17.91	--	--	--	--	--	--	--	--	--	
10/24/2000	--	37.60	18.78	--	18.82	--	--	--	--	--	--	--	--	--	
1/19/2001	--	37.60	--	--	--	--	--	--	--	--	--	--	--	--	f
7/25/2001	--	37.60	--	--	--	--	--	--	--	--	--	--	--	--	f
1/18/2002	--	37.60	--	--	--	--	--	--	--	--	--	--	--	--	o
8/1/2002	--	37.60	--	--	--	--	--	--	--	--	--	--	--	--	o

**Table 1. Summary of Ground-Water Monitoring Data: Relative Water Elevations and Laboratory Analyses**

**Station #11133, 2220 98th Ave., Oakland, CA**

Well and Sample Date	P/NP	TOC Elevation (feet msl)	Depth to Water (feet bgs)	Product Thickness (feet)	Water Level Elevation (feet msl)	Concentrations in (µg/L)						DO (mg/L)	Lab	pH	Comments
						GRO/TPHg	Benzene	Toluene	Ethyl-Benzene	Total Xylenes	MTBE				
<b>AW-7 Cont.</b>															
1/16/2003	--	37.60	--	--	--	--	--	--	--	--	--	--	--	--	o
7/7/2003	--	37.60	--	--	--	--	--	--	--	--	--	--	--	--	o
02/05/2004	--	37.60	--	--	--	--	--	--	--	--	--	--	--	--	o
07/01/2004	--	37.60	--	--	--	--	--	--	--	--	--	--	--	--	o
03/16/2005	--	37.60	--	--	--	--	--	--	--	--	--	--	--	--	o
07/22/2005	--	37.60	--	--	--	--	--	--	--	--	--	--	--	--	o
01/25/2006	--	37.60	--	--	--	--	--	--	--	--	--	--	--	--	o
<b>AW-8</b>															
4/5/1991	--	40.86	26.68	--	14.18	80	1.9	2.2	0.5	1.3	--	--	SUP	--	
4/1/1992	--	40.86	25.11	--	15.75	73	<0.5	0.7	<0.5	0.6	--	--	APP	--	
7/6/1992	--	40.86	26.43	--	14.43	<50	<0.5	<0.5	<0.5	<0.5	--	--	ANA	--	
10/7/1992	--	40.86	28.59	--	12.27	<50	<0.5	<0.5	<0.5	<0.5	--	--	ANA	--	
1/14/1993	--	40.86	25.55	--	15.31	<50	<0.5	<0.5	<0.5	<0.5	--	--	PACE	--	m
4/22/1993	--	40.86	22.29	--	18.57	<50	<0.5	<0.5	<0.5	<0.5	--	--	PACE	--	m
7/15/1993	--	40.86	23.42	--	17.44	<50	<0.5	<0.5	<0.5	<0.5	<5.0	--	PACE	--	m
10/21/1993	--	40.86	25.15	--	15.71	<50	1.9	1.8	1.3	3.3	<5.0	--	PACE	--	m
1/27/1994	--	40.86	25.42	--	15.44	<50	<0.5	0.5	0.6	8.5	<5.0	--	PACE	--	m
4/21/1994	--	40.86	24.14	--	16.72	<50	<0.5	<0.5	<0.5	<0.5	<5.0	1.5	PACE	--	m
9/9/1994	--	40.86	24.55	--	16.31	<50	<0.5	<0.5	<0.5	<0.5	--	2.4	PACE	--	m
12/21/1994	--	40.86	22.72	--	18.14	<50	<0.5	<0.5	<0.5	<0.5	<5.0	1.1	PACE	--	m
1/30/1995	--	40.86	19.75	--	21.11	<50	<0.50	1	<0.50	1	--	0.8	ATI	--	
4/10/1995	--	40.86	17.78	--	23.08	<50	<0.50	<0.50	<0.50	<1.0	--	8.3	ATI	--	
6/29/1995	--	40.86	18.18	--	22.68	<50	<0.50	<0.50	<0.50	<1.0	--	8.3	ATI	--	
9/18/1995	--	40.86	20.20	--	20.66	--	--	--	--	--	--	--	--	--	
9/19/1995	--	40.86	--	--	--	<50	<0.50	<0.50	<0.50	<1.0	<5.0	7.7	ATI	--	
12/7/1995	--	40.86	21.54	--	19.32	<50	<0.50	<0.50	<0.50	<1.0	<5.0	4.4	ATI	--	
3/28/1996	--	40.86	15.77	--	25.09	<50	<0.5	<1	<1	<1	<10	3.8	SPL	--	
6/20/1996	--	40.86	16.41	--	24.45	<50	<0.5	<1	<1	<1	<10	3.6	SPL	--	
10/11/1996	--	40.86	19.90	--	20.96	<50	<0.5	<1.0	<1.0	<1.0	<10	6.4	SPL	--	
1/2/1997	--	40.86	15.89	--	24.97	<50	<0.5	<1.0	<1.0	<1.0	<10	5.9	SPL	--	

**Table 1. Summary of Ground-Water Monitoring Data: Relative Water Elevations and Laboratory Analyses**  
**Station #11133, 2220 98th Ave., Oakland, CA**

Well and Sample Date	P/NP	TOC Elevation (feet msl)	Depth to Water (feet bgs)	Product Thickness (feet)	Water Level Elevation (feet msl)	Concentrations in (µg/L)						DO (mg/L)	Lab	pH	Comments
						GRO/TPHg	Benzene	Toluene	Ethyl-Benzene	Total Xylenes	MTBE				
<b>AW-8 Cont.</b>															
4/14/1997	--	40.86	17.07	--	23.79	<50	<0.5	<1.0	<1.0	<1.0	<10	4.6	SPL	--	
7/2/1997	--	40.86	18.67	--	22.19	<50	<0.5	<1.0	<1.0	<1.0	<10	5.6	SPL	--	
9/30/1997	--	40.86	22.52	--	18.34	<50	<5	<10	<10	<10	820	6.7	SPL	--	
1/21/1998	--	40.86	16.01	--	24.85	<50	<0.5	<1.0	<1.0	<1.0	<10	5.2	SPL	--	
4/9/1998	--	40.86	11.18	--	29.68	<50	<0.5	<1.0	<1.0	<1.0	<10	4.4	SPL	--	
6/19/1998	--	40.86	13.01	--	27.85	<50	<0.5	<1.0	<1.0	<1.0	<10	4.1	SPL	--	
11/30/1998	--	40.86	17.46	--	23.40	--	--	--	--	--	--	--	--	--	
1/21/1999	--	40.86	17.47	--	23.39	--	--	--	--	--	--	--	--	--	
4/30/1999	--	40.86	17.60	--	23.26	--	--	--	--	--	--	--	--	--	
7/9/1999	--	40.86	16.50	--	24.36	--	--	--	--	--	--	--	--	--	
11/3/1999	--	40.86	19.29	--	21.57	--	--	--	--	--	--	--	--	--	
1/12/2000	--	40.86	21.49	--	19.37	--	--	--	--	--	--	--	--	--	
4/13/2000	--	40.86	21.60	--	19.26	--	--	--	--	--	--	--	--	--	
7/26/2000	--	40.86	21.53	--	19.33	--	--	--	--	--	--	--	--	--	
10/24/2000	--	40.86	19.37	--	21.49	--	--	--	--	--	--	--	--	--	
1/19/2001	--	40.86	18.60	--	22.26	--	--	--	--	--	--	--	--	--	
7/24/2001	--	40.86	18.22	--	22.64	--	--	--	--	--	--	--	--	--	
1/18/2002	--	40.86	16.29	--	24.57	--	--	--	--	--	--	--	--	--	
8/1/2002	--	40.86	17.25	--	23.61	--	--	--	--	--	--	--	--	--	
1/16/2003	--	40.86	15.82	--	25.04	--	--	--	--	--	--	--	--	--	
7/7/2003	--	40.86	18.55	--	22.31	--	--	--	--	--	--	--	--	--	
02/05/2004	--	40.86	--	--	--	--	--	--	--	--	--	--	--	--	t
07/01/2004	--	40.86	18.25	--	22.61	--	--	--	--	--	--	--	--	--	t
03/16/2005	P	40.86	15.20	--	25.66	<50	<0.50	<0.50	<0.50	<0.50	<0.50	1.5	SEQM	7.3	
07/22/2005	--	40.86	--	--	--	--	--	--	--	--	--	--	--	--	f
01/25/2006	--	40.86	--	--	--	--	--	--	--	--	--	--	--	--	f
7/6/2006	--	40.86	13.05	--	27.81	--	--	--	--	--	--	--	--	--	
1/8/2007	--	40.86	16.57	--	24.29	--	--	--	--	--	--	--	--	--	
<b>7/10/2007</b>	--	<b>40.86</b>	<b>17.73</b>	--	<b>23.13</b>	--	--	--	--	--	--	--	--	--	
<b>AW-9</b>															

**Table 1. Summary of Ground-Water Monitoring Data: Relative Water Elevations and Laboratory Analyses**  
**Station #11133, 2220 98th Ave., Oakland, CA**

Well and Sample Date	P/NP	TOC Elevation (feet msl)	Depth to Water (feet bgs)	Product Thickness (feet)	Water Level Elevation (feet msl)	Concentrations in (µg/L)						DO (mg/L)	Lab	pH	Comments
						GRO/TPHg	Benzene	Toluene	Ethyl-Benzene	Total Xylenes	MTBE				
<b>AW-9 Cont.</b>															
1/2/1997	--	37.78	10.00	--	27.78	<50	<0.5	<1.0	<1.0	<1.0	<10	6.7	SPL	--	
4/14/1997	--	37.78	--	--	--	--	--	--	--	--	--	--	--	--	f
7/2/1997	--	37.78	12.71	--	25.07	<50	<0.5	<1.0	<1.0	<1.0	<10	6.0	SPL	--	
9/30/1997	--	37.78	21.22	--	16.56	<50	<0.5	<1.0	<1.0	<1.0	<10	6.8	SPL	--	
1/21/1998	--	37.78	10.26	--	27.52	<50	<0.5	<1.0	<1.0	<1.0	<10	5.3	SPL	--	
4/9/1998	--	37.78	6.77	--	31.01	<50	<0.5	<1.0	<1.0	<1.0	<10	5.6	SPL	--	
6/19/1998	--	37.78	8.96	--	28.82	<50	<0.5	<1.0	<1.0	<1.0	<10	4.8	SPL	--	
1/8/2007	--	37.78	17.35	--	20.43	--	--	--	--	--	--	--	--	--	
<b>7/10/2007</b>	<b>--</b>	<b>37.78</b>	<b>18.65</b>	<b>--</b>	<b>19.13</b>	<b>--</b>	<b>--</b>	<b>--</b>	<b>--</b>	<b>--</b>	<b>--</b>	<b>--</b>	<b>--</b>	<b>--</b>	
<b>MW-1</b>															
4/5/1991	--	34.46	--	--	--	--	--	--	--	--	--	--	--	--	
4/1/1992	--	34.46	11.25	--	23.21	--	--	--	--	--	--	--	--	--	
7/6/1992	--	34.46	13.61	--	20.85	--	--	--	--	--	--	--	--	--	
10/7/1992	--	34.46	15.15	--	19.31	--	--	--	--	--	--	--	--	--	
1/14/1993	--	34.46	10.73	--	23.73	--	--	--	--	--	--	--	--	--	
4/22/1993	--	34.46	11.64	--	22.82	--	--	--	--	--	--	--	--	--	
7/15/1993	--	34.46	13.50	--	20.96	--	--	--	--	--	--	--	--	--	
10/21/1993	--	34.46	15.21	--	19.25	--	--	--	--	--	--	--	--	--	
1/27/1994	--	34.46	17.48	--	16.98	--	--	--	--	--	--	--	--	--	
4/21/1994	--	34.46	10.94	--	23.52	110,000	1,400	9,100	3,400	30,000	11,000	1.6	PACE	--	c
9/9/1994	--	34.46	13.80	--	20.66	--	--	--	--	--	--	--	--	--	
12/21/1994	--	34.46	12.60	--	21.86	--	--	--	--	--	--	--	--	--	
1/30/1995	--	34.46	--	--	--	--	--	--	--	--	--	--	--	--	
4/10/1995	--	34.46	10.62	--	23.84	--	--	--	--	--	--	--	--	--	
6/29/1995	--	34.46	18.72	--	15.74	--	--	--	--	--	--	--	--	--	
9/18/1995	--	34.46	12.92	--	21.54	--	--	--	--	--	--	--	--	--	
12/7/1995	--	34.46	13.82	--	20.64	--	--	--	--	--	--	--	--	--	
3/28/1996	--	34.46	10.03	--	24.43	--	--	--	--	--	--	--	--	--	
6/20/1996	--	34.46	11.29	--	23.17	--	--	--	--	--	--	--	--	--	
10/11/1996	--	34.46	14.86	--	19.60	--	--	--	--	--	--	--	--	--	

Table 1. Summary of Ground-Water Monitoring Data: Relative Water Elevations and Laboratory Analyses

Station #11133, 2220 98th Ave., Oakland, CA

Well and Sample Date	P/NP	TOC Elevation (feet msl)	Depth to Water (feet bgs)	Product Thickness (feet)	Water Level Elevation (feet msl)	Concentrations in (µg/L)						DO (mg/L)	Lab	pH	Comments
						GRO/TPHg	Benzene	Toluene	Ethyl-Benzene	Total Xylenes	MTBE				
MW-1 Cont.															
1/2/1997	--	34.46	11.03	--	23.43	--	--	--	--	--	--	--	--	--	
4/14/1997	--	34.46	12.25	--	22.21	--	--	--	--	--	--	--	--	--	
4/15/1997	--	34.46	--	--	--	35,000	130	650	1,700	8,200	4,800	--	SPL	--	
7/2/1997	--	34.46	14.11	--	20.35	42,000	<250	<500	2,000	9,600	<5000	5.5	SPL	--	
9/30/1997	--	34.46	14.40	--	20.06	61,000	130	1,100	2,700	14,600	2,000	6.7	SPL	--	
1/21/1998	--	34.46	7.99	--	26.47	14,000	11	60	310	1,790	1,300	4.5	SPL	--	
4/9/1998	--	34.46	7.89	--	26.57	--	--	--	--	--	--	--	--	--	
4/10/1998	--	34.46	--	--	--	45,000	380	520	2,100	6,800	9,300	5.3	SPL	--	
6/19/1998	--	34.46	10.31	--	24.15	35,000	170	100	1,100	3,590	5,000	4.9	SPL	--	
11/30/1998	--	34.46	11.16	--	23.30	10,000	100	24	350	1,040	1800/2800	--	SPL	--	g
1/21/1999	--	34.46	10.76	--	23.70	18,000	120	37	590	1,800	2,700	--	SPL	--	
4/30/1999	--	34.46	10.78	--	23.68	17,000	240	89	1,100	1,900	1,600	--	SPL	--	
7/9/1999	--	34.46	12.62	--	21.84	58,000	140	100	1,800	6,900	1,200	--	SPL	--	
11/3/1999	--	34.46	14.00	--	20.46	20,000	62	42	620	2,100	630	--	PACE	--	
1/12/2000	--	34.46	15.25	--	19.21	72,000	110	120	2,400	8,200	630	--	PACE	--	
4/13/2000	--	34.46	15.57	--	18.89	37,000	300	32	1,000	1,700	810	--	PACE	--	
5/24/2000	--	34.46	11.75	--	22.71	--	--	--	--	--	--	--	--	--	
6/1/2000	--	34.46	11.41	--	23.05	--	--	--	--	--	--	--	--	--	
6/8/2000	--	34.46	11.68	--	22.78	--	--	--	--	--	--	--	--	--	
6/15/2000	--	34.46	11.85	--	22.61	--	--	--	--	--	--	--	--	--	
7/26/2000	--	34.46	16.19	--	18.27	10,000	480	210	470	710	1,100	--	PACE	--	
10/24/2000	--	34.46	13.89	--	20.57	9,900	31	7.2	550	1,200	4,400	--	PACE	--	
1/19/2001	--	34.46	12.90	--	21.56	57,000	199	7.66	1,170	3,260	514	--	PACE	--	
7/24/2001	--	34.46	13.55	--	20.91	27,000	96.7	<5.0	548	1,460	285	--	PACE	--	
1/18/2002	--	34.46	10.91	--	23.55	25,000	150	31.5	597	1,040	138	--	PACE	--	
8/1/2002	--	34.46	12.97	--	21.49	25,000	80.2	17.7	714	1,280	489	--	PACE	--	
1/16/2003	--	34.46	10.45	--	24.01	22,000	170	110	630	670	<500	--	SEQ	--	p
7/7/2003	--	34.46	12.40	--	22.06	9,900	42	<5.0	160	150	24	--	SEQ	--	q, u
02/05/2004	--	34.46	10.26	--	24.20	6,200	56	11	250	210	9.2	--	SEQM	6.9	
07/01/2004	--	34.46	13.20	--	21.26	18,000	<50	<50	210	300	<50	--	SEQM	--	u
03/16/2005	P	34.46	9.62	--	24.84	7,600	33	5.4	200	130	<5.0	0.9	SEQM	6.9	



Table 1. Summary of Ground-Water Monitoring Data: Relative Water Elevations and Laboratory Analyses

Station #11133, 2220 98th Ave., Oakland, CA

Well and Sample Date	P/NP	TOC Elevation (feet msl)	Depth to Water (feet bgs)	Product Thickness (feet)	Water Level Elevation (feet msl)	Concentrations in (µg/L)						DO (mg/L)	Lab	pH	Comments
						GRO/TPHg	Benzene	Toluene	Ethyl-Benzene	Total Xylenes	MTBE				
<b>MW-1 Cont.</b>															
07/22/2005	P	34.46	11.23	--	23.23	15,000	<10	<10	110	130	<10	--	SEQM	6.8	u
01/25/2006	P	34.46	8.75	--	25.71	8,300	8.4	4.8	130	120	<2.5	--	SEQM	7.3	u
7/6/2006	P	34.46	10.36	--	24.10	5,100	<2.5	<2.5	16	12	<2.5	--	TAMC	6.9	
1/8/2007	P	34.46	11.55	--	22.91	2700	4.6	0.66	35	27	2.1	1.83	TAMC	6.92	
<b>7/10/2007</b>	<b>P</b>	<b>34.46</b>	<b>13.01</b>	<b>SHEEN</b>	<b>21.45</b>	<b>1,800</b>	<b>1.9</b>	<b>&lt;0.50</b>	<b>13</b>	<b>4.8</b>	<b>2.4</b>	<b>2.16</b>	<b>TAMC</b>	<b>7.04</b>	
<b>MW-2</b>															
4/5/1991	--	35.50	16.62	--	18.88	<50	0.6	0.9	<0.3	<0.3	--	--	SUP	--	
4/1/1992	--	35.50	11.25	--	24.25	--	--	--	--	--	--	--	--	--	
4/2/1992	--	35.50	--	--	--	<50	<0.5	<0.5	<0.5	<0.5	--	--	APP	--	
7/6/1992	--	35.50	12.72	--	22.78	<50	<0.5	<0.5	<0.5	<0.5	--	--	ANA	--	
10/7/1992	--	35.50	15.08	--	20.42	<50	<0.5	1.8	<0.5	2.3	--	--	ANA	--	
1/14/1993	--	35.50	9.69	--	25.81	<50	<0.5	<0.5	<0.5	<0.5	--	--	PACE	--	m
4/22/1993	--	35.50	10.46	--	25.04	<50	<0.5	<0.5	<0.5	<0.5	30	--	PACE	--	c
7/15/1993	--	35.50	12.02	--	23.48	<50	<0.5	<0.5	<0.5	<0.5	21.7	--	PACE	--	c, m
10/21/1993	--	35.50	13.12	--	22.38	<50	0.7	0.9	<0.5	0.9	14.9	--	PACE	--	m
1/27/1994	--	35.50	12.01	--	23.49	<50	0.6	<0.5	<0.5	<0.5	11.5	--	PACE	--	m
4/21/1994	--	35.50	10.60	--	24.90	<50	<0.5	<0.5	<0.5	<0.5	11.4	1.1	PACE	--	m
9/9/1994	--	35.50	12.42	--	23.08	<50	<0.5	<0.5	<0.5	0.6	--	2.2	PACE	--	m
12/21/1994	--	35.50	10.85	--	24.65	<50	<0.5	<0.5	<0.5	<0.5	<5.0	1.2	PACE	--	m
1/30/1995	--	35.50	8.38	--	27.12	<50	<0.50	<0.50	<0.50	<1.0	--	1.7	ATI	--	
4/10/1995	--	35.50	9.00	--	26.50	<50	<0.50	<0.50	<0.50	<1.0	--	7.8	ATI	--	
6/29/1995	--	35.50	9.91	--	25.59	<50	<0.50	<0.50	<0.50	<1.0	--	9.1	ATI	--	
9/18/1995	--	35.50	10.98	--	24.52	--	--	--	--	--	--	--	--	--	
9/19/1995	--	35.50	--	--	--	<50	<0.50	<0.50	<0.50	<1.0	<5.0	7.2	ATI	--	
12/7/1995	--	35.50	12.30	--	23.20	<50	<0.50	<0.50	<0.50	<1.0	<5.0	2.4	ATI	--	
3/28/1996	--	35.50	8.57	--	26.93	<50	<0.5	<1	<1	<1	<10	3.2	SPL	--	
6/20/1996	--	35.50	9.77	--	25.73	<50	<0.5	<1	<1	<1	<10	4.2	SPL	--	
10/11/1996	--	35.50	13.32	--	22.18	<50	<0.5	<1.0	<1.0	<1.0	<10	6.3	SPL	--	
1/2/1997	--	35.50	9.60	--	25.90	<50	<0.5	<1.0	<1.0	<1.0	<10	6.7	SPL	--	
4/14/1997	--	35.50	10.93	--	24.57	<50	<0.5	<1.0	<1.0	<1.0	<10	5.7	SPL	--	

**Table 1. Summary of Ground-Water Monitoring Data: Relative Water Elevations and Laboratory Analyses**  
**Station #11133, 2220 98th Ave., Oakland, CA**

Well and Sample Date	P/NP	TOC Elevation (feet msl)	Depth to Water (feet bgs)	Product Thickness (feet)	Water Level Elevation (feet msl)	Concentrations in (µg/L)						DO (mg/L)	Lab	pH	Comments
						GRO/TPHg	Benzene	Toluene	Ethyl-Benzene	Total Xylenes	MTBE				
<b>MW-2 Cont.</b>															
7/2/1997	--	35.50	12.57	--	22.93	<50	<0.5	<1.0	<1.0	<1.0	<10	5.9	SPL	--	
9/30/1997	--	35.50	12.91	--	22.59	<50	<0.5	<1.0	<1.0	<1.0	<10	6.3	SPL	--	
1/21/1998	--	35.50	10.12	--	25.38	160	<0.5	<1.0	<1.0	<1.0	100	5.4	SPL	--	
4/9/1998	--	35.50	6.82	--	28.68	--	--	--	--	--	--	--	--	--	
4/10/1998	--	35.50	--	--	--	<50	1	<1.0	<1.0	<1.0	23	5.0	SPL	--	
6/19/1998	--	35.50	9.00	--	26.50	<50	<0.5	<1.0	<1.0	<1.0	<10	4.9	SPL	--	
11/30/1998	--	35.50	9.44	--	26.06	--	--	--	--	--	--	--	--	--	
1/21/1999	--	35.50	8.96	--	26.54	<50	<1.0	<1.0	<1.0	<1.0	1.9	--	SPL	--	
4/30/1999	--	35.50	9.15	--	26.35	--	--	--	--	--	--	--	--	--	
7/9/1999	--	35.50	10.82	--	24.68	--	--	--	--	--	--	--	--	--	
11/3/1999	--	35.50	11.86	--	23.64	--	--	--	--	--	--	--	--	--	
1/12/2000	--	35.50	12.35	--	23.15	<50	<0.5	<0.5	<0.5	<0.5	<0.5	--	PACE	--	
4/13/2000	--	35.50	13.01	--	22.49	--	--	--	--	--	--	--	--	--	
7/26/2000	--	35.50	13.01	--	22.49	--	--	--	--	--	--	--	--	--	
10/24/2000	--	35.50	11.57	--	23.93	--	--	--	--	--	--	--	--	--	
1/19/2001	--	35.50	10.52	--	24.98	--	--	--	--	--	--	--	--	--	
7/24/2001	--	35.50	11.13	--	24.37	--	--	--	--	--	--	--	--	--	
1/18/2002	--	35.50	8.85	--	26.65	--	--	--	--	--	--	--	--	--	
8/1/2002	--	35.50	10.47	--	25.03	--	--	--	--	--	--	--	--	--	
1/14/2003	--	35.50	8.49	--	27.01	--	--	--	--	--	--	--	--	--	
7/7/2003	--	35.50	9.63	--	25.87	--	--	--	--	--	--	--	--	--	
02/05/2004	--	35.50	8.40	--	27.10	--	--	--	--	--	--	--	--	--	
07/01/2004	NP	35.50	9.94	--	25.56	--	--	--	--	--	--	--	--	--	
03/16/2005	P	35.50	8.39	--	27.11	<50	<0.50	<0.50	<0.50	<0.50	<0.50	1.3	SEQM	7.1	
07/22/2005	--	35.50	8.80	--	26.70	--	--	--	--	--	--	--	--	--	
01/25/2006	--	35.50	7.85	--	27.65	--	--	--	--	--	--	--	--	--	
7/6/2006	--	35.50	8.33	--	27.17	--	--	--	--	--	--	--	--	--	
1/8/2007	--	35.50	9.35	--	26.15	--	--	--	--	--	--	--	--	--	
<b>7/10/2007</b>	--	<b>35.50</b>	<b>10.45</b>	--	<b>25.05</b>	--	--	--	--	--	--	--	--	--	
<b>MW-3</b>															

Table 1. Summary of Ground-Water Monitoring Data: Relative Water Elevations and Laboratory Analyses

Station #11133, 2220 98th Ave., Oakland, CA

Well and Sample Date	P/NP	TOC Elevation (feet msl)	Depth to Water (feet bgs)	Product Thickness (feet)	Water Level Elevation (feet msl)	Concentrations in (µg/L)						DO (mg/L)	Lab	pH	Comments
						GRO/TPHg	Benzene	Toluene	Ethyl-Benzene	Total Xylenes	MTBE				
MW-3 Cont.															
4/5/1991	--	36.53	17.84	--	18.69	<50	<0.3	<0.3	<0.3	<0.3	--	--	SUP	--	
4/1/1992	--	36.53	15.64	--	20.89	--	--	--	--	--	--	--	--	--	
4/2/1992	--	36.53	--	--	--	<50	1.4	<0.5	<0.5	<0.5	--	--	APP	--	
7/6/1992	--	36.53	19.03	--	17.50	<50	<0.5	<0.5	<0.5	<0.5	--	--	ANA	--	
10/7/1992	--	36.53	21.83	--	14.70	<50	<0.5	<0.5	<0.5	<0.5	--	--	ANA	--	
1/14/1993	--	36.53	15.96	--	20.57	350	<0.5	<0.5	<0.5	<0.5	714	--	PACE	--	c, m
4/22/1993	--	36.53	16.20	--	20.33	2,800	<0.5	<0.5	<0.5	<0.5	3,600	--	PACE	--	c, m
7/15/1993	--	36.53	16.82	--	19.71	1,400	1.2	<0.5	2	3.5	2,204	--	PACE	--	c, m
10/21/1993	--	36.53	18.84	--	17.69	370	2.1	2.3	2.3	6	847	--	PACE	--	c, m
1/27/1994	--	36.53	18.00	--	18.53	1,300	6.3	<0.5	<0.5	<0.5	3,892	--	PACE	--	c, m
4/21/1994	--	36.53	16.62	--	19.91	2,000	<0.5	<0.5	<0.5	<0.5	3,864	1.4	PACE	--	c, m
9/9/1994	--	36.53	18.38	--	18.15	1,300	<0.5	<0.5	0.5	1.2	--	3.0	PACE	--	m
12/21/1994	--	36.53	15.28	--	21.25	420	16	0.7	3.5	5.9	800	1.9	PACE	--	m
1/30/1995	--	36.53	12.62	--	23.91	<50	<0.50	<0.50	<0.50	<1.0	--	2.5	ATI	--	
4/10/1995	--	36.53	12.41	--	24.12	150	<0.50	<0.50	<0.50	<1.0	--	6.9	ATI	--	
6/29/1995	--	36.53	14.95	--	21.58	100	<0.50	<0.50	<0.50	<1.0	--	6.4	ATI	--	d (TPH-g)
9/18/1995	--	36.53	15.82	--	20.71	--	--	--	--	--	--	--	--	--	
9/19/1995	--	36.53	--	--	--	82	<0.50	<0.50	<0.50	<1.0	260	7.0	ATI	--	
12/7/1995	--	36.53	17.09	--	19.44	<50	<0.50	<0.50	<0.50	<1.0	91	4.5	ATI	--	
3/28/1996	--	36.53	11.90	--	24.63	<50	<0.5	<1	<1	<1	230	4.2	SPL	--	
6/20/1996	--	36.53	12.66	--	23.87	260	<0.5	<1	<1	<1	370	4.4	SPL	--	
10/11/1996	--	36.53	16.23	--	20.30	330	<0.5	<1.0	<1.0	<1.0	440	5.8	SPL	--	
1/2/1997	--	36.53	12.17	--	24.36	<50	<0.5	<1.0	<1.0	<1.0	140	6.0	SPL	--	
4/14/1997	--	36.53	13.45	--	23.08	--	--	--	--	--	--	--	--	--	
4/15/1997	--	36.53	--	--	--	1,500	<0.5	<1.0	<1.0	<1.0	1,800	5.6	SPL	--	
7/2/1997	--	36.53	15.60	--	20.93	880	<0.5	<1.0	<1.0	<1.0	940	5.3	SPL	--	
9/30/1997	--	36.53	17.16	--	19.37	40,000	13,000	2,400	870	3,100	510	6.6	SPL	--	
1/21/1998	--	36.53	11.77	--	24.76	120	<0.5	<1.0	<1.0	<1.0	98	4.7	SPL	--	
4/9/1998	--	36.53	9.42	--	27.11	950	<0.5	<1.0	<1.0	<1.0	890	5.7	SPL	--	
6/19/1998	--	36.53	12.09	--	24.44	1,800	<0.5	<1.0	<1.0	<1.0	1,900	4.7	SPL	--	
6/19/1998	--	36.53	15.28	--	21.25	1,800	<0.5	<1.0	<1.0	<1.0	1,900	4.7	SPL	--	

Table 1. Summary of Ground-Water Monitoring Data: Relative Water Elevations and Laboratory Analyses

Station #11133, 2220 98th Ave., Oakland, CA

Well and Sample Date	P/NP	TOC Elevation (feet msl)	Depth to Water (feet bgs)	Product Thickness (feet)	Water Level Elevation (feet msl)	Concentrations in (µg/L)						DO (mg/L)	Lab	pH	Comments
						GRO/TPHg	Benzene	Toluene	Ethyl-Benzene	Total Xylenes	MTBE				
<b>MW-3 Cont.</b>															
1/21/1999	--	36.53	14.67	--	21.86	1,100	<1.0	<1.0	<1.0	<1.0	1,200	--	SPL	--	
4/30/1999	--	36.53	16.00	--	20.53	--	--	--	--	--	--	--	--	--	
7/9/1999	--	36.53	14.64	--	21.89	470	<1.0	<1.0	<1.0	<1.0	460/470	--	SPL	--	g
11/3/1999	--	36.53	16.39	--	20.14	--	--	--	--	--	--	--	--	--	
1/12/2000	--	36.53	16.80	--	19.73	<50	<0.5	<0.5	<0.5	<0.5	34	--	PACE	--	
4/13/2000	--	36.53	16.43	--	20.10	--	--	--	--	--	--	--	--	--	
7/26/2000	--	36.53	16.93	--	19.60	<50	<0.5	<0.5	<0.5	<0.5	<0.5	--	PACE	--	
10/24/2000	--	36.53	15.69	--	20.84	--	--	--	--	--	--	--	--	--	
1/19/2001	--	36.53	14.84	--	21.69	<50	<0.5	<0.5	<0.5	1	25.9	--	PACE	--	
7/23/2001	--	36.53	15.11	--	21.42	62	<0.5	<0.5	<0.5	<1.5	28.7	--	PACE	--	
1/18/2002	--	36.53	12.37	--	24.16	<50	<0.5	<0.5	<0.5	<1.0	17.8	--	PACE	--	
8/1/2002	--	36.53	14.44	--	22.09	66	<0.5	<0.5	<0.5	<1.0	<0.5	--	PACE	--	
1/16/2003	--	36.53	12.07	--	24.46	<50	<0.50	<0.50	<0.50	<0.50	20	--	SEQ	--	p
7/7/2003	--	36.53	13.90	--	22.63	<50	<0.50	<0.50	<0.50	<0.50	8.8	--	SEQ	--	q
02/05/2004	--	36.53	12.60	--	23.93	<50	<0.50	<0.50	<0.50	<0.50	4.6	--	SEQM	7.0	
07/01/2004	--	36.53	14.57	--	21.96	<50	<0.50	<0.50	<0.50	<0.50	3.3	--	SEQM	--	
03/16/2005	P	36.53	11.03	--	25.50	<50	<0.50	<0.50	<0.50	<0.50	4.4	1.5	SEQM	6.8	
07/22/2005	P	36.53	12.68	--	23.85	<50	<0.50	<0.50	<0.50	<0.50	4.1	--	SEQM	6.8	
01/25/2006	P	36.53	11.35	--	25.18	81	<0.50	<0.50	<0.50	<0.50	3.0	--	SEQM	6.9	
7/6/2006	P	36.53	11.47	--	25.06	<50	<0.50	<0.50	<0.50	<0.50	3.0	--	TAMC	6.9	
1/8/2007	P	36.53	12.92	--	23.61	<50	<0.50	<0.50	<0.50	<0.50	3.2	2.87	TAMC	7.12	
<b>7/10/2007</b>	<b>P</b>	<b>36.53</b>	<b>14.46</b>	<b>--</b>	<b>22.07</b>	<b>&lt;50</b>	<b>&lt;0.50</b>	<b>&lt;0.50</b>	<b>&lt;0.50</b>	<b>&lt;0.50</b>	<b>2.8</b>	<b>2.87</b>	<b>TAMC</b>	<b>7.25</b>	
<b>QC-2</b>															
10/7/1992	--	37.73	--	--	--	<50	<0.5	<0.5	<0.5	<0.5	--	--	ANA	--	i
1/14/1993	--	37.73	--	--	--	<50	<0.5	<0.5	<0.5	<0.5	--	--	PACE	--	i, m
4/22/1993	--	37.73	--	--	--	<50	<0.5	<0.5	<0.5	<0.5	--	--	PACE	--	i, m
7/15/1993	--	37.73	--	--	--	<50	<0.5	<0.5	<0.5	<0.5	<5.0	--	PACE	--	i, m
10/21/1993	--	37.73	--	--	--	<50	<0.5	<0.5	<0.5	<0.5	--	--	PACE	--	i
1/27/1994	--	37.73	--	--	--	<50	<0.5	<0.5	<0.5	<0.5	--	--	PACE	--	i
4/21/1994	--	37.73	--	--	--	<50	<0.5	<0.5	<0.5	<0.5	--	--	PACE	--	i

**Table 1. Summary of Ground-Water Monitoring Data: Relative Water Elevations and Laboratory Analyses**

**Station #11133, 2220 98th Ave., Oakland, CA**

Well and Sample Date	P/NP	TOC Elevation (feet msl)	Depth to Water (feet bgs)	Product Thickness (feet)	Water Level Elevation (feet msl)	Concentrations in (µg/L)						DO (mg/L)	Lab	pH	Comments
						GRO/TPHg	Benzene	Toluene	Ethyl-Benzene	Total Xylenes	MTBE				
<b>QC-2 Cont.</b>															
9/9/1994	--	37.73	--	--	--	<50	<0.5	<0.5	<0.5	<0.5	--	--	PACE	--	i
12/21/1994	--	37.73	--	--	--	<50	<0.5	<0.5	<0.5	<0.5	--	--	PACE	--	i
1/30/1995	--	37.73	--	--	--	<50	<0.50	<0.50	<0.50	<1.0	--	--	ATI	--	i
4/10/1995	--	37.73	--	--	--	<50	<0.50	<0.50	<0.50	<1.0	--	--	ATI	--	i
6/27/1995	--	37.73	--	--	--	<50	<0.50	<0.50	<0.50	<1.0	--	--	ATI	--	i
9/19/1995	--	37.73	--	--	--	<50	<0.50	<0.50	<0.50	<1.0	<5.0	--	ATI	--	i
12/7/1995	--	37.73	--	--	--	<50	<0.50	<0.50	<0.50	<1.0	<5.0	--	ATI	--	i
3/28/1996	--	37.73	--	--	--	<50	<0.5	<1	<1	<1	<10	--	SPL	--	i
6/20/1996	--	37.73	--	--	--	<50	<0.5	<1	<1	<1	<10	--	SPL	--	i
<b>RW-1</b>															
4/5/1991	--	37.73	--	--	--	--	--	--	--	--	--	--	--	--	--
4/1/1992	--	37.73	22.81	--	14.92	--	--	--	--	--	--	--	--	--	--
7/6/1992	--	37.73	26.92	--	10.81	--	--	--	--	--	--	--	--	--	--
10/7/1992	--	37.73	28.51	--	9.22	--	--	--	--	--	--	--	--	--	--
1/14/1993	--	37.73	23.75	--	13.98	--	--	--	--	--	--	--	--	--	--
4/22/1993	--	37.73	22.70	--	15.03	--	--	--	--	--	--	--	--	--	--
7/15/1993	--	37.73	26.10	--	11.63	--	--	--	--	--	--	--	--	--	--
10/21/1993	--	37.73	25.40	--	12.33	--	--	--	--	--	--	--	--	--	--
1/27/1994	--	37.73	28.02	--	9.71	--	--	--	--	--	--	--	--	--	--
4/21/1994	--	37.73	23.10	--	14.63	--	--	--	--	--	--	--	--	--	--
9/9/1994	--	37.73	24.39	--	13.34	--	--	--	--	--	--	--	--	--	--
12/21/1994	--	37.73	--	--	--	--	--	--	--	--	--	--	--	--	h
12/7/1995	--	37.73	25.71	--	12.02	150,000	34,000	35,000	4,300	21,000	2,700	--	ATI	--	--
3/28/1996	--	37.73	16.75	--	20.98	--	--	--	--	--	--	--	--	--	--
6/20/1996	--	37.73	25.10	--	12.63	--	--	--	--	--	--	--	--	--	h
10/11/1996	--	37.73	25.51	--	12.22	130,000	20,000	32,000	2,800	20,700	1400/1200	7.4	SPL	--	g
1/2/1997	--	37.73	24.49	--	13.24	--	--	--	--	--	--	--	--	--	--
4/14/1997	--	37.73	23.99	--	13.74	--	--	--	--	--	--	--	--	--	--
4/15/1997	--	37.73	--	--	--	1,800,000	38,000	190,000	48,000	281,000	<25000	--	SPL	--	--
7/2/1997	--	37.73	16.40	--	21.33	140,000	19,000	55,000	4,400	32,400	<10000	5.7	SPL	--	--

**Table 1. Summary of Ground-Water Monitoring Data: Relative Water Elevations and Laboratory Analyses**

**Station #11133, 2220 98th Ave., Oakland, CA**

Well and Sample Date	P/NP	TOC Elevation (feet msl)	Depth to Water (feet bgs)	Product Thickness (feet)	Water Level Elevation (feet msl)	Concentrations in (µg/L)						DO (mg/L)	Lab	pH	Comments
						GRO/TPHg	Benzene	Toluene	Ethyl-Benzene	Total Xylenes	MTBE				
<b>RW-1 Cont.</b>															
7/2/1997	--	37.73	--	--	--	130,000	19,000	54,000	4,700	33,400	<10000	--	SPL	--	e
9/30/1997	--	37.73	--	--	--	140,000	17,000	29,000	2,500	15,900	1,200	--	SPL	--	e
9/30/1997	--	37.73	27.97	--	9.76	110,000	13,000	22,000	2,000	12,500	1,100	7.0	SPL	--	
1/21/1998	--	37.73	14.14	--	23.59	270,000	21,000	48,000	3,500	25,000	1,100	4.8	SPL	--	
4/9/1998	--	37.73	25.01	--	12.72	--	--	--	--	--	--	--	--	--	
4/10/1998	--	37.73	--	--	--	220,000	26,000	46,000	4,400	24,500	<2500	5.1	SPL	--	
6/19/1998	--	37.73	11.43	--	26.30	180,000	19,000	32,000	3,000	17,400	<2500	4.6	SPL	--	
11/30/1998	--	37.73	7.87	--	29.86	--	--	--	--	--	--	--	--	--	
1/21/1999	--	37.73	18.90	--	18.83	260,000	24,000	46,000	5,100	30,000	1,700	--	SPL	--	
7/9/1999	--	37.73	18.58	--	19.15	--	--	--	--	--	--	--	--	--	
11/3/1999	--	37.73	20.85	--	16.88	160,000	19,000	37,000	3,800	25,000	1,500	--	PACE	--	
1/12/2000	--	37.73	21.20	--	16.53	240,000	18,000	46,000	5,800	26,000	2,100	--	PACE	--	
4/13/2000	--	37.73	21.71	--	16.02	120,000	2,100	33,000	2,800	28,000	1,500	--	PACE	--	
5/24/2000	--	37.73	21.89	--	15.84	--	--	--	--	--	--	--	--	--	
6/1/2000	--	37.73	16.30	--	21.43	--	--	--	--	--	--	--	--	--	
6/8/2000	--	37.73	17.88	--	19.85	--	--	--	--	--	--	--	--	--	
6/15/2000	--	37.73	16.72	--	21.01	--	--	--	--	--	--	--	--	--	
6/20/2000	--	37.73	21.04	--	16.69	--	--	--	--	--	--	--	--	--	
7/7/2000	--	37.73	17.21	--	20.52	--	--	--	--	--	--	--	--	--	
7/20/2000	--	37.73	21.87	--	15.86	--	--	--	--	--	--	--	--	--	
7/26/2000	--	37.73	21.45	--	16.28	67,000	160	5,300	2,100	18,000	1,100	--	PACE	--	
7/31/2000	--	37.73	22.11	--	15.62	--	--	--	--	--	--	--	--	--	
8/8/2000	--	37.73	17.80	--	19.93	--	--	--	--	--	--	--	--	--	
8/16/2000	--	37.73	17.92	--	19.81	--	--	--	--	--	--	--	--	--	
8/23/2000	--	37.73	18.11	--	19.62	--	--	--	--	--	--	--	--	--	
10/24/2000	--	37.73	18.93	--	18.80	--	--	--	--	--	--	--	--	--	
10/25/2000	--	37.73	19.04	--	18.69	360,000	18,000	78,000	34,000	180,000	2,100	--	PACE	--	k
1/19/2001	--	37.73	18.19	--	19.54	110,000	9,450	19,600	3,510	21,100	1,270	--	PACE	--	
7/24/2001	--	37.73	17.93	--	19.80	--	--	--	--	--	--	--	--	--	l
1/18/2002	--	37.73	14.87	--	22.86	63,000	2,060	4,370	1,770	13,900	491	--	PACE	--	
8/1/2002	--	37.73	16.84	--	20.89	60,000	1,210	2,200	1,520	10,600	390	--	PACE	--	

**Table 1. Summary of Ground-Water Monitoring Data: Relative Water Elevations and Laboratory Analyses**  
**Station #11133, 2220 98th Ave., Oakland, CA**

Well and Sample Date	P/NP	TOC Elevation (feet msl)	Depth to Water (feet bgs)	Product Thickness (feet)	Water Level Elevation (feet msl)	Concentrations in (µg/L)						DO (mg/L)	Lab	pH	Comments
						GRO/TPHg	Benzene	Toluene	Ethyl-Benzene	Total Xylenes	MTBE				
<b>RW-1 Cont.</b>															
1/16/2003	--	37.73	14.42	--	23.31	34,000	2,500	2,700	780	5,300	680	--	SEQ	--	p
7/7/2003	--	37.73	16.11	--	21.62	50,000	640	280	1,600	10,000	<250	--	SEQ	--	q, u
07/01/2004	P	37.73	16.75	--	20.98	47,000	320	87	1,900	7,500	72	--	SEQM	6.7	
03/16/2005	P	37.73	12.48	--	25.25	17,000	28	23	350	590	53	1.0	SEQM	6.8	
07/22/2005	P	37.73	14.40	--	23.33	5,900	50	35	120	220	51	--	SEQM	6.7	u
01/25/2006	P	37.73	12.00	--	25.73	7,000	22	5.9	190	--	34	--	SEQM	7.1	
7/6/2006	P	37.73	13.01	--	24.72	16,000	37	14	470	230	64	--	TAMC	6.8	
1/8/2007	P	37.73	14.75	--	22.98	2400	16	10	56	54	22	3.61	TAMC	6.86	
<b>7/10/2007</b>	<b>P</b>	<b>37.73</b>	<b>16.21</b>	<b>--</b>	<b>21.52</b>	<b>3,800</b>	<b>4.4</b>	<b>2.8</b>	<b>72</b>	<b>22</b>	<b>21</b>	<b>2.65</b>	<b>TAMC</b>	<b>6.98</b>	
<b>VEW-4</b>															
07/22/2005	P	--	14.04	--	--	680	41	24	20	67	<0.50	--	SEQM	6.8	
<b>VEW-5</b>															
07/22/2005	--	--	--	--	--	--	--	--	--	--	--	--	--	--	v
<b>VEW-8</b>															
07/22/2005	P	--	14.24	--	--	<50	<0.50	<0.50	<0.50	<0.50	<0.50	--	SEQM	6.8	

ABBREVIATIONS & SYMBOLS:

-- = Not analyzed/applicable/measured/available  
< = Not detected at or above specified laboratory reporting limit  
DO = Dissolved oxygen  
DTW = Depth to water in ft bgs  
ft bgs = Feet below ground surface  
ft MSL = Feet above mean sea level  
GRO = Gasoline range organics  
GWE = Groundwater elevation in ft MSL  
mg/L = Milligrams per liter  
MTBE = Methyl tert-butyl ether  
NP = Well not purged prior to sampling  
P = Well purged prior to sampling  
TOC = Top of casing in ft MSL  
TPH-g = Total petroleum hydrocarbons as gasoline  
µg/L = Micrograms per liter  
ANA = Anamatrix, Inc.  
PACE = Pace, Inc.  
ATI = Analytical Technologies, Inc.  
CEI = Ceimic Corporation  
SPL = Southern Petroleum Laboratories  
SEQ/SEQM= Sequoia Analytical/Sequoia Analytical Morgan Hill Laboratories

FOOTNOTES:

c = A copy of the documentation for this data is included in Appendix C of Alistoreport 10-025-13-003.  
d = MTBE peak. See documentation in Appendix C of Alisto report 10-025-13-003.  
e = Blind duplicate.  
f = Well inaccessible.  
g = EPA Methods 8020/8260 used.  
h = Well not monitored and/or sampled due to vapor extraction system.  
i = Travel blank.  
j = This gasoline does not include MTBE.  
k = Well was sampled on a different date from the other wells due to lack of proper equipment.  
l = Unable to sample due to nature of product.  
m = A copy of the documentation for this data is included in Blaine Tech Services, Inc., Report 010724-B-2. The data for sampling events January 14, 1993 and April 22, 1993 has been destroyed. No chromatograms could be located for samples AW-2 on January 27, 1994, and for samples AW-1, AW-2, AW-3, AW-4, AW-5, AW-6, AW-7, AW-8, MW-2 and MW-3 on September 9, 1994.  
n = On June 1, 2001, after reviewing chromatograms, Sequoia reported the value as <5.0.  
o = Unable to locate well.  
p = TPH-g data analyzed by EPA Method 8015B modified; BTEX and MTBE by EPA Method 8021B  
q = TPH-g, BTEX, and MTBE analyzed by EPA method 8260B beginning on the third quarter 2003 sampling event 07/07/03.  
r = Discrete peak at C5.  
t = Well was not gauged during the quarter due to an oversight by the technician.  
u = Sheen in well.  
v = Well was dry.  
w = Hydrocarbon result partly due to individ. peak(s) in quant. range.

NOTES:

Beginning in the fourth quarter 2003, the laboratory modified the reported analyte list. TPH-g was changed to GRO. The resulting data may be impacted by the potential of non-TPH-g analytes within the requested fuel range resulting in a higher concentration being reported.

Beginning in the second quarter 2004, the carbon range for GRO was changed from C6-C10 to C4-C12.

Values for DO and pH were obtained through field measurements.



GWEs adjusted assuming a specific gravity of 0.75 for free product

Note: The data within this table collected prior to April 2006 was provided to Broadbent & Associates, Inc. by Atlantic Richfield Company and their previous consultants. Broadbent & Associates, Inc. has not verified the accuracy of this information.

**Table 2. Summary of Fuel Additives Analytical Data**  
**Station #11133, 2220 98th Ave., Oakland, CA**

Well and Sample Date	Concentrations in (µg/L)								Comments
	Ethanol	TBA	MTBE	DIPE	ETBE	TAME	1,2-DCA	EDB	
<b>AW-1</b>									
7/7/2003	<5,000	<1,000	1,100	<25	<25	190	--	--	
02/05/2004	<10,000	<2,000	930	<50	<50	160	<50	<50	
07/01/2004	<5,000	<1,000	1,100	<25	<25	170	<25	<25	
03/16/2005	<5,000	<1,000	720	<25	<25	130	<25	<25	
07/22/2005	<1,000	<200	510	<5.0	<5.0	93	31	<5.0	
01/25/2006	<6,000	<400	490	<10	<10	94	21	<10	
7/6/2006	<6,000	<400	270	<10	<10	49	<10	<10	
1/8/2007	<3000	240	380	<5.0	<5.0	64	<5.0	--	
<b>7/10/2007</b>	<b>&lt;6,000</b>	<b>&lt;400</b>	<b>220</b>	<b>&lt;10</b>	<b>&lt;10</b>	<b>36</b>	<b>&lt;10</b>	<b>&lt;10</b>	
<b>AW-2</b>									
02/05/2004	<100	<20	5.1	<0.50	<0.50	<0.50	<0.50	<0.50	
03/16/2005	<100	<20	<0.50	<0.50	<0.50	<0.50	<0.50	<0.50	
01/25/2006	<600	<40	12	<1.0	<1.0	1.0	<1.0	<1.0	
1/8/2007	<3000	<200	40	<5.0	<5.0	<5.0	<5.0	--	
<b>AW-3</b>									
03/16/2005	<100	<20	<0.50	<0.50	<0.50	<0.50	<0.50	<0.50	
<b>AW-4</b>									
7/7/2003	<1,000	<200	56	<5.0	<5.0	<5.0	--	--	
02/05/2004	<200	<40	40	<1.0	<1.0	3.7	<1.0	<1.0	
07/01/2004	<1,000	<200	64	<5.0	<5.0	9.6	<5.0	<5.0	
03/16/2005	<500	<100	23	<2.5	<2.5	<2.5	<2.5	<2.5	
07/22/2005	<2,000	<400	59	<10	<10	<10	<10	<10	
01/25/2006	<3,000	<200	12	<5.0	<5.0	<5.0	<5.0	<5.0	
7/6/2006	<3,000	<5.0	39	<5.0	<5.0	<5.0	<5.0	<5.0	
1/8/2007	<300	<20	38	<0.50	<0.50	6.2	<0.50	--	
<b>7/10/2007</b>	<b>&lt;300</b>	<b>&lt;20</b>	<b>27</b>	<b>&lt;0.50</b>	<b>&lt;0.50</b>	<b>4.2</b>	<b>&lt;0.50</b>	<b>&lt;0.50</b>	
<b>AW-5</b>									
7/7/2003	<2,000	1,200	980	<10	<10	210	--	--	
02/05/2004	<2,000	1,200	810	<10	<10	160	<10	<10	

**Table 2. Summary of Fuel Additives Analytical Data**  
**Station #11133, 2220 98th Ave., Oakland, CA**

Well and Sample Date	Concentrations in (µg/L)								Comments
	Ethanol	TBA	MTBE	DIPE	ETBE	TAME	1,2-DCA	EDB	
<b>AW-5 Cont.</b>									
07/01/2004	<1,000	1,600	550	<5.0	<5.0	94	<5.0	<5.0	
03/16/2005	<10,000	2,100	890	<50	<50	190	<50	<50	
07/22/2005	<1,000	370	390	<5.0	<5.0	78	<5.0	<5.0	
01/25/2006	<3,000	580	26	<5.0	<5.0	5.2	<5.0	<5.0	
7/6/2006	<3,000	240	170	<5.0	<5.0	37	<5.0	<5.0	
1/8/2007	<1500	240	220	<2.5	<2.5	51	<2.5	--	
<b>7/10/2007</b>	<b>&lt;1,500</b>	<b>110</b>	<b>360</b>	<b>&lt;2.5</b>	<b>&lt;2.5</b>	<b>92</b>	<b>&lt;2.5</b>	<b>&lt;2.5</b>	
<b>AW-6</b>									
02/05/2004	<10,000	<2,000	5,400	<50	<50	1,800	<50	<50	
07/01/2004	<10,000	<2,000	4,600	<50	<50	1,600	<50	<50	
03/16/2005	<5,000	<1,000	4,400	<25	<25	1,400	<25	<25	
07/22/2005	<10,000	<2,000	5,500	<50	<50	1,400	<50	<50	
01/25/2006	<30,000	<2,000	3,000	<50	<50	940	<50	<50	
7/6/2006	<30,000	<2,000	2,800	<50	<50	780	<50	<50	
1/8/2007	<30000	<2000	7400	<50	<50	1900	<50	--	
<b>7/10/2007</b>	<b>&lt;60,000</b>	<b>&lt;4,000</b>	<b>3,900</b>	<b>&lt;100</b>	<b>&lt;100</b>	<b>890</b>	<b>&lt;100</b>	<b>&lt;100</b>	
<b>AW-7</b>									
<b>AW-8</b>									
03/16/2005	<100	<20	<0.50	<0.50	<0.50	<0.50	<0.50	<0.50	a
<b>MW-1</b>									
7/7/2003	<1,000	<200	24	<5.0	<5.0	<5.0	--	--	
02/05/2004	<1,000	<200	9.2	<5.0	<5.0	<5.0	<5.0	<5.0	
07/01/2004	<10,000	<2,000	<50	<50	<50	<50	<50	<50	
03/16/2005	<1,000	<200	<5.0	<5.0	<5.0	<5.0	<5.0	<5.0	
07/22/2005	<2,000	<400	<10	<10	<10	<10	<10	<10	
01/25/2006	<1,500	<100	<2.5	<2.5	<2.5	<2.5	<2.5	<2.5	
7/6/2006	<1,500	<100	<2.5	<2.5	<2.5	<2.5	<2.5	<2.5	
1/8/2007	<300	<20	2.1	<0.50	<0.50	<0.50	<0.50	--	
<b>7/10/2007</b>	<b>&lt;300</b>	<b>&lt;20</b>	<b>2.4</b>	<b>&lt;0.50</b>	<b>&lt;0.50</b>	<b>&lt;0.50</b>	<b>&lt;0.50</b>	<b>&lt;0.50</b>	

**Table 2. Summary of Fuel Additives Analytical Data**  
**Station #11133, 2220 98th Ave., Oakland, CA**

Well and Sample Date	Concentrations in (µg/L)								Comments
	Ethanol	TBA	MTBE	DIPE	ETBE	TAME	1,2-DCA	EDB	
<b>MW-2</b>									
03/16/2005	<100	<20	<0.50	<0.50	<0.50	<0.50	<0.50	<0.50	
<b>MW-3</b>									
7/7/2003	<100	<20	8.8	<0.50	<0.50	0.65	--	--	
02/05/2004	<100	<20	4.6	<0.50	<0.50	<0.50	<0.50	<0.50	
07/01/2004	<100	<20	3.3	<0.50	<0.50	<0.50	<0.50	<0.50	
03/16/2005	<100	<20	4.4	<0.50	<0.50	<0.50	<0.50	<0.50	
07/22/2005	<100	<20	4.1	<0.50	<0.50	<0.50	<0.50	<0.50	
01/25/2006	<300	<20	3.0	<0.50	<0.50	<0.50	<0.50	<0.50	
7/6/2006	<300	<50	3.0	<0.50	<0.50	<0.50	<0.50	<0.50	
1/8/2007	<300	<20	3.2	<0.50	<0.50	<0.50	<0.50	--	
<b>7/10/2007</b>	<b>&lt;300</b>	<b>&lt;20</b>	<b>2.8</b>	<b>&lt;0.50</b>	<b>&lt;0.50</b>	<b>&lt;0.50</b>	<b>&lt;0.50</b>	<b>&lt;0.50</b>	
<b>RW-1</b>									
7/7/2003	<50,000	<10,000	<250	<250	<250	<250	--	--	
07/01/2004	<10,000	<2,000	72	<50	<50	<50	<50	<50	
03/16/2005	<2,000	<400	53	<10	<10	<10	<10	<10	
07/22/2005	<500	<100	51	<2.5	<2.5	5.6	<2.5	<2.5	
01/25/2006	<3,000	<200	34	<5.0	<5.0	<5.0	<5.0	<5.0	
7/6/2006	<6,000	<400	64	<10	<10	<10	<10	<10	
1/8/2007	<6000	<400	22	<10	<10	<10	<10	--	
<b>7/10/2007</b>	<b>&lt;600</b>	<b>&lt;40</b>	<b>21</b>	<b>&lt;1.0</b>	<b>&lt;1.0</b>	<b>&lt;1.0</b>	<b>&lt;1.0</b>	<b>&lt;1.0</b>	
<b>VEW-4</b>									
07/22/2005	<100	<20	<0.50	<0.50	<0.50	<0.50	<0.50	<0.50	
<b>VEW-5</b>									
<b>VEW-8</b>									
07/22/2005	<100	<20	<0.50	<0.50	<0.50	<0.50	<0.50	<0.50	

ABBREVIATIONS & SYMBOLS:

-- = Not analyzed/applicable/measured/available

< = Not detected at or above specified laboratory reporting limit

1,2-DCA = 1,2-Dichloroethane

DIPE = Di-isopropyl ether

EDB = 1,2-Dibromoethane

ETBE = Ethyl tert-butyl ether

MTBE = Methyl tert-butyl ether

TAME = tert-Amyl methyl ether

TBA = tert-Butyl alcohol

µg/L = Micrograms per Liter

FOOTNOTES:

a = Calibration verification for ethanol is within method limits but outside contractual limits.

NOTES:

All volatile organic compounds analyzed using EPA Method 8260B.

Note: The data within this table collected prior to April 2006 was provided to Broadbent & Associates, Inc. by Atlantic Richfield Company and their previous consultants. Broadbent & Associates, Inc. has not verified the accuracy of this information.

**Table 3. Historical Ground-Water Flow Direction and Gradient  
Station #11133, 2220 98th Ave., Oakland, CA**

<b>Date Sampled</b>	<b>Approximate Flow Direction</b>	<b>Approximate Hydraulic Gradient</b>
1/25/2006	Variable: East to Southwest	0.03 to 0.09
7/6/2006	Variable: East to W towards Center	0.04 to 0.05
1/8/2007	Variable: East to W towards Center	0.03 to 0.05
<b>7/10/2007</b>	<b>West</b>	<b>0.01</b>

Note: The data within this table collected prior to April 2006 was provided to Broadbent & Associates, Inc. by Atlantic Richfield Company and their previous consultants. Broadbent & Associates, Inc. has not verified the accuracy of this information.

**APPENDIX A**

**STRATUS GROUND-WATER SAMPLING DATA PACKAGE  
(INCLUDES FIELD DATA SHEETS, LABORATORY REPORT  
AND CHAIN-OF-CUSTODY DOCUMENTATION)**



3330 Cameron Park Drive, Ste 550  
Cameron Park, California 95682  
(530) 676-6004 ~ Fax: (530) 676-6005

July 26, 2007

Mr. Rob Miller  
Broadbent & Associates, Inc.  
2000 Kirman Avenue  
Reno, NV 89502

Re: Groundwater Sampling Data Package, BP Service Station No. 11133, located at 2220 98<sup>th</sup> Avenue, Oakland, California

### **General Information**

*Data Submittal Prepared / Reviewed by:* Sandy Hayes / Jay Johnson

*Phone Number:* (530) 676-6000

*On-Site Supplier Representative:* Jerry Gonzales

*Sampling Date:* July 10, 2007

*Arrival:* 11:00                      *Departure:* 15:45

*Weather Conditions:* Clear

*Unusual Field Conditions:* None

*Scope of Work Performed:* Quarterly monitoring and sampling

*Variations from Work Scope:* Well AW-7 could not be located. A Stratus technician will visit the site to try to locate.

This submittal presents the tabulation of data collected in association with routine groundwater monitoring. The attachments include bill of lading, field data sheets, chain of custody documentation, and certified analytical results. The information is being provided to BP-ARCO's Scoping Supplier for use in preparing a report for regulatory submittal. This submittal is limited to presentation of collected data and does not include data interpretation or conclusions or recommendations. Any questions concerning this submittal should be addressed to the Preparer/Reviewer identified above.



Sincerely,

**STRATUS ENVIRONMENTAL, INC.**

Jay R. Johnson, P.G.  
Project Manager



**Attachments:**

- Bill of Lading
- Field Data Sheets
- Chain of Custody Documentation
- Certified Analytical Results

CC: Mr. Paul Supple, BP/ARCO

NO. 662240

# NON-HAZARDOUS WASTE DATA FORM

SITE:

EPA I.D. NO.

NOT REQUIRED

NAME BP WEST COAST PRODUCTS LLC ARCO # 11133

PROFILE NO.

ADDRESS P.O. BOX 80249  
RANCHO SANTA MARGARITA

CITY, STATE, ZIP CA 92688

PHONE NO.                     

CONTAINERS: No.                      VOLUME 214 WEIGHT                     

TYPE:  TANK TRUCK  DUMP TRUCK  DRUMS  CARTONS  OTHER                     

WASTE DESCRIPTION NON-HAZARDOUS WATER GENERATING PROCESS WELL PURGING/DECON WATER

1. WATER 99-100% PPM                      %                      5.                      PPM                      %                     

2. TPH <1% PPM                      %                      6.                      PPM                      %                     

3.                      PPM                      %                      7. BESI# PPM                      %                     

4.                      PPM                      %                      8.                      PPM                      %                     

PROPERTIES: 7-10  SOLID  LIQUID  SLUDGE  SLURRY  OTHER                     

HANDLING INSTRUCTIONS: WEAR ALL APPROPRIATE PROTECTIVE CLOTHING

THE GENERATOR CERTIFIES THAT THE WASTE AS DESCRIBED IS 100% NON-HAZARDOUS.

*Larry Moorhart*  
TYPED OR PRINTED FULL NAME & SIGNATURE Larry Moorhart BESI for BP DATE 7/10/07

TO BE COMPLETED BY GENERATOR

TRANSPORTER

NAME Transporter #1 STRATUS ENVIRONMENTAL Transporter #2

EPA I.D. NO.

ADDRESS 3330 CAMERON PARK DRIVE STE 530

SERVICE ORDER NO.                     

CITY, STATE, ZIP CAMERON PARK CA 95682

PICK UP DATE                     

PHONE NO. 530-676-6004

*Jerry Gonzalez*  
TYPED OR PRINTED FULL NAME & SIGNATURE Jerry Gonzalez DATE 7/10/07

TRUCK, UNIT, I.D. NO.                     

TSD FACILITY

NAME SEAPORT REFINING & ENVIRONMENTAL, LLC

EPA I.D. NO.

DISPOSAL METHOD

ADDRESS 700 SEAPORT BLVD.

LANDFILL  OTHER                     

CITY, STATE, ZIP REDWOOD CITY, CA 94063

PHONE NO. 650-364-1024

TYPED OR PRINTED FULL NAME & SIGNATURE                      DATE                     

GEN	OLD/NEW	L	A	TONS
TRANS		S	B	
CAQ		RT/CD	HWDF	NONE

DISCREPANCY



**BP ALAMEDA PORTFOLIO**  
**WATER SAMPLE FIELD DATA SHEET**

PROJECT #: 11133 PURGED BY: [Signature] WELL I.D.: MW-1  
 CLIENT NAME: \_\_\_\_\_ SAMPLED BY: [Signature] SAMPLE I.D.: MW-1  
 LOCATION: Oakland - 2220 98th Avenue QA SAMPLES: \_\_\_\_\_

DATE PURGED 7-10-07 START (2400hr) 13:47 END (2400hr) 15:30  
 DATE SAMPLED 7-10-07 SAMPLE TIME (2400hr) 13:55  
 SAMPLE TYPE: Groundwater  Surface Water \_\_\_\_\_ Treatment Effluent \_\_\_\_\_ Other \_\_\_\_\_

CASING DIAMETER: 2"  3" \_\_\_\_\_ 4" \_\_\_\_\_ 5" \_\_\_\_\_ 6" \_\_\_\_\_ 8" \_\_\_\_\_ Other \_\_\_\_\_  
 Casing Volume: (gallons per foot) (0.17) (0.38) (0.67) (1.02) (1.50) (2.60) ( )

DEPTH TO BOTTOM (feet) = 28.18 CASING VOLUME (gal) = 2.5  
 DEPTH TO WATER (feet) = 13.01 CALCULATED PURGE (gal) = 1.7  
 WATER COLUMN HEIGHT (feet) = 15.1 ACTUAL PURGE (gal) = 8.0

FIELD MEASUREMENTS

DATE	TIME (2400hr)	VOLUME (gal)	TEMP. (degrees F)	CONDUCTIVITY (umhos/cm)	pH (units)	COLOR (visual)	TURBIDITY (NTU)
<u>7/10/07</u>	<u>13:48</u>	<u>2.5</u>	<u>23.9</u>	<u>644</u>	<u>6.82</u>	<u>Clear</u>	
<u>1</u>	<u>13:49</u>	<u>5.5</u>	<u>23.3</u>	<u>675</u>	<u>6.97</u>	<u>1</u>	
<u>1</u>	<u>13:50</u>	<u>8.0</u>	<u>23.4</u>	<u>682</u>	<u>7.04</u>	<u>1</u>	

SAMPLE INFORMATION

SAMPLE DEPTH TO WATER: 14.63 SAMPLE TURBIDITY: Clear

80% RECHARGE:  YES  NO ANALYSES: See work order  
 ODOR: yes SAMPLE VESSEL / PRESERVATIVE: 3 Vol-HCL

PURGING EQUIPMENT

Bladder Pump  Bailer (Teflon)  
 Centrifugal Pump  Bailer (PVC)  
 Submersible Pump  Bailer (Stainless Steel)  
 Peristaltic Pump  Dedicated \_\_\_\_\_  
 Other: \_\_\_\_\_  
 Pump Depth: 25

SAMPLING EQUIPMENT

Bladder Pump  Bailer (Teflon)  
 Centrifugal Pump  Bailer (  PVC or  disposable)  
 Submersible Pump  Bailer (Stainless Steel)  
 Peristaltic Pump  Dedicated \_\_\_\_\_  
 Other: \_\_\_\_\_

WELL INTEGRITY: \_\_\_\_\_ LOCK#: 110575

REMARKS: LT Shear in well  
DO 2/6

SIGNATURE: [Signature] Page \_\_\_\_\_ of \_\_\_\_\_

**BP ALAMEDA PORTFOLIO**  
**WATER SAMPLE FIELD DATA SHEET**

PROJECT #: 11133 PURGED BY: Jc WELL I.D.: MW 3  
 CLIENT NAME: \_\_\_\_\_ SAMPLED BY: Jc SAMPLE I.D.: MW 3  
 LOCATION: Oakland - 2220 98th Avenue QA SAMPLES: \_\_\_\_\_

DATE PURGED 7-10-07 START (2400hr) 14:07 END (2400hr) 14:10  
 DATE SAMPLED 7-10-07 SAMPLE TIME (2400hr) 14:10  
 SAMPLE TYPE: Groundwater  Surface Water \_\_\_\_\_ Treatment Effluent \_\_\_\_\_ Other \_\_\_\_\_

CASING DIAMETER: 2"  3" \_\_\_\_\_ 4" \_\_\_\_\_ 5" \_\_\_\_\_ 6" \_\_\_\_\_ 8" \_\_\_\_\_ Other \_\_\_\_\_  
 Casing Volume: (gallons per foot) (0.17) (0.38) (0.67) (1.02) (1.50) (2.60) ( )

DEPTH TO BOTTOM (feet) = 24.00 CASING VOLUME (gal) = 3.2  
 DEPTH TO WATER (feet) = 14.16 CALCULATED PURGE (gal) = 10.0  
 WATER COLUMN HEIGHT (feet) = 19.6 ACTUAL PURGE (gal) = 10.5

FIELD MEASUREMENTS

DATE	TIME (2400hr)	VOLUME (gal)	TEMP. (degrees F)	CONDUCTIVITY (umhos/cm)	pH (units)	COLOR (visual)	TURBIDITY (NTU)
<u>7-10-07</u>	<u>14:08</u>	<u>3.2</u>	<u>21.7</u>	<u>435.1</u>	<u>7.33</u>	<u>Clear</u>	
<u>/</u>	<u>14:09</u>	<u>2.0</u>	<u>21.2</u>	<u>412.5</u>	<u>7.35</u>	<u>/</u>	
<u>/</u>	<u>14:10</u>	<u>10.5</u>	<u>21.5</u>	<u>411.2</u>	<u>7.35</u>	<u>/</u>	

SAMPLE INFORMATION

SAMPLE DEPTH TO WATER: 16.97 SAMPLE TURBIDITY: Clear

80% RECHARGE:  YES  NO ANALYSES: See work order  
 ODOR: Yes SAMPLE VESSEL / PRESERVATIVE: 3 Vol-H CC

PURGING EQUIPMENT

Bladder Pump  Bailer (Teflon)  
 Centrifugal Pump  Bailer (PVC)  
 Submersible Pump  Bailer (Stainless Steel)  
 Peristaltic Pump  Dedicated \_\_\_\_\_  
 Other: \_\_\_\_\_  
 Pump Depth: 20

SAMPLING EQUIPMENT

Bladder Pump  Bailer (Teflon)  
 Centrifugal Pump  Bailer ( \_\_\_\_\_ PVC or  disposable)  
 Submersible Pump  Bailer (Stainless Steel)  
 Peristaltic Pump  Dedicated \_\_\_\_\_  
 Other: \_\_\_\_\_

WELL INTEGRITY: - good LOCK#: Master

REMARKS: DO 2.85

SIGNATURE: [Signature] Page \_\_\_\_\_ of \_\_\_\_\_

# BP ALAMEDA PORTFOLIO

## WATER SAMPLE FIELD DATA SHEET

PROJECT #: 11133 PURGED BY: JC WELL I.D.: 1"  
 CLIENT NAME: \_\_\_\_\_ SAMPLED BY: JC SAMPLE I.D.: 1  
 LOCATION: Oakland - 2220 98th Avenue QA SAMPLES: \_\_\_\_\_

DATE PURGED 7-10-07 START (2400hr) 14:25 END (2400hr) 14:28  
 DATE SAMPLED 7-10-07 SAMPLE TIME (2400hr) 14:40  
 SAMPLE TYPE: Groundwater  Surface Water \_\_\_\_\_ Treatment Effluent \_\_\_\_\_ Other \_\_\_\_\_

CASING DIAMETER: 2"  3" \_\_\_\_\_ 4" \_\_\_\_\_ 5" \_\_\_\_\_ 6" \_\_\_\_\_ 8" \_\_\_\_\_ Other \_\_\_\_\_  
 Casing Volume: (gallons per foot) (0.17) (0.38) (0.67) (1.02) (1.50) (2.60) ( )

DEPTH TO BOTTOM (feet) = 28.40 CASING VOLUME (gal) = 3.5  
 DEPTH TO WATER (feet) = 17.30 CALCULATED PURGE (gal) = 10.7  
 WATER COLUMN HEIGHT (feet) = 2.1 ACTUAL PURGE (gal) = 11.0

### FIELD MEASUREMENTS

DATE	TIME (2400hr)	VOLUME (gal)	TEMP. (degrees F)	CONDUCTIVITY (umhos/cm)	pH (units)	COLOR (visual)	TURBIDITY (NTU)
<u>7-10-07</u>	<u>14:26</u>	<u>3.5</u>	<u>25.1</u>	<u>808</u>	<u>6.79</u>	<u>clear</u>	
<u>7-10-07</u>	<u>14:27</u>	<u>3.5</u>	<u>25.2</u>	<u>876</u>	<u>6.97</u>	<u>1</u>	
<u>7-10-07</u>	<u>14:28</u>	<u>11.0</u>	<u>25.3</u>	<u>888</u>	<u>6.90</u>	<u>1</u>	

SAMPLE DEPTH TO WATER: 19.63 SAMPLE INFORMATION SAMPLE TURBIDITY: clear

80% RECHARGE:  YES  NO ANALYSES: See work order  
 ODOR: yes SAMPLE VESSEL / PRESERVATIVE: 3:400-HCC

#### PURGING EQUIPMENT

Bladder Pump  Bailer (Teflon)  
 Centrifugal Pump  Bailer (PVC)  
 Submersible Pump  Bailer (Stainless Steel)  
 Peristaltic Pump  Dedicated \_\_\_\_\_  
 Other: \_\_\_\_\_  
 Pump Depth: 35

#### SAMPLING EQUIPMENT

Bladder Pump  Bailer (Teflon)  
 Centrifugal Pump  Bailer (  PVC or  disposable)  
 Submersible Pump  Bailer (Stainless Steel)  
 Peristaltic Pump  Dedicated \_\_\_\_\_  
 Other: \_\_\_\_\_

WELL INTEGRITY: good LOCK#: MAST

REMARKS: DO 1.79

SIGNATURE: JC Page    of

**BP ALAMEDA PORTFOLIO**  
**WATER SAMPLE FIELD DATA SHEET**

PROJECT #: 11133 PURGED BY: Je WELL I.D.: AW-4  
 CLIENT NAME: \_\_\_\_\_ SAMPLED BY: J SAMPLE I.D.: AW-4  
 LOCATION: Oakland - 2220 98th Avenue QA SAMPLES: \_\_\_\_\_

DATE PURGED 7-10-07 START (2400hr) 12:33 END (2400hr) 12:36  
 DATE SAMPLED 7/10/07 SAMPLE TIME (2400hr) 12:45  
 SAMPLE TYPE: Groundwater  Surface Water \_\_\_\_\_ Treatment Effluent \_\_\_\_\_ Other \_\_\_\_\_

CASING DIAMETER: 2"  3" \_\_\_\_\_ 4" \_\_\_\_\_ 5" \_\_\_\_\_ 6" \_\_\_\_\_ 8" \_\_\_\_\_ Other \_\_\_\_\_  
 Casing Volume: (gallons per foot) (0.17) (0.38) (0.67) (1.02) (1.50) (2.60) ( )

DEPTH TO BOTTOM (feet) = 32.63 CASING VOLUME (gal) = 2.5  
 DEPTH TO WATER (feet) = 19.95 CALCULATED PURGE (gal) = 7.5  
 WATER COLUMN HEIGHT (feet) = 14.7 ACTUAL PURGE (gal) = 8.0

FIELD MEASUREMENTS

DATE	TIME (2400hr)	VOLUME (gal)	TEMP. (degrees F)	CONDUCTIVITY (umhos/cm)	pH (units)	COLOR (visual)	TURBIDITY (NTU)
<u>7/10/07</u>	<u>12:34</u>	<u>2.5</u>	<u>22.1</u>	<u>1118</u>	<u>7.19</u>	<u>clear</u>	
	<u>12:35</u>	<u>5.0</u>	<u>22.1</u>	<u>1225</u>	<u>7.51</u>	<u>/</u>	
	<u>12:36</u>	<u>8.0</u>	<u>21.8</u>	<u>1295</u>	<u>7.19</u>	<u>/</u>	

SAMPLE INFORMATION

SAMPLE DEPTH TO WATER: 19.41 SAMPLE TURBIDITY: clear  
 80% RECHARGE:  YES  NO ANALYSES: see work order  
 ODOR: NO SAMPLE VESSEL / PRESERVATIVE: 10 Vol% HCL

PURGING EQUIPMENT

Bladder Pump  Bailer (Teflon)  
 Centrifugal Pump  Bailer (PVC)  
 Submersible Pump  Bailer (Stainless Steel)  
 Peristaltic Pump  Dedicated \_\_\_\_\_  
 Other: \_\_\_\_\_  
 Pump Depth: 25

SAMPLING EQUIPMENT

Bladder Pump  Bailer (Teflon)  
 Centrifugal Pump  Bailer (  PVC or  disposable)  
 Submersible Pump  Bailer (Stainless Steel)  
 Peristaltic Pump  Dedicated \_\_\_\_\_  
 Other: \_\_\_\_\_

WELL INTEGRITY: Good LOCK#: MACT

REMARKS: DO 2.54

SIGNATURE: [Signature] Page \_\_\_\_\_ of \_\_\_\_\_

**BP ALAMEDA PORTFOLIO**  
**WATER SAMPLE FIELD DATA SHEET**

PROJECT #: 11133 PURGED BY: JC WELL I.D.: AW-5  
 CLIENT NAME: \_\_\_\_\_ SAMPLED BY: [Signature] SAMPLE I.D.: AW-5  
 LOCATION: Oakland - 2220 98th Avenue QA SAMPLES: \_\_\_\_\_

DATE PURGED 7-10-07 START (2400hr) 12:55 END (2400hr) 13:04  
 DATE SAMPLED 7-10-07 SAMPLE TIME (2400hr) 13:10  
 SAMPLE TYPE: Groundwater  Surface Water \_\_\_\_\_ Treatment Effluent \_\_\_\_\_ Other \_\_\_\_\_

CASING DIAMETER: 2" \_\_\_\_\_ 3" \_\_\_\_\_ 4"  5" \_\_\_\_\_ 6" \_\_\_\_\_ 8" \_\_\_\_\_ Other \_\_\_\_\_  
 Casing Volume: (gallons per foot) 2" (0.17) 3" (0.38) 4" (0.67) 5" (1.02) 6" (1.50) 8" (2.60) Other ( )

DEPTH TO BOTTOM (feet) = 42.90 CASING VOLUME (gal) = 16.0  
 DEPTH TO WATER (feet) = 19.00 CALCULATED PURGE (gal) = 48.0  
 WATER COLUMN HEIGHT (feet) = 23.9 ACTUAL PURGE (gal) = 48.5

FIELD MEASUREMENTS							
DATE	TIME (2400hr)	VOLUME (gal)	TEMP. (degrees F)	CONDUCTIVITY (umhos/cm)	pH (units)	COLOR (visual)	TURBIDITY (NTU)
<u>7/10/07</u>	<u>12:58</u>	<u>16.0</u>	<u>71.9</u>	<u>624</u>	<u>7.18</u>	<u>clear</u>	
<u>/</u>	<u>13:01</u>	<u>323</u>	<u>72.1</u>	<u>567</u>	<u>7.06</u>	<u>/</u>	
<u>/</u>	<u>13:04</u>	<u>495</u>	<u>72.1</u>	<u>567</u>	<u>7.02</u>	<u>/</u>	

SAMPLE DEPTH TO WATER: 23.18 SAMPLE INFORMATION SAMPLE TURBIDITY: clear

80% RECHARGE:  YES  NO ANALYSES: 228-1011-1012-1013-1014-1015-1016-1017-1018-1019-1020-1021-1022-1023-1024-1025-1026-1027-1028-1029-1030-1031-1032-1033-1034-1035-1036-1037-1038-1039-1040-1041-1042-1043-1044-1045-1046-1047-1048-1049-1050-1051-1052-1053-1054-1055-1056-1057-1058-1059-1060-1061-1062-1063-1064-1065-1066-1067-1068-1069-1070-1071-1072-1073-1074-1075-1076-1077-1078-1079-1080-1081-1082-1083-1084-1085-1086-1087-1088-1089-1090-1091-1092-1093-1094-1095-1096-1097-1098-1099-1100-1101-1102-1103-1104-1105-1106-1107-1108-1109-1110-1111-1112-1113-1114-1115-1116-1117-1118-1119-1120-1121-1122-1123-1124-1125-1126-1127-1128-1129-1130-1131-1132-1133-1134-1135-1136-1137-1138-1139-1140-1141-1142-1143-1144-1145-1146-1147-1148-1149-1150-1151-1152-1153-1154-1155-1156-1157-1158-1159-1160-1161-1162-1163-1164-1165-1166-1167-1168-1169-1170-1171-1172-1173-1174-1175-1176-1177-1178-1179-1180-1181-1182-1183-1184-1185-1186-1187-1188-1189-1190-1191-1192-1193-1194-1195-1196-1197-1198-1199-1200-1201-1202-1203-1204-1205-1206-1207-1208-1209-1210-1211-1212-1213-1214-1215-1216-1217-1218-1219-1220-1221-1222-1223-1224-1225-1226-1227-1228-1229-1230-1231-1232-1233-1234-1235-1236-1237-1238-1239-1240-1241-1242-1243-1244-1245-1246-1247-1248-1249-1250-1251-1252-1253-1254-1255-1256-1257-1258-1259-1260-1261-1262-1263-1264-1265-1266-1267-1268-1269-1270-1271-1272-1273-1274-1275-1276-1277-1278-1279-1280-1281-1282-1283-1284-1285-1286-1287-1288-1289-1290-1291-1292-1293-1294-1295-1296-1297-1298-1299-1300-1301-1302-1303-1304-1305-1306-1307-1308-1309-1310-1311-1312-1313-1314-1315-1316-1317-1318-1319-1320-1321-1322-1323-1324-1325-1326-1327-1328-1329-1330-1331-1332-1333-1334-1335-1336-1337-1338-1339-1340-1341-1342-1343-1344-1345-1346-1347-1348-1349-1350-1351-1352-1353-1354-1355-1356-1357-1358-1359-1360-1361-1362-1363-1364-1365-1366-1367-1368-1369-1370-1371-1372-1373-1374-1375-1376-1377-1378-1379-1380-1381-1382-1383-1384-1385-1386-1387-1388-1389-1390-1391-1392-1393-1394-1395-1396-1397-1398-1399-1400-1401-1402-1403-1404-1405-1406-1407-1408-1409-1410-1411-1412-1413-1414-1415-1416-1417-1418-1419-1420-1421-1422-1423-1424-1425-1426-1427-1428-1429-1430-1431-1432-1433-1434-1435-1436-1437-1438-1439-1440-1441-1442-1443-1444-1445-1446-1447-1448-1449-1450-1451-1452-1453-1454-1455-1456-1457-1458-1459-1460-1461-1462-1463-1464-1465-1466-1467-1468-1469-1470-1471-1472-1473-1474-1475-1476-1477-1478-1479-1480-1481-1482-1483-1484-1485-1486-1487-1488-1489-1490-1491-1492-1493-1494-1495-1496-1497-1498-1499-1500-1501-1502-1503-1504-1505-1506-1507-1508-1509-1510-1511-1512-1513-1514-1515-1516-1517-1518-1519-1520-1521-1522-1523-1524-1525-1526-1527-1528-1529-1530-1531-1532-1533-1534-1535-1536-1537-1538-1539-1540-1541-1542-1543-1544-1545-1546-1547-1548-1549-1550-1551-1552-1553-1554-1555-1556-1557-1558-1559-1560-1561-1562-1563-1564-1565-1566-1567-1568-1569-1570-1571-1572-1573-1574-1575-1576-1577-1578-1579-1580-1581-1582-1583-1584-1585-1586-1587-1588-1589-1590-1591-1592-1593-1594-1595-1596-1597-1598-1599-1600-1601-1602-1603-1604-1605-1606-1607-1608-1609-1610-1611-1612-1613-1614-1615-1616-1617-1618-1619-1620-1621-1622-1623-1624-1625-1626-1627-1628-1629-1630-1631-1632-1633-1634-1635-1636-1637-1638-1639-1640-1641-1642-1643-1644-1645-1646-1647-1648-1649-1650-1651-1652-1653-1654-1655-1656-1657-1658-1659-1660-1661-1662-1663-1664-1665-1666-1667-1668-1669-1670-1671-1672-1673-1674-1675-1676-1677-1678-1679-1680-1681-1682-1683-1684-1685-1686-1687-1688-1689-1690-1691-1692-1693-1694-1695-1696-1697-1698-1699-1700-1701-1702-1703-1704-1705-1706-1707-1708-1709-1710-1711-1712-1713-1714-1715-1716-1717-1718-1719-1720-1721-1722-1723-1724-1725-1726-1727-1728-1729-1730-1731-1732-1733-1734-1735-1736-1737-1738-1739-1740-1741-1742-1743-1744-1745-1746-1747-1748-1749-1750-1751-1752-1753-1754-1755-1756-1757-1758-1759-1760-1761-1762-1763-1764-1765-1766-1767-1768-1769-1770-1771-1772-1773-1774-1775-1776-1777-1778-1779-1780-1781-1782-1783-1784-1785-1786-1787-1788-1789-1790-1791-1792-1793-1794-1795-1796-1797-1798-1799-1800-1801-1802-1803-1804-1805-1806-1807-1808-1809-1810-1811-1812-1813-1814-1815-1816-1817-1818-1819-1820-1821-1822-1823-1824-1825-1826-1827-1828-1829-1830-1831-1832-1833-1834-1835-1836-1837-1838-1839-1840-1841-1842-1843-1844-1845-1846-1847-1848-1849-1850-1851-1852-1853-1854-1855-1856-1857-1858-1859-1860-1861-1862-1863-1864-1865-1866-1867-1868-1869-1870-1871-1872-1873-1874-1875-1876-1877-1878-1879-1880-1881-1882-1883-1884-1885-1886-1887-1888-1889-1890-1891-1892-1893-1894-1895-1896-1897-1898-1899-1900-1901-1902-1903-1904-1905-1906-1907-1908-1909-1910-1911-1912-1913-1914-1915-1916-1917-1918-1919-1920-1921-1922-1923-1924-1925-1926-1927-1928-1929-1930-1931-1932-1933-1934-1935-1936-1937-1938-1939-1940-1941-1942-1943-1944-1945-1946-1947-1948-1949-1950-1951-1952-1953-1954-1955-1956-1957-1958-1959-1960-1961-1962-1963-1964-1965-1966-1967-1968-1969-1970-1971-1972-1973-1974-1975-1976-1977-1978-1979-1980-1981-1982-1983-1984-1985-1986-1987-1988-1989-1990-1991-1992-1993-1994-1995-1996-1997-1998-1999-2000-2001-2002-2003-2004-2005-2006-2007-2008-2009-2010-2011-2012-2013-2014-2015-2016-2017-2018-2019-2020-2021-2022-2023-2024-2025-2026-2027-2028-2029-2030-2031-2032-2033-2034-2035-2036-2037-2038-2039-2040-2041-2042-2043-2044-2045-2046-2047-2048-2049-2050-2051-2052-2053-2054-2055-2056-2057-2058-2059-2060-2061-2062-2063-2064-2065-2066-2067-2068-2069-2070-2071-2072-2073-2074-2075-2076-2077-2078-2079-2080-2081-2082-2083-2084-2085-2086-2087-2088-2089-2090-2091-2092-2093-2094-2095-2096-2097-2098-2099-2100-2101-2102-2103-2104-2105-2106-2107-2108-2109-2110-2111-2112-2113-2114-2115-2116-2117-2118-2119-2120-2121-2122-2123-2124-2125-2126-2127-2128-2129-2130-2131-2132-2133-2134-2135-2136-2137-2138-2139-2140-2141-2142-2143-2144-2145-2146-2147-2148-2149-2150-2151-2152-2153-2154-2155-2156-2157-2158-2159-2160-2161-2162-2163-2164-2165-2166-2167-2168-2169-2170-2171-2172-2173-2174-2175-2176-2177-2178-2179-2180-2181-2182-2183-2184-2185-2186-2187-2188-2189-2190-2191-2192-2193-2194-2195-2196-2197-2198-2199-2200-2201-2202-2203-2204-2205-2206-2207-2208-2209-2210-2211-2212-2213-2214-2215-2216-2217-2218-2219-2220-2221-2222-2223-2224-2225-2226-2227-2228-2229-2230-2231-2232-2233-2234-2235-2236-2237-2238-2239-2240-2241-2242-2243-2244-2245-2246-2247-2248-2249-2250-2251-2252-2253-2254-2255-2256-2257-2258-2259-2260-2261-2262-2263-2264-2265-2266-2267-2268-2269-2270-2271-2272-2273-2274-2275-2276-2277-2278-2279-2280-2281-2282-2283-2284-2285-2286-2287-2288-2289-2290-2291-2292-2293-2294-2295-2296-2297-2298-2299-2300-2301-2302-2303-2304-2305-2306-2307-2308-2309-2310-2311-2312-2313-2314-2315-2316-2317-2318-2319-2320-2321-2322-2323-2324-2325-2326-2327-2328-2329-2330-2331-2332-2333-2334-2335-2336-2337-2338-2339-2340-2341-2342-2343-2344-2345-2346-2347-2348-2349-2350-2351-2352-2353-2354-2355-2356-2357-2358-2359-2360-2361-2362-2363-2364-2365-2366-2367-2368-2369-2370-2371-2372-2373-2374-2375-2376-2377-2378-2379-2380-2381-2382-2383-2384-2385-2386-2387-2388-2389-2390-2391-2392-2393-2394-2395-2396-2397-2398-2399-2400-2401-2402-2403-2404-2405-2406-2407-2408-2409-2410-2411-2412-2413-2414-2415-2416-2417-2418-2419-2420-2421-2422-2423-2424-2425-2426-2427-2428-2429-2430-2431-2432-2433-2434-2435-2436-2437-2438-2439-2440-2441-2442-2443-2444-2445-2446-2447-2448-2449-2450-2451-2452-2453-2454-2455-2456-2457-2458-2459-2460-2461-2462-2463-2464-2465-2466-2467-2468-2469-2470-2471-2472-2473-2474-2475-2476-2477-2478-2479-2480-2481-2482-2483-2484-2485-2486-2487-2488-2489-2490-2491-2492-2493-2494-2495-2496-2497-2498-2499-2500-2501-2502-2503-2504-2505-2506-2507-2508-2509-2510-2511-2512-2513-2514-2515-2516-2517-2518-2519-2520-2521-2522-2523-2524-2525-2526-2527-2528-2529-2530-2531-2532-2533-2534-2535-2536-2537-2538-2539-2540-2541-2542-2543-2544-2545-2546-2547-2548-2549-2550-2551-2552-2553-2554-2555-2556-2557-2558-2559-2560-2561-2562-2563-2564-2565-2566-2567-2568-2569-2570-2571-2572-2573-2574-2575-2576-2577-2578-2579-2580-2581-2582-2583-2584-2585-2586-2587-2588-2589-2590-2591-2592-2593-2594-2595-2596-2597-2598-2599-2600-2601-2602-2603-2604-2605-2606-2607-2608-2609-2610-2611-2612-2613-2614-2615-2616-2617-2618-2619-2620-2621-2622-2623-2624-2625-2626-2627-2628-2629-2630-2631-2632-2633-2634-2635-2636-2637-2638-2639-2640-2641-2642-2643-2644-2645-2646-2647-2648-2649-2650-2651-2652-2653-2654-2655-2656-2657-2658-2659-2660-2661-2662-2663-2664-2665-2666-2667-2668-2669-2670-2671-2672-2673-2674-2675-2676-2677-2678-2679-2680-2681-2682-2683-2684-2685-2686-2687-2688-2689-2690-2691-2692-2693-2694-2695-2696-2697-2698-2699-2700-2701-2702-2703-2704-2705-2706-2707-2708-2709-2710-2711-2712-2713-2714-2715-2716-2717-2718-2719-2720-2721-2722-2723-2724-2725-2726-2727-2728-2729-2730-2731-2732-2733-2734-2735-2736-2737-2738-2739-2740-2741-2742-2743-2744-2745-2746-2747-2748-2749-2750-2751-2752-2753-2754-2755-2756-2757-2758-2759-2760-2761-2762-2763-2764-2765-2766-2767-2768-2769-2770-2771-2772-2773-2774-2775-2776-2777-2778-2779-2780-2781-2782-2783-2784-2785-2786-2787-2788-2789-2790-2791-2792-2793-2794-2795-2796-2797-2798-2799-2800-2801-2802-2803-2804-2805-2806-2807-2808-2809-2810-2811-2812-2813-2814-2815-2816-2817-2818-2819-2820-2821-2822-2823-2824-2825-2826-2827-2828-2829-2830-2831-2832-2833-2834-2835-2836-2837-2838-2839-2840-2841-2842-2843-2844-2845-2846-2847-2848-2849-2850-2851-2852-2853-2854-2855-2856-2857-2858-2859-2860-2861-2862-2863-2864-2865-2866-2867-2868-2869-2870-2871-2872-2873-2874-2875-2876-2877-2878-2879-2880-2881-2882-2883-2884-2885-2886-2887-2888-2889-2890-2891-2892-2893-2894-2895-2896-2897-2898-2899-2900-2901-2902-2903-2904-2905-2906-2907-2908-2909-2910-2911-2912-2913-2914-2915-2916-2917-2918-2919-2920-2921-2922-2923-2924-2925-2926-2927-2928-2929-2930-2931-2932-2933-2934-2935-2936-2937-2938-2939-2940-2941-2942-2943-2944-2945-2946-2947-2948-2949-2950-2951-2952-2953-2954-2955-2956-2957-2958-2959-2960-2961-2962-2963-2964-2965-2966-2967-2968-2969-2970-2971-2972-2973-2974-2975-2976-2977-2978-2979-2980-2981-2982-2983-2984-2985-2986-2987-2988-2989-2990-2991-2992-2993-2994-2995-2996-2997-2998-2999-3000-3001-3002-3003-3004-3005-3006-3007-3008-3009-3010-3011-3012-3013-3014-3015-3016-3017-3018-3019-3020-3021-3022-3023-3024-3025-3026-3027-3028-3029-3030-3031-3032-3033-3034-3035-3036-3037-3038-3039-3040-3041-3042-3043-3044-3045-3046-3047-3048-3049-3050-3051-3052-3053-3054-3055-3056-3057-3058-3059-3060-3061-3062-3063-3064-3065-3066-3067-3068-3069-3070-3071-3072-3073-3074-3075-3076-3077-3078-3079-3080-3081-3082-3083-3084-3085-3086-3087-3088-3089-3090-3091-3092-3093-3094-3095-3096-3097-3098-3099-3100-3101-3102-3103-3104-3105-3



# BP ALAMEDA PORTFOLIO

## WATER SAMPLE FIELD DATA SHEET

PROJECT #: 11133 PURGED BY: Je WELL I.D.: AW-6  
 CLIENT NAME: \_\_\_\_\_ SAMPLED BY: J SAMPLE I.D.: AW-6  
 LOCATION: Oakland - 2220 98th Avenue QA SAMPLES: \_\_\_\_\_

DATE PURGED 7-10-07 START (2400hr) 13:15 END (2400hr) 13:24  
 DATE SAMPLED 7-10-07 SAMPLE TIME (2400hr) 13:35  
 SAMPLE TYPE: Groundwater  Surface Water \_\_\_\_\_ Treatment Effluent \_\_\_\_\_ Other \_\_\_\_\_

CASING DIAMETER: 2" \_\_\_\_\_ 3" \_\_\_\_\_ 4"  5" \_\_\_\_\_ 6" \_\_\_\_\_ 8" \_\_\_\_\_ Other \_\_\_\_\_  
 Casing Volume: (gallons per foot) (0.17) (0.38) (0.67) (1.02) (1.50) (2.60) ( )

DEPTH TO BOTTOM (feet) = 34.00 CASING VOLUME (gal) = 11.3  
 DEPTH TO WATER (feet) = 16.79 CALCULATED PURGE (gal) = 241  
 WATER COLUMN HEIGHT (feet) = 17.0 ACTUAL PURGE (gal) = 345

### FIELD MEASUREMENTS

DATE	TIME (2400hr)	VOLUME (gal)	TEMP. (degrees F)	CONDUCTIVITY (umhos/cm)	pH (units)	COLOR (visual)	TURBIDITY (NTU)
<u>7-10-07</u>	<u>13:18</u>	<u>11.3</u>	<u>22.8</u>	<u>376.3</u>	<u>6.77</u>	<u>clear</u>	_____
<u>/</u>	<u>13:31</u>	<u>226</u>	<u>24.0</u>	<u>411.5</u>	<u>6.89</u>	<u>/</u>	_____
<u>/</u>	<u>13:34</u>	<u>345</u>	<u>23.8</u>	<u>420.1</u>	<u>6.83</u>	<u>/</u>	_____

### SAMPLE INFORMATION

SAMPLE DEPTH TO WATER: 20-31 SAMPLE TURBIDITY: clear

80% RECHARGE:  YES  NO ANALYSES: see work order  
 ODOR: \_\_\_\_\_ SAMPLE VESSEL / PRESERVATIVE: 3 Vol. HCL

#### PURGING EQUIPMENT

Bladder Pump  Bailer (Teflon)  
 Centrifugal Pump  Bailer (PVC)  
 Submersible Pump  Bailer (Stainless Steel)  
 Peristaltic Pump  Dedicated \_\_\_\_\_  
 Other: \_\_\_\_\_  
 Pump Depth: 30

#### SAMPLING EQUIPMENT

Bladder Pump  Bailer (Teflon)  
 Centrifugal Pump  Bailer (  PVC or  disposable )  
 Submersible Pump  Bailer (Stainless Steel)  
 Peristaltic Pump  Dedicated \_\_\_\_\_  
 Other: \_\_\_\_\_

WELL INTEGRITY: good LOCK#: None

REMARKS: DO 2.09

SIGNATURE: [Signature] Page \_\_\_\_\_ of \_\_\_\_\_

# BP ALAMEDA PORTFOLIO

## WATER SAMPLE FIELD DATA SHEET

PROJECT #: 11133 PURGED BY: JO WELL I.D.: RW-1  
 CLIENT NAME: \_\_\_\_\_ SAMPLED BY: JB SAMPLE I.D.: RW-1  
 LOCATION: Oakland - 2220 98th Avenue QA SAMPLES: \_\_\_\_\_

DATE PURGED: 7/10/07 START (2400hr): 14:50 END (2400hr): 15:00  
 DATE SAMPLED: 7/10/07 SAMPLE TIME (2400hr): 15:25  
 SAMPLE TYPE: Groundwater  Surface Water \_\_\_\_\_ Treatment Effluent \_\_\_\_\_ Other \_\_\_\_\_

CASING DIAMETER: 2" \_\_\_\_\_ 3" \_\_\_\_\_ 4" \_\_\_\_\_ 5" \_\_\_\_\_ 6"  8" \_\_\_\_\_ Other \_\_\_\_\_  
 Casing Volume: (gallons per foot) (0.17) (0.38) (0.67) (1.02) (1.50) (2.60) ( )

DEPTH TO BOTTOM (feet) = 37.10 CASING VOLUME (gal) = 313  
 DEPTH TO WATER (feet) = 16.21 CALCULATED PURGE (gal) = 940  
 WATER COLUMN HEIGHT (feet) = 20.8 ACTUAL PURGE (gal) = 99

### FIELD MEASUREMENTS

DATE	TIME (2400hr)	VOLUME (gal)	TEMP. (degrees F)	CONDUCTIVITY (umhos/cm)	pH (units)	COLOR (visual)	TURBIDITY (NTU)
<u>7/10/07</u>	<u>14:55</u>	<u>313</u>	<u>24.9</u>	<u>728</u>	<u>7.01</u>	<u>clear</u>	
<u>/</u>	<u>15:00</u>	<u>63</u>	<u>26.0</u>	<u>718</u>	<u>7.01</u>		
<u>/</u>	<u>15:05</u>	<u>81</u>	<u>25.5</u>	<u>722</u>	<u>6.78</u>		

### SAMPLE INFORMATION

SAMPLE DEPTH TO WATER: 18.93 SAMPLE TURBIDITY: clear  
 80% RECHARGE:  YES  NO ANALYSES: see work order  
 ODOR: yes SAMPLE VESSEL / PRESERVATIVE: 3 Vol - HCL

#### PURGING EQUIPMENT

Bladder Pump  Bailer (Teflon)  
 Centrifugal Pump  Bailer (PVC)  
 Submersible Pump  Bailer (Stainless Steel)  
 Peristaltic Pump  Dedicated \_\_\_\_\_  
 Other: \_\_\_\_\_  
 Pump Depth: 35

#### SAMPLING EQUIPMENT

Bladder Pump  Bailer (Teflon)  
 Centrifugal Pump  Bailer (  PVC or  disposable)  
 Submersible Pump  Bailer (Stainless Steel)  
 Peristaltic Pump  Dedicated \_\_\_\_\_  
 Other: \_\_\_\_\_

WELL INTEGRITY: good LOCK#: 1103700  
 REMARKS: D.O. 2.65

SIGNATURE: [Signature] Page    of





### Chain of Custody Record

Project Name: ARCO 11133  
 BP BU/AR Region/Enfos Segment: BP > Americas > West > Retail > Alameda > 11133  
 State or Lead Regulatory Agency: \_\_\_\_\_  
 Requested Due Date (mm/dd/yy): \_\_\_\_\_

On-site Time	<u>1100</u>	Temp	<u>65</u>
Off-site Time	<u>1545</u>	Temp	<u>95</u>
Sky Conditions	<u>overcast</u>		
Meteorological Events	<u>none</u>		
Wind Speed	<u>5 N</u>	Direction	

Lab Name: <u>TestAmerica</u>	BP/AR Facility No.: <u>11133</u>	Consultant/Contractor: <u>Stratus Environmental Inc</u>
Address: <u>885 Jarvis Drive</u>	BP/AR Facility Address: <u>2220 98th Avenue, Oakland</u>	Address: <u>3330 Cameron Park Drive, Suite 550</u>
<u>Morgan Hill, CA 95037</u>	Site Lat/Long:	<u>Cameron Park, CA 95682</u>
Lab PM: <u>Lisa Race</u>	California Global ID No.: <u>T0600100210</u>	Consultant/Contractor Project No.:
Tele/Fax: <u>408-782-8156 408-782-6308 (fax)</u>	Enfos Project No.: <u>G07TT-0037</u>	Consultant/Contractor PM: <u>Jay Johnson</u>
BP/AR PM Contact: <u>Paul Supple</u>	Provision or OOC (circle one) <u>Provision</u>	Tele/Fax: <u>(530) 676-6000 / (530) 676-6005</u>
Address: <u>2010 Crow Canyon Place, Suite 150</u>	Phase/WBS: <u>04-Monitoring</u>	Report Type & QC Level: <u>Level I with EDF</u>
<u>San Ramon, CA</u>	Sub Phase/Task: <u>03-Analytical</u>	E-mail EDD To: <u>shayes@stratusinc.net</u>
Tele/Fax: <u>925-275-3506</u>	Cost Element: <u>01-Contractor labor</u>	Invoice to: <u>Atlantic Richfield Co.</u>

Item No.	Sample Description	Time	Date	Matrix			Laboratory No.	No. of Containers	Preservative				Requested Analysis				Sample Point Lat/Long and Comments Oxy* = MTBE, TAME, ETBE, DIPE, TBA
				Soil/Solid	Water/Liquid	Air			Unpreserved	H <sub>2</sub> SO <sub>4</sub>	HNO <sub>3</sub>	HCl	Methanol	CHROMTECH/Oxy*	1,2-DCA	Ethanol	
1	MW-1	1355	7/10/07	X				3			X	X	X	X			
2	MW-3	1417		X				3			X	X	X	X			
3	AW-1	1440		X				3			X	X	X	X			
4	AW-4	1345		X				6			X	X	X	X			
5	AW-5	1310		X				3			X	X	X	X			
6	AW-6	1335		X				3			X	X	X	X			
7	RW-1	1525		X				3			X	X	X	X			
8	1B11133 07102007	500		X				2			X	X	X	X			4/04/07

Sampler's Name: <u>JAY GONZALES</u>	Relinquished By / Affiliation: <u>[Signature]</u>	Date: <u>7/12/07</u>	Time: <u>1145</u>	Accepted By / Affiliation: <u>[Signature]</u>	Date: <u>7/12/07</u>	Time: <u>1145</u>
Sampler's Company: <u>DOLOS ENV</u>						
Release Date:						
Release Method:						
Release Tracking No.:						

If Instructions: Please cc results to [rmiller@broadbentinc.com](mailto:rmiller@broadbentinc.com)

Custody Seals In Place: Yes / No    Temp Blank: Yes / No    Cooler Temp on Receipt: \_\_\_\_\_ °F/C    Trip Blank: Yes / No

26 July, 2007

Jay Johnson  
Stratus Environmental Inc. [Arco]  
3330 Cameron Park Dr., Suite 550  
Cameron Park, CA 95682

RE: BP Heritage #11133, Oakland, CA  
Work Order: MQG0510

Enclosed are the results of analyses for samples received by the laboratory on 07/12/07 19:45. If you have any questions concerning this report, please feel free to contact me.

Sincerely,



Lisa Race  
Senior Project Manager

CA ELAP Certificate # 1210

The results in this laboratory report pertain only to the samples tested in the laboratory. The analyses contained in this report were performed in accordance with the BPGCLN Technical Specifications, applicable Federal, State, local regulations and certification requirements as well as the methodologies as described in laboratory SOPs reviewed by the BPGCLN. This entire report was reviewed and approved for release.

Stratus Environmental Inc. [Arco] 3330 Cameron Park Dr., Suite 550 Cameron Park CA, 95682	Project: BP Heritage #11133, Oakland, CA Project Number: G07TT-0037 Project Manager: Jay Johnson	MQG0510 Reported: 07/26/07 10:30
---	--	--

ANALYTICAL REPORT FOR SAMPLES

Sample ID	Laboratory ID	Matrix	Date Sampled	Date Received
MW-1	MQG0510-01	Water	07/10/07 13:55	07/12/07 19:45
MW-3	MQG0510-02	Water	07/10/07 14:17	07/12/07 19:45
AW-1	MQG0510-03	Water	07/10/07 14:40	07/12/07 19:45
AW-4	MQG0510-04	Water	07/10/07 12:45	07/12/07 19:45
AW-5	MQG0510-05	Water	07/10/07 13:10	07/12/07 19:45
AW-6	MQG0510-06	Water	07/10/07 13:35	07/12/07 19:45
RW-1	MQG0510-07	Water	07/10/07 15:25	07/12/07 19:45
TB11133 07102007	MQG0510-08	Water	07/10/07 05:00	07/12/07 19:45

The carbon range for the TPH-GRO has been changed from C6-C10 to C4-C12. The carbon range for TPH-DRO has been changed from C10-C28 to C10-C36. EPA 8015B has been modified to better meet the requirements of California regulatory agencies.

These samples were received with no custody seals.

Stratus Environmental Inc. [Arco] 3330 Cameron Park Dr., Suite 550 Cameron Park CA, 95682	Project: BP Heritage #11133, Oakland, CA Project Number: G07TT-0037 Project Manager: Jay Johnson	MQG0510 Reported: 07/26/07 10:30
---	--	--

**Total Purgeable Hydrocarbons by GC/MS (CA LUFT)**  
**TestAmerica - Morgan Hill, CA**

Analyte	Result	Reporting Limit	Units	Dilution	Batch	Prepared	Analyzed	Method	Notes
---------	--------	-----------------	-------	----------	-------	----------	----------	--------	-------

**MW-1 (MQG0510-01) Water** Sampled: 07/10/07 13:55 Received: 07/12/07 19:45

Gasoline Range Organics (C4-C12)	1800	50	ug/l	1	7G17034	07/17/07	07/18/07	LUFT GCMS
Surrogate: 1,2-Dichloroethane-d4	108 %	60-125			"	"	"	"
Surrogate: Dibromofluoromethane	110 %	75-120			"	"	"	"
Surrogate: Toluene-d8	105 %	80-120			"	"	"	"
Surrogate: 4-Bromofluorobenzene	104 %	60-135			"	"	"	"

**MW-3 (MQG0510-02) Water** Sampled: 07/10/07 14:17 Received: 07/12/07 19:45

Gasoline Range Organics (C4-C12)	ND	50	ug/l	1	7G17034	07/17/07	07/18/07	LUFT GCMS
Surrogate: 1,2-Dichloroethane-d4	99 %	60-125			"	"	"	"
Surrogate: Dibromofluoromethane	98 %	75-120			"	"	"	"
Surrogate: Toluene-d8	101 %	80-120			"	"	"	"
Surrogate: 4-Bromofluorobenzene	101 %	60-135			"	"	"	"

**AW-1 (MQG0510-03) Water** Sampled: 07/10/07 14:40 Received: 07/12/07 19:45

Gasoline Range Organics (C4-C12)	4200	1000	ug/l	20	7G17034	07/17/07	07/18/07	LUFT GCMS
Surrogate: 1,2-Dichloroethane-d4	102 %	60-125			"	"	"	"
Surrogate: Dibromofluoromethane	99 %	75-120			"	"	"	"
Surrogate: Toluene-d8	99 %	80-120			"	"	"	"
Surrogate: 4-Bromofluorobenzene	98 %	60-135			"	"	"	"

**AW-4 (MQG0510-04) Water** Sampled: 07/10/07 12:45 Received: 07/12/07 19:45

Gasoline Range Organics (C4-C12)	160	50	ug/l	1	7G17034	07/17/07	07/18/07	LUFT GCMS
Surrogate: 1,2-Dichloroethane-d4	105 %	60-125			"	"	"	"
Surrogate: Dibromofluoromethane	101 %	75-120			"	"	"	"
Surrogate: Toluene-d8	99 %	80-120			"	"	"	"
Surrogate: 4-Bromofluorobenzene	99 %	60-135			"	"	"	"

Stratus Environmental Inc. [Arco] 3330 Cameron Park Dr., Suite 550 Cameron Park CA, 95682	Project: BP Heritage #11133, Oakland, CA Project Number: G07TT-0037 Project Manager: Jay Johnson	MQG0510 Reported: 07/26/07 10:30
---	--	--

**Total Purgeable Hydrocarbons by GC/MS (CA LUFT)  
TestAmerica - Morgan Hill, CA**

Analyte	Result	Reporting Limit	Units	Dilution	Batch	Prepared	Analyzed	Method	Notes
<b>AW-5 (MQG0510-05) Water</b> Sampled: 07/10/07 13:10 Received: 07/12/07 19:45									
<b>Gasoline Range Organics (C4-C12)</b>	<b>350</b>	<b>250</b>	ug/l	5	7G17034	07/17/07	07/18/07	LUFT GCMS	
Surrogate: 1,2-Dichloroethane-d4		98 %	60-125		"	"	"	"	
Surrogate: Dibromofluoromethane		98 %	75-120		"	"	"	"	
Surrogate: Toluene-d8		98 %	80-120		"	"	"	"	
Surrogate: 4-Bromofluorobenzene		103 %	60-135		"	"	"	"	
<b>AW-6 (MQG0510-06) Water</b> Sampled: 07/10/07 13:35 Received: 07/12/07 19:45									
<b>Gasoline Range Organics (C4-C12)</b>	<b>3700</b>	<b>1000</b>	ug/l	20	7G18021	07/18/07	07/19/07	LUFT GCMS	PV
Surrogate: 1,2-Dichloroethane-d4		90 %	60-125		"	"	"	"	
Surrogate: Dibromofluoromethane		93 %	75-120		"	"	"	"	
Surrogate: Toluene-d8		82 %	80-120		"	"	"	"	
Surrogate: 4-Bromofluorobenzene		67 %	60-135		"	"	"	"	
<b>RW-1 (MQG0510-07) Water</b> Sampled: 07/10/07 15:25 Received: 07/12/07 19:45									
<b>Gasoline Range Organics (C4-C12)</b>	<b>3800</b>	<b>100</b>	ug/l	2	7G17034	07/17/07	07/18/07	LUFT GCMS	
Surrogate: 1,2-Dichloroethane-d4		106 %	60-125		"	"	"	"	
Surrogate: Dibromofluoromethane		99 %	75-120		"	"	"	"	
Surrogate: Toluene-d8		98 %	80-120		"	"	"	"	
Surrogate: 4-Bromofluorobenzene		100 %	60-135		"	"	"	"	



Stratus Environmental Inc. [Arco] 3330 Cameron Park Dr., Suite 550 Cameron Park CA, 95682	Project: BP Heritage #11133, Oakland, CA Project Number: G07TT-0037 Project Manager: Jay Johnson	MQG0510 Reported: 07/26/07 10:30
---	--	--

**Volatile Organic Compounds by EPA Method 8260B**  
**TestAmerica - Morgan Hill, CA**

Analyte	Result	Reporting Limit	Units	Dilution	Batch	Prepared	Analyzed	Method	Notes
---------	--------	-----------------	-------	----------	-------	----------	----------	--------	-------

**MW-1 (MQG0510-01) Water** Sampled: 07/10/07 13:55 Received: 07/12/07 19:45

tert-Amyl methyl ether	ND	0.50	ug/l	1	7G17034	07/17/07	07/18/07	EPA 8260B	
<b>Benzene</b>	<b>1.9</b>	0.50	"	"	"	"	"	"	
tert-Butyl alcohol	ND	20	"	"	"	"	"	"	
Di-isopropyl ether	ND	0.50	"	"	"	"	"	"	
1,2-Dibromoethane (EDB)	ND	0.50	"	"	"	"	"	"	
1,2-Dichloroethane	ND	0.50	"	"	"	"	"	"	
Ethanol	ND	300	"	"	"	"	"	"	
Ethyl tert-butyl ether	ND	0.50	"	"	"	"	"	"	
<b>Ethylbenzene</b>	<b>13</b>	0.50	"	"	"	"	"	"	
<b>Methyl tert-butyl ether</b>	<b>2.4</b>	0.50	"	"	"	"	"	"	
Toluene	ND	0.50	"	"	"	"	"	"	
<b>Xylenes (total)</b>	<b>4.8</b>	0.50	"	"	"	"	"	"	

<i>Surrogate: Dibromofluoromethane</i>		110 %		75-120	"	"	"	"	
<i>Surrogate: 1,2-Dichloroethane-d4</i>		108 %		60-125	"	"	"	"	
<i>Surrogate: Toluene-d8</i>		105 %		80-120	"	"	"	"	
<i>Surrogate: 4-Bromofluorobenzene</i>		104 %		60-135	"	"	"	"	

**MW-3 (MQG0510-02) Water** Sampled: 07/10/07 14:17 Received: 07/12/07 19:45

tert-Amyl methyl ether	ND	0.50	ug/l	1	7G17034	07/17/07	07/18/07	EPA 8260B	
Benzene	ND	0.50	"	"	"	"	"	"	
tert-Butyl alcohol	ND	20	"	"	"	"	"	"	
Di-isopropyl ether	ND	0.50	"	"	"	"	"	"	
1,2-Dibromoethane (EDB)	ND	0.50	"	"	"	"	"	"	
1,2-Dichloroethane	ND	0.50	"	"	"	"	"	"	
Ethanol	ND	300	"	"	"	"	"	"	
Ethyl tert-butyl ether	ND	0.50	"	"	"	"	"	"	
Ethylbenzene	ND	0.50	"	"	"	"	"	"	
<b>Methyl tert-butyl ether</b>	<b>2.8</b>	0.50	"	"	"	"	"	"	
Toluene	ND	0.50	"	"	"	"	"	"	
Xylenes (total)	ND	0.50	"	"	"	"	"	"	

<i>Surrogate: Dibromofluoromethane</i>		98 %		75-120	"	"	"	"	
<i>Surrogate: 1,2-Dichloroethane-d4</i>		99 %		60-125	"	"	"	"	
<i>Surrogate: Toluene-d8</i>		101 %		80-120	"	"	"	"	
<i>Surrogate: 4-Bromofluorobenzene</i>		101 %		60-135	"	"	"	"	

Stratus Environmental Inc. [Arco] 3330 Cameron Park Dr., Suite 550 Cameron Park CA, 95682	Project: BP Heritage #11133, Oakland, CA Project Number: G07TT-0037 Project Manager: Jay Johnson	MQG0510 Reported: 07/26/07 10:30
---	--	--

**Volatile Organic Compounds by EPA Method 8260B**  
**TestAmerica - Morgan Hill, CA**

Analyte	Result	Reporting Limit	Units	Dilution	Batch	Prepared	Analyzed	Method	Notes
---------	--------	-----------------	-------	----------	-------	----------	----------	--------	-------

**AW-1 (MQG0510-03) Water** Sampled: 07/10/07 14:40 Received: 07/12/07 19:45

<b>tert-Amyl methyl ether</b>	<b>36</b>	10	ug/l	20	7G17034	07/17/07	07/18/07	EPA 8260B	
<b>Benzene</b>	<b>560</b>	10	"	"	"	"	"	"	
tert-Butyl alcohol	ND	400	"	"	"	"	"	"	
Di-isopropyl ether	ND	10	"	"	"	"	"	"	
1,2-Dibromoethane (EDB)	ND	10	"	"	"	"	"	"	
1,2-Dichloroethane	ND	10	"	"	"	"	"	"	
Ethanol	ND	6000	"	"	"	"	"	"	
Ethyl tert-butyl ether	ND	10	"	"	"	"	"	"	
<b>Ethylbenzene</b>	<b>93</b>	10	"	"	"	"	"	"	
<b>Methyl tert-butyl ether</b>	<b>220</b>	10	"	"	"	"	"	"	
<b>Toluene</b>	<b>12</b>	10	"	"	"	"	"	"	
<b>Xylenes (total)</b>	<b>40</b>	10	"	"	"	"	"	"	
<i>Surrogate: Dibromofluoromethane</i>		99 %		75-120	"	"	"	"	
<i>Surrogate: 1,2-Dichloroethane-d4</i>		102 %		60-125	"	"	"	"	
<i>Surrogate: Toluene-d8</i>		99 %		80-120	"	"	"	"	
<i>Surrogate: 4-Bromofluorobenzene</i>		98 %		60-135	"	"	"	"	

**AW-4 (MQG0510-04) Water** Sampled: 07/10/07 12:45 Received: 07/12/07 19:45

<b>tert-Amyl methyl ether</b>	<b>4.2</b>	0.50	ug/l	1	7G17034	07/17/07	07/18/07	EPA 8260B	
<b>Benzene</b>	<b>2.7</b>	0.50	"	"	"	"	"	"	
tert-Butyl alcohol	ND	20	"	"	"	"	"	"	
Di-isopropyl ether	ND	0.50	"	"	"	"	"	"	
1,2-Dibromoethane (EDB)	ND	0.50	"	"	"	"	"	"	
1,2-Dichloroethane	ND	0.50	"	"	"	"	"	"	
Ethanol	ND	300	"	"	"	"	"	"	
Ethyl tert-butyl ether	ND	0.50	"	"	"	"	"	"	
<b>Ethylbenzene</b>	<b>0.90</b>	0.50	"	"	"	"	"	"	
<b>Methyl tert-butyl ether</b>	<b>27</b>	0.50	"	"	"	"	"	"	
<b>Toluene</b>	<b>ND</b>	0.50	"	"	"	"	"	"	
<b>Xylenes (total)</b>	<b>1.0</b>	0.50	"	"	"	"	"	"	
<i>Surrogate: Dibromofluoromethane</i>		101 %		75-120	"	"	"	"	
<i>Surrogate: 1,2-Dichloroethane-d4</i>		105 %		60-125	"	"	"	"	
<i>Surrogate: Toluene-d8</i>		99 %		80-120	"	"	"	"	
<i>Surrogate: 4-Bromofluorobenzene</i>		99 %		60-135	"	"	"	"	

Stratus Environmental Inc. [Arco] 3330 Cameron Park Dr., Suite 550 Cameron Park CA, 95682	Project: BP Heritage #11133, Oakland, CA Project Number: G07TT-0037 Project Manager: Jay Johnson	MQG0510 Reported: 07/26/07 10:30
---	--	--

**Volatile Organic Compounds by EPA Method 8260B**  
**TestAmerica - Morgan Hill, CA**

Analyte	Result	Reporting Limit	Units	Dilution	Batch	Prepared	Analyzed	Method	Notes
---------	--------	-----------------	-------	----------	-------	----------	----------	--------	-------

**AW-5 (MQG0510-05) Water Sampled: 07/10/07 13:10 Received: 07/12/07 19:45**

<b>tert-Amyl methyl ether</b>	<b>92</b>	2.5	ug/l	5	7G17034	07/17/07	07/18/07	EPA 8260B	
Benzene	ND	2.5	"	"	"	"	"	"	
<b>tert-Butyl alcohol</b>	<b>110</b>	100	"	"	"	"	"	"	
Di-isopropyl ether	ND	2.5	"	"	"	"	"	"	
1,2-Dibromoethane (EDB)	ND	2.5	"	"	"	"	"	"	
1,2-Dichloroethane	ND	2.5	"	"	"	"	"	"	
Ethanol	ND	1500	"	"	"	"	"	"	
Ethyl tert-butyl ether	ND	2.5	"	"	"	"	"	"	
Ethylbenzene	ND	2.5	"	"	"	"	"	"	
<b>Methyl tert-butyl ether</b>	<b>360</b>	2.5	"	"	"	"	"	"	
Toluene	ND	2.5	"	"	"	"	"	"	
Xylenes (total)	ND	2.5	"	"	"	"	"	"	

<i>Surrogate: Dibromofluoromethane</i>	98 %	75-120	"	"	"	"	"	"	
<i>Surrogate: 1,2-Dichloroethane-d4</i>	98 %	60-125	"	"	"	"	"	"	
<i>Surrogate: Toluene-d8</i>	98 %	80-120	"	"	"	"	"	"	
<i>Surrogate: 4-Bromofluorobenzene</i>	103 %	60-135	"	"	"	"	"	"	

**AW-6 (MQG0510-06) Water Sampled: 07/10/07 13:35 Received: 07/12/07 19:45**

<b>tert-Amyl methyl ether</b>	<b>890</b>	100	ug/l	200	7G17034	07/17/07	07/18/07	EPA 8260B	
Benzene	ND	100	"	"	"	"	"	"	
tert-Butyl alcohol	ND	4000	"	"	"	"	"	"	
Di-isopropyl ether	ND	100	"	"	"	"	"	"	
1,2-Dibromoethane (EDB)	ND	100	"	"	"	"	"	"	
1,2-Dichloroethane	ND	100	"	"	"	"	"	"	
Ethanol	ND	60000	"	"	"	"	"	"	
Ethyl tert-butyl ether	ND	100	"	"	"	"	"	"	
Ethylbenzene	ND	100	"	"	"	"	"	"	
<b>Methyl tert-butyl ether</b>	<b>3900</b>	100	"	"	"	"	"	"	
Toluene	ND	100	"	"	"	"	"	"	
Xylenes (total)	ND	100	"	"	"	"	"	"	

<i>Surrogate: Dibromofluoromethane</i>	96 %	75-120	"	"	"	"	"	"	
<i>Surrogate: 1,2-Dichloroethane-d4</i>	86 %	60-125	"	"	"	"	"	"	
<i>Surrogate: Toluene-d8</i>	93 %	80-120	"	"	"	"	"	"	
<i>Surrogate: 4-Bromofluorobenzene</i>	100 %	60-135	"	"	"	"	"	"	

TestAmerica - Morgan Hill, CA

*The results in this report apply to the samples analyzed in accordance with the chain of custody document. Unless otherwise stated, results are reported on a wet weight basis. This analytical report must be reproduced in its entirety.*

Stratus Environmental Inc. [Arco] 3330 Cameron Park Dr., Suite 550 Cameron Park CA, 95682	Project: BP Heritage #11133, Oakland, CA Project Number: G07TT-0037 Project Manager: Jay Johnson	MQG0510 Reported: 07/26/07 10:30
---	--	--

**Volatile Organic Compounds by EPA Method 8260B**  
**TestAmerica - Morgan Hill, CA**

Analyte	Result	Reporting Limit	Units	Dilution	Batch	Prepared	Analyzed	Method	Notes
<b>RW-1 (MQG0510-07) Water Sampled: 07/10/07 15:25 Received: 07/12/07 19:45</b>									
tert-Amyl methyl ether	ND	1.0	ug/l	2	7G17034	07/17/07	07/18/07	EPA 8260B	
<b>Benzene</b>	<b>4.4</b>	1.0	"	"	"	"	"	"	
tert-Butyl alcohol	ND	40	"	"	"	"	"	"	
Di-isopropyl ether	ND	1.0	"	"	"	"	"	"	
1,2-Dibromoethane (EDB)	ND	1.0	"	"	"	"	"	"	
1,2-Dichloroethane	ND	1.0	"	"	"	"	"	"	
Ethanol	ND	600	"	"	"	"	"	"	
Ethyl tert-butyl ether	ND	1.0	"	"	"	"	"	"	
<b>Ethylbenzene</b>	<b>72</b>	1.0	"	"	"	"	"	"	
<b>Methyl tert-butyl ether</b>	<b>21</b>	1.0	"	"	"	"	"	"	
<b>Toluene</b>	<b>2.8</b>	1.0	"	"	"	"	"	"	
<b>Xylenes (total)</b>	<b>22</b>	1.0	"	"	"	"	"	"	
<i>Surrogate: Dibromofluoromethane</i>		99 %		75-120	"	"	"	"	
<i>Surrogate: 1,2-Dichloroethane-d4</i>		106 %		60-125	"	"	"	"	
<i>Surrogate: Toluene-d8</i>		98 %		80-120	"	"	"	"	
<i>Surrogate: 4-Bromofluorobenzene</i>		100 %		60-135	"	"	"	"	

Stratus Environmental Inc. [Arco] 3330 Cameron Park Dr., Suite 550 Cameron Park CA, 95682	Project: BP Heritage #11133, Oakland, CA Project Number: G07TT-0037 Project Manager: Jay Johnson	MQG0510 Reported: 07/26/07 10:30
---	--	--

**Total Purgeable Hydrocarbons by GC/MS (CA LUFT) - Quality Control**  
**TestAmerica - Morgan Hill, CA**

Analyte	Result	Reporting Limit	Units	Spike Level	Source Result	%REC	%REC Limits	RPD	RPD Limit	Notes
---------	--------	-----------------	-------	-------------	---------------	------	-------------	-----	-----------	-------

**Batch 7G17034 - EPA 5030B P/T / LUFT GCMS**

**Blank (7G17034-BLK1)** Prepared: 07/17/07 Analyzed: 07/18/07

Gasoline Range Organics (C4-C12)	ND	50	ug/l							
Surrogate: 1,2-Dichloroethane-d4	2.38		"	2.50		95	60-125			
Surrogate: Dibromofluoromethane	2.44		"	2.50		98	75-120			
Surrogate: Toluene-d8	2.36		"	2.50		94	80-120			
Surrogate: 4-Bromofluorobenzene	2.44		"	2.50		98	60-135			

**Laboratory Control Sample (7G17034-BS2)** Prepared & Analyzed: 07/17/07

Gasoline Range Organics (C4-C12)	457	50	ug/l	500		91	65-120			
Surrogate: 1,2-Dichloroethane-d4	2.56		"	2.50		102	60-125			
Surrogate: Dibromofluoromethane	2.57		"	2.50		103	75-120			
Surrogate: Toluene-d8	2.50		"	2.50		100	80-120			
Surrogate: 4-Bromofluorobenzene	2.65		"	2.50		106	60-135			

**Laboratory Control Sample Dup (7G17034-BSD2)** Prepared & Analyzed: 07/17/07

Gasoline Range Organics (C4-C12)	457	50	ug/l	500		91	65-120	0.02	20	
Surrogate: 1,2-Dichloroethane-d4	2.37		"	2.50		95	60-125			
Surrogate: Dibromofluoromethane	2.29		"	2.50		92	75-120			
Surrogate: Toluene-d8	2.39		"	2.50		96	80-120			
Surrogate: 4-Bromofluorobenzene	2.67		"	2.50		107	60-135			

**Batch 7G18021 - EPA 5030B P/T / LUFT GCMS**

**Blank (7G18021-BLK1)** Prepared & Analyzed: 07/18/07

Gasoline Range Organics (C4-C12)	ND	50	ug/l							
Surrogate: 1,2-Dichloroethane-d4	2.57		"	2.50		103	60-125			
Surrogate: Dibromofluoromethane	2.47		"	2.50		99	75-120			
Surrogate: Toluene-d8	2.17		"	2.50		87	80-120			
Surrogate: 4-Bromofluorobenzene	1.86		"	2.50		74	60-135			

Stratus Environmental Inc. [Arco] 3330 Cameron Park Dr., Suite 550 Cameron Park CA, 95682	Project: BP Heritage #11133, Oakland, CA Project Number: G07TT-0037 Project Manager: Jay Johnson	MQG0510 Reported: 07/26/07 10:30
---	--	--

**Total Purgeable Hydrocarbons by GC/MS (CA LUFT) - Quality Control**  
**TestAmerica - Morgan Hill, CA**

Analyte	Result	Reporting Limit	Units	Spike Level	Source Result	%REC	%REC Limits	RPD	RPD Limit	Notes
---------	--------	-----------------	-------	-------------	---------------	------	-------------	-----	-----------	-------

**Batch 7G18021 - EPA 5030B P/T / LUFT GCMS**

**Laboratory Control Sample (7G18021-BS2)**

Prepared & Analyzed: 07/18/07

Gasoline Range Organics (C4-C12)	380	50	ug/l	500		76	65-120			
Surrogate: 1,2-Dichloroethane-d4	2.29		"	2.50		92	60-125			
Surrogate: Dibromofluoromethane	2.29		"	2.50		92	75-120			
Surrogate: Toluene-d8	2.59		"	2.50		104	80-120			
Surrogate: 4-Bromofluorobenzene	2.47		"	2.50		99	60-135			

**Laboratory Control Sample Dup (7G18021-BSD2)**

Prepared & Analyzed: 07/18/07

Gasoline Range Organics (C4-C12)	369	50	ug/l	500		74	65-120	3	20	
Surrogate: 1,2-Dichloroethane-d4	2.44		"	2.50		98	60-125			
Surrogate: Dibromofluoromethane	2.43		"	2.50		97	75-120			
Surrogate: Toluene-d8	2.58		"	2.50		103	80-120			
Surrogate: 4-Bromofluorobenzene	2.58		"	2.50		103	60-135			

Stratus Environmental Inc. [Arco] 3330 Cameron Park Dr., Suite 550 Cameron Park CA, 95682	Project: BP Heritage #11133, Oakland, CA Project Number: G07TT-0037 Project Manager: Jay Johnson	MQG0510 Reported: 07/26/07 10:30
---	--	--

**Volatile Organic Compounds by EPA Method 8260B - Quality Control**  
**TestAmerica - Morgan Hill, CA**

Analyte	Result	Reporting Limit	Units	Spike Level	Source Result	%REC	%REC Limits	RPD	RPD Limit	Notes
---------	--------	-----------------	-------	-------------	---------------	------	-------------	-----	-----------	-------

**Batch 7G17034 - EPA 5030B P/T / EPA 8260B**

<b>Blank (7G17034-BLK1)</b>										
Prepared: 07/17/07 Analyzed: 07/18/07										
tert-Amyl methyl ether	ND	0.50	ug/l							
Benzene	ND	0.50	"							
tert-Butyl alcohol	ND	20	"							
Di-isopropyl ether	ND	0.50	"							
1,2-Dibromoethane (EDB)	ND	0.50	"							
1,2-Dichloroethane	ND	0.50	"							
Ethanol	ND	300	"							
Ethyl tert-butyl ether	ND	0.50	"							
Ethylbenzene	ND	0.50	"							
Methyl tert-butyl ether	ND	0.50	"							
Toluene	ND	0.50	"							
Xylenes (total)	ND	0.50	"							
<i>Surrogate: Dibromofluoromethane</i>	2.44		"	2.50		98	75-120			
<i>Surrogate: 1,2-Dichloroethane-d4</i>	2.38		"	2.50		95	60-125			
<i>Surrogate: Toluene-d8</i>	2.36		"	2.50		94	80-120			
<i>Surrogate: 4-Bromofluorobenzene</i>	2.44		"	2.50		98	60-135			

<b>Laboratory Control Sample (7G17034-BS1)</b>										
Prepared & Analyzed: 07/17/07										
tert-Amyl methyl ether	8.61	0.50	ug/l	10.0		86	65-135			
Benzene	8.54	0.50	"	10.0		85	75-120			
tert-Butyl alcohol	173	20	"	200		86	60-135			
Di-isopropyl ether	8.69	0.50	"	10.0		87	70-130			
1,2-Dibromoethane (EDB)	9.00	0.50	"	10.0		90	80-135			
1,2-Dichloroethane	9.46	0.50	"	10.0		95	70-125			
Ethanol	140	300	"	200		70	15-150			
Ethyl tert-butyl ether	8.84	0.50	"	10.0		88	65-130			
Ethylbenzene	8.88	0.50	"	10.0		89	75-120			
Methyl tert-butyl ether	9.34	0.50	"	10.0		93	50-140			
Toluene	9.34	0.50	"	10.0		93	75-120			
Xylenes (total)	26.4	0.50	"	30.0		88	75-130			
<i>Surrogate: Dibromofluoromethane</i>	2.45		"	2.50		98	75-120			
<i>Surrogate: 1,2-Dichloroethane-d4</i>	2.39		"	2.50		96	60-125			
<i>Surrogate: Toluene-d8</i>	2.60		"	2.50		104	80-120			
<i>Surrogate: 4-Bromofluorobenzene</i>	2.54		"	2.50		102	60-135			

Stratus Environmental Inc. [Arco] 3330 Cameron Park Dr., Suite 550 Cameron Park CA, 95682	Project: BP Heritage #11133, Oakland, CA Project Number: G07TT-0037 Project Manager: Jay Johnson	MQG0510 Reported: 07/26/07 10:30
---	--	--

**Volatile Organic Compounds by EPA Method 8260B - Quality Control**  
**TestAmerica - Morgan Hill, CA**

Analyte	Result	Reporting Limit	Units	Spike Level	Source Result	%REC	%REC Limits	RPD	RPD Limit	Notes
---------	--------	-----------------	-------	-------------	---------------	------	-------------	-----	-----------	-------

**Batch 7G17034 - EPA 5030B P/T / EPA 8260B**

Matrix Spike (7G17034-MS1)	Source: MQG0510-04	Prepared & Analyzed: 07/17/07								
tert-Amyl methyl ether	13.1	0.50	ug/l	10.0	4.20	89	65-135			
Benzene	13.2	0.50	"	10.0	2.73	104	75-120			
tert-Butyl alcohol	191	20	"	200	ND	95	60-135			
Di-isopropyl ether	9.76	0.50	"	10.0	ND	98	70-130			
1,2-Dibromoethane (EDB)	9.39	0.50	"	10.0	ND	94	80-135			
1,2-Dichloroethane	9.48	0.50	"	10.0	ND	95	70-125			
Ethanol	154	300	"	200	ND	77	15-150			
Ethyl tert-butyl ether	9.57	0.50	"	10.0	ND	96	65-130			
Ethylbenzene	10.9	0.50	"	10.0	0.900	100	75-120			
Methyl tert-butyl ether	33.2	0.50	"	10.0	27.0	63	50-140			
Toluene	10.2	0.50	"	10.0	ND	102	75-120			
Xylenes (total)	31.5	0.50	"	30.0	1.01	102	75-130			
Surrogate: Dibromofluoromethane	2.39		"	2.50		96	75-120			
Surrogate: 1,2-Dichloroethane-d4	2.25		"	2.50		90	60-125			
Surrogate: Toluene-d8	2.60		"	2.50		104	80-120			
Surrogate: 4-Bromofluorobenzene	2.57		"	2.50		103	60-135			

Matrix Spike Dup (7G17034-MSD1)	Source: MQG0510-04	Prepared & Analyzed: 07/17/07								
tert-Amyl methyl ether	14.0	0.50	ug/l	10.0	4.20	98	65-135	6	25	
Benzene	13.2	0.50	"	10.0	2.73	104	75-120	0.2	20	
tert-Butyl alcohol	207	20	"	200	ND	104	60-135	8	25	
Di-isopropyl ether	10.0	0.50	"	10.0	ND	100	70-130	3	25	
1,2-Dibromoethane (EDB)	9.95	0.50	"	10.0	ND	100	80-135	6	30	
1,2-Dichloroethane	10.0	0.50	"	10.0	ND	100	70-125	5	25	
Ethanol	176	300	"	200	ND	88	15-150	13	25	
Ethyl tert-butyl ether	9.73	0.50	"	10.0	ND	97	65-130	2	25	
Ethylbenzene	10.8	0.50	"	10.0	0.900	99	75-120	1	20	
Methyl tert-butyl ether	36.8	0.50	"	10.0	27.0	98	50-140	10	25	
Toluene	10.6	0.50	"	10.0	ND	106	75-120	4	25	
Xylenes (total)	29.9	0.50	"	30.0	1.01	96	75-130	5	20	
Surrogate: Dibromofluoromethane	2.45		"	2.50		98	75-120			
Surrogate: 1,2-Dichloroethane-d4	2.42		"	2.50		97	60-125			
Surrogate: Toluene-d8	2.40		"	2.50		96	80-120			
Surrogate: 4-Bromofluorobenzene	2.43		"	2.50		97	60-135			

TestAmerica - Morgan Hill, CA

The results in this report apply to the samples analyzed in accordance with the chain of custody document. Unless otherwise stated, results are reported on a wet weight basis. This analytical report must be reproduced in its entirety.



Stratus Environmental Inc. [Arco]  
3330 Cameron Park Dr., Suite 550  
Cameron Park CA, 95682

Project: BP Heritage #11133, Oakland, CA  
Project Number: G07TT-0037  
Project Manager: Jay Johnson

MQG0510  
Reported:  
07/26/07 10:30

**Notes and Definitions**

PV Hydrocarbon result partly due to individ. peak(s) in quant. range  
DET Analyte DETECTED  
ND Analyte NOT DETECTED at or above the reporting limit or MDL, if MDL is specified  
NR Not Reported  
dry Sample results reported on a dry weight basis  
RPD Relative Percent Difference



# Chain of Custody Record

Project Name: ARCO 11133  
 BP BU/AR Region/Enfos Segment: BP > Americas > West > Retail > Alameda > 11133  
 State or Lead Regulatory Agency: \_\_\_\_\_  
 Requested Due Date (mm/dd/yy): \_\_\_\_\_

On-site Time: <u>1100</u>	Temp: <u>65</u>
Off-site Time: <u>1545</u>	Temp: <u>75</u>
Sky Conditions: <u>Overcast</u>	
Meteorological Events: <u>None</u>	
Wind Speed: <u>5 W</u>	Direction: _____

Lab Name: <u>TestAmerica</u>	BP/AR Facility No.: <u>11133</u>	Consultant/Contractor: <u>Stratus Environmental, Inc.</u>
Address: <u>885 Jarvis Drive</u>	BP/AR Facility Address: <u>2220 98th Avenue, Oakland</u>	Address: <u>3330 Cameron Park Drive, Suite 550</u>
<u>Morgan Hill, CA 95937</u>	Site Lat/Long: _____	<u>Cameron Park, CA 95682</u>
Lab PM: <u>Lisa Race</u>	California Global ID No.: <u>T0600100210</u>	Consultant/Contractor Project No.: _____
Tele/Fax: <u>408-782-8156 408-782-6308 (fax)</u>	Enfos Project No.: <u>G07TT-0037</u>	Consultant/Contractor PM: <u>Jay Johnson</u>
BP/AR PM Contact: <u>Paul Supple</u>	Provision or OOC (circle one) <u>Provision</u>	Tele/Fax: <u>(530) 676-6000 / (530) 676-6005</u>
Address: <u>2010 Crow Canyon Place, Suite 150</u>	Phase/WBS: <u>04-Monitoring</u>	Report Type & QC Level: <u>Level 1 with EDF</u>
<u>San Ramon, CA</u>	Sub Phase/Task: <u>03-Analytical</u>	E-mail EDD To: <u>shaves@stratusinc.net</u>
Tele/Fax: <u>925-275-3506</u>	Cost Element: <u>01-Contractor labor</u>	Invoice to: <u>Atlantic Richfield Co.</u>

Item No.	Sample Description	Time	Date	Matrix			Laboratory No.	No. of Containers	Preservative					Requested Analysis					Sample Point Lat/Long and Comments Oxy* = MTBE, TAME, ETBE, DIPE, TBA				
				Soil/Solid	Water/Liquid	Air			Unpreserved	H <sub>2</sub> SO <sub>4</sub>	HNO <sub>3</sub>	HCl	Methanol	GRO/BTEX/Oxy*	1,2-DCA	Ethanol	EDB	DRO					
1	MW-1	1355	7-10-07	X			-01	3						X	X	X	X						
2	MW-3	1417	7-10-07	X			-02	3						X	X	X	X						
3	AW-1	1440	7-10-07	X			-03	3						X	X	X	X						
4	AW-4	1245	7-10-07	X			-04	6						X	X	X	X						
5	AW-5	1310	7-10-07	X			-05	3						X	X	X	X						
6	AW-6	1335	7-10-07	X			-06	3						X	X	X	X						
7	RW-1	1525	7-10-07	X			-07	3						X	X	X	X						
8	TB11133 07102007	560	7-10-07	X			-08	3						X	X	X	X						Hold
9																							
10																							

Sampler's Name: <u>Jerry Gonzalez</u>	Relinquished By / Affiliation: _____	Date: <u>7/12/07</u>	Time: <u>1145</u>	Accepted By / Affiliation: _____	Date: <u>7/12/07</u>	Time: <u>1145</u>
Sampler's Company: <u>Douglas ENW</u>	_____	<u>7/12/07</u>	<u>1540</u>	_____	<u>7/12/07</u>	<u>1540</u>
Shipment Date: _____	_____	<u>7/12/07</u>	<u>1945</u>	_____	<u>7/12/07</u>	<u>1945</u>
Shipment Method: _____	_____	_____	_____	_____	_____	_____
Shipment Tracking No: _____	_____	_____	_____	_____	_____	_____

Special Instructions: Please cc results to rmiller@broadbentinc.com

Custody Seals In Place: Yes / (No) | Temp Blank: (Yes) / No | Cooler Temp on Receipt: 3.0 °F | Trip Blank: (Yes) / No | MS/MSD Sample Submitted: (Yes) / No

# TEST AMERICA SAMPLE RECEIPT LOG

CLIENT NAME: Arco 11133  
 REC. BY (PRINT) A.M.  
 WORKORDER: MOG0510

DATE REC'D AT LAB: 7/12/07  
 TIME REC'D AT LAB: 1945  
 DATE LOGGED IN: 7/16/07

For Regulatory Purposes?  
 DRINKING WATER YES / NO  
 WASTE WATER YES / NO

CIRCLE THE APPROPRIATE RESPONSE	LAB SAMPLE #	CLIENT ID	CONTAINER DESCRIPTION	PRESERVATIVE	pH	SAMPLE MATRIX	DATE SAMPLED	REMARKS: CONDITION (ETC.)
1. Custody Seal(s) Present / <input checked="" type="radio"/> Absent Intact / Broken*								See Coc 7/12/07 A.M.
2. Chain-of-Custody Present / <input checked="" type="radio"/> Absent*								
3. Traffic Reports or Packing List: Present / <input checked="" type="radio"/> Absent								
4. Airbill: Airbill / Sticker Present / <input checked="" type="radio"/> Absent								
5. Airbill #:								
6. Sample Labels: Present / <input checked="" type="radio"/> Absent								
7. Sample IDs: Listed / Not Listed on Chain-of-Custody								
8. Sample Condition: Intact / Broken* / Leaking*								
9. Does information on chain-of-custody, traffic reports and sample labels agree? Yes / <input checked="" type="radio"/> No*								
10. Sample received within hold time? Yes / <input checked="" type="radio"/> No*								
11. Adequate sample volume received? Yes / <input checked="" type="radio"/> No*								
12. Proper preservatives used? Yes / <input checked="" type="radio"/> No*								
13. Trip Blank / Temp Blank Received? (circle which, if yes) Yes / <input checked="" type="radio"/> No*								
14. Read Temp: <u>5.0°C</u> Corrected Temp: <u>3.0°C</u> Is corrected temp 4 +/-2°C? Yes / <input checked="" type="radio"/> No**								

(Acceptance range for samples requiring thermal pres.)  
 \*\*Exception (if any): METALS / DFF ON ICE or Problem COC

\*IF CIRCLED, CONTACT PROJECT MANAGER AND ATTACH RECORD OF RESOLUTION.

**APPENDIX B**

**GEOTRACKER UPLOAD CONFIRMATION**

# Electronic Submittal Information

[Main Menu](#) | [View/Add Facilities](#) | [Upload EDD](#) | [Check EDD](#)

## UPLOADING A GEO\_WELL FILE

Processing is complete. No errors were found!  
Your file has been successfully submitted!

<b>Submittal Title:</b>	3Q07 GEO_WELL 11133
<b>Facility Global ID:</b>	T0600100210
<b>Facility Name:</b>	BP #11133
<b>Submittal Date/Time:</b>	10/25/2007 10:53:34 AM
<b>Confirmation Number:</b>	<b>8604369938</b>

[Back to Main Menu](#)

Logged in as BROADBENT-C  
(CONTRACTOR)

CONTACT SITE [ADMINISTRATOR](#).

# Electronic Submittal Information

[Main Menu](#) | [View/Add Facilities](#) | [Upload EDD](#) | [Check EDD](#)

Your EDF file has been successfully uploaded!

**Confirmation Number:** 7140405237

**Date/Time of Submittal:** 10/18/2007 2:11:12 PM

**Facility Global ID:** T0600100210

**Facility Name:** BP #11133

**Submittal Title:** 3Q07 GW Monitoring

**Submittal Type:** GW Monitoring Report

[Click here](#) to view the detections report for this upload.

<b>BP #11133</b> 2220 98TH OAKLAND, CA 94603	<b>Regional Board - Case #: 01-0224</b> SAN FRANCISCO BAY RWQCB (REGION 2) <b>Local Agency (lead agency) - Case #: RO0000403</b> ALAMEDA COUNTY LOP - (SP)
--	---

<u>CONF #</u>	<u>TITLE</u>	<u>QUARTER</u>
7140405237	3Q07 GW Monitoring	Q3 2007
<u>SUBMITTED BY</u>	<u>SUBMIT DATE</u>	<u>STATUS</u>
Broadbent & Associates, Inc.	10/18/2007	PENDING REVIEW

## **SAMPLE DETECTIONS REPORT**

# FIELD POINTS SAMPLED	7
# FIELD POINTS WITH DETECTIONS	7
# FIELD POINTS WITH WATER SAMPLE DETECTIONS ABOVE MCL	6
SAMPLE MATRIX TYPES	WATER

## **METHOD QA/QC REPORT**

METHODS USED	8260FA,8260TPH
TESTED FOR REQUIRED ANALYTES?	Y
LAB NOTE DATA QUALIFIERS	Y

## **QA/QC FOR 8021/8260 SERIES SAMPLES**

TECHNICAL HOLDING TIME VIOLATIONS	0
METHOD HOLDING TIME VIOLATIONS	0
LAB BLANK DETECTIONS ABOVE REPORTING DETECTION LIMIT	0
LAB BLANK DETECTIONS	0
DO ALL BATCHES WITH THE 8021/8260 SERIES INCLUDE THE FOLLOWING?	
- LAB METHOD BLANK	Y
- MATRIX SPIKE	N
- MATRIX SPIKE DUPLICATE	N
- BLANK SPIKE	Y
- SURROGATE SPIKE	Y

## **WATER SAMPLES FOR 8021/8260 SERIES**

MATRIX SPIKE / MATRIX SPIKE DUPLICATE(S) % RECOVERY BETWEEN 65-135%	Y
MATRIX SPIKE / MATRIX SPIKE DUPLICATE(S) RPD LESS THAN 30%	Y
SURROGATE SPIKES % RECOVERY BETWEEN 85-115%	Y
BLANK SPIKE / BLANK SPIKE DUPLICATES % RECOVERY BETWEEN 70-130%	Y

**SOIL SAMPLES FOR 8021/8260 SERIES**

MATRIX SPIKE / MATRIX SPIKE DUPLICATE(S) % RECOVERY BETWEEN 65-135% n/a  
MATRIX SPIKE / MATRIX SPIKE DUPLICATE(S) RPD LESS THAN 30% n/a  
SURROGATE SPIKES % RECOVERY BETWEEN 70-125% n/a  
BLANK SPIKE / BLANK SPIKE DUPLICATES % RECOVERY BETWEEN 70-130% n/a

---

**FIELD QC SAMPLES**

<u>SAMPLE</u>	<u>COLLECTED</u>	<u>DETECTIONS &gt; REPD</u>
QCTB SAMPLES	N	0
QCEB SAMPLES	N	0
QCAB SAMPLES	N	0