



Scott T. Hooton
Portfolio Manager

**BP Oil Company
Midwest Environmental Services
295 SW 41st Street
Bldg. 13, Suite N
Renton, WA 98055**

**Switchboard: 425/251-0667
Central Fax: 425/251-0736**

May 11, 2001

Ms. Eva Chu
Alameda County Health Care Services
Agency
1131 Harbor Bay Parkway, Room 250
Alameda, CA 94502-6577

*Some piezometer wells showing increase
in TPHg. Could it be due to fact that
GWB system has been turned off?*

RE: Former BP Oil Site No. 11133
~~2220 95th~~ Avenue (at Bancroft)
Oakland, CA

Direct: 425/251-0689
Cell: 206/335-0689
hootonst@bp.com
www.bp.com

Dear Ms. Chu:

This letter transmits the 8 March 2001 *First Quarter 2001 Groundwater Monitoring* report prepared by Blaine Tech Services on behalf of BP. The report summarizes monitoring data obtained since 1991, including results associated with samples obtained on 19 January 2001.

Revisions to the report address comments received from the San Francisco Regional Water Quality Control Board (RWQCB) on June 13, 2000. The following revisions were made to the report in response to these comments:

Please give me a call at (425) 251-0689 if you have any questions or comments regarding this submittal.

Sincerely,



Scott Hooton

Attachment

cc: site file
David Camille - Tosco (w/attachment)
Emerging Star Enterprises, Attention Mr. Clifford Hoskins, 655 S. Fair Oaks Avenue, B215,
Sunnyvale, CA 94086 (w/ attachment)
City of Oakland, Public Works Agency - Environmental Services, Attention Mr. Mark
Gomez, 250 Frank Ogawa Plaza, STE 5301, Oakland, CA 94612 (w/attachment)

*What are these
revisions?*

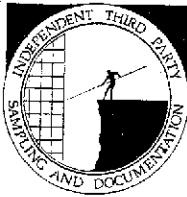
BLAINE
TECH SERVICES, INC.



1680 ROGERS AVENUE
SAN JOSE, CA 95112-1105
(408) 573-7771 FAX
(408) 573-0555 PHONE
CONTRACTOR'S LICENSE #746684
www.blainetech.com

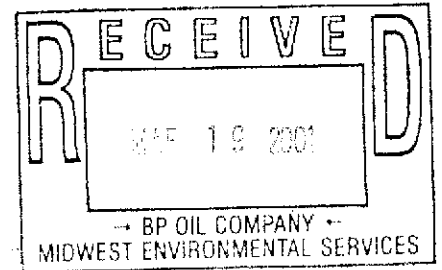

March 8, 2001

Scott Hooton
BP Oil Company
295 SW 41st Street, Bldg. 13, Suite N
Renton, WA 98055-4931

1st Quarter 2001 Monitoring at 11133

First Quarter 2001 Groundwater Monitoring
BP Service Station Number 11133
2220 98th Avenue
Oakland, CA

Monitoring Performed on January 19, 2001

Groundwater Sampling Report 010119-F-1

This report covers the routine monitoring of groundwater wells at this BP facility. Blaine Tech Services, Inc.'s work at the site includes inspection, gauging, evacuation, purgewater containment, sample collection and sample handling in accordance with standard procedures that conform to Regional Water Quality Control Board requirements.

Routine field data collection includes depth to water, total well depth, thickness of any separate immiscible layer, water column volume, the appropriate calculated purge volume, elapsed evacuation time, total volume of water removed, and standard water parameter instrument readings. Sample material is collected, contained, stored, and transported to the laboratory in conformance with EPA standards. Purgewater is, likewise, collected and transported to Seaport Petroleum Corporation for disposal.

Basic field information is presented alongside analytical values excerpted from the laboratory report in the cumulative table of **WELL DATA AND ANALYTICAL RESULTS**. The full analytical report for the most recent samples is located in the **Analytical Appendix**. The **Professional Engineering Appendix** contains a **Groundwater Elevation Map** and a **Dissolved Petroleum Hydrocarbon Concentration Map**.

At a minimum, Blaine Tech Services, Inc. field personnel are certified upon completion of a forty-hour Hazardous Materials and Emergency Response training course per 29 CFR 1910.120. Field personnel are also enrolled in annual eight hour refresher courses.

Blaine Tech Services, Inc. conducts sampling and documentation assignments of this type as an independent third party. In order to avoid compromising the objectivity necessary for the proper and disinterested performance of this work, Blaine Tech Services, Inc. concentrates on objective data collection and does not participate in the interpretation of analytical results, the definition of geological or hydrological conditions, the formulation of recommendations, or the marketing of remedial systems.

Please call if you have any questions.

Yours truly,

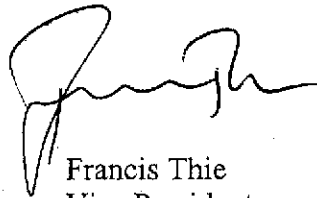

Francis Thie
Vice President

FPT/ks

attachments: Professional Engineering Appendix
Cumulative Table of Well Data and Analytical Results
Analytical Appendix
Field Data Sheets

Professional Engineering Appendix

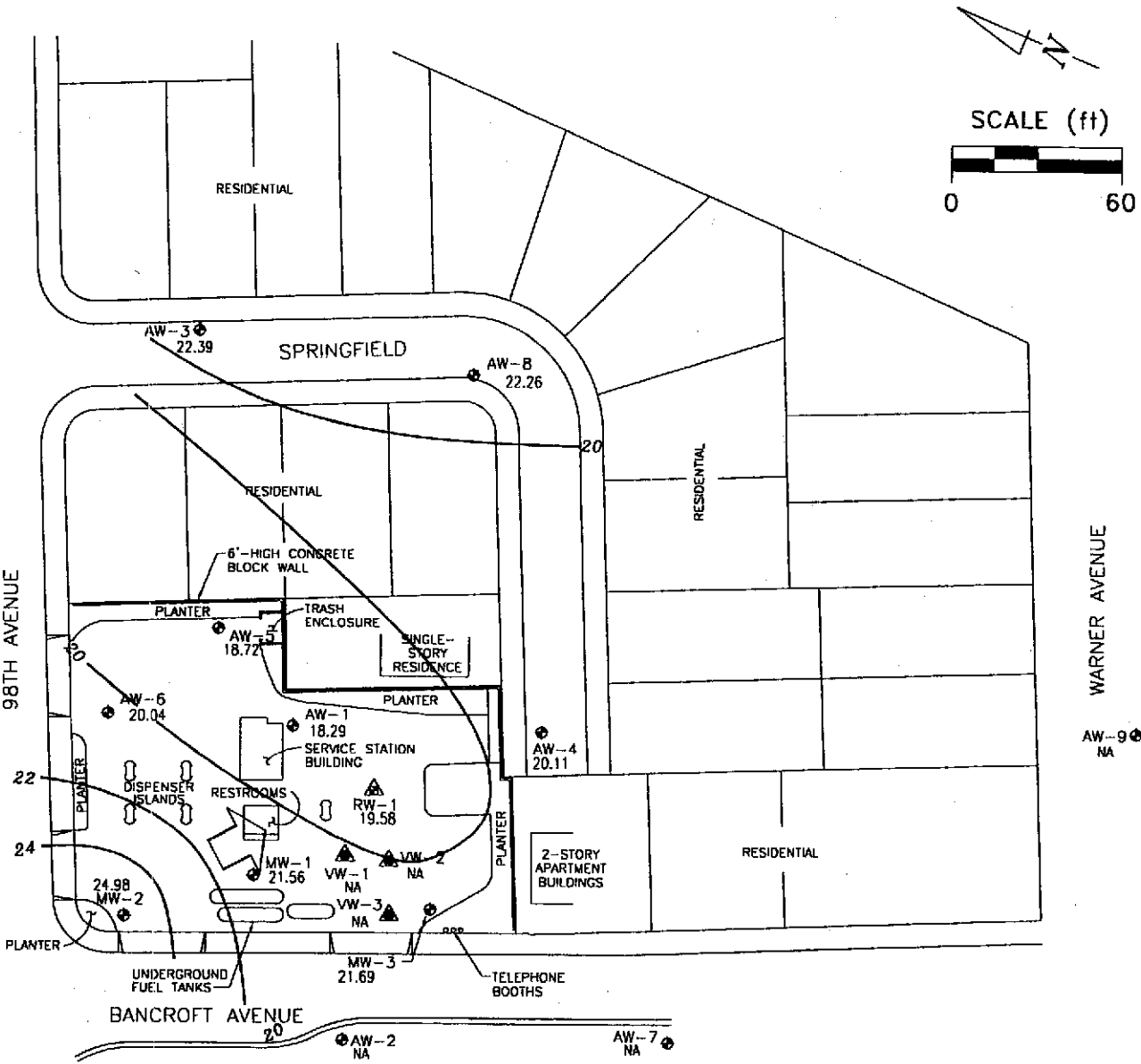

- EXPLANATION**
- ⊕ GROUNDWATER MONITORING WELL
 - ▲ VAPOR EXTRACTION WELL
 - ▲ COMBINED GROUNDWATER RECOVERY/VAPOR EXTRACTION WELL
 - 22.26 GROUNDWATER ELEVATION (FT. MSL)
 - 22— GROUNDWATER ELEVATION CONTOUR (FT. MSL)
 - NA DATA NOT AVAILABLE
 - APPROXIMATE GROUNDWATER FLOW DIRECTION; APPROXIMATE AVERAGE GRADIENT = 0.04
 - NOT USED IN CONTOURING

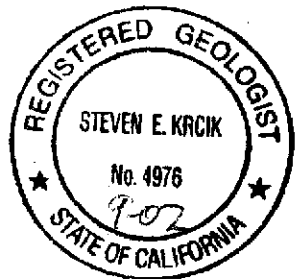

Ref. 11133bm.dwg
Base map from Alisto Engineering Group

PREPARED BY
RRM
engineering contracting firm

BP Service Station 11133
2220 98th Avenue
Oakland, California

GROUNDWATER ELEVATION CONTOUR MAP,
JANUARY 19, 2001

FIGURE:
1
PROJECT:
DAC04

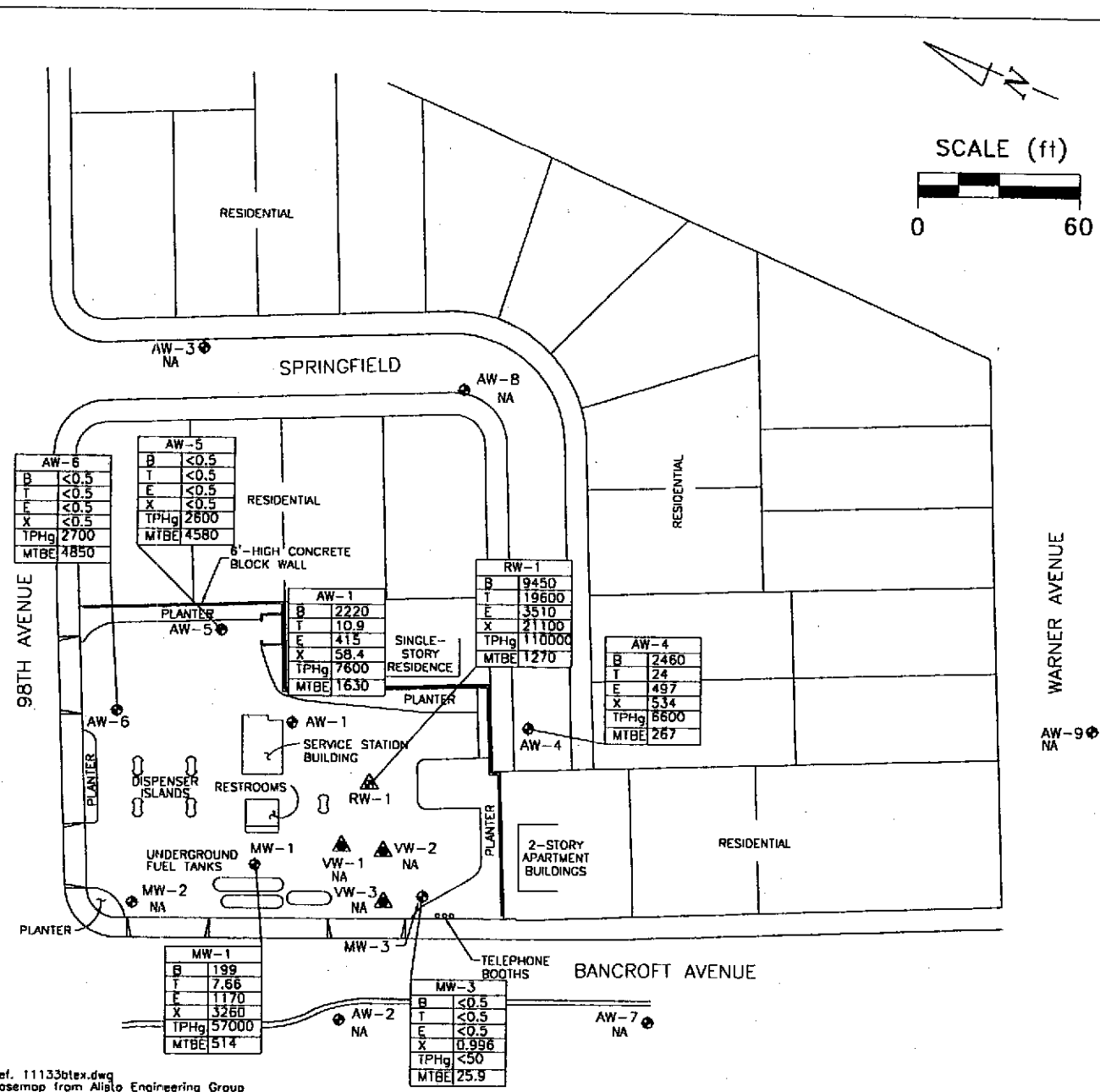
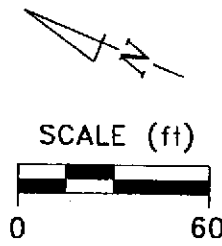

- EXPLANATION**
- ⊙ GROUNDWATER MONITORING WELL
 - ▲ VAPOR EXTRACTION WELL
 - ▲ COMBINED GROUNDWATER RECOVERY/VAPOR EXTRACTION WELL
 - TPHg TOTAL PETROLEUM HYDROCARBON CALCULATED AS GASOLINE IN PARTS PER BILLION (ppb)
 - B BENZENE, ppb
 - T TOLUENE, ppb
 - E ETHYLBENZENE, ppb
 - X XYLENE, ppb
 - MTBE METHYL-TERT-BUTYL-ETHER, ppb
 - NA DATA NOT AVAILABLE

Ref. 11133btex.dwg
Basemap from Aliato Engineering Group

PREPARED BY

BP Service Station 11133
2220 98th Avenue
Oakland, California

HYDROCARBON CONCENTRATION MAP,
JANUARY 19, 2001

FIGURE:
2
PROJECT:
DAC04

Table of Well Data and Analytical Results

TABLE 1 - SUMMARY OF RESULTS OF GROUNDWATER MONITORING

WELL ID	DATE OF MONITORING/ SAMPLING	CASING ELEVATION (a) (Feet)	DEPTH TO WATER (Feet)	PRODUCT THICKNESS (Feet)	GROUNDWATER ELEVATION (b) (Feet)	TPH-G (ug/l)	B (ug/l)	T (ug/l)	E (ug/l)	X (ug/l)	MTBE (ug/l)	DO (ppm)	LAB	
MW-1	04/05/91	34.46	---	---	---	---	---	---	---	---	---	---	---	
MW-1	04/01/92	34.46	11.25	0.01	23.22	---	---	---	---	---	---	---	---	
MW-1	07/06/92	34.46	13.61	0.02	20.87	---	---	---	---	---	---	---	---	
MW-1	10/07/92	34.46	15.15	0.09	19.38	---	---	---	---	---	---	---	---	
MW-1	01/14/93	34.46	10.73	0.01	23.74	---	---	---	---	---	---	---	---	
MW-1	04/22/93	34.46	11.64	0.16	22.94	---	---	---	---	---	---	---	---	
MW-1	07/15/93	34.46	13.50	1.11	21.79	---	---	---	---	---	---	---	---	
MW-1	10/21/93	34.46	15.21	1.00	20.00	---	---	---	---	---	---	---	---	
MW-1	01/27/94	34.46	17.48	0.81	17.59	---	---	---	---	---	---	---	---	
MW-1	04/21/94	34.46	10.94	---	23.52	110000	1400	9100	3400	30000	11000	(c)	1.6	PACE
MW-1	09/09/94	34.46	13.80	---	20.66	---	---	---	---	---	---	---	---	---
MW-1	12/21/94	34.46	12.60	0.02	21.88	---	---	---	---	---	---	---	---	---
MW-1	01/30/95	34.46	---	---	---	---	---	---	---	---	---	---	---	---
MW-1	04/10/95	34.46	10.62	---	23.84	---	---	---	---	---	---	---	---	---
MW-1	06/29/95	34.46	18.72	---	15.74	---	---	---	---	---	---	---	---	---
MW-1	09/18/95	34.46	12.92	---	21.54	---	---	---	---	---	---	---	---	---
MW-1	12/07/95	34.46	13.82	---	20.64	---	---	---	---	---	---	---	---	---
MW-1	03/28/96	34.46	10.03	0.01	24.44	---	---	---	---	---	---	---	---	---
MW-1	06/20/96	34.46	11.29	0.02	23.19	---	---	---	---	---	---	---	---	---
MW-1	10/11/96	34.46	14.86	0.01	19.61	---	---	---	---	---	---	---	---	---
MW-1	01/02/97	34.46	11.03	0.01	23.44	---	---	---	---	---	---	---	---	---
MW-1	04/14/97	34.46	12.25	0.01	22.22	---	---	---	---	---	---	---	---	---
MW-1	04/15/97	34.46	---	---	---	35000	130	650	1700	8200	4800	---	---	SPL
MW-1	07/02/97	34.46	14.11	---	20.35	42000	ND<250	ND<500	2000	9600	ND<5000	5.5	---	SPL
MW-1	09/30/97	34.46	14.40	---	20.06	61000	130	1100	2700	14600	2000	6.7	---	SPL
MW-1	01/21/98	34.46	7.99	0.01	26.48	14000	11	60	310	1790	1300	4.5	---	SPL
MW-1	04/09/98	34.46	7.89	---	26.57	---	---	---	---	---	---	---	---	---
MW-1	04/10/98	34.46	---	---	---	45000	380	520	2100	6800	9300	5.3	---	SPL
MW-1	06/19/98	34.46	10.31	---	24.15	35000	170	100	1100	3590	5000	4.9	---	SPL
MW-1	11/30/98	34.46	11.16	---	23.30	10000	100	24	350	1040	1800/2800 (g)	---	---	SPL
MW-1	01/21/99	34.46	10.76	---	23.70	18000	120	37	590	1800	2700	---	---	SPL
MW-1	04/30/99	34.46	10.78	---	23.68	17000	240	89	1100	1900	1600	---	---	SPL
MW-1	07/09/99	34.46	12.62	---	21.84	58000	140	100	1800	6900	1200	---	---	SPL
MW-1	11/03/99	34.46	14.00	---	20.46	20000	62	42	620	2100	630	---	---	PACE
MW-1	01/12/00	34.46	15.25	---	19.21	72000	110	120	2400	8200	630	---	---	PACE
MW-1	04/13/00	34.46	15.57	---	18.89	37000	300	32	1000	1700	810	---	---	PACE
MW-1	05/24/00	34.46	11.75	---	22.71	---	---	---	---	---	---	---	---	---
MW-1	06/01/00	34.46	11.41	---	23.05	---	---	---	---	---	---	---	---	---
MW-1	06/08/00	34.46	11.68	---	22.78	---	---	---	---	---	---	---	---	---

TABLE 1 - SUMMARY OF RESULTS OF GROUNDWATER MONITORING

WELL ID	DATE OF MONITORING/ SAMPLING	CASING ELEVATION (Feet)	DEPTH TO WATER (Feet)	PRODUCT THICKNESS (Feet)	GROUNDWATER ELEVATION (Feet)	TPH-G (ug/l)	B (ug/l)	T (ug/l)	E (ug/l)	X (ug/l)	MTBE (ug/l)	DO (ppm)	LAB
MW-1	06/15/00	34.46	11.85	---	22.61	---	---	---	---	---	---	---	---
MW-1	07/26/00	34.46	16.19	---	18.27	10000	480	210	470	710	1100	---	PACE
MW-1	10/24/00	34.46	13.89	---	20.57	9900	31	7.2	550	1200	4400	---	PACE
MW-1	01/19/01	34.46	12.90	---	21.56	57000	199	7.66	1170	3260	514	---	PACE

TABLE 1 - SUMMARY OF RESULTS OF GROUNDWATER MONITORING

WELL ID	DATE OF MONITORING/ SAMPLING	CASING ELEVATION (Feet)	DEPTH TO WATER (Feet)	PRODUCT THICKNESS (Feet)	GROUNDWATER ELEVATION (Feet)	TPH-G (ug/l)	B (ug/l)	T (ug/l)	E (ug/l)	X (ug/l)	MTBE (ug/l)	DO (ppm)	LAB
MW-2	04/05/91	35.50	16.62	---	18.88	ND<50	0.6	0.9	ND<0.3	ND<0.3	---	---	---
MW-2	04/01/92	35.50	11.25	---	24.25	---	---	---	---	---	---	---	SUP
MW-2	04/02/92	35.50	---	---	---	ND<50	ND<0.5	ND<0.5	ND<0.5	ND<0.5	---	---	---
MW-2	07/06/92	35.50	12.72	---	22.78	ND<50	ND<0.5	ND<0.5	ND<0.5	ND<0.5	---	---	APP
MW-2	10/07/92	35.50	15.08	---	20.42	ND<50	ND<0.5	1.8	ND<0.5	2.3	---	---	ANA
MW-2	01/14/93	35.50	9.69	---	25.81	ND<50	ND<0.5	ND<0.5	ND<0.5	ND<0.5	---	---	ANA
MW-2	04/22/93	35.50	10.46	---	25.04	ND<50	ND<0.5	ND<0.5	ND<0.5	ND<0.5	---	---	PACE
MW-2	07/15/93	35.50	12.02	---	23.48	ND<50	ND<0.5	ND<0.5	ND<0.5	ND<0.5	30	(c)	PACE
MW-2	10/21/93	35.50	13.12	---	22.38	ND<50	0.7	0.9	ND<0.5	ND<0.5	22	(c)	PACE
MW-2	01/27/94	35.50	12.01	---	23.49	ND<50	0.6	ND<0.5	ND<0.5	ND<0.5	---	---	PACE
MW-2	04/21/94	35.50	10.60	---	24.90	ND<50	ND<0.5	ND<0.5	ND<0.5	ND<0.5	---	1.1	PACE
MW-2	09/09/94	35.50	12.42	---	23.08	ND<50	ND<0.5	ND<0.5	ND<0.5	0.6	---	2.2	PACE
MW-2	12/21/94	35.50	10.85	---	24.65	ND<50	ND<0.5	ND<0.5	ND<0.5	ND<0.5	---	1.2	PACE
MW-2	01/30/95	35.50	8.38	---	27.12	ND<50	ND<0.50	ND<0.50	ND<0.50	ND<1.0	---	1.7	ATI
MW-2	04/10/95	35.50	9.00	---	26.50	ND<50	ND<0.50	ND<0.50	ND<0.50	ND<1.0	---	7.8	ATI
MW-2	06/29/95	35.50	9.91	---	25.59	ND<50	ND<0.50	ND<0.50	ND<0.50	ND<1.0	---	9.1	ATI
MW-2	09/18/95	35.50	10.98	---	24.52	---	---	---	---	---	---	---	---
MW-2	09/19/95	35.50	---	---	---	ND<50	ND<0.50	ND<0.50	ND<0.50	ND<1.0	ND<5.0	7.2	ATI
MW-2	12/07/95	35.50	12.30	---	23.20	ND<50	ND<0.50	ND<0.50	ND<0.50	ND<1.0	ND<5.0	2.4	ATI
MW-2	03/28/96	35.50	8.57	---	26.93	ND<50	ND<0.5	ND<1	ND<1	ND<1	ND<10	3.2	SPL
MW-2	06/20/96	35.50	9.77	---	25.73	ND<50	ND<0.5	ND<1	ND<1	ND<1	ND<10	4.2	SPL
MW-2	10/11/96	35.50	13.32	---	22.18	ND<50	ND<0.5	ND<1.0	ND<1.0	ND<1.0	ND<10	6.3	SPL
MW-2	01/02/97	35.50	9.60	---	25.90	ND<50	ND<0.5	ND<1.0	ND<1.0	ND<1.0	ND<10	6.7	SPL
MW-2	04/14/97	35.50	10.93	---	24.57	ND<50	ND<0.5	ND<1.0	ND<1.0	ND<1.0	ND<10	5.7	SPL
MW-2	07/02/97	35.50	12.57	---	22.93	ND<50	ND<0.5	ND<1.0	ND<1.0	ND<1.0	ND<10	5.9	SPL
MW-2	09/30/97	35.50	12.91	---	22.59	ND<50	ND<0.5	ND<1.0	ND<1.0	ND<1.0	ND<10	6.3	SPL
MW-2	01/21/98	35.50	10.12	---	25.38	160	ND<0.5	ND<1.0	ND<1.0	ND<1.0	100	5.4	SPL
MW-2	04/09/98	35.50	6.82	---	28.68	---	---	---	---	---	---	---	---
MW-2	04/10/98	35.50	---	---	---	ND<50	1.0	ND<1.0	ND<1.0	ND<1.0	23	5.0	SPL
MW-2	06/19/98	35.50	9.00	---	26.50	ND<50	ND<0.5	ND<1.0	ND<1.0	ND<1.0	ND<10	4.9	SPL
MW-2	11/30/98	35.50	9.44	---	26.06	---	---	---	---	---	---	---	---
MW-2	01/21/99	35.50	8.96	---	26.54	ND<50	ND<1.0	ND<1.0	ND<1.0	ND<1.0	1.9	---	SPL
MW-2	04/30/99	35.50	9.15	---	26.35	---	---	---	---	---	---	---	---
MW-2	07/09/99	35.50	10.82	---	24.68	---	---	---	---	---	---	---	---
MW-2	11/03/99	35.50	11.86	---	23.64	---	---	---	---	---	---	---	---
MW-2	01/12/00	35.50	12.35	---	23.15	ND<50	ND<0.5	ND<0.5	ND<0.5	ND<0.5	ND<0.5	---	PACE
MW-2	04/13/00	35.50	13.01	---	22.49	---	---	---	---	---	---	---	---
MW-2	07/26/00	35.50	13.01	---	22.49	---	---	---	---	---	---	---	---
MW-2	10/24/00	35.50	11.57	---	23.93	---	---	---	---	---	---	---	---

TABLE 1 - SUMMARY OF RESULTS OF GROUNDWATER MONITORING

WELL ID	DATE OF MONITORING/ SAMPLING	CASING ELEVATION (a) (Feet)	DEPTH TO WATER (Feet)	PRODUCT THICKNESS (Feet)	GROUNDWATER ELEVATION (b) (Feet)	TPH-G (ug/l)	B (ug/l)	T (ug/l)	E (ug/l)	X (ug/l)	MTBE (ug/l)	DO (ppm)	LAB
MW-2	01/19/01	35.50	10.52	---	24.98	---	---	---	---	---	---	---	---

TABLE 1 - SUMMARY OF RESULTS OF GROUNDWATER MONITORING

WELL ID	DATE OF MONITORING/ SAMPLING	CASING ELEVATION (a) (Feet)	DEPTH TO WATER (Feet)	PRODUCT THICKNESS (Feet)	GROUNDWATER ELEVATION (b) (Feet)	TPH-G (ug/l)	B (ug/l)	T (ug/l)	E (ug/l)	X (ug/l)	MTBE (ug/l)	DO (ppm)	LAB
MW-3	04/05/91	36.53	17.84	---	18.69	ND<50	ND<0.3	ND<0.3	ND<0.3	ND<0.3	---	---	SUP
MW-3	04/01/92	36.53	15.64	---	20.89	---	---	---	---	---	---	---	---
MW-3	04/02/92	36.53	---	---	---	ND<50	1.4	ND<0.5	ND<0.5	ND<0.5	---	---	APP
MW-3	07/06/92	36.53	19.03	---	17.50	ND<50	ND<0.5	ND<0.5	ND<0.5	ND<0.5	---	---	ANA
MW-3	10/07/92	36.53	21.83	---	14.70	ND<50	ND<0.5	ND<0.5	ND<0.5	ND<0.5	---	---	ANA
MW-3	01/14/93	36.53	15.96	---	20.57	350	ND<0.5	ND<0.5	ND<0.5	ND<0.5	714	(c)	PACE
MW-3	04/22/93	36.53	16.20	---	20.33	2800	ND<0.5	ND<0.5	ND<0.5	ND<0.5	3600	(c)	PACE
MW-3	07/15/93	36.53	16.82	---	19.71	1400	1.2	ND<0.5	2.0	3.5	2200	(c)	PACE
MW-3	10/21/93	36.53	18.84	---	17.69	370	2.1	2.3	2.3	6.0	850	(c)	PACE
MW-3	01/27/94	36.53	18.00	---	18.53	1300	6.3	ND<0.5	ND<0.5	ND<0.5	4000	(c)	PACE
MW-3	04/21/94	36.53	16.62	---	19.91	2000	ND<0.5	ND<0.5	ND<0.5	ND<0.5	4300	(c)	PACE
MW-3	09/09/94	36.53	18.38	---	18.15	1300	ND<0.5	ND<0.5	0.5	1.2	---	3.0	PACE
MW-3	12/21/94	36.53	15.28	---	21.25	420	16	0.7	3.5	5.9	---	1.9	PACE
MW-3	01/30/95	36.53	12.62	---	23.91	ND<50	ND<0.50	ND<0.50	ND<0.50	ND<1.0	---	2.5	ATI
MW-3	04/10/95	36.53	12.41	---	24.12	150	ND<0.50	ND<0.50	ND<0.50	ND<1.0	---	6.9	ATI
MW-3	06/29/95	36.53	14.95	---	21.58	100	(d) ND<0.50	ND<0.50	ND<0.50	ND<1.0	---	6.4	ATI
MW-3	09/18/95	36.53	15.82	---	20.71	---	---	---	---	---	---	---	---
MW-3	09/19/95	36.53	---	---	---	82	ND<0.50	ND<0.50	ND<0.50	ND<1.0	260	7.0	ATI
MW-3	12/07/95	36.53	17.09	---	19.44	ND<50	ND<0.50	ND<0.50	ND<0.50	ND<1.0	91	4.5	ATI
MW-3	03/28/96	36.53	11.90	---	24.63	ND<50	ND<0.5	ND<1	ND<1	ND<1	230	4.2	SPL
MW-3	06/20/96	36.53	12.66	---	23.87	260	ND<0.5	ND<1	ND<1	ND<1	370	4.4	SPL
MW-3	10/11/96	36.53	16.23	---	20.30	330	ND<0.5	ND<1.0	ND<1.0	ND<1.0	440	5.8	SPL
MW-3	01/02/97	36.53	12.17	---	24.36	ND<50	ND<0.5	ND<1.0	ND<1.0	ND<1.0	140	6.0	SPL
MW-3	04/14/97	36.53	13.45	---	23.08	---	---	---	---	---	---	---	---
MW-3	04/15/97	36.53	---	---	---	1500	ND<0.5	ND<1.0	ND<1.0	ND<1.0	1800	5.6	SPL
MW-3	07/02/97	36.53	15.60	---	20.93	880	ND<0.5	ND<1.0	ND<1.0	ND<1.0	940	5.3	SPL
MW-3	09/30/97	36.53	17.16	---	19.37	40000	13000	2400	870	3100	510	6.6	SPL
MW-3	01/21/98	36.53	11.77	---	24.76	120	ND<0.5	ND<1.0	ND<1.0	ND<1.0	98	4.7	SPL
MW-3	04/09/98	36.53	9.42	---	27.11	950	ND<0.5	ND<1.0	ND<1.0	ND<1.0	890	5.7	SPL
MW-3	06/19/98	36.53	12.09	---	24.44	1800	ND<0.5	ND<1.0	ND<1.0	ND<1.0	1900	4.7	SPL
MW-3	06/19/98	36.53	15.28	---	21.25	1800	ND<0.5	ND<1.0	ND<1.0	ND<1.0	1900	4.7	SPL
MW-3	01/21/99	36.53	14.67	---	21.86	1100	ND<1.0	ND<1.0	ND<1.0	ND<1.0	1200	---	SPL
MW-3	04/30/99	36.53	16.00	---	20.53	---	---	---	---	---	---	---	---
MW-3	07/09/99	36.53	14.64	---	21.89	470	ND<1.0	ND<1.0	ND<1.0	ND<1.0	460/470	(g)	SPL
MW-3	11/03/99	36.53	16.39	---	20.14	---	---	---	---	---	---	---	---
MW-3	01/12/00	36.53	16.80	---	19.73	ND<50	ND<0.5	ND<0.5	ND<0.5	ND<0.5	34	---	PACE
MW-3	04/13/00	36.53	16.43	---	20.10	---	---	---	---	---	---	---	---
MW-3	07/26/00	36.53	16.93	---	19.60	ND<50	ND<0.5	ND<0.5	ND<0.5	ND<0.5	ND<0.5	---	PACE
MW-3	10/24/00	36.53	15.69	---	20.84	---	---	---	---	---	---	---	---

TABLE 1 - SUMMARY OF RESULTS OF GROUNDWATER MONITORING

WELL ID	DATE OF MONITORING/ SAMPLING	CASING ELEVATION (a) (Feet)	DEPTH TO WATER (Feet)	PRODUCT THICKNESS (Feet)	GROUNDWATER ELEVATION (b) (Feet)	TPH-G (ug/l)	B (ug/l)	T (ug/l)	E (ug/l)	X (ug/l)	MTBE (ug/l)	DO (ppm)	LAB
MW-3	01/19/01	36.53	14.84	---	21.69	ND<50	ND<0.5	ND<0.5	ND<0.5	0.996	25.9	---	PACE

TABLE 1 - SUMMARY OF RESULTS OF GROUNDWATER MONITORING

WELL ID	DATE OF MONITORING/ SAMPLING	CASING ELEVATION (a) (Feet)	DEPTH TO WATER (Feet)	PRODUCT THICKNESS (Feet)	GROUNDWATER ELEVATION (b) (Feet)	TPH-G (ug/l)	B (ug/l)	T (ug/l)	E (ug/l)	X (ug/l)	MTBE (ug/l)	DO (ppm)	LAB
AW-1	04/05/91	38.11	25.44	---	12.67	4100	1500	69	100	83	---	---	SUP
AW-1	04/01/92	38.11	23.22	---	14.89	---	---	---	---	---	---	---	---
AW-1	04/02/92	38.11	---	---	---	11000	1800	210	210	490	---	---	APP
AW-1	07/06/92	38.11	24.89	---	13.22	6500	4000	40	290	530	---	---	ANA
AW-1	10/07/92	38.11	26.55	---	11.56	4700	1500	41	47	300	---	---	ANA
QC-1 (e)	10/07/92	---	---	---	---	2900	1200	25	37	210	---	---	ANA
AW-1	01/14/93	38.11	23.73	---	14.38	2800	830	31	140	240	---	---	PACE
QC-1 (e)	01/14/93	---	---	---	---	4100	1700	28	130	230	---	---	PACE
AW-1	04/22/93	38.11	---	---	38.11	39000	14000	530	1800	6100	987 (c)	---	PACE
AW-1	07/15/93	38.11	22.50	---	15.61	6200	2200	28	210	540	840 (c)	---	PACE
AW-1	10/21/93	38.11	24.32	---	13.79	2400	820	13	55	120	830 (c)	---	PACE
AW-1	01/27/94	38.11	23.72	---	14.39	3500	1400	26	130	220	650 (c)	---	PACE
AW-1	04/21/94	38.11	22.48	---	15.63	40000	12000	1900	1600	5000	---	1.4	PACE
AW-1	09/09/94	38.11	23.04	---	15.07	3500	1600	5.0	200	250	---	2.1	PACE
QC-1 (e)	09/09/94	---	---	---	---	3900	1900	5.5	190	240	---	---	PACE
AW-1	12/21/94	38.11	21.70	---	16.41	7600	3100	36	370	320	---	1.6	PACE
AW-1	01/30/95	38.11	17.71	---	20.40	35000	23000	650	3200	4100	---	1.7	ATI
AW-1	04/10/95	38.11	20.04	---	18.07	60000	18000	2000	4300	11000	---	7.9	ATI
QC-1 (e)	04/10/95	---	---	---	---	56000	17000	2000	3900	10000	---	---	ATI
AW-1	06/29/95	38.11	20.60	---	17.51	72000	10000	7300	4200	15000	---	6.2	ATI
QC-1 (e)	06/29/95	---	---	---	---	86000	12000	8400	4800	18000	---	---	ATI
AW-1	09/18/95	38.11	21.87	---	16.24	---	---	---	---	---	---	---	---
AW-1	09/19/95	38.11	---	---	---	65000	12000	3100	4400	14000	1000	8.5	ATI
AW-1	12/07/95	38.11	22.06	---	16.05	25000	8700	ND<50	2500	1300	1100	2.9	ATI
AW-1	03/28/96	38.11	16.91	---	21.20	24000	11000	ND<100	3200	3390	ND<1000	6.6	SPL
AW-1	06/20/96	38.11	20.82	---	17.29	38000	6900	1100	3200	7300	ND<100	6.4	SPL
AW-1	10/11/96	38.11	23.20	---	14.91	33000	8500	69	3300	4230	580	6.3	SPL
AW-1	01/02/97	38.11	20.41	---	17.70	32000	8000	ND<50	3100	2300	700	6.7	SPL
AW-1	04/14/97	38.11	21.61	---	16.50	---	---	---	---	---	---	---	---
AW-1	04/15/97	38.11	---	---	---	31000	5000	160	2400	4540	340	5.4	SPL
AW-1	07/02/97	38.11	21.17	---	16.94	26000	5800	ND<100	2600	2200	ND<1000	6.2	SPL
AW-1	09/30/97	38.11	21.48	---	16.63	29000	9200	17	1400	130	560	6.9	SPL
AW-1	01/21/98	38.11	20.02	---	18.09	50000	6900	450	3200	4450	720	5.8	SPL
AW-1	04/09/98	38.11	13.37	---	24.74	---	---	---	---	---	---	---	---
AW-1	04/10/98	38.11	---	---	---	46000	5800	1900	3000	7400	1000	4.3	SPL
AW-1	06/19/98	38.11	19.12	---	18.99	42000	6600	200	3000	3350	660	4.9	SPL
QC-1 (e)	06/19/98	---	---	---	---	43000	6800	260	3100	3490	620	---	SPL
AW-1	11/30/98	38.11	21.13	---	16.98	23000	6700	ND<25	3100	130	710/820 (g)	---	SPL

TABLE 1 - SUMMARY OF RESULTS OF GROUNDWATER MONITORING

WELL ID	DATE OF MONITORING/ SAMPLING	CASING ELEVATION (a) (Feet)	DEPTH TO WATER (Feet)	PRODUCT THICKNESS (Feet)	GROUNDWATER ELEVATION (b) (Feet)	TPH-G (ug/l)	B (ug/l)	T (ug/l)	E (ug/l)	X (ug/l)	MTBE (ug/l)	DO (ppm)	LAB
AW-1	01/21/99	38.11	20.77	---	17.34	25000	4800	54	2800	780	1000	---	SPL
AW-1	04/30/99	38.11	20.80	---	17.31	21000	5300	67	2800	750	1500	---	SPL
AW-1	07/09/99	38.11	20.41	---	17.70	11000	3000	ND<10	760	180	1300	---	SPL
AW-1	11/03/99	38.11	20.82	---	17.29	---	---	---	---	---	---	---	---
AW-1	01/12/00	38.11	19.99	---	18.12	330000	5300	10	2900	560	2200	---	PACE
AW-1	04/13/00	38.11	20.14	---	17.97	---	---	---	---	---	---	---	---
AW-1	05/24/00	38.11	20.17	---	17.94	---	---	---	---	---	---	---	---
AW-1	06/01/00	38.11	23.05	---	15.06	---	---	---	---	---	---	---	---
AW-1	06/08/00	38.11	17.08	---	21.03	---	---	---	---	---	---	---	---
AW-1	06/15/00	38.11	16.93	---	21.18	---	---	---	---	---	---	---	---
AW-1	07/26/00	38.11	20.07	---	18.04	15000	290	98	77	220	37000	---	PACE
AW-1	10/24/00	38.11	20.10	---	18.01	---	---	---	---	---	---	---	---
AW-1	01/19/01	38.11	19.82	---	18.29	7600	2220	10.9	415	58.4	1630	---	PACE

TABLE 1 - SUMMARY OF RESULTS OF GROUNDWATER MONITORING

WELL ID	DATE OF MONITORING/ SAMPLING	CASING ELEVATION (a) (Feet)	DEPTH TO WATER (Feet)	PRODUCT THICKNESS (Feet)	GROUNDWATER ELEVATION (b) (Feet)	TPH-G (ug/l)	B (ug/l)	T (ug/l)	E (ug/l)	X (ug/l)	MTBE (ug/l)	DO (ppm)	LAB
AW-2	04/05/91	36.83	22.36	---	14.47	ND<50	ND<0.3	ND<0.3	ND<0.3	ND<0.3	---	---	SUP
AW-2	04/01/92	36.83	20.81	---	16.02	---	---	---	---	---	---	---	---
AW-2	04/02/92	36.83	---	---	---	130	25	2.3	0.7	2.1	---	---	APP
AW-2	07/06/92	36.83	23.57	---	13.26	ND<50	ND<0.5	ND<0.5	ND<0.5	ND<0.5	---	---	ANA
AW-2	10/07/92	36.83	25.24	---	11.59	ND<50	ND<0.5	ND<0.5	ND<0.5	ND<0.5	---	---	ANA
AW-2	01/14/93	36.83	20.82	---	16.01	ND<50	ND<0.5	ND<0.5	ND<0.5	ND<0.5	---	---	PACE
AW-2	04/22/93	36.83	19.37	---	17.46	ND<50	ND<0.5	ND<0.5	ND<0.5	ND<0.5	---	---	PACE
AW-2	07/15/93	36.83	21.29	---	15.54	ND<50	ND<0.5	ND<0.5	ND<0.5	ND<0.5	---	---	PACE
AW-2	10/21/93	36.83	23.14	---	13.69	ND<50	1.3	1.1	0.9	2.1	---	---	PACE
AW-2	01/27/94	36.83	22.34	---	14.49	ND<50	ND<0.5	ND<0.5	ND<0.5	ND<0.5	---	---	PACE
AW-2	04/21/94	36.83	21.15	---	15.68	ND<50	ND<0.5	ND<0.5	ND<0.5	ND<0.5	---	2.0	PACE
AW-2	09/09/94	36.83	22.09	---	14.74	ND<50	ND<0.5	ND<0.5	ND<0.5	ND<0.5	---	4.1	PACE
AW-2	12/21/94	36.83	20.12	---	16.71	ND<50	ND<0.5	ND<0.5	ND<0.5	ND<0.5	---	2.0	PACE
AW-2	01/30/95	36.83	16.65	---	20.18	ND<50	ND<0.50	ND<0.50	ND<0.50	ND<1.0	---	2.5	ATI
AW-2	04/10/95	36.83	16.22	---	20.61	ND<50	ND<0.50	ND<0.50	ND<0.50	ND<1.0	---	4.4	ATI
AW-2	06/29/95	36.83	17.55	---	19.28	ND<50	ND<0.50	ND<0.50	ND<0.50	ND<1.0	---	7.8	ATI
AW-2	09/18/95	36.83	19.87	---	16.96	---	---	---	---	---	---	---	---
AW-2	09/19/95	36.83	---	---	---	ND<50	ND<0.50	ND<0.50	ND<0.50	ND<1.0	ND<5.0	4.5	ATI
QC-1 (e)	09/19/95	---	---	---	---	ND<50	ND<0.50	ND<0.50	ND<0.50	ND<1.0	ND<5.0	---	ATI
AW-2	12/07/95	36.83	21.31	---	15.52	ND<50	ND<0.50	ND<0.50	ND<0.50	ND<1.0	ND<5.0	4.9	ATI
AW-2	03/28/96	36.83	15.61	---	21.22	ND<50	ND<0.5	ND<1	ND<1	ND<1	ND<10	4.1	SPL
AW-2	06/20/96	36.83	16.30	---	20.53	ND<50	ND<0.5	ND<1	ND<1	ND<1	ND<10	5.2	SPL
AW-2	10/11/96	36.83	19.60	---	17.23	ND<50	ND<0.5	ND<1.0	ND<1.0	ND<1.0	ND<10	6.0	SPL
AW-2	01/02/97	36.83	15.97	---	20.86	ND<50	ND<0.5	ND<1.0	ND<1.0	ND<1.0	ND<10	6.1	SPL
AW-2	04/14/97	36.83	17.19	---	19.64	ND<50	ND<0.5	ND<1.0	ND<1.0	ND<1.0	ND<10	5.3	SPL
AW-2	07/02/97	36.83	18.11	---	18.72	ND<50	ND<0.5	ND<1.0	ND<1.0	ND<1.0	ND<10	5.7	SPL
AW-2	09/30/97	36.83	18.52	---	18.31	ND<50	ND<0.5	ND<1.0	ND<1.0	ND<1.0	860	5.4	SPL
AW-2	01/21/98	36.83	14.46	---	22.37	160	13	ND<1.0	ND<1.0	ND<1.0	110	4.9	SPL
AW-2	04/09/98	36.83	12.85	---	23.98	---	---	---	---	---	---	---	---
AW-2	04/10/98	36.83	---	---	---	ND<50	ND<0.5	ND<1.0	ND<1.0	ND<1.0	ND<10	3.9	SPL
AW-2	06/19/98	36.83	14.37	---	22.46	60	ND<0.5	ND<1.0	ND<1.0	ND<1.0	ND<10	3.6	SPL
AW-2	11/30/98	36.83	16.90	---	19.93	---	---	---	---	---	---	---	---
AW-2	01/21/99	36.83	16.87	---	19.96	ND<50	ND<1.0	ND<1.0	ND<1.0	ND<1.0	ND<1.0	---	SPL
AW-2	04/30/99	36.83	17.01	---	19.82	---	---	---	---	---	---	---	---
AW-2	07/09/99	36.83	17.83	---	19.00	---	---	---	---	---	---	---	---
AW-2	11/03/99	36.83	19.74	---	17.09	---	---	---	---	---	---	---	---
AW-2	01/12/00	36.83	19.90	---	16.93	ND<50	ND<0.5	ND<0.5	ND<0.5	ND<0.5	ND<0.5	---	PACE
AW-2	04/13/00	36.83	19.75	---	17.08	---	---	---	---	---	---	---	---
AW-2	07/26/00	36.83	19.86	---	16.97	---	---	---	---	---	---	---	---

TABLE 1 - SUMMARY OF RESULTS OF GROUNDWATER MONITORING

WELL ID.	DATE OF MONITORING/ SAMPLING	CASING ELEVATION (a) (Feet)	DEPTH TO WATER (Feet)	PRODUCT THICKNESS (Feet)	GROUNDWATER ELEVATION (b) (Feet)	TPH-G (ug/l)	B (ug/l)	T (ug/l)	E (ug/l)	X (ug/l)	MTBE (ug/l)	DO (ppm)	LAB
AW-2	10/24/00	36.83	18.77	--	18.06	--	--	--	--	--	--	--	--
AW-2 (f)	01/19/01	36.83	--	--	--	--	--	--	--	--	--	--	--

TABLE 1 - SUMMARY OF RESULTS OF GROUNDWATER MONITORING

WELL ID	DATE OF MONITORING/ SAMPLING	CASING ELEVATION (a) (Feet)	DEPTH TO WATER (Feet)	PRODUCT THICKNESS (Feet)	GROUNDWATER ELEVATION (b) (Feet)	TPH-G (ug/l)	B (ug/l)	T (ug/l)	E (ug/l)	X (ug/l)	MTBE (ug/l)	DO (ppm)	LAB
AW-3	04/05/91	39.13	23.90	---	15.23	5200	980	450	95	310	---	---	SUP
AW-3	04/01/92	39.13	22.50	---	16.63	4700	890	47	43	110	---	---	APP
AW-3	07/06/92	39.13	23.26	---	15.87	3900	3100	30	80	99	---	---	ANA
AW-3	10/07/92	39.13	24.75	---	14.38	5000	2600	ND<0.5	ND<0.5	59	---	---	ANA
AW-3	01/14/93	39.13	23.59	---	15.54	350	250	ND<0.5	ND<0.5	ND<0.5	---	---	PACE
AW-3	04/22/93	39.13	19.42	---	19.71	240	71	2.4	0.6	4.0	---	---	PACE
AW-3	07/15/93	39.13	20.09	---	19.04	650	71	2.8	1.5	1.1	38	(c)	PACE
AW-3	10/21/93	39.13	21.88	---	17.25	160	4.8	1.7	1.6	3.6	---	---	PACE
QC-1 (e)	10/21/93	---	---	---	---	170	6.1	2.0	1.7	4.4	---	---	PACE
AW-3	01/27/94	39.13	22.33	---	16.80	92	2.1	ND<0.5	ND<0.5	ND<0.5	---	---	PACE
QC-1 (e)	01/27/94	---	---	---	---	90	2.9	0.5	ND<0.5	ND<0.5	---	---	PACE
AW-3	04/21/94	39.13	20.96	---	18.17	150	3.6	0.8	0.9	2.5	---	1.3	PACE
AW-3	09/09/94	39.13	21.60	---	17.53	53	ND<0.5	ND<0.5	ND<0.5	ND<0.5	---	1.9	PACE
AW-3 (f)	12/21/94	39.13	---	---	---	---	---	---	---	---	---	---	---
AW-3 (f)	01/30/95	39.13	---	---	---	---	---	---	---	---	---	---	---
AW-3 (f)	04/10/95	39.13	---	---	---	---	---	---	---	---	---	---	---
AW-3	06/29/95	39.13	15.41	---	23.72	ND<50	ND<0.50	ND<0.50	ND<0.50	ND<1.0	---	8.0	ATI
AW-3	09/18/95	39.13	17.83	---	21.30	---	---	---	---	---	---	---	---
AW-3	09/19/95	39.13	---	---	---	61000	11000	2900	4100	13000	790	7.4	ATI
AW-3	12/07/95	39.13	19.27	---	19.86	ND<50	ND<0.50	ND<0.50	ND<0.50	ND<1.0	ND<5.0	3.4	ATI
QC-1 (e)	12/07/95	---	---	---	---	ND<50	ND<0.50	ND<0.50	ND<0.50	ND<1.0	ND<5.0	---	ATI
AW-3	03/28/96	39.13	13.85	---	25.28	ND<50	ND<0.5	ND<1	ND<1	ND<1	ND<10	4.1	SPL
QC-1 (e)	03/28/96	---	---	---	---	ND<50	ND<0.5	ND<1	ND<1	ND<1	ND<10	---	SPL
AW-3	06/20/96	39.13	14.47	---	24.66	ND<50	ND<0.5	ND<1	ND<1	ND<1	ND<10	4.2	SPL
QC-1 (e)	06/20/96	---	---	---	---	ND<50	ND<0.5	ND<1	ND<1	ND<1	ND<10	---	SPL
AW-3	10/11/96	39.13	17.97	---	21.16	ND<50	ND<0.5	ND<1.0	ND<1.0	ND<1.0	ND<10	4.7	SPL
QC-1 (e)	10/11/96	---	---	---	---	ND<50	ND<0.5	ND<1.0	ND<1.0	ND<1.0	ND<10	---	SPL
AW-3	01/02/97	39.13	13.00	---	26.13	ND<50	ND<0.5	ND<1.0	ND<1.0	ND<1.0	ND<10	5.6	SPL
AW-3	04/14/97	39.13	14.36	---	24.77	ND<50	ND<0.5	ND<1.0	ND<1.0	ND<1.0	ND<10	5.0	SPL
QC-1 (e)	04/15/97	---	---	---	---	ND<50	ND<0.5	ND<1.0	ND<1.0	ND<1.0	ND<10	---	SPL
AW-3	07/02/97	39.13	15.87	---	23.26	ND<50	ND<0.5	ND<1.0	ND<1.0	ND<1.0	ND<10	5.4	SPL
AW-3	09/30/97	39.13	17.50	---	21.63	ND<250	ND<2.5	ND<5.0	ND<5.0	ND<5.0	810	5.7	SPL
AW-3	01/21/98	39.13	11.98	---	27.15	140	ND<0.5	ND<1.0	ND<1.0	ND<1.0	99	4.6	SPL
QC-1 (e)	01/21/98	---	---	---	---	150	ND<0.5	ND<1.0	ND<1.0	1.2	110	---	SPL
AW-3	04/09/98	39.13	9.45	---	29.68	---	---	---	---	---	---	---	---
AW-3	04/10/98	39.13	---	---	---	ND<50	ND<0.5	ND<1.0	ND<1.0	1.6	ND<10	4.5	SPL
QC-1 (e)	04/10/98	---	---	---	---	ND<50	ND<0.5	ND<1.0	1.4	1.7	ND<10	---	SPL
AW-3	06/19/98	39.13	12.13	---	27.00	ND<50	ND<0.5	ND<1.0	ND<1.0	ND<1.0	ND<10	4.4	SPL
AW-3	11/30/98	39.13	15.91	---	23.22	---	---	---	---	---	---	---	---

TABLE 1 - SUMMARY OF RESULTS OF GROUNDWATER MONITORING

WELL ID	DATE OF MONITORING/ SAMPLING	CASING ELEVATION (a) (Feet)	DEPTH TO WATER (Feet)	PRODUCT THICKNESS (Feet)	GROUNDWATER ELEVATION (b) (Feet)	TPH-G (ug/l)	B (ug/l)	T (ug/l)	E (ug/l)	X (ug/l)	MTBE (ug/l)	DO (ppm)	LAB
AW-3	01/21/99	39.13	15.93	---	23.20	ND<50	ND<1.0	ND<1.0	ND<1.0	ND<1.0	ND<1.0	---	SPL
AW-3	04/30/99	39.13	15.98	---	23.15	---	---	---	---	---	---	---	---
AW-3	07/09/99	39.13	14.58	---	24.55	---	---	---	---	---	---	---	---
AW-3	11/03/99	39.13	17.43	---	21.70	---	---	---	---	---	---	---	---
AW-3	01/12/00	39.13	18.30	---	20.83	ND<50	ND<0.5	ND<0.5	ND<0.5	ND<0.5	ND<0.5	---	PACE
AW-3	04/13/00	39.13	18.89	---	20.24	---	---	---	---	---	---	---	---
AW-3	07/26/00	39.13	18.67	---	20.46	---	---	---	---	---	---	---	---
AW-3	10/24/00	39.13	18.98	---	20.15	---	---	---	---	---	---	---	---
AW-3	01/19/01	39.13	16.74	---	22.39	---	---	---	---	---	---	---	---

TABLE 1 - SUMMARY OF RESULTS OF GROUNDWATER MONITORING

WELL ID	DATE OF MONITORING/ SAMPLING	CASING ELEVATION (a) (Feet)	DEPTH TO WATER (Feet)	PRODUCT THICKNESS (Feet)	GROUNDWATER ELEVATION (b) (Feet)	TPH-G (ug/l)	B (ug/l)	T (ug/l)	E (ug/l)	X (ug/l)	MTBE (ug/l)	DO (ppm)	LAB
AW-4	04/05/91	39.08	25.12	---	13.96	110000	40000	13000	2000	5500	---	---	SUP
AW-4	04/01/92	39.08	23.56	---	15.52	230000	57000	31000	2900	7600	---	---	APP
QC-1 (e)	04/01/92	---	---	---	---	210000	55000	23000	2900	7000	---	---	APP
AW-4	07/06/92	39.08	25.87	---	13.21	38000	16000	5400	2000	6100	---	---	ANA
AW-4	10/07/92	39.08	27.53	---	11.55	120000	41000	26000	4700	13000	---	---	ANA
AW-4	01/14/93	39.08	24.12	---	14.96	62000	18000	14000	2700	7700	1400 (c)	---	PACE
AW-4	04/22/93	39.08	21.47	---	17.61	18000	1100	2100	320	3500	---	---	PACE
AW-4	07/15/93	39.08	23.30	---	15.78	21000	820	2300	590	3800	2000 (c)	---	PACE
AW-4	10/21/93	39.08	25.08	---	14.00	11000	570	83	630	2300	4600 (c)	---	PACE
AW-4	01/27/94	39.08	24.61	---	14.47	12000	420	460	600	2200	6400 (c)	---	PACE
AW-4	04/21/94	39.08	22.96	---	16.12	12000	110	250	150	1900	16 (c)	1.5	PACE
QC-1 (e)	04/21/94	---	---	---	---	14000	71	160	29	1200	13000 (c)	---	PACE
AW-4	09/09/94	39.08	23.85	---	15.23	9700	75	64	280	2000	---	2.1	PACE
AW-4 (f)	12/21/94	39.08	---	---	---	---	---	---	---	---	---	---	---
AW-4 (f)	01/30/95	39.08	---	---	---	---	---	---	---	---	---	---	---
AW-4	04/10/95	39.08	18.07	---	21.01	3700	69	8.7	44	130	---	8.5	ATI
AW-4	06/29/95	39.08	19.25	---	19.83	8000	62	190	190	1100	---	7.5	ATI
AW-4	09/18/95	39.08	20.73	---	18.35	---	---	---	---	---	---	---	---
AW-4	09/19/95	39.08	---	---	---	12000	660	1600	200	1900	7100	8.3	ATI
AW-4	12/07/95	39.08	22.49	---	16.59	41000	8400	7200	710	6300	5200	3.6	ATI
AW-4 (f)	03/28/96	39.08	16.49	---	22.59	---	---	---	---	---	---	---	---
AW-4	06/20/96	39.08	16.00	---	23.08	ND<50	ND<0.5	ND<1	ND<1	ND<1	12	---	SPL
AW-4	10/11/96	39.08	19.52	---	19.56	36000	12000	5500	ND<25	3800	880/1000 (g)	6.2	SPL
AW-4	01/02/97	39.08	15.80	---	23.28	ND<50	ND<0.5	ND<1.0	ND<1.0	ND<1.0	22	6.4	SPL
QC-1 (e)	01/02/97	---	---	---	---	ND<50	61	3.8	3.5	8.1	110	---	SPL
AW-4	04/14/97	39.08	17.01	---	22.07	---	---	---	---	---	---	---	---
AW-4	04/15/97	39.08	---	---	---	ND<50	ND<0.5	ND<1.0	ND<1.0	ND<1.0	ND<10	5.4	SPL
AW-4	07/02/97	39.08	19.68	---	19.40	ND<50	21	ND<1.0	ND<1.0	ND<1.0	41	4.1	SPL
AW-4 (f)	09/30/97	39.08	22.71	---	16.37	---	---	---	---	---	---	---	---
AW-4	01/21/98	39.08	15.89	---	23.19	13000	2900	ND<10	230	314	3100	3.9	SPL
AW-4	04/09/98	39.08	13.50	---	25.58	---	---	---	---	---	---	---	---
AW-4	04/10/98	39.08	---	---	---	890	ND<0.5	ND<1	ND<1	ND<1	730	4.9	SPL
AW-4	06/19/98	39.08	14.75	---	24.33	60	ND<0.5	ND<1.0	ND<1.0	ND<1.0	34	4.3	SPL
AW-4	11/30/98	39.08	19.25	---	19.83	---	---	---	---	---	---	---	---
AW-4	01/21/99	39.08	18.94	---	20.14	3700	830	93	200	360	30	---	---
AW-4	04/30/99	39.08	19.10	---	19.98	---	---	---	---	---	---	---	---
AW-4	07/09/99	39.08	18.93	---	20.15	76000	12000	6600	2000	8700	320	---	SPL
AW-4	11/03/99	39.08	20.65	---	18.43	---	---	---	---	---	---	---	---

TABLE 1 - SUMMARY OF RESULTS OF GROUNDWATER MONITORING

WELL ID	DATE OF MONITORING/ SAMPLING	CASING ELEVATION (a) (Feet)	DEPTH TO WATER (Feet)	PRODUCT THICKNESS (Feet)	GROUNDWATER ELEVATION (b) (Feet)	TPH-G (ug/l)	B (ug/l)	T (ug/l)	E (ug/l)	X (ug/l)	MTBE (ug/l)	DO (ppm)	LAB
AW-4	01/12/00	39.08	21.21	---	17.87	67000	12000	3500	2900	15000	280	---	PACE
AW-4	04/13/00	39.08	21.33	---	17.75	---	---	---	---	---	---	---	---
AW-4	05/24/00	39.08	19.84	---	19.24	---	---	---	---	---	---	---	---
AW-4	06/01/00	39.08	19.04	---	20.04	---	---	---	---	---	---	---	---
AW-4	06/08/00	39.08	18.32	---	20.76	---	---	---	---	---	---	---	---
AW-4	06/15/00	39.08	16.70	---	22.38	---	---	---	---	---	---	---	---
AW-4	07/26/00	39.08	21.50	---	17.58	910	ND<0.5	ND<0.5	ND<0.5	ND<0.5	3500	---	PACE
AW-4	10/24/00	39.08	22.00	---	17.08	---	---	---	---	---	---	---	---
AW-4	01/19/01	39.08	18.97	---	20.11	6600	2460	24	497	534	267	---	PACE

TABLE 1 - SUMMARY OF RESULTS OF GROUNDWATER MONITORING

WELL ID	DATE OF MONITORING/ SAMPLING	CASING ELEVATION (a) (Feet)	DEPTH TO WATER (Feet)	PRODUCT THICKNESS (Feet)	GROUNDWATER ELEVATION (b) (Feet)	TPH-G (ug/l)	B (ug/l)	T (ug/l)	E (ug/l)	X (ug/l)	MTBE (ug/l)	DO (ppm)	LAB
AW-5	04/05/91	38.51	25.48	---	13.03	420	31	7.5	20	68	---	---	SUP
AW-5	04/01/92	38.51	23.95	---	14.56	---	---	---	---	---	---	---	---
AW-5	04/02/92	38.51	---	---	---	4000	270	63	190	290	---	---	APP
AW-5	07/06/92	38.51	26.48	---	12.03	1400	160	ND<2.5	250	58	---	---	ANA
AW-5	10/07/92	38.51	28.18	---	10.33	360	12	0.6	8.7	5	---	---	ANA
AW-5	01/14/93	38.51	24.15	---	14.36	1700	270	7.5	130	62	---	---	PACE
AW-5	04/22/93	38.51	22.43	---	16.08	2700	780	30	220	180	---	---	PACE
QC-1 (e)	04/22/93	---	---	---	---	3500	780	29	240	210	---	---	PACE
AW-5	07/15/93	38.51	24.31	---	14.20	1300	69	16	67	120	---	---	PACE
QC-1 (e)	07/15/93	---	---	---	---	1300	68	8.3	64	99	---	---	PACE
AW-5	10/21/93	38.51	26.05	---	12.46	510	9.6	1.5	17	45	75	(c)	PACE
AW-5	01/27/94	38.51	26.42	---	12.09	420	3.3	ND<0.5	1.0	0.9	---	---	PACE
AW-5	04/21/94	38.51	24.36	---	14.15	1000	110	25	56	27	75	(c)	PACE
AW-5	09/09/94	38.51	24.55	---	13.96	210	ND<0.5	ND<0.5	0.5	0.9	---	---	PACE
AW-5	12/21/94	38.51	22.30	---	16.21	410	ND<0.5	20	4.3	1.4	---	---	PACE
QC-1 (e)	12/21/94	---	---	---	---	340	ND<0.5	15	3.3	1.4	---	---	PACE
AW-5	01/30/95	38.51	18.88	---	19.63	210	0.6	11	8.8	2	---	---	ATI
AW-5	04/10/95	38.51	18.44	---	20.07	500	1.4	0.59	6.5	4.3	---	---	ATI
AW-5	06/29/95	38.51	19.92	---	18.59	490	(d) 1.2	0.58	7.3	2.2	---	---	ATI
AW-5	09/18/95	38.51	22.15	---	16.36	---	---	---	---	---	---	---	---
AW-5	09/19/95	38.51	---	---	---	260	0.62	ND<0.50	3.1	1.1	110	---	ATI
AW-5	12/07/95	38.51	23.75	---	14.76	60	ND<0.50	ND<0.50	ND<0.50	ND<1.0	210	---	ATI
AW-5	03/28/96	38.51	17.76	---	20.75	ND<50	ND<0.5	ND<1	ND<1	ND<1	63	---	SPL
AW-5	06/20/96	38.51	18.46	---	20.05	ND<50	ND<0.5	ND<1	ND<1	ND<1	ND<10	---	SPL
AW-5	10/11/96	38.51	21.84	---	16.67	ND<50	ND<0.5	ND<1.0	ND<1.0	ND<1.0	ND<10	---	SPL
AW-5	01/02/97	38.51	18.01	---	20.50	ND<50	ND<0.5	ND<1.0	ND<1.0	ND<1.0	ND<10	---	SPL
AW-5	04/14/97	38.51	19.35	---	19.16	ND<50	ND<0.5	ND<1.0	ND<1.0	ND<1.0	ND<10	---	SPL
AW-5	07/02/97	38.51	20.29	---	18.22	ND<50	ND<0.5	ND<1.0	ND<1.0	ND<1.0	ND<10	---	SPL
AW-5	09/30/97	38.51	23.15	---	15.36	ND<250	ND<2.5	ND<5.0	ND<5.0	ND<5.0	1300	---	SPL
AW-5	01/21/98	38.51	17.33	---	21.18	6100	ND<0.5	2.1	ND<1.0	ND<1.0	3700	---	SPL
AW-5	04/09/98	38.51	15.25	---	23.26	---	---	---	---	---	---	---	---
AW-5	04/10/98	38.51	---	---	---	3500	ND<0.5	ND<1.0	ND<1.0	ND<1.0	3000	---	SPL
AW-5	06/19/98	38.51	17.39	---	21.12	3300	ND<0.5	ND<1.0	ND<1.0	ND<1.0	2500	---	SPL
AW-5 (f)	11/30/98	38.51	---	---	---	---	---	---	---	---	---	---	---
AW-5	01/21/99	38.51	21.22	---	17.29	2800	ND<1.0	ND<1.0	ND<1.0	ND<1.0	1800	---	SPL
AW-5	04/30/99	38.51	21.50	---	17.01	---	---	---	---	---	---	---	---
AW-5	07/09/99	38.51	20.15	---	18.36	4000	ND<1.0	ND<1.0	ND<1.0	ND<1.0	3400/3500 (g)	---	SPL
AW-5	11/03/99	38.51	22.04	---	16.47	---	---	---	---	---	---	---	---

TABLE 1 - SUMMARY OF RESULTS OF GROUNDWATER MONITORING

WELL ID	DATE OF MONITORING/ SAMPLING	CASING ELEVATION (a) (Feet)	DEPTH TO WATER (Feet)	PRODUCT THICKNESS (Feet)	GROUNDWATER ELEVATION (b) (Feet)	TPH-G (ug/l)	B (ug/l)	T (ug/l)	E (ug/l)	X (ug/l)	MTBE (ug/l)	DO (ppm)	LAB
AW-5	01/12/00	38.51	22.59	---	15.92	1000 (j)	7.3	30	6.7	40	4600	---	PACE
AW-5	04/13/00	38.51	23.11	---	15.40	---	---	---	---	---	---	---	---
AW-5	07/26/00	38.51	22.72	---	15.79	1800	94	35	5.9	27	16000	---	PACE
AW-5	10/24/00	38.51	20.15	---	18.36	---	---	---	---	---	---	---	---
AW-5	01/19/01	38.51	19.79	---	18.72	2600	ND<0.5	ND<0.5	ND<0.5	ND<0.5	4580	---	PACE

TABLE 1 - SUMMARY OF RESULTS OF GROUNDWATER MONITORING

WELL ID	DATE OF MONITORING/ SAMPLING	CASING ELEVATION (a) (Feet)	DEPTH TO WATER (Feet)	PRODUCT THICKNESS (Feet)	GROUNDWATER ELEVATION (b) (Feet)	TPH-G (ug/l)	B (ug/l)	T (ug/l)	E (ug/l)	X (ug/l)	MTBE (ug/l)	DO (ppm)	LAB
AW-6	04/05/91	37.08	22.48	---	14.60	1100	80	19	1.4	230	---	---	SUP
AW-6	04/01/92	37.08	22.50	---	14.58	---	---	---	---	---	---	---	---
AW-6	04/02/92	37.08	---	---	---	ND<50	ND<0.5	ND<0.5	ND<0.5	ND<0.5	---	---	APP
AW-6	07/06/92	37.08	22.74	---	14.34	ND<50	ND<0.5	ND<0.5	ND<0.5	ND<0.5	---	---	ANA
AW-6	10/07/92	37.08	24.64	---	12.44	ND<50	ND<0.5	ND<0.5	ND<0.5	ND<0.5	---	---	ANA
AW-6	01/14/93	37.08	22.36	---	14.72	ND<50	ND<0.5	ND<0.5	ND<0.5	ND<0.5	---	---	PACE
AW-6	04/22/93	37.08	22.82	---	14.26	ND<50	ND<0.5	ND<0.5	ND<0.5	ND<0.5	---	---	PACE
AW-6	07/15/93	37.08	20.49	---	16.59	ND<50	ND<0.5	ND<0.5	ND<0.5	0.8	---	---	PACE
AW-6	10/21/93	37.08	22.84	---	14.24	ND<50	0.5	0.6	ND<0.5	0.7	---	---	PACE
AW-6	01/27/94	37.08	22.33	---	14.75	ND<50	ND<0.5	0.9	3.1	12	---	---	PACE
AW-6	04/21/94	37.08	20.66	---	16.42	ND<50	ND<0.5	ND<0.5	ND<0.5	ND<0.5	---	1.7	PACE
AW-6	09/09/94	37.08	21.57	---	15.51	ND<50	0.9	ND<0.5	ND<0.5	0.5	---	2.9	PACE
AW-6	12/21/94	37.08	19.40	---	17.68	ND<50	1.8	0.8	0.8	3.2	---	1.1	PACE
AW-6	01/30/95	37.08	16.74	---	20.34	ND<50	ND<0.50	ND<0.50	ND<0.50	ND<1.0	---	2.2	ATI
QC-1 (e)	01/30/95	---	---	---	---	ND<50	ND<0.50	ND<0.50	ND<0.50	ND<1.0	---	---	ATI
AW-6	04/10/95	37.08	16.01	---	21.07	ND<50	ND<0.50	ND<0.50	ND<0.50	ND<1.0	---	8.6	ATI
AW-6	06/29/95	37.08	17.54	---	19.54	ND<50	ND<0.50	ND<0.50	ND<0.50	ND<1.0	---	6.3	ATI
AW-6	09/18/95	37.08	19.65	---	17.43	---	---	---	---	---	---	---	---
AW-6	09/19/95	37.08	---	---	---	ND<50	ND<0.50	ND<0.50	ND<0.50	ND<1.0	25	8.3	ATI
AW-6	12/07/95	37.08	20.35	---	16.73	ND<50	ND<0.50	ND<0.50	ND<0.50	ND<1.0	16	4.7	ATI
AW-6	03/28/96	37.08	14.99	---	22.09	ND<50	ND<0.5	ND<1	ND<1	ND<1	ND<10	4.0	SPL
AW-6	06/20/96	37.08	15.59	---	21.49	ND<50	ND<0.5	ND<1	ND<1	ND<1	ND<10	4.6	SPL
AW-6	10/11/96	37.08	19.09	---	17.99	ND<50	ND<0.5	ND<1.0	ND<1.0	ND<1.0	ND<10	5.3	SPL
AW-6	01/02/97	37.08	15.11	---	21.97	ND<50	ND<0.5	ND<1.0	ND<1.0	ND<1.0	ND<10	5.5	SPL
AW-6	04/14/97	37.08	16.25	---	20.83	ND<50	ND<0.5	ND<1.0	ND<1.0	ND<1.0	ND<10	3.9	SPL
AW-6	07/02/97	37.08	17.99	---	19.09	ND<50	ND<0.5	ND<1.0	ND<1.0	ND<1.0	ND<10	5.2	SPL
AW-6	09/30/97	37.08	20.50	---	16.58	ND<50	ND<0.5	ND<1.0	ND<1.0	ND<1.0	ND<10	6.0	SPL
AW-6	01/21/98	37.08	15.72	---	21.36	160	ND<0.5	ND<1.0	ND<1.0	ND<1.0	110	5.0	SPL
AW-6	04/09/98	37.08	13.31	---	23.77	---	---	---	---	---	---	---	---
AW-6	04/10/98	37.08	---	---	---	370	ND<0.5	ND<1.0	ND<1.0	ND<1.0	300	4.3	SPL
AW-6	06/19/98	37.08	15.18	---	21.90	830	2.0	ND<1.0	ND<1.0	ND<1.0	690	4.0	SPL
AW-6 (f)	11/30/98	37.08	---	---	---	---	---	---	---	---	---	---	---
AW-6	01/21/99	37.08	15.78	---	21.30	2300	ND<1.0	ND<1.0	ND<1.0	ND<1.0	1900	---	SPL
AW-6	04/30/99	37.08	16.01	---	21.07	---	---	---	---	---	---	---	---
AW-6	07/09/99	37.08	17.63	---	19.45	---	---	---	---	---	---	---	---
AW-6	11/03/99	37.08	18.42	---	18.66	---	---	---	---	---	---	---	---

TABLE 1 - SUMMARY OF RESULTS OF GROUNDWATER MONITORING

WELL ID	DATE OF MONITORING/ SAMPLING	CASING ELEVATION (a) (Feet)	DEPTH TO WATER (Feet)	PRODUCT THICKNESS (Feet)	GROUNDWATER ELEVATION (b) (Feet)	TPH-G (ug/l)	B (ug/l)	T (ug/l)	E (ug/l)	X (ug/l)	MTBE (ug/l)	DO (ppm)	LAB
AW-6	01/12/00	37.08	19.92	---	17.16	ND<50	ND<0.5	ND<0.5	ND<0.5	ND<0.5	2700	---	PACE
AW-6	04/13/00	37.08	19.87	---	17.21	---	---	---	---	---	---	---	---
AW-6	07/26/00	37.08	19.99	---	17.09	---	---	---	---	---	---	---	---
AW-6	10/24/00	37.08	18.12	---	18.96	---	---	---	---	---	---	---	---
AW-6	01/19/01	37.08	17.04	---	20.04	2700	ND<0.5	ND<0.5	ND<0.5	ND<0.5	4850	---	PACE

TABLE 1 - SUMMARY OF RESULTS OF GROUNDWATER MONITORING

WELL ID	DATE OF MONITORING/ SAMPLING	CASING ELEVATION (a) (Feet)	DEPTH TO WATER (Feet)	PRODUCT THICKNESS (Feet)	GROUNDWATER ELEVATION (b) (Feet)	TPH-G (ug/l)	B (ug/l)	T (ug/l)	E (ug/l)	X (ug/l)	MTBE (ug/l)	DO (ppm)	LAB
AW-7	04/05/91	37.60	23.38	---	14.22	ND<50	0.4	0.7	ND<0.3	ND<0.3	---	---	SUP
AW-7	04/01/92	37.60	21.92	---	15.68	---	---	---	---	---	---	---	---
AW-7	04/02/92	37.60	---	---	---	ND<50	ND<0.5	3.2	1.0	5.4	---	---	APP
AW-7	07/06/92	37.60	24.50	---	13.10	ND<50	ND<0.5	ND<0.5	ND<0.5	ND<0.5	---	---	ANA
AW-7	10/07/92	37.60	26.18	---	11.42	ND<50	ND<0.5	ND<0.5	ND<0.5	ND<0.5	---	---	ANA
AW-7	01/14/93	37.60	22.03	---	15.57	ND<50	ND<0.5	ND<0.5	ND<0.5	ND<0.5	---	---	PACE
AW-7	04/22/93	37.60	21.18	---	16.42	ND<50	ND<0.5	ND<0.5	ND<0.5	ND<0.5	---	---	PACE
AW-7	07/15/93	37.60	22.09	---	15.51	ND<50	ND<0.5	ND<0.5	ND<0.5	ND<0.5	---	---	PACE
AW-7	10/21/93	37.60	24.05	---	13.55	51	5.0	4.2	3.5	8.2	---	---	PACE
AW-7	01/27/94	37.60	23.40	---	14.20	ND<50	ND<0.5	ND<0.5	ND<0.5	ND<0.5	---	---	PACE
AW-7	04/21/94	37.60	22.24	---	15.36	ND<50	ND<0.5	ND<0.5	ND<0.5	ND<0.5	---	2.5	PACE
AW-7	09/09/94	37.60	22.94	---	14.66	ND<50	ND<0.5	ND<0.5	ND<0.5	0.5	---	4.3	PACE
AW-7	12/21/94	37.60	20.86	---	16.74	ND<50	ND<0.5	ND<0.5	ND<0.5	ND<0.5	---	2.2	PACE
AW-7	01/30/95	37.60	17.51	---	20.09	ND<50	ND<0.50	ND<0.50	ND<0.50	ND<1.0	---	2.7	ATI
AW-7	04/10/95	37.60	16.69	---	20.91	ND<50	ND<0.50	ND<0.50	ND<0.50	ND<1.0	---	4.8	ATI
AW-7	06/29/95	37.60	18.33	---	19.27	ND<50	ND<0.50	ND<0.50	ND<0.50	ND<1.0	---	7.6	ATI
AW-7	09/18/95	37.60	20.68	---	16.92	---	---	---	---	---	---	---	---
AW-7	09/19/95	37.60	---	---	---	ND<50	ND<0.50	ND<0.50	ND<0.50	ND<1.0	ND<5.0	5.1	ATI
AW-7	12/07/95	37.60	22.15	---	15.45	ND<50	ND<0.50	ND<0.50	ND<0.50	ND<1.0	ND<5.0	5.2	ATI
AW-7	03/28/96	37.60	16.38	---	21.22	ND<50	ND<0.5	ND<1	ND<1	ND<1	ND<10	3.9	SPL
AW-7	06/20/96	37.60	17.02	---	20.58	ND<50	ND<0.5	ND<1	ND<1	ND<1	ND<10	5.0	SPL
AW-7	10/11/96	37.60	20.47	---	17.13	ND<50	ND<0.5	ND<1.0	ND<1.0	ND<1.0	ND<10	6.3	SPL
AW-7	01/02/97	37.60	16.70	---	20.90	ND<50	ND<0.5	ND<1.0	ND<1.0	ND<1.0	ND<10	6.2	SPL
AW-7	04/14/97	37.60	17.96	---	19.64	ND<50	ND<0.5	ND<1.0	ND<1.0	ND<1.0	ND<10	5.0	SPL
AW-7	07/02/97	37.60	19.11	---	18.49	ND<50	ND<0.5	ND<1.0	ND<1.0	ND<1.0	ND<10	5.4	SPL
AW-7	09/30/97	37.60	22.97	---	14.63	ND<250	ND<2.5	ND<5.0	ND<5.0	ND<5.0	1100	6.5	SPL
AW-7	01/21/98	37.60	16.50	---	21.10	ND<50	ND<0.5	ND<1.0	ND<1.0	ND<1.0	ND<10	4.9	SPL
AW-7	04/09/98	37.60	13.56	---	24.04	ND<50	ND<0.5	ND<1.0	ND<1.0	ND<1.0	ND<10	4.9	SPL
AW-7	06/19/98	37.60	15.41	---	22.19	ND<50	ND<0.5	ND<1.0	ND<1.0	ND<1.0	ND<10	4.4	SPL
AW-7	11/30/98	37.60	18.90	---	18.70	---	---	---	---	---	---	---	---
AW-7	01/21/99	37.60	18.39	---	19.21	---	---	---	---	---	---	---	---
AW-7	04/30/99	37.60	18.54	---	19.06	---	---	---	---	---	---	---	---
AW-7	07/09/99	37.60	17.98	---	19.62	---	---	---	---	---	---	---	---
AW-7	11/03/99	37.60	20.22	---	17.38	---	---	---	---	---	---	---	---
AW-7	01/12/00	37.60	19.46	---	18.14	---	---	---	---	---	---	---	---
AW-7	04/13/00	37.60	19.59	---	18.01	---	---	---	---	---	---	---	---
AW-7	07/26/00	37.60	19.69	---	17.91	---	---	---	---	---	---	---	---
AW-7	10/24/00	37.60	18.78	---	18.82	---	---	---	---	---	---	---	---
AW-7 (f)	01/19/01	37.60	---	---	---	---	---	---	---	---	---	---	---

TABLE 1 - SUMMARY OF RESULTS OF GROUNDWATER MONITORING

WELL ID	DATE OF MONITORING/ SAMPLING	CASING ELEVATION (a) (Feet)	DEPTH TO WATER (Feet)	PRODUCT THICKNESS (Feet)	GROUNDWATER ELEVATION (b) (Feet)	TPH-G (ug/l)	B (ug/l)	T (ug/l)	E (ug/l)	X (ug/l)	MTBE (ug/l)	DO (ppm)	LAB
AW-9	01/02/97	37.78	10.00	--	27.78	ND<50	ND<0.5	ND<1.0	ND<1.0	ND<1.0	ND<10	6.7	SPL
AW-9 (f)	04/14/97	37.78	--	--	--	--	--	--	--	--	--	--	--
AW-9	07/02/97	37.78	12.71	--	25.07	ND<50	ND<0.5	ND<1.0	ND<1.0	ND<1.0	ND<10	6.0	SPL
AW-9	09/30/97	37.78	21.22	--	16.56	ND<50	ND<0.5	ND<1.0	ND<1.0	ND<1.0	ND<10	6.8	SPL
AW-9	01/21/98	37.78	10.26	--	27.52	ND<50	ND<0.5	ND<1.0	ND<1.0	ND<1.0	ND<10	5.3	SPL
AW-9	04/09/98	37.78	6.77	--	31.01	ND<50	ND<0.5	ND<1.0	ND<1.0	ND<1.0	ND<10	5.6	SPL
AW-9	06/19/98	37.78	8.96	--	28.82	ND<50	ND<0.5	ND<1.0	ND<1.0	ND<1.0	ND<10	4.8	SPL

TABLE 1 - SUMMARY OF RESULTS OF GROUNDWATER MONITORING

WELL ID	DATE OF MONITORING/ SAMPLING	CASING ELEVATION (a) (Feet)	DEPTH TO WATER (Feet)	PRODUCT THICKNESS (Feet)	GROUNDWATER ELEVATION (b) (Feet)	TPH-G (ug/l)	B (ug/l)	T (ug/l)	E (ug/l)	X (ug/l)	MTBE (ug/l)	DO (ppm)	LAB
RW-1	04/05/91	37.73	---	---	---	---	---	---	---	---	---	---	---
RW-1	04/01/92	37.73	22.81	0.30	15.15	---	---	---	---	---	---	---	---
RW-1	07/06/92	37.73	26.92	0.41	11.12	---	---	---	---	---	---	---	---
RW-1	10/07/92	37.73	28.51	1.26	10.17	---	---	---	---	---	---	---	---
RW-1	01/14/93	37.73	23.75	0.25	14.17	---	---	---	---	---	---	---	---
RW-1	04/22/93	37.73	22.70	1.38	16.07	---	---	---	---	---	---	---	---
RW-1	07/15/93	37.73	26.10	0.81	12.24	---	---	---	---	---	---	---	---
RW-1	10/21/93	37.73	25.40	0.49	12.70	---	---	---	---	---	---	---	---
RW-1	10/21/93	37.73	25.40	0.49	12.70	---	---	---	---	---	---	---	---
RW-1	01/27/94	37.73	28.02	0.37	9.99	---	---	---	---	---	---	---	---
RW-1	04/21/94	37.73	23.10	0.91	15.31	---	---	---	---	---	---	---	---
RW-1	09/09/94	37.73	24.39	1.04	14.12	---	---	---	---	---	---	---	---
RW-1 (h)	12/21/94	37.73	---	---	---	---	---	---	---	---	---	---	---
RW-1	12/07/95	37.73	25.71	1.04	12.80	150000	34000	35000	4300	21000	2700	---	ATI
RW-1	03/28/96	37.73	16.75	0.18	21.12	---	---	---	---	---	---	---	---
RW-1 (h)	06/20/96	37.73	25.10	0.02	12.65	---	---	---	---	---	---	---	---
RW-1	10/11/96	37.73	25.51	0.00	12.22	130000	20000	32000	2800	20700	1400/1200 (g)	7.4	SPL
RW-1	01/02/97	37.73	24.49	0.01	13.25	---	---	---	---	---	---	---	---
RW-1	04/14/97	37.73	23.99	0.04	13.77	---	---	---	---	---	---	---	---
RW-1	04/15/97	37.73	---	---	---	1800000	38000	190000	48000	281000	ND<25000	---	SPL
RW-1	07/02/97	37.73	16.40	0.20	21.48	140000	19000	55000	4400	32400	ND<10000	5.7	SPL
QC-1 (e)	07/02/97	---	---	---	---	130000	19000	54000	4700	33400	ND<10000	---	SPL
RW-1	09/30/97	37.73	27.97	0.02	9.78	110000	13000	22000	2000	12500	1100	7.0	SPL
QC-1 (e)	09/30/97	---	---	---	---	140000	17000	29000	2500	15900	1200	---	SPL
RW-1	01/21/98	37.73	14.14	0.44	23.92	270000	21000	48000	3500	25000	1100	4.8	SPL
RW-1	04/09/98	37.73	25.01	0.05	12.76	---	---	---	---	---	---	---	---
RW-1	04/10/98	37.73	---	---	---	220000	26000	46000	4400	24500	ND<2500	5.1	SPL
RW-1	06/19/98	37.73	11.43	---	26.30	180000	19000	32000	3000	17400	ND<2500	4.6	SPL
RW-1	11/30/98	37.73	7.87	---	29.86	---	---	---	---	---	---	---	---
RW-1	01/21/99	37.73	18.90	0.03	18.85	260000	24000	46000	5100	30000	1700	---	SPL
RW-1	07/09/99	37.73	18.58	0.26	19.36	---	---	---	---	---	---	---	---
RW-1	11/03/99	37.73	20.85	0.60	17.36	160000	19000	37000	3800	25000	1500	---	PACE
RW-1	01/12/00	37.73	21.20	0.23	16.71	240000	18000	46000	5800	26000	2100	---	PACE
RW-1	04/13/00	37.73	21.71	0.11	16.11	120000	2100	33000	2800	28000	1500	---	PACE
RW-1	05/24/00	37.73	21.89	0.24	16.03	---	---	---	---	---	---	---	---
RW-1	06/01/00	37.73	16.30	0.01	21.44	---	---	---	---	---	---	---	---
RW-1	06/08/00	37.73	17.88	0.20	20.01	---	---	---	---	---	---	---	---
RW-1	06/15/00	37.73	16.72	0.04	21.04	---	---	---	---	---	---	---	---
RW-1	06/20/00	37.73	21.04	0.20	16.85	---	---	---	---	---	---	---	---

TABLE 1 - SUMMARY OF RESULTS OF GROUNDWATER MONITORING

WELL ID	DATE OF MONITORING/ SAMPLING	CASING ELEVATION (a) (Feet)	DEPTH TO WATER (Feet)	PRODUCT THICKNESS (Feet)	GROUNDWATER ELEVATION (b) (Feet)	TPH-G (ug/l)	B (ug/l)	T (ug/l)	E (ug/l)	X (ug/l)	MTBE (ug/l)	DO (ppm)	LAB
RW-1	07/07/00	37.73	17.21	0.01	20.53	---	---	---	---	---	---	---	---
RW-1	07/20/00	37.73	21.87	0.18	16.00	---	---	---	---	---	---	---	---
RW-1	07/26/00	37.73	21.45	0.13	16.38	67000	160	5300	2100	18000	1100	---	PACE
RW-1	07/31/00	37.73	22.11	---	15.62	---	---	---	---	---	---	---	---
RW-1	08/08/00	37.73	17.80	0.01	19.94	---	---	---	---	---	---	---	---
RW-1	08/16/00	37.73	17.92	---	19.81	---	---	---	---	---	---	---	---
RW-1	08/23/00	37.73	18.11	0.02	19.64	---	---	---	---	---	---	---	---
RW-1	10/24/00	37.73	18.93	---	18.80	---	---	---	---	---	---	---	---
RW-1 (k)	10/25/00	37.73	19.04	---	18.69	360000	18000	78000	34000	180000	2100	---	PACE
RW-1	01/19/01	37.73	18.19	0.05	19.58	110000	9450	19600	3510	21100	1270	---	PACE
QC-2 (i)	10/07/92	---	---	---	---	ND<50	ND<0.5	ND<0.5	ND<0.5	ND<0.5	---	---	ANA
QC-2 (i)	01/14/93	---	---	---	---	ND<50	ND<0.5	ND<0.5	ND<0.5	ND<0.5	---	---	PACE
QC-2 (i)	04/22/93	---	---	---	---	ND<50	ND<0.5	ND<0.5	ND<0.5	ND<0.5	---	---	PACE
QC-2 (i)	07/15/93	---	---	---	---	ND<50	ND<0.5	ND<0.5	ND<0.5	ND<0.5	---	---	PACE
QC-2 (i)	10/21/93	---	---	---	---	ND<50	ND<0.5	ND<0.5	ND<0.5	ND<0.5	---	---	PACE
QC-2 (i)	01/27/94	---	---	---	---	ND<50	ND<0.5	ND<0.5	ND<0.5	ND<0.5	---	---	PACE
QC-2 (i)	04/21/94	---	---	---	---	ND<50	ND<0.5	ND<0.5	ND<0.5	ND<0.5	---	---	PACE
QC-2 (i)	09/09/94	---	---	---	---	ND<50	ND<0.5	ND<0.5	ND<0.5	ND<0.5	---	---	PACE
QC-2 (i)	12/21/94	---	---	---	---	ND<50	ND<0.5	ND<0.5	ND<0.5	ND<0.5	---	---	PACE
QC-2 (i)	01/30/95	---	---	---	---	ND<50	ND<0.50	ND<0.50	ND<0.50	ND<1.0	---	---	ATI
QC-2 (i)	04/10/95	---	---	---	---	ND<50	ND<0.50	ND<0.50	ND<0.50	ND<1.0	---	---	ATI
QC-2 (i)	06/27/95	---	---	---	---	ND<50	ND<0.50	ND<0.50	ND<0.50	ND<1.0	---	---	ATI
QC-2 (i)	09/19/95	---	---	---	---	ND<50	ND<0.50	ND<0.50	ND<0.50	ND<1.0	ND<5.0	---	ATI
QC-2 (i)	12/07/95	---	---	---	---	ND<50	ND<0.50	ND<0.50	ND<0.50	ND<1.0	ND<5.0	---	ATI
QC-2 (i)	03/28/96	---	---	---	---	ND<50	ND<0.5	ND<1	ND<1	ND<1	ND<10	---	SPL
QC-2 (i)	06/20/96	---	---	---	---	ND<50	ND<0.5	ND<1	ND<1	ND<1	ND<10	---	SPL

TABLE 1 - SUMMARY OF RESULTS OF GROUNDWATER MONITORING

ABBREVIATIONS

TPH-G	Total petroleum hydrocarbons as gasoline	(a) Top of casing elevations surveyed to the nearest 0.01 foot above mean sea level.
B	Benzene	(b) Groundwater elevations adjusted assuming a specific gravity of 0.75 for free product.
T	Toluene	(c) A copy of the documentation for this data is included in Appendix C of Alisto report 10-025-13-003.
E	Ethylbenzene	(d) MTBE peak. See documentation in Appendix C of Alisto report 10-025-13-003.
X	Total xylenes	(e) Blind duplicate.
MTBE	Methyl tert butyl ether	(f) Well inaccessible.
DO	Dissolved oxygen	(g) EPA Methods 8020/8260 used.
ug/l	Micrograms per liter	(h) Well not monitored and/or sampled due to vapor extraction system.
ppm	Parts per million	(i) Travel blank.
---	Not available/applicable/measurable	(j) This gasoline does not include MTBE.
ND	Not detected above reported detection limit	(k) Well was sampled on a different date from the other wells due to lack of proper equipment.
PACE	Pace, Inc.	
SUP	Superior Analytical Laboratories, Inc.	
APP	Applied Analytical Laboratory	
ANA	Anametrix, Inc.	
ATI	Analytical Technologies, Inc.	
SPL	Southern Petroleum Laboratories	

TABLE 2 - PRODUCT REMOVAL STATUS

WELL ID	DATE OF MONITORING	PRODUCT REMOVED (Gallons)	PRODUCT REMOVED CUMULATIVE (Gallons)
RW-1	10/06/93	1.00	1.00
	10/14/94	1.00	2.00
	10/20/94	18.00	20.00
	10/26/94	3.00	23.00
	11/02/93	5.00	28.00
	11/10/94	6.00	34.00
	11/16/94	2.50	36.50
	11/23/94	5.00	41.50
	11/30/93	2.00	43.50
	12/07/93	4.00	47.50
	12/17/93	1.50	49.00
	01/04/94	5.00	54.00
	01/12/94	3.50	57.50
	01/20/94	2.50	60.00
	02/11/94	4.00	64.00
	02/18/93	3.50	67.50
	02/25/94	3.00	70.50
	03/04/94	3.50	74.00
	03/18/94	5.50	79.50
	03/30/94	4.00	83.50
	04/13/94	4.60	88.10
	04/21/94	4.20	92.30
	04/29/94	4.50	96.80
	05/06/94	5.50	102.30
	05/13/94	3.50	105.80
	05/20/94	3.50	109.30
	05/26/94	4.50	113.80
	06/02/94	3.50	117.30
	06/09/94	2.50	119.80
	06/16/94	3.50	123.30
	06/23/94	4.00	127.30
	06/29/94	2.50	129.80
	07/07/94	2.00	131.80
	07/12/94	3.00	134.80
	07/20/94	1.50	136.30
	07/29/94	3.50	139.80
	08/05/94	1.50	141.30
	08/12/94	2.00	143.30
	08/18/94	2.50	145.80
	09/09/94	3.50	149.30
	09/16/94	4.00	153.30
	09/23/94	2.00	155.30
	12/07/95	0.00	155.30
	03/28/96	0.01	155.31
	06/20/96	0.00	155.31
	04/14/97	<0.05	155.31
	07/02/97	0.25	155.56
	09/30/97	<0.01	155.56
	01/21/98	0.5	156.06
	04/10/98	0.09	156.15
	06/19/98	<0.01	156.15
	11/30/98	0.00	156.15
	01/21/99	0.00	156.15
	04/30/99	0.11	156.26
	07/09/99	0.00	156.26
	11/03/99	1.06	157.32
	01/12/00	0.53	157.85
	04/13/00	0.26	158.11
	05/24/00	0.53	158.64

TABLE 2 - PRODUCT REMOVAL STATUS

WELL ID	DATE	PRODUCT REMOVED (Gallons)	PRODUCT REMOVED CUMULATIVE (Gallons)
RW-1	06/01/00	0.00	158.64
	06/08/00	0.26	158.90
	06/15/00	0.13	159.03
	06/20/00	0.53	159.56
	07/07/00	0.01	159.57
	07/20/00	0.11	159.68
	07/26/00	0.13	159.81
	07/31/00	0.00	159.81
	08/08/00	0.01	159.82
	08/16/00	0.00	159.82
	08/23/00	0.13	159.95
	08/31/00	0.40	160.35
	09/08/00	0.53	160.88
	09/25/00	0.01	160.89
	10/24/00	0.00	160.89
01/19/01	0.11	161.00	
MW-1	10/20/93	0.10	0.10
	11/10/93	0.10	0.20
	09/09/94	SHEEN	0.20
	10/26/94	SHEEN	0.20
	11/16/94	SHEEN	0.20
	12/21/94	0.25	0.45
	02/08/95	0.00	0.45
	04/10/95	0.25	0.70
	06/29/95	SHEEN	0.70
	09/18/95	SHEEN	0.70
	12/07/95	SHEEN	0.70
	03/28/96	<0.001	0.70
	06/20/96	0.002	0.70
	10/11/96	<0.001	0.70
	01/02/97	<0.01	0.70
	04/14/97	<0.01	0.70
	07/02/97	<0.01	0.70
	01/21/98	<0.01	0.70
	06/19/98	<0.01	0.70
	11/30/98	0.00	0.70
	01/21/99	SHEEN	0.70
	04/30/99	SHEEN	0.70
	07/09/99	SHEEN	0.70
	11/03/99	0.00	0.70
01/12/00	0.00	0.70	
04/13/00	0.00	0.70	
05/24/00	0.00	0.70	
06/01/00	0.00	0.70	
06/08/00	0.00	0.70	
06/15/00	0.00	0.70	

NOTE: Groundwater and soil vapor extraction equipment installed in RW-1 in October 1994.

Analytical Appendix



Pace Analytical Services, Inc.
900 Gemini Avenue
Houston, TX 77058
Phone: 281.488.1810
Fax: 281.488.4661

February 05, 2001

Mr. Scott Boor
Blaine Tech Services, Inc.
1680 Rogers Ave.
San Jose, CA 95112

RE: Lab Project Number: 8519500
Client Project ID: BP Site# 11133

Dear Mr. Boor:

Enclosed are the analytical results for sample(s) received by the laboratory on January 25, 2001. If you have any questions concerning this report, please feel free to contact me.

Sincerely,



Paula Kirtley
Project Manager

Enclosures

REPORT OF LABORATORY ANALYSIS

This report shall not be reproduced, except in full,
without the written consent of Pace Analytical Services, Inc.



Pace Analytical Services, Inc.
 900 Gemini Avenue
 Houston, TX 77058
 Phone: 281.488.1810
 Fax: 281.488.4661

Blaine Tech Services, Inc.
 1680 Rogers Ave.
 San Jose, CA 95112

Lab Project Number: 8519500
 Client Project ID: BP Site# 11133

Attn: Mr. Scott Boor
 Phone:

Lab Sample No: 851674017 Project Sample Number: 8519500-001 Date Collected: 01/19/01 11:25
 Client Sample ID: A (11133) Matrix: Water Date Received: 01/25/01 09:20

Parameters	Results	Units	PRL	Dilution	Analyzed	Analyst	CAS#	Frnote	Limit
------------	---------	-------	-----	----------	----------	---------	------	--------	-------

GC Volatiles

GAS by Mod 8015, Water		Method: EPA 8015 Modified			Prep Method: EPA 8015 Modified				
Gasoline Range Organics	2700	ug/l	50.	1.0	02/02/01 00:36	WRIC			
1,4-Difluorobenzene (S)	2210	%		1.0	02/02/01 00:36	WRIC		1	
4-Bromofluorobenzene (S)	101	%		1.0	02/02/01 00:36	WRIC	460-00-4		
SW8021 Aromatics, Water		Method: EPA 8021			Prep Method: See analytical meth				
Benzene	ND	ug/l	0.500	1.0	02/02/01 00:36	WRIC	71-43-2		
Ethylbenzene	ND	ug/l	0.500	1.0	02/02/01 00:36	WRIC	100-41-4		
Toluene	ND	ug/l	0.500	1.0	02/02/01 00:36	WRIC	108-88-3		
Xylene (Total)	ND	ug/l	0.500	1.0	02/02/01 00:36	WRIC	1330-20-7		
Methyl-tert-butyl ether	4850	ug/l	12.5	25.0	02/02/01 00:36	WRIC	1634-04-4		
1,4-Difluorobenzene (S)	2060	%		1.0	02/02/01 00:36	WRIC		1	
4-Bromofluorobenzene (S)	107	%		1.0	02/02/01 00:36	WRIC	460-00-4		

Date: 02/05/01

Page: 1

REPORT OF LABORATORY ANALYSIS

This report shall not be reproduced, except in full,
 without the written consent of Pace Analytical Services, Inc.

Lab Project Number: 8519500
Client Project ID: BP Site# 11133

Lab Sample No: 851674018 Project Sample Number: 8519500-002 Date Collected: 01/19/01 11:47
Client Sample ID: B (11133) Matrix: Water Date Received: 01/25/01 09:20

Parameters	Results	Units	PRL	Dilution	Analyzed	Analyst	CAS#	Ftnote	Limit
------------	---------	-------	-----	----------	----------	---------	------	--------	-------

GC Volatiles

GAS by Mod 8015, Water		Method: EPA 8015 Modified		Prep Method: EPA 8015 Modified					
Gasoline Range Organics	2600	ug/l	50.	1.0	02/02/01 02:08	WRIC			
1,4-Difluorobenzene (S)	1450	%		1.0	02/02/01 02:08	WRIC		1	
4-Bromofluorobenzene (S)	101	%		1.0	02/02/01 02:08	WRIC	460-00-4		
SW8021 Aromatics, Water		Method: EPA 8021		Prep Method: See analytical meth					
Benzene	ND	ug/l	0.500	1.0	02/02/01 02:08	WRIC	71-43-2		
Ethylbenzene	ND	ug/l	0.500	1.0	02/02/01 02:08	WRIC	100-41-4		
Toluene	ND	ug/l	0.500	1.0	02/02/01 02:08	WRIC	108-88-3		
Xylene (Total)	ND	ug/l	0.500	1.0	02/02/01 02:08	WRIC	1330-20-7		
Methyl-tert-butyl ether	4580	ug/l	12.5	25.0	02/02/01 02:08	WRIC	1634-04-4		
1,4-Difluorobenzene (S)	1480	%		1.0	02/02/01 02:08	WRIC		1	
4-Bromofluorobenzene (S)	106	%		1.0	02/02/01 02:08	WRIC	460-00-4		

REPORT OF LABORATORY ANALYSIS

This report shall not be reproduced, except in full,
without the written consent of Pace Analytical Services, Inc.

Lab Project Number: 8519500
Client Project ID: BP Site# 11133

Lab Sample No: 851674019 Project Sample Number: 8519500-003 Date Collected: 01/19/01 12:15
Client Sample ID: C (11133) Matrix: Water Date Received: 01/25/01 09:20

Parameters	Results	Units	PRL	Dilution	Analyzed	Analyst	CAS#	Ftnote	Limit
------------	---------	-------	-----	----------	----------	---------	------	--------	-------

GC Volatiles

GAS by Mod 8015, Water		Method: EPA 8015 Modified			Prep Method: EPA 8015 Modified				
Gasoline Range Organics	ND	ug/l	50.	1.0	02/02/01 02:26	WRIC			
1,4-Difluorobenzene (S)	106	%		1.0	02/02/01 02:26	WRIC			
4-Bromofluorobenzene (S)	102	%		1.0	02/02/01 02:26	WRIC	460-00-4		
SW8021 Aromatics, Water		Method: EPA 8021			Prep Method: See analytical meth				
Benzene	ND	ug/l	0.500	1.0	02/02/01 11:59	WRIC	71-43-2		
Ethylbenzene	ND	ug/l	0.500	1.0	02/02/01 11:59	WRIC	100-41-4		
Toluene	ND	ug/l	0.500	1.0	02/02/01 11:59	WRIC	108-88-3		
Xylene (Total)	0.996	ug/l	0.500	1.0	02/02/01 11:59	WRIC	1330-20-7		
Methyl-tert-butyl ether	25.9	ug/l	0.500	1.0	02/02/01 11:59	WRIC	1634-04-4		
1,4-Difluorobenzene (S)	98	%		1.0	02/02/01 11:59	WRIC			
4-Bromofluorobenzene (S)	102	%		1.0	02/02/01 11:59	WRIC	460-00-4		

REPORT OF LABORATORY ANALYSIS

This report shall not be reproduced, except in full,
without the written consent of Pace Analytical Services, Inc.

Lab Project Number: 8519500
Client Project ID: BP Site# 11133

Lab Sample No: 851674020 Project Sample Number: 8519500-004 Date Collected: 01/19/01 12:35
Client Sample ID: D (11133) Matrix: Water Date Received: 01/25/01 09:20

Parameters	Results	Units	PRL	Dilution	Analyzed	Analyst	CAS#	Ftnote	Limit
------------	---------	-------	-----	----------	----------	---------	------	--------	-------

GC Volatiles

GAS by Mod 8015, Water		Method: EPA 8015 Modified			Prep Method: EPA 8015 Modified				
Gasoline Range Organics	6600	ug/l	500	10.0	02/02/01 12:55	WRIC			
1,4-Difluorobenzene (S)	115	%		1.0	02/02/01 12:55	WRIC			
4-Bromofluorobenzene (S)	116	%		1.0	02/02/01 12:55	WRIC	460-00-4		
SW8021 Aromatics, Water		Method: EPA 8021			Prep Method: See analytical meth				
Benzene	2460	ug/l	5.00	10.0	02/02/01 12:55	WRIC	71-43-2		
Ethylbenzene	497	ug/l	5.00	10.0	02/02/01 12:55	WRIC	100-41-4		
Toluene	24.0	ug/l	5.00	10.0	02/02/01 12:55	WRIC	108-88-3		
Xylene (Total)	534	ug/l	5.00	10.0	02/02/01 12:55	WRIC	1330-20-7		
Methyl-tert-butyl ether	267	ug/l	5.00	10.0	02/02/01 12:55	WRIC	1634-04-4		
1,4-Difluorobenzene (S)	108	%		1.0	02/02/01 12:55	WRIC			
4-Bromofluorobenzene (S)	112	%		1.0	02/02/01 12:55	WRIC	460-00-4		

REPORT OF LABORATORY ANALYSIS

This report shall not be reproduced, except in full,
without the written consent of Pace Analytical Services, Inc.

Lab Project Number: 8519500
Client Project ID: BP Site# 11133

Lab Sample No: 851674021 Project Sample Number: 8519500-005 Date Collected: 01/19/01 13:06
Client Sample ID: E (11133) Matrix: Water Date Received: 01/25/01 09:20

Parameters	Results	Units	PRL	Dilution	Analyzed	Analyst	CAS#	Ftnote	Limit
------------	---------	-------	-----	----------	----------	---------	------	--------	-------

GC Volatiles

GAS by Mod 8015, Water		Method: EPA 8015 Modified		Prep Method: EPA 8015 Modified					
Gasoline Range Organics	57000	ug/l	1200	25.0	02/02/01 14:09	WRIC			
1,4-Difluorobenzene (S)	120	%		1.0	02/02/01 14:09	WRIC			
4-Bromofluorobenzene (S)	220	%		1.0	02/02/01 14:09	WRIC	460-00-4	1	

SW8021 Aromatics, Water		Method: EPA 8021		Prep Method: See analytical meth					
Benzene	199.	ug/l	5.00	10.0	02/02/01 13:13	WRIC	71-43-2		
Ethylbenzene	1170	ug/l	5.00	10.0	02/02/01 13:13	WRIC	100-41-4		
Toluene	7.66	ug/l	5.00	10.0	02/02/01 13:13	WRIC	108-88-3		
Xylene (Total)	3260	ug/l	5.00	10.0	02/02/01 13:13	WRIC	1330-20-7		
Methyl-tert-butyl ether	514.	ug/l	5.00	10.0	02/02/01 13:13	WRIC	1634-04-4		
1,4-Difluorobenzene (S)	105	%		1.0	02/02/01 13:13	WRIC			
4-Bromofluorobenzene (S)	152	%		1.0	02/02/01 13:13	WRIC	460-00-4	1	

REPORT OF LABORATORY ANALYSIS

This report shall not be reproduced, except in full,
without the written consent of Pace Analytical Services, Inc.

Lab Project Number: 8519500
Client Project ID: BP Site# 11133

Lab Sample No: 851674022 Project Sample Number: 8519500-006 Date Collected: 01/19/01 13:31
Client Sample ID: F (11133) Matrix: Water Date Received: 01/25/01 09:20

Parameters	Results	Units	PRL	Dilution	Analyzed	Analyst	CAS#	Ftnote	Limit
------------	---------	-------	-----	----------	----------	---------	------	--------	-------

GC Volatiles

GAS by Mod 8015, Water		Method: EPA 8015 Modified		Prep Method: EPA 8015 Modified					
Gasoline Range Organics	7600	ug/l	1200	25.0	02/02/01 16:05	WRIC			
1,4-Difluorobenzene (S)	122	%		1.0	02/02/01 16:05	WRIC			
4-Bromofluorobenzene (S)	117	%		1.0	02/02/01 16:05	WRIC	460-00-4		
SW8021 Aromatics, Water		Method: EPA 8021		Prep Method: See analytical meth					
Benzene	2220	ug/l	5.00	10.0	02/02/01 13:32	WRIC	71-43-1		
Ethylbenzene	415	ug/l	5.00	10.0	02/02/01 13:32	WRIC	100-41-4		
Toluene	10.9	ug/l	5.00	10.0	02/02/01 13:32	WRIC	108-88-3		
Xylene (Total)	58.4	ug/l	5.00	10.0	02/02/01 13:32	WRIC	1330-20-7		
Methyl-tert-butyl ether	1630	ug/l	5.00	10.0	02/02/01 13:32	WRIC	1634-04-4		
1,4-Difluorobenzene (S)	148	%		1.0	02/02/01 13:32	WRIC			1
4-Bromofluorobenzene (S)	123	%		1.0	02/02/01 13:32	WRIC	460-00-4		

REPORT OF LABORATORY ANALYSIS

This report shall not be reproduced, except in full,
without the written consent of Pace Analytical Services, Inc.

Lab Project Number: 8519500

Client Project ID: BP Site# 11133

Lab Sample No: 851674023
Client Sample ID: G (11133)

Project Sample Number: 8519500-007
Matrix: Water

Date Collected: 01/19/01 14:39
Date Received: 01/25/01 09:20

Parameters	Results	Units	PRL	Dilution	Analyzed	Analyst	CAS#	Ftnote	Limit
------------	---------	-------	-----	----------	----------	---------	------	--------	-------

GC Volatiles

GAS by Mod 8015, Water		Method: EPA 8015 Modified			Prep Method: EPA 8015 Modified				
Gasoline Range Organics	110000	ug/l	2500	50.0	02/02/01 13:50	WRIC			
1,4-Difluorobenzene (S)	131	%		1.0	02/02/01 13:50	WRIC		1	
4-Bromofluorobenzene (S)	123	%		1.0	02/02/01 13:50	WRIC	460-00-4		
SW8021 Aromatics, Water		Method: EPA 8021			Prep Method: See analytical meth				
Benzene	9450	ug/l	25.0	50.0	02/02/01 13:50	WRIC	71-43-2		
Ethylbenzene	3510	ug/l	25.0	50.0	02/02/01 13:50	WRIC	100-41-4		
Toluene	19600	ug/l	25.0	50.0	02/02/01 13:50	WRIC	108-88-3		
Xylene (Total)	21100	ug/l	25.0	50.0	02/02/01 13:50	WRIC	1330-20-7		
Methyl-tert-butyl ether	1270	ug/l	25.0	50.0	02/02/01 13:50	WRIC	1634-04-4		
1,4-Difluorobenzene (S)	107	%		1.0	02/02/01 13:50	WRIC			
4-Bromofluorobenzene (S)	117	%		1.0	02/02/01 13:50	WRIC	460-00-4		

Date: 02/05/01

Page: 7

REPORT OF LABORATORY ANALYSIS

This report shall not be reproduced, except in full,
without the written consent of Pace Analytical Services, Inc.

Lab Project Number: 8519500
Client Project ID: BP Site# 11133

PARAMETER FOOTNOTES

ND Not Detected
NC Not Calculable
PRL Pace Reporting Limit
(S) Surrogate
[1] Surrogate recovery outside of control limits. The data was accepted based on valid recovery of remaining surrogate.

REPORT OF LABORATORY ANALYSIS

This report shall not be reproduced, except in full,
without the written consent of Pace Analytical Services, Inc.

QUALITY CONTROL DATA

QC Batch: 48433
Analysis Method: EPA 8021
Associated Lab Samples: 851674017 851674022
851674018 851674023
851674019 851674023
851674020 851674023
851674021 851674023

Lab Project Number: 8519500
Client Project ID: BP Site# 11133

QC Batch Method: See analytical meth
Analysis Description: SW8021 Aromatics, Water

METHOD BLANK: 851675119
Associated Lab Samples:

Parameter	Units	851674017	851674018	851674019	851674020	851674021	851674022	851674023		
		Method Blank Result							PRL	Footnotes
Benzene	ug/l								0.5	
Ethylbenzene	ug/l								0.5	
Toluene	ug/l								0.5	
Xylene (Total)	ug/l								0.5	
Methyl-tert-butyl ether	ug/l								0.5	
1,4-Difluorobenzene (S)	%								95	
4-Bromofluorobenzene (S)	%								109	

MATRIX SPIKE & MATRIX SPIKE DUPLICATE: 851675120 851675121

Parameter	Units	851673523	Spike	Matrix	Matrix	Spike	RPD	Footnotes
			Conc.	Spike Result	Sp. Dup. Result	Dup % Rec		
Benzene	ug/l	0	50.00	51.21	102	49.31	99	4
Ethylbenzene	ug/l	0	50.00	52.82	106	51.46	103	3
Toluene	ug/l	0	50.00	51.18	102	49.65	99	3
Xylene (Total)	ug/l	0	150.00	164.9	110	161.7	108	2
Methyl-tert-butyl ether	ug/l	0	50.00	54.64	109	52.19	104	5
1,4-Difluorobenzene (S)							98	
4-Bromofluorobenzene (S)							112	

LABORATORY CONTROL SAMPLE: 851675122

Parameter	Units	Spike	LCS	Spike	Footnotes
		Conc.	Result	% Rec	
Benzene	ug/l	50	47.45	95	
Ethylbenzene	ug/l	50	51.16	102	
Toluene	ug/l	50	49.18	98	

Date: 02/05/01

Page: 9

REPORT OF LABORATORY ANALYSIS

This report shall not be reproduced, except in full,
without the written consent of Pace Analytical Services, Inc.

QUALITY CONTROL DATA

Lab Project Number: 8519500
Client Project ID: BP Site# 11133

LABORATORY CONTROL SAMPLE: 851675122

Parameter	Units	Spike Conc.	LCS Result	Spike % Rec	Footnotes
Xylene (Total)	ug/l	100	105.6	106	
Methyl-tert-butyl ether	ug/l	50	48.90	98	
1,4-Difluorobenzene (S)				98	
4-Bromofluorobenzene (S)				111	

REPORT OF LABORATORY ANALYSIS

This report shall not be reproduced, except in full,
without the written consent of Pace Analytical Services, Inc.

QUALITY CONTROL DATA

QC Batch: 48434
Analysis Method: EPA 8015 Modified
Associated Lab Samples: 851674017 851674022
851674018 851674023
851674019 851674020
851674021 851674023

Lab Project Number: 8519500
Client Project ID: BP Site# 11133
QC Batch Method: EPA 8015 Modified
Analysis Description: GAS by Mod 8015, Water

METHOD BLANK: 851675123
Associated Lab Samples:

Parameter	Units	851674017	851674018 Method Blank Result	851674019 PRL	851674020	851674021	851674022	851674023	Footnotes
Gasoline Range Organics	ug/l		ND	50					
1,4-Difluorobenzene (S)	%		102						
4-Bromofluorobenzene (S)	%		105						

MATRIX SPIKE & MATRIX SPIKE DUPLICATE: 851675125 851675126

Parameter	Units	851673527 Spike Conc.	851675126 Spike Conc.	Matrix Spike Result	Matrix Spike % Rec	Matrix Sp. Dup. Result	Spike Dup % Rec	RPD	Footnotes
Gasoline Range Organics	ug/l	25.27	900.00	908.0	98	894.9	97	1	
1,4-Difluorobenzene (S)					104		104		
4-Bromofluorobenzene (S)					115		113		

LABORATORY CONTROL SAMPLE: 851675124

Parameter	Units	Spike Conc.	LCS Result	Spike % Rec	Footnotes
Gasoline Range Organics	ug/l	1000	962.1	96	
1,4-Difluorobenzene (S)				103	
4-Bromofluorobenzene (S)				117	

REPORT OF LABORATORY ANALYSIS

This report shall not be reproduced, except in full,
without the written consent of Pace Analytical Services, Inc.

Lab Project Number: 8519500
Client Project ID: BP Site# 11133

QUALITY CONTROL DATA PARAMETER FOOTNOTES

Consistent with EPA guidelines unrounded concentrations are displayed and have been used to calculate % Rec and RPD values.

ND Not Detected
NC Not Calculable
PRL Pace Reporting Limit
RPD Relative Percent Difference
(S) Surrogate

Date: 02/05/01

Page: 12

REPORT OF LABORATORY ANALYSIS

This report shall not be reproduced, except in full,
without the written consent of Pace Analytical Services, Inc.



CHAIN OF CUSTODY

CONSULTANT'S NAME Blaine Tech Services, Inc.		CONSULTANT'S ADDRESS 1680 Rogers Ave., San Jose CA 95112			
BP SITE NUMBER 11133	BP SITE / FACILITY ADDRESS 2220 98th Ave., Oakland			CONSULTANT PROJECT NUMBER 010119-F1	
CONSULTANT PROJECT MANAGER Scott Boor		PHONE NUMBER (408) 573-0555 x 223	FAX NUMBER (408) 573-7771		CONSULTANT CONTRACT NUMBER J588468
BP CONTACT Scott Hooton	BP ADDRESS 295 SW 41st Street, Suite N, Renton WA		PHONE NUMBER (425) 251-0689	FAX NO. (425) 251-0736	
LAB CONTACT Pace - Paula Kirtley	LABORATORY ADDRESS 900 Gemini Ave., Houston, TX.77058		PHONE NUMBER (281) 488-1810	FAX NO. (281) 488-4661	
BP CONTACT REQUESTING RUSH TAT (Print BP Contact Name)		RUSH REQUESTED OF (Print Consultant Contact Name)		DATE/TIME	SHIPMENT DATE
					SHIPMENT METHOD

TAT: 24 HOURS 48 HOURS 72 HOURS Standard 7 or 14 Days

ANALYSIS REQUIRED

AIRBILL NUMBER

SAMPLE DESCRIPTION	COLLECTION DATE	COLLECTION TIME	MATRIX SOIL/WATER	CONTAINERS		PRESERVATIVE	TPH-G + BTEX / MTBE (8015M)	TPH-D (8015M)	FUEL OXYGENATES (8266)	1,2 DCA + EDB (8010)									COMMENTS			
				NO.	TYPE (VOL)	LAB SAMPLE #																
A	1/19/01	1125	W	3	HCl VOA	85767 4017	X															
B	↓	1147	↓			18	X															
C		1215				19	X															
D		1235				20	X															
E		1306				21	X															
F		1331				22	X															
G		1439				23	X															

SAMPLED BY (Please Print Name) Jeremy Buens			SAMPLED BY (Signature) 			ADDITIONAL COMMENTS		
RELINQUISHED BY / AFFILIATION (Print Name / Signature)	DATE	TIME	ACCEPTED BY / AFFILIATION (Print Name / Signature)	DATE	TIME	1.5°C		
	1/23/01	1400	Christina Potholace	1/25/01	0920			

Field Data Sheets

BP WELL MONITORING DATA SHEET

Project #: 010214-ED	Station # 11133
Sampler: PTE.	Date: 2-14-01
Well I.D.: RW-1	Well Diameter: 2 3 <u>6</u> 8
Total Well Depth:	Depth to Water: 16.33
Depth to Free Product: 16.32	Thickness of Free Product (feet): .01
Referenced to: <u>PVC</u> Grade	D.O. Meter (if req'd): YSI HACH

Well Diameter	Multiplier	Well Diameter	Multiplier
1"	0.04	4"	0.65
2"	0.16	6"	1.47
3"	0.37	Other	radius ² * 0.163

Purge Method: Bailer Sampling Method: Bailer

Disposable Bailer Disposable Bailer

Middleburg Extraction Port

Electric Submersible Other: _____

Extraction Pump

Other: _____

_____	X	_____	=	_____ Gals.
1 Case Volume (Gals.)		Specified Volumes		Calculated Volume

Time	Temp (°F)	pH	Cond.	Gals. Removed	Observations
		removed	25 mb.	5 Pit	
		emptied	5 bitum cr		

Did well dewater? Yes No Gallons actually evacuated: _____

Sampling Time: _____ Sampling Date: _____

Sample I.D. (Blind): _____ Laboratory: Pace Other: _____

Analyzed for: TPH-G BTEX MTBE TPH-D Other: _____

D.O. (if req'd):	Pre-purge:	mg/L	Post-purge:	mg/L
O.R.P. (if req'd):	Pre-purge:	mV	Post-purge:	mV

WELL GAUGING DATA

Project # 010119-E1 Date 8/19/01 Client BP-11133

Site 2220 98TH AVE OAKLAND CA.

Well ID	Well Size (in.)	Sheen / Odor	Depth to Immiscible Liquid (ft.)	Thickness of Immiscible Liquid (ft.)	Volume of Immiscibles Removed (ml)	Depth to water (ft.)	Depth to well bottom (ft.)	Survey Point: TOB or TOC		
10 MW-1	2	E				12.90	28.31			
3 MW-2	2					10.52	31.37		G	
5 MW-3	2	C				14.84	34.10			
11 AW-1	2	F				19.82	38.38			
- AW-2	WELL COVERED BY NEW LANDSCAPING									
1 AW-3	2					16.74	35.63		G	
8 AW-4	2	D				18.97	32.77			
9 AW-5	4	B				19.79	42.59			
4 AW-6	4	A				17.04	34.06			
- AW-7	WELL COVERED BY NEW LANDSCAPING								G	
2 AW-8	2					18.60	37.49		G	
12 RW-1	6	G ODOR	18.14	.05	434ML	18.19	37.30		✓	

BP WELL MONITORING DATA SHEET

Project #: 010119-P1	Station # 11133
Sampler: <u>Jeremy</u>	Date: 1/19/01
Well I.D.: <u>MW-1</u>	Well Diameter: <u>2</u> 3 4 6 8
Total Well Depth: <u>28.31</u>	Depth to Water: <u>12.90</u>
Depth to Free Product:	Thickness of Free Product (feet):
Referenced to: <u>PVC</u> Grade	D.O. Meter (if req'd): YSI HACH

Well Diameter	Multiplier	Well Diameter	Multiplier
1"	0.04	4"	0.65
2"	0.16	6"	1.47
3"	0.37	Other	radius ² * 0.163

Purge Method: Bailer Disposable Bailer <u>Middleburg</u> Electric Submersible Extraction Pump Other: _____	Sampling Method: Bailer <u>Disposable Bailer</u> Extraction Port Other: _____
---	--

<u>2.5</u>	X	<u>3</u>	=	<u>7.5</u>	Gals.
1 Case Volume (Gals.)		Specified Volumes		Calculated Volume	

Time	Temp (°F)	pH	Cond.	Gals. Removed	Observations
1253	68.9	6.9	608	2.5	Clear / Light Brown
1257	68.3	6.7	565	5.0	"
1301	68.3	6.7	555	7.5	"

Did well dewater? Yes No Gallons actually evacuated: 7.5

Sampling Time: 1306 Sampling Date: 1/19/01

Sample I.D. (Blind): F Laboratory: Pace Other: _____

Analyzed for: TPH-G BTEX MTBE TPH-D Other: _____

D.O. (if req'd):	Pre-purge:	mg/L	Post-purge:	mg/L
O.R.P. (if req'd):	Pre-purge:	mV	Post-purge:	mV

BP WELL MONITORING DATA SHEET

Project #: 010119-P1	Station # 11133
Sampler: Jerome	Date: 1/19/01
Well I.D.: MW-3	Well Diameter: <u>2</u> 3 4 6 8
Total Well Depth: 34.10	Depth to Water: 14.84
Depth to Free Product:	Thickness of Free Product (feet):
Referenced to: <u>PVC</u> Grade	D.O. Meter (if req'd): YSI HACH

Well Diameter	Multiplier	Well Diameter	Multiplier
1"	0.04	4"	0.65
2"	0.16	6"	1.47
3"	0.37	Other	radius ² * 0.163

Purge Method: Bailer Sampling Method: Bailer

Disposable Bailer Disposable Bailer

Middleburg Extraction Port

Electric Submersible Other: _____

Extraction Pump

Other: _____

3.1	X	3	=	9.3	Gals.
1 Case Volume (Gals.)		Specified Volumes		Calculated Volume	

Time	Temp (°F)	pH	Cond.	Gals. Removed	Observations
1201	64.7	6.9	345	3.25	CLOUDY
1206	64.9	6.9	327	6.50	"
1210	65.7	6.9	327	9.50	"

Did well dewater? Yes No Gallons actually evacuated: 9.50

Sampling Time: 1215 Sampling Date: 1/19/01

Sample I.D. (Blind): C Laboratory: Pace Other: _____

Analyzed for: TPH-G BTEX MTBE TPH-D Other: _____

D.O. (if req'd):	Pre-purge:	mg/L	Post-purge:	mg/L
O.R.P. (if req'd):	Pre-purge:	mV	Post-purge:	mV

BP WELL MONITORING DATA SHEET

Project #: 010119-P1	Station # 11133
Sampler: Jeremy	Date: 1/19/01
Well I.D.: AW-1	Well Diameter: <u>2</u> 3 4 6 8
Total Well Depth: 38.38	Depth to Water: 19.82
Depth to Free Product:	Thickness of Free Product (feet):
Referenced to: <u>PVC</u> Grade	D.O. Meter (if req'd): YSI HACH

Well Diameter	Multiplier	Well Diameter	Multiplier
1"	0.04	4"	0.65
2"	0.16	6"	1.47
3"	0.37	Other	radius ² * 0.163

Purge Method: Bailer
 Disposable Bailer
 Middleburg
 Electric Submersible Extraction Pump
 Other: _____

Sampling Method: Bailer
 Disposable Bailer
 Extraction Port
 Other: _____

3.0	X	3	=	9.0	Gals.
1 Case Volume (Gals.)		Specified Volumes		Calculated Volume	

Time	Temp (°F)	pH	Cond.	Gals. Removed	Observations
1315	66.4	6.7	812	3.0	Clear / LIGHT ODR
1322	66.2	6.6	834	6.0	li
1326	66.1	6.6	873	9.0	li

Did well dewater? Yes No

Gallons actually evacuated: 9.0

Sampling Time: 1331

Sampling Date: 1/19/01

Sample I.D. (Blind): F

Laboratory: Pace Other: _____

Analyzed for: TPH-G BTEX MTBE TPH-D Other: _____

D.O. (if req'd):	Pre-purge:	mg/L	Post-purge:	mg/L
O.R.P. (if req'd):	Pre-purge:	mV	Post-purge:	mV

BP WELL MONITORING DATA SHEET

Project #: 010119-D1	Station # 1133
Sampler: Jeremy	Date: 1/19/01
Well I.D.: AW-4	Well Diameter: <u>2</u> 3 4 6 8
Total Well Depth: 32.77	Depth to Water: 18.97
Depth to Free Product:	Thickness of Free Product (feet):
Referenced to: <u>PVC</u> Grade	D.O. Meter (if req'd): YSI HACH

Well Diameter	Multipier	Well Diameter	Multipier
1"	0.04	4"	0.65
2"	0.16	6"	1.47
3"	0.37	Other	radius ² * 0.163

Purge Method: Bailer Disposable Bailer Middleburg Electric Submersible Extraction Pump

Other: _____

Sampling Method: Bailer Disposable Bailer Extraction Port

Other: _____

<u>2.2</u>	X	<u>3</u>	=	<u>6.6</u>	Gals.
Case Volume (Gals.)		Specified Volumes		Calculated Volume	

Time	Temp (°F)	pH	Cond.	Gals. Removed	Observations
1224	66.3	6.6	1367	2.25	DARK COLOR / ODDR
1227	66.3	7.0	1276	4.50	MURDER CLARER / NO ODDR
1230	66.1	6.6	1332	6.75	"

Did well dewater? Yes No

Gallons actually evacuated: 6.75

Sampling Time: 1235 Sampling Date: 1/19/01

Sample I.D. (Blind): D Laboratory: Pace Other: _____

Analyzed for: TPH-G BTEX MTBE TPH-D Other: _____

D.O. (if req'd):	Pre-purge:	mg/L	Post-purge:	mg/L
O.R.P. (if req'd):	Pre-purge:	mV	Post-purge:	mV

BP WELL MONITORING DATA SHEET

Project #: 010119-P1	Station # 11133
Sampler: J. Roman	Date: 1/19/01
Well I.D.: AW. 5	Well Diameter: 2 3 <u>4</u> 6 8
Total Well Depth: 42.59	Depth to Water: 19.79
Depth to Free Product:	Thickness of Free Product (feet):
Referenced to: <u>PVC</u> Grade	D.O. Meter (if req'd): YSI HACH

Well Diameter	Multiplier	Well Diameter	Multiplier
1"	0.04	4"	0.65
2"	0.16	6"	1.47
3"	0.37	Other	radius ² * 0.163

Purge Method:	Sampling Method:
<input type="checkbox"/> Bailer <input type="checkbox"/> Disposable Bailer <input type="checkbox"/> Middleburg <input checked="" type="checkbox"/> Electric Submersible <input type="checkbox"/> Extraction Pump Other: _____	<input type="checkbox"/> Bailer <input checked="" type="checkbox"/> Disposable Bailer <input type="checkbox"/> Extraction Port Other: _____

<u>14.8</u>	X	<u>3</u>	=	<u>44.4</u>	Gals.
1 Case Volume (Gals.)		Specified Volumes		Calculated Volume	

Time	Temp (°F)	pH	Cond.	Gals. Removed	Observations
1138	63.8	6.6	529	15	
1140	65.9	6.6	560	30	GRAY / SILTY
1142	66.6	6.7	560	45	"

Did well dewater? Yes <input type="checkbox"/> No <input checked="" type="checkbox"/>	Gallons actually evacuated: 45
Sampling Time: 1147	Sampling Date: 1/19/01
Sample I.D. (Blind): <u>B</u>	Laboratory: <u>Pace</u> Other: _____
Analyzed for: <u>TPH-G BTEX MTBE</u> TPH-D Other: _____	
D.O. (if req'd):	Pre-purge: mg/L Post-purge: mg/L
O.R.P. (if req'd):	Pre-purge: mV Post-purge: mV

BP WELL MONITORING DATA SHEET

Project #: 010119-P1	Station # 11133
Sampler: Jeremy	Date: 1/19/01
Well I.D.: AW-6	Well Diameter: 2 3 <u>4</u> 6 8
Total Well Depth: 34.06	Depth to Water: 17.04
Depth to Free Product:	Thickness of Free Product (feet):
Referenced to: <u>PVC</u> Grade	D.O. Meter (if req'd): YSI HACH

Well Diameter	Multipier	Well Diameter	Multipier
1"	0.04	4"	0.65
2"	0.16	6"	1.47
3"	0.27	Other	radius ² * 0.165

Purge Method:

- Bailer
- Disposable Bailer
- Middleburg
- Electric Submersible
- Extraction Pump

Sampling Method:

- Bailer
- Disposable Bailer
- Extraction Port

Other: _____

Other: _____

<u>11.1</u>	X	<u>3</u>	=	<u>33.3</u>	Gals.
1 Case Volume (Gals.)		Specified Volumes		Calculated Volume	

Time	Temp (°F)	pH	Cond.	Gals. Removed	Observations
1116	62.0	6.0	503	12	
1118	65.0	6.3	508	23	
1120	66.2	6.4	505	34	

Did well dewater? Yes No Gallons actually evacuated: 34

Sampling Time: 1125 Sampling Date: 1/19/01

Sample I.D. (Blind): A Laboratory: Pace Other: _____

Analyzed for: TPH-G BTEX MTBE TPH-D Other: _____

D.O. (if req'd):	Pre-purge:	mg/L	Post-purge:	mg/L
------------------	------------	------	-------------	------

O.R.P. (if req'd):	Pre-purge:	mV	Post-purge:	mV
--------------------	------------	----	-------------	----

BP WELL MONITORING DATA SHEET

Project #: 010119-A1	Station # 1133
Sampler: JEROME	Date: 1/19/01
Well I.D.: RW-1	Well Diameter: 2 3 4 <u>6</u> 8
Total Well Depth: 37.30	Depth to Water: 18.19
Depth to Free Product: 18.14	Thickness of Free Product (feet): .05
Referenced to: <u>PVC</u> Grade	D.O. Meter (if req'd): YSI HACH

Well Diameter	Multiplier	Well Diameter	Multiplier
1"	0.04	4"	0.55
2"	0.16	6"	1.47
3"	0.37	Other	radius ² * 0.163

Purge Method: DEDICATED Bailer 3" PVC 1st Case Vol.
 Disposable Bailer
 Middleburg
Electric Submersible 2nd & 3rd Case Vol.
 Extraction Pump

Sampling Method: Bailer
Disposable Bailer
 Extraction Port
 Other: _____

<u>28.1</u>	X	<u>3</u>	=	<u>84.3</u>	Gals.
1 Case Volume (Gals.)		Specified Volumes		Calculated Volume	

Time	Temp (°F)	pH	Cond.	Gals. Removed	Observations
1414	71.5	6.8	813	30	SHOWN/STRONG GASOLINE ODOOR SWITCHED TO ELEC. SUB FOR SEVERAL
1422	WELL DEWATERED @ ~36 GALS.				DTW 36.29'
1435	67.9	6.9	821	—	SHOWN/STRONG ODOOR DTW = 33.45'
BAILED FREE PRODUCT					

Did well dewater? Yes No Gallons actually evacuated: 36

Sampling Time: 1439 Sampling Date: 1/19/01

Sample I.D. (Blind): 6 Laboratory: Pace Other: _____

Analyzed for: TPH-G BTEX MTBE TPH-D Other: _____

D.O. (if req'd):	Pre-purge:	mg/L	Post-purge:	mg/L
	O.R.P. (if req'd):	Pre-purge:	mV	Post-purge: