

Scott T. Hooton  
Portfolio Manager

**BP Oil Company**  
**Midwest Environmental Services**  
295 SW 41<sup>st</sup> Street  
Bldg. 13, Suite N  
Renton, WA 98055

Switchboard: 425/251-0667  
Central Fax: 425/251-0736

Date

Ms. Eva Chu  
Alameda County Health Care Services  
Agency  
1131 Harbor Bay Parkway, Room 250  
Alameda, CA 94502-6577

Site should be on following monitoring  
schedule:

2x: MW-1, MW-3, AW-1, AW-4, AW-5  
RW-1

Annual: AW-2, AW-6 for NTBE

RE: Former BP Oil Site No. 11133  
2220 98<sup>th</sup> Avenue (at Bancroft)  
Oakland, CA

Direct: 425/251-0689  
Cell: 206/919-5029  
hootonst@bp.com  
www.bp.com

Dear Ms. Chu:

This letter transmits the *Fourth Quarter 2000 Groundwater Monitoring* report prepared on behalf of BP by Blaine Tech Services, Inc.

The enclosed groundwater monitoring and sampling reports includes laboratory data for samples collected on 24 and 25 October 2000. You will note that aromatic petroleum hydrocarbons were detected in samples obtained from two of the monitoring wells. Product was not observed in well RW-1.

Please give me a call at (425) 251-0689 if you have any questions or comments regarding this submittal.

Sincerely,

  
Scott Hooton

attachment

cc: site file  
David Camille - Tosco (w/attachments)

00 DEC 27 AM 11:15

ENVIRONMENTAL  
PROTECTION

**BLAINE**  
TECH SERVICES, INC.



1680 ROGERS AVENUE  
SAN JOSE, CA 95112-1105  
(408) 573-7771 FAX  
(408) 573-0555 PHONE  
CONTRACTOR'S LICENSE #746684  
www.blainetech.com

December 7, 2000

Scott Hooton  
BP Oil Company  
295 SW 41st Street, Bldg. 13, Suite N  
Renton, WA 98055-4931

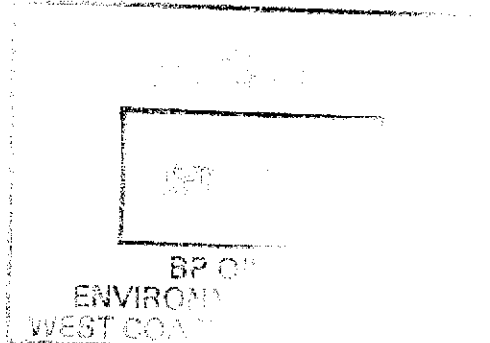

#### 4th Quarter 2000 Monitoring at 11133

Fourth Quarter 2000 Groundwater Monitoring  
BP Service Station Number 11133  
2220 98<sup>th</sup> Avenue  
Oakland, CA

Monitoring Performed on October 24 and 25, 2000

---

#### Groundwater Sampling Report 001024-X-2

This report covers the routine monitoring of groundwater wells at this BP facility. Blaine Tech Services, Inc.'s work at the site includes inspection, gauging, evacuation, purgewater containment, sample collection and sample handling in accordance with standard procedures that conform to Regional Water Quality Control Board requirements.

Routine field data collection includes depth to water, total well depth, thickness of any separate immiscible layer, water column volume, the appropriate calculated purge volume, elapsed evacuation time, total volume of water removed, and standard water parameter instrument readings. Sample material is collected, contained, stored, and transported to the laboratory in conformance with EPA standards. Purgewater is, likewise, collected and transported to Seaport Petroleum Corporation for disposal.

Basic field information is presented alongside analytical values excerpted from the laboratory report in the cumulative table of **WELL DATA AND ANALYTICAL RESULTS**. The full analytical report for the most recent samples is located in the **Analytical Appendix**. The **Professional Engineering Appendix** contains a **Groundwater Elevation Map** and a **Dissolved Petroleum Hydrocarbon Concentration Map**.

At a minimum, Blaine Tech Services, Inc. field personnel are certified upon completion of a forty-hour Hazardous Materials and Emergency Response training course per 29 CFR 1910.120. Field personnel are also enrolled in annual eight hour refresher courses.

Blaine Tech Services, Inc. conducts sampling and documentation assignments of this type as an independent third party. In order to avoid compromising the objectivity necessary for the proper and disinterested performance of this work, Blaine Tech Services, Inc. concentrates on objective data collection and does not participate in the interpretation of analytical results, the definition of geological or hydrological conditions, the formulation of recommendations, or the marketing of remedial systems.

Please call if you have any questions.

Yours truly,

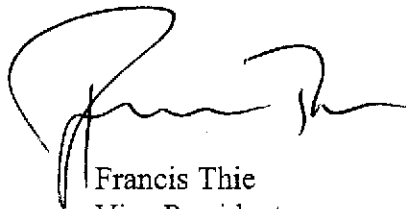
A handwritten signature in black ink, appearing to read 'Francis Thie', written in a cursive style.

Francis Thie  
Vice President

FPT/cm

attachments: Professional Engineering Appendix  
Cumulative Table of Well Data and Analytical Results  
Analytical Appendix  
Field Data Sheets

# **Professional Engineering Appendix**

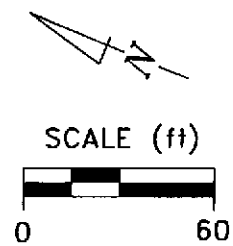
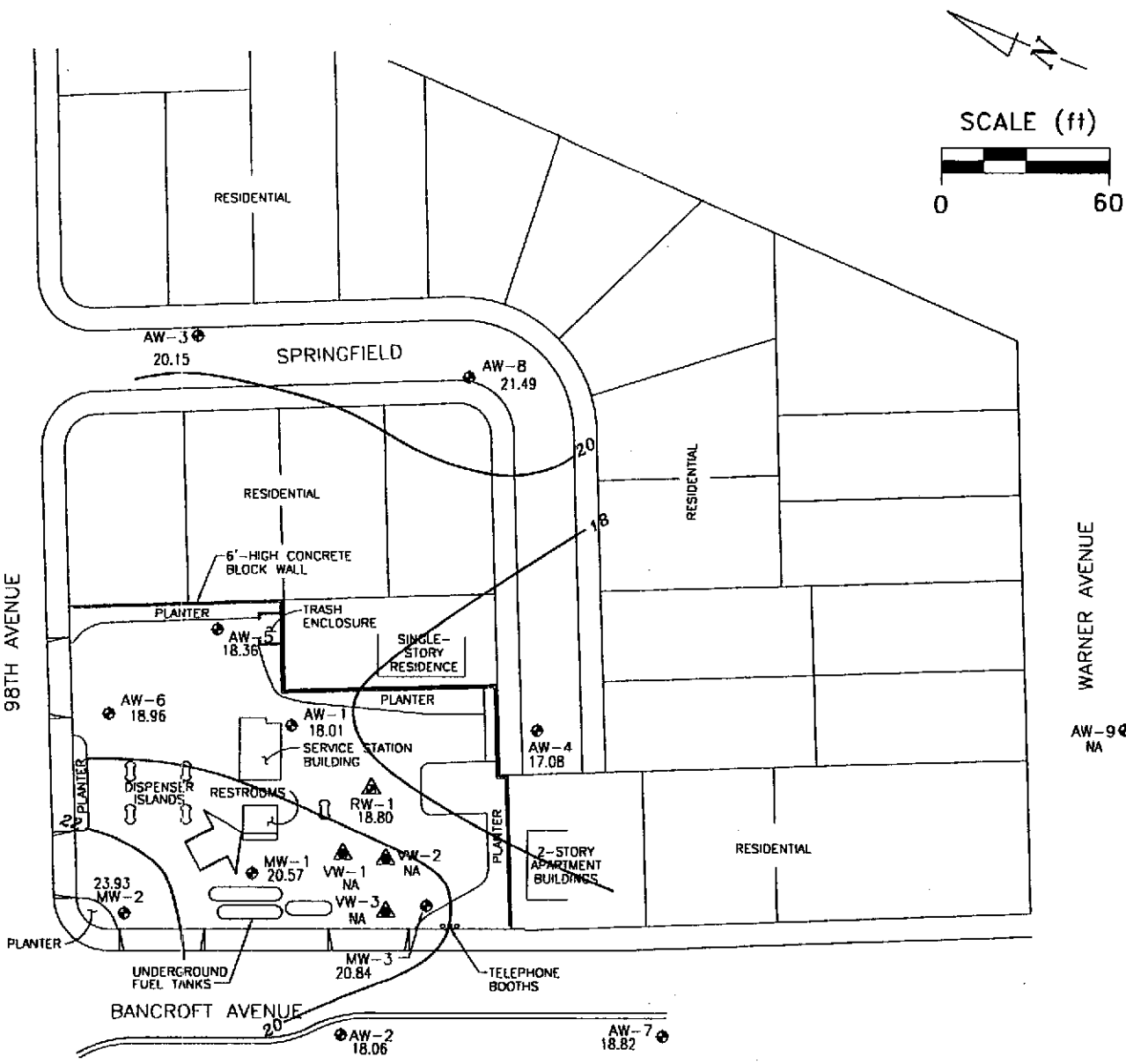

- EXPLANATION**
- ⊕ GROUNDWATER MONITORING WELL
  - ▲ VAPOR EXTRACTION WELL
  - ▲ COMBINED GROUNDWATER RECOVERY/VAPOR EXTRACTION WELL
  - 18.82 GROUNDWATER ELEVATION (FT, MSL)
  - 22 — GROUNDWATER ELEVATION CONTOUR (FT, MSL)
  - NA DATA NOT AVAILABLE
  - ➔ APPROXIMATE GROUNDWATER FLOW DIRECTION; APPROXIMATE AVERAGE GRADIENT = 0.04
  - NOT USED IN CONTOURING



Ref. 11133bm.dwg  
 Basemap from Alisto Engineering Group

PREPARED BY

**BP Service Station 11133**  
 2220 98th Avenue  
 Oakland, California

**GROUNDWATER ELEVATION CONTOUR MAP,**  
 OCTOBER 24, 2000

FIGURE:  
**1**  
 PROJECT:  
 DAC04

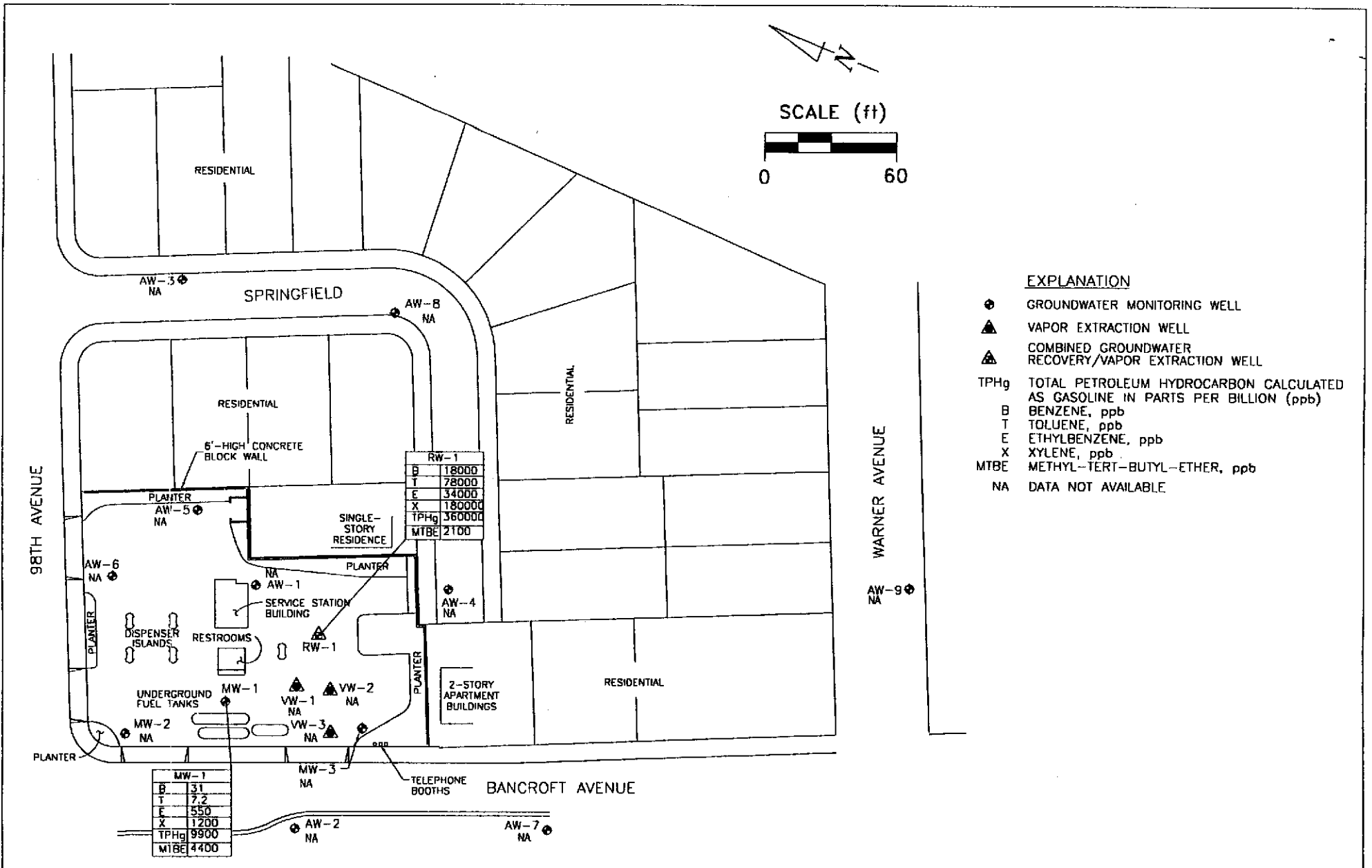

Ref. 11133blex.dwg  
 Base map from Alfoto Engineering Group

PREPARED BY

**RRM**  
 engineering contracting firm

**BP Service Station 11133**  
 2220 98th Avenue  
 Oakland, California

**HYDROCARBON CONCENTRATION MAP,**  
 OCTOBER 24 AND 25, 2000

**FIGURE:**  
**2**  
**PROJECT:**  
 DAC04

# **Table of Well Data and Analytical Results**

TABLE 1 - SUMMARY OF RESULTS OF GROUNDWATER MONITORING

WELL ID	DATE OF MONITORING/ SAMPLING	CASING ELEVATION (a) (Feet)	DEPTH TO WATER (Feet)	PRODUCT THICKNESS (Feet)	GROUNDWATER ELEVATION (b) (Feet)	TPH-G (ug/l)	B (ug/l)	T (ug/l)	E (ug/l)	X (ug/l)	MTBE (ug/l)	DO (ppm)	LAB	
MW-1	04/05/91	34.46	---	---	---	---	---	---	---	---	---	---	---	
MW-1	04/01/92	34.46	11.25	0.01	23.22	---	---	---	---	---	---	---	---	
MW-1	07/06/92	34.46	13.61	0.02	20.87	---	---	---	---	---	---	---	---	
MW-1	10/07/92	34.46	15.15	0.09	19.38	---	---	---	---	---	---	---	---	
MW-1	01/14/93	34.46	10.73	0.01	23.74	---	---	---	---	---	---	---	---	
MW-1	04/22/93	34.46	11.64	0.16	22.94	---	---	---	---	---	---	---	---	
MW-1	07/15/93	34.46	13.50	1.11	21.79	---	---	---	---	---	---	---	---	
MW-1	10/21/93	34.46	15.21	1.00	20.00	---	---	---	---	---	---	---	---	
MW-1	01/27/94	34.46	17.48	0.81	17.59	---	---	---	---	---	---	---	---	
MW-1	04/21/94	34.46	10.94	---	23.52	110000	1400	9100	3400	30000	11000	(c)	1.6	PACE
MW-1	09/09/94	34.46	13.80	---	20.66	---	---	---	---	---	---	---	---	---
MW-1	12/21/94	34.46	12.60	0.02	21.88	---	---	---	---	---	---	---	---	---
MW-1	01/30/95	34.46	---	---	---	---	---	---	---	---	---	---	---	---
MW-1	04/10/95	34.46	10.62	---	23.84	---	---	---	---	---	---	---	---	---
MW-1	06/29/95	34.46	18.72	---	15.74	---	---	---	---	---	---	---	---	---
MW-1	09/18/95	34.46	12.92	---	21.54	---	---	---	---	---	---	---	---	---
MW-1	12/07/95	34.46	13.82	---	20.64	---	---	---	---	---	---	---	---	---
MW-1	03/28/96	34.46	10.03	0.01	24.44	---	---	---	---	---	---	---	---	---
MW-1	06/20/96	34.46	11.29	0.02	23.19	---	---	---	---	---	---	---	---	---
MW-1	10/11/96	34.46	14.86	0.01	19.61	---	---	---	---	---	---	---	---	---
MW-1	01/02/97	34.46	11.03	0.01	23.44	---	---	---	---	---	---	---	---	---
MW-1	04/14/97	34.46	12.25	0.01	22.22	---	---	---	---	---	---	---	---	---
MW-1	04/15/97	34.46	---	---	---	35000	130	650	1700	8200	4800	---	---	SPL
MW-1	07/02/97	34.46	14.11	---	20.35	42000	ND<250	ND<500	2000	9600	ND<5000	5.5	---	SPL
MW-1	09/30/97	34.46	14.40	---	20.06	61000	130	1100	2700	14600	2000	6.7	---	SPL
MW-1	01/21/98	34.46	7.99	0.01	26.48	14000	11	60	310	1790	1300	4.5	---	SPL
MW-1	04/09/98	34.46	7.89	---	26.57	---	---	---	---	---	---	---	---	---
MW-1	04/10/98	34.46	---	---	---	45000	380	520	2100	6800	9300	5.3	---	SPL
MW-1	06/19/98	34.46	10.31	---	24.15	35000	170	100	1100	3590	5000	4.9	---	SPL
MW-1	11/30/98	34.46	11.16	---	23.30	10000	100	24	350	1040	1800/2800 (g)	---	---	SPL
MW-1	01/21/99	34.46	10.76	---	23.70	18000	120	37	590	1800	2700	---	---	SPL
MW-1	04/30/99	34.46	10.78	---	23.68	17000	240	89	1100	1900	1600	---	---	SPL
MW-1	07/09/99	34.46	12.62	---	21.84	58000	140	100	1800	6900	1200	---	---	SPL
MW-1	11/03/99	34.46	14.00	---	20.46	20000	62	42	620	2100	630	---	---	PACE
MW-1	01/12/00	34.46	15.25	---	19.21	72000	110	120	2400	8200	630	---	---	PACE
MW-1	04/13/00	34.46	15.57	---	18.89	37000	300	32	1000	1700	810	---	---	PACE
MW-1	05/24/00	34.46	11.75	---	22.71	---	---	---	---	---	---	---	---	---
MW-1	06/01/00	34.46	11.41	---	23.05	---	---	---	---	---	---	---	---	---
MW-1	06/08/00	34.46	11.68	---	22.78	---	---	---	---	---	---	---	---	---



TABLE 1 - SUMMARY OF RESULTS OF GROUNDWATER MONITORING

WELL ID	DATE OF MONITORING/ SAMPLING	CASING ELEVATION (Feet)	DEPTH TO WATER (Feet)	PRODUCT THICKNESS (Feet)	GROUNDWATER ELEVATION (Feet)	TPH-G (ug/l)	B (ug/l)	T (ug/l)	E (ug/l)	X (ug/l)	MTBE (ug/l)	DO (ppm)	LAB
MW-1	06/15/00	34.46	11.85	---	22.61	---	---	---	---	---	---	---	---
MW-1	07/26/00	34.46	16.19	---	18.27	10000	480	210	470	710	1100	---	PACE
MW-1	10/24/00	34.46	13.89	---	20.57	9900	31	7.2	550	1200	4400	---	PACE

TABLE 1 - SUMMARY OF RESULTS OF GROUNDWATER MONITORING

WELL ID	DATE OF MONITORING/ SAMPLING	CASING ELEVATION (Feet)	DEPTH TO WATER (Feet)	PRODUCT THICKNESS (Feet)	GROUNDWATER ELEVATION (Feet)	TPH-G (ug/l)	B (ug/l)	T (ug/l)	E (ug/l)	X (ug/l)	MTBE (ug/l)	DO (ppm)	LAB
MW-2	04/05/91	35.50	16.62	---	18.88	ND<50	0.6	0.9	ND<0.3	ND<0.3	---	---	SUP
MW-2	04/01/92	35.50	11.25	---	24.25	---	---	---	---	---	---	---	---
MW-2	04/02/92	35.50	---	---	---	ND<50	ND<0.5	ND<0.5	ND<0.5	ND<0.5	---	---	APP
MW-2	07/06/92	35.50	12.72	---	22.78	ND<50	ND<0.5	ND<0.5	ND<0.5	ND<0.5	---	---	ANA
MW-2	10/07/92	35.50	15.08	---	20.42	ND<50	ND<0.5	1.8	ND<0.5	2.3	---	---	ANA
MW-2	01/14/93	35.50	9.69	---	25.81	ND<50	ND<0.5	ND<0.5	ND<0.5	ND<0.5	---	---	PACE
MW-2	04/22/93	35.50	10.46	---	25.04	ND<50	ND<0.5	ND<0.5	ND<0.5	ND<0.5	30	(c)	PACE
MW-2	07/15/93	35.50	12.02	---	23.48	ND<50	ND<0.5	ND<0.5	ND<0.5	ND<0.5	22	(c)	PACE
MW-2	10/21/93	35.50	13.12	---	22.38	ND<50	0.7	0.9	ND<0.5	0.9	---	---	PACE
MW-2	01/27/94	35.50	12.01	---	23.49	ND<50	0.6	ND<0.5	ND<0.5	ND<0.5	---	---	PACE
MW-2	04/21/94	35.50	10.60	---	24.90	ND<50	ND<0.5	ND<0.5	ND<0.5	ND<0.5	---	1.1	PACE
MW-2	09/09/94	35.50	12.42	---	23.08	ND<50	ND<0.5	ND<0.5	ND<0.5	0.6	---	2.2	PACE
MW-2	12/21/94	35.50	10.85	---	24.65	ND<50	ND<0.5	ND<0.5	ND<0.5	ND<0.5	---	1.2	PACE
MW-2	01/30/95	35.50	8.38	---	27.12	ND<50	ND<0.50	ND<0.50	ND<0.50	ND<1.0	---	1.7	ATI
MW-2	04/10/95	35.50	9.00	---	26.50	ND<50	ND<0.50	ND<0.50	ND<0.50	ND<1.0	---	7.8	ATI
MW-2	06/29/95	35.50	9.91	---	25.59	ND<50	ND<0.50	ND<0.50	ND<0.50	ND<1.0	---	9.1	ATI
MW-2	09/18/95	35.50	10.98	---	24.52	---	---	---	---	---	---	---	---
MW-2	09/19/95	35.50	---	---	---	ND<50	ND<0.50	ND<0.50	ND<0.50	ND<1.0	ND<5.0	7.2	ATI
MW-2	12/07/95	35.50	12.30	---	23.20	ND<50	ND<0.50	ND<0.50	ND<0.50	ND<1.0	ND<5.0	2.4	ATI
MW-2	03/28/96	35.50	8.57	---	26.93	ND<50	ND<0.5	ND<1	ND<1	ND<1	ND<10	3.2	SPL
MW-2	06/20/96	35.50	9.77	---	25.73	ND<50	ND<0.5	ND<1	ND<1	ND<1	ND<10	4.2	SPL
MW-2	10/11/96	35.50	13.32	---	22.18	ND<50	ND<0.5	ND<1.0	ND<1.0	ND<1.0	ND<10	6.3	SPL
MW-2	01/02/97	35.50	9.60	---	25.90	ND<50	ND<0.5	ND<1.0	ND<1.0	ND<1.0	ND<10	6.7	SPL
MW-2	04/14/97	35.50	10.93	---	24.57	ND<50	ND<0.5	ND<1.0	ND<1.0	ND<1.0	ND<10	5.7	SPL
MW-2	07/02/97	35.50	12.57	---	22.93	ND<50	ND<0.5	ND<1.0	ND<1.0	ND<1.0	ND<10	5.9	SPL
MW-2	09/30/97	35.50	12.91	---	22.59	ND<50	ND<0.5	ND<1.0	ND<1.0	ND<1.0	ND<10	6.3	SPL
MW-2	01/21/98	35.50	10.12	---	25.38	160	ND<0.5	ND<1.0	ND<1.0	ND<1.0	100	5.4	SPL
MW-2	04/09/98	35.50	6.82	---	28.68	---	---	---	---	---	---	---	---
MW-2	04/10/98	35.50	---	---	---	ND<50	1.0	ND<1.0	ND<1.0	ND<1.0	23	5.0	SPL
MW-2	06/19/98	35.50	9.00	---	26.50	ND<50	ND<0.5	ND<1.0	ND<1.0	ND<1.0	ND<10	4.9	SPL
MW-2	11/30/98	35.50	9.44	---	26.06	---	---	---	---	---	---	---	---
MW-2	01/21/99	35.50	8.96	---	26.54	ND<50	ND<1.0	ND<1.0	ND<1.0	ND<1.0	1.9	---	SPL
MW-2	04/30/99	35.50	9.15	---	26.35	---	---	---	---	---	---	---	---
MW-2	07/09/99	35.50	10.82	---	24.68	---	---	---	---	---	---	---	---
MW-2	11/03/99	35.50	11.86	---	23.64	---	---	---	---	---	---	---	---
MW-2	01/12/00	35.50	12.35	---	23.15	ND<50	ND<0.5	ND<0.5	ND<0.5	ND<0.5	ND<0.5	---	PACE
MW-2	04/13/00	35.50	13.01	---	22.49	---	---	---	---	---	---	---	---
MW-2	07/26/00	35.50	13.01	---	22.49	---	---	---	---	---	---	---	---
MW-2	10/24/00	35.50	11.57	---	23.93	---	---	---	---	---	---	---	---

TABLE 1 - SUMMARY OF RESULTS OF GROUNDWATER MONITORING

WELL ID	DATE OF MONITORING/ SAMPLING	CASING ELEVATION (a) (Feet)	DEPTH TO WATER (Feet)	PRODUCT THICKNESS (Feet)	GROUNDWATER ELEVATION (b) (Feet)	TPH-G (ug/l)	B (ug/l)	T (ug/l)	E (ug/l)	X (ug/l)	MTBE (ug/l)	DO (ppm)	LAB
MW-3	04/05/91	36.53	17.84	---	18.69	ND<50	ND<0.3	ND<0.3	ND<0.3	ND<0.3	---	---	SUP
MW-3	04/01/92	36.53	15.64	---	20.89	---	---	---	---	---	---	---	---
MW-3	04/02/92	36.53	---	---	---	ND<50	1.4	ND<0.5	ND<0.5	ND<0.5	---	---	APP
MW-3	07/06/92	36.53	19.03	---	17.50	ND<50	ND<0.5	ND<0.5	ND<0.5	ND<0.5	---	---	ANA
MW-3	10/07/92	36.53	21.83	---	14.70	ND<50	ND<0.5	ND<0.5	ND<0.5	ND<0.5	---	---	ANA
MW-3	01/14/93	36.53	15.96	---	20.57	350	ND<0.5	ND<0.5	ND<0.5	ND<0.5	714	(c)	PACE
MW-3	04/22/93	36.53	16.20	---	20.33	2800	ND<0.5	ND<0.5	ND<0.5	ND<0.5	3600	(c)	PACE
MW-3	07/15/93	36.53	16.82	---	19.71	1400	1.2	ND<0.5	2.0	3.5	2200	(c)	PACE
MW-3	10/21/93	36.53	18.84	---	17.69	370	2.1	2.3	2.3	6.0	850	(c)	PACE
MW-3	01/27/94	36.53	18.00	---	18.53	1300	6.3	ND<0.5	ND<0.5	ND<0.5	4000	(c)	PACE
MW-3	04/21/94	36.53	16.62	---	19.91	2000	ND<0.5	ND<0.5	ND<0.5	ND<0.5	4300	(c)	PACE
MW-3	09/09/94	36.53	18.38	---	18.15	1300	ND<0.5	ND<0.5	0.5	1.2	---	---	PACE
MW-3	12/21/94	36.53	15.28	---	21.25	420	16	0.7	3.5	5.9	---	---	PACE
MW-3	01/30/95	36.53	12.62	---	23.91	ND<50	ND<0.50	ND<0.50	ND<0.50	ND<1.0	---	---	ATI
MW-3	04/10/95	36.53	12.41	---	24.12	150	ND<0.50	ND<0.50	ND<0.50	ND<1.0	---	---	ATI
MW-3	06/29/95	36.53	14.95	---	21.58	100	(d) ND<0.50	ND<0.50	ND<0.50	ND<1.0	---	---	ATI
MW-3	09/18/95	36.53	15.82	---	20.71	---	---	---	---	---	---	---	---
MW-3	09/19/95	36.53	---	---	---	82	ND<0.50	ND<0.50	ND<0.50	ND<1.0	260	---	ATI
MW-3	12/07/95	36.53	17.09	---	19.44	ND<50	ND<0.50	ND<0.50	ND<0.50	ND<1.0	91	---	ATI
MW-3	03/28/96	36.53	11.90	---	24.63	ND<50	ND<0.5	ND<1	ND<1	ND<1	230	---	SPL
MW-3	06/20/96	36.53	12.66	---	23.87	260	ND<0.5	ND<1	ND<1	ND<1	370	---	SPL
MW-3	10/11/96	36.53	16.23	---	20.30	330	ND<0.5	ND<1.0	ND<1.0	ND<1.0	440	---	SPL
MW-3	01/02/97	36.53	12.17	---	24.36	ND<50	ND<0.5	ND<1.0	ND<1.0	ND<1.0	140	---	SPL
MW-3	04/14/97	36.53	13.45	---	23.08	---	---	---	---	---	---	---	---
MW-3	04/15/97	36.53	---	---	---	1500	ND<0.5	ND<1.0	ND<1.0	ND<1.0	1800	---	SPL
MW-3	07/02/97	36.53	15.60	---	20.93	880	ND<0.5	ND<1.0	ND<1.0	ND<1.0	940	---	SPL
MW-3	09/30/97	36.53	17.16	---	19.37	40000	13000	2400	870	3100	510	---	SPL
MW-3	01/21/98	36.53	11.77	---	24.76	120	ND<0.5	ND<1.0	ND<1.0	ND<1.0	98	---	SPL
MW-3	04/09/98	36.53	9.42	---	27.11	950	ND<0.5	ND<1.0	ND<1.0	ND<1.0	890	---	SPL
MW-3	06/19/98	36.53	12.09	---	24.44	1800	ND<0.5	ND<1.0	ND<1.0	ND<1.0	1900	---	SPL
MW-3	06/19/98	36.53	15.28	---	21.25	1800	ND<0.5	ND<1.0	ND<1.0	ND<1.0	1900	---	SPL
MW-3	01/21/99	36.53	14.67	---	21.86	1100	ND<1.0	ND<1.0	ND<1.0	ND<1.0	1200	---	SPL
MW-3	04/30/99	36.53	16.00	---	20.53	---	---	---	---	---	---	---	---
MW-3	07/09/99	36.53	14.64	---	21.89	470	ND<1.0	ND<1.0	ND<1.0	ND<1.0	460/470	(g)	SPL
MW-3	11/03/99	36.53	16.39	---	20.14	---	---	---	---	---	---	---	---
MW-3	01/12/00	36.53	16.80	---	19.73	ND<50	ND<0.5	ND<0.5	ND<0.5	ND<0.5	34	---	PACE
MW-3	04/13/00	36.53	16.43	---	20.10	---	---	---	---	---	---	---	---
MW-3	07/26/00	36.53	16.93	---	19.60	ND<50	ND<0.5	ND<0.5	ND<0.5	ND<0.5	ND<0.5	---	PACE
MW-3	10/24/00	36.53	15.69	---	20.84	---	---	---	---	---	---	---	---

TABLE 1 - SUMMARY OF RESULTS OF GROUNDWATER MONITORING

WELL ID	DATE OF MONITORING/ SAMPLING	CASING ELEVATION (a) (Feet)	DEPTH TO WATER (Feet)	PRODUCT THICKNESS (Feet)	GROUNDWATER ELEVATION (b) (Feet)	TPH-G (ug/l)	B (ug/l)	T (ug/l)	E (ug/l)	X (ug/l)	MTBE (ug/l)	DO (ppm)	LAB
AW-1	04/05/91	38.11	25.44	---	12.67	4100	1500	69	100	83	---	---	SUP
AW-1	04/01/92	38.11	23.22	---	14.89	---	---	---	---	---	---	---	---
AW-1	04/02/92	38.11	---	---	---	11000	1800	210	210	490	---	---	APP
AW-1	07/06/92	38.11	24.89	---	13.22	6500	4000	40	290	530	---	---	ANA
AW-1	10/07/92	38.11	26.55	---	11.56	4700	1500	41	47	300	---	---	ANA
QC-1 (e)	10/07/92	---	---	---	---	2900	1200	25	37	210	---	---	ANA
AW-1	01/14/93	38.11	23.73	---	14.38	2800	830	31	140	240	---	---	PACE
QC-1 (e)	01/14/93	---	---	---	---	4100	1700	28	130	230	---	---	PACE
AW-1	04/22/93	38.11	---	---	38.11	39000	14000	530	1800	6100	987 (c)	---	PACE
AW-1	07/15/93	38.11	22.50	---	15.61	6200	2200	28	210	540	840 (c)	---	PACE
AW-1	10/21/93	38.11	24.32	---	13.79	2400	820	13	55	120	830 (c)	---	PACE
AW-1	01/27/94	38.11	23.72	---	14.39	3500	1400	26	130	220	650 (c)	---	PACE
AW-1	04/21/94	38.11	22.48	---	15.63	40000	12000	1900	1600	5000	---	1.4	PACE
AW-1	09/09/94	38.11	23.04	---	15.07	3500	1600	5.0	200	250	---	2.1	PACE
QC-1 (e)	09/09/94	---	---	---	---	3900	1900	5.5	190	240	---	---	PACE
AW-1	12/21/94	38.11	21.70	---	16.41	7600	3100	36	370	320	---	1.6	PACE
AW-1	01/30/95	38.11	17.71	---	20.40	35000	23000	650	3200	4100	---	1.7	ATI
AW-1	04/10/95	38.11	20.04	---	18.07	60000	18000	2000	4300	11000	---	7.9	ATI
QC-1 (e)	04/10/95	---	---	---	---	56000	17000	2000	3900	10000	---	---	ATI
AW-1	06/29/95	38.11	20.60	---	17.51	72000	10000	7300	4200	15000	---	6.2	ATI
QC-1 (e)	06/29/95	---	---	---	---	86000	12000	8400	4800	18000	---	---	ATI
AW-1	09/18/95	38.11	21.87	---	16.24	---	---	---	---	---	---	---	---
AW-1	09/19/95	38.11	---	---	---	65000	12000	3100	4400	14000	1000	8.5	ATI
AW-1	12/07/95	38.11	22.06	---	16.05	25000	8700	ND<50	2500	1300	1100	2.9	ATI
AW-1	03/28/96	38.11	16.91	---	21.20	24000	11000	ND<100	3200	3390	ND<1000	6.6	SPL
AW-1	06/20/96	38.11	20.82	---	17.29	38000	6900	1100	3200	7300	ND<100	6.4	SPL
AW-1	10/11/96	38.11	23.20	---	14.91	33000	8500	69	3300	4230	580	6.3	SPL
AW-1	01/02/97	38.11	20.41	---	17.70	32000	8000	ND<50	3100	2300	700	6.7	SPL
AW-1	04/14/97	38.11	21.61	---	16.50	---	---	---	---	---	---	---	---
AW-1	04/15/97	38.11	---	---	---	31000	5000	160	2400	4540	340	5.4	SPL
AW-1	07/02/97	38.11	21.17	---	16.94	26000	5800	ND<100	2600	2200	ND<1000	6.2	SPL
AW-1	09/30/97	38.11	21.48	---	16.63	29000	9200	17	1400	130	560	6.9	SPL
AW-1	01/21/98	38.11	20.02	---	18.09	50000	6900	450	3200	4450	720	5.8	SPL
AW-1	04/09/98	38.11	13.37	---	24.74	---	---	---	---	---	---	---	---
AW-1	04/10/98	38.11	---	---	---	46000	5800	1900	3000	7400	1000	4.3	SPL
AW-1	06/19/98	38.11	19.12	---	18.99	42000	6600	200	3000	3350	660	4.9	SPL
QC-1 (e)	06/19/98	---	---	---	---	43000	6800	260	3100	3490	620	---	SPL
AW-1	11/30/98	38.11	21.13	---	16.98	23000	6700	ND<25	3100	130	710/820 (g)	---	SPL
AW-1	01/21/99	38.11	20.77	---	17.34	25000	4800	54	2800	780	1000	---	SPL

TABLE 1 - SUMMARY OF RESULTS OF GROUNDWATER MONITORING

WELL ID	DATE OF MONITORING/ SAMPLING	CASING ELEVATION (a) (Feet)	DEPTH TO WATER (Feet)	PRODUCT THICKNESS (Feet)	GROUNDWATER ELEVATION (b) (Feet)	TPH-G (ug/l)	B (ug/l)	T (ug/l)	E (ug/l)	X (ug/l)	MTBE (ug/l)	DO (ppm)	LAB
AW-1	04/30/99	38.11	20.80	---	17.31	21000	5300	67	2800	750	1500	---	SPL
AW-1	07/09/99	38.11	20.41	---	17.70	11000	3000	ND<10	760	180	1300	---	SPL
AW-1	11/03/99	38.11	20.82	---	17.29	---	---	---	---	---	---	---	---
AW-1	01/12/00	38.11	19.99	---	18.12	330000	5300	10	2900	560	2200	---	PACE
AW-1	04/13/00	38.11	20.14	---	17.97	---	---	---	---	---	---	---	---
AW-1	05/24/00	38.11	20.17	---	17.94	---	---	---	---	---	---	---	---
AW-1	06/01/00	38.11	23.05	---	15.06	---	---	---	---	---	---	---	---
AW-1	06/08/00	38.11	17.08	---	21.03	---	---	---	---	---	---	---	---
AW-1	06/15/00	38.11	16.93	---	21.18	---	---	---	---	---	---	---	---
AW-1	07/26/00	38.11	20.07	---	18.04	15000	290	98	77	220	37000	---	PACE
AW-1	10/24/00	38.11	20.10	---	18.01	---	---	---	---	---	---	---	---

TABLE 1 - SUMMARY OF RESULTS OF GROUNDWATER MONITORING

WELL ID	DATE OF MONITORING/ SAMPLING	CASING ELEVATION (a) (Feet)	DEPTH TO WATER (Feet)	PRODUCT THICKNESS (Feet)	GROUNDWATER ELEVATION (b) (Feet)	TPH-G (ug/l)	B (ug/l)	T (ug/l)	E (ug/l)	X (ug/l)	MTBE (ug/l)	DO (ppm)	LAB
AW-2	04/05/91	36.83	22.36	---	14.47	ND<50	ND<0.3	ND<0.3	ND<0.3	ND<0.3	---	---	SUP
AW-2	04/01/92	36.83	20.81	---	16.02	---	---	---	---	---	---	---	---
AW-2	04/02/92	36.83	---	---	---	130	25	2.3	0.7	2.1	---	---	APP
AW-2	07/06/92	36.83	23.57	---	13.26	ND<50	ND<0.5	ND<0.5	ND<0.5	ND<0.5	---	---	ANA
AW-2	10/07/92	36.83	25.24	---	11.59	ND<50	ND<0.5	ND<0.5	ND<0.5	ND<0.5	---	---	ANA
AW-2	01/14/93	36.83	20.82	---	16.01	ND<50	ND<0.5	ND<0.5	ND<0.5	ND<0.5	---	---	PACE
AW-2	04/22/93	36.83	19.37	---	17.46	ND<50	ND<0.5	ND<0.5	ND<0.5	ND<0.5	---	---	PACE
AW-2	07/15/93	36.83	21.29	---	15.54	ND<50	ND<0.5	ND<0.5	ND<0.5	ND<0.5	---	---	PACE
AW-2	10/21/93	36.83	23.14	---	13.69	ND<50	1.3	1.1	0.9	2.1	---	---	PACE
AW-2	01/27/94	36.83	22.34	---	14.49	ND<50	ND<0.5	ND<0.5	ND<0.5	ND<0.5	---	---	PACE
AW-2	04/21/94	36.83	21.15	---	15.68	ND<50	ND<0.5	ND<0.5	ND<0.5	ND<0.5	---	2.0	PACE
AW-2	09/09/94	36.83	22.09	---	14.74	ND<50	ND<0.5	ND<0.5	ND<0.5	ND<0.5	---	4.1	PACE
AW-2	12/21/94	36.83	20.12	---	16.71	ND<50	ND<0.5	ND<0.5	ND<0.5	ND<0.5	---	2.0	PACE
AW-2	01/30/95	36.83	16.65	---	20.18	ND<50	ND<0.50	ND<0.50	ND<0.50	ND<1.0	---	2.5	ATI
AW-2	04/10/95	36.83	16.22	---	20.61	ND<50	ND<0.50	ND<0.50	ND<0.50	ND<1.0	---	4.4	ATI
AW-2	06/29/95	36.83	17.55	---	19.28	ND<50	ND<0.50	ND<0.50	ND<0.50	ND<1.0	---	7.8	ATI
AW-2	09/18/95	36.83	19.87	---	16.96	---	---	---	---	---	---	---	---
AW-2	09/19/95	36.83	---	---	---	ND<50	ND<0.50	ND<0.50	ND<0.50	ND<1.0	ND<5.0	4.5	ATI
QC-1 (e)	09/19/95	---	---	---	---	ND<50	ND<0.50	ND<0.50	ND<0.50	ND<1.0	ND<5.0	---	ATI
AW-2	12/07/95	36.83	21.31	---	15.52	ND<50	ND<0.50	ND<0.50	ND<0.50	ND<1.0	ND<5.0	4.9	ATI
AW-2	03/28/96	36.83	15.61	---	21.22	ND<50	ND<0.5	ND<1	ND<1	ND<1	ND<10	4.1	SPL
AW-2	06/20/96	36.83	16.30	---	20.53	ND<50	ND<0.5	ND<1	ND<1	ND<1	ND<10	5.2	SPL
AW-2	10/11/96	36.83	19.60	---	17.23	ND<50	ND<0.5	ND<1.0	ND<1.0	ND<1.0	ND<10	6.0	SPL
AW-2	01/02/97	36.83	15.97	---	20.86	ND<50	ND<0.5	ND<1.0	ND<1.0	ND<1.0	ND<10	6.1	SPL
AW-2	04/14/97	36.83	17.19	---	19.64	ND<50	ND<0.5	ND<1.0	ND<1.0	ND<1.0	ND<10	5.3	SPL
AW-2	07/02/97	36.83	18.11	---	18.72	ND<50	ND<0.5	ND<1.0	ND<1.0	ND<1.0	ND<10	5.7	SPL
AW-2	09/30/97	36.83	18.52	---	18.31	ND<50	ND<0.5	ND<1.0	ND<1.0	ND<1.0	860	5.4	SPL
AW-2	01/21/98	36.83	14.46	---	22.37	160	13	ND<1.0	ND<1.0	ND<1.0	110	4.9	SPL
AW-2	04/09/98	36.83	12.85	---	23.98	---	---	---	---	---	---	---	---
AW-2	04/10/98	36.83	---	---	---	ND<50	ND<0.5	ND<1.0	ND<1.0	ND<1.0	ND<10	3.9	SPL
AW-2	06/19/98	36.83	14.37	---	22.46	60	ND<0.5	ND<1.0	ND<1.0	ND<1.0	ND<10	3.6	SPL
AW-2	11/30/98	36.83	16.90	---	19.93	---	---	---	---	---	---	---	---
AW-2	01/21/99	36.83	16.87	---	19.96	ND<50	ND<1.0	ND<1.0	ND<1.0	ND<1.0	ND<1.0	---	SPL
AW-2	04/30/99	36.83	17.01	---	19.82	---	---	---	---	---	---	---	---
AW-2	07/09/99	36.83	17.83	---	19.00	---	---	---	---	---	---	---	---
AW-2	11/03/99	36.83	19.74	---	17.09	---	---	---	---	---	---	---	---
AW-2	01/12/00	36.83	19.90	---	16.93	ND<50	ND<0.5	ND<0.5	ND<0.5	ND<0.5	ND<0.5	---	PACE
AW-2	04/13/00	36.83	19.75	---	17.08	---	---	---	---	---	---	---	---
AW-2	07/26/00	36.83	19.86	---	16.97	---	---	---	---	---	---	---	---

TABLE 1 - SUMMARY OF RESULTS OF GROUNDWATER MONITORING

WELL ID	DATE OF MONITORING/ SAMPLING	CASING ELEVATION (a) (Feet)	DEPTH TO WATER (Feet)	PRODUCT THICKNESS (Feet)	GROUNDWATER ELEVATION (b) (Feet)	TPH-G (ug/l)	B (ug/l)	T (ug/l)	E (ug/l)	X (ug/l)	MTBE (ug/l)	DO (ppm)	LAB
AW-2	10/24/00	36.83	18.77	---	18.06	---	---	---	---	---	---	---	---

TABLE 1 - SUMMARY OF RESULTS OF GROUNDWATER MONITORING

WELL ID	DATE OF MONITORING/SAMPLING	CASING ELEVATION (a) (Feet)	DEPTH TO WATER (Feet)	PRODUCT THICKNESS (Feet)	GROUNDWATER ELEVATION (b) (Feet)	TPH-G (ug/l)	B (ug/l)	T (ug/l)	E (ug/l)	X (ug/l)	MTBE (ug/l)	DO (ppm)	LAB
AW-3	04/05/91	39.13	23.90	---	15.23	5200	980	450	95	310	---	---	SUP
AW-3	04/01/92	39.13	22.50	---	16.63	4700	890	47	43	110	---	---	APP
AW-3	07/06/92	39.13	23.26	---	15.87	3900	3100	30	80	99	---	---	ANA
AW-3	10/07/92	39.13	24.75	---	14.38	5000	2600	ND<0.5	ND<0.5	59	---	---	ANA
AW-3	01/14/93	39.13	23.59	---	15.54	350	250	ND<0.5	ND<0.5	ND<0.5	---	---	PACE
AW-3	04/22/93	39.13	19.42	---	19.71	240	71	2.4	0.6	4.0	---	---	PACE
AW-3	07/15/93	39.13	20.09	---	19.04	650	71	2.8	1.5	1.1	38	(c)	PACE
AW-3	10/21/93	39.13	21.88	---	17.25	160	4.8	1.7	1.6	3.6	---	---	PACE
QC-1 (e)	10/21/93	---	---	---	---	170	6.1	2.0	1.7	4.4	---	---	PACE
AW-3	01/27/94	39.13	22.33	---	16.80	92	2.1	ND<0.5	ND<0.5	ND<0.5	---	---	PACE
QC-1 (e)	01/27/94	---	---	---	---	90	2.9	0.5	ND<0.5	ND<0.5	---	---	PACE
AW-3	04/21/94	39.13	20.96	---	18.17	150	3.6	0.8	0.9	2.5	---	1.3	PACE
AW-3	09/09/94	39.13	21.60	---	17.53	53	ND<0.5	ND<0.5	ND<0.5	ND<0.5	---	1.9	PACE
AW-3 (f)	12/21/94	39.13	---	---	---	---	---	---	---	---	---	---	---
AW-3 (f)	01/30/95	39.13	---	---	---	---	---	---	---	---	---	---	---
AW-3 (f)	04/10/95	39.13	---	---	---	---	---	---	---	---	---	---	---
AW-3	06/29/95	39.13	15.41	---	23.72	ND<50	ND<0.50	ND<0.50	ND<0.50	ND<1.0	---	8.0	ATI
AW-3	09/18/95	39.13	17.83	---	21.30	---	---	---	---	---	---	---	---
AW-3	09/19/95	39.13	---	---	---	61000	11000	2900	4100	13000	790	7.4	ATI
AW-3	12/07/95	39.13	19.27	---	19.86	ND<50	ND<0.50	ND<0.50	ND<0.50	ND<1.0	ND<5.0	3.4	ATI
QC-1 (e)	12/07/95	---	---	---	---	ND<50	ND<0.50	ND<0.50	ND<0.50	ND<1.0	ND<5.0	---	ATI
AW-3	03/28/96	39.13	13.85	---	25.28	ND<50	ND<0.5	ND<1	ND<1	ND<1	ND<10	4.1	SPL
QC-1 (e)	03/28/96	---	---	---	---	ND<50	ND<0.5	ND<1	ND<1	ND<1	ND<10	---	SPL
AW-3	06/20/96	39.13	14.47	---	24.66	ND<50	ND<0.5	ND<1	ND<1	ND<1	ND<10	4.2	SPL
QC-1 (e)	06/20/96	---	---	---	---	ND<50	ND<0.5	ND<1	ND<1	ND<1	ND<10	---	SPL
AW-3	10/11/96	39.13	17.97	---	21.16	ND<50	ND<0.5	ND<1.0	ND<1.0	ND<1.0	ND<10	4.7	SPL
QC-1 (e)	10/11/96	---	---	---	---	ND<50	ND<0.5	ND<1.0	ND<1.0	ND<1.0	ND<10	---	SPL
AW-3	01/02/97	39.13	13.00	---	26.13	ND<50	ND<0.5	ND<1.0	ND<1.0	ND<1.0	ND<10	5.6	SPL
AW-3	04/14/97	39.13	14.36	---	24.77	ND<50	ND<0.5	ND<1.0	ND<1.0	ND<1.0	ND<10	5.0	SPL
QC-1 (e)	04/15/97	---	---	---	---	ND<50	ND<0.5	ND<1.0	ND<1.0	ND<1.0	ND<10	---	SPL
AW-3	07/02/97	39.13	15.87	---	23.26	ND<50	ND<0.5	ND<1.0	ND<1.0	ND<1.0	ND<10	5.4	SPL
AW-3	09/30/97	39.13	17.50	---	21.63	ND<250	ND<2.5	ND<5.0	ND<5.0	ND<5.0	810	5.7	SPL
AW-3	01/21/98	39.13	11.98	---	27.15	140	ND<0.5	ND<1.0	ND<1.0	ND<1.0	99	4.6	SPL
QC-1 (e)	01/21/98	---	---	---	---	150	ND<0.5	ND<1.0	ND<1.0	1.2	110	---	SPL
AW-3	04/09/98	39.13	9.45	---	29.68	---	---	---	---	---	---	---	---
AW-3	04/10/98	39.13	---	---	---	ND<50	ND<0.5	ND<1.0	ND<1.0	1.6	ND<10	4.5	SPL
QC-1 (e)	04/10/98	---	---	---	---	ND<50	ND<0.5	ND<1.0	1.4	1.7	ND<10	---	SPL
AW-3	06/19/98	39.13	12.13	---	27.00	ND<50	ND<0.5	ND<1.0	ND<1.0	ND<1.0	ND<10	4.4	SPL
AW-3	11/30/98	39.13	15.91	---	23.22	---	---	---	---	---	---	---	---



TABLE 1 - SUMMARY OF RESULTS OF GROUNDWATER MONITORING

WELL ID	DATE OF MONITORING/ SAMPLING	CASING ELEVATION (a) (Feet)	DEPTH TO WATER (Feet)	PRODUCT THICKNESS (Feet)	GROUNDWATER ELEVATION (b) (Feet)	TPH-G (ug/l)	B (ug/l)	T (ug/l)	E (ug/l)	X (ug/l)	MTBE (ug/l)	DO (ppm)	LAB
AW-3	01/21/99	39.13	15.93	---	23.20	ND<50	ND<1.0	ND<1.0	ND<1.0	ND<1.0	ND<1.0	---	SPL
AW-3	04/30/99	39.13	15.98	---	23.15	---	---	---	---	---	---	---	---
AW-3	07/09/99	39.13	14.58	---	24.55	---	---	---	---	---	---	---	---
AW-3	11/03/99	39.13	17.43	---	21.70	---	---	---	---	---	---	---	---
AW-3	01/12/00	39.13	18.30	---	20.83	ND<50	ND<0.5	ND<0.5	ND<0.5	ND<0.5	ND<0.5	---	PACE
AW-3	04/13/00	39.13	18.89	---	20.24	---	---	---	---	---	---	---	---
AW-3	07/26/00	39.13	18.67	---	20.46	---	---	---	---	---	---	---	---
AW-3	10/24/00	39.13	18.98	---	20.15	---	---	---	---	---	---	---	---

TABLE 1 - SUMMARY OF RESULTS OF GROUNDWATER MONITORING

WELL ID	DATE OF MONITORING/ SAMPLING	CASING ELEVATION (a) (Feet)	DEPTH TO WATER (Feet)	PRODUCT THICKNESS (Feet)	GROUNDWATER ELEVATION (b) (Feet)	TPH-G (ug/l)	B (ug/l)	T (ug/l)	E (ug/l)	X (ug/l)	MTBE (ug/l)	DO (ppm)	LAB
AW-4	04/05/91	39.08	25.12	---	13.96	110000	40000	13000	2000	5500	---	---	SUP
AW-4	04/01/92	39.08	23.56	---	15.52	230000	57000	31000	2900	7600	---	---	APP
QC-1 (e)	04/01/92	---	---	---	---	210000	55000	23000	2900	7000	---	---	APP
AW-4	07/06/92	39.08	25.87	---	13.21	38000	16000	5400	2000	6100	---	---	ANA
AW-4	10/07/92	39.08	27.53	---	11.55	120000	41000	26000	4700	13000	---	---	ANA
AW-4	01/14/93	39.08	24.12	---	14.96	62000	18000	14000	2700	7700	1400 (c)	---	PACE
AW-4	04/22/93	39.08	21.47	---	17.61	18000	1100	2100	320	3500	---	---	PACE
AW-4	07/15/93	39.08	23.30	---	15.78	21000	820	2300	590	3800	2000 (c)	---	PACE
AW-4	10/21/93	39.08	25.08	---	14.00	11000	570	83	630	2300	4600 (c)	---	PACE
AW-4	01/27/94	39.08	24.61	---	14.47	12000	420	460	600	2200	6400 (c)	---	PACE
AW-4	04/21/94	39.08	22.96	---	16.12	12000	110	250	150	1900	16 (c)	1.5	PACE
QC-1 (e)	04/21/94	---	---	---	---	14000	71	160	29	1200	13000 (c)	---	PACE
AW-4	09/09/94	39.08	23.85	---	15.23	9700	75	64	280	2000	---	2.1	PACE
AW-4 (f)	12/21/94	39.08	---	---	---	---	---	---	---	---	---	---	---
AW-4 (f)	01/30/95	39.08	---	---	---	---	---	---	---	---	---	---	---
AW-4	04/10/95	39.08	18.07	---	21.01	3700	69	8.7	44	130	---	8.5	ATI
AW-4	06/29/95	39.08	19.25	---	19.83	8000	62	190	190	1100	---	7.5	ATI
AW-4	09/18/95	39.08	20.73	---	18.35	---	---	---	---	---	---	---	---
AW-4	09/19/95	39.08	---	---	---	12000	660	1600	200	1900	7100	8.3	ATI
AW-4	12/07/95	39.08	22.49	---	16.59	41000	8400	7200	710	6300	5200	3.6	ATI
AW-4 (f)	03/28/96	39.08	16.49	---	22.59	---	---	---	---	---	---	---	---
AW-4	06/20/96	39.08	16.00	---	23.08	ND<50	ND<0.5	ND<1	ND<1	ND<1	12	---	SPL
AW-4	10/11/96	39.08	19.52	---	19.56	36000	12000	5500	ND<25	3800	880/1000 (g)	6.2	SPL
AW-4	01/02/97	39.08	15.80	---	23.28	ND<50	ND<0.5	ND<1.0	ND<1.0	ND<1.0	22	6.4	SPL
QC-1 (e)	01/02/97	---	---	---	---	ND<50	61	3.8	3.5	8.1	110	---	SPL
AW-4	04/14/97	39.08	17.01	---	22.07	---	---	---	---	---	---	---	---
AW-4	04/15/97	39.08	---	---	---	ND<50	ND<0.5	ND<1.0	ND<1.0	ND<1.0	ND<10	5.4	SPL
AW-4	07/02/97	39.08	19.68	---	19.40	ND<50	21	ND<1.0	ND<1.0	ND<1.0	41	4.1	SPL
AW-4 (f)	09/30/97	39.08	22.71	---	16.37	---	---	---	---	---	---	---	---
AW-4	01/21/98	39.08	15.89	---	23.19	13000	2900	ND<10	230	314	3100	3.9	SPL
AW-4	04/09/98	39.08	13.50	---	25.58	---	---	---	---	---	---	---	---
AW-4	04/10/98	39.08	---	---	---	890	ND<0.5	ND<1	ND<1	ND<1	730	4.9	SPL
AW-4	06/19/98	39.08	14.75	---	24.33	60	ND<0.5	ND<1.0	ND<1.0	ND<1.0	34	4.3	SPL
AW-4	11/30/98	39.08	19.25	---	19.83	---	---	---	---	---	---	---	---
AW-4	01/21/99	39.08	18.94	---	20.14	3700	830	93	200	360	30	---	---
AW-4	04/30/99	39.08	19.10	---	19.98	---	---	---	---	---	---	---	---
AW-4	07/09/99	39.08	18.93	---	20.15	76000	12000	6600	2000	8700	320	---	SPL
AW-4	11/03/99	39.08	20.65	---	18.43	---	---	---	---	---	---	---	---
AW-4	01/12/00	39.08	21.21	---	17.87	67000	12000	3500	2900	15000	280	---	PACE

TABLE 1 - SUMMARY OF RESULTS OF GROUNDWATER MONITORING

WELL ID	DATE OF MONITORING/ SAMPLING	CASING ELEVATION (a) (Feet)	DEPTH TO WATER (Feet)	PRODUCT THICKNESS (Feet)	GROUNDWATER ELEVATION (b) (Feet)	TPH-G (ug/l)	B (ug/l)	T (ug/l)	E (ug/l)	X (ug/l)	MTBE (ug/l)	DO (ppm)	LAB
AW-4	04/13/00	39.08	21.33	---	17.75	---	---	---	---	---	---	---	---
AW-4	05/24/00	39.08	19.84	---	19.24	---	---	---	---	---	---	---	---
AW-4	06/01/00	39.08	19.04	---	20.04	---	---	---	---	---	---	---	---
AW-4	06/08/00	39.08	18.32	---	20.76	---	---	---	---	---	---	---	---
AW-4	06/15/00	39.08	16.70	---	22.38	---	---	---	---	---	---	---	---
AW-4	07/26/00	39.08	21.50	---	17.58	910	ND<0.5	ND<0.5	ND<0.5	ND<0.5	3500	---	PACE
AW-4	10/24/00	39.08	22.00	---	17.08	---	---	---	---	---	---	---	---

TABLE 1 - SUMMARY OF RESULTS OF GROUNDWATER MONITORING

WELL ID	DATE OF MONITORING/ SAMPLING	CASING ELEVATION (a) (Feet)	DEPTH TO WATER (Feet)	PRODUCT THICKNESS (Feet)	GROUNDWATER ELEVATION (b) (Feet)	TPH-G (ug/l)	B (ug/l)	T (ug/l)	E (ug/l)	X (ug/l)	MTBE (ug/l)	DO (ppm)	LAB
AW-5	04/05/91	38.51	25.48	---	13.03	420	31	7.5	20	68	---	---	SUP
AW-5	04/01/92	38.51	23.95	---	14.56	---	---	---	---	---	---	---	---
AW-5	04/02/92	38.51	---	---	---	4000	270	63	190	290	---	---	APP
AW-5	07/06/92	38.51	26.48	---	12.03	1400	160	ND<2.5	250	58	---	---	ANA
AW-5	10/07/92	38.51	28.18	---	10.33	360	12	0.6	8.7	5	---	---	ANA
AW-5	01/14/93	38.51	24.15	---	14.36	1700	270	7.5	130	62	---	---	PACE
AW-5	04/22/93	38.51	22.43	---	16.08	2700	780	30	220	180	---	---	PACE
QC-1 (e)	04/22/93	---	---	---	---	3500	780	29	240	210	---	---	PACE
AW-5	07/15/93	38.51	24.31	---	14.20	1300	69	16	67	120	---	---	PACE
QC-1 (e)	07/15/93	---	---	---	---	1300	68	8.3	64	99	---	---	PACE
AW-5	10/21/93	38.51	26.05	---	12.46	510	9.6	1.5	17	45	75 (c)	---	PACE
AW-5	01/27/94	38.51	26.42	---	12.09	420	3.3	ND<0.5	1.0	0.9	---	---	PACE
AW-5	04/21/94	38.51	24.36	---	14.15	1000	110	25	56	27	75 (c)	1.3	PACE
AW-5	09/09/94	38.51	24.55	---	13.96	210	ND<0.5	ND<0.5	0.5	0.9	---	2.7	PACE
AW-5	12/21/94	38.51	22.30	---	16.21	410	ND<0.5	20	4.3	1.4	---	1.1	PACE
QC-1 (e)	12/21/94	---	---	---	---	340	ND<0.5	15	3.3	1.4	---	---	PACE
AW-5	01/30/95	38.51	18.88	---	19.63	210	0.6	11	8.8	2	---	1.5	ATI
AW-5	04/10/95	38.51	18.44	---	20.07	500	1.4	0.59	6.5	4.3	---	8.3	ATI
AW-5	06/29/95	38.51	19.92	---	18.59	490 (d)	1.2	0.58	7.3	2.2	---	6.9	ATI
AW-5	09/18/95	38.51	22.15	---	16.36	---	---	---	---	---	---	---	---
AW-5	09/19/95	38.51	---	---	---	260	0.62	ND<0.50	3.1	1.1	110	8.2	ATI
AW-5	12/07/95	38.51	23.75	---	14.76	60	ND<0.50	ND<0.50	ND<0.50	ND<1.0	210	4.3	ATI
AW-5	03/28/96	38.51	17.76	---	20.75	ND<50	ND<0.5	ND<1	ND<1	ND<1	63	3.0	SPL
AW-5	06/20/96	38.51	18.46	---	20.05	ND<50	ND<0.5	ND<1	ND<1	ND<1	ND<10	3.6	SPL
AW-5	10/11/96	38.51	21.84	---	16.67	ND<50	ND<0.5	ND<1.0	ND<1.0	ND<1.0	ND<10	4.5	SPL
AW-5	01/02/97	38.51	18.01	---	20.50	ND<50	ND<0.5	ND<1.0	ND<1.0	ND<1.0	ND<10	4.6	SPL
AW-5	04/14/97	38.51	19.35	---	19.16	ND<50	ND<0.5	ND<1.0	ND<1.0	ND<1.0	ND<10	5.1	SPL
AW-5	07/02/97	38.51	20.29	---	18.22	ND<50	ND<0.5	ND<1.0	ND<1.0	ND<1.0	ND<10	4.0	SPL
AW-5	09/30/97	38.51	23.15	---	15.36	ND<250	ND<2.5	ND<5.0	ND<5.0	ND<5.0	1300	6.3	SPL
AW-5	01/21/98	38.51	17.33	---	21.18	6100	ND<0.5	2.1	ND<1.0	ND<1.0	3700	4.5	SPL
AW-5	04/09/98	38.51	15.25	---	23.26	---	---	---	---	---	---	---	---
AW-5	04/10/98	38.51	---	---	---	3500	ND<0.5	ND<1.0	ND<1.0	ND<1.0	3000	5.4	SPL
AW-5	06/19/98	38.51	17.39	---	21.12	3300	ND<0.5	ND<1.0	ND<1.0	ND<1.0	2500	5.2	SPL
AW-5 (f)	11/30/98	38.51	---	---	---	---	---	---	---	---	---	---	---
AW-5	01/21/99	38.51	21.22	---	17.29	2800	ND<1.0	ND<1.0	ND<1.0	ND<1.0	1800	---	SPL
AW-5	04/30/99	38.51	21.50	---	17.01	---	---	---	---	---	---	---	---
AW-5	07/09/99	38.51	20.15	---	18.36	4000	ND<1.0	ND<1.0	ND<1.0	ND<1.0	3400/3500 (g)	---	SPL
AW-5	11/03/99	38.51	22.04	---	16.47	---	---	---	---	---	---	---	---
AW-5	01/12/00	38.51	22.59	---	15.92	1000 (j)	7.3	30	6.7	40	4600	---	PACE

TABLE 1 - SUMMARY OF RESULTS OF GROUNDWATER MONITORING

WELL ID	DATE OF MONITORING/ SAMPLING	CASING ELEVATION (a) (Feet)	DEPTH TO WATER (Feet)	PRODUCT THICKNESS (Feet)	GROUNDWATER ELEVATION (b) (Feet)	TPH-G (ug/l)	B (ug/l)	T (ug/l)	E (ug/l)	X (ug/l)	MTBE (ug/l)	DO (ppm)	LAB
AW-5	04/13/00	38.51	23.11	---	15.40	---	---	---	---	---	---	---	---
AW-5	07/26/00	38.51	22.72	---	15.79	1800	94	35	5.9	27	16000	---	PACE
AW-5	10/24/00	38.51	20.15	---	18.36	---	---	---	---	---	---	---	---

TABLE 1 - SUMMARY OF RESULTS OF GROUNDWATER MONITORING

WELL ID	DATE OF MONITORING/ SAMPLING	CASING ELEVATION (a) (Feet)	DEPTH TO WATER (Feet)	PRODUCT THICKNESS (Feet)	GROUNDWATER ELEVATION (b) (Feet)	TPH-G (ug/l)	B (ug/l)	T (ug/l)	E (ug/l)	X (ug/l)	MTBE (ug/l)	DO (ppm)	LAB
AW-6	04/05/91	37.08	22.48	---	14.60	1100	80	19	1.4	230	---	---	SUP
AW-6	04/01/92	37.08	22.50	---	14.58	---	---	---	---	---	---	---	---
AW-6	04/02/92	37.08	---	---	---	ND<50	ND<0.5	ND<0.5	ND<0.5	ND<0.5	---	---	APP
AW-6	07/06/92	37.08	22.74	---	14.34	ND<50	ND<0.5	ND<0.5	ND<0.5	ND<0.5	---	---	ANA
AW-6	10/07/92	37.08	24.64	---	12.44	ND<50	ND<0.5	ND<0.5	ND<0.5	ND<0.5	---	---	ANA
AW-6	01/14/93	37.08	22.36	---	14.72	ND<50	ND<0.5	ND<0.5	ND<0.5	ND<0.5	---	---	PACE
AW-6	04/22/93	37.08	22.82	---	14.26	ND<50	ND<0.5	ND<0.5	ND<0.5	ND<0.5	---	---	PACE
AW-6	07/15/93	37.08	20.49	---	16.59	ND<50	ND<0.5	ND<0.5	ND<0.5	0.8	---	---	PACE
AW-6	10/21/93	37.08	22.84	---	14.24	ND<50	0.5	0.6	ND<0.5	0.7	---	---	PACE
AW-6	01/27/94	37.08	22.33	---	14.75	ND<50	ND<0.5	0.9	3.1	12	---	---	PACE
AW-6	04/21/94	37.08	20.66	---	16.42	ND<50	ND<0.5	ND<0.5	ND<0.5	ND<0.5	---	1.7	PACE
AW-6	09/09/94	37.08	21.57	---	15.51	ND<50	0.9	ND<0.5	ND<0.5	0.5	---	2.9	PACE
AW-6	12/21/94	37.08	19.40	---	17.68	ND<50	1.8	0.8	0.8	3.2	---	1.1	PACE
AW-6	01/30/95	37.08	16.74	---	20.34	ND<50	ND<0.50	ND<0.50	ND<0.50	ND<1.0	---	2.2	ATI
QC-1 (e)	01/30/95	---	---	---	---	ND<50	ND<0.50	ND<0.50	ND<0.50	ND<1.0	---	---	ATI
AW-6	04/10/95	37.08	16.01	---	21.07	ND<50	ND<0.50	ND<0.50	ND<0.50	ND<1.0	---	8.6	ATI
AW-6	06/29/95	37.08	17.54	---	19.54	ND<50	ND<0.50	ND<0.50	ND<0.50	ND<1.0	---	6.3	ATI
AW-6	09/18/95	37.08	19.65	---	17.43	---	---	---	---	---	---	---	---
AW-6	09/19/95	37.08	---	---	---	ND<50	ND<0.50	ND<0.50	ND<0.50	ND<1.0	25	8.3	ATI
AW-6	12/07/95	37.08	20.35	---	16.73	ND<50	ND<0.50	ND<0.50	ND<0.50	ND<1.0	16	4.7	ATI
AW-6	03/28/96	37.08	14.99	---	22.09	ND<50	ND<0.5	ND<1	ND<1	ND<1	ND<10	4.0	SPL
AW-6	06/20/96	37.08	15.59	---	21.49	ND<50	ND<0.5	ND<1	ND<1	ND<1	ND<10	4.6	SPL
AW-6	10/11/96	37.08	19.09	---	17.99	ND<50	ND<0.5	ND<1.0	ND<1.0	ND<1.0	ND<10	5.3	SPL
AW-6	01/02/97	37.08	15.11	---	21.97	ND<50	ND<0.5	ND<1.0	ND<1.0	ND<1.0	ND<10	5.5	SPL
AW-6	04/14/97	37.08	16.25	---	20.83	ND<50	ND<0.5	ND<1.0	ND<1.0	ND<1.0	ND<10	3.9	SPL
AW-6	07/02/97	37.08	17.99	---	19.09	ND<50	ND<0.5	ND<1.0	ND<1.0	ND<1.0	ND<10	5.2	SPL
AW-6	09/30/97	37.08	20.50	---	16.58	ND<50	ND<0.5	ND<1.0	ND<1.0	ND<1.0	ND<10	6.0	SPL
AW-6	01/21/98	37.08	15.72	---	21.36	160	ND<0.5	ND<1.0	ND<1.0	ND<1.0	110	5.0	SPL
AW-6	04/09/98	37.08	13.31	---	23.77	---	---	---	---	---	---	---	---
AW-6	04/10/98	37.08	---	---	---	370	ND<0.5	ND<1.0	ND<1.0	ND<1.0	300	4.3	SPL
AW-6	06/19/98	37.08	15.18	---	21.90	830	2.0	ND<1.0	ND<1.0	ND<1.0	690	4.0	SPL
AW-6 (f)	11/30/98	37.08	---	---	---	---	---	---	---	---	---	---	---
AW-6	01/21/99	37.08	15.78	---	21.30	2300	ND<1.0	ND<1.0	ND<1.0	ND<1.0	1900	---	SPL
AW-6	04/30/99	37.08	16.01	---	21.07	---	---	---	---	---	---	---	---
AW-6	07/09/99	37.08	17.63	---	19.45	---	---	---	---	---	---	---	---
AW-6	11/03/99	37.08	18.42	---	18.66	---	---	---	---	---	---	---	---
AW-6	01/12/00	37.08	19.92	---	17.16	ND<50	ND<0.5	ND<0.5	ND<0.5	ND<0.5	2700	---	PACE
AW-6	04/13/00	37.08	19.87	---	17.21	---	---	---	---	---	---	---	---
AW-6	07/26/00	37.08	19.99	---	17.09	---	---	---	---	---	---	---	---

TABLE 1 - SUMMARY OF RESULTS OF GROUNDWATER MONITORING

WELL ID	DATE OF MONITORING/ SAMPLING	CASING ELEVATION (a) (Feet)	DEPTH TO WATER (Feet)	PRODUCT THICKNESS (Feet)	GROUNDWATER ELEVATION (b) (Feet)	TPH-G (ug/l)	B (ug/l)	T (ug/l)	E (ug/l)	X (ug/l)	MTBE (ug/l)	DO (ppm)	LAB
AW-6	10/24/00	37.08	18.12	--	18.96	--	--	--	--	--	--	--	--

TABLE 1 - SUMMARY OF RESULTS OF GROUNDWATER MONITORING

WELL ID	DATE OF MONITORING/ SAMPLING	CASING ELEVATION (a) (Feet)	DEPTH TO WATER (Feet)	PRODUCT THICKNESS (Feet)	GROUNDWATER ELEVATION (b) (Feet)	TPH-G (ug/l)	B (ug/l)	T (ug/l)	E (ug/l)	X (ug/l)	MTBE (ug/l)	DO (ppm)	LAB
AW-7	04/05/91	37.60	23.38	---	14.22	ND<50	0.4	0.7	ND<0.3	ND<0.3	---	---	SUP
AW-7	04/01/92	37.60	21.92	---	15.68	---	---	---	---	---	---	---	---
AW-7	04/02/92	37.60	---	---	---	ND<50	ND<0.5	3.2	1.0	5.4	---	---	APP
AW-7	07/06/92	37.60	24.50	---	13.10	ND<50	ND<0.5	ND<0.5	ND<0.5	ND<0.5	---	---	ANA
AW-7	10/07/92	37.60	26.18	---	11.42	ND<50	ND<0.5	ND<0.5	ND<0.5	ND<0.5	---	---	ANA
AW-7	01/14/93	37.60	22.03	---	15.57	ND<50	ND<0.5	ND<0.5	ND<0.5	ND<0.5	---	---	PACE
AW-7	04/22/93	37.60	21.18	---	16.42	ND<50	ND<0.5	ND<0.5	ND<0.5	ND<0.5	---	---	PACE
AW-7	07/15/93	37.60	22.09	---	15.51	ND<50	ND<0.5	ND<0.5	ND<0.5	ND<0.5	---	---	PACE
AW-7	10/21/93	37.60	24.05	---	13.55	51	5.0	4.2	3.5	8.2	---	---	PACE
AW-7	01/27/94	37.60	23.40	---	14.20	ND<50	ND<0.5	ND<0.5	ND<0.5	ND<0.5	---	---	PACE
AW-7	04/21/94	37.60	22.24	---	15.36	ND<50	ND<0.5	ND<0.5	ND<0.5	ND<0.5	---	2.5	PACE
AW-7	09/09/94	37.60	22.94	---	14.66	ND<50	ND<0.5	ND<0.5	ND<0.5	0.5	---	4.3	PACE
AW-7	12/21/94	37.60	20.86	---	16.74	ND<50	ND<0.5	ND<0.5	ND<0.5	ND<0.5	---	2.2	PACE
AW-7	01/30/95	37.60	17.51	---	20.09	ND<50	ND<0.50	ND<0.50	ND<0.50	ND<1.0	---	2.7	ATI
AW-7	04/10/95	37.60	16.69	---	20.91	ND<50	ND<0.50	ND<0.50	ND<0.50	ND<1.0	---	4.8	ATI
AW-7	06/29/95	37.60	18.33	---	19.27	ND<50	ND<0.50	ND<0.50	ND<0.50	ND<1.0	---	7.6	ATI
AW-7	09/18/95	37.60	20.68	---	16.92	---	---	---	---	---	---	---	---
AW-7	09/19/95	37.60	---	---	---	ND<50	ND<0.50	ND<0.50	ND<0.50	ND<1.0	ND<5.0	5.1	ATI
AW-7	12/07/95	37.60	22.15	---	15.45	ND<50	ND<0.50	ND<0.50	ND<0.50	ND<1.0	ND<5.0	5.2	ATI
AW-7	03/28/96	37.60	16.38	---	21.22	ND<50	ND<0.5	ND<1	ND<1	ND<1	ND<10	3.9	SPL
AW-7	06/20/96	37.60	17.02	---	20.58	ND<50	ND<0.5	ND<1	ND<1	ND<1	ND<10	5.0	SPL
AW-7	10/11/96	37.60	20.47	---	17.13	ND<50	ND<0.5	ND<1.0	ND<1.0	ND<1.0	ND<10	6.3	SPL
AW-7	01/02/97	37.60	16.70	---	20.90	ND<50	ND<0.5	ND<1.0	ND<1.0	ND<1.0	ND<10	6.2	SPL
AW-7	04/14/97	37.60	17.96	---	19.64	ND<50	ND<0.5	ND<1.0	ND<1.0	ND<1.0	ND<10	5.0	SPL
AW-7	07/02/97	37.60	19.11	---	18.49	ND<50	ND<0.5	ND<1.0	ND<1.0	ND<1.0	ND<10	5.4	SPL
AW-7	09/30/97	37.60	22.97	---	14.63	ND<250	ND<2.5	ND<5.0	ND<5.0	ND<5.0	1100	6.5	SPL
AW-7	01/21/98	37.60	16.50	---	21.10	ND<50	ND<0.5	ND<1.0	ND<1.0	ND<1.0	ND<10	4.9	SPL
AW-7	04/09/98	37.60	13.56	---	24.04	ND<50	ND<0.5	ND<1.0	ND<1.0	ND<1.0	ND<10	4.9	SPL
AW-7	06/19/98	37.60	15.41	---	22.19	ND<50	ND<0.5	ND<1.0	ND<1.0	ND<1.0	ND<10	4.4	SPL
AW-7	11/30/98	37.60	18.90	---	18.70	---	---	---	---	---	---	---	---
AW-7	01/21/99	37.60	18.39	---	19.21	---	---	---	---	---	---	---	---
AW-7	04/30/99	37.60	18.54	---	19.06	---	---	---	---	---	---	---	---
AW-7	07/09/99	37.60	17.98	---	19.62	---	---	---	---	---	---	---	---
AW-7	11/03/99	37.60	20.22	---	17.38	---	---	---	---	---	---	---	---
AW-7	01/12/00	37.60	19.46	---	18.14	---	---	---	---	---	---	---	---
AW-7	04/13/00	37.60	19.59	---	18.01	---	---	---	---	---	---	---	---
AW-7	07/26/00	37.60	19.69	---	17.91	---	---	---	---	---	---	---	---
AW-7	10/24/00	37.60	18.78	---	18.82	---	---	---	---	---	---	---	---



TABLE 1 - SUMMARY OF RESULTS OF GROUNDWATER MONITORING

WELL ID	DATE OF MONITORING/ SAMPLING	CASING ELEVATION (Feet)	DEPTH TO WATER (Feet)	PRODUCT THICKNESS (Feet)	GROUNDWATER ELEVATION (Feet)	TPH-G (ug/l)	B (ug/l)	T (ug/l)	E (ug/l)	X (ug/l)	MTBE (ug/l)	DO (ppm)	LAB
AW-8	04/05/91	40.86	26.68	---	14.18	80	1.9	2.2	0.5	1.3	---	---	SUP
AW-8	04/01/92	40.86	25.11	---	15.75	73	ND<0.5	0.7	ND<0.5	0.6	---	---	APP
AW-8	07/06/92	40.86	26.43	---	14.43	ND<50	ND<0.5	ND<0.5	ND<0.5	ND<0.5	---	---	ANA
AW-8	10/07/92	40.86	28.59	---	12.27	ND<50	ND<0.5	ND<0.5	ND<0.5	ND<0.5	---	---	ANA
AW-8	01/14/93	40.86	25.55	---	15.31	ND<50	ND<0.5	ND<0.5	ND<0.5	ND<0.5	---	---	PACE
AW-8	04/22/93	40.86	22.29	---	18.57	ND<50	ND<0.5	ND<0.5	ND<0.5	ND<0.5	---	---	PACE
AW-8	07/15/93	40.86	23.42	---	17.44	ND<50	ND<0.5	ND<0.5	ND<0.5	ND<0.5	---	---	PACE
AW-8	10/21/93	40.86	25.15	---	15.71	ND<50	1.9	1.8	1.3	3.3	---	---	PACE
AW-8	01/27/94	40.86	25.42	---	15.44	ND<50	ND<0.5	0.5	0.6	8.5	---	---	PACE
AW-8	04/21/94	40.86	24.14	---	16.72	ND<50	ND<0.5	ND<0.5	ND<0.5	ND<0.5	---	1.5	PACE
AW-8	09/09/94	40.86	24.55	---	16.31	ND<50	ND<0.5	ND<0.5	ND<0.5	ND<0.5	---	2.4	PACE
AW-8	12/21/94	40.86	22.72	---	18.14	ND<50	ND<0.5	ND<0.5	ND<0.5	ND<0.5	---	1.1	PACE
AW-8	01/30/95	40.86	19.75	---	21.11	ND<50	ND<0.50	1	ND<0.50	1	---	0.8	ATI
AW-8	04/10/95	40.86	17.78	---	23.08	ND<50	ND<0.50	ND<0.50	ND<0.50	ND<1.0	---	8.3	ATI
AW-8	06/29/95	40.86	18.18	---	22.68	ND<50	ND<0.50	ND<0.50	ND<0.50	ND<1.0	---	8.3	ATI
AW-8	09/18/95	40.86	20.20	---	20.66	---	---	---	---	---	---	---	---
AW-8	09/19/95	40.86	---	---	---	ND<50	ND<0.50	ND<0.50	ND<0.50	ND<1.0	ND<5.0	7.7	ATI
AW-8	12/07/95	40.86	21.54	---	19.32	ND<50	ND<0.50	ND<0.50	ND<0.50	ND<1.0	ND<5.0	4.4	ATI
AW-8	03/28/96	40.86	15.77	---	25.09	ND<50	ND<0.5	ND<1	ND<1	ND<1	ND<10	3.8	SPL
AW-8	06/20/96	40.86	16.41	---	24.45	ND<50	ND<0.5	ND<1	ND<1	ND<1	ND<10	3.6	SPL
AW-8	10/11/96	40.86	19.90	---	20.96	ND<50	ND<0.5	ND<1.0	ND<1.0	ND<1.0	ND<10	6.4	SPL
AW-8	01/02/97	40.86	15.89	---	24.97	ND<50	ND<0.5	ND<1.0	ND<1.0	ND<1.0	ND<10	5.9	SPL
AW-8	04/14/97	40.86	17.07	---	23.79	ND<50	ND<0.5	ND<1.0	ND<1.0	ND<1.0	ND<10	4.6	SPL
AW-8	07/02/97	40.86	18.67	---	22.19	ND<50	ND<0.5	ND<1.0	ND<1.0	ND<1.0	ND<10	5.6	SPL
AW-8	09/30/97	40.86	22.52	---	18.34	ND<50	ND<5	ND<10	ND<10	ND<10	820	6.7	SPL
AW-8	01/21/98	40.86	16.01	---	24.85	ND<50	ND<0.5	ND<1.0	ND<1.0	ND<1.0	ND<10	5.2	SPL
AW-8	04/09/98	40.86	11.18	---	29.68	ND<50	ND<0.5	ND<1.0	ND<1.0	ND<1.0	ND<10	4.4	SPL
AW-8	06/19/98	40.86	13.01	---	27.85	ND<50	ND<0.5	ND<1.0	ND<1.0	ND<1.0	ND<10	4.1	SPL
AW-8	11/30/98	40.86	17.46	---	23.40	---	---	---	---	---	---	---	---
AW-8	01/21/99	40.86	17.47	---	23.39	---	---	---	---	---	---	---	---
AW-8	04/30/99	40.86	17.60	---	23.26	---	---	---	---	---	---	---	---
AW-8	07/09/99	40.86	16.50	---	24.36	---	---	---	---	---	---	---	---
AW-8	11/03/99	40.86	19.29	---	21.57	---	---	---	---	---	---	---	---
AW-8	01/12/00	40.86	21.49	---	19.37	---	---	---	---	---	---	---	---
AW-8	04/13/00	40.86	21.60	---	19.26	---	---	---	---	---	---	---	---
AW-8	07/26/00	40.86	21.53	---	19.33	---	---	---	---	---	---	---	---
AW-8	10/24/00	40.86	19.37	---	21.49	---	---	---	---	---	---	---	---

TABLE 1 - SUMMARY OF RESULTS OF GROUNDWATER MONITORING

WELL ID	DATE OF MONITORING/ SAMPLING	CASING ELEVATION (a) (Feet)	DEPTH TO WATER (Feet)	PRODUCT THICKNESS (Feet)	GROUNDWATER ELEVATION (b) (Feet)	TPH-G (ug/l)	B (ug/l)	T (ug/l)	E (ug/l)	X (ug/l)	MTBE (ug/l)	DO (ppm)	LAB
AW-9	01/02/97	37.78	10.00	---	27.78	ND<50	ND<0.5	ND<1.0	ND<1.0	ND<1.0	ND<10	6.7	SPL
AW-9 (f)	04/14/97	37.78	---	---	---	---	---	---	---	---	---	---	---
AW-9	07/02/97	37.78	12.71	---	25.07	ND<50	ND<0.5	ND<1.0	ND<1.0	ND<1.0	ND<10	6.0	SPL
AW-9	09/30/97	37.78	21.22	---	16.56	ND<50	ND<0.5	ND<1.0	ND<1.0	ND<1.0	ND<10	6.8	SPL
AW-9	01/21/98	37.78	10.26	---	27.52	ND<50	ND<0.5	ND<1.0	ND<1.0	ND<1.0	ND<10	5.3	SPL
AW-9	04/09/98	37.78	6.77	---	31.01	ND<50	ND<0.5	ND<1.0	ND<1.0	ND<1.0	ND<10	5.6	SPL
AW-9	06/19/98	37.78	8.96	---	28.82	ND<50	ND<0.5	ND<1.0	ND<1.0	ND<1.0	ND<10	4.8	SPL

TABLE 1 - SUMMARY OF RESULTS OF GROUNDWATER MONITORING

WELL ID	DATE OF MONITORING/ SAMPLING	CASING ELEVATION (a) (Feet)	DEPTH TO WATER (Feet)	PRODUCT THICKNESS (Feet)	GROUNDWATER ELEVATION (b) (Feet)	TPH-G (ug/l)	B (ug/l)	T (ug/l)	E (ug/l)	X (ug/l)	MTBE (ug/l)	DO (ppm)	LAB
RW-1	04/05/91	37.73	---	---	---	---	---	---	---	---	---	---	---
RW-1	04/01/92	37.73	22.81	0.30	15.15	---	---	---	---	---	---	---	---
RW-1	07/06/92	37.73	26.92	0.41	11.12	---	---	---	---	---	---	---	---
RW-1	10/07/92	37.73	28.51	1.26	10.17	---	---	---	---	---	---	---	---
RW-1	01/14/93	37.73	23.75	0.25	14.17	---	---	---	---	---	---	---	---
RW-1	04/22/93	37.73	22.70	1.38	16.07	---	---	---	---	---	---	---	---
RW-1	07/15/93	37.73	26.10	0.81	12.24	---	---	---	---	---	---	---	---
RW-1	10/21/93	37.73	25.40	0.49	12.70	---	---	---	---	---	---	---	---
RW-1	10/21/93	37.73	25.40	0.49	12.70	---	---	---	---	---	---	---	---
RW-1	01/27/94	37.73	28.02	0.37	9.99	---	---	---	---	---	---	---	---
RW-1	04/21/94	37.73	23.10	0.91	15.31	---	---	---	---	---	---	---	---
RW-1	09/09/94	37.73	24.39	1.04	14.12	---	---	---	---	---	---	---	---
RW-1 (h)	12/21/94	37.73	---	---	---	---	---	---	---	---	---	---	---
RW-1	12/07/95	37.73	25.71	1.04	12.80	150000	34000	35000	4300	21000	2700	---	ATI
RW-1	03/28/96	37.73	16.75	0.18	21.12	---	---	---	---	---	---	---	---
RW-1 (h)	06/20/96	37.73	25.10	0.02	12.65	---	---	---	---	---	---	---	---
RW-1	10/11/96	37.73	25.51	0.00	12.22	130000	20000	32000	2800	20700	1400/1200 (g)	7.4	SPL
RW-1	01/02/97	37.73	24.49	0.01	13.25	---	---	---	---	---	---	---	---
RW-1	04/14/97	37.73	23.99	0.04	13.77	---	---	---	---	---	---	---	---
RW-1	04/15/97	37.73	---	---	---	1800000	38000	190000	48000	281000	ND<25000	---	SPL
RW-1	07/02/97	37.73	16.40	0.20	21.48	140000	19000	55000	4400	32400	ND<10000	5.7	SPL
QC-1 (e)	07/02/97	---	---	---	---	130000	19000	54000	4700	33400	ND<10000	---	SPL
RW-1	09/30/97	37.73	27.97	0.02	9.78	110000	13000	22000	2000	12500	1100	7.0	SPL
QC-1 (e)	09/30/97	---	---	---	---	140000	17000	29000	2500	15900	1200	---	SPL
RW-1	01/21/98	37.73	14.14	0.44	23.92	270000	21000	48000	3500	25000	1100	4.8	SPL
RW-1	04/09/98	37.73	25.01	0.05	12.76	---	---	---	---	---	---	---	---
RW-1	04/10/98	37.73	---	---	---	220000	26000	46000	4400	24500	ND<2500	5.1	SPL
RW-1	06/19/98	37.73	11.43	---	26.30	180000	19000	32000	3000	17400	ND<2500	4.6	SPL
RW-1	11/30/98	37.73	7.87	---	29.86	---	---	---	---	---	---	---	---
RW-1	01/21/99	37.73	18.90	0.03	18.85	260000	24000	46000	5100	30000	1700	---	SPL
RW-1	07/09/99	37.73	18.58	0.26	19.36	---	---	---	---	---	---	---	---
RW-1	11/03/99	37.73	20.85	0.60	17.36	160000	19000	37000	3800	25000	1500	---	PACE
RW-1	01/12/00	37.73	21.20	0.23	16.71	240000	18000	46000	5800	26000	2100	---	PACE
RW-1	04/13/00	37.73	21.71	0.11	16.11	120000	2100	33000	2800	28000	1500	---	PACE
RW-1	05/24/00	37.73	21.89	0.24	16.03	---	---	---	---	---	---	---	---
RW-1	06/01/00	37.73	16.30	0.01	21.44	---	---	---	---	---	---	---	---
RW-1	06/08/00	37.73	17.88	0.20	20.01	---	---	---	---	---	---	---	---
RW-1	06/15/00	37.73	16.72	0.04	21.04	---	---	---	---	---	---	---	---
RW-1	06/20/00	37.73	21.04	0.20	16.85	---	---	---	---	---	---	---	---

TABLE 1 - SUMMARY OF RESULTS OF GROUNDWATER MONITORING

WELL ID	DATE OF MONITORING/ SAMPLING	CASING ELEVATION (a) (Feet)	DEPTH TO WATER (Feet)	PRODUCT THICKNESS (Feet)	GROUNDWATER ELEVATION (b) (Feet)	TPH-G (ug/l)	B (ug/l)	T (ug/l)	E (ug/l)	X (ug/l)	MTBE (ug/l)	DO (ppm)	LAB
RW-1	07/07/00	37.73	17.21	0.01	20.53	---	---	---	---	---	---	---	---
RW-1	07/20/00	37.73	21.87	0.18	16.00	---	---	---	---	---	---	---	---
RW-1	07/26/00	37.73	21.45	0.13	16.38	67000	160	5300	2100	18000	1100	---	PACE
RW-1	07/31/00	37.73	22.11	---	15.62	---	---	---	---	---	---	---	---
RW-1	08/08/00	37.73	17.80	0.01	19.94	---	---	---	---	---	---	---	---
RW-1	08/16/00	37.73	17.92	---	19.81	---	---	---	---	---	---	---	---
RW-1	08/23/00	37.73	18.11	0.02	19.64	---	---	---	---	---	---	---	---
RW-1	10/24/00	37.73	18.93	---	18.80	---	---	---	---	---	---	---	---
RW-1 (k)	10/25/00	37.73	19.04	---	18.69	360000	18000	78000	34000	180000	2100	---	PACE
QC-2 (i)	10/07/92	---	---	---	---	ND<50	ND<0.5	ND<0.5	ND<0.5	ND<0.5	---	---	ANA
QC-2 (i)	01/14/93	---	---	---	---	ND<50	ND<0.5	ND<0.5	ND<0.5	ND<0.5	---	---	PACE
QC-2 (i)	04/22/93	---	---	---	---	ND<50	ND<0.5	ND<0.5	ND<0.5	ND<0.5	---	---	PACE
QC-2 (i)	07/15/93	---	---	---	---	ND<50	ND<0.5	ND<0.5	ND<0.5	ND<0.5	---	---	PACE
QC-2 (i)	10/21/93	---	---	---	---	ND<50	ND<0.5	ND<0.5	ND<0.5	ND<0.5	---	---	PACE
QC-2 (i)	01/27/94	---	---	---	---	ND<50	ND<0.5	ND<0.5	ND<0.5	ND<0.5	---	---	PACE
QC-2 (i)	04/21/94	---	---	---	---	ND<50	ND<0.5	ND<0.5	ND<0.5	ND<0.5	---	---	PACE
QC-2 (i)	09/09/94	---	---	---	---	ND<50	ND<0.5	ND<0.5	ND<0.5	ND<0.5	---	---	PACE
QC-2 (i)	12/21/94	---	---	---	---	ND<50	ND<0.5	ND<0.5	ND<0.5	ND<0.5	---	---	PACE
QC-2 (i)	01/30/95	---	---	---	---	ND<50	ND<0.50	ND<0.50	ND<0.50	ND<1.0	---	---	ATI
QC-2 (i)	04/10/95	---	---	---	---	ND<50	ND<0.50	ND<0.50	ND<0.50	ND<1.0	---	---	ATI
QC-2 (i)	06/27/95	---	---	---	---	ND<50	ND<0.50	ND<0.50	ND<0.50	ND<1.0	---	---	ATI
QC-2 (i)	09/19/95	---	---	---	---	ND<50	ND<0.50	ND<0.50	ND<0.50	ND<1.0	ND<5.0	---	ATI
QC-2 (i)	12/07/95	---	---	---	---	ND<50	ND<0.50	ND<0.50	ND<0.50	ND<1.0	ND<5.0	---	ATI
QC-2 (i)	03/28/96	---	---	---	---	ND<50	ND<0.5	ND<1	ND<1	ND<1	ND<10	---	SPL
QC-2 (i)	06/20/96	---	---	---	---	ND<50	ND<0.5	ND<1	ND<1	ND<1	ND<10	---	SPL

TABLE 1 - SUMMARY OF RESULTS OF GROUNDWATER MONITORING

ABBREVIATIONS

TPH-G	Total petroleum hydrocarbons as gasoline	(a) Top of casing elevations surveyed to the nearest 0.01 foot above mean sea level.
B	Benzene	(b) Groundwater elevations adjusted assuming a specific gravity of 0.75 for free product.
T	Toluene	(c) A copy of the documentation for this data is included in Appendix C of Alisto report 10-025-13-003.
E	Ethylbenzene	(d) MTBE peak. See documentation in Appendix C of Alisto report 10-025-13-003.
X	Total xylenes	(e) Blind duplicate.
MTBE	Methyl tert butyl ether	(f) Well inaccessible.
DO	Dissolved oxygen	(g) EPA Methods 8020/8260 used.
ug/l	Micrograms per liter	(h) Well not monitored and/or sampled due to vapor extraction system.
ppm	Parts per million	(i) Travel blank.
---	Not available/applicable/measurable	(j) This gasoline does not include MTBE.
ND	Not detected above reported detection limit	(k) Well was sampled on a different date from the other wells due to lack of proper equipment.
PACE	Pace, Inc.	
SUP	Superior Analytical Laboratories, Inc.	
APP	Applied Analytical Laboratory	
ANA	Anamatrix, Inc.	
ATI	Analytical Technologies, Inc.	
SPL	Southern Petroleum Laboratories	

TABLE 2 - PRODUCT REMOVAL STATUS

WELL ID	DATE OF MONITORING	PRODUCT REMOVED (Gallons)	PRODUCT REMOVED CUMULATIVE (Gallons)
RW-1	10/06/93	1.00	1.00
	10/14/94	1.00	2.00
	10/20/94	18.00	20.00
	10/26/94	3.00	23.00
	11/02/93	5.00	28.00
	11/10/94	6.00	34.00
	11/16/94	2.50	36.50
	11/23/94	5.00	41.50
	11/30/93	2.00	43.50
	12/07/93	4.00	47.50
	12/17/93	1.50	49.00
	01/04/94	5.00	54.00
	01/12/94	3.50	57.50
	01/20/94	2.50	60.00
	02/11/94	4.00	64.00
	02/18/93	3.50	67.50
	02/25/94	3.00	70.50
	03/04/94	3.50	74.00
	03/18/94	5.50	79.50
	03/30/94	4.00	83.50
	04/13/94	4.60	88.10
	04/21/94	4.20	92.30
	04/29/94	4.50	96.80
	05/06/94	5.50	102.30
	05/13/94	3.50	105.80
	05/20/94	3.50	109.30
	05/26/94	4.50	113.80
	06/02/94	3.50	117.30
	06/09/94	2.50	119.80
	06/16/94	3.50	123.30
	06/23/94	4.00	127.30
	06/29/94	2.50	129.80
	07/07/94	2.00	131.80
	07/12/94	3.00	134.80
	07/20/94	1.50	136.30
	07/29/94	3.50	139.80
	08/05/94	1.50	141.30
	08/12/94	2.00	143.30
	08/18/94	2.50	145.80
	09/09/94	3.50	149.30
	09/16/94	4.00	153.30
	09/23/94	2.00	155.30
	12/07/95	0.00	155.30
	03/28/96	0.01	155.31
	06/20/96	0.00	155.31
	04/14/97	<0.05	155.31
	07/02/97	0.25	155.56
	09/30/97	<0.01	155.56
	01/21/98	0.5	156.06
	04/10/98	0.09	156.15
	06/19/98	<0.01	156.15
	11/30/98	0.00	156.15
	01/21/99	0.00	156.15
	04/30/99	0.11	156.26
	07/09/99	0.00	156.26
	11/03/99	1.06	157.32
	01/12/00	0.53	157.85
	04/13/00	0.26	158.11
	05/24/00	0.53	158.64

TABLE 2 - PRODUCT REMOVAL STATUS

WELL ID	DATE	PRODUCT REMOVED (Gallons)	PRODUCT REMOVED CUMULATIVE (Gallons)
RW-1	06/01/00	0.00	158.64
	06/08/00	0.26	158.90
	06/15/00	0.13	159.03
	06/20/00	0.53	159.56
	07/07/00	0.01	159.57
	07/20/00	0.11	159.68
	07/26/00	0.13	159.81
	07/31/00	0.00	159.81
	08/08/00	0.01	159.82
	08/16/00	0.00	159.82
	08/23/00	0.13	159.95
	08/31/00	0.40	160.35
	09/08/00	0.53	160.88
	09/25/00	0.01	160.89
10/24/00	0.00	160.89	
MW-1	10/20/93	0.10	0.10
	11/10/93	0.10	0.20
	09/09/94	SHEEN	0.20
	10/26/94	SHEEN	0.20
	11/16/94	SHEEN	0.20
	12/21/94	0.25	0.45
	02/08/95	0.00	0.45
	04/10/95	0.25	0.70
	06/29/95	SHEEN	0.70
	09/18/95	SHEEN	0.70
	12/07/95	SHEEN	0.70
	03/28/96	<.001	0.70
	06/20/96	0.002	0.70
	10/11/96	<0.001	0.70
	01/02/97	<0.01	0.70
	04/14/97	<0.01	0.70
	07/02/97	<0.01	0.70
	01/21/98	<0.01	0.70
	06/19/98	<0.01	0.70
	11/30/98	0.00	0.70
	01/21/99	SHEEN	0.70
	04/30/99	SHEEN	0.70
	07/09/99	SHEEN	0.70
	11/03/99	0.00	0.70
01/12/00	0.00	0.70	
04/13/00	0.00	0.70	
05/24/00	0.00	0.70	
06/01/00	0.00	0.70	
06/08/00	0.00	0.70	
06/15/00	0.00	0.70	

NOTE: Groundwater and soil vapor extraction equipment installed in RW-1 in October 1994.

# Analytical Appendix





**Pace Analytical Services, Inc.**  
3970 Gilman Street  
Long Beach, CA 90815  
Phone: 562.498.9515  
Fax: 562.597.0766

November 03, 2000

Mr. MORGAN HARGRAVE  
BLAINE TECH SERVICES, INC.  
1680 ROGERS AVE.  
SAN JOSE, CA 95112

RE: Pace Project Number: 6046120  
Client Project ID: BP 11133

Dear Mr. HARGRAVE:

Enclosed are the analytical results for sample(s) received by the laboratory on October 30, 2000. If you have any questions concerning this report, please feel free to contact me.

Sincerely,

Lily Bayati  
Project Manager

Enclosures

## **REPORT OF LABORATORY ANALYSIS**

This report shall not be reproduced, except in full,  
without the written consent of Pace Analytical Services, Inc.



**Pace Analytical Services, Inc.**  
 3970 Gilman Street  
 Long Beach, CA 90815  
 Phone: 562.498.9515  
 Fax: 562.597.0786

DATE: 11/03/00  
 PAGE: 1

BLAINE TECH SERVICES, INC.  
 1680 ROGERS AVE.  
 SAN JOSE, CA 95112

Pace Project Number: 6046120  
 Client Project ID: BP 11133

Attn: Mr. MORGAN HARGRAVE  
 Phone: (408)573-0555 x218

Solid results are reported on a wet weight basis

Pace Sample No:	603939364	Date Collected:	10/24/00	Matrix:	Water
Client Sample ID:	A	Date Received:	10/30/00		

Parameters	Results	Units	PRL	Analyzed	Analyst	CAS#	Footnotes
------------	---------	-------	-----	----------	---------	------	-----------

Long Beach Lab

GAS BTEX by 8015, Water		Method: EPA 8015/8020 Modif		Prep Method: EPA 8015/8020 Modif	
Gasoline	9900	ug/L	50	11/01/00	RV
Benzene	31	ug/L	0.5	11/01/00	RV 71-43-2
Toluene	7.2	ug/L	0.5	11/01/00	RV 108-88-3
Ethylbenzene	550	ug/L	75	11/01/00	RV 100-41-4
Methyl-tert-butyl Ether	4400	ug/L	75	11/01/00	RV 1634-04-4
Xylene (Total)	1200	ug/L	75	11/01/00	RV 1330-20-7
a,a,a-Trifluorotoluene (S)	112	%		11/01/00	RV 2164-17-2

## REPORT OF LABORATORY ANALYSIS

This report shall not be reproduced, except in full,  
 without the written consent of Pace Analytical Services, Inc.



**Pace Analytical Services, Inc.**  
3970 Gilman Street  
Long Beach, CA 90815  
Phone: 562.498.9515  
Fax: 562.597.0786

DATE: 11/03/00  
PAGE: 2

Pace Project Number: 6046120  
Client Project ID: BP 11133

Pace Sample No: 603939372      Date Collected: 10/25/00      Matrix: Water  
Client Sample ID: B      Date Received: 10/30/00

Parameters      Results      Units      PRL      Analyzed      Analyst      CAS#      Footnotes

Long Beach Lab

Parameters	Results	Units	PRL	Analyzed	Analyst	CAS#	Footnotes
GAS BTEX by 8015, Water      Method: EPA 8015/8020 Modif      Prep Method: EPA 8015/8020 Modif							
Gasoline	360000	ug/l	7500	11/01/00	RV		
Benzene	18000	ug/l	750	11/01/00	RV	71-43-2	
Toluene	78000	ug/l	750	11/01/00	RV	108-88-3	
Ethylbenzene	34000	ug/l	750	11/01/00	RV	100-41-4	
Methyl-tert-butyl Ether	2100	ug/l	75	11/01/00	RV	1634-04-4	
Xylene (Total)	180000	ug/l	750	11/01/00	RV	1330-20-7	
a,a,b-Trifluorotoluene (S)	180	%		11/01/00	RV	2164-17-2	1

## REPORT OF LABORATORY ANALYSIS

This report shall not be reproduced, except in full,  
without the written consent of Pace Analytical Services, Inc.



**Pace Analytical Services, Inc.**  
3970 Gilman Street  
Long Beach, CA 90815  
Phone: 562.498.9515  
Fax: 562.597.0786

DATE: 11/03/00  
PAGE: 3

Pace Project Number: 6046120  
Client Project ID: BP 11133

---

PARAMETER FOOTNOTES

ND Not Detected  
NC Not Calculable  
PRL Pace Reporting Limit  
(S) Surrogate  
[1] Sample matrix effect.

## **REPORT OF LABORATORY ANALYSIS**

This report shall not be reproduced, except in full,  
without the written consent of Pace Analytical Services, Inc.





**Pace Analytical Services, Inc.**  
3970 Gilman Street  
Long Beach, CA 90815  
Phone: 562.498.9515  
Fax: 562.597.0786

DATE: 11/03/00  
PAGE: 5

Pace Project Number: 6046120  
Client Project ID: BP 11133

---

QUALITY CONTROL DATA PARAMETER FOOTNOTES

Consistent with EPA guidelines unrounded concentrations are displayed and have been used to calculate % Rec and RPD values.

ND	Not Detected
NC	Not Calculable
PRL	Pace Reporting Limit
RPD	Relative Percent Difference
(S)	Surrogate

## REPORT OF LABORATORY ANALYSIS

This report shall not be reproduced, except in full,  
without the written consent of Pace Analytical Services, Inc.



CHAIN OF CUSTODY

172854 604 6120  
Page 1 of 1

CONSULTANT'S NAME: Blaine Tech Services, Inc. CONSULTANT'S ADDRESS: 1680 Rogers Ave., San Jose CA 95112

BP SITE NUMBER: 11133 BP SITE / FACILITY ADDRESS: 2220 98th Ave., Oakland CONSULTANT PROJECT NUMBER: 001024-X3

CONSULTANT PROJECT MANAGER: Morgan Hargrave PHONE NUMBER: (408) 573-0555 x 218 FAX NUMBER: (408) 573-7771 CONSULTANT CONTRACT NUMBER: J496900

BP CONTACT: Scott Hoolon BP ADDRESS: 295 SW 41st Street, Suite N, Renton WA PHONE NUMBER: (425) 251-0689 FAX NO.: (425) 251-0736

LAB CONTACT: Pace - Lily Bayati LABORATORY ADDRESS: 3970 Gilman Street, Long Beach, CA PHONE NUMBER: (562) 498-9515 FAX NO.: (562) 597-0786

BP CONTACT REQUESTING RUSH TAT (Print BP Contact Name): RUSH REQUESTED OF (Print Consultant Contact Name): DATE/TIME: SHIPMENT DATE: SHIPMENT METHOD: Airborne

TAT:  24 HOURS  48 HOURS  72 HOURS  Standard 7 or 14 Days ANALYSIS REQUIRED AIRBILL NUMBER: 336134850

SAMPLE DESCRIPTION	COLLECTION DATE	COLLECTION TIME	MATRIX SOIL/WATER	CONTAINERS		PRESERVATIVE	TPH-G - STEK / MTE (8015M) (8020)	TPH-O (8015M)	FUEL OXYGENATES (8020)	1,2 DCA - EDB (8010)									COMMENTS	
				NO.	TYPE (VOL)	LAB SAMPLE #														
A	10/24/00	1445	WATER	3	WV	ACC	X													
B	10/25/00	1614	↓	↓	↓	↓	X													

SAMPLED BY (Please Print Name): Hoyt Ryales SAMPLER BY (Signature): [Signature] ADDITIONAL COMMENTS: 6.2°C

RELINQUISHED BY / AFFILIATION (Print Name / Signature): Hoyt Ryales / [Signature] DATE: 10/25/00 TIME: 14:00 ACCEPTED BY / AFFILIATION (Print Name / Signature): [Signature] DATE: 10/30/00 TIME: 10:15

# Field Data Sheets





## BP WELL MONITORING DATA SHEET

Project #: <u>001024-X2</u>	Station #
Sampler: <u>HOYT</u>	Date: <u>10/24/00</u>
Well I.D.: <u>MW-1</u>	Well Diameter: <u>(2)</u> 3 4 6 8
Total Well Depth: <u>28.29</u>	Depth to Water: <u>13.89</u>
Depth to Free Product:	Thickness of Free Product (feet):
Referenced to: PVC Grade	D.O. Meter (if req'd): YSI HACH

Well Diameter	Multiplier	Well Diameter	Multiplier
1"	0.04	4"	0.65
2"	0.16	6"	1.47
3"	0.37	Other	radius <sup>2</sup> * 0.163

Purge Method: Bailer      Sampling Method: Bailer

Disposable Bailer       Disposable Bailer  
 Middleburg       Extraction Port  
 Electric Submersible  
 Extraction Pump  
 Other: \_\_\_\_\_

<u>2.3</u>	x	<u>3</u>	=	<u>6</u>	Gals.
1 Case Volume (Gals.)		Specified Volumes		Calculated Volume	

Time	Temp (°F)	pH	Cond.	Gals. Removed	Observations
<u>1438</u>	<u>72.3</u>	<u>7.30</u>	<u>521</u>	<u>2</u>	<u>odor</u>
<u>1440</u>	<u>70.8</u>	<u>7.25</u>	<u>524</u>	<u>4</u>	
<u>1442</u>	<u>70.0</u>	<u>7.50</u>	<u>509</u>	<u>6</u>	
<u>Sample Bottles has been</u>					

Did well dewater? Yes <input type="checkbox"/> No <input checked="" type="checkbox"/>	Gallons actually evacuated: <u>6</u>
Sampling Time: <u>1445</u>	Sampling Date: <u>10/24/00</u>
Sample I.D. (Blind): <u>A</u>	Laboratory: <u>Pace</u> Other _____
Analyzed for: TPH-G BTEX MTBE TPH-D Other:	
D.O. (if req'd):	Pre-purge: <u>mg/L</u> Post-purge: <u>mg/L</u>
O.R.P. (if req'd):	Pre-purge: <u>mV</u> Post-purge: <u>mV</u>

## BP WELL MONITORING DATA SHEET

Project #: <u>001025-X2</u>	Station #: <u>11133</u>
Sampler: <u>HOYT</u>	Date: <u>10/25/00</u>
Well I.D.: <u>RW-1</u>	Well Diameter: 2 3 4 <u>6</u> 8
Total Well Depth: <u>19.04</u>	Depth to Water: <u>37.30</u>
Depth to Free Product: <u>Ø</u>	Thickness of Free Product (feet): <u>Ø</u>
Referenced to: <u>PVC</u> Grade	D.O. Meter (if req'd): YSI HACH

Well Diameter	Multiplier	Well Diameter	Multiplier
1"	0.04	4"	0.65
2"	0.16	6"	1.47
3"	0.37	Other	radius <sup>2</sup> * 0.163

Purge Method:

- Bailer Dedicated
- Disposable Bailer
- Middleburg
- Electric Submersible
- Extraction Pump

Sampling Method:

- Bailer
- Disposable Bailer
- Extraction Port
- Other: \_\_\_\_\_

Other: \_\_\_\_\_

<u>26.0</u>	x	<u>3</u>	=	<u>80</u>	Gals.
1 Case Volume (Gals.)		Specified Volumes		Calculated Volume	

Time	Temp (°F)	pH	Cond.	Gals. Removed	Observations
<u>1608</u>	<u>66.2</u>	<u>6.85</u>	<u>898</u>	<u>26</u>	<u>Dewatered @ First</u>
				<u>52</u>	<u>Parameter Sheen</u>
				<u>88</u>	<u>in Sample Bottle</u>
					<u>and odor</u>

Did well dewater?  Yes  No

Gallons actually evacuated: 26

Sampling Time: 1614

Sampling Date: 10/25/00

Sample I.D. (Blind): B

Laboratory: Pace Other: \_\_\_\_\_

Analyzed for: TPH-G BTEX MTBE TPH-D Other: \_\_\_\_\_

D.O. (if req'd):	Pre-purge:	mg/L	Post-purge:	mg/L
O.R.P. (if req'd):	Pre-purge:	mV	Post-purge:	mV





### BP WELL MONITORING DATA SHEET

Project #: <u>000908-S3</u>	Station # <u>1133</u>
Sampler: <u>Stephan</u>	Date: <u>9/8/00</u>
Well I.D.: <u>RW-1</u>	Well Diameter: 2 3 4 <u>6</u> 8
Total Well Depth:	Depth to Water:
Depth to Free Product:	Thickness of Free Product (feet):
Referenced to: <u>PVC</u> Grade	D.O. Meter (if req'd): YSI HACH

Well Diameter	Multiplier	Well Diameter	Multiplier
1"	0.04	4"	0.65
2"	0.16	6"	1.47
3"	0.37	Other	radius <sup>2</sup> * 0.163

Purge Method: ~~Bailer~~  
~~Disposable Bailer~~  
 Middleburg  
 Electric Submersible  
 Extraction Pump  
 Other: \_\_\_\_\_

Sampling Method: ~~Bailer~~  
~~Disposable Bailer~~  
 Extraction Port  
 Other: \_\_\_\_\_

_____	X	_____	=	_____ Gals.
1 Case Volume (Gals.)		Specified Volumes		Calculated Volume

Time	Temp (°F)	pH	Cond.	Gals. Removed	Observations
<u>1330</u>					<u>Bailed 2000 ML</u> <u>5 Gal. H<sub>2</sub>O</u>

Did well dewater? Yes <input type="checkbox"/> No <input type="checkbox"/>	Gallons actually evacuated: _____
Sampling Time: _____	Sampling Date: _____
Sample I.D. (Blind): _____	Laboratory: Pace Other _____
Analyzed for: TPH-G BTEX MTBE TPH-D Other: _____	
D.O. (if req'd):	Pre-purge: _____ mg/L Post-purge: _____ mg/L
O.R.P. (if req'd):	Pre-purge: _____ mV Post-purge: _____ mV



## BP WELL MONITORING DATA SHEET

Project #: <u>000837-A3</u>	Station # <u>11133</u>
Sampler: <u>Oscar</u>	Date: <u>8-21-00</u>
Well I.D.: <u>RW-1</u>	Well Diameter: 2 3 4 <u>6</u> 8
Total Well Depth:	Depth to Water: <u>21.98</u>
Depth to Free Product: <u>22.13</u>	Thickness of Free Product (feet):
Referenced to: <u>PVC</u> Grade	D.O. Meter (if req'd): YSI HACH

Well Diameter	Multiplier	Well Diameter	Multiplier
1"	0.04	4"	0.65
2"	0.16	<u>6"</u>	1.47
3"	0.37	Other	radius <sup>2</sup> * 0.163

Purge Method:	Sampling Method:
<input type="checkbox"/> Bailer <input type="checkbox"/> Disposable Bailer <input type="checkbox"/> Middleburg <input type="checkbox"/> Electric Submersible <input type="checkbox"/> Extraction Pump Other: _____	<input type="checkbox"/> Bailer <input checked="" type="checkbox"/> Disposable Bailer <input type="checkbox"/> Extraction Port Other: _____

_____	_____	_____
1 Case Volume (Gals.)	Specified Volumes	Calculated Volume

Bail SPH = \_\_\_\_\_ Gals.

Time	Temp (°F)	pH	Cond.	Gals. Removed	Observations
		<u>Bail</u>	<u>≈ 1500 ml</u>		

Did well dewater? Yes <input type="checkbox"/> No <input type="checkbox"/>	Gallons actually evacuated: _____
Sampling Time: _____	Sampling Date: _____
Sample I.D. (Blind): _____	Laboratory: Pace Other _____
Analyzed for: TPH-G BTEX MTBE TPH-D Other: _____	
D.O. (if req'd): _____	Pre-purge: _____ mg/L Post-purge: _____ mg/L
O.R.P. (if req'd): _____	Pre-purge: _____ mV Post-purge: _____ mV











## BP WELL MONITORING DATA SHEET

Project #: <b>000731 F1</b>	Station # <b>11133</b>
Sampler: <b>MIKE S.</b>	Date: <b>7-31-00</b>
Well I.D.: <b>RW-1</b>	Well Diameter: 2 3 4 <b>6</b> 8
Total Well Depth: <b>37.35</b>	Depth to Water: <b>22.11</b>
Depth to Free Product:	Thickness of Free Product (feet):
Referenced to: <b>PVC</b> Grade	D.O. Meter (if req'd): YSI HACH

Well Diameter	Multiplier	Well Diameter	Multiplier
1"	0.04	4"	0.65
2"	0.16	6"	1.47
3"	0.37	Other	radius <sup>2</sup> * 0.163

Purge Method: Bailer	Sampling Method: Bailer
<input checked="" type="checkbox"/> Disposable Bailer	<input type="checkbox"/> Disposable Bailer
<input type="checkbox"/> Middleburg	<input type="checkbox"/> Extraction Port
<input type="checkbox"/> Electric Submersible	Other: _____
<input type="checkbox"/> Extraction Pump	
Other: _____	

_____	X	_____	=	_____	Gals.
1 Case Volume (Gals.)		Specified Volumes		Calculated Volume	

Time	Temp (°F)	pH	Cond.	Gals. Removed	Observations
<b>030</b>					<b>Bailed 1 gal. of Semi-Product H<sub>2</sub>O.</b>
					<b>Did not get a layer in the bailer.</b>

Did well dewater? Yes <input type="checkbox"/> <b>No</b> <input checked="" type="checkbox"/>	Gallons actually evacuated: <b>1</b>	
Sampling Time: _____	Sampling Date: <b>7-31-00</b>	
Sample I.D. (Blind): _____	Laboratory: Pace Other: _____	
Analyzed for: TPH-G BTEX MTBE TPH-D Other:		
D.O. (if req'd):	Pre-purge: _____ mg/L	Post-purge: _____ mg/L
O.R.P. (if req'd):	Pre-purge: _____ mV	Post-purge: _____ mV