



Alameda-Contra Costa Transit District

RECEIVED

9:09 am, Jun 17, 2010

Alameda County
Environmental Health

June 16, 2010

Mr. Stephen Plunkett
Alameda County Health Division
Division of Environmental Protection
Department of Environmental Health
1131 Harbor Bay Parkway, Second Floor
Alameda, CA 94502

Dear Mr. Plunkett:

Subject: Groundwater Monitoring Report – Second Quarter 2010
AC Transit, 1177 47th Street, Emeryville

AC Transit hereby submits the enclosed groundwater monitoring report for the AC Transit facility located at 1177 47th Street in Emeryville. The report was prepared by our consultant, Cameron-Cole, and contains the results of groundwater monitoring performed on May 12, 2010, from three on-site (MW-11, MW-12, and MW-13) and three off-site (MW-14, MW-15, MW-16) groundwater monitoring wells. Well MW-13 was measured to have 0.34 feet of free product and was not sampled for chemical analysis.

Sampling results indicated total petroleum hydrocarbons as degraded diesel were measured in monitoring wells MW-11 (184 ppb), MW-14 (209 ppb), and W-16 (255 ppb). Methyl tertiary butyl ether (MTBE) was detected above the Maximum Contaminant Level (MCL) of 5 ppb but below the Environmental Screening Level (ESL) of 13 ppb in monitoring wells MW-14 (7.5 ppb) and MW-15 (6.5 ppb). Monthly purging of well MW-13 continues to be performed as an interim remedial measure.

I declare, under penalty of perjury, that the information and/or recommendations contained in the attached document or report is true and correct to the best of my knowledge.

If you have any questions or comments regarding the enclosed report, please call me at (510) 577-8869.

Sincerely,

Suzanne Chaewsky, P.E.
Environmental Engineer

Enclosure

**GROUNDWATER MONITORING REPORT
FOR THE AC TRANSIT FACILITY
LOCATED AT 1177 47th STREET,
EMERYVILLE, CALIFORNIA**

June 2010

Prepared For:

Ms. Suzanne Chaewsky
AC Transit
10626 International Boulevard
Oakland, California 94603



Prepared By:

Cameron-Cole
50 Hegenberger Loop
Oakland, California 94621



**GROUNDWATER MONITORING REPORT
FOR THE AC TRANSIT FACILITY
LOCATED AT 1177 47th STREET,
EMERYVILLE, CALIFORNIA**

June 2010

Prepared For:

Ms. Suzanne Chaewsky
AC Transit
10626 International Boulevard
Oakland, California 94603



Prepared By:

Cameron-Cole
50 Hegenberger Loop
Oakland, California 94621



A circular professional seal for Bradley D. Wright, a Registered Geologist in the State of California. The seal contains the text: 'STATE OF CALIFORNIA', 'REGISTERED GEOLOGIST', '#6276', 'Exp. 9/10', 'BRADLEY D. WRIGHT', and 'REGISTERED GEOLOGIST'.
Brad Wright
Reviewed By
Brad Wright, PG, CHG
Principal Hydrogeologist

Dennis Baker
for: Written By
Dennis Baker
Environmental Specialist

TABLE OF CONTENTS

INTRODUCTION	1
GROUNDWATER MONITORING	1
Groundwater Elevations and Flow Direction.....	2
Groundwater Sampling Activities	2
Groundwater Analytical Results	2
SUMMARY OF RESULTS	2
PROJECTED WORK AND RECOMMENDATIONS.....	3
APPENDIX A ...Chain-of-Custody Documentation, Certified Analytical Reports, and Field Data Sheets	

LIST OF FIGURES

Figure 1	Site Location Map
Figure 2	Potentiometric Surface Map Including Groundwater Flow Direction

LIST OF TABLES

Table 1	Groundwater Level Measurements
Table 2	Analytical Results of Groundwater Samples

INTRODUCTION

This report presents the results from the second quarter 2010 groundwater monitoring event for the AC Transit Facility located at 1177 47th Street, Emeryville, California (Figure 1, Site Location Map). Cameron-Cole performed groundwater sampling of monitor wells MW-11 through MW-16 on May 12, 2010, in accordance with directives from Alameda County Health Care Services (ACHCS).

GROUNDWATER MONITORING

Work performed during this sampling event included measuring depth to water in all monitor wells and collecting groundwater samples from monitor wells MW-11 through MW-16. A groundwater sample was not collected from MW-13 due to the presence of a free-phase hydrocarbon layer. Groundwater samples were analyzed for total extractable petroleum hydrocarbons (TEPH) using Environmental Protection Agency (EPA) Method 8015 Modified and for gasoline and benzene, toluene, ethylbenzene, xylenes (BTEX) and methyl tertiary butyl ether (MTBE) by EPA Method 8260B.

A site map displaying the monitor well locations is presented as Figure 2. Chain-of-custody documents, field data sheets, and certified analytical reports are included in Appendix A.

Groundwater Elevations and Flow Direction

On May 12, 2010, all 19 monitor wells (16 on-site and 3 off-site; MW-1 through MW-16, W-1, W-3, and W-4) were inspected and measured for the presence of free-phase hydrocarbons and depth to groundwater. Measurements of depths to groundwater are presented in Table 1 and were used to construct the groundwater elevation contours in Figure 2. As shown, groundwater flow is to the west at a gradient of 0.029 feet/foot. Monitor well MW-13 was the only well with a free-phase hydrocarbon layer detected. The free-phase hydrocarbon layer in MW-13 measured 0.34 feet.

Groundwater Sampling Activities

The monitor wells were purged a minimum of three casing volumes using a centrifugal pump, and samples were collected using disposable polyethylene bailers. During well purging, field parameters for temperature, electrical conductivity, pH, and turbidity were monitored using calibrated field meters. Due to the presence of the hydrocarbon layer measured in monitor well MW-13, a groundwater sample was not collected. However, MW-13 was purged to remove the product layer, an activity that has been repeated monthly as an interim remedial measure.

Groundwater samples were collected in 40-milliliter glass vials preserved with hydrochloric acid and one-liter non-preserved amber glass containers and placed in an ice-filled cooler for shipment under chain-of-custody to a State of California certified laboratory. A trip blank was submitted for analysis by EPA Method 8260B.

Groundwater Analytical Results

Table 2 presents groundwater analytical results for the second quarter 2010 sampling event. TPH as degraded diesel was detected in monitor wells MW-11, MW-14, and MW-16. MTBE was detected above the State of California maximum contaminant level (MCL) of 5.0 micrograms per liter (ug/l) but below the ESL of 13 ug/l in W-14 and MW-15. All other compounds were below laboratory limits. No analytes were detected in the trip blank or method blank. A lab control spike and lab control spike duplicate passed the EPA's criteria for acceptance.

SUMMARY OF RESULTS

- Groundwater flow is to the west at a gradient of 0.029 feet/foot.
- TPH as degraded diesel was detected in MW-11 (184 ug/l), MW-14 (209 ug/l), and MW-16 (255 ug/l).
- MTBE was detected above the MCL of 5 ug/l but below the ESL of 13 mg/l in MW-14 (7.5 ug/l) and MW-15 (6.5 ug/l).

PROJECTED WORK AND RECOMMENDATIONS

Quarterly groundwater monitoring of monitor wells MW-1 through MW-16 and W-1 is scheduled for August 2010. This event will include site-wide depth to groundwater level measurements including inspection of each monitor well for free-phase hydrocarbon. Additionally, monthly over purging of MW-13 to remove the free-phase hydrocarbon layer will continue.

FIGURES

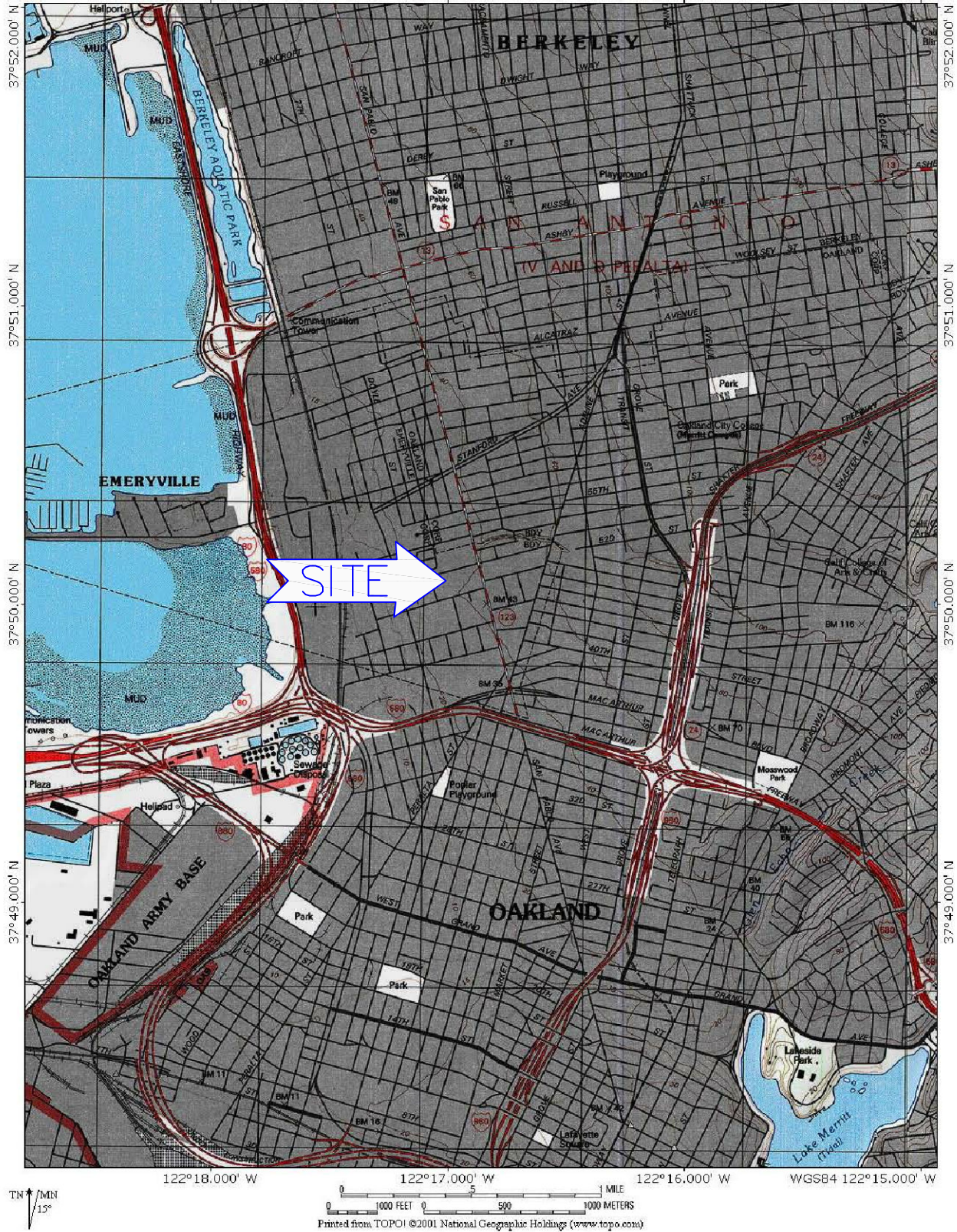

2036-003A



Cameron-Cole
101 WEST ATLANTIC AVENUE, BUILDING 90
ALAMEDA, CALIFORNIA 94501
PHONE: 510-337-8660
FAX: 510-337-3994
<http://www.cameron-cole.com>

FIGURE 1
SITE LOCATION MAP
AC TRANSIT – EMERYVILLE
EMERYVILLE, CALIFORNIA

SCALE:	AS NOTED	DATE:	05-08-09
--------	----------	-------	----------

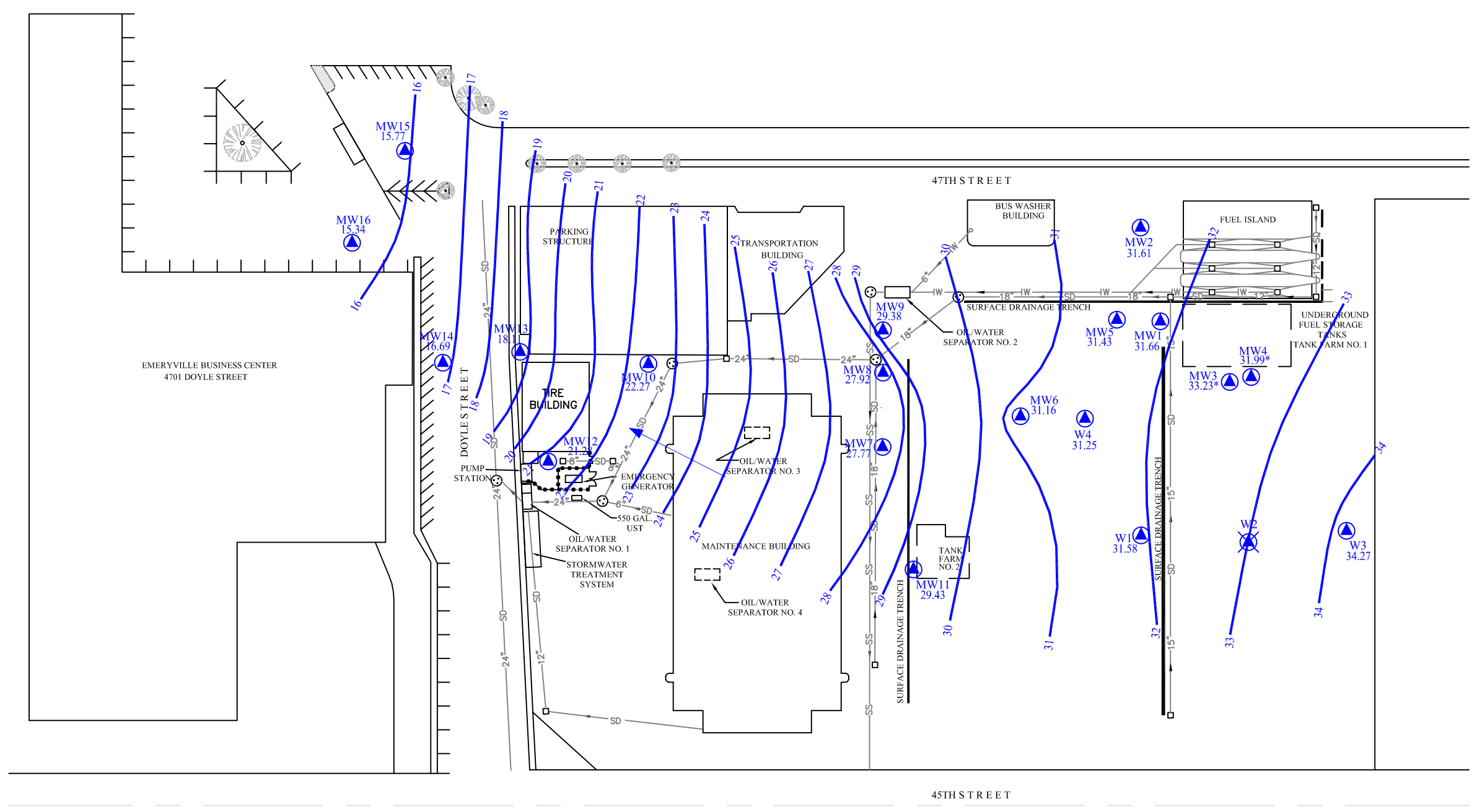

LEGEND	
	MANHOLE
	CATCH BASIN
	MONITOR WELL
	ABANDONED MONITOR WELL
	POTENTIOMETRIC SURFACE ELEVATION VALUE NOT USED IN CONTOURING
	POTENTIOMETRIC SURFACE CONTOUR
	GROUNDWATER FLOW DIRECTION
	PROPOSED SOIL BORING
	STORM DRAIN PIPELINE
	SANITARY SEWER PIPELINE
	INDUSTRIAL WASTE PIPELINE
	CHAIN LINK FENCE

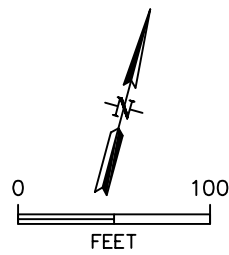

BY	DATE
DRAWN SPS	6/10/10
CHECKED	
APPROVED	
APPROVED	
APPROVED	

Cameron-Cole
 101 WEST ATLANTIC AVENUE, BUILDING 90
 ALAMEDA, CALIFORNIA 94501
 PHONE: 510-337-8660
 FAX: 510-337-3994
<http://www.cameron-cole.com>

FIGURE 2 POTENTIOMETRIC SURFACE CONTOUR MAP MAY 12, 2010 AC TRANSIT, EMERYVILLE FACILITY - OAKLAND, CA	
SCALE: 1" = 100'	DWG. NO.: 2036-011A

TABLES

TABLE 1
GROUNDWATER LEVEL MEASUREMENTS
AC TRANSIT
1177 47TH STREET, EMERYVILLE, CALIFORNIA

Well	Date	Top of Casing Elevation (ft-msl)	Product Thickness (feet)	Depth To Water (feet)	Groundwater Elevation (ft-msl)	Groundwater Elevation Corrected from Product Thickness* (ft-msl)
MW-1	8/31/1999	32.56	None	3.24	29.32	NA
	11/23/1999		None	4.55	28.01	NA
	3/1/2000		None	3.65	28.91	NA
	5/17/2000		None	4.08	28.48	NA
	8/30/2000		None	5.18	27.38	NA
	12/18/2000		None	4.86	27.7	NA
	3/20/2001		None	4.22	28.34	NA
	6/7/2001		None	4.88	27.68	NA
	9/20/2001		None	4.97	27.59	NA
	12/14/2001		None	3.59	28.97	NA
	2/27/2002		None	4.03	28.53	NA
	5/16/2002		None	4.32	28.24	NA
	9/18/2002		None	4.61	27.95	NA
	10/30/2002		None	4.74	27.82	NA
	2/6/2003		None	4.08	28.48	NA
	5/1/2003		None	3.68	28.88	NA
	8/26/2003		None	4.64	27.92	NA
	11/20/2003		None	4.57	27.99	NA
	2/10/2004		None	3.95	28.61	NA
	5/18/2004		None	4.45	28.11	NA
	8/30/2004		None	5.14	27.42	NA
	11/17/2004		None	4.2	28.36	NA
	2/23/2005		None	3.55	29.01	NA
	11/2/2005**		None	5.14	27.42	NA
	5/28/2006**		None	4.05	28.51	NA
	11/12/2006**		None	3.36	29.20	NA
	5/27/2007**		None	4.90	27.66	NA
	11/10/2007**		None	4.65	27.91	NA
	5/25/2008**		None	4.65	27.91	NA
	3/24/2009	35.66	None	3.86	31.80	NA
	6/11/2009		None	4.39	31.27	NA
	8/27/2009		None	5.00	30.66	NA
	11/24/2009		None	4.41	31.25	NA
	2/18/2010		None	3.79	31.87	NA
	5/12/2010		None	4.00	31.66	NA

TABLE 1
GROUNDWATER LEVEL MEASUREMENTS
AC TRANSIT
1177 47TH STREET, EMERYVILLE, CALIFORNIA

Well	Date	Top of Casing Elevation (ft-msl)	Product Thickness (feet)	Depth To Water (feet)	Groundwater Elevation (ft-msl)	Groundwater Elevation Corrected from Product Thickness* (ft-msl)
MW-2	8/31/1999	32.12	None	5.24	26.88	NA
	11/23/1999		None	4.03	28.09	NA
	3/1/2000		None	3.11	29.01	NA
	5/17/2000		None	3.66	28.46	NA
	8/30/2000		None	4.65	27.47	NA
	12/18/2000		None	4.06	28.06	NA
	3/20/2001		None	3.91	28.21	NA
	6/7/2001		None	4.40	27.72	NA
	9/20/2001		None	4.45	27.67	NA
	12/14/2001		None	3.19	28.93	NA
	2/27/2002		None	3.45	28.67	NA
	5/16/2002		None	3.74	28.38	NA
	9/18/2002		None	4.20	27.92	NA
	10/30/2002		None	4.23	27.89	NA
	2/6/2003		None	3.70	28.42	NA
	5/1/2003		None	3.59	28.53	NA
	8/26/2003		None	4.24	27.88	NA
	11/20/2003		None	4.35	27.77	NA
	2/10/2004		None	3.61	28.51	NA
	5/18/2004		None	3.91	28.21	NA
	8/30/2004		None	4.62	27.50	NA
	11/17/2004		None	3.91	28.21	NA
	2/23/2005		None	3.05	29.07	NA
	11/2/2005**		None	4.65	27.47	NA
	5/28/2006**		None	3.55	28.57	NA
	11/16/2006**		None	3.60	28.52	NA
	5/27/2007**		None	3.73	28.39	NA
	11/10/2007**		None	4.20	27.92	NA
	5/25/2008**		None	4.10	28.02	NA
	3/24/2009	35.14	None	3.52	31.62	NA
	6/11/2009		None	4.02	31.12	NA
	8/27/2009		None	4.63	30.51	NA
	11/24/2009		None	4.01	31.13	NA
	2/18/2010		None	3.43	31.71	NA
	5/12/2010		None	3.53	31.61	NA

TABLE 1
GROUNDWATER LEVEL MEASUREMENTS
AC TRANSIT
1177 47TH STREET, EMERYVILLE, CALIFORNIA

Well	Date	Top of Casing Elevation (ft-msl)	Product Thickness (feet)	Depth To Water (feet)	Groundwater Elevation (ft-msl)	Groundwater Elevation Corrected from Product Thickness* (ft-msl)
MW-3	8/31/1999	34.06	None	6.15	27.91	NA
	11/23/1999		None	5.78	28.28	NA
	3/1/2000		None	4.82	29.24	NA
	5/17/2000		None	5.29	28.77	NA
	8/30/2000		None	6.20	27.86	NA
	12/18/2000		None	5.65	28.41	NA
	3/20/2001		None	5.18	28.88	NA
	6/7/2001		None	6.01	28.05	NA
	9/20/2001		None	5.9	28.16	NA
	12/14/2001		None	4.66	29.40	NA
	2/27/2002		None	5.00	29.06	NA
	5/16/2002		None	5.21	28.85	NA
	9/18/2002		None	5.61	28.45	NA
	10/30/2002		None	5.72	28.34	NA
	2/6/2003		None	4.97	29.09	NA
	5/1/2003		None	4.89	29.17	NA
	8/26/2003		None	5.82	28.24	NA
	11/20/2003		None	5.92	28.14	NA
	2/10/2004		None	4.99	29.07	NA
	5/18/2004		None	5.52	28.54	NA
	8/30/2004		None	6.25	27.81	NA
	11/17/2004		None	5.25	28.81	NA
	2/23/2005		None	4.80	29.26	NA
	11/2/2005**		None	6.21	27.85	NA
	5/28/2006**		None	4.95	29.11	NA
	11/16/2006**		None	5.50	28.56	NA
	5/27/2007**		None	5.28	28.78	NA
	11/10/2007**		None	5.75	28.31	NA
	5/25/2008**		None	5.70	28.36	NA
	3/24/2009	37.15	None	4.79	32.36	NA
	6/11/2009		None	5.40	31.75	NA
	8/27/2009		None	6.22	30.93	NA
	11/24/2009		None	5.50	31.65	NA
	2/18/2010		None	4.83	32.32	NA
	5/12/2010		None	4.92	32.23	NA

**TABLE 1
GROUNDWATER LEVEL MEASUREMENTS
AC TRANSIT
1177 47TH STREET, EMERYVILLE, CALIFORNIA**

Well	Date	Top of Casing Elevation (ft-msl)	Product Thickness (feet)	Depth To Water (feet)	Groundwater Elevation (ft-msl)	Groundwater Elevation Corrected from Product Thickness* (ft-msl)
MW-4	8/31/1999	34.11	None	6.22	27.89	NA
	11/23/1999		None	6.01	28.10	NA
	3/1/2000		None	4.74	29.37	NA
	5/17/2000		None	5.33	28.78	NA
	8/30/2000		None	6.26	27.85	NA
	12/18/2000		None	5.66	28.45	NA
	3/20/2001		None	5.46	28.65	NA
	6/7/2001		None	6.02	28.09	NA
	9/20/2001		None	6.06	28.05	NA
	12/14/2001		None	5.39	28.72	NA
	2/27/2002		None	5.28	28.83	NA
	5/16/2002		None	5.39	28.72	NA
	9/18/2002		None	5.61	28.50	NA
	10/30/2002		None	5.70	28.41	NA
	2/6/2003		None	5.39	28.72	NA
	5/1/2003		None	5.25	28.86	NA
	8/26/2003		None	5.88	28.23	NA
	11/20/2003		None	5.84	28.27	NA
	2/10/2004		None	5.10	29.01	NA
	5/18/2004		None	5.58	28.53	NA
	8/30/2004		None	6.30	27.81	NA
	11/17/2004		None	5.34	28.77	NA
	2/23/2005		None	4.75	29.36	NA
	11/2/2005**		None	6.30	27.81	NA
	5/28/2006**		None	5.15	28.96	NA
	11/16/2006**		None	5.40	28.71	NA
	5/27/2007**		None	5.61	28.50	NA
	11/10/2007**		None	5.85	28.26	NA
	5/25/2008**		None	5.80	28.31	NA
	3/24/2009	37.15	None	5.12	32.03	NA
	6/11/2009		None	5.62	31.53	NA
	8/27/2009		None	6.21	30.94	NA
	11/24/2009		None	5.84	31.31	NA
	2/18/2010		None	5.32	31.83	NA
	5/12/2010		None	5.16	31.99	NA

**TABLE 1
GROUNDWATER LEVEL MEASUREMENTS
AC TRANSIT
1177 47TH STREET, EMERYVILLE, CALIFORNIA**

Well	Date	Top of Casing Elevation (ft-msl)	Product Thickness (feet)	Depth To Water (feet)	Groundwater Elevation (ft-msl)	Groundwater Elevation Corrected from Product Thickness* (ft-msl)
MW-5	8/31/1999	31.70	None	4.51	27.19	NA
	11/23/1999		None	4.00	27.70	NA
	3/1/2000		None	3.31	28.39	NA
	5/17/2000		None	3.59	28.11	NA
	8/30/2000		None	4.53	27.17	NA
	12/18/2000		None	3.97	27.73	NA
	3/20/2001		None	3.68	28.02	NA
	6/7/2001		None	4.37	27.33	NA
	9/20/2001		None	4.46	27.24	NA
	12/14/2001		None	3.23	28.47	NA
	2/27/2002		None	3.44	28.26	NA
	5/16/2002		None	3.68	28.02	NA
	9/18/2002		None	4.04	27.66	NA
	10/30/2002		None	4.21	27.49	NA
	2/6/2003		None	3.61	28.09	NA
	5/1/2003		None	3.15	28.55	NA
	8/26/2003		None	4.00	27.70	NA
	11/20/2003		None	4.20	27.50	NA
	2/10/2004		None	3.38	28.32	NA
	5/18/2004		None	3.75	27.95	NA
	8/30/2004		None	4.55	27.15	NA
	11/17/2004		None	3.62	28.08	NA
	2/23/2005		None	2.98	28.72	NA
	11/2/2005**		None	4.55	27.15	NA
	5/28/2006**		None	3.62	28.08	NA
	11/12/2006**		None	2.50	29.20	NA
	5/27/2007**		None	3.64	28.06	NA
	11/10/2007**		None	4.10	27.60	NA
	5/25/2008**		None	4.05	27.65	NA
	3/24/2009	34.84	None	3.22	31.62	NA
	6/11/2009		None	3.85	30.99	NA
	8/27/2009		None	4.47	30.37	NA
	11/24/2009		None	3.87	30.97	NA
	2/18/2010		None	3.24	31.60	NA
	5/12/2010		None	3.41	31.43	NA

TABLE 1
GROUNDWATER LEVEL MEASUREMENTS
AC TRANSIT
1177 47TH STREET, EMERYVILLE, CALIFORNIA

Well	Date	Top of Casing Elevation (ft-msl)	Product Thickness (feet)	Depth To Water (feet)	Groundwater Elevation (ft-msl)	Groundwater Elevation Corrected from Product Thickness* (ft-msl)
MW-6	8/31/1999	31.02	None	4.40	26.62	NA
	11/23/1999		None	3.81	27.21	NA
	3/1/2000		None	2.88	28.14	NA
	5/17/2000		None	3.44	27.58	NA
	8/30/2000		None	4.40	26.62	NA
	12/18/2000		None	3.61	27.41	NA
	3/20/2001		None	3.16	27.86	NA
	6/7/2001		None	4.18	26.84	NA
	9/20/2001		Sheen	4.22	26.80	NA
	12/14/2001		None	3.62	27.40	NA
	2/27/2002		None	2.94	28.08	NA
	5/16/2002		None	3.53	27.49	NA
	9/18/2002		None	3.97	27.05	NA
	10/30/2002		None	3.96	27.06	NA
	2/6/2003		None	2.97	28.05	NA
	5/1/2003		None	3.98	27.04	NA
	8/26/2003		None	3.82	27.20	NA
	11/20/2003		None	3.78	27.24	NA
	2/10/2004		None	2.94	28.08	NA
	5/18/2004		None	3.47	27.55	NA
	8/30/2004		None	4.22	26.80	NA
	11/17/2004		None	3.19	27.83	NA
	2/23/2005		None	2.32	28.70	NA
	11/2/2005**		None	4.21	26.81	NA
	5/28/2006**		None	3.00	28.02	NA
	11/16/2006**		None	3.30	27.72	NA
	5/27/2007**		None	3.20	27.82	NA
	11/10/2007**		None	3.65	27.37	NA
	5/25/2008**		None	3.70	27.32	NA
	3/24/2007	34.09	None	2.78	31.31	NA
	6/11/2009		None	3.46	30.63	NA
	8/27/2009		None	4.10	29.99	NA
	11/24/2009		None	3.47	30.62	NA
	2/18/2010		None	2.72	31.37	NA
	5/12/2010		None	2.93	31.16	NA

TABLE 1
GROUNDWATER LEVEL MEASUREMENTS
AC TRANSIT
1177 47TH STREET, EMERYVILLE, CALIFORNIA

Well	Date	Top of Casing Elevation (ft-msl)	Product Thickness (feet)	Depth To Water (feet)	Groundwater Elevation (ft-msl)	Groundwater Elevation Corrected from Product Thickness* (ft-msl)
MW-7	8/31/1999	29.62	None	5.47	24.15	NA
	11/23/1999		None	4.93	24.69	NA
	3/1/2000		None	4.06	25.56	NA
	5/17/2000		None	4.69	24.93	NA
	8/30/2000		None	5.50	24.12	NA
	12/18/2000		None	5.78	23.84	NA
	3/20/2001		None	4.83	24.79	NA
	6/7/2001		None	4.80	24.82	NA
	9/20/2001		None	5.19	24.43	NA
	12/14/2001		None	4.68	24.94	NA
	2/27/2002		None	4.53	25.09	NA
	5/16/2002		None	4.34	25.28	NA
	9/18/2002		None	5.28	24.34	NA
	10/30/2002		None	5.51	24.11	NA
	2/6/2003		None	4.36	25.26	NA
	5/1/2003		None	4.76	24.86	NA
	8/26/2003		None	5.25	24.37	NA
	11/20/2003		None	5.26	24.36	NA
	2/10/2004		None	4.31	25.31	NA
	5/18/2004		None	4.46	25.16	NA
	8/30/2004		None	5.61	24.01	NA
	11/17/2004		None	4.82	24.80	NA
	2/23/2005		None	4.14	25.48	NA
	11/2/2005**		None	5.50	24.12	NA
	5/28/2006**		None	4.25	25.37	NA
	11/16/2006**		None	5.70	23.92	NA
	5/27/2007**		None	4.54	25.08	NA
	11/10/2007**		None	5.15	24.47	NA
	5/25/2008**		None	5.40	24.22	NA
	3/24/2009	32.67	None	4.31	28.36	NA
	6/11/2009		None	5.16	27.51	NA
	8/27/2009		None	5.39	27.28	NA
	11/24/2009		None	5.19	27.48	NA
	2/18/2010		None	5.30	27.37	NA
	5/12/2010		None	4.90	27.77	NA

TABLE 1
GROUNDWATER LEVEL MEASUREMENTS
AC TRANSIT
1177 47TH STREET, EMERYVILLE, CALIFORNIA

Well	Date	Top of Casing Elevation (ft-msl)	Product Thickness (feet)	Depth To Water (feet)	Groundwater Elevation (ft-msl)	Groundwater Elevation Corrected from Product Thickness* (ft-msl)
MW-8	8/31/1999	29.43	None	5.35	24.08	NA
	11/23/1999		None	4.75	24.68	NA
	3/1/2000		None	4.48	24.95	NA
	5/17/2000		None	4.78	24.65	NA
	8/30/2000		None	5.02	24.41	NA
	12/18/2000		None	5.23	24.20	NA
	3/20/2001		None	4.70	24.73	NA
	6/7/2001		None	5.13	24.30	NA
	9/20/2001		None	5.68	23.75	NA
	12/14/2001		None	4.26	25.17	NA
	2/27/2002		None	4.18	25.25	NA
	5/16/2002		None	4.58	24.85	NA
	9/18/2002		None	4.96	24.47	NA
	10/30/2002		None	4.99	24.44	NA
	2/6/2003		None	4.41	25.02	NA
	5/1/2003		None	4.29	25.14	NA
	8/26/2003		None	4.58	24.85	NA
	11/20/2003		None	4.69	24.74	NA
	2/10/2004		None	4.22	25.21	NA
	5/18/2004		None	4.52	24.91	NA
	8/30/2004		None	4.79	24.64	NA
	11/17/2004		None	4.56	24.87	NA
	2/23/2005		None	4.08	25.35	NA
	11/2/2005**		None	5.05	24.38	NA
	5/28/2006**		None	4.95	24.48	NA
	11/12/2006**		None	4.70	24.73	NA
	5/27/2007**		None	4.08	25.35	NA
	11/10/2007**		None	4.70	24.73	NA
	5/25/2008**		None	4.70	24.73	NA
	3/24/2009	32.44	None	4.21	28.23	NA
	6/11/2009		None	4.56	27.88	NA
	8/27/2009		None	4.90	27.54	NA
	11/24/2009		None	4.64	27.80	NA
	2/18/2010		None	4.23	28.21	NA
	5/12/2010		None	4.52	27.92	NA

TABLE 1
GROUNDWATER LEVEL MEASUREMENTS
AC TRANSIT
1177 47TH STREET, EMERYVILLE, CALIFORNIA

Well	Date	Top of Casing Elevation (ft-msl)	Product Thickness (feet)	Depth To Water (feet)	Groundwater Elevation (ft-msl)	Groundwater Elevation Corrected from Product Thickness* (ft-msl)
MW-9	8/31/1999	29.18	None	4.15	25.03	NA
	11/23/1999		None	3.93	25.25	NA
	3/1/2000		None	3.69	25.49	NA
	5/17/2000		None	3.56	25.62	NA
	8/30/2000		None	4.64	24.54	NA
	12/18/2000		None	4.02	25.16	NA
	3/20/2001		None	3.92	25.26	NA
	6/7/2001		None	4.28	24.90	NA
	9/20/2001		None	5.12	24.06	NA
	12/14/2001		None	3.87	25.31	NA
	2/27/2002		None	4.48	24.70	NA
	5/16/2002		None	5.13	24.05	NA
	9/18/2002		None	4.48	24.70	NA
	10/30/2002		None	3.90	25.28	NA
	2/6/2003		None	3.65	25.53	NA
	5/1/2003		None	4.50	24.68	NA
	8/26/2003		None	4.33	24.85	NA
	11/20/2003		None	3.83	25.35	NA
	2/10/2004		None	3.17	26.01	NA
	5/18/2004		None	3.42	25.76	NA
	8/30/2004		None	3.45	25.73	NA
	11/17/2004		None	3.44	25.74	NA
	2/23/2005		None	3.28	25.90	NA
	11/2/2005**		None	4.26	24.92	NA
	5/28/2006**		None	3.70	25.48	NA
	11/12/2006**		None	3.50	25.68	NA
	5/27/2007**		None	3.43	25.75	NA
	11/10/2007**		None	3.75	25.43	NA
	5/25/2008**		None	2.80	26.38	NA
	3/24/2009	32.31	None	3.31	29.00	NA
	6/11/2009		None	3.48	28.83	NA
	8/27/2009		None	3.58	28.73	NA
	11/24/2009		None	3.69	28.62	NA
	2/18/2010		None	3.29	29.02	NA
	5/12/2010		None	2.93	29.38	NA

TABLE 1
GROUNDWATER LEVEL MEASUREMENTS
AC TRANSIT
1177 47TH STREET, EMERYVILLE, CALIFORNIA

Well	Date	Top of Casing Elevation (ft-msl)	Product Thickness (feet)	Depth To Water (feet)	Groundwater Elevation (ft-msl)	Groundwater Elevation Corrected from Product Thickness* (ft-msl)	
MW-10	8/31/1999	29.13	None	9.59	19.54	NA	
	11/23/1999		None	9.44	19.69	NA	
	3/1/2000		None	9.06	20.07	NA	
	5/17/2000		None	9.31	19.82	NA	
	8/30/2000		None	9.68	19.45	NA	
	12/18/2000		None	9.41	19.72	NA	
	3/20/2001		None	9.23	19.90	NA	
	6/7/2001		None	9.60	19.53	NA	
	9/20/2001		None	9.70	19.43	NA	
	12/14/2001		None	8.83	20.30	NA	
	2/27/2002		None	9.15	19.98	NA	
	5/16/2002		None	9.45	19.68	NA	
	9/18/2002		None	9.65	19.48	NA	
	10/30/2002		None	9.73	19.40	NA	
	2/6/2003		None	9.34	19.79	NA	
	5/1/2003		None	9.14	19.99	NA	
	8/26/2003		None	9.69	19.44	NA	
	11/20/2003		None	9.62	19.51	NA	
	2/10/2004		None	9.20	19.93	NA	
	5/18/2004		None	9.58	19.55	NA	
	8/30/2004		None	9.85	19.28	NA	
	11/17/2004		None	9.26	19.87	NA	
	2/23/2005		None	8.60	20.53	NA	
	11/2/2005**		None	9.81	19.32	NA	
	5/28/2006**		None	9.55	19.58	NA	
	11/16/2006**		Well not accessible.				
	2/24/2007**		None	9.00	20.13	NA	
	5/27/2007**		None	9.45	19.68	NA	
	11/10/2007**		None	9.70	19.43	NA	
	5/25/2008**		None	10.15	18.98	NA	
	3/24/2009	31.92	None	9.45	22.47	NA	
	6/11/2009		None	9.93	21.99	NA	
	8/27/2009		None	9.89	22.03	NA	
	11/24/2009		None	9.46	22.46	NA	
	2/18/2010		None	9.31	22.61	NA	
	5/12/2010		None	9.65	22.27	NA	

**TABLE 1
GROUNDWATER LEVEL MEASUREMENTS
AC TRANSIT
1177 47TH STREET, EMERYVILLE, CALIFORNIA**

Well	Date	Top of Casing Elevation (ft-msl)	Product Thickness (feet)	Depth To Water (feet)	Groundwater Elevation (ft-msl)	Groundwater Elevation Corrected from Product Thickness* (ft-msl)
MW-11	9/20/2001	28.93	None	4.41	24.52	NA
	12/14/2001		None	1.82	27.11	NA
	2/27/2002		None	2.39	26.54	NA
	5/16/2002		None	2.98	25.95	NA
	9/18/2002		None	4.00	24.93	NA
	10/30/2002		None	4.14	24.79	NA
	2/6/2003		None	2.59	26.34	NA
	5/1/2003		None	2.26	26.67	NA
	8/26/2003		None	3.79	25.14	NA
	11/20/2003		None	3.66	25.27	NA
	2/10/2004		None	2.40	26.53	NA
	5/18/2004		None	3.20	25.73	NA
	8/30/2004		None	4.43	24.50	NA
	11/17/2004		None	2.36	26.57	NA
	2/23/2005		None	2.05	26.88	NA
	11/2/2005**		None	4.30	24.63	NA
	2/22/2006**		None	2.50	26.43	NA
	5/28/2006**		None	2.85	26.08	NA
	8/27/2006**		None	3.00	25.93	NA
	11/12/2006**		None	3.02	25.91	NA
	2/24/2007**		None	2.15	26.78	NA
	5/27/2007**		None	2.78	26.15	NA
	9/2/2007**		None	4.20	24.73	NA
	11/10/2007**		None	3.30	25.63	NA
	2/28/2008**		None	2.31	26.62	NA
	5/25/2008**		None	3.70	25.23	NA
	11/2/2008**		None	2.98	25.95	NA
	3/24/2009	31.95	None	2.37	29.58	NA
	6/11/2009		None	3.18	28.77	NA
	8/27/2009		None	4.32	27.63	NA
	11/24/2009		None	3.04	28.91	NA
	2/18/2010		None	2.44	29.51	NA
	5/12/2010		None	2.48	29.47	NA

**TABLE 1
GROUNDWATER LEVEL MEASUREMENTS
AC TRANSIT
1177 47TH STREET, EMERYVILLE, CALIFORNIA**

Well	Date	Top of Casing Elevation (ft-msl)	Product Thickness (feet)	Depth To Water (feet)	Groundwater Elevation (ft-msl)	Groundwater Elevation Corrected from Product Thickness* (ft-msl)
MW-12	9/20/2001	28.68	None	10.41	18.27	NA
	12/14/2001		None	9.62	19.06	NA
	2/27/2002		None	10.09	18.59	NA
	5/16/2002		None	10.04	18.64	NA
	9/18/2002		None	10.66	18.02	NA
	10/30/2002		None	10.62	18.06	NA
	2/6/2003		None	9.97	18.71	NA
	5/1/2003		None	9.78	18.90	NA
	8/26/2003		None	10.70	17.98	NA
	11/20/2003		None	10.53	18.15	NA
	2/10/2004		None	9.80	18.88	NA
	5/18/2004		None	10.13	18.55	NA
	8/30/2004		None	10.32	18.36	NA
	11/17/2004		None	9.91	18.77	NA
	2/23/2005		None	9.29	19.39	NA
	11/2/2005**		None	10.76	17.92	NA
	2/22/2006**		None	10.50	18.18	NA
	5/28/2006**		None	10.82	17.86	NA
	8/27/2006**		None	10.50	18.18	NA
	11/16/2006**		None	10.80	17.88	NA
	2/24/2007**		None	10.30	18.38	NA
	5/27/2007**		None	10.88	17.80	NA
	9/2/2007**		None	10.70	17.98	NA
	11/10/2007**		None	10.90	17.78	NA
	2/28/2008**		None	11.35	17.33	NA
	5/25/2008**		None	11.80	16.88	NA
	11/2/2008**		None	10.50	18.18	NA
	3/24/2009	31.76	None	10.31	21.45	NA
	6/11/2009		None	10.38	21.38	NA
	8/27/2009		None	10.99	20.77	NA
	11/24/2009		None	10.35	21.41	NA
	2/18/2010		None	9.78	21.98	NA
	5/12/2010		None	10.48	21.28	NA

TABLE 1
GROUNDWATER LEVEL MEASUREMENTS
AC TRANSIT
1177 47TH STREET, EMERYVILLE, CALIFORNIA

Well	Date	Top of Casing Elevation (ft-msl)	Product Thickness (feet)	Depth To Water (feet)	Groundwater Elevation (ft-msl)	Groundwater Elevation Corrected from Product Thickness* (ft-msl)	
MW-13	9/20/2001	22.715	None	8.83	13.89	NA	
	12/14/2001		None	7.95	14.77	NA	
	2/27/2002		None	7.64	15.08	NA	
	5/16/2002		None	8.43	14.29	NA	
	9/18/2002		6.86	15.09	7.63	13.11	
	10/30/2002		6.04	14.29	8.43	13.26	
	2/6/2003		0.09	8.25	14.47	14.54	
	5/1/2003		0.24	7.29	15.43	15.62	
	8/26/2003		0.39	9.70	13.02	13.33	
	11/20/2003		0.85	9.85	12.87	13.55	
	2/10/2004		0.88	10.59	12.13	12.83	
	5/18/2004		0.92	10.70	12.02	12.75	
	8/30/2004		1.06	9.36	13.36	14.20	
	11/17/2004		0.25	9.74	12.98	13.18	
	2/23/2005		0.07	6.49	16.23	16.28	
	11/2/2005**		0.063	9.10	13.62	13.67	
	2/22/2006**		0.167	NM	NM	NM	
	5/28/2006**		NM	NM	NM	NM	
	11/16/2006**		0.017	NM	NM	NM	
	5/27/2007**		0.045	9.45	13.27	13.30	
	9/2/2007**		1.1	10.30	12.42	13.30	
	11/10/2007**		1.22	10.62	12.10	13.07	
	2/28/2008**		0.7	9.90	12.82	13.38	
	5/25/2008**		1.1	10.50	12.22	13.10	
	11/2/2008**		1.1	10.40	12.32	13.20	
	3/24/2009		26.70	0.36	9.25	17.45	17.74
	6/11/2009			0.28	10.45	16.25	16.47
	8/27/2009			0.35	10.78	15.92	16.20
	11/24/2009			0.38	9.55	17.15	17.45
	2/18/2010			0.35	9.13	17.57	17.85
	5/12/2010		0.34	8.86	17.84	18.11	
MW-14	3/24/2009	25.98	None	8.63	17.35	NA	
	6/11/2009		None	9.16	16.82	NA	
	8/27/2009		None	9.46	16.52	NA	
	11/24/2009		None	9.82	16.16	NA	
	2/18/2010		None	8.58	17.40	NA	
		5/12/2010		None	9.29	16.69	NA

TABLE 1
GROUNDWATER LEVEL MEASUREMENTS
AC TRANSIT
1177 47TH STREET, EMERYVILLE, CALIFORNIA

Well	Date	Top of Casing Elevation (ft-msl)	Product Thickness (feet)	Depth To Water (feet)	Groundwater Elevation (ft-msl)	Groundwater Elevation Corrected from Product Thickness* (ft-msl)
MW-15	3/24/2009	24.22	None	6.95	17.27	NA
	6/11/2009		None	8.82	15.40	NA
	8/27/2009		None	9.51	14.71	NA
	11/24/2009		None	8.63	15.59	NA
	2/18/2010		None	7.62	16.60	NA
	5/12/2010		None	8.45	15.77	NA
MW-16	3/24/2009	22.90	None	6.43	16.47	NA
	6/11/2009		None	7.36	15.54	NA
	8/27/2009		None	8.89	14.01	NA
	11/24/2009		None	7.18	15.72	NA
	2/18/2010		None	6.17	16.73	NA
	5/12/2010		None	7.56	15.34	NA
W-1	3/2/2000	33.43	None	4.08	29.35	NA
	5/17/2000		None	5.41	28.02	NA
	8/30/2000		None	6.71	26.72	NA
	12/18/2000		None	5.73	27.70	NA
	3/20/2001		None	5.16	28.27	NA
	6/7/2001		None	6.10	27.33	NA
	9/20/2001		None	6.58	26.85	NA
	12/14/2001		None	4.69	28.74	NA
	2/27/2002		None	4.94	28.49	NA
	5/16/2002		None	5.54	27.89	NA
	9/18/2002		None	6.08	27.35	NA
	10/30/2002		None	6.24	27.19	NA
	2/6/2003		None	5.17	28.26	NA
	5/1/2003		None	4.71	28.72	NA
	8/26/2003		None	6.14	27.29	NA
	11/20/2003		None	6.19	27.24	NA
	2/10/2004		None	4.95	28.48	NA
	5/18/2004		None	5.70	27.73	NA
	8/30/2004		None	6.64	26.79	NA
	11/17/2004		None	5.36	28.07	NA
	2/23/2005		None	4.26	29.17	NA
	11/2/2005**		None	6.59	26.84	NA
	5/28/2006**		None	5.15	28.28	NA
	11/16/2006**		None	5.50	27.93	NA
	5/27/2007**		None	5.80	27.63	NA
	11/10/2007**		None	5.95	27.48	NA
	5/25/2008**		None	5.95	27.48	NA
3/24/2009		36.57	None	4.77	31.80	NA
6/11/2009			None	5.68	30.89	NA
8/27/2009			None	6.67	29.90	NA
11/24/2009			None	5.71	30.86	NA
2/18/2010			None	4.72	31.85	NA
5/12/2010			None	4.99	31.58	NA

TABLE 1
GROUNDWATER LEVEL MEASUREMENTS
AC TRANSIT
1177 47TH STREET, EMERYVILLE, CALIFORNIA

Well	Date	Top of Casing Elevation (ft-msl)	Product Thickness (feet)	Depth To Water (feet)	Groundwater Elevation (ft-msl)	Groundwater Elevation Corrected from Product Thickness* (ft-msl)
W-2	5/17/2000	34.21	None	5.60	28.61	NA
	8/30/2000		None	7.37	26.84	NA
	12/18/2000		None	6.44	27.77	NA
	1/23/2001					abandoned
W-3	5/17/2000	37.46	None	6.38	31.08	NA
	8/30/2000		None	8.16	29.30	NA
	12/18/2000		None	7.19	30.27	NA
	3/20/2001		None	5.70	31.76	NA
	6/7/2001		None	7.51	29.95	NA
	9/20/2001		None	7.83	29.63	NA
	12/14/2001		None	4.76	32.70	NA
	2/27/2002		None	5.32	32.14	NA
	5/16/2002		None	6.45	31.01	NA
	9/18/2002		None	7.10	30.36	NA
	10/30/2002		None	7.30	30.16	NA
	2/6/2003		None	5.69	31.77	NA
	5/1/2003		None	4.97	32.49	NA
	8/26/2003		None	7.52	29.94	NA
	11/20/2003		None	7.58	29.88	NA
	2/10/2004		None	5.63	31.83	NA
	5/18/2004		None	6.20	31.26	NA
	8/30/2004		None	8.39	29.07	NA
	11/17/2004		None	6.57	30.89	NA
	2/23/2005		None	4.24	33.22	NA
	11/2/2005**		None	8.24	29.22	NA
	5/28/2006**		None	6.32	31.14	NA
	11/16/2006**		None	6.80	30.66	NA
	5/27/2007**		None	6.73	30.73	NA
	11/10/2007**		None	7.55	29.91	NA
	5/25/2008**		None	7.50	29.96	NA
	3/24/2009		40.41	None	5.67	34.74
6/11/2009			None	4.09	36.32	NA
8/27/2009			None	8.30	32.11	NA
11/24/2009			None	7.21	33.20	NA
2/18/2010			None	5.56	34.85	NA
	5/12/2010		None	6.14	34.27	NA

TABLE 1
GROUNDWATER LEVEL MEASUREMENTS
AC TRANSIT
1177 47TH STREET, EMERYVILLE, CALIFORNIA

Well	Date	Top of Casing Elevation (ft-msl)	Product Thickness (feet)	Depth To Water (feet)	Groundwater Elevation (ft-msl)	Groundwater Elevation Corrected from Product Thickness* (ft-msl)	
W-4	3/2/2000	31.72	None	3.34	28.38	NA	
	5/17/2000		None	3.86	27.86	NA	
	8/30/2000		None	4.99	26.73	NA	
	12/18/2000		None	4.20	27.52	NA	
	3/20/2001		None	3.75	27.97	NA	
	6/7/2001		None	4.67	27.05	NA	
	9/20/2001		None	4.80	26.92	NA	
	12/14/2001		None	3.22	28.50	NA	
	2/27/2002		None	3.58	28.14	NA	
	5/16/2002		None	3.89	27.83	NA	
	9/18/2002		None	4.24	27.48	NA	
	10/30/2002		None	4.56	27.16	NA	
	2/6/2003		None	3.67	28.05	NA	
	5/1/2003		None	2.61	29.11	NA	
	8/26/2003		None	4.47	27.25	NA	
	11/20/2003		None	4.42	27.30	NA	
	2/10/2004		None	3.54	28.18	NA	
	5/18/2004		None	4.11	27.61	NA	
	8/30/2004		None	4.85	26.87	NA	
	11/17/2004		None	3.81	27.91	NA	
	2/23/2005		None	2.97	28.75	NA	
	11/2/2005**		None	4.70	27.02	NA	
	5/28/2006**		None	4.50	27.22	NA	
	11/16/2006**		None	3.90	27.82	NA	
	5/27/2007**		None	3.82	27.90	NA	
	11/10/2007**		None	4.30	27.42	NA	
	5/25/2008**		None	4.40	27.32	NA	
	3/24/2009		34.81	None	3.63	31.18	NA
	6/11/2009			None	7.26	27.55	NA
	8/27/2009			None	4.43	30.38	NA
11/24/2009			None	4.12	30.69	NA	
2/18/2010			None	3.73	31.08	NA	
	5/12/2010		None	3.56	31.25	NA	

Notes:

* used 0.8 specific gravity of product

ft-msl: feet mean sea level

DTW: Depth to water

NA: not applicable

** Essel Technology Services, Inc. data.

TABLE 2
ANALYTICAL RESULTS GROUNDWATER SAMPLES
AC TRANSIT
1177 47TH STREET, EMERYVILLE, CALIFORNIA

Well	Date	TPH-8015 (diesel)	TPH-8015 (gas)	Benzene	Toluene	Ethylbenzene	Xylenes	MTBE
MCL (ug/l)		None	None	1.0	150	300	1750	13
ESL (ug/l)		100	100	1.0	40	30	20	5
MW-1	8/31/1999	310	NA	<1.0	2.4	1	1.6	NA
	11/23/1999	250	NA	<1.0	<1.0	<1.0	<1.0	NA
	3/1/2000	310	62	<1.0	<1.0	<1.0	<2.0	687
	5/17/2000	390	63	<1.0	<1.0	<1.0	<2.0	74
	8/31/2000	180	<50	<1.0	<1.0	<1.0	<2.0	49
	12/18/2000	310	<50	<1.0	<1.0	<1.0	<2.0	44
	3/21/2001	240	<50	<1.0	<1.0	<1.0	<2.0	17
	6/7/2001	540	<50	<1.0	<1.0	<1.0	<2.0	32
	9/20/2001	290	<50	<1.0	<1.0	<1.0	<2.0	29
	2/27/2002	<250	<50	<1.0	<1.0	<1.0	<2.0	14
	9/18/2002	230	<50	<1.0	<1.0	<1.0	<2.0	30
	2/6/2003	82	<50	<0.5	<0.5	<0.5	<1.0	17
	8/26/2003	200	<50	<0.5	<0.5	<0.5	<1.0	9.8
	2/10/2004	4,800	<50	<0.5	<0.5	<0.5	<1.0	6.6
	8/30/2004	<56	<50	<0.5	<0.5	<0.5	<1.5	4.2
	2/23/2005	<50	<50	<0.5	<0.5	<0.5	<1.0	6.1
	11/3/2005*	70	<50	<0.5	<0.5	<0.5	<0.5	4.5
	5/29/2006*	89	<50	<0.5	<0.5	<0.5	<0.5	<5.0
	11/12/2006*	65	<50	<0.5	<0.5	<0.5	<0.5	<5.0
	5/27/2007*	65	<50	<0.5	<0.5	<0.5	<0.5	<5.0
	11/10/2007*	59	<50	<0.5	<0.5	<0.5	<0.5	<5.0
	5/25/2008*	60	<50	<0.5	<0.5	<0.5	<0.5	<5.0
	3/24/2009	<100	<50	<1.0	<1.0	<1.0	<2.0	1.1
	8/27/2009	<95	<50	<1.0	<1.0	<1.0	<2.0	1.5
	2/18/2010	<94	<50	<1.0	<1.0	<1.0	<2.0	<1.0

TABLE 2
ANALYTICAL RESULTS GROUNDWATER SAMPLES
AC TRANSIT
1177 47TH STREET, EMERYVILLE, CALIFORNIA

Well	Date	TPH-8015 (diesel)	TPH-8015 (gas)	Benzene	Toluene	Ethylbenzene	Xylenes	MTBE
MCL (ug/l)		None	None	1.0	150	300	1750	13
ESL (ug/l)		100	100	1.0	40	30	20	5
MW-2	8/31/1999	180	NA	<1.0	<1.0	<1.0	1.2	NA
	11/23/1999	120	NA	<1.0	<1.0	<1.0	<5.0	NA
	3/1/2000	510	<50	<1.0	<1.0	<1.0	<2.0	81
	5/17/2000	1,100	<50	<1.0	<1.0	<1.0	<2.0	87
	8/31/2000	620	<50	<1.0	<1.0	<1.0	<2.0	65
	12/19/2000	830	<50	<1.0	<1.0	<1.0	<2.0	70
	3/21/2001	900	<50	<2.0	<2.0	<2.0	<4.0	33
	6/7/2001	810	<50	<1.0	<1.0	<1.0	<2.0	43
	9/20/2001	1,200	<50	<1.0	<1.0	<1.0	<2.0	35
	2/27/2002	<250	<50	<1.0	<1.0	<1.0	<2.0	19
	9/18/2002	180	<50	<1.0	<1.0	<1.0	<2.0	17
	2/6/2003	58	<50	<0.5	<0.5	<0.5	<1.0	18
	8/26/2003	150	<50	<0.5	<0.5	<0.5	<1.0	15
	2/11/2004	<50	<50	<0.5	<0.5	<0.5	<1.0	5.2
	8/30/2004	<56	<50	<0.5	<0.5	<0.5	<1.5	6.3
	2/23/2005	<50	<50	<0.5	<0.5	<0.5	<1.0	8.4
	11/3/2005*	110	<50	<0.5	<0.5	<0.5	<0.5	4.9
	5/29/2006*	70	<50	<0.5	<0.5	<0.5	<0.5	<5.0
	11/16/2006*	<50	<50	<0.5	<0.5	<0.5	<0.5	<5.0
	5/27/2007*	75	<50	<0.5	<0.5	<0.5	<0.5	<5.0
	11/10/2007*	62	<50	<0.5	<0.5	<0.5	<0.5	<5.0
	5/25/2008*	<50	<50	<0.5	<0.5	<0.5	<0.5	<5.0
	3/24/2009	<97	<50	<1.0	<1.0	<1.0	<2.0	2.9
	8/27/2009	<95	<50	<1.0	<1.0	<1.0	<2.0	2.4
	2/18/2010	<130	<50	<1.0	<1.0	<1.0	<2.0	2.5

TABLE 2
ANALYTICAL RESULTS GROUNDWATER SAMPLES
AC TRANSIT
1177 47TH STREET, EMERYVILLE, CALIFORNIA

Well	Date	TPH-8015 (diesel)	TPH-8015 (gas)	Benzene	Toluene	Ethylbenzene	Xylenes	MTBE
MCL (ug/l)		None	None	1.0	150	300	1750	13
ESL (ug/l)		100	100	1.0	40	30	20	5
MW-3	8/31/1999	2,700	NA	<1.0	<1.0	<1.0	<1.0	NA
	11/23/1999	640	NA	<1.0	<1.0	<1.0	<1.0	NA
	3/1/2000	<250	<50	<1.0	<1.0	<1.0	<2.0	<5.0
	5/17/2000	620	<50	<1.0	<1.0	<1.0	<2.0	<5.0
	8/31/2000	1,800	<50	<1.0	<1.0	<1.0	<2.0	<5.0
	12/18/2000	NA	<50	<1.0	<1.0	<1.0	<2.0	<5.0
	3/21/2001	1,700	<50	<1.0	<1.0	<1.0	<2.0	<5.0
	6/7/2001	770	<50	<1.0	<1.0	<1.0	<2.0	<5.0
	9/21/2001	260	<50	<1.0	<1.0	<1.0	<2.0	<5.0
	2/27/2002	560	<50	<1.0	<1.0	<1.0	<2.0	<5.0
	9/18/2002	340	<50	<1.0	<1.0	<1.0	<2.0	<5.0
	2/6/2003	<50	<50	<0.5	<0.5	<0.5	<1.0	3.9
	8/26/2003	5,800	<50	<0.5	<0.5	<0.5	<1.0	4.9
	2/11/2004	<50	<50	<0.5	<0.5	<0.5	<1.0	3.4
	8/30/2004	<56	<50	<0.5	<0.5	<0.5	1.5	4
	2/23/2005	<50	<50	<0.5	<0.5	<0.5	<1.0	5.4
	11/3/2005*	180	<50	<0.5	<0.5	<0.5	<0.5	3.2
	5/29/2006*	180	<50	<0.5	<0.5	<0.5	<0.5	<5.0
	11/16/2006*	<50	<50	<0.5	<0.5	<0.5	<0.5	<5.0
	5/27/2007*	<50	<50	<0.5	<0.5	<0.5	<0.5	<5.0
	11/10/2007*	730	<50	<0.5	<0.5	<0.5	<0.5	<5.0
	5/25/2008*	910	<50	<0.5	<0.5	<0.5	<0.5	<5.0
	3/25/2009	<110	<50	<1.0	<1.0	<1.0	<2.0	<1.0
8/27/2009	<95	<50	<1.0	<1.0	<1.0	<2.0	<1.0	
2/18/2010	<95	<50	<1.0	<1.0	<1.0	<2.0	<1.0	
MW-4	8/31/1999	<50	NA	<1.0	<1.0	<1.0	1.6	NA
	11/23/1999	<50	NA	<1.0	<1.0	<1.0	<1.0	NA
	3/1/2000	<250	<50	<1.0	<1.0	<1.0	<2.0	<5.0
	5/17/2000	80	<50	<1.0	<1.0	<1.0	<2.0	<5.0
	8/31/2000	<250	<50	<1.0	<1.0	<1.0	<2.0	<5.0
	12/18/2000	<250	<50	<1.0	<1.0	<1.0	<2.0	<5.0
	3/20/2001	<250	<50	<1.0	<1.0	<1.0	<2.0	<5.0
	6/7/2001	<250	<50	<1.0	<1.0	<1.0	<2.0	<5.0
	11/3/2005*	<50	<50	<0.5	<0.5	<0.5	<0.5	4.1
	5/29/2006*	<50	<50	<0.5	<0.5	<0.5	<0.5	<5.0
	11/16/2006*	<50	<50	<0.5	<0.5	<0.5	<0.5	<5.0
	5/27/2007*	<50	<50	<0.5	<0.5	<0.5	<0.5	<5.0
	11/10/2007*	<50	<50	<0.5	<0.5	<0.5	<0.5	<5.0
	5/25/2008*	<50	<50	<0.5	<0.5	<0.5	<0.5	<5.0
	3/25/2009	<95	<50	<1.0	<1.0	<1.0	<2.0	1.0
	8/27/2009	<95	<50	<1.0	<1.0	<1.0	<2.0	<1.0
	2/18/2010	<95	<50	<1.0	<1.0	<1.0	<2.0	<1.0

TABLE 2
ANALYTICAL RESULTS GROUNDWATER SAMPLES
AC TRANSIT
1177 47TH STREET, EMERYVILLE, CALIFORNIA

Well	Date	TPH-8015 (diesel)	TPH-8015 (gas)	Benzene	Toluene	Ethylbenzene	Xylenes	MTBE
MCL (ug/l)		None	None	1.0	150	300	1750	13
ESL (ug/l)		100	100	1.0	40	30	20	5
MW-5	8/31/1999	250	NA	<1.0	<1.0	<1.0	1	NA
	11/23/1999	300	NA	<1.0	<1.0	<1.0	<5.0	NA
	3/1/2000	340	<50	<1.0	<1.0	<1.0	<2.0	100
	5/17/2000	230	<50	<1.0	<1.0	<1.0	<2.0	86
	8/31/2000	220	<50	<1.0	<1.0	<1.0	<2.0	59
	12/18/2000	360	<50	<1.0	<1.0	<1.0	<2.0	57
	3/20/2001	250	<50	<5.0	<5.0	<5.0	<10	87
	6/7/2001	600	<50	<1.0	<1.0	<1.0	<2.0	74
	11/3/2005*	1,500	<50	<0.5	<0.5	<0.5	<0.5	5.7
	5/29/2006*	200	<50	<0.5	<0.5	<0.5	<0.5	<5.0
	11/12/2006*	130	<50	<0.5	<0.5	<0.5	<0.5	<5.0
	5/27/2007*	180	140	<0.5	<0.5	<0.5	<0.5	<10
	11/10/2007*	110	170	<0.5	<0.5	0.59	1.3	<10
	5/25/2008*	200	82	<0.5	<0.5	<0.5	<0.5	<5.0
	3/25/2009	<95	<50	<1.0	<1.0	<1.0	<2.0	1.1
	8/28/2009	<95	435	<1.0	<1.0	<1.0	<2.0	3.6
	2/18/2010	<94	<50	<1.0	<1.0	<1.0	<2.0	1.9
MW-6	8/31/1999	140,000	NA	77	18	31	49	NA
	11/23/1999	6,100	NA	45	14	6.9	48	NA
	3/1/2000	22,000	2,800	6.8	<2.0	<2.0	<10	<5.0
	5/17/2000	1,800	6,200	77	16	39	37	<5.0
	8/31/2000	76,000	5,300	60	13	43	45.7	<5.0
	12/19/2000	6,300	1,300	26.0	4.9	8.4	11.5	<5.0
	3/21/2001	5,100	1,900	49.0	9.5	13	12	<10
	6/7/2001	14,000	2,600	47.0	10	13	19	<10
	9/21/2001	15,000	4,000	180	14	24	40	<50
	2/27/2002	43,000	5,000	68	16	52	41.8	<25
	9/18/2002	320,000	2,000	74	7.3	22	25	<5.0
	2/6/2003	4,300	2,600	63	8.2	18	15	<1.0
	8/26/2003	68,000	6,500	110	16	44	42	<10
	2/10/2004	19,000	3,500	37	4.9	24	15	<5
	8/30/2004	<56	<50	86	7.8	15	27	<5
	2/23/2005	4,930	687	7.9	2	0.9	4.3	<0.5
	11/3/2005*	2,000	750	13	1.9	2.9	4.6	1.4
	5/29/2006*	12,000	2,700	55	5.7	16	26	<15
	11/16/2006*	2,100	530	12	0.82	0.58	2.8	<5.0
	5/27/2007*	2,500	5,200	110	5.1	23	17	<60
11/10/2007*	9,300	2,100	30	<1.7	3.9	4	<17	
5/25/2008*	20,000	5,000	88	<2.5	31	14	<25	
3/25/2009	2,610	785	8.9	<2.0	2.9	<4.0	<2.0	
8/28/2009	4,080	5,160	112	<10	27.1	21.5	<10	
2/19/2010	2,330	1,790	39.8	4.9	8.2	8.3	<2.0	

TABLE 2
ANALYTICAL RESULTS GROUNDWATER SAMPLES
AC TRANSIT
1177 47TH STREET, EMERYVILLE, CALIFORNIA

Well	Date	TPH-8015 (diesel)	TPH-8015 (gas)	Benzene	Toluene	Ethylbenzene	Xylenes	MTBE
MCL (ug/l)		None	None	1.0	150	300	1750	13
ESL (ug/l)		100	100	1.0	40	30	20	5
MW-7	8/31/1999	1,400	NA	<1.0	2.9	2.3	2.7	NA
	11/23/1999	530	NA	<1.0	<1.0	<1.0	<1.0	NA
	3/1/2000	640	860	<1.0	<1.0	<1.0	<2.0	<20
	5/17/2000	430	410	<1.0	<1.0	<1.0	<2.0	9.5
	8/31/2000	950	1100	<1.0	<1.0	<1.0	<2.0	<5.0
	12/18/2000	1,100	820	<1.0	<1.0	<1.0	<2.0	<5.0
	3/20/2001	770	1000	<1.0	1.4	<1.0	<2.0	<5.0
	6/7/2001	1,400	870	<1.0	<1.0	<1.0	<2.0	<5.0
	9/21/2001	940	1000	<1.0	<1.0	<2.0	<5.0	<5.0
	2/27/2002	430	930	<1.0	<1.0	<1.0	<2.0	<5.0
	9/18/2002	440	870	<1.0	<1.0	<1.0	<2.0	<5.0
	2/6/2003	230	890	<0.5	<0.5	<0.5	<1.0	1.6
	8/26/2003	470	590	<0.5	<0.5	<0.5	<1.0	1.5
	2/11/2004	140	690	<0.5	1.9	0.57	1.0	1.1
	8/30/2004	<56	200	<0.5	<0.5	<0.5	<1.5	1.5
	2/23/2005	290	283	<0.5	<0.5	<0.5	<1.0	1.1
	11/3/2005*	140	310	<0.5	<0.5	<0.5	<0.5	2.3
	5/29/2006*	120	260	<0.5	<0.5	<0.5	<0.5	<5.0
	11/12/2006*	96	120	<0.5	<0.5	<0.5	0.76	<5.0
	5/27/2007*	220	700	<0.5	<0.5	1.0	2.0	<5.0
11/10/2007*	150	220	<0.5	<0.5	<0.5	1.0	<5.0	
5/25/2008*	270	620	0.81	<0.5	0.85	1.8	<10	
3/25/2009	<99	529	<1.0	<1.0	<1.0	<2.0	<1.0	
8/28/2009	<95	205	<1.0	<1.0	<1.0	<2.0	1.3	
2/19/2010	<100	173	<1.0	<1.0	<1.0	<2.0	<1.0	
MW-8	8/31/1999	230	NA	<1.0	<1.0	1.2	<1.0	NA
	11/23/1999	220	NA	<1.0	<1.0	<1.0	<1.0	NA
	3/1/2000	260	150	<1.0	<1.0	<1.0	<2.0	<5.0
	5/17/2000	660	310	<1.0	<1.0	<1.0	<2.0	<5.0
	8/31/2000	460	300	<1.0	<1.0	<1.0	1.4	<5.0
	12/18/2000	370	230	<1.0	<1.0	<1.0	<2.0	<5.0
	3/20/2001	1,700	64	<1.0	<1.0	<1.0	<2.0	<5.0
	6/7/2001	1,300	180	<1.0	<1.0	<1.0	<2.0	<5.0
	11/3/2005*	280	150	<0.5	<0.5	<0.5	<0.5	0.69
	5/29/2006*	150	<50	<0.5	<0.5	<0.5	<0.5	<5.0
	11/12/2006*	<50	95	<0.5	<0.5	<0.5	<0.5	<5.0
	5/27/2007*	140	140	<0.5	<0.5	<0.5	<0.5	<5.0
	11/10/2007*	160	240	<0.5	<0.5	<0.5	<0.5	<5.0
	5/25/2008*	160	230	<0.5	<0.5	<0.5	0.61	<5.0
	3/25/2009	<95	72.8	<1.0	<1.0	<1.0	<2.0	1.2
	8/28/2009	<95	62.1	<1.0	<1.0	<1.0	<2.0	1.0
	2/19/2010	<100	<50	<1.0	<1.0	<1.0	<2.0	1.1

TABLE 2
ANALYTICAL RESULTS GROUNDWATER SAMPLES
AC TRANSIT
1177 47TH STREET, EMERYVILLE, CALIFORNIA

Well	Date	TPH-8015 (diesel)	TPH-8015 (gas)	Benzene	Toluene	Ethylbenzene	Xylenes	MTBE
MCL (ug/l)		None	None	1.0	150	300	1750	13
ESL (ug/l)		100	100	1.0	40	30	20	5
MW-9	8/31/1999	2,800	NA	<1.0	<1.0	<1.0	1.1	NA
	11/23/1999	1,300	NA	<1.0	<1.0	<1.0	<1.0	NA
	3/1/2000	510	<50	<1.0	<1.0	<1.0	<2.0	<5.0
	5/17/2000	990	<50	<1.0	<1.0	<1.0	<2.0	<5.0
	8/31/2000	1,100	<50	<1.0	<1.0	<1.0	<2.0	<5.0
	12/18/2000	1,900	<50	<1.0	<1.0	<1.0	<2.0	5.9
	3/20/2001	1,500	<50	<1.0	<1.0	<1.0	<2.0	5.5
	6/7/2001	590	<50	<1.0	<1.0	<1.0	<2.0	8.1
	9/20/2001	790	<50	<1.0	<1.0	<1.0	<2.0	8.5
	2/27/2002	650	<50	<1.0	<1.0	<1.0	<2.0	9.5
	9/18/2002	480	<50	<1.0	<1.0	<1.0	<2.0	6.2
	2/6/2003	54	<50	<0.5	<0.5	<0.5	<1.0	5.5
	8/26/2003	1,300	<50	<0.5	<0.5	<0.5	<1.0	6.6
	2/10/2004	6,200	250	<0.5	<0.5	<0.5	<1.0	4.4
	8/30/2004	<50	<50	<0.5	<0.5	<0.5	<1.5	3.6
	2/23/2005	<0.5	<50	<0.5	<0.5	<0.5	<1.0	6.0
	11/3/2005*	470	<50	<0.5	<0.5	<0.5	<0.5	4.8
	5/29/2006*	190	<50	<0.5	<0.5	<0.5	<0.5	5.2
	11/12/2006*	65	<50	<0.5	<0.5	<0.5	<0.5	<5.0
	5/27/2007*	1,000	<50	<0.5	0.92	<0.5	<0.5	<5.0
	11/10/2007*	930	<50	<0.5	<0.5	<0.5	<0.5	<5.0
	5/25/2008*	740	<50	<0.5	<0.5	<0.5	<0.5	<5.0
	3/25/2009	<390	<50	<1.0	<1.0	<1.0	<2.0	3.5
	8/28/2009	<480	<50	<1.0	<1.0	<1.0	<2.0	3.7
	2/19/2010	<190	<50	<1.0	<1.0	<1.0	<2.0	3.7

TABLE 2
ANALYTICAL RESULTS GROUNDWATER SAMPLES
AC TRANSIT
1177 47TH STREET, EMERYVILLE, CALIFORNIA

Well	Date	TPH-8015 (diesel)	TPH-8015 (gas)	Benzene	Toluene	Ethylbenzene	Xylenes	MTBE
MCL (ug/l)		None	None	1.0	150	300	1750	13
ESL (ug/l)		100	100	1.0	40	30	20	5
MW-10	8/31/1999	1,100	NA	<1.0	1.2	2.0	<1.0	NA
	11/23/1999	1,200	NA	<1.0	<1.0	<1.0	<1.0	NA
	3/1/2000	1,300	540	<1.0	<1.0	<1.0	<2.0	NA
	5/17/2000	990	460	<1.0	<1.0	<1.0	<2.0	6.9
	8/31/2000	840	320	<1.0	<1.0	<1.0	<2.0	25
	12/18/2000	900	290	<1.0	<1.0	<1.0	<2.0	<9.0
	3/21/2001	620	220	<1.0	<1.0	<1.0	<2.0	<5.0
	6/7/2001	1,300	360	<1.0	<1.0	<1.0	<2.0	15
	9/20/2001	1,000	350	<1.0	<1.0	<1.0	<2.0	44
	2/27/2002	610	150	<1.0	<1.0	<1.0	<2.0	<5.0
	9/18/2002	850	240	<1.0	1.2	<1.0	<2.0	20
	2/6/2003	510	200	<0.5	<0.5	<0.5	<1.0	2.8
	8/26/2003	1,100	250	<0.5	<0.5	<0.5	<1.0	14
	2/10/2004	260	190	<0.5	<0.5	<0.5	<1.0	1.6
	8/30/2004	310	240	<0.5	<0.5	<0.5	<1.5	6.7
	2/23/2005	310	207	<0.5	0.7	1.4	1.3	<0.5
	11/3/2005*	600	300	<0.5	<0.5	<0.5	<0.5	4.1
	5/29/2006*	540	140	<0.5	<0.5	<0.5	<0.5	<5.0
	11/16/2006*				Well Not Accessible			
	2/24/2007*	970	190	<0.5	<0.5	<0.5	<0.5	<5.0
	5/27/2007*	850	330	<0.5	<0.5	<0.5	<0.5	<5.0
	11/10/2007*	1,200	420	<0.5	<0.5	<0.5	<0.5	<5.0
	5/28/2008*	930	330	<0.5	<0.5	0.92	1.1	<5.0
	3/25/2009	948	173	<1.0	<1.0	<1.0	<2.0	<1.0
	8/28/2009	547	389	<1.0	<1.0	<1.0	<2.0	1.6
	2/19/2010	398	72.9	<1.0	<1.0	<1.0	<2.0	<1.0

TABLE 2
ANALYTICAL RESULTS GROUNDWATER SAMPLES
AC TRANSIT
1177 47TH STREET, EMERYVILLE, CALIFORNIA

Well	Date	TPH-8015 (diesel)	TPH-8015 (gas)	Benzene	Toluene	Ethylbenzene	Xylenes	MTBE
MCL (ug/l)		None	None	1.0	150	300	1750	13
ESL (ug/l)		100	100	1.0	40	30	20	5
MW-11	9/20/2001	460	88	<1.0	<1.0	<1.0	<2.0	<5.0
	12/14/2002	320	<50	<1.0	<1.0	<1.0	<2.0	<5.0
	2/27/2002	<50	<50	<1.0	<1.0	<1.0	<2.0	<5.0
	5/16/2002	380	<50	<1.0	<1.0	<1.0	<2.0	<5.0
	9/18/2002	250	<50	<1.0	<1.0	<1.0	<2.0	<5.0
	10/30/2002	260	<50	<0.5	<0.5	<0.5	<1.5	<2.5
	2/6/2003	250	<50	<0.5	<0.5	<0.5	<1.0	<1.0
	5/1/2003	220	<50	<0.5	<0.5	<0.5	<1.0	<1.0
	8/26/2003	300	<50	<0.5	<0.5	<0.5	<1.0	<1.0
	11/20/2003	77	<50	<0.5	<0.5	<0.5	<1.0	<1.0
	5/18/2004	<50	<50	<0.5	<0.5	<0.5	<1.0	<1.0
	8/30/2004	<56	<50	<0.5	<0.5	<0.5	<1.5	<1.0
	11/17/2004	<50	<50	<0.5	<0.5	<0.5	<1.0	<0.5
	2/23/2005	<50	<50	<0.5	<0.5	<0.5	<1.0	<0.5
	11/3/2005*	290	<50	<0.5	<0.5	<0.5	<0.5	<0.5
	2/22/2006*	<50	<50	<0.5	<0.5	<0.5	<0.5	<0.5
	5/29/2006*	250	<50	<0.5	<0.5	<0.5	<0.5	<5.0
	8/27/2006*	57	<50	<0.5	<0.5	<0.5	<0.5	<5.0
	11/12/2006*	56	<50	<0.5	<0.5	<0.5	<0.5	<5.0
	2/24/2007*	<50	<50	<0.5	<0.5	<0.5	<0.5	<5.0
	5/27/2007*	61	<50	<0.5	<0.5	<0.5	<0.5	<5.0
	9/2/2007*	67	<50	<0.5	<0.5	<0.5	<0.5	<5.0
	11/10/2007*	55	<50	<0.5	<0.5	<0.5	<0.5	<5.0
	2/28/2008*	71	<50	<0.5	<0.5	<0.5	<0.5	<5.0
	5/28/2008*	110	<50	<0.5	<0.5	<0.5	<0.5	<5.0
	11/2/2008*	200	<50	2.1	<0.5	0.51	0.70	<5.0
	3/25/2009	<99	<50	<1.0	<1.0	<1.0	<2.0	<1.0
	6/11/2009	<95	<50	<1.0	<1.0	<1.0	<2.0	<1.0
	8/28/2009	<94	<50	<1.0	<1.0	<1.0	<2.0	<1.0
	11/24/2009	<100	<50	<1.0	<1.0	<1.0	<2.0	<1.0
	2/19/2010	<95	<50	<1.0	<1.0	<1.0	<2.0	<1.0
	5/12/2010	184	<50	<1.0	<1.0	<1.0	<2.0	<1.0

TABLE 2
ANALYTICAL RESULTS GROUNDWATER SAMPLES
AC TRANSIT
1177 47TH STREET, EMERYVILLE, CALIFORNIA

Well	Date	TPH-8015 (diesel)	TPH-8015 (gas)	Benzene	Toluene	Ethylbenzene	Xylenes	MTBE
MCL (ug/l)		None	None	1.0	150	300	1750	13
ESL (ug/l)		100	100	1.0	40	30	20	5
MW-12	9/20/2001	540	960	<1.0	<1.0	<2.0	<5.0	11
	12/14/2002	170	670	<1.0	<1.0	<1.0	<2.0	9.4
	2/27/2002	350	950	<1.0	<1.0	<1.0	<2.0	11
	5/16/2002	500	1100	<1.0	<1.0	<1.0	<2.0	6.7
	9/18/2002	1,600	570	<1.0	<1.0	<1.0	<3.0	7.1
	10/30/2002	440	420	<0.5	<0.5	<0.5	<1.5	<2.5
	2/6/2003	190	340	<0.5	<0.5	<0.5	<1.0	6.8
	5/1/2003	580	950	<2.5	<2.5	3.7	9.0	8.8
	8/26/2003	110	260	<0.5	<0.5	<0.5	<1.0	11
	11/20/2003	100	160	<0.5	<0.5	<0.5	<1.0	8.9
	2/10/2004	210	490	<0.5	0.6	<0.5	<1.0	6.7
	5/18/2004	190	620	<0.5	<0.5	0.8	<1.0	5.6
	8/30/2004	<56	430	<0.5	<0.5	<0.5	<1.5	5.6
	11/17/2004	320	186	<0.5	0.5	0.5	<1.0	10.8
	2/23/2005	340	790	3.0	6.9	1.4	4.2	6.2
	11/3/2005*	120	440	<0.5	<0.5	<0.5	<0.5	6.6
	2/22/2006*	140	400	<0.5	<0.5	<0.5	<0.5	7.8
	5/29/2006*	140	310	<0.5	<0.5	<0.5	<0.5	5.7
	8/27/2006*	120	530	<0.5	<0.5	<0.5	<0.5	6.6
	11/16/2006*	200	740	<0.5	2.1	<0.5	6.3	<10
	2/24/2007*	87	200	<0.5	<0.5	<0.5	<0.5	<10
	5/27/2007*	140	340	<0.5	<0.5	1.4	1.8	<10
	9/2/2007*	130	430	<0.5	<0.5	<0.5	0.77	8.3
	11/10/2007*	94	360	<0.5	<0.5	<0.5	<0.5	<10
	2/28/2008*	160	55	<0.5	<0.5	<0.5	<0.5	10
	5/28/2008*	850	120	<0.5	<0.5	<0.5	<0.5	8.9
	11/2/2008*	200	320	0.64	<0.5	<0.5	<0.5	<5.0
	3/25/2009	<96	89.0	<1.0	<1.0	<1.0	<2.0	4.3
	6/11/2009	<95	115	<1.0	<1.0	<1.0	<2.0	1.7
	8/28/2009	<95	97.6	<1.0	<1.0	<1.0	<2.0	4.0
	11/24/2009	<96	104	<1.0	<1.0	<1.0	<2.0	<1.0
	2/19/2010	<95	107	<1.0	<1.0	<1.0	<2.0	2.6
	5/12/2010	<96	71.4	<1.0	<1.0	<1.0	<2.0	2.9

TABLE 2
ANALYTICAL RESULTS GROUNDWATER SAMPLES
AC TRANSIT
1177 47TH STREET, EMERYVILLE, CALIFORNIA

Well	Date	TPH-8015 (diesel)	TPH-8015 (gas)	Benzene	Toluene	Ethylbenzene	Xylenes	MTBE
MCL (ug/l)		None	None	1.0	150	300	1750	13
ESL (ug/l)		100	100	1.0	40	30	20	5
MW-13	9/21/2001	<250	<50	<1.0	<1.0	<1.0	<2.0	7.4
	12/14/2002	160	<50	<1.0	<1.0	<1.0	<2.0	11
	2/27/2002	1,100	450	<1.0	<5.0	<1.0	<2.0	9.9
	11/3/2005*			Not sampled - free-phase product in well				
	2/22/2006*			Not sampled - free-phase product in well				
	5/29/2006*			Not sampled - free-phase product in well				
	11/16/2006*			Not sampled - free-phase product in well				
	5/27/2007*			Not sampled - free-phase product in well				
	9/2/2007*			Not sampled - free-phase product in well				
	11/10/2007*			Not sampled - free-phase product in well				
	2/28/2008*			Not sampled - free-phase product in well				
	5/25/2008*			Not sampled - free-phase product in well				
	3/24/2009			Not sampled - free-phase product in well				
	6/11/2009			Not sampled - free-phase product in well				
	8/28/2009			Not sampled - free-phase product in well				
	11/24/2009			Not sampled - free-phase product in well				
2/19/2010			Not sampled - free-phase product in well					
	5/12/2010			Not sampled - free-phase product in well				
MW-14	3/25/2009	<95	<50	<1.0	<1.0	<1.0	<2.0	5.8
	6/11/2009	<95	<50	<1.0	<1.0	<1.0	<2.0	6.9
	8/28/2009	<95	<50	<1.0	<1.0	<1.0	<2.0	7.7
	11/24/2009	<96	<50	<1.0	<1.0	<1.0	<2.0	5.4
	2/19/2010	<94	<50	<1.0	<1.0	<1.0	<2.0	7.5
		5/12/2010	209	<50	<1.0	<1.0	<1.0	<2.0
MW-15	3/24/2009	<95	<50	<1.0	<1.0	<1.0	<2.0	5.0
	6/11/2009	<95	<50	<1.0	<1.0	<1.0	<2.0	6.2
	8/28/2009	<96	<50	<1.0	<1.0	<1.0	<2.0	7.1
	11/24/2009	<95	<50	<1.0	<1.0	<1.0	<2.0	5.3
	2/19/2010	<94	<50	<1.0	<1.0	<1.0	<2.0	6.5
		5/12/2010	<97	<50	<1.0	<1.0	<1.0	<2.0
MW-16	3/24/2009	<96	62.9	<1.0	<1.0	<1.0	<2.0	10.3
	6/11/2009	<95	<50	<1.0	<1.0	<1.0	<2.0	7.2
	8/28/2009	<96	<50	<1.0	<1.0	<1.0	<2.0	7.8
	11/24/2009	<96	<50	<1.0	<1.0	<1.0	<2.0	6.3
	2/19/2010	<100	<50	<1.0	<1.0	<1.0	<2.0	7.4
		5/12/2010	255	<50	<1.0	<1.0	<1.0	<2.0

TABLE 2
ANALYTICAL RESULTS GROUNDWATER SAMPLES
AC TRANSIT
1177 47TH STREET, EMERYVILLE, CALIFORNIA

Well	Date	TPH-8015 (diesel)	TPH-8015 (gas)	Benzene	Toluene	Ethylbenzene	Xylenes	MTBE
MCL (ug/l)		None	None	1.0	150	300	1750	13
ESL (ug/l)		100	100	1.0	40	30	20	5
W-1	5/16/2002	520	150	<1.0	<1.0	<1.0	<2.0	8.7
	3/2/2000	1,800	3,400	20.0	5.3	30	23.8	<5.0
	5/17/2000	1,100	7,300	35.0	11	59	45	<1.0
	8/31/2000	2,200	6,200	20.0	7.9	36	38.2	<10
	12/19/2000	1,700	5,600	20.0	8.4	30	35.6	<5.0
	3/20/2001	2,100	7,200	32.0	13	56	40	<10
	6/7/2001	2,100	7,300	26.0	18	42	38.3	<10
	9/21/2001	1,800	7,100	27	<10	48	40	<10
	2/27/2002	1,800	7,100	24	9	52	34	<25
	2/6/2003	990	5,300	11	4.7	27	24	<1.0
	8/26/2003	1,700	5,800	7.5	5.4	24	25	<10
	2/10/2004	940	6,000	16.0	4.9	20	21	<1.0
	8/30/2004	<56	2,500	8.6	3.6	11	18	<1.30
	2/23/2005	1,910	3,900	74.1	12.2	64.4	48.2	<0.5
	11/3/2005*	2,400	6,200	7.2	3.6	5.7	20	0.73
	5/29/2006*	1,700	4,600	18.0	4.4	17	32	<17
	11/16/2006*	760	2,600	18.0	3.7	10	19	<10
	5/27/2007*	1,200	4,200	20.0	34	12	17	<45
	11/10/2007*	1,200	6,100	32.0	<2.5	9.4	14	<25
	5/25/2008*	1,300	5,700	18.0	1.8	11	13	<17
3/24/2009	637	3,850	10.9	<10	<10	<20	<10	
8/27/2009	681	5,010	<10	<10	<10	<20	<10	
	2/18/2010	<95	5,820	12.4	<10	11	20.3	<10
W-2	9/18/2002	1,000	5900	11	<22	23	22	<5.0
	5/17/2000	19,000	870	<2.0	<1.0	<2.0	<4.0	<5.0
	8/31/2000	7,400	2200	4.6	2.5	3.8	11	<5.0
W-3	12/19/2000	10,000	290	8.8	3.4	8.6	17.4	<5.0
	5/17/2000	<50	<50	<1.0	<1.0	<1.0	<2.0	<5.0
	8/31/2000	<50	<50	<1.0	<1.0	<1.0	<2.0	<5.0
	12/18/2000	<250	<50	<1.0	<1.0	<1.0	<2.0	<5.0
	3/20/2001	630	<50	<1.0	<1.0	<1.0	<2.0	<5.0
	11/3/2005*	<50	<50	<0.5	<0.5	<0.5	<0.5	1.2
	5/29/2006*	<50	240	<0.5	<0.5	<0.5	<0.5	<5.0
	11/16/2006*	<50	<50	<0.5	<0.5	<0.5	<0.5	<5.0
	5/27/2007*	<50	<50	<0.5	<0.5	<0.5	<0.5	<5.0
	11/10/2007*	<50	<50	<0.5	<0.5	<0.5	<0.5	<5.0
5/25/2008*	<50	<50	<0.5	<0.5	<0.5	<0.5	<5.0	

TABLE 2
ANALYTICAL RESULTS GROUNDWATER SAMPLES
AC TRANSIT
1177 47TH STREET, EMERYVILLE, CALIFORNIA

Well	Date	TPH-8015 (diesel)	TPH-8015 (gas)	Benzene	Toluene	Ethylbenzene	Xylenes	MTBE
MCL (ug/l)		None	None	1.0	150	300	1750	13
ESL (ug/l)		100	100	1.0	40	30	20	5
W-4	6/7/2001	1,200	<50	<1.0	<1.0	<1.0	<2.0	<5.0
	3/2/2000	190	<50	1.1	<1.0	<1.0	<2.0	<5.0
	5/17/2000	230	<50	<1.0	<1.0	<1.0	<2.0	<5.0
	8/31/2000	240	<50	<1.0	<1.0	<1.0	<2.0	<5.0
	12/19/2000	320	<50	<1.0	<1.0	<1.0	<2.0	<5.0
	3/21/2001	220	<50	<1.0	<1.0	<1.0	<2.0	<5.0
	6/7/2001	430	<50	<1.0	<1.0	<1.0	<2.0	<5.0
	11/3/2005*	66	<50	<0.5	<0.5	<0.5	<0.5	2.0
	5/29/2006*	110	<50	<0.5	<0.5	<0.5	<0.5	<5.0
	11/16/2006*	72	<50	<0.5	<0.5	<0.5	<0.5	<5.0
	5/27/2007*	180	99	0.89	<0.5	<0.5	<0.5	<5.0
	11/10/2007*	83	<50	<0.5	<0.5	<0.5	<0.5	<5.0
	5/25/2008*	71	<50	<0.5	<0.5	<0.5	<0.5	<5.0

Notes:

ug/l: micrograms per liter
TPH: Total Petroleum Hydrocarbons
MTBE: methyl tert butylether
MCL: Maximum Contaminant Level
NA: not analyzed

* Essel Technology Services, Inc.

APPENDIX A

**CHAIN-OF-CUSTODY DOCUMENTATION
FIELD DATA SHEETS
CERTIFIED ANALYTICAL REPORTS**



Technical Report for

Cameron-Cole

T0600118672-AC Transit, Emeryville, CA

02-10005-002036-001

Accutest Job Number: C11051

Sampling Date: 05/12/10

Report to:

Cameron-Cole
50 Hegenberger Loop
Oakland, CA 94621
dbaker@cameron-cole.com; dmetz@cameron-cole.com;
ssurani@cameron-cole.com
ATTN: Dennis Baker

Total number of pages in report: **29**



Test results contained within this data package meet the requirements of the National Environmental Laboratory Accreditation Conference and/or state specific certification programs as applicable.

Laurie Glantz-Murphy
Laboratory Director

Client Service contact: Anne Kathain 408-588-0200

Certifications: CA (08258CA) DoD/ISO/IEC 17025:2005 (L2242)

This report shall not be reproduced, except in its entirety, without the written approval of Accutest Laboratories.
Test results relate only to samples analyzed.



Table of Contents

-1-

Section 1: Sample Summary	3
Section 2: Case Narrative/Conformance Summary	4
Section 3: Sample Results	5
3.1: C11051-1: TB-01	6
3.2: C11051-2: MW-15	7
3.3: C11051-3: MW-16	9
3.4: C11051-4: MW-14	11
3.5: C11051-5: MW-11	13
3.6: C11051-6: MW-12	15
Section 4: Misc. Forms	17
4.1: Chain of Custody	18
Section 5: GC/MS Volatiles - QC Data Summaries	21
5.1: Method Blank Summary	22
5.2: Blank Spike Summary	23
5.3: Matrix Spike/Matrix Spike Duplicate Summary	25
Section 6: GC Semi-volatiles - QC Data Summaries	26
6.1: Method Blank Summary	27
6.2: Blank Spike/Blank Spike Duplicate Summary	28
6.3: Matrix Spike/Matrix Spike Duplicate Summary	29



Sample Summary

Cameron-Cole

Job No: C11051

T0600118672-AC Transit, Emeryville, CA
 Project No: 02-10005-002036-001

Sample Number	Collected		Received	Matrix		Client Sample ID
	Date	Time By		Code	Type	
C11051-1	05/12/10	10:00 DB	05/14/10	AQ	Trip Blank Water	TB-01
C11051-2	05/12/10	10:15 DB	05/14/10	AQ	Ground Water	MW-15
C11051-3	05/12/10	11:05 DB	05/14/10	AQ	Ground Water	MW-16
C11051-4	05/12/10	11:40 DB	05/14/10	AQ	Ground Water	MW-14
C11051-5	05/12/10	12:30 DB	05/14/10	AQ	Ground Water	MW-11
C11051-6	05/12/10	13:10 DB	05/14/10	AQ	Ground Water	MW-12

SAMPLE DELIVERY GROUP CASE NARRATIVE

Client: Cameron-Cole

Job No C11051

Site: T0600118672-AC Transit, Emeryville, CA

Report Date 5/27/2010 7:52:47 PM

5 Sample(s), 1 Trip Blank(s) and 0 Field Blank(s) were collected on 05/12/2010 and were received at Accutest on 05/14/2010 properly preserved, at 3.6 Deg. C and intact. These Samples received an Accutest job number of C11051. A listing of the Laboratory Sample ID, Client Sample ID and dates of collection are presented in the Results Summary Section of this report.

Except as noted below, all method specified calibrations and quality control performance criteria were met for this job. For more information, please refer to QC summary pages.

Volatiles by GCMS By Method SW846 8260B

Matrix AQ

Batch ID: VM489

- Sample(s) C11081-1MS, C11081-1MSD were used as the QC samples indicated.

Extractables by GC By Method SW846 8015B M

Matrix AQ

Batch ID: OP2143

- Sample(s) C11050-7MS, C11050-7MSD were used as the QC samples indicated.

Accutest Laboratories Northern California (ALNCA) certifies that this report meets the project requirements for analytical data produced for the samples as received at ALNCA and as stated on the COC. ALNCA certifies that the data meets the Data Quality Objectives for precision, accuracy and completeness as specified in the ALNCA Quality Manual except as noted above. This report is to be used in its entirety. ALNCA is not responsible for any assumptions of data quality if partial data packages are used



Sample Results

Report of Analysis

Report of Analysis

3.1
3

Client Sample ID: TB-01		Date Sampled: 05/12/10
Lab Sample ID: C11051-1		Date Received: 05/14/10
Matrix: AQ - Trip Blank Water		Percent Solids: n/a
Method: SW846 8260B		
Project: T0600118672-AC Transit, Emeryville, CA		

Run #	File ID	DF	Analyzed	By	Prep Date	Prep Batch	Analytical Batch
Run #1	M14990.D	1	05/22/10	XB	n/a	n/a	VM489
Run #2							

Run #	Purge Volume
Run #1	10.0 ml
Run #2	

Purgeable Aromatics, MTBE

CAS No.	Compound	Result	RL	Units	Q
71-43-2	Benzene	ND	1.0	ug/l	
108-88-3	Toluene	ND	1.0	ug/l	
100-41-4	Ethylbenzene	ND	1.0	ug/l	
1330-20-7	Xylene (total)	ND	2.0	ug/l	
1634-04-4	Methyl Tert Butyl Ether	ND	1.0	ug/l	
	TPH-GRO (C6-C10)	ND	50	ug/l	

CAS No.	Surrogate Recoveries	Run# 1	Run# 2	Limits
1868-53-7	Dibromofluoromethane	100%		60-130%
2037-26-5	Toluene-D8	103%		60-130%
460-00-4	4-Bromofluorobenzene	99%		60-130%

ND = Not detected
 RL = Reporting Limit
 E = Indicates value exceeds calibration range

J = Indicates an estimated value
 B = Indicates analyte found in associated method blank
 N = Indicates presumptive evidence of a compound

Report of Analysis

32
3

Client Sample ID: MW-15	Date Sampled: 05/12/10
Lab Sample ID: C11051-2	Date Received: 05/14/10
Matrix: AQ - Ground Water	Percent Solids: n/a
Method: SW846 8260B	
Project: T0600118672-AC Transit, Emeryville, CA	

Run #	File ID	DF	Analyzed	By	Prep Date	Prep Batch	Analytical Batch
Run #1	M14991.D	1	05/22/10	XB	n/a	n/a	VM489
Run #2							

Run #	Purge Volume
Run #1	10.0 ml
Run #2	

Purgeable Aromatics, MTBE

CAS No.	Compound	Result	RL	Units	Q
71-43-2	Benzene	ND	1.0	ug/l	
108-88-3	Toluene	ND	1.0	ug/l	
100-41-4	Ethylbenzene	ND	1.0	ug/l	
1330-20-7	Xylene (total)	ND	2.0	ug/l	
1634-04-4	Methyl Tert Butyl Ether	5.6	1.0	ug/l	
	TPH-GRO (C6-C10)	ND	50	ug/l	

CAS No.	Surrogate Recoveries	Run# 1	Run# 2	Limits
1868-53-7	Dibromofluoromethane	100%		60-130%
2037-26-5	Toluene-D8	102%		60-130%
460-00-4	4-Bromofluorobenzene	98%		60-130%

ND = Not detected
 RL = Reporting Limit
 E = Indicates value exceeds calibration range

J = Indicates an estimated value
 B = Indicates analyte found in associated method blank
 N = Indicates presumptive evidence of a compound

Report of Analysis

32
3

Client Sample ID: MW-15	Date Sampled: 05/12/10
Lab Sample ID: C11051-2	Date Received: 05/14/10
Matrix: AQ - Ground Water	Percent Solids: n/a
Method: SW846 8015B M SW846 3510C	
Project: T0600118672-AC Transit, Emeryville, CA	

Run #	File ID	DF	Analyzed	By	Prep Date	Prep Batch	Analytical Batch
Run #1	GG14198.D	1	05/18/10	MT	05/17/10	OP2143	GGG438
Run #2							

Run #	Initial Volume	Final Volume
Run #1	1030 ml	1.0 ml
Run #2		

TPH Extractable w/ Silica Gel Cleanup

CAS No.	Compound	Result	RL	Units	Q
	TPH (Diesel) ^a	ND	0.097	mg/l	
	TPH (Motor Oil)	ND	0.19	mg/l	

CAS No.	Surrogate Recoveries	Run# 1	Run# 2	Limits
630-01-3	Hexacosane	79%		45-140%

(a) Petroleum hydrocarbon pattern elutes primarily between C16 and C38. No Diesel pattern present.

ND = Not detected
 RL = Reporting Limit
 E = Indicates value exceeds calibration range

J = Indicates an estimated value
 B = Indicates analyte found in associated method blank
 N = Indicates presumptive evidence of a compound

Report of Analysis

Client Sample ID: MW-16	Date Sampled: 05/12/10
Lab Sample ID: C11051-3	Date Received: 05/14/10
Matrix: AQ - Ground Water	Percent Solids: n/a
Method: SW846 8260B	
Project: T0600118672-AC Transit, Emeryville, CA	

Run #	File ID	DF	Analyzed	By	Prep Date	Prep Batch	Analytical Batch
Run #1	M14992.D	1	05/22/10	XB	n/a	n/a	VM489
Run #2							

Run #	Purge Volume
Run #1	10.0 ml
Run #2	

Purgeable Aromatics, MTBE

CAS No.	Compound	Result	RL	Units	Q
71-43-2	Benzene	ND	1.0	ug/l	
108-88-3	Toluene	ND	1.0	ug/l	
100-41-4	Ethylbenzene	ND	1.0	ug/l	
1330-20-7	Xylene (total)	ND	2.0	ug/l	
1634-04-4	Methyl Tert Butyl Ether	3.4	1.0	ug/l	
	TPH-GRO (C6-C10)	ND	50	ug/l	

CAS No.	Surrogate Recoveries	Run# 1	Run# 2	Limits
1868-53-7	Dibromofluoromethane	98%		60-130%
2037-26-5	Toluene-D8	102%		60-130%
460-00-4	4-Bromofluorobenzene	98%		60-130%

ND = Not detected
 RL = Reporting Limit
 E = Indicates value exceeds calibration range

J = Indicates an estimated value
 B = Indicates analyte found in associated method blank
 N = Indicates presumptive evidence of a compound

Report of Analysis

Client Sample ID: MW-16		Date Sampled: 05/12/10
Lab Sample ID: C11051-3		Date Received: 05/14/10
Matrix: AQ - Ground Water		Percent Solids: n/a
Method: SW846 8015B M SW846 3510C		
Project: T0600118672-AC Transit, Emeryville, CA		

Run #	File ID	DF	Analyzed	By	Prep Date	Prep Batch	Analytical Batch
Run #1	GG14199.D	1	05/18/10	MT	05/17/10	OP2143	GGG438
Run #2							

Run #	Initial Volume	Final Volume
Run #1	1020 ml	1.0 ml
Run #2		

TPH Extractable w/ Silica Gel Cleanup

CAS No.	Compound	Result	RL	Units	Q
	TPH (Diesel) ^a	0.255	0.098	mg/l	
	TPH (Motor Oil)	ND	0.20	mg/l	

CAS No.	Surrogate Recoveries	Run# 1	Run# 2	Limits
630-01-3	Hexacosane	69%		45-140%

(a) Petroleum hydrocarbon pattern elutes primarily between C16 and C38. No Diesel pattern present.

ND = Not detected
 RL = Reporting Limit
 E = Indicates value exceeds calibration range

J = Indicates an estimated value
 B = Indicates analyte found in associated method blank
 N = Indicates presumptive evidence of a compound

Report of Analysis

34
3

Client Sample ID: MW-14	Date Sampled: 05/12/10
Lab Sample ID: C11051-4	Date Received: 05/14/10
Matrix: AQ - Ground Water	Percent Solids: n/a
Method: SW846 8260B	
Project: T0600118672-AC Transit, Emeryville, CA	

Run #	File ID	DF	Analyzed	By	Prep Date	Prep Batch	Analytical Batch
Run #1	M14993.D	1	05/22/10	XB	n/a	n/a	VM489
Run #2							

Run #	Purge Volume
Run #1	10.0 ml
Run #2	

Purgeable Aromatics, MTBE

CAS No.	Compound	Result	RL	Units	Q
71-43-2	Benzene	ND	1.0	ug/l	
108-88-3	Toluene	ND	1.0	ug/l	
100-41-4	Ethylbenzene	ND	1.0	ug/l	
1330-20-7	Xylene (total)	ND	2.0	ug/l	
1634-04-4	Methyl Tert Butyl Ether	6.3	1.0	ug/l	
	TPH-GRO (C6-C10)	ND	50	ug/l	

CAS No.	Surrogate Recoveries	Run# 1	Run# 2	Limits
1868-53-7	Dibromofluoromethane	99%		60-130%
2037-26-5	Toluene-D8	103%		60-130%
460-00-4	4-Bromofluorobenzene	98%		60-130%

ND = Not detected
 RL = Reporting Limit
 E = Indicates value exceeds calibration range

J = Indicates an estimated value
 B = Indicates analyte found in associated method blank
 N = Indicates presumptive evidence of a compound

Report of Analysis

34
3

Client Sample ID: MW-14	Date Sampled: 05/12/10
Lab Sample ID: C11051-4	Date Received: 05/14/10
Matrix: AQ - Ground Water	Percent Solids: n/a
Method: SW846 8015B M SW846 3510C	
Project: T0600118672-AC Transit, Emeryville, CA	

Run #	File ID	DF	Analyzed	By	Prep Date	Prep Batch	Analytical Batch
Run #1	GG14207.D	1	05/18/10	MT	05/17/10	OP2143	GGG438
Run #2							

Run #	Initial Volume	Final Volume
Run #1	1040 ml	1.0 ml
Run #2		

TPH Extractable w/ Silica Gel Cleanup

CAS No.	Compound	Result	RL	Units	Q
	TPH (Diesel) ^a	0.209	0.096	mg/l	
	TPH (Motor Oil)	ND	0.19	mg/l	

CAS No.	Surrogate Recoveries	Run# 1	Run# 2	Limits
630-01-3	Hexacosane	75%		45-140%

(a) Petroleum hydrocarbon pattern elutes primarily between C16 and C38. No Diesel pattern present.

ND = Not detected
 RL = Reporting Limit
 E = Indicates value exceeds calibration range

J = Indicates an estimated value
 B = Indicates analyte found in associated method blank
 N = Indicates presumptive evidence of a compound

Report of Analysis

3.5
3

Client Sample ID: MW-11	
Lab Sample ID: C11051-5	Date Sampled: 05/12/10
Matrix: AQ - Ground Water	Date Received: 05/14/10
Method: SW846 8260B	Percent Solids: n/a
Project: T0600118672-AC Transit, Emeryville, CA	

Run #	File ID	DF	Analyzed	By	Prep Date	Prep Batch	Analytical Batch
Run #1	M14994.D	1	05/22/10	XB	n/a	n/a	VM489
Run #2							

Run #	Purge Volume
Run #1	10.0 ml
Run #2	

Purgeable Aromatics, MTBE

CAS No.	Compound	Result	RL	Units	Q
71-43-2	Benzene	ND	1.0	ug/l	
108-88-3	Toluene	ND	1.0	ug/l	
100-41-4	Ethylbenzene	ND	1.0	ug/l	
1330-20-7	Xylene (total)	ND	2.0	ug/l	
1634-04-4	Methyl Tert Butyl Ether	ND	1.0	ug/l	
	TPH-GRO (C6-C10)	ND	50	ug/l	

CAS No.	Surrogate Recoveries	Run# 1	Run# 2	Limits
1868-53-7	Dibromofluoromethane	99%		60-130%
2037-26-5	Toluene-D8	103%		60-130%
460-00-4	4-Bromofluorobenzene	97%		60-130%

ND = Not detected
 RL = Reporting Limit
 E = Indicates value exceeds calibration range

J = Indicates an estimated value
 B = Indicates analyte found in associated method blank
 N = Indicates presumptive evidence of a compound

Report of Analysis

Client Sample ID: MW-11	Date Sampled: 05/12/10
Lab Sample ID: C11051-5	Date Received: 05/14/10
Matrix: AQ - Ground Water	Percent Solids: n/a
Method: SW846 8015B M SW846 3510C	
Project: T0600118672-AC Transit, Emeryville, CA	

Run #	File ID	DF	Analyzed	By	Prep Date	Prep Batch	Analytical Batch
Run #1	GG14208.D	1	05/18/10	MT	05/17/10	OP2143	GGG438
Run #2							

Run #	Initial Volume	Final Volume
Run #1	1030 ml	1.0 ml
Run #2		

TPH Extractable w/ Silica Gel Cleanup

CAS No.	Compound	Result	RL	Units	Q
	TPH (Diesel) ^a	0.184	0.097	mg/l	
	TPH (Motor Oil)	ND	0.19	mg/l	

CAS No.	Surrogate Recoveries	Run# 1	Run# 2	Limits
630-01-3	Hexacosane	74%		45-140%

(a) Petroleum hydrocarbon pattern elutes primarily between C16 and C38. No Diesel pattern present.

ND = Not detected
 RL = Reporting Limit
 E = Indicates value exceeds calibration range

J = Indicates an estimated value
 B = Indicates analyte found in associated method blank
 N = Indicates presumptive evidence of a compound

Report of Analysis

Client Sample ID: MW-12	Date Sampled: 05/12/10
Lab Sample ID: C11051-6	Date Received: 05/14/10
Matrix: AQ - Ground Water	Percent Solids: n/a
Method: SW846 8260B	
Project: T0600118672-AC Transit, Emeryville, CA	

Run #	File ID	DF	Analyzed	By	Prep Date	Prep Batch	Analytical Batch
Run #1	M14995.D	1	05/22/10	XB	n/a	n/a	VM489
Run #2							

Run #	Purge Volume
Run #1	10.0 ml
Run #2	

Purgeable Aromatics, MTBE

CAS No.	Compound	Result	RL	Units	Q
71-43-2	Benzene	ND	1.0	ug/l	
108-88-3	Toluene	ND	1.0	ug/l	
100-41-4	Ethylbenzene	ND	1.0	ug/l	
1330-20-7	Xylene (total)	ND	2.0	ug/l	
1634-04-4	Methyl Tert Butyl Ether	2.9	1.0	ug/l	
	TPH-GRO (C6-C10)	71.4	50	ug/l	

CAS No.	Surrogate Recoveries	Run# 1	Run# 2	Limits
1868-53-7	Dibromofluoromethane	99%		60-130%
2037-26-5	Toluene-D8	103%		60-130%
460-00-4	4-Bromofluorobenzene	102%		60-130%

ND = Not detected
 RL = Reporting Limit
 E = Indicates value exceeds calibration range

J = Indicates an estimated value
 B = Indicates analyte found in associated method blank
 N = Indicates presumptive evidence of a compound

Report of Analysis

Client Sample ID: MW-12	Date Sampled: 05/12/10
Lab Sample ID: C11051-6	Date Received: 05/14/10
Matrix: AQ - Ground Water	Percent Solids: n/a
Method: SW846 8015B M SW846 3510C	
Project: T0600118672-AC Transit, Emeryville, CA	

Run #	File ID	DF	Analyzed	By	Prep Date	Prep Batch	Analytical Batch
Run #1	GG14209.D	1	05/18/10	MT	05/17/10	OP2143	GGG438
Run #2							

Run #	Initial Volume	Final Volume
Run #1	1040 ml	1.0 ml
Run #2		

TPH Extractable w/ Silica Gel Cleanup

CAS No.	Compound	Result	RL	Units	Q
	TPH (Diesel) ^a	ND	0.096	mg/l	
	TPH (Motor Oil)	ND	0.19	mg/l	

CAS No.	Surrogate Recoveries	Run# 1	Run# 2	Limits
630-01-3	Hexacosane	75%		45-140%

(a) Petroleum hydrocarbon pattern elutes primarily between C16 and C38. No Diesel pattern present.

ND = Not detected
 RL = Reporting Limit
 E = Indicates value exceeds calibration range

J = Indicates an estimated value
 B = Indicates analyte found in associated method blank
 N = Indicates presumptive evidence of a compound



Misc. Forms

Custody Documents and Other Forms

Includes the following where applicable:

- Chain of Custody



Northern California

CHAIN OF CUSTODY

3334 Victor Court, Santa Clara, CA 95054
 (408) 588-0200 FAX: (408) 588-0201

Fed-Ex Tracking #	Bottle Order Control #
Account Quote #	Account NC Job #: C11051

CCCAA1635

Client/Reporting Information				Project Information				Requested Analysis												Matrix Codes
Company Name CAMERON-COLE, LLC				Project Name ACT-EMERYVILLE 2Q2010				<p>0 TEX, MTBE, TPH-g by 52608 TPH-diesel/motor oil by BSM with Silica Gel Cleanup</p>												WW-WWef GW- Ground Water SW- Surface Water SO- Soil OJ- Oil VPA-Wipe LIQ- Non-aqueous Liquid AIR DW- Drinking Water (Petroleum Only)
Address 50 HEGENBERGER LOOP				Street 45TH ST.																
City OAKLAND, CA 94621				City EMERYVILLE, CA																
Project Contact DENNIS BAKER				Project # 02-10005-002036-001																
Phone # 510-777-1872				EMAIL DBAKER@CAMERON-COLE.COM																
Sampler's Name				Client Purchase Order #																
Sample #	Field ID/Point of Collection	Date	Time	Sampled by	Matrix	# of bottles	Number of preserved Bottles												LAB USE ONLY	
							ED	SO	AP	BA	MS	MT	ME	MT	MT	MT	MT	MT		MT
-1	TB-01	5/19/10	1000	DB	GW	3	X										X			
-2	MW-15		1015			3	X										X			
			↓			2							X				X			
-3	MW-16		1105			3	X										X			
			↓			2							X				X			
-4	MW-14		1140			3	X										X			
			↓			2							X				X			
-5	MW-11		1230			3	X										X			
			↓			2							X				X			
-6	MW-12		1310			3	X										X			
Turnaround Time (Business days)				Data Deliverable Information				Comments/Remarks												
<input type="checkbox"/> Std. 15 Business Days <input checked="" type="checkbox"/> 10-Day (Workload dependent) <i>Standard</i> <input type="checkbox"/> 5 Day (Workload dependent) <input type="checkbox"/> 3 Day (125% markup) <input type="checkbox"/> 2 Day (150% markup) <input type="checkbox"/> 1 Day (200% markup) <input type="checkbox"/> Same Day (300% markup)				Approved By: <i>DB</i> <input type="checkbox"/> Commercial "A" <input checked="" type="checkbox"/> Commercial "B" N <input type="checkbox"/> EDF for Geotracker <input type="checkbox"/> EDD Format Provide EDF Global ID: <u>10600118672</u> Provide EDF Logcode:				3ials (0) HCL (X6) each 2x 1 Lit Ambers (X5) NLP												
Emergency T/A data available via LabLink																				
* Sample Custody must be documented below each time samples change possession, including courier delivery.																				
Relinquished By: <i>Dennis C. Baker</i>	Date/Time: <i>5/19/10 4:25</i>	Received By: <i>[Signature]</i>	Date/Time: <i>15:16</i>	Relinquished By: <i>[Signature]</i>	Date/Time: <i>05/19/10</i>	Received By: <i>[Signature]</i>										Colony Temp: <i>38-0.2=3.6</i> °C				
Relinquished By:	Date/Time:	Received By:	Date/Time:	Relinquished By:	Date/Time:	Received By:										Colony Temp:				
Relinquished By:	Date/Time:	Received By:	Date/Time:	Relinquished By:	Date/Time:	Received By:										Colony Temp:				

4.1
4

Page 1 of 2

C11051: Chain of Custody
 Page 1 of 3

CHAIN OF CUSTODY

3334 Victor Court, Santa Clara, CA 95054
(408) 588-0200 FAX: (408) 588-0201

FED-EX Tracking #
Accutest Quote #
Bottle Order Control # C11051
Accutest NC Job # C

Client/Reporting Information				Project Information		Requested Analysis		Matrix Codes	
Company Name CAMERON-COLE, LLC				Project Name# ACT-EMERYVILLE 202610				<input type="checkbox"/> WW-Water <input type="checkbox"/> GW- Ground Water <input type="checkbox"/> SW- Surface Water <input type="checkbox"/> SO- Soil <input type="checkbox"/> CEGL <input type="checkbox"/> WP-Wipe <input type="checkbox"/> LIQ- Non-aqueous Liquid <input type="checkbox"/> AIR <input type="checkbox"/> DW- Drinking Water <input type="checkbox"/> (Perchlorate Cnly)	
Address 50 HEGENBERGER LOOP				Street 45th ST.					
City, State, Zip OAKLAND, CA 94621				City, State EMERYVILLE, CA					
Project Contact DENNIS BAKER				Project # 02-16005-002036-001					
Phone # 510-777-1872				EMAIL DBAKER@CAMERON-COLE.COM					
Sampler's Name				Client Purchase Order #					

Sample #	Field ID / Point of Collection	Collection		Number of preserved Bottles																
		Date	Time	Sampled by	Matrix	# of bottles	41	42	43	44	45	46	47	48	49	50				
-6	mw-12	5/12/10	1310	DB	GW	2														

Turnaround Time (Business days)	Approved By / Date	Data Deliverable Information	Comments / Remarks
<input type="checkbox"/> Std. 15 Business Days <input checked="" type="checkbox"/> 10 Day (Workload dependent) <input type="checkbox"/> 5 Day (Workload dependent) <input type="checkbox"/> 3 Day (125% markup) <input type="checkbox"/> 2 Day (160% markup) <input type="checkbox"/> 1 Day (200% markup) <input type="checkbox"/> Same Day (300% markup)	<i>S. Baker</i> _____	<input type="checkbox"/> Commercial "A" <input checked="" type="checkbox"/> Commercial "B" <input type="checkbox"/> EDF for Geotracker <input type="checkbox"/> EDD Format Provide EDF Global ID: <u>7068018673</u> Provide EDF Logcode: _____	

Emergency T/A data available VIA LabLink

* **Sample Custody must be documented below each time sample change possession, including courier delivery.**

Relinquished by:	Date/Time:	Received By:	Relinquished by:	Date/Time:	Received By:
<i>S. Baker</i>	<i>5/14/10 6:38</i>	<i>[Signature]</i>			
			<i>[Signature]</i>	<i>15:16</i>	<i>[Signature]</i>
			<i>[Signature]</i>	<i>5/14/10</i>	<i>[Signature]</i>

4.1
4

page 2 of 2

Accutest Laboratories Northern California
Sample Receiving Check List

Job# : C11051
Sample Control Rep. Initial: EK JM
C11051

Review Chain of Custody Chain of Custody is to be complete and legible.

- Are these regulatory (NPDES) samples? GWA Yes / No
- Is pH requested? Yes / No
- Was Client informed that hold time is 15 min? **Yes / No** Continue Yes / No
- Was ortho-Phosphate filtered with in 15 min? **Yes / No** Continue Yes / No
- Are sample within hold time? Yes / No
Are sample in danger of exceeding hold-time Yes / No
- Existing Client? **Yes / No** Existing Project? Yes / No
If No: Is Report to info complete and legible, including;
 deliverable Name Address phone e-mail
Is Bill to info complete and legible, including;
 PO# Credit card Contact address phone e-mail
Is Contact and/or Project Manager identified, including;
 phone e-mail
- Project name / number Special requirements? Yes / No
- Sample IDs / date & time of collection provided? Yes / No
- Is Matrix listed and correct? Yes / No
- Analyses listed we do or client has authorized a subcontract? Yes / No
- Chain is signed and dated by both client and sample custodian? Yes / No
- TAT requested available? **Yes / No** Approved by JM

Review Coolers:

- Were Coolers temperatures measured at ≤6°C? Cooler # 1 Temp 3.6 °C
• If cooler is outside the ≤6°C; note down below the affected bottles in that cooler
• Note that ANC does NOT accept evidentiary samples. (We do not lock refrigerators)
- Shipment Received Method AL
- Custody Seals: Present: **Yes / No** If Yes; Unbroken: **Yes / No**

Review of Sample Bottles: If you answer no, explain to the side

- Chain matches bottle labels? **Yes / No** Sample bottle intact? **Yes / No**
- Is there enough sample volume in proper bottle for requested analyses? **Yes / No**
- Proper Preservatives? **Yes / No** Check pH on preserved samples except 1664, 625, 8270 and VOAs .
- Headspace-VOAs? **Greater than 6mm in diameter** **Yes / No**
List sample ID and affected container

Client Sample ID	pH Check	Other Comments/Issues

4.1
4

Non-Compliance issues and discrepancies on the COC are forwarded to Project Management
\\anc-srv-file1\d\$\Entech-Data\Laboratory\SOPs\SOP_CompleteListing\SC001F1_1_Form1_SampleControl_SampleReceivingChecklist_2010-02-15.doc



GC/MS Volatiles

5

QC Data Summaries

Includes the following where applicable:

- Method Blank Summaries
- Blank Spike Summaries
- Matrix Spike and Duplicate Summaries

Method Blank Summary

Job Number: C11051
Account: CCCAA Cameron-Cole
Project: T0600118672-AC Transit, Emeryville, CA

Sample	File ID	DF	Analyzed	By	Prep Date	Prep Batch	Analytical Batch
VM489-MB	M14989.D	1	05/22/10	XB	n/a	n/a	VM489

The QC reported here applies to the following samples:

Method: SW846 8260B

C11051-1, C11051-2, C11051-3, C11051-4, C11051-5, C11051-6

CAS No.	Compound	Result	RL	Units	Q
71-43-2	Benzene	ND	1.0	ug/l	
100-41-4	Ethylbenzene	ND	1.0	ug/l	
1634-04-4	Methyl Tert Butyl Ether	ND	1.0	ug/l	
108-88-3	Toluene	ND	1.0	ug/l	
1330-20-7	Xylene (total)	ND	2.0	ug/l	
	TPH-GRO (C6-C10)	ND	50	ug/l	

CAS No.	Surrogate Recoveries	Limits
1868-53-7	Dibromofluoromethane	99% 60-130%
2037-26-5	Toluene-D8	103% 60-130%
460-00-4	4-Bromofluorobenzene	99% 60-130%

Blank Spike Summary

Job Number: C11051
Account: CCCAA Cameron-Cole
Project: T0600118672-AC Transit, Emeryville, CA

Sample	File ID	DF	Analyzed	By	Prep Date	Prep Batch	Analytical Batch
VM489-BS	M14987.D	1	05/22/10	XB	n/a	n/a	VM489

The QC reported here applies to the following samples:

Method: SW846 8260B

C11051-1, C11051-2, C11051-3, C11051-4, C11051-5, C11051-6

CAS No.	Compound	Spike ug/l	BSP ug/l	BSP %	Limits
71-43-2	Benzene	20	17.8	89	60-130
100-41-4	Ethylbenzene	20	19.0	95	60-130
1634-04-4	Methyl Tert Butyl Ether	20	18.5	93	60-130
108-88-3	Toluene	20	18.6	93	60-130
1330-20-7	Xylene (total)	60	56.5	94	60-130

CAS No.	Surrogate Recoveries	BSP	Limits
1868-53-7	Dibromofluoromethane	103%	60-130%
2037-26-5	Toluene-D8	101%	60-130%
460-00-4	4-Bromofluorobenzene	102%	60-130%

Blank Spike Summary

Job Number: C11051
Account: CCCAA Cameron-Cole
Project: T0600118672-AC Transit, Emeryville, CA

Sample	File ID	DF	Analyzed	By	Prep Date	Prep Batch	Analytical Batch
VM489-BS	M14988.D	1	05/22/10	XB	n/a	n/a	VM489

The QC reported here applies to the following samples:

Method: SW846 8260B

C11051-1, C11051-2, C11051-3, C11051-4, C11051-5, C11051-6

CAS No.	Compound	Spike ug/l	BSP ug/l	BSP %	Limits
	TPH-GRO (C6-C10)	125	132	106	60-130

CAS No.	Surrogate Recoveries	BSP	Limits
1868-53-7	Dibromofluoromethane	99%	60-130%
2037-26-5	Toluene-D8	102%	60-130%
460-00-4	4-Bromofluorobenzene	100%	60-130%

Matrix Spike/Matrix Spike Duplicate Summary

Job Number: C11051
Account: CCCAA Cameron-Cole
Project: T0600118672-AC Transit, Emeryville, CA

Sample	File ID	DF	Analyzed	By	Prep Date	Prep Batch	Analytical Batch
C11081-1MS	M15007.D	1	05/22/10	XB	n/a	n/a	VM489
C11081-1MSD	M15008.D	1	05/22/10	XB	n/a	n/a	VM489
C11081-1	M15004.D	1	05/22/10	XB	n/a	n/a	VM489

The QC reported here applies to the following samples:

Method: SW846 8260B

C11051-1, C11051-2, C11051-3, C11051-4, C11051-5, C11051-6

CAS No.	Compound	C11081-1 ug/l	Spike Q ug/l	MS ug/l	MS %	MSD ug/l	MSD %	RPD	Limits Rec/RPD
71-43-2	Benzene	ND	20	19.5	98	19.5	98	0	60-130/25
100-41-4	Ethylbenzene	ND	20	20.2	101	20.6	103	2	60-130/25
1634-04-4	Methyl Tert Butyl Ether	ND	20	19.0	95	19.1	96	1	60-130/25
108-88-3	Toluene	ND	20	19.9	100	20.1	101	1	60-130/25
1330-20-7	Xylene (total)	ND	60	60.2	100	60.4	101	0	60-130/25

CAS No.	Surrogate Recoveries	MS	MSD	C11081-1	Limits
1868-53-7	Dibromofluoromethane	102%	102%	103%	60-130%
2037-26-5	Toluene-D8	100%	101%	101%	60-130%
460-00-4	4-Bromofluorobenzene	101%	101%	99%	60-130%

5.3.1
5



GC Semi-volatiles

QC Data Summaries

Includes the following where applicable:

- Method Blank Summaries
- Blank Spike Summaries
- Matrix Spike and Duplicate Summaries

Method Blank Summary

Job Number: C11051
Account: CCCAA Cameron-Cole
Project: T0600118672-AC Transit, Emeryville, CA

Sample	File ID	DF	Analyzed	By	Prep Date	Prep Batch	Analytical Batch
OP2143-MB	GG14189.D	1	05/18/10	MT	05/17/10	OP2143	GGG438

The QC reported here applies to the following samples:

Method: SW846 8015B M

C11051-2, C11051-3, C11051-4, C11051-5, C11051-6

CAS No.	Compound	Result	RL	Units	Q
	TPH (Diesel)	ND	0.10	mg/l	
	TPH (Motor Oil)	ND	0.20	mg/l	

CAS No.	Surrogate Recoveries	Limits
630-01-3	Hexacosane	74% 45-140%

6.1.1
6

Blank Spike/Blank Spike Duplicate Summary

Job Number: C11051
Account: CCCAA Cameron-Cole
Project: T0600118672-AC Transit, Emeryville, CA

Sample	File ID	DF	Analyzed	By	Prep Date	Prep Batch	Analytical Batch
OP2143-BS	GG14190.D	1	05/18/10	MT	05/17/10	OP2143	GGG438
OP2143-BSD	GG14191.D	1	05/18/10	MT	05/17/10	OP2143	GGG438

The QC reported here applies to the following samples:

Method: SW846 8015B M

C11051-2, C11051-3, C11051-4, C11051-5, C11051-6

CAS No.	Compound	Spike mg/l	BSP mg/l	BSP %	BSD mg/l	BSD %	RPD	Limits Rec/RPD
	TPH (Diesel)	1	0.821	82	0.805	81	2	45-140/30
	TPH (Motor Oil)	1	0.685	69	0.716	72	4	45-140/30

CAS No.	Surrogate Recoveries	BSP	BSD	Limits
630-01-3	Hexacosane	71%	76%	45-140%

6.2.1
6

Matrix Spike/Matrix Spike Duplicate Summary

Job Number: C11051
Account: CCCAA Cameron-Cole
Project: T0600118672-AC Transit, Emeryville, CA

Sample	File ID	DF	Analyzed	By	Prep Date	Prep Batch	Analytical Batch
OP2143-MS	GG14252.D	1	05/19/10	MT	05/18/10	OP2143	GGG439
OP2143-MSD	GG14253.D	1	05/19/10	MT	05/18/10	OP2143	GGG439
C11050-7	GG14251.D	1	05/19/10	MT	05/18/10	OP2143	GGG439

The QC reported here applies to the following samples:

Method: SW846 8015B M

C11051-2, C11051-3, C11051-4, C11051-5, C11051-6

CAS No.	Compound	C11050-7 mg/l	Spike Q mg/l	MS mg/l	MS %	MSD mg/l	MSD %	RPD	Limits Rec/RPD
	TPH (Diesel)	ND	2	1.67	84	1.54	77	8	45-140/25
	TPH (Motor Oil)	ND	2	1.37	69	1.33	67	3	45-140/25

CAS No.	Surrogate Recoveries	MS	MSD	C11050-7	Limits
630-01-3	Hexacosane	75%	71%	77%	45-140%

HYDRODATA

PROJECT: AC Transit - Emeryville

EVENT: 2Q2010

SAMPLER: Dennis Baker

NO.	WELL OR LOCATION	DATE	TIME	MEASUREMENT	CODE	COMMENTS
1	MW-1	5/12/2010	0831	4.00	SWL	
2	MW-2	5/12/2010	0837	3.53	SWL	
3	MW-3	5/12/2010	0824	4.92	SWL	
4	MW-4	5/12/2010	0827	5.16	SWL	
5	MW-5	5/12/2010	0834	3.41	SWL	
6	MW-6	5/12/2010	0853	2.93	SWL	
7	MW-7	5/12/2010	0904	4.90	SWL	
8	MW-8	5/12/2010	0909	4.52	SWL	
9	MW-9	5/12/2010	0915	2.93	SWL	
10	MW-10	5/12/2010	0923	9.65	SWL	
11	MW-11	5/12/2010	0900	2.48	SWL	
12	MW-12	5/12/2010	0929	10.48	SWL	
13	MW-13	5/12/2010	0943	9.20	OIL	
14	MW-13	5/12/2010	0943	8.86	SWL	
15	MW-14	5/12/2010	0935	9.29	SWL	
16	MW-15	5/12/2010	0948	8.45	SWL	
17	MW-16	5/12/2010	0939	7.56	SWL	
18	W-1	5/12/2010	0817	4.99	SWL	
19	W-3	5/12/2010	0811	6.14	SWL	
20	W-4	5/12/2010	0848	3.56	SWL	

CODES:

SWL - Static Water Level

OIL - Oil Level

OWI - Oil/Water Interface

MTD - Measured Total Depth

CAMERON-COLE
SAMPLING EVENT DATA SHEET

WELL OR LOCATION MW-12

PROJECT AC Transit - Emeryville EVENT 2Q2010 SAMPLER Dennis Baker DATE 5/12/2010

	ACTION	TIME	PUMP RATE (gpm)	DTW
	Well type <u>MW</u> (MW, EW, PZ, etc.)	Start Pump / Begin	<u>12:58</u>	<u>1.0</u>
Diameter <u>2"</u>				
<u>0.165</u> gal/ft. casing				
Intake depth <u>25'</u>				
SWL <u>10.48</u> (if above screen)				
SWL _____ (if in screen)				
Measured TD _____				
TD (as built) _____				
	Stop	<u>13:08</u>		<u>15.02</u>
	Sampled	<u>13:10</u>		
	Final IWL			
PURGE CALCULATION				
$0.165 \text{ gal/ft.} \times \frac{19.52 \text{ ft.}}{\text{SWL to TD}} = \frac{3.22 \text{ gals.}}{\text{one volume}} \times 3 = \frac{9.66 \text{ gals.}}{\text{purge volume - 3 casings}}$				
2" = 0.165 gal/ft. 4" = 0.65 gal/ft. 6" = 1.47 gal/ft.				

Equipment Used / Sampling Method / Description of Event:

Centrifugal pump used to purge;
disposable bailer used to sample.

Actual gallons purged	<u>10</u>
Actual volumes purged	<u>3.11</u>
Well Yield ⊕	<u>MY</u>
COC # _____	

Additional Comments:

Sample I.D.	Analysis	Lab
<u>MW-12</u>	BTEX, MTBE, TPH-g by 8260B	Accutest
↓	TPH-d/mo by 8015 M with Silica Gel Cleanup	↓

Gallons Purged *	Temp °C	EC (us / cm)	pH	Turbidity (NTU)	Other
3	21.8	586	6.68	7.86	
6	20.5	588	6.66	9.10	
9	20.5	592	6.63	10.84	

*Take measurement at approximately each casing volume purged. ⊕
 HY-Minimal W.L. drop MY - WL drop - able to purge 3 volumes during one sitting by reducing pump rate or cycling pump LY - Able to purge 3 volumes by returing later or next day. VLY - Minimal recharge - unable to purge 3 volumes.

CAMERON-COLE
SAMPLING EVENT DATA SHEET

WELL OR LOCATION MW-14

PROJECT AC Transit - Emeryville EVENT 2Q2010 SAMPLER Dennis Baker DATE 5/12/2010

	Well type <u>MW</u> (MW, EW, PZ, etc.)	ACTION	TIME	PUMP RATE (gpm)	DTW
	Diameter <u>2"</u>	Start Pump / Begin	<u>11:32</u>	<u>1.0</u>	<u>8.93</u>
	<u>0.165</u> gal/ft. casing				
	<u>13</u> =TOP	Stop	<u>11:39</u>		
	<u>23</u> =BOP	Sampled	<u>11:40</u>		
	<u>23</u> =TD (as built)	Final IWL			<u>10.92</u>

PURGE CALCULATION

0.165 gal/ft. * 14.07 ft. = 2.32 gals. X 3 = 6.96 gals.

SWL to TD one volume purge volume - 3 casings

2" = 0.165 gal/ft. 4" = 0.65 gal/ft. 6" = 1.47 gal/ft.

<p>Equipment Used / Sampling Method / Description of Event:</p> <p>Centrifugal pump used to purge; disposable bailer used to sample.</p>	<p>Actual gallons purged <u>7</u></p> <p>Actual volumes purged <u>3.02</u></p> <p>Well Yield ⊕ <u>MY</u></p> <p>COC # _____</p>
--	---

Additional Comments:	Sample I.D.	Analysis	Lab
	<u>MW-14</u>	BTEX, MTBE, TPH-g by 8260B	Accutest
	↓	TPH-d/mo by 8015 M with Silica Gel Cleanup	↓

Gallons Purged *	Temp °C	EC (us / cm)	pH	Turbidity (NTU)	Other
<u>2</u>	<u>20.8</u>	<u>815</u>	<u>6.63</u>	<u>5.44</u>	
<u>4</u>	<u>20.7</u>	<u>756</u>	<u>6.59</u>	<u>4.49</u>	
<u>6.5</u>	<u>20.8</u>	<u>758</u>	<u>6.55</u>	<u>3.73</u>	
4.					
5.					

*Take measurement at approximately each casing volume purged. ⊕ HY-Minimal W.L. drop MY - WL drop - able to purge 3 volumes during one sitting by reducing pump rate or cycling pump LY - Able to purge 3 volumes by returning later or next day. VLY - Minimal recharge - unable to purge 3 volumes.

**CAMERON-COLE
SAMPLING EVENT DATA SHEET**

WELL OR LOCATION mw-15

PROJECT AC Transit - Emeryville EVENT 2Q2010 SAMPLER Dennis Baker DATE 5/12/2010

<p>Intake depth <u>20'</u></p> <p>SWL <u>8.45</u> (if above screen)</p> <p>SWL _____ (if in screen)</p> <p>Measured TD _____ TD (as built)</p> <p style="margin-left: 100px;">→ d ←</p> <p style="margin-left: 100px;"><u>20</u> = TOP</p> <p style="margin-left: 100px;"><u>25</u> = BOP</p> <p style="margin-left: 100px;"><u>25</u> = TD</p>	Well type <u>MW</u> (MW, EW, PZ, etc.)	ACTION	TIME	PUMP RATE (gpm)	DTW
	Diameter <u>2"</u>	Start Pump / Begin	<u>1006</u>	<u>1.3</u>	<u>8.45</u>
	<u>0.165</u> gal/ft. casing				
		Stop	<u>1013</u>		
		Sampled	<u>1015</u>		
		Final IWL			<u>10.15</u>
PURGE CALCULATION					
$0.165 \text{ gal/ft.} * \frac{16.55 \text{ ft.}}{\text{SWL to TD}} = \frac{2.73 \text{ gals.}}{\text{one volume}} * 3 = \frac{8.19 \text{ gals.}}{\text{purge volume - 3 casings}}$					
<p>2" = 0.165 gal/ft. 4" = 0.65 gal/ft. 6" = 1.47 gal/ft.</p>					

Equipment Used / Sampling Method / Description of Event:
 Centrifugal pump used to purge;
 disposable bailer used to sample.

Actual gallons purged	<u>9</u>
Actual volumes purged	<u>3.30</u>
Well Yield ⊕	<u>HY</u>
COC # _____	

Additional Comments:
Trip Blank TB-01 collected @ 10:00

Sample I.D.	Analysis	Lab
<u>MW-15</u>	BTEX, MTBE, TPH-g by 8260B	Accutest
↓	TPH-d/mo by 8015 M with Silica Gel Cleanup	↓
<u>TB-01</u>	BTEX, MTBE, TPH-g by 8260B	↓

Gallons Purged *	Temp °C	EC (us / cm)	pH	Turbidity (NTU)	Other
<u>2.5</u>	<u>20.7</u>	<u>1005</u>	<u>6.32</u>	<u>19.46</u>	
<u>5</u>	<u>20.5</u>	<u>948</u>	<u>6.36</u>	<u>11.27</u>	
<u>8</u>	<u>20.5</u>	<u>961</u>	<u>6.37</u>	<u>9.13</u>	
4.					
5.					

*Take measurement at approximately each casing volume purged. ⊕ HY-Minimal W.L. drop MY - WL drop - able to purge 3 volumes during one sitting by reducing pump rate or cycling pump LY - Able to purge 3 volumes by returning later or next day. VLY - Minimal recharge - unable to purge 3 volumes.

CAMERON-COLE
SAMPLING EVENT DATA SHEET

WELL OR LOCATION MW-16

PROJECT <u>AC Transit - Emeryville</u>		EVENT <u>2Q2010</u>	SAMPLER <u>Dennis Baker</u>	DATE <u>5/12/2010</u>
--	--	---------------------	-----------------------------	-----------------------

	Well type <u>MW</u> (MW, EW, PZ, etc.)	ACTION	TIME	PUMP RATE (gpm)	DTW
	Diameter <u>2"</u>	Start Pump / Begin	<u>10:55</u>	<u>1.3</u>	<u>7.20</u>
	<u>0.165</u> gal/ft. casing				
	<u>19</u> =TOP	Stop	<u>11:02</u>		
	<u>24</u> =BOP	Sampled	<u>11:05</u>		
	<u>24</u> =TD (as built)	Final IWL			<u>11.39</u>

PURGE CALCULATION			
0.165 gal/ft. *	<u>16.8</u> ft. =	<u>2.77</u> gals. X 3	<u>= 8.32</u> gals.
	SWL to TD	one volume	purge volume - 3 casings
2" = 0.165 gal/ft.	4" = 0.65 gal/ft.	6" = 1.47 gal/ft.	

Equipment Used / Sampling Method / Description of Event: Centrifugal pump used to purge; disposable bailer used to sample.	Actual gallons purged <u>9</u> Actual volumes purged <u>3.25</u> Well Yield ⊕ <u>MY</u> COC # _____
--	--

Additional Comments:	<table border="1" style="width:100%; border-collapse: collapse;"> <tr> <th style="width:30%;">Sample I.D.</th> <th style="width:30%;">Analysis</th> <th style="width:40%;">Lab</th> </tr> <tr> <td><u>MW-16</u></td> <td>BTEX, MTBE, TPH-g by 8260B</td> <td>Accutest</td> </tr> <tr> <td align="center">↓</td> <td>TPH-d/mo by 8015 M with Silica Gel Cleanup</td> <td align="center">↓</td> </tr> <tr><td> </td><td> </td><td> </td></tr> <tr><td> </td><td> </td><td> </td></tr> <tr><td> </td><td> </td><td> </td></tr> </table>	Sample I.D.	Analysis	Lab	<u>MW-16</u>	BTEX, MTBE, TPH-g by 8260B	Accutest	↓	TPH-d/mo by 8015 M with Silica Gel Cleanup	↓									
Sample I.D.	Analysis	Lab																	
<u>MW-16</u>	BTEX, MTBE, TPH-g by 8260B	Accutest																	
↓	TPH-d/mo by 8015 M with Silica Gel Cleanup	↓																	

Gallons Purged *	Temp °C	EC (us / cm)	pH	Turbidity (NTU)	Other
<u>1. 2.5</u>	<u>21.7</u>	<u>871</u>	<u>6.76</u>	<u>16.61</u>	
<u>2. 5</u>	<u>20.3</u>	<u>855</u>	<u>6.79</u>	<u>10.12</u>	
<u>3. 8</u>	<u>20.6</u>	<u>847</u>	<u>6.83</u>	<u>6.41</u>	
<u>4.</u>					
<u>5.</u>					

*Take measurement at approximately each casing volume purged. ⊕

HY-Minimal W.L. drop MY - WL drop - able to purge 3 volumes during one sitting by reducing pump rate or cycling pump LY - Able to purge 3 volumes by returning later or next day. VLY - Minimal recharge - unable to purge 3 volumes.