



May 7, 2008

Ms. Donna Drogos  
Supv. Hazardous Materials Specialist  
Alameda County HCSA-Environmental Health  
1131 Harbor Bay Parkway, Alameda, CA

Dear Donna,

RE: AlcoPark Garage, 165-13<sup>th</sup> Ave., Oakland, California

On September 28, 2005, I sent a letter to your department formally requesting that the AlcoPark groundwater contamination case be considered for closure. In light of the State Water Resources Control Board's interest in closing some of these older cases, and in accordance with the ongoing recommendation of PSI, GSA's consultant for this site, I again request that this case be considered for closure.

The last monitoring event for the AlcoPark site was in February of this year. On March 21, 2008, the monitoring report was submitted electronically in accordance with the Alameda County Environmental Cleanup Oversight Programs' requirements. The report documents the most recent monitoring results, as well as results from other monitoring events conducted since 1989. These results are presented in the attached drawing, table and charts.

Groundwater monitoring at the site was initiated in response to a piping leak that was repaired in 1989. Since that time, GSA has installed a total of seven wells to assess and document the stability of the plume. GSA also had PSI prepare a Site Conceptual Model in 2000 and conduct supplemental fate and transport studies in 2001 to document the lack of sensitive receptors. Those documents are on file with your department.

We appreciate your attention to this closure request. Please contact me at (510) 208-9522 if you have questions or require additional information.

Sincerely,

Rod Freitag, P.E.  
Environmental Program Manager

RDF:rdi:\e&em\prj\env\7001\April 2008 closure request.doc

**Attachments**

- cc: George Lockwood, UST Program, State Water Resources Control Board
- Ariu Levi, Division Chief, HCSA-Environmental Health
- Frank Poss, Dept. Manager, Professional Services, Inc.
- Jim Kachik, Deputy Director, GSA-TSD

JACKSON STREET

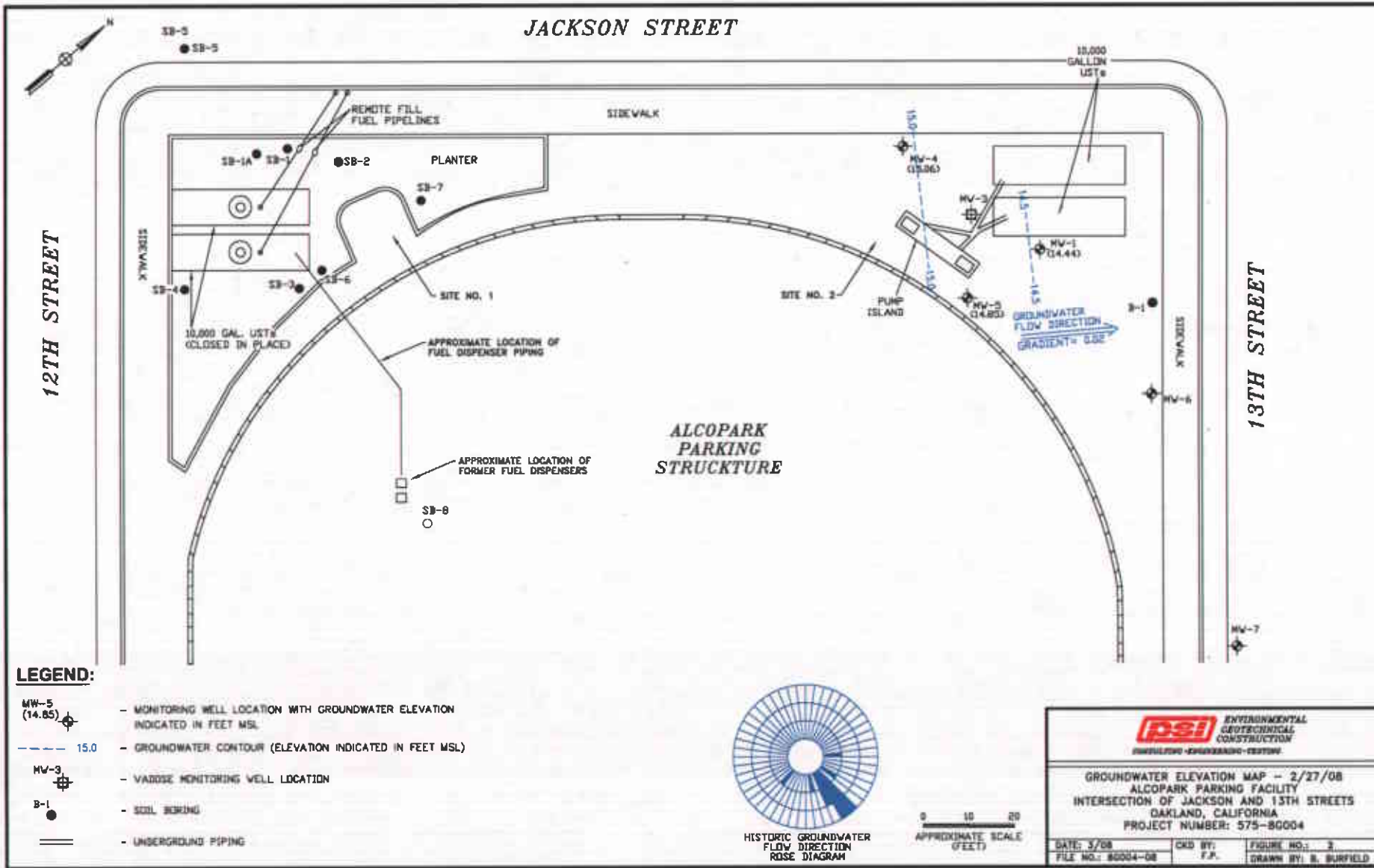

**LEGEND:**

- MW-5 (14.85) - MONITORING WELL LOCATION WITH GROUNDWATER ELEVATION INDICATED IN FEET MSL
- 15.0 - GROUNDWATER CONTOUR (ELEVATION INDICATED IN FEET MSL)
- MW-3 - VADOSE MONITORING WELL LOCATION
- SB-1 - SOIL BORING
- UNDERGROUND PIPING

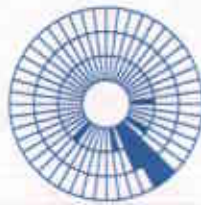

ENVIRONMENTAL GEOTECHNICAL CONSTRUCTION CONSULTING - ENGINEERING - TESTING		
GROUNDWATER ELEVATION MAP - 2/27/08 ALCOPARK PARKING FACILITY INTERSECTION OF JACKSON AND 13TH STREETS OAKLAND, CALIFORNIA PROJECT NUMBER: 575-80004		
DATE: 3/08	CKD BY: F.P.	FIGURE NO.: 3
FILE NO.: 80004-08		DRAWN BY: B. BURFIELD

**TABLE 1**  
**GROUNDWATER ELEVATION AND ANALYTICAL DATA SUMMARY**  
**ALCOPARK FUELING FACILITY SITE NO. 2**  
**OAKLAND, CALIFORNIA**

<i>All concentrations in ug/l (PPB).</i>									
<b>Well</b>	<b>Date</b>	<b>Groundwater Elevation</b>	<b>TPH-G</b>	<b>MTBE</b>	<b>Benzene</b>	<b>Toluene</b>	<b>Ethylbenzene</b>	<b>Xylenes</b>	
MW-1	3/21/1989	12.2	ND	NA	21	3.9	0.4	4.5	
	7/26/1990	12.3	1,400	NA	200	45	ND	53	
	10/25/1990	12.1	1,200	NA	ND	7.3	2.2	46	
	1/25/1991	11.9	270	NA	23	1.5	ND	3.1	
	4/25/1991	11.8	230	NA	ND	ND	ND	ND	
	8/27/1991	11.8	8,300	NA	370	64	ND	120	
	11/25/1991	11.7	810	NA	9.3	ND	7.8	32	
	6/11/1992	12.85	2,600	NA	810	16	21	42	
	7/16/1997	14.36	19,000	ND (150)	1,400	2,800	500	2,600	
	10/21/1997	13.92	14,000	29	1,200	1,000	590	2,800	
	3/11/1998	17.14	NS	NS	NS	NS	NS	NS	
	4/1/1998	17.14	ND (50)	6.3	5.4	ND (0.5)	ND (0.5)	0.82	
	7/15/1998	16.41	71	57	31	ND (0.5)	ND (0.5)	3.1	
	10/22/1998	15.62	5,100	360	520	140	250	950	
	9/9/1999	15.42	2,400	400	680	140	130	370	
	1/18/2000	14.49	4,100	180	420	11	210	350	
	5/4/2000	16.19	NS	NS	NS	NS	NS	NS	
	8/22/2000	15.34	9,400	410	1,200	130	410	920	
	2/8/2001	14.53	NS	NS	NS	NS	NS	NS	
	7/20/2001	14.60	9,600	ND (50)	1,000	300	350	2,000	
	2/18/2002	15.08	1,500	ND (100)	260	6.5	2.8	49	
	7/19/2002	14.84	180	28	68	ND (1.7)	ND (1.7)	6.8	
	2/10/2003	14.83	210	11	14	0.75	ND (0.5)	4.0	
	7/15/2003	14.80	370	4.6	31	0.99	22	75	
	2/12/2004	14.87	1,800	29	170	2.7	140	87	
	7/7/2004	14.81	800	37	120	ND (2.5)	67	38	
	3/24/2005	15.92	ND (50)	4.7	4	ND (0.5)	2.5	2	
	8/17/2005	15.60	4,100	59	410	35	380	1,500	
	3/29/2006	16.97	NA	2.4	4.7	ND (0.5)	ND (0.5)	ND (0.5)	
	2/8/2007	14.93	100	3.7	13	ND (0.5)	1.1	3.9	
	2/27/2008	14.44	270	ND (10)	49	0.81	3.2	17.0	
	MW-4	3/21/1989	12.4	ND	NA	13	1.4	1.0	ND
		7/26/1990	12.5	NA	NA	0.8	ND	ND	ND
10/25/1990		12.2	NA	NA	120	1.2	1.1	0.9	
1/25/1991		12.0	NA	NA	230	2.8	1.2	2.0	
4/25/1991		13.0	170	NA	12	ND	ND	2.3	
8/27/1991		11.8	ND	NA	87	1.3	0.8	0.8	
11/25/1991		11.8	1,400	NA	ND	1.7	8.6	3.6	
6/11/1992		12.93	560	NA	150	1.8	1.8	1.1	
7/16/1997		14.46	50	ND	ND	ND	ND	ND	
10/21/1997		14.10	ND	ND	ND	ND	ND	ND	
3/11/1998		17.39	NS	NS	NS	NS	NS	NS	
4/1/1998		17.40	ND (50)	ND (5.0)	ND (0.5)	ND (0.5)	ND (0.5)	ND (0.5)	
7/15/1998		16.92	ND (50)	ND (5.0)	ND (0.5)	ND (0.5)	ND (0.5)	ND (0.5)	
10/22/1998		15.75	ND (50)	ND (5.0)	ND (0.5)	ND (0.5)	ND (0.5)	ND (0.5)	
9/9/1999		15.57	NS	NS	NS	NS	NS	NS	
1/18/2000		14.32	NS	NS	NS	NS	NS	NS	
5/4/2000	16.34	NS	NS	NS	NS	NS	NS		

**TABLE 1  
GROUNDWATER ELEVATION AND ANALYTICAL DATA SUMMARY  
ALCOPARK FUELING FACILITY SITE NO. 2  
OAKLAND, CALIFORNIA**

<i>All concentrations in ug/l (PPB).</i>								
Well	Date	Groundwater Elevation	TPH-G	MTBE	Benzene	Toluene	Ethylbenzene	Xylenes
MW-4 cont	8/22/2000	15.47	NS	NS	NS	NS	NS	NS
	2/8/2001	14.73	NS	NS	NS	NS	NS	NS
	7/20/2001	14.72	NS	NS	NS	NS	NS	NS
	2/18/2002	15.05	NS	NS	NS	NS	NS	NS
	7/19/2002	14.97	NS	NS	NS	NS	NS	NS
	2/10/2003	14.94	NS	NS	NS	NS	NS	NS
	7/15/2003	14.94	NS	NS	NS	NS	NS	NS
	2/12/2004	14.93	NS	NS	NS	NS	NS	NS
	7/7/2004	14.94	NS	NS	NS	NS	NS	NS
	3/24/2005	16.05	NS	NS	NS	NS	NS	NS
	8/17/2005	15.82	NS	NS	NS	NS	NS	NS
	3/29/2006	17.22	NS	NS	NS	NS	NS	NS
	2/8/2007	15.15	NS	NS	NS	NS	NS	NS
	2/27/2008	15.06	NS	NS	NS	NS	NS	NS
MW-5	3/21/1989	12.2	ND	NA	ND	ND	ND	ND
	7/26/1990	12.4	670	NA	0.8	ND	ND	ND
	10/25/1990	12.1	120	NA	13	ND	ND	ND
	1/25/1991	11.9	120	NA	3.2	ND	ND	ND
	4/25/1991	12.3	ND	NA	ND	ND	ND	ND
	8/27/1991	11.5	ND	NA	20	ND	0.5	ND
	11/25/1991	11.7	190	NA	2.7	ND	0.8	2.5
	6/11/1992	12.85	150	NA	37	ND	ND	ND
	7/16/1997	14.33	ND	22	ND	ND	ND	ND
	10/21/1997	13.88	ND	14	ND	ND	ND	ND
	3/11/1998	17.14	NS	NS	NS	NS	NS	NS
	4/1/1998	17.14	ND (50)	11	ND (0.5)	ND (0.5)	ND (0.5)	ND (0.5)
	7/15/1998	16.43	ND (50)	ND (5.0)	ND (0.5)	ND (0.5)	ND (0.5)	ND (0.5)
	10/22/1998	15.60	ND (50)	ND (5.0)	ND (0.5)	ND (0.5)	ND (0.5)	ND (0.5)
	9/9/1999	15.44	NS	NS	NS	NS	NS	NS
	1/18/2000	14.67	NS	NS	NS	NS	NS	NS
	5/4/2000	16.18	NS	NS	NS	NS	NS	NS
	8/22/2000	15.32	NS	NS	NS	NS	NS	NS
	2/8/2001	14.53	NS	NS	NS	NS	NS	NS
	7/20/2001	14.59	NS	NS	NS	NS	NS	NS
	2/18/2002	14.94	NS	NS	NS	NS	NS	NS
	7/19/2002	14.83	NS	NS	NS	NS	NS	NS
	2/10/2003	14.83	NS	NS	NS	NS	NS	NS
	7/15/2003	14.80	NS	NS	NS	NS	NS	NS
	2/12/2004	14.87	NS	NS	NS	NS	NS	NS
	7/7/2004	14.82	NS	NS	NS	NS	NS	NS
	3/24/2005	15.91	NS	NS	NS	NS	NS	NS
	8/17/2005	15.59	NS	NS	NS	NS	NS	NS
	3/29/2006	16.97	NS	NS	NS	NS	NS	NS
	2/8/2007	14.93	NS	NS	NS	NS	NS	NS
2/27/2008	14.85	NS	NS	NS	NS	NS	NS	

**TABLE 1  
GROUNDWATER ELEVATION AND ANALYTICAL DATA SUMMARY  
ALCOPARK FUELING FACILITY SITE NO. 2  
OAKLAND, CALIFORNIA**

<i>All concentrations in ug/l (PPB).</i>								
Well	Date	Groundwater Elevation	TPH-G	MTBE	Benzene	Toluene	Ethylbenzene	Xylenes
MW-6	4/1/1998	NA	740	4,600	9.8	3.2	3.0	15
	7/15/1998	NA	6,200	11,000	280	43	180	350
	7/15/1998	NA	NA	13,000	ND (500)	ND (500)	ND (500)	ND (500)
	10/22/1998	NA	4,700	9,600	450	13	200	200
	10/22/1998	NA	NA	9,100	470	ND (250)	ND (250)	ND (250)
	9/9/1999	NA	6,600	3,700	2,500	43	310	250
	1/18/2000	NA	3,500	4,600	800	ND (5.0)	40	13
	5/4/2000	NA	NS	NS	NS	NS	NS	NS
	8/22/2000	NA	1,400	1,700	370	4.8	12	35
	2/8/2001	NA	NS	NS	NS	NS	NS	NS
	7/20/2001	NA	1,100	800	240	2.9	2.3	3.4
	2/18/2002	NA	1,500	570	260	ND (2.0)	11	4.3
	7/19/2002	NA	1,800	800	1,400	ND (50)	ND (50)	ND (50)
	2/10/2003	NA	4,000	830	1,000	ND (50)	ND (50)	ND (50)
	7/15/2003	NA	4,100	1,200	2,200	ND (25)	180	260
	2/12/2004	NA	7,200	980	1,600	ND (25)	100	440
	7/7/2004	NA	4,000	840	1,500	ND (25)	150	210
	3/24/2005	NA	4,600	480	520	ND (10)	86	280
	8/17/2005	NA	2,800	610	820	ND (17)	190	250
	3/29/2006	NA	NA	410	940	ND (50)	85	140
2/15/2007	NA	NA	6,800	340	2,000	ND (50)	130	190
2/14/2008	NA	NA	780	80	11	1.3	8.8	37
MW-7	9/9/1999	NA	92	1,200	1.6	ND (0.5)	ND (0.5)	ND (0.5)
	1/18/2000	NA	ND	2,100	ND (0.5)	ND (0.5)	ND (0.5)	ND (0.5)
	5/4/2000	NA	140	1,100	ND (0.5)	ND (0.5)	ND (0.5)	ND (0.5)
	8/22/2000	NA	160	830	0.62	ND (0.5)	ND (0.5)	ND (0.5)
	2/8/2001	NA	130	650	ND (0.5)	0.53	ND (0.5)	ND (0.5)
	7/20/2001	NA	56	400	ND (0.5)	ND (0.5)	ND (0.5)	ND (0.5)
	2/18/2002	NA	ND (50)	200	ND (0.5)	ND (0.5)	ND (0.5)	ND (0.5)
	7/19/2002	NA	ND (50)	300	ND (5.0)	ND (5.0)	ND (5.0)	ND (5.0)
	2/10/2003	NA	ND (50)	140	ND (5.0)	ND (5.0)	ND (5.0)	ND (5.0)
	7/15/2003	NA	ND (50)	140	ND (2.5)	ND (2.5)	ND (2.5)	ND (2.5)
	2/12/2004	NA	ND (50)	100	ND (1.7)	ND (1.7)	ND (1.7)	ND (1.7)
	7/7/2004	NA	56	200	ND (2.5)	ND (2.5)	ND (2.5)	ND (2.5)
	3/24/2005	NA	ND (50)	350	ND (5.0)	ND (5.0)	ND (5.0)	ND (5.0)
	8/17/2005	NA	66	230	9	ND (5.0)	ND (5.0)	7
	3/29/2006	NA	NA	160	ND (5.0)	ND (5.0)	ND (5.0)	ND (5.0)
	2/15/2007	NA	NA	70	87	ND (1.7)	ND (1.7)	ND (1.7)
2/14/2008	NA	NA	ND (50)	13	ND (0.5)	ND (0.5)	ND (0.5)	ND (0.5)
W-B1	3/23/1998	NA	3,100	4,200	250	18	160	290

**Notes:**

TPH-G denotes Total Petroleum Hydrocarbons as Gasoline. MTBE denotes Methyl tert-Butyl Ether.  
 NA denotes Not Analyzed. NS denotes Not Sampled. ND denotes Not Detected. ( ) denotes detection limit.  
 Data collected prior to 1998 was reported in Alameda County Request for Proposal dated December 2, 1997.

### Benzene Concentrations (ug/L)

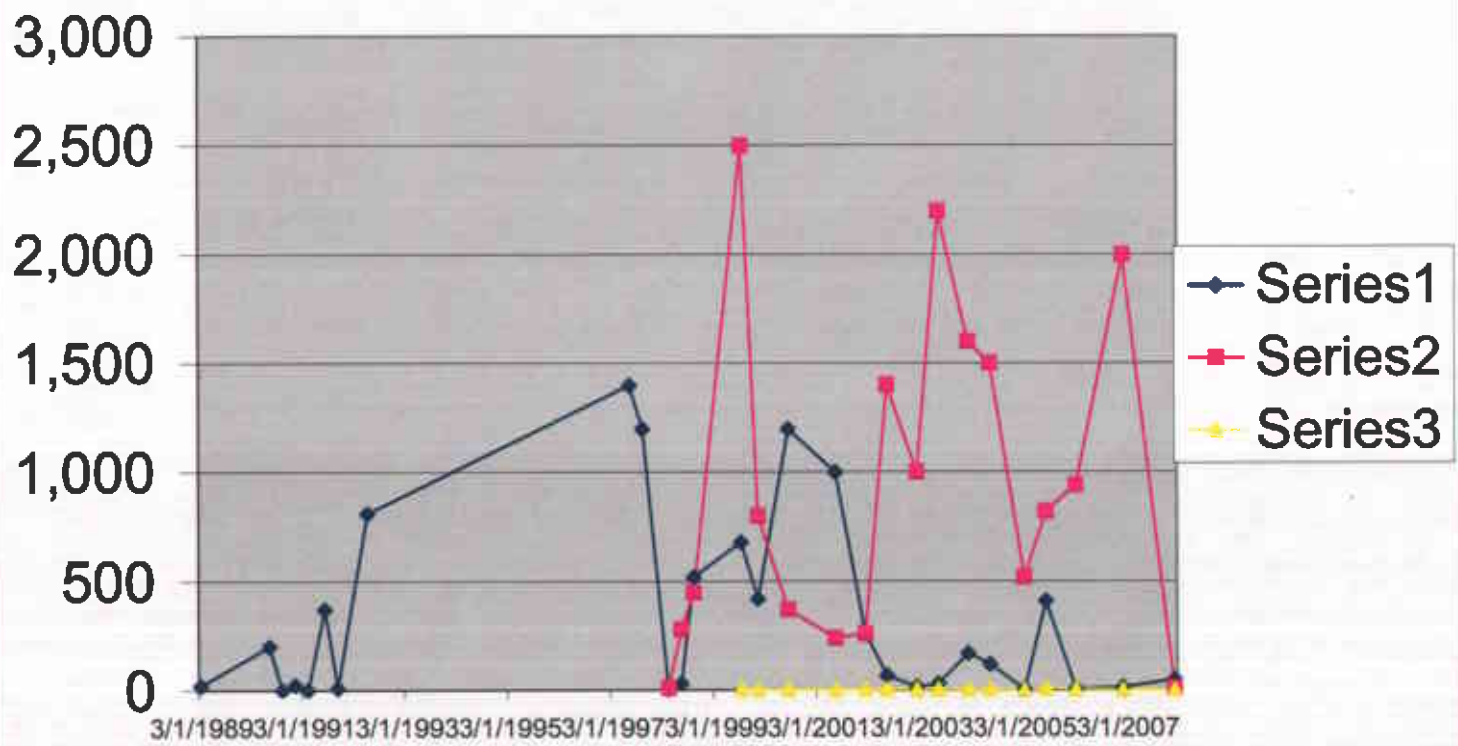

## MTBE Concentrations (ug/L)

