



Environmental  
Science &  
Engineering, Inc.

**FACSIMILE**

DATE: 10/1/92 TIME: 1:30 pm

TO: Ravi FROM: ESE Kerry Lefever  
Alameda Co. 4090 Nelson Way, Suite I  
Env. Health Concord, CA 94520

FAX #: (510) 569-4757 JOB #: 6-92-5413

SUBJECT: Alcopark Facility, 13th ~~St~~ Street, Oakland

Number of Pages

(Including this Cover Sheet)

6

**ADDITIONAL MESSAGE:**

Ravi -

Enclosed is a workplan to install one  
gw well near former waste oil tank.

We have scheduled drilling on 10/12/92.

We will also be drilling soil borings & collecting  
gw samples at this facility on 10/13/92. A workplan

If you have any questions, please call us immediately at (510) 685-4053.

for this work was sent 9/24/92. Please call  
if you have any questions.

*Kerry*



Environmental  
Science &  
Engineering, Inc.

September 30, 1992

ESE Project No. 6-92-5413

Mr. Peter Kinney  
Alameda County General Services Agency  
Building Maintenance Department  
4400 MacArthur Boulevard  
Oakland, California 94619

*Approved*  
*10/2/92*

**SUBJECT: Ground Water Investigation, Former Used Oil Tank, ALCOPARK Facility, 165 13th Street, Oakland, California**

Dear Mr. Kinney:

Environmental Science & Engineering, Inc. (ESE) has prepared this workplan, at the request of Alameda County General Service Agency (ACGSA) to outline the scope of work to be performed during this investigation to be conducted at the Alameda County ALCOPARK facility (Site). The ALCOPARK facility is located at 1655 13th Street in Oakland, California (Figure 1 - Location Map). The scope of work for this project was developed based upon discussions between Patrick Galvin and Peter Kinney and is in accordance with present regulatory requirements for leaking underground storage tank sites. The proposed scope of work is as follows:

**Obtain Well Permits and Prepare a Health and Safety Plan**

ESE will obtain all permits required to install a ground water monitoring well at the subject site. ESE has prepared a health and safety plan for an investigation to be conducted at another portion of the ALCOPARK facility. This plan will be modified to include this investigation.

**Drill, Sample and Install One Ground Water Monitoring Well**

ESE will install one two-inch diameter well inside the parking garage within 15 feet of the former used oil tank location (Figure 2 - Site Map). A low clearance hollow-stem auger rig will be used and will be operated by a State Licensed water well driller. The well will be located east of the former tank location. The well will be drilled approximately 20 feet deep with screening from 20 to 5 feet below the floor. A traffic-rated, flush-mounted well box will be installed at the surface. The reference elevation of this well will be surveyed relative to the existing monitoring wells at the site. This will provide for compilation of site data for ground water gradient confirmation.

Mr. Peter Kinney  
September 30, 1992  
Page 2

During the drilling of this well, ESE will collect one soil sample at a depth of 5 to 8 feet below the floor (approximately 1 foot above the anticipated water table). This sample will be analyzed for Total Oil and Grease (TOG), Total Petroleum Hydrocarbons (TPH) as gasoline and diesel, and Benzene, Toluene, Ethylbenzene, and Total Xylenes (BTEX) using EPA methods 413.1, 8015M, and 8020, respectively. In addition, because chlorinated compounds were found during the preliminary stages of investigation, the soil sample will also be analyzed for halogenated volatile organics (HVO) using EPA Method 8010.

ESE will develop the well prior to placement of grout. A minimum of 48-hours after grout emplacement, ESE will purge and sample the well. This sampling will be considered the first quarterly sampling event. The ground water sample will be analyzed for TOG, TPH-gas, TPH-diesel, BTEX, and HVO. One duplicate sample will be collected and analyzed for BTEX for quality control purposes.

Soil generated as part of well construction will be drummed and temporarily stored on site pending analytical results and proper disposal/recycling by ACGSA. Water generated from well development and purging activities will also be drummed and temporarily retained on site pending analytical results and proper disposal/recycling by ACGSA.

#### **Report of Findings**

ESE will prepare a brief report of findings which will contain a location map, geologic boring log, well construction specifications, and soil and ground water analytical results. The report will also contain a discussion of the field activities conducted during the investigation, and a discussion of the analytical results for the soil and ground water samples. Copies of this report will be submitted to ACGSA, Alameda County Department of Environmental Health (ACDEH), and the Regional Water Quality Control Board, San Francisco Bay Region (RWQCB, SFBR).

#### **Quarterly Ground Water Monitoring**

ESE will collect depth to ground water measurements and ground water samples from the one well on a quarterly basis for three quarters after the initial sampling conducted 48-hours subsequent to well installation. The well will be purged and sampled according to ACDEH requirements and analyzed for TOG, TPH-gas, TPH-diesel, BTEX, and HVO. One duplicate sample will be collected and analyzed for BTEX for quality control purposes. Well purge water generated will be temporarily stored on site in a 55-gallon drum pending analytical results and proper disposal/recycling by ACGSA. A brief report suitable for submission to ACDEH will be prepared documenting the quarterly monitoring activities.

Mr. Peter Kinney  
September 30, 1992  
Page 3

Please call Michael Edmonson at (510) 685-4053 with any questions or comments regarding this workplan. ESE anticipates conducting the well installation and initial sampling event during the week of October 12, 1992.

Sincerely,

**ENVIRONMENTAL SCIENCE & ENGINEERING, INC.**



Michael K. Edmonson  
Project Geologist

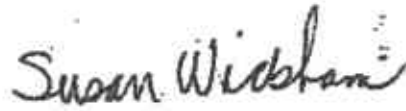

Susan Wickham, RG  
Senior Geologist

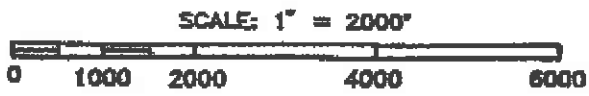

**ESE** Environmental Science & Engineering, Inc.  
A CORP. COMPANY

ALAMEDA COUNTY  
ALCOPARK  
OAKLAND, CALIFORNIA

FIGURE 1  
LOCATION MAP

DESIGN BY DNE	APPROVED BY	REVISED
DATE 10/91	FILE NAME FITZPOLD	PROJ. NO. 6-90-5042

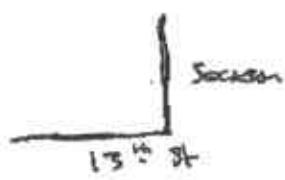
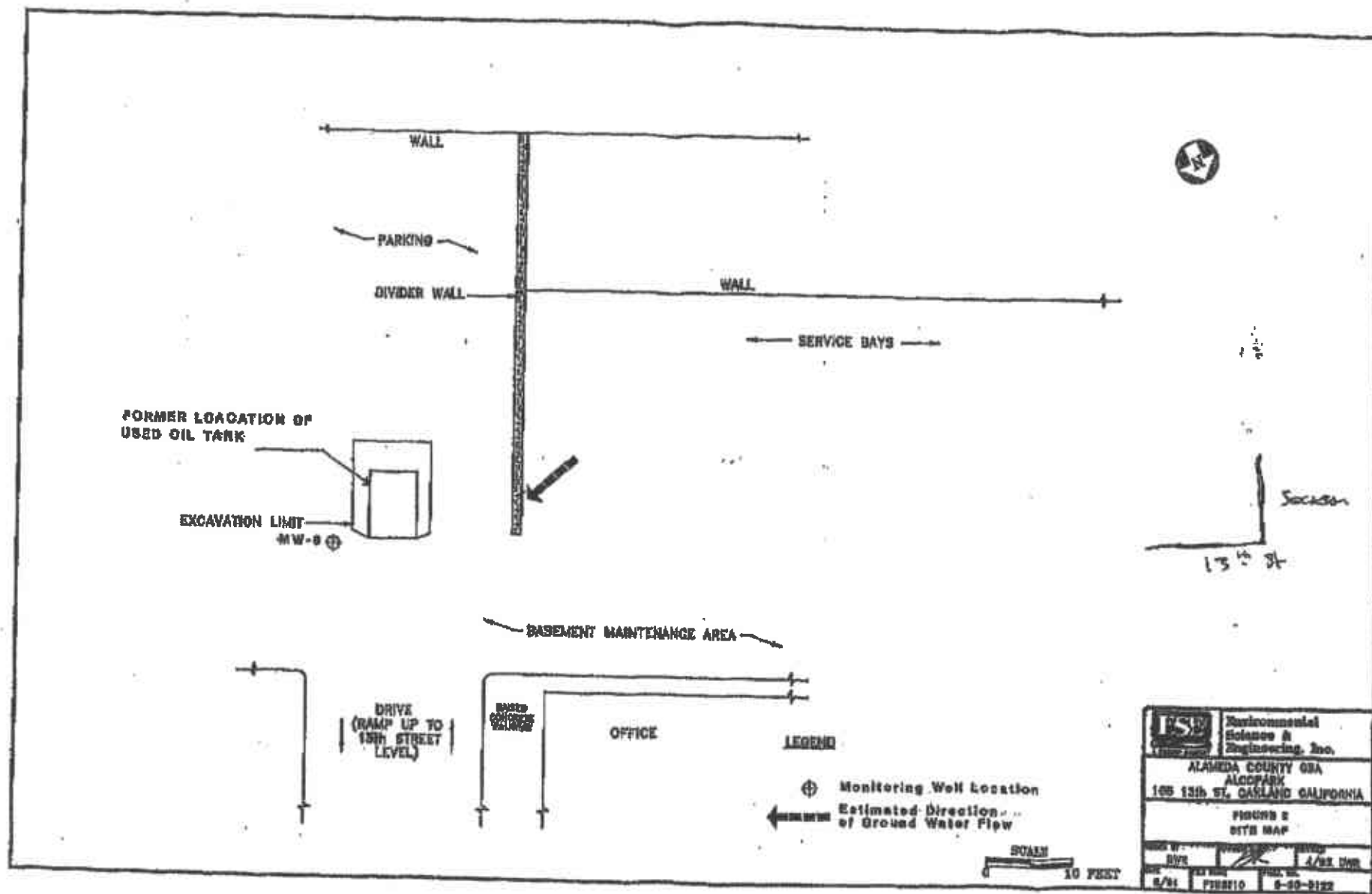

	Environmental Science & Engineering, Inc.
	ALAMEDA COUNTY O&A ALCOFFICE 105 13th ST, OAKLAND CALIFORNIA
FIGURE 2 SITE MAP	
DATE: 8/91 BY: DVS	CHECKED: J/91 DMR DRAWN: PIERRE SCALE: 8-00-0122