

ENVIRONMENTAL  
PROTECTION

97 FEB -4 PM 3: 28

**Electro-  
Coatings  
Inc.**

Electro-Coatings Inc.  
893 Carleton Street  
Berkeley, CA 94710  
Tel: 510/284-8332  
Fax: 510/284-7068

1/31/97

Susan L. Hugo  
Alameda County Dept. of Environmental Health  
Environmental Protection Division  
1131 Harbor Bay Parkway, #250  
Alameda, CA 94502-6577

RE: Results of Quarterly Groundwater Sampling at 1401 and 1421 Park Avenue  
December 10, 1996

Dear Susan:

Enclosed is one copy of the subject report which was prepared for Electro-Coatings by Geraghty & Miller Inc. The next sampling event is scheduled for March 1997.

We look forward to meeting with you on Friday, February 14, 1997.

Yours very truly,



Judy Garvens  
Administrative Manager

cc: Mr. Sum Arigala, RWQCB

enclosure

January 16, 1997  
Project No. RC0304.003

97 FEB -4 PM 2:29

Ms. Judy Garvens  
Administrative Manager  
Electro-Coatings Inc.  
893 Carleton Street  
Berkeley, California 94710

**SUBJECT:** Quarterly Groundwater Sampling Results, Electro-Coatings Facility at 1401  
and 1421 Park Avenue, Emeryville, California.

Dear Ms. Garvens:

This letter presents the results of the quarterly groundwater sampling activities performed on behalf of ECI at the Electro-Coatings Inc. (ECI) site referenced above. The scope of work for the quarterly sampling was presented in the Geraghty & Miller letter dated August 27, 1996.

#### **FIELD ACTIVITIES AND LABORATORY ANALYSIS**

Monitoring Wells MW-3A, MW-4, MW-6, MW-12, MW-13, MW-16, and MW-17 were sampled on December 10, 1996 as part of the quarterly groundwater monitoring program. Prior to purging, depth to water and total well depth measurements were obtained from each well. The wells were then purged of at least three casing volumes of water. The well purging was accomplished using an aboveground diaphragm pump. New polyethylene tubing was used for each well. The purged water was monitored for temperature, pH, and specific conductance. A summary of the field data is presented in Table 1. Depth-to-water and groundwater elevation data are presented in Table 2.

Following purging, groundwater samples were collected using a new polyethylene bailer for each well. The water samples were collected into the appropriate USEPA-approved containers, placed on ice, and transported to Sequoia Analytical Laboratory in Walnut Creek, California, along with chain-of-custody documentation.



## RESULTS

### Depth to Water and Groundwater Elevations

Depth to water ranged from 3.19 feet below ground surface (Well MW-6) to 6.02 feet below ground surface (Well MW-13). A summary of depth to water and groundwater elevations is presented in Table 2. The groundwater elevations and a groundwater contour map are presented in Figure 1. Based on the depth to water data recorded on December 10 1996, the direction of groundwater flow is toward the west, which is consistent with the previous sampling event (Geraghty & Miller, October 9, 1996).

### Laboratory Analytical Results

#### *Chromium Results*

The historical and current analytical results for total and hexavalent chromium are summarized in Table 3 and the current results are presented in Figure 2. The laboratory reports that the total chromium results obtained during this sampling event are questionable due to lack of preservative in the sample bottles. However, the overall pattern is consistent with previous sampling events. The highest concentrations of both total and hexavalent chromium were detected in Monitoring Wells MW-13 and MW-17 on the ECI site and decreasing concentrations were detected with increased distance downgradient of the ECI site in Wells MW-6 and MW-16. Hexavalent chromium was not detected in the water samples collected from the deep well (MW-3A) sampled during this quarterly event while total chromium was detected at 13 micrograms per liter ( $\mu\text{g}/\text{L}$ ).

#### *Purgeable Halocarbon Results*

The historical and current analytical results for purgeable halocarbons are summarized in Table 4. Figure 3 presents the concentrations of trichloroethylene (TCE) and tetrachloroethylene (PCE) detected during the December 1996 sampling event. TCE, PCE, and trans-1,2-DCE were the most frequently detected halocarbons. TCE was the most frequently detected compound, and it was detected at the highest concentrations. The highest concentrations of TCE were detected in Monitoring Well MW-16, to the west of the ECI site. TCE was not detected in the farthest downgradient well (Well MW-6).



Geraghty & Miller appreciates the opportunity to be of service. If you have any questions regarding this report, please do not hesitate to call.

Sincerely,  
GERAGHTY & MILLER, INC.



Jeffrey W. Hawkins, R.G.  
Senior Geologist

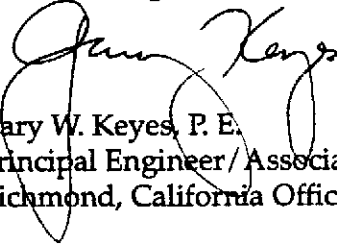

Gary W. Keyes, P. E.  
Principal Engineer/ Associate  
Richmond, California Office Manager

Attachments: Table 1	Summary of Field Data
Table 2	Summary of Groundwater Elevation Data
Table 3	Summary of Groundwater Analytical Data – Total and Hexavalent Chromium
Table 4	Summary of Groundwater Analytical Data – Purgeable Halocarbons
Figure 1	Groundwater Contour Map
Figure 2	Groundwater Analytical Results, December 1996 – Total Chromium and Hexavalent Chromium
Figure 3	Groundwater Analytical Results, December 1996 – TCE and PCE
Attachment 1	Copies of Laboratory Analytical Reports and Chain-of-Custody Documentation



**Table 1: Summary of Field Sampling Data**

Electro-Coatings, Inc.

1401 and 1421 Park Avenue, Emeryville, California

Well	Date	Calculated Purge Volume (a) (gallons)	Actual Purge Volume (gallons)	-----Field Measurements-----			Depth to Water (feet)	Measured Depth of Well (feet)	Casing Diameter (inches)
				pH	SC ( $\mu$ mhos/cm)	Temperature (°F)			
MW-1	13-Sep-96	59	45	6.0	570	64.4	6.15	28.91	4
	<b>10-Dec-96</b>	<b>NM</b>	<b>NM</b>	<b>NM</b>	<b>NM</b>	<b>NM</b>	<b>NM</b>	<b>NM</b>	
MW-3A	19-Sep-95	15	6 (c)	7.3	2,800	71.2	5.70	61.21	1.5
	14-Dec-95	3.41	4	7.0	2,000	65.6	5.00	16.10	
	6-Mar-96	17.34	8	6.0	1,190	76.5	4.73	61.05	
	12-Jun-96	17.57	8	6.0	620	65.4	5.28	61.05	
	12-Sep-96	17.03	13	7.1	430	67.9	5.47	60.79	
	<b>10-Dec-96</b>	<b>17.15</b>	<b>7</b>	<b>6.0</b>	<b>1,530</b>	<b>69.5</b>	<b>5.61</b>	<b>61.3</b>	
MW-4	19-Sep-95	4	4	7.1	1,970	70.9	6.50	19.9	1.5
	15-Dec-95	4.47	5	6.0	2,350	65.8	5.36	19.9	
	6-Mar-96	4.31	5	NM	2,050	69.3	5.90	19.9	
	11-Jun-96	4.16	5	6.0	1,030	70.7	6.39	19.9	
	12-Sep-96	4.10	4.5	7.3	710	71.2	6.40	19.73	
	<b>10-Dec-96</b>	<b>4.35</b>	<b>5</b>	<b>6.5</b>	<b>2,110</b>	<b>60.9</b>	<b>5.78</b>	<b>19.93</b>	
MW-6	19-Sep-95	3	5	7.0	1,482	70.3	3.72	16.24	1.5
	14-Dec-95	2.27	3	6.5	3,650	67.6	3.01	11.69	
	6-Mar-96	2.56	3	6.0	3,750	71.5	3.31	11.69	
	11-Jun-96	1.97	2	6.5	1,900	72.7	5.34	11.71	
	12-Sep-96	3.84	4	7.3	1,550	71.3	3.60	16.09	
	<b>10-Dec-96</b>	<b>4.05</b>	<b>6.5</b>	<b>6.5</b>	<b>3,780</b>	<b>66.9</b>	<b>3.19</b>	<b>16.35</b>	



**Table 1: Summary of Field Sampling Data**

Electro-Coatings, Inc.

1401 and 1421 Park Avenue, Emeryville, California

Well	Date	Calculated Purge Volume (a) (gallons)	Actual Purge Volume (gallons)	-----Field Measurements-----			Depth to Water (feet)	Measured Depth of Well (feet)	Casing Diameter (inches)
				pH	SC ( $\mu$ mhos/cm)	Temperature ( $^{\circ}$ F)			
MW-9	13-Sep-96	40	40	7.0	700	64.3	6.71	21.98	4
	<b>10-Dec-96</b>	<b>NM</b>	<b>NM</b>	<b>NM</b>	<b>NM</b>	<b>NM</b>	<b>NM</b>	<b>NM</b>	
MW-11	12-Sep-96	122	125	6.3	650	65.2	6.40	27.3	6
	<b>10-Dec-96</b>	<b>NM</b>	<b>NM</b>	<b>NM</b>	<b>NM</b>	<b>NM</b>	<b>NM</b>	<b>NM</b>	
MW-12	19-Sep-95	39	40	6.2	2,320	71.1	6.61	26.56	4
	14-Dec-95	56.10	60	6.0	2,180	69.1	5.12	26.70	
	6-Mar-96	54.70	55	6.0	2,570	71.9	5.61	26.65	
	12-Jun-96	52.75	55	6.0	1,200	65.5	6.46	26.75	
	12-Sep-96	51.92	55	6.4	980	65.7	6.53	26.5	
	<b>10-Dec-96</b>	<b>54.75</b>	<b>55</b>	<b>6.0</b>	<b>2,820</b>	<b>71.3</b>	<b>5.76</b>	<b>26.82</b>	
MW-13	19-Sep-95	36	35	6.4	2,610	69.6	6.94	15.00	6
	15-Dec-95	55.88	25 (b)	6.0	2,990	68.6	5.45	15.02	
	6-Mar-96	51.01	30 (b)	6.0	2,120	71.4	5.94	15.05	
	11-Jun-96	48.53	30 (b)	6.0	1,500	74.0	6.75	15.06	
	13-Sep-96	46.89	45	6.0	980	65.7	6.80	14.83	
	<b>10-Dec-96</b>	<b>52.85</b>	<b>55</b>	<b>6.0</b>	<b>2,570</b>	<b>69.1</b>	<b>6.02</b>	<b>15.07</b>	
MW-14	12-Sep-96	48	15 (b)	6.0	820	65.8	6.74	25.25	4
	<b>10-Dec-96</b>	<b>NM</b>	<b>NM</b>	<b>NM</b>	<b>NM</b>	<b>NM</b>	<b>NM</b>	<b>NM</b>	



**Table 1: Summary of Field Sampling Data**

Electro-Coatings, Inc.

1401 and 1421 Park Avenue, Emeryville, California

Well	Date	Calculated Purge Volume (a) (gallons)	Actual Purge Volume (gallons)	-----Field Measurements-----			Depth to Water (feet)	Measured Depth of Well (feet)	Casing Diameter (inches)	
				pH	SC ( $\mu$ mhos/cm)	Temperature (°F)				
MW-16	19-Sep-95	40	40	6.7	1,710	32.0	4.64	25.00	4	
	14-Dec-95	54	55	6.5	2,750	64.4	4.28	25.05		
	6-Mar-96	54.70	55	6.0	1,800	59.8	4.01	25.05		
	11-Jun-96	53.37	55	6.0	1,370	77.5	4.50	25.03		
	12-Sep-96	52.67	55	7.2	980	68.9	4.55	24.81		
	<b>10-Dec-96</b>	<b>54.39</b>	<b>55</b>	<b>6.5</b>	<b>2,730</b>	<b>67.1</b>	<b>3.98</b>	<b>24.90</b>		
MW-17	19-Sep-95	39	40	6.8	2,410	72.1	4.78	24.5	4	
	14-Dec-95	55.25	20 (b)	6.0	3,140	65.3	3.31	24.56		
	6-Mar-96	54.10	26 (b)	7.0	2,630	61.1	3.75	24.56		
	11-Jun-96	52.00	30 (b)	6.0	1,600	65.8	4.55	24.56		
	12-Sep-96	51.29	40	7.1	1,270	70.1	4.61	24.34		
	<b>10-Dec-96</b>	<b>54.00</b>	<b>55</b>	<b>6.5</b>	<b>2,000</b>	<b>69.4</b>	<b>3.89</b>	<b>24.66</b>		
MW-18	19-Sep-95	40	20 (b)	4.1	1,920	73.6	5.00	25.34	4	
	14-Dec-95	56.86	57	5.0	3,140	69.2	3.48	25.35		
	6-Mar-96	55.69	55	5.0	2,480	69.0	3.96	25.38		
	11-Jun-96	53.56	55	5.0	1,280	64.8	4.86	25.46		
	12-Sep-96	NM	NM	NM	NM	NM	NM	NM	NM	
	<b>10-Dec-96</b>	<b>NM</b>	<b>NM</b>	<b>NM</b>	<b>NM</b>	<b>NM</b>	<b>NM</b>	<b>NM</b>	<b>NM</b>	



**Table 1: Summary of Field Sampling Data**

Electro-Coatings, Inc.

1401 and 1421 Park Avenue, Emeryville, California

Well	Date	Calculated Purge Volume (a) (gallons)	Actual Purge Volume (gallons)	-----Field Measurements-----			Depth to Water (feet)	Measured Depth of Well (feet)	Casing Diameter (inches)
				pH	SC ( $\mu$ mhos/cm)	Temperature (°F)			
MW-18A	19-Sep-95	68	20 (c)	6.0	920	72.1	5.76	40.72	4
	15-Dec-95	91.31	40 (b)	6.5	1,960	64.9	5.66	40.72	
	6-Mar-96	96.17	80	6.0	810	67.8	3.86	40.85	
	11-Jun-96	93.47	95	6.0	680	65.2	4.85	40.8	
	12-Sep-96	NM	NM	NM	NM	NM	NM	NM	
	10-Dec-96	NM	NM	NM	NM	NM	NM	NM	
MW-20	19-Sep-95	89	90	6.9	2,530	68.4	2.47	47.97	4
	15-Dec-95	116.87	120	7.0	2,560	70.6	2.95	47.90	
	6-Mar-96	121.44	125	6.0	950	69.9	1.43	48.14	
	11-Jun-96	119.15	120	6.0	780	68.5	2.29	48.12	
	12-Sep-96	117.05	120	6.8	450	68.9	2.90	47.92	
	10-Dec-96	NM	NM	NM	NM	NM	NM	NM	

(a) Based on three casing volumes.

(b) Purged dry.

(c) Represents approximately one casing volume. Equipment problems encountered during sampling.

SC = Specific Conductance

NM = Not measured





**Table 2: Summary of Groundwater Elevation Data**  
**Electro-Coatings Inc.**  
**1401 and 1421 Park Avenue, Emeryville, California**

Monitoring Well	Date Sampled	DTW (feet)	TOC (feet - MSL)	Groundwater Elevation (feet - MSL)
MW-1	19-Apr-95	Not Located		--
	19-Sep-95	NM	15.19	--
	14-Dec-95	NM		--
	6-Mar-96	NM		--
	11-Jun-96	NM		--
	12-Sep-96	6.15		9.04
	9-Dec-96	NM		--
MW-2	19-Apr-95	Not Located		--
	19-Sep-95	NM		--
	14-Dec-95	NM		--
	6-Mar-96	NM		--
	11-Jun-96	NM		--
	12-Sep-96	NM		--
	9-Dec-96	NM		--
MW-3A	19-Apr-95	4.87	16.1	11.23
	19-Sep-95	5.70		10.40
	14-Dec-95	5.00		11.10
	6-Mar-96	4.73		11.37
	11-Jun-96	5.28		10.82
	12-Sep-96	5.47		10.63
	9-Dec-96	5.61		10.49
MW-3B	19-Apr-95	6.76	16.3	9.54
	19-Sep-95	NM		--
	14-Dec-95	NM		--
	6-Mar-96	NM		--
	11-Jun-96	NM		--
	12-Sep-96	NM		--
	9-Dec-96	NM		--
MW-3C	19-Apr-95	6.19	16.21	10.02
	19-Sep-95	NM		--
	14-Dec-95	NM		--
	6-Mar-96	NM		--
	11-Jun-96	NM		--
	12-Sep-96	NM		--
	9-Dec-96	NM		--



**Table 2: Summary of Groundwater Elevation Data**  
**Electro-Coatings Inc.**  
**1401 and 1421 Park Avenue, Emeryville, California**

Monitoring Well	Date Sampled	DTW (feet)	TOC (feet - MSL)	Groundwater Elevation (feet - MSL)
MW-4	19-Apr-95	6.52	14.29	7.77
	19-Sep-95	6.50		7.79
	14-Dec-95	5.36		8.93
	6-Mar-96	5.90		8.39
	11-Jun-96	6.39		7.90
	12-Sep-96	6.40		7.89
	<b>9-Dec-96</b>	<b>5.78</b>		<b>8.51</b>
	MW-5	19-Apr-95	6.95	15.87
19-Sep-95		NM		--
14-Dec-95		NM		--
6-Mar-96		NM		--
11-Jun-96		NM		--
12-Sep-96		NM		--
<b>9-Dec-96</b>		<b>NM</b>		<b>--</b>
MW-6		19-Apr-95	3.55	9.24
	19-Sep-95	3.72		5.52
	14-Dec-95	3.01		6.23
	6-Mar-96	3.31		5.93
	11-Jun-96	5.34		3.90
	12-Sep-96	3.60		5.64
	<b>9-Dec-96</b>	<b>3.19</b>		<b>6.05</b>
	MW-7	19-Apr-95	Not Located	
19-Sep-95		NM		--
14-Dec-95		NM		--
6-Mar-96		NM		--
11-Jun-96		NM		--
12-Sep-96		NM		--
<b>9-Dec-96</b>		<b>NM</b>		<b>--</b>
MW-8		19-Apr-95	5.50	16.42
	19-Sep-95	NM		--
	14-Dec-95	NM		--
	6-Mar-96	NM		--
	11-Jun-96	NM		--
	12-Sep-96	NM		--
	<b>9-Dec-96</b>	<b>NM</b>		<b>--</b>



**Table 2: Summary of Groundwater Elevation Data**  
**Electro-Coatings Inc.**  
**1401 and 1421 Park Avenue, Emeryville, California**

Monitoring Well	Date Sampled	DTW (feet)	TOC (feet - MSL)	Groundwater Elevation (feet - MSL)
MW-9	19-Apr-95	6.67	16.03	9.36
	19-Sep-95	NM		--
	14-Dec-95	NM		--
	6-Mar-96	NM		--
	11-Jun-96	NM		--
	12-Sep-96	6.71		9.32
	9-Dec-96	NM		--
MW-10	19-Apr-95	6.94	15.1	8.16
	19-Sep-95	NM		--
	14-Dec-95	NM		--
	6-Mar-96	NM		--
	11-Jun-96	NM		--
	12-Sep-96	NM		--
	9-Dec-96	NM		--
MW-11	19-Apr-95	6.38	15.94	9.56
	19-Sep-95	NM		--
	14-Dec-95	NM		--
	6-Mar-96	NM		--
	11-Jun-96	NM		--
	12-Sep-96	6.40		9.54
	9-Dec-96	NM		--
MW-12	19-Apr-95	6.52	16.04	9.52
	19-Sep-95	6.61		9.43
	14-Dec-95	5.12		10.92
	6-Mar-96	5.61		10.43
	11-Jun-96	6.46		9.58
	12-Sep-96	6.53		9.51
	9-Dec-96	5.76		10.28
MW-13	19-Apr-95	6.75	15.37	8.62
	19-Sep-95	6.94		8.43
	14-Dec-95	5.45		9.92
	6-Mar-96	5.94		9.43
	11-Jun-96	6.75		8.62
	12-Sep-96	6.80		8.57
	9-Dec-96	6.02		9.35



**Table 2: Summary of Groundwater Elevation Data**  
**Electro-Coatings Inc.**  
 1401 and 1421 Park Avenue, Emeryville, California

Monitoring Well	Date Sampled	DTW (feet)	TOC (feet - MSL)	Groundwater Elevation (feet - MSL)
MW-14	19-Apr-95	6.71	15.49	8.78
	19-Sep-95	NM		--
	14-Dec-95	NM		--
	6-Mar-96	NM		--
	11-Jun-96	NM		--
	12-Sep-96	6.74		8.75
	9-Dec-96	NM		--
MW-15	19-Apr-95	7.94	17.26	9.32
	19-Sep-95	NM		--
	14-Dec-95	NM		--
	6-Mar-96	NM		--
	11-Jun-96	NM		--
	12-Sep-96	NM		--
	9-Dec-96	NM		--
MW-16	19-Apr-95	4.57	12.08	7.51
	19-Sep-95	4.64		7.44
	14-Dec-95	4.28		7.80
	6-Mar-96	4.01		8.07
	11-Jun-96	4.50		7.58
	12-Sep-96	4.55		7.53
	9-Dec-96	3.98		8.10
MW-17	19-Apr-95	4.48	12.76	8.28
	19-Sep-95	4.78		7.98
	14-Dec-95	3.31		9.45
	6-Mar-96	3.75		9.01
	11-Jun-96	4.55		8.21
	12-Sep-96	4.61		8.15
	9-Dec-96	3.89		8.87
MW-18	19-Apr-95	4.79	13.57	8.78
	19-Sep-95	5.00		8.57
	14-Dec-95	3.48		10.09
	6-Mar-96	3.96		9.61
	11-Jun-96	4.86		8.71
	12-Sep-96	NM		--
	9-Dec-96	NM		--



**Table 2: Summary of Groundwater Elevation Data**  
 Electro-Coatings Inc.  
 1401 and 1421 Park Avenue, Emeryville, California

Monitoring Well	Date Sampled	DTW (feet)	TOC (feet - MSL)	Groundwater Elevation (feet - MSL)
MW-18A	19-Apr-95	4.67	13.36	8.69
	19-Sep-95	5.76		7.60
	14-Dec-95	5.60		7.76
	6-Mar-96	3.86		9.50
	11-Jun-96	4.85		8.51
	12-Sep-96	NM		--
	9-Dec-96	NM		--
MW-19	19-Apr-95	Not Located		--
	19-Sep-95	NM		--
	14-Dec-95	NM		--
	6-Mar-96	NM		--
	11-Jun-96	NM		--
	12-Sep-96	NM		--
	9-Dec-96	NM		--
MW-20	19-Apr-95	2.78	14.93	12.15
	19-Sep-95	2.47		12.46
	14-Dec-95	2.95		11.98
	6-Mar-96	1.43		13.50
	11-Jun-96	2.29		12.64
	12-Sep-96	2.90		12.03
	9-Dec-96	NM		--
MW-21	19-Apr-95	Not Located		--
	19-Sep-95	NM		--
	14-Dec-95	NM		--
	6-Mar-96	NM		--
	11-Jun-96	NM		--
	12-Sep-96	NM		--
	9-Dec-96	NM		--

NM = Not Measured as part of the quarterly sampling program.



**Table 3: Summary of Groundwater Analytical Data  
Total and Hexavalent Chromium**  
Electro-Coatings Inc.  
1401 and 1421 Park Avenue, Emeryville, California

Monitor Well	Date Sampled	Total Chromium ( $\mu\text{g/L}$ ) (a)	Hexavalent Chromium ( $\mu\text{g/L}$ ) (b)
MW-1	Aug-77	200	NA
	Sep-81	ND(<1)	NA
	Oct-81	1	NA
	Nov-81	2.5	NA
	Dec-81	32	NA
	Feb-85	ND(<20)	ND(<20)
	Oct-91	ND(<50)	50
	20-Apr-95	Not Located	
	19-Sep-95	NS	NS
	15-Dec-95	NS	NS
	8-Mar-96	NS	NS
	11-Jun-96	NS	NS
	13-Sep-96	330	ND(<5.0)
	<b>11-Dec-96</b>	NS	NS
MW-2	Aug-77	60	NA
	Sep-81	ND(<1)	NA
	Oct-81	4	NA
	Nov-81	1.1	NA
	Dec-81	2	NA
	20-Apr-95	Not Located	
	19-Sep-95	NS	NS
	15-Dec-95	NS	NS
	8-Mar-96	NS	NS
	11-Jun-96	NS	NS
	13-Sep-96	NS	NS
	<b>11-Dec-96</b>	NS	NS



**Table 3: Summary of Groundwater Analytical Data  
Total and Hexavalent Chromium**  
Electro-Coatings Inc.  
1401 and 1421 Park Avenue, Emeryville, California

Monitor Well	Date Sampled	Total Chromium ( $\mu\text{g/L}$ ) (a)	Hexavalent Chromium ( $\mu\text{g/L}$ ) (b)
MW-3A	Aug-77	50	NA
	Sep-81	ND (<1)	NA
	Oct-81	ND (<1)	NA
	Nov-81	230	NA
	Dec-81	14	NA
	Feb-85	770	80
	Oct-91	130	ND (<500)
	20-Apr-95	36	ND (<5.0)
	19-Sep-95	65	ND (<5.0)
	14-Dec-95	110	7.5
	8-Mar-96	92	ND (<5.0)
	11-Jun-96	51	ND (<5.0)
	13-Sep-96	ND(<10)	ND (<5.0)
	11-Dec-96	13 (d)	ND (<5.0)
MW-3B (c)	Aug-77	60	NA
	Sep-81	ND (<1)	NA
	Oct-81	480	NA
	Nov-81	2,000	NA
	Dec-81	190	NA
	Feb-85	NA	NA
	Oct-91	110,000	100,000
	20-Apr-95	8,000	7,600
	19-Sep-95	NS	NS
	15-Dec-95	NS	NS
	8-Mar-96	NS	NS
	11-Jun-96	NS	NS
	13-Sep-96	NS	NS
	11-Dec-96	NS	NS



**Table 3: Summary of Groundwater Analytical Data  
Total and Hexavalent Chromium**  
Electro-Coatings Inc.  
1401 and 1421 Park Avenue, Emeryville, California

Monitor Well	Date Sampled	Total Chromium ( $\mu\text{g/L}$ ) (a)	Hexavalent Chromium ( $\mu\text{g/L}$ ) (b)
MW-3C	Aug-77	18,000	NA
	Sep-81	30,000	NA
	Oct-81	28,000	NA
	Nov-81	22,000	NA
	Dec-81	17,000	NA
	Feb-85	7,250	6,300
	Oct-91	2,300	1,600
	20-Apr-95	1,400	ND (<5.0)
	19-Sep-95	NS	NS
	15-Dec-95	NS	NS
	8-Mar-96	NS	NS
	11-Jun-96	NS	NS
	13-Sep-96	NS	NS
	11-Dec-96	NS	NS
MW-4	Aug-77	90,000	67,000
	Sep-81	57,000	NA
	Oct-81	61,000	NA
	Nov-81	56,000	NA
	Dec-81	55,000	NA
	Feb-85	59,000	59,000
	Jun-91	17,000	17,800
	Oct-91	22,000	22,000
	Jul-94	NA	6,300
	21-Apr-95	16,000	17,000
	19-Sep-95	14,000	15,000
	15-Dec-95	16,000	16,000
	8-Mar-96	16,000	23,000
	11-Jun-96	5,400	9,100
	13-Sep-96	14,000	1,400
11-Dec-96	17,000 (d)	47,000	





**Table 3: Summary of Groundwater Analytical Data  
Total and Hexavalent Chromium**  
Electro-Coatings Inc.  
1401 and 1421 Park Avenue, Emeryville, California

Monitor Well	Date Sampled	Total Chromium ( $\mu\text{g/L}$ ) (a)	Hexavalent Chromium ( $\mu\text{g/L}$ ) (b)
MW-5	Aug-77	360,000	295,000
	Sep-81	NA	NA
	Oct-81	880,000	2,240
	Nov-81	610,000	NA
	Dec-81	280,000	NA
	Feb-85	480,000	480,000
	Jun-91	390,000	NA
	Oct-91	260,000	250,000
	Jul-94	NA	454,000
	21-Apr-95	140,000	160,000
	19-Sep-95	NS	NS
	15-Dec-95	NS	NS
	8-Mar-96	NS	NS
	11-Jun-96	NS	NS
	13-Sep-96	NS	NS
<b>11-Dec-96</b>	<b>NS</b>	<b>NS</b>	
MW-6	Sep-81	630	NA
	Oct-81	80	NA
	Nov-81	790	NA
	Dec-81	630	NA
	Feb-85	3,330	3,300
	Jun-91	NA	NA
	Oct-91	31,000	25,000
	Jul-94	NA	4,800
	20-Apr-95	39,000	40,000
	19-Sep-95	45,000	43,000
	14-Dec-95	35,000	50,000
	8-Mar-96	42,000	50,000
	11-Jun-96	41,000	44,000
	13-Sep-96	46,000	44,000
	<b>11-Dec-96</b>	<b>45,000 (d)</b>	<b>54,000</b>



**Table 3: Summary of Groundwater Analytical Data  
Total and Hexavalent Chromium**  
Electro-Coatings Inc.  
1401 and 1421 Park Avenue, Emeryville, California

Monitor Well	Date Sampled	Total Chromium ( $\mu\text{g/L}$ ) (a)	Hexavalent Chromium ( $\mu\text{g/L}$ ) (b)
MW-7	20-Apr-95	Not Located	
	19-Sep-95	NS	NS
	15-Dec-95	NS	NS
	8-Mar-96	NS	NS
	11-Jun-96	NS	NS
	13-Sep-96	NS	NS
	<b>11-Dec-96</b>	<b>NS</b>	<b>NS</b>
MW-8	Sep-81	ND (<1)	NA
	Oct-81	2	NA
	Nov-81	3	NA
	Dec-81	70	NA
	Feb-85	ND (<20)	ND (<20)
	Jun-91	NA	NA
	Oct-91	ND (<50)	ND (<10)
	21-Apr-95	33	ND (<5.0)
	19-Sep-95	NS	NS
	15-Dec-95	NS	NS
	8-Mar-96	NS	NS
	11-Jun-96	NS	NS
	13-Sep-96	NS	NS
<b>11-Dec-96</b>	<b>NS</b>	<b>NS</b>	



**Table 3: Summary of Groundwater Analytical Data  
Total and Hexavalent Chromium**  
Electro-Coatings Inc.  
1401 and 1421 Park Avenue, Emeryville, California

Monitor Well	Date Sampled	Total Chromium ( $\mu\text{g/L}$ ) (a)	Hexavalent Chromium ( $\mu\text{g/L}$ ) (b)
MW-9	Jan-81	258,000	185,000
	Sep-81	NA	NA
	Oct-81	NA	NA
	Nov-81	NA	NA
	Dec-81	NA	NA
	Feb-85	892,000	877,000
	Jun-91	NA	NA
	Oct-91	140,000	130,000
	21-Apr-95	66,000	70,000
	19-Sep-95	NS	NS
	15-Dec-95	NS	NS
	8-Mar-96	NS	NS
	11-Jun-96	NS	NS
	13-Sep-96	56,000	5,800
11-Dec-96	NS	NS	
MW-10 (c)	Jan-81	17,000	14,000
	Sep-81	NA	NA
	Oct-81	NA	NA
	Nov-81	NA	NA
	Dec-81	NA	NA
	Feb-85	746,000	740,000
	Jun-91	NA	NA
	Oct-91	490,000	450,000
	21-Apr-95	160,000	170,000
	19-Sep-95	NS	NS
	15-Dec-09	NS	NS
	8-Mar-96	NS	NS
	11-Jun-96	NS	NS
	13-Sep-96	NS	NS
11-Dec-96	NS	NS	



**Table 3: Summary of Groundwater Analytical Data  
Total and Hexavalent Chromium**  
Electro-Coatings Inc.  
1401 and 1421 Park Avenue, Emeryville, California

Monitor Well	Date Sampled	Total Chromium ( $\mu\text{g/L}$ ) (a)	Hexavalent Chromium ( $\mu\text{g/L}$ ) (b)
MW-11 (c)	Jan-81	129,000	115,000
	Jul-81	340	34
	Sep-81	NA	NA
	Oct-81	NA	NA
	Nov-81	NA	NA
	Dec-81	NA	NA
	Feb-85	2,440	2,410
	Jun-91	NA	NA
	Oct-91	470	410
	20-Apr-95	420	950
	19-Sep-95	NS	NS
	15-Dec-95	NS	NS
	8-Mar-96	NS	NS
	11-Jun-96	NS	NS
	13-Sep-96	170	6.0
<b>11-Dec-96</b>	<b>NS</b>	<b>NS</b>	
MW-12 (c)	Jan-81	32,000	12,000
	Jul-81	NA	NA
	Sep-81	NA	NA
	Oct-81	NA	NA
	Nov-81	NA	NA
	Dec-81	NA	NA
	Feb-85	240,000	240,000
	Jun-91	38,000	29,700
	Oct-91	44,000	39,000
	20-Apr-95	10,000	10,000
	19-Sep-95	18,000	19,000
	14-Dec-95	17,000	20,000
	8-Mar-96	NS	NS
	11-Jun-96	130	16
	13-Sep-96	260	ND(<5.0)
<b>11-Dec-96</b>	<b>1,100 (d)</b>	<b>1,400</b>	



**Table 3: Summary of Groundwater Analytical Data  
Total and Hexavalent Chromium**  
Electro-Coatings Inc.  
1401 and 1421 Park Avenue, Emeryville, California

Monitor Well	Date Sampled	Total Chromium ( $\mu\text{g/L}$ ) (a)	Hexavalent Chromium ( $\mu\text{g/L}$ ) (b)
MW-13	Jan-81	381,000	325,000
	Jul-81	NA	NA
	Sep-81	NA	NA
	Oct-81	NA	NA
	Nov-81	NA	NA
	Dec-81	NA	NA
	Feb-85	676,000	676,000
	Jun-91	NA	NA
	Oct-91	510,000	430,000
	Jul-94	230,000	130,000
	20-Apr-95	210,000	220,000
	19-Sep-95	200,000	210,000
	15-Dec-95	170,000	210,000
	8-Mar-96	170,000	200,000
	11-Jun-96	170,000	160,000
	13-Sep-96	160,000	13,000
	<b>11-Dec-96</b>	<b>160,000 (d)</b>	<b>170,000</b>
MW-14	Feb-85	654,000	632,000
	Jun-91	NA	
	Oct-91	320,000	310,000
	Jul-94	NA	
	21-Apr-95	130,000	140,000
	19-Sep-95	NS	NS
	15-Dec-95	NS	NS
	8-Mar-96	NS	NS
	11-Jun-96	NS	NS
	13-Sep-96	100,000	9,700
		<b>11-Dec-96</b>	<b>NS</b>



**Table 3: Summary of Groundwater Analytical Data  
Total and Hexavalent Chromium**  
Electro-Coatings Inc.  
1401 and 1421 Park Avenue, Emeryville, California

Monitor Well	Date Sampled	Total Chromium ( $\mu\text{g/L}$ ) (a)	Hexavalent Chromium ( $\mu\text{g/L}$ ) (b)
MW-15	Feb-85	ND (<20)	ND (<20)
	Jun-91	30	NA
	Oct-91	ND (<50)	ND (<10)
	Jul-94	NA	ND (<10)
	21-Apr-95	ND (<10)	ND (<5.0)
	19-Sep-95	NS	NS
	15-Dec-95	NS	NS
	8-Mar-96	NS	NS
	11-Jun-96	NS	NS
	13-Sep-96	NS	NS
	11-Dec-96	NS	NS
MW-16 (c)	Feb-85	460,000	460,000
	Jun-91	NA	NA
	Oct-91	240,000	290,000
	Jul-94	120,000	320,000
	20-Apr-95	100,000	100,000
	19-Sep-95	83,000	87,000
	14-Dec-95	57,000	74,000
	8-Mar-96	73,000	83,000
	11-Jun-96	67,000	20,000
	13-Sep-96	60,000	6,400
	11-Dec-96	65,000 (d)	73,000



**Table 3: Summary of Groundwater Analytical Data  
Total and Hexavalent Chromium**  
Electro-Coatings Inc.  
1401 and 1421 Park Avenue, Emeryville, California

Monitor Well	Date Sampled	Total Chromium ( $\mu\text{g/L}$ ) (a)	Hexavalent Chromium ( $\mu\text{g/L}$ ) (b)
MW-17	Feb-85	90,000	38,200
	Jun-91	NA	NA
	Oct-91	250,000	300,000
	Jul-94	190,000	200,000
	20-Apr-95	150,000	160,000
	19-Sep-95	170,000	180,000
	14-Dec-95	160,000	200,000
	8-Mar-96	140,000	150,000
	11-Jun-96	130,000	150,000
	13-Sep-96	130,000	12,000
	<b>11-Dec-96</b>	<b>170,000 (d)</b>	<b>200,000</b>
MW-18	Feb-85	60,500	55,000
	Jun-91	NA	NA
	Oct-91	31,000	24,000
	Jul-94	NA	NA
	22-Apr-95	24,000	23,000
	19-Sep-95	25,000	27,000
	14-Dec-95	20,000	22,000
	8-Mar-96	22,000	23,000
	11-Jun-96	19,000	17,000
	13-Sep-96	NS	NS
<b>11-Dec-96</b>	<b>NS</b>	<b>NS</b>	
MW-18A	Jun-83	20	ND (<20)
	Feb-85	ND (<20)	ND (<20)
	Oct-91	ND (<50)	ND (<10)
	20-Apr-95	ND (<10)	ND (<5.0)
	19-Sep-95	ND (<10)	ND (<5.0)
	15-Dec-95	17	ND (<5.0)
	8-Mar-96	ND (<50)	ND (<5.0)
	11-Jun-96	38	ND (<0.0050)
	13-Sep-96	NS	NS
	<b>11-Dec-96</b>	<b>NS</b>	<b>NS</b>



**Table 3: Summary of Groundwater Analytical Data  
Total and Hexavalent Chromium**  
Electro-Coatings Inc.  
1401 and 1421 Park Avenue, Emeryville, California

Monitor Well	Date Sampled	Total Chromium ( $\mu\text{g/L}$ ) (a)	Hexavalent Chromium ( $\mu\text{g/L}$ ) (b)
MW-19	Jun-83	NA (<20)	NA (<20)
	Feb-85	20	20
	Oct-91	NA	NA
	20-Apr-95	Not Located	
	19-Sep-95	NS	NS
	15-Dec-95	NS	NS
	8-Mar-96	NS	NS
	11-Jun-96	NS	NS
	13-Sep-96	NS	NS
	<b>11-Dec-96</b>	<b>NS</b>	<b>NS</b>
MW-20	Jun-83	1,300	1,200
	Aug-83	90	40
	Feb-85	ND (<20)	ND (<20)
	Oct-91	ND (<50)	14
	21-Apr-95	ND (<10)	ND (<5.0)
	19-Sep-95	ND (<10)	ND (<5.0)
	15-Dec-95	22	ND (<5.0)
	8-Mar-96	22	ND (<5.0)
	11-Jun-96	96	ND (<0.0050)
	13-Sep-96	120	ND(5.0)
<b>11-Dec-96</b>	<b>NS</b>	<b>NS</b>	
MW-21	Jun-83	20	ND (<20)
	Feb-85	40	ND (<20)
	20-Apr-95	Not Located	
	19-Sep-95	NS	NS
	15-Dec-95	NS	NS
	8-Mar-96	NS	NS
	11-Jun-96	NS	NS
	13-Sep-96	NS	NS
	<b>11-Dec-96</b>	<b>NS</b>	<b>NS</b>

Notes appear on the following page.





**Table 3: Summary of Groundwater Analytical Data  
Total and Hexavalent Chromium**  
Electro-Coatings Inc.  
1401 and 1421 Park Avenue, Emeryville, California

Monitor Well	Date Sampled	Total Chromium ( $\mu\text{g/L}$ ) (a)	Hexavalent Chromium ( $\mu\text{g/L}$ ) (b)
(a)	Analysis by USEPA Method 200.7.		
(b)	Analysis by USEPA Method 7196.		
(c)	Denotes well that was part of the pilot study performed during August 1995 through February 1996.		
(d)	Laboratory indicates results are questionable due to samples being marked preserved which were not.		
NA	Not Analyzed		
NS	Not Sampled as part of the quarterly monitoring program.		
ND()	Not detected; laboratory method detection limit in parentheses.		
$\mu\text{g/L}$	Micrograms per liter.		



**Table 4: Summary of Groundwater Analytical Data - Purgeable Halocarbons**  
 Electro-Coatings Inc.  
 1401 and 1421 Park Avenue, Emeryville, California

Monitor Well	Date Sampled	TCE (µg/L) (a)	PCE (µg/L) (a)	TCA (µg/L) (a)	1,1-DCE (µg/L) (a)	trans 1,2-DCE (µg/L) (a)	cis 1,2-DCE (µg/L) (a)	1,1-DCA (µg/L) (a)	1,2-DCA (µg/L) (a)	Chloro-benzene (µg/L) (a)	1,2-Dichloro-benzene (µg/L) (a)	Vinyl Chloride (µg/L) (a)
MW-1 <i>copy</i>	21-Mar-85	33	21	ND (<0.5)	ND (<0.5)	ND (<0.5)	NR	ND (<0.5)	NR	NR	NR	ND (<0.5)
	15-Nov-91	11	0.6	ND (<0.5)	0.5	4.8	NR	1.6	NR	NR	NR	ND (<1)
	20-Apr-95	Not Located	---	---	---	---	---	---	---	---	---	---
	19-Sep-95	Not Sampled as Part of Quarterly Monitoring Program										
	15-Dec-95	Not Sampled as Part of Quarterly Monitoring Program										
	8-Mar-96	Not Sampled as Part of Quarterly Monitoring Program										
	11-Jun-96	Not Sampled as Part of Quarterly Monitoring Program										
	13-Sep-96	14	ND(<0.50)	ND(<0.50)	0.63	ND(<0.50)	1.9	ND(<0.50)	0.78	ND(<0.50)	ND(<0.50)	ND(<0.50)
11-Dec-96	Not Sampled as Part of Quarterly Monitoring Program											
MW-2	15-Nov-91	Not Sampled	---	---	---	---	---	---	---	---	---	---
	20-Apr-95	Not Located	---	---	---	---	---	---	---	---	---	---
	19-Sep-95	Not Sampled as Part of Quarterly Monitoring Program										
	15-Dec-95	Not Sampled as Part of Quarterly Monitoring Program										
	8-Mar-96	Not Sampled as Part of Quarterly Monitoring Program										
	11-Jun-96	Not Sampled as Part of Quarterly Monitoring Program										
	13-Sep-96	Not Sampled as Part of Quarterly Monitoring Program										
11-Dec-96	Not Sampled as Part of Quarterly Monitoring Program											
MW-3A <i>copy</i>	29-Oct-91	ND (<0.5)	ND (<0.5)	ND (<0.5)	ND (<0.5)	ND (<0.5)	NR	ND (<0.5)	NR	NR	NR	ND (<1)
	20-Apr-95	ND (<0.5)	ND (<0.5)	ND (<0.5)	ND (<0.5)	ND (<0.5)	ND (<0.5)	ND (<0.5)	ND (<0.5)	ND (<0.5)	ND (<0.5)	ND(<1.0)
	19-Sep-95	0.56	ND (<0.5)	ND (<0.5)	ND (<0.5)	ND (<0.5)	ND (<0.5)	ND (<0.5)	ND (<0.5)	ND (<0.5)	ND (<0.5)	ND(<1.0)
	14-Dec-95	ND (<0.50)	ND (<0.50)	ND (<0.50)	ND (<0.50)	ND (<0.50)	ND (<0.50)	ND (<0.50)	ND (<0.50)	ND (<0.50)	ND (<0.50)	ND(<1.0)
	8-Mar-96	Not Sampled as Part of Quarterly Monitoring Program										
	11-Jun-96	ND (<0.50)	ND (<0.50)	ND (<0.50)	ND (<0.50)	ND (<0.50)	ND (<0.50)	ND (<0.50)	ND (<0.50)	ND (<0.50)	ND (<0.50)	ND(<1.0)
	13-Sep-96	ND (<0.50)	ND (<0.50)	ND (<0.50)	ND (<0.50)	ND (<0.50)	ND (<0.50)	ND (<0.50)	ND (<0.50)	ND (<0.50)	ND (<0.50)	ND (<0.50)
11-Dec-96	ND (<0.50)	ND (<0.50)	ND (<0.50)	ND (<0.50)	ND (<0.50)	ND (<0.50)	ND (<0.50)	ND (<0.50)	ND (<0.50)	ND (<0.50)	ND (<0.50)	ND(<1.0)



**Table 4: Summary of Groundwater Analytical Data - Purgeable Halocarbons**  
 Electro-Coatings Inc.  
 1401 and 1421 Park Avenue, Emeryville, California

Monitor Well	Date Sampled	TCE (µg/L) (a)	PCE (µg/L) (a)	TCA (µg/L) (a)	1,1-DCE (µg/L) (a)	trans	cis	1,1-DCA (µg/L) (a)	1,2-DCA (µg/L) (a)	Chloro- benzene (µg/L) (a)	1,2-Dichloro- benzene (µg/L) (a)	Vinyl Chloride (µg/L) (a)
						1,2-DCE (µg/L) (a)	1,2-DCE (µg/L) (a)					
MW-3B (b)	29-Oct-91	650	6.8	ND (<0.5)	13	45	NR	1.2	NR	NR	NR	6.4
	20-Apr-95	260	ND (<10)	ND (<10)	ND (<10)	23	17	ND (<10)	ND (<10)	ND (<10)	ND (<10)	ND (<20)
	19-Sep-95	Not Sampled as Part of Quarterly Monitoring Program										
	15-Dec-95	Not Sampled as Part of Quarterly Monitoring Program										
	8-Mar-96	Not Sampled as Part of Quarterly Monitoring Program										
	11-Jun-96	Not Sampled as Part of Quarterly Monitoring Program										
	13-Sep-96	Not Sampled as Part of Quarterly Monitoring Program										
	11-Dec-96	Not Sampled as Part of Quarterly Monitoring Program										
MW-3C	11-Jun-85	150	1.7	2.4	ND (<0.5)	23	NR	ND (<0.5)	NR	NR	NR	ND (<0.5)
	21-Oct-91	180	1.7	34	61	26	NR	5.4	NR	NR	NR	18
	20-Apr-95	30	ND (<0.5)	0.66	1.6	ND (<0.5)	11	2.0	ND (<0.5)	ND (<0.5)	ND (<0.5)	2.2
	19-Sep-95	Not Sampled as Part of Quarterly Monitoring Program										
	15-Dec-95	Not Sampled as Part of Quarterly Monitoring Program										
	8-Mar-96	Not Sampled as Part of Quarterly Monitoring Program										
	11-Jun-96	Not Sampled as Part of Quarterly Monitoring Program										
	13-Sep-96	Not Sampled as Part of Quarterly Monitoring Program										
11-Dec-96	Not Sampled as Part of Quarterly Monitoring Program											
MW-4	4-Nov-91	2,100	31	ND (<5)	ND (<5)	269	NR	ND (<5)	NR	NR	NR	10
	28-Jul-94	6,500	NA	NA	NA	NA	NR	NA	NR	NR	NR	NA
	21-Apr-95	4,400	ND (<50)	ND (<50)	ND (<50)	ND (<50)	430	ND (<50)	ND (<50)	ND (<50)	ND (<50)	ND (<100)
	19-Sep-95	3,500	65	ND (<50)	ND (<50)	92	590	ND (<50)	ND (<50)	ND (<50)	ND (<50)	ND (<100)
	15-Dec-95	2,900	27	ND (<10)	ND (<10)	44	330	ND (<10)	ND (<10)	ND (<10)	ND (<10)	ND (<20)
	8-Mar-96	3,100	84	ND (<50)	ND (<50)	ND (<50)	360	ND (<50)	ND (<50)	ND (<50)	ND (<50)	ND (<100)
	11-Jun-96	3,100	ND (<100)	ND (<100)	ND (<100)	ND (<100)	280	ND (<100)	ND (<100)	ND (<100)	ND (<100)	ND (<200)
	13-Sep-96	1,800	63	ND (<50)	ND (<50)	58	410	ND (<50)	ND (<50)	ND (<50)	ND (<50)	ND (<100)
	11-Dec-96	1,600	ND (<50)	ND (<50)	ND (<50)	ND (<50)	260	ND (<50)	ND (<50)	ND (<50)	ND (<50)	ND (<100)



**Table 4: Summary of Groundwater Analytical Data - Purgeable Halocarbons**  
 Electro-Coatings Inc.  
 1401 and 1421 Park Avenue, Emeryville, California

Monitor Well	Date Sampled	TCE (µg/L) (a)	PCE (µg/L) (a)	TCA (µg/L) (a)	1,1-DCE (µg/L) (a)	trans 1,2-DCE (µg/L) (a)	cis 1,2-DCE (µg/L) (a)	1,1-DCA (µg/L) (a)	1,2-DCA (µg/L) (a)	Chloro-benzene (µg/L) (a)	1,2-Dichloro-benzene (µg/L) (a)	Vinyl Chloride (µg/L) (a)
MW-5	4-Nov-91	410	8.9	1.3	4.2	120	NR	42				54
	21-Apr-95	210	10	ND (<5)	ND (<5)	13	31	13	ND (<5)	ND (<5)	ND (<5)	ND (<10)
	19-Sep-95	Not Sampled as Part of Quarterly Monitoring Program										
	15-Dec-95	Not Sampled as Part of Quarterly Monitoring Program										
	8-Mar-96	Not Sampled as Part of Quarterly Monitoring Program										
	11-Jun-96	Not Sampled as Part of Quarterly Monitoring Program										
	13-Sep-96	Not Sampled as Part of Quarterly Monitoring Program										
	11-Dec-96	Not Sampled as Part of Quarterly Monitoring Program										
MW-6	11-Jun-85	220	ND (<0.5)	3.9	ND (<5)	54	NR	ND (<5)	NR	NR	NR	ND (<5)
	5-Nov-91	420	5.9	6.4	29	78	NR	ND (<0.5)	NR	NR	NR	19
	28-Jul-94	790	NA	NA	NA	NA	NR	NA	NR	NR	NR	NA
	20-Apr-95	320	ND (<10)	ND (<10)	34	ND (<10)	55	ND (<10)	ND (<10)	ND (<10)	ND (<10)	ND (<20)
	19-Sep-95	210	6.4	ND (<5)	46	12	48	ND (<5)	ND (<5)	5.1	ND (<5)	13
	14-Dec-95	400	ND (<10)	ND (<10)	74	ND (<10)	53	ND (<10)	ND (<10)	ND (<10)	ND (<10)	ND (<20)
	8-Mar-96	290	ND (<50)	ND (<50)	ND (<50)	ND (<50)	ND (<50)	ND (<50)	ND (<50)	ND (<50)	ND (<50)	ND (<100)
	11-Jun-96	300	ND (<50)	ND (<50)	ND (<50)	ND (<50)	ND (<50)	ND (<50)	ND (<50)	ND (<50)	ND (<50)	ND (<100)
	13-Sep-96	480	ND (<50)	ND (<50)	64	ND (<50)	ND (<50)	ND (<50)	ND (<50)	ND (<50)	ND (<50)	ND (<100)
	11-Dec-96	360	ND (<50)	ND (<50)	59	ND (<50)	ND (<50)	ND (<50)	ND (<50)	ND (<50)	ND (<50)	ND (<100)
MW-7	20-Apr-95	Not Located	---	---	---	---	---	---	---	---	---	---
	19-Sep-95	Not Sampled as Part of Quarterly Monitoring Program										
	15-Dec-95	Not Sampled as Part of Quarterly Monitoring Program										
	8-Mar-96	Not Sampled as Part of Quarterly Monitoring Program										
	11-Jun-96	Not Sampled as Part of Quarterly Monitoring Program										
	13-Sep-96	Not Sampled as Part of Quarterly Monitoring Program										
	11-Dec-96	Not Sampled as Part of Quarterly Monitoring Program										



**Table 4: Summary of Groundwater Analytical Data - Purgeable Halocarbons**  
 Electro-Coatings Inc.  
 1401 and 1421 Park Avenue, Emeryville, California

Monitor Well	Date Sampled	TCE (µg/L) (a)	PCE (µg/L) (a)	TCA (µg/L) (a)	1,1-DCE (µg/L) (a)	trans 1,2-DCE (µg/L) (a)	cis 1,2-DCE (µg/L) (a)	1,1-DCA (µg/L) (a)	1,2-DCA (µg/L) (a)	Chloro-benzene (µg/L) (a)	1,2-Dichloro-benzene (µg/L) (a)	Vinyl Chloride (µg/L) (a)
MW-8	10-Jun-85	46	18	ND (<1)	ND (<1)	19	NR	1	NR	NR	NR	3
	11-Jun-85	93	35	ND (<0.5)	1	32	NR	1	NR	NR	NR	NA
	5-Nov-91	38	35	ND (<0.5)	0.8	23	NR	1.8	NR	NR	NR	4.9
	21-Apr-95	40	18	ND(<1.0)	ND(<1.0)	6.7	46	1.2	5.6	ND(<1.0)	ND(<1.0)	16
	19-Sep-95	Not Sampled as Part of Quarterly Monitoring Program										
	15-Dec-95	Not Sampled as Part of Quarterly Monitoring Program										
	8-Mar-96	Not Sampled as Part of Quarterly Monitoring Program										
	11-Jun-96	Not Sampled as Part of Quarterly Monitoring Program										
	13-Sep-96	Not Sampled as Part of Quarterly Monitoring Program										
	11-Dec-96	Not Sampled as Part of Quarterly Monitoring Program										
MW-9	13-Jun-85	700	26	ND (<5)	ND (<5)	31	NR	ND (<5)	NR	NR	NR	ND (<5)
	30-Oct-91	200	11	ND (<0.5)	ND (<0.5)	13	NR	1.3	NR	NR	NR	ND (<1)
	21-Apr-95	73	13	ND (<2)	ND (<2)	ND (<2)	6.4	ND (<2)	ND (<2)	ND (<2)	ND (<2)	ND (<4)
	19-Sep-95	Not Sampled as Part of Quarterly Monitoring Program										
	15-Dec-95	Not Sampled as Part of Quarterly Monitoring Program										
	8-Mar-96	Not Sampled as Part of Quarterly Monitoring Program										
	11-Jun-96	Not Sampled as Part of Quarterly Monitoring Program										
	13-Sep-96	ND(<50)	75	ND(<50)	ND(<50)	ND(<50)	ND(<50)	ND(<50)	ND(<50)	ND(<50)	ND(<50)	ND(<50)
11-Dec-96	Not Sampled as Part of Quarterly Monitoring Program											
MW-10 (b)	12-Jun-85	5,100	81	ND(<50)	ND(<50)	ND(<50)	NR	ND(<50)	NR	NR	NR	ND(<50)
	12-Jun-85	12,000	ND(<50)	ND(<50)	ND(<50)	600	NR	ND(<50)	NR	NR	NR	NA
	7-Nov-91	14,000	ND(<50)	6,500	3,800	640	NR	ND(<50)	NR	NR	NR	ND(<100)
	21-Apr-95	10,000	ND (<100)	1,000	1,200	ND (<100)	900	ND (<100)	ND (<100)	ND (<100)	ND (<100)	ND (<200)
	19-Sep-95	Not Sampled as Part of Quarterly Monitoring Program										
	15-Dec-95	Not Sampled as Part of Quarterly Monitoring Program										
	8-Mar-96	Not Sampled as Part of Quarterly Monitoring Program										
	11-Jun-96	Not Sampled as Part of Quarterly Monitoring Program										
	13-Sep-96	Not Sampled as Part of Quarterly Monitoring Program										
11-Dec-96	Not Sampled as Part of Quarterly Monitoring Program											



**Table 4: Summary of Groundwater Analytical Data - Purgeable Halocarbons**  
 Electro-Coatings Inc.  
 1401 and 1421 Park Avenue, Emeryville, California

Monitor Well	Date Sampled	TCE (µg/L) (a)	PCE (µg/L) (a)	TCA (µg/L) (a)	1,1-DCE (µg/L) (a)	trans 1,2-DCE (µg/L) (a)	cis 1,2-DCE (µg/L) (a)	1,1-DCA (µg/L) (a)	1,2-DCA (µg/L) (a)	Chloro-benzene (µg/L) (a)	1,2-Dichloro-benzene (µg/L) (a)	Vinyl Chloride (µg/L) (a)
MW-11 (b)	12-Jun-85	19	5.3	1.3	ND (<0.5)	3.4	NR	ND (<0.5)	NR	NR	NR	ND (<0.5)
	15-Nov-91	10	1.5	ND (<0.5)	ND (<0.5)	3.1	NR	ND (<0.5)	NR	NR	NR	ND (<1)
	20-Apr-95	67	7.4	ND (<5)	ND (<5)	ND (<5)	6.2	ND (<5)	ND (<5)	ND (<5)	ND (<5)	ND (<10)
	19-Sep-95	Not Sampled as Part of Quarterly Monitoring Program										
	15-Dec-95	Not Sampled as Part of Quarterly Monitoring Program										
	8-Mar-96	Not Sampled as Part of Quarterly Monitoring Program										
	11-Jun-96	Not Sampled as Part of Quarterly Monitoring Program										
	13-Sep-96	6.0	0.73	ND (<0.50)	ND (<0.50)	ND (<0.50)	3.6	0.6	1.0	ND (<0.50)	ND (<0.50)	ND (<1.0)
	11-Dec-96	Not Sampled as Part of Quarterly Monitoring Program										
MW-12 (b)	11-Nov-91	130	10	4.6	3.3	9	NR	1.3	NR	NR	NR	ND (<2)
	20-Apr-95	52	9.4	3.9	9.0	ND (<2.5)	5.0	ND (<2.5)	ND (<2.5)	ND (<2.5)	ND (<2.5)	ND (<5)
	19-Sep-95	67	14	7.2	15	3.8	9.1	1.6	2.9	ND (<1.3)	ND (<1.3)	ND (<2.5)
	15-Dec-95	79	ND (<10)	ND (<10)	ND (<10)	ND (<10)	ND (<10)	ND (<10)	ND (<10)	ND (<10)	ND (<10)	ND (<20)
	8-Mar-96	ND (<50)	850	ND (<50)	ND (<50)	ND (<50)	ND (<50)	ND (<50)	ND (<50)	ND (<50)	ND (<50)	ND (<100)
	11-Jun-96	2.7	ND (<1.0)	2.6	3.9	1.4	39	1.6	1.4	ND (<1.0)	ND (<1.0)	13
	13-Sep-96	23	2.3	5.9	12	1.5	15	2.9	1.9	ND (<0.50)	ND (<0.50)	ND (<1.0)
	11-Dec-96	55	5.0	4.9	6.2	0.83	11	1.4	1.5	ND (<0.50)	ND (<0.50)	ND (<1.0)
MW-13	8-Nov-91	630	8.9	ND (<5)	6.8	89	NR	15	NR	NR	NR	20
	28-Jul-94	770	NA	NA	NA	NA	NR	NA	NR	NR	NR	NA
	20-Apr-95	360	8.9	ND (<5)	ND (<5)	16	70	14	ND (<5)	ND (<5)	ND (<5)	20
	19-Sep-95	240	12.0	ND (<5)	ND (<5)	25	72	18	ND (<5)	ND (<5)	ND (<5)	42
	15-Dec-95	380	ND (<10)	ND (<10)	ND (<10)	17	68	ND (<10)	ND (<10)	ND (<10)	ND (<10)	ND (<20)
	8-Mar-96	270	ND (<50)	ND (<50)	ND (<50)	ND (<50)	68	ND (<50)	ND (<50)	ND (<50)	ND (<50)	ND (<100)
	11-Jun-96	250	ND (<50)	ND (<50)	ND (<50)	ND (<50)	ND (<50)	ND (<50)	ND (<50)	ND (<50)	ND (<50)	ND (<100)
	13-Sep-96	430	ND (<50)	ND (<50)	ND (<50)	ND (<50)	84	ND (<50)	ND (<50)	ND (<50)	ND (<50)	ND (<100)
11-Dec-96	250	ND (<50)	ND (<50)	ND (<50)	ND (<50)	56	ND (<50)	ND (<50)	ND (<50)	ND (<50)	ND (<100)	



**Table 4: Summary of Groundwater Analytical Data - Purgeable Halocarbons**  
 Electro-Coatings Inc.  
 1401 and 1421 Park Avenue, Emeryville, California

Monitor Well	Date Sampled	TCE ( $\mu\text{g/L}$ ) (a)	PCE ( $\mu\text{g/L}$ ) (a)	TCA ( $\mu\text{g/L}$ ) (a)	1,1-DCE ( $\mu\text{g/L}$ ) (a)	trans 1,2-DCE ( $\mu\text{g/L}$ ) (a)	cis 1,2-DCE ( $\mu\text{g/L}$ ) (a)	1,1-DCA ( $\mu\text{g/L}$ ) (a)	1,2-DCA ( $\mu\text{g/L}$ ) (a)	Chloro- benzene ( $\mu\text{g/L}$ ) (a)	1,2-Dichloro- benzene ( $\mu\text{g/L}$ ) (a)	Vinyl Chloride ( $\mu\text{g/L}$ ) (a)	
MW-14 <i>Sand</i>	21-Mar-85	580	26	ND (<0.5)	ND (<0.5)	ND (<0.5)	NR	ND (<0.5)	NR	NR	NR	ND (<0.5)	
	11-Nov-91	4,300	13	17	13	150	NR	19	NR	NR	NR	30	
	21-Apr-95	8,100	ND (<10)	ND (<10)	ND (<10)	ND (<10)	36	ND (<10)	ND (<10)	ND (<10)	ND (<10)	ND (<20)	
	19-Sep-95	Not Sampled as Part of Quarterly Monitoring Program											
	15-Dec-95	Not Sampled as Part of Quarterly Monitoring Program											
	8-Mar-96	Not Sampled as Part of Quarterly Monitoring Program											
	11-Jun-96	Not Sampled as Part of Quarterly Monitoring Program											
	13-Sep-96	4,700	ND (<1000)	ND (<1000)	ND (<1000)	ND (<1000)	ND (<1000)	ND (<1000)	ND (<1000)	ND (<1000)	ND (<1000)	ND (<1000)	ND (<2000)
	11-Dec-96	Not Sampled as Part of Quarterly Monitoring Program											
MW-15	13-Jun-85	1,200	ND (<50)	ND (<50)	ND (<50)	410	NR	ND (<50)	NR	NR	NR	ND (<50)	
	21-Nov-91	650	ND (<5)	ND (<5)	ND (<5)	220	NR	ND (<5)	NR	NR	NR	ND (<10)	
	21-Apr-95	300	ND (<10)	ND (<10)	ND (<10)	130	88	ND (<10)	ND (<10)	ND (<10)	ND (<10)	ND (<20)	
	19-Sep-95	Not Sampled as Part of Quarterly Monitoring Program											
	15-Dec-95	Not Sampled as Part of Quarterly Monitoring Program											
	8-Mar-96	Not Sampled as Part of Quarterly Monitoring Program											
	11-Jun-96	Not Sampled as Part of Quarterly Monitoring Program											
	13-Sep-96	Not Sampled as Part of Quarterly Monitoring Program											
	11-Dec-96	Not Sampled as Part of Quarterly Monitoring Program											
MW-16 <i>SP</i>	21-Mar-85	360	42	ND (<0.5)	ND (<0.5)	ND (<0.5)	NR	ND (<0.5)	NR	NR	NR	ND (<0.5)	
	(b) 19-Nov-91	19,000	ND (<5)	1,300	1,200	2299	NR	ND (<5)	NR	NR	NR	420	
	28-Jul-94	22,000	NA	NA	NA	NA	NR	NA	NR	NR	NR	NA	
	20-Apr-95	10,000	13	180	390	67	2,400	28	ND (<10)	12	ND (<10)	300	
	19-Sep-95	7,800	ND (<125)	190	590	190	2,500	ND (<125)	ND (<125)	ND (<125)	ND (<125)	730	
	14-Dec-95	11,000	ND (<0.50)	140	620	100	2,300	26	ND (<0.50)	ND (<0.50)	ND (<0.50)	460	
	8-Mar-96	9,900	ND (<200)	ND (<200)	460	ND (<200)	2,400	ND (<200)	ND (<200)	ND (<200)	ND (<200)	ND (<400)	
	11-Jun-96	9,700	ND (<200)	ND (<200)	ND (<200)	ND (<200)	2,100	ND (<200)	ND (<200)	ND (<200)	ND (<200)	440	
	13-Sep-96	11,000	ND (<1000)	ND (<1000)	ND (<1000)	ND (<1000)	2,200	ND (<1000)	ND (<1000)	ND (<1000)	ND (<1000)	ND (<2000)	
11-Dec-96	11,000	ND (<1000)	ND (<1000)	ND (<1000)	ND (<1000)	2,900	ND (<1000)	ND (<1000)	ND (<1000)	ND (<1000)	ND (<2000)		



**Table 4: Summary of Groundwater Analytical Data - Purgeable Halocarbons**  
 Electro-Coatings Inc.  
 1401 and 1421 Park Avenue, Emeryville, California

Monitor Well	Date Sampled	TCE (µg/L) (a)	PCE (µg/L) (a)	TCA (µg/L) (a)	1,1-DCE (µg/L) (a)	trans 1,2-DCE (µg/L) (a)	cis 1,2-DCE (µg/L) (a)	1,1-DCA (µg/L) (a)	1,2-DCA (µg/L) (a)	Chloro-benzene (µg/L) (a)	1,2-Dichloro-benzene (µg/L) (a)	Vinyl Chloride (µg/L) (a)	
MW-17	13-Jun-85	200	18	22	46	23	NR	ND (<5)	NR	NR	NR	ND (<5)	
	19-Nov-91	460	8.9	30	54	54	NR	7.8	NR	NR	NR	420	
	28-Jul-95	780	NA	NA	NA	NA	NR	NA	NR	NR	NR	NA	
	20-Apr-95	410	ND (<10)	ND (<10)	37	11	42	ND (<10)	ND (<10)	31	17	ND (<20)	
	19-Sep-95	260	9.8	11	42	23	50	ND (<5)	ND (<5)	52	28	ND (<10)	
	14-Dec-95	360	13	ND (<10)	38	ND (<10)	24	ND (<10)	ND (<10)	27	15	ND (<20)	
	8-Mar-96	310	ND (<0.50)	ND (<0.50)	ND (<0.50)	ND (<0.50)	ND (<0.50)	ND (<0.50)	ND (<0.50)	ND (<0.50)	ND (<0.50)	ND (<0.50)	ND (<100)
	11-Jun-96	270	ND (<0.50)	ND (<0.50)	ND (<0.50)	ND (<0.50)	ND (<0.50)	ND (<0.50)	ND (<0.50)	ND (<0.50)	ND (<0.50)	ND (<0.50)	ND (<100)
	13-Sep-96	1,900	ND(<200)	ND(<200)	410	ND(<200)	ND(<200)	ND(<200)	ND(<200)	ND(<200)	ND(<200)	ND(<200)	ND (<400)
	11-Dec-96	450	ND(<200)	ND(<200)	ND(<200)	ND(<200)	ND(<200)	ND(<200)	ND(<200)	ND(<200)	ND(<200)	ND(<200)	ND (<400)
MW-18	12-Jun-85	430	32	52	ND (<0.5)	140	NR	ND (<0.5)	NR	NR	NR	ND (<0.5)	
	12-Jun-85	340	ND(<50)	66	ND (<50)	ND (<50)	NR	ND (<50)	NR	NR	NR	NA	
	19-Nov-91	560	11	23	ND (<5)	160	NR	ND (<5)	NR	NR	NR	30	
	22-Apr-95	330	ND (<10)	16	ND (<10)	13	35	ND (<10)	ND (<10)	ND (<10)	ND (<10)	ND (<20)	
	19-Sep-95	200	14	16	ND (<5)	20	34	ND (<5)	ND (<5)	ND (<5)	ND (<5)	ND (<10)	
	14-Dec-95	280	ND (<10)	ND (<10)	ND (<10)	ND (<10)	18	ND (<10)	ND (<10)	ND (<10)	ND (<10)	ND (<20)	
	8-Mar-96	200	ND (<50)	ND (<50)	ND (<50)	ND (<50)	ND (<50)	ND (<50)	ND (<50)	ND (<50)	ND (<50)	ND (<100)	
	11-Jun-96	200	ND (<50)	ND (<50)	ND (<50)	ND (<50)	ND (<50)	ND (<50)	ND (<50)	ND (<50)	ND (<50)	ND (<100)	
	13-Sep-96	Not Sampled as Part of Quarterly Monitoring Program											
	11-Dec-96	Not Sampled as Part of Quarterly Monitoring Program											
MW-18A	13-Jun-85	10	ND (<0.5)	ND (<0.5)	ND (<0.5)	ND (<0.5)	NR	ND (<0.5)	NR	NR	NR	ND (<0.5)	
	19-Nov-91	ND (<0.5)	ND (<0.5)	ND (<0.5)	ND (<0.5)	ND (<0.5)	NR	ND (<0.5)	NR	NR	NR	ND (<1)	
	20-Apr-95	ND (<0.5)	ND (<0.5)	ND (<0.5)	ND (<0.5)	ND (<0.5)	ND (<0.5)	ND (<0.5)	ND (<0.5)	ND (<0.5)	ND (<0.5)	ND (<1.0)	
	19-Sep-95	ND (<0.5)	ND (<0.5)	ND (<0.5)	ND (<0.5)	ND (<0.5)	ND (<0.5)	ND (<0.5)	ND (<0.5)	ND (<0.5)	ND (<0.5)	ND (<1.0)	
	15-Dec-95	ND (<0.50)	ND (<0.50)	ND (<0.50)	ND (<0.50)	ND (<0.50)	ND (<0.50)	ND (<0.50)	ND (<0.50)	ND (<0.50)	ND (<0.50)	ND (<1.0)	
	8-Mar-96	ND (<0.50)	ND (<0.50)	ND (<0.50)	ND (<0.50)	ND (<0.50)	ND (<0.50)	ND (<0.50)	ND (<0.50)	ND (<0.50)	ND (<0.50)	ND (<1.0)	
	11-Jun-96	ND (<0.50)	ND (<0.50)	ND (<0.50)	ND (<0.50)	ND (<0.50)	ND (<0.50)	ND (<0.50)	ND (<0.50)	ND (<0.50)	ND (<0.50)	ND (<1.0)	
	13-Sep-96	Not Sampled as Part of Quarterly Monitoring Program											
11-Dec-96	Not Sampled as Part of Quarterly Monitoring Program												





**Table 4: Summary of Groundwater Analytical Data - Purgeable Halocarbons**  
 Electro-Coatings Inc.  
 1401 and 1421 Park Avenue, Emeryville, California

Monitor Well	Date Sampled	TCE (µg/L) (a)	PCE (µg/L) (a)	TCA (µg/L) (a)	1,1-DCE (µg/L) (a)	trans 1,2-DCE (µg/L) (a)	cis 1,2-DCE (µg/L) (a)	1,1-DCA (µg/L) (a)	1,2-DCA (µg/L) (a)	Chloro-benzene (µg/L) (a)	1,2-Dichloro-benzene (µg/L) (a)	Vinyl Chloride (µg/L) (a)
MW-19	21-Mar-85	91	23	ND (<0.5)	ND (<0.5)	ND (<0.5)	NR	ND (<0.5)	NR	NR	NR	ND (<0.5)
	20-Apr-95	Not Located	---	---	---	---	---	---	---	---	---	---
	19-Sep-95	Not Sampled as Part of Quarterly Monitoring Program										
	15-Dec-95	Not Sampled as Part of Quarterly Monitoring Program										
	8-Mar-96	Not Sampled as Part of Quarterly Monitoring Program										
	11-Jun-96	Not Sampled as Part of Quarterly Monitoring Program										
	13-Sep-96	Not Sampled as Part of Quarterly Monitoring Program										
	11-Dec-96	Not Sampled as Part of Quarterly Monitoring Program										
MW-20	15-Nov-91	ND (<0.5)	ND (<0.5)	ND (<0.5)	ND (<0.5)	ND (<0.5)	NR	ND (<0.5)	NR	NR	NR	ND (<1)
	21-Apr-95	3.5	ND (<0.5)	ND (<0.5)	ND (<0.5)	ND (<0.5)	ND (<0.5)	ND (<0.5)	ND (<0.5)	ND (<0.5)	ND (<0.5)	ND (<1.0)
	19-Sep-95	ND (<0.5)	ND (<0.5)	ND (<0.5)	ND (<0.5)	ND (<0.5)	ND (<0.5)	ND (<0.5)	ND (<0.5)	ND (<0.5)	ND (<0.5)	ND (<1.0)
	15-Dec-95	ND (<0.50)	ND (<0.50)	ND (<0.50)	ND (<0.50)	ND (<0.50)	ND (<0.50)	ND (<0.50)	ND (<0.50)	ND (<0.50)	ND (<0.50)	ND (<1.0)
	8-Mar-96	Not Sampled as Part of Quarterly Monitoring Program										
	11-Jun-96	ND (<0.50)	ND (<0.50)	ND (<0.50)	ND (<0.50)	ND (<0.50)	ND (<0.50)	ND (<0.50)	ND (<0.50)	ND (<0.50)	ND (<0.50)	ND (<1.0)
	13-Sep-96	ND (<0.50)	ND (<0.50)	ND (<0.50)	ND (<0.50)	ND (<0.50)	ND (<0.50)	ND (<0.50)	ND (<0.50)	ND (<0.50)	ND (<0.50)	ND (<1.0)
	11-Dec-96	Not Sampled as Part of Quarterly Monitoring Program										
MW-21	13-Jun-85	2,200	ND (<50)	110	NA (<50)	800	NR	NA (<50)	NR	NR	NR	NA (<50)
	21-Apr-95	Not Located	---	---	---	---	---	---	---	---	---	---
	19-Sep-95	Not Sampled as Part of Quarterly Monitoring Program										
	15-Dec-95	Not Sampled as Part of Quarterly Monitoring Program										
	8-Mar-96	Not Sampled as Part of Quarterly Monitoring Program										
	11-Jun-96	Not Sampled as Part of Quarterly Monitoring Program										
	13-Sep-96	Not Sampled as Part of Quarterly Monitoring Program										
	11-Dec-96	Not Sampled as Part of Quarterly Monitoring Program										
TB-LB	11-Dec-96	---	---	---	---	---	---	---	---	---	---	---

Notes appear on the following page.



**Table 4: Summary of Groundwater Analytical Data - Purgeable Halocarbons**  
 Electro-Coatings Inc.  
 1401 and 1421 Park Avenue, Emeryville, California

Monitor Well	Date Sampled	TCE ( $\mu\text{g/L}$ ) (a)	PCE ( $\mu\text{g/L}$ ) (a)	TCA ( $\mu\text{g/L}$ ) (a)	1,1-DCE ( $\mu\text{g/L}$ ) (a)	trans 1,2-DCE ( $\mu\text{g/L}$ ) (a)	cis 1,2-DCE ( $\mu\text{g/L}$ ) (a)	1,1-DCA ( $\mu\text{g/L}$ ) (a)	1,2-DCA ( $\mu\text{g/L}$ ) (a)	Chloro- benzene ( $\mu\text{g/L}$ ) (a)	1,2-Dichloro- benzene ( $\mu\text{g/L}$ ) (a)	Vinyl Chloride ( $\mu\text{g/L}$ ) (a)
--------------	--------------	--------------------------------	--------------------------------	--------------------------------	------------------------------------	---	---	------------------------------------	------------------------------------	---	---	--

NR - Not Reported

NA - Not Analyzed

(a) Analysis by USEPA Method 8010

(b) Denotes well that was part of the pilot study performed during August 1995 through February 1996.

ND( ) Not detected; laboratory method detection limit in parentheses.

TB-LB Trip blank-laboratory blank.

$\mu\text{g/L}$  Micrograms per liter.

--- Not sampled.





# Sequoia Analytical

680 Chesapeake Drive  
404 N. Wiget Lane  
819 Striker Avenue, Suite 8

Redwood City, CA 94063  
Walnut Creek, CA 94598  
Sacramento, CA 95854

(415) 364-9600  
(510) 988-9600  
(916) 921-9600

FAX (415) 364-9233  
FAX (510) 988-9673  
FAX (916) 921-0100

Geraghty & Miller, Inc.  
1050 Marina Way South  
Richmond, CA 94804  
Attention: Teresa Payne

Client Project ID: #RC0304.003  
Sample Descript: Water, MW-3A  
Analysis Method: EPA 5030/8010  
Lab Number: 812-0674

Sampled: Dec 11, 1996  
Received: Dec 11, 1996  
Analyzed: Dec 12, 1996  
Reported: Dec 30, 1996

QC Batch Number: GC121296801007A  
Instrument ID: HP-7

## HALOGENATED VOLATILE ORGANICS (EPA 8010)

Analyte	Detection Limit µg/L	Sample Results µg/L
Bromodichloromethane.....	0.50	N.D.
Bromoform.....	0.50	N.D.
Bromomethane.....	1.0	N.D.
Carbon tetrachloride.....	0.50	N.D.
Chlorobenzene.....	0.50	N.D.
Chloroethane.....	1.0	N.D.
2-ChloroethylVinyl ether.....	1.0	N.D.
Chloroform.....	0.50	N.D.
Chloromethane.....	1.0	N.D.
Dibromochloromethane.....	0.50	N.D.
1,3-Dichlorobenzene.....	0.50	N.D.
1,4-Dichlorobenzene.....	0.50	N.D.
1,2-Dichlorobenzene.....	0.50	N.D.
1,1-Dichloroethane.....	0.50	N.D.
1,2-Dichloroethane.....	0.50	N.D.
1,1-Dichloroethene.....	0.50	N.D.
cis-1,2-Dichloroethene.....	0.50	N.D.
trans-1,2-Dichloroethene.....	0.50	N.D.
1,2-Dichloropropane.....	0.50	N.D.
cis-1,3-Dichloropropene.....	0.50	N.D.
trans-1,3-Dichloropropene.....	0.50	N.D.
Methylene chloride.....	5.0	N.D.
1,1,1,2-Tetrachloroethane.....	0.50	N.D.
Tetrachloroethene.....	0.50	N.D.
1,1,1-Trichloroethane.....	0.50	N.D.
1,1,2-Trichloroethane.....	0.50	N.D.
Trichloroethene.....	0.50	N.D.
Trichlorofluoromethane.....	0.50	N.D.
Vinyl chloride.....	1.0	N.D.

Surrogates	Control Limit %	% Recovery
Dibromodifluoromethane.....	50 150.....	92
4-Bromofluorobenzene.....	50 150.....	94

Analytes reported as N.D. were not present above the stated limit of detection.

SEQUOIA ANALYTICAL, #1271

*Melissa A. Brewer*

Melissa A. Brewer  
Client Services Representative

8120574.GER <1>





# Sequoia Analytical

680 Chesapeake Drive  
404 N. Wiget Lane  
819 Striker Avenue, Suite 8

Redwood City, CA 94063  
Walnut Creek, CA 94598  
Sacramento, CA 95834

(415) 364-9600  
(510) 988-9600  
(916) 921-9600

FAX (415) 364-9233  
FAX (510) 988-9673  
FAX (916) 921-0100

Geraghty & Miller, Inc. 1050 Marina Way South Richmond, CA 94804 Attention: Teresa Payne	Client Project ID: #RC0304.003 Sample Descript: Water, MW-4 Analysis Method: EPA 5030/8010 Lab Number: 612-0675	Sampled: Dec 11, 1996 Received: Dec 11, 1996 Analyzed: Dec 12, 1996 Reported: Dec 30, 1996
---	--	---

QC Batch Number: GC121296801007A  
Instrument ID: HP-7

## HALOGENATED VOLATILE ORGANICS (EPA 8010)

Analyte	Detection Limit µg/L	Sample Results µg/L
Bromodichloromethane.....	50	N.D.
Bromoform.....	50	N.D.
Bromomethane.....	100	N.D.
Carbon tetrachloride.....	50	N.D.
Chlorobenzene.....	50	N.D.
Chloroethane.....	100	N.D.
2-Chloroethylvinyl ether.....	100	N.D.
Chloroform.....	50	N.D.
Chloromethane.....	100	N.D.
Dibromochloromethane.....	50	N.D.
1,3-Dichlorobenzene.....	50	N.D.
1,4-Dichlorobenzene.....	50	N.D.
1,2-Dichlorobenzene.....	50	N.D.
1,1-Dichloroethane.....	50	N.D.
1,2-Dichloroethane.....	50	N.D.
1,1-Dichloroethene.....	50	N.D.
<b>cis-1,2-Dichloroethene.....</b>	<b>50</b>	<b>280</b>
trans-1,2-Dichloroethene.....	50	N.D.
1,2-Dichloropropane.....	50	N.D.
cis-1,3-Dichloropropene.....	50	N.D.
trans-1,3-Dichloropropene.....	50	N.D.
Methylene chloride.....	500	N.D.
1,1,2,2-Tetrachloroethane.....	50	N.D.
Tetrachloroethene.....	50	N.D.
1,1,1-Trichloroethane.....	50	N.D.
1,1,2-Trichloroethane.....	50	N.D.
<b>Trichloroethene.....</b>	<b>50</b>	<b>1,600</b>
Trichlorofluoromethane.....	50	N.D.
Vinyl chloride.....	100	N.D.

Surrogates	Control Limit %	% Recovery	
Dibromodifluoromethane.....	50	150	95
4-Bromofluorobenzene.....	50	150	85

Analytes reported as N.D. were not present above the stated limit of detection. Because matrix effects and/or other factors required additional sample dilution, detection limits for this sample have been raised.

SEQUOIA ANALYTICAL, #1271  
*Melissa A. Brewer*  
Melissa A. Brewer  
Client Services Representative





# Sequoia Analytical

680 Chesapeake Drive  
404 N. Wiget Lane  
819 Striker Avenue, Suite 8

Redwood City, CA 94063  
Walnut Creek, CA 94598  
Sacramento, CA 95854

(415) 364-9600  
(510) 988-9600  
(916) 921-9600

FAX (415) 364-9239  
FAX (510) 988-9673  
FAX (916) 921-0100

Geraghty & Miller, Inc.  
1050 Marina Way South  
Richmond, CA 94804  
Attention: Teresa Payne

Client Project ID: #RC0304.003  
Sample Descript: Water, MW-6  
Analysis Method: EPA 5030/8010  
Lab Number: 612-0676

Sampled: Dec 11, 1996  
Received: Dec 11, 1996  
Analyzed: Dec 12, 1996  
Reported: Dec 30, 1996

QC Batch Number: GC121298801007A

Instrument ID: HP-7

## HALOGENATED VOLATILE ORGANICS (EPA 8010)

Analyte	Detection Limit µg/L	Sample Results µg/L
Bromodichloromethane.....	50	N.D.
Bromoform.....	50	N.D.
Bromomethane.....	100	N.D.
Carbon tetrachloride.....	50	N.D.
Chlorobenzene.....	50	N.D.
Chloroethane.....	100	N.D.
2-Chloroethylvinyl ether.....	100	N.D.
Chloroform.....	50	N.D.
Chloromethane.....	100	N.D.
Dibromochloromethane.....	50	N.D.
1,3-Dichlorobenzene.....	50	N.D.
1,4-Dichlorobenzene.....	50	N.D.
1,2-Dichlorobenzene.....	50	N.D.
1,1-Dichloroethane.....	50	N.D.
1,2-Dichloroethane.....	50	N.D.
<b>1,1-Dichloroethene.....</b>	<b>50</b>	<b>58</b>
cis-1,2-Dichloroethene.....	50	N.D.
trans-1,2-Dichloroethene.....	50	N.D.
1,2-Dichloropropane.....	50	N.D.
cis-1,3-Dichloropropene.....	50	N.D.
trans-1,3-Dichloropropene.....	50	N.D.
Methylene chloride.....	500	N.D.
1,1,2,2-Tetrachloroethane.....	50	N.D.
Tetrachloroethene.....	50	N.D.
1,1,1-Trichloroethane.....	50	N.D.
1,1,2-Trichloroethane.....	50	N.D.
<b>Trichloroethene.....</b>	<b>50</b>	<b>360</b>
Trichlorofluoromethane.....	50	N.D.
Vinyl chloride.....	100	N.D.

Surrogates	Control Limit %	% Recovery	
Dibromodifluoromethane.....	50	150	97
4-Bromofluorobenzene.....	50	150	96

Analytes reported as N.D. were not present above the stated limit of detection. Because matrix effects and/or other factors required additional sample dilution, detection limits for this sample have been raised.

SEQUOIA ANALYTICAL, #1271

*Melissa A. Brewer*

Melissa A. Brewer  
Client Services Representative

8120574.GER <3>





**Sequoia Analytical**

680 Chesapeake Drive  
404 N. Wiget Lane  
819 Striker Avenue, Suite 8

Redwood City, CA 94063  
Walnut Creek, CA 94598  
Sacramento, CA 95834

(415) 364-9600  
(510) 988-9600  
(916) 921-9600

FAX (415) 364-9233  
FAX (510) 988-9673  
FAX (916) 921-0100

Geraghty & Miller, Inc.  
1050 Marina Way South  
Richmond, CA 94804  
Attention: Teresa Payne

Client Project ID: #RC0304.003  
Sample Descript: Water, MW-12  
Analysis Method: EPA 5030/8010  
Lab Number: 612-0677

Sampled: Dec 11, 1996  
Received: Dec 11, 1996  
Analyzed: Dec 12, 1996  
Reported: Dec 30, 1996

QC Batch Number: GC121295801007A

Instrument ID: HP-7

**HALOGENATED VOLATILE ORGANICS (EPA 8010)**

Analyte	Detection Limit µg/L	Sample Results µg/L
Bromodichloromethane.....	0.50	N.D.
Bromoform.....	0.50	N.D.
Bromomethane.....	1.0	N.D.
Carbon tetrachloride.....	0.50	N.D.
Chlorobenzene.....	0.50	N.D.
Chloroethane.....	1.0	N.D.
2-Chloroethylvinyl ether.....	1.0	N.D.
Chloroform.....	0.50	N.D.
Chloromethane.....	1.0	N.D.
Dibromochloromethane.....	0.50	N.D.
1,3-Dichlorobenzene.....	0.50	N.D.
1,4-Dichlorobenzene.....	0.50	N.D.
1,2-Dichlorobenzene.....	0.50	N.D.
<b>1,1-Dichloroethane.....</b>	<b>0.50</b>	<b>1.4</b>
<b>1,2-Dichloroethane.....</b>	<b>0.50</b>	<b>1.5</b>
<b>1,1-Dichloroethene.....</b>	<b>0.50</b>	<b>6.2</b>
<b>cis-1,2-Dichloroethane.....</b>	<b>0.50</b>	<b>11</b>
<b>trans-1,2-Dichloroethene.....</b>	<b>0.50</b>	<b>0.83</b>
1,2-Dichloropropane.....	0.50	N.D.
cis-1,3-Dichloropropene.....	0.50	N.D.
trans-1,3-Dichloropropene.....	0.50	N.D.
Methylene chloride.....	5.0	N.D.
1,1,2,2-Tetrachloroethane.....	0.50	N.D.
<b>Tetrachloroethene.....</b>	<b>0.50</b>	<b>5.0</b>
<b>1,1,1-Trichloroethane.....</b>	<b>0.50</b>	<b>4.9</b>
1,1,2-Trichloroethane.....	0.50	N.D.
<b>Trichloroethene.....</b>	<b>5.0</b>	<b>55</b>
Trichlorofluoromethane.....	0.50	N.D.
Vinyl chloride.....	1.0	N.D.

Surrogates	Control Limit %	% Recovery
Dibromodifluoromethane.....	50	150
4-Bromofluorobenzene.....	50	150

Analytes reported as N.D. were not present above the stated limit of detection.

SEQUOIA ANALYTICAL, #1271

*Melissa A. Brewer*

Melissa A. Brewer  
Client Services Representative

6120674.GER <4>





# Sequoia Analytical

680 Chesapeake Drive  
404 N. Wiget Lane  
819 Striker Avenue, Suite 8

Redwood City, CA 94063  
Walmur Creek, CA 94598  
Sacramento, CA 95834

(415) 364-9600  
(910) 988-9600  
(916) 921-9600

FAX (415) 364-9233  
FAX (510) 988-9673  
FAX (916) 921-0100

Geraghty & Miller, Inc.  
1050 Marina Way South  
Richmond, CA 94804  
Attention: Teresa Payne

Client Project ID: #RC0304.003  
Sample Descript: Water, MW-13  
Analysis Method: EPA 5030/8010  
Lab Number: 612-0678

Sampled: Dec 11, 1996  
Received: Dec 11, 1996  
Analyzed: Dec 12, 1996  
Reported: Dec 30, 1996

QC Batch Number: GC121296801007A  
Instrument ID: HP-7

## HALOGENATED VOLATILE ORGANICS (EPA 8010)

Analyte	Detection Limit µg/L	Sample Results µg/L
Bromodichloromethane.....	50	N.D.
Bromoform.....	50	N.D.
Bromomethane.....	100	N.D.
Carbon tetrachloride.....	50	N.D.
Chlorobenzene.....	50	N.D.
Chloroethane.....	100	N.D.
2-Chloroethylvinyl ether.....	100	N.D.
Chloroform.....	50	N.D.
Chloromethane.....	100	N.D.
Dibromochloromethane.....	50	N.D.
1,3-Dichlorobenzene.....	50	N.D.
1,4-Dichlorobenzene.....	50	N.D.
1,2-Dichlorobenzene.....	50	N.D.
1,1-Dichloroethane.....	50	N.D.
1,2-Dichloroethane.....	50	N.D.
1,1-Dichloroethene.....	50	N.D.
<b>cis-1,2-Dichloroethene.....</b>	<b>50</b>	<b>56</b>
trans-1,2-Dichloroethene.....	50	N.D.
1,2-Dichloropropane.....	50	N.D.
cis-1,3-Dichloropropene.....	50	N.D.
trans-1,3-Dichloropropene.....	50	N.D.
Methylene chloride.....	500	N.D.
1,1,2,2-Tetrachloroethane.....	50	N.D.
Tetrachloroethene.....	50	N.D.
1,1,1-Trichloroethane.....	50	N.D.
1,1,2-Trichloroethane.....	50	N.D.
<b>Trichloroethane.....</b>	<b>50</b>	<b>250</b>
Trichlorofluoromethane.....	50	N.D.
Vinyl chloride.....	100	N.D.
<b>Surrogates</b>	<b>Control Limit %</b>	<b>% Recovery</b>
Dibromodifluoromethane.....	50	150
4-Bromofluorobenzene.....	50	150
		91
		94

Analytes reported as N.D. were not present above the stated limit of detection. Because matrix effects and/or other factors required additional sample dilution, detection limits for this sample have been raised.

SEQUOIA ANALYTICAL, #1271

*Melissa A. Brewer*

Melissa A. Brewer  
Client Services Representative

8120674.GER <5>





# Sequoia Analytical

680 Chesapeake Drive  
404 N. Wiget Lane  
819 Striker Avenue, Suite 8

Redwood City, CA 94063  
Walnut Creek, CA 94598  
Sacramento, CA 95834

(415) 364-9600  
(510) 988-9600  
(916) 921-9600

FAX (415) 364-9233  
FAX (510) 988-9673  
FAX (916) 921-0100

Geraghty & Miller, Inc. 1050 Marina Way South Richmond, CA 94804 Attention: Teresa Payne	Client Project ID: #RC0304.003 Sample Descript: Water, MW-16 Analysis Method: EPA 8030/8010 Lab Number: 612-0679	Sampled: Dec 11, 1996 Received: Dec 11, 1996 Analyzed: Dec 12, 1996 Reported: Dec 30, 1996
---	---	---

QC Batch Number: GC121296801007A  
Instrument ID: HP-7

## HALOGENATED VOLATILE ORGANICS (EPA 8010)

Analyte	Detection Limit µg/L	Sample Results µg/L
Bromodichloromethane.....	1,000	N.D.
Bromoform.....	1,000	N.D.
Bromomethane.....	2,000	N.D.
Carbon tetrachloride.....	1,000	N.D.
Chlorobenzene.....	1,000	N.D.
Chloroethane.....	2,000	N.D.
2-Chloroethylvinyl ether.....	2,000	N.D.
Chloroform.....	1,000	N.D.
Chloromethane.....	2,000	N.D.
Dibromochloromethane.....	1,000	N.D.
1,3-Dichlorobenzene.....	1,000	N.D.
1,4-Dichlorobenzene.....	1,000	N.D.
1,2-Dichlorobenzene.....	1,000	N.D.
1,1-Dichloroethane.....	1,000	N.D.
1,2-Dichloroethane.....	1,000	N.D.
1,1-Dichloroethene.....	1,000	N.D.
<b>cis-1,2-Dichloroethene.....</b>	<b>1,000</b>	<b>2,900</b>
trans-1,2-Dichloroethene.....	1,000	N.D.
1,2-Dichloropropane.....	1,000	N.D.
cis-1,3-Dichloropropane.....	1,000	N.D.
trans-1,3-Dichloropropane.....	1,000	N.D.
Methylene chloride.....	10,000	N.D.
1,1,2,2-Tetrachloroethane.....	1,000	N.D.
Tetrachloroethane.....	1,000	N.D.
1,1,1-Trichloroethane.....	1,000	N.D.
1,1,2-Trichloroethane.....	1,000	N.D.
<b>Trichloroethene.....</b>	<b>1,000</b>	<b>11,000</b>
Trichlorofluoromethane.....	1,000	N.D.
Vinyl chloride.....	2,000	N.D.

Surrogates	Control Limit %	% Recovery
Dibromodifluoromethane.....	50	150
4-Bromofluorobenzene.....	50	150

Analytes reported as N.D. were not present above the stated limit of detection. Because matrix effects and/or other factors required additional sample dilution, detection limits for this sample have been raised.

SEQUOIA ANALYTICAL, #1271

*Melissa A. Brewer*

Melissa A. Brewer  
Client Services Representative







**Sequoia  
Analytical**

680 Chesapeake Drive  
404 N. Wigat Lane  
819 Striker Avenue, Suite 8

Redwood City, CA 94063  
Walnut Creek, CA 94598  
Sacramento, CA 95834

(415) 364-9600  
(510) 988-9600  
(916) 921-9600

FAX (415) 364-9233  
FAX (510) 988-9673  
FAX (916) 921-0100

Geraghty & Miller, Inc.  
1050 Marina Way South  
Richmond, CA 94804  
Attention: Teresa Payne

Client Project ID: #RC0304.003  
Sample Descript: Water, MW-17  
Analysis Method: EPA 5030/8010  
Lab Number: 612-0880

Sampled: Dec 11 1996  
Received: Dec 11 1996  
Analyzed: Dec 12 1996  
Reported: Dec 30 1996

QC Batch Number: GC121296601007A

Instrument ID: HP-7

### HALOGENATED VOLATILE ORGANICS (EPA 8010)

Analyte	Detection Limit µg/L	Sample Results µg/L	
Bromodichloromethane.....	200	N.D.	
Bromoform.....	200	N.D.	
Bromomethane.....	400	N.D.	
Carbon tetrachloride.....	200	N.D.	
Chlorobenzene.....	200	N.D.	
Chloroethane.....	400	N.D.	
2-Chloroethylvinyl ether.....	400	N.D.	
Chloroform.....	200	N.D.	
Chloromethane.....	400	N.D.	
Dibromochloromethane.....	200	N.D.	
1,3-Dichlorobenzene.....	200	N.D.	
1,4-Dichlorobenzene.....	200	N.D.	
1,2-Dichlorobenzene.....	200	N.D.	
1,1-Dichloroethane.....	200	N.D.	
1,2-Dichloroethane.....	200	N.D.	
1,1-Dichloroethene.....	200	N.D.	
cis-1,2-Dichloroethene.....	200	N.D.	
trans-1,2-Dichloroethene.....	200	N.D.	
1,2-Dichloropropane.....	200	N.D.	
cis-1,3-Dichloropropane.....	200	N.D.	
trans-1,3-Dichloropropane.....	200	N.D.	
Methylene chloride.....	2,000	N.D.	
1,1,2,2-Tetrachloroethane.....	200	N.D.	
Tetrachloroethene.....	200	N.D.	
1,1,1-Trichloroethane.....	200	N.D.	
1,1,2-Trichloroethane.....	200	N.D.	
<b>Trichloroethene.....</b>	<b>200</b>	<b>450</b>	
Trichlorofluoromethane.....	200	N.D.	
Vinyl chloride.....	400	N.D.	
<b>Surrogates</b>	<b>Control Limit %</b>	<b>% Recovery</b>	
Dibromodifluoromethane.....	50	150	96
4-Bromofluorobenzene.....	60	150	97

Analytes reported as N.D. were not present above the stated limit of detection. Because matrix effects and/or other factors required additional sample dilution, detection limits for this sample have been raised.

SEQUOIA ANALYTICAL, #1271

*Melissa A. Brewer*

Melissa A. Brewer  
Client Services Representative

6120874.GER <7>



**Sequoia  
Analytical**Geraghty & Miller, Inc.  
1050 Marina Way South  
Richmond, CA 94804  
Attention: Teresa PayneClient Project ID: #RC0304.003  
Sample Descript: Water  
Analysis for: Chromium  
First Sample #: 612-0674Sampled: Dec 11, 1996  
Received: Dec 11, 1996  
Digested: Dec 18, 1996  
Analyzed: Dec 23, 1996  
Reported: Dec 30, 1996**LABORATORY ANALYSIS FOR: Chromium**

Sample Number	Sample Description	Detection Limit mg/L	Sample Result mg/L	QC Batch Number	Instrument ID
612-0674	MW-3A	0.010	0.013	ME1218962007MDA	MV-3
612-0675	MW-4	0.010	17	ME1218962007MDA	MV-3
612-0676	MW-6	0.010	45	ME1218962007MDA	MV-3
612-0677	MW-12	0.010	1.1	ME1218962007MDA	MV-3
612-0678	MW-13	0.010	160	ME1218962007MDA	MV-3
612-0679	MW-16	0.010	65	ME1218962007MDA	MV-3
612-0680	MW-17	0.010	170	ME1218962007MDA	MV-3

Analytes reported as N.D. were not present above the stated limit of detection.

SEQUOIA ANALYTICAL, #1271

Please Note:  
See Laboratory Narrative*Melissa A. Brewer*Melissa A. Brewer  
Client Services Representative

6120674.GER &lt;8&gt;





**Sequoia  
Analytical**

680 Chesapeake Drive  
404 N. Wiget Lane  
819 Striker Avenue, Suite 8

Redwood City, CA 94063  
Walnut Creek, CA 94598  
Sacramento, CA 95834

(415) 364-9600  
(510) 988-9600  
(916) 921-9600

FAX (415) 364-9233  
FAX (510) 988-9679  
FAX (916) 921-0100

Geraghty & Miller, Inc.  
1050 Marina Way South  
Richmond, CA 94804  
Attention: Teresa Payne

Client Project ID: #RC0304.003  
Sample Descript: Water  
Analysis for: Hexavalent Chromium  
First Sample #: 612-0674

Sampled: Dec 11, 1996  
Received: Dec 11, 1996  
Analyzed: Dec 12, 1996  
Reported: Dec 30, 1996

**LABORATORY ANALYSIS FOR: Hexavalent Chromium**

Sample Number	Sample Description	Detection Limit mg/L	Sample Result mg/L	QC Batch Number	Instrument ID
612-0674	MW-3A	0.0050	N.D.	IN121296719613A	INSPC-1
612-0675	MW-4 *	0.0050	47	IN121296719613A	INSPC-1
612-0676	MW-6	0.0050	54	IN121296719613A	INSPC-1
612-0677	MW-12	0.0050	1.4	IN121296719613A	INSPC-1
612-0678	MW-13	0.0050	170	IN121296719613A	INSPC-1
612-0679	MW-16	0.0050	73	IN121296719613A	INSPC-1
612-0680	MW-17	0.0050	200	IN121296719613A	INSPC-1

Analytes reported as N.D. were not present above the stated limit of detection.

SEQUOIA ANALYTICAL, #1271

*Melissa A. Brewer*

Melissa A. Brewer  
Client Services Representative

**Please Note:**

\* Sample was re-analyzed (past hold time) on 12/31/96. Cr-6 result was 16 mg/L, which is probably much lower than original result due to reduction of Cr-6 to Cr-3.

6120674.GER <8>





**Sequoia Analytical**

680 Chesapeake Drive  
404 N. Wiget Lane  
819 Striker Avenue, Suite 8

Redwood City, CA 94063  
Walnut Creek, CA 94598  
Sacramento, CA 95834

(415) 364-9600  
(510) 988-9600  
(916) 921-9600

FAX (415) 364-9233  
FAX (510) 988-9673  
FAX (916) 921-0100

Geraghty & Miller, Inc.  
1050 Marina Way South  
Richmond, CA 94804  
Attention: Teresa Payne

Client Project ID: #RC0304.003  
Matrix: Liquid

QC Sample Group: 6120674-680

Reported: Dec 30, 1996

**QUALITY CONTROL DATA REPORT**

Analyte:	1,1-Dichloro-ethene	Trichloro-ethene	Chloro-benzene	Chromium	Hexavalent Chromium
QC Batch#:	GC121296 801007A	GC121296 801007A	GC121296 801007A	ME121896 2007MDA	IN121296 719613A
Analy. Method:	EPA 8010	EPA 8010	EPA 8010	EPA 200.7	EPA 7196
Prep. Method:	EPA 5030	EPA 5030	EPA 5030	EPA 200.7	EPA 7196
Analyst:	P. Horton	P. Horton	P. Horton	J. Kelly	Y. Borinshteyn
MS/MSD #:	6120743	6120743	6120743	6121102	6120674
Sample Conc.:	N.D.	N.D.	N.D.	N.D.	N.D.
Prepared Date:	12/12/96	12/12/96	12/12/96	12/18/96	12/12/96
Analyzed Date:	12/12/96	12/12/96	12/12/96	12/23/96	12/12/96
Instrument I.D.#:	HP-7	HP-7	HP-7	MV-3	INSPC-1
Conc. Spiked:	10 µg/L	10 µg/L	10 µg/L	1.0 mg/L	0.050 mg/L
Result:	11	11	9.8	0.90	0.059
MS % Recovery:	111	108	98	80	118
Dup. Result:	11	11	10	0.97	0.058
MSD % Recov.:	113	111	101	97	116
RPD:	1.8	2.7	3.0	7.5	1.7
RPD Limit:	0-25	0-25	0-25	0-20	0-20

LCS #:	LCS121296	LCS121296	LCS121296	LCS121896	LCS121296
Prepared Date:	12/12/96	12/12/96	12/12/96	12/18/96	12/12/96
Analyzed Date:	12/12/96	12/12/96	12/12/96	12/23/96	12/12/96
Instrument I.D.#:	HP-7	HP-7	HP-7	MV-3	INSPC-1
Conc. Spiked:	10 µg/L	10 µg/L	10 µg/L	1.0 mg/L	0.050 mg/L
LCS Result:	11	11	9.9	1.0	0.053
LCS % Recov.:	114	113	99	100	106

MS/MSD LCS Control Limits	65-135	70-130	70-130	80-120	80-120
---------------------------	--------	--------	--------	--------	--------

**Please Note:**  
The LCS is a control sample of known, interferent-free matrix that is analyzed using the same reagents, preparation, and analytical methods employed for the samples. The matrix spike is an aliquot of sample fortified with known quantities of specific compounds and subjected to the entire analytical procedure. If the recovery of analytes from the matrix spike does not fall within specified control limits due to matrix interference, the LCS recovery is to be used to validate the batch.  
\*\* MS = Matrix Spike, MSD = MS Duplicate, RPD = Relative % Difference

SEQUOIA ANALYTICAL, #1271

*Melissa A. Brewer*

Melissa A. Brewer  
Client Services Representative





**Sequoia Analytical**

680 Chesapeake Drive  
404 N. Wiget Lane  
819 Striker Avenue, Suite 8

Redwood City, CA 94063  
Walnut Creek, CA 94598  
Sacramento, CA 95834

(415) 364-9600  
(510) 988-9600  
(916) 921-9600

FAX (415) 364-9233  
FAX (510) 988-9673  
FAX (916) 921-0100

Geraghty & Miller, Inc. 1050 Marina Way South Richmond, CA 94804 Attention: Teresa Payne	Client Project ID: #RC0304.003	Received: Dec 11, 1996
	Lab Number: 6120674-680	Reported: Jan 2, 1997

**LABORATORY NARRATIVE**

**EPA 200.7: Chromium**

Sample results are questionable due to lack of proper preservation of sample containers. Though the sample bottles were indicated by the client to contain preservative, the pH's of these samples fell within the neutral range.

SEQUOIA ANALYTICAL, #1271

*Melissa A. Brewer*

Melissa A. Brewer  
Client Services Representative

6120674.GER <11>



Project Number RC0304-003

Project Location ECF - Emeryville

Laboratory Sequoia

Sampler(s)/Affiliation Geraghty & Miller  
G. Crowley

SAMPLE IDENTITY Code Date/Time Sampled Lab ID

			SAMPLE BOTTLE / CONTAINER DESCRIPTION								
			Total Chromium	Hexavalent Chromium	Polychlorinated Biphenyls	Organics 800					TOTAL
MW-3A	L	12/11/96 7:20	X	X	X		6120674	A-E			25
MW-4	L	12/11/96 6:45	X	X	X		6120675				25
MW-6	L	12/11/96 6:20	X	X	X		6120676				25
MW-12	L	12/11/96 7:10	X	X	X		6120677				25
MW-13	L	12/11/96 7:00	X	X	X		6120678				25
MW-16	L	12/11/96 6:00	X	X	X		6120679				25
MW-17	L	12/11/96 6:10	X	X	X		6120680				25
3-8-03											

Sample Code: L = Liquid; S = Solid; A = Air

Total No. of Bottles/Containers 55

Relinquished by: <u>[Signature]</u>	Organization: <u>Geraghty &amp; Miller</u>	Date: <u>12/11/96</u> Time: <u>2:10</u>	Seal Intact? Yes No N/A
Received by: <u>[Signature]</u>	Organization: <u>SAT</u>	Date: <u>2/11/96</u> Time: <u>14:10</u>	
Relinquished by: <u>[Signature]</u>	Organization: <u>SAT</u>	Date: <u>12/11/96</u> Time: <u>1:05</u>	Seal Intact? Yes No N/A
Received by: <u>[Signature]</u>	Organization: <u>SAT</u>	Date: <u>2/11/96</u> Time: <u>1:05</u>	

Special Instructions/Remarks:  
Filter in Lab NOT dissolved

Delivery Method:  In Person  Common Carrier  Lab Courier  Other

SENT BY: SEQUOIA ANALYTICAL ; 1-2-97 ; 9:41 ; WALNUT CREEK ; 510 233 3204 ; #13

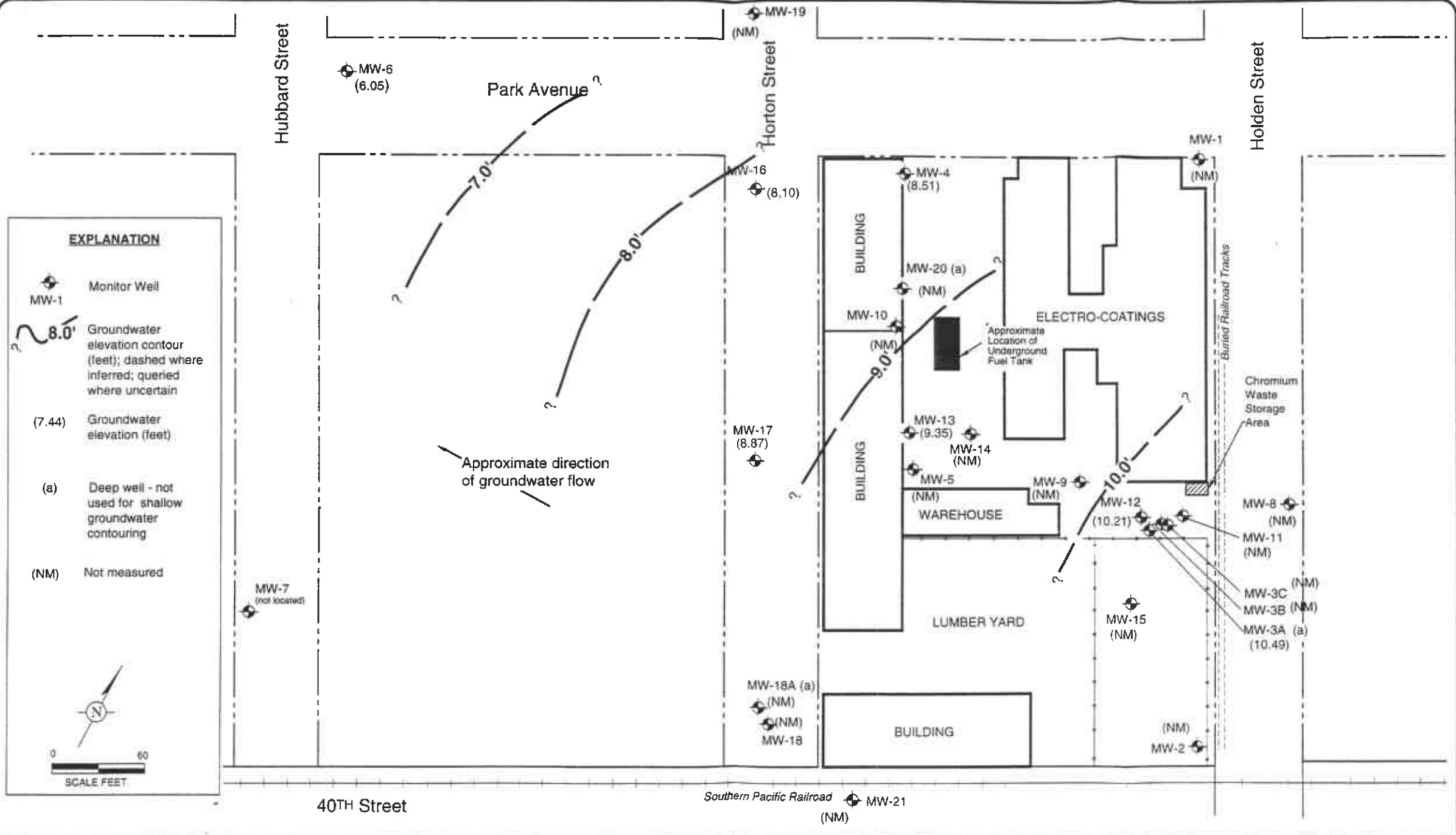

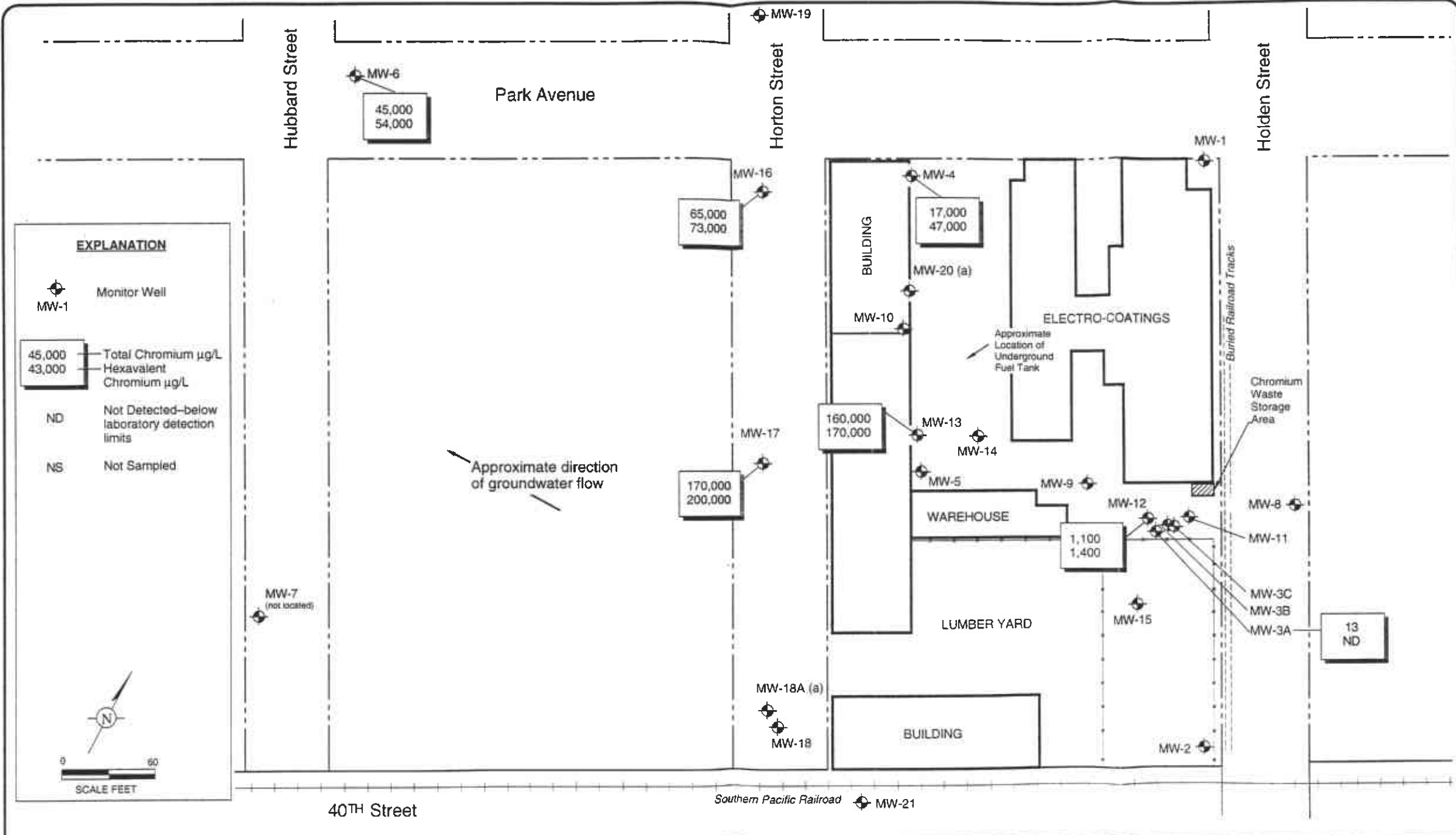

**GROUNDWATER ANALYTICAL RESULTS—TOTAL CHROMIUM AND HEXAVALENT CHROMIUM—DECEMBER 1996**

Electro-Coatings, Inc.  
1401 and 1421 Park Avenue  
Emeryville, California

FIGURE  
**2**



