

Oakland City Center
500 12th Street
Suite 100
Oakland, CA 94607-4014
(415) 893-3600

Woodward-Clyde Consultants

December 27, 1988
8810220A

City of Livermore
Redevelopment Agency
1052 South Livermore Ave.
Livermore, Ca 94550

Attention: Ms. Karen Majors,
Redevelopment Coordinator

Subject: Phase I Site Environmental Assessment
Railroad Avenue Property,
Livermore, California

Dear Ms. Majors:

INTRODUCTION

At your request we have performed an environmental assessment of the subject property. The purpose of the study is to evaluate the presence of hazardous materials at the site, and the potential impacts on the site from possible off-site sources. The site is located on the north side of Railroad Avenue between North "L" and North "N" streets and is bordered by the Western Pacific Railroad on the north, as shown on Figure 1. The site is presently occupied by small businesses, residences, and vacant land. We understand that the site is intended by the City of Livermore for redevelopment.

SCOPE OF WORK

To assess whether there is evidence of possible environmental contamination at the site from hazardous materials or waste, available data was reviewed, a site reconnaissance was performed, and the results were analyzed and are summarized in this report. The evaluation of data included a review of site history from aerial photographs, and an interview with a long time city employee. Available information about spills or releases of hazardous material was obtained from the Livermore City Fire Department, The Alameda County Environmental Health Division, the California Regional Water Quality Control Board (RWQCB) and the U.S. Environmental Protection Agency (Appendix A).

A reconnaissance of the site was performed on December 7, 1988 by Albert Ridley, a senior project geologist, and Ann McDonald, a senior staff scientist for Woodward-Clyde Consultants. The purpose of the reconnaissance was to observe the surface of the site and inspect the interior of the buildings for evidence of spills or present and past use or storage of hazardous materials. This work is summarized in this report along with supporting documents.

Consulting Engineers, Geologists
and Environmental Scientists

Offices in Other Principal Cities



SITE HISTORY

Aerial photographs of the site taken in 1957, 1971 and 1984 were reviewed. The photographs taken on 5/16/57 show the site as entirely residential on the west half of the area, locally referred to as Tubbsville, located east of North "N" Street. There were 36 structures on this section in 1957. The building at 1948-1954 Railroad Avenue was in place, there were residences at 1962 Railroad Avenue, and 141 North "L" Street, and a gas station at 187 North "L" Street. There were storage buildings to the west and south of the gas station. The railroad had a maintenance facility south of the subject property.

The photographs taken on 4/12/71 show that the storage building to the west of the gas station was removed. The commercial buildings observed during our site visit were in place in 1971. The activity in the railroad yard appeared to have decreased.

The photographs taken on 5/7/84 show the gas station pump island had been removed. There is no apparent activity by the railroad on the south side of Railroad Avenue, and a few of the structures in the residential complex, Tubbsville, had been removed.

Leon Horst, Associate Planner for the City of Livermore was interviewed as the "local Historian" for the city. Mr. Horst said he has been with the Livermore City Planning Department for 22 years and has worked with every city planner. The Planning department was created in 1960 according to Mr. Horst. According to Mr. Horst, there are no building records of any kind before 1960. There have been no city projects up to this point in time in the vicinity of the subject property. This area is part of the original city limits, which was designated as industrial, but it was not necessarily developed as such. According to Mr. Horst the area bordering North "N" street was housing built in the late 1940's, and is known locally as Tubbsville. The industrial buildings on Railroad Avenue. were built about 1968. There have been a number of tenants in the building but none ever stayed a significant length of time. Mr. Ed Hudtka built the building and still has offices in Livermore. The location occupied by Arrow Rental, 185 North "L" Street, was vacant when Mr. Horst came to Livermore in 1966, but was occupied by a service station before then. The storage area adjacent to Arrow Rental and behind it to the west was a retail nursery until about eight years ago. The Taxidermy Shop at 153 North "L" street was once a gun shop. The property at 1948 Railroad Avenue which was occupied by Gibbon's Electric from the early 1970's until fall of 1988, was previously a pottery business where classes were taught in ceramics. According to Mr. Horst, domestic water wells are potentially present in this area because it is part of the original town of Livermore.

REPORTED SPILLS AND RELEASES

Federal and State regulatory lists related to fuel leak and toxic waste sites were consulted to identify known fuel leaks and toxic waste sites near the project site. The federal listings consulted were the National Priorities List (NPL), Final and Proposed Sites, July 1987, and the Federal Register, June 24, 1988. There are no sites on the National Priority List in the vicinity of the site within a one half mile radius.

A letter was sent to the Environmental Protection Agency, Office of External Affairs to obtain Comprehensive Environmental Response, Compensation and Liability Information System (CERCLIS) and Resource Conservation and Recovery Act of 1976 (RCRA) updated copies of pertinent records regarding surrounding properties to evaluate whether hazardous waste or toxic substance activities in the area may impact the site. The results and interpretation of the CERCLIS and RCRA updated records will be forwarded to you when they are received from EPA. Meanwhile, the currently available data bases were reviewed and are reported as follows.

The CERCLIS data base contains potential uncontrolled hazardous waste sites. The CERCLIS system contains only those potential hazardous waste sites that have been brought to the attention of EPA. The EPA CERCLIS data base for June 8, 1988 contains the following site location listing (Appendix A and Figure 1).

- CAD981415102
PG&E Gas Plant Livermore
200 to 375 Ft west of N St. at railroad
Livermore, CA 94550

The facilities listed in the EPA HWDS data base are regulated under the Resources Conservation and Recovery Act. The HWDS system contains only those regulated facilities that have notified the EPA of their status as hazardous waste generators, transporters, or treatment, storage or disposal facilities. The EPA HWDS data base for June 1988 contains the following site location listings within a one half mile radius of the subject property (Appendix A and Figure 1).

- CAT00613380
Alameda County Dept. of Agriculture
2418 Railroad Ave.
Livermore, CA 94550
- CAD981614597
Mike One Hour Cleaners
1430 First Street
Livermore, CA 94550

- CAT080020365
Pacific Bell
2388 Second Street
Livermore, CA 94550
- CAT080020357
Pacific Bell
2324 Second Street
Livermore, CA 94550
- CAD981695133
Purity Cleaners
183 N. Livermore Ave.
Livermore, CA 94550
- CAD981403058
Reds Livermore Body Shop
222 Church St.
Livermore, CA 94550
- CAD9814003058
Shell Station #204-438
318 S. Livermore Ave.
Livermore, CA 94550

The state listings consulted for this review included: (1) North Bay Toxic Cases List (RWQCB, September 1988); Fuel Leaks List (RWQCB, October 1988); and (3) Expenditure Plan for the Hazardous Substance Cleanup Bond Act of 1984, January 1988, Revision No. 3 (Department of Health Services, Toxic Substance Control Division).

There are no reported cases within approximately a 2,000 foot radius of the subject property on the North Bay Toxics Cases List (Appendix A). As shown on Figure 1, there are two reported fuel leaks in the site vicinity (Appendix A). The fuel leaks reported are listed below.

- Mobil
2008 First Street
Livermore
- Pacific Bell
2324 Second Street
Livermore

There are no reported cases within approximately a 2,000 foot radius of the subject property listed on the Expenditure Plan for Hazardous Substance Cleanup Bond Act of 1984.

Other agencies consulted were: (1) City of Livermore Fire Department and (2) Alameda County Department of Environmental Health, Division of Hazardous Materials

Eric Carlson, Deputy Fire Marshal, City of Livermore Fire Prevention was contacted to obtain records and information concerning underground storage tanks (USTs) in the site vicinity. According to Deputy Carlson the Fire Department has purged all records older than seven years. He has been with the Department for eight years. Ms. Ann McDonald of WCC, was given the following information in a telephone interview with Deputy Carlson on 12/6/88. The Fire Department never kept records until 11 or 12 years ago, and did not keep a fee schedule until one year ago. Therefore, the Department records are very limited and incomplete. There are a number of USTs within a one half mile radius of the subject property. The following locations were sited by Deputy Carlson:

- Lucky's Depot Plaza
2073 Railroad Ave.
may have had a gas station and tanks
- Mobil Station
NE corner of First & S. "L" Streets
- Arrow Rentals
187 N. "L" Street
formally 175 N. "L"

A letter has been sent to the Alameda County Department of Environmental Health, Division of Hazardous Materials requesting information concerning hazardous waste or toxic substance activities on the subject property or within the immediate vicinity of the property. The results and interpretation of information will be forwarded to you when they are received from the Department of Environmental Health.

Mr. Lowell Miller, Hazardous Materials Specialist, of the Alameda County Department of Environmental Health was contacted concerning a remedial activity taking place on the south side of Railroad Ave. between South "L" and South "P" Streets. This area was referred to by Mr. Miller as the Super Block Project. According to Mr. Miller the problem concerned an underground storage bunker vault area associated with the railroad. He viewed the material at the bottom of the concrete vault and described it as "a tar like material which was not very mobile." The material is number six grade fuel oil seeping from the vault and pipeline. Soil contamination is confined to the surface soil. Contamination levels have been found in concentrations of 530 ppm, stock piled material has been tested at 1000 ppm total petroleum hydrocarbons, and oil and grease at 13,000 ppm at 8 to 14 inch depths, and 2,100 ppm at four foot depths. The contaminated soil will be removed from the premises as soon as a disposal site is located. Mr. Miller says there is no concern about groundwater contamination, however the contractor has been requested to install a monitoring well as soon as practical in light of the present construction taking place. If the well is not installed they will be cited by the County as being in violation of regulations. Depth to groundwater has not been adequately explored and measured in the vicinity of the site.

GROUNDWATER CONDITIONS

A report prepared by the California Department of Water Resources (1974) shows the site is located in the Mocho Groundwater Subbasin. A near-surface unconfined groundwater zone is reported to occur within 25 feet of the ground surface. The near-surface water level surface is reported as sloping generally northward or northwestward. A deeper confined groundwater zone has a potentiometric surface 75 to 150 feet below the ground.

Whether the groundwater conditions reported in 1974 are present today is uncertain. A considerable amount of groundwater usage since 1974 may have affected the present groundwater conditions.

SITE RECONNAISSANCE

The site surface and buildings were observed during the site visit, and whenever possible, occupants of the building were interviewed (see Figure 2). The buildings are generally concrete and wood non-insulated structures.

Arrow Rentals is located at 187 North "L" Street. The owner of the property, Tony Sullins, was interviewed. He bought the property in 1972. There were five underground storage tanks in place at that time, one 6,000 gallon, one 4,000 gallon, and three 1,500 gallon tanks. The three 1,500 gallon tanks were removed in 1972 because they were tested and found to be leaking in either the connecting pipes or the tanks. The 6,000 and 4,000 gallon tanks were removed in 1984. They had been in place more than 40 years. There is one 1,000 gallon tank in place and being used now (Figure 2). It is located in the southeast corner of the property, near the street. According to Mr. Sullins, it is a single wall tank. According to Deputy Fire Marshall Eric Carlson, the permit was issued for it in 1984.

This small business rents a variety of construction equipment which is stored and maintained on the premises. Five barrels of diesel and two barrels of waste oil are kept on the premises. The back storage area was paved three or four years ago. There are two catch basins located about 50 feet from the street on the south side of the building. They are used for washing equipment and they drain into the storm sewer.

Fabtronics is located at 1940 Railroad Avenue. Richard Arney, the owner of Fabtronics, was interviewed. This business builds specialized electronic equipment to specification in small quantities. It has been in this location for 18 years. Solvents such as laquer thinner are used to clean silk screens. Approximately 10 gallons per year are used. There are approximately fifty 1-gallon partially used paint cans, approximately thirty 1-pint containers of epoxy and resin, three 5-gallon cans of laquer thinner, several empty laquer thinner cans, three gallons of lubricant for cutting metal and a 55 gallon drum of kerosene for the heater. There is a vented paint room in the north east corner of the building.

The Ross McDonald Company is located at 1938 Railroad Avenue. Barbara McDonald, one of the owners of the company was interviewed. The company has been at this location for 15 years. The company occupied the north half of the building only until 1984 when it expanded into the south half also. The south half was formally occupied by a T-shirt silk screening business before 1984. The Ross McDonald Company assembles and sells shelving systems and component parts. The following chemicals are stored on the premises:

- one 55-gallon drum of laquer paint thinner
- three 55-gallon drums of waterbased contact adhesive
- approximately seventy 1-gallon cans of laquer
- one 1-gallon can of karosene
- approximately thirty 1-pint cans of paint
- approximately 65 used cans of spray paint

Quality Painting Company is located at 1934 Railroad Avenue. It was not possible to inspect this facility because the owner was not present as previously arranged. There were approximately fifty 5-gallon containers and fifteen 1-gallon containers of acrylic paints observed to be stored in the north half of the building. There was also evidence of an underground storage tank at the north east corner of the building (Figure 2) where a gas pump and tank vent pipe were located. There is no information available on this tank from local, regional or state sources.

Accelerated Printing is located at 1908 Railroad Avenue. Donald Petrilli, owner of Accelerated Printing was interviewed, and the work area of the building toured. The following items were stored on the premises:

- solvents used in printing processes
- one 5-gallon can of "Blanket Wash"
- nine empty 5-gallon solvent cans
- tank for washing equipment, contents unknown.

Scheeringa Bros. Meat Processing is located at 1900 Railroad Ave. Alice Scheeringa, one of the owners of Scheeringa Bros. was interviewed. She said there are no hazardous materials used in meat processing, nor stored on the premises.

Award Signs was located at 1920 Railroad Ave. This building was vacated by Award Signs in October 1988. There was no access to this building.

Gibbons Electric is located at 1948 Railroad Ave. This building was occupied by Gibbons Electric from the early 1970's until fall 1988. The storage area behind the building has a concrete slab-on-grade. The storage area and building were filled with debris and approximately thirty empty 1-gallon paint thinner and paint cans.

Rooney Graphics is located at 1954 Railroad Ave. Joel Streufert, owner of Rooney Graphics, was interviewed. This is a small printing business. All processes are self contained according to Mr. Streufert. The following chemicals were found on the premises:

- one 5-gallon can of "Quick Wash", a solvent for cleaning presses
- one 1-gallon can of stablizer
- one 1-gallon can of developer
- inks and color cans.

A vacant residence is located at 1962 Railroad Ave. A neighbor, Mrs. Denise Minoggio, claims there was once a domestic well on this property. A well house is located behind the residence on the north west corner of the property. There is no record of a well on the property according to Craig Mayfield, Alameda County Flood Control-Zone 7, however, there were no records maintained with this agency prior to 1963.

Residence is located at 141 "L" Street. According to Mrs. Denise Minoggio, the owner and occupant, the house had new heat and electrical systems installed in 1982.

A Taxidermy Shop is located at 153 "L" Street. Joe Troutman, the owner of the shop, was interviewed. The materials used on the premises are salt, water and alum. The salt water is disposed of occasionally at Mr. Troutman's ranch.

The storage lot south of and to the west of Arrow Rentals is presently used for storage by a landscaper, an electrical contractor and the owner, John Regan, who has a tree farm, according to Ms. Karen Majors. Miscellaneous machinery, building materials, lumber, bark, old cars, 2 containerized storage units and a 30 foot trailer are stored on the property. There are four storage buildings, wooden structures apparently filled with building materials, debris, and about eight 1-gallon paint cans. There are empty cans, 1- and 5-gallon size empty cans of oil, paints, and gas scattered through out the property. There were two decomposing ceiling tiles, possibly asbestos, on the south side of the last building to the west. The material in question was saturated with water.

Tubbsville, a residential area, is located between the commercial buildings and North "N" Street.

This area is largely vacant land now with three dilapidated residences on the premises. Only one appears to be occupied, the other two were filled and surrounded with debris and abandoned cars.

SUMMARY

A review of aerial photographs showed that the residential area, Tubbsville, had approximately 36 structures until 1984, when a number of houses were demolished. At present there are only three residences

remaining on the site. The 1971 aerial photographs showed the existing commercial structures to be in place in 1971. Five underground storage tanks have been removed from "Arrow Rentals". These tanks were in use prior to 1972 as storage tanks for petroleum products for a service station. The three 1,500 gallon tanks removed in 1972 were tested and found to be leaking in either the connecting pipes and/or tanks. The 4,000 and 6,000 gallon tanks removed in 1984 had been in place for more than 40 years.

There is a 1,000 gallon unleaded underground gasoline storage tank, permitted in 1984, presently in use at 187 North "L" Street. There is a vent pipe and gas pump located at 1934 Railroad Ave. indicating the presence of an underground gasoline storage tank. However, no information was found from state, county or local records indicating the size, age or past history of the tank. Buildings and storage areas on the commercial section of the site have concrete slab-on-grade floors. The area south of the site between South "L" and South "P" Streets, known as Super Block, is in the process of remediation for soil contaminated by petroleum products. The contamination is confined to the near surface soils according to the Alameda County Department of Environmental Health. No groundwater contamination is anticipated by the County, and the contaminated soil is scheduled to be removed. Alameda County DEH has requested that a monitoring well be installed at the Super Block site as soon as construction activities permit.

There are two reported fuel leaks about 500 feet south of the site, which are probably upgradient from the subject property if groundwater flows northwestward. There is one potential hazardous waste site (PG&E gas plant) reported by CERCLIS about 200 feet downgradient from the site. There are seven sites within approximately 2,000 feet of the subject property listed on the RCRA data base, four of which are probably cross gradient. Three sites, two Pacific Bell sites, and a Shell Station are probably upgradient from the subject property.

CONCLUSIONS AND RECOMMENDATIONS

On-Site Sources

A review of the site history indicates that underground gasoline and petroleum product storage tanks at the "Arrow Rentals" location experienced leakage prior to their removal in 1971. The two largest tanks removed had been in place more than 40 years, raising the possibility they may have developed leaks due to deterioration over time. The history of these tanks indicates there is a potential for soil being contaminated with petroleum products. There is also evidence of an underground gasoline storage tank at 1934 Railroad Avenue. However, there are no available records or information about the age or contents of this tank.

We recommend that one soil boring be drilled at the location of each of the five storage tanks which have been removed. One boring should be drilled downgradient and in the backfill material of the 1,000 gallon tank

now in use at Arrow Rentals. We recommend one soil boring be drilled at the location of the underground storage tank at 1934 Railroad Avenue. The purpose of these borings is to explore for evidence of soil contamination. Laboratory analyses should be performed on soil samples from the borings to evaluate possible contamination from petroleum products or solvents, which might have been stored in the tanks. The exploratory borings should be about 20 to 25 feet deep and samples should be collected from near the surface and at 5 foot intervals using a drive sampler. If groundwater is encountered, several of the borings could be converted to groundwater monitoring wells.

A pile of ceiling tile was observed during the site reconnaissance in the storage area south of the Arrow Rentals property. We recommend that one sample of ceiling tile be collected and tested for asbestos in the laboratory.

We recommend that if domestic wells are found on the site prior to, or during site demolition, that the wells be properly sealed in accordance with state and local regulations. The purpose of sealing the wells is to reduce the potential for vertical migration of potential contaminants downward to the groundwater.

Off-Site Source

There is a low potential for contaminants from the fuel leaks located 500 feet south of the site migrating to the site, considering the distance. Contaminants from the former PG&E gas plant also have a low potential for affecting the site since the PG&E site is probably downgradient from the site. Based upon information from the Alameda County DEH, there is a low potential for migration of contaminants from the Super Block site to the subject site.

We understand that a monitoring well is scheduled to be installed south of the site on the Super Block project. We recommend that the City of Livermore obtain groundwater reports from that well in order to further evaluate the possibility of off site contamination moving toward the subject property from the Super Block site.

LIMITATIONS

The scope of this investigation is limited to visual observation of surface conditions at the site, and a review of readily available reports and literature. Sampling and laboratory analyses were beyond the scope of this environmental review.

The environmental review addressed the likelihood of hazardous substance contamination resulting from past and current known uses of the site and adjacent properties. As a result, certain conditions may not be revealed: 1) naturally occurring toxics in the subsurface soils, rocks, water, or the toxicity of the on-site flora; 2) toxicity of substances common in current habitable environments, such as, stored house hold

products, building materials, and consumables; 3) biological pathogens; 4) contaminants or contaminant concentrations that do not violate present regulatory standards but may violate future such standards; and, 5) unknown site contamination, such as, "midnight" dumping and/or accidental spillage which may occur following the site visit by WCC.

Services for this project are performed in accordance with the Agreement between The City of Livermore and WCC. No warranty or guarantee of site conditions is intended. This report is solely for the use of the City of Livermore and any reliance of this report by third parties shall be at such party's sole risk.

CLOSURE

We appreciate the opportunity to provide this Phase I Site Environmental Assessment. When the requested information from the EPA becomes available, we will forward it to you with our comments. Please call if you have any questions regarding this report or the recommendations. We can prepare an estimate of costs and schedule for the recommended exploratory soil boring program at your request.

Sincerely,

WOODWARD-CLYDE CONSULTANTS



Ann McDonald
Senior Staff Scientist



Albert P. Ridley, CEG #926
Associate

Attachments: References

Figure 1 - Fuel Leaks, RCRA and CERCLIS Cases

Figure 2 - Property Location Map

Appendix A - CERCLIS: RCRA: Toxic Cases for Livermore, CA, Fuel Leak Cases for Alameda County

REFERENCES

Pacific Resources, Inc., Aerial Photographic Division, Oakland Airport, Oakland, California: Black and white photographs AV-253-31-40, and AV 253-31-41, dated 5/12/57; AV-994-04-9 and AV-994-04-10, dated 4/12/71; AV-2460-03-09 and AV-2460-03-10, dated 5/7/84.

California Department of Water Resources, 1974, Bulletin No. 118-2; Department of Water Resources in Cooperation with Alameda County Flood Control and Water Conservation District, Zone 7; "Evaluation of Groundwater Resources: Livermore and Sunol Valley"; June 1974.



LEGEND

* FUEL LEAKS + RCRA x CERCLIS

- * 1 MOBILE STATION
- * 2 PACIFIC BELL
- x 3 PG&E GAS PLANT
- + 4 ALAMEDA CO. DEP. AG.
- + 5 MIKE ONE HOUR CLEANERS
- + 6 PACIFIC BELL
- + 7 PACIFIC BELL
- + 8 PURITY CLEANERS
- + 9 REDS LIVERMORE BODY SHOP
- + 10 SHELL STATION



Project No. 8810220A	RAILROAD AVENUE PROPERTY	FUEL LEAKS CERCLIS AND RCRA SITES	FIGURE 1
Woodward-Clyde Consultants			

Woodward-Clyde Consultants	Project No. 8810220A	RAILROAD AVENUE PROPERTY
	PROPERTY LOCATION MAP	
		FIGURE 2

LEGEND

- | | |
|--------------------------------------|-------------------------|
| 1 ARROW RENTALS | 8 AWARD SIGNS |
| 2 TAXIDERMIST | 9 ROSS McDONALD CO. |
| 3 RESIDENCE - 141 "L" ST. | 10 QUALITY PAINTING CO. |
| 4 RESIDENCE- 1962 RAILROAD | 11 FABTRONICS |
| 5 GIBBONS ELECTRIC & ROONEY GRAPHICS | 12 STORAGE LOT |
| 6 SCHEERINGA BROS. MEATS | 13 TUBBSVILLE |
| 7 ACCELERATED PRINTING | |

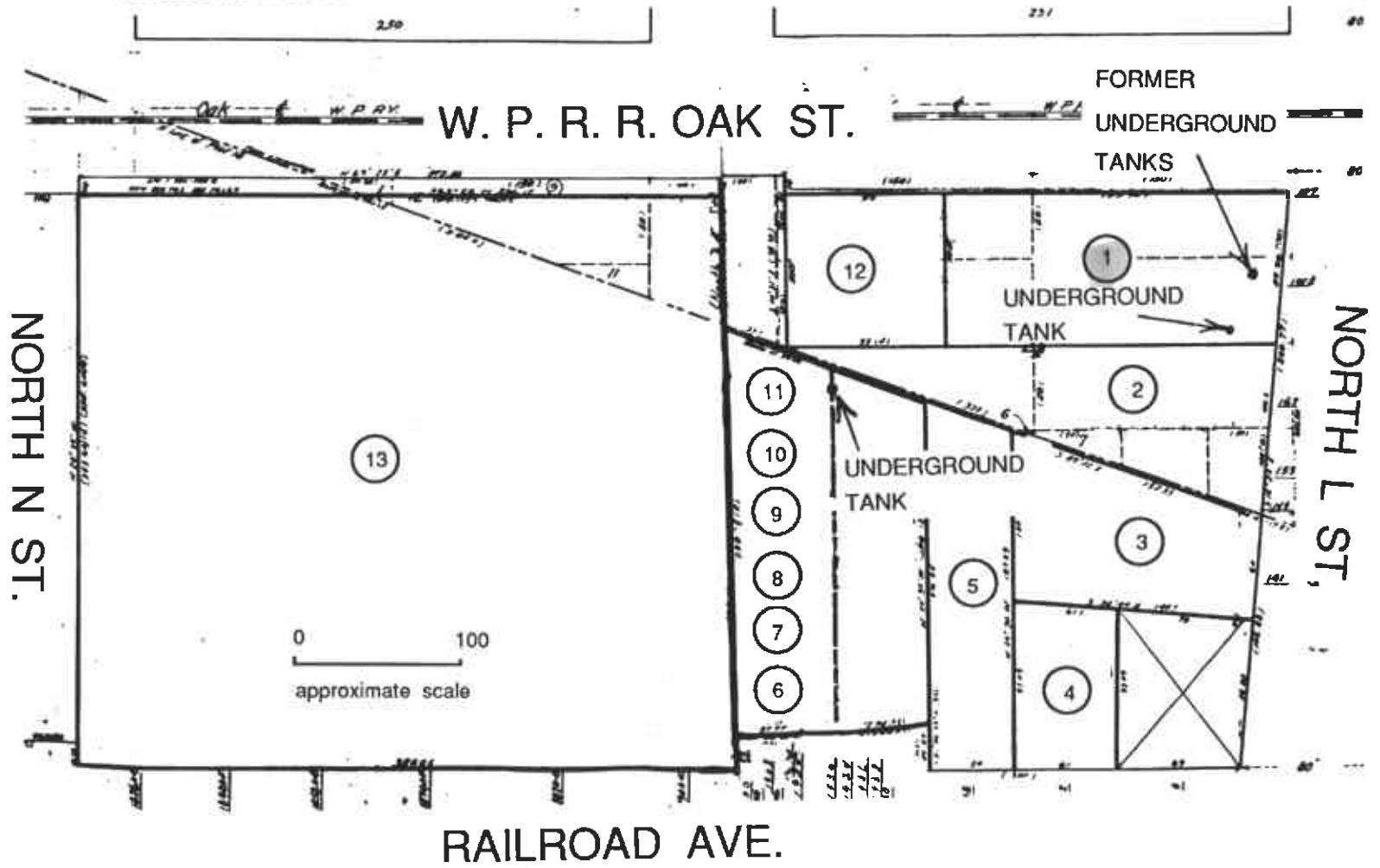

APPENDIX A

EPA NPL LISTINGS
CERCLIS AND RCRA SITES

EPA REGION 9 NATIONAL PRIORITIES LIST

(P) - SITE REMAINS PROPOSED
(P*) - SITE PROPOSED 5/86

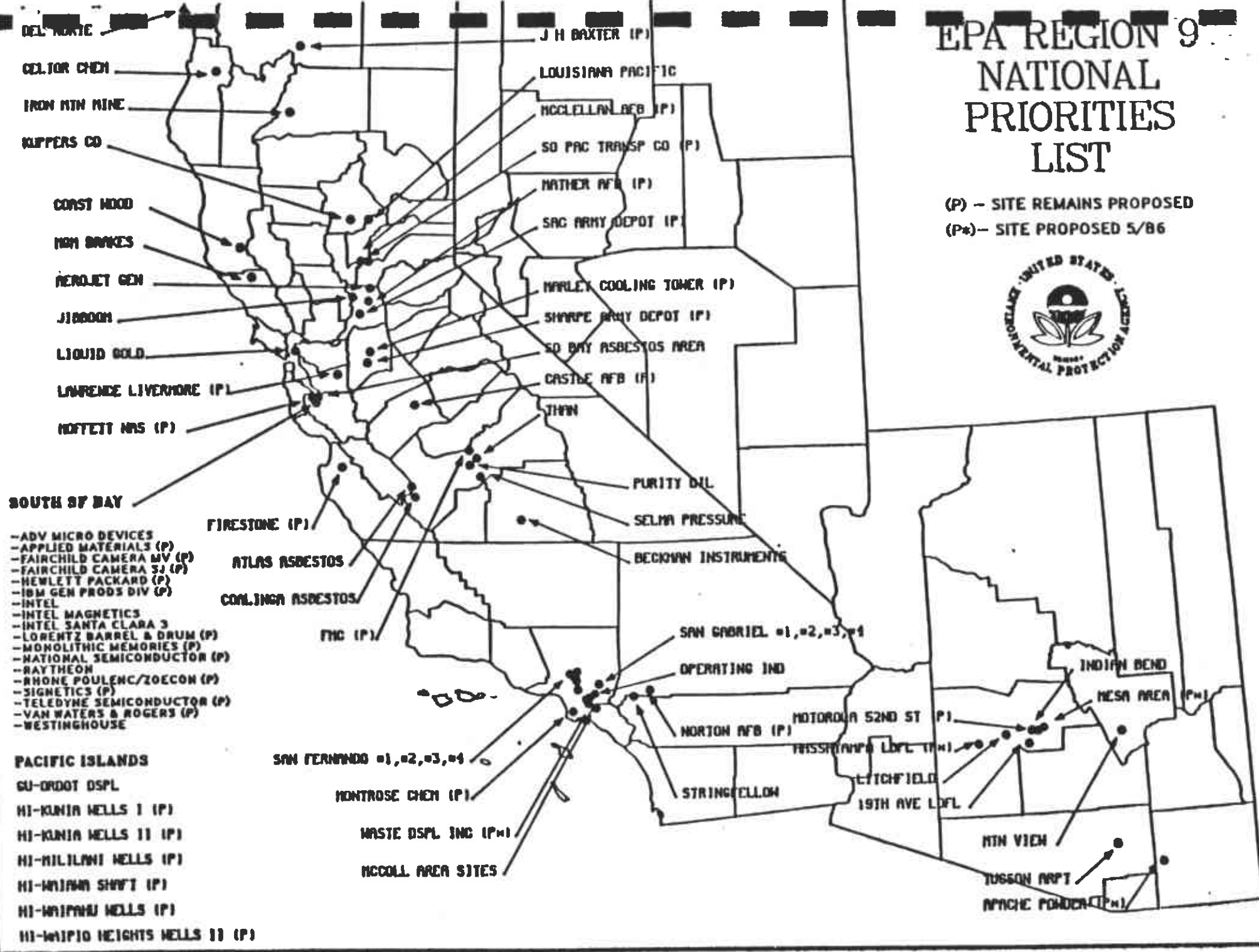

National Priorities List,
Final and Proposed Sites (by State)
July 1987

St	Site Name	City/County	Date		Rank/ Group ₂	Response Category ₃	Cleanup Status ₄
			Proposed or Announced ₁	Final			
AL	Alabama Army Ammunition Plant	Childersburg	10/84	7/87	Gr 10F	R	0
AL	Anniston Army Depot (SE Ind Area)	Anniston	10/84		Gr 4F	R	0
AL	Ciba-Geigy Corp. (McIntosh Plant)	McIntosh	9/83	9/84	126		I
AL	Interstate Lead Co. (ILCO)	Leeds	9/85	6/86	309	V R F S	0
AL	Nowbray Engineering Co.	Greenville	12/82	9/83	120	R	0
AL	Olin Corp. (McIntosh Plant)	McIntosh	9/83	9/84	400		D
AL	Perdido Ground Water Contamin	Perdido	12/82	9/83	716	V	0
AL	Stauffer Chem (Cold Creek Plant)	Bucks	9/83	9/84	230	V	
AL	Stauffer Chem (LeMayne Plant)	Axis	9/83	9/84	637	V	
AL	Triana/Tennessee River	Limestone/Morgan	10/81	9/83	31	V R F	0
9 Final + 1 Proposed = 10 Total Sites							
AR	Arkwood, Inc.	Osaha	9/85		Gr 12	V F S	0
AR	Cecil Lindsey	Newport	12/82	9/83	504	R	I
AR	Frit Industries	Walnut Ridge	10/81	9/83	406	V F	C
AR	Gurley Pit	Edmondson	12/82	9/83	385	F	
AR	Industrial Waste Control	Fort Smith	12/82	9/83	713	F	
AR	Jacksonville Municipal Landfill	Jacksonville	1/87	7/87	735		D
AR	Mid-South Wood Products	Mena	10/81	9/83	257	F	
AR	Midland Products	Ola/Birta	10/84	6/86	699	R	
AR	Rogers Road Municipal Landfill	Jacksonville	1/87	7/87	736		D
AR	Vertac, Inc.	Jacksonville	10/81	9/83	18	V F	0
9 Final + 1 Proposed = 10 Total Sites							
AZ	Apache Powder Co.	Benson	6/86		Gr 4		D

* State top priority site

- 1: Date first eligible for Superfund action. First NPL proposed 12/82. Some sites announced earlier in Interim Priorities List (10/81) and Expanded Eligibility List (7/82).
- 2: Sites on the final NPL are numbered. Proposed NPL sites and all sites in the Federal (F) sections are placed into groups (Gr) corresponding to groups of 50 on the final NPL.
- 3: V = Voluntary or negotiated response R = Federal and State response D = Category to be determined
F = Federal enforcement S = State enforcement
- 4: I = Implementation activity underway, one or more operable units
0 = One or more operable units completed; others may be underway
C = Implementation activity completed for all operable units

National Priorities List,
Final and Proposed Sites (by State)
July 1987

St	Site Name	City/County	Date		Rank/ Group ₂	Response Category ₃	Cleanup Status ₄
			Proposed or Announced ₁	Final			
AZ	Nassayampa Landfill	Nassayampa	6/86	7/87	310		D
AZ	Indian Bend Wash Area	Scottsdale/Tempe/Phnx	12/82	9/83	340	V F	
AZ	Litchfield Airport Area	Goodyear/Avondale	12/82	9/83	254	F	
AZ	Mesa Area Ground Water Contamin	Mesa	6/86		Gr 13		D
AZ	Motorola, Inc.(52nd Street Plant)	Phoenix	10/84		Gr 8		D
AZ	Mountain View Mobile Homes *	Globe	7/82	9/83	94	R F	C
AZ	Nineteenth Avenue Landfill	Phoenix	10/81	9/83	116	S	
AZ	Tucson Intl Airport Area	Tucson	7/82	9/83	70	R	

6 Final + 3 Proposed = 9 Total Sites

CA	Advanced Micro Devices, Inc.	Sunnyvale	10/84	6/86	447		D
CA	Aerojet General Corp.	Rancho Cordova	10/81	9/83	110	F	I
CA	Applied Materials	Santa Clara	10/84	7/87	659		D O
CA	Atlas Asbestos Mine	Fresno County	9/83	9/84	259	R	
CA	Beckman Instruments (Porterville)	Porterville	10/84	6/86	568		D
CA	Castle Air Force Base	Merced	10/84	7/87	Gr 9F	R	I
CA	Celtor Chemical Works	Hoop	12/82	9/83	714	R	O
CA	Coalinga Asbestos Mine	Coalinga	9/83	9/84	260	R	
CA	Coast Wood Preserving	Ukiah	12/82	9/83	275		S
CA	Del Norte Pesticide Storage	Crescent City	9/83	9/84	496	R	
CA	Fairchild Camera (Mountain View)	Mountain View	10/84		Gr 14	F	
CA	Fairchild Camera(S San Jose Plnt)	South San Jose	10/84		Gr 9		D I
CA	Firestone Tire (Salinas Plant)	Salinas	10/84	7/87	255	S	O
CA	FMC Corp. (Fresno Plant)	Fresno	10/84		Gr 9		D
CA	Hewlett-Packard	Palo Alto	10/84		Gr 15		D
CA	IBM Corp. (San Jose Plant)	San Jose	10/84		Gr 16		D I
CA	Intel Corp. (Mountain View Plant)	Mountain View	10/84	6/86	732	F	
CA	Intel Corp. (Santa Clara-III)	Santa Clara	10/84	6/86	661		D
CA	Intel Magnetics	Santa Clara	10/84	6/86	660		D
CA	Iron Mountain Mine	Redding	10/81	9/83	73	R	
CA	J.N. Baxter Co.	Weed	10/84		Gr 11		D
CA	Jibboom Junkyard	Sacramento	12/82	9/83	749	R	
CA	Koppers Co., Inc. (Oroville Plant)	Oroville	9/83	9/84	599	S	
CA	Lawrence Livermore Lab (USDOE)	Livermore	10/84	7/87	Gr 7F	R	O
CA	Liquid Gold Oil Corp.	Richmond	12/82	9/83	296	S	
CA	Lorentz Barrel & Drum Co.	San Jose	10/84		Gr 12	S	
CA	Louisiana-Pacific Corp.	Oroville	10/84	6/86	600		D
CA	Marley Cooling Tower Co.	Stockton	10/84		Gr 13		D
CA	Mather AFB (AC&W Disposal Site)	Sacramento	10/84	7/87	Gr 16F	R	
CA	McClellan AFB (Ground Water Cont)	Sacramento	10/84	7/87	Gr 2F	R	O
CA	McColl	Fullerton	12/82	9/83	353	R F	I

National Priorities List,
Final and Proposed Sites (by State)
July 1987

St	Site Name	City/County	Date		Rank/ Group ₂	Response Category ₃	Cleanup Status ₄
			Proposed or Announced ₁	Final			
CA	MGM Brakes	Cloverdale	12/82	9/83	549	S	
CA	Hoffett Naval Air Station	Sunnyvale	4/85	7/87	Gr 15F	R	
CA	Monolithic Memories	Sunnyvale	10/84	7/87	515		D
CA	Montrose Chemical Corp.	Torrance	10/84		Gr 12	F	
CA	National Semiconductor Corp.	Santa Clara	10/84	7/87	516		D
CA	Norton Air Force Base	San Bernardino	10/84	7/87	Gr 9F	R	
CA	Operating Industries, Inc. Lndfll	Monterey Park	10/84	6/86	71	F	
CA	Purity Oil Sales, Inc.	Malaga	12/82	9/83	297	R	O
CA	Raytheon Corp.	Mountain View	10/84	6/86	733	F	I
CA	Rhone-Poulenc, Inc./Zoecon Corp.	East Palo Alto	10/84		Gr 14		S
CA	S.CA Edison (Visalia Poleyard)	Visalia	1/87		Gr 3		D
CA	Sacramento Army Depot	Sacramento	10/84	7/87	Gr 6F	R	
CA	San Fernando Valley (Area 1)	Los Angeles	10/84	6/86	343		D
CA	San Fernando Valley (Area 2)	Los Angeles/Glendale	10/84	6/86	344		D
CA	San Fernando Valley (Area 3)	Glendale	10/84	6/86	345		D
CA	San Fernando Valley (Area 4)	Los Angeles	10/84	6/86	514		D
CA	San Gabriel Valley (Area 1)	El Monte	9/83	5/84	341	R	I
CA	San Gabriel Valley (Area 2)	Baldwin Park Area	9/83	5/84	342	R	
CA	San Gabriel Valley (Area 3)	Alhambra	9/83	5/84	756	R	
CA	San Gabriel Valley (Area 4)	La Puente	9/83	5/84	757	R	
CA	Selma Treating Co.	Selma	12/82	9/83	195	F	
CA	Sharpe Army Depot	Lathrop	10/84	7/87	Gr 7F	R	O
CA	Signetics, Inc.	Sunnyvale	10/84		Gr 14		D
CA	South Bay Asbestos Area	Alviso	10/84	6/86	276	R	I
CA	Southern Pacific Transportation	Roseville	10/84		Gr 14	F	
CA	Stringfellow *	Glen Avon Heights	10/81	9/83	32	R F	O
CA	T.W. Agriculture & Nutrition Co.	Fresno	10/84	6/86	346		D
CA	Teledyne Semiconductor	Mountain View	10/84	7/87	528		D
CA	Van Waters & Rogers, Inc.	San Jose	10/84		Gr 3		D
CA	Waste Disposal, Inc.	Santa Fe Springs	6/86	7/87	555		D
CA	Watkins-Johnson Co. (Stewart Div)	Scotts Valley	1/87		Gr 6	S	I
CA	Westinghouse (Sunnyvale Plant)	Sunnyvale	10/84	6/86	393		D

48 Final + 15 Proposed = 63 Total Sites

CO	Broderick Wood Products	Denver	9/83	9/84	534	V F	
CO	California Gulch	Leadville	12/82	9/83	75	F	
CO	Central City-Clear Creek	Idaho Springs	7/82	9/83	157	R	
CO	Denver Radium Site	Denver	10/81	9/83	284	R	I
CO	Eagle Mine	Hinturn/Redcliff	10/84	6/86	221	R S	O
CO	Lincoln Park	Canon City	9/83	9/84	678	F	
CO	Lowry Landfill	Arapahoe County	9/83	9/84	201	V R	O

38

U.S. EPA SUPERFUND PROGRAM

** C E R C L I S **

LIST-1-B: SITE LOCATION LISTING

REPORT OPTIONS: EXTERNAL REPORT
SELECTION: ** SPECIAL **
SEQUENCE: STATE, CITY NAME, SITE NAME

WHERE CLAUSE: C0120 EQ ALAMEDA AND C0002 EQ CA AND C0001 EQ 09:

RIN-9-0699-88
L.I listing of
Alameda County.
Sorted by city and
site name.

U.S. EPA SUPERFUND PROGRAM

SELECTION: ** SPECIAL **
SEQUENCE: STATE, CITY NAME, SITE NAME

** C E R C L I S **

PAGE: 6
RUN DATE: 06/08/88
RUN TIME: 19:02:24

LIST-1-B: SITE LOCATION LISTING

VERSION: 1

REGION: 09

EPA ID	SITE NAME STREET CITY COUNTY	STATE COUNTY	ZIP CODE
CAD066569278	THERMO-FUSION INC 2342 AMERICAN AVE HAYWARD ALAMEDA	CA 001	94545
CAD982399842	WIEGMAN FARMS 3177 WEIGMAN RD HAYWARD ALAMEDA	CA 001	94544
CAD982399735	26569-75 CORPORATE AVE PROPERTY 26569 CORPORATE AVE HAYWARD ALAMEDA	CA 001	94545
CAD980637094	COAST MFG AND SUPPLY 67 TREVARN RD LIVERMORE ALAMEDA	CA 001	94550
CAD058783952	HEXCEL CORP 10 TREVARN RD LIVERMORE ALAMEDA	CA 001	94550
CAD980818934	INDUSTRIAL LADDER 115 N MINES RD LIVERMORE ALAMEDA	CA 001	94550
CAD066562836	INTEL CORP 250 N MINES RD LIVERMORE ALAMEDA	CA 001	94550
CA2890012584	LAWRENCE LIVERMORE LAB (USDOE) 7000 EAST AVE LIVERMORE ALAMEDA	CA 001	94550

U.S. EPA SUPERFUND PROGRAM

PAGE: 7
 RUN DATE: 06/08/88
 RUN TIME: 19:02:24
 VERSION: 1

** C E R C L I S **

LIST-1-B: SITE LOCATION LISTING

SELECTION: ** SPECIAL **
 SEQUENCE: STATE, CITY NAME, SITE NAME

REGION: 09

EPA ID	SITE NAME STREET CITY COUNTY	STATE COUNTY	ZIP CODE
CAD982400236	LIVERMORE SEWAGE POND/CWS # 10-01 RICHEN AVE & SUNSET DRIVE LIVERMORE ALAMEDA	CA 001	94550
CAD981415102	PG&E GAS PLANT LIVERMORE 200 TO 375 FT W OF N ST 8RR LIVERMORE ALAMEDA	CA 001	94550
CA2890012923	SANDIA NATIONAL LABORATORY 7261 EAST AVE LIVERMORE ALAMEDA	CA 001	94550
CAT080013360	ABE OIL INC 8130 ENTERPRISE DR NEWARK ALAMEDA	CA 001	94560
CAD066562521	ASHLAND CHEM CO 8600 ENTERPRISE DR NEWARK ALAMEDA	CA 001	94560
CAD009125923	CERRO METAL PROD CALIF WORKS 6707 MOWRY AVE NEWARK ALAMEDA	CA 001	94560
CAD045291192	COLUMBUS COATED FABRICS 38083 CHERRY ST NEWARK ALAMEDA	CA 001	94560
CAD009147000	FMC CORP NEWARK 8787 ENTERPRISE DR NEWARK ALAMEDA	CA 001	94560

← California water service
 well #10-1
 Juniper near P street
 between Rincon & P
 Rincon & P St. old
 treatment site
 PCE found 300-400 ppm
 outside our area of concern

Federal Register

Friday
June 24, 1988

Part VIII

Environmental Protection Agency

40 CFR Part 300
National Priorities List for Uncontrolled
Waste Sites—Update 7; Proposed Rule

of 1177 final and proposed sites. EPA is proposing to include on the NPL sites at which there are or have been releases or threatened releases of hazardous substances, or of "pollutants or contaminants." The discussion below may refer to "releases or threatened releases" simply as "releases," "facilities," or "sites."

II. Purpose of the NPL

The primary purpose of the NPL is stated in the legislative history of CERCLA (Report of the Committee on Environment and Public Works, Senate Report No. 96-848, 96th Cong., 2d Sess. 60 (1980)):

The priority lists serve primarily informational purposes, identifying for the States and the public those facilities and sites or other releases which appear to warrant remedial actions. Inclusion of a facility or site on the list does not in itself reflect a judgment of the activities of its owner or operator, it does not require those persons to undertake any action, nor does it assign liability to any person. Subsequent government action in the form of remedial actions or enforcement actions will be necessary in order to do so, and these actions will be attended by all appropriate procedural safeguards.

The primary purpose of the NPL, therefore, is to serve as an informational tool for use by EPA in identifying sites that appear to warrant further investigation and possible remedial action under CERCLA. Inclusion of a site on the NPL does not establish that EPA necessarily will undertake remedial actions. Moreover, listing does not require any action of any private party, nor does it determine the liability of any party for the cost of cleanup at the site. In addition, a site need not be on the NPL to be the subject of CERCLA-financed removal actions, remedial investigations/feasibility studies, or actions brought pursuant to section 106 or 107(a)(4)(B) of CERCLA.

In addition, although the HRS scores used to place sites on the NPL may be helpful to the Agency in determining priorities for cleanup and other response activities, EPA does not rely on the scores as the sole means of determining such priorities. The information collected to develop HRS scores is not sufficient in itself to determine the appropriate remedy for a particular site. EPA relies on further, more detailed studies to determine what response, if any, is appropriate. These studies will take into account the extent and magnitude of the contaminants in the environment, the risk to affected populations, the cost to correct problems at the site, and the response actions that have been taken by potentially responsible parties or others. Decisions

on the type and extent of action to be taken at these sites are made in accordance with the criteria contained in Subpart F of the NCP. After conducting these additional studies, EPA may conclude that it is not desirable to conduct response action at some sites on the NPL because of more pressing needs at other sites, or because an enforcement action may instigate or force private-party cleanup. Given the limited resources available in the Hazardous Substances Superfund, the Agency must carefully balance the relative needs for response at the numerous sites it has studied. It is also possible that EPA will conclude after further analysis that the site does not warrant response action.

III. NPL Update Process

There are three mechanisms for placing sites on the NPL. The principal mechanism is the application of the HRS. The HRS serves as a screening device to evaluate the relative potential of uncontrolled hazardous substances to cause human health or safety problems, or ecological or environmental damage. The HRS takes into account "pathways" to human health or environmental exposure in terms of numerical scores. Those sites that score 28.50 or greater on the HRS, and which meet listing policies, are proposed.

The Superfund Amendments and Reauthorization Act ("SARA"), enacted on October 17, 1986, directs EPA to revise the HRS. The Agency will continue to use the existing HRS until the effective date for the revised HRS. Sites on the final NPL prior to the effective date of the revised HRS will not be reevaluated, as provided by CERCLA section 105(c)(3).

The second mechanism for adding sites to the NPL is by State designation. Each State may designate a single site as its top priority, regardless of the HRS score. This mechanism is provided by section 105(a)(8)(B) of CERCLA, as amended, which requires that, to the extent practicable, the NPL include within the one hundred highest priorities at least one facility designated by each State as representing the greatest danger to public health, welfare, or the environment among known facilities in the State.

The third mechanism for listing, included in the NCP at 40 CFR 300.66(b)(4) (50 FR 37824, September 18, 1985), has been used only in rare instances; it allows certain sites with HRS scores below 28.50 to be eligible for the NPL. These sites may qualify for the NPL if all of the following occur:

- The Agency for Toxic Substances and Disease Registry of the U.S.

Department of Health and Human Services has issued a health advisory which recommends dissociation of individuals from the release.

- EPA determines that the release poses a significant threat to public health.
- EPA anticipates that it will be more cost-effective to use its remedial authority than to use its removal authority to respond to the release.

States have the primary responsibility for identifying sites, computing HRS scores, and submitting candidate sites to the EPA Regional Offices. EPA Regional Offices conduct a quality control review of the States' candidate sites, and may assist in investigating, monitoring, and scoring sites. Regional Offices may consider candidate sites in addition to those submitted by States. EPA Headquarters conducts further quality assurance audits to ensure accuracy and consistency among the various EPA and State offices participating in the scoring. The Agency then proposes the new sites that meet the criteria for listing and solicits public comments on the proposal. Based on these comments and further EPA review, the Agency determines final scores and promulgates those sites that still qualify for listing.

An original NPL of 406 sites was promulgated on September 8, 1983 (48 FR 40658). The NPL has since been expanded (see 49 FR 19480, May 8, 1984; 49 FR 37070, September 21, 1984; 50 FR 6320, February 14, 1985; 50 FR 37630, September 18, 1985; 51 FR 21054, June 10, 1986, and 52 FR 27620, July 22, 1987). On March 7, 1986 (51 FR 7935), EPA deleted eight sites from the NPL and on April 18, 1988 (53 FR 12680) deleted three more sites. The number of final NPL sites is 799, including 32 Federal facility sites. Another 149 sites (including 16 Federal facility sites) from previous updates remain proposed for the NPL (see 46 FR 40674, September 8, 1983; 49 FR 40320, October 15, 1984; 50 FR 14115, April 10, 1985; 50 FR 37950, September 18, 1985; 51 FR 21099, June 10, 1986, and 52 FR 2492, January 22, 1987). With the 229 sites in proposed Update #7, 378 sites are not proposed for the NPL. Final and proposed sites total 1177.

IV. Public Comment Period

This Federal Register notice, which proposes sites for NPL Update #7, opens the formal 60-day comment period. Comments may be mailed to Stephen Lingle, Director, Hazardous Site Evaluation Division (Attn: NPL staff), Office of Emergency and Remedial Response (WH-548A), U.S. Environmental Protection Agency, 401 M Street SW., Washington, DC 20460.

**ENVIRONMENTAL PROTECTION
AGENCY**
40 CFR Part 300
(FRL-3404-2)
**National Priorities List for
Uncontrolled Hazardous Waste Sites—
Update 7**
AGENCY: Environmental Protection
Agency.

ACTION: Proposed rule.

SUMMARY: The Environmental Protection Agency ("EPA") is proposing the seventh update to the National Priorities List ("NPL"). This update proposes 229 new sites and the expansion of one final site, and repropose four already proposed sites. The NPL is Appendix B to the National Oil and Hazardous Substances Contingency Plan ("NCP"), which EPA promulgated pursuant to Section 105 of the Comprehensive Environmental Response, Compensation, and Liability Act of 1980 ("CERCLA"), as amended by the Superfund Amendments and Reauthorization Act of 1986, and Executive Order 12316. CERCLA requires that the NPL be revised at least annually. Today's notice proposed the seventh major revision to the NPL.

These sites are being proposed because they meet the requirements of the NPL. EPA has included on the NPL sites at which there are or have been releases or threatened releases of designated hazardous substances, or of "pollutants or contaminants" which may present an imminent and substantial danger to the public health or welfare. This notice provides the public with an opportunity to comment on placing these sites on the NPL.

DATES: Comments must be submitted on or before August 23, 1988.

ADDRESSES: Comments may be mailed to Stephen Lingle, Director, Hazardous Site Evaluation Division (Attn: NPL Staff), Office of Emergency and Remedial Response (WH-548A), U.S. Environmental Protection Agency, 401 M Street SW., Washington, DC 20460. Addresses for the Headquarters and Regional dockets are provided below. For further details on what these dockets contain, see the Public

Comment Section, Section IV, of the **SUPPLEMENTARY INFORMATION** portion of this preamble.

Tina Maragousis, Headquarters, U.S. EPA CERCLA Docket Office, Waterside Mall Subbasement, 401 M Street, SW., Washington, DC 20460, 202/382-3048

Evo Cunha, Region 1, U.S. EPA Waste Management Division Records Center, HES-CAN 6, 90 Canal Street, Boston, MA 02203, 617/573-5729

U.S. EPA Region 2, Document Control Center, Superfund Docket, 28 Federal Plaza, 7th Floor, Room 740, New York, NY 10278, Latchmin Serrano 212/264-5540, Ophelia Brown 212/264-1154

Diane McCreary, Region 3, U.S. EPA Library, 5th Floor, 841 Chestnut Bldg., 9th & Chestnut Streets, Philadelphia, PA 19107, 215/597-0580

Gayle Alston, Region 4, U.S. EPA Library, Room C-6, 345 Courtland Street NE., Atlanta, GA 30365, 404/347-4218

Cathy K. Freeman, Region 5, U.S. EPA 5 HR-11, 230 South Dearborn Street, Chicago, IL 60604, 312/886-6214

Deborah Vaughn-Wright, Region 6, U.S. EPA 1445 Ross Avenue, Mail Code 6H-ES, Dallas, TX 75202-2733, 214/655-6740

Connie McKenzie, Region 7, U.S. EPA Library, 726 Minnesota Avenue, Kansas City, KS 66101, 913/236-2828

Dolores Eddy, Region 8, U.S. EPA Library, 999 18th Street, Suite 500, Denver, CO 80202-2405, 303/293-1444

Linda Sunnen, Region 9, U.S. EPA Library, 6th Floor, 215 Fremont Street, San Francisco, CA 94105, 415/974-8082

David Bennett, Region 10, U.S. EPA, 11th Floor, Mail Stop HW-113, 1200 6th Avenue, Seattle, WA 98101, 206/442-2103.

FOR FURTHER INFORMATION CONTACT:

Robert Myers, Hazardous Site Evaluation Division, Office of Emergency and Remedial Response (WH-548A), U.S. Environmental Protection Agency, 401 M Street SW., Washington, DC, 20460, or the Superfund Hotline, Phone (800) 424-6346 (or 382-3000 in the Washington, DC, metropolitan area).

SUPPLEMENTARY INFORMATION:
Table of Contents

- I. Introduction
- II. Purpose of the NPL
- III. NPL Update Process
- IV. Public Comment Period
- V. Listing Policies
- VI. Contents of the Proposed Seventh NPL Update
- VII. Regulatory Impact Analysis
- VIII. Regulatory Flexibility Act Analysis

I. Introduction

In 1980, Congress enacted the Comprehensive Environmental Response, Compensation, and Liability Act, 42 U.S.C. 9601, *et seq.* ("CERCLA" or "the Act") in response to the dangers of uncontrolled hazardous waste sites. To implement CERCLA, the Environmental Protection Agency ("EPA" or the "Agency") promulgated the revised National Oil and Hazardous Substances Contingency Plan, 40 CFR Part 300, on July 16, 1983 (47 FR 31180), pursuant to Section 105 of CERCLA and Executive Order 12316 (46 FR 42237, August 20, 1981). The National Contingency Plan ("NCP"), further revised by EPA on September 16, 1985 (50 FR 37624) and November 20, 1985 (50 FR 47912), sets forth the guidelines and procedures needed to respond under CERCLA to releases and threatened releases of hazardous substances, pollutants, or contaminants.

Section 105(a)(8)(A) of CERCLA, as amended, required that the NCP include criteria for determining priorities among releases or threatened releases for the purpose of taking remedial or removal action. Removal action involves cleanup or other actions that are taken in response to emergency conditions or on a short-term or temporary basis (CERCLA section 101(23)). Remedial action tends to be long-term in nature and involves response actions which are consistent with a permanent remedy for a release (CERCLA section 101(24)). These criteria are included in Appendix A of the NCP, *Uncontrolled Hazardous Waste Site Ranking System: A User's Manual* (the "Hazard Ranking System" or "HRS") (47 FR 31219, July 16, 1982).

Section 105(a)(8)(B) of CERCLA, as amended, requires that the statutory criteria described in the HRS be used to prepare a list of national priorities among the known releases or threatened releases throughout the United States. The list, which is Appendix B of the NCP, is the National Priorities List ("NPL").

In this notice, EPA is proposing to add 229 sites to the NPL. In addition, four proposed sites are being repropose and one final site is being proposed for expansion. Adding the 149 sites previously proposed brings the total number of proposed sites to 378. The final NPL contains 799 sites, for a total

The "ADDRESSES" portion of this notice contains information on where to obtain documents relating to the scoring of these proposed sites. Documents providing EPA's justification for proposing these sites are available to the public in both the Headquarters public docket and in the appropriate Regional Office public docket.

The Headquarters public docket for NPL Update #7 contains: HRS score sheets for each proposed site; a Documentation Record for each site describing the technical rationale for the HRS scores; pertinent information for any site affected by special study waste or Resource Conservation and Recovery Act (RCRA) or other listing policies; and a list of documents referenced in the Documentation Record. The Headquarters public docket is located in EPA Headquarters, Waterside Mall Subbasement, 401 M Street SW., Washington, DC 20460, and is available for viewing by appointment only from 9:00 a.m. to 4:00 p.m., Monday through Friday excluding Federal holidays. Requests for copies of the HRS documents may be directed to the EPA Headquarters docket office.

The Regional public dockets contain all information available in the Headquarters docket, including HRS score sheets, Documentation Records, pertinent RCRA or special study waste information, and a list of reference documents for each site in that Region. These Regional dockets also include the reference documents themselves, which contain the data EPA relied upon in calculating or evaluating the HRS scores. The reference documents are available only in the Regional public dockets. These reference documents may be viewed by appointment only in the appropriate Regional Office, and requests for copies may be directed to the appropriate Regional docket or Superfund Branch. Documents relevant to the scoring of each site, but which were not used as formal references, are also available in the appropriate Regional Office, and, in some cases, State or EPA contractor offices. These may be viewed and copied by arrangement with the appropriate office. In all cases, an informal written request, rather than a formal request, should be the ordinary procedure for obtaining copies of any document.

EPA considers all comments received during this formal comment period. Comments are placed into the Headquarters docket and, during the comment period, are available to the public only in the Headquarters docket. A complete set of comments pertaining to sites in a particular EPA Region will

be available for viewing in the Regional Office docket approximately one week following the close of the formal comment period. Comments received after the close of the comment period will be available in the Headquarters docket and in the appropriate Regional Office docket on an "as received" basis. An informal written request, rather than a formal request, should be the ordinary procedure for obtaining copies of these comments. After considering the relevant comments received during the comment period, EPA will add to the NPL all proposed sites that meet EPA's criteria for listing. In past NPL rulemakings, EPA has considered, to the extent practicable, comments received after the close of the comment period. EPA will attempt to do so in this rulemaking as well. However, because of the large number of sites proposed, and the need to respond to comments and finalize sites prior to the effective date of the revised HRS, EPA may no longer be able to consider late comments.

In certain instances, interested parties have written to EPA concerning sites which were not at that time proposed to the NPL. If those sites are later proposed to the NPL, parties should review their earlier concerns and, if still appropriate, resubmit those concerns for consideration during the formal comment period. Site-specific correspondence received prior to the period of formal proposal and comment will not generally be included in the docket.

A statement describing what information the Agency discloses in response to Freedom of Information Act requests from the public was published on February 25, 1987 (52 FR 5578).

V. Listing Policies

CERCLA restricts EPA's authority to respond to certain categories of releases and expressly excludes some substances from the definition of a release. In addition, as a matter of policy, EPA may choose not to use CERCLA to respond to certain types of releases because other authorities such as RCRA can be used to achieve cleanup of these releases. Preambles to previous NPL rulemakings have discussed examples of these deferral policies. (See 48 FR 40858 (September 8, 1983); 49 FR 37070 (September 21, 1984); 49 FR 40320 (October 15, 1984); 51 FR 21056 (June 10, 1986); and 52 FR 27820 (July 22, 1987)). In addition, EPA is considering broadening the deferral approach, such that listing of sites on the NPL would be deferred in cases where a Federal authority and its implementing program are found to have

corrective action authority. EPA is also considering extending this policy to States that have implementing programs with cleanup authorities to address CERCLA releases, and to sites where the potentially responsible parties (PRPS) enter into Federal enforcement agreements for site cleanup under CERCLA. EPA plans to propose this policy in the preamble to the NCP revisions which are scheduled for publication later in 1988. Sites included in today's proposed rule could be affected by that policy if, after public comment, it is adopted by EPA.

Sites proposed for the NPL in this update meet current criteria and listing policies. The NPL policies of relevance to this update—Federal facility sites, RCRA sites, special study waste sites, and mining sites—are discussed below.

Federal Facility Sites

On June 18, 1986 (51 FR 21057), the Agency announced a decision on components of a listing and deferral policy for non-Federal RCRA sites and requested comments on several additional components. The policy was intended to reflect RCRA's broadened corrective action authorities as a result of the Hazardous and Solid Waste Amendments of 1984 (HSWA). As explained in greater detail below, the policy generally defers the listing of sites subject to RCRA Subtitle C corrective action authorities unless one or more of three criteria is met: (1) The owner/operator is bankrupt; (2) the owner/operator has lost authorization to operate and has indicated an unwillingness to undertake corrective action; or (3) in cases other than loss of authorization to operate, the owner/operator has a clear history of unwillingness to undertake corrective action. In announcing this policy, the Agency reserved for a later date the question of whether this or another policy would be applicable for Federal facility sites. The Agency explained that this issue would be considered along with other issues relating to Federal facility sites (51 FR 21059, June 10, 1986).

Since that time, the Agency has considered the issue of placing Federal facility sites on the NPL. As part of its deliberations, EPA considered pertinent sections of SARA and a policy published for comment regarding RCRA Subtitle C corrective action at Federal facilities with RCRA operating units (51 FR 7722, March 5, 1986). Specifically, that policy stated that: (1) RCRA section 3004(u) subjects Federal facilities to corrective action requirements to the same extent as privately-owned or privately-operated facilities and (2) the

definition of a Federal facility boundary is equivalent to the property-wide definition of facility at privately-owned or privately-operated facilities. This policy was of particular interest because the Agency has determined that the vast majority of Federal facilities that could be placed on the NPL have RCRA-regulated units within their boundaries.

The Agency has interpreted SARA and its legislative history to indicate that Congress clearly intended that Federal facilities be placed on the NPL and that, if appropriate, cleanup should be effected at those sites. In the floor debates, Senator Robert T. Stafford explained Section 120 as follows:

[T]he amendments require a comprehensive nationwide effort to identify and assess all Federal hazardous waste sites that warrant attention . . . The legislation . . . requires that any Federal facility that meets the criteria applied to private sites listed on the National Priorities List (NPL) must be placed on the NPL." 132 Cong. Rec. S. 14902 (daily ed., October 3, 1986).

Section 120 of SARA includes requirements for the assessment of releases at Federal facilities, placement on the NPL, and if appropriate, implementation of remedial action. Sections 120(a) and 120(d) also require that Federal facility sites be evaluated for the NPL based upon the same guidelines, rules, regulations, and criteria that are applicable to other sites.

Given that Congress clearly contemplated that Federal facility sites be on the NPL, the Agency interprets these provisions of section 120 to mean that the criteria to list Federal facility sites should not be more exclusionary than the criteria to list non-Federal sites. Key elements of the current policy for listing non-Federal sites subject to RCRA Subtitle C corrective action authorities include whether the owner or operator either has demonstrated an inability to finance a cleanup as evidenced by the invocation of the bankruptcy laws or has clearly demonstrated unwillingness to comply with applicable RCRA requirements or regulations. Since bankruptcy proceedings are not applicable to Federal agencies and unwillingness to comply with Federal laws is unlikely, application of the non-Federal NPL/RCRA policy would have the effect of listing few Federal sites. The Agency believes that this result would be inconsistent with the spirit and intent of section 120.

To avoid being more exclusionary in placing Federal facility sites on the NPL, the Agency announced its intent to adopt a policy for Federal facility sites that would allow eligible Federal facility sites to be on the NPL regardless of

whether RCRA Subtitle C corrective action authorities are applicable (52 FR 17991, May 13, 1987).

In summary, the Agency believes that placing Federal facility sites with or without RCRA units on the NPL is consistent with the intent of section 120 of SARA and will serve the purposes originally intended by the NCP at 40 CFR 300.66(e)(2)—to advise the public of the status of Federal government cleanup efforts (50 FR 47931, November 20, 1985). In addition, listing will help other Federal agencies set priorities and focus cleanup efforts on those sites presenting the most serious problems.

For Update #7, the Agency is proposing 14 Federal facility sites, bringing the total number of such proposed sites to 30. Of these 14 proposed sites, four are sub-areas of the Hanford site, the Department of Energy (DOE) facility in the State of Washington. The installation assessment for Hanford identified 337 potentially contaminated areas, and most of these have been aggregated into four larger areas termed the 100, 200, 300 and 1100 areas. Each of these four larger areas has been evaluated and each is being proposed for the NPL.

Releases From Resource Conservation and Recovery Act (RCRA) Sites

On June 10, 1986 (51 FR 21057), EPA announced a decision on components of a policy for the listing or the deferral from listing on the NPL of several categories of potential RCRA sites. At the same time, the Agency requested comment on several other components of the NPL/RCRA policy (51 FR 21109).

Under the policy, sites not subject to RCRA Subtitle C corrective action authorities will continue to be placed on the NPL. Examples of such sites include:

- Facilities that ceased treating, storing, or disposing of hazardous waste prior to November 19, 1980 (the effective date of Phase I of the Subtitle C regulations).
- Sites at which only materials exempted from the statutory or regulatory definition of solid waste or hazardous waste are managed.
- Hazardous waste generators or transporters which are not required to have Interim Status or a final RCRA permit.

Also under the policy, certain RCRA sites at which Subtitle C corrective action authorities are available may also be listed if they meet the criteria for listing (e.g., an HRS score of 28.50 or greater) and they fall within one of the following categories:

- (1) Facilities owned by persons who have demonstrated an inability to

finance a cleanup as evidenced by their invocation of the bankruptcy laws.

- (2) Facilities that have lost authorization to operate, and for which there are additional indications that the owner or operator will be unwilling to undertake corrective action.

- (3) Sites, analyzed on a case-by-case basis, whose owners or operators have a clear history of unwillingness to undertake corrective action.

Elsewhere in today's Federal Register, the Agency has described in greater detail several other categories of RCRA sites which it considers appropriate for the NPL. One category is non- or late filers. These are facilities that were treating, storing, or disposing of hazardous waste after November 19, 1980, but did not file a Part A permit by that date and have little or no history of compliance with RCRA. EPA has found that treatment, storage, and disposal facilities (TSDFs) that fail to file Part A of the RCRA permit application generally remain outside the range of cognizance of authorities responsible for compliance with RCRA, and generally are without the institutional mechanisms such as ground water monitoring programs, necessary to assure prompt compliance with the standards and goals of the RCRA program.

Another category of RCRA sites appropriate for listing is converters (the rationale for which is discussed elsewhere in today's Federal Register). These are facilities that at one time were treating or storing RCRA Subtitle C hazardous waste but have since converted to generator-only status, or any other hazardous waste activity for which interim status is not required. Their Part A applications have been withdrawn. This category is considered appropriate for listing because the RCRA corrective action program currently focuses primarily on TSDFs (due to statutory deadlines in RCRA), and thus EPA has not routinely reviewed converters under RCRA Subtitle C. Therefore, EPA has decided to propose these sites in order to ensure that they are expeditiously addressed.

Two other categories of RCRA sites are appropriate for the NPL because the sites are not subject to Subtitle C corrective action authorities of RCRA. The protective filer category includes facilities which have filed Part A permit applications for treatment, storage and disposal of hazardous wastes as a precautionary measure only. The second category includes facilities for which permits for the treatment, storage, or disposal of hazardous waste were

issued prior to the enactment of the Hazardous and Solid Waste Amendments (HSWA) of 1984 and the owner/operator will not voluntarily modify the permit to incorporate corrective action requirements. Facilities in this category are referred to as pre-HSWA permittees. If a pre-HSWA permittee consents to include corrective action authority, EPA will consider not adding the facility to the NPL.

Update #7 includes eight RCRA sites meeting the inability to pay criterion, and 15 sites having converter or non- or late filer status. These sites are presented in Table 1. In addition, Update #7 includes generators, protective filers, and one pre-HSWA permittee, Solvent Service, Inc., San Jose, CA. Documents supporting the RCRA determinations for these sources are available for review in both the Headquarters and appropriate Regional dockets. Commenters are encouraged to provide documentation for any site where they believe EPA's RCRA determination is in error.

Table 1.—Proposed Update #7 Sites Subject to RCRA Subtitle C Corrective Action Authorities

Inability to Pay

Kaiser Steel Corp. (Fontana Plant), Fontana, CA
 Lenz Oil Service, Inc., Lemont, IL
 Continental Steel Corp., Kokomo, IN
 Pester Refinery Co., El Dorado, KS
 Bofor Nobel, Inc., Muskegon, MI
 Mattiace Petrochemical Co., Inc., Glen Cove, NY
 Oklahoma Refining Co., Cyril, OK
 Tomoli Corp., Nesquehoning, PA

Non- or Later Filer

Apache Powder Co., St. David, AZ
 Brown & Bryant, Inc. (Arvin Plant), Arvin, CA
 Kearney-KPE, Stockton, CA
 Marzone Inc./Chevron Chemical Co., Tifton, GA
 Hada Energy Co., East Cape Girardeau, IL
 Warner Electric Brake & Clutch Co., Roscoe, IL
 Brook Industrial Park, Bound Brook, NJ

Converters

Advanced Micro Devices (Building 915), Sunnyvale, CA
 Hexcel Corp., Livermore, CA
 Firestone Tire & Rubber Co. (Albany Plant), Albany, GA
 John Deere (Ottumwa Works Landfills), Ottumwa, IA
 Muskegon Chemical Co., Whitehall, MI
 AMP, Inc. (Glen Rock Facility), Glen Rock, PA
 Westinghouse Electric Corp. (Sharon Plant), Sharon, PA
 Carrier Air Conditioning Co., Collierville, TN

* Site includes several facilities, including a RCRA non-filer facility.

Releases of Special Study Wastes

Sections 105(g) and 125 of CERCLA, as amended by SARA, require additional information before sites involving RCRA "special study wastes" can be proposed for the NPL. Section 105(g) applies to sites that (1) were not on or proposed for the NPL as of October 17, 1988, and (2) contain sufficient quantities of special study wastes as defined under sections 3001(b)(2), 3001(b)(3)(A)(ii), and 3001(b)(3)(A)(iii) of RCRA. Before these sites can be proposed for the NPL, SARA requires that the following information be considered:

- The extent to which the HRS score for the facility is affected by the presence of the special study waste at or released from the facility.
- Available information as to the quantity, toxicity and concentration of hazardous substances that are constituents of any special study waste at, or released from, the facility; the extent of or potential for release of such hazardous constituents; the exposure or potential exposure to human population and the environment, and the degree of hazard to human health or the environment posed by the release of such hazardous constituents at the facility.

Section 125 of CERCLA, as amended, applies to facilities that were neither on nor proposed for the NPL on the date of enactment of SARA and which contain "substantial volumes" of waste described in section 3001(b)(A)(i) of RCRA. Until the HRS is revised, these sites may not be included on the NPL "on the basis of an evaluation made principally on the volume of such waste and not on the concentration of the hazardous constituents of such waste." Even though section 125 does not contain specific requirements for the interim period, the Agency believes that wastes covered under section 125 should follow the requirements of section 105(g) until these issues are addressed in the revised HRS.

To comply with SARA, the Agency has prepared addenda that evaluate, for each proposed site containing or potentially containing special study wastes, the information called for in section 105(g). Section 125 addresses fly ash waste, bottom ash waste, slag waste, and flue gas emission control waste, and not site in Update #7 has been scored using these special study wastes. Addenda are available for review in the public docket.

This proposed NPL update includes 20 new sites and one final site being proposed for expansion which contain or potentially contain the following

special study wastes: cement kiln dust; mining wastes from the extraction, beneficiation, and processing of ores and minerals (including coal tar from coal gasification plants and spent pot liners from aluminum production); and oil drilling muds, produced waters, and other wastes from the exploration, production, or development of crude oil or natural gas. The addenda for these sites indicate that the special study wastes present a threat to human health and the environment, and that the sites should be proposed to the NPL. The sites and the special study wastes are:

- Sulphur Bank Mercury Mine, Clear Lake, CA (mining wastes)
- Sealand Limited, Mount Pleasant, DE (coal tar)
- Fairfield Coal Gasification Plant, Fairfield, IA (coal tar)
- Lehigh Portland Cement Co., Mason City, IA (cement kiln dust)
- Northwestern States Portland Cement Co., Mason City, IA (cement kiln dust)
- People's Natural Gas Co., Dubuque, IA (coal tar)
- Central Illinois Public Service Co., Taylorville, IL (coal tar)
- D.L. Mud, Inc., Abbeville, LA (oil drilling mud and produced waters)
- Gulf Coast Vacuum Services, Abbeville, LA (oil drilling mud and produced waters)
- PAB Oil & Chemical Service, Inc., Abbeville, LA (oil drilling mud and produced waters)
- Oronogo-Duenweg Mining Belt, Jasper County, MO (mining wastes)
- Weldon Spring Quarry (USDOE/Army), St. Charles County, MO (mining wastes from uranium ore processing)
- Cimarron Mining Corp., Carrizozo, NM (mining wastes from metal ore beneficiation)
- Cleveland Mill, Silver City, NM (mining wastes)
- Lee Acres Landfill (USDO), Farmington, NM (oil drilling mud and produced waters)
- Niagara Mohawk Power Corp. (Saratoga Springs Plant), Saratoga Springs, NY (coal tar)
- Reilly Tar & Chemical Corp. (Dover Plant), Dover, OH (coal tar)
- Jacks Creek/Sitkin Smelting & Refining, Inc., Maitland, PA (mining wastes)
- Tex-Tin Corp., Texas City, TX (mining wastes)
- Richardson Flat Tailings, Summit County, UT (mining wastes)
- Aluminum Co. of America (Vancouver Smelter), Vancouver, WA (spent pot liners from aluminum production)

Mining Sites

The Agency's position, as discussed in the preambles to previous NPL final rulemakings (48 FR 40858, September 8, 1983; 49 FR 37070, September 21, 1984; 51 FR 21054, June 10, 1986; 52 FR 27620, July 22, 1987), is that mining wastes may be hazardous substances, pollutants, or contaminants under CERCLA and, therefore, are eligible for the NPL. This position was affirmed in 1986 by the United States Court of Appeals for the District of Columbia Circuit (*Eagle-Schacher Industries, Inc. v. EPA*, 759 F. 2d 922 (D.C. Cir 1985)).

As in past final rules (51 FR 21034 (June 10, 1986) and 52 FR 27620 (July 22, 1987)), the Agency, prior to listing mining sites, has considered whether they might be addressed satisfactorily pursuant to the Surface Mining Control and Reclamation Act of 1977 (SMCRA). EPA has determined that 23 States have an approved Abandoned Mine Land Reclamation (AMLR) program under SMCRA. The funds in these programs are primarily intended to address the public health problems associated with abandoned coal mines. However, in certain cases the Governor of a State with an approved program can decide to use AMLR funds to address non-coal sites abandoned prior to August 3, 1977, the enactment date of SMCRA.

Seven mining sites are being proposed for the NPL, and one final mining site, Weldon Spring Quarry (USDOE/Army), is being proposed for expansion. Two of these sites operated after August 3, 1977 and are not subject to SMCRA, so they are being proposed:

- Cimarron Mining Corp., Carrizozoa, NM
- Tex-Tin Corp., Texas City, TX

One site is being proposed because it is located in a State which does not have an approved AMLR program:

- Sulphur Bank Mercury Mine, Clear Lake, CA

The remaining five mining sites, including Weldon Spring Quarry (USDOE/Army), were abandoned prior to the August 3, 1977 enactment date of SMCRA and are being proposed for the NPL:

- Oronogo-Duenweg Mining Belt, Jasper County, MO
- Weldon Spring Quarry (USDOE/Army), St. Charles County, MO
- Cleveland Mill, Silver City, NM
- Jacks Creek/Sitkin Smelting & Refining, Inc., Maitland, PA
- Richardson Flat Tailings, Summit County, UT

These five mining sites are in States (Missouri, New Mexico, Pennsylvania, and Utah) which have approved AMLR

programs. The Agency has had preliminary discussions with the Department of the Interior and these States on their AMLR programs for addressing mining sites, and plans to continue these discussions in order to develop a more comprehensive policy for listing mining sites which are potentially eligible for SMCRA funds on the NPL. While this policy is under development, the Agency will propose to list these five sites in order to avoid delaying CERCLA activities. Information outlining the States' position on use of AMLR funds at these sites is available in the docket.

Sites Being Re-proposed

Four previously proposed sites are being re-proposed, and one final Federal facility site is being proposed for expansion. These sites are:

- Apache Powder Co., St. David, AZ. Procedural issues arose and new technical information became available following proposal on June 10-1986 (51 FR 21099).
- Chem-Solv, Inc., Cheswold, DE. Procedural issues arose and new technical information became available following proposal on January 22, 1987 (52 FR 2492).
- Combustion, Inc., Denham Springs, LA. New technical information became available following proposal on June 10, 1986 (51 FR 21099).
- Paoli Rail Yard, Paoli, PA. New technical information became available following proposal on January 22, 1987 (52 FR 2492).
- Weldon Spring Quarry (USDOE/Army), St. Charles County, MO. This Federal facility site was placed on the final NPL on July 22, 1987 (52 FR 27620). Since then, EPA has determined that the Weldon Spring Feed Materials Plant and Raffinate Pits, located less than three miles from the Quarry, are linked to the contamination problems at the original site. Consequently, EPA proposes to expand the original site and requests comment on the expanded site. The new site will be renamed "Weldon Spring Quarry/Plant/Pits (USDOE/Army)."

VI. Contents of the Proposed Seventh NPL Update

Following this preamble is a list of the 229 sites proposed for the NPL. See Table 2 and Table 3. Each entry on the list contains the name of the facility and the State and city or county in which it is located. All sites other than N.W. Mauthe Co., Appleton, WI, received HRS scores of 28.50 or above. N.W. Mauthe is the State top priority site, and received an HRS score of 25.35.

Each proposed site is placed by score in a group corresponding to groups of 50 sites presented within the final NPL. For example, sites in Group 8 of the proposed update have scores that fall within the range of scores covered by the eighth group of 50 sites on the final NPL. Any site designated by a State as its top priority is included within the one hundred highest priority sites, as provided by section 106(a)(5)(B) of CERCLA, as amended. Since States are not required to rely exclusively on the HRS in designating their top priority sites, lower scoring State priority sites such as N.W. Mauthe are listed at the bottom of the first one hundred sites on the NPL.

Each entry is accompanied by one or more notations reflecting the status of response and cleanup activities at the site at the time this list was prepared. Because this information may change periodically, these notations may become outdated.

Five response categories are used to designate the type of response underway. One or more categories may apply to each site. The categories are: Federal and/or State response (R), Federal enforcement (F), State enforcement (S), Voluntary or negotiated response (V), and Category to be determined (D).

EPA also indicates the status of significant Fund-financed or private-party cleanup activities underway or completed at proposed and final NPL sites. There are three cleanup status codes; only one code is necessary to designate the status of cleanup activities at each site since the codes are mutually exclusive. The codes are: Implementation activities are underway for one or more operable units (I), Implementation activities are completed for one or more (but not all) operable units, but additional site cleanup actions are necessary (O), and Implementation activities are completed for all operable units (C).

These categories and codes are explained in detail in earlier rulemakings, most recently on June 10, 1986 (51 FR 21075).

VII. Regulatory Impact Analysis

The costs of cleanup actions that may be taken at sites are not directly attributable to listing on the NPL, as explained below. Therefore, the Agency has determined that this rulemaking is not a "major" regulation under Executive Order No. 12291. EPA has conducted a preliminary analysis of the economic implications of today's proposal to add new sites. EPA believes that the kinds of economic effects

associated with this revision are generally similar to those identified in the regulatory impact analysis (RIA) prepared in 1982 for the revisions to the NCP pursuant to section 105 of CERCLA (47 FR 31180, July 16, 1982) and the economic analysis prepared when the amendments to the NCP were proposed (50 FR 5882, February 12, 1985). The Agency believes the anticipated economic effects related to proposing the addition of these sites to the NPL can be characterized in terms of the conclusions of the earlier RIA and the most recent economic analysis. This rule was submitted to the Office of Management and Budget (OMB) for review as requested by Executive Order No. 12291.

Costs

EPA has determined that this proposed rulemaking is not "major" regulation under Executive Order No. 12291 because inclusion of a site on the NPL does not itself impose any costs. It does not establish that EPA will necessarily undertake remedial action, nor does it require any action by a private party or determine its liability for site response costs. Costs that arise out of site responses result from site-by-site decisions about what actions to take, not directly from the act of listing itself. Nonetheless, it is useful to consider the costs associated with responding to all sites included in a proposed rulemaking. This action was submitted to the Office of Management and Budget for review.

The major events that generally follow the proposed listing of a site on the NPL are a search for responsible parties and a remedial investigation/feasibility study (RI/FS) to determine if remedial actions will be undertaken at a site. Design and construction of the selected remedial alternative follow completion of the RI/FS, and operation and maintenance (O&M) activities may continue after construction has been completed.

Costs associated with responsible party searches are initially borne by EPA. Responsible parties may bear some or all the costs of the RI/FS, design and construction, and O&M, or the costs may be shared by EPA and the States.

The State cost share for cleanup activities has been amended by section 104 of SARA. For privately-owned sites, as well as publicly-owned but not publicly-operated sites, EPA will pay for 100% of the costs of the RI/FS and remedial planning, and 90% of the costs associated with remedial action. The State will be responsible for 10% of the remedial action costs. For publicly-operated sites, the State cost share is at

least 50% of all response costs, including the RI/FS, remedial design and construction, and O&M.

With regard to O&M for cleanup activities other than ground water or surface water, EPA will share, for up to 1 year, in the cost of that portion of O&M that is necessary to assure that a remedy is operational and functional. After that time, the State assumes full responsibility for O&M. SARA provides that EPA will share in the operational cost associated with ground water/surface water restoration for up to 10 years.

In previous NPL rulemakings, the Agency has provided estimates of the costs associated with these activities (RI/FS, remedial design, remedial action, and O&M) on an average per site and total cost basis. At this time, however, there is insufficient information to determine what these costs will be as a result of the new requirements under SARA. Until such information is available, the Agency will provide cost estimates based on CERCLA prior to enactment of SARA; these estimates are presented below. EPA is unable to predict that portions of the total costs will be borne by responsible parties, since the distribution of costs depends on the extent of voluntary and negotiated response and the success of any cost-recovery actions.

Cost category	Average total cost per site ¹
RI/FS	\$875,000
Remedial design	\$50,000
Remedial action	\$6,500,000
Net present value of O&M ²	\$3,770,000

¹ 1986 U.S. Dollars

² Includes State cost-share

³ Assumes cost of O&M over 90 years, \$400,000 for the first year and 10% discount rate.

Source: Hazardous Site Control Division, Office of Emergency and Remedial Response, U.S. EPA.

Costs to States associated with today's proposed amendment arise from the required State cost-share of: (1) 10% of remedial actions and 10% of first-year O&M costs at privately-owned sites and sites which are publicly-owned but not publicly-operated; and (2) at least 50% of the remedial planning (RI/FS and remedial design), remedial action, and first-year O&M costs at publicly-operated sites. States will assume the cost for O&M after EPA's period of participation. Using the assumptions developed in the 1982 RIA for the NCP, EPA has assumed that 90% of the 215 non-Federal sites proposed for the NPL in this amendment will be privately-owned and 10% will be State- or locally-operated. Therefore, using the budget

projections presented above, the cost to States of undertaking Federal remedial actions at all 215 non-Federal sites would be approximately \$1.02 billion, of which approximately 744 million is attributable to the State O&M cost. As a result of the changes to State cost share under SARA, however, the Agency believes that State O&M costs may actually decrease. When new cost information is available, it will be presented in future rulemakings.

Proposing a hazardous waste site for the NPL does not itself cause firms responsible for the site to bear costs. Nonetheless, a listing may induce firms to clean up the site voluntarily, or it may act as a potential trigger for subsequent enforcement or cost-recovery actions. Such actions may impose costs on firms, but the decisions to take such actions are discretionary and made on a case-by-case basis. Consequently, precise estimates of these effects cannot be made. EPA does not believe that every site will be cleaned up by a responsible party. EPA cannot project at this time which firms or industry sectors will bear specific portions of response costs, but the Agency considers: the volume and nature of the wastes at the site, the parties' ability to pay, and other factors when deciding whether and how to proceed against potentially responsible parties.

Economy-wide effects of this proposed amendment are aggregations of effects on firms and State and local governments. Although effects could be felt by some individual firms and States, the total impact of this revision on output, prices, and employment is expected to be negligible at the national level, as was the case in the 1982 RIA.

Benefits

The benefits associated with today's proposed amendment to list additional sites are increased health and environmental protection as a result of increased public awareness of potential hazards. In addition to the potential for more Federally-financed remedial actions, this proposed expansion of the NPL could accelerate privately-financed, voluntary cleanup efforts to avoid potential adverse publicity, private lawsuits, and/or Federal or State enforcement actions.

As a result of the additional NPL remedies, there will be lower human exposure to high-risk chemicals, and higher-quality surface water, ground water, soil, and air. These benefits are expected to be significant, although difficult to estimate in advance of completing the RI/FS at these particular sites.

Associated with the costs of remedial actions are significant potential benefits and cost offsets. The distributional costs to firms of financing NPL remedies have corresponding "benefits" in that funds expended for a response generate employment, directly or indirectly (through purchased materials).

VIII. Regulatory Flexibility Act Analysis

The Regulatory Flexibility Act of 1980 requires EPA to review the impacts of this action on small entities, or certify that the action will not have a significant impact on a substantial number of small entities. By small entities, the Act refers to small businesses, small governmental jurisdictions, and nonprofit organizations.

While proposed modifications to the NPL are considered revisions to the NCP, they are not typical regulatory changes since the revisions do not automatically impose costs. Proposing sites for the NPL does not in itself require any action by any private party, nor does it determine the liability of any party for the cost of cleanup at the site.

Further, no identifiable groups are affected as a whole. As a consequence, it is hard to predict impacts on any group. A site's proposed inclusion on the NPL could increase the likelihood that adverse impacts to responsible parties (in the form of cleanup costs) will occur, but EPA cannot identify the potentially affected businesses at this time nor estimate the number of small businesses that might be affected.

The Agency does expect that certain industries and firms within industries that have caused a proportionately high percentage of waste site problems could be significantly affected by CERCLA actions. However, EPA does not expect the impacts from the proposed listing of these sites to have a significant economic impact on a substantial number of small businesses.

In any case, economic impacts would only occur through enforcement and cost-recovery actions, which are taken at EPA's discretion on a site-by-site basis. EPA considers many factors when determining what enforcement actions to take, including the firm's contribution

to the problem and the firm's ability to pay. The impacts from cost recovery on small governments and nonprofit organizations would be determined on a similar case-by-case basis.

List of Subjects in 40 CFR Part 300

Air pollution control, Chemicals, Hazardous materials, Intergovernmental relations, Natural resources, Oil pollution, Reporting and recordkeeping requirements, Superfund, Waste treatment and disposal, Water pollution control, Water supply.

Jack W. McGraw,

Deputy Assistant Administrator, Office of Solid Waste and Emergency Response.

Date: June 18, 1988.

It is proposed to amend 40 CFR Part 300 as follows:

PART 300—(AMENDED)

1. The authority citation for Part 300 is revised to read as follows:

Authority: 42 U.S.C. 9605(a)(8)(B).

2. It is proposed to add the following sites by group to Appendix B of Part 300.

TABLE 2.—NATIONAL PRIORITIES LIST, PROPOSED UPDATE 7 SITES (BY GROUP), JUNE 1988

NPL Gr ¹	SI	Site name	City/county	Response category ²	Cleanup status ³
2	IA	Northwestern States Portland Cem.	Mason City	D	
2	KY	Brantley Landfill	Island	O	
2	NJ	Brook Industrial Park	Bound Brook	D	
2	IA	Lehigh Portland Cement Co.	Mason City	D	
2	CA	Kearney-KPF	Stockton	D	
2	WA	ALCOA (Vancouver Smelter)	Vancouver	D	
2	WA	General Electric (Spokane Shop)	Spokane	R S	
2	WI	N.W. Maue Co., Inc.	Appleton	D	
3	NY	Circuitron Corp.	East Farmingdale	D	
3	IA	White Farm Equipment Co. Dump	Charles City	R S	
3	MI	Bofors Nobel, Inc.	Muskogon	F	
3	PA	Raymark	Hatboro	D	
3	CA	Brown & Bryant, Inc. (Arvin Plant)	Arvin	D	
3	VT	Burgess Brothers Landfill	Woodford	D	
3	WA	Seattle Mun Landfill (Kant Highinds)	Kent	D	
3	CT	Barkhamsted-New Hartford Landfill	Barkhamsted	D	
4	CA	Kaiser Steel Corp (Fontana Plant)	Fontana	D	
4	IN	Whitford Sales&Ser/Nationallease	South Bend	R	
4	NY	Rosen Brothers Scrap Yard/Dump	Cortland	R	
4	IL	Woodstock Municipal Landfill	Woodstock	R	
4	SC	Rock Hill Chemical Co	Rock Hill	D	
4	MI	M-Mill Manufacturing Co	Highland	D	
4	CT	Precision Plating Corp	Vernon	D	
4	VT	Bennington Municipal Sanitary LI.	Bennington	D	
4	IL	Central Illinois Public Serv Co	Taylorville	D	
4	MT	Comet Oil Co	Billings	D	
5	IA	Mid-America Tanning Co	Sergeant Bluff	D	
5	WI	Hachimovich Sanitary Landfill	Williamstown	D	
5	CA	Sulphur Bank Mercury Mine	Clear Lake	D	
5	PA	Tonoffi Corp	Nesquehoning	D	
5	MO	Oronogo-Duerweg Mining Belt	Jasper County	D	
5	CT	Gallup's Quarry	Plainfield	D	
5	VT	Parker Sanitary Landfill	Lyndon	D	
5	IA	Peoples Natural Gas Co	Dubuque	D	
5	PA	Berks Landfill	Spring Township	D	
5	CA	Pacific Coast Pipe Lines	Falmore	D	
5	IA	E.I. Du Pont (County Rd X23)	West Point	D	
5	IL	Interstate Pollution Control, Inc	Rockford	D	
5	OK	Oklahoma Refining Co	Cyle	D	
5	NJ	Global Sanitary Landfill	Old Bridge Township	D	
6	PA	Occidental Chem/Firestone Tire	Lower Pottsgrove Twp.	D	
6	VT	Darling Hill Dump	Lyndon	D	

TABLE 2.—NATIONAL PRIORITIES LIST, PROPOSED UPDATE 7 SITES (BY GROUP), JUNE 1988—Continued

NPL Gr 1	St	Site name	City/county	Response category ²	Cleanup status ³
6	WY	Mystery Bridge Rd/U.S. Highway 20	Evansville	R	0
6	FL	Agrico Chemical Co	Pensacola	D	0
6	AL	T.H. Agricul & Nutri (Montgomery)	Montgomery	D	1
6	CA	Solvent Service, Inc	San Jose	D	0
6	WA	Pasco Sanitary Landfill	Pasco	D	0
6	KY	Fort Hartford Coal Co Stone Quarry	Olaton	D	0
7	FL	Standard Auto Bumper Corp	Hialeah	D	0
7	KS	29th & Mead Ground Water Contamin	Wichita	D	0
7	KS	Hydro-Flex Inc	Topeka	D	0
7	LA	Gulf Coast Vacuum Services	Abbeville	D	0
7	FL	Airco Plating Co	Miami	D	0
7	PA	A.I.W. Frank/Mid-County Mustang	Elton	D	0
7	IL	Lenz Oil Service, Inc	Lamont	D	0
7	WA	Pacific Car & Foundry Co	Renton	D	0
7	IA	John Deere (Dubuque Works Lndfls)	Ottumwa	D	0
7	IN	Himco, Inc., Dump	Elkhart	D	1
7	GA	Woolfolk Chemical Works, Inc	Fort Valley	V	0
7	IA	Electro-Coatings, Inc	Cedar Rapids	D	0
7	IL	Southeast Rockford Grnd Wtr Con	Rockford	D	0
7	IN	Conrail Rail Yard (Elkhart)	Elkhart	R	0
7	IN	Galen Myers Dump/Drum Salvage	Oceola	R	0
7	IN	Tippecanoe Sanitary Landfill, Inc	Lafayette	D	0
7	MI	State Disposal Landfill, Inc	Grand Rapids	D	0
7	NJ	South Jersey Clothing Co	Minotola	D	0
7	GA	Cedartown Industries, Inc	Cedartown	D	0
8	VT	BFI Sanitary Landfill (Rockingham)	Rockingham	D	0
8	NC	Koppers Co Inc (Morrisville Plant)	Morrisville	D	0
8	PA	Westinghouse Elec (Sharon Plant)	Sharon	S	0
8	GA	T.H. Agricul & Nutn (Albany)	Albany	D	1
8	NC	FCX, Inc (Washington Plant)	Washington	D	0
8	NM	Cleveland Mill	Silver City	D	0
8	PA	Jacks Creek/Sitkin Smelting & Ref	Mt Laurel	D	0
8	MD	Bush Valley Landfill	Abingdon	D	0
8	TN	Murray-Ohio Mfg (Horseshoe Bend)	Lawrenceburg	D	0
8	IL	Balot Corp	Rockton	D	0
8	CA	Crazy Horse Sanitary Landfill	Salinas	D	0
8	CA	Spectra-Physics, Inc	Mountain View	D	0
8	IL	Warner Electric Brake & Clutch Co	Roscoe	D	0
8	PA	Boarhead Farms	Bridgeton Township	D	0
8	FL	Woodbury Chemical (Princeton Plant)	Princeton	D	0
9	NC	New Hanover Cnty Airport Burn Pit	Wilmington	D	0
9	UT	Richardson Flat Tailings	Summit County	D	0
9	NC	JFD Electronics/Channel Master	Oxford	D	1
9	PA	AMP, Inc (Glen Rock Facility)	Glen Rock	D	0
9	MI	Peerless Plating Co	Muskegon	R	0
9	LA	PAB Oil & Chemical Service, Inc	Abbeville	R	0
9	NM	Cimarron Mining Corp	Camazon	R	0
9	TX	Tex-Tin Corp	Texas City	D	0
9	FL	Beulah Landfill	Pensacola	D	0
9	DE	Kent County Landfill (Houston)	Houston	D	0
9	RI	Rose Hill Regional Landfill	South Kingstown	D	0
9	KY	Red Penn Sanitation Co. Landfill	Peewee Valley	D	0
9	OK	Mosley Road Sanitary Landfill	Oklahoma City	D	0
9	CA	Hexcel Corp	Livermore	D	0
9	CO	Chemical Sales Co	Commerce City	V	0
9	FL	BMI-Tadron	Lake Park	S	0
9	FL	Chemform, Inc	Pompano Beach	D	0
9	FL	Madison County Sanitary Landfill	Madison	V	0
9	FL	Wilson Concepts of Florida, Inc	Pompano Beach	D	0
9	MD	Anne Arundel County Landfill	Glen Burnie	D	0
9	NC	FCX, Inc (Statesville Plant)	Statesville	D	0
9	SC	Lexington County Landfill Area	Cayce	D	0
9	WA	Yakima Plating Co	Yakima	D	0
9	CA	Interall Inc./Siemens Components	Cupertino	D	0
9	MI	Carter Industries, Inc	Detroit	R	0
10	MI	Bendix Corp./Allied Automotive	St Joseph	D	0
10	VA	Arrowhead Assoc/Boovill Corp	Montross	F	0
10	TX	Rio Grande Oil Co. Refinery	Sour Lake	F	0
10	VA	Abex Corp	Portsmouth	T	0
10	WA	Centrale Municipal Landfill	Centrale	D	0
10	TN	Wrigley Charcoal Plant	Wrigley	D	0
10	CT	Cheshire Associates Property	Cheshire	S	0
10	SC	Townsend Sew Chain Co	Pontiac	D	0
10	VA	Suffolk City Landfill	Suffolk	D	0
10	NJ	Higgins Disposal	Kingston	D	0
10	VT	Tanator Electronics, Inc	Barnington	D	0
11	CA	Fresno Municipal Sanitary Landfill	Fresno	D	0
11	CA	Newmark Ground Water Contamin	San Bernardino	D	0
11	CA	Bola Optical USA, Inc	Petaluma	D	0

TABLE 2.—NATIONAL PRIORITIES LIST, PROPOSED UPDATE 7 SITES (BY GROUP), JUNE 1988—Continued

NPL Gr 1	St	Site name	City/county	Response category ¹	Cleanup status ²
11	IL	DuPage Cty Ldt/Blackwell Forest	Warrerville	D	
11	NM	Pagano Salvage	Los Lunas	D	
11	TN	Carner Air Conditioning Co.	Collierville	D	
11	NY	Niagara Mohawk Power (Saratoga Sp)	Saratoga Springs	D	
11	OK	Sunray Oil Co. Refinery	Allen	D	
11	IN	Carter Lee Lumber Co.	Indianapolis	D	O
11	CA	CTS Printex, Inc.	Mountain View	D	
11	GA	Firestone Tire (Albany Plant)	Albany	D	
11	NH	Fletcher's Paint Works & Storage	Milford	D	
11	CA	Jasco Chemical Corp.	Mountain View	D	
11	FL	B&B Chemical Co., Inc.	Hialeah	D	
11	NY	C & J Deposal Leasing Co. Dump	Hamilton	D	
11	PA	Bell Landfill	Tarry Township	D	
11	NY	Action Anodizing, Plating Polish	Copague	D	
12	IL	Adams County Quincy Landfills 2&3	Quincy	F	
12	IL	Ilada Energy Co.	East Cape Girardeau	F	
12	KY	Caldwell Lace Leather Co., Inc.	Auburn	F	O
12	MI	Kaydon Corp.	Muskegon	F	O
12	TX	Durie Oil Processors, Inc.	Friendswood	F	O
12	WI	Sauk County Landfill	Excelsior	S	O
12	MI	Muskegon Chemical Co.	Whitehall	S	O
12	IN	Lakeland Disposal Service, Inc.	Claypool	S	O
12	CT	Durham Meadows	Durham	S	O
12	SC	Helena Chemical Co. Landfill	Fairfax	S	
12	KY	Tri-City Disposal Co.	Shepherdsville	S	
12	MI	Albion-Sheridan Township Landfill	Albion	S	
12	IA	Fairfield Coal Gasification Plant	Fairfield	S	S
12	IA	Farmers' Mutual Cooperative	Hospers	S	
12	NY	Carroll & Dubois Sewage Disposal	Pon Jervis	S	F, S
12	CT	Linemaster Switch Corp.	Woodstock	S	
13	GA	Cedartown Municipal Landfill	Cedartown	S	
13	NY	Jones Chemicals, Inc.	Caledonia	S	
13	PA	Saegertown Industrial Area	Saegertown	S	
13	ND	Minot Landfill	Minot	S	
13	MO	Missouri Electric Works	Cape Girardeau	S	O
13	IL	Yeoman Creek Landfill	Waukegan	S	
13	DE	Sealand Limited	Mount Pleasant	S	
13	NC	Geigy Chemical Corp (Aberdeen Pnt)	Aberdeen	S	
13	KY	General Tire/Rubber (Mayfield Lnf)	Mayfield	S	
13	WI	Madison Metro Sewage District Lag	Blooming Grove	S	
13	WA	Tosco Corp. (Spokane Terminal)	Spokane	S	
13	OR	Joseph Forest Products	Joseph	S	
13	IL	Amoco Chemicals (Joliet Landfill)	Joliet	S	
13	SC	Beaunt Corp (Circular Knt & Dye)	Fountain Inn	S	O
13	NJ	Industrial Latex Corp.	Wallington Borough	S	O
13	LA	D.L. Mud, Inc.	Abbeville	S	
13	PA	Recticon/Alfred Steel Corp.	East Coventry Twp	S	
13	CA	GBF, Inc., Dump	Antioch	S	
13	CA	Valley Wood Preserving, Inc.	Turlock	S	
13	PA	Butz Landfill	Stroudsburg	S	O
14	CA	Advanced Micro Devices (Bldg. 915)	Sunnyvale	S	O
14	CA	Symtek, Inc. (Building 1)	Santa Clara	S	O
14	CA	TRW Microwave, Inc (Building 825)	Sunnyvale	S	O
14	NH	Holton Circle Ground Water Contam	Londonderry	S	O
14	NY	Mathaco Petrochemical Co., Inc.	Glen Cove	S	
14	MA	Atlas Tack Corp.	Fairhaven	S	
14	IN	Continental Steel Corp.	Kokomo	S	
14	FL	Wingate Road Munic Incinerat Dump	Fort Lauderdale	S	
14	NC	Benfield Industries, Inc.	Hazelwood	S	O
14	SC	Eimore Waste Disposal	Greer	S	
14	OH	Reilly Tar & Chemical (Dover Pnt)	Dover	S	
14	MI	Parsons Chemical Works, Inc.	Grand Ledge	S	
14	KY	Green River Disposal, Inc.	Macedo	S	
14	FL	Anodyne, Inc.	North Miami Beach	S	
14	AK	Alaska Battery Enterprises	Fairbanks N Star Bor	S	
14	AL	Redwing Carners, Inc. (Saraland)	Saraland	S	
14	OK	Double Eagle Refinery Co.	Oklahoma City	S	O
14	WI	Fort Howard Paper Co. Lagoons	Green Bay	S	O
14	PA	Strasburg Landfill	Newlin Township	S	O
14	OK	Fourth Street Abandoned Refinery	Oklahoma City	S	O
14	NJ	Witco Chemical Corp. (Oakland Pnt)	Oakland	S	O
15	WA	Northwest Transformer (S Harkness)	Everson	S	O
15	NJ	Higgins Farm	Franklin Township	S	O
15	WA	American Crossarm & Conduit Co.	Chelalis	S	O
15	GA	Marzone Inc./Chevron Chemical Co.	Tifton	S	
15	PA	Keyser Avenue Borehole	Scranton	S	
15	KS	Pester Refinery Co.	El Dorado	S	
15	MI	Cannerton Industries, Inc.	Sault Sainte Marie	S	
15	PA	Berkley Products Co. Dump	Denver	S	

TABLE 2.—NATIONAL PRIORITIES LIST, PROPOSED UPDATE 7 SITES (BY GROUP), JUNE 1988—Continued

NPL Gr ¹	St	Site name	City/county	Response category ²	Cleanup status ³
15	MS	Gautier Oil Co., Inc.	Gautier	V, F	O
15	CA	Hewlett-Packard (620-40) Page Mill	Palo Alto	D	
15	MI	Adam's Plating	Lansing	D	
15	ME	Seco Municipal Landfill	Seco	D	
15	NM	Prewitt Abandoned Refinery	Prewitt	D	
15	NY	Sidney Landfill	Sidney	D	
15	NC	Potter's Septic Tank Service Pits	Masco	R	O
15	NC	ABC One Hour Cleaners	Jacksonville	D	
15	PA	Elizabethtown Landfill	Elizabethtown	D	O
16	CA	Modesto Ground Water Contamin.	Modesto	D	
16	DE	Sussex County Landfill No. 5	Laurel	D	
16	NJ	Garden State Cleaners Co	Minotola	D	
16	NJ	Pohatcong Valley Ground Water Con.	Warren County	D	
16	WI	Waste Management (Brookfield Ltd)	Brookfield	D	
16	NJ	Kauffman & Mntzer, Inc.	Jobstown	D	

Number of Sites Proposed for Listing: 215

¹ Sites are placed in groups (Gr) corresponding to groups of 50 on the final NPL.
² V=Voluntary or negotiated response; F=Federal enforcement; D=Category to be determined; R=Federal and State response; S=State enforcement.
³ I=Implementation activity underway, one or more operable units; O=One or more operable units completed, others may be underway; C=Implementation activity completed for all operable units.
⁴ State top priority site.

TABLE 3.—NATIONAL PRIORITIES LIST, FEDERAL FACILITY SITES, PROPOSED UPDATE 7 (BY GROUP), JUNE 1988

NPL Gr ¹	St	Site name	City/county	Response category ²	Cleanup status ³
1	WA	Hanford 200-Area (USDOE)	Benton County	D	
1	WA	Hanford 300-Area (USDOE)	Benton County	D	
1	CA	Riverbank Army Ammunition Plant	Riverbank	R	
1	NM	Cal West Metals (SBA)	Lamar	O	
2	OH	Wright-Patterson Air Force Base	Dayton	R	
5	WA	Hanford 100-Area (USDOE)	Benton County	D	
8	CA	El Toro Marine Corps Air Station	El Toro	R	
10	NM	Lee Acres Landfill (USDOI)	Farmington	D	O
10	NC	Camp Lejeune Marine Corps Base	Onslow County	R	
10	WA	Hanford 1100-Area (USDOE)	Benton County	D	
12	PR	Naval Security Group Activity	Sabana Seca	R	
13	WA	Fairchild Air Force Base (4 Areas)	Spokane County	R	
15	CA	Concord Naval Weapons Station	Concord	R	
15	AZ	Yuma Marine Corps Air Station	Yuma	R	

Number of Federal Facility Sites Proposed for Listing: 14

¹ Sites are placed in groups (Gr) corresponding to groups of 50 on the final NPL.
² V=Voluntary or negotiated response; F=Federal enforcement; D=Category to be determined; R=Federal and State response; S=State enforcement.
³ I=Implementation activity underway, one or more operable units; O=One or more operable units completed, others may be underway; C=Implementation activity completed for all operable units.

FACILITY ID	FACILITY NAME	FACILITY STREET	FACILITY CITY	ZIP	COUNTY	ACTIVITY TYPE		
						GEN	TRANS	TSDF
* CAT000613380	ALAMEDA CO DEPT OF AGR I	2418 RAILROAD AVE	LIVERMORE	94550	ALAMEDA	1	X	
* CAD980892400	ALAMEDA COUNTY WATER DISTRICT	43885 SOUTH GRIMMER BLVD	FREMONT	94538	ALAMEDA	1		
* CA2170023236	ALAMEDA NAVAL AIR STA	W END CITY OF ALAMEDA	ALAMEDA	94501	ALAMEDA	1		X
* CAD981968167	ALAMEDA WASHETT CLNRS	1916 ENDINAL AVE	ALAMEDA	94501	ALAMEDA	1		
* CAD981450844	ALAMEDA, CITY OF BUR ELECTRICTY	2004 WEBSTER ST	ALAMEDA	94501	ALAMEDA	1		
* CAD027909886	ALCAN INGOT & POWDERS	1069 SECOND ST	BERKELEY	94710	ALAMEDA	1		
* CAD981443062	ALL FOREIGN AUTO SALVAGE	1507 2ND ST	BERKELEY	94710	ALAMEDA	1		
* CAD981683493	ALLSTAR CHEVROLET	3800 1ST	LIVERMORE	94550	ALAMEDA	1		
* CAD085849255	ALTA PLATING & CHEM CORP	1732 PERALTA ST	OAKLAND	94607	ALAMEDA	1		
* CAD092739515	ALTEX SCIENTIFIC INC	1780 FOURTH ST	BERKELEY	94710	ALAMEDA	1		X
* CAD009152364	AMCHEM PRODS	37899 NILES BLVD	FREMONT	94536	ALAMEDA	1		
* CAD009142324	AMCO CHEM CORP	1414 THIRD ST	OAKLAND	94607	ALAMEDA			X
* CAD981573751	AMERICAN AUTO WRECKERS	3744 DEPOT RD	HAYWARD	94545	ALAMEDA	1		
* CAD041852716	AMERICAN BIO NUCLEAR	4560 HORTON ST	EMERYVILLE	94608	ALAMEDA	1		
* CAD021774559	AMERICAN BRASS & IRON FOUNDRY	7825 SAN LEANDRO ST	OAKLAND	94546	ALAMEDA	1		
* CAD009162116	AMERICAN CAN PACKAGING INC	3801 E 8TH ST	OAKLAND	94604	ALAMEDA	1		
* CAD098317563	AMERICAN CONTRACTING SERV	3229 SAN LEANDRO ST	OAKLAND	94601	ALAMEDA	1	X	
* CAD009162603	AMERICAN ELECTROFINISHING CO	4933 SAN LEANDRO ST	OAKLAND	94601	ALAMEDA	1		
* CAD009126905	AMERICAN NATIONAL CAN CO	2050 WILLIAMS ST	SAN LEANDRO	94577	ALAMEDA	1	X	
* CAD980674188	AMERICAN PRESIDENT LINES LTD	1395 MIDDLE HBR RD	OAKLAND	94607	ALAMEDA	1	X	
* CAD981168636	AMERICAN VALENCE CORP	5650 STEWART AVE	FREMONT	94538	ALAMEDA	1		
* CAD990803967	AMERIGAS	2311 MAGNOLIA ST	OAKLAND	94607	ALAMEDA	1		
* CAD009113499	AMERON PIPE DIV NO CA	29901 INDUSTRIAL PKWY SW	HAYWARD	94540	ALAMEDA	1	X	
* CAD982039034	AMPECO	3051 TEAGARDEN ST	SAN LEANDRO	94577	ALAMEDA	1		
* CAD981389232	ANALYSTS INC	2910 FORD ST	OAKLAND	94601	ALAMEDA	1		
* CAD051903847	ANCHOR GLASS CONTAINER CORP	22302 HATHAWAY AVE	HAYWARD	94541	ALAMEDA	1		
* CAD981375330	ANDY'S ONE HR MARTINIZING	600 GRAND AVE #100	OAKLAND	94610	ALAMEDA	1		
* CAD981171671	ANIXTER, INC	1050 ALADDIN AVE	SAN LEANDRO	94577	ALAMEDA		X	X
* CAD982414971	ANNS CLEANERS	2631 BLANDING AVE	ALAMEDA	94501	ALAMEDA	1		

FACILITY ID	FACILITY NAME	FACILITY STREET	FACILITY CITY	ZIP	COUNTY	ACTIVITY TYPE GEN TRANS TSDF
* CAD981614597	MIKE ONE HR CLEANERS	1430 FIRST ST	LIVERMORE	94550	ALAMEDA	1
* CAD029319050	MILLER & HODGE AUTOM M ACHINE	14505 E 14TH ST	SAN LEANDRO	94578	ALAMEDA	1
* CAD066566860	MILLER MATERIALS CO	990 BEECHER ST	SAN LEANDRO	94577	ALAMEDA	1
* CAD009183591	MILLER-WEST MFG	1362 53RD AVE	OAKLAND	94601	ALAMEDA	1
* CAD981580699	MILTS COIN OP CLNRS	3055 TELEGRAPH AVE	BERKELEY	94705	ALAMEDA	1
* CAD980887558	MIRACLE AUTO PAINTING	14140 WASHINGTO N AVE	SAN LEANDRO	94578	ALAMEDA	1
* CAD981376833	MIRACLE AUTO PAINTING	6500 SCARLETT C T	DUBLIN	94568	ALAMEDA	1
* CAD981372428	MIRACLE AUTO PAINTING	575 W GRAND AVE	OAKLAND	94612	ALAMEDA	1
* CAD981168818	MIRACLE AUTO PAINTING	4525 PERALTA ST	FREMONT	94536	ALAMEDA	1
* CAD981573280	MIRACLE TRUCK PAINTING	3393 ENTERPRISE AVENUE	HAYWARD	94545	ALAMEDA	1
* CAD981444466	MIRANDES ONE HOUR CLEA NERS	21120 REDWOOD R D	CASTRO VALLEY	94546	ALAMEDA	1
* CAD981442528	MISSION BLVD LINCOLN M ERCURY INC	24644 MISSION B LVD	HAYWARD	94544	ALAMEDA	1
* CAD981967748	MISSION CLEANERS	2000 E DRISCOLL RD	FREMONT	94538	ALAMEDA	1
* CAD981385578	MJB-HBCI	1555 ATLANTIC S T	UNION CITY	94587	ALAMEDA	1
* CAD073930869	MOBILITY INDUSTRIES IN C	3755 WILLOW ST	NEWARK	94560	ALAMEDA	1
* CAD982039828	MODEL GARAGE INC THE	2170 DWIGHT WAY	BERKELEY	94704	ALAMEDA	1
* CAD009152877	MONTAGUE CO THE	1830 STEARMAN A VE	HAYWARD	94545	ALAMEDA	1
* CAD981386311	MONTGOMERY WARD CO	VARIOUS LOCATIO NS	OAKLAND	94000	ALAMEDA	1
* CAD982329864	MONUZ TRANSPORTATION	49630 SKY ROAD	FREMONT	94539	ALAMEDA	X
* CAD982029811	MOREY TRANSPORT INC	48870 KATO RD	FREMONT	94539	ALAMEDA	X
* CAT080033442	MORGAN BILL TRUCKING	251 LOUETTE CT	HAYWARD	94541	ALAMEDA	X
* CAD009200478	MORTON SALT	7380 CENTRAL AV E	NEWARK	94560	ALAMEDA	1
* CAD028724128	MT EDEN NURSERY CO INC	25801 INDUSTRIA L BLVD	HAYWARD	94545	ALAMEDA	1
* CAD981430465	MV CALIFORNIA STAR	1 MARKET ST	OAKLAND	94607	ALAMEDA	1
* CAD009123217	MYERS DRUM CO	6549 SAN PABLO AVE	OAKLAND	94608	ALAMEDA	1 X
* CAT000624957	MYERS DRUM CO	4500 SHELLMOUND AVE	EMERYVILLE	94608	ALAMEDA	1 X
* CAD083790899	NADY SYSTEMS INC	1145 65TH ST	OAKLAND	94608	ALAMEDA	1
* CAD045757515	NAPKO CO	40600 ALBRAE AV E	FREMONT	94538	ALAMEDA	1
* CAT080034242	NASH SOLVENT & THINER	1520 POWELL	EMERYVILLE	94608	ALAMEDA	1
* CAD080709587	NATIONAL AIRMOTIVE COR P	7200 LOCKHEED	OAKLAND	94614	ALAMEDA	1
* CAD981372410	NATIONAL FABITRONIX IN C	1841 NATIONAL A VE	HAYWARD	94545	ALAMEDA	1
* CAD058777251	NATIONAL STARCH & CHEM CORP	742 GRAYSON STR EET	BERKELEY	94710	ALAMEDA	1

FACILITY ID	FACILITY NAME	FACILITY STREET	FACILITY CITY	ZIP	COUNTY	ACTIVITY TYPE	
						GEN	TRANS TSDF
* CAT080021553	PACIFIC BELL	L4N UNION STREE T	FREMONT	94538	ALAMEDA	1	X
* CAT080021561	PACIFIC BELL	L3N WARM SPRING S	FREMONT	94538	ALAMEDA	1	X
* CAT080020803	PACIFIC BELL	MISSION & NURSE RY	FREMONT	94536	ALAMEDA	1	X
* CAT080021595	PACIFIC BELL	WALPERT RIDGE	HAYWARD	94541	ALAMEDA	1	X
* CAT080021603	PACIFIC BELL	575 C ST	HAYWARD	94541	ALAMEDA	1	X
* CAT080020381	PACIFIC BELL	120 RAY STREET	PLEASANTON	94566	ALAMEDA	1	X
* CAT080020373	PACIFIC BELL	N/S MAIN STREET	SUNOL	94586	ALAMEDA	1	X
* CAT080020365	PACIFIC BELL	2388 SECOND STR EET	LIVERMORE	94550	ALAMEDA	1	X
* CAT080020357	PACIFIC BELL	2324 SECOND STR EET	LIVERMORE	94550	ALAMEDA	1	X
* CAT080020340	PACIFIC BELL	1580 CHABOT COU RT	HAYWARD	94545	ALAMEDA	1	X
* CAT080020332	PACIFIC BELL	1880 DEPOT COUR T	HAYWARD	94545	ALAMEDA	1	X
* CAT080020324	PACIFIC BELL	4073 ADAMS AVEN UE	FREMONT	94538	ALAMEDA	1	X
* CAT080020316	PACIFIC BELL	1129 "B" STREET	HAYWARD	94541	ALAMEDA	1	X
* CAT080020308	PACIFIC BELL	118 "E" STREET	UNION CITY	94587	ALAMEDA	1	X
* CAT080020290	PACIFIC BELL	36789 FREMONT B OULEVARD	FREMONT	94536	ALAMEDA	1	X
* CAT080021611	PACIFIC BELL	24801 HUNTWOOD	HAYWARD	94544	ALAMEDA	1	X
* CAT080020902	PACIFIC BELL	7074A COMMERCE CIRCLE	PLEASANTON	94566	ALAMEDA	1	X
* CAT080021728	PACIFIC BELL	498 PASEO GRAND E	SAN LORENZO	94580	ALAMEDA	1	X
* CAT080021629	PACIFIC BELL	100 ORCHARD AVE NUE	HAYWARD	94544	ALAMEDA	1	X
* CAT080021686	PACIFIC BELL	3654 SANTA RITA ROAD	PLEASANTON	94566	ALAMEDA	1	X
* CAT080020845	PACIFIC BELL	30691 VANDERBIL T	HAYWARD	94544	ALAMEDA	1	X
* CAT080020829	PACIFIC BELL	24005 MISSION B OULEVARD	HAYWARD	94544	ALAMEDA	1	X
* CAT080021652	PACIFIC BELL	3597 FIRST STRE ET	LIVERMORE ^{vd}	94550	ALAMEDA	1	X
* CAT080021645	PACIFIC BELL	1015 EAST STANL EY BOULEVARD	LIVERMORE ^{vd}	94550	ALAMEDA	1	X
* CAT080021637	PACIFIC BELL	26212 INDUSTRIA L BOULEVARD	HAYWARD	94545	ALAMEDA	1	X
* CAD054391776	PACIFIC BELL	2116 BANCROFT W AY	BERKELEY	94704	ALAMEDA	1	X
* CAD053904231	PACIFIC BELL	1655 - 1661 DOO LITTLE DRIVE	SAN LEANDRO	94577	ALAMEDA	1	X
* CAD980895205	PACIFIC BELL	7300 EDGEWATER DR	OAKLAND	94621	ALAMEDA	1	X
* CAT080015431	PACIFIC BELL	1519 FRANKLIN S TREET	OAKLAND	94612	ALAMEDA	1	X

FACILITY ID	FACILITY NAME	FACILITY STREET	FACILITY CITY	ZIP	COUNTY	ACTIVITY TYPE	
						GEN	TRANS TSDF
* CAT080010481	PIQUET CHEMICAL COMPAN Y	2310 DAVIS STRE ET	SAN LEANDRO	94577	ALAMEDA		X
* CAD009236621	PLANT INSULATION CO	1300 64TH ST	EMERYVILLE	94662	ALAMEDA		X
* CAD981976475	PLEASANTON DRY CLEANER S	3120 SANTA RITA	PLEASANTON	94566	ALAMEDA	1	
* CAD980891519	POLIMAC MACHINE SHOP	383 PRED A ST	SAN LEANDRO	94577	ALAMEDA	1	
* CAD057503823	PORTER COATINGS	5900 CHRISTIE A VE	EMERYVILLE	94608	ALAMEDA	1	
* CAD982039075	POTSTADA MFG	680 MARINA AVE	SAN LEANDRO	94577	ALAMEDA	1	
* CAD981658628	POTSTADA MFG CO	660 MARINE BLVD	SAN LEANDRO	94577	ALAMEDA	1	
* CAT080012925	POWERINE OIL CO	2701 7TH STREET	OAKLAND	94607	ALAMEDA	1	
* CAD980888671	PPG IND INC LOC #0161	2300 CYPRESS AV E	OAKLAND	94607	ALAMEDA	1	
* CAD980888689	PPG IND INC LOC #1855 & 2156	1601-63RD AVE	EMERYVILLE	94608	ALAMEDA	1	
* CAD981158926	PPG INDUSTRIES	14100 DOOLITTLE DR	SAN LEANDRO	94577	ALAMEDA	1	
* CAT080032568	PPG/HASLETT COMPANY	1345 DOOLITTLE DRIVE	SAN LEANDRO	94577	ALAMEDA	1	
* CAD009146663	PQ CORP THE	801 GRAYSON ST	BERKELEY	94710	ALAMEDA	1	
* CAD009109794	PRECISION FOUNDERS INC	414 HESTER ST	SAN LEANDRO	94577	ALAMEDA	1	
* CAD009169830	PRECISION METAL FABRIC ATORS	3402 ENTERPRISE AV	HAYWARD	94540	ALAMEDA	1	
* CAD009139718	PRESCOLITE	1251 DOOLITTLE DR	SAN LEANDRO	94577	ALAMEDA	1	
* CAD066568429	PROCESS TECHNOLOGY COM PANY	609 WINDE MERE ISLE	ALAMEDA	94511	ALAMEDA	1	
* CAD981683261	PROFICIENT FOOD CO	5675 SONOL BLVD	PLEASANTON	94566	ALAMEDA	1	
* CAD981972383	PRUDENTIAL OVERALL SUP PLY	3095 OSGOOD CT	FREMONT	94539	ALAMEDA	1	
* CAD076547298	PSA STORAGE TANKS NUMB ERS 20A AND 20B	OAKLAND INTERNA TIONAL AIRPORT	OAKLAND	94614	ALAMEDA	1	
* CAD981583529	PSI STAR	6453 KAISER DR	FREMONT	94586	ALAMEDA	1	
* CAD980888192	PUBLIC WRKS DEPT, STS & SANIT DIV	1326 ALLSTON WA Y	BERKELEY	94702	ALAMEDA	1	
* CAD980893226	PULLBRITE INC	45473 WARM SPRI NGS BLVD	FREMONT	94539	ALAMEDA	1	
* CAD981695133	PURITY CLEANERS	183 N LIVERMORE AVE	LIVERMORE	94550	ALAMEDA	1	
* CAD981367972	QUALITY AUTO BODY	57 CALIFORNIA A VE #D	PLEASANTON	94566	ALAMEDA	1	
* CAD981982929	QUALITY CLEANERS	31864 ALVARADO BLVD	UNION CITY	94587	ALAMEDA	1	
* CAT000611152	QUALITY TRANSPORT INC	620 WARREN AVEN UE	WARM SPRINGS	94538	ALAMEDA		X
* CAD981976533	QUICK WAY CLEANERS	7061 VILLAGE PA RKWAY	DUBLIN	94568	ALAMEDA	1	
* CAD064154693	QUME CORPORATION	2323 INDUSTRIAL PARKWAY W	HAYWARD	94545	ALAMEDA	1	
* CAD981159155	RAINBOW BODY & FENDER REPAIR SERV	387 A ST	HAYWARD	94541	ALAMEDA	1	

FACILITY ID	FACILITY NAME	FACILITY STREET	FACILITY CITY	ZIP	COUNTY	ACTIVITY TYPE	
						GEN TRANS	TSDF
* CAD0009176058	RAN-ROB INC	631 85TH AVE	OAKLAND	94621	ALAMEDA	1	
* CAD981385149	RCA OIL RECOVERY	8175 WELLS AVE	NEWARK	94560	ALAMEDA		X
* CAD981170954	REDCO	1975 NATIONAL B LVD	HAYWARD	94545	ALAMEDA	1	
* CAD981372832	REDS LIVERMORE BODYSHO P	222 CHURCH ST	LIVERMORE <i>yp</i>	94550	ALAMEDA	1	
* CAD980736565	REFINERIES SERVICE	1696 MARTINEZ S T	SAN LEANDRO	94577	ALAMEDA	1	X
* CAD133286245	REHRIG PACIFIC CO	44799 INDUSTRIA L DR	FREMONT	94538	ALAMEDA	1	
* CAD981658859	RENTAL WORLD	6457 DUBLIN CT	DUBLIN	94566	ALAMEDA	1	
* CAD982356693	REXNORD CHEMICAL PRODU CTS	2359 LINCOLN AV E	HAYWARD	94943	ALAMEDA	1	
* CAD981658560	RHODES & JAMIESON	1645 STANLEY BL VD	PLEASANTON	94566	ALAMEDA	1	
* CAD051899151	ROBELLO TRUCKING	2523 ERSKINE LA NE	HAYWARD	94545	ALAMEDA		X
* CAD982415838	ROBERT C HEAD	39523 PARDEE CT	FREMONT	94538	ALAMEDA		X
* CAD071690325	ROBERT CATALUNA TRUCKI NG INC	185 KING AVE	FREMONT	94536	ALAMEDA		X
* CAD981161672	ROBIDEAUX LEASING, INC	2217 WILLOW ST	OAKLAND	94607	ALAMEDA	1	
* CAD000629857	ROC SALES, INC. HAYWARD WAREHOUSE	27285 INDUSTRIA L BLVD.	HAYWARD	94545	ALAMEDA	1	
* CAT080031636	ROCK AND ROLL TRUCK LI NE	962 SUNSET DRIV E	LIVERMORE <i>wo</i>	94550	ALAMEDA		X
* CAD981571532	ROCK TRANSPORT	5900 COLISEUM W AY	OAKLAND	94606	ALAMEDA	1	
* CAD981966732	ROCKRIDGE ROYALE CLEAN ERS	5444 COLLEGE AV E	OAKLAND	94518	ALAMEDA	1	
* CAD981159163	ROCKYS AUTO BODY	2405 EAGLE AVE	ALAMEDA	94501	ALAMEDA	1	
* CAD020028072	ROHM & HAAS CA INC	25500 WHITESELL ST	HAYWARD	94545	ALAMEDA	1	
* CAD076554997	ROLLINS, J R TRUCKING	2732 SANDERLING WY	PLEASANTON	94566	ALAMEDA		X
* CAD981573264	RON GOODE RAMBLER & TO YOTA	1825 PARK ST	ALAMEDA	94501	ALAMEDA	1	
* CAD981435167	ROTORQUE TECHNOLOGY CO RP	47915 WESINGHO SE DR	FREMONT	94539	ALAMEDA	1	
* CAD028779304	ROY L BURGE INC	2310 PACIFIC AV E	ALAMEDA	94501	ALAMEDA	1	
* CAD982039125	ROYS AUTO BODY	1432 HARRISON S T	OAKLAND	94612	ALAMEDA	1	
* CAD982041113	RPC INDUSTRIES	3210 INVESTMENT BLVD	HAYWARD	94545	ALAMEDA	1	
* CAD981388580	RUBE & DAN'S BODY SHOP , INC	6017 E 14TH ST	OAKLAND	94621	ALAMEDA	1	
* CAD981401763	RUSSETT DIESEL SERVICE INC	2090 WARM SPRIN GS COURT	FREMONT	94539	ALAMEDA	1	
* CAD981165582	RYAN PAINT MFG CO	630 E 10TH ST	OAKLAND	94606	ALAMEDA	1	
* CAD981427628	RYDER TRUCK RENTAL	8001 OAKPORT ST	OAKLAND	94621	ALAMEDA	1	
* CAD981163827	S & A AUTO BODY	7609 THORTON AV E	FREMONT	94560	ALAMEDA	1	

see last st

Mark Center

FACILITY ID	FACILITY NAME	FACILITY STREET	FACILITY CITY	ZIP	COUNTY	ACTIVITY TYPE GEN TRANS TSDF
* CAD981402456	SHELL STATION #204-227 7-0204	11989 DUBLIN BL /SAN RAMON RD	DUBLIN	94566	ALAMEDA	1
* CAD981402753	SHELL STATION #204-286 4-0906	42816 MISSION/M ISSION PASS	FREMONT	94539	ALAMEDA	1
* CAD981402696	SHELL STATION #204-286 4-1003	39080 FREMONT B LVD/MOWRY	FREMONT	94538	ALAMEDA	1
* CAD981402639	SHELL STATION #204-286 4-1201	5505 STEVENSON/ FARWELL	FREMONT	94538	ALAMEDA	1
* CAD981403231	SHELL STATION #204-333 6-0706	1097 W. TENNYSO N/TAMPA	HAYWARD	94544	ALAMEDA	1
* CAD981403058	SHELL STATION #204-438 0-0303	318 S. LIVERMOR E	LIVERMORE <i>yes</i>	94550	ALAMEDA	1
* CAD981402993	SHELL STATION #204-438 0-0709	1155 PORTOLA/MU RIETTA	LIVERMORE <i>ws</i>	94550	ALAMEDA	1
* CAD981401961	SHELL STATION #204-438 0-0808	809 E. STANLEY/ MURIETTA	LIVERMORE <i>wd</i>	94550	ALAMEDA	1
* CAD981402621	SHELL STATION #204-534 0-0101	6005 JARVIS/NEW ARK	NEWARK	94560	ALAMEDA	1
* CAD981402563	SHELL STATION #204-534 0-0606	5489 THORNTON/C EDAR	NEWARK	94560	ALAMEDA	1
* CAD981402506	SHELL STATION #204-550 8-1008	4150 REDWOOD RD	OAKLAND	94619	ALAMEDA	1
* CAD981403041	SHELL STATION #204-550 8-1206	2101 PARK BLVD/ NEWTON	OAKLAND	94608	ALAMEDA	1
* CAD981402985	SHELL STATION #204-550 8-1305	8930 BANCROFT	OAKLAND	94608	ALAMEDA	1
* CAD981402928	SHELL STATION #204-550 8-2303	2800 TELEGRAPH/ 28TH	OAKLAND	94609	ALAMEDA	1
* CAD981402860	SHELL STATION #204-550 8-2402	7915 E. 14TH/79 TH AVE	OAKLAND	94602	ALAMEDA	1
* CAD981402803	SHELL STATION #204-550 8-2709	3750 E. 14TH ST REET/38TH AVE	OAKLAND	94601	ALAMEDA	1
* CAD981403108	SHELL STATION #204-550 8-2808	9750 GOLF LINKS RD/KNOWLAND	OAKLAND	94605	ALAMEDA	1
* CAD981402746	SHELL STATION #204-550 8-3400	4411 FOOTHILL B LVD/HIGH	OAKLAND	94601	ALAMEDA	1
* CAD981403165	SHELL STATION #204-550 8-4002	4496 BROADWAY	OAKLAND	94611	ALAMEDA	1
* CAD981403223	SHELL STATION #204-550 8-4507	2142 E. 14TH ST REET/2ND AVE	OAKLAND	94606	ALAMEDA	1
* CAD981402688	SHELL STATION #204-550 8-5306	3420 SAN PABLO AVE/35TH	OAKLAND	94608	ALAMEDA	1
* CAD981402019	SHELL STATION #204-550 8-5504	285 HEGENBERGER RD	OAKLAND	94621	ALAMEDA	1
* CAD981401953	SHELL STATION #204-550 8-6007	510 E 14TH ST/S TH	OAKLAND	94601	ALAMEDA	1
* CAD981402795	SHELL STATION #204-613 8-0402	1801 SANTA RITA RD	PLEASANTON	94566	ALAMEDA	1
* CAD981402738	SHELL STATION #204-613 8-0501	3790 HOPYARD/LO S POSITAS	PLEASANTON	94566	ALAMEDA	1
* CAD990788168	SHEREX CHEMICAL COMPAN Y INC	1401 MIDDLE HAR BOR RD	OAKLAND	94607	ALAMEDA	1

List of Cases Included in Site Management System

As of: 09/19/88

Case Name	Street Address	City/Zip	County
1208 SHELL OIL COMPANY	1601 WEBSTER & LINCOLN	ALAMEDA	ALAMEDA
1000 ALAMEDA NAS		ALAMEDA/CA	ALAMEDA
1131 ALLIED ENGINEERING AND PRODUCT CORP.	2421 BLANDING AVE.	ALAMEDA/CA/94501	ALAMEDA
1255 CRYSTAL CLEANERS	2006 ENCINAL AVENUE	ALAMEDA/CA/94501	ALAMEDA
1005 EKOTEK LUBE	4200 ALAMEDA AVENUE	ALAMEDA/CA/94605	ALAMEDA
1000 WILANCO (WILLIAMS & LANE, SIERRA DETROIT)	1077 EASTSHORE HIGHWAY	ALBANY	ALAMEDA
1002 ALCAN POWDERS & PIGMENTS	END OF 2ND ST.	ALBANY/CA/94710	ALAMEDA
1000 CIROCO	536 CLEVELAND AVE.	ALBANY/CA/94710	ALAMEDA
1009 WESTERN FORGE AND FLANGE	540-A CLEVELAND AVE.	ALBANY/CA	ALAMEDA
1245 2366-78 SAN PABLO AVENUE	2366-78 SAN PABLO AVENUE	BERKELEY	ALAMEDA
1253 803 HEARST AVENUE	803 HEARST AVENUE	BERKELEY	ALAMEDA
1001 ALLSTON WAY OFFICE PROJECT	2161 ALLSTON WAY	BERKELEY	ALAMEDA
1006 CAL/INK	1404 4th ST.	BERKELEY/CA	ALAMEDA
1249 CARLETON BUSINESS CENTER	2700 7TH STREET	BERKELEY/CA/94710	ALAMEDA
1006 COLGATE PALMOLIVE	SEVENTH AND CARLTON STREETS	BERKELEY/CA	ALAMEDA
1001 DE SOTO	FOURTH AND CEDAR ST.	BERKELEY/CA	ALAMEDA
1182 LAWRENCE BERKELEY LABORATORY	1 CYCLOTRON RD.	BERKELEY/CA	ALAMEDA
1162 MACAULAY FOUNDRY, INC.	811 CARLETON ST.	BERKELEY/CA/94710	ALAMEDA
1002 MANASSE - BLOCK TANNING CO.	GILMAN ST.	BERKELEY/CA	ALAMEDA
1198 MEYER SOUND	2832 SAN PABLO AVE.	BERKELEY/CA/	ALAMEDA
1113 NILES LABORATORIES / CUTTER	4TH AND PARKER STS.	BERKELEY/CA/94701	ALAMEDA
1000 NEUBERRY STATION OFFICE PARK	2929 SHATTUCK AVENUE	BERKELEY	ALAMEDA
1003 PEERLESS ELECTRIC COMPANY	747 BANCROFT WAY	BERKELEY/CA	ALAMEDA
1272 RVEEKO	1335 6TH STREET	BERKELEY/CA/94710	ALAMEDA
1005 SIERRA DETROIT DIESEL & WILLIAM & LANE	1077 EASTSHORE HWY.	BERKELEY/CA/94710	ALAMEDA
1005 TEMESCAL	2850 7th ST.	BERKELEY/CA	ALAMEDA
1277 TRIANGLE PAINT FACTORY	2222 THIRD STREET	BERKELEY	ALAMEDA
1279 U.C. BERKELEY	MURRAY ST/FOLGER ST/7TH ST	BERKELEY	ALAMEDA
1008 URBAN DESIGNS	1812 DWIGHT WAY	BERKELEY/CA	ALAMEDA
1025 VILLA CONSTRUCTION CO.(BERKELEY VILLAGE)	VIRGINIA AND SHATTUCK	BERKELEY/CA	ALAMEDA
1079 WAREHAM DEVELOPMENT	SEVENTH ST. PROPERTIES	BERKELEY/CA	ALAMEDA
1008 WEXCEL	11711 DUBLIN BLVD.	DUBLIN/CA/94568-0705	ALAMEDA
1020 FORMER SHELL STATION LOT	SAN PABLO AND CARLSON BLVD.	EL CERRITO/CA	ALAMEDA
1081 CHEVRON EMERYVILLE TERMINAL	CORNER LANDREGAN & POWELL	EMERYVILLE/CA	ALAMEDA
1003 ELECTRICAL COATINGS CO.	1421 PARK AVENUE	EMERYVILLE/CA	ALAMEDA
1007 GARRETT FREIGHT LINES	64th ST. AND LA COSTE	EMERYVILLE/CA	ALAMEDA
1130 MICHEL AND PELTON	5743 LANDREGAN ST.	EMERYVILLE/CA	ALAMEDA
1070 PGE MATERIALS DISTRIBUTION CENTER	4525 HOLLIS STREET	EMERYVILLE/CA	ALAMEDA
1006 PIE NATIONWIDE	5500 EASTSHORE FREEWAY	EMERYVILLE/CA/94608	ALAMEDA
1062 WESTINGHOUSE ELECTRICAL CORP-EMERYVILLE	5899 PELADEAN	EMERYVILLE/CA	ALAMEDA
1265 CERRO METALS		FREMONT	ALAMEDA
10078 DIVIDEND DEVELOPMENT CORPORATION	MISSION BLVD & MARTINEZ DRIVE	FREMONT	ALAMEDA
10074 35631 FREMONT BLVD.	35631 FREMONT BLVD.	FREMONT/CA	ALAMEDA
1220 CARBOLINE	40600 ALBRAE STREET	FREMONT/CA	ALAMEDA
1204 TEMPGLASS FACILITY	48999 KATO RD.	FREMONT/CA	ALAMEDA
1092 25495 & 25503 WHITESELL STREET	25495 & 25503 WHITESELL STREET	WAYNARD	ALAMEDA
1247 XEROX CORPORATION	24500 INDUSTRIAL BOULEVARD	WAYNARD	ALAMEDA

List of Cases Included in Site Management System

As of: 09/19/88

Site#	Case Name	Street Address	City/Zip	County
102	GENERAL ELECTRIC CO.	5441 EAST 14TH ST.	OAKLAND/CA	ALAMEDA
1222	IMO DE LAVAL INC.	550 85TH AVE.	OAKLAND/CA/94612	ALAMEDA
1184	L & PLATING	920 54th AVE.	OAKLAND/CA	ALAMEDA
129	OAKLAND NATIONAL ENGRAVING INC.	1001 42ND STREET	OAKLAND/CA/94608	ALAMEDA
1169	OLIVER RUBBER CO.	1200 65th ST.	OAKLAND/CA/94662	ALAMEDA
1173	OMENS-ILLINOIS, INC. (GCD # 20)	3600 ALAMEDA AVE.	OAKLAND/CA/94601	ALAMEDA
113	PORT OF OAKLAND EMBARCADERO COVE	LIVINGSTON-OAKLAND INNER HARBR	OAKLAND/CA	ALAMEDA
107	PORT OF OAKLAND-NOWARD TERMINAL	EMBARCADERO(MARKET & GROVE)	OAKLAND/CA	ALAMEDA
1276	QUAKER OATS COMPANY	5625 EAST 14TH STREET	OAKLAND/CA/94627	ALAMEDA
1192	SAFETY-KLEEN	404 MARKET ST.	OAKLAND/CA	ALAMEDA
11	SCHMITZER STEEL PRODUCTS CO.	ADELINE ST., BOX # 747	OAKLAND/CA/94604	ALAMEDA
1195	SHEREX CHEMICAL CO.	1401 MIDDLE HARBOR RD.	OAKLAND/CA	ALAMEDA
1228	SOUTHERN PACIFIC TRANSPORTATION COMPANY	1707 WOOD STREET	OAKLAND/CA/94607	ALAMEDA
10	UMOCAL	401 HIGH ST.	OAKLAND/CA	ALAMEDA
1234	MACIENDA BUSINESS PARK	MACIENDA BUSINESS PARK	PLEASANTON	ALAMEDA
1193	INDUSTRIAL ASPHALT FACILITY		PLEASANTON/CA	ALAMEDA
10	KAISER ALUMINUM & CHEMICAL CORP.	P.O. BOX 877	PLEASANTON/CA	ALAMEDA
11	KAISER ALUMINUM & CHEMICAL CORP.	6177 BUNOL BLVD.	PLEASANTON/CA	ALAMEDA
1039	MUCLEPORE CORP.	7035 COMMERCE CIRCLE	PLEASANTON/CA	ALAMEDA
1040	MUCDEX	5555 BUNOL BLVD.	PLEASANTON/CA	ALAMEDA
10	139th STREET PROPERTY	750 139th STREET	SAN LEANDRO/CA	ALAMEDA
1135	1955 DAVIS ST.	1955 DAVIS ST.	SAN LEANDRO/CA	ALAMEDA
1073	425 NESTER ST.	425 NESTER ST.	SAN LEANDRO	ALAMEDA
12	CATERPILLAR, INC	800 DAVIS ST.	SAN LEANDRO/CA	ALAMEDA
11	CINTAS OPERATION NO. 54	777 139TH AVE.	SAN LEANDRO/CA/94578	ALAMEDA
1159	CONTINENTAL CAN COMPANY, INC.	PLANT # 481, 1951 FAIRWAY DR.	SAN LEANDRO/CA/94577	ALAMEDA
10	CROWN ZELLERBACH	2101 WILLIAMS ST.	SAN LEANDRO/CA	ALAMEDA
11	DAVIDSON HOMES	MAAS AVE, TRACT 4696	SAN LEANDRO/CA	ALAMEDA
1143	DONTAR GYPSUM CO.	1980 MARINA BLVD.	SAN LEANDRO/CA/94577	ALAMEDA
1105	F.N. BAILEY MOTOR CO.	800 DAVIS ST.	SAN LEANDRO/CA/94578	ALAMEDA
11	FARIA BROTHERS HARDWARE	519 MANOR BLVD.	SAN LEANDRO/CA/94577	ALAMEDA
1203	KAISER ALUMINUM	1937 DAVIS ST.	SAN LEANDRO/CA/94577	ALAMEDA
1141	MAJOR SALVAGE	1770 NEPTUNE DR.	SAN LEANDRO/CA	ALAMEDA
11	NEPTUNE DRIVE PROPERTY	NEPTUNE & WILLIAMS	SAN LEANDRO	ALAMEDA
11	OLIVER WIRE AND PLATING CO.	555 MONTAGUE	SAN LEANDRO/CA	ALAMEDA
1116	PACKAGING INDUSTRIES, INC.	2450 ALVARADO	SAN LEANDRO/CA/94577	ALAMEDA
11	PRODUCTION GRINDING	1977 PIKE STREET	SAN LEANDRO/CA/94577	ALAMEDA
11	REALITE INCORPORATED	375-377 PREDIA STREET	SAN LEANDRO/CA/94577	ALAMEDA
1258	STAEFA CONTROL SYSTEMS	2481 WASHINGTON AVENUE	SAN LEANDRO	ALAMEDA
1287	TROJAN POWDER WORKS	WICKS & LEWELLING	SAN LEANDRO/CA/94579	ALAMEDA
111	VIJON LABORATORIES	2055 ADAMS AVE.	SAN LEANDRO/CA/94577	ALAMEDA
1109	W.R. BRACE & COMPANY	2140 DAVIS ST.	SAN LEANDRO/CA/94577	ALAMEDA
1014	EASTMAN KODAK COMPANY	1900 ALCOSTA BLVD.	SAN RAMON/CA	ALAMEDA
11	CAMPBELL CHAIN FACILITY		UNION CITY/CA	ALAMEDA
1105	CHEMSECO FACILITY	1 TARA COURT	UNION CITY/CA	ALAMEDA
1093	CONTINENTAL CAN COMPANY	33280 CENTRAL AVE.	UNION CITY/CA/94587	ALAMEDA
1038	LIBERTY VINYL	33063 WESTERN AVENUE	UNION CITY	ALAMEDA

List of Cases Included in Site Management System

As of: 09/19/88

Site#	Case Name	Street Address	City/Zip	County
1006	RICHMOND PLATING COMPANY	738 HARBOUR WAY SOUTH	RICHMOND/CA/94804	CONTRA COSTA
1011	SANTA FE LAND IMPROVEMENT CO.-PT.ISABEL	POINT ISABEL	RICHMOND/CA	CONTRA COSTA
1235	SANTA FE RAILROAD RICHMOND RAILYARD	101 GARRARD BOULEVARD	RICHMOND	CONTRA COSTA
1004	SOUTHERN PACIFIC PIPELINE, RICHMOND		RICHMOND	CONTRA COSTA
1013	SUMMER DEL CARIBE	2020 WRIGHT AVE.	RICHMOND/CA	CONTRA COSTA
1059	U.S. POST OFFICE - POINT ISABEL	POINT ISABEL	RICHMOND/CA	CONTRA COSTA
1244	UNION CARBIDE CORPORATION	PORT OF RICHMOND TERMINAL #2	RICHMOND	CONTRA COSTA
1004	WIEGMANN-ROSE INTER. CORP.	2 GIANT RD.	RICHMOND/CA	CONTRA COSTA
1009	WILDCAT GARDENS		RICHMOND/CA	CONTRA COSTA
1129	AMERICAN STANDARD	3002 GIANT RD.	SAN PABLO/CA	CONTRA COSTA
1006	LAKE ELEMENTARY SCHOOL	2700 11TH STREET	SAN PABLO/CA/94806	CONTRA COSTA
1013	WICKLAND OIL CO.-SELBY SLAG SITE	SHORELINE @ SELBY-1 MI.W.CROCK	SELBY/CA	CONTRA COSTA
1270	POLYVINYL CHEMICAL INDUSTRIES	501 GREEN ISLAND ROAD	VALLEJO	CONTRA COSTA
1273	STEAD CADILLAC	1800 MOUNT DIABLO BOULEVARD	WALNUT CREEK/CA/94596	CONTRA COSTA
1006	RCA GLOBAL ANTENNA FARM	BOLINAS MESA	BOLINAS/CA	MARIN
1225	MILL VALLEY MIDDLE SCHOOL	CAMINO ALTO @ SYCAMORE	MILL VALLEY	MARIN
1187	14 COMMERCIAL BLVD.	14 COMMERCIAL BLVD.	NOVATO/CA	MARIN
1017	HAMILTON AIR FORCE BASE (SALE PROPERTY)		NOVATO/CA	MARIN
1006	NOVATO STORAGE PARK-RANCHO DEL PANTANO	AIRPORT AND BINFORD RD.	NOVATO/CA	MARIN
1017	FAIRCHILD SEMICONDUCTOR CORPORATION	4300 REDWOOD RD.	SAN RAFAEL/CA	MARIN
1002	PG&E SERVICE CENTER	LINDARDO AND BROOK STREETS	SAN RAFAEL/CA	MARIN
1013	POINT TIBURON - INNISFREE CO.	1920 PARADISE DR.	TIBURON/CA	MARIN
1291	1385 SALVEDOR AVENUE	1385 SALVEDOR AVENUE	NAPA	NAPA
1170	JENSEN MOTOR CENTER	495 BOSCOL AVE.	NAPA/CA	NAPA
1005	PG&E-NW. CORNER ELM & RIVERSIDE STS.	NW. CORNER ELM & RIVERSIDE STS	NAPA/CA	NAPA
1067	2222 LIMITED	2222 23RD ST.	SAN FRANCISCO/CA	SAN FRANCISCO
1168	5700 THIRD ST.	5700 THIRD ST.	SAN FRANCISCO/CA	SAN FRANCISCO
1004	BAY AREA DRUM et.al.	CORNER THOMAS AVE. NAMES ST.	SAN FRANCISCO	SAN FRANCISCO
1005	CONTINENTAL CONSTRUCTION	301 HOWARD ST.	SAN FRANCISCO	SAN FRANCISCO
1019	FEDERATED FRY METALS	1901 ARMY ST.	SAN FRANCISCO/CA	SAN FRANCISCO
1074	HAWLEY FORGE LOT B	JERROLD AVENUE	SAN FRANCISCO	SAN FRANCISCO
1000	HILLS PLAZA	FOLSOM & STEWART	SAN FRANCISCO	SAN FRANCISCO
1088	MUNTERS POINT NAVAL SHIPYARD(DISESTABLIS	MUNTERS POINT	SAN FRANCISCO/CA	SAN FRANCISCO
1281	KAISER FOUNDATION HEALTH PLAN	2130 O'FARRELL STREET	SAN FRANCISCO	SAN FRANCISCO
1005	KELLY-MOORE PAINT CO.	1463 VALENCIA ST.	SAN FRANCISCO/CA	SAN FRANCISCO
1097	MAJOR PAINT & VARNISH CO.	3 MASONIC AVE.	SAN FRANCISCO/CA	SAN FRANCISCO
1038	MUNI KIRKLAND BUS YARD	POWELL,BEACH,STOCKTON,N.POINT	SAN FRANCISCO/CA	SAN FRANCISCO
1053	PG&E (COLUMBUS BTWN. LEAVENWORTH&HYDE ST	COLUMBUS ST.	SAN FRANCISCO/CA	SAN FRANCISCO
1051	PG&E (FILMORE,STEINER,BAY,FRANCISCO STS.	FILMORE,STEINER,BAY,FRANCISCO	SAN FRANCISCO/CA	SAN FRANCISCO
1150	PG&E - KING & SECOND STS.	KING & SECOND ST.	SAN FRANCISCO/CA	SAN FRANCISCO
1052	PG&E-BAY,NORTHPOINT,BUCHANAN&LAGUNA STS.	BAY,NORTHPOINT,BUCHANAN&LAGUNA	SAN FRANCISCO/CA	SAN FRANCISCO
1054	PG&E-BEACH,POWELL,JEFFERSON,& MASON STS.	BEACH,POWELL,JEFFERSON & MASON	SAN FRANCISCO/CA	SAN FRANCISCO
1280	SAN FRANCISCO NEWSPAPER PRINTING AGENCY	1901 ARMY STREET	SAN FRANCISCO	SAN FRANCISCO
1284	SAN FRANCISCO REDEVELOPMENT AGENCY	BUTTER ST & STEINER ST	SAN FRANCISCO	SAN FRANCISCO
1008	SMELL OIL STATION	701 PORTOLA	SAN FRANCISCO/CA/94127 -	SAN FRANCISCO
1093	TREAT AVENUE PARKING FACILITY	1822 HARRISON STREET	SAN FRANCISCO	SAN FRANCISCO
1243	UNION PACIFIC REALTY / SANTA FE	ARMY STREET / PIER 80	SAN FRANCISCO	SAN FRANCISCO

FUEL LEAKS - ALAMEDA COUNTY

SITENAME	STREET #	STREET	CITY
ALAMEDA NAVAL AIR STATION			ALAMEDA
CHERRY BLOSSOM INN/PALMA PROP.			SAN LEANDRO
FREMONT UNIFIED SCHOOL DIST.			FREMONT
KANTOZ PROPERTY			SAN LEANDRO
LAWRENCE LIVER. NL-BLDG 403			LIVERMORE <i>no</i>
LAWRENCE LIVER. NL-SW CORN			LIVERMORE <i>no</i>
LIFETILE			FREMONT
MORTON SALT			NEWARK
NCPA/TODD SHIPYARD			ALAMEDA
SANDIA NATIONAL LABORATORIES			LIVERMORE <i>no</i>
SHELL DEVELOPMENT CO.			EMERYVILLE
U.C. BERKELEY LAB-BLDG. 62			BERKELEY
US NAVY: ALAMEDA AIR STATION			ALAMEDA
CHINATOWN REDEVELOPMENT PROJ.			OAKLAND
HARBOR WAY PROPERTIES	155	11TH & WEBSTER	RICHMOND
UNKNOWN		11TH ST.	OAKLAND
BRAMALEA PACIFIC		11TH ST.	OAKLAND
SERVICE PLASTERING	1090	12TH & CLAY	OAKLAND
GOLDEN GRAINS	1111	139TH	SAN LEANDRO
CINTAS CORPORATION	777	139TH AVE.	SAN LEANDRO
ALCOPARK GARAGE	165	139TH ST.	SAN LEANDRO
NABISCO BRANDS, INC	1267	13TH ST.	OAKLAND
MOBIL	160	14TH ST.	OAKLAND
C & H DEVELOPMENT		14TH ST.	OAKLAND
CHEVRON		150TH & E 14TH	SAN LEANDRO
LAKE POINT TOWERS LTD		17TH & HARRISON	OAKLAND
ARCO/ARMOUR OIL CO./GAS N SAVE	4191	17TH & LAKESIDE DR	OAKLAND
MOBIL	2008	1ST ST.	PLEASANTON
MOBIL	4707	1ST ST.	LIVERMORE <i>no</i>
CHEVRON		1ST ST.	LIVERMORE <i>no</i>
PACIFIC SUPPLY	1735	23RD AVE	OAKLAND
PATTERSON PROPERTY		24TH ST.	OAKLAND
ARATEX SERVICES	958	27TH & HARRISON	OAKLAND
EYCHNER	1120	28TH ST.	OAKLAND
CHEVRON		2ND	BERKELEY
ALCAN POWDERS & PIGMENTS		2ND & B ST.	HAYWARD
BERKELEY WAREHOUSE	1920	2ND ST.	ALBANY
BLUE PRINT SERVICE	149	2ND ST.	BERKELEY
PACIFIC BELL	2324	2ND ST.	SAN FRANCIS
ARCO		2ND ST.	LIVERMORE <i>no</i>
BYRD'S AUTO SERVICE	3055	2ND ST.	OAKLAND
MOBIL	3201	34TH & PARK BLVD.	OAKLAND
R.D. MINER CO.	750	35TH	OAKLAND
JOHNSTON & SONS	801	35TH AVE.	OAKLAND
PACIFIC WESTERN SHIPPING	1221	37TH ST.	OAKLAND
GROW GROUP		3RD AVE.	OAKLAND
DUNNE QUALITY PAINTS	1007	3RD ST.	OAKLAND
OAKLAND NATIONAL ENGRAVING		41ST ST	EMERYVILLE
A.C. TRANSIT		41ST ST.	OAKLAND
CITY OF EMERYVILLE	1420	41ST-42ND ST	OAKLAND/EME
KAISER ENGINEERS	1140	45TH & SAN PABLO	EMERYVILLE
		45TH ST.	EMERYVILLE
		45TH ST.	EMERYVILLE

FUEL LEAKS - ALAMEDA COUNTY

SITENAME	STREET #	STREET	CITY
LEARNER	768	46TH AVE	OAKLAND
A.C. TRANSIT		47TH & SAN PABLO	EMERYVILLE
F&K INVESTMENT CO.	1259	48TH AVE.	OAKLAND
MANNASE-BLOCK INVESTMENT	1300	4TH	BERKELEY
UNIVERSITY OF CA.		4TH & HARRISON	BERKELEY
MILES LABORATORY/CUTTER		4TH & PARKER	BERKELEY
PEERLESS LIGHTING	2220	4TH ST.	BERKELEY
TRUST SECURITY MANAGEMENT	2321	4TH ST.	BERKELEY
AAA EQUIPMENT CO.	745	50TH AVE.	OAKLAND
BERKELEY FARMS	1313	53RD. AVE.	EMERYVILLE
UNKNOWN		5TH ST & CAMELIA	BERKELEY
PACIFIC DRY DOCK		5TH ST.	OAKLAND
PETERSON MANUFACTURING CO.	1600	63RD ST.	EMERYVILLE
GARRETT FREIGHT LINE		64TH & LACOSTE	EMERYVILLE
EMERYVILLE MARKET PLAZA		64TH & LACOSTE ST.	EMERYVILLE
EMERYVILLE BAYFRONT/US POSTAL	1650	65TH	EMERYVILLE
OLIVER	1200	65TH	OAKLAND
BAY CENTER PROJECT		65TH & CHRISTIE	EMERYVILLE
HENRY HORN AND SONS	1301	65TH ST.	EMERYVILLE
FABCO	1249	67TH ST.	OAKLAND
ACE RECYCLERS ENTERPRISES	830	69TH AVE.	OAKLAND
RVEECO INC.	1335	6TH ST.	BERKELEY
ATLAS WELDING SUPPLY	1224	6TH STREET	BERKELEY
ERNIES VAN AND STORAGE	1650	6TH STREET	BERKELEY
CALTRANS		6TH/GROVE&JEFFERSON	BERKELEY
WESTERN EXTERMINATOR	901	76TH	OAKLAND
GREYHOUND		7TH & BUSH	OAKLAND
PARKING STRUCTURE		7TH & JEFFERSON ST.	OAKLAND
CUTTER LABORATORIES		7TH & PARKER	BERKELEY
CHEVRON		7TH AND CYPRESS	OAKLAND
CHRONICLE DEPOT	2817	7TH ST.	BERKELEY
GARY STEEL CO./DUCOMMUN METALS	2560	7TH ST.	BERKELEY
MCKESSON CHEMICAL CO.	33950	7TH ST.	UNION CITY
UNKNOWN	34200	7TH ST.	UNION CITY
CHEVRON	1395	7TH STREET	OAKLAND
IMO DELAVAL ENGINE MFG.	550	85TH AVE.	OAKLAND
TRANSAMERICA DE LAVAL, INC.	550	85TH AVE.	OAKLAND
WEST COAST WIRE ROPE & RIGGING	597	85TH AVE.	OAKLAND
RODRIGUES MANUEL	1009	89TH	OAKLAND
DINWIDDIE CONSTRUCTION COMPANY	1201	8TH ST.	BERKELEY
MOUIS DRAZAGE CO.	190	96TH AVE.	OAKLAND
ANGELO PARDISO	1031	98TH	OAKLAND
OAKLAND SCAVENGER	156	98TH	OAKLAND
CITY OF OAKLAND	816	98TH AVE.	OAKLAND
MOBIL	2220	98TH AVE.	OAKLAND
PIONEER PACKING	1025	98TH AVE.	OAKLAND
AMERICAN TRACTOR	9131	98TH AVE.	SAN LEANDRO
GTE TELEPHONE COMPANY	670	9TH STREET	OAKLAND
GOODYEAR TIRE & RUBBER CO	1051	A ST	HAYWARD
UNKNOWN	1015	A ST	HAYWARD
HUTCH'S CAR WASH	1367	A ST.	HAYWARD

FUEL LEAKS - ALAMEDA COUNTY

SITENAME	STREET #	STREET	CITY
MOBIL	486	A ST.	HAYWARD
S & J DETAIL	352	A ST.	HAYWARD
THRIFTY OIL	207	A ST.	HAYWARD
KITAYAMA BROS.	2324	ABREU RD.	UNION CITY
SAFWAY MILK PLANT	2000	ADAMS	SAN LEANDRO
VIJON LABORATORIES	2055	ADAMS AVE.	SAN LEANDRO
MILNE TRUCK LINES	1750	ADAMS AVENUE	SAN LEANDRO
ADDISON STREET PROP.	2040	ADDISON	BERKELEY
AUTOMOTIVE UNLIMITED	2020	ADDISON	BERKELEY
BERKELEY GLASS	2011	ADDISON	BERKELEY
BLOCK PROPERTY	651	ADDISON	BERKELEY
CA. SCHOOL PROF. PSYCHOLOGY	1900	ADDISON	BERKELEY
DON & REINHARDS, INC.	1917	ADDISON ST.	BERKELEY
EBMUD	2127	ADELINE	OAKLAND
E-Z-REST PRODUCTS	2528	ADELINE ST.	OAKLAND
HANG LUNG PLASTICS	1960	ADELINE ST.	OAKLAND
GM-FREMONT		ADJACENT TO NUMMI	FREMONT
WINCHELL'S DONUTS	30150	AHEARN STREET	UNION CITY
PACIFIC CROWN DISTRIBUTORS	30022	AHERN ST.	UNION CITY
SAN LEANDRO SCHOOLS	1145	ALADDIN DR.	SAN LEANDRO
OWENS-ILLINOIS	3600	ALAMEDA AVE.	OAKLAND
U.S. COLD STORAGE	3925	ALAMEDA AVE.	OAKLAND
EKO-TEK	4200	ALAMEDA AVENUE	OAKLAND
CARBOLINE	40500	ALBRAE ST.	FREMONT
FOOD & LIQUOR STORE #5	4050	ALDER AVE	FREMONT
CITY OF BERKELEY - YARD	1326	ALLSTON WAY	BERKELEY
J&B FERTILIZER CO.	32650	ALMADEN BLVD.	UNION CITY
MONTGOMERY WARD	3000	ALVARADO	SAN LEANDRO
PACKAGING INDUSTRIES, INC.	2450	ALVARADO	SAN LEANDRO
ALVARADO PLAZA	32655	ALVARADO BLVD.	UNION CITY
CHEVRON	31890	ALVARADO BLVD.	UNION CITY
MOBIL	31901	ALVARADO BLVD.	UNION CITY
ROBINSON AUTO WORKS	1860	ALVARADO ST.	SAN LEANDRO
HIRAMINE NURSERY	32727	ALVARADO-NILES BLVD.	UNION CITY
SHELL	31301	ALVARADO-NILES BLVD.	UNION CITY
SHELL	31889	ALVARADO-NILES BLVD.	UNION CITY
SHELL	32187	ALVARADO-NILES BLVD.	UNION CITY
UNOCAL	34000	ALVARADO-NILES BLVD.	UNION CITY
CITY OF UNION CITY/CIVIC CENT.	34009	ALVARADO-NILES RD.	UNION CITY
MOBIL	31300	ALVARADO-NILES RD.	UNION CITY
CITY OF UNION CITY/CORP. YARD	34900	ALVARADO-NILES RD.	UNION CITY
HAYWARD UNIFIED SCHOOL DIST.	2440	AMADOR	HAYWARD
SHELL	7194	AMADOR VALLEY BLVD.	DUBLIN
UNOCAL	7375	AMADOR VALLEY RD.	DUBLIN
DREISBACH ASSOCIATES	8410	AMELIA ST.	OAKLAND
FOODMAKER INC.	2395	AMERICAN AVE.	HAYWARD
UNIVERSITY OF CALIFORNIA	1750	ARCH ST	BERKELEY
SHELL		ARMSTRONG/WHITE	OAKLAND
MAC BEATH HARDWARE	930	ASHBY	BERKELEY
MEADOWS, ELWOOD & CLARA	1440	ASHBY	BERKELEY
CLAREMONT RESORT		ASHBY & DOMINGO	BERKELEY

FUEL LEAKS - ALAMEDA COUNTY

SITENAME	STREET #	STREET	CITY
SUPER-7	901	ASHBY AVE.	BERKELEY
TEXACO	840	ASHBY AVE.	BERKELEY
UNKNOWN	2076	ASHBY AVE.	BERKELEY
CHEVRON	3048	ASHBY STREET	BERKELEY
DISTILLERS COMPANY LTD.	1350	ATLANTIC	UNION CITY
NAS GAS STATION		ATLANTIC & MAIN	ALAMEDA
THIELS TIRE SERVICE	1147	ATLANTIC AVE.	UNION CITY
ORCON CORPORATION	1570	ATLANTIC ST.	UNION CITY
PAC BELL	2115	BANCROFT	BERKELEY
UNOCAL	500	BANCROFT	SAN LEANDRO
GARCIA PROPERTY	12051	BANCROFT	SAN LEANDRO
UNOCAL		BANCROFT & 98TH	OAKLAND
UNOCAL	4710	BANCROFT AVE.	OAKLAND
TRANSAMERICA DEVAUAL	829	BANCROFT WAY	BERKELEY
CHEVRON	1925	BARCELONA ST.	LIVERMORE ^{MO}
GALLO	2411	BAUMANN	SAN LORENZO
STATE ARCHITECT-BAY BRIDGE		BAY BRIDGE	OAKLAND
PAT PATTERSON CADILLAC	230	BAY PLACE	OAKLAND
SOUTHERN PACIFIC-DESERT YARD	515	BAY ST.	OAKLAND
BAYFAIR MALL	248	BAYFAIR	SAN LEANDRO
ATLAS FREIGHT CO.	993	BEECHER	SAN LEANDRO
PARADISO CONSTRUCTION COMPANY	990	BEECHER ST.	SAN LEANDRO
ALVARADO WASTEWATER TREATMENT	5072	BENSON RD.	UNION CITY
KENNEDY HIGH SCHOOL	39999	BLACOW	FREMONT
MOBIL	37630	BLACOW	FREMONT
ARCO	40055	BLACOW RD.	FREMONT
IRVINGTON HIGH SCHOOL	41800	BLACOW RD.	FREMONT
CENTURY INSULATION	37345	BLACOW RD.	FREMONT
EL CAMINO CROP SUPPLY CO.	37343	BLACOW RD.	FREMONT
LONGVIEW FIBER CO.	8511	BLAINE STREET	OAKLAND
KALMAR PROPERTY	2036	BLAKE	BERKELEY
ALPHA BETA		BLANDING/BROADWAY	ALAMEDA
BORDEN INDUSTRIAL	41100	BOYCE RD.	FREMONT
CBI SERVICES INC.	41777	BOYCE RD.	FREMONT
ECONO LINE EXPRESS	42600	BOYCE RD.	FREMONT
UNOCAL	3500	BREAKWATER AVE.	HAYWARD
WEYERHAEUSER COMPANY	3495	BREAKWATER CT.	HAYWARD
7-ELEVEN	4100	BROADWAY	OAKLAND
CHEVRON	3701	BROADWAY	OAKLAND
SHELL		BROADWAY & TAFT	OAKLAND
WILMAC METALS	529	C ST.	HAYWARD
J.C. PENNY	21105	CABOT BLVD.	HAYWARD
SOUTHERN PACIFIC		CABOT RD.	HAYWARD
OLIVER & CO.	1035	CARLETON ST.	BERKELEY
UNKNOWN	811	CARLTON	BERKELEY
UNKNOWN	2691	CASTRO VALLEY BLVD	CASTRO VALL
CASTRO VALLEY CAR WASH	3098	CASTRO VALLEY BLVD	CASTRO VALL
ODS SITE #2		CASTRO VALLEY BLVD.	CASTRO VALL
THRIFTY OIL	2504	CASTRO VALLEY BLVD.	CASTRO VALL
THRIFTY OIL	2540	CASTRO VALLEY BLVD.	CASTRO VALL
ARCO	2770	CASTRO VALLEY RD	CASTRO VALL

FUEL LEAKS - ALAMEDA COUNTY

SITENAME	STREET #	STREET	CITY
TEXACO	3940	CASTRO VALLEY RD.	CASTRO VALL
ODS SITE #1		CASTRO VLY & FOOOTHIL	CASTRO VALL
COAST CRANE CO.	14951	CATALINA	SAN LEANDRO
TEXACO	1175	CATALINA DR.	LIVERMORE <i>kd</i>
PENHALL	13750	CATALINA ST.	SAN LEANDRO
CASE POWER & LIGHTING	13880	CATALNA	SAN LEANDRO
PACIFIC ENGINEERS	801	CEDAR	BERKELEY
STAN ANDERSON SERVICE	1745	CEDAR	BERKELEY
EMPIRE TRACTOR CO.	38600	CEDAR BLVD.	NEWARK
PACIFIC STEEL CASTING	650	CEDAR ST.	BERKELEY
SOUTHERN PACIFIC	721	CEDAR ST.	OAKLAND
ARCO	22141	CENTER ST	CASTRO VALL
CHEVRON	19201	CENTER ST.	CASTRO VALL
DEPT. OF TRANS./CASTRO VALLEY	21195	CENTER ST.	CASTRO VALL
AUTOMOTIVE AUTO REPAIR	2425	CENTRAL AVE.	ALAMEDA
BAY CITIES METAL PRODUCTS, INC	6756	CENTRAL AVE.	NEWARK
CONTINENTAL CAN CO.	33280	CENTRAL AVE.	UNION CITY
EOFF MANUFACTURING	32410	CENTRAL AVE.	UNION CITY
H. FULLER CO.	6925	CENTRAL AVE.	NEWARK
PACIFIC BELL	5275	CENTRAL AVE.	FREMONT
PARADISO CONSTRUCITON COMPANY	2100	CENTRAL AVE.	ALAMEDA
LESLIE SALT CO.	7200	CENTRAL AVENUE	NEWARK
PACIFIC DISTRIBUTION CENTER	21001	CHABOT RD.	HAYWARD
J.R. TRUCKING	2001	CHABOT ST.	HAYWARD
UC BERKELEY	2515	CHANNING WAY	BERKELEY
UNKNOWN	38083	CHERRY	NEWARK
PETERBILT MOTORS	38801	CHERRY ST.	NEWARK
TNT INC.	38201	CHERRY ST.	NEWARK
SUMMERHILL COMMON	26840	CHERRY ST.	NEWARK
CON-WAY EXPRESS	2200	CLAREMONT COURT	HAYWARD
LUCKY STORES	6300	CLARK AVE	DUBLIN
ALHAMBRA HAYWARD	22990	CLAWITER	HAYWARD
OLIVER DE SILVA	22991	CLAWITER	HAYWARD
YELLOW FREIGHT SYSTEM	25555	CLAWITER	HAYWARD
SUPER STRUCTURES/WENDLAND TRKG	24200	CLAWITER RD	HAYWARD
CONTINENTAL WHITE CAP, INC.	22493	CLAWITER RD.	HAYWARD
HERRICK CORP.	25450	CLAWITER RD.	HAYWARD
PG&E	24300	CLAWITER RD.	HAYWARD
CITY OF OAKLAND	1417	CLAY ST.	OAKLAND
WESTERN DRUMS, INC.	21301	CLOUD WAY	HAYWARD
ALAMEDA MUNICIPAL GOLF COURSE		CLUBHOUSE MEMORIAL R	ALAMEDA
ALTA BATES HOSPITAL	3001	COLBY STREET	BERKELEY
BENZ SHOP(FORMER NAME)	3170	COLLEGE AVE.	BERKELEY
JACK RIPSTEEN PROJECT	3170	COLLEGE AVE.	BERKELEY
PG&E	4930	COLLISEUM WAY	OAKLAND
SUNSET VIEW	101	COLUSA	BERKELEY
FIRE FAB INC.	23315	CONNECTICUT	HAYWARD
NORPAK	20550	CORSAIR BLVD.	HAYWARD
MOBIL		COTTER WAY	HAYWARD
HANSON PROPERTY	10250	CROW CANYON RD	CASTRO VALL
CHEVRON	5269	CROW CANYON RD.	CASTRO VALL

FUEL LEAKS - ALAMEDA COUNTY

SITENAME	STREET #	STREET	CITY
LAWRENCE BERKELEY LABORATORY	1	CYCLOTRON RD.	BERKELEY
U.C. LAWRENCE BERKELEY LABORAT	1	CYCLOTRON RD.	BERKELEY
MILLER'S ALUMINUM	25362	CYPRESS AVE.	HAYWARD
STONETREE TOWNHOUSES/JAMES PRP	811	D STREET	HAYWARD
HIGGINS LUMBER	600	DAGGETT	UNION CITY
KAISER ALUMINUM	1937	DAVIS ST.	SAN LEANDRO
WORLD SAVINGS	800	DAVIS ST.	SAN LEANDRO
HOHENER MEAT COMPANY, INC.	2500	DAVIS ST.	SAN LEANDRO
W.R. GRACE & COMPANY	2140	DAVIS STREET	SAN LEANDRO
WESTGATE PROJECT	1933	DAVIS STREET	SAN LEANDRO
FERMA CORPORATION		DAVIS/SAN LEANDRO	ALAMEDA
CHEVRON	1990	DECOTO RD.	UNION CITY
SHELL	2001	DECOTO RD.	UNION CITY
TEXACO	2601	DECOTO RD.	UNION CITY
7-ELEVEN	3868	DELAWARE STREET	FREMONT
SOUTHERN PACIFIC		DELWARE & VIRGINIA	BERKELEY
SIMMONS OIL CORPORATION	315	DERBY AVENUE	OAKLAND
NIELSON AIRCRAFT	1501	DIXON LANDING RD.	FREMONT
C.G.A. CORP.	14100	DOLITTLE DR.	SAN LEANDRO
WALSH PROPERTY	844	DOLITTLE DR.	SAN LEANDRO
DSRSD FIRE STATION #1	7494	DONOHUE DR.	DUBLIN
LIKIT WINDOW	888	DOOLITTLE	SAN LEANDRO
PRESCOLITE	1251	DOOLITTLE	SAN LEANDRO
WEST COAST TANK TESTING	390	DOOLITTLE	SAN LEANDRO
ADITOR FARMS	1400	DOOLITTLE DR.	SAN LEANDRO
BAY COUNTY PROPERTIES	900	DOOLITTLE DR.	SAN LEANDRO
CHEVRON	13700	DOOLITTLE DR.	SAN LEANDRO
ROUSE & ASSOCIATES	1555	DOOLITTLE DR.	SAN LEANDRO
UNOCAL	1903	DOOLITTLE DR.	SAN LEANDRO
SAN LEANDRO DISTRIBUTION CNTR	33300	DOWE AVE.	UNION CITY
CHEVRON	2020	DRISCOLL	FREMONT
PUBLIC STORAGE	11828	DUBLIN BLVD.	DUBLIN
CHEVROLET-CROWN	7544	DUBLIN BOULEVARD	DUBLIN
SIMAS PROPERTY/GAS STATION	2200	DURANT ST.	BERKELEY
OAKLAND SCAVENGER CO.	7010	DURHAM RD.	FREMONT
DURHAM LANDFILL CORP. YARD		DURHAM RD.	FREMONT
CHEVRON	600	DUTTON AVE	SAN LEANDRO
HERRICK HOSPITAL & HEALTH CARE	2001	DWIGHT WAY	BERKELEY
URBAN DESIGNS	1812	DWIGHT WAY	BERKELEY
SHELL		DYER & ALVARADO BLVD	UNION CITY
ALL COUNTIES EXPRESS	30664	DYER ST.	UNION CITY
GUTHMILLER TRUCKING	30700	DYER ST.	UNION CITY
ERNIE'S AUTOMOTIVE	2400	E 12TH AVE.	OAKLAND
FORDOM PARK	5725	E 14TH	OAKLAND
MOBIL	14994	E 14TH ST.	SAN LEANDRO
TEXACO	9331	E 14TH ST.	OAKLAND
SHELL	510	E 14TH ST.	OAKLAND
PAC BELL	118	E ST.	UNION CITY
LMC CONSTRUCTION	1400	E. 14TH	SAN LEANDRO
E. OAKLAND YOUTH CENTER	8200	E. 14TH ST	OAKLAND
NOHR'S IMPORTS	2089	E. 14TH ST	SAN LEANDRO

FUEL LEAKS - ALAMEDA COUNTY

SITENAME	STREET #	STREET	CITY
ED CHOVANES FORD, INC.	13889	E. 14TH ST.	SAN LEANDRO
KERRY & ASSOCIATES	14180	E. 14TH ST.	SAN LEANDRO
SAN LEANDRO CHRYSLER	232	E. 14TH ST.	SAN LEANDRO
UNKNOWN		E. 14TH ST./HAVENCT.	OAKLAND
NATIONAL AIROMOTIVE		EARHART RD.	OAKLAND
CONTINENTAL VOLVO	4030	EAST 14TH STREET	OAKLAND
STANDARD BRANDS PAINT COMPANY	2445	EAST 14TH STREET	OAKLAND
AMERICAN CAN COMPANY	3801	EAST 8TH STREET	OAKLAND
DEL MONTE PLANT #37	2980	EAST 9TH STREET	OAKLAND
LAWRENCE LIVERMORE LAB	7000	EAST AVE.	LIVERMORE <i>29</i>
UNOCAL	2701	EAST AVE.	HAYWARD
PIE NATIONWIDE PROPERTY	5500	EASTSHORE FREEWAY	EMERYVILLE
ALL FOREIGN AUTO	1475	EASTSHORE HWY.	BERKELEY
PORT OF OAKLAND	7101	EDGEWATER DR.	OAKLAND
REEVE TRUCKING		END OF VALLEY ROAD	PLEASANTON
MCDONALD CONSTRUCTION	3500	ENTERPRISE AVE.	HAYWARD
PRECISION METALS	3402	ENTERPRISE AVE.	HAYWARD
RUNNELS INDUSTRIES	3590	ENTERPRISE AVE.	HAYWARD
ALLGOOD INDUSTRIES	3466	ENTERPRISE AVENUE	HAYWARD
ASHLAND CHEMICAL	8600	ENTERPRISE DR.	NEWARK
HOLLAND OIL FACILITY	8130	ENTERPRISE DR.	NEWARK
JONES-HAMILTON CO.	8400	ENTERPRISE DR.	NEWARK
M. LA FLEUR MACHINERY	8025	ENTERPRISE DR.	NEWARK
E&R AUTO WRECKERS	3230	ETTIE ST.	OAKLAND
SAAG'S WAREHOUSE/S.F. NEWSPAPE	1799	FACTOR AVE.	SAN LEANDRO
QUICK STOP	38995	FARWELL DR.	FREMONT
CHEVRON		FERNSIDE/GIBBONS	ALAMEDA
ASHLAND OIL		FERRY & PETROLEUM	OAKLAND
SHELL	4226	FIRST AVE.	PLEASANTON
HOLLAND OIL	789	FLETCHER LN.	HAYWARD
K-MART	250	FLORESTA	SAN LEANDRO
GRING PEST CONTROL	741	FOLGER ST.	BERKELEY
CHEVRON	16304	FOOTHILL BLVD	SAN LEANDRO
7-ELEVEN	10501	FOOTHILL BLVD.	OAKLAND
CHEVRON	21995	FOOTHILL BLVD.	HAYWARD
G.I. TRUCKING	22300	FOOTHILL BLVD.	HAYWARD
MERVYN'S DEPT. STORE	22301	FOOTHILL BLVD.	HAYWARD
STOP-N-GO	4100	FOOTHILL BLVD.	OAKLAND
CHEVRON	4265	FOOTHILL BOULEVARD	OAKLAND
FAIRMONT HOSPITAL	15400	FOOTHILL DR.	SAN LEANDRO
DE SOTO		FOURTH & CEDAR	BERKELEY
KAISER REGIONAL PARKING	1901	FRANKLIN ST.	OAKLAND
NEW UNITED MOTORS	45500	FREMONT	FREMONT
S&S BLDG SUPPLY	701	FREMONT AVE	SAN LEANDRO
HERITAGE VILLAGE	38050	FREMONT BLVD	FREMONT
TEXACO	43600	FREMONT BLVD	FREMONT
AUTOBRITE CAR WASH	37063	FREMONT BLVD	FREMONT
ARCO	35900	FREMONT BLVD.	FREMONT
AUTOWEST MITSUBISHI	37156	FREMONT BLVD.	FREMONT
BEACON	40500	FREMONT BLVD.	FREMONT
BEACON	42245	FREMONT BLVD.	FREMONT

FUEL LEAKS - ALAMEDA COUNTY

SITENAME	STREET #	STREET	CITY
EXXON	39990	FREMONT BLVD.	FREMONT
FREMONT HUB	39201	FREMONT BLVD.	FREMONT
ROTTEN ROBBIE/FREMONT SHOPPING	40575	FREMONT BLVD.	FREMONT
FREMONT UNIFIED SCHOOL DISTR.	38442	FREMONT BLVD.	FREMONT SEE
KAL GAS	41093	FREMONT BLVD.	FREMONT
SOLOMON & SOLOMON	37250	FREMONT BLVD.	FREMONT
SUPER-7	35015	FREMONT BLVD.	FREMONT
TEXACO	43600	FREMONT BLVD.	FREMONT
PACIFIC LUMBER	43962	FREMONT BLVD.	FREMONT
DIRTY DUNBAR SERVICE STATION	44770	FREMONT BOULEVARD	FREMONT
CHEVRON	2681	FRUITVALE AVE.	OAKLAND
BROCKWAY GLASS	8717	G ST.	OAKLAND
SCHOOL FOR THE DEAF	39350	GALLAUDET DR.	FREMONT
EAST BAY REGIONAL PARK DIST.		GEARY RD.	SUNCL
FRANK'S TIRE SERVICE	820	GILMAN ST.	BERKLEY
RMC LONESTAR	808	GILMAN ST.	BERKELEY
QUICK STOP MARKET	363	GRAND AVE	OAKLAND
LEWIS CONSTRUCTION COMPANY	1345	GRAND AVE.	PIEDMONT
PENNZOIL GAS STATION	2015	GRAND AVE.	ALAMEDA
UNKNOWN	3234	GRAND AVE.	OAKLAND
ARCO	1401	GRAND AVE.	SAN LEANDRO
ALAMEDA FIRE STATION #3	1703	GRAND ST.	ALAMEDA
ENCINAL MARINA	2051	GRANT ST.	ALAMEDA
PQ CORPORATION	801	GRAYSON ST.	BERKELEY
ARCO	43500	GRIMMER	FREMONT
FREMONT UNIFIED SCHOOL DIST.	43770	GRIMMER	FREMONT SEE
UNOCAL	43411	GRIMMER	FREMONT
SHELL	41700	GRIMMER BLVD.	FREMONT
MELROSE METALS	44533	GRIMMER BOULEVARD	FREMONT
EXXON	43250	GRIMMER RD	FREMONT
TILDEN CORPORATION YARD	2501	GRIZZLY PEAK BLVD.	BERKELEY
MOBIL	5425	GROVE ST.	OAKLAND
LIBERTY SERVICE STATION	967	H ST.	UNION CITY
BELOUS PROPERTY	3423	HARLAN	OAKLAND
DIAMOND BATHURST	22302	HATHWAY AVE.	HAYWARD
ABC SERVICES	31845	HAYMAN ST.	HAYWARD
CLEMENTINA LTD	31823	HAYMAN ST.	HAYWARD
DEXTER CORP.-MIDLAND DIVISION	31500	HAYMAN ST.	HAYWARD
DeCANION IMPORT TILE	611	HEARST AVE.	BERKELEY
ARCO	566	HEGENBERGER RD.	OAKLAND
GENERAL TIRE	240	HEGENBERGER RD.	OAKLAND
DURKEE-WAREHAM	700	HEINZ	BERKELEY
ROTTEN ROBBIE	27814	HESPERIAN BLVD.	HAYWARD
EXXON	26115	HESPERIAN	HAYWARD
ARCO	17601	HESPERIAN BLVD.	HAYWARD
CHABOT COLLEGE	25555	HESPERIAN BLVD.	HAYWARD
MOBIL	15884	HESPERIAN BLVD.	SAN LORENZO
PUBLIC STORAGE	15285	HESPERIAN BLVD.	SAN LEANDRO
REGIONAL OCCUPATIONAL CENTER	26316	HESPERIAN BLVD.	HAYWARD
SVOCO GAS	15120	HESPERIAN BLVD.	SAN LEANDRO
THRIFTY OIL	20200	HESPERIAN BLVD.	HAYWARD

FUEL LEAKS - ALAMEDA COUNTY

SITENAME	STREET #	STREET	CITY
CHEVRON	15002	HESPERIAN BOULEVARD	SAN LEANDRO
SCHMITZ MEAT	410	HESTER	SAN LEANDRO
HESTER STREET	425	HESTER ST.	SAN LEANDRO
MOBIL	3315	HIGH ST.	OAKLAND
TEXACO	1357	HIGH ST.	ALAMEDA
UNOCAL	401	HIGH ST.	OAKLAND
EXXON	720	HIGH STREET	OAKLAND
RANSOME COMPANY	4030	HOLLIS ST	EMERYVILLE
HFH, LIMITED	6400	HOLLIS ST.	EMERYVILLE
HOLLIS STREET PROJECT	6050	HOLLIS ST.	EMERYVILLE
PACIFIC BELL	8259	HOLLY ST.	OAKLAND
ADN CORPORATION	29001	HOPKINS STREET	HAYWARD
EXXON	2991	HOPYARD & VALLEY	PLEASANTON
SHELL		HOPYARD& LAS POSITAS	PLEASANTON
FLORSTONE PRODUCTS	4700	HORNER	UNION CITY
J&G UNION CITY GLASS	3992	HORNER ST.	UNION CITY
SHELL	4250	HORTON	EMERYVILLE
RED TOP ELECTRIC	24967	HUNTWOOD	HAYWARD
VALLEY PET SUPPLY	30845	HUNTWOOD	HAYWARD
TRACT 5716		INDEPENDENCE WAY	ALAMEDA
DREWRY PHOTCOLOR CORPORATION	27105	INDUSTRIAL BLVD.	HAYWARD
LAURA SCUDDERS	27751	INDUSTRIAL BLVD.	HAYWARD
CALIFORNIA LIFETILE	45111	INDUSTRIAL DRIVE	FREMONT
AMERICAN PIPE PROCESSING	29901	INDUSTRIAL PARKWAY	HAYWARD
SMISER FRIEGHT	2340	INDUSTRIAL PARKWAY W	HAYWARD
BAY FORD TRACTORS	975	INDUSTRIAL PKWY WEST	HAYWARD
BAY CITY AUTO AUCTION		INDUSTRIAL WAY	HAYWARD
FAIRBANKS SCALES	3494	INVESTMENT BLVD.	HAYWARD
PORT OF OAKLAND		JACK LONDON SQUARE	OAKLAND
SHELL	138	JACKSON	HAYWARD
TEXACO	528	JACKSON ST	HAYWARD
ARCO	365	JACKSON ST.	HAYWARD
CHEVRON	6104	JARVIS BLVD.	NEWARK
BLUE PAINT SERVICE COMPANY	1700	JEFFERSON	OAKLAND
UNKNOWN	880	JONES	BERKELEY
PG&E	37465	JOSEPH ST.	FREMONT
HYSTER COMPANY	47132	KATO RD.	FREMONT
TEMPGLASS	48999	KATO ROAD	FREMONT
BRADFORD PROPERTIES	48870	KATO ROAD	FREMONT
RHODES-JAMIESON BATCH PLANT	333	KENNEDY ST.	OAKLAND
CATALINA TRUCKING	185	KING AVENUE	FREMONT
INTERLOCKING ROOF/CALIF. TERR.	500	KING ST.	FREMONT
CHEVRON	3026	LAKESHORE BOULEVARD	OAKLAND
REGILLUS CONDOMINIUMS	200	LAKESHORE DR.	OAKLAND
MICHEL & PELTON	5743	LANDREGAN ST.	EMERYVILLE
DEPT OF TRANS, SAN LEANDRO	600	LEWELLING	SAN LEANDRO
KAYO	44	LEWELLING BLVD.	SAN LORENZO
UNKNOWN	699	LEWELLING BLVD.	SAN LEANDRO
UNOCAL	376	LEWELLING BLVD.	SAN LORENZO
SMITH PROPERTY	63	LINCOLN AVE.	PEIDMONT
SHELL	27501	LOYOLA	HAYWARD

FUEL LEAKS - ALAMEDA COUNTY

SITENAME	STREET #	STREET	CITY
ARCO	71	MACARTHUR	OAKLAND
KRAGEN AUTO SUPPLY	4200	MACARTHUR	OAKLAND
UNKNOWN	1581-89	MACARTHUR BLVD.	OAKLAND
COLLINS PROPERTY	2452	MAGNOLIA ST	OAKLAND
NORTHERN CALIFORNIA POWER	2900	MAIN	ALAMEDA
LOUTHAN PROPERTY	11930	MAIN ST.	SUNOL
FARIA BROTHERS HARDWARE	519	MANOR BLVD.	SAN LEANDRO
CALTRANS - SHOP#4	1993	MARINA BLVD.	SAN LEANDRO
KAYO	1088	MARINA BLVD.	SAN LEANDRO
LUCKY DISTRIBUTION	1701	MARINA BLVD.	SAN LEANDRO
PETERSON TRACTOR COMPANY	995	MARINA BLVD.	SAN LEANDRO
PRODUCTION PATTERN AND FOUNDRY	700	MARINA BLVD.	SAN LEANDRO
UNOCAL	346	MARINA DR.	SAN LEANDRO
UNOCAL	846	MARINA DR.	SAN LEANDRO
SAFETY-KLEEN CORP.	404	MARKET	OAKLAND
MARINE TERMINALS CORP.	333	MARKET ST.	OAKLAND
BEACON	1900	MARTIN LUTHER KING	BERKELEY
CHEVRON	2500	MARTIN LUTHER KING	BERKELEY
UNKNOWN	1400	MARTIN LUTHER KING	BERKELEY
UNKNOWN	1149	MARTIN LUTHER KING	BERKELEY
OAKLAND REDEVLOPMENT AGENCY	1330	MARTIN LUTHER KING	OAKLAND
OGAWA-MUNE NURSERY	123	MAYHEW RD.	FREMONT
NATURE'S FARM	2707	MCCONE AVE.	HAYWARD
EDWARDS HEAT TREATING	642	MCCORMICK ST.	SAN LEANDRO
NORMANDY PROJECT		MECARTNEY RD.	ALAMEDA
COREMARK INC.	31300	MEDALLION ST.	HAYWARD
REYNOLDS AND BROWN	2565	MERCED	SAN LEANDRO
AERVOE PACIFIC	2420	MERCED ST.	SAN LEANDRO
FABRICATED METALS	2410	MERCED ST.	SAN LEANDRO
SHEREX CHEMICAL COMPANY, INC.	1401	MIDDLE HARBOR RD.	OAKLAND
SOUTHERN PACIFIC	1726	MIDDLE HARBOR RD.	OAKLAND
EMCO DIST.	48900	MILMONT DR.	FREMONT
U.C. BERKELEY CORP. YARD	2000	MILVIA ST.	BERKELEY
UNKNOWN	33365	MISSION	UNION CITY
MOBIL		MISSION & WARMSRING	FREMONT
EXXON	46494	MISSION BLVD	FREMONT
BEACON	29705	MISSION BLVD	HAYWARD
CAL TRANS PROPERTY	25030	MISSION BLVD.	HAYWARD
CALIF. STATE UNIV. HAYWARD		MISSION BLVD.	HAYWARD
CHAPEL OF THE CHIMES MEM. PARK	32992	MISSION BLVD.	HAYWARD
CHEVRON	24086	MISSION BLVD.	HAYWARD
DINO'S FURNITURE	21564	MISSION BLVD.	HAYWARD
HAYWARD DODGE, INC.	24773	MISSION BLVD.	HAYWARD
HOLY SEPULCHRE CEMETERY	26320	MISSION BLVD.	HAYWARD
LIBERTY STATION	36389	MISSION BLVD.	FREMONT
MAURY COX VANS	25700	MISSION BLVD.	HAYWARD
MEEK'S CAMPERS	33503	MISSION BLVD.	UNION CITY
MOBIL	4111	MISSION BLVD.	FREMONT
MOBIL	94544	MISSION BLVD.	UNION CITY
PESTANA PROPERTY	29234	MISSION BLVD.	HAYWARD
SUPER-7	38010	MISSION BLVD.	FREMONT

FUEL LEAKS - ALAMEDA COUNTY

SITENAME	STREET #	STREET	CITY
THRIFTY OIL	25225	MISSION BLVD.	HAYWARD
UNION CITY TEEN CENTER	33623	MISSION BLVD.	UNION CITY
UNOCAL	25995	MISSION BLVD.	HAYWARD
UNKNOWN	1649	MLK JR. WAY	BERKELEY
EVERGREEN	797	MONTAGUE	SAN LEANDRO
STELLA D'ORO BISCUIT CO.	1000	MONTAGUE	SAN LEANDRO
MUNSON, WARREN	21011	MONTGOMERY AVE	HAYWARD
ARCO		MOUNTAIN & MERCED	OAKLAND
NAVAL HOSPITAL		MOUNTAIN BLVD.	OAKLAND
OAK KNOLL NAVAL HOSPITAL	8750	MOUNTAIN BLVD.	OAKLAND
CERRO METALS	6707	MOWRY AVE.	NEWARK
CHEVRON	5300	MOWRY AVE.	FREMONT
EXXON	4995	MOWRY AVE.	FREMONT
TEXACO	377	MOWRY AVE.	FREMONT
TEXACO	4004	MOWRY AVE.	FREMONT
UNOCAL	5100	MOWRY AVE.	FREMONT
UNOCAL	5301	MOWRY AVE.	FREMONT
WASHINGTON HOSPITAL	2000	MOWRY AVE.	FREMONT
CITY OF FREMONT FIRE STN. #1	4200	MOWRY ST.	FREMONT
FOLGER MURPHY PROPERTY	1020	MURRAY ST	BERKELEY
STANLEY STEEL STRAPPING	255	N. PARKSIDE DR.	PITTSBURG
REDCO	1975	NATIONAL AVE.	HAYWARD
TOSCANO BAKING COMPANY	2227	NATIONAL AVE.	HAYWARD
GOLDENBERG PROPERTY	1791	NEPTUNE DR.	SAN LEANDRO
MERCURY ELECTRIC	2553	NICHOLSON	SAN LEANDRO
UNKNOWN		NIELSON & GRANT	SAN LORENZO
L&M AUTO REPAIR	37822	NILES BLVD.	FREMONT
MOBIL	37810	NILES BLVD.	FREMONT
SOUTHERN PACIFIC	37516	NILES BLVD.	FREMONT
7-ELEVEN		NILES CYN/MISSION BV	FREMONT
VANDERSON CONSTRUCTION		NORTH DYER TRIANGLE	UNION CITY
CHEVRON	609	OAK	OAKLAND
ALAMEDA POLICE DEPARTMENT	1555	OAK ST.	ALAMEDA
CHEVRON		OAKLAND INTERN'L AIR	OAKLAND
PG&E	4801	OAKPORT	OAKLAND
EBMUD		OAKPORT RD.	OAKLAND
GETZ CONSTRUCTION COMPANY	1351	OCEAN AVE	EMERYVILLE
BAYOX	1171	OCEAN AVE.	OAKLAND
KELLY'S CONCRETE	4430	OLD WARM SPRINGS RD.	FREMONT
AT&T	100	ORCHARD AVE.	HAYWARD
BAY AREA CONCRETES, INC.	43055	OSGOOD RD.	FREMONT
FEE CONSTRUCTION	42000	OSGOOD RD.	FREMONT
GRADE WAY CONSTRUCTION	438012	OSGOOD RD.	FREMONT
HOWARD'S BACKHOE RENTAL	41875	OSGOOD RD.	FREMONT
MISSION VALLEY EQUIPMENT RENTL	41655	OSGOOD RD.	FREMONT
UC BERKELEY SITE GARAGE	1952	OXFORD ST	BERKELEY
TEXACO	1899	OXFORD ST.	BERKELEY
BOLDEMANN CHOCOLATE COMPANY	1515	PACIFIC ST.	UNION CITY
LEW'S DIESEL REPAIR	29318	PACIFIC ST.	HAYWARD
PEN BULLET EXPRESS	1143	PACIFIC ST.	UNION CITY
SAN FRANCISCO NEWSPAPER AGENCY	1550	PACIFIC ST.	UNION CITY

FUEL LEAKS - ALAMEDA COUNTY

SITENAME	STREET #	STREET	CITY
DUNCAN & SON PETROLEUM	29303	PACIFICA ST.	HAYWARD
XEROX	901	PAGE AVE.	FREMONT
S.F. WATER DEPARTMENT	505	PALOMA WAY	SUNOL
COBURN CONSTRUCTION	1006	PARDEE ST.	BERKELEY
UPRIGHT INC.	1013	PARDEE ST.	BERKELEY
ARCO	1260	PARK	ALAMEDA
GOOD CHEVROLET	1630	PARK	ALAMEDA
DEL MONTE PLANT #35	1250	PARK AVE.	EMERYVILLE
SHELL	2101	PARK BLVD.	OAKLAND
ALAMEDA COLLISION	1911	PARK ST	ALAMEDA
REGAL/EXXON	1725	PARK ST	ALAMEDA
BIG O TIRE	1200	PARK ST.	ALAMEDA
MOBIL	1541 ST.	PARK ST.	ALAMEDA
NOR CAL WASTE EQUIPMENT	299	PARK ST.	SAN LEANDRO
MACAULAY FOUNDRY		PARKER ST.	BERKELEY
SAN LORENZO VILLAGE HOMES ASS.	427	PASEO GRANDE	SAN LORENZO
UNKNOWN		PASEO PADRE & SPRR	FREMONT
SCHWABACKER-FREY	5733	PELLEDEAU	EMERYVILLE
ALL COUNTIES EXPRESS	863	PERALTA	SAN LEANDRO
EUROCAL	863	PERALTA	SAN LEANDRO
WM CONCRETE	851	PERALTA	SAN LEANDRO
UNOCAL		PERALTA & JOSEPH	FREMONT
PG&E	2121	PERALTA ST.	OAKLAND
MOBIL		PETROLEUM ST.	OAKLAND
LA MANCHA DEVELOPMENT COMPANY	4299	PIEDMONT AVE.	OAKLAND
UNKNOWN	4299	PIEDMONT AVE.	OAKLAND
YOUNG'S FOOD & LIQUOR	4193	PIEDMONT AVE.	OAKLAND
CERT. ENGR. & TESTING	1997	PIKE ST.	SAN LEANDRO
COCA-COLA	2080	PIKE ST.	SAN LEANDRO
SOUTHERN PACIFIC		PINE ST.	OAKLAND
ALAMEDA COUNTY FAIRGROUNDS	4501	PLEASANTON AVE.	PLEASANTON
CRAIN PACIFIC	2451	POLVOROSA DR.	SAN LEANDRO
MOBIL		PORT OF OAKLAND	OAKLAND
SHELL	1155	PORTOLA AVE	LIVERMORE <i>hd</i>
BAY EXPORT SERVICES	717	POTTER ST.	BERKELEY
SUNSET HIGH SCHOOL	22100	PRINCETON	HAYWARD
SOUTHERN PACIFIC		PRIVATE RD.	OAKLAND
SHERMAN TRUCKING	1000	RAILROAD	SAN LORENZO
JOHNSON INVESTMENT CORP.	33379	RAILROAD AVE.	UNION CITY
S.T.M., INC.	33395	RAILROAD AVE.	UNION CITY
SHELL		RAND & LAKESHORE AVE	OAKLAND
CHEVRON		REDWOOD & GROVE	CASTRO VALL
BEACON	22315	REDWOOD RD.	CASTRO VALL
EAST BAY REGIONAL PARK DIST.	7867	REDWOOD RD.	OAKLAND
PACIFIC ELECTRIC SUPPLY	1906	REPUBLIC AVE.	SAN LEANDRO
ARCO	899	RINCON AVE.	LIVERMORE
ECONO	41100	ROBERTS AVE.	FREMONT
BERKELEY HOUSING AUTHORITY		ROSE & MARTIN L KING	BERKELEY
MOBIL	494	ROUSSEAU ST.	HAYWARD
BART	601	S. 8TH ST.	OAKLAND
CHEVRON	4904	S. FRONT	LIVERMORE <i>hd</i>

Health and Welfare Agency
Department of Health Services
Toxic Substances Control Division

Joel Kushins

**EXPENDITURE PLAN FOR THE
HAZARDOUS SUBSTANCE CLEANUP BOND ACT
OF 1984**



Revised January, 1988
(Originally Published January 1985)
Revision No. 3
Volume 1

**Overview of the Five Year Expenditure Plan
and the Site Cleanup Process in California**

STATE OF CALIFORNIA
HEALTH AND WELFARE AGENCY

EXPENDITURE PLAN FOR THE
HAZARDOUS SUBSTANCE CLEANUP BOND ACT
OF 1984

Revised January, 1988
(Originally Published January 1985)
Revision No. 3

Volume I.
Overview of the five-year Expenditure Plan
and the Site Cleanup Process in California

Department of Health Services

Kenneth W. Kizer, M.D., M.P.H.
Director

Alex R. Cunningham
Chief Deputy Director

C. David Willis
Deputy Director

TOXIC SUBSTANCES CONTROL PROGRAM

NOTICE TO READERS

Readers who are using the Expenditure Plan as a reference for financial or real estate planning should be advised that this document does not necessarily reflect the entire population of known or potential hazardous waste sites in California. Sites listed include only those targeted for expenditure of State bond funds, either for total cleanup costs or for State oversight.

Not included in this Expenditure Plan are any references to sites where work is being undertaken by local agencies, a Regional Water Quality Control Board, or a responsible party without State knowledge. Also absent are potential sites currently being reviewed by the Toxic Substances Control Division's Site Evaluation or Rural County Survey Programs. Anyone wishing to obtain information on a specific site not listed in the Expenditure Plan should contact the Toxic Substances Control Division, Office of External Affairs, P.O. Box 942372, Sacramento, CA. 94234.

Information contained in this document is current as of December, 1987.

APPENDIX 2: LIST OF SITES BY COUNTY

SITE NAME	CITY
** COUNTY: Alameda	
AERO QUALITY PLATING	Oakland
ALAMEDA NAVAL AIR STATION	Alameda
AMCHEM PRODUCTS, INC.	Fremont
AUTO REPAIR - BERKELEY	Berkeley
CLOROX COMPANY, THE	Oakland
EKOTEK LUBE	Oakland
ELECTRO-COATINGS	Emeryville
FACTOR AVENUE PLUME (NO. 1465), SAN LEANDRO	San Leandro
FMC CORPORATION - NEWARK	Newark
L&M PLATING	Oakland
LAWRENCE LIVERMORE NATIONAL LABORATORY	Livermore
LESLIE SALT	Newark
ONE HUNDRED THIRTY-NINTH STREET (No. 750) - SAN LEANDRO	San Leandro
PACIFIC GAS AND ELECTRIC - EMERYVILLE	Emeryville
PACIFIC STATES STEEL	Union City
PORT OF OAKLAND - EMBARCADERO COVE	Oakland
SOUTHERN PACIFIC TRANSPORTATION CO. - OAKLAND	Oakland
TROJAN POWDER WORKS COMPANY	San Leandro
U. S. PIPE AND FOUNDRY COMPANY	Union City
WAREHAM PROPERTIES	Berkeley
WESTERN FORGE AND FLANGE	Albany
WESTINGHOUSE ELECTRIC COMPANY - EMERYVILLE	Emeryville
** COUNTY: Alpine	
LEVIATHAN MINE	
** COUNTY: Amador	
A F P - MARTELL	Martell
** COUNTY: Butte	
CHICO AREA GROUND WATER	Main City Area of Chico
CHICO MUNICIPAL AIRPORT	Chico
CHICO SCRAP METAL YARD	Chico
KOPPERS COMPANY, INC. - OROVILLE	Oroville
LOUISIANA PACIFIC CORPORATION	Oroville
** COUNTY: Calaveras	
COPPER COVE VILLAGE SUBDIVISION	Copperopolis
** COUNTY: Contra Costa	
AMERICAN STANDARD PRODUCTS	San Pablo
ASARCO	Selby
BURMAH-CASTROL, INC. (BCI)	Richmond