

3315 Almaden Expressway, Suite 34  
San Jose, CA 95118  
Phone: (408) 264-7723  
Fax: (408) 264-2345

## TRANSMITTAL

**TO:** Ms. Susan Hugo  
Alameda County Health Care Services  
80 Swan Way, Room 200  
Oakland, California 94621

**DATE:** December 3, 1992  
**PROJECT NUMBER:** 69028.10  
**SUBJECT:** Construction Plans and  
Specifications for ARCO Station 6113, 785  
East Stanley Blvd., Livermore, California.

**FROM:** Valli Voruganti  
**TITLE:** Project Engineer

**WE ARE SENDING YOU:**

COPIES	DATED	NO.	DESCRIPTION
1	12/3/92	69028.10	Construction Plans and Specifications for the above subject site.

THESE ARE TRANSMITTED as checked below:

- For review and comment     Approved as submitted     Resubmit \_\_\_ copies for approval  
 As requested     Approved as noted     Submit \_\_\_ copies for distribution  
 For approval     Return for corrections     Return \_\_\_ corrected prints  
 For your files

**REMARKS:** cc: Mr. Michael Whelan, ARCO Products Company  
Mr. Joel Coffman, RESNA Industries Inc.  
Mr. Paul Shapple, Roux Associates

Copies: 1 to RESNA project file no. 69028.10



Working To Restore Nature

3315 Almaden Expressway, Suite 34  
San Jose, CA 95118  
Phone: (408) 264-7723  
Fax: (408) 264-2345

December 3, 1992  
1204shgo  
69028.10

Ms. Susan Hugo  
Alameda County Health Care Services Agency  
Department of Environmental Health  
80 Swan Way, Room 200  
Oakland, California 94612

Subject: Construction Plans and Specifications for Subgrade Remediation Piping  
Installation, ARCO Station 6113, 785 East Sanely Boulevard, Livermore, CA.

Ms. Hugo:

Pursuant to your telephone conversation with Mr. Paul Supple of Roux Associates, enclosed herewith is a copy of the construction plans and specifications submitted to the Contractor for installation of subsurface remediation piping for the subject site (Plates G-1, C-1 and C-2). These plans and specifications are to assist the Contractor in the construction of the subsurface portion of an interim soil and groundwater remediation system to be designed and installed at a later date. RESNA Industries Inc. (RESNA) understands that the installation will be performed in conjunction with product line removal and replacement scheduled for December 1992. Please call us at (408) 264-7723 if you have any questions.

Sincerely,  
RESNA Industries Inc.

Valli Voruganti  
Project Engineer

Attachments: One Set of Construction Plans

cc: Michael Whelan, ARCO Products Company  
Joel Coffman, RESNA  
Paul Supple, Roux Associates

*3 lines for structure line*  
**EAST STANLEY BOULEVARD**  
*in Springer*

*2/18/93*  
*2/18/93*

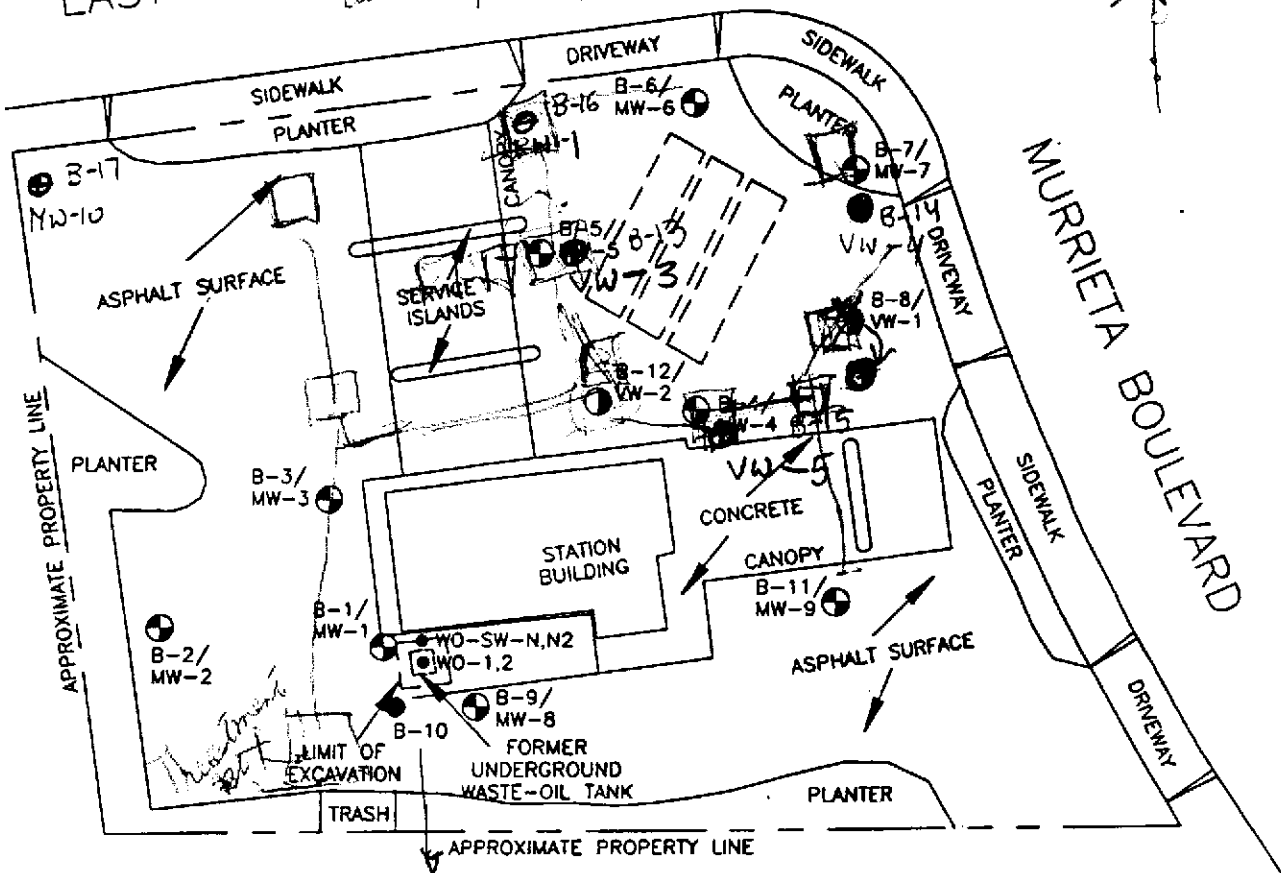

B-15/VW-5

⊙ = Proposed boring/vapor extraction well

B-16/RW-1

⊕ = Proposed boring/recovery well

B-17/MW-10

⊗ = Proposed boring/monitoring well

**EXPLANATION**

- B-11/  
MW-9 ⊗ = Boring/monitoring well  
(RESNA, 09/89, 02/91, and 06/92)
- B-12/  
VW-2 ⊙ = Boring/vapor extraction well  
(RESNA, 06/92)
- B-10 ● = Boring  
(RESNA, 06/92)
- WO-SW-N,N2 ● = Soil sample collected by Pacific (1989)

*met: 1) Ron Archer, Representative  
 (Todd)  
 2) Michael Wheeler  
 -Arco*

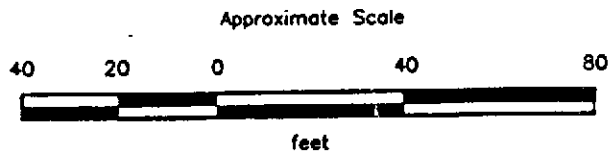

Source: Modified from plan supplied by Ron Archer, Civil Engineer Inc., October 1988.

**RESNA**  
 Working to Restore Nature

PROJECT P1870.13/69028.00

**GENERALIZED SITE PLAN**  
**ARCO Service Station 6113**  
**785 East Stanley Boulevard**  
**Livermore, California**

**PLATE**

*BA*

*B P200B.13/69028.11*

STANLEY BUS

129-

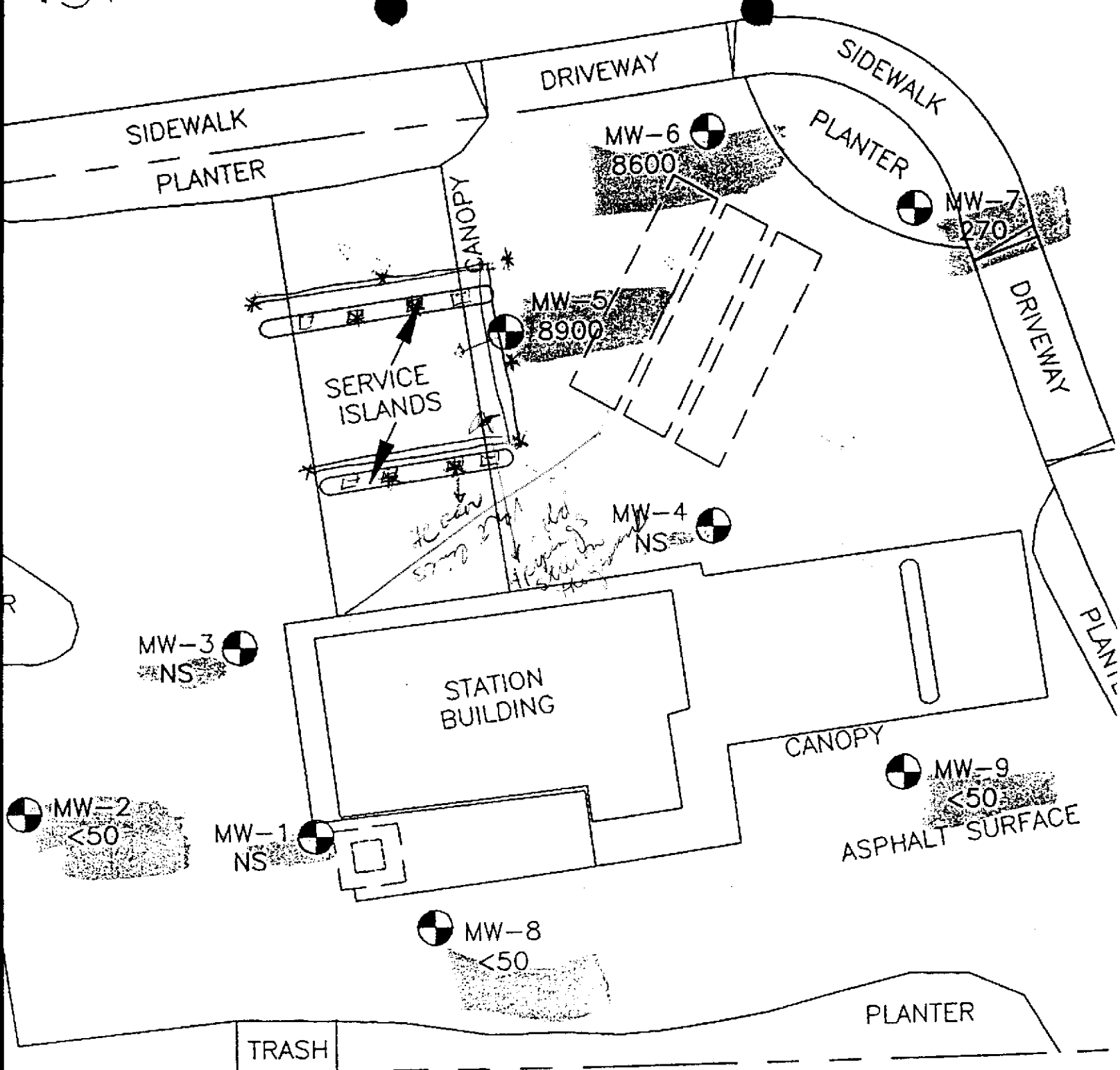

APPROXIMATE PROPERTY LINE

12/7/92 on site for sampling