

Atlantic Richfield Company

Chuck Carmel
Environmental Business Manager

RECEIVED

9:58 am, Apr 26, 2010

Alameda County
Environmental Health

PO Box 1257
San Ramon, CA 94583
Phone: (925) 275-3803
Fax: (925) 275-3815
E-Mail: charles.carmel@bp.com

April 20, 2010

Re: First Quarter 2010 Status Report
Atlantic Richfield Company Station #6113
785 East Stanley Boulevard, Livermore, California
ACEH Case #RO0000393

"I declare, that to the best of my knowledge at the present time, that the information and/or recommendations contained in the attached document are true and correct.

Submitted by,



Chuck Carmel
Environmental Business Manager

Attachment

FIRST QUARTER 2010 STATUS REPORT

Atlantic Richfield Company Station #6113
785 East Stanley Blvd., Livermore, California
ACEH Case # RO0000393

Prepared for

Mr. Chuck Carmel
Environmental Business Manager
Atlantic Richfield Company
P.O. Box 1257
San Ramon, California 94583

Prepared by



1324 Mangrove Avenue, Suite 212
Chico, California 95926
(530) 566-1400
www.broadbentinc.com

April 20, 2010

Project No. 06-82-637

April 20, 2010

Project No. 06-82-637

Atlantic Richfield Company
P.O. Box 1257
San Ramon, California 94583
Submitted via ENFOS

Attn.: Mr. Chuck Carmel

Re: First Quarter 2010 Status Report, Atlantic Richfield Company Station #6113
785 East Stanley Blvd, Livermore, California; ACEH Case #RO0000393

Dear Mr. Carmel:

Provided herein is the *First Quarter 2010 Status Report* for Atlantic Richfield Company (a BP affiliated company) Station #6113 located at 785 East Stanley Blvd., Livermore, Alameda County, California (Site). This report presents a summary of current developments regarding the Site through the First Quarter 2010.

Should you have questions regarding this submission, please do not hesitate to contact us at (530) 566-1400.

Sincerely,

BROADBENT & ASSOCIATES, INC.



Jason Duda
Project Scientist



Matthew G. Herrick, P.G., C.H.G.
Senior Hydrogeologist

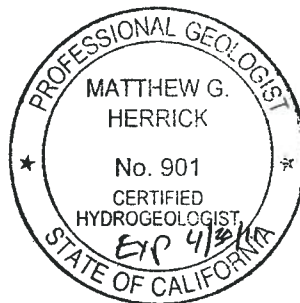

Enclosures

cc: Mr. Paresh Khatri, ACEH (Submitted via ACEH ftp Site)
Mr. Paul M. Smith/Ms. Danielle Stefani, Livermore-Pleasanton Fire Department
(submitted via GeoTracker)
Electronic copy uploaded to GeoTracker

STATION #6113 QUARTERLY STATUS REPORT

Facility: #6113	Address:	785 East Stanley Boulevard, Livermore, California
Environmental Business Manager:		Mr. Chuck Carmel
Consulting Company/Contact Person:		Broadbent & Associates, Inc. (BAI)/Jason Duda and Matt Herrick (530) 566-1400
Primary Agency/Regulatory ID No.:		Alameda County Environmental Health (ACEH) ACEH Case #RO0000393
Consultant Project No.:		06-82-637

WORK PERFORMED THIS QUARTER (First Quarter 2010):

1. Prepared and submitted the *Fourth Quarter 2009 Semi-Annual Ground-Water Monitoring Report* (BAI, 1/05/2010).
2. No ground-water monitoring/sampling activities were conducted at the Site during First Quarter 2010.
3. Implemented *Replacement Well Work Plan* (BAI, 9/4/2009). Installed one replacement well (RMW-13) on March 11, 2010. Work performed by BAI.
4. Conducted well development activities for well RMW-13 on March 25, 2010. Work performed by BAI.

WORK PROPOSED FOR NEXT QUARTER (Second Quarter 2010):

1. Prepared and submitted this *First Quarter 2010 Status Report* (contained herein).
2. Conduct semi-annual ground-water monitoring/sampling for Second Quarter 2010. Work to be performed by BAI.
3. Conduct surveying activities for replacement well RMW-13.
4. Prepare and submit a Soil and Ground-Water Investigation Report along with Second Quarter 2010 Semi-Annual Monitoring results to ACEH by May 14, 2010.

QUARTERLY RESULTS SUMMARY:

Current phase of project:	Ground-water monitoring/sampling
Frequency of ground-water monitoring:	Semi-Annually (2Q and 4Q): Wells MW-2, MW-4, MW-7, MW-9, MW-11, MW-12, VW-1, VW-2, VW-4
Frequency of ground-water sampling:	Semi-Annually (2Q and 4Q): Wells MW-4, MW-7, MW-11, MW-12, VW-1 Annually (4Q): Well MW-9
Is free product (FP) present on-site:	NA
FP recovered this quarter:	NA
Bulk Soil Removed to Date:	288 cubic yards TPH impacted soil
Current remediation techniques:	Air Diffusion (discontinued in September 2008 as a result of station raze and rebuild activities)
Depth to ground water (below TOC):	NA
General ground-water flow direction:	NA
Approximate hydraulic gradient:	NA

DISCUSSION:

A *Replacement Well Work Plan* for environmental work at Station #6113 was prepared and submitted on September 4, 2009 to ACEH in accordance with an email from Mr. Paresh Khatri, dated August 18, 2008. An ACEH letter dated October 22, 2009 approved the work plan for the installation of one replacement well (RMW-13) approximately 15 feet south of abandoned well MW-13. BAI supervised the installation of replacement monitoring well RMW-13 on March 11, 2010. Well development activities for well RMW-13 took place on March 25, 2010. Surveying is scheduled to occur during the Second Quarter 2010. A Soil and Ground-Water Investigation and Second Quarter 2010 Semi-Annual Ground-Water Monitoring Report will be submitted to ACEH by May 14, 2010 as directed. No ground-water monitoring and sampling activities took place at the Site during First Quarter 2010. For reference, a Site Location Map is provided as Drawing 1. Provided as Drawing 2 is the Ground-Water Elevation Contours and Analytical Summary Map from the *Fourth Quarter 2009 Ground-Water Monitoring Report* (BAI, 1/05/2010) for ground-water monitoring/sampling conducted on November 9, 2009.

ATTACHMENTS:

- Drawing 1 Site Location Map, Station #6113, 785 East Stanley Boulevard, Livermore, California

- Drawing 2. Ground-Water Elevation Contour and Analytical Summary Map, Station #6113, 785 East Stanley Boulevard, Livermore, California

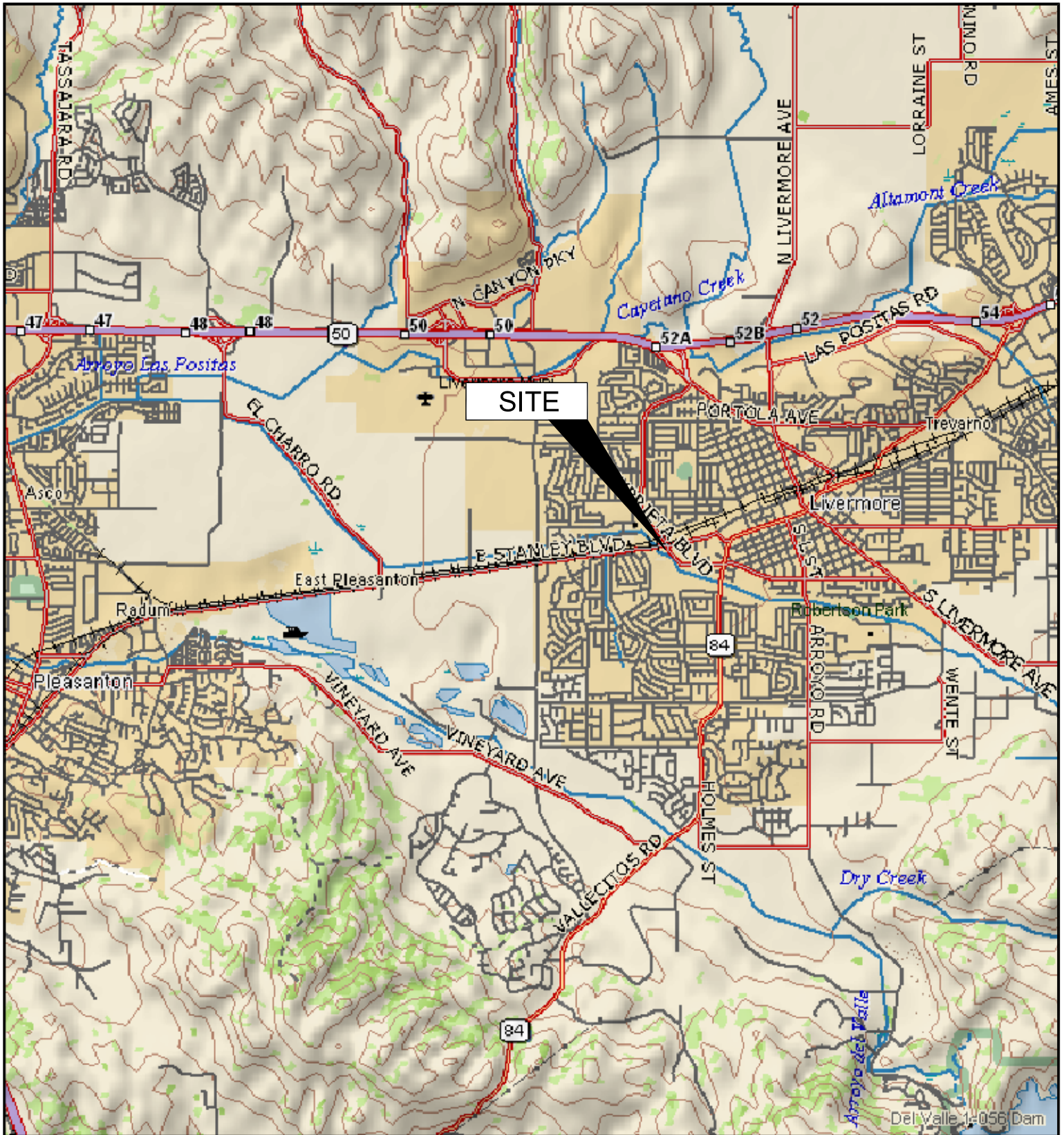

APPROXIMATE SCALE (mi)

IMAGE SOURCE: DELORME

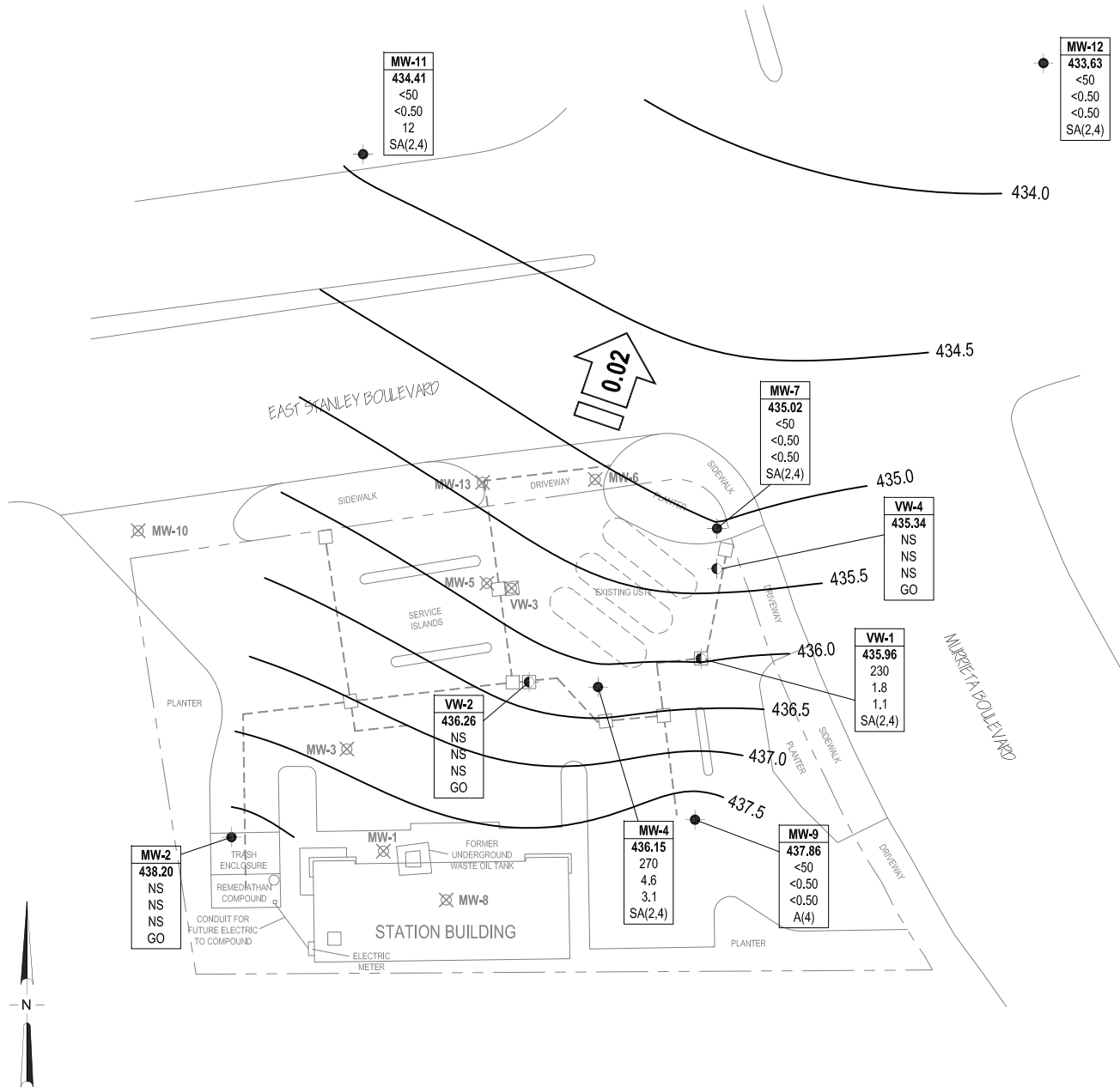

LEGEND

- Monitoring well
- Vapor extraction well
- Abandoned well
- 434.0 Ground-water elevation contour (ft/MSL)

Well	Well Designation
ELEV	Ground-water Elevation
GRO	GRO, Benzene and MTBE concentration (µg/L)
Benzene	
MTBE	
A/SA	Sampling frequency
A(4)	Sampled annually, 4th quarter
SA(2,4)	Semi-annual sampling, 2nd and 4th quarters
GO	Gauge only
NS	Not Sampled
NM	Not Measured

- Approximate ground-water flow direction and gradient (ft/ft)
- Vault box
- Piping trench

NOTE: SITE MAP ADAPTED FROM CAMBRIA ENVIRONMENTAL FIGURES. SITE DIMENSIONS AND FACILITY LOCATIONS NOT VERIFIED.



BROADBENT & ASSOCIATES, INC.
 ENGINEERING, WATER RESOURCES & ENVIRONMENTAL
 1324 Mangrove Ave, Suite 212, Chico, California 95926
 Project No.: 06-82-637 Date: 12/23/2009

Station #6113
 785 East Stanley Boulevard
 Livermore, California

Ground-Water Elevation Contour
 and Analytical Summary Map
 November 9, 2009