

Broadbent & Associates, Inc.
1324 Mangrove Ave., Suite 212
Chico, CA 95926
Voice (530) 566-1400
Fax (530) 566-1401

RECEIVED

10:55 am, May 01, 2009

Alameda County
Environmental Health

 **BROADBENT & ASSOCIATES, INC**
ENVIRONMENTAL, WATER RESOURCES & ENGINEERING

April 27, 2009

Project No. 06-82-637

Atlantic Richfield Company
P.O. Box 1257
San Ramon, CA 94583
Submitted via ENFOS

Attn.: Mr. Paul Supple

Re: First Quarter, 2009 Status Report, Atlantic Richfield Company (a BP affiliated company) Station #6113, 785 East Stanley Boulevard, Livermore, CA. Case No. RO0000393.

Dear Mr. Supple:

Attached is the *First Quarter, 2009 Status Report* for Atlantic Richfield Company Station #6113 (herein referred to as Station #6113) located at 785 East Stanley Boulevard, Livermore, CA (Property).

Should you have questions please do not hesitate to contact us at (530) 566-1400.

Sincerely,

BROADBENT & ASSOCIATES, INC.



Matthew G. Herrick, P.G., C.H.G.
Senior Hydrogeologist



Robert H. Miller, P.G., C.H.G.
Principal Hydrogeologist

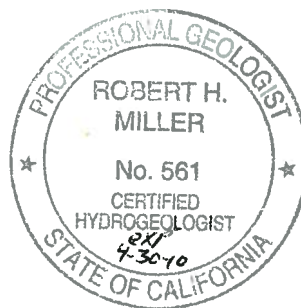

Enclosures

cc: Mr. Paresh Khatri, Alameda County Environmental Health (submitted via ACEH ftp site)
Mr. Paul M. Smith/Ms. Danielle Stefani, Livermore-Pleasanton Fire Department (submitted via GeoTracker)
Mr. Bejan Farahbakhsh, Property Owner, 4501 Main Street, Oakley, CA 94561
GeoTracker

STATION #6113 QUARTERLY STATUS REPORT

Facility: <u>6113</u>	Address: <u>785 East Stanley Boulevard, Livermore, CA</u>
Station <u>6113 Environmental Business</u>	
Manager: <u>Mr. Paul Supple</u>	
Consulting Co./Contact Persons: <u>Broadbent & Associates, Inc. (BAI) / Rob Miller & Matt Herrick</u>	
Primary Agency/Regulatory ID No.: <u>Alameda County Environmental Health (ACEH) / Case No. RO0000393</u>	
Consultant Project No.: <u>06-82-637</u>	
Facility Permits/Permitting Agency.: <u>NA</u>	

WORK PERFORMED THIS QUARTER (First Quarter, 2009):

1. Submitted Fourth Quarter, 2008 Semi-Annual Ground-Water Monitoring Report. Report completed by BAI.
2. No ground-water monitoring/sampling work activities were completed on the Property during the First Quarter, 2009.
3. Installed new well boxes for wells MW-2 and MW-7. Work completed by Stratus.

WORK PROPOSED FOR NEXT QUARTER (Second Quarter, 2009):

1. Submit First Quarter, 2009 Status Report (contained herein).
2. Conduct ground-water monitoring/sampling for Second Quarter, 2009.
3. Field verify site layout and completion of workplan for replacement well locations

QUARTERLY RESULTS SUMMARY:

Current phase of project:	<u>Groundwater monitoring/sampling</u>
Frequency of ground-water sampling:	<u>Wells MW-4, MW-7, MW-11, MW-12, and VW-1: Semi Annually (2Q and 4Q)</u> <u>Well MW-9: Annually (4Q)</u>
Frequency of ground-water monitoring:	<u>Semi-Annually (2Q and 4Q)</u>
Is free product (FP) present on-site:	<u>No</u>
FP recovered this quarter:	<u>NA</u>
Bulk Soil Removed to Date:	<u>288 cubic yards TPH impacted soil</u>
Current remediation techniques:	<u>Air Diffusion</u>
Depth to ground water (below TOC):	<u>NA</u>
General ground-water flow direction:	<u>NA</u>
Approximate hydraulic gradient:	<u>NA</u>

DISCUSSION:

No groundwater monitoring/sampling activities took place at Station #6113 during the First Quarter, 2009. The attached Drawing 1 depicts the site and monitor well locations. The most recent quarterly data is provided in the *Fourth Quarter, 2008 Semi-Annual Ground-Water Monitoring Report*.

Station #6113 has been sold. The new property owner has recently completed raze and rebuild activities. With approval from the ACEH (email dated June 5, 2008) wells MW-1 and MW-8 were properly abandoned in June 2008 as these wells were within the footprint of the new station building. With approval from the ACEH (email dated August 18, 2008) wells MW-3, MW-6, MW-10, and MW-13 were properly abandoned in September 2008 to facilitate construction activities associated with the raze and rebuild. Abandonment of wells MW-6, MW-10, and MW-13 were required to allow for the widening of East Stanley Boulevard and abandonment of MW-3 was necessary as the well was within the construction demolition area of the Property. Field verification

of the new site layout and completion of a workplan for replacement well locations is scheduled to be completed during Second Quarter, 2009.

Monthly field inspections were completed through February to verify conditions of existing well boxes during construction activities. Construction was near completion at the end of February, thus monthly field inspections were no longer necessary. New well boxes were installed for wells MW-2 and MW-7.

ATTACHMENTS:

Drawing 1. Site Map, Station #6113, Livermore, CA

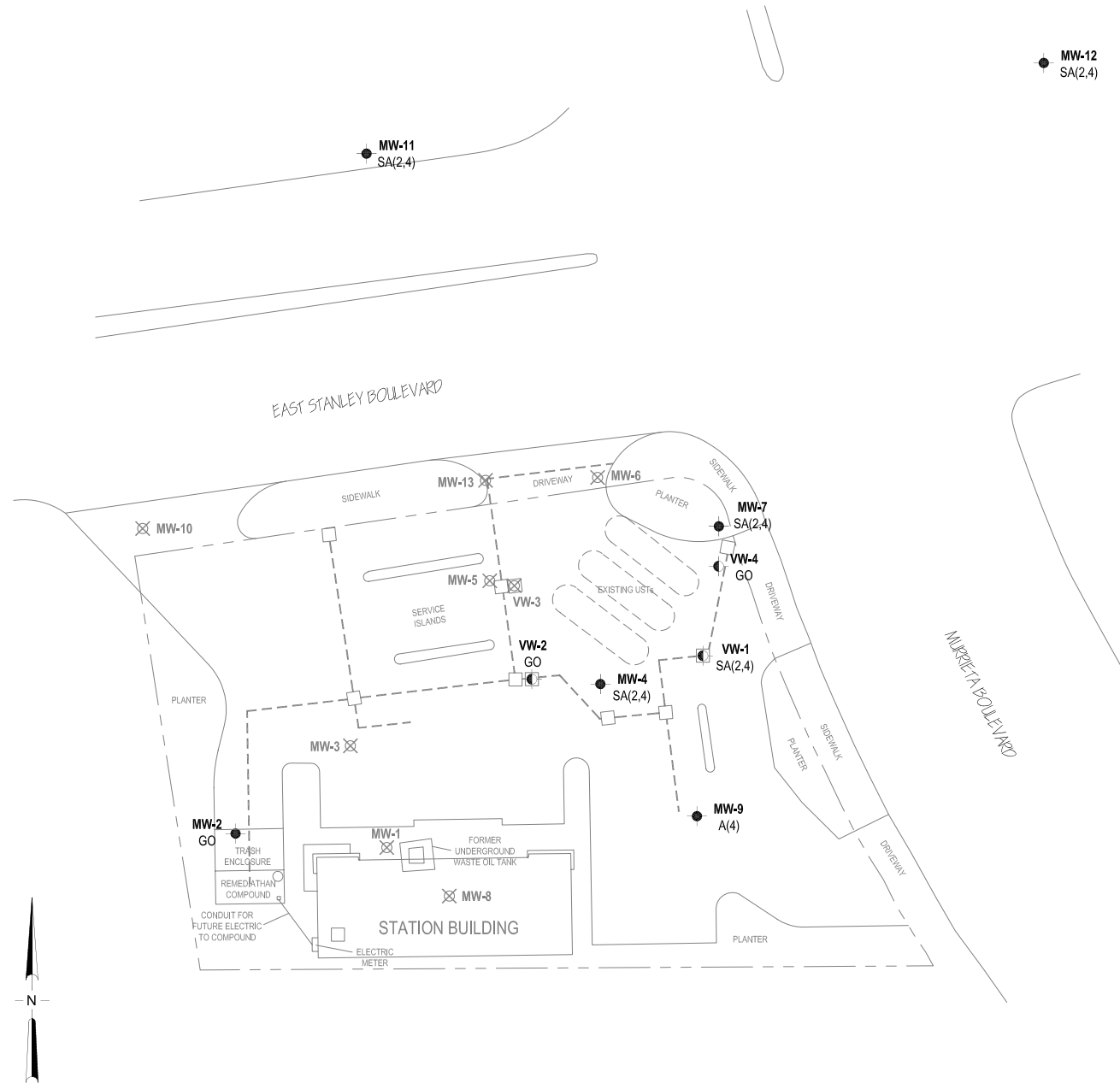

LEGEND

- Monitoring well
- ◐ Vapor extraction well
- ⊗ Abandoned well
- Well / Sampling Frequency
- A(4) Sampled annually, 4th quarter
- SA(2,4) Semi-annual sampling, 2nd and 4th quarters
- GO Gauge Only
- Vault box
- - - Piping trench

NOTE: SITE MAP ADAPTED FROM CAMBRIA ENVIRONMENTAL FIGURES. SITE DIMENSIONS AND FACILITY LOCATIONS NOT VERIFIED. STATION BUILDING LOCATION REVISED IN 2009 BASED ON WD PARTNERS DESIGN DRAWINGS FOR RAZE AND REBUILD.

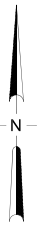

BROADBENT & ASSOCIATES, INC.
 ENGINEERING, WATER RESOURCES & ENVIRONMENTAL
 1324 Mangrove Ave, Suite 212, Chico, California 95926
 Project No.: 06-82-637 Date: 4/15/2009

Station #6113
 785 East Stanley Boulevard
 Livermore, California

Site Map