



Atlantic Richfield Company
(a BP affiliated company)

P.O. Box 1257
San Ramon, CA 94583
Phone: (925) 275-3801
Fax: (925) 275-3815

RECEIVED

2:44 pm, Jan 31, 2008

Alameda County
Environmental Health



January 30, 2008

Re: Fourth Quarter, 2007 Semi-Annual Ground-Water Monitoring Report
Atlantic Richfield Company Station #6113
785 East Stanley Boulevard
Livermore, CA
ACEH Case No. RO0000393

"I declare, that to the best of my knowledge at the present time, that the information and/or recommendations contained in the attached document are true and correct."

Submitted by:

Paul Supple
Environmental Business Manager

**Fourth Quarter, 2007 Semi-Annual Ground-Water Monitoring
Report**

Atlantic Richfield Company Station #6113
785 East Stanley Boulevard
Livermore, California

Prepared for

Mr. Paul Supple
Environmental Business Manager
Atlantic Richfield Company
P.O. Box 1257
San Ramon, California 94583

Prepared by



1324 Mangrove Avenue, Suite 212
Chico, California 95926
(530) 566-1400
www.broadbentinc.com

January 2008

Project No. 06-02-637

Broadbent & Associates, Inc.
1324 Mangrove Ave., Suite 212
Chico, CA 95926
Voice (530) 566-1400
Fax (530) 566-1401



January 30, 2008

Project No. 06-02-637

Atlantic Richfield Company
P.O. Box 1257
San Ramon, CA 94583
Submitted via ENFOS

Attn.: Mr. Paul Supple

Re: Fourth Quarter, 2007 Semi-Annual Ground-Water Monitoring Report, Atlantic Richfield Company (a BP affiliated company) Station #6113, 785 East Stanley Boulevard, Livermore, CA. ACEH Case No. RO0000393.

Dear Mr. Supple:

Attached is the *Fourth Quarter, 2007 Semi-Annual Ground-Water Monitoring Report* for Atlantic Richfield Company Station #6113 (herein referred to as Station #6113) located at 785 East Stanley Boulevard, Livermore, CA (Property). This report presents a summary of Fourth Quarter, 2007 ground-water monitoring results.

Should you have questions regarding the work performed or results obtained, please do not hesitate to contact us at (530) 566-1400.

Sincerely,

BROADBENT & ASSOCIATES, INC.

A handwritten signature in black ink, appearing to read 'M. G. Herrick'.

Matthew G. Herrick, P.G.
Project Hydrogeologist

A handwritten signature in black ink, appearing to read 'Robert H. Miller'.

Robert H. Miller, P.G., C.H.G.
Principal Hydrogeologist

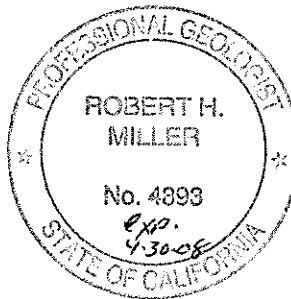

Enclosures

cc: Mr. Steven Plunkett, Alameda County Environmental Health (submitted via ACEH ftp site)
Mr. Paul M. Smith/Ms. Danielle Stefani, Livermore-Pleasanton Fire Department (submitted via GeoTracker)
GeoTracker

STATION # 6113 SEMI-ANNUAL GROUND-WATER MONITORING REPORT

Facility: 6113	Address:	785 East Stanley Boulevard, Livermore, CA
Station 6113 Environmental Business Manager:		Mr. Paul Supple
Consulting Co./Contact Persons:		Broadbent & Associates, Inc. (BAI) / Rob Miller & Matt Herrick
Primary Agency/Regulatory ID No.:		Alameda County Environmental Health (ACEH) / ACEH Case No. RO0000393
Consultant Project No.:		06-02-637
Facility Permits/Permitting Agency.:		NA

WORK PERFORMED THIS QUARTER (Fourth Quarter, 2007):

1. Submit Third Quarter, 2007 Status Report. Report completed by BAI.
2. Conducted ground-water monitoring/sampling for Fourth Quarter, 2007. Work performed by Stratus Environmental, Inc.

WORK PROPOSED FOR NEXT QUARTER (First Quarter, 2008):

1. Submit Fourth Quarter, 2007 Report (contained herein).
2. No ground-water monitoring/sampling activities are scheduled to be completed on the Property during the First Quarter, 2008.

QUARTERLY RESULTS SUMMARY:

Current phase of project:	Groundwater monitoring/sampling
Frequency of ground-water sampling:	Wells MW-4, MW-6, MW-7, MW-11 through MW-13, VW-1: Semi Annually (2Q and 4Q) Wells MW-3, MW-9, and MW-10: Annually (4Q)
Frequency of ground-water monitoring:	Semi-Annually (2Q and 4Q)
Is free product (FP) present on-site:	No
FP recovered this quarter:	NA
Bulk Soil Removed to Date:	288 cubic yards TPH impacted soil
Current remediation techniques:	Air Diffusion
Depth to ground water (below TOC):	24.22 (VW-4) to 38.99 (MW-10)
General ground-water flow direction:	Northeast
Approximate hydraulic gradient:	0.031 feet per foot

DISCUSSION:

Gasoline range organics were detected in three wells sampled during Fourth Quarter, 2007 at concentrations ranging from 140 micrograms per liter ($\mu\text{g/L}$) in well MW-7 to 12,000 $\mu\text{g/L}$ in well VW-1. Benzene was detected in four wells ranging from 0.83 $\mu\text{g/L}$ (MW-9) to 2,300 $\mu\text{g/L}$ (VW-1). Toluene was detected in wells MW-7 and VW-1 at concentrations of 6.8 $\mu\text{g/L}$ and 1,900 $\mu\text{g/L}$, respectively. Ethylbenzene was detected in two wells at 50 $\mu\text{g/L}$ (MW-6) and 860 $\mu\text{g/L}$ (VW-1). Xylenes were detected in three wells ranging from 5 $\mu\text{g/L}$ (MW-7) to 2,800 $\mu\text{g/L}$ (VW-1). Methyl tert-butyl ether was detected in wells MW-6, MW-7, MW-11, and VW-1 with concentrations ranging from 6.6 $\mu\text{g/L}$ (MW-11) to 2,600 $\mu\text{g/L}$ (MW-6). No other analytes were detected in samples collected during the Fourth Quarter, 2007.

Ground-water samples were not collected from wells MW-3, MW-4, MW-12, and MW-13 during Fourth Quarter, 2007 as there was either insufficient water in the wells or the wells were dry.

Additionally, depth to ground water was not monitored in VW-4 because the well was dry. The elevated pH measurements collected from MW-6 over the last three sampling events are believed to be erroneous. We have directed Stratus Environmental, Inc. to double check the pH measurement collected from MW-6 during the next sampling event.

Drawing 1 depicts a ground-water elevation contour and an analytical summary map for the Fourth Quarter, 2007. Table 1 includes a summary of ground-water monitoring data including relative water elevations and laboratory analyses. Table 2 provides a summary of fuel additives analytical data. Table 3 lists historical ground-water flow direction and gradient data.

Analytes detected during Fourth Quarter, 2007 were all within the historic minimum and maximum concentration ranges recorded for each well, with the following exceptions: GRO, benzene, toluene, and xylenes in MW-7 and GRO, benzene, toluene, ethylbenzene, and xylenes in VW-1 are the highest concentrations historically detected in each well (data collected since March 1995). Ground-water elevations measured during the Fourth Quarter, 2007 were at historic minimum elevations in wells MW-1, MW-3, MW-6, MW-7, MW-8, MW-9, MW-10, MW-11, MW-12, MW-13, VW-1, VW-2, and VW-4 (data collected since March 1995).

The elevated constituent concentrations in wells MW-7 and VW-1 and the historic low ground-water elevations were unexpected. Since the last ground-water monitoring event (Second Quarter, 2007), ground-water elevations decreased by approximately 15 feet across the Property from 435 feet above mean sea level (MSL) to 420 feet above MSL. Ground-water elevations have typically fluctuated in the two to four foot range between semi-annual monitoring events. The ground-water flow direction is consistent with prior directions (to the Northeast); however, the gradient magnitude is about twice as steep as what has been observed over the last couple years. Well MW-8 is screened in a lower water bearing formation relative to other wells on the Property. Ground-water elevations in neighboring well MW-1, completed in the shallow water bearing formation, are typically about 1.5 feet higher than ground-water elevations in MW-8 which indicates a downward vertical gradient. This downward vertical gradient steepened during Fourth Quarter, 2007 with the ground-water elevation in MW-1 2.34 feet higher than MW-8.

As stated above, the constituent concentrations and ground-water levels observed during Fourth Quarter, 2007 have been compared to historic data included in the attached tables which dates back to March 1995. Files provided to Broadbent & Associates, Inc. by the prior consultant were examined and ground-water elevation contour and analytical summary maps were found that cover the time period 1992 through 1994. Ground-water elevations in November of 1992 were at approximately 392 feet above MSL, 28 feet lower than levels observed during Fourth Quarter, 2007. Over the next three months, November 1992 to February 1993, ground-water levels increased by approximately 40 feet to 432 feet above mean sea level. Significant fluctuations in analyte concentrations were also observed during this time period in various wells on the Property.

At this point in time, the elevated concentrations observed in wells MW-7 and VW-1 are believed to be a result of the rapid drop in ground-water levels. Data collected in future ground-water monitoring/sampling events should provide additional insight on the relation of change in constituent concentrations relative to change in ground-water elevations. Additional discussions will be included in future reports regarding this topic.

Station #6113 is in the process of being divested. Once the sale is complete, the new property owner plans to raze and rebuild the station building. It is our understanding that the new station building will be constructed along the southern boundary of the Property. The new station building will require abandonment of wells MW-1 and MW-8 prior to commencement of construction. Once we are provided

a schedule for construction by the new property owner, we will work with the ACEH on well abandonment.

CLOSURE:

The findings presented in this report are based upon: observations of Stratus Environmental, Inc. and/or their subcontractors' field personnel (see Appendix A), the points investigated, and results of laboratory tests performed by TestAmerica (Morgan Hill, CA). Our services were performed in accordance with the generally accepted standard of practice at the time this report was written. No other warranty, expressed or implied was made. This report has been prepared for the exclusive use of Atlantic Richfield Company. It is possible that variations in soil or ground-water conditions could exist beyond points explored in this investigation. Also, changes in site conditions could occur in the future due to variations in rainfall, temperature, regional water usage, or other factors.

ATTACHMENTS:

- Drawing 1. Ground-Water Elevation Contour and Analytical Summary Map, Station #6113, Livermore, CA
- Table 1. Summary of Ground-Water Monitoring Data: Relative Water Elevations and Laboratory Analyses, Station #6113, Livermore CA
- Table 2. Summary of Fuel Additives Analytical Data, Station #6113, Livermore, CA
- Table 3. Historical Ground-Water Flow Direction and Gradient, Station #6113, Livermore, CA
- Appendix A. Stratus Environmental, Inc. Groundwater Sampling Data Package (Field Data Sheets, Non-Hazardous Waste Data Form, Chain of Custody Documentation, Certified Analytical Results).
- Appendix B. GeoTracker Upload Confirmation.

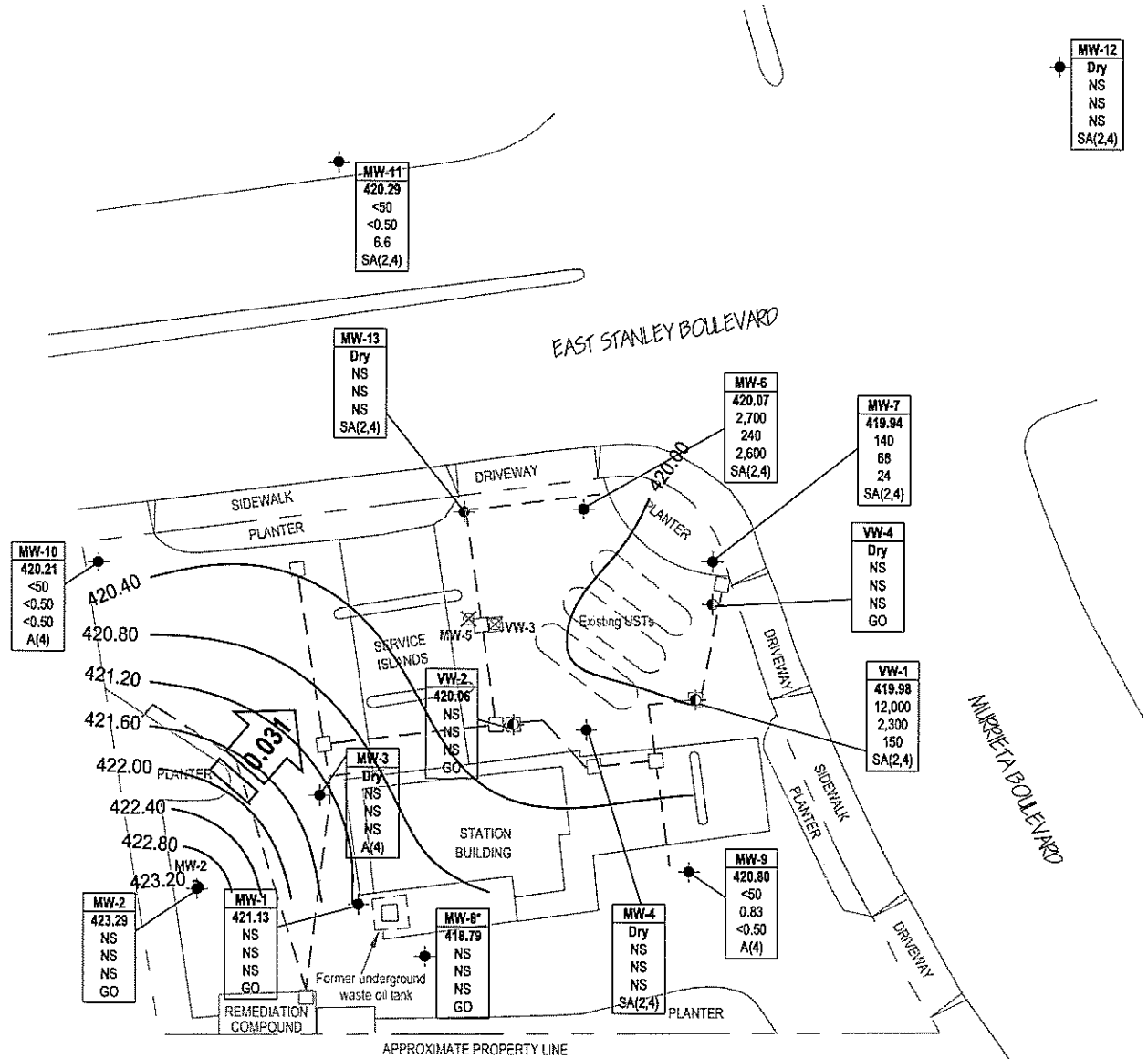

MW-12
Dry
NS
NS
NS
NS
SA(2,4)

MW-11
420.29
<50
<0.50
6.6
SA(2,4)

MW-13
Dry
NS
NS
NS
SA(2,4)

MW-6
420.07
2,700
240
2,600
SA(2,4)

MW-7
419.94
140
68
24
SA(2,4)

VW-4
Dry
NS
NS
NS
NS
GO

VW-1
419.98
12,000
2,300
150
SA(2,4)

MW-10
420.21
<50
<0.50
<0.50
A(4)

MW-5
420.06
NS
NS
NS
NS
GO

MW-3
Dry
NS
NS
NS
NS
A(4)

MW-9
420.80
<50
0.83
<0.50
A(4)

MW-2
423.29
NS
NS
NS
NS
GO

MW-1
421.13
NS
NS
NS
NS
GO

MW-6*
418.79
NS
NS
NS
NS
GO

MW-4
Dry
NS
NS
NS
NS
SA(2,4)

LEGEND

- Monitoring well
- ⊕ Vapor extraction well
- ⊗ Abandoned well
- 422.00 Ground-water elevation contour (ft/MSL)

Well	Well Designation
ELEV	Ground-water Elevation
GRO	GRO, Benzene and MTBE concentration (µg/L)
Benzene	
MTBE	
MTBE	
NSA	Sampling frequency
A(4)	Sampled annually, 4th quarter
SA(2,4)	Semi-annual sampling, 2nd and 4th quarters
GO	Gauge only
NS	Not Sampled
.	Not used in contouring due to screen interval

← 0.031 Approximate ground-water flow direction and gradient (ft/ft)

- Vault box
- - - Piping trench

NOTE: SITE MAP ADAPTED FROM CAMBRIA ENVIRONMENTAL FIGURES. SITE DIMENSIONS AND FACILITY LOCATIONS NOT VERIFIED.

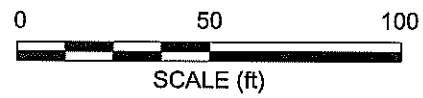
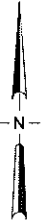

BROADBENT & ASSOCIATES, INC.
ENGINEERING, WATER RESOURCES & ENVIRONMENTAL
1324 Mangrove Ave, Suite 212, Chico, California 95926
Project No.: 06-02-637 Date: 1/15/2008

Station #6113
785 East Stanley Boulevard
Livermore, California

Ground-Water Elevation Contour
and Analytical Summary Map
October 16, 2007

Drawing
1

Table 1. Summary of Ground-Water Monitoring Data: Relative Water Elevations and Laboratory Analyses

Station #6113, 785 East Stanley Blvd., Livermore, CA

Well and Sample Date	P/NP	Comments	TOC (feet msl)	Top of Screen (ft bgs)	Bottom of Screen (ft bgs)	DTW (feet bgs)	Water Level Elevation (feet msl)	Concentrations in (µg/L)						DO (mg/L)	pH
								GRO/TPHg	Benzene	Toluene	Ethyl-Benzene	Total Xylenes	MTBE		
MW-1															
3/23/1995	--	e	457.04	29.0	44.0	14.12	442.92	--	--	--	--	--	--	--	--
5/31/1995	--	e	457.04	29.0	44.0	14.45	442.59	--	--	--	--	--	--	--	--
8/31/1995	--	e	457.04	29.0	44.0	17.12	439.92	--	--	--	--	--	--	--	--
11/28/1995	--		457.04	29.0	44.0	16.34	440.70	<50	<0.5	<0.5	<0.5	<0.5	<3	--	--
2/22/1996	--	e	457.04	29.0	44.0	13.23	443.81	--	--	--	--	--	--	--	--
5/23/1996	--	e	457.04	29.0	44.0	14.02	443.02	--	--	--	--	--	--	--	--
8/8/1996	--	e	457.04	29.0	44.0	16.13	440.91	--	--	--	--	--	--	--	--
11/7/1996	--		457.04	29.0	44.0	17.28	439.76	<50	<0.5	<0.5	<0.5	<0.5	<3	--	--
3/27/1997	--	e	457.04	29.0	44.0	14.91	442.13	--	--	--	--	--	--	--	--
5/19/1997	--	e	457.04	29.0	44.0	16.47	440.57	--	--	--	--	--	--	--	--
5/18/1998	--	e	457.04	29.0	44.0	14.69	442.35	--	--	--	--	--	--	--	--
11/2/1998	--		457.04	29.0	44.0	25.94	431.10	<50	<0.5	<0.5	<0.5	<0.5	<3	--	--
6/4/1999	--	e	457.04	29.0	44.0	17.38	439.66	--	--	--	--	--	--	--	--
11/11/1999	P		457.04	29.0	44.0	18.63	438.41	<50	<0.5	<0.5	<0.5	<1	<3	1.03	--
6/20/2000	--	e	457.04	29.0	44.0	17.09	439.95	--	--	--	--	--	--	3.1	--
8/29/2000	--	e	457.04	29.0	44.0	18.20	438.84	--	--	--	--	--	--	2.66	--
11/29/2000	P		457.04	29.0	44.0	20.30	436.74	<50.0	<0.500	<0.500	<0.500	1.36	<2.50	0.71	--
5/2/2001	--	e	457.04	29.0	44.0	22.39	434.65	--	--	--	--	--	--	--	--
8/15/2001	--	e	457.04	29.0	44.0	24.97	432.07	--	--	--	--	--	--	--	--
10/5/2001	P		457.04	29.0	44.0	25.09	431.95	<50	<0.50	<0.50	<0.50	<0.50	<2.5	0.78	--
1/21/2002	--	e	457.04	29.0	44.0	24.58	432.46	--	--	--	--	--	--	--	--
4/26/2002	--	e	457.04	29.0	44.0	24.19	432.85	--	--	--	--	--	--	--	--
10/7/2002	--		457.04	29.0	44.0	20.13	436.91	<50	<0.50	<0.50	<0.50	<0.50	<0.50	1.8	--
05/01/2003	--	r	457.04	29.0	44.0	17.98	439.06	--	--	--	--	--	--	--	--
10/27/2005	--		459.41	29.0	44.0	18.45	440.96	--	--	--	--	--	--	--	--
04/12/2006	--		459.41	29.0	44.0	15.18	444.23	--	--	--	--	--	--	--	--
10/31/2006	--		459.41	29.0	44.0	19.18	440.23	--	--	--	--	--	--	--	--
4/19/2007	--		459.41	29.0	44.0	23.20	436.21	--	--	--	--	--	--	--	--

Table 1. Summary of Ground-Water Monitoring Data: Relative Water Elevations and Laboratory Analyses

Station #6113, 785 East Stanley Blvd., Livermore, CA

Well and Sample Date	P/NP	Comments	TOC (feet msl)	Top of Screen (ft bgs)	Bottom of Screen (ft bgs)	DTW (feet bgs)	Water Level Elevation (feet msl)	Concentrations in (µg/L)						DO (mg/L)	pH
								GRO/TPHg	Benzene	Toluene	Ethyl-Benzene	Total Xylenes	MTBE		
MW-1 Cont.															
10/16/2007	--		459.41	29.0	44.0	38.28	421.13	--	--	--	--	--	--	--	--
MW-2															
3/23/1995	--		457.74	28.0	38.0	14.15	443.59	--	--	--	--	--	--	--	--
5/31/1995	--	e	457.74	28.0	38.0	14.67	443.07	--	--	--	--	--	--	--	--
8/31/1995	--	e	457.74	28.0	38.0	17.24	440.50	--	--	--	--	--	--	--	--
11/28/1995	--		457.74	28.0	38.0	16.40	441.34	<50	<0.5	<0.5	<0.5	<0.5	<3	--	--
2/22/1996	--	e	457.74	28.0	38.0	13.55	444.19	--	--	--	--	--	--	--	--
5/23/1996	--	e	457.74	28.0	38.0	14.29	443.45	--	--	--	--	--	--	--	--
8/8/1996	--	e	457.74	28.0	38.0	16.19	441.55	--	--	--	--	--	--	--	--
11/7/1996	--		457.74	28.0	38.0	17.50	440.24	65	0.6	7.4	2.1	12	5	--	--
3/27/1997	--	e	457.74	28.0	38.0	15.32	442.42	--	--	--	--	--	--	--	--
5/19/1997	--	e	457.74	28.0	38.0	16.62	441.12	--	--	--	--	--	--	--	--
5/18/1998	--	e	457.74	28.0	38.0	15.12	442.62	--	--	--	--	--	--	--	--
11/2/1998	--		457.74	28.0	38.0	26.66	431.08	<50	<0.5	<0.5	<0.5	<0.5	<3	--	--
6/4/1999	--	e	457.74	28.0	38.0	17.74	440.00	--	--	--	--	--	--	--	--
11/11/1999	P		457.74	28.0	38.0	18.75	438.99	<50	<0.5	<0.5	<0.5	<1	<3	0.82	--
6/20/2000	--	e	457.74	28.0	38.0	17.21	440.53	--	--	--	--	--	--	2.6	--
8/29/2000	--	e	457.74	28.0	38.0	18.25	439.49	--	--	--	--	--	--	2.65	--
11/29/2000	P		457.74	28.0	38.0	20.69	437.05	<50.0	<0.500	0.581	0.827	4.38	<2.50	0.88	--
5/2/2001	--	e	457.74	28.0	38.0	22.69	435.05	--	--	--	--	--	--	--	--
8/15/2001	--	e	457.74	28.0	38.0	25.15	432.59	--	--	--	--	--	--	--	--
10/5/2001	P		457.74	28.0	38.0	25.22	432.52	<50	<0.50	<0.50	<0.50	<0.50	<2.5	0.8	--
1/21/2002	--	e	457.74	28.0	38.0	24.70	433.04	--	--	--	--	--	--	--	--
4/26/2002	--	e	457.74	28.0	38.0	24.53	433.21	--	--	--	--	--	--	--	--
10/7/2002	--		457.74	28.0	38.0	19.45	438.29	<50	<0.50	<0.50	<0.50	<0.50	<0.50	1.5	--
05/01/2003	--	r	457.74	28.0	38.0	18.18	439.56	--	--	--	--	--	--	--	--
10/27/2005	--	t	460.07	28.0	38.0	--	--	--	--	--	--	--	--	--	--

Table 1. Summary of Ground-Water Monitoring Data: Relative Water Elevations and Laboratory Analyses

Station #6113, 785 East Stanley Blvd., Livermore, CA

Well and Sample Date	P/NP	Comments	TOC (feet msl)	Top of Screen (ft bgs)	Bottom of Screen (ft bgs)	DTW (feet bgs)	Water Level Elevation (feet msl)	Concentrations in (µg/L)						DO (mg/L)	pH
								GRO/TPHg	Benzene	Toluene	Ethyl-Benzene	Total Xylenes	MTBE		
MW-2 Cont.															
04/12/2006	--		460.07	28.0	38.0	15.30	444.77	--	--	--	--	--	--	--	--
10/31/2006	--		460.07	28.0	38.0	38.62	421.45	--	--	--	--	--	--	--	--
4/19/2007	--		460.07	28.0	38.0	23.85	436.22	--	--	--	--	--	--	--	--
10/16/2007	--		460.07	28.0	38.0	36.78	423.29	--	--	--	--	--	--	--	--
MW-3															
3/23/1995	--	e	456.97	28.5	38.5	14.13	442.84	--	--	--	--	--	--	--	--
5/31/1995	--	e	456.97	28.5	38.5	14.46	442.51	--	--	--	--	--	--	--	--
8/31/1995	--	e	456.97	28.5	38.5	17.06	439.91	--	--	--	--	--	--	--	--
11/28/1995	--		456.97	28.5	38.5	16.27	440.70	<50	<0.5	<0.5	<0.5	<0.5	<3	--	--
2/22/1996	--	e	456.97	28.5	38.5	13.14	443.83	--	--	--	--	--	--	--	--
5/23/1996	--	e	456.97	28.5	38.5	13.95	443.02	--	--	--	--	--	--	--	--
8/8/1996	--	e	456.97	28.5	38.5	16.03	440.94	--	--	--	--	--	--	--	--
11/7/1996	--		456.97	28.5	38.5	17.26	439.71	<50	<0.5	0.9	<0.5	1.5	<3	--	--
3/27/1997	--	e	456.97	28.5	38.5	14.85	442.12	--	--	--	--	--	--	--	--
5/19/1997	--	e	456.97	28.5	38.5	16.40	440.57	--	--	--	--	--	--	--	--
5/18/1998	--	e	456.97	28.5	38.5	14.66	442.31	--	--	--	--	--	--	--	--
11/2/1998	--		456.97	28.5	38.5	25.85	431.12	<1,000	<10	<10	<10	<10	1,700	--	--
6/4/1999	--	e	456.97	28.5	38.5	17.35	439.62	--	--	--	--	--	--	--	--
11/11/1999	P		456.97	28.5	38.5	18.58	438.39	<50	<0.5	<0.5	<0.5	<1	<3	0.79	--
6/20/2000	--	e	456.97	28.5	38.5	17.03	439.94	--	--	--	--	--	--	2.8	--
8/29/2000	--	e	456.97	28.5	38.5	18.25	438.72	--	--	--	--	--	--	3.39	--
11/29/2000	--		456.97	28.5	38.5	20.27	436.70	<50.0	<0.500	<0.500	1.08	3.34	<2.50	0.67	--
5/2/2001	--	e	456.97	28.5	38.5	22.33	434.64	--	--	--	--	--	--	--	--
8/15/2001	--	e	456.97	28.5	38.5	25.03	431.94	--	--	--	--	--	--	--	--
10/5/2001	P		456.97	28.5	38.5	25.17	431.80	<50	<0.50	<0.50	<0.50	<0.50	<2.5	0.79	--
1/21/2002	--	e	456.97	28.5	38.5	24.79	432.18	--	--	--	--	--	--	--	--
4/26/2002	--	e	456.97	28.5	38.5	24.27	432.70	--	--	--	--	--	--	--	--

Table 1. Summary of Ground-Water Monitoring Data: Relative Water Elevations and Laboratory Analyses

Station #6113, 785 East Stanley Blvd., Livermore, CA

Well and Sample Date	P/NP	Comments	TOC (feet msl)	Top of Screen (ft bgs)	Bottom of Screen (ft bgs)	DTW (feet bgs)	Water Level Elevation (feet msl)	Concentrations in (µg/L)					DO (mg/L)	pH	
								GRO/TPHg	Benzene	Toluene	Ethyl-Benzene	Total Xylenes			MTBE
MW-3 Cont.															
10/7/2002	--		456.97	28.5	38.5	20.20	436.77	<50	<0.50	<0.50	<0.50	<0.50	<0.50	1.2	--
05/01/2003	--	c, e	456.97	28.5	38.5	18.27	438.70	--	--	--	--	--	--	--	--
10/03/2003	P	d	456.97	28.5	38.5	20.07	436.90	<50	<0.50	<0.50	<0.50	<0.50	<0.50	5.2	7.3
04/06/2004	--	e	459.32	28.5	38.5	17.24	442.08	--	--	--	--	--	--	--	--
10/28/2004	P		459.32	28.5	38.5	19.38	439.94	<50	<0.50	<0.50	<0.50	<0.50	<0.50	8.1	7.3
04/13/2005	--		459.32	28.5	38.5	16.02	443.30	--	--	--	--	--	--	--	--
10/27/2005	--	t	459.32	28.5	38.5	--	--	--	--	--	--	--	--	--	--
04/12/2006	--		459.32	28.5	38.5	15.12	444.20	--	--	--	--	--	--	--	--
10/31/2006	P		459.32	28.5	38.5	19.14	440.18	400	5.5	<0.50	5.5	9.6	22	--	7.64
4/19/2007	--		459.32	28.5	38.5	23.07	436.25	--	--	--	--	--	--	--	--
10/16/2007	--	f	459.32	28.5	38.5	--	--	--	--	--	--	--	--	--	--
MW-4															
3/23/1995	--		456.55	21.0	27.0	15.39	441.16	210	2.1	0.6	0.8	2.1	--	--	--
5/31/1995	--		456.55	21.0	27.0	15.32	441.23	190	1.6	<0.5	0.7	0.9	--	--	--
8/31/1995	--		456.55	21.0	27.0	17.86	438.69	160	1.2	0.7	<0.5	<2	<3	--	--
11/28/1995	--		456.55	21.0	27.0	17.18	439.37	150	0.7	<0.5	0.7	1.4	<3	--	--
2/22/1996	--		456.55	21.0	27.0	14.80	441.75	100	<0.5	<0.5	<0.6	0.8	<3	--	--
5/23/1996	--		456.55	21.0	27.0	14.43	442.12	86	<0.5	<0.5	<0.5	<0.7	<3	--	--
8/8/1996	--		456.55	21.0	27.0	16.80	439.75	98	<0.5	<0.5	<0.5	1.3	<3	--	--
11/7/1996	--		456.55	21.0	27.0	17.90	438.65	140	<0.5	<0.5	<0.9	1.3	<3	--	--
3/27/1997	--		456.55	21.0	27.0	15.22	441.33	<50	1.1	<0.5	<0.5	1.6	<3	--	--
5/19/1997	--		456.55	21.0	27.0	16.98	439.57	62	<0.5	<0.5	<0.5	0.6	<3	--	--
5/18/1998	--		456.55	21.0	27.0	14.99	441.56	<50	<0.5	<0.5	<0.5	<0.5	64	--	--
11/2/1998	--		456.55	21.0	27.0	25.29	431.26	74	<0.5	<0.5	<0.5	<0.5	96	--	--
6/4/1999	P		456.55	21.0	27.0	17.95	438.60	100	<0.5	<0.5	<0.5	<0.5	38	--	--
11/11/1999	P		456.55	21.0	27.0	19.25	437.30	88	<0.5	<0.5	<0.5	<1	10	0.77	--
6/20/2000	P		456.55	21.0	27.0	17.79	438.76	<50.0	<0.500	<0.500	<0.500	<0.500	82.4	1.3	--

Table 1. Summary of Ground-Water Monitoring Data: Relative Water Elevations and Laboratory Analyses

Station #6113, 785 East Stanley Blvd., Livermore, CA

Well and Sample Date	P/NP	Comments	TOC (feet msl)	Top of Screen (ft bgs)	Bottom of Screen (ft bgs)	DTW (feet bgs)	Water Level Elevation (feet msl)	Concentrations in (µg/L)					DO (mg/L)	pH	
								GRO/TPHg	Benzene	Toluene	Ethyl-Benzene	Total Xylenes			MTBE
MW-4 Cont.															
6/20/2000	--	q	456.55	21.0	27.0	--	--	<50.0	<0.500	<0.500	<0.500	<0.500	62.3	--	--
8/29/2000	P		456.55	21.0	27.0	18.90	437.65	56	<0.500	<0.500	<0.500	<0.500	47.9	0.97	--
11/29/2000	P	s	456.55	21.0	27.0	20.50	436.05	<50.0	<0.500	<0.500	<0.500	<0.500	9.88/10.4	0.59	--
5/2/2001	P	q, s	456.55	21.0	27.0	22.65	433.90	<50.0	<0.500	<0.500	<0.500	<0.500	61.1/70.9	0.74	--
5/2/2001	--	s	456.55	21.0	27.0	--	--	<50.0	<0.500	<0.500	<0.500	<0.500	59.4/68.4	--	--
8/15/2001	--	f	456.55	21.0	27.0	--	--	--	--	--	--	--	--	--	--
10/5/2001	--	f	456.55	21.0	27.0	--	--	--	--	--	--	--	--	--	--
1/21/2002	--	f	456.55	21.0	27.0	--	--	--	--	--	--	--	--	--	--
4/26/2002	P		456.55	21.0	27.0	20.15	436.40	110	<0.50	<0.50	<0.50	<0.50	150	0.21	--
10/7/2002	P	a	456.55	21.0	27.0	20.76	435.79	96	<0.50	<0.50	0.54	<0.50	260	1.0	--
05/01/2003	P	c	456.55	21.0	27.0	19.67	436.88	120	1.3	<0.50	<0.50	<0.50	86	1.7	--
10/03/2003	P	d	456.55	21.0	27.0	20.23	436.32	<50	<0.50	<0.50	<0.50	<0.50	22	13.5	6.8
04/06/2004	P		458.88	21.0	27.0	18.13	440.75	96	<0.50	<0.50	<0.50	<0.50	17	1.6	6.8
10/28/2004	P		458.88	21.0	27.0	20.02	438.86	<50	<0.50	<0.50	<0.50	<0.50	4.5	1.2	6.7
04/13/2005	P		458.88	21.0	27.0	16.68	442.20	<50	<0.50	<0.50	<0.50	<0.50	2.8	0.8	6.7
10/27/2005	P		458.88	21.0	27.0	19.05	439.83	400	14	<0.50	11	1.8	22	1.0	6.9
04/12/2006	P		458.88	21.0	27.0	15.47	443.41	100	<0.50	<0.50	<0.50	<0.50	1.9	1.6	7.2
10/31/2006	P		458.88	21.0	27.0	19.67	439.21	<50	<0.50	<0.50	<0.50	<0.50	<0.50	--	7.63
4/19/2007	NP		458.88	21.0	27.0	22.72	436.16	<50	<0.50	<0.50	<0.50	<0.50	<0.50	2.92	7.36
10/16/2007	--	f	458.88	21.0	27.0	--	--	--	--	--	--	--	--	--	--
MW-5															
3/23/1995	--		455.84	43.0	63.0	13.97	441.87	68	4.2	3.4	2.3	12	--	--	--
5/31/1995	--	g	455.84	43.0	63.0	--	--	--	--	--	--	--	--	--	--
8/31/1995	--	g	455.84	43.0	63.0	--	--	--	--	--	--	--	--	--	--
11/28/1995	--		455.84	43.0	63.0	16.46	439.38	960	41	24	38	210	<5	--	--
2/22/1996	--	f	455.84	43.0	63.0	13.34	442.50	--	--	--	--	--	--	--	--
5/23/1996	--		455.84	43.0	63.0	14.36	441.48	7,100	440	180	270	1,700	<50	--	--

Table 1. Summary of Ground-Water Monitoring Data: Relative Water Elevations and Laboratory Analyses

Station #6113, 785 East Stanley Blvd., Livermore, CA

Well and Sample Date	P/NP	Comments	TOC (feet msl)	Top of Screen (ft bgs)	Bottom of Screen (ft bgs)	DTW (feet bgs)	Water Level Elevation (feet msl)	Concentrations in (µg/L)						DO (mg/L)	pH
								GRO/TPHg	Benzene	Toluene	Ethyl-Benzene	Total Xylenes	MTBE		
MW-5 Cont.															
8/8/1996	--	f	455.84	43.0	63.0	16.38	439.46	--	--	--	--	--	--	--	--
11/7/1996	--		455.84	43.0	63.0	17.26	438.58	5,600	230	86	210	1,100	<80	--	--
3/27/1997	--	f	455.84	43.0	63.0	15.95	439.89	--	--	--	--	--	--	--	--
5/19/1997	--		455.84	43.0	63.0	16.64	439.20	7,600	480	140	400	1,200	<40	--	--
5/18/1998	--		455.84	43.0	63.0	14.75	441.09	990	46	13	45	180	4	--	--
11/2/1998	--		455.84	43.0	63.0	27.83	428.01	14,000	690	140	550	2,200	100	--	--
6/4/1999	P		455.84	43.0	63.0	17.47	438.37	8,300	690	370	90	440	1,400	--	--
11/11/1999	P		455.84	43.0	63.0	18.80	437.04	18,000	900	190	1,100	3,200	72	0.86	--
6/20/2000	P		455.84	43.0	63.0	17.14	438.70	10,200	618	122	832	2,020	<50.0	1.6	--
8/29/2000	P		455.84	43.0	63.0	18.60	437.24	12,300	436	166	711	2,120	517	0.79	--
11/29/2000	P	s	455.84	43.0	63.0	20.57	435.27	26,000	491	149	1,090	3,810	671/<20.0	0.51	--
5/2/2001	--	k	--	--	--	--	--	--	--	--	--	--	--	--	--
MW-6															
3/23/1995	--		454.93	48.0	68.0	13.38	441.55	<50	1.5	<0.5	<0.5	0.9	--	--	--
5/31/1995	--		454.93	48.0	68.0	13.96	440.97	<50	<0.5	<0.5	<0.5	<0.5	--	--	--
8/31/1995	--		454.93	48.0	68.0	16.71	438.22	150	9	1.8	4	12	<3	--	--
11/28/1995	--		454.93	48.0	68.0	15.65	439.28	<50	0.6	<0.5	<0.5	0.8	<3	--	--
2/22/1996	--		454.93	48.0	68.0	12.53	442.40	<50	1.9	<0.5	0.8	2.1	<3	--	--
5/23/1996	--		454.93	48.0	68.0	13.24	441.69	<50	<0.5	<0.5	<0.5	<0.5	<3	--	--
8/8/1996	--		454.93	48.0	68.0	16.65	438.28	<50	0.5	<0.5	<0.5	0.5	<3	--	--
11/7/1996	--		454.93	48.0	68.0	16.65	438.28	110	5.3	1.3	3.1	6.6	<3	--	--
3/27/1997	--		454.93	48.0	68.0	14.25	440.68	<50	2.3	<0.5	0.9	3.5	4	--	--
5/19/1997	--		454.93	48.0	68.0	15.87	439.06	<50	<0.5	<0.5	<0.5	<0.5	<3	--	--
5/18/1998	--		454.93	48.0	68.0	14.00	440.93	<50	<0.5	<0.5	<0.5	<0.5	<3	--	--
11/2/1998	--		454.93	48.0	68.0	24.95	429.98	<50	1.2	<0.5	<0.5	<0.5	3	--	--
6/4/1999	P		454.93	48.0	68.0	16.68	438.25	310	41	3.8	11	19	33	--	--
11/11/1999	P		454.93	48.0	68.0	16.12	438.81	<50	0.5	<0.5	<0.5	<1	<3	0.92	--

Table 1. Summary of Ground-Water Monitoring Data: Relative Water Elevations and Laboratory Analyses

Station #6113, 785 East Stanley Blvd., Livermore, CA

Well and Sample Date	P/NP	Comments	TOC (feet msl)	Top of Screen (ft bgs)	Bottom of Screen (ft bgs)	DTW (feet bgs)	Water Level Elevation (feet msl)	Concentrations in (µg/L)					DO (mg/L)	pH	
								GRO/TPHg	Benzene	Toluene	Ethyl-Benzene	Total Xylenes			MTBE
MW-6 Cont.															
6/20/2000	P		454.93	48.0	68.0	16.63	438.30	<50.0	<0.500	<0.500	<0.500	<0.500	17.3	1.9	--
8/29/2000	--	q	454.93	48.0	68.0	--	--	<50.0	<0.500	<0.500	<0.500	<0.500	<2.50	--	--
8/29/2000	P		454.93	48.0	68.0	17.91	437.02	<50.0	<0.500	0.551	<0.500	<0.500	<2.50	1.67	--
11/29/2000	P		454.93	48.0	68.0	20.30	434.63	<50.0	<0.500	<0.500	<0.500	1.03	<2.50	0.79	--
5/2/2001	P	s	454.93	48.0	68.0	22.20	432.73	3,230	1,300	33.6	89.4	136	1,810/2,310	0.95	--
8/15/2001	P	s	454.93	48.0	68.0	27.95	426.98	<50	<0.50	<0.50	<0.50	<0.50	21/25	0.63	--
10/5/2001	P		454.93	48.0	68.0	28.05	426.88	<50	<0.50	<0.50	<0.50	<0.50	<2.5	0.85	--
1/21/2002	P		454.93	48.0	68.0	26.81	428.12	<50	<0.50	<0.50	<0.50	<0.50	<5.0	0.91	--
4/26/2002	P		454.93	48.0	68.0	26.27	428.66	<50	<0.50	<0.50	<0.50	<0.50	17	0.75	--
10/7/2002	P	a	454.93	48.0	68.0	20.05	434.88	60	13	1.7	1.7	3.5	8	2.8	--
05/01/2003	P	c	454.93	48.0	68.0	17.62	437.31	<50	5.4	<0.50	0.63	1.3	12	1.6	--
10/03/2003	P	d	454.93	48.0	68.0	19.62	435.31	80	2.6	<2.5	<2.5	<2.5	120	5.1	6.9
04/06/2004	P		457.24	48.0	68.0	16.88	440.36	<2,500	<25	<25	<25	<25	1,700	4.1	7.0
10/28/2004	P		457.24	48.0	68.0	19.20	438.04	3,200	<25	<25	<25	<25	3,100	6.8	6.9
04/13/2005	P		457.24	48.0	68.0	15.15	442.09	<5,000	<50	<50	<50	<50	3,900	3.9	7.0
10/27/2005	P		457.24	48.0	68.0	18.12	439.12	<5,000	<50	<50	<50	<50	2,900	3.15	7.0
04/12/2006	P		457.24	48.0	68.0	15.32	441.92	<5,000	<50	<50	<50	<50	3,400	4.3	7.6
10/31/2006	P	u, v	457.24	48.0	68.0	18.85	438.39	2,700	<25	<25	<25	<25	3,400	--	10.36
4/19/2007	P	v	457.24	48.0	68.0	22.25	434.99	970	<25	<25	<25	<25	2,200	5.54	10.52
10/16/2007	P	v, w (MTBE)	457.24	48.0	68.0	37.17	420.07	2,700	240	<25	50	55	2,600	4.56	10.26
MW-7															
3/23/1995	--		454.92	48.0	68.0	13.29	441.63	<50	<0.5	<0.5	<0.5	<0.5	--	--	--
5/31/1995	--		454.92	48.0	68.0	13.72	441.20	<50	<0.5	<0.5	<0.5	<0.5	--	--	--
8/31/1995	--		454.92	48.0	68.0	16.53	438.39	<50	<0.5	<0.5	<0.5	1.2	<3	--	--
11/28/1995	--		454.92	48.0	68.0	15.50	439.42	<50	<0.5	<0.5	<0.5	<0.5	<3	--	--
2/22/1996	--		454.92	48.0	68.0	12.30	442.62	<50	<0.5	<0.5	<0.5	<0.5	<3	--	--
5/23/1996	--		454.92	48.0	68.0	13.02	441.90	<50	<0.5	<0.5	<0.5	<0.5	<3	--	--

Table 1. Summary of Ground-Water Monitoring Data: Relative Water Elevations and Laboratory Analyses

Station #6113, 785 East Stanley Blvd., Livermore, CA

Well and Sample Date	P/NP	Comments	TOC (feet msl)	Top of Screen (ft bgs)	Bottom of Screen (ft bgs)	DTW (feet bgs)	Water Level Elevation (feet msl)	Concentrations in (µg/L)						DO (mg/L)	pH
								GRO/TPHg	Benzene	Toluene	Ethyl-Benzene	Total Xylenes	MTBE		
MW-7 Cont.															
8/8/1996	--	m	454.92	48.0	68.0	--	--	--	--	--	--	--	--	--	--
11/7/1996	--		454.92	48.0	68.0	16.50	438.42	<50	<0.5	<0.5	<0.5	0.8	<3	--	--
3/27/1997	--		454.92	48.0	68.0	14.22	440.70	<50	<0.5	<0.5	<0.5	<0.5	<3	--	--
5/19/1997	--		454.92	48.0	68.0	15.74	439.18	<50	<0.5	<0.5	<0.5	<0.5	<3	--	--
5/18/1998	--		454.92	48.0	68.0	13.82	441.10	<50	<0.5	<0.5	<0.5	<0.5	<3	--	--
11/2/1998	--		454.92	48.0	68.0	24.80	430.12	<50	<0.5	<0.5	<0.5	<0.5	4	--	--
6/4/1999	P		454.92	48.0	68.0	16.55	438.37	<50	<0.5	<0.5	<0.5	<0.5	<3	--	--
11/11/1999	P		454.92	48.0	68.0	18.02	436.90	<50	<0.5	<0.5	<0.5	<1	<3	1.03	--
6/20/2000	P		454.92	48.0	68.0	16.50	438.42	<50.0	<0.500	<0.500	<0.500	<0.500	<2.50	1.3	--
8/29/2000	P		454.92	48.0	68.0	17.80	437.12	<50.0	<0.500	<0.500	<0.500	<0.500	<2.50	1.67	--
11/29/2000	P		454.92	48.0	68.0	19.61	435.31	<50.0	<0.500	<0.500	<0.500	<0.500	<2.50	0.51	--
5/2/2001	P	s	454.92	48.0	68.0	22.05	432.87	<50.0	<0.500	<0.500	<0.500	<0.500	<2.50/2.66	0.9	--
8/15/2001	P		454.92	48.0	68.0	27.55	427.37	<50	<0.50	<0.50	<0.50	<0.50	<2.5	0.84	--
10/5/2001	P		454.92	48.0	68.0	27.59	427.33	<50	<0.50	<0.50	<0.50	<0.50	<2.5	0.62	--
1/21/2002	P	s	454.92	48.0	68.0	26.50	428.42	<50	<0.50	<0.50	<0.50	<0.50	15/21	0.65	--
4/26/2002	P		454.92	48.0	68.0	26.22	428.70	<50	<0.50	<0.50	<0.50	<0.50	18	0.61	--
10/7/2002	--		454.92	48.0	68.0	20.04	434.88	<50	1.2	<0.50	<0.50	0.77	41	4.8	--
05/01/2003	P	c	454.92	48.0	68.0	17.47	437.45	<50	<0.50	<0.50	<0.50	0.5	43	2.7	--
10/03/2003	P	d	454.92	48.0	68.0	19.55	435.37	<50	<1.0	<1.0	<1.0	<1.0	49	5.7	7.1
04/06/2004	P		457.17	48.0	68.0	16.60	440.57	<50	<0.50	<0.50	<0.50	0.75	0.76	0.7	7.0
10/28/2004	P		457.17	48.0	68.0	19.17	438.00	<50	<0.50	<0.50	<0.50	<0.50	14	6.7	6.9
04/13/2005	P		457.17	48.0	68.0	14.84	442.33	<50	<0.50	<0.50	<0.50	<0.50	1.7	2.3	6.9
10/27/2005	P		457.17	48.0	68.0	17.38	439.79	<50	<0.50	<0.50	<0.50	<0.50	2.3	2.16	7.0
04/12/2006	P		457.17	48.0	68.0	14.84	442.33	<50	<0.50	<0.50	<0.50	<0.50	1.1	3.0	7.2
10/31/2006	P		457.17	48.0	68.0	18.74	438.43	<50	<0.50	<0.50	<0.50	<0.50	<0.50	--	7.55
4/19/2007	P		457.17	48.0	68.0	22.11	435.06	<50	<0.50	<0.50	<0.50	<0.50	<0.50	4.37	7.60
10/16/2007	P		457.17	48.0	68.0	37.23	419.94	140	68	6.8	<0.50	5.0	24	4.87	8.02

Table 1. Summary of Ground-Water Monitoring Data: Relative Water Elevations and Laboratory Analyses

Station #6113, 785 East Stanley Blvd., Livermore, CA

Well and Sample Date	P/NP	Comments	TOC (feet msl)	Top of Screen (ft bgs)	Bottom of Screen (ft bgs)	DTW (feet bgs)	Water Level Elevation (feet msl)	Concentrations in (µg/L)						DO (mg/L)	pH
								GRO/TPHg	Benzene	Toluene	Ethyl-Benzene	Total Xylenes	MTBE		
MW-8															
3/23/1995	--	e	456.97	47.0	67.0	11.55	445.42	--	--	--	--	--	--	--	--
5/31/1995	--	e	456.97	47.0	67.0	12.37	444.60	--	--	--	--	--	--	--	--
8/31/1995	--	e	456.97	47.0	67.0	15.68	441.29	--	--	--	--	--	--	--	--
11/28/1995	--		456.97	47.0	67.0	14.15	442.82	<50	<0.5	<0.5	<0.5	<0.5	<3	--	--
2/22/1996	--	e	456.97	47.0	67.0	10.97	446.00	--	--	--	--	--	--	--	--
5/23/1996	--	e	456.97	47.0	67.0	11.90	445.07	--	--	--	--	--	--	--	--
8/8/1996	--	e	456.97	47.0	67.0	13.85	443.12	--	--	--	--	--	--	--	--
11/7/1996	--		456.97	47.0	67.0	15.08	441.89	<50	<0.5	<0.5	<0.5	<0.5	<3	--	--
3/27/1997	--	e	456.97	47.0	67.0	12.96	444.01	--	--	--	--	--	--	--	--
5/19/1997	--	e	456.97	47.0	67.0	14.35	442.62	--	--	--	--	--	--	--	--
5/18/1998	--	e	456.97	47.0	67.0	12.97	444.00	--	--	--	--	--	--	--	--
11/2/1998	--		456.97	47.0	67.0	26.01	430.96	<50	<0.5	<0.5	<0.5	<0.5	<3	--	--
6/4/1999	--	e	456.97	47.0	67.0	15.53	441.44	--	--	--	--	--	--	--	--
11/11/1999	P		456.97	47.0	67.0	16.67	440.30	<50	<0.5	<0.5	<0.5	<1	<3	1.01	--
6/20/2000	--	e	456.97	47.0	67.0	15.29	441.68	--	--	--	--	--	--	2.4	--
8/29/2000	--	e	456.97	47.0	67.0	16.59	440.38	--	--	--	--	--	--	3.37	--
11/29/2000	P		456.97	47.0	67.0	19.80	437.17	<50.0	<0.500	<0.500	<0.500	0.772	<2.50	1.35	--
5/2/2001	--	e	456.97	47.0	67.0	22.12	434.85	--	--	--	--	--	--	--	--
8/15/2001	--	e	456.97	47.0	67.0	27.63	429.34	--	--	--	--	--	--	--	--
10/5/2001	P		456.97	47.0	67.0	27.65	429.32	<50	<0.50	<0.50	<0.50	<0.50	<2.5	1.07	--
1/21/2002	--	e	456.97	47.0	67.0	26.73	430.24	--	--	--	--	--	--	--	--
4/26/2002	--	e	456.97	47.0	67.0	26.39	430.58	--	--	--	--	--	--	--	--
10/7/2002	--		456.97	47.0	67.0	18.43	438.54	<50	<0.50	<0.50	<0.50	0.86	<0.50	4.2	--
05/01/2003	--	r	456.97	47.0	67.0	16.47	440.50	--	--	--	--	--	--	--	--
10/27/2005	--		456.97	47.0	67.0	17.14	439.83	--	--	--	--	--	--	--	--
04/12/2006	--		456.97	47.0	67.0	14.08	442.89	--	--	--	--	--	--	--	--
10/31/2006	--		456.97	47.0	67.0	18.12	438.85	--	--	--	--	--	--	--	--
4/19/2007	--		456.97	47.0	67.0	22.39	434.58	--	--	--	--	--	--	--	--

Table 1. Summary of Ground-Water Monitoring Data: Relative Water Elevations and Laboratory Analyses

Station #6113, 785 East Stanley Blvd., Livermore, CA

Well and Sample Date	P/NP	Comments	TOC (feet msl)	Top of Screen (ft bgs)	Bottom of Screen (ft bgs)	DTW (feet bgs)	Water Level Elevation (feet msl)	Concentrations in (µg/L)						DO (mg/L)	pH
								GRO/TPHg	Benzene	Toluene	Ethyl-Benzene	Total Xylenes	MTBE		
MW-8 Cont.															
10/16/2007	--		456.97	47.0	67.0	38.18	418.79	--	--	--	--	--	--	--	--
MW-9															
3/23/1995	--	e	456.18	48.0	68.0	13.18	443.00	--	--	--	--	--	--	--	--
5/31/1995	--	e	456.18	48.0	68.0	12.66	443.52	--	--	--	--	--	--	--	--
8/31/1995	--	e	456.18	48.0	68.0	14.40	441.78	--	--	--	--	--	--	--	--
11/28/1995	--		456.18	48.0	68.0	14.26	441.92	<50	<0.5	<0.5	<0.5	<0.5	<3	--	--
2/22/1996	--	e	456.18	48.0	68.0	12.05	444.13	--	--	--	--	--	--	--	--
5/23/1996	--	e	456.18	48.0	68.0	12.07	444.11	--	--	--	--	--	--	--	--
8/8/1996	--	e	456.18	48.0	68.0	14.12	442.06	--	--	--	--	--	--	--	--
11/7/1996	--		456.18	48.0	68.0	15.42	440.76	<50	<0.5	<0.5	<0.5	<0.5	<3	--	--
3/27/1997	--	e	456.18	48.0	68.0	13.01	443.17	--	--	--	--	--	--	--	--
5/19/1997	--	e	456.18	48.0	68.0	14.60	441.58	--	--	--	--	--	--	--	--
5/18/1998	--	e	456.18	48.0	68.0	12.60	443.58	--	--	--	--	--	--	--	--
11/2/1998	--	e	456.18	48.0	68.0	25.08	431.10	--	--	--	--	--	--	--	--
6/4/1999	P		456.18	48.0	68.0	15.87	440.31	<50	<0.5	<0.5	<0.5	<0.5	<3	--	--
11/11/1999	P		456.18	48.0	68.0	17.02	439.16	<50	<0.5	<0.5	<0.5	<1	<3	0.96	--
6/20/2000	--	e	456.18	48.0	68.0	15.54	440.64	--	--	--	--	--	--	2.1	--
8/29/2000	--	e	456.18	48.0	68.0	16.81	439.37	--	--	--	--	--	--	2.59	--
11/29/2000	P		456.18	48.0	68.0	18.81	437.37	<50.0	<0.500	<0.500	<0.500	<0.500	<2.50	0.81	--
5/2/2001	--	e	456.18	48.0	68.0	22.09	434.09	--	--	--	--	--	--	--	--
8/15/2001	--	e	456.18	48.0	68.0	27.59	428.59	--	--	--	--	--	--	--	--
10/5/2001	P		456.18	48.0	68.0	27.63	428.55	<50	<0.50	<0.50	<0.50	<0.50	<2.5	0.93	--
10/5/2001	--	q	456.18	48.0	68.0	27.63	428.55	<50	<0.50	<0.50	<0.50	<0.50	<2.5	--	--
1/21/2002	--	e	456.18	48.0	68.0	26.77	429.41	--	--	--	--	--	--	--	--
4/26/2002	--	e	456.18	48.0	68.0	26.41	429.77	--	--	--	--	--	--	--	--
10/7/2002	P		456.18	48.0	68.0	18.85	437.33	<50	<0.50	<0.50	<0.50	<0.50	<0.50	2.6	--
05/01/2003	--	c, e	456.18	48.0	68.0	17.84	438.34	--	--	--	--	--	--	--	--

Table 1. Summary of Ground-Water Monitoring Data: Relative Water Elevations and Laboratory Analyses

Station #6113, 785 East Stanley Blvd., Livermore, CA

Well and Sample Date	P/NP	Comments	TOC (feet msl)	Top of Screen (ft bgs)	Bottom of Screen (ft bgs)	DTW (feet bgs)	Water Level Elevation (feet msl)	Concentrations in (µg/L)						DO (mg/L)	pH
								GRO/TPHg	Benzene	Toluene	Ethyl-Benzene	Total Xylenes	MTBE		
MW-9 Cont.															
10/03/2003	P	d	456.18	48.0	68.0	18.69	437.49	<50	1.1	0.57	<0.50	<0.50	<0.50	4.9	6.8
04/06/2004	--	e	458.55	48.0	68.0	16.08	442.47	--	--	--	--	--	--	--	--
10/28/2004	P		458.55	48.0	68.0	18.35	440.20	<50	<0.50	<0.50	<0.50	<0.50	<0.50	6.8	6.9
04/13/2005	--	e	458.55	48.0	68.0	14.09	444.46	--	--	--	--	--	--	--	--
10/27/2005	P		458.55	48.0	68.0	17.41	441.14	<50	0.51	<0.50	<0.50	<0.50	1.4	2.56	7.0
04/12/2006	--		458.55	48.0	68.0	14.18	444.37	--	--	--	--	--	--	--	--
10/31/2006	P		458.55	48.0	68.0	17.97	440.58	<50	<0.50	<0.50	<0.50	<0.50	<0.50	--	7.46
4/19/2007	--		458.55	48.0	68.0	22.37	436.18	--	--	--	--	--	--	--	--
10/16/2007	P		458.55	48.0	68.0	37.75	420.80	<50	0.83	<0.50	<0.50	<0.50	<0.50	1.27	7.59
MW-10															
3/23/1995	--	e	456.85	32.0	52.0	14.86	441.99	--	--	--	--	--	--	--	--
5/31/1995	--	e	456.85	32.0	52.0	15.63	441.22	--	--	--	--	--	--	--	--
8/31/1995	--	e	456.85	32.0	52.0	14.40	442.45	--	--	--	--	--	--	--	--
11/28/1995	--		456.85	32.0	52.0	17.24	439.61	<50	<0.5	<0.5	<0.5	<0.5	<3	--	--
2/22/1996	--	e	456.85	32.0	52.0	14.30	442.55	--	--	--	--	--	--	--	--
5/23/1996	--	e	456.85	32.0	52.0	14.93	441.92	--	--	--	--	--	--	--	--
8/8/1996	--	e	456.85	32.0	52.0	17.20	439.65	--	--	--	--	--	--	--	--
11/7/1996	--		456.85	32.0	52.0	18.25	438.60	<50	<0.5	<0.5	<0.5	<0.5	<3	--	--
3/27/1997	--	e	456.85	32.0	52.0	15.77	441.08	--	--	--	--	--	--	--	--
5/19/1997	--	e	456.85	32.0	52.0	17.38	439.47	--	--	--	--	--	--	--	--
5/18/1998	--	e	456.85	32.0	52.0	15.47	441.38	--	--	--	--	--	--	--	--
11/2/1998	--		456.85	32.0	52.0	26.94	429.91	<50	<0.5	<0.5	<0.5	<0.5	<3	--	--
6/4/1999	--	e	456.85	32.0	52.0	17.19	439.66	--	--	--	--	--	--	--	--
11/11/1999	P		456.85	32.0	52.0	19.35	437.50	<50	<0.5	<0.5	<0.5	<1	<3	0.68	--
6/20/2000	--	e	456.85	32.0	52.0	17.92	438.93	--	--	--	--	--	--	2.9	--
8/29/2000	--	e	456.85	32.0	52.0	19.15	437.70	--	--	--	--	--	--	1.54	--
11/29/2000	P		456.85	32.0	52.0	21.30	435.55	<50.0	<0.500	<0.500	<0.500	<0.500	<2.50	0.95	--

Table 1. Summary of Ground-Water Monitoring Data: Relative Water Elevations and Laboratory Analyses

Station #6113, 785 East Stanley Blvd., Livermore, CA

Well and Sample Date	P/NP	Comments	TOC (feet msl)	Top of Screen (ft bgs)	Bottom of Screen (ft bgs)	DTW (feet bgs)	Water Level Elevation (feet msl)	Concentrations in (µg/L)						DO (mg/L)	pH
								GRO/TPHg	Benzene	Toluene	Ethyl-Benzene	Total Xylenes	MTBE		
MW-10 Cont.															
5/2/2001	--	e	456.85	32.0	52.0	29.95	426.90	--	--	--	--	--	--	--	--
8/15/2001	--	e	456.85	32.0	52.0	30.74	426.11	--	--	--	--	--	--	--	--
10/5/2001	P		456.85	32.0	52.0	30.95	425.90	<50	<0.50	<0.50	<0.50	<0.50	<2.5	0.89	--
1/21/2002	--	e	456.85	32.0	52.0	28.97	427.88	--	--	--	--	--	--	--	--
4/26/2002	--	e	456.85	32.0	52.0	28.50	428.35	--	--	--	--	--	--	--	--
10/7/2002	--		456.85	32.0	52.0	21.15	435.70	<50	<0.50	<0.50	<0.50	<0.50	<0.50	3.0	--
05/01/2003	--	c, e	456.85	32.0	52.0	18.90	437.95	--	--	--	--	--	--	--	--
10/03/2003	P	d	456.85	32.0	52.0	20.64	436.21	<50	<0.50	<0.50	<0.50	<0.50	<0.50	2.4	7.1
04/06/2004	--	e	459.20	32.0	52.0	17.99	441.21	--	--	--	--	--	--	--	--
10/28/2004	P		459.20	32.0	52.0	20.27	438.93	<50	<0.50	<0.50	<0.50	<0.50	<0.50	5.9	7.1
04/13/2005	--	e	459.20	32.0	52.0	16.25	442.95	--	--	--	--	--	--	--	--
10/27/2005	P		459.20	32.0	52.0	19.03	440.17	<50	<0.50	<0.50	<0.50	<0.50	<0.50	3.38	7.2
04/12/2006	--		459.20	32.0	52.0	14.95	444.25	--	--	--	--	--	--	--	--
10/31/2006	P		459.20	32.0	52.0	20.20	439.00	<50	<0.50	<0.50	<0.50	<0.50	<0.50	--	7.30
4/19/2007	--		459.20	32.0	52.0	24.00	435.20	--	--	--	--	--	--	--	--
10/16/2007	NP		459.20	32.0	52.0	38.99	420.21	<50	<0.50	<0.50	<0.50	<0.50	<0.50	2.20	7.36
MW-11															
3/23/1995	--		455.07	38.0	45.0	17.34	437.73	--	--	--	--	--	--	--	--
5/31/1995	--		455.07	38.0	45.0	16.68	438.39	<50	<0.5	<0.5	<0.5	<0.5	--	--	--
8/31/1995	--	h	455.07	38.0	45.0	20.20	434.87	--	--	--	--	--	--	--	--
11/28/1995	--		455.07	38.0	45.0	17.80	437.27	<50	<0.5	<0.5	<0.5	<0.5	<3	--	--
2/22/1996	--	h	455.07	38.0	45.0	15.97	439.10	--	--	--	--	--	--	--	--
5/23/1996	--		455.07	38.0	45.0	15.50	439.57	<50	<0.5	<0.5	<0.5	<0.5	<3	--	--
8/8/1996	--	h	455.07	38.0	45.0	17.77	437.30	--	--	--	--	--	--	--	--
11/7/1996	--		455.07	38.0	45.0	17.45	437.62	<50	<0.5	<0.5	<0.5	<0.5	<3	--	--
3/27/1997	--	h	455.07	38.0	45.0	15.77	439.30	--	--	--	--	--	--	--	--
5/19/1997	--		455.07	38.0	45.0	16.80	438.27	<50	1.1	4.5	<0.5	2.2	<3	--	--

Table 1. Summary of Ground-Water Monitoring Data: Relative Water Elevations and Laboratory Analyses

Station #6113, 785 East Stanley Blvd., Livermore, CA

Well and Sample Date	P/NP	Comments	TOC (feet msl)	Top of Screen (ft bgs)	Bottom of Screen (ft bgs)	DTW (feet bgs)	Water Level Elevation (feet msl)	Concentrations in (µg/L)						DO (mg/L)	pH
								GRO/TPHg	Benzene	Toluene	Ethyl-Benzene	Total Xylenes	MTBE		
MW-11 Cont.															
5/18/1998	--		455.07	38.0	45.0	15.38	439.69	<50	<0.5	<0.5	<0.5	<0.5	<3	--	--
11/2/1998	--		455.07	38.0	45.0	24.15	430.92	<50	<0.5	<0.5	<0.5	<0.5	<3	--	--
6/4/1999	P		455.07	38.0	45.0	18.39	436.68	<50	<0.5	<0.5	<0.5	<0.5	<3	--	--
11/11/1999	P		455.07	38.0	45.0	18.62	436.45	<50	<0.5	<0.5	<0.5	<1	<3	1.01	--
6/20/2000	P		455.07	38.0	45.0	17.82	437.25	<50.0	0.631	<0.500	<0.500	<0.500	<2.50	4.1	--
8/29/2000	--	h	455.07	38.0	45.0	19.50	435.57	--	--	--	--	--	--	--	--
11/29/2000	P		455.07	38.0	45.0	20.60	434.47	<50.0	<0.500	<0.500	<0.500	1.63	<2.50	0.97	--
5/2/2001	P		455.07	38.0	45.0	22.42	432.65	<50.0	<0.500	<0.500	<0.500	<0.500	<2.50	1.04	--
8/15/2001	--	h	455.07	38.0	45.0	27.41	427.66	--	--	--	--	--	--	--	--
10/5/2001	P		455.07	38.0	45.0	27.59	427.48	<50	<0.50	<0.50	<0.50	<0.50	<2.5	1.05	--
1/21/2002	--	h	455.07	38.0	45.0	26.75	428.32	--	--	--	--	--	--	--	--
4/26/2002	P		455.07	38.0	45.0	26.50	428.57	<50	<0.50	<0.50	<0.50	<0.50	<2.5	0.47	--
10/7/2002	--		455.07	38.0	45.0	20.79	434.28	<50	<0.50	<0.50	<0.50	<0.50	1.0	1.4	--
05/01/2003	P	c	455.07	38.0	45.0	20.55	434.52	<50	<0.50	<0.50	<0.50	<0.50	1.5	3.2	--
10/03/2003	P	d	455.07	38.0	45.0	20.58	434.49	<50	<0.50	<0.50	<0.50	<0.50	3.1	3.0	7.1
04/06/2004	P		457.40	38.0	45.0	17.52	439.88	<50	<0.50	<0.50	<0.50	<0.50	14	5.1	6.7
10/28/2004	P		457.40	38.0	45.0	20.32	437.08	<50	<0.50	<0.50	<0.50	<0.50	29	1.3	7.2
04/13/2005	P		457.40	38.0	45.0	16.20	441.20	<50	<0.50	<0.50	<0.50	<0.50	3.7	2.8	7.0
10/27/2005	P		457.40	38.0	45.0	21.98	435.42	<50	<0.50	<0.50	<0.50	<0.50	21	1.04	7.2
04/12/2006	--	Well inaccessible	457.40	38.0	45.0	--	--	--	--	--	--	--	--	--	--
10/31/2006	--		457.40	38.0	45.0	--	--	--	--	--	--	--	--	--	--
4/19/2007	P		457.40	38.0	45.0	22.38	435.02	<50	<0.50	<0.50	<0.50	<0.50	12	7.11	7.57
10/16/2007	P		457.40	38.0	45.0	37.11	420.29	<50	<0.50	<0.50	<0.50	<0.50	6.6	0.60	7.57
MW-12															
3/23/1995	--	h	455.04	18.0	34.5	15.54	439.50	--	--	--	--	--	--	--	--
5/31/1995	--		455.04	18.0	34.5	15.66	439.38	<50	<0.5	<0.5	<0.5	<0.5	--	--	--
8/31/1995	--	h	455.04	18.0	34.5	18.23	436.81	--	--	--	--	--	--	--	--

Table I. Summary of Ground-Water Monitoring Data: Relative Water Elevations and Laboratory Analyses

Station #6113, 785 East Stanley Blvd., Livermore, CA

Well and Sample Date	P/NP	Comments	TOC (feet msl)	Top of Screen (ft bgs)	Bottom of Screen (ft bgs)	DTW (feet bgs)	Water Level Elevation (feet msl)	Concentrations in (µg/L)						DO (mg/L)	pH
								GRO/TPHg	Benzene	Toluene	Ethyl-Benzene	Total Xylenes	MTBE		
MW-12 Cont.															
11/28/1995	--		455.04	18.0	34.5	17.53	437.51	<50	<0.5	<0.5	<0.5	<0.5	<3	--	--
2/22/1996	--	h	455.04	18.0	34.5	14.45	440.59	--	--	--	--	--	--	--	--
5/23/1996	--		455.04	18.0	34.5	14.88	440.16	<50	<0.5	<0.5	<0.5	<0.5	<3	--	--
8/8/1996	--	h	455.04	18.0	34.5	17.30	437.74	--	--	--	--	--	--	--	--
11/7/1996	--		455.04	18.0	34.5	18.30	436.74	<50	<0.5	<0.5	<0.5	<0.5	<3	--	--
3/27/1997	--	h	455.04	18.0	34.5	15.69	439.35	--	--	--	--	--	--	--	--
5/19/1997	--		455.04	18.0	34.5	17.41	437.63	<50	<0.5	<0.5	<0.5	<0.5	<3	--	--
5/18/1998	--		455.04	18.0	34.5	15.21	439.83	<50	<0.5	<0.5	<0.5	<0.5	<3	--	--
11/2/1998	--	m	455.04	18.0	34.5	--	--	--	--	--	--	--	--	--	--
6/4/1999	--	m	455.04	18.0	34.5	--	--	--	--	--	--	--	--	--	--
11/11/1999	--	m	455.04	18.0	34.5	--	--	--	--	--	--	--	--	--	--
6/20/2000	--	m	455.04	18.0	34.5	--	--	--	--	--	--	--	--	--	--
8/29/2000	--	m	455.04	18.0	34.5	--	--	--	--	--	--	--	--	--	--
11/29/2000	--	m	455.04	18.0	34.5	--	--	--	--	--	--	--	--	--	--
5/2/2001	--	m	455.04	18.0	34.5	--	--	--	--	--	--	--	--	--	--
8/15/2001	--	m	455.04	18.0	34.5	--	--	--	--	--	--	--	--	--	--
10/5/2001	--	m	455.04	18.0	34.5	--	--	--	--	--	--	--	--	--	--
1/21/2002	--	m	455.04	18.0	34.5	--	--	--	--	--	--	--	--	--	--
4/26/2002	--	m	455.04	18.0	34.5	--	--	--	--	--	--	--	--	--	--
10/7/2002	--	m	455.04	18.0	34.5	--	--	--	--	--	--	--	--	--	--
05/01/2003	--	c, m	455.04	18.0	34.5	--	--	--	--	--	--	--	--	--	--
10/03/2003	--	m	455.04	18.0	34.5	--	--	--	--	--	--	--	--	--	--
04/06/2004	P		457.37	18.0	34.5	18.14	439.23	<50	<0.50	<0.50	<0.50	<0.50	<0.50	2.4	6.4
10/28/2004	P		457.37	18.0	34.5	20.66	436.71	<50	<0.50	<0.50	<0.50	<0.50	<0.50	1.7	6.8
04/13/2005	P		457.37	18.0	34.5	16.25	441.12	<50	<0.50	<0.50	<0.50	0.55	<0.50	1.9	7.5
10/27/2005	P		457.37	18.0	34.5	19.77	437.60	<50	<0.50	<0.50	<0.50	<0.50	<0.50	1.81	7.0
04/12/2006	P		457.37	18.0	34.5	16.08	441.29	<50	<0.50	<0.50	<0.50	<0.50	<0.50	2.6	7.2
10/31/2006	--		457.37	18.0	34.5	--	--	--	--	--	--	--	--	--	--

Table 1. Summary of Ground-Water Monitoring Data: Relative Water Elevations and Laboratory Analyses

Station #6113, 785 East Stanley Blvd., Livermore, CA

Well and Sample Date	P/NP	Comments	TOC (feet msl)	Top of Screen (ft bgs)	Bottom of Screen (ft bgs)	DTW (feet bgs)	Water Level Elevation (feet msl)	Concentrations in (µg/L)						DO (mg/L)	pH
								GRO/TPHg	Benzene	Toluene	Ethyl-Benzene	Total Xylenes	MTBE		
MW-12 Cont.															
4/19/2007	NP		457.37	18.0	34.5	22.34	435.03	<50	<0.50	<0.50	<0.50	<0.50	<0.50	4.66	7.28
10/16/2007	--	f	457.37	18.0	34.5	--	--	--	--	--	--	--	--	--	--
MW-13															
1/21/2002	P		--	--	--	24.61	--	15,000	160	68	1,700	3,200	4,900/5,200	0.71	--
4/26/2002	P		--	--	--	24.20	--	17,000	98	<100	1,700	3,400	1,600	0.6	--
10/7/2002	--	b	--	--	--	20.12	--	14,000	510	<50	2,200	2,300	2,800	0.8	--
05/01/2003	P	c	--	--	--	17.82	--	21,000	230	<50	1,900	2,300	1,600	1.9	--
10/03/2003	P	d	--	--	--	19.91	--	19,000	570	55	1,900	2,300	2,400	0.8	6.9
04/06/2004	P		457.91	--	--	17.14	440.77	15,000	470	35	1,600	1,300	1,800	2.0	6.7
10/28/2004	P		457.91	--	--	18.83	439.08	18,000	350	<25	1,900	1,800	1,800	0.8	6.7
04/13/2005	P		457.91	--	--	15.23	442.68	9,700	110	<25	860	280	920	0.9	6.9
10/27/2005	P		457.91	--	--	18.45	439.46	11,000	120	12	1,500	450	580	0.75	6.8
04/12/2006	P		457.91	--	--	15.06	442.85	4,700	65	<10	450	69	470	1.2	6.8
10/31/2006	P		457.91	--	--	19.06	438.85	15,000	150	<25	1,700	400	710	--	6.87
4/19/2007	NP		457.91	--	--	22.21	435.70	14,000	60	<25	1,800	640	330	1.44	7.09
10/16/2007	--	f	457.91	--	--	--	--	--	--	--	--	--	--	--	--
VW-1															
8/29/2000	P		--	24	45	17.40	--	2,360	27.6	11.6	26.3	33.2	110	4.47	--
11/29/2000	P		--	24.0	45	18.75	--	<50.0	<0.500	<0.500	<0.500	<0.500	<2.50	0.46	--
5/2/2001	--		--	24.0	45	21.59	--	--	--	--	--	--	--	--	--
8/15/2001	P	s	--	24.0	45	24.62	--	1,200	6.3	4.3	1.7	1.3	20/17	--	--
8/15/2001	--	q	--	24.0	45	--	--	1,200	6.2	4.1	1.8	1.1	20/17	--	--
10/5/2001	P	s	--	24.0	45	24.75	--	1,500	140	55	28	82	610/660	0.71	--
1/21/2002	--	q, s	--	24.0	45	--	--	8,000	770	320	96	1,100	2,500/3,200	--	--
1/21/2002	P	s	--	24.0	45	24.59	--	6,700	810	350	270	1,100	2,600/3,400	0.69	--
4/26/2002	P		--	24.0	45	24.27	--	370	26	2.1	6.6	1.7	48	0.5	--
4/26/2002	--	q	--	24.0	45	--	--	350	24	1.6	5.9	1.6	45	--	--

Table 1. Summary of Ground-Water Monitoring Data: Relative Water Elevations and Laboratory Analyses
Station #6113, 785 East Stanley Blvd., Livermore, CA

Well and Sample Date	P/NP	Comments	TOC (feet msl)	Top of Screen (ft bgs)	Bottom of Screen (ft bgs)	DTW (feet bgs)	Water Level Elevation (feet msl)	Concentrations in (µg/L)						DO (mg/L)	pH
								GRO/TPHg	Benzene	Toluene	Ethyl-Benzene	Total Xylenes	MTBE		
VW-1 Cont.															
10/7/2002	P	b	--	24.0	45	19.20	--	410	25	2.2	8	4.3	88	1.7	--
05/01/2003	P	c	--	24.0	45	16.60	--	240	6.4	<0.50	3.3	1.3	36	1.7	--
10/03/2003	P	d	--	24.0	45	18.82	--	180	1.5	<0.50	0.69	<0.50	12	1.1	7.3
04/06/2004	P		457.08	24.0	45	15.78	441.30	300	2.2	<0.50	3.0	1.3	13	2.4	7.2
10/28/2004	P		457.08	24.0	45	18.33	438.75	210	<0.50	<0.50	0.67	<0.50	<0.50	1.2	7.1
04/13/2005	P		457.08	24.0	45	14.02	443.06	740	1.8	<0.50	3.6	1.1	9.6	2.4	7.1
10/27/2005	P		457.08	24.0	45	17.65	439.43	1,500	78	73	36	81	13	1.64	7.3
04/12/2006	P		457.08	24.0	45	13.89	443.19	230	1.4	<0.50	2.2	0.76	1.6	1.4	7.3
10/31/2006	P		457.08	24.0	45	17.87	439.21	80	<0.50	<0.50	2.3	0.82	<0.50	--	7.76
4/19/2007	P		457.08	24.0	45	21.09	435.99	250	1.6	<0.50	4.7	1.3	3.0	1.15	7.66
10/16/2007	NP		457.08	24.0	45	37.10	419.98	12,000	2,300	1,900	860	2,800	150	2.65	7.61
VW-2															
8/29/2000	--	g	--	28	49.5	--	--	--	--	--	--	--	--	--	--
11/29/2000	--	g	--	28	49.5	--	--	--	--	--	--	--	--	--	--
5/2/2001	--		--	28	49.5	--	--	--	--	--	--	--	--	--	--
10/5/2001	--	g	--	28	49.5	--	--	--	--	--	--	--	--	--	--
1/21/2002	--	g	--	28	49.5	--	--	--	--	--	--	--	--	--	--
4/26/2002	--	m	--	28	49.5	--	--	--	--	--	--	--	--	--	--
10/7/2002	--	g	--	28	49.5	--	--	--	--	--	--	--	--	--	--
05/01/2003	--	c, g	--	28	49.5	--	--	--	--	--	--	--	--	--	--
10/03/2003	--	Well inaccessible g	--	28	49.5	--	--	--	--	--	--	--	--	--	--
04/06/2004	--		458.64	28	49.5	16.96	441.68	--	--	--	--	--	--	--	--
10/28/2004	--		458.64	28	49.5	19.35	439.29	--	--	--	--	--	--	--	--
04/13/2005	--		458.64	28	49.5	15.51	443.13	--	--	--	--	--	--	--	--
10/27/2005	--		458.64	28	49.5	18.50	440.14	--	--	--	--	--	--	--	--
04/12/2006	--		458.64	28	49.5	14.92	443.72	--	--	--	--	--	--	--	--
10/31/2006	--		458.64	28	49.5	19.01	439.63	--	--	--	--	--	--	--	--

Table 1. Summary of Ground-Water Monitoring Data: Relative Water Elevations and Laboratory Analyses

Station #6113, 785 East Stanley Blvd., Livermore, CA

Well and Sample Date	P/NP	Comments	TOC (feet msl)	Top of Screen (ft bgs)	Bottom of Screen (ft bgs)	DTW (feet bgs)	Water Level Elevation (feet msl)	Concentrations in (µg/L)						DO (mg/L)	pH
								GRO/TPHg	Benzene	Toluene	Ethyl-Benzene	Total Xylenes	MTBE		
VW-2 Cont.															
4/19/2007	--		458.64	28	49.5	22.52	436.12	--	--	--	--	--	--	--	--
10/16/2007	--		458.64	28	49.5	38.58	420.06	--	--	--	--	--	--	--	--
VW-3															
8/29/2000	P		--	15.5	24	17.93	--	25,400	3,540	10,600	1,280	43,000	44,700	--	--
11/29/2000	P	s	--	15.5	24	19.75	--	54,200	9,450	1,870	2,350	9,400	12,300/15,100	0.47	--
5/2/2001	--	k	--	15.5	24	--	--	--	--	--	--	--	--	--	--
VW-4															
8/29/2000	--	g	--	17	30	--	--	--	--	--	--	--	--	--	--
11/29/2000	P	s	--	17	30	19.45	--	37,500	4,510	206	2,100	9,030	6,770/7,880	0.42	--
11/29/2000	--	q, s	--	17	30	--	--	36,100	3,700	206	1,850	7,890	6,430/8,460	--	--
5/2/2001	--		--	17	30	21.66	--	--	--	--	--	--	--	--	--
8/15/2001	--		--	17	30	--	--	--	--	--	--	--	--	--	--
10/5/2001	--	f	--	17	30	--	--	--	--	--	--	--	--	--	--
1/21/2002	--	f	--	17	30	--	--	--	--	--	--	--	--	--	--
4/26/2002	--	f	--	17	30	--	--	--	--	--	--	--	--	--	--
10/7/2002	--		--	17	30	19.25	--	--	--	--	--	--	--	--	--
05/01/2003	--	c	--	17	30	17.29	--	--	--	--	--	--	--	--	--
10/03/2003	P	d, n	--	17	30	19.10	--	48,000	3,300	1,700	3,600	21,000	1,600	10.5	6.7
04/06/2004	--		456.99	17	30	18.05	438.94	--	--	--	--	--	--	--	--
10/28/2004	--		456.99	17	30	18.71	438.28	--	--	--	--	--	--	--	--
04/13/2005	--		456.99	17	30	14.62	442.37	--	--	--	--	--	--	--	--
10/27/2005	--		456.99	17	30	18.00	438.99	--	--	--	--	--	--	--	--
04/12/2006	--		456.99	17	30	14.42	442.57	--	--	--	--	--	--	--	--
10/31/2006	--		456.99	17	30	18.30	438.69	--	--	--	--	--	--	--	--
4/19/2007	--		456.99	17	30	20.91	436.08	--	--	--	--	--	--	--	--
10/16/2007	--	f	456.99	17	30	--	--	--	--	--	--	--	--	--	--

ABBREVIATIONS & SYMBOLS:

-- = Not analyzed/applicable/measured/available
< = Not detected at or above specified laboratory reporting limit
DO = Dissolved oxygen
DTW = Depth to water in ft bgs
ft bgs = Feet below ground surface
ft MSL = Feet above mean sea level
GRO = Gasoline range organics
GWE = Groundwater elevation measured in ft MSL
mg/L = Milligrams per liter
MTBE = Methyl tert-butyl ether
NP = Well not purged prior to sampling
P = Well purged prior to sampling
TOC = Top of casing measured in ft MSL
TPH-g = Total petroleum hydrocarbons as gasoline
µg/L = Micrograms per liter

FOOTNOTES:

a = Hydrocarbon pattern is present in the requested fuel quantitation range but does not resemble the pattern of the requested fuel.
b = Chromatogram Pattern: C6-C10.
c = TPH-g, benzene, toluene, ethylbenzene, and total xylenes (BTEX), and MTBE analyzed using EPA Method 8260B beginning second quarter 2003 (05/01/03).
d = This sample was analyzed 3 days after the EPA recommended holding time. The results may still be useful for their intended purpose.
e = Well sampled annually in the fourth quarter.
f = Well dry.
g = Well inaccessible.
h = Well sampled semi-annually in second and fourth quarters.
k = Well abandoned.
m = Unable to locate well.
n = Sheen in well.
q = Duplicate sample.
r = Well removed from sampling schedule.
s = Original sample analyzed by 8021B and confirmation by 8260.
t = Bolts securing well box cover stripped at head. Unable to sample well.
u = Hydrocarbon result partly due to individ. peak(s) in quant. range.
v = pH measurement is believed to be erroneous.
w = Sample > 4x spike concentration.

NOTES:

Beginning in the second quarter 2003 (05/01/03) TPH-g and BTEX were analyzed using EPA Method 8260B, and MTBE was analyzed by EPA Method 8260B beginning in fourth quarter 2002. Prior to 05/01/03, TPH-g was analyzed by EPA Method 8015; BTEX by EPA Method 8021B (EPA method 8020 before 11/11/99); and MTBE by EPA Method 8021B. (EPA method 8020 before 11/11/99). Any MTBE detection by 8021B was confirmed by EPA Method 8260 beginning third quarter 2000 (08-29-00 results).

Beginning in the fourth quarter 2003, the laboratory modified the reported analyte list. TPH-g was changed to GRO. The resulting data may be impacted by the potential of non-TPH-g analytes within the requested fuel range resulting in a higher concentration being reported.

Beginning in the second quarter 2004, the carbon range for GRO was changed from C6-C10 to C4-C12.

Wells were resurveyed to NAVD '88 datum by URS Corporation on March 8, 2004.

Values for DO and pH were obtained through field measurements.

Note: The data within this table collected prior to April 2006 was provided to Broadbent & Associates, Inc. by Atlantic Richfield Company and their previous consultants. Broadbent & Associates, Inc. has not verified the accuracy of this information.

**Table 2. Summary of Fuel Additives Analytical Data
Station #6113, 785 East Stanley Blvd., Livermore, CA**

Well and Sample Date	Concentrations in (µg/L)								Comments
	Ethanol	TBA	MTBE	DIPE	ETBE	TAME	1,2-DCA	EDB	
MW-1									
10/7/2002	<40	<20	<0.50	<0.50	<0.50	<0.50	<0.50	<0.50	
MW-2									
10/7/2002	<40	<20	<0.50	<0.50	<0.50	<0.50	<0.50	<0.50	
MW-3									
10/7/2002	<40	<20	<0.50	<0.50	<0.50	<0.50	<0.50	<0.50	
10/03/2003	<100	<20	<0.50	<1.0	<1.0	<1.0	<0.50	<0.50	a
10/28/2004	<100	<20	<0.50	<0.50	<0.50	<0.50	<0.50	<0.50	
10/31/2006	<300	<20	22	<0.50	<0.50	<0.50	<0.50	<0.50	
MW-4									
10/7/2002	<400	<200	260	<5.0	<5.0	<5.0	<5.0	<5.0	
5/1/2003	<100	25	86	<0.50	<0.50	<0.50	<0.50	<0.50	
10/03/2003	<100	<20	22	<1.0	<1.0	<1.0	<0.50	<0.50	a
04/06/2004	<100	<20	17	<0.50	<0.50	<0.50	<0.50	<0.50	
10/28/2004	<100	<20	4.5	<0.50	<0.50	<0.50	<0.50	<0.50	
04/13/2005	<100	<20	2.8	<0.50	<0.50	<0.50	<0.50	<0.50	
10/27/2005	<100	<20	22	<0.50	<0.50	<0.50	<0.50	<0.50	
04/12/2006	<300	<20	1.9	<0.50	<0.50	<0.50	<0.50	<0.50	b
10/31/2006	<300	<20	<0.50	<0.50	<0.50	<0.50	<0.50	<0.50	
4/19/2007	<300	<20	<0.50	<0.50	<0.50	0.66	<0.50	<0.50	
MW-6									
10/7/2002	<40	<20	8	<0.50	<0.50	<0.50	<0.50	<0.50	
5/1/2003	<100	<20	12	<0.50	<0.50	<0.50	<0.50	<0.50	
10/03/2003	<500	<100	120	<5.0	<5.0	<5.0	<2.5	<2.5	a
04/06/2004	<5,000	<1,000	1,700	<25	<25	<25	<25	<25	
10/28/2004	<5,000	<1,000	3,100	<25	<25	<25	<25	<25	
04/13/2005	<10,000	<2,000	3,900	<50	<50	<50	<50	<50	
10/27/2005	<10,000	<2,000	2,900	<50	<50	<50	<50	<50	b
04/12/2006	<30,000	<2,000	3,400	<50	<50	<50	<50	<50	b
10/31/2006	<15,000	<1,000	3,400	<25	<25	<25	<25	<25	b

Table 2. Summary of Fuel Additives Analytical Data
Station #6113, 785 East Stanley Blvd., Livermore, CA

Well and Sample Date	Concentrations in (µg/L)								Comments
	Ethanol	TBA	MTBE	DIPE	ETBE	TAME	1,2-DCA	EDB	
MW-6 Cont.									
4/19/2007	<15,000	<1,000	2,200	<25	<25	<25	<25	<25	
10/16/2007	<15,000	<1,000	2,600	<25	<25	<25	<25	<25	c (MTBE)
MW-7									
10/7/2002	<40	<20	41	<0.50	<0.50	<0.50	<0.50	<0.50	
5/1/2003	<100	<20	43	<0.50	<0.50	<0.50	<0.50	<0.50	
10/03/2003	<200	<40	49	<2.0	<2.0	<2.0	<1.0	<1.0	a
04/06/2004	<100	<20	0.76	<0.50	<0.50	<0.50	<0.50	<0.50	
10/28/2004	<100	<20	14	<0.50	<0.50	<0.50	<0.50	<0.50	
04/13/2005	<100	<20	1.7	<0.50	<0.50	<0.50	<0.50	<0.50	
10/27/2005	<100	<20	2.3	<0.50	<0.50	<0.50	<0.50	<0.50	b
04/12/2006	<300	<20	1.1	<0.50	<0.50	<0.50	<0.50	<0.50	b
10/31/2006	<300	<20	<0.50	<0.50	<0.50	<0.50	<0.50	<0.50	b
4/19/2007	<300	<20	<0.50	<0.50	<0.50	<0.50	<0.50	<0.50	
10/16/2007	<300	<20	24	<0.50	<0.50	<0.50	<0.50	<0.50	
MW-8									
10/7/2002	<40	<20	<0.50	<0.50	<0.50	<0.50	<0.50	<0.50	
MW-9									
10/7/2002	<40	<20	<0.50	<0.50	<0.50	<0.50	<0.50	<0.50	
10/03/2003	<100	<20	<0.50	<1.0	<1.0	<1.0	<0.50	<0.50	a
10/28/2004	<100	<20	<0.50	<0.50	<0.50	<0.50	<0.50	<0.50	
10/27/2005	<100	<20	1.4	<0.50	<0.50	<0.50	<0.50	<0.50	b
10/31/2006	<300	<20	<0.50	<0.50	<0.50	<0.50	<0.50	<0.50	b
10/16/2007	<300	<20	<0.50	<0.50	<0.50	<0.50	<0.50	<0.50	
MW-10									
10/7/2002	<40	<20	<0.50	<0.50	<0.50	<0.50	<0.50	<0.50	
10/03/2003	<100	<20	<0.50	<1.0	<1.0	<1.0	<0.50	<0.50	a
10/28/2004	<100	<20	<0.50	<0.50	<0.50	<0.50	<0.50	<0.50	
10/27/2005	<100	<20	<0.50	<0.50	<0.50	<0.50	<0.50	<0.50	
10/31/2006	<300	<20	<0.50	<0.50	<0.50	<0.50	<0.50	<0.50	b

**Table 2. Summary of Fuel Additives Analytical Data
Station #6113, 785 East Stanley Blvd., Livermore, CA**

Well and Sample Date	Concentrations in (µg/L)								Comments
	Ethanol	TBA	MTBE	DIPE	ETBE	TAME	1,2-DCA	EDB	
MW-10 Cont.									
10/16/2007	<300	<20	<0.50	<0.50	<0.50	<0.50	<0.50	<0.50	
MW-11									
10/7/2002	<40	<20	1.0	<0.50	<0.50	<0.50	<0.50	<0.50	
5/1/2003	<100	<20	--	<0.50	<0.50	<0.50	<0.50	<0.50	
10/03/2003	<100	<20	3.1	<1.0	<1.0	<1.0	<0.50	<0.50	a
04/06/2004	<100	<20	14	<0.50	<0.50	<0.50	<0.50	<0.50	
10/28/2004	<100	<20	29	<0.50	<0.50	<0.50	<0.50	<0.50	
04/13/2005	<100	<20	3.7	<0.50	<0.50	<0.50	<0.50	<0.50	
10/27/2005	<100	<20	21	<0.50	<0.50	<0.50	<0.50	<0.50	
04/12/2006	--	--	--	--	--	--	--	--	Well inaccessible
4/19/2007	<300	<20	12	<0.50	<0.50	<0.50	<0.50	<0.50	
10/16/2007	<300	<20	6.6	<0.50	<0.50	<0.50	<0.50	<0.50	
MW-12									
04/06/2004	<100	<20	<0.50	<0.50	<0.50	<0.50	<0.50	<0.50	
10/28/2004	<100	<20	<0.50	<0.50	<0.50	<0.50	<0.50	<0.50	
04/13/2005	<100	<20	<0.50	<0.50	<0.50	<0.50	<0.50	<0.50	
10/27/2005	<100	<20	<0.50	<0.50	<0.50	<0.50	<0.50	<0.50	
04/12/2006	<300	<20	<0.50	<0.50	<0.50	<0.50	<0.50	<0.50	b
4/19/2007	<300	<20	<0.50	<0.50	<0.50	<0.50	<0.50	<0.50	
MW-13									
10/7/2002	<4,000	<2,000	2,800	<50	<50	<50	<50	<50	
5/1/2003	<10,000	<2,000	--	<50	<50	<50	<50	<50	
10/03/2003	<10,000	<2,000	2,400	<100	<100	<100	<50	<50	a
04/06/2004	<5,000	<1,000	1,800	<25	<25	<25	<25	<25	
10/28/2004	<5,000	<1,000	1,800	<25	<25	<25	<25	<25	
04/13/2005	<5,000	<1,000	920	<25	<25	<25	<25	<25	
10/27/2005	<2,000	<400	580	<10	<10	<10	<10	<10	
04/12/2006	<6,000	<400	470	<10	<10	<10	<10	<10	b
10/31/2006	<15,000	<1,000	710	<25	<25	<25	<25	<25	b
4/19/2007	<15,000	<1,000	330	<25	<25	<25	<25	<25	

**Table 2. Summary of Fuel Additives Analytical Data
Station #6113, 785 East Stanley Blvd., Livermore, CA**

Well and Sample Date	Concentrations in (µg/L)								Comments
	Ethanol	TBA	MTBE	DIPE	ETBE	TAME	1,2-DCA	EDB	
VW-1									
10/7/2002	<80	<40	--	<1.0	<1.0	<1.0	<1.0	<1.0	
5/1/2003	<100	<20	--	<0.50	<0.50	<0.50	<0.50	<0.50	
10/03/2003	<100	<20	12	<1.0	<1.0	<1.0	<0.50	<0.50	a
04/06/2004	<100	<20	13	<0.50	<0.50	<0.50	<0.50	<0.50	
10/28/2004	<100	<20	<0.50	<0.50	<0.50	<0.50	<0.50	<0.50	
04/13/2005	<100	<20	9.6	<0.50	<0.50	<0.50	<0.50	<0.50	
10/27/2005	<100	<20	13	<0.50	<0.50	<0.50	<0.50	<0.50	
04/12/2006	<300	<20	1.6	<0.50	<0.50	<0.50	<0.50	<0.50	b
10/31/2006	<300	<20	<0.50	<0.50	<0.50	<0.50	<0.50	<0.50	b
4/19/2007	<300	<20	3.0	<0.50	<0.50	<0.50	<0.50	<0.50	
10/16/2007	<15,000	<1,000	150	<25	<25	<25	<25	<25	b
VW-2									
10/03/2003	--	--	--	--	--	--	--	--	Well inaccessible
VW-4									
10/03/2003	<100,000	<20,000	1,600	<1,000	<1,000	<1,000	<500	<500	a

ABBREVIATIONS & SYMBOLS:

-- = Not analyzed/applicable/measured/available

< = Not detected at or above specified laboratory reporting limit

1,2-DCA = 1,2-Dichloroethane

DIPE = Di-isopropyl ether

EDB = 1,2-Dibromoethane

ETBE = Ethyl tert-butyl ether

MTBE = Methyl tert-butyl ether

TAME = tert-Amyl methyl ether

TBA = tert-Butyl alcohol

µg/L = Micrograms per Liter

FOOTNOTES:

a = This sample was analyzed 3 days after the EPA recommended holding time. The results may still be useful for their intended purpose.

b = Calibration verification for ethanol was within method limits but outside contract limits.

c = Sample >4x spike concentration.

NOTES:

All volatile organic compounds analyzed using EPA Method 8260B.

Note: The data within this table collected prior to April 2006 was provided to Broadbent & Associates, Inc. by Atlantic Richfield Company and their previous consultants. Broadbent & Associates, Inc. has not verified the accuracy of this information.

Table 3. Historical Ground-Water Flow Direction and Gradient
Station #6113, 785 East Stanley Blvd., Livermore, CA

Date Sampled	Approximate Flow Direction	Approximate Hydraulic Gradient
3/23/1995	Northwest	0.035
5/31/1995	North-Northwest	0.028
8/31/1995	North-Northwest	0.03
11/28/1995	North-Northwest	0.025
2/22/1996	North-Northwest	0.031
5/23/1996	North-Northwest	0.025
8/8/1996	North	0.019
11/7/1996	North-Northeast	0.019
3/27/1997	North-Northwest	0.021
5/19/1997	North	0.019
5/18/1998	North	0.02
11/2/1998	North	0.02
6/4/1999	North	0.02
11/11/1999	North	0.03
6/20/2000	North-Northeast	0.014
8/29/2000	North-Northeast	0.013
11/29/2000	North-Northwest	0.026
5/2/2001	Northeast	0.026
8/15/2001	Northeast	0.047
10/5/2001	Northeast	0.031
1/21/2002	Northeast	0.033
4/26/2002	Northeast	0.031
10/7/2002	Northeast	0.017
5/1/2003	North-Northeast	0.011
10/3/2003	North-Northeast	0.016
4/6/2004	North-Northeast	0.013
10/28/2004	North-Northeast	0.014
4/13/2005	North-Northwest	0.02
10/27/2005	North-Northwest	0.01 to 0.03
4/12/2006	Northeast	0.01
10/31/2006	Northeast	0.014
4/19/2007	Northeast	0.013
10/16/2007	Northeast	0.031

Note: The data within this table collected prior to April 2006 was provided to Broadbent & Associates, Inc. by Atlantic Richfield Company and their previous consultants. Broadbent & Associates, Inc. has not verified the accuracy of this information.

APPENDIX A

STRATUS ENVIRONMENTAL, INC. GROUNDWATER SAMPLING DATA PACKAGE
(INCLUDES FIELD DATA SHEETS, NON-HAZARDOUS WASTE DATA FORM,
CHAIN OF CUSTODY DOCUMENTATION, AND CERTIFIED ANALYTICAL
RESULTS)



3330 Cameron Park Drive, Ste 550
Cameron Park, California 95682
(530) 676-6004 ~ Fax: (530) 676-6005

November 9, 2007

Mr. Rob Miller
Broadbent & Associates, Inc.
2000 Kirman Avenue
Reno, NV 89502

Re: Groundwater Sampling Data Package, BP Service Station No. 6113, located at
785 E. Stanley, Livermore, California

General Information

Data Submittal Prepared / Reviewed by: Sandy Hayes / Jay Johnson

Phone Number: (530) 676-6000

On-Site Supplier Representatives: Vince Zalutka and David Demello

Date: October 16, 2007

Arrival: 04:30 *Departure:* 10:30

Weather Conditions: Overcast/Cloudy

Unusual Field Conditions: None

Scope of Work Performed: Quarterly monitoring and sampling

Variations from Work Scope: Well MW-11 purged dry before three casing volumes were removed. Wells MW-3, MW-4, MW-12 and MW-13 were dry.

This submittal presents the tabulation of data collected in association with routine groundwater monitoring. The attachments include field data sheets, non-hazardous waste data form, chain of custody documentation, and certified analytical results. The information is being provided to BP-ARCO's Scoping Supplier for use in preparing a report for regulatory submittal. This submittal is limited to presentation of collected data and does not include data interpretation or conclusions or recommendations. Any questions concerning this submittal should be addressed to the Preparer/Reviewer identified above.

Sincerely,

STRATUS ENVIRONMENTAL, INC.

Jay R. Johnson, P.G.
Project Manager



Attachments:

- Field Data Sheets
- Non-Hazardous Waste Data Form
- Chain of Custody Documentation
- Certified Analytical Results

CC: Mr. Paul Supple, BP/ARCO



Chain of Custody Record

ORIGINAL

Project Name: ARCO 6113
 BP BU/AR Region/Enfos Segment: BP > Americas > West > Retail > Alameda > 6113
 State or Lead Regulatory Agency: _____
 Requested Due Date (mm/dd/yy): STD-TAX

On-site Time: <u>0430</u>	Temp: <u>60's</u>
Off-site Time: <u>1030</u>	Temp: <u>60's</u>
Sky Conditions: <u>Overcast/Cloudy</u>	
Meteorological Events: _____	
Wind Speed: _____	Direction: _____

Lab Name: <u>TestAmerica</u>	BP/AR Facility No.: <u>6113</u>	Consultant/Contractor: <u>Stratus Environmental, Inc.</u>
Address: <u>885 Jarvis Drive</u>	BP/AR Facility Address: <u>785 E. Stanley Blvd., Livermore</u>	Address: <u>3330 Cameron Park Drive, Suite 550</u>
<u>Morgan Hill, CA 95937</u>	Site Lat/Long: _____	<u>Cameron Park, CA 95682</u>
Lab PM: <u>Lisa Race</u>	California Global ID No.: <u>T0600100111</u>	Consultant/Contractor Project No.: <u>E6113-04</u>
Tele/Fax: <u>408-782-8156 408-782-6308 (fax)</u>	Enfos Project No.: <u>G0C54-0015</u>	Consultant/Contractor PM: <u>Jay Johnson</u>
BP/AR PM Contact: <u>Paul Supple</u>	Provision or OOC (circle one) <u>Provision</u>	Tele/Fax: <u>(530) 676-6000 / (530) 676-6005</u>
Address: <u>2010 Crow Canyon Place, Suite 150</u>	Phase/WBS: <u>04-Monitoring</u>	Report Type & QC Level: <u>Level 1 with EDF</u>
<u>San Ramon, CA</u>	Sub Phase/Task: <u>03-Analytical</u>	E-mail EDD To: <u>shayes@stratusinc.net</u>
Tele/Fax: <u>925-275-3506</u>	Cost Element: <u>01-Contractor labor</u>	Invoice to: <u>Atlantic Richfield Co.</u>

Item No.	Sample Description	Time	Date	Matrix			Laboratory No.	No. of Containers	Preservative						Requested Analysis						Sample Point Lat/Long and Comments	
				Soil/Solid	Water/Liquid	Air			Unpreserved	H ₂ SO ₄	HNO ₃	HCl	Methanol	GRD	BTEX	5 Oxy's	EDB	1,2-DCA	Ethanol			
1	MW-6	0918	10/16	X				6							X	X	X	X	X	X		
2	MW-7	0826						3														
3	MW-9	1003						3														
4	MW-10	0600						3														
5	MW-11	0551						3														
6	VW-1	0719						3														
7																						
8	TB-6113-10162007	0600	10/16	X				2														Hold
9																						
10																						

Sampler's Name: <u>David DeMello</u>	Relinquished By / Affiliation: <u>David DeMello / STRATUS</u>	Date: <u>10/16/07</u>	Time: <u>1220</u>	Accepted By / Affiliation: <u>[Signature]</u>	Date: <u>10-16</u>	Time: <u>1220</u>
Sampler's Company: <u>STRATUS ENVIRONMENTAL INC</u>						
Shipment Date: <u>10-16-07</u>						
Shipment Method: _____						
Shipment Tracking No: _____						

Special Instructions: Please cc results to rmiller@broadbentinc.com

Custody Seals In Place: <u>Yes / No</u>	Temp Blank: <u>Yes / No</u>	Cooler Temp on Receipt: <u>°F/C</u>	Trip Blank: <u>Yes / No</u>	MS/MSD Sample Submitted: <u>Yes / No</u>
---	-----------------------------	-------------------------------------	-----------------------------	--

SITE INFORMATION			WELL SAMPLING SCHEDULE				FIELD TESTING			WELL CONSTRUCTION AND SAMPLING VOLUMES										
SITE	CITY	COUNTY	Well ID	1st	2nd	3rd	4th	Purge Method	pH/temp temp.	DO	Redox	well diameter	top of screen	well depth	water depth	Qtr	3 well volumes	free product	Fire Watch	Traffic Control
			MW-2	--	--	--	--	TBD	no	no	no	2	28.0	38.62	15.30	3	11.41	No	Yes	No
Sampler:	Stratus		MW-3	--	--	--	GBOE	TBD	yes	yes	no	4	28.5	38.98	15.12	3	46.70	No	Yes	No
			MW-4	--	GBOE	--	GBOE	TBD	yes	yes	no	4	21.0	26.68	15.47	3	21.94	No	Yes	No
Last sampled:			MW-6	--	GBOE	--	GBOE	TBD	yes	yes	no	4	48.0	66.30	15.32	3	99.78	No	Yes	No
GW Disposal:			MW-7	--	GBOE	--	GBOE	TBD	yes	yes	no	4	48.0	67.45	14.84	3	102.97	No	Yes	No
			MW-8	--	--	--	--	TBD	no	no	no	4	47.0	66.44	14.08	3	102.48	No	Yes	No
Comments: Extra voas for MW-3; bimonthly manual air-bubbling required.			MW-9	--	--	--	GBOE	TBD	yes	yes	no	4	48.0	67.92	14.18	3	105.18	No	Yes	No
			MW-10	--	--	--	GBOE	TBD	yes	yes	no	4	32.0	59.75	14.95	3	87.69	No	No	No
			MW-11	--	GBOE	--	GBOE	TBD	yes	yes	no	2	38.0	45.00		3	22.02	No	No	No
Take Post-Purge D.O. Readings (in a cup) on all sampled wells.			MW-12	--	GBOE	--	GBOE	TBD	yes	yes	no	2	18.0	34.04	16.08	3	8.79	No	No	Yes
			MW-13	--	GBOE	--	GBOE	TBD	yes	yes	no	4	18.0	30.39	15.06	3	30.00	No	Yes	Yes
May need to bring purge water trailer (Oct. Event)			VW-1	--	GBOE	--	GBOE	TBD	yes	yes	no	4	24.0	44.34	13.89	3	59.60	No	Yes	No
			VW-2	--	--	--	--		no	no	no	4	28.0	48.95	14.92	3	66.61	No	Yes	No
			VW-4	--	--	--	--		no	no	no	4	17.0	24.50	14.42	3	19.73	No	Yes	No

GBOE - GRO/BTEX/5 FO + EDB, 1,2-DCA, Ethanol all by 8260

MW-11 Covered in dirt

MW-12 May be gone - new apartment complex under construction

GUAGING FREQUENCY: BIENNIAL (15 wells)

Purge Method:
 P = Purge
 NP = No Purge
 TBD = To Be Determined based on DTW vs. Top of Screen

ORIGINAL

QA/QC: Trip & Temp blanks to be submitted with all sampling events. Contact coordinator if blanks are not supplied with bottle set.
 Trip blanks to be submit "ON HOLD". TB ID = TB - "site#" - "MMDDYYYY" (ex. TB - 6113 - 011807)

O&M (Phase 3)

Comments/Notes:
 Please make the changes ABOVE to the size of the pipe/well diameter for wells 3 & 13 from 4" to 2"

4907
 10/16/07

For Internal Use only	
Stratus Submittal Date:	SH-6/28/07
Broadbent Approval Date:	MH - 4/2/2007

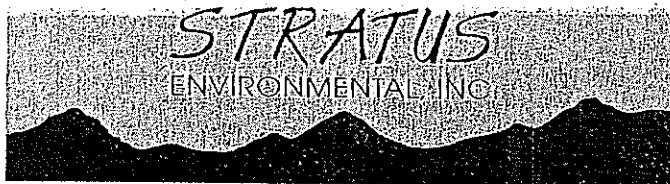

Site Address: 785 East Stanley ORIGINAL
 City Livermore
 Sampled By D. Samella
V. Zalutka

Site Number: ARCO 6113
 Project No. EL113-04
 Project PM JAY JOHNSON
 Date Sampled 10-16-07

Site Contact Phone No.

* - 6 VOA's

Water Level Data					Purge Volume Calculations					Well Purge Method				Sample Record			Field Data	
Well ID	Time	Depth to water feet	Top of Screen feet	Total Depth of Well feet	Casing Water Column (A)	Well Diameter (inches)	Multiplier Value (B)	Three Casing Volumes (gallons)	Actual Water Purged (gallons)	No Purge	Bailer	Pump	Other	DTW At Sample Time	Sample I.D.	Sample Time	Dissolved Oxygen (mg/L)	
MW-1	0630	38.28	29.0	44.45	-	2	.5	-	-	X				-	MW-1	-	-	
MW-2	0620	36.78	28.0	38.10	-	2	.5	-	-	X				-	MW-2	-	-	
MW-3	0638	38.40	28.25	38.85	DRY	2	.5	-	DRY	X	DRY			-	MW-3	N/S	-	
MW-4	0636	26.49	21.0	26.49	DRY	4	2	-	DRY	X	DRY			-	MW-4	N/S	-	
MW-6	0626	37.17	48.0	66.44	29.27	4	2	58.54	58.5			X		37.32	MW-6	0918	4.56 *	
MW-7	0653	37.23	48.0	67.40	30.17	4	2	60.34	60			X		37.32	MW-7	0826	4.87	
MW-8	0658	38.18	47.0	66.45	-	4	2	-	-	X				-	MW-8	-	-	
MW-9	0723	37.75	48.0	67.65	29.90	4	2	59.80	60			X		48.50	MW-9	1003	1.27	
MW-10	0544	38.99	32.0	49.82	-	4	2	-	-	X	X			-	MW-10	0600	2.20	
MW-11	0529	37.11	38.0	44.25	7.14	2	.5	3.57	2.5		X	DRY @ 2.5		38.16	MW-11	0551	.60	
MW-12	0530	33.75	DRY	33.75	DRY	2	.5	-	DRY	X	DRY			-	MW-12	N/S	-	
MW-13	0615	29.85	18.0	29.97	DRY	2	.5	-	DRY	X	DRY			-	MW-13	N/S	-	
VW-1	0715	37.10	24.0	43.98	-	4	2	-	-	X	X			-	VW-1	0719	2.65	
VW-2	0752	38.058	28.0	49.85	-	4	2	-	-	X				-	VW-2	-	-	
VW-4	0657	24.22	17.0	24.22	DRY	4	2	-	DRY	X				-	VW-4	-	-	
TB-6113-10162007																	0600	-
Total									181 gal									

(A) Casing water Column
 Depth wtr. Depth to Bottom

Multiplier Values
 2"=0.5 4"=2.0 6"=4.4



City Livermore, CA
 Site Sampled by D. DeMello
V. Zalutka

Project No. E-6113-04
 Project PM Jay Johnson
 Date Sampled 10-16-07

ORIGINAL

Page 1 of 2

Well ID <u>MW-10 0600</u>					Well ID <u>MW-3 MEASURED/Readings only</u>				
purge start time <u>Back No odor</u>					purge start time <u>Not Sampled - Dry w/ odor!</u>				
	Temp C	pH	cond	gallons		Temp C	pH	cond	gallons
time	<u>18.2</u>	<u>7.36</u>	<u>861</u>	<u>Ø</u>	time	<u>17.2</u>	<u>7.16</u>	<u>663</u>	<u>Ø</u>
time					time				
time					time				
time					time				
purge stop time					purge stop time				
Well ID <u>VW-1 0719</u>					Well ID <u>MW-6 0918</u>				
purge start time <u>Back Odor!</u>					purge start time <u>0840 Odor</u>				
	Temp C	pH	cond	gallons		Temp C	pH	cond	gallons
time	<u>17.2</u>	<u>7.61</u>	<u>839</u>	<u>Ø</u>	time	<u>17.9</u>	<u>7.21</u>	<u>976</u>	<u>Ø</u>
time	<u>402</u>				time	<u>17.8</u>	<u>7.50</u>	<u>886</u>	<u>28</u>
time					time	<u>18.3</u>	<u>10.26</u>	<u>446</u>	<u>58.5</u>
time					time				
purge stop time					purge stop time <u>0908</u>				
Well ID <u>MW-9 1003</u>					Well ID				
purge start time <u>0834 Odor</u>					purge start time				
	Temp C	pH	cond	gallons		Temp C	pH	cond	gallons
time	<u>17.2</u>	<u>8.08</u>	<u>559</u>	<u>Ø</u>	time				
time	<u>17.2</u>	<u>7.85</u>	<u>557</u>	<u>30</u>	time				
time	<u>17.3</u>	<u>7.59</u>	<u>562</u>	<u>60</u>	time				
time					time				
purge stop time <u>0958</u>					purge stop time				
Well ID					Well ID				
purge start time					purge start time				
	Temp C	pH	cond	gallons		Temp C	pH	cond	gallons
time					time				
time					time				
time					time				
time					time				
purge stop time					purge stop time				

DO-(1.06)

100



City Livermore, CA
 Site Sampled by D. Demello
V. Zolotka

Project No. E-6113-04
 Project PM JAY JOHNSON
 Date Sampled 10-16-07

ORIGINAL

Page 2 of 2

Well ID <u>MW-11 0551</u>					Well ID <u>MW-7 0826</u>				
purge start time <u>Basler No Odor</u>					purge start time <u>0735</u> <u>NO Odor</u>				
	Temp C	pH	cond	gallons		Temp C	pH	cond	gallons
time	<u>17.5</u>	<u>7.58</u>	<u>738</u>	<u>2</u>	time	<u>17.3</u>	<u>8.09</u>	<u>694</u>	<u>2</u>
time		<u>Dry @</u>	<u>2-5</u>		time	<u>17.3</u>	<u>7.76</u>	<u>700</u>	<u>30</u>
time	<u>17.5</u>	<u>7.57</u>	<u>711</u>	<u>(2.5)</u>	time	<u>17.9</u>	<u>8.02</u>	<u>644</u>	<u>6</u>
time					time				
purge stop time <u>ORP (65)</u>					purge stop time <u>0808</u>				
Well ID					Well ID				
purge start time					purge start time				
	Temp C	pH	cond	gallons		Temp C	pH	cond	gallons
time					time				
time					time				
time					time				
time					time				
purge stop time					purge stop time				
Well ID					Well ID				
purge start time					purge start time				
	Temp C	pH	cond	gallons		Temp C	pH	cond	gallons
time					time				
time					time				
time					time				
time					time				
purge stop time					purge stop time				
Well ID					Well ID				
purge start time					purge start time				
	Temp C	pH	cond	gallons		Temp C	pH	cond	gallons
time					time				
time					time				
time					time				
time					time				
purge stop time					purge stop time				

Wellhead Observation Form

ORIGINAL

Account: ARCO 6113

Sampled by: D. Demello, V. Zolotka Date: 10-16-07

Well ID	Box in good condition	Lock Missing (Replaced with new)	Water in Box	Bolts Missing	Bolts Stripped	Bolt-Holes Stripped	Cracked or Broken Lid	Cracked Box and/or Bolt-Holes	Misc.	Add'l -- Notes and Other Stuff
MW-1			X	(1)						DIRT IN BOX AT RISER OPENING
2				(2)						
3				(1)						
4	X									
6	X									
7									X	Cover come off w/ Bolts Attached
8				(2)						
9	X									
10	X									
11	X									
12			X							
13	X									
VW-1	X									
VW-2							X			Big STEEL Plate w/ BROKEN HINGES
VW-4							X			Big Lid - Broken Hinges

ORIGINAL

NO. 662221

NON-HAZARDOUS WASTE DATA FORM

TO BE COMPLETED BY GENERATOR	NAME <u>BP WEST COAST PRODUCTS LLC</u> ARCD # <u>715</u>		EPA I.D. NO. NOT REQUIRED															
	ADDRESS <u>P.O. BOX 80249</u> <u>RANCHO SANTA MARGARITA</u>		PROFILE NO. 															
	CITY, STATE, ZIP <u>CA 92688</u>		PHONE NO. () -															
	CONTAINERS: No. _____ VOLUME <u>181</u> WEIGHT _____																	
	TYPE: <input type="checkbox"/> TANK TRUCK <input type="checkbox"/> DUMP TRUCK <input type="checkbox"/> DRUMS <input type="checkbox"/> CARTONS <input type="checkbox"/> OTHER _____																	
WASTE DESCRIPTION <u>NON-HAZARDOUS WATER</u>		GENERATING PROCESS <u>WELL PURGING/DECON WATER</u>																
COMPONENTS OF WASTE PPM %		COMPONENTS OF WASTE PPM %																
1. <u>WATER</u> <u>99-100%</u>		5. _____																
2. <u>TPH</u> <u><1%</u>		6. _____																
3. _____		7. <u>BESI#</u>																
4. _____		8. _____																
PROPERTIES: <u>7-10 pH</u> <input type="checkbox"/> SOLID <input type="checkbox"/> LIQUID <input type="checkbox"/> SLUDGE <input type="checkbox"/> SLURRY <input type="checkbox"/> OTHER _____																		
HANDLING INSTRUCTIONS: <u>WEAR ALL APPROPRIATE PROTECTIVE CLOTHING</u>																		
<div style="border: 1px solid black; padding: 5px; width: fit-content;"> THE GENERATOR CERTIFIES THAT THE WASTE AS DESCRIBED IS 100% NON-HAZARDOUS. </div>		<u>Larry Woodhart</u> TYPED OR PRINTED FULL NAME & SIGNATURE DATE <u>10/16/07</u>																
TRANSPORTER	Transporter #1 <u>STRATUS ENVIRONMENTAL</u>		EPA I.D. NO. 															
	ADDRESS <u>3330 CAMERON PARK DRIVE STE 530</u>		SERVICE ORDER NO. _____															
	CITY, STATE, ZIP <u>CAMERON PARK CA 93682</u>		PICK UP DATE _____															
	PHONE NO. <u>530-676-6004</u>																	
	<u>Vince Zabeltka</u> TYPED OR PRINTED FULL NAME & SIGNATURE DATE <u>10-16-07</u>																	
TSD FACILITY	NAME <u>SEAPORT REFINING & ENVIRONMENTAL, LLC</u>		EPA I.D. NO. 															
	ADDRESS <u>700 SEAPORT BLVD.</u>		DISPOSAL METHOD <input type="checkbox"/> LANDFILL <input type="checkbox"/> OTHER _____															
	CITY, STATE, ZIP <u>REDWOOD CITY, CA 94063</u>																	
	PHONE NO. <u>650-354-1024</u>																	
	_____ TYPED OR PRINTED FULL NAME & SIGNATURE DATE _____																	
<table border="1" style="width:100%; border-collapse: collapse;"> <tr> <td style="width: 25%;">GEN</td> <td style="width: 25%;">OLD/NEW</td> <td style="width: 25%;">L</td> <td style="width: 25%;">A</td> <td rowspan="2">TONS</td> </tr> <tr> <td>TRANS</td> <td></td> <td>S</td> <td>B</td> </tr> <tr> <td>C/Q</td> <td></td> <td>RT/CD</td> <td>HWDF</td> <td>NONE</td> </tr> </table>	GEN	OLD/NEW	L	A	TONS	TRANS		S	B	C/Q		RT/CD	HWDF	NONE	DISCREPANCY _____			
GEN	OLD/NEW	L	A	TONS														
TRANS		S	B															
C/Q		RT/CD	HWDF	NONE														

6 November, 2007

Jay Johnson
Stratus Environmental Inc. [Arco]
3330 Cameron Park Dr., Suite 550
Cameron Park, CA 95682

RE: ARCO #6113, Livermore, CA
Work Order: MQJ0773

Enclosed are the results of analyses for samples received by the laboratory on 10/16/07 21:15. If you have any questions concerning this report, please feel free to contact me.

Sincerely,



Lisa Race
Senior Project Manager

CA ELAP Certificate # 1210

The results in this laboratory report pertain only to the samples tested in the laboratory. The analyses contained in this report were performed in accordance with the BPGCLN Technical Specifications, applicable Federal, State, local regulations and certification requirements as well as the methodologies as described in laboratory SOPs reviewed by the BPGCLN. This entire report was reviewed and approved for release.

Stratus Environmental Inc. [Arco] 3330 Cameron Park Dr., Suite 550 Cameron Park CA, 95682	Project: ARCO #6113, Livermore, CA Project Number: G0C54-0015 Project Manager: Jay Johnson	MQJ0773 Reported: 11/06/07 15:27
---	--	--

ANALYTICAL REPORT FOR SAMPLES

Sample ID	Laboratory ID	Matrix	Date Sampled	Date Received
MW-6	MQJ0773-01	Water	10/16/07 09:18	10/16/07 21:15
MW-7	MQJ0773-02	Water	10/16/07 08:26	10/16/07 21:15
MW-9	MQJ0773-03	Water	10/16/07 10:03	10/16/07 21:15
MW-10	MQJ0773-04	Water	10/16/07 06:00	10/16/07 21:15
MW-11	MQJ0773-05	Water	10/16/07 05:51	10/16/07 21:15
VW-1	MQJ0773-06	Water	10/16/07 07:19	10/16/07 21:15
TB-6113-10162007	MQJ0773-07	Water	10/16/07 06:00	10/16/07 21:15

The carbon range for the TPH-GRO has been changed from C6-C10 to C4-C12. The carbon range for TPH-DRO has been changed from C10-C28 to C10-C36. EPA 8015B has been modified to better meet the requirements of California regulatory agencies.

These samples were received with no custody seals.

Stratus Environmental Inc. [Arco]
3330 Cameron Park Dr., Suite 550
Cameron Park CA, 95682

Project: ARCO #6113, Livermore, CA
Project Number: G0C54-0015
Project Manager: Jay Johnson

MQJ0773
Reported:
11/06/07 15:27

Total Purgeable Hydrocarbons by GC/MS (CA LUFT)
TestAmerica - Morgan Hill, CA

Analyte	Result	Reporting Limit	Units	Dilution	Batch	Prepared	Analyzed	Method	Notes
MW-6 (MQJ0773-01) Water Sampled: 10/16/07 09:18 Received: 10/16/07 21:15									
Gasoline Range Organics (C4-C12)	2700	2500	ug/l	50	7J26010	10/26/07	10/26/07	LUFT GCMS	
Surrogate: 1,2-Dichloroethane-d4		103 %	60-150		"	"	"	"	
Surrogate: Dibromofluoromethane		100 %	75-130		"	"	"	"	
Surrogate: Toluene-d8		100 %	75-120		"	"	"	"	
Surrogate: 4-Bromofluorobenzene		91 %	55-130		"	"	"	"	
MW-7 (MQJ0773-02) Water Sampled: 10/16/07 08:26 Received: 10/16/07 21:15									
Gasoline Range Organics (C4-C12)	140	50	ug/l	1	7J26010	10/26/07	10/26/07	LUFT GCMS	
Surrogate: 1,2-Dichloroethane-d4		114 %	60-150		"	"	"	"	
Surrogate: Dibromofluoromethane		96 %	75-130		"	"	"	"	
Surrogate: Toluene-d8		98 %	75-120		"	"	"	"	
Surrogate: 4-Bromofluorobenzene		88 %	55-130		"	"	"	"	
MW-9 (MQJ0773-03) Water Sampled: 10/16/07 10:03 Received: 10/16/07 21:15									
Gasoline Range Organics (C4-C12)	ND	50	ug/l	1	7J26010	10/26/07	10/26/07	LUFT GCMS	
Surrogate: 1,2-Dichloroethane-d4		108 %	60-150		"	"	"	"	
Surrogate: Dibromofluoromethane		94 %	75-130		"	"	"	"	
Surrogate: Toluene-d8		96 %	75-120		"	"	"	"	
Surrogate: 4-Bromofluorobenzene		85 %	55-130		"	"	"	"	
MW-10 (MQJ0773-04) Water Sampled: 10/16/07 06:00 Received: 10/16/07 21:15									
Gasoline Range Organics (C4-C12)	ND	50	ug/l	1	7J26010	10/26/07	10/26/07	LUFT GCMS	
Surrogate: 1,2-Dichloroethane-d4		110 %	60-150		"	"	"	"	
Surrogate: Dibromofluoromethane		100 %	75-130		"	"	"	"	
Surrogate: Toluene-d8		97 %	75-120		"	"	"	"	
Surrogate: 4-Bromofluorobenzene		88 %	55-130		"	"	"	"	

Stratus Environmental Inc. [Arco]
3330 Cameron Park Dr., Suite 550
Cameron Park CA, 95682

Project: ARCO #6113, Livermore, CA
Project Number: G0C54-0015
Project Manager: Jay Johnson

MQJ0773
Reported:
11/06/07 15:27

Total Purgeable Hydrocarbons by GC/MS (CA LUFT)
TestAmerica - Morgan Hill, CA

Analyte	Result	Reporting Limit	Units	Dilution	Batch	Prepared	Analyzed	Method	Notes
MW-11 (MQJ0773-05) Water Sampled: 10/16/07 05:51 Received: 10/16/07 21:15									
Gasoline Range Organics (C4-C12)	ND	50	ug/l	1	7J29015	10/29/07	10/29/07	LUFT GCMS	
Surrogate: 1,2-Dichloroethane-d4		94 %	60-150		"	"	"	"	
Surrogate: Dibromofluoromethane		97 %	75-130		"	"	"	"	
Surrogate: Toluene-d8		97 %	75-120		"	"	"	"	
Surrogate: 4-Bromofluorobenzene		92 %	55-130		"	"	"	"	
VW-1 (MQJ0773-06) Water Sampled: 10/16/07 07:19 Received: 10/16/07 21:15									
Gasoline Range Organics (C4-C12)	12000	500	ug/l	10	7J29015	10/29/07	10/29/07	LUFT GCMS	
Surrogate: 1,2-Dichloroethane-d4		90 %	60-150		"	"	"	"	
Surrogate: Dibromofluoromethane		94 %	75-130		"	"	"	"	
Surrogate: Toluene-d8		102 %	75-120		"	"	"	"	
Surrogate: 4-Bromofluorobenzene		101 %	55-130		"	"	"	"	

Stratus Environmental Inc. [Arco]
3330 Cameron Park Dr., Suite 550
Cameron Park CA, 95682

Project: ARCO #6113, Livermore, CA
Project Number: G0C54-0015
Project Manager: Jay Johnson

MQJ0773
Reported:
11/06/07 15:27

Volatile Organic Compounds by EPA Method 8260B
TestAmerica - Morgan Hill, CA

Analyte	Result	Reporting Limit	Units	Dilution	Batch	Prepared	Analyzed	Method	Notes
MW-6 (MQJ0773-01) Water Sampled: 10/16/07 09:18 Received: 10/16/07 21:15									
tert-Amyl methyl ether	ND	25	ug/l	50	7J26010	10/26/07	10/26/07	EPA 8260B	
Benzene	240	25	"	"	"	"	"	"	
tert-Butyl alcohol	ND	1000	"	"	"	"	"	"	
Di-isopropyl ether	ND	25	"	"	"	"	"	"	
1,2-Dibromoethane (EDB)	ND	25	"	"	"	"	"	"	
1,2-Dichloroethane	ND	25	"	"	"	"	"	"	
Ethanol	ND	15000	"	"	"	"	"	"	
Ethyl tert-butyl ether	ND	25	"	"	"	"	"	"	
Ethylbenzene	50	25	"	"	"	"	"	"	
Methyl tert-butyl ether	2600	25	"	"	"	"	"	"	BB
Toluene	ND	25	"	"	"	"	"	"	
Xylenes (total)	55	25	"	"	"	"	"	"	
<i>Surrogate: Dibromofluoromethane</i>		100 %	75-130	"	"	"	"	"	
<i>Surrogate: 1,2-Dichloroethane-d4</i>		103 %	60-150	"	"	"	"	"	
<i>Surrogate: Toluene-d8</i>		100 %	75-120	"	"	"	"	"	
<i>Surrogate: 4-Bromofluorobenzene</i>		91 %	55-130	"	"	"	"	"	
MW-7 (MQJ0773-02) Water Sampled: 10/16/07 08:26 Received: 10/16/07 21:15									
tert-Amyl methyl ether	ND	0.50	ug/l	1	7J26010	10/26/07	10/26/07	EPA 8260B	
Benzene	68	0.50	"	"	"	"	"	"	
tert-Butyl alcohol	ND	20	"	"	"	"	"	"	
Di-isopropyl ether	ND	0.50	"	"	"	"	"	"	
1,2-Dibromoethane (EDB)	ND	0.50	"	"	"	"	"	"	
1,2-Dichloroethane	ND	0.50	"	"	"	"	"	"	
Ethanol	ND	300	"	"	"	"	"	"	
Ethyl tert-butyl ether	ND	0.50	"	"	"	"	"	"	
Ethylbenzene	ND	0.50	"	"	"	"	"	"	
Methyl tert-butyl ether	24	0.50	"	"	"	"	"	"	
Toluene	6.8	0.50	"	"	"	"	"	"	
Xylenes (total)	5.0	0.50	"	"	"	"	"	"	
<i>Surrogate: Dibromofluoromethane</i>		96 %	75-130	"	"	"	"	"	
<i>Surrogate: 1,2-Dichloroethane-d4</i>		114 %	60-150	"	"	"	"	"	
<i>Surrogate: Toluene-d8</i>		98 %	75-120	"	"	"	"	"	
<i>Surrogate: 4-Bromofluorobenzene</i>		88 %	55-130	"	"	"	"	"	

Stratus Environmental Inc. [Arco]
3330 Cameron Park Dr., Suite 550
Cameron Park CA, 95682

Project: ARCO #6113, Livermore, CA
Project Number: G0C54-0015
Project Manager: Jay Johnson

MQJ0773
Reported:
11/06/07 15:27

Volatile Organic Compounds by EPA Method 8260B
TestAmerica - Morgan Hill, CA

Analyte	Result	Reporting Limit	Units	Dilution	Batch	Prepared	Analyzed	Method	Notes
MW-9 (MQJ0773-03) Water Sampled: 10/16/07 10:03 Received: 10/16/07 21:15									
tert-Amyl methyl ether	ND	0.50	ug/l	1	7J26010	10/26/07	10/26/07	EPA 8260B	
Benzene	0.83	0.50	"	"	"	"	"	"	
tert-Butyl alcohol	ND	20	"	"	"	"	"	"	
Di-isopropyl ether	ND	0.50	"	"	"	"	"	"	
1,2-Dibromoethane (EDB)	ND	0.50	"	"	"	"	"	"	
1,2-Dichloroethane	ND	0.50	"	"	"	"	"	"	
Ethanol	ND	300	"	"	"	"	"	"	
Ethyl tert-butyl ether	ND	0.50	"	"	"	"	"	"	
Ethylbenzene	ND	0.50	"	"	"	"	"	"	
Methyl tert-butyl ether	ND	0.50	"	"	"	"	"	"	
Toluene	ND	0.50	"	"	"	"	"	"	
Xylenes (total)	ND	0.50	"	"	"	"	"	"	
<i>Surrogate: Dibromofluoromethane</i>		94 %	75-130	"	"	"	"	"	
<i>Surrogate: 1,2-Dichloroethane-d4</i>		108 %	60-150	"	"	"	"	"	
<i>Surrogate: Toluene-d8</i>		96 %	75-120	"	"	"	"	"	
<i>Surrogate: 4-Bromofluorobenzene</i>		85 %	55-130	"	"	"	"	"	
MW-10 (MQJ0773-04) Water Sampled: 10/16/07 06:00 Received: 10/16/07 21:15									
tert-Amyl methyl ether	ND	0.50	ug/l	1	7J26010	10/26/07	10/26/07	EPA 8260B	
Benzene	ND	0.50	"	"	"	"	"	"	
tert-Butyl alcohol	ND	20	"	"	"	"	"	"	
Di-isopropyl ether	ND	0.50	"	"	"	"	"	"	
1,2-Dibromoethane (EDB)	ND	0.50	"	"	"	"	"	"	
1,2-Dichloroethane	ND	0.50	"	"	"	"	"	"	
Ethanol	ND	300	"	"	"	"	"	"	
Ethyl tert-butyl ether	ND	0.50	"	"	"	"	"	"	
Ethylbenzene	ND	0.50	"	"	"	"	"	"	
Methyl tert-butyl ether	ND	0.50	"	"	"	"	"	"	
Toluene	ND	0.50	"	"	"	"	"	"	
Xylenes (total)	ND	0.50	"	"	"	"	"	"	
<i>Surrogate: Dibromofluoromethane</i>		100 %	75-130	"	"	"	"	"	
<i>Surrogate: 1,2-Dichloroethane-d4</i>		110 %	60-150	"	"	"	"	"	
<i>Surrogate: Toluene-d8</i>		97 %	75-120	"	"	"	"	"	
<i>Surrogate: 4-Bromofluorobenzene</i>		88 %	55-130	"	"	"	"	"	

Stratus Environmental Inc. [Arco]
3330 Cameron Park Dr., Suite 550
Cameron Park CA, 95682

Project: ARCO #6113, Livermore, CA
Project Number: G0C54-0015
Project Manager: Jay Johnson

MQJ0773
Reported:
11/06/07 15:27

Volatile Organic Compounds by EPA Method 8260B
TestAmerica - Morgan Hill, CA

Analyte	Result	Reporting Limit	Units	Dilution	Batch	Prepared	Analyzed	Method	Notes
MW-11 (MQJ0773-05) Water Sampled: 10/16/07 05:51 Received: 10/16/07 21:15									
tert-Amyl methyl ether	ND	0.50	ug/l	1	7J29015	10/29/07	10/29/07	EPA 8260B	
Benzene	ND	0.50	"	"	"	"	"	"	
tert-Butyl alcohol	ND	20	"	"	"	"	"	"	
Di-isopropyl ether	ND	0.50	"	"	"	"	"	"	
1,2-Dibromoethane (EDB)	ND	0.50	"	"	"	"	"	"	
1,2-Dichloroethane	ND	0.50	"	"	"	"	"	"	
Ethanol	ND	300	"	"	"	"	"	"	
Ethyl tert-butyl ether	ND	0.50	"	"	"	"	"	"	
Ethylbenzene	ND	0.50	"	"	"	"	"	"	
Methyl tert-butyl ether	6.6	0.50	"	"	"	"	"	"	
Toluene	ND	0.50	"	"	"	"	"	"	
Xylenes (total)	ND	0.50	"	"	"	"	"	"	
<i>Surrogate: Dibromofluoromethane</i>		97 %	75-130	"	"	"	"	"	
<i>Surrogate: 1,2-Dichloroethane-d4</i>		94 %	60-150	"	"	"	"	"	
<i>Surrogate: Toluene-d8</i>		97 %	75-120	"	"	"	"	"	
<i>Surrogate: 4-Bromofluorobenzene</i>		92 %	55-130	"	"	"	"	"	
VW-1 (MQJ0773-06) Water Sampled: 10/16/07 07:19 Received: 10/16/07 21:15									
tert-Amyl methyl ether	ND	25	ug/l	50	7J30001	10/29/07	10/30/07	EPA 8260B	
Benzene	2300	25	"	"	"	"	"	"	
tert-Butyl alcohol	ND	1000	"	"	"	"	"	"	
Di-isopropyl ether	ND	25	"	"	"	"	"	"	
1,2-Dibromoethane (EDB)	ND	25	"	"	"	"	"	"	
1,2-Dichloroethane	ND	25	"	"	"	"	"	"	
Ethanol	ND	15000	"	"	"	"	"	"	IC
Ethyl tert-butyl ether	ND	25	"	"	"	"	"	"	
Ethylbenzene	860	25	"	"	"	"	"	"	
Methyl tert-butyl ether	150	25	"	"	"	"	"	"	
Toluene	1900	25	"	"	"	"	"	"	
Xylenes (total)	2800	25	"	"	"	"	"	"	
<i>Surrogate: Dibromofluoromethane</i>		101 %	75-130	"	"	"	"	"	
<i>Surrogate: 1,2-Dichloroethane-d4</i>		96 %	60-150	"	"	"	"	"	
<i>Surrogate: Toluene-d8</i>		98 %	75-120	"	"	"	"	"	
<i>Surrogate: 4-Bromofluorobenzene</i>		98 %	55-130	"	"	"	"	"	

Stratus Environmental Inc. [Arco]
3330 Cameron Park Dr., Suite 550
Cameron Park CA, 95682

Project: ARCO #6113, Livermore, CA
Project Number: G0C54-0015
Project Manager: Jay Johnson

MQJ0773
Reported:
11/06/07 15:27

Total Purgeable Hydrocarbons by GC/MS (CA LUFT) - Quality Control
TestAmerica - Morgan Hill, CA

Analyte	Result	Reporting Limit	Units	Spike Level	Source Result	%REC	%REC Limits	RPD	RPD Limit	Notes
---------	--------	-----------------	-------	-------------	---------------	------	-------------	-----	-----------	-------

Batch 7J26010 - EPA 5030B P/T / LUFT GCMS

Blank (7J26010-BLK1)

Prepared & Analyzed: 10/26/07

Gasoline Range Organics (C4-C12)	ND	50	ug/l							
Surrogate: 1,2-Dichloroethane-d4	2.45		"	2.50		98	60-150			
Surrogate: Dibromofluoromethane	2.39		"	2.50		96	75-130			
Surrogate: Toluene-d8	2.54		"	2.50		102	75-120			
Surrogate: 4-Bromofluorobenzene	2.29		"	2.50		92	55-130			

Laboratory Control Sample (7J26010-BS2)

Prepared & Analyzed: 10/26/07

Gasoline Range Organics (C4-C12)	507	50	ug/l	500		101	55-130			
Surrogate: 1,2-Dichloroethane-d4	2.37		"	2.50		95	60-150			
Surrogate: Dibromofluoromethane	2.40		"	2.50		96	75-130			
Surrogate: Toluene-d8	2.59		"	2.50		104	75-120			
Surrogate: 4-Bromofluorobenzene	2.53		"	2.50		101	55-130			

Laboratory Control Sample Dup (7J26010-BSD2)

Prepared & Analyzed: 10/26/07

Gasoline Range Organics (C4-C12)	514	50	ug/l	500		103	55-130	1	20	
Surrogate: 1,2-Dichloroethane-d4	2.46		"	2.50		98	60-150			
Surrogate: Dibromofluoromethane	2.40		"	2.50		96	75-130			
Surrogate: Toluene-d8	2.59		"	2.50		104	75-120			
Surrogate: 4-Bromofluorobenzene	2.54		"	2.50		102	55-130			

Matrix Spike (7J26010-MS1)

Source: MQJ0773-01

Prepared & Analyzed: 10/26/07

Gasoline Range Organics (C4-C12)	30400	2500	ug/l	27500	2690	101	25-150			
Surrogate: 1,2-Dichloroethane-d4	2.54		"	2.50		102	60-150			
Surrogate: Dibromofluoromethane	2.52		"	2.50		101	75-130			
Surrogate: Toluene-d8	2.54		"	2.50		102	75-120			
Surrogate: 4-Bromofluorobenzene	2.54		"	2.50		102	55-130			

Matrix Spike Dup (7J26010-MSD1)

Source: MQJ0773-01

Prepared & Analyzed: 10/26/07

Gasoline Range Organics (C4-C12)	31200	2500	ug/l	27500	2690	104	25-150	2	20	
Surrogate: 1,2-Dichloroethane-d4	2.46		"	2.50		98	60-150			
Surrogate: Dibromofluoromethane	2.59		"	2.50		104	75-130			
Surrogate: Toluene-d8	2.54		"	2.50		102	75-120			
Surrogate: 4-Bromofluorobenzene	2.52		"	2.50		101	55-130			

Stratus Environmental Inc. [Arco]
3330 Cameron Park Dr., Suite 550
Cameron Park CA, 95682

Project: ARCO #6113, Livermore, CA
Project Number: G0C54-0015
Project Manager: Jay Johnson

MQJ0773
Reported:
11/06/07 15:27

Total Purgeable Hydrocarbons by GC/MS (CA LUFT) - Quality Control
TestAmerica - Morgan Hill, CA

Analyte	Result	Reporting Limit	Units	Spike Level	Source Result	%REC	%REC Limits	RPD	RPD Limit	Notes
---------	--------	-----------------	-------	-------------	---------------	------	-------------	-----	-----------	-------

Batch 7J29015 - EPA 5030B P/T / LUFT GCMS

Blank (7J29015-BLK1)

Prepared & Analyzed: 10/29/07

Gasoline Range Organics (C4-C12)	ND	50	ug/l							
Surrogate: 1,2-Dichloroethane-d4	2.11		"	2.50		84	60-150			
Surrogate: Dibromofluoromethane	2.31		"	2.50		92	75-130			
Surrogate: Toluene-d8	2.43		"	2.50		97	75-120			
Surrogate: 4-Bromofluorobenzene	2.20		"	2.50		88	55-130			

Laboratory Control Sample (7J29015-BS2)

Prepared & Analyzed: 10/29/07

Gasoline Range Organics (C4-C12)	467	50	ug/l	500		93	55-130			
Surrogate: 1,2-Dichloroethane-d4	2.40		"	2.50		96	60-150			
Surrogate: Dibromofluoromethane	2.49		"	2.50		100	75-130			
Surrogate: Toluene-d8	2.57		"	2.50		103	75-120			
Surrogate: 4-Bromofluorobenzene	2.47		"	2.50		99	55-130			

Laboratory Control Sample Dup (7J29015-BSD2)

Prepared & Analyzed: 10/29/07

Gasoline Range Organics (C4-C12)	452	50	ug/l	500		90	55-130	3	20	
Surrogate: 1,2-Dichloroethane-d4	2.29		"	2.50		92	60-150			
Surrogate: Dibromofluoromethane	2.34		"	2.50		94	75-130			
Surrogate: Toluene-d8	2.51		"	2.50		100	75-120			
Surrogate: 4-Bromofluorobenzene	2.55		"	2.50		102	55-130			

Matrix Spike (7J29015-MS1)

Source: MQJ0773-05

Prepared & Analyzed: 10/29/07

Gasoline Range Organics (C4-C12)	467	50	ug/l	550	ND	85	25-150			
Surrogate: 1,2-Dichloroethane-d4	2.29		"	2.50		92	60-150			
Surrogate: Dibromofluoromethane	2.35		"	2.50		94	75-130			
Surrogate: Toluene-d8	2.44		"	2.50		98	75-120			
Surrogate: 4-Bromofluorobenzene	2.19		"	2.50		88	55-130			

Matrix Spike Dup (7J29015-MSD1)

Source: MQJ0773-05

Prepared & Analyzed: 10/29/07

Gasoline Range Organics (C4-C12)	470	50	ug/l	550	ND	85	25-150	0.5	20	
Surrogate: 1,2-Dichloroethane-d4	2.24		"	2.50		90	60-150			
Surrogate: Dibromofluoromethane	2.54		"	2.50		102	75-130			
Surrogate: Toluene-d8	2.49		"	2.50		100	75-120			
Surrogate: 4-Bromofluorobenzene	2.31		"	2.50		92	55-130			

Stratus Environmental Inc. [Arco]
3330 Cameron Park Dr., Suite 550
Cameron Park CA, 95682

Project: ARCO #6113, Livermore, CA
Project Number: G0C54-0015
Project Manager: Jay Johnson

MQJ0773
Reported:
11/06/07 15:27

Volatile Organic Compounds by EPA Method 8260B - Quality Control
TestAmerica - Morgan Hill, CA

Analyte	Result	Reporting Limit	Units	Spike Level	Source Result	%REC	%REC Limits	RPD	RPD Limit	Notes
---------	--------	-----------------	-------	-------------	---------------	------	-------------	-----	-----------	-------

Batch 7J26010 - EPA 5030B P/T / EPA 8260B

Blank (7J26010-BLK1)				Prepared & Analyzed: 10/26/07						
tert-Amyl methyl ether	ND	0.50	ug/l							
Benzene	ND	0.50	"							
tert-Butyl alcohol	ND	5.0	"							
Di-isopropyl ether	ND	0.50	"							
1,2-Dibromoethane (EDB)	ND	0.50	"							
1,2-Dichloroethane	ND	0.50	"							
Ethanol	ND	300	"							
Ethyl tert-butyl ether	ND	0.50	"							
Ethylbenzene	ND	0.50	"							
Methyl tert-butyl ether	ND	0.50	"							
Toluene	ND	0.50	"							
Xylenes (total)	ND	0.50	"							
<i>Surrogate: Dibromofluoromethane</i>	2.39		"	2.50		96	75-130			
<i>Surrogate: 1,2-Dichloroethane-d4</i>	2.45		"	2.50		98	60-150			
<i>Surrogate: Toluene-d8</i>	2.54		"	2.50		102	75-120			
<i>Surrogate: 4-Bromofluorobenzene</i>	2.29		"	2.50		92	55-130			

Laboratory Control Sample (7J26010-BS1)				Prepared & Analyzed: 10/26/07						
tert-Amyl methyl ether	12.4	0.50	ug/l	10.0		124	75-125			
Benzene	10.4	0.50	"	10.0		104	75-120			
tert-Butyl alcohol	203	5.0	"	200		102	80-120			
Di-isopropyl ether	12.8	0.50	"	10.0		128	70-130			
1,2-Dibromoethane (EDB)	10.8	0.50	"	10.0		108	75-130			
1,2-Dichloroethane	10.5	0.50	"	10.0		105	65-130			
Ethanol	222	300	"	200		111	50-150			
Ethyl tert-butyl ether	12.5	0.50	"	10.0		125	75-130			
Ethylbenzene	11.1	0.50	"	10.0		111	80-125			
Methyl tert-butyl ether	10.9	0.50	"	10.0		109	80-130			
Toluene	10.4	0.50	"	10.0		104	80-120			
Xylenes (total)	31.4	0.50	"	30.0		105	80-125			
<i>Surrogate: Dibromofluoromethane</i>	2.49		"	2.50		100	75-130			
<i>Surrogate: 1,2-Dichloroethane-d4</i>	2.48		"	2.50		99	60-150			
<i>Surrogate: Toluene-d8</i>	2.58		"	2.50		103	75-120			
<i>Surrogate: 4-Bromofluorobenzene</i>	2.52		"	2.50		101	55-130			

Stratus Environmental Inc. [Arco]
3330 Cameron Park Dr., Suite 550
Cameron Park CA, 95682

Project: ARCO #6113, Livermore, CA
Project Number: G0C54-0015
Project Manager: Jay Johnson

MQJ0773
Reported:
11/06/07 15:27

Volatile Organic Compounds by EPA Method 8260B - Quality Control
TestAmerica - Morgan Hill, CA

Analyte	Result	Reporting Limit	Units	Spike Level	Source Result	%REC	%REC Limits	RPD	RPD Limit	Notes
---------	--------	-----------------	-------	-------------	---------------	------	-------------	-----	-----------	-------

Batch 7J26010 - EPA 5030B P/T / EPA 8260B

Matrix Spike (7J26010-MS1)	Source: MQJ0773-01			Prepared & Analyzed: 10/26/07						
tert-Amyl methyl ether	608	25	ug/l	500	ND	122	75-140			
Benzene	738	25	"	500	241	99	80-120			
tert-Butyl alcohol	9600	250	"	10000	210	94	80-125			
Di-isopropyl ether	645	25	"	500	ND	129	75-135			
1,2-Dibromoethane (EDB)	521	25	"	500	ND	104	80-135			
1,2-Dichloroethane	528	25	"	500	ND	106	65-145			
Ethanol	11000	15000	"	10000	ND	110	50-150			
Ethyl tert-butyl ether	621	25	"	500	ND	124	80-135			
Ethylbenzene	584	25	"	500	49.5	107	75-130			
Methyl tert-butyl ether	3070	25	"	500	2600	95	75-145			BB
Toluene	500	25	"	500	12.5	97	80-125			
Xylenes (total)	1520	25	"	1500	55.0	98	75-125			
<i>Surrogate: Dibromofluoromethane</i>	2.52		"	2.50		101	75-130			
<i>Surrogate: 1,2-Dichloroethane-d4</i>	2.54		"	2.50		102	60-150			
<i>Surrogate: Toluene-d8</i>	2.54		"	2.50		102	75-120			
<i>Surrogate: 4-Bromofluorobenzene</i>	2.54		"	2.50		102	55-130			

Matrix Spike Dup (7J26010-MSD1)	Source: MQJ0773-01			Prepared & Analyzed: 10/26/07						
tert-Amyl methyl ether	599	25	ug/l	500	ND	120	75-140	1	25	
Benzene	746	25	"	500	241	101	80-120	1	20	
tert-Butyl alcohol	10200	250	"	10000	210	100	80-125	6	25	
Di-isopropyl ether	643	25	"	500	ND	129	75-135	0.3	25	
1,2-Dibromoethane (EDB)	518	25	"	500	ND	104	80-135	0.7	30	
1,2-Dichloroethane	526	25	"	500	ND	105	65-145	0.5	25	
Ethanol	12500	15000	"	10000	ND	125	50-150	13	25	
Ethyl tert-butyl ether	632	25	"	500	ND	126	80-135	2	25	
Ethylbenzene	614	25	"	500	49.5	113	75-130	5	20	
Methyl tert-butyl ether	2930	25	"	500	2600	65	75-145	5	25	BB
Toluene	516	25	"	500	12.5	101	80-125	3	25	
Xylenes (total)	1620	25	"	1500	55.0	104	75-125	6	20	
<i>Surrogate: Dibromofluoromethane</i>	2.59		"	2.50		104	75-130			
<i>Surrogate: 1,2-Dichloroethane-d4</i>	2.46		"	2.50		98	60-150			
<i>Surrogate: Toluene-d8</i>	2.54		"	2.50		102	75-120			
<i>Surrogate: 4-Bromofluorobenzene</i>	2.52		"	2.50		101	55-130			

Stratus Environmental Inc. [Arco]
3330 Cameron Park Dr., Suite 550
Cameron Park CA, 95682

Project: ARCO #6113, Livermore, CA
Project Number: G0C54-0015
Project Manager: Jay Johnson

MQJ0773
Reported:
11/06/07 15:27

Volatile Organic Compounds by EPA Method 8260B - Quality Control
TestAmerica - Morgan Hill, CA

Analyte	Result	Reporting Limit	Units	Spike Level	Source Result	%REC	%REC Limits	RPD	RPD Limit	Notes
---------	--------	-----------------	-------	-------------	---------------	------	-------------	-----	-----------	-------

Batch 7J29015 - EPA 5030B P/T / EPA 8260B

Blank (7J29015-BLK1)				Prepared & Analyzed: 10/29/07						
tert-Amyl methyl ether	ND	0.50	ug/l							
Benzene	ND	0.50	"							
tert-Butyl alcohol	ND	5.0	"							
Di-isopropyl ether	ND	0.50	"							
1,2-Dibromoethane (EDB)	ND	0.50	"							
1,2-Dichloroethane	ND	0.50	"							
Ethanol	ND	300	"							
Ethyl tert-butyl ether	ND	0.50	"							
Ethylbenzene	ND	0.50	"							
Methyl tert-butyl ether	ND	0.50	"							
Toluene	ND	0.50	"							
Xylenes (total)	ND	0.50	"							
<i>Surrogate: Dibromofluoromethane</i>	2.31		"	2.50		92	75-130			
<i>Surrogate: 1,2-Dichloroethane-d4</i>	2.11		"	2.50		84	60-150			
<i>Surrogate: Toluene-d8</i>	2.43		"	2.50		97	75-120			
<i>Surrogate: 4-Bromofluorobenzene</i>	2.20		"	2.50		88	55-130			

Laboratory Control Sample (7J29015-BS1)				Prepared & Analyzed: 10/29/07						
tert-Amyl methyl ether	11.1	0.50	ug/l	10.0		111	75-125			
Benzene	10.2	0.50	"	10.0		102	75-120			
tert-Butyl alcohol	191	5.0	"	200		96	80-120			
Di-isopropyl ether	10.2	0.50	"	10.0		102	70-130			
1,2-Dibromoethane (EDB)	12.8	0.50	"	10.0		128	75-130			
1,2-Dichloroethane	10.3	0.50	"	10.0		103	65-130			
Ethanol	242	300	"	200		121	50-150			
Ethyl tert-butyl ether	11.1	0.50	"	10.0		111	75-130			
Ethylbenzene	9.95	0.50	"	10.0		100	80-125			
Methyl tert-butyl ether	11.3	0.50	"	10.0		113	80-130			
Toluene	10.1	0.50	"	10.0		101	80-120			
Xylenes (total)	29.4	0.50	"	30.0		98	80-125			
<i>Surrogate: Dibromofluoromethane</i>	2.42		"	2.50		97	75-130			
<i>Surrogate: 1,2-Dichloroethane-d4</i>	2.41		"	2.50		96	60-150			
<i>Surrogate: Toluene-d8</i>	2.49		"	2.50		100	75-120			
<i>Surrogate: 4-Bromofluorobenzene</i>	2.17		"	2.50		87	55-130			

Stratus Environmental Inc. [Arco]
3330 Cameron Park Dr., Suite 550
Cameron Park CA, 95682

Project: ARCO #6113, Livermore, CA
Project Number: G0C54-0015
Project Manager: Jay Johnson

MQJ0773
Reported:
11/06/07 15:27

Volatile Organic Compounds by EPA Method 8260B - Quality Control
TestAmerica - Morgan Hill, CA

Analyte	Result	Reporting Limit	Units	Spike Level	Source Result	%REC	%REC Limits	RPD	RPD Limit	Notes
---------	--------	-----------------	-------	-------------	---------------	------	-------------	-----	-----------	-------

Batch 7J29015 - EPA 5030B P/T / EPA 8260B

Matrix Spike (7J29015-MS1)	Source: MQJ0773-05			Prepared & Analyzed: 10/29/07						
tert-Amyl methyl ether	10.2	0.50	ug/l	10.0	ND	102	75-140			
Benzene	9.93	0.50	"	10.0	ND	99	80-120			
tert-Butyl alcohol	189	5.0	"	200	5.37	92	80-125			
Di-isopropyl ether	9.76	0.50	"	10.0	ND	98	75-135			
1,2-Dibromoethane (EDB)	11.1	0.50	"	10.0	ND	111	80-135			
1,2-Dichloroethane	9.94	0.50	"	10.0	0.350	96	65-145			
Ethanol	191	300	"	200	ND	96	50-150			
Ethyl tert-butyl ether	9.75	0.50	"	10.0	ND	98	80-135			
Ethylbenzene	10.1	0.50	"	10.0	ND	101	75-130			
Methyl tert-butyl ether	15.6	0.50	"	10.0	6.56	90	75-145			
Toluene	9.76	0.50	"	10.0	ND	98	80-125			
Xylenes (total)	29.6	0.50	"	30.0	ND	99	75-125			
<i>Surrogate: Dibromofluoromethane</i>	2.35		"	2.50		94	75-130			
<i>Surrogate: 1,2-Dichloroethane-d4</i>	2.29		"	2.50		92	60-150			
<i>Surrogate: Toluene-d8</i>	2.44		"	2.50		98	75-120			
<i>Surrogate: 4-Bromofluorobenzene</i>	2.19		"	2.50		88	55-130			

Matrix Spike Dup (7J29015-MSD1)	Source: MQJ0773-05			Prepared & Analyzed: 10/29/07						
tert-Amyl methyl ether	10.3	0.50	ug/l	10.0	ND	103	75-140	1	25	
Benzene	10.0	0.50	"	10.0	ND	100	80-120	1	20	
tert-Butyl alcohol	192	5.0	"	200	5.37	93	80-125	1	25	
Di-isopropyl ether	9.79	0.50	"	10.0	ND	98	75-135	0.3	25	
1,2-Dibromoethane (EDB)	11.4	0.50	"	10.0	ND	114	80-135	2	30	
1,2-Dichloroethane	9.94	0.50	"	10.0	0.350	96	65-145	0	25	
Ethanol	201	300	"	200	ND	100	50-150	5	25	
Ethyl tert-butyl ether	10.1	0.50	"	10.0	ND	101	80-135	4	25	
Ethylbenzene	10.0	0.50	"	10.0	ND	100	75-130	0.6	20	
Methyl tert-butyl ether	15.8	0.50	"	10.0	6.56	92	75-145	1	25	
Toluene	9.80	0.50	"	10.0	ND	98	80-125	0.4	25	
Xylenes (total)	29.2	0.50	"	30.0	ND	97	75-125	1	20	
<i>Surrogate: Dibromofluoromethane</i>	2.54		"	2.50		102	75-130			
<i>Surrogate: 1,2-Dichloroethane-d4</i>	2.24		"	2.50		90	60-150			
<i>Surrogate: Toluene-d8</i>	2.49		"	2.50		100	75-120			
<i>Surrogate: 4-Bromofluorobenzene</i>	2.31		"	2.50		92	55-130			

TestAmerica - Morgan Hill, CA

The results in this report apply to the samples analyzed in accordance with the chain of custody document. Unless otherwise stated, results are reported on a wet weight basis. This analytical report must be reproduced in its entirety.

Stratus Environmental Inc. [Arco]
3330 Cameron Park Dr., Suite 550
Cameron Park CA, 95682

Project: ARCO #6113, Livermore, CA
Project Number: G0C54-0015
Project Manager: Jay Johnson

MQJ0773
Reported:
11/06/07 15:27

Volatile Organic Compounds by EPA Method 8260B - Quality Control
TestAmerica - Morgan Hill, CA

Analyte	Result	Reporting Limit	Units	Spike Level	Source Result	%REC	%REC Limits	RPD	RPD Limit	Notes
---------	--------	-----------------	-------	-------------	---------------	------	-------------	-----	-----------	-------

Batch 7J30001 - EPA 5030B P/T / EPA 8260B

Blank (7J30001-BLK1)

Prepared & Analyzed: 10/30/07

tert-Amyl methyl ether	ND	0.50	ug/l							
Benzene	ND	0.50	"							
tert-Butyl alcohol	ND	20	"							
Di-isopropyl ether	ND	0.50	"							
1,2-Dibromoethane (EDB)	ND	0.50	"							
1,2-Dichloroethane	ND	0.50	"							
Ethanol	ND	300	"							
Ethyl tert-butyl ether	ND	0.50	"							
Ethylbenzene	ND	0.50	"							
Methyl tert-butyl ether	ND	0.50	"							
Toluene	ND	0.50	"							
Xylenes (total)	ND	0.50	"							
<i>Surrogate: Dibromofluoromethane</i>	2.58		"	2.50		103	75-130			
<i>Surrogate: 1,2-Dichloroethane-d4</i>	2.43		"	2.50		97	60-150			
<i>Surrogate: Toluene-d8</i>	2.38		"	2.50		95	75-120			
<i>Surrogate: 4-Bromofluorobenzene</i>	2.22		"	2.50		89	55-130			

Laboratory Control Sample (7J30001-BS1)

Prepared & Analyzed: 10/30/07

tert-Amyl methyl ether	10.2	0.50	ug/l	10.0		102	75-125			
Benzene	8.55	0.50	"	10.0		86	75-120			
tert-Butyl alcohol	185	20	"	200		93	80-120			
Di-isopropyl ether	9.79	0.50	"	10.0		98	70-130			
1,2-Dibromoethane (EDB)	11.1	0.50	"	10.0		111	75-130			
1,2-Dichloroethane	9.06	0.50	"	10.0		91	65-130			
Ethanol	174	300	"	200		87	50-150			
Ethyl tert-butyl ether	9.94	0.50	"	10.0		99	75-130			
Ethylbenzene	9.25	0.50	"	10.0		92	80-125			
Methyl tert-butyl ether	7.98	0.50	"	10.0		80	80-130			
Toluene	9.33	0.50	"	10.0		93	80-120			
Xylenes (total)	28.7	0.50	"	30.0		96	80-125			
<i>Surrogate: Dibromofluoromethane</i>	2.65		"	2.50		106	75-130			
<i>Surrogate: 1,2-Dichloroethane-d4</i>	2.37		"	2.50		95	60-150			
<i>Surrogate: Toluene-d8</i>	2.49		"	2.50		100	75-120			
<i>Surrogate: 4-Bromofluorobenzene</i>	2.58		"	2.50		103	55-130			

Stratus Environmental Inc. [Arco]
3330 Cameron Park Dr., Suite 550
Cameron Park CA, 95682

Project: ARCO #6113, Livermore, CA
Project Number: G0C54-0015
Project Manager: Jay Johnson

MQJ0773
Reported:
11/06/07 15:27

Volatile Organic Compounds by EPA Method 8260B - Quality Control
TestAmerica - Morgan Hill, CA

Analyte	Result	Reporting Limit	Units	Spike Level	Source Result	%REC	%REC Limits	RPD	RPD Limit	Notes
---------	--------	-----------------	-------	-------------	---------------	------	-------------	-----	-----------	-------

Batch 7J30001 - EPA 5030B P/T / EPA 8260B

Matrix Spike (7J30001-MS1)	Source: MQJ0847-17			Prepared & Analyzed: 10/30/07						
tert-Amyl methyl ether	11.5	0.50	ug/l	10.0	ND	115	75-140			
Benzene	9.08	0.50	"	10.0	ND	91	80-120			
tert-Butyl alcohol	198	20	"	200	ND	99	80-125			
Di-isopropyl ether	10.9	0.50	"	10.0	ND	109	75-135			
1,2-Dibromoethane (EDB)	12.3	0.50	"	10.0	ND	123	80-135			
1,2-Dichloroethane	10.1	0.50	"	10.0	ND	101	65-145			
Ethanol	164	300	"	200	ND	82	50-150			
Ethyl tert-butyl ether	11.3	0.50	"	10.0	ND	113	80-135			
Ethylbenzene	9.51	0.50	"	10.0	ND	95	75-130			
Methyl tert-butyl ether	9.41	0.50	"	10.0	0.580	88	75-145			
Toluene	9.73	0.50	"	10.0	ND	97	80-125			
Xylenes (total)	29.6	0.50	"	30.0	ND	99	75-125			
<i>Surrogate: Dibromofluoromethane</i>	2.70		"	2.50		108	75-130			
<i>Surrogate: 1,2-Dichloroethane-d4</i>	2.56		"	2.50		102	60-150			
<i>Surrogate: Toluene-d8</i>	2.50		"	2.50		100	75-120			
<i>Surrogate: 4-Bromofluorobenzene</i>	2.52		"	2.50		101	55-130			

Matrix Spike Dup (7J30001-MSD1)	Source: MQJ0847-17			Prepared & Analyzed: 10/30/07						
tert-Amyl methyl ether	11.5	0.50	ug/l	10.0	ND	115	75-140	0.2	25	
Benzene	8.96	0.50	"	10.0	ND	90	80-120	1	20	
tert-Butyl alcohol	191	20	"	200	ND	95	80-125	4	25	
Di-isopropyl ether	11.0	0.50	"	10.0	ND	110	75-135	1	25	
1,2-Dibromoethane (EDB)	11.9	0.50	"	10.0	ND	119	80-135	3	30	
1,2-Dichloroethane	10.4	0.50	"	10.0	ND	104	65-145	2	25	
Ethanol	159	300	"	200	ND	80	50-150	3	25	
Ethyl tert-butyl ether	11.2	0.50	"	10.0	ND	112	80-135	0.3	25	
Ethylbenzene	9.44	0.50	"	10.0	ND	94	75-130	0.7	20	
Methyl tert-butyl ether	9.62	0.50	"	10.0	0.580	90	75-145	2	25	
Toluene	9.79	0.50	"	10.0	ND	98	80-125	0.6	25	
Xylenes (total)	30.0	0.50	"	30.0	ND	100	75-125	1	20	
<i>Surrogate: Dibromofluoromethane</i>	2.81		"	2.50		112	75-130			
<i>Surrogate: 1,2-Dichloroethane-d4</i>	2.63		"	2.50		105	60-150			
<i>Surrogate: Toluene-d8</i>	2.49		"	2.50		100	75-120			
<i>Surrogate: 4-Bromofluorobenzene</i>	2.57		"	2.50		103	55-130			

TestAmerica - Morgan Hill, CA

The results in this report apply to the samples analyzed in accordance with the chain of custody document. Unless otherwise stated, results are reported on a wet weight basis. This analytical report must be reproduced in its entirety.

Stratus Environmental Inc. [Arco]
3330 Cameron Park Dr., Suite 550
Cameron Park CA, 95682

Project: ARCO #6113, Livermore, CA
Project Number: G0C54-0015
Project Manager: Jay Johnson

MQJ0773
Reported:
11/06/07 15:27

Notes and Definitions

IC Calib. verif. is within method limits but outside contract limits
BB Sample > 4x spike concentration
DET Analyte DETECTED
ND Analyte NOT DETECTED at or above the reporting limit or MDL, if MDL is specified
NR Not Reported
dry Sample results reported on a dry weight basis
RPD Relative Percent Difference



bp
A BP affiliated company

Chain of Custody Record

Project Name: ARCO 6113
 BP BU/AR Region/Enfos Segment: BP > Americas > West > Retail > Alameda > 6113
 State or Lead Regulatory Agency: _____
 Requested Due Date (mm/dd/yy): STO-TAT

On-site Time: <u>0430</u>	Temp: <u>60's</u>
Off-site Time: <u>1030</u>	Temp: <u>60's</u>
Sky Conditions: <u>OVERCAST/Cloudy</u>	
Meteorological Events: _____	
Wind Speed: <u>-</u>	Direction: <u>-</u>

Lab Name: <u>TestAmerica</u>	BP/AR Facility No.: <u>6113</u>	Consultant/Contractor: <u>Stratus Environmental, Inc.</u>
Address: <u>885 Jarvis Drive</u>	BP/AR Facility Address: <u>785 E. Stanley Blvd., Livermore</u>	Address: <u>3330 Cameron Park Drive, Suite 550</u>
<u>Morgan Hill, CA 95937</u>	Site Lat/Long: _____	<u>Cameron Park, CA 95682</u>
Lab PM: <u>Lisa Race</u>	California Global ID No.: <u>T0600100111</u>	Consultant/Contractor Project No.: <u>E6113-04</u>
Tele/Fax: <u>408-782-8156 408-782-6308 (fax)</u>	Enfos Project No.: <u>GOC54-0015</u>	Consultant/Contractor PM: <u>Jay Johnson</u>
BP/AR PM Contact: <u>Paul Supple</u>	Provision or OOC (circle one) <u>Provision</u>	Tele/Fax: <u>(530) 676-6000 / (530) 676-6005</u>
Address: <u>2010 Crow Canyon Place, Suite 150</u>	Phase/WBS: <u>04-Monitoring</u>	Report Type & QC Level: <u>Level 1 with EDF</u>
<u>San Ramon, CA</u>	Sub Phase/Task: <u>03-Analytical</u>	E-mail EDD To: <u>shayes@stratusinc.net</u>
Tele/Fax: <u>925-275-3506</u>	Cost Element: <u>01-Contractor labor</u>	Invoice to: <u>Atlantic Richfield Co.</u>

Item No.	Sample Description	Time	Date	Matrix			Laboratory No.	No. of Containers	Preservative					ALL by 9260 Requested Analysis						Sample Point Lat/Long and Comments		
				Soil/Solid	Water/Liquid	Air			Unpreserved	H ₂ SO ₄	HNO ₃	HCl	Methanol	GRD	BTEX	5 Oxy's	EDS	1,2-DCA	Ethanol			
1	MW-6	0918	10/16	X			MQJ0773	6							X	X	X	X	X	X		
2	MW-7	0826					02	3														
3	MW-9	1003					03	3														
4	MW-10	0600					04	3														
5	MW-11	0551					05	3														
6	VW-1	0718					06	3														
7																						
8	TB-6113-10162007	0600	10/16	X			07	2														
9																						
10																						

Sampler's Name: <u>David DeMello</u>	Relinquished By / Affiliation: <u>David DeMello / STRATUS</u>	Date: <u>10-16-07</u>	Time: <u>1220</u>	Accepted By / Affiliation: <u>[Signature]</u>	Date: <u>10-16</u>	Time: <u>1220</u>
Sampler's Company: <u>STRATUS ENVIRONMENTAL INC</u>	<u>[Signature]</u>	<u>10-16</u>	<u>1220</u>	<u>[Signature]</u>	<u>10-16</u>	<u>1220</u>
Shipment Date: <u>10-16-07</u>	<u>[Signature]</u>	<u>10-16</u>	<u>1220</u>	<u>[Signature]</u>	<u>10-16</u>	<u>1220</u>
Shipment Method: _____	<u>[Signature]</u>	<u>10-16</u>	<u>1220</u>	<u>[Signature]</u>	<u>10-16</u>	<u>1220</u>
Shipment Tracking No: _____	<u>[Signature]</u>	<u>10-16</u>	<u>1220</u>	<u>[Signature]</u>	<u>10-16</u>	<u>1220</u>

Special Instructions: Please cc results to rmler@broadbentinc.com

Custody Seals In Place: Yes / No | Temp Blank: Yes / No | Cooler Temp on Receipt: 5.8 °F/C | Trip Blank: Yes / No | MS/MSD Sample Submitted: Yes / No

TEST AMERICA SAMPLE RECEIPT LOG

CLIENT NAME: ARCO (G113)
REC. BY (PRINT): JULIE N.
WORKORDER: MQJ0773

DATE REC'D AT LAB: 10/16/07
TIME REC'D AT LAB: 2:15
DATE LOGGED IN: 10/18/07

For Regulatory Purposes?
DRINKING WATER YES/NO
WASTE WATER YES/NO

CIRCLE THE APPROPRIATE RESPONSE	LAB SAMPLE #	CLIENT ID	CONTAINER DESCRIPTION	PRESERVATIVE	pH	SAMPLE MATRIX	DATE SAMPLED	REMARKS: CONDITION (ETC.)
1. Custody Seal(s) Present / Absent Intact / Broken*								<div style="position: absolute; top: 0; right: 0; text-align: right;">10/17/07</div> <div style="position: absolute; top: 50%; left: 50%; transform: translate(-50%, -50%); opacity: 0.5;"> JULIE N. MQJ0773 </div>
2. Chain-of-Custody Present / Absent*								
3. Traffic Reports or Packing List: Present / Absent*								
4. Airbill: Airbill / Sticker Present / Absent*								
5. Airbill #:								
6. Sample Labels: Present / Absent								
7. Sample IDs: Listed / Not Listed on Chain-of-Custody								
8. Sample Condition: Intact / Broken* / Leaking*								
9. Does information on chain-of-custody, traffic reports and sample labels agree? Yes / No*								
10. Sample received within hold time? Yes / No*								
11. Adequate sample volume received? Yes / No*								
12. Proper preservatives used? Yes / No*								
13. Trip Blank / Temp Blank Received? (circle which, if yes) Yes / No*								
14. Read Temp: <u>5.8°C</u> Correction Factor: <u>-0°C</u> Corrected Temp: <u>5.8°C</u> Is corrected temp. 0-6°C? Yes / No**								

**Exception (if any): METALS / DFF ON ICE or Problem COC

*IF CIRCLED, CONTACT PROJECT MANAGER AND ATTACH RECORD OF RESOLUTION.

APPENDIX B

GEOTRACKER UPLOAD CONFIRMATION

Electronic Submittal Information

[Main Menu](#) | [View/Add Facilities](#) | [Upload EDD](#) | [Check EDD](#)

Your EDF file has been successfully uploaded!

Confirmation Number: 9032014906

Date/Time of Submittal: 1/8/2008 1:15:34 PM

Facility Global ID: T0600100111

Facility Name: ARCO #06113

Submittal Title: 4Q07 GW Monitoring

Submittal Type: GW Monitoring Report

[Click here](#) to view the detections report for this upload.

ARCO #06113 785 STANLEY LIVERMORE, CA 94550	Regional Board - Case #: 01-0119 SAN FRANCISCO BAY RWQCB (REGION 2) Local Agency (lead agency) - Case #: RO0000393 ALAMEDA COUNTY LOP - (SP)
--	---

CONF #	TITLE	QUARTER
9032014906	4Q07 GW Monitoring	Q4 2007
SUBMITTED BY	SUBMIT DATE	STATUS
Broadbent & Associates, Inc.	1/8/2008	PENDING REVIEW

SAMPLE DETECTIONS REPORT

# FIELD POINTS SAMPLED	6
# FIELD POINTS WITH DETECTIONS	5
# FIELD POINTS WITH WATER SAMPLE DETECTIONS ABOVE MCL	3
SAMPLE MATRIX TYPES	WATER

METHOD QA/QC REPORT

METHODS USED	8260FA,8260TPH
TESTED FOR REQUIRED ANALYTES?	Y
LAB NOTE DATA QUALIFIERS	Y

QA/QC FOR 8021/8260 SERIES SAMPLES

TECHNICAL HOLDING TIME VIOLATIONS	0
METHOD HOLDING TIME VIOLATIONS	0
LAB BLANK DETECTIONS ABOVE REPORTING DETECTION LIMIT	0
LAB BLANK DETECTIONS	0
DO ALL BATCHES WITH THE 8021/8260 SERIES INCLUDE THE FOLLOWING?	
- LAB METHOD BLANK	Y
- MATRIX SPIKE	Y
- MATRIX SPIKE DUPLICATE	Y
- BLANK SPIKE	Y
- SURROGATE SPIKE	Y

WATER SAMPLES FOR 8021/8260 SERIES

MATRIX SPIKE / MATRIX SPIKE DUPLICATE(S) % RECOVERY BETWEEN 65-135%	Y
MATRIX SPIKE / MATRIX SPIKE DUPLICATE(S) RPD LESS THAN 30%	Y
SURROGATE SPIKES % RECOVERY BETWEEN 85-115%	Y
BLANK SPIKE / BLANK SPIKE DUPLICATES % RECOVERY BETWEEN 70-130%	Y

SOIL SAMPLES FOR 8021/8260 SERIES

MATRIX SPIKE / MATRIX SPIKE DUPLICATE(S) % RECOVERY BETWEEN 65-135% n/a
MATRIX SPIKE / MATRIX SPIKE DUPLICATE(S) RPD LESS THAN 30% n/a
SURROGATE SPIKES % RECOVERY BETWEEN 70-125% n/a
BLANK SPIKE / BLANK SPIKE DUPLICATES % RECOVERY BETWEEN 70-130% n/a

FIELD QC SAMPLES

<u>SAMPLE</u>	<u>COLLECTED</u>	<u>DETECTIONS > REPD</u>
QCTB SAMPLES	N	0
QCEB SAMPLES	N	0
QCAB SAMPLES	N	0

Logged in as BROADBENT-C (CONTRACTOR)

CONTACT SITE ADMINISTRATOR.

Electronic Submittal Information

[Main Menu](#) | [View/Add Facilities](#) | [Upload EDD](#) | [Check EDD](#)

UPLOADING A GEO_WELL FILE

**Processing is complete. No errors were found!
Your file has been successfully submitted!**

<u>Submittal Title:</u>	4Q07 GEO_WELL 6113
<u>Facility Global ID:</u>	T0600100111
<u>Facility Name:</u>	ARCO #06113
<u>Submittal Date/Time:</u>	1/8/2008 1:22:03 PM
<u>Confirmation Number:</u>	8578007578

[Back to Main Menu](#)

Logged in as BROADBENT-C
(CONTRACTOR)

[CONTACT SITE ADMINISTRATOR](#)